

GOVERNMENT OF THE REPUBLIC OF GHANA

MINISTRY OF ROAD AND TRANSPORT GHANA HIGHWAY AUTHORITY

KATAHIRA & ENGINEERS INTERNATIONAL

NOTES:

PROJECT: THE PROJECT FOR REHABILITATION OF TRUNK ROAD

TITLE: PLAN AND PROFILE (41/83)

SCALE: V = 1:200 H = 1:2000

DRAWING No: PL-41

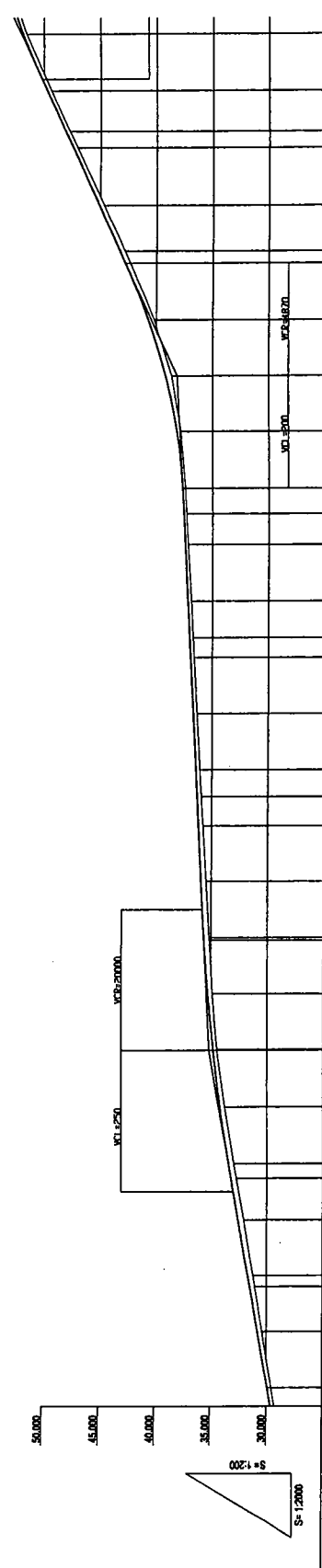
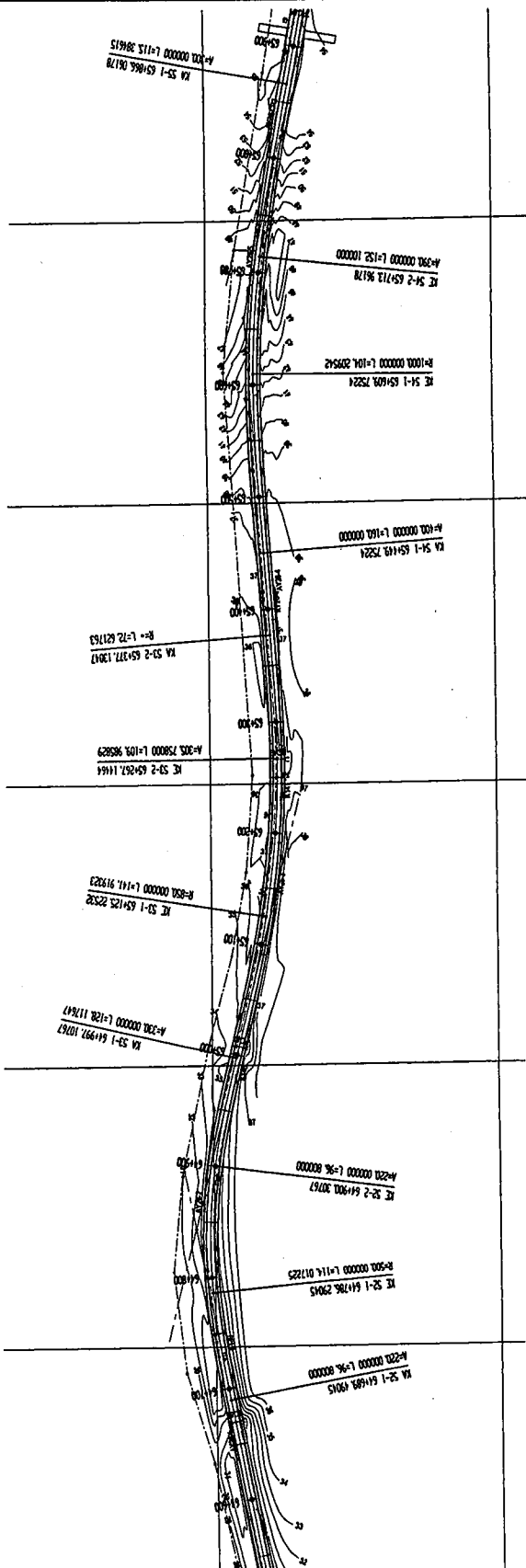

VERTICAL ALIGNMENT	PAVEMENT LEVELS	SURFACE LEVELS	PEGGED CHAINAGE	HORIZONTAL CURVATURE	SUPER-ELEVATION	WIDENING (SHOULDER ONLY)
6000	29.37	29.92	6000	0.00	0.00	
6100	30.40	30.795	6100	0.00	0.00	
6200	31.05	31.496	6200	0.00	0.00	
6300	31.21	31.670	6300	0.00	0.00	
6400	32.04	32.545	6400	0.00	0.00	
6500	32.70	33.186	6500	0.00	0.00	
6600	33.73	34.154	6600	0.00	0.00	
6700	34.41	34.739	6700	0.00	0.00	
6800	34.88	35.279	6800	0.00	0.00	
6900	35.19	35.630	6900	0.00	0.00	
7000	36.33	36.670	7000	0.00	0.00	
7100	36.69	37.009	7100	0.00	0.00	
7200	37.16	37.420	7200	0.00	0.00	
7300	37.31	37.558	7300	0.00	0.00	
7400	37.43	37.670	7400	0.00	0.00	
7500	37.87	37.170	7500	0.00	0.00	
7600	38.65	39.197	7600	0.00	0.00	
7700	38.65	39.197	7700	0.00	0.00	
7800	38.65	39.197	7800	0.00	0.00	
7900	38.65	39.197	7900	0.00	0.00	
8000	40.19	42.732	8000	0.00	0.00	
8100	42.33	42.780	8100	0.00	0.00	
8200	42.81	43.253	8200	0.00	0.00	
8300	44.67	43.083	8300	0.00	0.00	
8400	47.01	47.390	8400	0.00	0.00	
8500	47.69	48.039	8500	0.00	0.00	
8600	49.34	49.695	8600	0.00	0.00	
8700	51.53	51.840	8700	0.00	0.00	

GOVERNMENT OF THE REPUBLIC OF GHANA

MINISTRY OF ROAD AND TRANSPORT GHANA HIGHWAY AUTHORITY

KATAHIRA & ENGINEERS INTERNATIONAL

NOTES:

PROJECT: THE PROJECT FOR REHABILITATION OF TRUNK ROAD

TITLE: PLAN AND PROFILE (42/83)

SCALE: V = 1:200 H = 1:2000

DRAWING No: PL-42

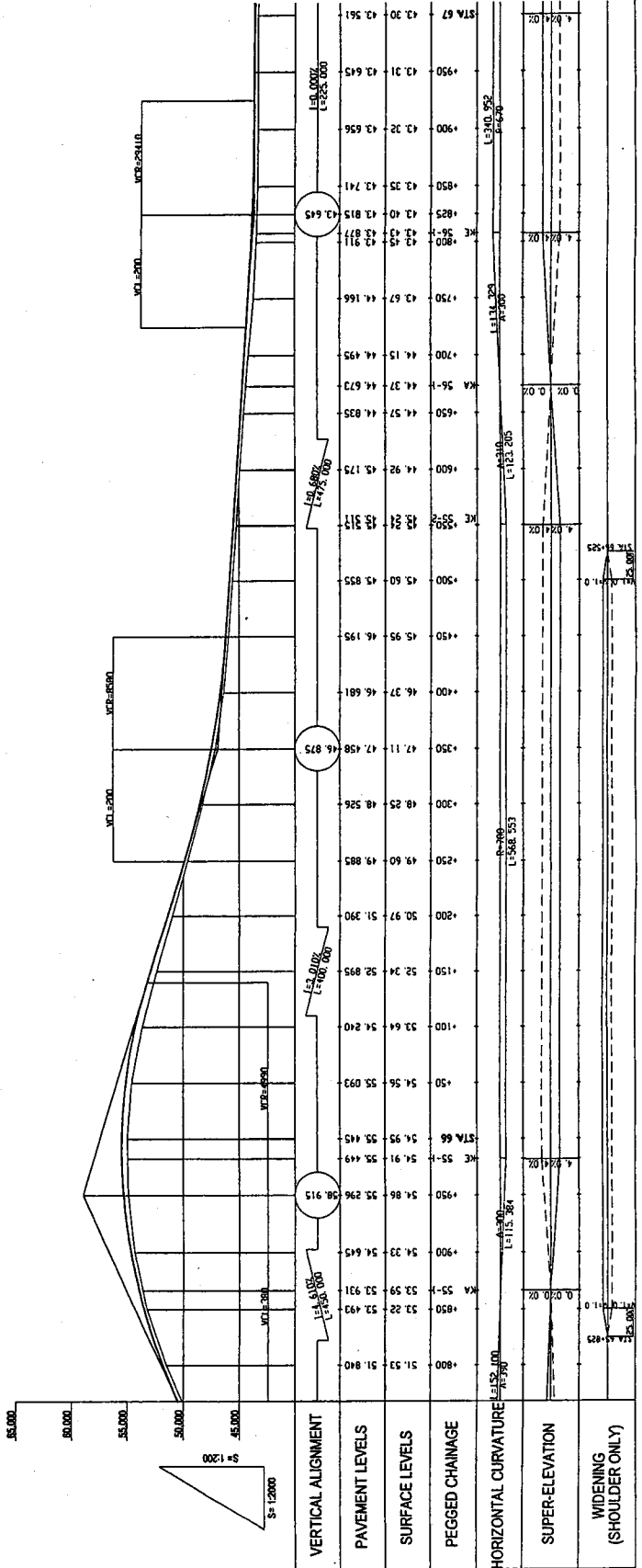
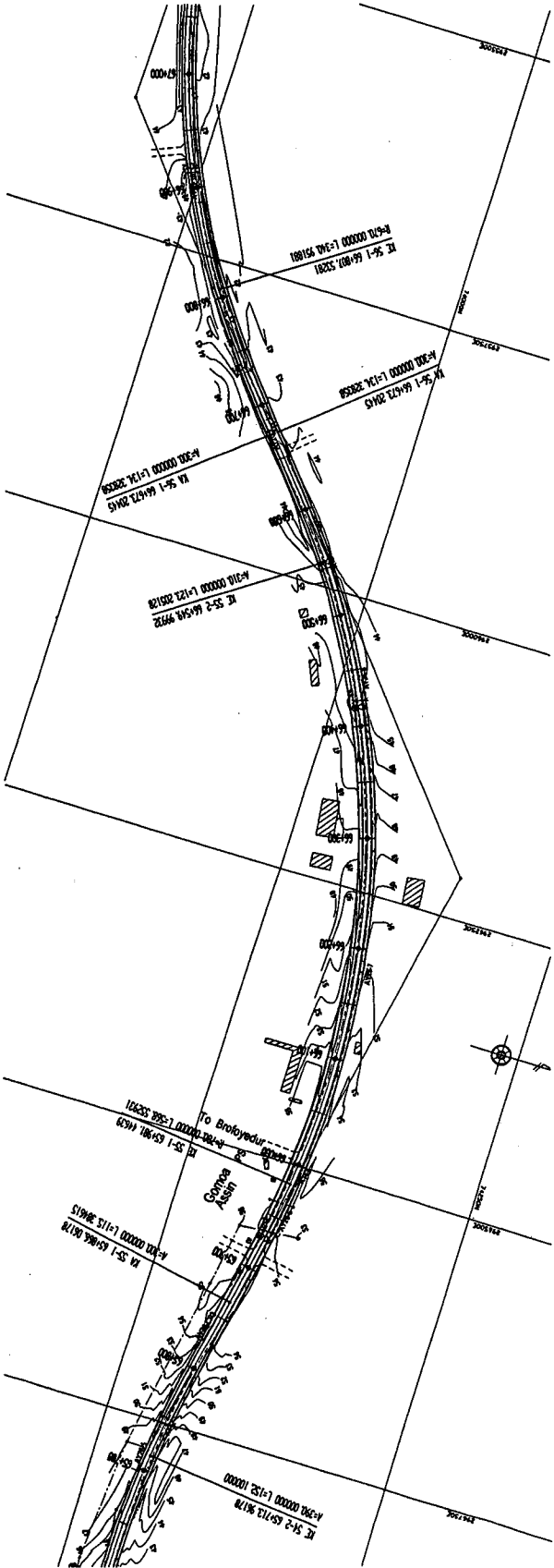

GOVERNMENT OF THE REPUBLIC OF GHANA  
 MINISTRY OF ROAD AND TRANSPORT GHANA HIGHWAY AUTHORITY  
 KATAHIRA & ENGINEERS INTERNATIONAL  
 NOTES:  
 PROJECT: THE PROJECT FOR THE REHABILITATION OF TRUNK ROAD  
 TITLE: PLAN AND PROFILE (43/83)  
 SCALE: V = 1:200 H = 1:2000  
 DRAWING No: PL-43

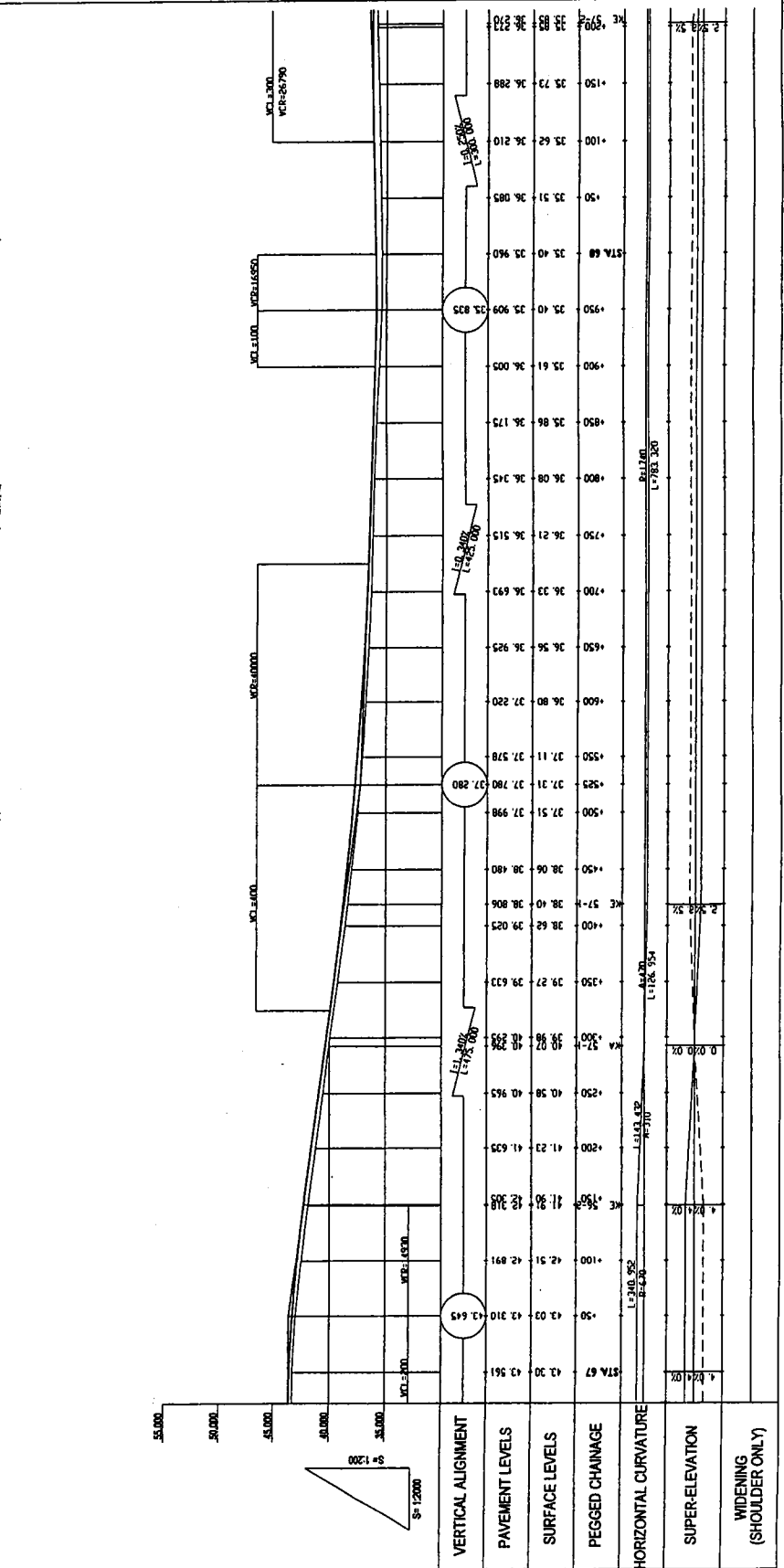
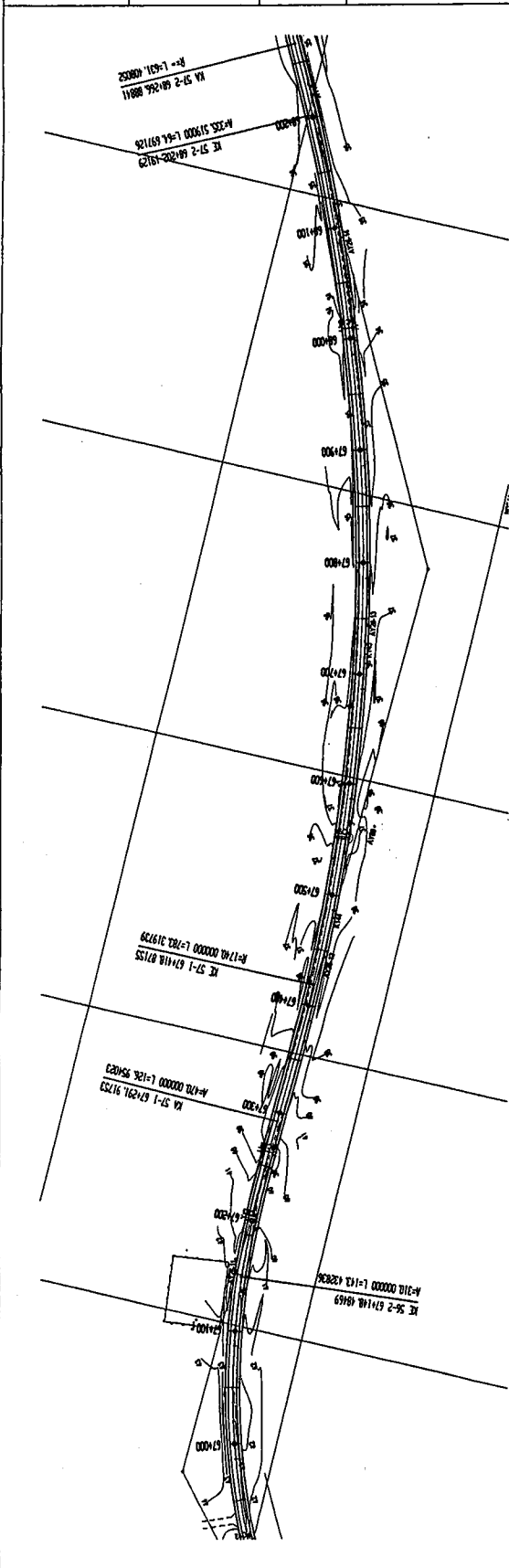

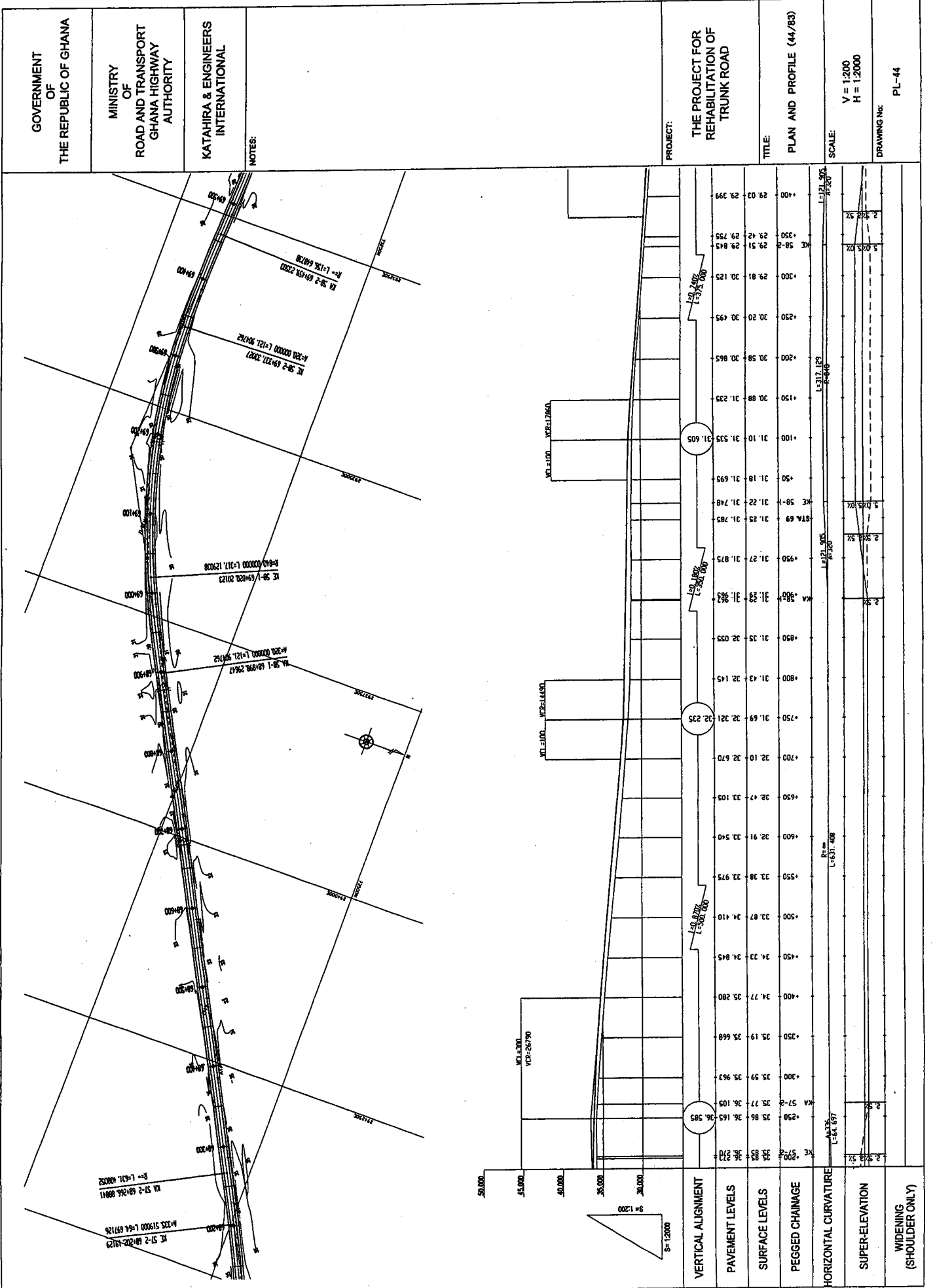

GOVERNMENT OF THE REPUBLIC OF GHANA

MINISTRY OF ROAD AND TRANSPORT GHANA HIGHWAY AUTHORITY

KATAHIRA & ENGINEERS INTERNATIONAL

NOTES:

PROJECT: THE PROJECT FOR REHABILITATION OF TRUNK ROAD

TITLE: PLAN AND PROFILE (44/83)

SCALE: V = 1:200 H = 1:2000

DRAWING No: PL-44

GOVERNMENT OF THE REPUBLIC OF GHANA  
 MINISTRY OF ROAD AND TRANSPORT GHANA HIGHWAY AUTHORITY  
 KATAHIRA & ENGINEERS INTERNATIONAL

NOTES:  
 PROJECT: THE PROJECT FOR THE REHABILITATION OF TRUNK ROAD  
 TITLE: PLAN AND PROFILE (45/83)

SCALE: V = 1:2000 H = 1:2000  
 DRAWING No: PL-45

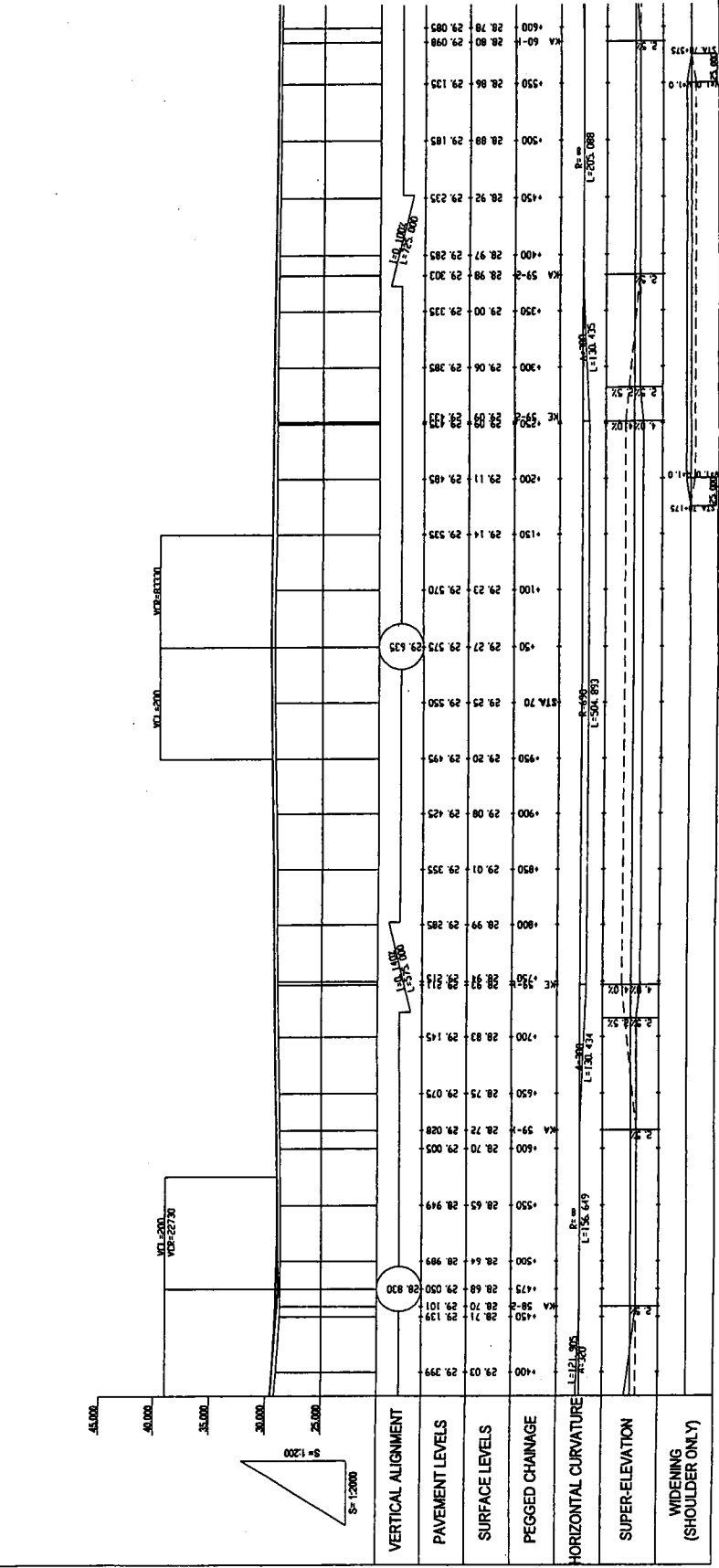
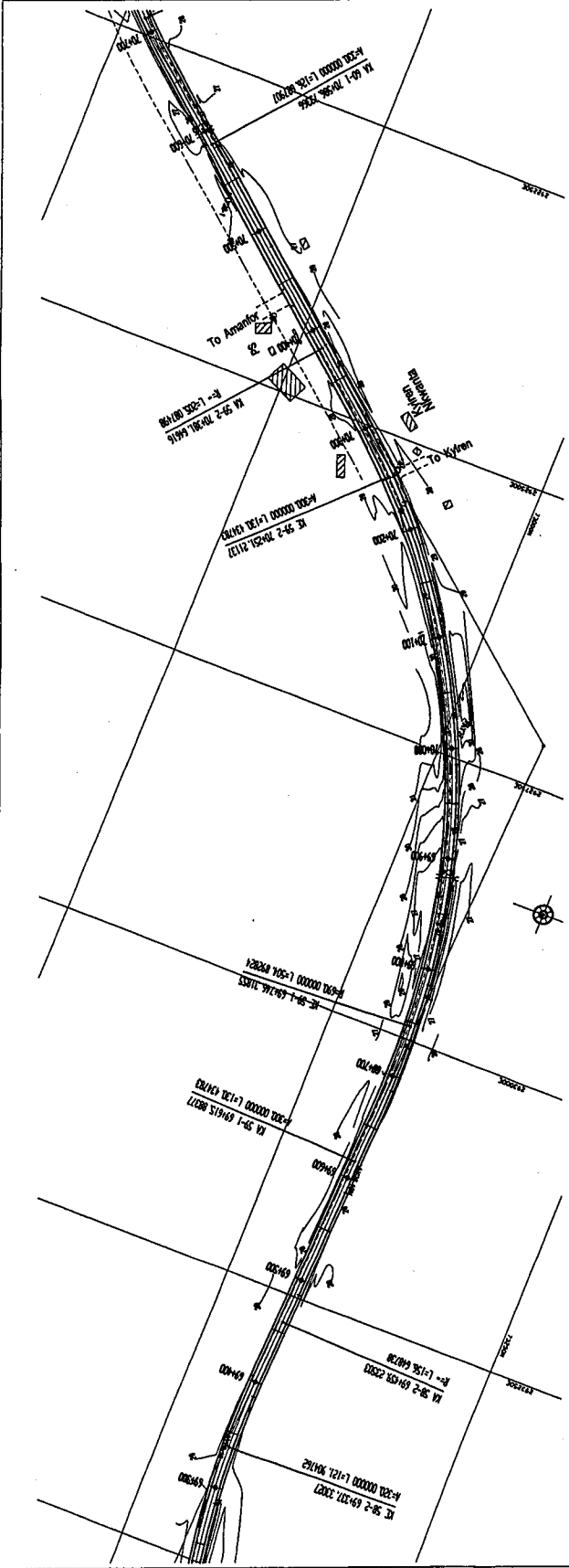

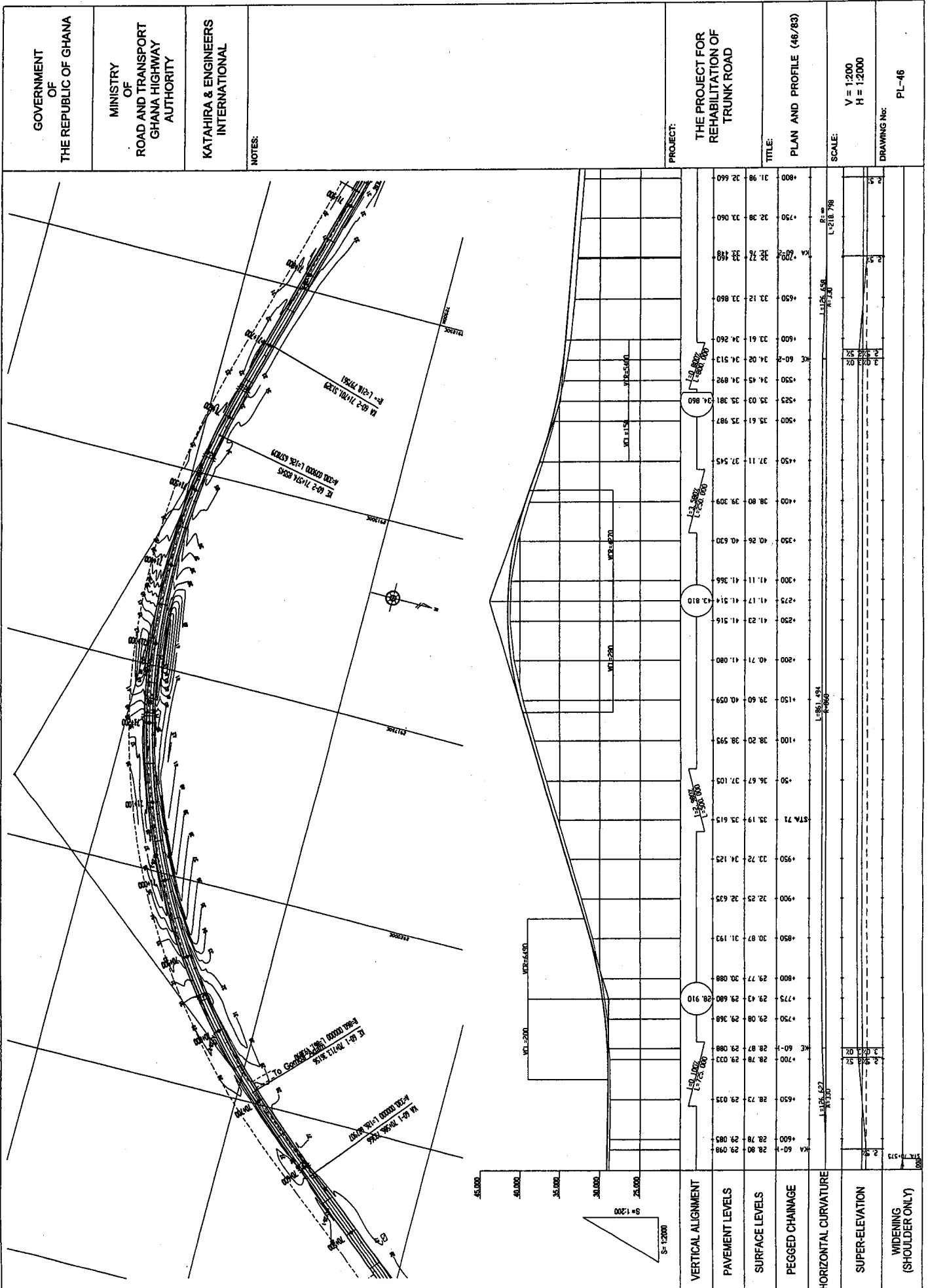

GOVERNMENT OF THE REPUBLIC OF GHANA

MINISTRY OF ROAD AND TRANSPORT GHANA HIGHWAY AUTHORITY

KATAHIRA & ENGINEERS INTERNATIONAL

NOTES:

PROJECT:

THE PROJECT FOR REHABILITATION OF TRUNK ROAD

TITLE:

PLAN AND PROFILE (48/83)

SCALE:

V = 1:200  
H = 1:2000

DRAWING No:

PL-46



GOVERNMENT OF THE REPUBLIC OF GHANA

MINISTRY OF ROAD AND TRANSPORT GHANA HIGHWAY AUTHORITY

KATAHIRA & ENGINEERS INTERNATIONAL

NOTES:

PROJECT: THE PROJECT FOR REHABILITATION OF TRUNK ROAD

TITLE: PLAN AND PROFILE (48/83)

SCALE: V = 1:200 H = 1:2000

DRAWING No: PL-48

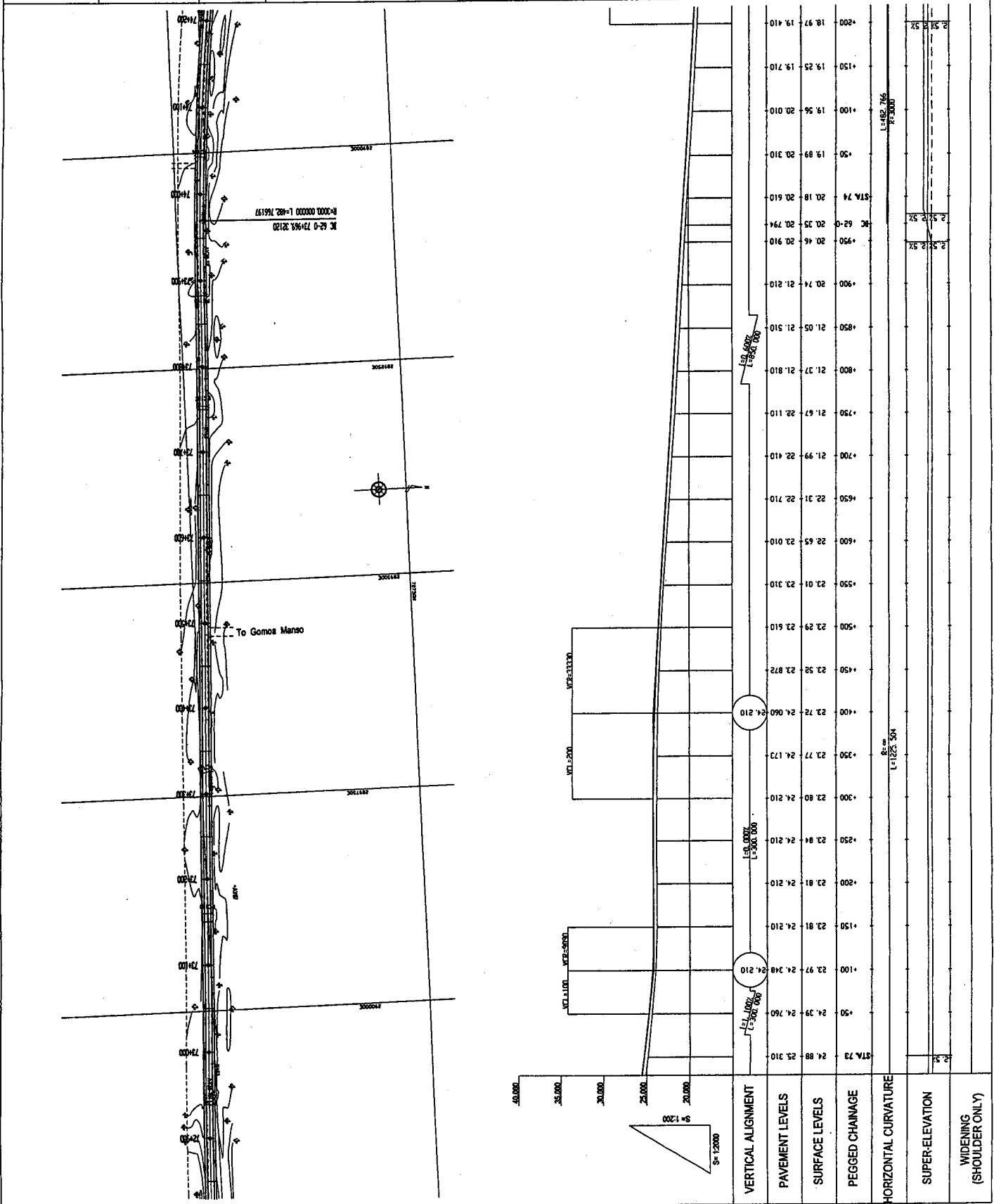



GOVERNMENT OF THE REPUBLIC OF GHANA  
 MINISTRY OF ROAD AND TRANSPORT GHANA HIGHWAY AUTHORITY  
 KATAHIRA & ENGINEERS INTERNATIONAL  
 NOTES:  
 PROJECT: THE PROJECT OF REHABILITATION OF TRUNK ROAD  
 TITLE: PLAN AND PROFILE (49/83)  
 SCALE: V = 1:200 H = 1:2000  
 DRAWING No: PL-49

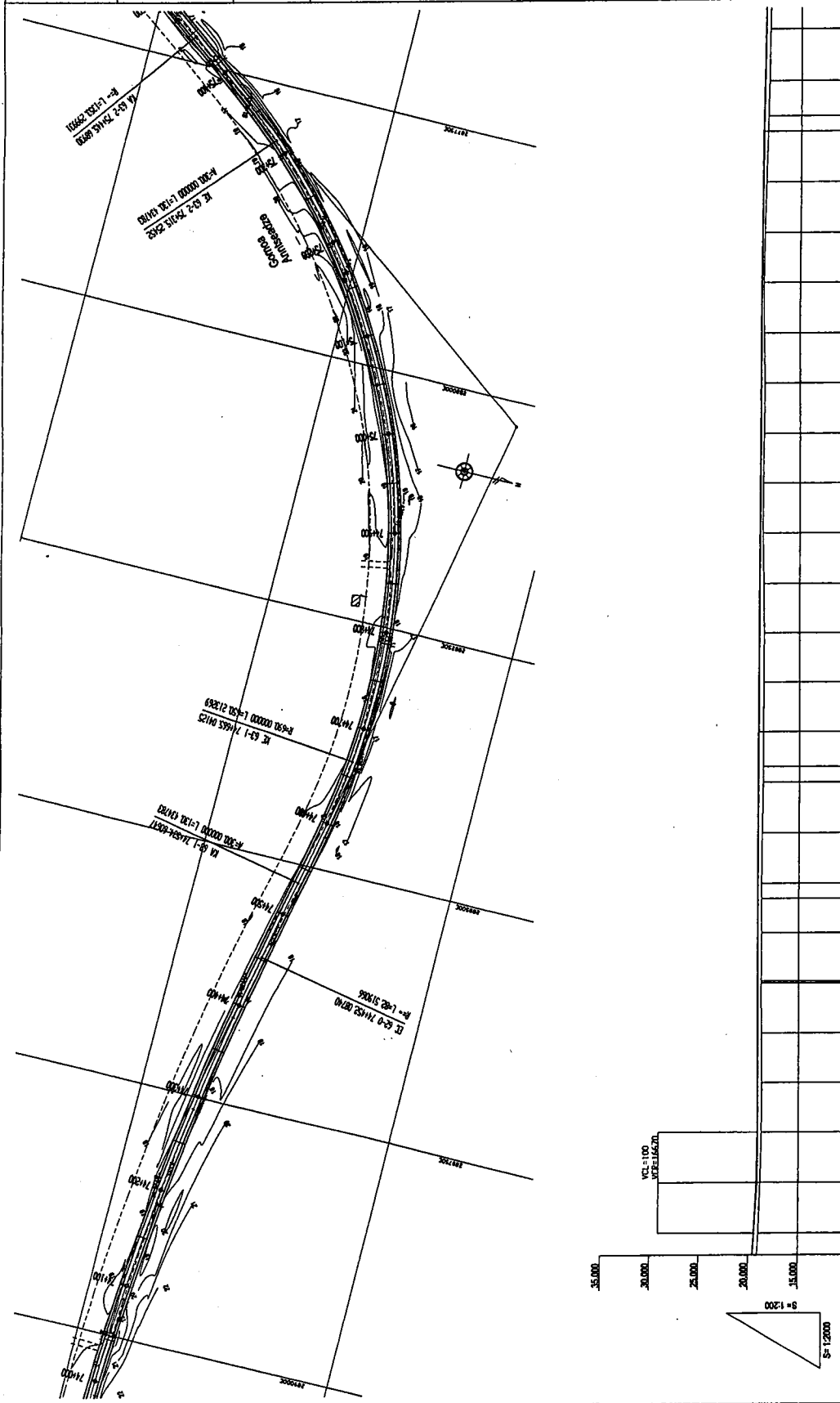

VERTICAL ALIGNMENT	PAVEMENT LEVELS	SURFACE LEVELS	PEGGED CHAINAGE	HORIZONTAL CURVATURE	SUPER-ELEVATION	WIDENING (SHOULDER ONLY)
18+00	18.97	19.410	18.97	19.110	0.3%	
18+10	18.82	19.185	18.82	19.110	0.3%	
18+20	18.71	19.110	18.71	19.110	0.3%	
18+30	18.68	19.110	18.68	19.110	0.3%	
18+40	18.73	19.110	18.73	19.110	0.3%	
18+50	18.71	19.110	18.71	19.110	0.3%	
18+60	18.74	19.110	18.74	19.110	0.3%	
18+70	18.69	19.110	18.69	19.110	0.3%	
18+80	18.57	19.050	18.57	19.050	0.3%	
18+90	18.69	18.990	18.69	18.990	0.3%	
19+00	18.67	18.960	18.67	18.960	0.3%	
19+10	18.52	18.900	18.52	18.900	0.3%	
19+20	18.58	18.910	18.58	18.910	0.3%	
19+30	18.60	19.020	18.60	19.020	0.3%	
19+40	18.63	19.110	18.63	19.110	0.3%	
19+50	18.63	19.110	18.63	19.110	0.3%	
19+60	18.63	19.110	18.63	19.110	0.3%	
19+70	18.52	19.110	18.52	19.110	0.3%	
19+80	18.59	19.080	18.59	19.080	0.3%	
19+90	18.52	18.900	18.52	18.900	0.3%	
20+00	18.52	18.900	18.52	18.900	0.3%	
20+10	18.58	18.910	18.58	18.910	0.3%	
20+20	18.58	18.910	18.58	18.910	0.3%	
20+30	18.59	18.870	18.59	18.870	0.3%	
20+40	18.64	18.840	18.64	18.840	0.3%	
20+50	18.64	18.840	18.64	18.840	0.3%	
20+60	18.66	18.790	18.66	18.790	0.3%	
20+70	18.62	18.750	18.62	18.750	0.3%	
20+80	18.59	18.710	18.59	18.710	0.3%	
20+90	18.59	18.710	18.59	18.710	0.3%	
21+00	18.59	18.710	18.59	18.710	0.3%	
21+10	18.59	18.710	18.59	18.710	0.3%	
21+20	18.59	18.710	18.59	18.710	0.3%	
21+30	18.59	18.710	18.59	18.710	0.3%	
21+40	18.59	18.710	18.59	18.710	0.3%	
21+50	18.59	18.710	18.59	18.710	0.3%	
21+60	18.59	18.710	18.59	18.710	0.3%	
21+70	18.59	18.710	18.59	18.710	0.3%	
21+80	18.59	18.710	18.59	18.710	0.3%	
21+90	18.59	18.710	18.59	18.710	0.3%	
22+00	18.59	18.710	18.59	18.710	0.3%	

GOVERNMENT OF THE REPUBLIC OF GHANA  
 MINISTRY OF ROAD AND TRANSPORT GHANA HIGHWAY AUTHORITY  
 KATAHIRA & ENGINEERS INTERNATIONAL  
 NOTES:  
 PROJECT: THE PROJECT FOR REHABILITATION OF TRUNK ROAD  
 TITLE: PLAN AND PROFILE (50/83)  
 SCALE: V = 1:200 H = 1:2000  
 DRAWING No: PL-50

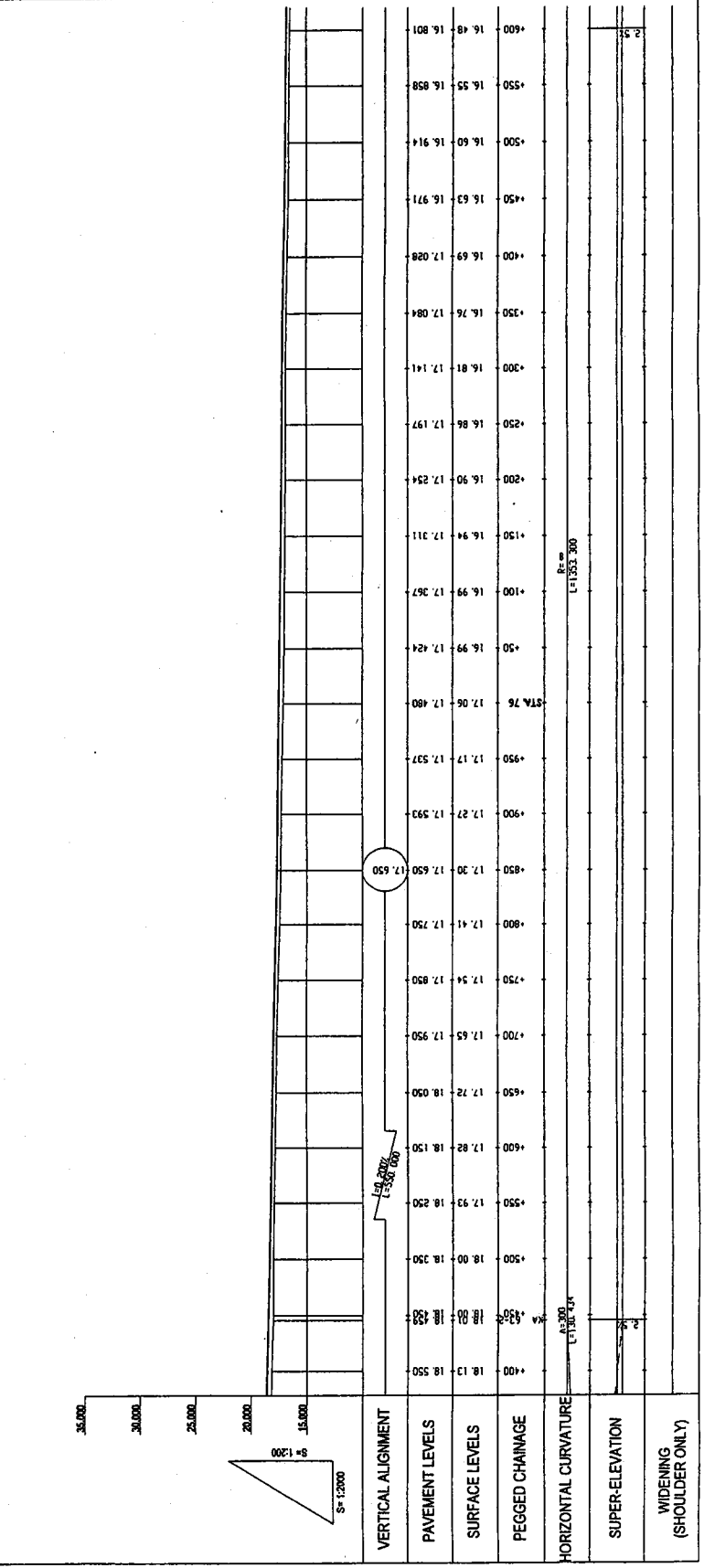
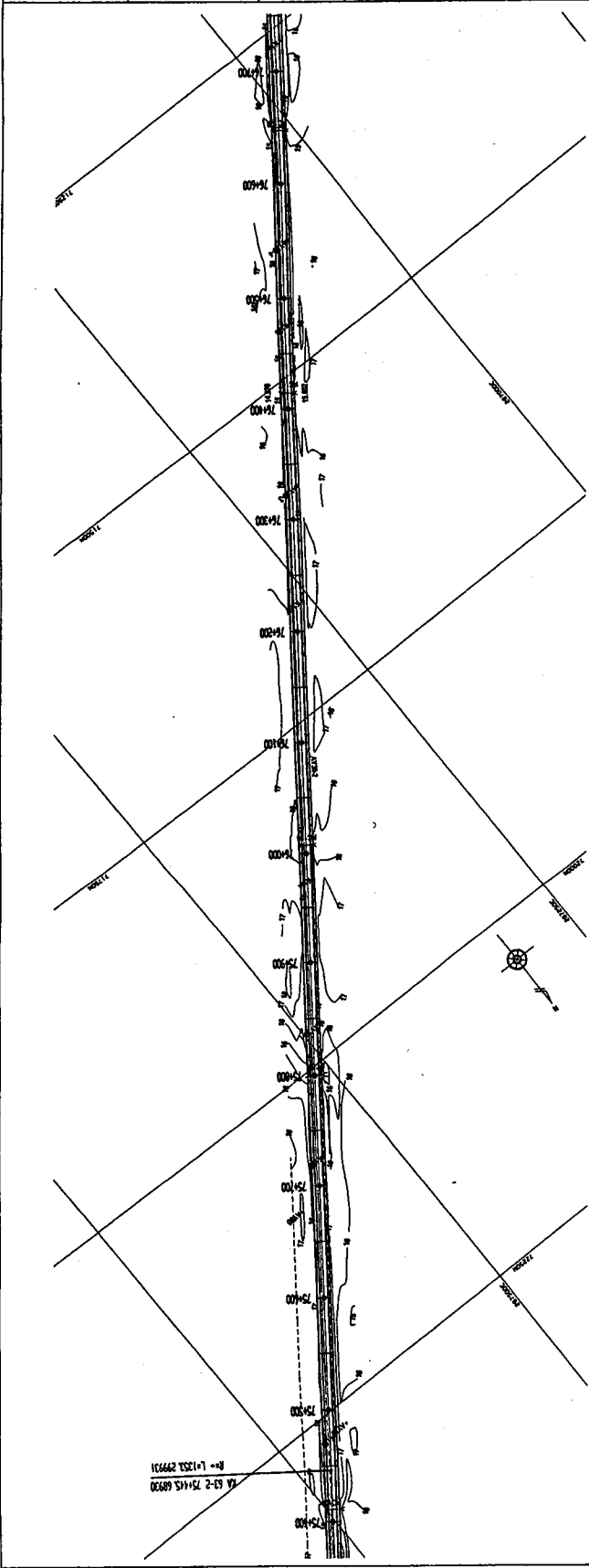

GOVERNMENT OF THE REPUBLIC OF GHANA

MINISTRY OF ROAD AND TRANSPORT GHANA HIGHWAY AUTHORITY

KATAHIRA & ENGINEERS INTERNATIONAL

NOTES:

PROJECT: THE PROJECT FOR REHABILITATION OF TRUNK ROAD

TITLE: PLAN AND PROFILE (51/83)

SCALE: V = 1:200 H = 1:2000

DRAWING No: PL-51

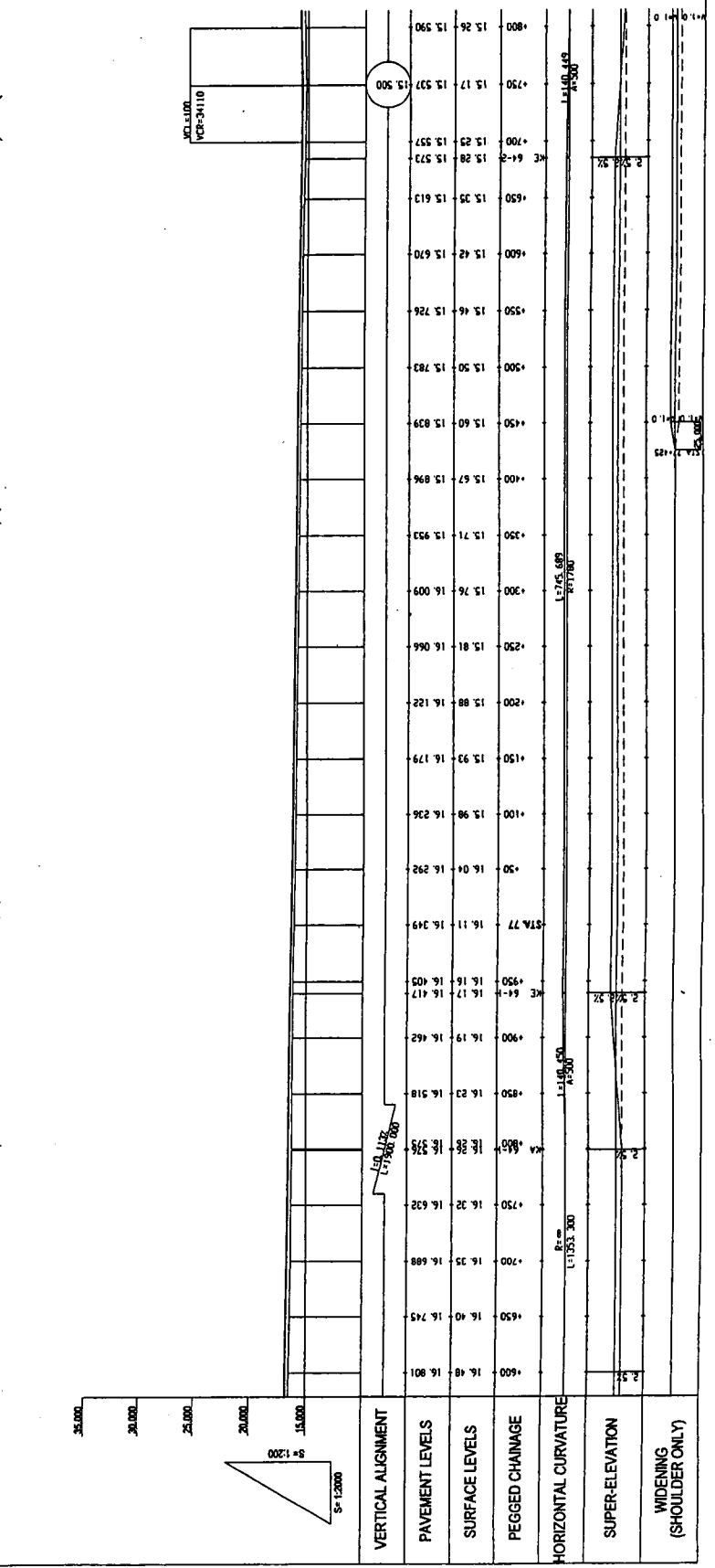
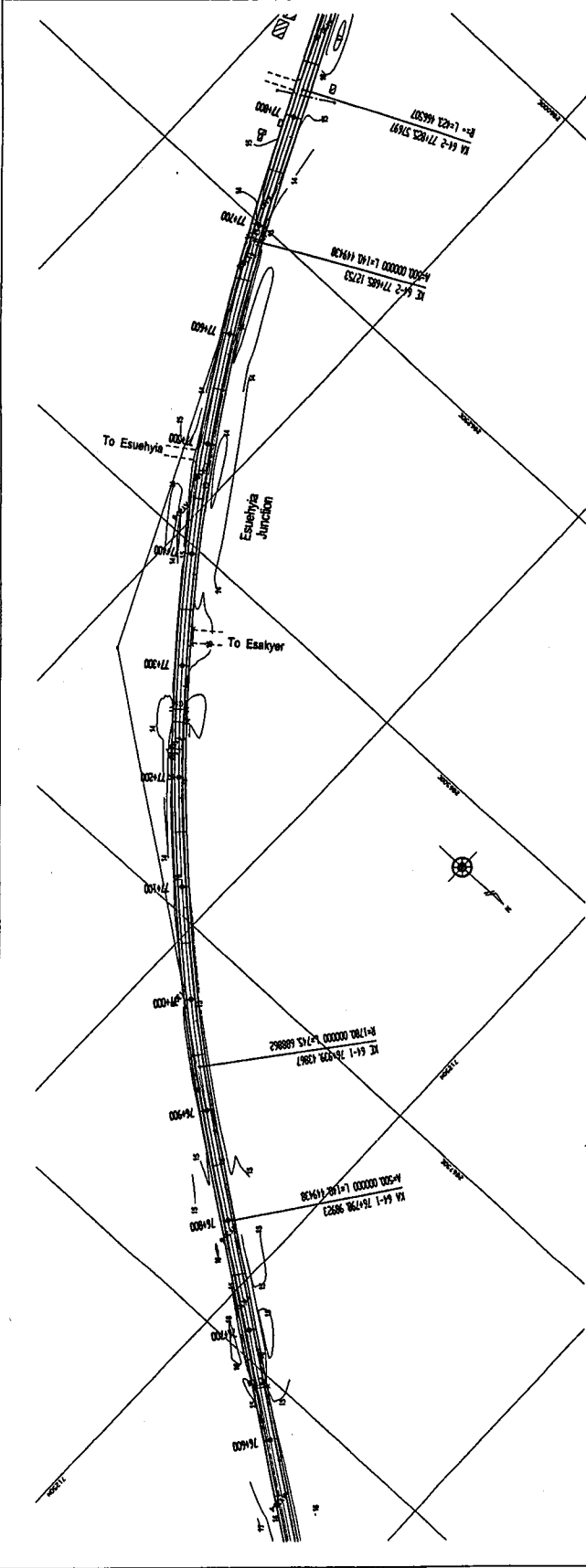

GOVERNMENT OF THE REPUBLIC OF GHANA	MINISTRY OF ROAD AND TRANSPORT GHANA HIGHWAY AUTHORITY	KATAHIRA & ENGINEERS INTERNATIONAL	NOTES:	PROJECT:  THE PROJECT FOR REHABILITATION OF TRUNK ROAD	TITLE:  PLAN AND PROFILE (52/83)	SCALE:  V = 1:200 H = 1:2000	DRAWING NO:  PL-52
---	--	---------------------------------------	--------	--	--	---------------------------------------	--------------------------

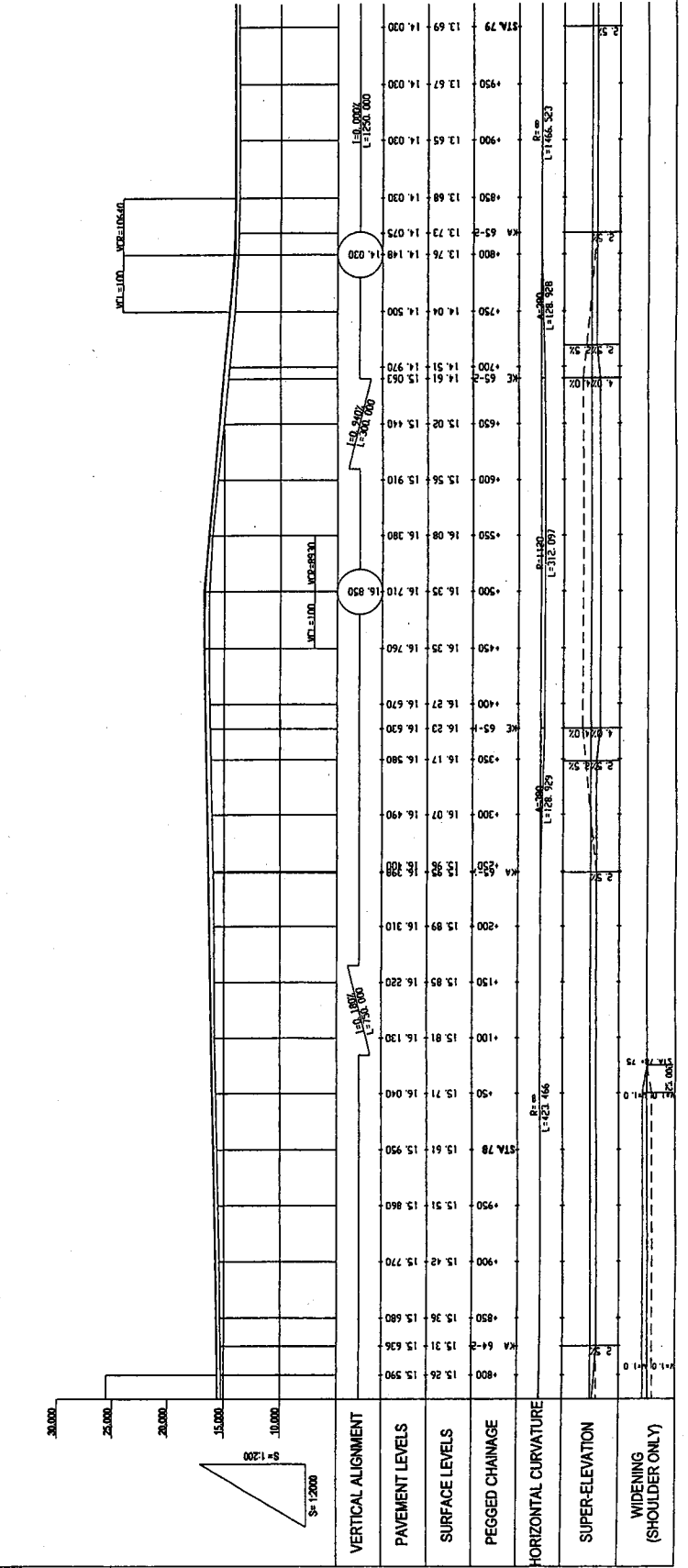
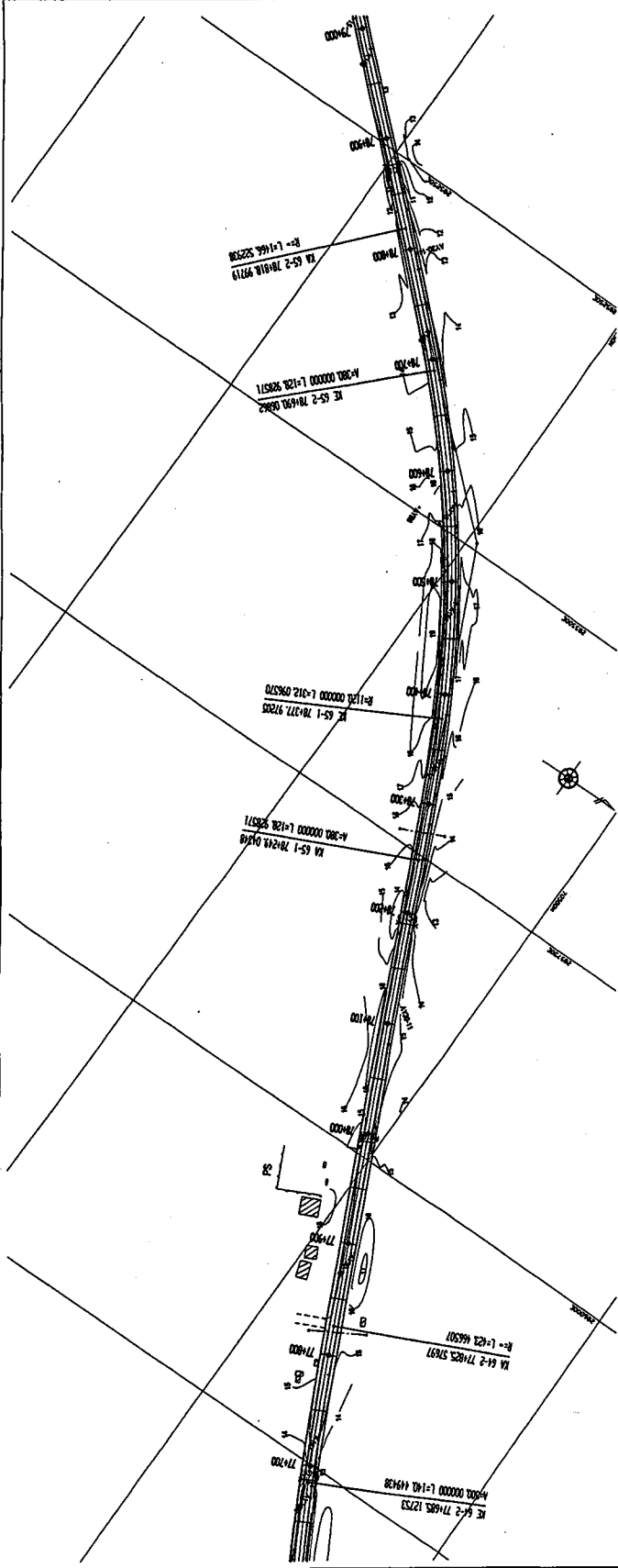

GOVERNMENT OF THE REPUBLIC OF GHANA

MINISTRY OF ROAD AND TRANSPORT GHANA HIGHWAY AUTHORITY

KATAHIRA & ENGINEERS INTERNATIONAL

NOTES:

PROJECT: THE PROJECT FOR REHABILITATION OF TRUNK ROAD

TITLE: PLAN AND PROFILE (53/83)

SCALE: V = 1:200 H = 1:2000

DRAWING No: PL-53

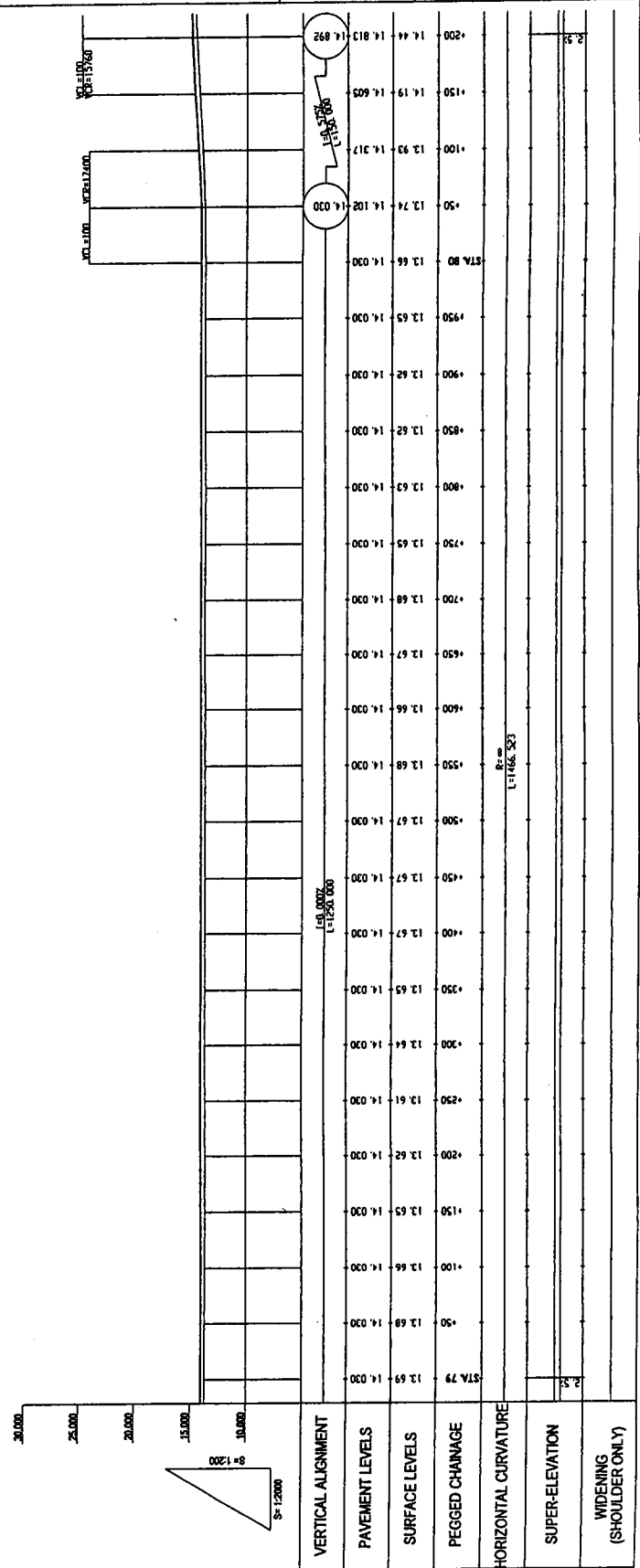
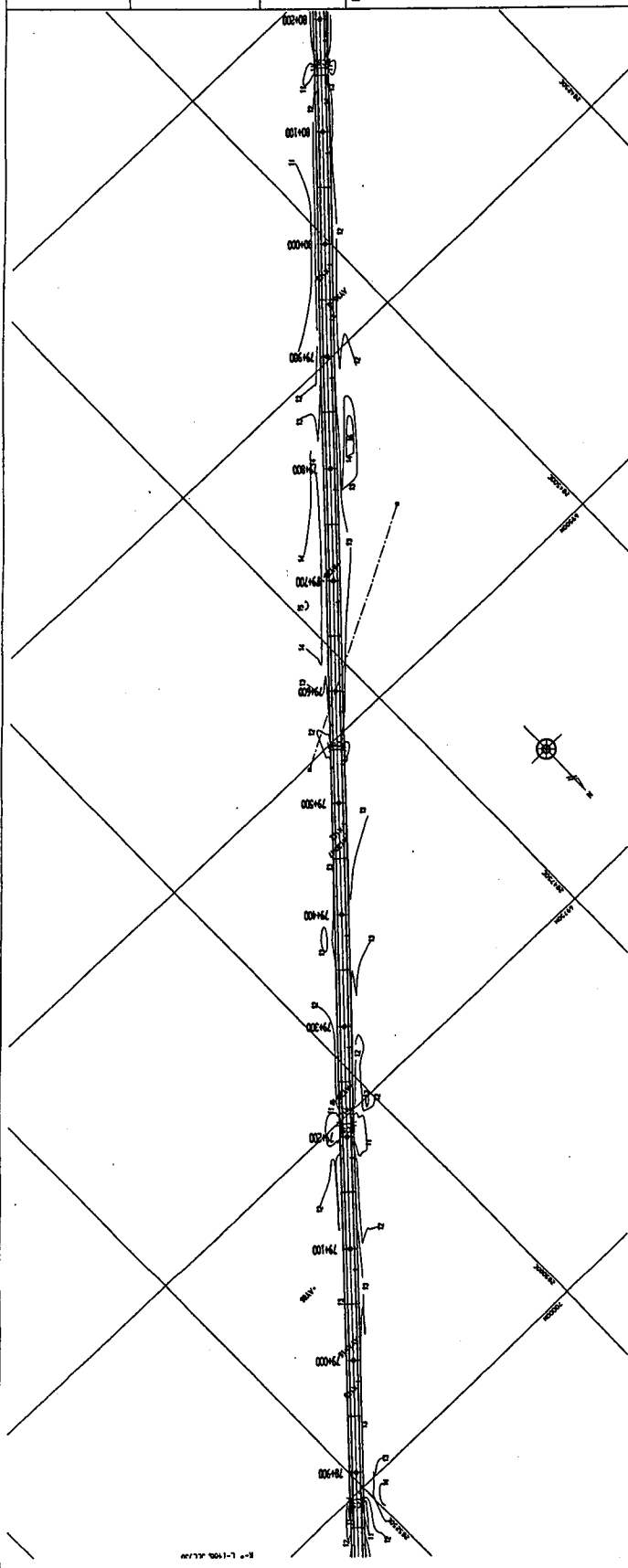

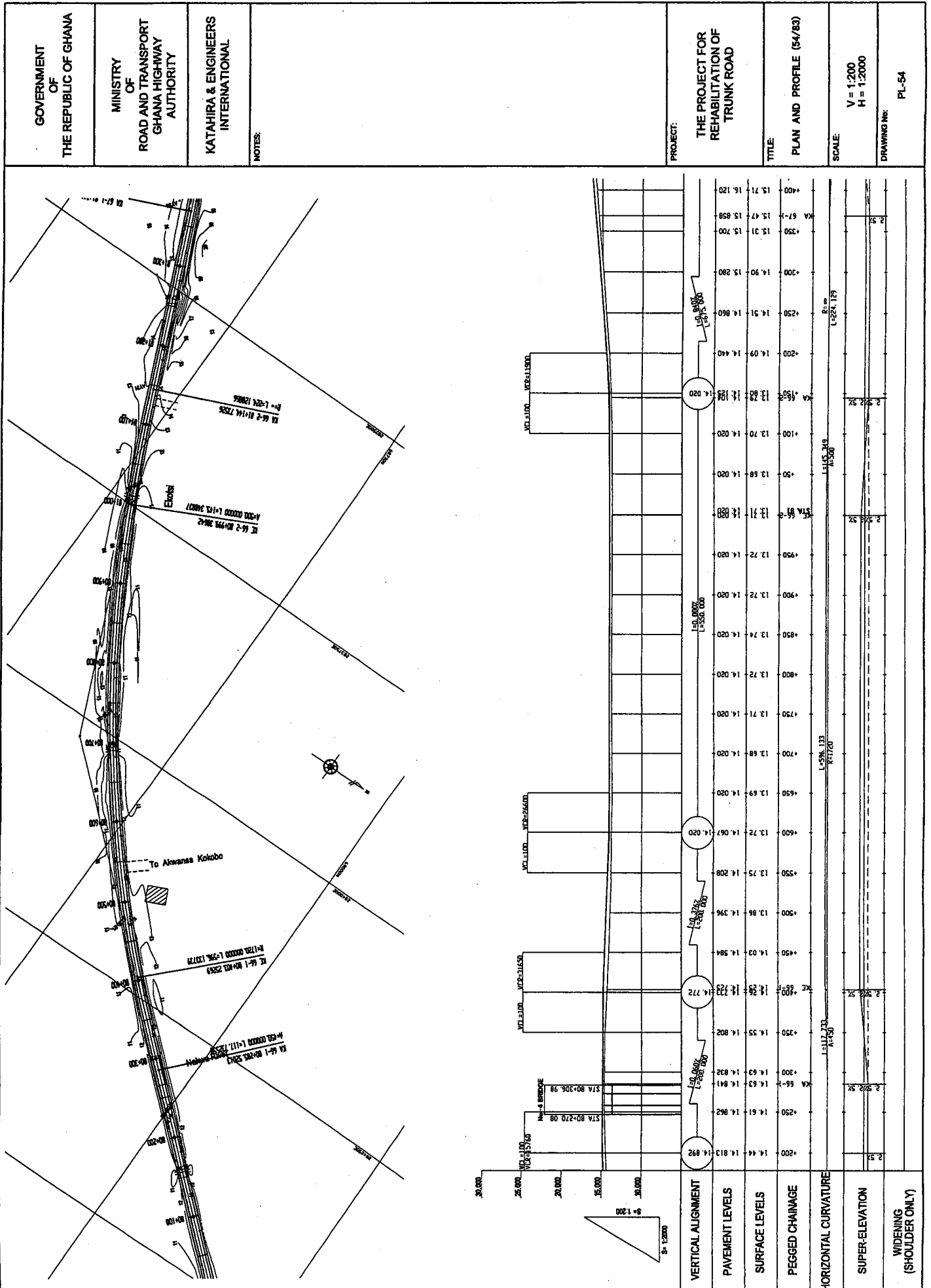

GOVERNMENT OF THE REPUBLIC OF GHANA

MINISTRY OF ROAD AND TRANSPORT GHANA HIGHWAY AUTHORITY

KATAHIRA & ENGINEERS INTERNATIONAL

NOTES:

PROJECT: THE PROJECT FOR REHABILITATION OF TRUNK ROAD

TITLE:

PLAN AND PROFILE (54/83)

SCALE: V = 1:200 H = 1:2000

DRAWING No: PL-54

VERTICAL ALIGNMENT	PAVEMENT LEVELS	SURFACE LEVELS	PEGGED CHAINAGE	HORIZONTAL CURVATURE	SUPER-ELEVATION	WIDENING (SHOULDER ONLY)
14.44	14.813	14.813	200			
14.61	14.841	14.841	250			
14.63	14.841	14.841	300			
14.63	14.841	14.841	350			
14.55	14.802	14.802	400			
14.56	14.723	14.723	450			
14.03	14.584	14.584	500			
13.86	14.336	14.336	550			
13.75	14.208	14.208	600			
13.72	14.067	14.067	650			
13.69	14.020	14.020	700			
13.68	14.020	14.020	750			
13.71	14.020	14.020	800			
13.72	14.020	14.020	850			
13.72	14.020	14.020	900			
13.72	14.020	14.020	950			
13.71	14.020	14.020	1000			
13.82	14.124	14.124	1050			
13.83	14.020	14.020	1100			
14.09	14.440	14.440	1150			
14.51	14.860	14.860	1200			
14.90	15.280	15.280	1250			
15.31	15.700	15.700	1300			
15.47	15.858	15.858	1350			
15.71	16.120	16.120	1400			

GOVERNMENT OF THE REPUBLIC OF GHANA  
 MINISTRY OF ROAD AND TRANSPORT GHANA HIGHWAY AUTHORITY  
 KATAHIRA & ENGINEERS INTERNATIONAL  
 NOTES:  
 PROJECT: THE PROJECT FOR THE REHABILITATION OF TRUNK ROAD  
 TITLE: PLAN AND PROFILE (55/83)  
 SCALE: V = 1:200 H = 1:2000  
 DRAWING No: PL-55

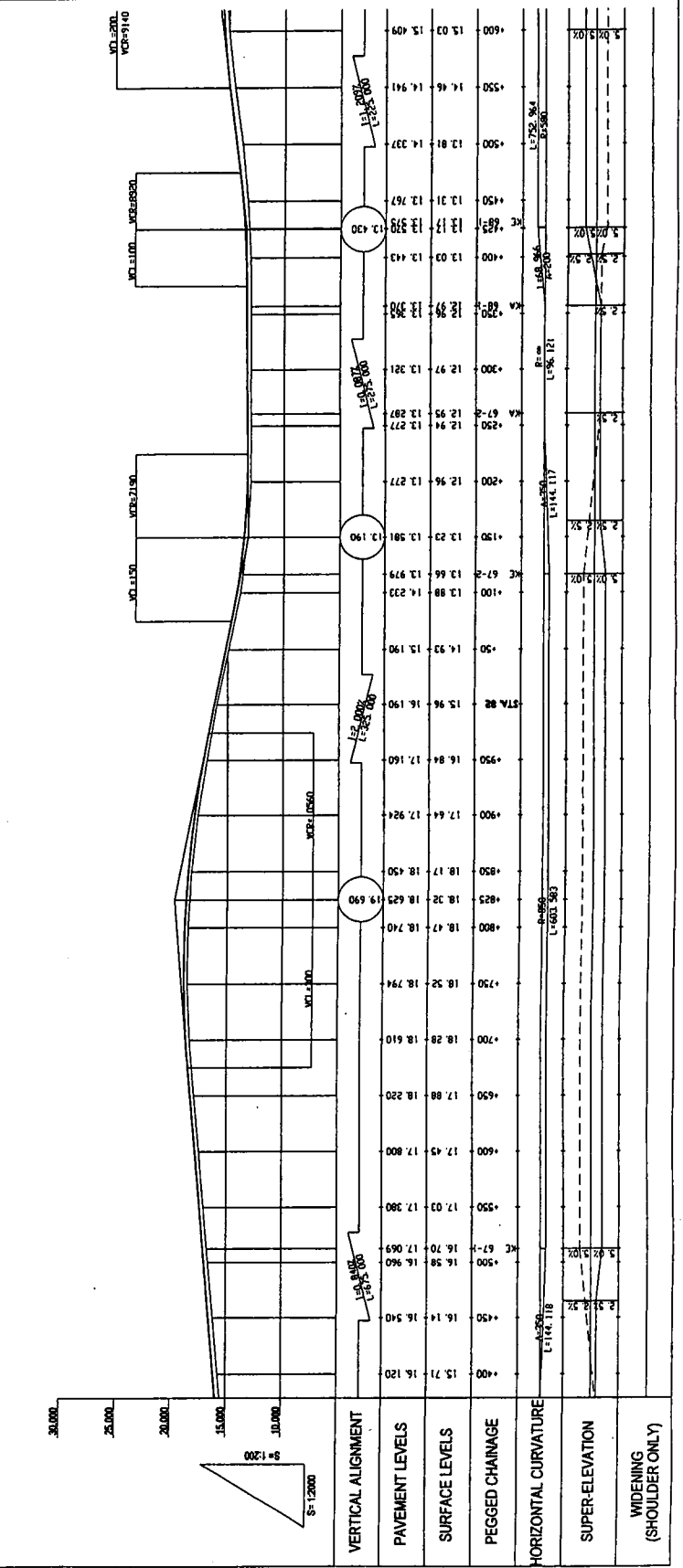
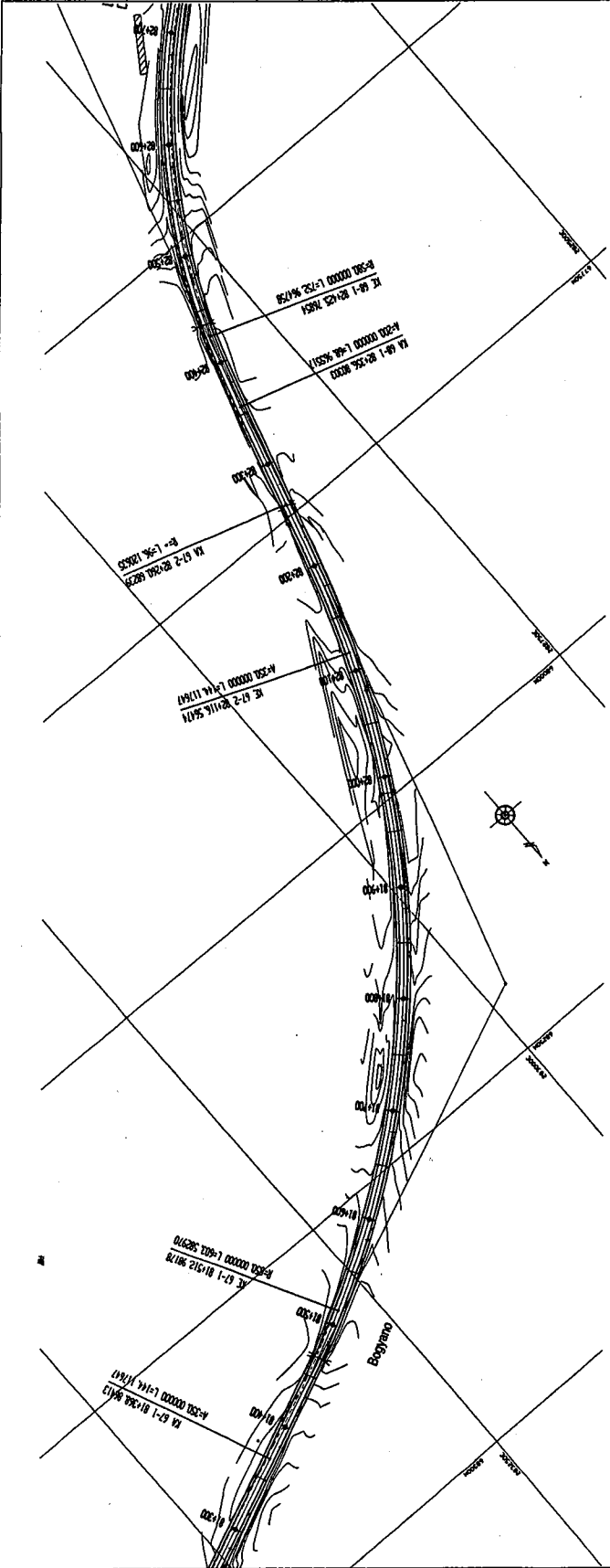

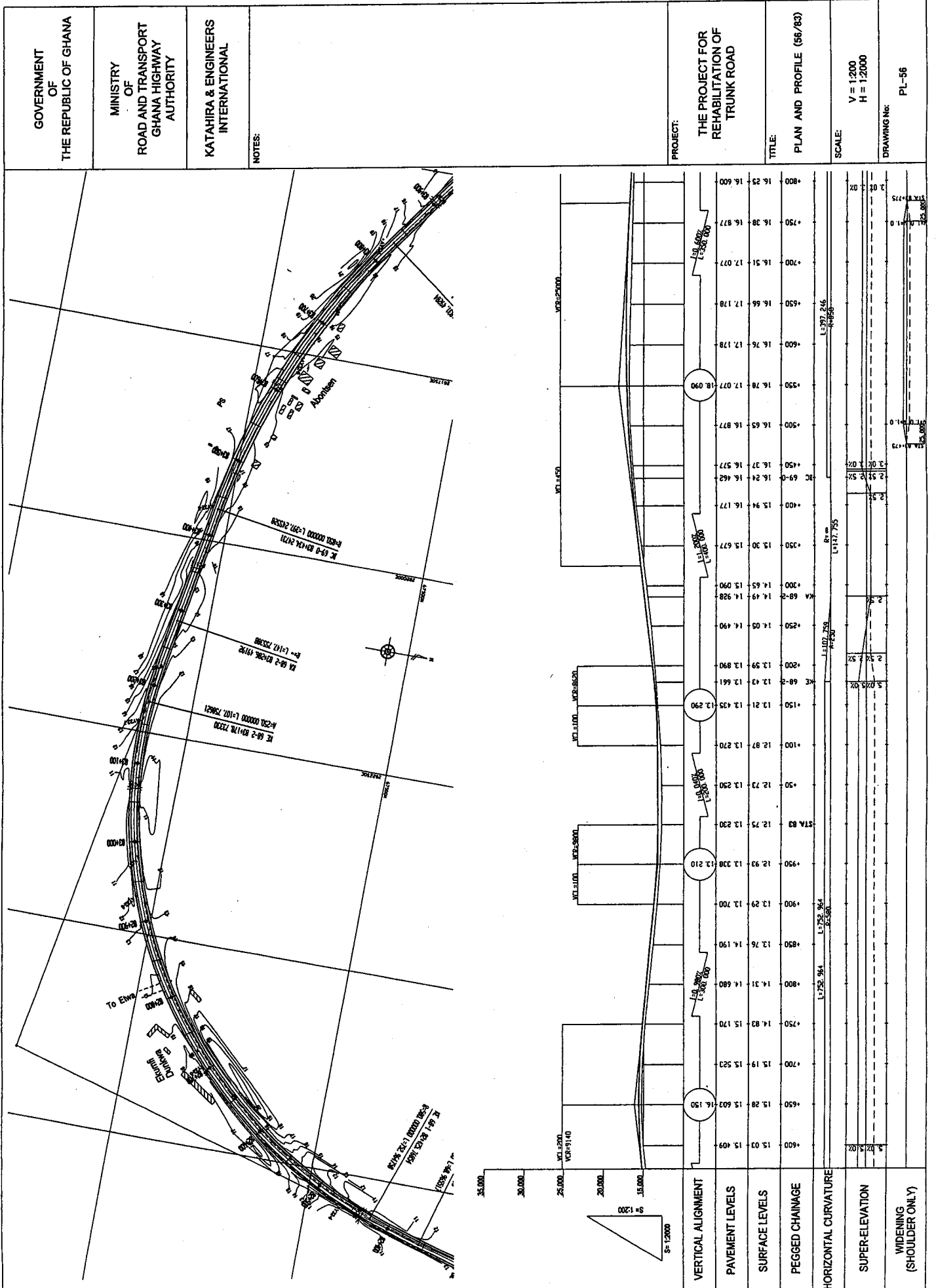



GOVERNMENT OF THE REPUBLIC OF GHANA  
 MINISTRY OF ROAD AND TRANSPORT GHANA HIGHWAY AUTHORITY  
 KATAHIRA & ENGINEERS INTERNATIONAL  
 NOTES:  
 PROJECT: THE PROJECT FOR REHABILITATION OF TRUNK ROAD  
 TITLE: PLAN AND PROFILE (57/83)  
 SCALE: V = 1:2000 H = 1:2000  
 DRAWING No. PL-57

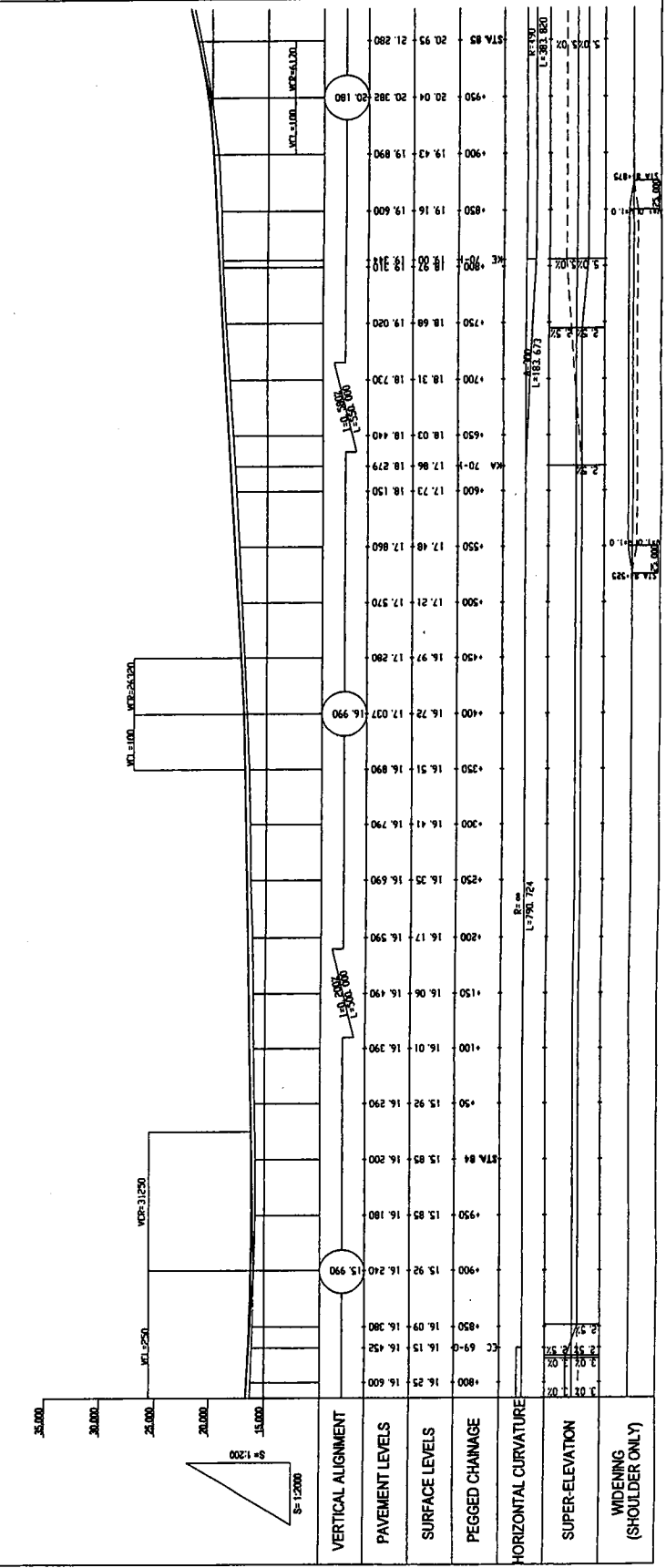
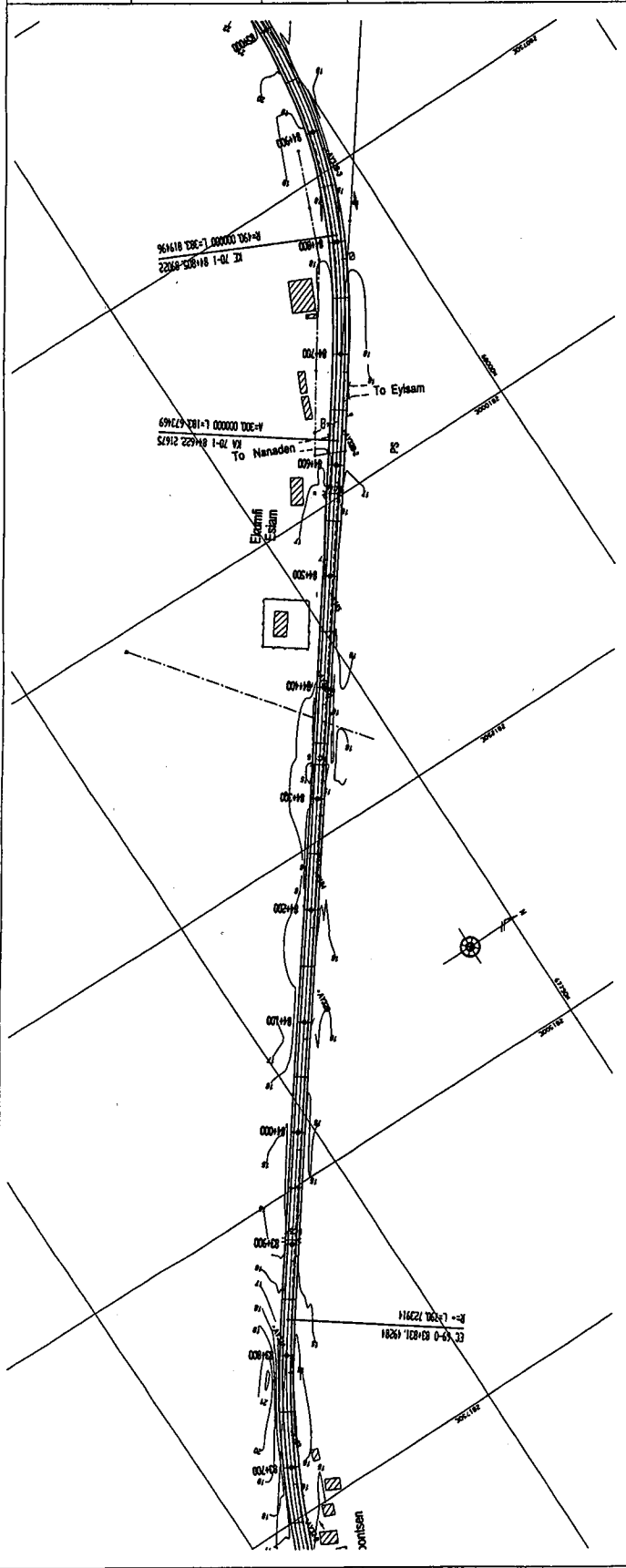

GOVERNMENT OF THE REPUBLIC OF GHANA  
 MINISTRY OF ROAD AND TRANSPORT GHANA HIGHWAY AUTHORITY  
 KATAHIRA & ENGINEERS INTERNATIONAL  
 NOTES:  
 PROJECT: THE PROJECT FOR THE REHABILITATION OF TRUNK ROAD  
 TITLE: PLAN AND PROFILE (58/83)  
 SCALE: V = 1:2000, H = 1:2000  
 DRAWING No: PL-58

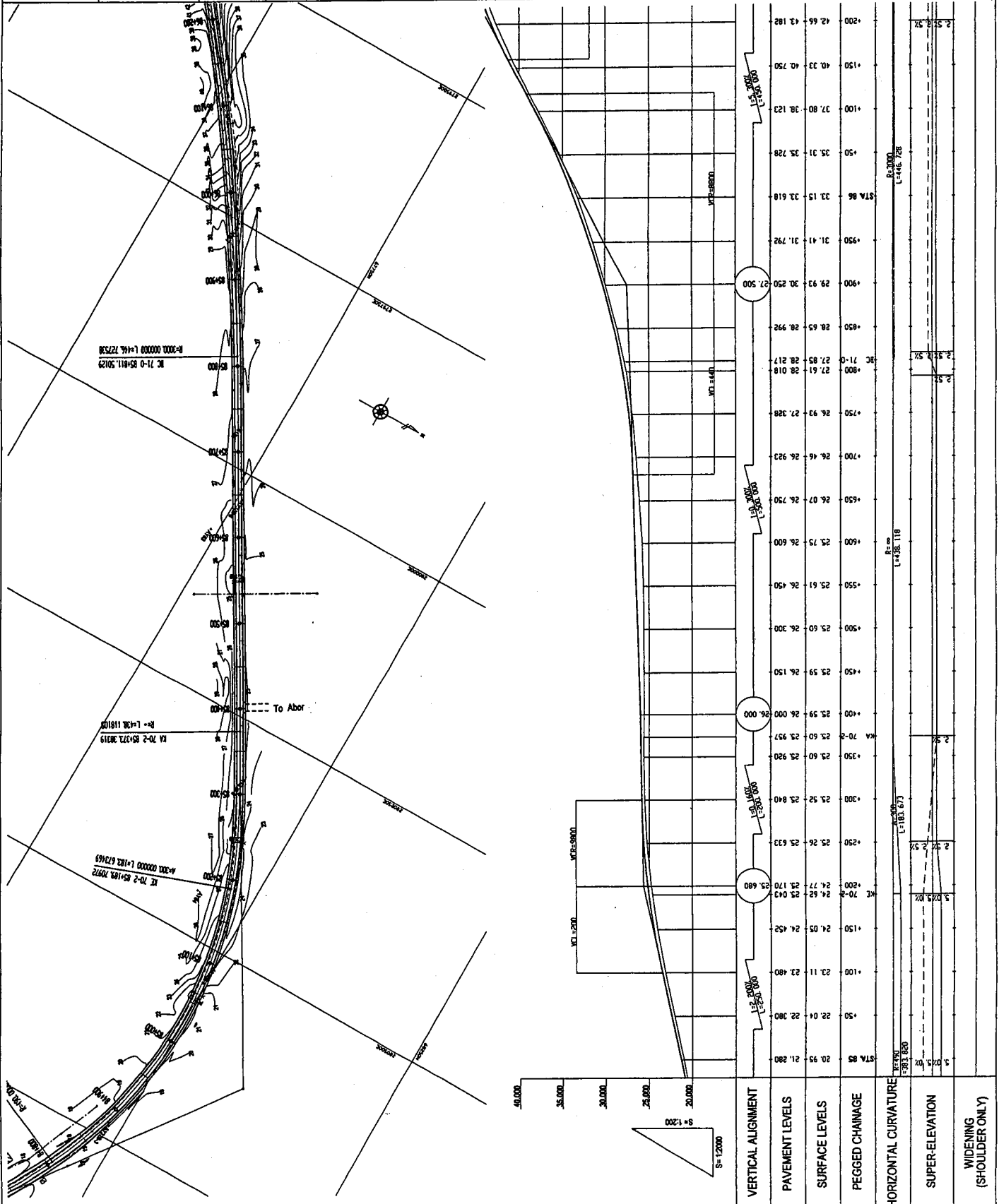

GOVERNMENT OF THE REPUBLIC OF GHANA	MINISTRY OF ROAD AND TRANSPORT GHANA HIGHWAY AUTHORITY	KATAHIRA & ENGINEERS INTERNATIONAL	NOTES:	PROJECT: THE PROJECT FOR REHABILITATION OF TRUNK ROAD	TITLE: PLAN AND PROFILE (59/83)	SCALE: V = 1:200 H = 1:2000	DRAWING No: PL-59
-------------------------------------	--	------------------------------------	--------	---	---------------------------------	-----------------------------	-------------------

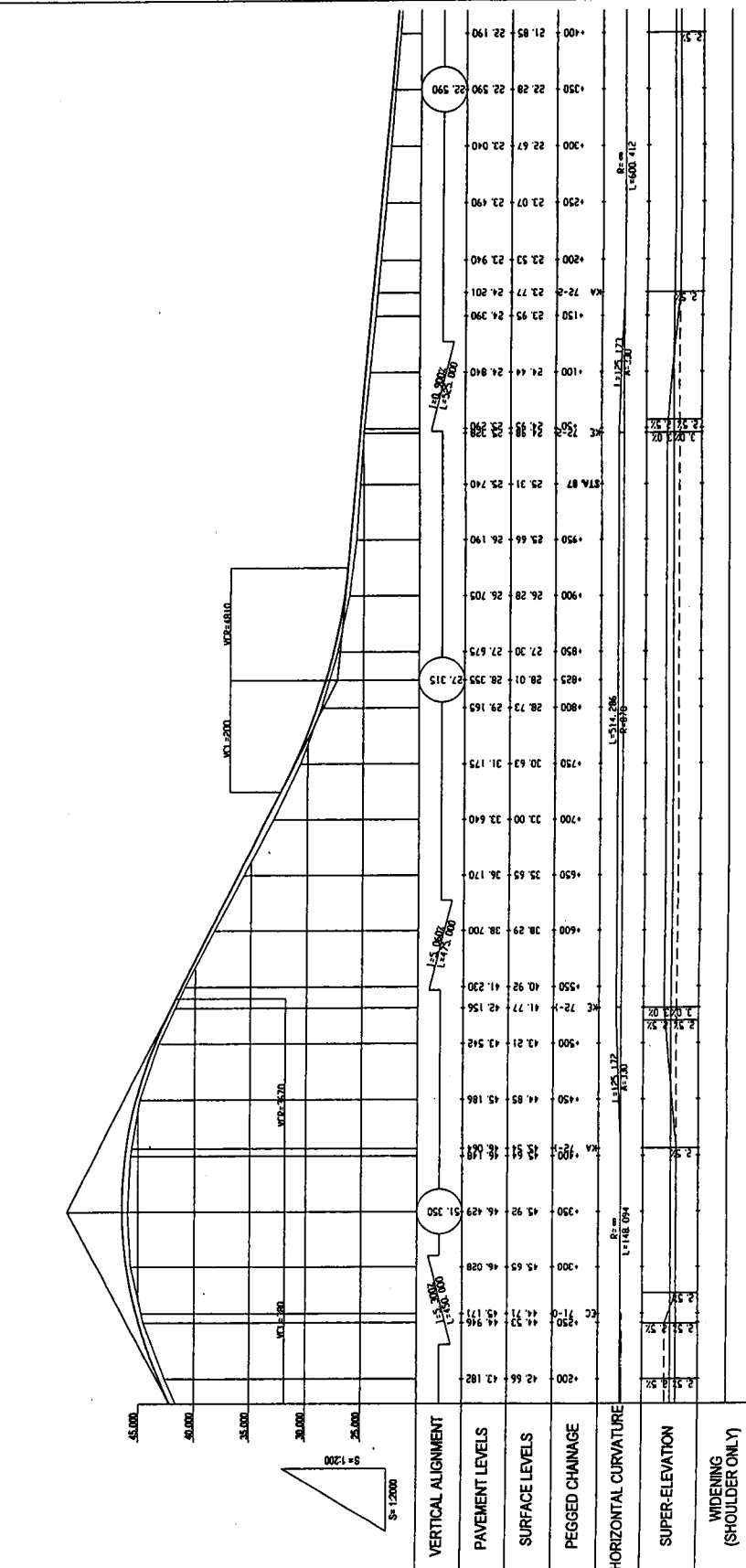
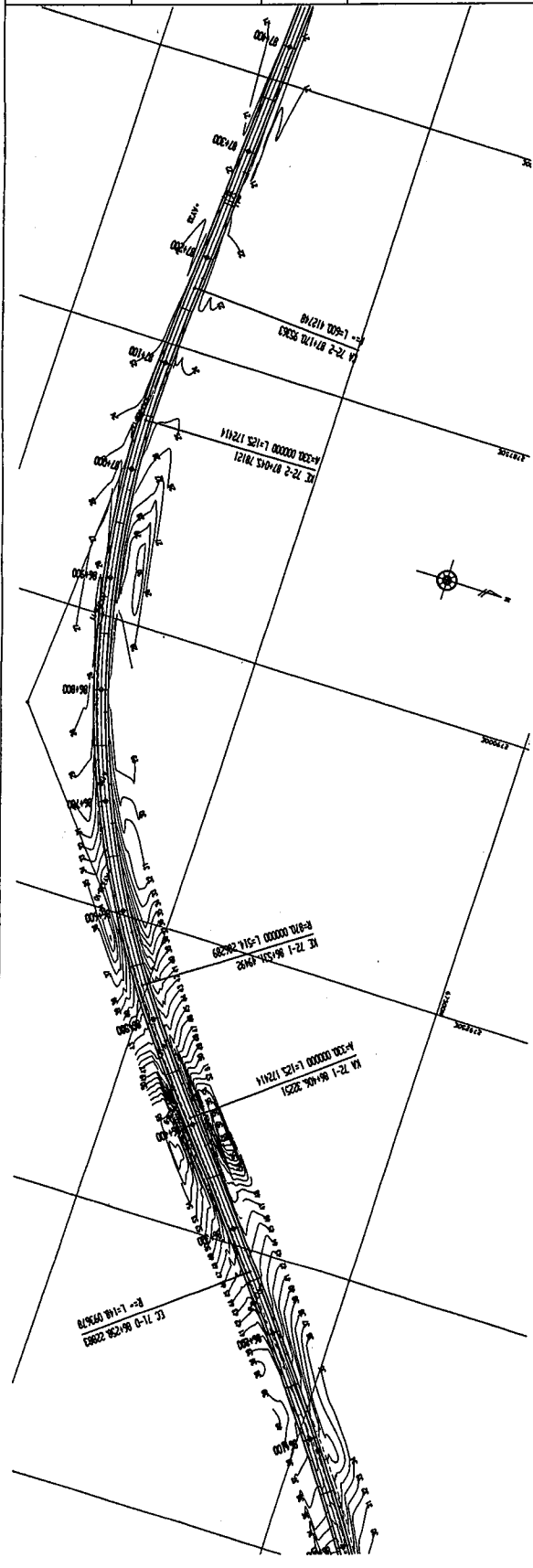

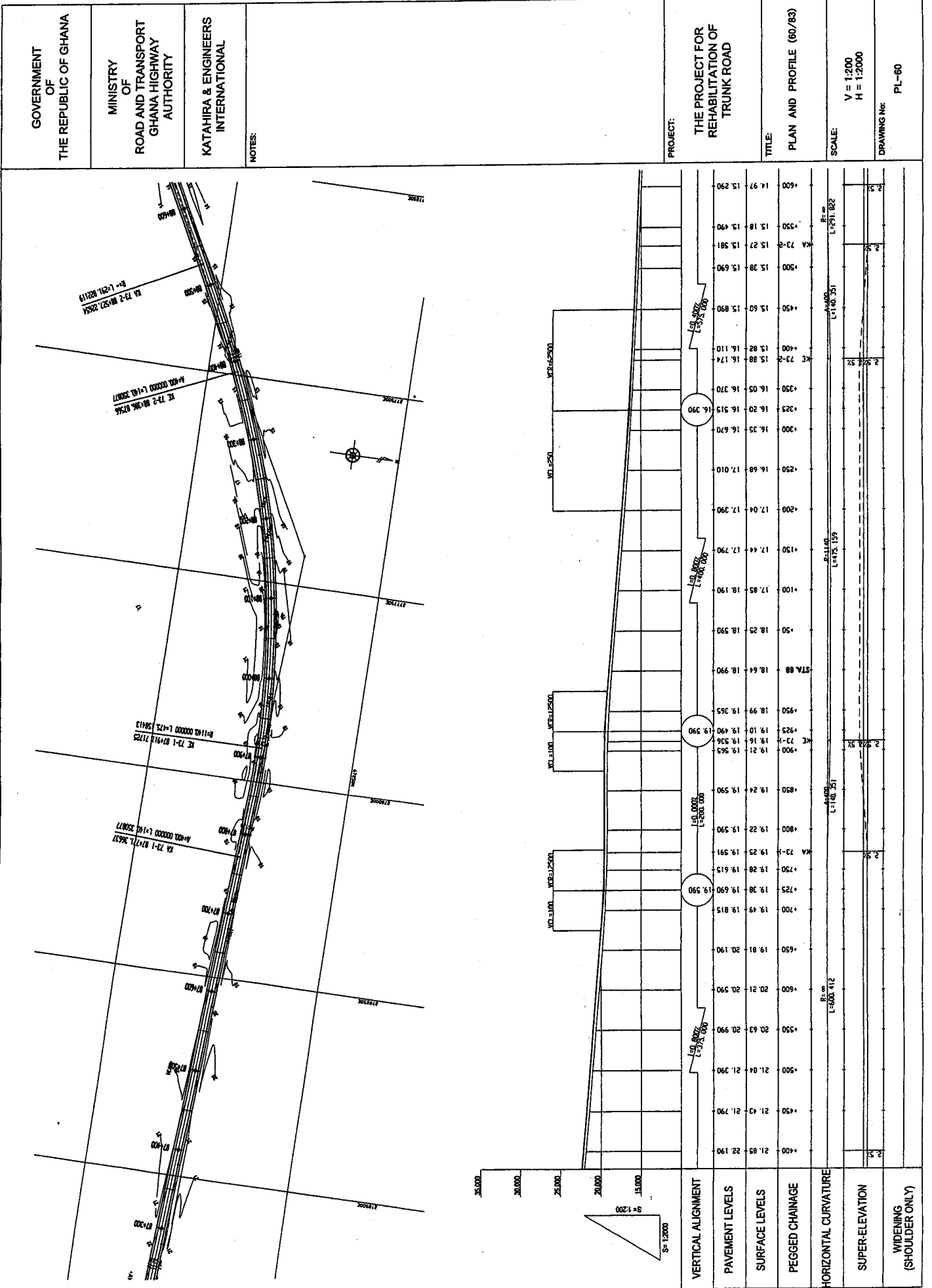

GOVERNMENT OF THE REPUBLIC OF GHANA  
 MINISTRY OF ROAD AND TRANSPORT GHANA HIGHWAY AUTHORITY  
 KATAHIRA & ENGINEERS INTERNATIONAL  
 NOTES:  
 PROJECT: THE PROJECT FOR REHABILITATION OF TRUNK ROAD  
 TITLE: PLAN AND PROFILE (61/83)  
 SCALE: V = 1:200 H = 1:2000  
 DRAWING No: PL-61

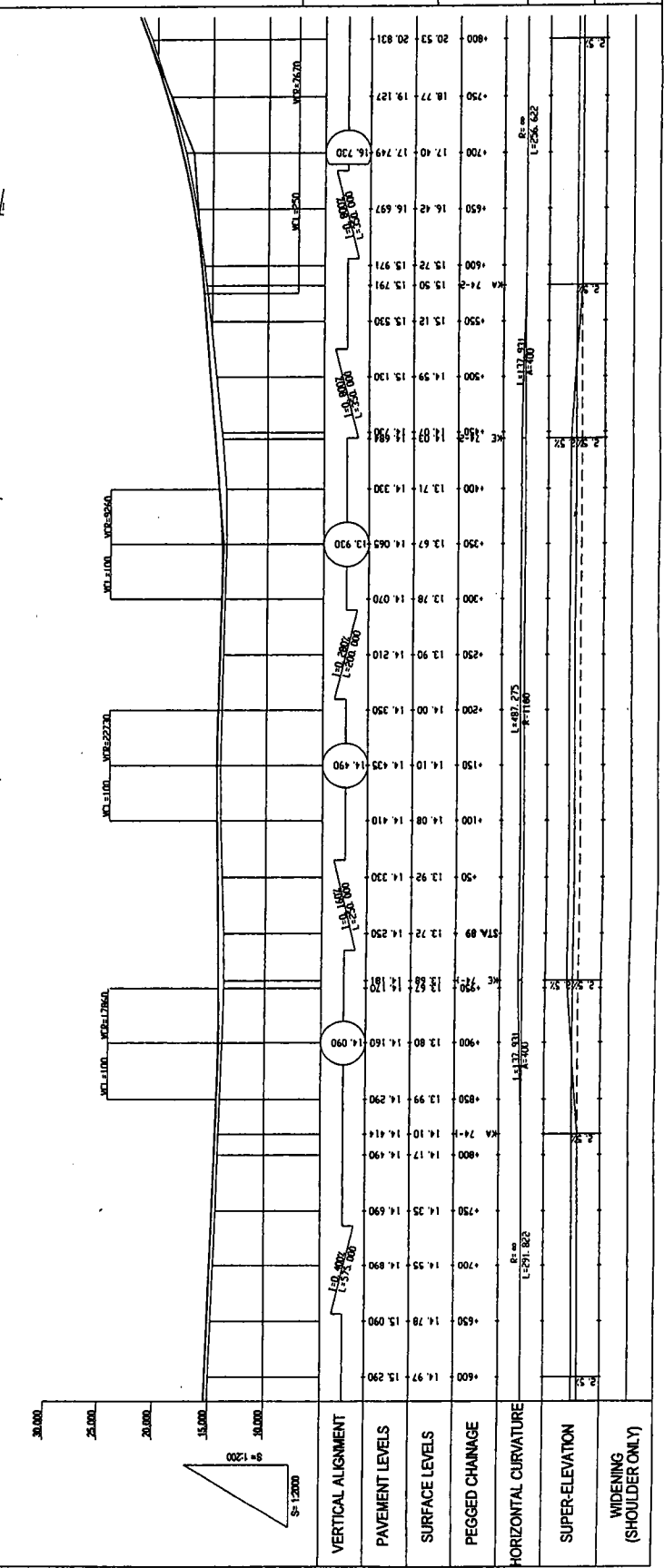
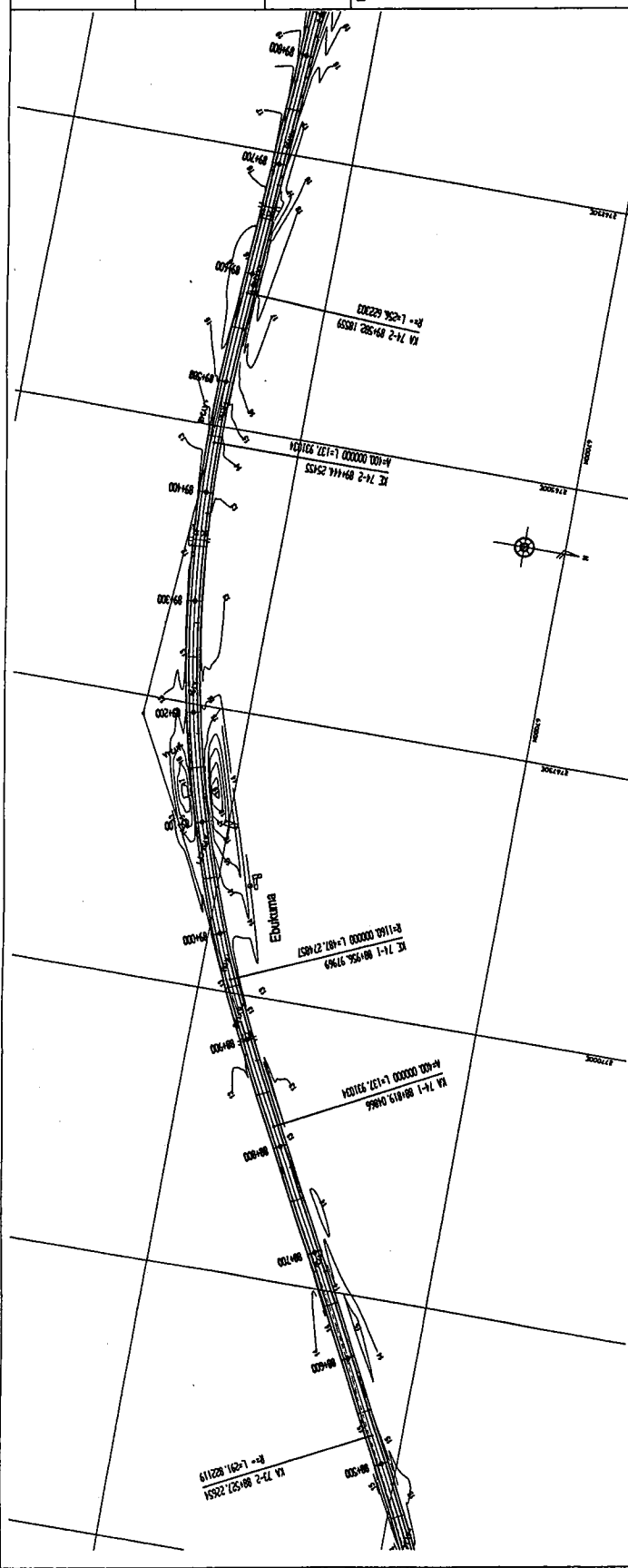

GOVERNMENT OF THE REPUBLIC OF GHANA  
 MINISTRY OF ROAD AND TRANSPORT GHANA HIGHWAY AUTHORITY  
 KATAHIRA & ENGINEERS INTERNATIONAL  
 NOTES:  
 PROJECT: THE PROJECT FOR THE REHABILITATION OF TRUNK ROAD  
 TITLE: PLAN AND PROFILE (62/83)  
 SCALE: V = 1:2000, H = 1:2000  
 DRAWING NO: PL-62

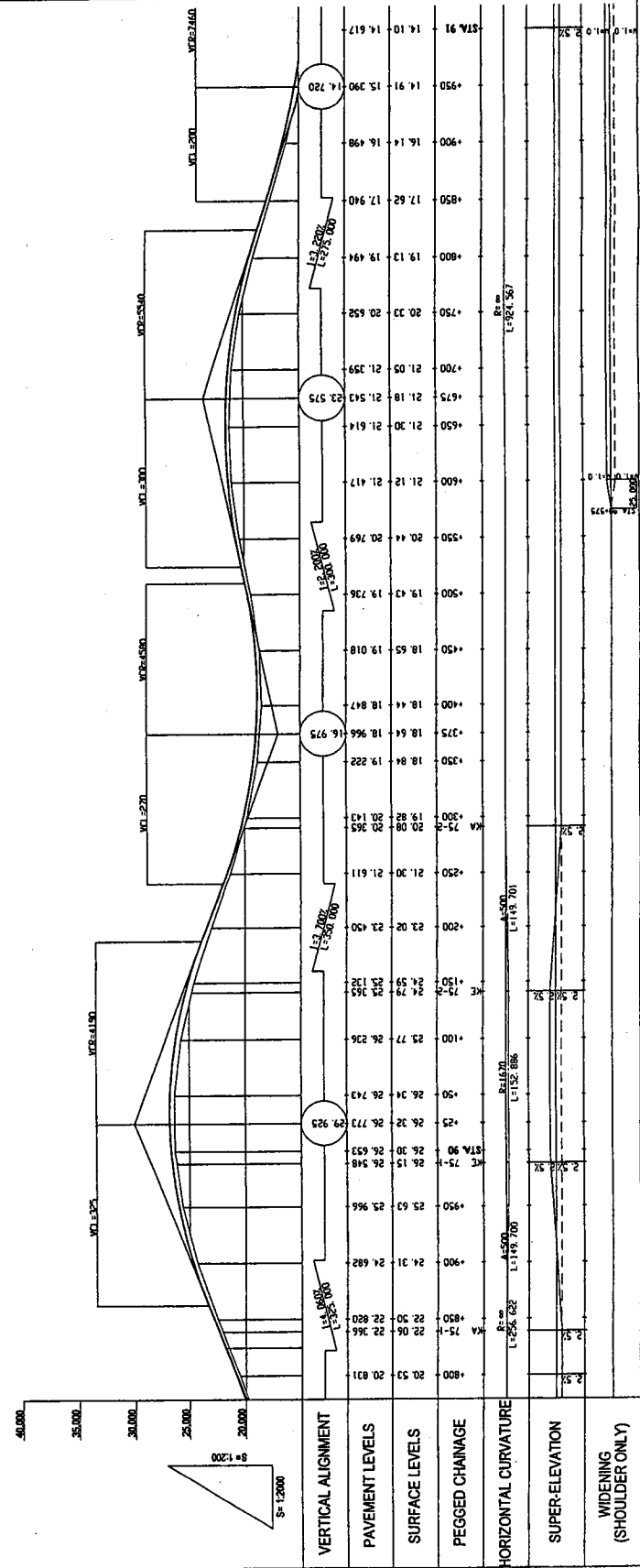
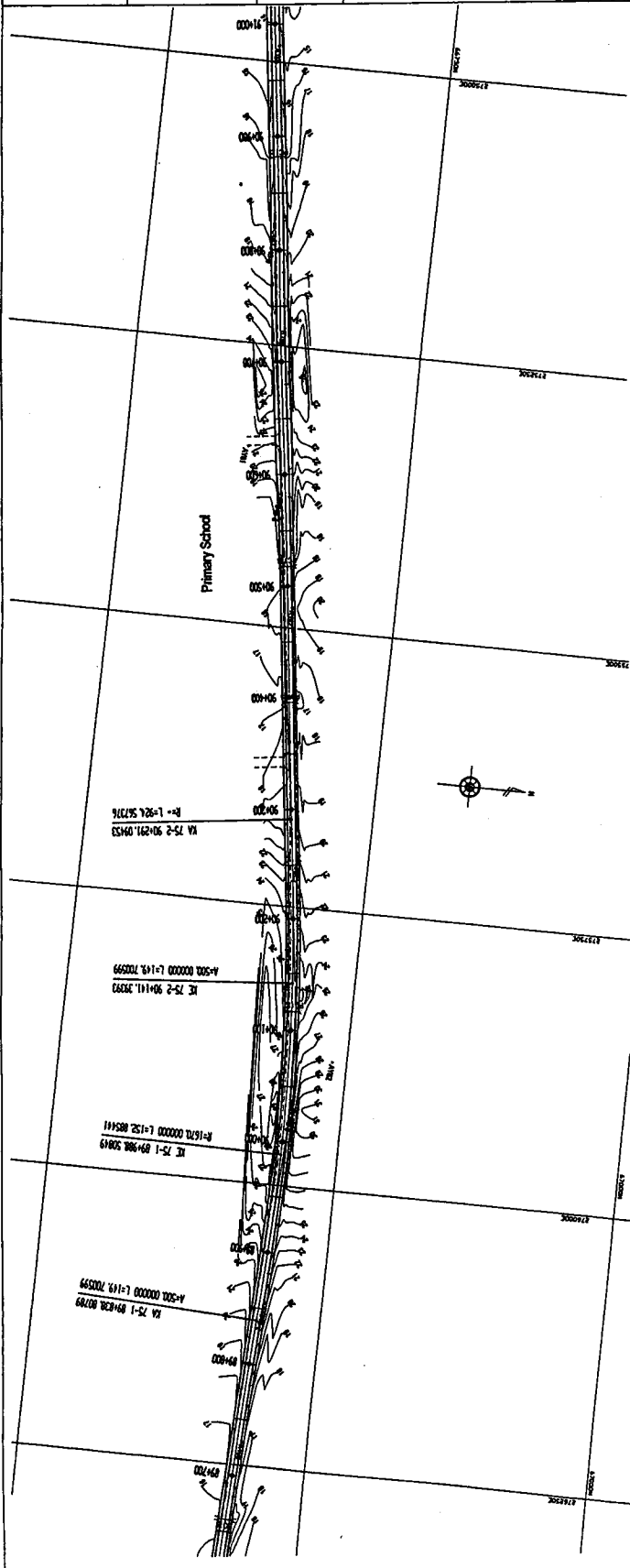

GOVERNMENT OF THE REPUBLIC OF GHANA

MINISTRY OF ROAD AND TRANSPORT GHANA HIGHWAY AUTHORITY

KATAHIRA & ENGINEERS INTERNATIONAL

NOTES:

PROJECT: THE PROJECT FOR REHABILITATION OF TRUNK ROAD

TITLE: PLAN AND PROFILE (63/83)

SCALE: V = 1:200 H = 1:2000

DRAWING No: PL-63

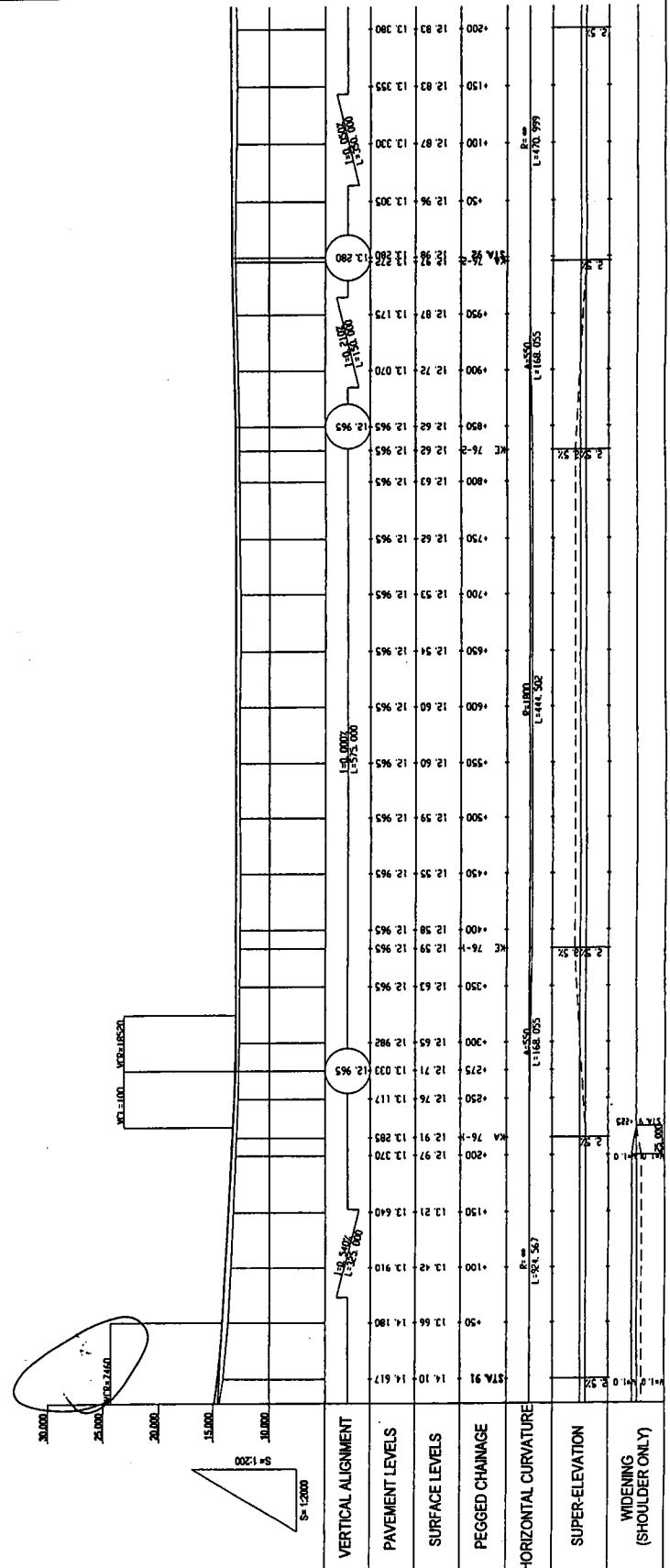
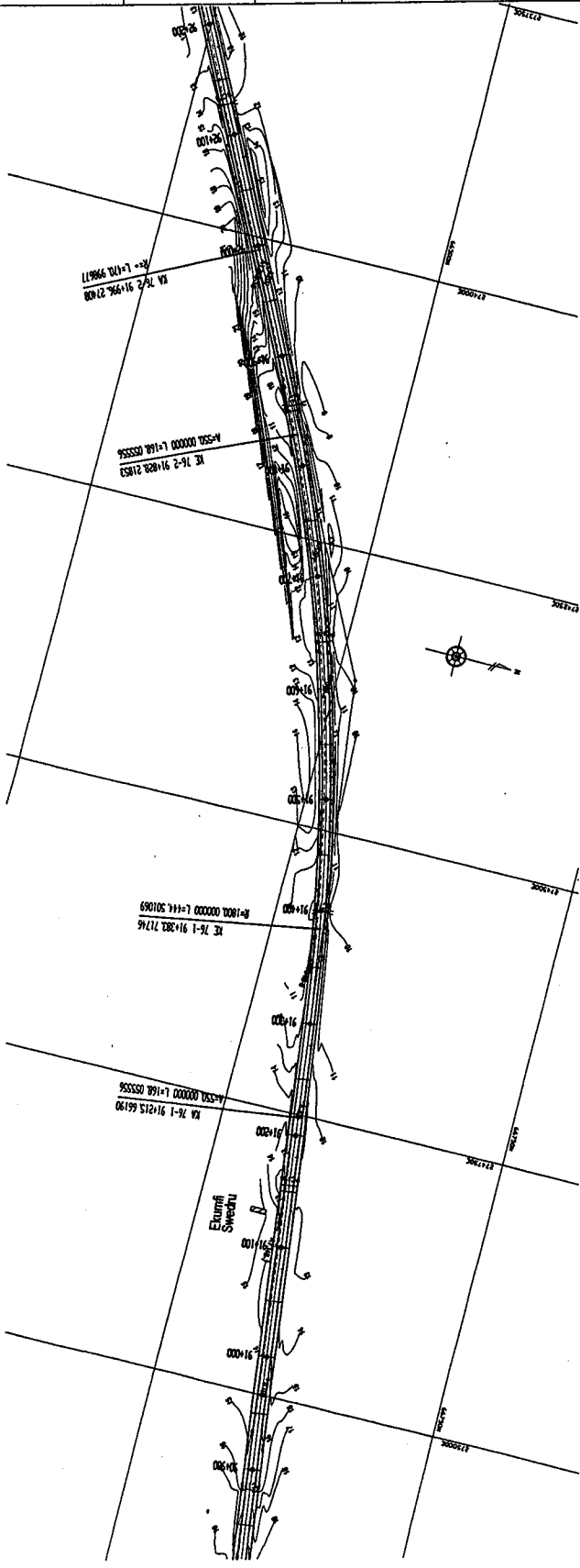

GOVERNMENT OF THE REPUBLIC OF GHANA	MINISTRY OF ROAD AND TRANSPORT GHANA HIGHWAY AUTHORITY	KATAHIRA & ENGINEERS INTERNATIONAL	NOTES:	PROJECT:  THE PROJECT FOR REHABILITATION OF TRUNK ROAD	TITLE:  PLAN AND PROFILE (64/83)	SCALE:  V = 1:200 H = 1:2000	DRAWING NO:  PL-64
---	--	---------------------------------------	--------	--	--	---------------------------------------	--------------------------

