

GOVERNMENT OF THE REPUBLIC OF GHANA

MINISTRY OF ROAD AND TRANSPORT GHANA HIGHWAY AUTHORITY

KATAHIRA & ENGINEERS INTERNATIONAL

NOTES:

PROJECT: THE PROJECT FOR REHABILITATION OF TRUNK ROAD

TITLE: PLAN AND PROFILE (16/83)

SCALE: V = 1:200 H = 1:2000

DRAWING No: PL-16

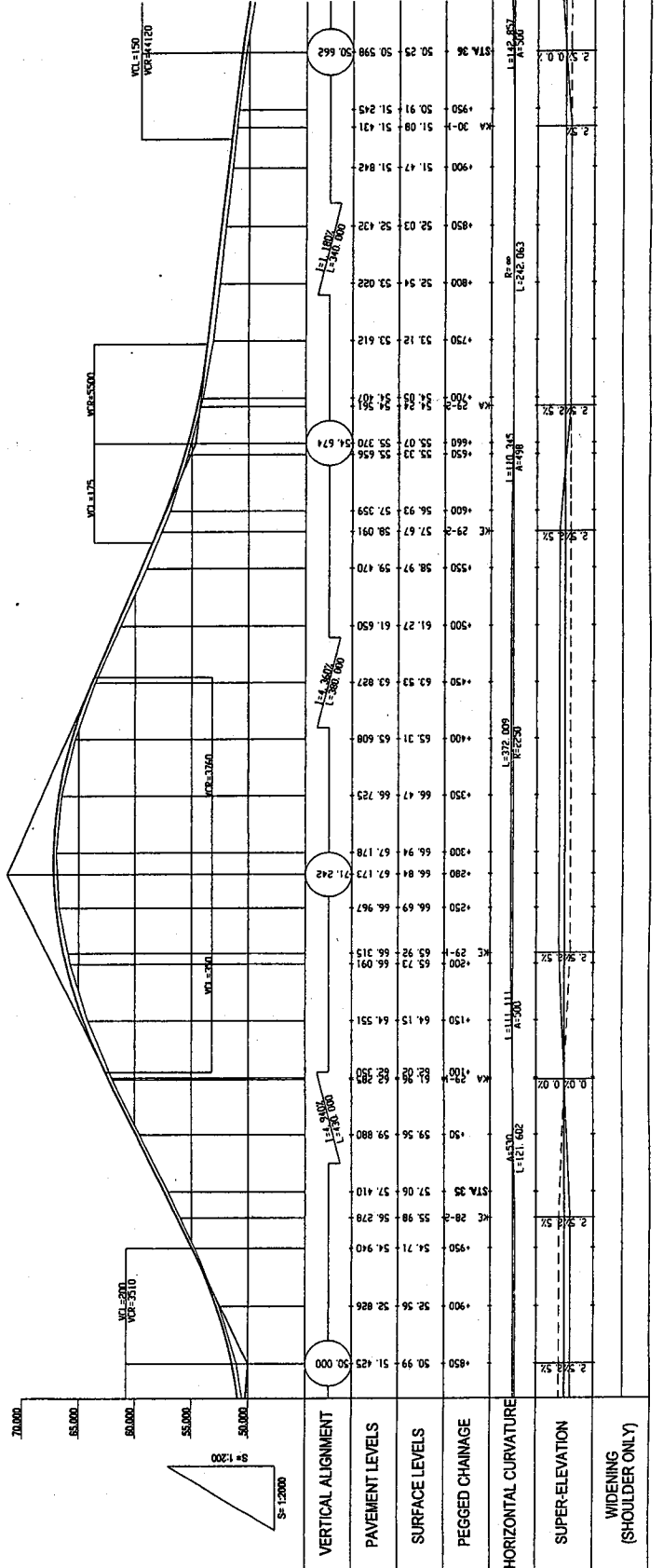
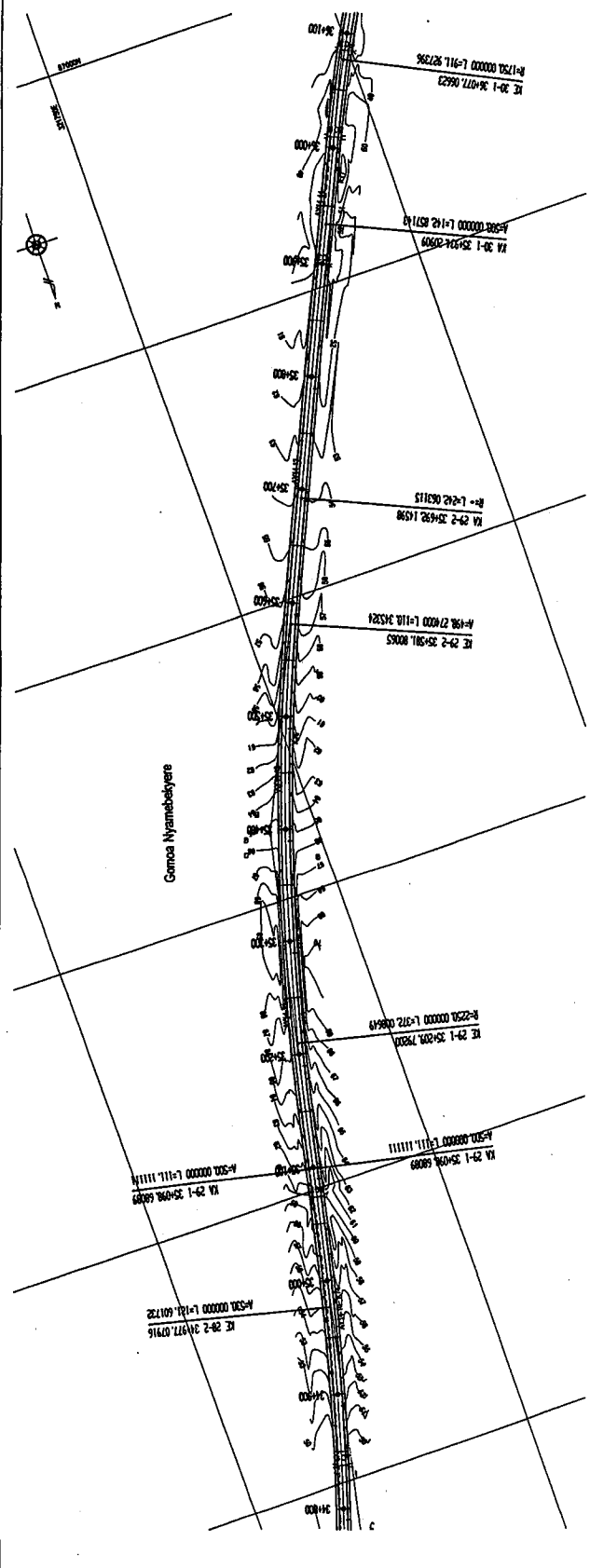

GOVERNMENT OF THE REPUBLIC OF GHANA
 MINISTRY OF ROAD AND TRANSPORT GHANA HIGHWAY AUTHORITY
 KATAHIRA & ENGINEERS INTERNATIONAL

NOTES:

PROJECT: THE PROJECT FOR REHABILITATION OF TRUNK ROAD

TITLE: PLAN AND PROFILE (17/83)

SCALE: V = 1:200 H = 1:2000

DRAWING No: PL-17

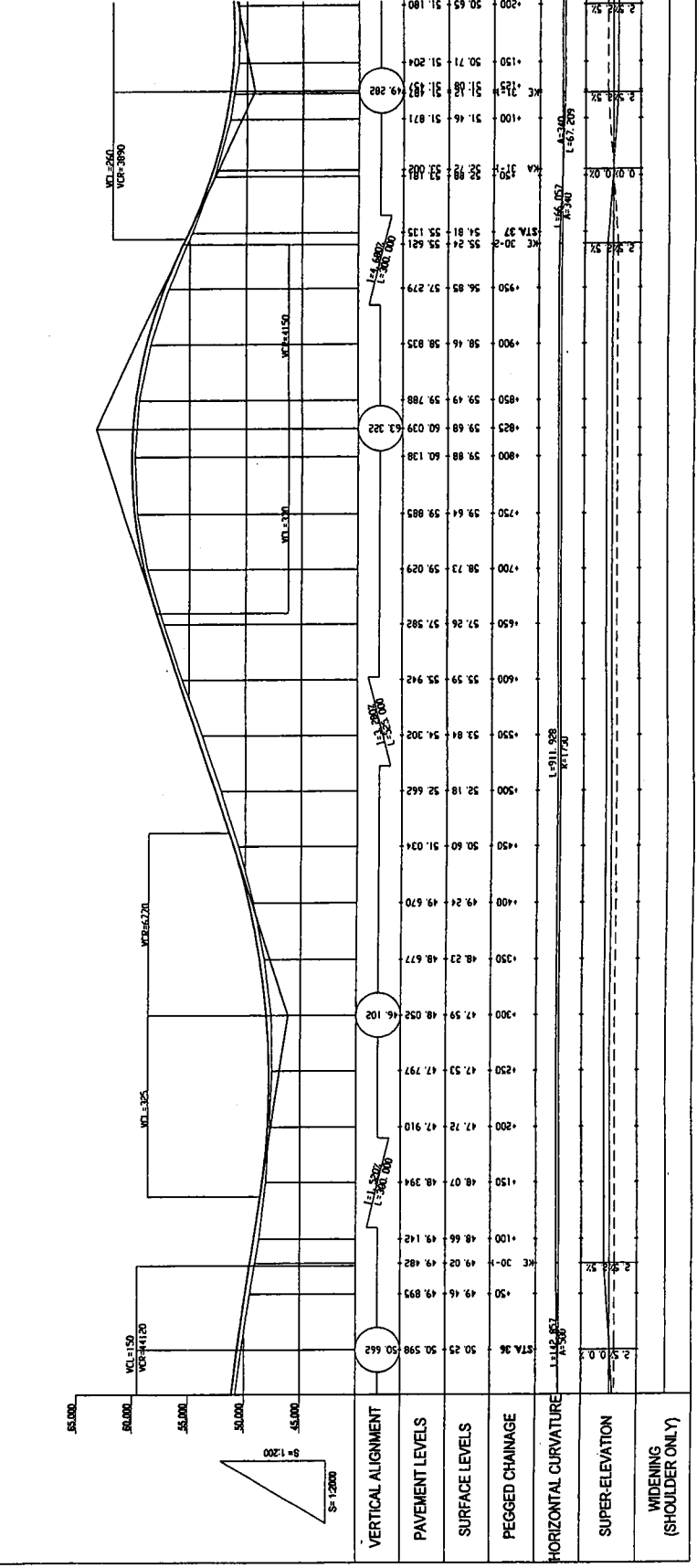
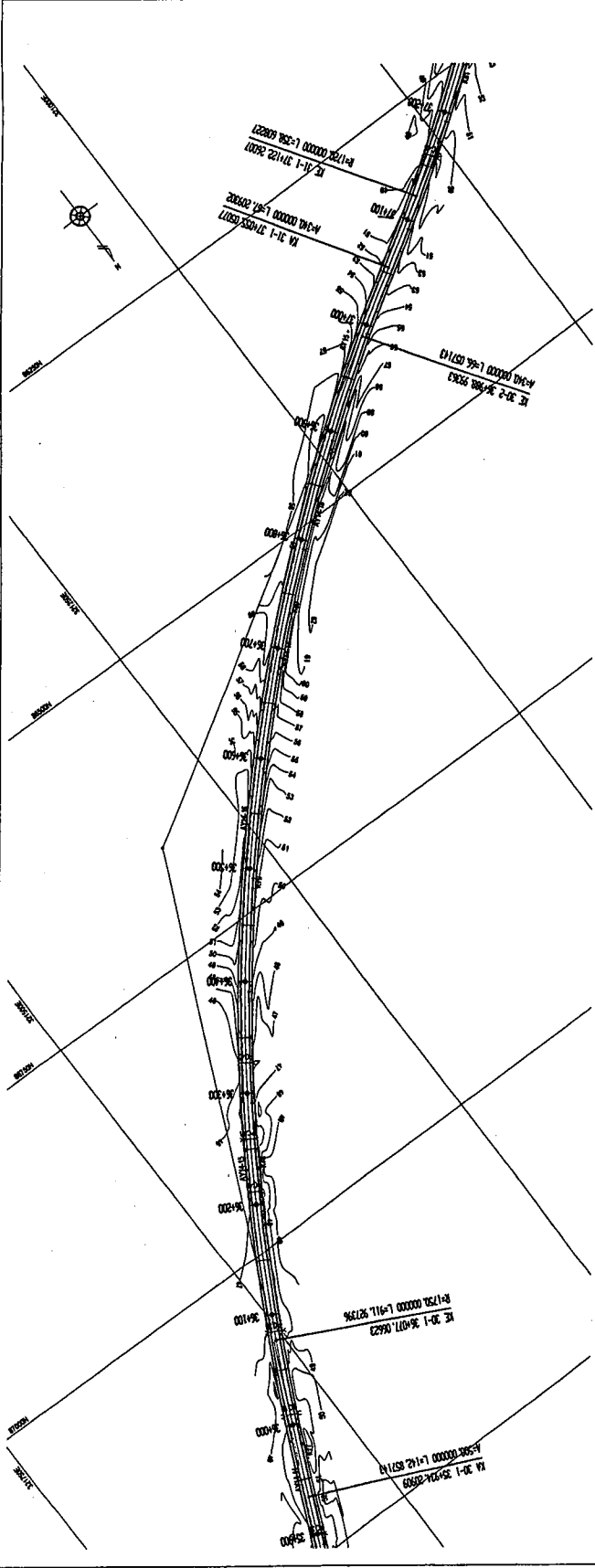

GOVERNMENT OF THE REPUBLIC OF GHANA	MINISTRY OF ROAD AND TRANSPORT GHANA HIGHWAY AUTHORITY	KATAHIRA & ENGINEERS INTERNATIONAL	NOTES:	PROJECT: THE PROJECT FOR REHABILITATION OF TRUNK ROAD	TITLE: PLAN AND PROFILE (18/83)	SCALE: V = 1:200 H = 1:2000	DRAWING No: PL-18
-------------------------------------	--	------------------------------------	--------	---	---------------------------------	-----------------------------	-------------------

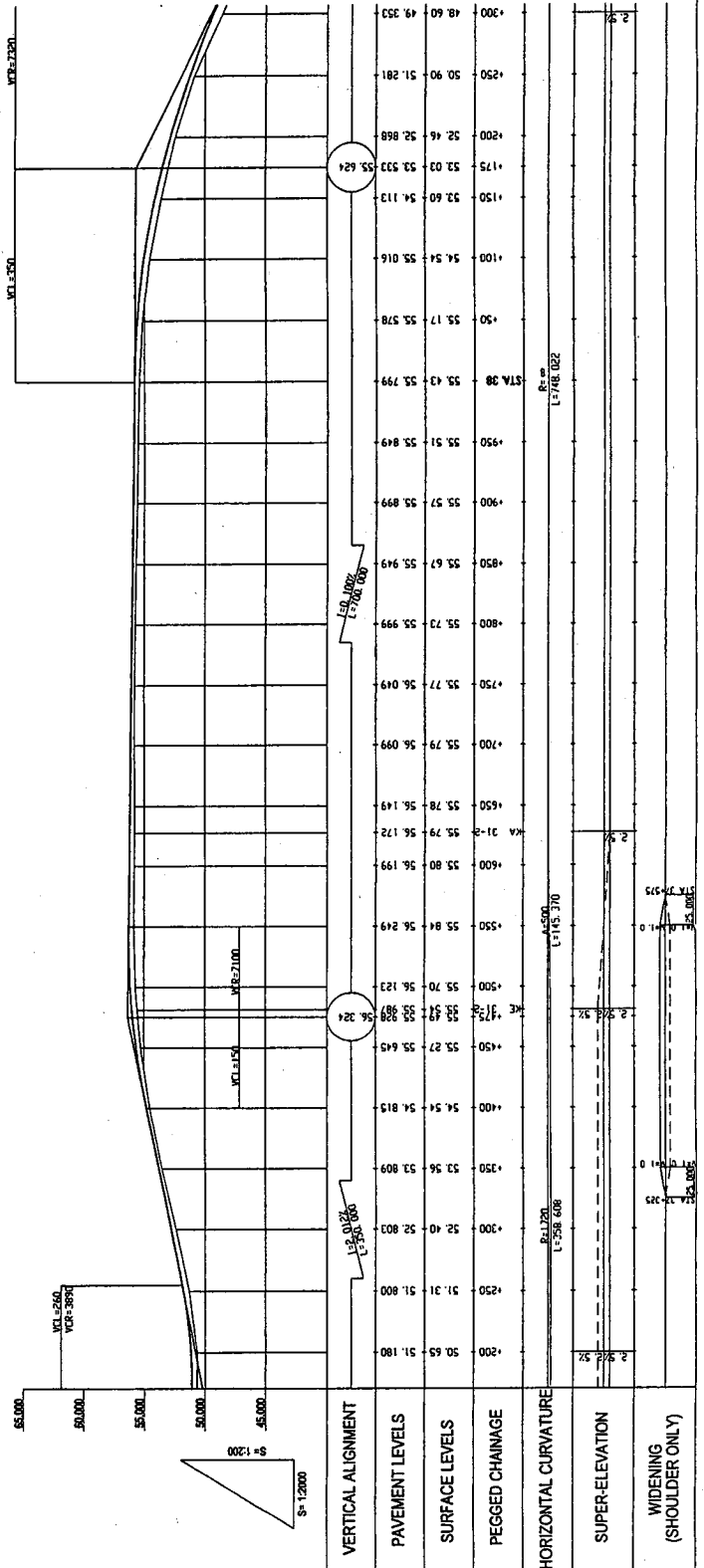
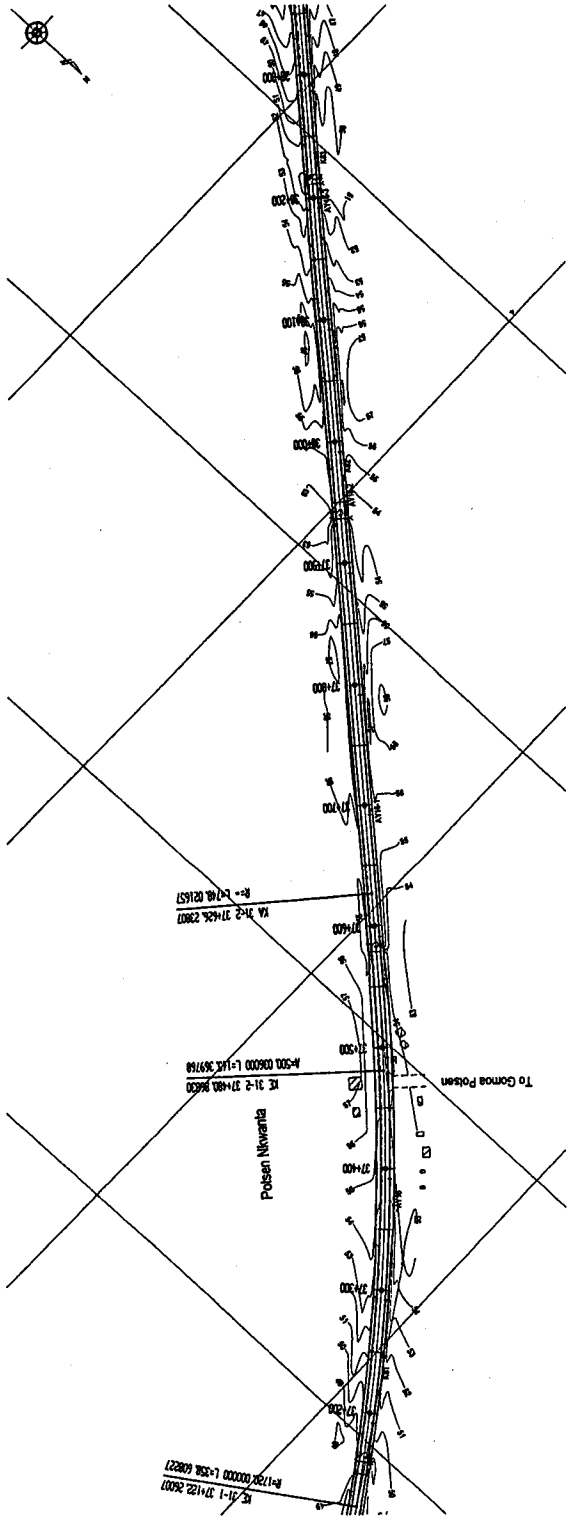

GOVERNMENT OF THE REPUBLIC OF GHANA	MINISTRY OF ROAD AND TRANSPORT GHANA HIGHWAY AUTHORITY	KATAHIRA & ENGINEERS INTERNATIONAL	NOTES:	PROJECT: THE PROJECT FOR REHABILITATION OF TRUNK ROAD	TITLE: PLAN AND PROFILE (19/83)	SCALE: V = 1:200 H = 1:2000	DRAWING No: PL-19
-------------------------------------	--	------------------------------------	--------	---	---------------------------------	-----------------------------	-------------------

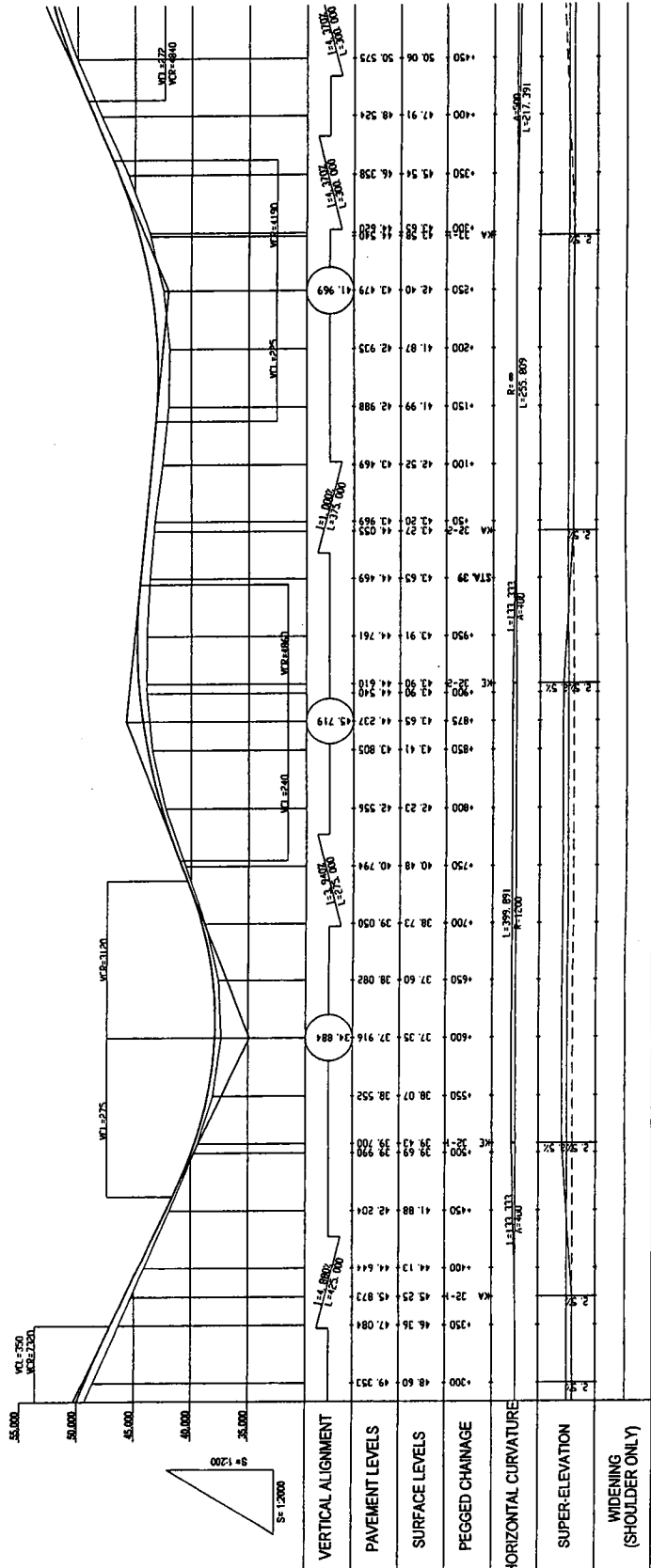
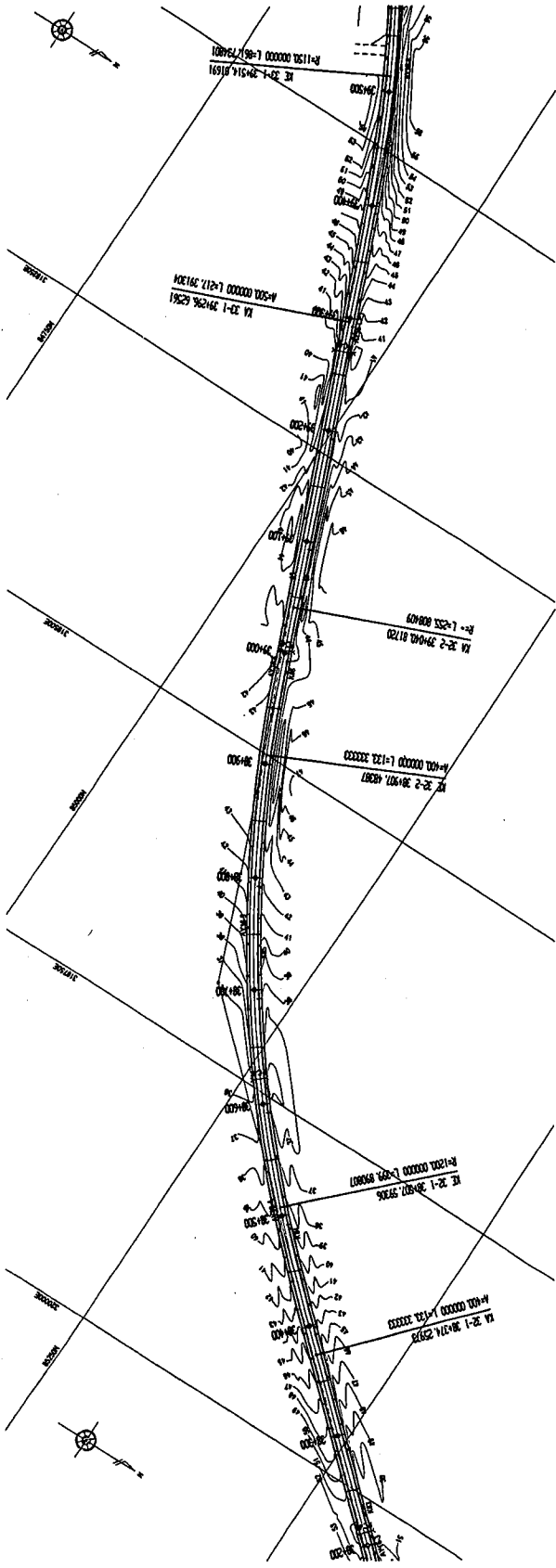

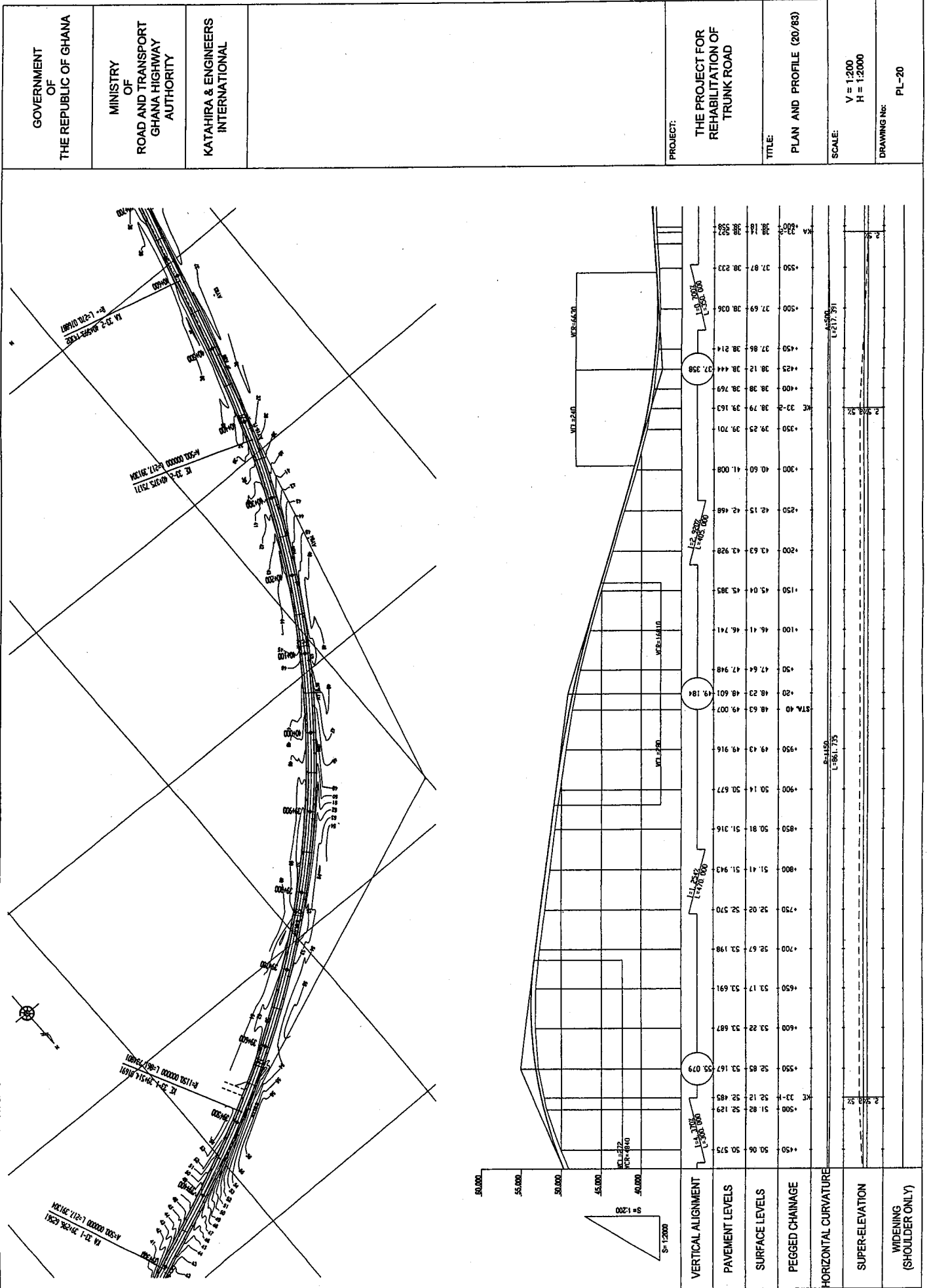

GOVERNMENT OF THE REPUBLIC OF GHANA

MINISTRY OF ROAD AND TRANSPORT GHANA HIGHWAY AUTHORITY

KATAHIRA & ENGINEERS INTERNATIONAL

NOTES:

PROJECT: THE PROJECT FOR THE REHABILITATION OF TRUNK ROAD

TITLE: PLAN AND PROFILE (22/83)

SCALE: V = 1:200 H = 1:2000

DRAWING No: PL-22

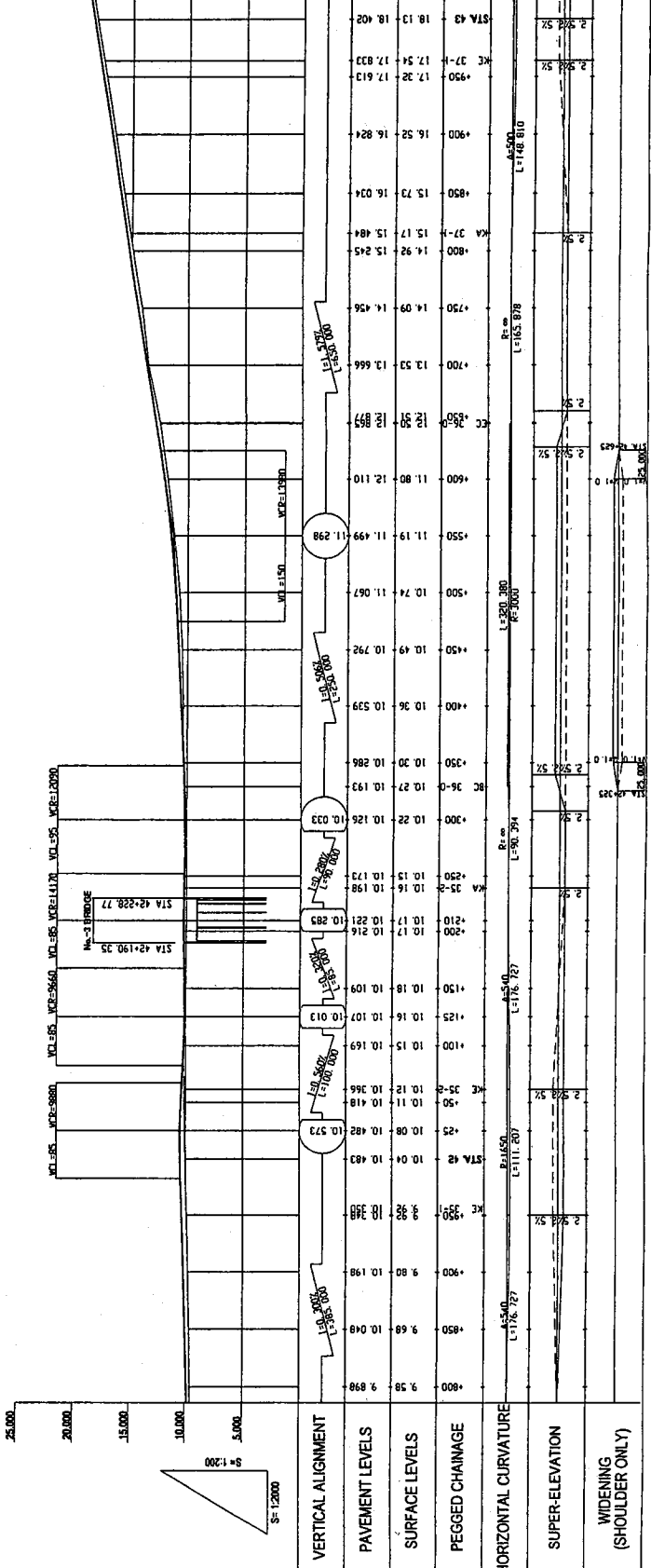
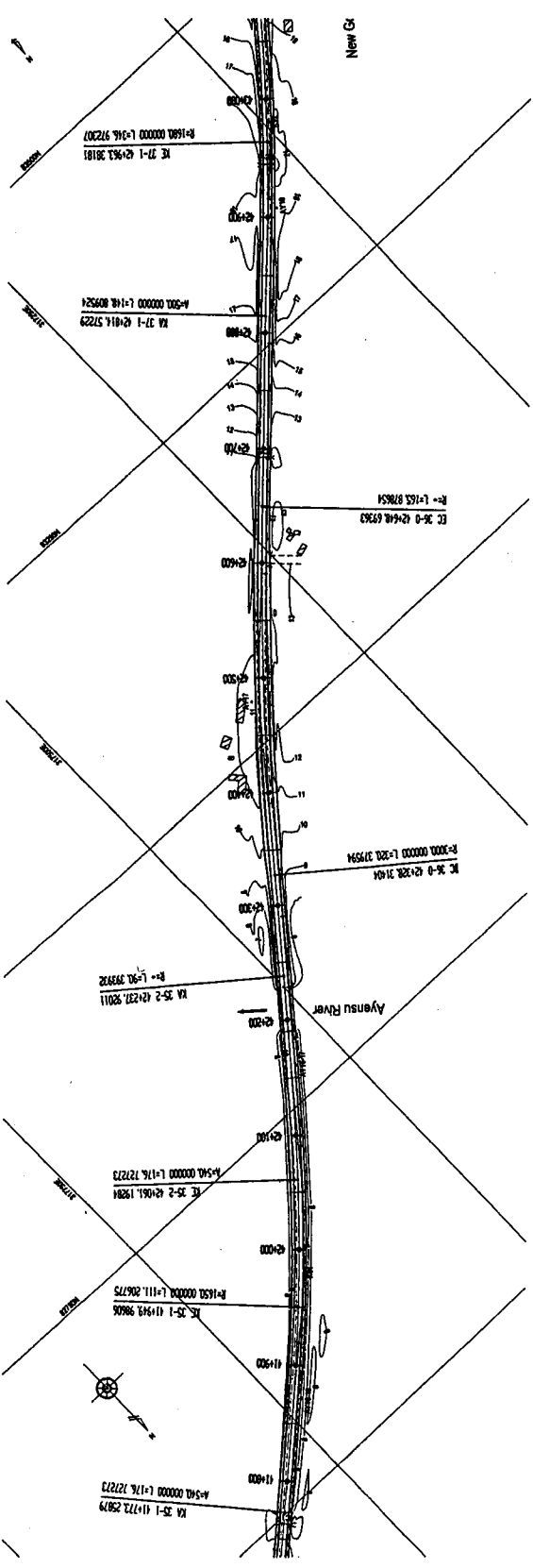

GOVERNMENT OF THE REPUBLIC OF GHANA
 MINISTRY OF ROAD AND TRANSPORT GHANA HIGHWAY AUTHORITY
 KATAHIRA & ENGINEERS INTERNATIONAL
 NOTES:
 PROJECT: THE PROJECT FOR REHABILITATION OF TRUNK ROAD
 TITLE: PLAN AND PROFILE (23/83)
 SCALE: V = 1:200 H = 1:2000
 DRAWING No: PL-23

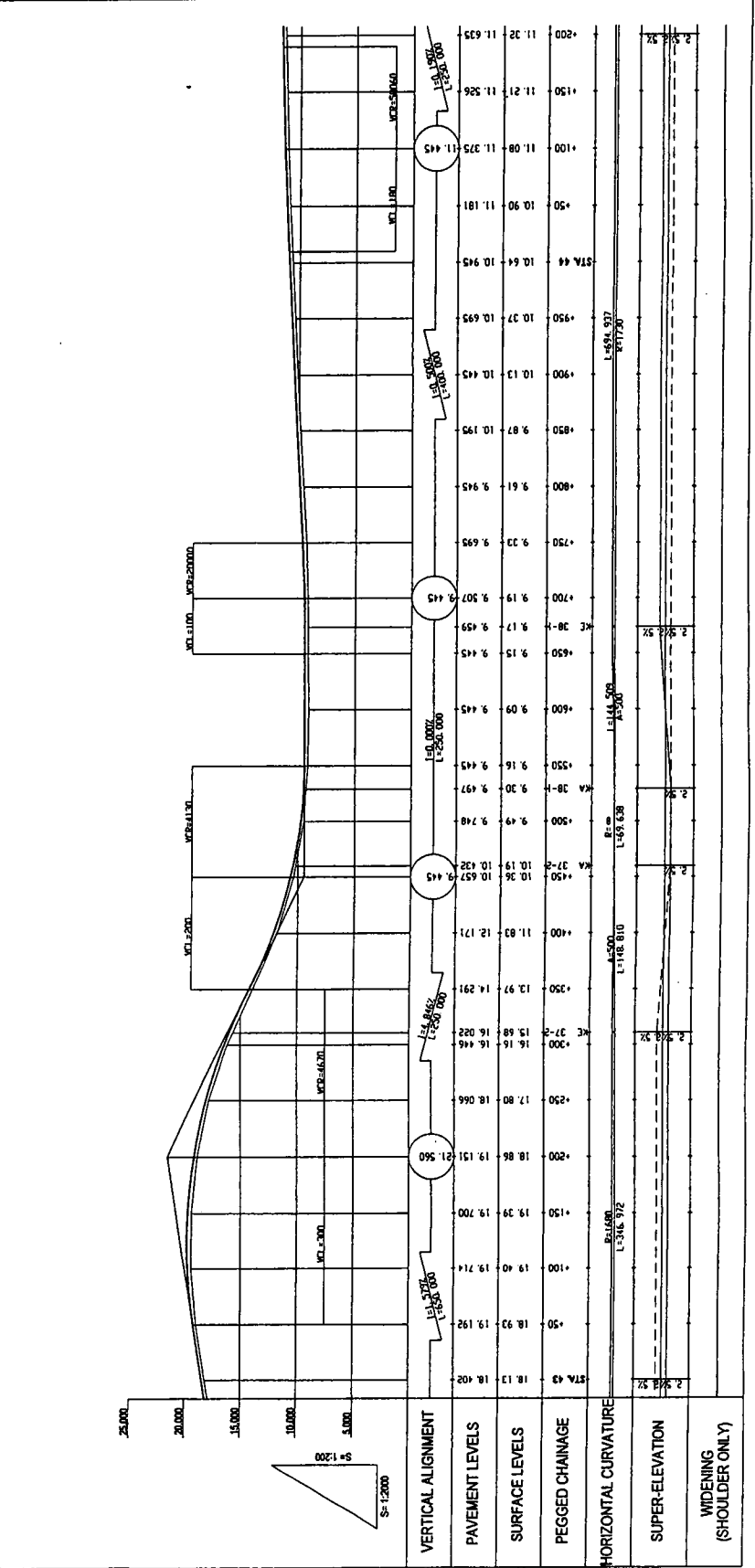
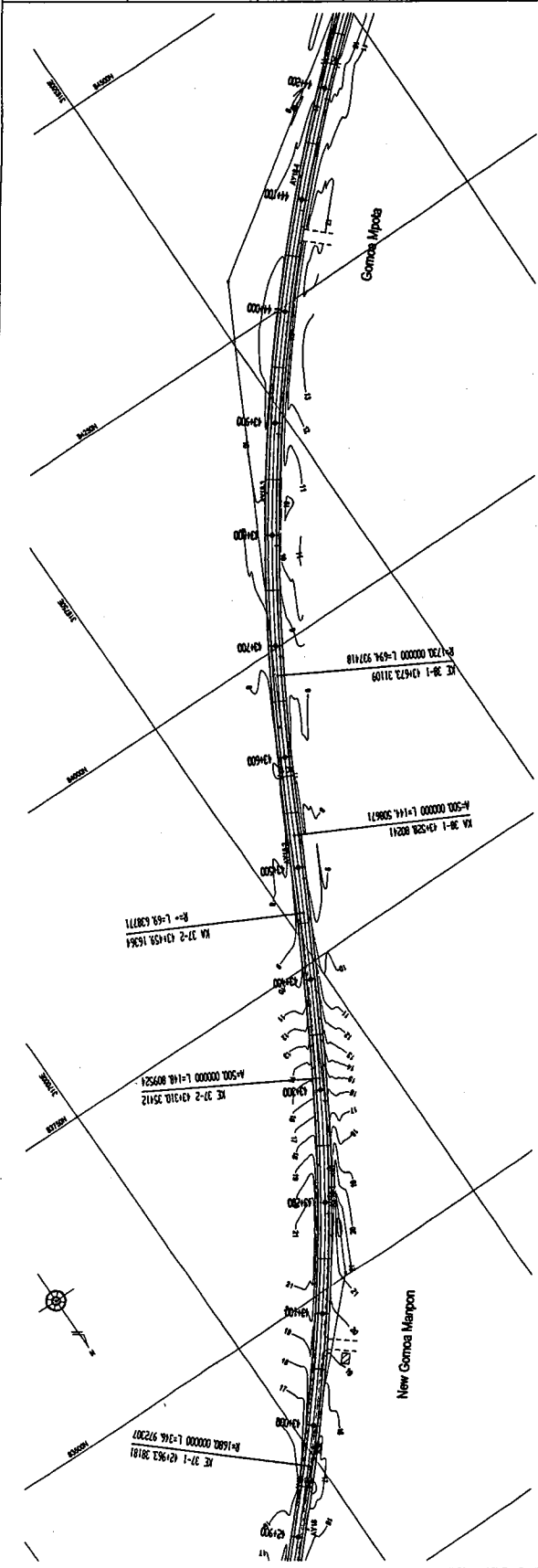

GOVERNMENT OF THE REPUBLIC OF GHANA	MINISTRY OF ROAD AND TRANSPORT GHANA HIGHWAY AUTHORITY	KATAHIRA & ENGINEERS INTERNATIONAL	NOTES:
PROJECT: THE PROJECT FOR REHABILITATION OF TRUNK ROAD			
TITLE: PLAN AND PROFILE (24/83)			
SCALE: V = 1:2000 H = 1:2000			
DRAWING No: PL-24			

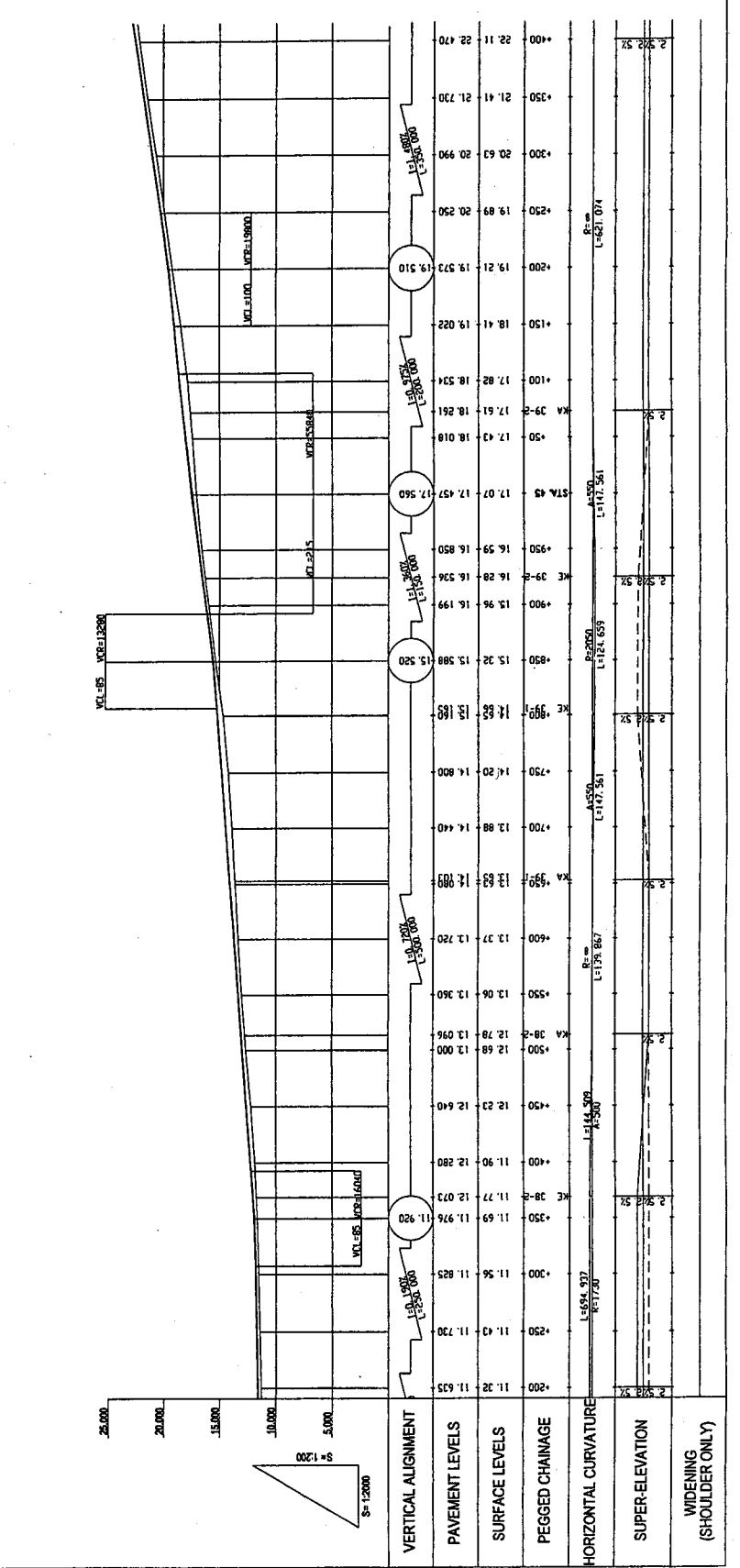
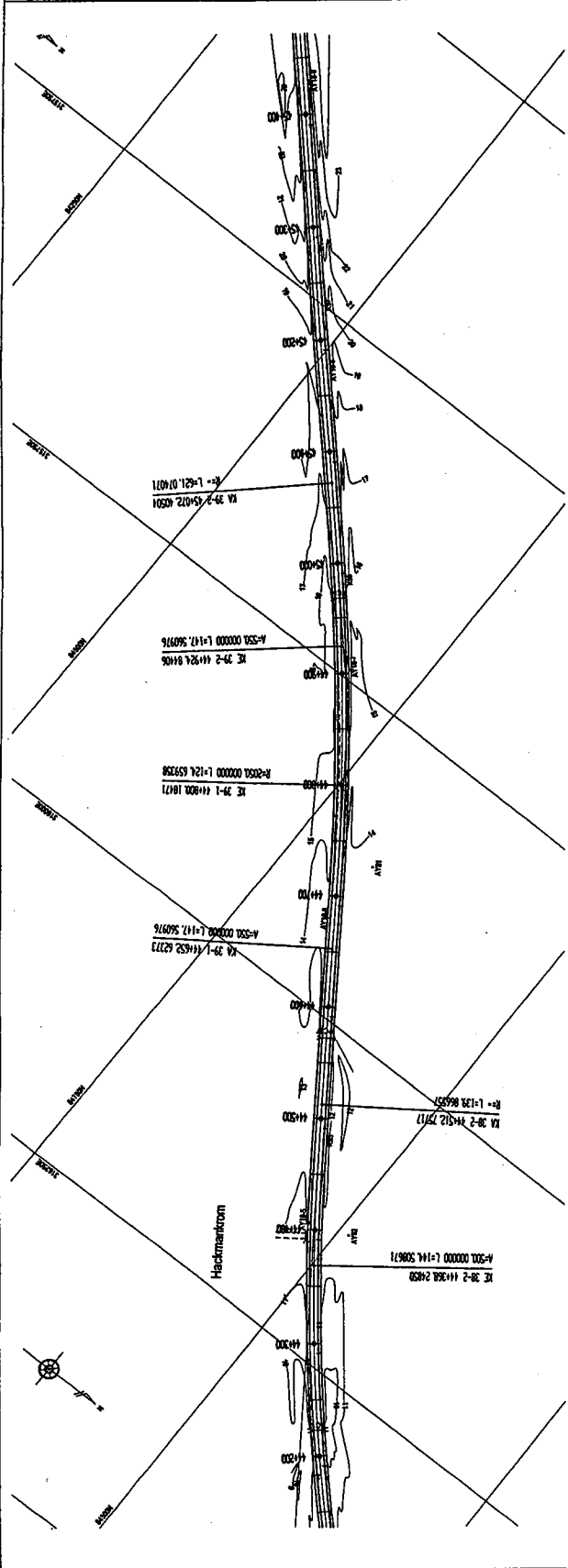

GOVERNMENT OF THE REPUBLIC OF GHANA

MINISTRY OF ROAD AND TRANSPORT GHANA HIGHWAY AUTHORITY

KATAHIRA & ENGINEERS INTERNATIONAL

NOTES:

PROJECT: THE PROJECT FOR REHABILITATION OF TRUNK ROAD

TITLE: PLAN AND PROFILE (25/83)

SCALE: V = 1:200 H = 1:2000

DRAWING No: PL-25

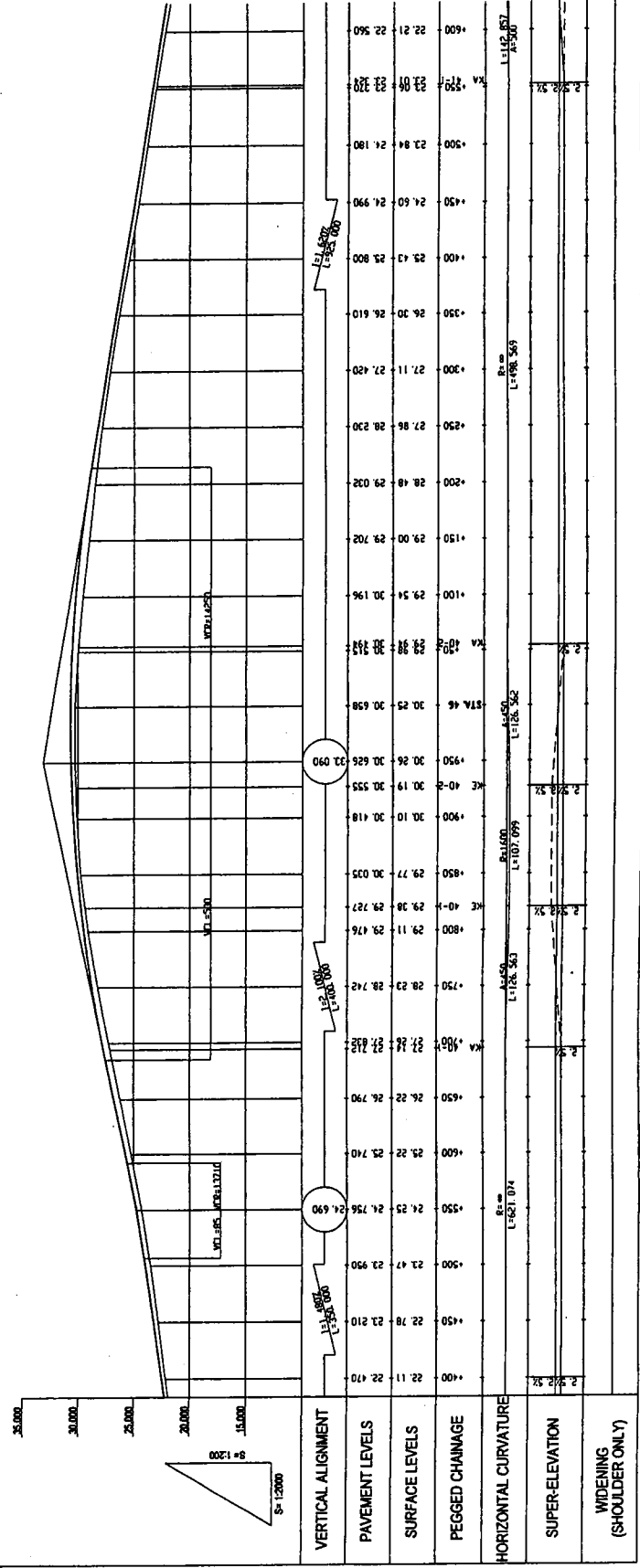
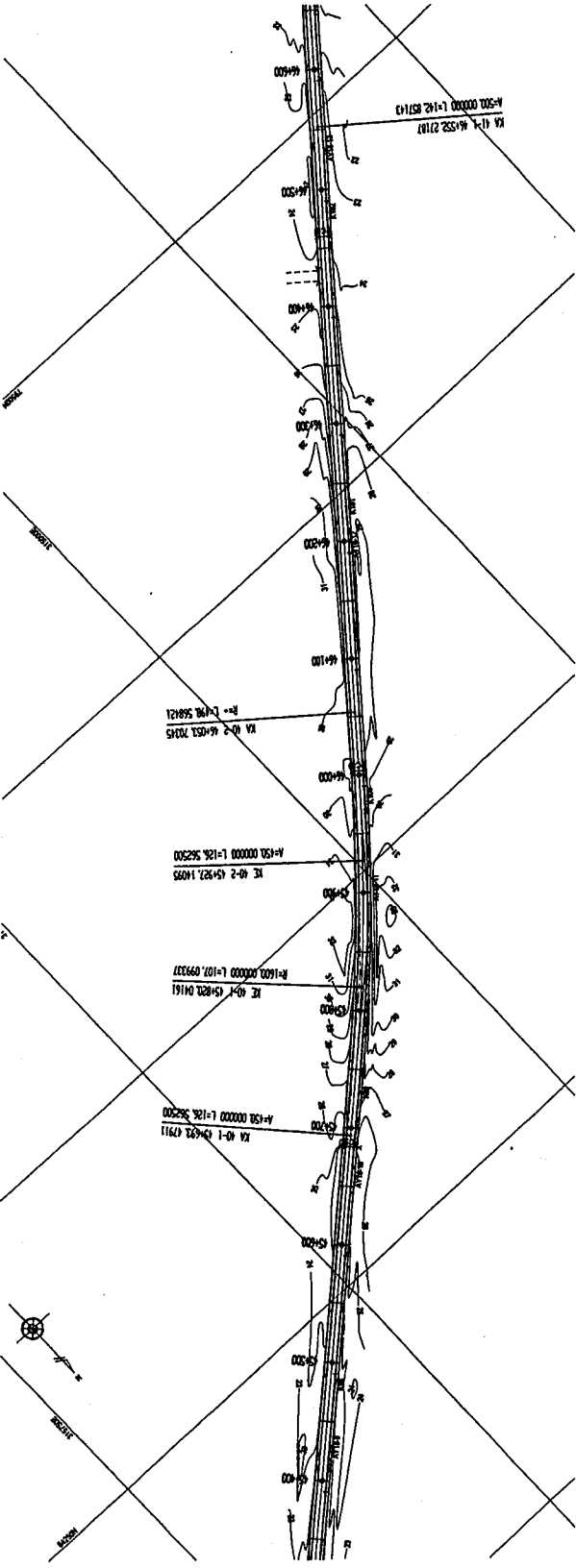

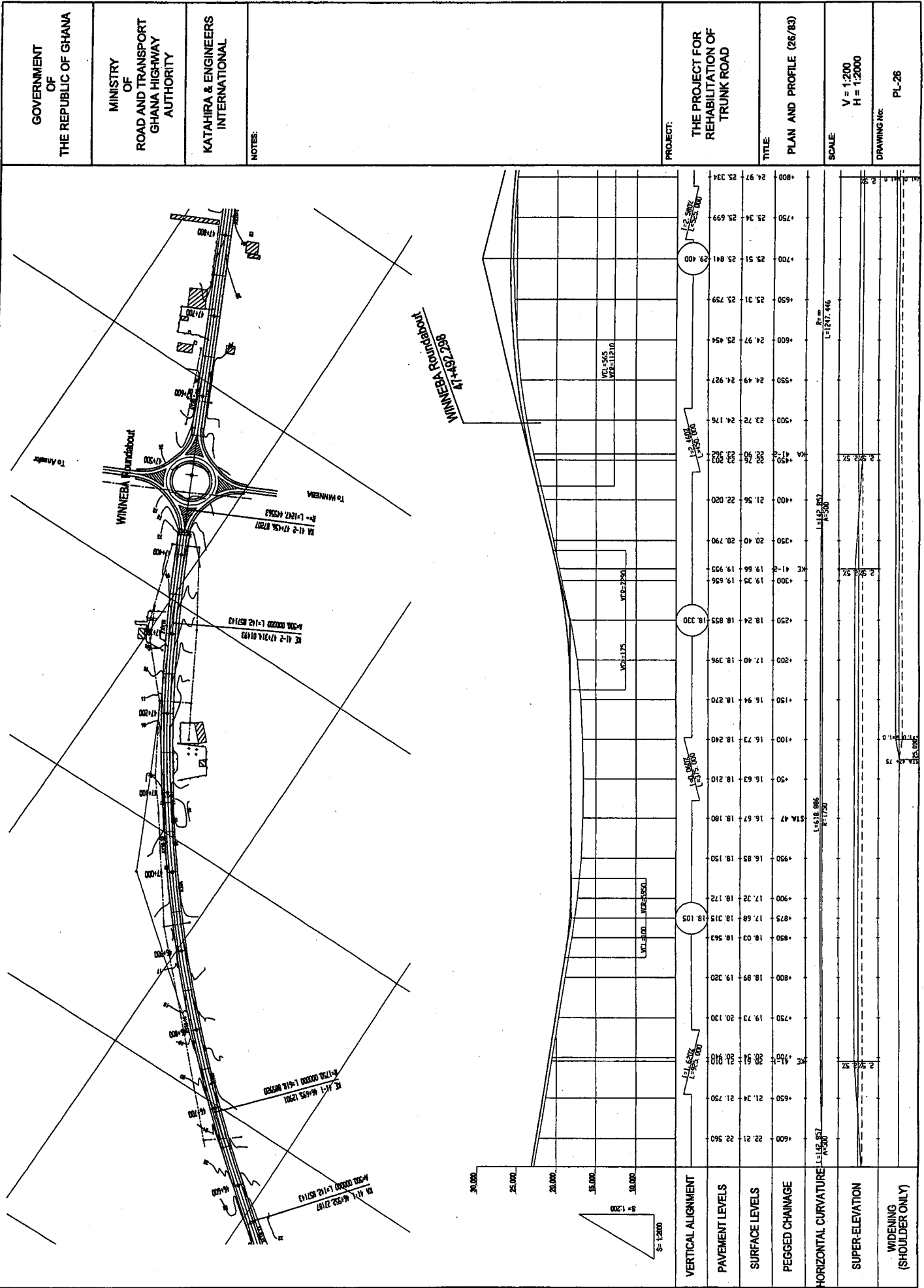

GOVERNMENT OF THE REPUBLIC OF GHANA	MINISTRY OF ROAD AND TRANSPORT GHANA HIGHWAY AUTHORITY	KATAHIRA & ENGINEERS INTERNATIONAL	NOTES:	PROJECT: THE PROJECT FOR REHABILITATION OF TRUNK ROAD	TITLE: PLAN AND PROFILE (27/83)	SCALE: V = 1:200 H = 1:2000	DRAWING No: PL-27
-------------------------------------	--	------------------------------------	--------	---	---------------------------------	-----------------------------	-------------------

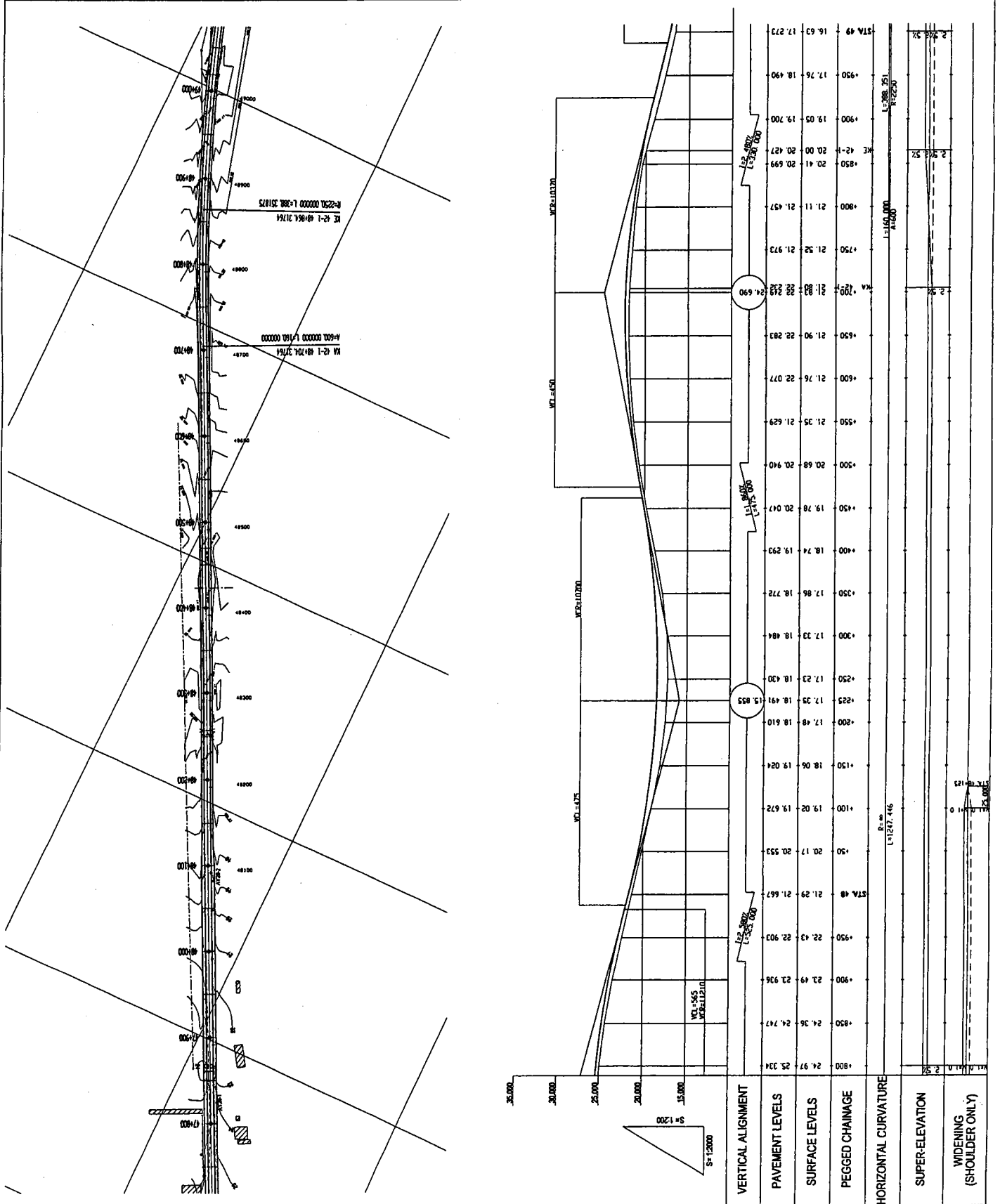

GOVERNMENT OF THE REPUBLIC OF GHANA

MINISTRY OF ROAD AND TRANSPORT GHANA HIGHWAY AUTHORITY

KATAHIRA & ENGINEERS INTERNATIONAL

NOTES:

PROJECT: THE PROJECT FOR REHABILITATION OF TRUNK ROAD

TITLE: PLAN AND PROFILE (28/83)

SCALE: V = 1:200 H = 1:2000

DRAWING No: PL-28

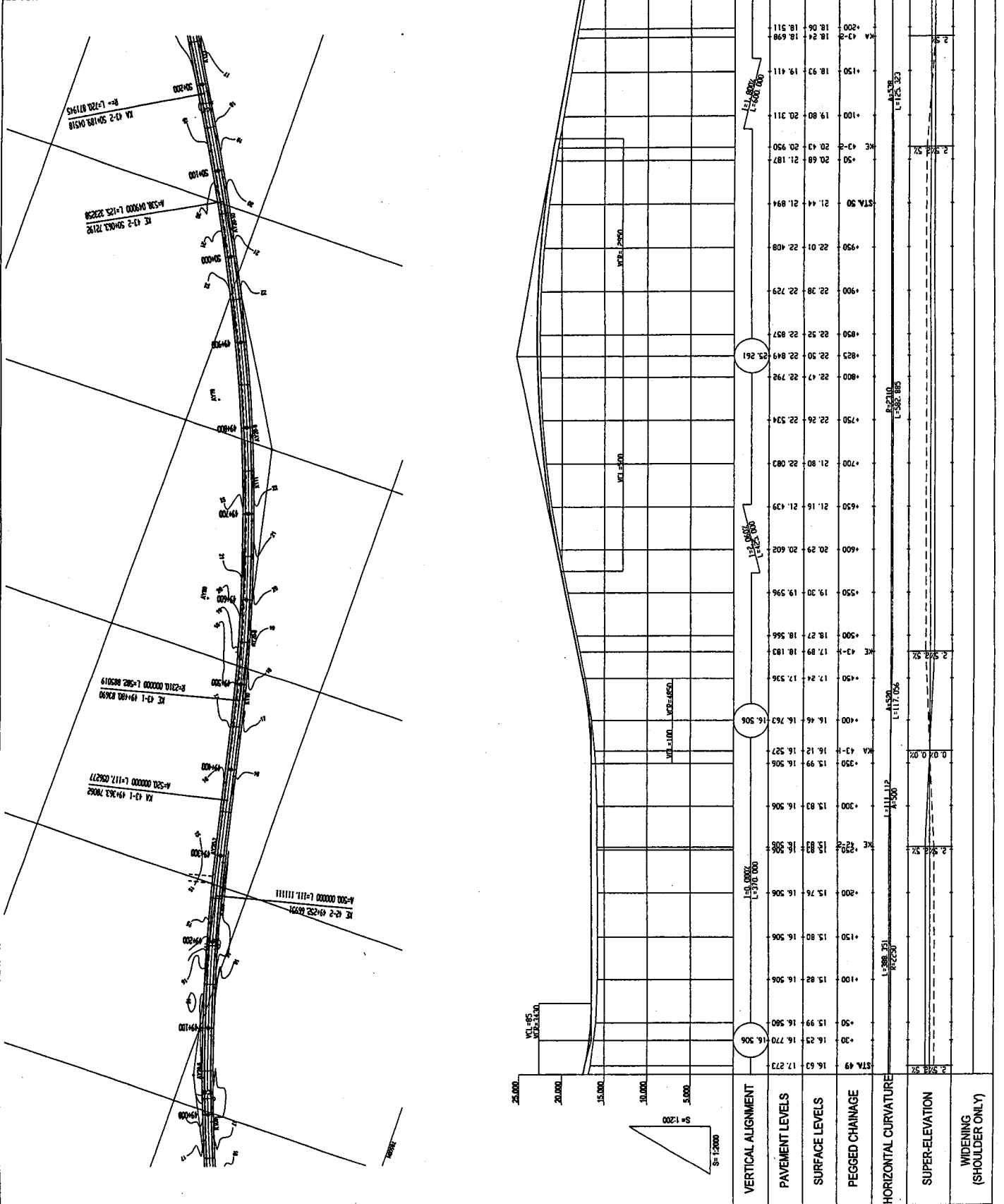

GOVERNMENT OF THE REPUBLIC OF GHANA
 MINISTRY OF ROAD AND TRANSPORT GHANA HIGHWAY AUTHORITY
 KATAHIRA & ENGINEERS INTERNATIONAL
 NOTES:
 PROJECT: THE PROJECT FOR THE REHABILITATION OF TRUNK ROAD
 TITLE: PLAN AND PROFILE (28/83)
 SCALE: V = 1:200 H = 1:2000
 DRAWING No: PL-28

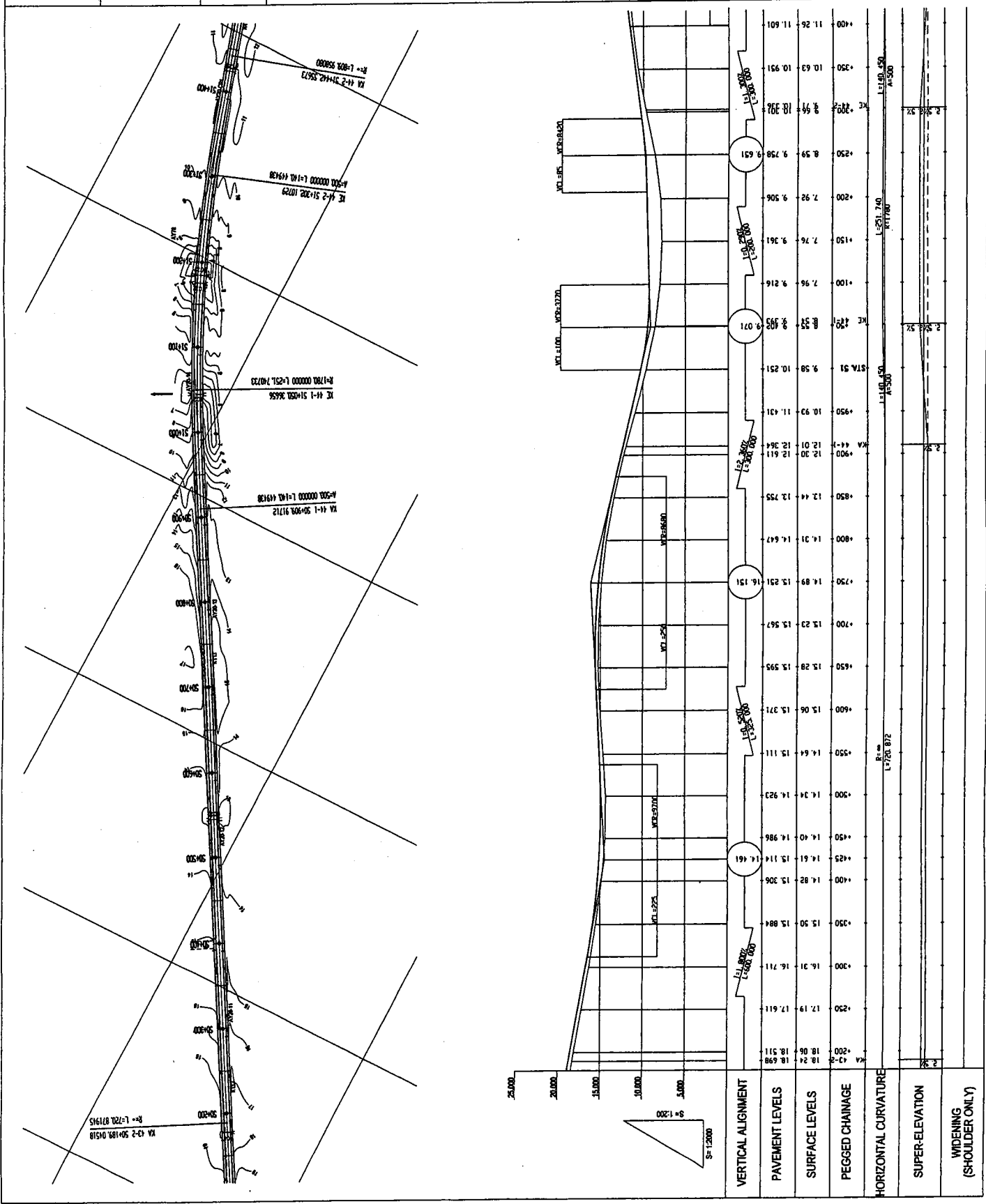

GOVERNMENT OF THE REPUBLIC OF GHANA

MINISTRY OF ROAD AND TRANSPORT GHANA HIGHWAY AUTHORITY

KATAHIRA & ENGINEERS INTERNATIONAL

NOTES:

PROJECT: THE PROJECT FOR REHABILITATION OF TRUNK ROAD

TITLE: PLAN AND PROFILE (30/83)

SCALE: V = 1:200 H = 1:2000

DRAWING No: PL-30

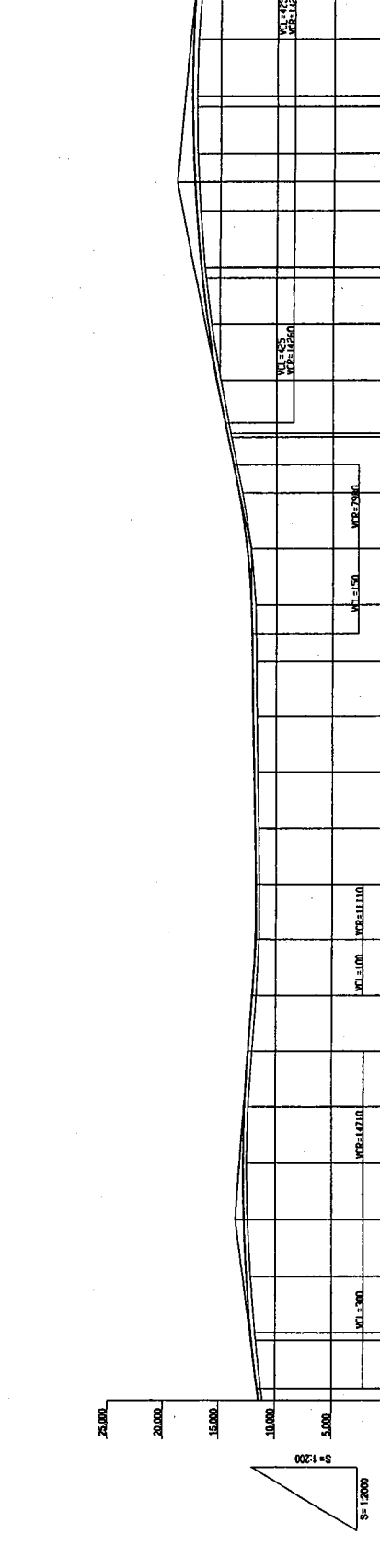
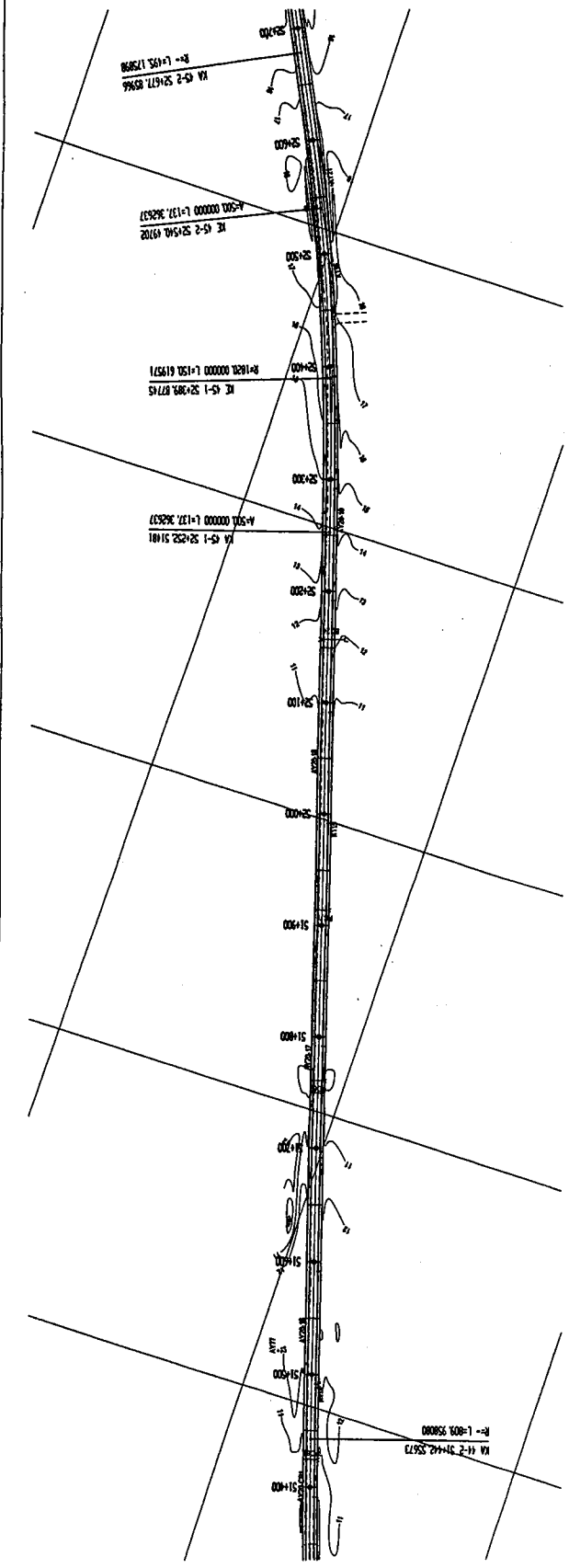

VERTICAL ALIGNMENT	PAYEMENT LEVELS	SURFACE LEVELS	PEGGED CHAINAGE	HORIZONTAL CURVATURE	SUPER-ELEVATION (SHOULDER ONLY)
11.26	11.26	11.26	51+00		
11.28	11.28	11.28	51+10		
11.32	11.32	11.32	51+20		
11.34	11.34	11.34	51+30		
11.37	11.37	11.37	51+40		
11.38	11.38	11.38	51+50		
11.39	11.39	11.39	51+60		
11.41	11.41	11.41	51+70		
11.42	11.42	11.42	51+80		
11.44	11.44	11.44	51+90		
11.47	11.47	11.47	52+00		
11.71	11.71	11.71	51+00		
11.71	11.71	11.71	51+10		
11.72	11.72	11.72	51+20		
11.72	11.72	11.72	51+30		
11.72	11.72	11.72	51+40		
11.72	11.72	11.72	51+50		
11.72	11.72	11.72	51+60		
11.72	11.72	11.72	51+70		
11.72	11.72	11.72	51+80		
11.72	11.72	11.72	51+90		
11.72	11.72	11.72	52+00		
11.72	11.72	11.72	51+00		
11.72	11.72	11.72	51+10		
11.72	11.72	11.72	51+20		
11.72	11.72	11.72	51+30		
11.72	11.72	11.72	51+40		
11.72	11.72	11.72	51+50		
11.72	11.72	11.72	51+60		
11.72	11.72	11.72	51+70		
11.72	11.72	11.72	51+80		
11.72	11.72	11.72	51+90		
11.72	11.72	11.72	52+00		
11.72	11.72	11.72	51+00		
11.72	11.72	11.72	51+10		
11.72	11.72	11.72	51+20		
11.72	11.72	11.72	51+30		
11.72	11.72	11.72	51+40		
11.72	11.72	11.72	51+50		
11.72	11.72	11.72	51+60		
11.72	11.72	11.72	51+70		
11.72	11.72	11.72	51+80		
11.72	11.72	11.72	51+90		
11.72	11.72	11.72	52+00		
11.72	11.72	11.72	51+00		
11.72	11.72	11.72	51+10		
11.72	11.72	11.72	51+20		
11.72	11.72	11.72	51+30		
11.72	11.72	11.72	51+40		
11.72	11.72	11.72	51+50		
11.72	11.72	11.72	51+60		
11.72	11.72	11.72	51+70		
11.72	11.72	11.72	51+80		
11.72	11.72	11.72	51+90		
11.72	11.72	11.72	52+00		

GOVERNMENT OF THE REPUBLIC OF GHANA
 MINISTRY OF ROAD AND TRANSPORT GHANA HIGHWAY AUTHORITY
 KATAHIRA & ENGINEERS INTERNATIONAL
 NOTES:
 PROJECT: THE PROJECT FOR REHABILITATION OF TRUNK ROAD
 TITLE: PLAN AND PROFILE (31/83)
 SCALE: V = 1:200 H = 1:2000
 DRAWING No: PL-31

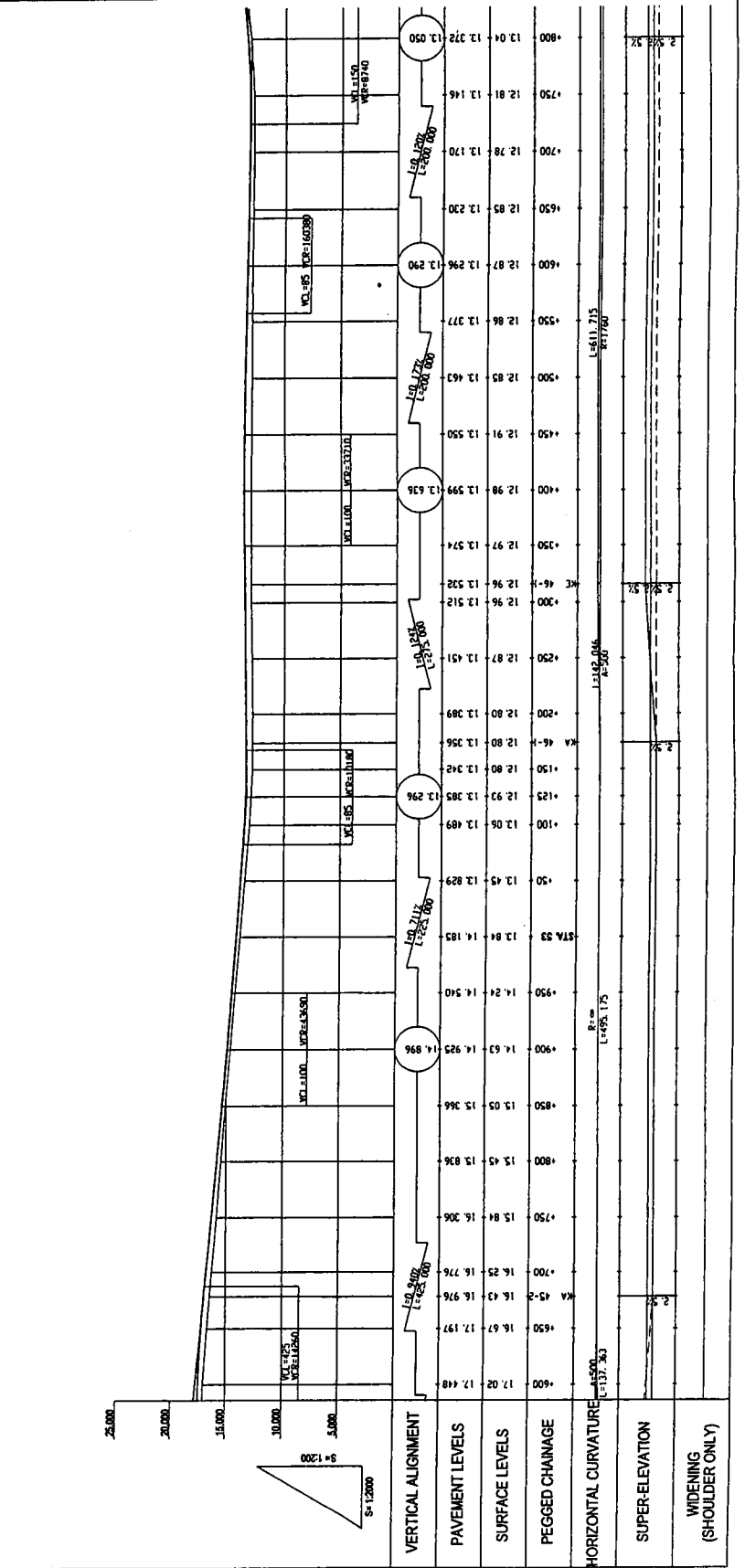
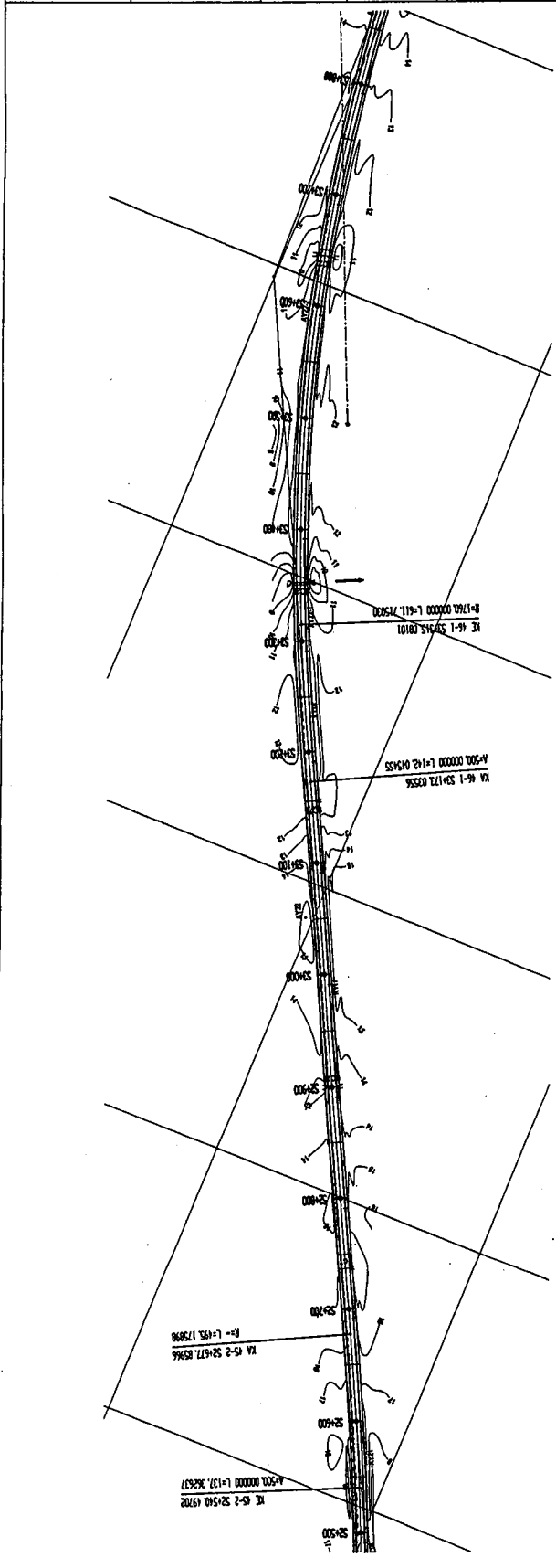

GOVERNMENT OF THE REPUBLIC OF GHANA
 MINISTRY OF ROAD AND TRANSPORT GHANA HIGHWAY AUTHORITY
 KATAHIRA & ENGINEERS INTERNATIONAL
 NOTES:
 PROJECT: THE PROJECT FOR REHABILITATION OF TRUNK ROAD
 TITLE: PLAN AND PROFILE (32/83)
 SCALE: V = 1:200 H = 1:2000
 DRAWING NO: PL-32

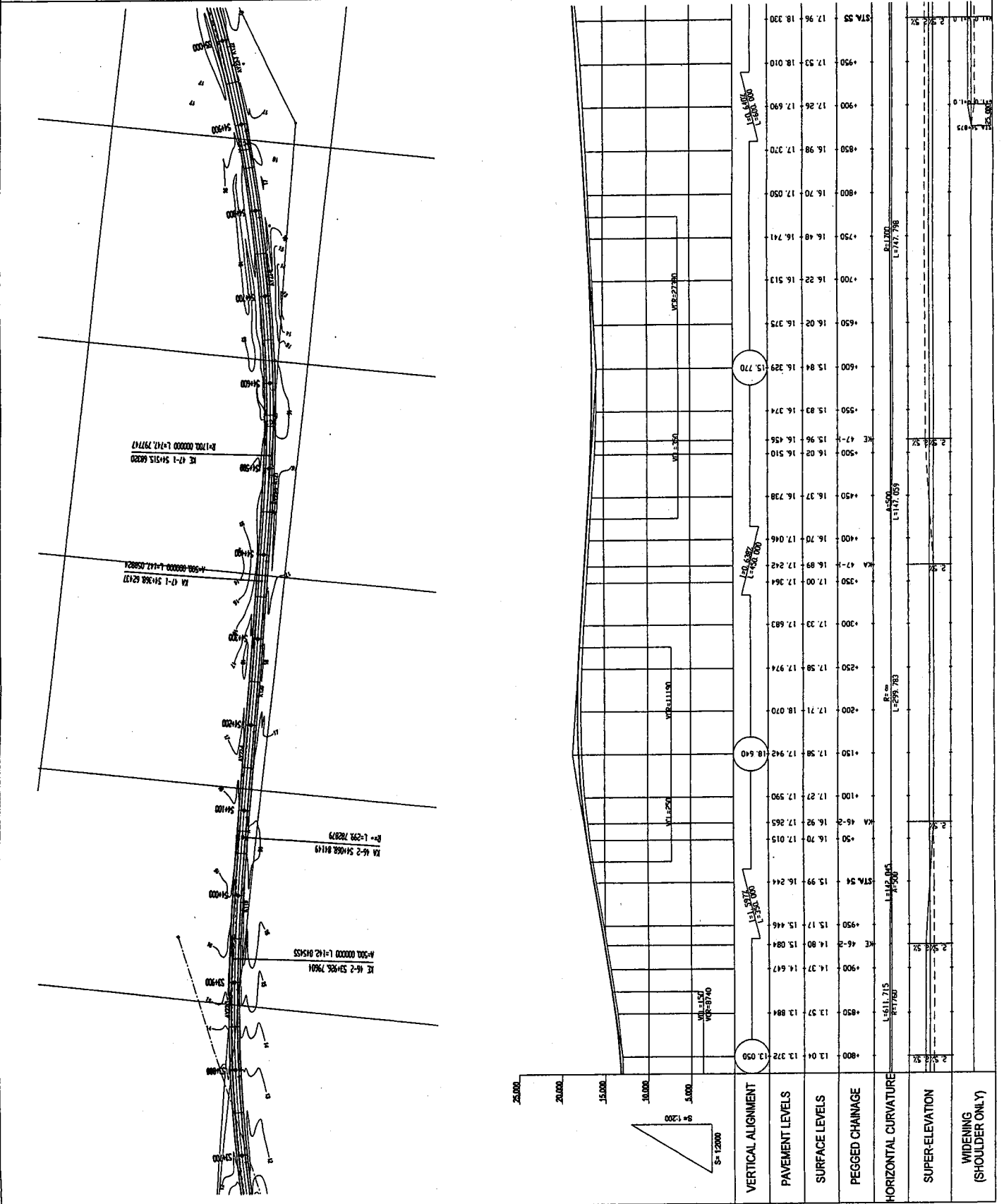

GOVERNMENT OF THE REPUBLIC OF GHANA

MINISTRY OF ROAD AND TRANSPORT GHANA HIGHWAY AUTHORITY

KATAHIRA & ENGINEERS INTERNATIONAL

NOTES:

PROJECT: THE PROJECT FOR REHABILITATION OF TRUNK ROAD

TITLE: PLAN AND PROFILE (33/183)

SCALE: V = 1:200 H = 1:2000

DRAWING No: PL-33

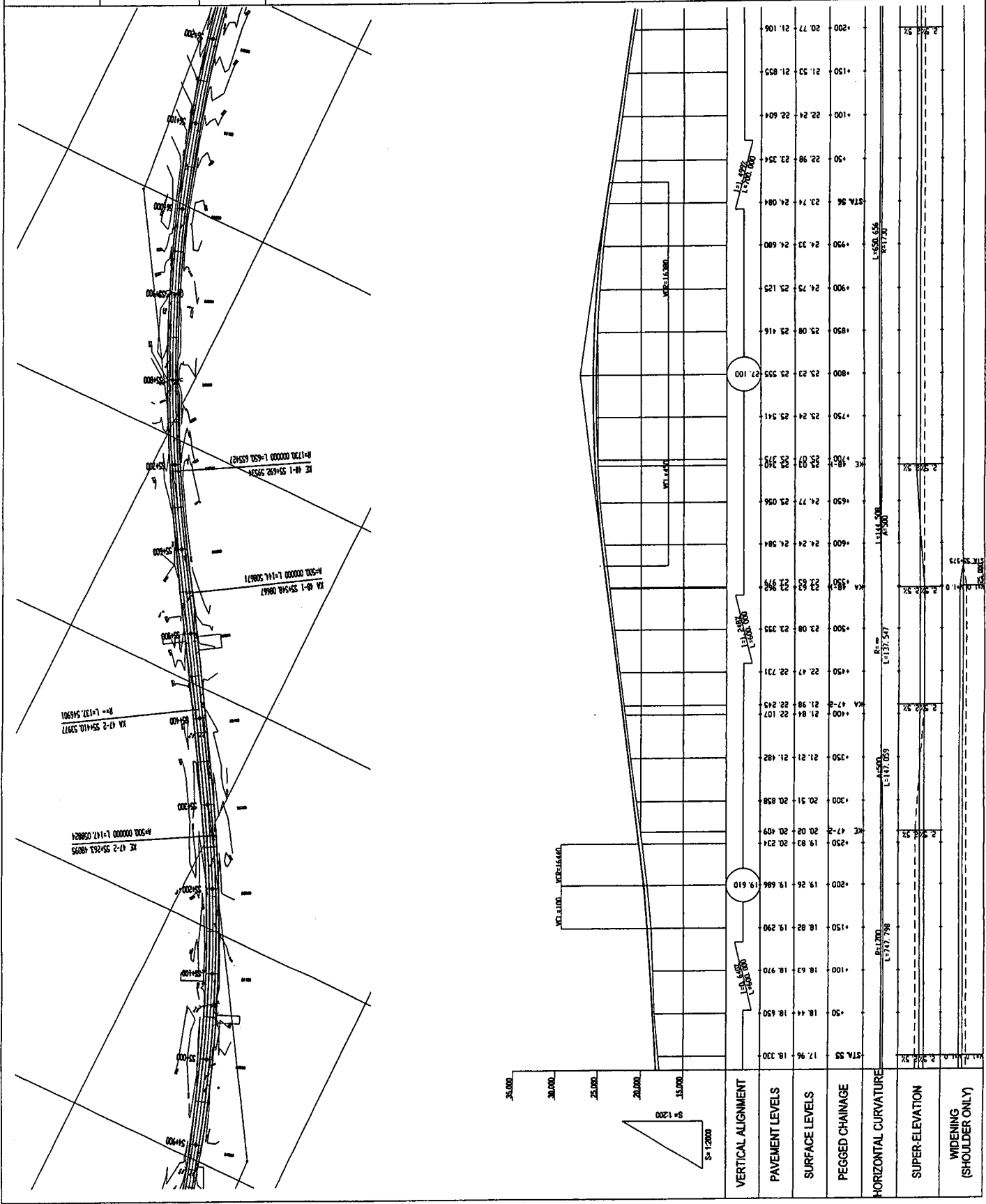

GOVERNMENT OF THE REPUBLIC OF GHANA

MINISTRY OF ROAD AND TRANSPORT GHANA HIGHWAY AUTHORITY

KATAHIRA & ENGINEERS INTERNATIONAL

NOTES:

PROJECT: THE PROJECT FOR REHABILITATION OF TRUNK ROAD

TITLE: PLAN AND PROFILE (34/83)

SCALE: V = 1:200 H = 1:2000

DRAWING No: PL-34

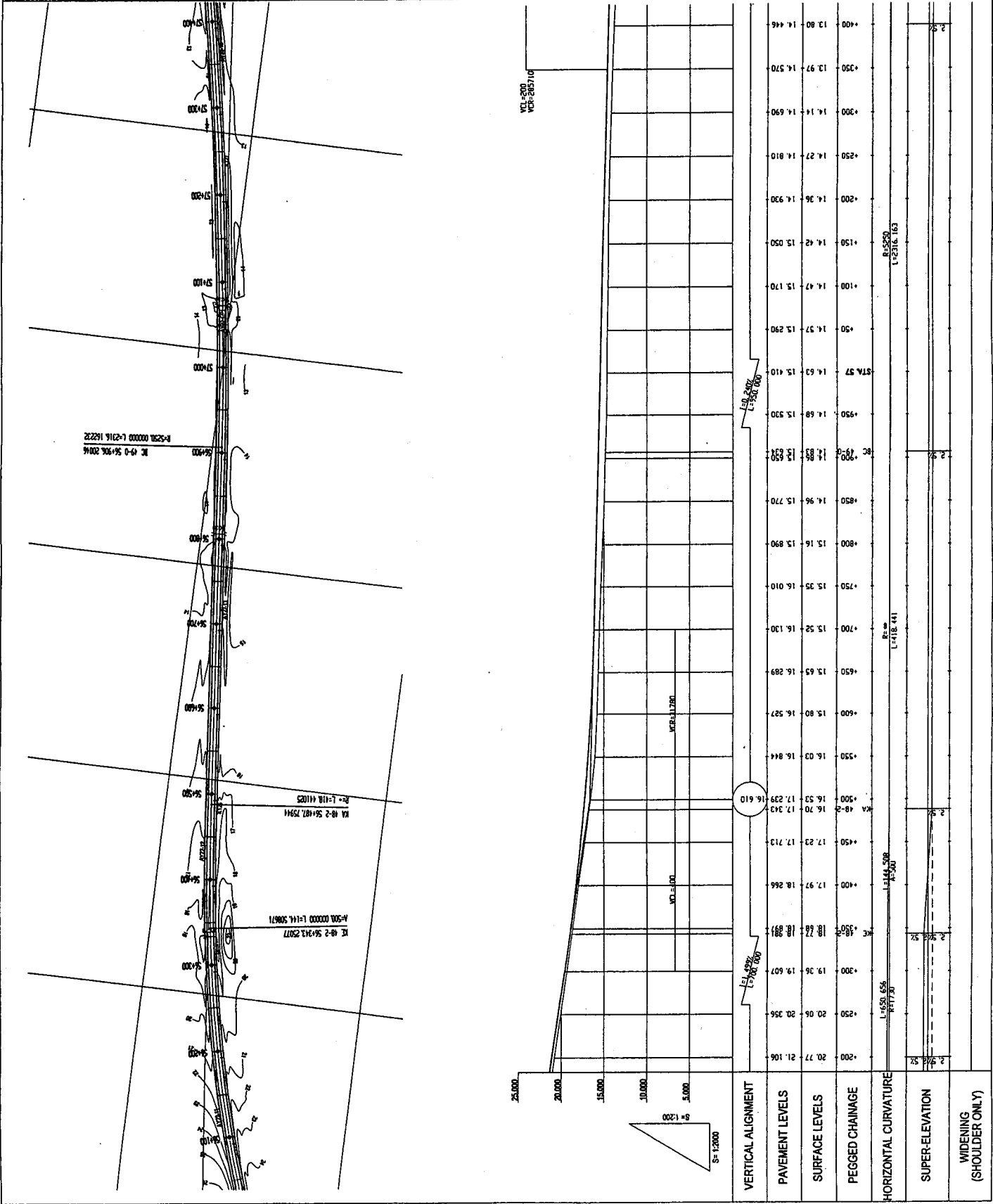

GOVERNMENT OF THE REPUBLIC OF GHANA

MINISTRY OF ROAD AND TRANSPORT GHANA HIGHWAY AUTHORITY

KATAHIRA & ENGINEERS INTERNATIONAL

NOTES:

PROJECT: THE PROJECT FOR REHABILITATION OF TRUNK ROAD

TITLE: PLAN AND PROFILE (35/83)

SCALE: V = 1:200 H = 1:2000

DRAWING No: PL-35

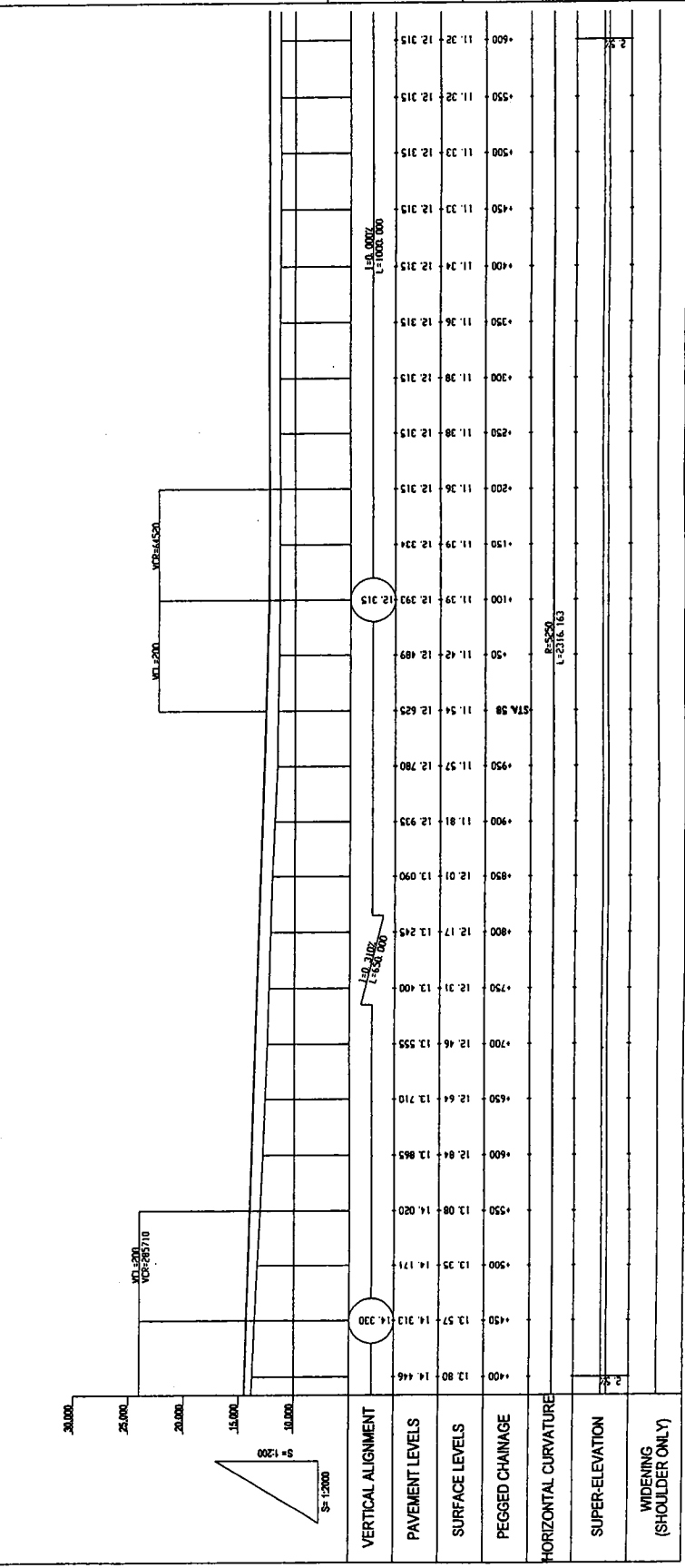
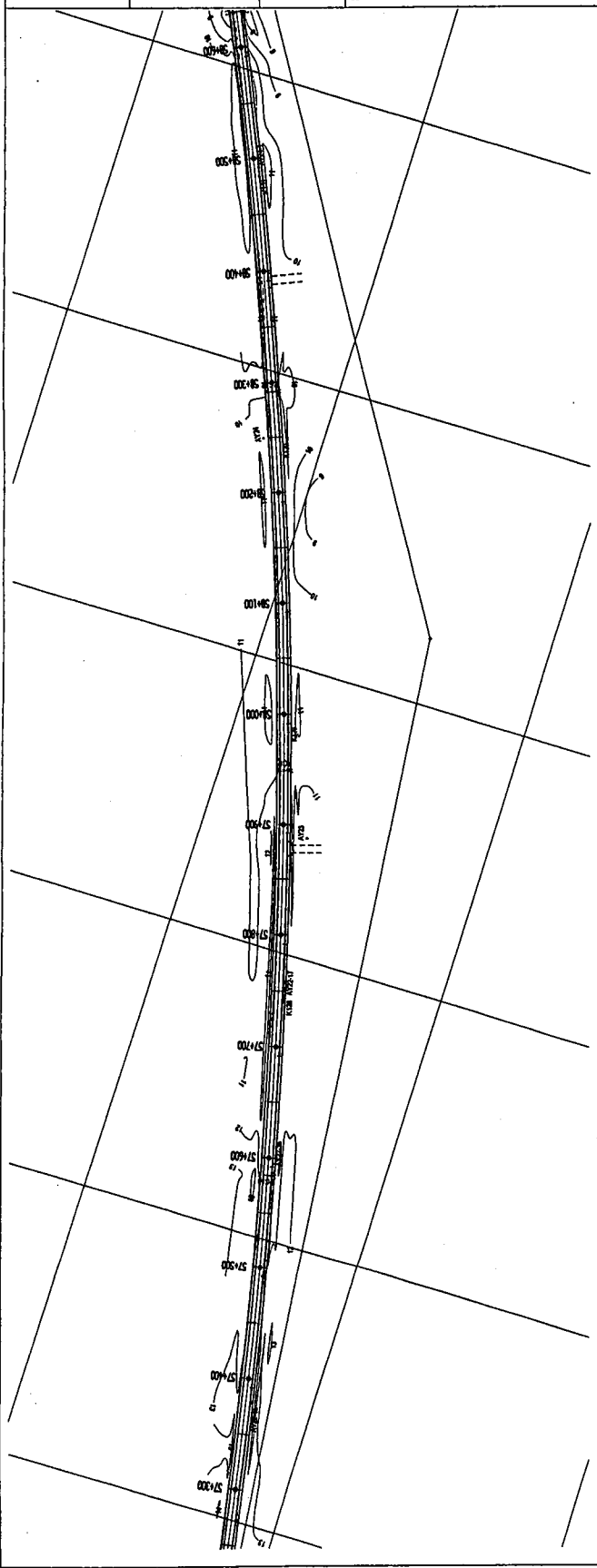

GOVERNMENT OF THE REPUBLIC OF GHANA
 MINISTRY OF ROAD AND TRANSPORT GHANA HIGHWAY AUTHORITY
 KATAHIRA & ENGINEERS INTERNATIONAL

NOTES:

PROJECT: THE PROJECT FOR REHABILITATION OF TRUNK ROAD
 TITLE: PLAN AND PROFILE (36/83)
 SCALE: V = 1:200 H = 1:2000
 DRAWING No: PL-36

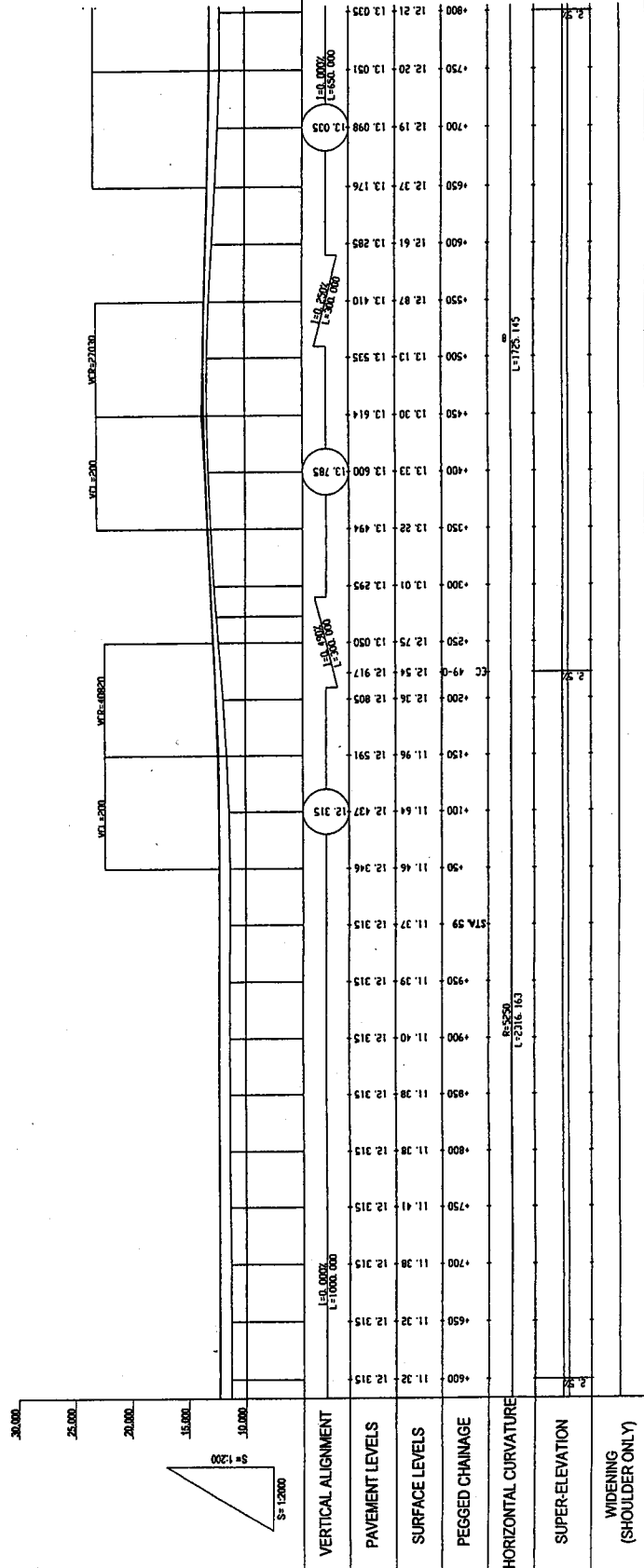
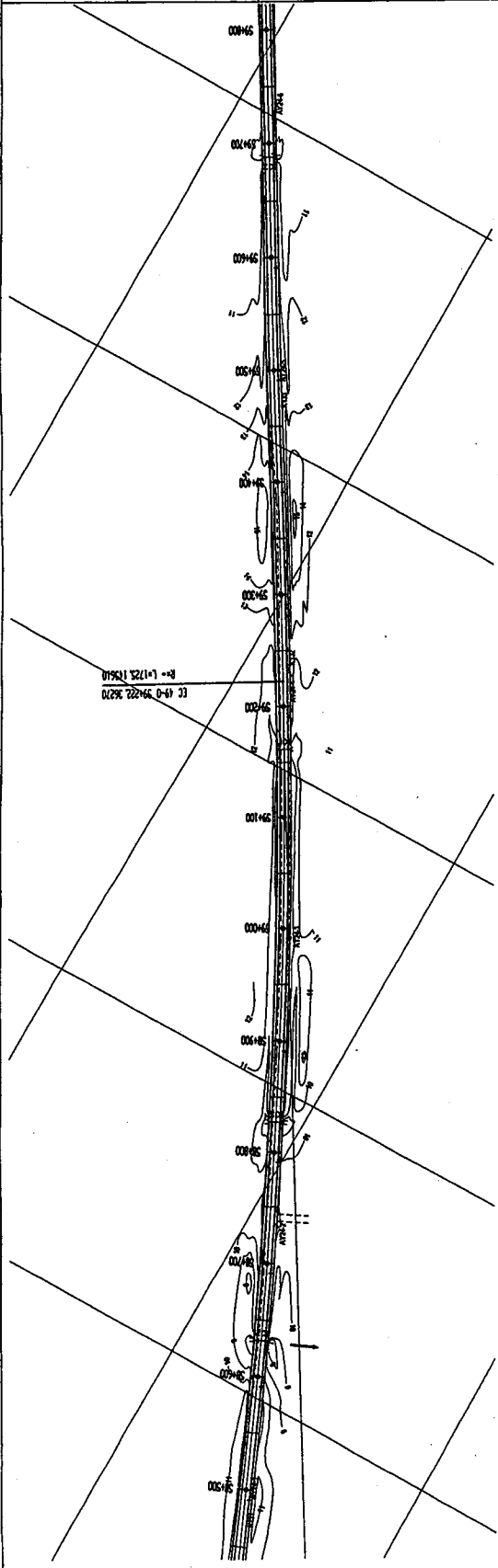

GOVERNMENT OF THE REPUBLIC OF GHANA
 MINISTRY OF ROAD AND TRANSPORT GHANA HIGHWAY AUTHORITY
 KATAHIRA & ENGINEERS INTERNATIONAL
 NOTES:
 PROJECT: THE PROJECT FOR REHABILITATION OF TRUNK ROAD
 TITLE: PLAN AND PROFILE (37/83)
 SCALE: V = 1:2000 H = 1:2000
 DRAWING No: PL-37

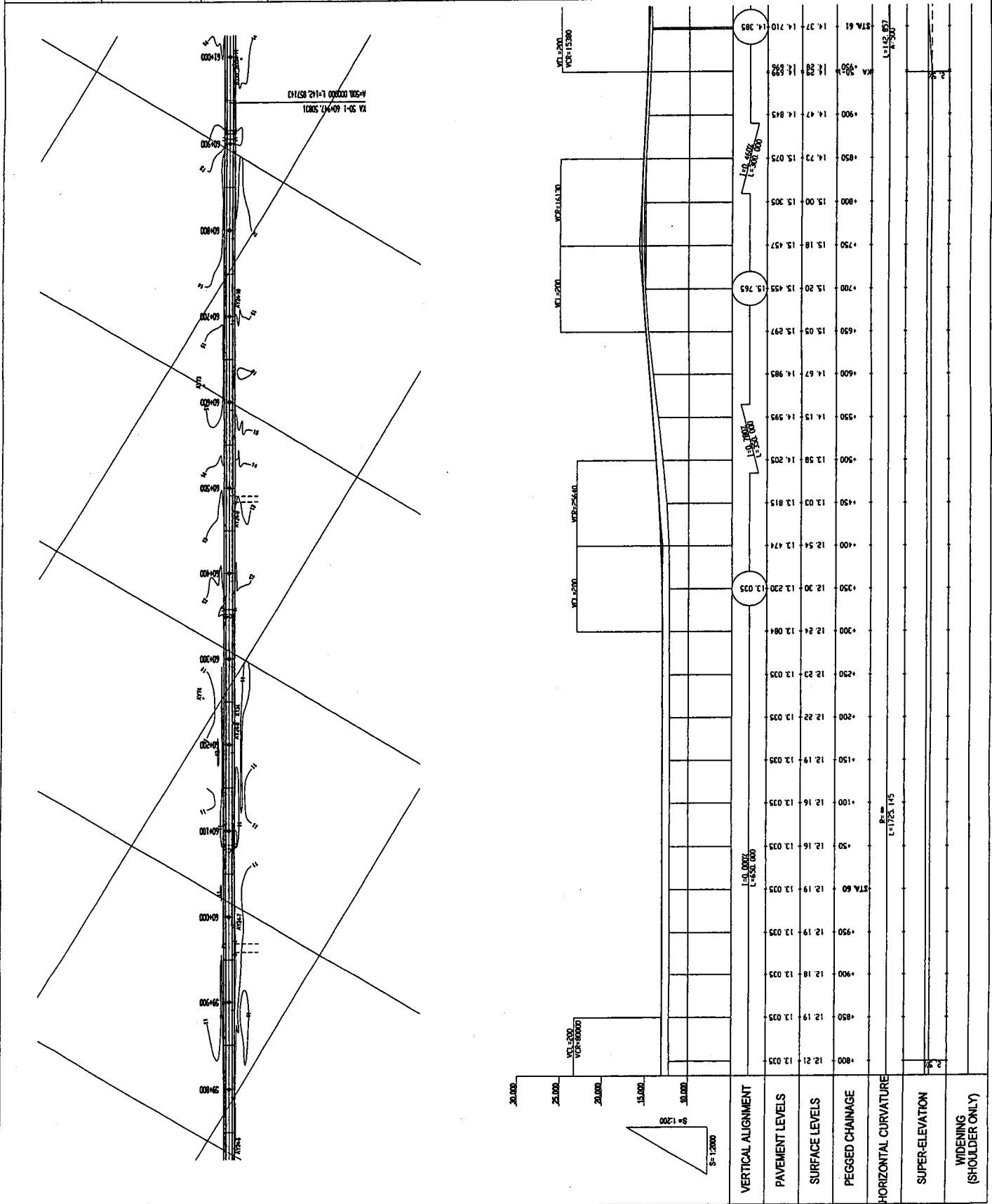

GOVERNMENT OF THE REPUBLIC OF GHANA
 MINISTRY OF ROAD AND TRANSPORT GHANA HIGHWAY AUTHORITY
 KATAHIRA & ENGINEERS INTERNATIONAL
 NOTES:
 PROJECT: THE PROJECT FOR REHABILITATION OF TRUNK ROAD
 TITLE: PLAN AND PROFILE (38/83)
 SCALE: V = 1/200 H = 1/2000
 DRAWING No: PL-38

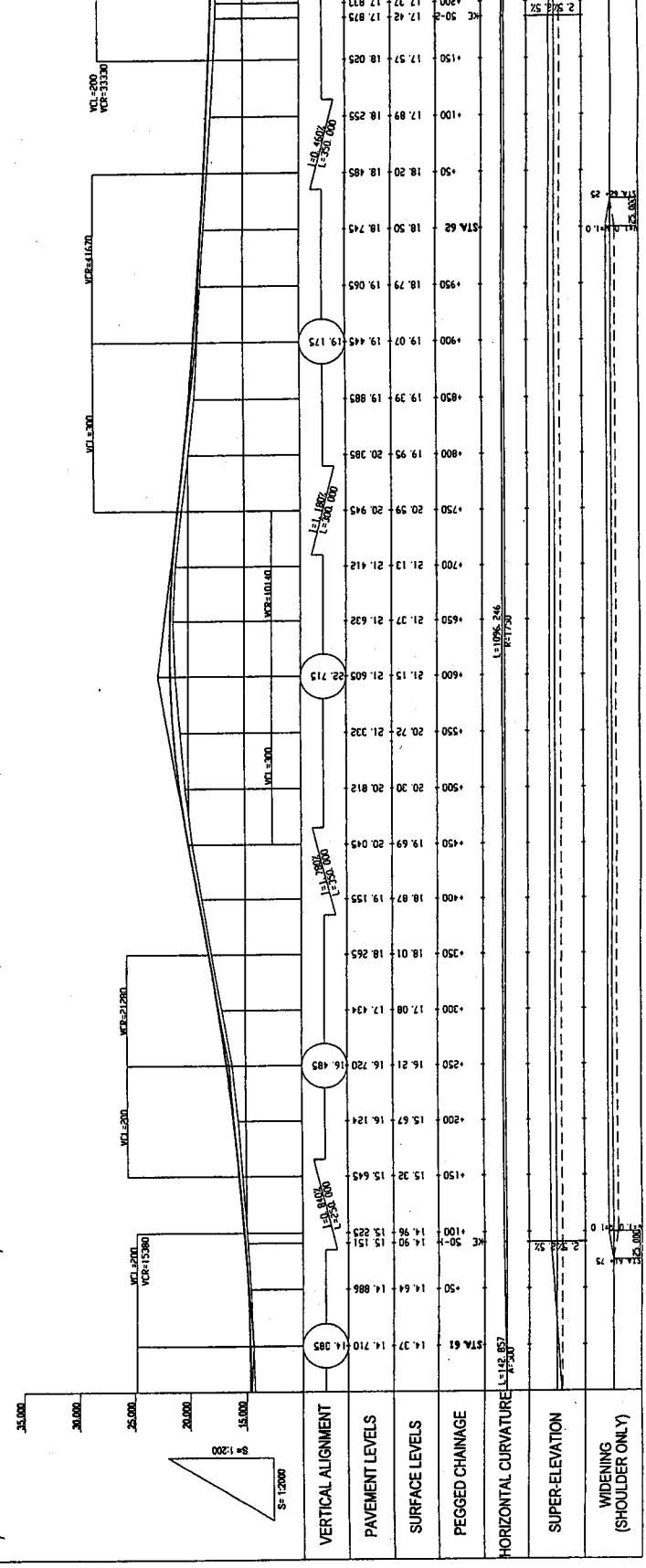
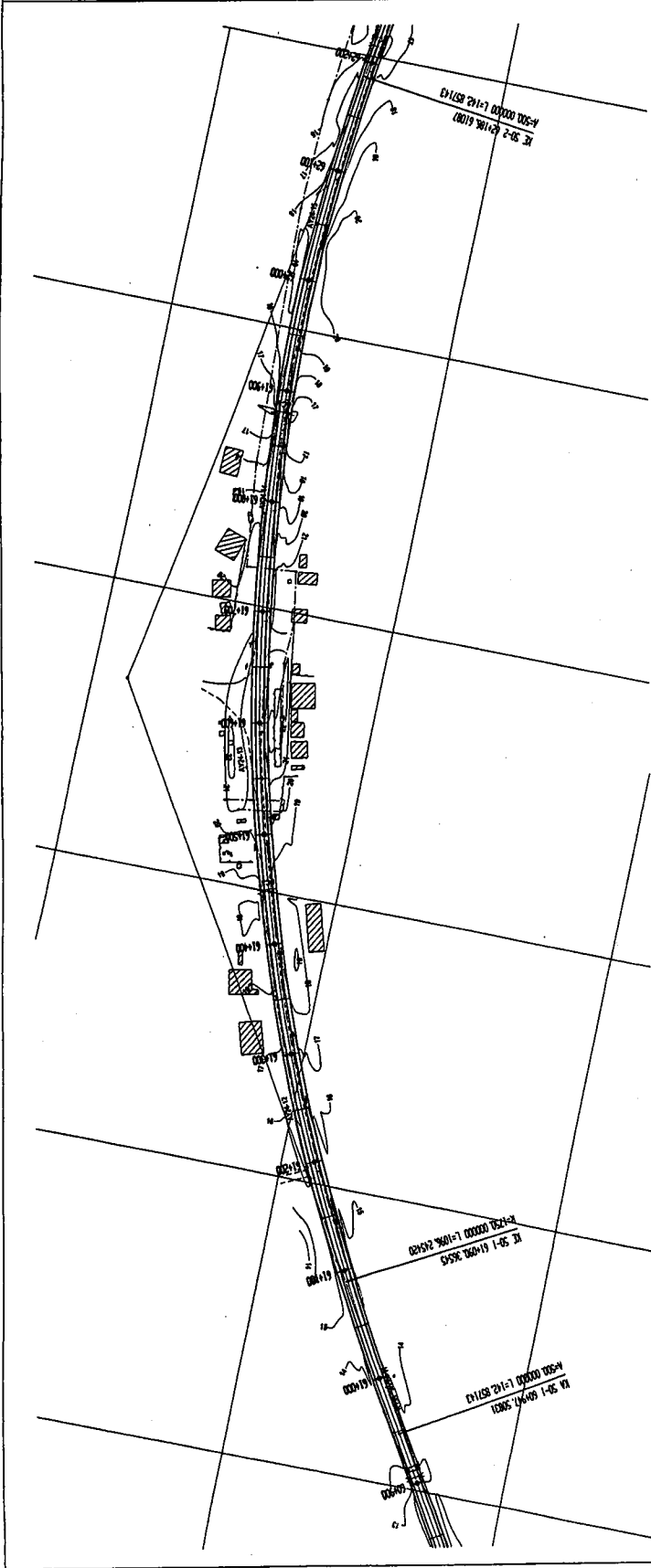

GOVERNMENT OF THE REPUBLIC OF GHANA

MINISTRY OF ROAD AND TRANSPORT GHANA HIGHWAY AUTHORITY

KATAHIRA & ENGINEERS INTERNATIONAL

NOTES:

PROJECT: THE PROJECT FOR REHABILITATION OF TRUNK ROAD

TITLE: PLAN AND PROFILE (38/83)

SCALE: V = 1:200 H = 1:2000

DRAWING No: PL-38

