

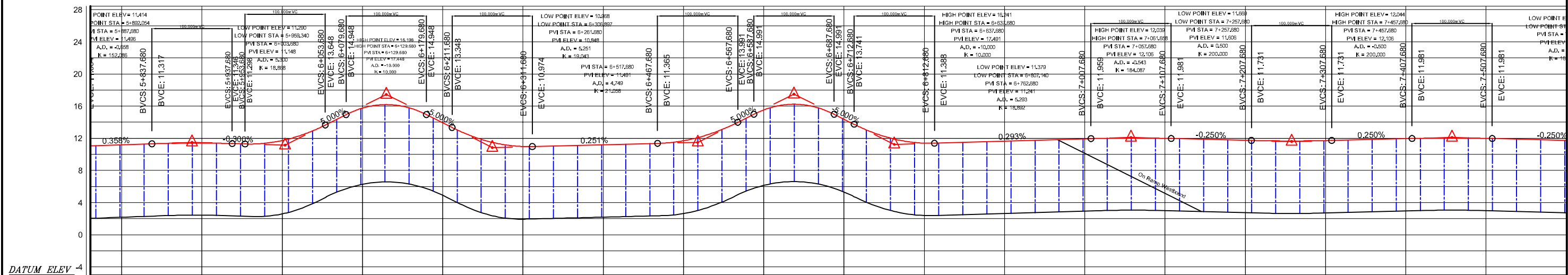

IP-9
 IPX: 1,620,800.5280
 IPY: 495,117.7000
 TL1: 123.6038
 TL2: 123.6038

IP-8
 IPX: 1,620,567.0000
 IPY: 494,831.4000
 TL1: 180.9428
 TL2: 180.9428

IP-10
 IPX: 1,621,177.7697
 IPY: 495,922.6292
 TL1: 272.8810
 TL2: 272.8810



STATION	5+800	6+000	6+200	6+400	6+600	6+800	7+000	7+200	7+400	7+500									
FINISHED GRADE EL.	11.183	11.448	11.728	15.279	13.932	10.945	11.195	11.644	15.143	14.375	11.393	11.644	11.937	12.000	11.750	11.712	11.962	12.000	11.750
EXISTING GROUND EL.	2.183	2.448	2.596	6.279	4.925	1.945	2.195	2.644	6.143	5.321	2.393	2.644	2.937	3.000	2.750	2.712	2.962	3.000	2.750
HORIZONTAL CURVATURE	ST: 5+852,828 A = 90		TS: 6+113,574 A = 180			BC: 6+531,989 R = 500		CT: 6+777,849 R = 1,000		TS: 7+270,309 A = 150			R = 250						

 JAPAN INTERNATIONAL COOPERATION AGENCY	 DEPARTMENT OF PUBLIC WORKS AND HIGHWAYS Republic of Philippines	 ALMEC CORPORATION NIPPON KOEI CO., LTD.	R10/C3/R9 EXPRESSWAY PROJECT	PLAN AND PROFILE Link Route to C5 Expressway (STA 5+800 ~ STA 7+500)	SCALE	DWG. No.
					HORIZONTAL 1:5,000	BD-19
					VERTICAL 1:500	

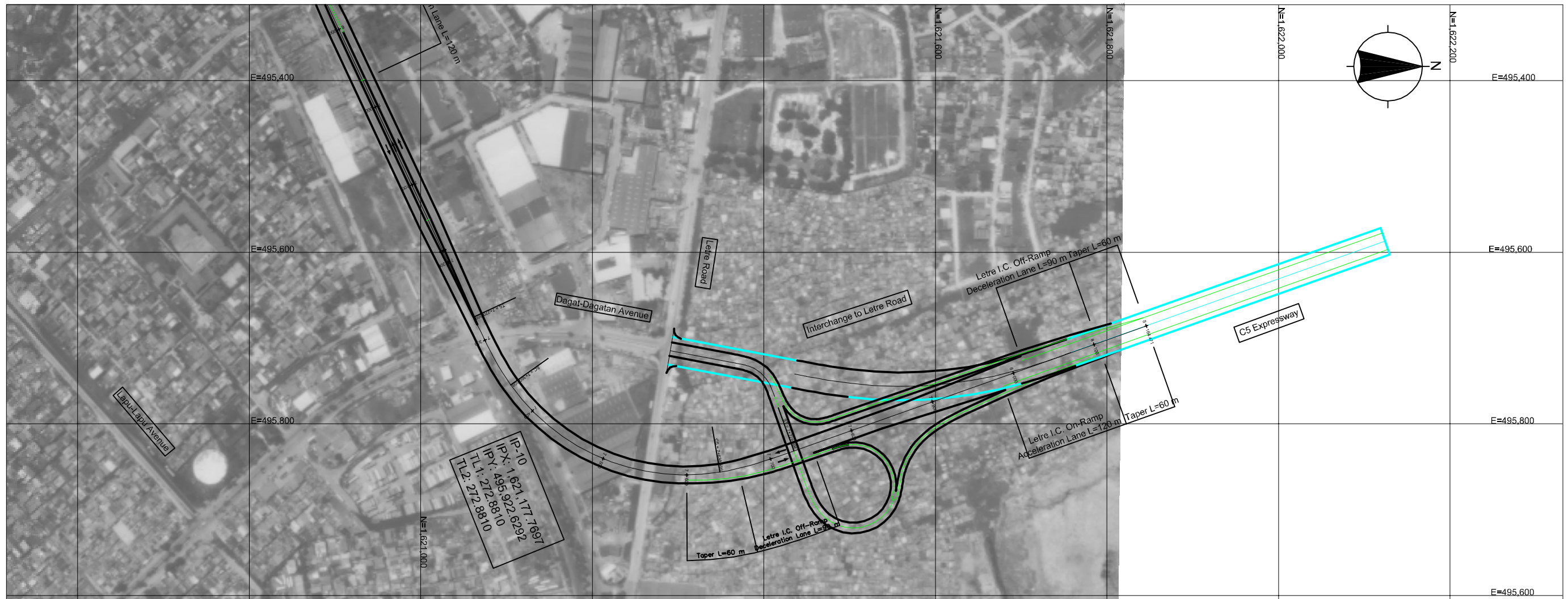

IP-10
 H.P.X.: 1,621,177,1,697
 H.P.Y.: 4,496,959,622,2,639,392
 TL: 1:1, 2:1, 2:1, 2:1, 2:1
 TL: 2:1, 2:1, 2:1, 2:1, 2:1

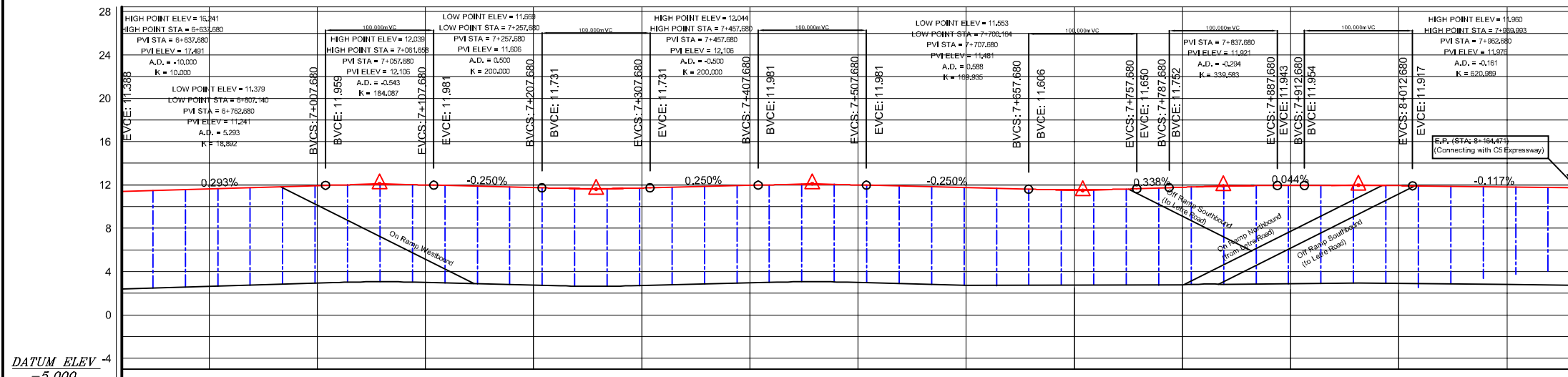

STATION	7+000	7+200	7+400	7+600	7+800	8+000
FINISHED GRADE EL.	11.644	11.937	12.000	11.750	11.793	11.948
EXISTING GROUND EL.	2.644	2.937	3.000	2.750	2.712	2.360
HORIZONTAL CURVATURE						

	R10/C3/R9 EXPRESSWAY PROJECT PLAN AND PROFILE Link Route to C5 Expressway (STA 7+500 ~ STA 8+164.471)		SCALE	DWG. No.
			HORIZONTAL VERTICAL	1:5,000 1:500

Side View of Standard Viaduct Scale 1:500

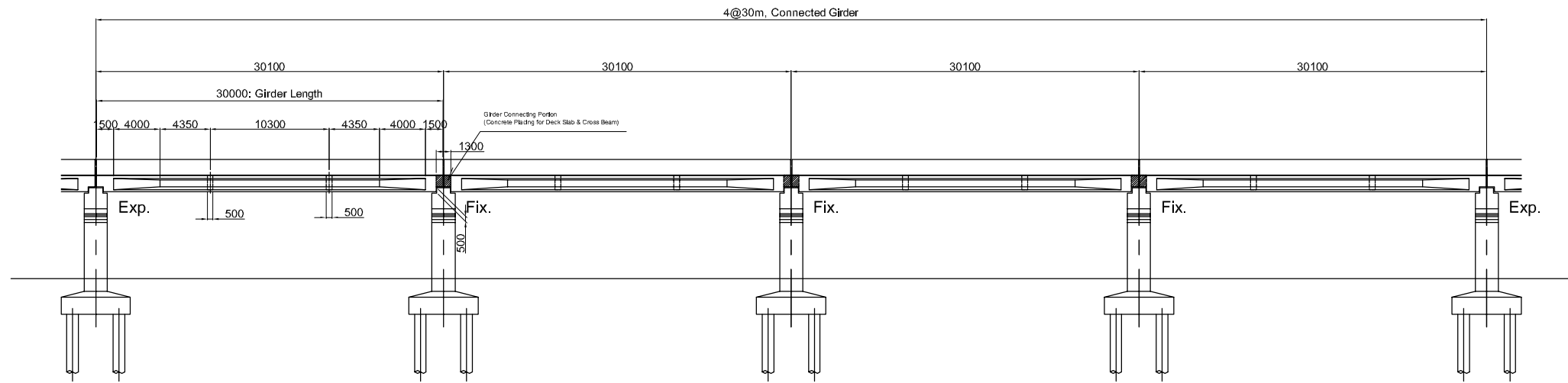

Plan (1 Span of 30m Length) Scale 1:250

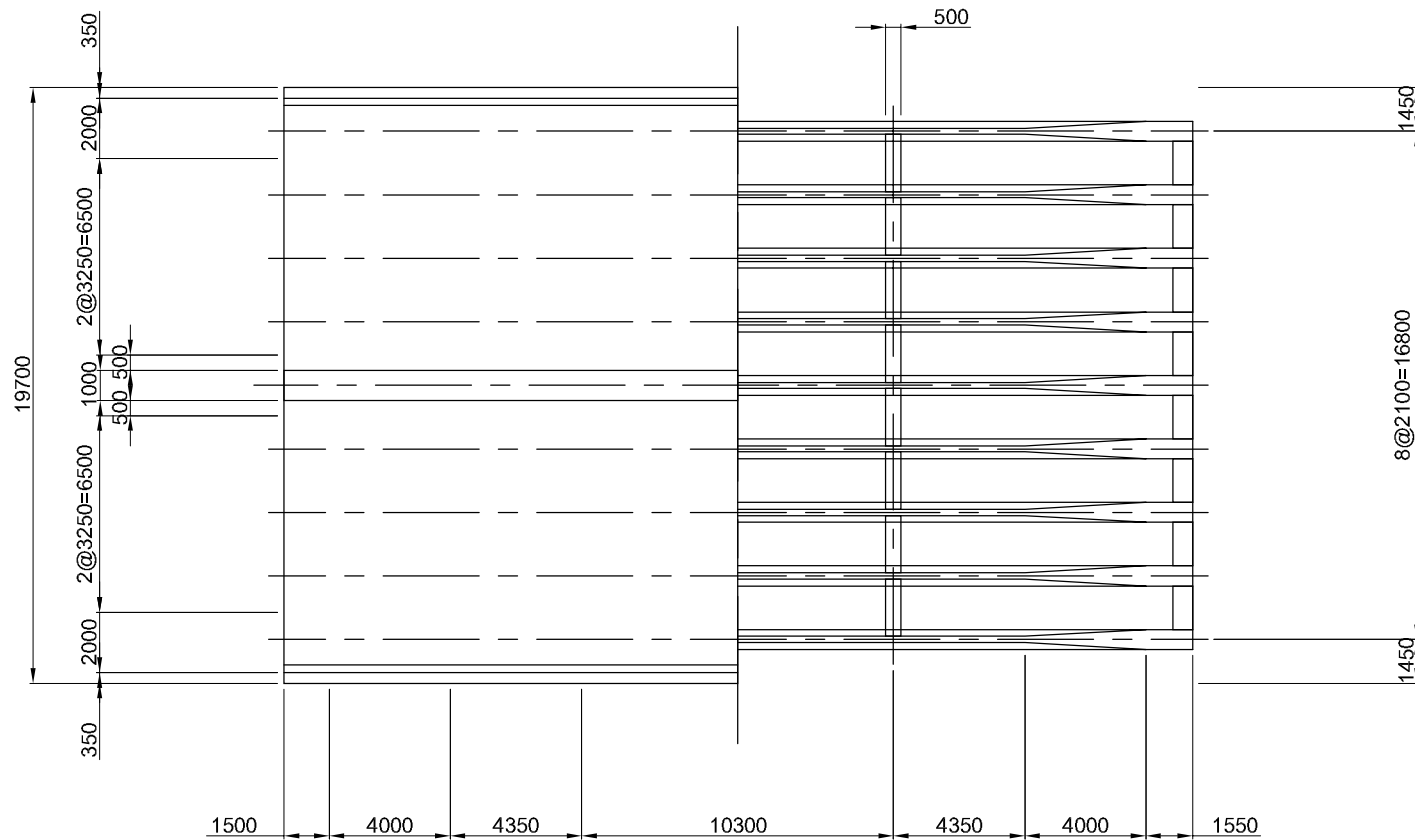

AASHTO Standard Girders Scale 1:200

Type IV-A
(Girder Length: 30m)

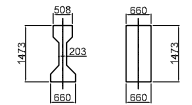

Type VI
(Girder Length: 40m)

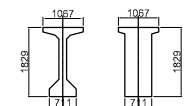

Typical Cross Section of Standard Viaduct (30m Length) Scale 1:200

