

(6) SITE PLANE S=1/1,000

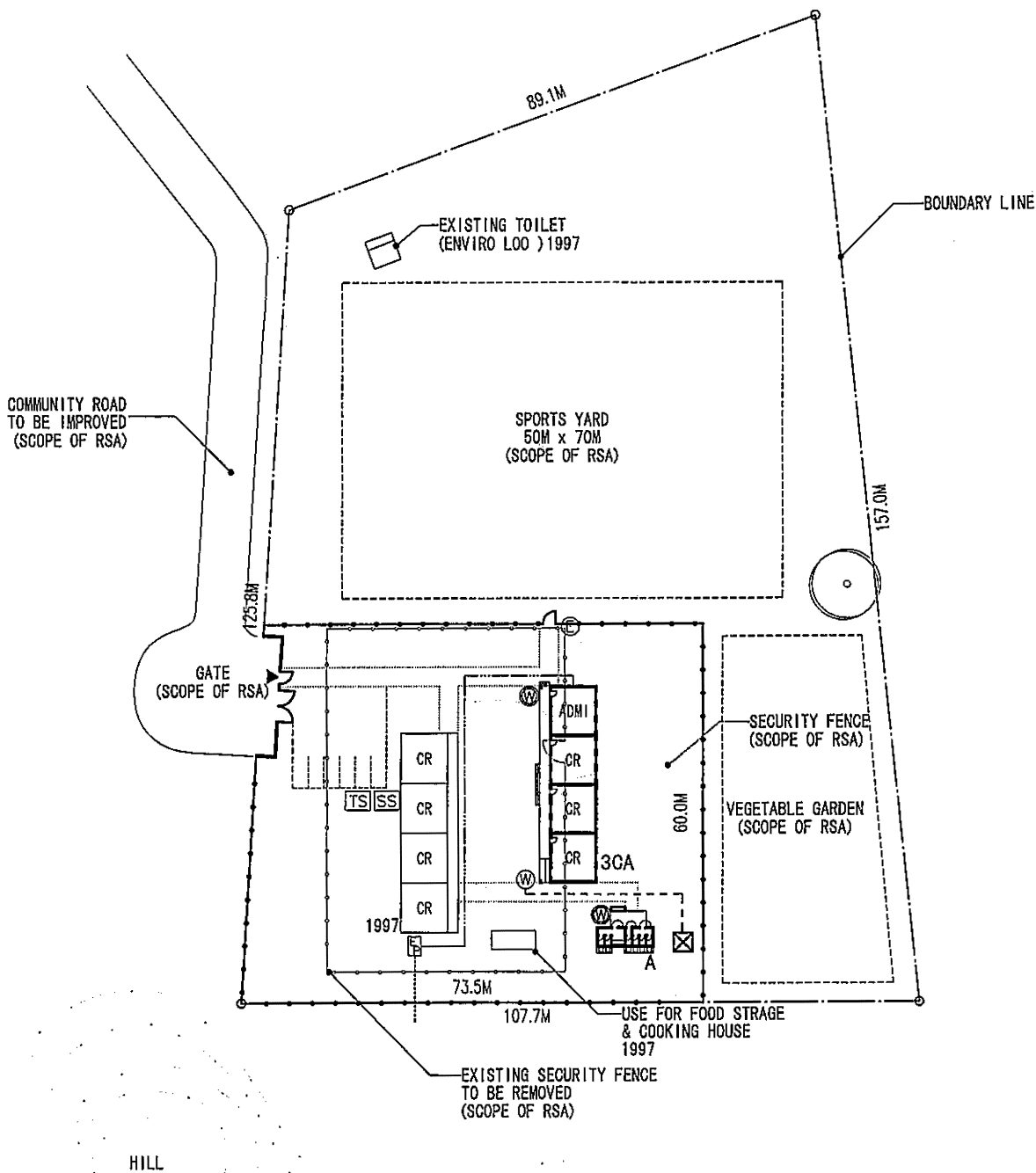

LEGEND

- | | | | |
|------------------------------------|--------------------------|---------------------|---------------------------------------|
| EXISTING BUILDING | EXISTING WATER TAP | PROPOSED WATER TAP | PROPOSED WATER LINE (SCOPE OF RSA) |
| NEW BUILDING | EXISTING E. POWER POLE | PROPOSED WATER TANK | PROPOSED E. POWER LINE (SCOPE OF RSA) |
| PROPOSED FENCE (SCOPE OF RSA) | EXISTING SOLAR SYSTEM | EXISTING TREE | PROPOSED E. POWER LINE |
| TO BE REMOVED FENCE (SCOPE OF RSA) | EXISTING TEL.COM. SYSTEM | | |
| | EXISTING E. POWER PANEL | | |

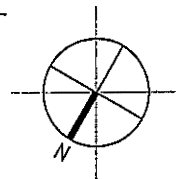
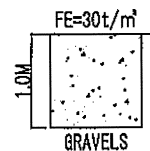

S=1:1000 0 5 10 20 30m

Code Number : BC1	Name of School : Dinoko Primary School	Site Area : 13,548.8sq.m
	District : Bochum	Community : Brodihill FarmB
		WC Type : A

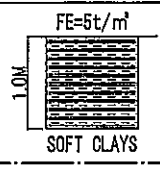
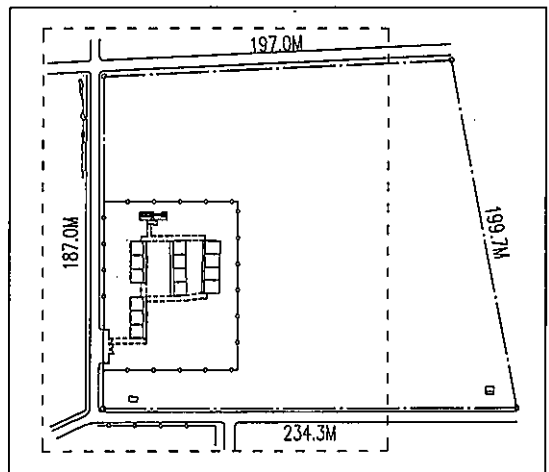
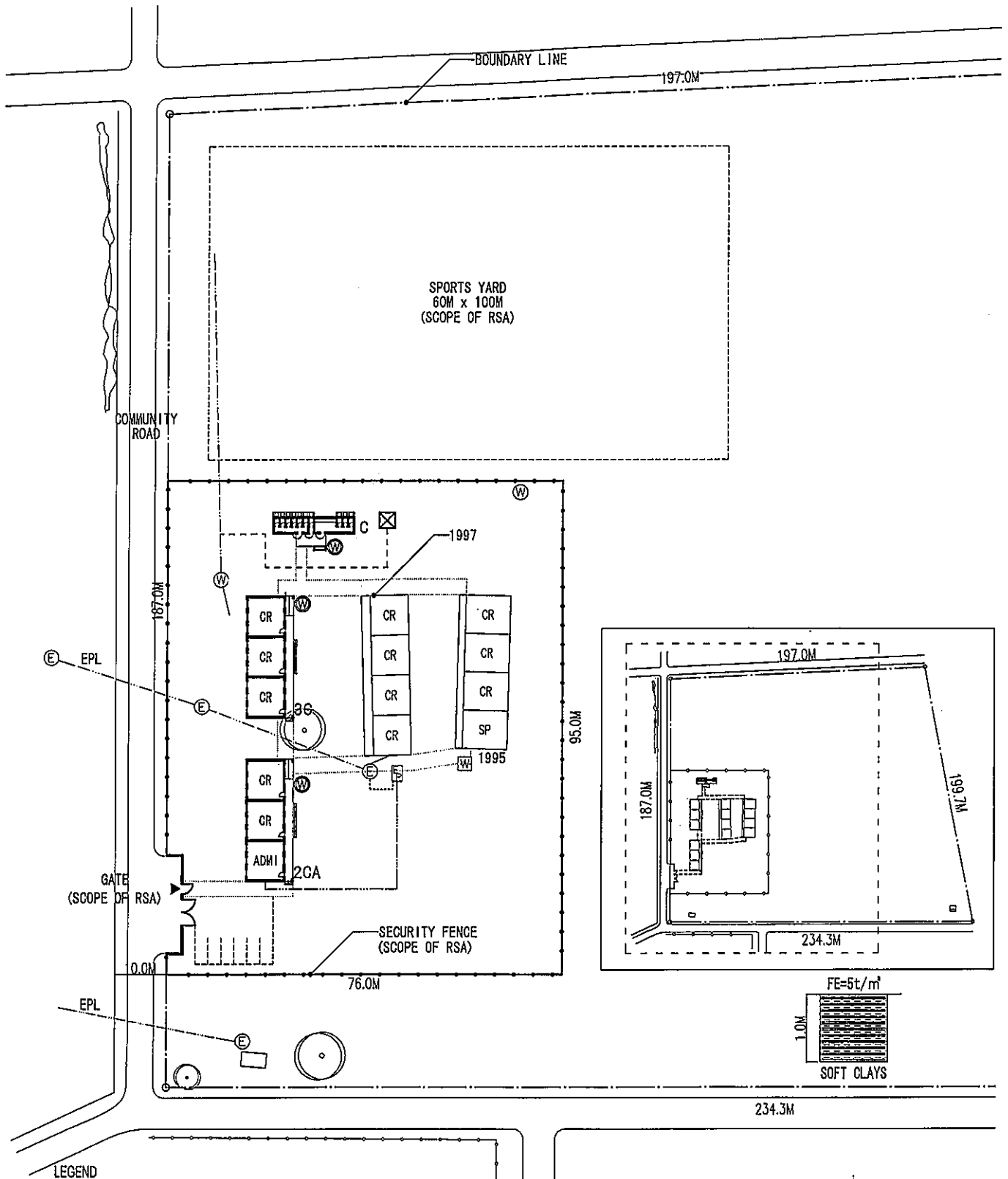

LEGEND

- EXISTING BUILDING
- NEW BUILDING
- PROPOSED FENCE (SCOPE OF RSA)
- EXISTING WATER LINE
- EXISTING E. POWER LINE
- EXISTING WATER TAP
- EXISTING E. POWER POLE
- EXISTING TREE
- PROPOSED WATER TAP
- PROPOSED WATER TANK
- EXISTING WATER TANK
- EXISTING E. POWER PANEL
- PROPOSED WATER LINE (SCOPE OF RSA)
- PROPOSED E. POWER LINE (SCOPE OF RSA)
- PROPOSED E. POWER LINE

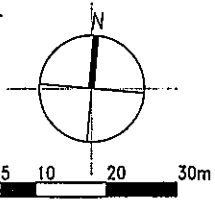

BC2	Code Number :		Name of School :		Site Area :	
			Kgopudi Secondary School		41,378.0sq.m	
	District : Bochum		Community : Mokgoeng Villege		CR. Type : 2CA, 3C	
				WC Type : C		

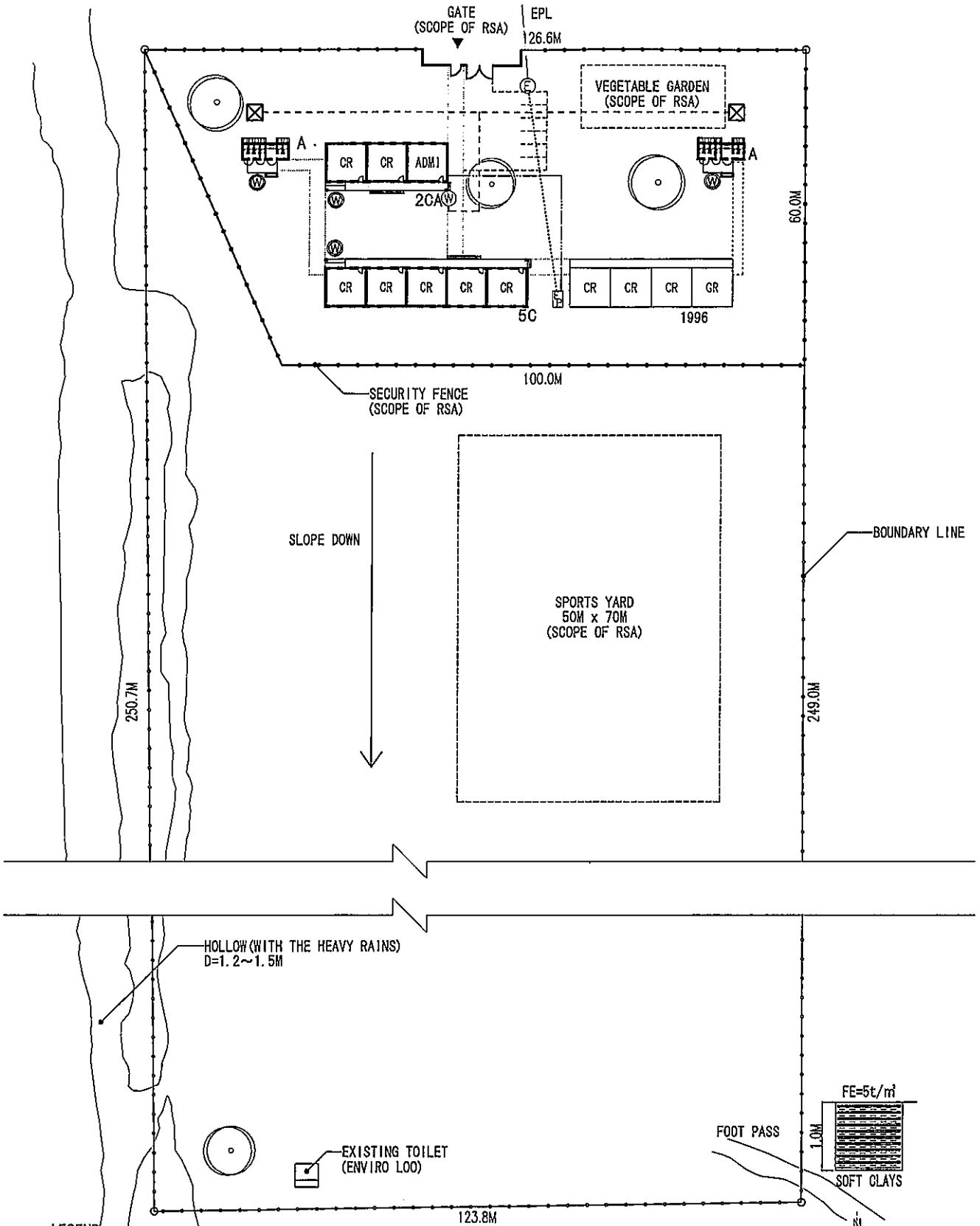

LEGEND

- | | | | |
|-------------------------------|-------------------------|---------------------|---------------------------------------|
| EXISTING BUILDING | EXISTING WATER TAP | PROPOSED WATER TAP | PROPOSED WATER LINE (SCOPE OF RSA) |
| NEW BUILDING | EXISTING E. POWER POLE | PROPOSED WATER TANK | PROPOSED E. POWER LINE (SCOPE OF RSA) |
| EXISTING FENCE | EXISTING E. POWER PANEL | EXISTING TREE | PROPOSED E. POWER LINE |
| PROPOSED FENCE (SCOPE OF RSA) | | | |
| EXISTING E. POWER LINE | | | |

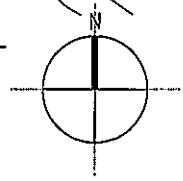

BC3	Code Number :		Name of School : Makgotlho Primary School		Site Area : 31,279.0sqm
	District : Bochum		Community : Buffelshoek		CR. Type : 2CA, 5C
					WC Type : A, A

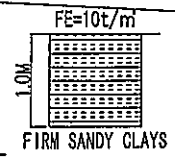
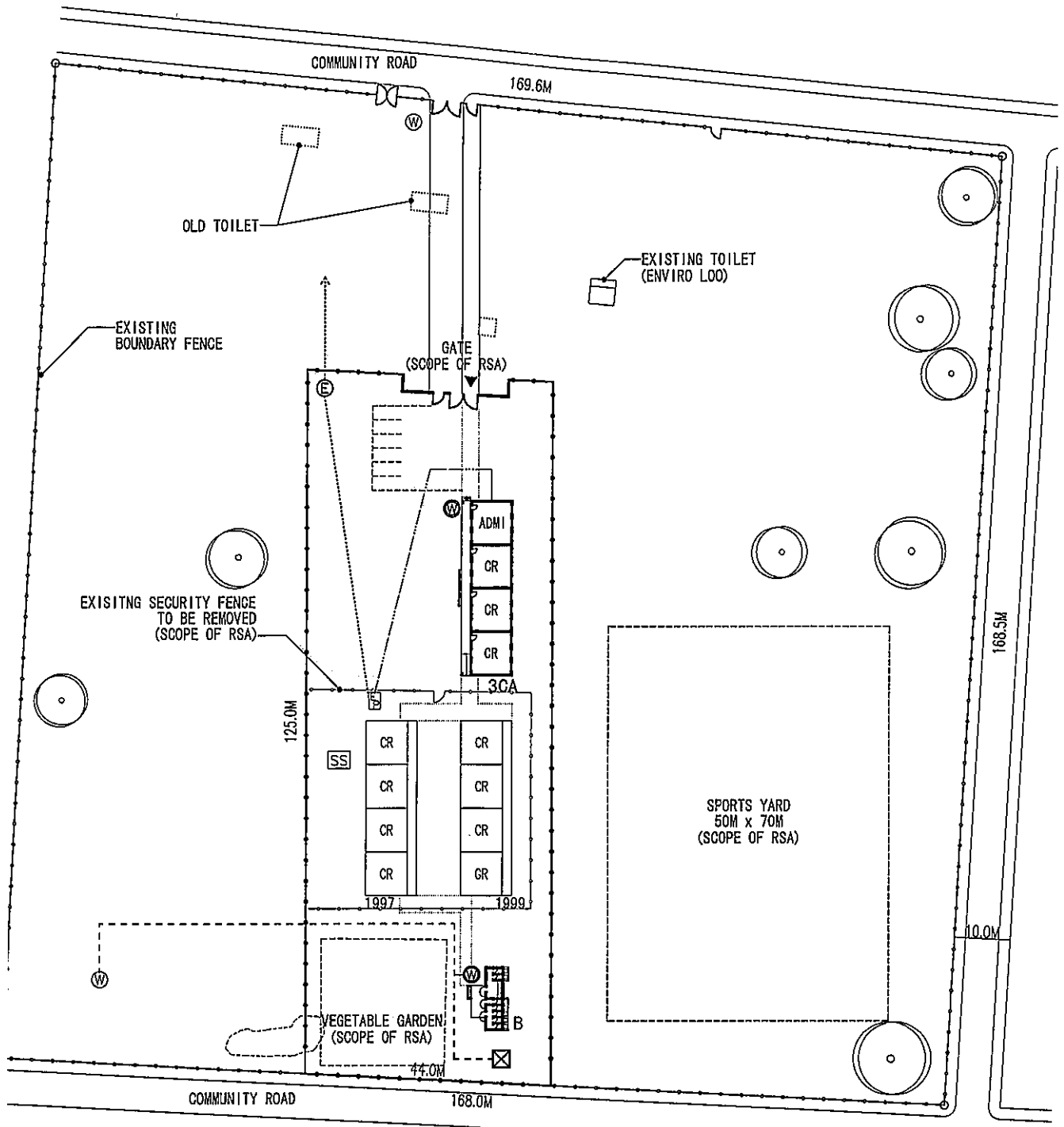

LEGEND

- EXISTING BUILDING
- NEW BUILDING
- TO BE DEMOLISHED BLDG. (SCOPE OF RSA)
- EXISTING FENCE
- PROPOSED FENCE (SCOPE OF RSA)
- TO BE REMOVED FENCE (SCOPE OF RSA)
- EXISTING WATER TAP
- PROPOSED WATER TAP
- EXISTING E. POWER PANEL
- PROPOSED E. POWER POLE (SCOPE OF RSA)
- EXISTING SOLAR SYSTEM
- PROPOSED WATER TANK
- EXISTING TREE
- PROPOSED WATER LINE (SCOPE OF RSA)
- PROPOSED E. POWER LINE

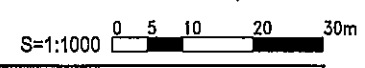
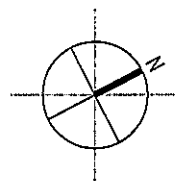

Code Number :	Name of School :	Site Area :
BC4	Mapotla Primary School	29,115.9sq.m
District :	Community :	CR. Type :
Bochum	Monyebodi Milbank	3CA
		WC Type :
		8

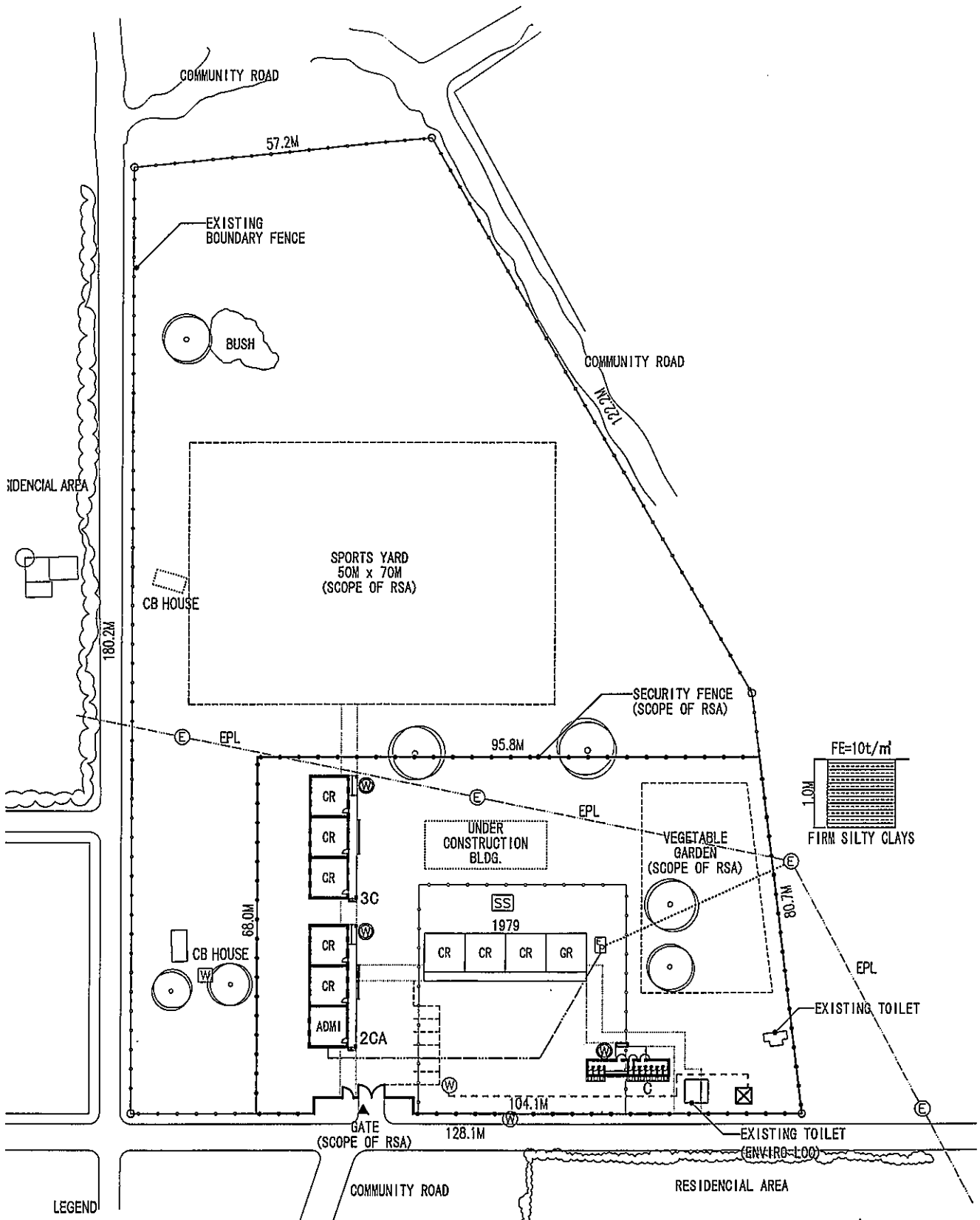

LEGEND

- | | | | |
|---------------------------------------|-------------------------|-----------------------|---------------------------------------|
| EXISTING BUILDING | EXISTING WATER TAP | PROPOSED WATER TAP | EXISTING E. POWER LINE |
| NEW BUILDING | EXISTING E. POWER POLE | PROPOSED WATER TANK | PROPOSED WATER LINE (SCOPE OF RSA) |
| TO BE DEMOLISHED BLDG. (SCOPE OF RSA) | EXISTING WATER TANK | EXISTING SOLAR SYSTEM | PROPOSED E. POWER LINE (SCOPE OF RSA) |
| EXISTING FENCE (SCOPE OF RSA) | EXISTING E. POWER PANEL | EXISTING TREE | PROPOSED E. POWER LINE |
| PROPOSED FENCE (SCOPE OF RSA) | | | |
| TO BE REMOVED FENCE (SCOPE OF RSA) | | | |

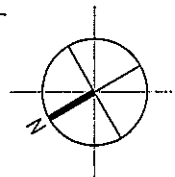

S=1:1000 0 5 10 20 30m

Code Number : BC5	Name of School : Matjeketlane Primary School	Site Area : 18,965.7sq.m
	District : Bochum	Community : Bognafarm Village
		WC Type : C

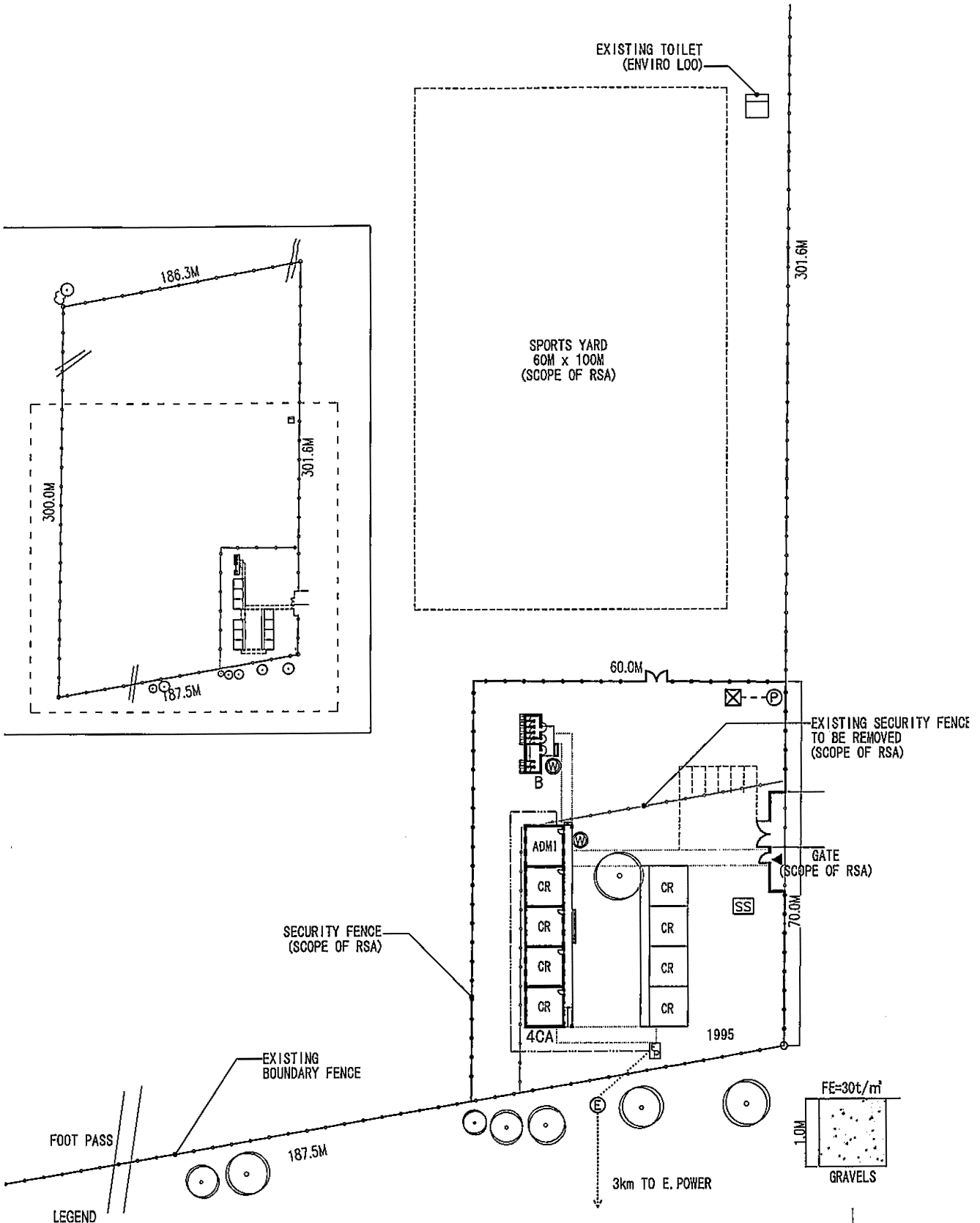

LEGEND

- EXISTING BUILDING
- NEW BUILDING
- EXISTING FENCE
- PROPOSED FENCE (SCOPE OF RSA)
- TO BE REMOVED FENCE (SCOPE OF RSA)
- SS EXISTING SOLAR SYSTEM
- E EXISTING E. POWER PANEL
- EXISTING TREE
- PROPOSED WATER TAP
- PROPOSED WATER TANK
- PROPOSED SOLAR SYSTEM (SCOPE OF RSA)
- PROPOSED WELL WITH HAND PUMP (SCOPE OF RSA)
- PROPOSED WATER LINE (SCOPE OF RSA)
- PROPOSED E. POWER LINE

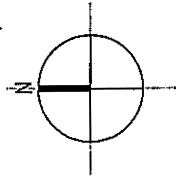

S=1:1000
0
5
10
20
30m

BC6	Name of School : Ngoakwana Secondary School		Site Area : 55,253.7sq.m
	District : Bochum		CR. Type : 4CA
	Community : Simson	WC Type : 8	

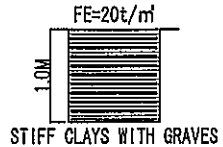
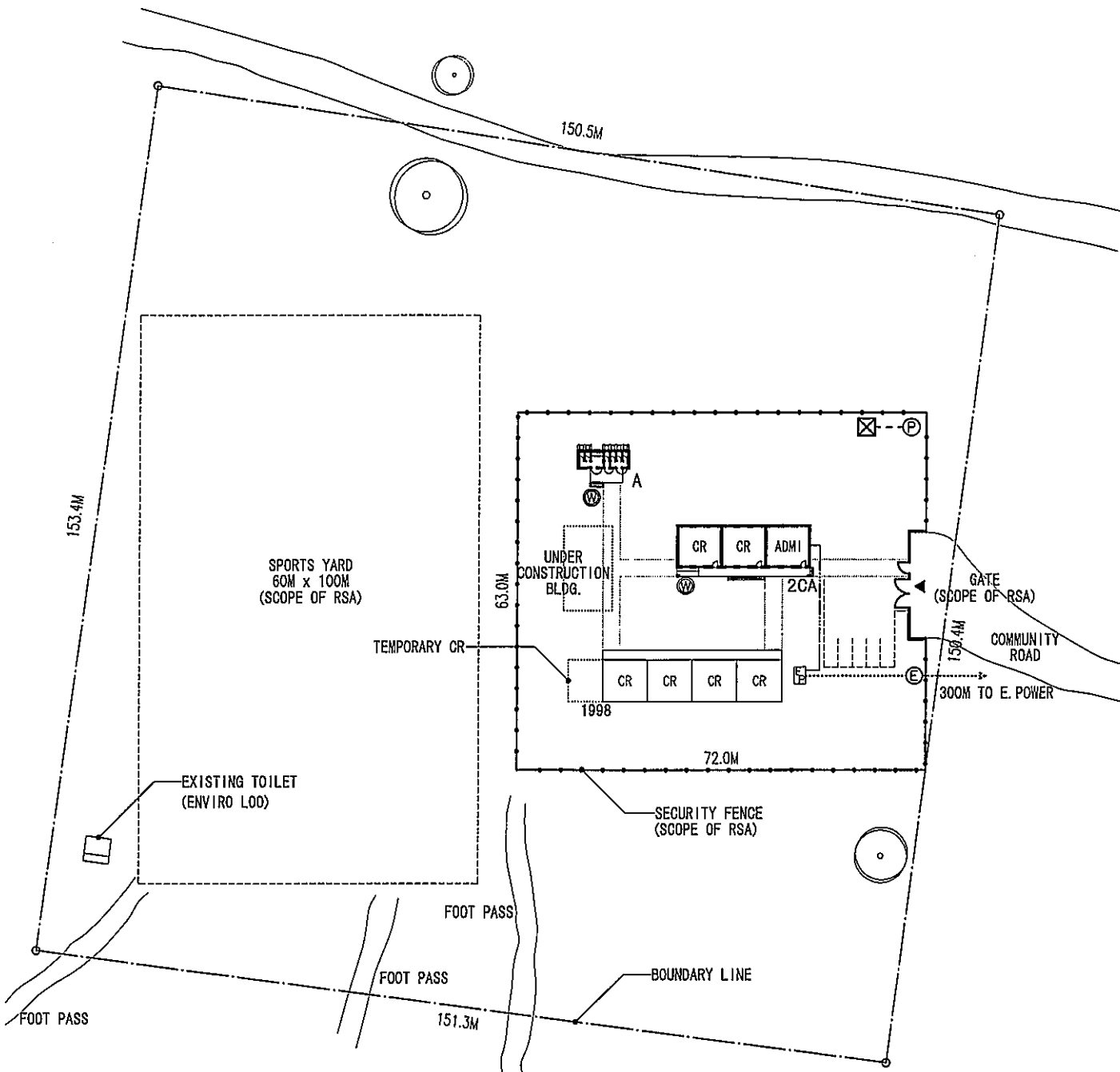

EXISTING BUILDING

- EXISTING BUILDING
- NEW BUILDING
- TO BE DEMOLISHED BLDG. (SCOPE OF RSA)
- PROPOSED FENCE (SCOPE OF RSA)
- E EXISTING E. POWER PANEL
- EXISTING TREE
- PROPOSED WATER TAP
- PROPOSED E. POWER POLE (SCOPE OF RSA)
- PROPOSED WATER TANK
- PROPOSED WELL WITH HAND PUMP (SCOPE OF RSA)
- PROPOSED WATER LINE (SCOPE OF RSA)
- PROPOSED E. POWER LINE (SCOPE OF RSA)
- PROPOSED E. POWER LINE

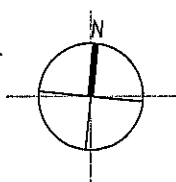

S=1:1000
0
5
10
20
30m

Code Number :	Name of School :	Site Area :
BC7	Rapetsoa Secondary School	22,920.4sq.m
District :	Community :	CR. Type :
Bochum	Grootdraai Village	2CA
		WC Type :
		A

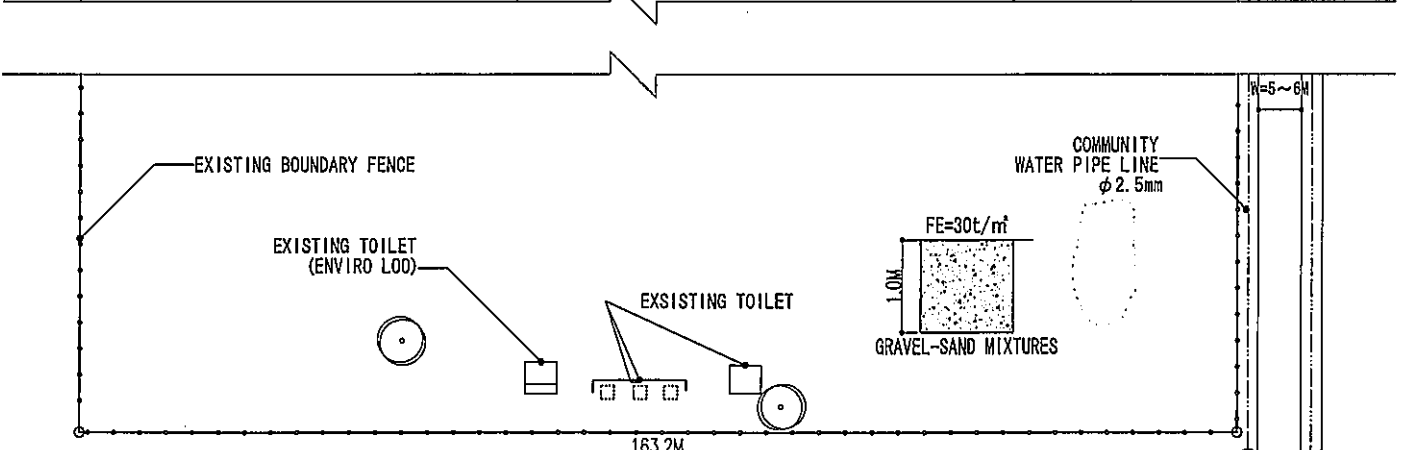
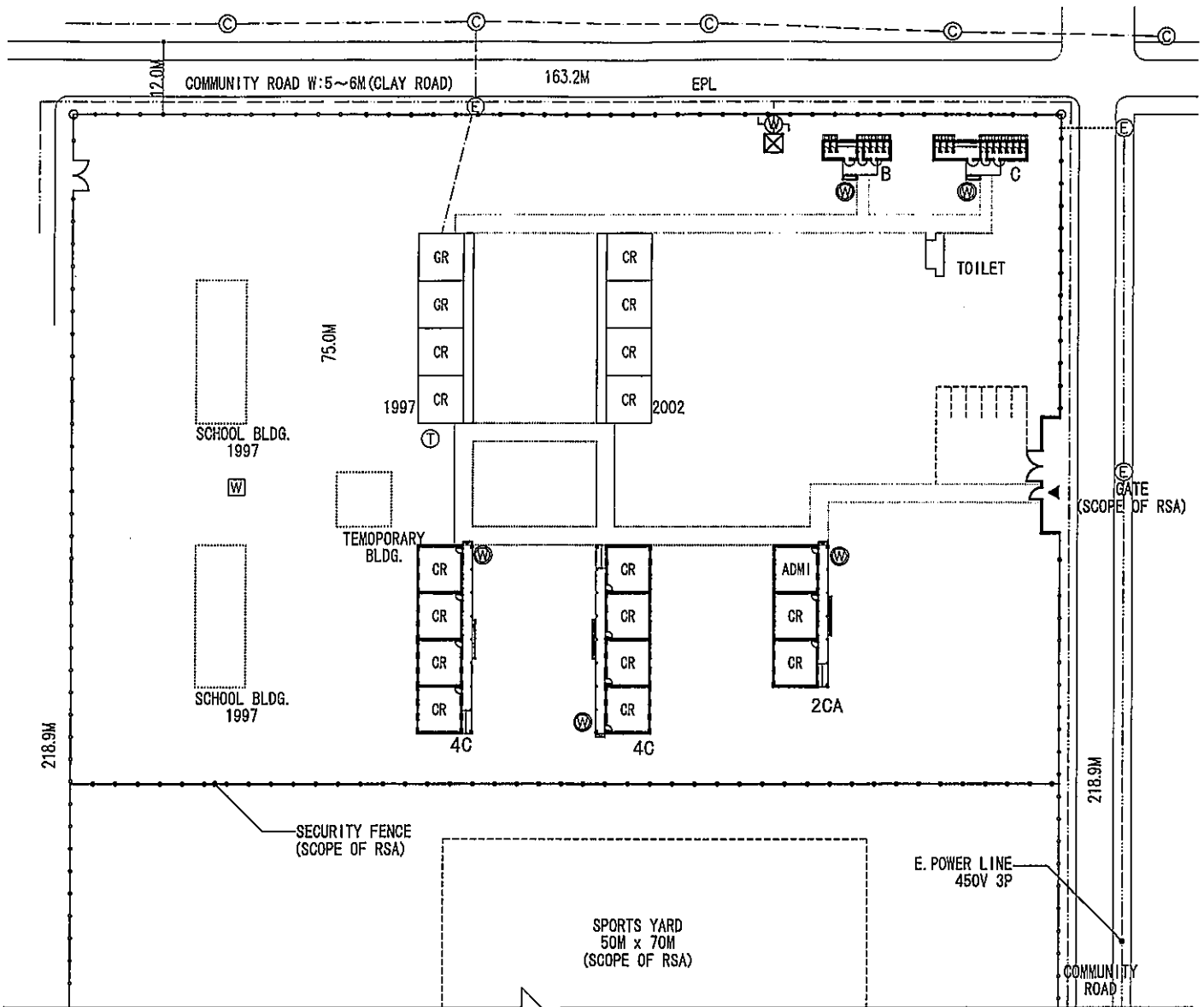

LEGEND

- | | | | |
|---------------------------------------|---------------------------------|---------------------------------------|--------------------------------------|
| EXISTING BUILDING | EXISTING TEL.COM.POLE | PROPOSED WATER TANK | EXISTING WATER LINE |
| NEW BUILDING | EXISTING WATER TAP | PROPOSED WATER TAP | EXISTING E. POWER LINE |
| TO BE DEMOLISHED BLDG. (SCOPE OF RSA) | EXISTING E.POWER POLE | PROPOSED E.POWER POLE (SCOPE OF RSA) | PROPOSED WATER LINE (SCOPE OF RSA) |
| EXISTING FENCE | EXISTING E.POWER & TEL.COM.POLE | PROPOSED E.POWER PANEL (SCOPE OF RSA) | PROPOSED E.POWER LINE (SCOPE OF RSA) |
| PROPOSED FENCE (SCOPE OF RSA) | EXISTING WATER TANK | PROPOSED WATER METER (SCOPE OF RSA) | PROPOSED E. POWER LINE |
| EXISTING E. POWER & TEL.COM. LINE | EXISTING TREE | | |

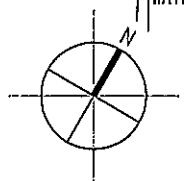

S=1:1000 0 5 10 20 30m

Code Number : BC9	Name of School : Rapoho Primary School	Site Area : 35,724.5sq.m
	District : Bochum	Community : Mohodi Manthata
		WC Type : B, C

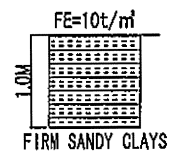
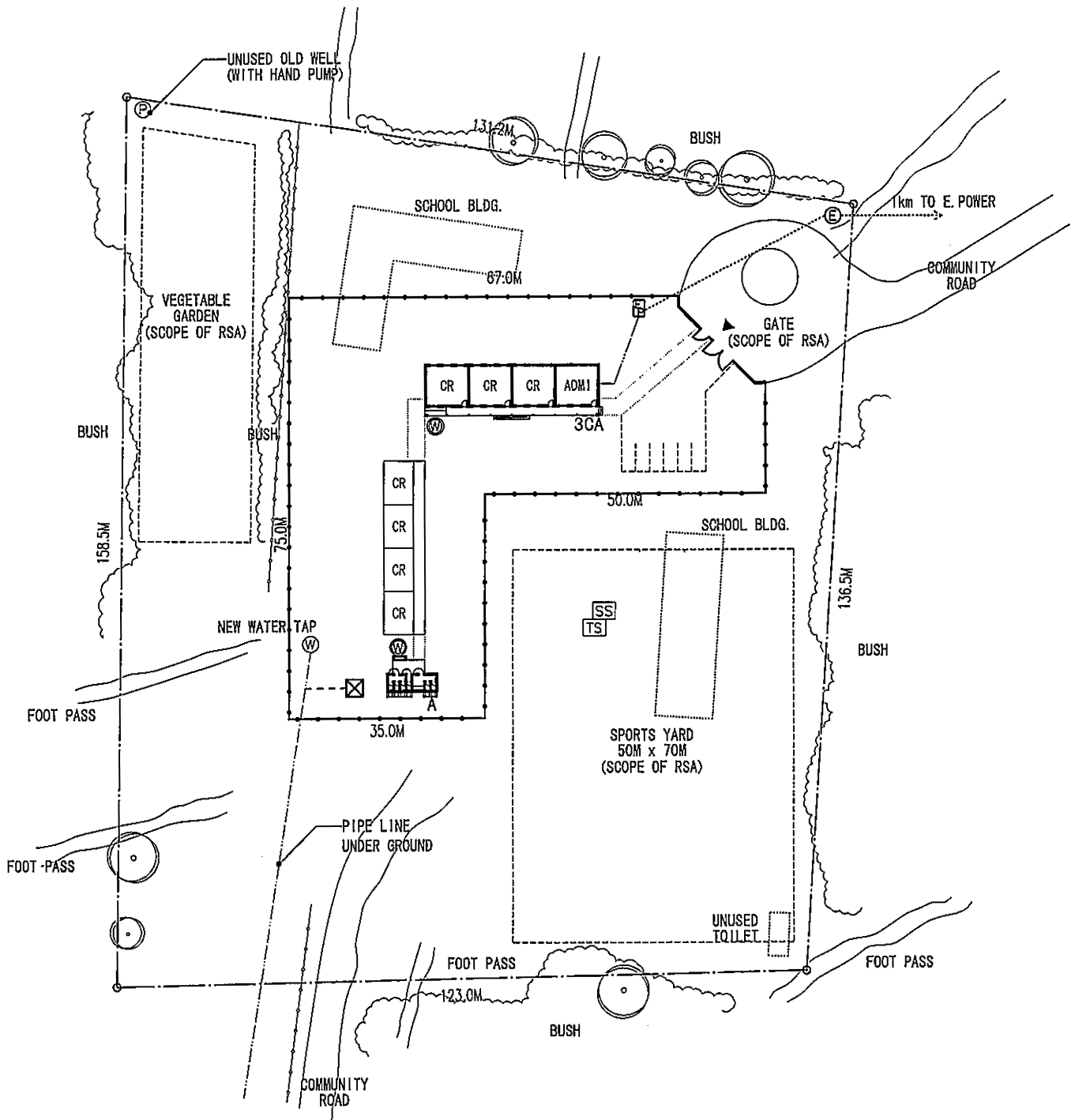

LEGEND

- | | | | |
|---------------------------------------|------------------------------|---------------------------------------|------------------------------------|
| EXISTING BUILDING | EXISTING WATER TAP | PROPOSED WATER TAP | EXISTING WATER LINE |
| NEW BUILDING | EXISTING WELL WITH HAND PUMP | PROPOSED WATER TANK | PROPOSED WATER LINE (SCOPE OF RSA) |
| TO BE DEMOLISHED BLDG. (SCOPE OF RSA) | EXISTING SOLAR SYSTEM | PROPOSED E.POWER POLE (SCOPE OF RSA) | PROPOSED E.POWER LINE |
| PROPOSED FENCE (SCOPE OF RSA) | EXISTING TEL.COM. SYSTEM | PROPOSED E.POWER PANEL (SCOPE OF RSA) | |
| TO BE REMOVED FENCE (SCOPE OF RSA) | EXISTING TREE | | |

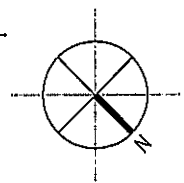

S=1:1000 0 5 10 20 30m

Code Number : BC10	Name of School : Kodumela Primary School	Site Area : 18,662.2sq.m
District : Bochum	Community : Schoonveld Terbrugge	CR. Type : 3CA
		WC Type : A

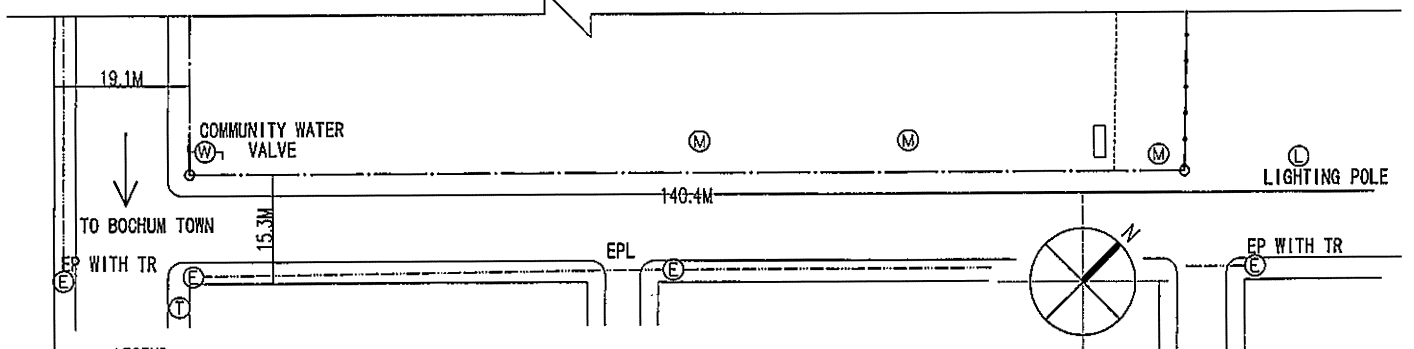
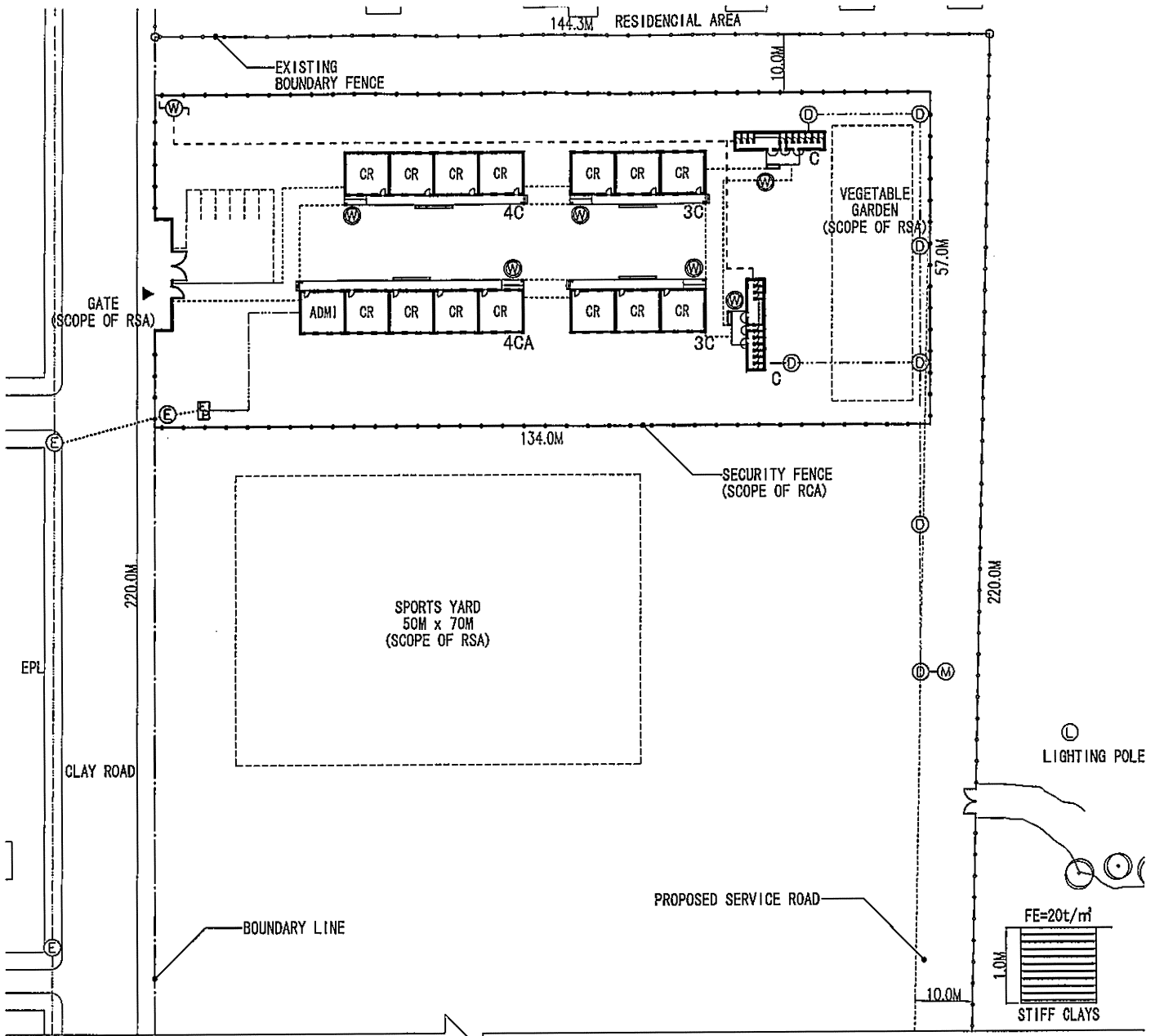

LEGEND

NEW BUILDING	EXISTING E. POWER POLE	PROPOSED WATER TAP	PROPOSED WATER LINE
EXISTING FENCE	EXISTING TEL. COM. POLE	PROPOSED E. POWER POLE (SCOPE OF RSA)	PROPOSED E. POWER LINE (SCOPE OF RSA)
PROPOSED FENCE (SCOPE OF RSA)	EXISTING MANHOLE	PROPOSED DRAIN	PROPOSED E. POWER LINE
EXISTING E. POWER LINE	EXISTING WATER VALVE	PROPOSED WATER TANK	PROPOSED DRAIN LINE
PROPOSED E. POWER PANEL (SCOPE OF RSA)	PROPOSED WATER METER (SCOPE OF RSA)		

S=1:1000

Code Number : BC11	Name of School : Bothanang Primary School	Site Area : 31,314.6sq.m
District : Bochum	Community : Bochum Township	CR. Type : 4CA, 4C, 3C, 3C
		WC Type : C, C

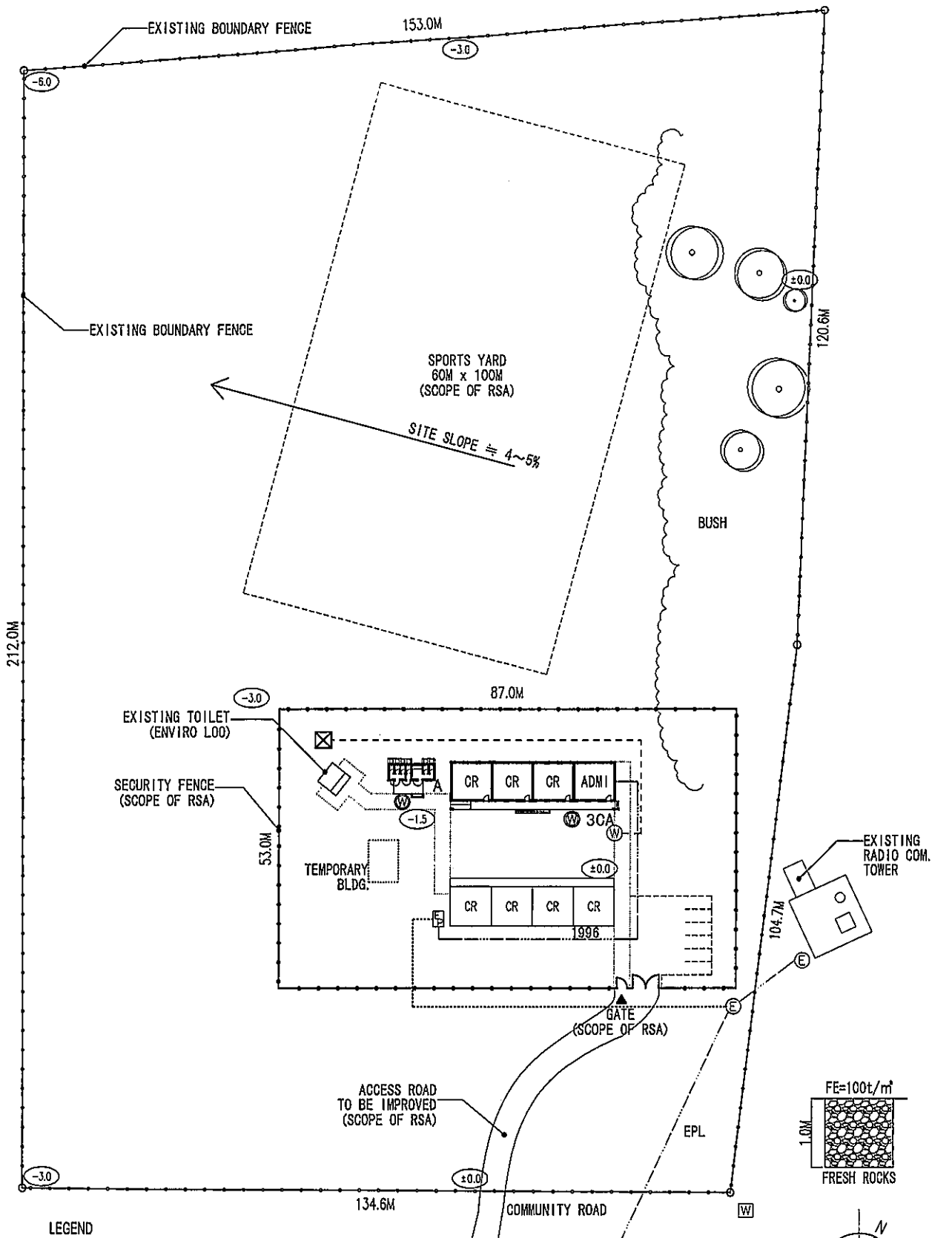

LEGEND

- | | | | |
|---------------------------------------|-------------------------|------------------------|---------------------------------------|
| EXISTING BUILDING | EXISTING WATER TAP | PROPOSED WATER TAP | EXISTING E. POWER LINE |
| NEW BUILDING | EXISTING E. POWER POLE | PROPOSED WATER TANK | PROPOSED WATER LINE (SCOPE OF RSA) |
| TO BE DEMOLISHED BLDG. (SCOPE OF RSA) | EXISTING WATER TANK | PROPOSED E. POWER LINE | PROPOSED E. POWER LINE (SCOPE OF RSA) |
| EXISTING FENCE | EXISTING E. POWER PANEL | EXISTING TREE | |
| PROPOSED FENCE (SCOPE OF RSA) | | | |

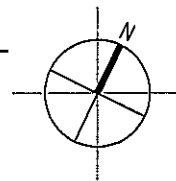

S=1:1000 0 5 10 20 30m

KK1	Code Number :		Name of School :		Site Area :
			Kwena A Peu Secondary School		31,792.3sq.m
District :		Community :		CR. Type :	
KoneKwena		Zaaiplaats		3CA	
					WC Type :
					A

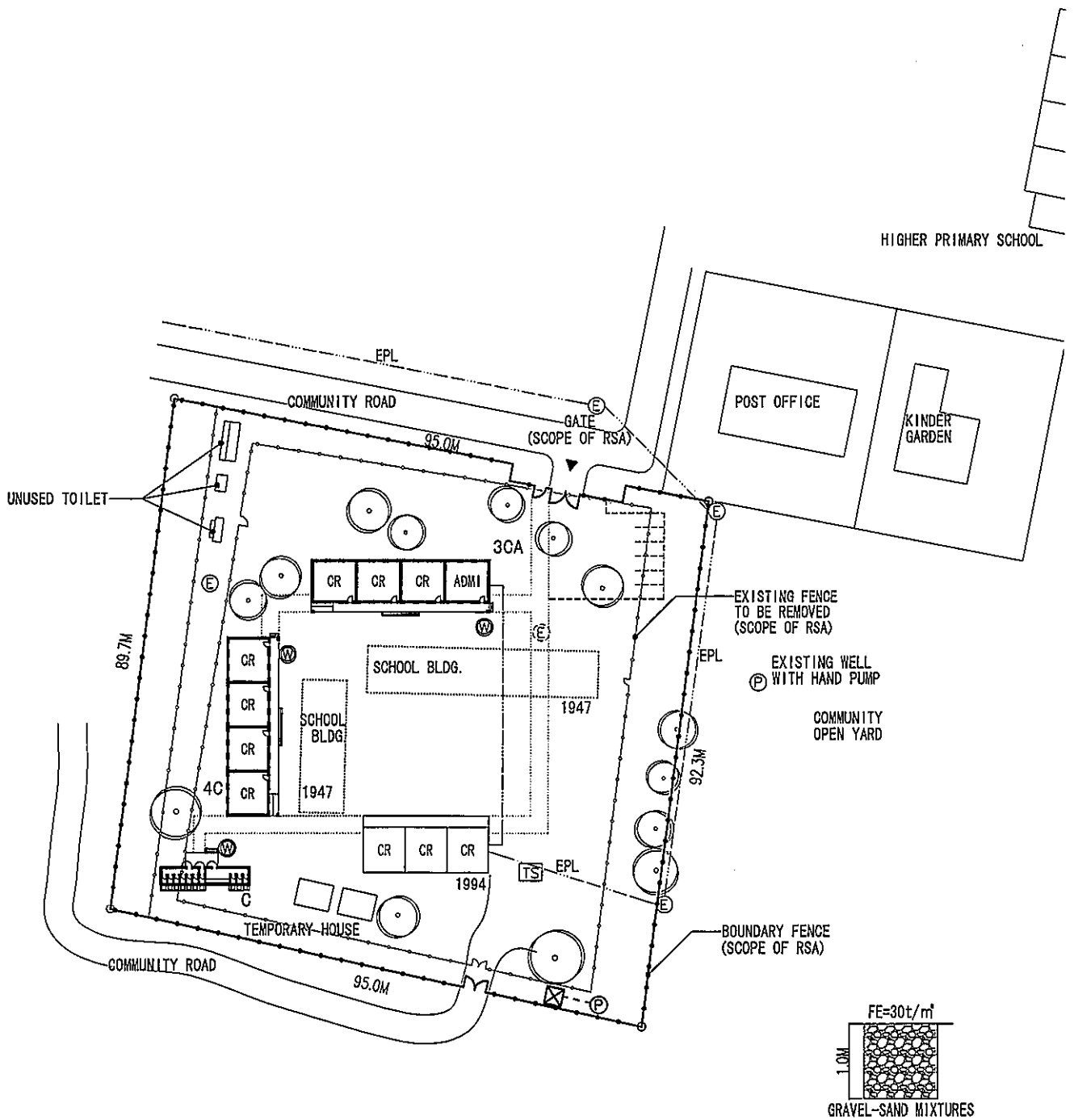

LEGEND

- | | | | |
|---------------------------------------|--------------------------|---|------------------------------------|
| EXISTING BUILDING | EXISTING E. POWER POLE | PROPOSED WATER TAP | E. POWER LINE |
| NEW BUILDING | EXISTING TEL.COM. SYSTEM | PROPOSED WATER TANK | PROPOSED WATER LINE (SCOPE OF RSA) |
| TO BE DEMOLISHED BLDG. (SCOPE OF RSA) | EXISTING TREE | PROPOSED WELL WITH HAND PUMP (SCOPE OF RSA) | PROPOSED E. POWER LINE |
| PROPOSED FENCE (SCOPE OF RSA) | | | |
| TO BE REMOVED FENCE (SCOPE OF RSA) | | | |

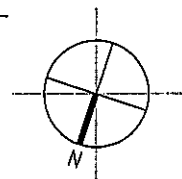
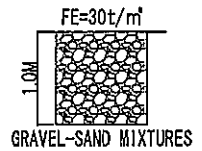

S=1:1000 0 5 10 20 30m

KK2	Code Number :		Name of School :		Site Area : 8,612.7sq.m	
			Ramertloana Lower Primary School		CR. Type : 3CA, 4C	
		District : KoneKwena		Community : Mabasoitho		WC Type : C

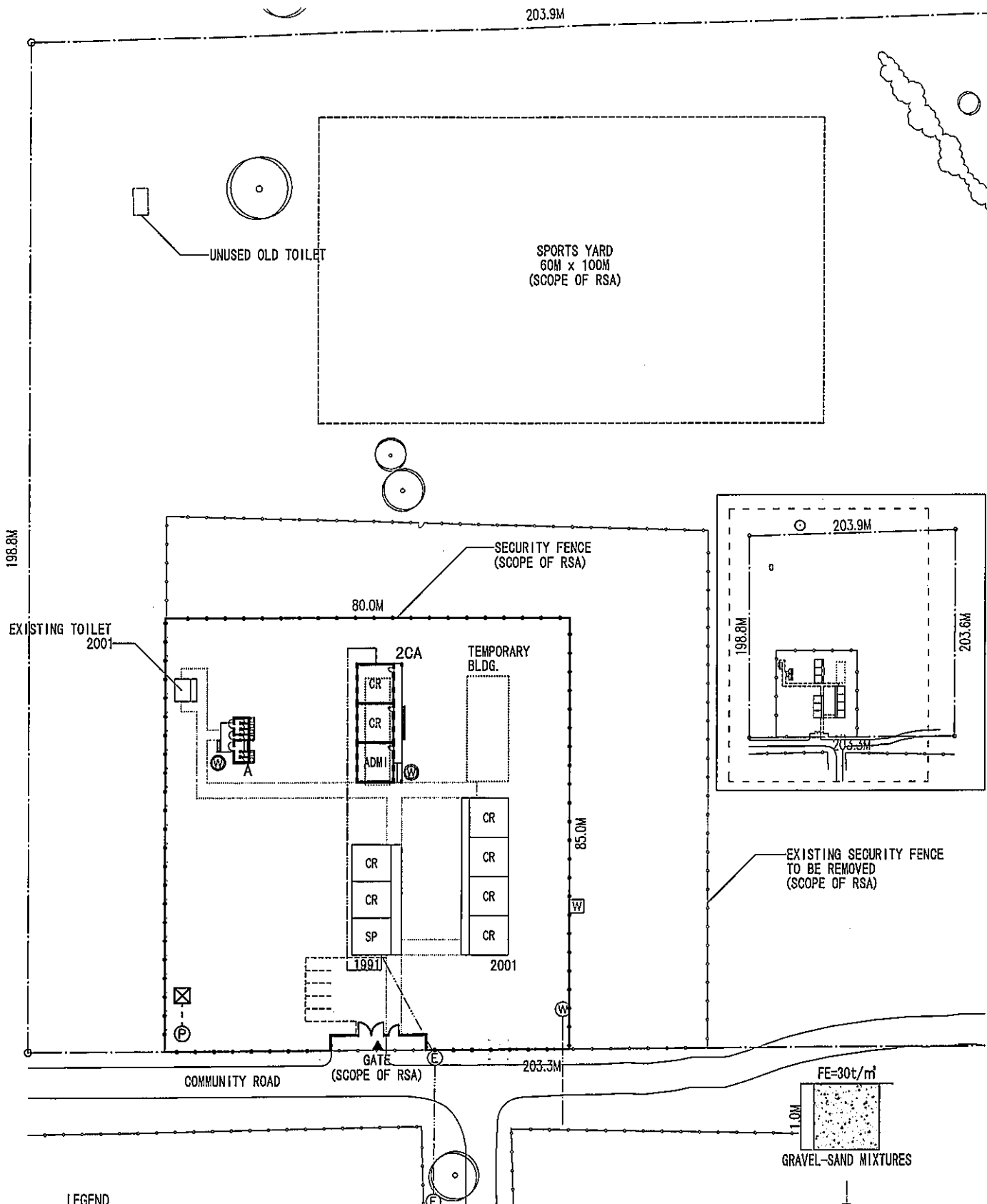

LEGEND

- | | | | |
|---------------------------------------|------------------------|---|------------------------------------|
| EXISTING BUILDING | EXISTING WATER TAP | PROPOSED WATER TAP | EXISTING WATER LINE |
| NEW BUILDING | EXISTING E. POWER POLE | PROPOSED WATER TANK | EXISTING E. POWER LINE |
| TO BE DEMOLISHED BLDG. (SCOPE OF RSA) | WATER TANK | PROPOSED WELL WITH HAND PUMP (SCOPE OF RSA) | PROPOSED WATER LINE (SCOPE OF RSA) |
| PROPOSED FENCE (SCOPE OF RSA) | EXISTING TREE | | PROPOSED E. POWER LINE |
| TO BE REMOVED FENCE (SCOPE OF RSA) | | | |

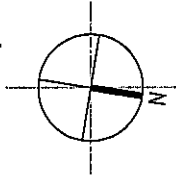
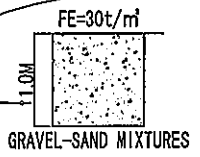

S=1:1000 0 5 10 20 30m

KK4	Code Number :		Name of School : Mahlabela Secondary School		Site Area : 40,954.1sq.m
	District : KoneKwena	Community : Rametlwane Village			CR. Type : 2CA
					WC Type : A