

(6) 配置計画 S=1/1,000

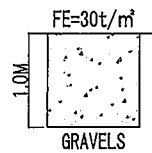

LEGEND

- |  |                                    |  |                          |  |                     |  |                                       |
|--|------------------------------------|--|--------------------------|--|---------------------|--|---------------------------------------|
|  | EXISTING BUILDING                  |  | EXISTING WATER TAP       |  | PROPOSED WATER TAP  |  | PROPOSED WATER LINE (SCOPE OF RSA)    |
|  | NEW BUILDING                       |  | EXISTING E. POWER POLE   |  | PROPOSED WATER TANK |  | PROPOSED E. POWER LINE (SCOPE OF RSA) |
|  | PROPOSED FENCE (SCOPE OF RSA)      |  | EXISTING SOLAR SYSTEM    |  | EXISTING TREE       |  | PROPOSED E. POWER LINE                |
|  | TO BE REMOVED FENCE (SCOPE OF RSA) |  | EXISTING TEL.COM. SYSTEM |  |                     |  |                                       |
|  |                                    |  | EXISTING E. POWER PANEL  |  |                     |  |                                       |

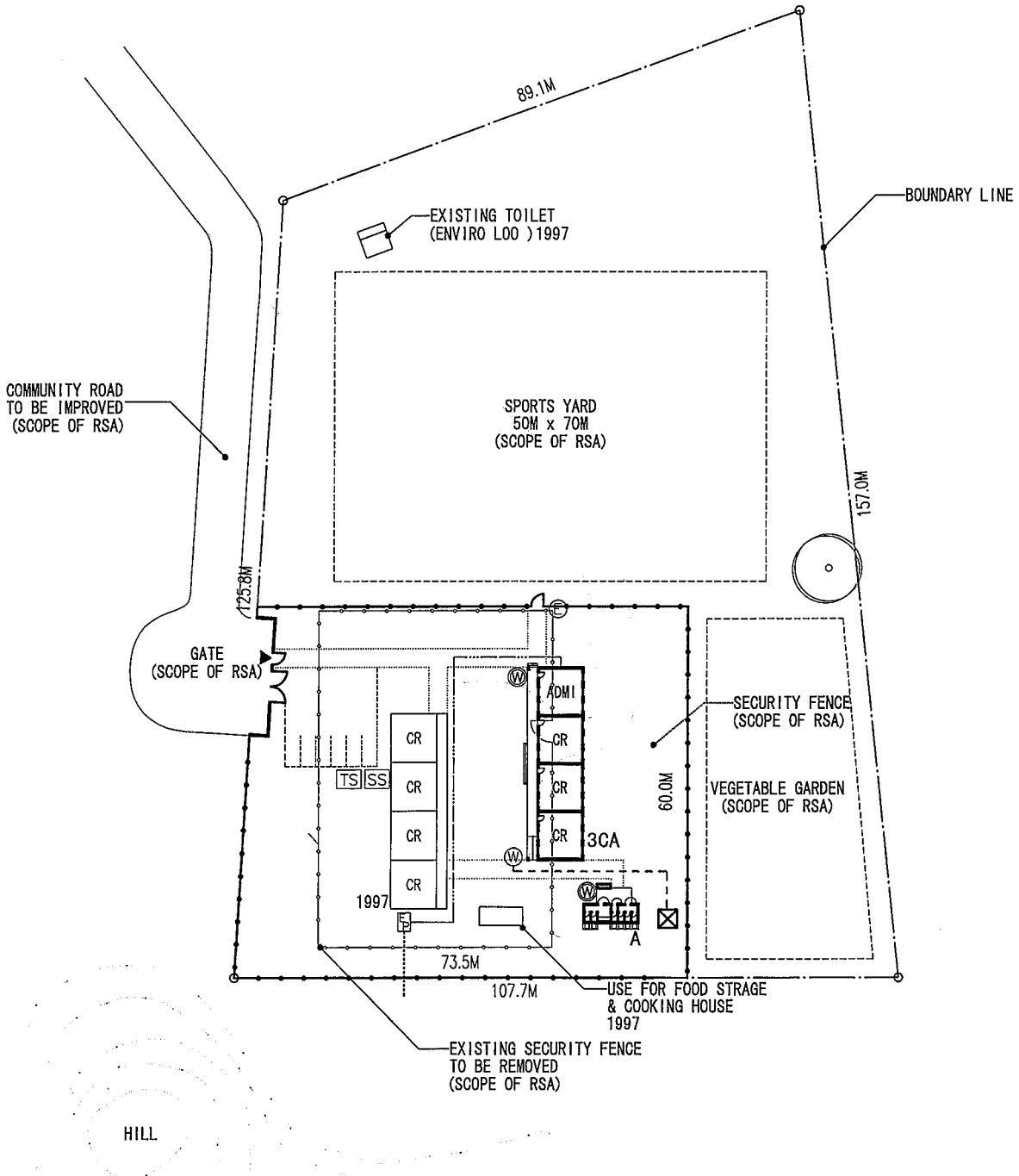
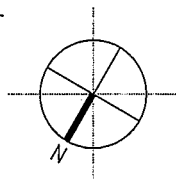

S=1:1000

Code Number : <b>BC1</b>	Name of School : <b>Dinoko Primary School</b>	Site Area : 13,546.6sq.m
	District : Bochum	Community : Brodihill FarmB
		WC Type : A

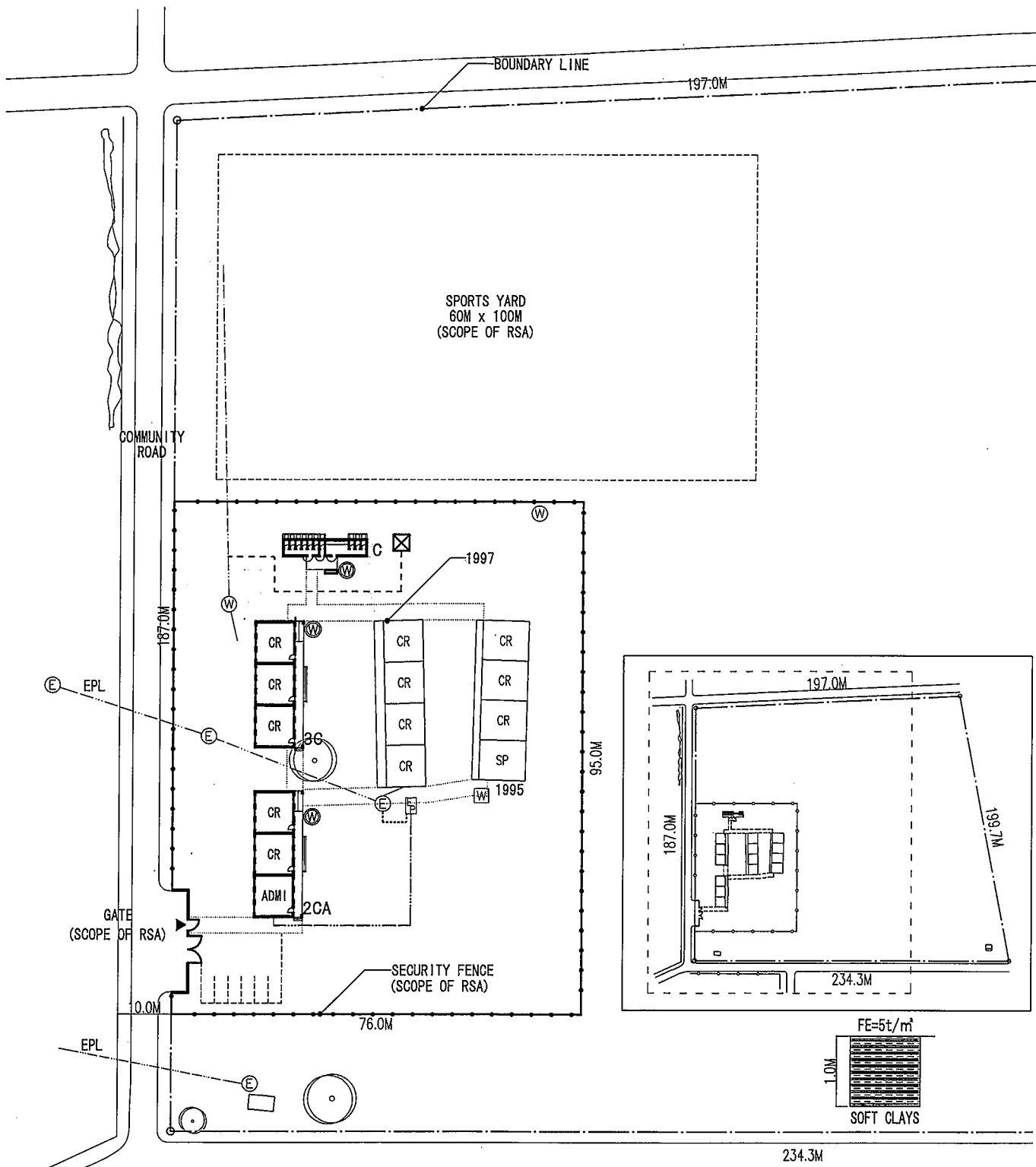

**LEGEND**

- |                               |                        |                     |                                      |
|-------------------------------|------------------------|---------------------|--------------------------------------|
| EXISTING BUILDING             | EXISTING WATER TAP     | PROPOSED WATER TAP  | PROPOSED WATER LINE (SCOPE OF RSA)   |
| NEW BUILDING                  | EXISTING E-POWER POLE  | PROPOSED WATER TANK | PROPOSED E-POWER LINE (SCOPE OF RSA) |
| PROPOSED FENCE (SCOPE OF RSA) | EXISTING TREE          | EXISTING WATER TANK | PROPOSED E-POWER LINE                |
| EXISTING WATER LINE           | EXISTING E-POWER PANEL |                     |                                      |
| EXISTING E-POWER LINE         |                        |                     |                                      |

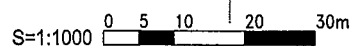
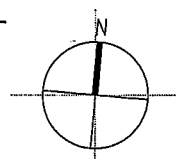

Code Number : <b>BC2</b>	Name of School : <b>Kgopudi Secondary School</b>	Site Area : 41,378.0sq.m
	District : Bochum	Community : Mokgoeng Villege
		CR. Type : 2CA, 3C
		WC Type : C

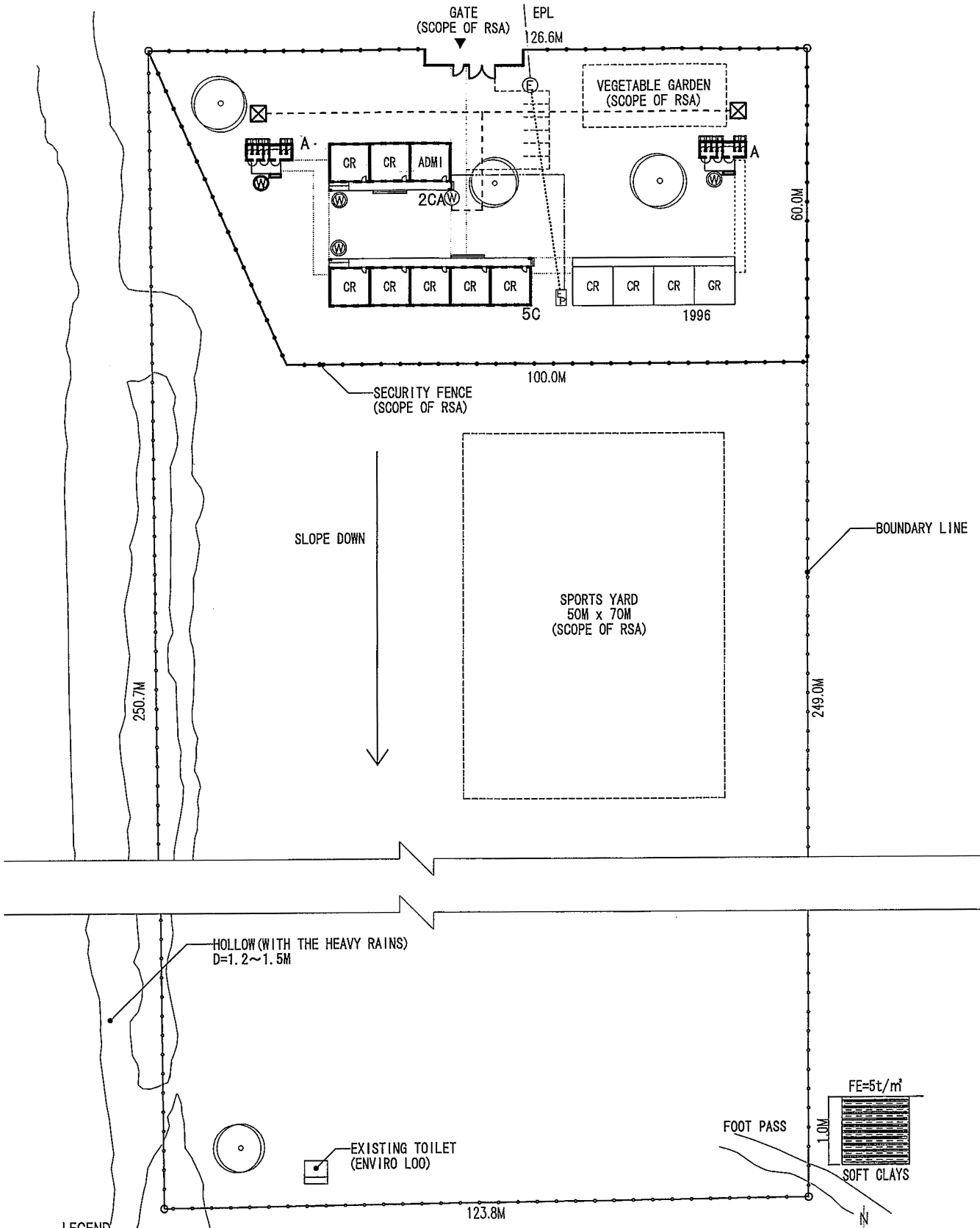

**LEGEND**

- EXISTING BUILDING
- NEW BUILDING
- EXISTING FENCE
- PROPOSED FENCE (SCOPE OF RSA)
- EXISTING E. POWER LINE
- EXISTING WATER TAP
- PROPOSED WATER TAP
- EXISTING E. POWER POLE
- PROPOSED E. POWER POLE
- EXISTING E. POWER PANEL
- PROPOSED WATER TANK
- EXISTING TREE
- PROPOSED WATER LINE (SCOPE OF RSA)
- PROPOSED E. POWER LINE (SCOPE OF RSA)
- PROPOSED E. POWER LINE

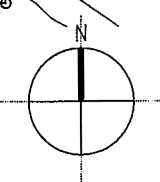

S=1:1000 0 5 10 20 30m

Code Number : <b>BC3</b>	Name of School : <b>Makgotlho Primary School</b>	Site Area : 31,279.0sqm
District : Bochum	Community : Buffelshoek	CR. Type : 2CA, 5C
		WC Type : A, A

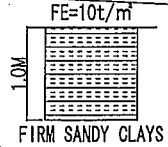
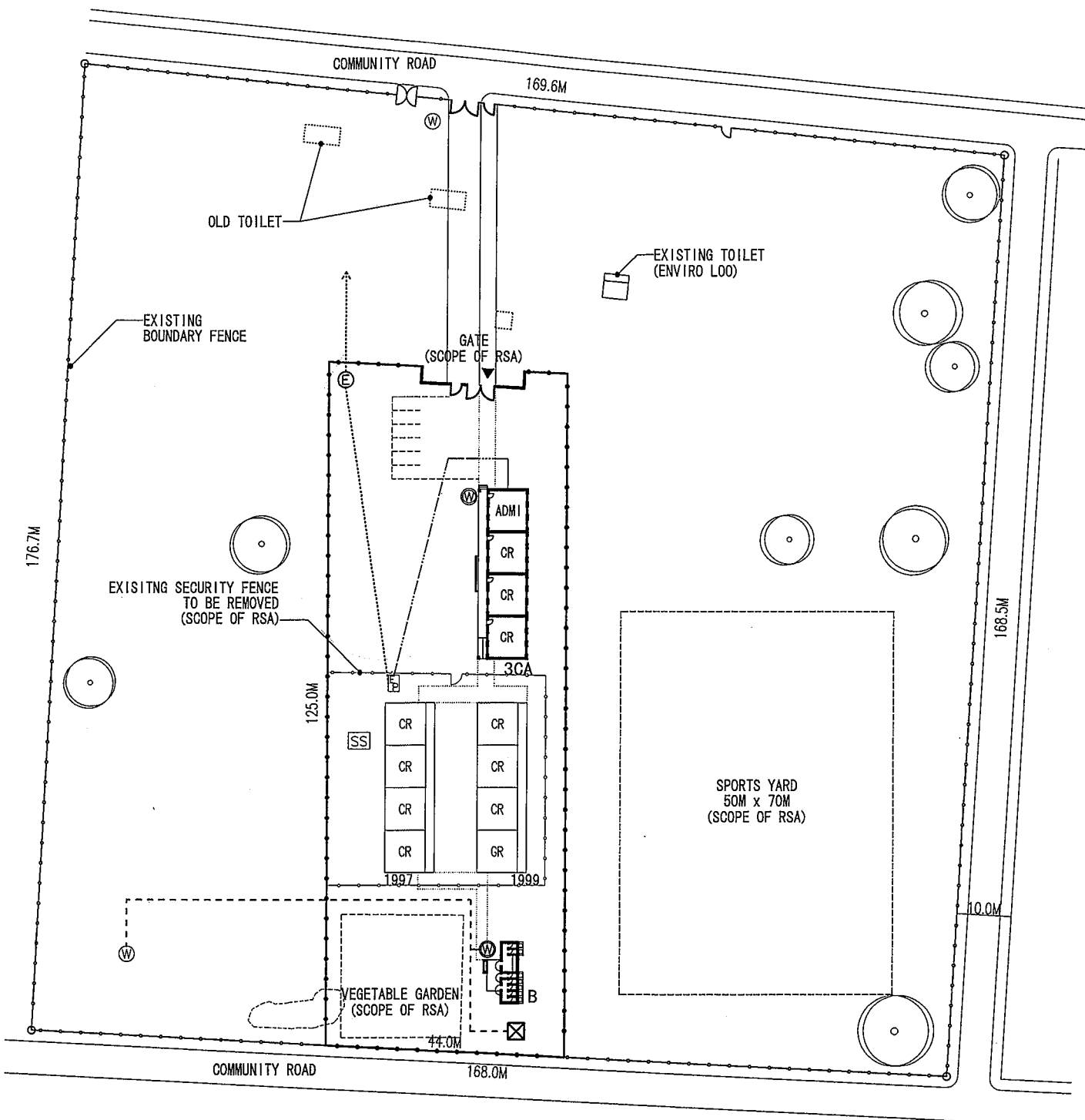

**LEGEND**

- |                                       |                         |                                       |                                    |
|---------------------------------------|-------------------------|---------------------------------------|------------------------------------|
| EXISTING BUILDING                     | EXISTING WATER TAP      | PROPOSED WATER TAP                    | PROPOSED WATER LINE (SCOPE OF RSA) |
| NEW BUILDING                          | EXISTING E. POWER PANEL | PROPOSED E. POWER POLE (SCOPE OF RSA) | PROPOSED E. POWER LINE             |
| TO BE DEMOLISHED BLDG. (SCOPE OF RSA) | EXISTING SOLAR SYSTEM   | PROPOSED WATER TANK                   |                                    |
| EXISTING FENCE                        | EXISTING TREE           |                                       |                                    |
| PROPOSED FENCE (SCOPE OF RSA)         |                         |                                       |                                    |
| TO BE REMOVED FENCE (SCOPE OF RSA)    |                         |                                       |                                    |

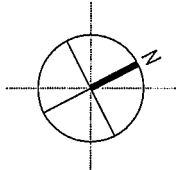

S=1:1000 0 5 10 20 30m

Code Number : <b>BC4</b>	Name of School : <b>Mapotla Primary School</b>	Site Area : 29,115.9sq.m
District : Bochum	Community : Moneybodi Milbank	CR. Type : 3CA
		WC Type : B

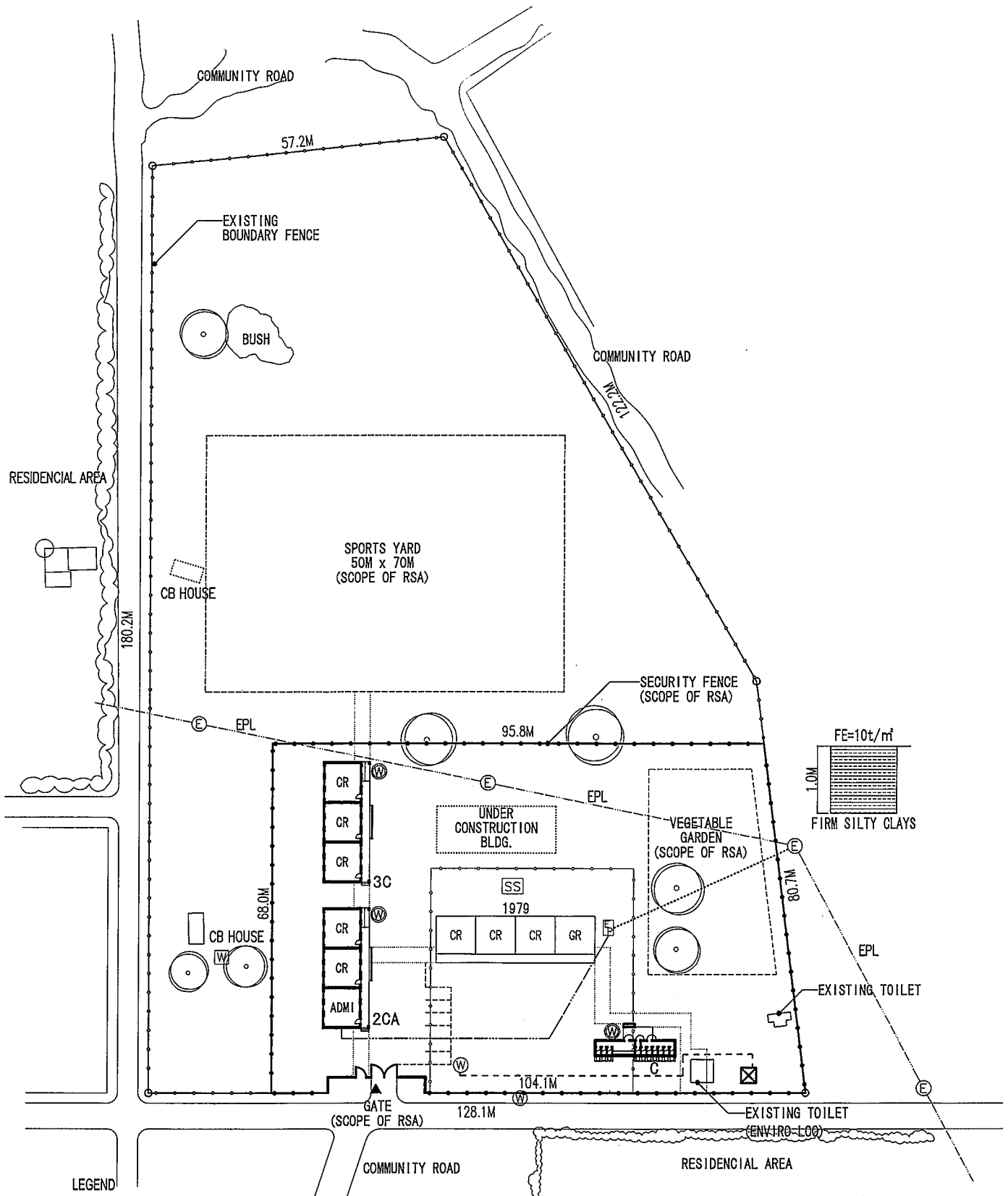

LEGEND

- |                                       |                         |                                       |                                       |
|---------------------------------------|-------------------------|---------------------------------------|---------------------------------------|
| EXISTING BUILDING                     | EXISTING WATER TAP      | PROPOSED WATER TAP                    | EXISTING E. POWER LINE                |
| NEW BUILDING                          | EXISTING E. POWER POLE  | PROPOSED WATER TANK                   | PROPOSED WATER LINE (SCOPE OF RSA)    |
| TO BE DEMOLISHED BLDG. (SCOPE OF RSA) | EXISTING WATER TANK     | PROPOSED E. POWER LINE (SCOPE OF RSA) | PROPOSED E. POWER LINE (SCOPE OF RSA) |
| EXISTING FENCE                        | EXISTING SOLAR SYSTEM   | EXISTING TREE                         | PROPOSED E. POWER LINE (SCOPE OF RSA) |
| PROPOSED FENCE (SCOPE OF RSA)         | EXISTING E. POWER PANEL |                                       | PROPOSED E. POWER LINE                |
| TO BE REMOVED FENCE (SCOPE OF RSA)    |                         |                                       |                                       |

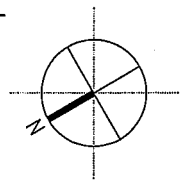

S=1:1000 0 5 10 20 30m

<b>BC5</b>	Code Number :		Name of School :		Site Area :	
			<b>Matjeketlane Primary School</b>		18,965.7sq.m	
	District : Bochum		Community : Bognafarm Village		CR. Type : 2CA, 3C	
				WC Type : C		

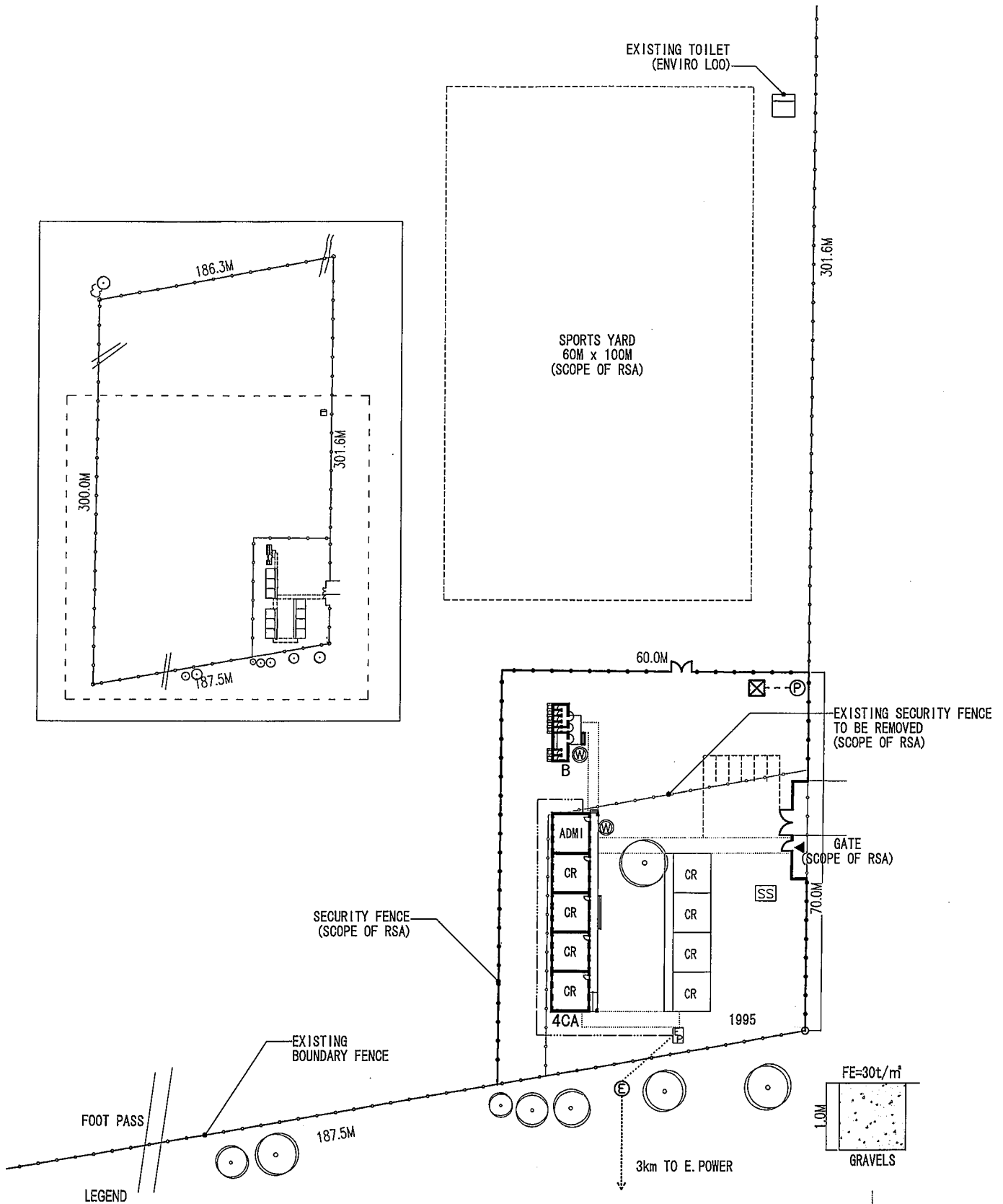

**LEGEND**

- |                                    |                         |   |                                    |
|------------------------------------|-------------------------|---|------------------------------------|
| EXISTING BUILDING                  | EXISTING SOLAR SYSTEM   | PROPOSED WATER TAP                          | PROPOSED WATER LINE (SCOPE OF RSA) |
| NEW BUILDING                       | EXISTING E. POWER PANEL | PROPOSED WATER TANK                         | PROPOSED E. POWER LINE             |
| EXISTING FENCE                     | EXISTING TREE           | PROPOSED SOLAR SYSTEM (SCOPE OF RSA)        |                                    |
| PROPOSED FENCE (SCOPE OF RSA)      |                         | PROPOSED WELL WITH HAND PUMP (SCOPE OF RSA) |                                    |
| TO BE REMOVED FENCE (SCOPE OF RSA) |                         |   |                                    |

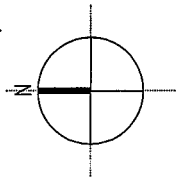
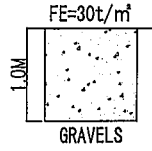

S=1:1000

<b>BC6</b>	Code Number :		Name of School : <b>Ngoakwana Secondary School</b>		Site Area : 55,253.7sq.m
	District : Bochum		Community : Simson		CR. Type : 4CA
					WC Type : B

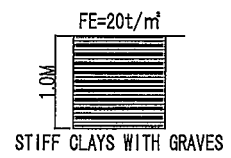
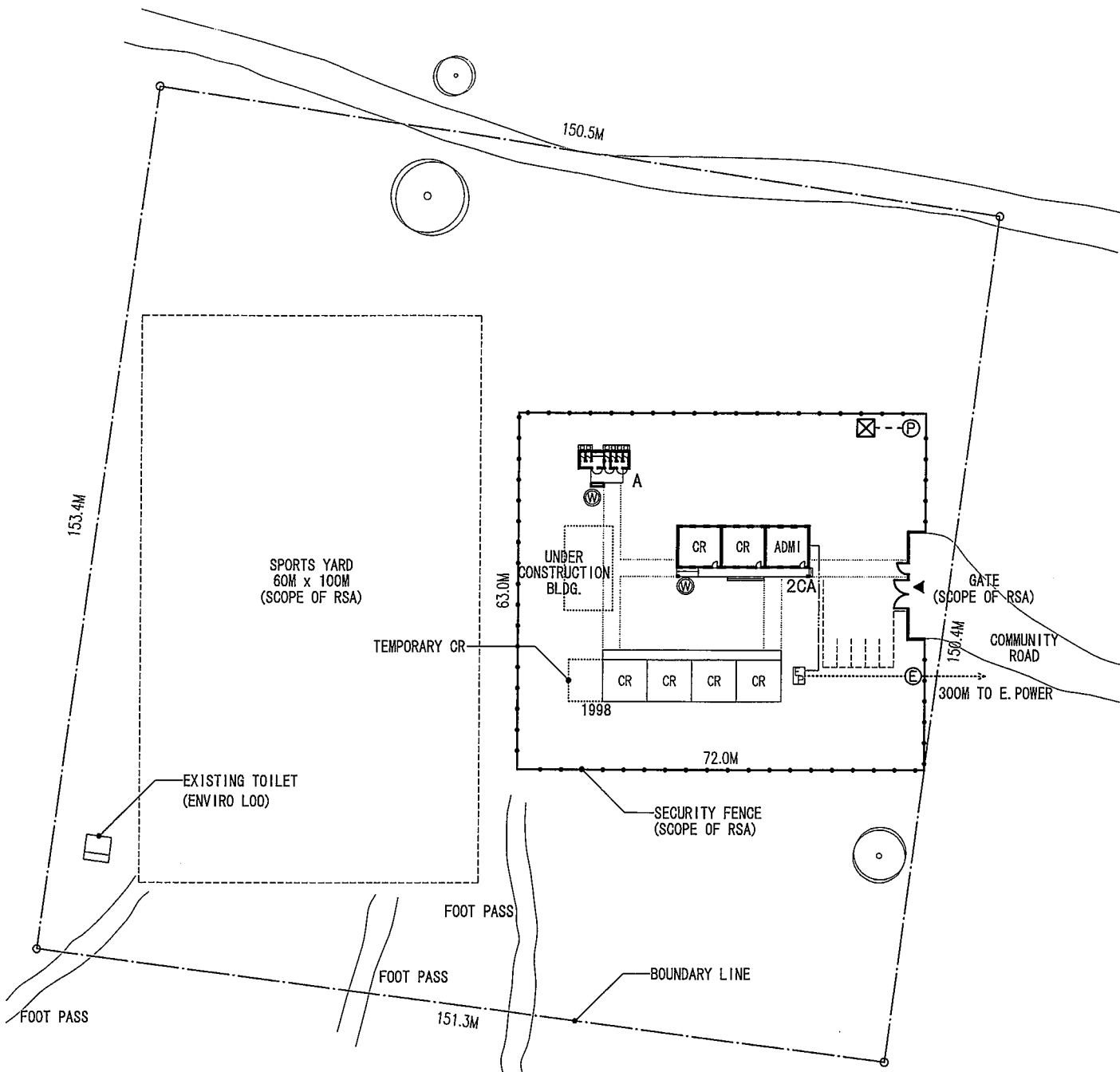

**EXISTING BUILDING**

- |                                       |                         |   |                                       |
|---------------------------------------|-------------------------|---|---------------------------------------|
| EXISTING BUILDING                     | EXISTING E. POWER PANEL | PROPOSED WATER TAP                          | PROPOSED WATER LINE (SCOPE OF RSA)    |
| NEW BUILDING                          | EXISTING TREE           | PROPOSED E. POWER POLE (SCOPE OF RSA)       | PROPOSED E. POWER LINE (SCOPE OF RSA) |
| TO BE DEMOLISHED BLDG. (SCOPE OF RSA) |                         | PROPOSED WATER TANK                         | PROPOSED E. POWER LINE                |
| PROPOSED FENCE (SCOPE OF RSA)         |                         | PROPOSED WELL WITH HAND PUMP (SCOPE OF RSA) |                                       |

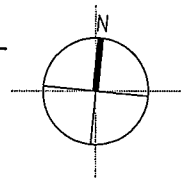

S=1:1000 0 5 10 20 30m

<b>BC7</b>	Name of School : <b>Rapetsoa Secondary School</b>		Site Area : 22,920.4sq.m
	District : <b>Bochum</b>	Community : <b>Grootdraai Village</b>	CR. Type : 2CA
			WC Type : A

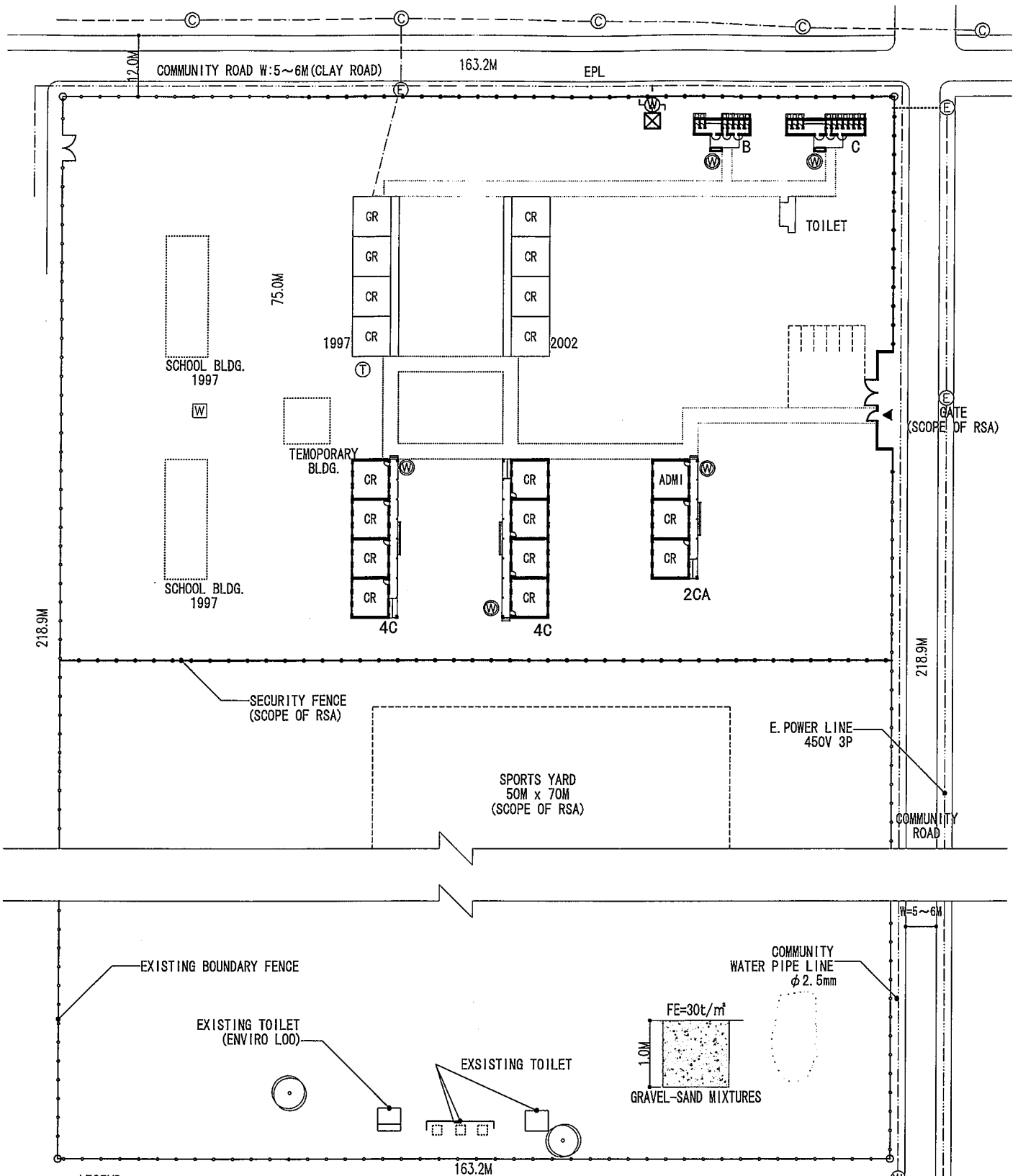

**LEGEND**

- |                                       |                                    |  |                                       |
|---------------------------------------|------------------------------------|--|---------------------------------------|
| EXISTING BUILDING                     | EXISTING TEL.COM.POLE              | PROPOSED WATER TANK                    | EXISTING WATER LINE                   |
| NEW BUILDING                          | EXISTING WATER TAP                 | PROPOSED WATER TAP                     | EXISTING E. POWER LINE                |
| TO BE DEMOLISHED BLDG. (SCOPE OF RSA) | EXISTING E. POWER POLE             | PROPOSED E. POWER POLE (SCOPE OF RSA)  | PROPOSED WATER LINE (SCOPE OF RSA)    |
| EXISTING FENCE                        | EXISTING E. POWER & TEL. COM. POLE | PROPOSED E. POWER PANEL (SCOPE OF RSA) | PROPOSED E. POWER LINE (SCOPE OF RSA) |
| PROPOSED FENCE (SCOPE OF RSA)         | EXISTING WATER TANK                | PROPOSED WATER METER (SCOPE OF RSA)    | PROPOSED E. POWER LINE                |
| EXISTING E. POWER & TEL.COM. LINE     | EXISTING TREE                      |  |                                       |

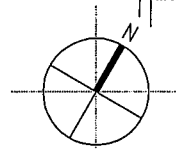

S=1:1000 0 5 10 20 30m

<b>BC9</b>	Name of School : <b>Rapoho Primary School</b>		Site Area : 35,724.5sq.m
	District : <b>Bochum</b>	Community : <b>Mohodi Manthata</b>	CR. Type : <b>2CA, 4C, 4C</b>
			WC Type : <b>B, C</b>



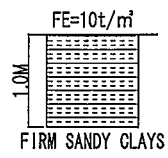
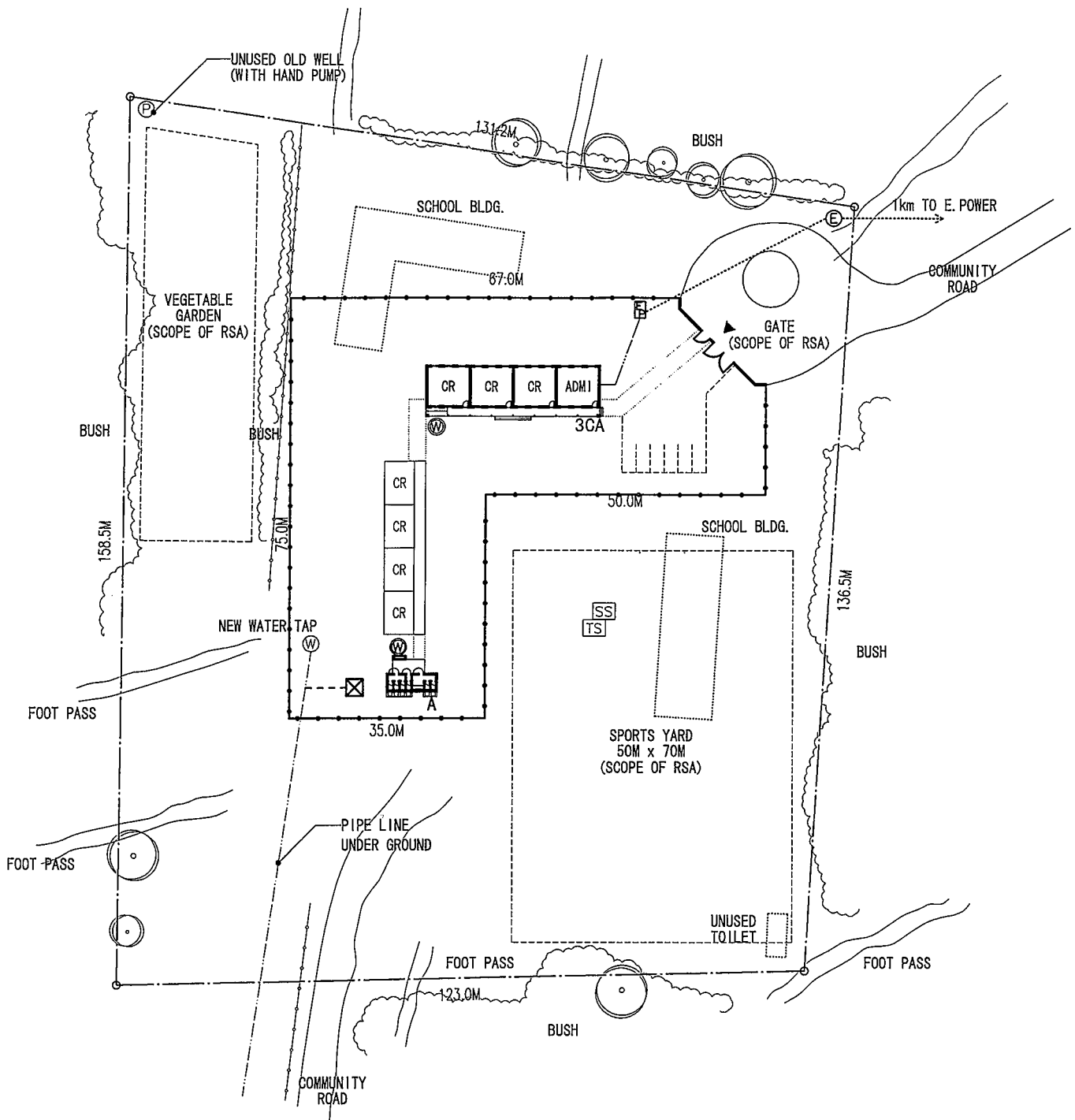

**LEGEND**

- |                                       |                              |                                       |                                    |
|---------------------------------------|------------------------------|---------------------------------------|------------------------------------|
| EXISTING BUILDING                     | EXISTING WATER TAP           | PROPOSED WATER TAP                    | EXISTING WATER LINE                |
| NEW BUILDING                          | EXISTING WELL WITH HAND PUMP | PROPOSED WATER TANK                   | PROPOSED WATER LINE (SCOPE OF RSA) |
| TO BE DEMOLISHED BLDG. (SCOPE OF RSA) | EXISTING SOLAR SYSTEM        | PROPOSED E.POWER POLE (SCOPE OF RSA)  | PROPOSED E.POWER LINE              |
| PROPOSED FENCE (SCOPE OF RSA)         | EXISTING TEL.COM. SYSTEM     | PROPOSED E.POWER PANEL (SCOPE OF RSA) |                                    |
| TO BE REMOVED FENCE (SCOPE OF RSA)    | EXISTING TREE                |                                       |                                    |

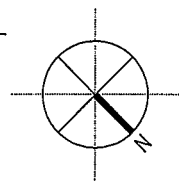

S=1:1000 0 5 10 20 30m

Code Number : <b>BC10</b>	Name of School : <b>Kodumela Primary School</b>	Site Area : 18,662.2sq.m
District : <b>Bochum</b>	Community : <b>Schoonveld Terbrugge</b>	CR. Type : <b>3CA</b>
		WC Type : <b>A</b>

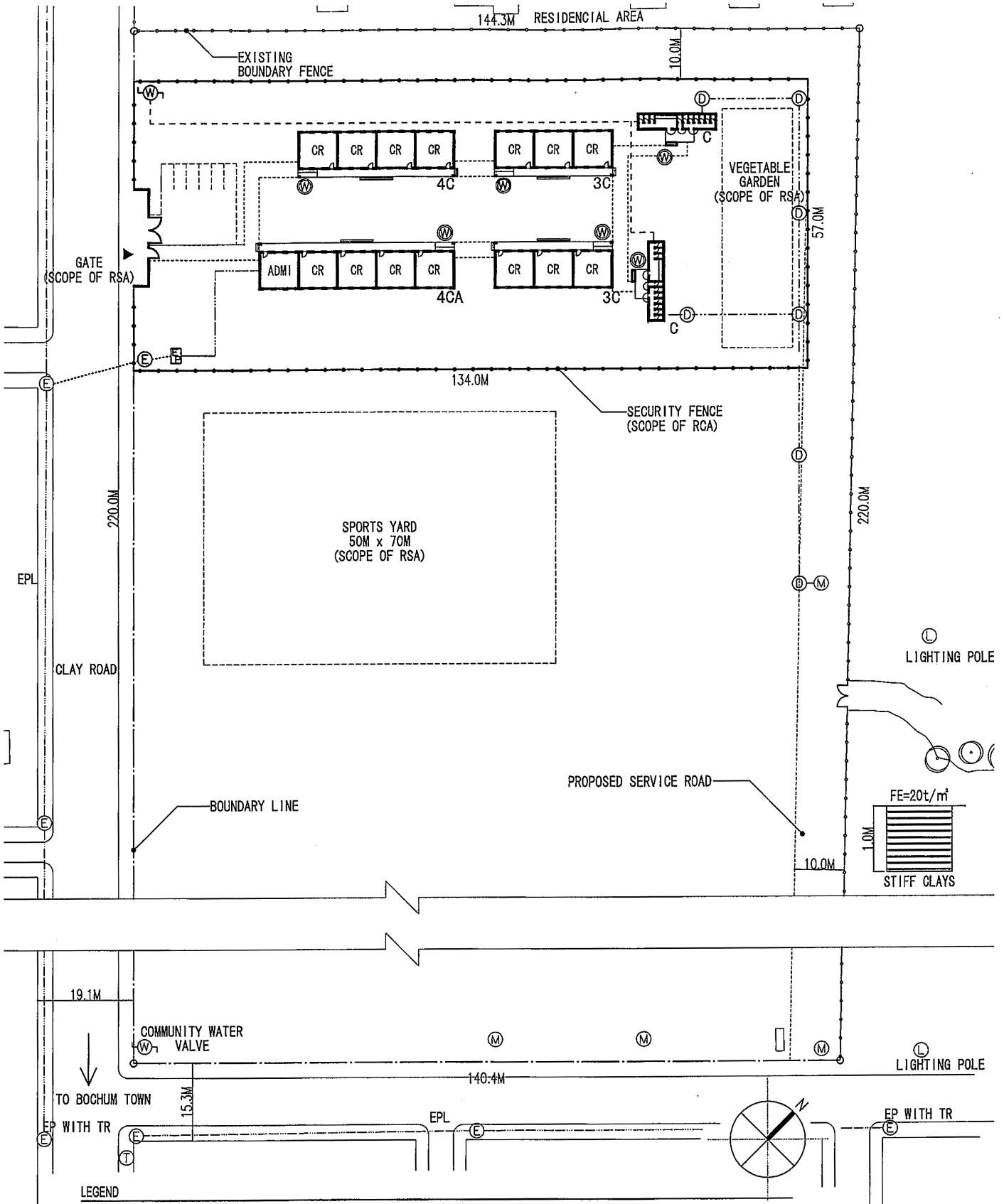

**LEGEND**

- |                               |  |                                       |                                       |
|-------------------------------|--|---------------------------------------|---------------------------------------|
| NEW BUILDING                  | EXISTING E. POWER POLE                 | PROPOSED WATER TAP                    | PROPOSED WATER LINE                   |
| EXISTING FENCE                | EXISTING TEL. COM. POLE                | PROPOSED E. POWER POLE (SCOPE OF RSA) | PROPOSED E. POWER LINE (SCOPE OF RSA) |
| PROPOSED FENCE (SCOPE OF RSA) | EXISTING MANHOLE                       | PROPOSED DRAIN                        | PROPOSED E. POWER LINE                |
| EXISTING E. POWER LINE        | EXISTING WATER VALVE                   | PROPOSED WATER TANK                   | PROPOSED DRAIN LINE                   |
|                               | PROPOSED E. POWER PANEL (SCOPE OF RSA) | PROPOSED WATER METER (SCOPE OF RSA)   |                                       |

S=1:1000

Code Number : <b>BC11</b>	Name of School : <b>Bothanang Primary School</b>	Site Area : 31,314.6sq.m
	District : Bochum	Community : Bochum Township
		WC Type : C, C

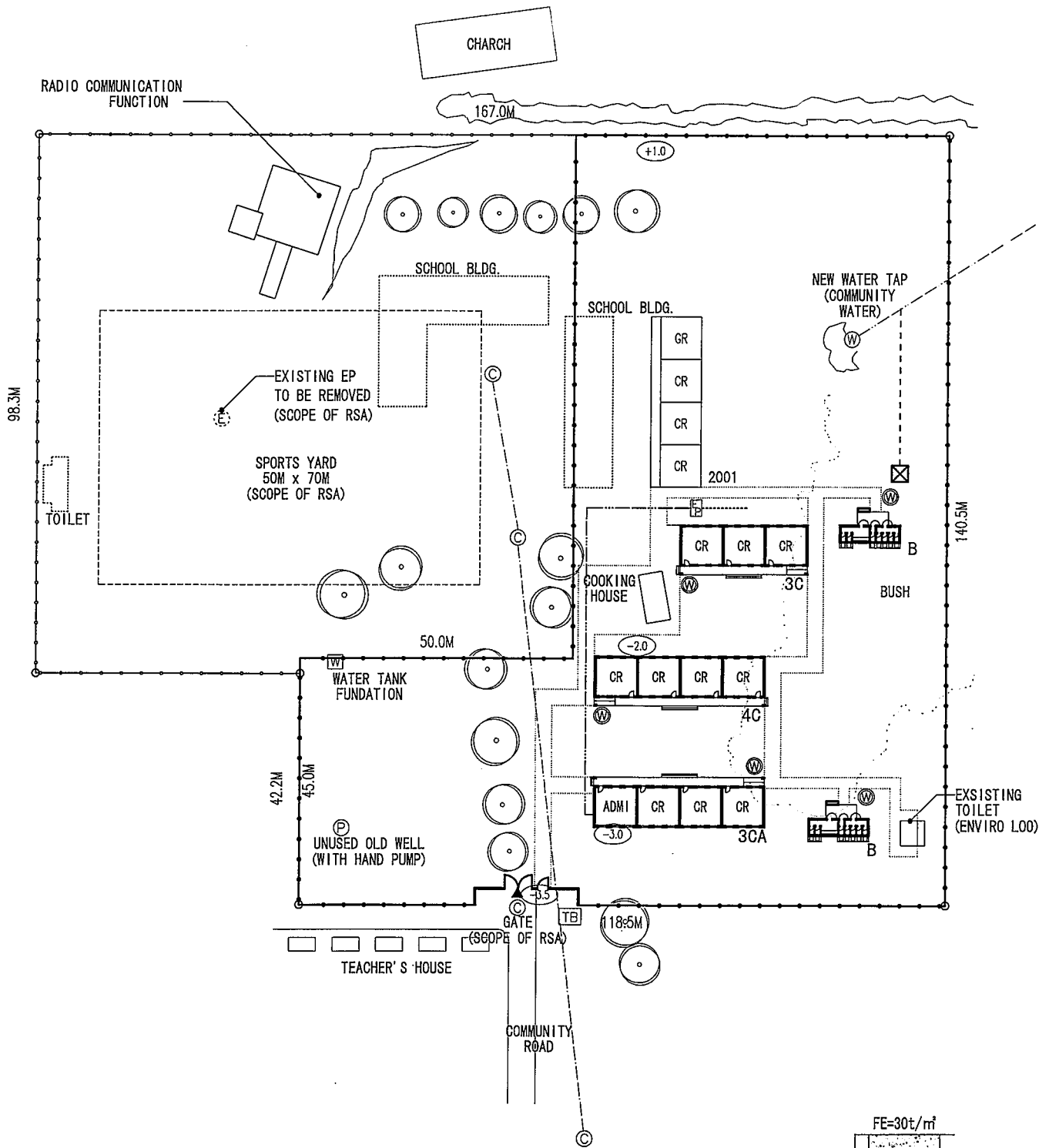

**LEGEND**

- |                                       |  |                        |                                      |
|---------------------------------------|--|------------------------|--------------------------------------|
| EXISTING BUILDING                     | EXISTING WATER TAP                         | PROPOSED WATER TAP     | PROPOSED WATER LINE (SCOPE OF RSA)   |
| NEW BUILDING                          | EXISTING E.POWER & TEL.COM. POLE           | PROPOSED WATER TANK    | PROPOSED E.POWER LINE (SCOPE OF RSA) |
| TO BE DEMOLISHED BLDG. (SCOPE OF RSA) | EXISTING WELL WITH HAND PUMP               | EXISTING E.POWER PANEL | PROPOSED E.POWER LINE                |
| EXISTING FENCE                        | EXISTING WATER TANK FUNDATION              | EXISTING TREE          |                                      |
| PROPOSED FENCE (SCOPE OF RSA)         | TELEPHONE BOX                              |                        |                                      |
| EXISTING WATER LINE                   | TO BE REMOVED E. POWER POLE (SCOPE OF RSA) |                        |                                      |
| EXISTING E.POWER & TEL.COM. LINE      |  |                        |                                      |

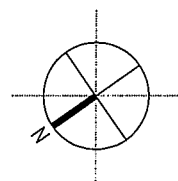
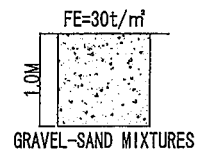

S=1:1000 0 5 10 20 30m

Code Number : <b>BC12</b>	Name of School : <b>Sekururwe Combined School</b>	Site Area : 21,416.8sq.m
District : Bochum	Community : Percy1 Westheim	CR. Type : 3CA, 4C, 3C
		WC Type : B, B

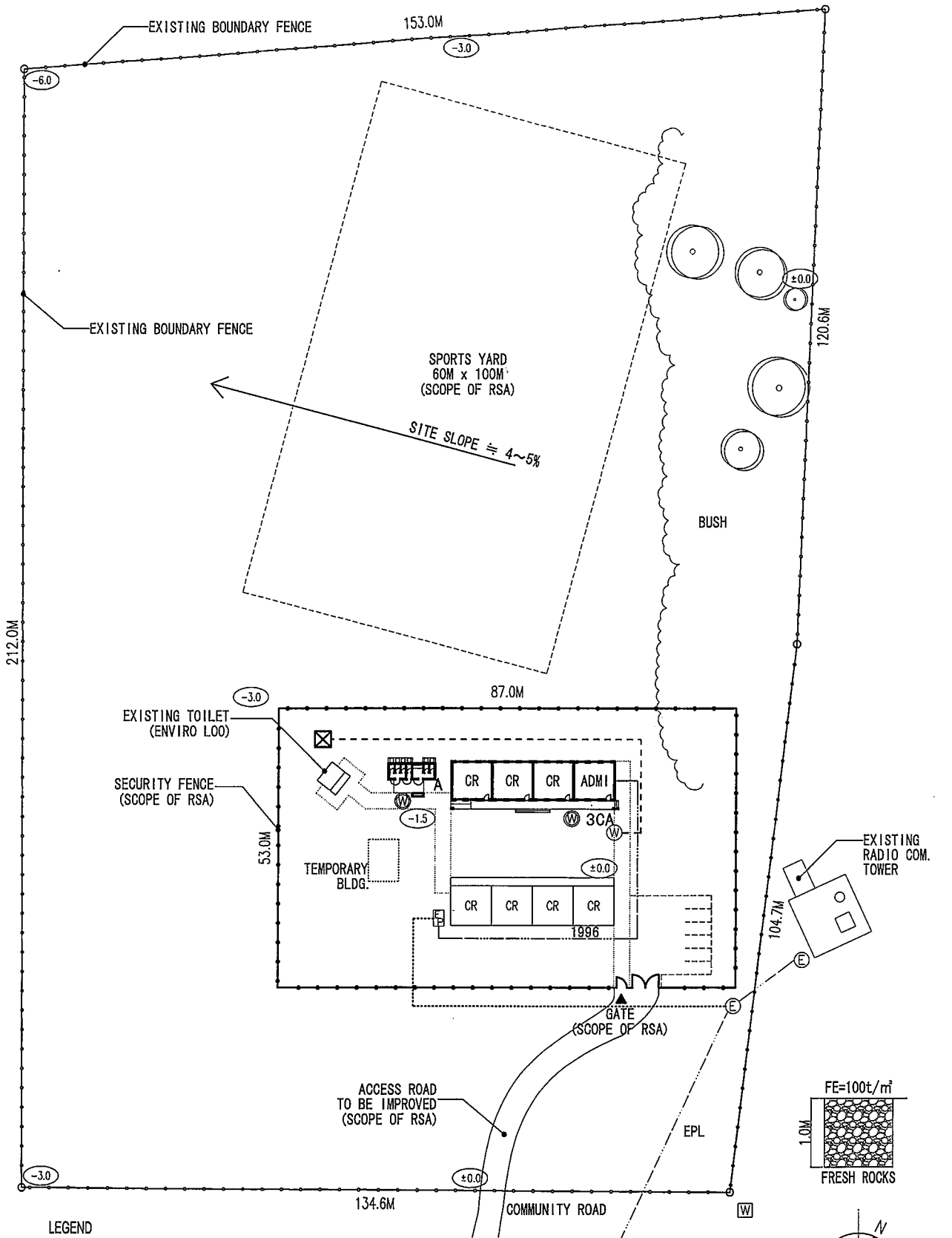

**LEGEND**

- |                                       |                         |                     |                                       |
|---------------------------------------|-------------------------|---------------------|---------------------------------------|
| EXISTING BUILDING                     | EXISTING WATER TAP      | PROPOSED WATER TAP  | EXISTING E. POWER LINE                |
| NEW BUILDING                          | EXISTING E. POWER POLE  | PROPOSED WATER TANK | PROPOSED WATER LINE (SCOPE OF RSA)    |
| TO BE DEMOLISHED BLDG. (SCOPE OF RSA) | EXISTING WATER TANK     | EXISTING TREE       | PROPOSED E. POWER LINE                |
| EXISTING FENCE                        | EXISTING E. POWER PANEL |                     | PROPOSED E. POWER LINE (SCOPE OF RSA) |
| PROPOSED FENCE (SCOPE OF RSA)         |                         |                     |                                       |

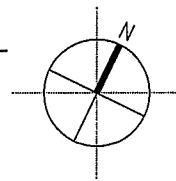

S=1:1000 0 5 10 20 30m

Code Number : <b>KK1</b>	Name of School : <b>Kwena A Peu Secondary School</b>		Site Area : 31,792.3sq.m
	District : KoneKwena	Community : Zaaipplaats	CR. Type : 3CA
			WC Type : A

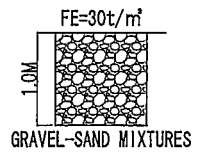
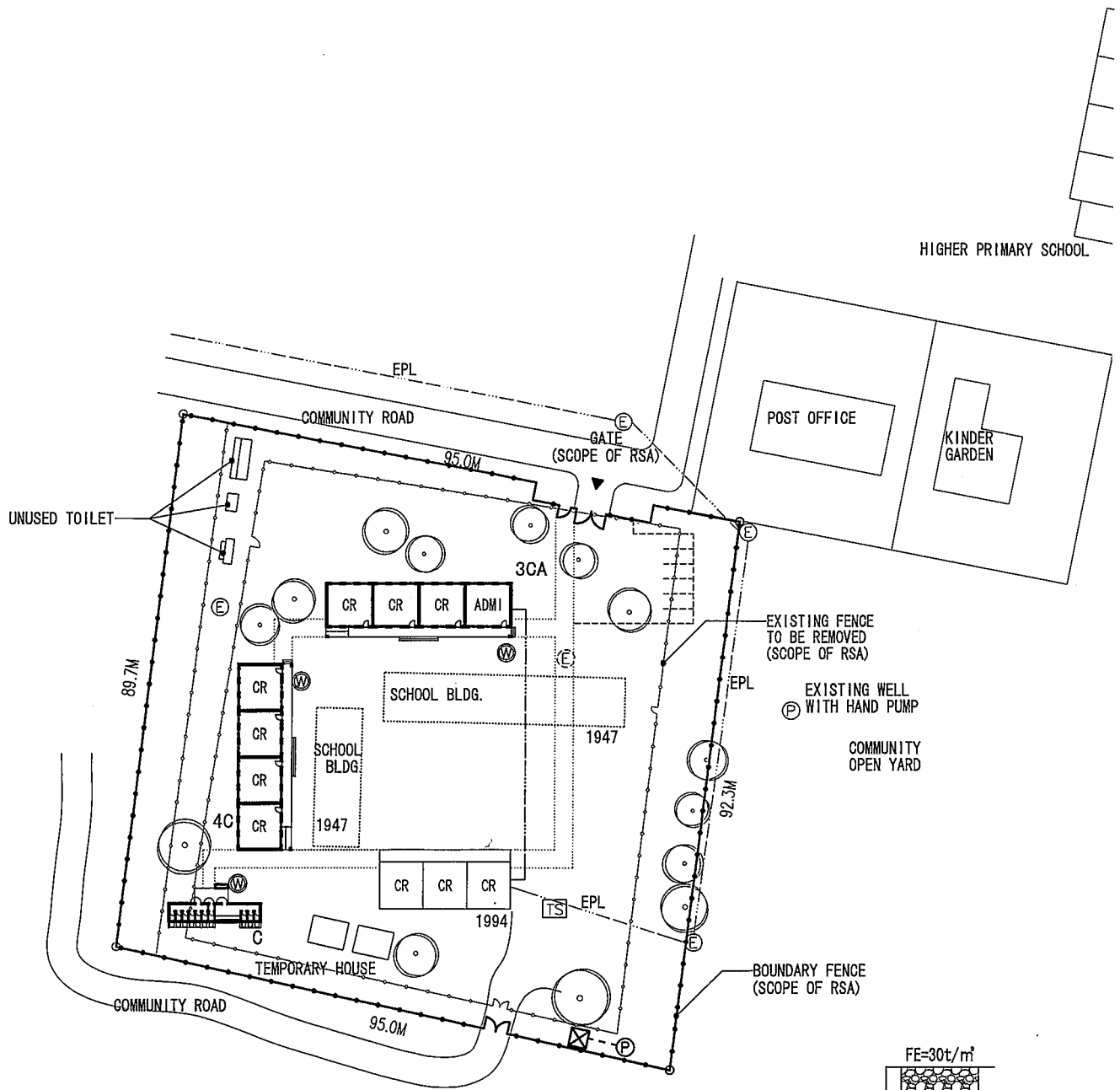

**LEGEND**

- |                                       |                          |   |                                    |
|---------------------------------------|--------------------------|---|------------------------------------|
| EXISTING BUILDING                     | EXISTING E. POWER POLE   | PROPOSED WATER TAP                          | E. POWER LINE                      |
| NEW BUILDING                          | EXISTING TEL.COM. SYSTEM | PROPOSED WATER TANK                         | PROPOSED WATER LINE (SCOPE OF RSA) |
| TO BE DEMOLISHED BLDG. (SCOPE OF RSA) | EXISTING TREE            | PROPOSED WELL WITH HAND PUMP (SCOPE OF RSA) | PROPOSED E. POWER LINE             |
| PROPOSED FENCE (SCOPE OF RSA)         |                          |   |                                    |
| TO BE REMOVED FENCE (SCOPE OF RSA)    |                          |   |                                    |

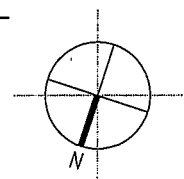

S=1:1000 0 5 10 20 30m

<b>KK2</b>	Code Number :		Name of School :		Site Area : 8,612.7sq.m	
			<b>Ramertloana Lower Primary School</b>		CR. Type : 3CA, 4C	
District : KoneKwena		Community : Mabasofo		WC Type : C		

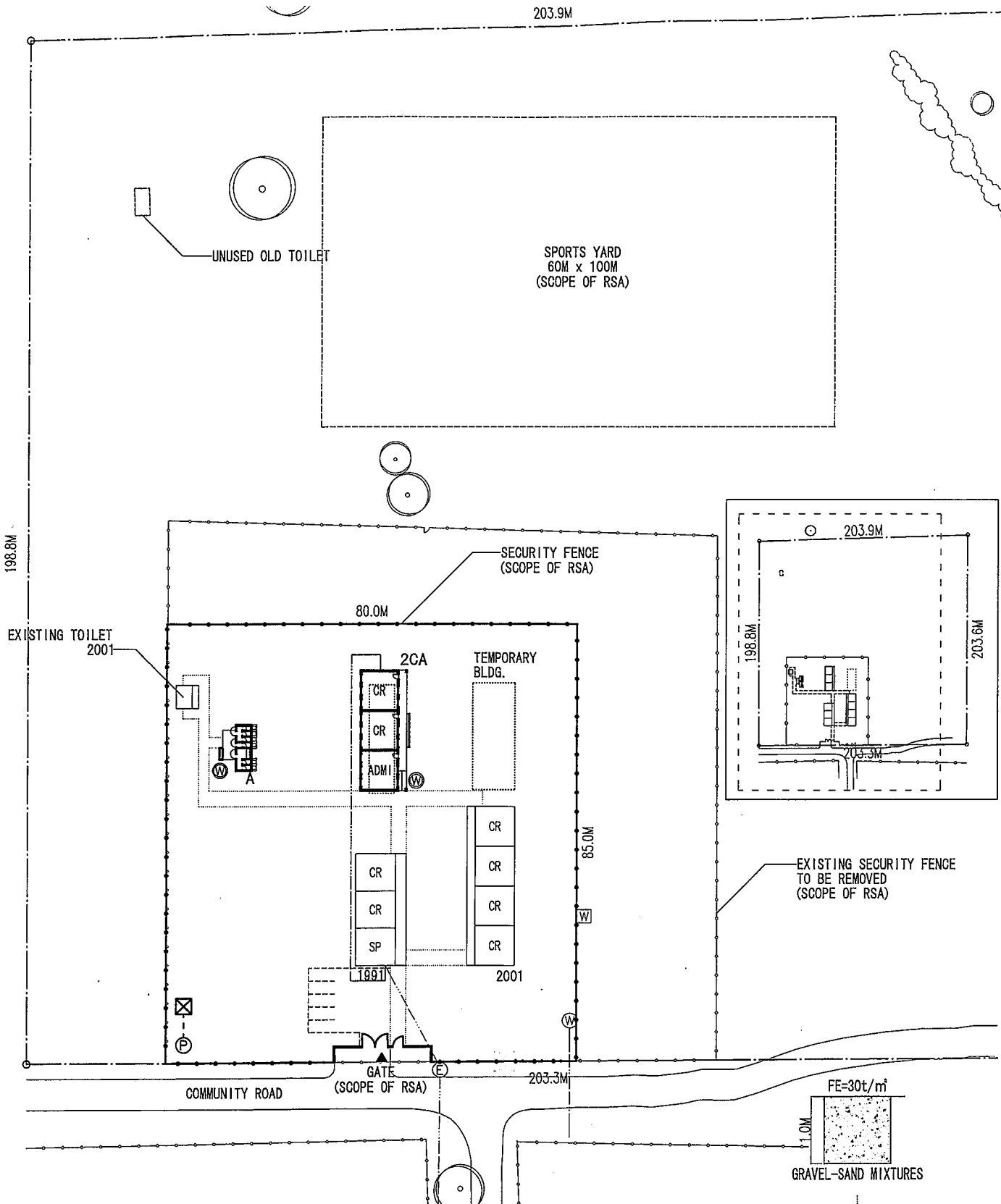

**LEGEND**

- |                                       |                        |   |                                    |
|---------------------------------------|------------------------|---|------------------------------------|
| EXISTING BUILDING                     | EXISTING WATER TAP     | PROPOSED WATER TAP                          | EXISTING WATER LINE                |
| NEW BUILDING                          | EXISTING E. POWER POLE | PROPOSED WATER TANK                         | EXISTING E. POWER LINE             |
| TO BE DEMOLISHED BLDG. (SCOPE OF RSA) | WATER TANK             | PROPOSED WELL WITH HAND PUMP (SCOPE OF RSA) | PROPOSED WATER LINE (SCOPE OF RSA) |
| PROPOSED FENCE (SCOPE OF RSA)         | EXISTING TREE          |   | PROPOSED E. POWER LINE             |
| TO BE REMOVED FENCE (SCOPE OF RSA)    |                        |   |                                    |

<b>KK4</b>	Code Number :		Name of School : <b>Mahlabela Secondary School</b>		Site Area : 40,954.1sq.m
	District : KoneKwena		Community : Rametlwane Village		CR. Type : 2CA
					WC Type : A

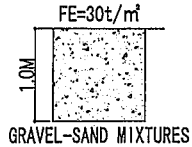
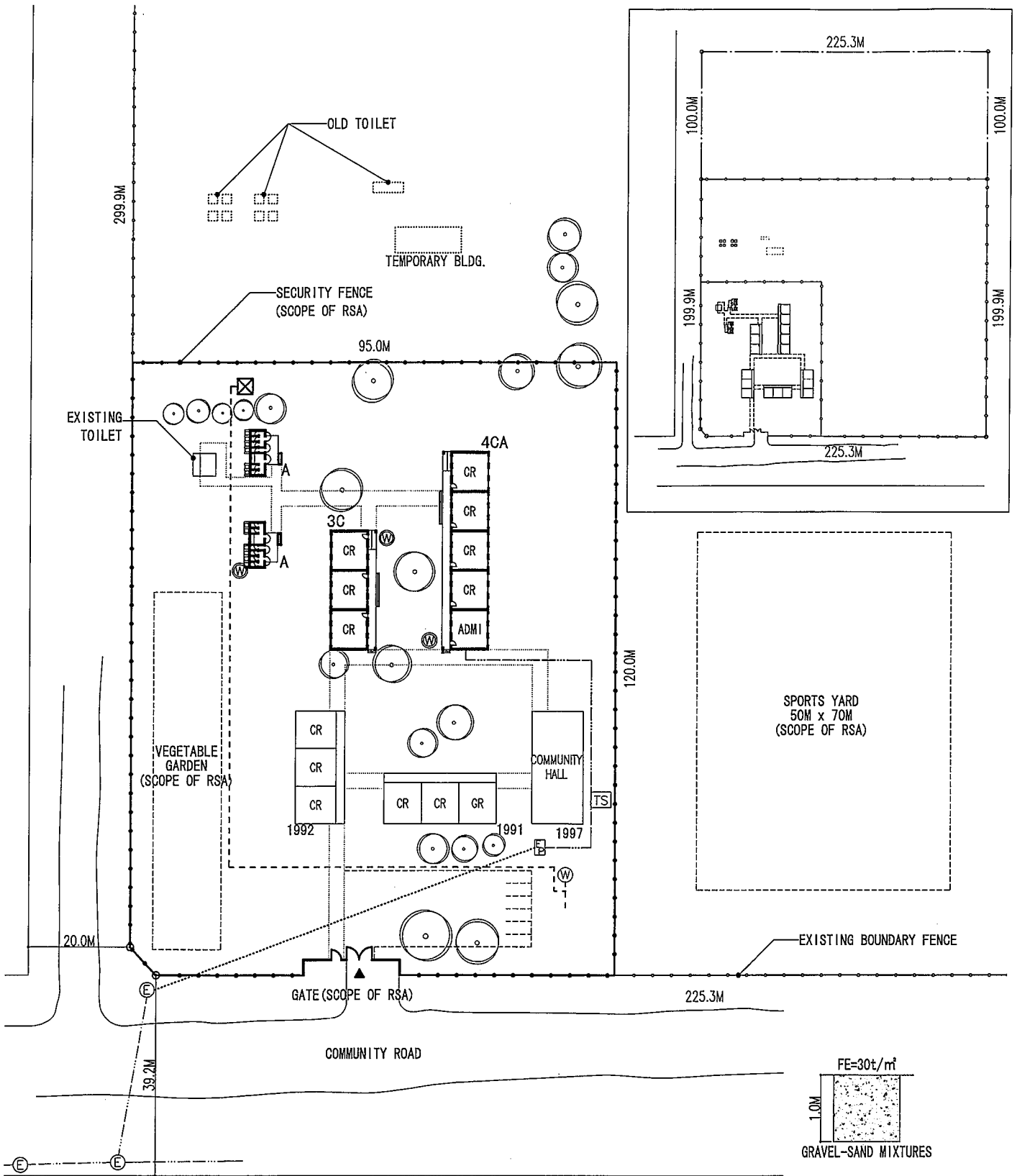

**LEGEND**

- |                                       |                        |                          |                                       |
|---------------------------------------|------------------------|--------------------------|---------------------------------------|
| EXISTING BUILDING                     | EXISTING WATER TAP     | PROPOSED WATER TAP       | PROPOSED WATER LINE (SCOPE OF RSA)    |
| NEW BUILDING                          | EXISTING E. POWER POLE | PROPOSED WATER TANK      | PROPOSED E. POWER LINE (SCOPE OF RSA) |
| TO BE DEMOLISHED BLDG. (SCOPE OF RSA) | EXISTING WATER TANK    | EXISTING E. POWER PANEL  | PROPOSED E. POWER LINE                |
| EXISTING FENCE                        | EXISTING TREE          | EXISTING TEL.COM. SYSTEM |                                       |
| PROPOSED FENCE (SCOPE OF RSA)         |                        |                          |                                       |
| EXISTING E. POWER LINE                |                        |                          |                                       |

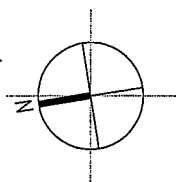

S=1:1000 0 5 10 20 30m

Code Number : <b>KK5</b>	Name of School : <b>Ikageleng Makobe Primary School</b>	Site Area : 67,553.4sq.m
	District : Konekwenwa	Community : Vlakfontein Ga-Matala
		WC Type : A, A

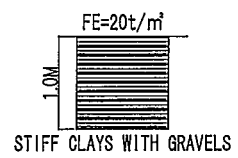
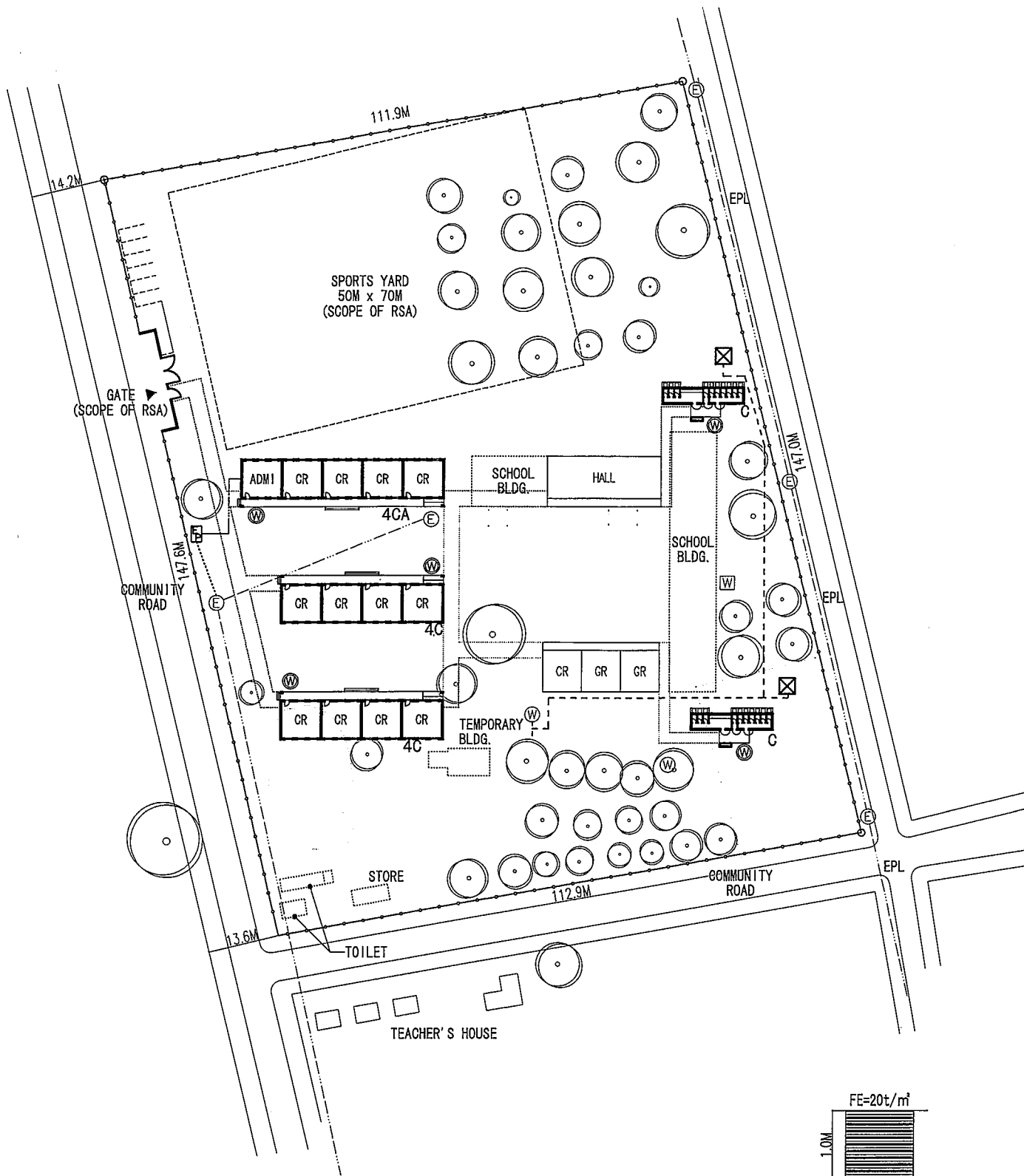

**LEGEND**

- |                                       |  |                     |                                       |
|---------------------------------------|--|---------------------|---------------------------------------|
| EXISTING BUILDING                     | EXISTING E. POWER POLE                 | PROPOSED WATER TAP  | PROPOSED WATER LINE (SCOPE OF RSA)    |
| NEW BUILDING                          | EXISTING WATER TANK                    | PROPOSED WATER TANK | PROPOSED E. POWER LINE (SCOPE OF RSA) |
| TO BE DEMOLISHED BLDG. (SCOPE OF RSA) | PROPOSED E. POWER PANEL (SCOPE OF RSA) | EXISTING TREE       | PROPOSED E. POWER LINE                |
| EXISTING FENCE                        |  |                     |                                       |
| EXISTING E. POWER LINE                |  |                     |                                       |

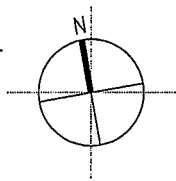

S=1:1000 0 5 10 20 30m

Code Number : <b>KK6</b>	Name of School : <b>Pula Seopa Primary School</b>	Site Area : 16,527,8sq.m
District : KoneKwena	Community : Phetole Village	CR. Type : 4CA, 4C, 4C
		WC Type : C, C



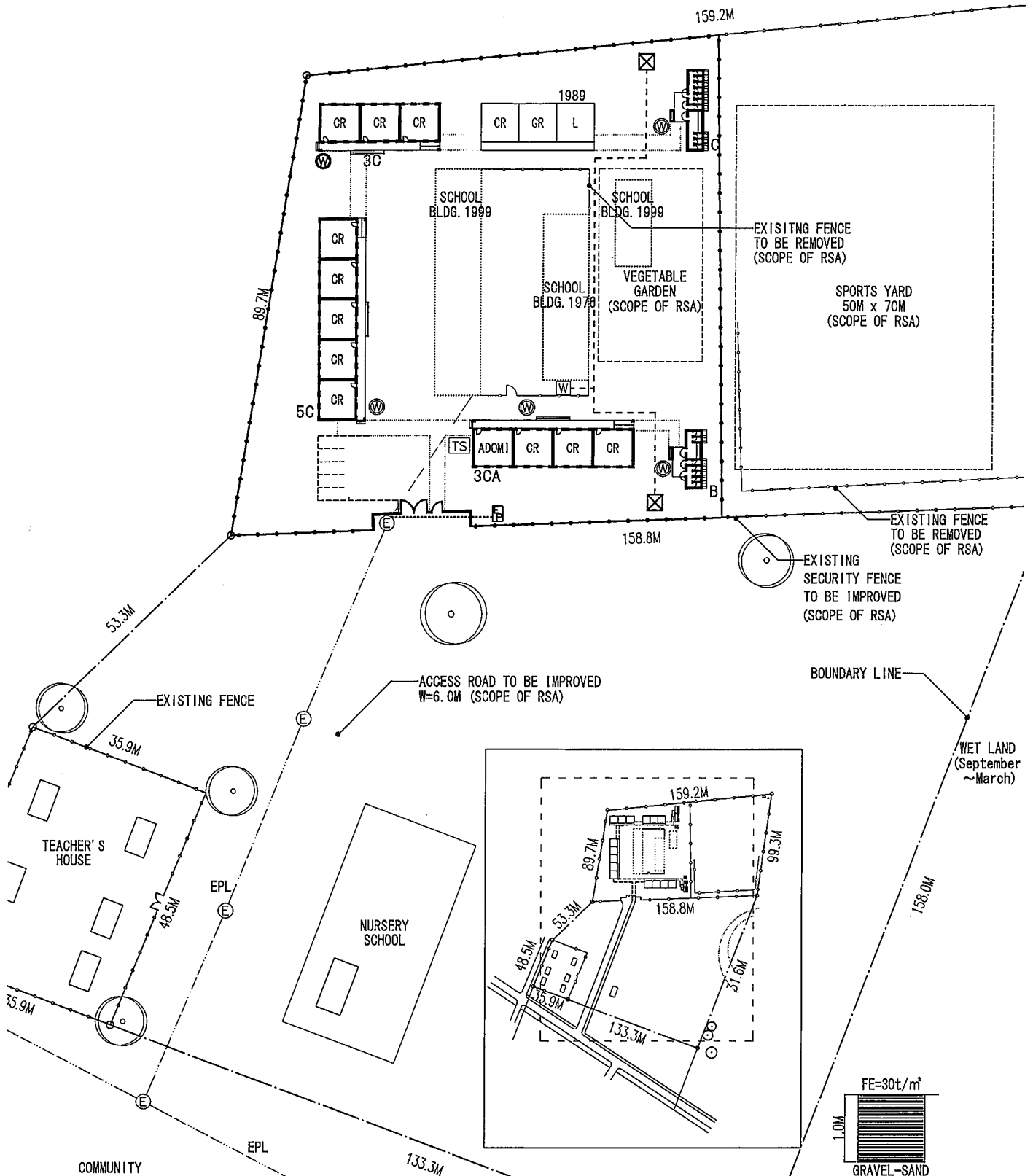

**LEGEND**

- |                                       |                           |  |                                       |
|---------------------------------------|---------------------------|--|---------------------------------------|
| EXISTING BUILDING                     | EXISTING E. POWER POLE    | PROPOSED WATER TAP                     | EXISTING E. POWER LINE                |
| NEW BUILDING                          | EXISTING TEL. COM. SYSTEM | PROPOSED WATER TANK                    | PROPOSED WATER LINE (SCOPE OF RSA)    |
| TO BE DEMOLISHED BLDG. (SCOPE OF RSA) | EXISTING TREE             | PROPOSED E. POWER PANEL (SCOPE OF RSA) | PROPOSED E. POWER LINE (SCOPE OF RSA) |
| EXISTING FENCE                        |                           |  | PROPOSED E. POWER LINE                |
| PROPOSED FENCE (SCOPE OF RSA)         |                           |  |                                       |
| TO BE REMOVED FENCE (SCOPE OF RSA)    |                           |  |                                       |

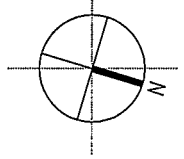
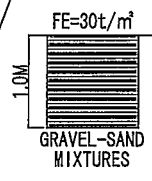

S=1:1000

Code Number : <b>KK7</b>	Name of School : <b>Sefataladi Primary School</b>	Site Area : 34,894.0sq.m
	District : Konekwena	Community : Ramoshoane
		CR. Type : 3CA, 3C, 5C
		WC Type : B, C

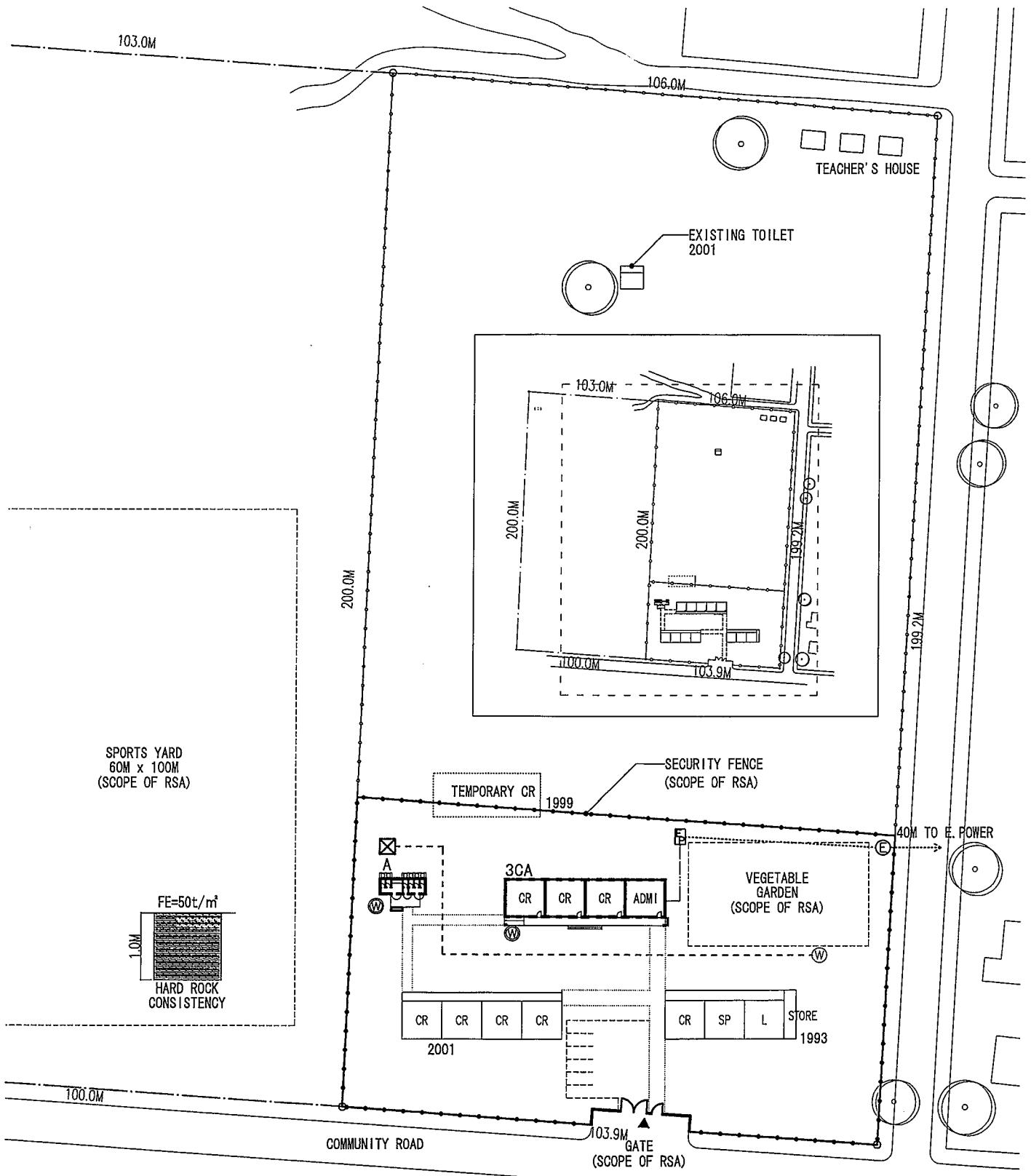

**LEGEND**

- |                                       |                    |  |                                       |
|---------------------------------------|--------------------|--|---------------------------------------|
| EXISTING BUILDING                     | EXISTING WATER TAP | PROPOSED WATER TAP                     | PROPOSED WATER LINE (SCOPE OF RSA)    |
| NEW BUILDING                          | EXISTING TREE      | PROPOSED WATER TANK                    | PROPOSED E. POWER LINE (SCOPE OF RSA) |
| TO BE DEMOLISHED BLDG. (SCOPE OF RSA) |                    | PROPOSED E. POWER POLE (SCOPE OF RSA)  | PROPOSED E. POWER LINE                |
| EXISTING FENCE                        |                    | PROPOSED E. POWER PANEL (SCOPE OF RSA) |                                       |
| PROPOSED FENCE (SCOPE OF RSA)         |                    |  |                                       |

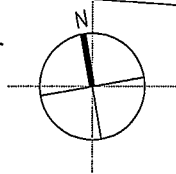

S=1:1000 0 5 10 20 30m

Code Number :	Name of School :	Site Area :
<b>KK8</b>	<b>Tlou Secondary School</b>	40,962.6sq.m
District :	Community :	CR. Type :
Konekwena	Phoffu Ga-Matlala	3CA
		WC Type :
		A