

*The Study on Storm Water Drainage Plan  
for the Colombo Metropolitan Region  
in the Democratic Socialist Republic of Sri Lanka*  
JAPAN INTERNATIONAL COOPERATION AGENCY

**Drawing 9**  
**Plan of Proposed Bolgoda Canal  
Improvement (2/2)**

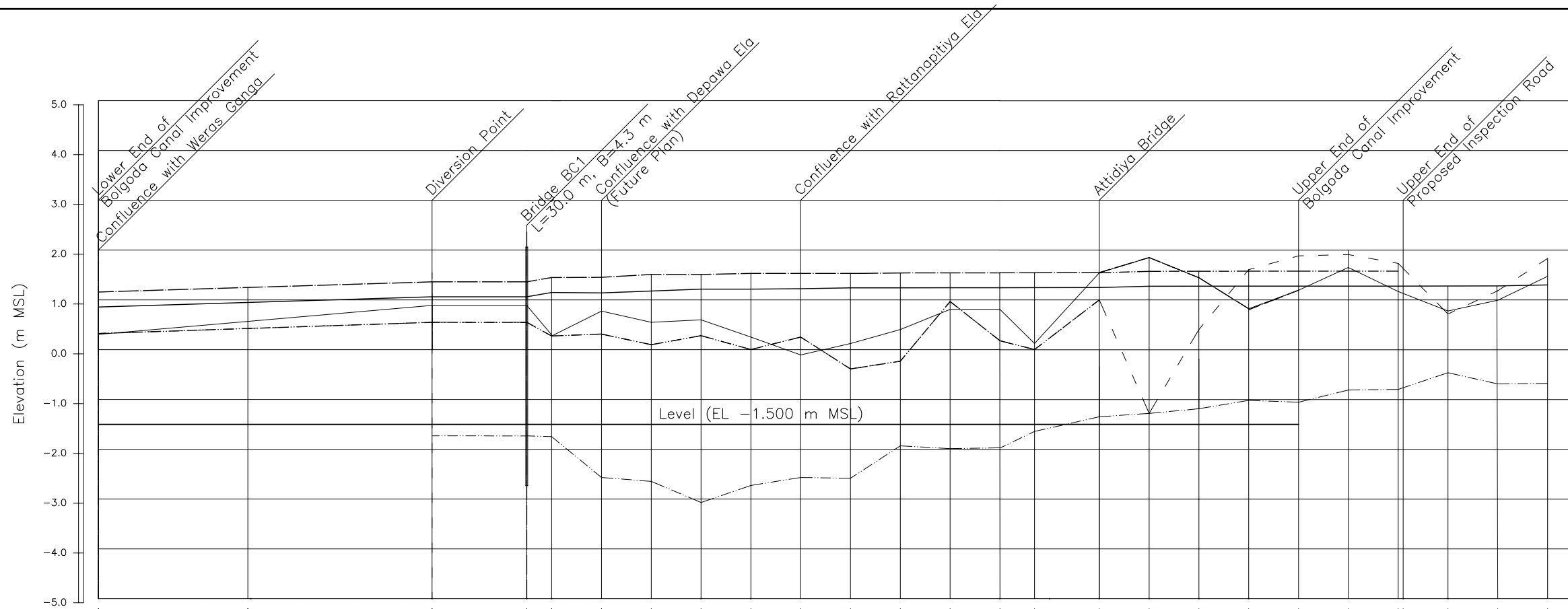

Design HWL (m MSL)	0.823	0.959	1.149	1.149	1.204	1.210	1.216	1.224	1.231	1.236	1.241	1.243	1.244	1.245	1.250	1.274	1.276	1.277	1.278	1.279	1.282	1.282	1.301	1.301	
Design RB (m MSL)	1.123	1.259	1.449	1.449	1.504	1.510	1.516	1.524	1.531	1.536	1.541	1.543	1.544	1.545	1.550	1.550	1.851	1.445	0.823	1.195	1.651	1.168	1.168	1.474	
Design LB (m MSL)	0.325	0.889	0.549	0.549	0.274	0.314	0.100	0.281	0.003	0.254	-0.387	-0.231	0.968	0.179	0.004	1.574	1.576	1.577	1.578	1.579	1.582	1.582	0.718	1.834	
Design Riverbed (m MSL)	-1.500	-1.500	-1.500	-1.500	-1.500	-1.500	-1.500	-1.500	-1.500	-1.500	-1.500	-1.500	-1.500	-1.500	-1.500	-1.500	-1.500	-1.500	-1.500	-1.500	-0.809	-0.797	-0.797	-0.676	
Original RB (m MSL)	0.307	0.789	0.889	0.889	0.274	0.774	0.550	-0.599	0.253	-0.106	0.123	0.404	0.808	0.809	0.124	1.544	1.851	1.445	0.823	1.195	1.651	1.168	1.168	1.474	
Original LB (m MSL)	0.325	0.803	0.549	0.549	0.274	0.314	0.100	0.281	0.003	0.254	-0.387	-0.231	0.968	0.179	0.004	1.044	-1.279	0.405	1.608	1.885	1.911	1.733	1.733	1.834	
Original Riverbed (m MSL)	-1.022		-1.731	-1.731	-1.746	-2.566	-2.645	-3.069	-2.727	-2.566	-2.583	-1.931	-1.987	-1.971	-1.641	-1.346	-1.279	-1.185	-1.017	-1.055	-0.809	-0.797	-0.797	-0.676	
Accum. Distance (m)	0	300	670	860	910	1,010	1,110	1,210	1,310	1,410	1,510	1,610	1,710	1,810	1,880	2,010	2,110	2,210	2,310	2,400	2,500	2,600	2,700	2,800	2,900
Distance (m)	0	300	370	190	50	100	100	100	100	100	100	100	100	100	70	130	100	100	100	90	100	100	90	100	
Station	ST 0+000	ST 0+300	ST 0+670	ST 0+860	ST 0+910	ST 1+010	ST 1+110	ST 1+210	ST 1+310	ST 1+410	ST 1+510	ST 1+610	ST 1+710	ST 1+810	ST 1+880	ST 2+010	ST 2+110	ST 2+210	ST 2+310	ST 2+400	ST 2+500	ST 2+600	ST 2+700	ST 2+800	ST 2+900

Note) HWL: High Water Level  
 RB : Right Bank  
 LB : Left Bank

The Study on Storm Water Drainage Plan  
 for the Colombo Metropolitan Region  
 in the Democratic Socialist Republic of Sri Lanka  
 JAPAN INTERNATIONAL COOPERATION AGENCY

Drawing 10  
 Longitudinal Profile of Proposed Bolgoda  
 Canal Improvement

TYPICAL CROSS SECTION (ST 0+300)

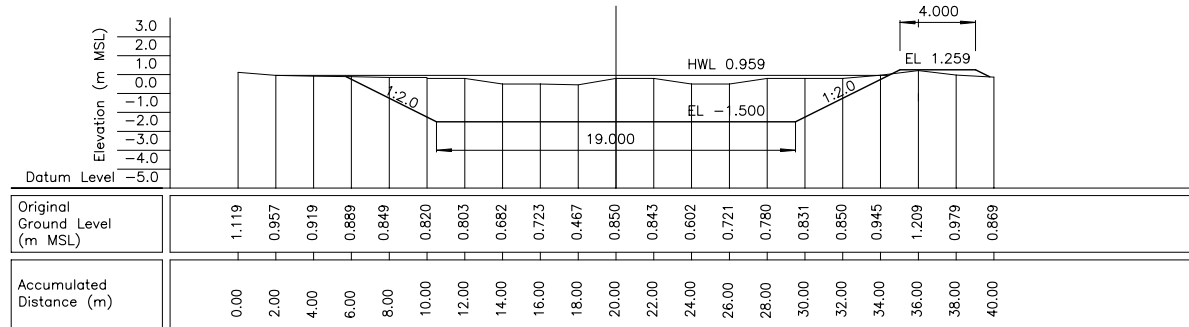

TYPICAL CROSS SECTION (ST 1+910)

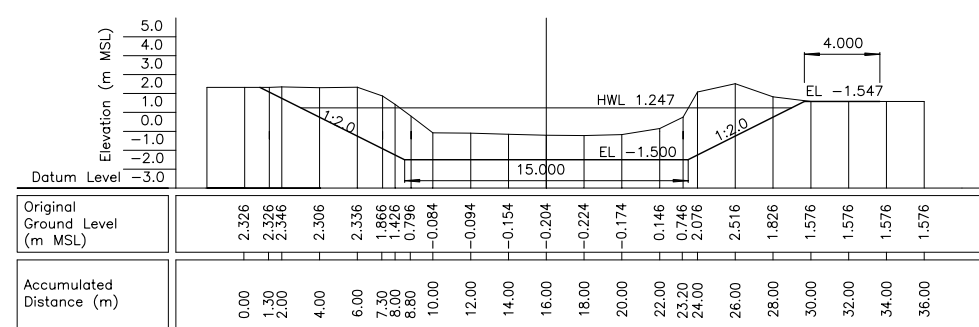

TYPICAL CROSS SECTION (ST 0+670)

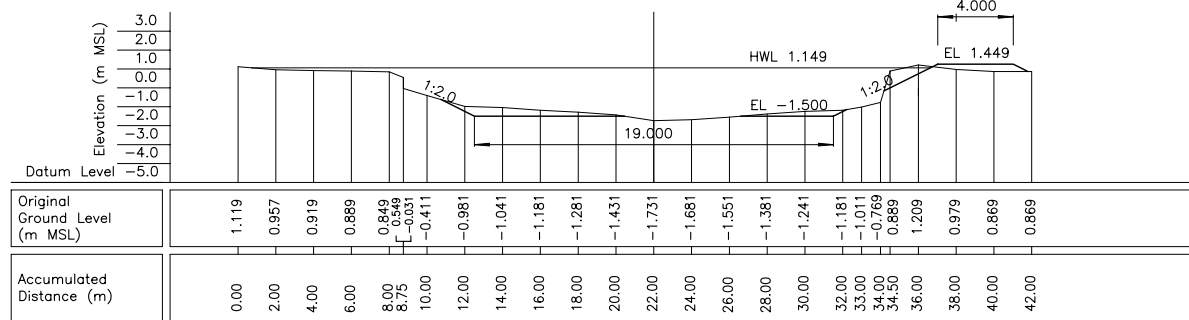

TYPICAL CROSS SECTION (ST 1+310)

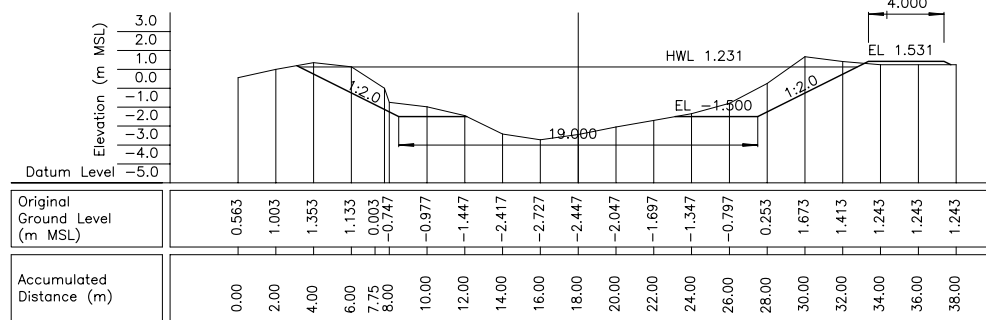

The Study on Storm Water Drainage Plan  
for the Colombo Metropolitan Region  
in the Democratic Socialist Republic of Sri Lanka  
JAPAN INTERNATIONAL COOPERATION AGENCY

Drawing 11  
Typical Cross Section of Proposed Bolgoda  
Canal Improvement

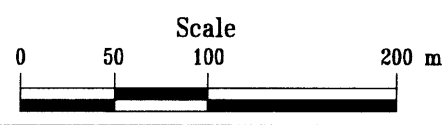
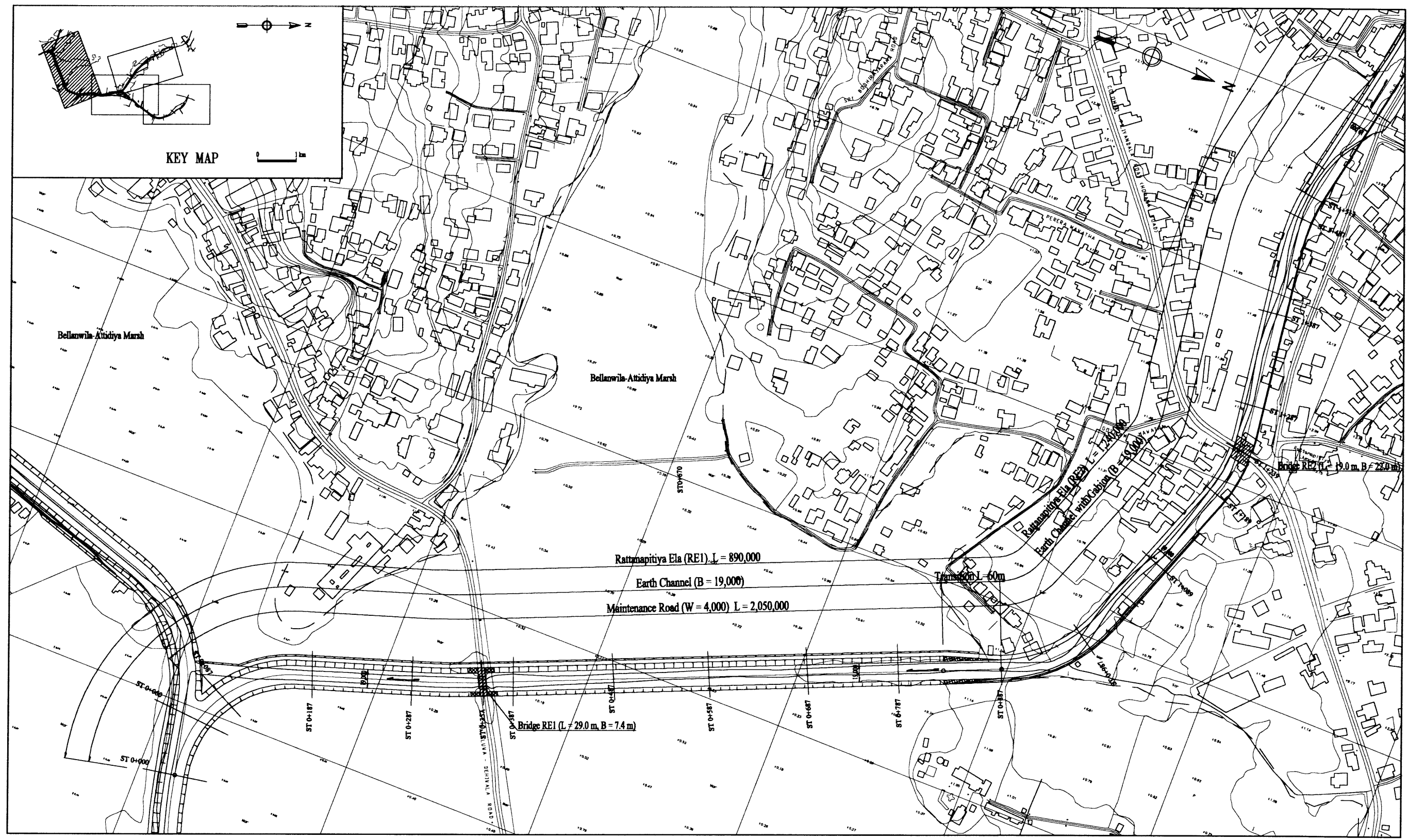

The Study on Storm Water Drainage Plan  
for the Colombo Metropolitan Region  
in the Democratic Socialist Republic of Sri Lanka  
JAPAN INTERNATIONAL COOPERATION AGENCY

Drawing 12  
Plan of Proposed Rattanapitiya Ela and  
Delkanda Ela Channel Improvement (1/3)

