

Note) HWL: High Water Level
RB : Right Bank
LB : Left Bank

TYPICAL CROSS SECTION (ST 0+300)

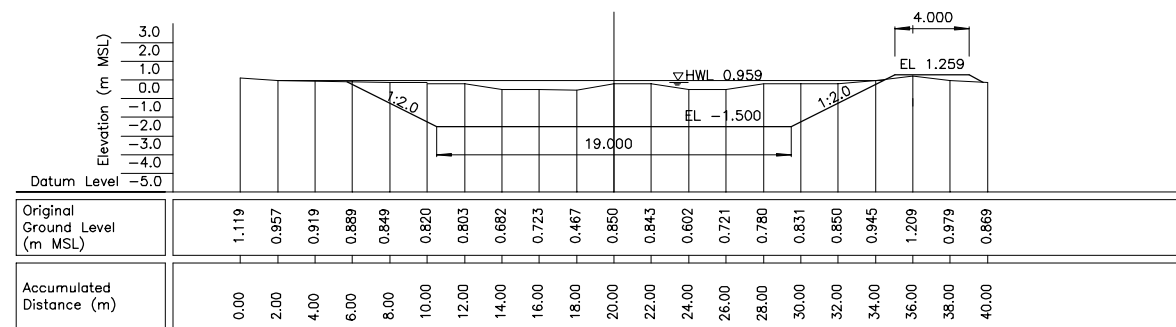

TYPICAL CROSS SECTION (ST 1+910)

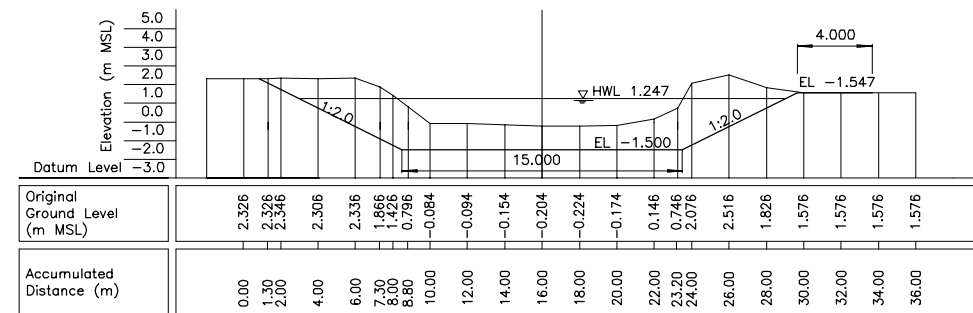

TYPICAL CROSS SECTION (ST 0+670)

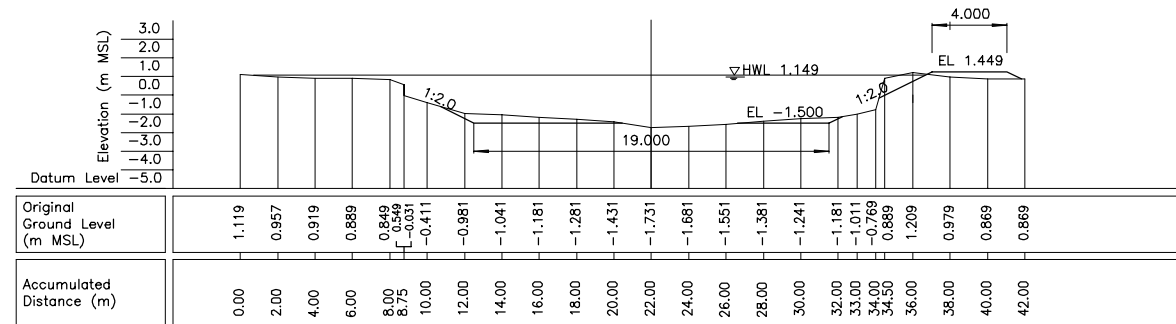

TYPICAL CROSS SECTION (ST 1+310)

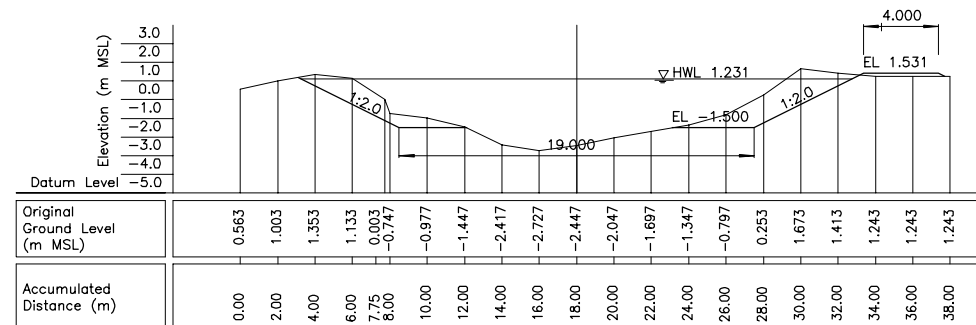

*The Study on Storm Water Drainage Plan
for the Colombo Metropolitan Region
in the Democratic Socialist Republic of Sri Lanka*

JAPAN INTERNATIONAL COOPERATION AGENCY

Drawing 11
Typical Cross Section of Proposed Bolgoda
Canal Improvement

