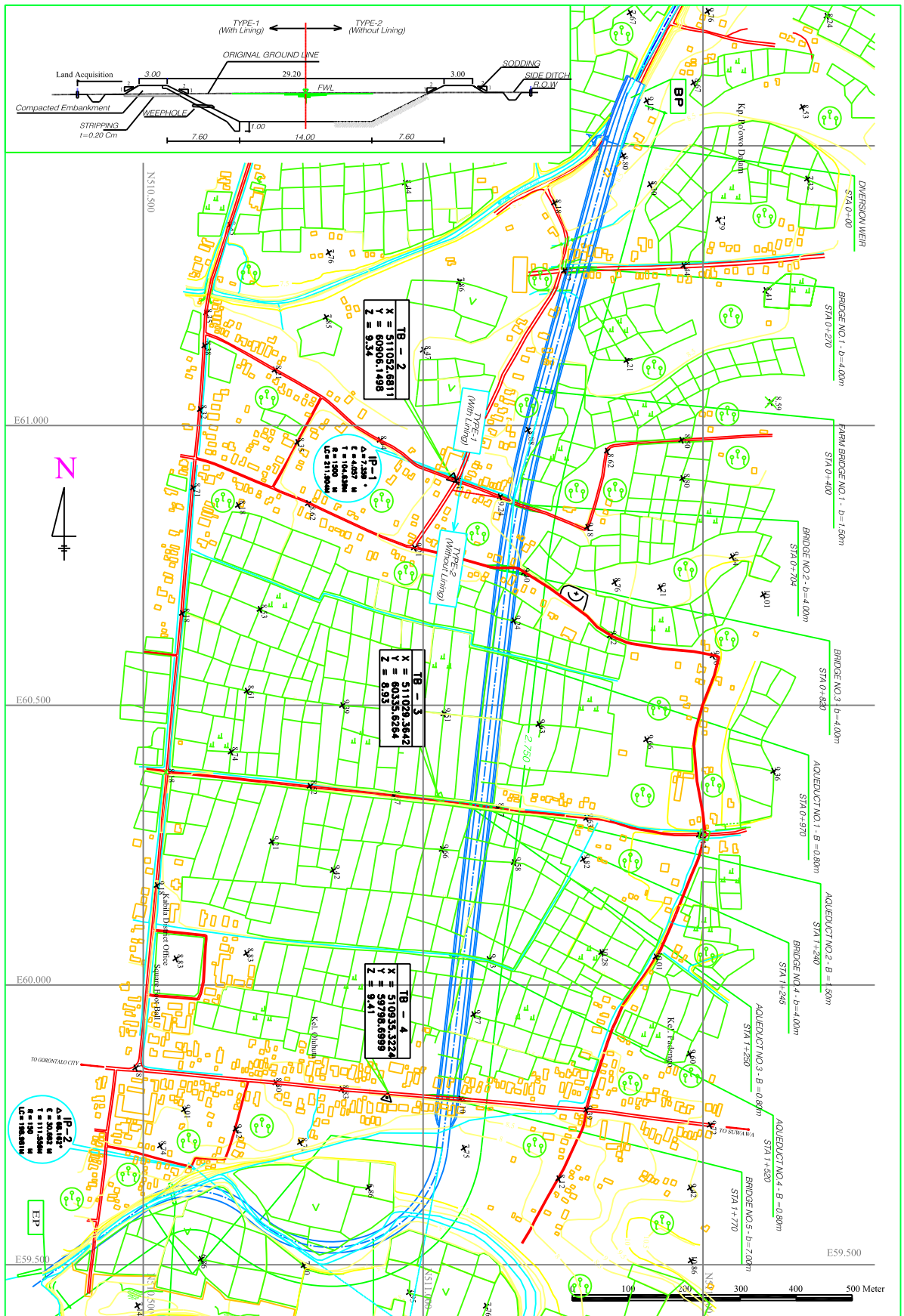
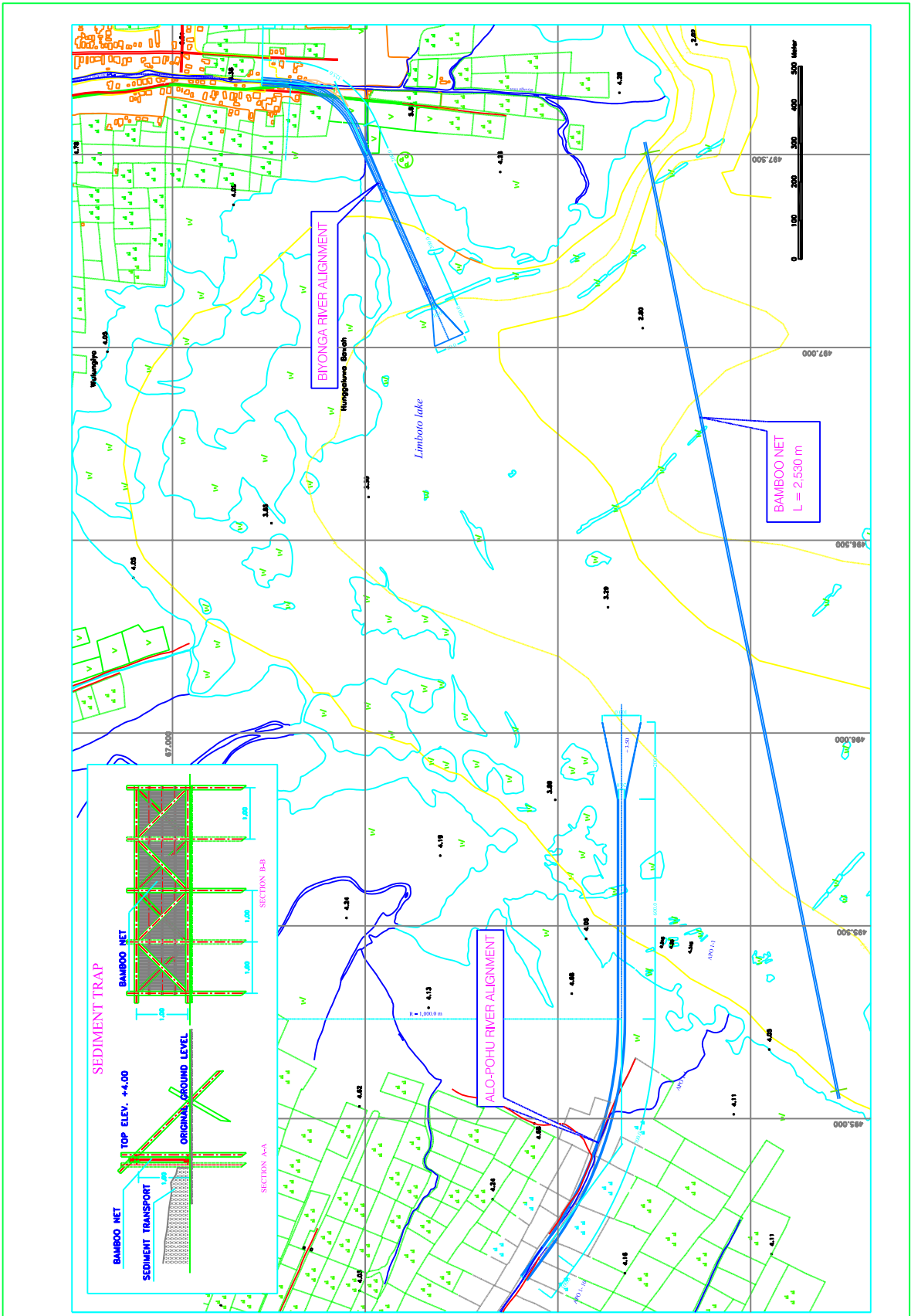

**Figure 5.7
DESIGN DISCHARGE DISTRIBUTION :
TAMALATE RIVER**



The Study on Flood Control
and Water Management
in Limboto-Bolango-Bone
Basin in the Republic of Indonesia
Japan International Cooperation Agency

Figure 5.8
TAMALATE FLOODWAY



*The Study on Flood Control
and Water Management
in Limboto-Bolango-Bone Basin
in the Republic of Indonesia*
Japan International Cooperation Agency

Figure 5.9
**SEDIMENT TRAP WORKS
IN LAKE LIMBOTO**

Sub-Project/Activities	Year (2003 - 2019)																
	03	04	05	06	07	08	09	10	11	12	13	14	15	16	17	18	19
National Five-Year-Plan																	
1 Preparatory Stage																	
1.1 Feasibility Study																	
1.2 Fund Arrangement																	
1.3 Definite Plan/Detail Design																	
1.4 Preservation of Lands																	
1.5 Research and Investigation																	
1.6 Coordination																	
2 Intensive Implementation Stage																	
Lower Bone River Improvement																	
Lower Bolango River Improvement																	
Topodu River Improvement with Topodu Gate																	
Sediment Trap Works																	
Tamalate Floodway																	
3 Sustainable Implementation Stage																	
Middle Bone River Improvement																	
Lower Tamalate River Improvement																	
Middle Bolango River Improvement																	
Biyonga River Improvement																	
Meluopo River Improvement																	
Marisa River Improvement																	
Alo-Pohu River Improvement																	
Rintenga River Improvement																	
East and West Dikes of Lake Limboto																	
4 Watershed Management																	
5 Flood Plain Management																	

The Study on Flood Control and Water Management in Limboto-Bolango-Bone Basin in the Republic of Indonesia

Japan International Cooperation Agency

Figure 5.10

IMPLEMENTATION SCHEDULE