

|                |                       |          |        |                |             |
|----------------|-----------------------|----------|--------|----------------|-------------|
| NAME OF SCHOOL | ALIAGA CENTRAL SCHOOL |          |        | SCHOOL ID      | E-23 (E-39) |
| DIVISION       | NUEVA ECIJA           | DISTRICT | ALIAGA | DATE OF SURVEY | 03/04/02    |

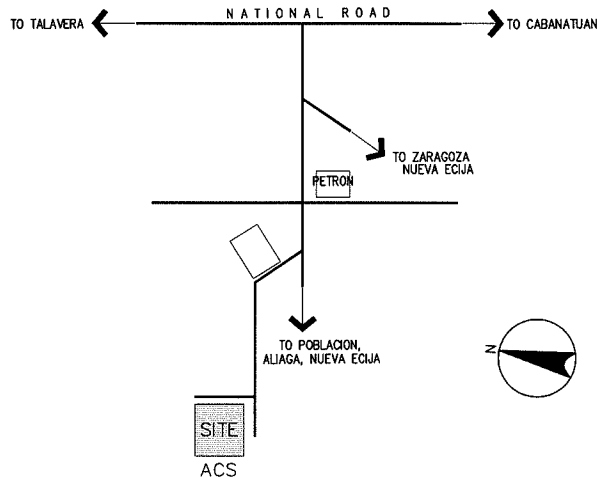

**VICINITY MAP**  
SCALE NTS

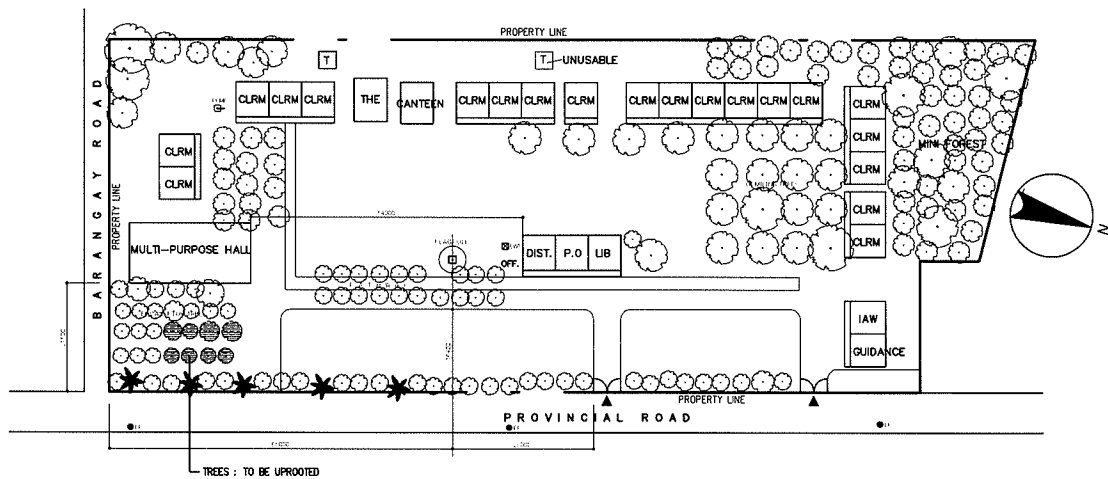

**EXISTING SITE PLAN**  
SCALE 1:1500M

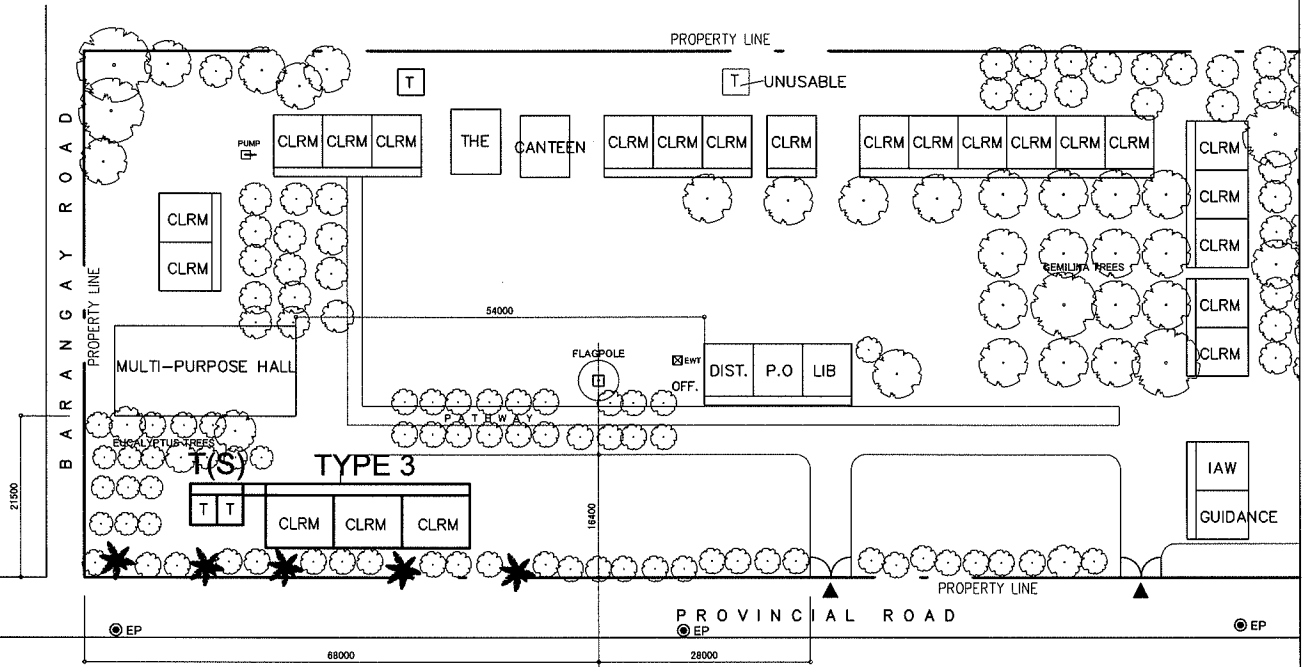
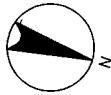

**PROPOSED SITE PLAN**  
 SCALE 1:1000M

**LEGEND:**

|      |                    |     |                             |     |                   |  |              |
|------|--------------------|-----|-----------------------------|-----|-------------------|--|--------------|
| CLRM | Class Room         | THE | Technology & Home Economics | St  | Stage             |  | Hand Pump    |
| F    | Office             | WT  | Water Tank                  | ST  | Septic Tank       |  | EWT          |
| L    | Library            | AD  | Administration Office       | WLM | Water Line Marker |  | Entrance     |
| SCI  | Science Laboratory | IAW | Ind.Arts Workshop           | ●   | EM Electric Meter |  | Cutting Area |
| Co   | Computer Room      | T   | Toilet                      | ⊙   | EP Electric Post  |  | Filling Area |
| MP   | Multi Purpose Room | C   | Conference Room             | ⊙   | W Well            |  |              |
| P.S  | Pre-School         | P.O | Principal Office            | ○   | DW Deep Well      |  |              |

|                |                                |          |                 |                |             |
|----------------|--------------------------------|----------|-----------------|----------------|-------------|
| NAME OF SCHOOL | CABANATUAN EAST CENTRAL SCHOOL |          |                 | SCHOOL ID      | E-24 (E-40) |
| DIVISION       | NUEVA ECIJA                    | DISTRICT | CABANATUAN CITY | DATE OF SURVEY | 02/21/02    |

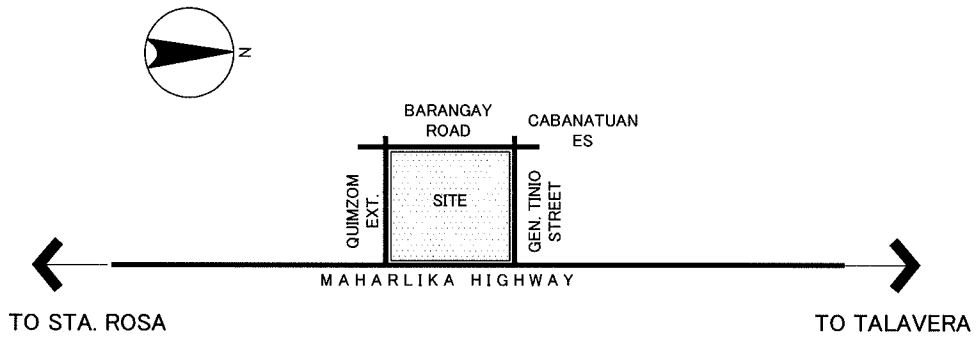

 VICINITY MAP  
SCALE NTS

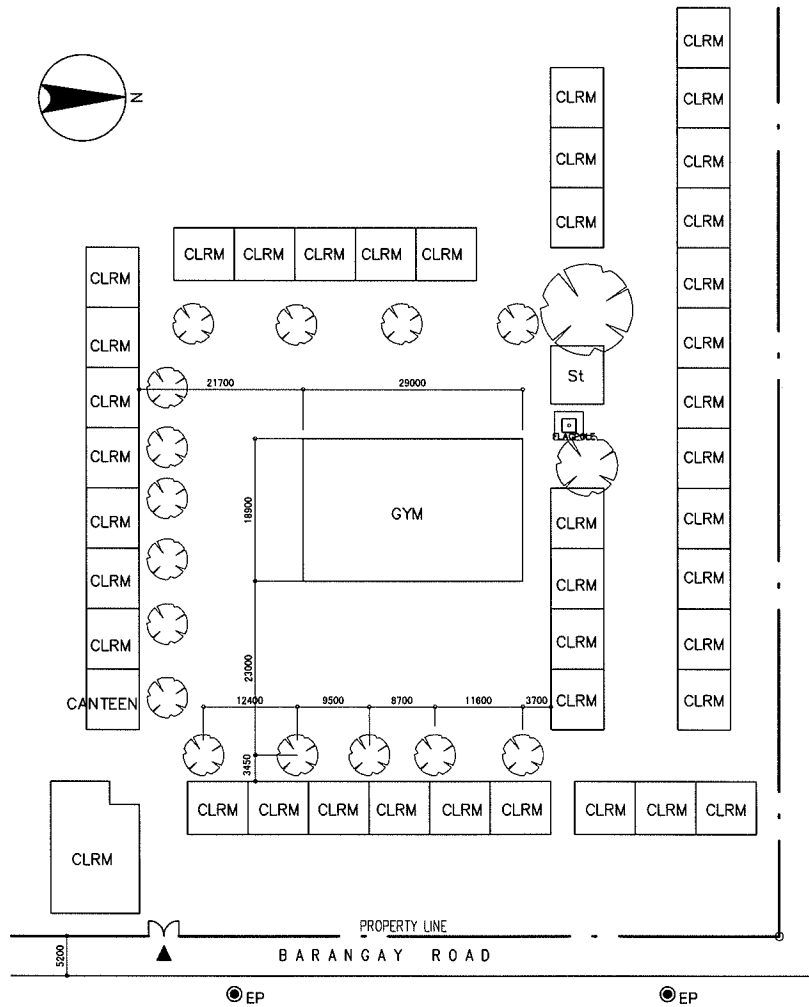

 EXISTING SITE PLAN  
SCALE 1:1000M

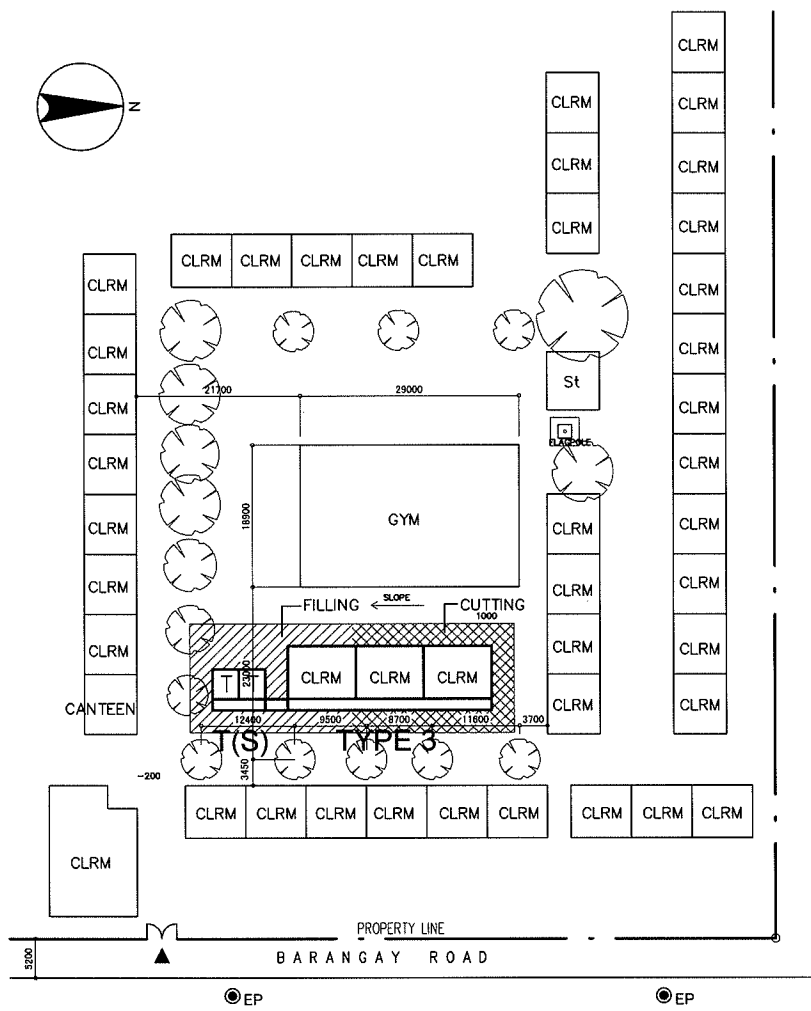

**PROPOSED SITE PLAN**  
 SCALE 1:1000M

|                        |                          |                                 |              |              |
|------------------------|--------------------------|---------------------------------|--------------|--------------|
| <b>LEGEND:</b>         | CLRM Class Room          | THE Technology & Home Economics | St Stage     | Hand Pump    |
| F Office               | WT Water Tank            | ST Septic Tank                  | EWT          | Entrance     |
| L Library              | AD Administration Office | WLM Water Line Marker           | Cutting Area | Filling Area |
| SCI Science Laboratory | IAW Ind.Arts Workshop    | ● EM Electric Meter             |              |              |
| Co Computer Room       | T Toilet                 | ⊙ EP Electric Post              |              |              |
| MP Multi Purpose Room  | C Conference Room        | ⊙ W Well                        |              |              |
| P.S Pre-School         | P.O Principal Office     | ○ DW Deep Well                  |              |              |

|                |                              |          |           |                |             |
|----------------|------------------------------|----------|-----------|----------------|-------------|
| NAME OF SCHOOL | CAMP TINIO ELEMENTARY SCHOOL |          |           | SCHOOL ID      | E-25 (E-41) |
| DIVISION       | NUEVA ECIJA                  | DISTRICT | CAB. CITY | DATE OF SURVEY | 02/21/02    |

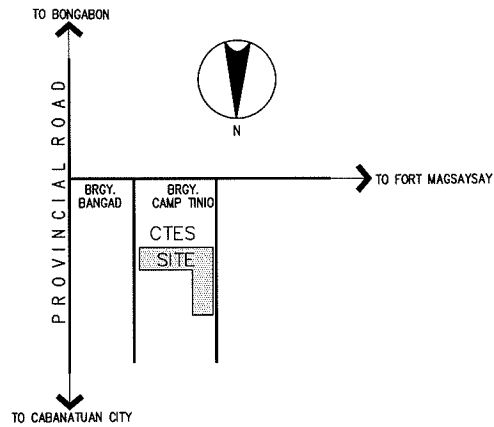

**VICINITY MAP**  
 SCALE NTS

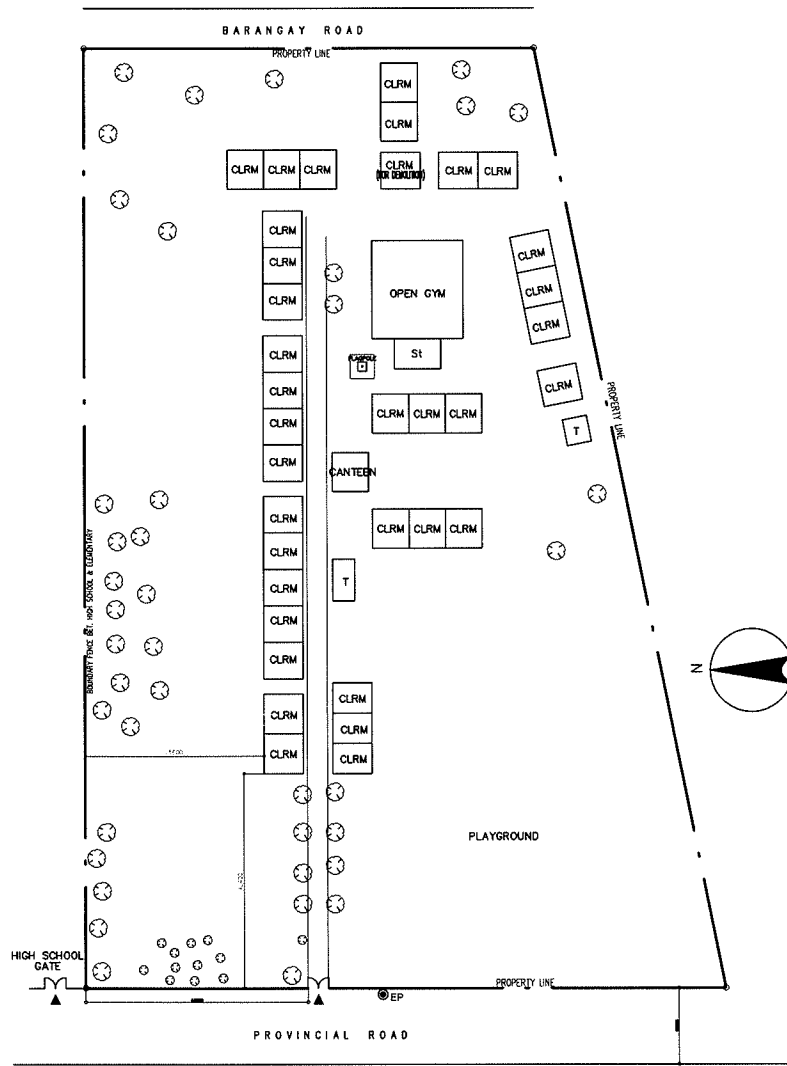

**EXISTING SITE PLAN**  
 SCALE 1:1500M

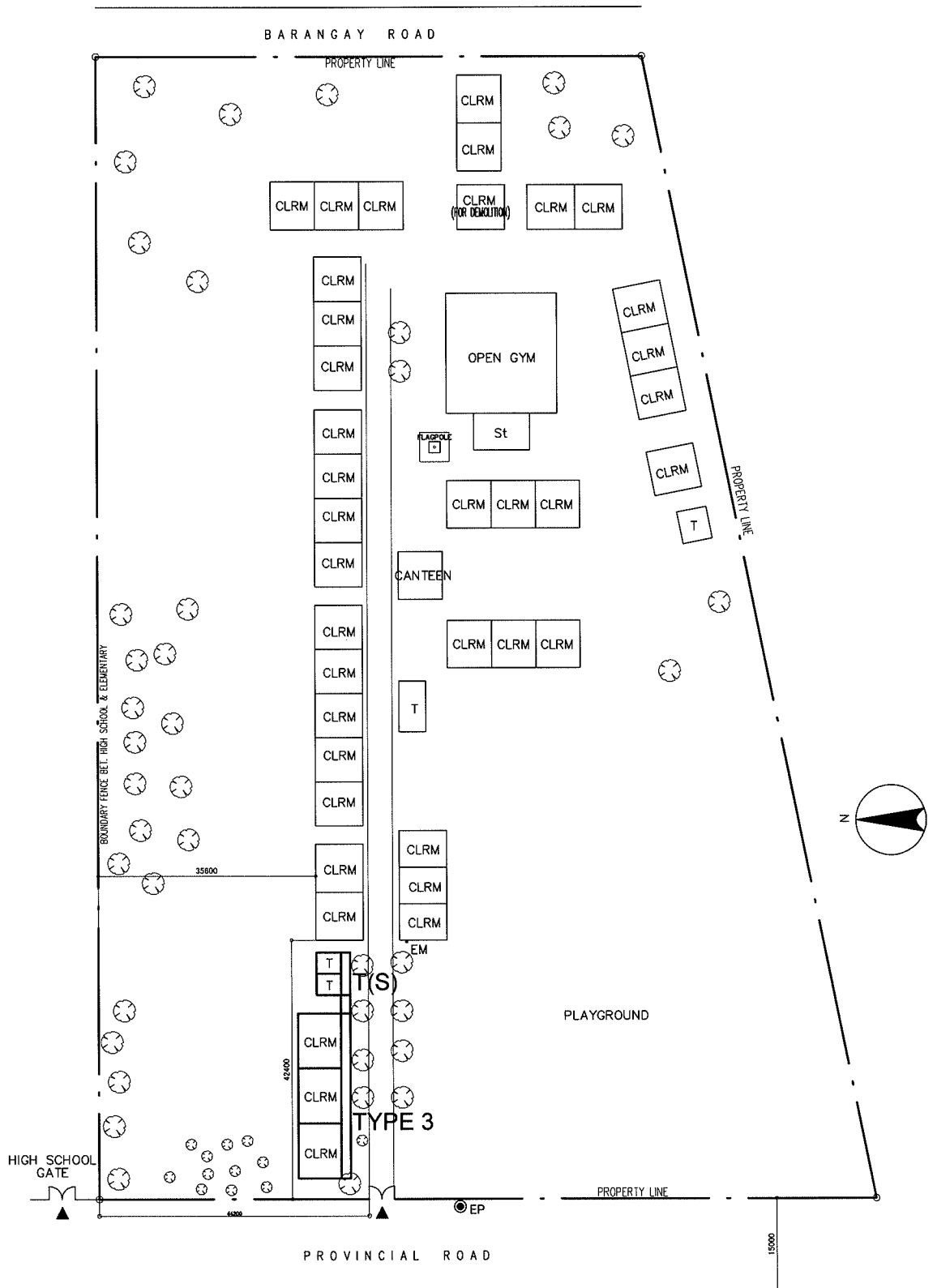

**PROPOSED SITE PLAN**  
 SCALE 1:1000M

**LEGEND:**

|      |                    |     |                             |     |                   |  |              |
|------|--------------------|-----|-----------------------------|-----|-------------------|--|--------------|
| CLRM | Class Room         | THE | Technology & Home Economics | St  | Stage             |  | Hand Pump    |
| F    | Office             | WT  | Water Tank                  | ST  | Septic Tank       |  | EWT          |
| L    | Library            | AD  | Administration Office       | WLM | Water Line Marker |  | Entrance     |
| SCI  | Science Laboratory | IAW | Ind.Arts Workshop           | EM  | Electric Meter    |  | Cutting Area |
| Co   | Computer Room      | T   | Toilet                      | EP  | Electric Post     |  | Filling Area |
| MP   | Multi Purpose Room | C   | Conference Room             | W   | Well              |  |              |
| P.S  | Pre-School         | P.O | Principal Office            | DW  | Deep Well         |  |              |

|                |                             |          |      |                |             |
|----------------|-----------------------------|----------|------|----------------|-------------|
| NAME OF SCHOOL | MAGSALISI ELEMENTARY SCHOOL |          |      | SCHOOL ID      | E-26 (E-42) |
| DIVISION       | NUEVA ECIJA                 | DISTRICT | JAEN | DATE OF SURVEY | 02/22/02    |

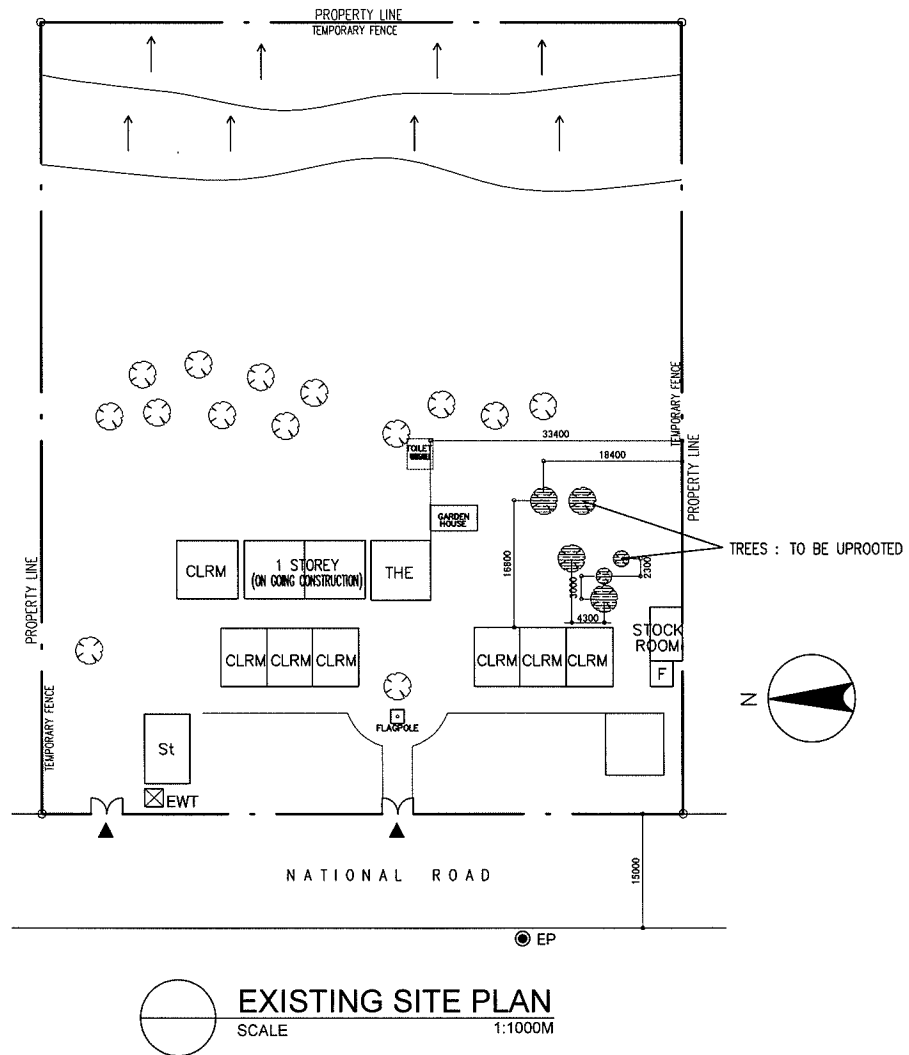
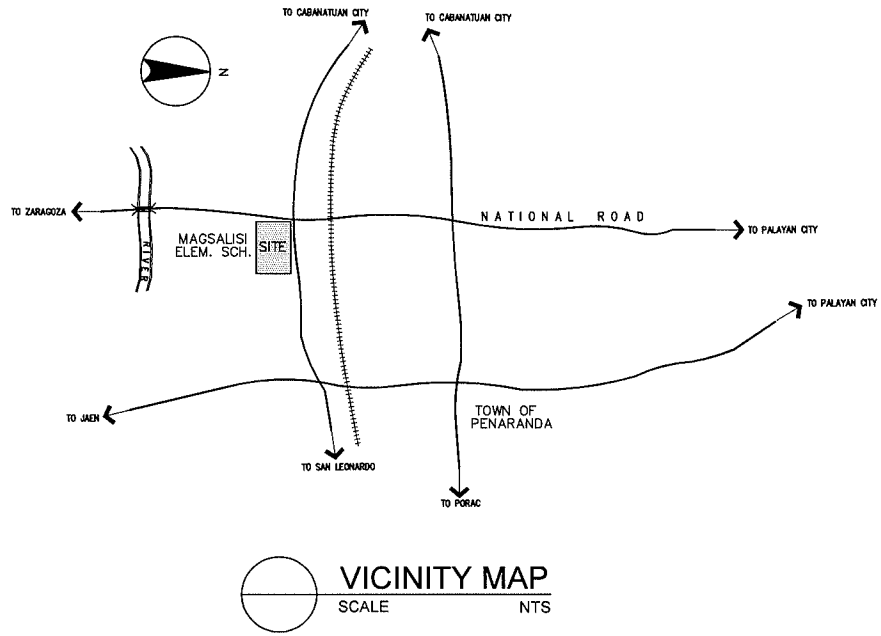

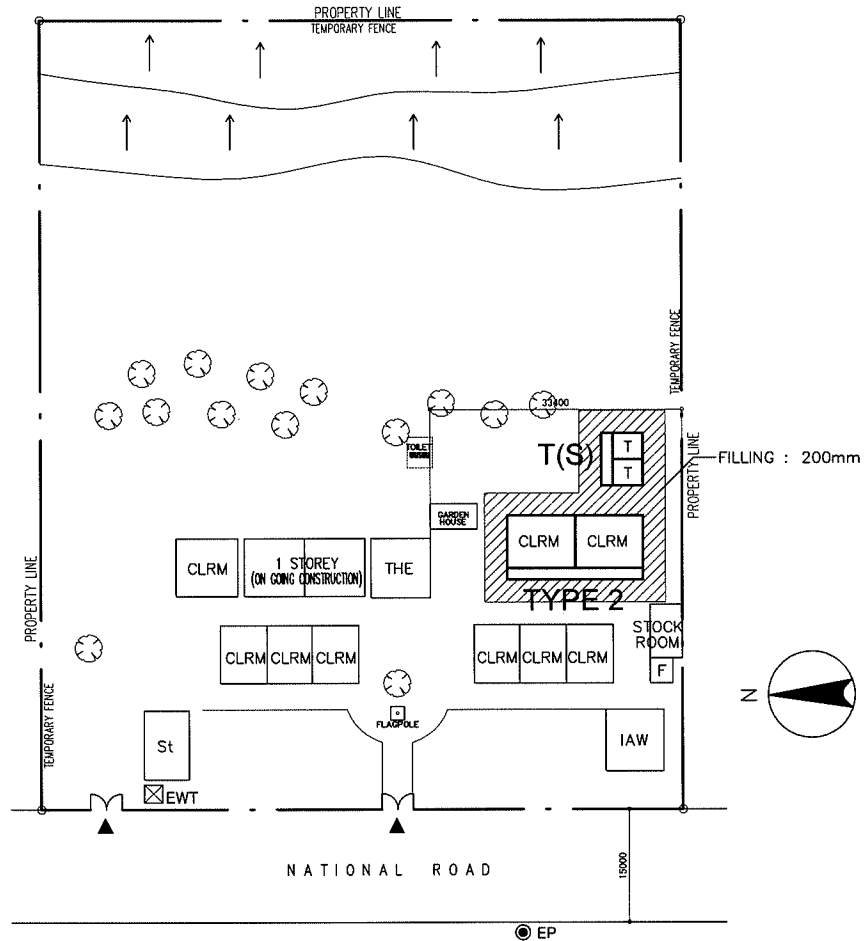

PROPOSED SITE PLAN  
SCALE 1:1000M

LEGEND:

|      |                    |     |                             |      |                   |  |              |
|------|--------------------|-----|-----------------------------|------|-------------------|--|--------------|
| CLRM | Class Room         | THE | Technology & Home Economics | St   | Stage             |  | Hand Pump    |
| F    | Office             | WT  | Water Tank                  | ST   | Septic Tank       |  | EWT          |
| L    | Library            | AD  | Administration Office       | WLM  | Water Line Marker |  | Entrance     |
| SCI  | Science Laboratory | IAW | Ind.Arts Workshop           | ● EM | Electric Meter    |  | Cutting Area |
| Co   | Computer Room      | T   | Toilet                      | ⊙ EP | Electric Post     |  | Filling Area |
| MP   | Multi Purpose Room | C   | Conference Room             | ○ W  | Well              |  |              |
| P.S  | Pre-School         | P.O | Principal Office            | ○ DW | Deep Well         |  |              |



|                |                                    |          |           |                |             |
|----------------|------------------------------------|----------|-----------|----------------|-------------|
| NAME OF SCHOOL | STA. ANA CENTRAL ELEMENTARY SCHOOL |          |           | SCHOOL ID      | E-27 (E-45) |
| DIVISION       | PAMPANGA                           | DISTRICT | SANTA ANA | DATE OF SURVEY | 02/22/02    |

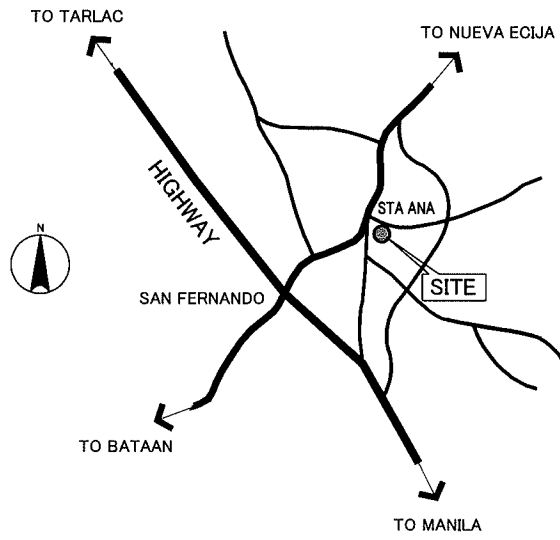

VICINITY MAP  
SCALE NTS

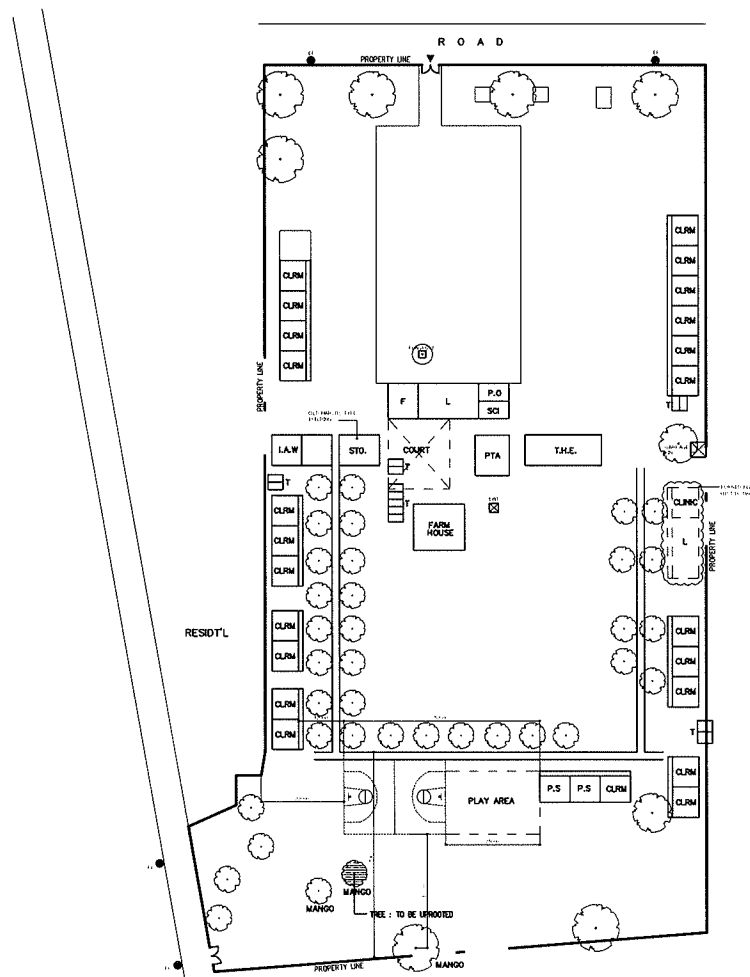

EXISTING SITE PLAN  
SCALE 1:2000M

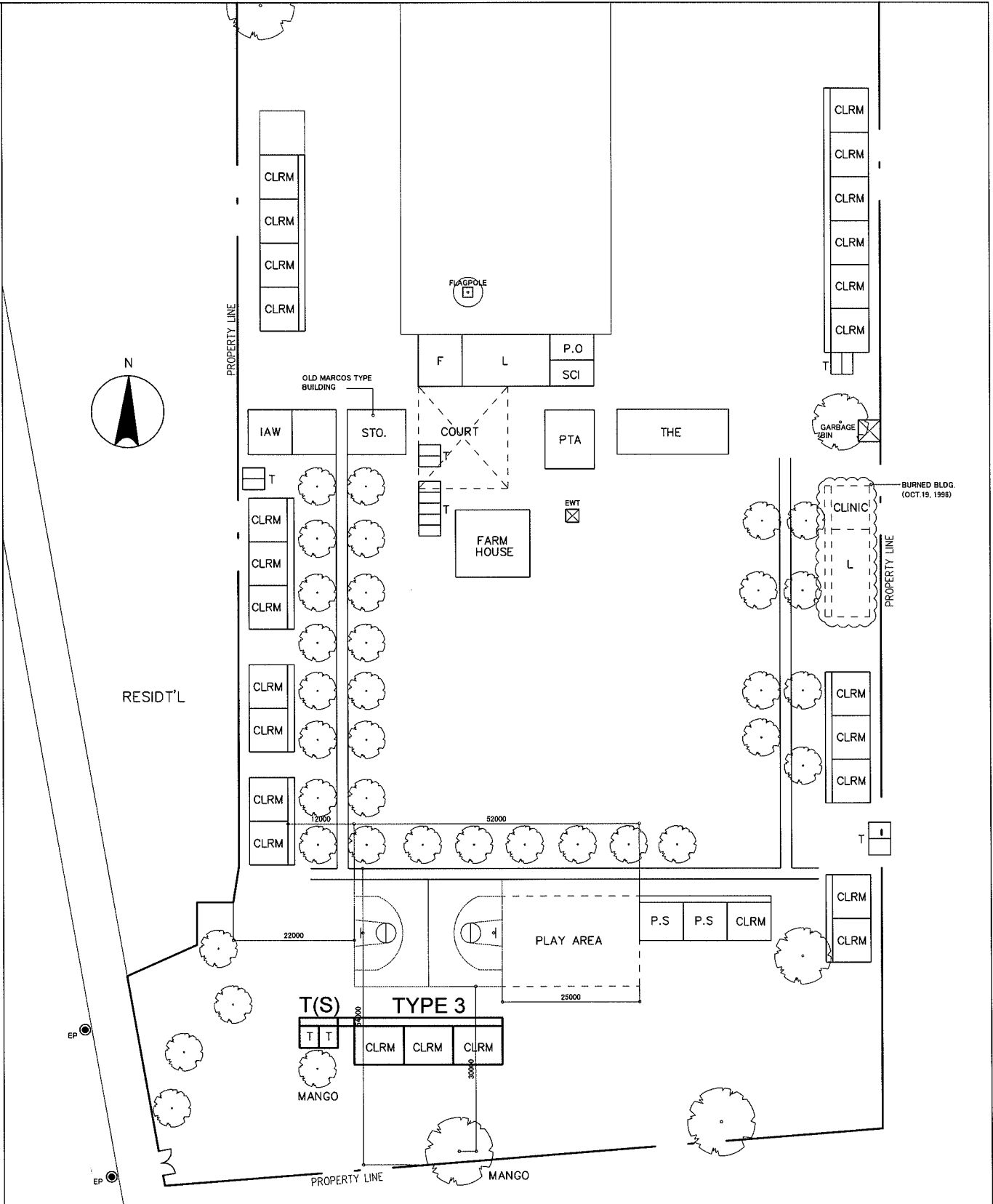

**PROPOSED SITE PLAN**  
SCALE 1:1000M

**LEGEND:**

|      |                    |     |                             |     |                   |  |              |
|------|--------------------|-----|-----------------------------|-----|-------------------|--|--------------|
| CLRM | Class Room         | THE | Technology & Home Economics | St  | Stage             |  | Hand Pump    |
| F    | Office             | WT  | Water Tank                  | ST  | Septic Tank       |  | EWT          |
| L    | Library            | AD  | Administration Office       | WLM | Water Line Marker |  | Entrance     |
| SCI  | Science Laboratory | IAW | Ind.Arts Workshop           | EM  | Electric Meter    |  | Cutting Area |
| Co   | Computer Room      | T   | Toilet                      | EP  | Electric Post     |  | Filling Area |
| MP   | Multi Purpose Room | C   | Conference Room             | W   | Well              |  |              |
| P.S  | Pre-School         | P.O | Principal Office            | DW  | Deep Well         |  |              |

|                |                        |          |              |                |             |
|----------------|------------------------|----------|--------------|----------------|-------------|
| NAME OF SCHOOL | EPZA ELEMENTARY SCHOOL |          |              | SCHOOL ID      | E-28 (E-47) |
| DIVISION       | PAMPANGA               | DISTRICT | ANGELES CITY | DATE OF SURVEY | 02/22/02    |

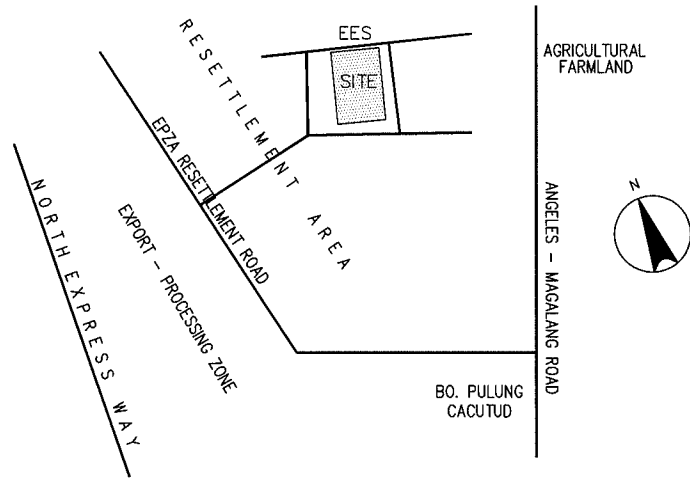

VICINITY MAP  
SCALE NTS

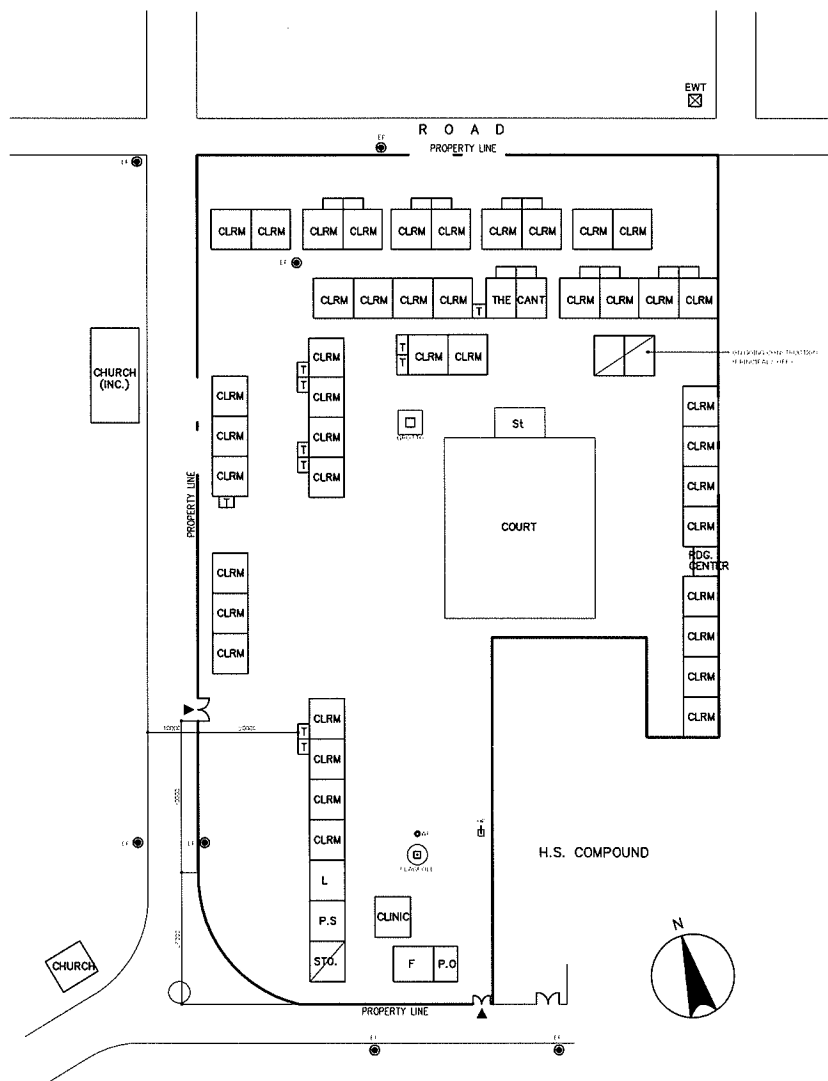

EXISTING SITE PLAN  
SCALE 1:1500M

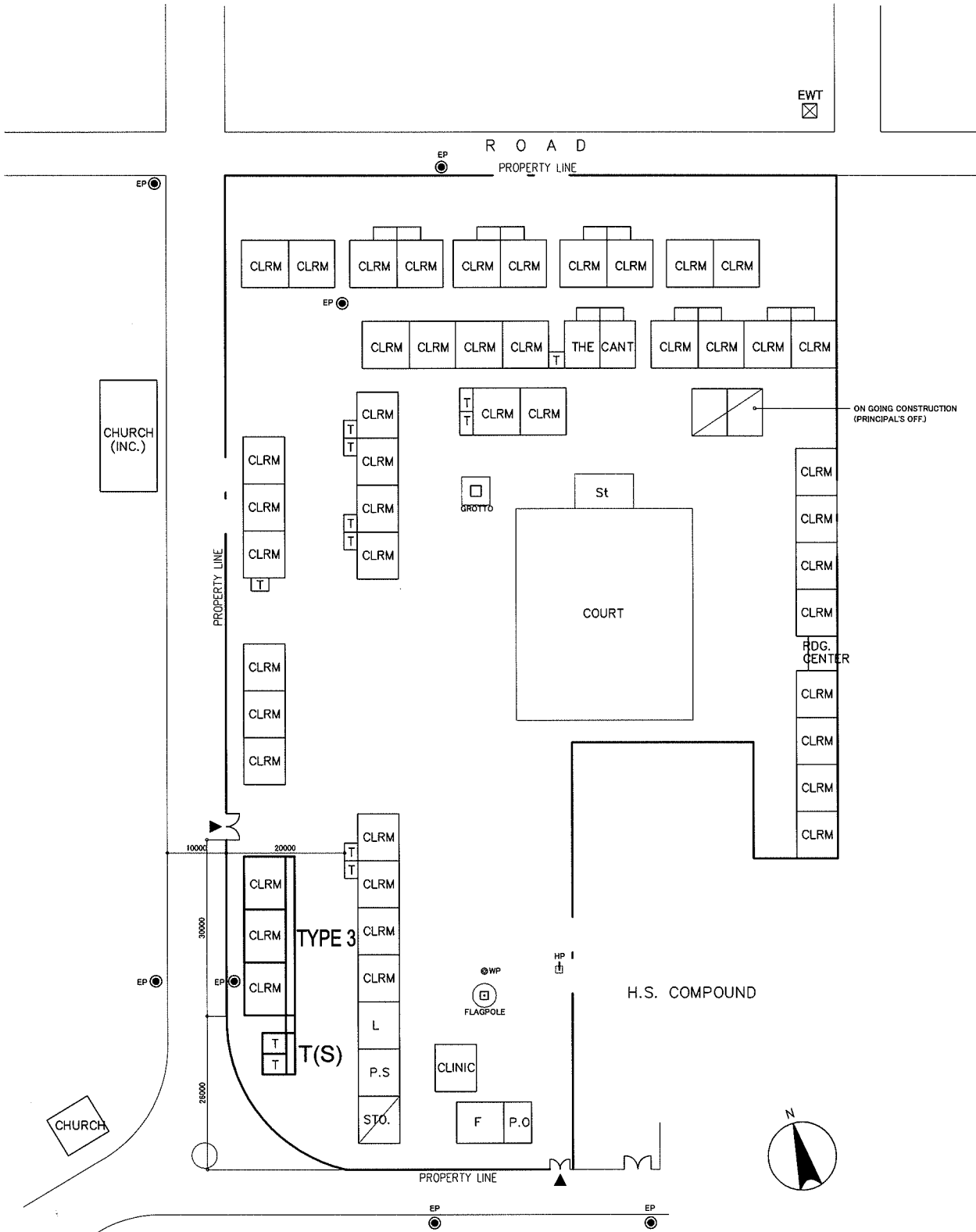

**PROPOSED SITE PLAN**  
 SCALE 1:1000M

**LEGEND:**

|      |                    |     |                             |     |                   |  |              |
|------|--------------------|-----|-----------------------------|-----|-------------------|--|--------------|
| CLRM | Class Room         | THE | Technology & Home Economics | St  | Stage             |  | Hand Pump    |
| F    | Office             | WT  | Water Tank                  | ST  | Septic Tank       |  | EWT          |
| L    | Library            | AD  | Administration Office       | WLM | Water Line Marker |  | Entrance     |
| SCI  | Science Laboratory | IAW | Ind.Arts Workshop           | ●   | Electric Meter    |  | Cutting Area |
| Co   | Computer Room      | T   | Toilet                      | ⊙   | Electric Post     |  | Filling Area |
| MP   | Multi Purpose Room | C   | Conference Room             | ⊙   | Well              |  |              |
| P.S  | Pre-School         | P.O | Principal Office            | ○   | Deep Well         |  |              |

|                |                            |          |          |                |             |
|----------------|----------------------------|----------|----------|----------------|-------------|
| NAME OF SCHOOL | MORIONES ELEMENTARY SCHOOL |          |          | SCHOOL ID      | E-29 (E-48) |
| DIVISION       | TARLAC                     | DISTRICT | SAN JOSE | DATE OF SURVEY | 02/22/02    |

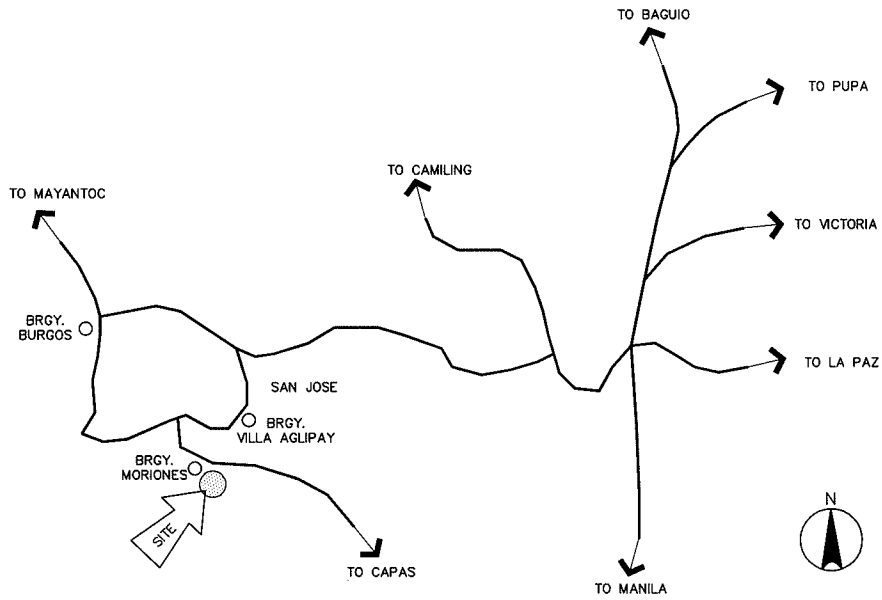

 **VICINITY MAP**  
SCALE NTS

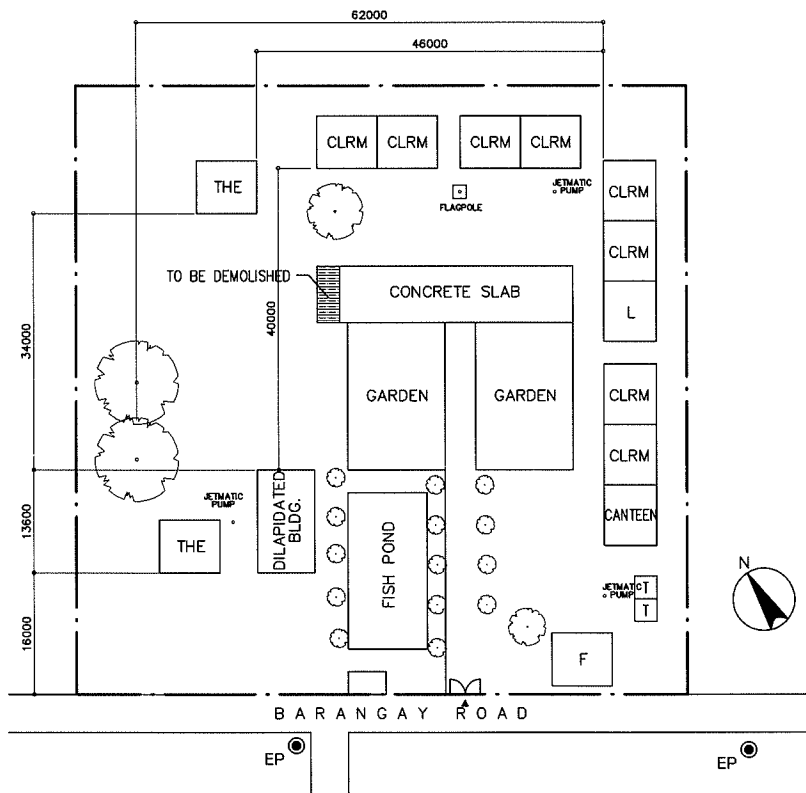

 **EXISTING SITE PLAN**  
SCALE 1:1000M

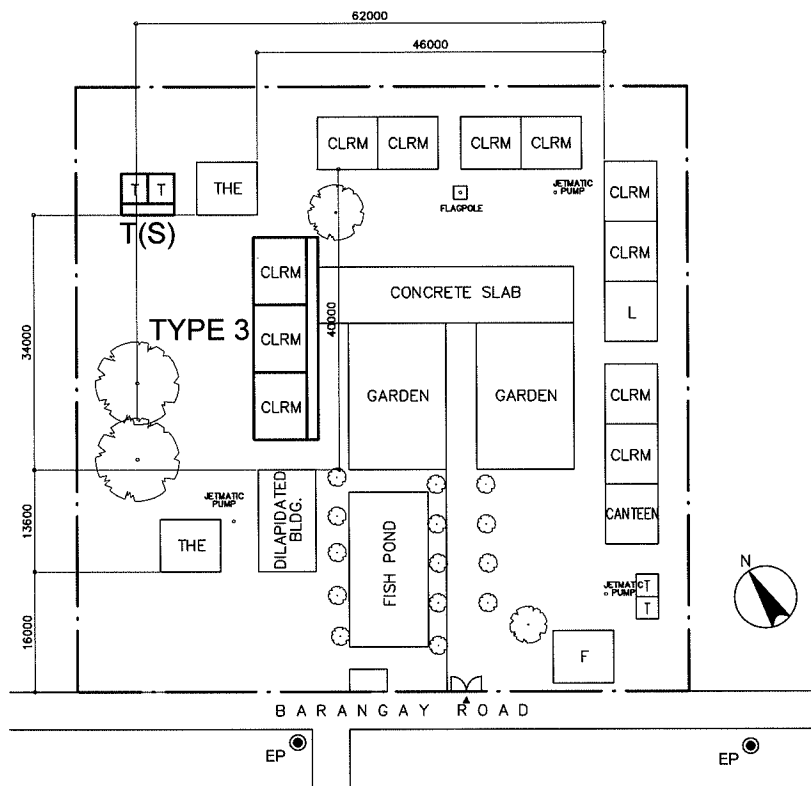

**PROPOSED SITE PLAN**  
SCALE 1:1000M

**LEGEND:**

|      |                    |     |                             |     |                   |                |           |              |
|------|--------------------|-----|-----------------------------|-----|-------------------|----------------|-----------|--------------|
| CLRM | Class Room         | THE | Technology & Home Economics | St  | Stage             |                | Hand Pump |              |
| F    | Office             | WT  | Water Tank                  | ST  | Septic Tank       |                | EWT       |              |
| L    | Library            | AD  | Administration Office       | WLM | Water Line Marker |                | Entrance  |              |
| SCI  | Science Laboratory | IAW | Ind.Arts Workshop           | ●   | EM                | Electric Meter |           | Cutting Area |
| Co   | Computer Room      | T   | Toilet                      | ⊙   | EP                | Electric Post  |           | Filling Area |
| MP   | Multi Purpose Room | C   | Conference Room             | ⊙   | W                 | Well           |           |              |
| P.S  | Pre-School         | P.O | Principal Office            | ○   | DW                | Deep Well      |           |              |



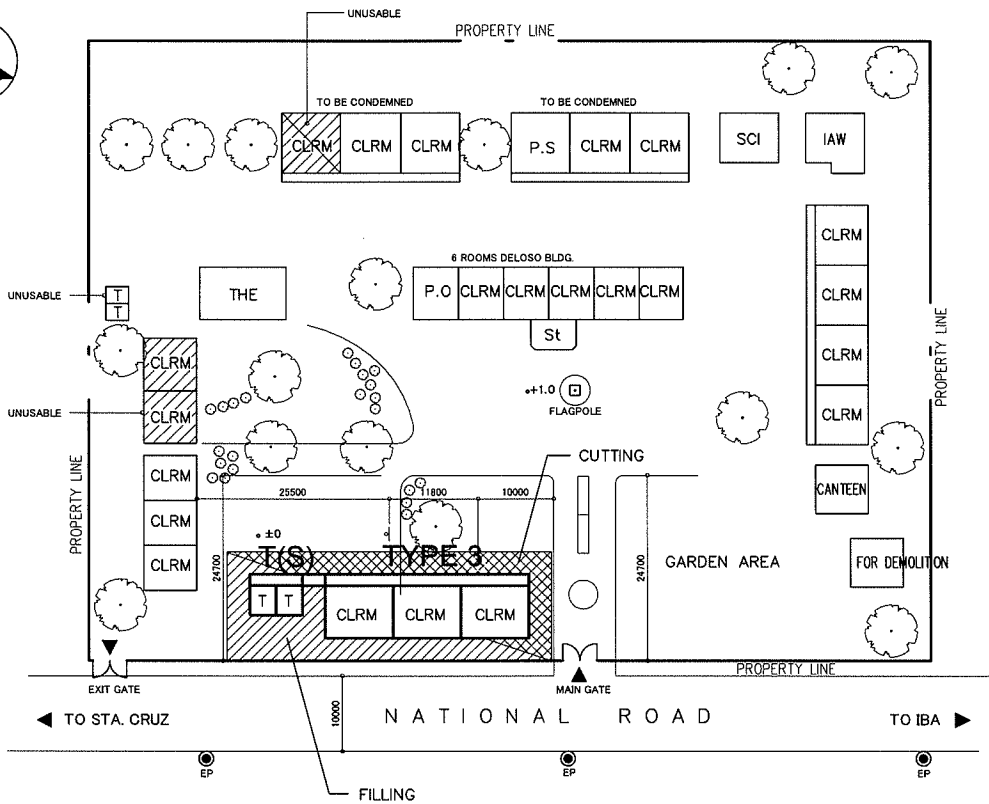

**PROPOSED SITE PLAN**  
 SCALE 1:1000M

**LEGEND:**

|      |                    |     |                             |     |                   |  |              |
|------|--------------------|-----|-----------------------------|-----|-------------------|--|--------------|
| CLRM | Class Room         | THE | Technology & Home Economics | St  | Stage             |  | Hand Pump    |
| F    | Office             | WT  | Water Tank                  | ST  | Septic Tank       |  | EWT          |
| L    | Library            | AD  | Administration Office       | WLM | Water Line Marker |  | Entrance     |
| SCI  | Science Laboratory | IAW | Ind.Arts Workshop           | ●   | Electric Meter    |  | Cutting Area |
| Co   | Computer Room      | T   | Toilet                      | ⊙   | Electric Post     |  | Filling Area |
| MP   | Multi Purpose Room | C   | Conference Room             | ○   | Well              |  |              |
| P.S  | Pre-School         | P.O | Principal Office            | ○   | Deep Well         |  |              |



|                |                      |          |       |                |             |
|----------------|----------------------|----------|-------|----------------|-------------|
| NAME OF SCHOOL | SUBIC CENTRAL SCHOOL |          |       | SCHOOL ID      | E-31 (E-55) |
| DIVISION       | ZAMBALES             | DISTRICT | SUBIC | DATE OF SURVEY | 02/28/02    |

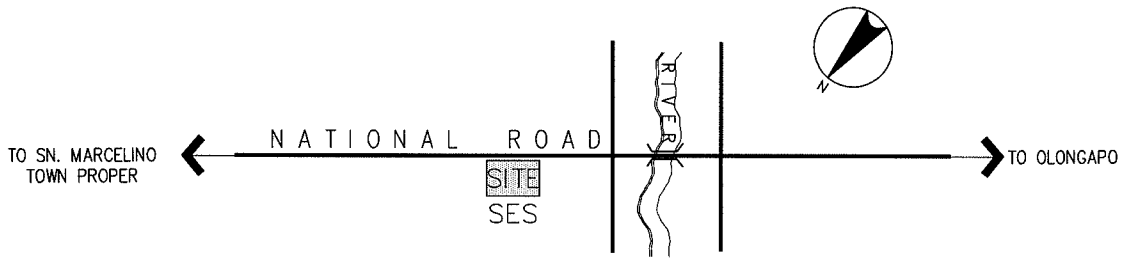

**VICINITY MAP**  
SCALE NTS

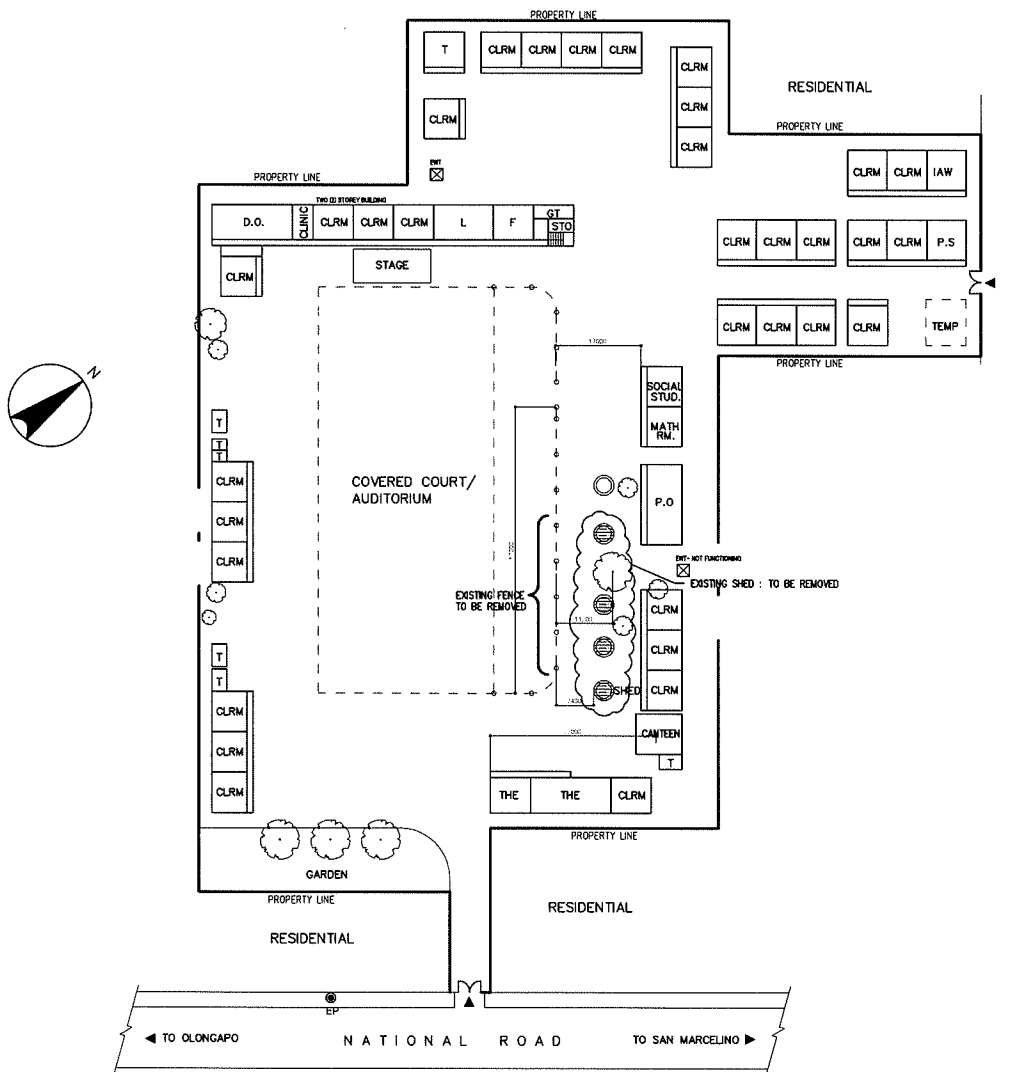

**EXISTING SITE PLAN**  
SCALE 1:1500M

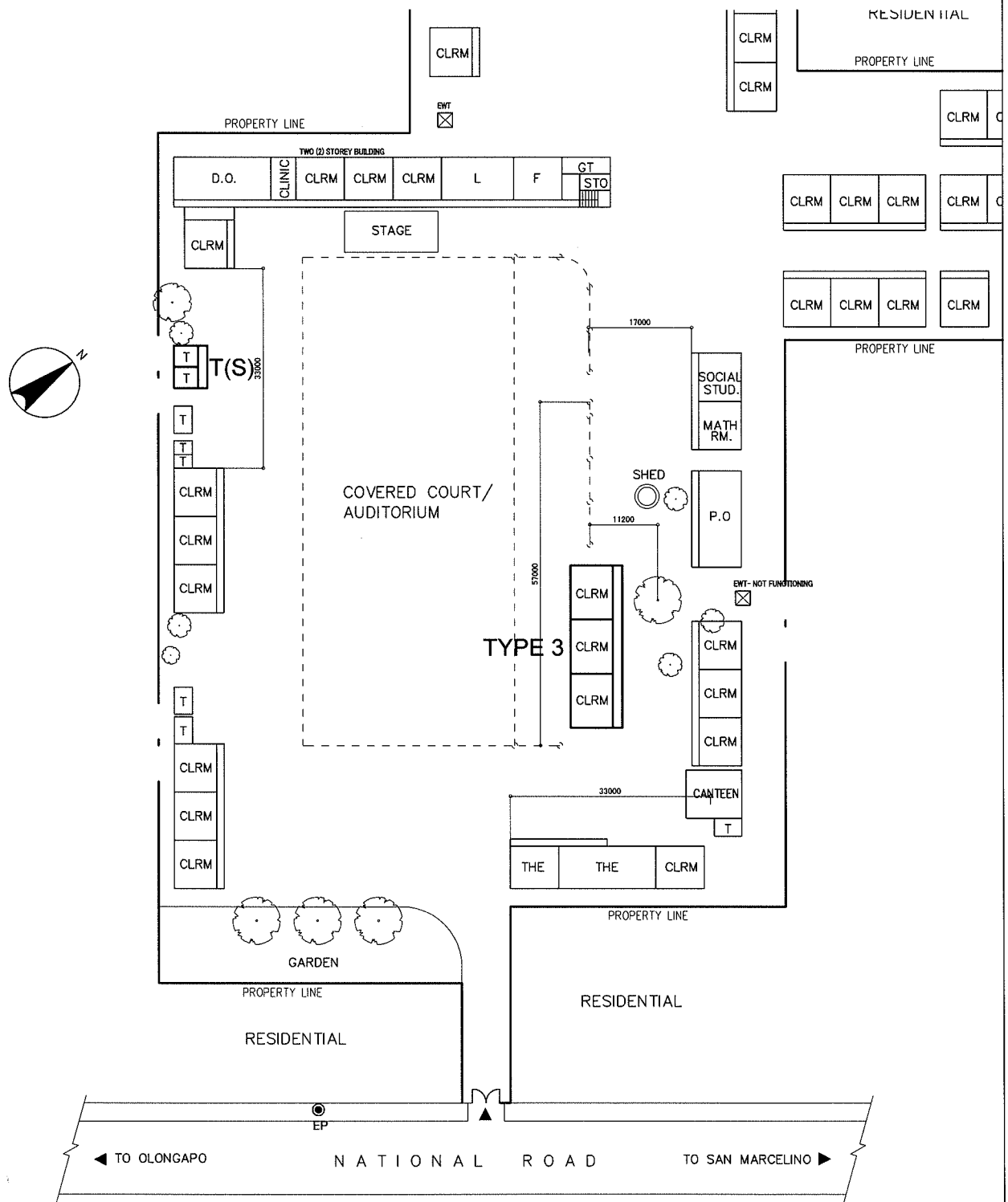

**PROPOSED SITE PLAN**  
SCALE 1:1000M

**LEGEND:**

|      |                    |     |                             |     |                   |  |              |
|------|--------------------|-----|-----------------------------|-----|-------------------|--|--------------|
| CLRM | Class Room         | THE | Technology & Home Economics | St  | Stage             |  | Hand Pump    |
| F    | Office             | WT  | Water Tank                  | ST  | Septic Tank       |  | EWT          |
| L    | Library            | AD  | Administration Office       | WLM | Water Line Marker |  | Entrance     |
| SCI  | Science Laboratory | IAW | Ind.Arts Workshop           | ●   | Electric Meter    |  | Cutting Area |
| Co   | Computer Room      | T   | Toilet                      | ●   | Electric Post     |  | Filling Area |
| MP   | Multi Purpose Room | C   | Conference Room             | ⊙   | Well              |  |              |
| P.S  | Pre-School         | P.O | Principal Office            | ○   | Deep Well         |  |              |

|                |                                      |          |                |             |
|----------------|--------------------------------------|----------|----------------|-------------|
| NAME OF SCHOOL | DON PABLO R. ROMAN N.H.S. (PILAR HS) |          | SCHOOL ID      | S-01 (S-01) |
| DIVISION       | BATAAN                               | DISTRICT | DATE OF SURVEY | 02/25/02    |

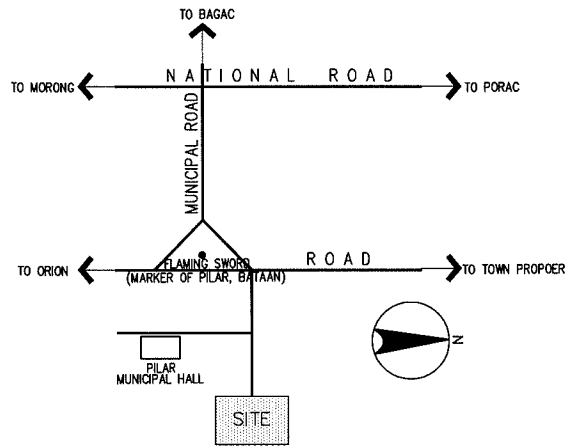

VICINITY MAP  
 SCALE NTS

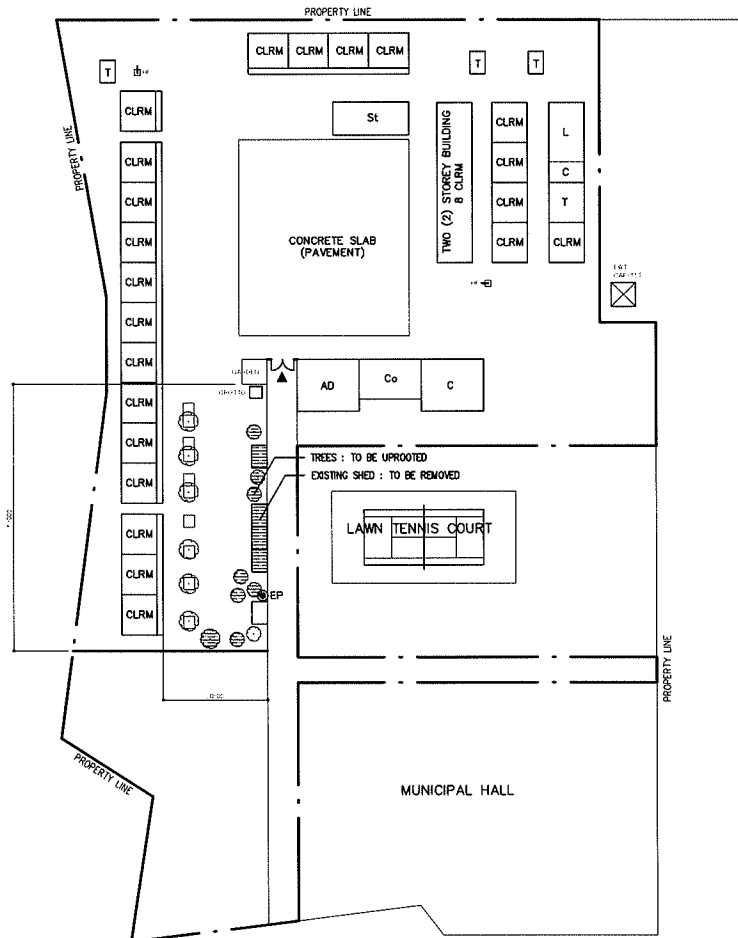

EXISTING SITE PLAN  
 SCALE 1:1500M

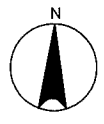
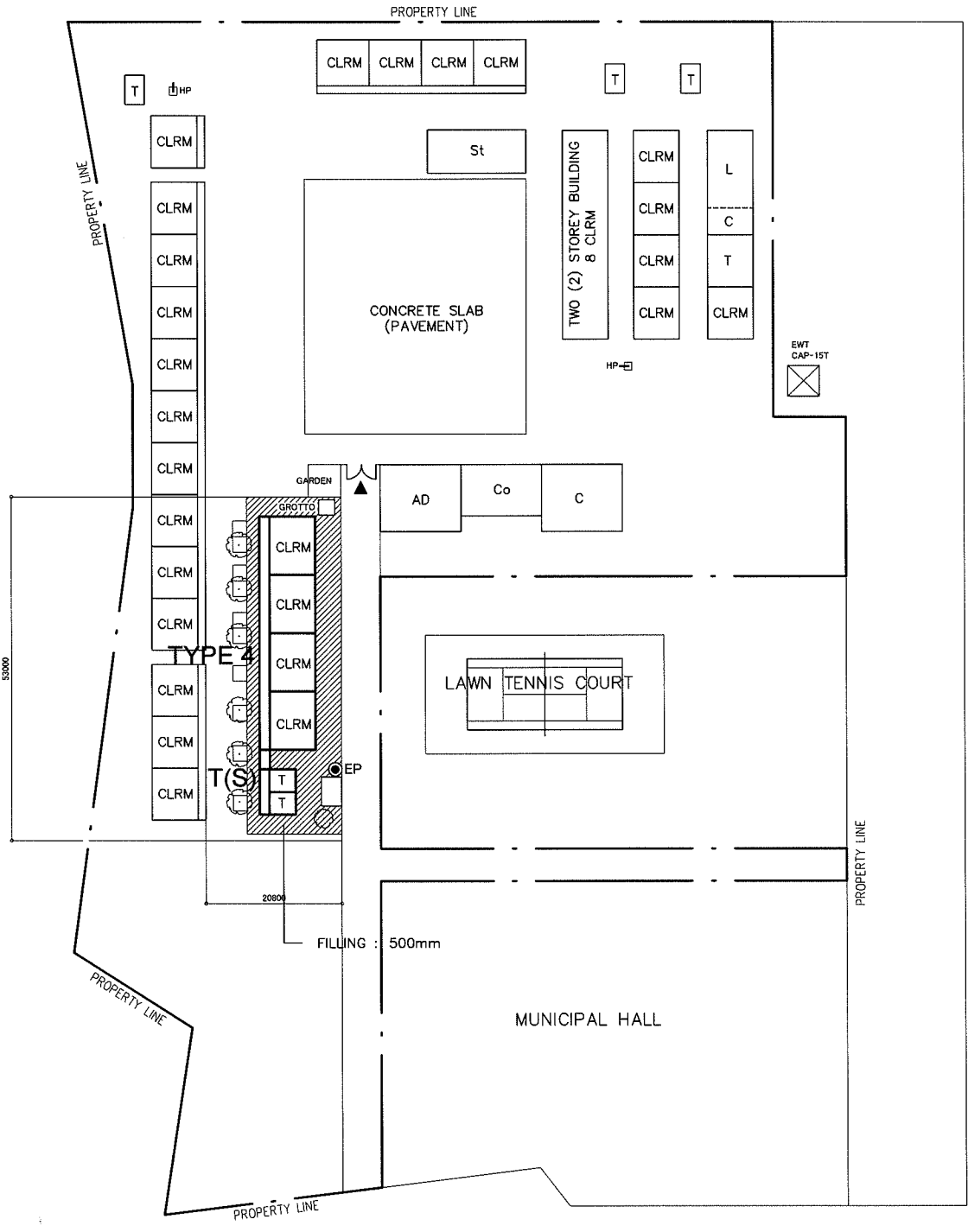

**PROPOSED SITE PLAN**  
 SCALE 1:1000M

**LEGEND:**

|      |                    |     |                             |     |                   |                |                |
|------|--------------------|-----|-----------------------------|-----|-------------------|----------------|----------------|
| CLRM | Class Room         | THE | Technology & Home Economics | St  | Stage             |                | Hand Pump      |
| F    | Office             | WT  | Water Tank                  | ST  | Septic Tank       |                | EWT            |
| L    | Library            | AD  | Administration Office       | WLM | Water Line Marker |                | Entrance       |
| SCI  | Science Laboratory | IAW | Ind.Arts Workshop           | ●   | EM                | Electric Meter | Electric Meter |
| Co   | Computer Room      | T   | Toilet                      | ●   | EP                | Electric Post  | Electric Post  |
| MP   | Multi Purpose Room | C   | Conference Room             | ○   | W                 | Well           | Well           |
| P.S  | Pre-School         | P.O | Principal Office            | ○   | DW                | Deep Well      | Deep Well      |
|      |                    |     |                             |     |                   |                | Cutting Area   |
|      |                    |     |                             |     |                   |                | Filling Area   |

|                |                               |          |                |             |
|----------------|-------------------------------|----------|----------------|-------------|
| NAME OF SCHOOL | BONIFACIO CAMACHO HIGH SCHOOL |          | SCHOOL ID      | S-02 (S-03) |
| DIVISION       | BATAAN                        | DISTRICT | DATE OF SURVEY | 02/26/02    |

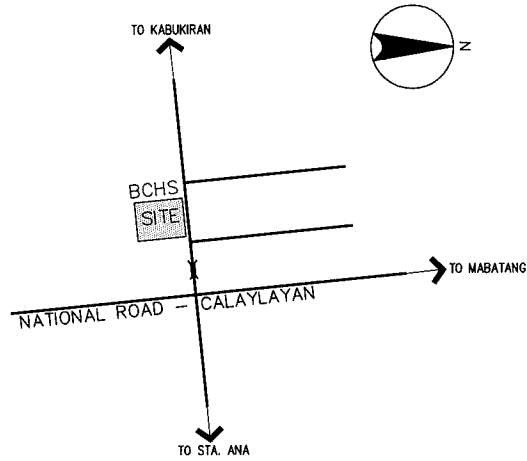

**VICINITY MAP**  
SCALE NTS

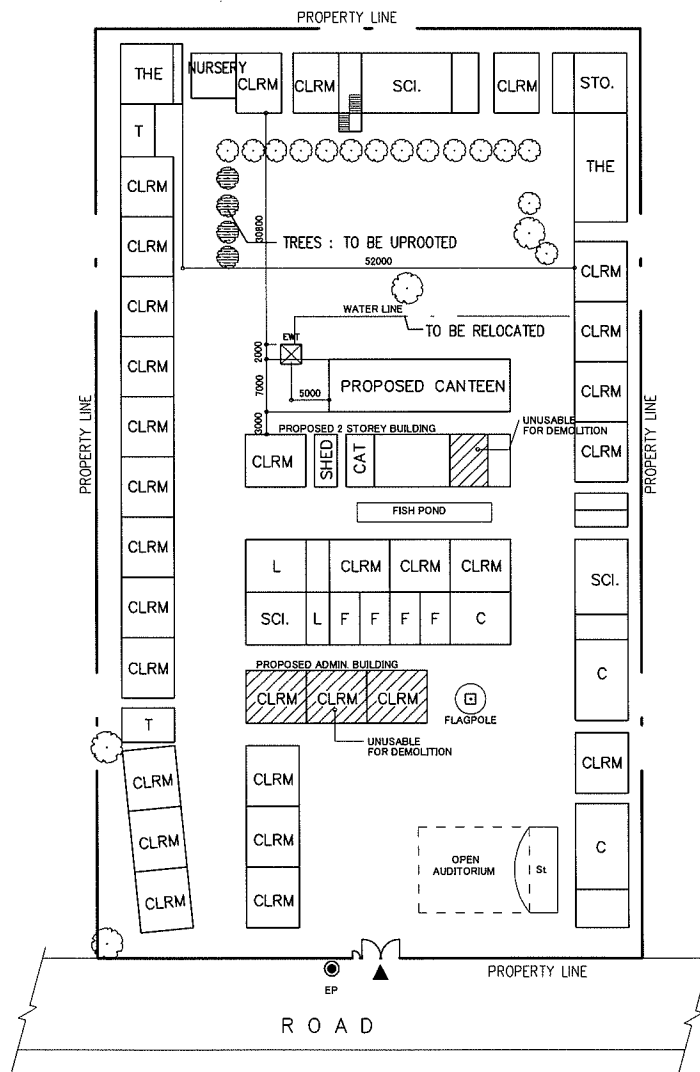

**EXISTING SITE PLAN**  
SCALE 1:1000M

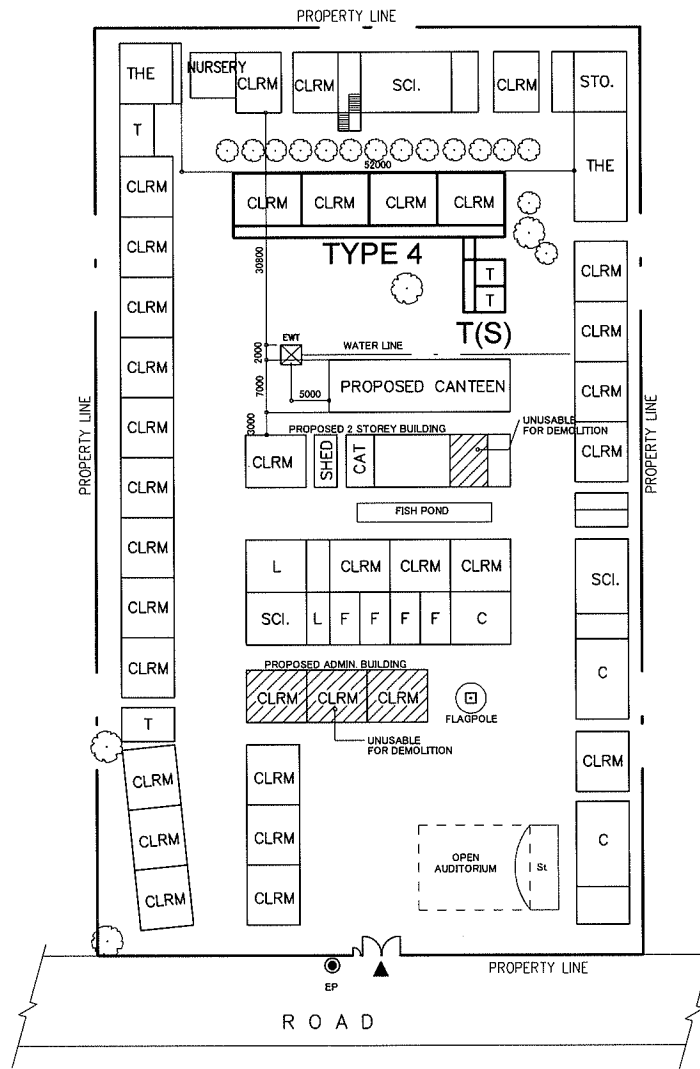

**PROPOSED SITE PLAN**  
 SCALE 1:1000M

**LEGEND:**

|      |                    |     |                             |     |                   |  |              |
|------|--------------------|-----|-----------------------------|-----|-------------------|--|--------------|
| CLRM | Class Room         | THE | Technology & Home Economics | St  | Stage             |  | Hand Pump    |
| F    | Office             | WT  | Water Tank                  | ST  | Septic Tank       |  | EWT          |
| L    | Library            | AD  | Administration Office       | WLM | Water Line Marker |  | Entrance     |
| SCI  | Science Laboratory | IAW | Ind.Arts Workshop           | ●   | EM Electric Meter |  | Cutting Area |
| Co   | Computer Room      | T   | Toilet                      | ●   | EP Electric Post  |  | Filling Area |
| MP   | Multi Purpose Room | C   | Conference Room             | ○   | W Well            |  |              |
| P.S  | Pre-School         | P.O | Principal Office            | ○   | DW Deep Well      |  |              |



BATAAN POLYTECHNIC  
COMPOUND (PROPOSED)



PROPERTY LINE

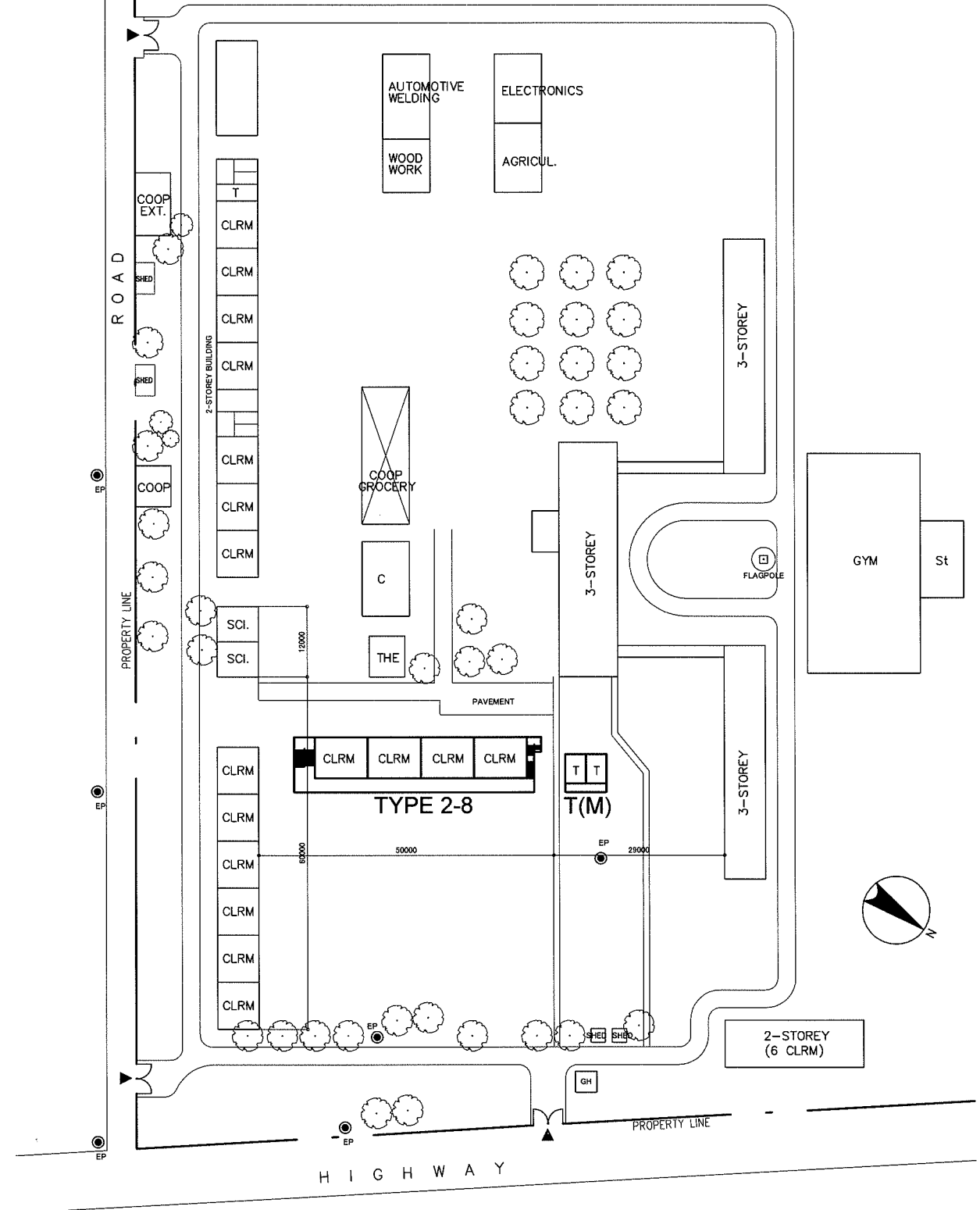

**PROPOSED SITE PLAN**  
SCALE 1:1000M

**LEGEND:**

|                        |                                 |                       |              |
|------------------------|---------------------------------|-----------------------|--------------|
| CLRM Class Room        | THE Technology & Home Economics | St Stage              | Hand Pump    |
| F Office               | WT Water Tank                   | ST Septic Tank        | EWT          |
| L Library              | AD Administration Office        | WLM Water Line Marker | Entrance     |
| SCI Science Laboratory | IAW Ind.Arts Workshop           | ● EM Electric Meter   | Cutting Area |
| Co Computer Room       | T Toilet                        | ● EP Electric Post    | Filling Area |
| MP Multi Purpose Room  | C Conference Room               | ○ W Well              |              |
| P.S Pre-School         | P.O Principal Office            | ○ DW Deep Well        |              |



|                |                                  |          |                |             |
|----------------|----------------------------------|----------|----------------|-------------|
| NAME OF SCHOOL | PAGALANGANG NATIONAL HIGH SCHOOL |          | SCHOOL ID      | S-04 (S-05) |
| DIVISION       | BATAAN                           | DISTRICT | DATE OF SURVEY | 02/27/02    |

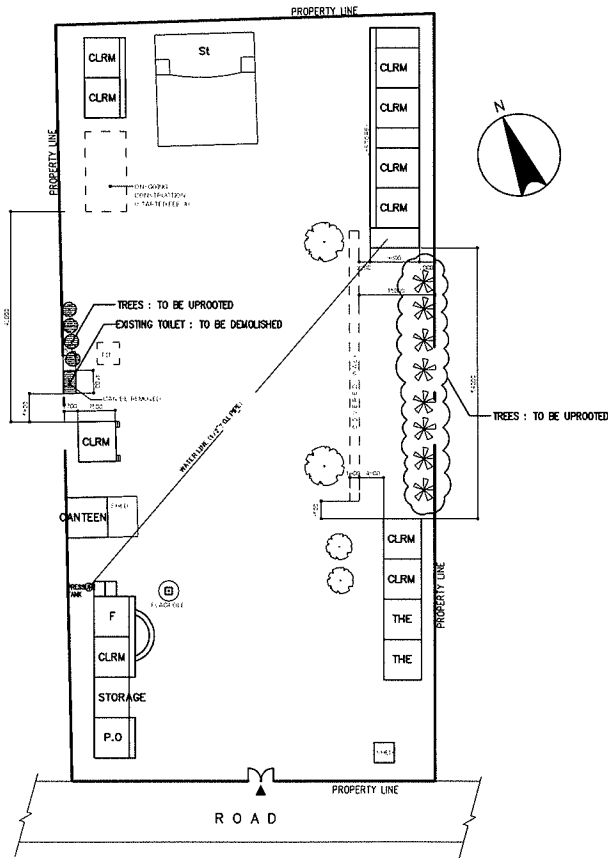
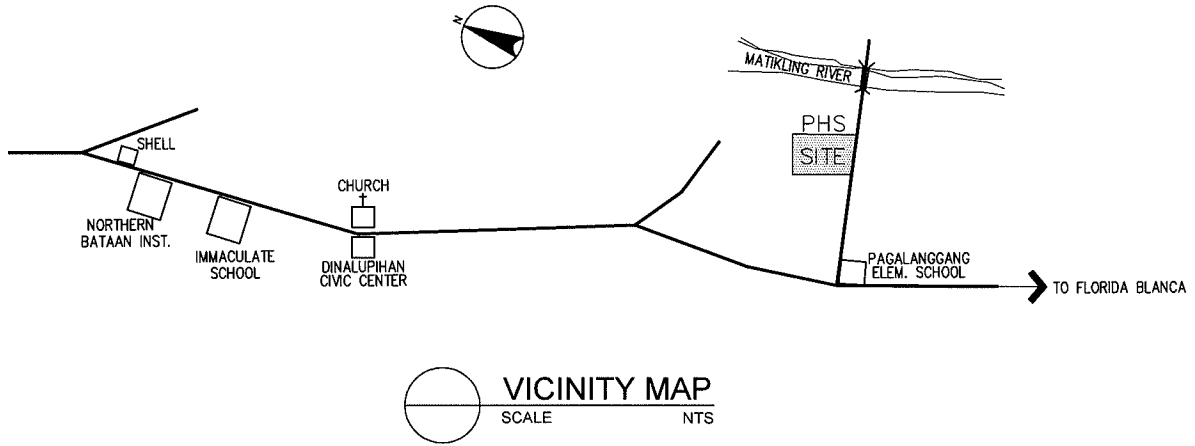

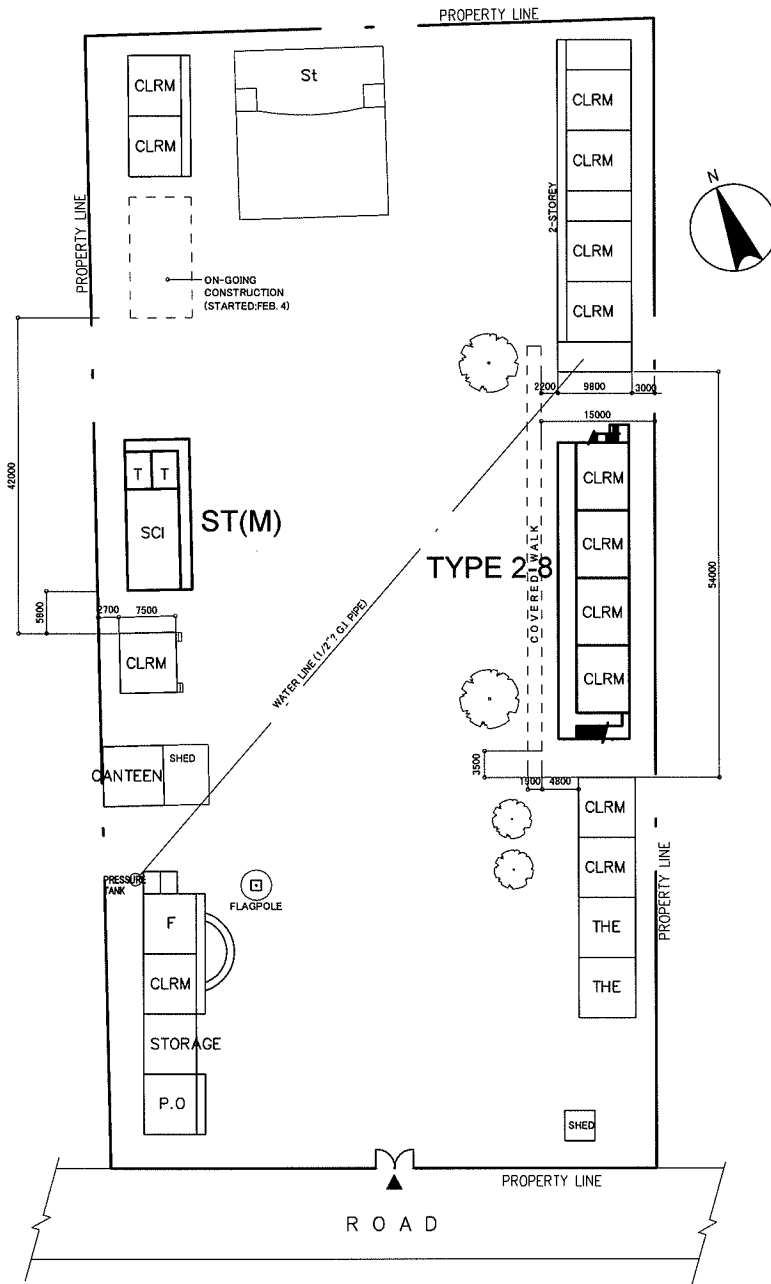

PROPOSED SITE PLAN  
SCALE 1:1000M

LEGEND:

CLRM Class Room  
F Office  
L Library  
SCI Science Laboratory  
Co Computer Room  
MP Multi Purpose Room  
P.S Pre-School

THE Technology & Home Economics  
WT Water Tank  
AD Administration Office  
IAW Ind.Arts Workshop  
T Toilet  
C Conference Room  
P.O Principal Office

St Stage  
ST Septic Tank  
WLM Water Line Marker  
EM Electric Meter  
EP Electric Post  
W Well  
DW Deep Well

Hand Pump  
EWT  
Entrance  
Cutting Area  
Filling Area

|                |                     |          |  |                |             |
|----------------|---------------------|----------|--|----------------|-------------|
| NAME OF SCHOOL | HERMOSA HIGH SCHOOL |          |  | SCHOOL ID      | S-05 (S-07) |
| DIVISION       | BATAAN              | DISTRICT |  | DATE OF SURVEY | 02/27/02    |

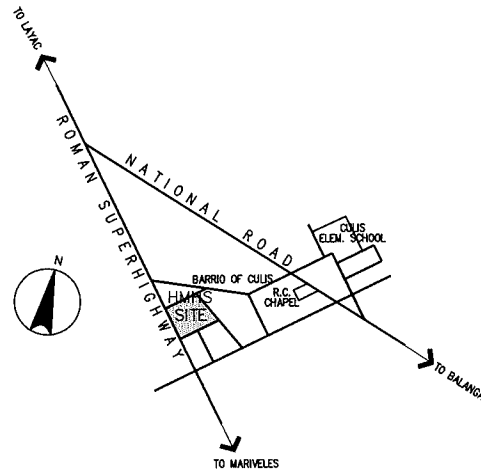

**VICINITY MAP**  
SCALE NTS

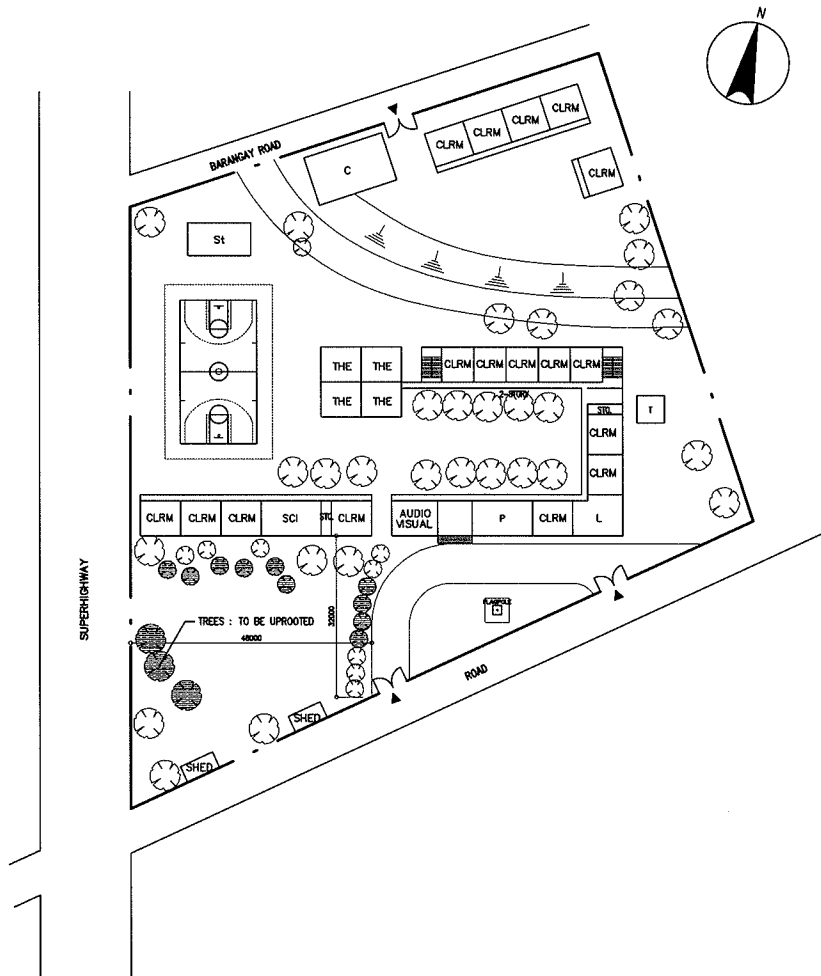

**EXISTING SITE PLAN**  
SCALE 1:1500M

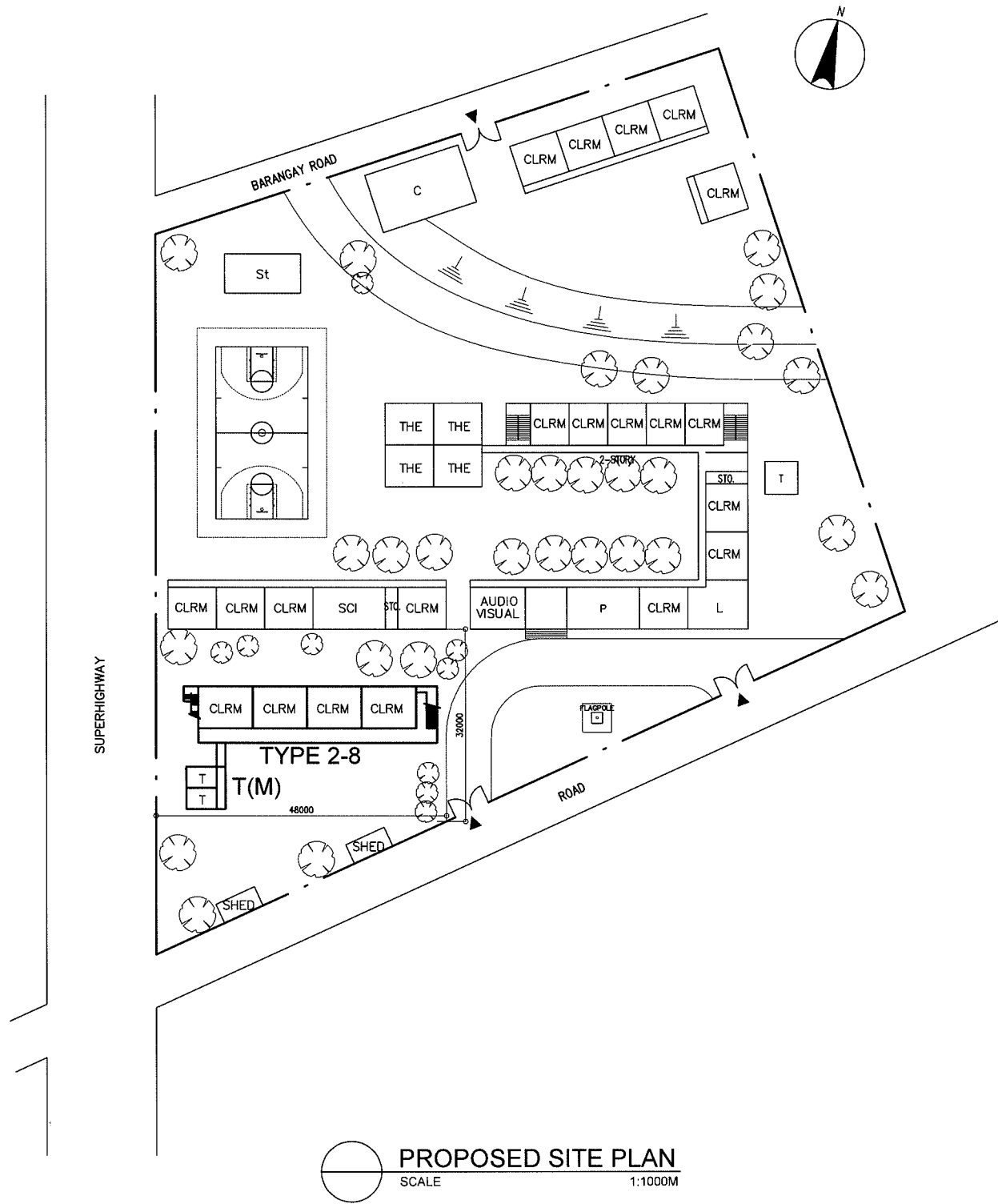

**PROPOSED SITE PLAN**  
SCALE 1:1000M

**LEGEND:**

|      |                    |     |                             |     |                   |  |              |
|------|--------------------|-----|-----------------------------|-----|-------------------|--|--------------|
| CLRM | Class Room         | THE | Technology & Home Economics | St  | Stage             |  | Hand Pump    |
| F    | Office             | WT  | Water Tank                  | ST  | Septic Tank       |  | EWT          |
| L    | Library            | AD  | Administration Office       | WLM | Water Line Marker |  | Entrance     |
| SCI  | Science Laboratory | IAW | Ind.Arts Workshop           | EM  | Electric Meter    |  | Cutting Area |
| Co   | Computer Room      | T   | Toilet                      | EP  | Electric Post     |  | Filling Area |
| MP   | Multi Purpose Room | C   | Conference Room             | W   | Well              |  |              |
| P.S  | Pre-School         | P.O | Principal Office            | DW  | Deep Well         |  |              |

|                |                   |          |           |                |
|----------------|-------------------|----------|-----------|----------------|
| NAME OF SCHOOL | LIMAY HIGH SCHOOL |          | SCHOOL ID | S-06 (S-08)    |
| DIVISION       | BATAAN            | DISTRICT | BALOGANON | DATE OF SURVEY |
|                |                   |          |           | 02/25/02       |

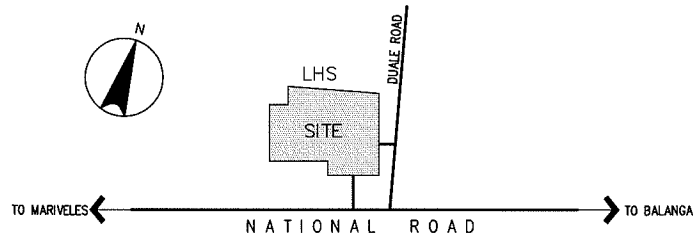

**VICINITY MAP**  
SCALE NTS

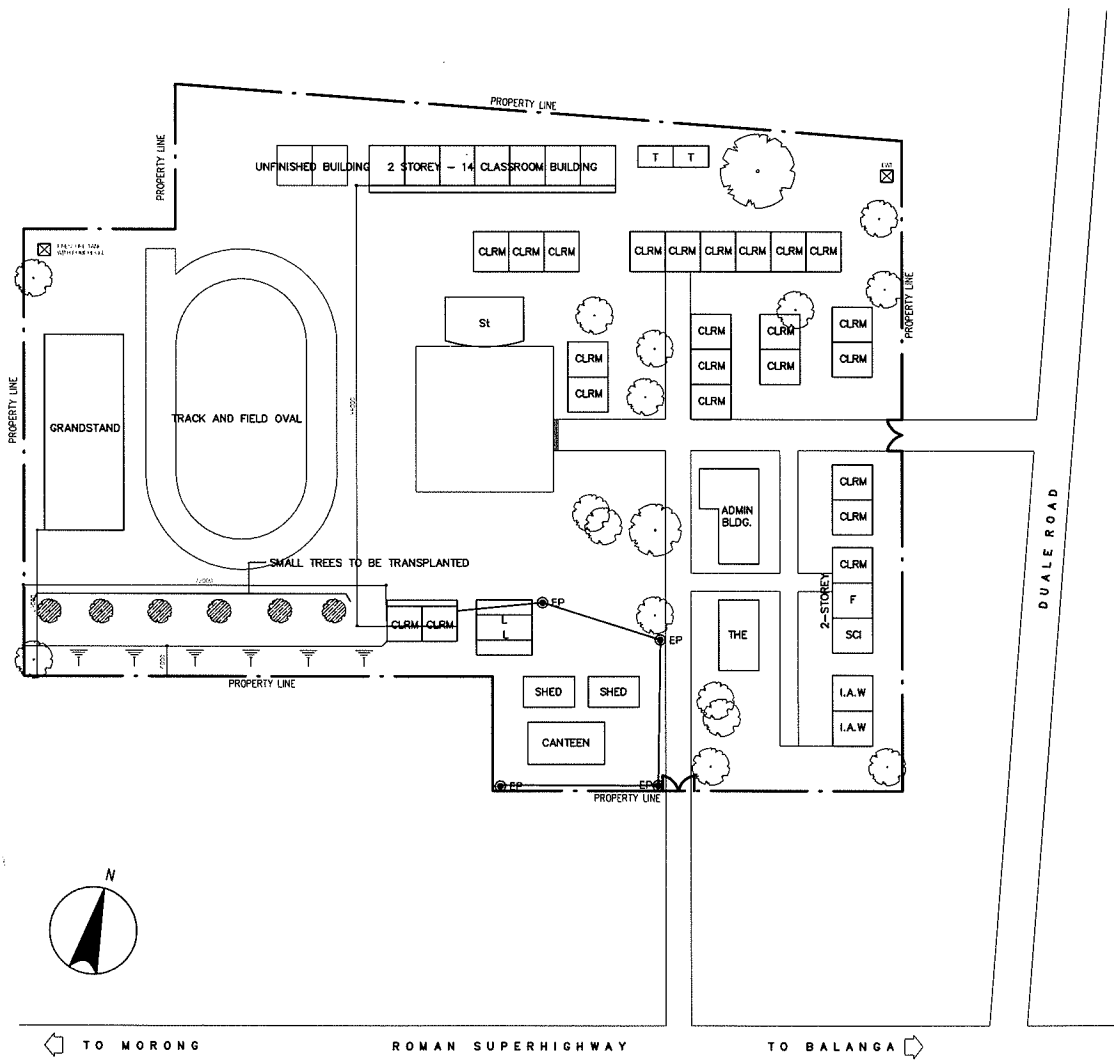

**EXISTING SITE PLAN**  
SCALE 1:1500M

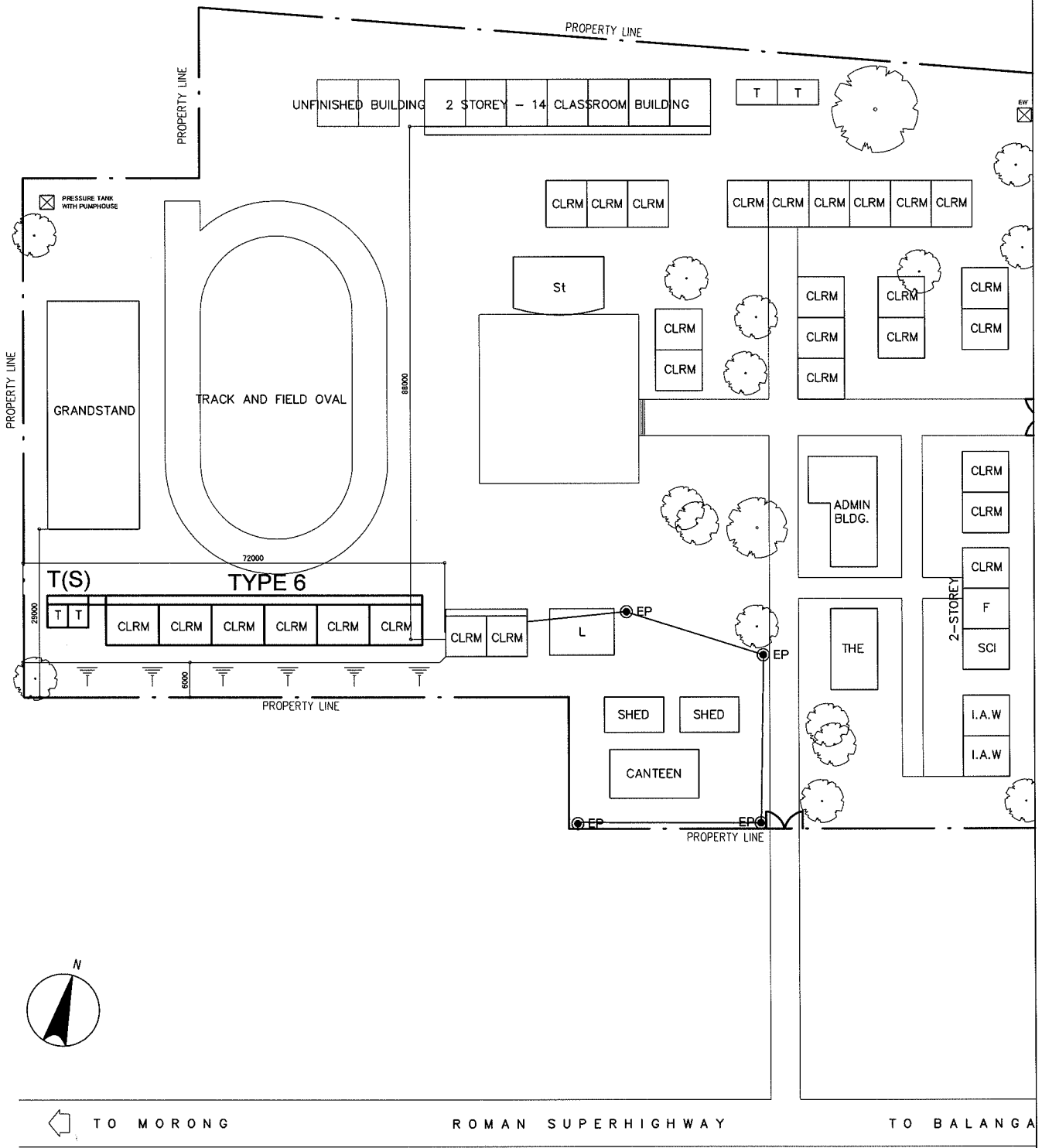

**PROPOSED SITE PLAN**  
SCALE 1:1000M

**LEGEND:**

|      |                    |     |                             |      |                   |  |              |
|------|--------------------|-----|-----------------------------|------|-------------------|--|--------------|
| CLRM | Class Room         | THE | Technology & Home Economics | St   | Stage             |  | Hand Pump    |
| F    | Office             | WT  | Water Tank                  | ST   | Septic Tank       |  | EWT          |
| L    | Library            | AD  | Administration Office       | WLM  | Water Line Marker |  | Entrance     |
| SCI  | Science Laboratory | IAW | Ind.Arts Workshop           | ● EM | Electric Meter    |  | Cutting Area |
| Co   | Computer Room      | T   | Toilet                      | ● EP | Electric Post     |  | Filling Area |
| MP   | Multi Purpose Room | C   | Conference Room             | ○ W  | Well              |  |              |
| P.S  | Pre-School         | P.O | Principal Office            | ○ DW | Deep Well         |  |              |

|                |                            |          |                |             |
|----------------|----------------------------|----------|----------------|-------------|
| NAME OF SCHOOL | ORANI NATIONAL HIGH SCHOOL |          | SCHOOL ID      | S-07 (S-09) |
| DIVISION       | BATAAN                     | DISTRICT | DATE OF SURVEY | 02/26/02    |

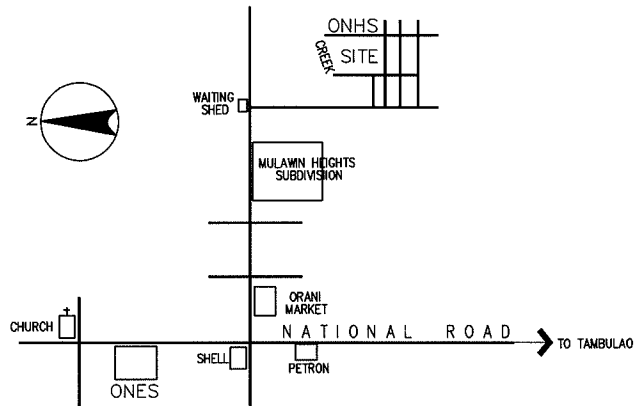

VICINITY MAP  
SCALE NTS

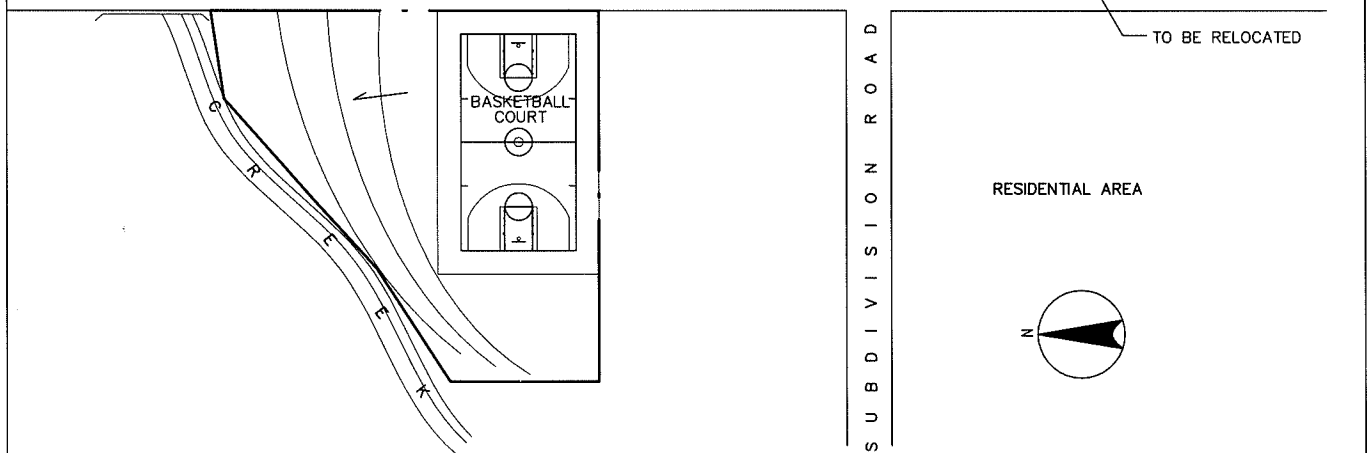
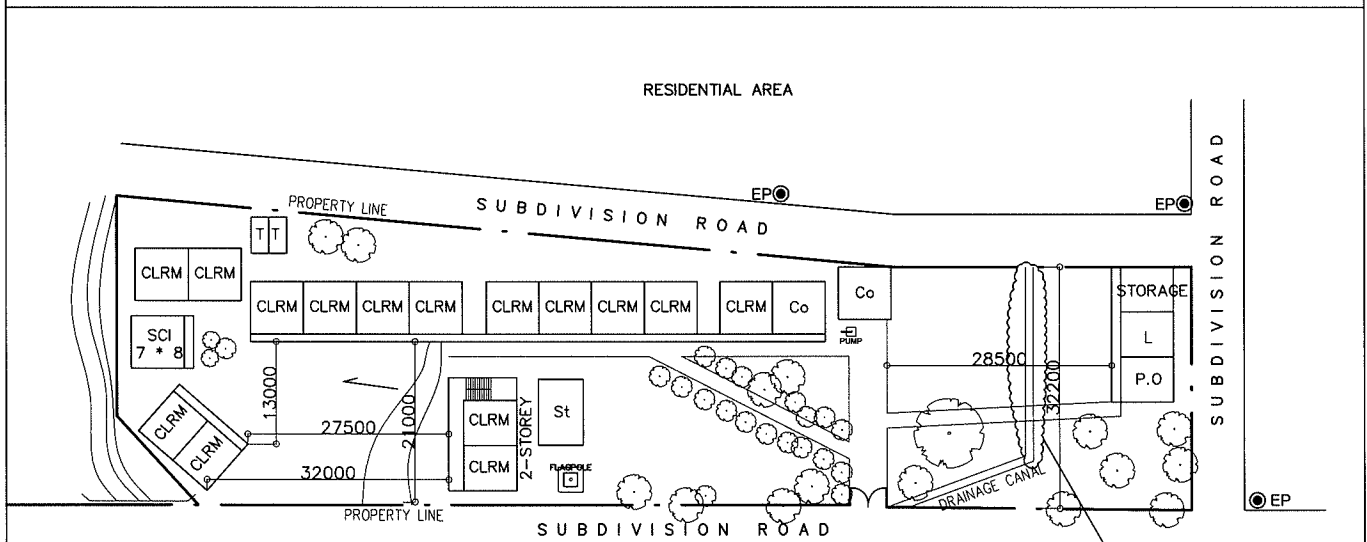

EXISTING SITE PLAN  
SCALE 1:1000M

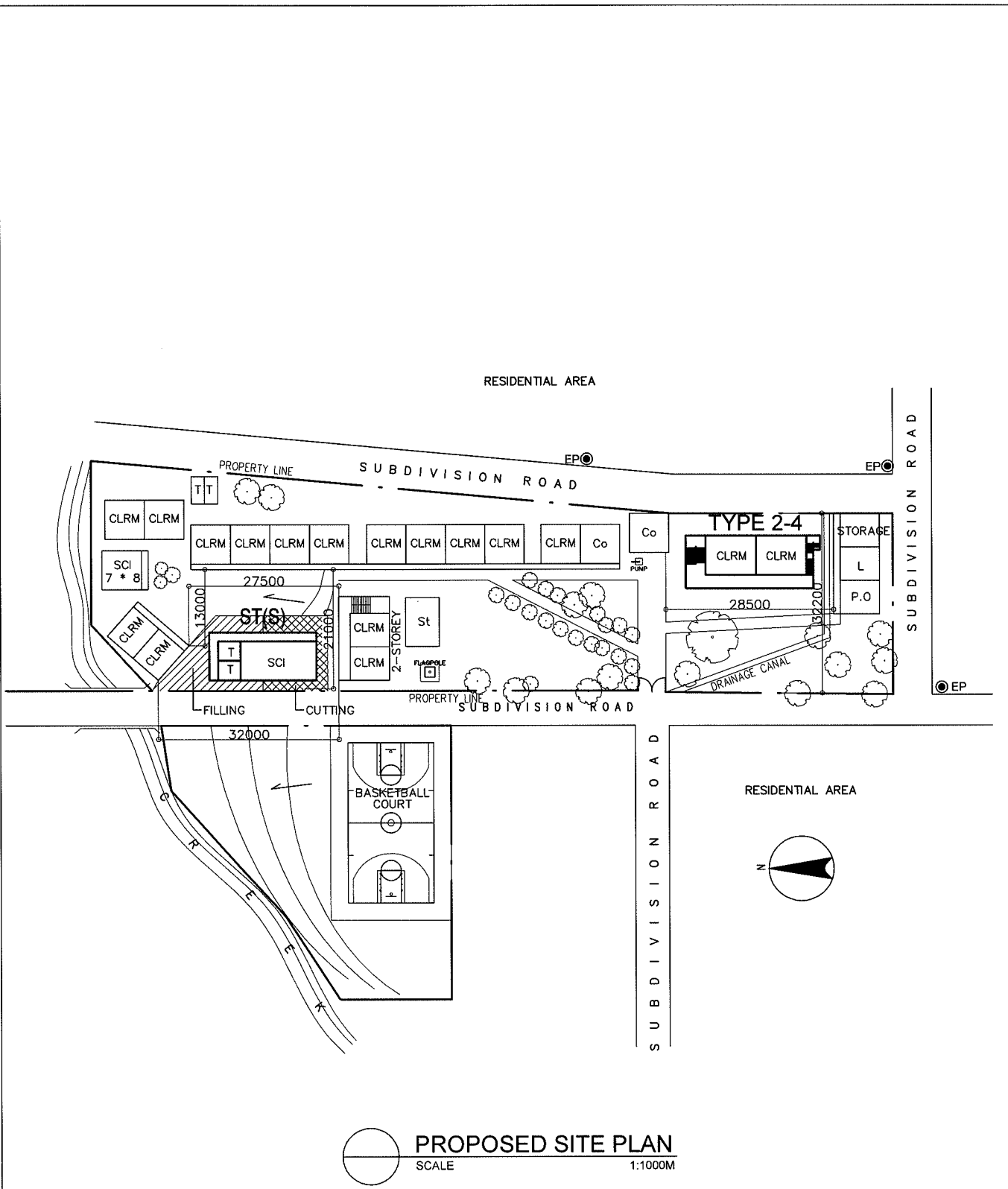

PROPOSED SITE PLAN  
SCALE 1:1000M

LEGEND:

|      |                    |     |                             |     |                   |  |              |
|------|--------------------|-----|-----------------------------|-----|-------------------|--|--------------|
| CLRM | Class Room         | THE | Technology & Home Economics | St  | Stage             |  | Hand Pump    |
| F    | Office             | WT  | Water Tank                  | ST  | Septic Tank       |  | EWT          |
| L    | Library            | AD  | Administration Office       | WLM | Water Line Marker |  | Entrance     |
| SCI  | Science Laboratory | IAW | Ind. Arts Workshop          | ●   | Electric Meter    |  | Cutting Area |
| Co   | Computer Room      | T   | Toilet                      | ⊙   | Electric Post     |  | Filling Area |
| MP   | Multi Purpose Room | C   | Conference Room             | ○   | Well              |  |              |
| P.S  | Pre-School         | P.O | Principal Office            | ○   | Deep Well         |  |              |



|                |                                       |          |                |             |
|----------------|---------------------------------------|----------|----------------|-------------|
| NAME OF SCHOOL | ALEXIS G. SANTOS NATIONAL HIGH SCHOOL |          | SCHOOL ID      | S-08 (S-10) |
| DIVISION       | BULACAN                               | DISTRICT | DATE OF SURVEY | 02/27/02    |

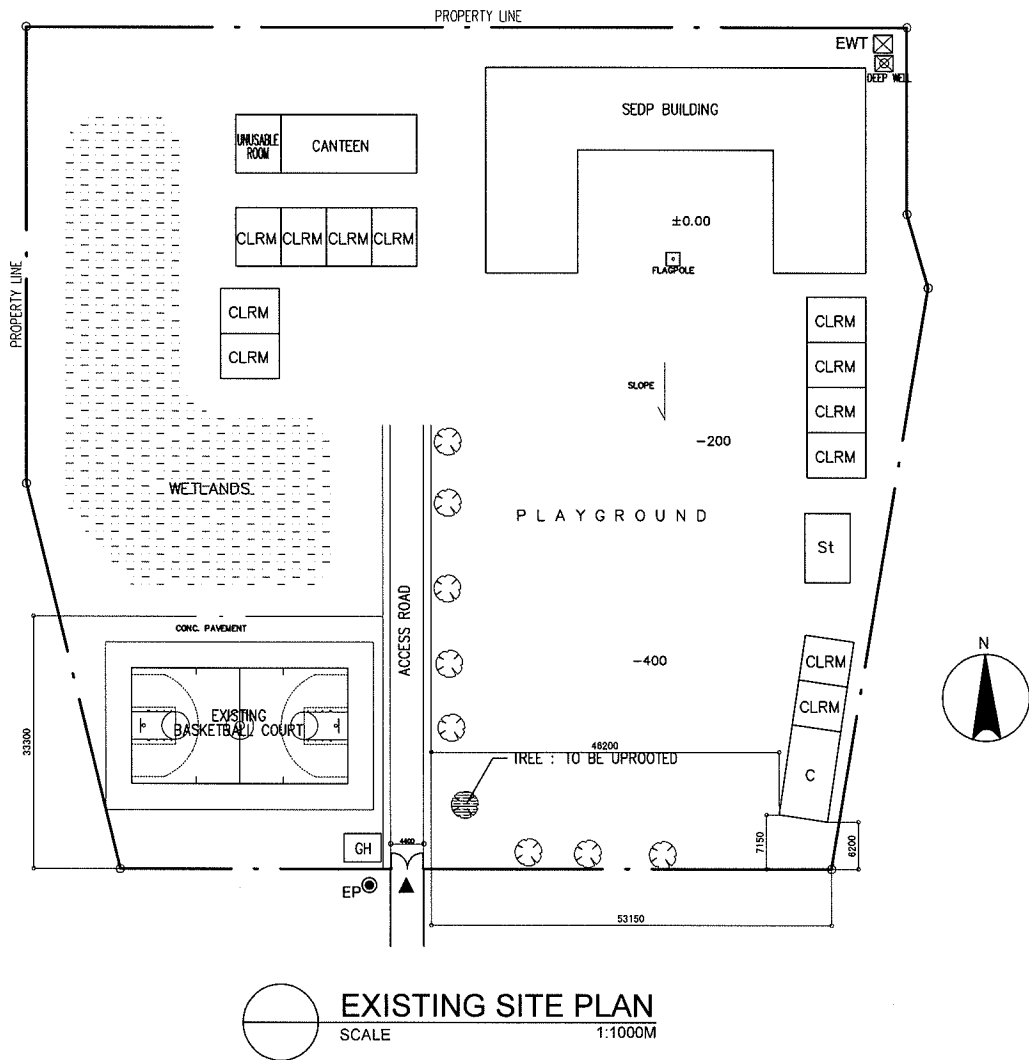
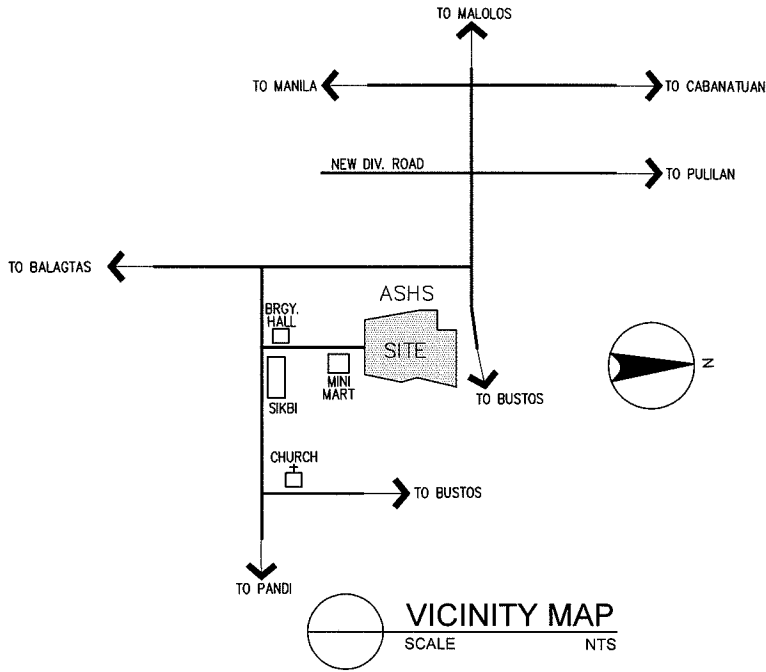

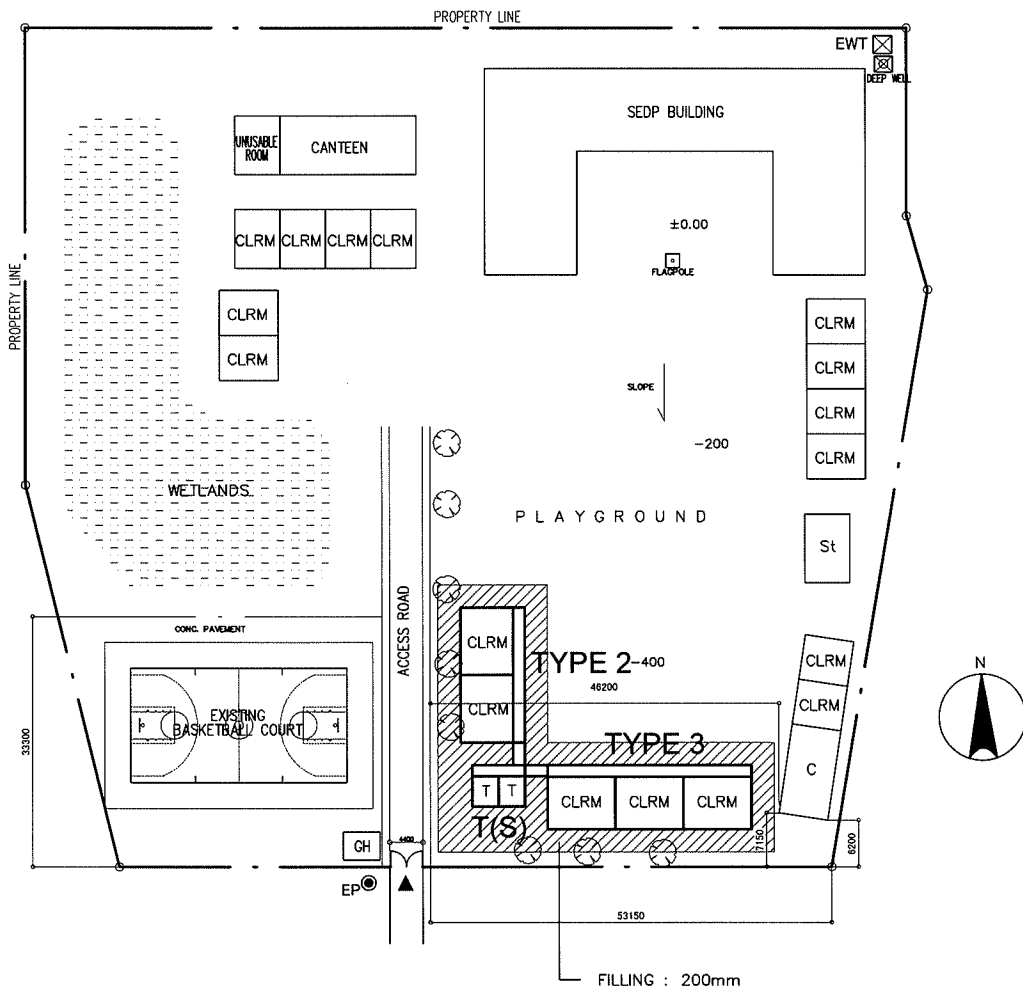

**PROPOSED SITE PLAN**  
SCALE 1:1000M

**LEGEND:**

|      |                    |     |                             |      |                   |  |              |
|------|--------------------|-----|-----------------------------|------|-------------------|--|--------------|
| CLRM | Class Room         | THE | Technology & Home Economics | St   | Stage             |  | Hand Pump    |
| F    | Office             | WT  | Water Tank                  | ST   | Septic Tank       |  | EWT          |
| L    | Library            | AD  | Administration Office       | WLM  | Water Line Marker |  | Entrance     |
| SCI  | Science Laboratory | IAW | Ind.Arts Workshop           | ● EM | Electric Meter    |  | Cutting Area |
| Co   | Computer Room      | T   | Toilet                      | ● EP | Electric Post     |  | Filling Area |
| MP   | Multi Purpose Room | C   | Conference Room             | ○ W  | Well              |  |              |
| P.S  | Pre-School         | P.O | Principal Office            | ○ DW | Deep Well         |  |              |

|                |                      |          |  |                |             |
|----------------|----------------------|----------|--|----------------|-------------|
| NAME OF SCHOOL | BUNSURAN HIGH SCHOOL |          |  | SCHOOL ID      | S-09 (S-11) |
| DIVISION       | BULACAN              | DISTRICT |  | DATE OF SURVEY | 02/27/02    |

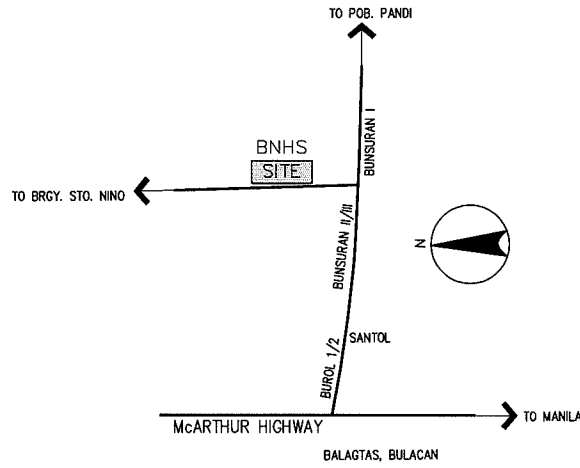

**VICINITY MAP**  
SCALE NTS

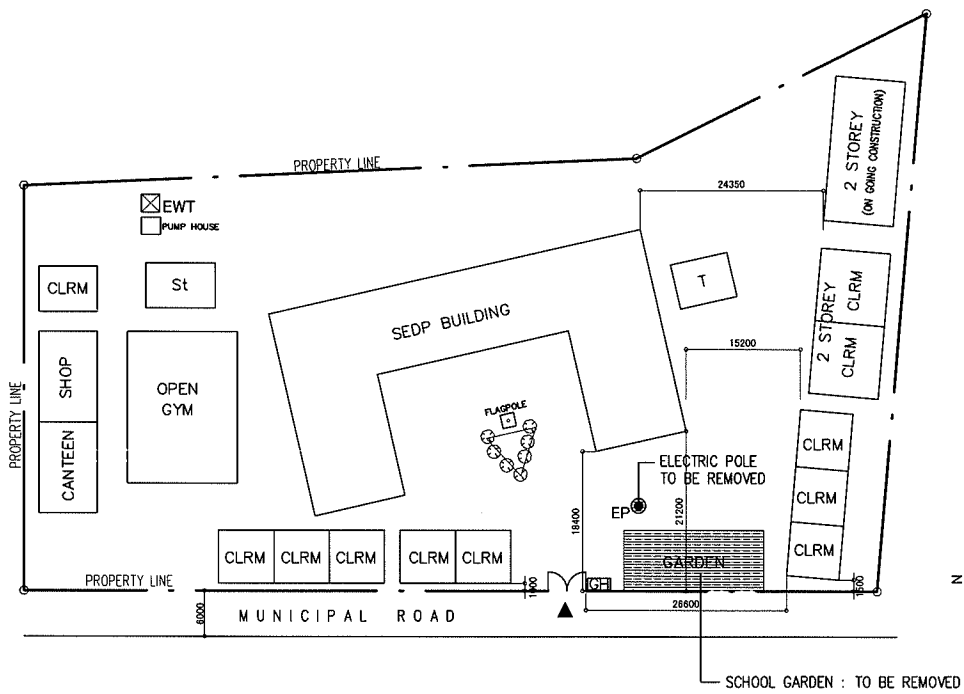

**EXISTING SITE PLAN**  
SCALE 1:1000M

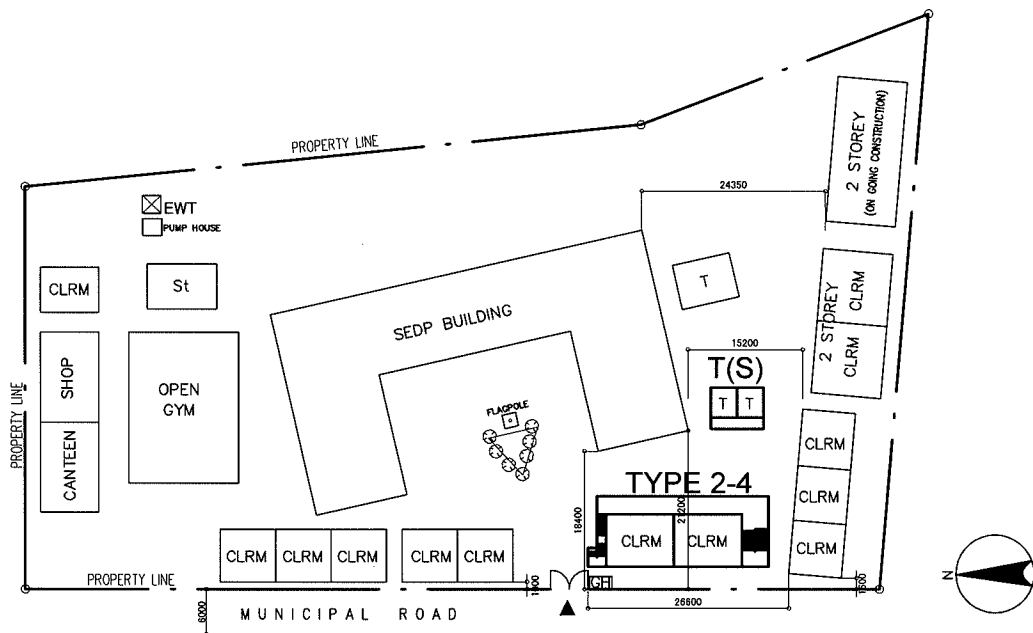

**PROPOSED SITE PLAN**  
 SCALE 1:1000M

**LEGEND:**

|      |                    |     |                             |      |                   |  |              |
|------|--------------------|-----|-----------------------------|------|-------------------|--|--------------|
| CLRM | Class Room         | THE | Technology & Home Economics | St   | Stage             |  | Hand Pump    |
| F    | Office             | WT  | Water Tank                  | ST   | Septic Tank       |  | EWT          |
| L    | Library            | AD  | Administration Office       | WLM  | Water Line Marker |  | Entrance     |
| SCI  | Science Laboratory | IAW | Ind.Arts Workshop           | ● EM | Electric Meter    |  | Cutting Area |
| Co   | Computer Room      | T   | Toilet                      | ⊙ EP | Electric Post     |  | Filling Area |
| MP   | Multi Purpose Room | C   | Conference Room             | ⊙ W  | Well              |  |              |
| P.S  | Pre-School         | P.O | Principal Office            | ○ DW | Deep Well         |  |              |

|                |                      |          |                |             |
|----------------|----------------------|----------|----------------|-------------|
| NAME OF SCHOOL | TALIPTIP HIGH SCHOOL |          | SCHOOL ID      | S-10 (S-13) |
| DIVISION       | BULACAN              | DISTRICT | DATE OF SURVEY | 03/04/02    |

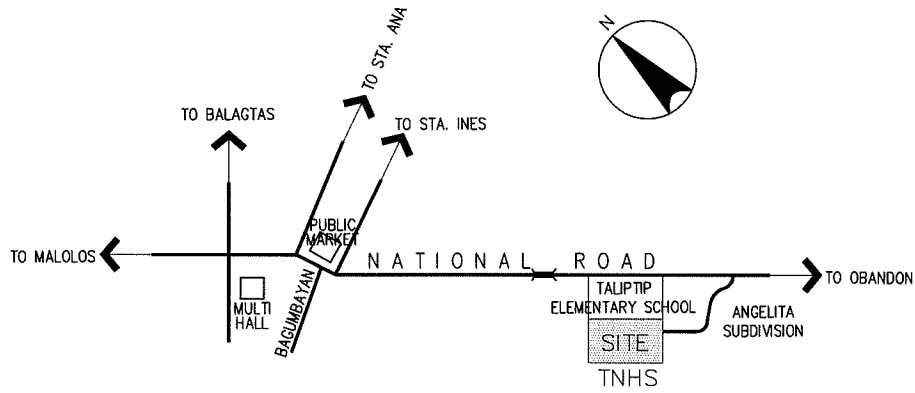

VICINITY MAP  
SCALE NTS

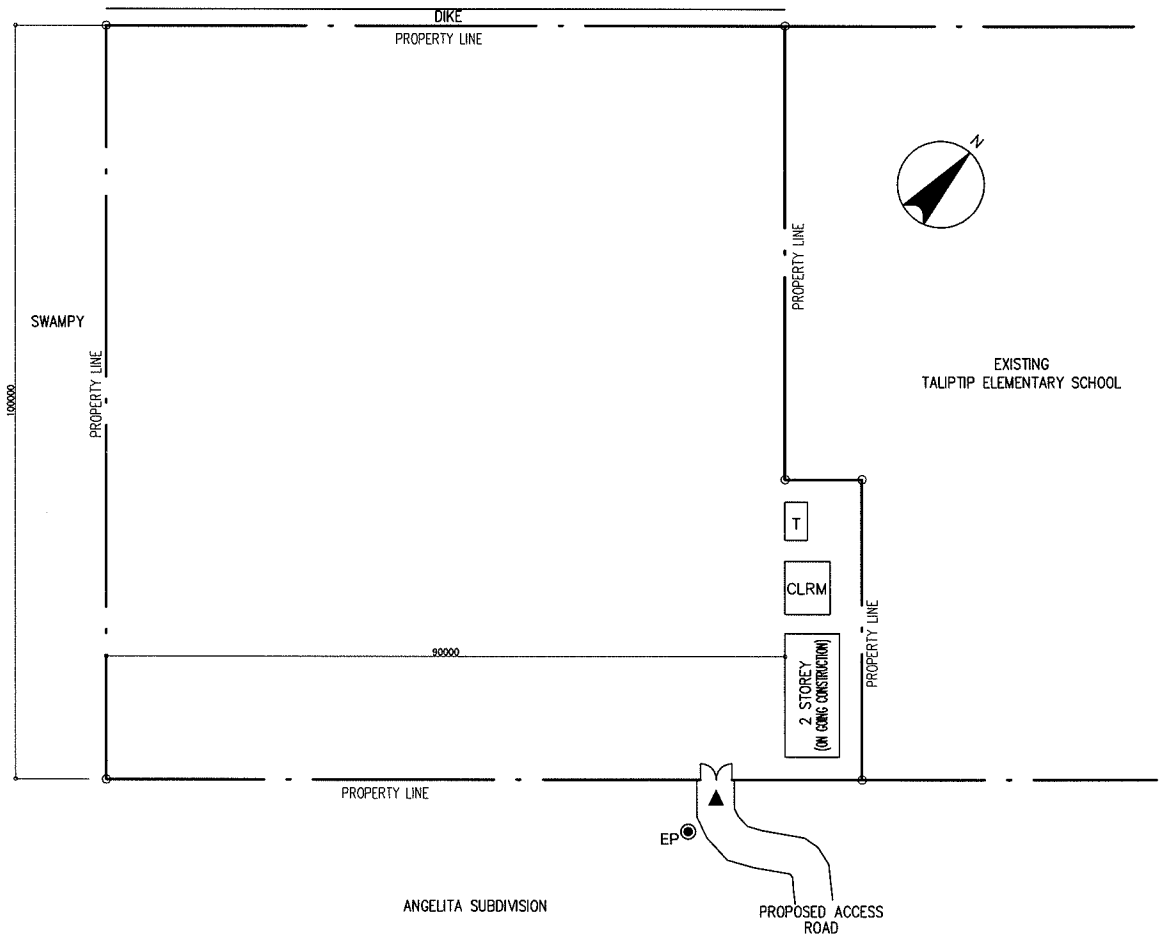

EXISTING SITE PLAN  
SCALE 1:1000M

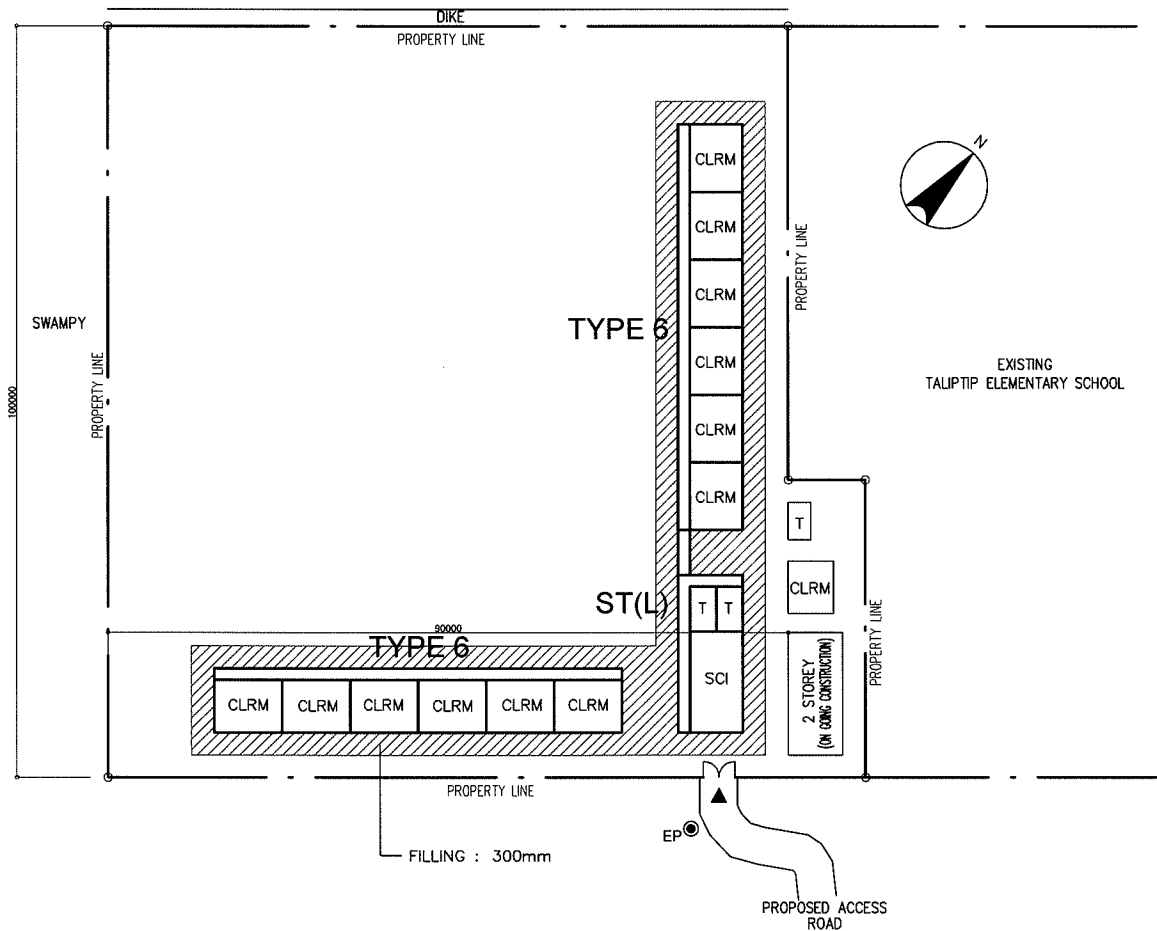

**PROPOSED SITE PLAN**  
 SCALE 1:1000M

**LEGEND:**

|      |                    |     |                             |     |                   |  |              |
|------|--------------------|-----|-----------------------------|-----|-------------------|--|--------------|
| CLRM | Class Room         | THE | Technology & Home Economics | St  | Stage             |  | Hand Pump    |
| F    | Office             | WT  | Water Tank                  | ST  | Septic Tank       |  | EWT          |
| L    | Library            | AD  | Administration Office       | WLM | Water Line Marker |  | Entrance     |
| SCI  | Science Laboratory | IAW | Ind.Arts Workshop           | ●   | EM                |  | Cutting Area |
| Co   | Computer Room      | T   | Toilet                      | ⊙   | EP                |  | Filling Area |
| MP   | Multi Purpose Room | C   | Conference Room             | ⊙   | W                 |  |              |
| P.S  | Pre-School         | P.O | Principal Office            | ○   | DW                |  |              |
|      |                    |     |                             |     |                   |  |              |

|                |  |          |                |             |
|----------------|--|----------|----------------|-------------|
| NAME OF SCHOOL | GUGUINTO NATIONAL VOCATIONAL HIGH SCHOOL |          | SCHOOL ID      | S-11 (S-15) |
| DIVISION       | BULACAN                                  | DISTRICT | DATE OF SURVEY | 02/28/02    |



**VICINITY MAP**  
 SCALE NTS

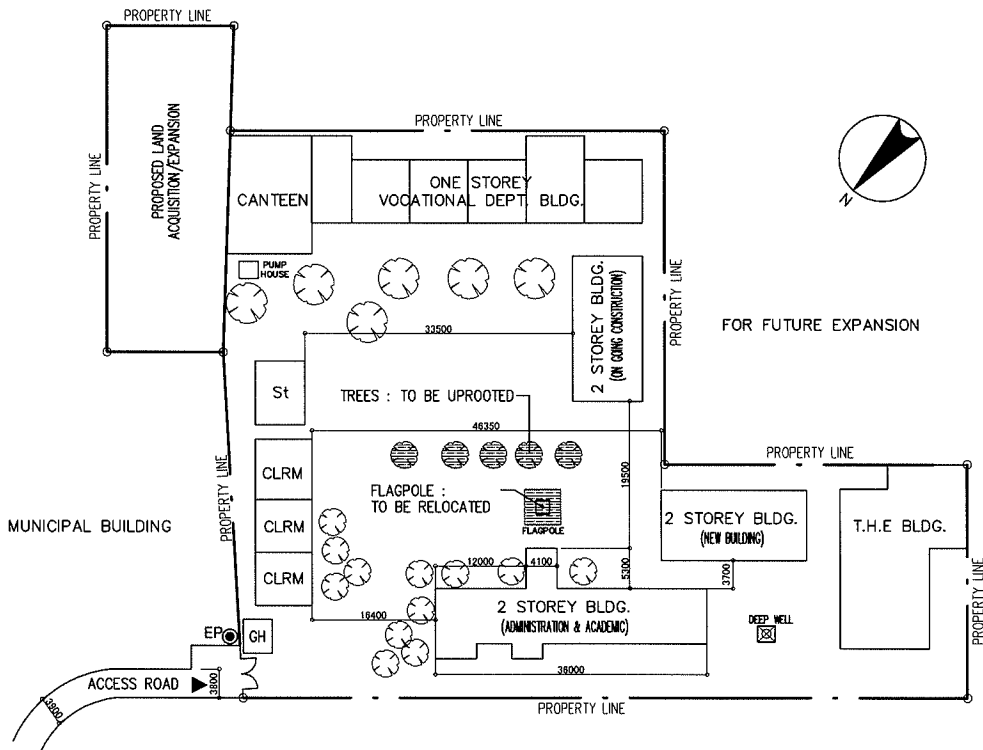

**EXISTING SITE PLAN**  
 SCALE 1:1000M

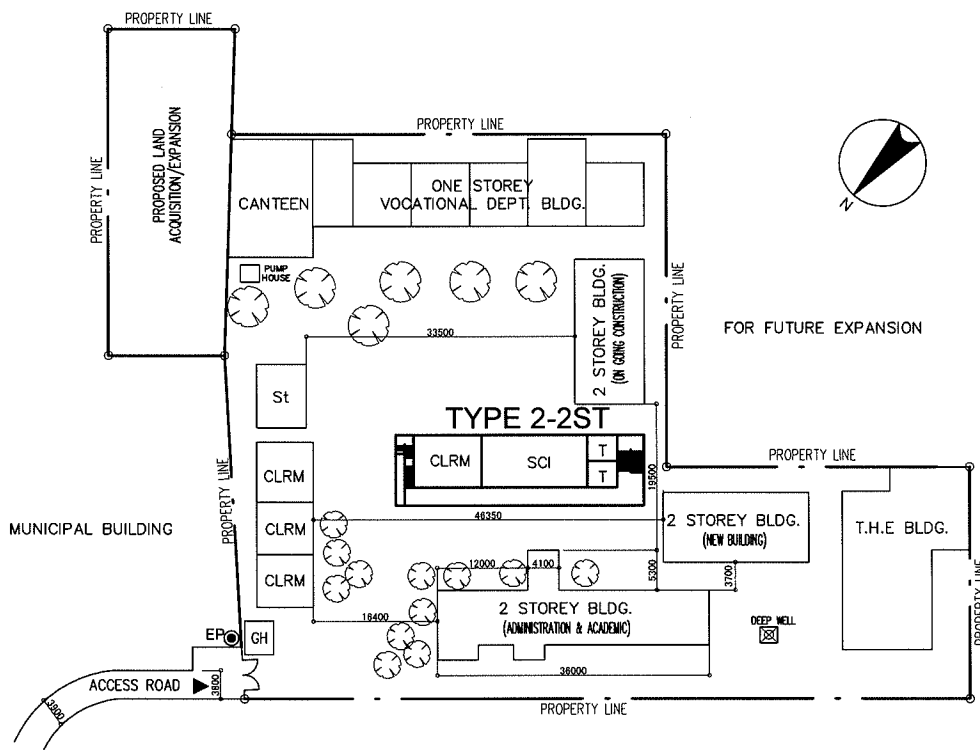

**PROPOSED SITE PLAN**  
 SCALE 1:1000M

**LEGEND:**

|      |                    |     |                             |     |                   |  |              |
|------|--------------------|-----|-----------------------------|-----|-------------------|--|--------------|
| CLRM | Class Room         | THE | Technology & Home Economics | St  | Stage             |  | Hand Pump    |
| F    | Office             | WT  | Water Tank                  | ST  | Septic Tank       |  | EWT          |
| L    | Library            | AD  | Administration Office       | WLM | Water Line Marker |  | Entrance     |
| SCI  | Science Laboratory | IAW | Ind.Arts Workshop           | ●   | Electric Meter    |  | Cutting Area |
| Co   | Computer Room      | T   | Toilet                      | ●   | Electric Post     |  | Filling Area |
| MP   | Multi Purpose Room | C   | Conference Room             | ⊙   | Well              |  |              |
| P.S  | Pre-School         | P.O | Principal Office            | ○   | Deep Well         |  |              |



|                |                                      |          |                |             |
|----------------|--------------------------------------|----------|----------------|-------------|
| NAME OF SCHOOL | FELIZARDO C. LIPANA MEM. HIGH SCHOOL |          | SCHOOL ID      | S-12 (S-16) |
| DIVISION       | BULACAN                              | DISTRICT | DATE OF SURVEY | 02/28/02    |

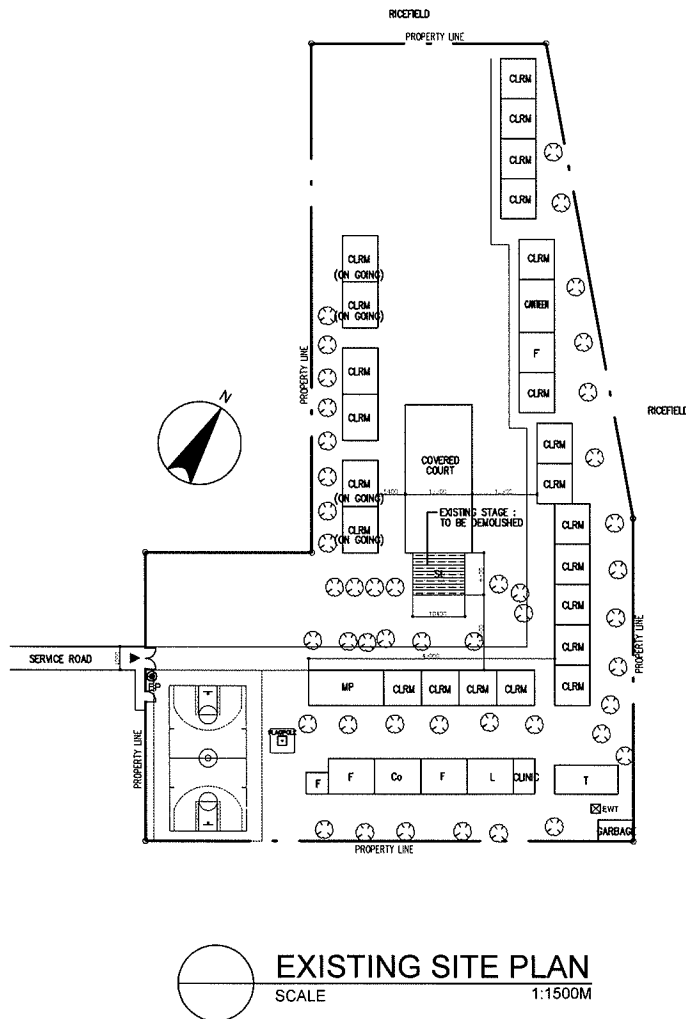
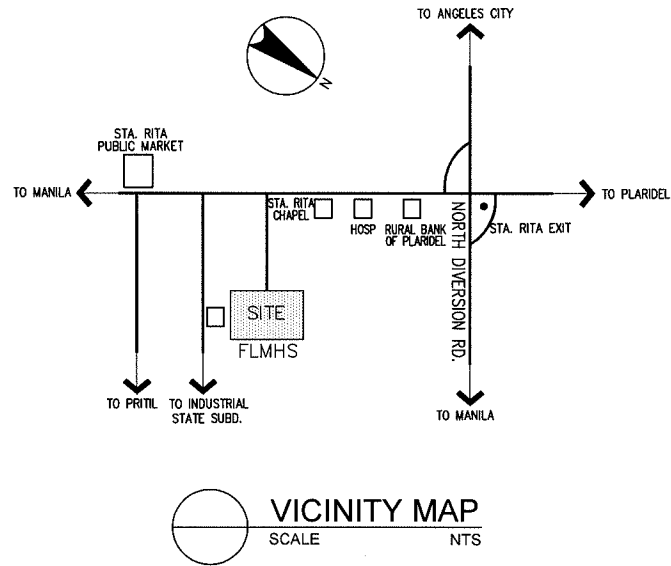

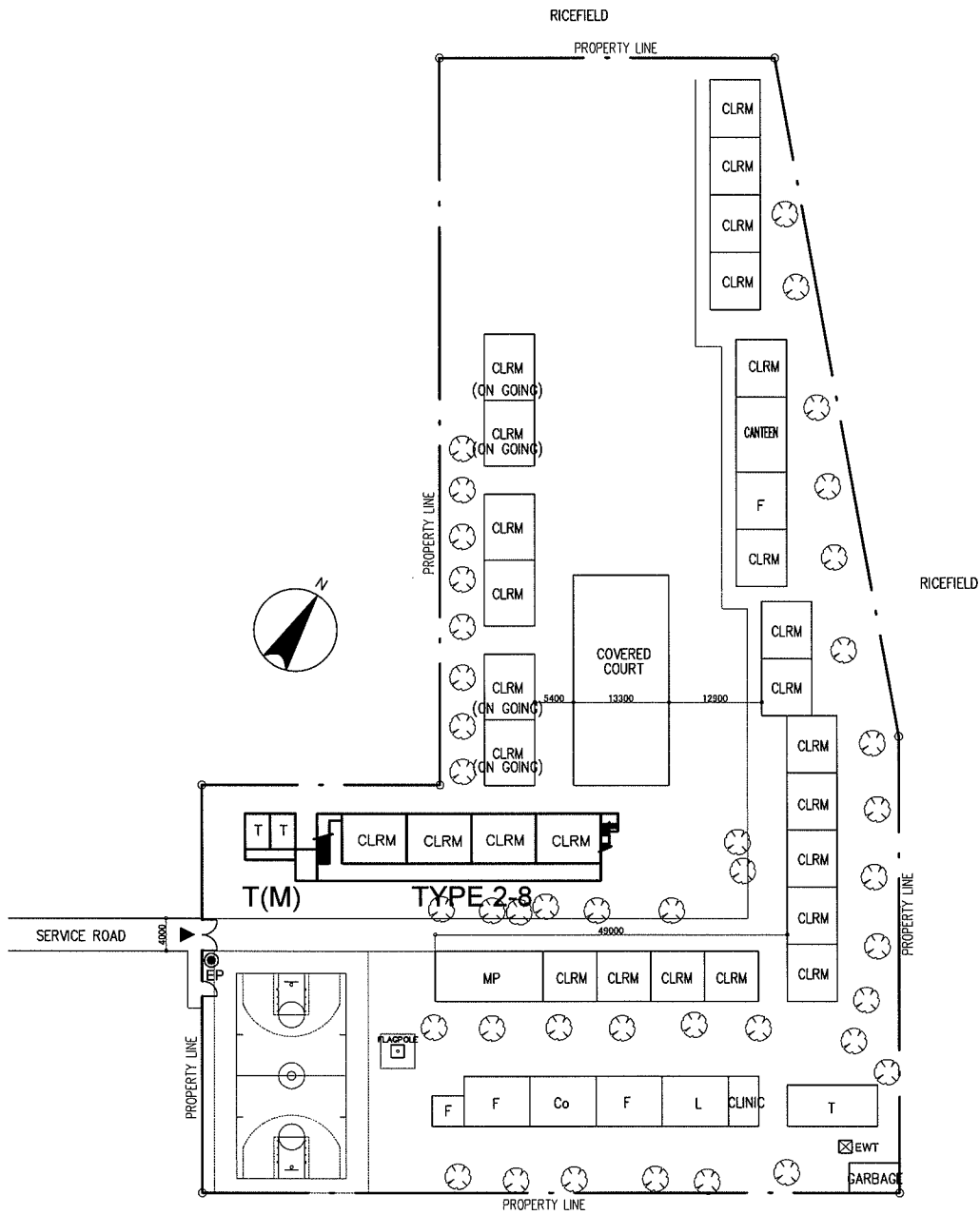

**PROPOSED SITE PLAN**  
 SCALE 1:1000M

**LEGEND:**

|      |                    |     |                             |     |                   |  |              |
|------|--------------------|-----|-----------------------------|-----|-------------------|--|--------------|
| CLRM | Class Room         | THE | Technology & Home Economics | St  | Stage             |  | Hand Pump    |
| F    | Office             | WT  | Water Tank                  | ST  | Septic Tank       |  | EWT          |
| L    | Library            | AD  | Administration Office       | WLM | Water Line Marker |  | Entrance     |
| SCI  | Science Laboratory | IAW | Ind.Arts Workshop           | ●   | EM Electric Meter |  | Cutting Area |
| Co   | Computer Room      | T   | Toilet                      | ⊙   | EP Electric Post  |  | Filling Area |
| MP   | Multi Purpose Room | C   | Conference Room             | ⊖   | W Well            |  |              |
| P.S  | Pre-School         | P.O | Principal Office            | ○   | DW Deep Well      |  |              |

|                |                        |          |                |             |
|----------------|------------------------|----------|----------------|-------------|
| NAME OF SCHOOL | MEYCAUAYAN HIGH SCHOOL |          | SCHOOL ID      | S-13 (S-17) |
| DIVISION       | BULACAN                | DISTRICT | DATE OF SURVEY | 03/04/02    |

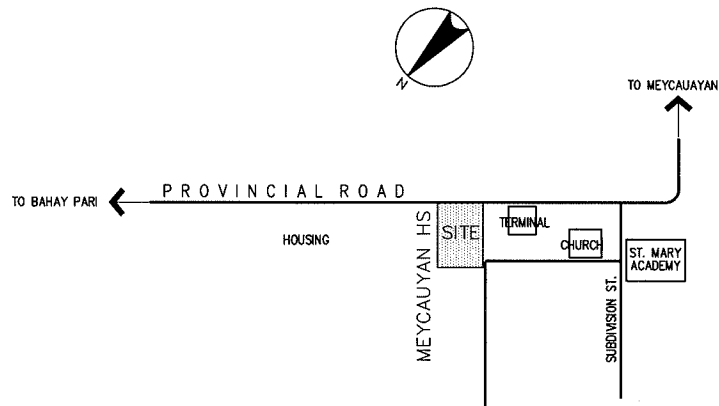

VICINITY MAP  
SCALE NTS

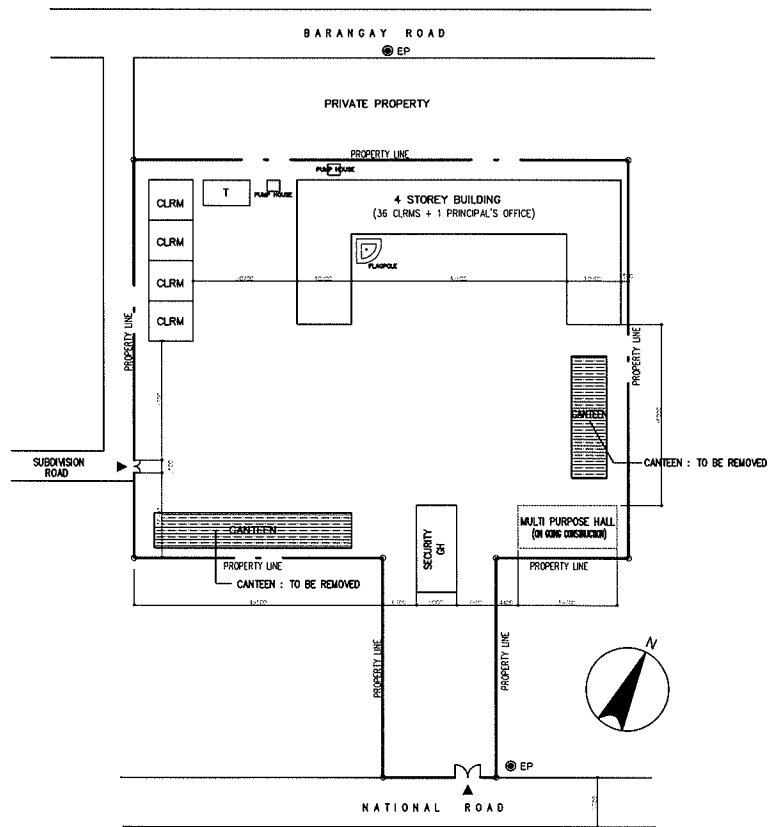

EXISTING SITE PLAN  
SCALE 1:1500M

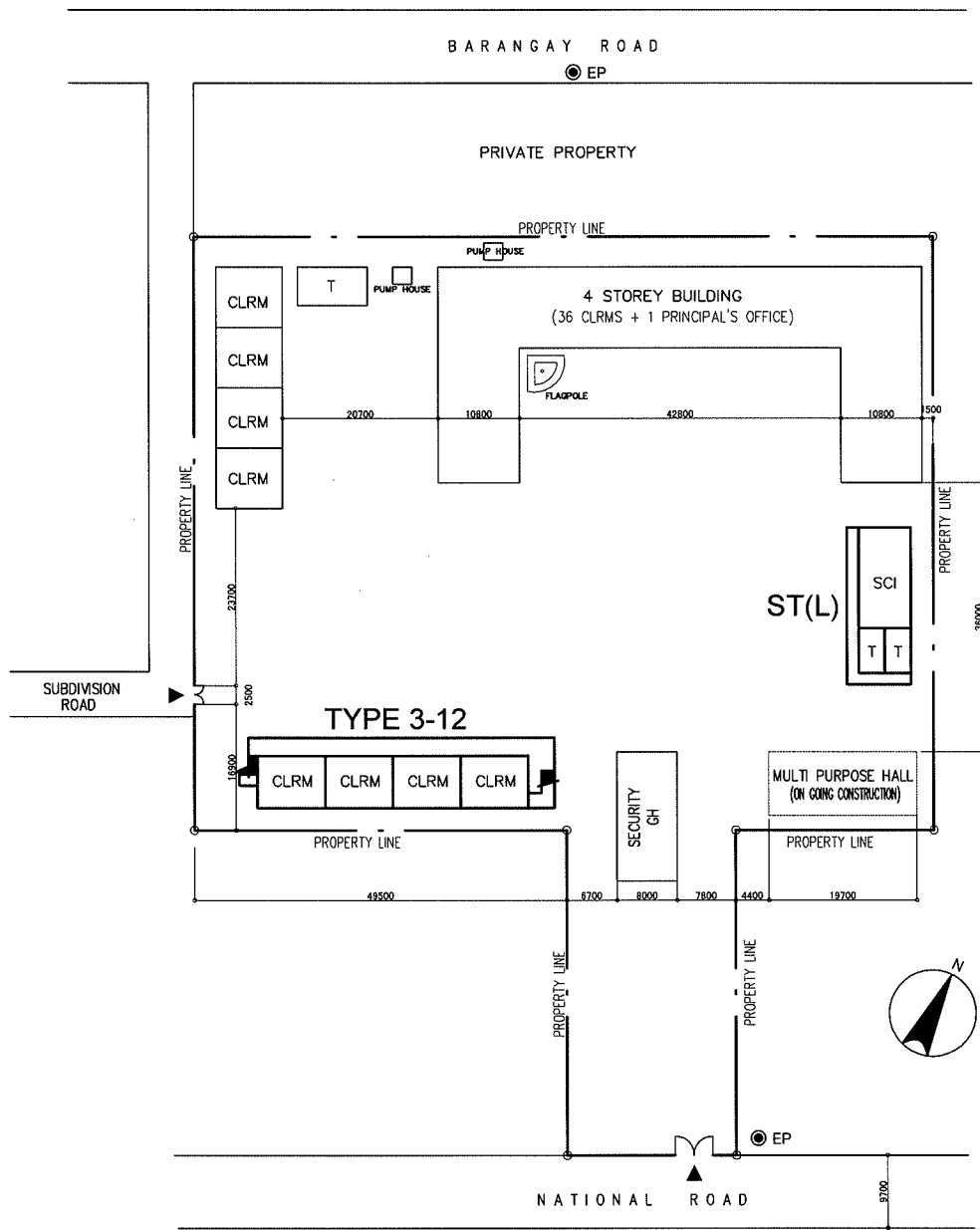

PROPOSED SITE PLAN  
SCALE 1:1000M

LEGEND:

|      |                    |     |                             |      |                   |  |              |
|------|--------------------|-----|-----------------------------|------|-------------------|--|--------------|
| CLRM | Class Room         | THE | Technology & Home Economics | St   | Stage             |  | Hand Pump    |
| F    | Office             | WT  | Water Tank                  | ST   | Septic Tank       |  | EWT          |
| L    | Library            | AD  | Administration Office       | WLM  | Water Line Marker |  | Entrance     |
| SCI  | Science Laboratory | IAW | Ind.Arts Workshop           | ● EM | Electric Meter    |  | Cutting Area |
| Co   | Computer Room      | T   | Toilet                      | ⊙ EP | Electric Post     |  | Filling Area |
| MP   | Multi Purpose Room | C   | Conference Room             | ⊙ W  | Well              |  |              |
| P.S  | Pre-School         | P.O | Principal Office            | ○ DW | Deep Well         |  |              |