

[資料編]

1. 調査団員・氏名
2. 調査行程
3. 関係者(面会者)リスト
4. 当該国の社会経済状況(国別基本情報抜粋)
5. 討議議事録 (M/D)
 - (1) 基本設計調査時
 - (2) 第2次基本設計調査時
 - (3) 概要説明調査時
6. 事業事前調査表
7. 参考資料 / 入手資料リスト
8. ソフト・コンポーネント実施計画工程表
9. 要請機材検討表

1. 調査団員・氏名

(1) 基本設計調査(期間：平成 13 年 9 月 29 日から同年 11 月 5 日まで)

| | | |
|---------------|--------|---|
| 総括 | 平林 国彦 | 厚生労働省 国立国際医療センター 国際医療協力局 派遣協力第 2 課 |
| 計画管理 | 永田 健 | 国際協力事業団 無償資金協力部 業務第 2 課 |
| 業務主任 / 病院建築計画 | 稲留 国彦 | 株式会社山下設計 |
| 建築計画・設計 | 鈴木 修 | 同上 |
| 構造計画・施工計画 | 岡本 隆之祐 | 同上 |
| 設備計画 | 加門 文隆 | 同上 |
| 機材計画 | 小川 貴志 | ピンコー株式会社 |
| 調達計画/積算 | 野口 睦男 | 株式会社山下設計 |

(2) 第 2 次基本設計調査(期間：平成 14 年 1 月 26 日から同年 2 月 9 日まで)

| | | |
|---------------|-------|----------|
| 業務主任 / 病院建築計画 | 稲留 国彦 | 株式会社山下設計 |
| 設備計画 | 加門 文隆 | 同上 |

(3) 概要書説明調査(期間：平成 14 年 4 月 8 日から同年 4 月 27 日まで)

| | | |
|---------------|------|---------------------------------|
| 総括 | 平林国彦 | 厚生労働省 国立国際医療協力局 派遣協力第 2 課 |
| 計画管理 | 永田健 | 国際協力事業団 無償資金協力部 業務第 2 課 |
| 無償資金協力 | 亀田明子 | 外務省経済協力局 無償資金協力課 |
| 業務主任 / 病院建築計画 | 稲留国彦 | 株式会社山下設計 |
| 建築計画・設計 | 鈴木修 | 同上 |
| 機材計画 | 小川貴志 | ピンコー株式会社 |

2. 調査行程

(1)基本設計調査(期間：平成13年9月29日から同年11月5日まで)

| 日順 | 日付 | 調査地 | 官団員 | コンサルタント団員 |
|-----|------------|-------------------|--|--------------------------------|
| 1. | 9月29日 (土) | | | • 成田発 メキシコシティー着 |
| 2. | 9月30日 (日) | | | • メキシコシティー発 カラカス着 |
| 3. | 10月1日 (月) | カラカス | | • 日本国大使館表敬 |
| 4. | 10月2日 (火) | カラカス | | • カラカス発 ジョージタウン着 |
| 5. | 10月3日 (水) | カラカス ジョージタウン | | • 保健省表敬 • 海外貿易国際協力省表敬 |
| 6. | 10月4日 (木) | カラカス ジョージタウン | | • 自然条件調査見積 • 市場調査 |
| 7. | 10月5日 (金) | ジョージタウン | | • ジョージタウン病院見学 |
| 8. | 10月6日 (土) | ジョージタウン | | • ニューアムステルダム移動 |
| 9. | 10月7日 (日) | ニューアムス | | • ニューアムステルダム病院にて合同会議 |
| 10. | 10月8日 (月) | ニューアムス | | • 地質調査 |
| 11. | 10月9日 (火) | ニューアムス | | • 既存病院実測調査 |
| 12. | 10月10日 (水) | ニューアムス | | |
| 13. | 10月11日 (木) | ニューアムス | | • 県庁調査 |
| 14. | 10月12日 (金) | ニューアムス | | • 団内協議、収集資料整理 |
| 15. | 10月13日 (土) | ニューアムス | | • 団内打ち合わせ、収集資料整理 |
| 16. | 10月14日 (日) | ニューアムス | | • 電力会社、電話会社調査 |
| 17. | 10月15日 (月) | ニューアムス | | • スケルドン地区病院、マイビクリ地区病院調査、看護学校調査 |
| 18. | 10月16日 (火) | ニューアムス | | • 「二」病院にて補足調査 |
| 19. | 10月17日 (水) | ニューアムス | | • フォートガンジ精神病院調査 |
| 20. | 10月18日 (木) | ニューアムス | | • 「二」病院にて補足調査 |
| 21. | 10月19日 (金) | ニューアムス | | • 計画予定地調査 |
| 22. | 10月20日 (土) | ニューアムス | | • ジョージタウンへ移動 |
| 23. | 10月21日 (日) | ジョージタウン | • 成田発 • カラカス着 | |
| 24. | 10月22日 (月) | ジョージタウン | • 日本大使館表敬 • ジョージタウン着 | • 保健省中間協議、質疑回答、 |
| 25. | 10月23日 (火) | ジョージタウン ニューアムス | • 保健省表敬 • 海外貿易国際協力省表敬 ジョージタウン公立病院調査 | • ジョージタウンにて調達調査 |
| 26. | 10月24日 (水) | ニューアムス | • ニューアムステルダム副市長表敬 • ニューアムステルダム病院調査 | |
| 27. | 10月25日 (木) | ニューアムス ジョージタウン | • ポートモウラン病院調査 • ウイリアムズバーグ保健センター調査 • ジョージタウンへ移動 | |
| 28. | 10月26日 (金) | ジョージタウン | • 保健省協議、協議議事録内容協議 | |
| 29. | 10月27日 (土) | ジョージタウン | • 協議議事録内容協議 | |
| 30. | 10月28日 (日) | ジョージタウン | • 団内協議 | |
| 31. | 10月29日 (月) | ジョージタウン | • 協議議事録署名 | |
| 32. | 10月30日 (火) | カラカス | • ジョージタウン発 カラカス着 | |
| 33. | 10月31日 (水) | カラカス | • 日本大使館報告 | • カラカス調達調査 |
| 34. | 11月1日 (木) | カラカス | • カラカス発、メキシコシティー着 | |
| 35. | 11月2日 (金) | | • メキシコシティー発 | |
| 36. | 11月3日 (土) | | • 成田着 | • カラカス発、メキシコシティー着 |
| 37. | 11月4日 (日) | | | • メキシコシティー発 |
| 38. | 11月5日 (月) | | | • 成田着 |

(2)第2次基本設計調査(期間：平成14年1月26日から同年2月9日まで)

| 日 順 | 日付 | 調査地 | コンサルタント団員 |
|--------|-----------|------------|--|
| 1 | 1月26日 (土) | | •成田発 ニューヨーク着 |
| 2 | 1月27日 (日) | | •ニューヨーク発 ジョージタウン着 |
| 3 | 1月28日 (月) | ジョージタウン | •保健省表敬 •ジョージタウン発 ニューアムステルダム着 |
| 4 | 1月29日 (火) | ニューアムステルダム | •県保健局打ち合わせ •敷地確認、周辺調査 |
| 5 | 1月30日 (水) | ニューアムステルダム | •ボーリング、測量現場説明 •県測量技師打ち合わせ (公図の確認等) •電力公社調査 •現場電力調査状況確認 |
| 6 | 1月31日 (木) | ニューアムステルダム | •敷地地下水水位調査 •ガイアナ電話電報公社 •現場電話調査状況確認 |
| 7 | 2月1日 (金) | ニューアムステルダム | •ニューアムステルダム病院にて補足調査 •住宅水道省ガイアナ水道局 •現場給水状況確認 |
| 8 | 2月2日 (土) | ニューアムステルダム | •浸水の影響等調査 •敷地排水調査 |
| 9 | 2月3日 (日) | ニューアムステルダム | •ニューアムステルダム発 ジョージタウン着 |
| 10 | 2月4日 (月) | ジョージタウン | •保健省打ち合わせ |
| 11 | 2月5日 (火) | ジョージタウン | •敷地の法的所有権等確認等調査 •敷地に対する法規制等調査 |
| 12 | 2月6日 (水) | カラカス | •ジョージタウン発 カラカス着 •日本大使館報告 |
| 13 | 2月7日 (木) | カラカス | •カラカス発 ニューヨーク着 |
| 14 | 2月8日 (金) | | •ニューヨーク発 |
| 15 | 2月9日 (土) | | •成田着 |

(3) 概要書説明 (期間：平成 14 年 4 月 8 日から同年 4 月 27 日まで)

| 日 順 | 日付 | 調査地 | 官団員 | コンサルタント団員 |
|--------|-----------|------------|---|--|
| 1 | 4月8日 (月) | | | •成田発 ニューヨーク着 |
| 2 | 4月9日 (火) | | | •ニューヨーク発 ジョージタウン着 |
| 3 | 4月10日 (水) | ジョージタウン | | •保健省表敬(概要書提出) •海外貿易国際協力省表敬 •ジョージタウン病院調査(廃棄物処理) |
| 4 | 4月11日 (木) | ニューアムステルダム | | •私立病院調査(廃棄物処理) •保健省にて概要書説明 |
| 5 | 4月12日 (金) | ニューアムステルダム | | •建設事情調査(単価再調査) |
| 6 | 4月13日 (土) | ニューアムステルダム | | •建設事情調査(単価再調査) |
| 7 | 4月14日 (日) | ニューアムステルダム | | •ジョージタウン発 ニューアムステルダム着 |
| 8 | 4月15日 (月) | ニューアムステルダム | | •「二」病院、市役所、隣接小学校表敬 |
| 9 | 4月16日 (火) | ニューアムステルダム | | •県知事表敬 |
| 10 | 4月17日 (水) | ジョージタウン | •成田発 ニューヨーク着 | •県庁にて概要書説明 |
| 11 | 4月18日 (木) | ジョージタウン | •ニューヨーク発 ジョージタウン着 | •ニューアムステルダム発 ジョージタウン着 |
| 12 | 4月19日 (金) | | •保健省表敬 •海外貿易国際協力省表敬 •ジョージタウン発 ニューアムステルダム着 | |
| 13 | 4月20日 (土) | | •県庁表敬、協議 •計画予定地調査、隣接小学校表敬 | |
| 14 | 4月21日 (日) | ジョージタウン | •ニューアムステルダム発 ジョージタウン着 | |
| 15 | 4月22日 (月) | ジョージタウン | •保健省協議 •日本国名誉総領事表敬 | |
| 16 | 4月23日 (火) | ジョージタウン | •協議議事録調印 | |
| 17 | 4月24日 (水) | カラカス | •ジョージタウン発 カラカス着 •日本大使館報告 | |
| 18 | 4月25日 (木) | カラカス | •カラカス発 ニューヨーク着 | |
| 19 | 4月26日 (金) | | •ニューヨーク発 | |
| 20 | 4月27日 (土) | | •成田着 | |

3. 関係者(面会者)リスト

海外貿易国際協力省

| | |
|--------------------|--|
| Clement J. Rohee | Minister |
| John Isaacs | Permanent Secretary |
| Donald Abrams | Director, Dept of International Cooperation |
| Choo AN-YIN(周 雅 欣) | Foreign service officer II, Dept of International Cooperation |

保健省

| | |
|-----------------------------|--|
| Leslie Ramsammy | Minister of Health |
| Doorga Persaud | Permanent Secretary |
| Rudorph Cummings | Chief Medical Officer |
| Dr Khemdat Umadat | Director Regional Health Service |
| Dennison Davis | Director Standards and Technical Service |
| Aubrey Williams | Director Planning |
| Frank C.S. ANTHONY, MD. MPH | Project Co-coordinator |

住宅・水供給省

| | |
|------------------------------|-------------------------------|
| Hon. Shaik K. Z. Baksh, M.P. | Minister of Housing and Water |
|------------------------------|-------------------------------|

財務省

| | |
|---------------|---------------------------|
| Neermal Rekha | Secretary to the Treasury |
|---------------|---------------------------|

環境保護局

| | |
|--------------------|-----------------------|
| Khalid Alladin | Environmental Officer |
| Alexander Ramessar | Environmental Officer |

ショージタウン上下水道委員会

| | |
|-------------|-------------------|
| G. Fausett | General Manager |
| David Dewar | Operation Manager |

第6県庁

| | |
|----------------------|-----------------------------------|
| Rohit Persaud | Chairman |
| Khadim Bacchus | Vice Chairman |
| Azad Ally | Regional Executive Officer |
| Dayaljee Persaud | Regional Executive Officer |
| Naz Rahjohn | Deputy Regional Executive Officer |
| Charles Baker | Regional Engineer |
| Joseph Khalikaprasad | Regional Health Officer |
| R.T. John | SLAD Lands & Survey Commission |
| Samuel Persaud | D&I Engineer |
| M.C. Khemraj | D&I Inspector of Works |

ニューアムステルダム市

| | |
|--------------------|--------------------|
| Neville R. Johnson | Mayor |
| Claude D. Henry | Deputy Mayor |
| Laurel S.P. Alfred | Town Clerk |
| Joycelyn Frank | Building Inspector |
| Steve Chichester | Health Officer |

ニューアムステルダム病院

| | |
|---------------|------------------------|
| John Austin | Medical Superintendent |
| Audrey Field | Hospital Administrator |
| Cicely Tinnie | Matron |

ジョージタウン病院

| | |
|--------------|----------------------------|
| Talimm Latif | Government Medical Officer |
| Ueejai Sawa | Government Medical Officer |

| | |
|--------------------------|--|
| Parmanand Samaroo | Director Facilities Management |
| Noshella Lalekecharan | Theatre Supervisor |
| Pooran Singh | Junior Dept. Supervisor |
| Coletta Benn Alfonso | Occupational Safety and Health Officer |
| Ruth Hammond | Radiographer |
| スケルドン地区病院 | |
| G. Krishendat Raghunauth | Medical Practitioner |
| J. Raghunauth | Medical Practitioner |
| R. Rahim | Staff-Nurse, Midwife |
| マイビクリ地区病院 | |
| Dr.Ganesh Shiv Kumar | Medical Officer |
| Altheha Paddy | Clerk-in-charge |
| Beverly A Watoson | Sister (a.g.) |
| ポートモウラン地区病院 | |
| Bibi S. Nabi | Clerk-In-Charge |
| Premnauth Mathoor | Medex |
| ニューアムステルダム母子保健センター | |
| Sandra Duff | Health Visitor |
| ウィリアムズパーク保健センター | |
| Elma Bristol | Midwife |
| ニューアムステルダム看護学校 | |
| Javitri Eugene | Senior Nursing Tutor |
| Peark Munroe | Senior Tutor (a.g.) |
| Valerie Sandy | Tutor |
| Brahaspati Khan | Staff Nurse |
| Denise Dover McCammon | Staff Nurse |
| Wendy Vyphuis | Staff Nurse |
| ガイアナ大学 | |
| William A. Willson | Head, Department of Civil engineering |
| Bernan Burgner | Professor, Faculty of Health Science |
| セント・アロイシアス小学校 | |
| Bacchus Nashmoon | Head Mistress |
| パーピス商工開発会議所 | |
| Ramesh Maraj | President |
| G. Mang | Junior Vice President |
| 人民国家会議(PNC) | |
| Barbara Pilgrim | Regional Supervisor |
| Steve Beeton | Member |
| ガイアナ国名誉日本総領事館 | |
| Hans W. Barrow M.T. | Honorary Consul General of Japan |
| ヴェネズエラ大使館 | |
| 伊藤 昌輝 | 特命全権大使 |
| 安居 徹 | 一等書記官 |
| 菱山 聡 | 一等書記官 |
| 国際協力事業団 | |
| 石井 暢夫 | 個別専門家(CARICOM 事務局派遣) |
| 青木 滋磨 | 個別専門家(CARICOM 事務局派遣) |

(敬称略)

4. 当該国の社会経済状況（国別基本情報抜粋）

| |
|---------------------------------|
| ガイアナ協同共和国 |
| Co-operative Republic of Guyana |

| 一般指標 | | | | | |
|----------|---------------------------------|------|----------|--------------------------|-----|
| 政体 | 共和制 | *1 | 首都 | ジョージタウン (Georgetown) | *2 |
| 元首 | 大統領/バラット・ジャグデオ (Bharrat Jagdeo) | *1,3 | 主要都市名 | | *3 |
| 独立年月日 | 1966年5月26日 | *3,4 | 労働力総計 | 千人 (年) | *6 |
| 主要民族/部族名 | インド系51%、7711系黒人43%、他6% | *1,3 | 義務教育年数 | 8年間 (年) | *13 |
| 主要言語 | 英語、ヒンディー語、ウルドゥー語 | *1,3 | 初等教育就学率 | % (年) | *6 |
| 宗教 | キリスト教、ヒンドゥー教、イスラム教 | *1,3 | 中等教育就学率 | % (年) | *6 |
| 国連加盟年 | 1966年9月20日 | *12 | 成人非識字率 | 1.5% (2000年) | *13 |
| 世銀加盟年 | 1966年9月26日 | *7 | 人口密度 | 人/km ² (年) | *6 |
| IMF加盟年 | 1966年9月26日 | *7 | 人口増加率 | % (年) | *6 |
| 国土面積 | 215.00 千km ² | *1,6 | 平均寿命 | 平均 63.30 男 59.30 女 67.50 | *10 |
| 総人口 | 856 千人 (1999年) | *6 | 5歳児未満死亡率 | (年) | *6 |
| | | | カロリー供給量 | 2,530.0 cal/日/人 (1997年) | *10 |

| 経済指標 | | | | | |
|------------|----------------------------|-----|--------------|----------------------------------|-----|
| 通貨単位 | ガイアナ・ドル (Dollar) | *3 | 貿易量 | (年) | |
| 為替レート | 1 US \$ = 179.60 (2002年3月) | *8 | 商品輸出 | 百万ドル | *15 |
| 会計年度 | | *6 | 商品輸入 | 百万ドル | *15 |
| 国家予算 | (年) | | 輸入カバー率 | (月) (1999年) | *14 |
| 歳入総額 | | *9 | 主要輸出品目 | 砂糖、ボーキサイト、金、米 | *1 |
| 歳出総額 | | *9 | 主要輸入品目 | 資本財、中間財、消費財 | *1 |
| 総合収支 | 百万ドル (年) | *15 | 日本への輸出 | 5百万ドル (2000年) | *16 |
| ODA受取額 | 26.6 百万ドル (1999年) | *18 | 日本からの輸入 | 12百万ドル (2000年) | *16 |
| 国内総生産(GDP) | 百万ドル (年) | *6 | | | |
| 一人当たりのGNI | 760.0 ドル (1999年) | *6 | 総国際準備 | 百万ドル (年) | *6 |
| 分野別GDP | 農業 35.1% (1999年) | *6 | 対外債務残高 | 1,526.6 百万ドル (1999年) | *6 |
| | 鉱工業 % (年) | *6 | 対外債務返済率(DSR) | % (1999年) | *6 |
| | サービス業 % (年) | *6 | インフレ率 | % (年) | *6 |
| 産業別雇用 | 農業 男 % 女 % (年) | *6 | (消費者価格物価上昇率) | (年) | |
| | 鉱工業 % (年) | *6 | | | |
| | サービス業 % (年) | *6 | 国家開発計画 | 拡大構造調整ファシリティー (ESAF) : 1998-2001 | *11 |
| 実質GDP成長率 | % (年) | *6 | | | |

| 気象 (1967年～1990年平均) 観測地：ジョージタウン (北緯6度48分、西経58度09分、標高2m) | | | | | | | | | | | | | | *4.5 |
|--|-------|-------|-------|-------|-------|-------|-------|-------|-------|-------|-------|-------|-----------|------|
| 月 | 1 | 2 | 3 | 4 | 5 | 6 | 7 | 8 | 9 | 10 | 11 | 12 | 平均/計 | |
| 降水量 | 243.4 | 143.6 | 109.9 | 170.9 | 287.1 | 336.4 | 271.9 | 206.2 | 108.5 | 136.6 | 233.6 | 240.7 | 2488.8 mm | |
| 平均気温 | 26.1 | 26.2 | 26.8 | 26.9 | 26.8 | 26.7 | 26.5 | 27.0 | 27.5 | 27.5 | 27.0 | 26.4 | 26.8 ℃ | |

- *1 各国概況 (外務省)
- *2 世界の国々一覧表 (外務省)
- *3 世界年鑑2000 (共同通信社)
- *4 最新世界各国要覧10訂版 (東京書籍)
- *5 理科年表2000 (国立天文台編)
- *6 World Development Indicators2001(WB)
- *7 BRD Membership List(WB)
- IMF Members' Financial Data by Country(IMF)
- *8 Universal Currency Converter

- *9 Government Finance Statistics Yearbook 2000 (IMF)
 - *10 Human Development Report2000,2001(UNDP)
 - *11 Country Profile(EIU),外務省資料等
 - *12 United Nations Member States
 - *13 Statistical Yearbook 1999(UNESCO)
 - *14 Global Development Finance2001(WB)
 - *15 International Financial Statistics Yearbook 2001(IMF)
 - *16 世界各国経済情報ファイル2001(世界経済情報サービス)
- 注：商品輸入については複式簿記の計上方式を採用しているため
支払い額はマイナス表記になる

MINUTES OF DISCUSSIONS
ON
THE BASIC DESIGN STUDY
ON
THE PROJECT FOR RECONSTRUCTION OF THE NEW AMSTERDAM HOSPITAL
IN
THE COOPERATIVE REPUBLIC OF GUYANA

Based on the results of the Preparatory Study, the Government of Japan decided to conduct a Basic Design Study on the project for Reconstruction of the New Amsterdam Hospital (hereinafter referred to as "the Project") and entrusted the study to the Japan International Cooperation Agency (hereinafter referred to as "JICA").

JICA sent to the Cooperative Republic of Guyana (hereinafter referred to as "Guyana") the Basic Design Study Team (hereinafter referred to as "the Team"), which was headed by Dr.Kunihiko Hirabayashi, Second Expert Service Division, Bureau of International Cooperation, International Medical Center of Japan, Ministry of Health, Labor and Welfare. The team was in the country from October 2,2001 to October 30,2001.

The Team held discussions with the relevant officials of the Government of Guyana and conducted a field survey of the study area.

In the course of discussions and field survey, both parties confirmed the main items described in the attached sheets. The Team will proceed to further works and prepare the Basic Design Study Report.

Georgetown, October 30, 2001

Dr.Kunihiko Hirabayashi
Leader
Basic Design Study Team
Japan International Cooperation Agency
(Japan)

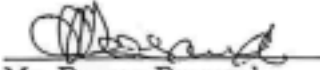
Mr. Doorga Persaud
Permanent Secretary
Ministry of Health
Cooperative Republic of Guyana

Witness

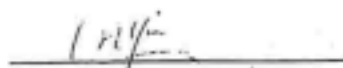
Mr. Donald Abrams
Director
Department of International Cooperation
Ministry of Foreign Trade and International Cooperation

ATTACHMENT

1. Objective of the Project

The objective of the Project is to improve the medical services to be provided by the New Amsterdam Hospital through construction of a new building and supply of medical equipment.

2. Project Site

The site for the Project : information will be provided by the Guyana side

3. Implementing and Executing Agency

3-1. The Implementing Agency : Ministry of Health

3-2. The Executing Agency : Regional Health Administration, Region VI

4. Items Requested by the Government of Guyana

4-1 After discussions with the Team, the items described in ANNEX-1 and ANNEX-2 were eventually requested by the Guyana side. JICA will assess the appropriateness of the request and will accordingly recommend to the Government of Japan for approval.

4-2 The Guyana side has assigned their priorities on the items in ANNEX-2 as mentioned below.

A = First Priority/ Essential
B = Second Priority / Need to study
C = Third Priority / If possible

5. Japan's Grant Aid Scheme

The Guyana side understands the Japan's Grant Aid Scheme and the necessary measures to be taken by the Government of Guyana as explained by the Team and described in ANNEX-3.

6. Schedule of the Study

6-1. JICA will prepare the draft report in English and dispatch a mission in order to explain its contents around February 2002.

6-2. In case the contents of the report are accepted in principle by the Government of Guyana, JICA will complete the final report and send it to the Government of Guyana by May 2002.

6-3. The above mentioned schedule is subject to change.

7 Project Site Issue

There is an outstanding issue regarding the area of the proposed project site which was indicated as "Site B" in the Minutes of Discussions signed by both parties on August 3, 2000. The Japanese side suggested that a site area of approximately 20,000m² would be necessary for the reconstruction of the New Amsterdam Hospital whereas the area secured by the Guyana side is approximately 8,500m². Both parties agreed that the following alternative options should be examined by the Guyana side to finalize the Project site issue:

- (1) The Guyana side secures sufficient area to accommodate the necessary facilities by means of removing the present occupants from the proposed site in an amicable way.
- (2) The Guyana side to propose an alternative site, other than those examined before, which satisfy the following conditions:
 - a. land area of approximately 20,000m² for the project,
 - b. no legal problems which may cause hindrance to the project,
 - c. adequate infrastructure of water supply, power supply, drainage system and telephone lines,
 - d. soil condition at least similar to the present construction site or better for a two-storey reinforced concrete building

The Guyana side will communicate the final decision to the Embassy of Japan in Venezuela with Note Verbal through the Ministry of Foreign Trade and International Cooperation by the end of November, 2001.

8 Other Relevant Issues

Both parties have confirmed the issues described below:

8-1. Organization Structure for the Project

| Agency | Institution | Responsible Official |
|---|--|---|
| Coordinating Agency | Ministry of Foreign Trade and International Cooperation | Director, Department of International Cooperation |
| Implementing Agency | Ministry of Health | Permanent Secretary |
| Project Management (Counterpart) Agency | Ministry of Health(Region VI)/ Regional Democratic Council | To be determined later |

8-2. Movement and installation of the existing equipment and facilities

The cost for movement and installation of the existing equipment and facilities in the New Amsterdam Hospital will be borne by the Guyana side.



8-3 Tax Exemption Issue

The tax exemption issue is described generally in Clause 5, Article 4 in ANNEX-3. The Japanese side stated that if Value Added Tax is introduced in Guyana, it should be treated in the same way as other taxes. The Ministry of Health could not give a commitment on this matter and stated that the issue would need to be examined by the competent authority if and when such tax is introduced.

8-4. Monitoring and Evaluation

Ministry of Health will establish the Monitoring and Evaluation Committee for the Project. The detail of the monitoring and evaluation framework will be discussed with the Draft Report Explanation Mission.

Handwritten initials 'KJ' inside a circle, followed by a signature and the date '1/14'.

1. Outpatient Department

General outpatient, Dentistry clinic, Ophthalmology clinic, Ear, Nose and Throat clinic, Surgery clinic, Orthopedic clinic, Medical clinic, Pediatrics clinic, Obstetrics & Gynecology clinic, Dermatology clinic, Pharmacy, Physical therapy room

2. Central Clinical Department

Laboratory, X-ray, Operating theater (general, ophthalmology), Labor/Delivery, Emergency, Central Sterile Supply Department

3. Administration Department

Medical Superintendent's office, Matron's office, Administration office, Administrator's office, Supervisors' office, Library, PABX, Security, Mortuary, etc.

4. Ward

Pediatric, Medical(male, female), Surgical/Orthopedic(Male, Female), Ophthalmology, Gynecology, Maternity, Scullery

5. Service

Kitchen, Canteen, Laundry, Sewing, Generator, Pump, Boiler room, Central Store

6. Training facilities for the New Amsterdam Nursing School

7. New Amsterdam Health Center

Handwritten initials in a circle and a signature.

Equipment List

| Department | No. | Description | Qty | Priority |
|---------------|------|-------------------------------------|-----|----------|
| CLINIC | A-01 | Doctor's Consulting Desk | 5 | A |
| CLINIC | A-02 | Doctor's Chair | 5 | A |
| CLINIC | A-03 | Patient Stool | 5 | A |
| CLINIC | A-04 | Examining Couch | 4 | A |
| CLINIC | A-05 | Examining Light | 5 | A |
| CLINIC | A-06 | X-Ray Film Illuminator | 5 | A |
| CLINIC | A-07 | Diagnostic Instrument Set | 5 | A |
| CLINIC | A-08 | Instrument & Dressings Cabinet | 5 | A |
| CLINIC | A-09 | Medicine Cabinet | 5 | B |
| CLINIC | A-10 | Weighing Scale for Adult | 5 | A |
| CLINIC | A-11 | Sphygmomanometer for Adult | 5 | A |
| CLINIC | A-12 | Two Basin Stand | 5 | A |
| CLINIC | A-13 | Clothes Basket | 5 | A |
| CLINIC | A-14 | Oxygen Inhaler Apparatus | 1 | A |
| CLINIC | A-15 | Treatment Instrument Set | 1 | A |
| CLINIC | A-16 | Plaster Instrument Set | 1 | A |
| CLINIC | A-17 | Gynecological Examining Table | 1 | A |
| CLINIC | A-18 | Gynecological Examining Unit | 1 | A |
| CLINIC | A-19 | Baby Scale | 1 | A |
| CLINIC | A-20 | Fetal Heart Detector | 1 | A |
| CLINIC | A-21 | 1-Channel Electrocardiograph | 1 | A |
| CLINIC | A-22 | Ultrasound Scanner | 1 | A |
| CLINIC | A-23 | Electric Boiling Sterilizer | 5 | A |
| OPHTHALMOLOGY | B-01 | Doctor's Consulting Desk | 1 | A |
| OPHTHALMOLOGY | B-02 | Doctor's Chair | 1 | A |
| OPHTHALMOLOGY | B-03 | Giant Electric Magnet | 1 | C |
| OPHTHALMOLOGY | B-04 | Microdiamond Knife | 1 | B |
| OPHTHALMOLOGY | B-05 | Microsurgery Instrument set | 1 | A |
| OPHTHALMOLOGY | B-06 | Ophthalmic Surgeon Stool | 1 | A |
| OPHTHALMOLOGY | B-07 | Ophthalmic Cryosurgery Apparatus | 1 | C |
| OPHTHALMOLOGY | B-08 | Instrument Storage Container | 1 | A |
| OPHTHALMOLOGY | B-09 | Instrument Cabinet | 1 | A |
| OPHTHALMOLOGY | B-10 | Auto Refractometer | 1 | A |
| OPHTHALMOLOGY | B-11 | Keratometer | 1 | B |
| OPHTHALMOLOGY | B-12 | Chart Projector | 1 | A |
| OPHTHALMOLOGY | B-13 | Slit Lamp | 1 | A |
| OPHTHALMOLOGY | B-14 | Trial Lens Set | 1 | A |
| OPHTHALMOLOGY | B-15 | Examination Chair for Ophthalmology | 1 | B |
| OPHTHALMOLOGY | B-16 | Electric Tonometer | 1 | A |
| OPHTHALMOLOGY | B-17 | Ophthalmoscope, Indirect Type | 1 | A |
| OPHTHALMOLOGY | B-18 | Ophthalmoscope, Direct Type | 1 | A |
| OPHTHALMOLOGY | B-19 | Operating Table | 1 | B |
| DENTAL | C-01 | Doctor's Consulting Desk | 1 | A |
| DENTAL | C-02 | Doctor's Chair | 1 | A |
| DENTAL | C-03 | Dental Unit | 1 | C |
| DENTAL | C-04 | Dental X-ray Unit | 1 | C |
| DENTAL | C-05 | Diagnostic Instrument Set | 1 | A |
| DENTAL | C-06 | Autoclave for Dental | 1 | B |
| PHARMACY | D-01 | Prescription Counter | 1 | A |
| PHARMACY | D-02 | Working Chair | 3 | A |
| PHARMACY | D-03 | Water Still | 1 | A |
| PHARMACY | D-04 | Work Table | 1 | A |
| PHARMACY | D-05 | Hot Plate | 1 | A |
| PHARMACY | D-06 | Medicine Balance | 1 | A |
| PHARMACY | D-07 | Weighing Balance | 1 | A |
| PHARMACY | D-08 | Medicine Refrigerator | 1 | A |
| PHARMACY | D-09 | Drug Safe, Medicine Cabinet | 1 | A |
| PHARMACY | D-10 | Hot Air Sterilizer | 1 | A |

| Department | No | Description | Qty | Priority |
|------------|------|-------------------------------------|-----|----------|
| PHARMACY | D-11 | Bottle Washer | 1 | C |
| X-RAY | E-01 | X-Ray Unit | 1 | A |
| X-RAY | E-02 | Mobile X-Ray Unit | 1 | A |
| X-RAY | E-03 | Reception Desk | 1 | A |
| X-RAY | E-04 | Working Chair | 2 | B |
| X-RAY | E-05 | Automatic X-Ray Film Processor | 1 | A |
| X-RAY | E-06 | Developing Tank | 1 | C |
| X-RAY | E-07 | X-Ray Film Illuminator | 1 | A |
| X-RAY | E-08 | Film Loading Table | 1 | A |
| X-RAY | E-09 | Cassette Pass Box | 1 | A |
| X-RAY | E-10 | X-Ray Accessories | 1 | A |
| X-RAY | E-11 | X-Ray Film Keeping Shelf | 1 | A |
| LABORATORY | F-01 | Medicine Refrigerator | 1 | A |
| LABORATORY | F-02 | Binocular Microscope | 2 | A |
| LABORATORY | F-03 | Hematocrit Centrifuge | 1 | A |
| LABORATORY | F-04 | Blood Glucose Meter | 1 | A |
| LABORATORY | F-05 | Blood Cell Counter, Manual Type | 3 | A |
| LABORATORY | F-06 | Hemoglobinometer | 1 | A |
| LABORATORY | F-07 | Conguro Meter | 1 | A |
| LABORATORY | F-08 | Bilirubin Meter | 1 | A |
| LABORATORY | F-09 | Blood Mixer (Test tube type) | 2 | A |
| LABORATORY | F-10 | System Laboratory Table | 1 | A |
| LABORATORY | F-11 | Laboratory Chair | 2 | A |
| LABORATORY | F-12 | Dark Field Microscope | 1 | B |
| LABORATORY | F-13 | Hot Plate | 2 | A |
| LABORATORY | F-14 | Colony Counter | 1 | A |
| LABORATORY | F-15 | Water Bath | 1 | A |
| LABORATORY | F-16 | Incubator | 1 | A |
| LABORATORY | F-17 | Drying Cabinet | 1 | B |
| LABORATORY | F-18 | Spectrophotometer | 1 | C |
| LABORATORY | F-19 | pH Meter | 1 | B |
| LABORATORY | F-20 | Electrolyte Analyzer | 1 | C |
| LABORATORY | F-21 | Centrifuge | 1 | A |
| LABORATORY | F-22 | Plate Mixer | 1 | A |
| LABORATORY | F-23 | Balance for Blood Bank | 1 | A |
| LABORATORY | F-24 | System Balance Table | 1 | C |
| LABORATORY | F-25 | Laboratory Sterilizer | 1 | A |
| LABORATORY | F-26 | Water Still | 1 | C |
| LABORATORY | F-27 | Ware Shelves | 1 | C |
| LABORATORY | F-28 | Laboratory Instruments Set | 1 | A |
| LABORATORY | F-29 | Laboratory Sink | 1 | A |
| LABORATORY | F-30 | Medium size Blood Bank Refrigerator | 1 | B |
| LABORATORY | F-31 | Donners Bed | 1 | B |
| LABORATORY | F-32 | Height & Weighing Scale | 1 | B |
| LABORATORY | F-33 | RH view box | 1 | B |
| EMERGENCY | G-01 | Doctor's Consulting Desk | 2 | A |
| EMERGENCY | G-02 | Doctor's Chair | 2 | A |
| EMERGENCY | G-03 | Patient Stool | 2 | A |
| EMERGENCY | G-04 | Examining Couch | 2 | A |
| EMERGENCY | G-05 | Emergency Light | 2 | A |
| EMERGENCY | G-06 | X-Ray Film Illuminator | 2 | A |
| EMERGENCY | G-07 | Diagnostic Instrument Set | 2 | A |
| EMERGENCY | G-08 | Treatment Instrument Set | 2 | A |
| EMERGENCY | G-09 | Medicine Cabinet | 1 | A |
| EMERGENCY | G-10 | Resuscitation Trolley | 1 | A |
| EMERGENCY | G-11 | Suction Unit | 2 | A |
| EMERGENCY | G-12 | Oxygen Inhaler Apparatus | 1 | A |
| EMERGENCY | G-13 | Emergency Resuscitation Kit | 2 | A |
| EMERGENCY | G-14 | Instrument & Dressings Cabinet | 1 | A |
| EMERGENCY | G-15 | Stretcher Trolley | 2 | A |
| EMERGENCY | G-16 | Patient Bed | 2 | A |
| EMERGENCY | G-17 | Bedside Cabinet | 2 | B |

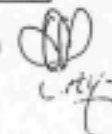
(24) 

| Department | No. | Description | Qty | Priority |
|----------------------|--------|--|-----|----------|
| EMERGENCY | G-18 | Nebulizer | 1 | B |
| EMERGENCY | G-19 | Sphygmomanometer | 2 | B |
| EMERGENCY | G-20 | Operating Table | 1 | B |
| OPERATING & RECOVERY | H-01 | Operating Table | 2 | A |
| OPERATING & RECOVERY | H-02 | Operating Light | 2 | A |
| OPERATING & RECOVERY | H-03 | Anesthesia Apparatus | 2 | A |
| OPERATING & RECOVERY | H-04 | Anesthesia Instrument Set | 2 | A |
| OPERATING & RECOVERY | H-05 | Electro Surgical Unit | 2 | A |
| OPERATING & RECOVERY | H-06 | Operating Microscope for Ophthalmology | 1 | A |
| OPERATING & RECOVERY | H-07 | Suction Unit | 2 | A |
| OPERATING & RECOVERY | H-08 | X-Ray Film Illuminator | 2 | A |
| OPERATING & RECOVERY | H-09 | Instrument & Dressings Cabinet | 2 | A |
| OPERATING & RECOVERY | H-10 | Medicine Refrigerator | 1 | A |
| OPERATING & RECOVERY | H-11 | Warming Cabinet | 1 | A |
| OPERATING & RECOVERY | H-12 | Brush Dispenser | 10 | A |
| OPERATING & RECOVERY | H-13 | Soap Dispenser | 5 | A |
| OPERATING & RECOVERY | H-14 | Recovery Bed | 2 | A |
| OPERATING & RECOVERY | H-15 | Ventilator for Anesthesia Apparatus | 2 | A |
| OPERATING & RECOVERY | H-16 | Resuscitation Trolley | 2 | A |
| OPERATING & RECOVERY | H-17 | Low Pressure Continuous Suction Unit | 3 | A |
| OPERATING & RECOVERY | H-18-1 | Laparotomy Instrument Set | 2 | A |
| OPERATING & RECOVERY | H-18-2 | Thoracotomy Instrument Set | 2 | A |
| OPERATING & RECOVERY | H-18-3 | Urological Surgery Instrument Set | 2 | B |
| OPERATING & RECOVERY | H-18-4 | Orthopedic Surgery Instrument Set | 2 | B |
| OPERATING & RECOVERY | H-18-5 | Burr Hole Instrument Set | 1 | B |
| OPERATING & RECOVERY | H-18-6 | Skull Traction Instrument Set | 2 | B |
| OPERATING & RECOVERY | H-18-7 | Skin Harvesting and Grating Instrument Set | 1 | A |
| OPERATING & RECOVERY | H-18-8 | Caesarean Section Instrument Set | 2 | A |
| OPERATING & RECOVERY | H-19 | Infusion Pump | 4 | A |
| OPERATING & RECOVERY | H-20 | Feeding Syringe Pump | 2 | A |
| OPERATING & RECOVERY | H-21 | Defibrillator | 1 | B |
| OPERATING & RECOVERY | H-22 | Patient Monitor for Anesthesia Apparatus | 2 | B |
| OPERATING & RECOVERY | H-23 | Local Anesthesia Set | 2 | A |
| OPERATING & RECOVERY | H-24 | Kick Bucket | 4 | B |
| OPERATING & RECOVERY | H-25 | Instrument tray stand | 4 | B |
| DELIVERY | I-01 | Labour Table | 1 | A |
| DELIVERY | I-02 | Bedside Cabinet | 2 | B |
| DELIVERY | I-03 | Delivery Table | 2 | A |
| DELIVERY | I-04 | Delivery Light | 2 | A |
| DELIVERY | I-05 | Resuscitator | 1 | A |
| DELIVERY | I-06 | Instrument & Dressings Cabinet | 1 | A |
| DELIVERY | I-07 | Obstetric Instrument Set | 4 | A |
| DELIVERY | I-08 | Pediatric Treatment Table | 1 | A |
| DELIVERY | I-09 | Body Balance | 1 | A |
| DELIVERY | I-10 | Nursing Bottle Sterilizer | 1 | C |
| DELIVERY | I-11 | Suction Unit | 2 | B |
| DELIVERY | I-12 | Electric Boiling Sterilizer | 1 | B |
| DELIVERY | I-13 | Incubator | 1 | B |
| DELIVERY | I-14 | Fetal Monitor | 1 | B |
| CSSD | J-01 | High Pressure Steam Sterilizer | 2 | A |
| CSSD | J-02 | Ultrasonic Washer | 1 | C |
| CSSD | J-03 | Working Table | 1 | A |
| CSSD | J-04 | Sterilizer Container | 1 | A |
| CSSD | J-05 | Dressing Case Cabinet | 1 | C |
| CSSD | J-06 | Dressing Drum Cabinet | 1 | A |
| INTERNAL WARD | K-01 | Patient Bed | * | A |
| INTERNAL WARD | K-02 | 2-Crank Bed | 4 | A |
| INTERNAL WARD | K-03 | Pediatrics Bed | 6 | A |
| INTERNAL WARD | K-04 | I.V.Hanger Rod | * | A |
| INTERNAL WARD | K-05 | Overbed Table | 2 | A |
| INTERNAL WARD | K-06 | Bedside Cabinet | * | B |
| INTERNAL WARD | K-07 | Working Chair | 4 | B |

Red [Signature]

| Department | No. | Description | Qty | Priority |
|----------------|------|--------------------------------|-----|----------|
| INTERNAL WARD | K-08 | X-Ray Film Illuminator | 1 | A |
| INTERNAL WARD | K-09 | Medicine Cabinet | 1 | B |
| INTERNAL WARD | K-10 | Instrument & Dressings Cabinet | 1 | A |
| INTERNAL WARD | K-11 | Weighing Scale | 1 | A |
| INTERNAL WARD | K-12 | Diagnostic Instrument Set | 1 | A |
| INTERNAL WARD | K-13 | Treatment Instrument Set | 1 | A |
| INTERNAL WARD | K-14 | Medicine Refrigerator | 1 | A |
| INTERNAL WARD | K-15 | Nebulizer | 1 | B |
| INTERNAL WARD | K-16 | Examining Light | 1 | A |
| INTERNAL WARD | K-17 | Wheel Chair | 4 | A |
| INTERNAL WARD | K-18 | Stretcher Trolley | 2 | A |
| INTERNAL WARD | K-19 | Oxygen Inhaler Apparatus | 1 | A |
| INTERNAL WARD | K-20 | Suction Unit | 1 | A |
| INTERNAL WARD | K-21 | Resuscitation Trolley | 1 | A |
| INTERNAL WARD | K-22 | Drug Safe | 1 | A |
| INTERNAL WARD | K-23 | Electric Boiling Sterilizer | 1 | A |
| INTERNAL WARD | K-24 | Ice Making Machine | 1 | B |
| INTERNAL WARD | K-25 | Bedpan Sterilizer | 1 | B |
| INTERNAL WARD | K-26 | Urinal & Bed Pan Rack | 2 | A |
| INTERNAL WARD | K-27 | Baby Scale | 2 | A |
| INTERNAL WARD | K-28 | Baby Bassinet | * | A |
| SURGICAL WARD | L-01 | Patient Bed | * | A |
| SURGICAL WARD | L-02 | Pediatrics Bed | * | A |
| SURGICAL WARD | L-03 | Orthopedic Bed | 2 | B |
| SURGICAL WARD | L-04 | Traction Apparatus | 2 | B |
| SURGICAL WARD | L-05 | I.V. Hanger Rod | * | A |
| SURGICAL WARD | L-06 | Overbed Table | 2 | B |
| SURGICAL WARD | L-07 | Bedside Cabinet | * | B |
| SURGICAL WARD | L-08 | Working Chair | 4 | B |
| SURGICAL WARD | L-09 | X-Ray Film Illuminator | 4 | A |
| SURGICAL WARD | L-10 | Medicine Cabinet | 1 | B |
| SURGICAL WARD | L-11 | Instrument & Dressings Cabinet | 1 | A |
| SURGICAL WARD | L-12 | Weighing Scale | 1 | A |
| SURGICAL WARD | L-13 | Diagnostic Instrument Set | 1 | A |
| SURGICAL WARD | L-14 | Treatment Instrument Set | 1 | A |
| SURGICAL WARD | L-15 | Medicine Refrigerator | 1 | A |
| SURGICAL WARD | L-16 | Nebulizer | 1 | B |
| SURGICAL WARD | L-17 | Examining Light | 1 | A |
| SURGICAL WARD | L-18 | Wheel Chair | 4 | A |
| SURGICAL WARD | L-19 | Stretcher Trolley | 2 | A |
| SURGICAL WARD | L-20 | Oxygen Inhaler Apparatus | 1 | A |
| SURGICAL WARD | L-21 | Suction Unit | 1 | A |
| SURGICAL WARD | L-22 | Resuscitation Trolley | 1 | A |
| SURGICAL WARD | L-23 | Drug Safe | 1 | A |
| SURGICAL WARD | L-24 | Electric Boiling Sterilizer | 1 | A |
| SURGICAL WARD | L-25 | Ice Making Machine | 1 | B |
| SURGICAL WARD | L-26 | Bedpan Sterilizer | 1 | B |
| SURGICAL WARD | L-27 | Urinal & Bed Pan Rack | 2 | A |
| SURGICAL WARD | L-28 | Baby Scale | 1 | A |
| LAUNDRY | M-01 | Automatic Washer Extractor | 1 | A |
| LAUNDRY | M-02 | Dryer | 1 | A |
| LAUNDRY | M-03 | Electric Ironing Machine | 1 | B |
| MORTUARY | N-01 | Mortuary Refrigerator | 1 | C |
| MORTUARY | N-02 | Autopsy Table | 1 | A |
| MORTUARY | N-03 | Autopsy Instrument Set | 1 | A |
| SEWING SERVICE | O-01 | Sewing Machine | 1 | C |
| SEWING SERVICE | O-02 | Ironing machine | 2 | C |

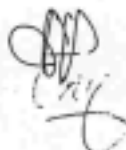
(EOT) 

Japan's Grant Aid Scheme

Exchange of Notes (E/N)

Japan's Grant Aid is extended in accordance with the Notes exchanged by the two Governments concerned, in which the objectives of the Project, period of execution, conditions and amount of the Grant Aid, etc., are confirmed.

- 1) "The period of the Grant Aid" means the one fiscal year which the Cabinet approves the Project for. Within the fiscal year, all procedures such as exchanging of the Notes, concluding contracts with consultant firms and contractors and final payment to them must be completed.

However, in case of delays in delivery, installation or construction due to unforeseen factors such as natural disaster, the period of the Grant Aid can be further extended for a maximum of one fiscal year at most by mutual agreement between the two Governments.

- 2) Under the Grant Aid, in principle, Japanese products and services including transport or those of the recipient country are to be purchased.

When the two Governments deem it necessary, the Grant Aid may be used for the purchase of the products or services of a third country.

However, the prime contractors, namely, consulting, constructing and procurement firms are limited to "Japanese nationals". (The term "Japanese nationals" means persons of Japanese nationality or Japanese corporations controlled by persons of Japanese nationality.)

- 3) Necessity of "Verification"

The Government of recipient country or its designated authority will conclude contracts denominated in Japanese yen with Japanese nationals. Those contracts shall be verified by the Government of Japan. This "Verification" is deemed necessary to secure accountability to Japanese taxpayers.

- 4) Undertakings required to the Government of the Recipient Country

In the implementation of the Grant Aid project, the recipient country is required to undertake such necessary measures as follows:

- ① to secure land necessary for the sites of the Project and to clear, level and reclaim the land prior to commencement of the construction,
- ② to provide facilities for the distribution of electricity, water supply and drainage and other incidental facilities in and around the sites,

- ④ to secure buildings prior to the procurement in case the installation of the equipment,
 - ④ to ensure all the expenses and prompt execution for unloading, customs clearance at the port of disembarkation and internal transportation of the products purchased under the Grant Aid,
 - ⑤ to exempt Japanese nationals from customs duties, internal taxes and other fiscal levies which will be imposed in the recipient country with respect to the supply of the products and services under the Verified Contracts,
 - ⑥ to accord Japanese nationals, whose services may be required in connection with the supply of the products and services under the Verified Contracts, such facilities as may be necessary for their entry into the recipient country and stay therein for the performance of their work.
- 5) "Proper Use"
- The recipient country is required to operate and maintain the facilities constructed and equipment purchased under the Grant Aid properly and effectively and to assign staff necessary for this operation and maintenance as well as to bear all the expenses other than those covered by the Grant Aid.
- 6) "Re-export"
- The products purchased under the Grant Aid shall not be re-exported from the recipient country.
- 7) Banking Arrangement (B/A)
- a) the Government of the recipient country or its designated authority should open an account in the name of the Government of the recipient country in a bank in Japan (hereinafter referred to as "the Bank"). The Government of Japan will execute the Grant Aid by making payments in Japanese yen to cover the obligations incurred by the Government of the recipient country or its designated authority under the Verified Contracts.
 - b) The payments will be made when payment requests are presented by the Bank to the Government of Japan under an Authorization to Pay (A/P) issued by the Government of the recipient country or its designated authority.
- 8) Authorization to Pay (A/P)
- The Government of the recipient country should bear an advising commission of an Authorization to Pay and payment commissions to the Bank.

Handwritten initials and a signature in the bottom right corner of the page.

Major Undertaking to be taken by Each Government

| No. | Items | To be covered by Grant Aid | To be covered by Guyana Side |
|-----|---|----------------------------|------------------------------|
| 1. | To secured land | | ● |
| 2. | To clear, level and reclaim the site when needed | | ● |
| 3. | To construct gates and fences in and around the site | | ● |
| 4. | To construct the parking lot | ● | |
| | To construct roads | | |
| 5. | 1) Within the site | ● | |
| | 2) Outside the site | | ● |
| 6. | To construct the buildings | ● | |
| | To provide facilities for the distribution of electricity, water supply, drainage and other incidental facilities | | |
| | 1) Electricity | | |
| | a. The distributing line to the site | | ● |
| | b. The drop wiring and internal wiring within the site | ● | |
| | c. The main circuit breaker and transformer | ● | |
| | 2) Water Supply | | |
| | a. The city water distribution main to the site | | ● |
| | b. The supply system within the site (receiving and elevated tanks) | ● | |
| | 3) Drainage | | |
| | a. The city drainage main (for storm, sewer and others) to the site | | ● |
| 7. | b. The drainage system (for toilet sewer, ordinary waste, storm drainage and others) within the site | ● | |
| | 4) Gas Supply | | |
| | a. The city gas main to the site | | ● |
| | b. The gas supply system within the site | ● | |
| | 5) Telephone System | | |
| | a. The telephone trunk line to the main distribution frame/panel (MDF) of the building | | ● |
| | b. The MDF and the extension after the frame/panel | ● | |
| | 6) Furniture and Equipment | | |
| | a. General furniture | | ● |
| | b. Project equipment | ● | |
| 8. | To bear the following commissions to the Japanese bank for the banking services based upon the B/A | | |
| | 1) Advising commission of A/P | | ● |
| | 2) Payment commission | | ● |
| | To ensure unloading and customs clearance at port of disembarkation in recipient country | | |
| 9. | 1) Marine (Air) transportation of the products from Japan to the recipient country | ● | |
| | 2) Tax exemption and custom clearance for the products at the port of disembarkation | | ● |
| | 3) Internal transportation from the port of disembarkation to the project site | ● | |
| 10. | To accord Japanese nationals, whose services may be required in connection with the supply of the products and the services under the verified contract, such facilities as may be necessary for their entry into the recipient country and stay therein for the performance of their work. | | ● |
| 11. | To exempt Japanese nationals from customs duties, internal taxes and other fiscal levies which may be imposed in the recipient country with respect to the supply of the products and services under the verified contracts. | | ● |
| 12. | To maintain and use properly and effectively the facilities constructed and equipment provided under the Grant | | ● |
| 13. | To bear all the expenses, other than those to be borne by the Grant, necessary for construction of the facilities as well as for the transportation and installation of the equipment. | | ● |

(Handwritten signature and initials)

1. Memorandum

(2) Basic Design Study-2

MEMORANDUM OF UNDERSTANDING

THE BASIC DESIGN STUDY-2

ON

THE PROJECT FOR RECONSTRUCTION OF THE NEW AMSTERDAM HOSPITAL

IN

THE COOPERATIVE REPUBLIC OF GUYANA

Based on the Note Verbal dated November 28, 2001, the Government of Japan decided to conduct a Basic Design Study-2 on the project for Reconstruction of the New Amsterdam Hospital (hereinafter referred to as "the Project") and entrusted the study to the Japan International Cooperation Agency (hereinafter referred to as "JICA").

JICA sent to the Cooperative Republic of Guyana (hereinafter referred to as "Guyana") the Basic Design Study Team-2 (hereinafter referred to as "the Team"), consisting of consultant members. The team was in the country from January 27, 2002 to February 6, 2002.

The Team conducted a field survey of the project site proposed in the Note Verbal and held discussions with the relevant officials of the Government of Guyana.

In the course of field survey and discussions, both parties confirmed the main items described in the attached sheets. The Team will proceed to further works and prepare the Basic Design Study Report.

Georgetown, February 5, 2002



Mr. Kuniyuki Inadome
Project Manager
Basic Design Study Team



Mr. Doorga Persaud
Permanent Secretary
Ministry of Health
Cooperative Republic of Guyana

Witness:

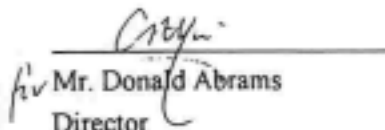

Mr. Donald Abrams
Director
Department of International Cooperation
Ministry of Foreign Trade and International Cooperation

ATTACHMENT

1. Minutes of Discussions

Both parties reconfirmed contents of the following items of the Minutes of Discussions signed on October 30, 2001.

- (1) 1. Objectives of the Project
- (2) 3. Implementing and Executing Agencies
- (3) 4. Items Requested by the Government of Guyana
- (4) 5. Japan's Grant Aid Scheme
- (5) 8-1. Organization Structure for the Project
- (6) 8-2. Movement and installation of the existing equipment and facilities
- (7) 8-3. Tax Exemption Issue
- (8) 8-4. Monitoring and Evaluation

2. Project Site

The site for the Project : Tract "B" being a portion of state land at ORDNANCE FORTLANDS situate in greater New Amsterdam in the county of Berbice. (A site drawing is attached)

Guyana side agreed to include the piece of land behind St. Aloysius School as part of proposed site for the Project.

Cabinet has assigned the plot of land to the Ministry of Health for the purpose of the construction of the New Amsterdam Hospital. (see the letter from Head of the Presidential Secretariat as attached)

3. Result of the Study

The site appears to be acceptable for the Project. However, the Japanese side will inform the Guyana side of the final result of the site survey of the proposed site after analysis in Japan.

4. Undertakings of the Guyana side

The Guyana side agreed that the following matters will be necessary to be undertaken by the Guyana side as part of the undertakings to facilitate implementation of the Project on its behalf.

- (1) To pass title of the land in favor of the Ministry of Health so as not to cause inconvenience in implementation of the Project.
- (2) To provide sufficient drainage in the proposed site.
- (3) To clear and level the land.
- (4) To provide telecommunication lines.
- (5) To record underground water level once a month at each of the three number of the observation pits which the Japanese side provided in the site.



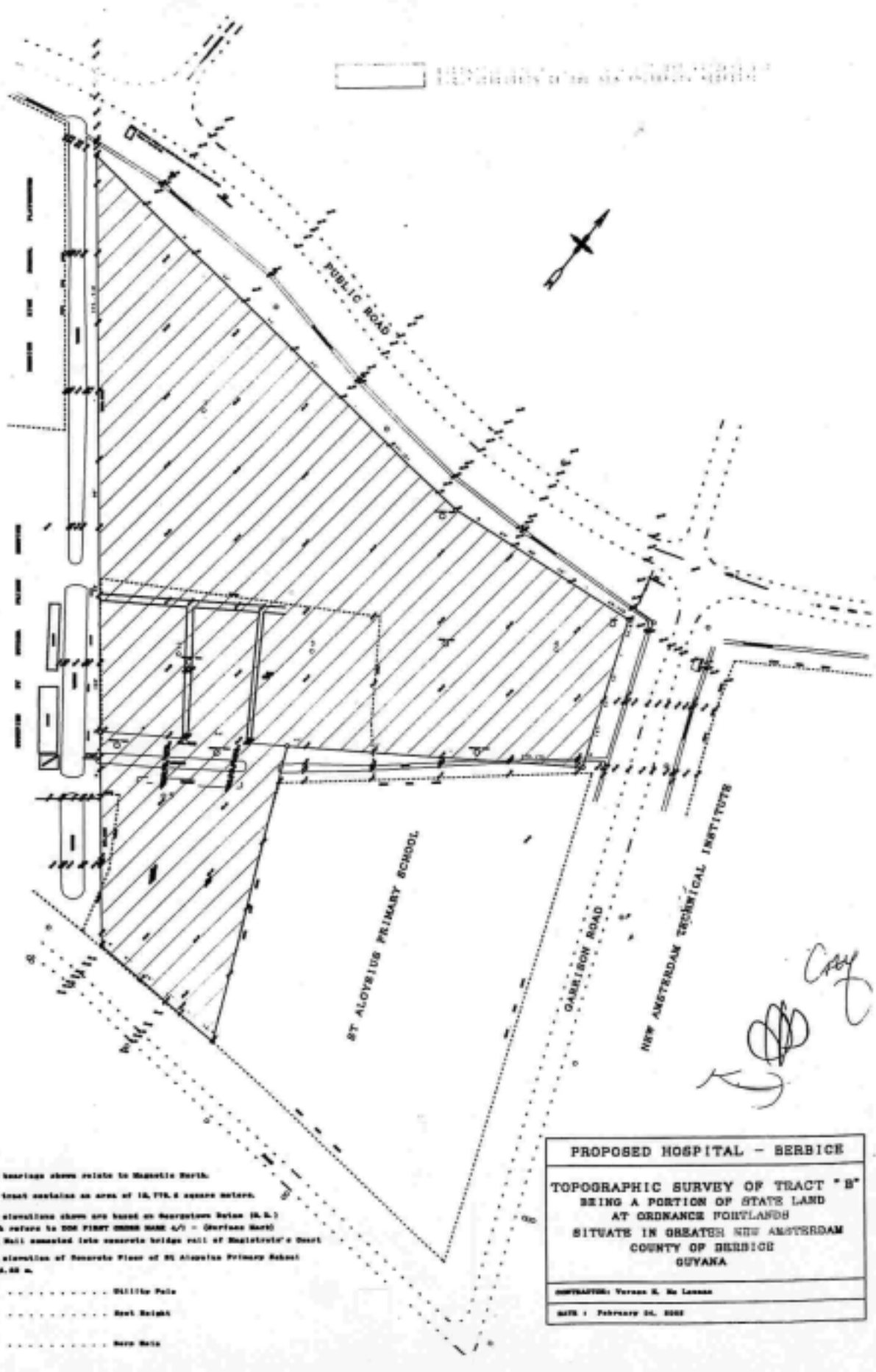

TOPOGRAPHIC SURVEY OF TRACT "B"
 BEING A PORTION OF STATE LAND
 AT ORDNANCE PORTLANDS
 SITUATE IN GREATER NEW AMSTERDAM
 COUNTY OF BERBICE
 GUYANA

NOTES

1. All bearings shown relate to Magnetic North.
2. The tract contains an area of 18,778.8 square meters.
3. All elevations shown are based on Georgetown Datum (A.S.L.) which refers to 508 FIRST CROSS MARK 4/7 - (Geometric Mark) Pipe Well connected into concrete bridge wall of Magistrate's Court.
4. The elevation of Concrete Floor of St Aloysius Primary School is 14.48 m.

- Dotted Line
- Level Mark
- Bench Mark

PROPOSED HOSPITAL - BERBICE

TOPOGRAPHIC SURVEY OF TRACT "B"
 BEING A PORTION OF STATE LAND
 AT ORDNANCE PORTLANDS
 SITUATE IN GREATER NEW AMSTERDAM
 COUNTY OF BERBICE
 GUYANA

CONTRACTOR: Vernon S. De Looze

DATE: February 24, 1968

Handwritten signatures and initials, including 'Coy' and a large scribble.



Office of the President

New Garden St, & South Rd,

*Georgetown
Guyana.*

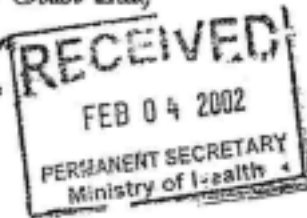

February 4, 2002

Honourable Minister of Health
Ministry of Health
Brickdam
Georgetown

Dear Minister

**RE: Draft Copy of Cadastral Survey Plan for Tract 'B' (portion of State Land)
Ordnance Fortlands, New Amsterdam, Berbice.**

Please find attached for your guidance and ease of reference a draft copy of a Cadastral Survey Plan of Ordnance Fortlands, showing Tract 'B' containing an area of 4.227 acres by R.T. John – Government Surveyor dated 2002-01-08.

I wish to further advise that the plot aforementioned is State Land and is available for allocation.

Cabinet has assigned this plot of land to the Ministry of Health for the purpose of the construction of the new New Amsterdam Hospital.

Registration of the Cadastral Plan is at present being undertaken by the Cadastral Division of Guyana Lands and Surveys Commission, which when completed a true copy will be forwarded to you.

With kindest regards.

Dr. Roger Luncheon
Head of Presidential Secretariat