

Date

2001-02-23

District, School Name

CEZWANA

Site No.

- 01

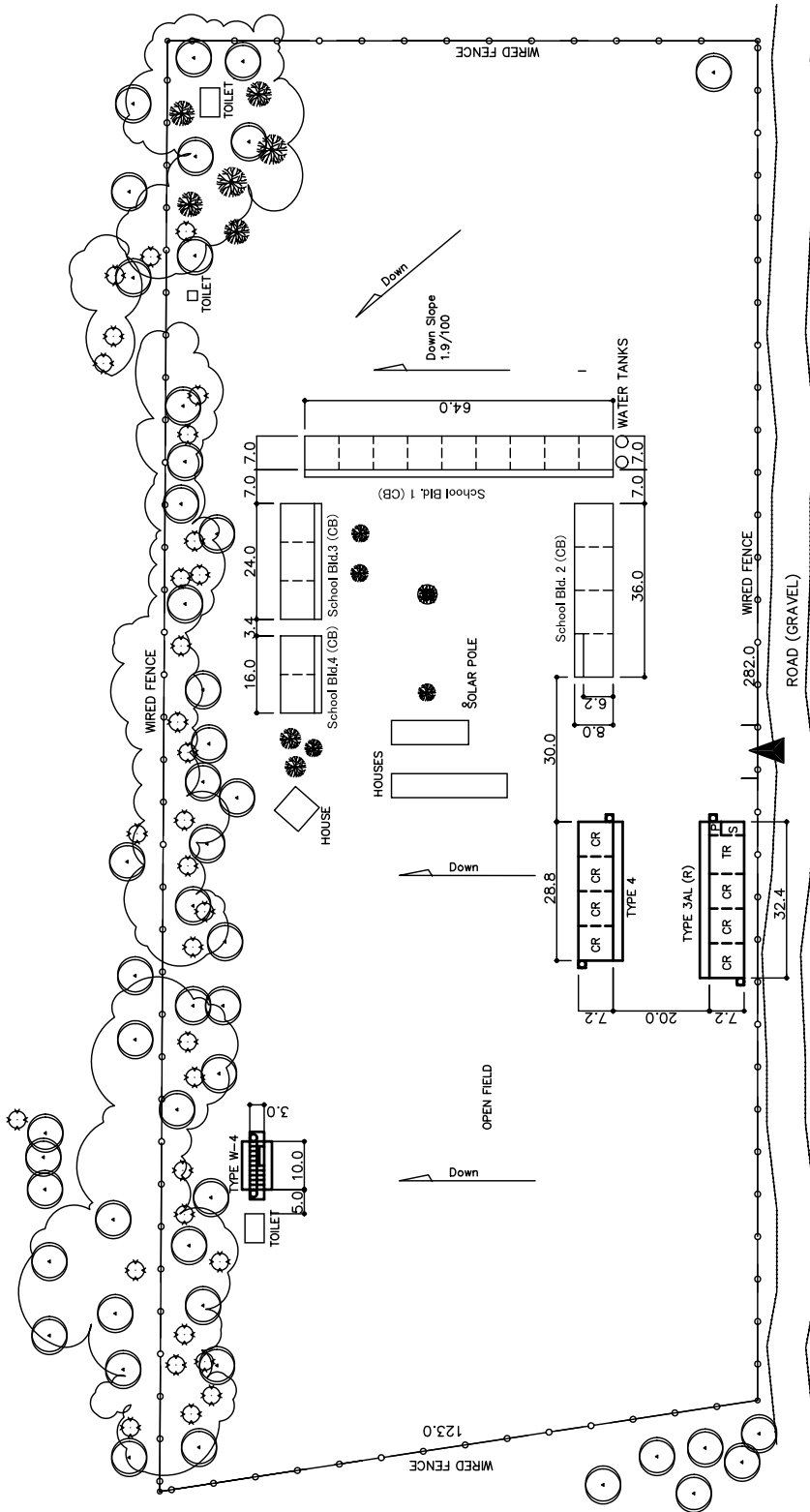

- (CB) : CONCRETE BLOCK BLDG.
- (M) : MUD BLDG.
- (B) : BRICK BLDG.
- (W) : WOOD BLDG.
- [Patterned Box] : DISUSABLE CLASS RM.



SITE PLAN  
S:1/1500

Date 2001-03-01

District, School Name MFINGOSE

Site No. - 02

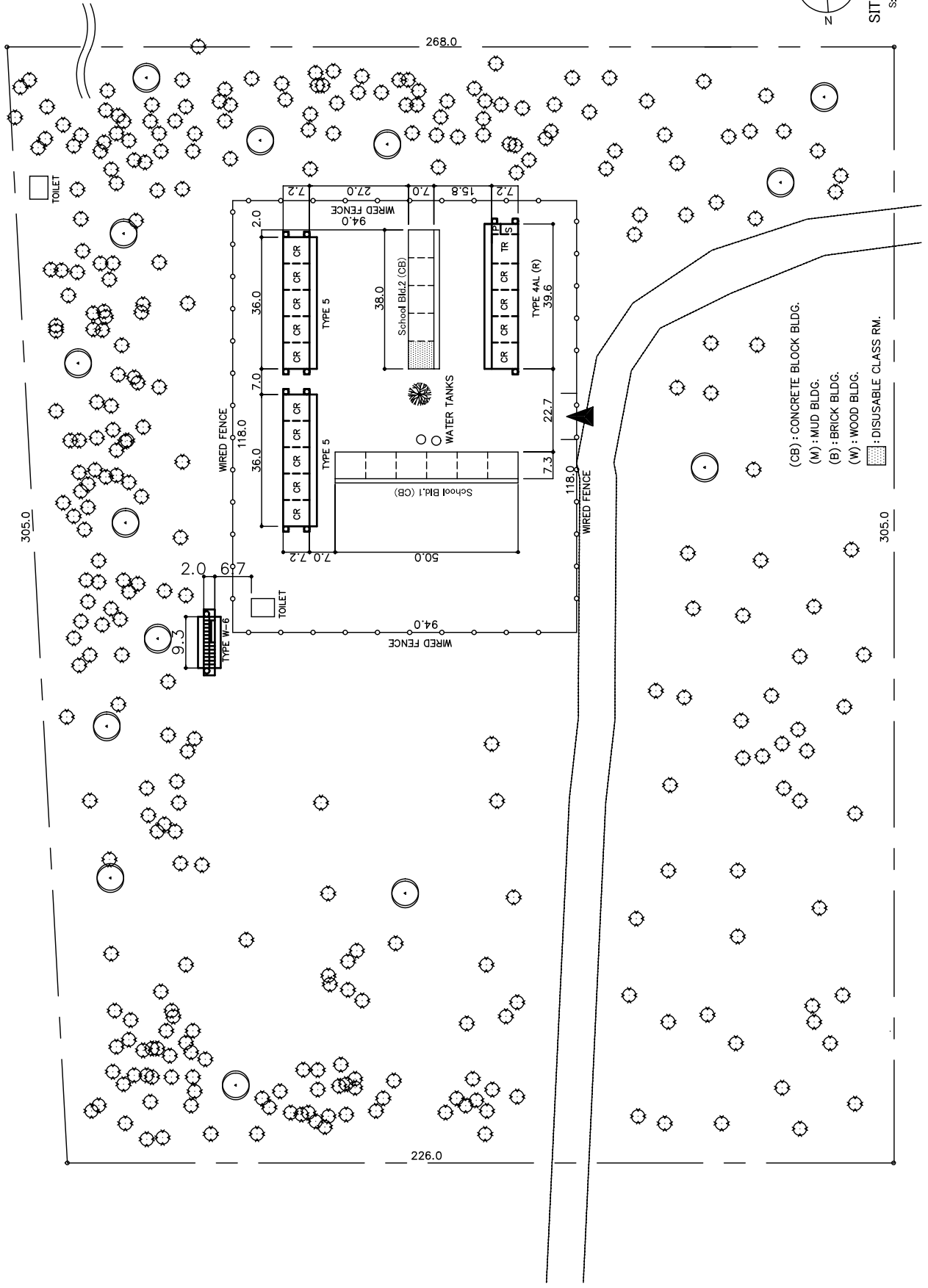
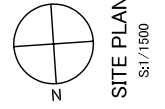

Date 2001-02-24

District, School Name MAKHANA

Site No. - 03

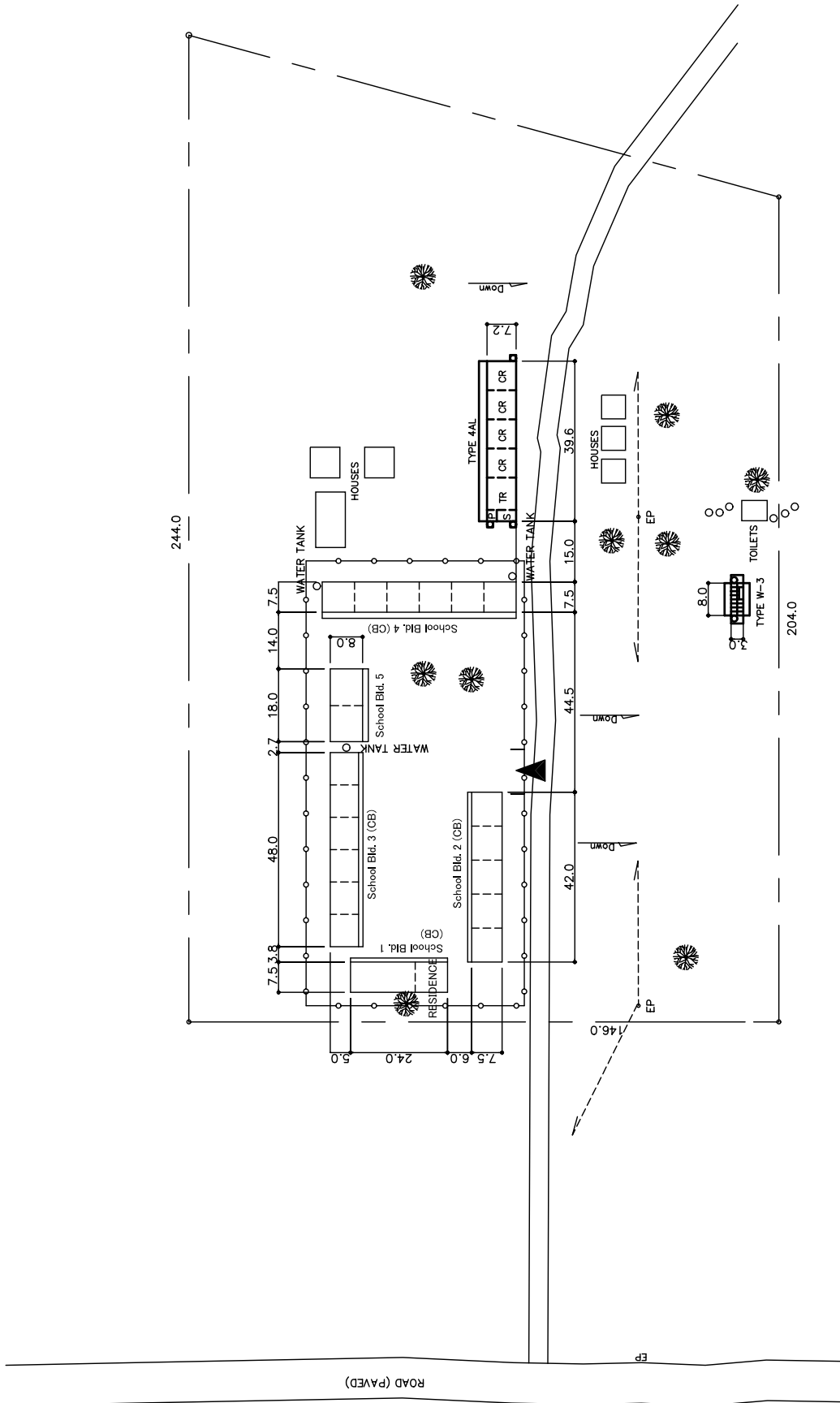

- (CB) : CONCRETE BLOCK BLDG.
- (M) : MUD BLDG.
- (B) : BRICK BLDG.
- (W) : WOOD BLDG.
- [Pattern] : DISUSABLE CLASS RM.

Date 2001-02-21

District, School Name NIBELA

Site No. -04

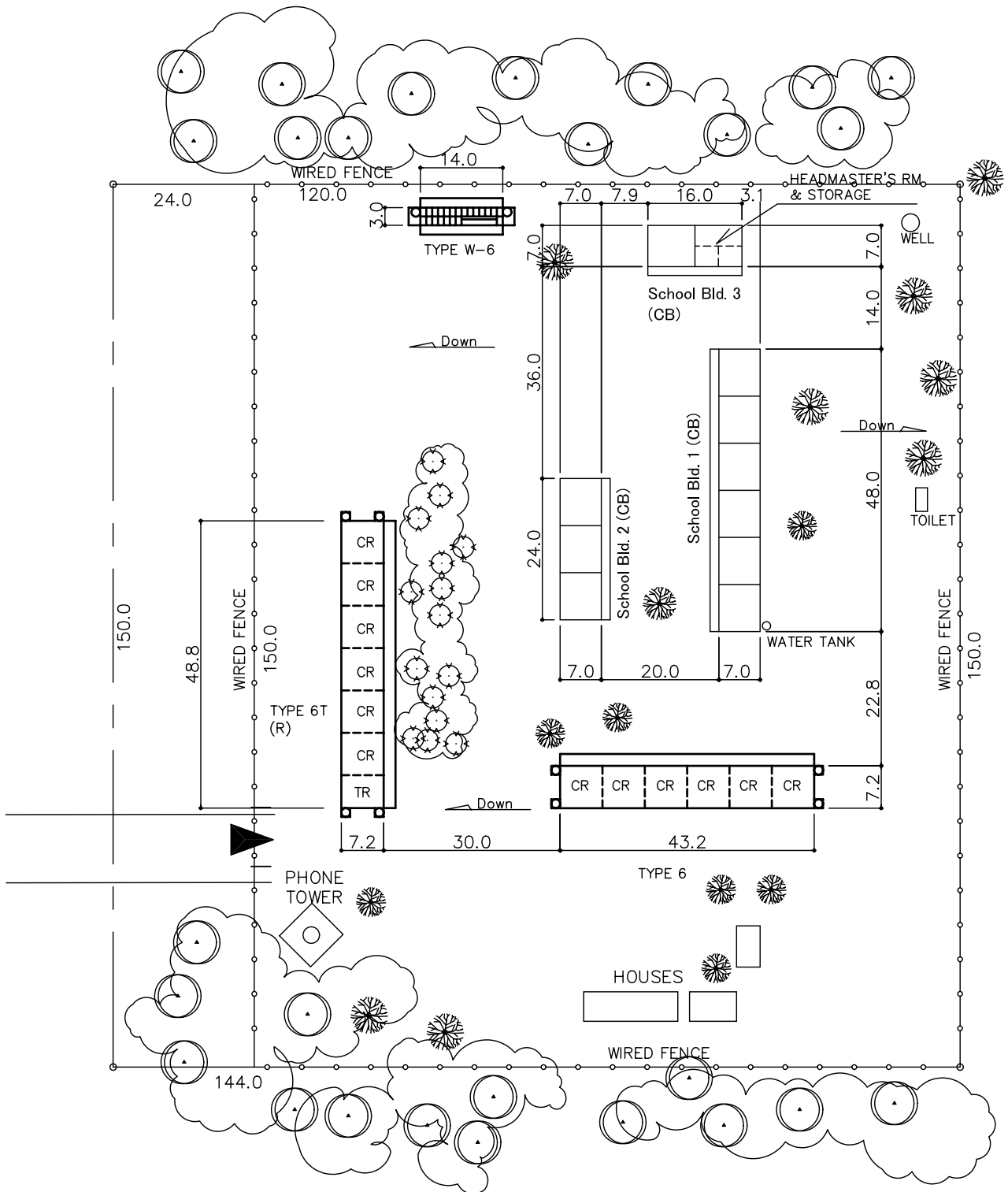

- (CB) : CONCRETE BLOCK BLDG.
- (M) : MUD BLDG.
- (B) : BRICK BLDG.
- (W) : WOOD BLDG.
- [Patterned Box] : DISUSABLE CLASS RM.

N  
SITE PLAN  
S: 1/1000

Date 2001-03-03

District, School Name

HOLY FAMILY

Site No. -05

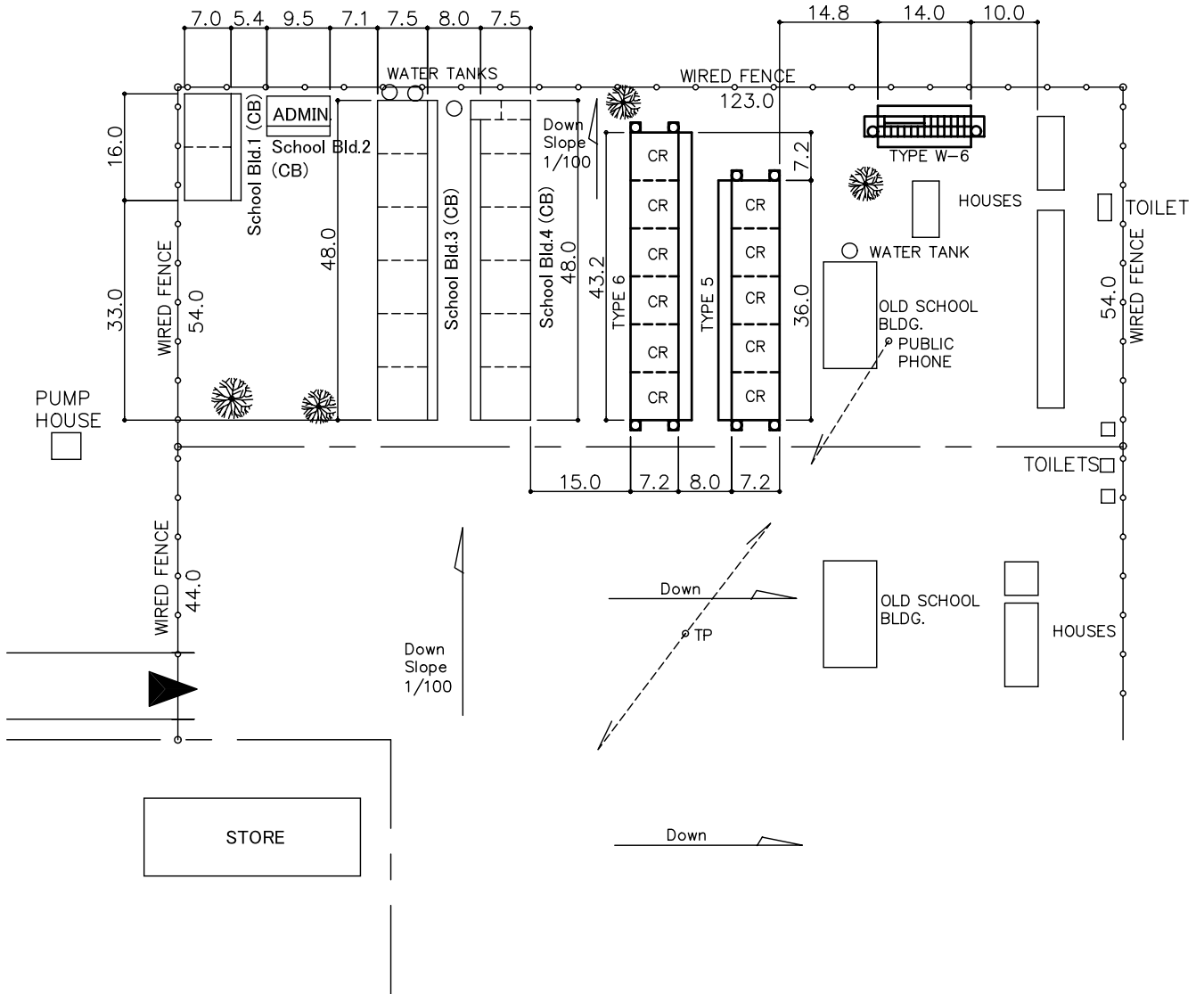

- (CB) : CONCRETE BLOCK BLDG.
- (M) : MUD BLDG.
- (B) : BRICK BLDG.
- (W) : WOOD BLDG.
- [Pattern] : DISUSABLE CLASS RM.



Date  
2001-03-01

District, School Name  
OPHONDWENI

Site No.  
- 06

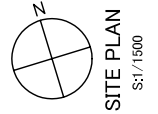

- (CB) : CONCRETE BLOCK BLDG.
- (M) : MUD BLDG.
- (B) : BRICK BLDG.
- (W) : WOOD BLDG.
- [Pattern] : DISUSABLE CLASS RM.

