

CROSS SECTION OF ROAD IN CONVEYANCE SEWER SIDE

SCALE : 1/100

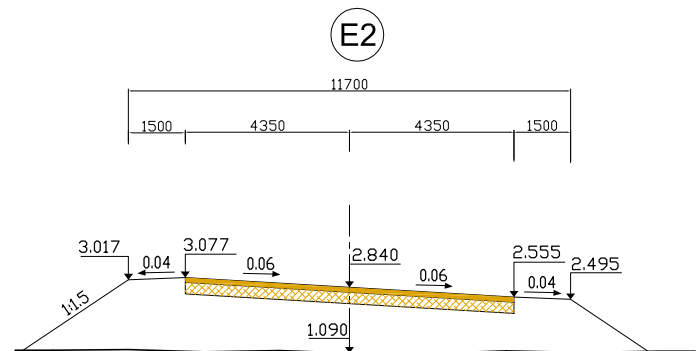

CT

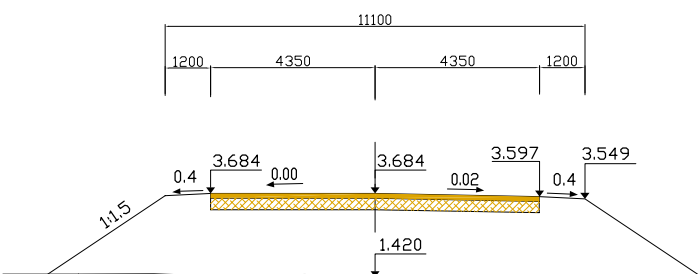

CROSS SECTION OF BRIDGE

SCALE : 1/100

3

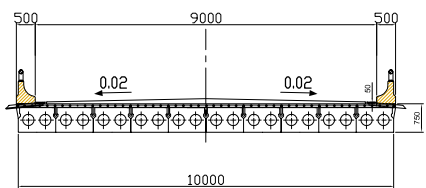

CROSS SECTION OF ROAD IN WWTP SIDE

SCALE : 1/100

B

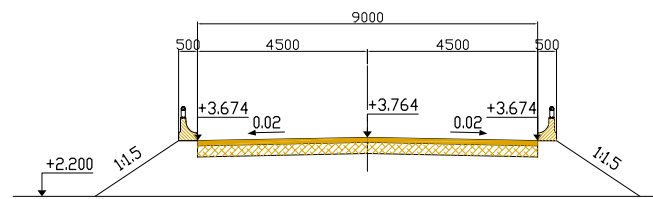

5

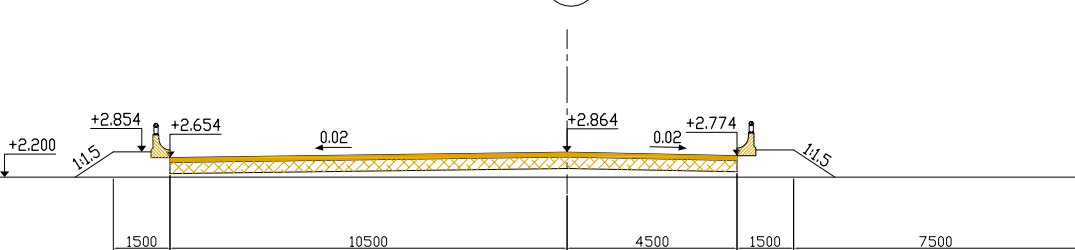

JETTY
AC PAVEMENT
TYPE P1

LAYOUT OF ROAD AT BOTH END OF TAC - RO BRIDGE

SCALE : 1/1000

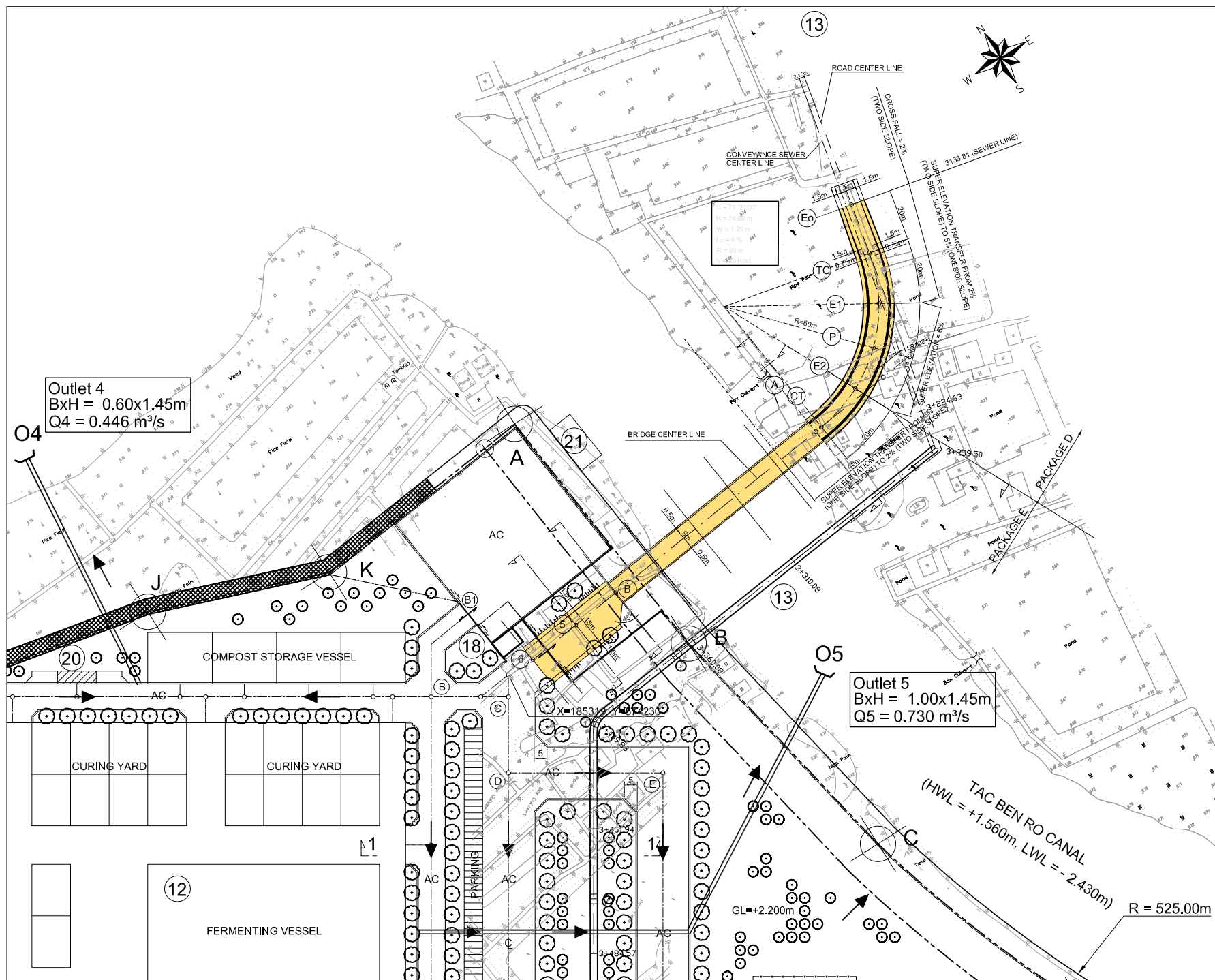

PROFILE OF BRIDGE SCALE: 1/ 1000

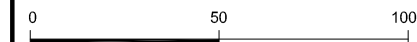
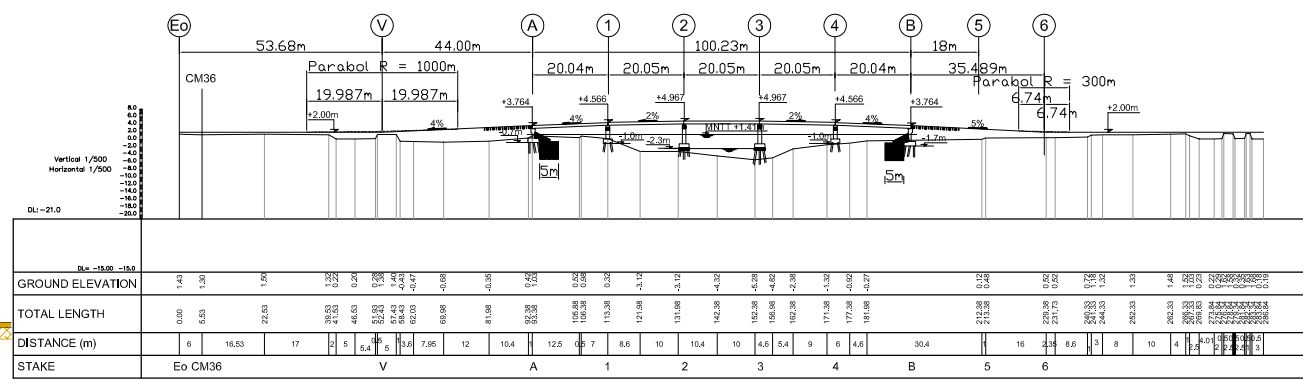

NO.	DATE	DESCRIPTIONS	BY	APRO.
REVISIONS				
PROJECT MANAGEMENT UNIT FOR HO CHI MINH CITY WATER ENVIRONMENT IMPROVEMENT				
THE DETAILED DESIGN STUDY ON HO CHI MINH CITY WATER ENVIRONMENT IMPROVEMENT PROJECT IN THE SOCIALIST REPUBLIC OF VIET NAM				
PACKAGE E WASTEWATER TREATMENT PLANT				
ROAD PLAN, SECTION AND DETAIL (No.2)				
SCALE = 1/1000, 1/100				
JICA JAPAN INTERNATIONAL COOPERATION AGENCY (JICA)				
PACIFIC CONSULTANTS INTERNATIONAL				
DESIGNED KIMURA TORU		CHECKED KONDO MASAMI		
DATE : JUNE 2001		DWG. No. PE - WWTP - 221 - 04		

NO. DATE DESCRIPTIONS BY APRO.

PROJECT MANAGEMENT UNIT FOR HO CHI MINH CITY WATER ENVIRONMENT IMPROVEMENT

THE DETAILED DESIGN STUDY ON HO CHI MINH CITY WATER ENVIRONMENT IMPROVEMENT PROJECT IN THE SOCIALIST REPUBLIC OF VIET NAM

PACKAGE E WASTEWATER TREATMENT PLANT

ROAD PLAN, SECTION AND DETAIL (No.2)

SCALE = 1/1000, 1/100

JICA JAPAN INTERNATIONAL COOPERATION AGENCY (JICA)

PACIFIC CONSULTANTS INTERNATIONAL

DESIGNED KIMURA TORU CHECKED KONDO MASAMI

DATE : JUNE 2001 DWG. No. PE - WWTP - 221 - 04

RAIN DISCHARGE PLAN OF WWTP (FINAL PHASE)

Scale: 1/ 2000

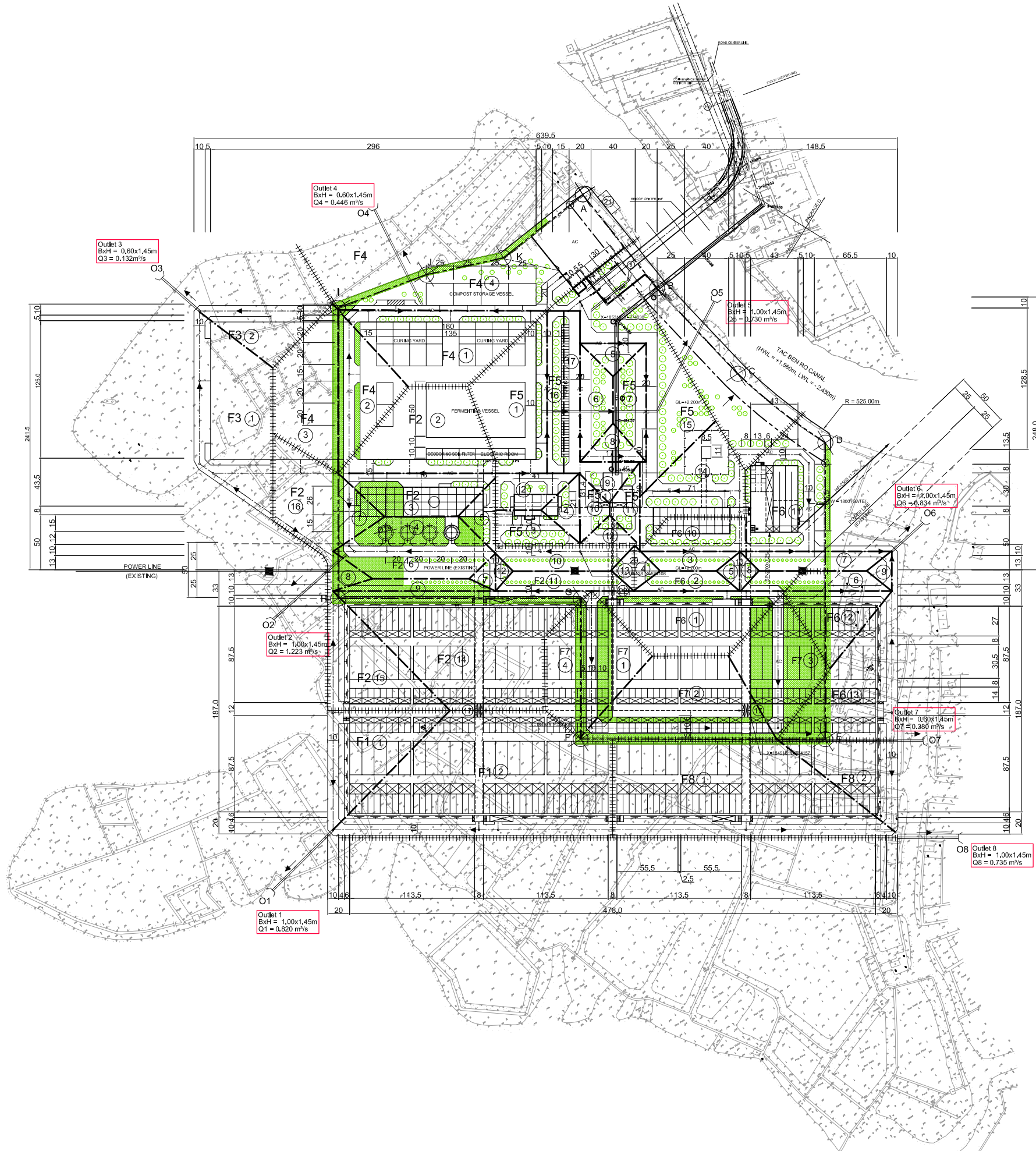
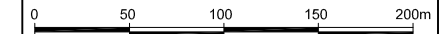

Outlet 3
BxH = 0,60x1,45m
Q3 = 0,132m³/s

Outlet 4
BxH = 0,60x1,45m
Q4 = 0,446 m³/s

Outlet 5
BxH = 1,00x1,45m
Q5 = 12,730 m³/s

Outlet 6
BxH = 2,00x1,45m
Q6 = 4,534 m³/s

Outlet 2
BxH = 1,00x1,45m
Q2 = 1,223 m³/s

Outlet 7
BxH = 0,60x1,45m
Q7 = 0,380 m³/s

Outlet 1
BxH = 1,00x1,45m
Q1 = 0,820 m³/s

Outlet 8
BxH = 1,00x1,45m
Q8 = 0,735 m³/s

Outlet No	F (ha)	Outlet No	F (ha)
O1 : Outlet Area 1		O5 : Outlet Area 5	
F1-1	0.55	F5-1	0.60
F1-2	2.25	F5-2	0.21
Sub Total	2.80	F5-3	0.21
		F5-4	0.14
		F5-5	0.09
O2 : Outlet Area 2		F5-6	0.24
F2-1	0.16	F5-7	0.24
F2-2	0.61	F5-8	0.09
F2-3	0.42	F5-9	0.06
F2-4	0.16	F5-10	0.15
F2-5	0.42	F5-11	0.15
F2-6	0.26	F5-12	0.06
F2-7	0.04	F5-13	0.06
F2-8	0.04	F5-14	0.24
F2-9	0.26	F5-15	0.48
F2-10	0.26	F5-16	0.22
F2-11	0.26	F5-17	0.22
F2-12	0.04	Sub Total	3.46
F2-13	0.04		
F2-14	1.73	O6 : Outlet Area 6	
F2-15	0.55	F6-1	0.75
F2-16	0.48	F6-2	0.16
Sub Total	5.73	F6-3	0.16
		F6-4	0.04
O3 : Outlet Area 3		F6-5	0.04
F3-1	0.90	F6-6	0.38
F3-2	0.39	F6-7	0.38
Sub Total	1.29	F6-8	0.04
		F6-9	0.04
O4 : Outlet Area 4		F6-10	0.27
F4-1	0.77	F6-11	0.48
F4-2	0.44	F6-12	0.27
F4-3	0.63	F6-13	0.60
F4-4	0.66	Sub Total	3.61
Sub Total	2.50		
		O7 : Outlet Area 7	
		F7-1	0.30
		F7-2	0.70
		F7-3	0.80
		F7-4	0.38
		Sub Total	2.18
		O8 : Outlet Area 8	
		F8-1	2.05
		F8-2	0.55
		Sub Total	2.60
		TOTAL	23.83

- CATCHING BOUNDARY OF Outlet
- DETAIL CATCHING BOUNDARY
- IN Outlet
- DITCHESE TO Outlet
- WATER FLOW DIRECTION
- AC : ASPHALT CONCRETE PAVEMENT

NO.	DATE	DESCRIPTIONS	BY	APRO.

REVISIONS

PROJECT MANAGEMENT UNIT FOR
HO CHI MINH CITY
WATER ENVIRONMENT IMPROVEMENT

THE DETAILED DESIGN STUDY ON HO CHI MINH CITY
WATER ENVIRONMENT IMPROVEMENT PROJECT
IN THE SOCIALIST REPUBLIC OF VIET NAM

PACKAGE E
WASTEWATER TREATMENT PLANT

RAIN DISCHARGE PLAN,
SECTION AND DETAIL

SCALE : 1/ 2000

JICA JAPAN INTERNATIONAL COOPERATION
AGENCY (JICA)

PACIFIC CONSULTANTS INTERNATIONAL

DESIGNED
KIMURA TORU

CHECKED
KONDO MASAMI

DATE : JUNE 2001

DWG. No. PE - WWTP - 222 - 01