

TYPICAL CROSS SECTION OF ROAD:

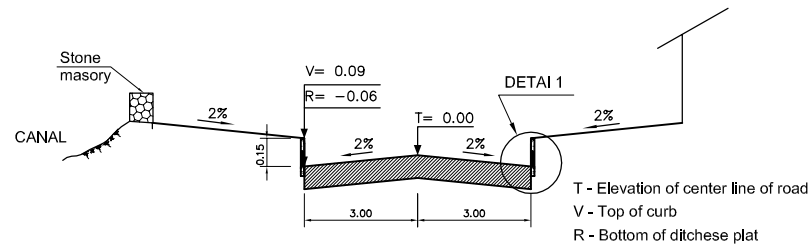

DETAIL 1:

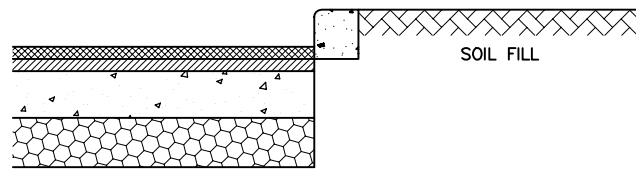

TYPICAL ROAD SURFACE:

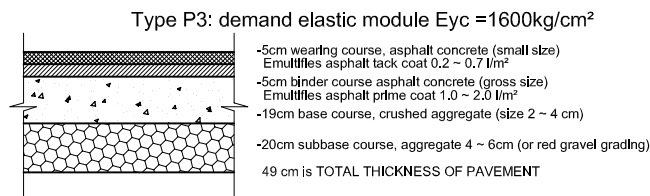

0+00

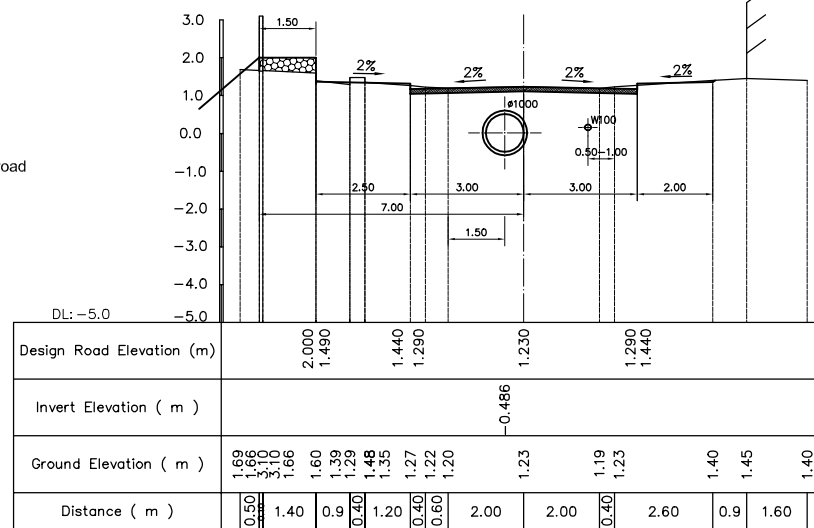

0+150

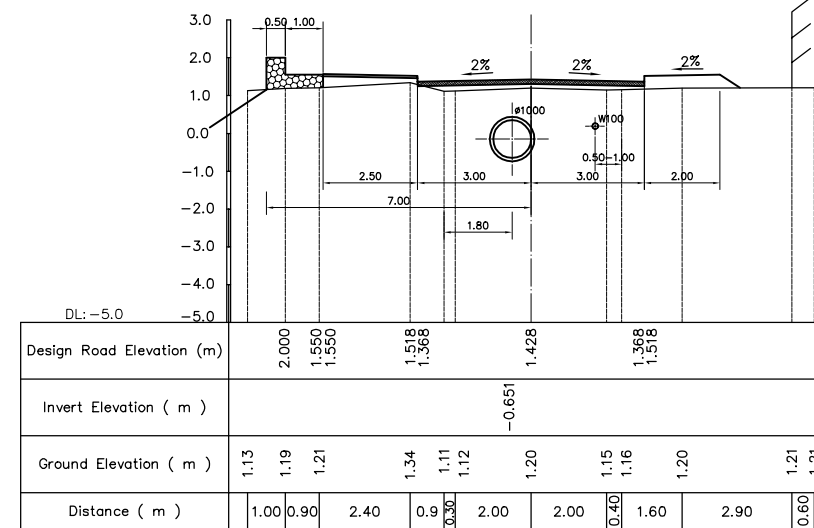

0+050

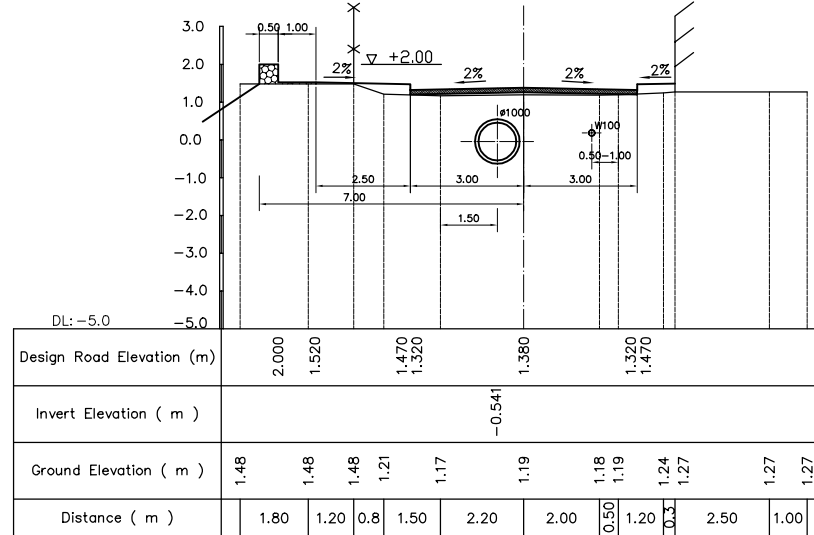

0+200

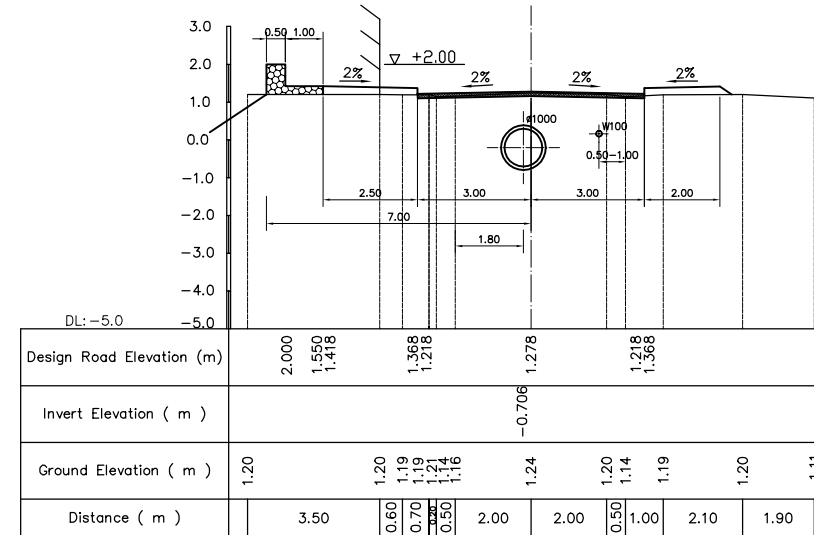

0+100

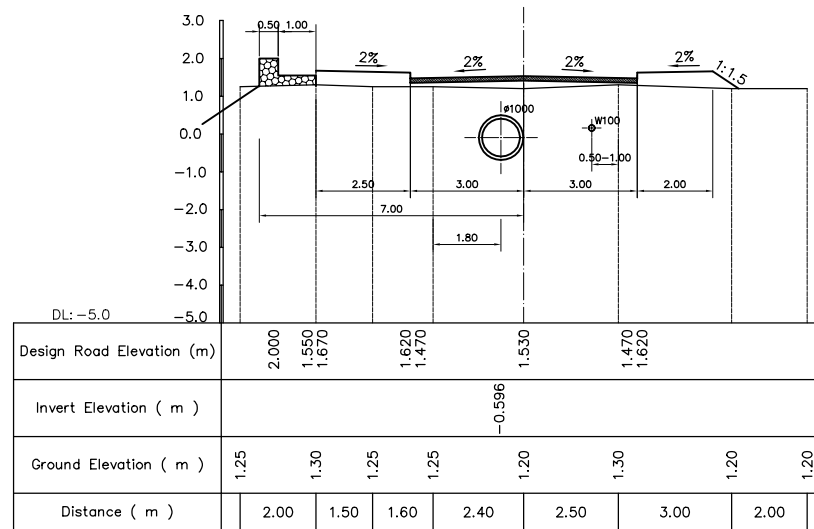

0+250

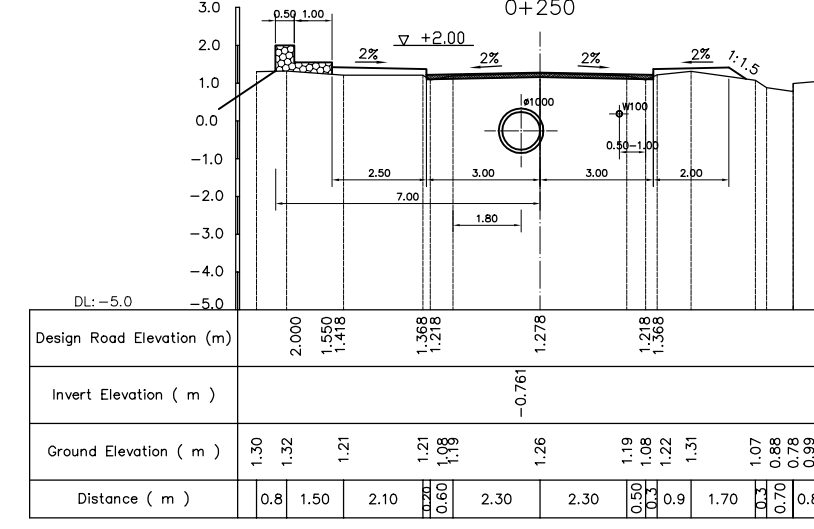

KEY MAP

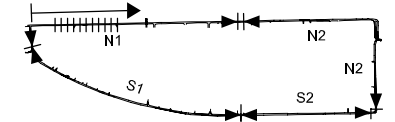

LEGEND

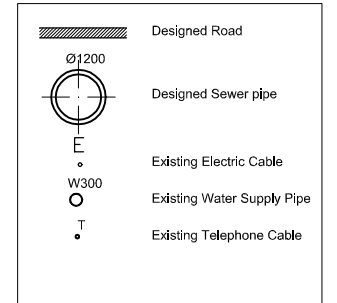

NO.	DATE	DESCRIPTIONS	BY	APRO.
REVISIONS				
PROJECT MANAGEMENT UNIT FOR HO CHI MINH CITY WATER ENVIRONMENT IMPROVEMENT				
THE DETAILED DESIGN STUDY ON HO CHI MINH CITY WATER ENVIRONMENT IMPROVEMENT PROJECT IN THE SOCIALIST REPUBLIC OF VIET NAM				
PACKAGE B PUMP DRAINAGE IMPROVEMENT BEN ME COC (2) AREA CROSS SECTION OF SEWER, ROAD AND TEMPORARY DIKE (1) BM2 - N1 (0+00 ~ 0+250)				
SCALE = 1 : 100				
JAPAN INTERNATIONAL COOPERATION AGENCY (JICA)				
PACIFIC CONSULTANTS INTERNATIONAL				
DESIGNED		CHECKED		
DATE :		DWG. No. PB - PDI - BMC2 - 218		

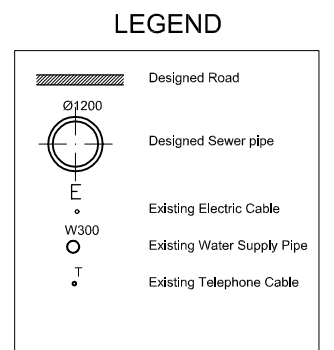
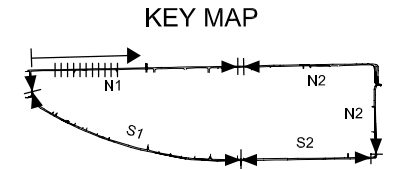
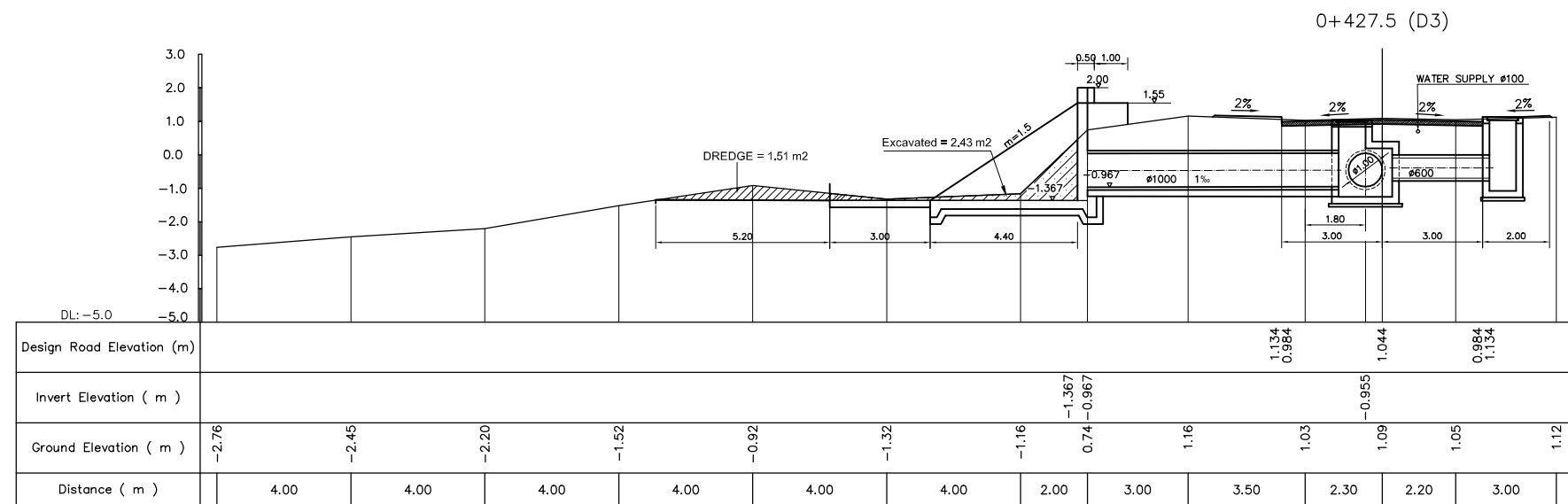
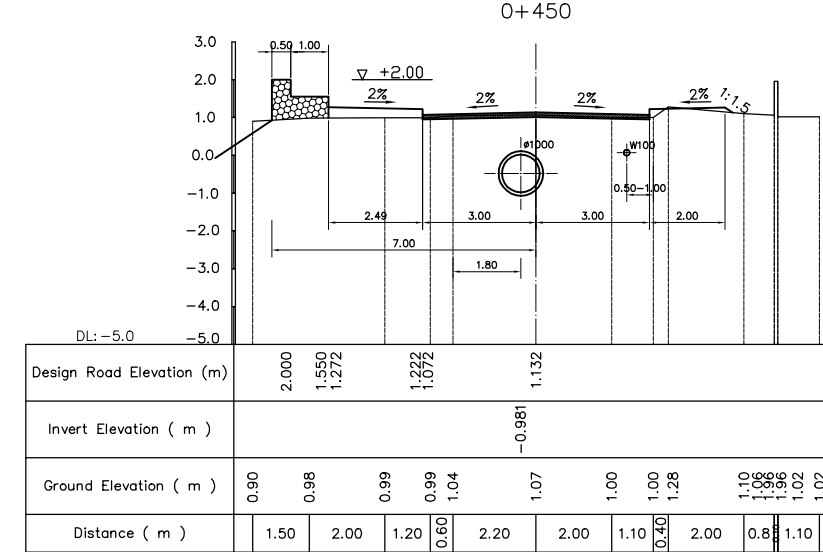
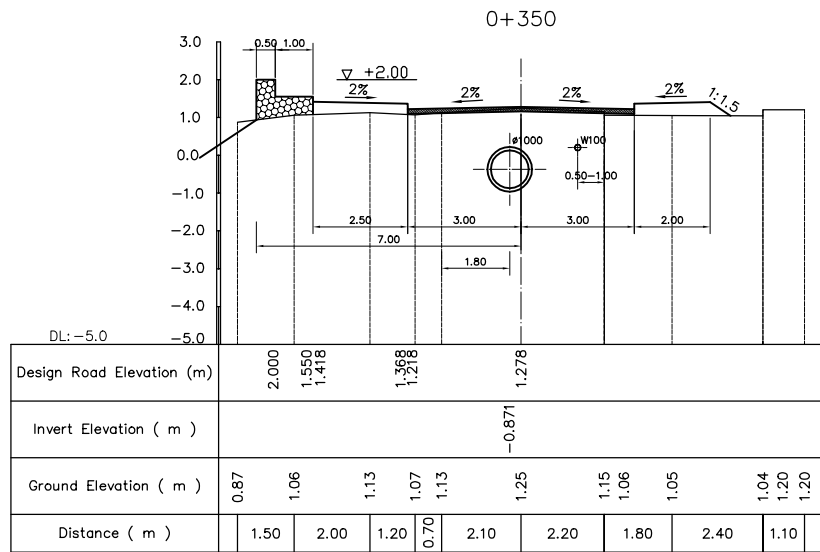
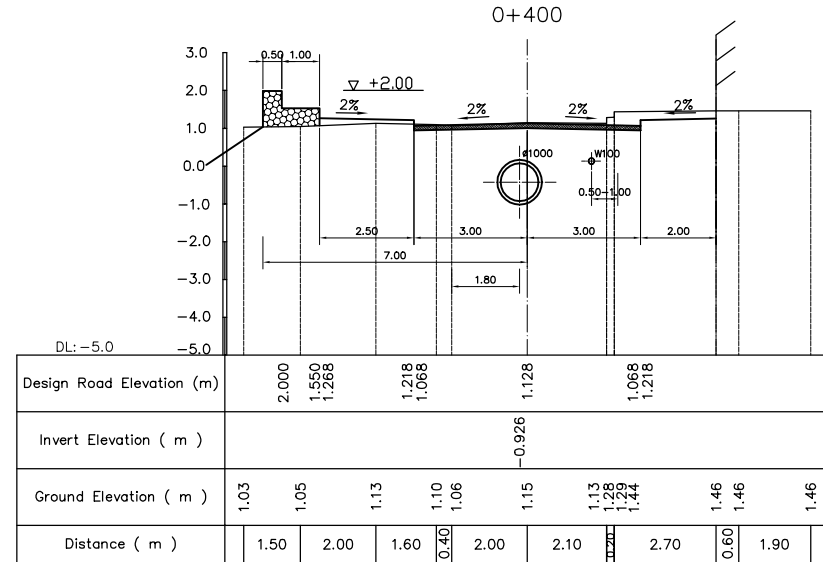
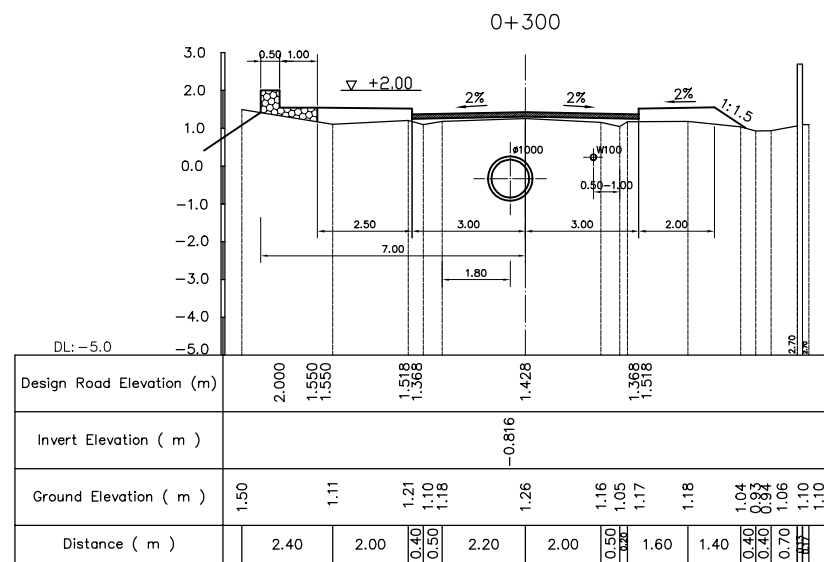

NO.	DATE	DESCRIPTIONS	BY	APRO.
REVISIONS				
PROJECT MANAGEMENT UNIT FOR HO CHI MINH CITY WATER ENVIRONMENT IMPROVEMENT				
THE DETAILED DESIGN STUDY ON HO CHI MINH CITY WATER ENVIRONMENT IMPROVEMENT PROJECT IN THE SOCIALIST REPUBLIC OF VIET NAM				
PACKAGE B PUMP DRAINAGE IMPROVEMENT BEN ME COC (2) AREA CROSS SECTION OF SEWER, ROAD AND TEMPORARY DIKE (2) BM2 - N1 (0+300 ~ 0+450)				
SCALE = 1 : 100				
JAPAN INTERNATIONAL COOPERATION AGENCY (JICA)				
PACIFIC CONSULTANTS INTERNATIONAL				
DESIGNED		CHECKED		
DATE :		DWG. No. PB - PDI - BMC2 - 219		

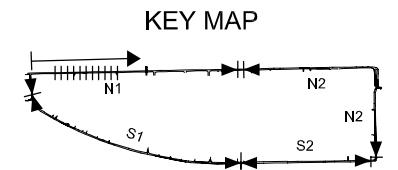
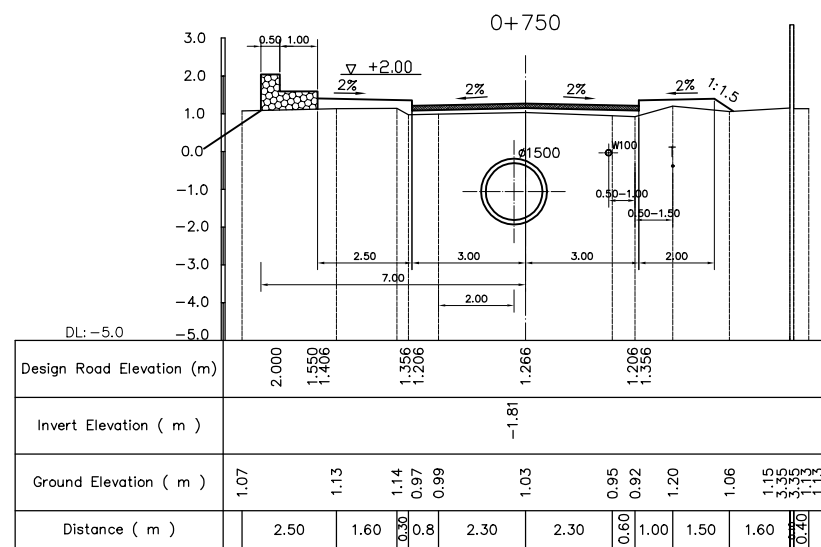
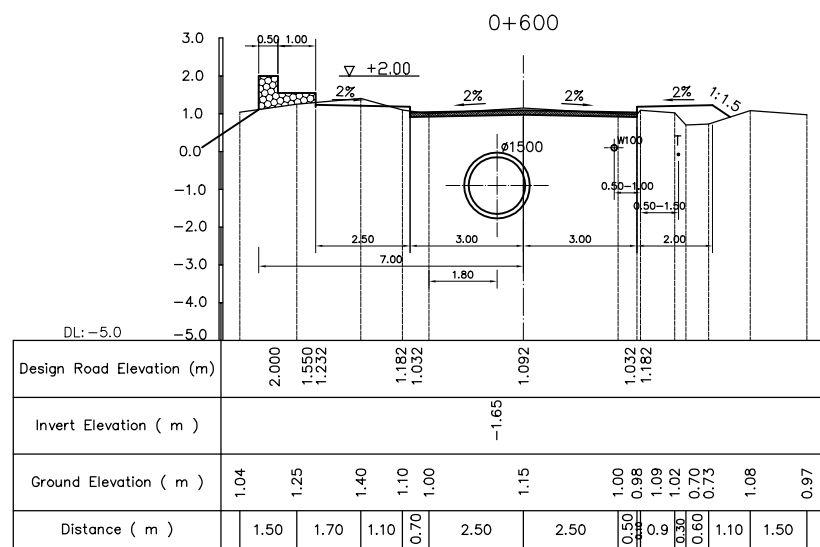
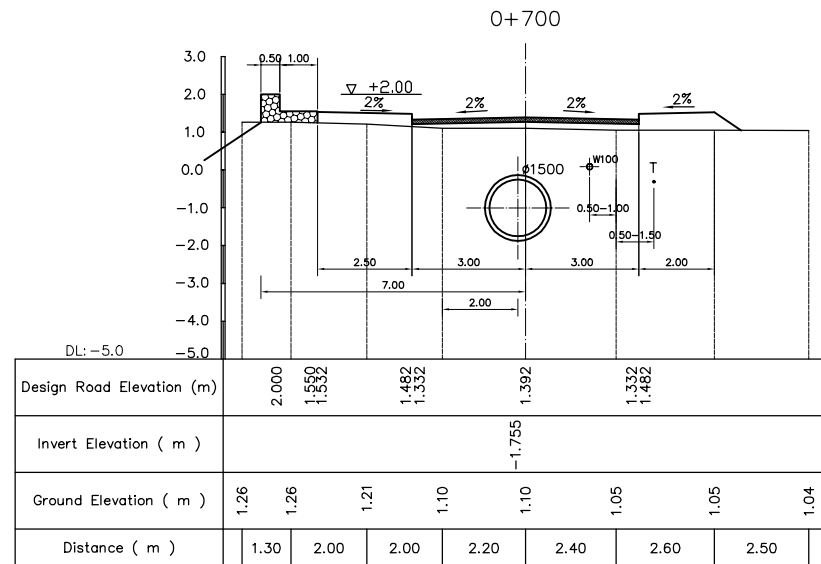
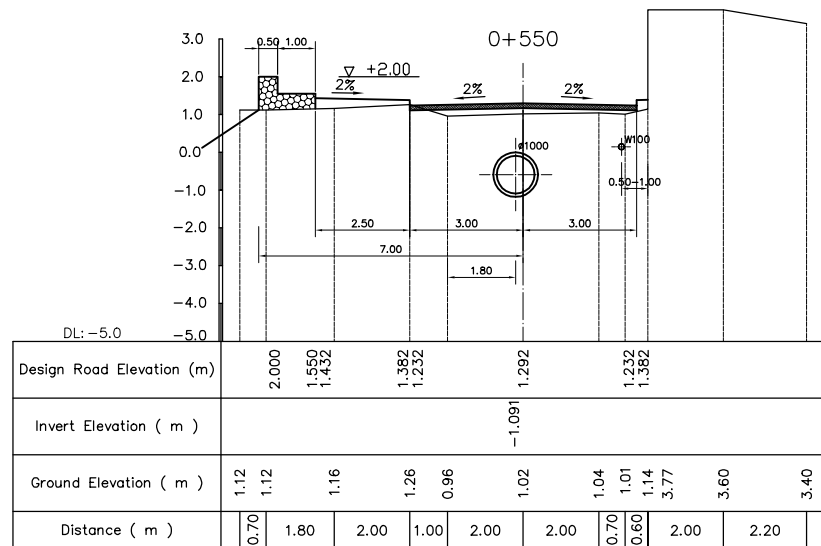
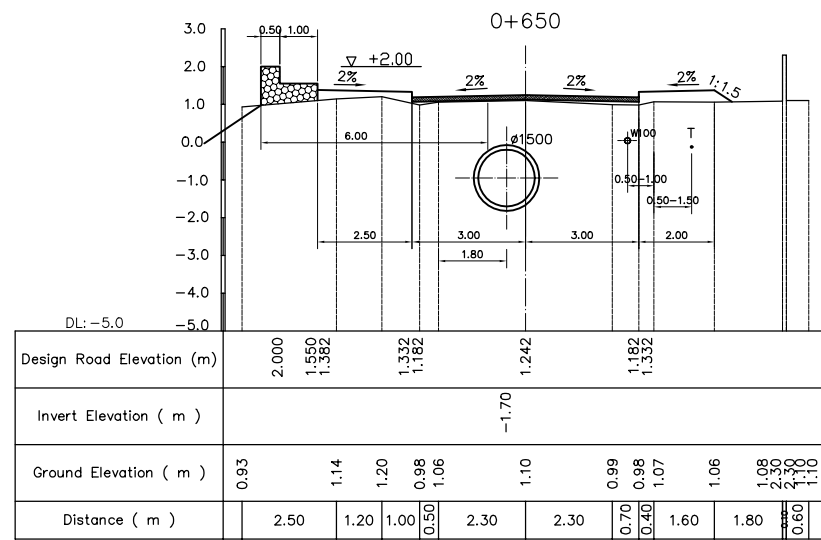
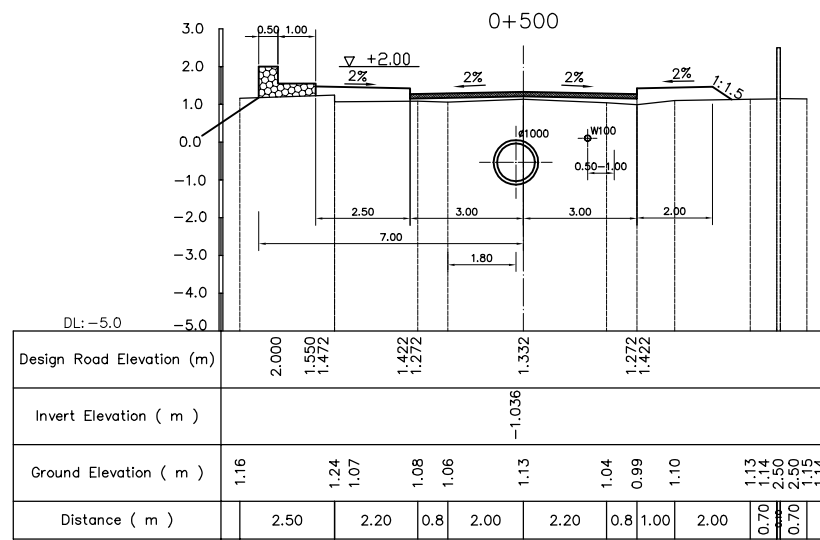

LEGEND

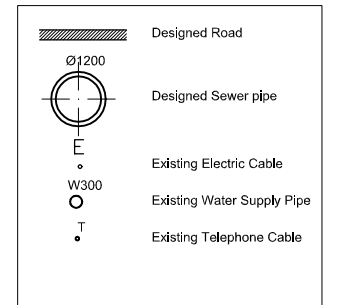

NO.	DATE	DESCRIPTIONS	BY	APRO.

REVISIONS

PROJECT MANAGEMENT UNIT FOR
HO CHI MINH CITY
WATER ENVIRONMENT IMPROVEMENT

THE DETAILED DESIGN STUDY ON HO CHI MINH CITY
WATER ENVIRONMENT IMPROVEMENT PROJECT
IN THE SOCIALIST REPUBLIC OF VIET NAM

PACKAGE B
PUMP DRAINAGE IMPROVEMENT
BEN ME COC (2) AREA
CROSS SECTION OF SEWER,
ROAD AND TEMPORARY DIKE (3)
BM2 - N1 (0+500 ~ 0+750)

SCALE = 1 : 100

JICA JAPAN INTERNATIONAL COOPERATION
AGENCY (JICA)

PACIFIC CONSULTANTS INTERNATIONAL

DESIGNED _____ CHECKED _____

DATE : _____ DWG. No. PB - PDI - BMC2 - 220

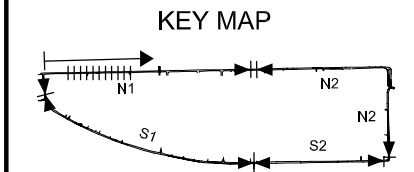
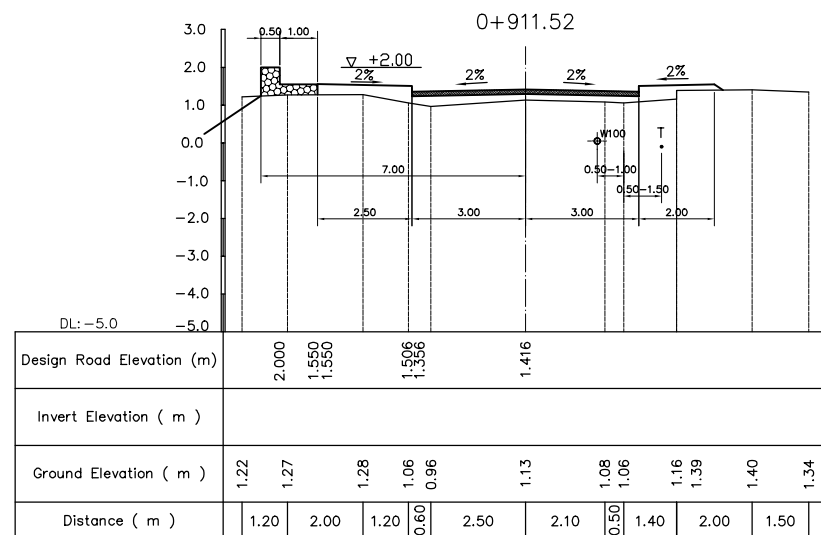
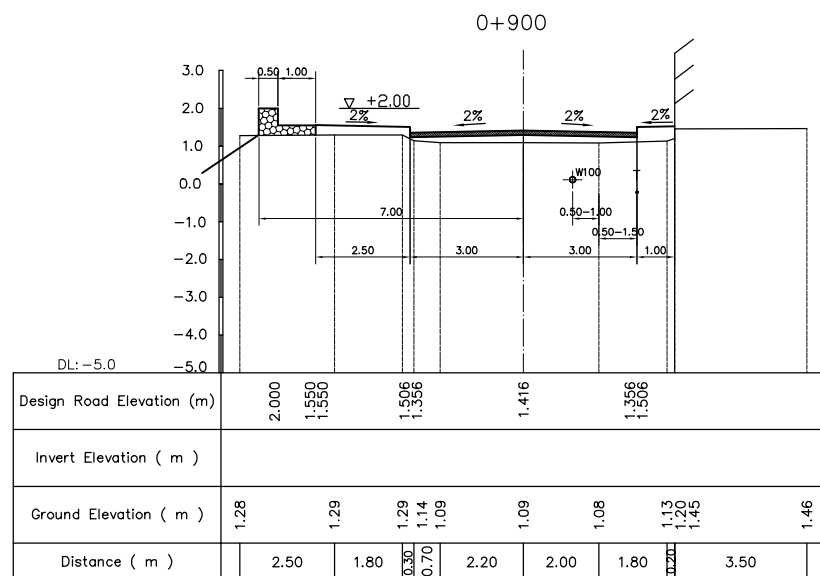
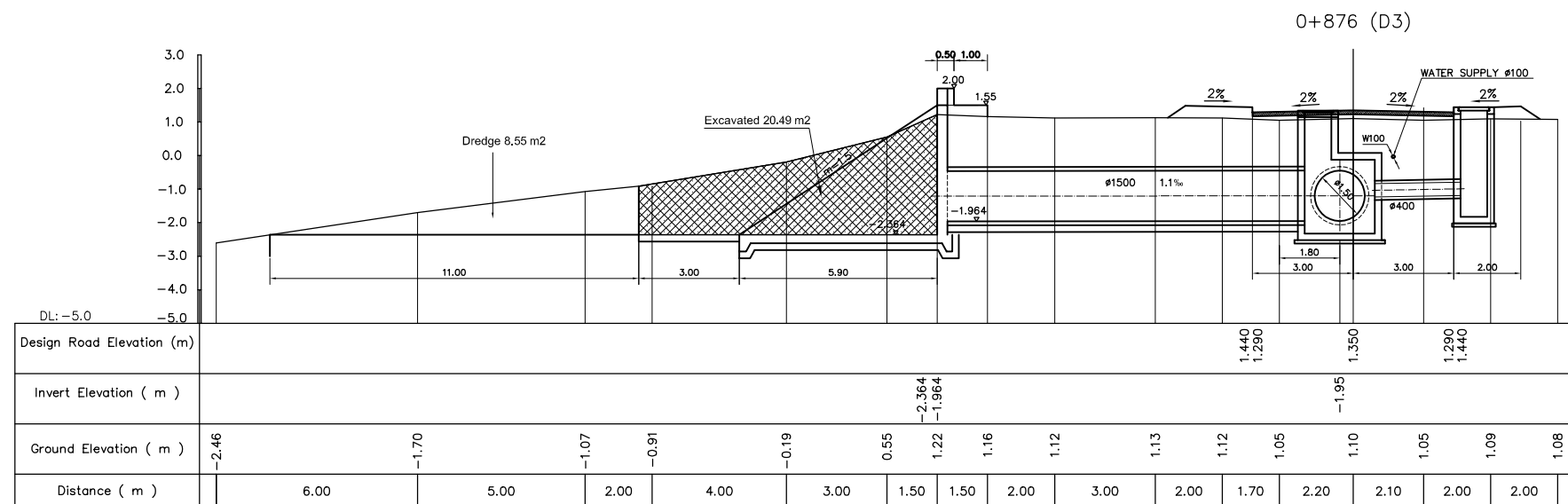
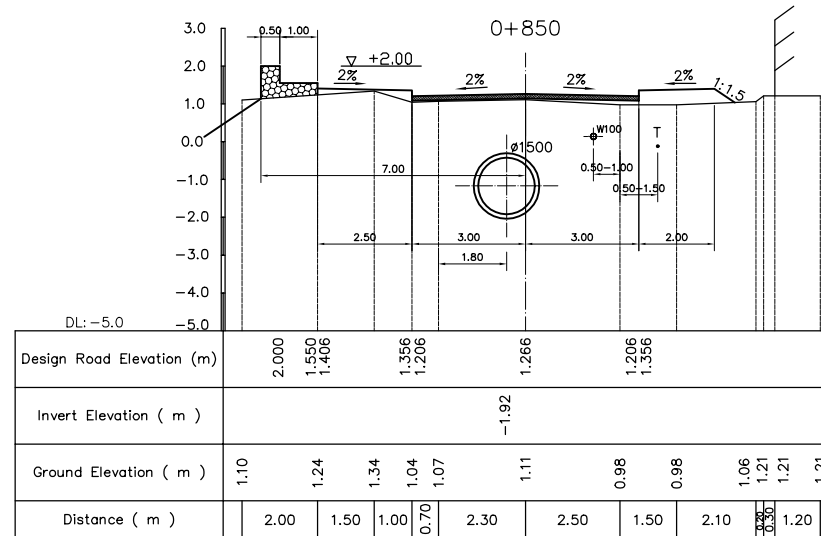
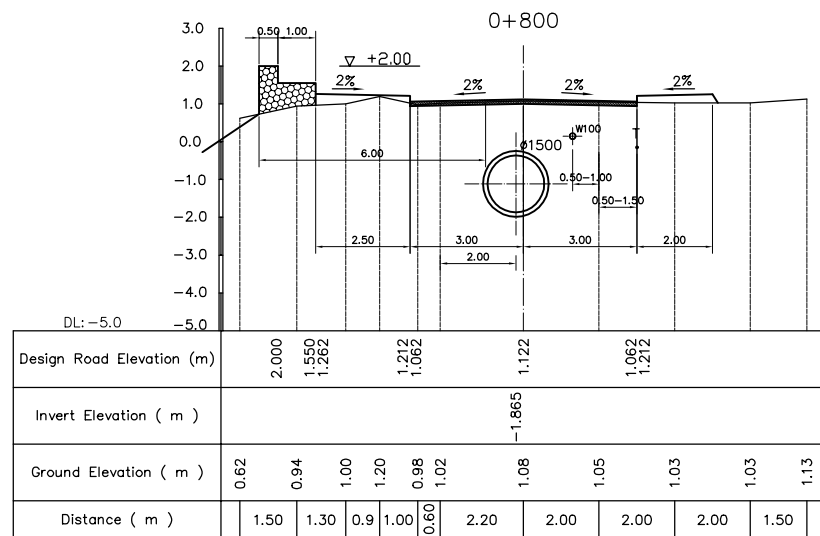

LEGEND

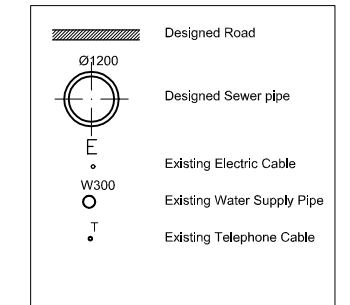

NO.	DATE	DESCRIPTIONS	BY	APRO.

REVISIONS

PROJECT MANAGEMENT UNIT FOR
HO CHI MINH CITY
WATER ENVIRONMENT IMPROVEMENT

THE DETAILED DESIGN STUDY ON HO CHI MINH CITY
WATER ENVIRONMENT IMPROVEMENT PROJECT
IN THE SOCIALIST REPUBLIC OF VIET NAM

PACKAGE B
PUMP DRAINAGE IMPROVEMENT
BEN ME COC (2) AREA
**CROSS SECTION OF SEWER,
ROAD AND TEMPORARY DIKE (4)**
BM2 - N1 (0+800 ~ 0+911.52)

SCALE = 1 : 100

JAPAN INTERNATIONAL COOPERATION AGENCY (JICA)

PACIFIC CONSULTANTS INTERNATIONAL

DESIGNED	CHECKED
DATE :	DWG. No. PB - PDI - BMC2 - 221

TYPICAL CROSS SECTION OF ROAD:

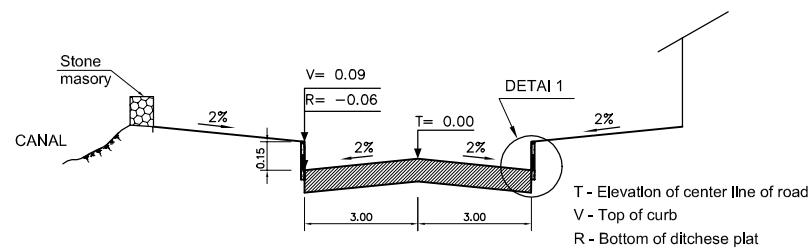

TYPICAL CROSS SECTION OF ROAD:

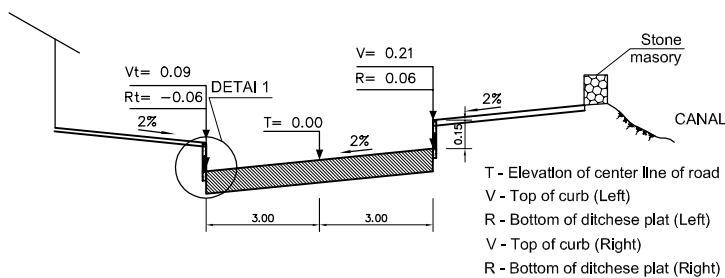

DETAIL 1:

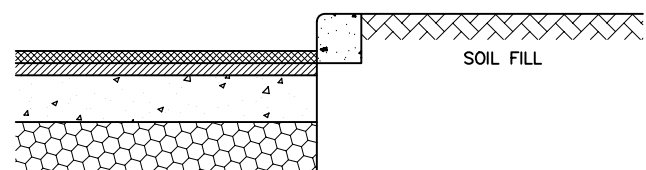

TYPICAL ROAD SURFACE:

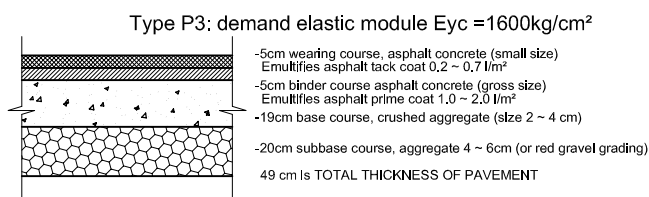

KEY MAP

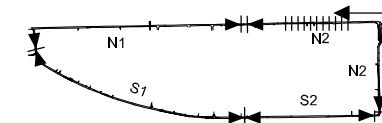

LEGEND

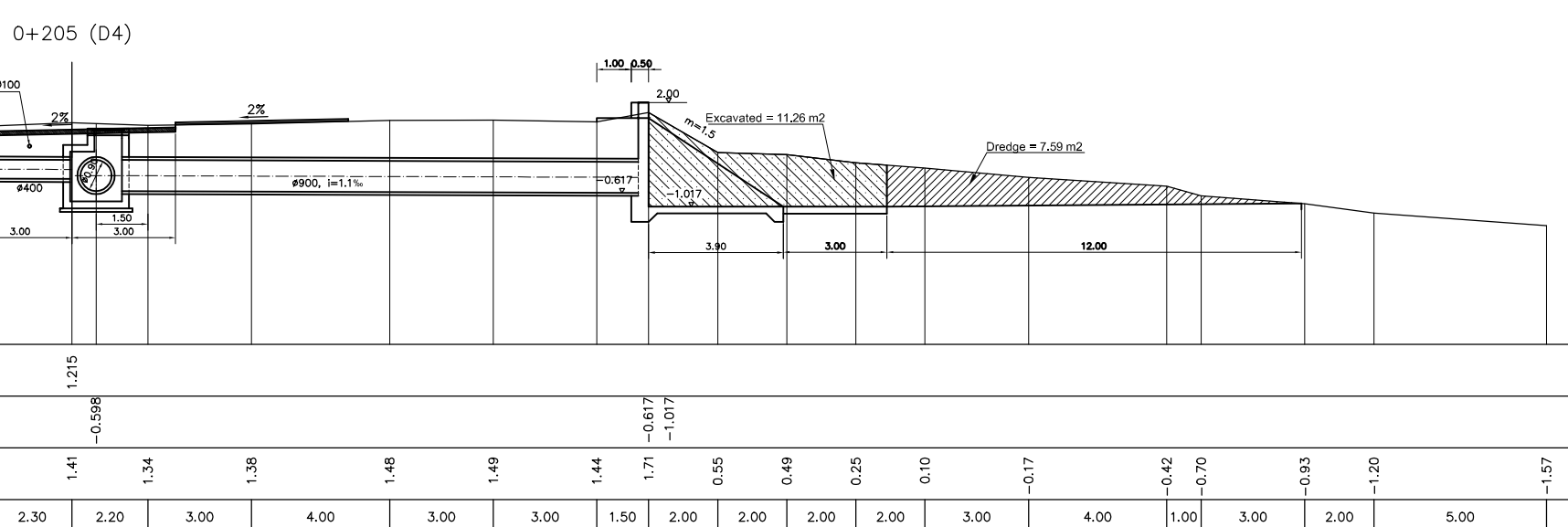
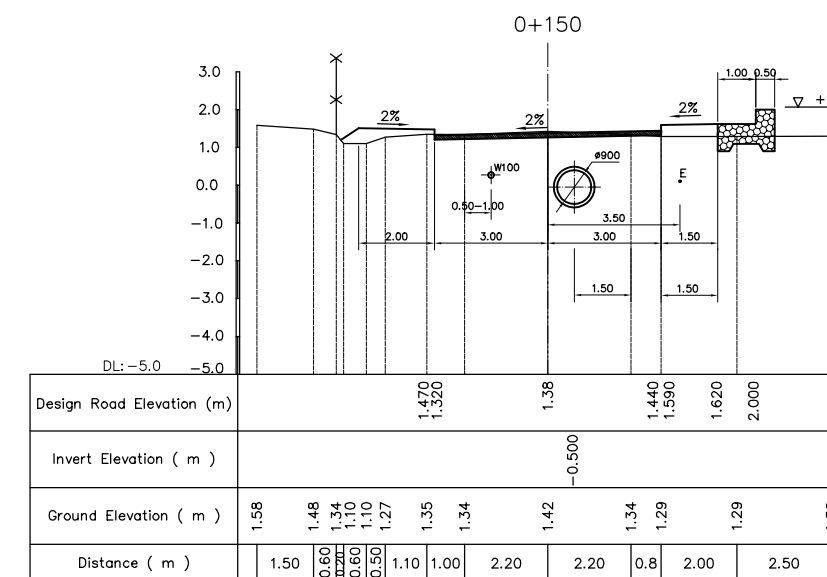
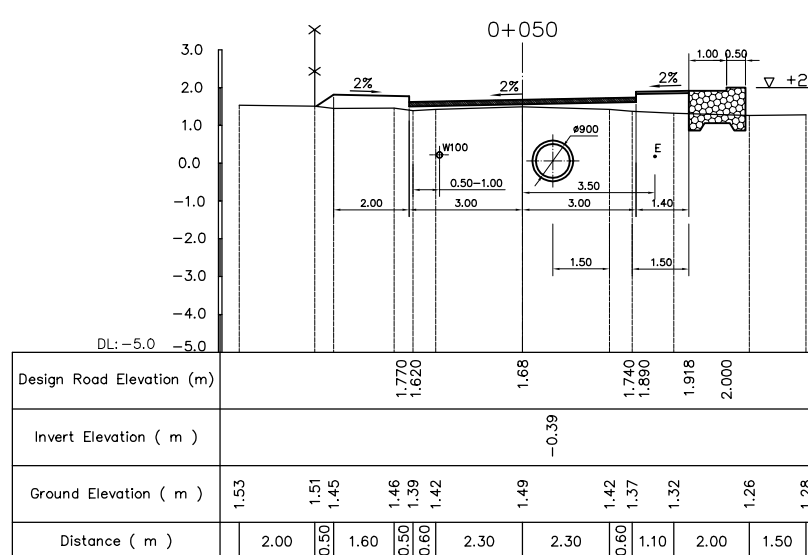
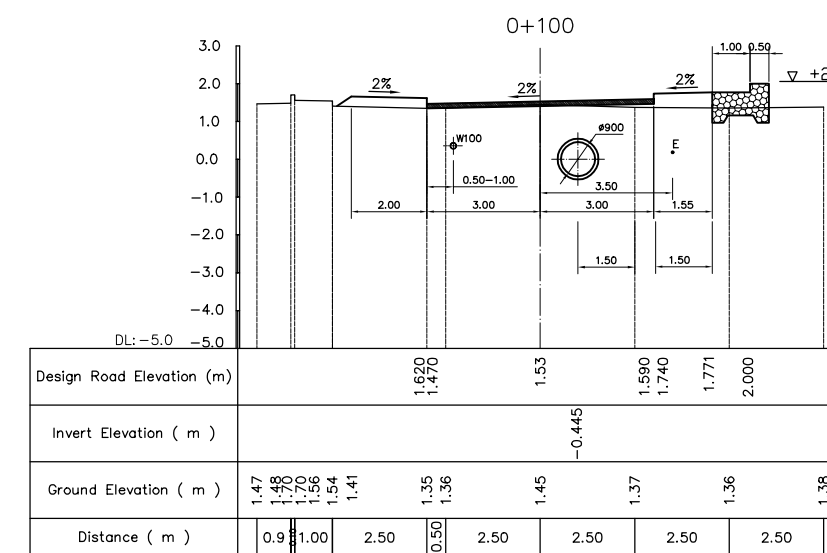
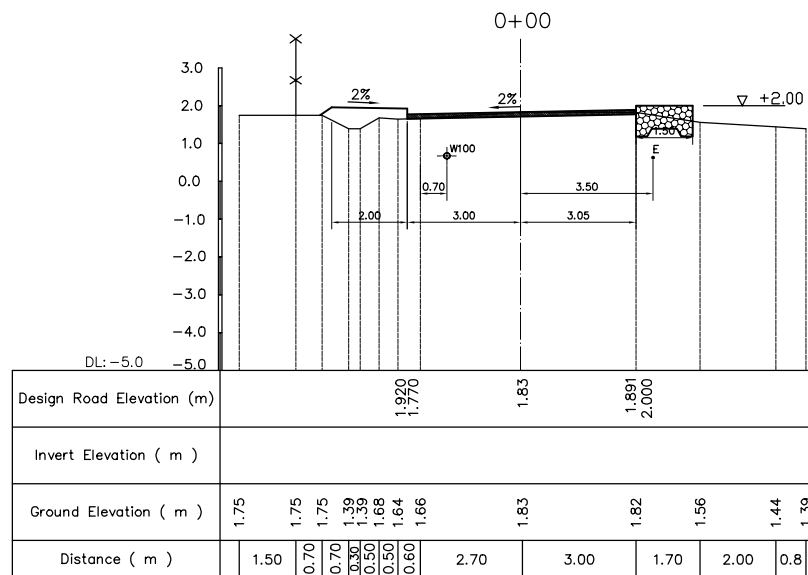
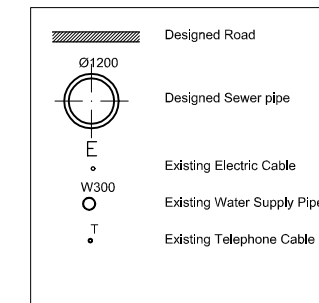

NO.	DATE	DESCRIPTIONS	BY	APRO.
REVISIONS				
PROJECT MANAGEMENT UNIT FOR HO CHI MINH CITY WATER ENVIRONMENT IMPROVEMENT				
THE DETAILED DESIGN STUDY ON HO CHI MINH CITY WATER ENVIRONMENT IMPROVEMENT PROJECT IN THE SOCIALIST REPUBLIC OF VIET NAM				
PACKAGE B PUMP DRAINAGE IMPROVEMENT BEN ME COC (2) AREA CROSS SECTION OF SEWER, ROAD AND TEMPORARY DIKE (5) BM2 - N2 (0+00 ~ 0+205)				
SCALE = 1 : 100				
JICA JAPAN INTERNATIONAL COOPERATION AGENCY (JICA)				
PACIFIC CONSULTANTS INTERNATIONAL				
DESIGNED		CHECKED		
DATE :		DWG. No. PB - PDI - BMC2 - 222		

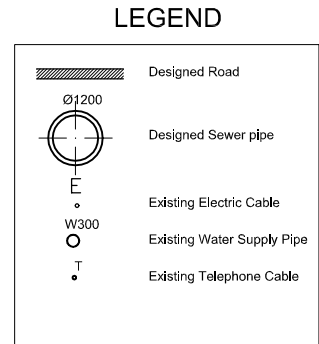
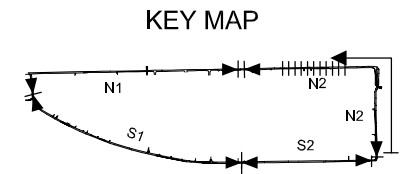
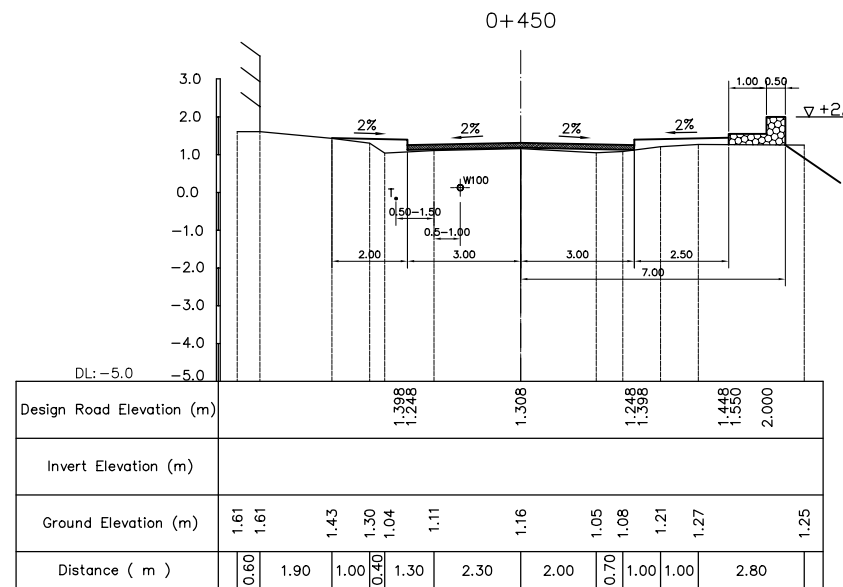
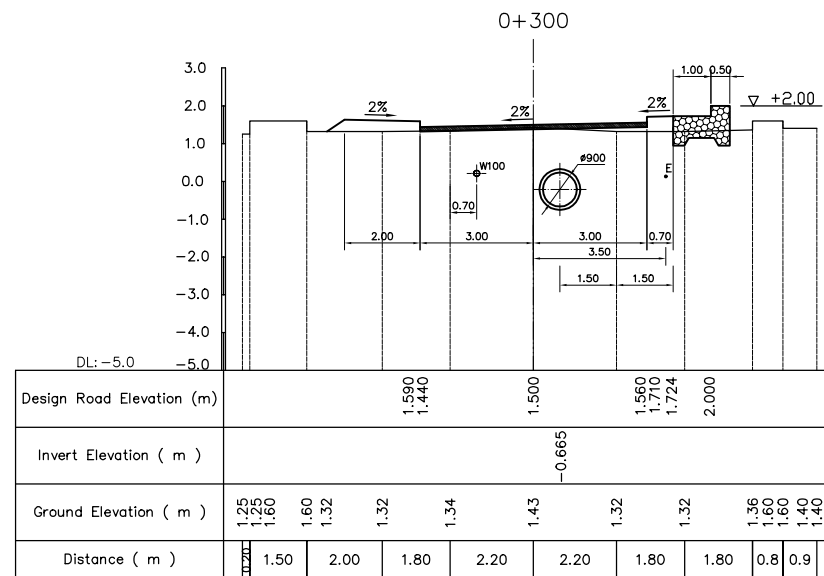
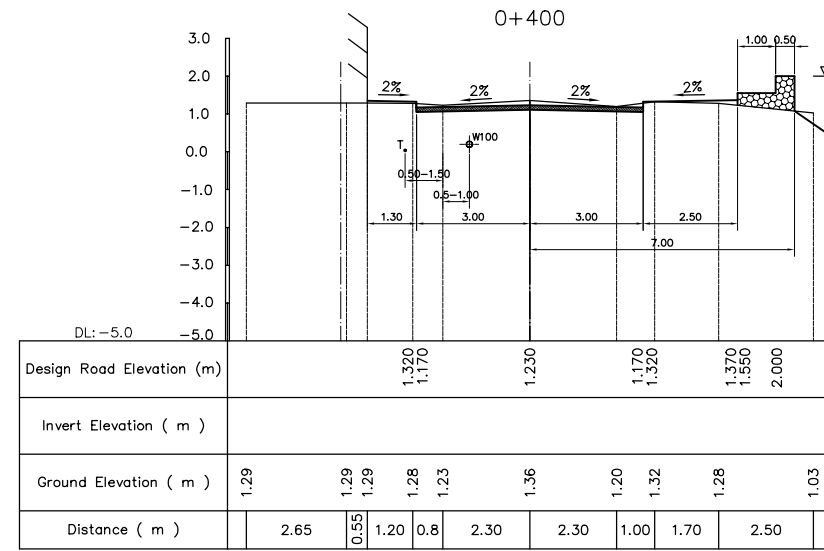
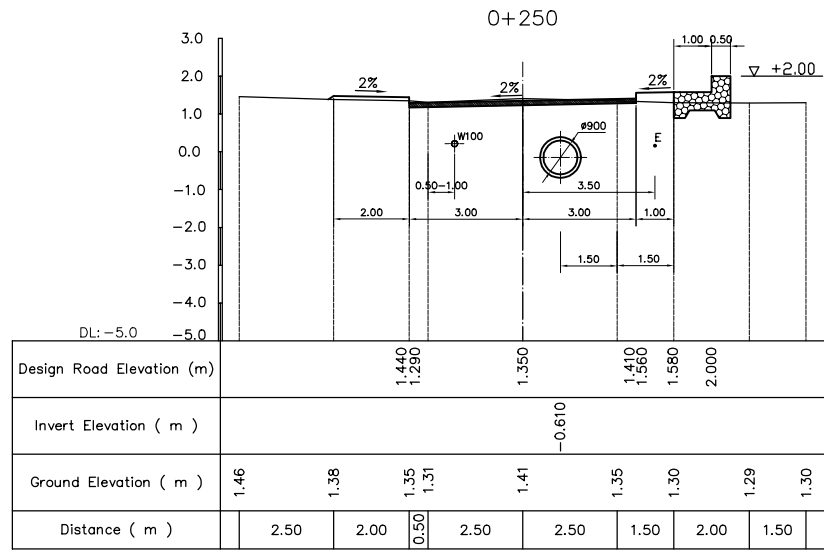
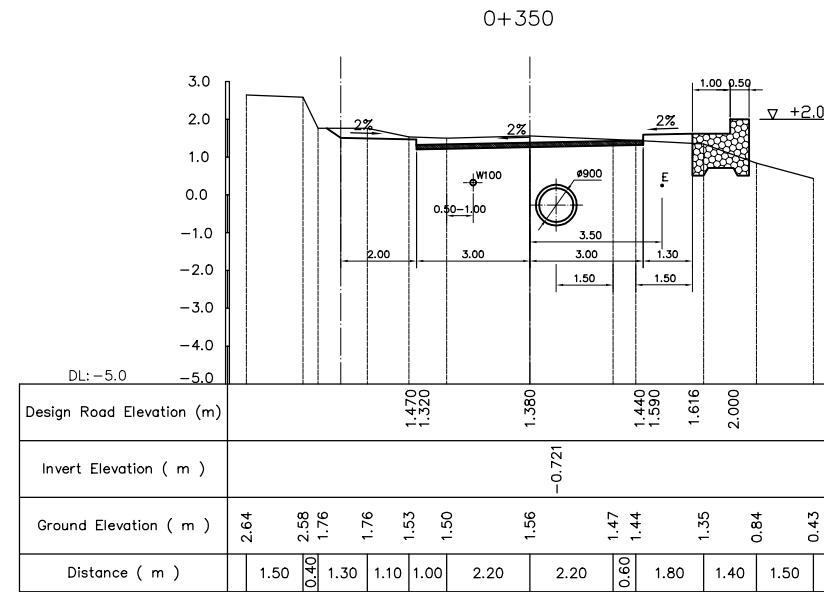
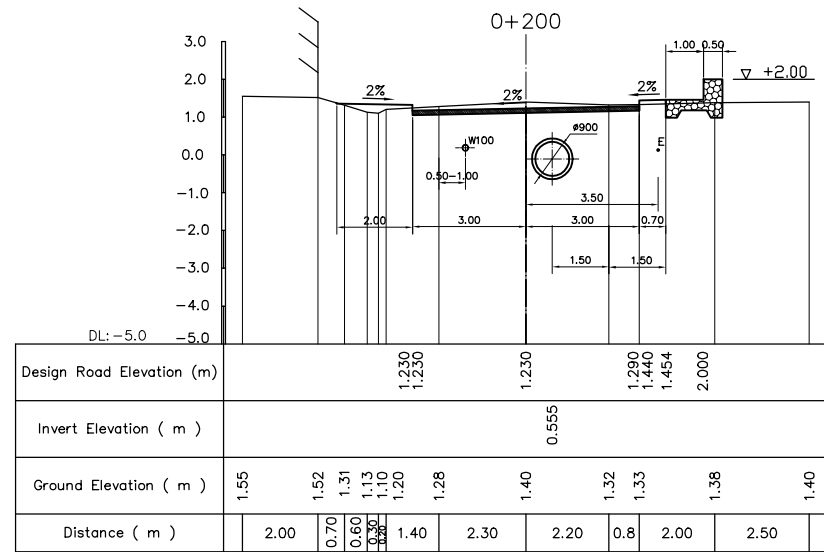

NO.	DATE	DESCRIPTIONS	BY	APRO.

REVISIONS

PROJECT MANAGEMENT UNIT FOR
HO CHI MINH CITY
WATER ENVIRONMENT IMPROVEMENT

THE DETAILED DESIGN STUDY ON HO CHI MINH CITY
WATER ENVIRONMENT IMPROVEMENT PROJECT
IN THE SOCIALIST REPUBLIC OF VIET NAM

PACKAGE B
PUMP DRAINAGE IMPROVEMENT
BEN ME COC (2) AREA
CROSS SECTION OF SEWER,
ROAD AND TEMPORARY DIKE (6)
BM2 - N2 (0+200 ~ 0+450)

SCALE = 1 : 100

JAPAN INTERNATIONAL COOPERATION AGENCY (JICA)

PACIFIC CONSULTANTS INTERNATIONAL

DESIGNED	CHECKED
DATE :	DWG. No. PB - PDI - BMC2 - 223

KEY MAP

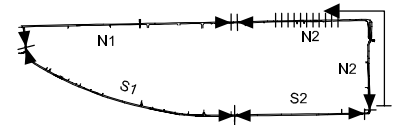

LEGEND

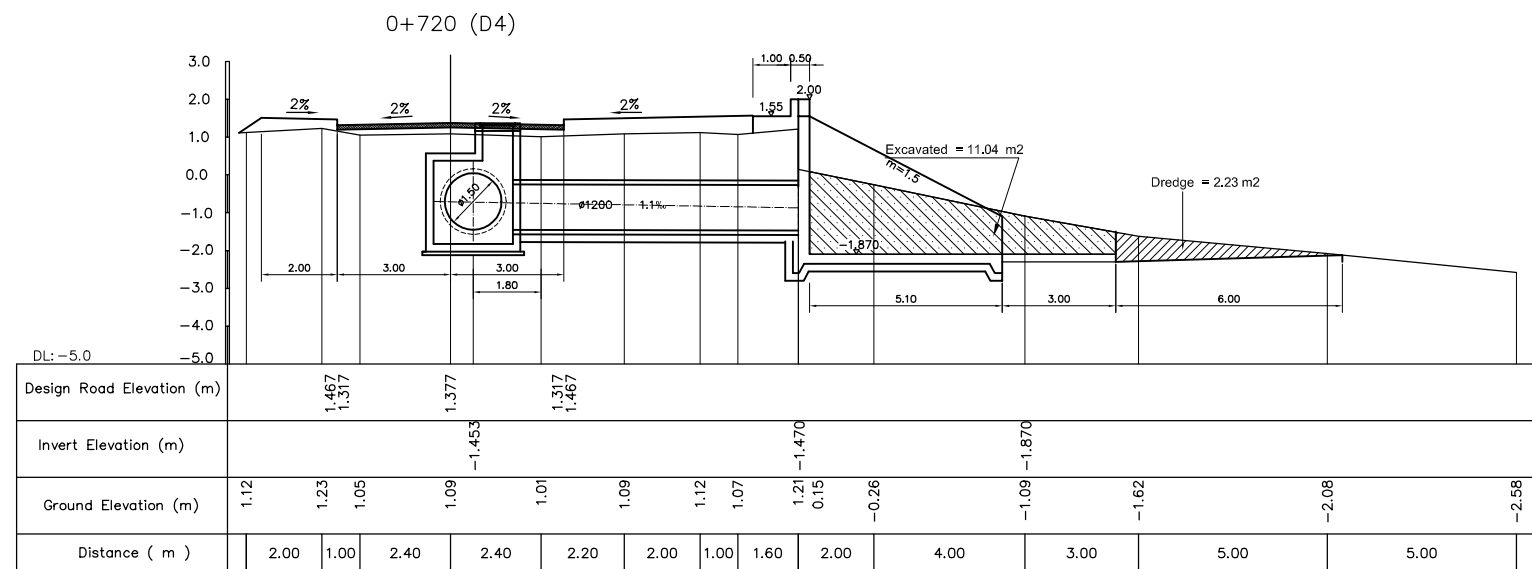
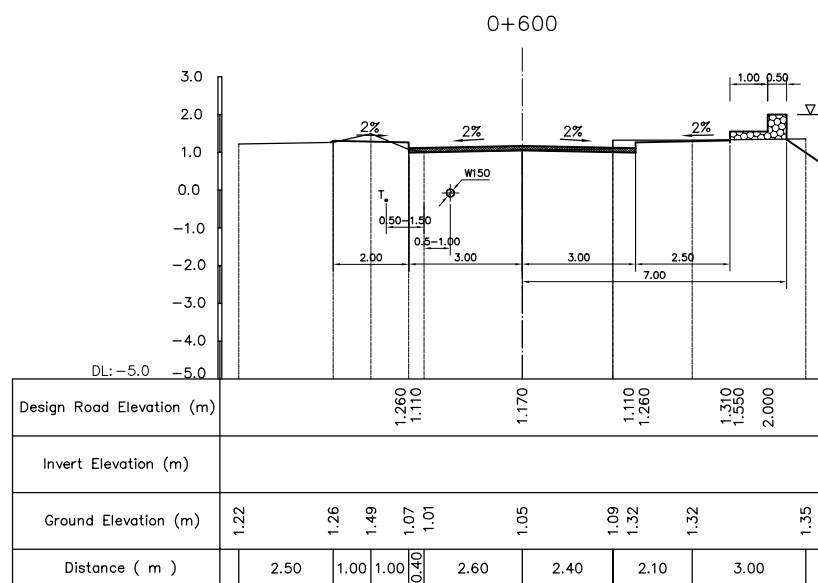
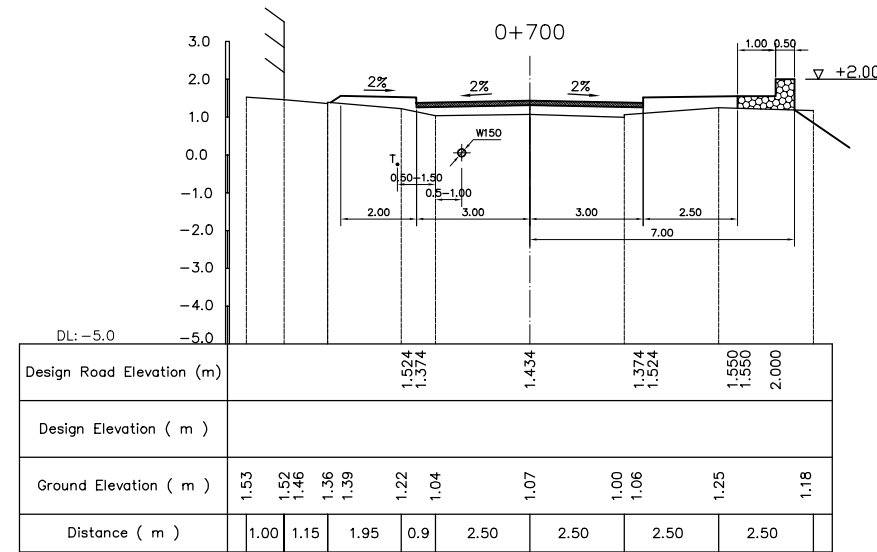
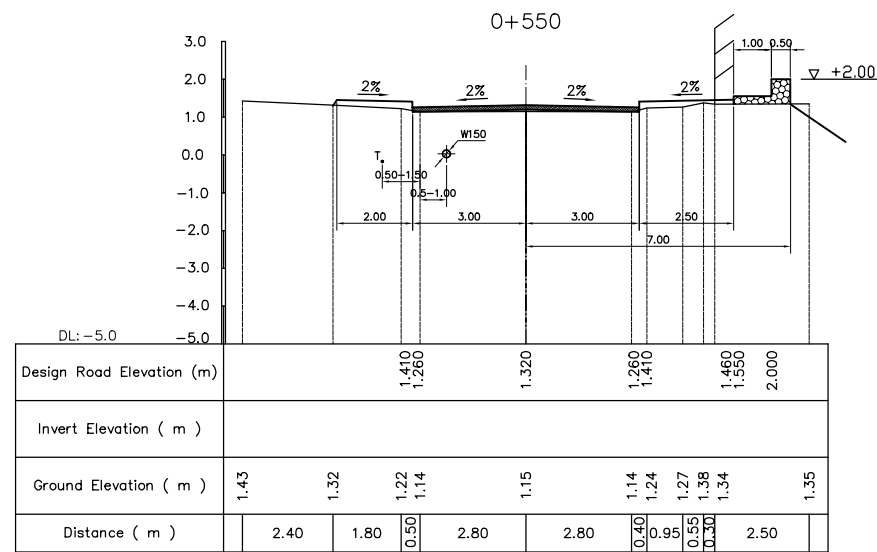
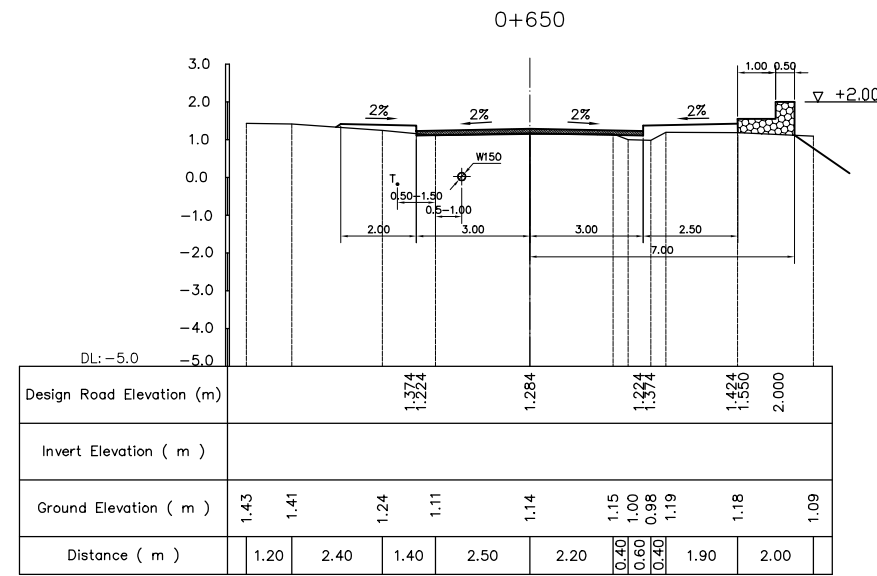
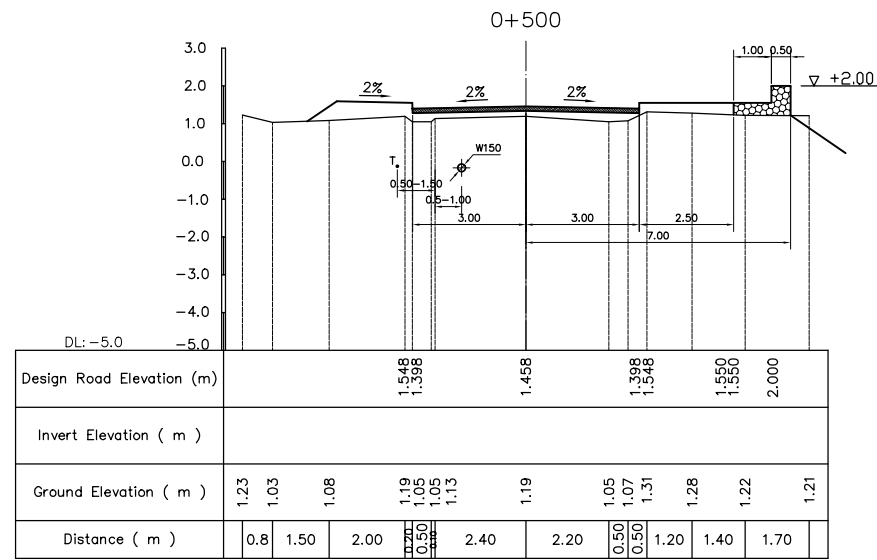
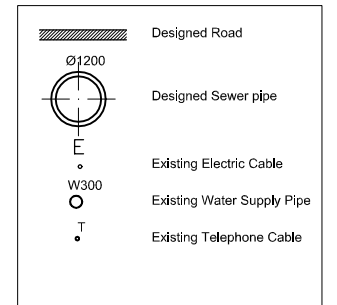

NO.	DATE	DESCRIPTIONS	BY	APRO.
REVISIONS				
PROJECT MANAGEMENT UNIT FOR HO CHI MINH CITY WATER ENVIRONMENT IMPROVEMENT				
THE DETAILED DESIGN STUDY ON HO CHI MINH CITY WATER ENVIRONMENT IMPROVEMENT PROJECT IN THE SOCIALIST REPUBLIC OF VIET NAM				
PACKAGE B PUMP DRAINAGE IMPROVEMENT BEN ME COC (2) AREA CROSS SECTION OF SEWER, ROAD AND TEMPORARY DIKE (7) BM2 - N2 (0+500 ~ 0+720)				
SCALE = 1 : 100				
JAPAN INTERNATIONAL COOPERATION AGENCY (JICA)				
PACIFIC CONSULTANTS INTERNATIONAL				
DESIGNED			CHECKED	
DATE :			DWG. No. PB - PDI - BMC2 - 224	

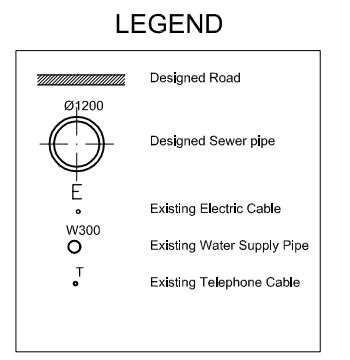
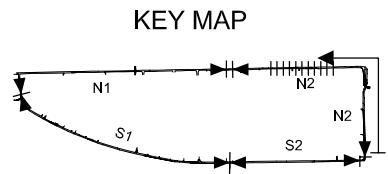
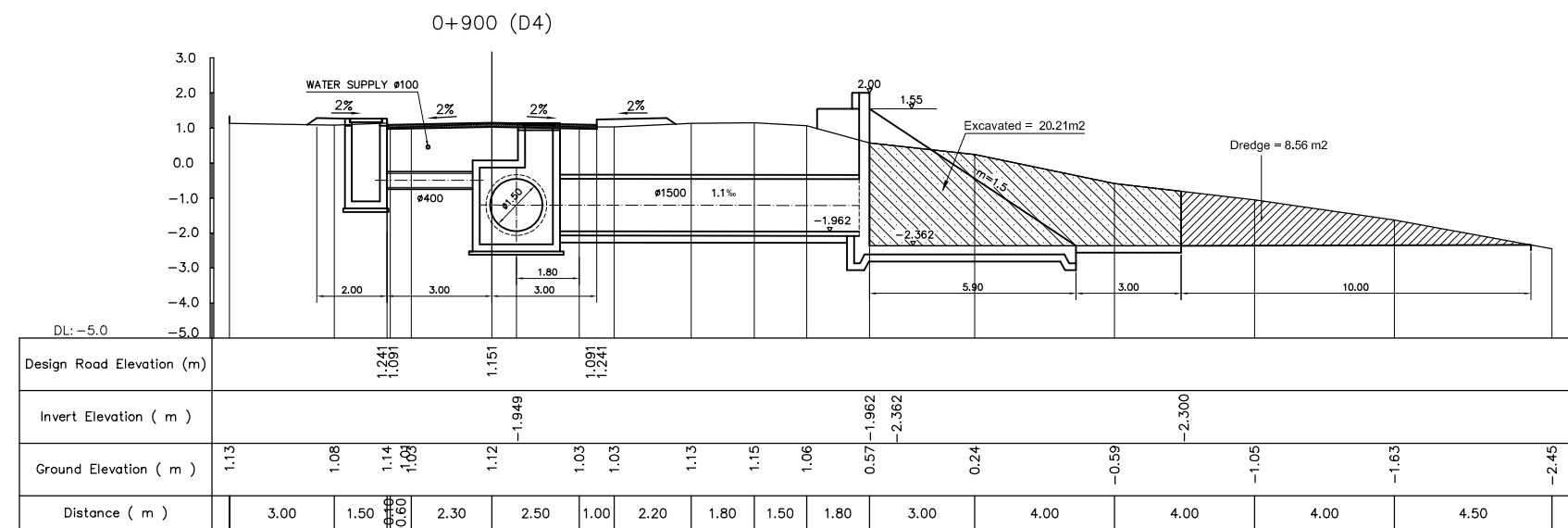
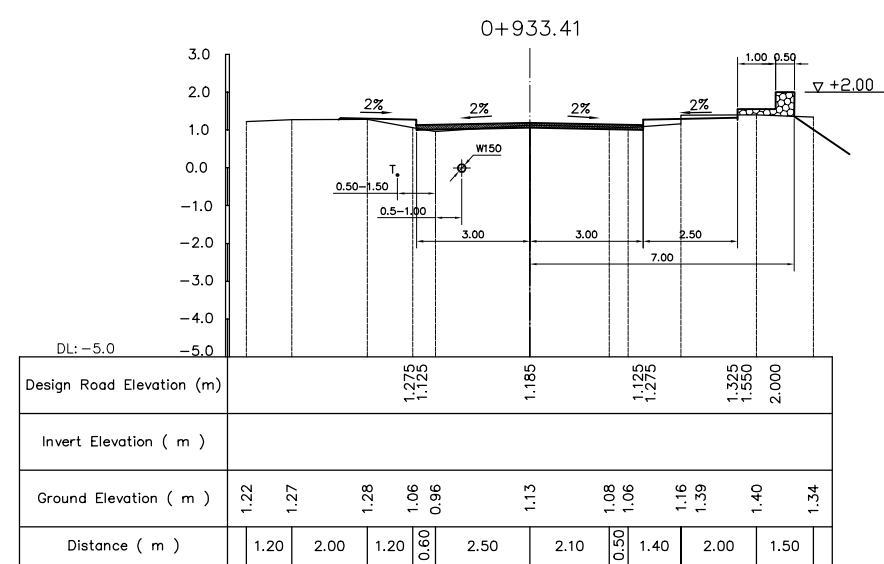
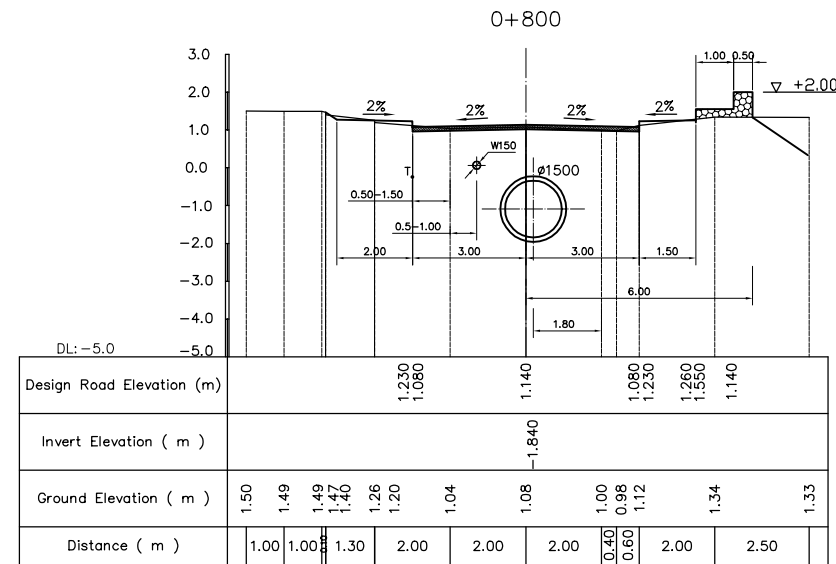
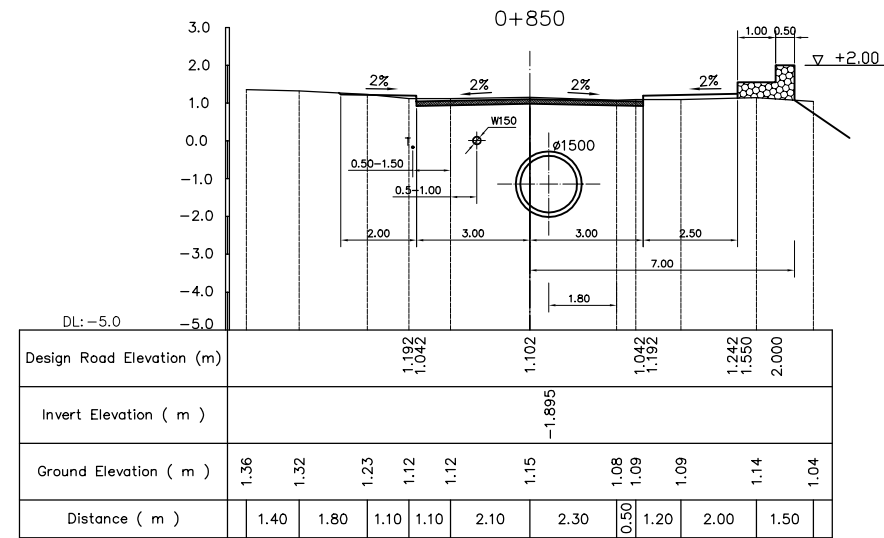
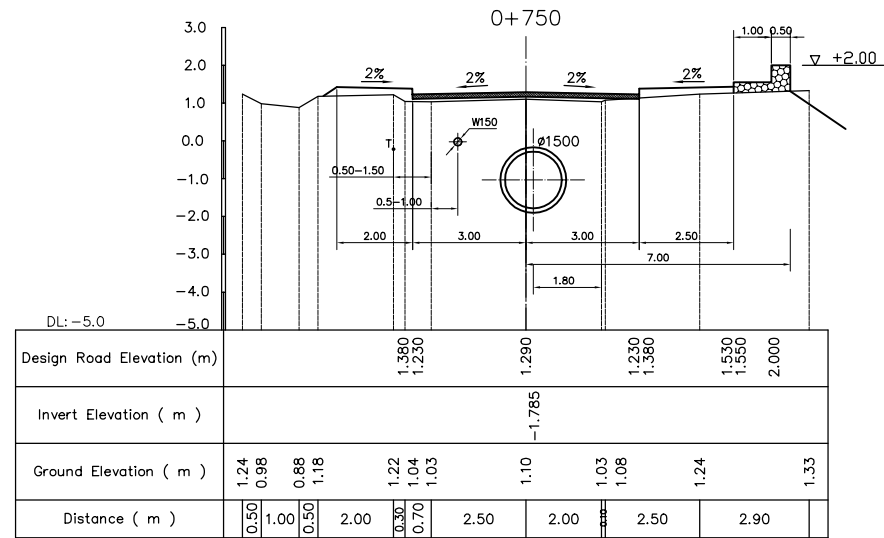

NO.	DATE	DESCRIPTIONS	BY	APRO.
REVISIONS				
PROJECT MANAGEMENT UNIT FOR HO CHI MINH CITY WATER ENVIRONMENT IMPROVEMENT				
THE DETAILED DESIGN STUDY ON HO CHI MINH CITY WATER ENVIRONMENT IMPROVEMENT PROJECT IN THE SOCIALIST REPUBLIC OF VIET NAM				
PACKAGE B PUMP DRAINAGE IMPROVEMENT BEN ME COC (2) AREA CROSS SECTION OF SEWER, ROAD AND TEMPORARY DIKE (8) BM2 - N2 (0+750 ~ 0+933.41)				
SCALE = 1 : 100				
JAPAN INTERNATIONAL COOPERATION AGENCY (JICA)				
PACIFIC CONSULTANTS INTERNATIONAL				
DESIGNED		CHECKED		
DATE :		DWG. No. PB - PDI - BMC2 - 225		

TYPICAL CROSS SECTION OF ROAD:

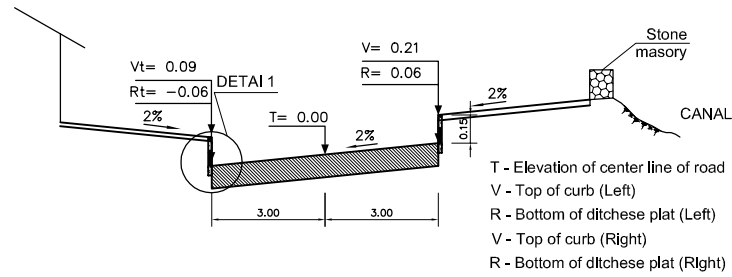

T - Elevation of center line of road
 V - Top of curb (Left)
 R - Bottom of ditchse plat (Left)
 V - Top of curb (Right)
 R - Bottom of ditchse plat (Right)

DETAIL 1:

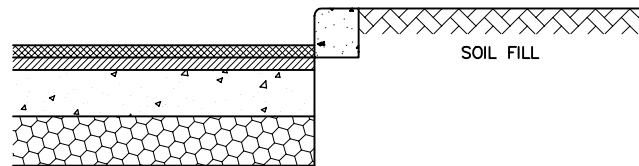

TYPICAL ROAD SURFACE:

Type P3: demand elastic module $E_{yc} = 1600 \text{ kg/cm}^2$

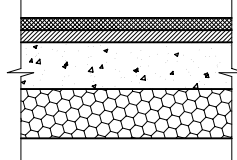

-5cm wearing course, asphalt concrete (small size)
 Emulsiões asphalt tack coat 0.2 ~ 0.7 lit/m^2
 -5cm binder course asphalt concrete (gross size)
 Emulsiões asphalt prime coat 1.0 ~ 2.0 lit/m^2
 -19cm base course, crushed aggregate (size 2 ~ 4 cm)
 -20cm subbase course, aggregate 4 ~ 6cm (or red gravel grading)
 49 cm IS TOTAL THICKNESS OF PAVEMENT

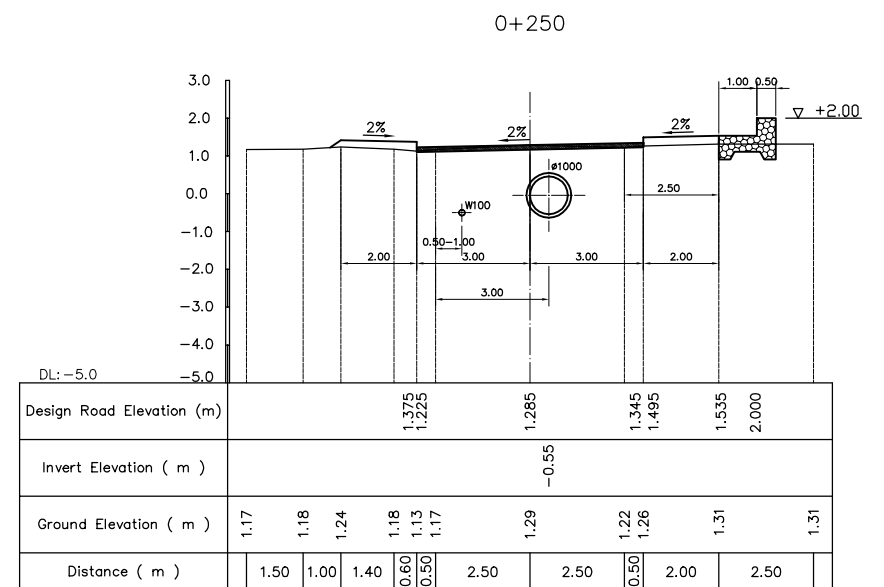
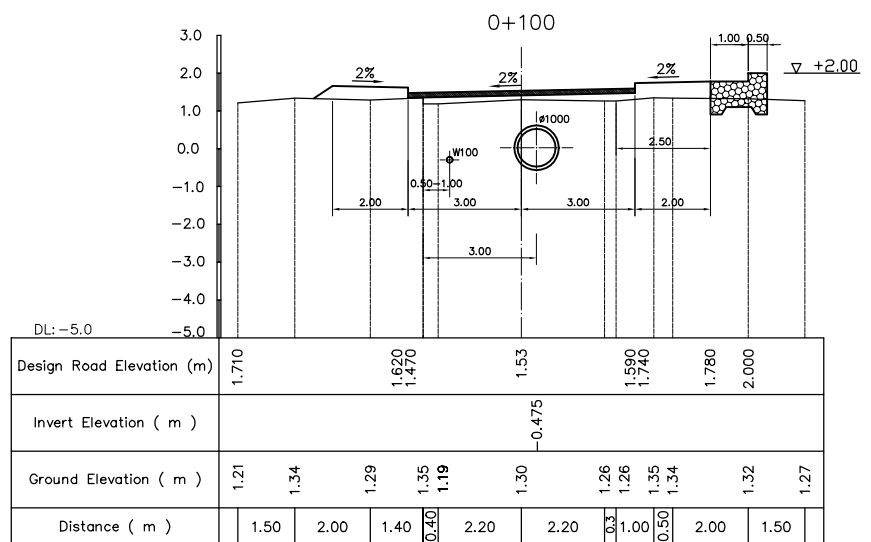
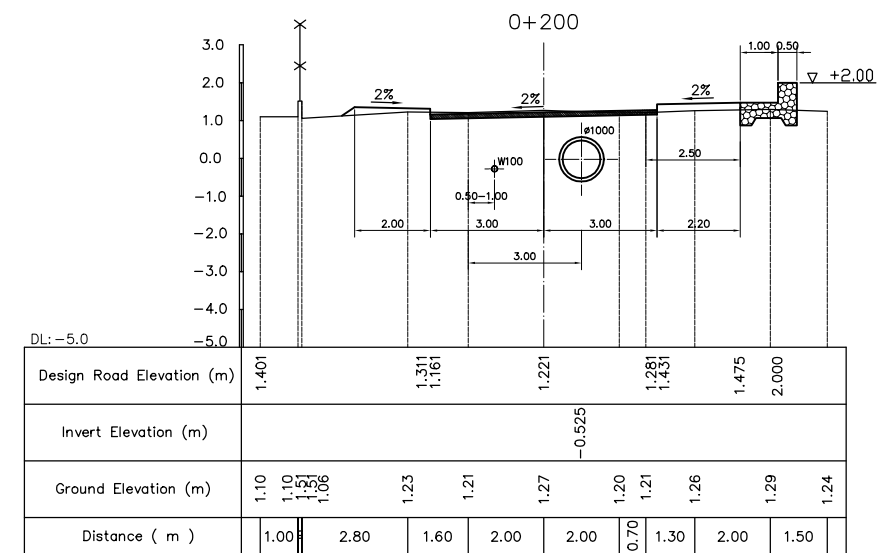
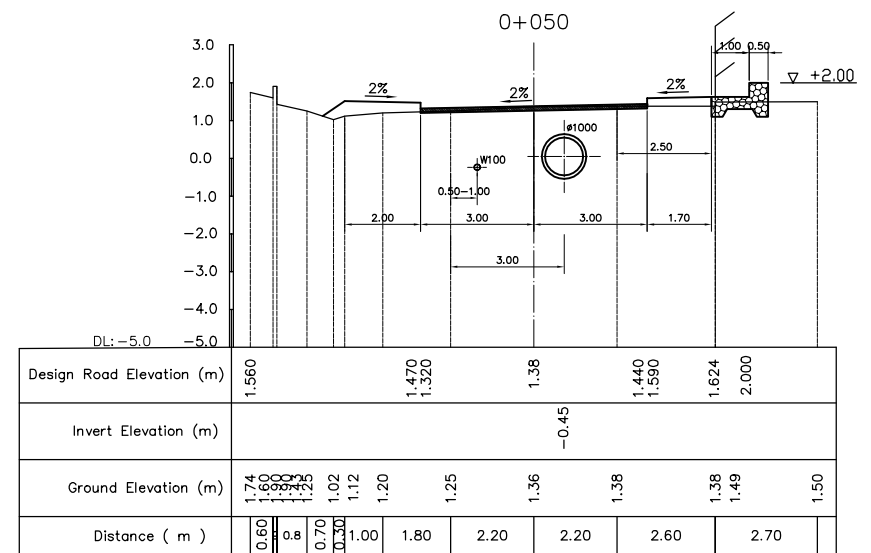
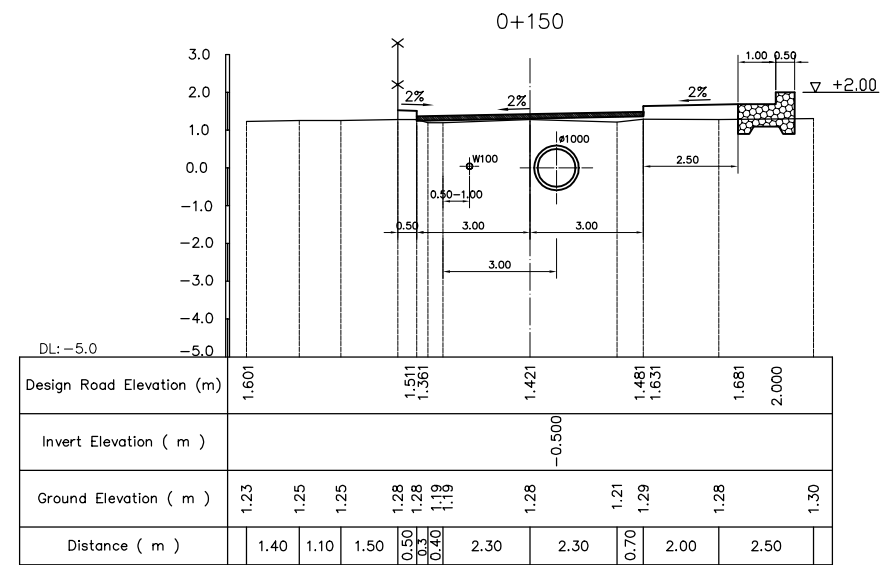
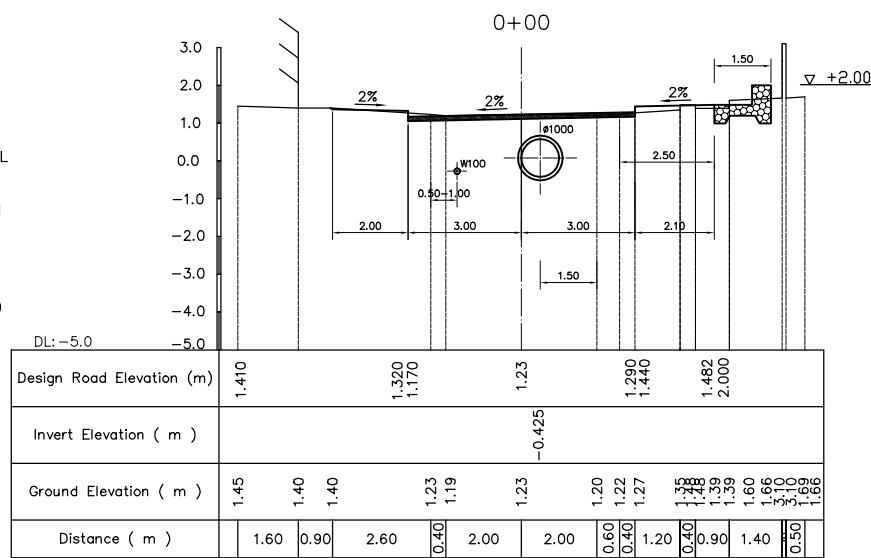

KEY MAP

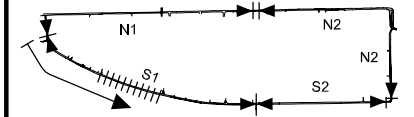

LEGEND

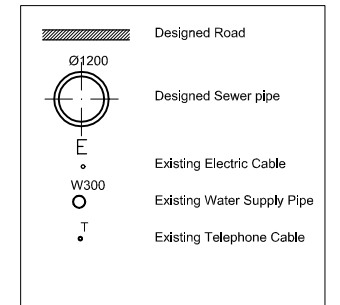

NO.	DATE	DESCRIPTIONS	BY	APRO.

REVISIONS

PROJECT MANAGEMENT UNIT FOR
 HO CHI MINH CITY
 WATER ENVIRONMENT IMPROVEMENT

THE DETAILED DESIGN STUDY ON HO CHI MINH CITY
 WATER ENVIRONMENT IMPROVEMENT PROJECT
 IN THE SOCIALIST REPUBLIC OF VIET NAM

PACKAGE B
 PUMP DRAINAGE IMPROVEMENT
 BEN ME COC (2) AREA
**CROSS SECTION OF SEWER,
 ROAD AND TEMPORARY DIKE (9)**

BM2 S - 1

SCALE = 1 : 100

JAPAN INTERNATIONAL COOPERATION AGENCY (JICA)

PACIFIC CONSULTANTS INTERNATIONAL

DESIGNED	CHECKED
DATE :	DWG. No. PB - PDI - BMC2 - 226

0+282 (D2)

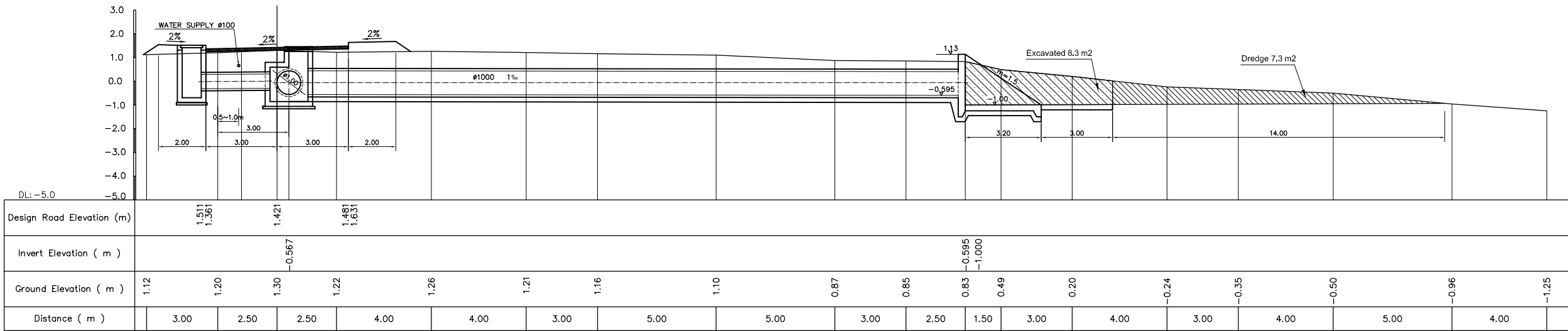

0+300

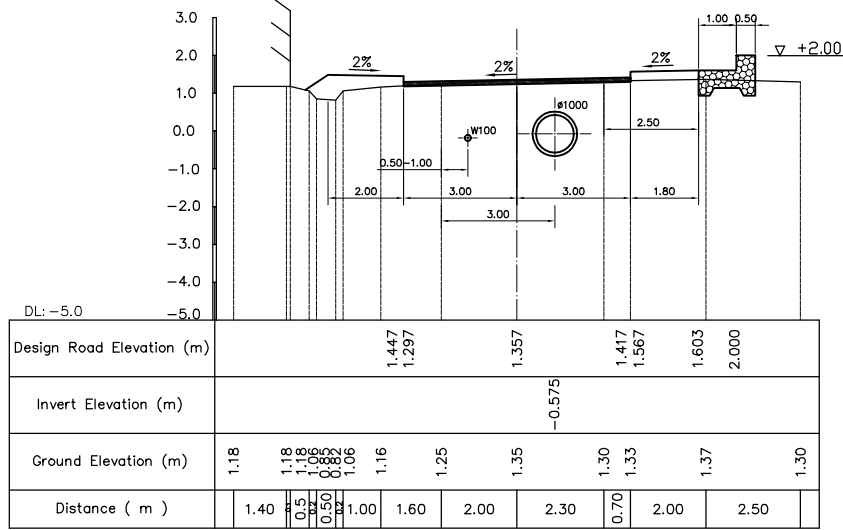

0+400

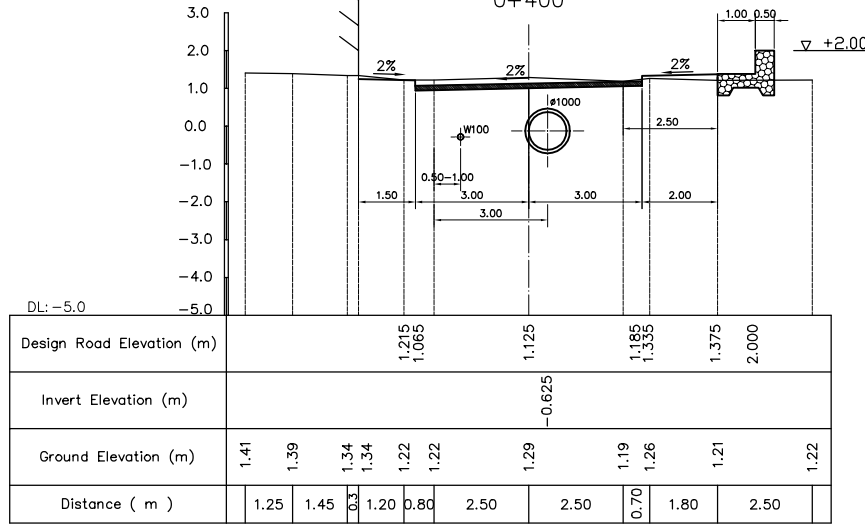

0+350

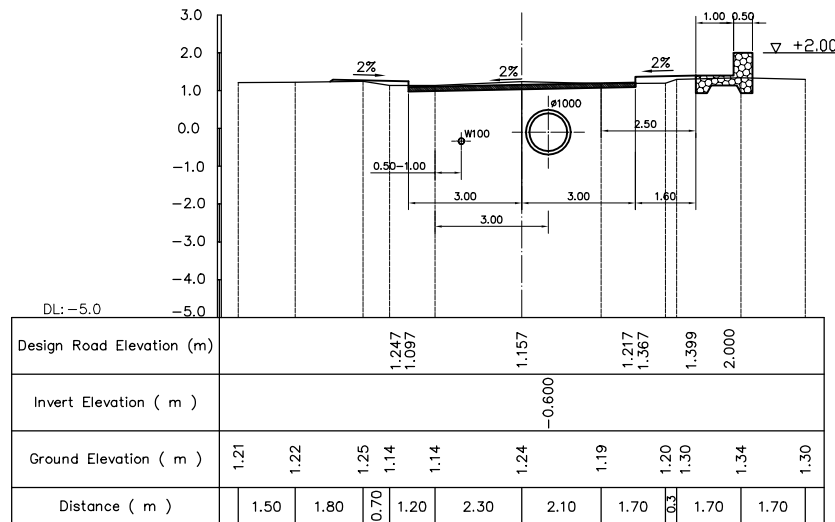

0+450

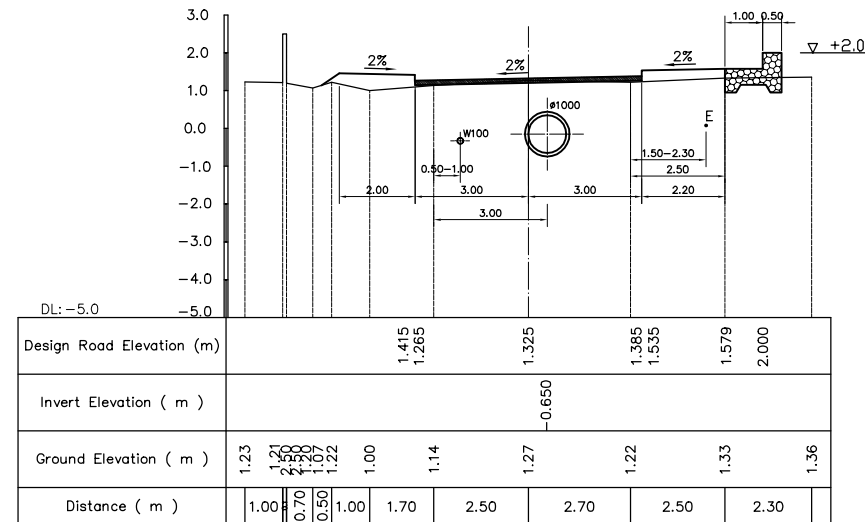

KEY MAP



LEGEND

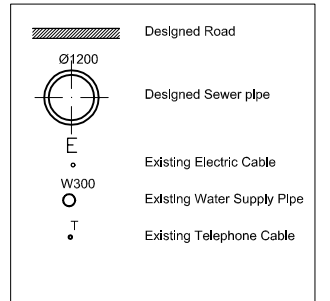

NO.	DATE	DESCRIPTIONS	BY	APRO.
REVISIONS				
PROJECT MANAGEMENT UNIT FOR HO CHI MINH CITY WATER ENVIRONMENT IMPROVEMENT				
THE DETAILED DESIGN STUDY ON HO CHI MINH CITY WATER ENVIRONMENT IMPROVEMENT PROJECT IN THE SOCIALIST REPUBLIC OF VIET NAM				
PACKAGE B PUMP DRAINAGE IMPROVEMENT BEN ME COC (2) AREA CROSS SECTION OF SEWER, ROAD AND TEMPORARY DIKE (10) BM2 S-1				
SCALE = 1 : 100				
JICA JAPAN INTERNATIONAL COOPERATION AGENCY (JICA)				
PACIFIC CONSULTANTS INTERNATIONAL				
DESIGNED		CHECKED		
DATE :		DWG. No. PB - PDI - BMC2 - 227		

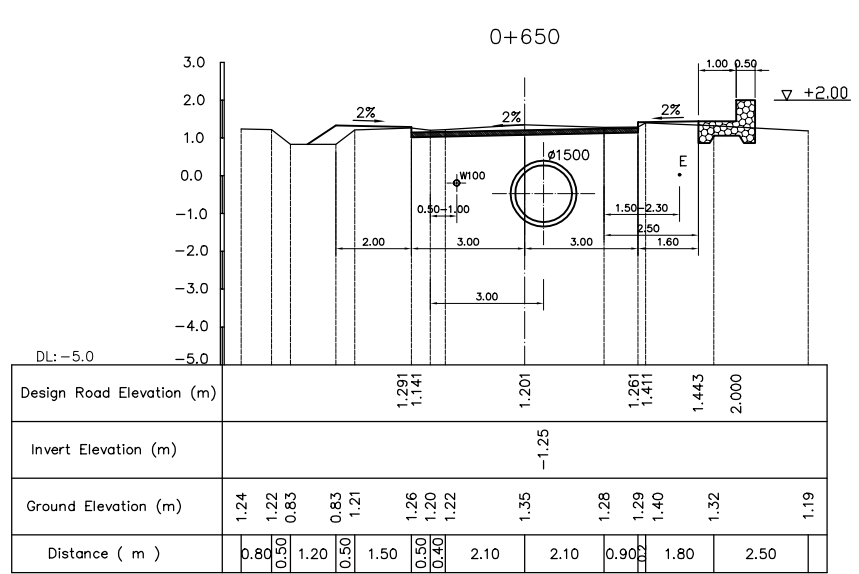
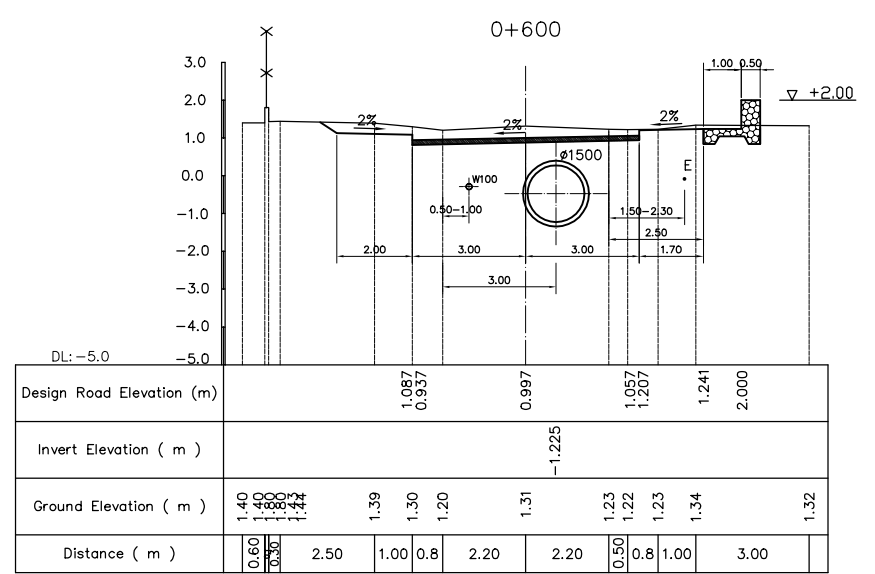
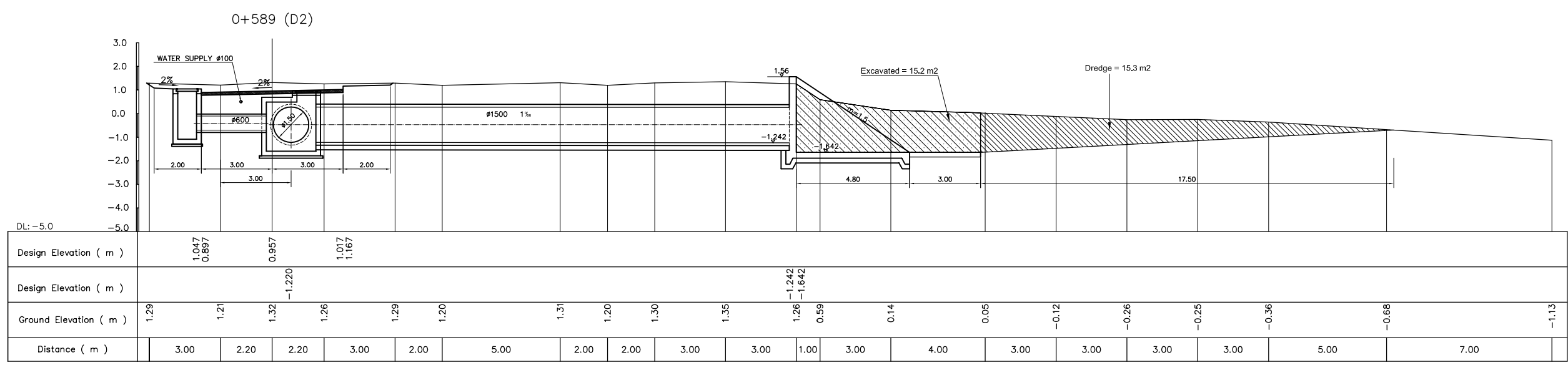
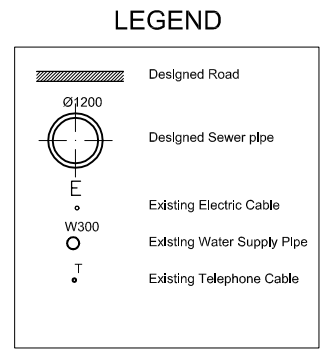
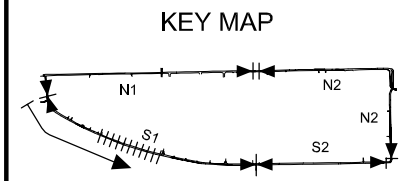
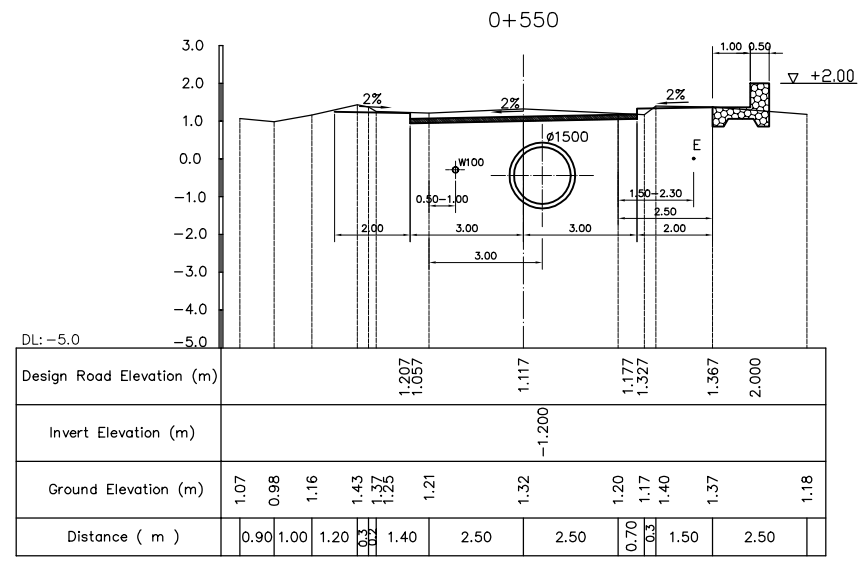
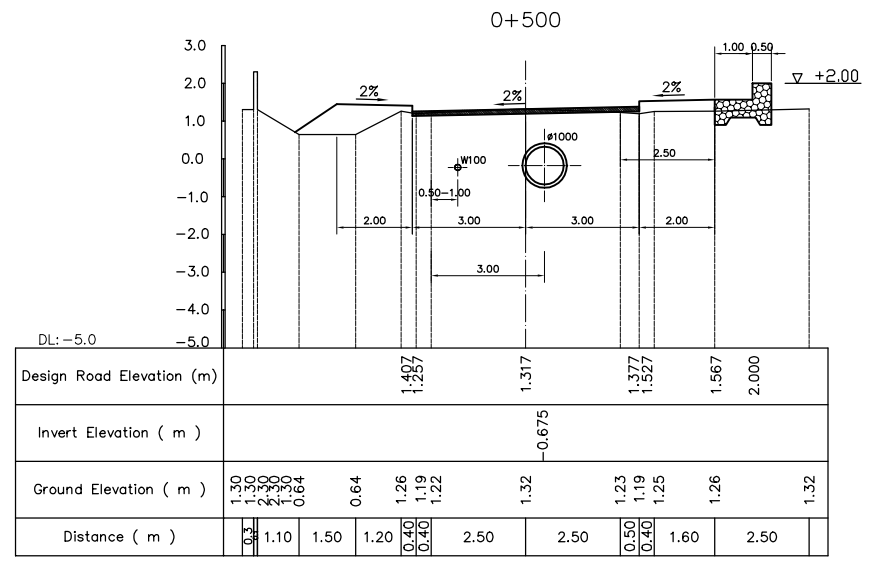

NO.	DATE	DESCRIPTIONS	BY	APPRO.

REVISIONS

PROJECT MANAGEMENT UNIT FOR
HO CHI MINH CITY
WATER ENVIRONMENT IMPROVEMENT

THE DETAILED DESIGN STUDY ON HO CHI MINH CITY
WATER ENVIRONMENT IMPROVEMENT PROJECT
IN THE SOCIALIST REPUBLIC OF VIET NAM

PACKAGE B
PUMP DRAINAGE IMPROVEMENT
BEN ME COC (2) AREA
CROSS SECTION OF SEWER,
ROAD AND TEMPORARY DIKE (11)
BM2 S-1

SCALE = 1 : 100

JICA JAPAN INTERNATIONAL COOPERATION AGENCY (JICA)

PACIFIC CONSULTANTS INTERNATIONAL

DESIGNED: _____ CHECKED: _____

DATE: _____ DWG. No. PB - PDI - BMC2 - 228

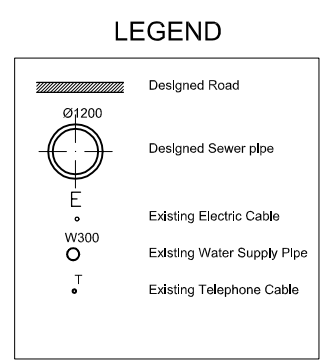
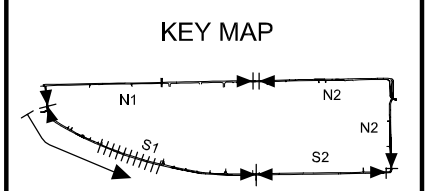
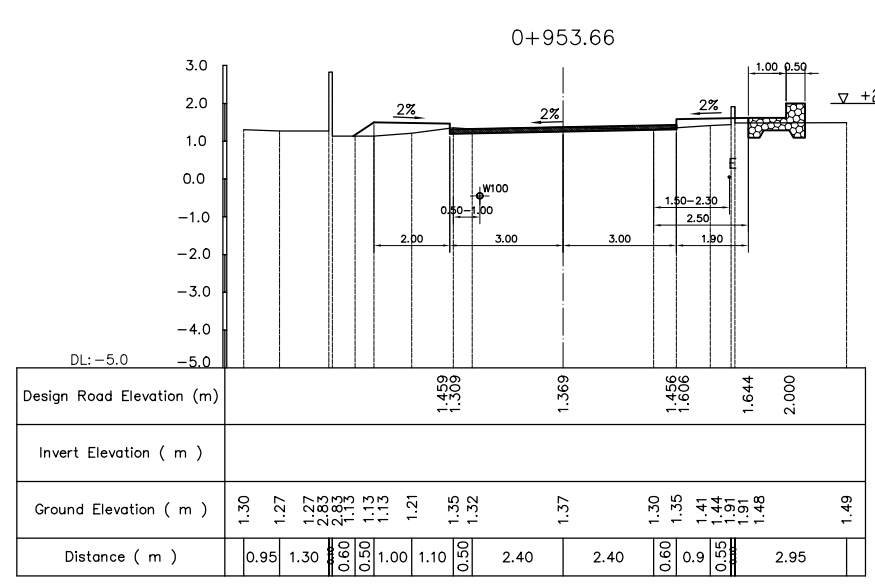
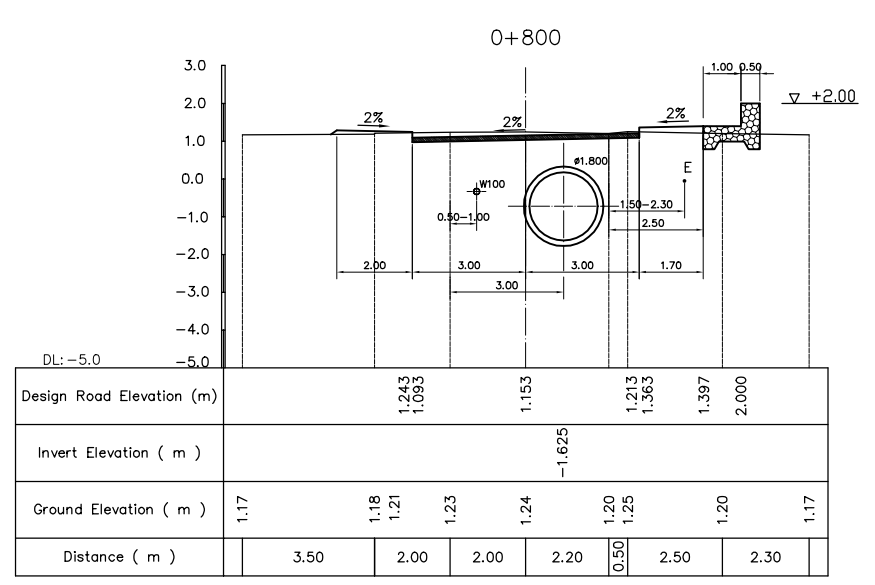
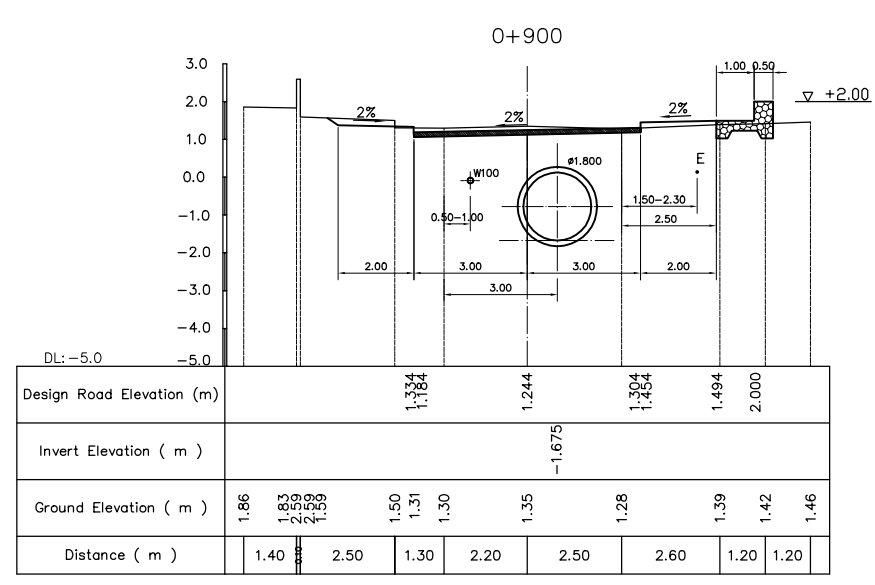
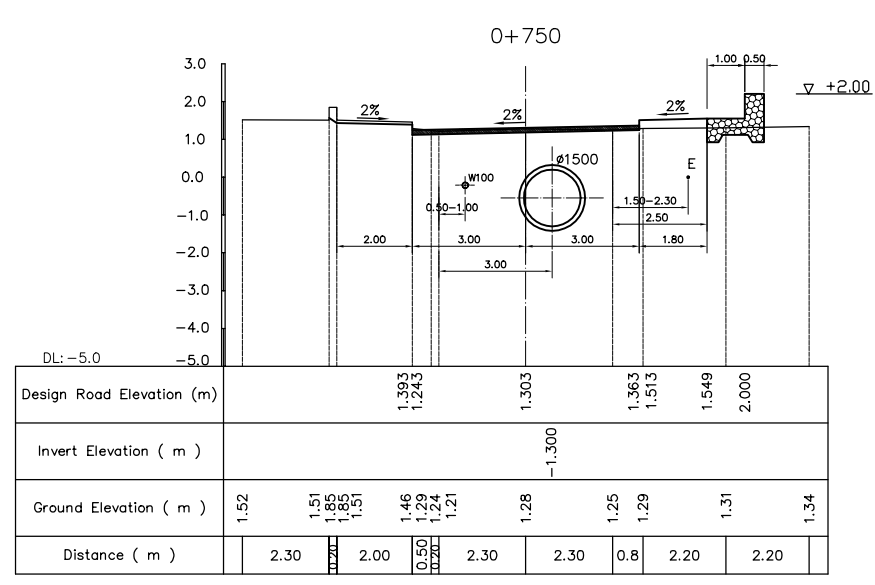
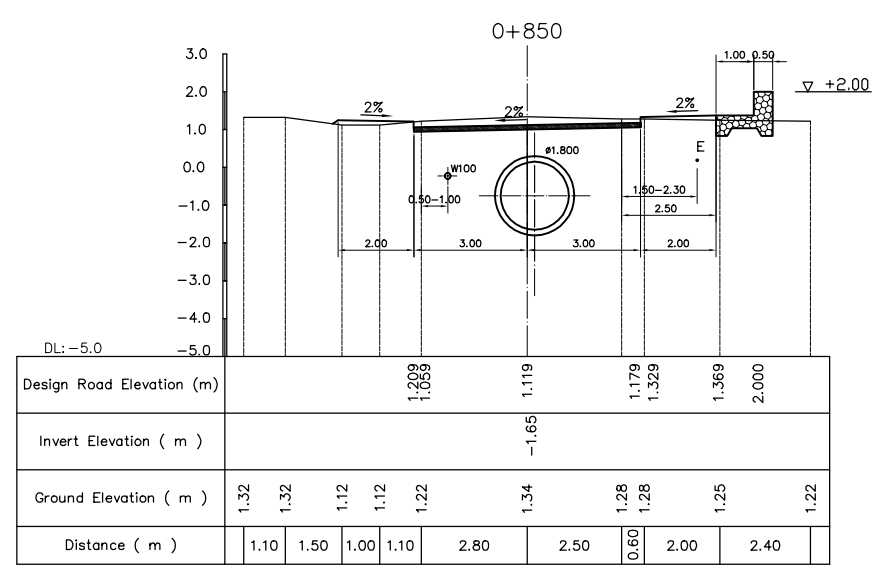
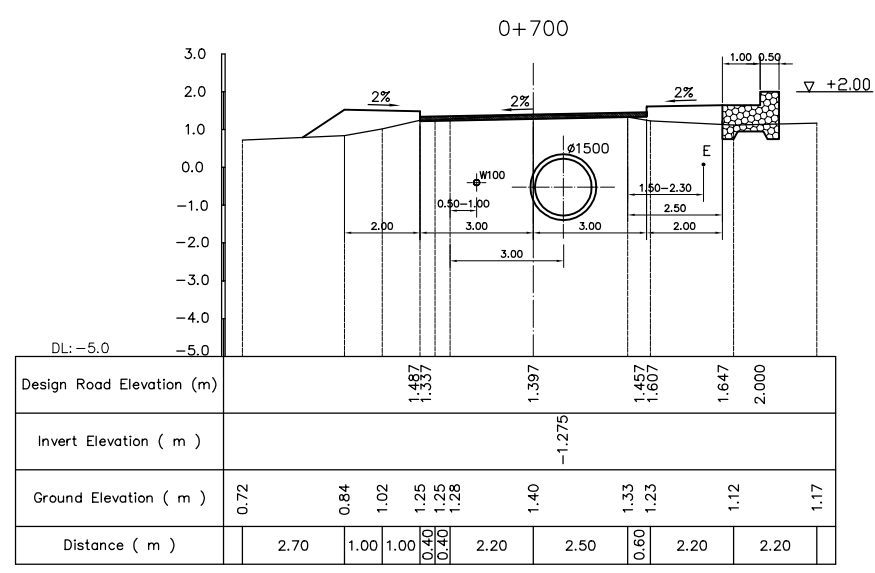

NO.	DATE	DESCRIPTIONS	BY	APRO.
-----	------	--------------	----	-------

REVISIONS

PROJECT MANAGEMENT UNIT FOR
HO CHI MINH CITY
WATER ENVIRONMENT IMPROVEMENT

THE DETAILED DESIGN STUDY ON HO CHI MINH CITY
WATER ENVIRONMENT IMPROVEMENT PROJECT
IN THE SOCIALIST REPUBLIC OF VIET NAM

PACKAGE B
PUMP DRAINAGE IMPROVEMENT
BEN ME COC (2) AREA
CROSS SECTION OF SEWER,
ROAD AND TEMPORARY DIKE (12)
BM2 S-1

SCALE = 1 : 100

JICA JAPAN INTERNATIONAL COOPERATION AGENCY (JICA)

PACIFIC CONSULTANTS INTERNATIONAL

DESIGNED _____ CHECKED _____

DATE : _____ DWG. No. PB - PDI - BMC2 - 229

KEY MAP

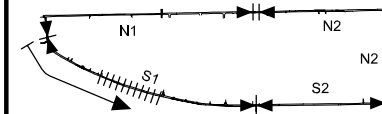

LEGEND

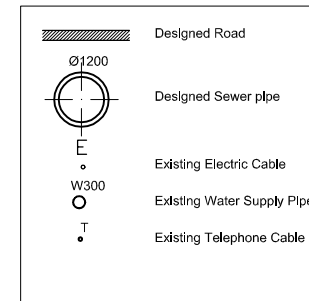

0+921 (D2)

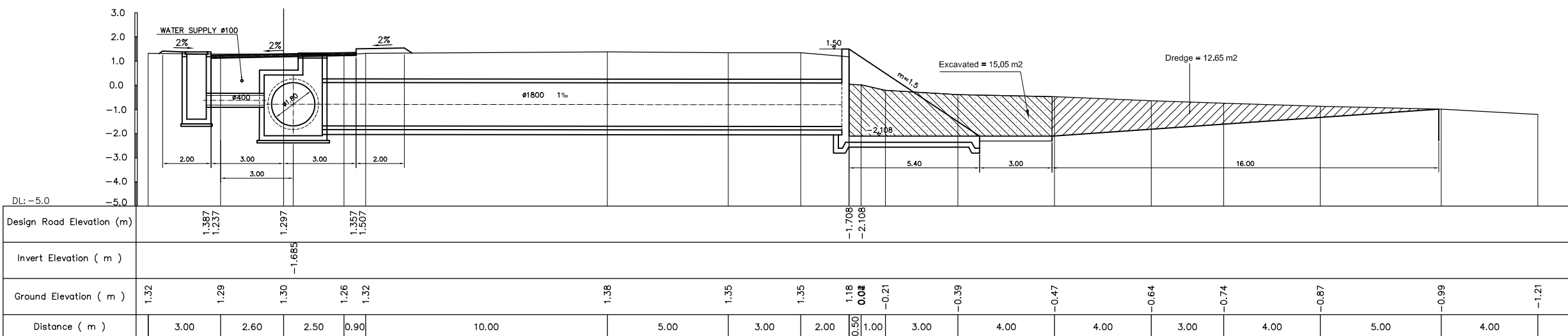

NO.	DATE	DESCRIPTIONS	BY	APPRO.

REVISIONS

PROJECT MANAGEMENT UNIT FOR
HO CHI MINH CITY
WATER ENVIRONMENT IMPROVEMENT

THE DETAILED DESIGN STUDY ON HO CHI MINH CITY
WATER ENVIRONMENT IMPROVEMENT PROJECT
IN THE SOCIALIST REPUBLIC OF VIET NAM

PACKAGE B
PUMP DRAINAGE IMPROVEMENT
BEN ME COC (2) AREA
CROSS SECTION OF SEWER,
ROAD AND TEMPORARY DIKE (13)
BM2 S-1

SCALE = 1 : 100

JICA JAPAN INTERNATIONAL COOPERATION
AGENCY (JICA)

PACIFIC CONSULTANTS INTERNATIONAL

DESIGNED _____ CHECKED _____

DATE : _____ DWG. No. PB - PDI - BMC2 - 230