

- Note:
- This detailed design has been executed by a team of consultants as shown below in accordance with the agreement between Japan International Cooperation Agency (JICA) and JICA Study Team.
 - The copyright of this drawing rests with JICA.
 - ALL MEASUREMENTS ARE IN CENTIMETERS.
 - DO NOT SCALE FROM DRAWING
 - FOR TRING DETAILS REFER TO D-13.D-14\SD.AD-03 & D-15.D-16\SD.AD-04
 - FOR TYPICAL STONE RISER DETAILS REFER TO D-01.D-02.D-03\SD.AD-01
 - FOR TREE FLOWER BED DETAILS REFER TO D-04.D-05\SD.AD-01
 - FOR SIGN TYPES REFER TO D-19.D-20.D-21, D-22\SD.AD-05
 - FOR MANHOLE DETAILS REFER TO D-15\SD.AD-04 & D-23\SD.AD-06
 - FOR BOLLARDS DETAILS REFER TO D-24\SD.AD-06
 - FOR LITTER BIN DETAILS REFER TO D-25\SD.AD-06
 - FOR TYPICAL CLOCK DETAIL REFER TO D-26\SD.AD-06
 - FOR BENCH DETAILS REFER TO D-27\SD.AD-07
 - FOR WET STONE CLADDING DETAILS REFER TO D-33\SD.AD-08

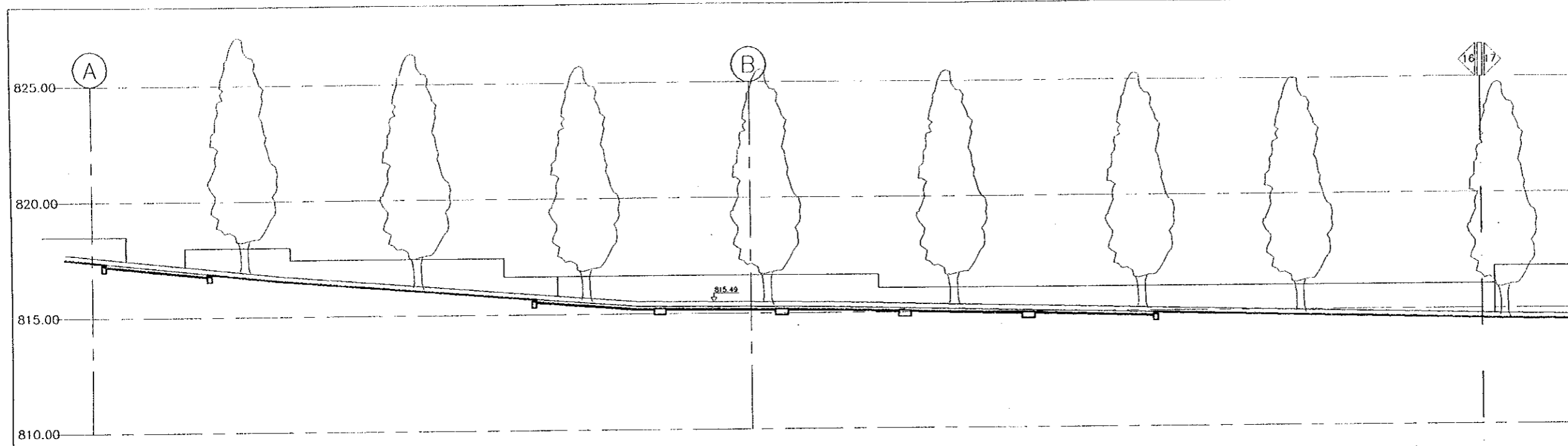

SECTION-PART-4

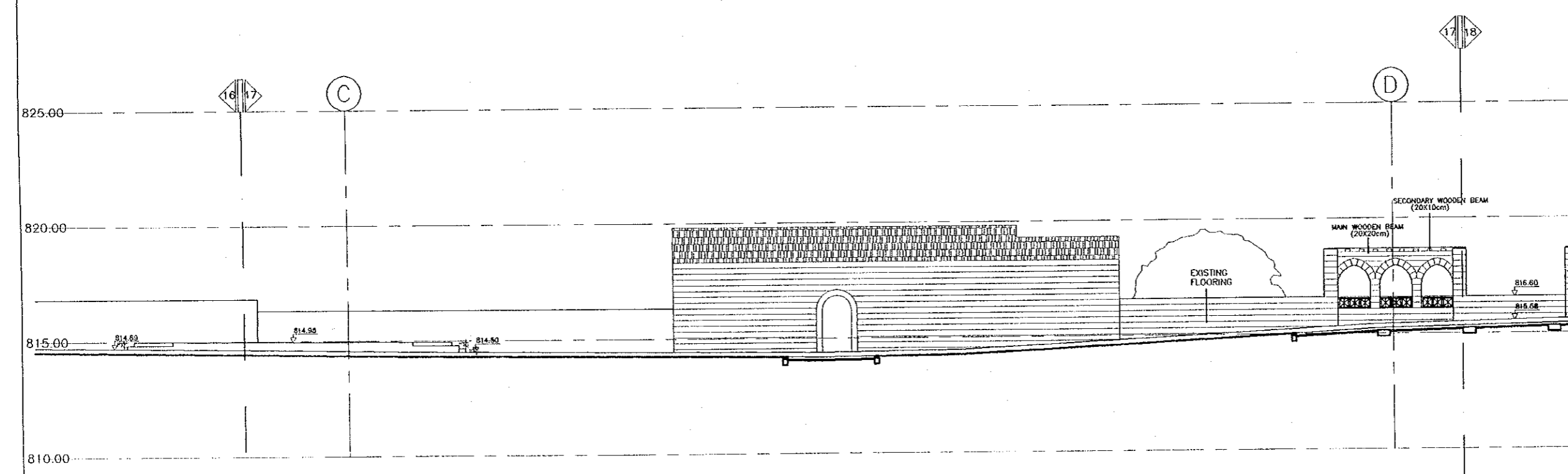

SECTION-PART-3

Designed by:
Japan International Cooperation Agency (JICA)
JICA Study Team:
Joint Venture of
Pacific Consultants International and
Yamasita Sekkei Inc.

Subcontracted Local Consultant:
TIBAH Consultants
Architects, Engineers

DATE: JUNE-10 / 2000

Tourist Trails
Drawing Title:
Upper Jadaa Street
SECTION A-D

Scale: 1:100
Drawing No.: SD.AT-44

- Note:**
- This detailed design has been executed by a team of consultants as shown below in accordance with the agreement between Japan International Cooperation Agency (JICA) and JICA Study Team.
 - The copyright of this drawing rests with JICA. ALL MEASUREMENTS ARE IN CENTIMETERS.
 - DO NOT SCALE FROM DRAWING
 - FOR TILING DETAILS REFER TO D-13.D-14\SD-AD-03 & D-15.D-16\SD-AD-04
 - FOR TYPICAL STONE RISER DETAILS REFER TO D-01.D-02.D-03\SD-AD-01
 - FOR TREE\FLOWER BED DETAILS REFER TO D-04.D-05\SD-AD-01
 - FOR SIGN TYPES REFER TO D-19.D-20.D-21, D-22\SD-AD-05
 - FOR MANHOLE DETAILS REFER TO D-15\SD-AD-04 & D-23\SD-AD-06
 - FOR BOLLARDS DETAILS REFER TO D-24\SD-AD-06
 - FOR LITTER BIN DETAILS REFER TO D-25\SD-AD-06
 - FOR TYPICAL CLOCK DETAIL REFER TO D-26\SD-AD-06
 - FOR BENCH DETAILS REFER TO D-27\SD-AD-07
 - FOR WET STONE CLADDING DETAILS REFER TO D-33\SD-AD-08

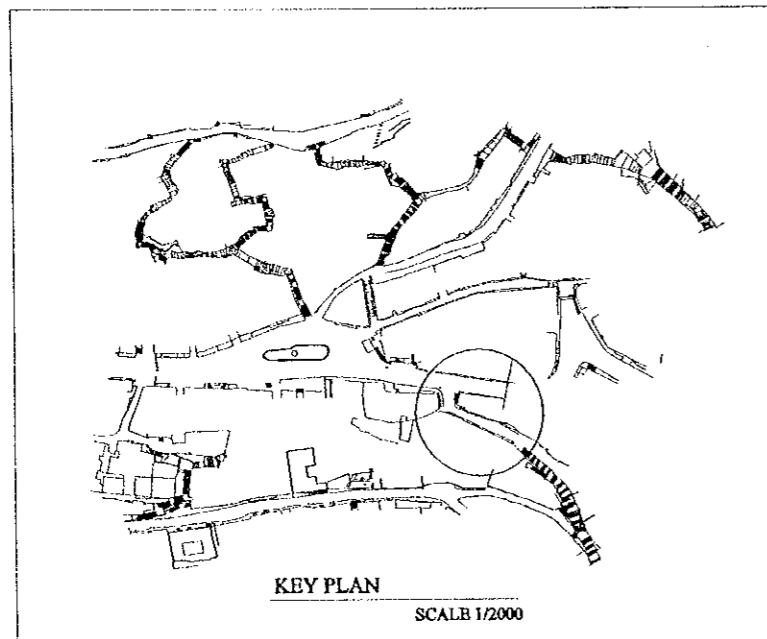
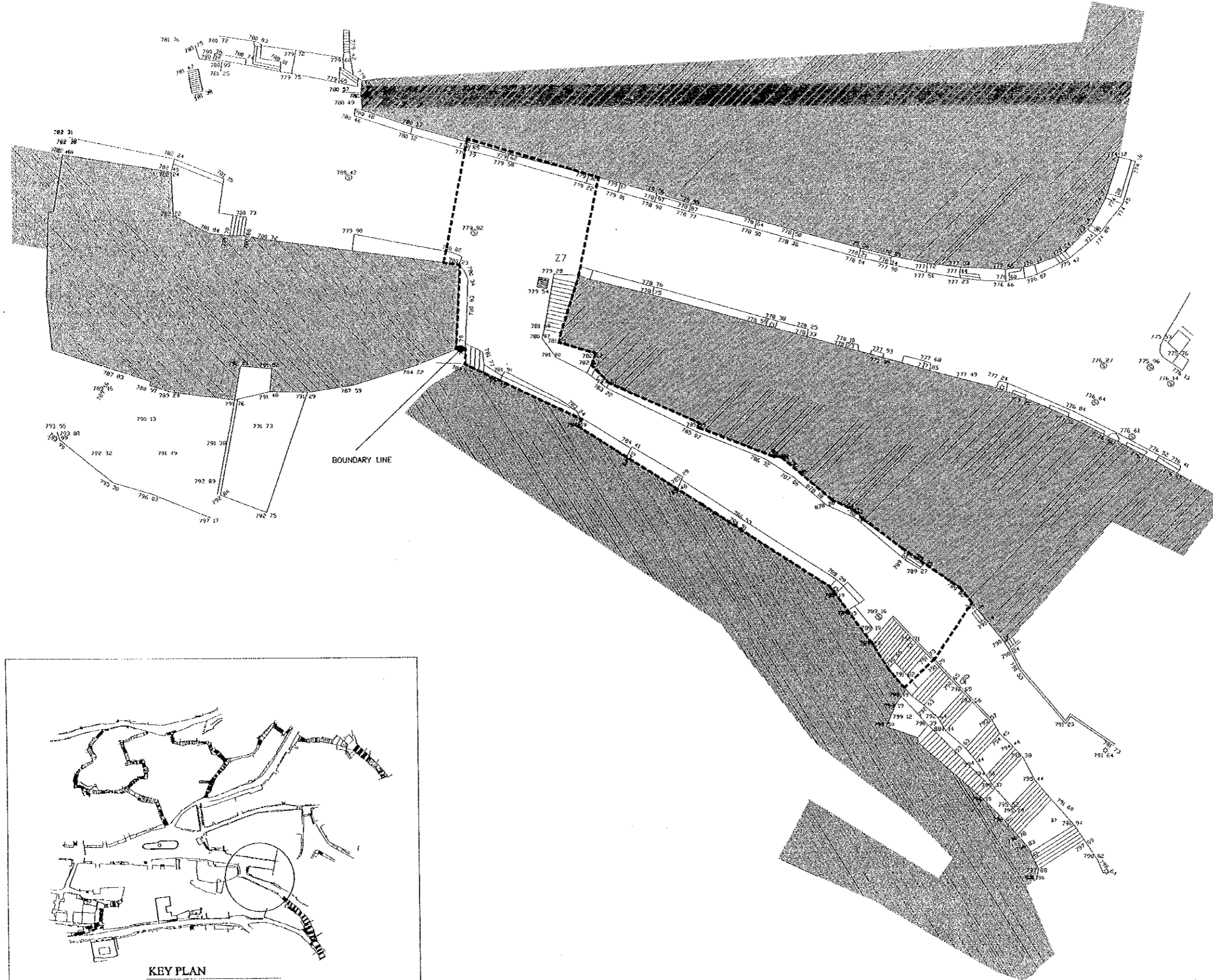

Designed by:
Japan International Cooperation Agency (JICA)
JICA Study Team:
Joint Venture of
Pacific Consultants International and
Yamasita Sekkei Inc.
Subcontracted Local Consultant:
TIBAH Consultants
Architects, Engineers

DATE	JUNE- 10 / 2000
------	-----------------

Tourist Trails
Drawing Title:
Lower East Jadaa Street
Existing Situation

Scale:	Drawing No.:
1:200	SD.AT-45

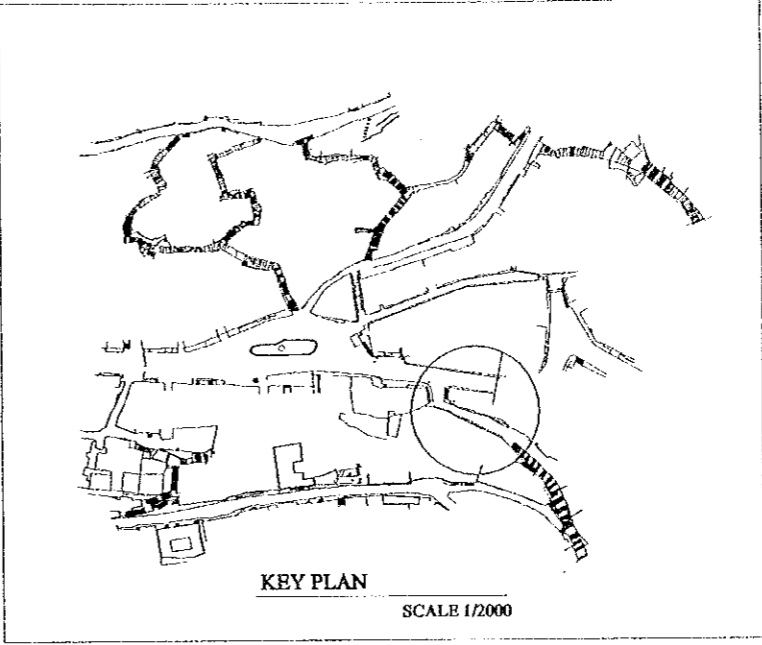
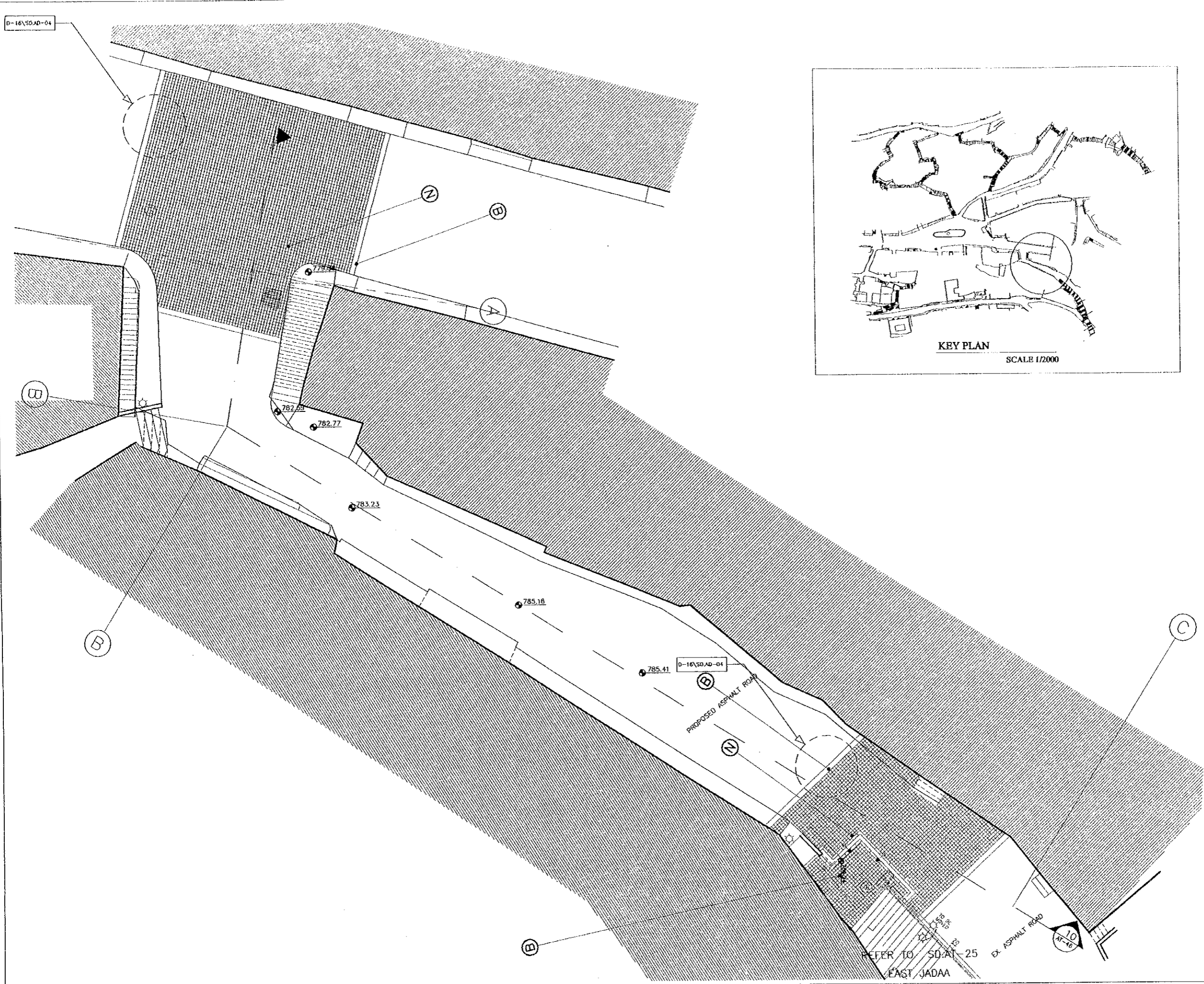

Tourism Sector Development Project
in the Hashemite Kingdom of Jordan

The Government of
the Hashemite Kingdom of Jordan
The Ministry of Tourism and Antiquities
The Ministry of Planning

Sub-Project:
Historic Old Salt Development

- Note:
- This detailed design has been executed by a team of consultants as shown below in accordance with the agreement between Japan International Cooperation Agency (JICA) and JICA Study Team.
 - The copyright of this drawing rests with JICA.
 - ALL MEASUREMENTS ARE IN CENTIMETERS.
 - DO NOT SCALE FROM DRAWING
 - FOR TILING DETAILS REFER TO D-13.D-14\SD\AD-03 & D-15.D-16\SD\AD-04
 - FOR TYPICAL STONE RISER DETAILS REFER TO D-01.D-02.D-03\SD\AD-01
 - FOR TREE/FLOWER BED DETAILS REFER TO D-04.D-05\SD\AD-01
 - FOR SIGN TYPES REFER TO D-19.D-20.D-21. D-22\SD\AD-05
 - FOR MANHOLE DETAILS REFER TO D-15\SD\AD-04 & D-23\SD\AD-06
 - FOR BOLLARDS DETAILS REFER TO D-24\SD\AD-06
 - FOR LITTER BIN DETAILS REFER TO D-25\SD\AD-06
 - FOR TYPICAL CLOCK DETAIL REFER TO D-26\SD\AD-06
 - FOR BENCH DETAILS REFER TO D-27\SD\AD-07
 - FOR WET STONE CLADDING DETAILS REFER TO D-33\SD\AD-08

Designed by:

Japan International Cooperation Agency (JICA)

JICA Study Team:

Joint Venture of
Pacific Consultants International and
Yamasita Sekkei Inc.

Subcontracted Local Consultant:

TIBAH Consultants
Architects, Engineers

DATE: JUNE-10 / 2000

Tourist Trails

Drawing Title:

Lower East Jadaa Street
PLAN

Scale: 1:100 / 1:2000

Drawing No.: SD.AT-46

Tourism Sector Development Project
in the Hashemite Kingdom of Jordan

The Government of
the Hashemite Kingdom of Jordan
The Ministry of Tourism and Antiquities
The Ministry of Planning

Sub-Project:
Historic Old Salt Development

Note:
This detailed design has been executed by a team of consultants as shown below in accordance with the agreement between Japan International Cooperation Agency (JICA) and JICA Study Team.
The copyright of this drawing rests with JICA.
ALL MEASUREMENTS ARE IN CENTIMETERS.
• DO NOT SCALE FROM DRAWING
• FOR FILING DETAILS REFER TO D-13,D-14,SD,AD-03 & D-15,D-16,SD,AD-04
• FOR TYPICAL STONE RISER DETAILS REFER TO D-01,D-02,D-03,SD,AD-01
• FOR TREE, FLOWER BED DETAILS REFER TO D-04,D-05,SD,AD-01
• FOR SIGN TYPES REFER TO D-19,D-20,D-21, D-22,SD,AD-05
• FOR MANHOLE DETAILS REFER TO D-15,SD,AD-04 & D-23,SD,AD-06
• FOR BOLLARDS DETAILS REFER TO D-24,SD,AD-06
• FOR LITTER BIN DETAILS REFER TO D-25,SD,AD-06
• FOR TYPICAL CLOCK DETAIL REFER TO D-26,SD,AD-06
• FOR BENCH DETAILS REFER TO D-27,SD,AD-07
• FOR WET STONE CLADDING DETAILS REFER TO D-33,SD,AD-08

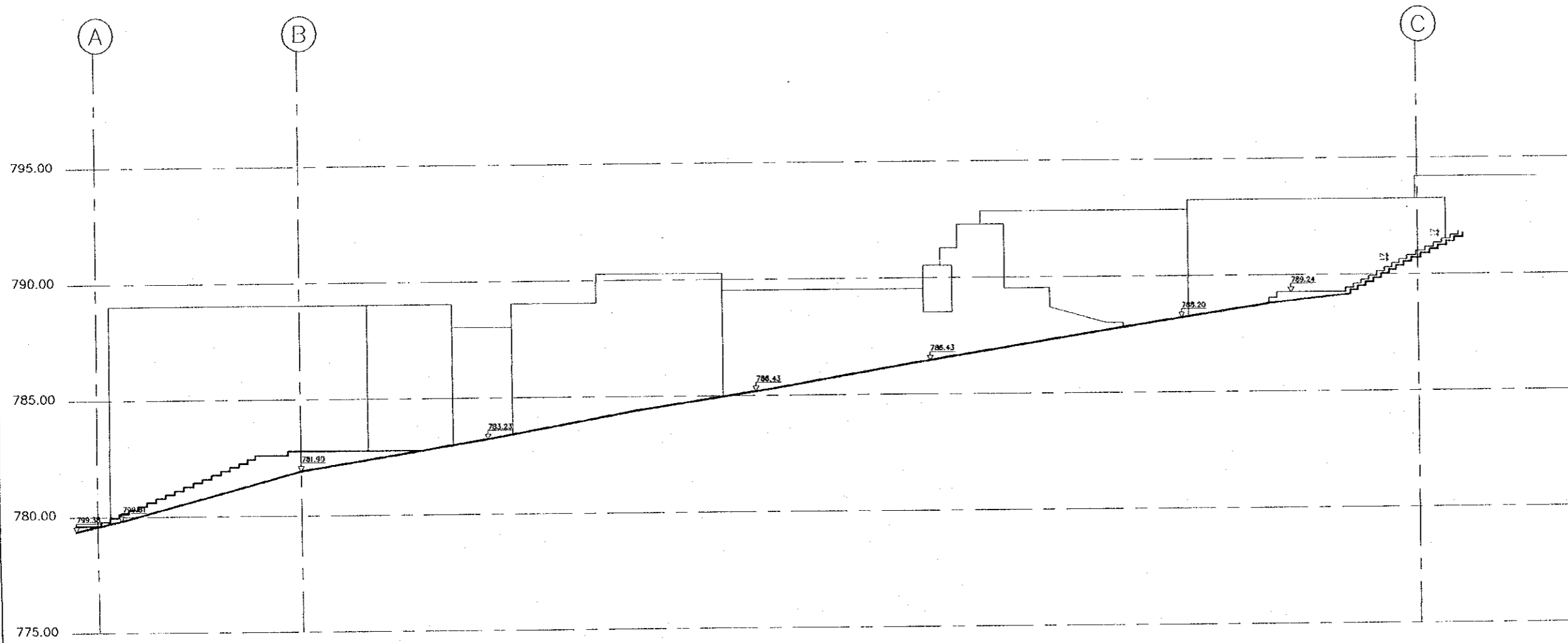

Designed by:
Japan International Cooperation Agency (JICA)
JICA Study Team:
Joint Venture of Pacific Consultants International and Yamasita Sekkei Inc.
Subcontracted Local Consultant:
TIBAH Consultants Architects, Engineers

DATE: JUNE-10 / 2000

Tourist Trails
Drawing Title:
Lower East Jadaa Street
SECTION A-C

Scale: 1:100
Drawing No.: SD,AT-47

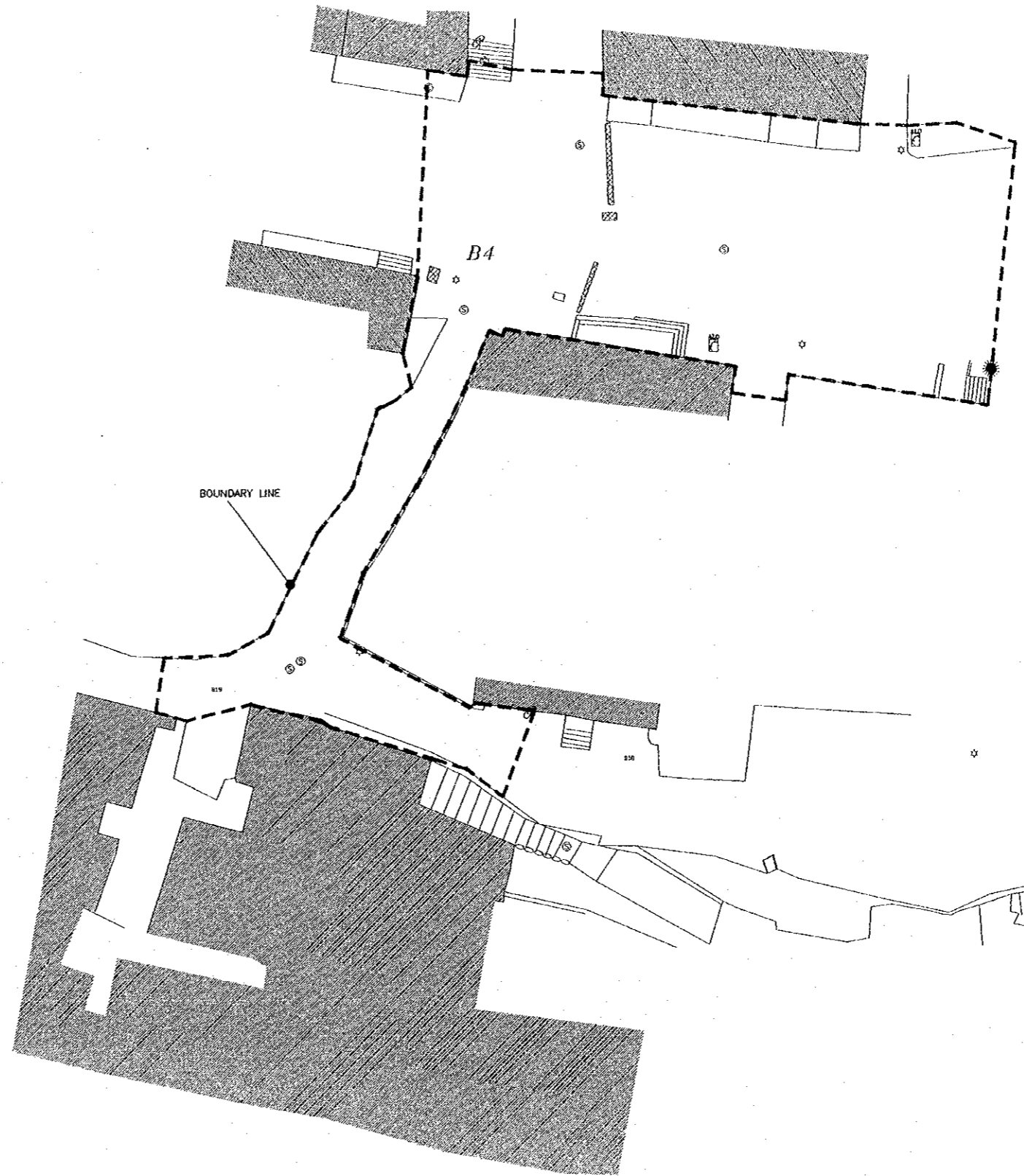
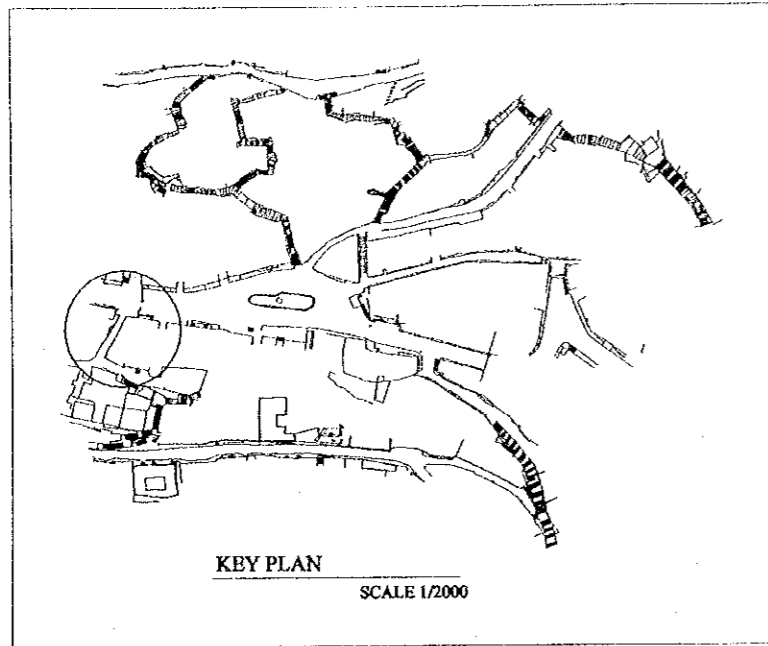

Tourism Sector Development Project
in the Hashemite Kingdom of Jordan

The Government of
the Hashemite Kingdom of Jordan
The Ministry of Tourism and Antiquities
The Ministry of Planning

Sub-Project:
Historic Old Salt Development

- Note:
- This detailed design has been executed by a team of consultants as shown below in accordance with the agreement between Japan International Cooperation Agency (JICA) and JICA Study Team.
 - The copyright of this drawing rests with JICA. ALL MEASUREMENTS ARE IN CENTIMETERS.
 - DO NOT SCALE FROM DRAWING
 - FOR TRILING DETAILS REFER TO D-13.D-1 \A\SD.AD-03 & D-15.D-16 \A\SD.AD-04
 - FOR TYPICAL STONE RISER DETAILS REFER TO D-01.D-02.D-03 \SD.AD-01
 - FOR TREE/FLOWER BED DETAILS REFER TO D-04.D-05 \SD.AD-01
 - FOR SIGN TYPES REFER TO D-19.D-20.D-21, D-22 \SD.AD-05
 - FOR MANHOLE DETAILS REFER TO D-15 \SD.AD-04 & D-23 \SD.AD-04
 - FOR BOLLARDS DETAILS REFER TO D-24 \SD.AD-06
 - FOR LITTER BIN DETAILS REFER TO D-25 \SD.AD-06
 - FOR TYPICAL CLOCK DETAIL REFER TO D-26 \SD.AD-06
 - FOR BENCH DETAILS REFER TO D-27 \SD.AD-07
 - FOR WET STONE CLADDING DETAILS REFER TO D-33 \SD.AD-08

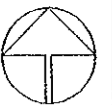

Designed by:
Japan International Cooperation Agency (JICA)
JICA Study Team:
Joint Venture of
Pacific Consultants International and
Yamasita Sekkei Inc.

Subcontracted Local Consultant:
TIBAH Consultants
Architects, Engineers

DATE: JUNE-10 / 2000

Tourist Trails
Drawing Title:
Lower West Jadaa Street
Existing Situation

Scale: 1:200
Drawing No.: SD.AT-48

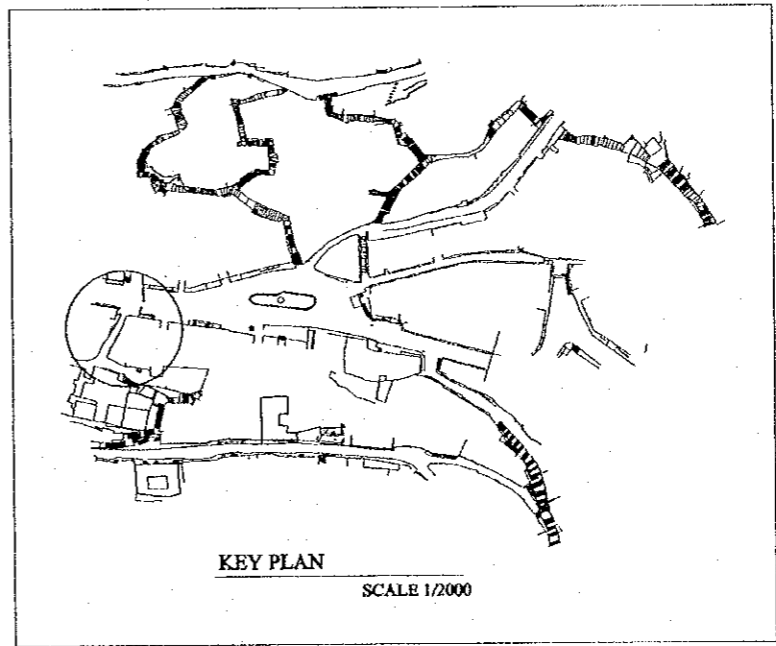
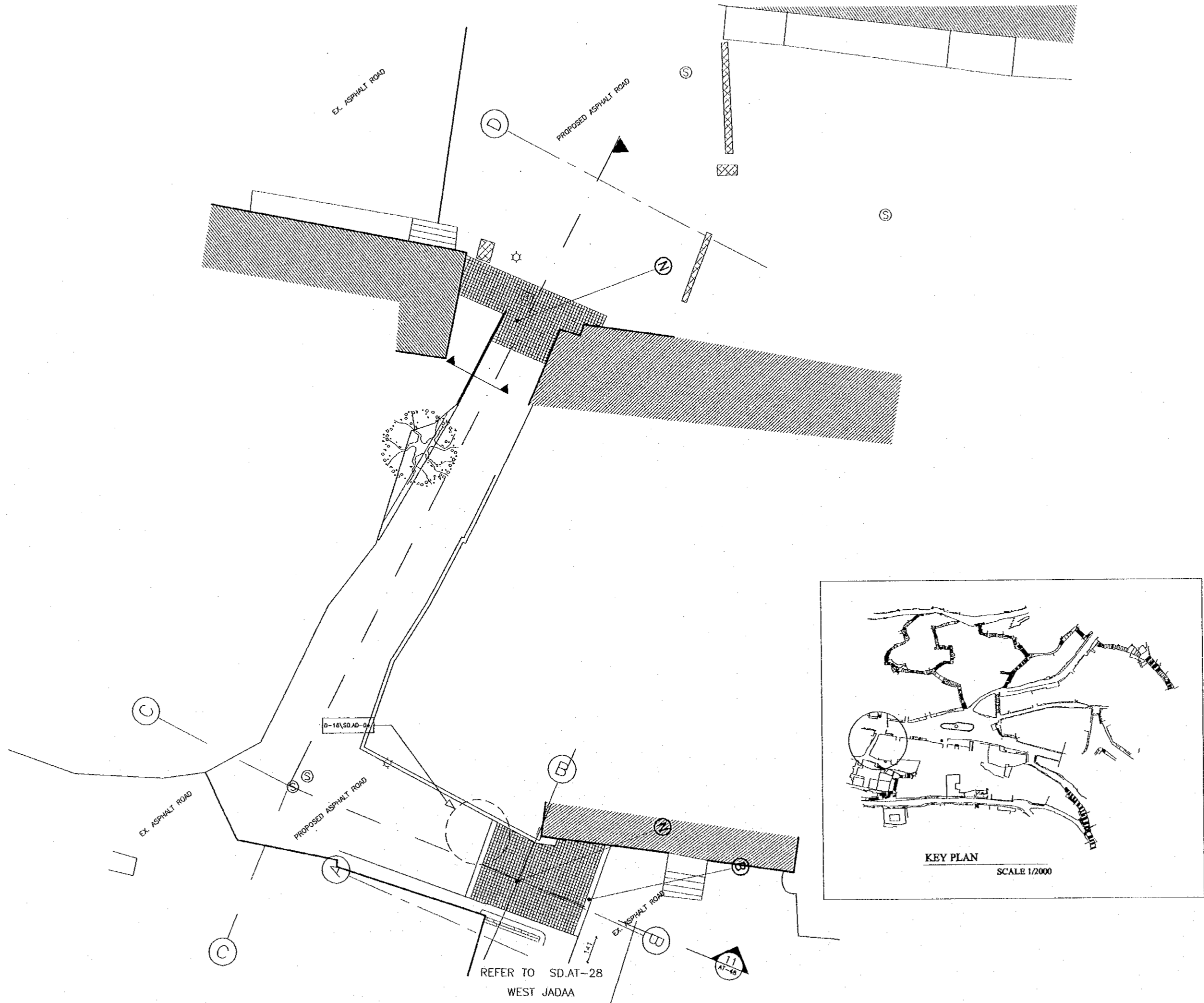

Tourism Sector Development Project
in the Hashemite Kingdom of Jordan

The Government of
the Hashemite Kingdom of Jordan
The Ministry of Tourism and Antiquities
The Ministry of Planning

Sub-Project:
Historic Old Salt Development

Note:
This detailed design has been executed by a team of consultants as shown below in accordance with the agreement between Japan International Cooperation Agency (JICA) and JICA Study Team.
The copyright of this drawing rests with JICA.
ALL MEASUREMENTS ARE IN CENTIMETERS.
• DO NOT SCALE FROM DRAWING
• FOR TILING DETAILS REFER TO D-13, D-14, SD, AD-03 & D-15, D-16, SD, AD-04
• FOR TYPICAL STONE RISER DETAILS REFER TO D-01, D-02, D-03, SD, AD-01
• FOR TREE/FLOWER BED DETAILS REFER TO D-04, D-05, SD, AD-01
• FOR SIGN TYPES REFER TO D-19, D-20, D-21, D-22, SD, AD-05
• FOR MANHOLE DETAILS REFER TO D-15, SD, AD-04 & D-23, SD, AD-06
• FOR BOLLARDS DETAILS REFER TO D-24, SD, AD-06
• FOR LITTER BIN DETAILS REFER TO D-25, SD, AD-06
• FOR TYPICAL CLOCK DETAIL REFER TO D-26, SD, AD-06
• FOR BENCH DETAILS REFER TO D-27, SD, AD-07
• FOR WET STONE CLADDING DETAILS REFER TO D-33, SD, AD-08

Designed by:
Japan International Cooperation Agency (JICA)
JICA Study Team:
Joint Venture of Pacific Consultants International and Yamashita Sekkei Inc.
Subcontracted Local Consultant:
TIBAH Consultants Architects, Engineers

DATE: JUNE- 10 / 2000

Tourist Trails

Drawing Title:
Lower West Jadaa Street plan

Scale: 1:100 Drawing No.: SD, AT-49

Note:
This detailed design has been executed by a team of consultants as shown below in accordance with the agreement between Japan International Cooperation Agency (JICA) and JICA Study Team.
The copyright of this drawing rests with JICA.
ALL MEASUREMENTS ARE IN CENTIMETERS.
• DO NOT SCALE FROM DRAWING
• FOR TILING DETAILS REFER TO D-13, D-14, SD, AD-03 & D-15, D-16, SD, AD-04
• FOR TYPICAL STONE PISER DETAILS REFER TO D-01, D-02, D-03, SD, AD-01
• FOR TREE/FLOWER BED DETAILS REFER TO D-04, D-05, SD, AD-01
• FOR SIGN TYPES REFER TO D-19, D-20, D-21, D-27, SD, AD-05
• FOR MANHOLE DETAILS REFER TO D-15, SD, AD-04 & D-23, SD, AD-06
• FOR BOLLARDS DETAILS REFER TO D-24, SD, AD-06
• FOR LITTER BIN DETAILS REFER TO D-25, SD, AD-06
• FOR TYPICAL CLOCK DETAIL REFER TO D-26, SD, AD-06
• FOR BENCH DETAILS REFER TO D-27, SD, AD-07
• FOR WET STONE CLADDING DETAILS REFER TO D-33, SD, AD-08

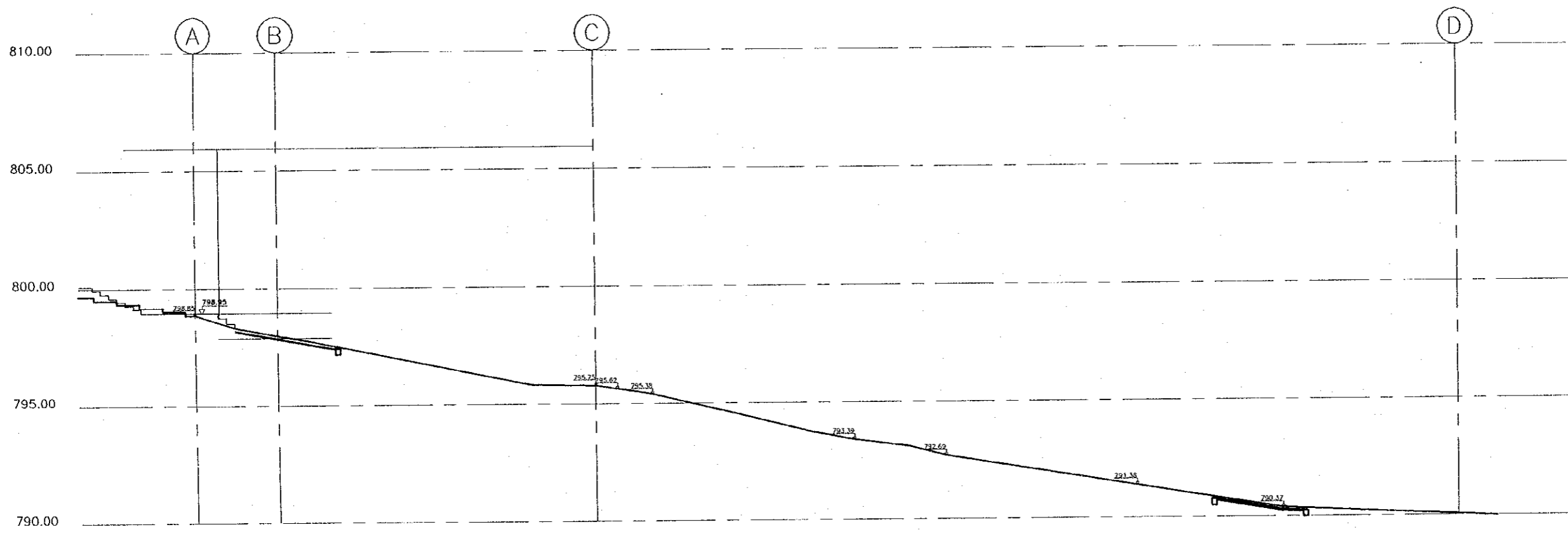

Designed by:
Japan International Cooperation Agency (JICA)
JICA Study Team:
Joint Venture of
Pacific Consultants International and
Yamasita Sekkei Inc.
Subcontracted Local Consultant:
TIBAH Consultants
Architects, Engineers

DATE: JUNE- 10 / 2000

Tourist Trails
Drawing Title:
Lower West Jadaa Street
SECTION A-D

Scale: 1:100
Drawing No.: SD,AT-50

Note:
This detailed design has been executed by a team of consultants as shown below in accordance with the agreement between Japan International Cooperation Agency (JICA) and JICA Study Team.
The copyright of this drawing rests with JICA.
ALL MEASUREMENTS ARE IN CENTIMETERS.
DO NOT SCALE FROM DRAWING

- FOR TILING DETAILS REFER TO D-13.D-14\SD.AD-03 & D-15.D-16\SD.AD-04
- FOR TYPICAL STONE RISER DETAILS REFER TO D-01.D-02.D-03\SD.AD-01
- FOR TREE/FLOWER BED DETAILS REFER TO D-04.D-05\SD.AD-01
- FOR SIGN TYPES REFER TO D-19.D-20.D-21, D-22\SD.AD-05
- FOR MANHOLE DETAILS REFER TO D-15\SD.AD-04 & D-23\SD.AD-06
- FOR BOLLARDS DETAILS REFER TO D-24\SD.AD-06
- FOR LITTER BIN DETAILS REFER TO D-25\SD.AD-06
- FOR TYPICAL CLOCK DETAIL REFER TO D-26\SD.AD-06
- FOR BENCH DETAILS REFER TO D-27\SD.AD-07
- FOR WET STONE CLADDING DETAILS REFER TO D-33\SD.AD-08

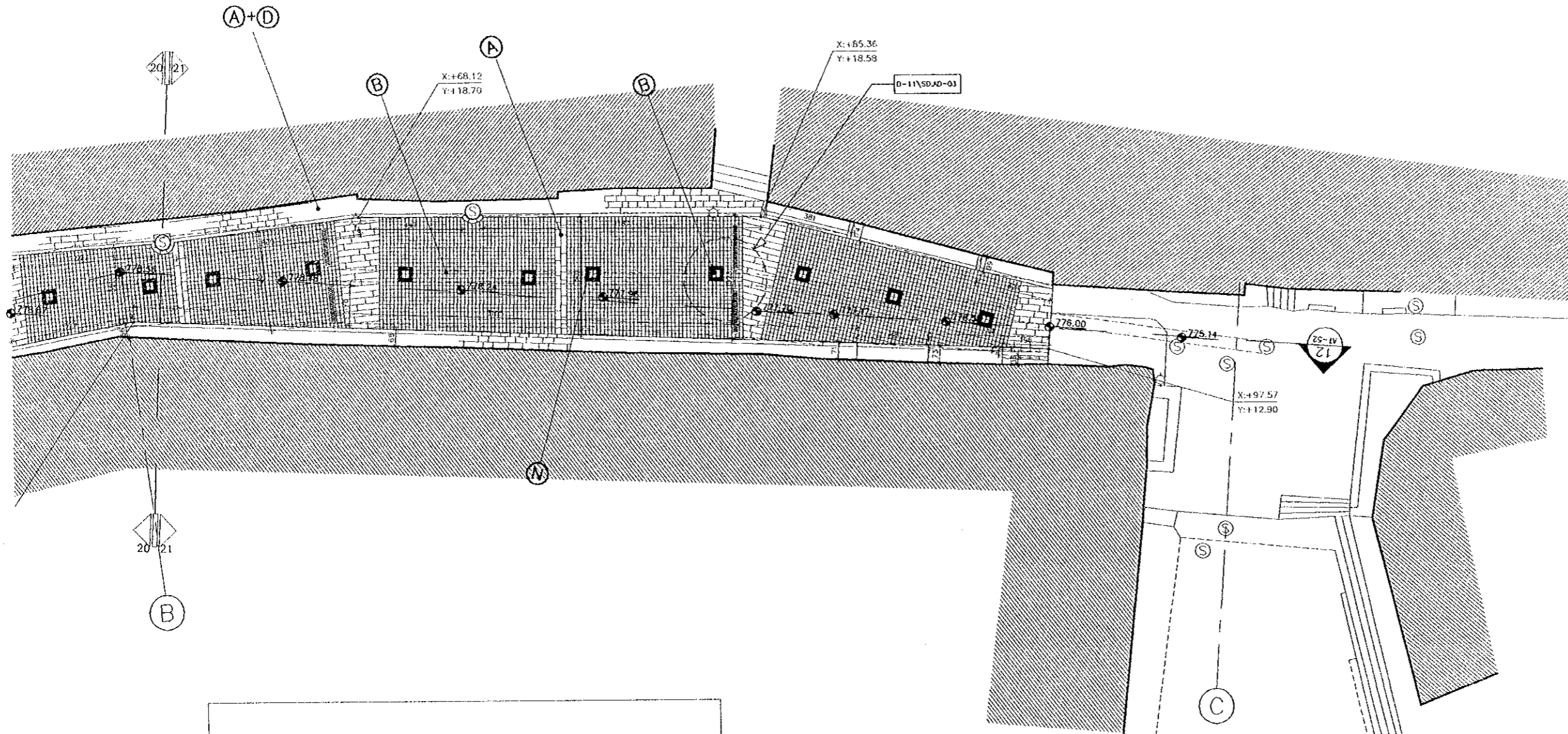

REFER TO SD.AP-06
BALADIEH PLAZA

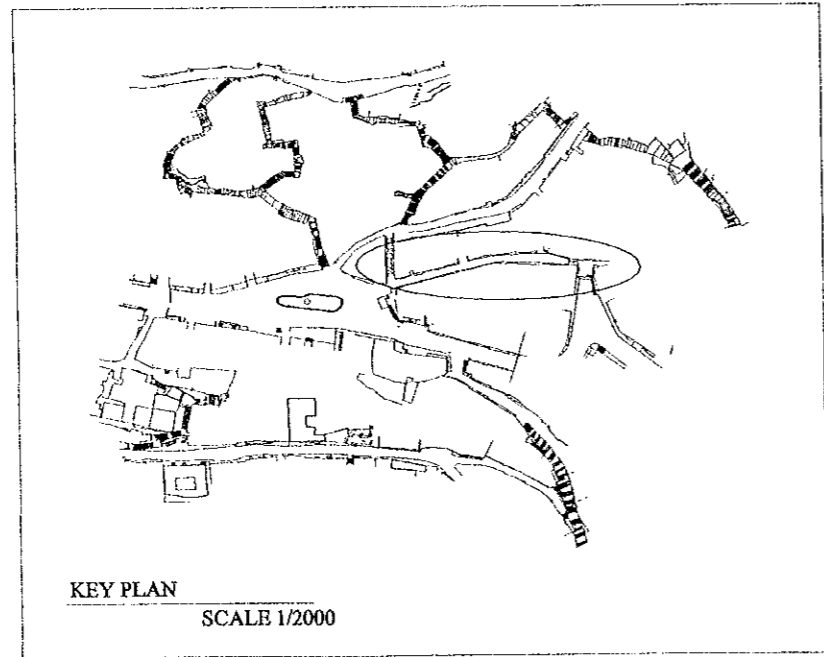

Designed by:
Japan International Cooperation Agency (JICA)
JICA Study Team:
Joint Venture of
Pacific Consultants International and
Yamasita Sekkei Inc.
Subcontracted Local Consultant:
TIBAH Consultants
Architects, Engineers

DATE	JUNE-10 / 2000
Tourist Trails	
Drawing Title: Hammam Street PLAN	
Scale: 1:100	Drawing No.: SD.AT-52

Tourism Sector Development Project
in the Hashemite Kingdom of Jordan

The Government of
the Hashemite Kingdom of Jordan
The Ministry of Tourism and Antiquities
The Ministry of Planning

Sub-Project:
Historic Old Salt Development

Note:
This detailed design has been executed by a team of consultants as shown below in accordance with the agreement between Japan International Cooperation Agency (JICA) and JICA Study Team.

- The copyright of this drawing rests with JICA. ALL MEASUREMENTS ARE IN CENTIMETERS.
- DO NOT SCALE FROM DRAWING
 - FOR TILING DETAILS REFER TO D-13,D-14,SD,AD-03 & D-15,D-16,SD,AD-04
 - FOR TYPICAL STONE RISER DETAILS REFER TO D-01,D-02,D-03,SD,AD-01
 - FOR TREE FLOWER BED DETAILS REFER TO D-04,D-05,SD,AD-01
 - FOR SIGN TYPES REFER TO D-19,D-20,D-21, D-22,SD,AD-05
 - FOR MANHOLE DETAILS REFER TO D-15,SD,AD-04 & D-23,SD,AD-04
 - FOR BOLLARDS DETAILS REFER TO D-24,SD,AD-06
 - FOR LITTER BIN DETAILS REFER TO D-25,SD,AD-06
 - FOR TYPICAL CLOCK DETAIL REFER TO D-26,SD,AD-06
 - FOR BENCH DETAILS REFER TO D-27,SD,AD-07
 - FOR WET STONE CLADDING DETAILS REFER TO D-33,SD,AD-08

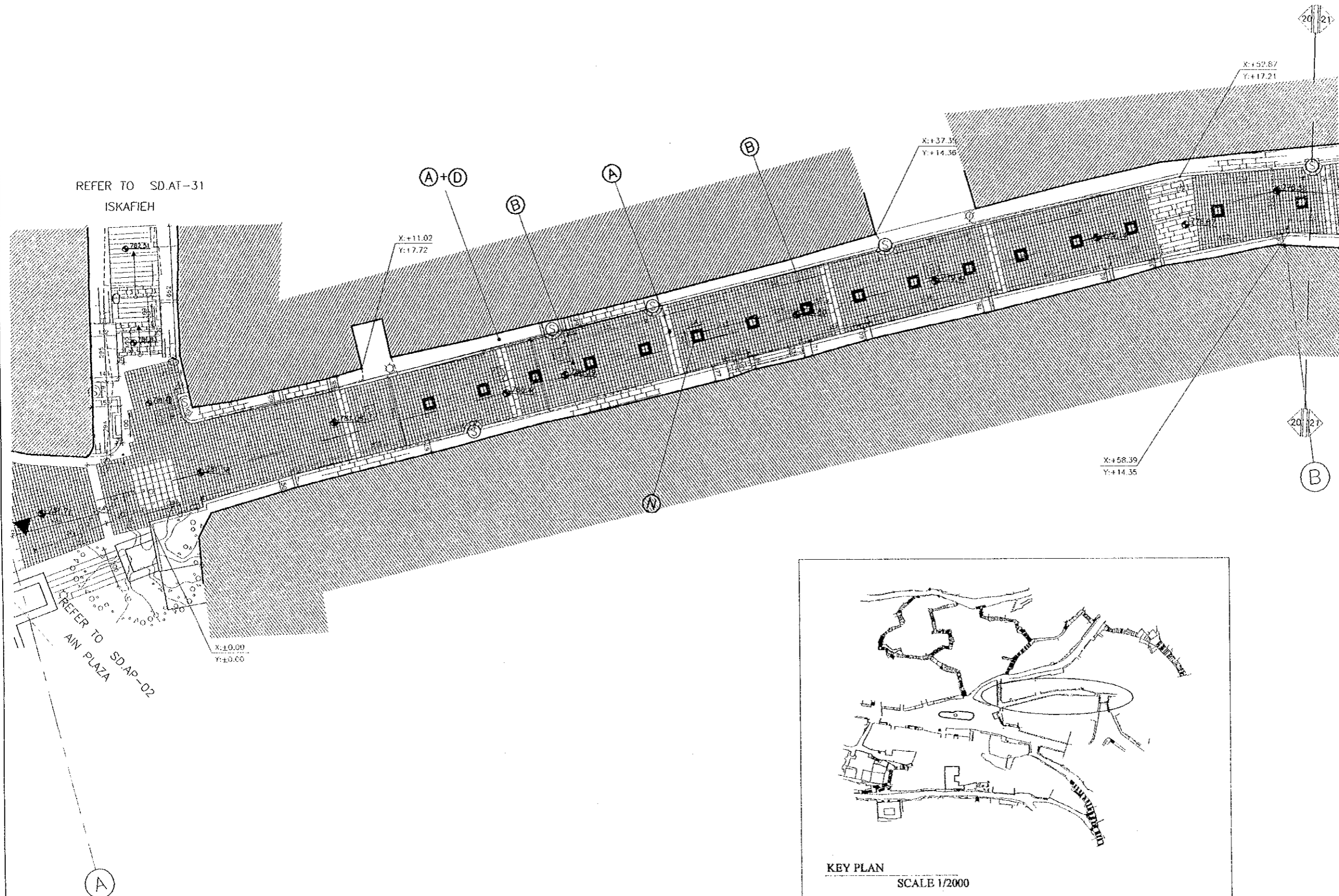

REFER TO SD.AT-31
ISKAFIEH

REFER TO SD.AP-02
AIN PLAZA

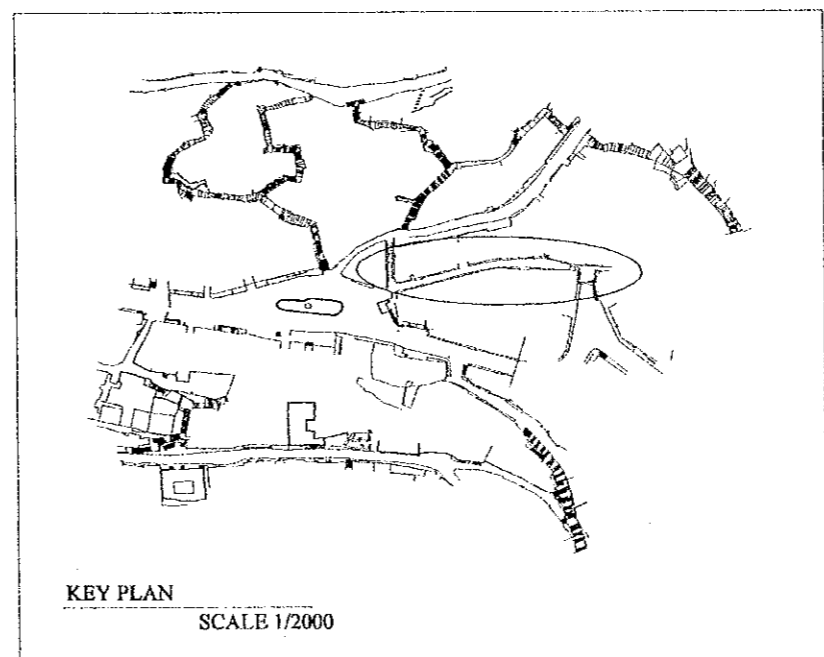

Designed by:
Japan International Cooperation Agency (JICA)
JICA Study Team:
Joint Venture of
Pacific Consultants International and
Yamasita Sekkel Inc.
Subcontracted Local Consultant:
TIBAH Consultants
Architects, Engineers

DATE: JUNE- 10 / 2000

Tourist Trails
Drawing title:
**Hammam Street
plan**

Scale: 1:100
Drawing No.: SD.AT-53

Tourism Sector Development Project
in the Hashemite Kingdom of Jordan

The Government of
the Hashemite Kingdom of Jordan
The Ministry of Tourism and Antiquities
The Ministry of Planning

Sub-Project:
Historic Old Salt Development

Note:
This detailed design has been executed by a team of consultants as shown below in accordance with the agreement between Japan International Cooperation Agency (JICA) and JICA Study Team.
The copyright of this drawing rests with JICA.
ALL MEASUREMENTS ARE IN CENTIMETERS.
DO NOT SCALE FROM DRAWING
• FOR TILING DETAILS REFER TO D-13, D-14, SD, AD-03 & D-15, D-16, SD, AD-04
• FOR TYPICAL STONE PISER DETAILS REFER TO D-01, D-02, D-03, SD, AD-01
• FOR TREE, FLOWER BED DETAILS REFER TO D-04, D-05, SD, AD-01
• FOR SIGN TYPES REFER TO D-19, D-20, D-21, D-22, SD, AD-05
• FOR MANHOLE DETAILS REFER TO D-15, SD, AD-04 & D-23, SD, AD-06
• FOR BOLLARDS DETAILS REFER TO D-24, SD, AD-06
• FOR LITTER BIN DETAILS REFER TO D-25, SD, AD-06
• FOR TYPICAL CLOCK DETAIL REFER TO D-26, SD, AD-06
• FOR BENCH DETAILS REFER TO D-27, SD, AD-07
• FOR WET STONE CLADDING DETAILS REFER TO D-33, SD, AD-08

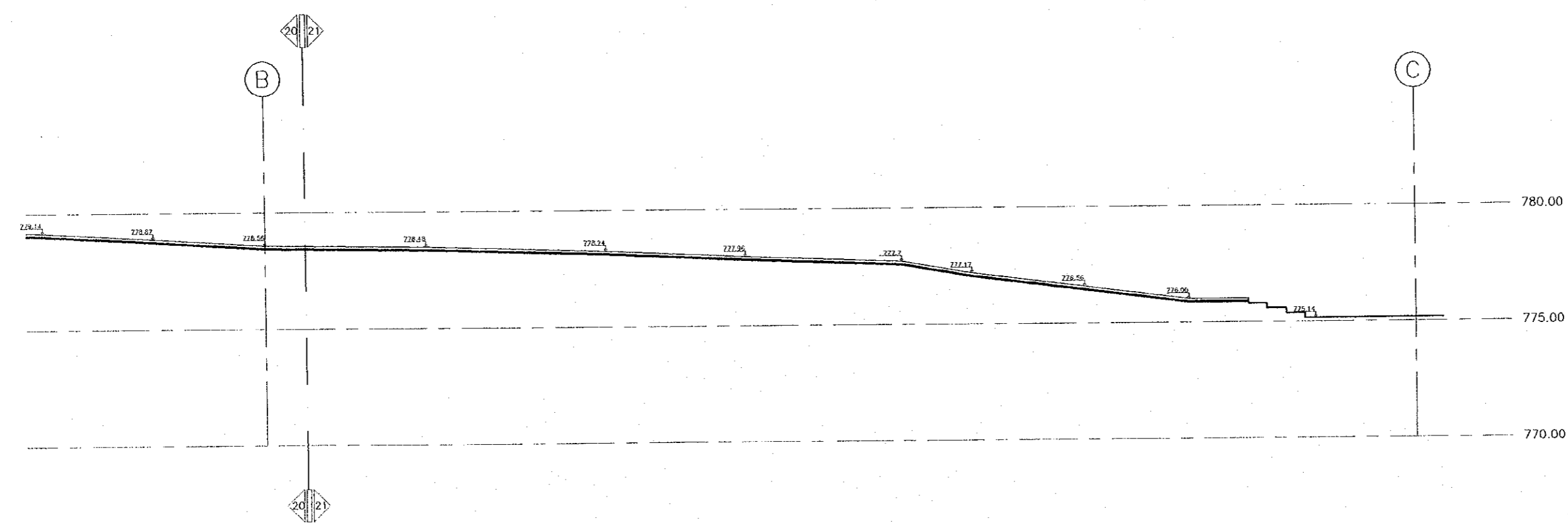
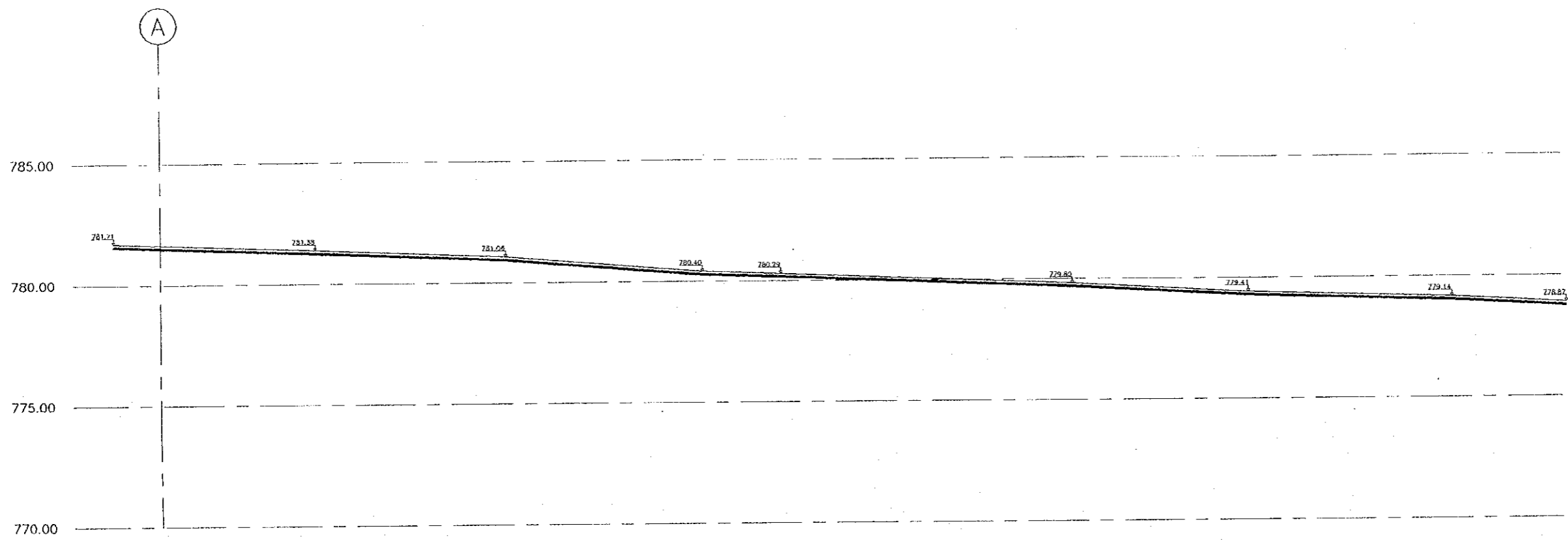

Designed by:
Japan International Cooperation Agency (JICA)
JICA Study Team:
Joint Venture of Pacific Consultants International and Yamashita Sekkei Inc.
Subcontracted Local Consultant:
TBAH Consultants Architects, Engineers

DATE: JUNE-10 / 2000

Tourist Trails
Drawing Title:
Hammam Street
SECTION A-C

Scale: 1:100 Drawing No.: SD.AT-54

TOPOGRAPHY PLAN
(EXISTING SITUATION)

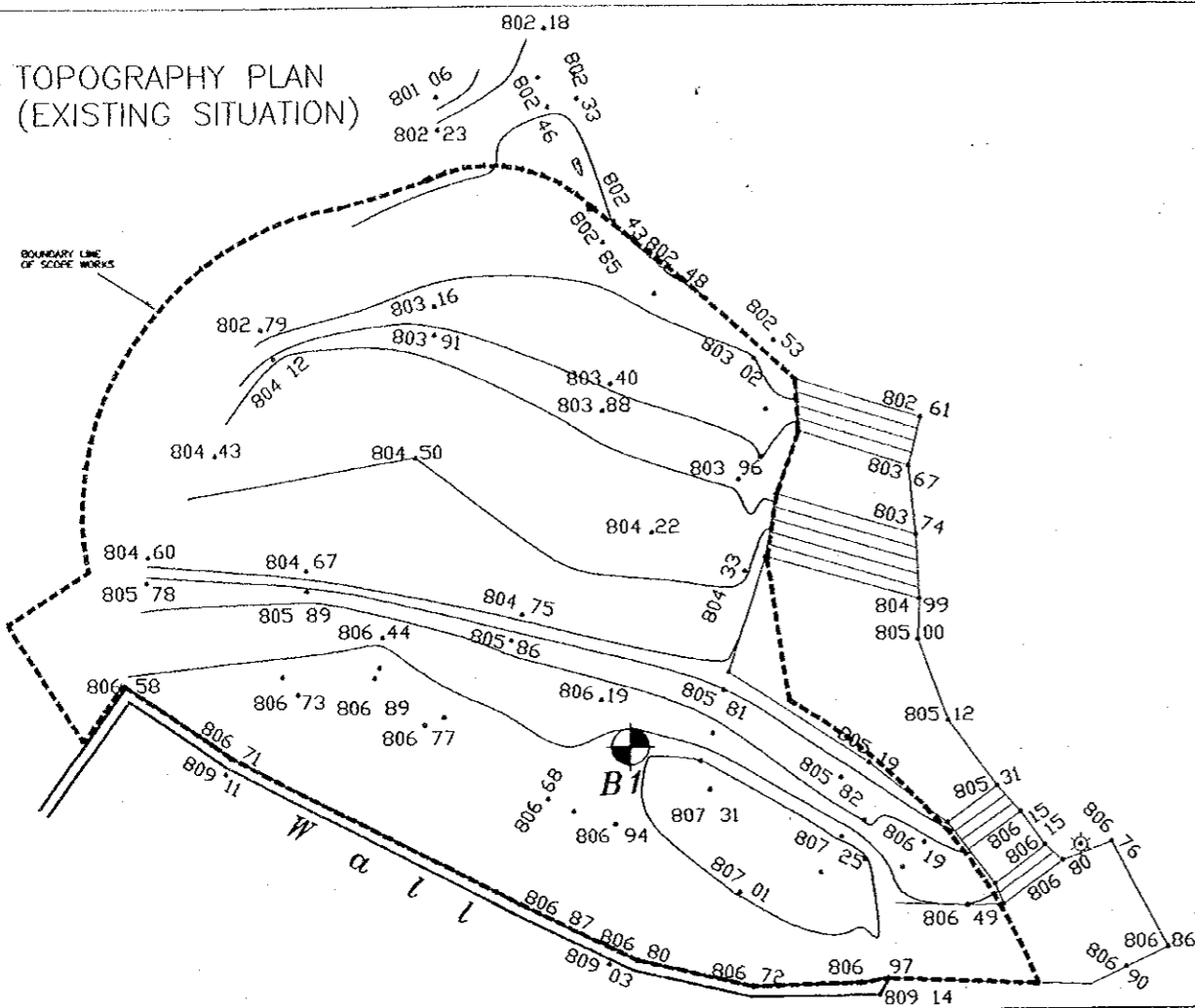

SITE PLAN-TO SLOPES

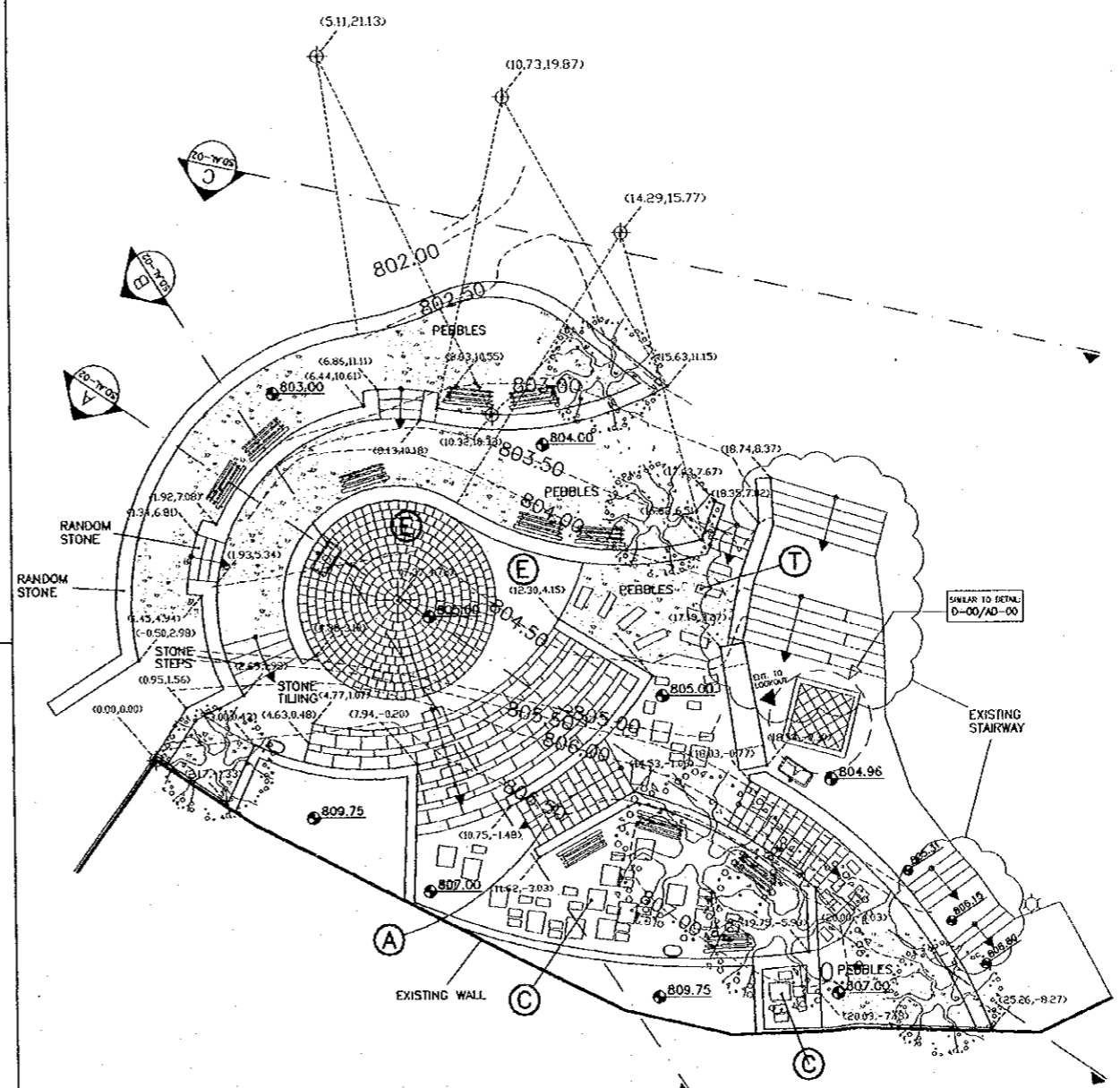
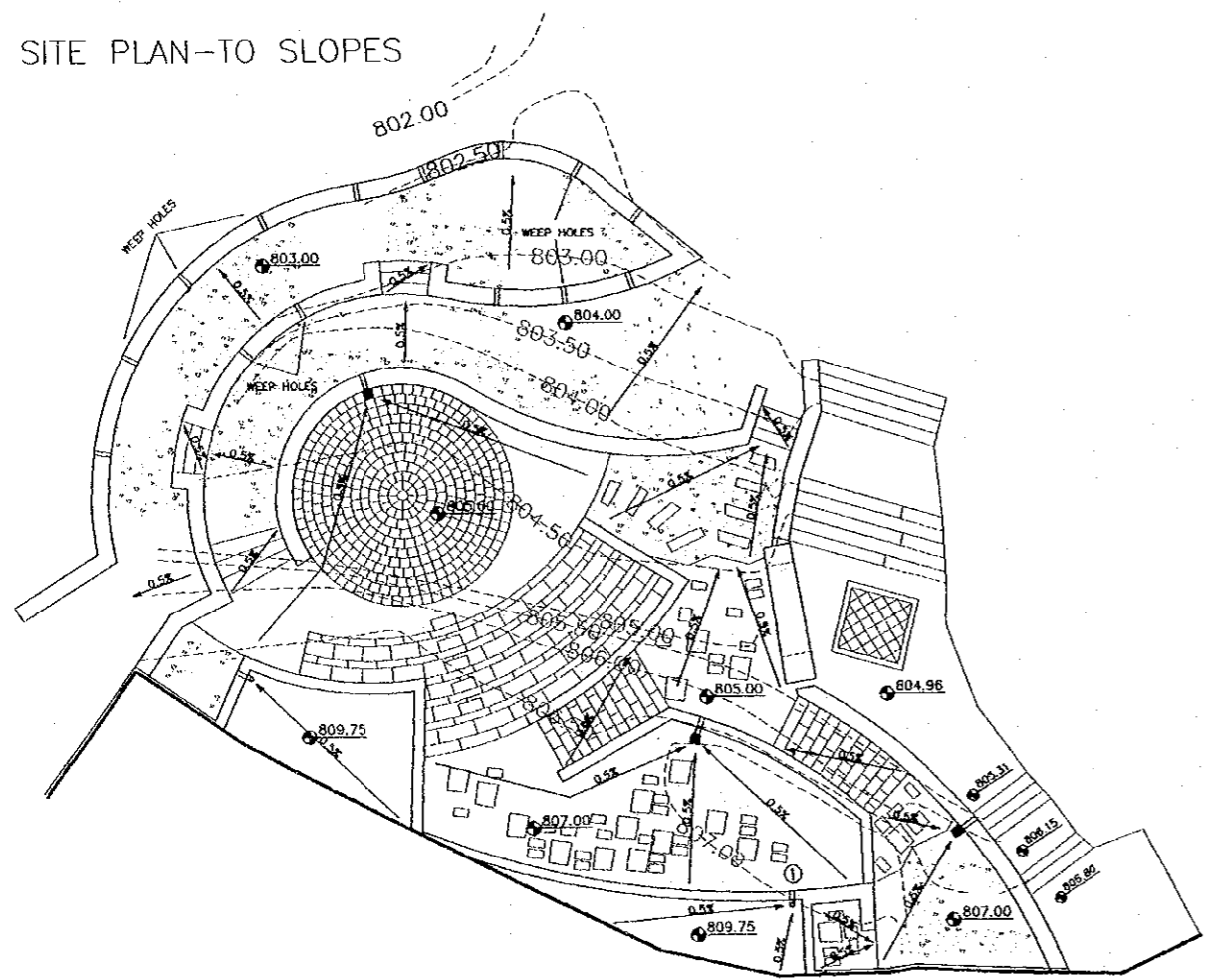

SITE PLAN-NEW PROPOSAL

Tourism Sector Development Project
In the Hashemite Kingdom of Jordan

The Government of
the Hashemite Kingdom of Jordan
The Ministry of Tourism and Antiquities
The Ministry of Planning

Sub-Project:
Historic Old Salt Development

- Note:
- This detailed design has been executed by a team of consultants as shown below in accordance with the agreement between Japan International Cooperation Agency (JICA) and JICA Study Team.
 - The copyright of this drawing rests with JICA.
 - ALL MEASUREMENTS ARE IN CENTIMETERS.
 - DO NOT SCALE FROM DRAWING
 - FOR TILING DETAILS REFER TO D-13.D-14.SD.AD-03
 - 8D-15.D-16.SD.AD-04
 - FOR TYPICAL STONE RISER DETAILS REFER TO D-01.D-02.D-03.SD.AD-01
 - FOR TREE/FLOWER BED DETAILS REFER TO D-04.D-05.SD.AD-01
 - FOR SIGN TYPES REFER TO D-19.D-20.D-21, D-22.SD.AD-05
 - FOR MANHOLE DETAILS REFER TO D-15.SD.AD-04 8D-23.SD.AD-06
 - FOR BOLLARDS DETAILS REFER TO D-24.SD.AD-06
 - FOR LITTER BIN DETAILS REFER TO D-25.SD.AD-06
 - FOR TYPICAL CLOCK DETAILS REFER TO D-26.SD.AD-06
 - FOR BENCH DETAILS REFER TO D-27.SD.AD-07
 - FOR WET STONE CLADDING DETAILS REFER TO D-33.SD.AD-08

Designed by:
Japan International Cooperation Agency (JICA)
JICA Study Team:
Joint Venture of
Pacific Consultants International and
Yamasita Sekkel Inc.
Subcontracted Local Consultant:
TIBAH Consultants
Architects, Engineers

DATE: JUNE-10 / 2000

Lookouts
Drawing Title:
Madrash Lookout
Existing Situation Down To Slopes

Scale: 1:100
Drawing No.: SD.AL-01

Sub-Project:
Historic Old Salt Development

- Note:
- This detailed design has been executed by a team of consultants as shown below in accordance with the agreement between Japan International Cooperation Agency (JICA) and JICA Study Team.
 - The copyright of this drawing rests with JICA.
 - ALL MEASUREMENTS ARE IN CENTIMETERS.
 - DO NOT SCALE FROM DRAWING
 - FOR TILING DETAILS REFER TO D-13, D-14, SD, AD-03
 - D-15, D-16, SD, AD-04
 - FOR TYPICAL STONE RISER DETAILS REFER TO D-01, D-02, D-03, SD, AD-01
 - FOR TREE FLOWER BED DETAILS REFER TO D-04, D-05, SD, AD-01
 - FOR SIGN TYPES REFER TO D-19, D-20, D-21, D-22, SD, AD-05
 - FOR MANHOLE DETAILS REFER TO D-15, SD, AD-04
 - D-23, SD, AD-06
 - FOR BOLLARDS DETAILS REFER TO D-24, SD, AD-06
 - FOR LITTER BIN DETAILS REFER TO D-25, SD, AD-06
 - FOR TYPICAL CLOCK DETAILS REFER TO D-26, SD, AD-06
 - FOR BENCH DETAILS REFER TO D-27, SD, AD-07
 - FOR WET STONE CLADDING DETAILS REFER TO D-33, SD, AD-08

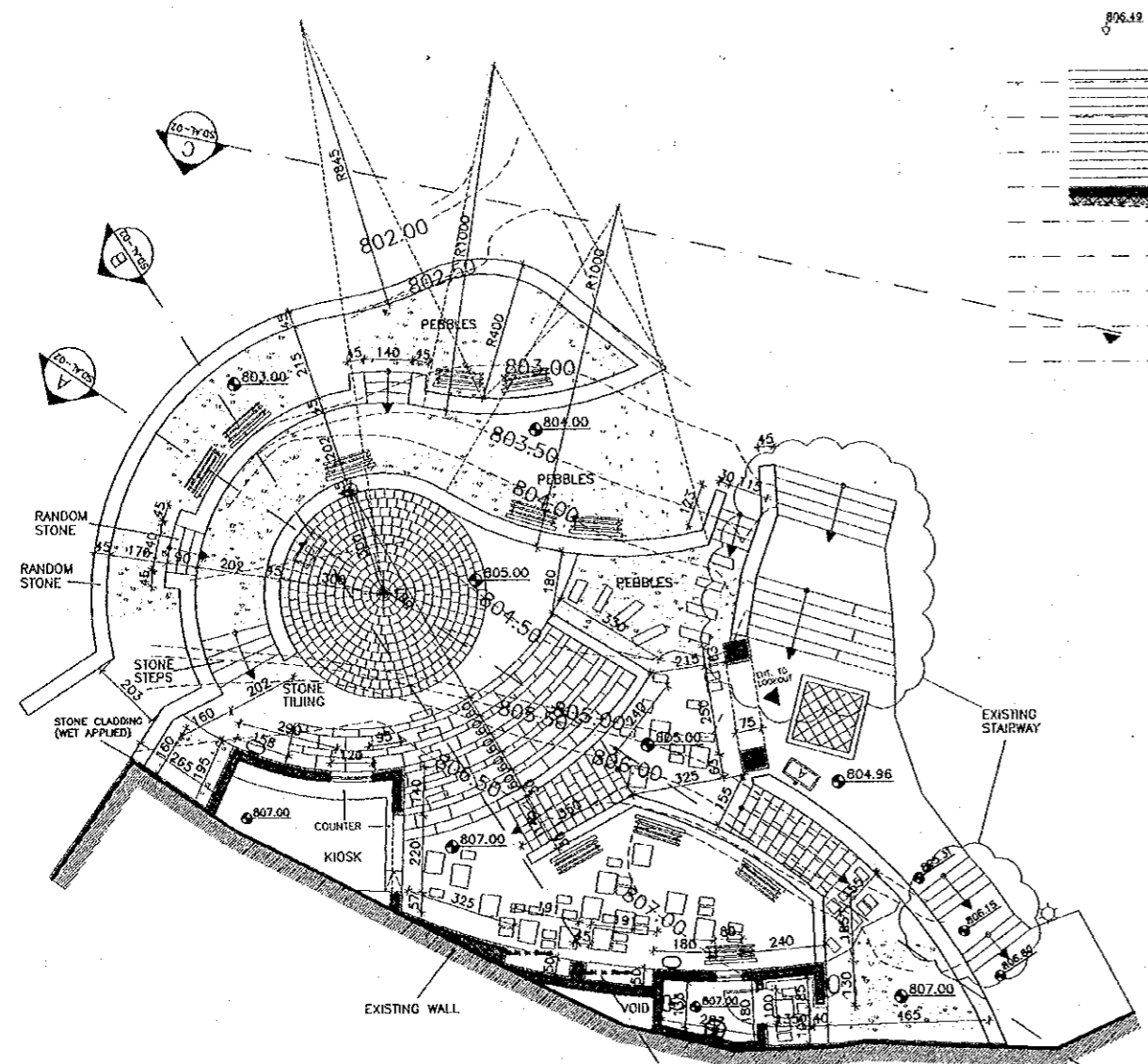

PLAN-NEW PROPOSAL

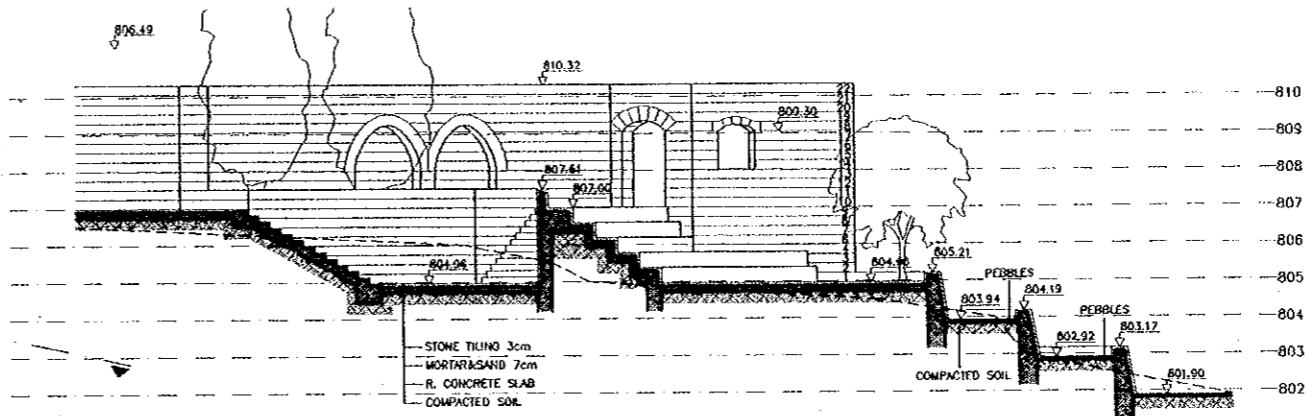

SECTION A-A

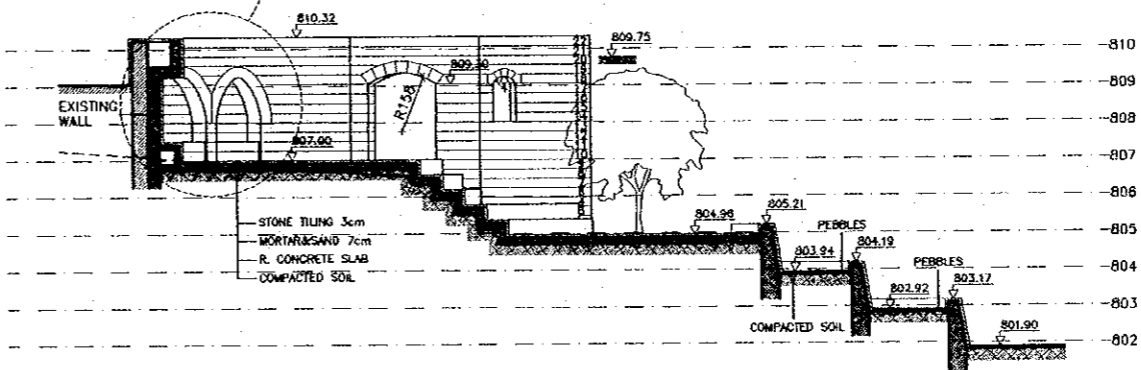
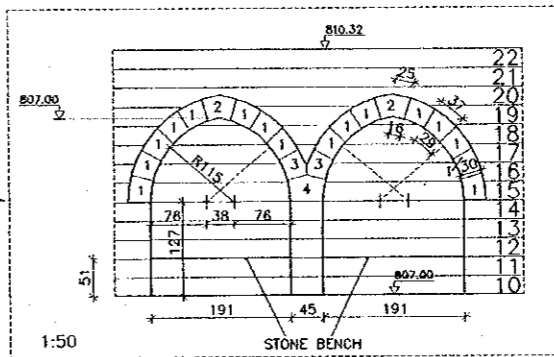

SECTION B-B

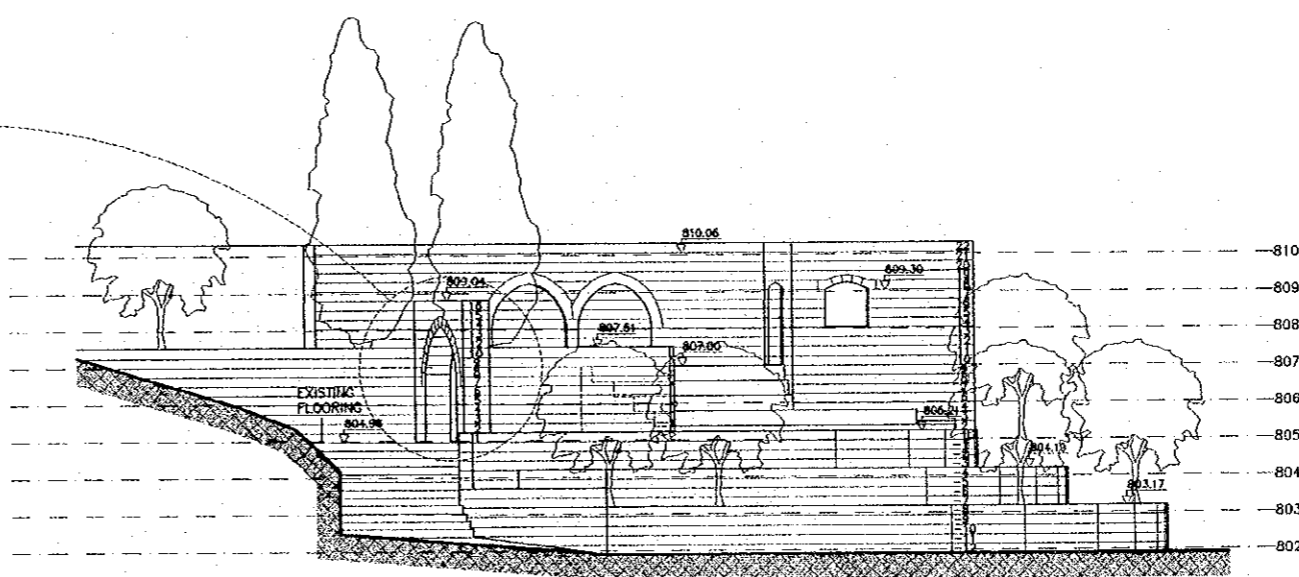
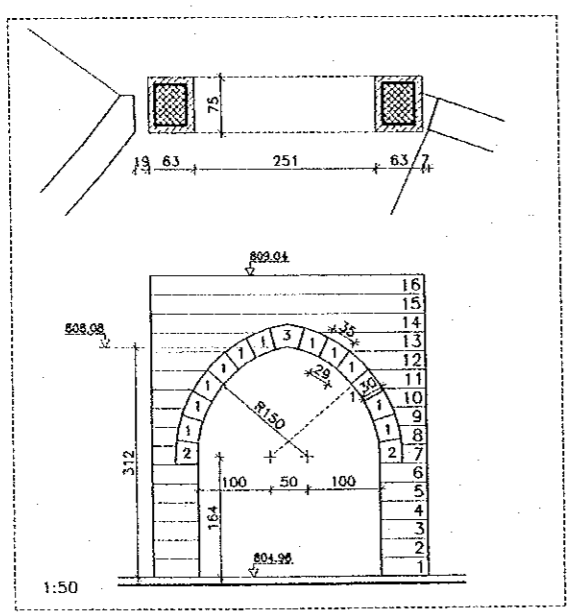

ELEVATION AT C-C

Designed by:
Japan International Cooperation Agency (JICA)

JICA Study Team:
Joint Venture of Pacific Consultants International and Yamashita Sekkei Inc.

Subcontracted Local Consultant:
TIBAH Consultants
Architects, Engineers

DATE: JUNE-10/2000

Lookouts
Drawing Title:
Madrasah Lookout
Plan, Section & Elevation

Scale: 1:50 / 1:100
Drawing No.: SD.AL-02

Tourism Sector Development Project
in the Hashemite Kingdom of Jordan

The Government of
the Hashemite Kingdom of Jordan
The Ministry of Tourism and Antiquities
The Ministry of Planning

Sub-Project:
Historic Old Salt Development

Note:
This detailed design has been executed by a team
of consultants as shown below in accordance with
the agreement between Japan International
Cooperation Agency (JICA) and JICA Study
Team.

- The copyright of this drawing rests with JICA.
ALL MEASUREMENTS ARE IN CENTIMETERS.
DO NOT SCALE FROM DRAWING
4" PVC RISER TO BE TERMINATED 15CM
ABOVE FINISHED FLOOR OR SOIL LEVEL.
• FOR TILING DETAILS REFER TO D-15.D-14.SD.AD-03
• SD-15.D-16.SD.AD-04
• FOR TYPICAL STONE RISER DETAILS REFER TO
D-01.D-02.D-03.SD.AD-01
• FOR TREE/FLOWER BED DETAILS REFER TO
D-04.D-05.SD.AD-01
• FOR SIGN TYPES REFER TO D-19.D-20.D-21.
D-22.SD.AD-05
• FOR MANHOLE DETAILS REFER TO D-18.SD.AD-04
SD-23.SD.AD-04
• FOR BOLLARDS DETAILS REFER TO D-24.SD.AD-04
• FOR LITTER BIN DETAILS REFER TO D-25.SD.AD-04
• FOR TYPICAL CLOCK DETAILS REFER TO D-26.SD.AD-04
• FOR BENCH DETAILS REFER TO D-27.SD.AD-07
• FOR WET STONE CLADDING DETAILS REFER TO
D-33.SD.AD-08

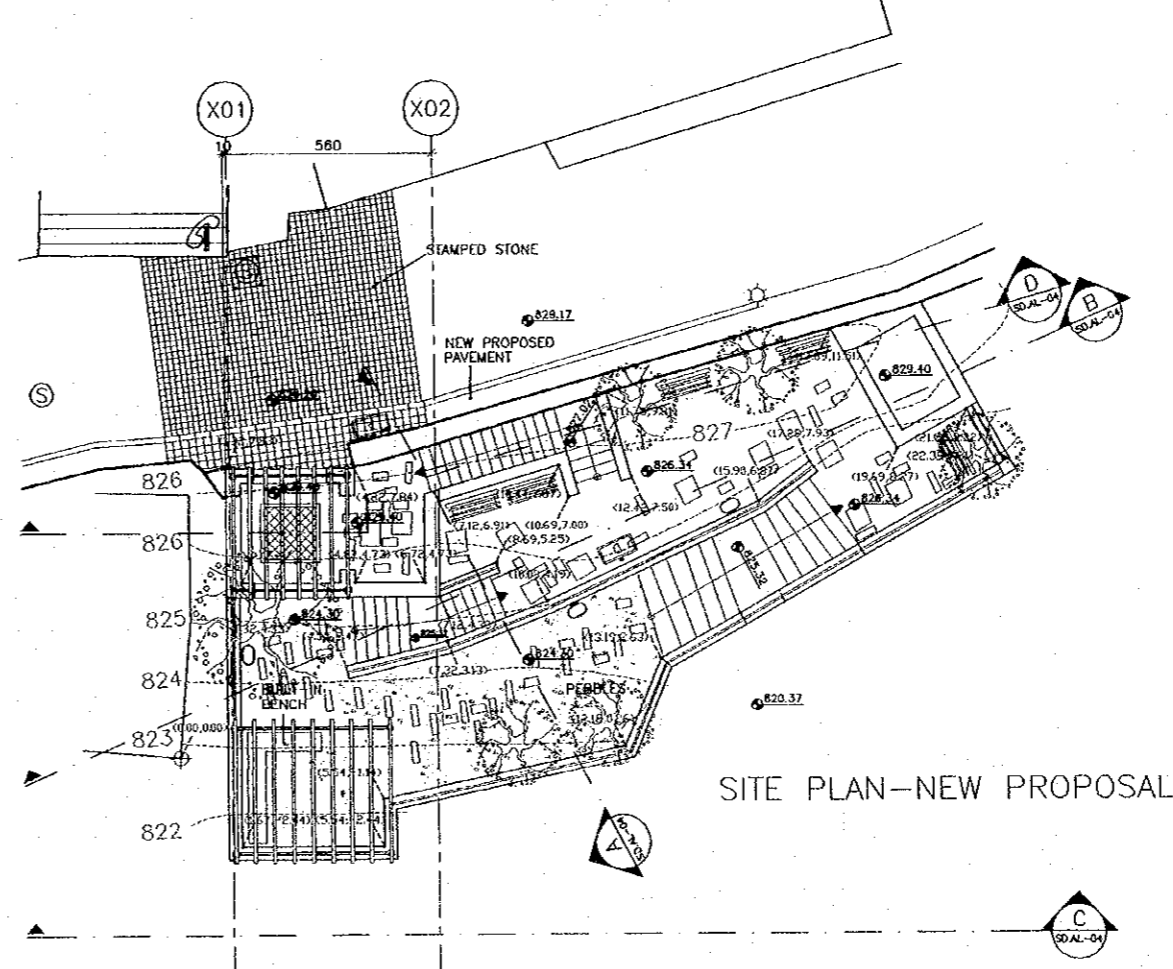
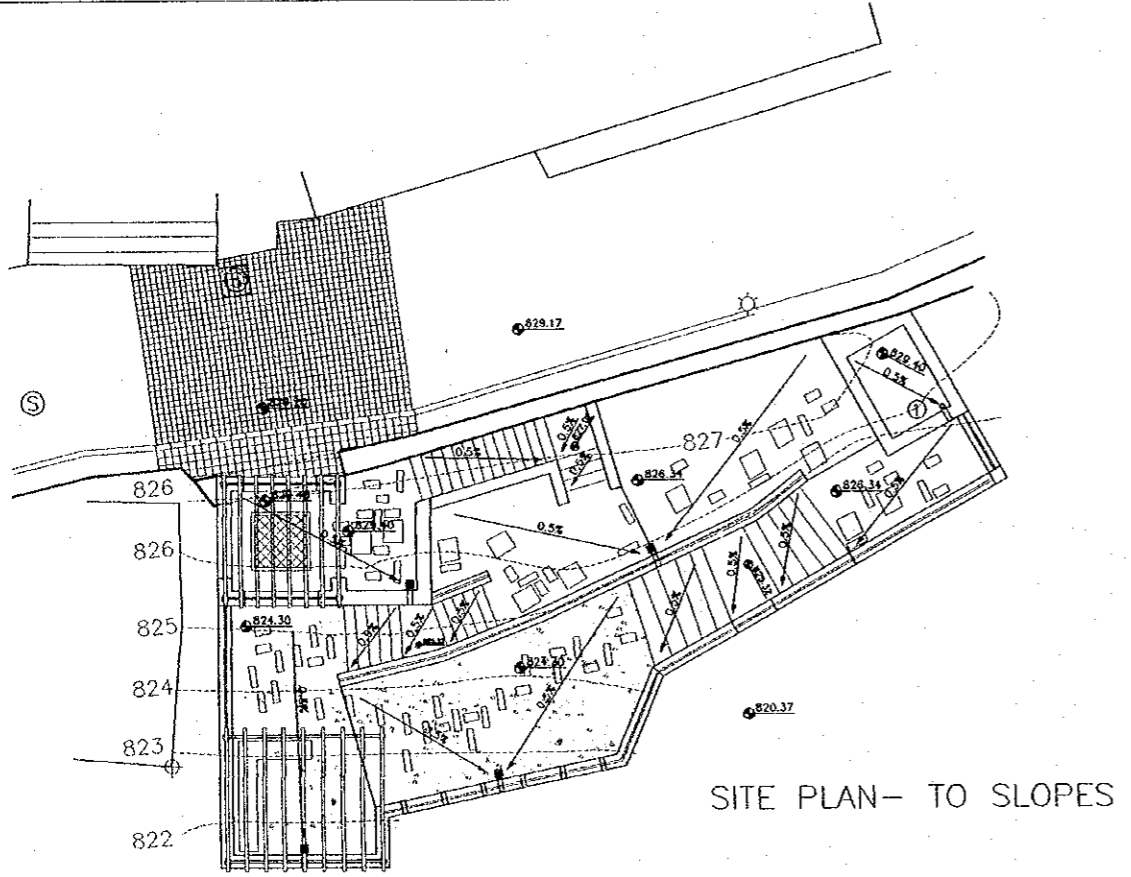
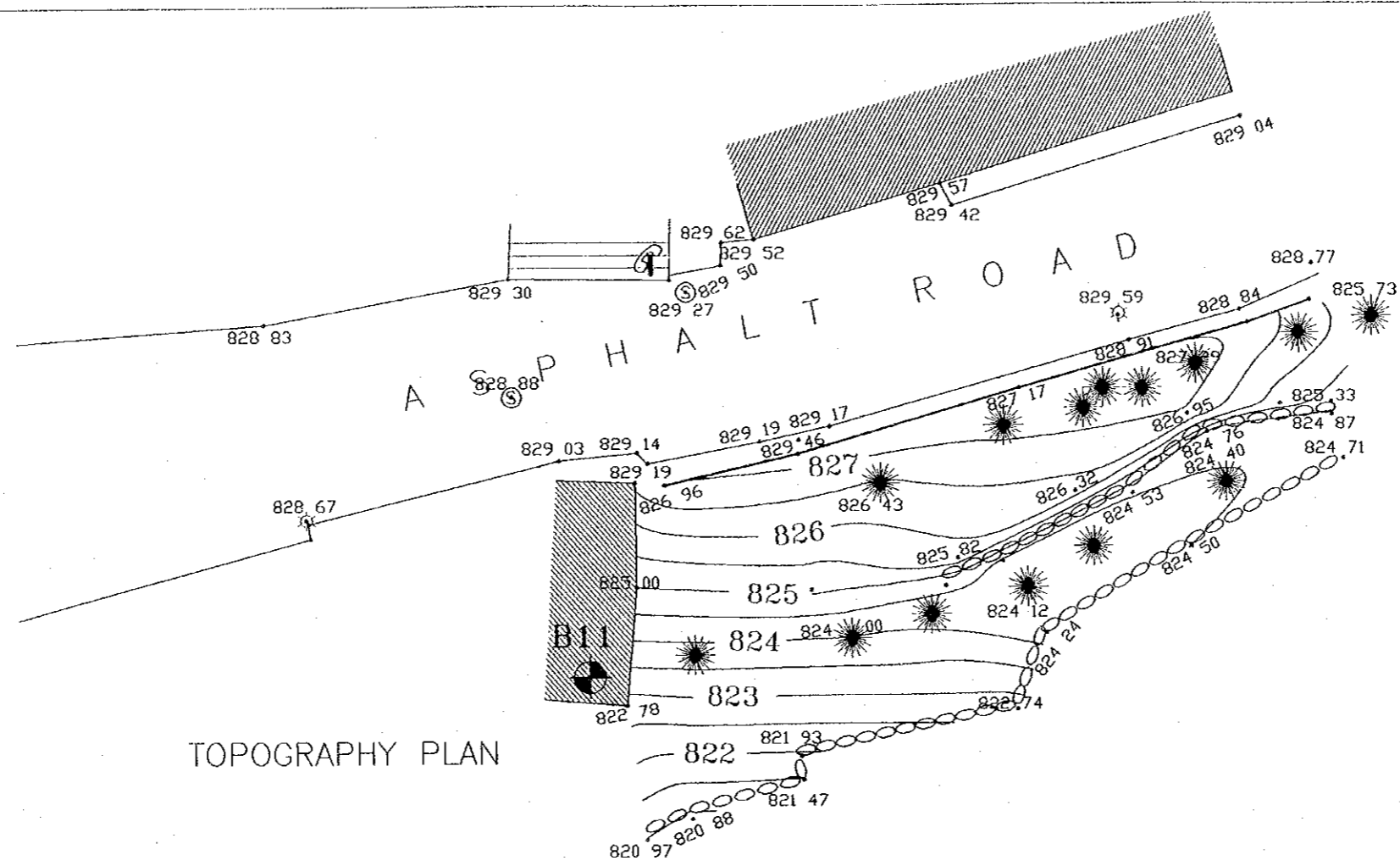

Designed by:
Japan International Cooperation
Agency (JICA)
JICA Study Team:
Joint Venture of
Pacific Consultants International and
Yamasita Sekkei Inc.

Subcontracted Local Consultant:
TIBAH Consultants
Architects, Engineers

DATE: JUNE-10/2000

Lookouts
Drawing title:
Qalaa Lookout
Existing Situation (Down To Slopes & Site plan)

Scale: 1:100
Drawing No.: SD.AL-03

Note:
This detailed design has been executed by a team of consultants as shown below in accordance with the agreement between Japan International Cooperation Agency (JICA) and JICA Study Team.
The copyright of this drawing rests with JICA. ALL MEASUREMENTS ARE IN CENTIMETERS. DO NOT SCALE FROM DRAWING.
• FOR TILING DETAILS REFER TO D-13, D-14, SD, AD-03
• D-15, D-16, SD, AD-04
• FOR TYPICAL STONE RISER DETAILS REFER TO D-01, D-02, D-03, SD, AD-01
• FOR TREE, FLOWER BED DETAILS REFER TO D-04, D-05, SD, AD-01
• FOR SIGN TYPES REFER TO D-19, D-20, D-21, D-22, SD, AD-05
• FOR MANHOLE DETAILS REFER TO D-15, SD, AD-04
• D-23, SD, AD-06
• FOR BOLLARDS DETAILS REFER TO D-24, SD, AD-06
• FOR LITTER BIN DETAILS REFER TO D-25, SD, AD-06
• FOR TYPICAL CLOCK DETAILS REFER TO D-26, SD, AD-06
• FOR BENCH DETAILS REFER TO D-27, SD, AD-07
• FOR WET STONE CLADDING DETAILS REFER TO D-33, SD, AD-08

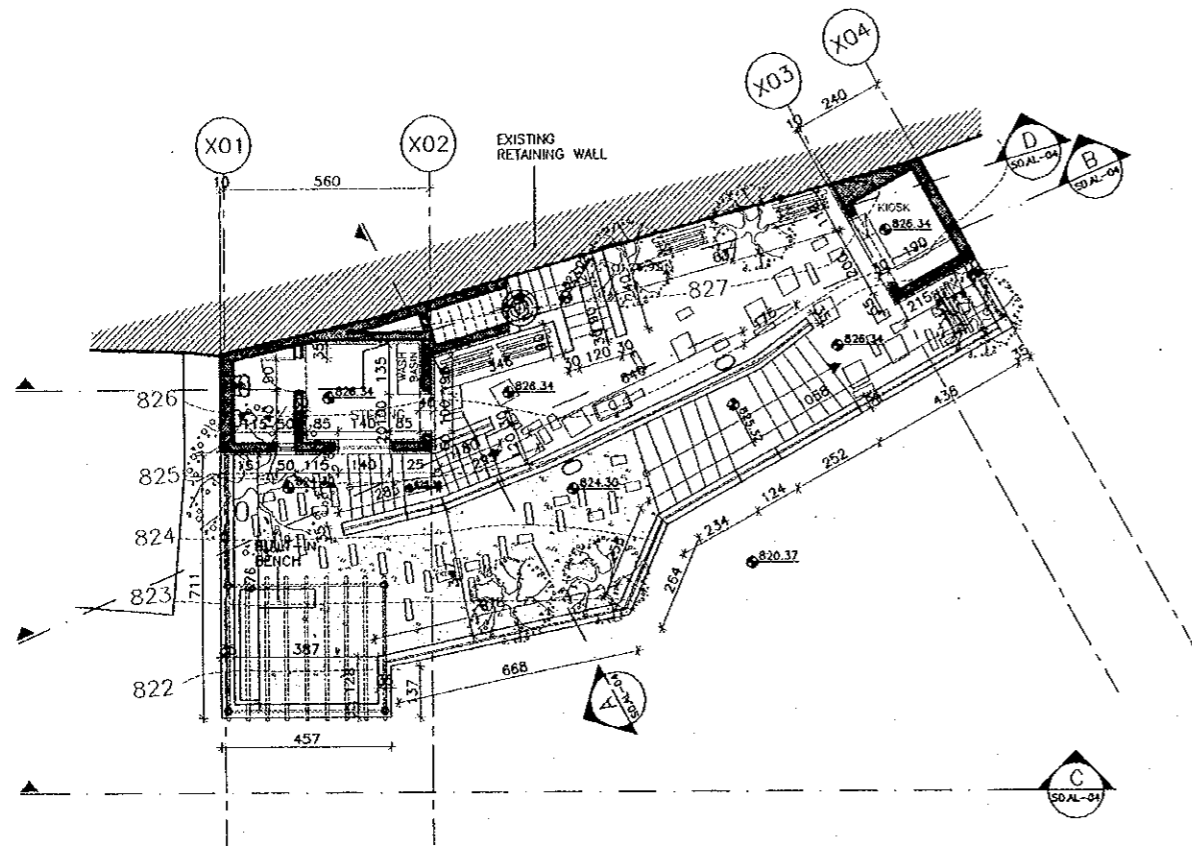

PLAN-NEW PROPOSAL

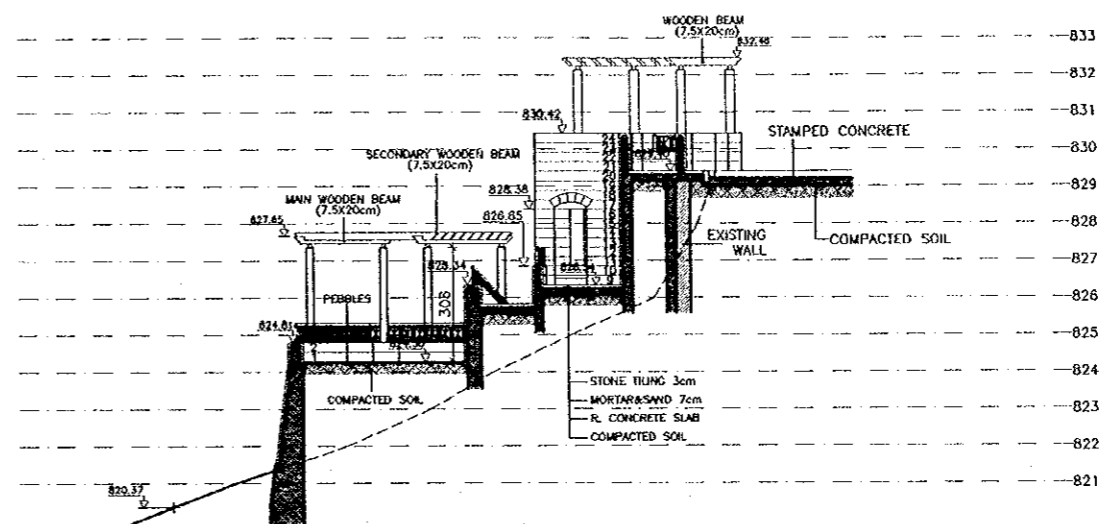

SECTION A-A

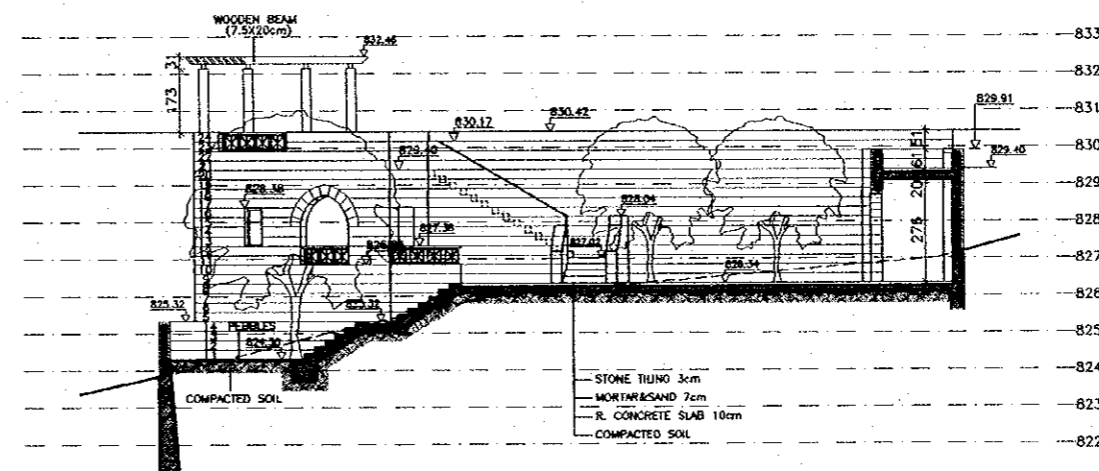

SECTION B-B

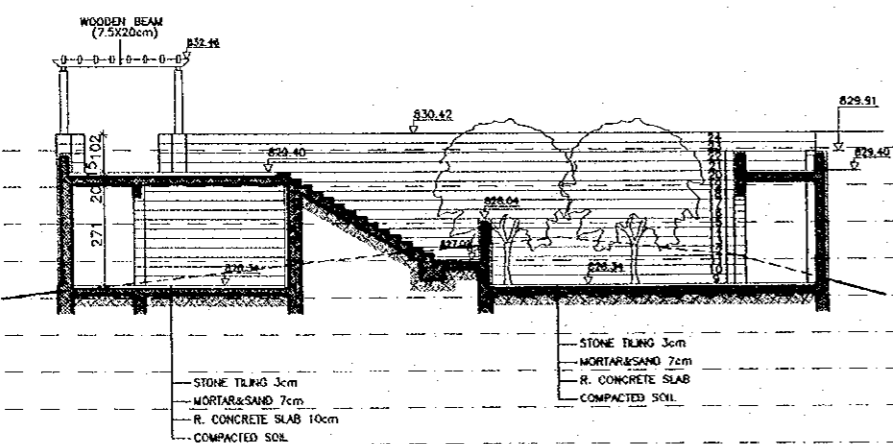

SECTION D-D

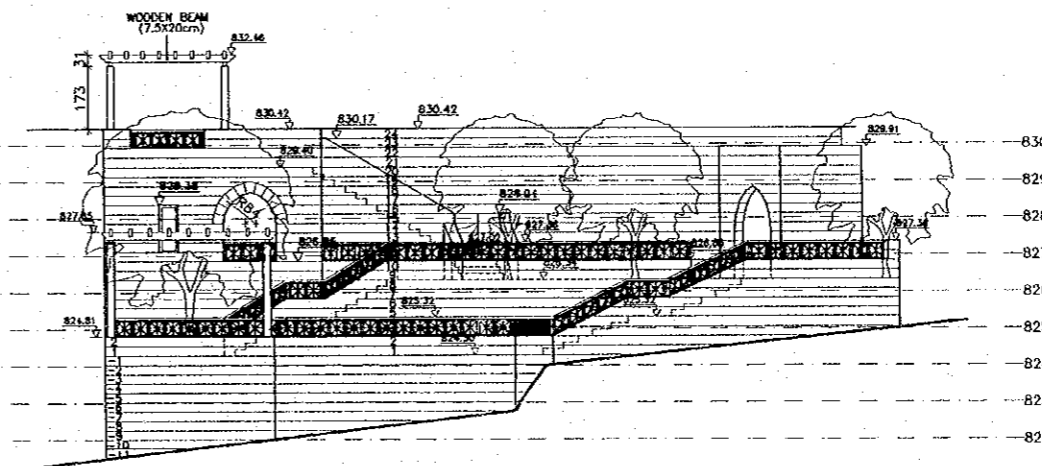

ELEVATION AT C-C

Designed by:
Japan International Cooperation Agency (JICA)
JICA Study Team:
Joint Venture of
Pacific Consultants International and
Yamasita Sekkei Inc.

Subcontracted Local Consultant:
TIBAH Consultants
Architects, Engineers

DATE: JUNE-10 / 2000

Lookouts

Drawing Title:
Qalaa Lookout
Plan, Section & Elevation

Scale: 1:100
Drawing No.: SD.AL-04

Note:
This detailed design has been executed by a team
of consultants as shown below in accordance with
the agreement between Japan International
Cooperation Agency (JICA) and JICA Study
Team.

- The copyright of this drawing rests with JICA.
- ALL MEASUREMENTS ARE IN CENTIMETERS.
- DO NOT SCALE FROM DRAWING
- 30X30cm TRENCH.
- FOR TILING DETAILS REFER TO D-13.D-1 A,SD,AD-03
- D-15.D-16,SD,AD-04
- FOR TYPICAL STONE RISER DETAILS REFER TO
D-01.D-02.D-03,SD,AD-01
- FOR TREE/FLOWER BED DETAILS REFER TO
D-04.D-05,SD,AD-01
- FOR SIGN TYPES REFER TO D-19.D-20.D-21,
D-22,SD,AD-05
- FOR MANHOLE DETAILS REFER TO D-15,SD,AD-04
AD-23,SD,AD-06
- FOR BOLLARDS DETAILS REFER TO D-24,SD,AD-06
- FOR LITTER BIN DETAILS REFER TO D-25,SD,AD-06
- FOR TYPICAL CLOCK DETAILS REFER TO D-26,SD,AD-06
- FOR BENCH DETAILS REFER TO D-27,SD,AD-07
- FOR WET STONE CLADDING DETAILS REFER TO
D-33,SD,AD-08

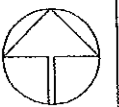

Designed by:
Japan International Cooperation
Agency (JICA)

JICA Study Team:
Joint Ventures of
Pacific Consultants International and
Yamasita Sekkei Inc.

Subcontracted Local Consultant:
TIBAH Consultants
Architects, Engineers

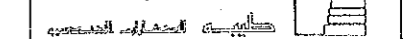

DATE	JUNE-10 / 2000
------	----------------

Lookouts

Drawing Title:
Kamal Al Shaer Lookout
Existing Situation / Down To Slopes / Site Plan

Scale: 1:100/1:150	Drawing No.: SD.AL-05
-----------------------	--------------------------

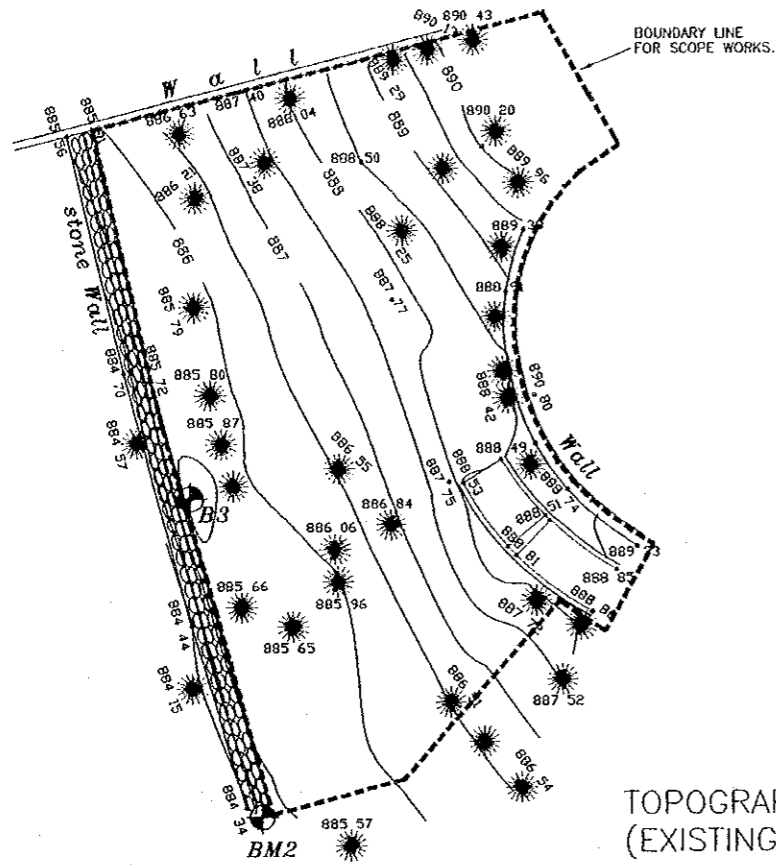

TOPOGRAPHY PLAN
(EXISTING SITUATION)
SCALE: 1-150

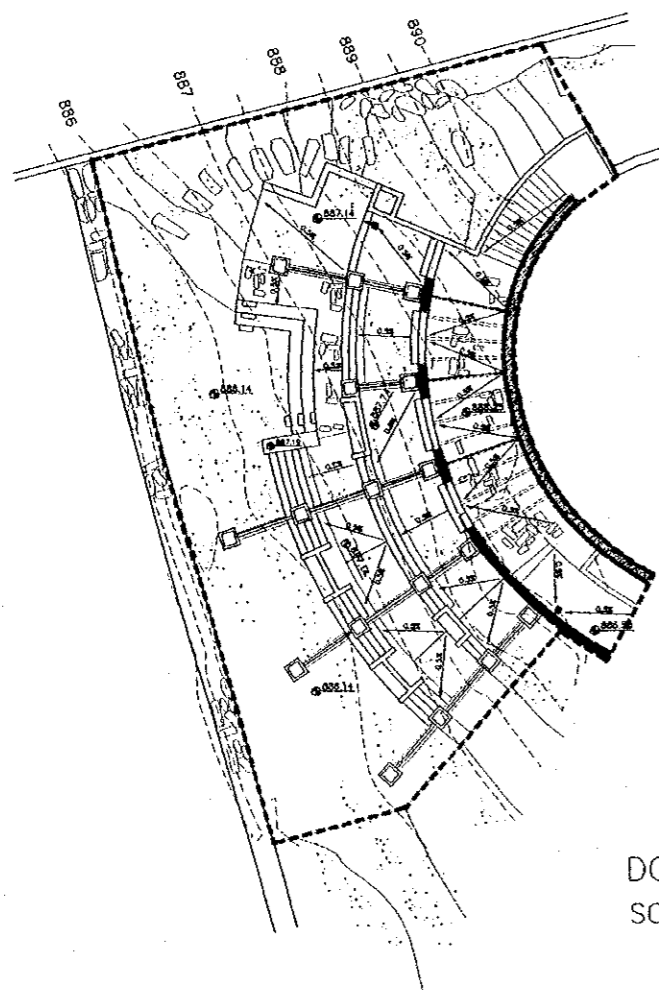

DOWN TO SLOPES
SCALE: 1-150

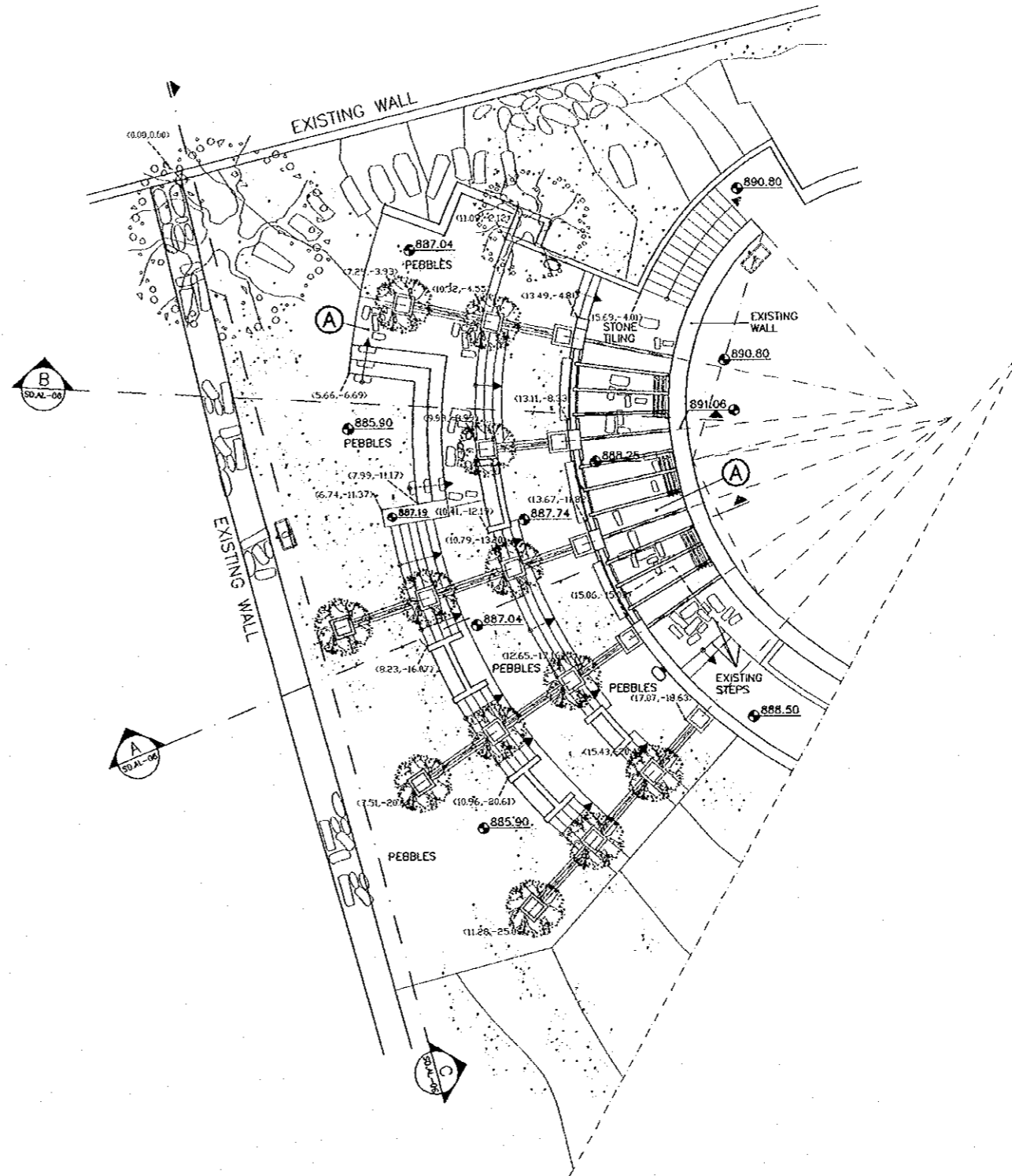

SITE PLAN-NEW PROPOSAL
SCALE: 1-100

Note:
This detailed design has been executed by a team of consultants as shown below in accordance with the agreement between Japan International Cooperation Agency (JICA) and JICA Study Team.

- The copyright of this drawing rests with JICA.
- ALL MEASUREMENTS ARE IN CENTIMETERS.
- DO NOT SCALE FROM DRAWING
- FOR TILING DETAILS REFER TO D-13, D-14, SD, AD-03
- & D-15, D-16, SD, AD-04
- FOR TYPICAL STONE RISER DETAILS REFER TO D-01, D-02, D-03, SD, AD-01
- FOR TREE/FLOWER BED DETAILS REFER TO D-04, D-05, SD, AD-01
- FOR SIGN TYPES REFER TO D-19, D-20, D-21, D-22, SD, AD-05
- FOR MANHOLE DETAILS REFER TO D-15, SD, AD-04 & D-23, SD, AD-06
- FOR BOLLARDS DETAILS REFER TO D-2, SD, AD-06
- FOR LITTER BIN DETAILS REFER TO D-25, SD, AD-06
- FOR TYPICAL CLOCK DETAILS REFER TO D-26, SD, AD-06
- FOR BENCH DETAILS REFER TO D-27, SD, AD-07
- FOR WET STONE CLADDING DETAILS REFER TO D-33, SD, AD-08

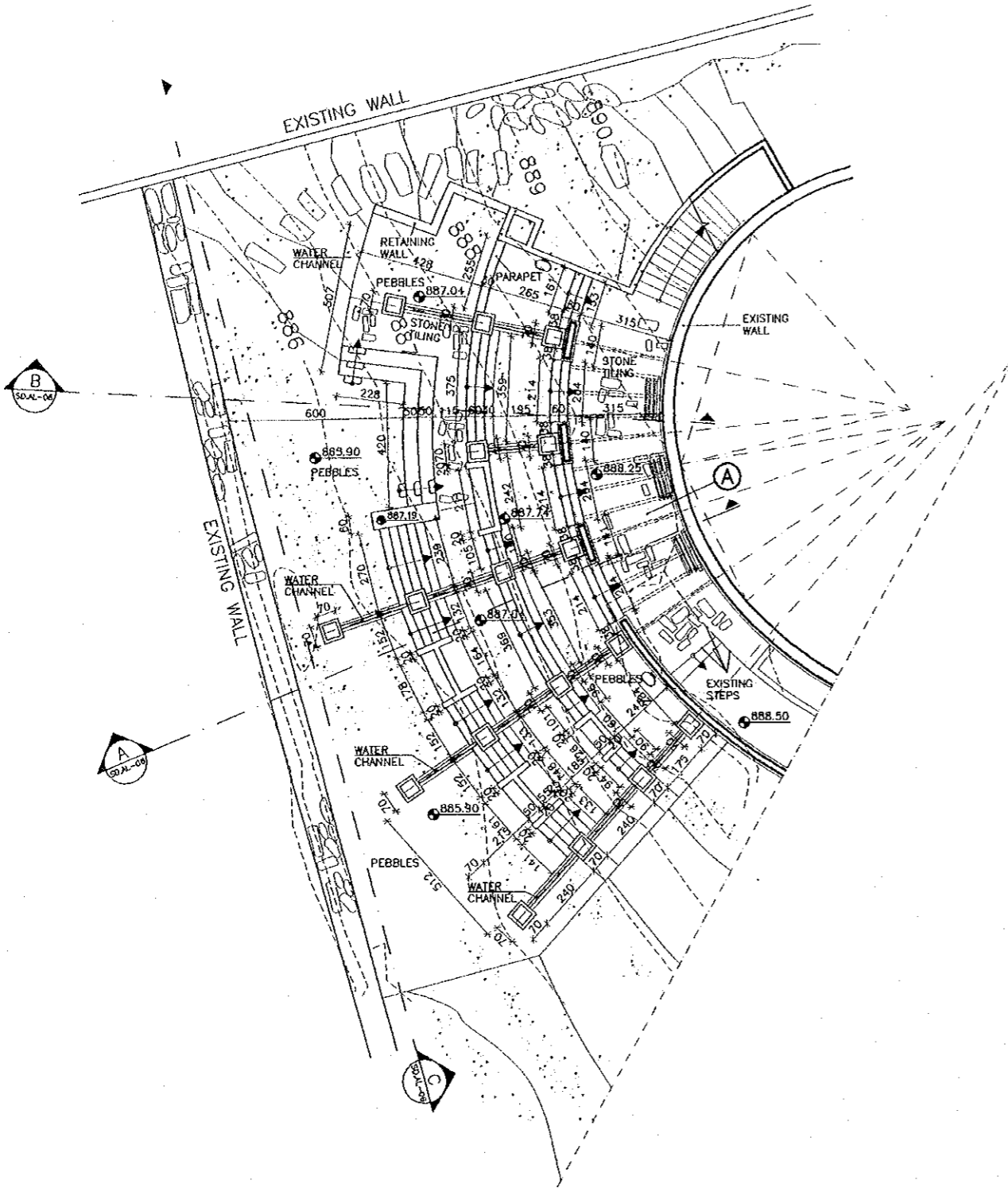

PLAN-NEW PROPOSAL

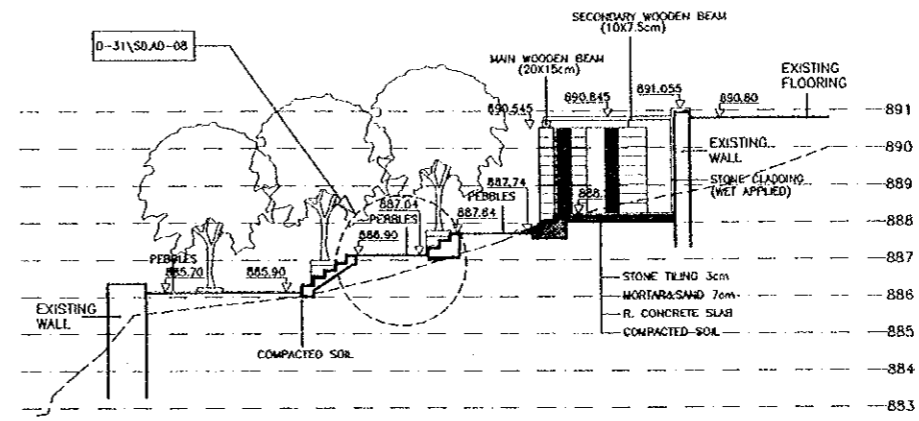

SECTION A-A

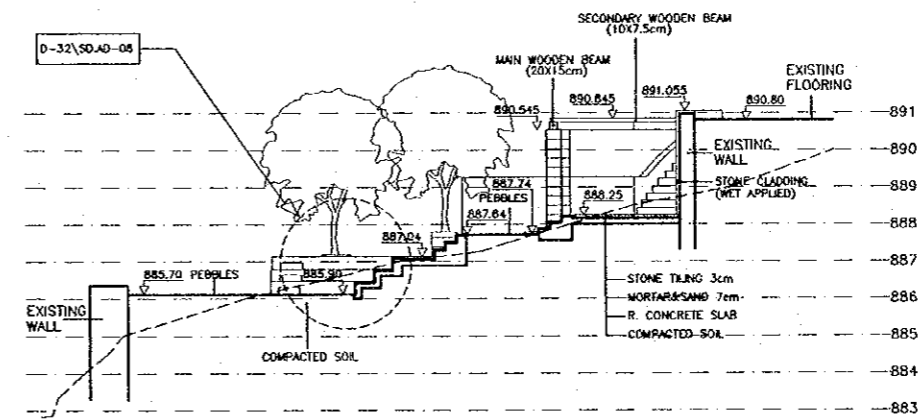

SECTION B-B

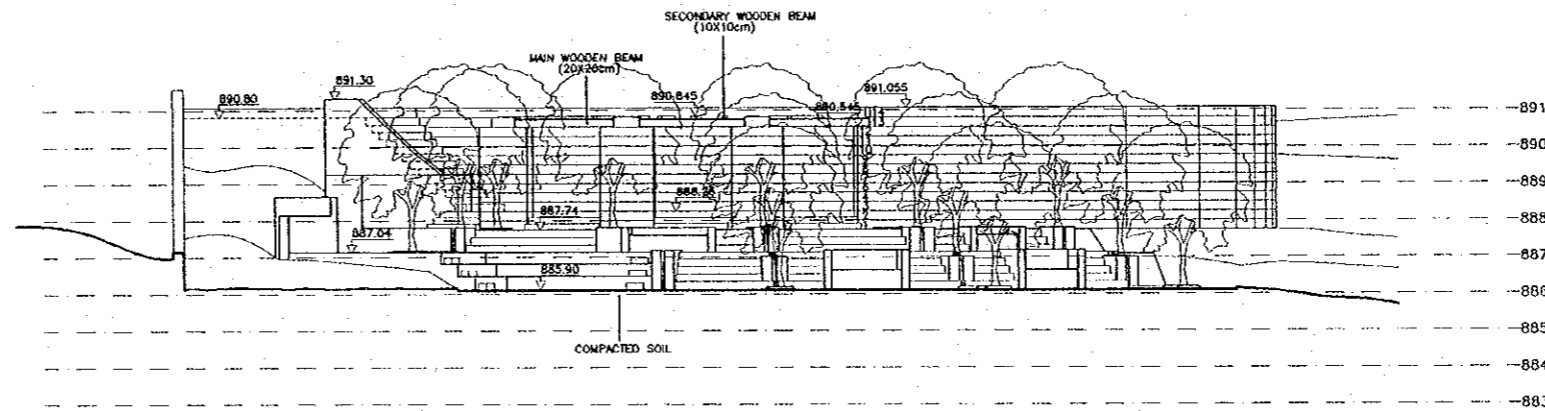

ELEVATION AT C-C

Designed by:
Japan International Cooperation Agency (JICA)
JICA Study Team:
Joint Venture of Pacific Consultants International and Yamasita Sekkei Inc.

Subcontracted Local Consultant:
TIBAH Consultants
Architects, Engineers

DATE: JUNE- 10 / 2000

Lookouts
Drawing Title:
Kamal Al Shaer Lookout
Plan, Section & Elevation

Scale: 1:100
Drawing No.: SD.AL-06

TOPOGRAPHY PLAN

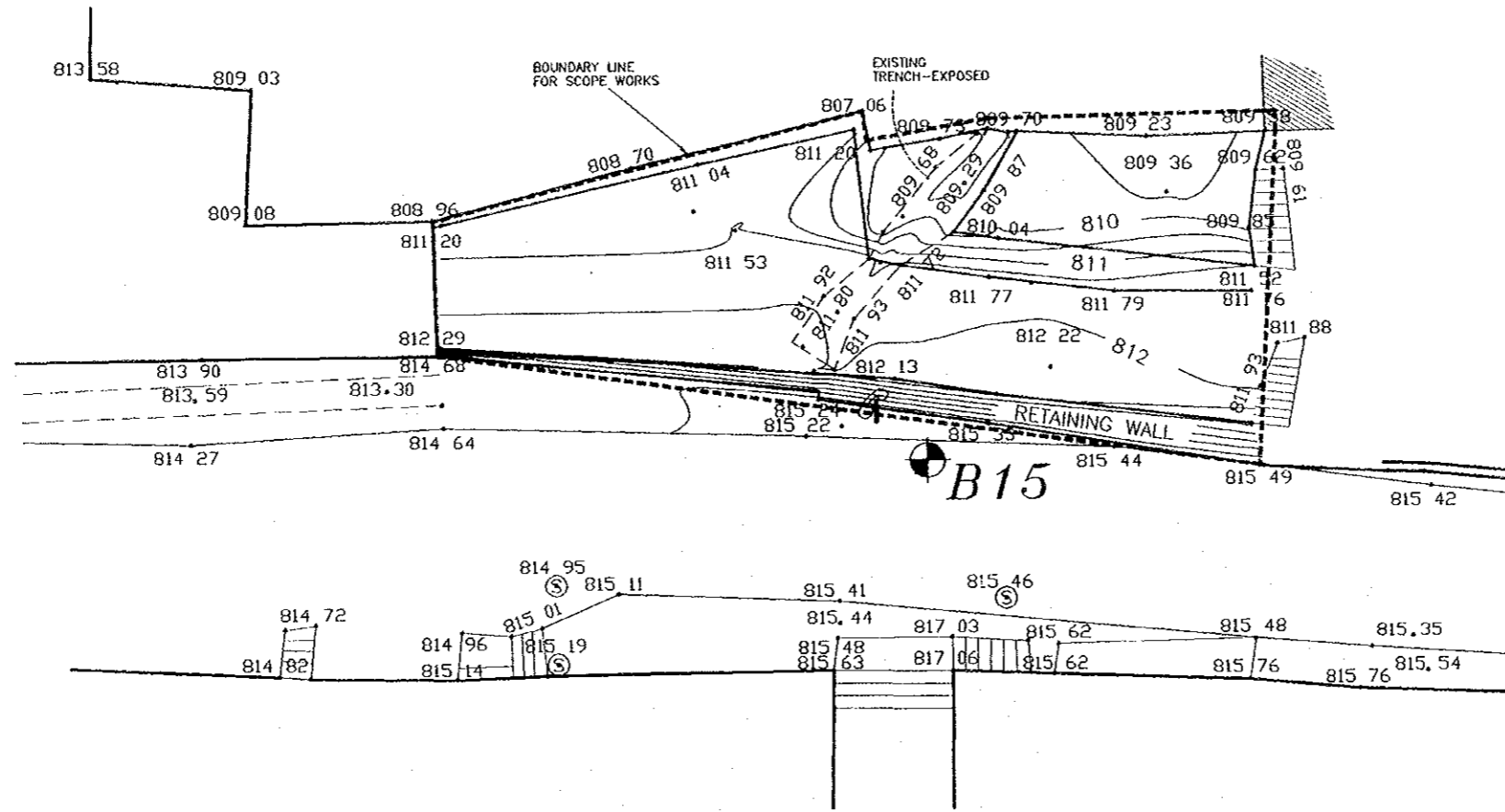

Tourism Sector Development Project
in the Hashemite Kingdom of Jordan

The Government of
the Hashemite Kingdom of Jordan
The Ministry of Tourism and Antiquities
The Ministry of Planning

Sub-Project:
Historic Old Salt Development

Note:
This detailed design has been executed by a team
of consultants as shown below in accordance with
the agreement between Japan International
Cooperation Agency (JICA) and JICA Study
Team.
The copyright of this drawing rests with JICA.
ALL MEASUREMENTS ARE IN CENTIMETERS.
DO NOT SCALE FROM DRAWING.
REFER TO SD.AG-02 FOR TILING TYPES.

- 30x30cm TRENCH.
- ① 4" PVC RISER TO BE TERMINATED 15CM
ABOVE FINISHED FLOOR OR SOIL LEVEL.

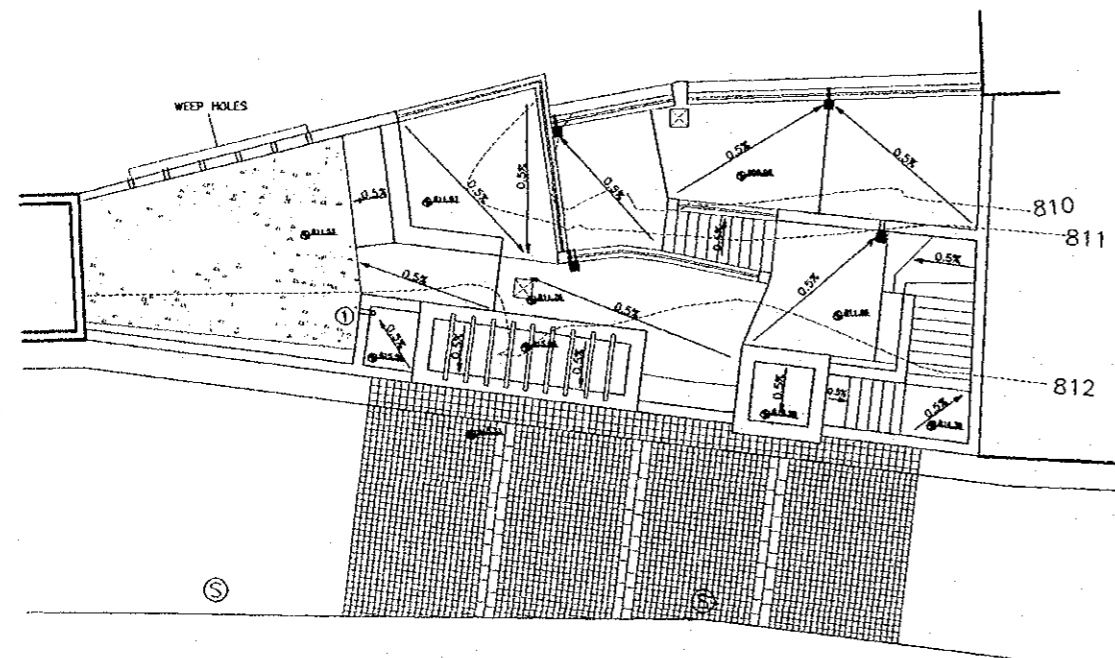

SITE PLAN-TO SLOPES

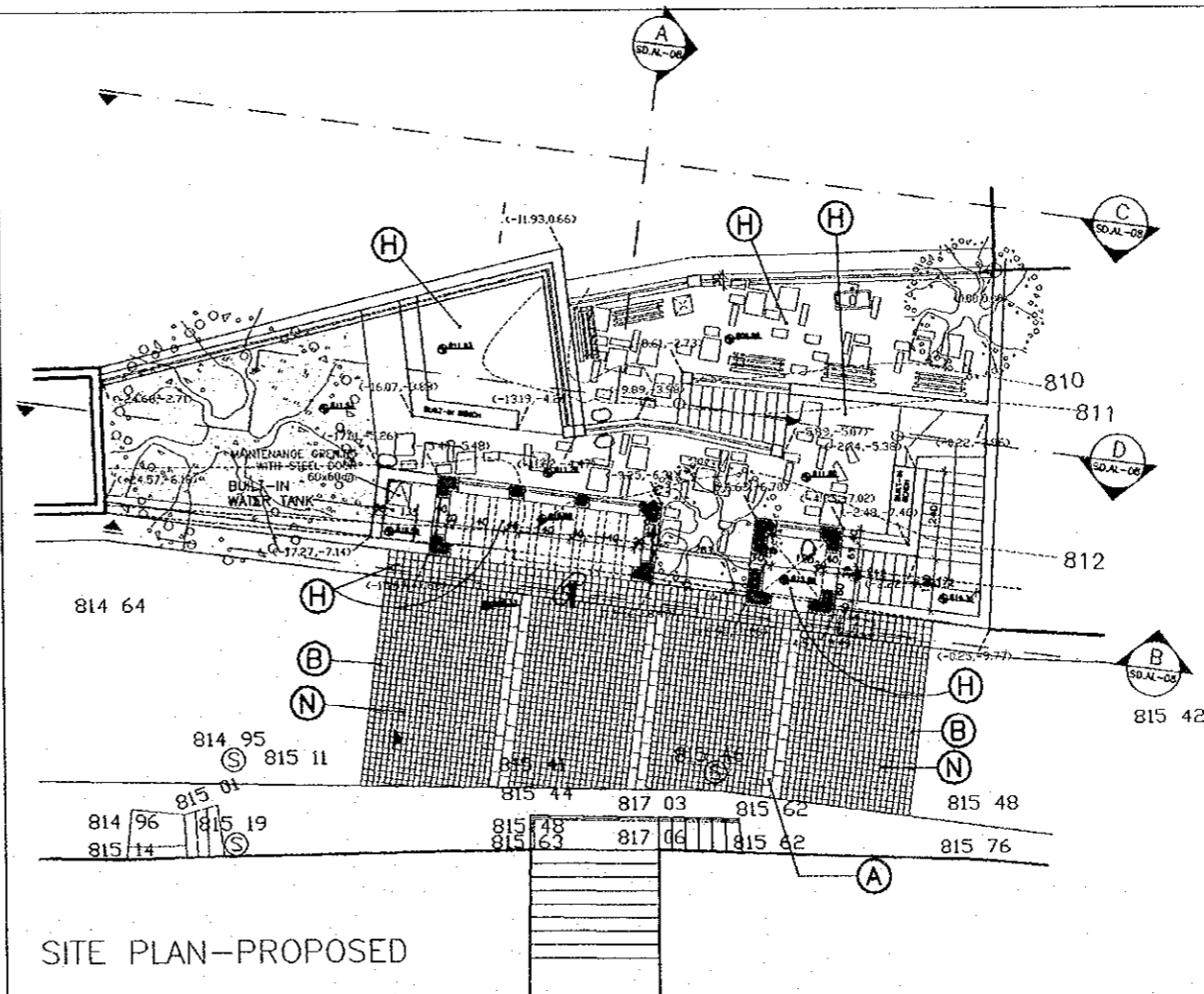

SITE PLAN-PROPOSED

Designed by:
Japan International Cooperation
Agency (JICA)
JICA Study Team:
Joint Venture of
Pacific Consultants International and
Yamasita Sekkei Inc.

Subcontracted Local Consultant:
TIBAH Consultants
Architects, Engineers

DATE: JUNE-10 / 2000

Lookouts
Drawing Title:
Jadaa Lookout
Existing Situation (Down To Slopes & Site Plan)

Scale: 1:100 Drawing No.: SD.AL-07