

PLAN 7

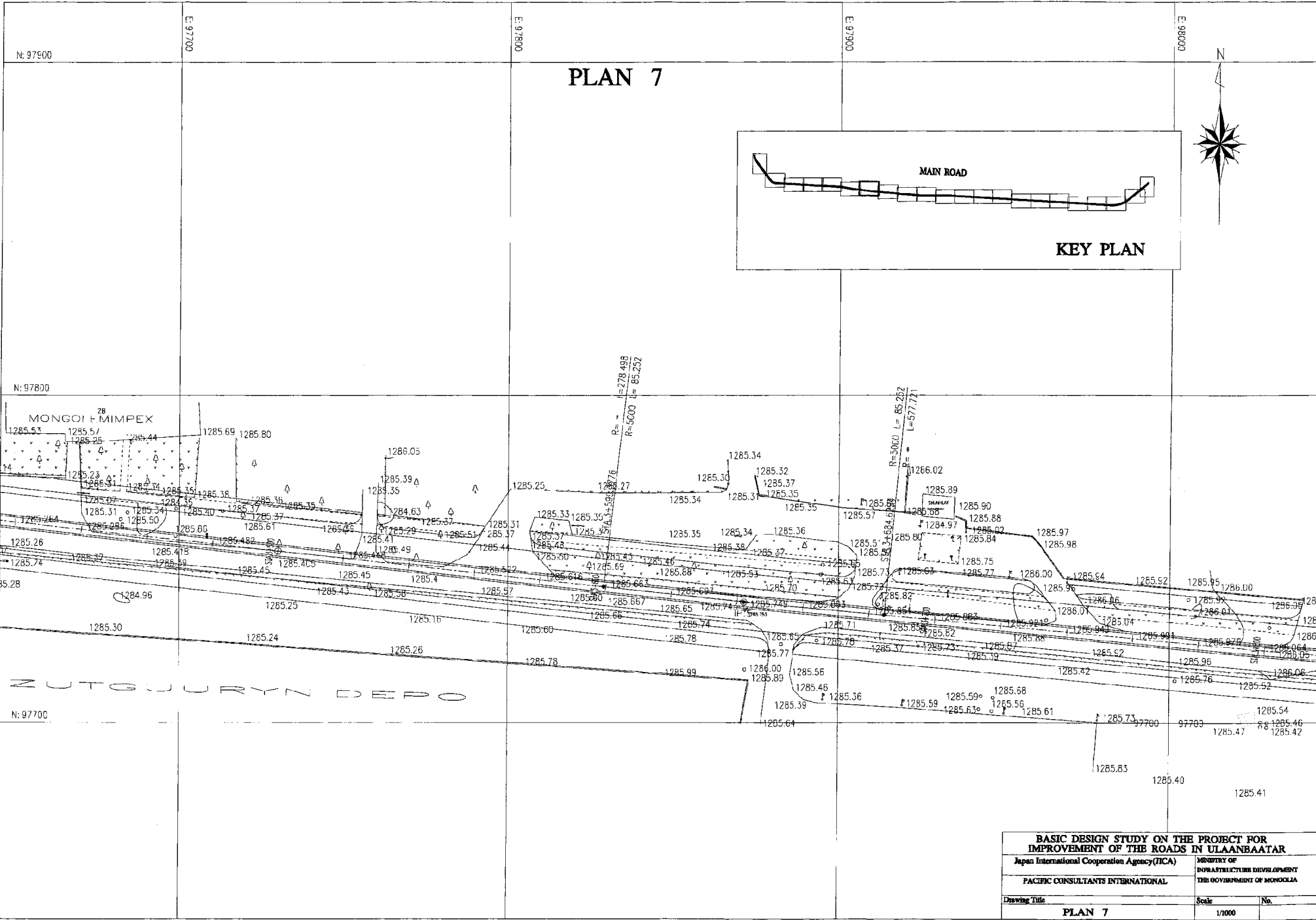

BASIC DESIGN STUDY ON THE PROJECT FOR IMPROVEMENT OF THE ROADS IN ULAANBAATAR		
Japan International Cooperation Agency (JICA)	MINISTRY OF INFRASTRUCTURE DEVELOPMENT	
PACIFIC CONSULTANTS INTERNATIONAL	THE GOVERNMENT OF MONGOLIA	
Drawing Title	Scale	No.
PLAN 7	1/1000	

PLAN 8

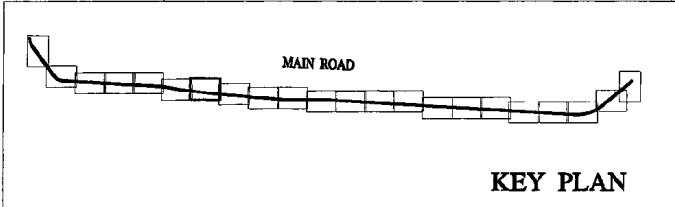
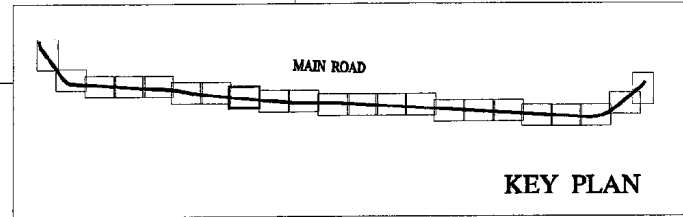

N: 97800

THIRD PARK OF BUS

ROAD D

GRAND HOTEL

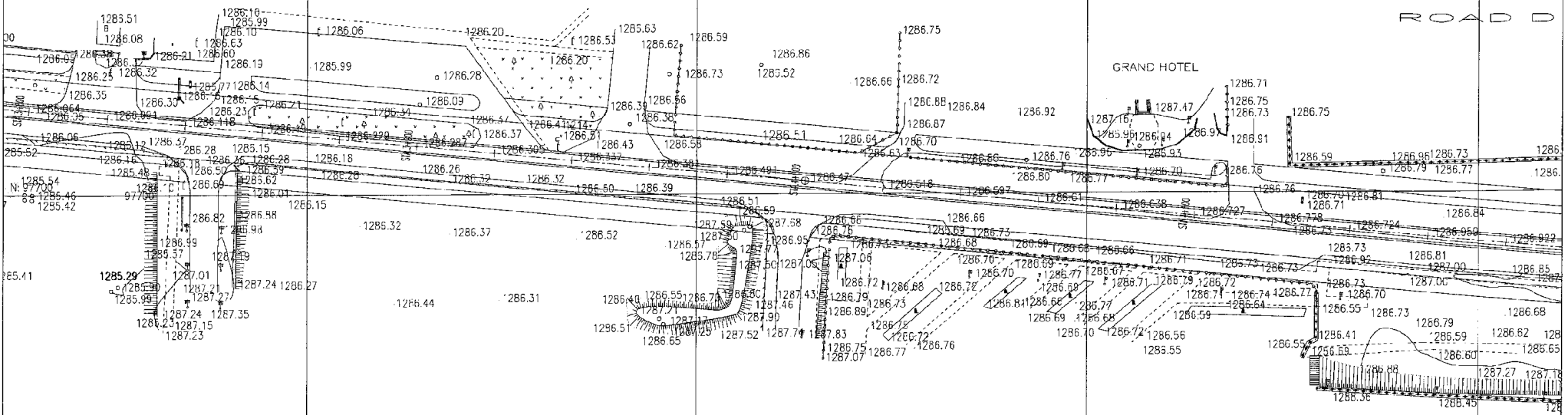

N: 97600

BASIC DESIGN STUDY ON THE PROJECT FOR IMPROVEMENT OF THE ROADS IN ULAANBAATAR		
Japan International Cooperation Agency (JICA)		MINISTRY OF INFRASTRUCTURE DEVELOPMENT
PACIFIC CONSULTANTS INTERNATIONAL		THE GOVERNMENT OF MONGOLIA
Drawing Title	Scale	No.
PLAN 8	1/1000	

N: 97800

E: 98300

E: 98600

E: 99700

E: 98800

PLAN 9



DEPARTMENT

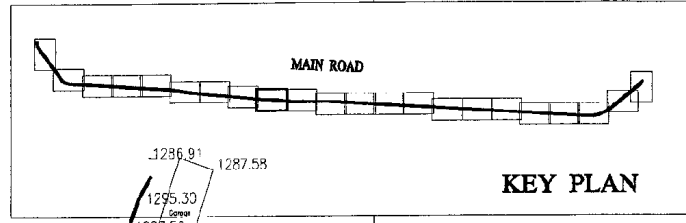

KEY PLAN

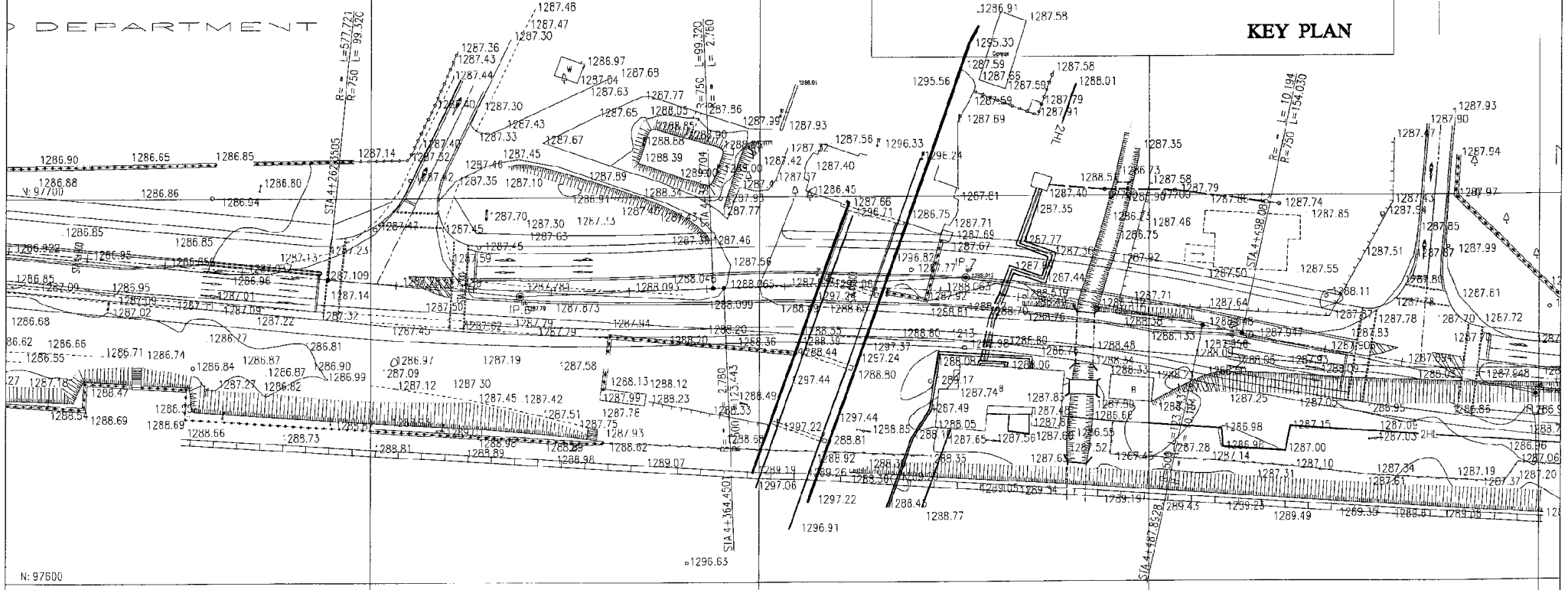

N: 97600

1296.64

BASIC DESIGN STUDY ON THE PROJECT FOR IMPROVEMENT OF THE ROADS IN ULAANBAATAR		
Japan International Cooperation Agency (JICA)	MINISTRY OF INFRASTRUCTURE DEVELOPMENT	
PACIFIC CONSULTANTS INTERNATIONAL	THE GOVERNMENT OF MONGOLIA	
Drawing Title	Scale	No.
PLAN 9	1/1000	

N: 97803

E: 98900

E: 99000

E: 99100

PLAN 10

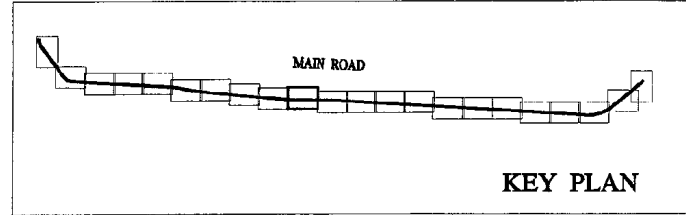

NATIONAL PARK

N: 97730

NATIONAL

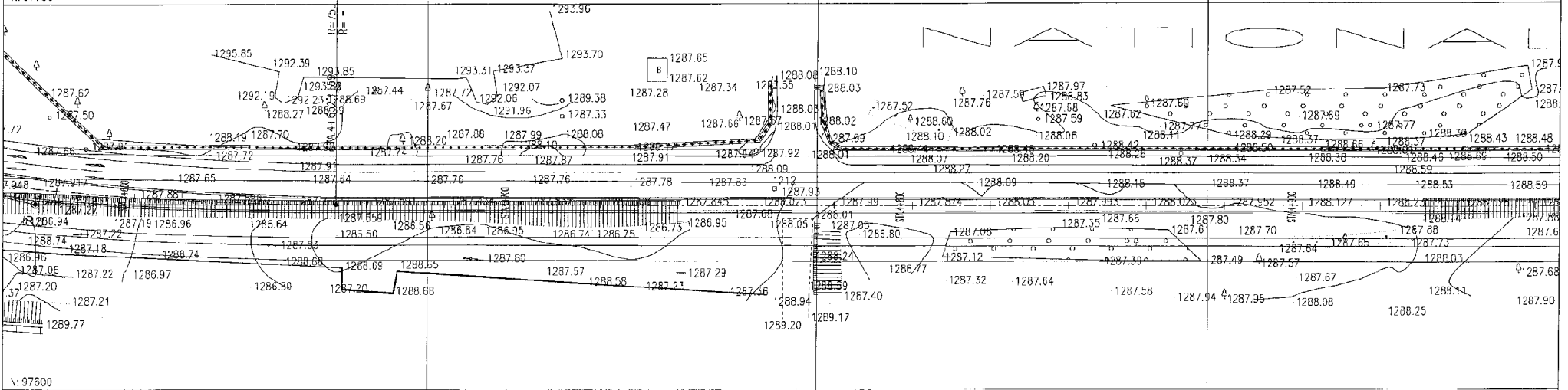

N: 97600

BASIC DESIGN STUDY ON THE PROJECT FOR IMPROVEMENT OF THE ROADS IN ULAANBAATAR		
Japan International Cooperation Agency (JICA)		MINISTRY OF INFRASTRUCTURE DEVELOPMENT THE GOVERNMENT OF MONGOLIA
PACIFIC CONSULTANTS INTERNATIONAL		
Drawing Title	Scale	No.
PLAN 10	1/1000	

PLAN 11

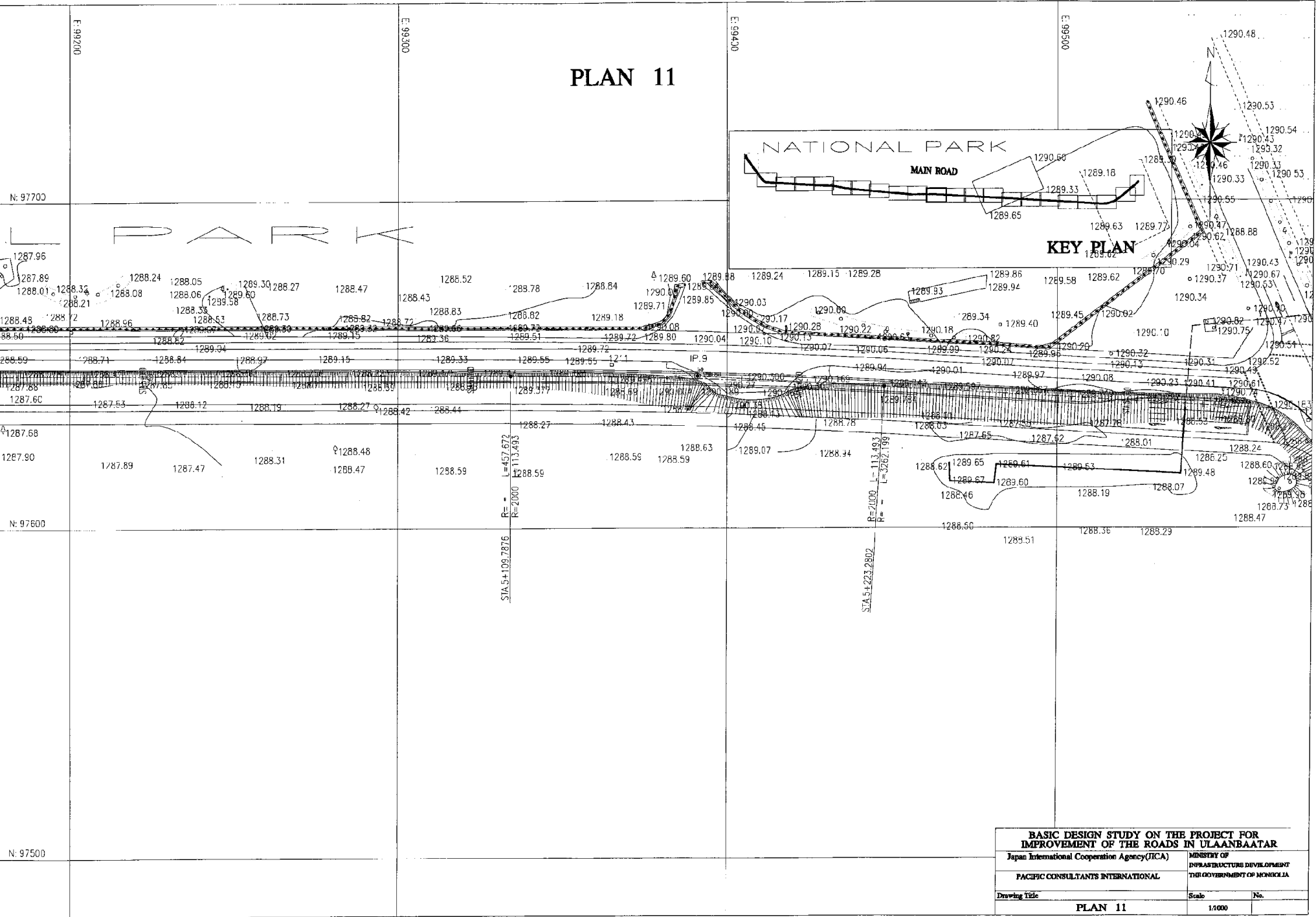

BASIC DESIGN STUDY ON THE PROJECT FOR IMPROVEMENT OF THE ROADS IN ULAANBAATAR		
Japan International Cooperation Agency (JICA)		MINISTRY OF INFRASTRUCTURE DEVELOPMENT THE GOVERNMENT OF MONGOLIA
PACIFIC CONSULTANTS INTERNATIONAL		
Drawing Title	Scale	No.
PLAN 11	1/4000	

PLAN 12

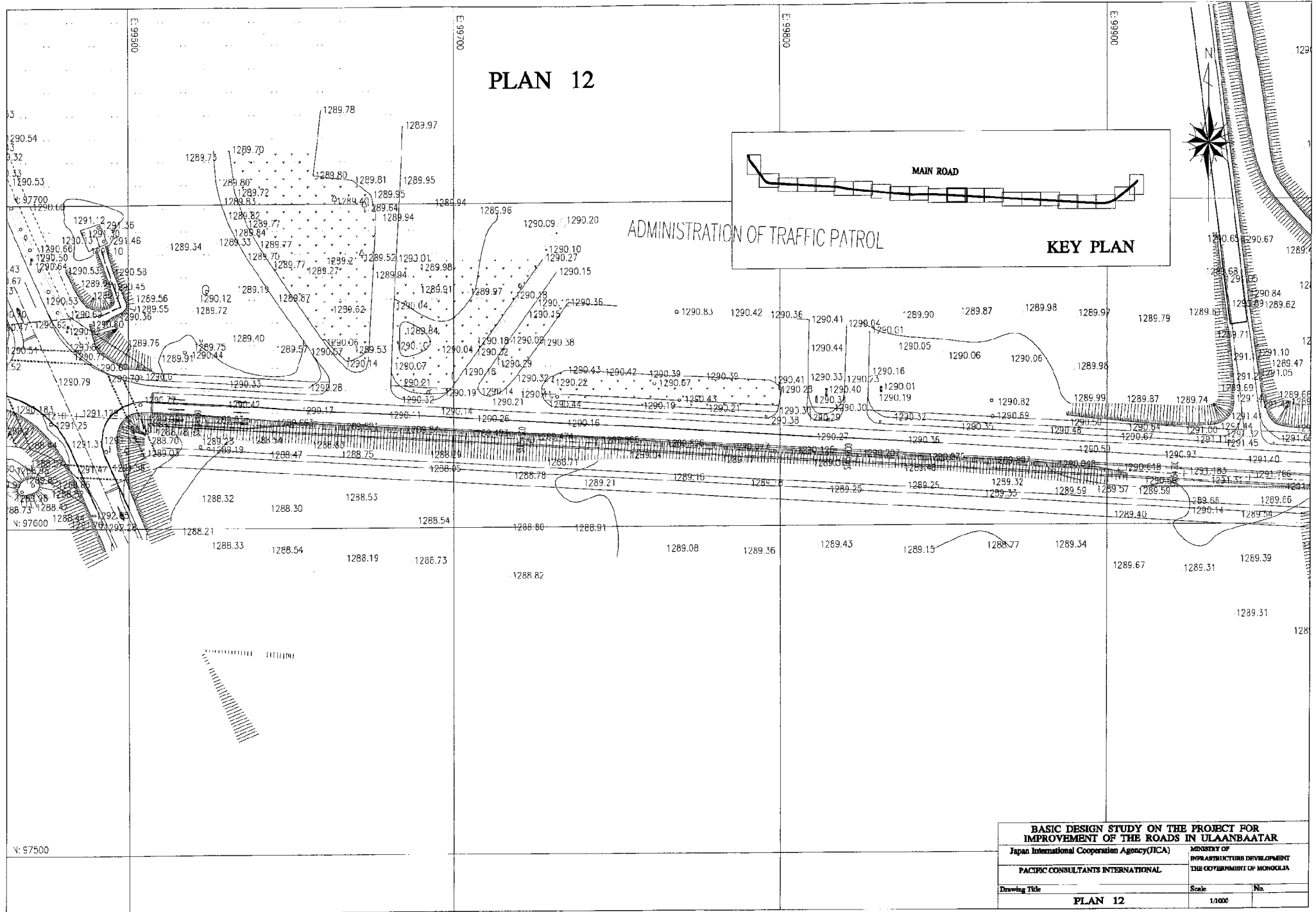

BASIC DESIGN STUDY ON THE PROJECT FOR IMPROVEMENT OF THE ROADS IN ULAANBAATAR		
Japan International Cooperation Agency (JICA)		MINISTRY OF INFRASTRUCTURE DEVELOPMENT
PACIFIC CONSULTANTS INTERNATIONAL		THE GOVERNMENT OF MONGOLIA
Drawing Title	Scale	No.
PLAN 12	1:1000	

PLAN 13

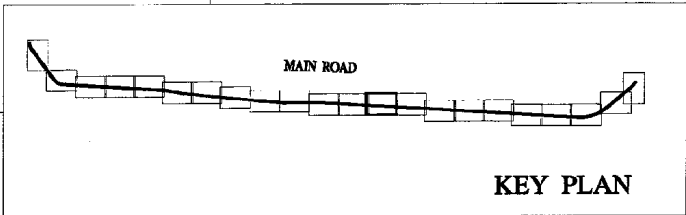
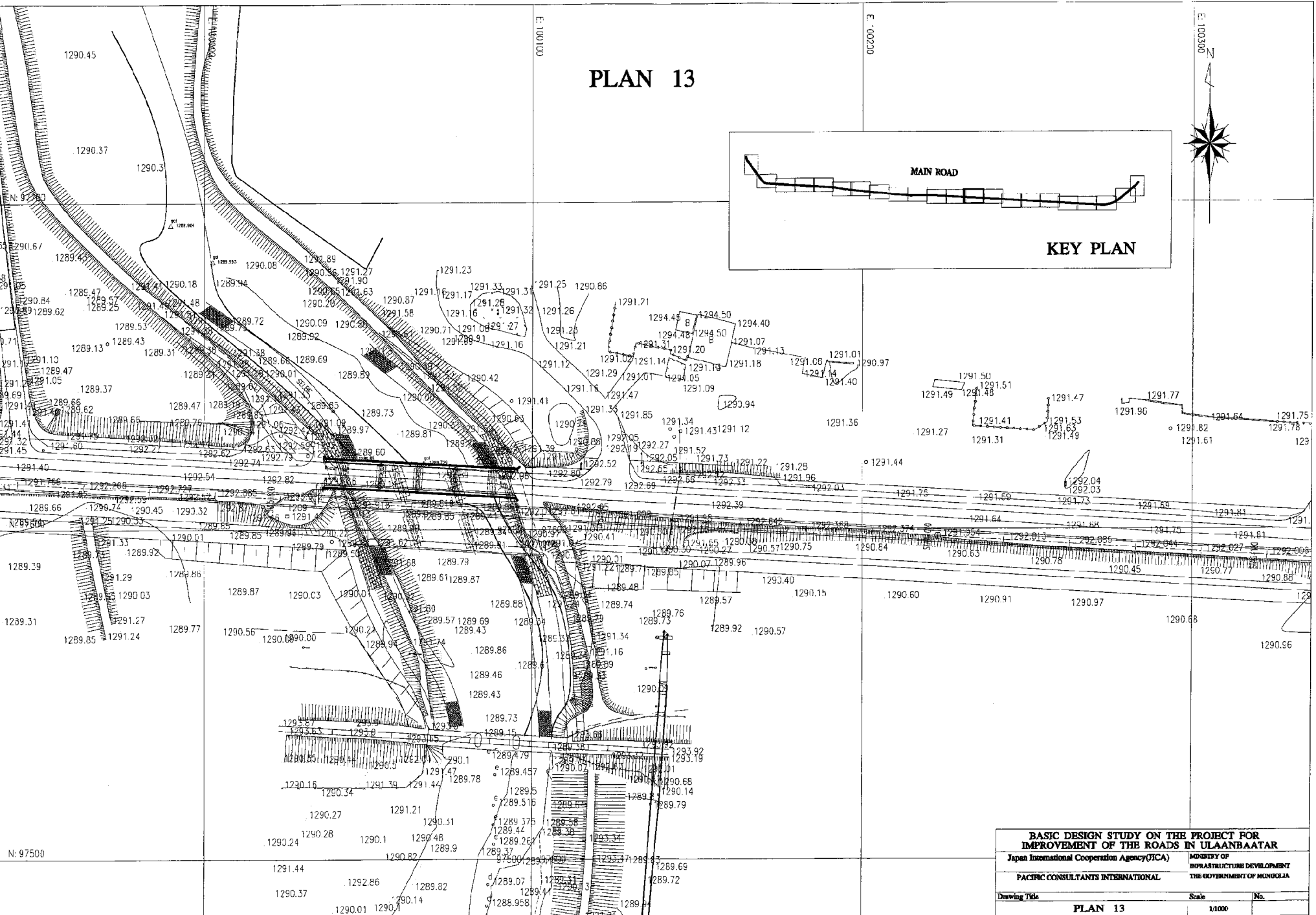

BASIC DESIGN STUDY ON THE PROJECT FOR IMPROVEMENT OF THE ROADS IN ULAANBAATAR		
Japan International Cooperation Agency (JICA)	MINISTRY OF INFRASTRUCTURE DEVELOPMENT	
PACIFIC CONSULTANTS INTERNATIONAL	THE GOVERNMENT OF MONGOLIA	
Drawing Title	Scale	No.
PLAN 13	1:1000	

PLAN 14

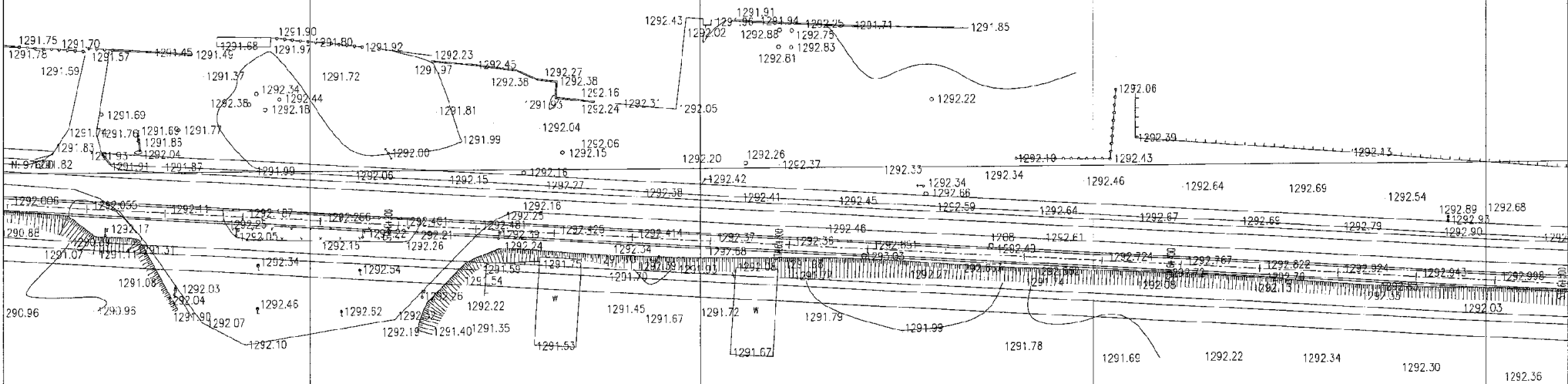
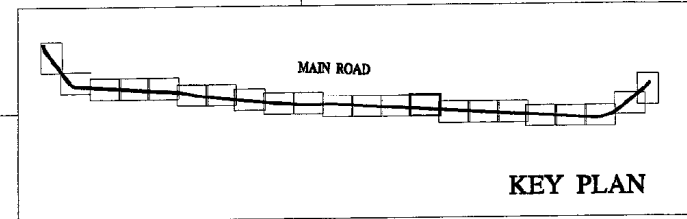

N: 97700

N: 97500

E: 100400

E: 100500

E: 100600

E: 100700

BASIC DESIGN STUDY ON THE PROJECT FOR IMPROVEMENT OF THE ROADS IN ULAANBAATAR		
Japan International Cooperation Agency(JICA)		MINISTRY OF INFRASTRUCTURE DEVELOPMENT FOR GOVERNMENT OF MONGOLIA
PACIFIC CONSULTANTS INTERNATIONAL		
Drawing Title	Scale	No.
PLAN 14	1/1000	

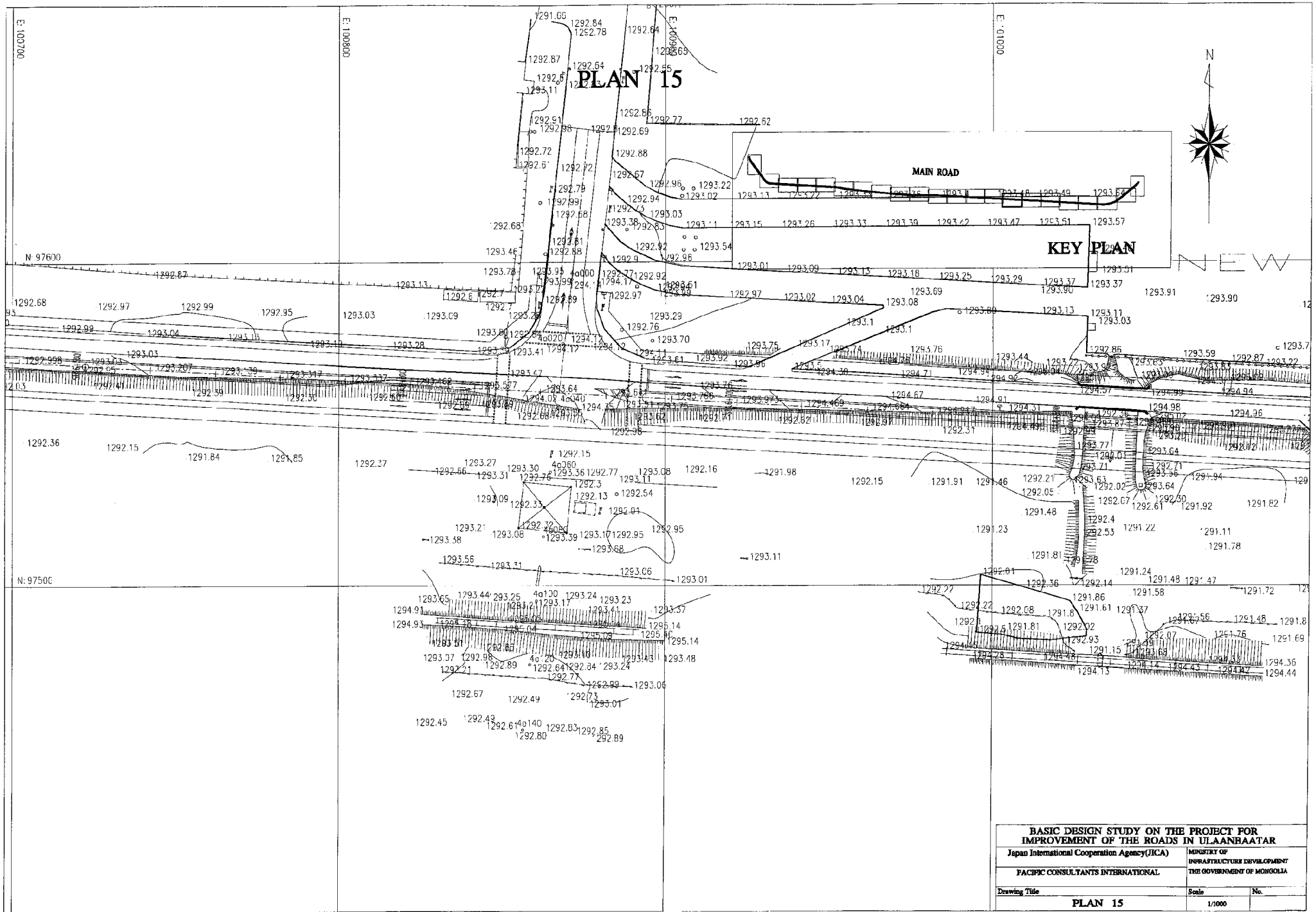

BASIC DESIGN STUDY ON THE PROJECT FOR IMPROVEMENT OF THE ROADS IN ULAANBAATAR		
Japan International Cooperation Agency (JICA)	MINISTRY OF INFRASTRUCTURE DEVELOPMENT THE GOVERNMENT OF MONGOLIA	
PACIFIC CONSULTANTS INTERNATIONAL		
Drawing Title	Scale	No.
PLAN 15	1/1000	

PLAN 16

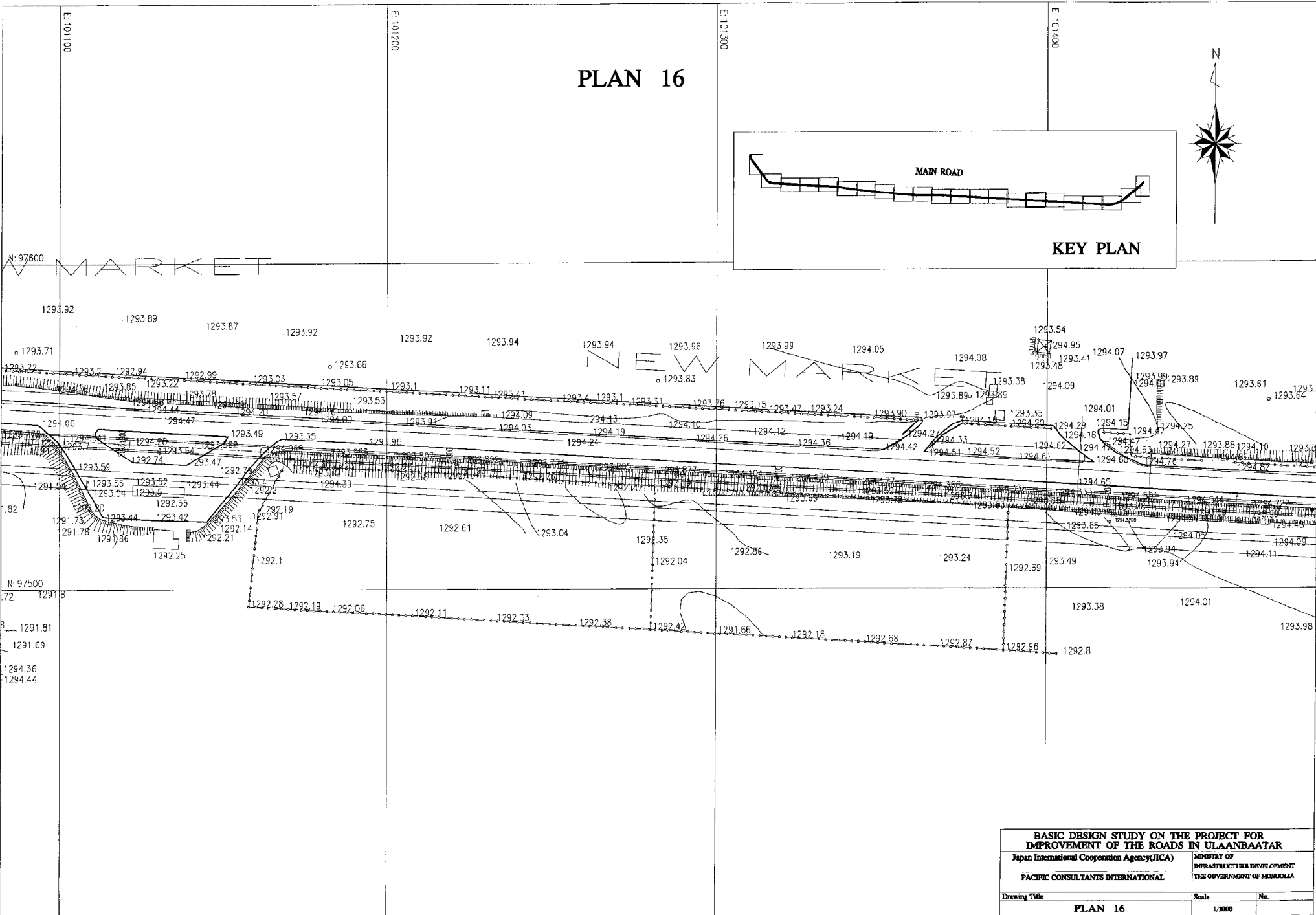
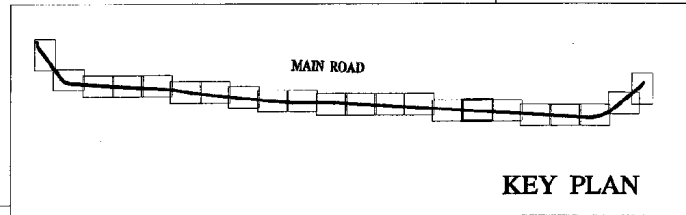

BASIC DESIGN STUDY ON THE PROJECT FOR IMPROVEMENT OF THE ROADS IN ULAANBAATAR		
Japan International Cooperation Agency (JICA)		MINISTRY OF INFRASTRUCTURE DEVELOPMENT
PACIFIC CONSULTANTS INTERNATIONAL		THE GOVERNMENT OF MONGOLIA
Drawing Title	Scale	No.
PLAN 16	1/1000	

PLAN 17

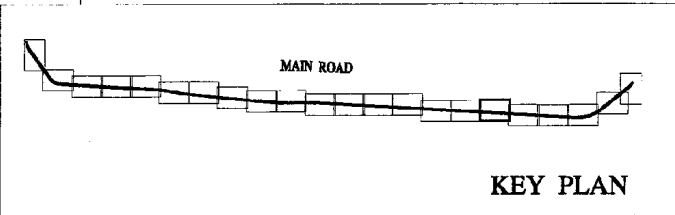

KEY PLAN

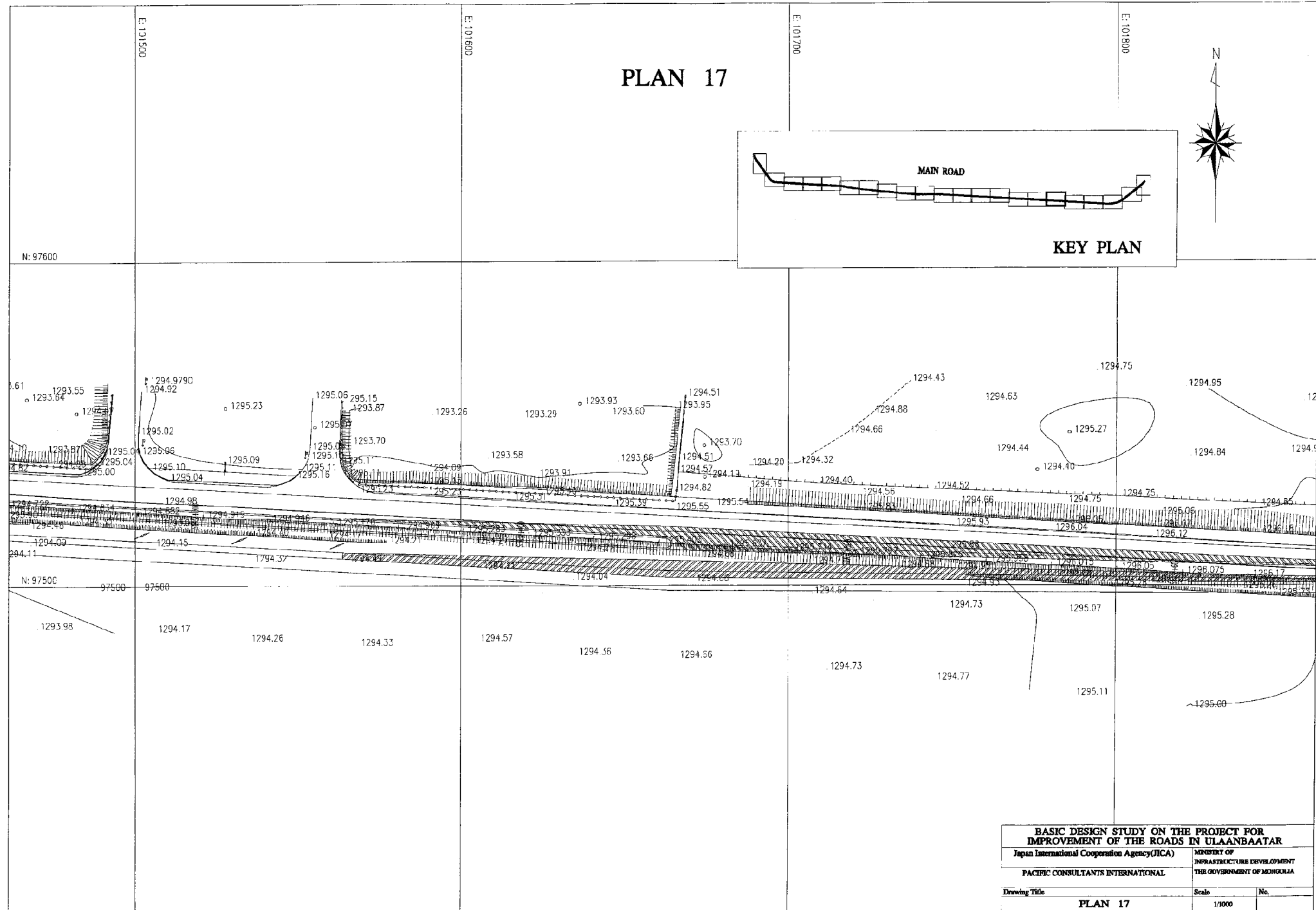

BASIC DESIGN STUDY ON THE PROJECT FOR IMPROVEMENT OF THE ROADS IN ULAANBAATAR		
Japan International Cooperation Agency (JICA)	MINISTRY OF INFRASTRUCTURE DEVELOPMENT THE GOVERNMENT OF MONGOLIA	
PACIFIC CONSULTANTS INTERNATIONAL		
Drawing Title	Scale	No.
PLAN 17	1/1000	[]

N: 97600

E: 101900

E: 102000

E: 102100

E: 102200

PLAN 18

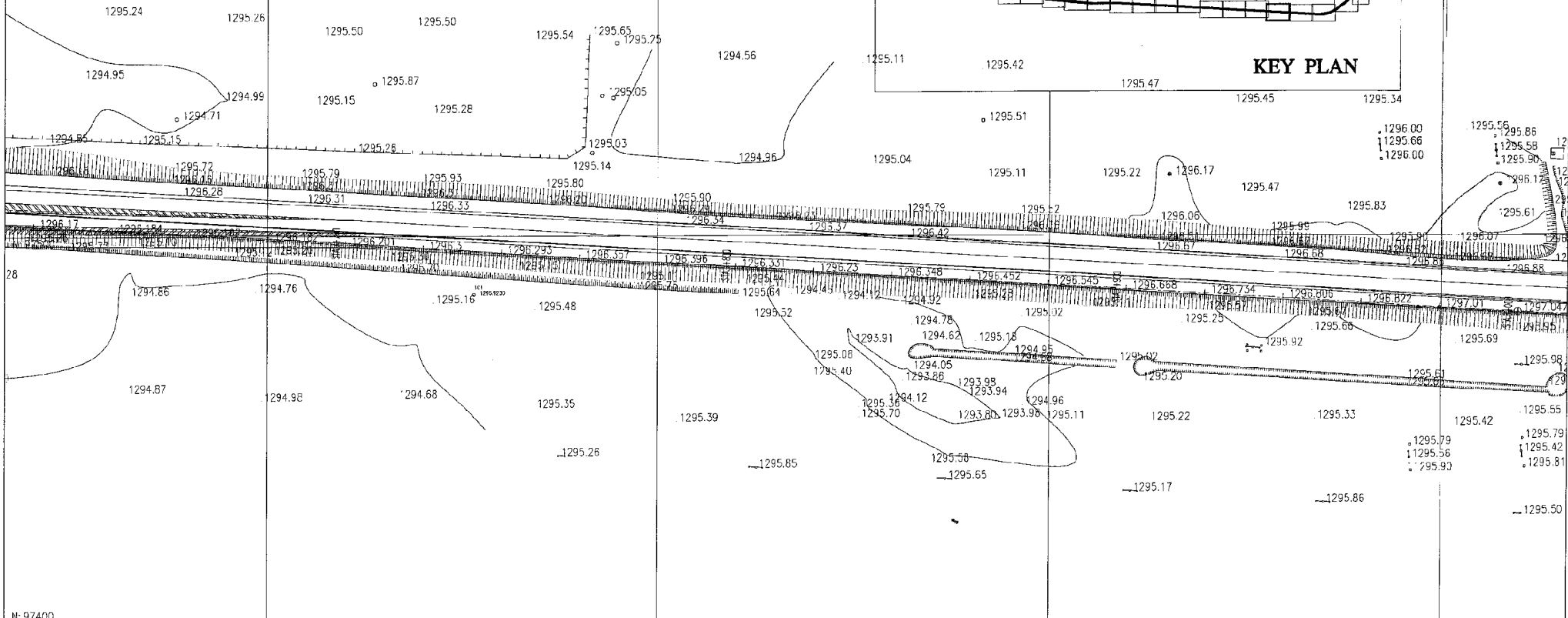
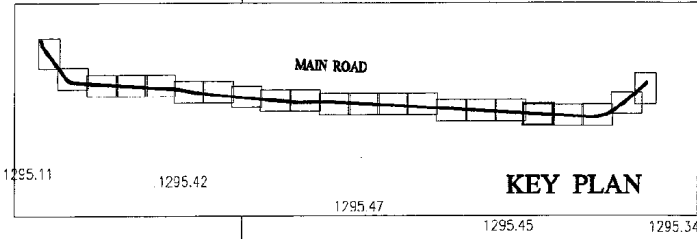

BASIC DESIGN STUDY ON THE PROJECT FOR IMPROVEMENT OF THE ROADS IN ULAANBAATAR		
Japan International Cooperation Agency (JICA)		MINISTRY OF INFRASTRUCTURE DEVELOPMENT
PACIFIC CONSULTANTS INTERNATIONAL		THE GOVERNMENT OF MONGOLIA
Drawing Title	Scale	No.
PLAN 18	1/1000	

PLAN 19

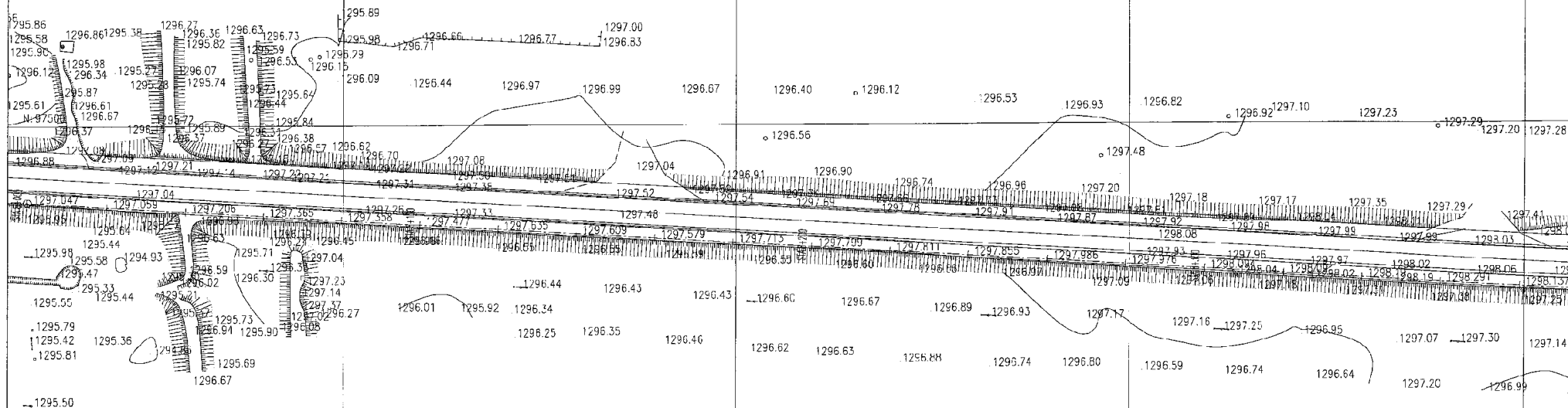
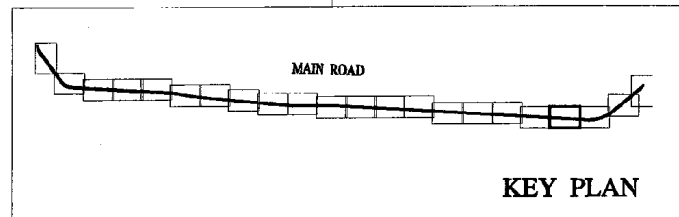

BASIC DESIGN STUDY ON THE PROJECT FOR IMPROVEMENT OF THE ROADS IN ULAANBAATAR		
Japan International Cooperation Agency (JICA)	MINISTRY OF INFRASTRUCTURE DEVELOPMENT THE GOVERNMENT OF MONGOLIA	
PACIFIC CONSULTANTS INTERNATIONAL		
Drawing Title	Scale	No.
PLAN 19	1/1000	

PLAN 20

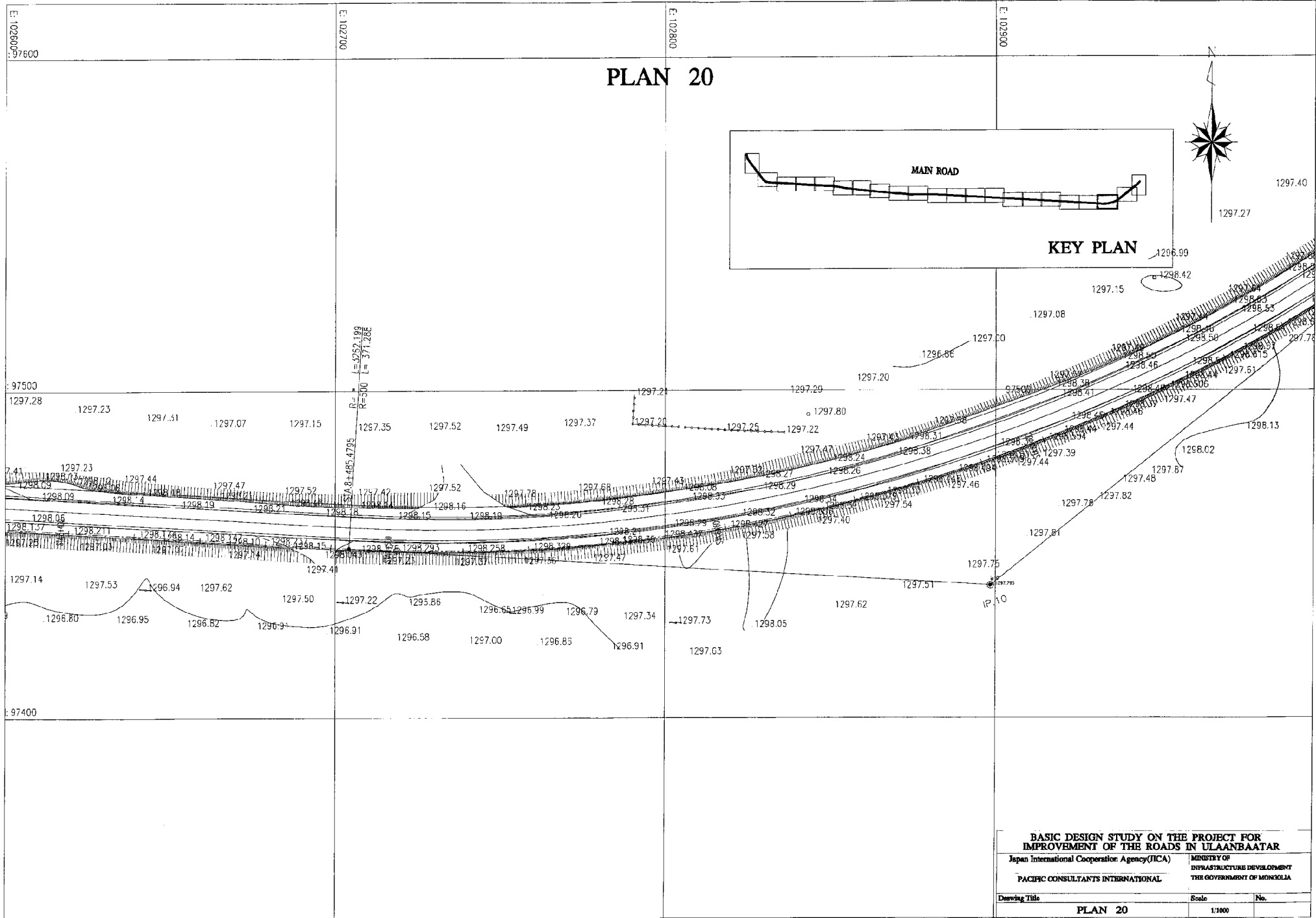
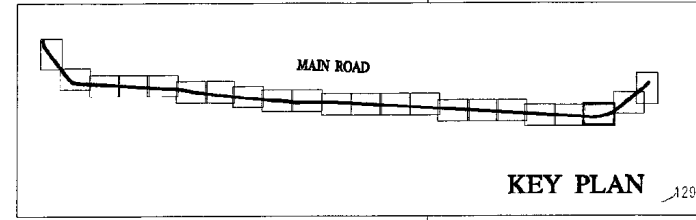

BASIC DESIGN STUDY ON THE PROJECT FOR IMPROVEMENT OF THE ROADS IN ULAANBAATAR		
Japan International Cooperation Agency (JICA)		MINISTRY OF INFRASTRUCTURE DEVELOPMENT THE GOVERNMENT OF MONGOLIA
PACIFIC CONSULTANTS INTERNATIONAL		
Drawing Title	Scale	No.
PLAN 20	1/1000	

PLAN 21

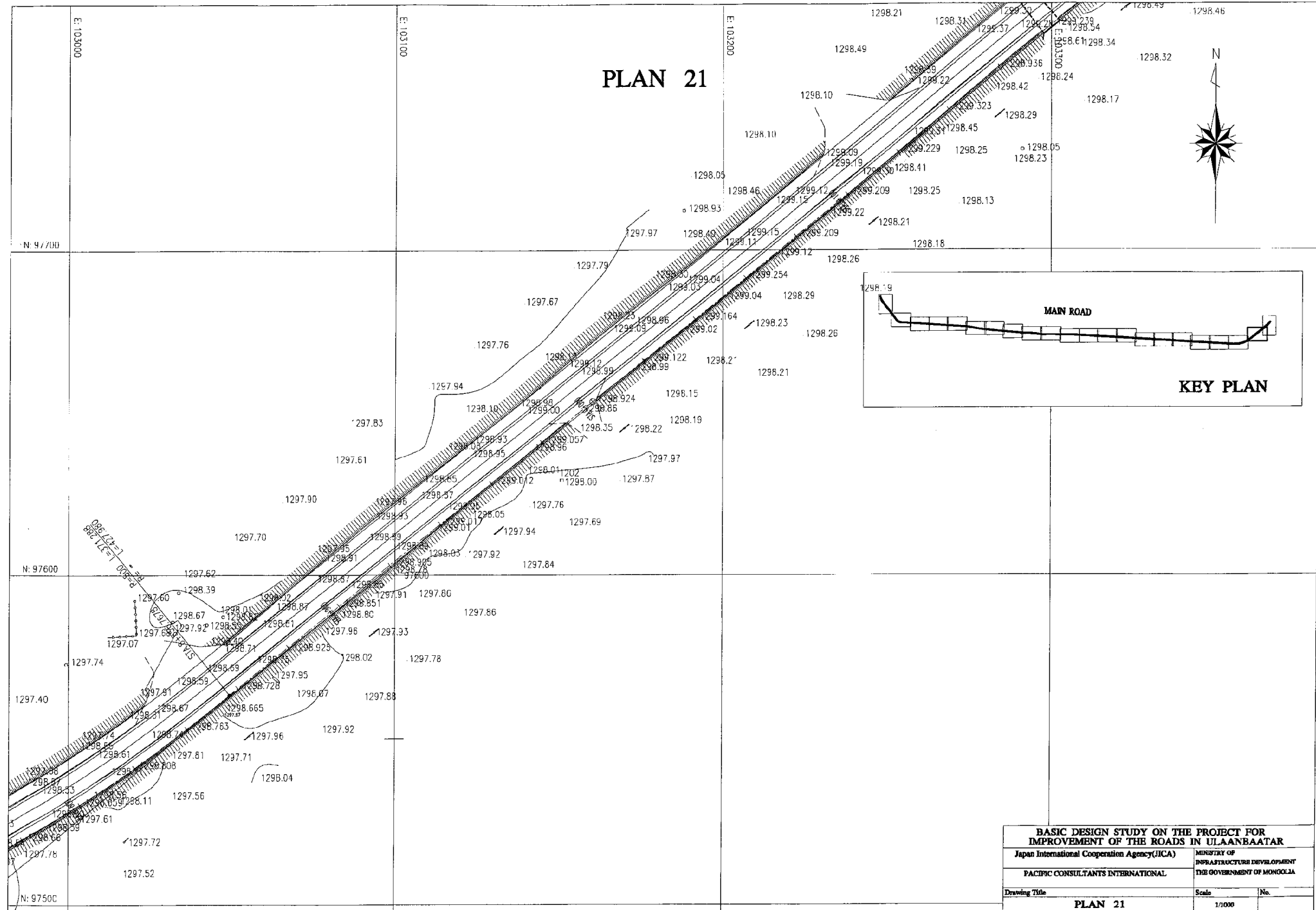
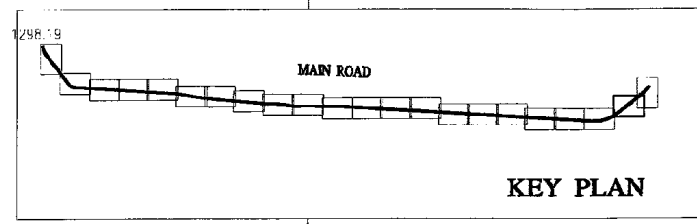

BASIC DESIGN STUDY ON THE PROJECT FOR IMPROVEMENT OF THE ROADS IN ULAANBAATAR		
Japan International Cooperation Agency (JICA)		MINISTRY OF INFRASTRUCTURE DEVELOPMENT
PACIFIC CONSULTANTS INTERNATIONAL		THE GOVERNMENT OF MONGOLIA
Drawing Title	Scale	No.
PLAN 21	1/1000	

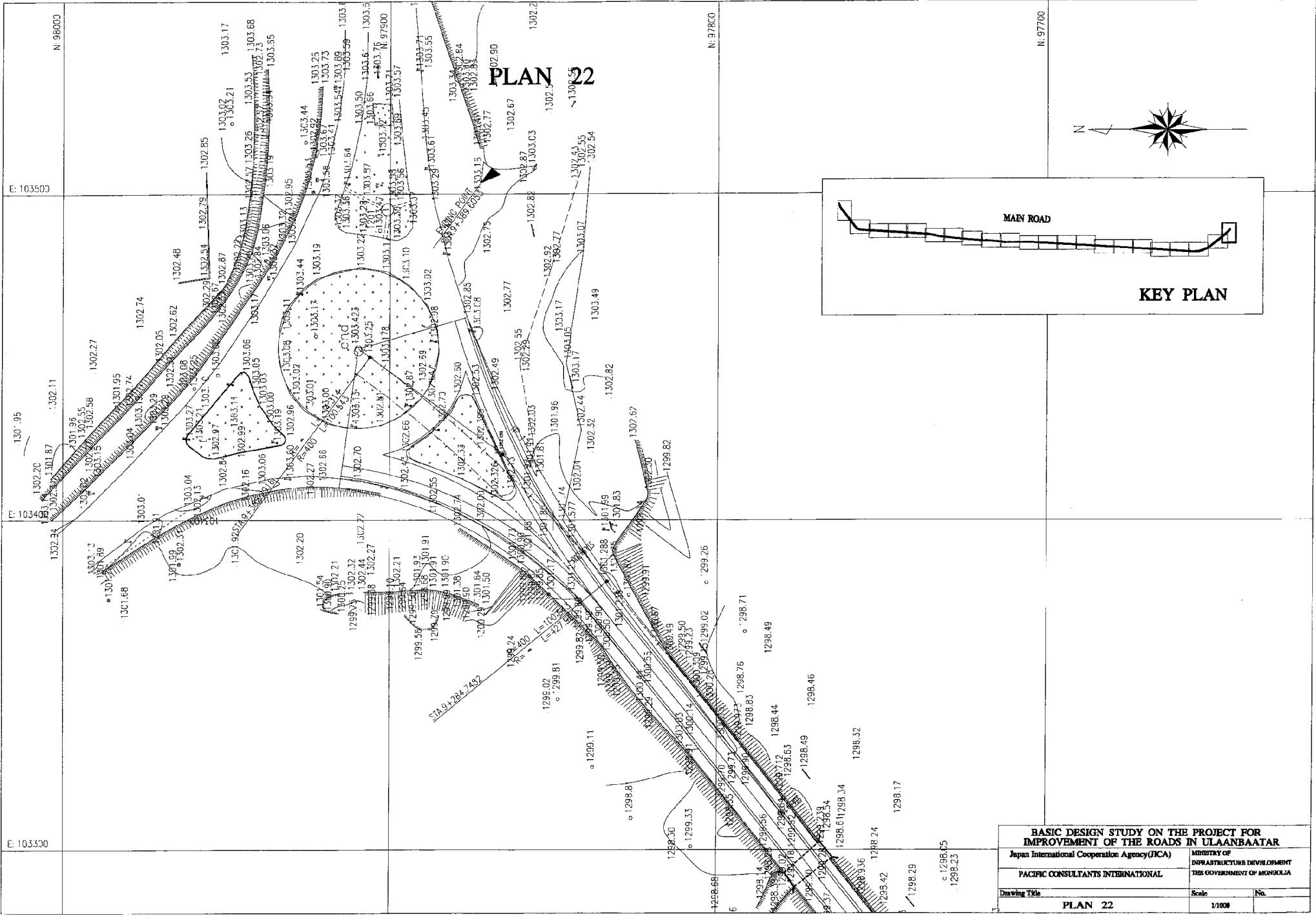

PLAN 22

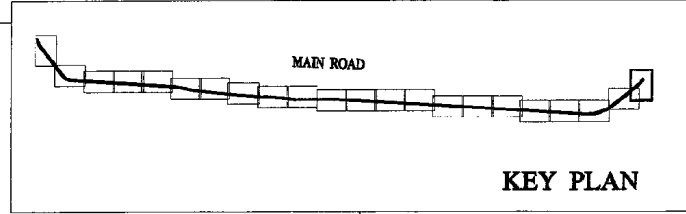

BASIC DESIGN STUDY ON THE PROJECT FOR IMPROVEMENT OF THE ROADS IN ULAANBAATAR		
Japan International Cooperation Agency (JICA)		MINISTRY OF INFRASTRUCTURE DEVELOPMENT THE GOVERNMENT OF MONGOLIA
PACIFIC CONSULTANTS INTERNATIONAL		
Drawing Title	Scale	No.
PLAN 22	1/1000	

INTERSECTION (EAST CROSS)

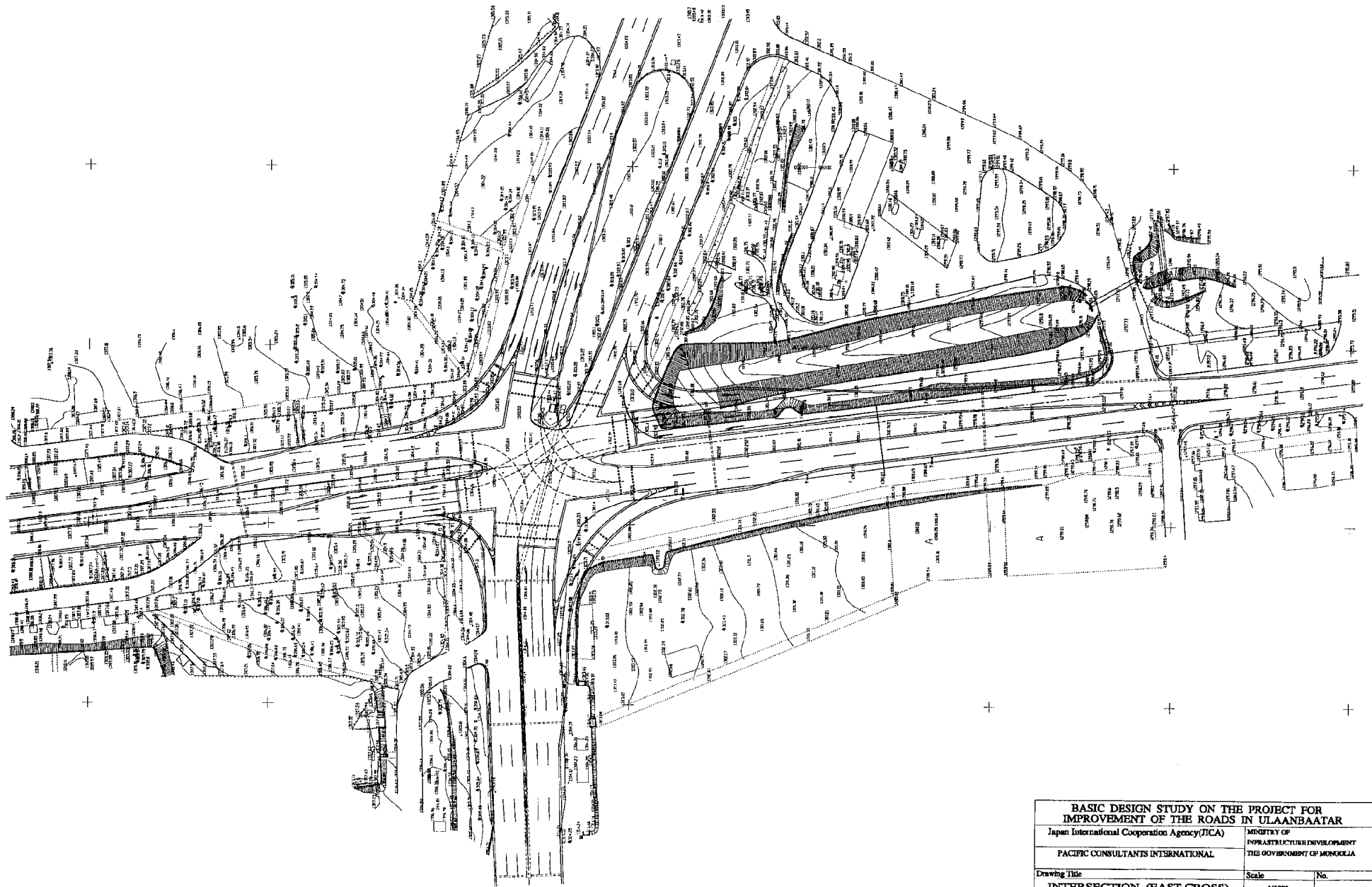

BASIC DESIGN STUDY ON THE PROJECT FOR IMPROVEMENT OF THE ROADS IN ULAANBAATAR		
Japan International Cooperation Agency(JICA)	MINISTRY OF INFRASTRUCTURE DEVELOPMENT THE GOVERNMENT OF MONGOLIA	
PACIFIC CONSULTANTS INTERNATIONAL		
Drawing Title	Scale	No.
INTERSECTION (EAST CROSS)	1/1000	

INTERSECTION (WEST CROSS)

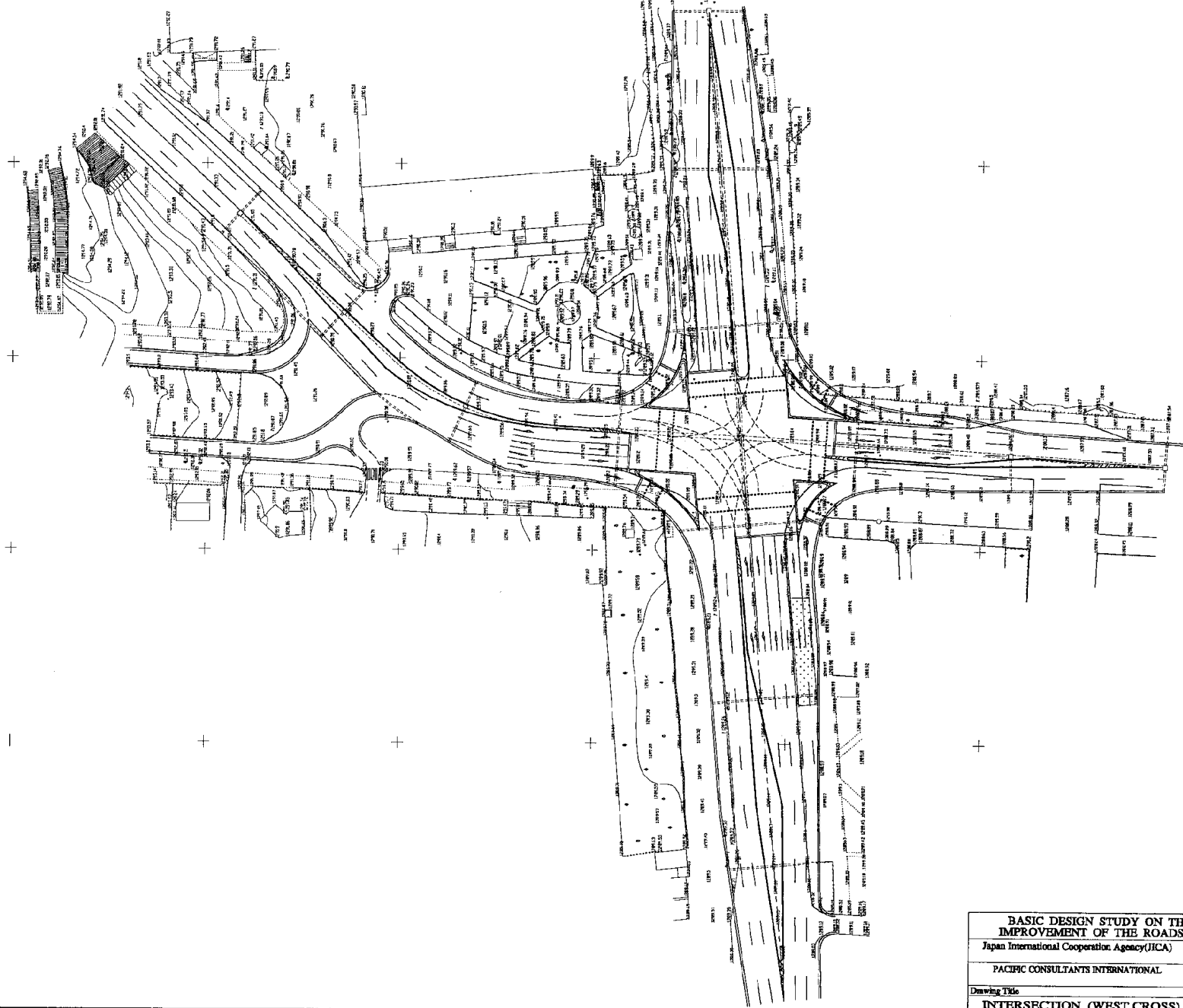

BASIC DESIGN STUDY ON THE PROJECT FOR IMPROVEMENT OF THE ROADS IN ULAANBAATAR		
Japan International Cooperation Agency (JICA)	MINISTRY OF INFRASTRUCTURE DEVELOPMENT THE GOVERNMENT OF MONGOLIA	
PACIFIC CONSULTANTS INTERNATIONAL		
Drawing Title	Scale	No.
INTERSECTION (WEST CROSS)	1/1000	

INTERSECTION (IN FRONT OF GESER TEMPLE)

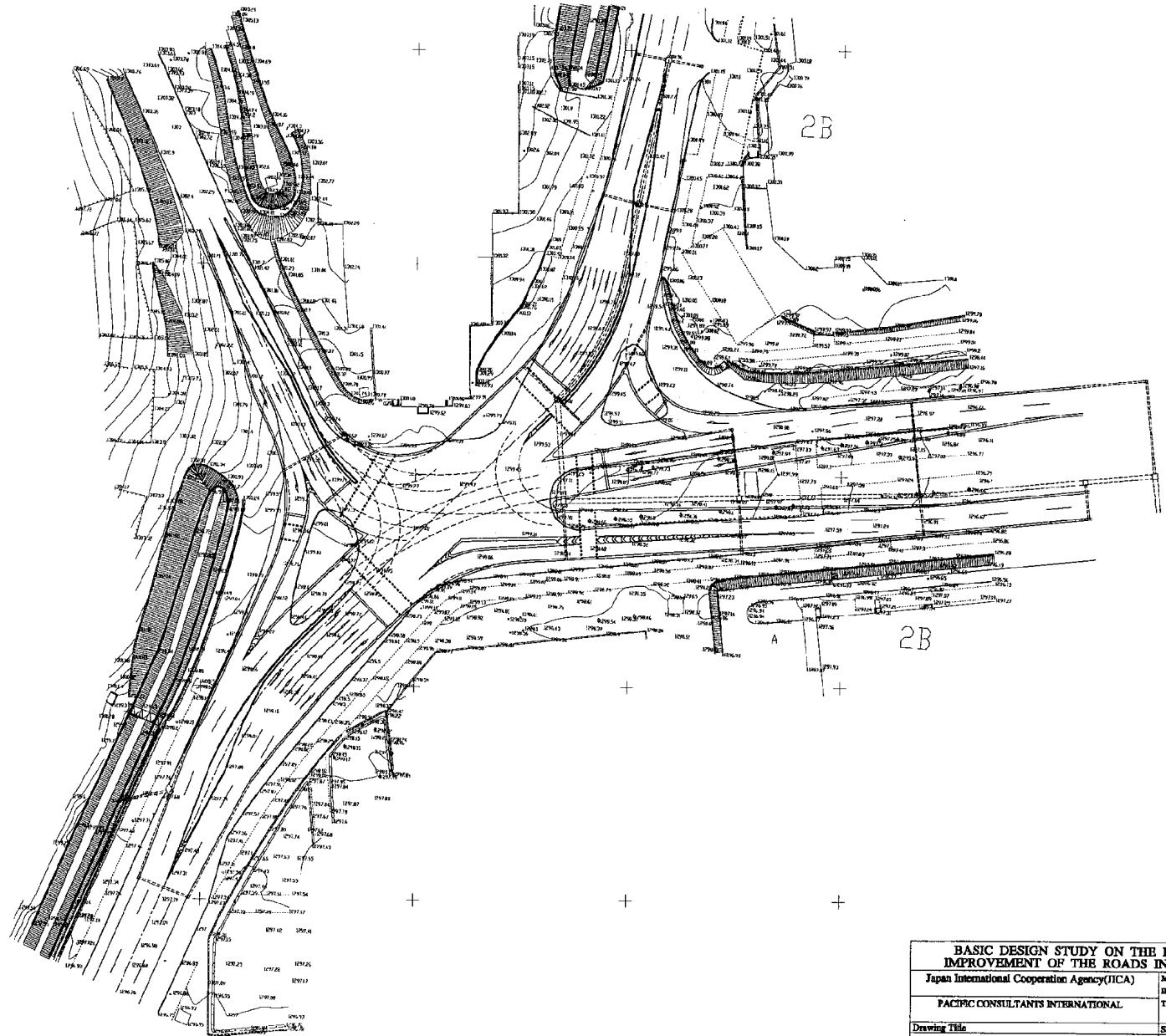

BASIC DESIGN STUDY ON THE PROJECT FOR IMPROVEMENT OF THE ROADS IN ULAANBAATAR		
Japan International Cooperation Agency (JICA)		MINISTRY OF INFRASTRUCTURE DEVELOPMENT THE GOVERNMENT OF MONGOLIA
PACIFIC CONSULTANTS INTERNATIONAL		
Drawing Title	Scale	No.
INTERSECTION (IN FRONT OF GESER TEMPLE)	1/1000	

General View of Dood Seibe Bridge Scale: 1/400

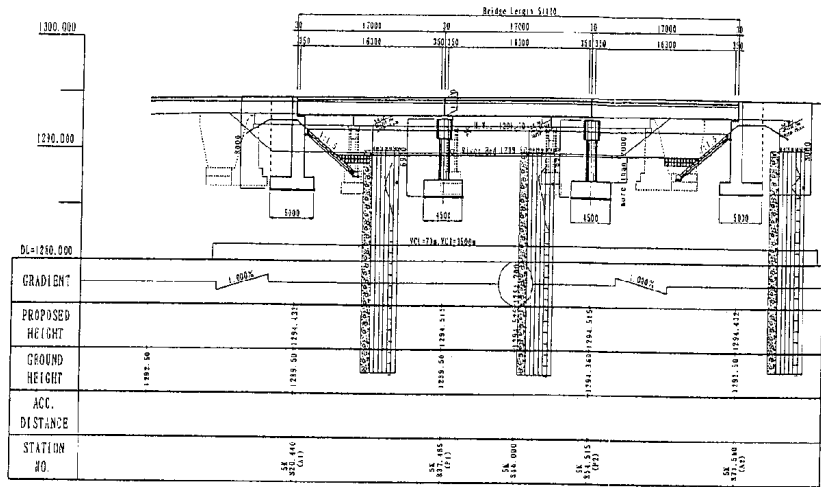

PROFILE

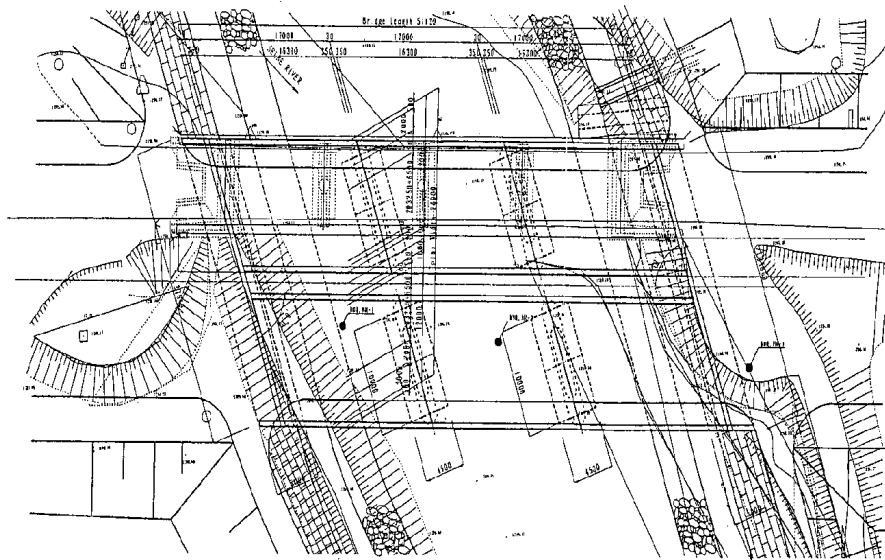

PLAN

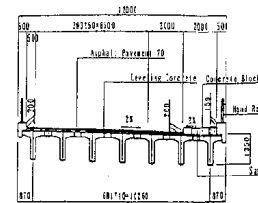

Cross Section of RC-T Shape Girder

Scale: 1/200

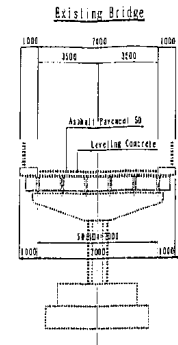

Existing Bridge

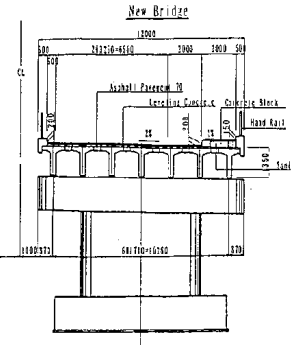

New Bridge

Relationship between Existing and New Bridge

Scale: 1/200

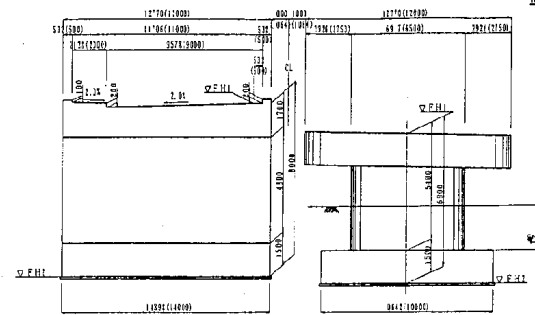

Abutment

Front View

Scale: 1/200

Pier

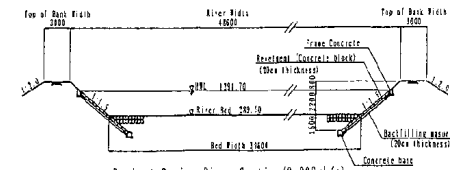

Project Design River Section (Q=300m³/s)

Scale: 1/400

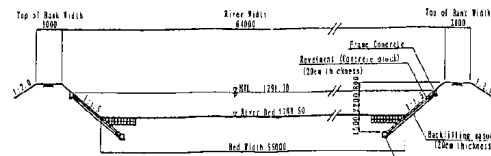

Zuluz Design River Section (Q=170m³/s)

Scale: 1/400

	F.I.	P.H.
A. at Abutment	1296.42	1286.42
P. at Pier	1296.42	1286.42

DESIGN CRITERIA

GENERAL CONDITION

Design Speed	70km/h
Bridge Length (Span Length)	51.15m (167.82ft)
Total Width	31.00m (101.67ft)
Longitudinal Gradient	1.00%
Cross-fall of Carriage way	1%
Superstructure Type	RC-T Shape Girder
Substructure Type	Abutment: RC Retained & Class Pier: RC Pile/Column/beam
Foundation Type	Spread
MATERIALS STRENGTH	
Superstructure Type	Girder: $f_{ck}=20\text{MPa}$ Slab: $f_{ck}=18\text{MPa}$
Surface	Asphalt Pavement: Thickness 150mm Curb Wall: $f_{ck}=18\text{MPa}$
Substructure Type	$f_{ck}=20\text{MPa}$
Reinforcing Steel	$f_{yk}=300\text{MPa}$

BASIC DESIGN STUDY FOR IMPROVEMENT OF THE BRIDGE IN ULANBATOR

Japan International Cooperation Agency (JICA)	MINISTRY OF INFRASTRUCTURE DEVELOPMENT THE GOVERNMENT OF MONGOLIA
PAATHIC CONSULTANTS INTERNATIONAL	SCALE: 1/400
Drawn: J. H.	DATE: 1/2000
General View of Dood Seibe Bridge	1/400

General View of Revetment Scale=1/1000

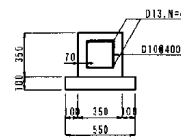
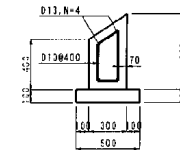
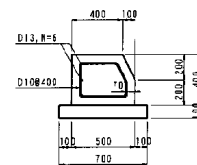
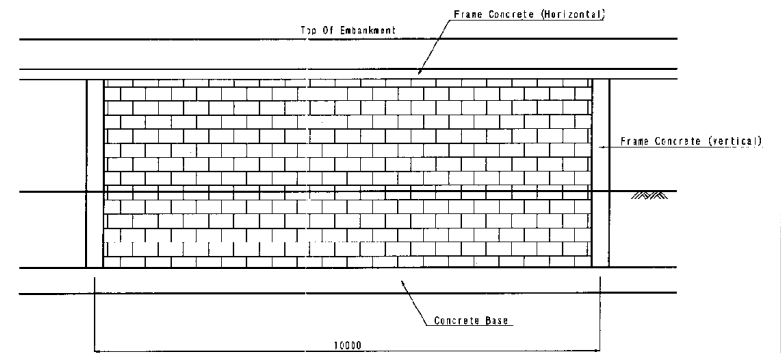
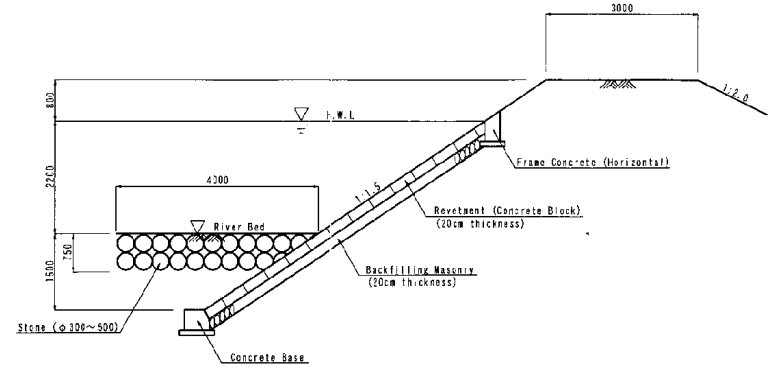
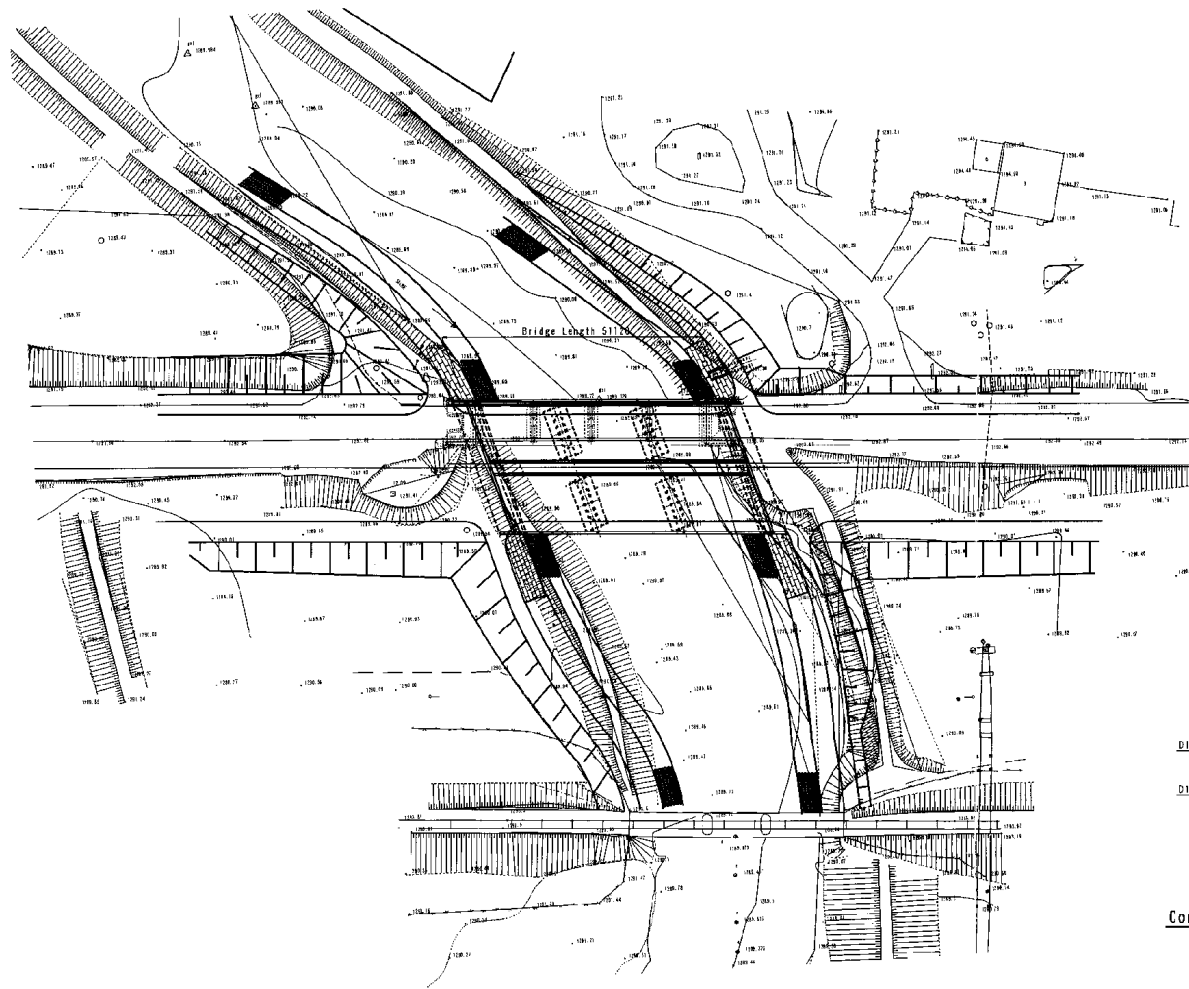

BASIC DESIGN STUDY ON THE PROJECT FOR IMPROVEMENT OF THE ROADS IN ULAANBAATAR		
Japan International Cooperation Agency (JICA)	MINISTRY OF INFRASTRUCTURE DEVELOPMENT THE GOVERNMENT OF MONGOLIA	
PACIFIC CONSULTANTS INTERNATIONAL		
Drawing Title	Scale	NC
General View of Revetment	1/1000	

添付資料 6 . 参考資料リスト

収集資料リスト

主管部長	文書管理課長	情報管理課長	技術情報課長
------	--------	--------	--------

地域	東アジア	調査団等名称	ウランバートル市道路整備計画	調査の種類	基本設計調査	作成部課	作成部課
国名	モンゴル国		基本設計調査	現地調査期間	00年 5月 15日 ~ 00年 7月 3日 00年 8月 28日 ~ 00年 9月 8日	担当者氏名	

番号	資料の名称	形態	版数	枚数	オリジナル・コピーの別	部数	収集先名称又は発行機関	寄贈・購入の別	取扱区分	利用表示	利用者所属氏名	納入予定日	納入確認欄	平成 年 月 日 作成		
														年	月	日
1	Yearbook of Statistics	A4		222	original	1	Statistics Department, Mongolia				K. Maruoka					
2	Yearbook of Statistics by UB City	CD		-	original	1	UB City				K. Maruoka					
3	Map (Scale 1:5,000)	A4		8	Copy	1	UB City				All Member					
4	Map (Scale 1:25,000)	A4		3	Copy	1	UB City				All Member					
5	Map (Scale 1:100,000)	A4		1	Copy	1	UB City				All Member					
6	Highway Design Standard 1998, Republic of Mongolia	A4		92	original	1	Road Department (RD)				Y. Takai and T. Takeuchi					
7	Road Designing BNhD 32-01-00	A4		92	original	1	Ministry of Infrastructure, Mongolia				T. Takeuchi					
8	Regulation on Operation of Facilities for Coordination of Traffic (MNS 4596:98)	A4		48	original	1	Standards, Weights and Measures Departments, Mongolia				T. Takeuchi					
9	Road Signs General Requirements (MNS 4597:98)	A4		45	original	1	Standards, Weights and Measures Departments, Mongolia				T. Takeuchi					

番号	資料の名称	形態	版型	枚数	オリジナル・コピーの別	部数	収集先名称又は発行機関	寄贈・購入の別	取扱区分	利用表示	利用者所属氏名	納入予定日	納入確認欄
10	Road Marking Basic Technical Requirements (MNS 4759:99)	A4		35	original	1	Standards, Weights and Measures Departments, Mongolia				T. Takeuchi		
11	Reinforced Concrete Poles for Road Signs and Posts Technical Requirements (MNS 4912:2000)	A4		7	original	1	Standards, Weights and Measures Departments, Mongolia				T. Takeuchi		
12	Data of Underground Facilities	Digital		-	Copy	1	UB City				T. Takeuchi		
13	Road Bridge and Pipe Standard BNbD.2.05.03-97	A4		122	original	1	Road Department (RD)				Y.Takai		
14	Plan the Selbe Bridge on Tsoeverchid	A2		1	copy	1	Sergelt Co.,Ltd				Y.Takai		
15	Drawing of the Selbe Bridge on Tsoeverchid	A2		8	copy	1	Sergelt Co.,Ltd				Y.Takai		
16	12,15 and 18m Beam and 6.5m Sub-structure Design Sheet, 1998	A3		43	copy	1	Sergelt Co.,Ltd				Y.Takai		
17	Meteorological Data (Temperature, etc)	A4		18	copy	1	Institute of Meteorology & Hydrology Ministry for Nature & Environment				I.Misono		
18	Information and data collection for the design study for river engineering	A4		21	original	1	Institute of Geo-ecology				I.Misono		
19	Rainfall Data (Buayant-Ukhaa and Takhilt Station)	A4		3	copy	1	Ministry for Nature & Environment				I.Misono		
20	Earthquake Division of the Territory of the UB City	A4		1	copy	1	Academy of Sience of USSR and Academy of Mongolia, Irkutsk - Ulaanbaatar 1980				M. Nakamura		
21	Report of Geological Mapping on the Territory of UB City by A.S. Ampilov and I.P. Jelubovski 1913	A4		1	copy	1	Geotech Company				M. Nakamura		

番号	資料の名称	形態	版型	冊数	オリジナル・コピーの別	部数	収集先名称又は発行機関	寄贈・購入の別	取扱区分	利用表示	利用者所属氏名	納入予定日	納入確認欄
22	Meteorological and Geophysical Characteristics for Construction Design BNbD 2.01.01.-93	A4		1	copy	1	Geotech Company				M. Nakamura		
23	Engineering Geological Map with Scale 1:100,000 of the Territory of the UB City by T. Bееijn 1986	A4		1	copy	1	Geotech Company				M. Nakamura		
24	Equipment list of the Erdene Zam Company	A4		4	Copy	1	the Erdene Zam Company				H. Fukuchi		
25	Equipment list of the Ulaanbaatar Zam Zasvar Company	A4		2	Copy	1	the Ulaanbaatar Zam Zasvar Company				H. Fukuchi		
26	Equipment list of the Road Repair and Maintenance Company	A4		2	Copy	1	the Road Repair and Maintenance Company				H. Fukuchi		
27	Equipment list of the Bat Zam Company	A4		1	Copy	1	the Bat Zam Company				H. Fukuchi		
28	Equipment list of the ASBI Company	A4		1	Copy	1	the ASBI Company				H. Fukuchi		
29	Equipment list of the Huchit Zam Company	A4		1	Copy	1	the Huchit Zam Company				H. Fukuchi		
30	Equipment list of the Gan Guur Company	A4		1	Copy	1	the Gan Guur Company				H. Fukuchi		
31	Equipment list of the Techno Arch Company	A4		1	Copy	1	the Techno-Arch Company				H. Fukuchi		
32	Equipment list of the Equipment Leasing TTTurees Company	A4		1	Copy	1	the Equipment Leasing TTTurees Company				H. Fukuchi		
33	Table of Exchange Rate (Tug v.s. U.S.Dollar)	A1		3	original	1	Mongol Bank				M. Takahashi		

番号	資料の名称	形態	版型	枚数	オリジナル・コピーの別	部数	収集先名称又は発行機関	寄贈・購入の別	取扱区分	利用表示	利用者所属氏名	納入予定日	納入確認欄
34	Breakdown of Cost Estimate of Widening Roads in Thirteenth District	A4		25	Copy	1	UB City				M. Takahashi		
35	Breakdown of Cost Estimate of Widening Roads in Third District	A4		20	Copy	1	UB City				M. Takahashi		
36													
37													
38													
39													
40													
41													
42													
43													
44													
45													