

C-C'

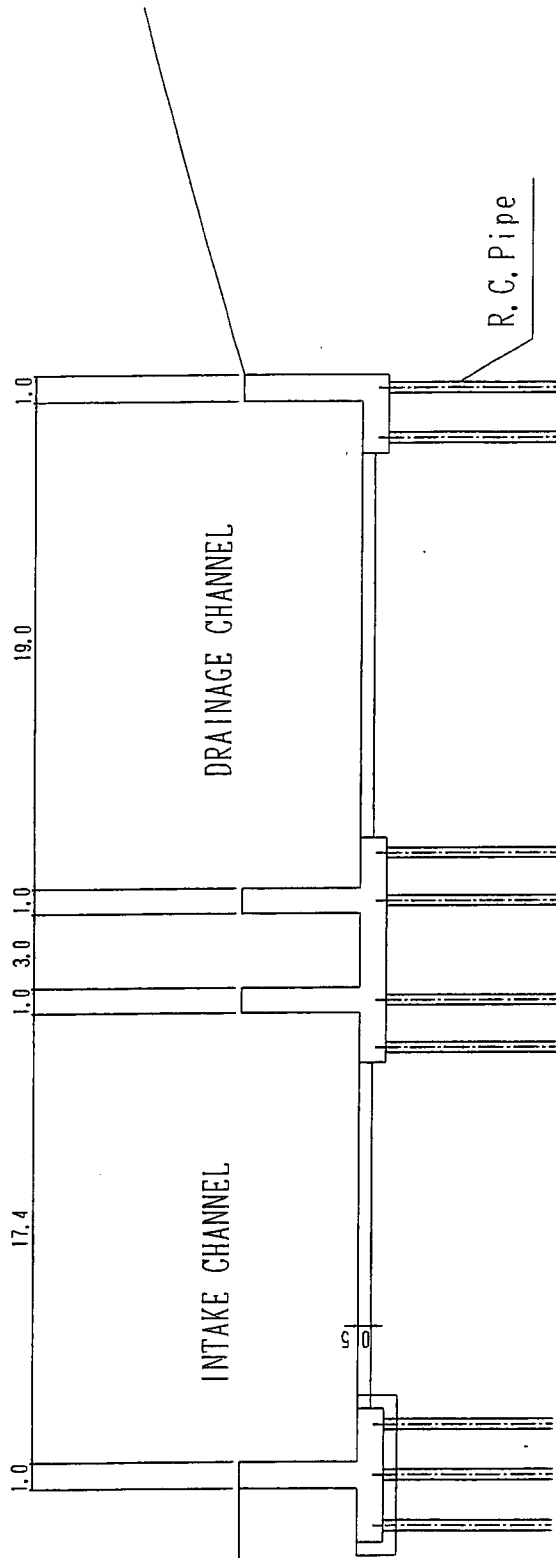

Figure 8.2.12
Profile of Intake Channel and Drainage Channel at Macabalo

COMPREHENSIVE DISASTER PREVENTION AROUND MAYON VOLCANO IN
THE REPUBLIC OF THE PHILIPPINES

JAPAN INTERNATIONAL COOPERATION AGENCY

Inlet
OVERFLOW SECTION SECTION-1

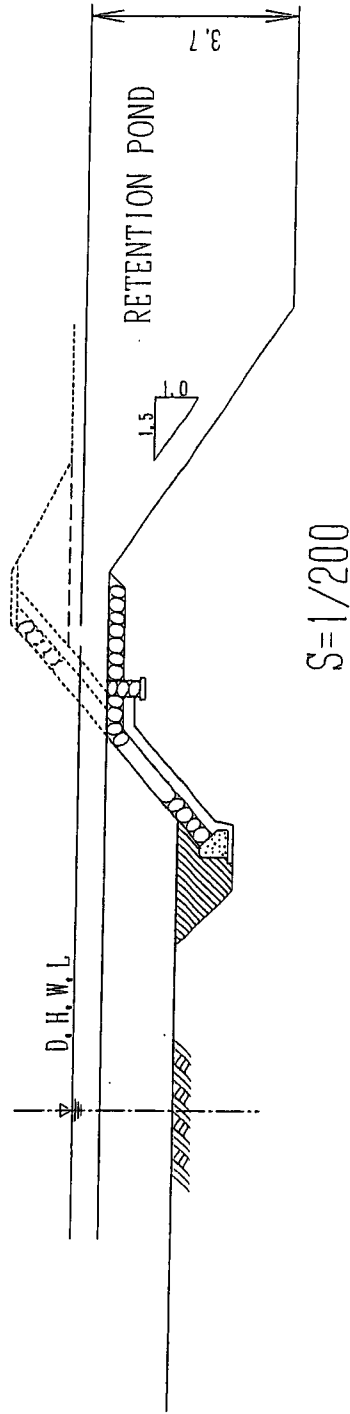

Figure 8.2.13
Profile of Inlet Overflow Section (Section-1)

COMPREHENSIVE DISASTER PREVENTION AROUND MAYON VOLCANO IN
THE REPUBLIC OF THE PHILIPPINES

JAPAN INTERNATIONAL COOPERATION AGENCY

Outlet

OVERFLOW SECTION SECTION-2

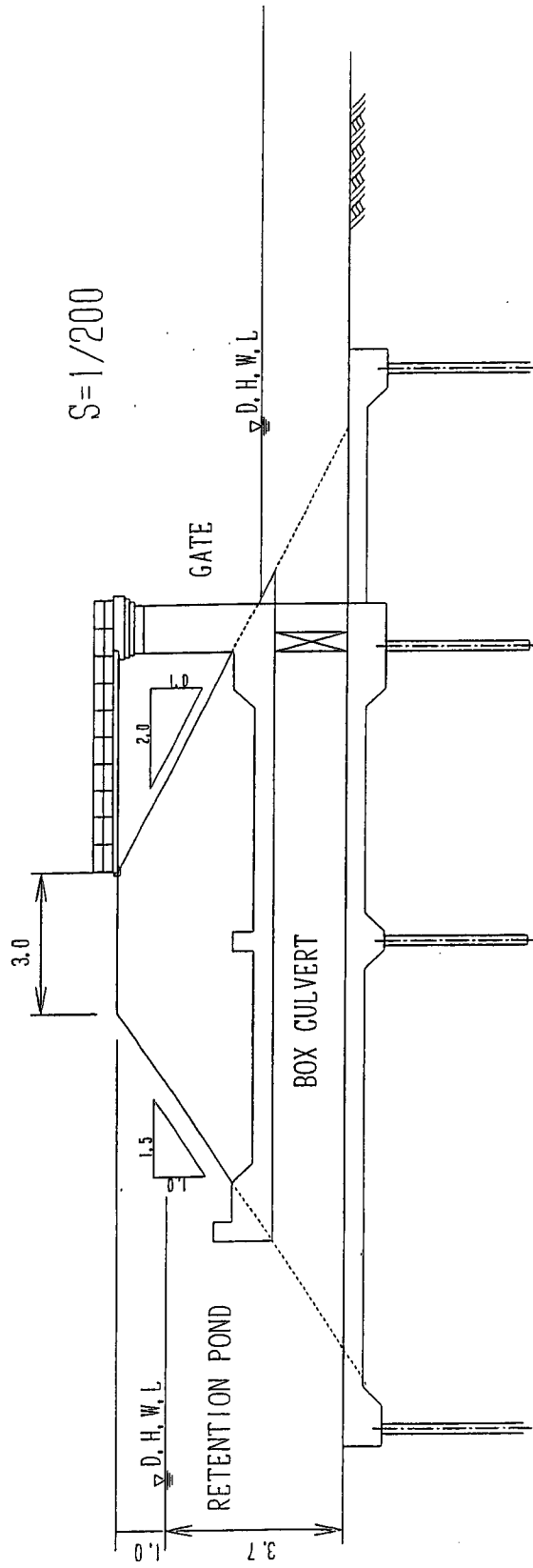

COMPREHENSIVE DISASTER PREVENTION AROUND MAYON VOLCANO IN THE REPUBLIC OF THE PHILIPPINES

JAPAN INTERNATIONAL COOPERATION AGENCY

Figure 8.2.14
Profile of Outlet Overflow Section (Section-2)

DIKE SECTION SECTION-3

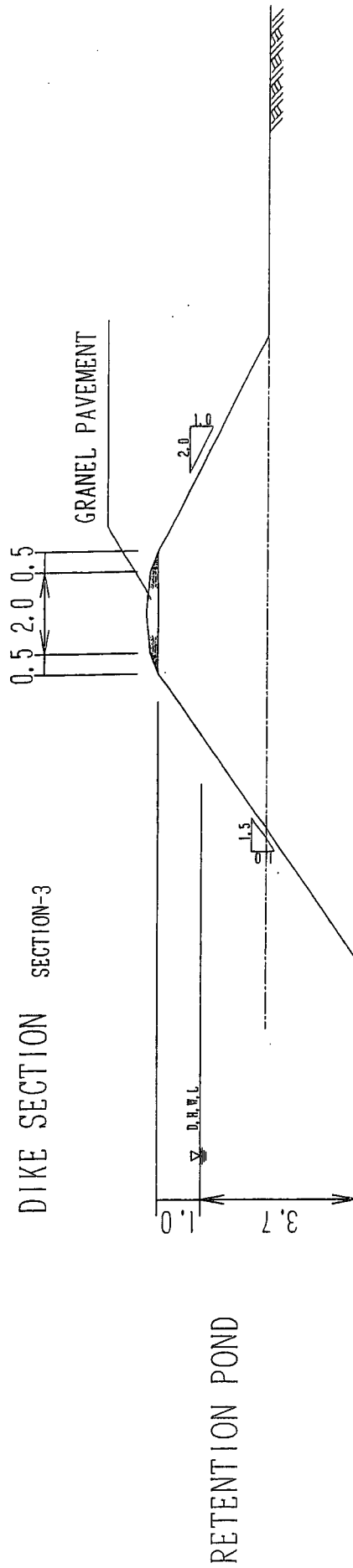

COMPREHENSIVE DISASTER PREVENTION AROUND MAYON VOLCANO IN
THE REPUBLIC OF THE PHILIPPINES

JAPAN INTERNATIONAL COOPERATION AGENCY

Figure 8.2.15
Profile of Dike Section (Section-3)

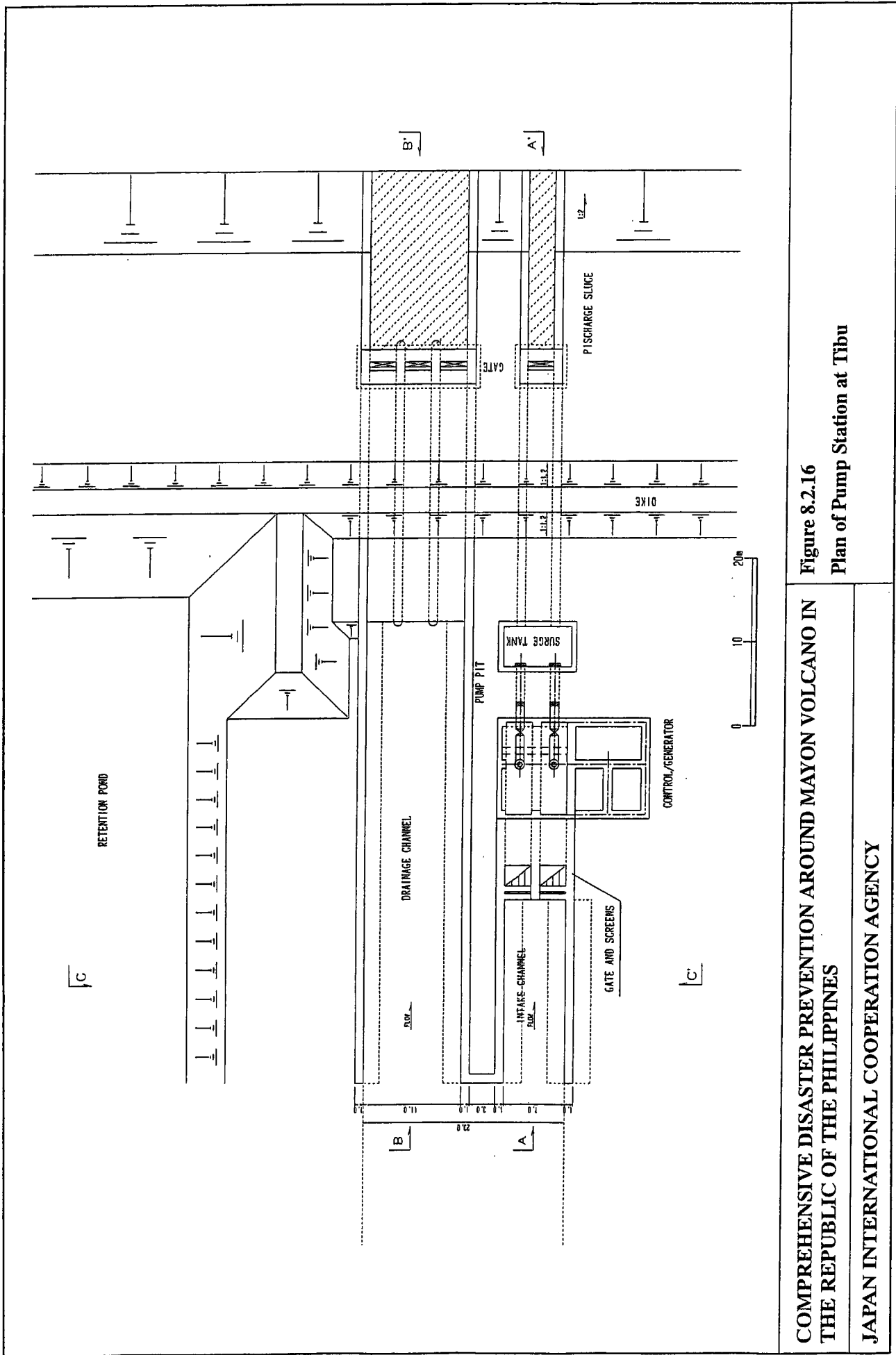
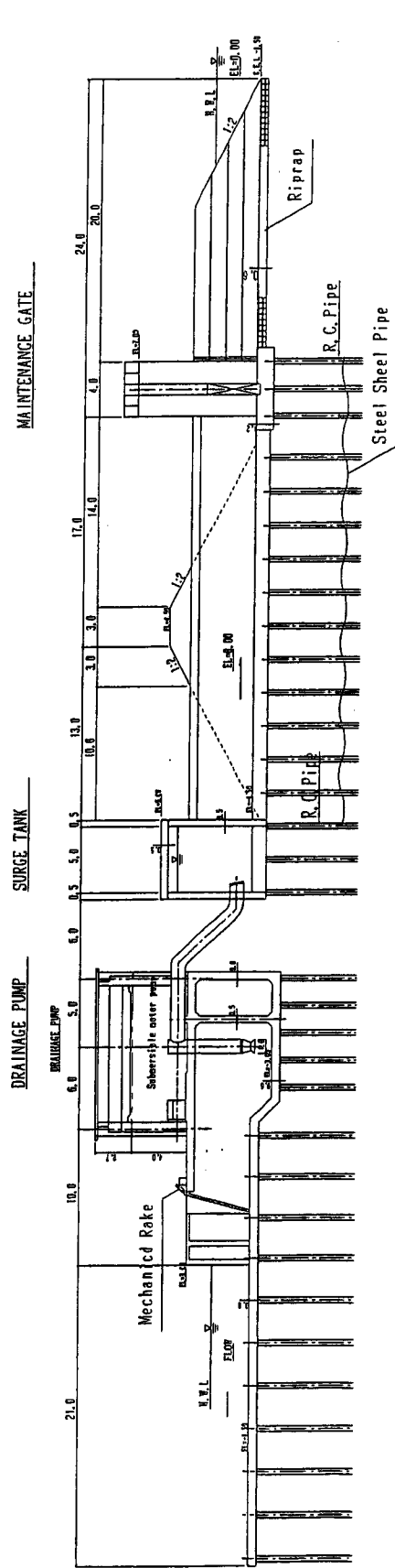

Figure 8.2.16
Plan of Pump Station at Tibu

COMPREHENSIVE DISASTER PREVENTION AROUND MAYON VOLCANO IN
THE REPUBLIC OF THE PHILIPPINES

JAPAN INTERNATIONAL COOPERATION AGENCY

A-A'



PROFILE OF DRAINAGE PUMP

Figure 8.2.17
Profile of Drainage Pump at Tibu

COMPREHENSIVE DISASTER PREVENTION AROUND MAYON VOLCANO IN
THE REPUBLIC OF THE PHILIPPINES

JAPAN INTERNATIONAL COOPERATION AGENCY

B-B'

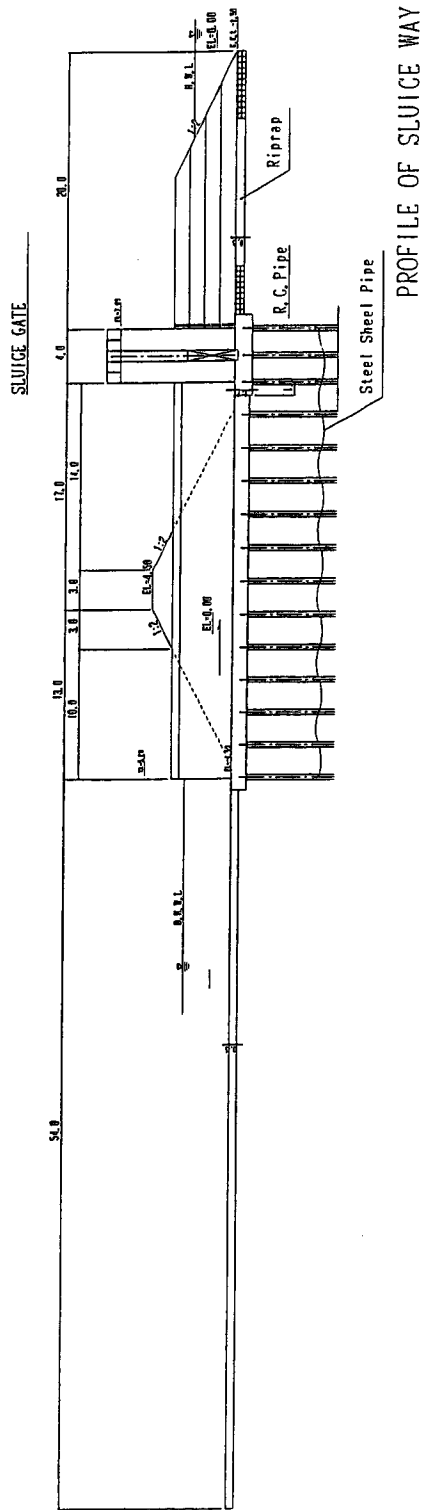

COMPREHENSIVE DISASTER PREVENTION AROUND MAYON VOLCANO IN
THE REPUBLIC OF THE PHILIPPINES

Figure 8.2.18
Profile of Sluice Way at Tibu

JAPAN INTERNATIONAL COOPERATION AGENCY

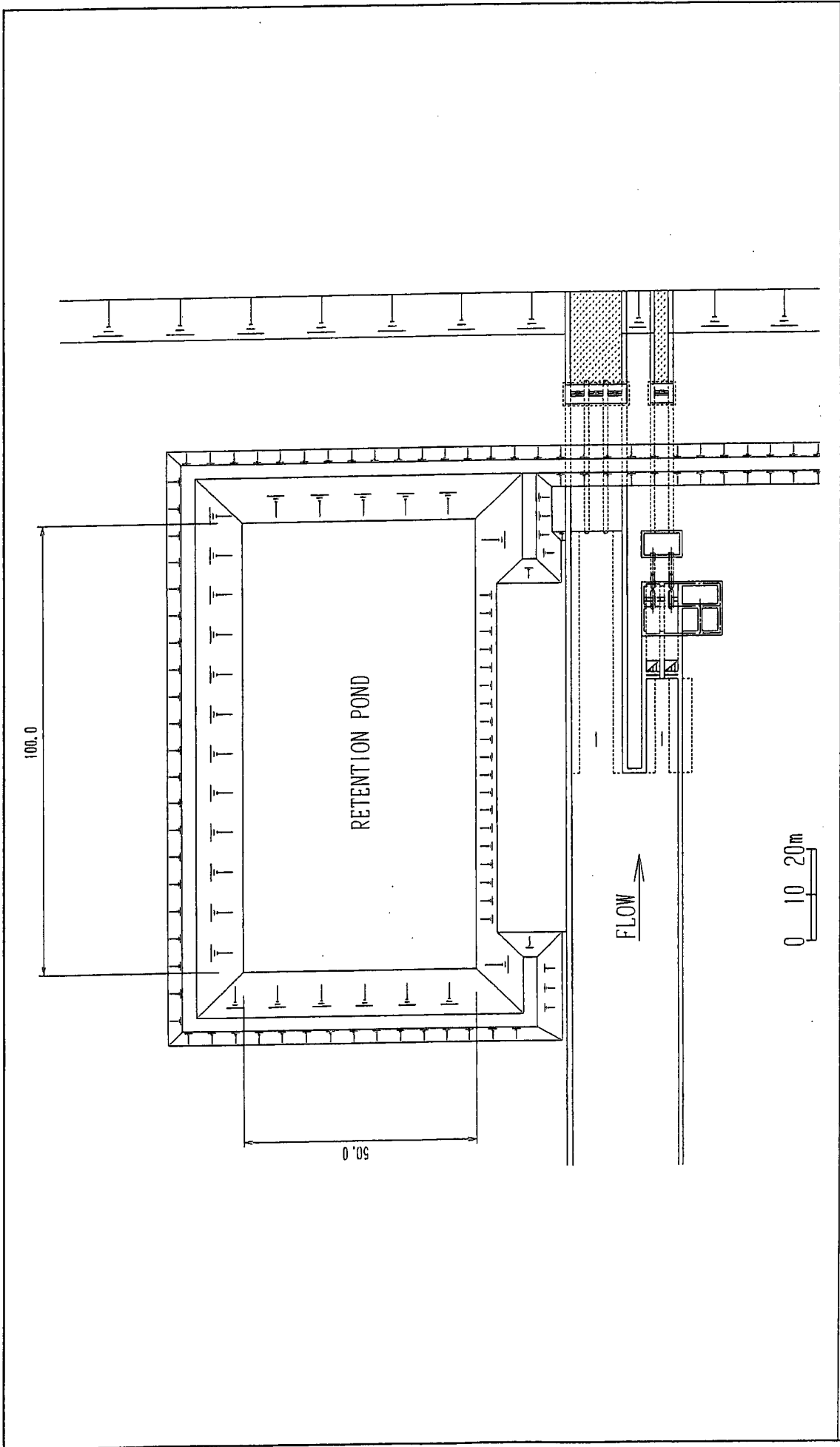
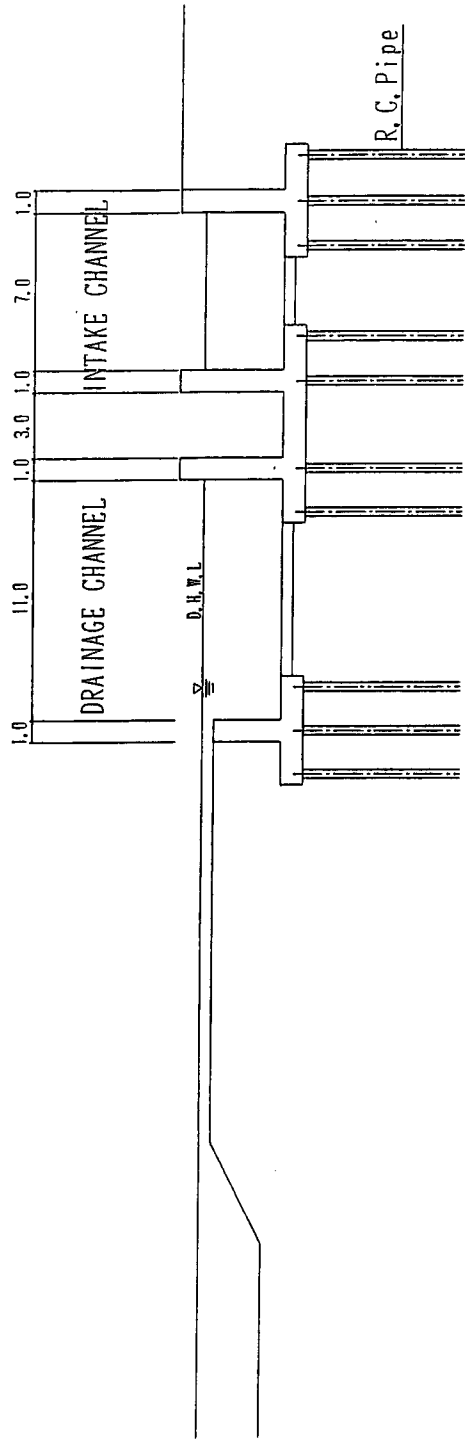

Figure 8.2.19
Plan of Retention Pond at Tibu

COMPREHENSIVE DISASTER PREVENTION AROUND MAYON VOLCANO IN
THE REPUBLIC OF THE PHILIPPINES

JAPAN INTERNATIONAL COOPERATION AGENCY

C-C'



COMPREHENSIVE DISASTER PREVENTION AROUND MAYON VOLCANO IN
THE REPUBLIC OF THE PHILIPPINES

Figure 8.2.20

Profile of Drainage Channel and Intake Channel at Tibu

JAPAN INTERNATIONAL COOPERATION AGENCY

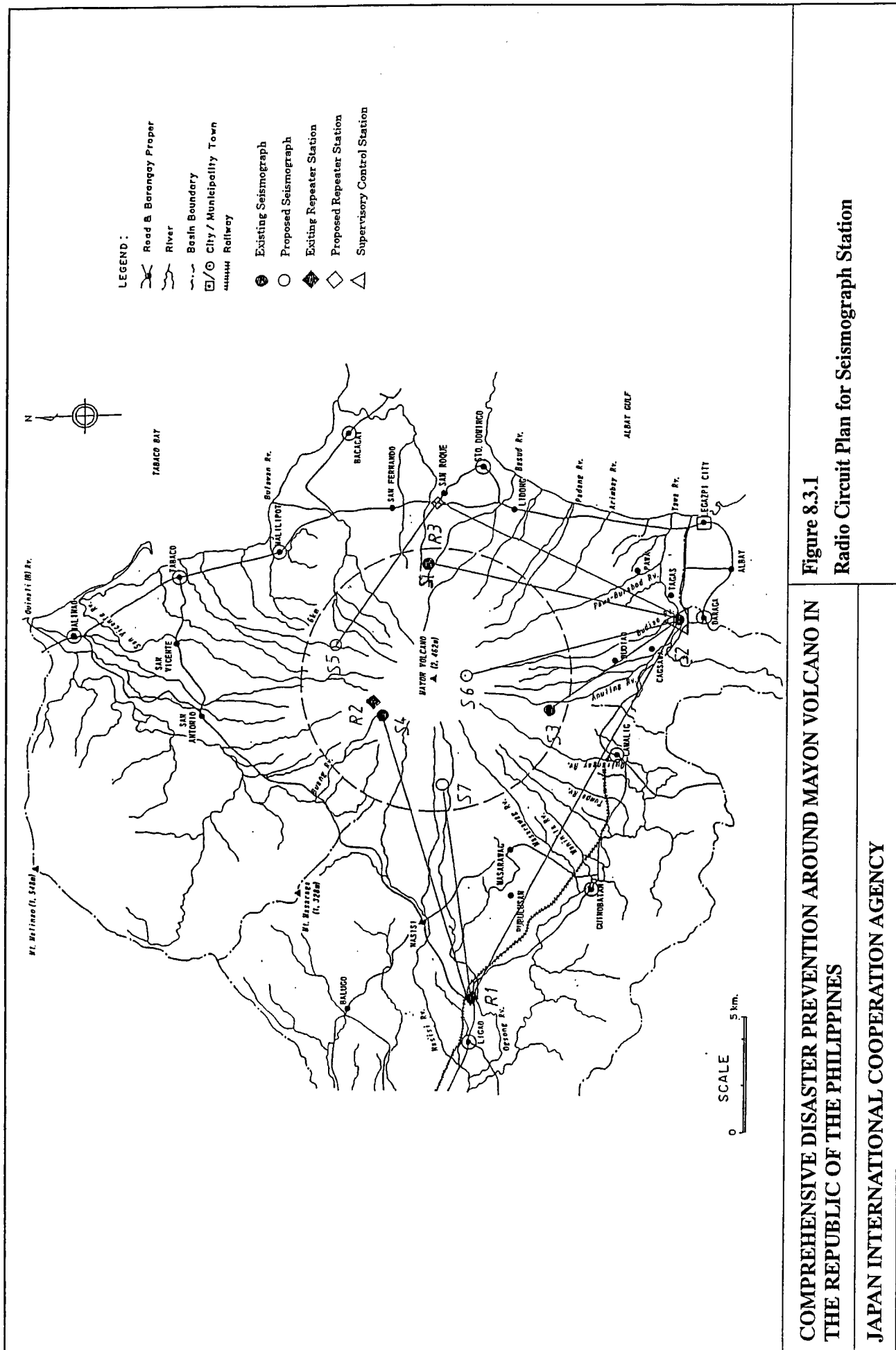

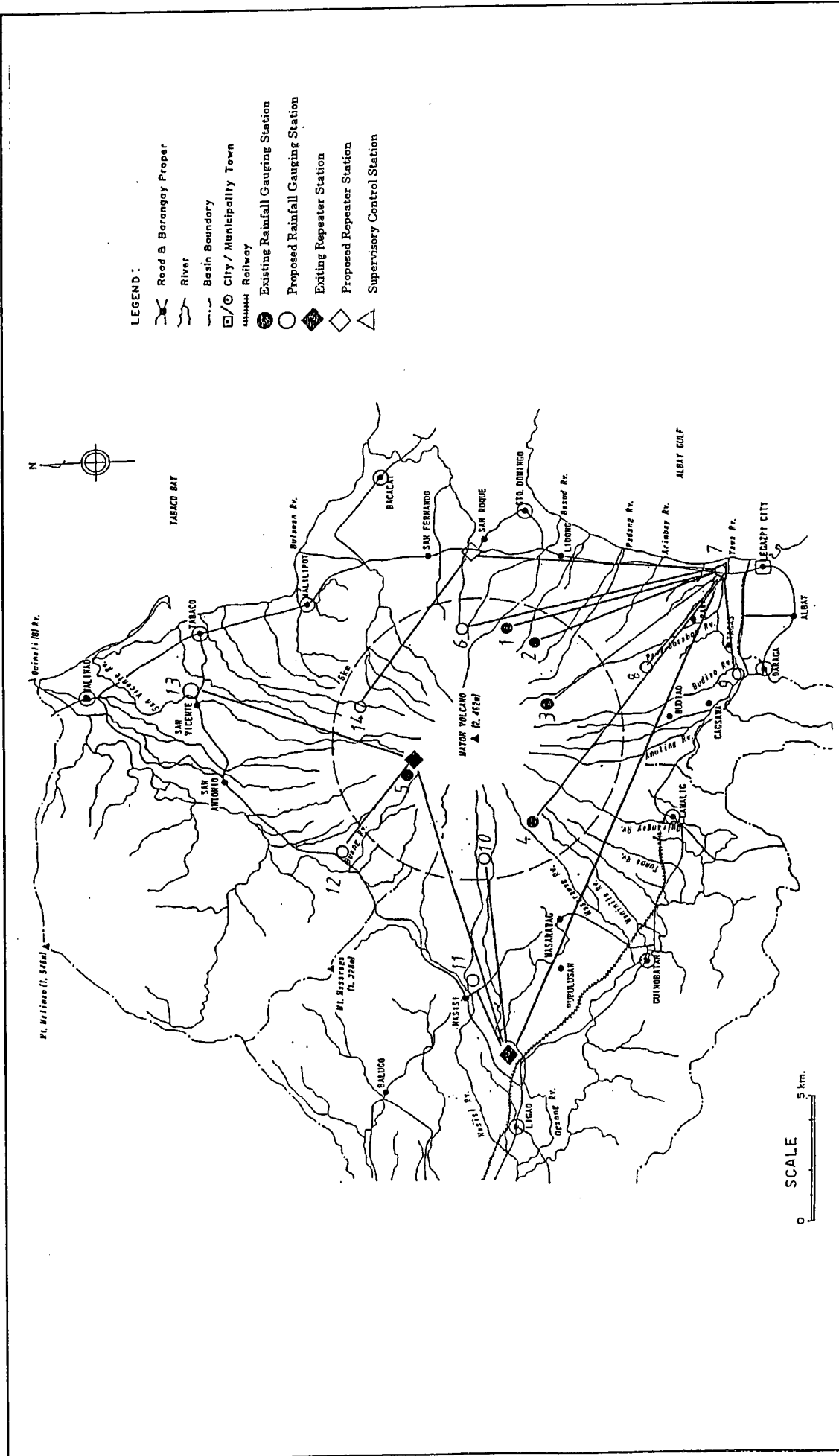

Figure 8.3.2
Radio Circuit Plan for Rainfall Gauging Station

COMPREHENSIVE DISASTER PREVENTION AROUND MAYON VOLCANO IN THE REPUBLIC OF THE PHILIPPINES

JAPAN INTERNATIONAL COOPERATION AGENCY

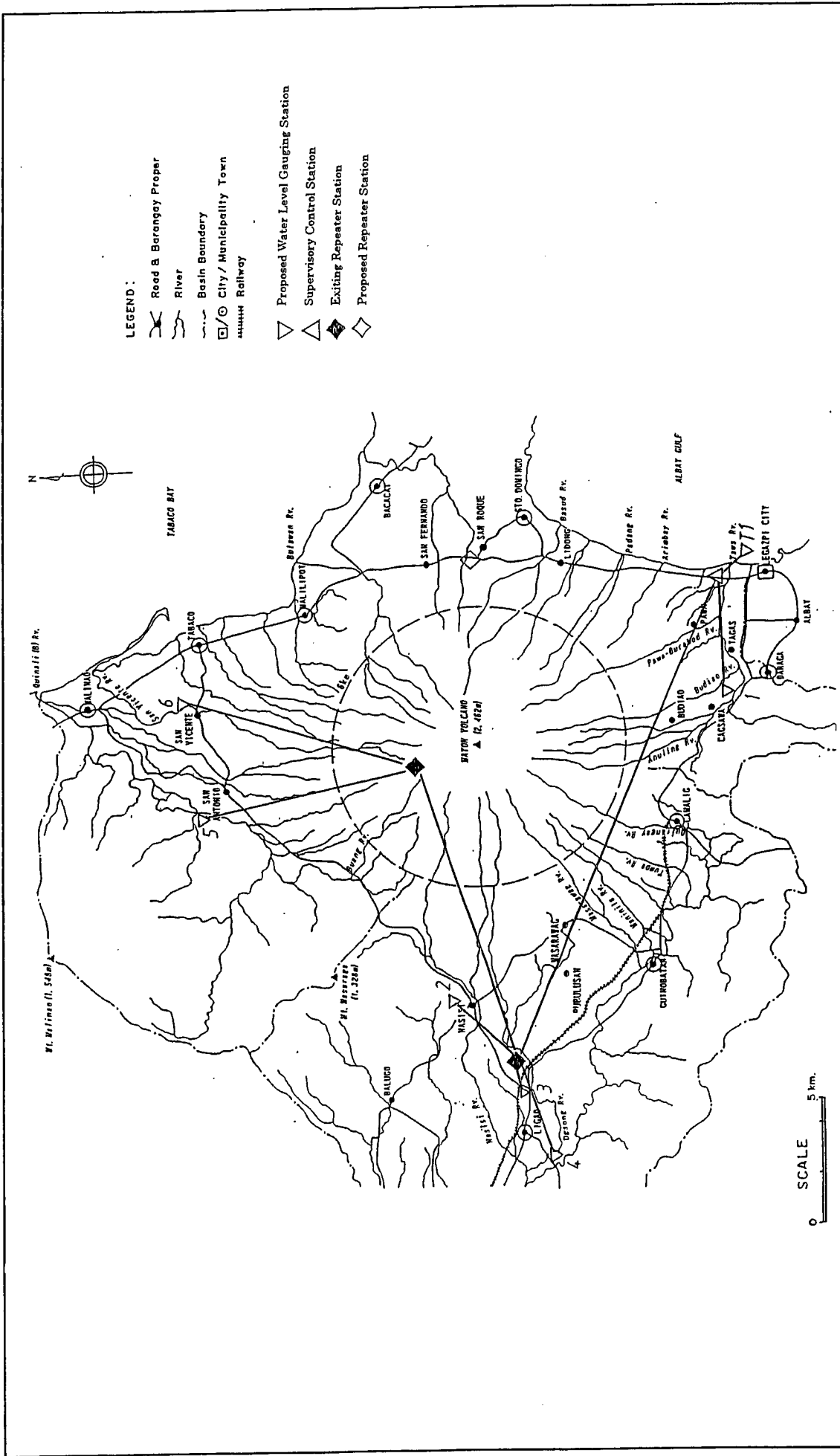
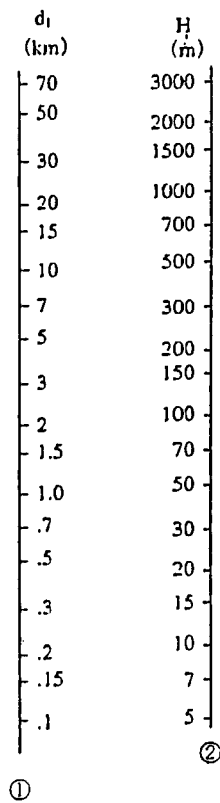
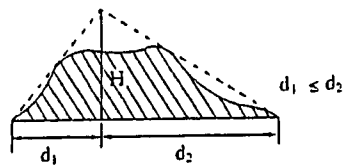
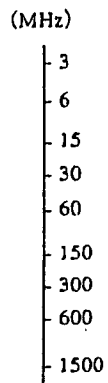

Figure 8.3.3
Radio Circuit Plan for Water Level Gauging Station

COMPREHENSIVE DISASTER PREVENTION AROUND MAYON VOLCANO IN THE REPUBLIC OF THE PHILIPPINES
JAPAN INTERNATIONAL COOPERATION AGENCY



Frequency



Loss

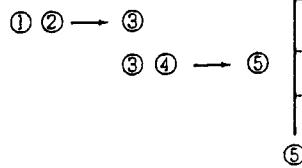
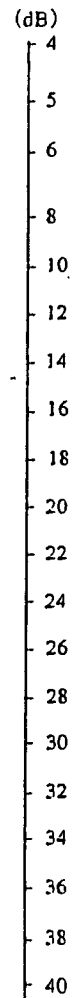

COMPREHENSIVE DISASTER PREVENTION
AROUND MAYON VOLCANO IN
THE REPUBLIC OF THE PHILIPPINES

JAPAN INTERNATIONAL COOPERATION AGENCY

Figure 8.3.4
Chart to Estimate Sharing Loss

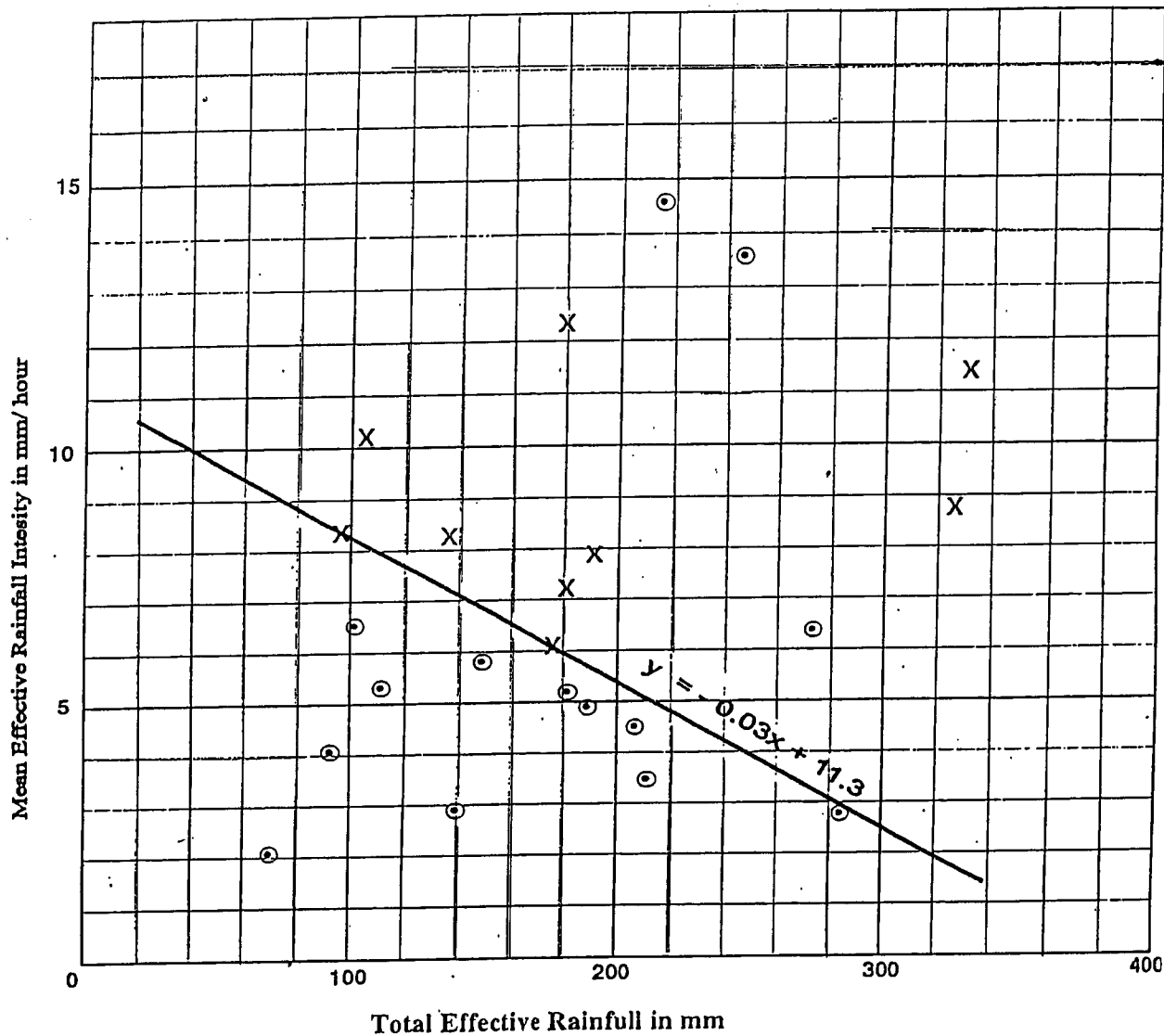

Legend:

⊙ : Plotting position for a heavy rainfall which did not record the occurrence of mud and debris flow.

X : Plotting position for a rainfall which is supposed to be the trigger of the occurred mud and debris flow

COMPREHENSIVE DISASTER PREVENTION
AROUND MAYON VOLCANO IN
THE REPUBLIC OF THE PHILIPPINES

JAPAN INTERNATIONAL COOPERATION AGENCY

Figure 8.3.5
Critical Line of Mud and Debris Flow

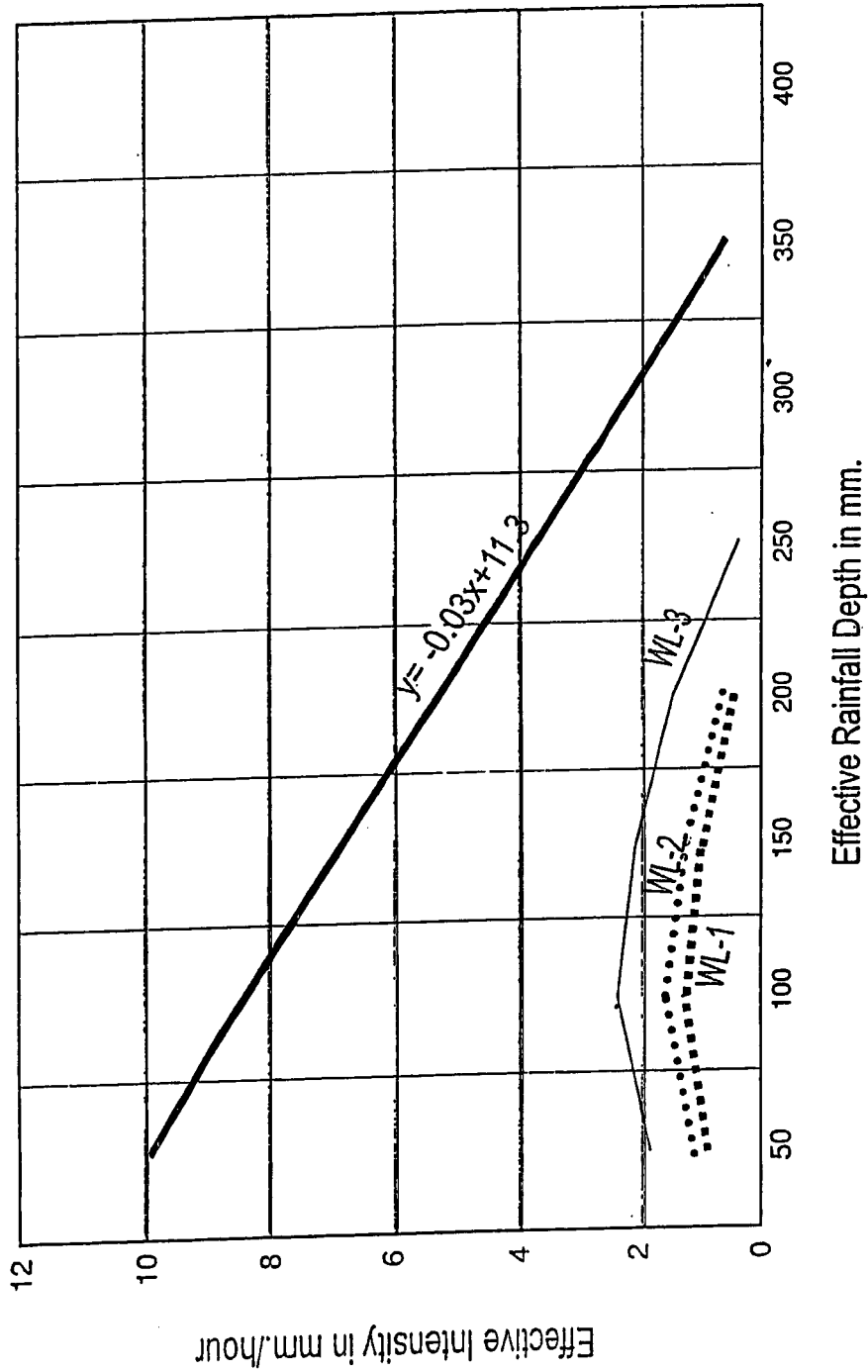

Figure 8.3.6
Critical and Warning Lines

COMPREHENSIVE DISASTER PREVENTION AROUND MAYON VOLCANO IN
THE REPUBLIC OF THE PHILIPPINES

JAPAN INTERNATIONAL COOPERATION AGENCY

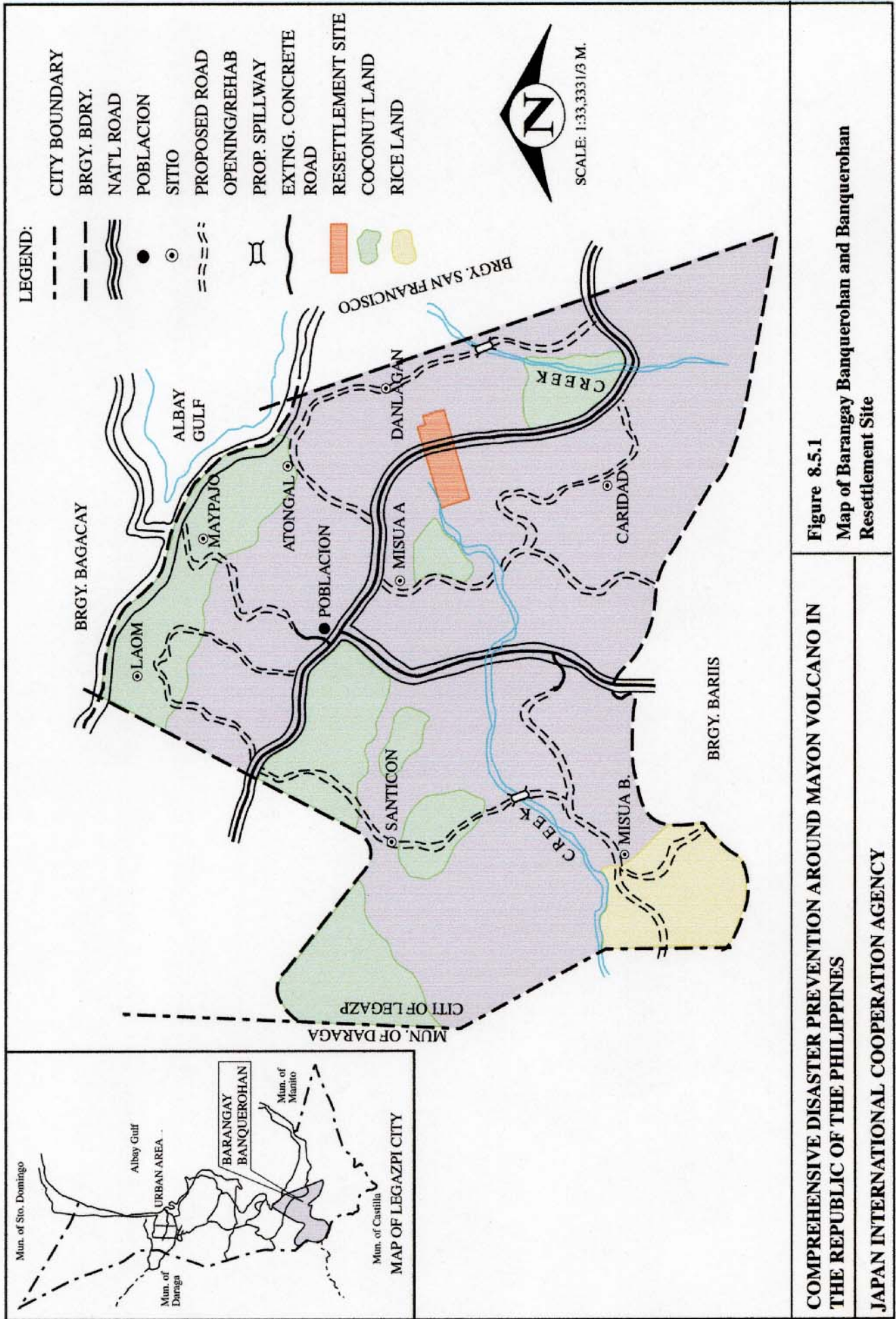

Figure 8.5.1
Map of Barangay Banquerohan and Banquerohan Resettlement Site

COMPREHENSIVE DISASTER PREVENTION AROUND MAYON VOLCANO IN THE REPUBLIC OF THE PHILIPPINES
JAPAN INTERNATIONAL COOPERATION AGENCY

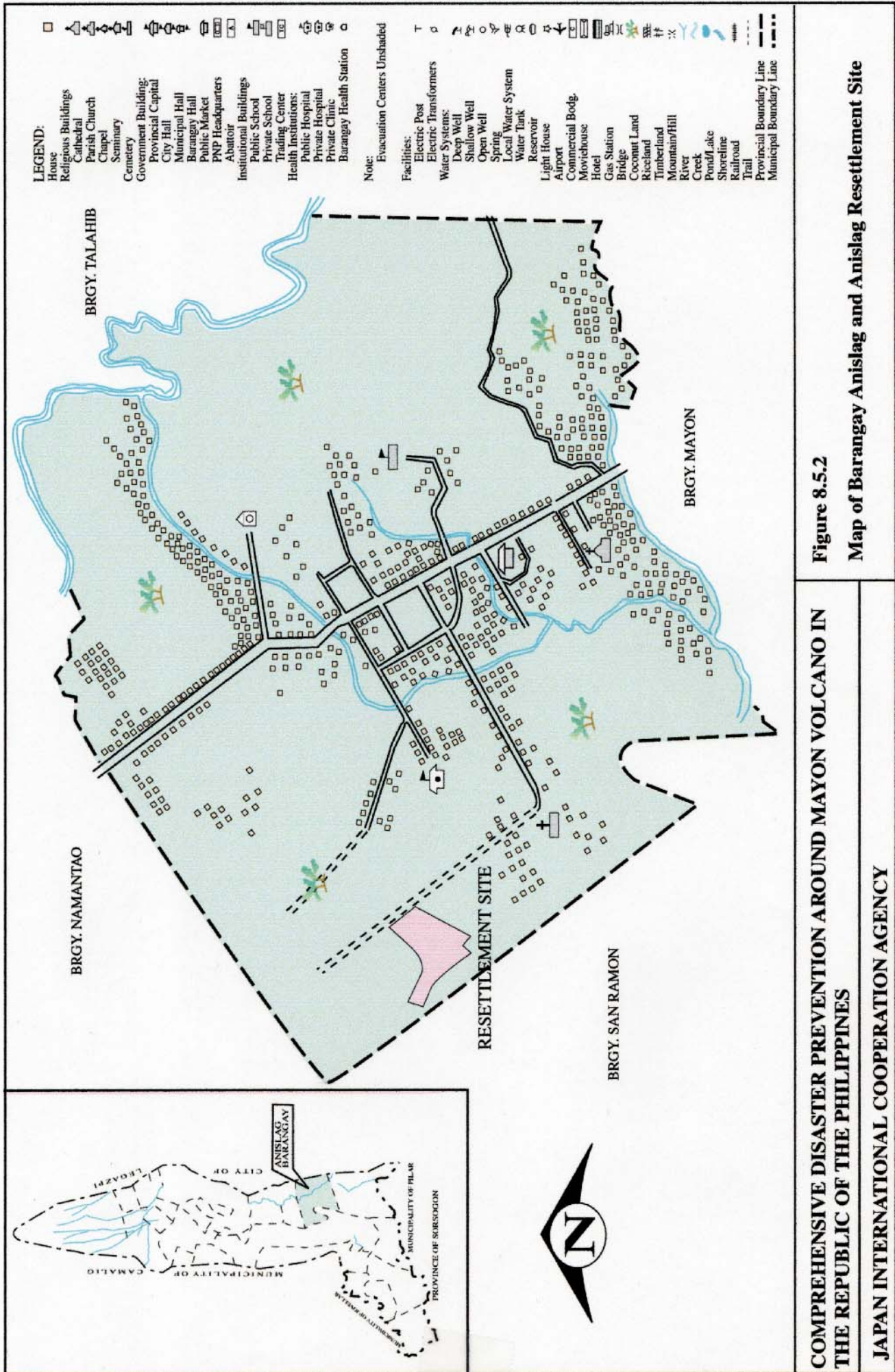

Figure 8.5.2
Map of Barangay Anislag and Anislag Resettlement Site

COMPREHENSIVE DISASTER PREVENTION AROUND MAYON VOLCANO IN THE REPUBLIC OF THE PHILIPPINES
JAPAN INTERNATIONAL COOPERATION AGENCY

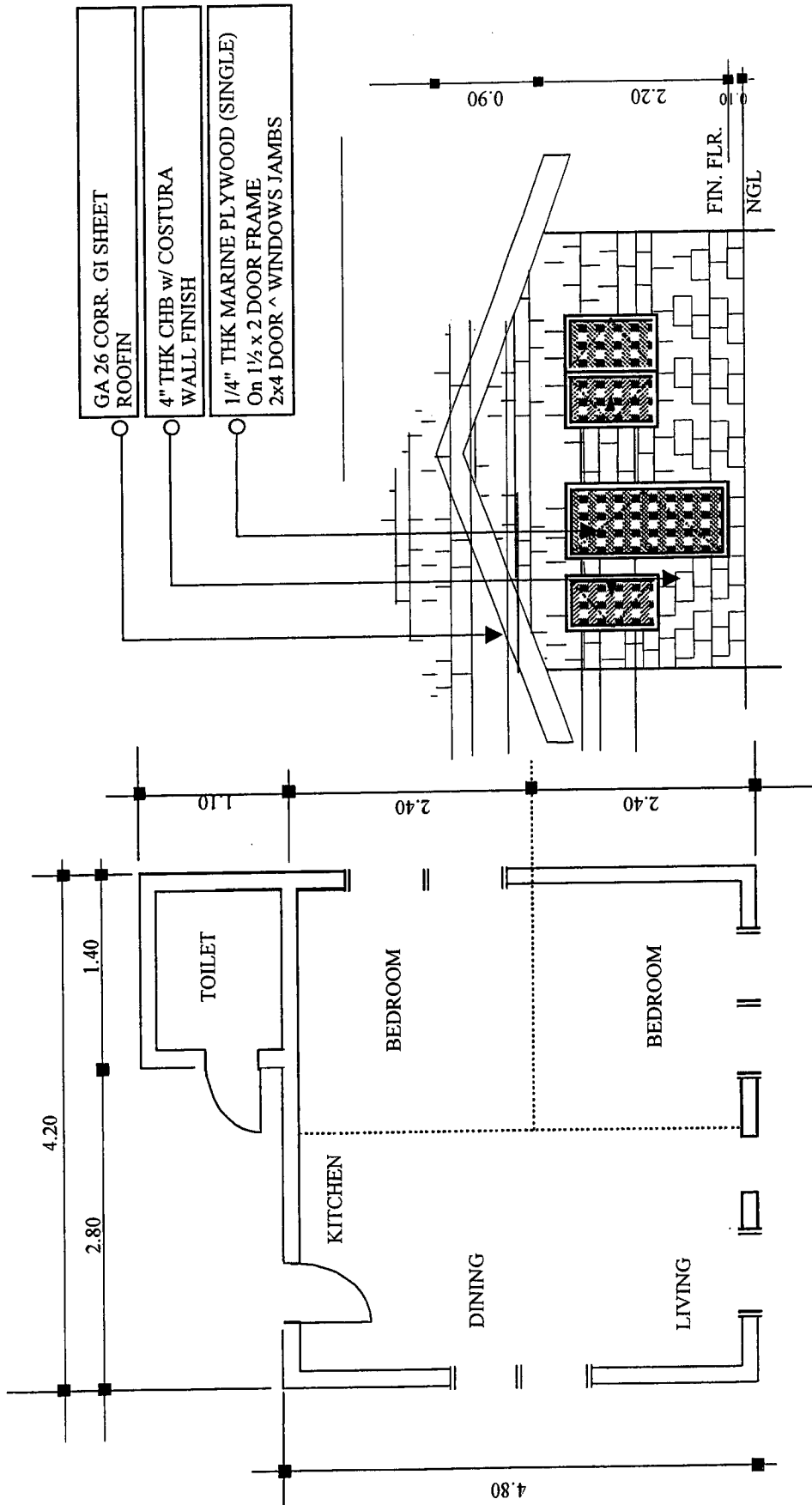
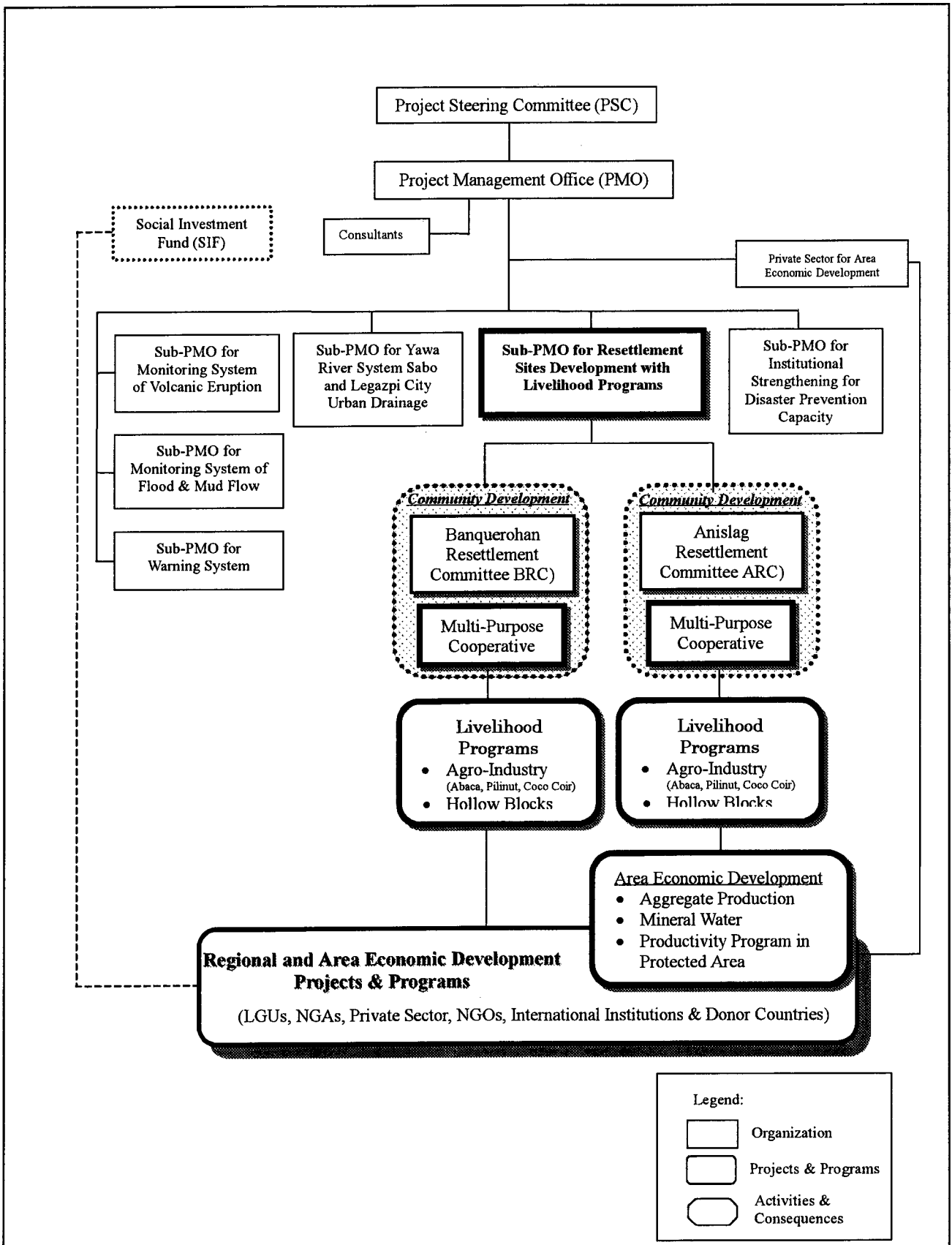

Figure 8.5.3
Standard Housing Layout Plan/Elevation

COMPREHENSIVE DISASTER PREVENTION AROUND MAYON VOLCANO IN THE REPUBLIC OF THE PHILIPPINES
JAPAN INTERNATIONAL COOPERATION AGENCY



COMPREHENSIVE DISASTER PREVENTION
AROUND MAYON VOLCANO IN
THE REPUBLIC OF THE PHILIPPINES

JAPAN INTERNATIONAL COOPERATION AGENCY

Figure 8.5.4

Supporting System for Livelihood and Area Socio-economic Development

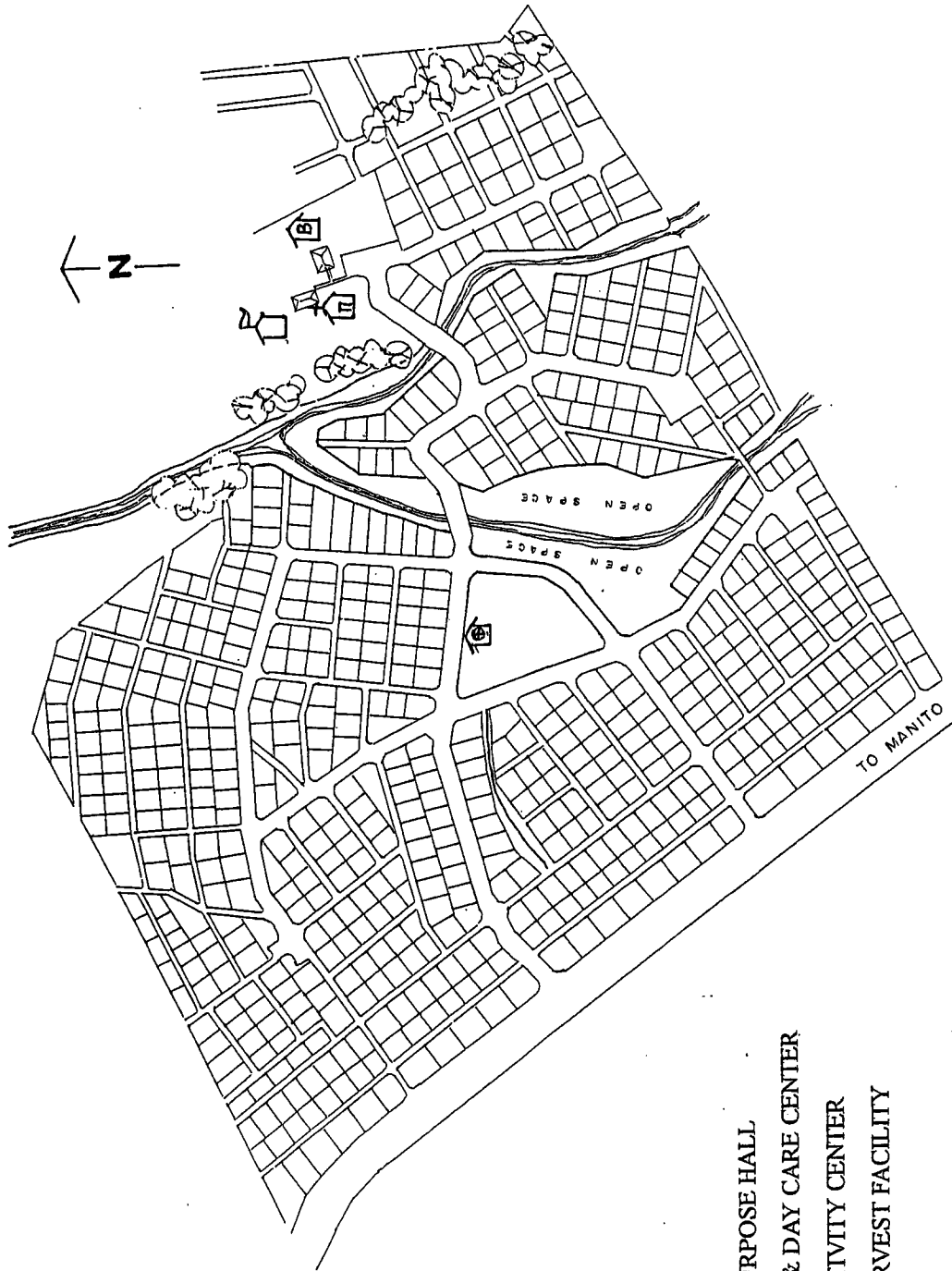





- LEGEND :
-  MULTI-PURPOSE HALL
 -  HEALTH & DAY CARE CENTER
 -  PRODUCTIVITY CENTER
 -  POST HARVEST FACILITY
 -  SCHOOL

Figure 8.5.5
Community and Livelihood Facilities Layout for Banquerohan
Phase I

COMPREHENSIVE DISASTER PREVENTION AROUND MAYON VOLCANO IN THE REPUBLIC OF THE PHILIPPINES

JAPAN INTERNATIONAL COOPERATION AGENCY

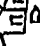

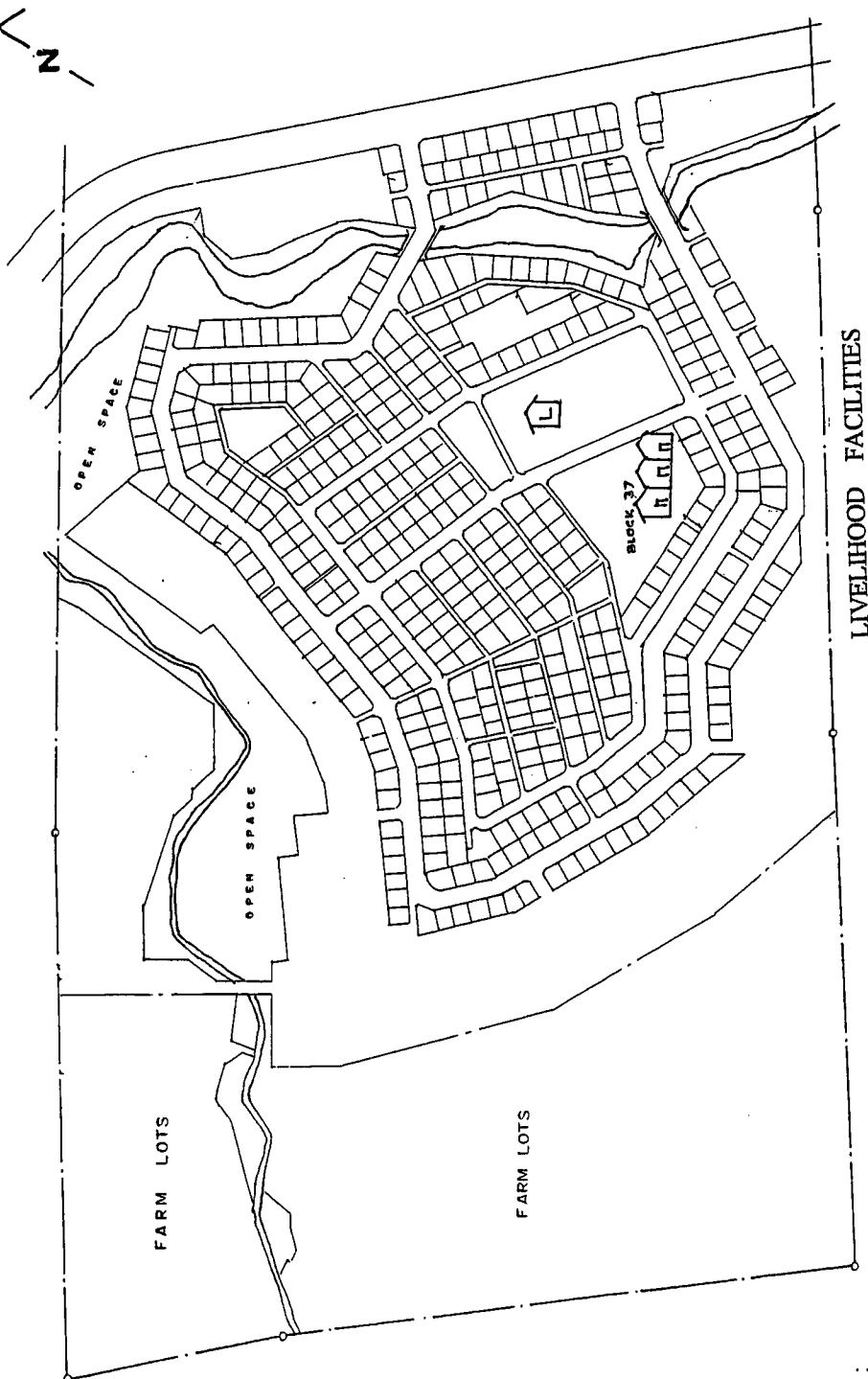
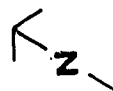
LEGEND :

-  PRODUCTIVITY CENTER
-  POST HARVEST FACILITY

**COMPREHENSIVE DISASTER PREVENTION AROUND MAYON VOLCANO IN
THE REPUBLIC OF THE PHILIPPINES**
JAPAN INTERNATIONAL COOPERATION AGENCY

Figure 8.5.6
Community and Livelihood Facilities Layout for Banquerohan
Phase II

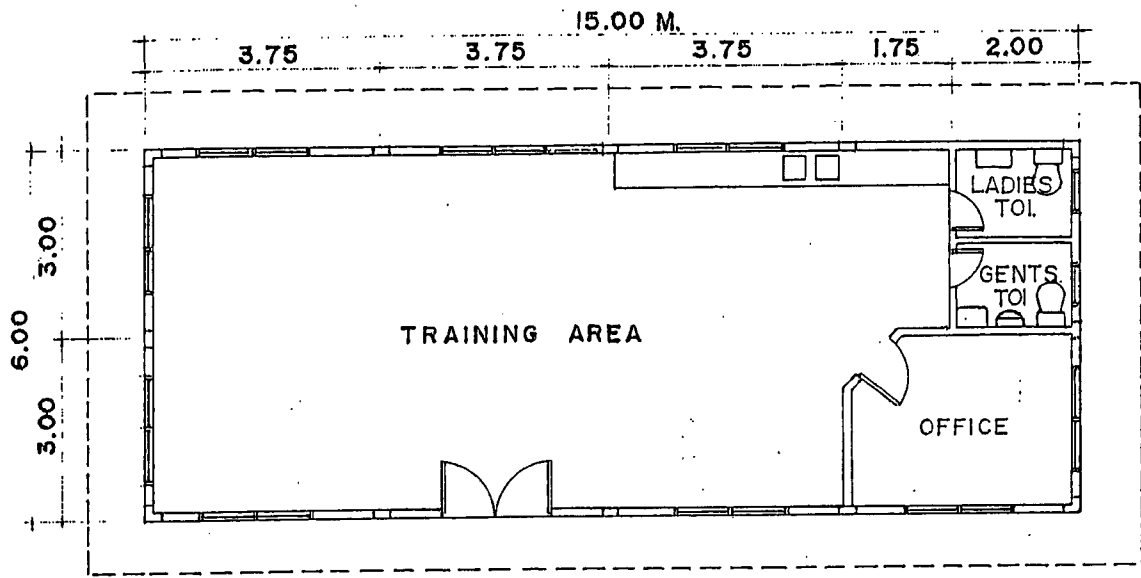

FLOOR PLAN

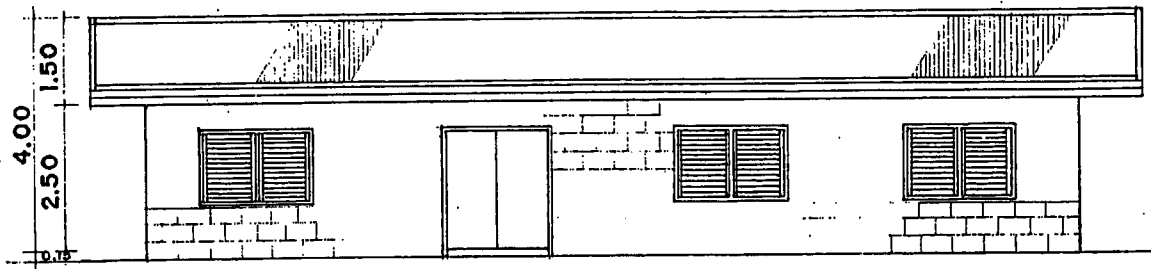

FRONT ELEVATION

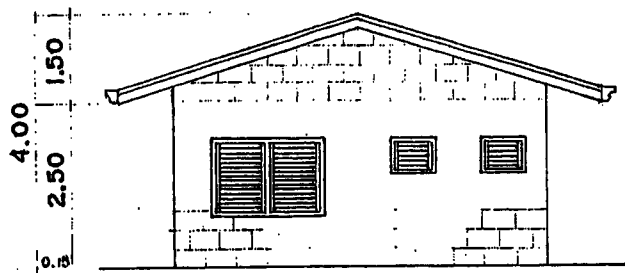

RIGHT SIDE ELEVATION

SCALE: 1:100M

COMPREHENSIVE DISASTER PREVENTION
AROUND MAYON VOLCANO IN
THE REPUBLIC OF THE PHILIPPINES

JAPAN INTERNATIONAL COOPERATION AGENCY

Figure 8.5.7
Productivity Center Layout Plan

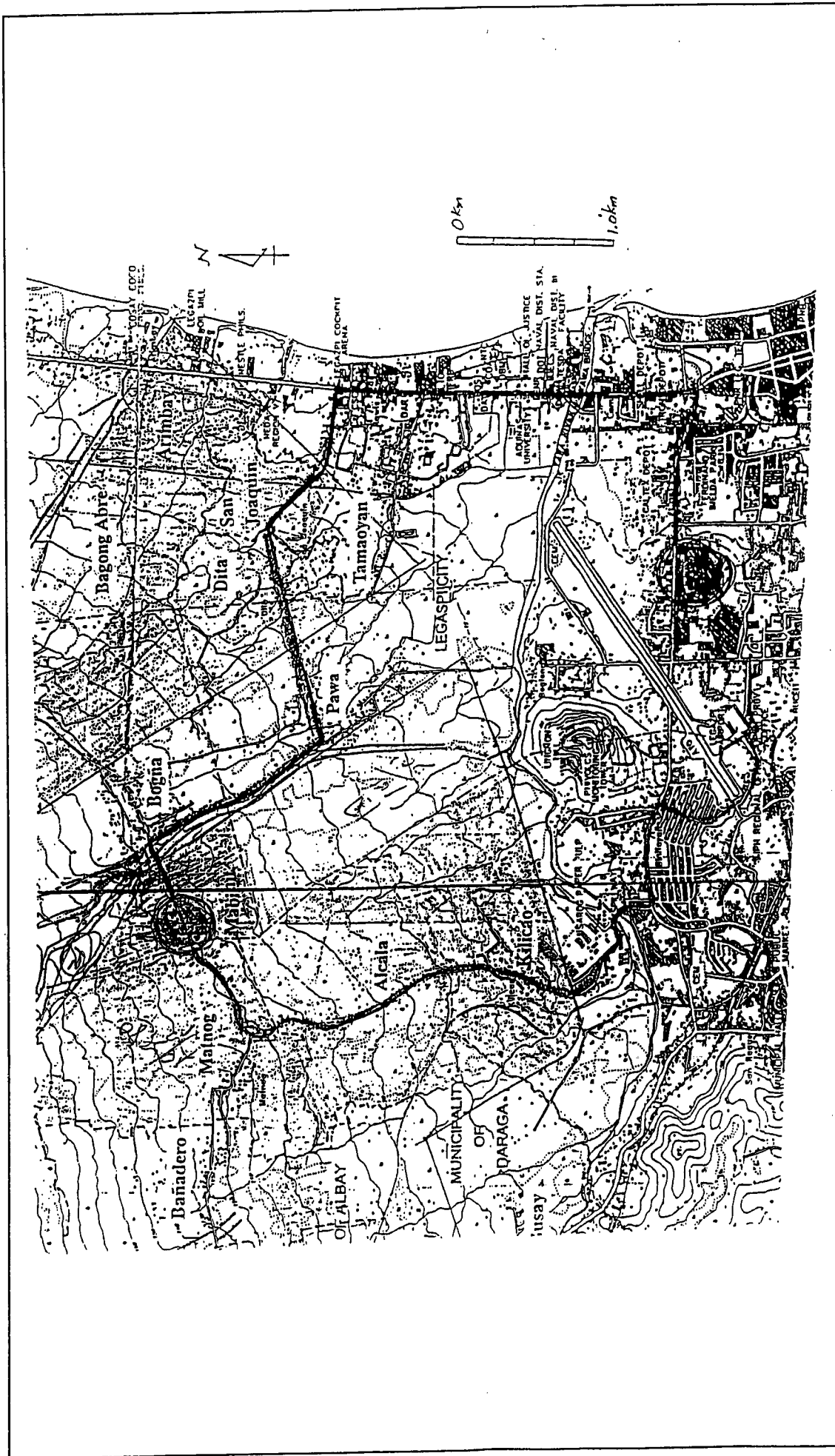

Figure 14.6.1
Location Map of Pilot Project

COMPREHENSIVE DISASTER PREVENTION AROUND MAYON VOLCANO IN
THE REPUBLIC OF THE PHILIPPINES

JAPAN INTERNATIONAL COOPERATION AGENCY