

APPENDICES

SECTION 7. APPENDICES

The following data is appended hereto :

Appendix 1 General Map

Appendix 2 Location of Project Site

Appendix 3a General Project Plan

3b Jatibarang Dam Management Complex

3c Approach Bridge to Goa Kreo Cave

Appendix 4 Summary of Major Work Items

Appendix 5 List of Eligible Source Countries

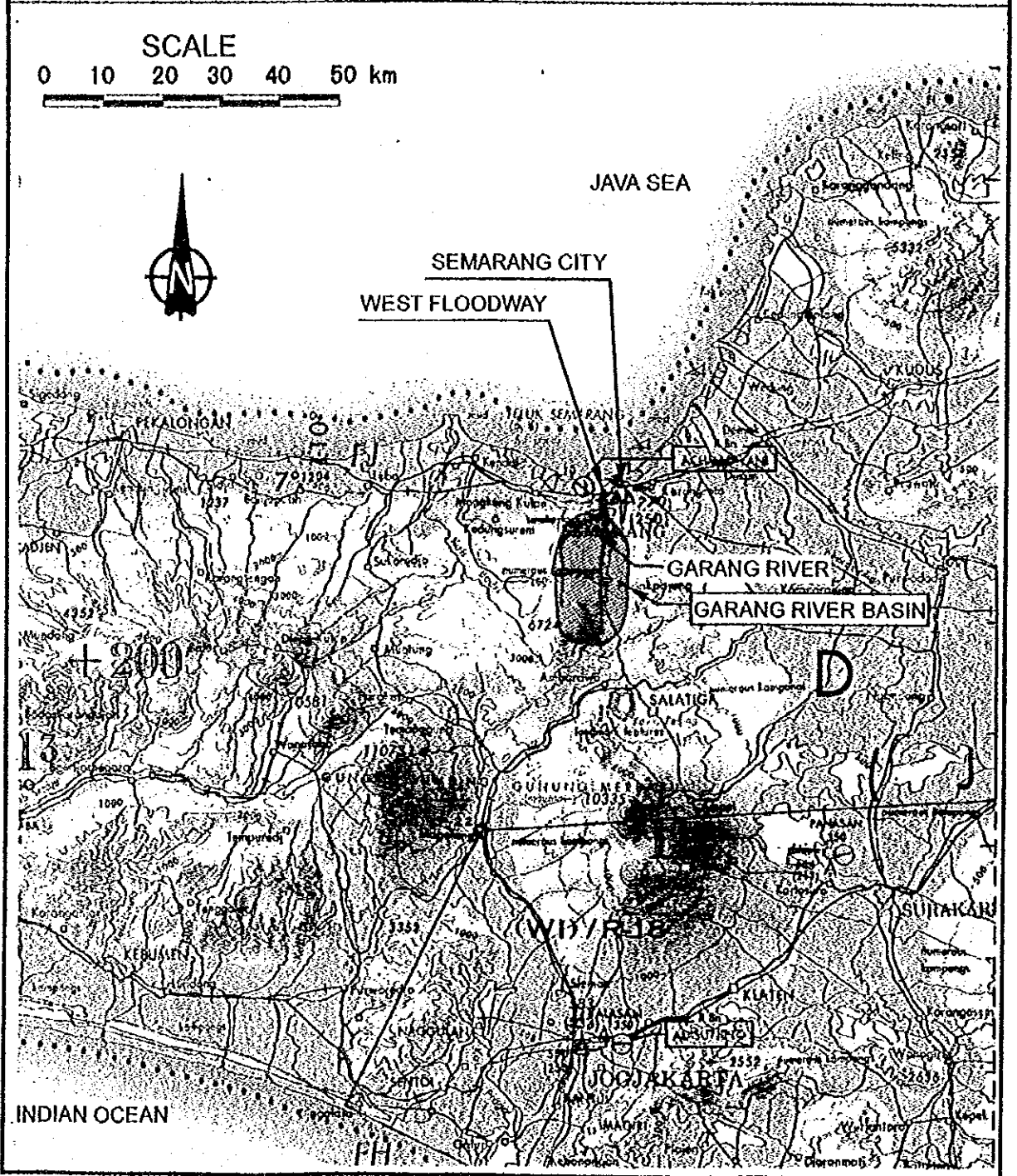
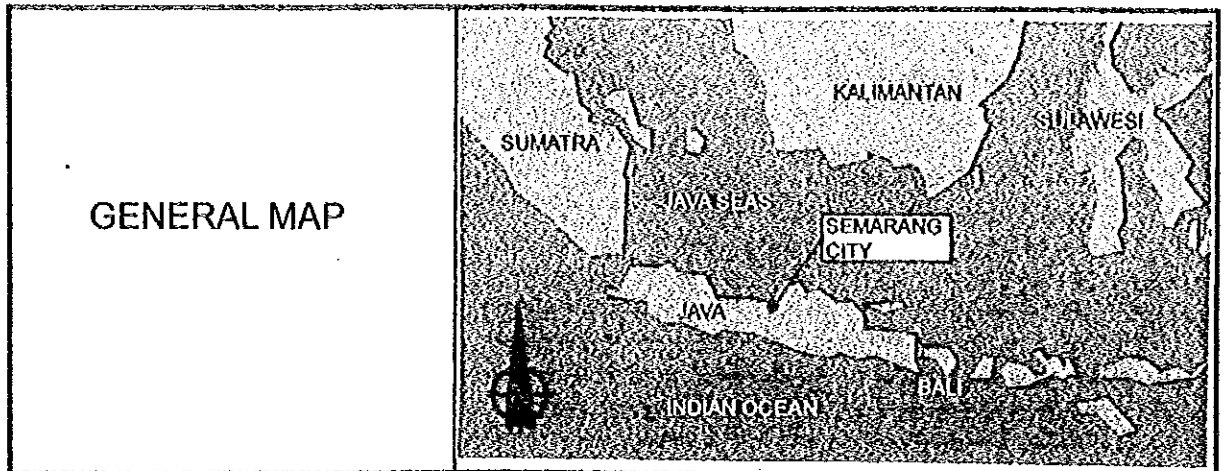

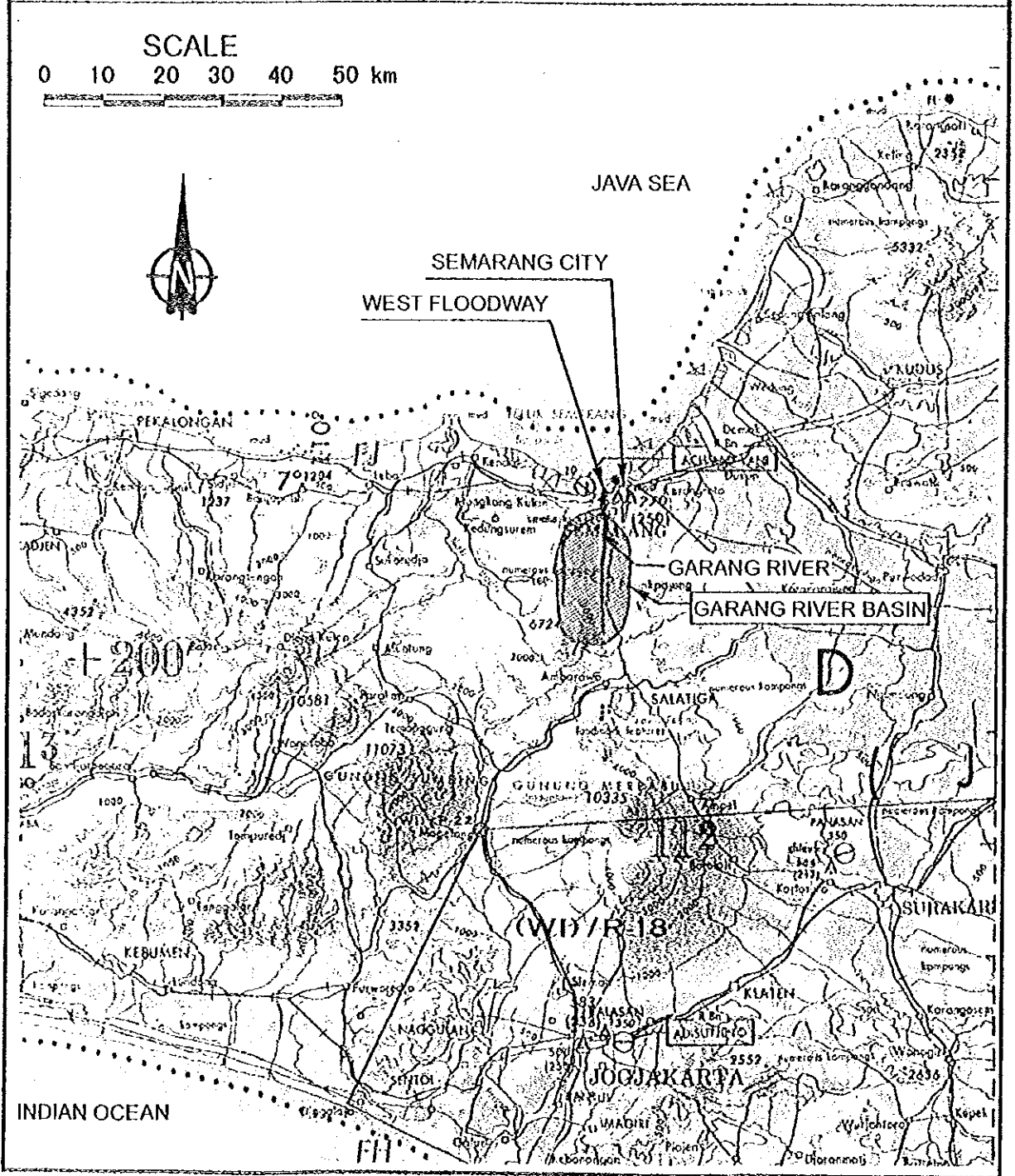
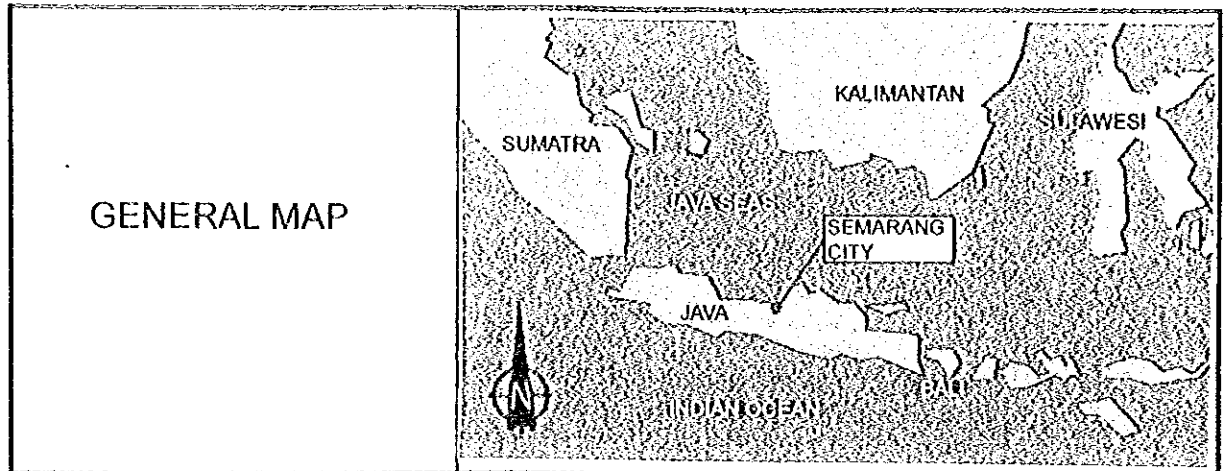

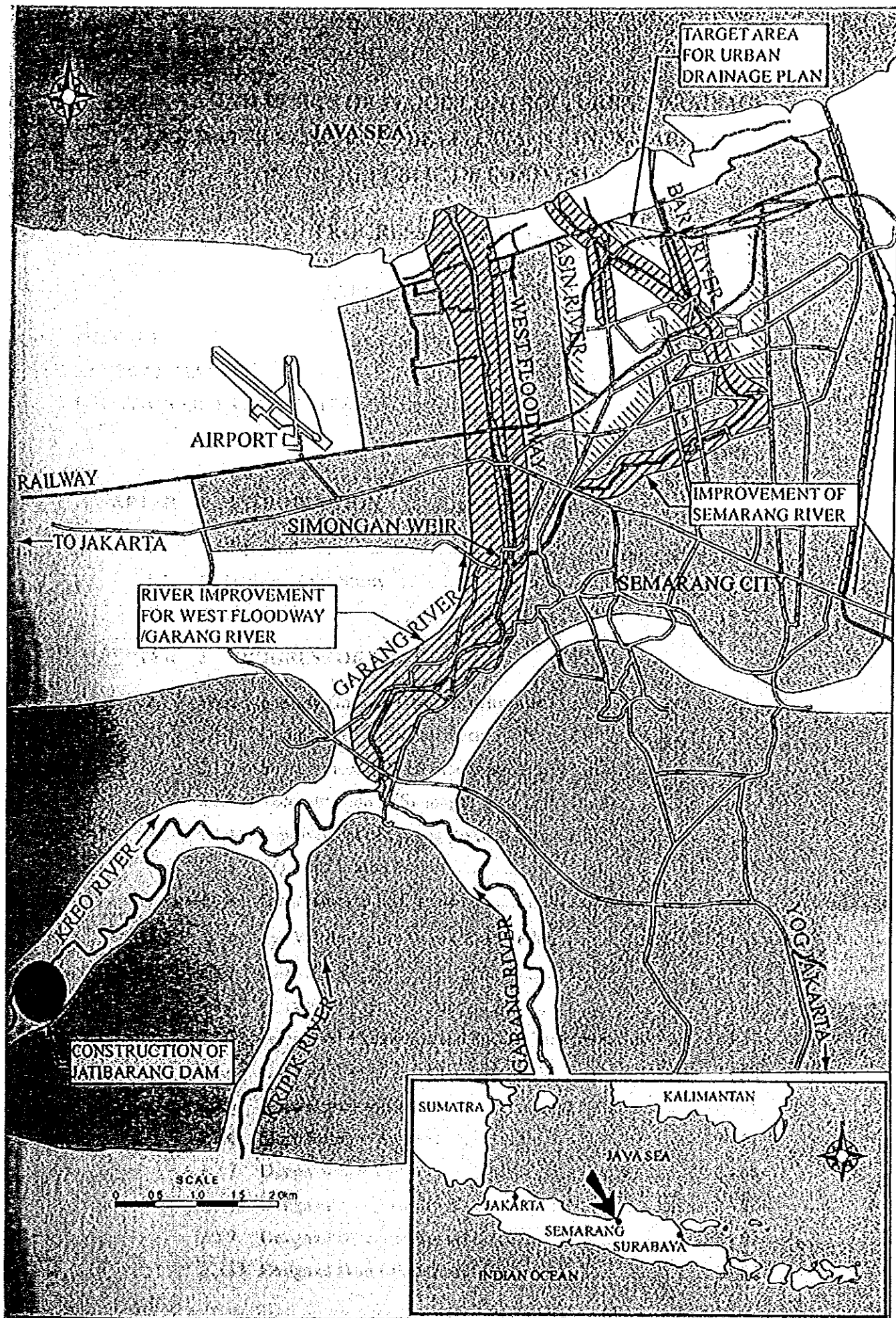

Appendix 2

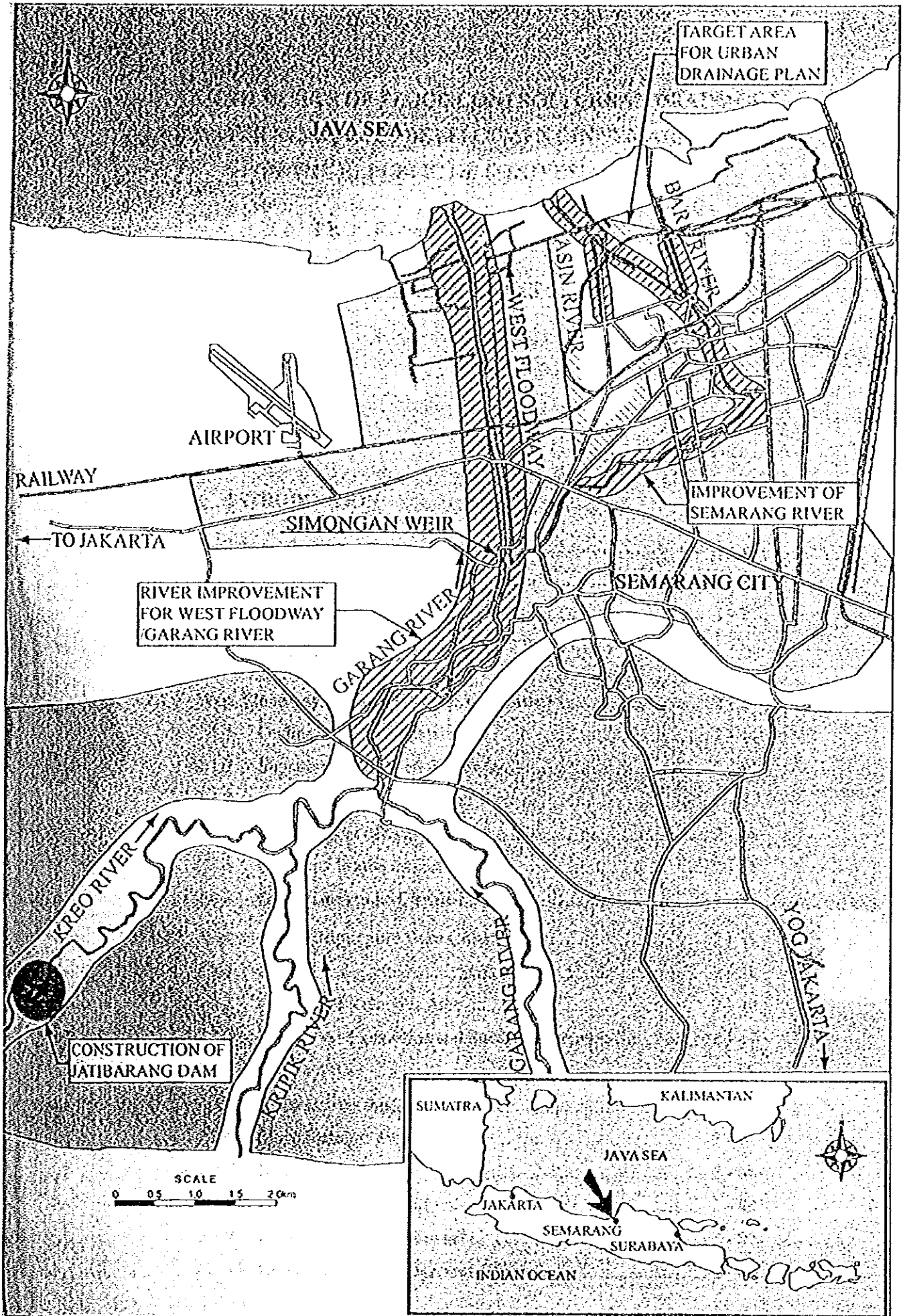

Appendix 2



NOTES

1. THE MAJOR WORKS TO BE CARRIED OUT UNDER THE CONTRACT PACKAGE 1 SHALL CONSIST OF, BUT NOT BE LIMITED TO, THE CONSTRUCTION OF JATIBARANG MULTIPURPOSE DAM INCLUDING THE APPURTENANT STRUCTURES SUCH AS SPILLWAY, OUTLET FACILITIES, DIVERSION FACILITIES, HYDROPOWER STATION, ACCESS ROADS AND RELOCATION OF EXISTING POWER TRANSMISSION LINE.
2. THE MAJOR WORKS TO BE CARRIED OUT UNDER THE CONTRACT PACKAGE 2 SHALL CONSIST OF, BUT NOT BE LIMITED TO, THE CONSTRUCTION OF THE BUILDINGS AND EXTERNAL WORKS IN THE DAM MANAGEMENT COMPLEX, AND THE APPROACH BRIDGE TO GOA KREO CAVE.
3. THE EXCAVATION WORKS OF THE DAM MANAGEMENT COMPLEX AREA SHALL BE CARRIED OUT BY THE PACKAGE 1 CONTRACTOR.

NO.	DATE	REVISIONS	ORIGINATOR	DESIGNER	APPROVED

THE REPUBLIC OF INDONESIA MINISTRY OF PUBLIC WORKS DIRECTORATE GENERAL OF WATER RESOURCES DEVELOPMENT AND DIRECTORATE GENERAL OF HUMAN SETTLEMENT		PROVINCE CENTRAL JAWA
PT. TUNJUNGA FLOOD CONTROL PROJECT COMPONENT : JATIBARANG DAM CONSTRUCTION		PROJECT NAME FLOOD CONTROL, LAND DRAINAGE AND WATER SUPPLY DEVELOPMENT IN BENGALANG IN THE SUB-BASIN OF KREO RIVER
GENERAL DRAWINGS GENERAL PROJECT PLAN		DISTRICT SEMARANG CITY
PT. INDIAPRATI KAWASAN KAWASAN CIVIL ENGINEERING CO., LTD. IN PARTNERSHIP WITH PT. INDIAPRATI KAWASAN KAWASAN CIVIL ENGINEERING CO., LTD.		DRAWING NO. JD-P1-GD-PI-2
DESIGNED CHECKED CITY OF PLANNING AND DESIGN PROJECT MANAGER	APPROVED	SHEET NO. 2
		DATE CONTRACT NO.

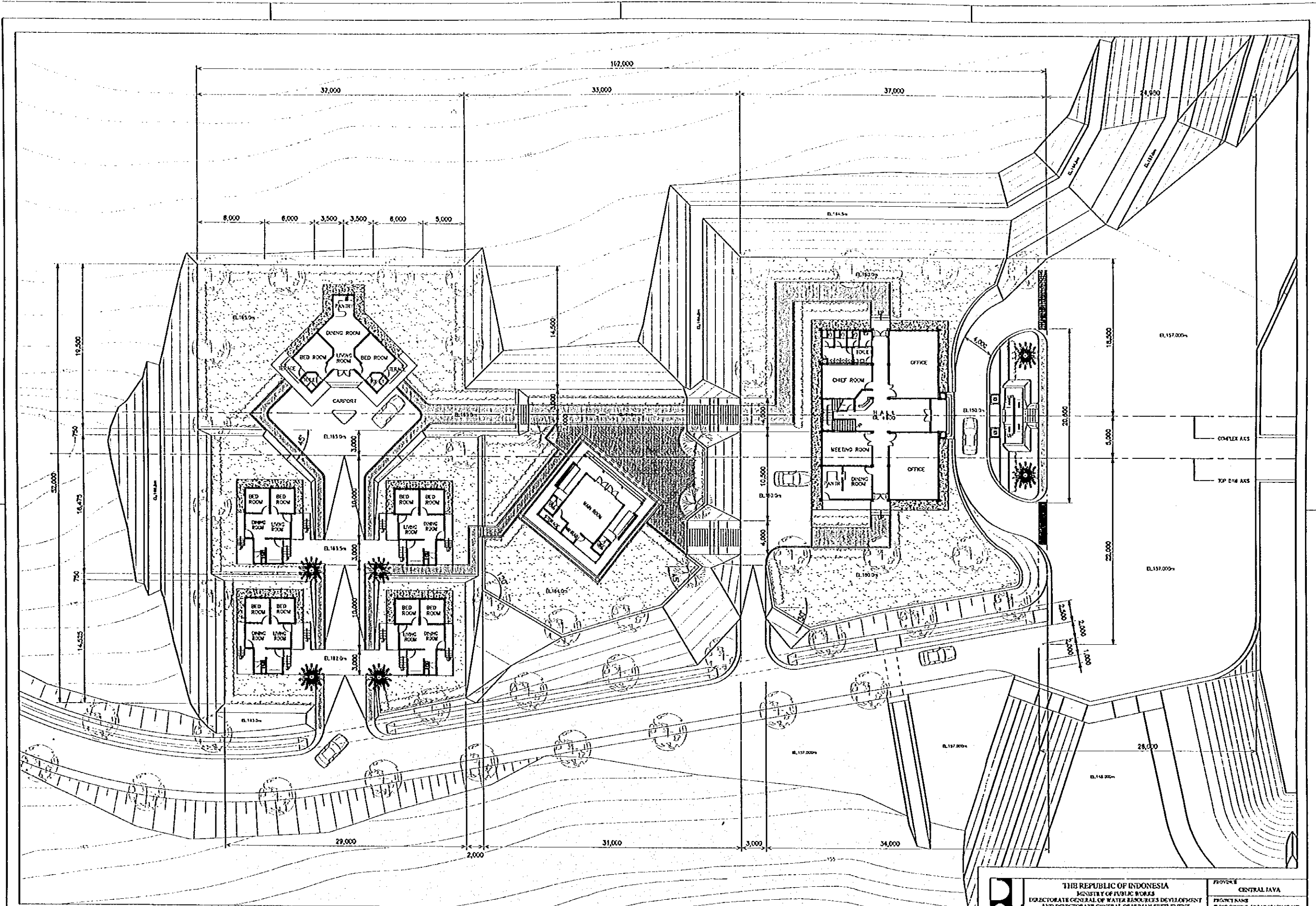

SITE PLAN
SCALE A

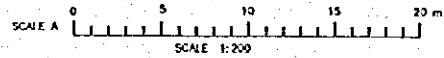

NO.	DATE	REVISIONS	EXECUTED	DESIGNED	APPROVED

THE REPUBLIC OF INDONESIA MINISTER OF PUBLIC WORKS DIRECTORATE GENERAL OF WATER RESOURCES DEVELOPMENT AND DIRECTORATE GENERAL OF HUMAN SETTLEMENT		PROVINCE CENTRAL JAWA	
MATUNSELUNA FLOOD CONTROL PROJECT COMPONENT : JATIBARANG DAM CONSTRUCTION JATIBARANG DAM MANAGEMENT COMPLEX SITE PLAN GENERAL		PROJECT NAME FLOOD CONTROL, URBAN DRAINAGE AND WATER SUPPLY DEVELOPMENT PROJECT IN BOJONEgara DISTRICT, REPUBLIC OF INDONESIA	
DISTRICT SEMARANG CITY		DRAWING NO. JD-PZ-MC-G6-5	
SHEET NO. 11		DATE _____	
PROJECT NUMBER _____		CONTRACT NO. _____	

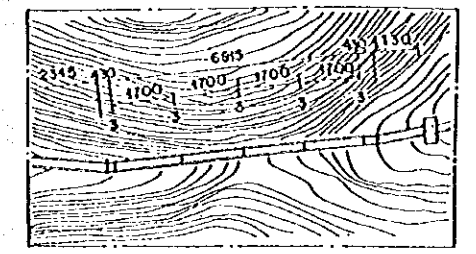

KEY MAP

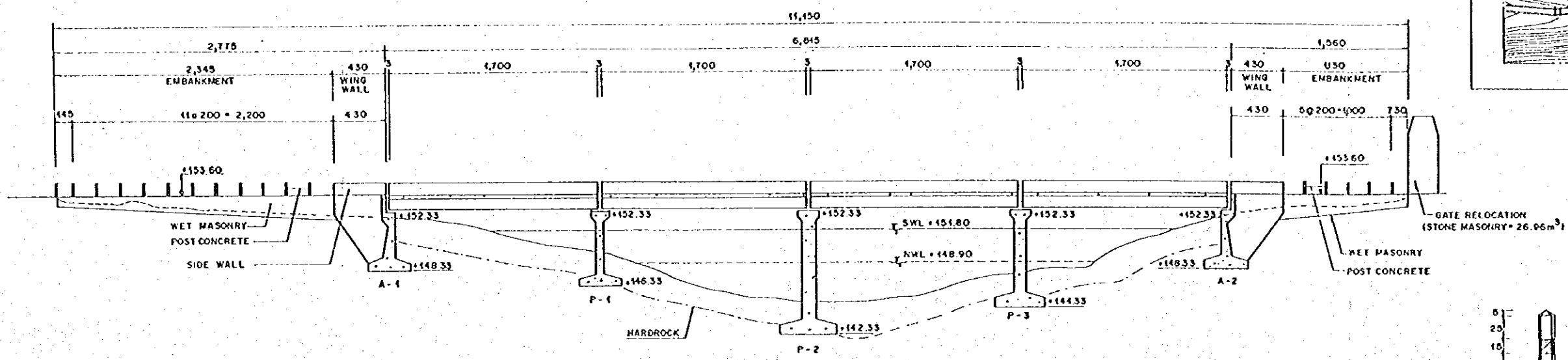

SECTION A - A
SCALE B

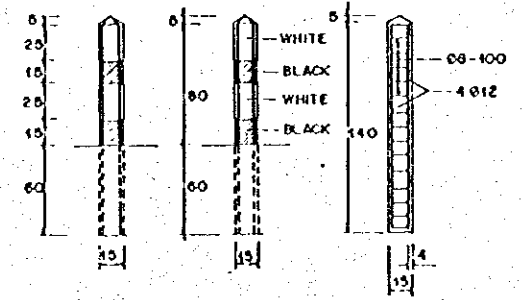

DETAIL OF POST CONCRETE
SCALE A

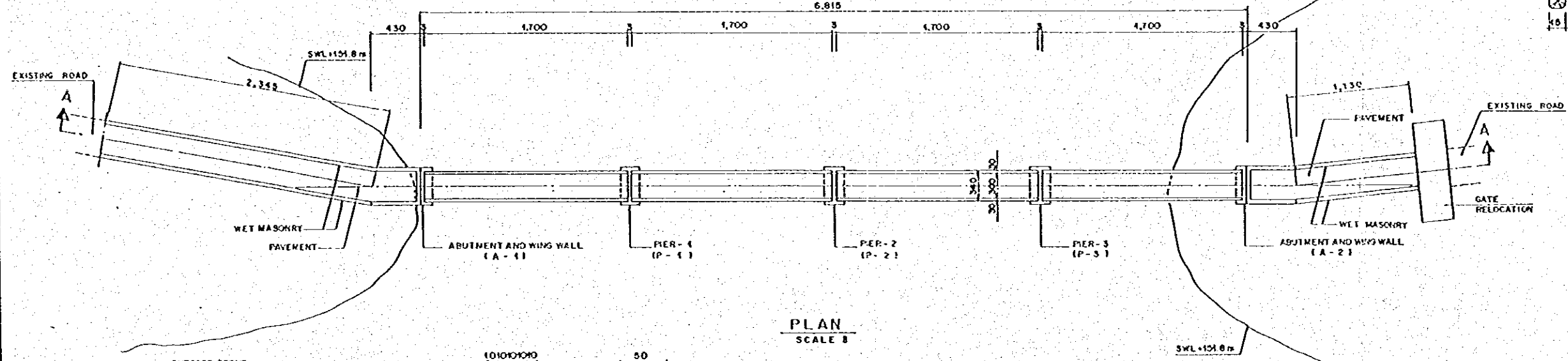

PLAN
SCALE B

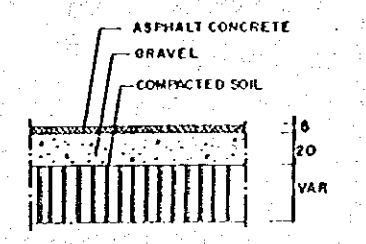

DETAIL OF PAVEMENT
SCALE A

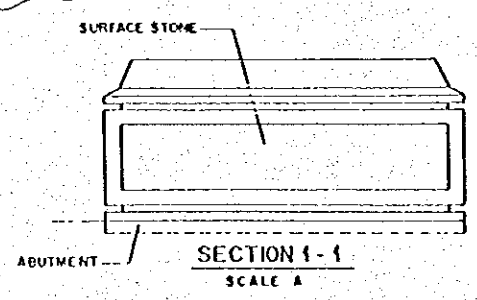

SECTION 1-1
SCALE A

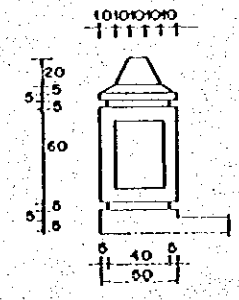

SECTION 2-2
SCALE A

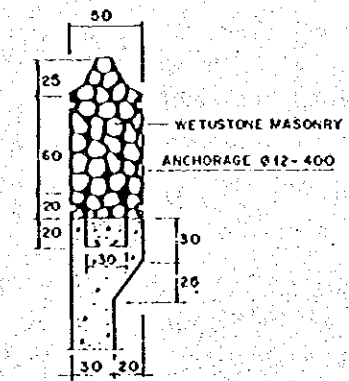

SECTION 3-3
SCALE A

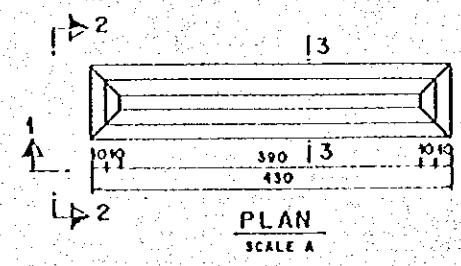

PLAN
SCALE A

DETAIL OF SIDE WALL

- NOTE
- 1 UNIT IN CENTIMETER
 - 2 CONCRETE QUALITY K 225
 - 3 STEEL QUALITY U 24
 - 4 CONCRETE COVER MINIMUM 40mm
 - 5 MAXIMUM AGREGATE 40mm

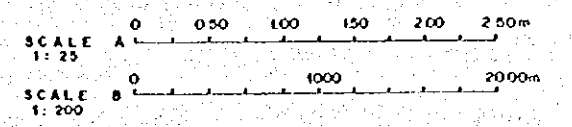

THE REPUBLIC OF INDONESIA MINISTRY OF PUBLIC WORKS DIRECTORATE GENERAL OF WATER RESOURCES DEVELOPMENT AND DIRECTORATE GENERAL OF HUMAN SETTLEMENT		PROVINCE CENTRAL JAVA PROJECT NAME FLOOD CONTROL, UPRIVER BANK AND RELOCATION OF THE BRIDGE OVER THE BRANGANG IN THE REPUBLIC OF INDONESIA
BRATUNGSILANA FLOOD CONTROL PROJECT COMPONENT: JATIBARANG DAM CONSTRUCTION APPROACH BRIDGE TO GOA KREO CAVE PLAN AND LONGITUDINAL SECTION OF BRIDGE DETAIL OF SIDE WALL AND POST CONCRETE (11/11)		DISTRICT BRABANG CITY DRAWING NO. 40-P2-AB-P1-1 SHEET NO. 62
DESIGNED BY DIPONEGARAJAYA DIPONEGARAJAYA	CHECKED BY S. S. S.	DATE CONTRACT NO.
APPROVED BY CHIEF OF PLANNING AND DESIGN PROJECT MANAGER		

NO	DATE	REVISIONS	OPERATION	ENGINEER	APPROVED

APPENDIX 4

Package 2: Operation and Maintenance Buildings and Goa Kreo Bridge

SUMMARY OF MAJOR WORK ITEMS

The following is a summary of the major work items to be completed in this package :

Construction of a reinforced concrete pedestrian bridge consisting :

- 4 No spans of 17.00 m simply supported reinforced concrete beams x 2 m wide
- 2 No reinforce concrete abutments
- 3 No reinforced concrete abutments
- 35 m of asphalt concrete surfaced approach road

Construction of the Jatibarang Dam Management Complex comprising:

- 1 No. Dam Management Office of 611 m²
- 4 No Staff Houses of 58 m² each
- 1 No Guest House of 70 m²
- 1 No. Mushola of 90 m²
- External Works

APPENDIX 5

LIST OF ELIGIBLE SOURCE COUNTRIES (Subject to Change)

1. General Untying

Under general untying scheme, the eligible source countries are all countries and areas

CONFIDENTIAL - SECURITY INFORMATION



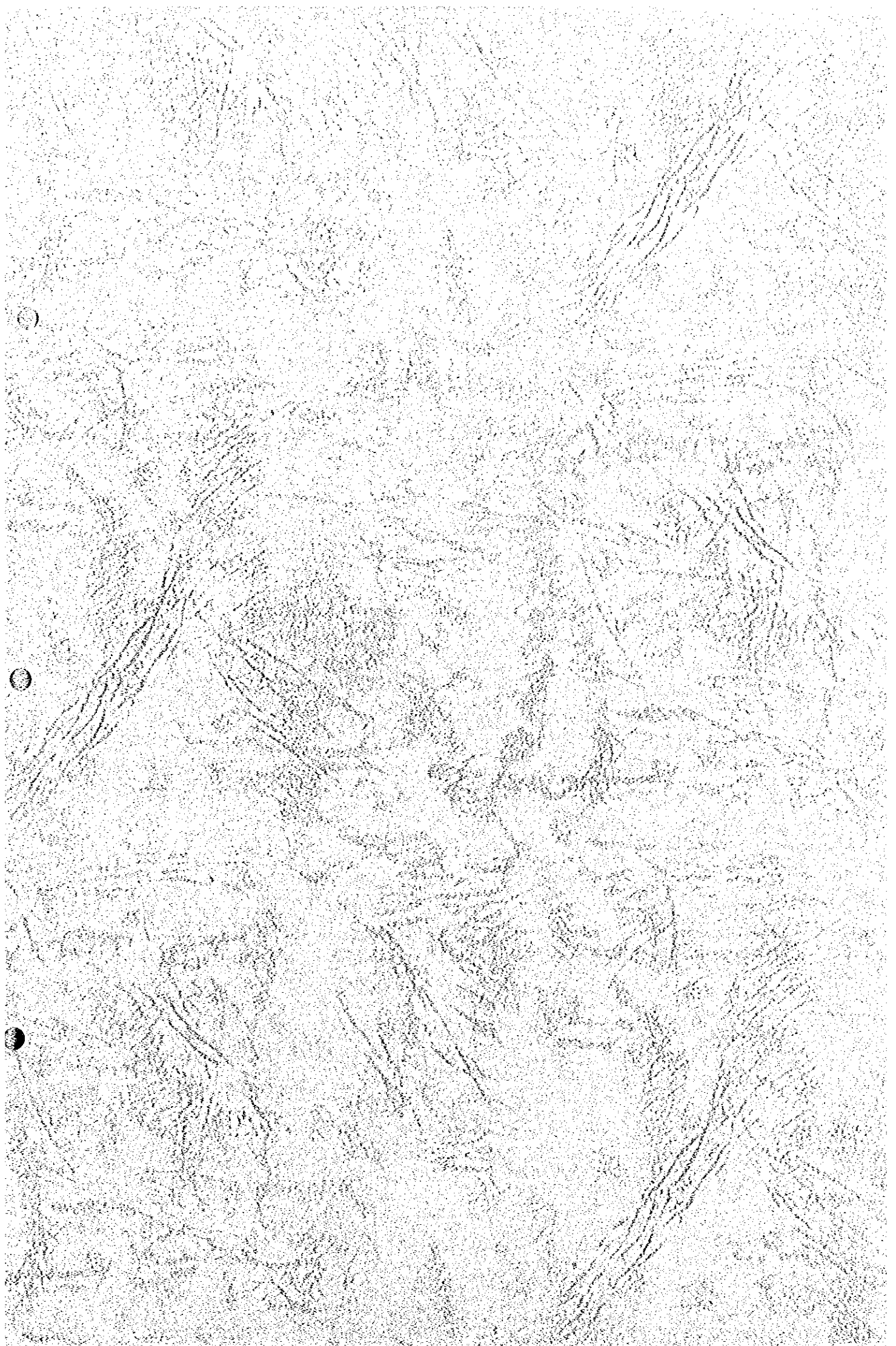

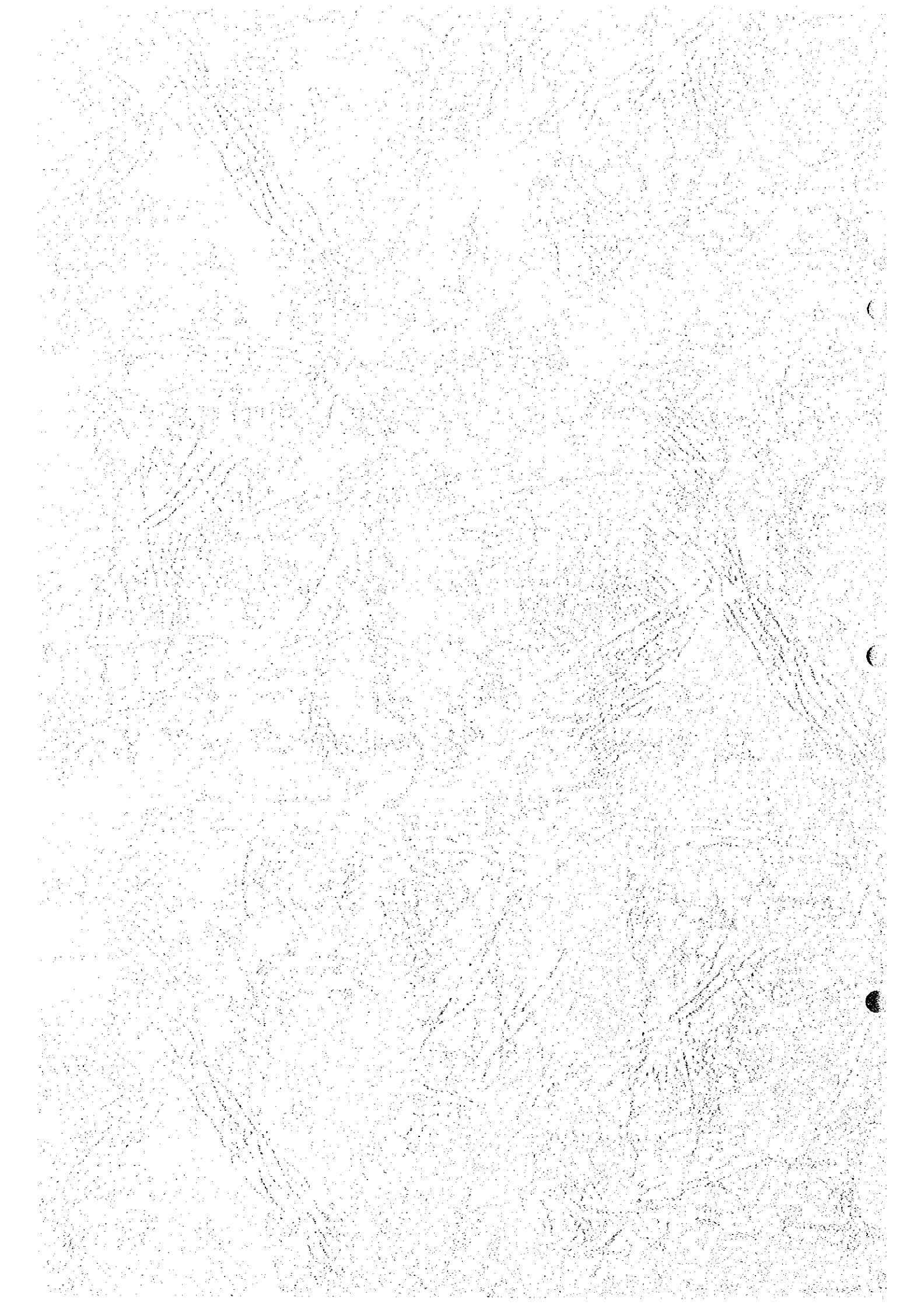

JICA