

THE STUDY ON
 INTEGRATED URBAN DRAINAGE IMPROVEMENT
 FOR MELAKA AND SUNGAI PETANI IN MALAYSIA
 JAPAN INTERNATIONAL COOPERATION AGENCY

Fig. 4-9 (1/6)
 Alignment and Typical Cross-section of
 Proposed Channel Improvement (Sg. Air
 Mendidih Basin)

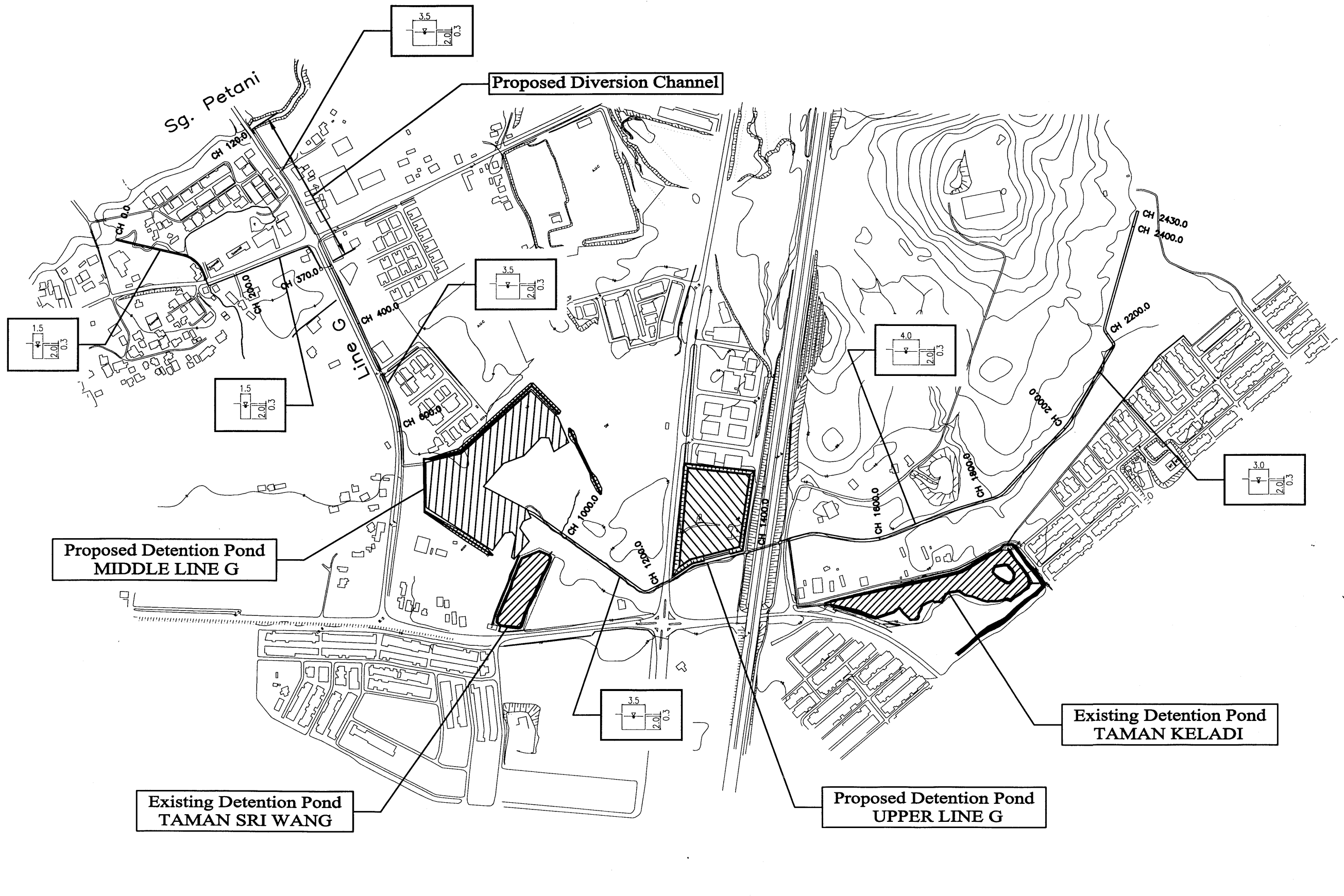

Proposed Detention Pond
MIDDLE LINE G

Existing Detention Pond
TAMAN SRI WANG

Proposed Diversion Channel

Existing Detention Pond
TAMAN KELADI

Proposed Detention Pond
UPPER LINE G



THE STUDY ON
INTEGRATED URBAN DRAINAGE IMPROVEMENT
FOR MELAKA AND SUNGAI PETANI IN MALAYSIA
JAPAN INTERNATIONAL COOPERATION AGENCY

Fig. 4-9 (2/6)
Alignment and Typical Cross-section of
Proposed Channel Improvement (Line-G
basin)

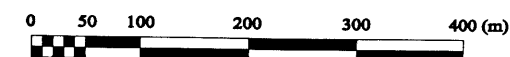
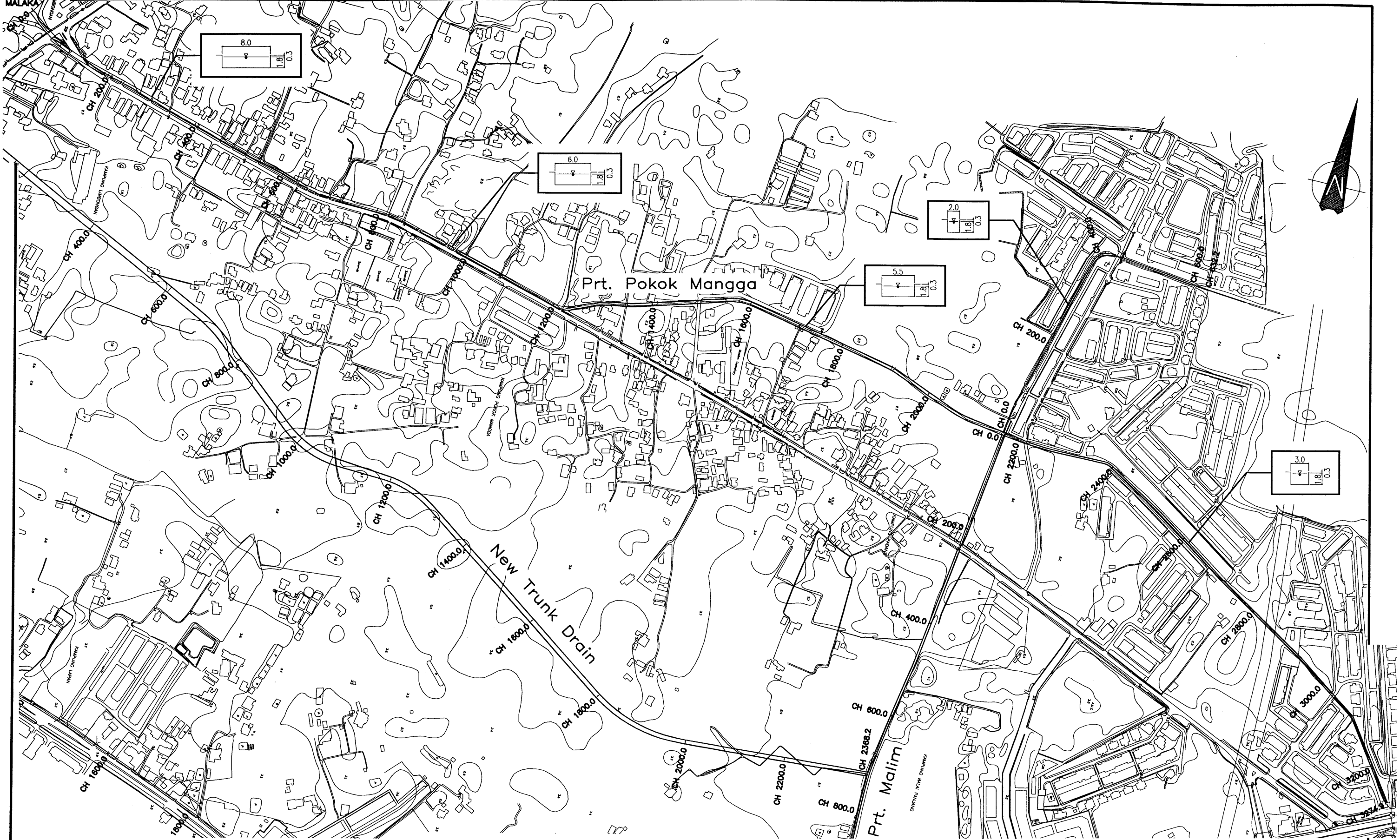

<p align="center">THE STUDY ON INTEGRATED URBAN DRAINAGE IMPROVEMENT FOR MELAKA AND SUNGAI PETANI IN MALAYSIA JAPAN INTERNATIONAL COOPERATION AGENCY</p>	<p>Fig. 4-9 (3/6) Alignment and Typical Cross-section of Proposed Channel Improvement (Upper Reaches of Prt. Pokok Mangga Basin)</p>
---	--