

11. Chemistry Laboratory

CODE	EQUIPMENT	QUANTITY			REQUEST		EVALUATION CRITERIA			FINAL JUDGE	NOTES
		Requested	Criteria	Planned	Grade	Priority	Necessity	Installation	O & M		
CH- 1-1	Analytical balance(300g/0.01g)	5	8G	8		A	<input type="radio"/>	<input type="radio"/>	<input type="radio"/>	<input type="radio"/>	
CH- 2	Analytical balance(3000r/0.01g)	5	4G	4		B	<input type="radio"/>	<input type="radio"/>	<input type="radio"/>	<input type="radio"/>	
CH- 3	Hot plates	3	8G	8		A	<input type="radio"/>	<input type="radio"/>	<input type="radio"/>	<input type="radio"/>	
CH- 4	Hot air oven	5	C	1		A	<input type="radio"/>	<input type="radio"/>	<input type="radio"/>	<input type="radio"/>	
CH- 5	pH meter	5	4G	4		A	<input type="radio"/>	<input type="radio"/>	<input type="radio"/>	<input type="radio"/>	
CH- 6	Air conditioner	1	N	0		A	<input checked="" type="radio"/>	<input type="radio"/>	<input type="radio"/>	<input checked="" type="radio"/>	
CH- 7	Water bath/temperature control system		G	2			<input type="radio"/>	<input type="radio"/>	<input type="radio"/>	<input type="radio"/>	
CH- 8	Magnetic stirrer		8G	8			<input type="radio"/>	<input type="radio"/>	<input type="radio"/>	<input type="radio"/>	
CH- 9	Mixer for test tube		8G	8			<input type="radio"/>	<input type="radio"/>	<input type="radio"/>	<input type="radio"/>	
CH- 10	Water purification apparatus		C	1			<input type="radio"/>	<input type="radio"/>	<input type="radio"/>	<input type="radio"/>	
CH- 11	Alcohol lamp		8G	4			<input type="radio"/>	<input type="radio"/>	<input type="radio"/>	<input type="radio"/>	
CH- 12	Steel stand		8G	8			<input type="radio"/>	<input type="radio"/>	<input type="radio"/>	<input type="radio"/>	
CH- 13	Test tube stand		8G	8			<input type="radio"/>	<input type="radio"/>	<input type="radio"/>	<input type="radio"/>	
CH- 14	Molecular model set		1G	1 set			<input type="radio"/>	<input type="radio"/>	<input type="radio"/>	<input type="radio"/>	
CH- 15	Chemical reagent		8G	1 set			<input type="radio"/>	<input type="radio"/>	<input type="radio"/>	<input type="radio"/>	
CH- 16	Glasswares		8G	1 set			<input type="radio"/>	<input type="radio"/>	<input type="radio"/>	<input type="radio"/>	
CH- 16	Furniture for Chemical Laboratory			1 set							

12. Physics Laboratory

CODE	EQUIPMENT	QUANTITY			REQUEST		EVALUATION CRITERIA			FINAL JUDGE	NOTES
		Requested	Criteria	Planned	Grade	Priority	Necessity	Installation	O & M		
PL- 1	Spherometer	10	2G	2							
PL- 2	Physical balance	5	4G	4							
PL- 3	Electronic balance	5	4G	4							
PL- 4	X-Y travelling microscope	5	1G	1							
PL- 5	Young's modulus apparatus	5	1G	1							
PL- 6	Viscosity apparatus	5	1G	1							
PL- 7	Model for demonstration of conservation of angular	4	1G	1							
PL- 8	Centripetal force apparatus	4	4G	4							
PL- 9	Pendulum bob set	4	4G	4							
PL- 10	Fortin's barometer, Wall Model	5	1G	1							
PL- 11	Aneroid barometer (portable)	5	4G	4							
PL- 12	Tuning fork	5	4G	4							
PL- 13	Sound level meter	3	2G	2							
PL- 14	Resonance air column apparatus	4	2G	2							
PL- 15	Steam boiler	2	1G	1							
PL- 16	Bimetallic thermometer	2	2G	2							
PL- 17	Thermal conductivity apparatus (Ingenhousz's)	2	2G	2							
PL- 18	Conductivity meter	2	2G	2							
PL- 19	Joule's calorimeter	2	2G	2							
PL- 20	Wet and dry bulb hygrometer	2	2G	2							
PL- 21	Spherical lenses	5	4G	4							
PL- 22	Prisms	2	4G	1							
PL- 23	Optical bench	5	2G	2							
PL- 24	Lux meter	5	N	0							
PL- 25	Refracting telescope	10	4G	4							
PL- 26	DC ammeter	10	4G	4							
PL- 27	DC milli ammeter	10	4G	4							
PL- 28	DC micro ammeter	10	4G	4							
PL- 29	DC voltmeter	10	4G	4							
PL- 30	Digital multimeter	10	4G	4							
PL- 31	Galvanometer	10	1G	1							
PL- 32	Demonstration type DC voltmeter	10	1G	1							
PL- 33	Demonstration type DC voltmeter	10	1G	1							
PL- 34	Demonstration DC galvanometer	10	4G	4							
PL- 35	AC/DC ammeter	5	N	0							
PL- 36	Multimeter	5	4G	4							
PL- 37	Resistance box	5	N	0							
PL- 38	Resistance Box	5	N	0							
PL- 39	Analog multimeter	5	2G	2							
PL- 40	Induction coil, spark length 50 mm	5	1G	1							
PL- 41	Electrostatic kit	5	4G	4							
PL- 42	Regulated power supply	5	4G	4							
PL- 43	Power supply	5	N	0							
PL- 44	Rheostat A	4	4G	4							
PL- 45	Rheostat B	4	4G	4							
PL- 46	Meter bridge	10	4G	4							
PL- 47	Potentiometer	5	4G	4							
PL- 48	Leclanché cell	5	1G	1							

12. Physics Laboratory

CODE	EQUIPMENT	QUANTITY		REQUEST		EVALUATION CRITERIA			FINAL JUDGE	NOTES
		Requested	Criteria	Planned	Grade	Priority	Necessity	Installation		
PL- 49	Daniel cell	5	1G	1						
PL- 50	Variac	5	4G	4						
PL- 51	Bourdon's gauge	4	1G	1						
—	Drilling machine, electric	2	N	0			X			X
PL- 52	Tool for physics laboratory	—	C	1 set						
—	Work benches, wood	15	N	0			X			X
—	Stools, wood	30	—	—			—			—
—	Steel Almirahs for storage	5	—	—			—			—
PL- 53	Air conditioner	1	N	0			X			X
PL- 54	Furniture for Physics Laboratory			1 set						

13. Maintenance Workshop

CODE	EQUIPMENT	QUANTITY		REQUEST			EVALUATION CRITERIA			FINAL JUDGE	NOTES
		Requested	Criteria	Planned	Grade	Priority	Necessity	Installation	O & M		
MW- 1	Milling machine	—	C	1	—	—	—	—	—	—	—
MW- 2	Turning centers	—	C	1	—	—	—	—	—	—	—
MW- 3	Air Compressor	—	C	1	—	—	—	—	—	—	—
MW- 4	Drilling machine	—	C	1	—	—	—	—	—	—	—
MW- 5	Bench grinder	—	C	1	—	—	—	—	—	—	—
MW- 6	Square	—	C	2	—	—	—	—	—	—	—
MW- 7	D.C. Arc welder	—	C	1	—	—	—	—	—	—	—
MW- 8	Gas welder	—	C	1	—	—	—	—	—	—	—
MW- 9	Chain block	—	C	1	—	—	—	—	—	—	—
MW- 10	Electric drill	—	C	1	—	—	—	—	—	—	—
MW- 11	Disc sander	—	C	1	—	—	—	—	—	—	—
MW- 12	Painting equipment	—	C	1	—	—	—	—	—	—	—
MW- 13	Bellow	—	C	1	—	—	—	—	—	—	—
MW- 14	Bicycles	—	4G	4	—	—	—	—	—	—	—
MW- 15	Tool for bicycle	—	4G	4	—	—	—	—	—	—	—
MW- 16	Tool for maintenance	—	C	1 set	—	—	—	—	—	—	—
MW- 17	Drafting equipment	—	1G	1 set	—	—	—	—	—	—	—
MW- 18	Safety equipment	—	C	4	—	—	—	—	—	—	—
MW- 19	Sharpener	—	C	1	—	—	—	—	—	—	—
MW- 20	Furniture for Maintenance Workshop	—	C	1 set	—	—	—	—	—	—	—

14. Commercial

CODE	EQUIPMENT	QUANTITY		REQUEST		EVALUATION CRITERIA		FINAL JUDGE	NOTES
		Requested	Criteria	Planned	Grade	Priority	Necessity		
CM- 1	Furniture for Commercial			1 set					

15. General Classroom

CODE	EQUIPMENT	QUANTITY		REQUEST		EVALUATION CRITERIA		FINAL JUDGE	NOTES
		Requested	Criteria	Planned	Grade	Priority	Necessity		
GC- 1	Furniture for General Classroom			1 set					

16. Audio Visual Equipment

CODE	EQUIPMENT	QUANTITY		REQUEST		EVALUATION CRITERIA		FINAL JUDGE	NOTES
		Requested	Criteria	Planned	Grade	Priority	Necessity		
AV- 1	Portable Overhead Projector	3	C	4	All	A	O	O	
AV- 2	Slide Projector	3	C	2	All	A	O	O	
AV- 3	Light Pointer	6	C	4	All	A	O	O	
AV- 4	Projection screen	6	C	4	All	A	O	O	
AV- 5	Stationary video cassette recorder	3	C	2	All	A	O	O	
AV- 6	Stationary color TV	3	C	2	All	A	O	O	
AV- 7	Digital video disc player	3	N	0	All	A	X	O	X
AV- 8	Compact digital audio disc player	3	N	0	All	A	X	O	X
AV- 9	Air conditioner	1	N	0	All	A	X	O	X

17. Vehicles

CODE	EQUIPMENT	QUANTITY		REQUEST		EVALUATION CRITERIA		FINAL JUDGE	NOTES
		Requested	Criteria	Planned	Grade	Priority	Necessity		
VE- 1	4WD Pickup car	1	C	0		A	X	O	X
VE- 2	Semi-high roof 4WD wagon	2	N	0		A	X	O	X
VE- 3	Mini bus	1	C	1		A	O	O	
VE- 4	Truck (2 ton)		C	1			O	O	
VE- 4	Water tank (2 ton)		C	1			O	O	
VE- 4	Pump		C	1			O	O	

18. Short Course (Food Processing)

CODE	EQUIPMENT	QUANTITY		REQUEST			EVALUATION CRITERIA			FINAL JUDGE	NOTES
		Requested	Criteria	Planned	Grade	Priority	Necessity	Installation	O & M		
SC- 1	Refrigerator	---	C	1	---	---	---	---	---	---	---
SC- 2	Freezer	---	C	1	---	---	---	---	---	---	---
SC- 3	Process Pressure Retort	---	2C	2	---	---	---	---	---	---	---
SC- 4	Gas Oven and Table	---	2G	2	---	---	---	---	---	---	---
SC- 5	Meat Mincer	---	1G	1	---	---	---	---	---	---	---
SC- 6	Stuffer	---	1G	1	---	---	---	---	---	---	---
SC- 7	Meat Tenderizer	---	2C	2	---	---	---	---	---	---	---
SC- 8	Blender	---	1G	1	---	---	---	---	---	---	---
SC- 9	Miller	---	1G	1	---	---	---	---	---	---	---
SC- 10	Slicer	---	1G	1	---	---	---	---	---	---	---
SC- 11	Smoke-Drying Machine	---	1G	1	---	---	---	---	---	---	---
SC- 12	Cabinet Solar Dryer Movable Type	---	1G	1	---	---	---	---	---	---	---
SC- 13	Balance (1) -50kg	---	2G	2	---	---	---	---	---	---	---
SC- 14	Balance (2) -1kg	---	4G	4	---	---	---	---	---	---	---
SC- 15	Kitchen Timer	---	4G	4	---	---	---	---	---	---	---
SC- 16	-1 Thermometer (1) -20°C-100°C	---	4G	4	---	---	---	---	---	---	---
SC- 16	-2 Thermometer (2) -0°C-360°C	---	2G	2	---	---	---	---	---	---	---
SC- 17	Meat Thermometer-0°C-360°C	---	C	4	---	---	---	---	---	---	---
SC- 18	Service Wagon with cooler	---	1G	1	---	---	---	---	---	---	---
SC- 19	Salinometer	---	C	1	---	---	---	---	---	---	---
SC- 20	Kitchen Utensils	---	C	1	---	---	---	---	---	---	---
SC- 21	Furniture for Short Courses	---		1 set	---	---	---	---	---	---	---

## TOOL LIST

1.	(CJT)	Tool for Carpentry and Joinery
2.	(MRT)	Tool for Masonry
3.	-	Secretary and Computer
4-1.	(TRT)	Tool for Tailoring(Sawing machine)
4-2.	(TRST)	Tool for Tailoring
5.	(PPT)	Tool for Plumbing and Pipe Fitting
6.	(AMT)	Tool for Auto Mechanics
7.	(AET)	Tool for Auto Electrician
8.	(WFT)	Tool for Welding and Fabrication
9.	(ELT)	Tool for Electrical Installation
10.	(WCT)	Tool for Wood Carving
11-1.	(CHG)	Glassware for Chemnical Laboratory
11-2.	(CHT)	Tool for Chemical Laboratory
12.	(PLT)	Tool for Physics Laboratory
13.	(MWT)	Tool for Maintenance Workshop
14.	-	Commercial
15.	-	General Classroom
16.	-	Audio Visual Equipment
17.	-	Vehicles
18.	(SC)	Tool for Short Course (Food Processing)

1.Tool for Carpentry and Joinery

CODE	TOOL	Q'ty		Specification
		Requested	Planned	
CJ- T-1	Adjustable wrench	16	16	24x200L 1 each
CJ- T-2	Angle Gauge set	10	8	18pcs set
CJ- T-3	Auger bit set	5	-	Included to electric drill
CJ- T-4	Ball peen hammer 350,450g	5	8	12oz.x13"L, 16oz.x14"L, 1 each
CJ- T-5	Bench - Stop	2	4	150mm,
CJ- T-6	Bevel, sliding "T"	16	0	Included to electric drill
CJ- T-7	Blade	16	-	Included to CJT40
CJ- T-8	Bradawls	16	16	300mmL
CJ- T-9	Brush	16	16	250mmL
CJ- T-10	Carpenter's barce	16	16	Circuit dia 250mm, with bit set
CJ- T-11	Center punch	16	0	
CJ- T-12	Chisel set for CJ	16	16	10 kinds set
CJ- T-13	Clamp Bar set	16	16	600x120mm, 800x120mm 1 each
CJ- T-14	Clamp Multipurpose, Picture	2	2	100x100mm
CJ- T-15	Clamp, T-Bar, (corner clamp)	5	4	90x60Tmm
CJ- T-16	Claw Hammer	16	16	12oz.x13"L
CJ- T-17	Combination plier	16	16	150mm, 200mm, 1 each
CJ- T-18	Double offset box wrench	16	16	45degree, 6pcs set with case
CJ- T-19	Expansive bit	5	4	13 kinds set
CJ- T-20	Engineer's file with file handle set	16	16	5kinds set, 250mm, wood handle
CJ- T-21	Gauge bevel, sliding	5	4	6"blade with lenz
CJ- T-22	Gauge marking	16	16	120mm
CJ- T-23	H.D.Diagonal plier, 160 mm	16	16	180mmL
CJ- T-24	Helmet	16	0	
CJ- T-25	Hex. Socket 1/2" 20 set and accessory	16	0	
CJ- T-26	Vice, Woodworking	2	16	150mm jaw width, jaw opening 145mm, jaw depth75mm
CJ- T-27	Magnetic plug wrench, 20.6 mm	16	0	
CJ- T-28	Mallet, Carpenter's	16	16	45 φx120 head, 300mmL
CJ- T-29	Measuring Tape	2	2	12mm width, 30m length
CJ- T-30	Oiler	3	2	Polyethylene, 250cc
CJ- T-31	Oilstone & box	16	8	100x25x13mm
CJ- T-32	Open end wrench set	16	16	8 pcs set
CJ- T-33	Pencil Compass	16	16	250mmL
CJ- T-34	Plane set	16	16	Rabbat, Smooth bottom Jack, Jack, 1 each
CJ- T-35	Rasp set	16	0	
CJ- T-36	Rose countersink bit	3	2	90degree, 10 φ, 20 φ, 1 each
CJ- T-37	Round nose plier	16	16	120mm
CJ- T-38	Rule set	16	16	Size:250x500mm, square 150mm, 1 each
CJ- T-39	Saw, Bow	16	16	Blade length:300mm, with spare blade
CJ- T-40	Saw-Set, Hand Universal	2	16	Bow saw, Coping saw, Dovetail saw, Crosscut saw, Back saw, 1 each
CJ- T-41	Scraper Blade	16	16	Blade wodth25mm, with spare blade
CJ- T-42	Screw Clamp (G Type) set	10	0	Duplicate with T-14
CJ- T-43	Screw driver baby(-), #2	16	16	+ 25x75Lmm
CJ- T-44	Screw driver baby(+), #2	16	16	±75x120Lmm, 1 each
CJ- T-45	Screw driver phillips(+ ) set	16	16	5kinds set
CJ- T-46	Screw driver common(-) set	16	16	5kinds set
CJ- T-47	Screw driver stubby	16	0	Duplicated with T-43
CJ- T-48	Screwdriver bit Set	5	0	
CJ- T-49	Spoke shave	16	4	255mm
CJ- T-50	Square Carpenter's	10	0	Included to T-38
CJ- T-51	Straight Edge	5	4	300x38x5mm, 500x50x5mm, 1 each
CJ- T-52	Straight Shank Twist Drill Set	15	0	Included to electric drill
CJ- T-53	Vice, Woodworking	16	0	Duplicated with T-26
CJ- T-54	Vinyl tape	16	0	
CJ- T-55	Quick clamp	1	1	Max opening 300mm
CJ- T-56	Level	-	4	450mm
CJ- T-57	Chalk line and reel	-	16	17 m



## 2. Tool for Masonry

CODE	TOOL	Q'ty		Specification
		Requested	Planned	
MR- T-1	6" stainless steel chamfer edger set	5	4	SUS, 6"W x 3/4" lip,
MR- T-2	Adjustable hacksaw frame and blade	5	4	250mm with spare blade
MR- T-3	Bench level	3	4	300mmL
MR- T-4	Bricklayer's tool kit	5	0	omit
MR- T-5	Brush	5	4	Nylon made
MR- T-6	Compass	5	4	120mm dia.
MR- T-7	Crimper	10	4	200mmL
MR- T-8	Drywall's tool kit	5	4	15 kinds set
MR- T-9	Finishing brush	5	4	24", for concrete
MR- T-10	Finishing trowel set	16	4	For cement, 4 kinds set
MR- T-11	Flagging tape (12 per set)	10	4	1.0x50mmx10m
MR- T-12	Folding rule with metal extension	16	8	6 fold, 0-1m
MR- T-13	Hammer, Club	16	4	1kg
MR- T-14	Hammer, Nail	16	4	430g
MR- T-15	Hammer, Seutch. Double-Ended	5	4	1.8kg
MR- T-16	Hammer, Seutch. Single-Ended	5	4	1.8kg
MR- T-17	Hand chipping equipment	5	4	130g
MR- T-18	Hart' hammer set	5	4	Point size:21mm,24mm
MR- T-19	Heat iron	3	4	250-300 degree
MR- T-20	Helmet	16	0	Included to Safety equipment
MR- T-21	Ladder for MR	2	2	3,500mm(L)
MR- T-22	Linoleum roller	3	4	4'dia, 75lbs
MR- T-23	Lufkin open reel tape	10	4	3,700mm(L)
MR- T-24	Meridian level	16	4	20 magnification, min.0.9m
MR- T-25	Pail	5	4	10L, steel made
MR- T-26	Plumb Bob & cord	16	4	450g, 1-1', 22m
MR- T-27	Pocket leveling rod	16	4	5m
MR- T-28	Rule, fold	16	0	Duplicated with MRT12
MR- T-29	Saw Rip	5	4	300mm(L)
MR- T-30	Saw, Masonry, 14'	5	0	Substituted MRT2
MR- T-31	Shovel, Mason's. Square Point	5	4	D type handle, square
MR- T-32	Sieve (riddle)	5	4	350mm dia., stainless steel made
MR- T-33	Soap stone marking stick (box of 144)	5	4	For block marking with holder
MR- T-34	Square Carpenter's	16	16	Blade length:150mm
MR- T-35	Stainless steel universal groover	5	4	6'
MR- T-36	Straight ripping bar	5	4	450 mm, 0.9kg
MR- T-37	Tile cutter	2	0	Substituted MRT38
MR- T-38	Tile saw	5	4	Diamond blade: 1.3φ x 155mm
MR- T-39	Tile scribe	16	16	0.04kg
MR- T-40	Triangular safety kit	3	4	Plastic made
MR- T-41	Trowel set for MR	16	0	Duplicated with MRT10
MR- T-42	Wheel Barrow, Contractor's struck	4	4	Capacity: 100L
MR- T-43	Wire Brush	5	16	Brush length: 50mm
MR- T-44	Wooden Float	16	0	Duplicated with MRT10
MR- T-45	Hoe for concrete	-8	4	110mm x 270mm
MR- T-46	Shovel for concrete	-8	8	800mm(L)
MR- T-47	Pipe wrench	-2	2	200,300mm
MR- T-48	Pipe threading equipment	-2	2	32mm φ

### 3.Tool for Secretary and Computer

4-1. Tool for Sawing machine maintenance

CODE	TOOL	Q'ty		Specification
		Requested	Planned	
TR- T -1	Driver(-)	-	1	75mm
TR- T -2	Driver for sawing machine	-	1	4.5 x 200 mm
TR- T -3	Driver(+)	-	1	#1
TR- T -4	Driver(-),150mm	-	1	150mm
TR- T -5	Driver(-),75mm	-	1	75mm
TR- T -6	Driver(+),#0	-	1	#0
TR- T -7	Adjustable spanner	-	1	150 mm
TR- T -8	Plier,150mm	-	1	150 mm
TR- T -9	Bobbin	-	1	150 mm
TR- T -10	Tweezers	-	1	Stainless steel made
TR- T -11	Hammer	-	1	230g
TR- T -12	Sand paper	-	1	S,5 pcs set
TR- T -13	Brush	-	1	Hair made
TR- T -14	Oiler	-	1	50cc, plastic made
TR- T -15	Metal case	-	1	340x120x70mm

4-2. Tool for Tailoring

CODE	TOOL	Q'ty		Specification
		Requested	Planned	
TR- ST -1	Tailor's scissors	-	1	Iron made, 240mm
TR- ST -2	Scissors for line cut	-	1	Iron made, 100mm
TR- ST -3	Needle set	-	1	8 kinds set
TR- ST -4	Pin cushion	-	1	60x60mm
TR- ST -5	Thimble	-	1	2 kinds, small and large needle
TR- ST -6	Thread(red,black,white)	-	1	5m each
TR- ST -7	Case for broken needle	-	1	Plastic made
TR- ST -8	Trassing spatula	-	1	Plastic made
TR- ST -9	Ripper	-	1	1 pc
TR- ST -10	Measure	-	1	1,500mm
TR- ST -11	Rule set	-	1	Small(SUS,15cm)Large(SUS,1m), Curve(71/2,0.6m)
TR- ST -12	Tailor's chalk	-	1	1 each
TR- ST -13	Cloth for handling of needle	-	1	1sheet
TR- ST -14	Shuttle bobbin	-	1	Iron made
TR- ST -15	Eyelet	-	1	Iron made
TR- ST -16	Case	-	1	Plastic made

5.Tool for Plumbing and Pipe Fitting

CODE	TOOL	Q'ty		Specification
		Requested	Planned	
PP- T -1	Adjustable wrench	16	16	200,300,450mm(L),3 kinds
PP- T -2	Assortment of taps and dies set	16	4	M2-M18
PP- T -3	Auger bit set	16	16	Included to PPT47
PP- T -4	Ball peen hammer 350,450g	16	16	350g
PP- T -5	Bradawls	16	16	Blade length:35mm(L),
PP- T -6	Carpenter's barce	5	16	250mm sweep
PP- T -7	Center punch	16	16	3 kinds(100,125,150mmL)
PP- T -8	Chain Cut & Rivet Tool Set	16	4	Applicable chain size: 40,50 φ mm
PP- T -9	Chain pipe wrench	16	16	330mm, chain size: 7-120 φ mm
PP- T -10	Chalk Line	16	16	Line length: 30m, with chalk (8oz)
PP- T -11	Chamfering tool	10	8	Applicable pipe size: 63-250mm
PP- T -12	Chisel set for PP	16	16	Flat,Concrete,
PP- T -13	Combination plier	16	16	2 kinds(150,200mm)
PP- T -14	Combination wrench (set of 6 pcs)	16	16	8 kinds set, 8-24mm
PP- T -15	Cross pein hammer	16	16	250g
PP- T -16	Cutter Glass	16	16	Nickel plate,130mm(L)
PP- T -17	Cutting Nipper	16	16	150mm
PP- T -18	Double offset box wrench	16	4	12 kinds set(6-30mm)
PP- T -19	Electric soldering iron set	16	0	
PP- T -20	Figure & Letter Punch set	16	8	Number and letter
PP- T -21	Grip plier	16	16	Opening:55mm
PP- T -22	Motor wrench	16	8	Opening:280 mm
PP- T -23	Hex. Socket 1/2' 20 set and accessory	16	4	1/2' socket, 20 kinds set
PP- T -24	Hex. Socket 1/4' 13 set and accessory	16	4	1/4' socket, 11 kinds set
PP- T -25	Jointing and dismantling tool set	16	8	4-16mm
PP- T -26	Ladle, Hand	16	16	250mm(L)
PP- T -27	Mechanists vise	10	16	Jaw opening:110mm, jaw width100mm
PP- T -28	Measuring Tape	16	16	30m
PP- T -29	Milled Tooth File	16	16	Flat:200mm, half-round:200mm
PP- T -30	Open end wrench set	16	4	6x6 - 20x32mm,12 kinds set
PP- T -31	Pipe bending springs set	16	4	2 kinds, for 8&10, for12&15
PP- T -32	Pipe Cutter set	16	4	2種(1/4'-2 5/8', 4'-6 5/8')
PP- T -33	Pipe vise set	16	8	3 kinds (1/8'-2,3,4'dia)
PP- T -34	Pliers gas	16	16	Grip size:150mm
PP- T -35	Plumb level	16	16	900mm(L)
PP- T -36	Round nose plier	16	16	150mm
PP- T -37	Rule set	16	16	Steel made, 1 m
PP- T -38	Screw driver common(-) set	16	16	50,100,150mm
PP- T -39	Screw driver phillips(+) set	16	16	#0,1,2,3,4
PP- T -40	Screwdriver bit Set	16	16	(-)0.8x0.0,(+)#2
PP- T -41	Scriber	16	16	220mm
PP- T -42	Self adjuster wrench	16	16	Applicable nut size:M10-M20
PP- T -43	Side cutting plier	16	16	2 kinds (175,200mm)
PP- T -44	Square(Base-fixed type)	16	16	サイズ100x70mm
PP- T -45	Stake set for PP	16	16	Anvil 215mm,ball head175mm, brick240mm
PP- T -46	Stillson Pipe Wrench set	16	16	3 kinds(10,14,18')
PP- T -47	Straight Shank Twist Drill Set	5	16	1-13mm
PP- T -48	T-handle set of 13 wrench	16	16	2.5-14mm
PP- T -49	Tinmen's snip set	16	16	3kinds(straight, combination, roof)
PP- T -50	Torch Lamp	5	8	1L, gasoline
PP- T -51	Ultra clamp set	4	4	3 kinds (100,150,300)
PP- T -52	Water pump plier	16	16	250mm
PP- T -53	Wire Brush	16	16	50mm
PP- T -54	Anvil	16	4	50kg
PP- T -55	Adjustable hacksaw frame and blade	16	16	250-300mm
PP- T -56	Pipe threading equipment	-	4	1/2"~2", 3kinds/set
PP- T -57	Concrete chisel	-	4	9,16,22mm, 3kinds/set
PP- T -58	Concrete hammer	-	4	2.7kg
PP- T -59	Hexagon wrench set	-	4	inch, 7pcs/set

6.Tool for Auto Mechanics

CODE	TOOL	Qty		Specification
		Requested	Planned	
AM- T -1	69-pcs drive socket 6 tool set	16	0	Substituted AMT25,26
AM- T -2	Adjustable hacksaw frame and blade	16	16	250-300mm
AM- T -3	Adjustable wrench	16	16	3 kinds (200,300,450mm)
AM- T -4	Assortment of taps and dies set	16	4	Tap and dies size:M2-M8
AM- T -5	Ball peen hammer 450,900g	16	16	2 kinds (450, 900g)
AM- T -6	Center punch	16	16	3 kinds (100,125,150mmL)
AM- T -7	Cold chisel 19 x 190 mm, 22 x 200 mm	16	16	19x190, 22x200mm
AM- T -8	Combination plier	16	16	2 kinds (150,200mm)
AM- T -9	Combination wrench (set of 17 pcs)	16	4	6-22mm, 17 kinds set
AM- T -10	Copper hammer 1,500 g	16	8	1,500g
AM- T -11	Cross Bar 25mm dia.600 mm	16	16	600m dia
AM- T -12	Cross Bar12 mm dia.250 mm	16	16	250mm dia
AM- T -13	Cutting Nipper	16	16	150mm
AM- T -14	Double offset box wrench	16	8	12 kinds set(6-30), 45 degree
AM- T -15	Engineer's file with file handle set	16	8	150mm, flat, half round, round, square, triangle (medium, fine)
AM- T -16	External micrometer	16	8	25-50mm, graduation 0.01mm
AM- T -17	Feeler gauge	16	16	9 pcs leaves
AM- T -18	Flexible hose clamp	16	4	11-20mm
AM- T -19	Funnel, plastic 90 mm	16	16	175mm x160mmL, plastic made
AM- T -20	Gasket scraper	16	16	Stainless blade, 22m(W)x1.4mm(L)
AM- T -21	Grease gun	16	8	100cc,100kgf/cm2
AM- T -22	Grip plier	16	16	Capacity:500kg
AM- T -23	Hand pump	16	2	For drum can, 200cc/stroke
AM- T -24	Heavy duty pipe wrench	16	16	3 kinds (250,350,450mm)
AM- T -25	Hex. Socket 1/2' 20 set and accessory	16	2	1/2' socket, 10-32mm
AM- T -26	Hex. Socket 3/4' 11 set and accessory	16	2	3/4' socket, 4-14mm
AM- T -27	Leather punch 6,8,10,12 mm dia.	16	0	
AM- T -28	L-type wrench (2 type)	16	16	6x6,12x12 mm dia.
AM- T -29	Magnetic finger, 510 mm	16	2	500mm(L)
AM- T -30	Mechanists vise	16	16	Jaw opening:110mm, jaw width:100mm
AM- T -31	Metal carrying case	16	4	400x200x200mm
AM- T -32	Mini tube cutter	16	16	3-16mm(ODtube)
AM- T -33	Needle file set (5 pcs)	16	16	160mm, triangle, round, half-round, square, flat
AM- T -34	Oiler,pistol type, 180 cc	16	8	180cc
AM- T -35	Oilstone & box	16	4	75x20x7mm
AM- T -36	Open end wrench set	16	8	5/16'-1 5/16,6kind set, 5.5-24,8kinds set
AM- T -37	Pin punch	16	16	130mm x 5,6,8mm
AM- T -38	Plug wrench 16 x 21 mm	16	16	16x21mm
AM- T -39	Radio pliers	16	16	150mm
AM- T -40	Rubber market	16	8	450g
AM- T -41	Screw driver baby(-), #2	16	16	#2,(+)
AM- T -42	Screw driver phillips(+) set	16	16	#1,2,3,4
AM- T -43	Screw driver stubby	16	16	50mm, (-), (+)
AM- T -44	Screw Extractor Set	16	16	3/16-3/4' round 5 kinds set
AM- T -45	Side cutting plier	16	16	Size:175,200mm, Cutting range:3,3.5φ
AM- T -46	Snapping pliers, inside	16	16	Range:4-10mm
AM- T -47	Snapping pliers, outside	16	16	Range:8-25mm
AM- T -48	Spark plug spanner	16	16	T type, 16mm x 500mm(L)
AM- T -49	Strap spanner	16	16	Aluminum strap, 15-280mm
AM- T -50	Stud remover 1/2 sq	16	16	12.7mm, 6-19φ
AM- T -51	Tappet wrench(3 type)	16	16	3 kinds (170,200,260mm)
AM- T -52	Test hammer, 115 g	16	16	100g
AM- T -53	T-handle set of 13 wrench	16	16	T type hex.wrenchレンチ, 7 kinds set,2.5-10mm
AM- T -54	Thickness gauge, 75 x 9 leaves	16	16	0.04-0.3mm(W), 9 kinds set
AM- T -55	T-type driver(+) phillips #2	16	16	#2,T-type
AM- T -56	Vernier caliper	16	8	2kinds (range0-150,0-200mm)
AM- T -57	Vise pliers 200 mm	16	16	200mm(L)
AM- T -58	Water pump plier	16	16	250mm(L)
AM- T -59	Connecting Rod Aligned	1	1	Capacity:50-100mm, con lod length:150-420mm
AM- T -60	Cylinder Liner Puller	2	2	Capacity:82-150mm
AM- T -61	Piston Ring Compressor	5	2	Capacity:50-125mm
AM- T -62	Clutch service tools	2	2	Pilot bearing atatch:14pcs, disk attach:11 pcs
AM- T -63	Hydraulic hub puller	5	4	For 2-6 ton truck
AM- T -64	Wheel wrench	8	1	Standard socket:21,41mm,
AM- T -65	Valve spring compressor for overhead cam en	2	2	Capacity:15-180mm, DOHC
AM- T -66	Valve refacer kit	2	2	Air valve lapper, hand valve lapper, lapping compound
AM- T -67	Drain plug key set	3	2	6 kinds set(8-19)

6.Tool for Auto Mechanics

CODE	TOOL	Q'ty		Specification
		Requested	Planned	
AM- T -68	Fuel injection & carburettor tool set	3	0	
AM- T -69	K Jetronic mixture adjustment key	3	2	3mm dia.
AM- T -70	Brake caliper piston tool	3	4	Max opening:65mm
AM- T -71	Ball joint separator (fork type)	10	4	Fork type, vehicle: small car - small truck
AM- T -72	Torque multiplier	5	2	Power ratio:1:6
AM- T -73	Circlip tool	3	1	12 kinds set (straight, 45,90degree)
AM- T -74	Concentric roller extractor set	3	0	Substituted AMT50
AM- T -75	Hydraulic nut splitters	3	2	Capacity: 16-22mm
AM- T -76	Bead braking system	5	4	300x700x400mm
AM- T -77	Coil spring compressor	5	4	Stroke:320mm
AM- T -78	Brake spring tool	3	4	For car, 500mm
AM- T -79	Brake clip tool	3	4	Piston touchment
AM- T -80	Hot patch	5	4	Circle, lozenge, ellipse
AM- T -81	Wheel bearing puller	4	4	For medium size car, capacity:100,110,127,137mm
AM- T -82	Cylinder ridge reamer	2	1	Capacity:68-120mm dia.
AM- T -83	Universal clutch aligner (for passenger car)	2	2	Bearing guide:10-22mm,12 pcs, disk guide 3kinds
AM- T -84	Universal clutch aligner (for truck/bus)	2	2	Bearing guide: 15-30mm
AM- T -85	Flywheel pilot bearing puller	5	2	Capacity:12-15mm $\phi$
AM- T -86	Soldering iron	10	0	
AM- T -87	Toe-in Gauge	1	1	100-2,350mm, range: center0, LR10 each, graduation0.2
AM- T -88	Turning Radius Gauge	1	1	Max tyre weight:5,000kg, table dia:350mm
AM- T -89	Torque Wrench set	3	2	5-28,10-85,200-1,300kgf/cm
AM- T -90	Thread restorer	5	4	Nut size: 0.75,1,1.25,1.5,1.75,2,3
AM- T -91	Tube Cutting & Flaring Tools .Set	2	2	Capacity:3-30mm Flare capacity3/8-16 $\phi$ mm
AM- T -92	Automotive puller set and accessories	1	2	Gear puller, Hole puller
AM- T -93	Stainless rule	-	4	15,30,60,1,000cm stainless made
AM- T -94	Scale stand	-	4	For 300mm scale
AM- T -95	Hight gauge	-	4	Range:0-300mm
AM- T -96	Square	-	4	150mm with base
AM- T -97	Caliper,inside,outside	-	4	Inside,outside,jenny
AM- T -98	Surface gauge	-	4	Size:200mm
AM- T -99	V block	-	4	Size:75mm
AM- T -100	Measure block	-	4	125mm,plate width:16mm
AM- T -101	Surface plate	-	4	300x350x50mm
AM- T -102	Vernier caliper	-	4	Max measuring range:200mm
AM- T -103	Inside micrometer	-	4	Graduation:0.01mm, Range:5-25mm
AM- T -104	Dial gauge	-	4	Graduation:0.01mm,Range:0-10mm
AM- T -105	Depth gauge	-	4	Range:50mm, Graduation:0.05mm
AM- T -106	Thermometer	-	8	100 degree
AM- T -107	Cylinder gauge	-	8	Range: 50-150mm
AM- T -108	Snap ring plier	-	8	Size: 175 mm, Type: L and straight
AM- T -109	Shock driver	-	8	(+X-), 2 each

## 7. Tool for Auto Electrician

CODE	TOOL	Q'ty		Specification
		Requested	Planned	
AE- T -1	Magnetic ratchet screw driver	16	8	Bit,ratchet set
AE- T -2	Adjustable hacksaw frame and blade	16	16	250-300mm
AE- T -3	Adjustable Wrench for AE	16	8	3 kinds (150,300,450mm)
AE- T -4	Adjustable Reamer Set	16	8	15-27mm, 6 kinds set
AE- T -5	Assortment of taps and dies set	16	8	M2-M18tap and dies, wrench, stock
AE- T -6	Ball peen hammer 450,900g	16	16	450,900g
AE- T -7	Bi-hex socket sets	16	8	1/2" socket, 8-32standard, 10-19deep
AE- T -8	Center punch	16	16	100,125,150 mmL
AE- T -9	Chisel set for AE	16	16	Flat chisel:10,13,16, anvil chisel:5,7
AE- T -10	Circuit Tester	16	0	
AE- T -11	Combination plier	16	16	150,200mm
AE- T -12	Combination wrench (set of 17 pcs)	16	8	17 kinds set, 6-22mm
AE- T -13	Copper Hammer 400g	16	16	400g
AE- T -14	Claw Hammer	16	16	300g
AE- T -15	Double Offset Box Wrench Set	16	8	8 kinds set, 8-24
AE- T -16	Drill Chuck & Handle	16	2	Range:0.8-13mm
AE- T -17	Electric soldering iron set	16	16	Soldering iron, plut
AE- T -18	Electrical insulated screw driver set	16	16	(+)2 kinds, (-)3kinds
AE- T -19	Electrician Knife	16	16	Blade length:90mm
AE- T -20	Engineer's file with file handle set	16	8	150mm, flat, half round, round, square, triangle (medium, fine)
AE- T -21	Feeler gauge	16	16	9 kinds leaves, Range:0.04-0.3mm
AE- T -22	Grip plier	16	16	Capacity:500kg, opening:55mm
AE- T -23	Hand Drill	16	16	Capacity:0.5-6.5mm $\phi$
AE- T -24	Hand Spring Balance	16	4	Graduation:100g, Max.measuring range:0kg
AE- T -25	Heavy duty pipe wrench	16	16	250,350,450mm
AE- T -26	Hexagon wrench set	16	8	8 kinds set (3/32-3/8)
AE- T -27	Long Nose Plier, 160mm	16	16	160mm
AE- T -28	Mechanists vise	16	16	Jaw opening:100mm, jaw width:140mm
AE- T -29	Open end wrench set	16	8	6x6-20x30mm,5/16x11/32'-3/4x7/8'
AE- T -30	Pin punch	16	16	130mm x 5,6,8mm
AE- T -31	Radio pliers	16	16	150mm
AE- T -32	Rubber Hammer	16	16	450g
AE- T -33	Side cutting plier	16	16	175,200mm
AE- T -34	Slip Joint Cutting Plier, 190 mm	16	16	190mm
AE- T -35	Soft Hammer	16	16	500g
AE- T -36	Solderless Terminal Plier	16	16	175mm
AE- T -37	Straight Rule	16	16	300,500,1000 mm, stainless made
AE- T -38	Straight Shank Twist Drill Set	16	2	1-13mm
AE- T -39	Torch Lamp	16	4	1L, gasoline
AE- T -40	Water pump plier	16	16	250mm
AE- T -41	Spark plug tool	2	2	Plug wrench:10,12,14mm, handle,extension bar
AE- T -42	Arbor press	1	1	Capacity: 1 ton
AE- T -43	Bar type grass thermometer	1	16	300mm
AE- T -44	Spark plug gap gauge	-	16	0.1mm-1.0 mm
AE- T -45	Solderless Terminal kit	-	16	Btype terminal

### 8. Tool for Welding and Fabrication

CODE	TOOL	Q'ty		Specification
		Requested	Planned	
WF- T -1	Adjustable hacksaw frame and blade	5	16	250-300mm
WF- T -2	Adjustable wrench	16	16	200,300,450mmL
WF- T -3	Air rivet gun	16	4	Rivet dia:2,4,3,2,4,8mm φ
WF- T -4	Anvil	16	8	50kg
WF- T -5	Ball peen hammer 450,650g	16	16	450,900g
WF- T -6	Bench vise heavy duty on stand	16	8	Capacity: 1/8-2 1/2
WF- T -7	Cast iron anvil stand	16	0	
WF- T -8	Cast iron swage block	16	8	75kg, 300mm
WF- T -9	Center punch	16	16	100,125,150x9,10,13mm
WF- T -10	Combination plier	16	16	150,200mm
WF- T -11	Combination wrench (set of 17 pcs)	5	8	17 kinds set (6-22mm)
WF- T -12	Compass	16	16	120mm
WF- T -13	Divider	16	16	200mm
WF- T -14	Double offset box wrench	16	8	12 kinds set(7-22), 45 degree
WF- T -15	Engineer's file with file handle set	16	16	150mm, flat, half round, round, square, triangle (medium, fine)
WF- T -16	Figure & Letter Punch set	2	4	Number, letter
WF- T -17	Hand lever shears	16	4	Capacity:5mm,8mm φ
WF- T -18	Oiler	16	16	250cc
WF- T -19	Open end wrench set	16	16	5.5x7-24x27mm,5/16x11/32-25/32x1/8
WF- T -20	Torch	16	8	1L
WF- T -21	Scriber	16	16	200mm
WF- T -22	Single bruck london pattern anvil	16	0	Substituted WFT4
WF- T -23	Square (Flat Type)	5	4	300x200mm
WF- T -24	Steel forged leg vise	5	4	Capacity: 150mm with stand
WF- T -25	Straight Rule	16	16	300,500,1000mm
WF- T -26	Straight Shank Twist Drill Set	3	0	Included electric drill
WF- T -27	Surface Plate	5	4	300x400x60mm
WF- T -28	Trammel, Beam Set	3	4	Size:1,000mm, steel made
WF- T -29	Vernier caliper	5	8	Range:0-150,0-200mm, Graduation:0.05
WF- T -30	Water pump plier	16	16	Size 150mm
WF- T -31	Wire Brush	16	16	Nylon
WF- T -32	Surface gauge	-	4	550 mm
WF- T -33	Fender tool set	-	16	Hammer, rubber hammer, etc.



### 9. Tool for Electrical Installation

CODE	TOOL	Q'ty		Specification
		Requested	Planned	
EL- T-1	Adjustable hacksaw frame and blade	16	16	250-300mm
EL- T-2	Adjustable wrench	16	16	200,300,450mm
EL- T-3	Allen key set	2	16	8 kinds set(2,3,4,5,6,7,8,10mm) with case
EL- T-4	Assortment of taps and dies set	4	4	M2-M8tap and dies, wrench ,stock
EL- T-5	Ball peen hammer 350,450g	8	8	350,450g
EL- T-6	Bench Level	16	16	200mm, 2 pcs of valve
EL- T-7	Cable Cutter	8	8	Capacity: 10mm
EL- T-8	Cable Knife	8	8	Capacity: 30mm
EL- T-9	Center drill countersink	2	2	Blade dia:10mm, shank dis:6mm
EL- T-10	Chalk Line	16	16	17m
EL- T-11	Claw Hammer	8	8	300g
EL- T-12	Combination plier	16	16	150,200mm
EL- T-13	Combination wrench (set of 6 pcs)	2	2	10 kinds set(8-24mm)
EL- T-14	Convex rule	16	16	5m
EL- T-15	Copper Hammer 400g	2	4	400g
EL- T-16	Crimper	16	16	300mm
EL- T-17	Electrician Knife	16	16	Blade length90mm
EL- T-18	Cutting Nipper	16	16	150mm
EL- T-19	Depth gauge	4	4	Range:0-200mm
EL- T-20	Desoldering braid	16	16	1.5m x 3.8mm
EL- T-21	Divider	16	16	150mm
EL- T-22	Double Offset Box Wrench Set	3	4	8 kinds set, 8-24
EL- T-23	Electric soldering iron set	16	16	Soldering iron, plut
EL- T-24	Engineer's file with file handle set	6	8	150mm, flat, half round, round, square, triangle (medium, fine)
EL- T-25	Gear puller	4	4	2 kinds set (capacity: 80,100mm)
EL- T-26	Heavy duty pipe wrench	16	16	3 kinds set(250,350,450mm)
EL- T-27	Heavy duty tweezer	16	16	2 kinds set(110,135mm)
EL- T-28	Heavy snips	16	16	Capacity: 1.2mm(iron), straight type
EL- T-29	Hex. Socket 1' 8 set and accessory	2	2	1'socket,32-65mm
EL- T-30	Hex. Socket 1/2' 20 set and accessory	2	2	1/2'socket, 8-32
EL- T-31	Hex. Socket 3/4' 11 set and accessory	2	2	3/4'socket, 26-50
EL- T-32	Hexagon wrench set	16	16	1.5-10mm 9 kinds set
EL- T-33	Ladder	2	2	3.5m, alminum
EL- T-34	Long Nose Plier, 160mm	16	16	160mm
EL- T-35	Mechanists vise	16	16	Jaw opening:100mm, jaw width:140mm
EL- T-36	Measuring Tape	16	16	30m
EL- T-37	Minature cutting pliers	16	16	100mm
EL- T-38	Minature radio pliers	16	16	120mm
EL- T-39	Open end wrench set	16	16	5.5x7-24x27mm,5/16x11/32-25/32x7/8'
EL- T-40	Outside Micrometer Caliper Set	2	2	4 kinds set(0-25-50-75-100mm)
EL- T-41	Pin vise	16	16	1.3-1.7x1.8x2.2mm φ
EL- T-42	Pipe Bender (Manual)	1	1	15mm φ
EL- T-43	Pipe Cutter for EL	8	8	Capacity: :65A-100A
EL- T-44	Pipe Reamer	4	4	Capacity: 1/8-2', ratchet type
EL- T-45	Pipe vise set	4	4	3 kinds set(1/8-2',1/8-3 1/2', 1/8-4 1/4')
EL- T-46	Plumb Line	16	16	weight:100g, line length:4.5m
EL- T-47	Radio pliers	16	16	150mm
EL- T-48	Screw driver common(-) set	16	16	4 kinds set(75,100,150,200mm)
EL- T-49	Screw driver phillips(+) set	16	16	4 kinds set(#1,2,3,4)
EL- T-50	Screw driver precision set	16	16	6 kinds set((+)#00,0,(-)0.9,1.2,1.8,2,3)
EL- T-51	Screw driver stubby	16	16	2 kinds set((+)#2,(-)4.7mm)
EL- T-52	Sheath Cutting Knife	16	16	Blade length:90mm
EL- T-53	Spark testing screwdriver	16	16	6 kinds set((+)2pcs, (-)3pcs, horn1pc)
EL- T-54	Straight Rule	16	16	300,500,1000mm
EL- T-55	Straight Shank Twist Drill Set	2	0	Included to electric drill
EL- T-56	Twist Drill Set	2	0	Included to electric drill
EL- T-57	Vernier caliper	16	16	2 kinds set(0-150,0-200)
EL- T-58	Water pump plier	16	16	Size:250mm
EL- T-59	Wire stripper	16	16	Range:0.5-2mm
EL- T-60	Crimping plier	-	16	180 mm, 1.25mm,2.0mm

10. Tool for Wood Carving

CODE	TOOL	Q'ty		Specification
		Requested	Planned	
WC- T -1	Bevel edge wood chisel (set of 4)	10	16	10 kinds set(3,6,9,12,15,18,24,30,36,42mm)
WC- T -2	Clamp head	10	16	Capacity:1,000mm
WC- T -3	Cutting gauge	20	16	Almirum made, 300mm
WC- T -4	L clamp	10	16	Max opening: 300mm
WC- T -5	Oilstone & box	20	4	100x25x13mm
WC- T -6	Rosewood try square	15	16	250 x 125(台)mm with base
WC- T -7	Screw driver common(-) set	20	16	4 kinds set(75,100,150,200mm)
WC- T -8	Screw driver phillips(+) set	20	16	4 kinds set(#1,2,3,4)
WC- T -9	Screw driver/round blade supa/pozidrive tip (	20	0	Included to WCT7,8
WC- T -10	Woodworking bit set	10	0	Included to electric drill
WC- T -11	Woodworking vice	20	16	Jaw width:125mm, jaw opening:300mm

11-1. Glassware for Chemical Laboratory

CODE	TOOL	Q'ty		Specification
		Requested	Planned	
CH- G -1	Beaker 1000cc	-	8	1,000cc
CH- G -2	Beaker 500 cc	-	12	500cc
CH- G -3	Beaker 100 cc	-	24	100cc
CH- G -4	Flask, flat bottom 500cc	-	12	500cc
CH- G -5	Flask, flat bottom 200cc	-	24	200cc
CH- G -6	Flask, erlenmeyer	-	24	200cc
CH- G -7	Petri dish	-	12	100x24mm
CH- G -8	Test tube	-	50	15x150mm
CH- G -9	Funnels	-	12	65x65mm(stand)
CH- G -10	Burette	-	8	10cc, 600mL
CH- G -11	Graduated cylinder	-	8	200cc
CH- G -12	Pipet	-	12	5cc
CH- G -13	Reagent bottle	-	24	100cc
CH- G -14	Glass tube	-	24	6x4x80mm
CH- G -15	Glass rod	-	24	4x1,200mm
CH- G -16	Rubber stopper	-	24	#1
CH- G -17	Rubber tube	-	10m	3x4.6mm

11-2. Tool for Chemical Laboratory

CODE	TOOL	Q'ty		Specification
		Requested	Planned	
CH- T -1	Tool set 30 kinds set	10	0	

12.Tool for Physics Laboratory

CODE	TOOL	Q'ty		Specification
		Requested	Planned	
PL- T -1	Screw gauge	5	1	Range:25mm, graduation0.001
PL- T -2	Screw gauge (conventional)	10	0	Substituted PLT1
PL- T -3	Vernier caliper(dial)	10	1	Range:150mm, graduation0.05mm
PL- T -4	Vernier caliper(decimal)	5	0	Substituted PLT3
PL- T -5	Vernier caliper(double scale)	10	0	Substituted PLT3
PL- T -6	Tool set		4	
	Side cutting plier		1	150mm
	Driver		1 式	L,M,S
	File set		1 式	5 kinds set
	Electrician knife		1	Blade length: 90mm
	Wire gauge		1	#1-#36
	Nipper		1	150mm
	Hand drill		1	6.5mm
	Radio plier		1	150mm
	Adjustable wrench		1	200mm
	Hacksaw		1	Blade length :250mm, with spare blade 3 pcs
	Soldering iron		1	40W
	Driver set		1	(-)(+)
	Paste		1	Small, 10g
	Nut spinner handle		1	200mm
	Hammer		1	200g
	Tweezer		1	150mm
	Case		1	600x280x100mm
PL- T -7	Tool set 30 kinds set	10	0	

13. Tool for Maintenance Workshop

CODE	TOOL	Q'ty		Specification
		Requested	Planned	
MW- T -1	Adjustable hacksaw frame and blade	-	2	250-300mm
MW- T -2	Adjustable wrench	-	2	3 kinds (200,300,450mm)
MW- T -3	Assortment of taps and dies set	-	2	Tap and dies size:M2-M8
MW- T -4	Ball peen hammer 450,900g	-	2	2 kinds (450, 900g)
MW- T -5	Center punch	-	2	3 kinds (100,125,150mmL)
MW- T -6	Cold chisel 19 x 190 mm, 22 x 200 mm	-	2	19x190, 22x200mm
MW- T -7	Combination plier	-	2	2 kinds (150,200mm)
MW- T -8	Combination wrench (set of 17 pcs)	-	2	6-22mm, 17 kinds set
MW- T -9	Copper hammer 1,500 g	-	2	1,500g
MW- T -10	Cross Bar 25mm dia.600 mm	-	2	600m dia
MW- T -11	Cross Bar 12 mm dia 250 mm	-	2	250mm dia
MW- T -12	Cutting Nipper	-	2	150mm
MW- T -13	Double offset box wrench	-	2	12 kinds set(6-30), 45 degree
MW- T -14	Engineer's file with file handle set	-	2	150mm, flat, half round, round, square, triangle (medium, fine)
MW- T -15	External micrometer	-	2	25-50mm, graduation 0.01mm
MW- T -16	Feeler gauge	-	2	9 pcs leaves
MW- T -17	Flexible hose clamp	-	2	11-20mm
MW- T -18	Funnel, plastic 90 mm	-	2	175mm x160mmL, plastic made
MW- T -19	Gasket scraper	-	2	Stainless blade, 22m(W)x1.4mm(L)
MW- T -20	Grease gun	-	2	100cc,100kgf/cm2
MW- T -21	Grip plier	-	2	Capacity:500kg
MW- T -22	Hand pump	-	2	For drum can, 200cc/stroke
MW- T -23	Heavy duty pipe wrench	-	2	3 kinds (250,350,450mm)
MW- T -24	Hex. Socket 1/2" 20 set and accessory	-	2	1/2" socket, 10-32mm
MW- T -25	Hex. Socket 3/4" 11 set and accessory	-	2	3/4" socket, 4-14mm
MW- T -26	Leather punch 6,8,10,12 mm dia.	-	2	
MW- T -27	L-type wrench (2 type)	-	2	6x6,12x12 mm dia.
MW- T -28	Magnetic finger, 510 mm	-	2	500mm(L)
MW- T -29	Mechanists vise	-	2	Jaw opening:110mm, jaw width:100mm
MW- T -30	Metal carrying case	-	2	400x200x200mm
MW- T -31	Mini tube cutter	-	2	3-16mm(ODtube)
MW- T -32	Needle file set (5 pcs)	-	2	160mm, triangle, round, half-round, square, flat
MW- T -33	Oiler,pistol type, 180 cc	-	2	180cc
MW- T -34	Oilstone & box	-	2	75x20x7mm
MW- T -35	Open end wrench set	-	2	5/16"-1 5/16,6kind set, 5.5-24,8kinds set
MW- T -36	Pin punch	-	2	130mm x 5,6,8mm
MW- T -37	Plug wrench 16 x 21 mm	-	2	16x21mm
MW- T -38	Radio pliers	-	2	150mm
MW- T -39	Rubber market	-	2	450g
MW- T -40	Screw driver baby(-), #2	-	2	#2,(+)
MW- T -41	Screw driver phillips(+ ) set	-	2	#1,2,3,4
MW- T -42	Screw driver stubby	-	2	50mm, (-), (+)
MW- T -43	Screw Extractor Set	-	2	3/16-3/4" round 5 kinds set
MW- T -44	Side cutting plier	-	2	Size:175,200mm, Cutting range:3,3.5 φ
MW- T -45	Chisel set	-	2	flat, Anvil, Concrete
MW- T -46	Folding bench	-	2	600 mm
MW- T -47	Cutting scissors	-	2	3 kinds
MW- T -48	Snapper	-	2	24 x 240 mm
MW- T -49	Snapper(against fire)	-	2	450mm
MW- T -50	Welding Solder	-	2	150W, point size:16mmdia.
MW- T -51	Torch lamp	-	2	1 L

- 14. Commercial
- 15. General Classroom
- 16. Audio Visual Equipment
- 17. Vehicles

**18. Tool for Short Course (Food Processing)**

CODE	TOOL	Q'ty		Specification
		Requested	Planned	
SC- T- 1	Sauce Pan (L,M,S)	-	4	3 kinds set
SC- T- 2	Frying pan	-	4	40 cm dia.
SC- T- 3	Bowl (L,M,S)	-	4	3 kinds set
SC- T- 4	Basket (L,M,S)	-	4	3 kinds set
SC- T- 5	Ladle	-	4	4 kinds set
SC- T- 6	Square Vat (L,L,L,M,S,SS)	-	4	4 kinds set
SC- T- 7	Steamer 3 layers	-	4	3 stages
SC- T- 8	Chopping Board (L,M)	-	4	2 kinds set
SC- T- 9	Kitchen Knife (L,M,S)	-	4	3 kinds set
SC- T- 10	Cleaver Knife	-	4	200 mm, copper made
SC- T- 11	Funnel (M)	-	4	plastic made
SC- T- 12	Kitchen Tong (L,M)	-	4	2 kinds set
SC- T- 13	Measure Cup ( 200cc, 1000cc, & 2000cc)	-	4	3 kinds set
SC- T- 14	Measure Spoon (2.5cc, 5cc, 15cc, & 30cc)	-	4	4 kinds set
SC- T- 15	Brush for bakery	-	4	Bakery use
SC- T- 16	Table ware set	-	4	Full set of table ware

## FURNITURE LIST

1. (CJF) Furniture for Carpentry and Joinery
2. (MRF) Furniture for Masonry
3. (STF) Furniture for Secretary and Computer
4. (TRF) Furniture for Tailoring
5. (PPF) Furniture for Plumbing and Pipe Fitting
6. (AMF) Furniture for Auto Mechanics
7. (AEF) Furniture for Auto Electrician
8. (WFF) Furniture for Welding and Fabrication
9. (ELF) Furniture for Electrical Installation
10. (WCF) Furniture for Wood Carving
11. (CHF) Furniture for Chemical Laboratory
12. (PLF) Furniture for Physics Laboratory
13. (MWF) Furniture for Maintenance Workshop
14. (CMF) Furniture for Commercial
15. (GCF) Furniture for General Classroom
16. (AVF) Furniture for Audio Visual Equipment
17. (VEF) Vehicles
18. (SCF) Furniture for Short Course (Food Processing)



**1. Furniture for Carpentry and Joinery**

CODE	Furniture	Q'ty		Specification
		Requested	Planned	
CJ- F-1	Student chair	43	16	Wood, 450mmH
CJ- F-2	Desk(2 person)	24	8	Wood, 1400x700x700Hmm
CJ- F-3	Teacher desk and chair	4	1	Wood desk1200x700x700Hmm, chair size,420mmH with arm rest
CJ- F-4	Cabinet	4	2	Wood, 1000x450x1800Hmm
CJ- F-5	Work bench(2 person)	20	12	Wood, 1400x800x850Hmm, Top board thickness,40 mm or more, accumulating plywood

**2. Furniture for Masonry**

CODE	Furniture	Q'ty		Specification
		Requested	Planned	
MR- F-1	Student chair	42	16	Wood, 450mmH
MR- F-2	Desk(2 person)	25	8	Wood, 1400x700x700Hmm
MR- F-3	Teacher desk and chair	4	1	Wood desk1200x700x700Hmm, chair size,420mmH with arm rest
MR- F-4	Cabinet	4	2	Wood, 1000x450x1800Hmm
MR- F-5	Work bench(2 person)	10	8	Wood, 1400x800x850Hmm Top board thickness,40 mm or more, accumulating plywood

**3. Furniture for Secretary and Computer**

CODE	Furniture	Q'ty		Specification
		Requested	Planned	
ST- F-1	Typewriter table(2 person)	17	8	Wood, 1400x700x700Hmm
ST- F-2	PC table(2 person)	17	8	Wood, 1800x800x700Hmm
ST- F-3	Student chair	34	32	Wood, 450mmH
ST- F-4	Teacher desk and chair	2	2	Wood desk1200x700x700Hmm, chair size,420mmH with arm rest
ST- F-5	Cabinet	-	4	Wood, 1000x450x1800Hmm

**4. Furniture for Tailoring**

CODE	Furniture	Q'ty		Specification
		Requested	Planned	
TR- F-1	Tailor's table	-	8	Wood, 1800x1200x850Hmm Top board thickness,40 mm or more, accumulating plywood
TR- F-2	Student chair	-	32	Wood, 450mmH
TR- F-3	Teacher desk and chair	-	2	Wood desk1200x700x700Hmm, chair size,420mmH with arm rest
TR- F-4	Cabinet	-	2	Wood, 1000x450x1800Hmm

**5. Furniture for Plumbing and Pipe Fitting**

CODE	Furniture	Q'ty		Specification
		Requested	Planned	
MR- F-1	Student chair	42	16	Wood, 450mmH
MR- F-2	Desk(2 person)	25	8	Wood, 1400x700x700Hmm
MR- F-3	Teacher desk and chair	4	1	Wood desk1200x700x700Hmm, chair size,420mmH with arm rest
MR- F-4	Cabinet	4	2	Wood, 1000x450x1800Hmm
MR- F-5	Work bench(2 person)	10	8	Wood, 1400x800x850Hmm Top board thickness,40 mm or more, accumulating plywood

**6. Furniture for Auto Mechanics**

CODE	Furniture	Q'ty		Specification
		Requested	Planned	
AM- F-1	Student chair	32	32	Wood, 450mmH
AM- F-2	Desk(2 person)	68	16	Wood, 1400x700x700Hmm
AM- F-3	Double desk	6	0	
AM- F-4	Shelves/Steel cabinet	4	0	
AM- F-5	Cabinet	-	4	Wood, 1000x450x1800Hmm
AM- F-6	Teacher desk and chair	4	2	Wood desk1200x700x700Hmm, chair size,420mmH with arm rest
AM- F-7	Work bench(2 person)	10	8	Wood, 1400x800x850Hmm Top board thickness,40 mm or more, accumulating plywood

7. Furniture for Auto Electrician

CODE	Furniture	Q'ty		Specification
		Requested	Planned	
AE- F-1	Student chair	100	16	Wood, 450mmH
AE- F-2	Desk(2 person)	32	8	Wood, 1400x700x700Hmm
AE- F-3	Double desk	20	0	
AE- F-4	Teacher desk and chair	5	1	Wood desk1200x700x700Hmm, chair size,420mmH with arm rest
AE- F-5	Shelves/Steel cabinet	7	0	
AE- F-6	Cabinet	-	2	Wood, 1000x450x1800Hmm
AE- F-7	Work bench(2 person)	10	8	Wood, 1400x800x850Hmm Top board thickness;40 mm or more, accumulating plywood

8. Furniture for Welding and Fabrication

CODE	Furniture	Q'ty		Specification
		Requested	Planned	
WF- F-1	Student chair	11	16	Wood, 450mmH
WF- F-2	Desk(2 person)	24	8	Wood, 1400x700x700Hmm
WF- F-3	Teacher desk and chair	5	2	Wood, 1000x450x1800Hmm
WF- F-4	Cabinet	1	1	Wood desk1200x700x700Hmm, chair size,420mmH with arm rest
WF- F-5	Work bench(2 person)	10	8	Wood, 1400x800x850Hmm Top board thickness;40 mm or more, accumulating plywood

9. Furniture for Electrical Installation

CODE	Furniture	Q'ty		Specification
		Requested	Planned	
EL- F-1	Student chair	100	16	Wood, 450mmH
EL- F-2	Desk(2 person)	32	8	Wood, 1400x700x700Hmm
EL- F-3	Double desk	20	0	
EL- F-4	Teacher desk and chair	5	1	Wood desk1200x700x700Hmm, chair size,420mmH with arm rest
EL- F-5	Cabinet	7	2	Wood, 1000x450x1800Hmm
EL- F-6	Work bench(2 person)	10	4	Wood, 1400x800x850Hmm Top board thickness;40 mm or more, accumulating plywood
EL- F-7	Work bench(1 person)	10	8	Wood, 1400x400x850Hmm Top board thickness;40 mm or more, accumulating plywood

10. Furniture for Wood Carving

CODE	Furniture	Q'ty		Specification
		Requested	Planned	
WC- F-1	Student chair	100	16	Wood, 450mmH
WC- F-2	Desk(2 person)	32	8	Wood, 1400x700x700Hmm
WC- F-3	Teacher desk and chair	5	1	Wood desk1200x700x700Hmm, chair size,420mmH with arm rest
WC- F-4	Cabinet	4	2	Wood, 1000x450x1800Hmm
WC- F-5	Work bench(2 person)	20	8	Wood, 1400x800x850Hmm Top board thickness;40 mm or more, accumulating plywood

11. Furniture for Chemical Laboratory

CODE	Furniture	Q'ty		Specification
		Requested	Planned	
CH- F-1	Laboratory table	5	0	既存
CH- F-2	Side rack	5	0	既存
CH- F-3	Wood rack	5	0	既存
CH- F-4	Cabinet	100	2	Wood, 1000x450x1800Hmm
CH- F-5	Stdent chair	100	32	Wood, 450mmH
CH- F-6	Teacher desk and chair		1	Wood desk1200x700x700Hmm, chair size,420mmH with arm rest

12. Furniture for Physics Laboratory

CODE	Furniture	Q'ty		Specification
		Requested	Planned	
PL- F-1	Work bench	15	0	
PL- F-2	Student chair	30	32	Wood, 450mmH
PL- F-3	Wood rack	5	0	
PL- F-4	Cabinet	15	2	Wood, 1000x450x1800Hmm
PL- F-5	Teacher desk and chair	30	1	Wood desk1200x700x700Hmm, chair size,420mmH with arm rest

13. Furniture for Maintenance Workshop

CODE	Furniture	Q'ty		Specification
		Requested	Planned	
MW- F -1	Stool	-	8	Wood, 450mmH
MW- F -2	Desk(2 person)	-	2	Wood, 1200x700x700Hmm
MW- F -3	Cabinet	-	2	Wood, 1000x450x1800Hmm
MW- F -4	Work bench(2 person)	-	4	Wood, 1400x800x850Hmm Top board thickness:40 mm or more, accumulating plywood

14. Furniture for Commercial

CODE	Furniture	Q'ty		Specification
		Requested	Planned	
CM- F 1	Student chair	-	16	Wood, 450mmH
CM- F 2	Desk(2 person)	-	8	Wood, 1400x700x700Hmm
CM- F 3	Teacher desk and chair	-	2	Wood desk1200x700x700Hmm, chair size,420mmH with arm rest
CM- F 4	Cabinet	-	4	Wood, 1000x450x1800Hmm

15. Furniture for General Classroom

CODE	Furniture	Q'ty		Specification
		Requested	Planned	
GC- F -1	Teacher desk and chair	3	3	Wood desk1200x700x700Hmm, chair size,420mmH with arm rest
GC- F -2	Desk(2 person)	100	24	Wood, 450mmH
GC- F -3	Student chair	100	48	Wood, 1400x700x700Hmm
GC- F -4	Cup board	3	0	
GC- F -5	Cabinet	48	3	Wood, 1000x450x1800Hmm

16. Audio Visual

17. Vehicle

18. Furniture for Short Course(Food Processing)

CODE	Furniture	Q'ty		Specification
		Requested	Planned	
SC- F -1	Student chair	-	16	Wood, 450mmH
SC- F -2	Cooking table	-	4	Wood, 1400x700x700Hmm
SC- F -3	Cabinet	-	2	Wood, 1000x450x1800mm

### Appendix 5 Layout Plan of Equipment

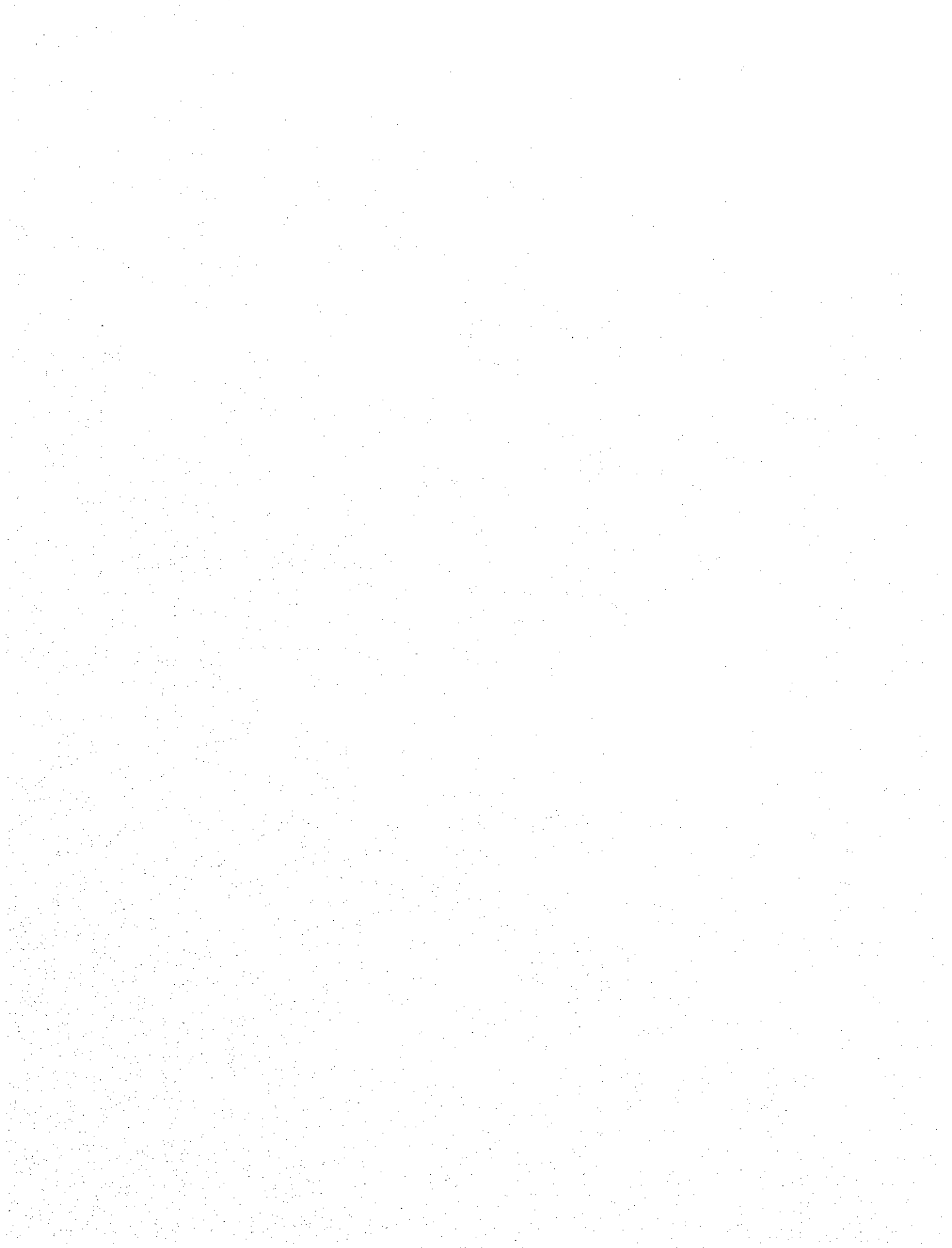

1	ARCHITECTURAL
2	STRUCTURAL
3	Mechanical
4	ELECTRICAL
5	PLUMBING
6	PAINTING
7	LANDSCAPE ARCHITECTURE
8	CONCRETE WORK
9	ROOFING
10	IRONWORK
11	STEELWORK
12	GLASSWORK
13	WOODWORK
14	CEILING
15	FLOORING
16	WALLS
17	DOORS
18	WINDOWS
19	SCREENS
20	SHUTTERS
21	BLINDS
22	VALVES
23	FIXTURES
24	APPLIANCES
25	MECHANICAL EQUIPMENT
26	ELECTRICAL EQUIPMENT
27	PLUMBING EQUIPMENT
28	PAINT
29	WOOD
30	GLASS
31	STEEL
32	IRON
33	CONCRETE
34	ROOFING
35	LANDSCAPE
36	CONCRETE
37	ROOFING
38	LANDSCAPE
39	CONCRETE
40	ROOFING
41	LANDSCAPE
42	CONCRETE
43	ROOFING
44	LANDSCAPE
45	CONCRETE

Scale 1:500

0 10m 20m 30m 40m 50m

Drawing No. 17318 PLAN SCALE 1:500

Block 17318 DATE 10/10/2010

17318

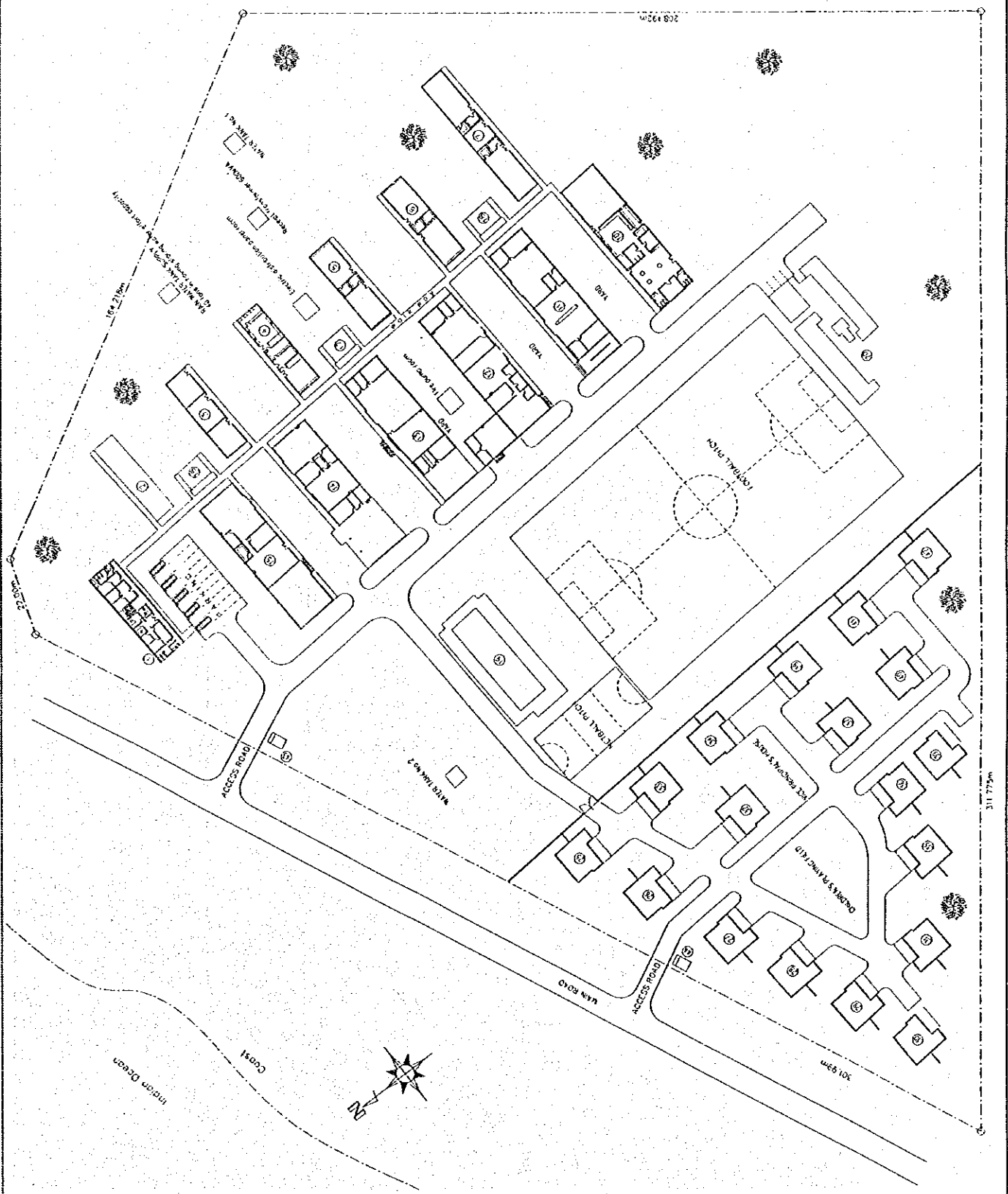

REFERENCE KEY

No.	Name	Quantity	Capacity	Remarks
1	Wood support table	15	15	
2	Wood support chair	15	15	
3	Wood support table chair	7	7	
4	Wood cabinet with tray	5	5	
5	Wood work bench	5	5	
A. BLACKBOARD				
Existing				

No.	Name	Quantity	Capacity	Remarks
1	Wood support table	15	15	
2	Wood support chair	15	15	
3	Wood support table chair	7	7	
4	Wood cabinet with tray	5	5	
5	Wood work bench	5	5	
6	Wood cabinet with tray	5	5	
7	Wood cabinet with tray	5	5	
8	Wood cabinet with tray	5	5	
9	Wood cabinet with tray	5	5	
10	Wood cabinet with tray	5	5	
11	Wood cabinet with tray	5	5	
12	Wood cabinet with tray	5	5	
13	Wood cabinet with tray	5	5	
14	Wood cabinet with tray	5	5	
15	Wood cabinet with tray	5	5	
16	Wood cabinet with tray	5	5	
17	Wood cabinet with tray	5	5	
18	Wood cabinet with tray	5	5	
19	Wood cabinet with tray	5	5	
20	Wood cabinet with tray	5	5	
21	Wood cabinet with tray	5	5	
22	Wood cabinet with tray	5	5	
23	Wood cabinet with tray	5	5	
24	Wood cabinet with tray	5	5	
25	Wood cabinet with tray	5	5	
26	Wood cabinet with tray	5	5	
27	Wood cabinet with tray	5	5	
28	Wood cabinet with tray	5	5	
29	Wood cabinet with tray	5	5	
30	Wood cabinet with tray	5	5	
31	Wood cabinet with tray	5	5	
32	Wood cabinet with tray	5	5	
33	Wood cabinet with tray	5	5	
34	Wood cabinet with tray	5	5	
35	Wood cabinet with tray	5	5	
36	Wood cabinet with tray	5	5	
37	Wood cabinet with tray	5	5	
38	Wood cabinet with tray	5	5	
39	Wood cabinet with tray	5	5	
40	Wood cabinet with tray	5	5	
41	Wood cabinet with tray	5	5	
42	Wood cabinet with tray	5	5	
43	Wood cabinet with tray	5	5	
44	Wood cabinet with tray	5	5	
45	Wood cabinet with tray	5	5	
46	Wood cabinet with tray	5	5	
47	Wood cabinet with tray	5	5	
48	Wood cabinet with tray	5	5	
49	Wood cabinet with tray	5	5	
50	Wood cabinet with tray	5	5	
51	Wood cabinet with tray	5	5	
52	Wood cabinet with tray	5	5	
53	Wood cabinet with tray	5	5	
54	Wood cabinet with tray	5	5	
55	Wood cabinet with tray	5	5	
56	Wood cabinet with tray	5	5	
57	Wood cabinet with tray	5	5	
58	Wood cabinet with tray	5	5	
59	Wood cabinet with tray	5	5	
60	Wood cabinet with tray	5	5	
61	Wood cabinet with tray	5	5	
62	Wood cabinet with tray	5	5	
63	Wood cabinet with tray	5	5	
64	Wood cabinet with tray	5	5	
65	Wood cabinet with tray	5	5	
66	Wood cabinet with tray	5	5	
67	Wood cabinet with tray	5	5	
68	Wood cabinet with tray	5	5	
69	Wood cabinet with tray	5	5	
70	Wood cabinet with tray	5	5	
71	Wood cabinet with tray	5	5	
72	Wood cabinet with tray	5	5	
73	Wood cabinet with tray	5	5	
74	Wood cabinet with tray	5	5	
75	Wood cabinet with tray	5	5	
76	Wood cabinet with tray	5	5	
77	Wood cabinet with tray	5	5	
78	Wood cabinet with tray	5	5	
79	Wood cabinet with tray	5	5	
80	Wood cabinet with tray	5	5	
81	Wood cabinet with tray	5	5	
82	Wood cabinet with tray	5	5	
83	Wood cabinet with tray	5	5	
84	Wood cabinet with tray	5	5	
85	Wood cabinet with tray	5	5	
86	Wood cabinet with tray	5	5	
87	Wood cabinet with tray	5	5	
88	Wood cabinet with tray	5	5	
89	Wood cabinet with tray	5	5	
90	Wood cabinet with tray	5	5	
91	Wood cabinet with tray	5	5	
92	Wood cabinet with tray	5	5	
93	Wood cabinet with tray	5	5	
94	Wood cabinet with tray	5	5	
95	Wood cabinet with tray	5	5	
96	Wood cabinet with tray	5	5	
97	Wood cabinet with tray	5	5	
98	Wood cabinet with tray	5	5	
99	Wood cabinet with tray	5	5	
100	Wood cabinet with tray	5	5	

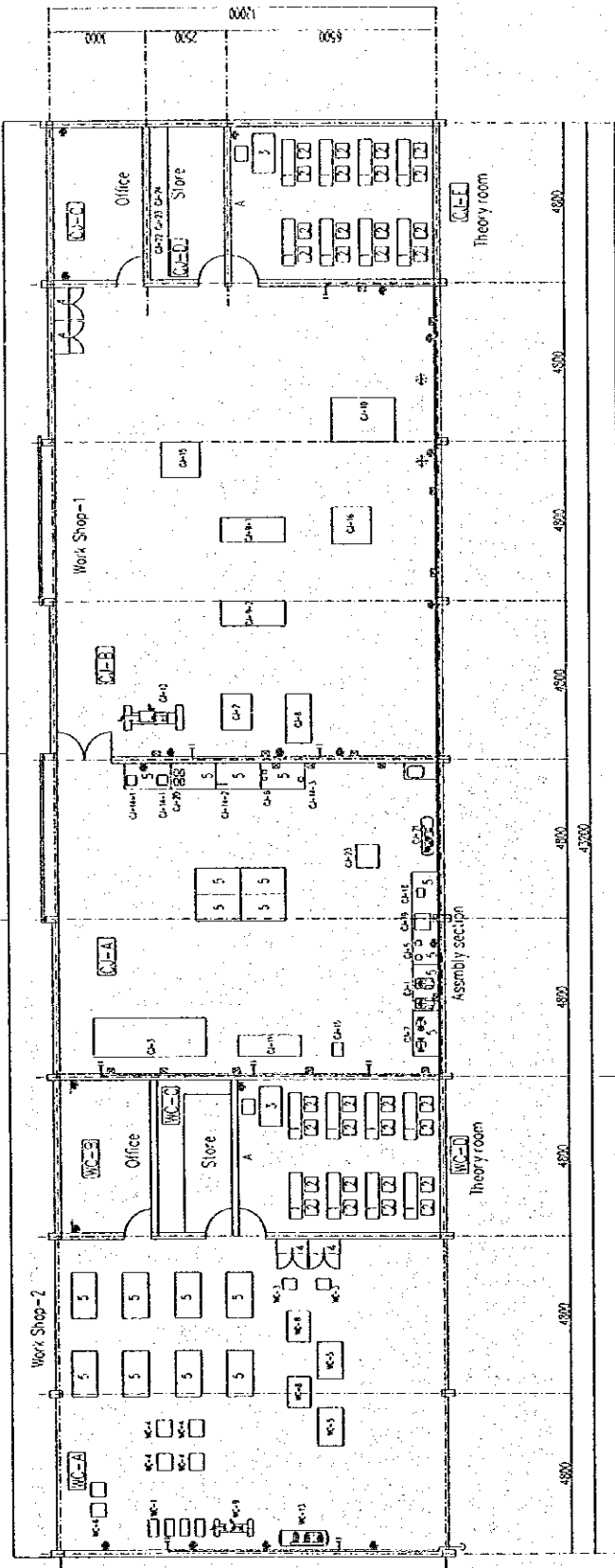

Carpentry W/Shop

Woodcarving W/Shop

Drawing No. 29 December, 1999

Block : 3/1/2

TITLE : Carpentry/Woodcarving W/Shop

S=1/100

Standard symbol

- ⊙ 240V single phase unit outlet
- ⊙ 240V single phase two outlet
- ⊙ 400V three-phase MCB box
- ⊙ Water supply cock
- ⊙ Active power supplies mark







NO.	DESCRIPTION	QUANTITY
1	Typewriter	4
2	Computer	4
3	Printer	4
4	Scanner	4
5	UPS	4
6	Office Chair	4
7	Desk	4
8	Storage Cabinet	4
9	Printer Cabinet	4
10	Scanner Cabinet	4
11	UPS Cabinet	4
12	Office Chair	4
13	Desk	4
14	Storage Cabinet	4
15	Printer Cabinet	4
16	Scanner Cabinet	4
17	UPS Cabinet	4
18	Office Chair	4
19	Desk	4
20	Storage Cabinet	4
21	Printer Cabinet	4
22	Scanner Cabinet	4
23	UPS Cabinet	4
24	Office Chair	4
25	Desk	4
26	Storage Cabinet	4
27	Printer Cabinet	4
28	Scanner Cabinet	4
29	UPS Cabinet	4
30	Office Chair	4
31	Desk	4
32	Storage Cabinet	4
33	Printer Cabinet	4
34	Scanner Cabinet	4
35	UPS Cabinet	4
36	Office Chair	4
37	Desk	4
38	Storage Cabinet	4
39	Printer Cabinet	4
40	Scanner Cabinet	4
41	UPS Cabinet	4
42	Office Chair	4
43	Desk	4
44	Storage Cabinet	4
45	Printer Cabinet	4
46	Scanner Cabinet	4
47	UPS Cabinet	4
48	Office Chair	4
49	Desk	4
50	Storage Cabinet	4
51	Printer Cabinet	4
52	Scanner Cabinet	4
53	UPS Cabinet	4
54	Office Chair	4
55	Desk	4
56	Storage Cabinet	4
57	Printer Cabinet	4
58	Scanner Cabinet	4
59	UPS Cabinet	4
60	Office Chair	4
61	Desk	4
62	Storage Cabinet	4
63	Printer Cabinet	4
64	Scanner Cabinet	4
65	UPS Cabinet	4
66	Office Chair	4
67	Desk	4
68	Storage Cabinet	4
69	Printer Cabinet	4
70	Scanner Cabinet	4
71	UPS Cabinet	4
72	Office Chair	4
73	Desk	4
74	Storage Cabinet	4
75	Printer Cabinet	4
76	Scanner Cabinet	4
77	UPS Cabinet	4
78	Office Chair	4
79	Desk	4
80	Storage Cabinet	4
81	Printer Cabinet	4
82	Scanner Cabinet	4
83	UPS Cabinet	4
84	Office Chair	4
85	Desk	4
86	Storage Cabinet	4
87	Printer Cabinet	4
88	Scanner Cabinet	4
89	UPS Cabinet	4
90	Office Chair	4
91	Desk	4
92	Storage Cabinet	4
93	Printer Cabinet	4
94	Scanner Cabinet	4
95	UPS Cabinet	4
96	Office Chair	4
97	Desk	4
98	Storage Cabinet	4
99	Printer Cabinet	4
100	Scanner Cabinet	4
101	UPS Cabinet	4
102	Office Chair	4
103	Desk	4
104	Storage Cabinet	4
105	Printer Cabinet	4
106	Scanner Cabinet	4
107	UPS Cabinet	4
108	Office Chair	4
109	Desk	4
110	Storage Cabinet	4
111	Printer Cabinet	4
112	Scanner Cabinet	4
113	UPS Cabinet	4
114	Office Chair	4
115	Desk	4
116	Storage Cabinet	4
117	Printer Cabinet	4
118	Scanner Cabinet	4
119	UPS Cabinet	4
120	Office Chair	4
121	Desk	4
122	Storage Cabinet	4
123	Printer Cabinet	4
124	Scanner Cabinet	4
125	UPS Cabinet	4
126	Office Chair	4
127	Desk	4
128	Storage Cabinet	4
129	Printer Cabinet	4
130	Scanner Cabinet	4
131	UPS Cabinet	4
132	Office Chair	4
133	Desk	4
134	Storage Cabinet	4
135	Printer Cabinet	4
136	Scanner Cabinet	4
137	UPS Cabinet	4
138	Office Chair	4
139	Desk	4
140	Storage Cabinet	4
141	Printer Cabinet	4
142	Scanner Cabinet	4
143	UPS Cabinet	4
144	Office Chair	4
145	Desk	4
146	Storage Cabinet	4
147	Printer Cabinet	4
148	Scanner Cabinet	4
149	UPS Cabinet	4
150	Office Chair	4

REFERENCE KEY

No.	Name	Size and specification	Computer classroom	Typewriter classroom	Quantity
1	Typewriter table	1400Wx700Lx700H		4	4
2	Computer table	1400Wx700Lx700H		4	4
3	Computer table	1400Wx700Lx700H		4	4
4	Student chair	450H			40
5	Teacher table	1200Wx700Lx700H			2
6	Teacher chair	450H			2
7	Air conditioner	1800Wx450Lx1500H			4
8	UPS	1800Wx450Lx1500H			4
9	Printer cabinet	1800Wx450Lx1500H			4
10	Scanner cabinet	1800Wx450Lx1500H			4
11	Printer bench	1800Wx450Lx1500H			4
12	Blackboard	1800Wx450Lx1500H			4
13	Teacher table chair	1800Wx450Lx1500H			4
14	Printer bench	1800Wx450Lx1500H			4
15	Blackboard	1800Wx450Lx1500H			4
16	Teacher table chair	1800Wx450Lx1500H			4
17	Printer bench	1800Wx450Lx1500H			4
18	Blackboard	1800Wx450Lx1500H			4
19	Teacher table chair	1800Wx450Lx1500H			4
20	Printer bench	1800Wx450Lx1500H			4
21	Blackboard	1800Wx450Lx1500H			4
22	Teacher table chair	1800Wx450Lx1500H			4
23	Printer bench	1800Wx450Lx1500H			4
24	Blackboard	1800Wx450Lx1500H			4
25	Teacher table chair	1800Wx450Lx1500H			4
26	Printer bench	1800Wx450Lx1500H			4
27	Blackboard	1800Wx450Lx1500H			4
28	Teacher table chair	1800Wx450Lx1500H			4
29	Printer bench	1800Wx450Lx1500H			4
30	Blackboard	1800Wx450Lx1500H			4
31	Teacher table chair	1800Wx450Lx1500H			4
32	Printer bench	1800Wx450Lx1500H			4
33	Blackboard	1800Wx450Lx1500H			4
34	Teacher table chair	1800Wx450Lx1500H			4
35	Printer bench	1800Wx450Lx1500H			4
36	Blackboard	1800Wx450Lx1500H			4
37	Teacher table chair	1800Wx450Lx1500H			4
38	Printer bench	1800Wx450Lx1500H			4
39	Blackboard	1800Wx450Lx1500H			4
40	Teacher table chair	1800Wx450Lx1500H			4
41	Printer bench	1800Wx450Lx1500H			4
42	Blackboard	1800Wx450Lx1500H			4
43	Teacher table chair	1800Wx450Lx1500H			4
44	Printer bench	1800Wx450Lx1500H			4
45	Blackboard	1800Wx450Lx1500H			4
46	Teacher table chair	1800Wx450Lx1500H			4
47	Printer bench	1800Wx450Lx1500H			4
48	Blackboard	1800Wx450Lx1500H			4
49	Teacher table chair	1800Wx450Lx1500H			4
50	Printer bench	1800Wx450Lx1500H			4
51	Blackboard	1800Wx450Lx1500H			4
52	Teacher table chair	1800Wx450Lx1500H			4
53	Printer bench	1800Wx450Lx1500H			4
54	Blackboard	1800Wx450Lx1500H			4
55	Teacher table chair	1800Wx450Lx1500H			4
56	Printer bench	1800Wx450Lx1500H			4
57	Blackboard	1800Wx450Lx1500H			4
58	Teacher table chair	1800Wx450Lx1500H			4
59	Printer bench	1800Wx450Lx1500H			4
60	Blackboard	1800Wx450Lx1500H			4
61	Teacher table chair	1800Wx450Lx1500H			4
62	Printer bench	1800Wx450Lx1500H			4
63	Blackboard	1800Wx450Lx1500H			4
64	Teacher table chair	1800Wx450Lx1500H			4
65	Printer bench	1800Wx450Lx1500H			4
66	Blackboard	1800Wx450Lx1500H			4
67	Teacher table chair	1800Wx450Lx1500H			4
68	Printer bench	1800Wx450Lx1500H			4
69	Blackboard	1800Wx450Lx1500H			4
70	Teacher table chair	1800Wx450Lx1500H			4
71	Printer bench	1800Wx450Lx1500H			4
72	Blackboard	1800Wx450Lx1500H			4
73	Teacher table chair	1800Wx450Lx1500H			4
74	Printer bench	1800Wx450Lx1500H			4
75	Blackboard	1800Wx450Lx1500H			4
76	Teacher table chair	1800Wx450Lx1500H			4
77	Printer bench	1800Wx450Lx1500H			4
78	Blackboard	1800Wx450Lx1500H			4
79	Teacher table chair	1800Wx450Lx1500H			4
80	Printer bench	1800Wx450Lx1500H			4
81	Blackboard	1800Wx450Lx1500H			4
82	Teacher table chair	1800Wx450Lx1500H			4
83	Printer bench	1800Wx450Lx1500H			4
84	Blackboard	1800Wx450Lx1500H			4
85	Teacher table chair	1800Wx450Lx1500H			4
86	Printer bench	1800Wx450Lx1500H			4
87	Blackboard	1800Wx450Lx1500H			4
88	Teacher table chair	1800Wx450Lx1500H			4
89	Printer bench	1800Wx450Lx1500H			4
90	Blackboard	1800Wx450Lx1500H			4
91	Teacher table chair	1800Wx450Lx1500H			4
92	Printer bench	1800Wx450Lx1500H			4
93	Blackboard	1800Wx450Lx1500H			4
94	Teacher table chair	1800Wx450Lx1500H			4
95	Printer bench	1800Wx450Lx1500H			4
96	Blackboard	1800Wx450Lx1500H			4
97	Teacher table chair	1800Wx450Lx1500H			4
98	Printer bench	1800Wx450Lx1500H			4
99	Blackboard	1800Wx450Lx1500H			4
100	Teacher table chair	1800Wx450Lx1500H			4
101	Printer bench	1800Wx450Lx1500H			4
102	Blackboard	1800Wx450Lx1500H			4
103	Teacher table chair	1800Wx450Lx1500H			4
104	Printer bench	1800Wx450Lx1500H			4
105	Blackboard	1800Wx450Lx1500H			4
106	Teacher table chair	1800Wx450Lx1500H			4
107	Printer bench	1800Wx450Lx1500H			4
108	Blackboard	1800Wx450Lx1500H			4
109	Teacher table chair	1800Wx450Lx1500H			4
110	Printer bench	1800Wx450Lx1500H			4
111	Blackboard	1800Wx450Lx1500H			4
112	Teacher table chair	1800Wx450Lx1500H			4
113	Printer bench	1800Wx450Lx1500H			4
114	Blackboard	1800Wx450Lx1500H			4
115	Teacher table chair	1800Wx450Lx1500H			4
116	Printer bench	1800Wx450Lx1500H			4
117	Blackboard	1800Wx450Lx1500H			4
118	Teacher table chair	1800Wx450Lx1500H			4
119	Printer bench	1800Wx450Lx1500H			4
120	Blackboard	1800Wx450Lx1500H			4
121	Teacher table chair	1800Wx450Lx1500H			4
122	Printer bench	1800Wx450Lx1500H			4
123	Blackboard	1800Wx450Lx1500H			4
124	Teacher table chair	1800Wx450Lx1500H			4
125	Printer bench	1800Wx450Lx1500H			4
126	Blackboard	1800Wx450Lx1500H			4
127	Teacher table chair	1800Wx450Lx1500H			4
128	Printer bench	1800Wx450Lx1500H			4
129	Blackboard	1800Wx450Lx1500H			4
130	Teacher table chair	1800Wx450Lx1500H			4
131	Printer bench	1800Wx450Lx1500H			4
132	Blackboard	1800Wx450Lx1500H			4
133	Teacher table chair	1800Wx450Lx1500H			4
134	Printer bench	1800Wx450Lx1500H			4
135	Blackboard	1800Wx450Lx1500H			4
136	Teacher table chair	1800Wx450Lx1500H			4
137	Printer bench	1800Wx450Lx1500H			4
138	Blackboard	1800Wx450Lx1500H			4
139	Teacher table chair	1800Wx450Lx1500H			4
140	Printer bench	1800Wx450Lx1500H			4
141	Blackboard	1800Wx450Lx1500H			4
142	Teacher table chair	1800Wx450Lx1500H			4
143	Printer bench	1800Wx450Lx1500H			4
144	Blackboard	1800Wx450Lx1500H			4
145	Teacher table chair	1800Wx450Lx1500H			4
146	Printer bench	1800Wx450Lx1500H			4
147	Blackboard	1800Wx450Lx1500H			4
148	Teacher table chair	1800Wx450Lx1500H			4
149	Printer bench	1800Wx450Lx1500H			4
150	Blackboard	1800Wx450Lx1500H			4

- Standard symbol
- ⊙ 240V single phase unit equip
  - ⊙ 240V single phase two outlet
  - Water supply cock
  - ⊞ 400V three-phase MCB box
  - ⊞ Active power supplies mark

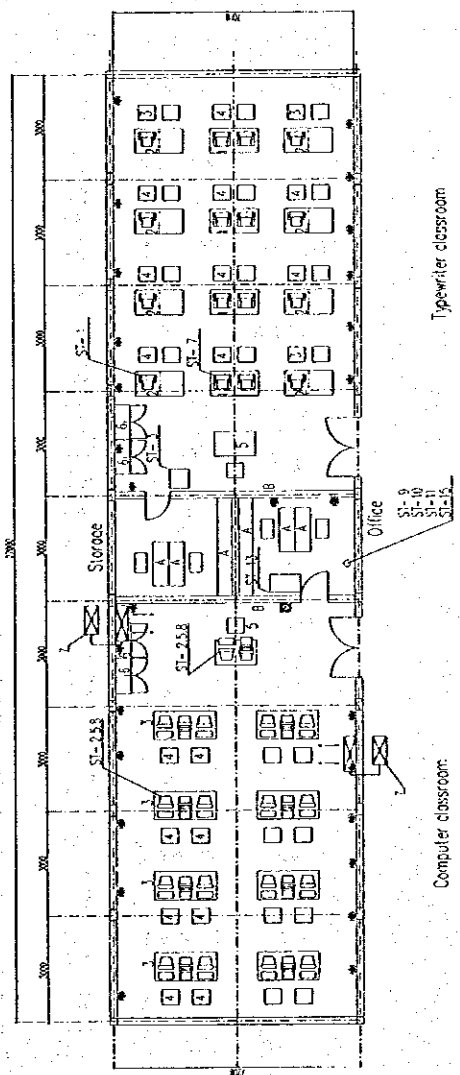

№	Name	Size and specification	Quantity
1	Work table	1500Wx700Lx850H	5
2	240V single phase unit outlet	450W	54
3	240V single phase unit outlet	1200Wx700Lx700H	3
4	Workbench	1500Wx2450Lx1900H	2
5	Workbench with key	1600Wx700Lx700H	2
6	Workbench	1600Wx700Lx700H	2
7	Standard table	1600Wx700Lx700H	2

REFERENCE KEY

Standard symbol

- ⊙ 240V single phase unit outlet
- 240V single phase two outlet
- ☐ Water supply cock
- ☒ 400V three-phase KCS box
- ☒ Active power supplies main

- A Blackboard
- B Standard sewing machine
- C Tailor's table chair

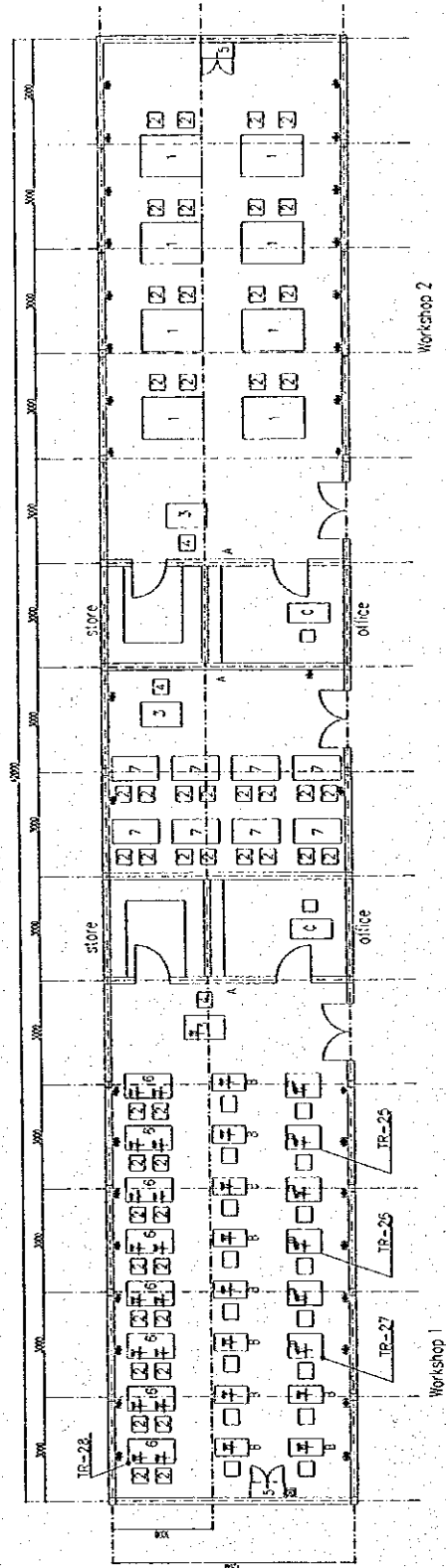

Drawing No. 29 December, 1999

Block 7

TITLE Tailoring workshop

S=1/100



Symbol	Quantity	Description	Notes
1	1	240V single phase unit outlet	
2	1	240V three-phase MCB box	
3	1	Water supply cock	
4	1	Active power supplies mark	
5	1	Office	
6	1	Maintenance workshop	
7	1	Theory room	
8	1	Workshop (domestic)	
9	1	Workshop (industrial)	
10	1	Office maintenance	
11	1	Store	
12	1	Slope	
13	1	AC-1	
14	1	AC-2	
15	1	AC-3	
16	1	AC-4	
17	1	AC-5	
18	1	AC-6	
19	1	AC-7	
20	1	AC-8	
21	1	AC-9	
22	1	AC-10	
23	1	AC-11	
24	1	AC-12	
25	1	AC-13	
26	1	AC-14	
27	1	AC-15	
28	1	AC-16	
29	1	AC-17	
30	1	AC-18	
31	1	AC-19	
32	1	AC-20	
33	1	AC-21	
34	1	AC-22	
35	1	AC-23	
36	1	AC-24	
37	1	AC-25	
38	1	AC-26	
39	1	AC-27	
40	1	AC-28	
41	1	AC-29	
42	1	AC-30	
43	1	AC-31	
44	1	AC-32	
45	1	AC-33	
46	1	AC-34	
47	1	AC-35	
48	1	AC-36	
49	1	AC-37	
50	1	AC-38	
51	1	AC-39	
52	1	AC-40	
53	1	AC-41	
54	1	AC-42	
55	1	AC-43	
56	1	AC-44	
57	1	AC-45	
58	1	AC-46	
59	1	AC-47	
60	1	AC-48	
61	1	AC-49	
62	1	AC-50	
63	1	AC-51	
64	1	AC-52	
65	1	AC-53	
66	1	AC-54	
67	1	AC-55	
68	1	AC-56	
69	1	AC-57	
70	1	AC-58	
71	1	AC-59	
72	1	AC-60	
73	1	AC-61	
74	1	AC-62	
75	1	AC-63	
76	1	AC-64	
77	1	AC-65	
78	1	AC-66	
79	1	AC-67	
80	1	AC-68	
81	1	AC-69	
82	1	AC-70	
83	1	AC-71	
84	1	AC-72	
85	1	AC-73	
86	1	AC-74	
87	1	AC-75	
88	1	AC-76	
89	1	AC-77	
90	1	AC-78	
91	1	AC-79	
92	1	AC-80	
93	1	AC-81	
94	1	AC-82	
95	1	AC-83	
96	1	AC-84	
97	1	AC-85	
98	1	AC-86	
99	1	AC-87	
100	1	AC-88	
101	1	AC-89	
102	1	AC-90	
103	1	AC-91	
104	1	AC-92	
105	1	AC-93	
106	1	AC-94	
107	1	AC-95	
108	1	AC-96	
109	1	AC-97	
110	1	AC-98	
111	1	AC-99	
112	1	AC-100	

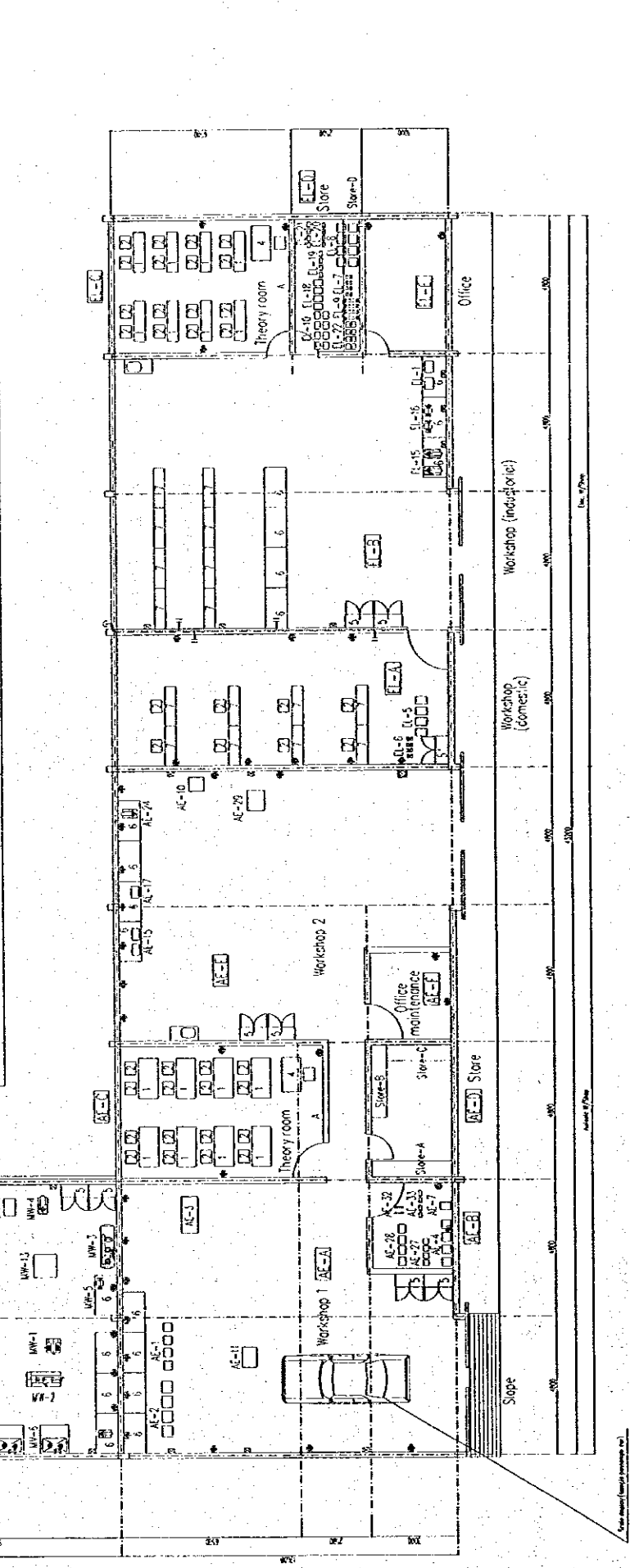

Scale display (sample passenger car)

Drawing No.	29 December 1959
Block	12
TITLE	Auto electrical / Electric / Maintenance w/Shop

Standard symbol

- ⊙ 240V single phase unit outlet
- ⊕ 240V three-phase MCB box
- ⊠ Water supply cock
- ⊡ Active power supplies mark

REFERENCE KEY

No.	Name	Size and specification	Quantity	Remarks
1	System Load	1.000 x 0.001 x 0.001	8	
2	System Load	1.000 x 0.001 x 0.001	8	
3	System Load	1.000 x 0.001 x 0.001	8	
4	System Load	1.000 x 0.001 x 0.001	8	
5	System Load	1.000 x 0.001 x 0.001	8	
6	System Load	1.000 x 0.001 x 0.001	8	
7	System Load	1.000 x 0.001 x 0.001	8	
8	System Load	1.000 x 0.001 x 0.001	8	
9	System Load	1.000 x 0.001 x 0.001	8	
10	System Load	1.000 x 0.001 x 0.001	8	
11	System Load	1.000 x 0.001 x 0.001	8	
12	System Load	1.000 x 0.001 x 0.001	8	
13	System Load	1.000 x 0.001 x 0.001	8	
14	System Load	1.000 x 0.001 x 0.001	8	
15	System Load	1.000 x 0.001 x 0.001	8	
16	System Load	1.000 x 0.001 x 0.001	8	
17	System Load	1.000 x 0.001 x 0.001	8	
18	System Load	1.000 x 0.001 x 0.001	8	
19	System Load	1.000 x 0.001 x 0.001	8	
20	System Load	1.000 x 0.001 x 0.001	8	
21	System Load	1.000 x 0.001 x 0.001	8	
22	System Load	1.000 x 0.001 x 0.001	8	
23	System Load	1.000 x 0.001 x 0.001	8	
24	System Load	1.000 x 0.001 x 0.001	8	
25	System Load	1.000 x 0.001 x 0.001	8	
26	System Load	1.000 x 0.001 x 0.001	8	
27	System Load	1.000 x 0.001 x 0.001	8	
28	System Load	1.000 x 0.001 x 0.001	8	
29	System Load	1.000 x 0.001 x 0.001	8	
30	System Load	1.000 x 0.001 x 0.001	8	
31	System Load	1.000 x 0.001 x 0.001	8	
32	System Load	1.000 x 0.001 x 0.001	8	
33	System Load	1.000 x 0.001 x 0.001	8	
34	System Load	1.000 x 0.001 x 0.001	8	
35	System Load	1.000 x 0.001 x 0.001	8	
36	System Load	1.000 x 0.001 x 0.001	8	
37	System Load	1.000 x 0.001 x 0.001	8	
38	System Load	1.000 x 0.001 x 0.001	8	
39	System Load	1.000 x 0.001 x 0.001	8	
40	System Load	1.000 x 0.001 x 0.001	8	
41	System Load	1.000 x 0.001 x 0.001	8	
42	System Load	1.000 x 0.001 x 0.001	8	
43	System Load	1.000 x 0.001 x 0.001	8	
44	System Load	1.000 x 0.001 x 0.001	8	
45	System Load	1.000 x 0.001 x 0.001	8	
46	System Load	1.000 x 0.001 x 0.001	8	
47	System Load	1.000 x 0.001 x 0.001	8	
48	System Load	1.000 x 0.001 x 0.001	8	
49	System Load	1.000 x 0.001 x 0.001	8	
50	System Load	1.000 x 0.001 x 0.001	8	
51	System Load	1.000 x 0.001 x 0.001	8	
52	System Load	1.000 x 0.001 x 0.001	8	
53	System Load	1.000 x 0.001 x 0.001	8	
54	System Load	1.000 x 0.001 x 0.001	8	
55	System Load	1.000 x 0.001 x 0.001	8	
56	System Load	1.000 x 0.001 x 0.001	8	
57	System Load	1.000 x 0.001 x 0.001	8	
58	System Load	1.000 x 0.001 x 0.001	8	
59	System Load	1.000 x 0.001 x 0.001	8	
60	System Load	1.000 x 0.001 x 0.001	8	
61	System Load	1.000 x 0.001 x 0.001	8	
62	System Load	1.000 x 0.001 x 0.001	8	
63	System Load	1.000 x 0.001 x 0.001	8	
64	System Load	1.000 x 0.001 x 0.001	8	
65	System Load	1.000 x 0.001 x 0.001	8	
66	System Load	1.000 x 0.001 x 0.001	8	
67	System Load	1.000 x 0.001 x 0.001	8	
68	System Load	1.000 x 0.001 x 0.001	8	
69	System Load	1.000 x 0.001 x 0.001	8	
70	System Load	1.000 x 0.001 x 0.001	8	
71	System Load	1.000 x 0.001 x 0.001	8	
72	System Load	1.000 x 0.001 x 0.001	8	
73	System Load	1.000 x 0.001 x 0.001	8	
74	System Load	1.000 x 0.001 x 0.001	8	
75	System Load	1.000 x 0.001 x 0.001	8	
76	System Load	1.000 x 0.001 x 0.001	8	
77	System Load	1.000 x 0.001 x 0.001	8	
78	System Load	1.000 x 0.001 x 0.001	8	
79	System Load	1.000 x 0.001 x 0.001	8	
80	System Load	1.000 x 0.001 x 0.001	8	
81	System Load	1.000 x 0.001 x 0.001	8	
82	System Load	1.000 x 0.001 x 0.001	8	
83	System Load	1.000 x 0.001 x 0.001	8	
84	System Load	1.000 x 0.001 x 0.001	8	
85	System Load	1.000 x 0.001 x 0.001	8	
86	System Load	1.000 x 0.001 x 0.001	8	
87	System Load	1.000 x 0.001 x 0.001	8	
88	System Load	1.000 x 0.001 x 0.001	8	
89	System Load	1.000 x 0.001 x 0.001	8	
90	System Load	1.000 x 0.001 x 0.001	8	
91	System Load	1.000 x 0.001 x 0.001	8	
92	System Load	1.000 x 0.001 x 0.001	8	
93	System Load	1.000 x 0.001 x 0.001	8	
94	System Load	1.000 x 0.001 x 0.001	8	
95	System Load	1.000 x 0.001 x 0.001	8	
96	System Load	1.000 x 0.001 x 0.001	8	
97	System Load	1.000 x 0.001 x 0.001	8	
98	System Load	1.000 x 0.001 x 0.001	8	
99	System Load	1.000 x 0.001 x 0.001	8	
100	System Load	1.000 x 0.001 x 0.001	8	

No	Name	Size and specification	Wiring	Fabrication	Quantity
1	Student table	1400W x 400L x 750H	15	3	8
2	Student chair				16
3	Leather table chair	1200W x 700L x 700H	1	1	2
4	Wood cabinet with key	1000W x 450L x 1200H	2	2	4
5	Wool bench	1400W x 200L x 500H	5	3	15
6	Blackboard				Existing

REFERENCE KEY

Standard symbol

- ⊙ 240V single phase unit outlet
- ⊙ 240V single phase two outlet
- Water supply cock
- ⊠ 400V three-phase MCB box
- ⊠ Active power supplies mark

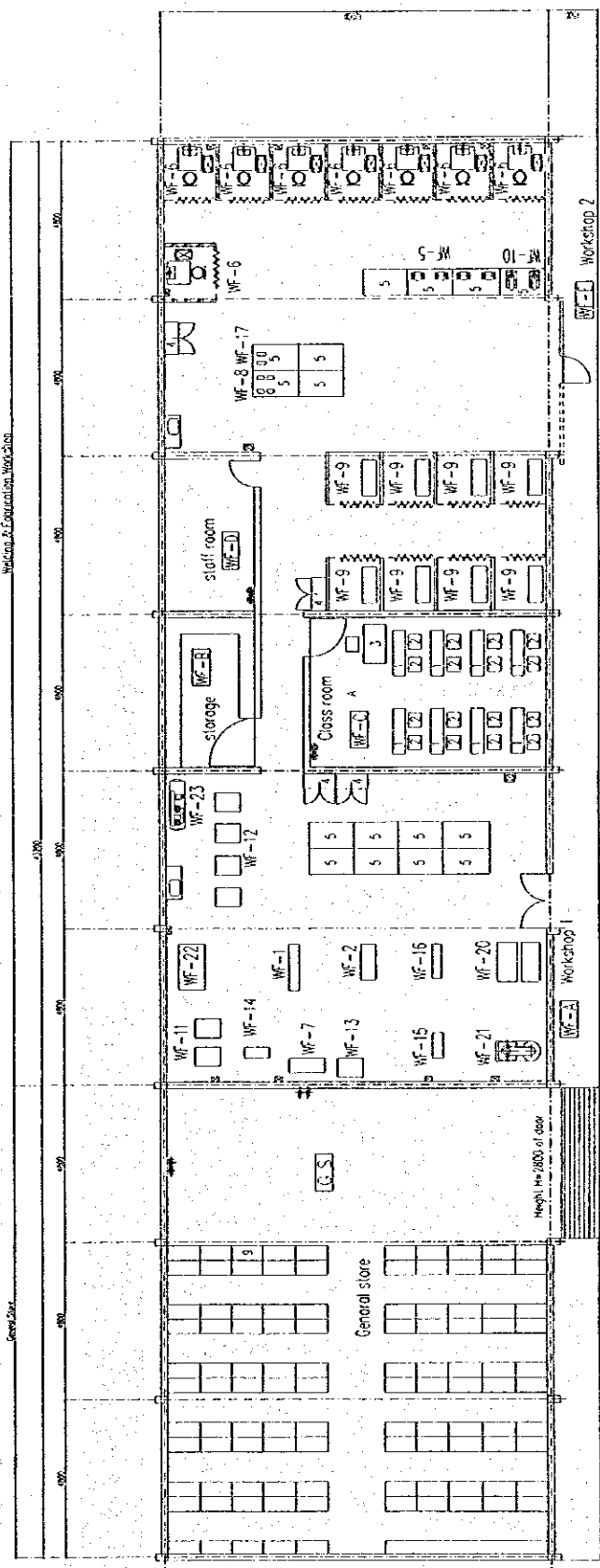

Drawing No. 29 December, 1999

Block 15

TITLE

General store/Welding & Fabrication w/stop

S=1/100



Code	Symbol	Quantity	Notes
1	1	1	Computer
2	2	1	Physical reference
3	3	1	Physical reference
4	4	1	Physical reference
5	5	1	Physical reference
6	6	1	Physical reference
7	7	1	Physical reference
8	8	1	Physical reference
9	9	1	Physical reference
10	10	1	Physical reference
11	11	1	Physical reference
12	12	1	Physical reference
13	13	1	Physical reference
14	14	1	Physical reference
15	15	1	Physical reference
16	16	1	Physical reference
17	17	1	Physical reference
18	18	1	Physical reference
19	19	1	Physical reference
20	20	1	Physical reference
21	21	1	Physical reference
22	22	1	Physical reference
23	23	1	Physical reference
24	24	1	Physical reference
25	25	1	Physical reference
26	26	1	Physical reference
27	27	1	Physical reference
28	28	1	Physical reference
29	29	1	Physical reference
30	30	1	Physical reference

Id	Name	500000 specification	Physical laboratory	Science laboratory	Capacity
1	Central chair	450H	32	32	64
2	Wood cabinet with key	1000W x 500L x 1800H	2	2	4
3	Teacher table chair	1200W x 700L x 700H	1	1	2
4					
5					
6					
7					
8					
9					
10					
11					
12					
13					
14					
15					
16					
17					
18					
19					
20					
21					
22					
23					
24					
25					
26					
27					
28					
29					
30					

REFERENCE KEY

Standard symbol

- ⊙ 240V single phase unit outlet
- ⊙ 240V single phase two outlet
- Water supply cock
- ⊠ 400V three-phase VCB box
- ⊞ Active power supplies mark

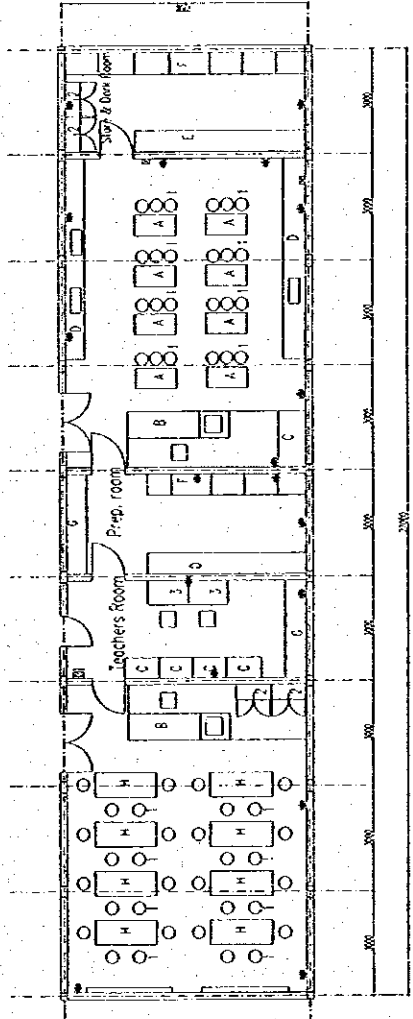

Science laboratory

Physical laboratory

Drawing No.	29-December, 1999	S-1/100
Block	4	
TITLE	Science Laboratory	





REFERENCE KEY

No.	Name	Size and Specification	Quantity
1	Legging's table chair	1700W x 700L x 700H	5
2	General chair	450mm	48
3	Wood cabinet	1000W x 450L x 1300H	3
4	Double desk	1400W x 700L x 700H	24

Standard symbol

- ⊕ 240V single phase unit outlet
- ⊙ 240V single phase two outlet
- ⊖ Water supply cock
- ⊗ 400V three-phase MCB box
- ⊠ Active power supplies mark

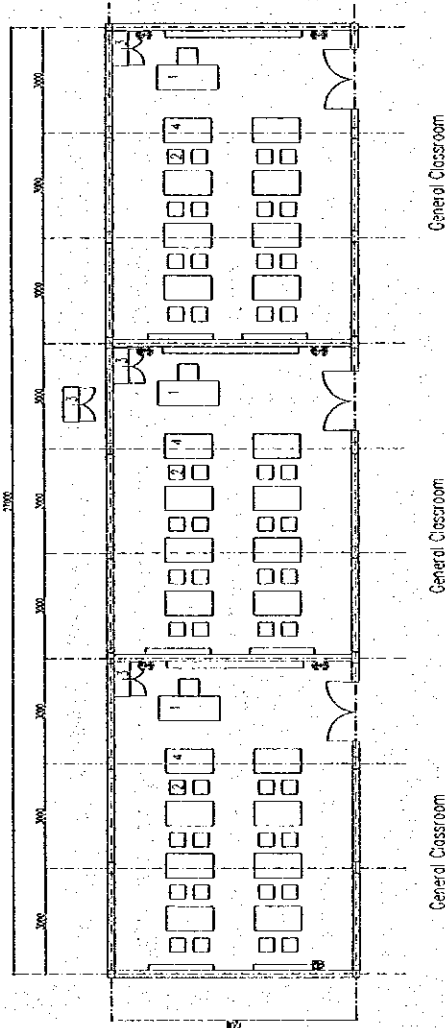

Drawing No. 29 December, 1999 S=1/100

Block 3

TITLE General Classrooms

REFERENCE KEY

Symbol	Material	Quantity
1	Concrete	1000
2	Brick	2000
3	Block	1500
4	Plaster	1000
5	Paint	500
6	Wood	1000
7	Steel	1000
8	Aluminum	1000
9	Glass	1000
10	Insulation	1000
11	Roofing	1000
12	Electrical	1000
13	Plumbing	1000
14	Mechanical	1000
15	Other	1000

Q1 floor overhead machine parts storage storage

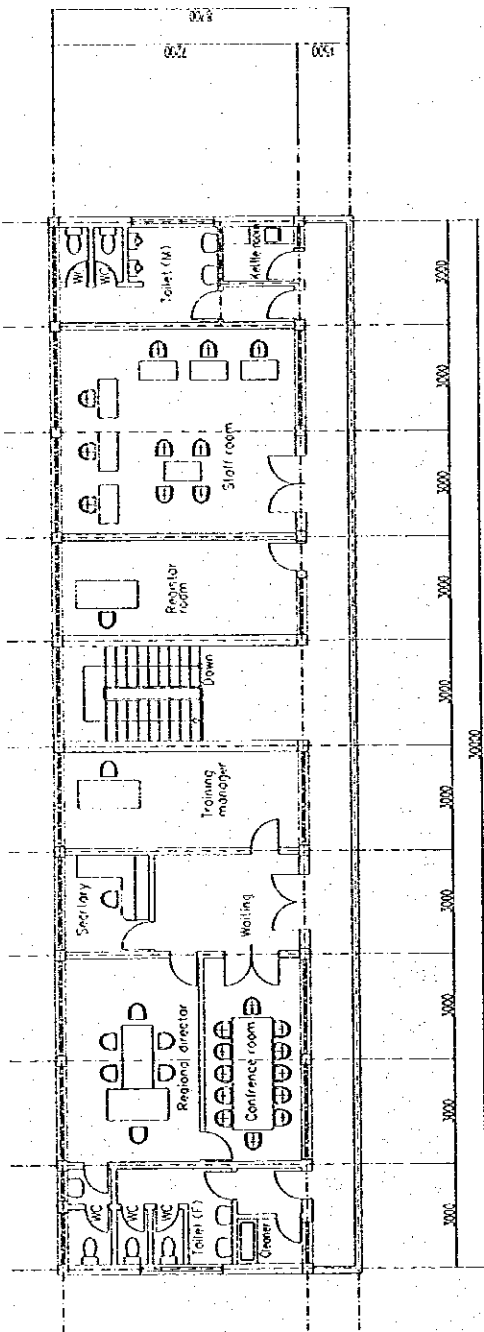

FIRST FLOOR

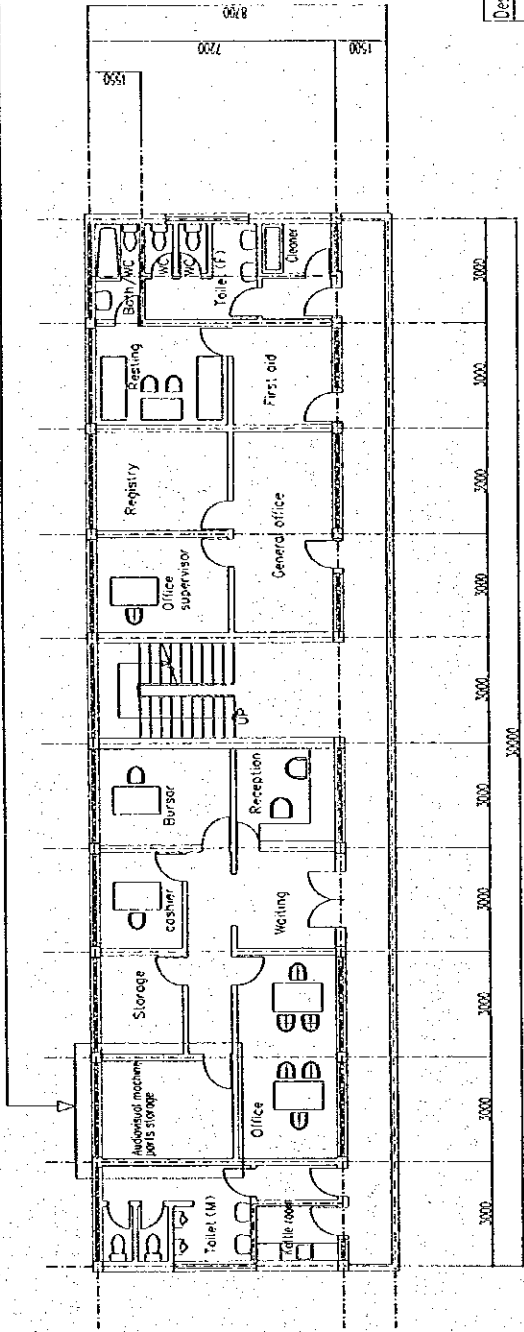

GROUND FLOOR

Design day: 29 December, 1999  
 Block: 1  
 Title: Administration  
 Scale: S=1/100

Cooking and food processing  
REFERENCE KEY

No.	Name	Size and Specification	Quantity
1	Sink	460Wx600Lx850H	1
2	Bin	1500Wx1500Lx1000H	2
3	Bin	600Wx500Lx500H	2
4	Bin	1000Wx600Lx500H	1

Standard symbol

- ⊙ 240V single phase unit outlet
- 240V single phase two outlet
- Water supply cock
- ⊠ 400V three-phase MCB box
- ⊞ Active power supplies mark

Code	Description	Quantity
SC-1	18" Hot Larder (1000) (2000) and counter top	1
SC-2	Freezer	1
SC-3	2000Wx1000Lx1000H	1
SC-4	2000Wx1000Lx1000H	1
SC-5	2000Wx1000Lx1000H	1
SC-6	2000Wx1000Lx1000H	1
SC-7	2000Wx1000Lx1000H	1
SC-8	2000Wx1000Lx1000H	1
SC-9	2000Wx1000Lx1000H	1
SC-10	2000Wx1000Lx1000H	1
SC-11	2000Wx1000Lx1000H	1
SC-12	2000Wx1000Lx1000H	1
SC-13	2000Wx1000Lx1000H	1
SC-14	2000Wx1000Lx1000H	1
SC-15	2000Wx1000Lx1000H	1
SC-16	2000Wx1000Lx1000H	1
SC-17	2000Wx1000Lx1000H	1
SC-18	2000Wx1000Lx1000H	1
SC-19	2000Wx1000Lx1000H	1
SC-20	2000Wx1000Lx1000H	1
SC-21	2000Wx1000Lx1000H	1
SC-22	2000Wx1000Lx1000H	1
SC-23	2000Wx1000Lx1000H	1
SC-24	2000Wx1000Lx1000H	1
SC-25	2000Wx1000Lx1000H	1
SC-26	2000Wx1000Lx1000H	1
SC-27	2000Wx1000Lx1000H	1
SC-28	2000Wx1000Lx1000H	1
SC-29	2000Wx1000Lx1000H	1
SC-30	2000Wx1000Lx1000H	1
SC-31	2000Wx1000Lx1000H	1
SC-32	2000Wx1000Lx1000H	1
SC-33	2000Wx1000Lx1000H	1
SC-34	2000Wx1000Lx1000H	1
SC-35	2000Wx1000Lx1000H	1
SC-36	2000Wx1000Lx1000H	1
SC-37	2000Wx1000Lx1000H	1
SC-38	2000Wx1000Lx1000H	1
SC-39	2000Wx1000Lx1000H	1
SC-40	2000Wx1000Lx1000H	1
SC-41	2000Wx1000Lx1000H	1
SC-42	2000Wx1000Lx1000H	1
SC-43	2000Wx1000Lx1000H	1
SC-44	2000Wx1000Lx1000H	1
SC-45	2000Wx1000Lx1000H	1
SC-46	2000Wx1000Lx1000H	1
SC-47	2000Wx1000Lx1000H	1
SC-48	2000Wx1000Lx1000H	1
SC-49	2000Wx1000Lx1000H	1
SC-50	2000Wx1000Lx1000H	1
SC-51	2000Wx1000Lx1000H	1
SC-52	2000Wx1000Lx1000H	1
SC-53	2000Wx1000Lx1000H	1
SC-54	2000Wx1000Lx1000H	1
SC-55	2000Wx1000Lx1000H	1
SC-56	2000Wx1000Lx1000H	1
SC-57	2000Wx1000Lx1000H	1
SC-58	2000Wx1000Lx1000H	1
SC-59	2000Wx1000Lx1000H	1
SC-60	2000Wx1000Lx1000H	1
SC-61	2000Wx1000Lx1000H	1
SC-62	2000Wx1000Lx1000H	1
SC-63	2000Wx1000Lx1000H	1
SC-64	2000Wx1000Lx1000H	1
SC-65	2000Wx1000Lx1000H	1
SC-66	2000Wx1000Lx1000H	1
SC-67	2000Wx1000Lx1000H	1
SC-68	2000Wx1000Lx1000H	1
SC-69	2000Wx1000Lx1000H	1
SC-70	2000Wx1000Lx1000H	1
SC-71	2000Wx1000Lx1000H	1
SC-72	2000Wx1000Lx1000H	1
SC-73	2000Wx1000Lx1000H	1
SC-74	2000Wx1000Lx1000H	1
SC-75	2000Wx1000Lx1000H	1
SC-76	2000Wx1000Lx1000H	1
SC-77	2000Wx1000Lx1000H	1
SC-78	2000Wx1000Lx1000H	1
SC-79	2000Wx1000Lx1000H	1
SC-80	2000Wx1000Lx1000H	1
SC-81	2000Wx1000Lx1000H	1
SC-82	2000Wx1000Lx1000H	1
SC-83	2000Wx1000Lx1000H	1
SC-84	2000Wx1000Lx1000H	1
SC-85	2000Wx1000Lx1000H	1
SC-86	2000Wx1000Lx1000H	1
SC-87	2000Wx1000Lx1000H	1
SC-88	2000Wx1000Lx1000H	1
SC-89	2000Wx1000Lx1000H	1
SC-90	2000Wx1000Lx1000H	1
SC-91	2000Wx1000Lx1000H	1
SC-92	2000Wx1000Lx1000H	1
SC-93	2000Wx1000Lx1000H	1
SC-94	2000Wx1000Lx1000H	1
SC-95	2000Wx1000Lx1000H	1
SC-96	2000Wx1000Lx1000H	1
SC-97	2000Wx1000Lx1000H	1
SC-98	2000Wx1000Lx1000H	1
SC-99	2000Wx1000Lx1000H	1
SC-100	2000Wx1000Lx1000H	1

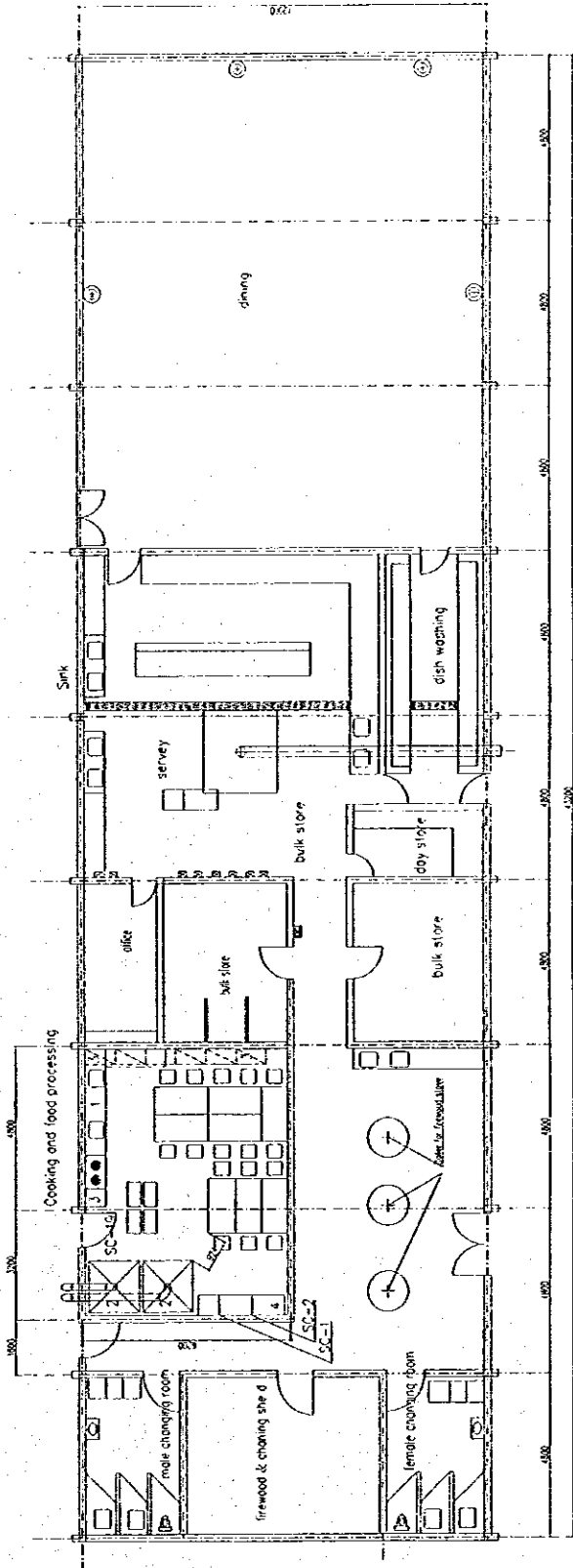

Drawing No.	29 December, 1999	S=1/100
Block	10	
TITLE	Kitchen / Dining	