

5. COST ESTIMATION BORNE BY THE PALESTINIAN AUTHORITY

Cost to be Borne by Palestinian Authority (1)

WORKS	Unit	Unit Price (US\$)	No 19B		No 20B		No 21B		No 22B		No 23		No 24		No 25B		No 26B		No 27		No 28B		No 29		Total of Phase 1	
			AL-MAHD		SA'IR		AL-MOQATA'AH		TARQOMIA		KHARAS		HABIEL AL-REYAH		ABU-ROMMAN		MOTAH		RAQA AL-JADIDAH		AL-TIAHFERIA		IHNA		Quantity	Amount(US\$)
			Quantity	Amount(US\$)	Quantity	Amount(US\$)	Quantity	Amount(US\$)	Quantity	Amount(US\$)	Quantity	Amount(US\$)	Quantity	Amount(US\$)	Quantity	Amount(US\$)	Quantity	Amount(US\$)	Quantity	Amount(US\$)	Quantity	Amount(US\$)	Quantity	Amount(US\$)		
1 Site Preparation																										
1) Site Leveling, Cut & Fills	m3	10.00	0	0.00	0	0.00	0	0.00	0	0.00	0	0.00	0	0.00	0	0.00	0	0.00	0	0.00	0	0.00	0	0.00	0	0.00
2) Earth Work, Construction of Retaining Wall																										
Excavation, Backfill & Disposal of Excavated Soil	m3	10.00	0	0.00	0	0.00	0	0.00	0	0.00	0	0.00	0	0.00	0	0.00	0	0.00	0	0.00	0	0.00	0	0.00	0	0.00
Reinforced Concrete	m3	190.00	0	0.00	0	0.00	0	0.00	0	0.00	0	0.00	0	0.00	0	0.00	0	0.00	0	0.00	0	0.00	0	0.00	0	0.00
Subtotal				0.00		0.00		0.00		0.00		0.00		0.00		0.00		0.00		0.00		0.00		0.00		0.00
2 Construction of Access Road W=6m, Compacted with Grav	m	60.00	0	0.00	0	0.00	0	0.00	0	0.00	0	0.00	0	0.00	0	0.00	0	0.00	0	0.00	0	0.00	0	0.00	0	0.00
Subtotal				0.00		0.00		0.00		0.00		0.00		0.00		0.00		0.00		0.00		0.00		0.00		0.00
3 Construction of Gate & Fence																										
1) Site Boundary Wall with Foundation, Made of C B, T = 200mm, H = 2.5m	m	190.00	0	0.00	335	63,650.00	0	0.00	175	33,250.00	47	8,930.00	0	0.00	0	0.00	182	34,580.00	258	49,020.00	0	0.00	273	51,870.00	1,270	241,300.00
2) Site Boundary Wall on Retaining Wall, Made of C B, T = 200mm, H = 2.5m	m	30.00	196	5,880.00	0	0.00	245	7,350.00	0	0.00	107	3,210.00	219	6,570.00	151	4,530.00	92	2,760.00	27	810.00	0	0.00	0	0.00	1,037	31,110.00
3) Steel Grill Gate, 4.0m x 2.5m, O.P.	set	1,430.00	1	1,430.00	1	1,430.00	1	1,430.00	1	1,430.00	1	1,430.00	1	1,430.00	1	1,430.00	1	1,430.00	1	1,430.00	1	1,430.00	1	1,430.00	11	15,730.00
Subtotal				7,310.00		65,080.00		8,780.00		34,680.00		13,570.00		8,000.00		5,960.00		38,770.00		51,260.00		1,430.00		53,300.00		288,140.00
4 Plumbing & Electrical Work																										
1) Piping for Water Supply D=50mm	m	20.00	10	200.00	10	200.00	10	200.00	10	200.00	80	1,600.00	10	200.00	100	2,000.00	10	200.00	150	3,000.00	10	200.00	10	200.00	410	8,200.00
2) Connection of Sewage, Manhole D=150mm	piece	220.00	0	0.00	0	0.00	0	0.00	0	0.00	0	0.00	2	440.00	0	0.00	0	0.00	0	0.00	0	0.00	0	0.00	2	440.00
	m	40.00	10	400.00	0	0.00	0	0.00	0	0.00	0	0.00	60	2,400.00	0	0.00	0	0.00	0	0.00	0	0.00	0	0.00	70	2,800.00
3) Intake of Electricity Poles	piece	370.00	0	0.00	0	0.00	0	0.00	0	0.00	1	370.00	0	0.00	2	740.00	0	0.00	3	1,110.00	0	0.00	0	0.00	6	2,220.00
Wire	m	30.00	10	300.00	10	300.00	10	300.00	10	300.00	50	1,500.00	10	300.00	100	3,000.00	10	300.00	150	4,500.00	10	300.00	10	300.00	380	11,400.00
Electrical Meter	piece	260.00	1	260.00	1	260.00	1	260.00	1	260.00	1	260.00	1	260.00	1	260.00	1	260.00	1	260.00	1	260.00	1	260.00	11	2,860.00
4) Connection of Telephone Poles	piece	370.00	0	0.00	0	0.00	0	0.00	0	0.00	40	14,800.00	0	0.00	2	740.00	0	0.00	3	1,110.00	0	0.00	0	0.00	45	16,650.00
Wire	m	20.00	10	200.00	10	200.00	0	0.00	10	200.00	2,000	40,000.00	10	200.00	100	2,000.00	10	200.00	150	3,000.00	10	200.00	10	200.00	2,320	46,400.00
Subtotal				1,360.00		960.00		760.00		960.00		58,530.00		3,860.00		8,740.00		960.00		12,980.00		960.00		960.00		90,970.00
5 Exterior Work																										
1) Pavement Work, Asphalt pavement for access	m2	20.00	741	14,820.00	319	6,380.00	327	6,540.00	556	11,120.00	116	2,320.00	526	10,520.00	594	11,880.00	281	5,620.00	682	13,640.00	273	5,460.00	297	5,940.00	4,712	94,240.00
Concrete Pavement for Plasy Gropund	m2	35.00	600	21,000.00	600	21,000.00	0	0.00	698	24,430.00	0	0.00	0	0.00	0	0.00	600	21,000.00	600	21,000.00	600	21,000.00	600	21,000.00	4,298	150,430.00
Interlocking Pavement	m2	18.00	857	15,426.00	207	3,726.00	507	9,126.00	387	6,966.00	184	3,312.00	929	16,722.00	132	2,376.00	382	6,876.00	328	5,904.00	249	4,482.00	548	9,864.00	4,710	84,780.00
2) Basketball with Goal Board	set	1,000.00	1	1,000.00	1	1,000.00	0	0.00	1	1,000.00	0	0.00	0	0.00	0	0.00	1	1,000.00	1	1,000.00	1	1,000.00	1	1,000.00	7	7,000.00
White Lines	set	280.00	1	280.00	1	280.00	0	0.00	1	280.00	0	0.00	0	0.00	0	0.00	1	280.00	1	280.00	1	280.00	1	280.00	7	1,960.00
Subtotal				52,526.00		32,386.00		15,666.00		43,796.00		5,632.00		27,242.00		14,256.00		34,776.00		41,824.00		32,222.00		38,684.00		338,410.00
Total				61,196.00		98,426.00		25,206.00		79,436.00		77,732.00		39,042.00		28,956.00		74,506.00		106,064.00		34,612.00		92,344.00		717,520.00

Cost to be Borne by Palestinian Authority (2)

WORKS	Unit	Unit Price (US\$)	No 7B		No 8		No 9		No 11		No 14		No 16		No 17B		No 18		Total of Phase II		
			AL-HAY AL-JANOUBY		AL-HADIQA		DAIR ISTIA		AQRABA		BETONIA		BIFLUQIA		ANATA		AL-NWAIMEH				
			Quantity	Amount(US\$)	Quantity	Amount(US\$)	Quantity	Amount(US\$)	Quantity	Amount(US\$)	Quantity	Amount(US\$)	Quantity	Amount(US\$)	Quantity	Amount(US\$)	Quantity	Amount(US\$)	Quantity	Amount(US\$)	Quantity
1 Site Preparation																					
1) Site Leveling, Cut & Fills	m3	10.00	0	0.00	0	0.00	0	0.00	0	0.00	2,000	20,000.00	0	0.00	2,700	27,000.00	0	0.00	4,700	47,000.00	
2) Earth Work; Construction of Retaining Wall																					
Excavation, Backfill & Disposal of Excavated Soil	m3	10.00	0	0.00	0	0.00	0	0.00	0	0.00	497	4,970.00	0	0.00	0	0.00	0	0.00	497	4,970.00	
Reinforced Concrete	m3	190.00	0	0.00	0	0.00	0	0.00	0	0.00	303	57,570.00	0	0.00	0	0.00	0	0.00	303	57,570.00	
Subtotal				0.00		0.00		0.00		0.00		82,540.00		0.00		27,000.00		0.00		109,540.00	
2 Construction of Access Road W=6m, Compacted with Grav.																					
	m	60.00	0	0.00	0	0.00	70	4,200.00	0	0.00	0	0.00	0	0.00	0	0.00	0	0.00	70	4,200.00	
Subtotal				0.00		0.00		4,200.00		0.00		0.00		0.00		0.00		0.00		4,200.00	
3 Construction of Gate & Fence																					
1) Site Boundary Wall with Foundation, Made of C B, T = 200mm, H = 2.5m	m	190.00	169	32,110.00	165	31,350.00	162	30,780.00	0	0.00	0	0.00	48	9,120.00	322	61,180.00	168	31,920.00	1,034	196,460.00	
2) Site Boundary Wall on Retaining Wall, Made of C B, T = 200mm, H = 2.5m	m	30.00	0	0.00	0	0.00	48	1,440.00	0	0.00	0	0.00	74	2,220.00	0	0.00	79	2,370.00	201	6,030.00	
3) Steel Grill Gate, 4.0m x 2.5m, O.P.	set	1,430.00	1	1,430.00	1	1,430.00	1	1,430.00	1	1,430.00	1	1,430.00	1	1,430.00	1	1,430.00	1	1,430.00	8	11,440.00	
Subtotal				33,540.00		32,780.00		33,650.00		1,430.00		1,430.00		12,770.00		62,610.00		35,720.00		213,930.00	
4 Plumbing & Electrical Work																					
1) Piping for Water Supply D=50mm	m	20.00	10	200.00	10	200.00	70	1,400.00	0	0.00	10	200.00	10	200.00	10	200.00	10	200.00	130	2,600.00	
2) Connection of Sewage; Manhole																					
D=150mm	m	40.00	10	400.00	10	400.00	0	0.00	0	0.00	0	0.00	0	0.00	0	0.00	0	0.00	20	800.00	
3) Intake of Electricity																					
Poles	piece	370.00	0	0.00	0	0.00	2	740.00	0	0.00	0	0.00	0	0.00	0	0.00	0	0.00	2	740.00	
Wire	m	30.00	10	300.00	10	300.00	80	2,400.00	10	300.00	10	300.00	10	300.00	10	300.00	10	300.00	150	4,500.00	
Electrical Meter	piece	260.00	1	260.00	1	260.00	1	260.00	1	260.00	1	260.00	1	260.00	1	260.00	1	260.00	8	2,080.00	
4) Connection of Telephone																					
Poles	piece	370.00	0	0.00	0	0.00	2	740.00	0	0.00	0	0.00	0	0.00	0	0.00	0	0.00	2	740.00	
Wire	m	20.00	10	200.00	10	200.00	80	1,600.00	0	0.00	10	200.00	0	0.00	10	200.00	10	200.00	130	2,600.00	
Subtotal				1,360.00		1,360.00		7,140.00		560.00		960.00		760.00		960.00		960.00		14,060.00	
5 Exterior Work																					
1) Pavement Work; Asphalt pavement for access																					
	m2	20.00	304	6,080.00	353	7,060.00	389	7,780.00	302	6,040.00	130	2,600.00	211	4,220.00	582	11,640.00	619	12,380.00	2,890	57,800.00	
Concrete Pavement for Pasy Gropund																					
	m2	35.00	669	23,415.00	600	21,000.00	600	21,000.00	600	21,000.00	0	0.00	600	21,000.00	600	21,000.00	600	21,000.00	4,269	149,415.00	
Interlocking Pavement																					
	m2	18.00	344	6,192.00	715	12,870.00	342	6,156.00	688	12,384.00	312	5,616.00	354	6,372.00	234	4,212.00	208	3,744.00	3,197	57,546.00	
2) Baseket Ball with Goal Board																					
	set	1,000.00	1	1,000.00	1	1,000.00	1	1,000.00	1	1,000.00	0	0.00	1	1,000.00	1	1,000.00	1	1,000.00	7	7,000.00	
White Lines																					
	set	280.00	1	280.00	1	280.00	1	280.00	1	280.00	0	0.00	1	280.00	1	280.00	1	280.00	7	1,960.00	
Subtotal				36,967.00		42,210.00		36,216.00		40,704.00		8,216.00		32,872.00		38,132.00		38,404.00		273,721.00	
Total				71,867.00		76,350.00		81,206.00		42,694.00		93,146.00		46,402.00		128,702.00		75,084.00		615,451.00	

Cost to be Borne by Palestinian Authority (3)

WORKS	Unit	Unit Price (US\$)	No 1		No 2B		No 3		No 6		No.10		No.12B		Total of Phase III		Grand Total	
			TUBAS PRIM		SFEREES		JENIN PRIM		BAQA SHARQIA		AL-MA AJFEN		RAFFEDIA		Quantity	Amount(US\$)	Quantity	Amount(US\$)
			Quantity	Amount(US\$)	Quantity	Amount(US\$)	Quantity	Amount(US\$)	Quantity	Amount(US\$)	Quantity	Amount(US\$)	Quantity	Amount(US\$)				
1 Site Preparation																		
1) Site Leveling, Cut & Fills	m3	10.00	0	0.00	0	0.00	0	0.00	0	0.00	0	0.00	3,360	33,600.00	3,360	33,600.00	8,060	80,600.00
2) Earth Work, Construction of Retaining Wall																		
Excavation, Backfill & Disposal of Excavated Soil	m3	10.00	0	0.00	0	0.00	0	0.00	0	0.00	0	0.00	252	2,520.00	252	2,520.00	749	7,490.00
Reinforced Concrete	m3	190.00	0	0.00	0	0.00	0	0.00	0	0.00	0	0.00	144	27,360.00	144	27,360.00	447	84,930.00
Subtotal				0.00		0.00		0.00		0.00		0.00		63,480.00		63,480.00		173,020.00
2 Construction of Access Road W=6m, Compacted with Grav																		
	m	60.00	0	0.00	0	0.00	0	0.00	0	0.00	0	0.00	0	0.00	0	0.00	70	4,200.00
Subtotal				0.00		0.00		0.00		0.00		0.00		0.00		0.00		4,200.00
3 Construction of Gate & Fence																		
1) Site Boundary Wall with Foundation, Made of C B, T = 200mm, H = 2.5m	m	190.00	195	37,050.00	249	47,310.00	124	23,560.00	226	42,940.00	11	2,090.00	230	43,700.00	1,035	196,650.00	3,339	634,410.00
2) Site Boundary Wall on Retaining Wall, Made of C B, T = 200mm, H = 2.5m	m	30.00	89	2,670.00	58	1,740.00	5	150.00	56	1,680.00	223	6,690.00	101	3,030.00	532	15,960.00	1,770	53,100.00
3) Steel Grill Gate, 4.0m x 2.5m, O.P.	set	1,430.00	1	1,430.00	1	1,430.00	1	1,430.00	1	1,430.00	1	1,430.00	1	1,430.00	6	8,580.00	25	35,750.00
Subtotal				41,150.00		50,480.00		25,140.00		46,050.00		10,210.00		48,160.00		221,190.00		723,260.00
4 Plumbing & Electrical Work																		
1) Piping for Water Supply D=50mm	m	20.00	10	200.00	0	0.00	10	200.00	35	700.00	100	2,000.00	80	1,600.00	235	4,700.00	775	15,500.00
2) Connection of Sewage; Manhole D=150mm	piece	220.00	0	0.00	0	0.00	0	0.00	0	0.00	4	880.00	0	0.00	4	880.00	6	1,320.00
	m	40.00	0	0.00	0	0.00	10	400.00	0	0.00	80	3,200.00	10	400.00	100	4,000.00	190	7,600.00
3) Intake of Electricity Poles	piece	370.00	0	0.00	0	0.00	0	0.00	1	370.00	0	0.00	0	0.00	1	370.00	9	3,330.00
Wire	m	30.00	10	300.00	10	300.00	10	300.00	35	1,050.00	10	300.00	10	300.00	85	2,550.00	615	18,450.00
Electrical Meter	piece	260.00	1	260.00	1	260.00	1	260.00	1	260.00	1	260.00	1	260.00	6	1,560.00	25	6,500.00
4) Connection of Telephone Poles	piece	370.00	0	0.00	0	0.00	0	0.00	1	370.00	0	0.00	0	0.00	1	370.00	48	17,760.00
Wire	m	20.00	10	200.00	10	200.00	10	200.00	35	700.00	10	200.00	10	200.00	85	1,700.00	2,535	50,700.00
Subtotal				960.00		760.00		1,360.00		3,450.00		6,840.00		2,760.00		16,130.00		121,160.00
5 Exterior Work																		
1) Pavement Work, Asphalt pavement for access	m2	20.00	236	4,720.00	227	4,540.00	197	3,940.00	657	13,140.00	243	4,860.00	477	9,540.00	2,037	40,740.00	9,639	192,780.00
Concrete Pavement for Plasy Gropund	m2	35.00	600	21,000.00	609	21,000.00	600	21,000.00	600	21,000.00	600	21,000.00	600	21,000.00	3,600	126,000.00	12,167	425,845.00
Interlocking Pavement	m2	18.00	569	10,242.00	288	5,184.00	696	12,528.00	261	4,698.00	652	11,736.00	261	4,698.00	2,727	49,086.00	10,634	191,412.00
2) BasketBall with Goal Board	set	1,000.00	1	1,000.00	1	1,000.00	1	1,000.00	1	1,000.00	1	1,000.00	1	1,000.00	6	6,000.00	20	20,000.00
White Lines	set	280.00	1	280.00	1	280.00	1	280.00	1	280.00	1	280.00	1	280.00	6	1,680.00	20	5,600.00
Subtotal				37,242.00		32,004.00		38,748.00		40,118.00		38,876.00		36,518.00		223,506.00		835,637.00
Total				79,352.00		83,244.00		65,248.00		89,618.00		55,926.00		150,918.00		524,306.00		1,857,277.00

6. PROJECT SITE LOCATION MAPS

Site Location Map

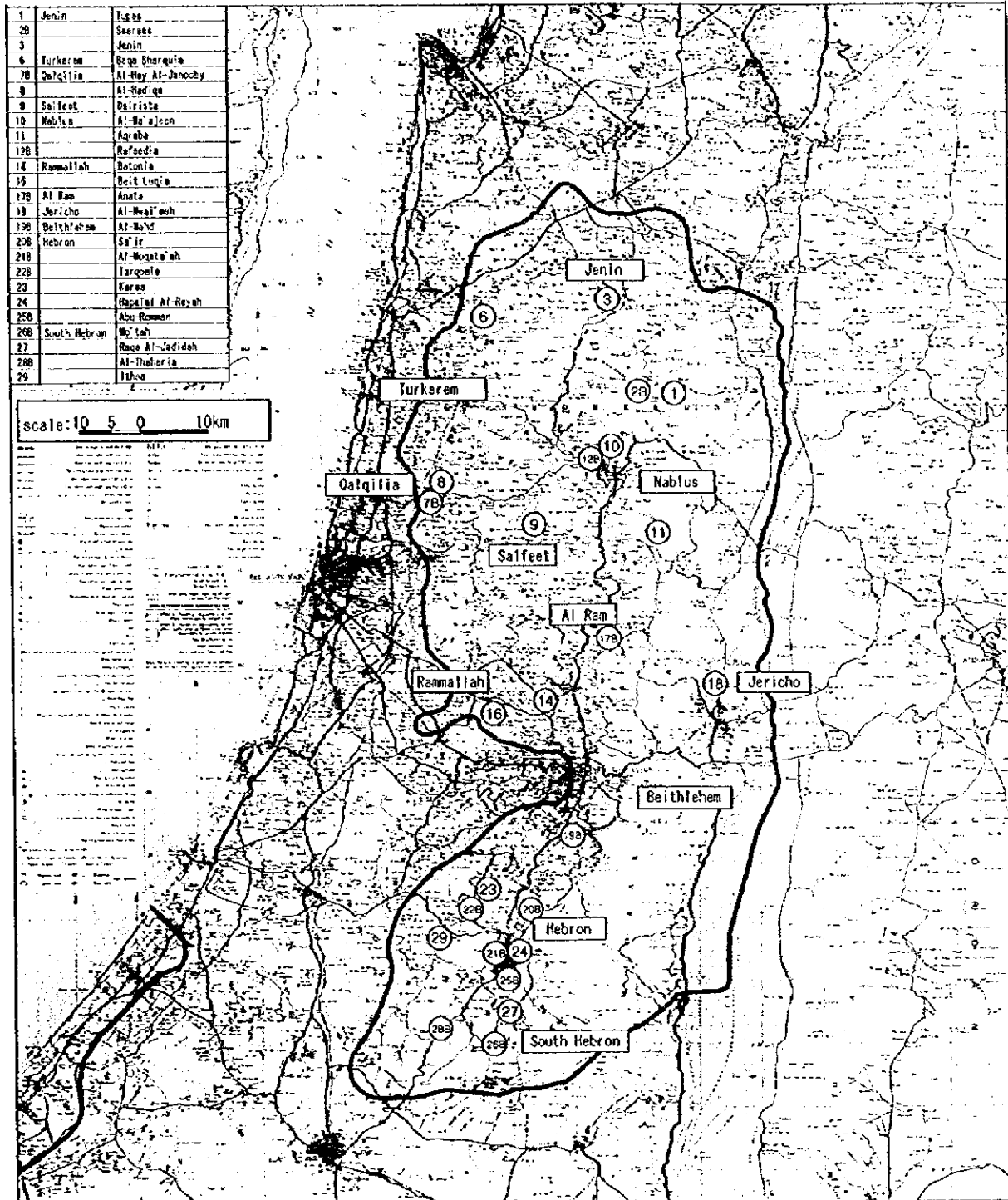

1 Tubas

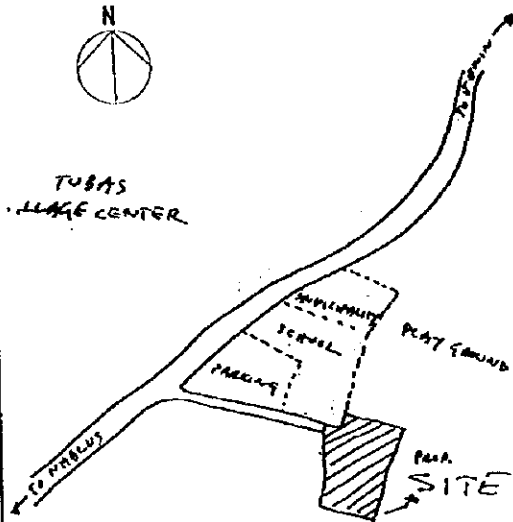

2B Seerees

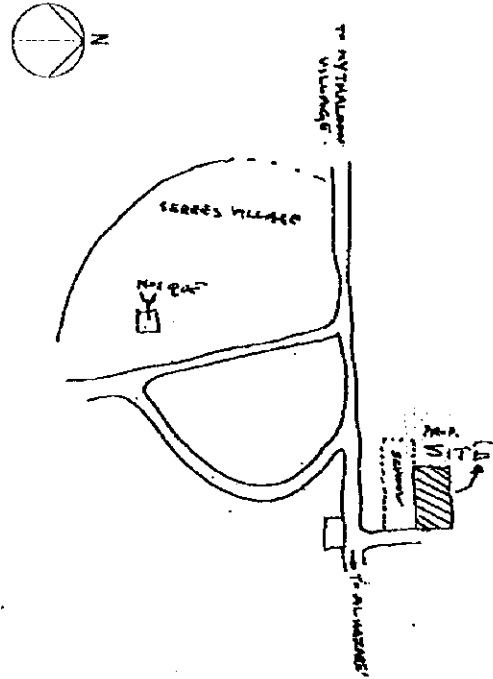

3 Jenin

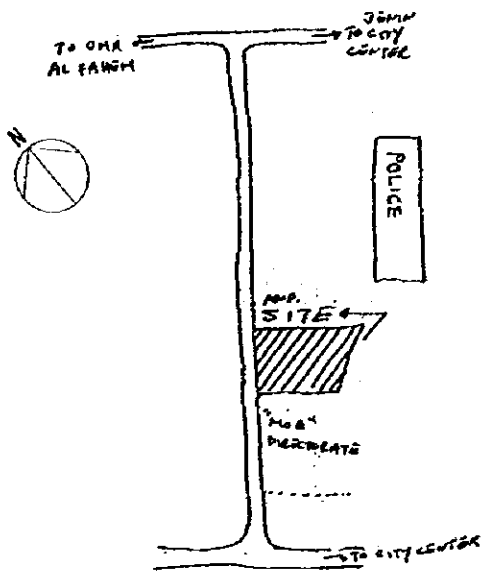

6 Baqa Al-Sharqia

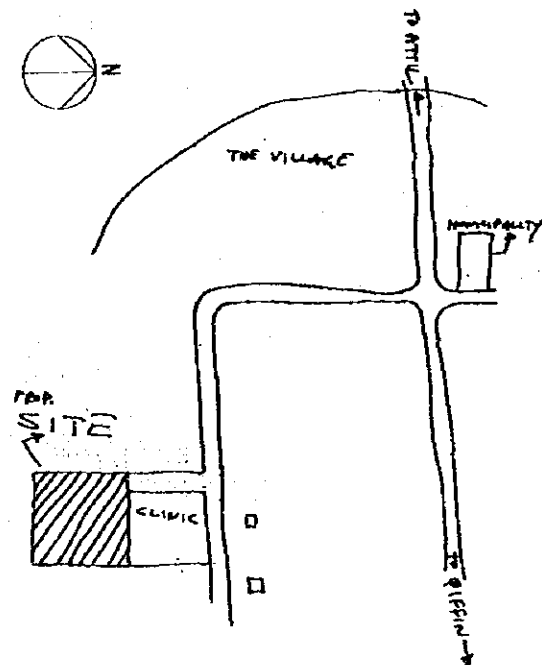

7B Al-Hairy Al-Janooby

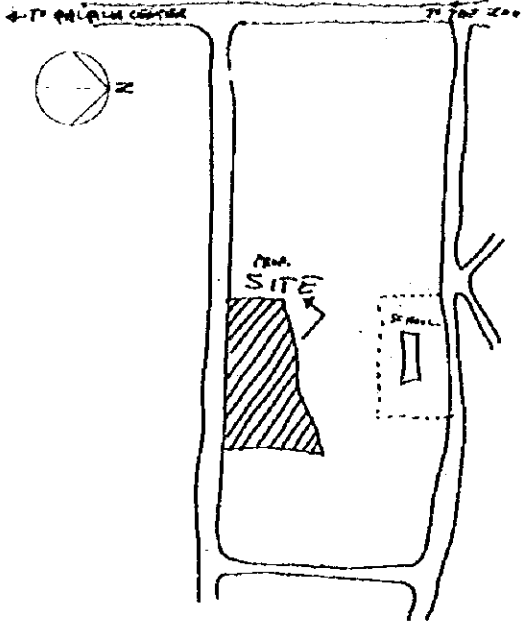

8 Al-Hadiqa

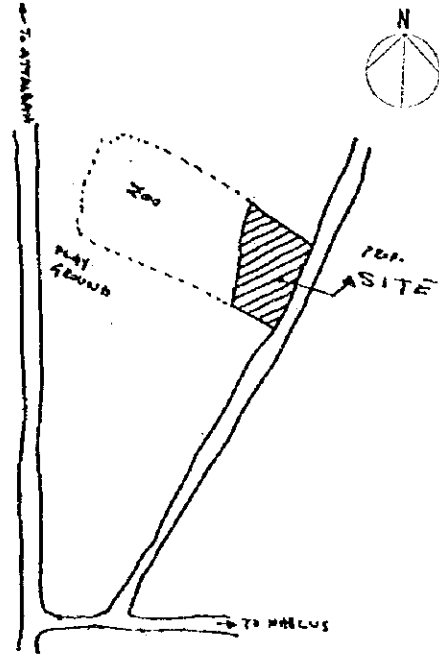

9 Dairista

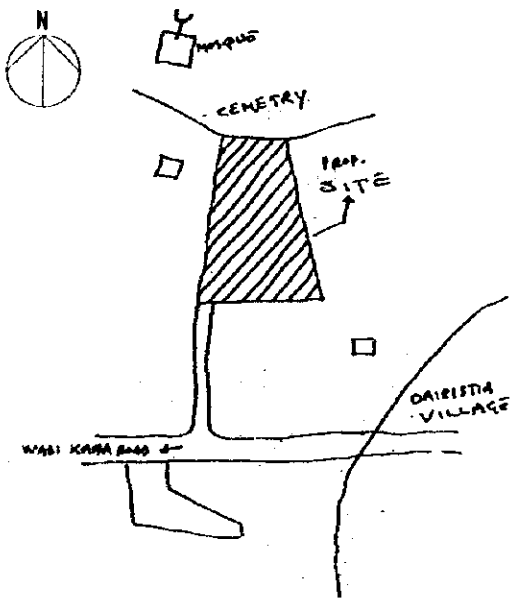

10 Al-Ma'ajeen

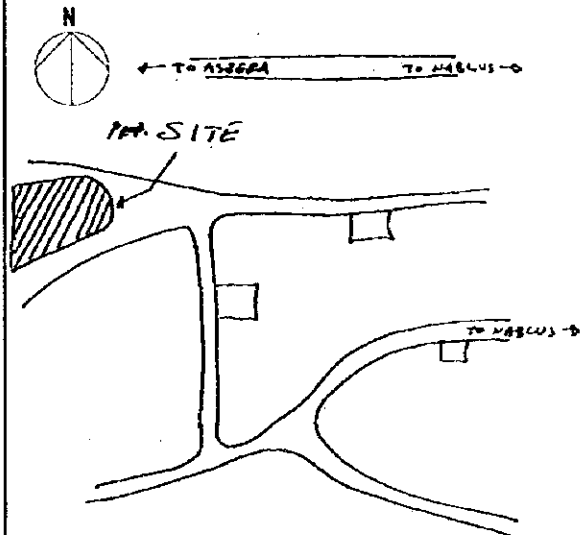

11 Aqraba

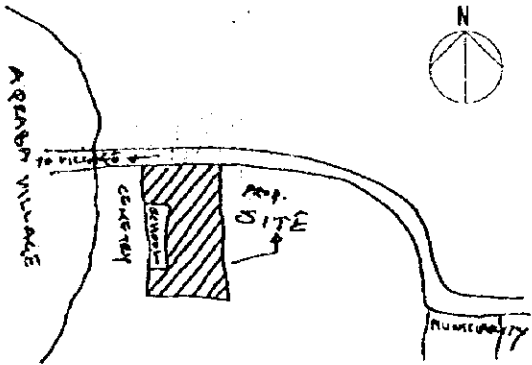

12B Rafecdia

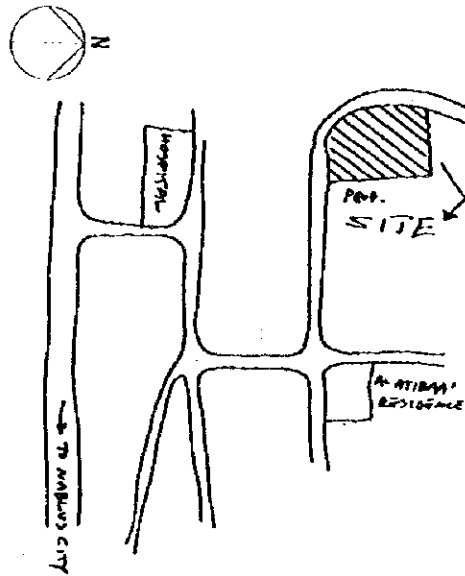

14 Betonia

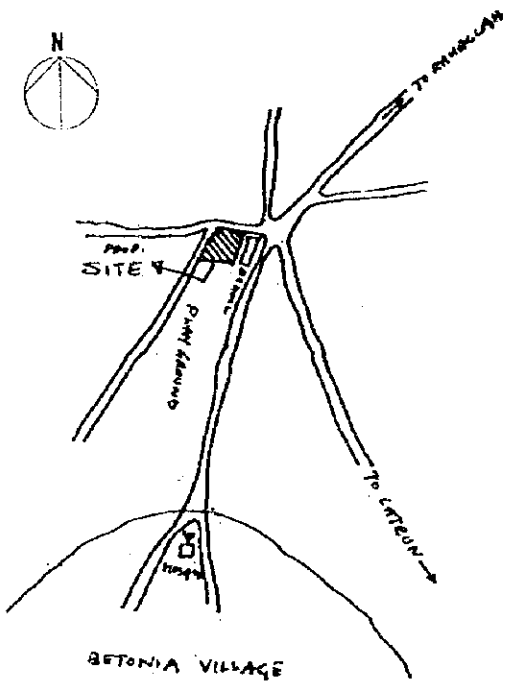

16 Beit Luqia

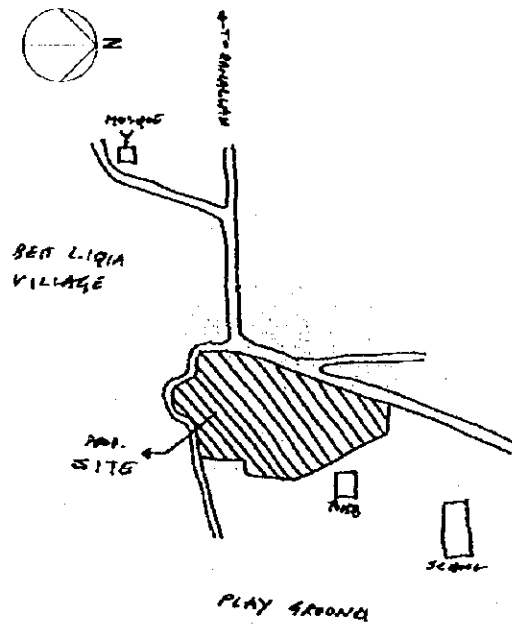

17B Anata

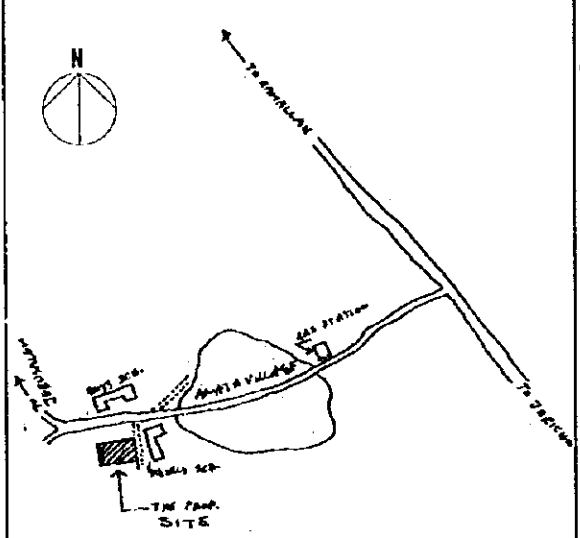

18 Al-Nwai'meh

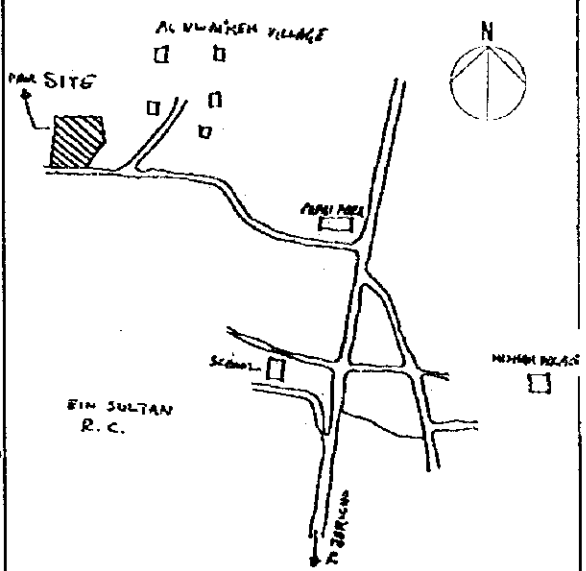

19B Al-Mahd

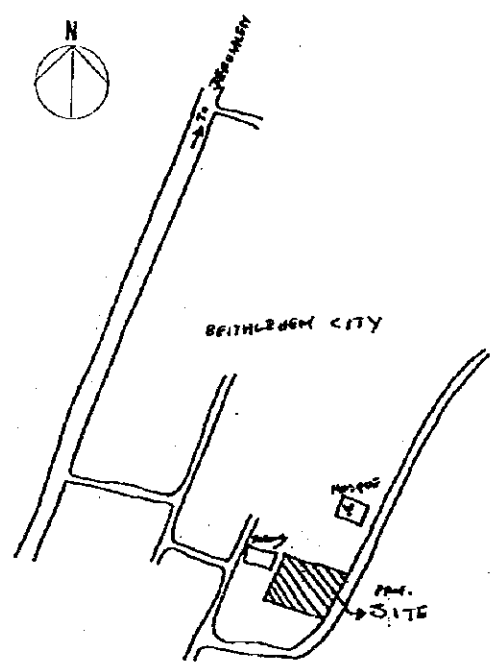

20B Sa'ir

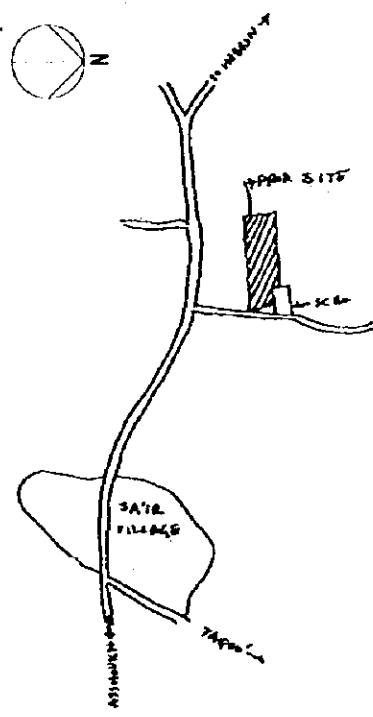

21B Al-Moqata'eh

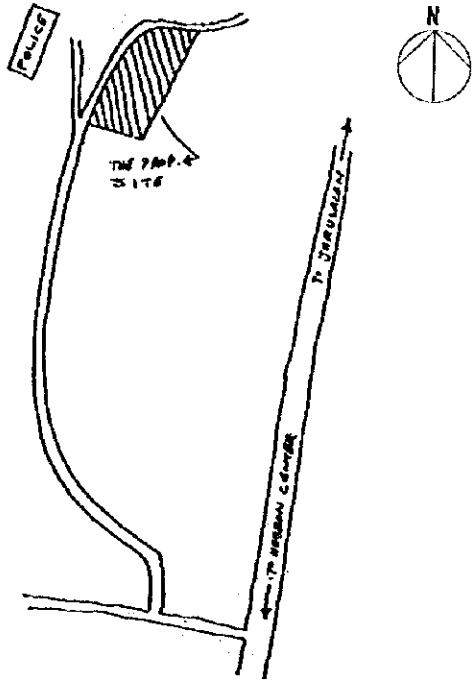

22B Tarqomia (Al-Aqsa)

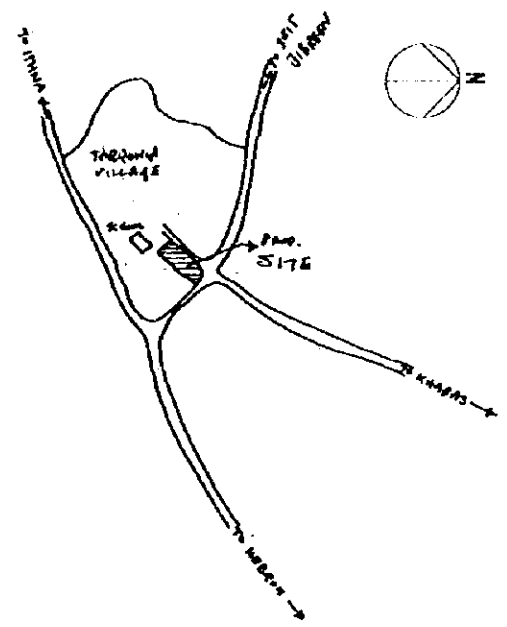

23 Kharas

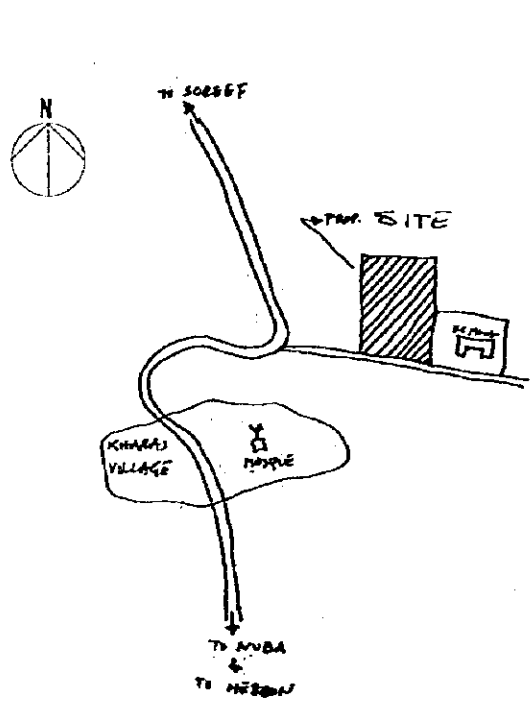

24 Habel Al-Reyah

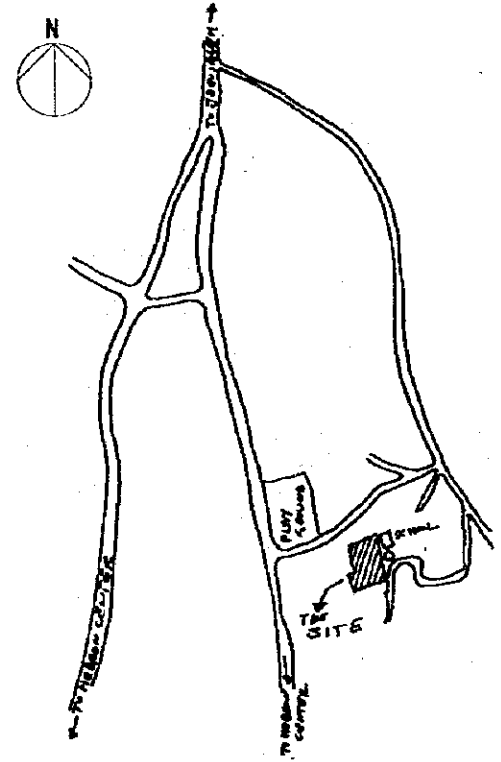

25 Abu-Romman

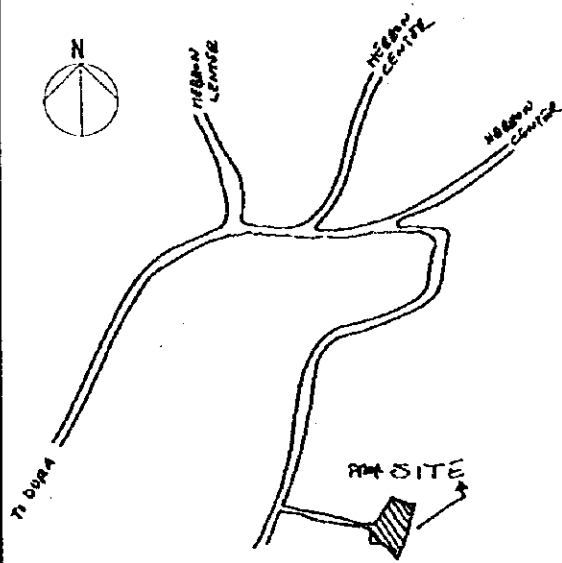

26 Mo'tah

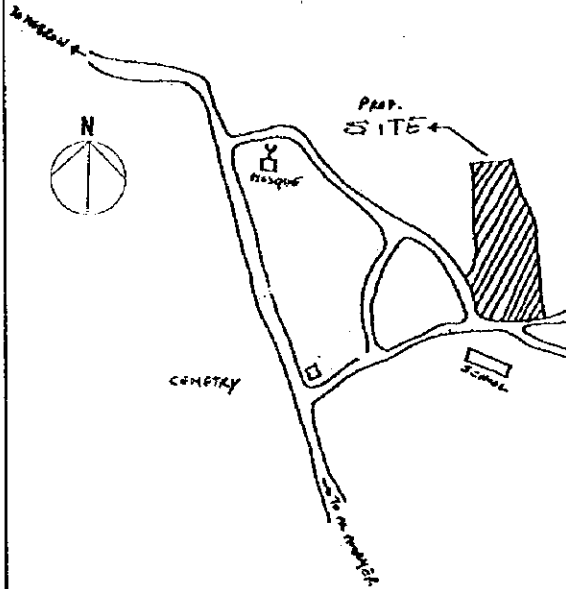

27 Raqa'a Al-Jadidah

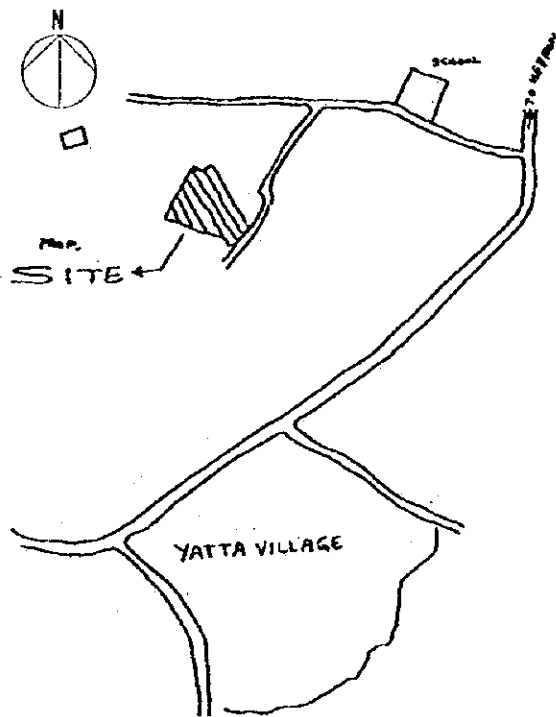

28B Al-Thaheria

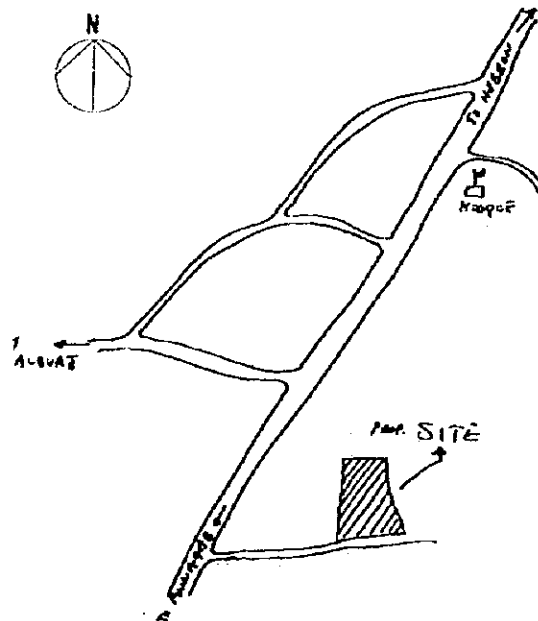

29 Ithna

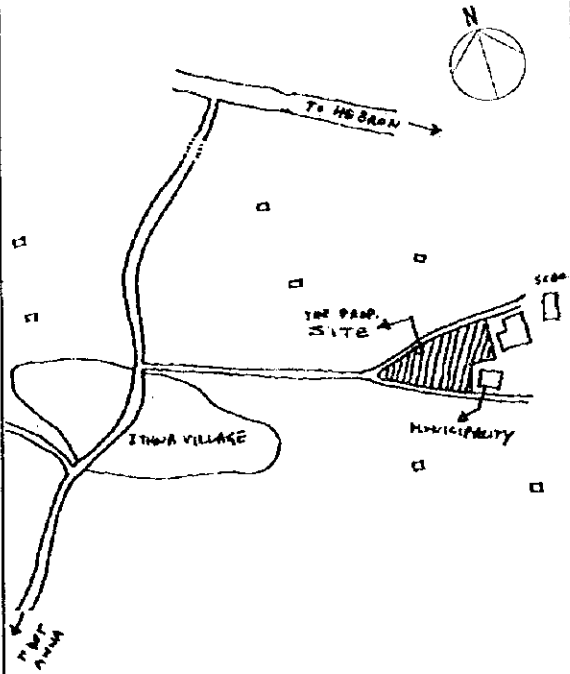

7. REFERENCES

7. REFERENCES

Name of References	Author or Publisher
Application Form for Japan's Grant Aid Rehabilitation and Development of the Education Physical Facilities, September, 1998	Ministry of Education Directorate General of Buildings and Projects
Answers to Questionnaire on the Japan Project for the Construction of School Facilities for Basic Education in West Bank, May 1999	Ministry of Education Director General of Buildings and Projects
Palestinian Development Plan 1999-2003 / January 1999	Ministry of Planning and International Cooperation
Palestinian Development Plan 1998-2000 / Dec 1997	Ministry of Planning and International Cooperation
Education Statistics 1998/ 1999	Palestinian Central Bureau of Statistics, Ministry of Education
Education Statistical Yearbook 1995/96, October 1996, Ditto 1997/98, June 1998	Palestinian Central Bureau of Statistics, Ministry of Education
Population, Housing and Establishment Census-1997	Palestinian Central Bureau of Statistics
First Palestinian Curriculum Plan, 1998	Ministry of Education Palestinian Curriculum Development Center
Outline of the West Bank and the Gaza, June, 1999	The Embassy of Japan in Israel
The Basic Design Study Report on the Project for Construction of School Facilities in the Gaza Strip	The Japan International Cooperation Agency
Detail Design Drawings of the Project for Construction of School Facilities in the Gaza Strip	Ministry of Education



JICA