

JAPAN INTERNATIONAL COOPERATION AGENCY(JICA)

MINISTRY OF SUSTAINABLE DEVELOPMENT AND PLANNING
DEPARTMENT OF SANTA CRUZ
REPUBLIC OF BOLIVIA

**THE FEASIBILITY STUDY
ON
FLOOD CONTROL IN THE NORTHERN
RURAL REGION OF SANTA CRUZ
IN
THE REPUBLIC OF BOLIVIA**

FINAL REPORT

DRAWINGS

JUNE 1999

JICA LIBRARY



J1150891 (8)

PACIFIC CONSULTANTS INTERNATIONAL, TOKYO

JAPAN INTERNATIONAL COOPERATION AGENCY(JICA)

MINISTRY OF SUSTAINABLE DEVELOPMENT AND PLANNING
DEPARTMENT OF SANTA CRUZ
REPUBLIC OF BOLIVIA

**THE FEASIBILITY STUDY
ON
FLOOD CONTROL IN THE NORTHERN
RURAL REGION OF SANTA CRUZ
IN
THE REPUBLIC OF BOLIVIA**

FINAL REPORT

DRAWINGS

JUNE 1999

PACIFIC CONSULTANTS INTERNATIONAL, TOKYO

1997-1998

1998-1999

1999-2000

2000-2001



1150891 [8]

1997-1998

1998-1999

1999-2000

2000-2001

TABLE OF CONTENTS

DATA BOOK

DATA BOOK A SOIL INVESTIGATION

DATA BOOK B RAINFALL DATA

DATA BOOK C FICHA AMBIENTAL

DATA BOOK – DRAWING

DATA BOOK – DRAWING A TOPOGRPHIC SURVEY

DATA BOOK – DRAWING B PRELIMINARY DESIGN

DATA BOOK - DRAWING A
TOPOGRAPHIC SURVEY

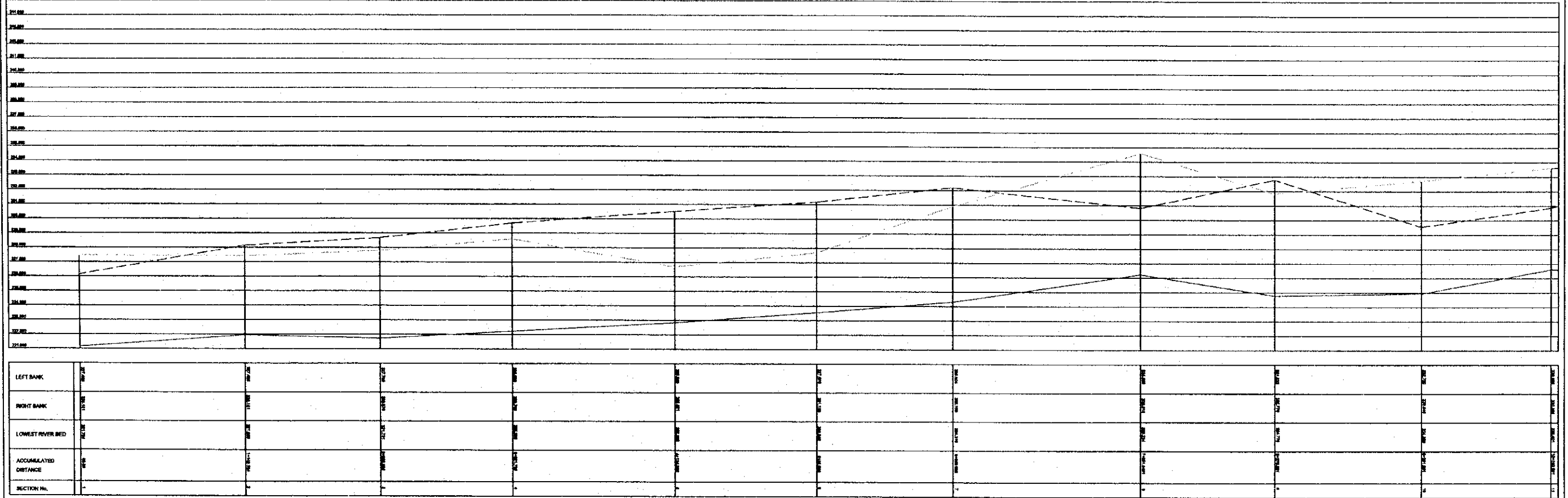

LEFT BANK	----
RIGHT BANK	----
LOWEST RIVER BED	----

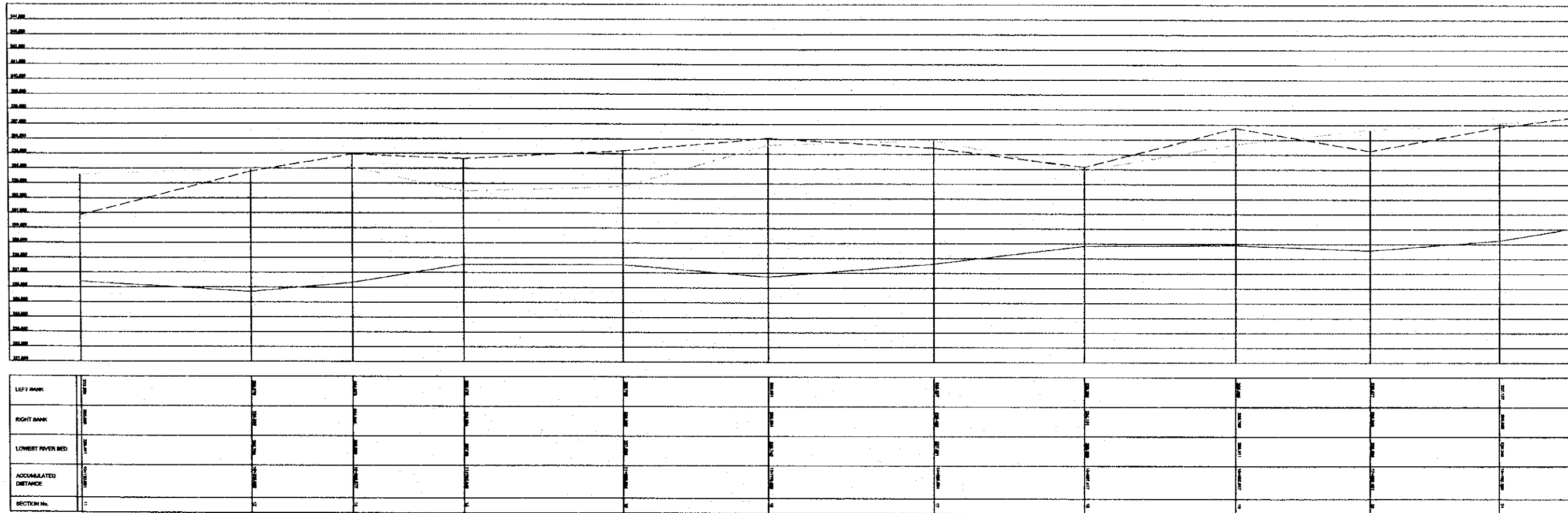

LEFT BANK	---
RIGHT BANK	---
LOWEST RIVER BED	---

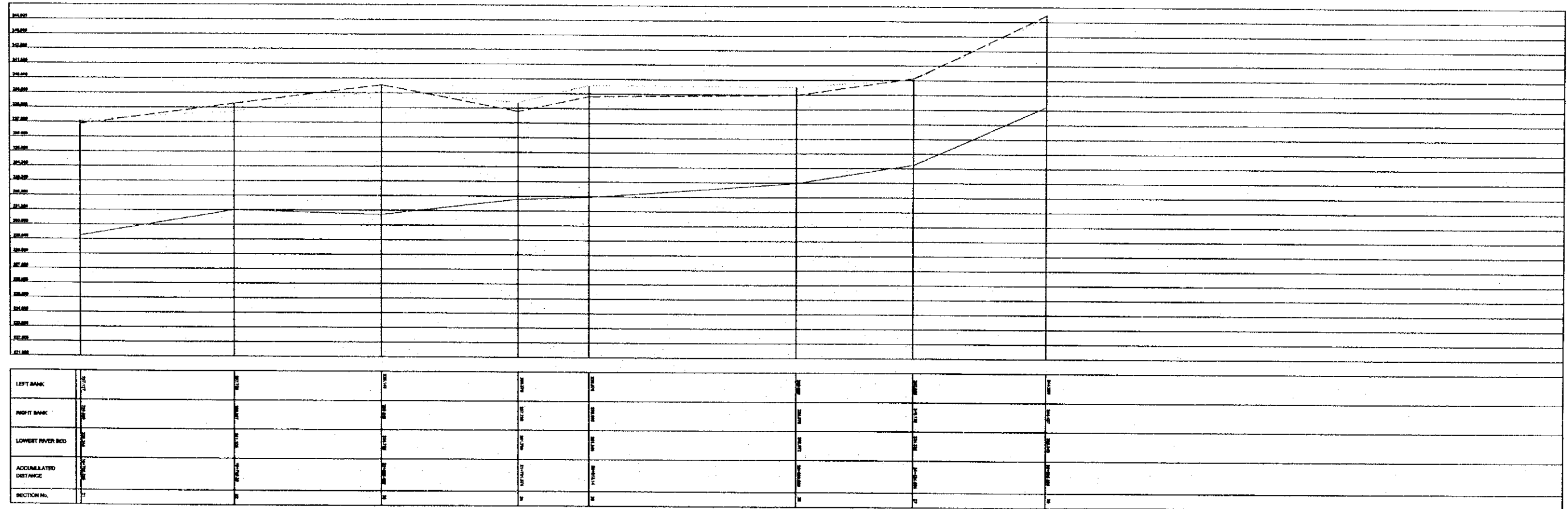

LEFT BANK	---
RIGHT BANK	---
LOWEST RIVER BED	---

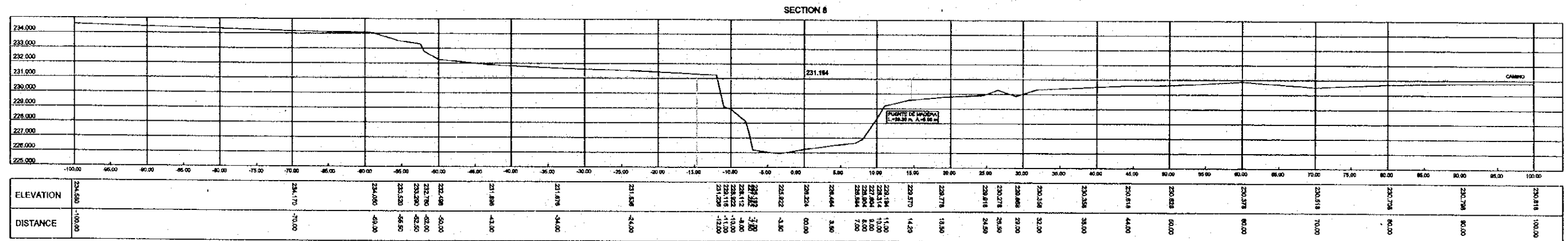
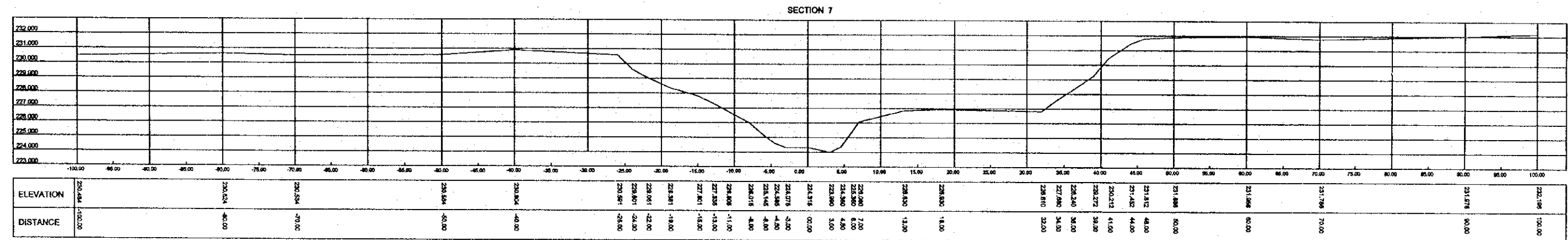
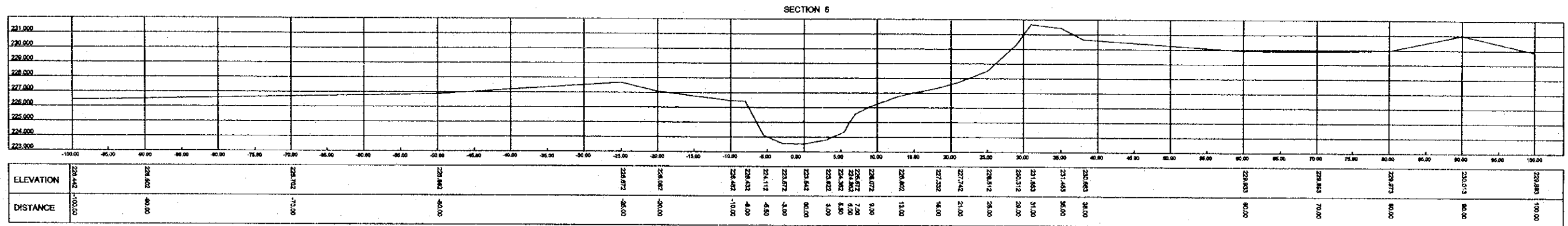
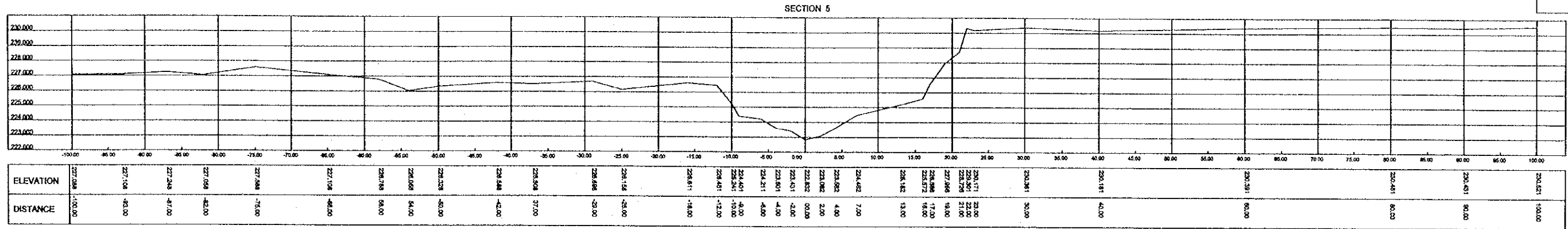

SECTION 21

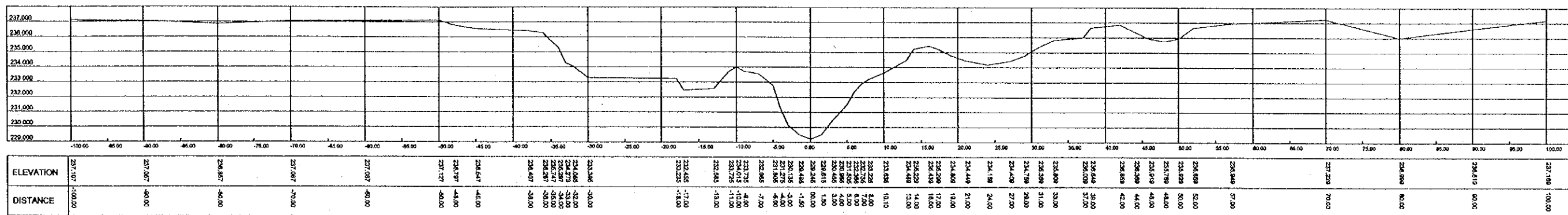

SECTION 22

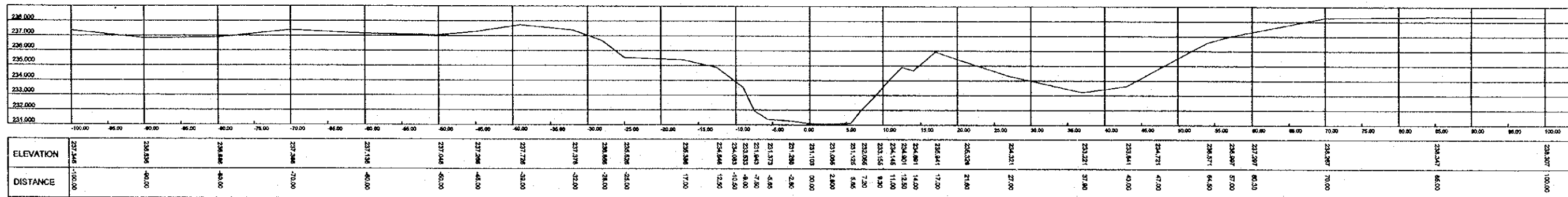

SECTION 23

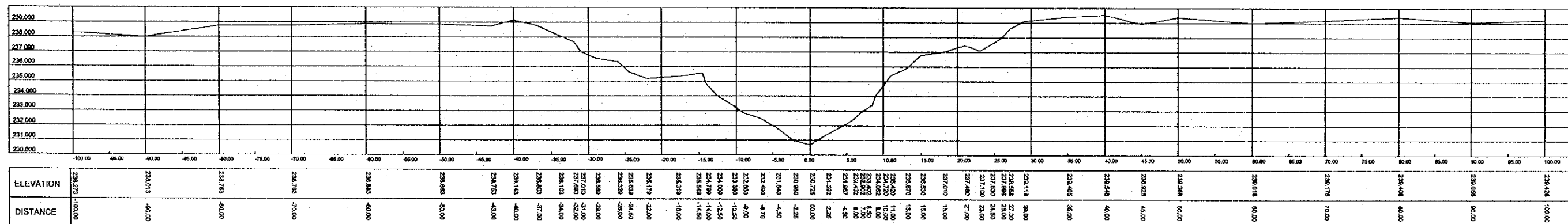

SECTION 24

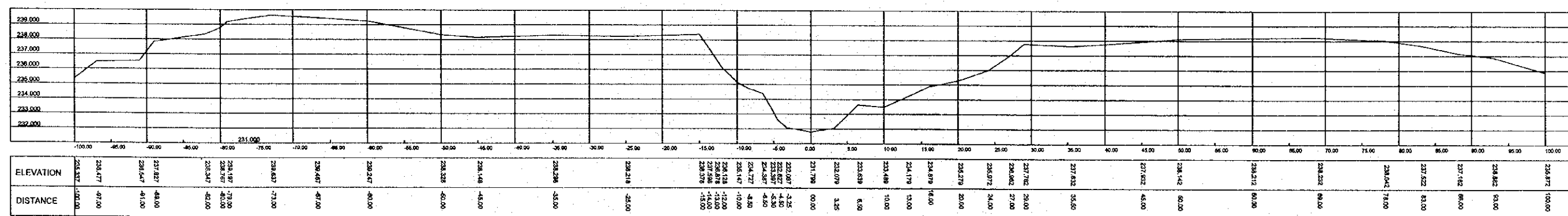

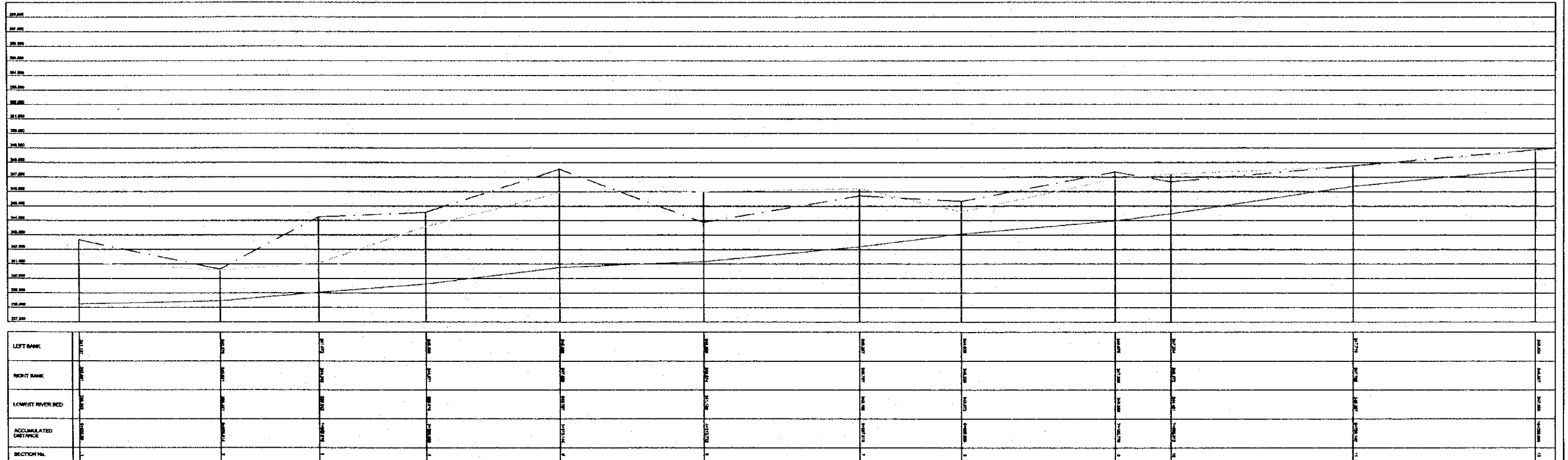

LEFT BANK	---
RIGHT BANK	---
LOWEST RIVER BED	---

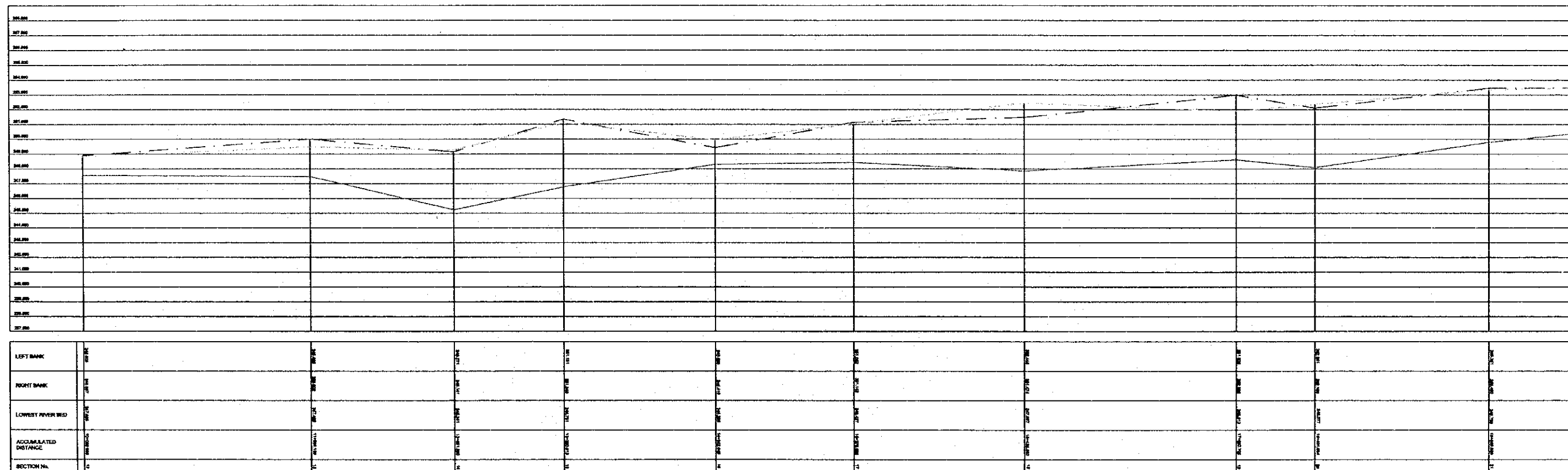

LEFT BANK	---
RIGHT BANK	---
LOWEST RIVER BED	---

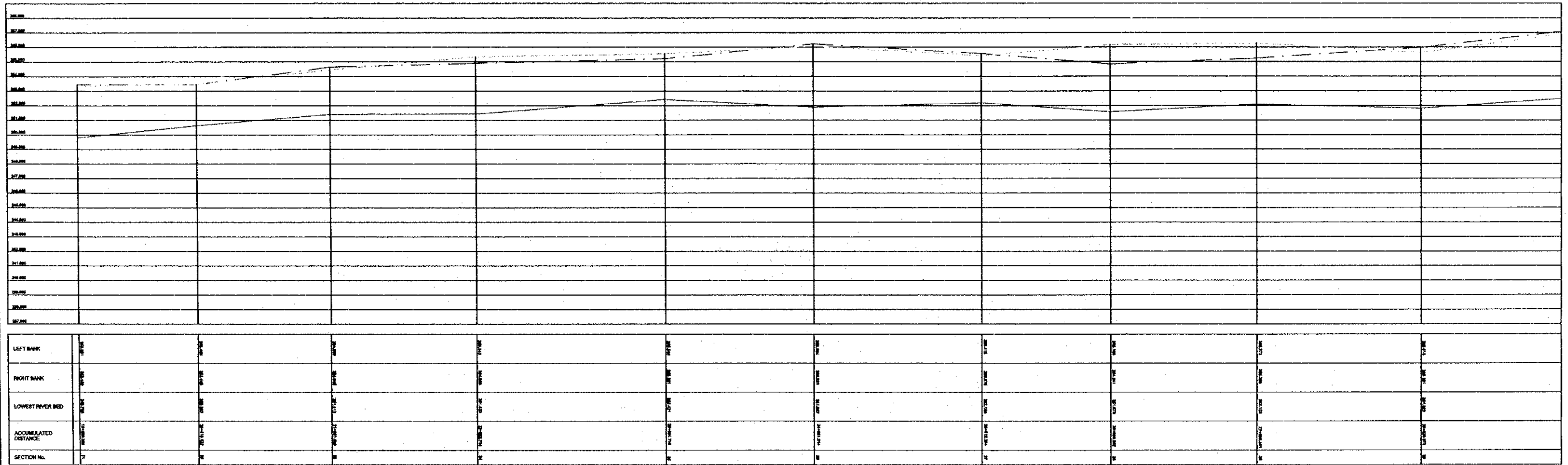

LEFT BANK	---
RIGHT BANK	---
LOWEST RIVER BED	---

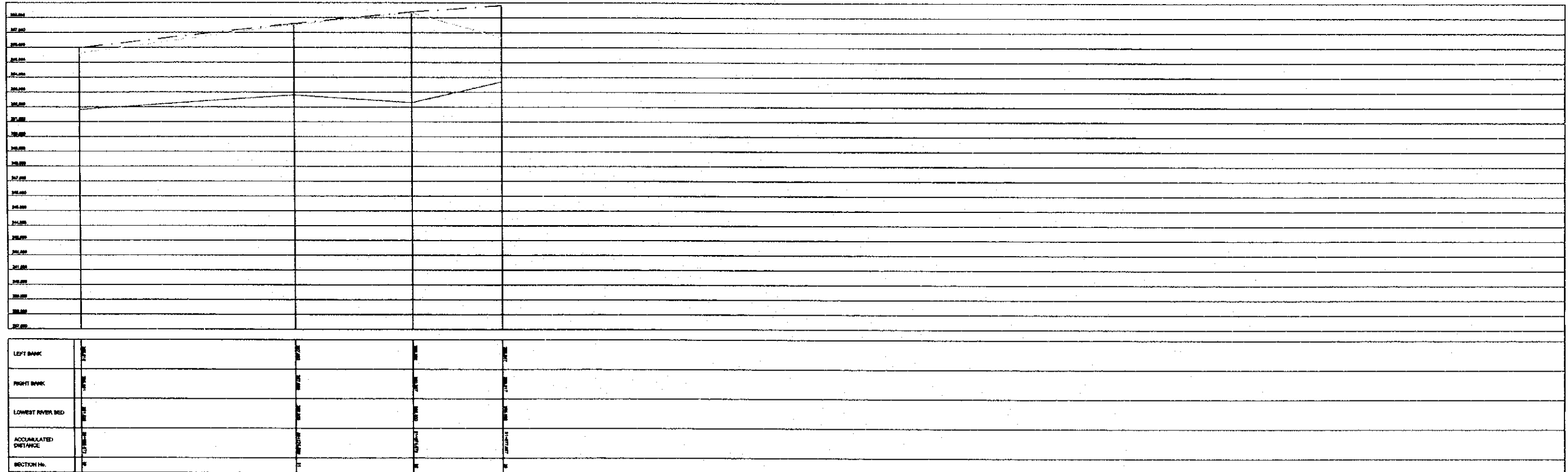

LEFT BANK	---
RIGHT BANK	---
LOWEST RIVER BED	---

SECTION 6

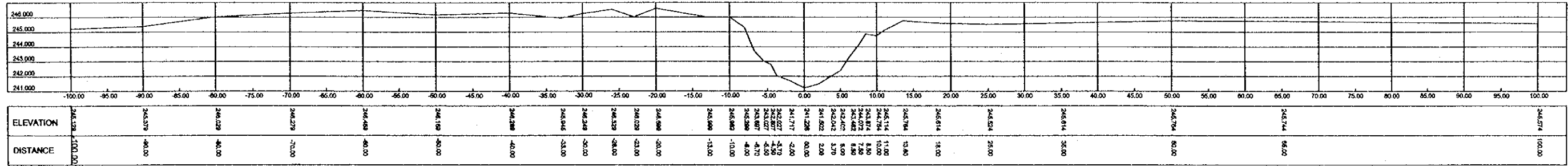

SECTION 7

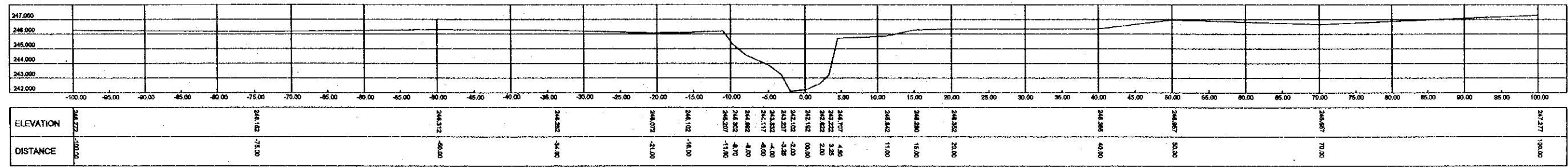

SECTION 8

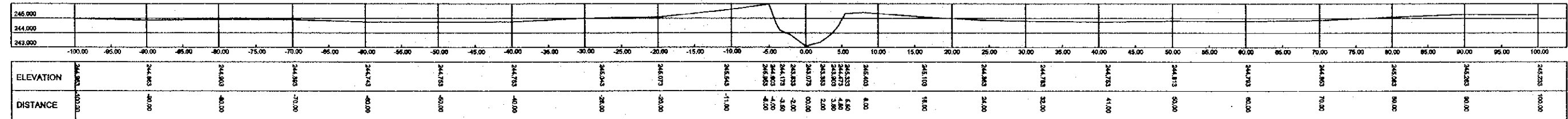

SECTION 9

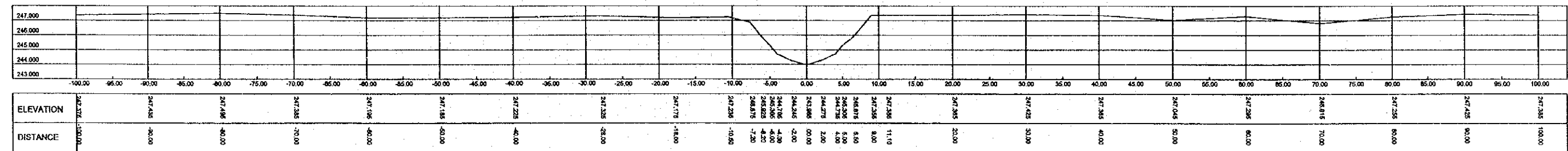

SECTION 10

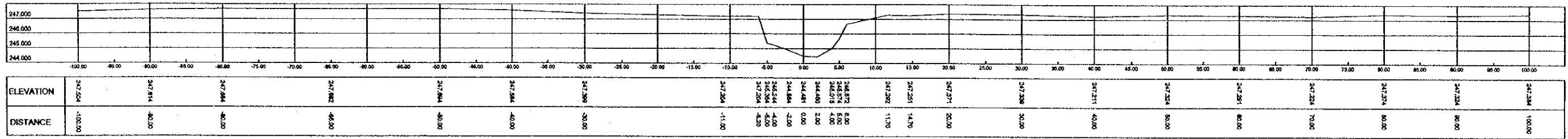

SECTION 11

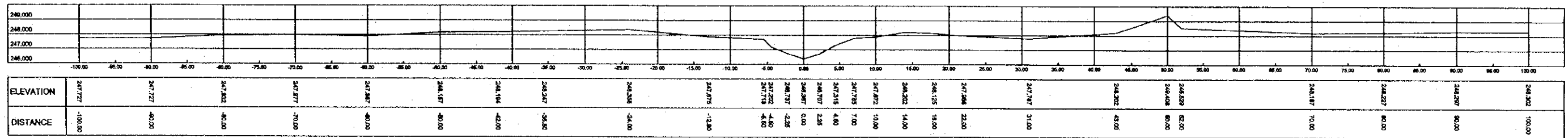

SECTION 12

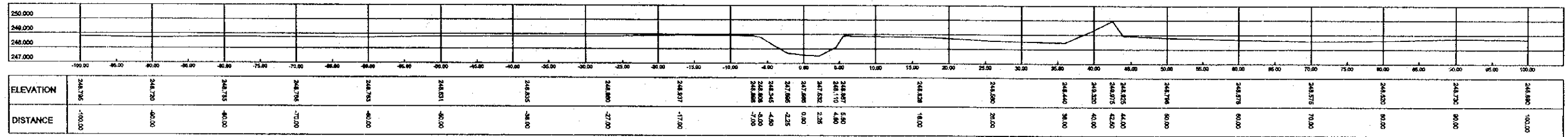

SECTION 13

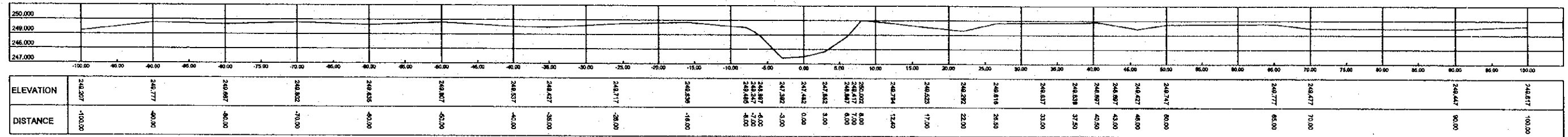

SECTION 14

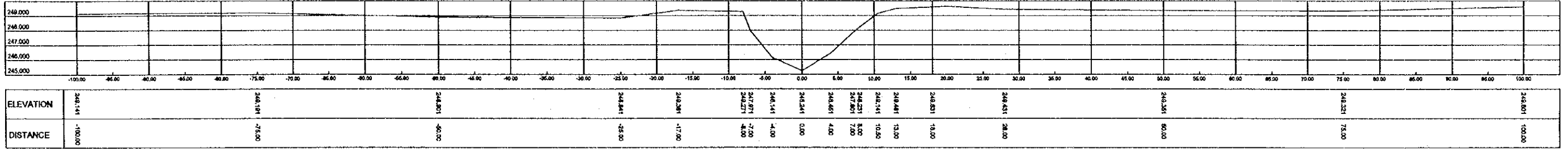

SECTION 15

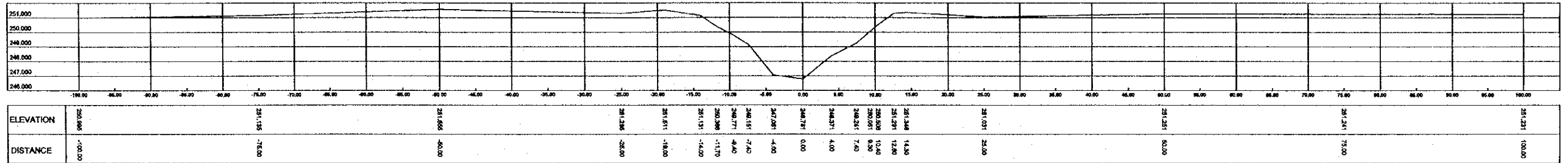

SECTION 16

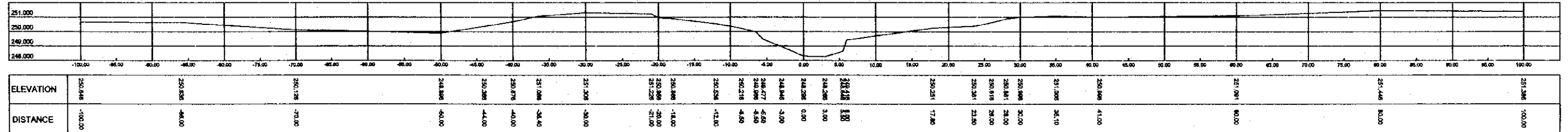

SECTION 17

