

## **APPENDIX 5**

### **COST ESTIMATION BORNE BY JORDAN**

The Jordanian side is expected to bear the cost of constructing a new garage at the following four fire stations at an estimated cost of some 20,000 JD (approximately ¥3.7 million).

(1) Amman Governorate

④ Qweismeh, ⑤ Mahatta, ⑧ Alijeeza

(2) Balqa Governorate

⑨ City Town

## APPENDIX 6 GARAGE OF FIRE STATION

Prefecture	AMMAN	fire station	① Directorate
------------	-------	--------------	---------------

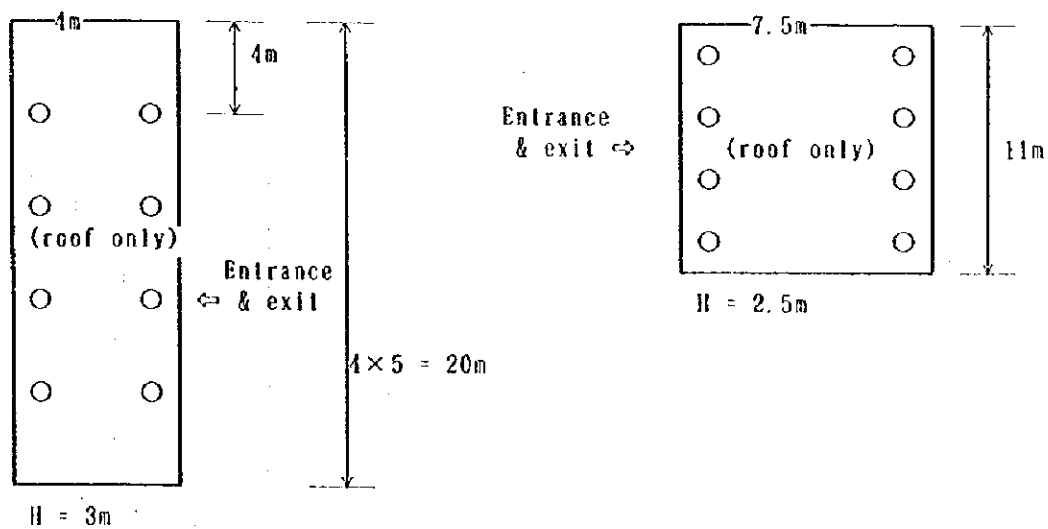
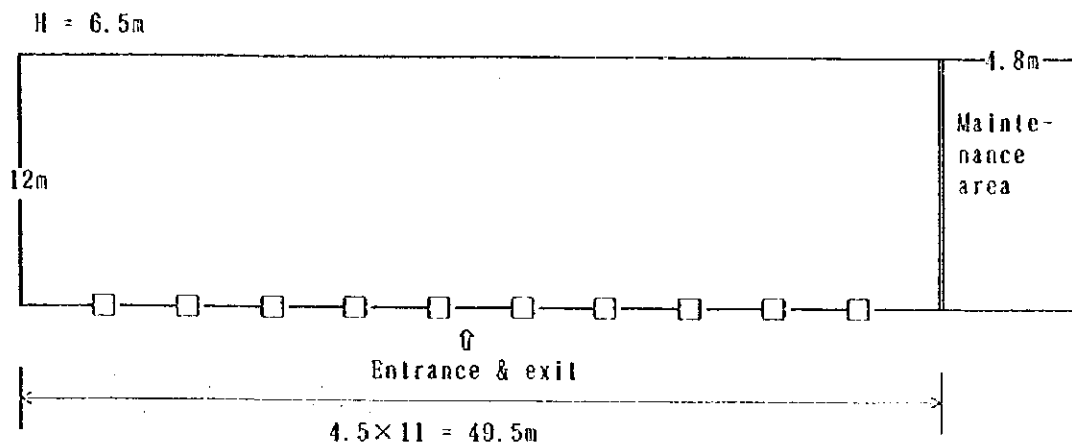

Prefecture	AMMAN	fire station	② Swelleh (covered by this Project )
------------	-------	--------------	--------------------------------------

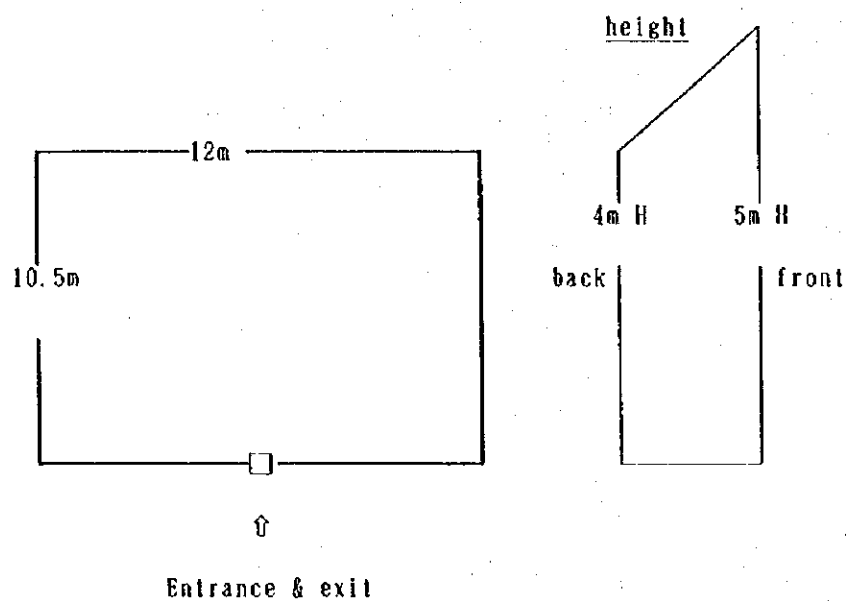

Prefecture	AMMAN	fire station	③ Sahab (covered by this Project )
------------	-------	--------------	------------------------------------

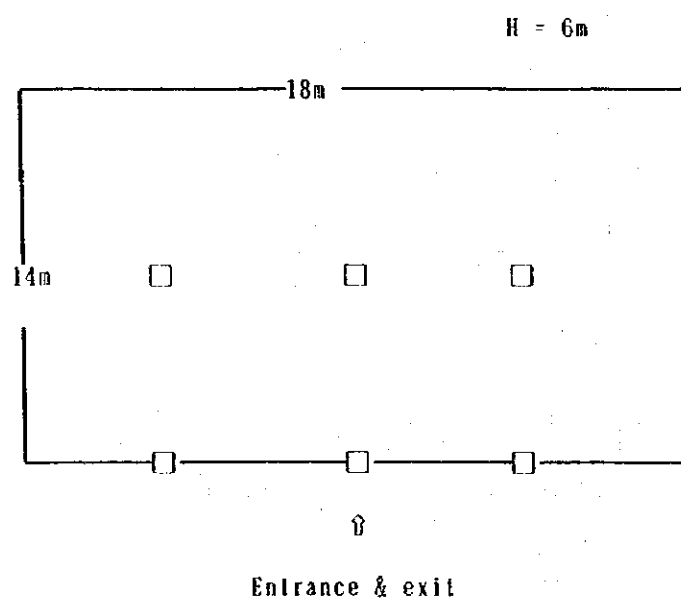

Prefecture	AMMAN	fire station	④ Qweismeh [covered by this Project]
------------	-------	--------------	--------------------------------------

H = 5m

(extension plan of new garage)

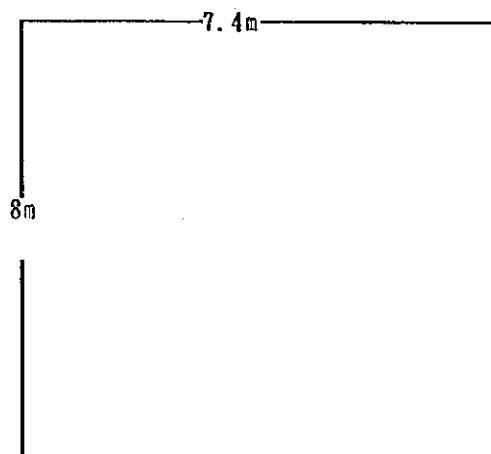

0

Entrance & exit

Prefecture	AMMAN	fire station	⑤ Mahatta (covered by this Project )
------------	-------	--------------	--------------------------------------

(plan of moving to other site)

Prefecture	AMMAN	fire station	⑥ Madina (City Center)
------------	-------	--------------	------------------------

(plan of moving to other site)

Prefecture	AMMAN	fire station	⑦ Na'aur (covered by this Project )
------------	-------	--------------	-------------------------------------

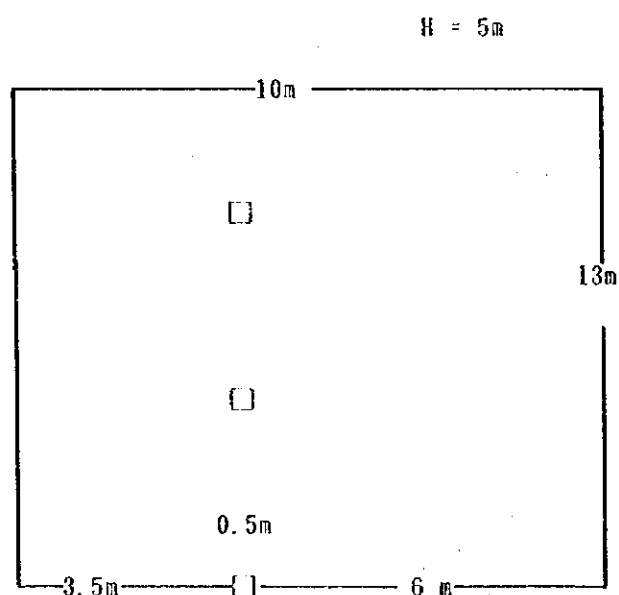

Entrance & exit

Prefecture	AMMAN	fire station	⑧ Alljeeza [covered by this Project]
------------	-------	--------------	--------------------------------------

H = 5m

(extension plan of new garage)

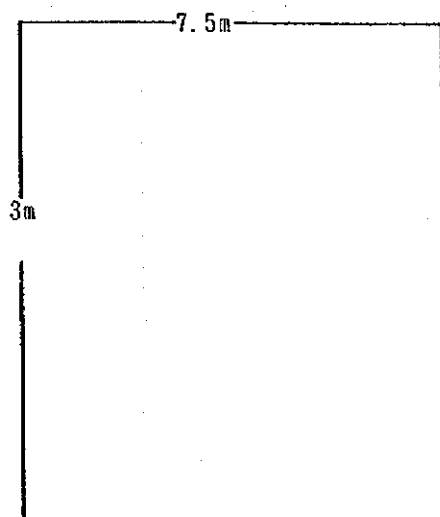

Entrance & exit

Prefecture	AMMAN	fire station	⑨ Al-Muwaggar
------------	-------	--------------	---------------

H = 5m

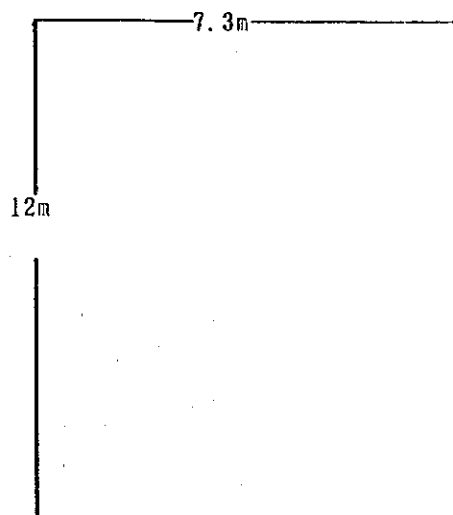

Entrance & exit

Prefecture	AMMAN	fire station	⑩ Manara (covered by this Project )
------------	-------	--------------	-------------------------------------

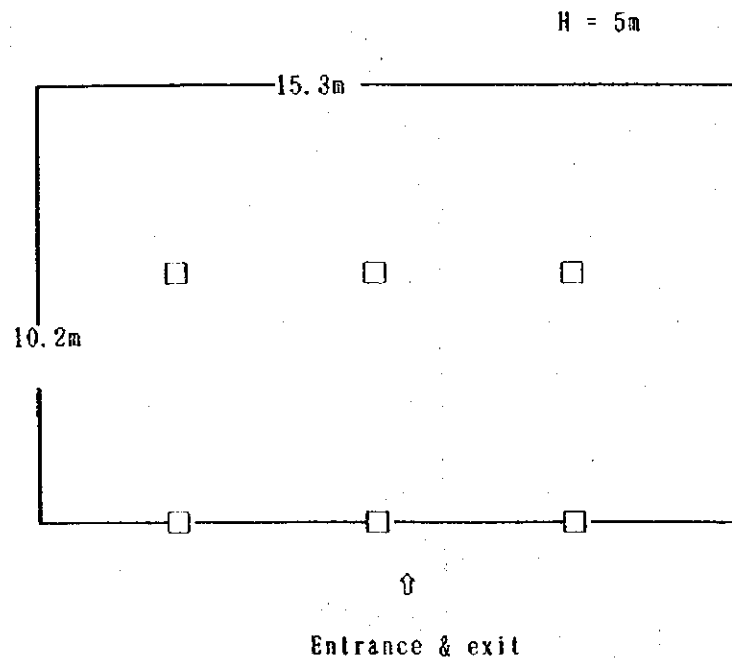

Prefecture	AMMAN	fire station	⑪ Sports City
------------	-------	--------------	---------------

(plan of moving to other site)

Prefecture	AMMAN	fire station	⑫ Jweldah (covered by this Project )
------------	-------	--------------	--------------------------------------

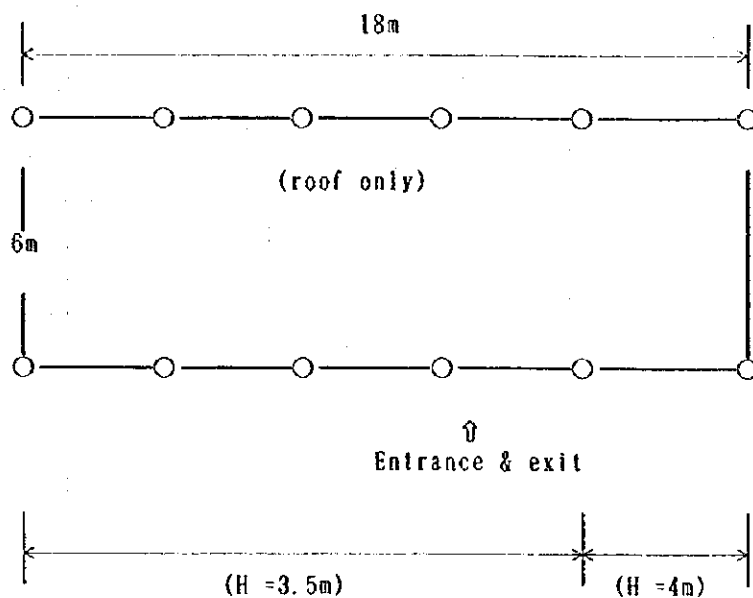

Prefecture	AMMAN	fire station	⑬ King Abdallah Garden
------------	-------	--------------	------------------------

(plan of a new garage)



Prefecture	AMMAN	fire station	⑭ Wadi Sir [covered by this Project]
------------	-------	--------------	--------------------------------------

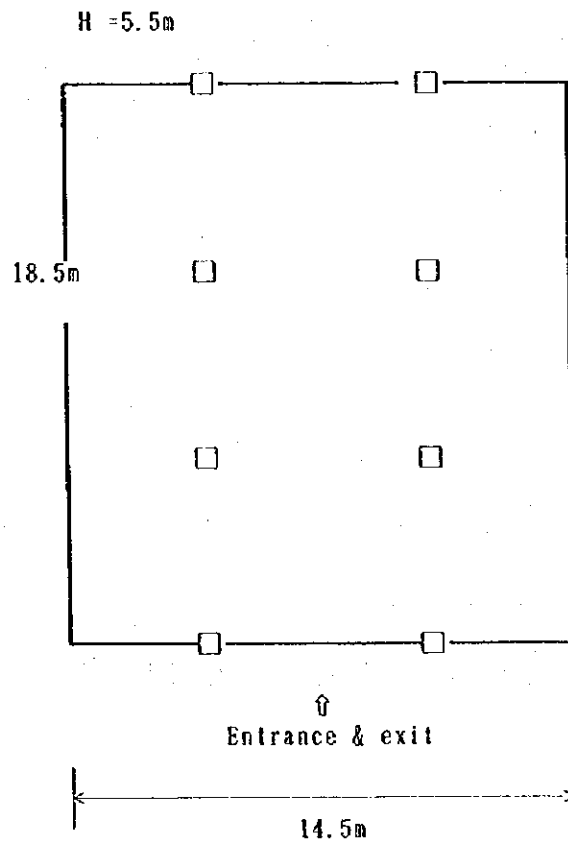

Prefecture	MADABA	fire station	① Directorate, ③ Directorate Center
(① & ③ are in the same site) {③ is covered by this Project}			

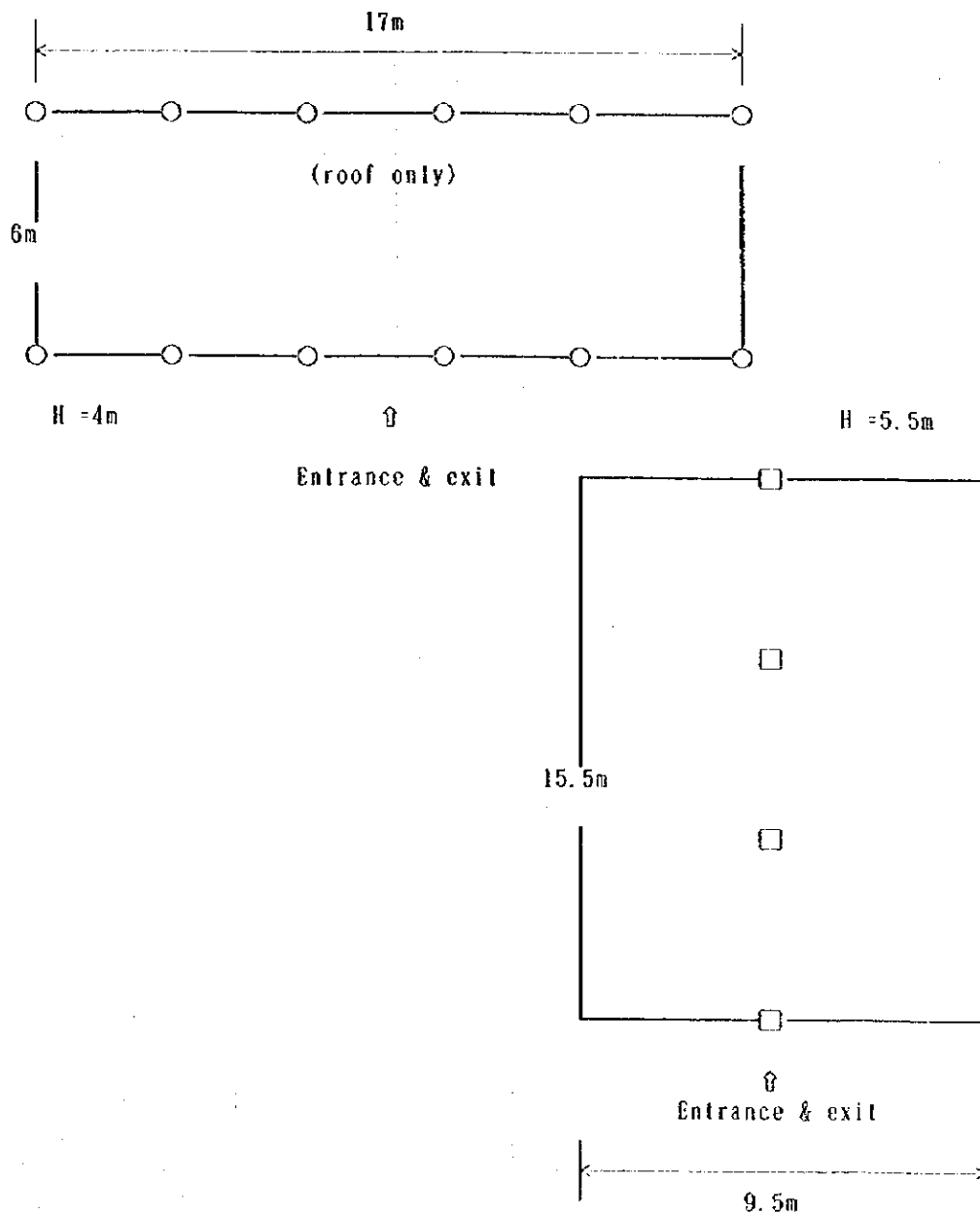

Prefecture	MADABA	fire station	② Dhiban
------------	--------	--------------	----------

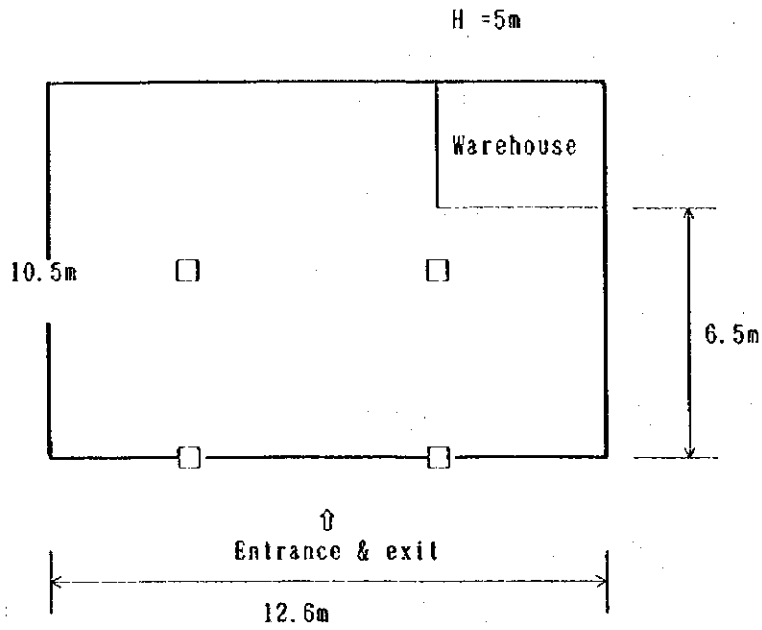

Prefecture	MADABA	fire station	④ Areed
------------	--------	--------------	---------

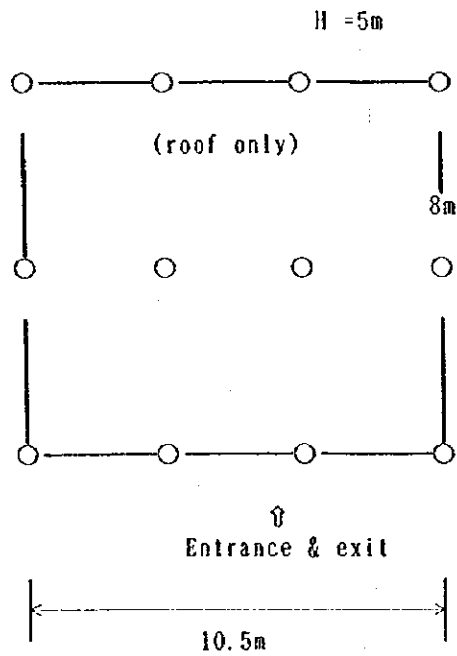

Prefecture	ZARGA	fire station	① Directorate, ⑨ Directorate Center
(① & ⑨ are in the same site) (⑨ is covered by this Project)			

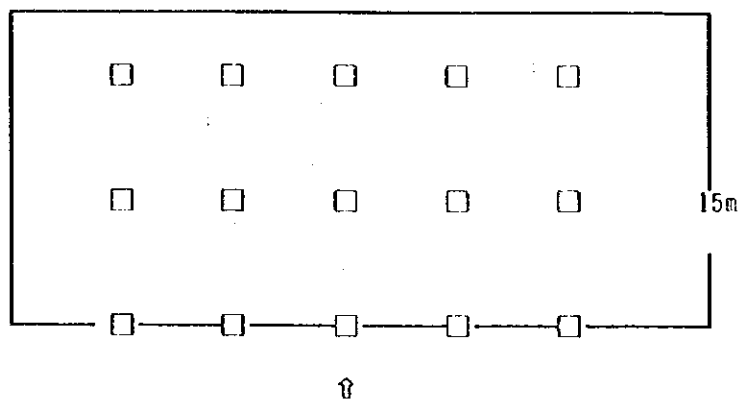

H = 5m

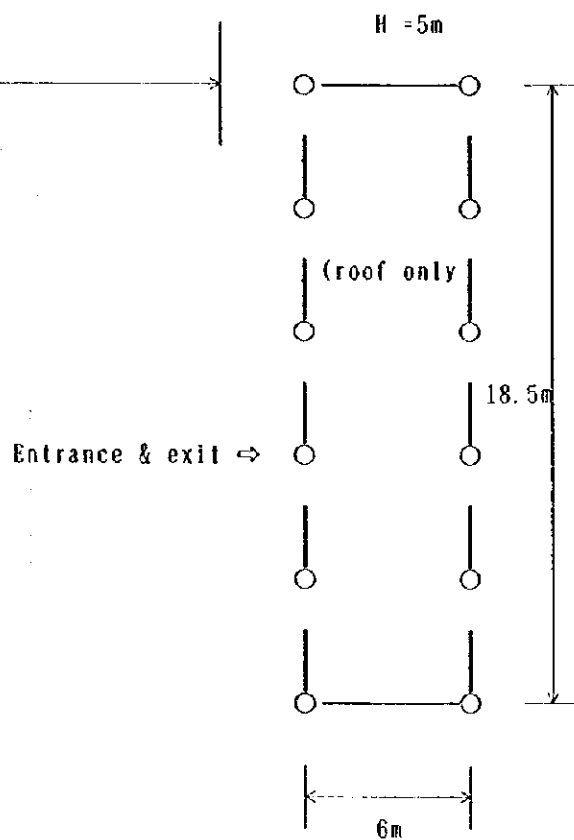
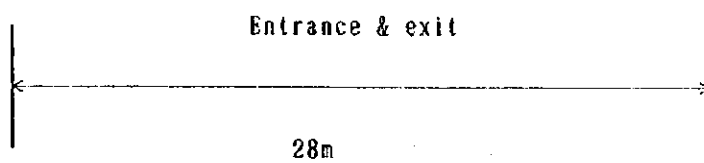

Prefecture	ZARGA	fire station	② Al-Hashimiya[covered by this Project]
------------	-------	--------------	---

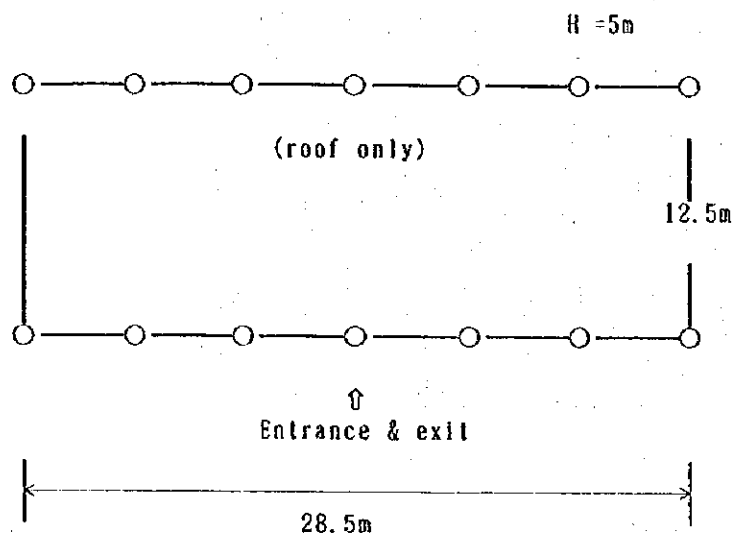

Prefecture	ZARGA	fire station	③ Al-Mari
------------	-------	--------------	-----------

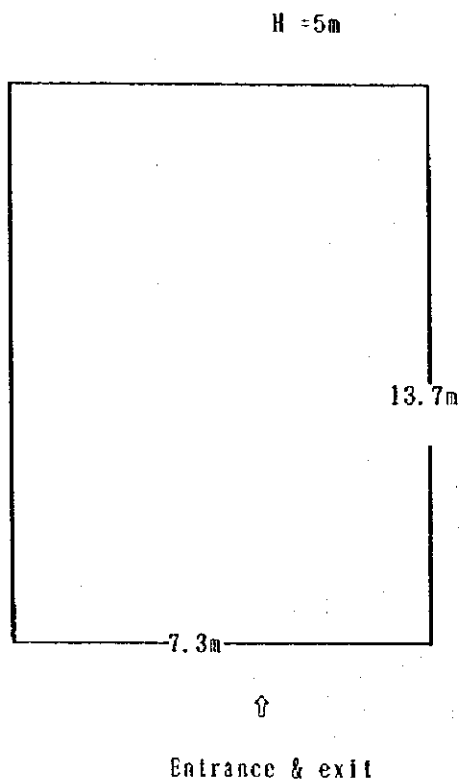

Prefecture	ZARGA	fire station	④ Awajan (covered by this Project )
------------	-------	--------------	-------------------------------------

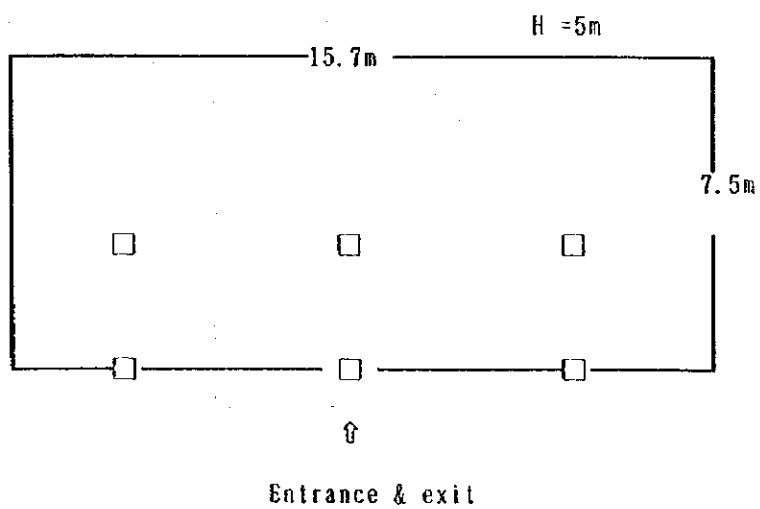

Prefecture	ZARGA	fire station	⑤ Madina (covered by this Project )
------------	-------	--------------	-------------------------------------

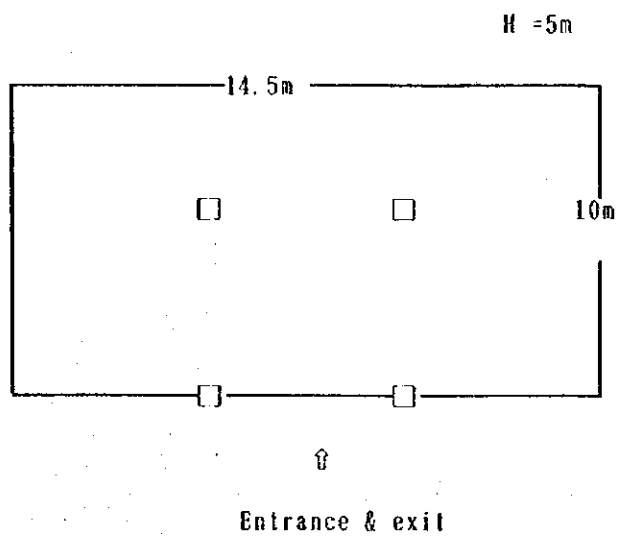

Prefecture	ZARGA	fire station	⑥ Nakab (covered by this Project )
------------	-------	--------------	------------------------------------

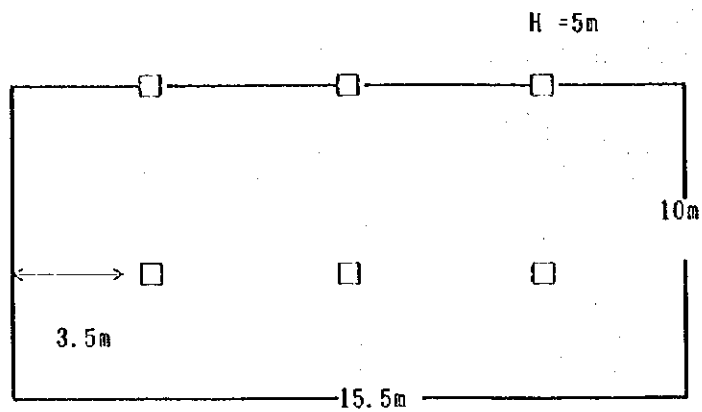

Entrance & exit

Prefecture	ZARGA	fire station	⑦ Prince Tablal (covered by this Project)
------------	-------	--------------	---

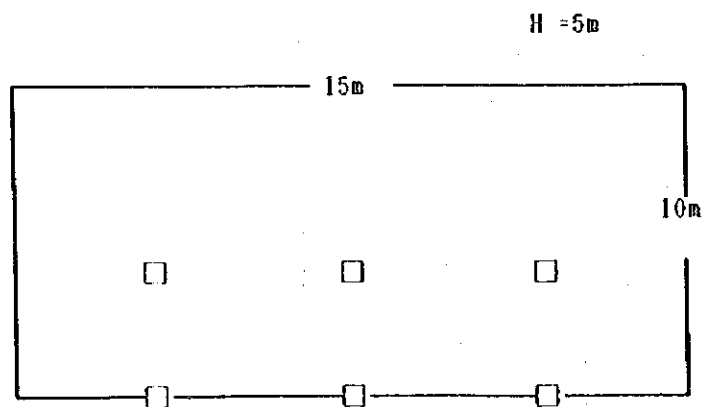

Entrance & exit

Prefecture	ZARGA	fire station	⑧ Al-Azrak
------------	-------	--------------	------------

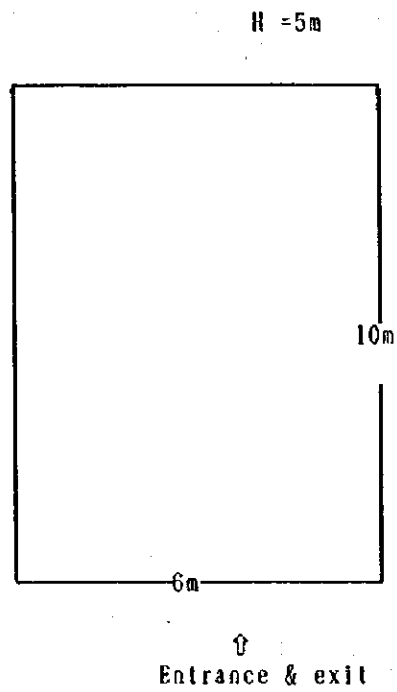



Prefecture	BALQA	fire station	① Directorate, ⑧ Directorate Center
(① & ⑧ are in the same site) [⑧ is covered by this Project]			

H = 6m

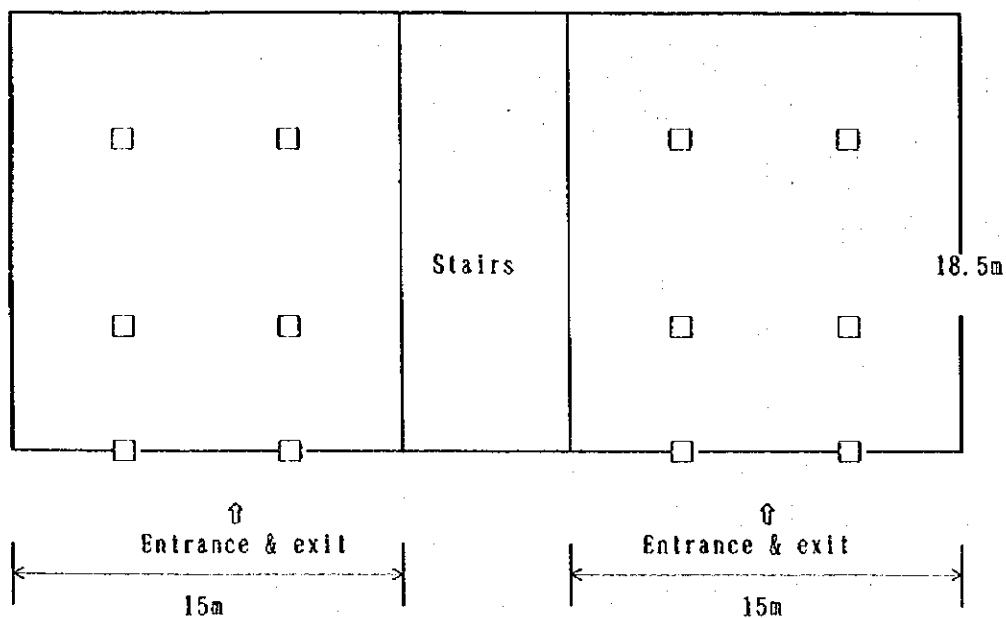

Prefecture	BALQA	fire station	② South Shuna
------------	-------	--------------	---------------

H = 5m

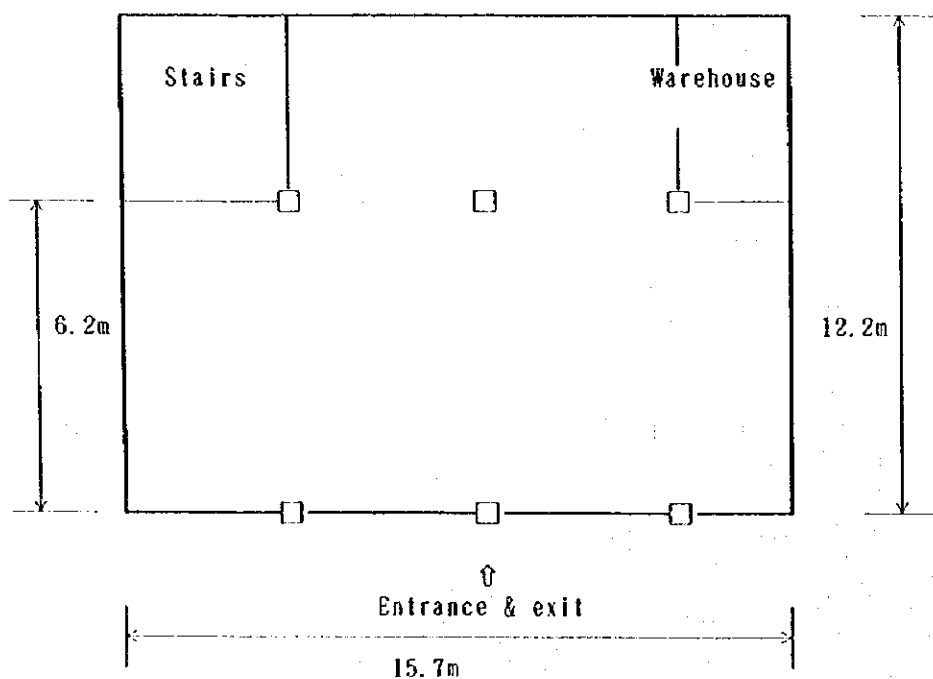

Prefecture	BALQA	fire station	③ Deir-Alla
------------	-------	--------------	-------------

Present

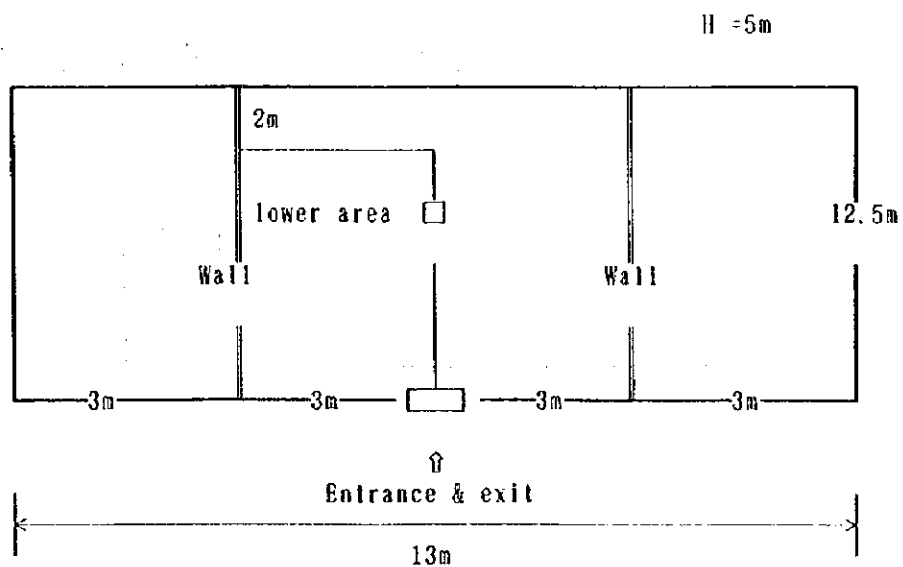

After moving to other site

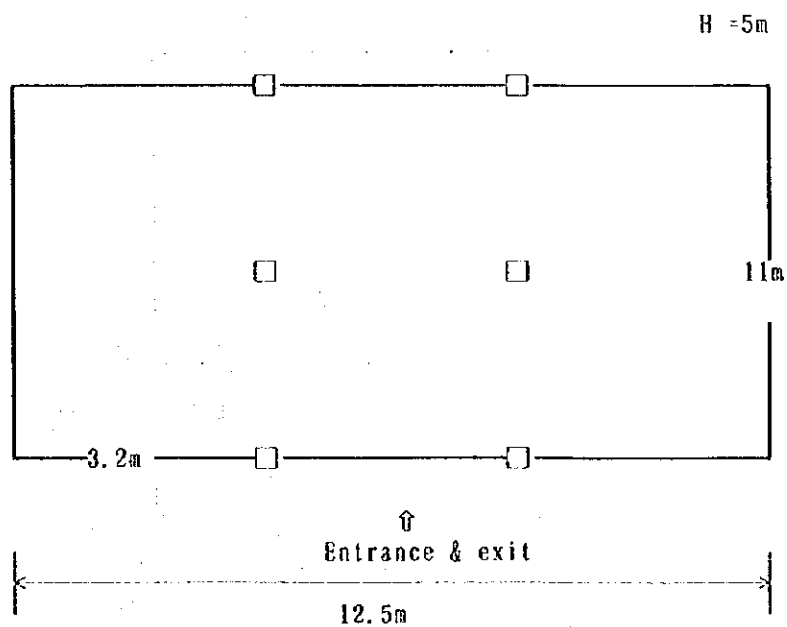

Prefecture	BALQA	fire station	④ Refugees Center
			(covered by this Project )

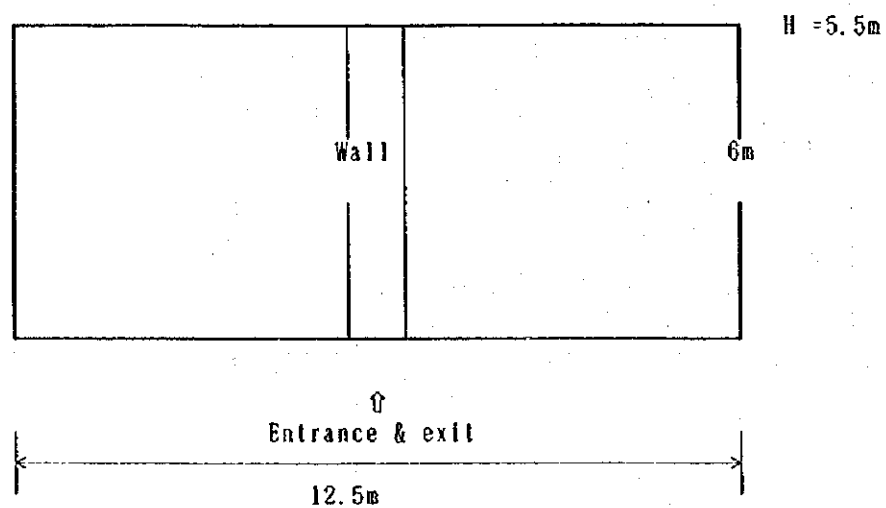

Prefecture	BALQA	fire station	⑤ Cement factory
------------	-------	--------------	------------------

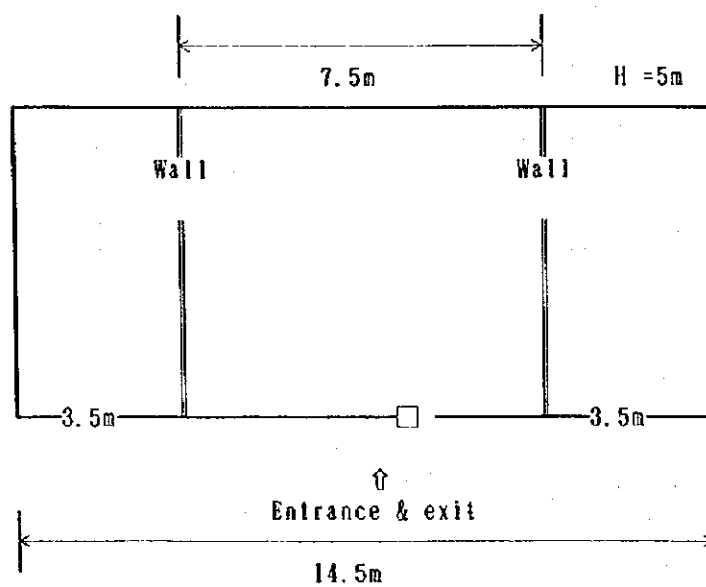

Prefecture	BALQA	fire station	⑥ Eirad & Yarka
------------	-------	--------------	-----------------

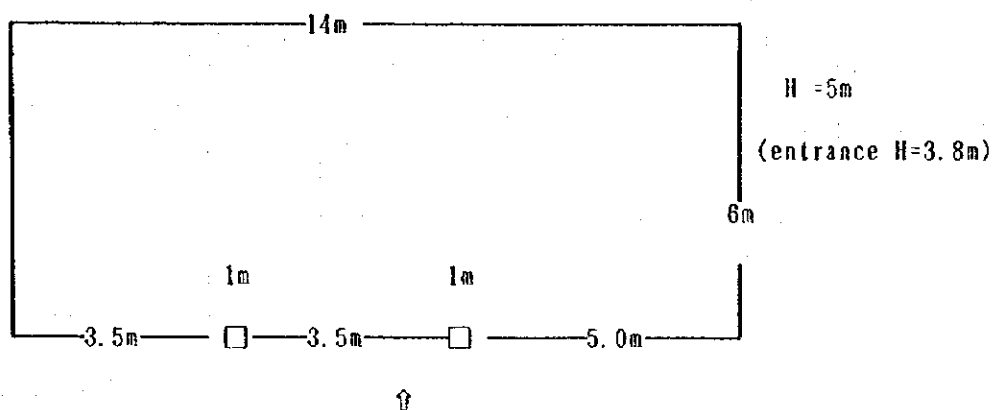

Prefecture	BALQA	fire station	⑦ City Town [covered by this Project]
------------	-------	--------------	---------------------------------------

(plan of moving to other site)

## APPENDIX 7 REFERENCES

Title	Year	Publisher
• Economic and Social Development Plan (1993 ~ 1997)	1992	Ministry of Planning
• Results of the General Census of Population and Housing of Jordan 1994	1997	Department of Statistics
1) Volume No.1 : Buildings and Housing Characteristics		
2) Volume No.2 : Population Characteristics		
• Statistical Yearbook 1996	1997	Department of Statistics
• Economic cooperation for developing countries [Jordan] (4th edition)	1984	International Cooperation Promotion Association
• Map	1996	Royal Jordanian Geographic Center
1) Jordan		
2) Governorate (Amman, Zarga, Madaba, Balqa)		









