

AFRICAN DEVELOPMENT BANK GOVERNMENT OF MAURITIUS	
BEAU BASSIN - PORT LOUIS LINK ROAD FINAL DESIGN	
CROSS SECTION	
Scale 1 : 200	SHEET NO. 105/217
Date:	1980
JAPAN INTERNATIONAL COOPERATION AGENCY	

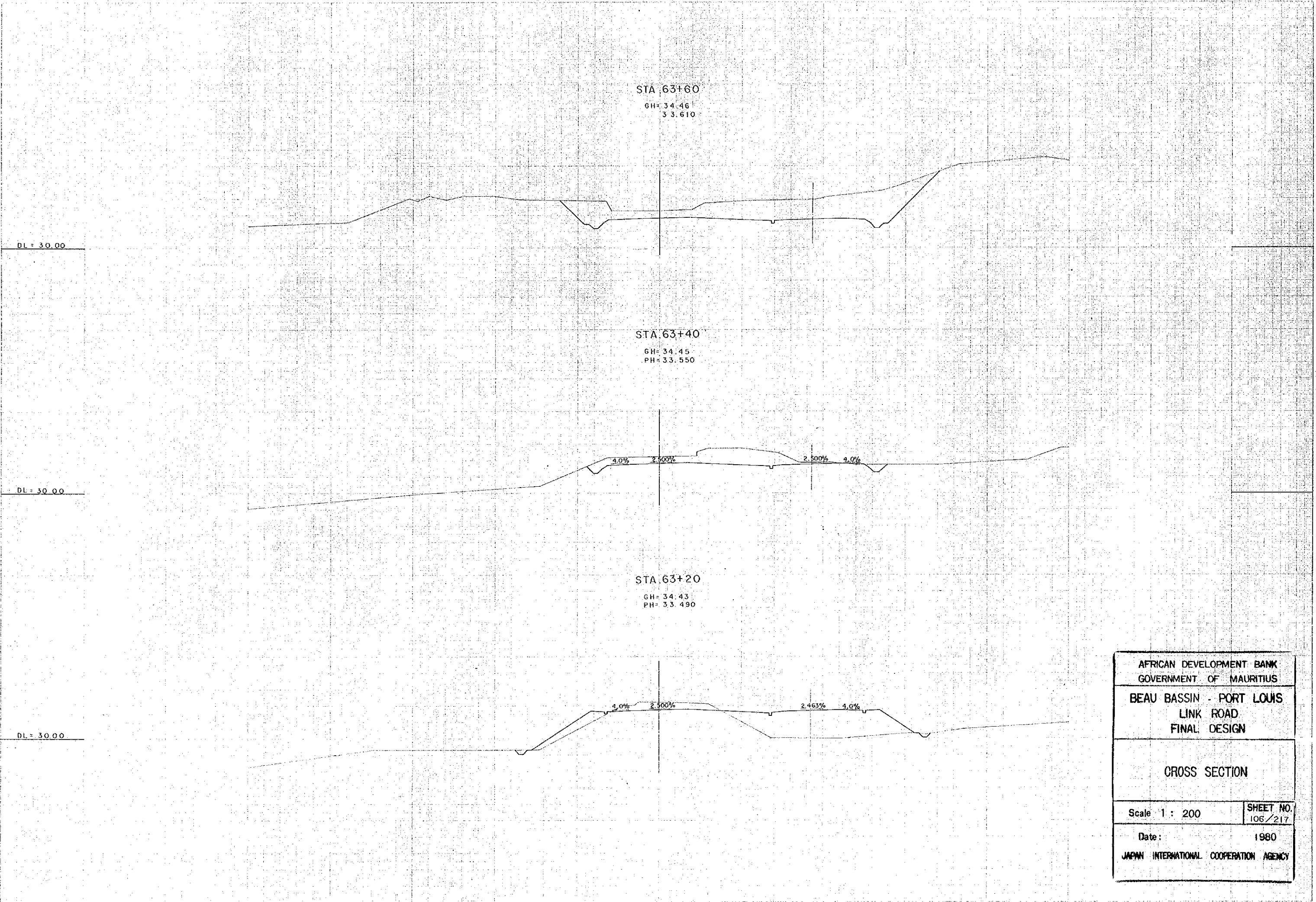

STA 63+60

GH= 34.46
PH= 33.610

STA 63+40

GH= 34.45
PH= 33.550

STA 63+20

GH= 34.43
PH= 33.490

AFRICAN DEVELOPMENT BANK GOVERNMENT OF MAURITIUS	
BEAU BASSIN - PORT LOUIS LINK ROAD FINAL DESIGN	
CROSS SECTION	
Scale 1 : 200	SHEET NO. 106 / 217
Date:	1980
JAPAN INTERNATIONAL COOPERATION AGENCY	

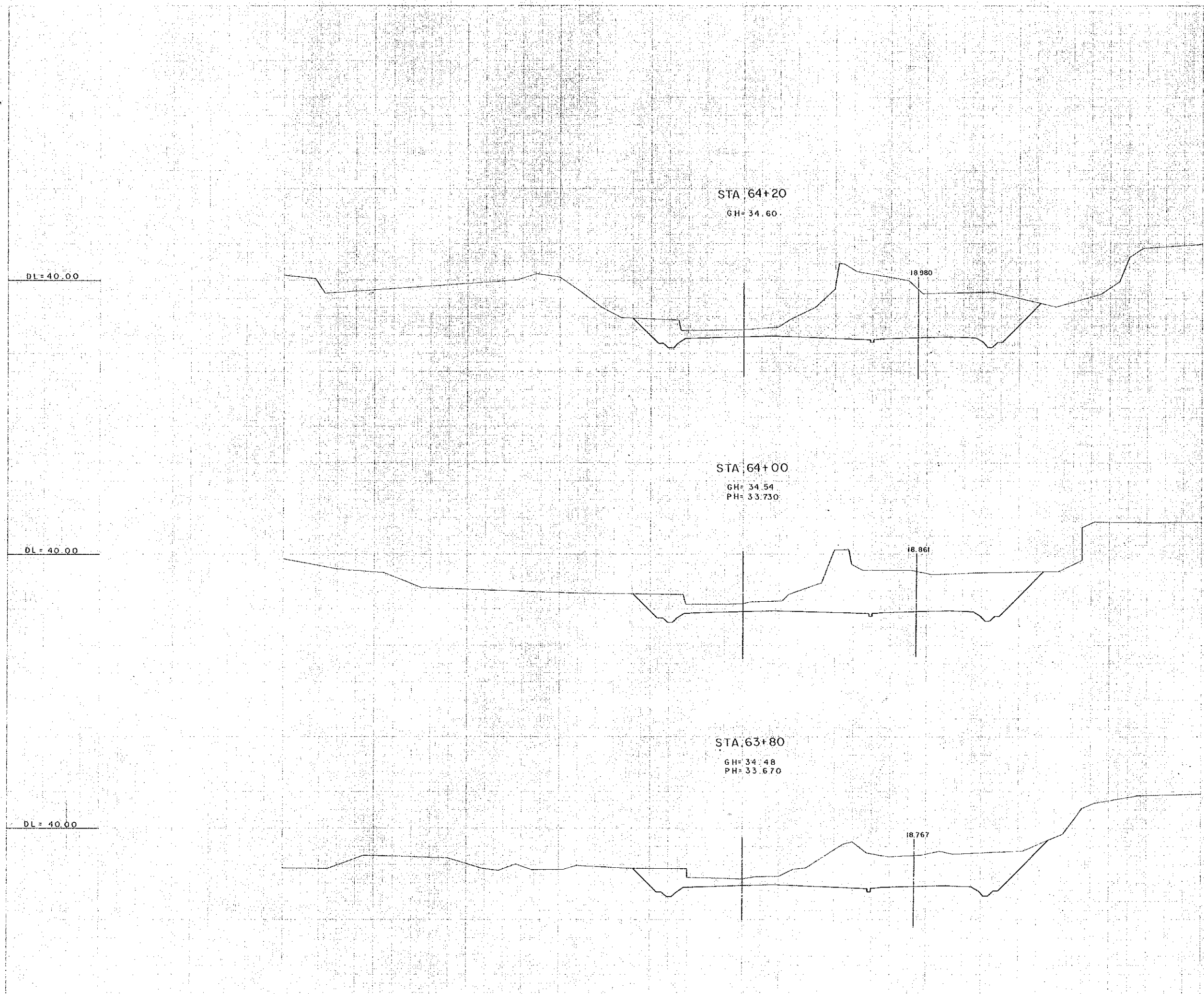

AFRICAN DEVELOPMENT BANK GOVERNMENT OF MAURITIUS	
BEAU BASSIN - PORT LOUIS LINK ROAD FINAL DESIGN	
CROSS SECTION	
Scale 1 : 200	SHEET NO. 107/217
Date:	1980
JAPAN INTERNATIONAL COOPERATION AGENCY	

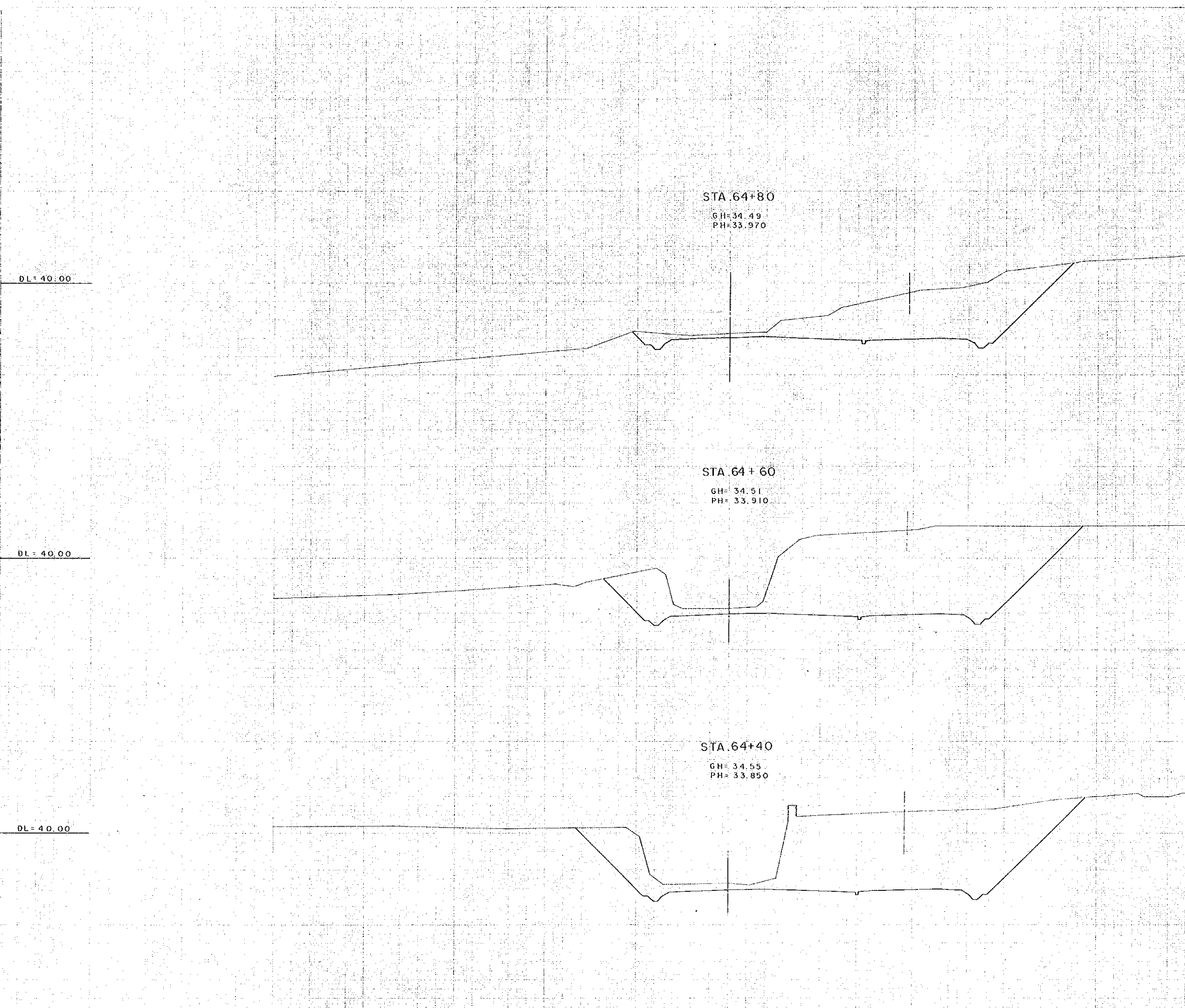

STA 64+80
 GH=34.49
 PH=33.970

STA 64+60
 GH=34.51
 PH=33.910

STA 64+40
 GH=34.55
 PH=33.850

AFRICAN DEVELOPMENT BANK GOVERNMENT OF MAURITIUS	
BEAU BASSIN - PORT LOUIS LINK ROAD FINAL DESIGN	
CROSS SECTION	
Scale 1 : 200	SHEET NO. 108/217
Date:	1980
JAPAN INTERNATIONAL COOPERATION AGENCY	

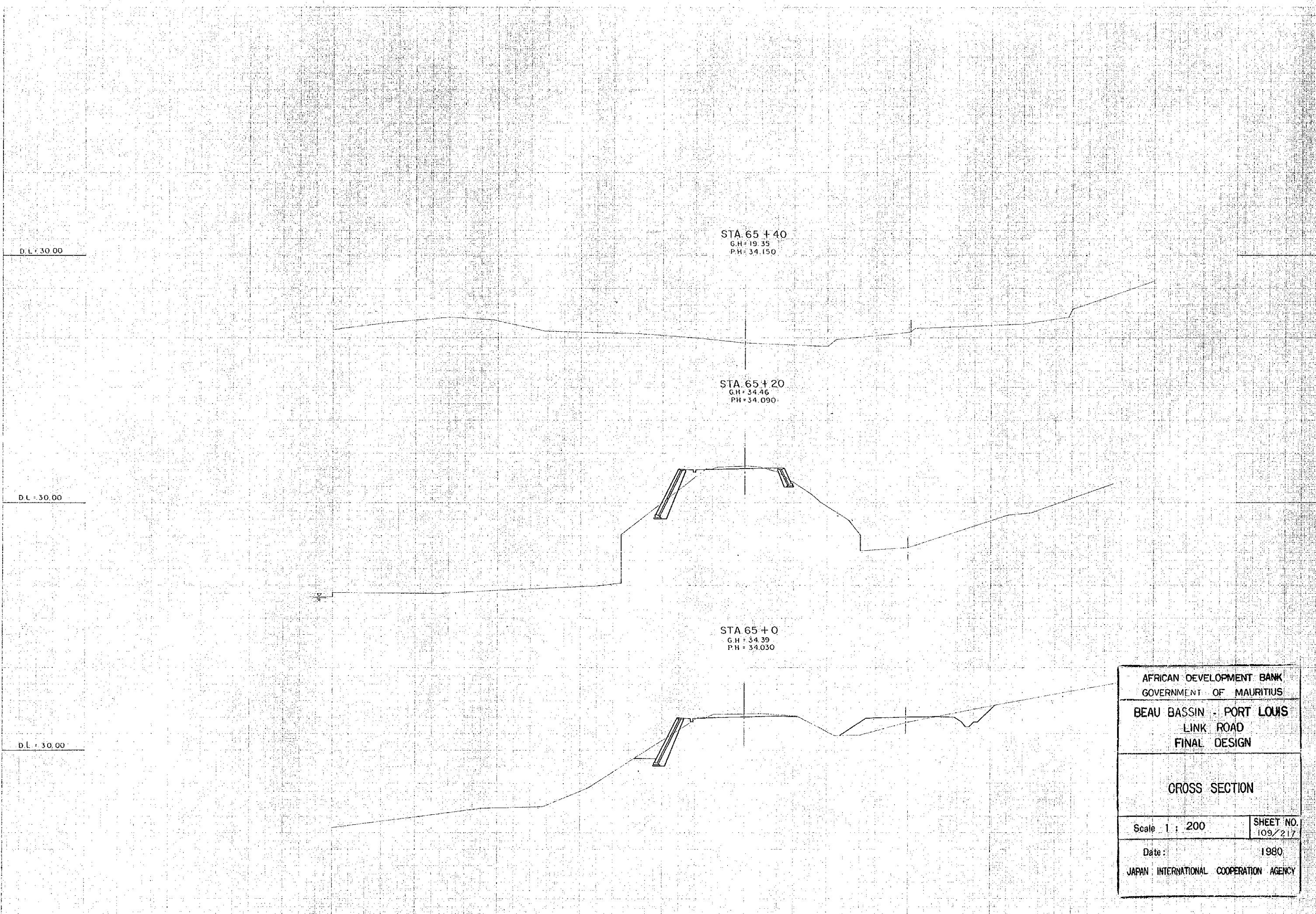

AFRICAN DEVELOPMENT BANK GOVERNMENT OF MAURITIUS	
BEAU BASSIN - PORT LOUIS LINK ROAD FINAL DESIGN	
CROSS SECTION	
Scale 1 : 200	SHEET NO. 109/217
Date:	1980
JAPAN INTERNATIONAL COOPERATION AGENCY	

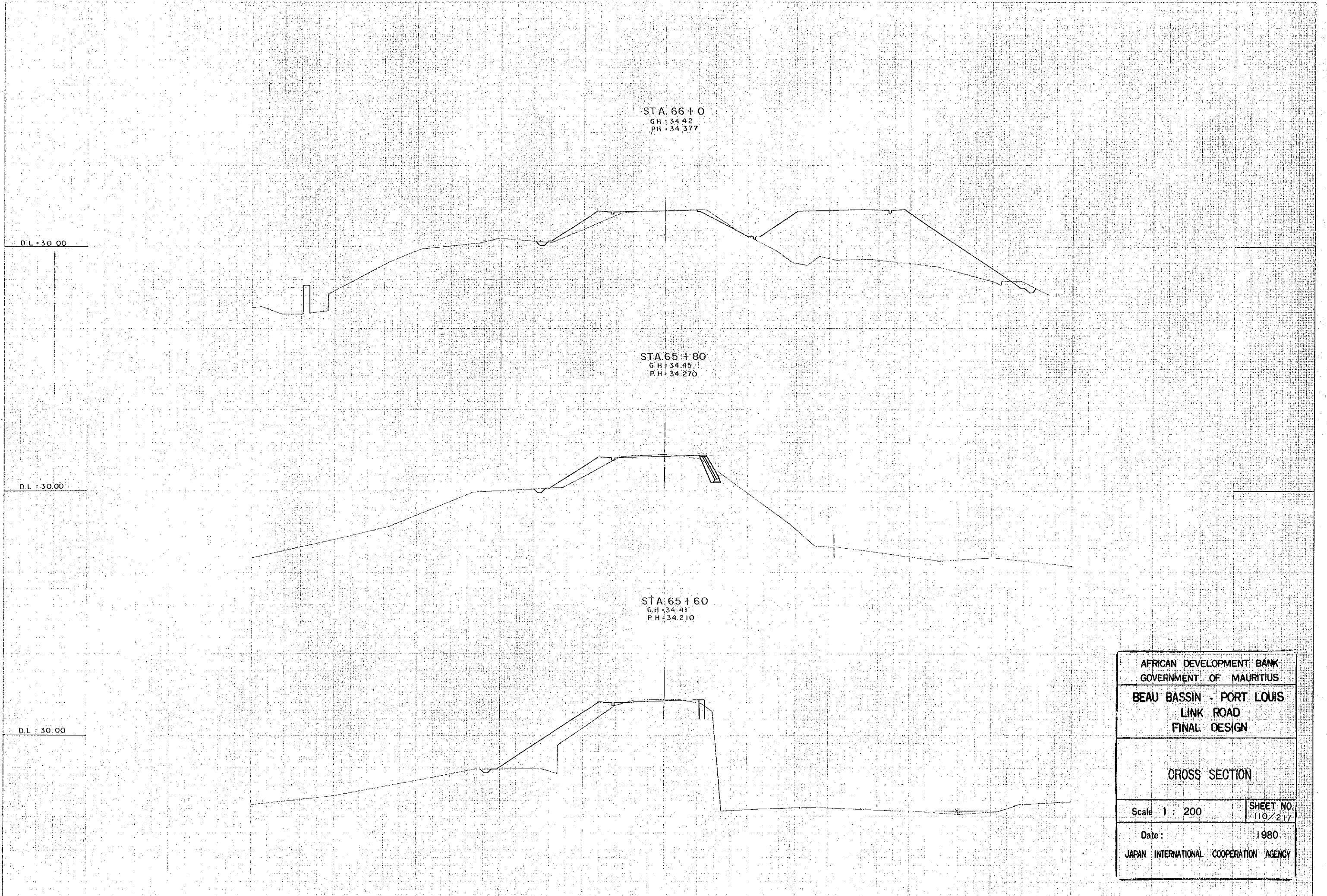

STA. 66+0
G.H. 34.42
P.H. 34.377

STA. 65+80
G.H. 34.45
P.H. 34.270

STA. 65+60
G.H. 34.41
P.H. 34.210

D.L. = 30.00

D.L. = 30.00

D.L. = 30.00

AFRICAN DEVELOPMENT BANK GOVERNMENT OF MAURITIUS	
BEAU BASSIN - PORT LOUIS LINK ROAD FINAL DESIGN	
CROSS SECTION	
Scale 1 : 200	SHEET NO. 110/217
Date:	1980
JAPAN INTERNATIONAL COOPERATION AGENCY	

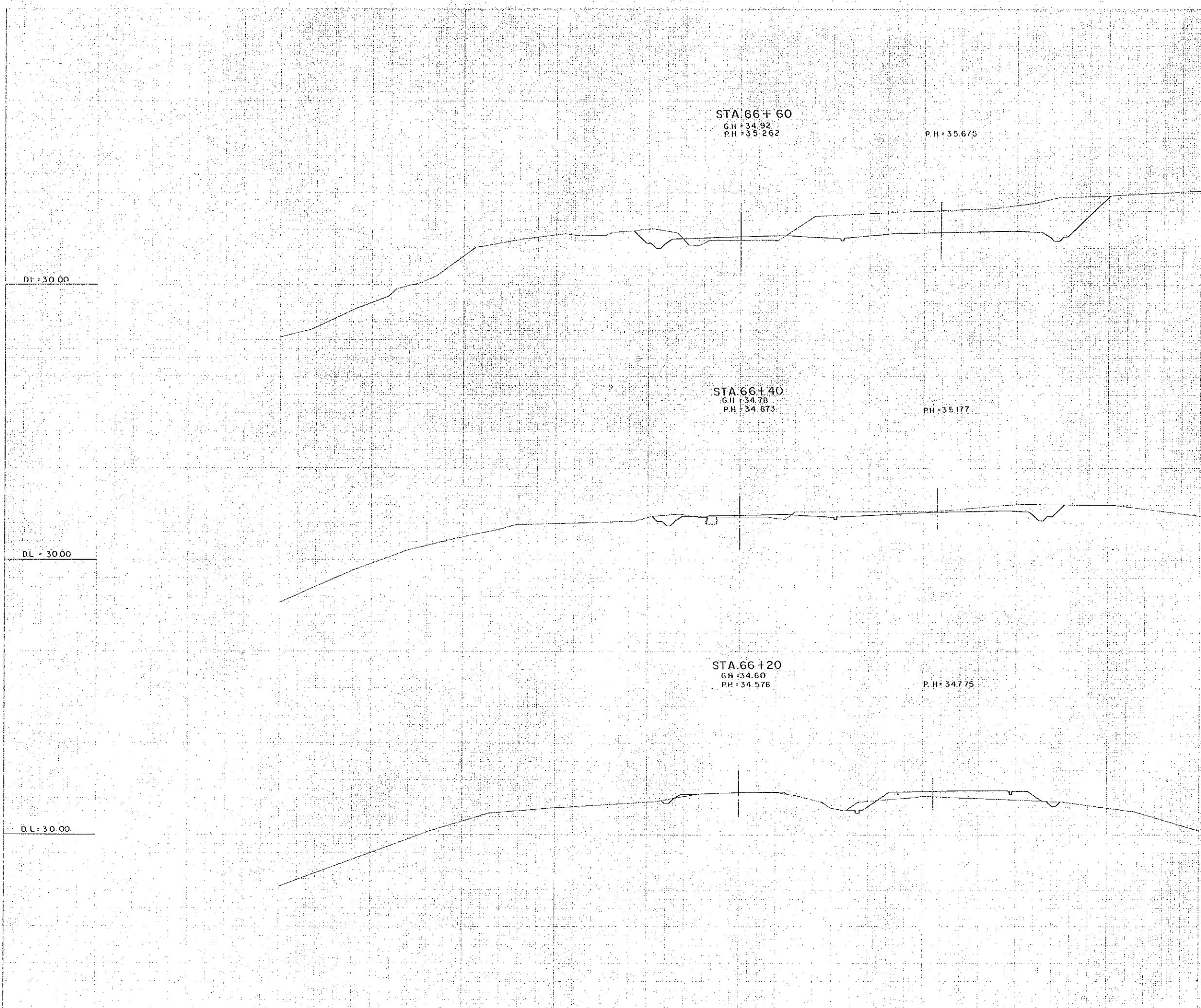

STA 66+60
G.H. 34.92
P.H. 35.262

P.H. 35.675

DL = 30.00

STA 66+40
G.H. 34.78
P.H. 34.873

P.H. 35.177

DL = 30.00

STA 66+20
G.H. 34.60
P.H. 34.578

P.H. 34.775

DL = 30.00

AFRICAN DEVELOPMENT BANK GOVERNMENT OF MAURITIUS	
BEAU BASSIN - PORT LOUIS LINK ROAD FINAL DESIGN	
CROSS SECTION	
Scale 1 : 200	SHEET NO. 111/217
Date:	1980
JAPAN INTERNATIONAL COOPERATION AGENCY	

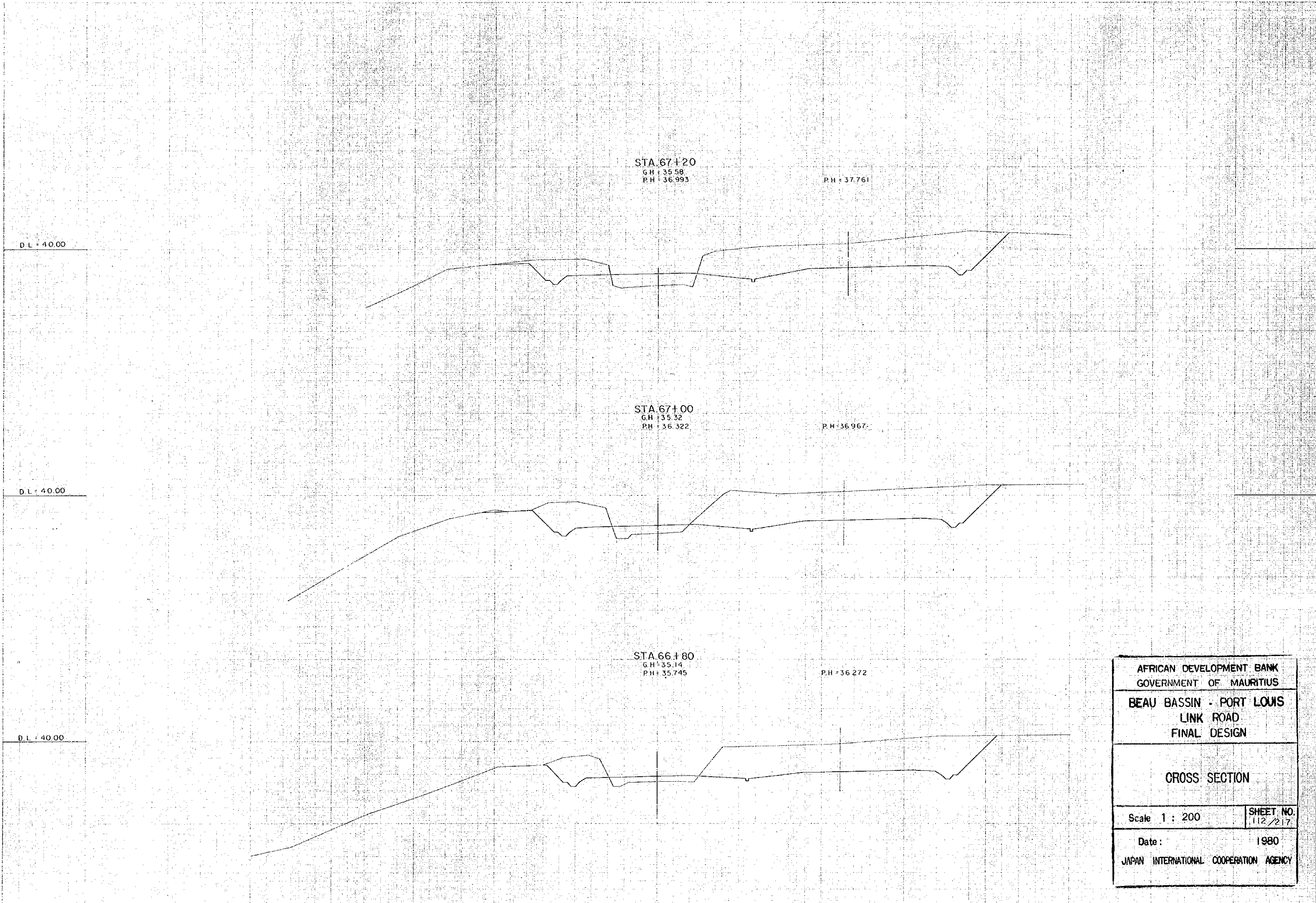

AFRICAN DEVELOPMENT BANK GOVERNMENT OF MAURITIUS	
BEAU BASSIN - PORT LOUIS LINK ROAD FINAL DESIGN	
CROSS SECTION	
Scale 1 : 200	SHEET NO. 112/217
Date:	1980
JAPAN INTERNATIONAL COOPERATION AGENCY	

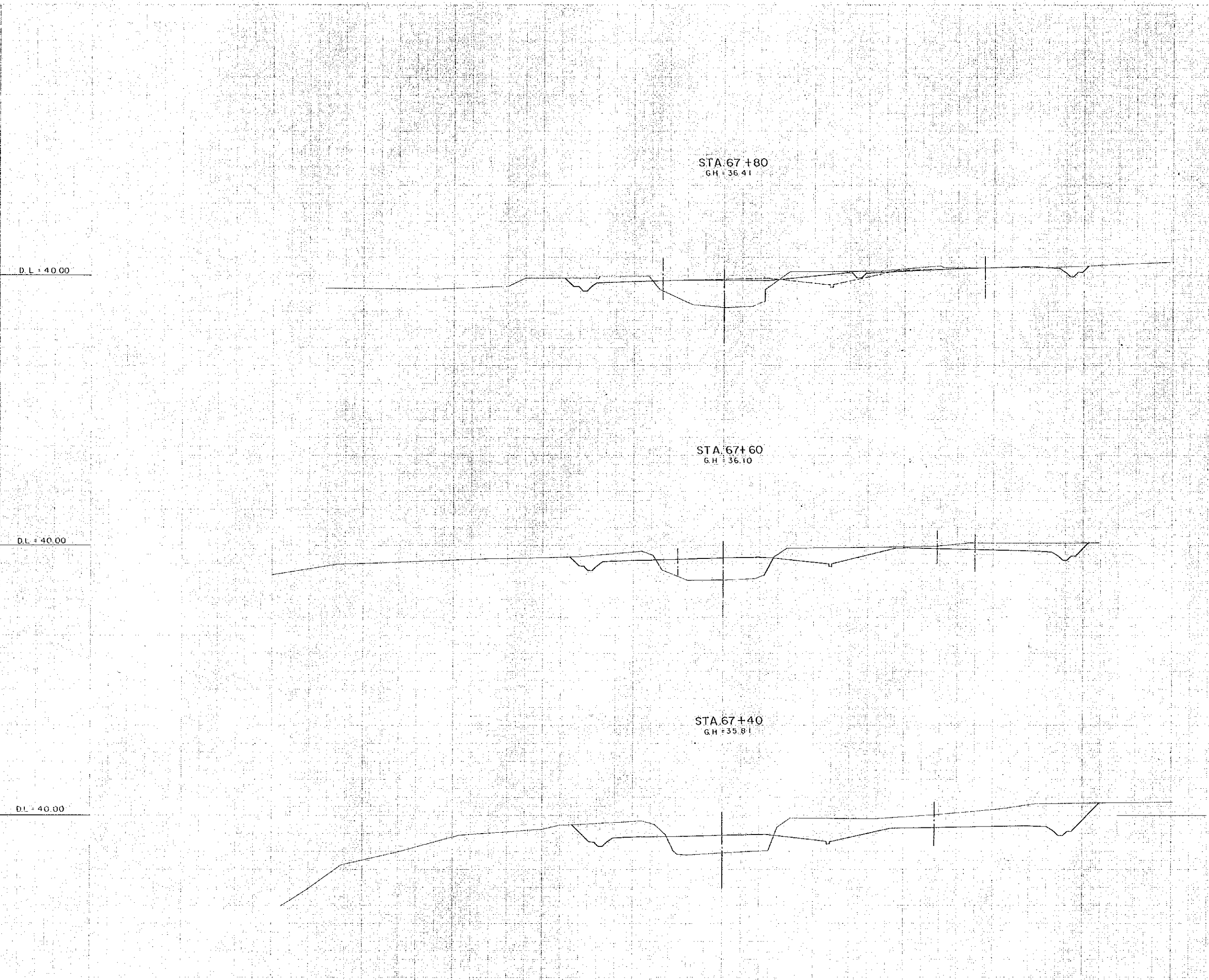

STA. 67+80
G.H. = 36.41

STA. 67+60
G.H. = 36.10

STA. 67+40
G.H. = 35.81

D.L. = 40.00

D.L. = 40.00

D.L. = 40.00

AFRICAN DEVELOPMENT BANK GOVERNMENT OF MAURITIUS	
BEAU BASSIN - PORT LOUIS LINK ROAD FINAL DESIGN	
CROSS SECTION	
Scale 1 : 200	SHEET NO. 113/217
Date:	1990
JAPAN INTERNATIONAL COOPERATION AGENCY	

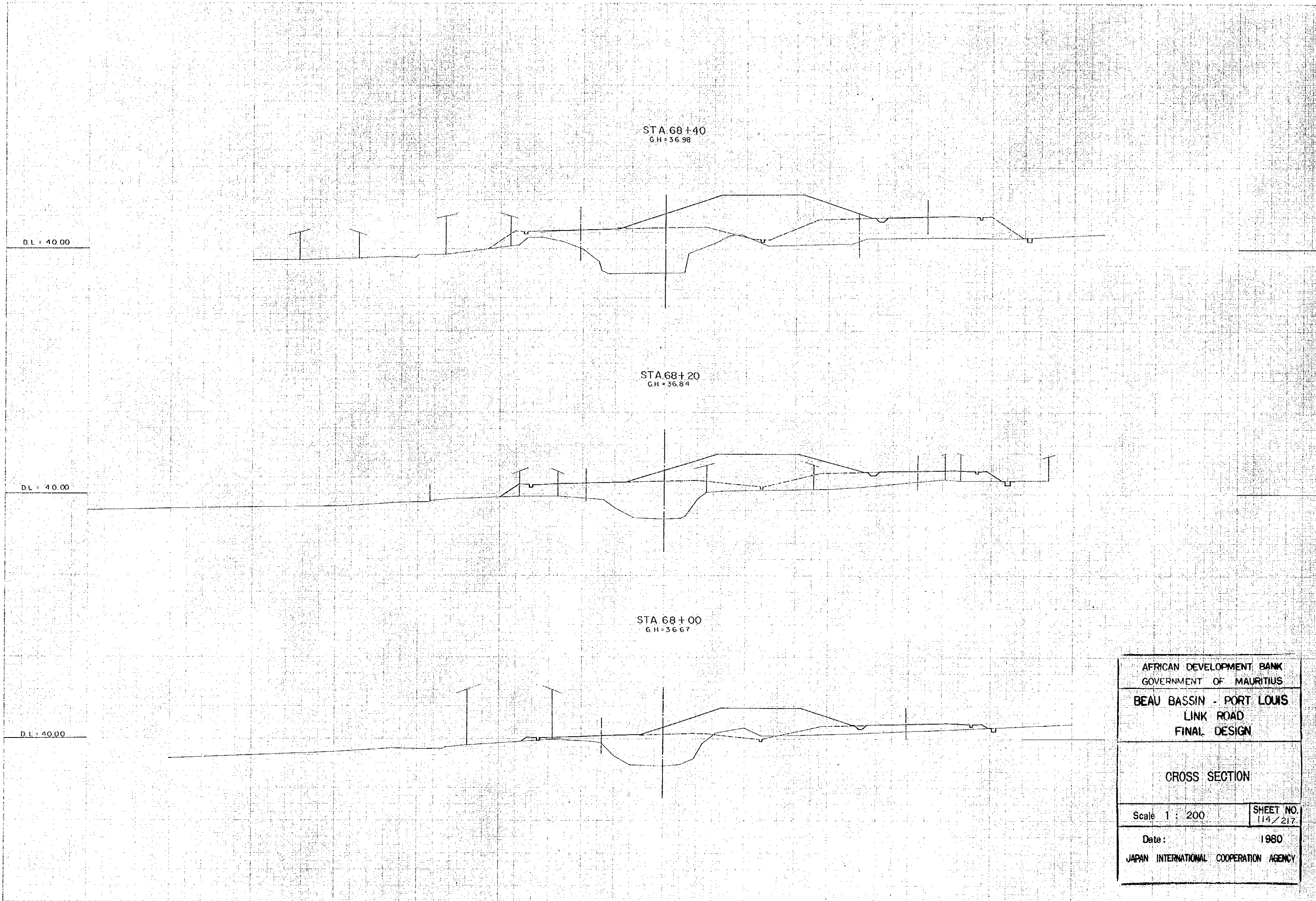

AFRICAN DEVELOPMENT BANK GOVERNMENT OF MAURITIUS	
BEAU BASSIN - PORT LOUIS LINK ROAD FINAL DESIGN	
CROSS SECTION	
Scale 1 : 200	SHEET NO. 114 / 217
Date:	1980
JAPAN INTERNATIONAL COOPERATION AGENCY	

D.L. = 40.00

STA. 69 + 00
G.H. = 39.48

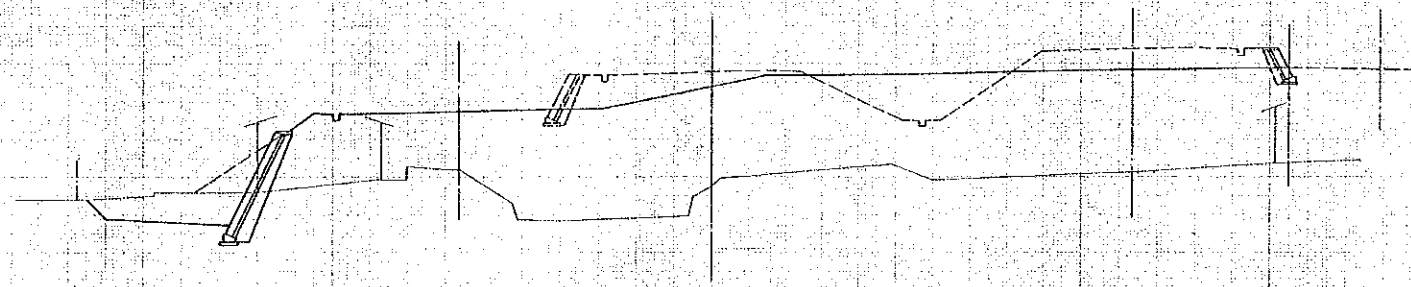

D.L. = 40.00

STA. 68 + 80
G.H. = 38.27

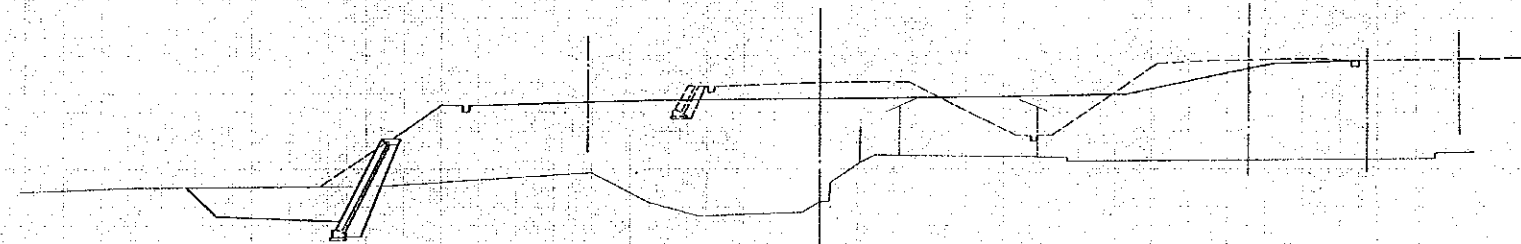

D.L. = 40.00

STA. 68 + 60
G.H. = 37.36

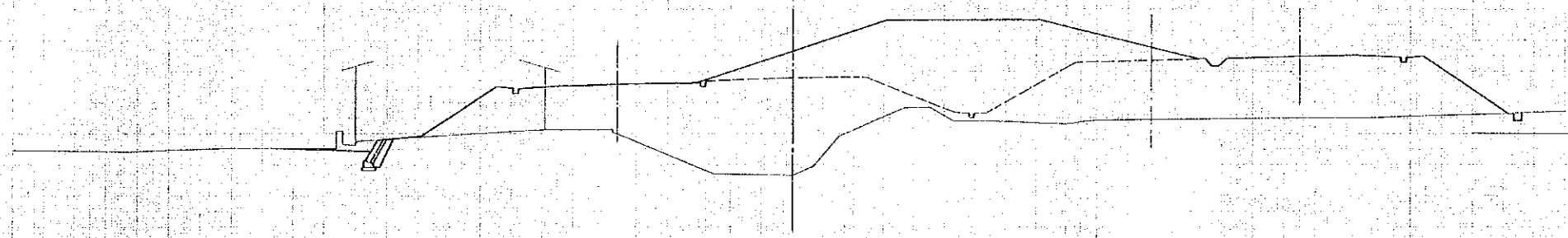

AFRICAN DEVELOPMENT BANK GOVERNMENT OF MAURITIUS	
BEAU BASSIN - PORT LOUIS LINK ROAD FINAL DESIGN	
CROSS SECTION	
Scale 1 : 200	SHEET NO. 115/217
Date:	1980
JAPAN INTERNATIONAL COOPERATION AGENCY	

STA. 69 + 40
G.H. = 39.91

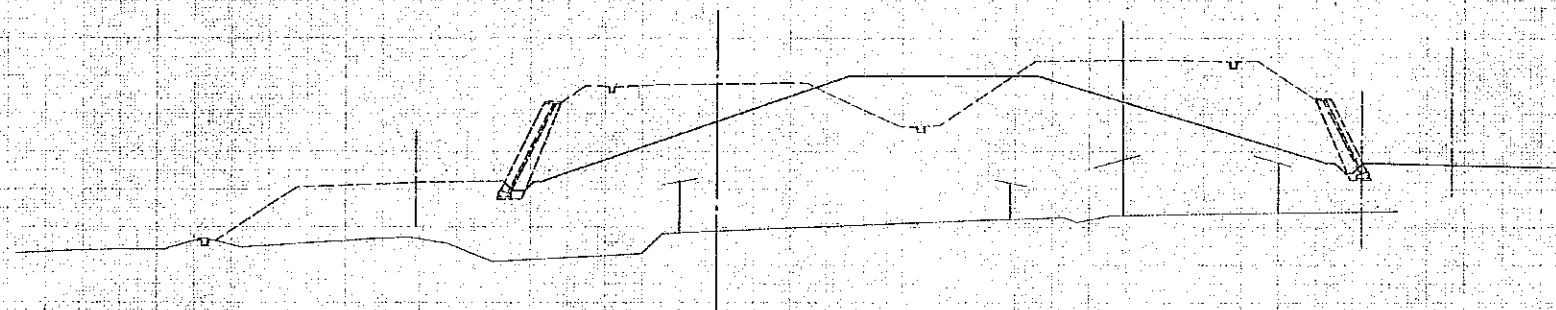

D.L. = 40.00

STA. 69 + 20
G.H. = 39.86

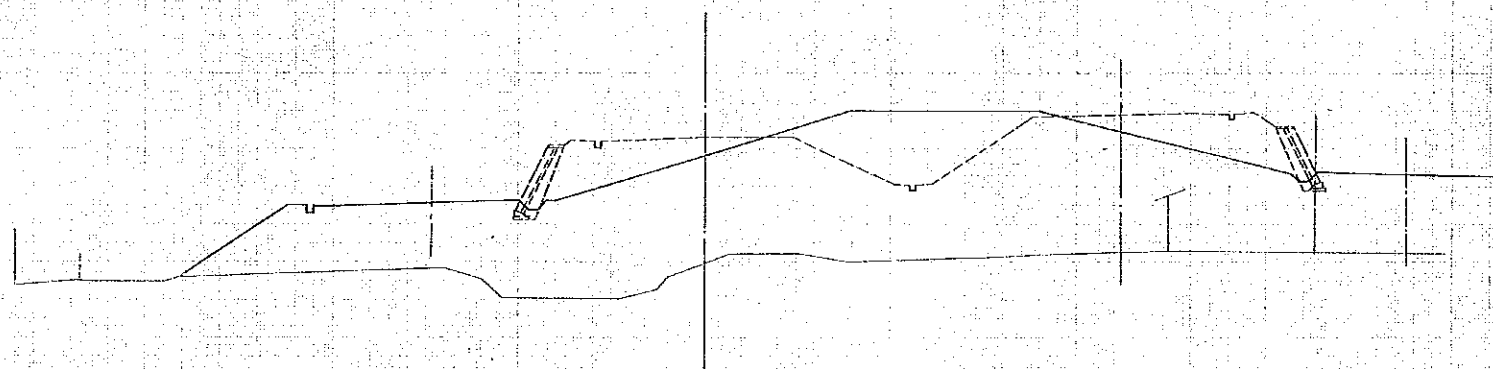

D.L. = 40.00

AFRICAN DEVELOPMENT BANK GOVERNMENT OF MAURITIUS	
BEAU BASSIN - PORT LOUIS LINK ROAD FINAL DESIGN	
CROSS SECTION	
Scale 1 : 200	SHEET NO. 116/217
Date :	1980
JAPAN INTERNATIONAL COOPERATION AGENCY	

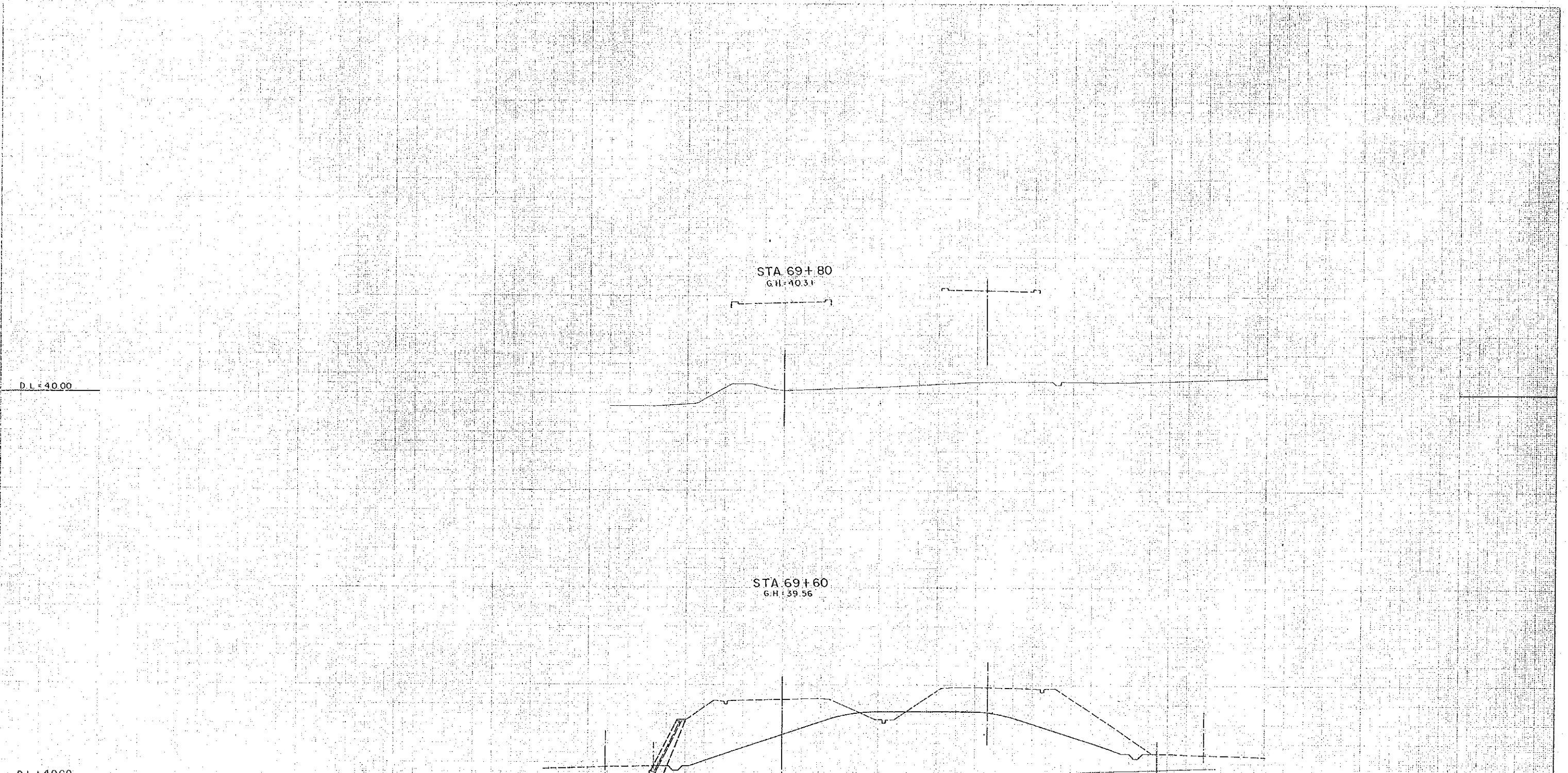

AFRICAN DEVELOPMENT BANK GOVERNMENT OF MAURITIUS	
BEAU BASSIN - PORT LOUIS LINK ROAD FINAL DESIGN	
CROSS SECTION	
Scale 1 : 200	SHEET NO. 117/217
Date:	1980
JAPAN INTERNATIONAL COOPERATION AGENCY	

STA. 70+20
G.H. 40.13

D.L. = 40.00

STA. 70+0
G.H. 40.69

D.L. = 40.00

AFRICAN DEVELOPMENT BANK GOVERNMENT OF MAURITIUS	
BEAU BASSIN - PORT LOUIS LINK ROAD FINAL DESIGN	
CROSS SECTION	
Scale 1 : 200	SHEET NO. 118/217
Date: 1980	
JAPAN INTERNATIONAL COOPERATION AGENCY	

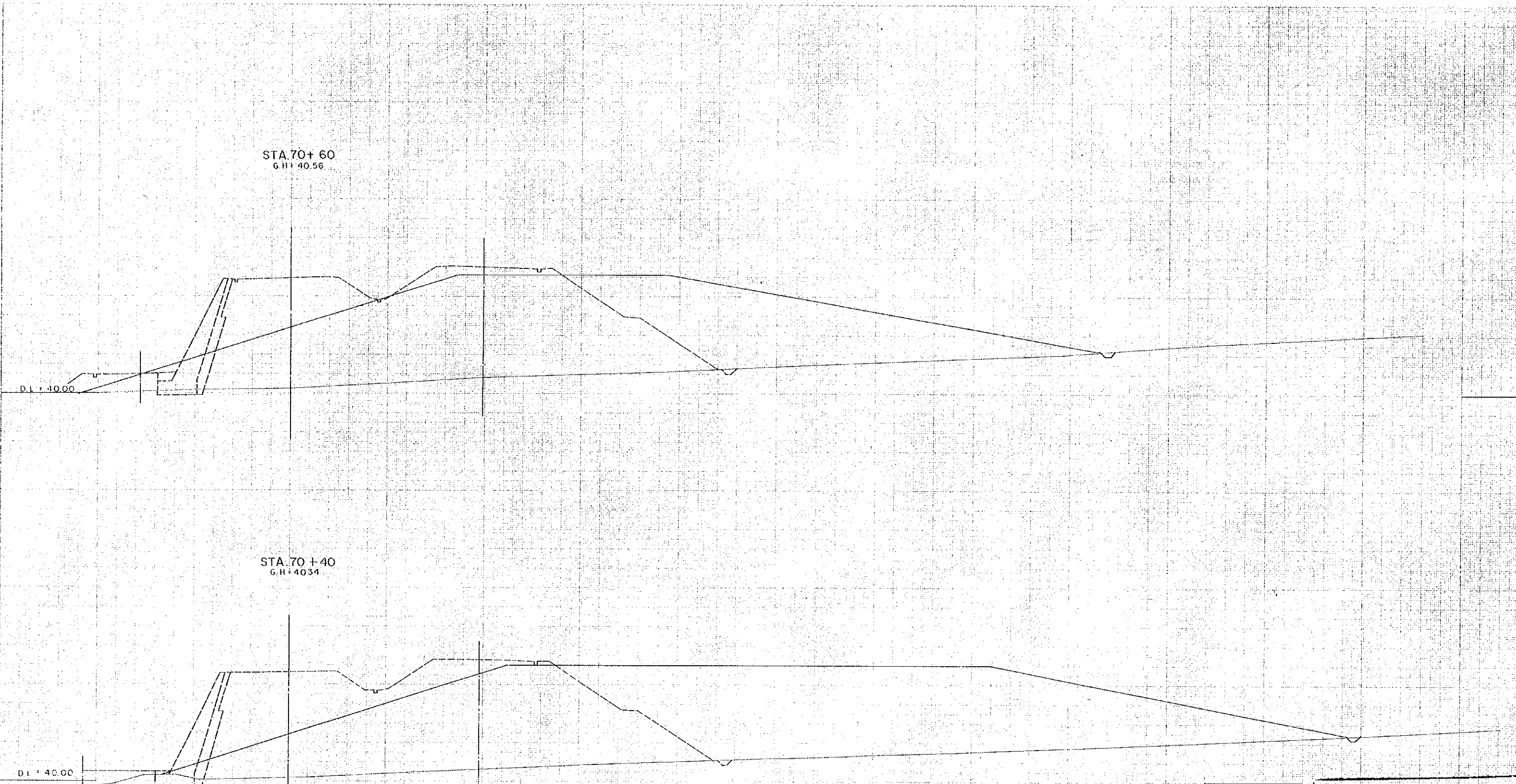

AFRICAN DEVELOPMENT BANK GOVERNMENT OF MAURITIUS	
BEAU BASSIN - PORT LOUIS LINK ROAD FINAL DESIGN	
CROSS SECTION	
Scale 1 : 200	SHEET NO. 119 / 217
Date : 1980	
JAPAN INTERNATIONAL COOPERATION AGENCY	

STA. 71+00
G.H. 41.67

D.L. 40.00

STA. 70+80
G.H. 41.15

D.L. 40.00

AFRICAN DEVELOPMENT BANK & GOVERNMENT OF MAURITIUS	
BEAU BASSIN - PORT LOUIS LINK ROAD FINAL DESIGN	
CROSS SECTION	
Scale 1 : 200	SHEET NO. 120 / 217
Date: 1980	
JAPAN INTERNATIONAL COOPERATION AGENCY	