

STA. 29 + 00  
 G.H.=122.23  
 P.H.=126.360

STA. 28 + 80  
 G.H.=123.37    127.045

STA. 28 + 60  
 G.H.=124.95  
 P.H.=127.700

4.0%    2.500%    2.500%    4.0%

D.L. = 120.00

D.L. = 120.00

D.L. = 120.00

AFRICAN DEVELOPMENT BANK GOVERNMENT OF MAURITIUS	
BEAU BASSIN - PORT LOUIS LINK ROAD FINAL DESIGN	
CROSS SECTION	
Scale 1 : 200	SHEET NO. 50/217
Date: 1980	JAPAN INTERNATIONAL COOPERATION AGENCY

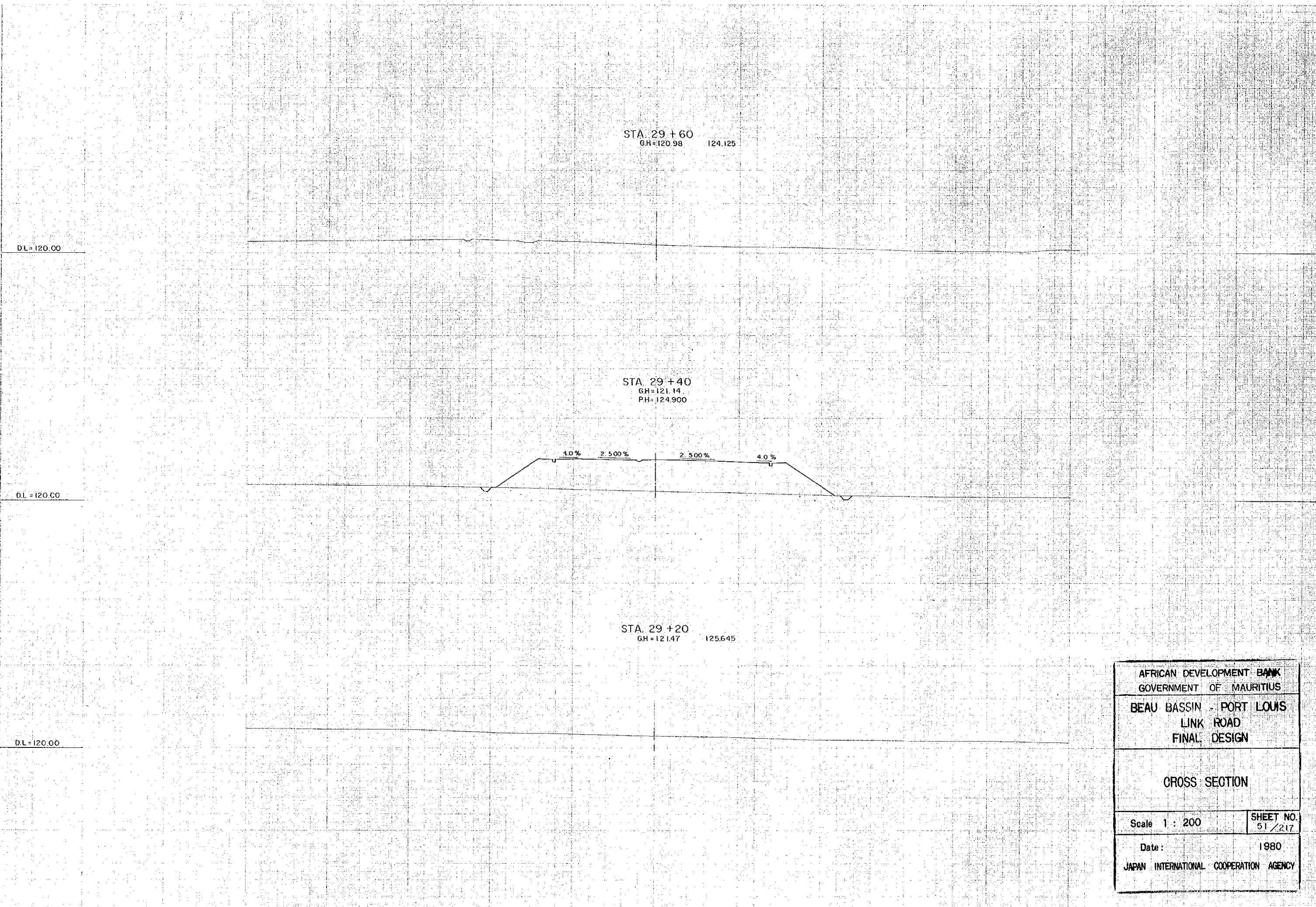

AFRICAN DEVELOPMENT BANK GOVERNMENT OF MAURITIUS	
BEAU BASSIN - PORT LOUIS LINK ROAD FINAL DESIGN	
CROSS SECTION	
Scale 1 : 200	SHEET NO. 51 / 217
Date: 1980	
JAPAN INTERNATIONAL COOPERATION AGENCY	

STA. 30 + 20  
G.H. = 119.41  
P.H. = 121.620

DL = 120.00

STA. 30 + 00  
G.H. = 120.30 . 122.485

DL = 120.00

STA. 20 + 80  
G.H. = 120.96  
P.H. = 123.320

DL = 120.00

4.0% 2.500% 2.500% 4.0%

AFRICAN DEVELOPMENT BANK GOVERNMENT OF MAURITIUS	
BEAU BASSIN - PORT LOUIS LINK ROAD FINAL DESIGN	
CROSS SECTION	
Scale 1 : 200	SHEET NO. 52/217
Date : 1980	
JAPAN INTERNATIONAL COOPERATION AGENCY	

DL = 120.00

DL = 120.00

DL = 120.00

STA. 30 + 80  
GH=116.14 118.845

STA. 30 + 60  
GH=117.21  
PH=119.800

STA. 30 + 40  
GH=118.35 120.725

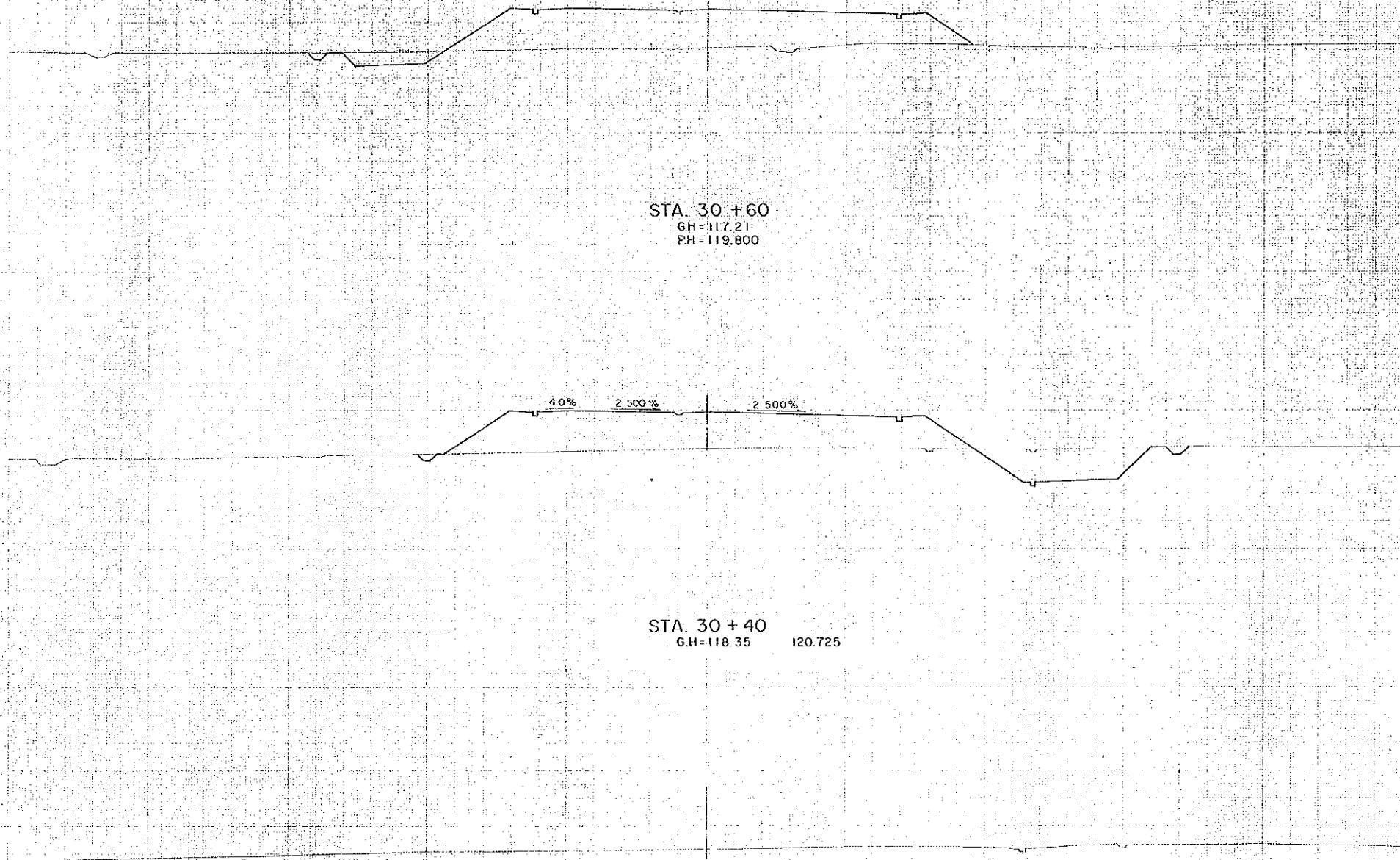

AFRICAN DEVELOPMENT BANK GOVERNMENT OF MAURITIUS	
BEAU BASSIN - PORT LOUIS LINK ROAD FINAL DESIGN	
CROSS SECTION	
Scale 1 : 200	SHEET NO. 53/217
Date: 1980	
JAPAN INTERNATIONAL COOPERATION AGENCY	



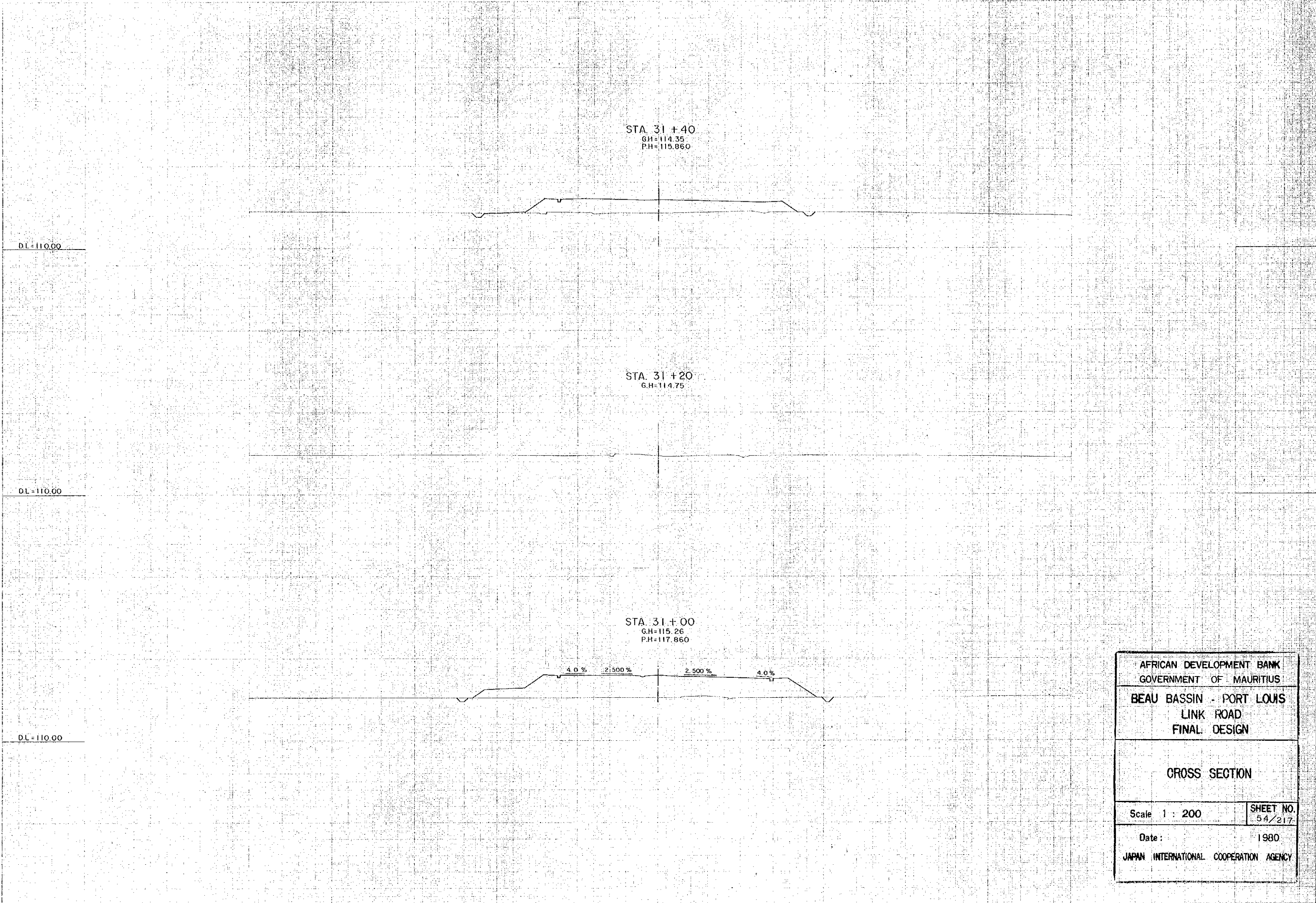

AFRICAN DEVELOPMENT BANK GOVERNMENT OF MAURITIUS	
BEAU BASSIN - PORT LOUIS LINK ROAD FINAL DESIGN	
CROSS SECTION	
Scale 1 : 200	SHEET NO. 54/217
Date:	1980
JAPAN INTERNATIONAL COOPERATION AGENCY	

DL = 110.00

DL = 110.00

DL = 110.00

STA. 32 + 00  
GH = 112.23    112.860

STA. 31 + 80  
GH = 113.29  
PH = 113.860

STA. 31 + 60  
GH = 114.02    114.860

4.0%    2.500%    2.500%    4.0%

AFRICAN DEVELOPMENT BANK  
GOVERNMENT OF MAURITIUS

BEAU BASSIN - PORT LOUIS  
LINK ROAD  
FINAL DESIGN

CROSS SECTION

Scale: 1 : 200

SHEET NO.  
55 / 217

Date: 1980

JAPAN INTERNATIONAL COOPERATION AGENCY

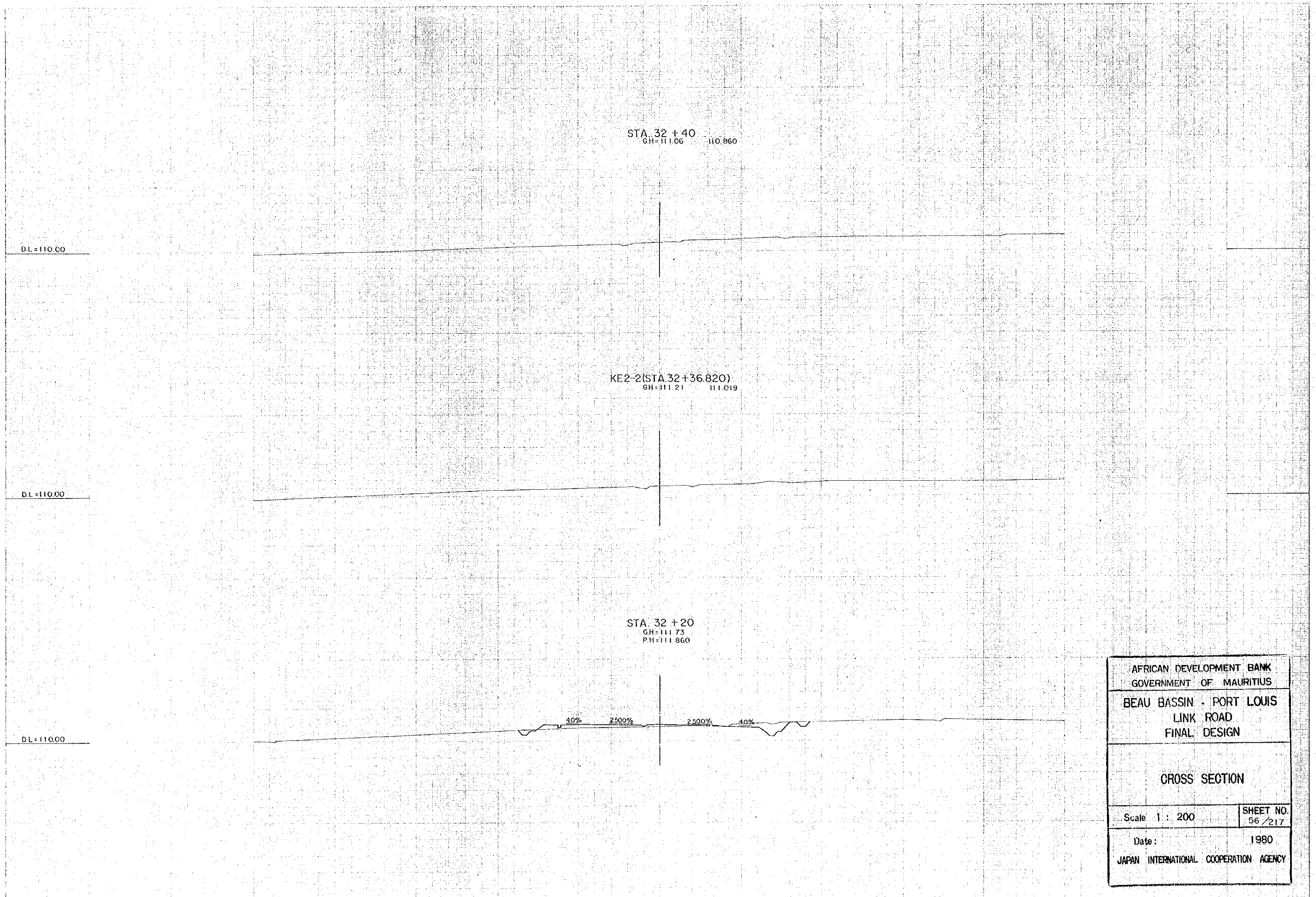

AFRICAN DEVELOPMENT BANK GOVERNMENT OF MAURITIUS	
BEAU BASSIN - PORT LOUIS LINK ROAD FINAL DESIGN	
CROSS SECTION	
Scale 1 : 200	SHEET NO. 56 / 217
Date:	1980
JAPAN INTERNATIONAL COOPERATION AGENCY	

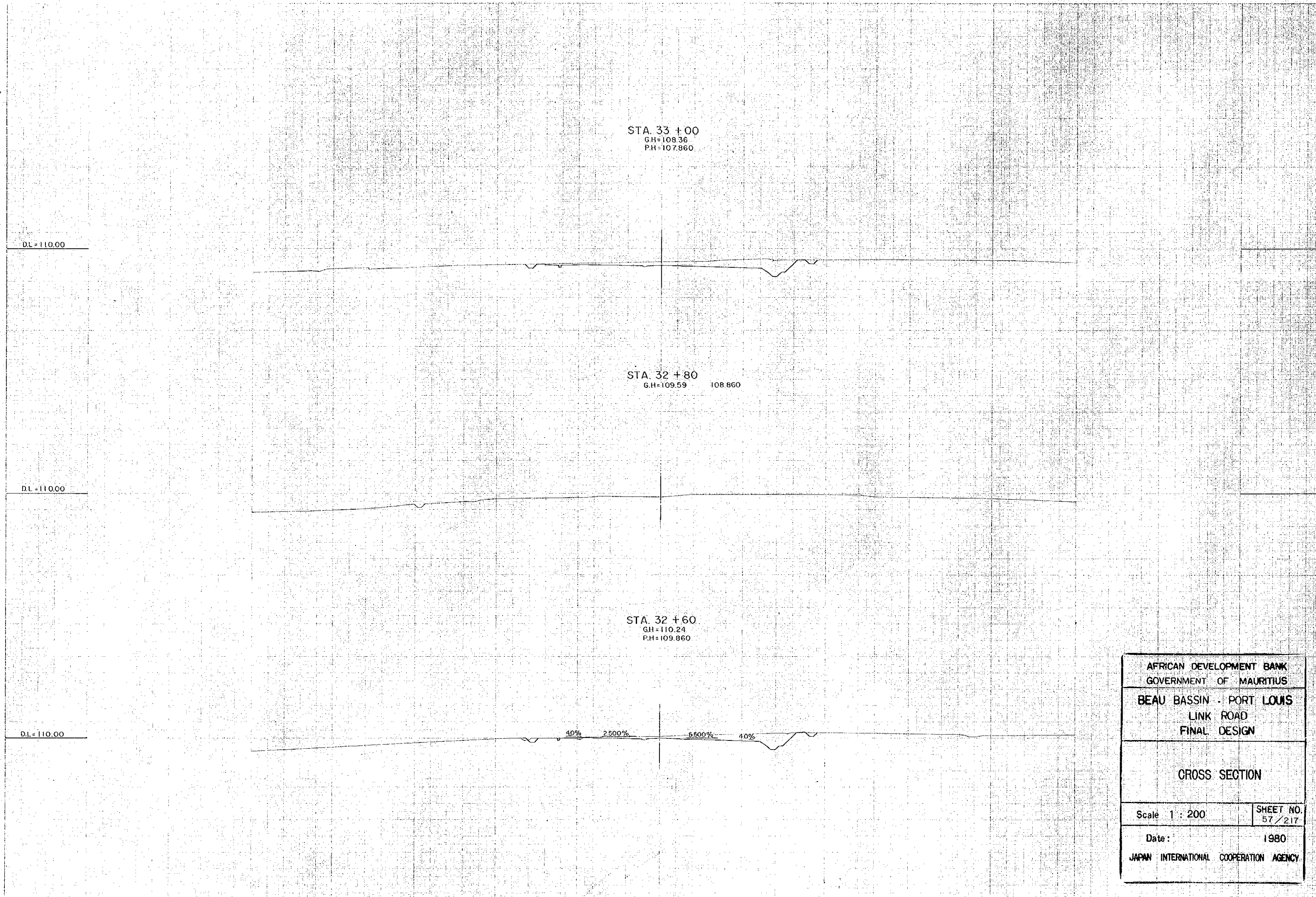

STA. 33 + 00  
GH=109.36  
PH=107.860

DL = 110.00

STA. 32 + 80  
GH=109.59 108.860

DL = 110.00

STA. 32 + 60  
GH=110.24  
PH=109.860

DL = 110.00

40% 2.500% 5.500% 40%

AFRICAN DEVELOPMENT BANK GOVERNMENT OF MAURITIUS	
BEAU BASSIN - PORT LOUIS LINK ROAD FINAL DESIGN	
CROSS SECTION	
Scale 1 : 200	SHEET NO. 57 / 217
Date : 1980	
JAPAN INTERNATIONAL COOPERATION AGENCY	



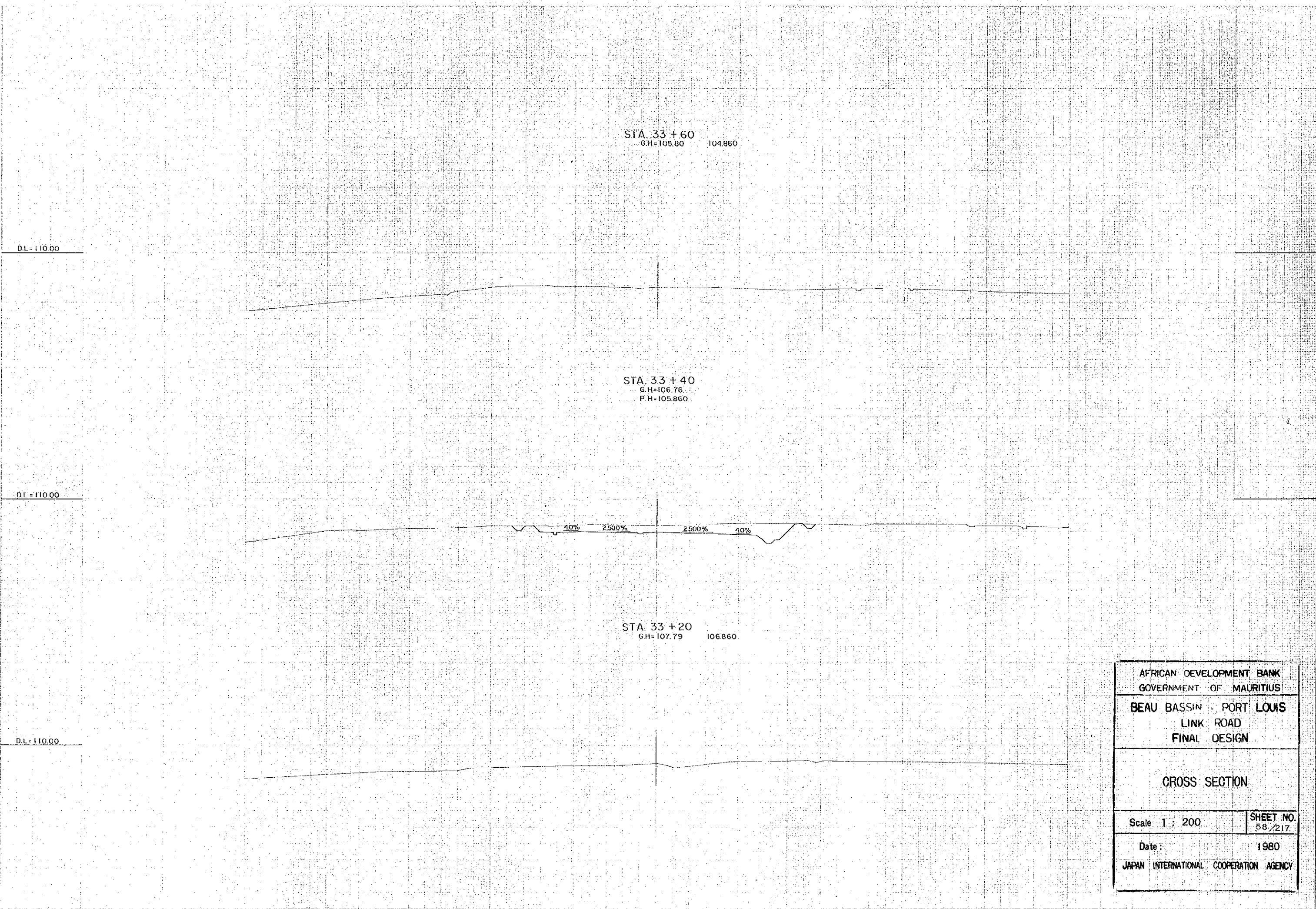

STA. 33 + 60  
G.H.=105.80 104.860

D.L.=110.00

STA. 33 + 40  
G.H.=106.76  
P.H.=105.860

D.L.=110.00

40% 2.500% 2.500% 40%

STA. 33 + 20  
G.H.=107.79 106.860

D.L.=110.00

AFRICAN DEVELOPMENT BANK GOVERNMENT OF MAURITIUS	
BEAU BASSIN - PORT LOUIS LINK ROAD FINAL DESIGN	
CROSS SECTION	
Scale 1 : 200	SHEET NO. 58 / 217
Date	1980
JAPAN INTERNATIONAL COOPERATION AGENCY	

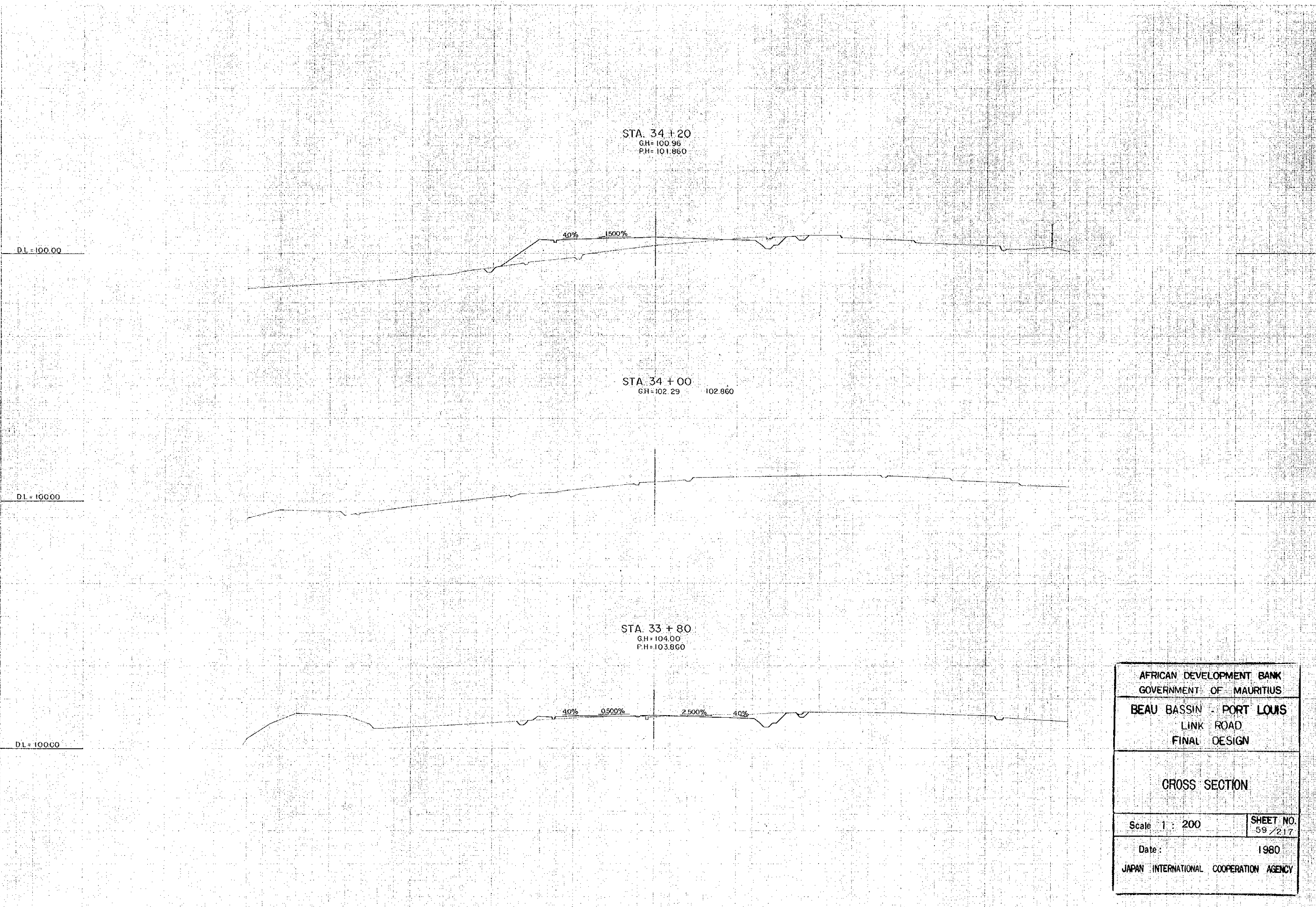

DL = 100.00

DL = 100.00

DL = 100.00

STA. 34 + 20  
GH = 100.96  
PH = 101.860

STA. 34 + 00  
GH = 102.29      102.860

STA. 33 + 80  
GH = 104.00  
PH = 103.860

AFRICAN DEVELOPMENT BANK GOVERNMENT OF MAURITIUS	
BEAU BASSIN - PORT LOUIS LINK ROAD FINAL DESIGN	
CROSS SECTION	
Scale 1 : 200	SHEET NO. 59 / 217
Date:	1980
JAPAN INTERNATIONAL COOPERATION AGENCY	

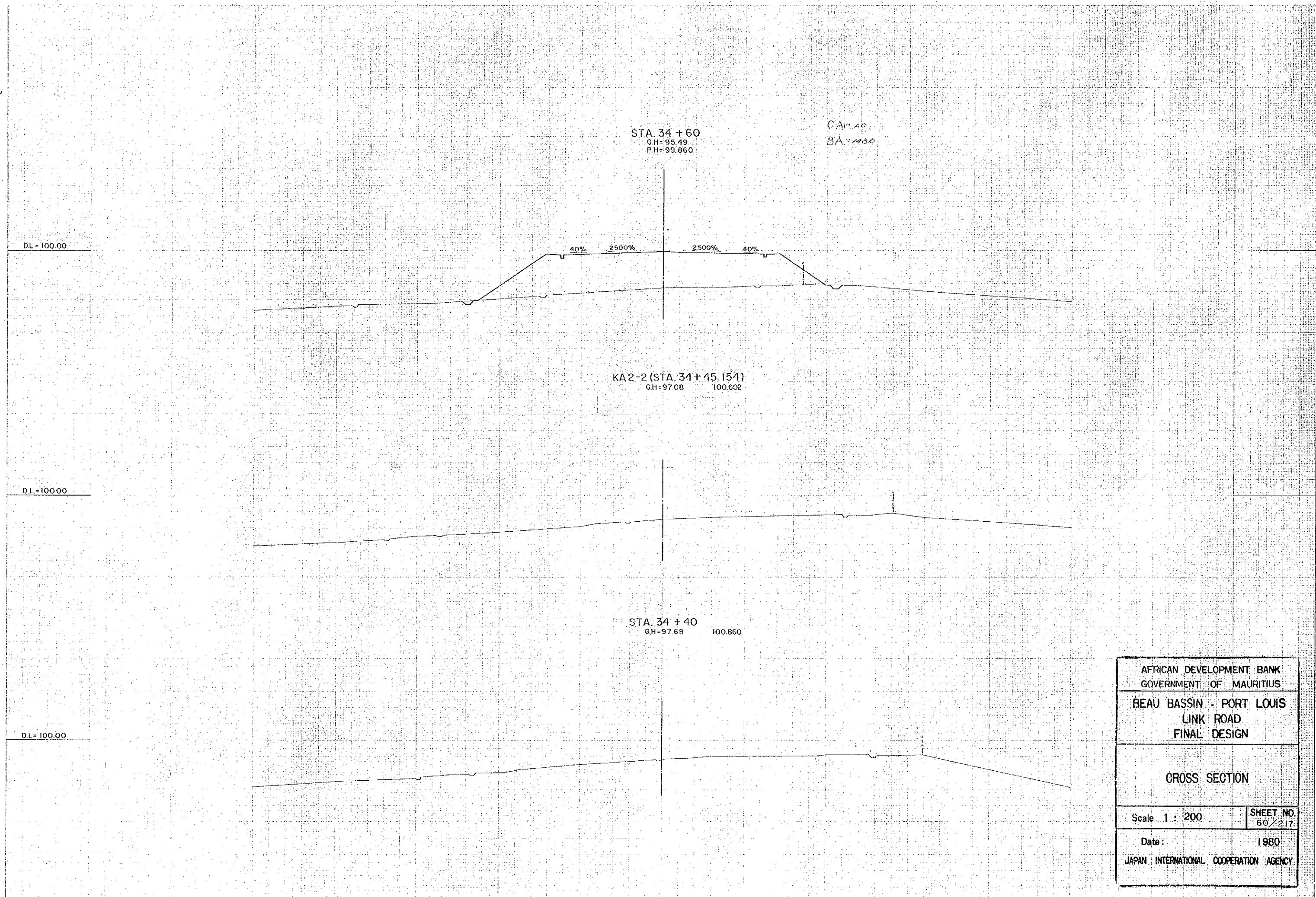

CA=20  
BA=1000

STA. 34 + 60  
G.H.=95.49  
P.H.=99.860

KA2-2 (STA. 34 + 45.154)  
G.H.=97.08      100.602

STA. 34 + 40  
G.H.=97.68      100.860

D.L.=100.00

D.L.=100.00

D.L.=100.00

AFRICAN DEVELOPMENT BANK GOVERNMENT OF MAURITIUS	
BEAU BASSIN - PORT LOUIS LINK ROAD FINAL DESIGN	
CROSS SECTION	
Scale 1 : 200	SHEET NO. 60/217
Date:	1980
JAPAN INTERNATIONAL COOPERATION AGENCY	

DL = 90.00

DL = 90.00

DL = 90.00

STA. 35 + 20  
GH = 88.59 96.860

STA. 35 + 00  
GH = 90.38  
PH = 97.860

CA = 1.0  
BA = 0.116

4.0% 2.500% 2.500% 4.0%

STA. 34 + 80  
GH = 93.11 98.860

AFRICAN DEVELOPMENT BANK GOVERNMENT OF MAURITIUS	
BEAU-BASSIN - PORT LOUIS LINK ROAD FINAL DESIGN	
CROSS SECTION	
Scale 1 : 200	SHEET NO. 61 / 217
Date: 1980	
JAPAN INTERNATIONAL COOPERATION AGENCY	



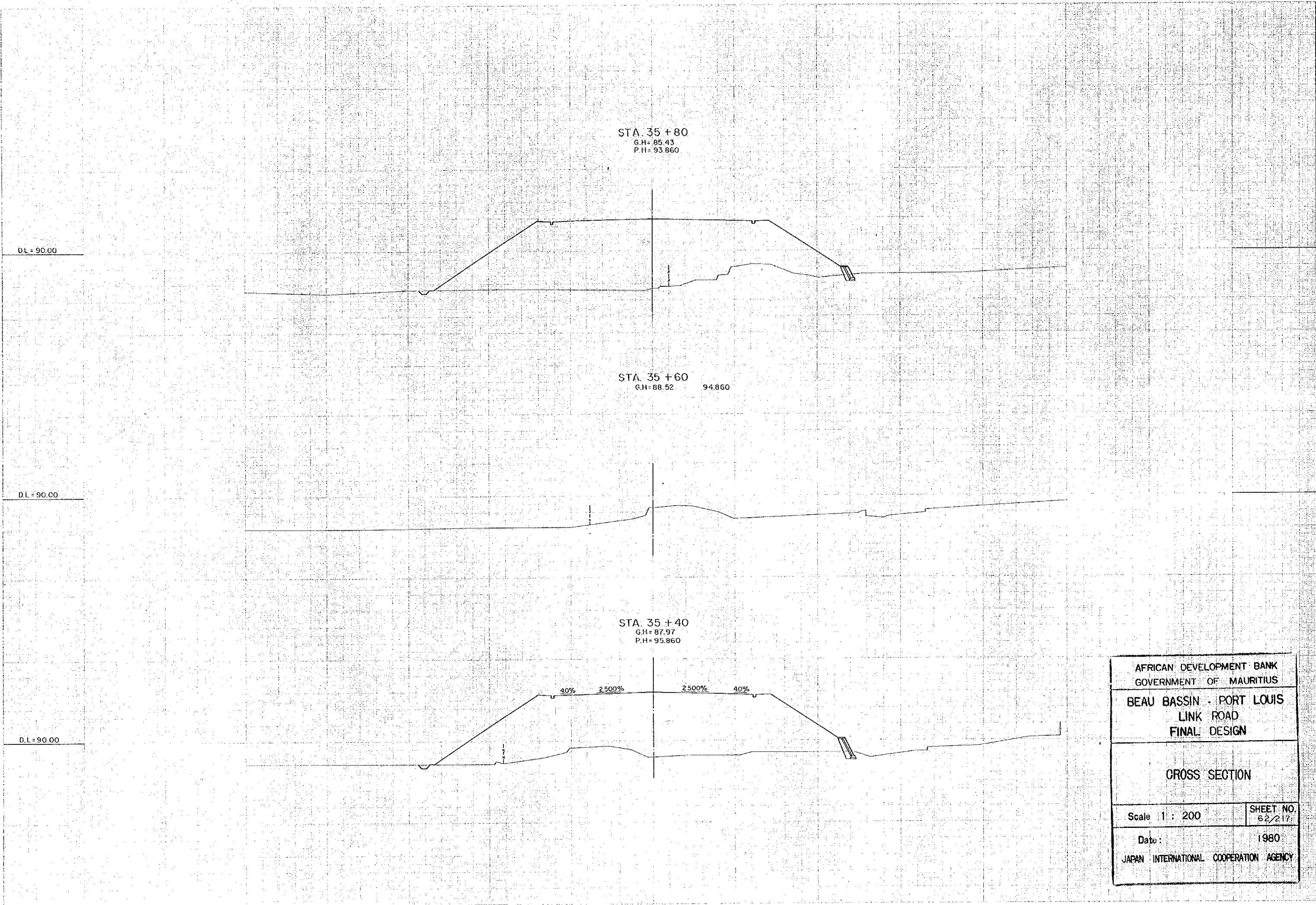

STA. 35 + 80  
 G.H = 85.43  
 P.H = 93.860

D.L = 90.00

STA. 35 + 60  
 G.H = 88.52  
 94.860

D.L = 90.00

STA. 35 + 40  
 G.H = 87.97  
 P.H = 95.860

D.L = 90.00

AFRICAN DEVELOPMENT BANK GOVERNMENT OF MAURITIUS	
BEAU BASSIN - PORT LOUIS LINK ROAD FINAL DESIGN	
CROSS SECTION	
Scale 1 : 200	SHEET NO. 62/217
Date: 1980	
JAPAN INTERNATIONAL COOPERATION AGENCY	

STA. 36 + 40  
GH = 83.74    90.860

STA. 36 + 20  
GH = 84.29  
PH = 91.860

STA. 36 + 00  
GH = 84.64    92.860

4.0%    2.500%    2.500%    4.0%

DL = 80.00

DL = 80.00

DL = 80.00

AFRICAN DEVELOPMENT BANK  
GOVERNMENT OF MAURITIUS

BEAU BASSIN - PORT LOUIS  
LINK ROAD  
FINAL DESIGN

CROSS SECTION

Scale 1 : 200

SHEET NO.  
63 / 217

Date: 1980

JAPAN INTERNATIONAL COOPERATION AGENCY

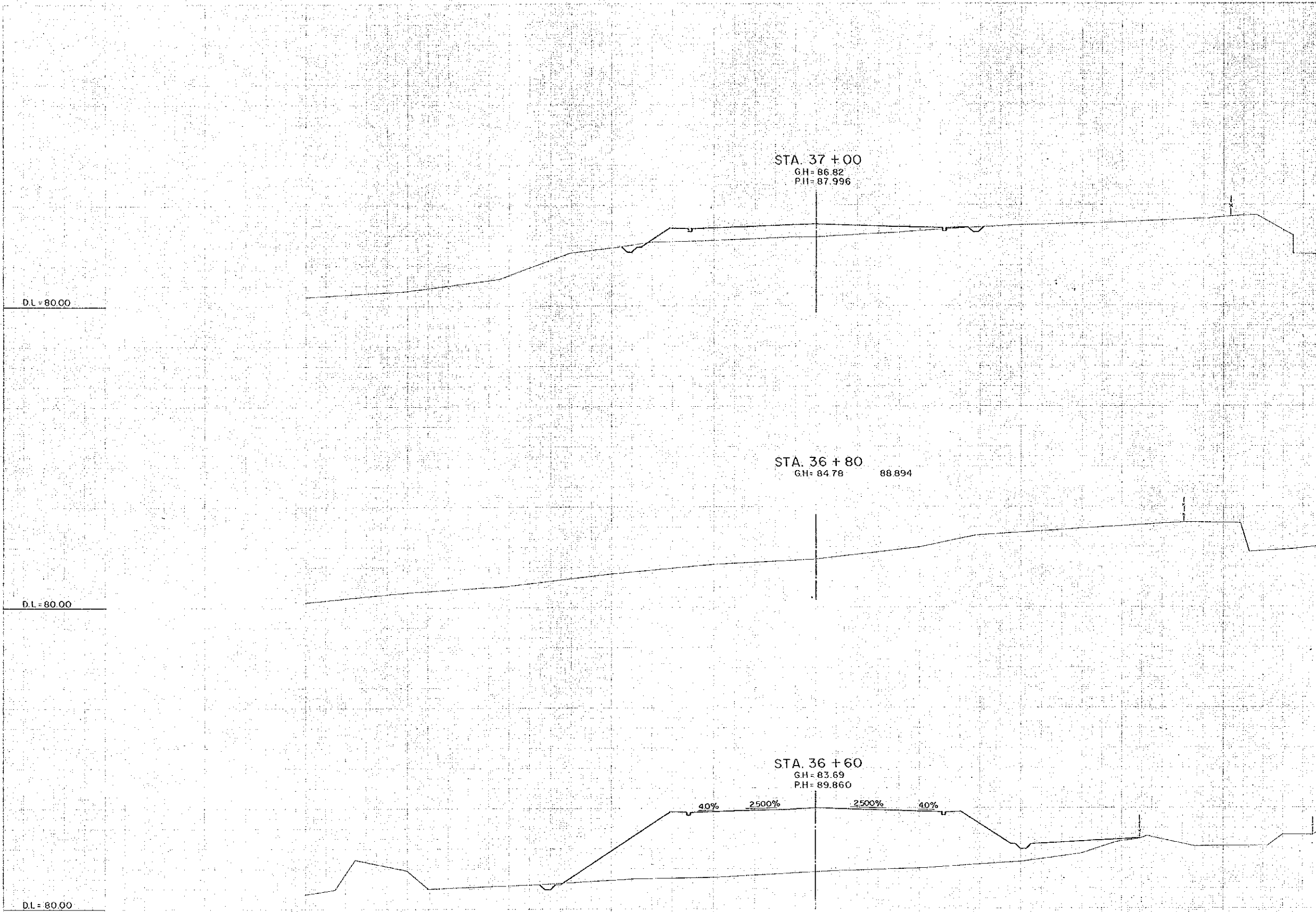

AFRICAN DEVELOPMENT BANK GOVERNMENT OF MAURITIUS	
BEAU BASSIN - PORT LOUIS LINK ROAD FINAL DESIGN	
CROSS SECTION	
Scale 1 : 200	SHEET NO. 64/217
Date:	1980
JAPAN INTERNATIONAL COOPERATION AGENCY	

D.L = 80.00

D.L = 80.00

D.L = 80.00

STA. 37 + 60  
GH = 83.34 85.710

STA. 37 + 40  
GH = 85.98  
PH = 86.404

STA. 37 + 20  
GH = 86.99 87.166

4.0% 2.500% 2.500% 4.0%

AFRICAN DEVELOPMENT BANK GOVERNMENT OF MAURITIUS	
BEAU BASSIN - PORT LOUIS LINK ROAD FINAL DESIGN	
CROSS SECTION	
Scale 1 : 200	SHEET NO. 65 / 217
Date :	1980
JAPAN INTERNATIONAL COOPERATION AGENCY	