

1

AFRICAN DEVELOPMENT BANK
 GOVERNMENT OF MAURITIUS
 CONTRACT FOR CONSTRUCTION
 OF
 BEAU BASSIN - PORT LOUIS LINK ROAD
 VOLUME C
 TECHNICAL DOCUMENTS

IV CROSS SECTION

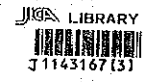

SEPTEMBER 1980

Japan International Cooperation Agency

Contract for construction of Beau Bassin - Port Louis Link Road.

JICA
 LL410
 614
 SDF
 LIBRARY

SDF
 80-100

D.L. = 200.00

D.L. = 200.00

D.L. = 200.00

STA. 0 + 40
GH = 207.22

STA. 0 + 20
GH = 207.38
PH = 207.120

STA. 0 + 00
GH = 207.30

4.0% 2.500% 2.500% 4.2%

AFRICAN DEVELOPMENT BANK
GOVERNMENT OF MAURITIUS

BEAU BASSIN - PORT LOUIS
LINK ROAD
FINAL DESIGN

CROSS SECTION

Scale 1 : 200

SHEET NO.
11/217

Date: 1980

JAPAN INTERNATIONAL COOPERATION AGENCY

STA. 1 + 00

GH = 206.39
PH = 206.400

D.L. = 200.00

STA. 0 + 80

GH = 206.81

D.L. = 200.00

STA. 0 + 60

GH = 206.97
PH = 206.760

D.L. = 200.00

4.0% 2.500% 2.500% 4.0%

AFRICAN DEVELOPMENT BANK
GOVERNMENT OF MAURITIUS
BEAU BASSIN - PORT LOUIS
LINK ROAD
FINAL DESIGN

CROSS SECTION

Scale 1 : 200

SHEET NO.
2 / 217

Date : 1980

JAPAN INTERNATIONAL COOPERATION AGENCY

D.L. = 200.00

D.L. = 200.00

D.L. = 200.00

STA. 1+60
G.H. = 205.63

STA. 1+40
G.H. = 205.78
P.H. = 206.040

STA. 1+20
G.H. = 205.97

4.0% 2.500% 2.500% 4.0%

AFRICAN DEVELOPMENT BANK GOVERNMENT OF MAURITIUS	
BEAU BASSIN - PORT LOUIS LINK ROAD FINAL DESIGN	
CROSS SECTION	
Scale 1 : 200	SHEET NO. 3 / 217
Date :	1980
JAPAN INTERNATIONAL COOPERATION AGENCY	

STA 2+20

GH=206.80
PH=205.320

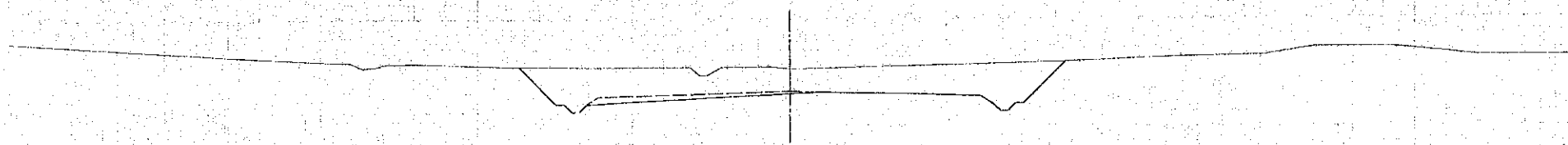

DL = 200.00

STA : 2 + 00

GH=206.05

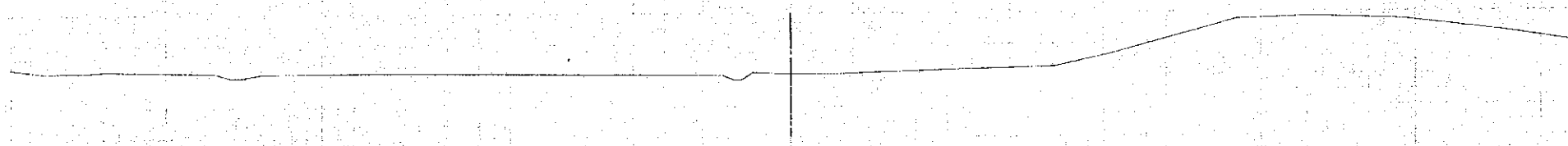

DL = 200.00

STA 1+80

GH = 205.70
PH = 205.680

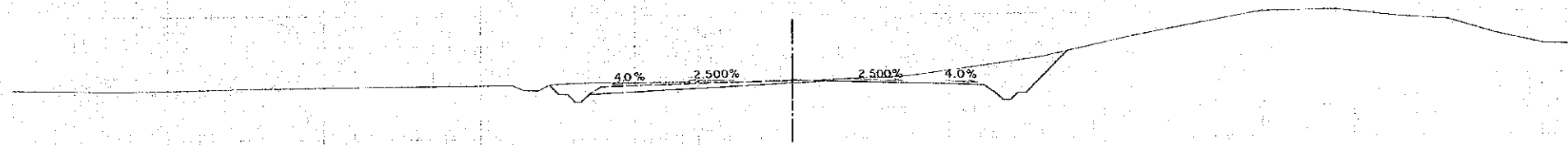

DL = 200.00

AFRICAN DEVELOPMENT BANK GOVERNMENT OF MAURITIUS	
BEAU BASSIN - PORT LOUIS LINK ROAD FINAL DESIGN	
CROSS SECTION	
Scale 1: 200	SHEET NO. 4 / 217
Date: 1980	
JAPAN INTERNATIONAL COOPERATION AGENCY	

STA 2+80
GH=207.32

STA 2+60
GH=207.56
PH=204.960

STA 2+40
GH=206.98

4.0% 2.500% 2.500% 4.0%

DL = 200.00

DL = 200.00

DL = 200.00

AFRICAN DEVELOPMENT BANK
GOVERNMENT OF MAURITIUS

BEAU BASSIN - PORT LOUIS
LINK ROAD
FINAL DESIGN

CROSS SECTION

Scale 1 : 200

SHEET NO.
5 / 217

Date: 1980

JAPAN INTERNATIONAL COOPERATION AGENCY

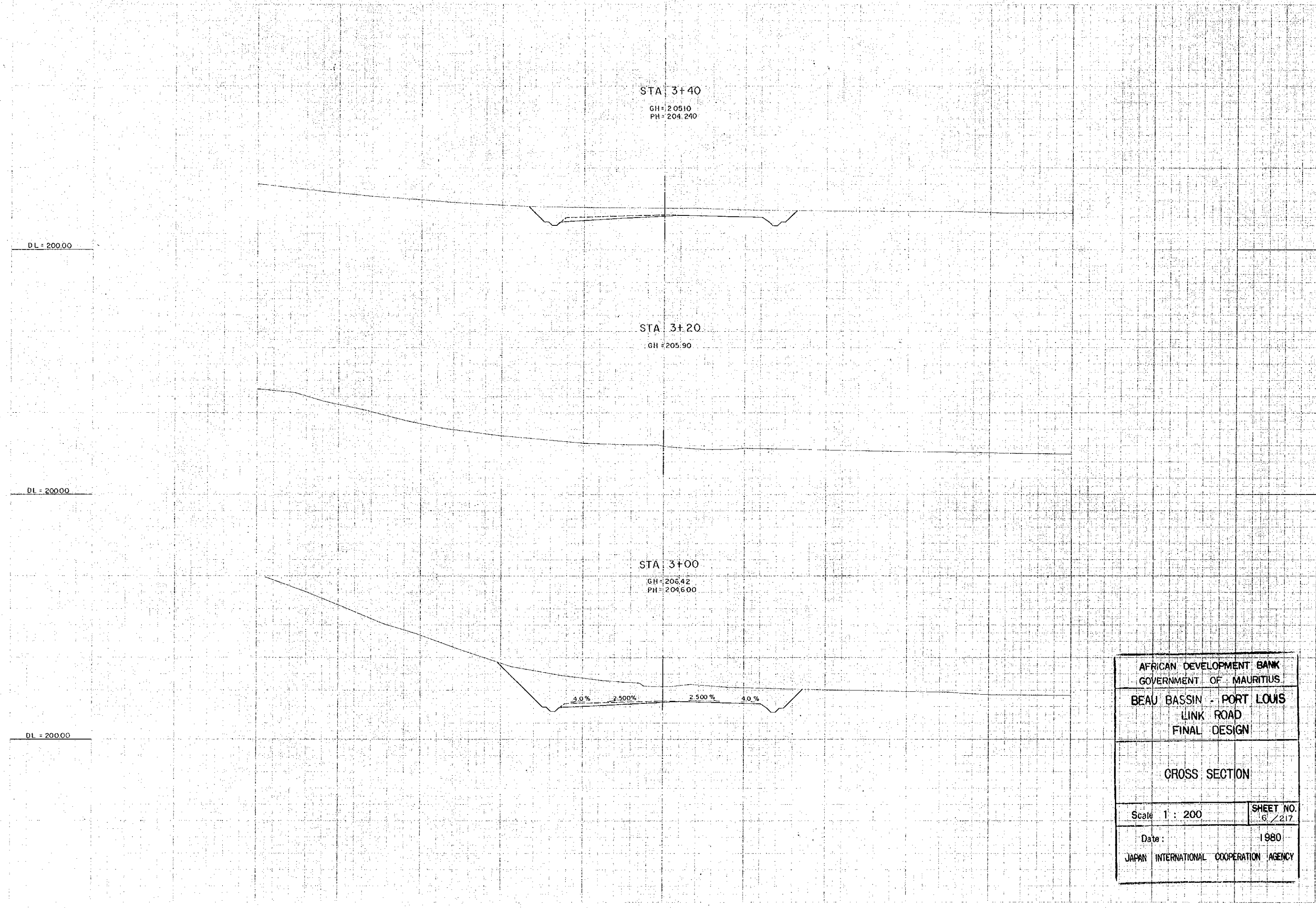

STA 3+40
 GH = 20510
 PH = 204.240

STA 3+20
 GH = 205.90

STA 3+00
 GH = 206.42
 PH = 204.600

4.0% 2.500% 2.500% 4.0%

DL = 200.00

DL = 200.00

DL = 200.00

AFRICAN DEVELOPMENT BANK GOVERNMENT OF MAURITIUS	
BEAU BASSIN - PORT LOUIS LINK ROAD FINAL DESIGN	
CROSS SECTION	
Scale 1 : 200	SHEET NO. 6 / 217
Date : 1980	
JAPAN INTERNATIONAL COOPERATION AGENCY	

STA 4+00
GH= 201.93

STA 3+80
GH=202.88
PH=203.825

STA 3+60
GH= 204.14

4.0% 2.500% 2.500% 4.0%

DL = 20000

DL = 20000

DL = 20000

AFRICAN DEVELOPMENT BANK GOVERNMENT OF MAURITIUS	
BEAU BASSIN - PORT LOUIS LINK ROAD FINAL DESIGN	
CROSS SECTION	
Scale 1 : 200	SHEET NO. 7 / 217
Date: 1980	
JAPAN INTERNATIONAL COOPERATION AGENCY	

STA. 4+60

GH = 200.06
PH = 202.114

199.74

DL = 200.00

STA. 4+40

GH = 200.48

DL = 200.00

STA. 4+20

GH = 200.95
PH = 203.218

DL = 200.00

40%

2.500%

2.500%

40%

200.60

AFRICAN DEVELOPMENT BANK GOVERNMENT OF MAURITIUS	
BEAU BASSIN - PORT LOUIS LINK ROAD FINAL DESIGN	
CROSS SECTION	
Scale 1 : 200	SHEET NO. 8 / 217
Date: 1980	
JAPAN INTERNATIONAL COOPERATION AGENCY	

STA. 5+20

GH=198.24

STA. 5+00

GH=198.44
PH=201.413

STA. 4+80

GH=198.92

DL = 200.00

DL = 200.00

DL = 200.00

40%

2.500%

2.500%

40%

198.98

AFRICAN DEVELOPMENT BANK GOVERNMENT OF MAURITIUS	
BEAU BASSIN - PORT LOUIS LINK ROAD FINAL DESIGN	
CROSS SECTION	
Scale 1 : 200	SHEET NO. 9 / 217
Date:	1980
JAPAN INTERNATIONAL COOPERATION AGENCY	

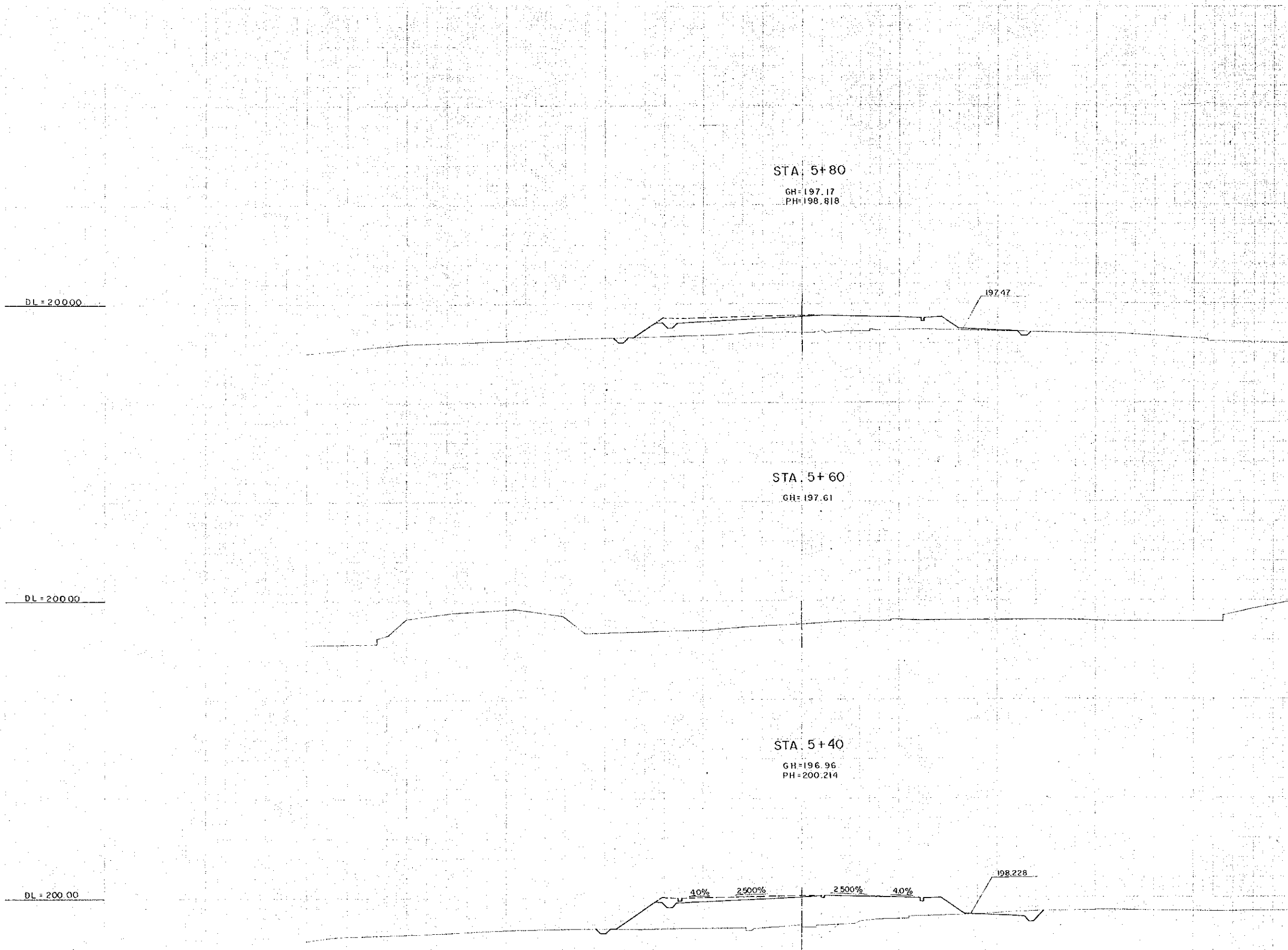

AFRICAN DEVELOPMENT BANK GOVERNMENT OF MAURITIUS	
BEAU BASSIN - PORT LOUIS LINK ROAD FINAL DESIGN	
CROSS SECTION	
Scale 1 : 200	SHEET NO. 10/217
Date:	1980
JAPAN INTERNATIONAL COOPERATION AGENCY	

STA. 6+40
GH=194.93

STA. 6+20
GH=195.67
PH=197.225

STA. 6+00
GH=196.28

DL = 20000

DL = 200.00

DL = 200.00

40% 2.500% 2.500% 40%

AFRICAN DEVELOPMENT BANK GOVERNMENT OF MAURITIUS	
BEAU BASSIN - PORT LOUIS LINK ROAD FINAL DESIGN	
CROSS SECTION	
Scale 1 : 200	SHEET NO. 11/217
Date:	1980
JAPAN INTERNATIONAL COOPERATION AGENCY	

DL = 19000

DL = 19000

DL = 19000

STA 7+00

GH=192.81
PH=193.600

STA 6+80

GH=193.37

STA 6+60

GH=194.13
PH=195.440

40% 2.500% 2.500% 40%

AFRICAN DEVELOPMENT BANK GOVERNMENT OF MAURITIUS	
BEAU BASSIN - PORT LOUIS LINK ROAD FINAL DESIGN	
CROSS SECTION	
Scale 1 : 200	SHEET NO. 12 / 217
Date:	1980
JAPAN INTERNATIONAL COOPERATION AGENCY	

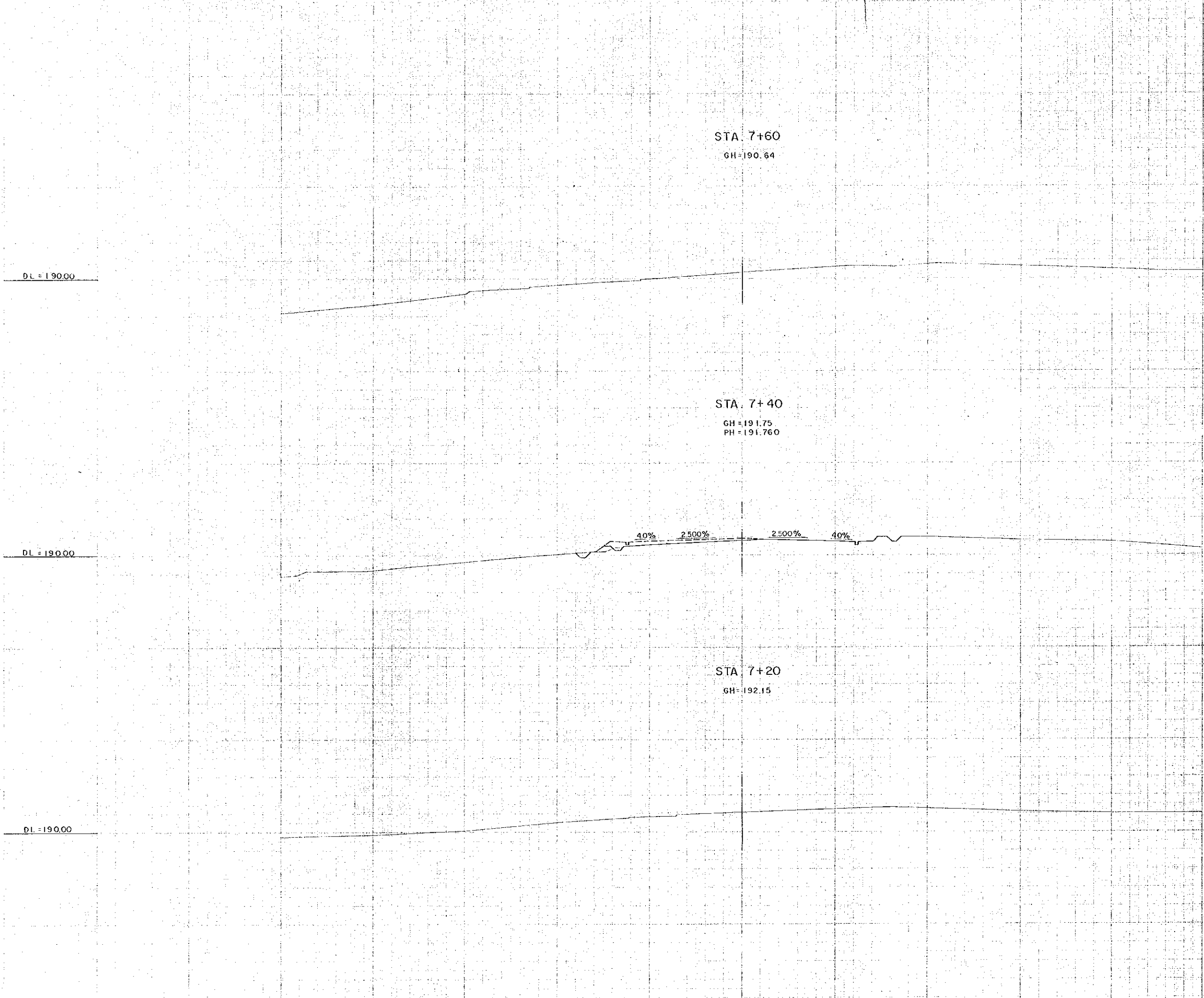

AFRICAN DEVELOPMENT BANK GOVERNMENT OF MAURITIUS	
BEAU BASSIN - PORT LOUIS LINK ROAD FINAL DESIGN	
CROSS SECTION	
Scale: 1 : 200	SHEET NO. 13 / 217
Date: 1980	
JAPAN INTERNATIONAL COOPERATION AGENCY	

STA 8+20
GH=186.39
PH=188.080

STA 8+00
GH=187.97

STA 7+80
GH=189.75
PH=189.920

4.0% 2.500% 2.500% 4.0%

DL = 180.00

DL = 180.00

DL = 180.00

AFRICAN DEVELOPMENT BANK GOVERNMENT OF MAURITIUS	
BEAU BASSIN - PORT LOUIS LINK ROAD FINAL DESIGN	
CROSS SECTION	
Scale 1 : 200	SHEET NO. 14/217
Date: 1980	
JAPAN INTERNATIONAL COOPERATION AGENCY	

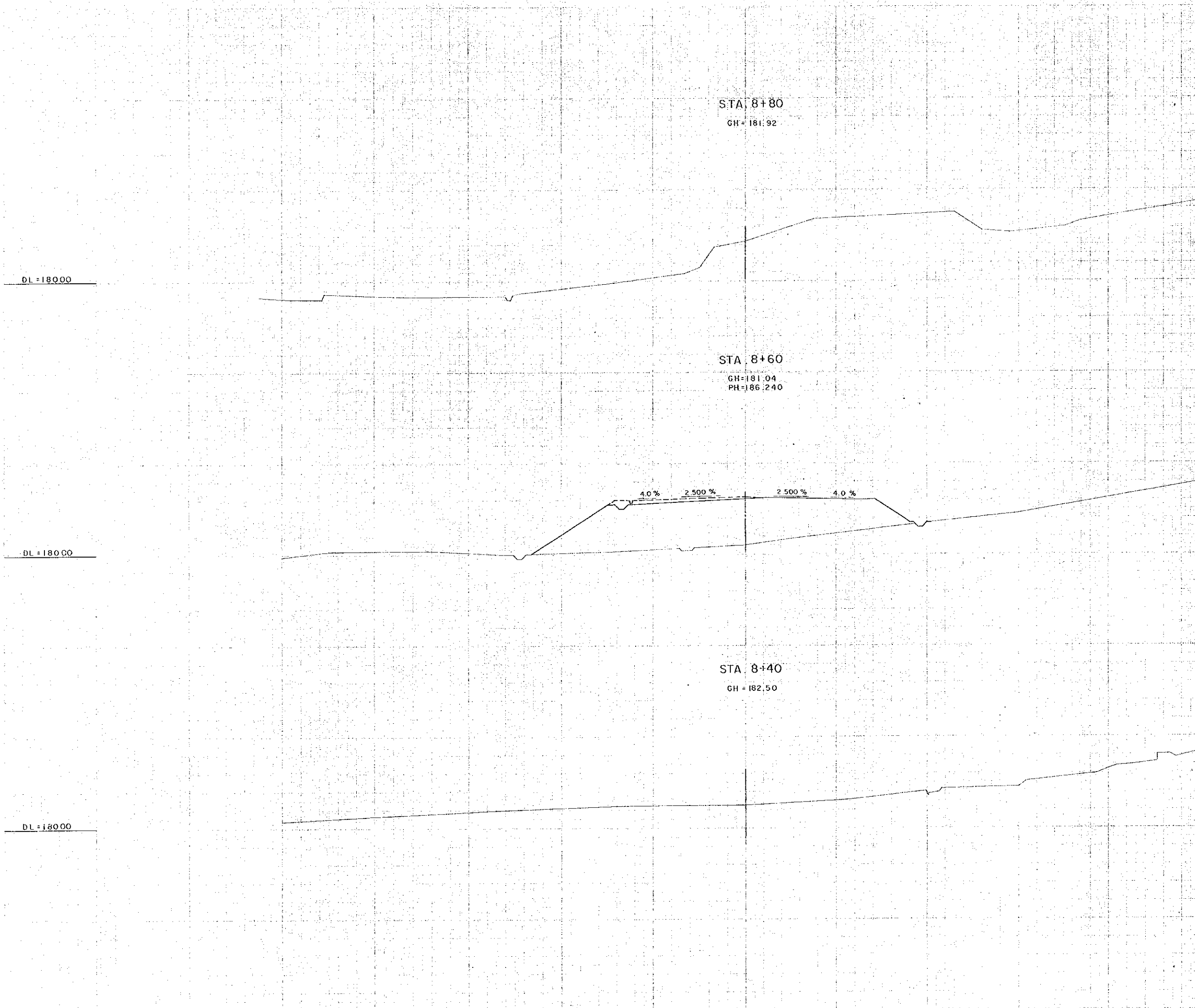

AFRICAN DEVELOPMENT BANK GOVERNMENT OF MAURITIUS	
BEAU BASSIN - PORT LOUIS LINK ROAD FINAL DESIGN	
CROSS SECTION	
Scale 1 : 200	SHEET NO. 15 / 217
Date: 1980	
JAPAN INTERNATIONAL COOPERATION AGENCY	

STA 9+40

GH=178.32
PH=182.560

STA 9+20

GH=178.76

STA 9+00

GH=180.40
PH=184.400

DL=180.00

DL=180.00

DL=180.00

4.0% 2.500% 2.500% 4.0%

AFRICAN DEVELOPMENT BANK
GOVERNMENT OF MAURITIUS

BEAU BASSIN - PORT LOUIS
LINK ROAD
FINAL DESIGN

CROSS SECTION

Scale 1 : 200

SHEET NO.
16 / 217

Date: 1980

JAPAN INTERNATIONAL COOPERATION AGENCY

STA. 10+00

GH = 178.17

STA. 9+80

GH = 177.26
PH = 180.720

STA. 9+60

GH = 177.25

4.0% 2.500% 2.500% 4.0%

DL = 180.00

DL = 180.00

DL = 180.00

AFRICAN DEVELOPMENT BANK GOVERNMENT OF MAURITIUS	
BEAU BASSIN - PORT LOUIS LINK ROAD FINAL DESIGN	
CROSS SECTION	
Scale 1 : 200	SHEET NO. 17/217
Date: 1980	
JAPAN INTERNATIONAL COOPERATION AGENCY	

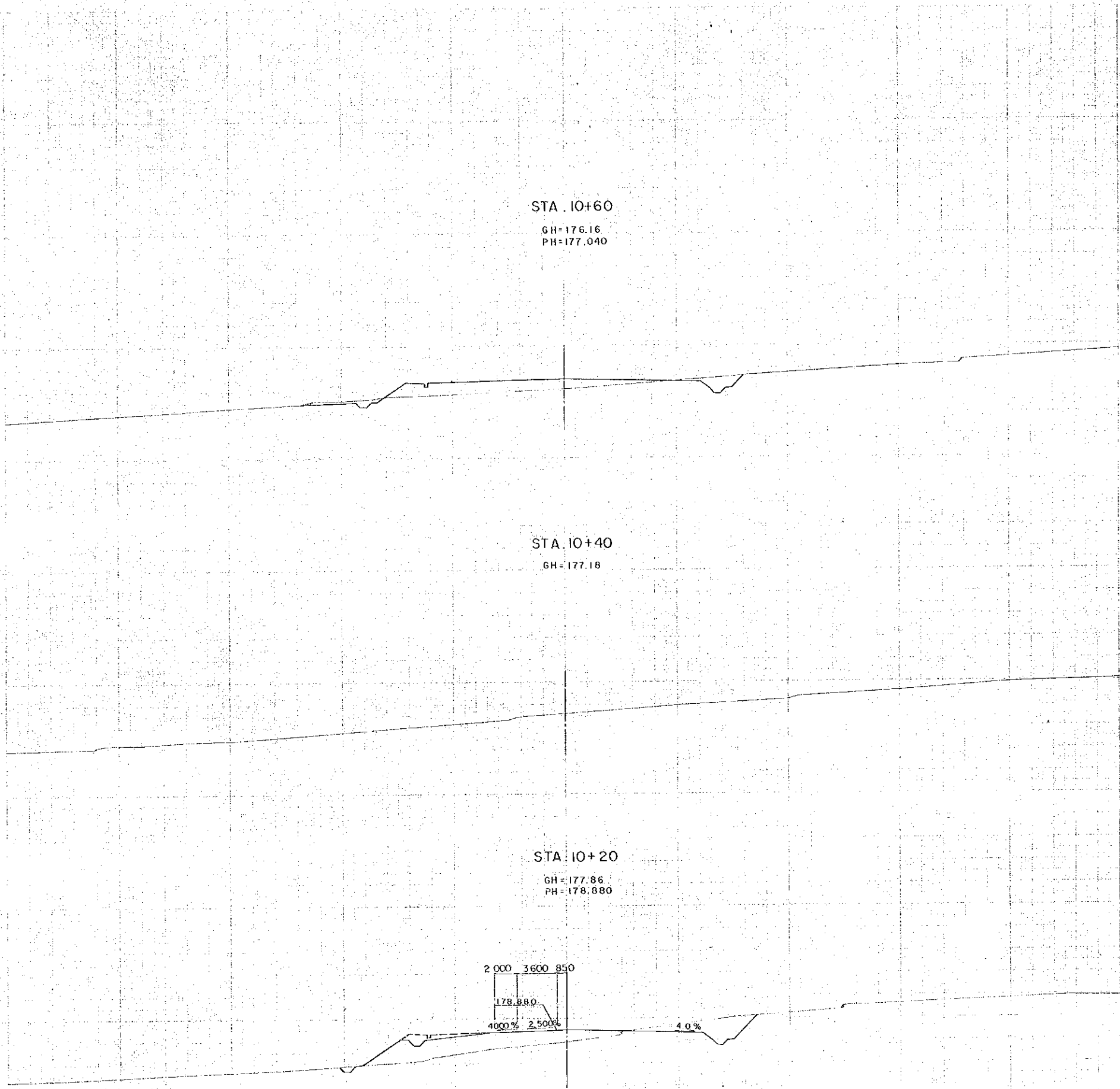

STA. 10+60
 GH=176.16
 PH=177.040

STA. 10+40
 GH=177.18

STA. 10+20
 GH=177.86
 PH=178.880

2 000 3 600 850
 178.98.0
 4.00% 2.500% 4.0%

DL = 180.00

DL = 180.00

DL = 180.00

AFRICAN DEVELOPMENT BANK GOVERNMENT OF MAURITIUS	
BEAU BASSIN - PORT LOUIS LINK ROAD FINAL DESIGN	
CROSS SECTION	
Scale 1 : 200	SHEET NO. 18 / 217
Date : 1980	
JAPAN INTERNATIONAL COOPERATION AGENCY	

DL = 180.00

DL = 180.00

DL = 180.00

STA 11+20
GH=174.64

STA 11+00
GH=175.06
PH=175.200

STA 10+80
GH=175.68

2.500% 4.0%

AFRICAN DEVELOPMENT BANK GOVERNMENT OF MAURITIUS	
BEAU BASSIN - PORT LOUIS LINK ROAD FINAL DESIGN	
CROSS SECTION	
Scale 1 : 200	SHEET NO. 19/217
Date: 1980	
JAPAN INTERNATIONAL COOPERATION AGENCY	

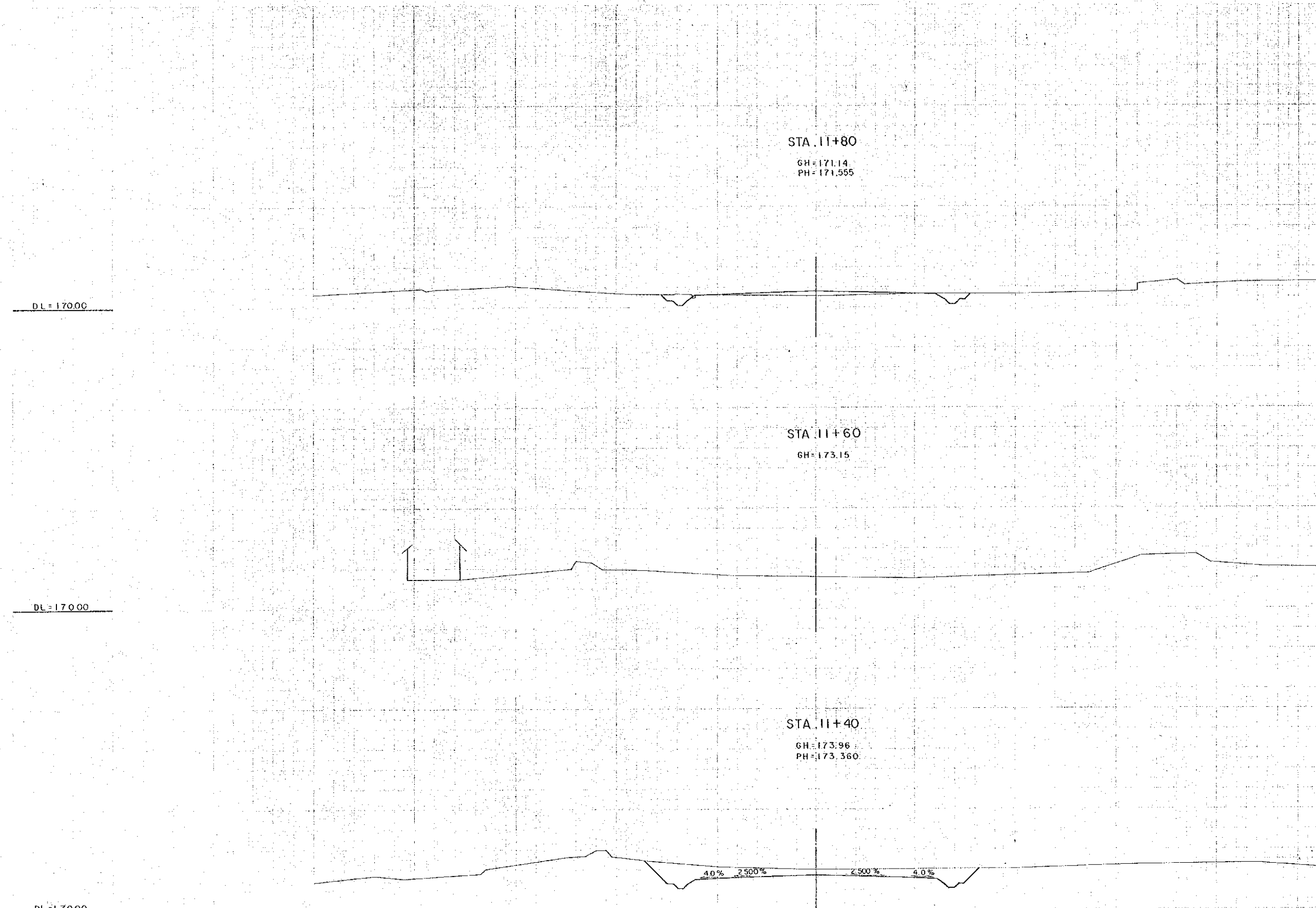

AFRICAN DEVELOPMENT BANK GOVERNMENT OF MAURITIUS	
BEAU BASSIN - PORT LOUIS LINK ROAD FINAL DESIGN	
CROSS SECTION	
Scale 1 : 200	SHEET NO. 20 / 217
Date:	1980
JAPAN INTERNATIONAL COOPERATION AGENCY	

STA 12+40
GH=165.75

STA 2+20
GH=167.03
PH=169.995

STA 12+00
GH=168.72

DL = 160.00

DL = 160.00

DL = 160.00

AFRICAN DEVELOPMENT BANK
GOVERNMENT OF MAURITIUS
BEAU BASSIN - PORT LOUIS
LINK ROAD
FINAL DESIGN

CROSS SECTION

Scale 1 : 200

SHEET NO.
21 / 217

Date : 1980

JAPAN INTERNATIONAL COOPERATION AGENCY

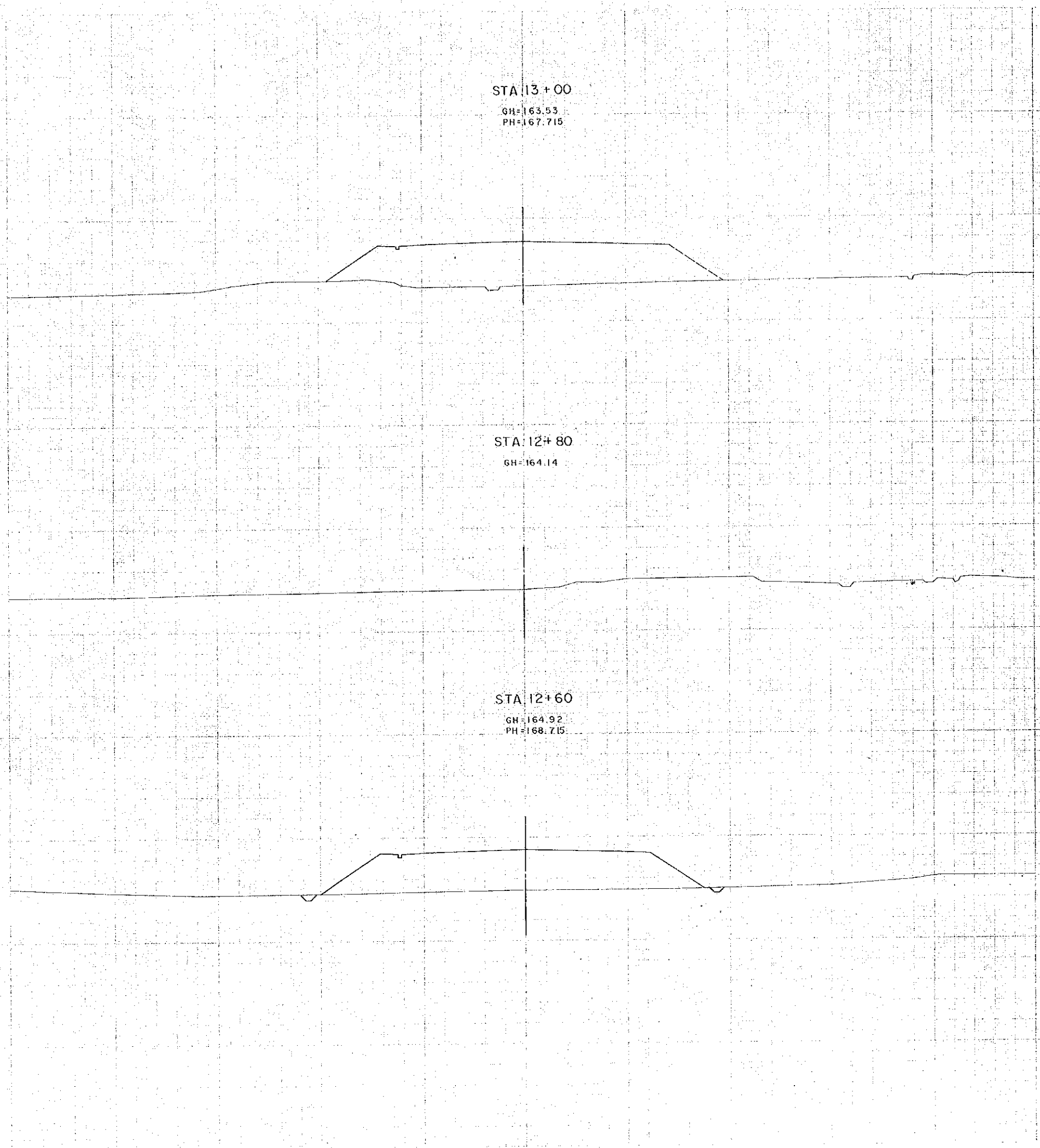

STA 13+00
 GH=163.53
 PH=167.715

STA 12+80
 GH=164.14

STA 12+60
 GH=164.92
 PH=168.715

DL = 160.00

DL = 160.00

DL = 160.00

AFRICAN DEVELOPMENT BANK GOVERNMENT OF MAURITIUS	
BEAU BASSIN - PORT LOUIS LINK ROAD FINAL DESIGN	
CROSS SECTION	
Scale 1 : 200	SHEET NO. 22 / 217
Date: 1980	
JAPAN INTERNATIONAL COOPERATION AGENCY	

DL = 160.00

DL = 160.00

DL = 160.00

STA 13+60
GH = 162.83

STA 13+40
GH = 162.75
PH = 166.960

STA 13+20
GH = 163.07

40% 2.500% 2.500% 40%

AFRICAN DEVELOPMENT BANK GOVERNMENT OF MAURITIUS	
BEAU BASSIN - PORT LOUIS LINK ROAD FINAL DESIGN	
CROSS SECTION	
Scale 1 : 200	SHEET NO. 23 / 217
Date: 1980	
JAPAN INTERNATIONAL COOPERATION AGENCY	

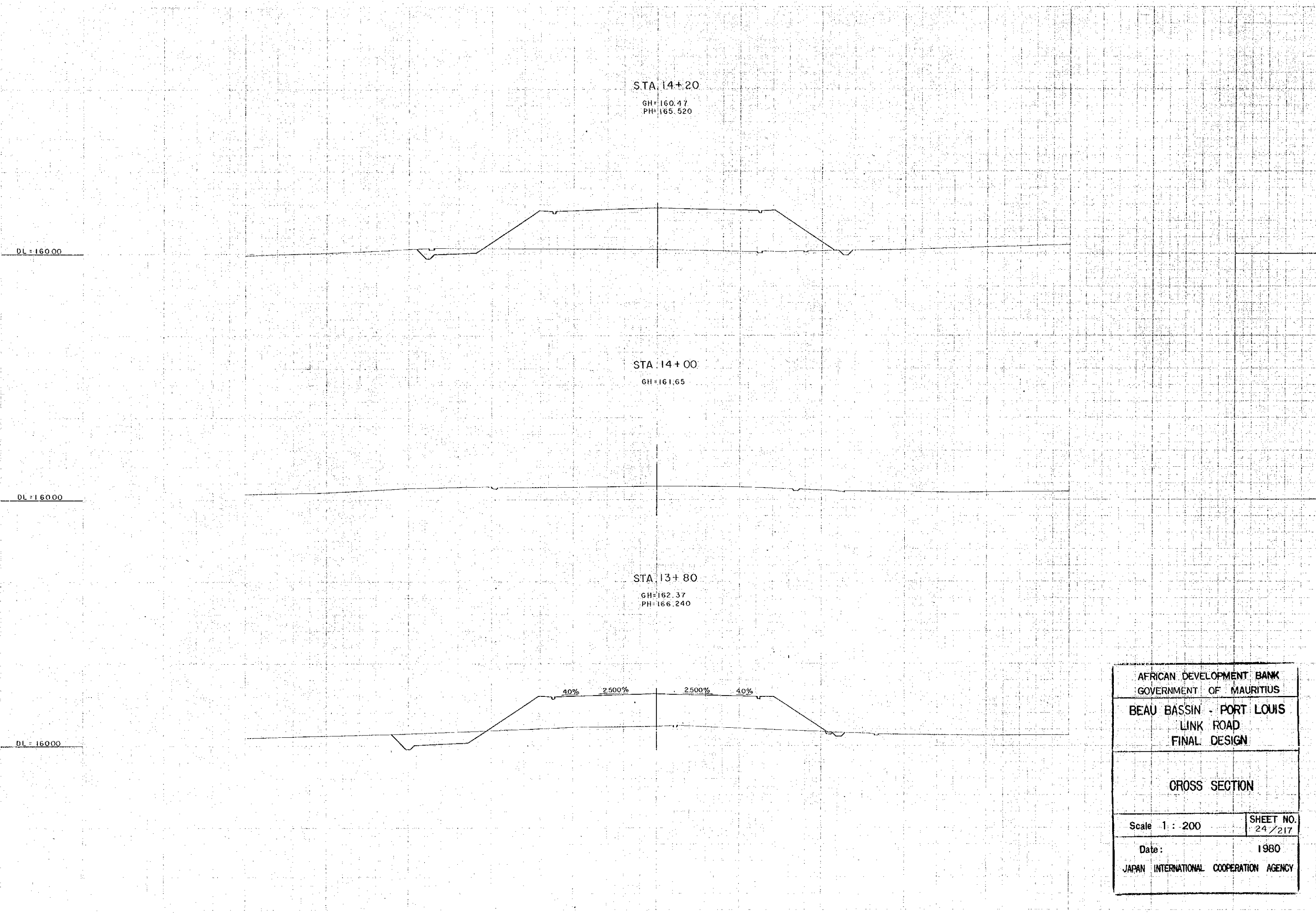

STA 14+20

GH=160.17
PH=165.520

STA 14+00

GH=161.65

STA 13+80

GH=162.37
PH=166.240

40% 2.500% 2.500% 40%

DL = 160.00

DL = 160.00

DL = 160.00

AFRICAN DEVELOPMENT BANK GOVERNMENT OF MAURITIUS	
BEAU BASSIN - PORT LOUIS LINK ROAD FINAL DESIGN	
CROSS SECTION	
Scale 1 : 200	SHEET NO. 24 / 217
Date:	1980
JAPAN INTERNATIONAL COOPERATION AGENCY	

DL = 160.00

DL = 160.00

DL = 160.00

STA 14+80
GH=159.32

STA 14+60
GH=159.61
PH=164.800

STA 14+40
GH=159.77

40% 2.500% 2.500% 40%

AFRICAN DEVELOPMENT BANK GOVERNMENT OF MAURITIUS	
BEAU BASSIN - PORT LOUIS LINK ROAD FINAL DESIGN	
CROSS SECTION	
Scale 1 : 200	SHEET NO. 25/217
Date: 1980	
JAPAN INTERNATIONAL COOPERATION AGENCY	

DL = 160.00

DL = 160.00

DL = 160.00

STA 15+20

GH = 158.87

BCI-I (STA 15+6.810)

GH = 158.85

STA 15+00

GH = 158.86
PH = 164.080

4.0%

2.500%

2.500%

4.0%

AFRICAN DEVELOPMENT BANK
GOVERNMENT OF MAURITIUS

BEAU BASSIN - PORT LOUIS
LINK ROAD
FINAL DESIGN

CROSS SECTION

Scale 1 : 200

SHEET NO.
26 / 217

Date: 1980

JAPAN INTERNATIONAL COOPERATION AGENCY

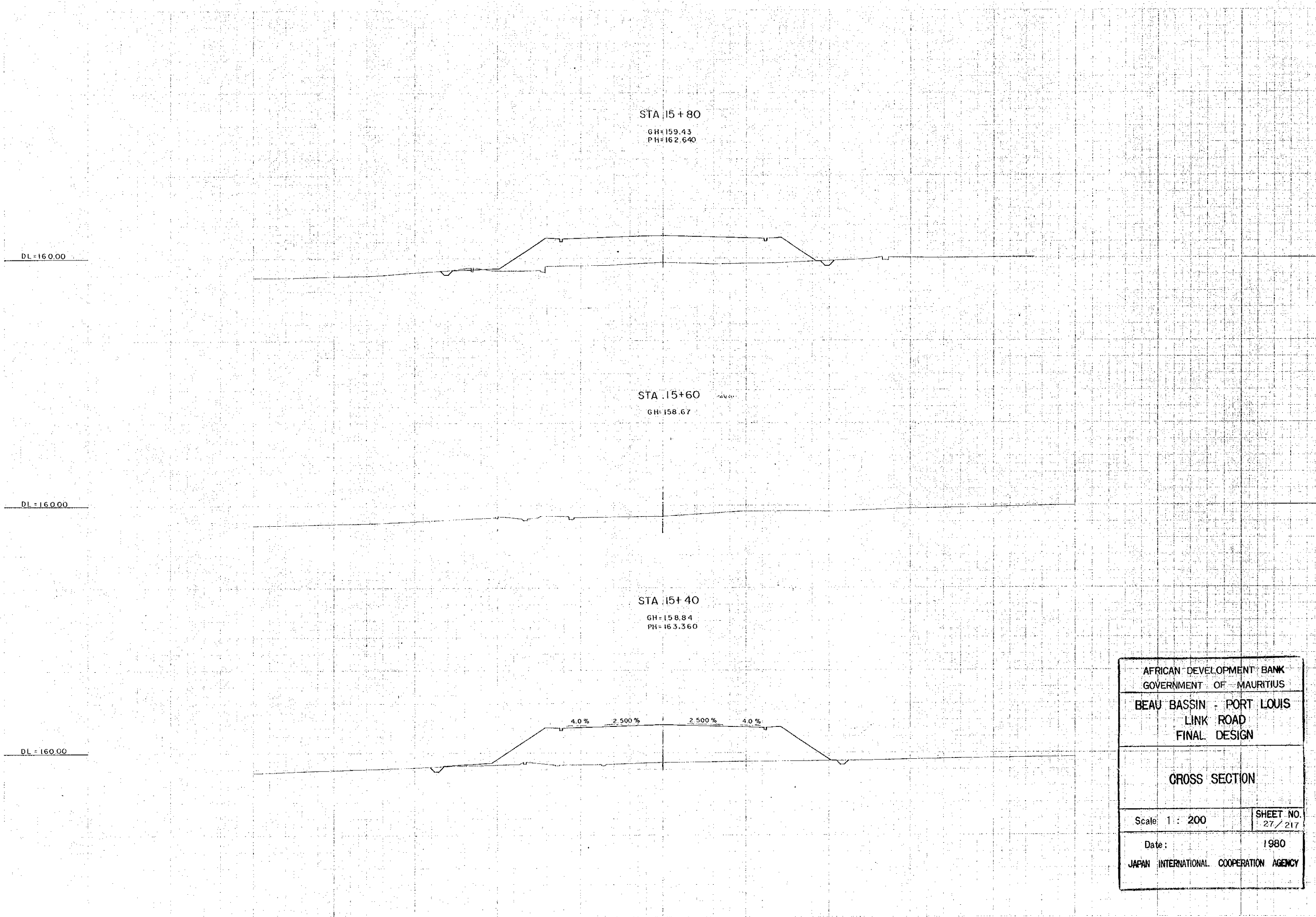

STA 15+80
 GH=159.43
 PH=162.640

STA 15+60
 GH=158.67

STA 15+40
 GH=158.84
 PH=163.360

4.0% 2.500% 2.500% 4.0%

AFRICAN DEVELOPMENT BANK GOVERNMENT OF MAURITIUS	
BEAU BASSIN - PORT LOUIS LINK ROAD FINAL DESIGN	
CROSS SECTION	
Scale: 1 : 200	SHEET NO. 27 / 217
Date: 1980	JAPAN INTERNATIONAL COOPERATION AGENCY

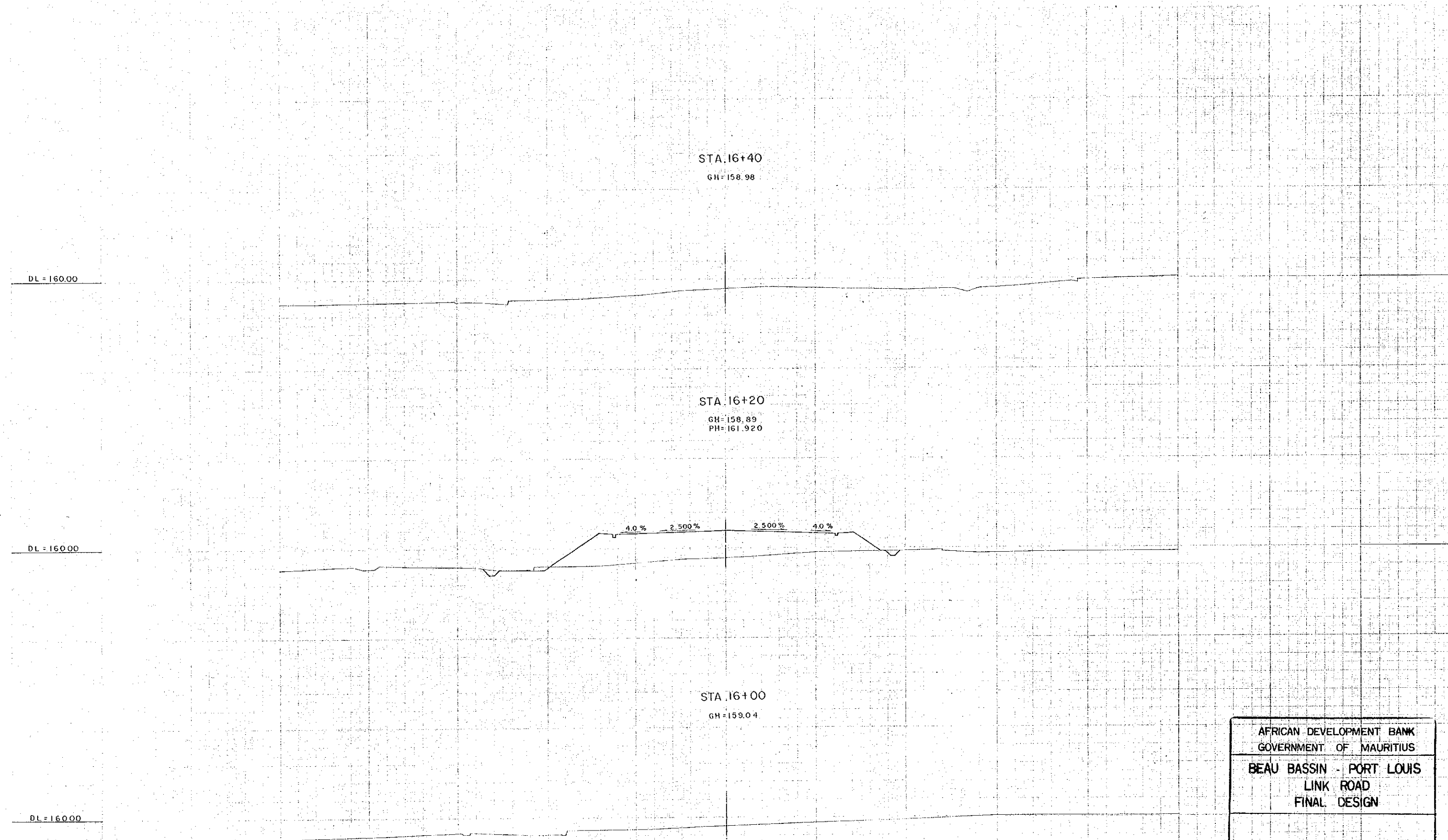

STA. 16+40
GH=158.98

STA. 16+20
GH=158.89
PH=161.920

STA. 16+00
GH=159.04

4.0% 2.500% 2.500% 4.0%

DL = 160.00

DL = 160.00

DL = 160.00

AFRICAN DEVELOPMENT BANK GOVERNMENT OF MAURITIUS	
BEAU BASSIN - PORT LOUIS LINK ROAD FINAL DESIGN	
CROSS SECTION	
Scale 1 : 200	SHEET NO. 28/217.
Date: 1980	
JAPAN INTERNATIONAL COOPERATION AGENCY	