

## Appendices

1. Member List of the Survey Team.....	A - 1
2. Survey Schedule.....	A - 3
3. List of Parties Concerned in the Syrian Arab Republic.....	A - 5
4. Minutes of Discussion.....	A - 7
5. Project cost to be borne by the Syrian Arab Government.....	A - 51
6. List of Equipment for the Project.....	A - 53
7. References .....	A - 61



## 1. Member List of the Survey Team

### (1) Basic Design Study ( from November 18, 1997 to December 12, 1997 )

- Leader : Ms. Yoshie MURAMATSU, Second Project Study Division,  
Grant Aid Study Dept., JICA
- Technical Advisor : Isamu NIWA, Member of International Affairs Committee, Japan  
Society for Rehabilitation on Disabled Persons
- Project Coordinator : Tetsuo KAMITANI, Third Experts Assignment Division, Experts  
Assignment Dept., JICA
- Chief Consultant/ O&M Planner : Masami SUDA, Chuo Kaihatsu Corporation
- Planner for Vocational Training and Education for the Person with Disabled  
: Yukio HOSAKA, Chuo Kaihatsu Corporation
- Equipment Planner : Isao DOJUN, Chuo Kaihatsu Corporation
- Procurement Planner : Michiyuki KEMMOTSU, Chuo Kaihatsu Corporation

### (2) Consultation on Draft Report ( from March 3, 1998 to March 13, 1998 )

- Leader : Katsuhiko EBINA, Resident Representative of JICA Syria Office
- Chief Consultant/ O&M Planner : Masami SUDA, Chuo Kaihatsu Corporation
- Planner for Vocational Training and Education for the Person with Disabled  
: Yukio HOSAKA, Chuo Kaihatsu Corporation



## 2. Study Schedule

### (1) Basic Design Study

No.	Month/ Date	Day	ITINERARY			
			OFFICIAL A: MURAMATSU, B: NIWA, C: KAMITANI	CONSULTANT		
				D: SUDA	E: HOSAKA	F: DOJUN
1	Nov. 18	Tue	Narita 10:35 (LH711) - Frankfurt 14:45			
2	19	Wed	Frankfurt 13:05 (LH668) - Damascus 18:25			
3	20	Thu	Meeting at JICA office, Courtesy call on Embassy of Japan Courtesy call on State Planning Commission, Council of Prime-Minister, Courtesy call on Ministry of Social Affairs and Labor (MSAL)			
4	21	Fri	Data analysis, internal meeting			
5	22	Sat	Meeting and discussion Site visit (Vocational Rehabilitation Center)			
6	23	Sun	Meeting and discussion Site visit ( School for Blind & School for Deaf-mute)			Narita 10:35(LH711) - Frankfurt 14:45
7	24	Mon	Meeting and discussion Site visit (Al-Amal School & other related institutions)			Frankfurt 13:05(LH668) - Damascus 18:25
8	25	Tue	Meeting and discussion			
9	26	Wed	Discussion on the Minutes of Meeting			Site survey
10	27	Thu	Signing the Minutes, Report to Embassy of Japan & JICA office			Collection of statistical data etc.
11	28	Fri	Data analysis, internal meeting			
12	29	Sat	Damascus 02:35 (KL515) - Amsterdam 6:40 B: Amsterdam 15:05 (KL867) - A: Amsterdam 19:30 (JAL412) -	Study & survey at site (Vocational Rehabilitation Center & School for Blind) (Operation & maintenance)		(Vocational training & education) (Equipment) (Procurement & cost estimation)
13	30	Sun	- B: Osaka 9:35 - A: Narita 5:15	Study & survey at site (School fro Deaf-mute & Al-Amal School) (Operation & maintenance)		(Vocational training & education) (Equipment) (Procurement & cost estimation)
14	Dec. 1	Mon	Study and data collection at MSAL			
15	2	Tue	Survey at Ministry of Education & Ministry of Higher Education			Procurement survey of equipment
16	3	Wed	Survey of trend in support activities by other donors, NGOs etc.	Survey at vocational schools and universities		Procurement survey of equipment
17	4	Thu	Survey of rehabilitation activities by hospitals			Survey of sales agent & after service
18	5	Fri	Data analysis and internal meeting			
19	6	Sat	Site survey at other related institutions for disabled persons (Education center for infantile paralysis in damascus, etc.)			Survey of working conditions, salary of workers, etc.
20	7	Sun	Survey of workplaces			Survey of port costs, internal transportation costs, etc.
21	8	Mon	Study (confirm contents of equipment) with staff of MSAL			
22	9	Tue	Study with staff of MSAL			Damascus 07:30 (LH 669) - Frankfurt 11:10
23	10	Wed	Report to Embassy of Japan & JICA office			Third country survey in Germany
24	11	Thu	Damascus 07:30 (LH 669) - Frankfurt 11:10, Frankfurt 13:30 (LH 711)-			Frankfurt 13:30 (LH 711)
25	12	Fri	- Narita 8:30			

(2) Consultation on Draft Report

	Month/ Date	Day	ITINERARY
1	Mar.3	Tue	Narita 12:30 (AF275) - Paris 17:10
2	4	Wed	Paris 12:30 (AF672) - Damascus 19:15
3	5	Thu	Meeting at JICA office, Courtesy call on Embassy of Japan and explanation of the draft report Explanation of purpose of the mission to State Planning Commission Explanation of purpose of the mission to MSAL, and schedule setting for discssion
4	6	Fri	Data analysis, internal meeting
5	7	Sat	Expanation of contents of the project (equipment) and project cost to be born by the syrian side Explanation of trainin course improvement plan of the Vocational Rehabilitation Center, equipment improvement plan, project cost to be born by the Sirian side and assistance plan to operation & training system of the center
6	8	Sun	Data analysis, internal meeting
7	9	Mon	Detail explanation of assistance plan to operation & training system of the Vocational Rehabilitation Center
8	10	Tue	Discussion on the Minutes of Meeting, repor to JICA office
9	11	Wed	Signing the Minutes, Report to Embassy of Japan
10	12	Thu	Damascus 01:50 (AF677) - Paris 05:455, Paris 13:30 (AF276) -
11	13	Fri	- Narita 09:15

### 3. List of Party Concerned in the Recipient Country

#### (1) Ministry of Social Affairs and labor

Mr. Ali Khalil	Minister
Dr. Tarek Akkash	Director of Social Service Department
Ms. Ferial Hamed	Chief of Child Care, Social Services Department
Ms. Lina Chameh	Head of Translation Division
Ms. Remda Taker	Supervisor on Disabled Sports in the Ministries Institutions
Mr. Abraham Balaana	Secretary of Minister
Ms. Wafa Fouyts	Social Specialist
Mr. Radwan Malla	Social Specialist
Ms. Heba Jerouday	Social Specialist
Mr. Mohd Kariri	Director of Social Affairs Directorate, Daraa Area

#### (2) State Planning Commission

Mr. Bassam Al Sibai	Director of Technical Cooperation Department
Mr. Mohammad Karkoosh	Director of Local and Services Planning

#### (3) Vocational Rehabilitation Center in Damascus

Mr. Yahya El - Niker	Director
Mr. Fadia Danora	Instructor for Typewriting Course
Mr. Sharif Al Hayek	Instructor for Photograph Course
Mr. Mustaf Sarhan	Instructor for Electric Maintenance Course
Mr. Mohd Ammar	Instructor for Watch-mending Course
Ms. Dalal Mardini	Instructor for Women's Sewing Course
Mr. Mohammad Ayoub	Instructor for Men's Sewing Course
Ms. Saeda Subh	Instructor for Knitting Course
Mr. Ali Al Hajali	Instructor for Wood Working Course
Mr. Mohammad Bashir Jakmiry	Instructor for Leather Works Course
Mr. Abdalla Khazmeh	Instructor for Shoe - making Course
Mr. Hisham Mously	Instructor for Mental Development

#### (4) School for the Blind in Damascus

Mr. Mandouh Azzo	Director
------------------	----------

#### (5) School for the Deaf in Damascus

Mr. Ahmad Touriman	Director
--------------------	----------

**(6) Al-Amal School for the Physically Disabled in Damascus**

Ms. Sowher Ramadan	Director
Mr. Awon Al - Shareff	Physio Therapist
Ms. Maisoun abul Fakher	Science Teacher

**(7) UNDP Office in Syria**

Ms. Maria Bances del Rey	Junior Program Officer
--------------------------	------------------------

**(8) Damascus Hospital**

Dr. M. Jamal Al- Wadi	General Surgeon, Director of Damascus Hospital
-----------------------	--

**(9) IBN Al- Nafees Hospital**

Dr. Muhamed Khir Al- Elabli	Director
Dr. Maesaim Ibrahim	

**(10) UNRWA Damascus Training Center**

(UNRWA: United Nation Relief and Works Agency for Palestine Refugees in the Near East)

Mr. Hiroshi Agawa	JICA Expert
Mr. Shigemi Kobayashi	JICA Expert on Electronic

**(11) Daraa Shoe's Factory**

Mr. Rifat Al Sari	Director
-------------------	----------

**(12) The Intermediate Third Industrial Institute**

Mr. Abdalla Nahhas	Director
--------------------	----------

**(13) Embassy of Japan in Syria**

Mr. Takeshi Kagami	Ambassador
Mr. Katsuhito Saka	First Secretary
Mr. Kazuo Shimogaki	Attache

**(14) JICA Syria Office**

Mr. Katsuhiko Ebina	Resident Representative of JICA Syria Office
Mr. Shinji Goto	Assistant Resident Representative of JICA Syria Office



#### 4. Minutes of Discussion

**Minutes of Discussions**  
**on**  
**the Basic Design Study on the Project for the Improvement of**  
**Equipment for Vocational Training for the People with Disability**  
**in**  
**The Syrian Arab Republic**

In response to a request from the Government of the Syrian Arab Republic, the Government of Japan has decided to conduct a Basic Design Study on the Project for the Improvement of Equipment for Vocational Training for the People with Disability (hereinafter referred to as "the Project"), and entrusted the study to Japan International Cooperation Agency (JICA).

JICA sent to Syria the Basic Design Study Team headed by Ms. Yoshie Muramatsu, Second Study Division, Grant Aid Project Study Department, JICA, and is scheduled to stay in the country from the 19th November to the 11th December, 1997.

The Team held a series of discussions on the Project with the concerned officials of the Government of the Syrian Arab Republic and conducted a field survey at the study area.

As a result of the discussions and field survey, both parties confirmed the main items described on the attached sheets.

The Team will proceed to further work and prepare the Basic Design Study Report.

Damascus, the 27th November, 1997



Yoshie Muramatsu  
Leader  
Basic Design Study Team  
Japan International Cooperation Agency

\_\_\_\_\_  
Ali Khalil  
Minister of Social Affairs and Labour



Witness

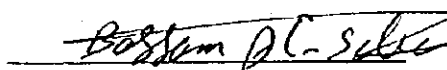

Bassam Al Sibai  
Director of Technical Cooperation Department  
State Planning Commission

## ATTACHMENT

### 1. Objective of the Project

The objective of the Project is to improve the vocational and educational function of four institutions in Damascus, which are Vocational Rehabilitation Centre, School for the Blind, School for the Deaf-mute, and Al-Amal School for the Physically Disabled, by replacing, renewing and reinforcing the equipment.

### 2. Responsible and Executing Organization

The responsible and executing organization of the Project is Social Services Department, the Ministry of Social Affairs and Labour (MSAL).

### 3. Sites of the Project

The project sites are Vocational Rehabilitation Centre, School for the Blind, School for the Deaf-mute, and Al-Amal School for Physically Disabled, and all are in Damascus.

### 4. Contents of the Request by the MSAL

- a. After a series of discussions, the MSAL requested the items attached as Annex-1.
- b. Both sides have agreed on the general criteria for the equipment selection for the Project as Annex-2.
- c. The final contents of the Project will be decided by the Japanese side at its discretion.

### 5. Japan's Grant Aid Programme

The MSAL has understood the system and characteristics of Japan's Grant Aid Programme explained in Annex-3 by the Team.

### 6. Necessary Measures to be taken by the MSAL

- a. The MSAL will submit the answer to the Questionair by the 30 of November.
- b. On condition that the Grant Aid Programme by the Government of Japan is extended to the Project, the MSAL will take the necessary measures described in Annex-4 for the smooth implementation of the Project.

The MSAL will secure the proper and effective operation and maintenance of the equipment procured under the Project.

- c. The Director of Social Services Department is assigned as a responsible parson for the supervision of the improvement of the institutions and maintenance of the equipment, and accompany the study team surveying the Project.

The Director of each institution will be assigned to be in charge of the Project and responsible for the operation and maintenance of equipment.

#### 7. Further Schedule of the Study

- a. The consultants will proceed the further study in Syria until 11th of December, 1997.
- b. JICA will complete the Basic Design Study Report by March, .1998 and send it to the Syrian side by May, 1998.

*hm*      *L*      *sk*

**Annex-1 Equipment Requested by  
The Ministry of Social Affairs and Labour**

Item No.	Name of Equipment requested	Requested quantity	
<b>A. Vocational Rehabilitation Center In Damascus</b>			
<i>a (1)</i>	<i>Typewriter course</i>	-	
a.1.1	Manual typewriter (Arabic)	5	
a.1.2	Manual typewriter (English)	5	
a.1.3	Electric typewriter (Arabic)	10	
a.1.4	Electric typewriter (English)	10	
a.1.5	Personal computer with word processing software	5	
<i>a (2)</i>	<i>Wood working course</i>	-	
a.2.1	Band saw	1 set	
a.2.2	Wood working bench with vise	2	
a.2.3	Circular saw	1	
a.2.4	Planner	1	
a.2.5	Bench drilling machine	2	
a.2.6	Pedestal grinder	2	
a.2.7	Wood working press	1	
a.2.8	Router	1	
a.2.9	Electric hand drill	2	
a.2.10	Electric hand grinder	2	
a.2.11	Electric sander	2	
a.2.12	Electric hand planner	2	
a.2.13	Electric hand circular saw	2	
a.2.14	Electric jig saw	2	
a.2.15	Air compressor	2	
a.2.16	Dust collector	1	
a.2.17	Spray gun	1	
a.2.18	Tool wagon	4	
a.2.19	Wood working hand tool set (Hand planner, Hammer, Chisel, Auger, Saw, Level, etc.)	10	
a.2.20	Chisel	1	
a.2.21	Lathe	1	
<i>a (3)</i>	<i>Tailoring course</i>	-	
	<i>Sewing, dress making course</i>	-	
a.3.1	Sewing machine	10	
a.3.2	Industrial sewing machine	10	
a.3.3	Vacuum press	1	
a.3.4	Electric cutting machine	2	
a.3.5	Steam iron and iron table	5	
a.3.6	Drawing set	2	

*MMA* *L* *Q*

Item No.	Name of Equipment requested	Requested quantity	
a.3.7	Working bench	2	
a.3.8	Tool wagon	5	
a.3.9	Tool set for tailoring (Scissors, Measure, Spray, Needle checker, Brush, etc.)		
a.3.10	Lock machine	2	
a.3.11	Button holing machine	2	
a.3.12	Button sewing machine	2	
a.3.13	Embroidery	2	
a.3.14	Double stitch machine	2	
a.3.15	Zigzag machine	2	
a.(4)	<i>Knitting course</i>	-	
a.4.1	Knitting machine (electric)	5	
a.4.2	Tool wagon	2	
a.4.3	Tool set for knitting (Knitting needle set, Scissors, Spray, Measure, etc.)	10	
a.4.4	Manual knitting machine	15	
a.4.5	Collar fitting machine	1	
a.4.6	Binding machine	1	
a.4.7	Embroidery machine	2	
a.4.8	Embroidery set	5	
a.(5)	<i>Electric maintenance course</i>	-	
a.5.1	Voltmeter	5	
a.5.2	Ammeter	5	
a.5.3	LCR meter	5	
a.5.4	Oscilloscope	5	
a.5.5	Digital multimeter	5	
a.5.6	Circuit tester	5	
a.5.7	Electric circuit training kit	5	
a.5.8	AM/FM signal generator	5	
a.5.9	Function generator	5	
a.5.10	AC/DC power supply	5	
a.5.11	Battery tester	5	
a.5.12	Watt meter	5	
a.5.13	Clamp meter	5	
a.5.14	Radio teaching kit	1 lot	
a.5.15	TV teaching kit	1 lot	
a.5.16	Lux meter	5	
a.5.17	Lighting stand	5	
a.5.18	Electric hand drill	2	
a.5.19	Electric hand grinder	2	
a.5.20	Tool wagon	5	
a.5.21	Working bench	2	
a.5.22	Soldering Iron	10	
a.5.23	Electric motor repair set	1 lot	

Item No.	Name of Equipment requested	Requested quantity	
a (6)	<i>Leather working course &amp; Shoe making course</i>	-	
a.6.1	Leather cutter	1	
a.6.2	Leather puncher	1	
a.6.3	Leather sewing machine	5	
a.6.4	Knife splitter	1	
a.6.5	Holding machine	1	
a.6.6	Napping machine	1	
a.6.7	Stitching machine	1	
a.6.8	Heel moulding machine	1	
a.6.9	Bind roll machine	1	
a.6.10	Dryer	1	
a.6.11	Finishing machine	1	
a.6.12	Leather combing machine	1	
a.6.13	Working bench	2	
a.6.14	Tool wagon	4	
a.6.15	Tool set for leather work (Hammer, Knife, Punch, Auger, Plier, Scissors, etc.)	10	
a.6.16	Tool set for shoe making (Hammer, Plier, Auger, Scissors, Brush, etc.)	10	
a (7)	<i>Photography course</i>	-	
a.7.1	Camera set with triangle	5	
a.7.2	Luxmeter	5	
a.7.3	Screen	2	
a.7.4	Lighting set	2	
a.7.5	DPE set for black & white	1 lot	
a (8)	<i>Wheel chairs</i>	-	
a.8.1	Wheel chairs	13	
a.8.2	Electric wheel chairs	10	
a.9	Auditorium equipment	1 lot	
a.10	Copy machine	1	
a.11	Transportation busses (large)	2	
a.12	Sports instruments	1 lot	
a.13	Hair dressing equipment for man, woman	1 lot	
a.14	Training instrument for Mental Development	1 lot	

*sm*

*Gr*

*Sy.*

Item No.	Name of Equipment requested	Requested quantity	
<b>B. School for the Blind in Damascus</b>			
b.1	Printing machine for braille	1	
b.2	Tape recorder with headphone	100	
b.3	Braille typewriter	100	
b.4	Music instruments	1 lot	
b.5	Audio library set	1 lot	
b.6	Cooking instruments	1 lot	
b.7	Washing machine	2	
b.8	Drying machine	2	
b.9	Transportation busses	2	
b.10	Braille board	70	
b.11	Computer with voice instruction	10	
b.12	Sports instrument	1 lot	
b.13	Education kit for the blind	1 lot	
<b>C. School for the Deaf in Damascus</b>			
c.1	Hearing measuring and training instrument	1 lot	
c.2	Speech correction instrument	1 lot	
c.3	Personal computer set for teaching	1 lot	
c.4	Musical instrument for rhythm education	1 lot	
c.5	Education kit for deaf	1 lot	
c.6	Sports instrument	1 lot	
c.7	Studio equipment for video editing	2	
c.8	Transportation busses	2	
<b>D. Al-Amal School for the Physically Handicapped in Damascus</b>			
d.1	Wheel chairs	50	
d.2	Mobile wheel chairs	5	
d.3	Physical therapy instrument	1 lot	
-	Shortwave therapy apparatus	1	
-	Frequency stimulator	2	
-	Rizer unit	1	
-	Infrared ultraviolet lamp	2 lot	
-	Goniometer kit	2	
-	Hydrotherapy set	1 lot	
-	Rotary exerciser	2	
-	Overhead suspension exerciser	1	
-	Tilting table	2	
d.4	Transportation busses	2	
d.5	Personal computer set for teaching	2	
d.6	Educational kit for physically disabled	1 lot	
d.7	TV and video camera set	1	
d.8	Music instruments	1 lot	
d.9	Sports instruments	1 lot	

*gm* *Le* *g.*



## Annex-2 Criteria for the Equipment Selection

1. Priority should be given to the equipment which is necessary for vocational training and education for the disabled.
2. Priority should be given to the equipment to be replaced to the existing one which has been deteriorated or outdated because of its necessity for vocational training or education for the disabled.
3. Priority should be given to the equipment to be added to the existing equipment which is short of quantity in consideration of size of classes and operation.
4. Each equipment should satisfy the minimal requirements complied with the curriculum and activities in each centre or school at present and in the near future.
5. The responsible person(s) for operation of the courses or classes to use each equipment should be clearly assigned and capable to use it.
6. The equipment which may be given and belong to a particular person will not be provided by the Project because of the nature of the Grant Aid by the Government of Japan.
7. Each equipment should have enough durability against the climate and under proper using conditions.
8. Equipment should be procurable in Syria as much as possible.
9. The maintenance of equipment should be easy and inexpensive, and its consumable materials must be supplied continuously by MASL.
10. Should other criteria be recognized through the Basic Design Study, they should be applied to the selection.

*mm* *L* *g.*

## Annex-3 Japan's Grant Aid Programme

### 1. Grant Aid Procedures

a. Japan's Grant Aid Program is executed through the following procedures.

- Application (A request made by the recipient country)
- Study (Basic Design Study conducted by JICA)
- Appraisal & Approval (Appraisal by the Government of Japan and Approval by the Cabinet of Japan)
- Determination of Implementation (Exchange of Notes between the Governments of Japan and the recipient country)

b. Firstly, the application or request for a Grant Aid project submitted by a recipient country is examined by the Government of Japan (the Ministry of Foreign Affairs) to determine whether or not it is eligible for Grant Aid. If the request is deemed appropriate, the Government of Japan assigns JICA (Japan International Cooperation Agency) to conduct a study on the request.

Secondly, JICA conducts the study (Basic Design Study) using (a) Japanese consulting firm(s).

Thirdly, the Government of Japan appraises the project to see whether or not it is suitable for Japan's Grant Aid Programme, based on the Basic Design Study Report prepared by JICA, and the results are then submitted to the Cabinet for an approval.

Fourthly, the project, once approved by the Cabinet, becomes official with the Exchange of Notes signed by the Governments of Japan and recipient country.

Finally, for the implementation of the project, JICA will assist the recipient country in such matters as preparing tenders, contract and so on.

### 2. Basic Design Study

#### a. Contents of the study

The aim of the Basic Design Study (hereafter referred to as "the Study") conducted by JICA on a requested project (hereafter referred to as "the Project") is to provide a basic document necessary for the appraisal of the Project by the Government of Japan. The contents of the Study are as follows :

- a) Confirmation of the background, objectives, and benefits of the Project and also institutional capacity of agencies concerned of the recipient country

*hjm*    *S*, *L*

necessary for the Project's implementation.

- b) Evaluation of the appropriateness of the Project to be implemented under the Grant Aid Scheme from a technical, social and economic-point of view.
- c) Confirmation of items agreed on by both parties concerning the basic concept of the Project.
- d) Preparation of a basic design of the Project.
- e) Estimation of costs of the Project.

The contents of the original request are not necessarily approved in their initial form as the contents of the Grant Aid project. The Basic Design of the Project is confirmed considering the guidelines of the Japan's Grant Aid Scheme.

The Government of Japan requests the Government of the recipient country to take whether measures are necessary to ensure its self-reliance in the implementation of the Project. Such measures must be guaranteed even though they may fall outside of the jurisdiction of the organization in the recipient country actually implementing the Project. Therefore, the implementation of the Project is confirmed by all relevant organizations of the recipient country through the Minutes of Discussions.

#### b. Selection of Consultants

For smooth implementation of the Study, JICA uses (a) registered consultant firm(s). JICA select (a) firm(s) based on proposals submitted by interested firms. The firm(s) selected carry(ies) out a Basic Design Study and write(s) a report, based upon terms of reference set by JICA.

The consultant firm(s) used for the Study is(are) recommended by JICA to the recipient country to also work on the Project's implementation after the Exchange of Notes, in order to maintain technical consistency and also to avoid undue delay in implementation should the selection process be repeated.

### 3. Japan's Grant Aid Scheme

#### a. Grant Aid

The Grant Aid Programme provides a recipient country with non-reimbursable funds to procure the facilities, equipment and services (engineering services and transportation of the products, etc.) for economic and social development of the country under principles in accordance with the relevant laws and regulations of Japan. Grant Aid is not supplied through the donation of materials as such.

W.M. L & S.

b. Exchange of Notes (E/N)

Japan's Grant Aid is extended in accordance with the Notes exchanged by the two Governments concerned, in which the objectives of the Project, period of execution, conditions and amount of the Grant Aid, etc., are confirmed.

c. Period

"The period of the Grant Aid" means the one fiscal year which the Cabinet approves the Project for. Within the fiscal year, all procedures such as exchanging of the Notes, concluding contracts with (a) consultant firm(s) and (a) contractor(s) and final payment to them must be completed.

However, in case of delays in delivery, installation or construction due to unforeseen factors such as weather, the period of the Grant Aid can be further extended for a maximum of one fiscal year at most by mutual agreement between the two Governments.

d. Purchase of the Products and or Services

Under the Grant Aid, in principle, Japanese products and services including transport or those of the recipient country are to be purchased.

When the two Governments deem it necessary, the Grant Aid may be used for the purchase of the products or services of a third country.

However, the prime contractors, namely, consulting constructing and procurement firms, are limited to "Japanese nationals". (The term "Japanese nationals" means persons of Japanese nationality or Japanese corporations controlled by persons of Japanese nationality.)

e. Necessity of "Verification"

The Government of recipient country or its designated authority will conclude contracts denominated in Japanese yen with Japanese nationals. Those contracts shall be verified by the Government of Japan. This "Verification" is deemed necessary to secure accountability to Japanese taxpayers.

f. Undertakings required of the Government of the Recipient Country

(As described in ANNEX 4)

g. Proper Use

The recipient country is required to maintain and use the facilities constructed and the equipment purchased under the Grant Aid properly and effectively and to assign staff necessary for this operation and maintenance as well as to bear all the expenses other than those covered by the Grant Aid.

*Handwritten signature*

**h. Re-export**

The products purchased under the Grant Aid should not be re-exported from the recipient country.

**i. Banking Arrangements (B/A)**

- a) The Government of the recipient country or its designated authority should open an account in the name of the Government of the recipient country in an authorized foreign exchange bank in Japan (hereinafter referred to as "the Bank"). The Government of Japan will execute the Grant Aid by making payments in Japanese yen to cover the obligations incurred by the Government of the recipient country or its designated authority under the Verified Contracts.
- b) The payments will be made when payment requests are presented by the Bank to the Government of Japan under an authorization to pay issued by the Government of the recipient country or its designated authority.

*mm* *le* *S.*

#### **Annex-4 Necessary Measures to be taken by the MASL**

Following necessary measures should be taken by the MASL on condition that the Grant Aid by the Government of Japan is extended to the Project:

1. To provide data and information necessary for the Project.
2. To complete the relocation of the existing equipment, facilities and civil works required prior to the installation of the equipment, if necessary.
3. To provide facilities for distribution of electricity, water supply, telephone, drainage, sewage and other incidental items required for the Project.
4. To provide the relevant financial support and staff members for the proper and effective operation and maintenance of equipment provided under the Grant Aid.
5. To bear commissions to the Japanese foreign exchange bank for its banking services based upon the Banking Arrangement, namely the advising commission of the "Authorization to Pay" and payment commission.
6. To ensure prompt unloading, tax exemption, customs clearance at the port of disembarkation and prompt internal transportation therein of the materials and equipment for the Project purchased under the Grant Aid.
7. To exempt Japanese juridical and physical nationals engaged in the Project from customs duties, internal taxes and other fiscal levies which may be imposed in Syria with respect to the supply of the products and services under the verified contracts.
8. To accord Japanese nationals whose services may be required in connection with the supply of the products and the services under the verified contract such facilities as may be necessary for their entry into Syria and stay therein for the performance of their work in accordance with the relevant laws and regulations of the Syrian Arab Republic.
9. To provide necessary permissions, licenses and other authorizations for implementing the Project, if necessary.
10. To maintain and use properly and effectively the facilities constructed and the equipment provided under the Project in responsibility of the MASL.
11. To bear all the expenses, other than those to be borne by the Japan's Grant Aid within the scope of the Project.



**Minutes of Discussions**  
**on**  
**the Basic Design Study on the Project for**  
**Improvement of Equipment for Vocational Training**  
**for the People with Disability**  
**in**  
**the Syrian Arab Republic**  
**(Consultation on Draft Report)**

In November 1997, the Japan International Cooperation Agency (JICA) dispatched the Basic Design Study Team on the Project for Improvement of Equipment for Vocational Training for the People with Disability (hereinafter referred to as "the Project") to Syria, and through discussions, field survey, and technical examination of the results in Japan, has prepared the draft Basic Design report of the study.

In order to Explain and consult the Ministry of Social Affairs and Labour, the Government of the Syrian Arab Republic, on the components of the draft report, JICA sent a study team, which is headed by Mr. Katsuhiko Ebina, and is scheduled to stay in Syria from 4th to 12th March, 1998.

As a result of discussions, both parties confirmed the main items described on the attached sheets.

Damascus, the 11th March, 1998

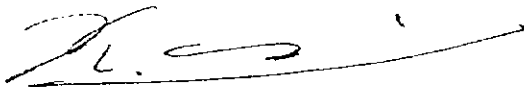

Katsuhiko Ebina  
Leader  
Basic Design Study Team  
(Consultation on Draft Report)  
Japan International Cooperation Agency

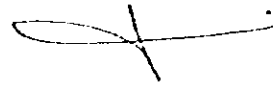

Ali Khalil  
Minister of Social Affairs and Labour

Witness



Bassam Al Sibai  
Director of Technical Cooperation Department  
State Planning Commission

## ATTACHMENT

### 1. Components of the Draft Basic Design Report

The Ministry of Social Affairs and Labour (MSAL) has agreed and accepted the components of the draft Basic Design report proposed by the Team.

MSAL understood the importance of improvement of operation and training system in the Vocational Rehabilitation Centre, and confirmed to take necessary measures described in the draft report under the responsibility of the Government of Syria.

A total of 4 buses, 1 for each facility, have been strongly requested by the Syrian side. The appropriateness of this request under the Project will be studied in detail by the Team upon its return to Japan. The reasons for the said request are attached as Annex-1.

### 2. Responsible and Executing Organization

The responsible and executing organization of the Project is Social Services Department, MSAL.

### 3. Contents of the Items of the Project

Both sides has confirmed the items which will be procured under the Japanese Grant Aid and the its location plan attached as Annex-2.

Services to assist the improvement plan of operation and training system in the Vocational Rehabilitation Centre, attached as Annex-3, will be also provided based on the contract between MSAL and consultant, and covered by the Japanese Grant Aid.

### 4. Japan's Grant Aid Programme

The MSAL has understood the system and characteristics of Japan's Grant Aid Programme explained in Annex-4 by the Team.



5. Necessary Measures to be taken by the MSAL

- a. On condition that the Grant Aid Programme by the Government of Japan is extended to the Project, the MSAL will take the necessary measures described in Annex-4 for the smooth implementation of the Project.  
The MSAL will secure the proper and effective operation and maintenance of the equipment procured under the Project.
- b. The MSAL will complete all of the necessary renovation of the rooms, in which the procured equipment would be installed, and electric works into the room by the end of April, 1999.
- c. The MSAL will nominate the core staff for the Vocational Rehabilitation Centre by May, 1998 in order to improve the evaluation system, course curricula, and prepare its text.
- d. The MSAL will recruit the necessary trainers to operate reorganized training courses by May, 1999.

If there is any delay or modification of the schedule, the MSAL will notice it to the Japanese side immediately.

6. Further Schedule of the Study

JICA will complete a final report of the Study in accordance with the confirmed items, and send it to the Syrian side by April, 1998.

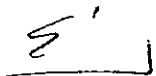

## Annex-1 The reasons for the request of 4 buses

### 1. Vocational Rehabilitation Centre

Existing buses are obsolete, and due to breakdown are not able to fully respond to the commuting needs of the Centre students. Also, since the number of students at the Centre is expected to increase under the Project, it is necessary to supply a bus with 50 passenger capacity to handle this expanded load.

### 2. School for the Blind in Damascus

The 3 number of bus on hand are all obsolete, and one of these is totally non-functional due to breakdown. Rental vehicles are used to cover for inoperable bus; however, these are subject to sudden cancellation and operation at uncertain hours resulting in students sometimes not arriving for classes. In order to achieve a stable and reliable commuting system for the school, it is considered necessary that at least one bus with 50 passenger capacity be supplied to the school.

### 3. School for the Deaf in Damascus

Of the 3 buses on hand, 2 are obsolete and are not able to fully respond to the commuting needs of the facility students. Due to unavailability of these buses, some 70 students commute to the school in buses chartered by their parents. To address this situation, it is considered necessary that at least one bus with 50 passenger capacity be supplied to the school.

### 4. Al-Arnal School for the Physically Disabled in Damascus

Of the 3 buses on hand, 2 are obsolete and are not able to fully respond to the commuting needs of the facility students. Particularly in the case of this school, good commuting bus service is essential in light of the fact that student body includes physically disabled children. To address this, it is considered necessary that at least one bus with 50 passenger capacity be supplied to the school.

**Annex-2 Items to Be Provided under the Japanese Grant Aid Project**

51

R.

4

2

## Equipment List

### A. Vocational Rehabilitation Center in Damascus

Item No.	Name of Equipment	Specification	Qty. Unit
<i>a 1</i>	<i>Business course</i>	-	-
a 1.1	Personal computer with word processing software	-	22 sets
a 1.1.1	Personal computer main set	Desk top type, Pentium 200 MHz	22
a 1.1.2	Laser printer	A4 Size, 600dpi x 600dpi	2
a 1.1.3	Dot-matrix printer	Dot-matrix type, A3 Size	2
a 1.1.4	Stabilizer	for the Computer	22
a 1.1.5	UPS	for the Computer	22
<i>a 2</i>	<i>Wood working course</i>	-	-
a 2.1	Band saw	Max Cutting Height 300 mm, Blade Dimensions 75 x 2,800 x 0.65 mm	1 set
a 2.2	Wood working bench with vise	Dimensions W1800xD900xH750, with vise	4
a 2.3	Circular saw	Blade diameter 40mm, Table size 650x800mm	1
a 2.4	Planner	Cutting width 400mm	1
a 2.5	Bench drilling machine	Max. drilling diameter 21mm with stand	2
a 2.6	Pedestal grinder	Grinder outer diameter 255xthickness 25mm, two grinder type	2
a 2.7	Wood working press	Table size 1000x2000mm, stroke 900mm, max. pressure 20ton	1
a 2.8	Router	Max. thickness 170mm, Table size 900x600mm	1
a 2.9	Electric hand drill	Drilling diameter 13mm portable type	2
a 2.10	Electric hand grinder	Grinder diameter 100x15mm portable type	2
a 2.11	Electric sander	Abrasive paper size 90x230mm portable type	2
a 2.12	Electric hand planner	Cutting width 110mm portable type	2
a 2.13	Electric hand circular saw	Blade diameter 260mm portable type	2
a 2.14	Electric jig saw	Max. cutting width 65mm portable type	2
a 2.15	Air compressor	Motor output 0.2kW, Air delivery 25 liter/min Pressure 5kg/cm <sup>2</sup>	2
a 2.16	Dust collector	Air volume 38m <sup>3</sup> /min, Motor output 2.2kW with filter movable type	1
a 2.17	Spray gun	Nozzle diameter 1.5mm Vacuum type with paint cup 600ml	1
a 2.18	Tool wagon	3 trays, Dimensions W660xD340xH800mm with caster	4
a 2.19	Wood working hand tool set	Saw, Planner, Drill, Wood hammer. Curved ruler set with wooden box	10
a 2.20	Chisel	Square chisel size 5~22mm Table size W550xD200mm	1
a 2.21	Lathe	Max. length for materials 1000mm, Max swing width 400mm, Main axle revolution 450~	1
<i>a 3</i>	<i>Sewing course</i>	-	-
a 3.1	Sewing machine	Electric type for home use 5 units, Foot operating type 5 units	10
a 3.2	Industrial sewing machine	Max sewing speed 4500spm, for medium and thick fabric with table, chair and stand	10
a 3.3	Vacuum press	Dimensions 1200x650mm Motor output 400W Universal type	1
a 3.4	Electric cutting machine	Max. cutting capacity 110mm	2
a 3.5	Steam iron and iron table	Iron 1000W Iron table dimensions 1,150x350mm with three stage, with supporting	4

### Equipment List

Item No.	Name of Equipment	Specification	Qty.	Unit
a 3.6	Drawing set	Rulers 3 kinds, Curved ruler, Square ruler, glass measure, Compass for tailoring, French ruler	2	
a 3.7	Working bench	Table for cutting work, Dimensions 1800x900xH780mm	2	
a 3.8	Tool wagon	4 trays, Dimensions 660x340xH900mm with caster	4	
a 3.9	Tool set for tailoring	Tools 32 kinds including wooden case	25	
a 3.10	Lock machine	Max sewing speed 6000spm Needle width 0.8~4.0mm Lock width 1.6~4.8mm with table, chair and stand	2	
a 3.11	Button holing machine	Max sewing speed 3600spm Max thickness 12mm Needle number 54~345 with table, chair	2	
a 3.12	Button sewing machine	Max. sewing speed 1,500RPM Button size 10~28mm with table, chair and stand	2	
a 3.13	Embroidery	Max sewing speed 2,000RPM Zigzag width 0~12mm with table, chair and stand	2	
a 3.14	Double stitch machine	Max sewing speed 3,000RPM Sewing length 5mm/reverse 5mm (Max.) with table, chair and stand	2	
a 3.15	Zigzag machine	Max sewing speed 5,000RPM, Zigzag width Max 8mm, with table, chair and stand	2	
<b>a. 4</b>	<b>Knitting course</b>	-	-	-
a.4.1	Knitting machine (electric)	Electric, Needle pitch 4.5mm with 200 needles	5	
a.4.2	Tool wagon	3 trays, Dimensions 600x480xH880mm with caster	2	
a.4.3	Tool set for knitting	Needle bar set 16 kinds, Crochet set 16 kinds, Needle bar caps	12	
a.4.4	Manual knitting machine	Needle pitch 4.5mm with 200 needles and punch cards	15	
a.4.5	Binding machine	for color and sleeve binding with table and motor	1	
a.4.6	Embroidery machine	Max sewing speed 2,000RPM, Zigzag width 0~12mm with table, chair and stand	2	
a.4.7	Embroidery set	Needle bar sets, Crochet needle sets, Embroidery samples	11	
<b>a. 5</b>	<b>Electric maintenance course</b>	-	-	-
a.5.1	Voltmeter	1 set consist of DC / AC	4	
a.5.2	Ammeter	1 set consist of DC / AC	4	
a.5.3	LCR meter	Measuring items : Inductance, capacitance, resistance and etc.	1	
a.5.4	Oscilloscope	40MHz, Vertical axes sensitivity 5mV/div~5V/div	1	
a.5.5	Circuit tester	DC voltage 0.3~1,200V, DC current 0.012~1,200mA, AC voltage 3~1200, Resistance 2~20,000k $\Omega$	4	
a.5.6	Electric circuit training kit	1 set consist of electric circuit study kit and electronic circuit study kit	4	
a.5.7	Function generator	Frequency 0.01Hz~10MHz	1	
a.5.8	AC/DC power supply	Output voltage 0~ $\pm$ 10V, Max output current 3mA, Max input voltage 250V	4	
a.5.9	Watt meter	5A, Accuracy $\pm$ 0.5%	4	
a.5.10	Clamp meter	1 set consists of 2 kinds (20~600V, 2~200A, 2~200kW and 20~600V, 0.2~20A, 0.2~	4	
a.5.11	Lux meter	Measurement range 0~3000lx, 3 steps range	4	

Equipment List

Item No.	Name of Equipment	Specification	Qty. Unit
a.5.12	Lighting stand	Florence lump, desktop type	1
a.5.13	Electric hand drill	for electrical works with stand	2
a.5.14	Electric hand grinder	Grinder diameter 100mm portable type	2
a.5.15	Tool wagon	Dimensions 660x340xH800mm, 3 trays with caster	4
a.5.16	Working bench	for electric works, Dimensions W1800xD900xH900mm	4
a.5.17	Soldering iron	100W with stand	4
a.5.18	Electric motor repair set	Motor wiring machine (manual type and electric type 1 each) with tools and tool box	1 set
<b>a. 6</b>	<b>Capability Development for the Mentally Impaired course</b>		-
a. 6.1	Roller conveyer with stand	Aluminum roller conveyer, W400 x L200mm 1 set consist of 2 units with stand	5 set
a. 6.2	Various type of weigh	Upper tray type 1kg, 4kg 1 each, Upper tray with beam type 1kg 1 unit	2 set
a. 6.3	Trays	Dimensions 300x200x100mm, plastics	50
a. 6.4	Assemble & disassemble kit	Peg boards and pegs	1 set
a. 6.5	Tool set	Combination tool sets	10 set
a. 6.6	Hand weaving machine	Small size weaving machine	1 set
a. 6.7	Vocational evaluation tools	8 kinds	1 set
a. 6.8	Musical instrument		
a. 6.8.1	- Keyboard	60keys 120 melody	1
a. 6.8.2	- Drum (Small size)	φ 35x14 cm with stand and sticks	4
a. 6.8.3	- Drum (large size)	φ 60x35 cm with stand and sticks	1
a. 6.8.4	- Cymbals	φ 21cm	2
a. 6.8.5	- Hand castanets	Wooden type	10
a. 6.8.6	- Triangle	21cm with sticks	2
<b>a. 7</b>	<b>Wheel chairs</b>		-
a.7.1	Wheel chairs	for adult, folding type	20
a.7.2	Electric wheel chairs	for adult with lever control	10
<b>a. 8</b>	Copy machine	Paper size A5~A3, 50%~200% with sorter	1
<b>a. 9</b>	Transportation busses (large)	Passenger capacity 50	under consideration of the appropriateness
<b>a. 10</b>	<b>Sports instruments</b>		-
a.10.1	Trampoline	Dimensions W450xD280xH100 folding type	1
a.10.2	Vaulting horse	Wooden 7 steps with step-up board and mattress	1 sets
a.10.3	Mat for wrestling	Floor mattress, 90x90cm, 30 sheets	1
a.10.4	Balance beam	Wooden, 10cm x10cm x 300cm, Height 30cm	1 set
a.10.5	Ping-Pong set	for disabled persons with rackets, balls and fence	2 sets
a.10.6	Balance Block	Walking Balance board and rocking stand 1 set 1 each	2 sets
a.10.7	Wheel chairs for basket ball	for basket ball	10
a.10.8	Wheel chairs for athletics	for slalom	10
a.10.9	Muscular strength training instruments	Multipurpose type (at least for kinds)	1 set
a.10.10	Medical ball	700g, 1000g, 2000g, 3000g 1 set 1 each	10
a.10.11	Basket ball instrument	Goals and balls	1 set

## Equipment List

### B. School for the Blind in Damascus

Item No.	Name of Equipment	Specification	Qty. Unit
b.1	Printing machine for Braille	—	—
b.1.1	Braille printer	Both sides printing, 600 papers/h, dot drawing size 1.25mm	1
b.1.2	Personal computer main set	Desk top type, Pentium 200MHz	2
b.1.3	Software for Braille	Braille software (English and Arabic)	2
b.1.4	Laser printer	A4 size, 600dpi x 600dpi	1
b.1.5	Stabilizer	for the computer	2
b.1.6	UPS	for the computer	2
b.2	Tape recorder with headphone	Plain type cassette tape recorder	100
b.3	Braille typewriter	—	—
b.3.1	Braille typewriter (manual)	Max paper width 300mm, Max. characters per line 44, dot drawing size 2.5mm	90
b.3.2	Braille typewriter (electric)	with memory	10
b.4	Music instruments	—	—
b.4.1	Accordion	32 keys with hard case	5
b.4.2	Tambourine	∅ 21cm	2
b.4.3	Keyboard	60 keys, 120 melody	3
b.4.4	Drum (Small size)	Diameter 35x14 cm with stand and sticks	2
b.4.5	Drum (large size)	Diameter 60x35 with stand and sticks	1
b.4.6	Cymbals	Diameter 21cm	1
b.4.7	Hand castanets	Wooden	5
b.4.8	Triangle	21cm with sticks	1
b.5	Audio library set	x 16 speeds, 1 master and 3 tapes	1 set
b.6	Homemaking instruments	—	—
b.6.1	Electric heater	Electrical heater 1kw	4
b.6.2	Meat mincer	100~150 kg/hour	1
b.6.3	Electric juicer mixer	Juicer and mixer	1
b.6.4	Refrigerator	2 doors, 450 liter	2
b.6.5	Pressure cooker	14 liter	4
b.6.6	Washing machine	2 tab type, Max washing capacity 5kg	2
b.7	Transportation busses (large)	Passenger capacity 50	under consideration of the appropriateness
b.8	Braille board	A4size, 30cells x 27 lines	200
b.9	Sports instrument	—	—
b.9.1	Goal ball set	—	—
b.9.1.1	- Goal	for Goal ball	10
b.9.1.2	- Goal ball	Goal	2
b.9.1.3	- Eye-mask	for Goal ball	10
b.9.2	Chess (for the blind)	for Blind	10 lot
b.9.3	Ping-Pong set for the Blind	for Blind with racket, ball, and fence	4 sets
b.10	Education kit for the blind	—	—
b.10.1	Model of human body	Actual size, 15 divided human body	1
b.10.2	Model of human skeleton	Actual size, plastics with stand	1
b.10.3	Eye model	x 5 size, 6 divided type	1
b.10.4	Ear model	x 3 size, 4 divided type with stand	1
b.10.5	Geometric tools	3D model	1
b.10.6	Toys of different animals	Animal models	1
b.10.7	Toys of transportation means	Vehicle models	1
b.10.8	Measures units	Clock model and weight	1

## Equipment List

### C. School for the Deaf in Damascus

Item No.	Name of Equipment	Specification	Qty. Unit
c.1	Hearing measuring and training instrument	--	--
c.1.1	Language laboratory	for teacher and 10 students	4 sets
c.1.2	Audiometer	Frequency 500,1000, 2000, 4000 Hz	2 sets
c.1.3	Impedance meter	0.2~9.99ml	2 sets
c.1.4	Hearing apparatus	with step less volume control	20
c.2	Musical instrument for rhythm education	--	--
c.2.1	Keyboard	60 keys, 120 melody	2
c.2.2	Drum (small size)	Diameter 35x14 cm with stand and sticks	4
c.2.3	Drum (large size)	Diameter 60x35 cm with stand and sticks	4
c.3	Education kit for deaf	--	--
c.3.1	Human body model	Actual size, 15 divided human body	1
c.3.2	Ear model	x 5 size, 6 divided type	1
c.4	Sports instrument	--	--
c.4.1	Trampoline	W450xD280xH100cm, folding type	1
c.4.2	Vaulting horse	Wooden, 7 steps with step-up board and mattress	1 sets
c.4.3	Mat for wrestling	Floor mattress 90x90x30 sheets	1
c.4.4	Bar for high jump	stand 2 units, height 2.1m with pit for high-jump	1
c.4.5	Balance beam	Wooden, 10cmx10cmx 300cm, height 30cm	1 set
c.4.6	Ping-Pong set	for disabled persons with racket, ball and fence	2 sets
c.4.7	Balance Block	Walking Balance board and rocking stand 1 set 1 each	2 sets
c.5	Studio equipment for video editing	Video camera, Video recorder and TV (PAL)	1 set
c.6	Transportation busses (large)	Passenger capacity 50	under consideration of the appropriateness



## Equipment List

### D. Al-Amal School for the Physically Disabled

Item No.	Name of Equipment	Specification	Qty. Unit
d.1	Wheel chairs	—	—
d.1.1	Wheel chairs (small size)	for children, folding type	15
d.1.2	Wheel chairs (standard size)	for adult, folding type	35
d.2	Mobile wheel chairs	for adult with lever control	5
d.3	Physical therapy instrument	—	—
d.3.1	Shortwave therapy apparatus	Shortwave, Pulse 400W (Max.1000W) , Generator frequency 27.12MHz±0.6%	1 set
d.3.2	Frequency stimulator	-	-
d.3.2.1	EMG feedback therapy	2 channel, 18 current patterns	1 set
d.3.2.2	Interferential therapy	Frequency 2, 2.5, 4, 6, 10kHz, 0~100mA	1 set
d.3.3	Laser unit	Max voltage 400mA, Battery 12V	1 set
d.3.4	Infrared ultraviolet lamp	Infrared lump and ultraviolet lump	2 sets
d.3.5	Goniometer kit	for elbow, knee, finger	2 sets
d.3.6	Hydrotherapy set	-	-
d.3.6.1	Whirlpool bath for full body	Dimensions W85xL200xH80cm	1 set
d.3.6.2	Whirlpool bath for arms	Dimensions 75x50xH80cm	1 set
d.3.6.3	Whirlpool bath for legs	Dimensions 75x50xH50cm	1 set
d.3.6.4	Ultrasound therapy	Ultrasound frequency 1 & 3 MHz, Dimensions 290x280x100cm	1 set
d.3.6.5	Pack heater and hot pack	Tank capacity 60liter, Output 1,100W with hot packs	1 set
d.3.7	Rotary exerciser	-	-
d.3.7.1	Ergometer	Load 50-250W	1 set
d.3.7.2	Pedal apparatus	Dimensions W50xD40xH35cm	2 sets
d.3.8	Overhead suspension exerciser	-	-
d.3.8.1	Quadriceps bench	Dimensions W60xD125xH70cm	1 set
d.3.8.2	Universal traction unit	at least for kinds traction units	1 set
d.3.9	Tilting table	-	-
d.3.9.1	Tilt table	Standup degree 0~90° size W70xL200cm	1 set
d.3.9.2	Treatment table	Dimensions W70xL200cm, H80cm	2 sets
d.4	Transportation busses (large)	Passenger capacity 50	under consideration of the appropriateness
d.5	Educational kit for physically disabled	—	—
d.5.1	Model of human skeleton	Actual size, plastics, with stand	1
d.5.2	Microscope	x 40~600	2
d.5.3	Model of human body	Actual size, 15 divided type	1
d.5.4	Eye model	x 6, 6 divided type	1
d.5.5	Spine model	Movable spine model with stand	1
d.5.6	Heart model	x 2 size, 4 divided type with stand	1
d.5.7	Ear model	x 3 size, 4 divided type with stand	1
d.5.8	Brain model	Actual size, 6 divided type	1
d.6	TV and video camera set	Video camera, Video recorder and TV (PAL)	1
d.7	Music instruments	—	—
d.7.1	Accordion	32 keys with hard case	3
d.7.2	Keyboard	60 keys 120 melody	2

## Equipment List

Item No.	Name of Equipment	Specification	Qty. Unit
d.7.3	Others	-	-
d.7.3.1	Hand castanets	Wooden	6
d.7.3.2	Triangle	21cm with sticks	2
d.7.3.3	Cymbals	Diameter 21cm	2
d.7.3.4	Drum (small size)	Diameter 35x14 cm with stand and sticks	4
d.7.3.5	Drum (large size)	Diameter 60x35 cm with stand and sticks	1
d.8	Sports instruments	-	-
d.8.1	Wheel chairs for basket ball	for basket ball	10
d.8.2	Wheel chairs for athletics	for slalom	10
d.8.3	Muscular strength training instruments	Multipurpose type (at least for kinds)	1 set
d.8.4	Ping-Pong set	for disabled persons with rackets, balls and fence	2 sets
d.8.5	Medical ball	700g, 1000g, 2000g, 3000g 1 set 1 each	10 sets
d.8.6	Mat for wrestling	Floor mattress 90x90x30 sheets	1 set
d.8.7	Basket ball instrument	Goals and balls	1 set

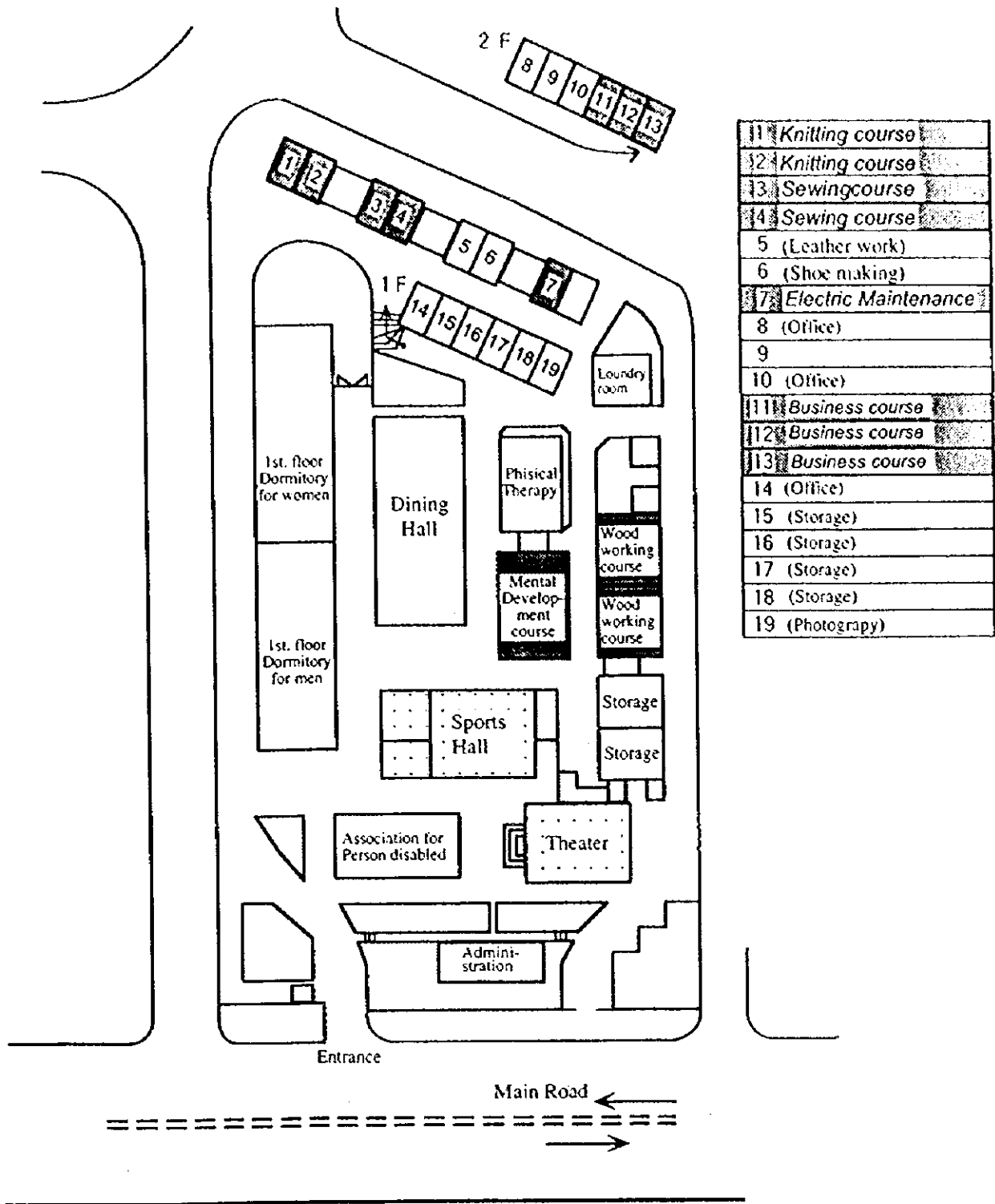

Layout plan for the Vocational Rehabilitation Center

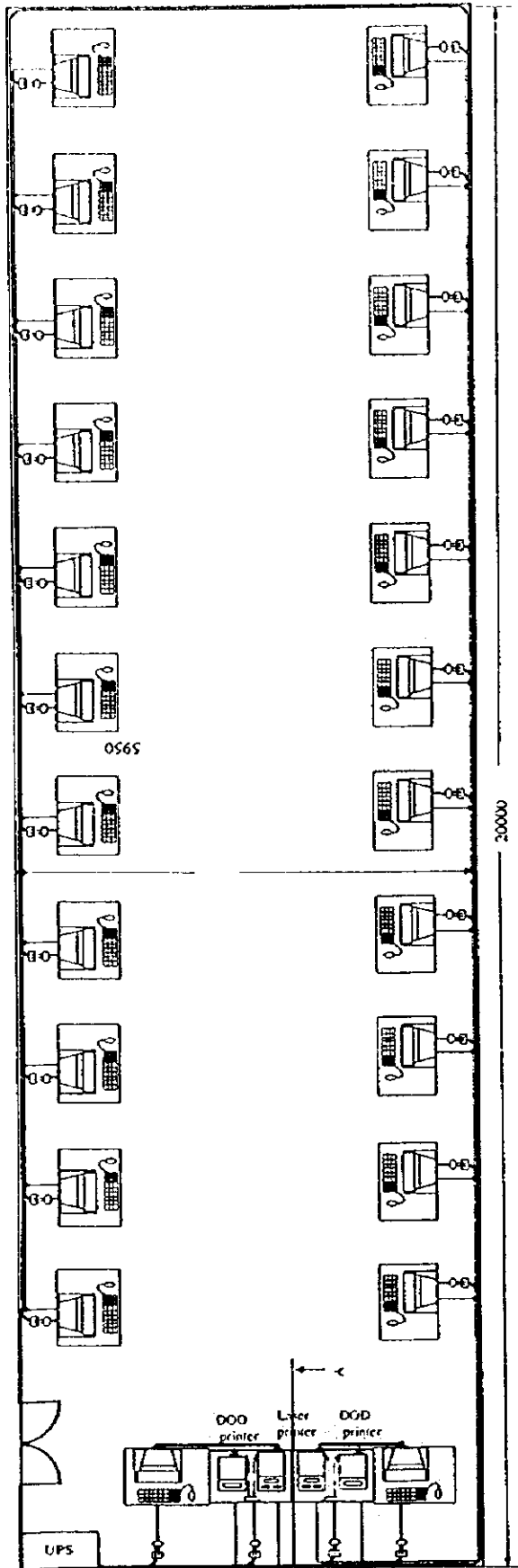

unit . mm

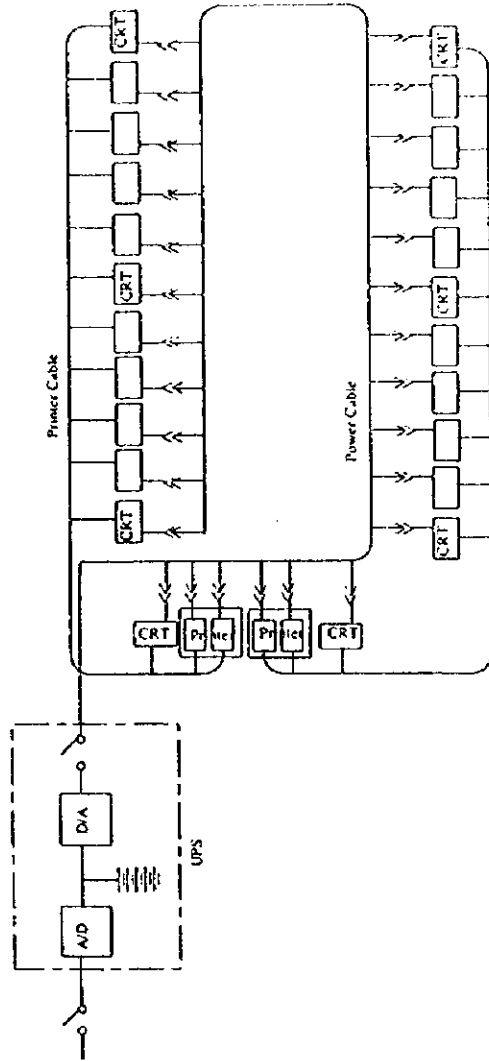

Single Diagram for Computer room

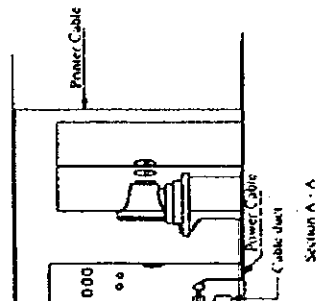

Model Layout for Business course

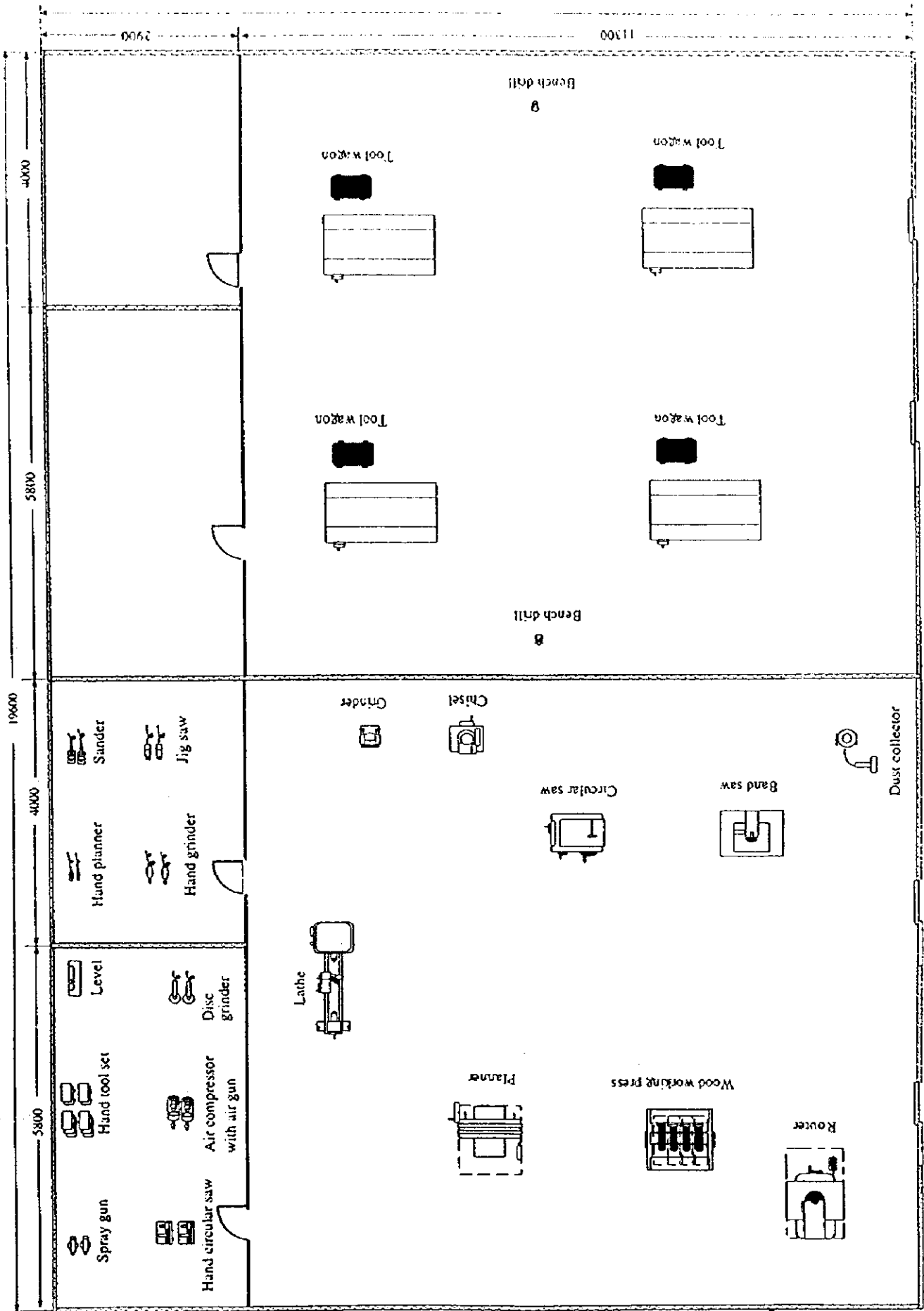

Model Layout for Wood working course

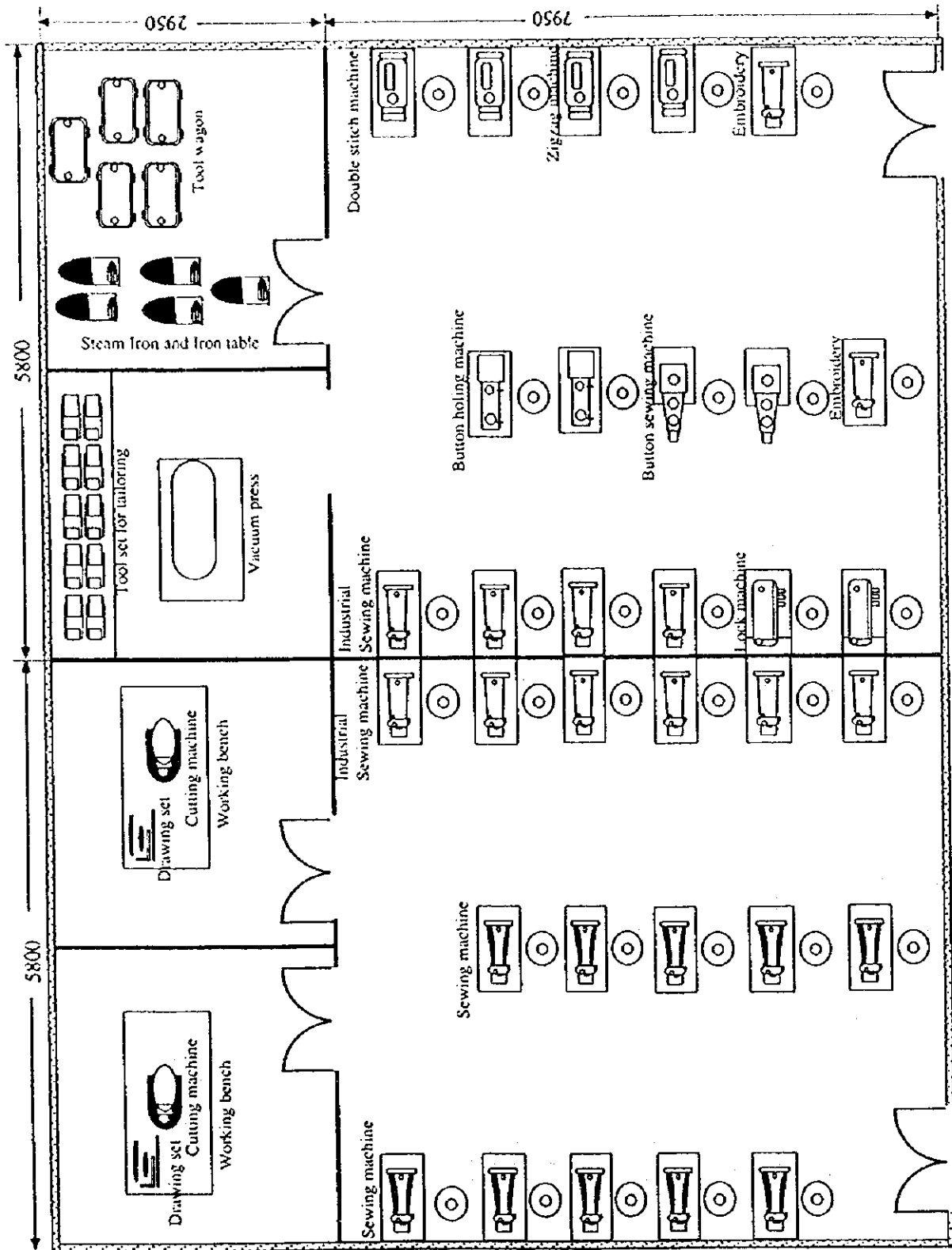

Model Layout for Sewing course

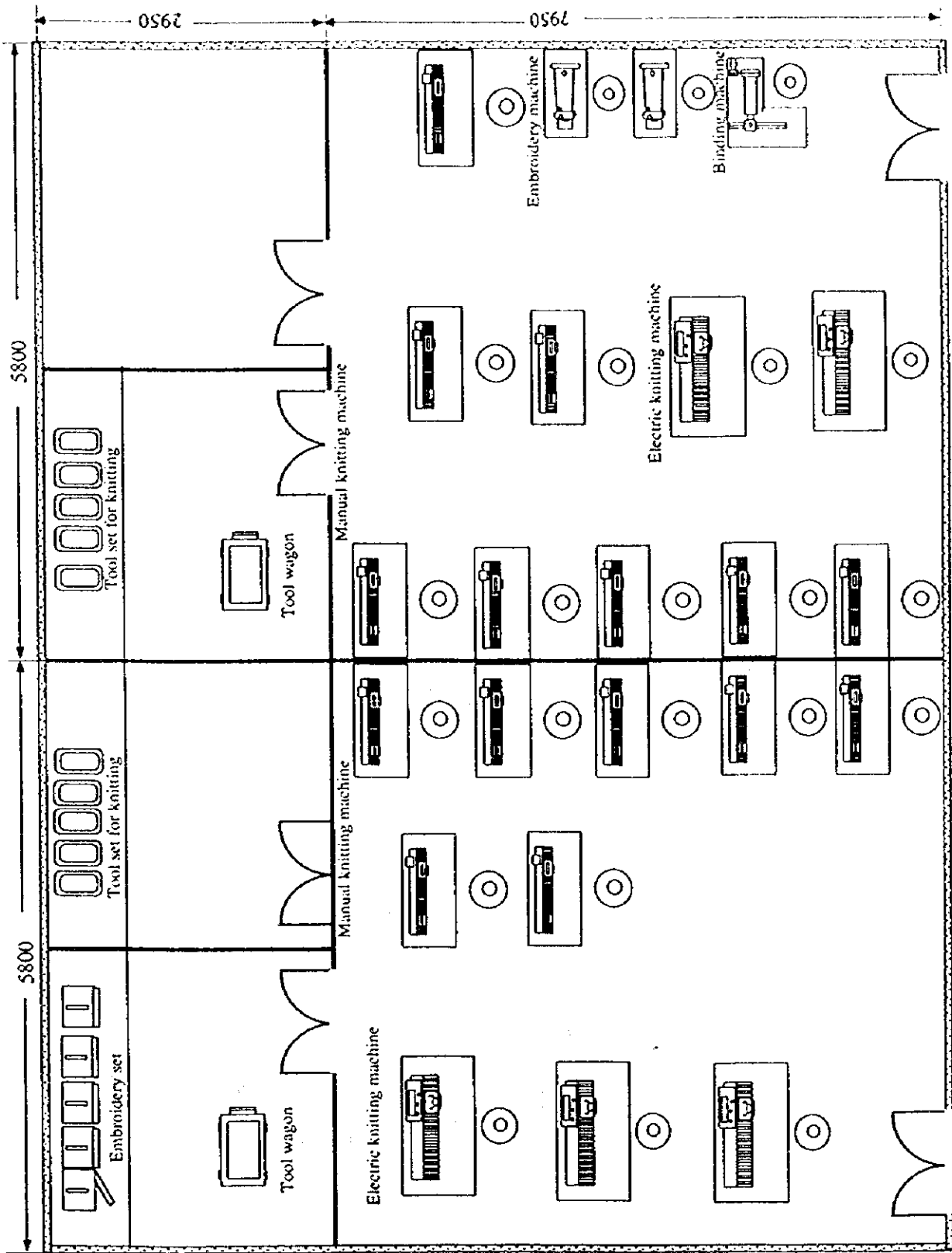

Model Layout for Knitting course

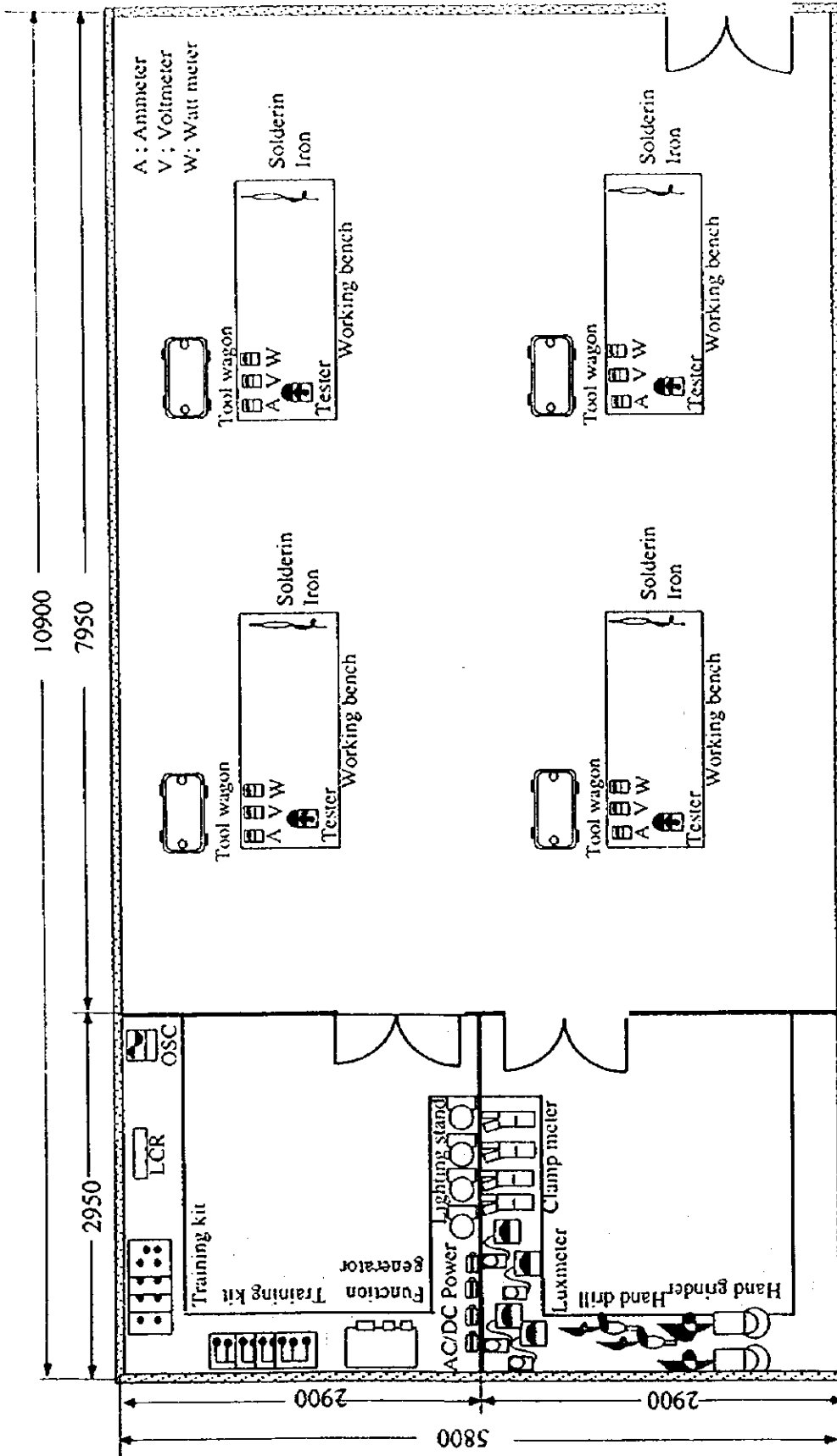

Model Layout for Electric Maintenance course



### **Annex-3 The Improvement Plan of Operation and Training System in the Vocational Rehabilitation Centre by MSAL**

The Vocational Rehabilitation Centre presently provides vocational rehabilitation and medical rehabilitation services to the physically disabled, the deaf and the mentally impaired. However, training toward the goal of "attainment of a stable vocation" as stipulated in governmental decree 54 is only being carried out in a very small part at the Centre. The Vocational Training Department of the facility in particular suffers from obsolescence and lack of training equipment / materials, as well as the need for more in-depth training of instructional staff and the formulation of set course curricula. To address this, the following plan to upgrade operations at the facility is proposed to be carried out in parallel with equipment supply. This plan, however, is premised on the full efforts by the Syrian side in improving the operational and training system at the Centre, including personnel deployment and budget allocation. The Japanese side will provide recommendations and "soft" aspect cooperation described below to render the operational and training structure at the Centre more effective.

The items indicated below represent the minimal required improvement by the Syrian side to enable the Centre to fulfill its originally intended functions with regard to vocational rehabilitation for the disabled.

#### **(1) Improvement of Evaluation System for Vocational Aptitude**

Vocational aptitude evaluation is designed to assess the vocational aptitude of the individual trainee on the basis of physical, mental and job skill capability. It comprises perhaps the single-most important task at the outset of formulating the vocational training program for the targeted student. The basis for such a vocational aptitude evaluation system was prepared in the 1970s under guidance by ILO. However, the basic guidelines set out have not been followed in practice. Accordingly, the work sampling method is to be introduced under the Project (whereby a component by component evaluation of work skills under each course is performed) as a basis for reorganizing, improving and systematizing the vocational aptitude testing procedure.

Specifically, the vocational aptitude testing and work sampling procedures used in Japan are to be introduced, with appropriate modification to the Syrian condition on the basis of in-depth discussions with the Syrian side, with the aim to enabling the executing agency to prepare and implement an evaluation system which is both optimally effective and responsive to local requirements.

(2) Formulation of Course Curricula

In the case of present courses taught at the Vocational Rehabilitation Centre, there are essentially no prescribed curricula. Proposed curricula prepared by the Study Team for the courses subject to equipment supply under the Project are as indicated in Table 1.5. This draft curricula is intended to serve as a reference for the Syrian side in preparing a practical course framework. It is recommended that formulation of course curricula be finalized prior to arrival of the equipment under the Project.

Also, with regard to capability development for the mentally impaired, the executing agency has expressed the desire that actual case studies from Japan be introduced as a basis for formulating a more comprehensive curriculum. Content of training and work skill practice in this regard in Japan based on actual case examples is as follows:

- a. Using roller type conveyor, trays, weighing scales, and devices subject to assembly and disassembly (toys, ball point pens, simple electronic components such as switches, etc., simple mechanical components such as nuts/bolts, washers, etc.), the following operational line works are performed in order to upgrade cooperation skills, punctuality, and patience/stamina:
  - Disassembly - assembly of electrical components, toys, pens, etc.
  - Separating, inspection, categorizing works
  - Boxing and packing works
  
- b. Simple fabrication works using simple weaving loom as a means of instilling self-confidence in the trainee.
  
- c. Floor cleaning, car washing works to upgrade cooperation skills, patience/stamina, etc.

On the basis of the above and the draft curriculum as set out in Table 1.5, it is envisioned that the executing agency will formulate the optimum curriculum suited to local conditions.

(3) Text Preparation

At present, there are no texts or other educational materials for use in vocational training at the Centre. Accordingly, it is necessary to examine the possibility of text and other material preparation centering on the initiative of the present instructional staff. In this regard, samples of texts can be obtained from vocational training agencies in Syria (other vocational training institutes, UNRWA, etc.) as well as from neighboring countries in the region and Japan as a basis for preparation of the optimum text material for the Centre educational objectives. It is recommended that this text preparation be done prior to equipment supply under the Project.

(4) Follow-up Training of Instructors

Examination will be made of a follow-up training program for instructors. Trainers in this regard would conceivably be personnel from other vocational training institutes, UNRWA and public-private enterprises with expertise in the designated course fields. It is recommended that MSAL be the prime entity in selecting the source of trainers for the envisioned follow-up training program for instructors.

(5) Vocational Adaptability Instruction

Vocational adaptability instruction aims to upgrade basic skills necessary in the productive worker, i.e. motivation, patience/stamina, punctuality, interactive skills, sense of responsibility, self confidence, etc. This is achieved through re-creation of an actual work environment. This approach is particularly effective for vocational training of individuals whose disability is the result of accident or illness later in life. Within the framework of capability development of the mentally impaired, this instructional method will serve to improve personality traits necessary in an effective worker, develop good work habits and instill in the trainee the sense of satisfaction which can be derived from productive work and the awareness of the fulfillment which results from performing as a functioning member of society.

MSAL will be the prime entity in executing the above mentioned vocational adaptability instruction. Implementation could be subcontracted out to the Vocational Rehabilitation Centre (sewing, word processing, knitting, wood working, motor repairing, simple device assembly, etc.) which would then effect the practical work environment necessary for the targeted training. At the same time, this implementation would cover a portion of Center operation and maintenance cost. The feasibility of such contracting of works is currently being studied by MSAL.

5'

JK

5

(6) Individual Training Instruction according to Individual Curriculum

The individual curriculum is targeted at acquirement of 1 skill unit, for example in the case of the sewing course the ability to perform at least one work component (i.e. straight seam sewing) would enable employment of the trainee. The more diverse the division of labor becomes per course content, the finer in scope a single unit of work operation becomes and this increases the variety of skill training range within a single course, as well as the eventual potential for employment. Study on training approach would not only consider (i) vocational training for the individual which would not be limited to a single course content, but rather would be flexible enough to span multiple course boundaries where appropriate, but also (ii) a module approach where one skill unit per category of work task is acquired.

One example would be the case where the student might receive both tailoring and PC training in order to become vocationally independent. Where physically stamina is lacking, the said student might further pursue sports therapy in order to reinforce vocational rehabilitation. Examination would thus be given to this type of cross-disciplinary training in order to best prepare the student for eventual employment.

(7) Work Placement

Work placement would actively be carried out on behalf of the training course graduate. At present, this is not being effectively done. Such work placement would entail establishing employment agreements at the earliest possible with interested employers as a basis for practical OJT training of the graduate in the actual work place. On the part of MASL, this activity would entail labor market survey, as well as guidance and follow-up support to the graduate trainee in the work place (including the case of self employment).

Since the ultimate objective of training at the Centre is to render the disabled individual socially independent, work placement is an extremely important component within the scope of Centre activities. In this regard, it is recommended that MSAL formulate a draft work placement plan and present the same to the Japanese side

## Annex-4 Japan's Grant Aid Programme

### 1. Grant Aid Procedures

1) Japan's Grant Aid Program is executed through the following procedures.

Application	(Request made by a recipient country)
Study	(Basic Design Study conducted by JICA)
Appraisal & Approval	(Appraisal by the Government of Japan and Approval by Cabinet)
Determination of Implementation	(The Exchange of Note between the Government of Japan and the recipient country)

2) Firstly, the application or request for a Grant Aid Project submitted by a recipient country is examined by the Government of Japan (the Ministry of Foreign Affairs) to determine whether or not it is eligible for Grant Aid. If the request is deemed appropriate, the Government of Japan assigns JICA (Japan International Cooperation Agency) to conduct a study on the request.

Secondly, JICA conducts the study (Basic Design Study), using (a) Japanese consulting firm(s).

Thirdly, the Government of Japan appraises the project to see whether or not it is suitable for Japan's Grant Aid Program, based on the Basic Design Study report prepared by JICA, and the results are then submitted to the Cabinet for approval.

Fourthly, the Project, once approved by the Cabinet, becomes official with the Exchange of Notes signed by the governments of Japan and the recipient country.

Finally, for the implementation of the Project, JICA assists the recipient country in such matters as preparing tenders, contract and so on.

## 2. Basic Design Study

### 1) Contents of the Study

The aim of the Basic Design Study (hereinafter referred to as "the Study"), conducted by JICA on a requested project (hereinafter referred to as "the Project") is to provide a basic document necessary for the appraisal of the Project by the Japanese Government. The contents of the Study are as follows:

- a) Confirmation of the background, objectives, and benefits of the requested Project and also institutional capacity of agencies concerned of the recipient country necessary for the Project's implementation.
- b) Evaluation of the appropriateness of the Project to be implemented under the Grant Aid Scheme from a technical, social and economic point of view.
- c) Confirmation of items agreed on by both parties concerning the basic concept of the Project.
- d) Preparation of a Basic Design of the Project
- e) Cost Estimation of the Project

The contents of the original request are not necessarily approved in their initial form as the contents of the Grant Aid Project. The Basic Design of the Project is confirmed considering the guidelines of Japan's Grant Aid Scheme.

The Government of Japan requests the government of the recipient country to take whatever measures are necessary to ensure its self-reliance in the implementation of the Project. Such measures must be guaranteed even though the recipient country actually implements the Project. Therefore, the implementation of the Project is to be confirmed by all relevant organizations of the recipient country through the Minutes of Discussions.

### 2) Selection of Consultants

For smooth implementation of the Study, JICA uses (a) registered consultant firm(s). JICA selects (a) firm(s) based on proposals submitted by interested firms. The firm(s) selected carry(ies) out a Basic Design Study and write(s) a report, based upon terms of reference set by JICA.

The consulting firm(s) used for the Study is (are) recommended by JICA to the recipient country to also work on the Project's implementation after the Exchange of Notes, in order to maintain technical consistency and also to avoid any undue delay in implementation should the selection process be repeated.

### 3. Japan's Grant Aid Scheme

#### 1) Grant Aid

The Grant Aid Program provides a recipient country with non-reimbursable funds to procure the facilities, equipment and services (engineering services and transportation of the products, etc.) for economic and social development of the country under principles in accordance with the relevant laws and regulations of Japan. Grant Aid is not supplied through the donation of materials as such.

#### 2) Exchange of Notes (E/N)

Japan's Grant Aid is extended in accordance with the Exchange of Notes by the two Governments concerned, in which the objectives of the Project, period of execution, conditions and amount of the Grant Aid, etc., are confirmed.

#### 3) Period

"The period of the Grant Aid" means the one fiscal year for which the Cabinet approves the Project. Within that fiscal year, all procedures such as Exchange of Notes, concluding contracts with (a) consultant firm(s) and (a) contractor(s) and final payment to them must be completed. However in case of delays in delivery, installation or construction due to unforeseen factors such as weather, the period of the Grant Aid can be further extended for a maximum of one fiscal year at most by mutual agreement between the two governments.

#### 4) Purchase of the Products and or Services

Under the Grant Aid, in principle, Japanese products and services including transport or those of the recipient country are to be procured.

When the two Governments deem it necessary, the Grant Aid may be used for the procured of the products or services of a third country.

However the prime contractors, namely, consulting, construction and procurement firms, are limited to "Japanese nationals". (The term "Japanese nationals" means persons of Japanese nationality or Japanese corporations controlled by persons of Japanese nationality.)

5) Necessity of "Verification"

The Government of the recipient country or its designated authority will conclude contracts denominated in Japanese yen with Japanese nationals. Those contracts shall be verified by the Government of Japan. This "verification" is deemed necessary to secure accountability to Japanese taxpayers.

6) Undertakings required of the Government of the Recipient Country

(As described in Annex-5)

7) Proper Use

The recipient country is required to maintain and use the facilities constructed and equipment purchased under the Grant Aid properly and effectively and to assign staff necessary for this operation and maintenance as well as to bear all the expenses other than covered by the Grant Aid.

8) Re-export

The products purchased under the Grant Aid should not be re-exported from the recipient country.

9) Banking Arrangement (B/A)

- a) The Government of the recipient country or its designated authority should open an account in the name of the Government of the recipient country in an authorized foreign exchange bank in Japan (hereinafter referred to as "the Bank"). The Government of Japan will execute the Grant Aid by making payments in Japanese yen to cover the obligations incurred by the Government of the recipient country to its designated authority under the Verified Contracts.



- b) The payments will be made when payment requests are presented by the Bank to the Government of Japan under an authorization to pay issued by the Government of the recipient country or its designated authority.

#### 4. Grant Aid Procedure

The contents of Japan's Grant Aid Procedures are as follows:

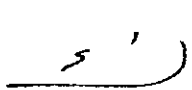

### Flow Chart of Japan's Grant Aid Procedures

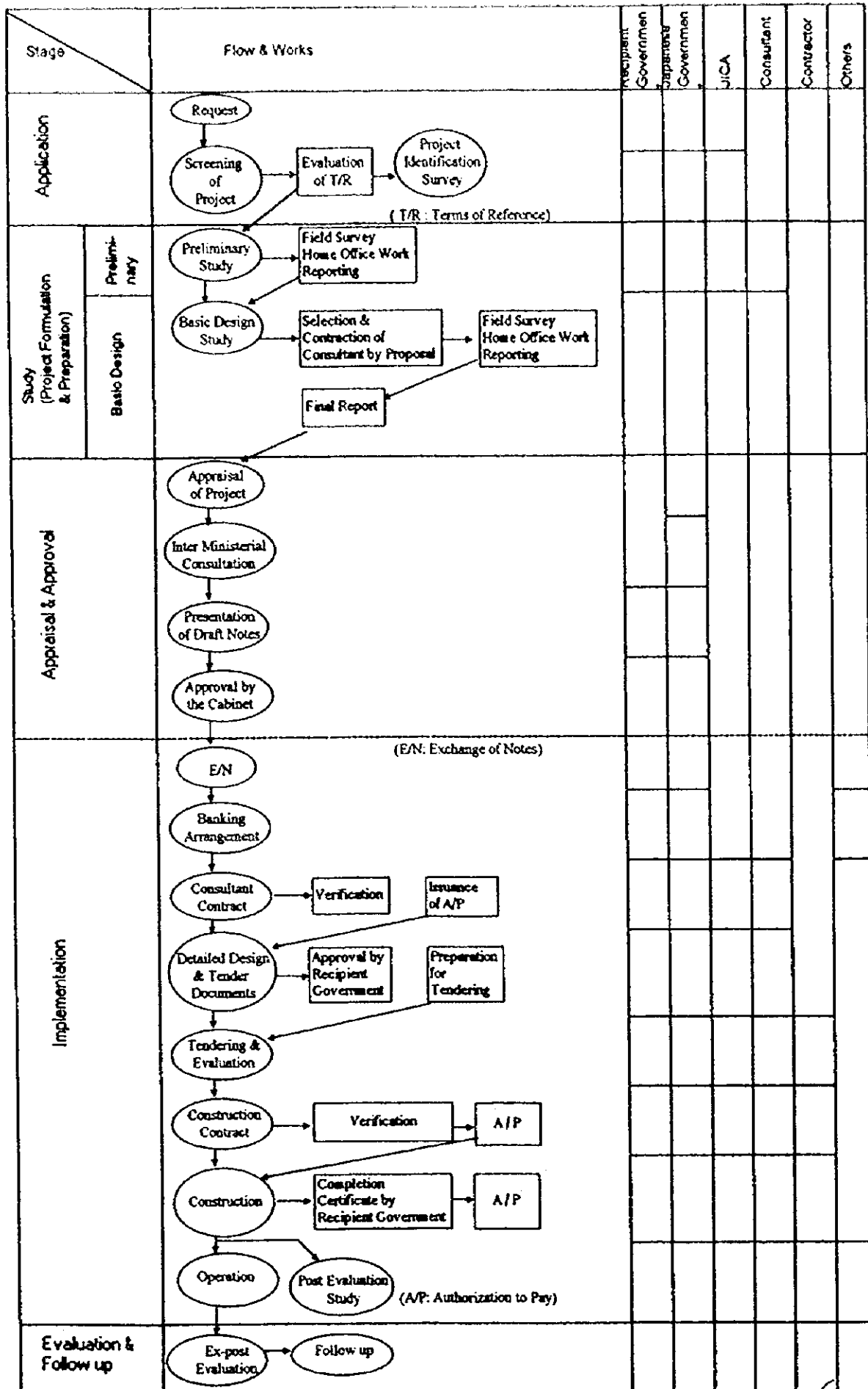

## Major Undertaking to be taken by Each Government

No.	Items	To be covered by Grant Aid	To be covered by Recipient Side
1	To secure land		●
2	To clear, level and reclaim the site when needed		●
3	To construct gates and fences in and around the site		●
4	To construct the parking lot	N.A.	
5	To construct roads		
	1) Within the site	N.A.	
	2) outside the site		●
6	To construct the buildings	N.A.	
7	To provide facilities for the distribution of electricity, water supply, drainage and other incidental facilities		
	1) Electricity		
	a. The distributing into the site		●
	b. The drop wiring and internal wiring within the site	N.A.	
	c. The main circuit breaker and transformer	N.A.	
	2) Water Supply		
	a. The city water distribution main to the site		●
	b. The supply system within the site (receiving and elevated tanks)	N.A.	
	3) Drainage		
	a. The city drainage main ( for storm, sewer and others) to the site		●
	b. The drainage system (for toilet sewer, ordinary waste, storm drainage and others)	N.A.	
	4) Gas supply		
	a. The city gas main to the site		●
	b. The gas supply system within the site	N.A.	
	5) Telephone System		
	a. The telephone trunk line to the main distribution frame/panel (MDF) of the building		●
	b. The MDF and the extension after the frame/panel	N.A.	
	6) Furniture and Equipment		
	a. General furniture		●
	b. Project equipment	●	
8	To bear the following commissions to the Japanese foreign exchange bank for the banking services based upon the B/A		
	1) Advising commission of A/P		●
	2) Payment commission		●
9	To ensure unloading and custom clearance at port of disembarkation in recipient country		
	1) Marine (Air) transportation of the products from Japan to recipient country	●	
	2) Tax exemption and custom clearance of the products at the port of disembarkation		●
	3) Internal transportation from the port of disembarkation to the project site	●	
10	To accord Japanese nationals whose services may be required in connection with supply of the products and the services under the verified contract such facilities as may be necessary for their entry into the recipient country and stay therein for the performance of their work.		●
11	To exempt Japanese nationals from customs duties, internal taxes and other fiscal levies which may be imposed in the recipient country with respect to the supply of the products and services under the verified contracts		●
12	To maintain and use properly and effectively the facilities installed and equipment provided under the Grant		●
13	To bear all the expense, other than those to be borne by the Grant, necessary for construction of the facilities as well as for the transportation and installation of the equipment		●

N.A. : not applicable

## Annex-5 Necessary Measures to be taken by the MASL

Following necessary measures should be taken by the MASL on condition that the Grant Aid by the Government of Japan is extended to the Project:

1. To provide data and information necessary for the Project.
2. To complete the relocation of the existing equipment, facilities and civil works required prior to the installation of the equipment, if necessary.
3. To provide facilities for distribution of electricity, water supply, telephone, drainage, sewage and other incidental items required for the Project.
4. To provide the relevant financial support and staff members for the proper and effective operation and maintenance of equipment provided under the Grant Aid.
5. To bear commissions to the Japanese foreign exchange bank for its banking services based upon the Banking Arrangement, namely the advising commission of the "Authorization to Pay" and payment commission.
6. To ensure prompt unloading, tax exemption, customs clearance at the port of disembarkation and prompt internal transportation therein of the materials and equipment for the Project purchased under the Grant Aid.
7. To exempt Japanese juridical and physical nationals engaged in the Project from customs duties, internal taxes and other fiscal levies which may be imposed in Syria with respect to the supply of the products and services under the verified contracts.
8. To accord Japanese nationals whose services may be required in connection with the supply of the products and the services under the verified contract such facilities as may be necessary for their entry into Syria and stay therein for the performance of their work in accordance with the relevant laws and regulations of the Syrian Arab Republic.
9. To provide necessary permissions, licenses and other authorizations for implementing the Project, if necessary.
10. To maintain and use properly and effectively the facilities constructed and the equipment provided under the Project in responsibility of the MASL.
11. To bear all the expenses, other than those to be borne by the Japan's Grant Aid within the scope of the Project.

5. Project cost to be borne by the Syrian Arab Government

No.	Name of facility	Estimated cost (Syrian Pounds)	Content
1	Vocational Rehabilitation Center	470,000	Installing of power line and removal equipment
2	School for the Blind in Damascus	300,000	Installing drainage for cooking class and power line
3	School for the Deaf in Damascus	100,000	Installing wooden floor for music class
4	Al-Amal School for the Physically Disabled	300,000	Removal hot tab and installing PT equipment
Total		1,170,000	



## 6. List of Equipment for the Project

## Equipment List

### A. Vocational Rehabilitation Center in Damascus

Item No.	Name of Equipment	Specification	Qty. Unit
<i>a. 1</i>	<i>Business course</i>	-	-
a.1.1	Personal computer with word processing software	-	22 sets
a.1.1.1	Personal computer main set	Desk top type, Pentium 200 MHz	22
a.1.1.2	MS Office Arabic	Windows 95 Arabic, MS Office 97	22
a.1.1.3	Laser printer	A4 Size, 600dpi x 600dpi	2
a.1.1.4	Dot-matrix printer	Dot-matrix type, A3 Size	2
a.1.1.5	Stabilizer	for the Computer	22
a.1.1.6	UPS	for the Computer	22
a.1.1.7	LAN cable etc.	LAN, LAN Cable, Printer cable, etc.	1 set
a.1.1.8	Desk for computer	for the computer	22
<i>a. 2</i>	<i>Wood working course</i>	-	-
a.2.1	Band saw	Max Cutting Height 300 mm, Blade Dimensions 75 x 2,800 x 0.65 mm	1 set
a.2.2	Wood working bench with vise	Dimensions W1800xD900xH750, with vice	4
a.2.3	Circular saw	Blade diameter 400mm, Table size 650x800mm	1
a.2.4	Planner	Cutting width 400mm	1
a.2.5	Bench drilling machine	Max. drilling diameter 20mm with stand	2
a.2.6	Pedestal grinder	Grinder outer diameter 255xthickness 25mm, two grinder type	2
a.2.7	Wood working press	Table size 1000x2000mm, stroke 900mm, max. pressure 20ton	1
a.2.8	Router	Max. thickness 170mm, Table size 900x600mm	1
a.2.9	Electric hand drill	Drilling diameter 13mm portable type	2
a.2.10	Electric hand grinder	Grinder diameter 100x15mm portable type	2
a.2.11	Electric sander	Abrasive paper size 90x230mm portable type	2
a.2.12	Electric hand planner	Cutting width 110mm portable type	2
a.2.13	Electric hand circular saw	Blade diameter 260mm portable type	2
a.2.14	Electric jig saw	Max. cutting width 65mm portable type	2
a.2.15	Air compressor	Motor output 0.2kW, Air delivery 25 liter/min Pressure 5kg/cm <sup>2</sup>	2
a.2.16	Dust collector	Air volume 38m <sup>3</sup> /min, Motor output 2.2kW with filter movable type	1
a.2.17	Spray gun	Nozzle diameter 1.5mm Vacuum type with paint cup 600ml	1
a.2.18	Tool wagon	3 trays, Dimensions W660xD340xH800mm with caster	4
a.2.19	Wood working hand tool set	Saw, Planner, Drill, Wood hammer. Curved ruler set with wooden box	10
a.2.20	Chisel	Square chisel size 5~22mm Table size W550xD200mm	1
a.2.21	Lathe	Max. length for materials 1000mm, Max swing width 400mm, Main axle revolution 450~	1
<i>a. 3</i>	<i>Sewing course</i>	-	-
a.3.1	Sewing machine	Electric type for home use 5 units, Foot operating type 5 units	10
a.3.2	Industrial sewing machine	Max sewing speed 4500spm, for medium and thick fabric with table, chair and stand	10
a.3.3	Vacuum press	Dimensions 1200x650mm Motor output 400W Universal type	1
a.3.4	Electric cutting machine	Max. cutting capacity 110mm	2



### Equipment List

Item No.	Name of Equipment	Specification	Qty.	Unit
a.3.5	Steam iron and iron table	Iron 1000W Iron table dimensions 1,150x350mm with three stage, with supporting	4	
a.3.6	Drawing set	Rulers 3 kinds, Curved ruler, Square ruler, glass measure, Compass for tailoring, French ruler	2	
a.3.7	Working bench	Table for cutting work, Dimensions 1800x900xH780mm	2	
a.3.8	Tool wagon	4 trays, Dimensions 660x340xH900mm with caster	4	
a.3.9	Tool set for tailoring	Tools 32 kinds including wooden case	25	
a.3.10	Lock machine	Max sewing speed 6000spm Needle width 0.8 ~ 4.0mm Lock width 1.6 ~ 4.8mm with table, chair and stand	2	
a.3.11	Button holing machine	Max sewing speed 3600spm Max thickness 12mm Needle number 54 ~ 345 with table, chair	2	
a.3.12	Button sewing machine	Max. sewing speed 1,500RPM Button size 10 ~ 28mm with table, chair and stand	2	
a.3.13	Embroidery	Max sewing speed 2,000RPM Zigzag width 0 ~ 12mm with table, chair and stand	2	
a.3.14	Double stitch machine	Max sewing speed 3,000RPM Sewing length 5mm/reverse 5mm (Max.) with table, chair and stand	2	
a.3.15	Zigzag machine	Max sewing speed 5,000RPM, Zigzag width Max.8mm, with table, chair and stand	2	
<b>a. 4</b>	<b>Knitting course</b>	-	-	
a.4.1	Knitting machine (electric)	Electric, Needle pitch 4.5mm with 200 needles	5	
a.4.2	Tool wagon	3 trays, Dimensions 600x480xH880mm with caster	2	
a.4.3	Tool set for knitting	Needle bar set 16 kinds, Crochet set 16 kinds, Needle bar caps	12	
a.4.4	Manual knitting machine	Needle pitch 4.5mm with 200 needles and punch cards	15	
a.4.5	Binding machine	for color and sleeve binding with table and motor	1	
a.4.6	Embroidery machine	Max sewing speed 2,000RPM, Zigzag width 0 ~ 12mm with table, chair and stand	2	
a.4.7	Embroidery set	Needle bar sets, Crochet needle sets, Embroidery samples	11	
<b>a. 5</b>	<b>Electric maintenance course</b>	-	-	
a.5.1	Voltmeter	1 set consist of DC / AC	4	
a.5.2	Ammeter	1 set consist of DC / AC	4	
a.5.3	LCR meter	Measuring items : Inductance, capacitance, resistance and etc.	1	
a.5.4	Oscilloscope	40MHz, Vertical axes sensitivity 5mV/div ~ 5V/div	1	
a.5.5	Circuit tester	DC voltage 0.3 ~ 1,200V, DC current 0.012 ~ 1,200mA, AC voltage 3 ~ 1200, Resistance 2 ~ 20,000k $\Omega$	4	
a.5.6	Electric circuit training kit	1 set consist of electric circuit study kit and electronic circuit study kit	4	
a.5.7	Function generator	Frequency 0.01Hz ~ 10MHz	1	
a.5.8	AC/DC power supply	Output voltage 0 ~ $\pm$ 10V, Max output current 3mA, Max input voltage 250V	4	
a.5.9	Watt meter	5A, Accuracy $\pm$ 0.5%	4	
a.5.10	Clamp meter	1 set consists of 2 kinds (20 ~ 600V, 2 ~ 200A, 2 ~ 200kW and 20 ~ 600V, 0.2 ~ 20A, 0.2 ~	4	
a.5.11	Lux meter	Measurement range 0 ~ 3000lx, 3 steps range	4	

### Equipment List

Item No.	Name of Equipment	Specification	Qty. Unit
a.5.12	Lighting stand	Florence lump, desktop type	4
a.5.13	Electric hand drill	for electrical works with stand	2
a.5.14	Electric hand grinder	Grinder diameter 100mm portable type	2
a.5.15	Tool wagon	Dimensions 660x340xH800mm, 3 trays with caster	4
a.5.16	Working bench	for electric works, Dimensions W1800xD900xH900mm	4
a.5.17	Soldering iron	100W with stand	4
a.5.18	Electric motor repair set	Motor wiring machine (manual type and electric type 1 each) with tools and tool box	1 set
<b>a. 6</b>	<b>Capability Development for the Mentally Impaired course</b>		-
a. 6.1	Roller conveyer with stand	Aluminum roller conveyer, W400 x L200mm 1 set consist of 2 units with stand	5 set
a. 6.2	Various type of weigh	Upper tray type 1kg, 4kg 1 each, Upper tray with beam type 1kg 1 unit	2 set
a. 6.3	Trays	Dimensions 300x200x100mm, plastics	50
a. 6.4	Assemble & disassemble kit	Peg boards and pegs	1 set
a. 6.5	Tool set	Combination tool sets	10 set
a. 6.6	Hand weaving machine	Small size weaving machine	1 set
a. 6.7	Vocational evaluation tools	8 kinds	1 set
a. 6.8	Musical instrument		
a. 6.8.1	- Keyboard	60keys 120 melody	1
a. 6.8.2	- Drum (Small size)	φ 35x14 cm with stand and sticks	4
a. 6.8.3	- Drum (large size)	φ 60x35 cm with stand and sticks	1
a. 6.8.4	- Cymbals	φ 21cm	2
a. 6.8.5	- Hand castanets	Wooden type	10
a. 6.8.6	- Triangle	21cm with sticks	2
<b>a. 7</b>	<b>Wheel chairs</b>		-
a.7.1	Wheel chairs	for adult, folding type	20
a.7.2	Electric wheel chairs	for adult with lever control	10
<b>a. 8</b>	Copy machine	Paper size A5 ~ A3, 50% ~ 200% with sorter	1
<b>a. 9</b>	Transportation busses (large)	Passenger capacity 50	
<b>a. 10</b>	<b>Sports instruments</b>		-
a.10.1	Trampoline	Dimensions W450xD280xH100 folding type	1
a.10.2	Vaulting horse	Wooden 7 steps with step-up board and mattress	1 sets
a.10.3	Mat for wrestling	Floor mattress, 90x90cm, 30 sheets	1
a.10.4	Balance beam	Wooden, 10cm x10cm x 300cm, Height 30cm	1 set
a.10.5	Ping-Pong set	for disabled persons with rackets, balls and fence	2 sets
a.10.6	Balance Block	Walking Balance board and rocking stand 1 set 1 each	2 sets
a.10.7	Wheel chairs for basket ball	for basket ball	10
a.10.8	Wheel chairs for athletics	for slalom	10
a.10.9	Muscular strength training instruments	Multipurpose type (at least for kinds)	1 set
a.10.10	Medical ball	700g, 1000g, 2000g, 3000g 1 set 1 each	10
a.10.11	Basket ball instrument	Goals and balls	1 set

## Equipment List

### B. School for the Blind in Damascus

Item No.	Name of Equipment	Specification	Qty.	Unit
b.1	Printing machine for Braille	—	—	—
b.1.1	Braille printer	Both sides printing, 600 papers/h, dot drawing size 1.25mm	1	
b.1.2	Personal computer main set	Desk top type, Pentium 200MHz	2	
b.1.3	Software for Braille	Braille software (English and Arabic)	2	
b.1.4	Laser printer	A4 size, 600dpi x 600dpi	1	
b.1.5	Stabilizer	for the computer	2	
b.1.6	UPS	for the computer	2	
b.1.7	Desk for computer	for the computer	2	
b.2	Tape recorder with headphone	Plain type cassette tape recorder	100	
b.3	Braille typewriter	—	—	—
b.3.1	Braille typewriter (manual)	Max paper width 300mm, Max. characters per 1 line 44, dot drawing size 2.5mm	90	
b.3.2	Braille typewriter (electric)	with memory	10	
b.4	Music instruments	—	—	—
b.4.1	Accordion	32 keys with hard case	5	
b.4.2	Tambourine	∅ 21cm	2	
b.4.3	Keyboard	60 keys, 120 melody	3	
b.4.4	Drum (Small size)	Diameter 35x14 cm with stand and sticks	2	
b.4.5	Drum (large size)	Diameter 60x35 with stand and sticks	1	
b.4.6	Cymbals	Diameter 21cm	1	
b.4.7	Hand castanets	Wooden	5	
b.4.8	Triangle	21cm with sticks	1	
b.5	Audio library set	x 16 speeds, 1 master and 3 tapes	1 set	
b.6	Homemaking instruments	—	—	—
b.6.1	Electric heater	Electrical heater 1kw	4	
b.6.2	Meat mincer	100 ~ 150 kg/hour	1	
b.6.3	Electric juicer mixer	Juicer and mixer	1	
b.6.4	Refrigerator	2 doors, 450 liter	2	
b.6.5	Pressure cooker	14 liter	4	
b.6.6	Washing machine	2 tab type, Max washing capacity 5kg	2	
b.7	Transportation busses	Max. passenger capacity 50		
b.8	Braille board	A4size, 30cells x 27 lines	200	
b.9	Sports instrument	—	—	—
b.9.1	Goal ball set	—	—	—
b.9.1.1	- Goal	for Goal ball	10	
b.9.1.2	- Goal ball	Goal	2	
b.9.1.3	- Eye-mask	for Goal ball	10	
b.9.2	Chess (for the blind)	for Blind	10 lot	
b.9.3	Ping-Pong set for the Blind	for Blind with racket, ball, and fence	4 sets	
b.10	Education kit for the blind	—	—	—
b.10.1	Model of human body	Actual size, 15 divided human body	1	
b.10.2	Model of human skeleton	Actual size, plastics with stand	1	
b.10.3	Eye model	x 5 size, 6 divided type	1	
b.10.4	Ear model	x 3 size, 4 divided type with stand	1	
b.10.5	Geometric tools	3D model	1	
b.10.6	Toys of different animals	Animal models	1	
b.10.7	Toys of different transportation means	Vehicle models	1	
b.10.8	Measures units	Clock model and weight	1	

## Equipment List

### C. School for the Deaf in Damascus

Item No.	Name of Equipment	Specification	Qty. Unit
c.1	Hearing measuring and training instrument	—	—
c.1.1	Language laboratory	for teacher and 10 students	4 sets
c.1.2	Audiometer	Frequency 500,1000, 2000, 4000 Hz	2 sets
c.1.3	Impedance meter	0.2~9.99ml	2 sets
c.1.4	Hearing apparatus	with step less volume control	20
c.2	Musical instrument for rhythm education	—	—
c.2.1	Keyboard	60 keys, 120 melody	2
c.2.2	Drum (small size)	Diameter 35x14 cm with stand and sticks	4
c.2.3	Drum (large size)	Diameter 60x35 cm with stand and sticks	4
c.3	Education kit for deaf	—	—
c.3.1	Model of human body	Actual size, 15 divided type	1
c.3.2	Ear model	x 3 size, 4 divided type with stand	1
c.4	Sports instrument	—	—
c.4.1	Trampoline	W450xD280xH100cm, folding type	1
c.4.2	Vaulting horse	Wooden, 7 steps with step-up board and mattress	1 sets
c.4.3	Mat for wrestling	Floor mattress 90x90x30 sheets	1
c.4.4	Bar for high jump	stand 2 units, height 2.1m with pit for high-jump	1
c.4.5	Balance beam	Wooden, 10cmx10cmx 300cm, height 30cm	1 set
c.4.6	Ping-Pong set	for disabled persons with racket, ball and fence	2 sets
c.4.7	Balance Block	Walking Balance board and rocking stand 1 set 1 each	2 sets
c.5	Studio equipment for video editing	Video camera, Video recorder and TV (PAL)	1 set
c.6	Transportation busses	Max passenger capacity 50	

Equipment List

D. Al-Amal School for the Physically Disabled

Item No.	Name of Equipment	Specification	Qty. Unit
d.1	Wheel chairs	--	--
d.1.1	Wheel chairs (small size)	for children, folding type	15
d.1.2	Wheel chairs (standard size)	for adult, folding type	35
d.2	Mobile wheel chairs	for adult with lever control	5
d.3	Physical therapy instrument	--	--
d.3.1	Shortwave therapy apparatus	Shortwave, Pulse 400W (Max.1000W) , Generator frequency 27.12MHz±0.6%	1 set
d.3.2	Frequency stimulator	-	-
d.3.2.1	EMG feedback therapy	2 channel, 18 current patterns	1 set
d.3.2.2	Interferential therapy	Frequency 2, 2.5, 4, 6, 10kHz, 0~100mA	1 set
d.3.3	Laser unit	Max voltage 400mA, Battery 12V	1 set
d.3.4	Infrared ultraviolet lamp	Infrared lamp and ultraviolet lamp	2 sets
d.3.5	Goniometer kit	for elbow, knee, finger	2 sets
d.3.6	Hydrotherapy set	-	-
d.3.6.1	Whirlpool bath for full body	Dimensions W85xL200xH80cm	1 set
d.3.6.2	Whirlpool bath for arms	Dimensions 75x50xH80cm	1 set
d.3.6.3	Whirlpool bath for legs	Dimensions 75x50xH50cm	1 set
d.3.6.4	Ultrasound therapy	Ultrasound frequency 1 & 3 MHz, Dimensions 290x280x100cm	1 set
d.3.6.5	Pack heater and hot pack	Tank capacity 60liter, Output 1,100W with hot packs	1 set
d.3.7	Rotary exerciser	-	-
d.3.7.1	Ergometer	Load 50-250W	1 set
d.3.7.2	Pedal apparatus	Dimensions W50xD40xH35cm	2 sets
d.3.8	Overhead suspension exerciser	-	-
d.3.8.1	Quadriceps bench	Dimensions W60xD125xH70cm	1 set
d.3.8.2	Universal traction unit	at least for kinds traction units	1 set
d.3.9	Tilting table	-	-
d.3.9.1	Tilt table	Standup degree 0~90°.Size W70xL200cm	1 set
d.3.9.2	Treatment table	Dimensions W70xL200cm, H80cm	2 sets
d.4	Transportation busses	Max. passenger capacity 50	
d.5	Educational kit for physically disabled	--	--
d.5.1	Model of human skeleton	Actual size, plastics, with stand	1
d.5.2	Microscope	x 40~600	2
d.5.3	Model of human body	Actual size, 15 divided type	1
d.5.4	Eye model	x 6, 6 divided type	1
d.5.5	Spine model	Movable spine model with stand	1
d.5.6	Heart model	x 2 size, 4 divided type with stand	1
d.5.7	Ear model	x 3 size, 4 divided type with stand	1
d.5.8	Brain model	Actual size, 6 divided type	1
d.6	TV and video camera set	Video camera, Video recorder and TV (PAL)	1
d.7	Music instruments	--	--
d.7.1	Accordion	32 keys with hard case	3
d.7.2	Keyboard	60 keys 120 melody	2
d.7.3	Others	-	-
d.7.3.1	Hand castanets	Wooden	6
d.7.3.2	Triangle	21cm with sticks	2

## Equipment List

Item No.	Name of Equipment	Specification	Qty. Unit
d.7.3.3	Cymbals	Diameter 21cm	2
d.7.3.4	Drum (small size)	Diameter 35x14 cm with stand and sticks	4
d.7.3.5	Drum (large size)	Diameter 60x35 cm with stand and sticks	1
d.8	Sports instruments	-	-
d.8.1	Wheel chairs for basket ball	for basket ball	10
d.8.2	Wheel chairs for athletics	for slalom	10
d.8.3	Muscular strength training instruments	Multipurpose type (at least for kinds)	1 set
d.8.4	Ping-Pong set	for disabled persons with rackets, balls and fence	2 sets
d.8.5	Medical ball	700g, 1000g, 2000g, 3000g 1 set 1 each	10 sets
d.8.6	Mat for wrestling	Floor mattress 90x90x30 sheets	1 set
d.8.7	Basket ball instrument	Goals and balls	1 set

## 7. References

No.	Title of document	Year published
1	Statistical Abstract 1997	1997
2	Statistical Abstract 1996	1996
3	The Annual Statistical Bulletin of the Ministry of Social Affairs & Labour 1995	1995
4	The Annual Statistical Bulletin of the Ministry of Social Affairs & Labour 1994	1994
5	The Oxford Business Guide 1995-6, Syrian Arab Republic	1995
6	Project Document SYR/95/004 Pilot 'Community Based Rehabilitation' Programme (CBR)	1997
7	Community Based Rehabilitation Project Syr/95/004, Damascus, Syria	1997
8	The Projected Yearly Plan of the Ministry of Labor and Social Affairs - Year 1998 (English translated from Arabic)	1997
9	Legislative Decree N.54, Pertaining to the Formation of Vocational Rehabilitation Centers for Disabled (English translated from Arabic)	
10	The Internal Statute for the Typical Establishment for Rehabilitation of the Blind (English translated from Arabic)	
11	The Internal Statute of the Vocational Rehabilitation Center for the Disabled in Damascus (English translated from Arabic)	
12	Leaflet on Vocational Rehabilitation Center ( in Arabic )	
13	Application Form on Vocational Rehabilitation Center ( in Arabic )	











JICA