

**EXT. SITE**

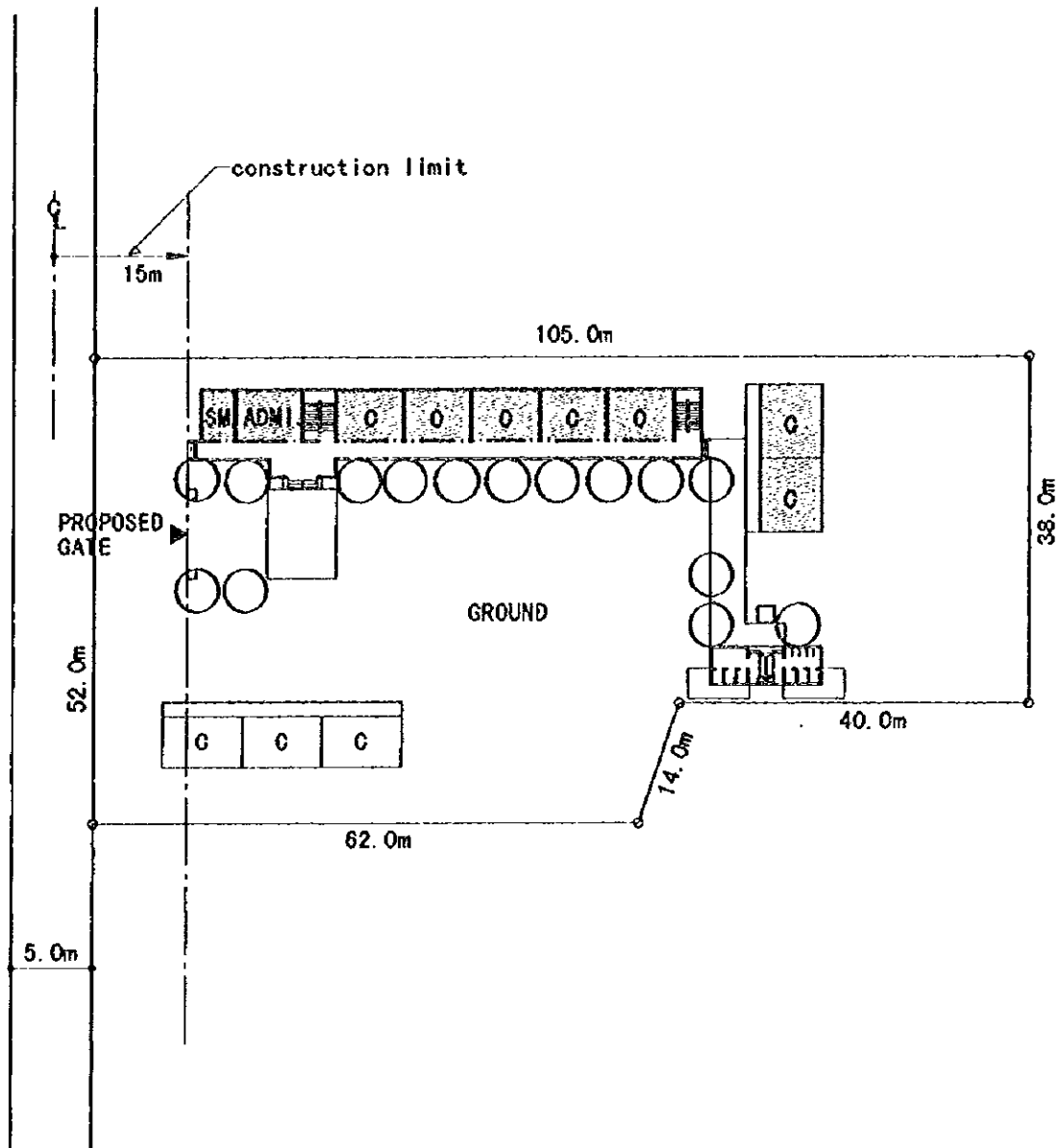

SCALE=1:800



<b>BT1</b>	<b>TAN HA 1</b> PROVINCE : BINH THUAN DISTRICT : DUC LINH COMMUNE : TRA TAN	BLOG. TYPE : 11A TOILET TYPE : A CLASS ROOM : 11CR+(2CR)	FOUNDATION : A FL. : GL+0.7m
------------	--	--	---------------------------------

**NEW SITE**

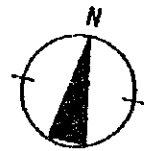
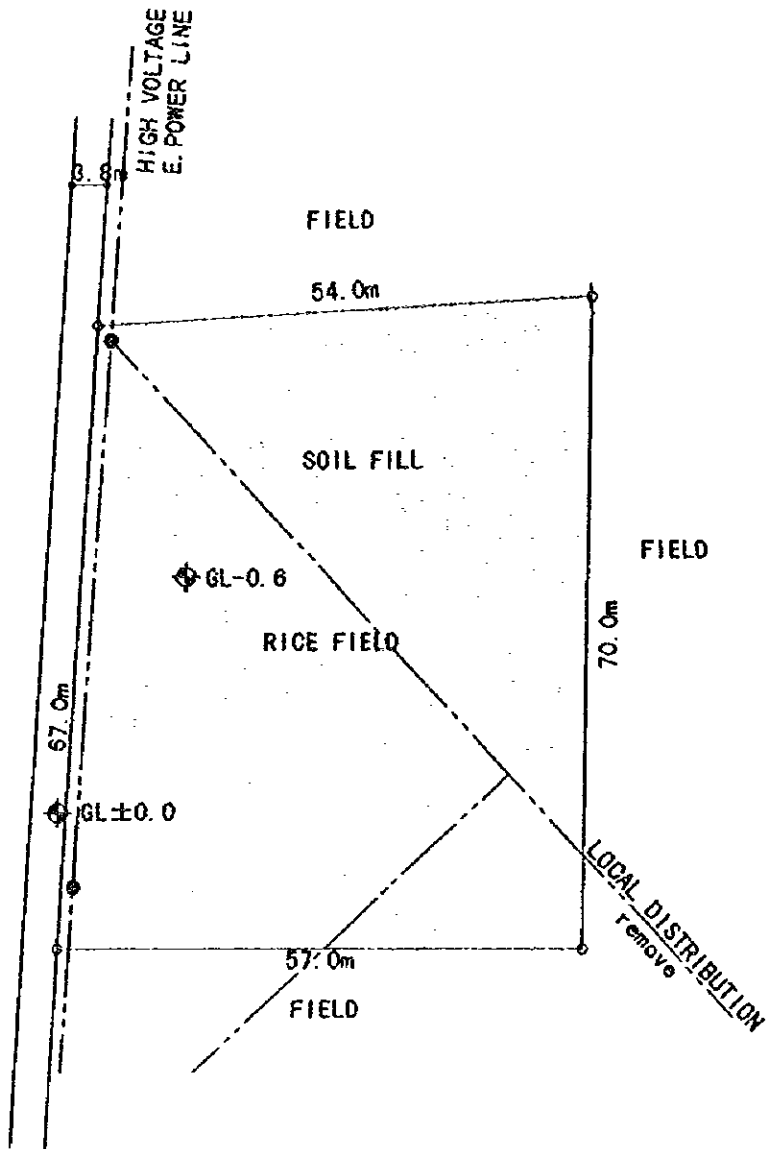

SCALE=1:800  
 0 5 10 20M

<p><b>BT2</b></p>	<p><b>HAM THANG 1</b>                  PROVINCE: BINH THUAN                  DISTRICT: HAM T HUAN BAC                  COMMUNE : HAM THANG</p>	<p>SITE AREA : 3,700m<sup>2</sup>                  FLOOD LEVEL : GL+1.0m                  WATER LEVEL :                  POWER SUPPLY : AVAILABLE</p>	<p>SOIL FILL : 2,300m<sup>3</sup></p>
-------------------	--	---	---------------------------------------

**NEW SITE**

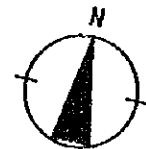
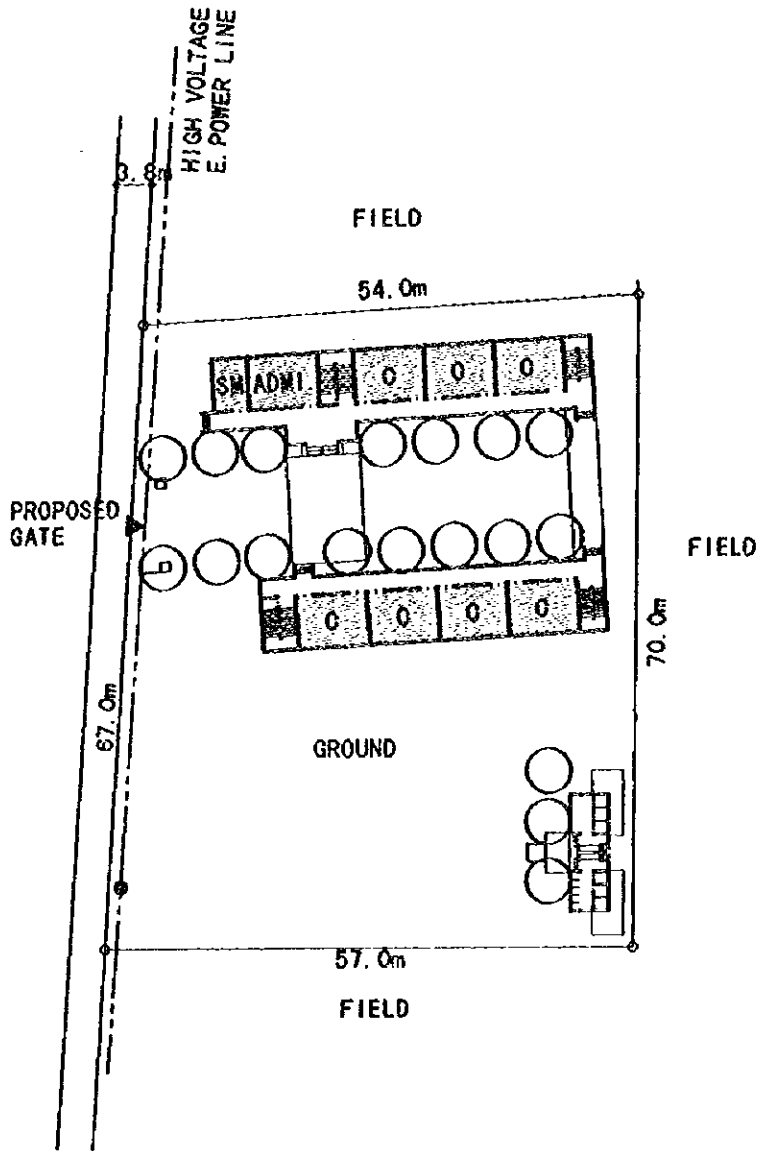

SCALE=1:800



<p><b>BT2</b></p>	<p><b>HAM THANG 1</b>          PROVINCE: BINH THUAN          DISTRICT: HAM T HUAN BAC          COMMUNE : HAM THANG</p>	<p>BLDG. TYPE : 8+7A          TOILET TYPE : A          CLASS ROOM : 15CR</p>	<p>FOUNDATION : C          FL. : GL+1.0m</p>
-------------------	--	--	--

**NEW SITE**

**RESIDENTIAL & COMMERCIAL AREA**

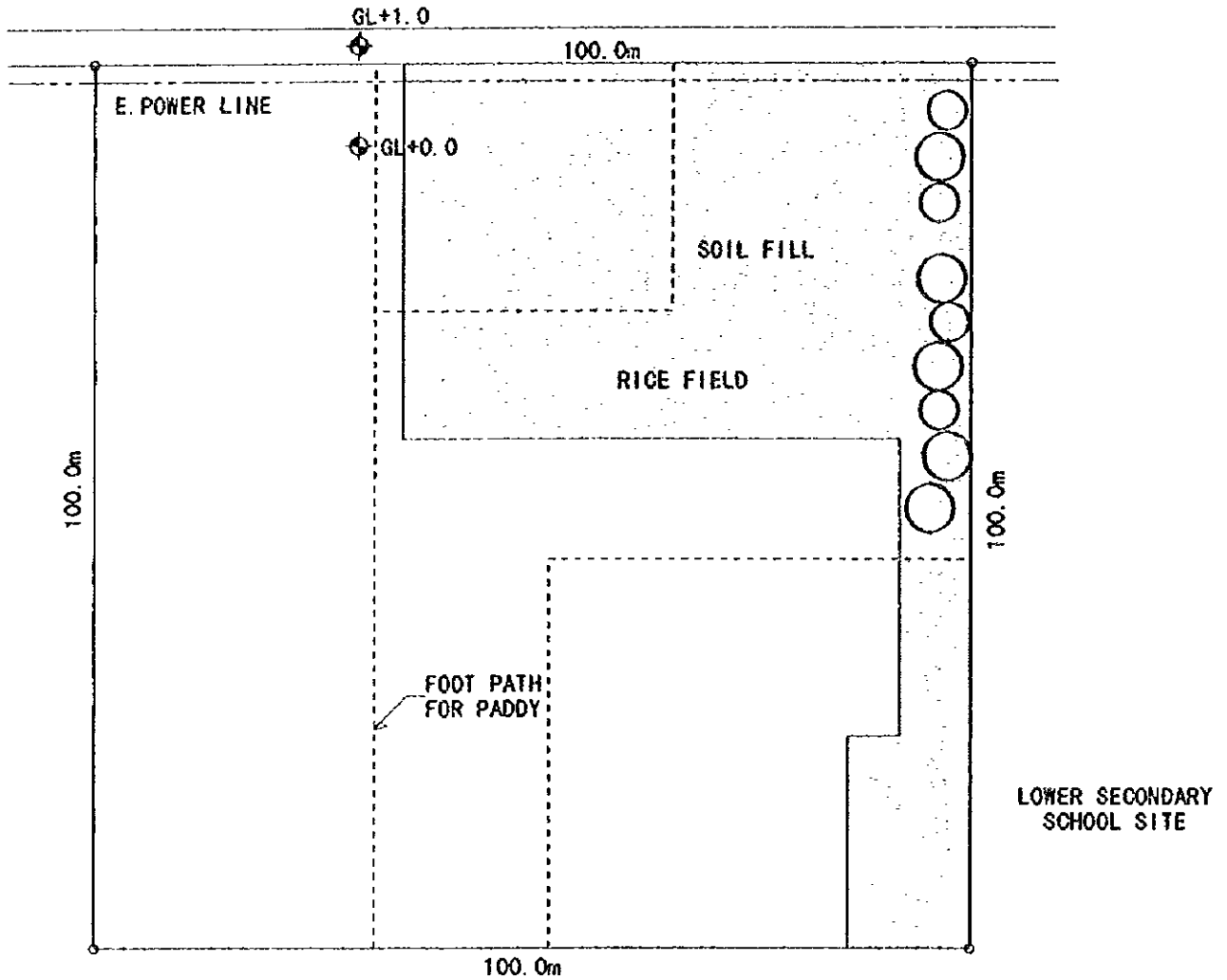

**FIELD**

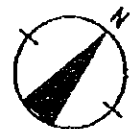

SCALE=1:800

0 5 10 20M

<b>BT3</b>	<b>LA GI 1</b> PROVINCE: BINH THUAN DISTRICT: HAM TAN COMMUNE : LAG1	SITE AREA : 10,000m <sup>2</sup> FLOOD LEVEL : GL+0.2m WATER LEVEL : CITY WATER POWER SUPPLY : AVAILABLE	SOIL FILL : 3,000m <sup>3</sup>
------------	---	---	---------------------------------

**NEW SITE**

**RESIDENTIAL & COMMERCIAL AREA**

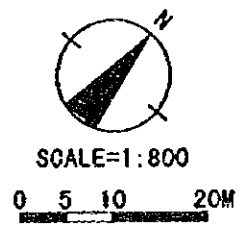
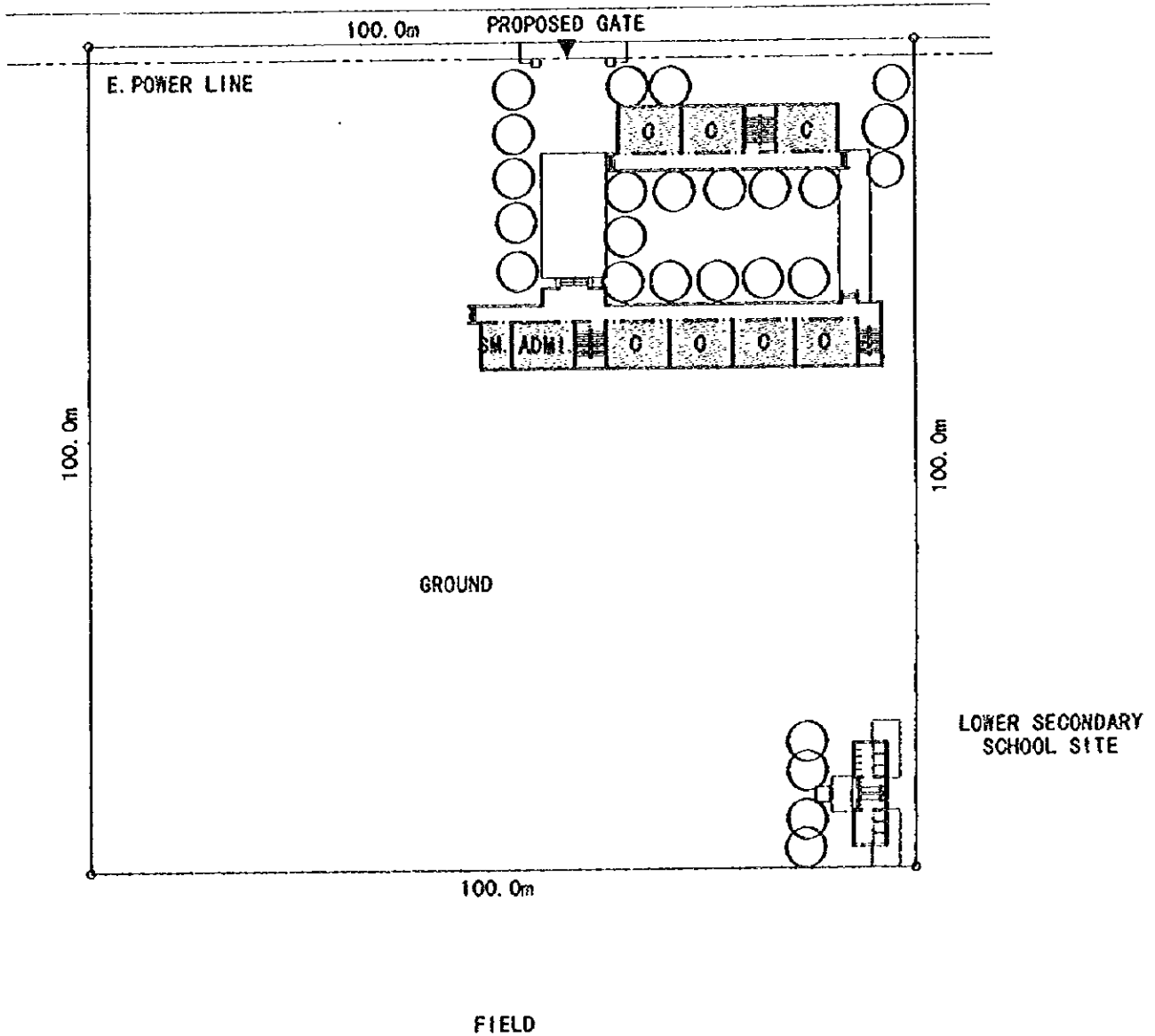

<p><b>BT3</b></p>	<p><b>LA GI 1</b>          PROVINCE: BINH THUAN          DISTRICT: HAM TAN          COMMUNE : LAQ1</p>	<p>BLDG. TYPE : 6+9A          TOILET TYPE : A          CLASS ROOM : 15CR</p>	<p>FOUNDATION : C          FL. : GL+0.7m</p>
-------------------	--	--	--

**NEW SITE**

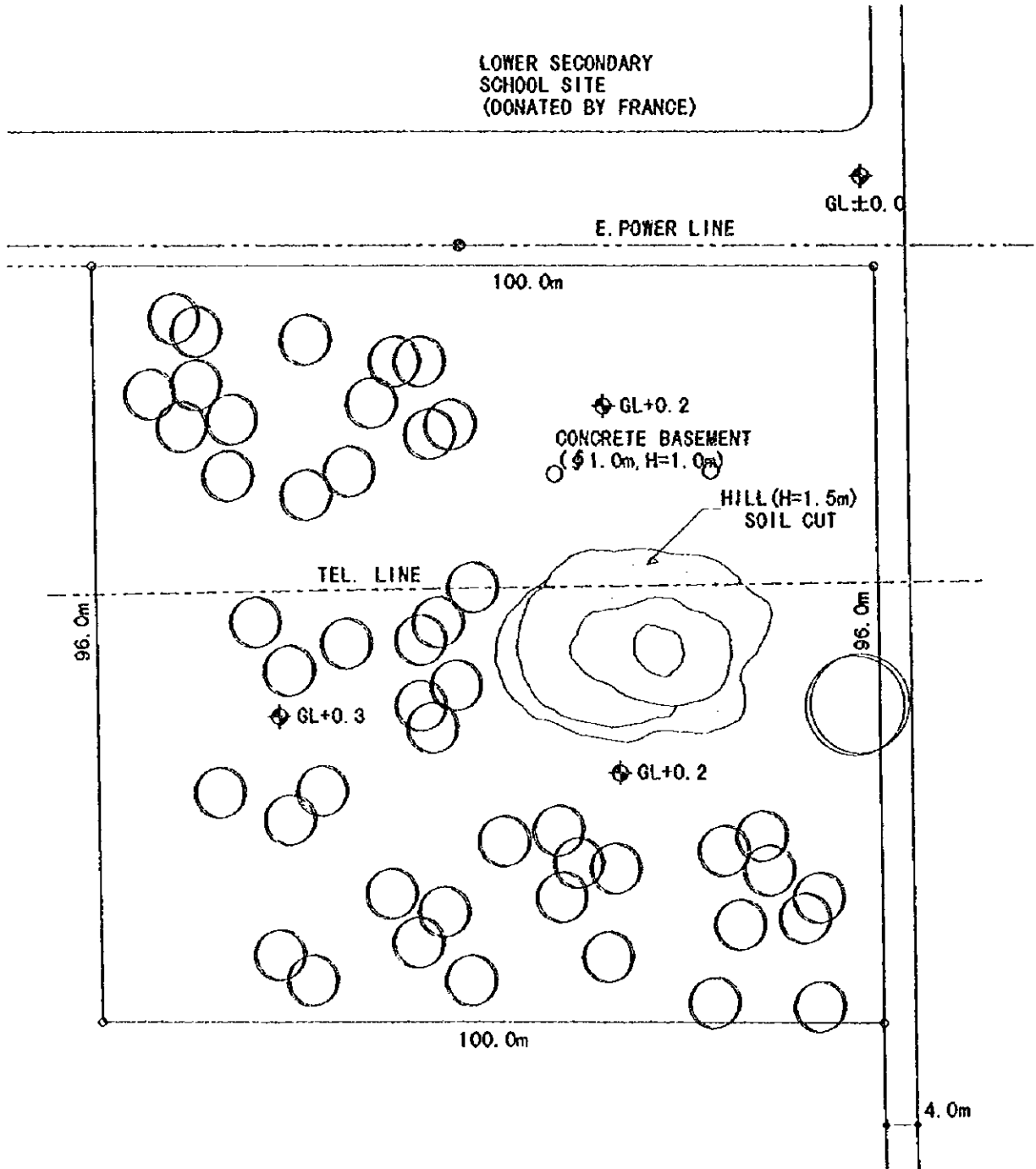

SCALE=1:800  
0 5 10 20M

BT4	PHAN RI THANH 2 PROVINCE: BINH THUAN DISTRICT: BAC BINH COMMUNE : PHAN RI THANH	SITE AREA : 9,600m <sup>2</sup> FLOOD LEVEL : NONE WATER LEVEL : POWER SUPPLY : AVAILABLE	SOIL FILL : NONE
-----	--	--	------------------

**NEW SITE**

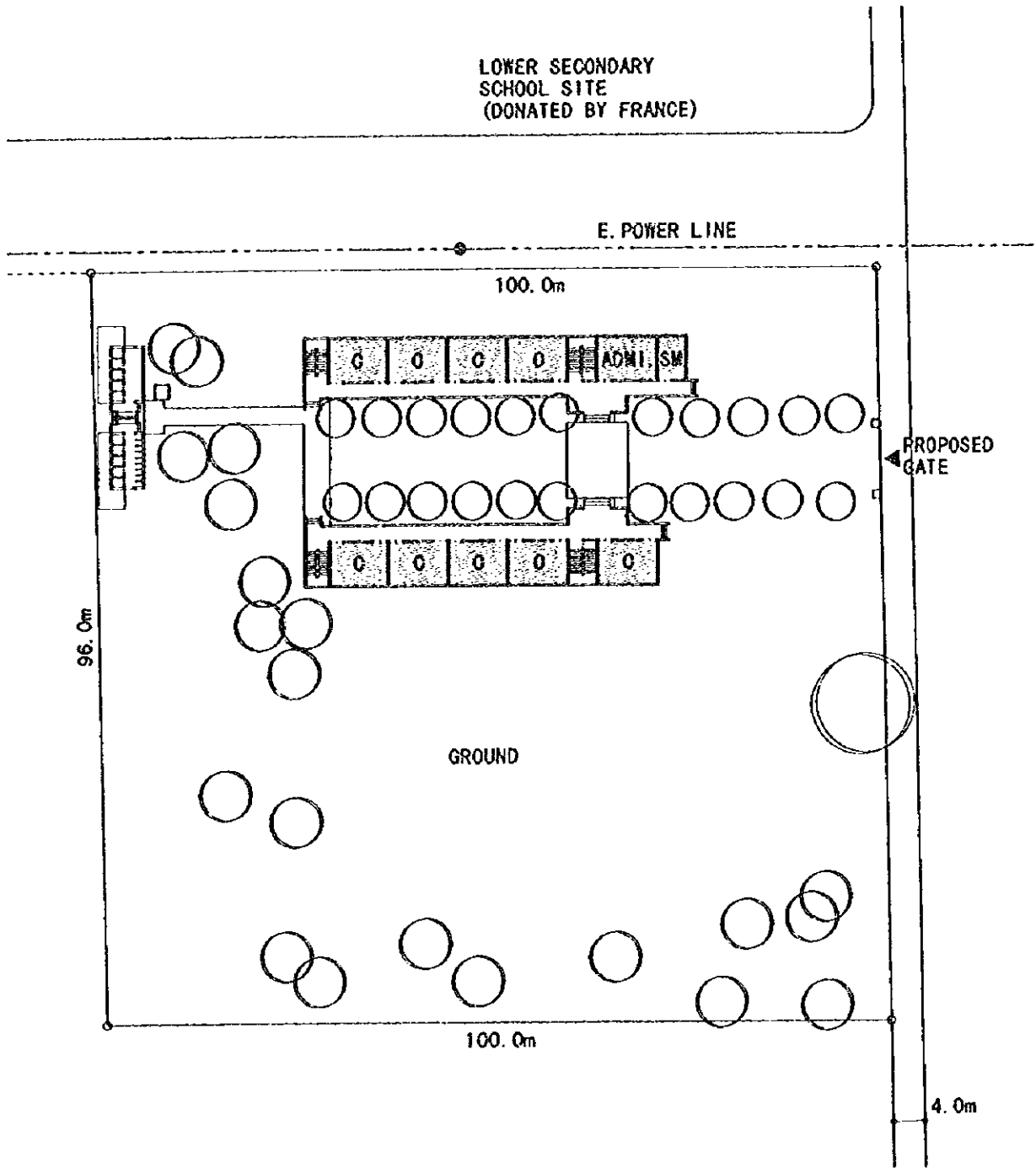

SCALE=1:800



<p><b>BT4</b></p>	<p><b>PHAN RI THANH 2</b>          PROVINCE: BINH THUAN          DISTRICT: BAG BINH          COMMUNE : PHAN RI THANH</p>	<p>BLDG. TYPE : 10+9A          TOILET TYPE : B          CLASS ROOM : 10CR</p>	<p>FOUNDATION : A          FL. : GL+0.7m</p>
-------------------	--	---	--

**EXT. SITE**

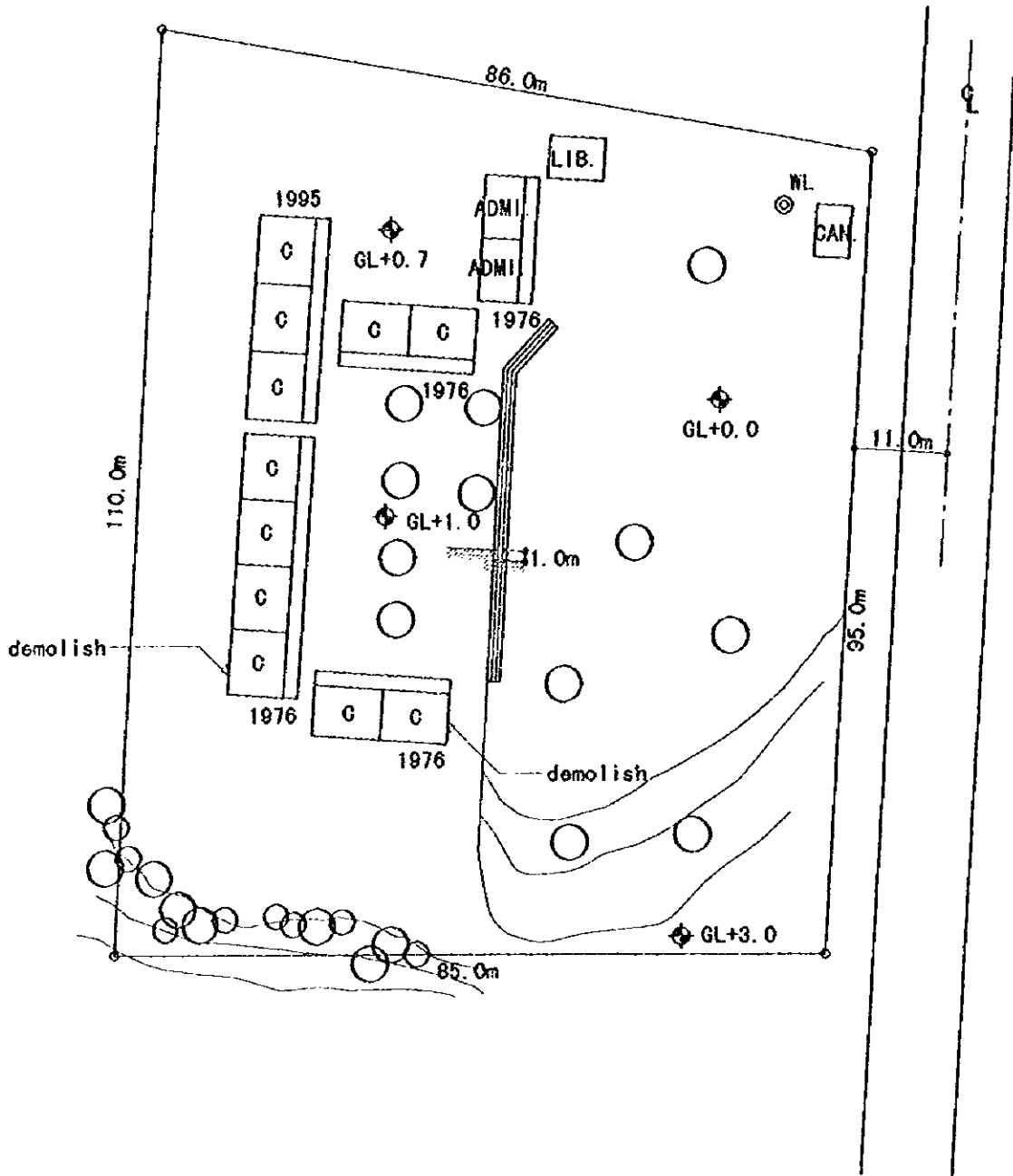

SCALE=1:800

0 5 10 20M

<p><b>BT5</b></p>	<p><b>DONG KHO</b>          PROVINCE : BINH THUAN          DISTRICT : TANH LINH          COMMUNE : DONG KHO</p>	<p>SITE AREA : 8,400m<sup>2</sup>          FLOOD LEVEL : NONE          WATER LEVEL : GL-7m          POWER SUPPLY : AVAILABLE</p>	<p>SOIL FILL : NONE</p>
-------------------	---	--	-------------------------



**EXT. SITE**

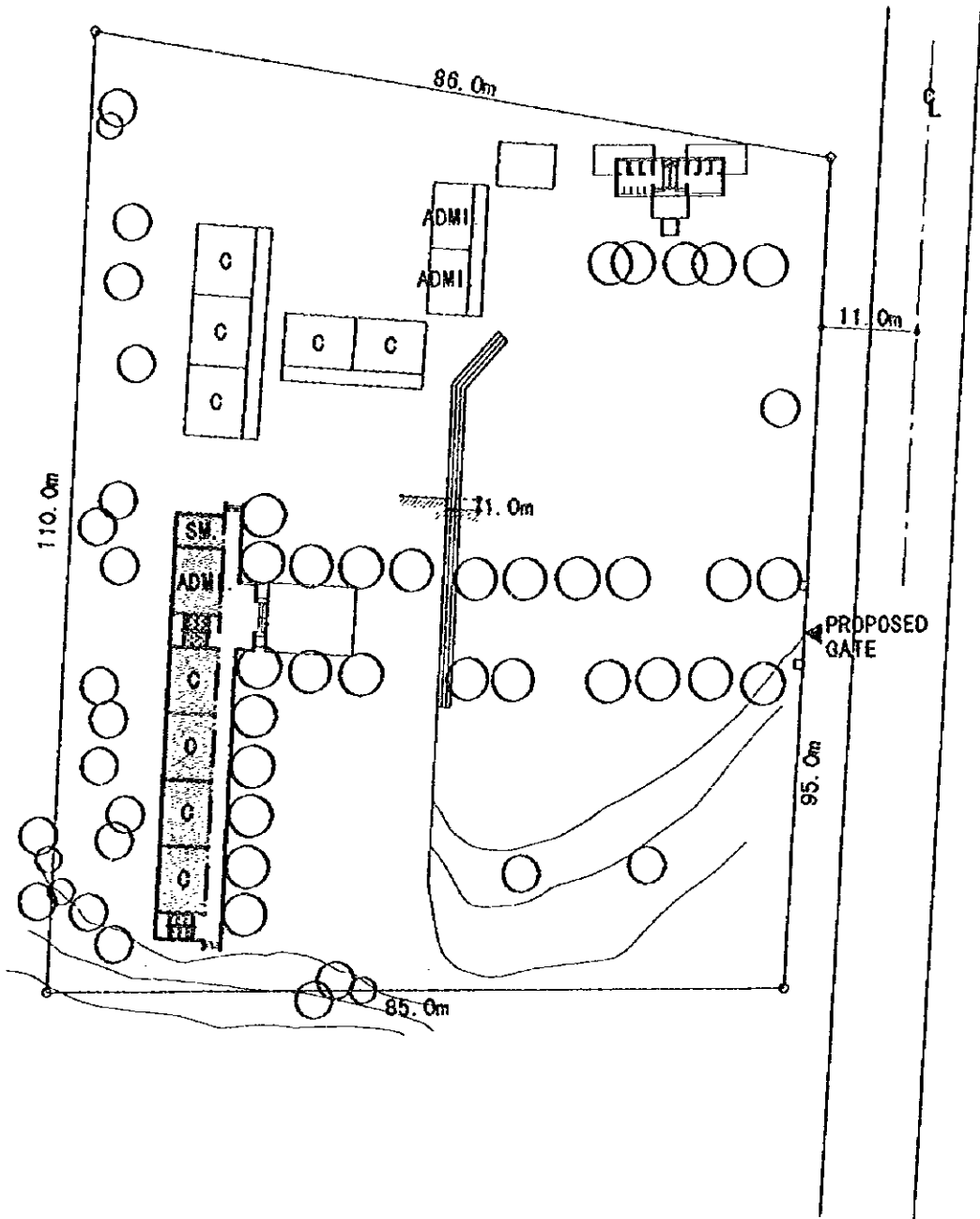

SCALE=1:800

0 5 10 20M

<p><b>BT5</b></p>	<p><b>DONG KHO</b>          PROVINCE : BINH THUAN          DISTRICT : TANH LINH          COMMUNE : DONG KHO</p>	<p>BLDG. TYPE : 9A          TOILET TYPE: A          CLASS ROOM : 9CR+(5CR)</p>	<p>FOUNDATION : A          FL. : GL+0.7m</p>
-------------------	---	--	--

**EXT. SITE**

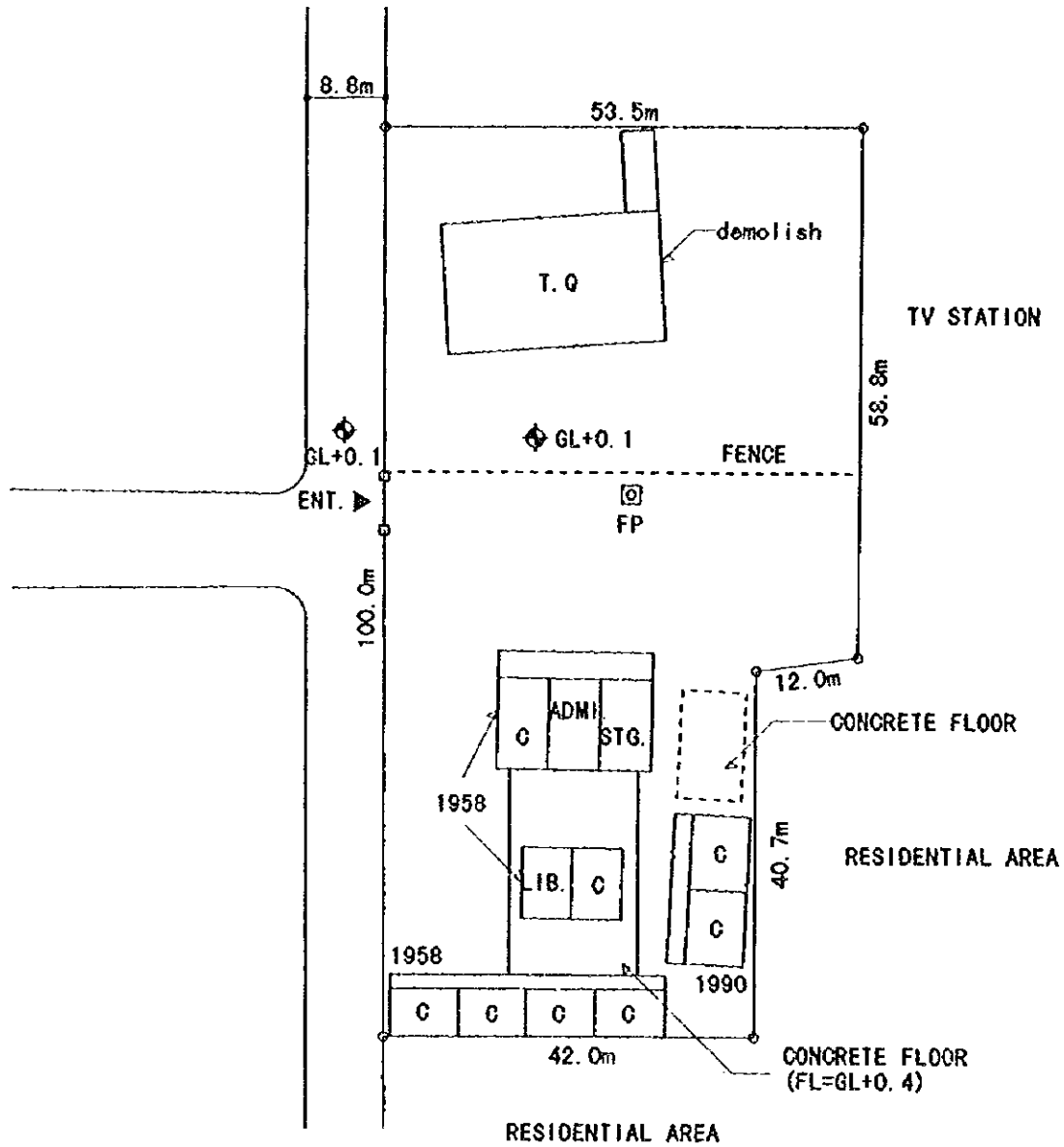

SCALE=1:800

0 5 10 20M

<p><b>BT6</b></p>	<p><b>PHAN RI CUA 4</b>          PROVINCE : BINH THUAN          DISTRICT : THY PHONG          COMMUNE : PHAN RI CUA</p>	<p>SITE AREA : 4,900m<sup>2</sup>          FLOOD LEVEL : GL+0.5m          WATER LEVEL :          POWER SUPPLY : AVAILABLE</p>	<p>SOIL FILL : NONE</p>
-------------------	---	---	-------------------------

**EXT. SITE**

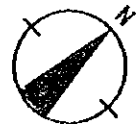
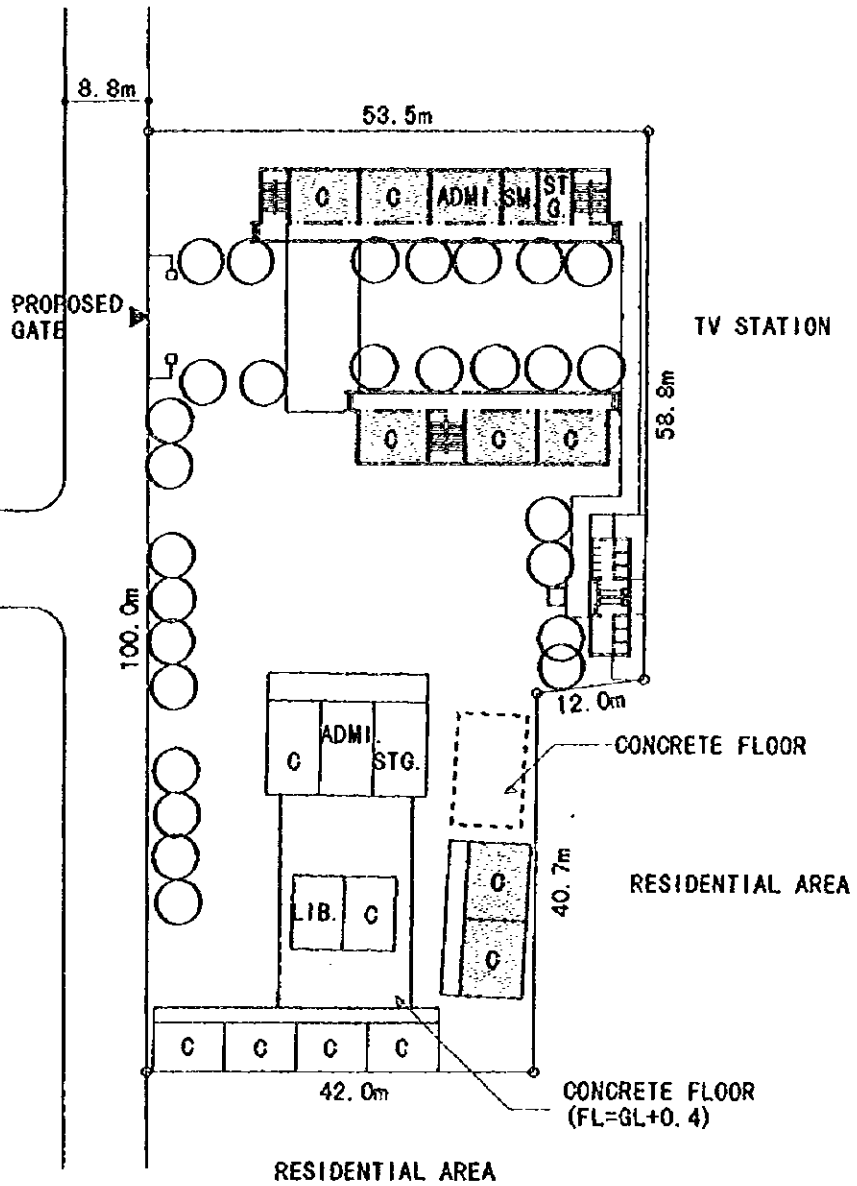

SCALE=1:800



<p><b>BT6</b></p>	<p><b>PHAN RI CUA 4</b>          PROVINCE : BINH THUAN          DISTRICT : THY PHONG          COMMUNE : PHAN RI CUA</p>	<p>BLDG. TYPE : 6+8          TOILET TYPE : A          CLASS ROOM : 12CR+(2CR)</p>	<p>FOUNDATION : 8          FL. : GL+0.7m</p>
-------------------	---	---	--

**EXT. SITE**

- NOTE:
- SURVEY TEAM REQUESTED EXTENSION OF SITE
  - RECIPIENT AGREED WITH US

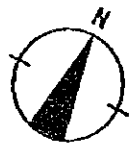
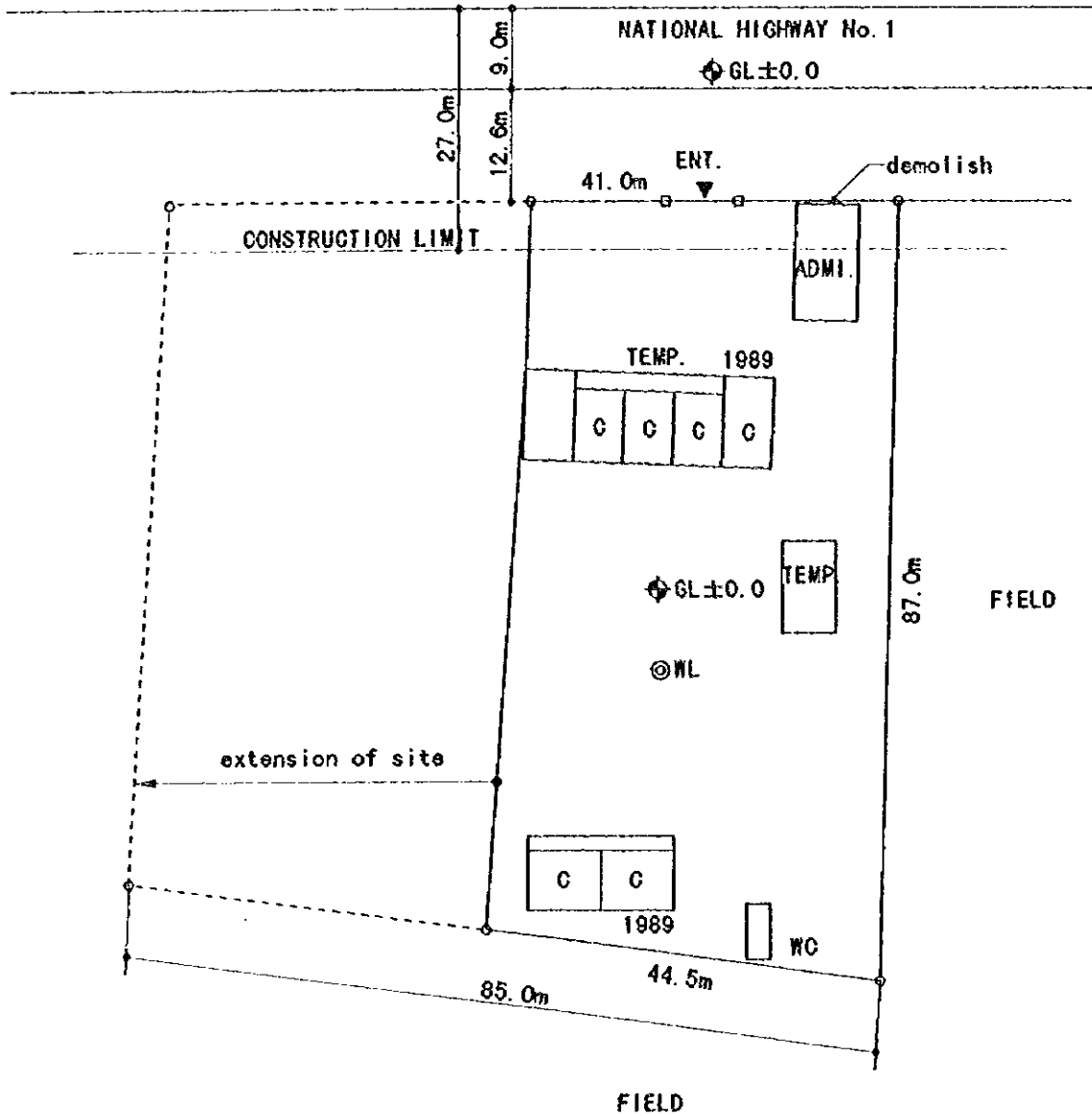

SCALE=1:800



<p><b>BT7</b></p>	<p><b>TAN LAP 1</b>                  PROVINCE: BINH THUAN                  DISTRICT: HAM T HUAN NAM                  COMMUNE : TAN LAP</p>	<p>SITE AREA : 7,200m<sup>2</sup>                  FLOOD LEVEL : GL+0.5m                  WATER LEVEL : GL-8.0m                  POWER SUPPLY : AVAILABLE</p>	<p>SOIL FILL : NONE</p>
-------------------	--	---	-------------------------

**EXT. SITE**

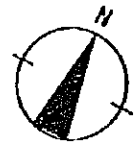
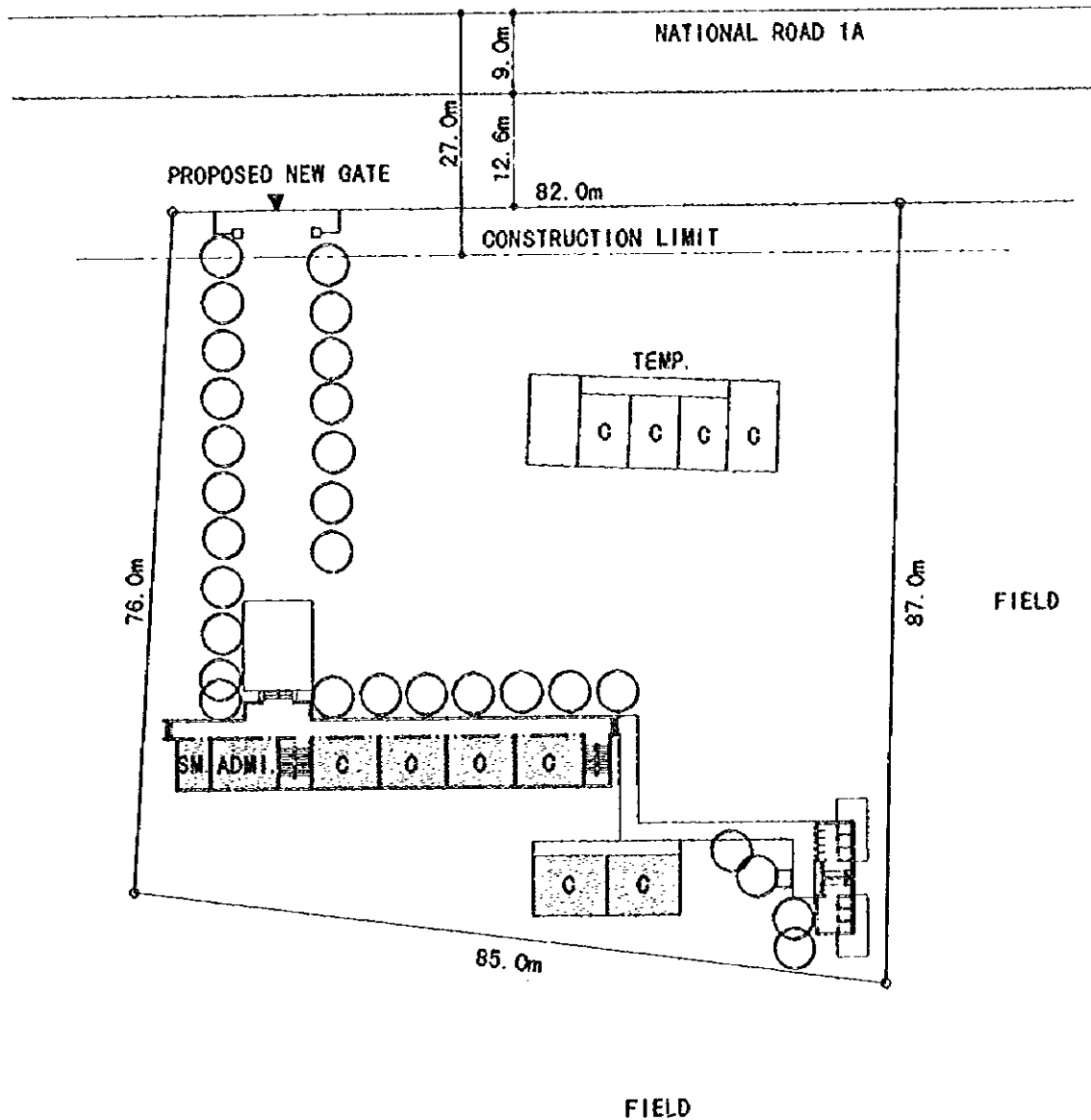

SCALE=1:800

0 5 10 20M

<p><b>BT7</b></p>	<p><b>TAN LAP 1</b>          PROVINCE: BINH THUAN          DISTRICT: HAM T HUAN NAM          COMMUNE : TAN LAP</p>	<p>BLDG. TYPE : 9A          TOILET TYPE : A          CLASS ROOM : 9CR</p>	<p>FOUNDATION : B          FL. : GL+0.7m</p>
-------------------	--	---	--

**EXT. SITE**

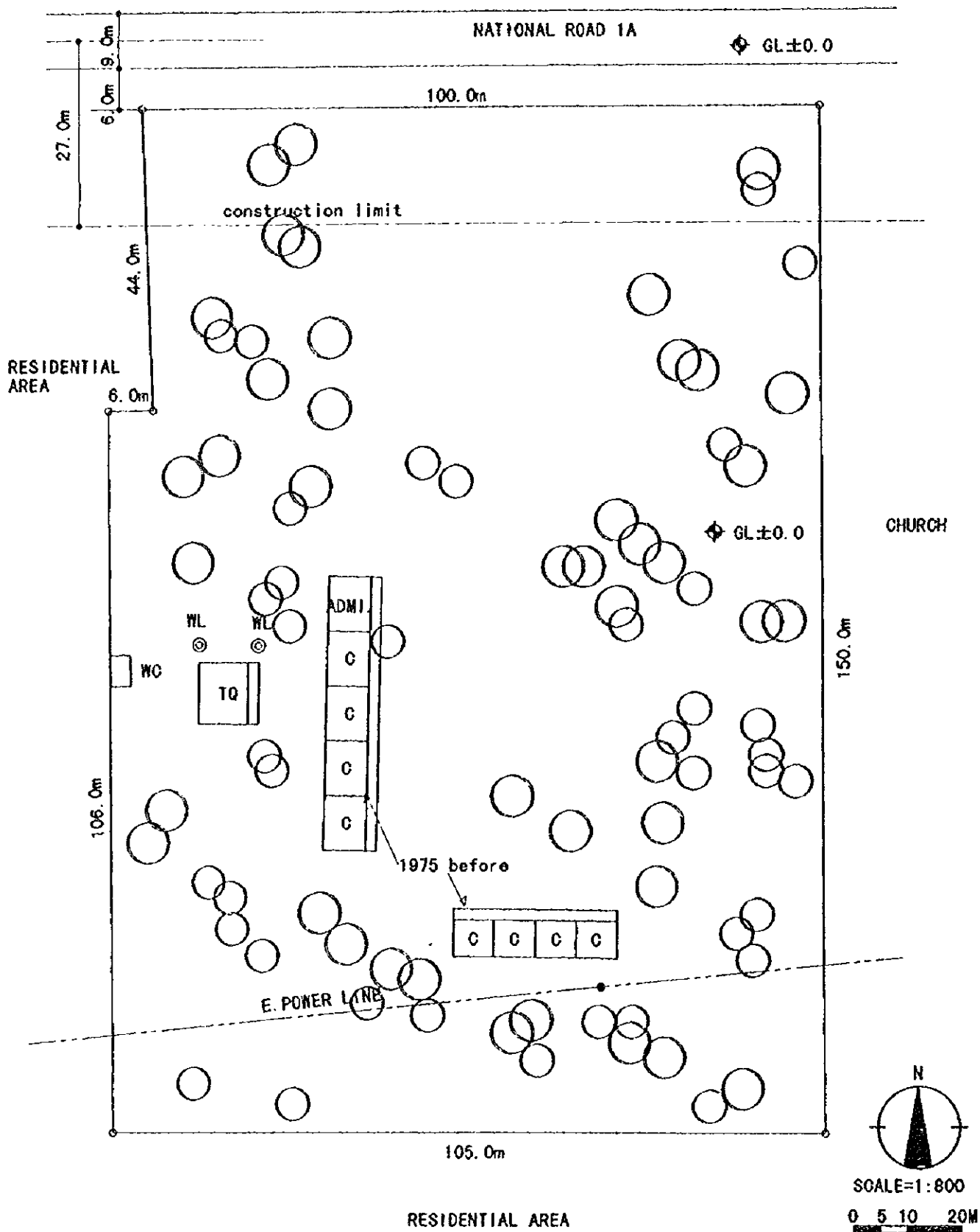

<p><b>BT8</b></p>	<p><b>TAN LAP 3</b>          PROVINCE : BINH THUAN          DISTRICT : HAM T NAM          COMMUNE : TAN LAP</p>	<p>SITE AREA : 15,500m<sup>2</sup>          FLOOD LEVEL : GL+1.0m          WATER LEVEL :          POWER SUPPLY : AVAILABLE</p>	<p>SOIL FILL : NONE</p>
-------------------	---	--	-------------------------

**EXT. SITE**

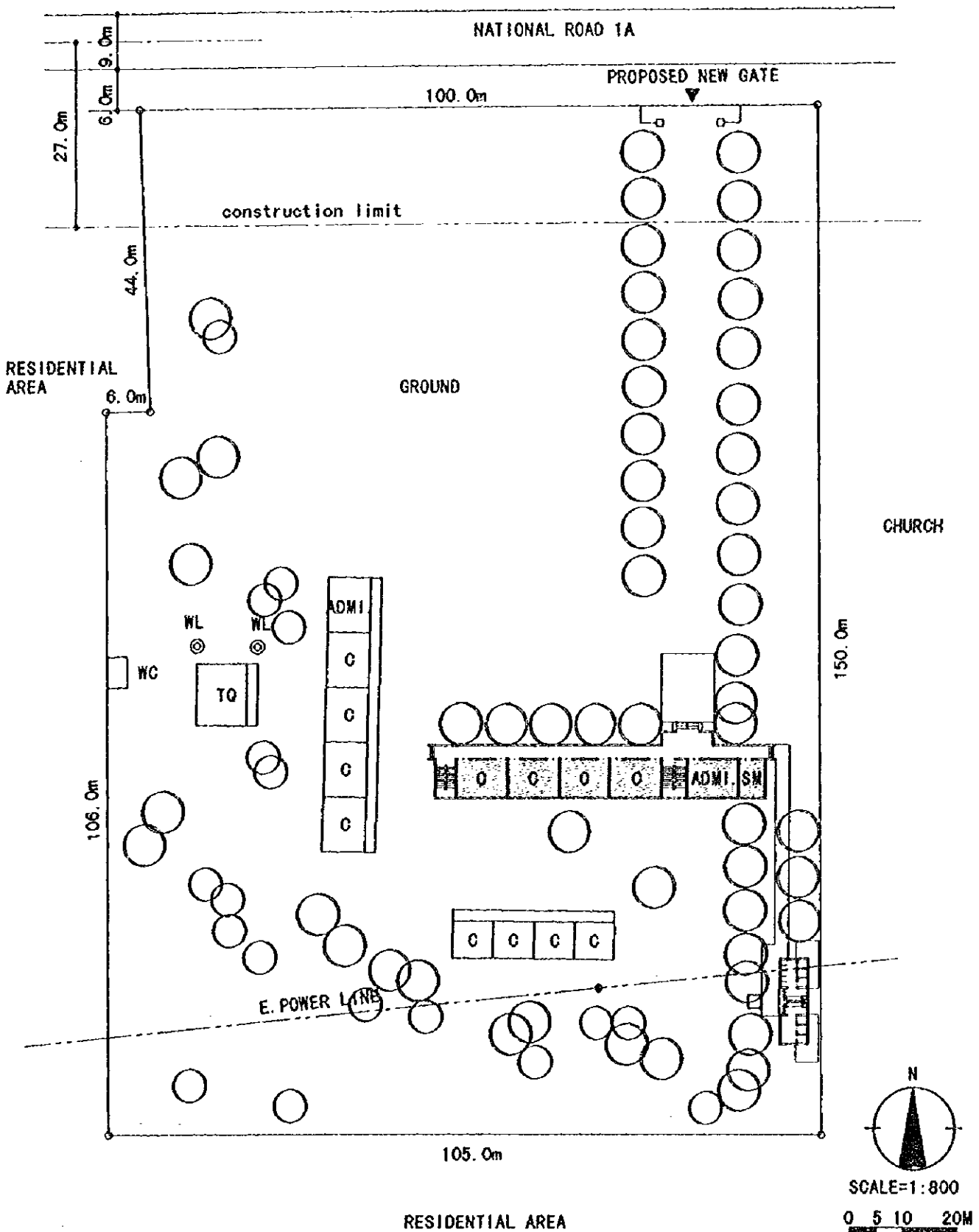

<p><b>BT8</b></p>	<p><b>TAN LAP 3</b>          PROVINCE : BINH THUAN          DISTRICT : HAM T NAM          COMMUNE : TAN LAP</p>	<p>BLDG. TYPE : 9A          TOILET TYPE : A          CLASS ROOM : 8CR</p>	<p>FOUNDATION : B          FL. : GL+1.0m</p>
-------------------	---	---	--

**EXT. SITE**

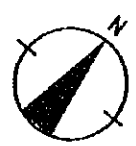
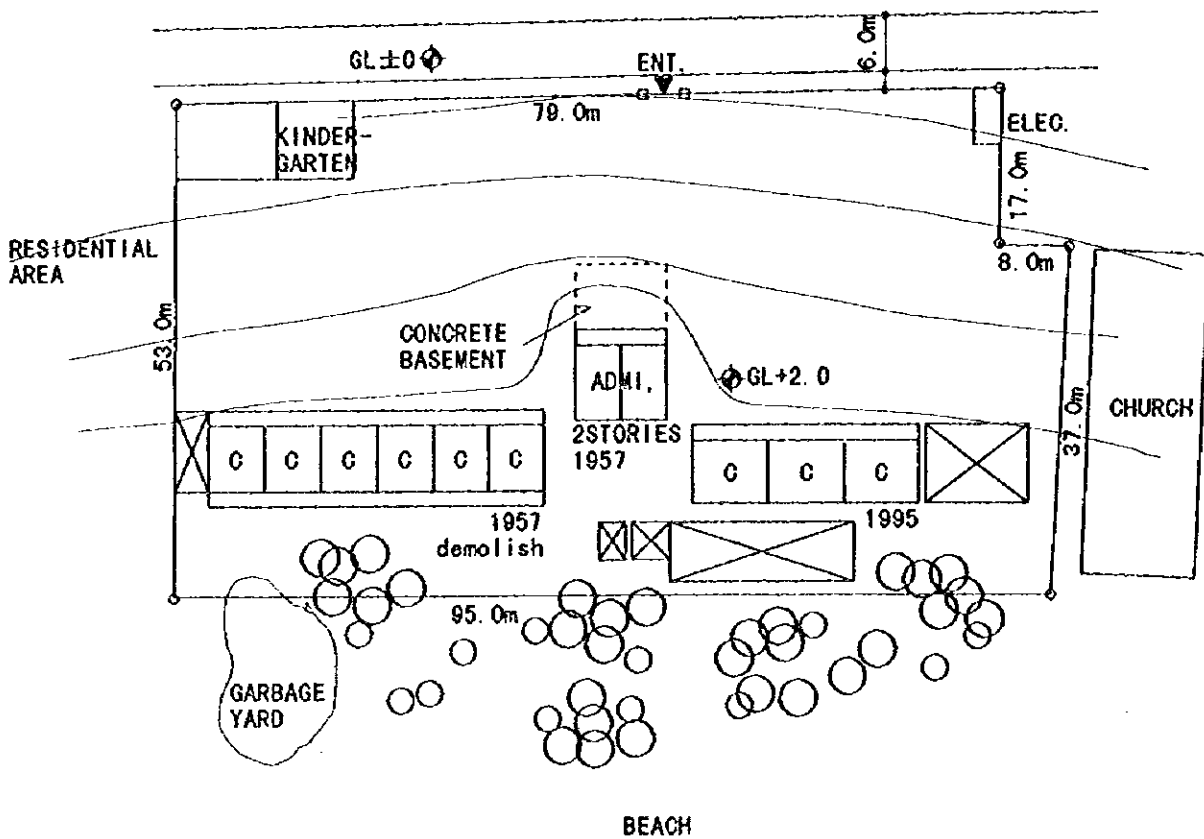

SCALE=1:800  
0 5 10 15M

<p><b>BT9</b></p>	<p><b>HUNG LONG</b>          PROVINCE: BINH THUAN          DISTRICT: TX. PHAN THIET          COMMUNE : PH. HUNG LONG</p>	<p>SITE AREA : 4,900m<sup>2</sup>          FLOOD LEVEL : NONE          WATER LEVEL :          POWER SUPPLY : AVAILABLE</p>	<p>SOIL FILL : NONE</p>
-------------------	--	--	-------------------------



**EXT. SITE**

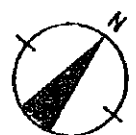
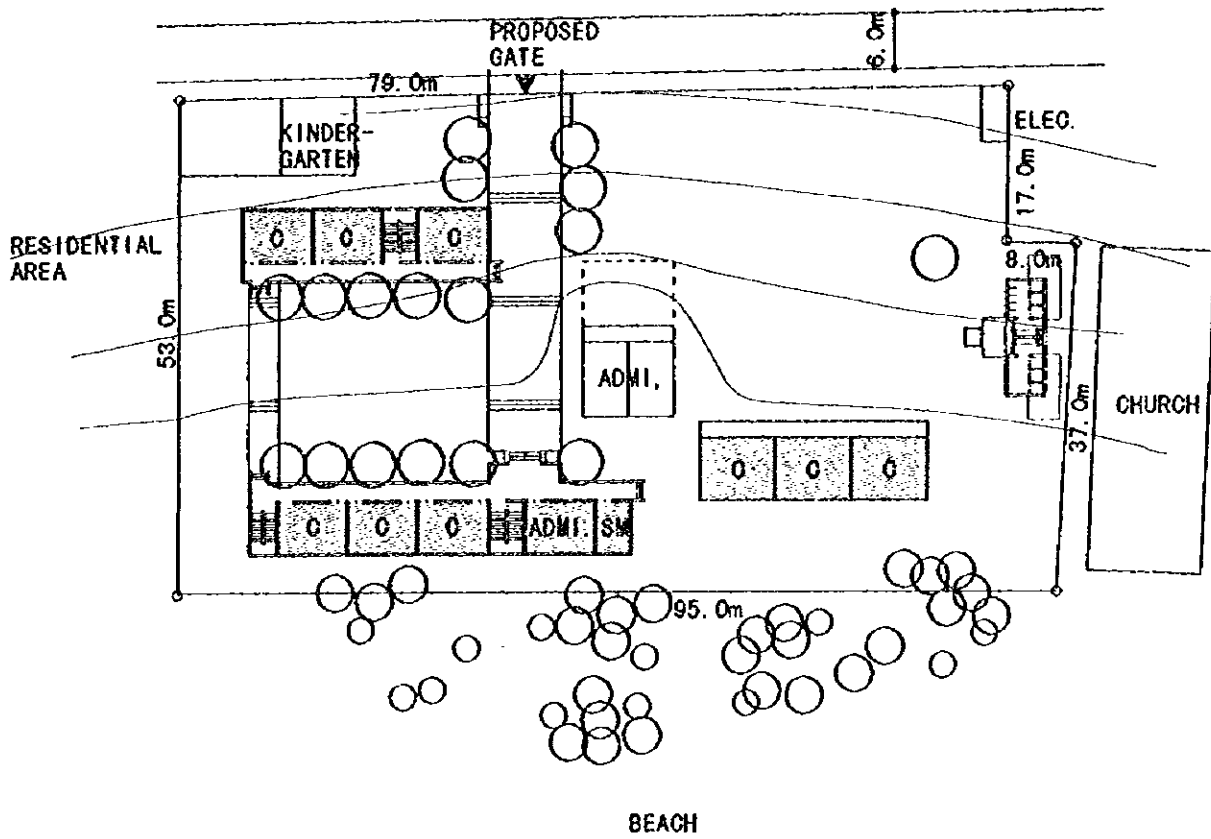

SCALE=1:800

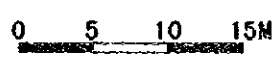

<p><b>BT9</b></p>	<p><b>HUNG LONG</b>          PROVINCE: BINH THUAN          DISTRICT: TX. PHAN THIET          COMMUNE : PH. HUNG LONG</p>	<p>BLDG. TYPE : 6+7A          TOILET TYPE : A          CLASS ROOM : 13CR+(3CR)</p>	<p>FOUNDATION : B          FL. : GL+0.7m</p>
-------------------	--	--	--

**EXT. SITE**

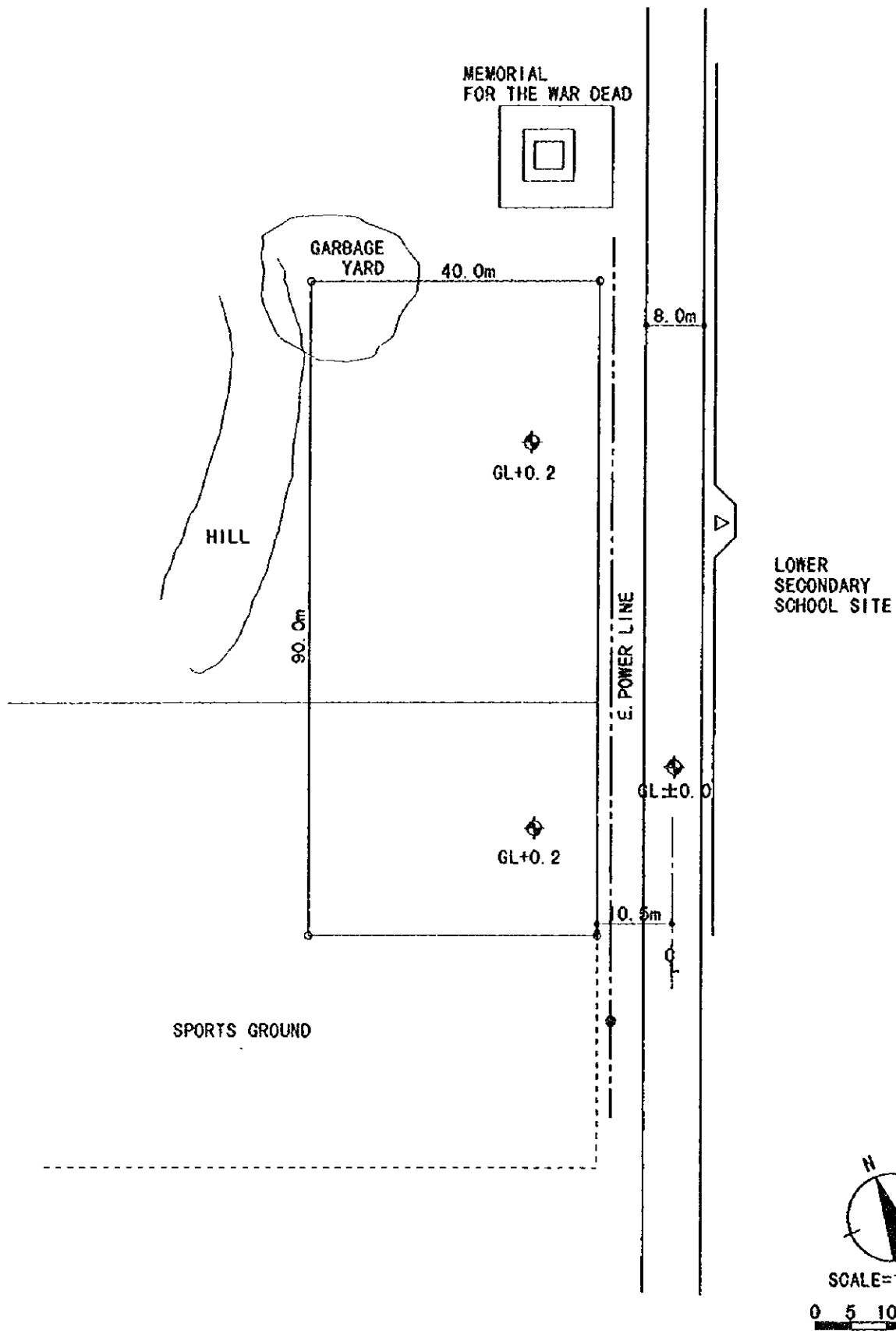

<b>BT10</b>	<b>MUI NE 1</b>	<b>SITE AREA : 3,600m<sup>2</sup></b>	<b>SOIL FILL : NONE</b>
	PROVINCE : BINH THUAN DISTRICT : TX. PHAN THIET COMMUNE : PH. MUI NE	FLOOD LEVEL : NONE WATER LEVEL : GL-4.0m POWER SUPPLY : OFF SITE	

**EXT. SITE**

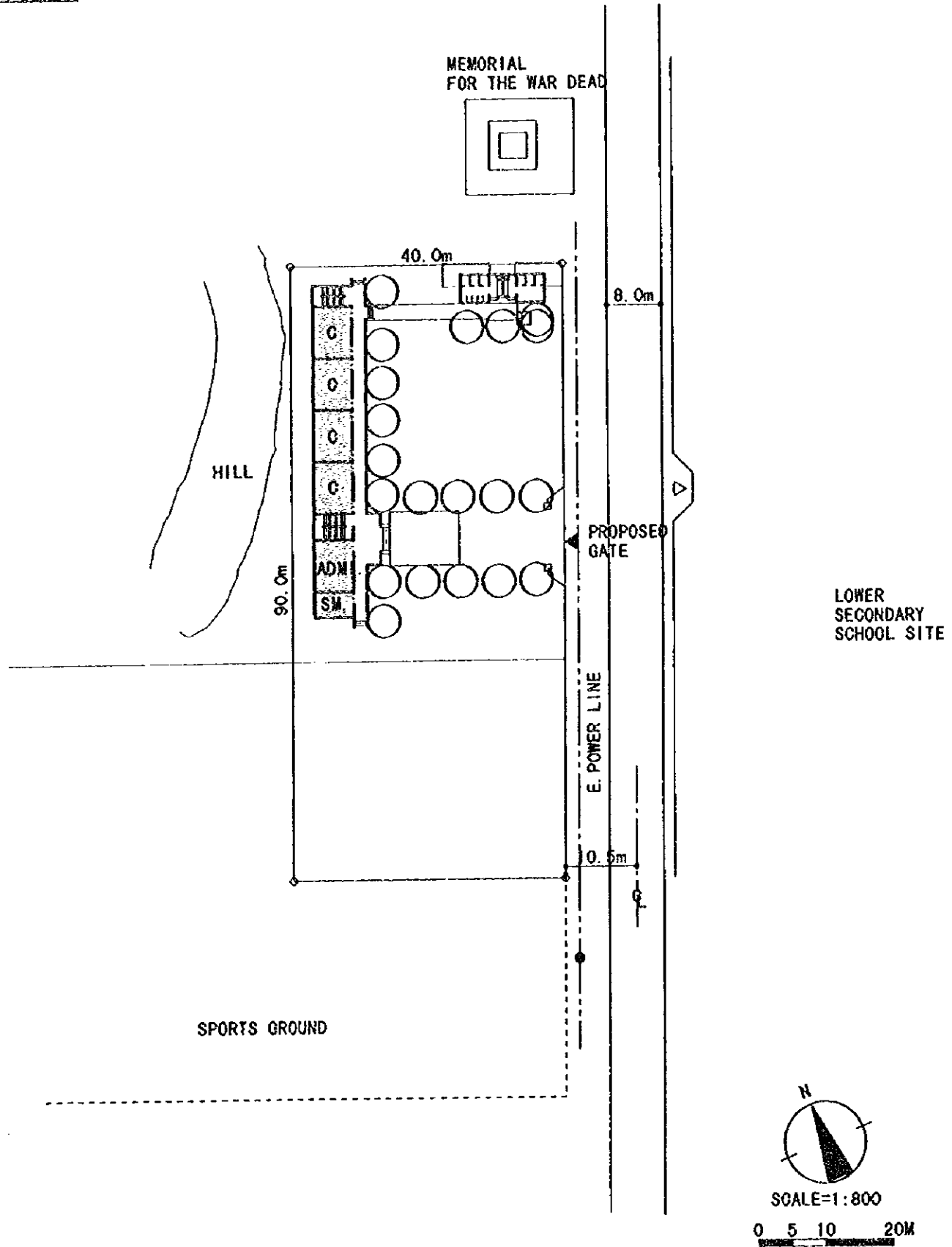

<p><b>BT10</b></p>	<p><b>MUI NE 1</b>          PROVINCE : BINH THUAN          DISTRICT : TX. PHAN THIET          COMMUNE : PH. MUI NE</p>	<p>BLDG. TYPE : 9A          TOILET TYPE : A          CLASS ROOM : 9CR</p>	<p>FOUNDATION : A          FL. : GL+0.7m</p>
--------------------	--	---	--

**EXT. SITE**

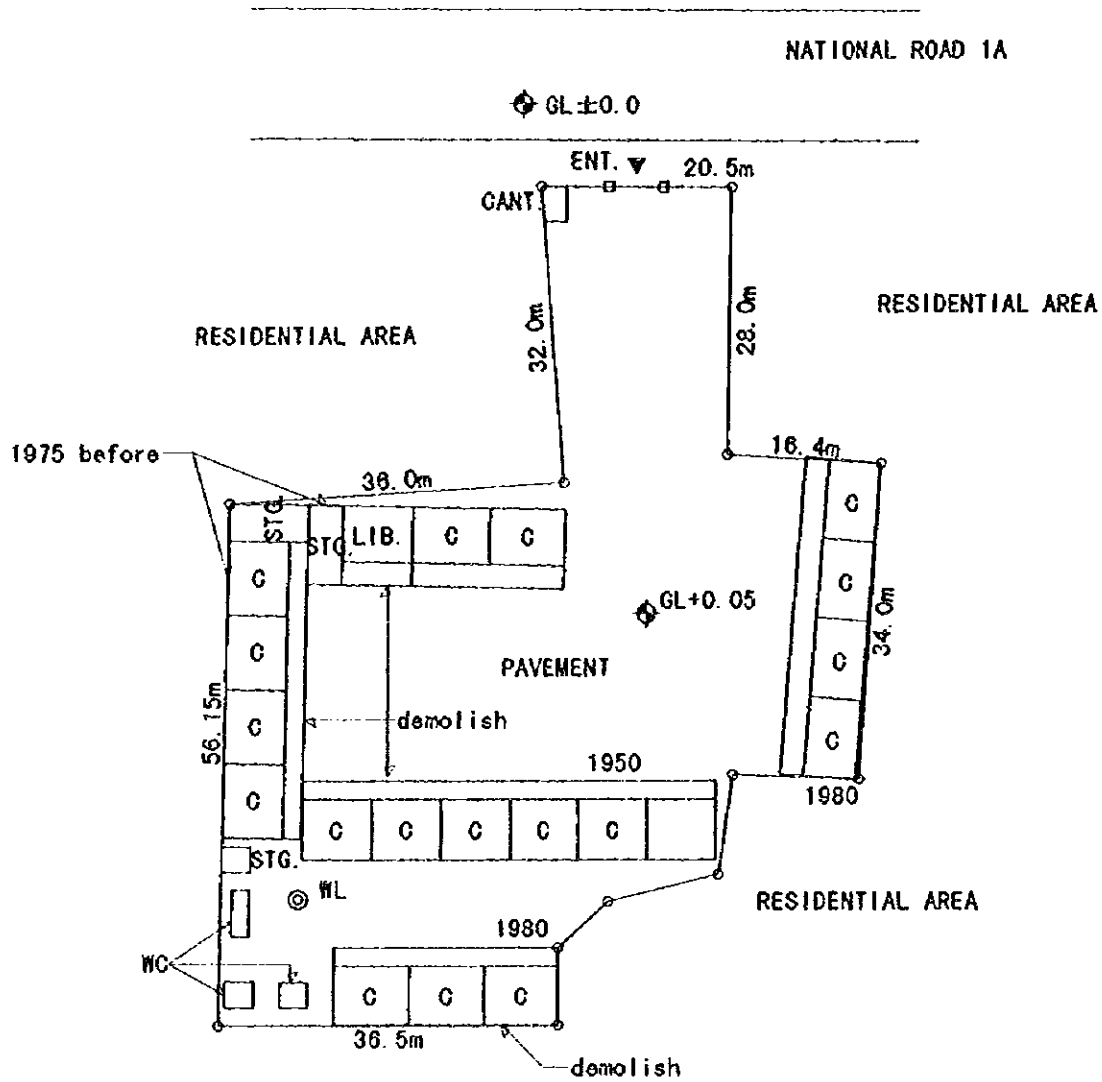

SCALE=1:800  
 0 5 10 20M

<p><b>BT11</b></p>	<p><b>DUC LONG</b>                  PROVINCE : BINH THUAN                  DISTRICT : TX. PHAN THIET                  COMMUNE : PH. DUC LONG</p>	<p>SITE AREA : 3,600m<sup>2</sup>                  FLOOD LEVEL : NONE                  WATER LEVEL :                  POWER SUPPLY : AVAILABLE</p>	<p>SOIL FILL : NONE</p>
--------------------	--	--	-------------------------

**EXT. SITE**

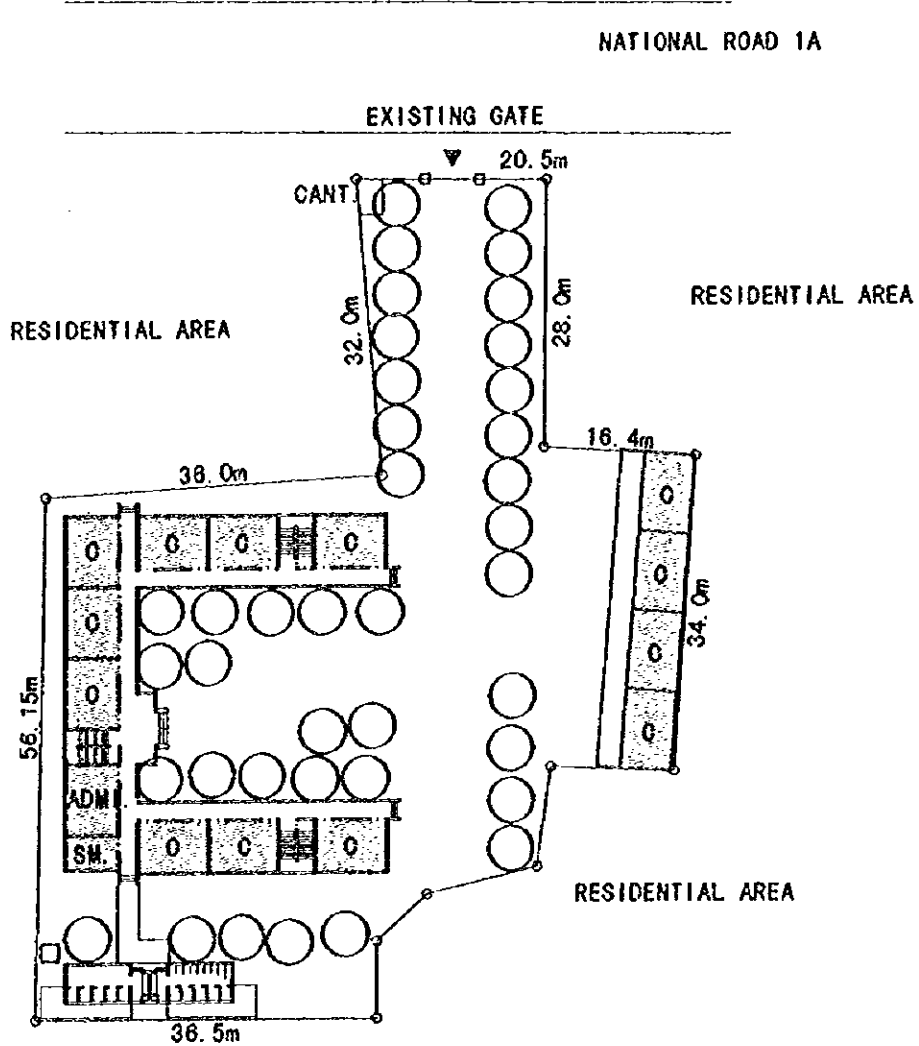

SCALE=1:800



<p><b>BT11</b></p>	<p><b>DUC LONG</b>          PROVINCE : BINH THUAN          DISTRICT : TX. PHAN THIET          COMMUNE : PH. DUC LONG</p>	<p>BLDG. TYPE : 6×2+7A          TOILET TYPE : B          CLASS ROOM : 19CR</p>	<p>FOUNDATION : A          FL. : GL+0.7m</p>
--------------------	--	--	--

**NEW SITE**

NOTE:  
 - PROPOSED SITE IS USED AS BOARDING SCHOOL FOR TEACHER TRAINEES.  
 - THIS SCHOOL WILL BE MOVED TO ANOTHER SITE.

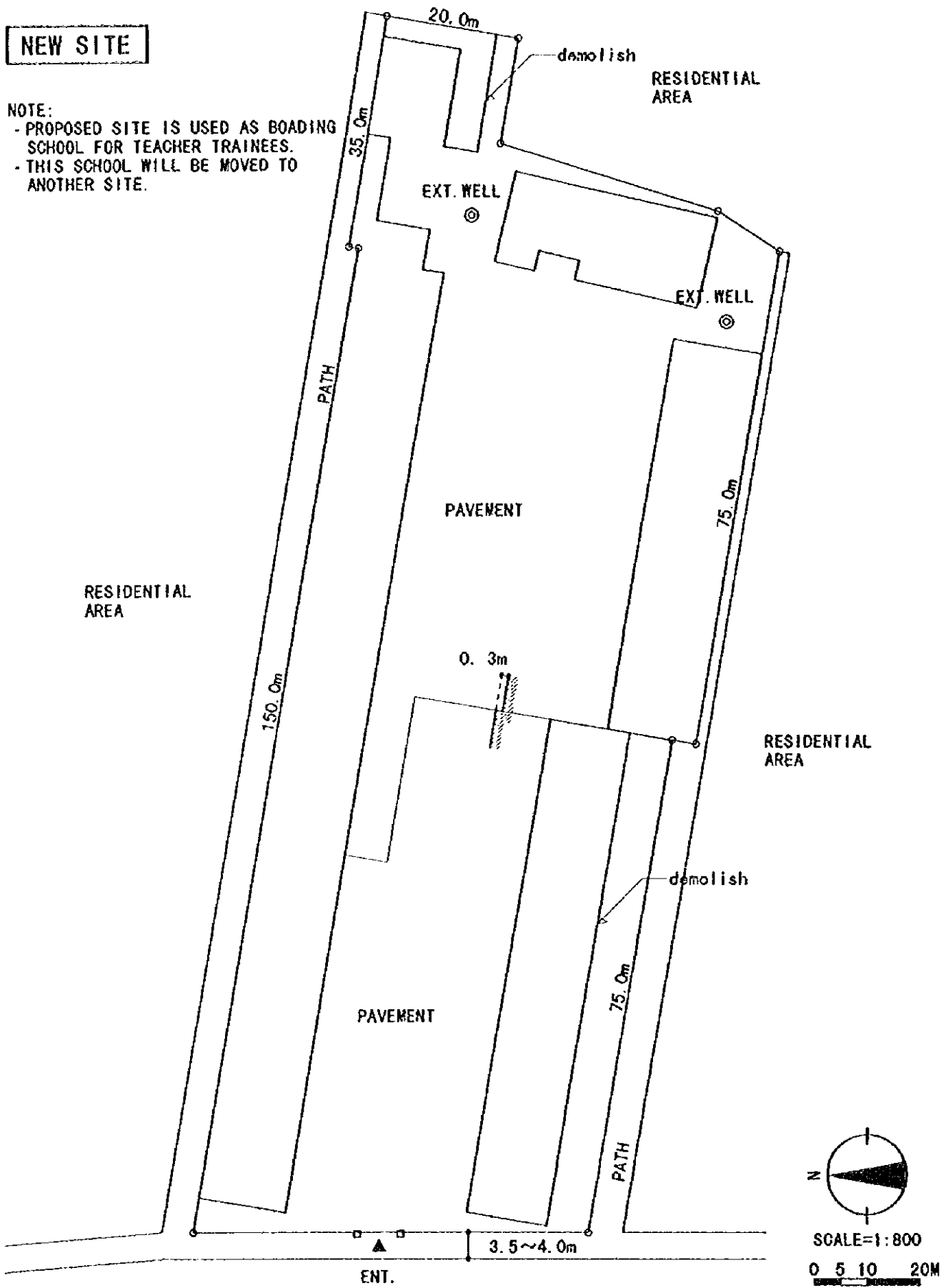

<p><b>Q11</b></p>	<p><b>TRAN QUOC TOAN</b>                  PROVINCE : QUANG NINH                  DISTRICT : TP. HA LONG                  COMMUNE : P. HONG HA</p>	<p>SITE AREA : 9,300m<sup>2</sup>                  FLOOD LEVEL : NONE                  WATER LEVEL :                  POWER SUPPLY : AVAILABLE</p>	<p>SOIL FILL : NONE</p>
-------------------	---	--	-------------------------

**NEW SITE**

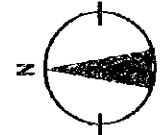
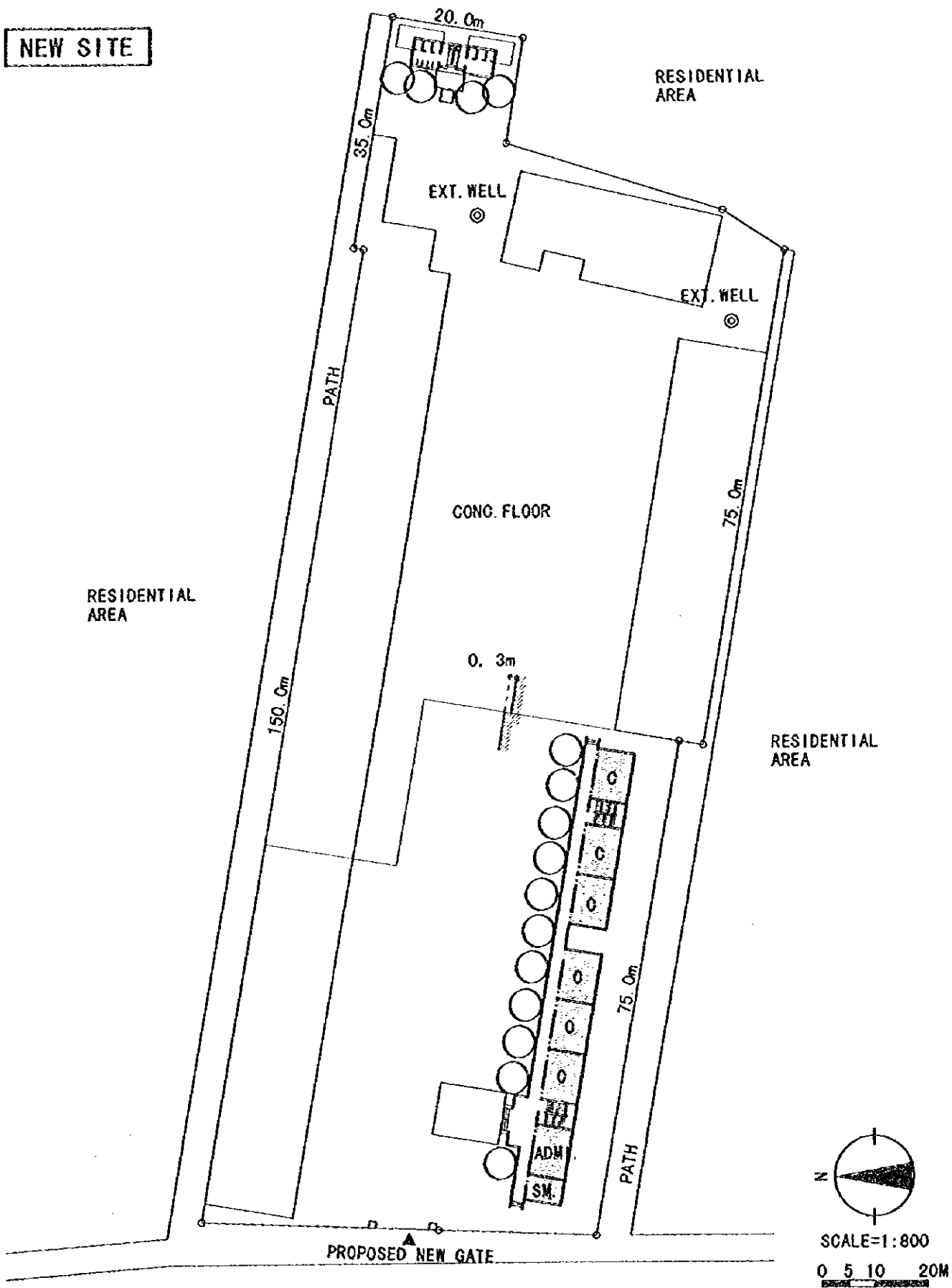

SCALE=1:800  
0 5 10 20M

<p><b>Q11</b></p>	<p><b>TRAN QUOC TOAN</b>          PROVINCE : QUANG NINH          DISTRICT : TP. HA LONG          COMMUNE : P. HONG HA</p>	<p>BLOG. TYPE : 6+7A          TOILET TYPE : A          CLASS ROOM : 13CR</p>	<p>FOUNDATION : A          FL. : GL+0.7m</p>
-------------------	---	--	--

**NEW SITE**

NOTE:  
- PROPOSED SITE IS ON  
A CLAIMED LAND

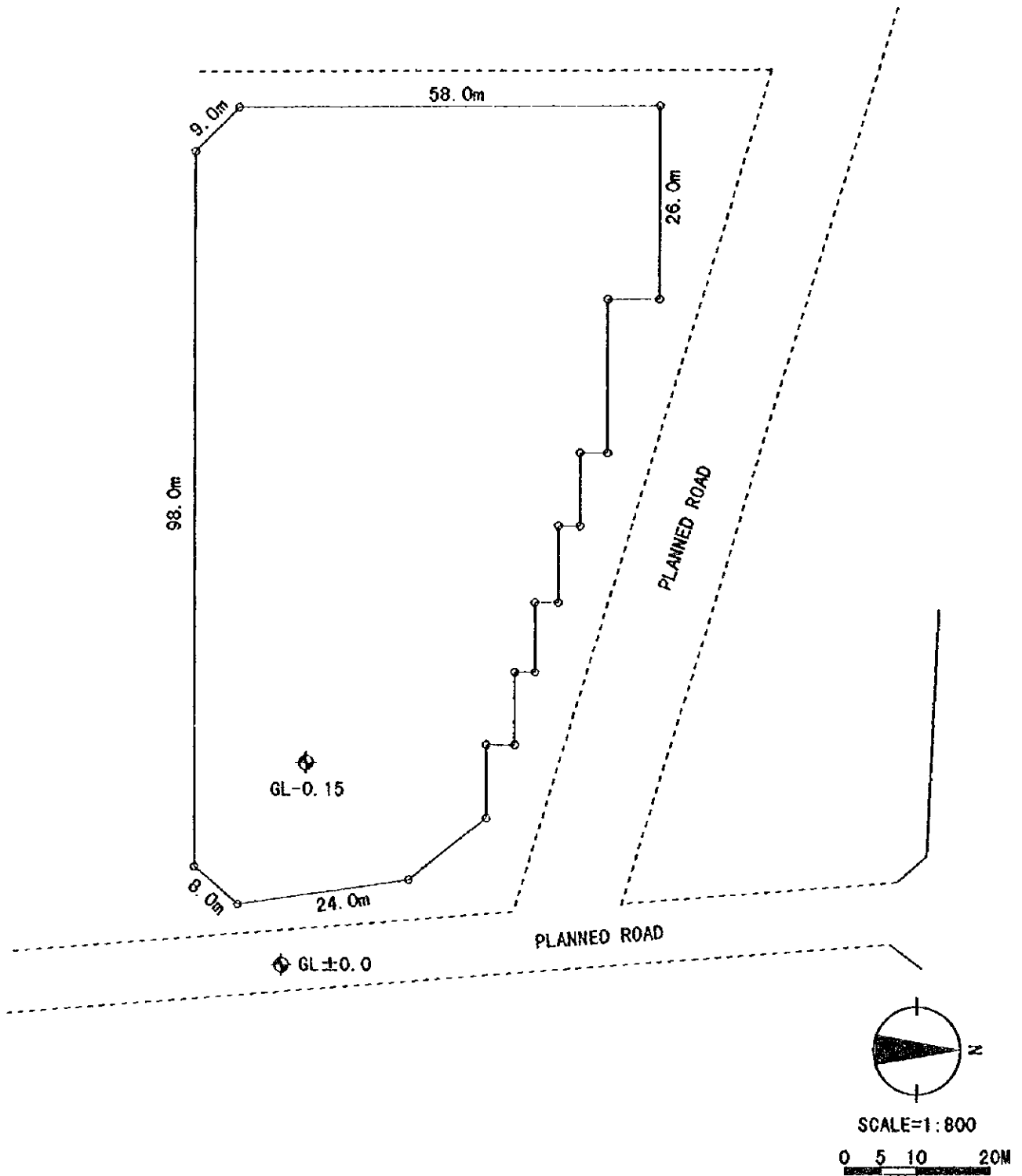

<b>Q12</b>	<b>CAM SON</b>	SITE AREA : 5,600m <sup>2</sup> FLOOD LEVEL : GL+0.1m WATER LEVEL : POWER SUPPLY : AVAILABLE	SOIL FILL : NONE
PROVINCE : QUANG NINH DISTRICT : TP. CAM PHA COMMUNE : CAM SON			



**NEW SITE**

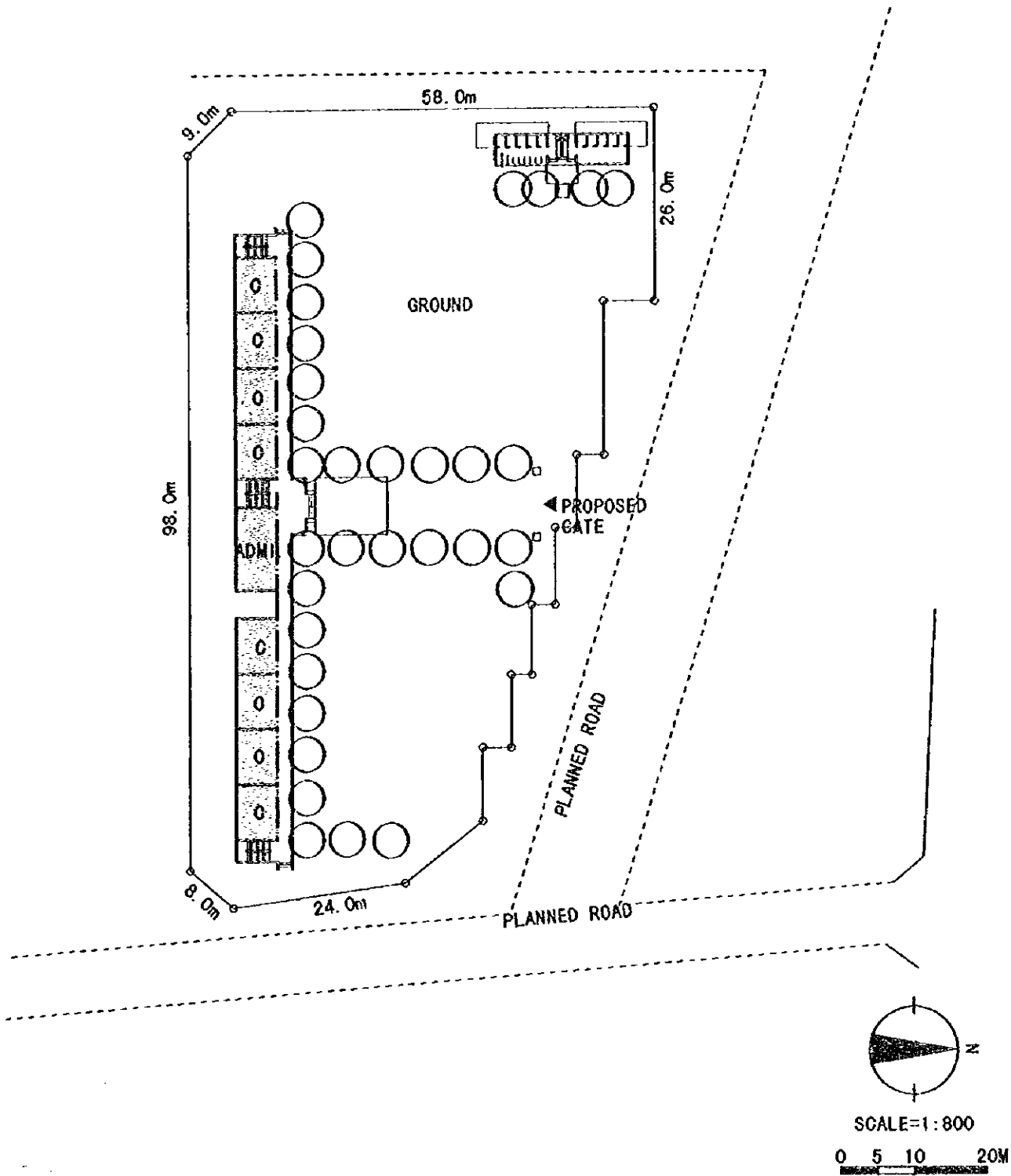

<p><b>Q12</b></p>	<p><b>CAM SON</b>          PROVINCE : QUANG NINH          DISTRICT : TP. CAM PHA          COMMUNE : CAM SON</p>	<p>BLDG. TYPE : 8+9A          TOILET TYPE : B          CLASS ROOM : 17CR</p>	<p>FOUNDATION : B          FL. : GL+0.7m</p>
-------------------	---	--	--

**EXT. SITE**

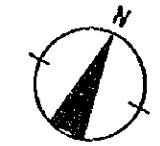
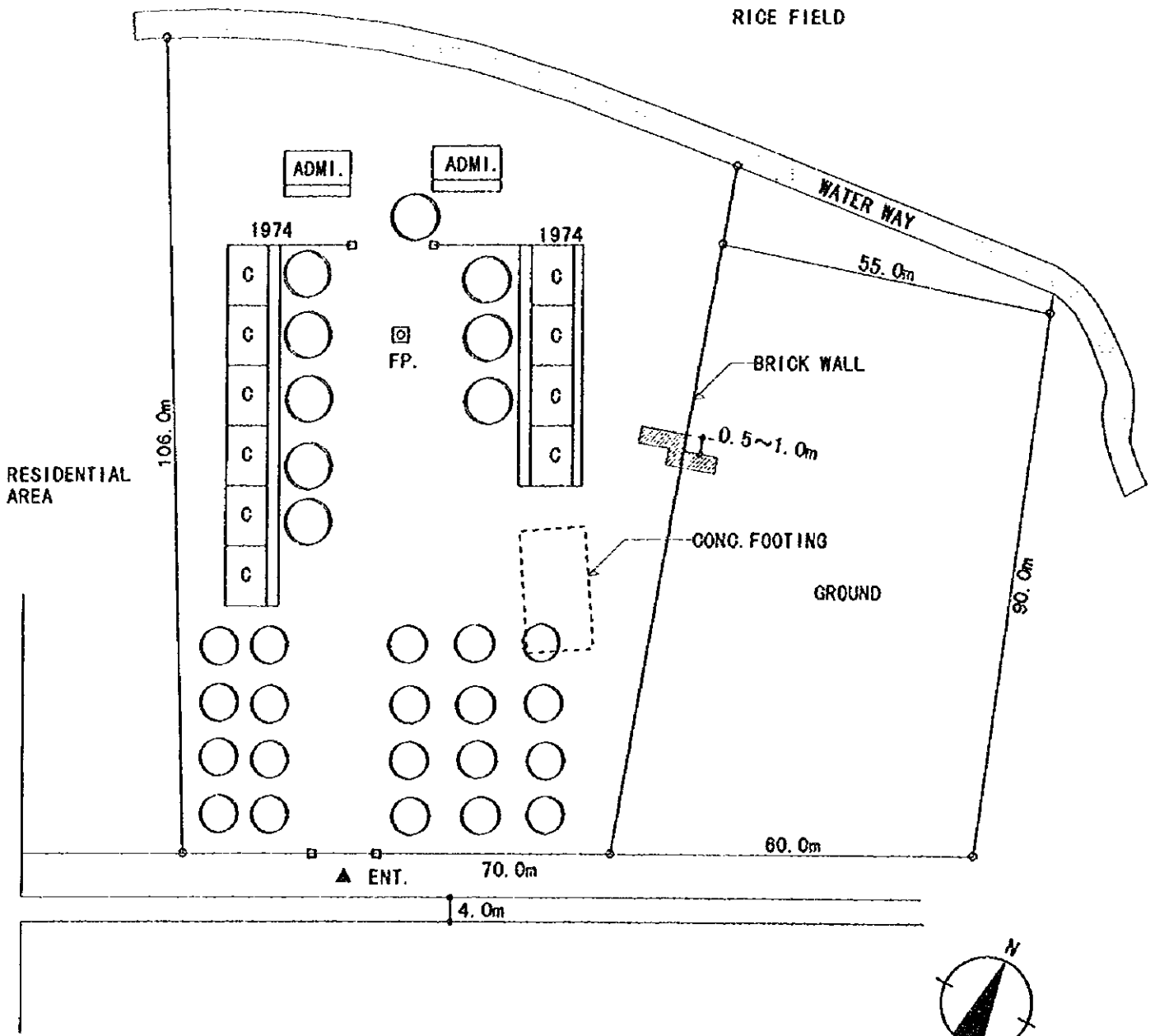

SCALE=1:1000  
0 5 10 20M

<p><b>Qi3</b></p>	<p><b>HONG THAI TAY</b>          PROVINCE : QUANG NINH          DISTRICT : DONG TRIEN          COMMUNE : HONG THAI TAY</p>	<p>SITE AREA : 12,000m<sup>2</sup>          FLOOD LEVEL : NONE          WATER LEVEL : GL-20.0m, MORE          POWER SUPPLY :</p>	<p>SOIL FILL : NEEDED</p>
-------------------	--	--	---------------------------

**EXT. SITE**

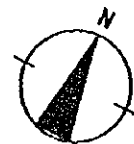
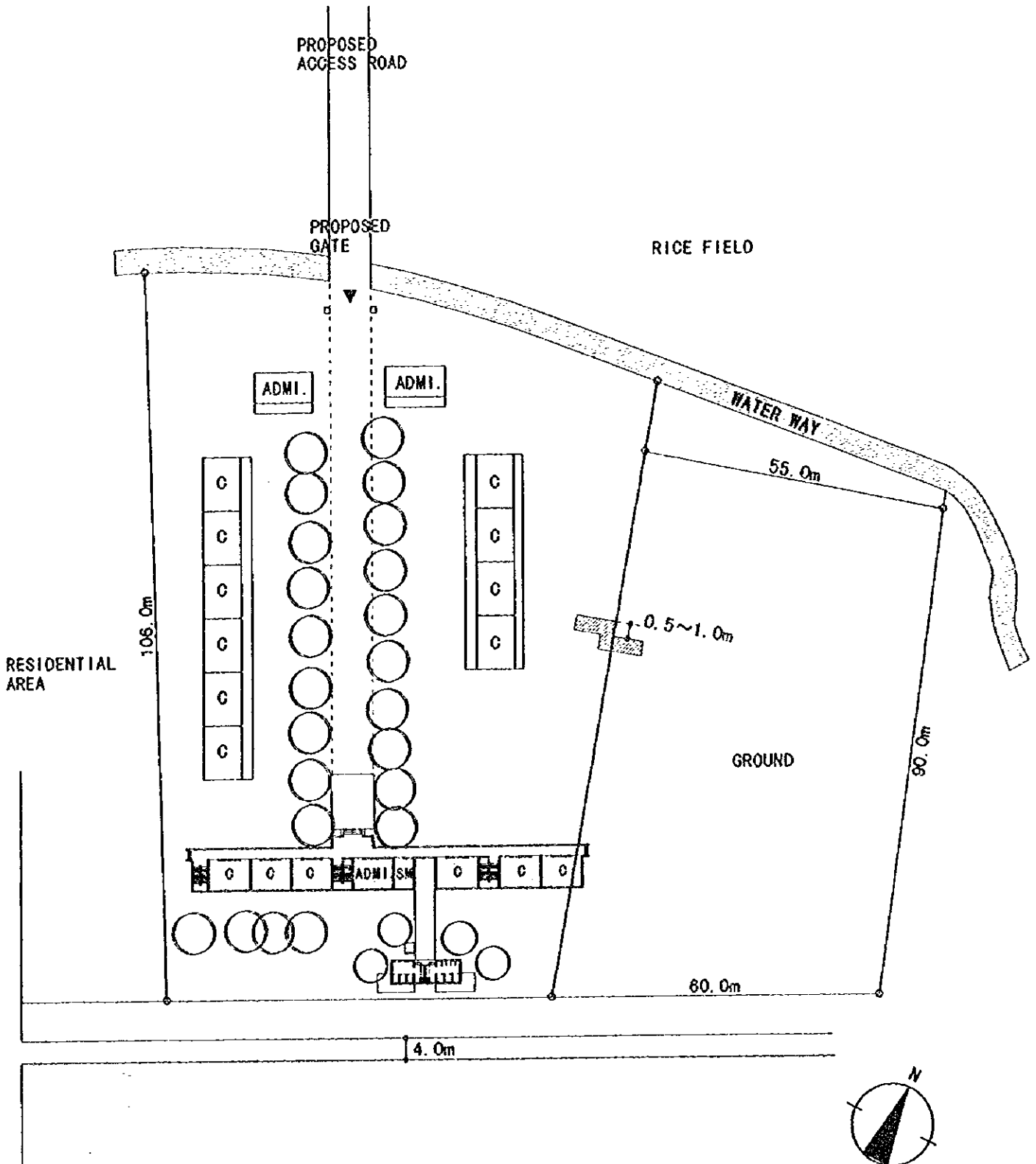

SCALE=1:1000

0 5 10 20M

<p><b>Q13</b></p>	<p><b>HONG THAI TAY</b>          PROVINCE : QUANG NINH          DISTRICT : DONG TRIEN          COMMUNE : HONG THAI TAY</p>	<p>BLDG. TYPE : 6+7A          TOILET TYPE : A          CLASS ROOM : 13CR</p>	<p>FOUNDATION : B          FL. : GL+0.7m</p>
-------------------	--	--	--

**EXT. SITE**

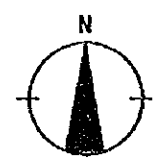
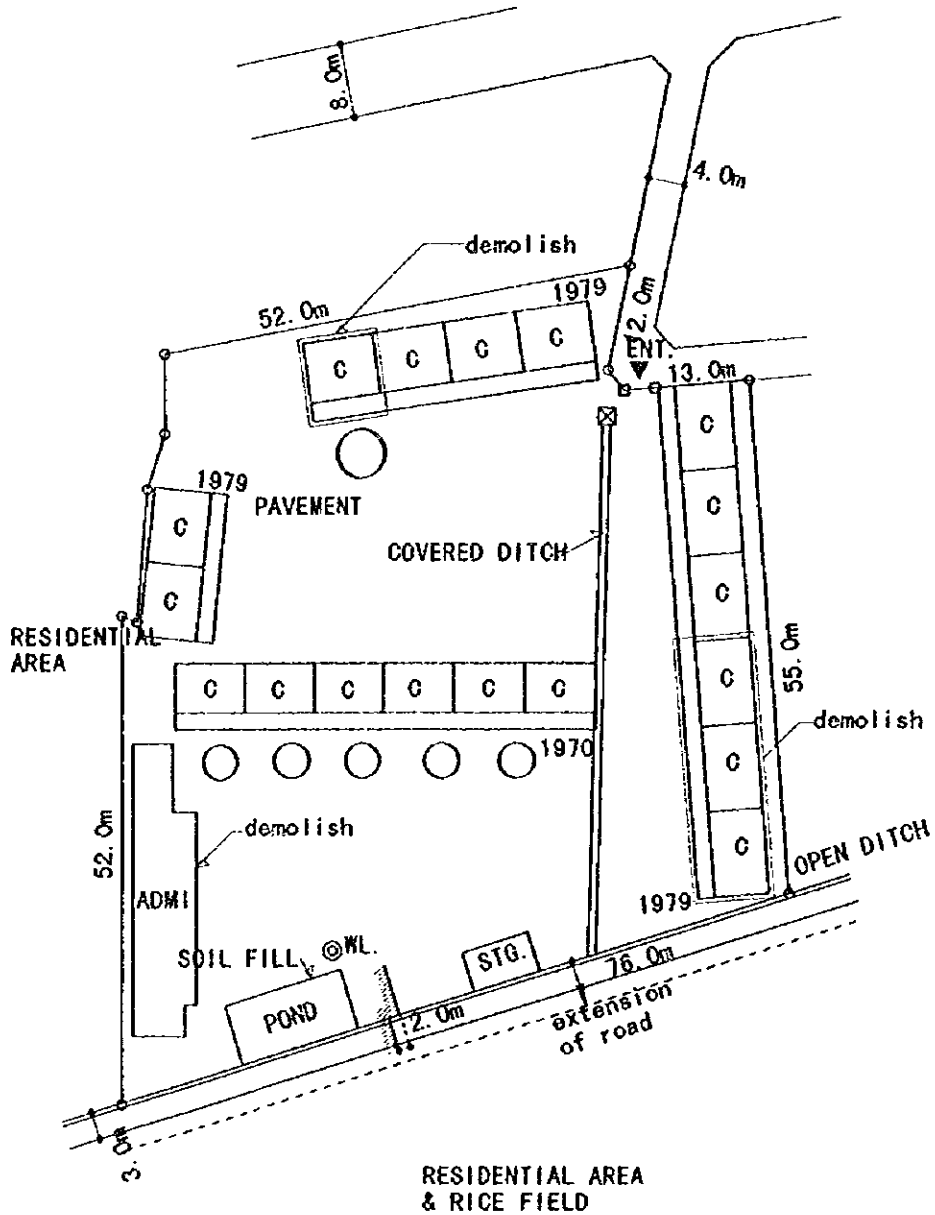

SCALE=1:800  
0 5 10 20M

<p><b>Qi4</b></p>	<p><b>QUANG TRUNG</b>          PROVINCE : QUANG NINH          DISTRICT : TX. UONG BI          COMMUNE : QUANG TRUNG</p>	<p>SITE AREA : 4,700m<sup>2</sup>          FLOOD LEVEL : NONE          WATER LEVEL : GL-5.0m          POWER SUPPLY : AVAILABLE</p>	<p>SOIL FILL : 400m<sup>3</sup></p>
-------------------	---	--	-------------------------------------

**EXT. SITE**

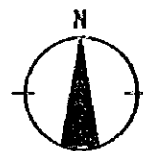
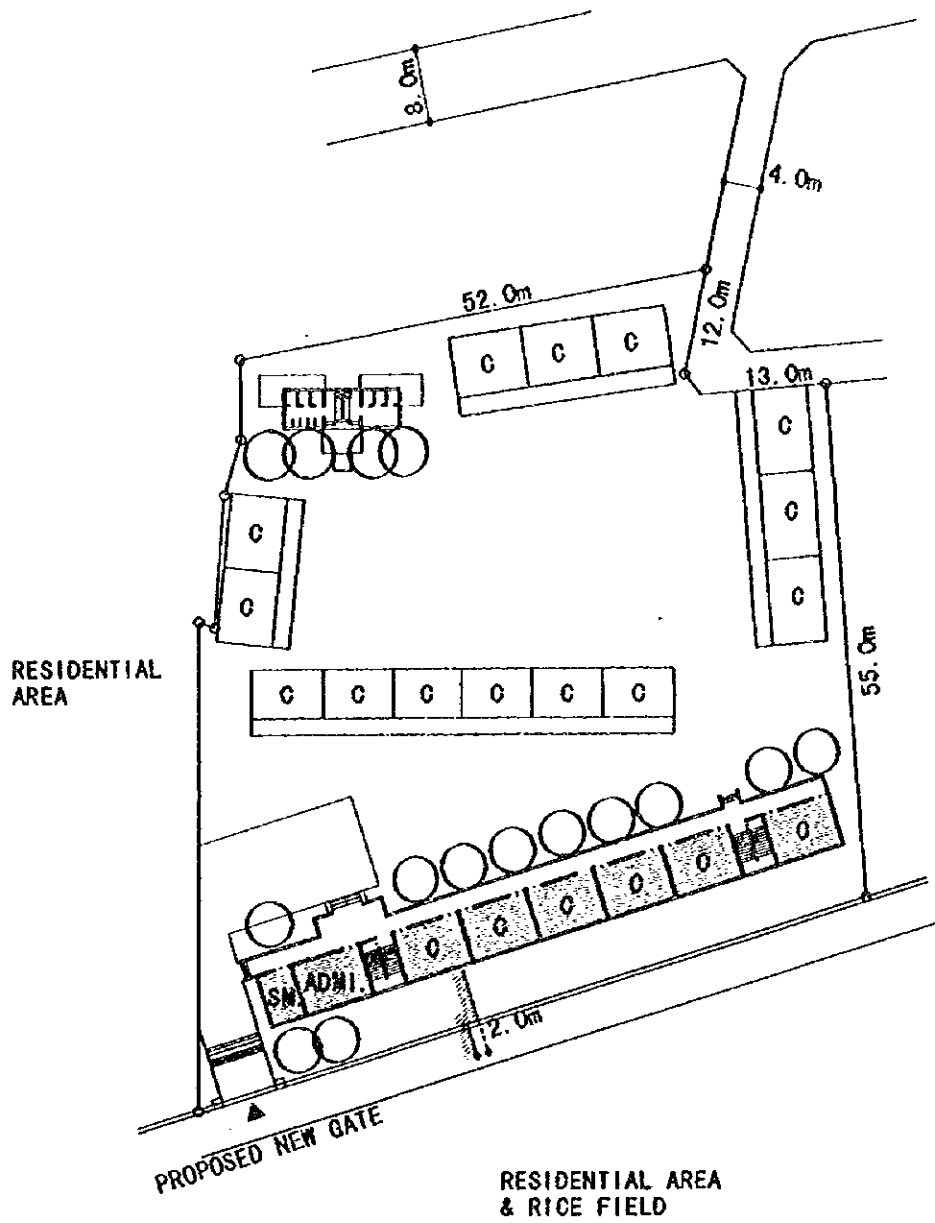

SCALE=1:800  
0 5 10 20M

<p><b>Qi4</b></p>	<p><b>QUANG TRUNG</b>          PROVINCE : QUANG NINH          DISTRICT : TX. UONG BI          COMMUNE : QUANG TRUNG</p>	<p>BLDG. TYPE : 6+7A          TOILET TYPE : A          CLASS ROOM : 13CR</p>	<p>FOUNDATION : B          FL. : GL+0.7m</p>
-------------------	---	--	--

**EXT. SITE**

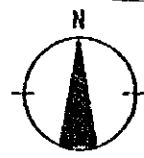
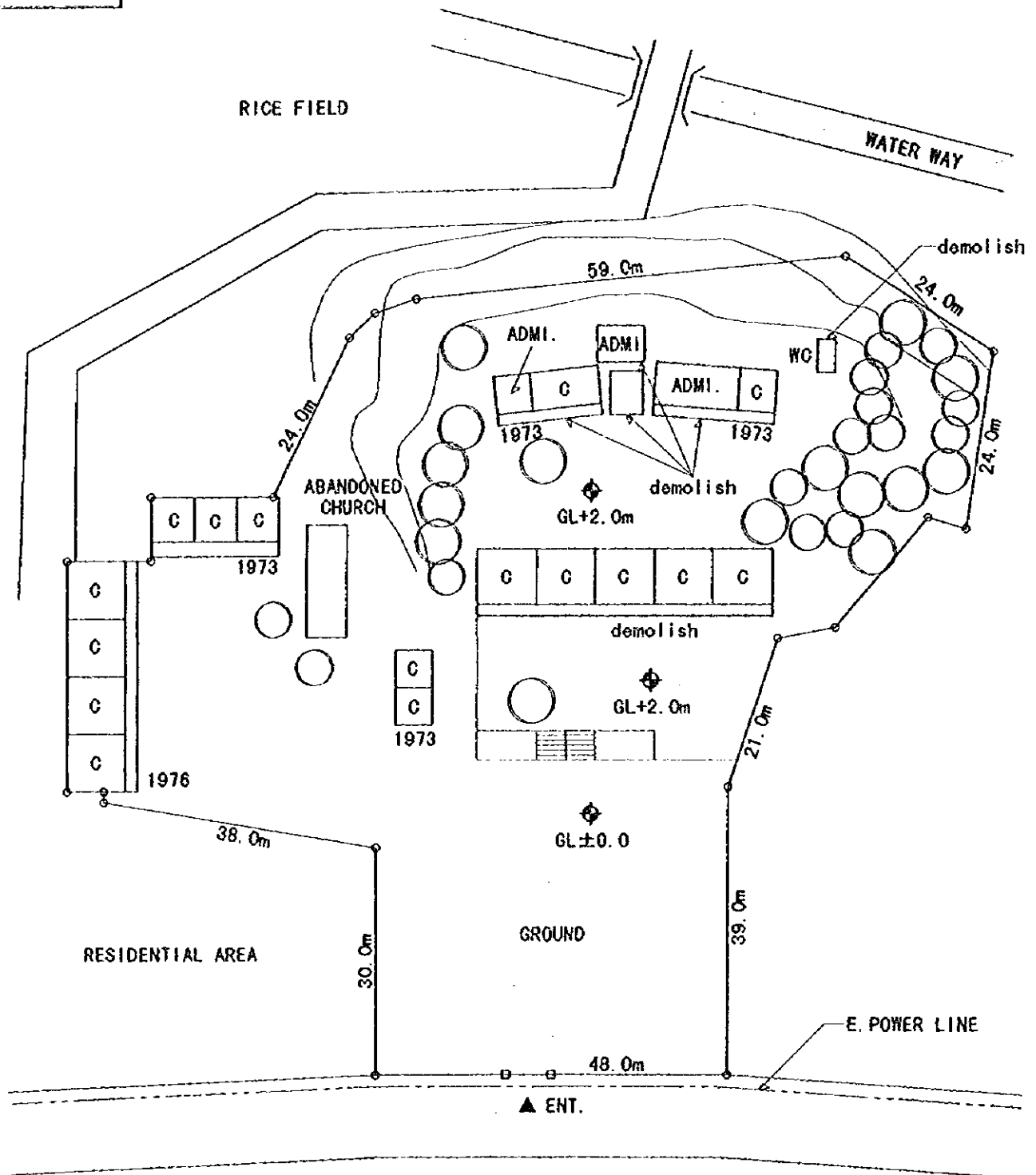

SCALE=1:800



<p><b>Qi5</b></p>	<p><b>CONG HOA 2</b>          PROVINCE : QUANG NINH          DISTRICT : YEN HUNG          COMMUNE : CONG HOA</p>	<p>SITE AREA : 8,600m<sup>2</sup>          FLOOD LEVEL : GL+0.8m          WATER LEVEL :          POWER SUPPLY : AVAILABLE</p>	<p>SOIL FILL : NONE</p>
-------------------	--	---	-------------------------

**EXT. SITE**

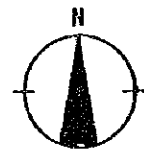
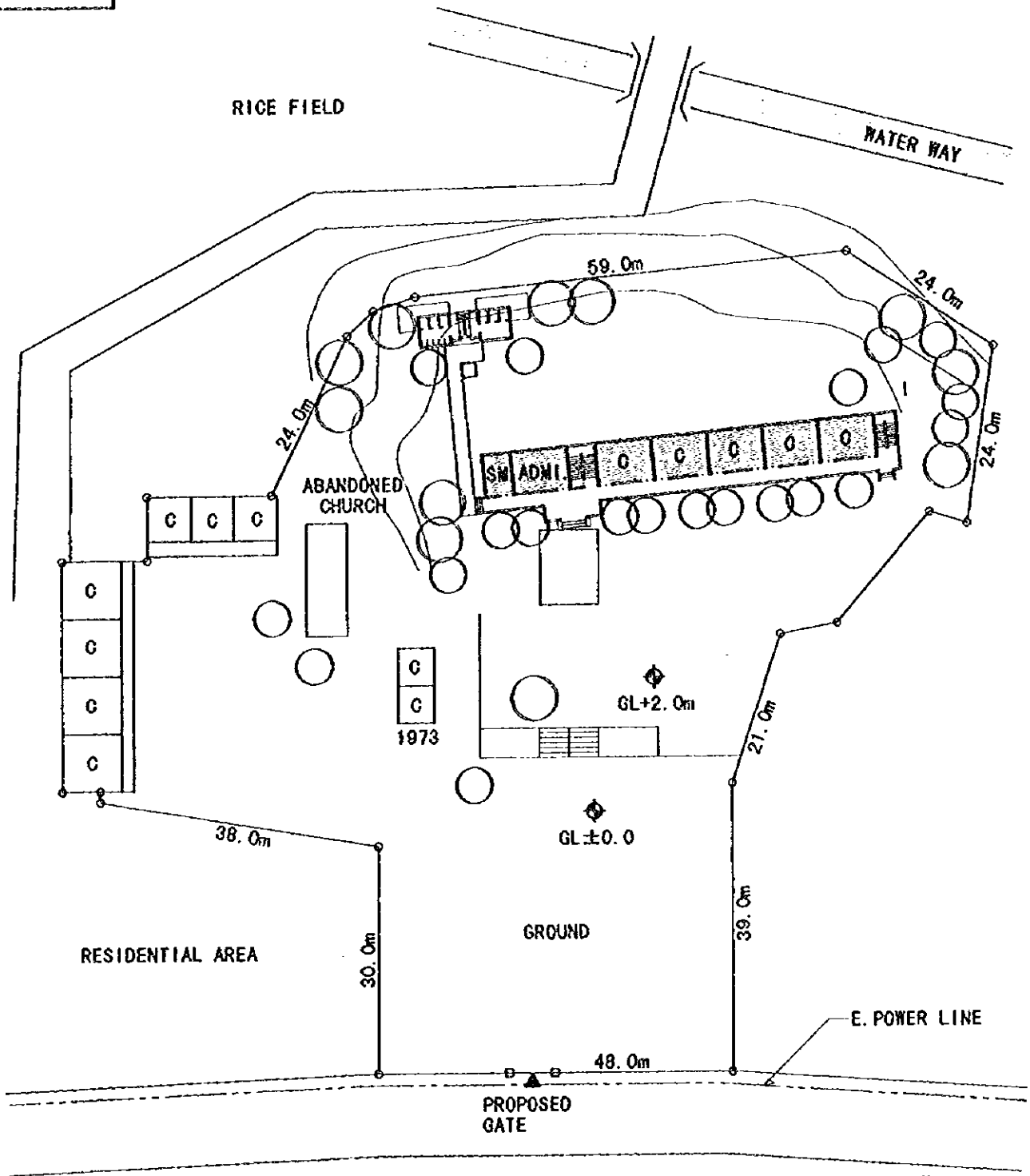

SCALE=1:800



<p><b>Q15</b></p>	<p><b>CONG HOA 2</b>          PROVINCE : QUANG NINH          DISTRICT : YEN HUNG          COMMUNE : CONG HOA</p>	<p>BLDG. TYPE : 11A          TOILET TYPE : A          CLASS ROOM : 11CR</p>	<p>FOUNDATION : A          FL. : GL+0.8m</p>
-------------------	--	---	--

**EXT. SITE**

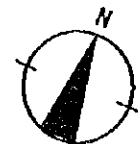
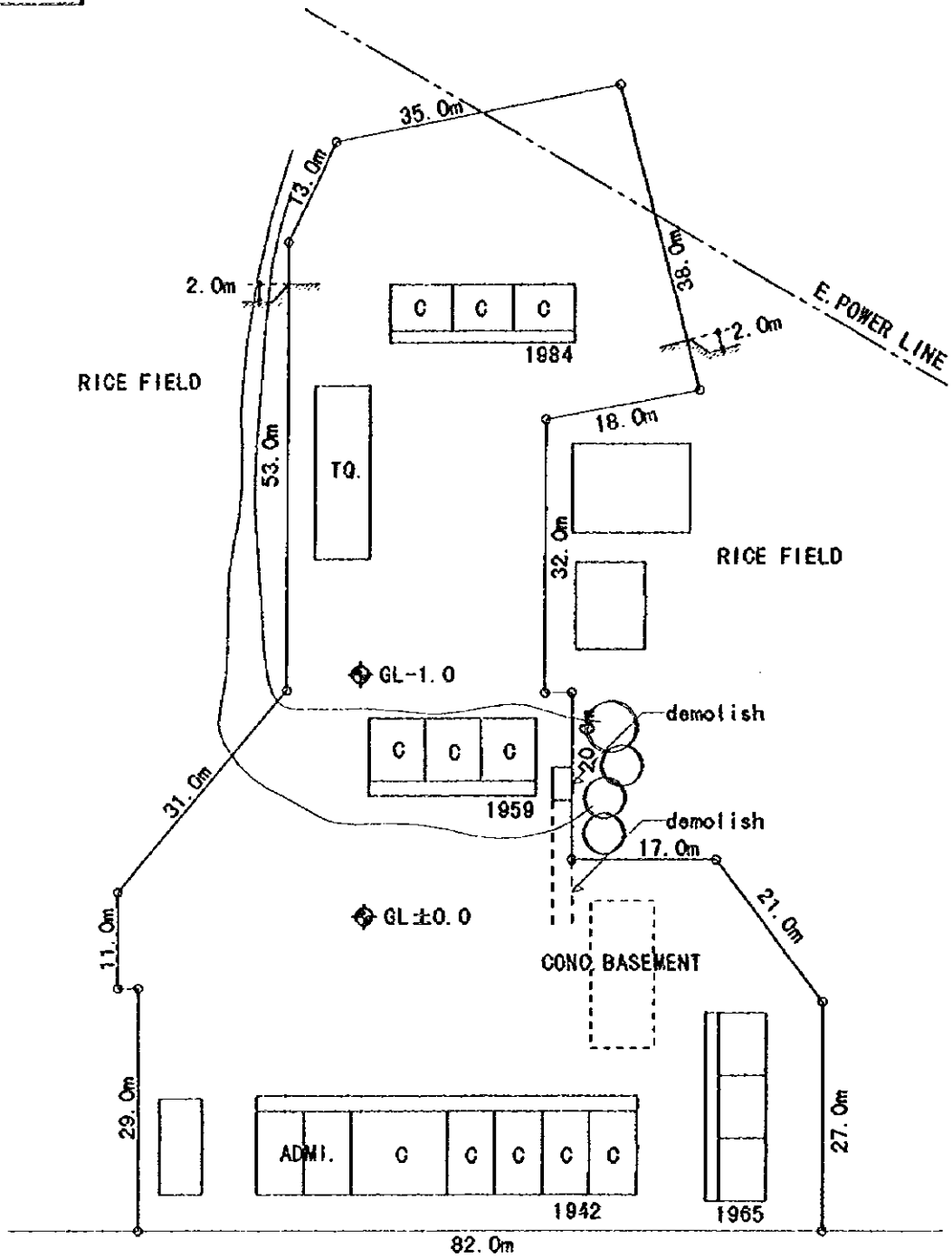

SCALE=1:800

0 5 10 20M

<b>Q16</b>	<b>T. T. TIEN YEN</b>	SITE AREA : 6,800m <sup>2</sup> FLOOD LEVEL : NONE WATER LEVEL : POWER SUPPLY : AVAILABLE	SOIL FILL : NONE
	PROVINCE : QUANG NINH DISTRICT : TIEN YEN COMMUNE : T. T. TIEN YEN		



**EXT. SITE**

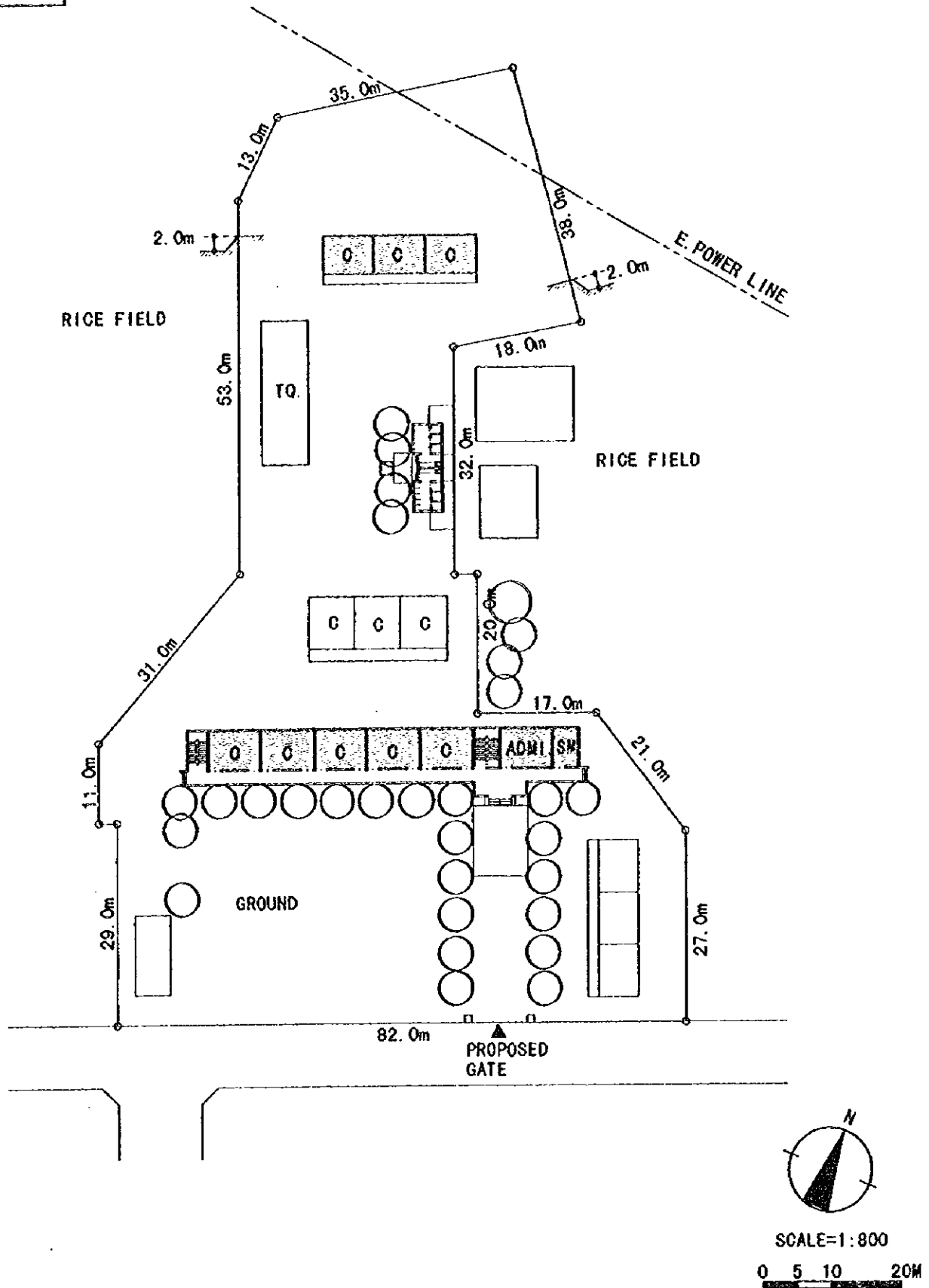

<p><b>Q16</b></p>	<p><b>T. T. TIEN YEN</b>          PROVINCE : QUANG NINH          DISTRICT : TIEN YEN          COMMUNE : T. T. TIEN YEN</p>	<p>BLDG. TYPE : 11A          TOILET TYPE : A          CLASS ROOM : 11CR+(3CR)</p>	<p>FOUNDATION : A          FL. : GL+0.7m</p>
-------------------	--	---	--

**EXT. SITE**

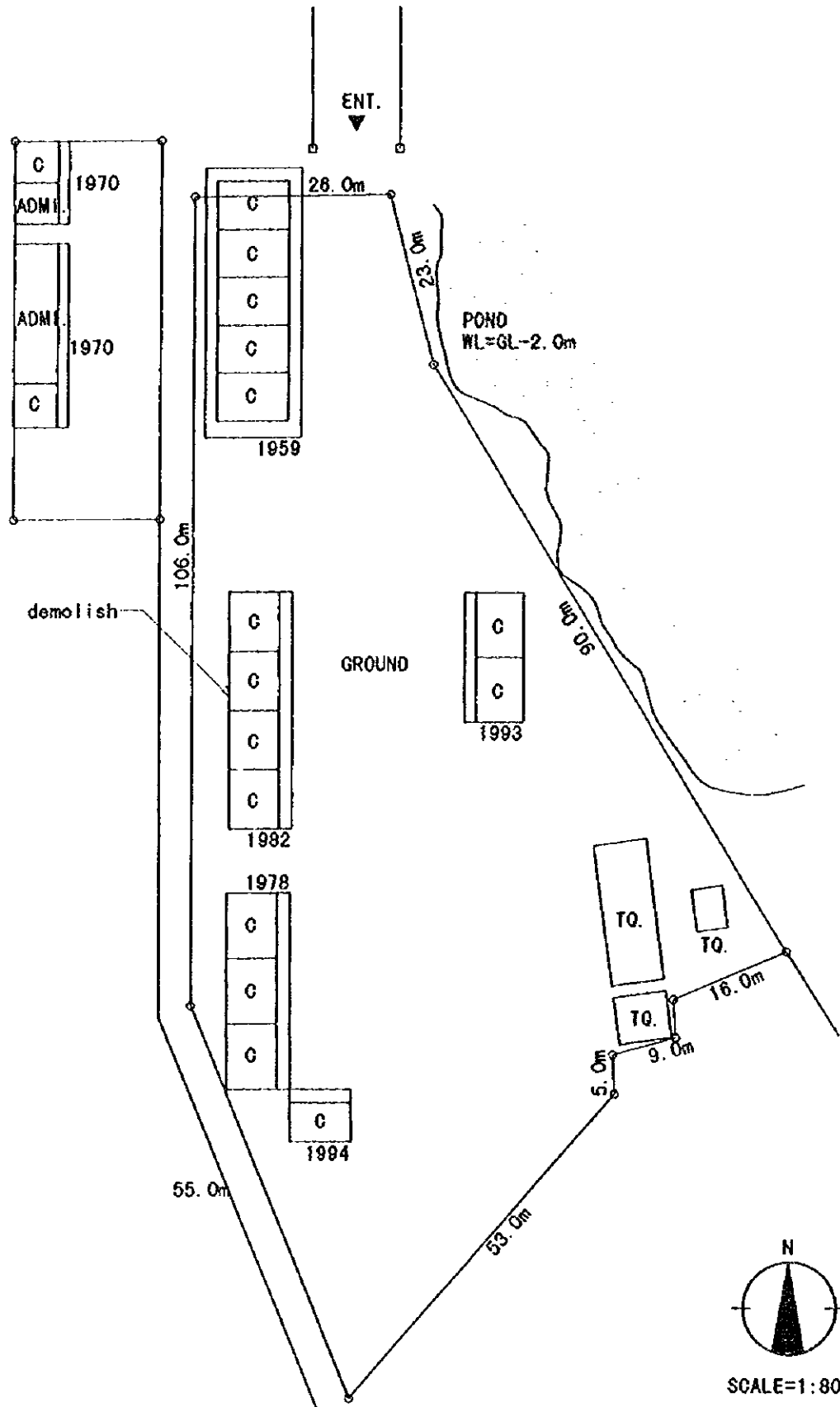

<b>Qi7</b>	<b>T. T. BINH LIEU</b>	SITE AREA : 7,600m <sup>2</sup> FLOOD LEVEL : NONE WATER LEVEL : GL-12.0m POWER SUPPLY : AVAILABLE	SOIL FILL : NONE
PROVINCE : QUANG NINH DISTRICT : BINH LIEU COMMUNE : T. T. BINH LIEU			

**EXT. SITE**

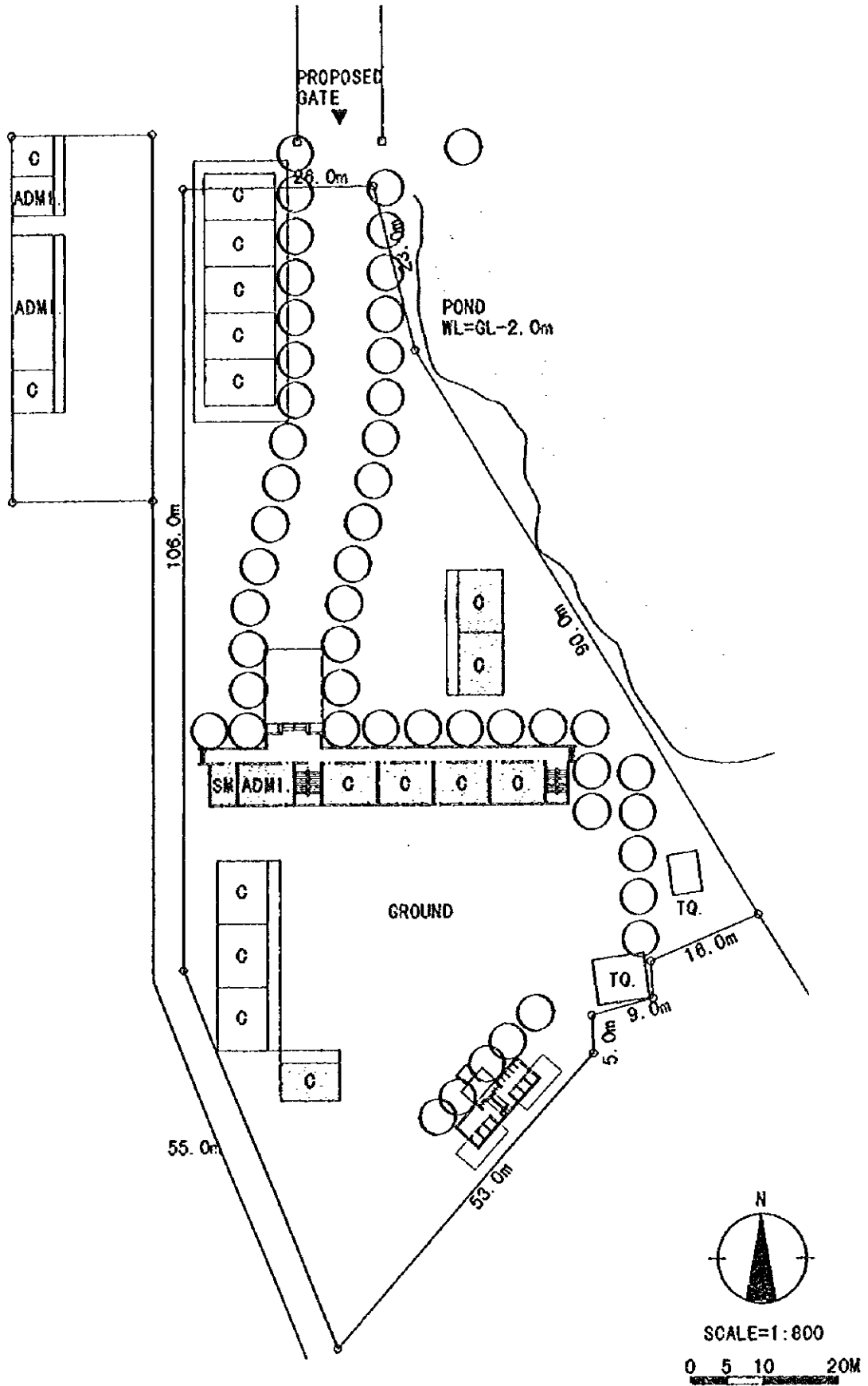

<p><b>Qi7</b></p>	<p><b>T. T. BINH LIEU</b>          PROVINCE : QUANG NINH          DISTRICT : BINH LIEU          COMMUNE : T. T. BINH LIEU</p>	<p>BLDG. TYPE : 9A          TOILET TYPE : A          CLASS ROOM : 9CR+(3CR)</p>	<p>FOUNDATION : A          FL. : GL+0.7m</p>
-------------------	---	---	--

**EXT. SITE**

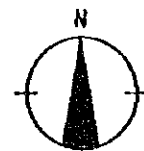
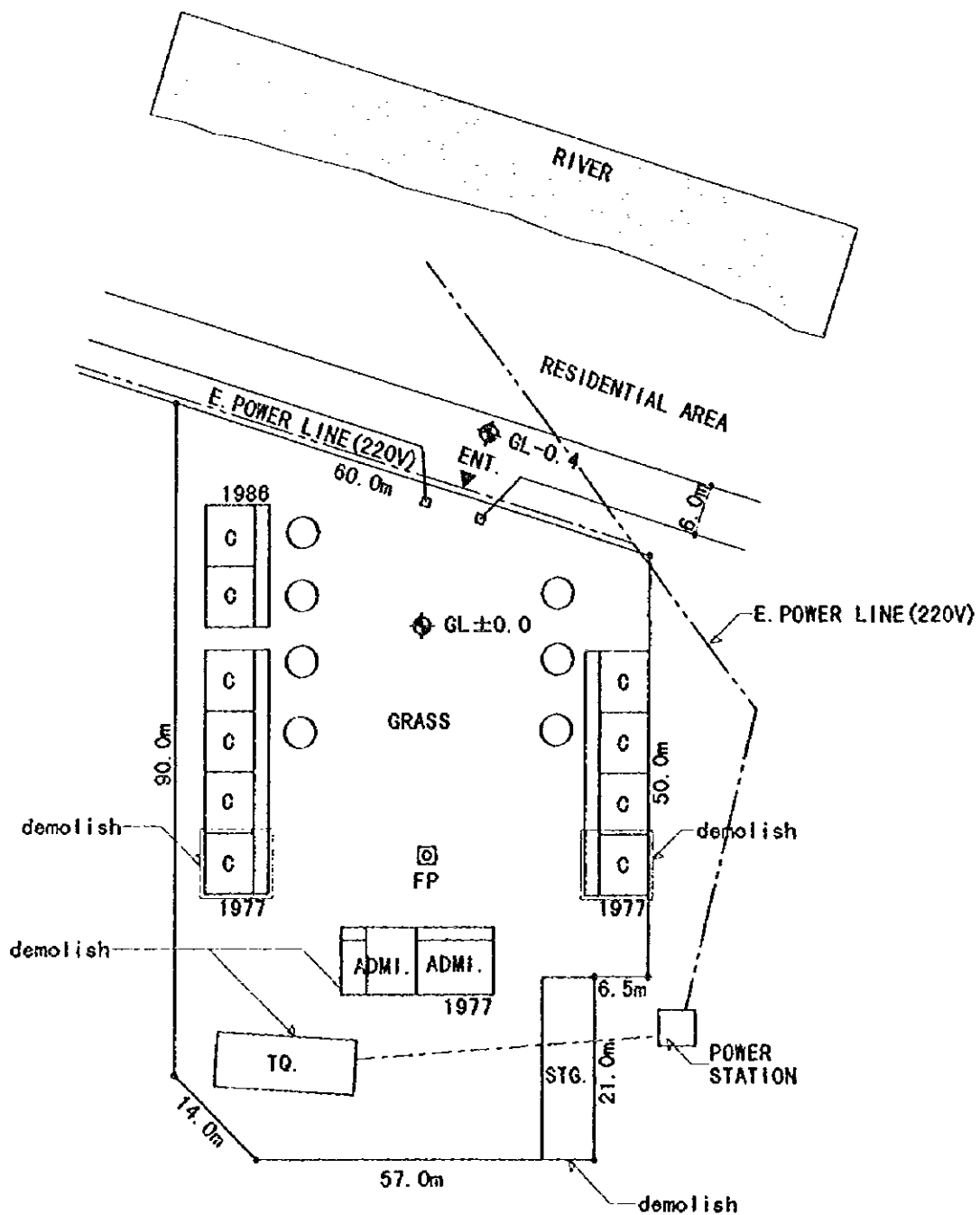

SCALE=1:800

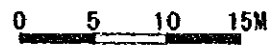

Qi8	BA CHE	SITE AREA : 4,500m <sup>2</sup>	SOIL FILL : NONE
	PROVINCE : QUANG NINH DISTRICT : BA CHE COMMUNE : T. T. BA CHE	FLOOD LEVEL : NONE WATER LEVEL : GL-15.0m POWER SUPPLY : AVAILABLE	

**EXT. SITE**

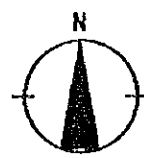
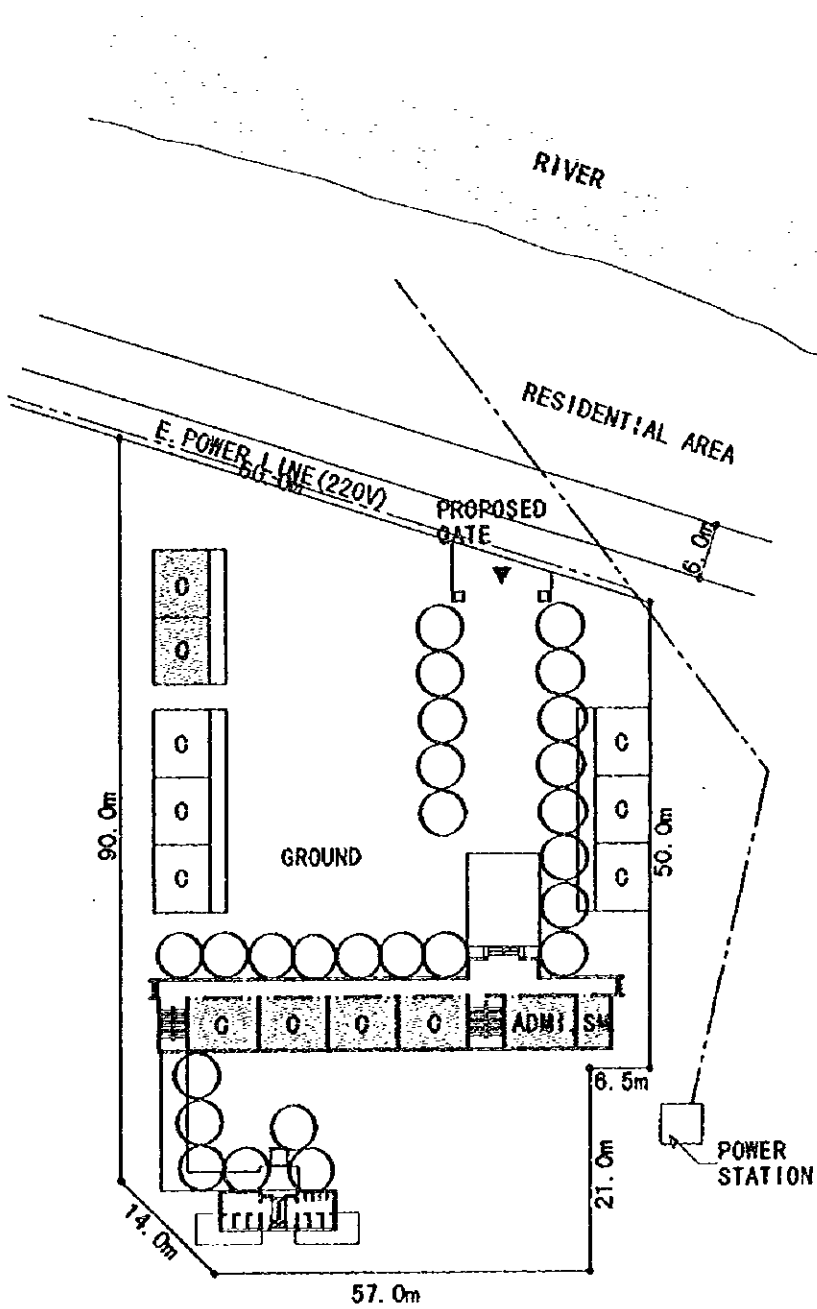

SCALE=1:500  
0 5 10 15M

<b>Qi8</b>	<b>BA CHE</b>	<b>BLDG. TYPE : 9A</b>	<b>FOUNDATION : A</b>
	PROVINCE : QUANG NINH DISTRICT : BA CHE COMMUNE : T. T. BA CHE	TOILET TYPE : A CLASS ROOM : 9CR+(2CR)	<b>FL. : GL+0.7m</b>

**EXT. SITE**

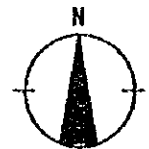
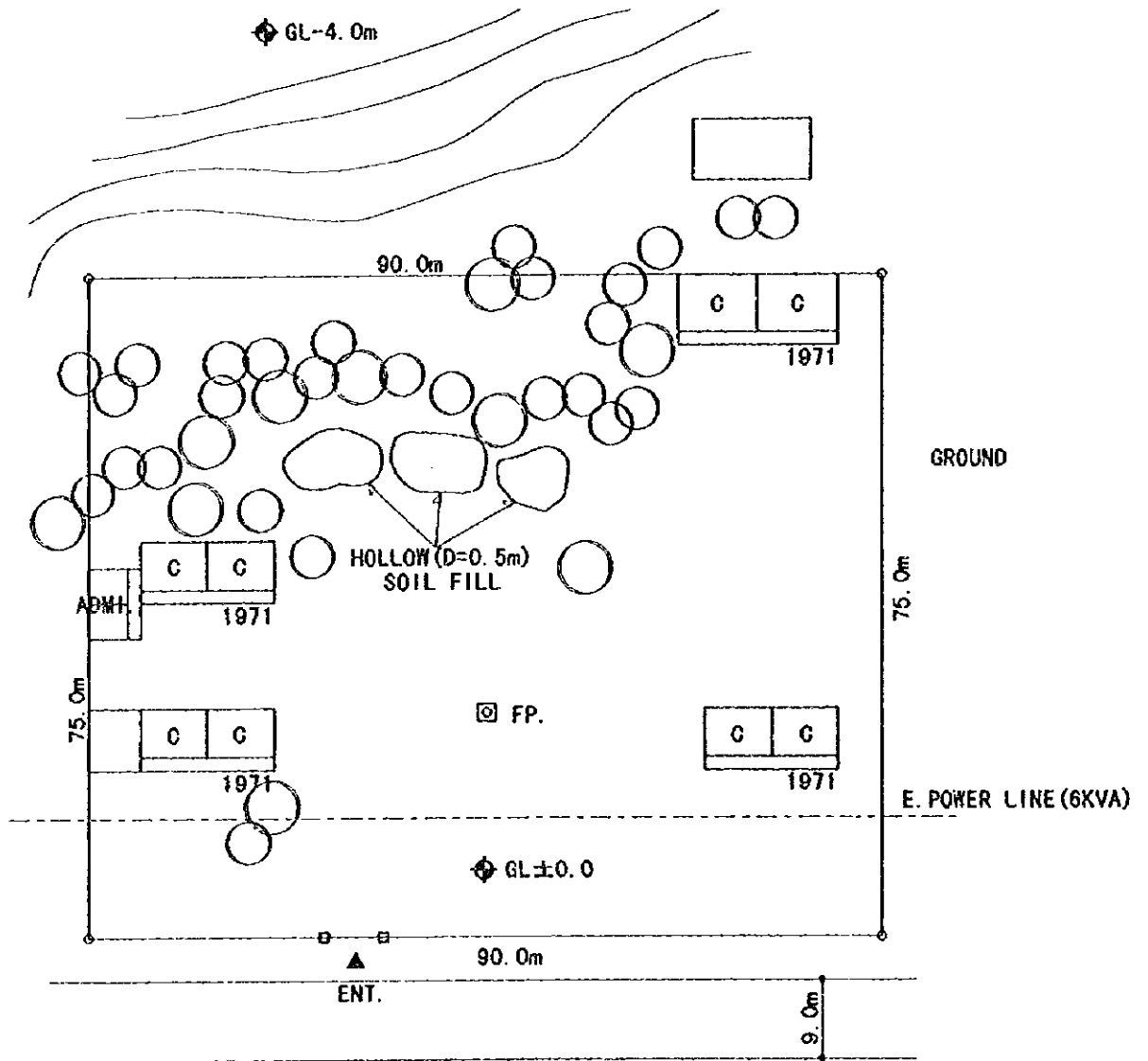

SCALE=1:800

0 5 10 20M

<p><b>Q19</b></p>	<p><b>HA LONG 1</b>          PROVINCE : QUANG NINH          DISTRICT : VAN DON          COMMUNE : HA LONG</p>	<p>SITE AREA : 6,700m<sup>2</sup>          FLOOD LEVEL : NONE          WATER LEVEL : GL-10.0m          POWER SUPPLY : AVAILABLE</p>	<p>SOIL FILL : NEEDED</p>
-------------------	---	---	---------------------------

**EXT. SITE**

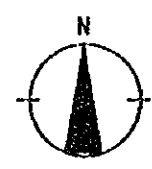
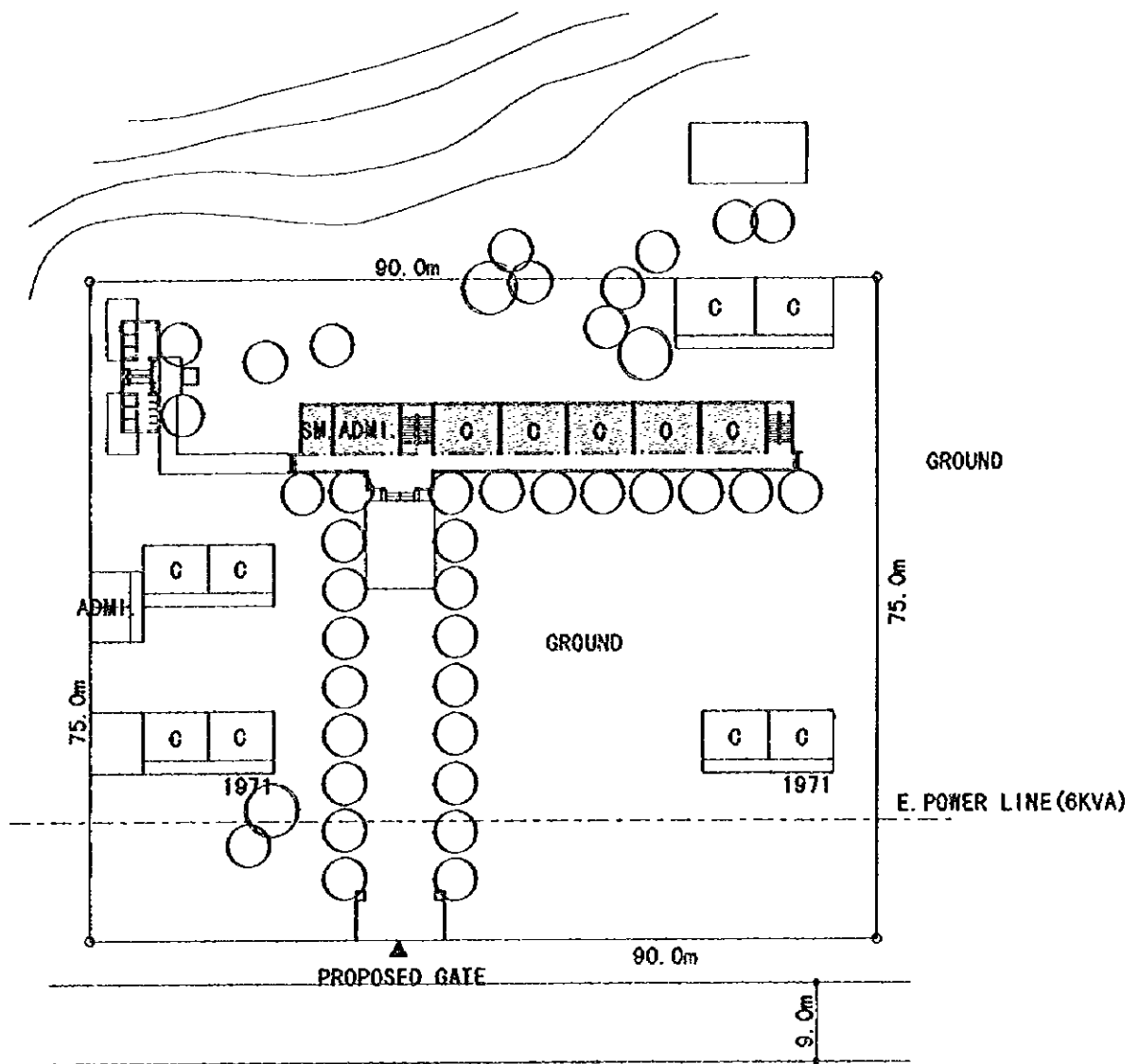

SCALE=1:800  
 0 5 10 20M

<b>Qi9</b>	<b>HA LONG 1</b>	BLDG. TYPE : 11A	FOUNDATION : 8
	PROVINCE : QUANG NINH DISTRICT : VAN DON COMMUNE : HA LONG	TOILET TYPE : A CLASS ROOM : 11CR	FL. : GL+0.7m

**EXT. SITE**

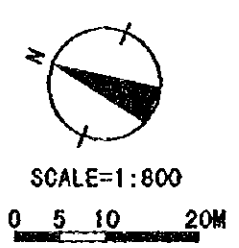
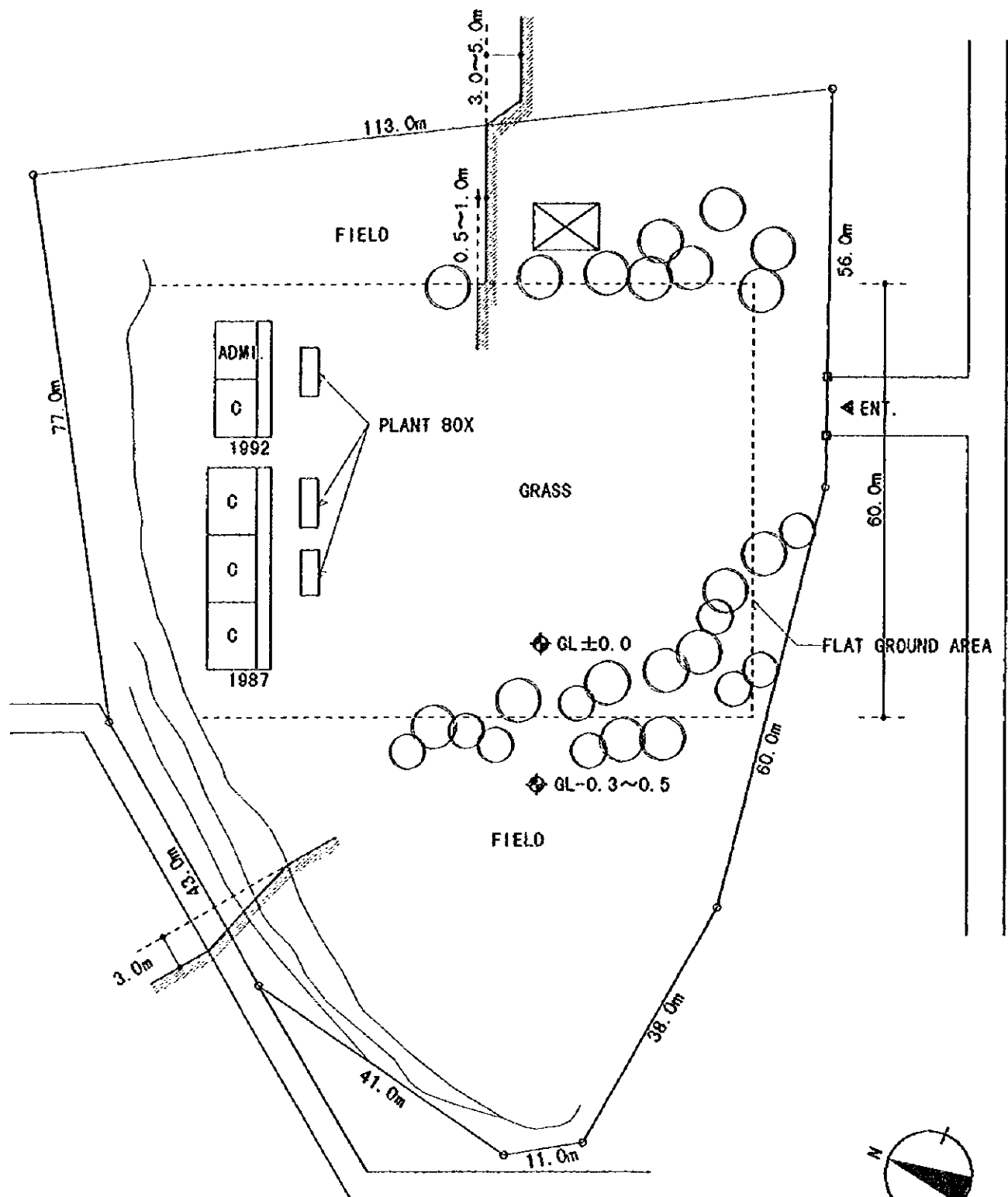

<b>Qi10</b>	<b>DAM HA</b>	<b>SITE AREA : 12,000m<sup>2</sup></b>	<b>SOIL FILL : NONE</b>
	PROVINCE : QUANG NINH DISTRICT : QUANG HA COMMUNE : T. T. QUANG HA	FLOOD LEVEL : NONE WATER LEVEL : GL-7.0m POWER SUPPLY : AVAILABLE	



**EXT. SITE**

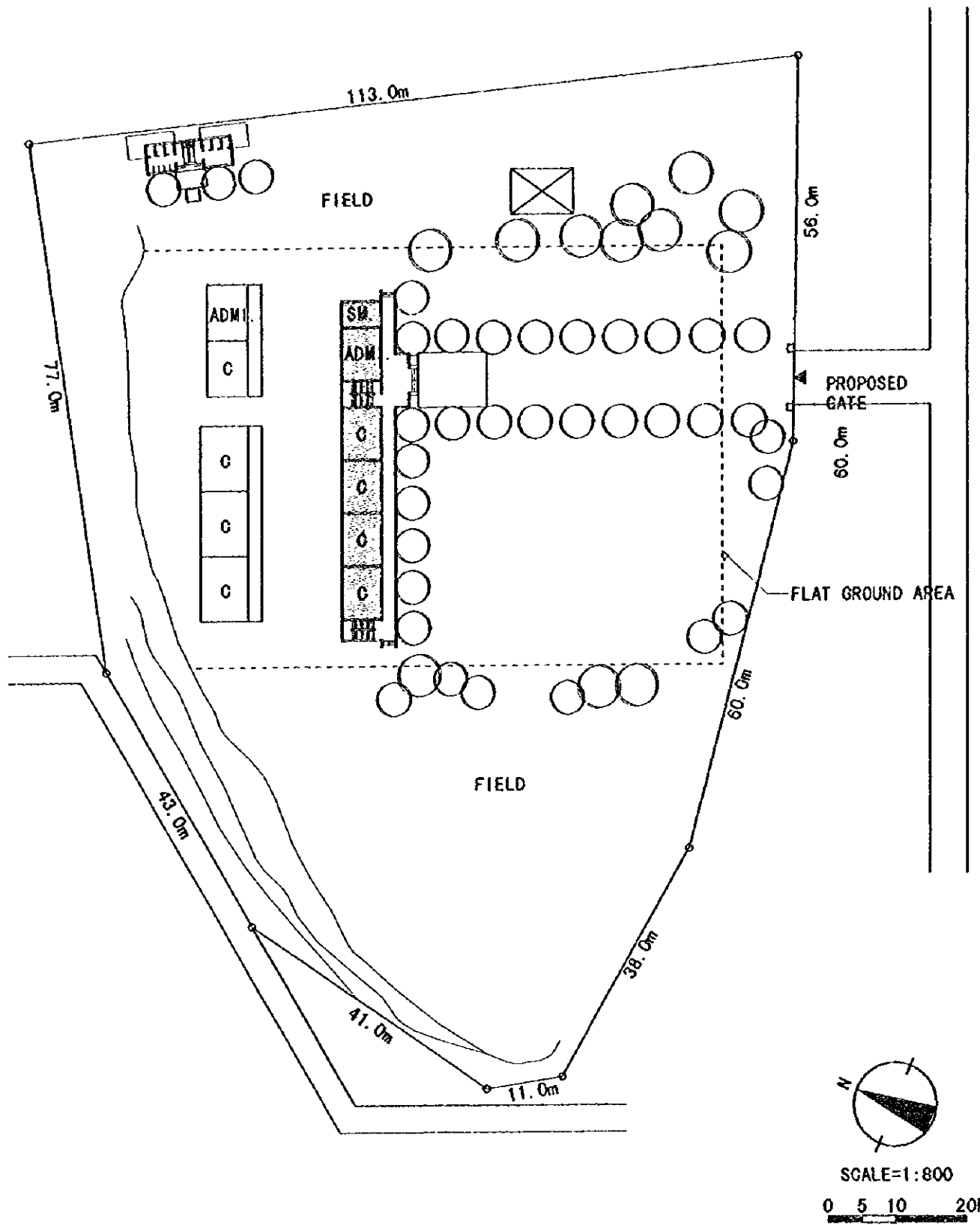

<b>Q10</b>	<b>DAM HA</b>	<b>BLDG. TYPE : 9A</b>	<b>FOUNDATION : A</b>
	PROVINCE : QUANG BINH DISTRICT : QUANG HA COMMUNE : T. T. QUANG HA	TOILET TYPE : A CLASS ROOM : 9CR	FL. : GL+0.7m



## APPENDIX 9 REFERENCE

### 1. CATCHING UP

- Capacity Development for Poverty Elimination in Viet Nam  
UNDP, UNICIEF, Oct. 1996
2. Ke Hoach 5 Nam Phat Trien Giao Duc (1996/97-2000/01)  
Five Year Plan to Develop Education (1996/97-2000/01)MOET, Dec. 1996
3. Danh Sach Cac Truong Tieu Hoc Duoc To Chuc Tam Nhin The Gioi Vien Tro  
List of primary schools aided by WVI
4. Nghi Quyet Ve Ke Hoach 5 Nam 1996-2000  
Decision on 1996-2000 Five Year Plan (news paper)
5. Education Financing Sector Study, The World Bank, Oct. 1996
6. Country Programme of Cooperation 1996-2000, UNICEF, Jun. 1995
7. NIEN GIAM THONG KE 1995, Statistical Yearbook,  
Statistical Publishing House, 1996
8. NGO Directory 1996/97, NGO Resource Centre, May 1996
9. RESOLUTION, 2<sup>nd</sup> Plenum of The Party Central Committee (VIII tenure)  
Viet Nam Communist Party, Central Committee, Dec. 1996
10. Memorandum of Understanding, The Lower Secondary Education  
Development Project, Asian Development Bank, Apr. 1997
11. So Lieu Thong Ke Giao Duc Va Dao Tao 1981-1990  
Statistical Data of Education and Training, 1981-1990, Hanoi, 1992
12. So Lieu Thong Ke Giao Duc, 1994/95  
Statistical Data of Education 1994/95 Hanoi Dec. 1994
13. So Lieu Thong Ke Giao Duc,  
Statistical Data of Education 1995/96 Hanoi Nov. 1995
14. So Lieu Thong Ke Giao Duc  
Statistical Data of Education 1996/97 Hanoi Nov. 1996
15. Tinh Hinh Dau Tu Va Co Che Quan Ly Ngan Sach Giao Duc Va Dao Tao  
Situation of investment and policy of educational and training budget  
management
16. Trung Hoc Su Pham (12+2) Dao Tao Gio Vien Cap 1  
Program for training teachers for primary schools, Hanoi, 1992
17. Muc Tieu, Ke Hoach, Chung Trinh Cao Dang Su Pham Dao Tao Giao  
Vien Tieu Hoc, Target, plan, program at High schools to train teachers  
for primary schools, Jul. 1995









JICA