

7. Plan de localisation et plan-masse

□対象校の分布:YAOUNDE

*●が計画対象サイト、○調査サイト

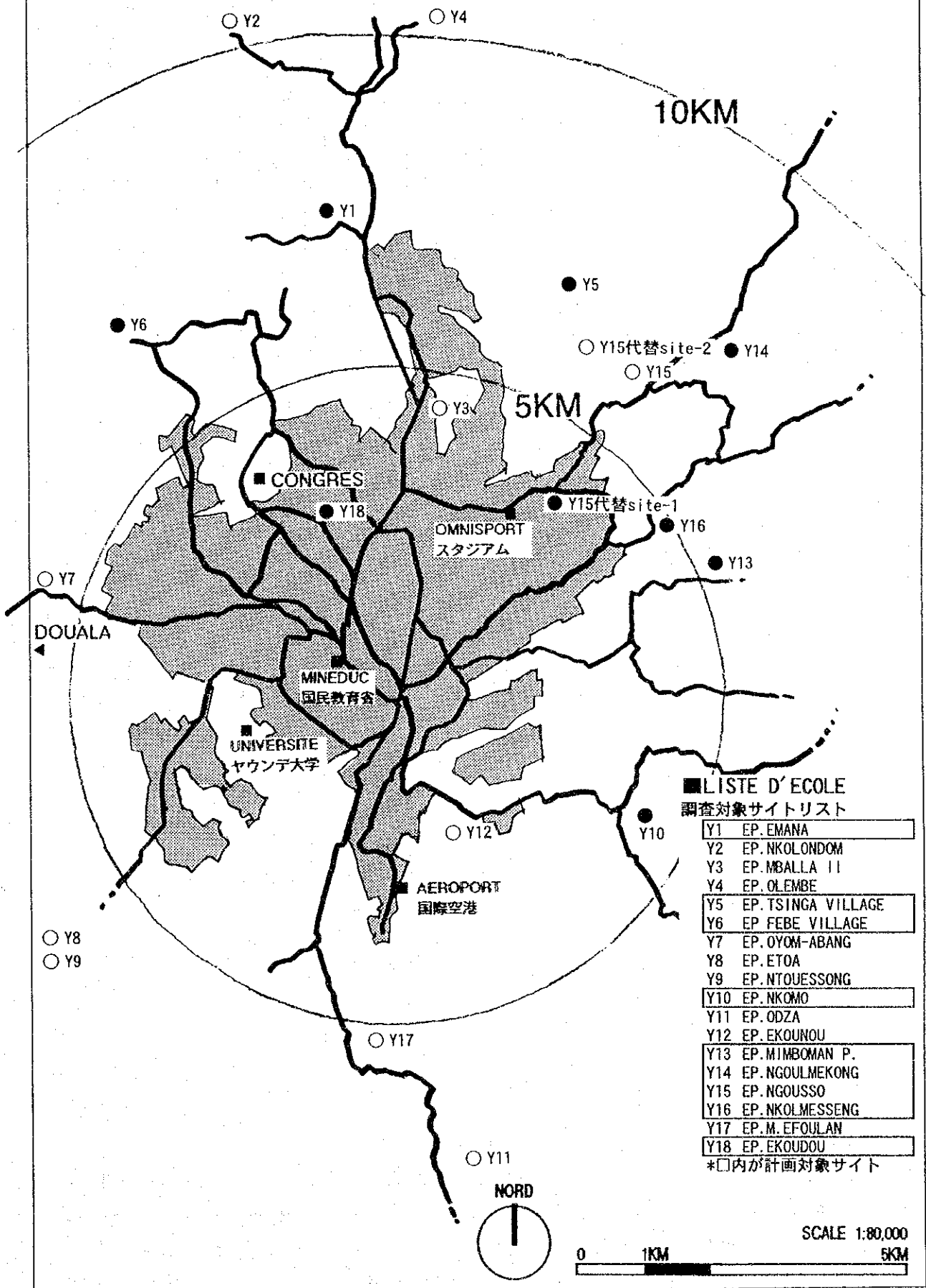

VALLEE
FORET

PENTE
←

4DS

M

VOIRIE

LYCEE

• ±0

+600

L3

LEGENDE

 BATIMENT A CONSTRUIRE

 BATIMENT EXISTANT

 A DEMOLIR AVANT CONSTRUCTION

ECH. 1: 500





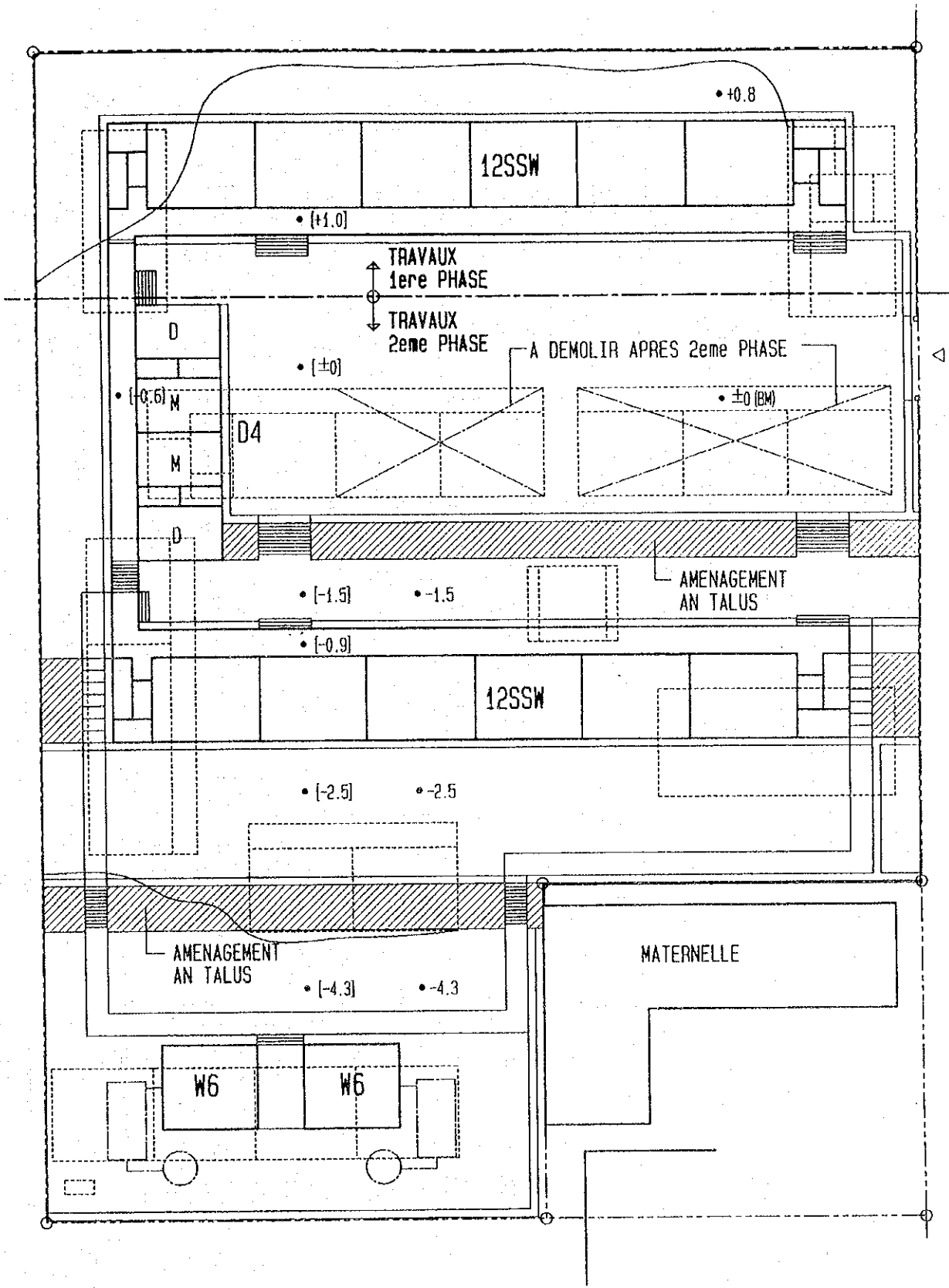

Y 1

EP EMANA
YAOUNDE-1

TYPE: 4DS+L3



LEGENDE

- | | |
|---|--|
|  BATIMENT A CONSTRUIRE |  A DEMOLIR AVANT CONSTRUCTION |
|  BATIMENT EXISTANT |  A DEMOLIR APRES CONSTRUCTION |

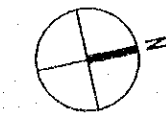

ECH. 1: 500

Y 3

EP MBALLA- II

SITE: YAOUNDE-1

TYPE: 24D4 (12SSW X 2 + D4) + W12 (W6 X 2)

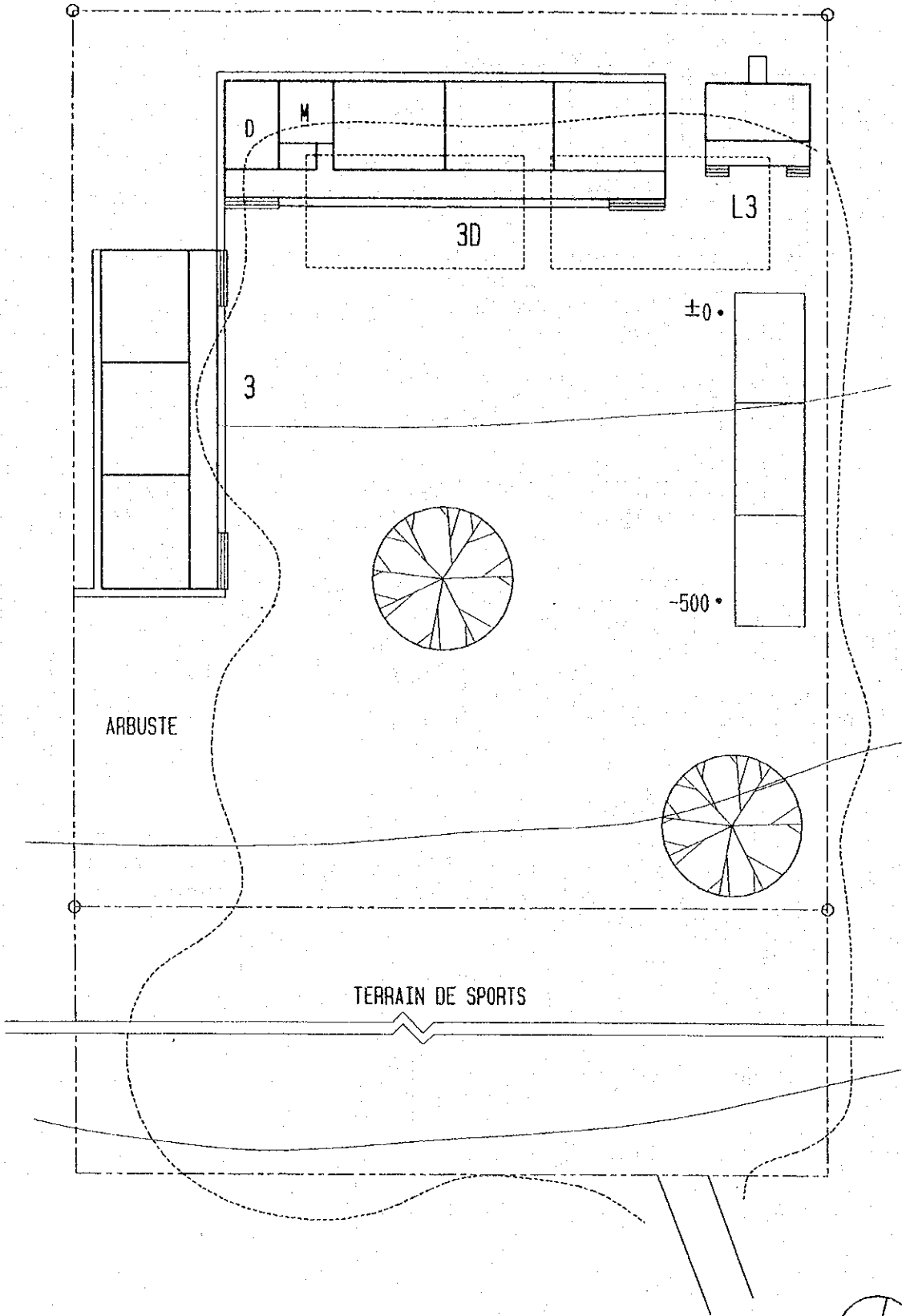

LEGENDE

- | | |
|---|--|
|  BATIMENT A CONSTRUIRE |  A DEMOLIR AVANT CONSTRUCTION |
|  BATIMENT EXISTANT |  A DEMOLIR APRES CONSTRUCTION |

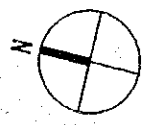

ECH. 1:500

Y 5

EP TSINGA-VILLAGE

YAOUNDE-2

TYPE: 6D (3D+3) +L3

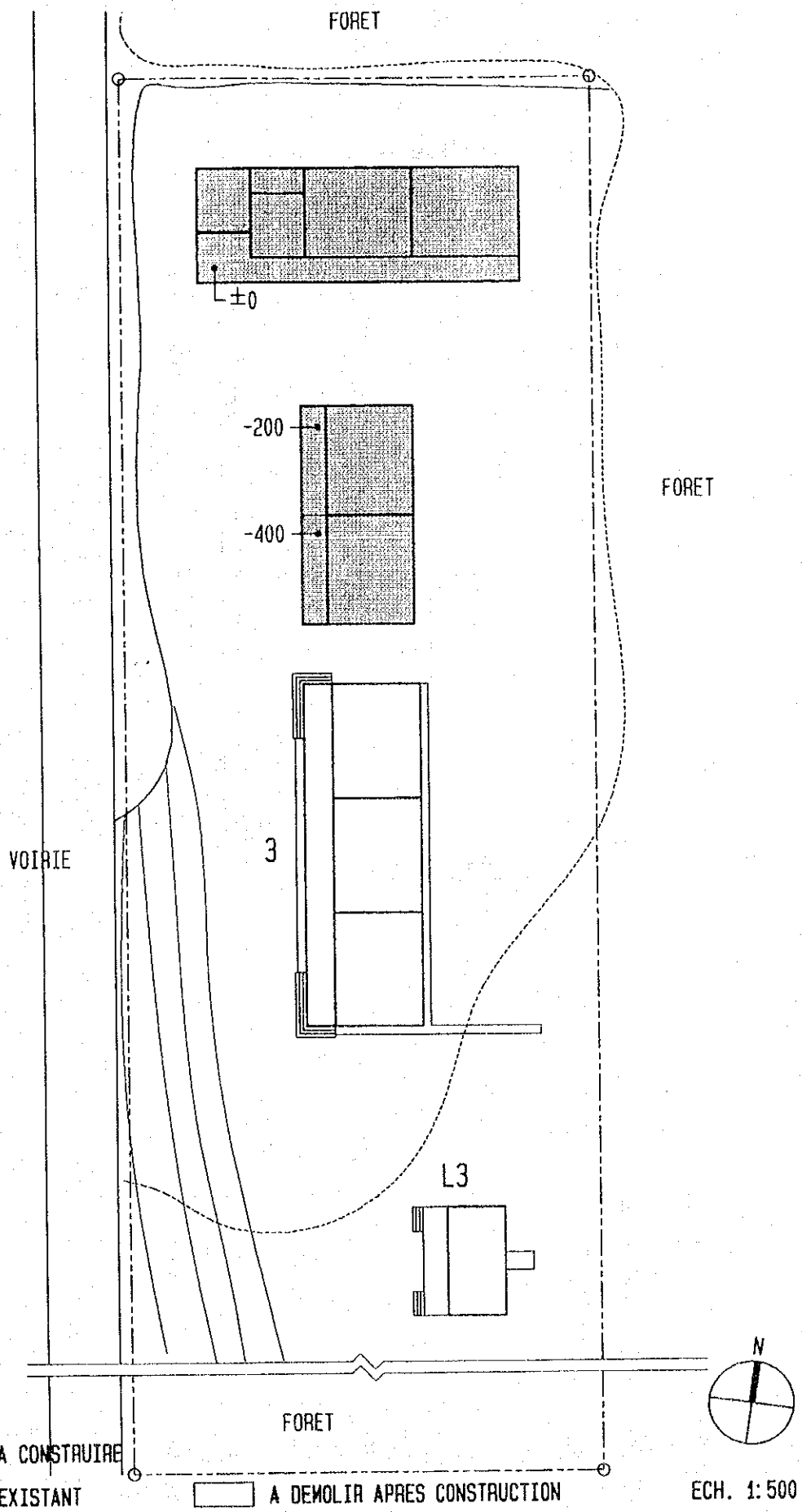

LEGENDE

 BATIMENT A CONSTRUIRE

 BATIMENT EXISTANT

 A DEMOLIR APRES CONSTRUCTION

ECH. 1:500

Y 6

EP FEBE-VILLAGE

YAOUNDE-2

TYPE: 3 +L3

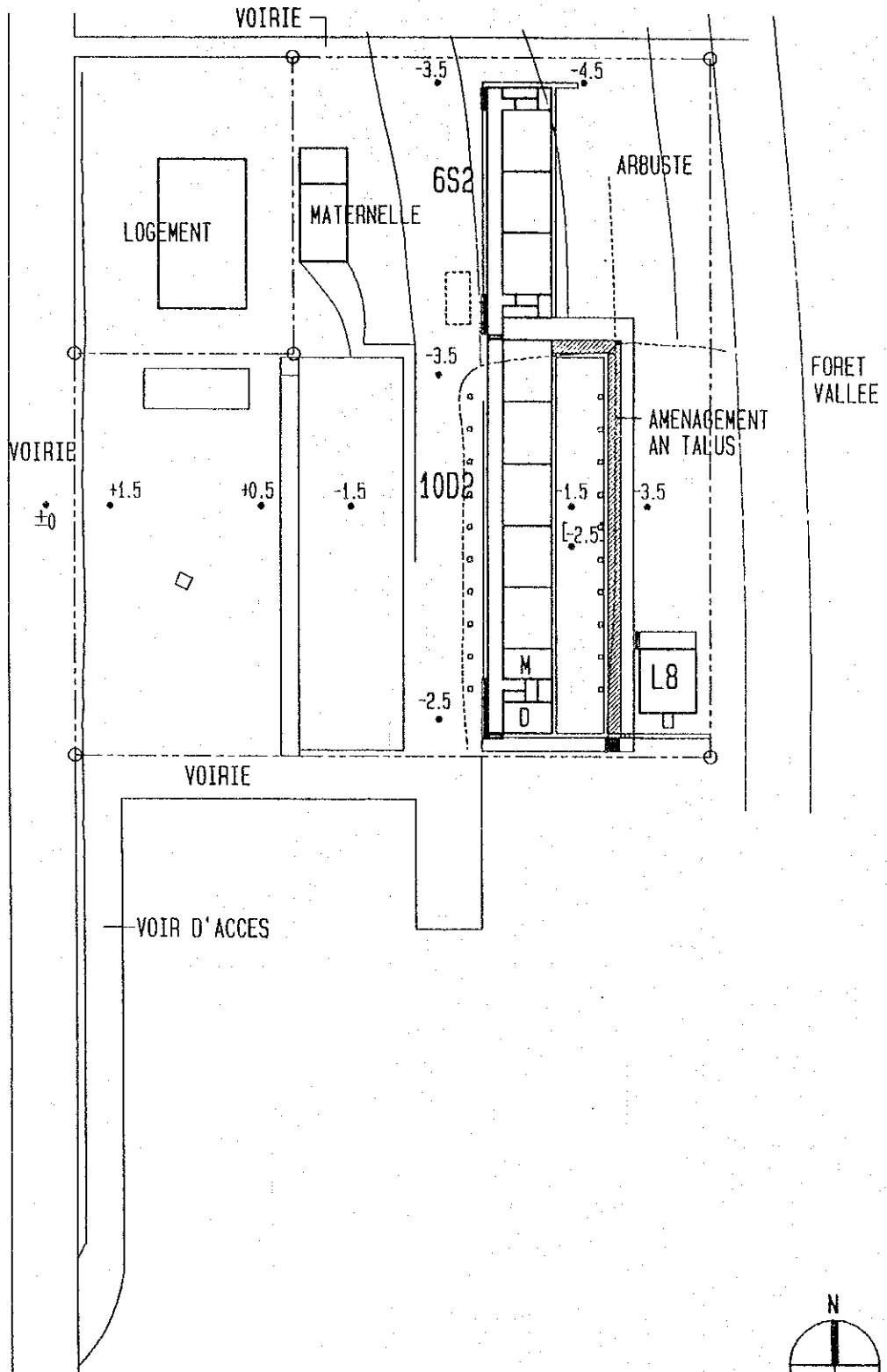

LEGENDE

- BATIMENT A CONSTRUIRE
- A DEMOLIR AVANT CONSTRUCTION
- BATIMENT EXISTANT
- A DEMOLIR APRES CONSTRUCTION

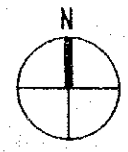

ECH. 1: 1000

Y10	EP NKOMO YAOUNDE-4	TYPE: 16D2 (6S2+10D2) +L8
------------	-----------------------	---------------------------

VOIRIE

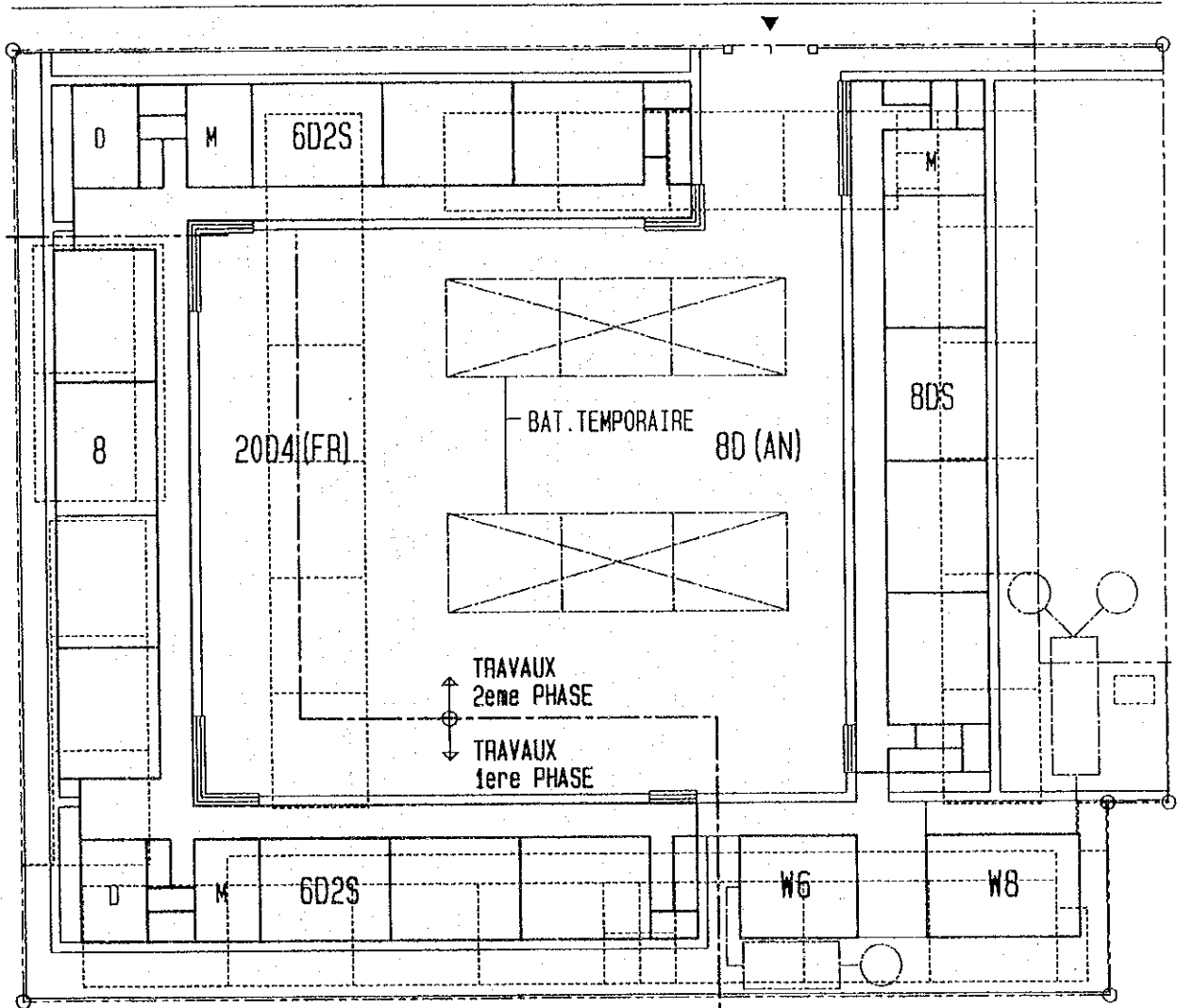

LEGENDE

 BATIMENT A CONSTRUIRE

 A DEMOLIR AVANT CONSTRUCTION

 BATIMENT EXISTANT

 A DEMOLIR APRES CONSTRUCTION

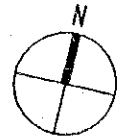

ECH. 1: 500

Y 1 2

EP EKOUNOU

YAOUNDE-4

TYPE: 2805= 2004 (6D2S X 2 + 8) + 8DS + W14 (W6+W8)

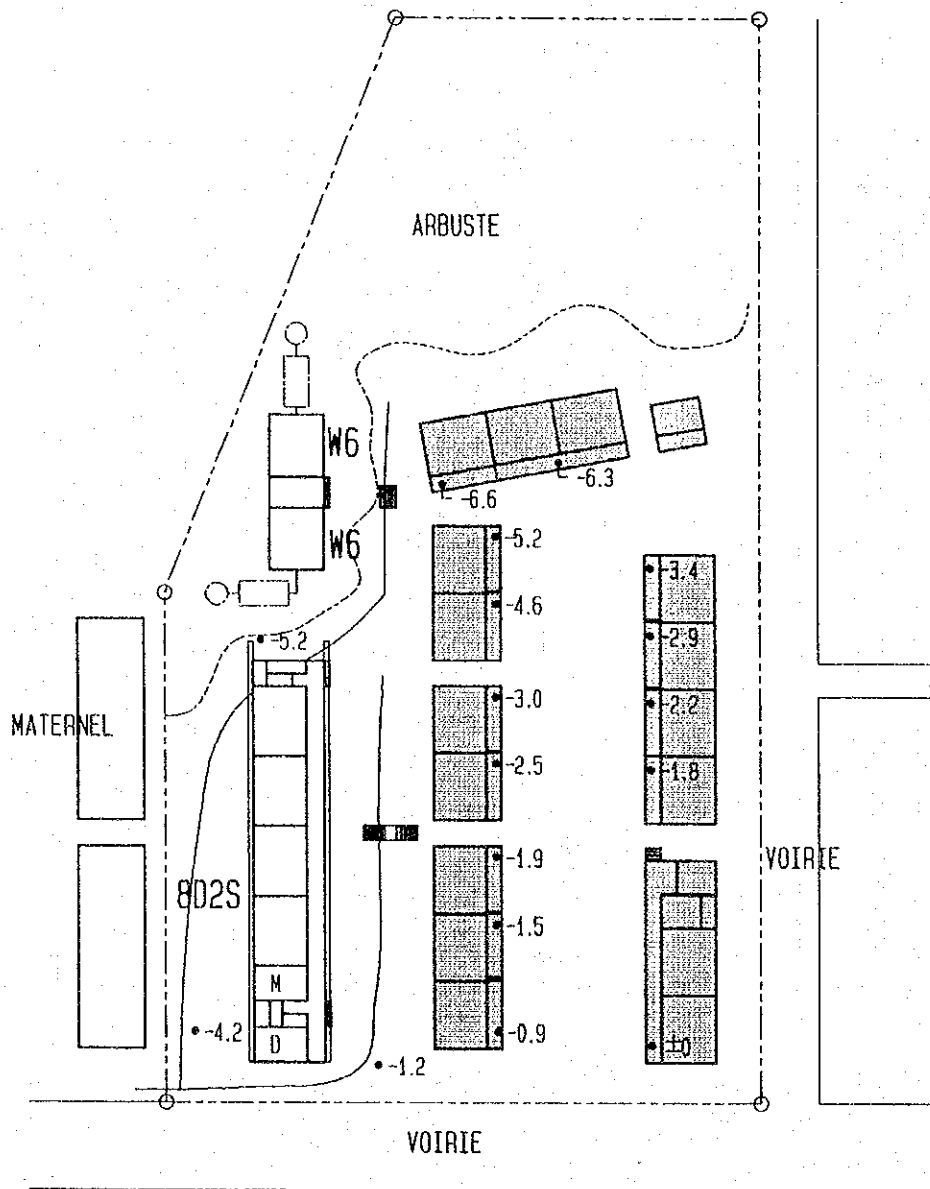

LEGENDE

- | | |
|---|--|
|  BATIMENT A CONSTRUIRE |  A DEMOLIR AVANT CONSTRUCTION |
|  BATIMENT EXISTANT |  A DEMOLIR APRES CONSTRUCTION |

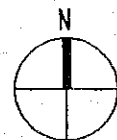

ECH. 1: 1000

Y 1 3

EP MIMBOMAN PLATEAU

YAOUNDE-4

TYPE: 8D2S +W12 (W6 X 2)

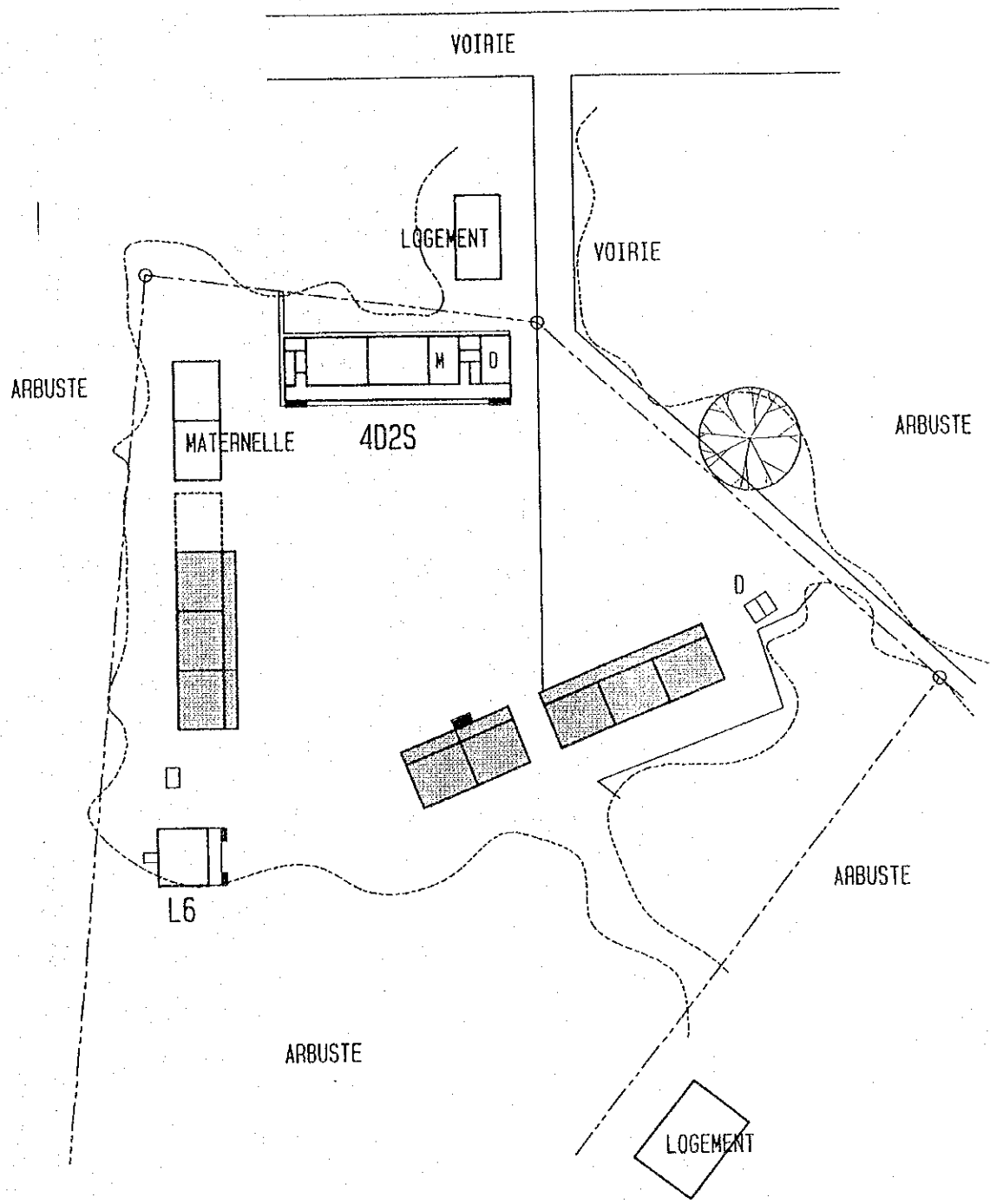

LEGENDE

- BATIMENT A CONSTRUIRE
- BATIMENT EXISTANT
- A DEMOLIR AVANT CONSTRUCTION
- A DEMOLIR APRES CONSTRUCTION

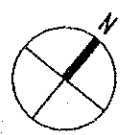

ECH. 1: 1000

Y 1 4

EP NGOULMEKONG
YAOUNDE-5

TYPE: 402S +L6

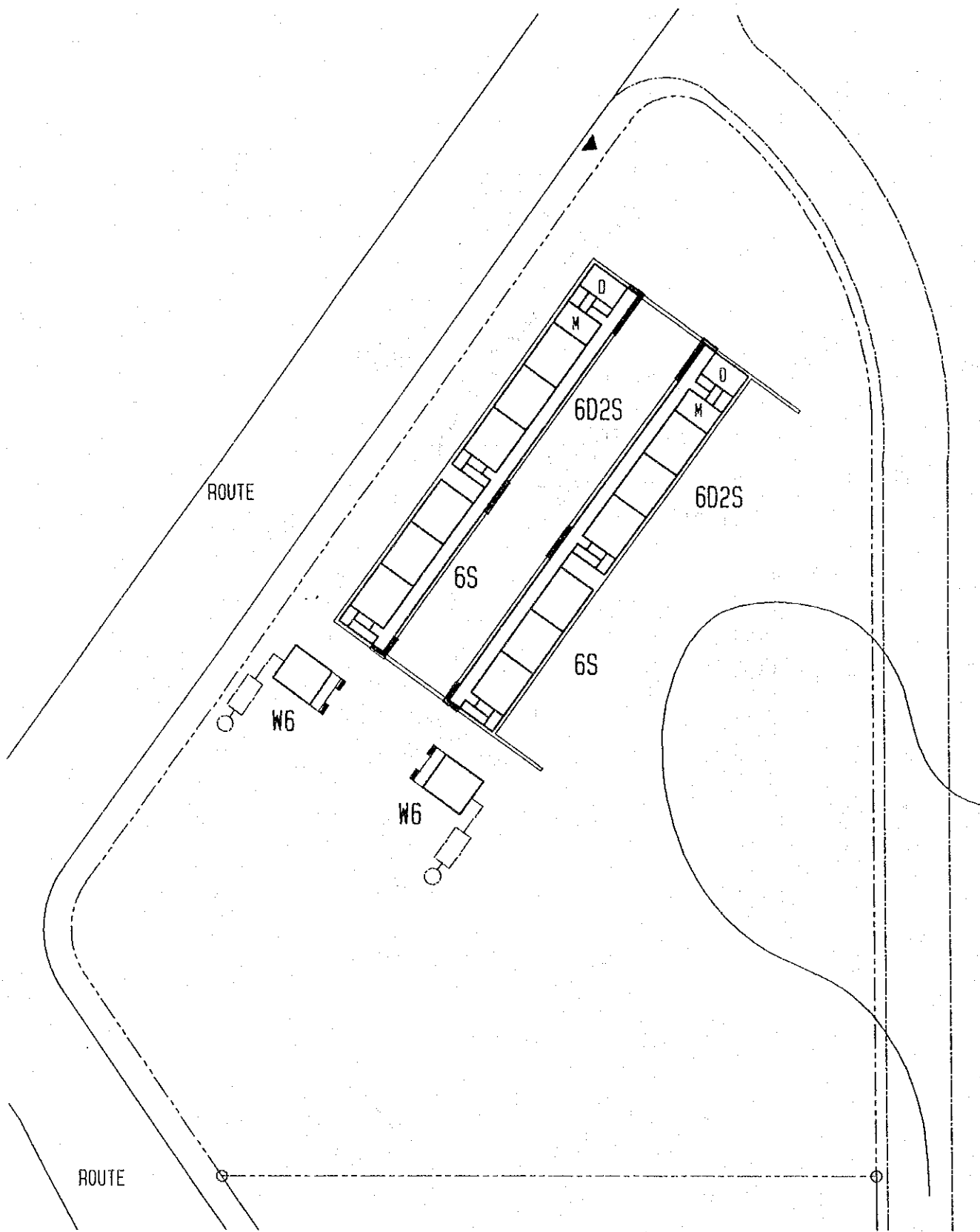

LEGENDE

- | | |
|---|--|
|  BATIMENT A CONSTRUIRE |  A DEMOLIR AVANT CONSTRUCTION |
|  BATIMENT EXISTANT |  A DEMOLIR APRES CONSTRUCTION |



ECH. 1: 1000

Y 15

EP NGOUSSO-2
YAOUNDE-5

TYPE: 2404 (6D2S+6S X 2) +W12 (W6 X 2)

VALLEE/FORET

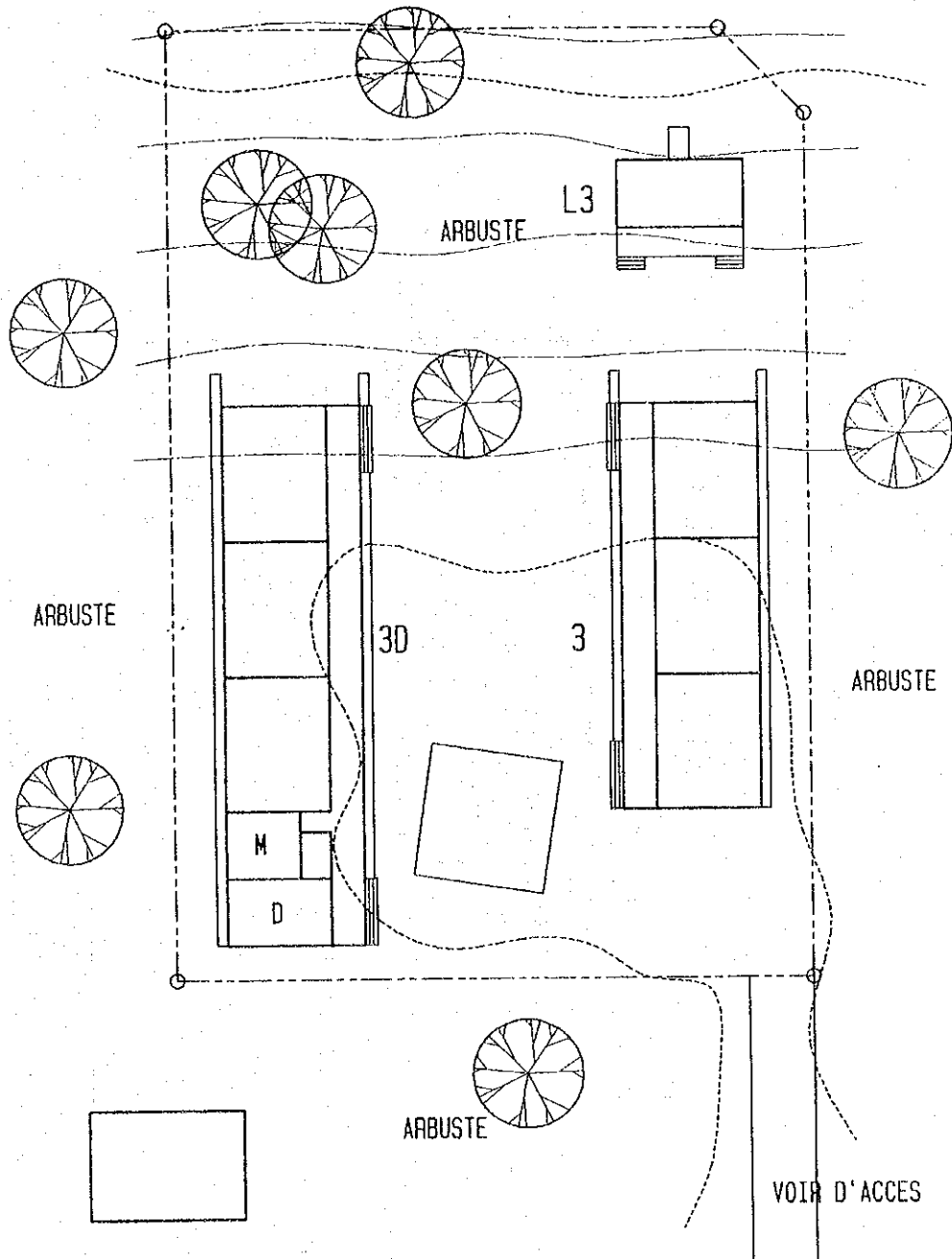

LEGENDE

 BATIMENT A CONSTRUIRE

 BATIMENT EXISTANT

 A DEMOLIR AVANT CONSTRUCTION

 A DEMOLIR APRES CONSTRUCTION

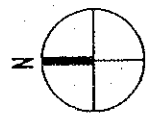

ECH. 1: 500

Y 1 6

EP NKOLMESSENG

YAOUNDE-5

TYPE: 6D (30+3) +L3

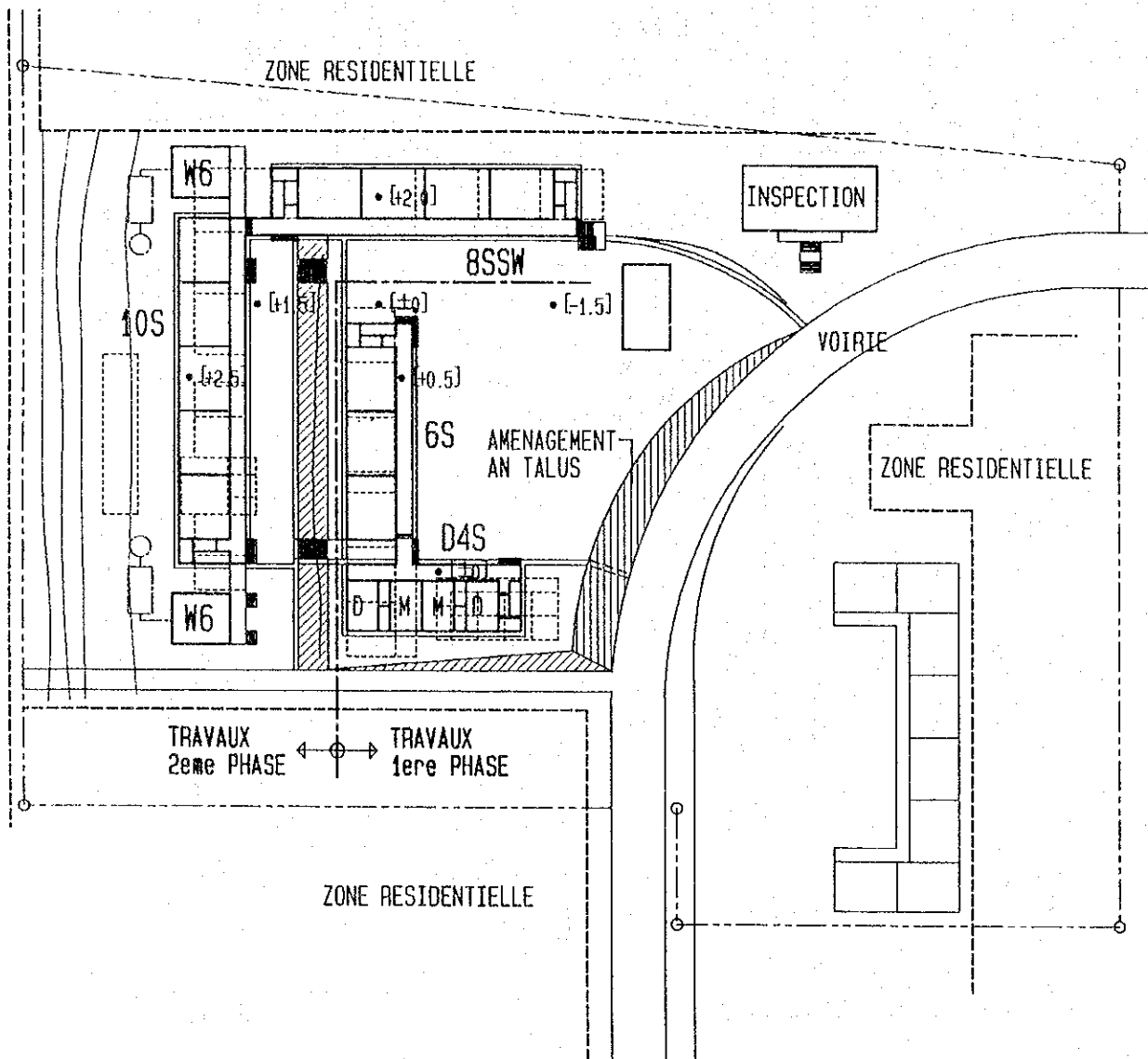

LEGENDE

- | | |
|---|--|
|  BATIMENT A CONSTRUIRE |  A DEMOLIR AVANT CONSTRUCTION |
|  BATIMENT EXISTANT |  A DEMOLIR APRES CONSTRUCTION |

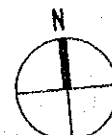

ECH. 1:1000

Y 1 8

EP EKOUDOU

YAOUNDE-2

TYPE: 24D4 (6S+8SSW+10S+D4S) +W12 (W6×2)

□対象校の分布:DOUALA

*●が計画対象サイト、○調査サイト

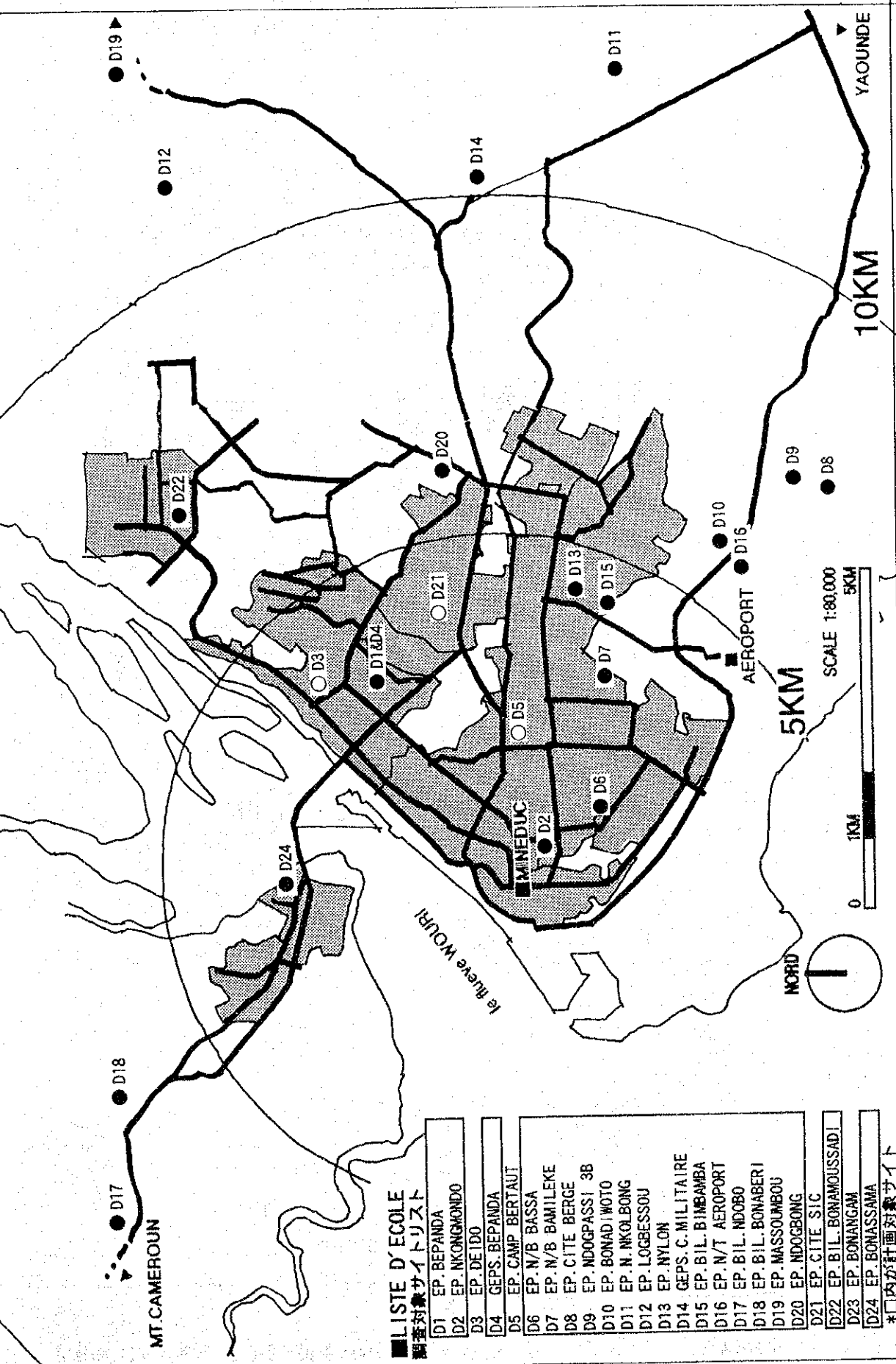

■LISTE D'ECOLE
調査対象サイトリスト

- D1 EP. BEPANDA
- D2 EP. NKONGONDO
- D3 EP. DE IDO
- D4 GEPS. BEPANDA
- D5 EP. CAMP BERTAUT
- D6 EP. N/B BASSA
- D7 EP. N/B BAMILEKE
- D8 EP. CITE BERGE
- D9 EP. NDOGPASSI 3B
- D10 EP. BONADIWOTO
- D11 EP. N. NKOLBONG
- D12 EP. LOGBESSOU
- D13 EP. NYLON
- D14 GEPS. C. MILITAIRE
- D15 EP. BIL. BAMBAMBA
- D16 EP. N/T AEROPORT
- D17 EP. BIL. NDOBO
- D18 EP. BIL. BONABERI
- D19 EP. MASSOUNBOU
- D20 EP. NDOGBONG
- D21 EP. CITE SIC
- D22 EP. BIL. BONAMOUSSADI
- D23 EP. BONANGAM
- D24 EP. BONASSAMA

*□内の計画対象サイト

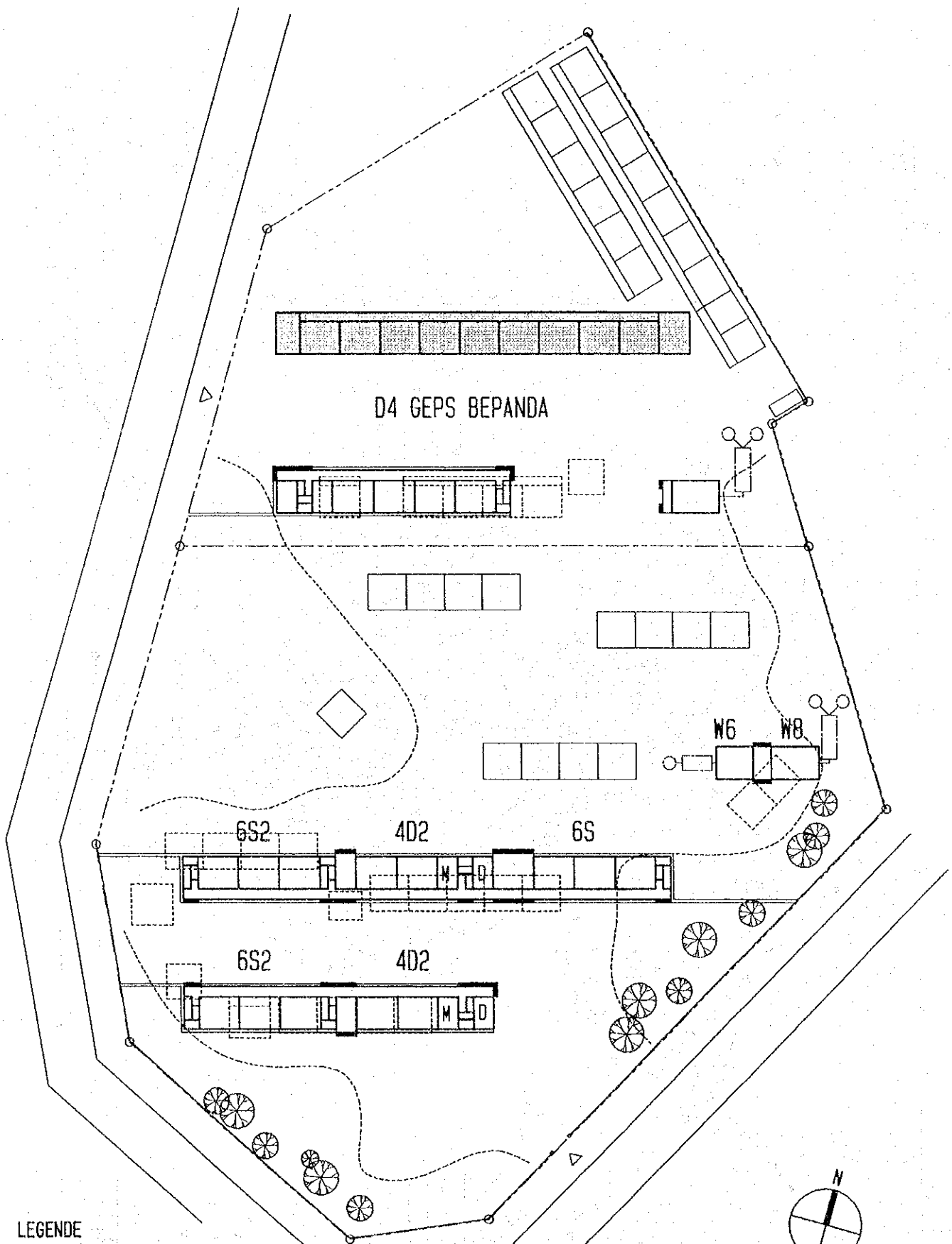

LEGENDE

 BATIMENT A CONSTRUIRE

 A DEMOLIR AVANT CONSTRUCTION

 BATIMENT EXISTANT

 A DEMOLIR APRES CONSTRUCTION

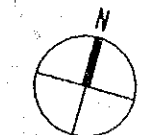

ECH. 1: 1200

D 1

EP BEPANDA
DOUALA-1

TYPE: 2604 (4D2 X 2 + 6S2 X 2 + 6S) + W14 (W8 + W6)

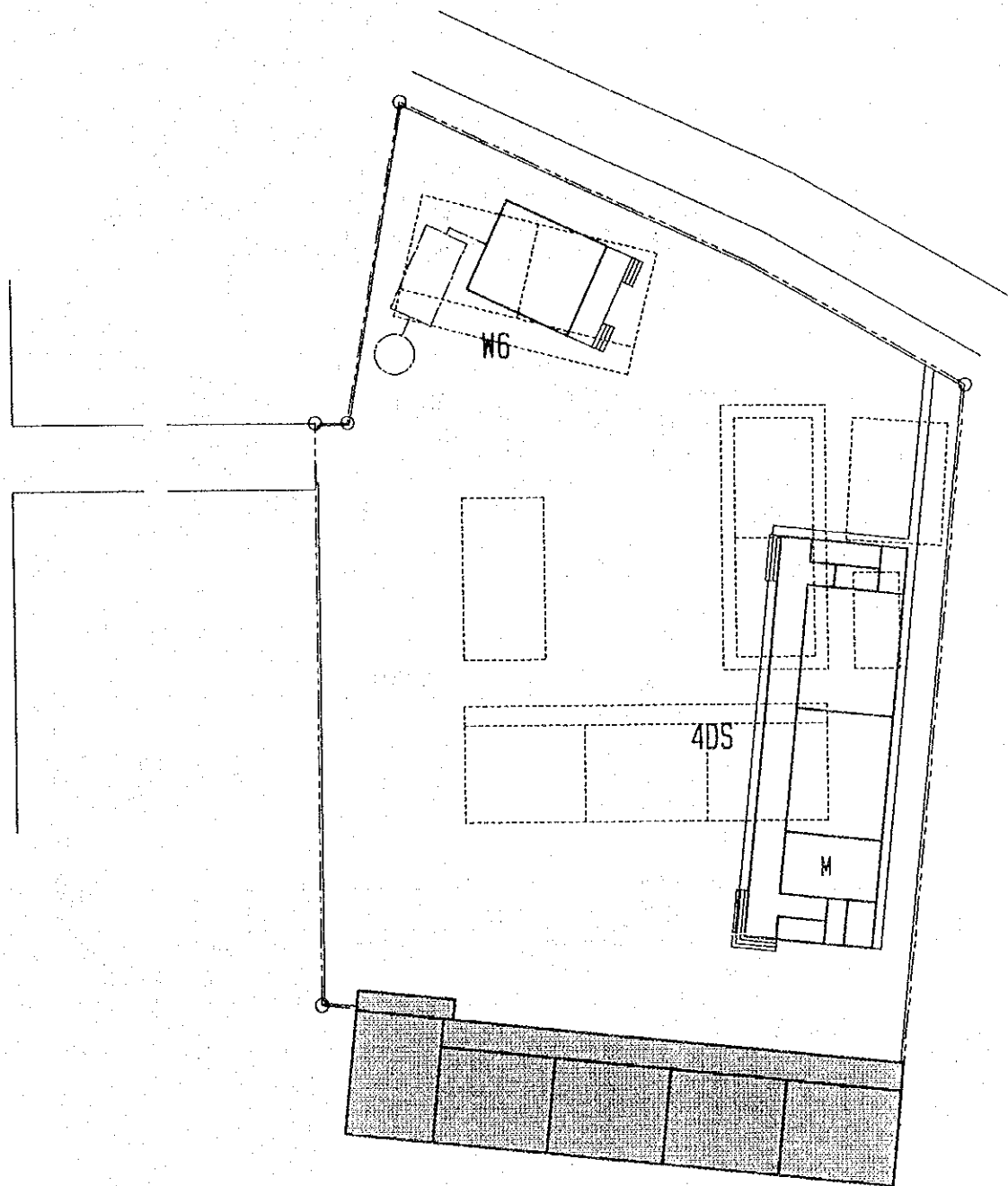

LEGENDE

 BATIMENT A CONSTRUIRE

 A DEMOLIR AVANT CONSTRUCTION

 BATIMENT EXISTANT

 A DEMOLIR APRES CONSTRUCTION



ECH. 1: 500

D 2

EP NKONGMONDO

DOUALA-1

TYPE: 4DS +N6

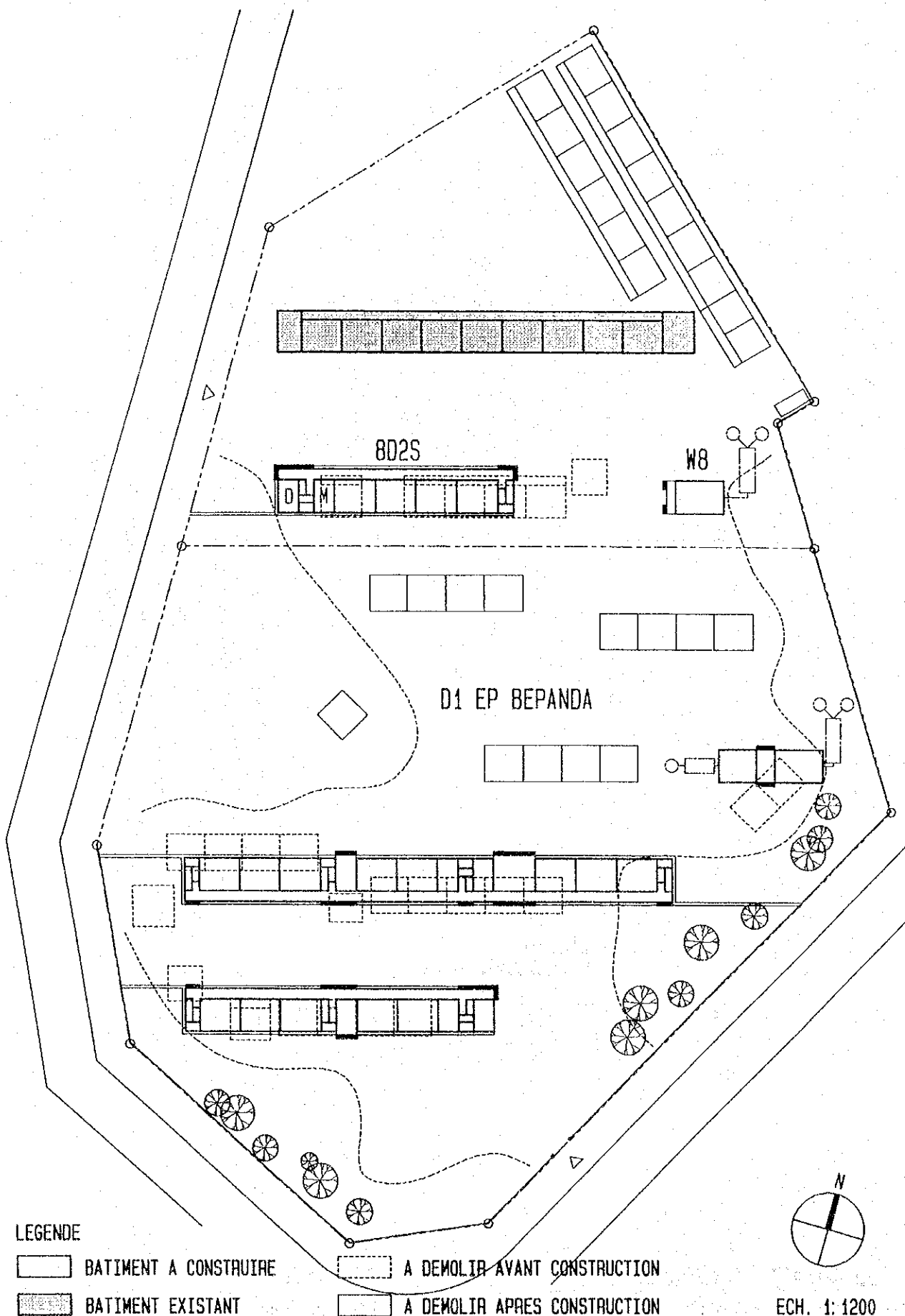

D 4

GEPs BEPANDA

DOUALA-1

TYPE: 802S +W8

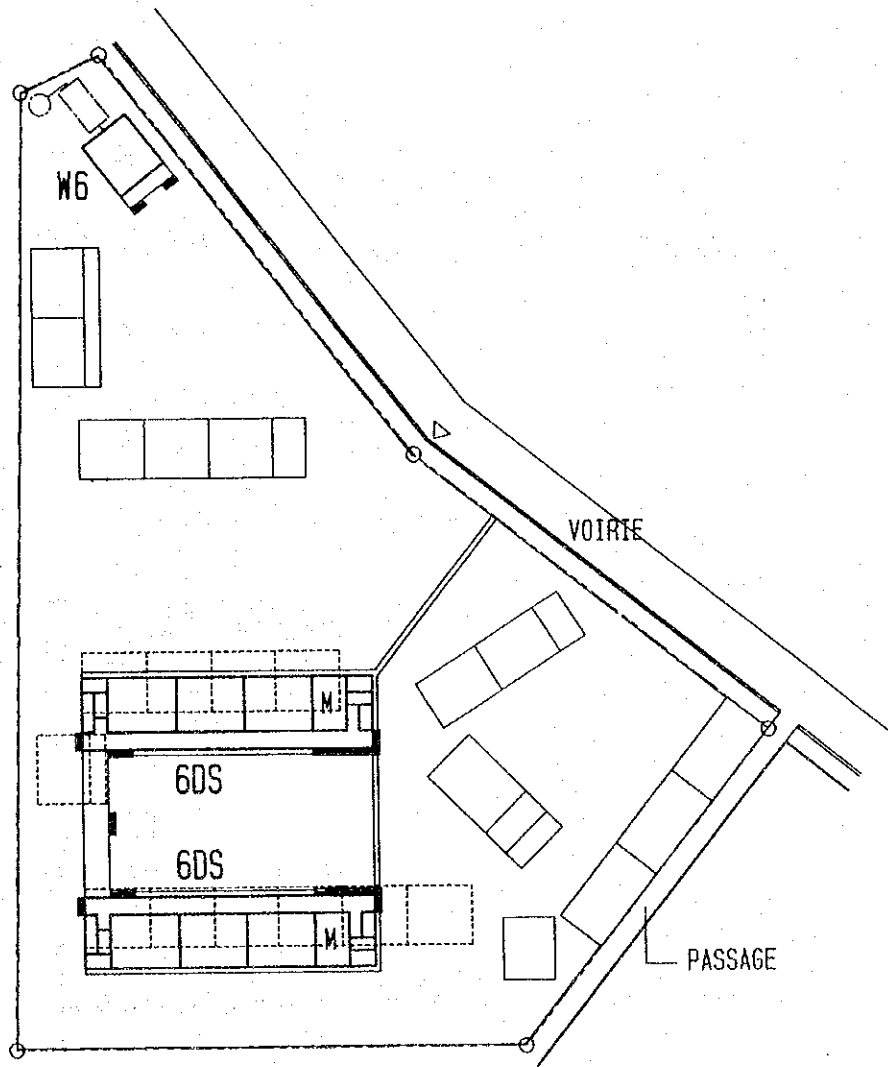

LEGENDE

 BATIMENT A CONSTRUIRE

 A DEMOLIR AVANT CONSTRUCTION

 BATIMENT EXISTANT

 A DEMOLIR APRES CONSTRUCTION



ECH. 1: 1000

D 6

EP NEWBELL BASSA

DOUALA-2

TYPE: 1202 (6DS X 2) + W6

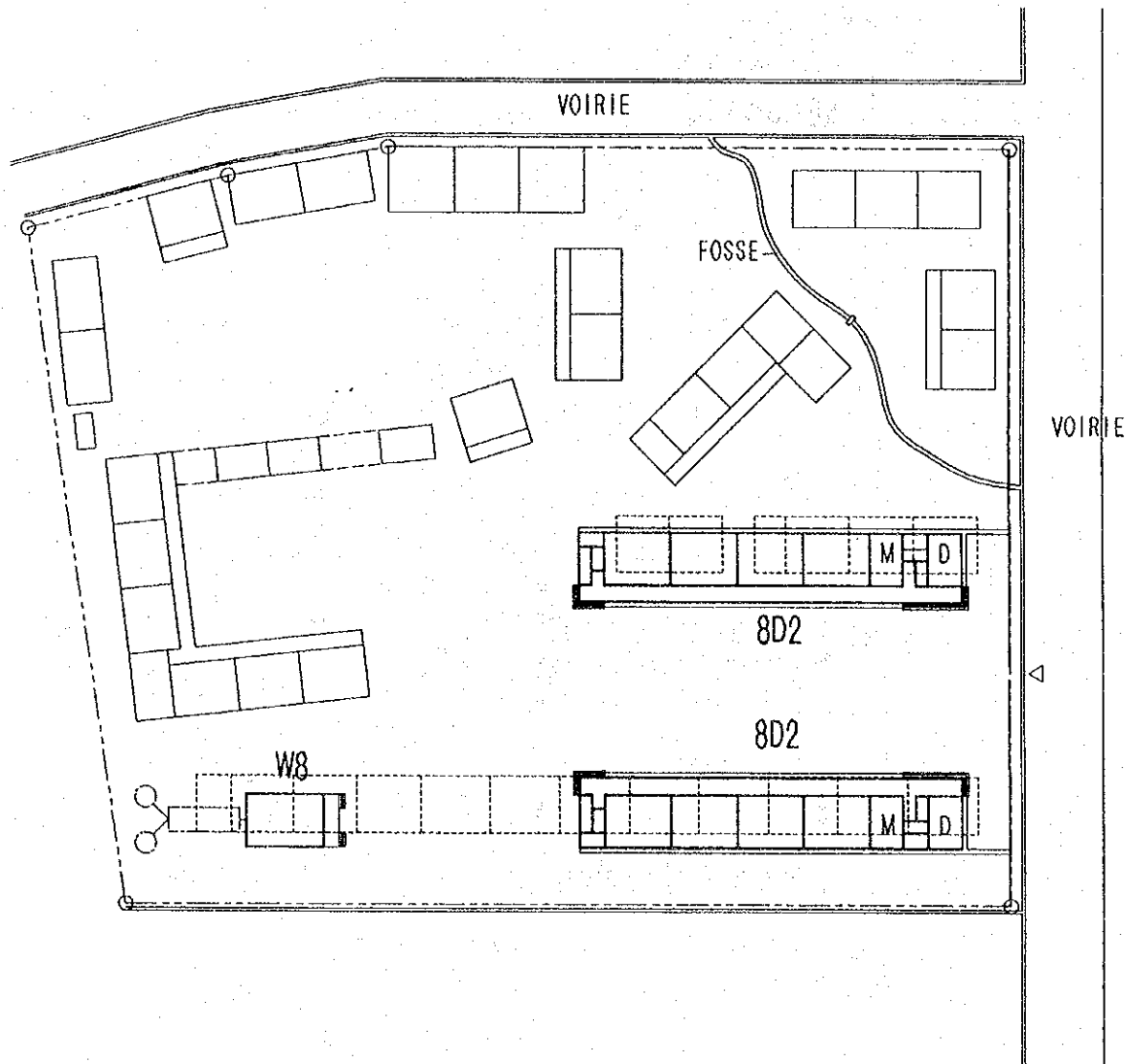

LEGENDE

- | | | | |
|---|-----------------------|---|------------------------------|
|  | BATIMENT A CONSTRUIRE |  | A DEMOLIR AVANT CONSTRUCTION |
|  | BATIMENT EXISTANT |  | A DEMOLIR APRES CONSTRUCTION |

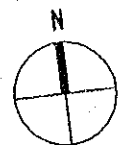

ECH 1:1000

D 7

EP NEWBELL BAMILEKE

DOUALA-2

TYPE: 16D4 (8D2S x 2) #W8

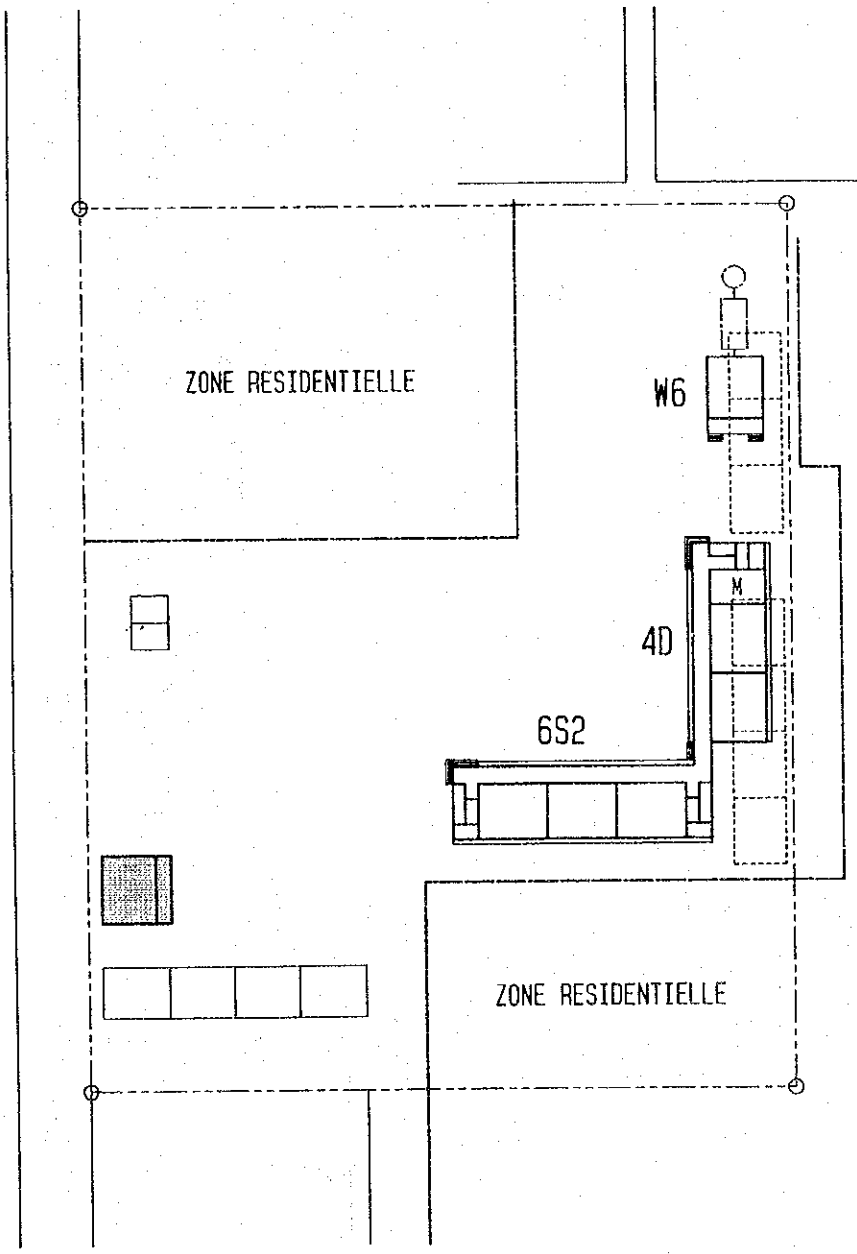

LEGENDE

- BATIMENT A CONSTRUIRE
- A DEMOLIR AVANT CONSTRUCTION
- BATIMENT EXISTANT
- A DEMOLIR APRES CONSTRUCTION

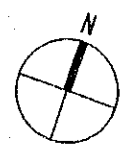

ECH. 1: 1000

D 8	EP CITE BERGE DQUALA-3	TYPE: 10D (4D+6S2) +W6
------------	---------------------------	------------------------

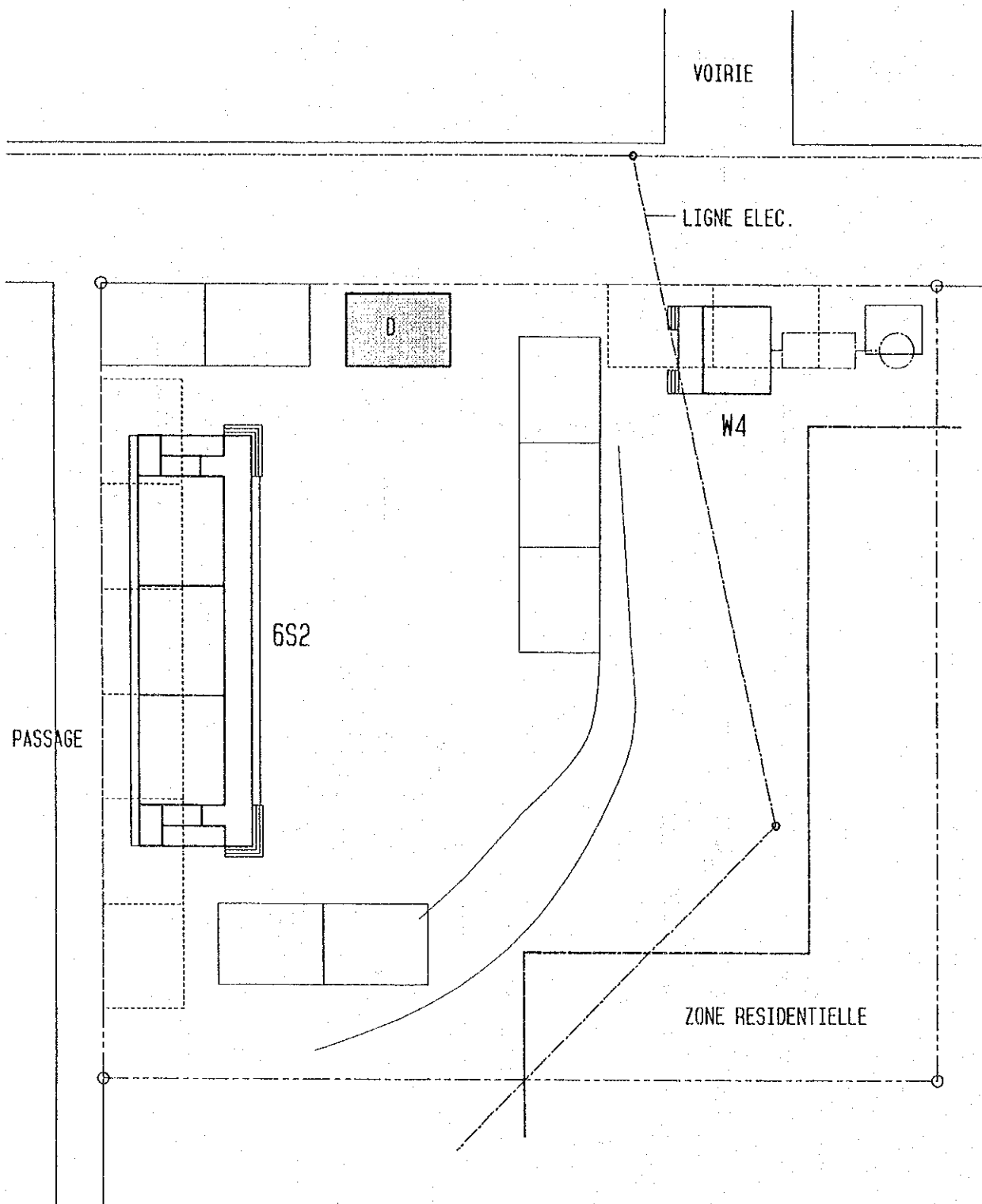

LEGENDE

- | | |
|---|--|
|  BATIMENT A CONSTRUIRE |  A DEMOLIR AVANT CONSTRUCTION |
|  BATIMENT EXISTANT |  A DEMOLIR APRES CONSTRUCTION |

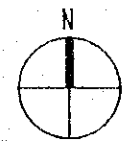

ECH. 1: 500

D 9

EP DE NDOGPASSI 3B

DOUALA-3

TYPE: 6S2 +W4

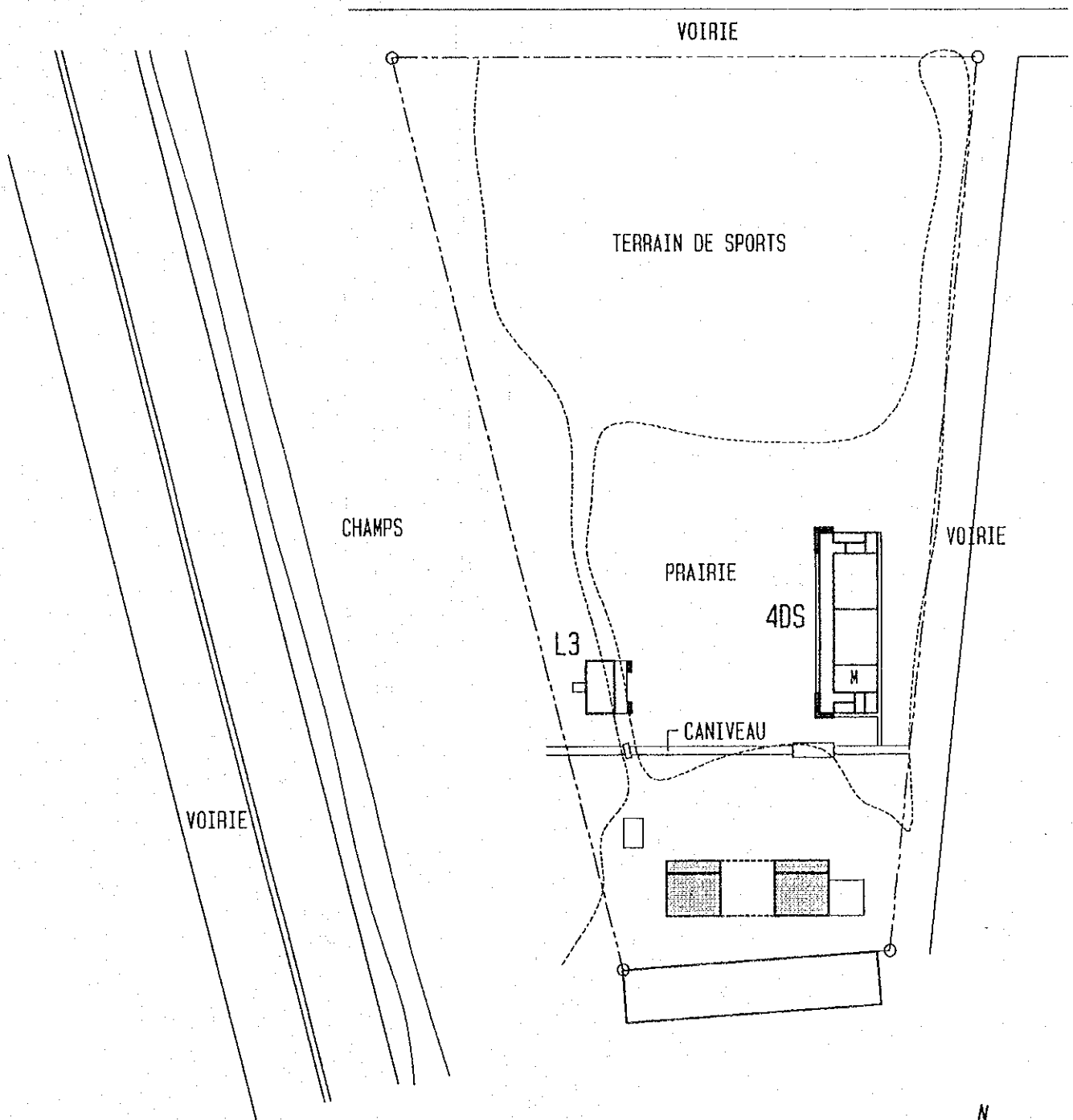

LEGENDE

- | | | | |
|---|-----------------------|---|------------------------------|
|  | BATIMENT A CONSTRUIRE |  | A DEMOLIR AVANT CONSTRUCTION |
|  | BATIMENT EXISTANT |  | A DEMOLIR APRES CONSTRUCTION |



ECH. 1: 1000

D 1 0	EP BONADIWOTO DOUALA-3	TYPE: 4DS +L3
--------------	---------------------------	---------------

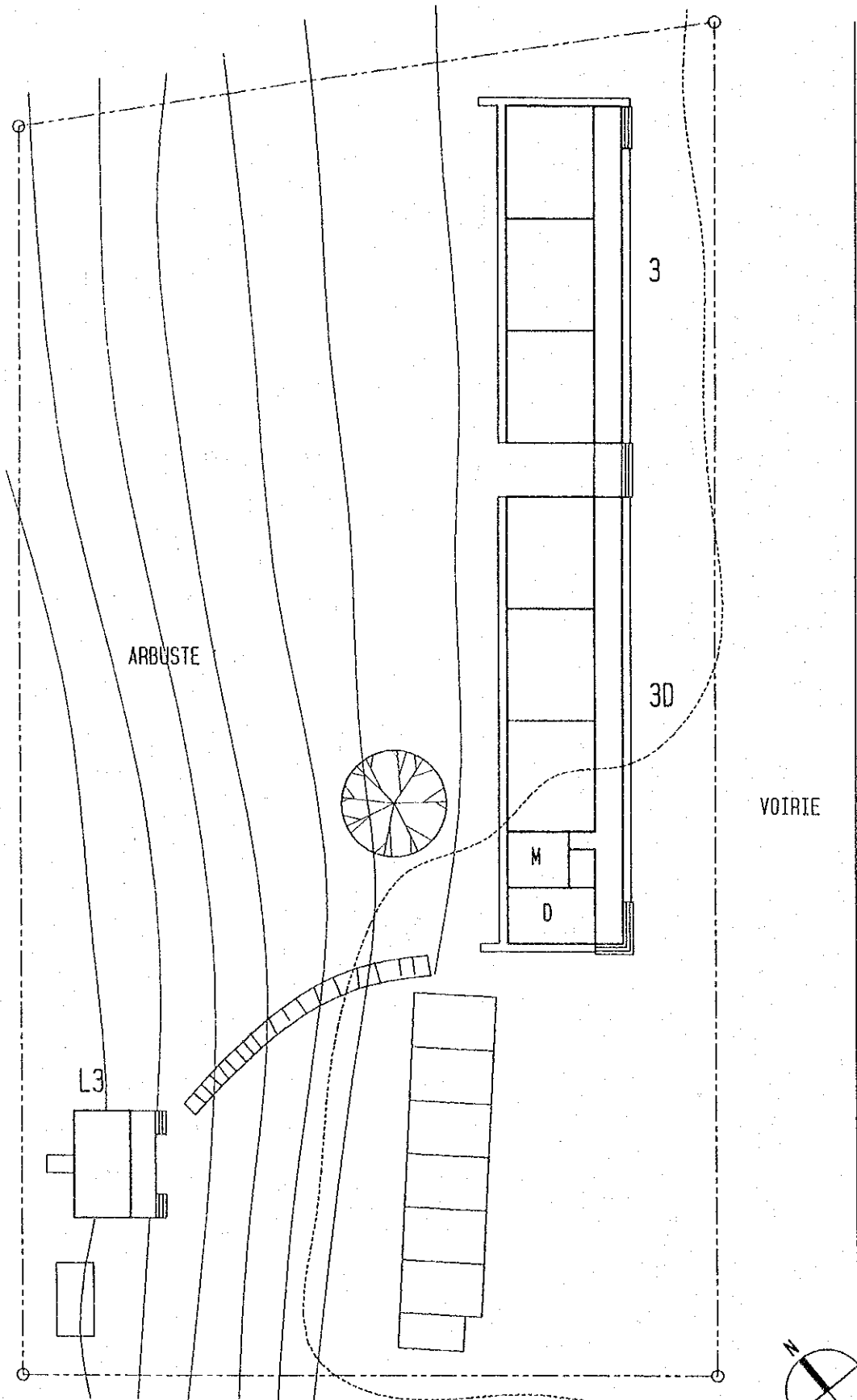

LEGENDE

 BATIMENT A CONSTRUIRE

 A DEMOLIR AVANT CONSTRUCTION

 BATIMENT EXISTANT

 A DEMOLIR APRES CONSTRUCTION

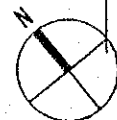

ECH. 1:500

D 1 1

EP NYALLA NKOLBONG

DOUALA-2

TYPE: 6D (30+3) +L3

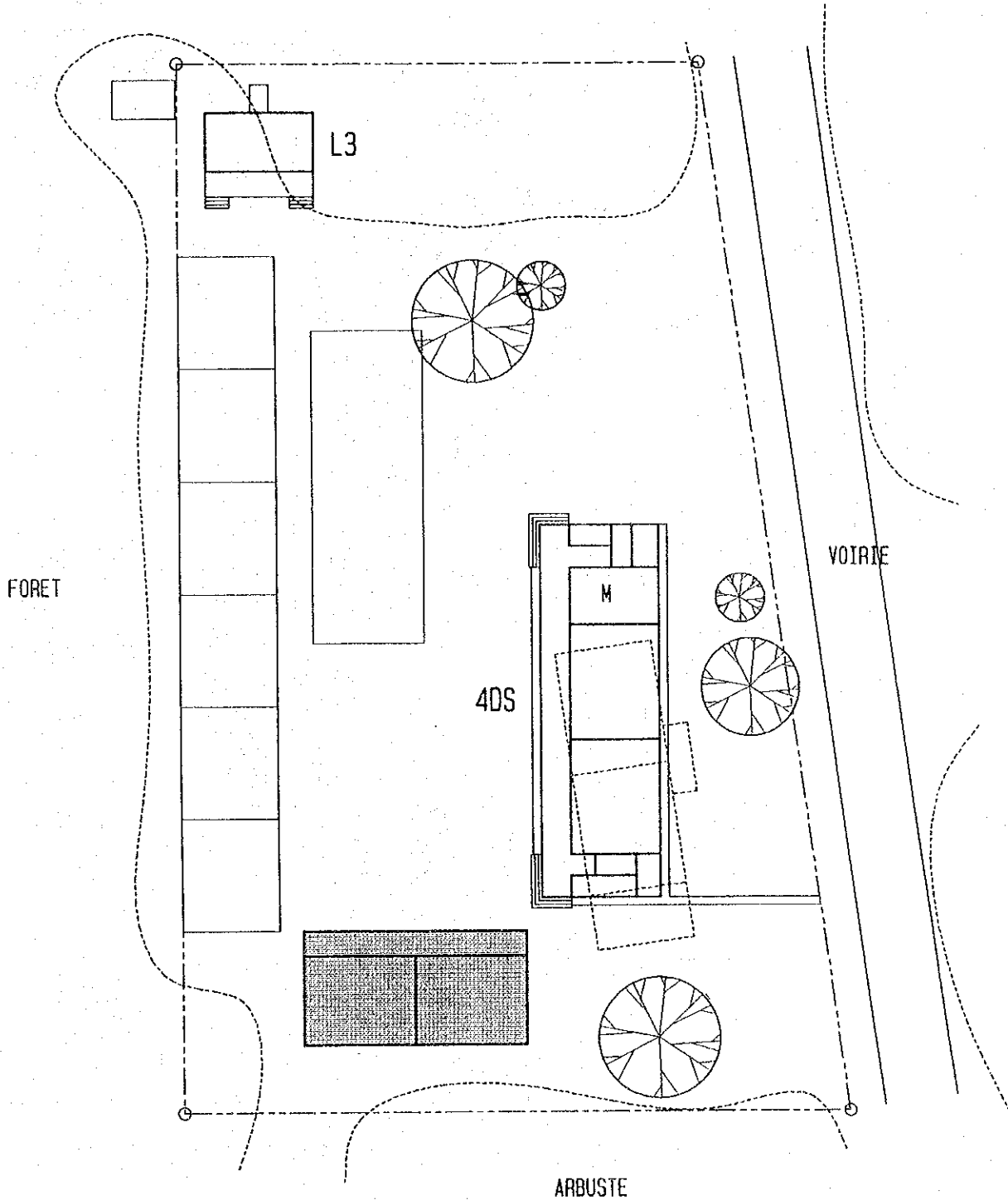

LEGENDE



BATIMENT A CONSTRUIRE



A DEMOLIR AVANT CONSTRUCTION



BATIMENT EXISTANT



A DEMOLIR APRES CONSTRUCTION

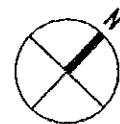

ECH. 1: 500

D 1 2

EP LOGBESSOU

DOUALA-5

TYPE: 4DS +L3

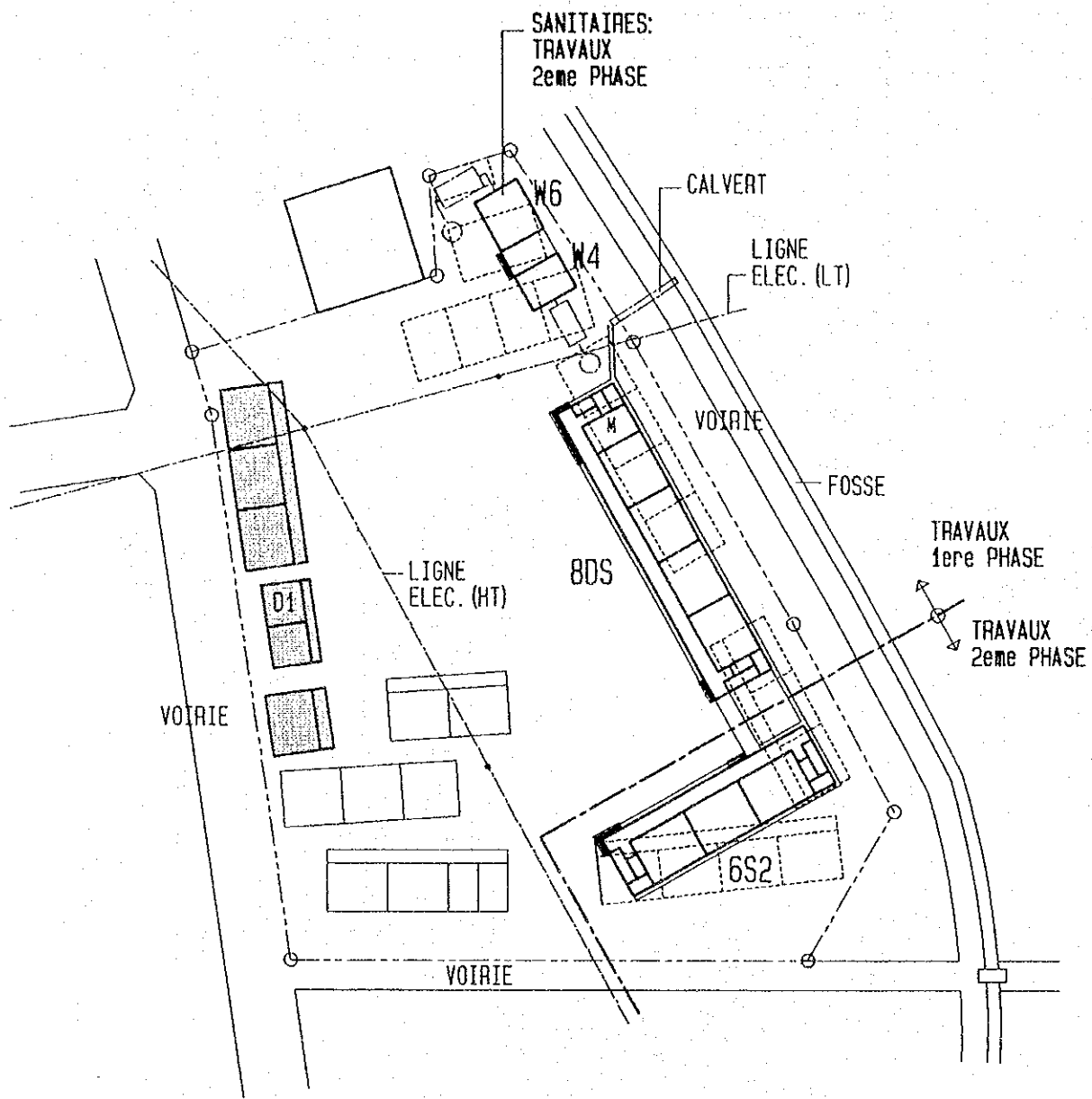

LEGENDE

- | | |
|---|--|
|  BATIMENT A CONSTRUIRE |  A DEMOLIR AVANT CONSTRUCTION |
|  BATIMENT EXISTANT |  A DEMOLIR APRES CONSTRUCTION |

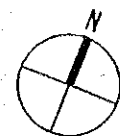

ECH. 1: 1000

D 1 3

EP NYLON
DOUALA-3

TYPE: 14D (BDS+6S2) +W10 (W6+W4)

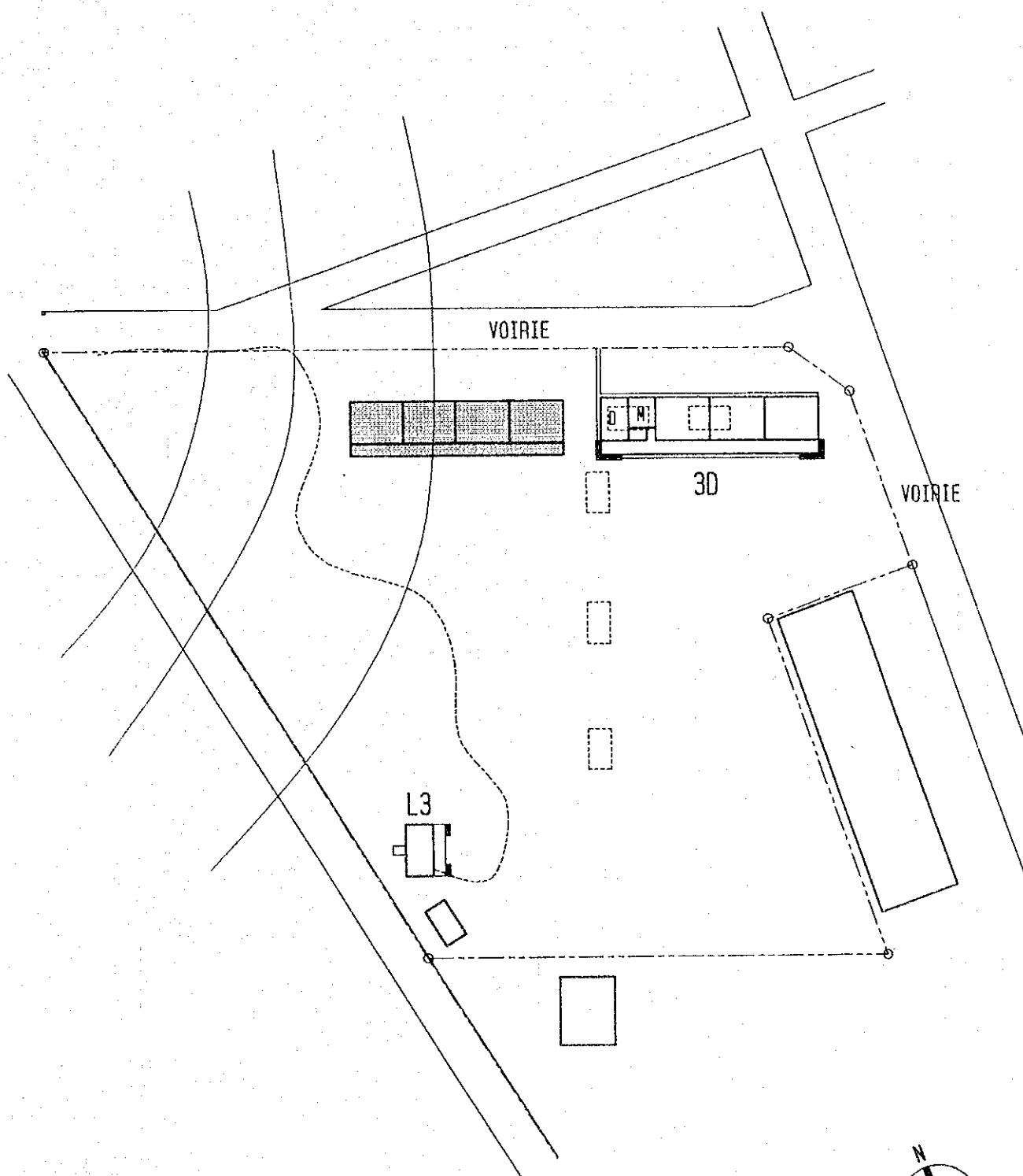

LEGENDE

 BATIMENT A CONSTRUIRE

 BATIMENT EXISTANT

 A DEMOLIR AVANT CONSTRUCTION

 A DEMOLIR APRES CONSTRUCTION



ECH. 1: 1000

D 1 4



GEPS CAMP MILITAIRE

DOUALA-3

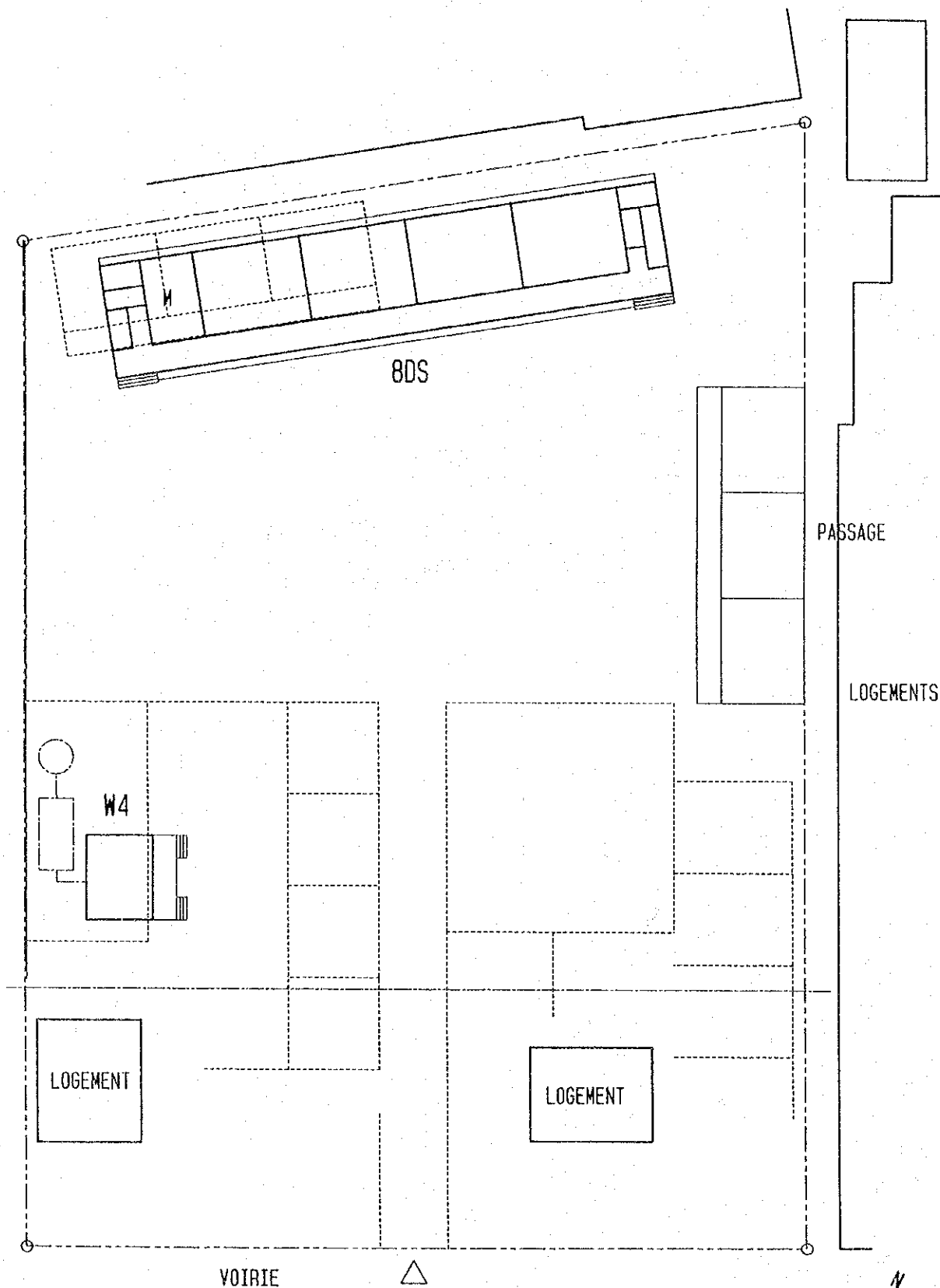
TYPE: 3D +L3



LEGENDE

- | | |
|---|--|
|  BATIMENT A CONSTRUIRE |  A DEMOLIR AVANT CONSTRUCTION |
|  BATIMENT EXISTANT |  A DEMOLIR APRES CONSTRUCTION |

ECH. 1: 500



D 1 5

EP BILINGUE BIMBAMBA-BANANL

DOUALA-3

TYPE: 8DS +W4

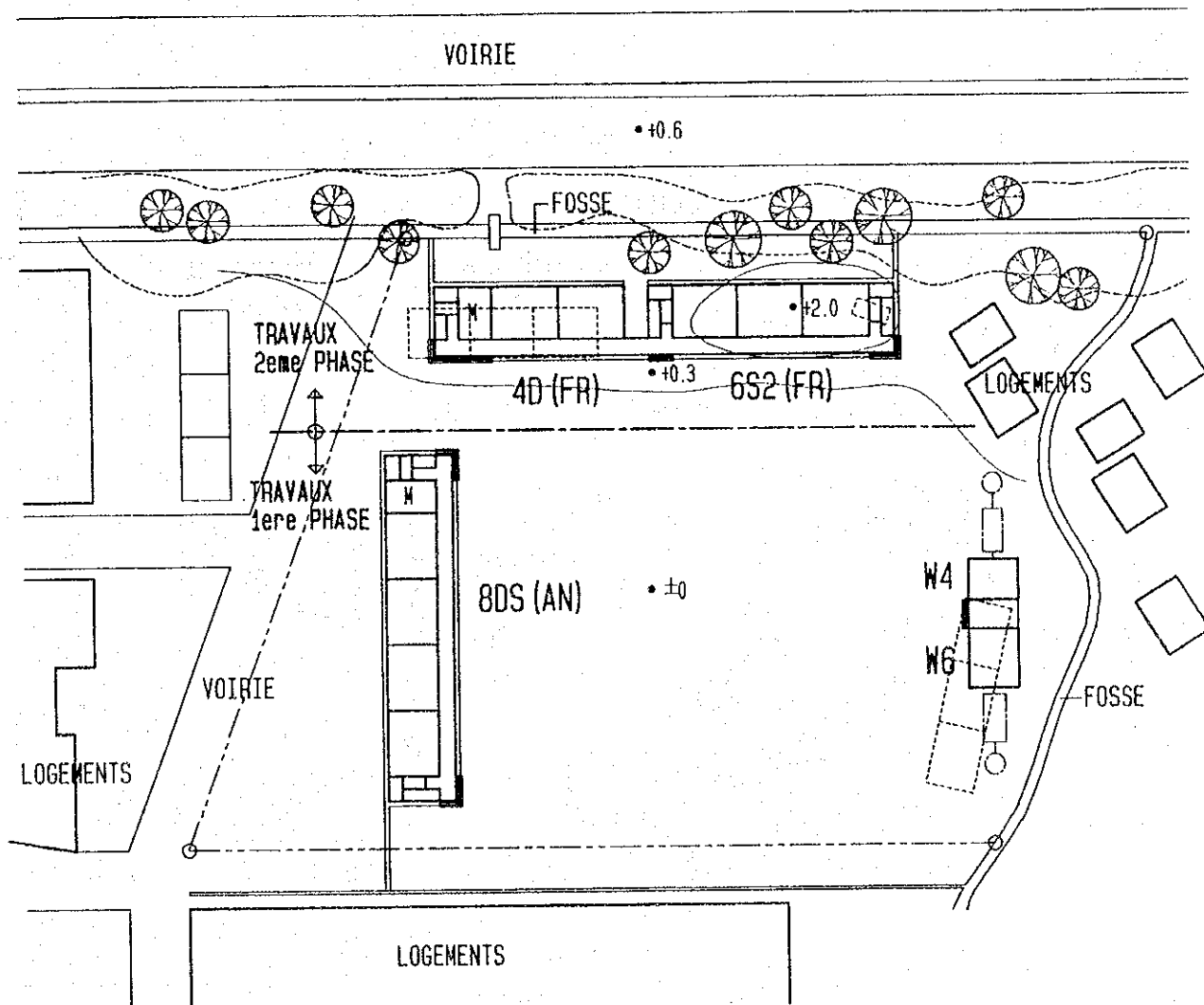

LEGENDE

- | | |
|---|--|
|  BATIMENT A CONSTRUIRE |  A DEMOLIR AVANT CONSTRUCTION |
|  BATIMENT EXISTANT |  A DEMOLIR APRES CONSTRUCTION |



ECH. 1: 1000



D 1 6

EP NEWTOWN AEROPORT
DOUALA-3

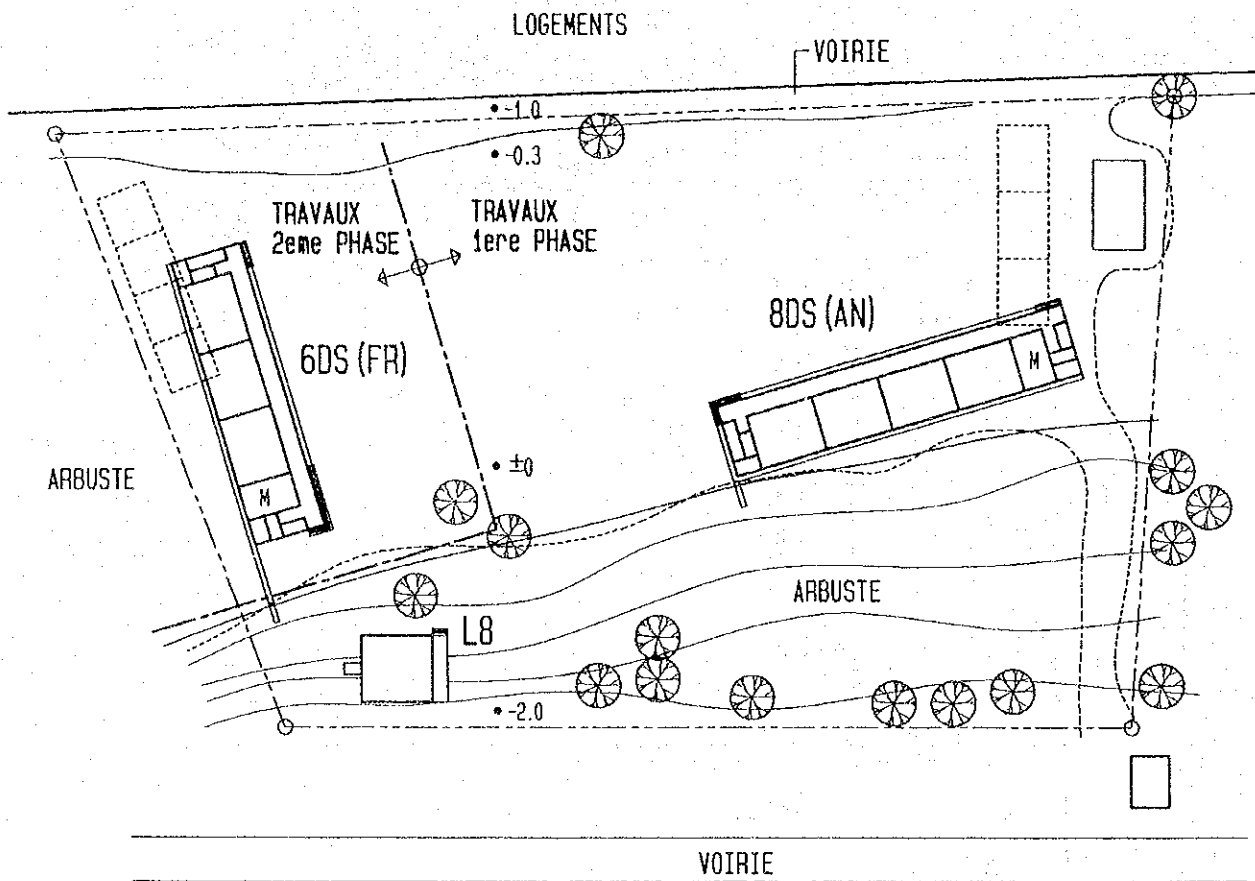
TYPE: 18D2 (4D+6S2 +8DS) +W10 (W4+W6)



LEGENDE

- | | |
|---|--|
|  BATIMENT A CONSTRUIRE |  A DEMOLIR AVANT CONSTRUCTION |
|  BATIMENT EXISTANT |  A DEMOLIR APRES CONSTRUCTION |

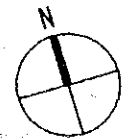

ECH. 1: 1000



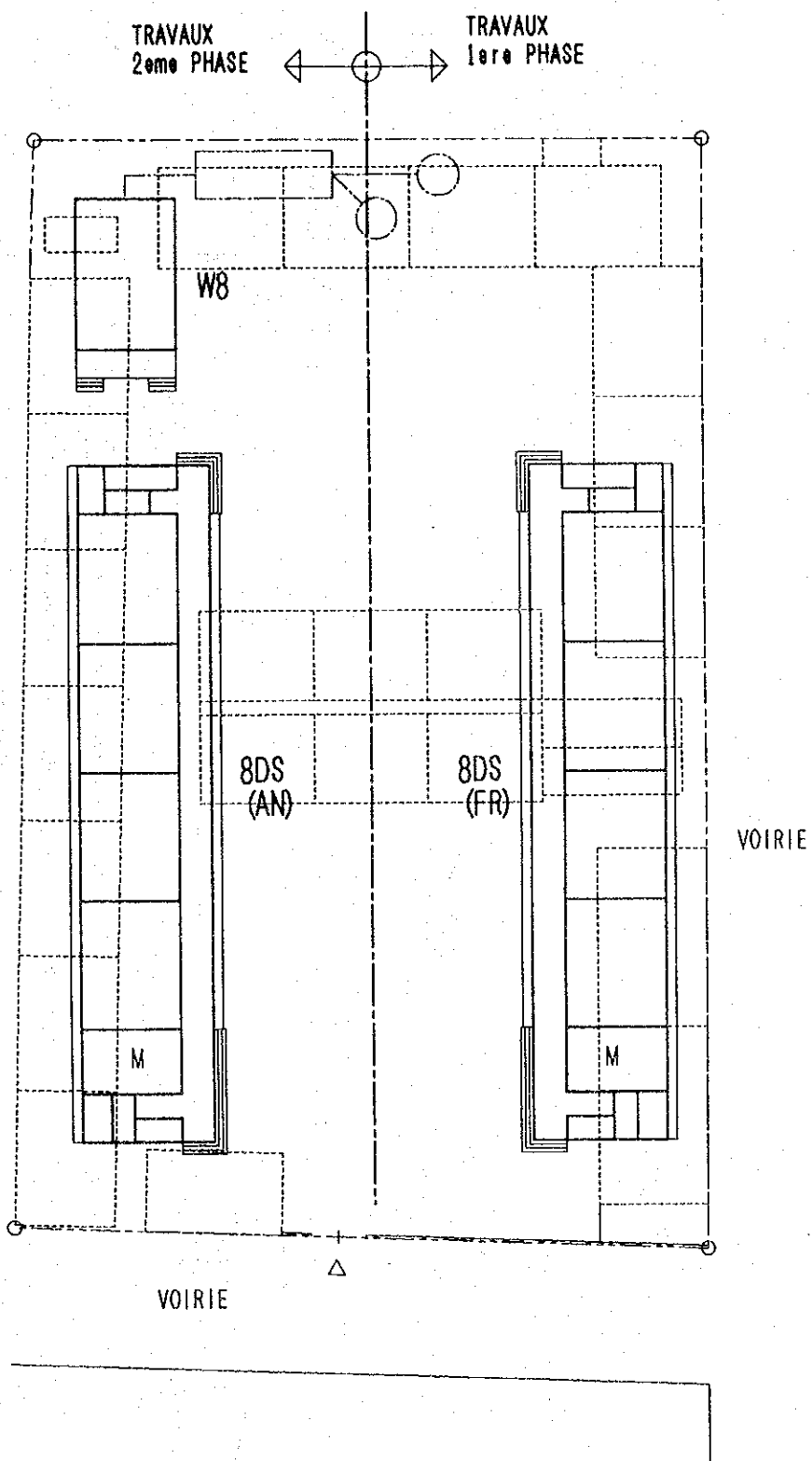

D 1 7

EP BILINGUE DE NDOBO
DOUALA-4

TYPE: 1402 (8DS +6DS) +L8



LEGENDE

- | | | | |
|---|------------------------|---|------------------------------|
|  | BATIMENTS A CONSTRUIRE |  | A DEMOLIR AVANT CONSTRUCTION |
|  | BATIMENTS EXISTANTES |  | A DEMOLIR APRES CONSTRUCTION |

ECH. 1:500

D 1 8

EP BILINGUE DE BONABERI

DOUALA-4

TYPE: 16D2 (8DS +8DS) +W8

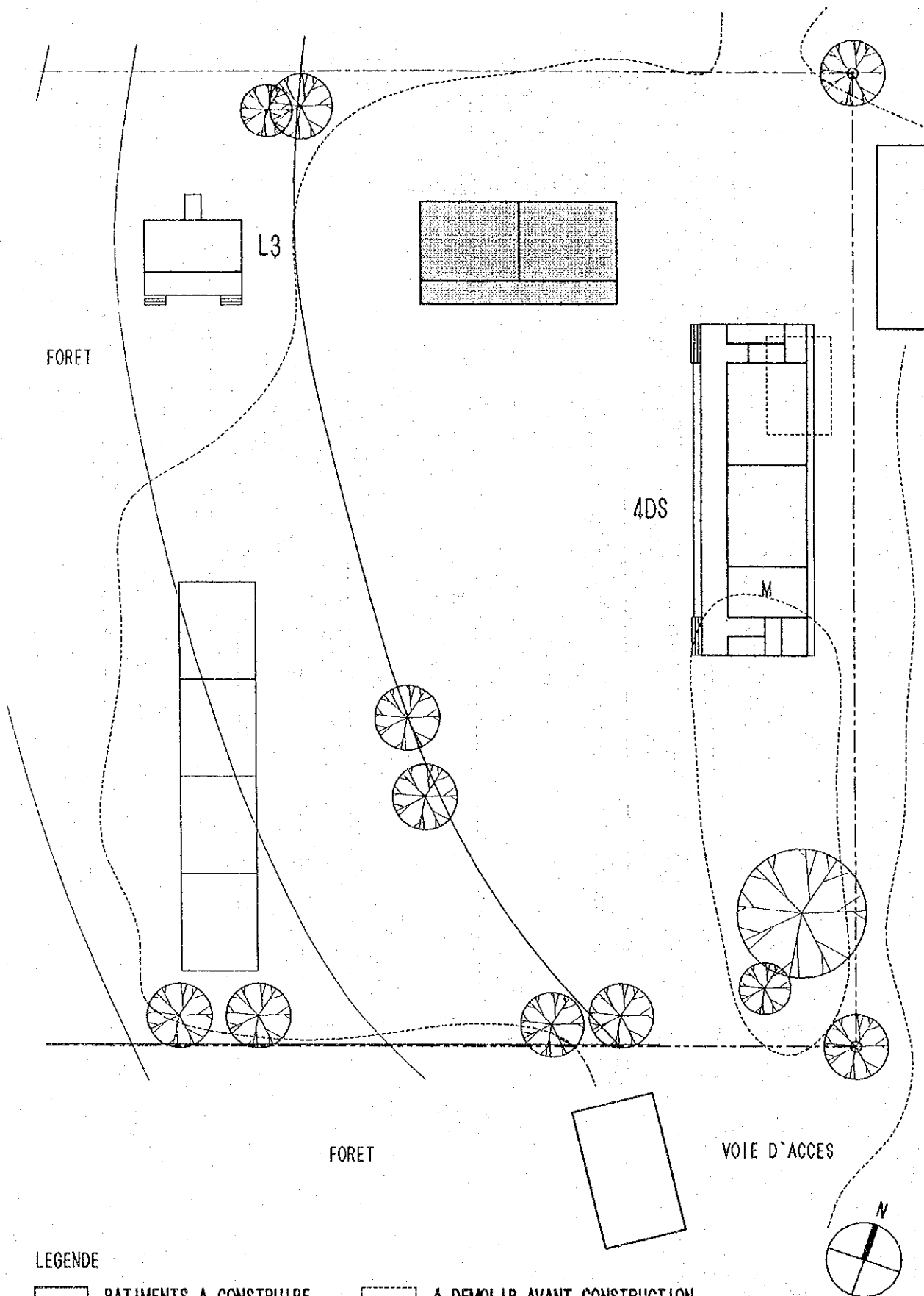

LEGENDE

- | | | | |
|---|------------------------|---|------------------------------|
|  | BATIMENTS A CONSTRUIRE |  | A DEMOLIR AVANT CONSTRUCTION |
|  | BATIMENTS EXISTANTES |  | A DEMOLIR APRES CONSTRUCTION |

ECH 1:500

D 1 9

EP MASSOUBOU
DOUALA-5

TYPE: 4DS +L3

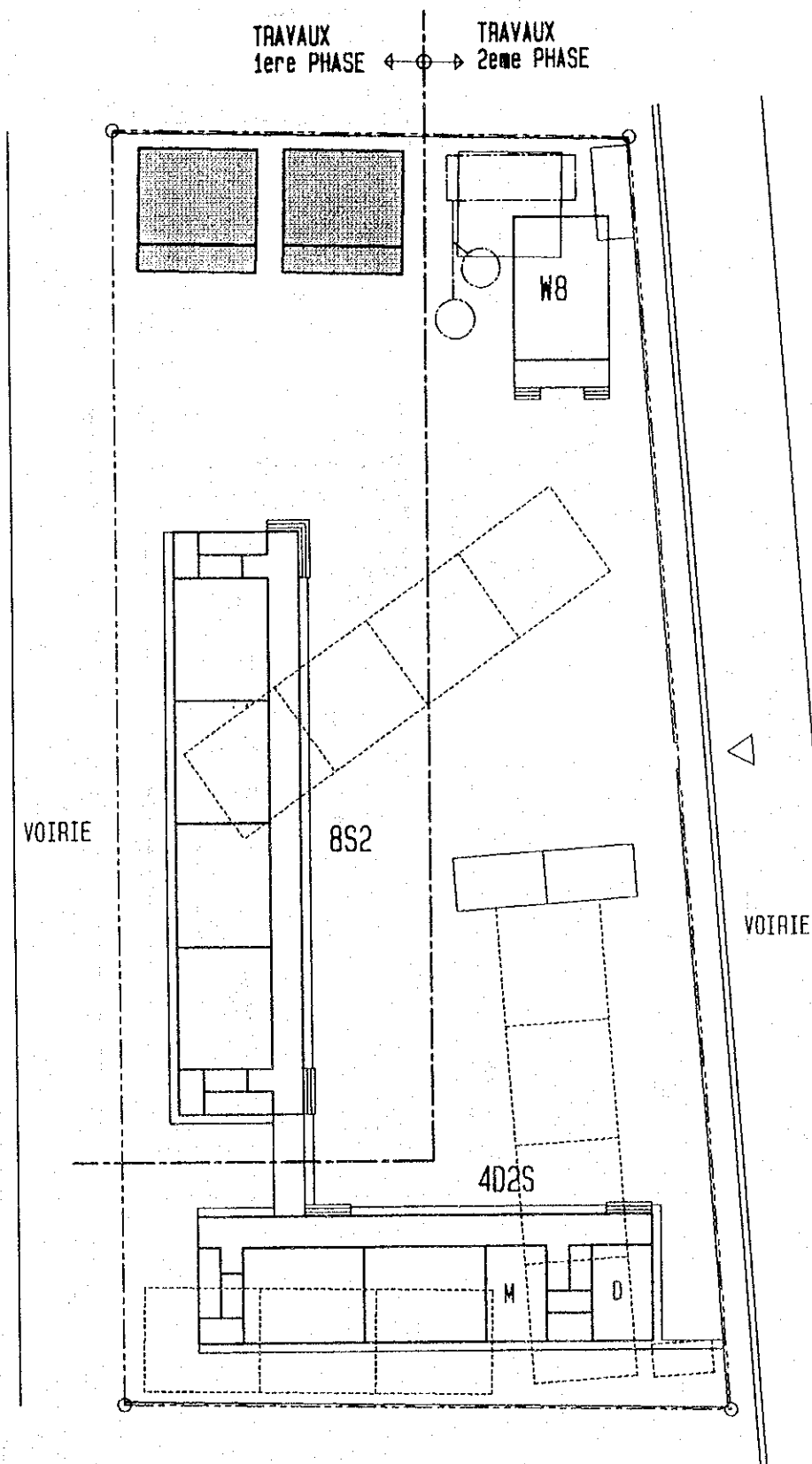

LEGENDE

- | | |
|---|--|
|  BATIMENT A CONSTRUIRE |  A DEMOLIR AVANT CONSTRUCTION |
|  BATIMENT EXISTANT |  A DEMOLIR APRES CONSTRUCTION |

ECH. 1: 500

D 2 0

EP NDOGBONG
DOUALA-5

TYPE: 12D2 (4D2S+8S2) +W8

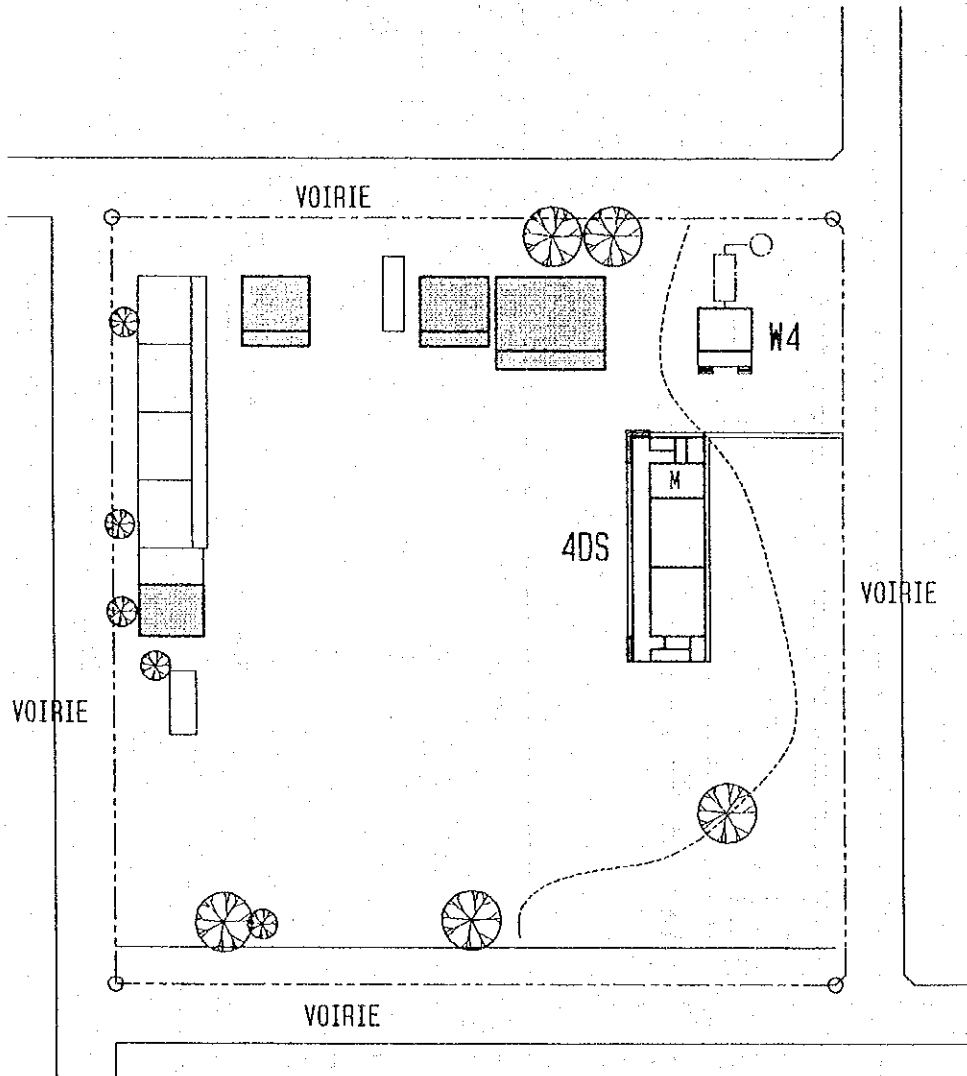

LEGENDE

- BATIMENT A CONSTRUIRE
- A DEMOLIR AVANT CONSTRUCTION
- BATIMENT EXISTANT
- A DEMOLIR APRES CONSTRUCTION

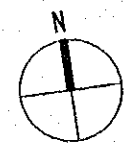

ECH. 1: 1000

D 2 2

EP BILINGUE BONAMOUSSADI
DOUALA-5

TYPE: 4DS +W4

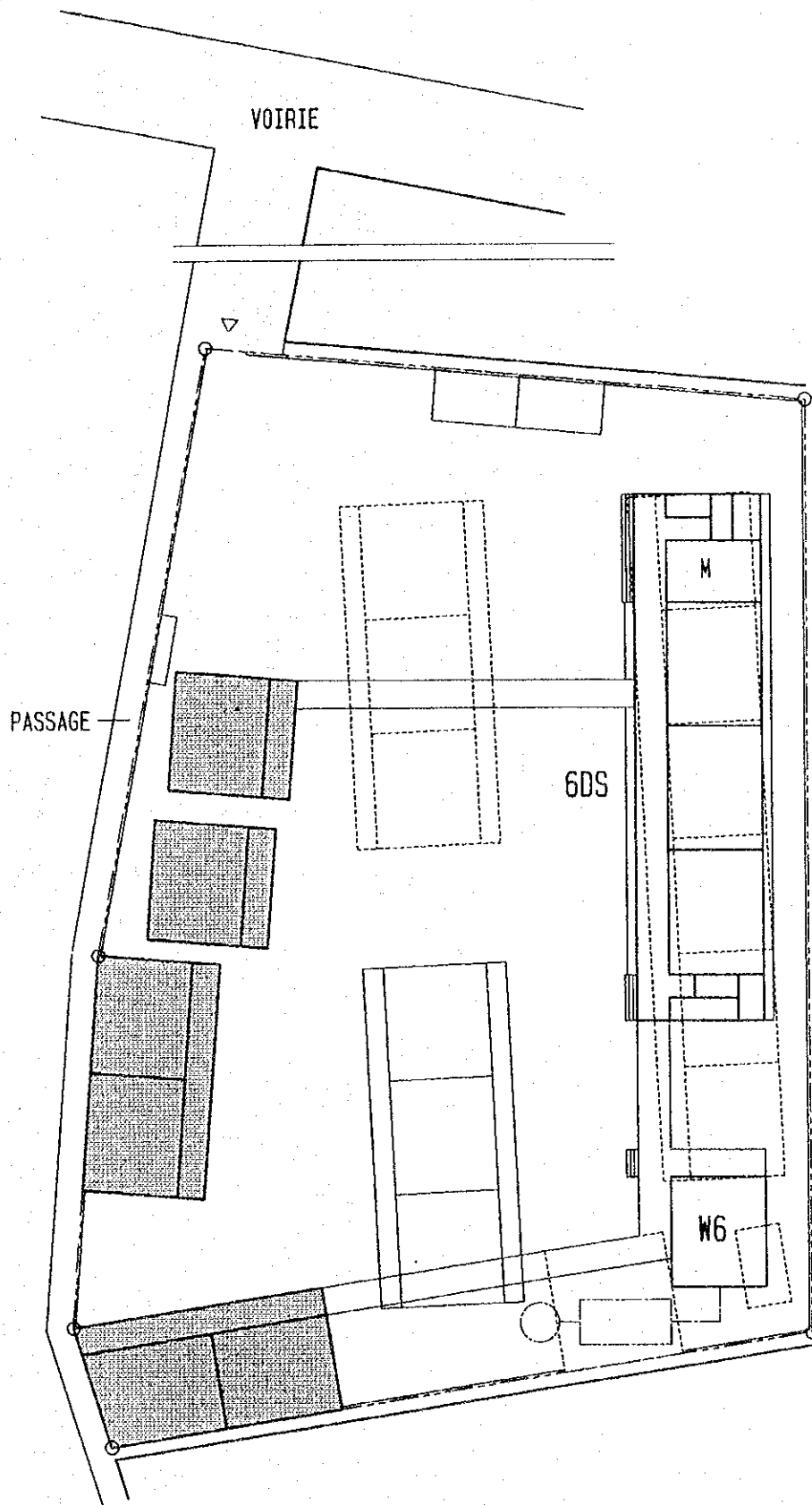

LEGENDE

 BATIMENT A CONSTRUIRE

 BATIMENT EXISTANT

 A DEMOLIR AVANT CONSTRUCTION

 A DEMOLIR APRES CONSTRUCTION



ECH. 1: 500

D 2 4

EP BONASSAMA

DOUALA-4

TYPE: 6DS +W6

8. Travaux à la charge de la partie camerounnaise et base de calcul

Tableau Calcul des coûts approximatifs des travaux à la charge de la parité comérounais

● YAOUNDE

Ecole	Construction de clôtures		Autres Travaux				Phasage			Total
	Longueur (m)	coûts	Branchement: eau	Terrassement (CFA)	Démolition (CFA)	Ourrages Provisoirs (CFA)	Phase 1	Phase 2	Phase 3	
Y1 EP.EMANA				3,024,000				3,024,000		3,024,000
Y3 EP.MBALLA II				12,800,000	537,500			13,337,500		13,337,500
Y5 EP.TSINGA VILLAGE				8,720,000	4,400,000				13,120,000	13,120,000
Y6 EP.FEBE VILLAGE				2,400,000				2,400,000		2,400,000
Y10 EP.NKOMO				17,280,000	400,000				17,680,000	17,680,000
Y12 EP.EKOUNOU	304	14,780,000			18,546,200	46,170,000		79,496,200		79,496,200
Y13 EP.MIMBOMAN P.			400,000	9,000,000				9,400,000		9,400,000
Y14 EP.NGOULMEKONG				8,600,000				8,600,000		8,600,000
Y15 EP.NGOUSSO	589	28,317,500	500,000	86,400,000				115,217,500		115,217,500
Y16 EP.NKOLMESSENG				12,000,000				12,000,000		12,000,000
Y18 EP.EKOUDOU	357	17,297,500		13,000,000	20,150,000			50,447,500		50,447,500
YAOUNDE TOTAL	1,250	60,395,000	900,000	173,224,000	44,033,700	46,170,000	0	148,705,200	176,017,500	324,722,700

● DOUALA

D1 EP.BEPANDA	129	6,467,500	450,000		16,600,000		23,517,500				23,517,500
D2 EP.NKONGMONDO					9,437,500			9,437,500			9,437,500
D4 GEPS.BEPANDA	70	3,665,000	350,000		6,262,500		10,277,500				10,277,500
D6 EP.N/B BASSA	130	6,515,000	400,000		11,625,000			18,540,000			18,540,000
D7 EP.N/B BAMILKE	463	22,332,500	400,000		16,675,000			39,407,500			39,407,500
D8 EP.CITE BERGE			400,000		4,145,400			4,545,400			4,545,400
D9 EP.NDOGPASSI 3B	276	13,450,000	400,000		4,737,600			18,587,600			18,587,600
D10 EP.BONADIWOTO			400,000				400,000				400,000
D11 EP.N.NKOLBONG				9,200,000	1,974,000		11,174,000				11,174,000
D12 EP.LOGBESSOU					2,500,000		2,500,000				2,500,000
D13 EP.NYLON	374	18,105,000			12,538,400		30,663,400				30,663,400
D14 GEPS.C.MILITAIRE					1,050,000		1,050,000				1,050,000
D15 EP.BIL.BIMBAMBA	309	15,017,500	500,000		15,773,400			31,290,900			31,290,900
D16 EP.N/T AEROPORT			500,000	10,000,000	2,021,000		12,521,000				12,521,000
D17 EP.BIL.NDOBO				3,200,000	3,553,200		6,753,200				6,753,200
D18 EP.BIL.BONABERI	256	12,500,000	400,000		20,575,000		95,035,000				95,035,000
D19 EP.MASSOUMBOU							0				0
D20 EP.NDOGBONG	278	13,545,000	400,000		11,100,000		55,825,000				55,825,000
D22 EP.BIL.BONAMOUSA							0				0
D24 EP.BONASSAMA			500,000		11,675,000			12,175,000			12,175,000
DOUALA TOTAL	2,285	111,597,500	5,100,000	22,400,000	152,263,000	92,340,000	254,262,000	129,438,500	0	0	383,700,500
GRAND TOTAL	3,535	171,992,500	6,000,000	195,624,000	196,296,700	138,510,000	254,262,000	278,143,700	176,017,500	0	708,423,200

JICA