

7. 主要機材の仕様

主要機材の仕様

| 計画番号 | 機材名 | 計画数量 | 構成 | 主な仕様 | 使用目的 |
|-------|----------------------------|------|--|--|--|
| L-001 | 顕微鏡、供覧用、5人用 | 1 | 1. 本体 2. 供覧用鏡筒 3. CCTV アダプター 4. 撮影アダプター | 1. 対物レンズ 4x, 10x, 40x, 100x 2. 100Wハロゲンランプ | 学生供覧用に使用する |
| L-002 | CCTVシステム、3モニター | 1 | 1. CCDカメラ 2. 29インチモニター 3. フック 4. VCR | 1. VHS方式 2. マルチ方式 | 学生実習室で顕微鏡に接続し使用する。 |
| L-003 | CCTVシステム、4モニター | 2 | 1. CCDカメラ 2. 29インチモニター 3. フック 4. VCR | 1. VHS方式 2. マルチ方式 | 同上 |
| L-004 | CCTVシステム、5モニター | 2 | 1. CCDカメラ 2. 29インチモニター 3. フック 4. VCR | 1. VHS方式 2. マルチ方式 | 同上 |
| L-005 | CCTVシステム、6モニター | 1 | 1. CCDカメラ 2. 29インチモニター 3. フック 4. VCR | 1. VHS方式 2. マルチ方式 | 同上 |
| L-007 | 顕微鏡、蛍光、偏向、透視アダプター、写真撮影装置付き | 12 | 1. 顕微鏡本体 2. 蛍光アダプター 3. 偏向アダプター 4. 透視アダプター | 1. 対物レンズ 4x, 10x, 40x, 100x 2. 100Wハロゲンランプ | 教育者用顕微鏡で、学生用スライド写真を作成するための顕微鏡、及びCCTVに接続する。 |
| L-013 | 分光光度計、ダブルビーム、200-1000nm | 2 | 1. 本体 | 1. 測定波長200~1000nm 2. パラメーター：吸光度、透過率、濃度 3. プリンター内蔵 | 各種の試薬による比色分析を行い、化学物質の定量、定性を行う。 |
| L-016 | 炎光光度計、デジタル | 3 | 1. 本体 2. プリンター | 1. 測定項目Na, K, Li 2. 検体：血清、尿 3. 直線性：+/- 1% 4. 測定時間：35秒 | 血液、尿中の電解質Na, K, Liを測定する。 |
| L-020 | クリオスタット・マイクロトーム | 2 | 1. 本体 | 1. 切片厚さ：0~20mic. 2. 庫内温度：-30℃ | 組織の病理学的顕微鏡検査を行うために、組織を凍結後薄層状にスライスする機材。 |
| L-021 | 超低温冷凍庫、-80℃、縦型 | 3 | 1. 本体 | 1. 庫内温度-80℃ 2. 記録計内蔵 | 標本（細菌・血液等）の保存に用いる |
| L-022 | 超低温冷凍庫、-80℃、横型 | 5 | 1. 本体 | 1. 庫内温度-80℃ 2. 記録計内蔵 | 標本（細菌・血液等）の保存に用いる |
| L-034 | 凍結乾燥機 | 2 | 1. 本体 2. 汎用アダプター 3. 試験管用アダプター 4. 真空ポンプ | 1. 温度-45℃ 2. 除湿量：4 L/回 3. 冷却器能力：400W | 標本（細菌・血液）の長期保存のためや試料の回収を凍結乾燥する機材。 |
| L-041 | バイオセーフ安全キャビネット、class IIA | 9 | 1. 本体 | 1. 安全クラスIIA 2. 寸法：1500x800x1700 3. パーナー | 細菌の検査を行う場合に菌が周囲に拡散し汚染しないよう収集する機能を有する機材 |
| L-043 | ドラフトチャンバー | 4 | 1. 本体 2. ファン 3. 排気ダクト | 1. 排気用ファン付き 2. 材質：スチール 3. 天板：セラミック 4. 1,500x750x2,300mm | 実験時に使用する有毒ガス等を排気しながら作業を行う機材 |
| L-044 | 遠心器、超高速、60,000 rpm | 1 | 1. 本体 2. アングルローター 3. スイングローター | 1. 遠心速度：60,000rpm 2. 遠心力：435,000 Xg | 血液や髄液中の細菌分離に使用する機材 |
| L-046 | 遠心器、微量冷却 | 3 | 1. 本体 2. アングルローター 3. スイングローター 4. 冷却装置 | 1. 遠心速度：20,000rpm 2. 遠心力：48,000 Xg | 血液、尿、血清、細胞成分または、抗原・抗体複合体等の分離、生成に使用する機材 |

主要機材の仕様

| 計画番号 | 機材名 | 計画数量 | 構成 | 主な仕様 | 使用目的 |
|-------|-------------------------|------|---|---|--|
| L-047 | 遠心器、微量 | 5 | 1. 本体 2. アングルローター 3. スイングローター | 1. 遠心速度：20,000rpm 2. 遠心力：48,000 Xg | 血液、尿、血清、細胞成分または、抗原・抗体複合体等の分離、生成に使用する機材 |
| L-064 | 電気泳動装置、水平ゲルタンク式 | 2 | 1. 電源装置 2. 水平泳動槽 3. 電極 | 1. 電源出力：5～1,000V 2. 出力端子数：4個 3. 槽寸法： 21x11.5x4.2cm | タンパク質などの両性電解質を個々のもつ固有の等電点の差を利用して分離する機材。 |
| L-067 | 電気泳動装置、濃度計付、セルロースアセテート式 | 3 | 1. 電源装置 2. セルロース泳動槽 3. 電極 4. 濃度計 | 1. 電源出力：1～1,000V 2. 出力端子数：4個 3. 槽寸法： 22.5x27x5.5cm | タンパク質、リポ蛋白、糖蛋白、各種酵素の分離検出定量を行う機材。 |
| L-095 | 自動屍体防腐処理装置 | 1 | 1. 保存槽（ヒーター付） 2. 操作卓 | 1. 防腐固定期間：7～10日 2. 寸法： 2440x860x1040mm | 病理組織検体用標本や骨格標本作成のため、人体組織を防腐処理する機材。 |
| L-096 | 屍体冷蔵庫（10体用） | 2 | 1. 本体（冷却機付） | 1. 10人用 2. 寸法： 1,160x1,950x1,825mm | 防腐固定された屍体を長期間保存するための機材。 |
| L-101 | X線装置、移動式 | 2 | 1. 本体 | 1. キャスター付 2. バッテリー内蔵 3. 消費電力：600VA | 病理検体用屍体を教育講習用、司法解剖用に部位を撮影する機材。 |
| L-106 | 自動染色装置 | 2 | 1. 本体 | 1. デジタライザー制御方式 2. 染色槽：18槽 | 石炭・ガラスに貼り付けたパラフィン切片を自動的に脱パラフィン、染色を行う機材。 |
| L-107 | 組織包埋センター | 1 | 1. 本体 | 1. 加熱板テーブル 2. 卓上型 | パラフィンを浸透させた組織片をパラフィン包埋とパラフィンブロックに同時にできる機材。 |
| L-140 | 粘度計 | 1 | 1. 本体 | 1. 表示部 デジタル表示 2. 卓上型 3. 攪拌装置付 | 薬理学用に薬剤等の粘度を計測するための機材。 |
| L-146 | グラスウェアセット | 14 | 1. ビーカー 2. 試験管 3. フラスコ 4. ピペット等 | 1. 耐熱ガラス | 検査部に於いて実験、研究するための汎用理科ガラス器具。 |
| L-147 | 実験動物飼育器具セット | 1 | 1. ラット、マウス、ウサギ等ケージ 2. 実験動物用飼料製造装置一式 | 1. マウス用ケージ150ヶ所（金属製） 2. ラット用150ヶ所 3. ウサギ用25ヶ所 4. モルモット50ヶ所 | 実験動物用の飼育に用いるケージ等。 |
| L-148 | ヘマトロジーアナライザー | 1 | 1. 本体 2. 希釈装置 | 1. 測定項目：5項目、白血球、赤血球、ヘモグロビン、ヘマトクリット、血小板 2. 演算項目：9項目 | 血液学的検査に用いられる分析装置である。 |
| L-149 | 生化学自動分析装置 | 1 | 1. 本体 2. 軟水器 | 1. 測定：200テスト/時 2. 測定波長：340-700nm 3. 試薬庫：2℃～8℃ | 血液中の酵素やリステール、尿酸等、肝機能検査、腎機能その他の検査に用いる。 |
| L-150 | 濃度計 | 1 | 1. 本体 | 1. 測定：血清蛋白、アミラーゼ、ポリタンパク 2. 測定波長：2波長 3. CRT付 | 電気泳動の泳動象を分析しその濃度を測定する機材。 |
| M-001 | 超音波心電計、モノドップラー付 | 1 | 1. 本体 2. プローブ 3. ドップラー 4. プリンター | 1. 方式 パルス反射法 2. 測定方式 リア・コンベックス・セクター 3. ドップラー | 各種腫瘍、胆石症、心臓の先天性疾患、心臓弁疾患等の診断に用いる機材。 |

主要機材の仕様

| 計画番号 | 機材名 | 計画数量 | 構成 | 主な仕様 | 使用目的 |
|-------|------------------|------|--|--|---|
| M-006 | 脳波計 | 2 | 1. 本体 2. 各種刺激装置 3. 移動式架台 | 1. チャンネル数(14ch) 2. 記録計 | 脳瘤、脳腫瘍、脳血管障害、頭部外傷、髄膜炎などに伴う中枢神経系の機能状態を診断する機材。 |
| M-007 | 誘発脳波測定装置 | 2 | 1. 本体 2. 各種刺激装置 3. フラッシュ 4. 移動式架台 | 1. チャンネル数(4ch) 2. 記録計 | 目視下で刺激することにより中枢神経系機能状態を診断する機材。 |
| M-011 | トレッドミル | 1 | 1. 本体 | ランニング方式 | 運動負荷試験時に必要な機材。 |
| M-013 | 血液ガス分析装置 | 1 | 1. 本体 2. 記録計 | 1. 検査項目 (pH, Pco2, pO2等) 2. 電極方式 | 呼吸機能検査や手術中の呼吸器官や水、電解質代謝、血液酸、塩基平衡機能検査等の目的に必要な機材。 |
| M-024 | 子宮鏡、切除用 | 1 | 1. 本体 2. 光源 3. 切除鉗子セット | 1. 硬性鏡、4mm 12° 2. 切除鉗子セット | 子宮頸管等の診断直視下小手術に使用する機材。 |
| M-027 | 腹腔鏡、ビデオ装置付 | 1 | 1. 本体 2. TVモニター 3. TVビデオシステム 4. 移動式架台 | 1. 腹腔鏡セット 2. 処置小物セット 3. ハガーン光源(100W) | 腹腔内腫瘍等の形態学的診断や直視下の穿刺生検等を行う機材。 |
| M-028 | 電気凝固器、双極性 | 1 | 1. 本体 2. ループ電極 | 1. ボディタイプ 2. 切除電極 | 内視鏡下で使用し主にポリープ等を切除するための機材。 |
| M-031 | 超音波診断装置(ヘッドアップ)付 | 1 | 1. 本体 2. プローブ 3. プリンター 4. ヘッドアップテ | 1. 方式 パルス反射法 2. 測定方式 リニア・コンベックス・セクター | 各種腫瘍、胆石症、心臓の先天性疾患、心臓弁疾患等の診断に用いる機材。 |
| M-032 | 電子内視鏡 | 1 | 1. 本体 2. 光源 3. 内視鏡用電気メス 4. TVモニター等 | 1. 軟性鏡タイプ 2. S状結腸用・胃部用・十二指腸用・大腸用 | 食道から胃、十二指腸、大腸にいたる消化管病変の診断、治療を行う機材。 |
| M-033 | 上部消化器用内視鏡、小児用 | 1 | 1. 本体 2. 光源 | 1. 軟性鏡タイプ 2. 光源ハガーン100W | 食道から胃、十二指腸にいたる上部消化管病変の診断を行う機材。 |
| M-038 | 患者監視装置、移動式 | 13 | 1. 本体 2. 移動式架台 | 1. 測定項目 (心電図、体温、心拍数、SpO2、非観血血圧等) 2. 除細動器保護回路 | 重症患者や手術後の患者に対して、肺や心臓の機能を連続的に監視する機材。 |
| M-040 | 手術台、小手術用 | 5 | 1. 本体 | 1. マニュアル油圧式 | 小手術を行う一般汎用タイプ。 |
| M-044 | 地域・家庭医療用診断セット | 3 | 1. 診察用セット等 | 1. 聴診器 2. 診断器セット等 3. 外来診察器具セット一式 | 家庭医療実習センターに用いる一般的診療セット。 |
| M-053 | インフュージョンポンプ、輸送用 | 2 | 1. トランスカプセル 2. 頭部固定台 3. 酸素流量計 | 1. 充電式バッテリー内蔵 2. マニュアルコントロール制御方式 3. 103x47x64cm 4. キャスター付 | 未熟児・新生児を安定した環境下(温度等)で安全に搬送するための保育器。 |

主要機材の仕様

| 計画番号 | 機材名 | 計画数量 | 構成 | 主な仕様 | 使用目的 |
|-------|---------------------------|------|---|--|--|
| M-057 | 人工呼吸器、小児用 | 3 | 1. 本体 2. 加湿器 3. エアコンプレッサー 4. 移動式架台 | 1. 作動/制御方式 ・ 換気量、時間、圧力、アラーム付 2. 換気量：1～30L/min | 呼吸中枢や呼吸器系の障害により、正常な換気が行えない患者に対して、十分な換気を補助する機材。 |
| M-060 | バス、小型 | 1 | 1. 車両本体 | 1. 燃料：ディーゼル 2. 排気量：4000cc | 地域医療推進実習のために学生移動用に使用。 |
| M-061 | 精神科用診断器セット | 1 | 1. 槌打器 2. プロッグ遊戯具 3. 砂トレイ 4. レゴセット | 1. 精神障害患者のトレーニング及び診断セット | 精神診断をするテストなど知覚発達などを調べる診断セット。 |
| M-066 | 高圧蒸気滅菌器 | 2 | 1. 本体 2. 内臓ボイラー 3. 軟水器 | 1. 内容量：150リットル 2. 滅菌温度130℃ | 手術器具等の滅菌に使用する。 |
| M-072 | 手術器具セット、上部消化器用 | 2 | 1. 手術器具一式 | ステンレス製 | 胃・十二指腸の外科手術器具 |
| M-073 | 万能手術台、整形外科用アタッチメント付 | 1 | 1. 手術台 2. 整形外科牽引器具 | 1. 電動式 2. 万能型 | 骨折等の手術にも対応できる万能型手術台 |
| M-079 | 手術器具セット、骨折整骨用 | 1 | 1. 手術器具一式 | ステンレス製 | 骨折時の整骨用手術器具 |
| M-081 | 人工呼吸器、終末炭酸ガス、酸素付バイパス付 | 3 | 1. 本体 2. 加湿器 3. エアコンプレッサー-内臓 4. ガスモニター-CO2, O2 | 1. 作動/制御方式 ・ 換気量、時間、圧力、アラーム付 2. 換気量：1～30L/min | 呼吸中枢や呼吸器系の障害により、正常な換気が行えない患者に対して、十分な換気を補助する機材。 |
| M-086 | セントラルモニター | 1 | 1. 本体 2. 記録計 | 1. 6床対応式 2. 無線式 | 集中治療室の患者監視装置を一括モニターするナースステーション用 |
| M-087 | 患者監視装置 | 6 | 1. 本体 2. カート | 1. ECG、心拍、体温、呼吸、非観血血圧 | 集中治療室の患者監視のための機材 |
| M-090 | X線診断装置、透視、立位 | 1 | 1. 透視台 2. 立位スタンド 3. イオン化管ファイバー 4. 高圧発生装置 | 1. 最大管電流：600mA 2. 最大管電圧：150Kv 3. 透視台長：2000mm 4. 角度：+90、-15° | 肺、消化器、骨の診断に用いられる放射線装置 |
| M-091 | 自動現像器 | 1 | 1. 本体 2. 現像液タンク 3. 定着液タンク | 1. 現像速度：90秒/枚 2. 乾燥機能付き 3. 暗室挿入、明室取り出し式 | 放射線フィルムの現像に使用する。 |
| M-092 | X線診断装置、単純撮影 | 1 | 1. 撮影テーブル 2. 高圧発生装置 3. 管球支持器 | 1. 最大管電流：80mA 2. 最大管電圧：150Kv | 骨折の診断に用いる放射線装置 |
| M-093 | X線診断装置、マンモ | 1 | 1. 本体 2. 高圧発生装置 3. 乳房保持器 | 1. 最大管電流：100mA 2. 最大管電圧：35Kv | 乳がんの健診用の放射線診断装置 |
| M-098 | X線防護カーテン、50m ² | 3 | 1. 放射線防護カーテン | 1. 始当量：0.35 | 放射線室の防護が充分に行われていないためカーテン式のものをつり下げる。 |

主要機材の仕様

| 計画番号 | 機材名 | 計画数量 | 構成 | 主な仕様 | 使用目的 |
|-------|------------------------|------|---|--|--------------------------------|
| M-100 | 脊椎牽引ベット | 1 | 1. 牽引器 2. ベッド 3. 支柱 | 1. 1人用 2. 頰椎、腰椎用 3. 最大牽引力：90kg | 脊椎の歪み等の矯正に使用する牽引装置 |
| M-108 | 膀胱鏡、大人用 | 1 | 1. 硬性膀胱鏡 2. 光源装置 3. 異物鉗子 4. 組織鉗子 | 1. 硬性鏡、30° 70° 2. 蒸気滅菌可能 3. フラッシュ機能付き | 膀胱内の異物の除去、病理組織の採取に用いる。 |
| M-109 | ファイバー気管支鏡、大人直径5mm、90cm | 2 | 1. 気管支用内規鏡 2. 光源装置 3. 吸引器 4. トロリー | 1. 有効長：900mm 2. 直径：5mm 3. 軟性鏡 | 気管支の内部の腫瘍、異物の状況を内視鏡的に観察する。 |
| M-113 | 腹腔鏡、手術用（産婦人科） | 1 | 1. 腹腔鏡、硬性 2. 気腹装置 3. 光源装置 4. 組織生検鉗子セット | 1. 腹腔鏡、10mm硬性 2. 蒸気滅菌可能 3. 炭酸ガス気腹装置 | 子宮頸管等の診断直視下小手術に使用する機材。 |
| M-115 | 手術器具セット、子宮切除 | 2 | 1. 手術器具一式 | ステンレス製 | 子宮切除用手術器具セット |
| M-116 | 手術器具セット、帝王切開 | 2 | 1. 手術器具一式 | ステンレス製 | 帝王切開用手術器具セット |
| M-121 | 治療ユニット | 2 | 1. 歯科用治療ユニット 2. コンプレッサー | 1. ハンドピース3種 2. 治療用ライト付 3. サラエボイェクター付 | 歯科、顎顔面外科用の治療ユニット |
| M-123 | 顎骨プレート固定器具セット | 1 | 1. マイクロプレート 2. スクリュー・ライナーセット 3. スクリューセット | 1. 原材料 チタン | 顎顔面の骨折・形成用に用いる器具 |
| M-126 | 手術器具セット、顎骨用 | 1 | 1. 手術器具一式 | 下顎骨矢状切断セット | 下顎骨の形成用に用いる手術器具セット |
| O-002 | 写真教材作成セット | 1 | 1. カメラ 2. スクリーン 3. 現像セット | 1. 35mmカメラ 2. フィルム現像セット等 | 教官の教育用写真作成機材。 |
| O-004 | ビデオカメラ、VHS | 1 | 1. VCR 2. ミキサー 3. マイクロフォン | 1. Pal カラーcamere 2. S-VHS ビデオカメラ 3. 編集コントロール付 4. 8ch ミキサー | 学生の教育用機材。カメラで撮影したものを編集する機材。 |
| O-005 | スライド作成システム | 1 | 1. マイコンコンピューター 2. フィルムスキャナー 3. カラープリンター 4. デジタライザー | 1. マルチ方式 2. フィルムサイズ4x5インチ 3. A3 プリンター | 顕微鏡写真やビデオ画像から教育・研究発表用の画像を作成する。 |
| O-006 | 聴講室視聴覚セット | 1 | 1. 29インチモニター 4台 2. VCR 3. プロジェクター 4. スピーカーシステム | 1. VHS方式 2. マルチ方式 3. 120インチスクリーン | 聴講室用の視聴覚機材。 |
| O-007 | 観察用TV、VIRセット | 2 | 1. ビデオカメラ 2. 29インチモニター 3. スピーカーシステム | 1. 双方向音声システム 2. CCD Pal カメラ 3. 遠隔観察式 | 精神患者の診療観察、経過観察を遠隔操作により操作できる機材。 |
| O-037 | 解剖模型、模擬訓練セット | 1 | 1. 人体内臓組織 2. 骨格組織 3. 筋組織等 4. 訓練具セット | 1. アクリル製標本 2. プラスチック製標本 | 医学生に対して臨床実習用に使用する教育用機材。 |

8. 維持管理費

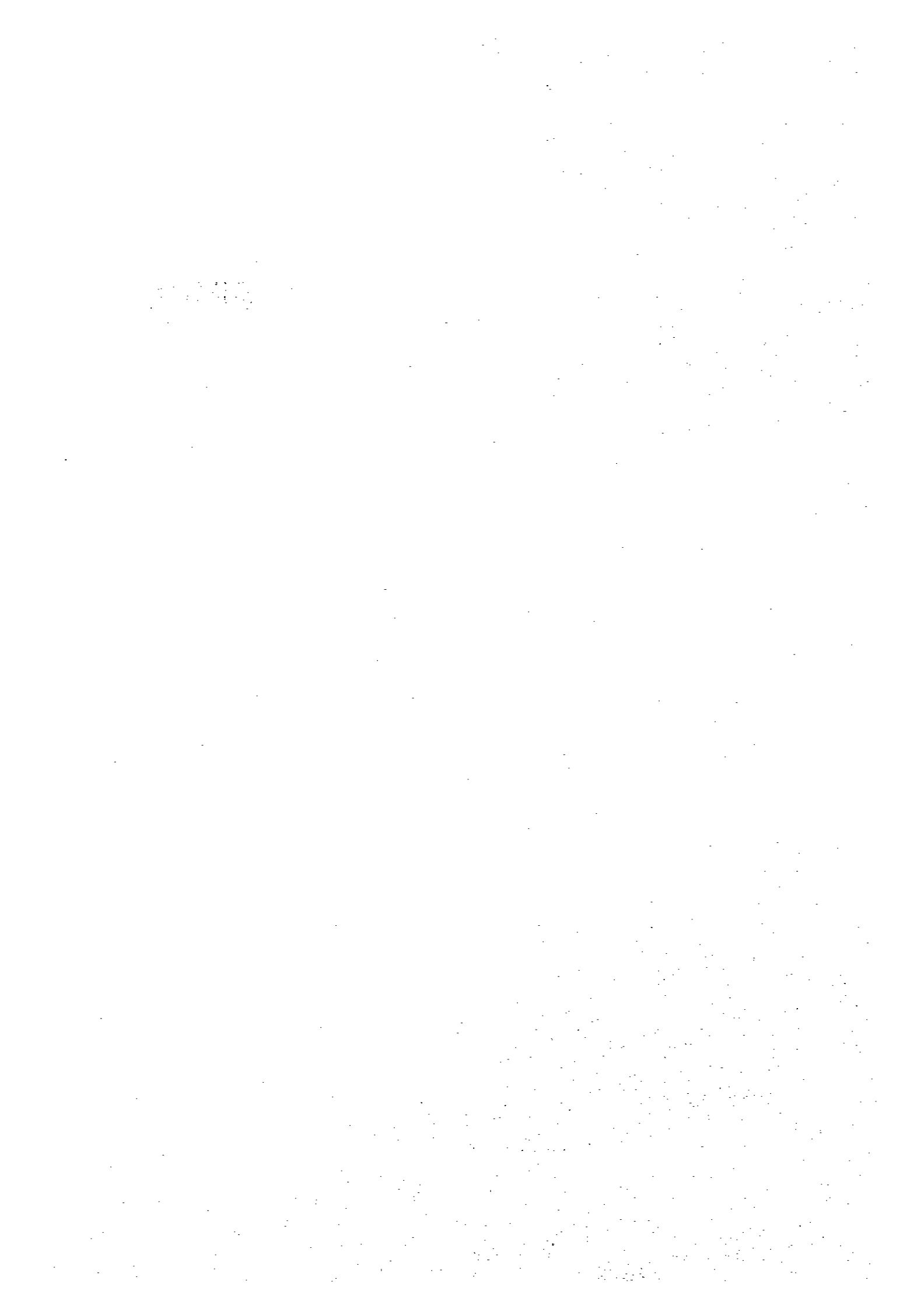

維持管理費（年間）
医学部

| No. | 機材名 | 使用量 | 単価(円) | 計(円) | 維持管理経費 /台・年 | 機材 数量 | 維持管理経費 小計(年間) |
|-------|--------------------------------|-----|----------|----------|----------------|----------|------------------|
| L-001 | 顕微鏡、供覧用、5人用 | | | | ¥5,400 | 1 | ¥5,400 |
| | 光源バルブ | 1 | ¥2,400 | ¥2,400 | | | |
| | オイル | 1 | ¥3,000 | ¥3,000 | | | |
| L-006 | 顕微鏡、3眼、CCTVカメラ、写真撮影装置付 | | | | ¥5,400 | 4 | ¥21,600 |
| | 光源バルブ | 1 | ¥2,400 | ¥2,400 | | | |
| | オイル | 1 | ¥3,000 | ¥3,000 | | | |
| L-007 | 顕微鏡、蛍光 | | | | ¥5,400 | 12 | ¥64,800 |
| | 光源バルブ | 1 | ¥2,400 | ¥2,400 | | | |
| | オイル | 1 | ¥3,000 | ¥3,000 | | | |
| L-008 | 顕微鏡、倒立、組織培養 | | | | ¥5,400 | 8 | ¥43,200 |
| | 光源バルブ | 1 | ¥2,400 | ¥2,400 | | | |
| | オイル | 1 | ¥3,000 | ¥3,000 | | | |
| L-009 | 顕微鏡、倒立、CCD・カメラ付 | | | | ¥5,400 | 1 | ¥5,400 |
| | 光源バルブ | 1 | ¥2,400 | ¥2,400 | | | |
| | オイル | 1 | ¥3,000 | ¥3,000 | | | |
| L-010 | 顕微鏡、双眼 | | | | ¥5,400 | 74 | ¥399,600 |
| | 光源バルブ | 1 | ¥2,400 | ¥2,400 | | | |
| | オイル | 1 | ¥3,000 | ¥3,000 | | | |
| L-011 | 顕微鏡、双眼 | | | | ¥5,400 | 80 | ¥432,000 |
| | 光源バルブ | 1 | ¥2,400 | ¥2,400 | | | |
| | オイル | 1 | ¥3,000 | ¥3,000 | | | |
| L-012 | 顕微鏡、立体 | | | | ¥5,400 | 5 | ¥27,000 |
| | 光源バルブ | 1 | ¥2,400 | ¥2,400 | | | |
| | オイル | 1 | ¥3,000 | ¥3,000 | | | |
| L-013 | 分光光度計、ダブルビーム、200-1000nm | | | | ¥45,000 | 2 | ¥90,000 |
| | 光源バルブ、タングステン | 1 | ¥5,000 | ¥5,000 | | | |
| | 光源バルブ、D2 | 1 | ¥30,000 | ¥30,000 | | | |
| | 記録紙 | 1 | ¥10,000 | ¥10,000 | | | |
| L-014 | 分光光度計、可視光、シングルビーム | | | | ¥5,000 | 5 | ¥25,000 |
| | 光源バルブ | 1 | ¥5,000 | ¥5,000 | | | |
| L-015 | 分光光度計、シングルビーム | | | | ¥5,000 | 1 | ¥5,000 |
| | 光源バルブ | 1 | ¥5,000 | ¥5,000 | | | |
| L-016 | 炎光光度、デジタル | | | | ¥184,500 | 2 | ¥369,000 |
| | チューブセット | 1 | ¥28,000 | ¥28,000 | | | |
| | 記録紙、リボン | 1 | ¥6,500 | ¥6,500 | | | |
| | 試薬 | 1 | ¥150,000 | ¥150,000 | | | |
| L-017 | 軟水化装置 | | | | ¥41,000 | 5 | ¥205,000 |
| | カートリッジ・フィルター | 4 | ¥5,500 | ¥22,000 | | | |
| | イオン交換樹脂カートリッジ | 1 | ¥19,000 | ¥19,000 | | | |
| L-041 | ハイパー・D安全注射器、Class IIA フィルター | 1 | ¥250,000 | ¥250,000 | ¥250,000 | 8 | ¥2,000,000 |
| L-058 | pHメーター | | | | ¥55,000 | 14 | ¥770,000 |
| | pHセンサー | 1 | ¥25,000 | ¥25,000 | | | |
| | 試薬 | 1 | ¥30,000 | ¥30,000 | | | |
| L-059 | pHメーター、携帯式 | | | | ¥30,000 | 7 | ¥210,000 |
| | 試薬 | 1 | ¥30,000 | ¥30,000 | | | |
| L-067 | 電気泳動装置、濃度計付、マイクロアッセイ式 | | | | ¥31,500 | 2 | ¥63,000 |
| | マイクロアッセイ膜 | 1 | ¥16,500 | ¥16,500 | | | |
| | 濾紙 | 1 | ¥3,000 | ¥3,000 | | | |
| | 緩衝液 | 1 | ¥12,000 | ¥12,000 | | | |
| | ボンソ | 1 | ¥6,000 | ¥6,000 | | | |

維持管理費（年間）
医学部

| No. | 機材名 | 使用量 | 単価(円) | 計(円) | 維持管理経費 /台・年 | 機材 数量 | 維持管理経費 小計(年間) |
|-------|---|-----------------------|--|--|----------------|----------|------------------|
| L-081 | 紫外線ランプ、手持ち式 紫外線バルブ | 1 | ¥19,500 | ¥19,500 | ¥19,500 | 1 | ¥19,500 |
| L-082 | 紫外線ランプ 紫外線バルブ | 1 | ¥19,500 | ¥19,500 | ¥19,500 | 2 | ¥39,000 |
| L-086 | 純水製造装置 カートリッジ・フィルター イオン交換樹脂カートリッジ | 4 1 | ¥5,500 ¥19,000 | ¥22,000 ¥19,000 | ¥41,000 | 1 | ¥41,000 |
| L-087 | 蒸留水製造装置 カートリッジ・フィルター イオン交換樹脂カートリッジ | 4 1 | ¥5,500 ¥19,000 | ¥22,000 ¥19,000 | ¥41,000 | 5 | ¥205,000 |
| M-001 | 超音波診断装置、モノロードアタッチ メント付 ジェル (12pcs/set) 記録紙 (5rolls/set) | 2 3 | ¥12,000 ¥11,000 | ¥24,000 ¥33,000 | ¥57,000 | 1 | ¥57,000 |
| M-002 | 心電計、3CH 電極・ケーブルセット 電極クリーム (200g) 記録紙 (60m x 10rolls/set) | 1 6 6 | ¥16,000 ¥1,100 ¥25,000 | ¥16,000 ¥6,600 ¥150,000 | ¥172,600 | 2 | ¥345,200 |
| M-006 | 脳波計 脳波電極クリーム (1200g) EEG電極クリーム (200g) 記録用インク (黒、400ml) 記録紙 (300m) | 1 1 1 6 | ¥9,000 ¥1,100 ¥5,000 ¥6,600 | ¥9,000 ¥1,100 ¥5,000 ¥39,600 | ¥54,700 | 2 | ¥109,400 |
| M-007 | 誘発脳波測定装置 脳波電極クリーム (1200g) EEG電極クリーム (200g) 記録用インク (黒、400ml) 記録紙 (50m) | 1 1 1 6 | ¥9,000 ¥1,100 ¥5,000 ¥6,600 | ¥9,000 ¥1,100 ¥5,000 ¥39,600 | ¥54,700 | 2 | ¥109,400 |
| M-010 | スパイロメーター パーパーマウス(100pcs/set) ノーズクリップ フィルター (100pcs/set) 記録紙 (10rolls/set) | 1 1 1 2 | ¥1,600 ¥2,400 ¥23,000 ¥11,000 | ¥1,600 ¥2,400 ¥23,000 ¥22,000 | ¥49,000 | 1 | ¥49,000 |
| M-013 | 血液ガス分析装置 試薬セット 記録紙 (5ヶ) チューブセット 校正ガス 電極セット | 1 2 1 2 1 | ¥431,000 ¥4,000 ¥33,000 ¥42,500 ¥317,000 | ¥431,000 ¥8,000 ¥33,000 ¥85,000 ¥317,000 | ¥557,000 | 1 | ¥557,000 |
| M-023 | ビリルビンアナライザー キャピラリー ランプ | 10 1 | ¥800 ¥1,000 | ¥8,000 ¥1,000 | ¥9,000 | 1 | ¥9,000 |
| M-027 | 腹腔鏡、ビデオ装置付 光源ランプ | 1 | ¥110,000 | ¥110,000 | ¥110,000 ¥0 | 1 | ¥110,000 |
| M-030 | 分焼監視装置 ゲル (5キロ) 記録紙 (10ロール) | 2 2 | ¥12,000 ¥17,300 | ¥24,000 ¥34,600 | ¥58,600 | 3 | ¥175,800 |
| M-031 | 超音波診断装置 ジェル (12pcs/set) 記録紙 (5rolls/set) | 3 6 | ¥12,000 ¥11,250 | ¥36,000 ¥67,500 | ¥103,500 | 1 | ¥103,500 |
| M-032 | 電子内視鏡 光源ランプ | 1 | ¥110,000 | ¥110,000 | ¥110,000 | 1 | ¥110,000 |

維持管理費（年間）
コロナ南教育病院中央サービス

| No. | 機材名 | 使用量 | 単価(円) | 計(円) | 維持管理経費/台・年 | 機材数量 | 維持管理経費小計(年間) |
|-------|---|-----|------------|------------|------------|------|--------------|
| L-006 | 顕微鏡、供覧用、5人用 光源バルブ オイル | 1 | ¥2,400 | ¥2,400 | ¥5,400 | 2 | ¥10,800 |
| | | 1 | ¥3,000 | ¥3,000 | | | ¥0 |
| | | | | | | | ¥0 |
| L-015 | 分光光度計、シングルビーム 光源バルブ | 1 | ¥5,000 | ¥5,000 | ¥5,000 | 1 | ¥5,000 ¥0 |
| L-016 | 蛍光光度、デジタル チューブセット 記録紙、リボン 試薬 | 1 | ¥28,000 | ¥28,000 | ¥184,500 | 1 | ¥184,500 |
| | | 1 | ¥6,500 | ¥6,500 | | | |
| | | 1 | ¥150,000 | ¥150,000 | | | |
| L-058 | pHメーター pHセンサー 試薬 | 1 | ¥25,000 | ¥25,000 | ¥55,000 | 1 | ¥55,000 |
| | | 1 | ¥30,000 | ¥30,000 | | | |
| | | | | | | | |
| L-067 | 電気泳動装置、濃度計付、セルロースゲル プレート式 セルロースゲル膜 濾紙 緩衝液 ボンソ | 1 | ¥16,500 | ¥16,500 | ¥31,500 | 1 | ¥31,500 |
| | | 1 | ¥3,000 | ¥3,000 | | | |
| | | 1 | ¥12,000 | ¥12,000 | | | |
| | | 1 | ¥6,000 | ¥6,000 | | | |
| L-081 | 紫外線ランプ、手持ち式 紫外線バルブ | 1 | ¥19,500 | ¥19,500 | ¥19,500 | 2 | ¥39,000 |
| L-086 | 純水製造装置 カートリッジ・フィルター イオン交換樹脂カートリッジ | 4 | ¥5,500 | ¥22,000 | ¥41,000 | 1 | ¥41,000 |
| | | 1 | ¥19,000 | ¥19,000 | | | |
| L-148 | ヘトジ-グラフィター 試薬 | 1 | ¥1,800,000 | ¥1,800,000 | ¥1,800,000 | 1 | ¥1,800,000 |
| L-149 | 生化学分析装置 試薬 | 1 | ¥2,000,000 | ¥2,000,000 | ¥2,000,000 | 1 | ¥2,000,000 |
| M-002 | 心電計、3CH 電極・ケーブルセット 電極クリーム (200g) 記録紙 (60m x 10rolls/set) | 1 | ¥16,000 | ¥16,000 | ¥172,600 | 1 | ¥172,600 |
| | | 6 | ¥1,100 | ¥6,600 | | | |
| | | 6 | ¥25,000 | ¥150,000 | | | |
| | | | | | | | |
| M-010 | スパイロメーター ペーパーマスキース(100pcs/set) ノーズクリップ フィルター (100pcs/set) 記録紙 (10rolls/set) | 1 | ¥1,600 | ¥1,600 | ¥4,000 | 1 | ¥4,000 |
| | | 1 | ¥2,400 | ¥2,400 | | | |
| | | 1 | ¥23,000 | ¥23,000 | | | |
| | | 2 | ¥11,000 | ¥22,000 | | | |
| M-021 | 診断器具セット ランプ | 4 | ¥500 | ¥2,000 | ¥2,000 | 4 | ¥8,000 |
| | | | | | | | |
| M-037 | 輸液ポンプ チューブ・セット | 300 | ¥258 | ¥77,400 | ¥77,400 | 4 | ¥309,600 |
| M-038 | 患者監視装置、移動式 デスポ電極 (250pcs/set) 生体電極 電極クリーム (200g) 電極リード線 | 3 | ¥14,500 | ¥43,500 | ¥66,900 | 5 | ¥334,500 |
| | | 1 | ¥7,800 | ¥7,800 | | | |
| | | 6 | ¥1,100 | ¥6,600 | | | |
| | | 1 | ¥9,000 | ¥9,000 | | | |
| M-043 | 診察灯 ランプ | 1 | ¥4,700 | ¥4,700 | ¥4,700 | 7 | ¥32,900 |
| M-048 | 電気凝固器 鉛板 鉛板用コード 双極性止血鉗子コード | 1 | ¥11,000 | ¥11,000 | ¥33,500 | 3 | ¥100,500 |
| | | 1 | ¥15,000 | ¥15,000 | | | |
| | | 1 | ¥7,500 | ¥7,500 | | | |
| M-051 | シリンジポンプ シリンジ (50ml) 延長チューブ | 300 | ¥92 | ¥27,600 | ¥48,000 | 16 | ¥768,000 |
| | | 300 | ¥68 | ¥20,400 | | | |
| M-057 | 人工呼吸器、小児用 蛇管ホース 気管内チューブセット(10pcs/set) マイクロフィルター | 1 | ¥4,500 | ¥4,500 | ¥107,000 | 1 | ¥107,000 |
| | | 1 | ¥2,500 | ¥2,500 | | | |
| | | 4 | ¥25,000 | ¥100,000 | | | |
| M-068 | 神経刺激器 (筋弛緩) 電極セット | 1 | ¥30,000 | ¥30,000 | ¥30,000 | 1 | ¥30,000 |

9. 水質検査結果

アイテック株式会社

水質分析報告書

| 試料番号 | | | |
|---|---------------------------|--|--|
| 試料名称 | リラン ^カ 国 水道水 | | |
| 試料の採取年月日 | 8.10.30 | | |
| 外観 色 にごり | 無色 なし | | |
| 試料の分析年月日 | 8.11.15 | | |
| pH (25°C) | 7.4 | | |
| 電気伝導率 ($\mu\text{S/cm}$) (25°C) | 58.0 | | |
| 透過光濁度 (度) | <1. | | |
| 酸消費量(pH8.3) (mgCaCO_3/L) | 0.0 | | |
| 酸消費量(pH4.8) (mgCaCO_3/L) | 11.6 | | |
| マグネシウム (mgCaCO_3/L) | 3.1 | | |
| カルシウム (mgCaCO_3/L) | 13.0 | | |
| 全硬度 (mgCaCO_3/L) | 16.1 | | |
| 塩化物イオン (mgCl/L) | 5.1 | | |
| 全鉄 (mgFe/L) | <0.05 | | |
| イオン状シリカ (mgSiO_2/L) | 7.7 | | |
| リン酸イオン (mgPO_4/L) | | | |
| 硝酸イオン (mgNO_3/L) | 1.4 | | |
| 硫酸イオン (mgSO_4/L) | 5.2 | | |
| COD _{Mn} (mgO/L) | <1. | | |
| 色度 (度) | <1. | | |
| マンガン (mgMn/L) | | | |
| 摘 要 | | | |

株式会社 東京科研

東京都文京区湯島3-20-9
電話 03-3831-9941
FAX 03-3831-8960

10. サイト図面

中央図書館 3, 4階「医学部」【現状】

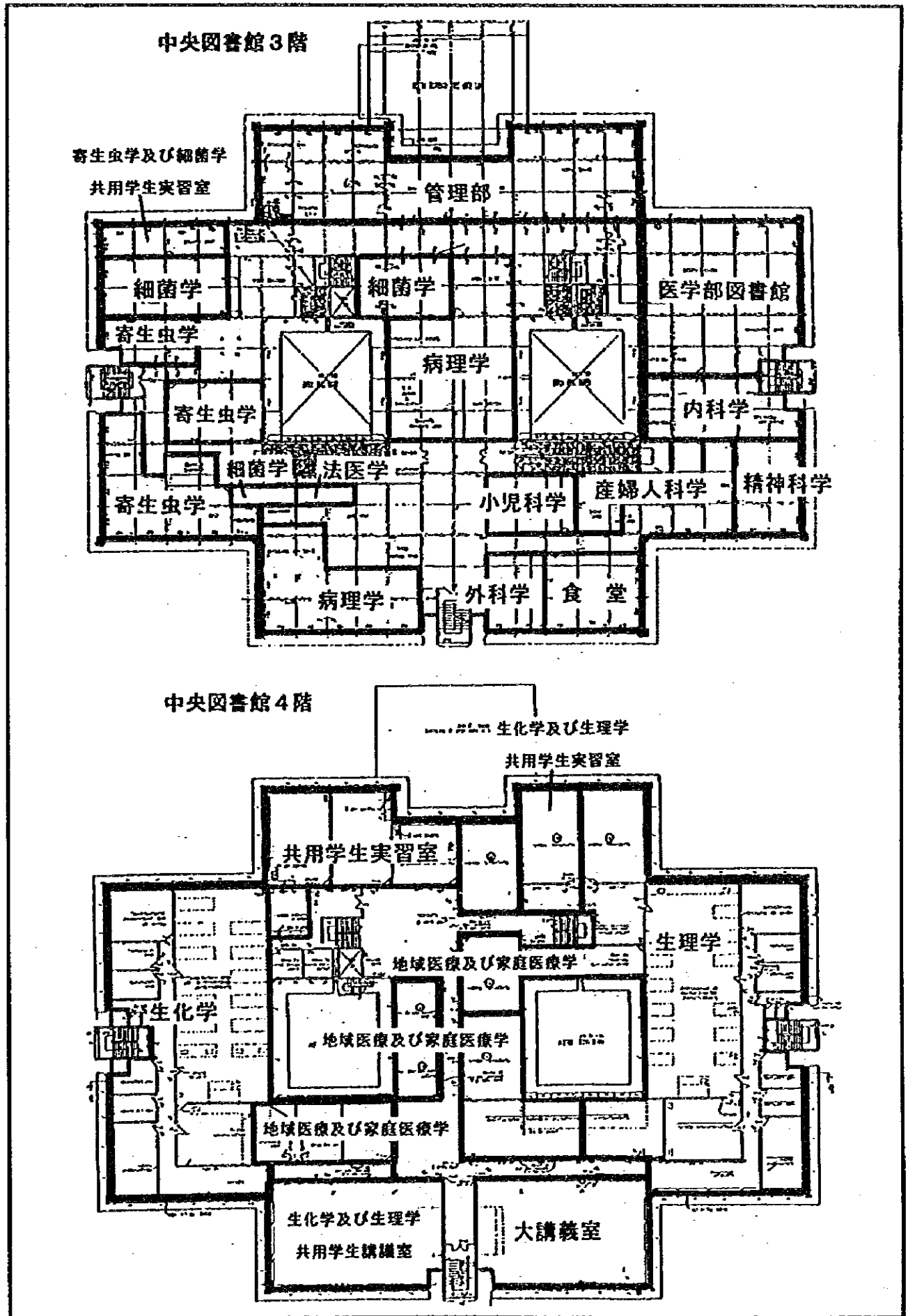

中央図書館 3, 4階「医学部」【計画実施後】

中央図書館3階

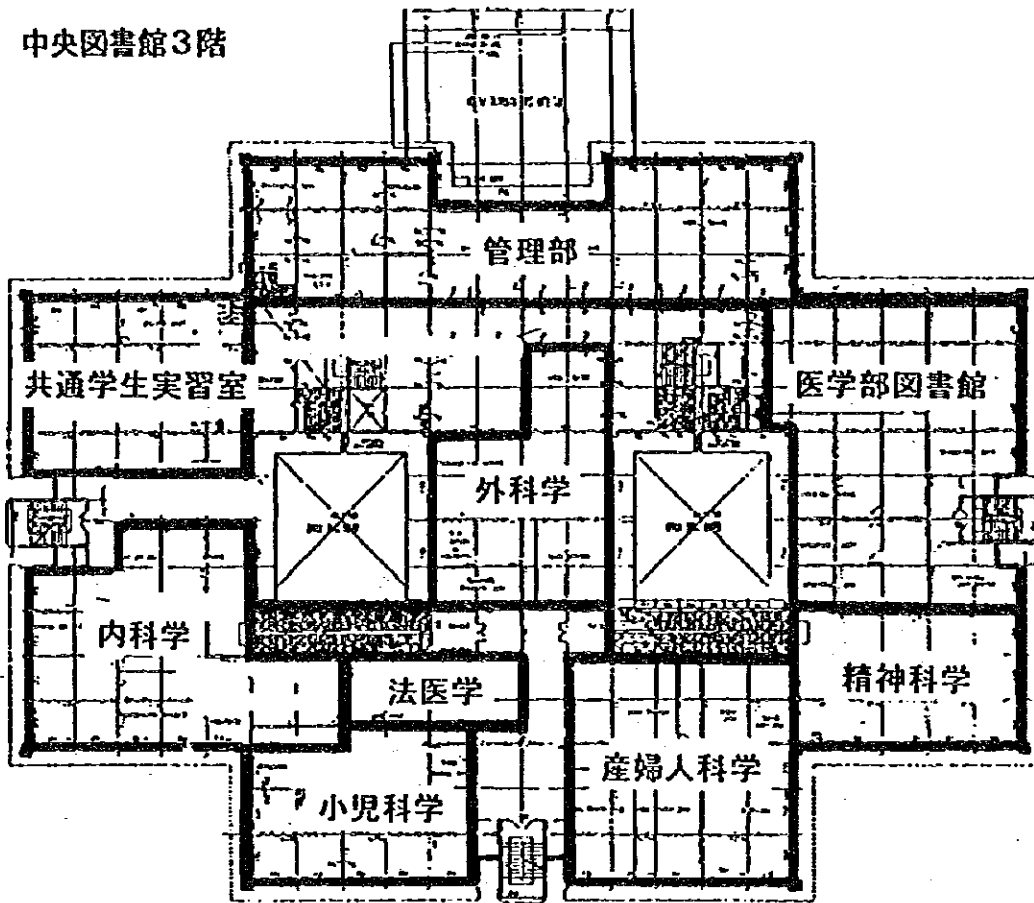

中央図書館4階

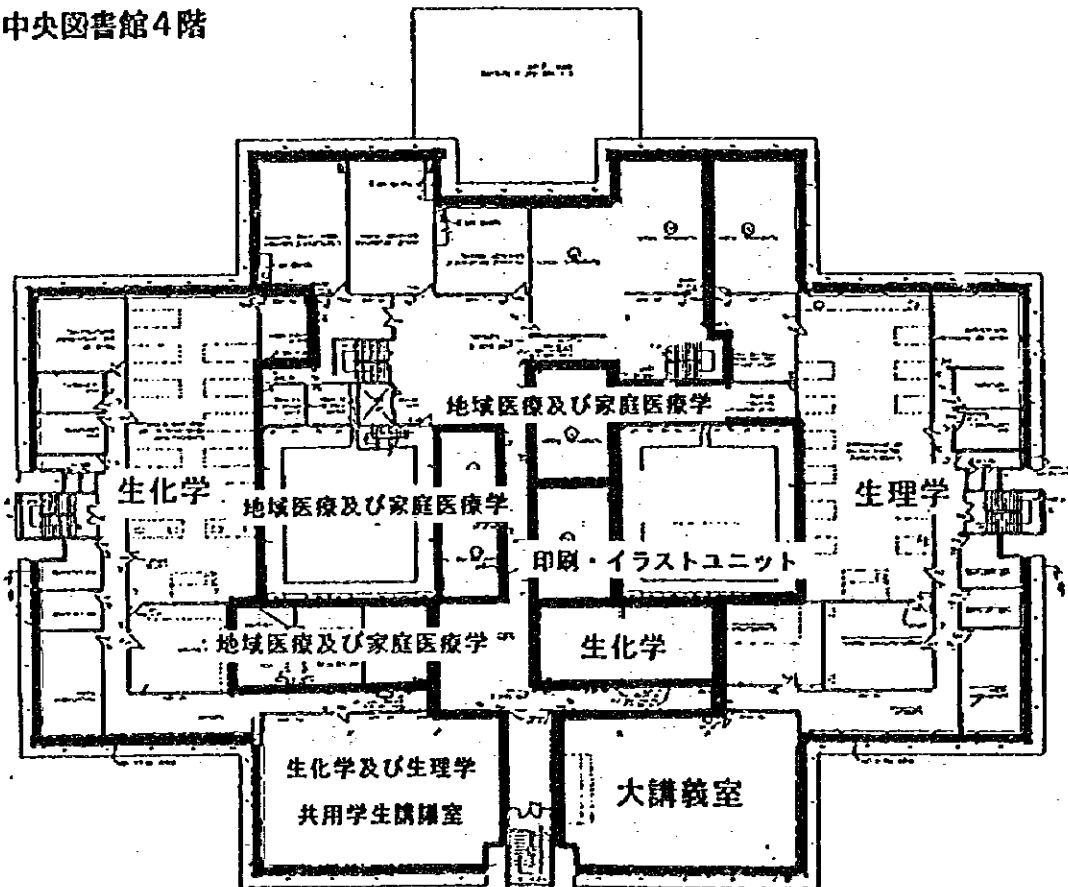

計画実施後

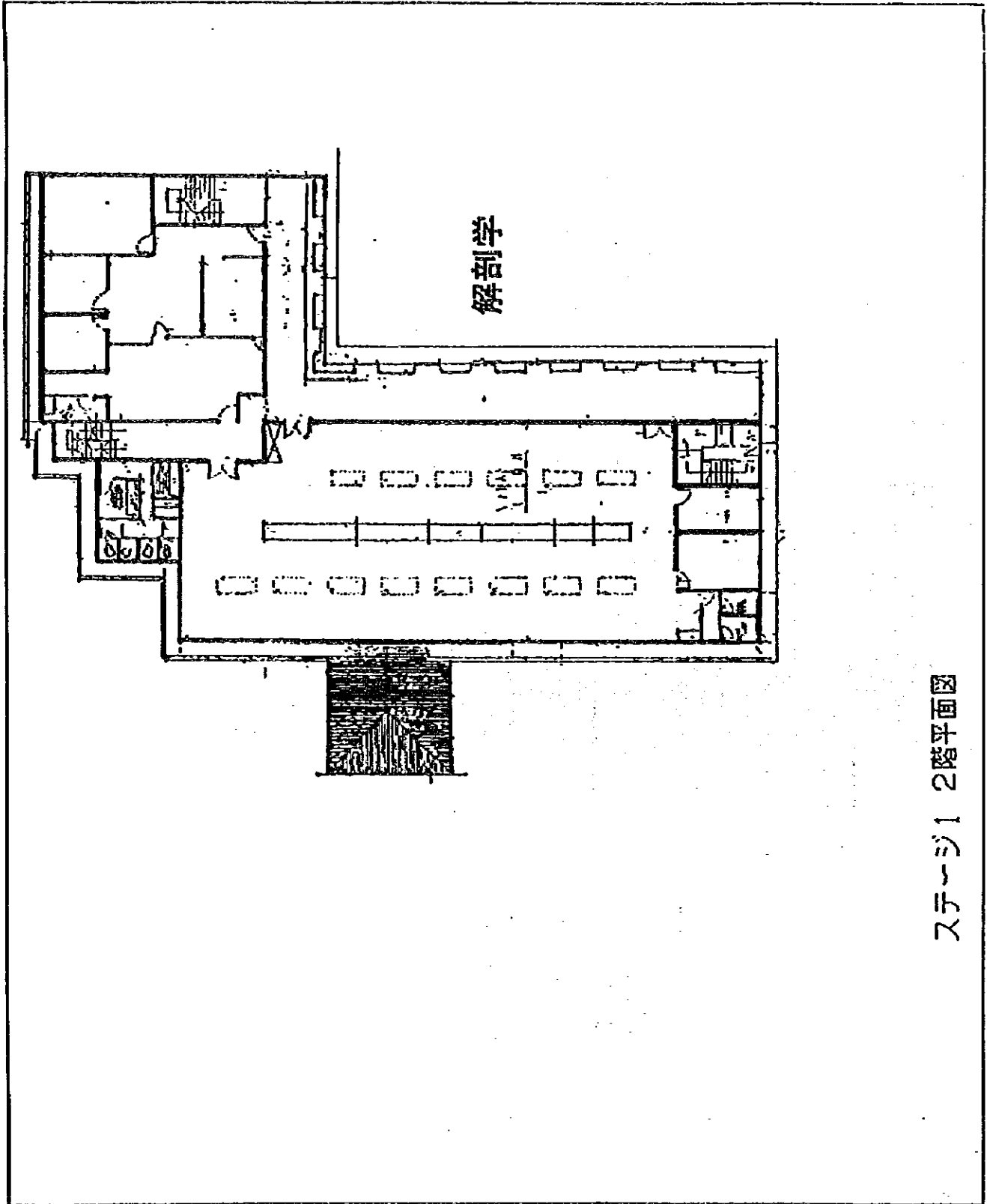

ステージ1 2階平面図

計画実施後

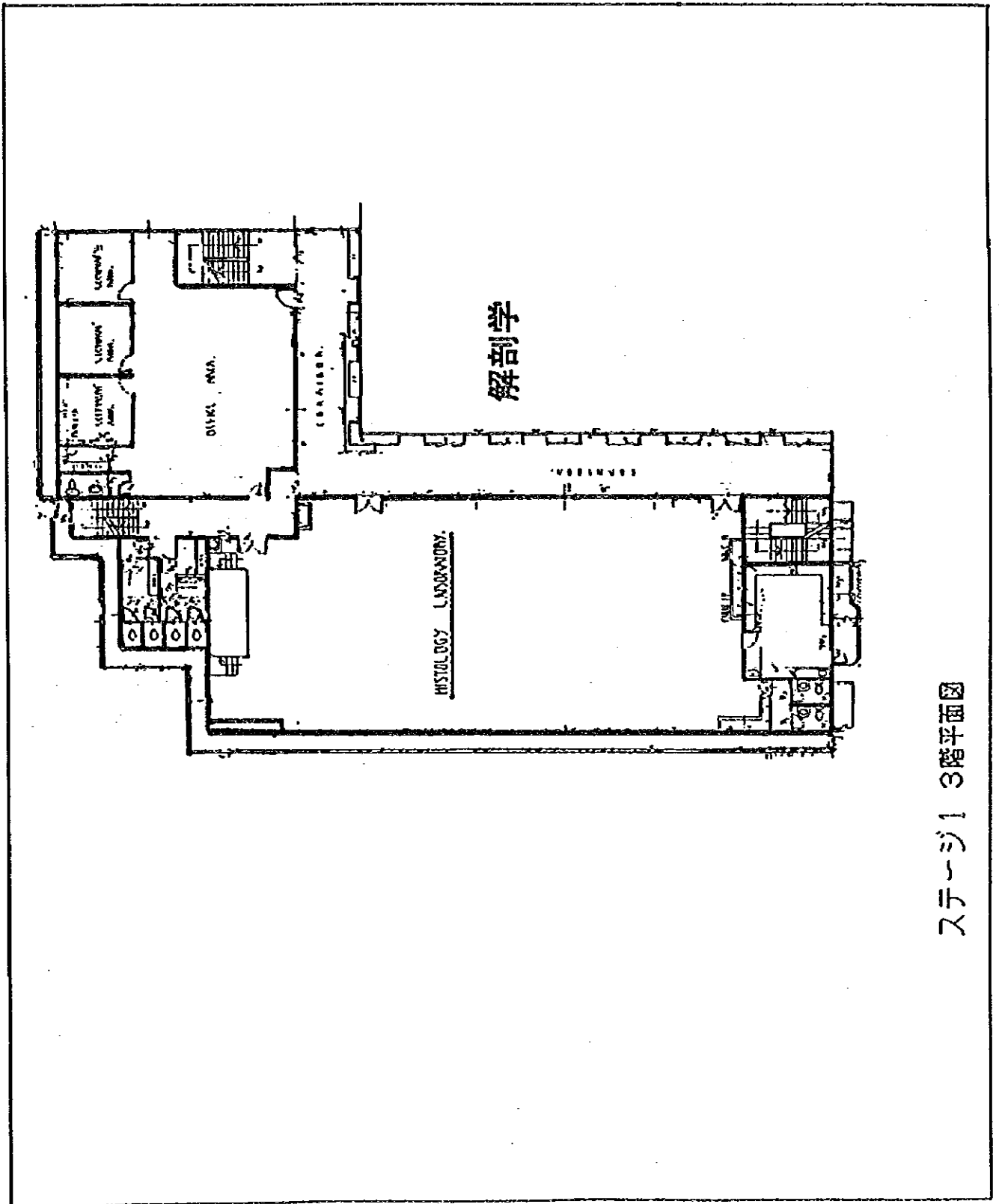

ステージ1 3階平面図

計画実施後

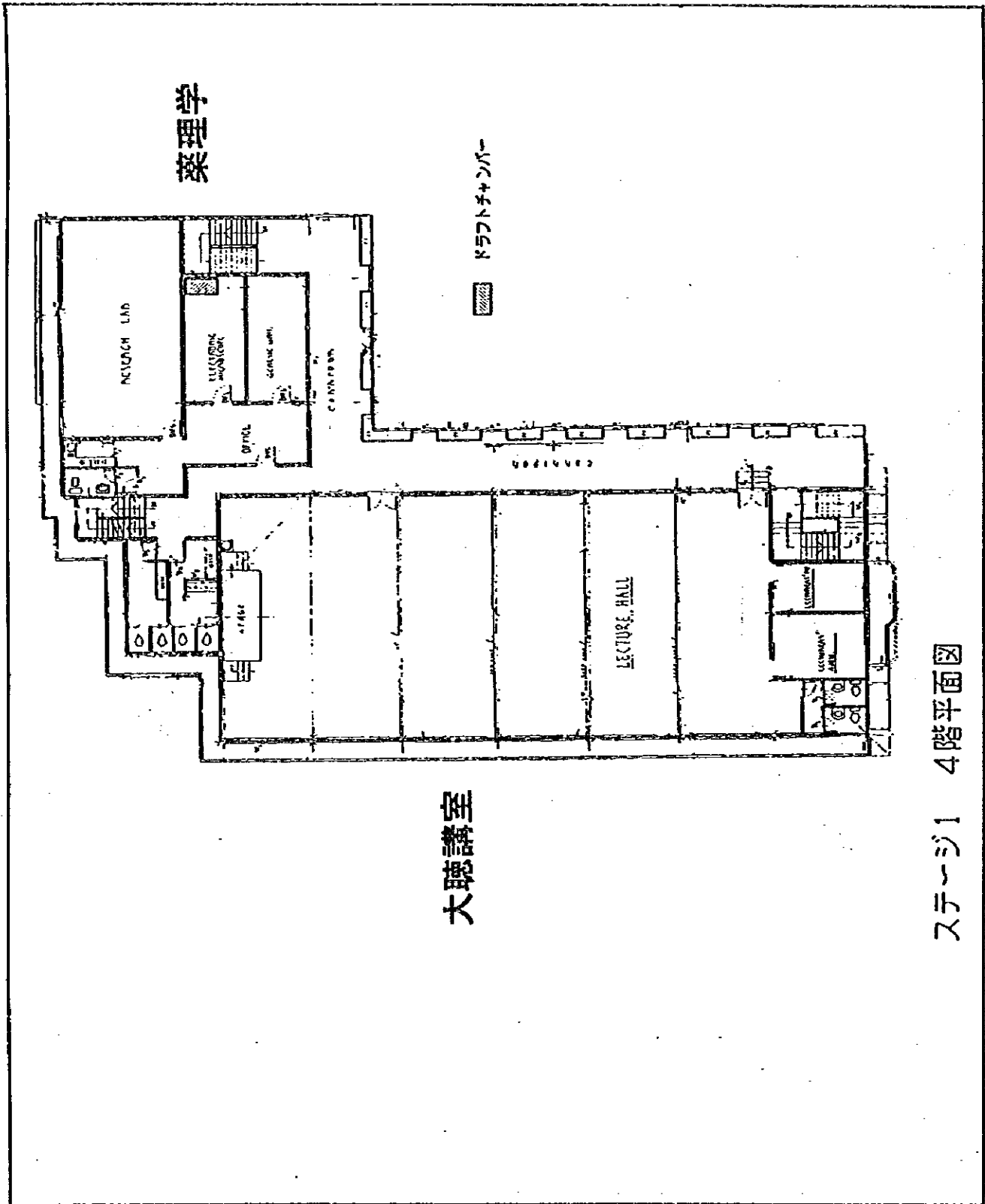

ステージ1 4階平面図

計画実施後

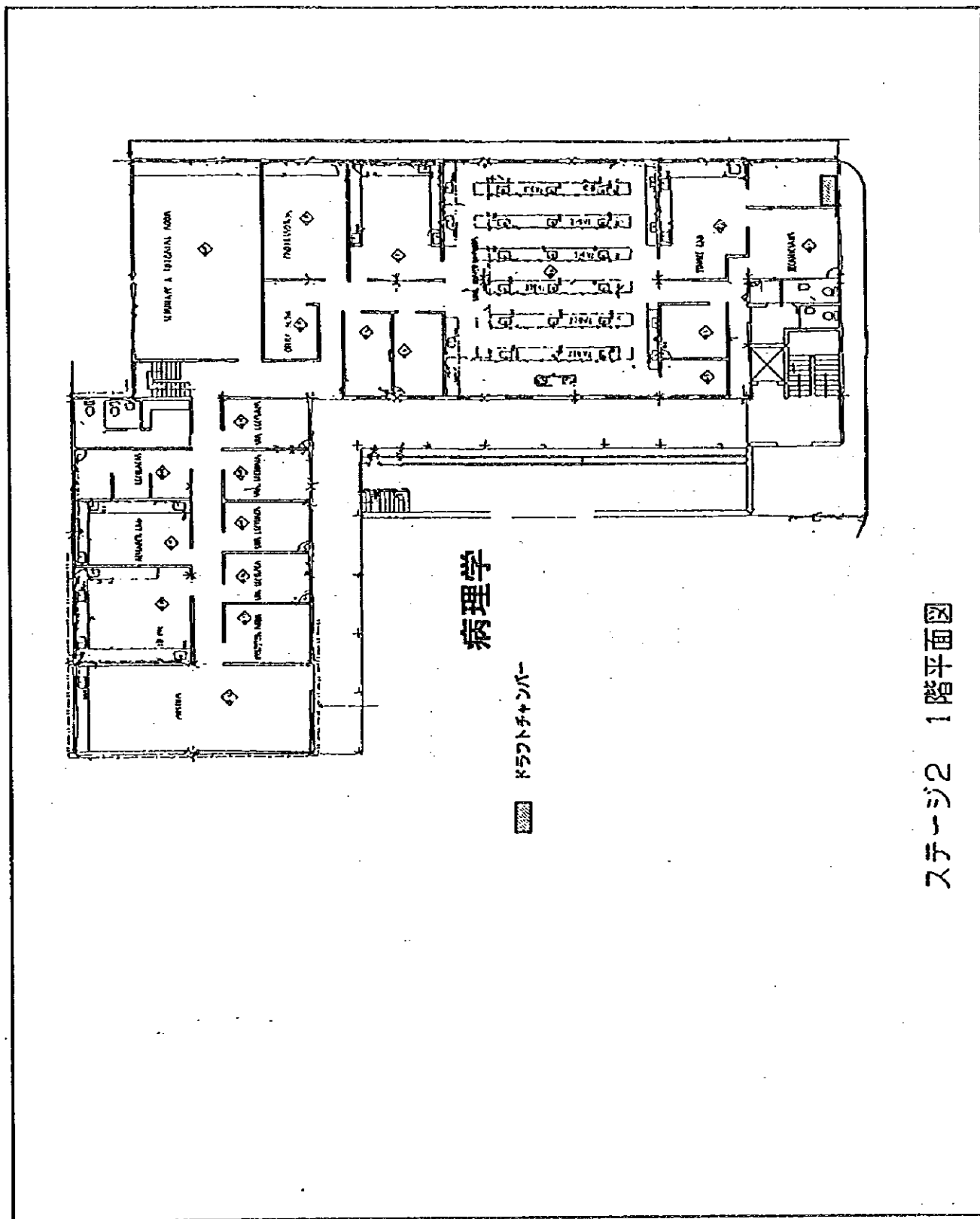

ステージ2 1階平面図

計画実施後

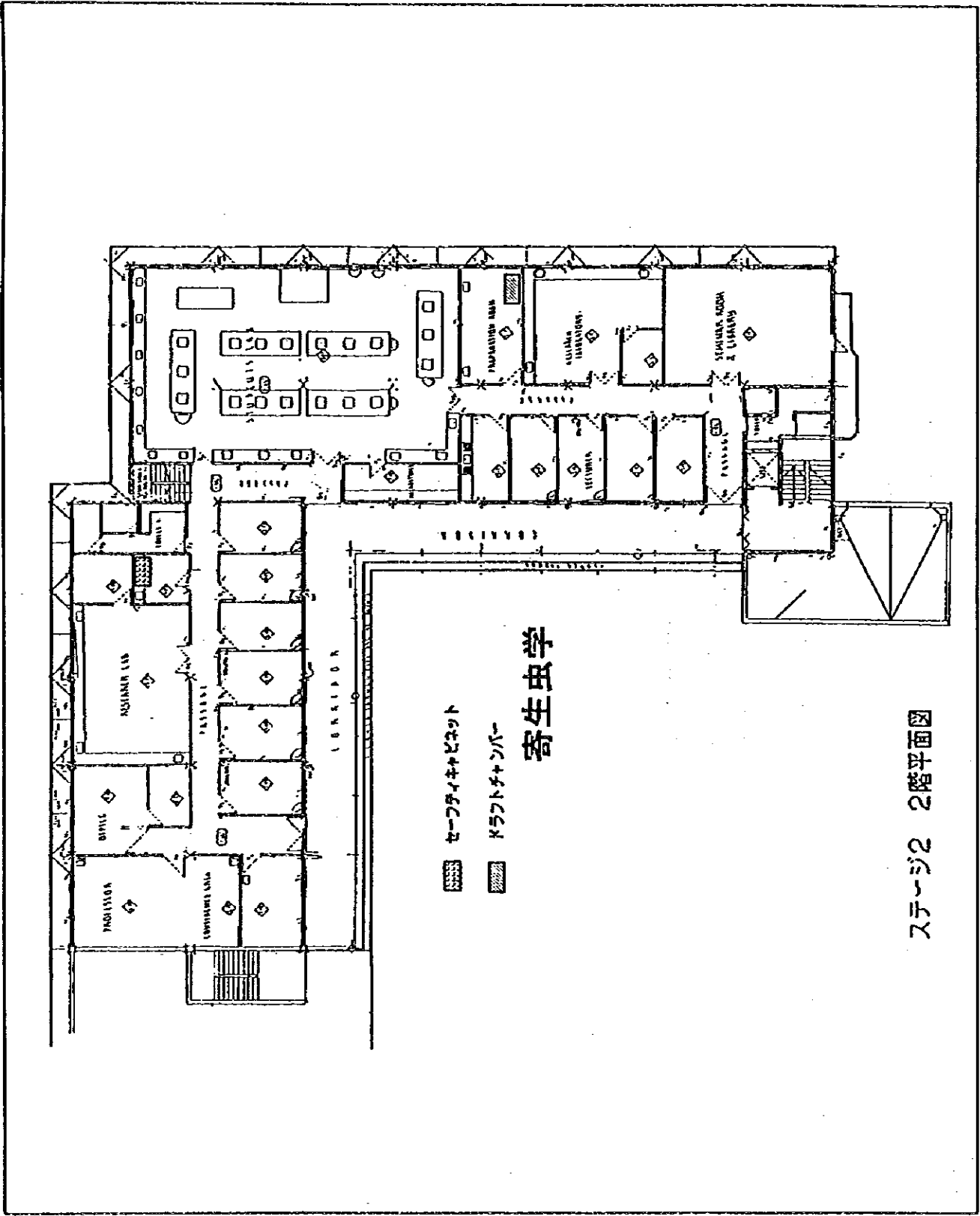

寄生虫学

ステージ2 2階平面図

1 1. ミニッツ (基本設計調査)

MINUTES OF DISCUSSIONS ON BASIC DESIGN STUDY ON
THE PROJECT FOR IMPROVEMENT OF THE EDUCATIONAL EQUIPMENT FOR
THE FACULTY OF MEDICAL SCIENCES, THE UNIVERSITY OF SRI JAYWARDENEPURA
IN
THE DEMOCRATIC SOCIALIST REPUBLIC OF SRI LANKA

In response to a request from the Government of the Democratic Socialist Republic of Sri Lanka, the Government of Japan decided to conduct a basic design study on the Project for Improvement of the Educational Equipment for the Faculty of Medical Sciences, the University of Sri Jaywardenepura (hereinafter referred to as "the Project"), and entrusted the study to Japan International Cooperation Agency (JICA).

JICA dispatched to Sri Lanka a study team (hereinafter referred to as "the Team") which was headed by Dr HANDA Yujiro, Development Specialist, JICA, and which was scheduled to stay in the country from October 7 to November 1, 1996.

The Team has had a series of discussions with relevant officials of the Government of Sri Lanka and conducted site survey.

In the course of discussion and site survey the team and Sri Lankan side have confirmed basic issues described in attached sheets.

The team will proceed to further works and prepare the Basic Design Study Report.

October 16, 1996 Colombo

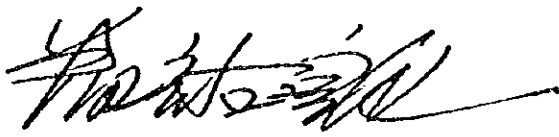

Dr. HANDA Yujiro
Leader
Basic Design Study Team
Japan International Cooperation Agency

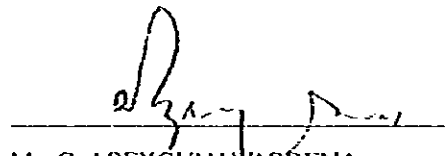

Ms. C. ABEGUNAWARDENA
Additional Secretary
Ministry of Education & Higher Education
The Democratic Socialist Republic of Sri Lanka



Prof. S. TILAKARATNA
University Grant Committee
Ministry of Education & Higher Education
The Democratic Socialist Republic of Sri Lanka



Prof. P. WILSON
Vice Chancellor
The University of Sri Jaywardenepura

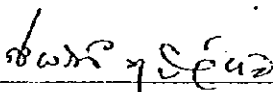

Mr. D.D.J. KUDALIGAMA
Additional Director General
Department of External Resources
Ministry of Finance & Planning
The Democratic Socialist Republic of Sri Lanka

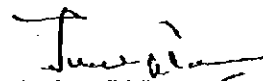

Dr. K.C.S. DALPATADU
Deputy Director General
Ministry of Health
The Democratic Socialist Republic of Sri Lanka

ATTACHMENT

1. Objective

The objective of the Project is to provide internationally standardized medical/paramedical training for all students of the Faculty of Medical Sciences, the University of Sri Jayewardenepura (hereinafter referred to as "the Faculty") through procurement of necessary equipment thereof.

2. Project site

1) The Faculty of Medical Sciences, the University of Sri Jayewardenepura (See Annex - I)

2) University Professorial Unit* and other teaching facilities* in the Colombo South Hospital

*Management Responsibility : the Faculty, the University of Sri Jayewardenepura under the Ministry of Education and Higher Education

3. Responsible and Executing Agency

Ministry of Education and Higher Education is responsible for the administration and execution of the Project.

4. Items requested by the Government of Sri Lanka

1) After the discussions between Sri Lankan side and the Team, items and quantities described in Annex-II were finally requested by the Government of Sri Lanka for consideration by the Government of Japan to be procured under the Grant Aid. However, items and quantities to be included in the Project will be decided after further study.

2) The Government of Sri Lanka agreed to give priority order to the requested equipment as follows :

A = 1st Priority

B = 2nd Priority

C = 3rd Priority

3) The Government of Sri Lanka agreed that the Japanese side will analyze the requested items based on 'policy and criteria for selection of equipment' referred in Annex-III.

5. Japan's Grant Aid System

1) The Government of Sri Lanka has understood the system of Japan's Grant Aid explained by the team (See ANNEX-IV).

2) The Government of Sri Lanka will take necessary measures, described in Annex-V, for smooth implementation of the Project on condition that the Japan's Grant Aid is extended to the Project.

6. Schedule of the study

1) The team will proceed to further study in Sri Lanka until November 1, 1996.

2) JICA will prepare a draft of the basic design and dispatch a mission to Sri Lanka in order to explain its contents in January 1997.

7. Other relevant issues

1) Concept of the Project as a result of consensus workshop

Consensus workshop with participation approach was held at the Faculty with the faculty teaching staffs and the members of the Team. Concept of the Project was reviewed and confirmed in the discussions. The result is summarized in Annex-VI with the identification of Goal, Project Purpose and Outputs.

ANNEX-I

UNIVERSITY OF SRI JAYAWARDANAPURA

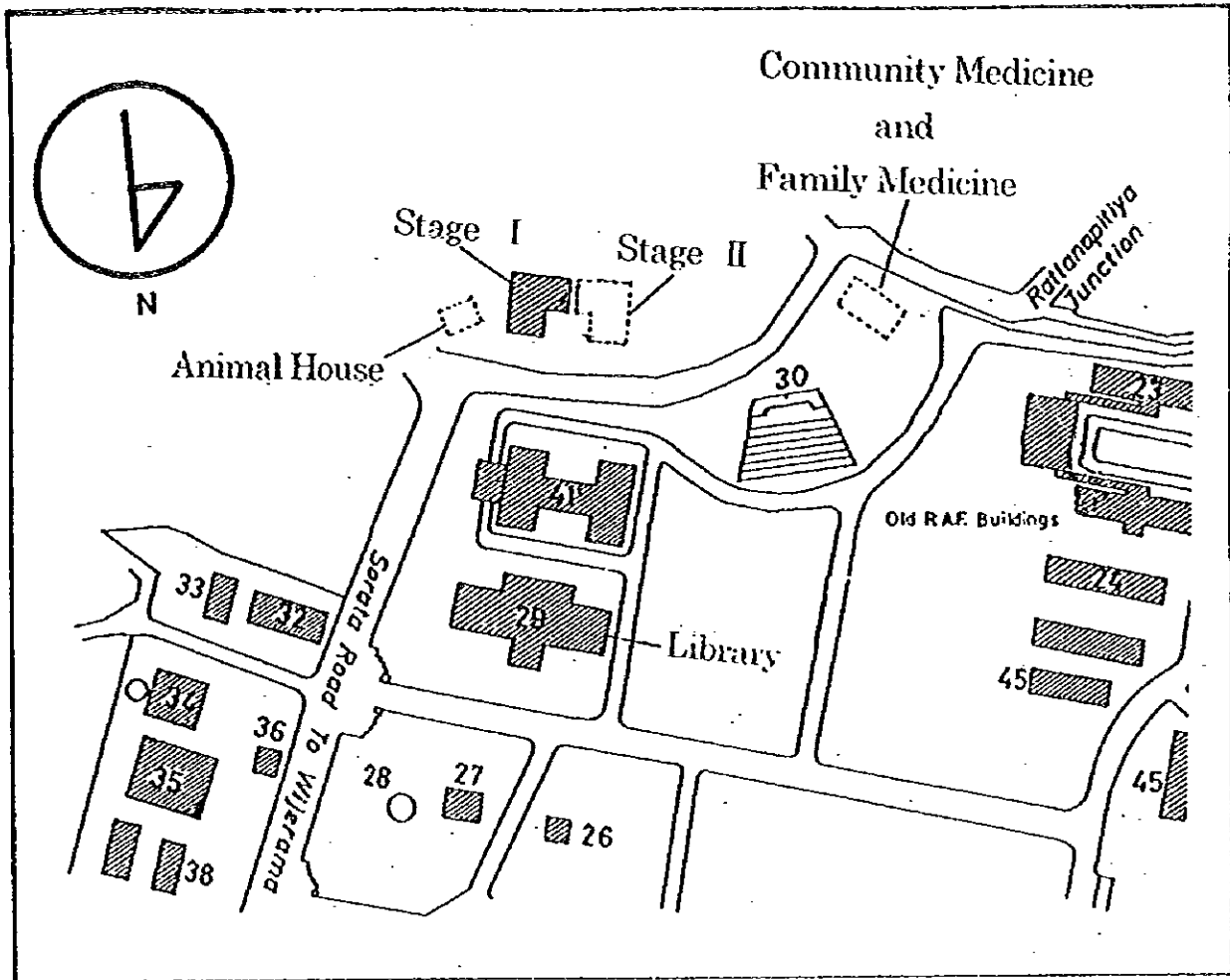

| BUILDING NAME | FLOOR | DEPARTMENT |
|--------------------------------------|----------|--------------------------------------|
| Stage 1 Bld. | GL | Anatomy |
| | 1st | Anatomy |
| | 2nd | Anatomy, Pharmacology |
| | 3rd | Auditorium |
| Stage 2 Bld. | GL | Pathology |
| | 1st | Parasitology, Student Lab. |
| | 2nd | Microbiology |
| Central Library Bld. | 2nd | Medicine |
| | | Surgery |
| | | Paediatrics |
| | | Obstetrics & Gynecology |
| | | Psychiatry |
| | | Forensic Medicine |
| | | Administration |
| | 3rd | Medical Education |
| | | Biochemistry |
| | | Physiology |
| Animal House | GL(only) | Animal House |
| Community Medicine & Family Medicine | GL(only) | Community Medicine & Family Medicine |

[Handwritten signatures and initials]

ANNEX-II

Equipment List

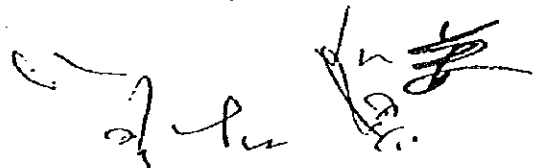
Handwritten signature and initials in the bottom right corner of the page.

ANNEX-II
EQUIPMENT LIST

| Common Items among the Department | | | |
|-----------------------------------|-----|--|------|
| New No. | No | Description | Q'ty |
| 10 | 17 | Double Beam Spectrophotometer,200-1000nm | A 2 |
| 12 | 19 | Digital Flame Photometer | A 2 |
| 13 | 20 | IR Spectrophotometer | C 1 |
| 15 | 23 | Fully Automatic Random Access Analyzer | C 1 |
| 29 | 38 | Ice Flake Maker | A 2 |
| 33 | 42 | Freeze Dryer | A 1 |
| 45 | 56 | Ultracentrifuge, 30000-150000 rpm | C 1 |
| 47 | 58 | Centrifuge, Cold, High Speed | A 1 |
| 48 | 59 | Centrifuge, Refrigerated | A 1 |
| 49 | 60 | Refrigerated Microfuge with Rotors | A 1 |
| 59 | 69 | Dilutors | A 2 |
| 94 | 112 | Gel Documentation and Analysis System | C 1 |
| 97 | 115 | Auto(Water) Still | A 1 |
| 105 | 125 | Programmable, Cell Harvester | C 1 |
| 111 | 136 | HPLC System | C 1 |
| 112 | 137 | Blood chemical concentration analyzer(Abbott TDX Analyzer) | C 1 |
| 151 | 195 | Blood Gas Analyzer | A 1 |
| 167 | 212 | Laparoscope with Video Unit | A 1 |
| 171 | 216 | Ultrasound Machine with Color Doppler | B 1 |
| 172 | 217 | Olympus Video Endoscopy System (EVIS) | A 1 |
| 173 | 218 | Gastrointestinal Fiberscope, Neonatal | A 1 |
| 241 | 363 | Laptop Computer | A 5 |
| 242 | 365 | Color Video Projector | A 1 |
| 246 | 375 | Bubble Jet Color printer | A 2 |
| 247 | 376 | Dot Matrix Printer 24 Pin | A 3 |
| 248 | 378 | Photocopying Machine | A 5 |
| 249 | 380 | Electronic Duplicating Machine (Rizograph) | A 5 |
| 252 | 387 | Electronic Stencil Scanning Machine | B 2 |
| 260 | 400 | Fax Machines | B 5 |
| 266 | 434 | Uninterrupted Power Supply (UPS) | A 1 |
| 267 | 435 | Stabilizers | A 5 |

lu

Handwritten signatures and initials

ANNEX-II
EQUIPMENT LIST

| Department of Anatomy | | | |
|-----------------------|-----|--|------|
| New No. | No | Description | Q'ty |
| 1 | 1 | Teaching Microscope with 5 teaching attachment | A 1 |
| 4 | 4 | Research Microscope(FL, Ph/C, Pol Attach) with Photo system | A 3 |
| 5 | 5 | Inverted Tissue Culture Microscope | B 1 |
| 8 | 12 | Biological Microscope | A 60 |
| 9 | 15 | Stereoscopic Zoom Microscope | A 1 |
| 20 | 29 | Cryostat with Knife | C 1 |
| 25 | 34 | Refrigerator (150L) | A 2 |
| 37 | 46 | Incubator (150L) | B 1 |
| 43 | 54 | Tissue Culture Glove Box | B 1 |
| 44 | 55 | Fume Hood | B 1 |
| 51 | 62 | Centrifuge, Bench | A 1 |
| 64 | 74 | Water Bath 12-16L | B 1 |
| 79 | 90 | Hot Air Oven (250L) | B 1 |
| 103 | 123 | Vacuum Pump | C 2 |
| 125 | 153 | Automatic Body Embalment System | A 1 |
| 126 | 154 | Body Preservation Locker For 10 Bodys | A 2 |
| 127 | 156 | Dissecting Instrument Set | A 2 |
| 128 | 157 | X-ray Film Cabinet | A 1 |
| 130 | 159 | X-ray Viewer (Illuminator) - Standard | A 1 |
| 131 | 160 | Portable X-ray Unit | A 1 |
| 132 | 161 | X-ray Accessories | A 1 |
| 133 | 162 | Cassette with intensifying screen | A 6 |
| 134 | 162 | X-ray Protection Screen with Lead Glass | A 1 |
| 135 | 164 | Developing Tank | A 1 |
| 136 | 168 | Automated Slide Stainer | C 1 |
| 137 | 169 | Tissue-Tek Embedding Centre | C 1 |
| 139 | 171 | Paraffin Trowel | C 1 |
| 140 | 172 | Shaker for Tissue Fixation | C 1 |
| 141 | 173 | Paraffin Oven | C 1 |
| 142 | 174 | Slide Warmer | C 1 |
| 143 | 175 | Microscopic Slide and Tissue Block Cabinet | C 1 |
| 144 | 176 | Microtome Knives Set | A 2 |
| 145 | 181 | Automatic Microtome Knife Sharpener | A 1 |
| 146 | 183 | Stop Watch/ Clock | A 1 |
| 147 | 184 | Interval Timers | A 1 |
| 148 | 185 | Slide Book | C 1 |
| 149 | 186 | Electronic Dry Housing for Microscopes | C 60 |
| 237 | 353 | Educational TV and VCR Set | A 1 |
| 243 | 366 | Laser Pointer | A 2 |
| 244 | 367 | Desk Top Computer Set | A 1 |
| 245 | 374 | Laser Printer | A 1 |

[Handwritten signature]

ANNEX-II
EQUIPMENT LIST

| Department of Anatomy | | | |
|-----------------------|-----|--|------|
| New No. | No | Description | Q'ty |
| 250 | 381 | Electronic Type Writer with Memory (English) | B 1 |
| 251 | 382 | Slide Viewer | A 1 |
| 259 | 399 | Magiboards | A 1 |
| 262 | 402 | Dehumidifier | A 1 |
| 266 | 434 | Uninterrupted Power Supply (UPS) | A 2 |
| 267 | 435 | Stabilizers | A 8 |
| 273 | | Glassware Set | A 1 |

de

(- 2/3) Pa. [Signature]

ANNEX-II
EQUIPMENT LIST

| Department of Physiology | | | |
|--------------------------|-----|--|------|
| New No. | No | Description | Q'ty |
| 4 | 4 | Research Microscope(FL, Ph/C, Pol Attach) with Photo system | A 1 |
| 7 | 7 | Binocular Microscopes | B 7 |
| 11 | 18 | Single Beam, Visible Light Spectrophotometer | B 1 |
| 16 | 24 | Automated Coulter Full Blood Analyzer (Coulter Counter) | C 1 |
| 18 | 26 | Electronic Precision balance (Readability 0.01g) | A 1 |
| 19 | 28 | Electronic Balance (Range 0.01mg-100mg) | A 1 |
| 25 | 34 | Refrigerator (150L) | A 1 |
| 37 | 46 | Incubator (150L) | A 1 |
| 51 | 62 | Centrifuge, Bench | A 1 |
| 61 | 71 | pH Meters | A 1 |
| 63 | 73 | Shaking Water Bath | C 1 |
| 64 | 74 | Water Bath 12-16L | A 1 |
| 107 | 132 | ECG Machine, 3CH | A 1 |
| 114 | 140 | Hand Grip Dynamometer/Ergograph for Isometric Exercise Testing | A 1 |
| 115 | 141 | Computerized Plethysmograph | A 1 |
| 116 | 142 | Tilting Table, Manual | A 1 |
| 117 | 144 | Electroencephalogram | A 1 |
| 118 | 145 | Electroneurogram with Visual Evoked Potentials and EMG | A 1 |
| 119 | 147 | Perimeter, Goldman | A 1 |
| 120 | 148 | Audiometer, Screening | A 1 |
| 121 | 149 | Automated Spirometer | A 1 |
| 122 | 150 | Treadmill for Exercise Testing | B 1 |
| 123 | 151 | Stethograph with Biorite | B 1 |
| 124 | 152 | Physiograph | C 1 |
| 147 | 184 | Interval Timers | A 10 |
| 150 | 194 | Digital Haemoglobinometer | C 1 |
| 152 | 196 | Haematocrit Centrifuge | A 1 |
| 153 | 197 | Silicon Resuscitation Bags | B 2 |
| 154 | 198 | Length Scale | A 2 |
| 155 | 200 | Instrument Tray Table with Castors | A 1 |
| 156 | 201 | Examination Table | A 3 |
| 159 | 204 | Electronic Weighing Scale | A 1 |
| 237 | 353 | Educational TV and VCR Set | A 1 |
| 244 | 367 | Desk Top Computer Set | A 1 |
| 245 | 374 | Laser Printer | A 1 |
| 250 | 381 | Electronic Type Writer with Memory (English) | B 1 |
| 259 | 399 | Magiboards | A 1 |
| 266 | 434 | Uninterrupted Power Supply (UPS) | A 2 |
| 267 | 435 | Stabilizers | A 8 |
| 270 | 442 | Audio Cassette Player with Speakers | A 1 |
| 273 | | Glassware Set | A 1 |

ANNEX-II
EQUIPMENT LIST

| Department of Biochemistry | | | |
|----------------------------|-----|--|------|
| New No. | No | Description | Q'ty |
| 4 | 4 | Research Microscope(FL, Ph/C, Pol Attach) with Photo system | A 1 |
| 5 | 5 | Inverted Tissue Culture Microscope | B 1 |
| 7 | 7 | Binocular Microscopes | A 1 |
| 14 | 22 | Autoanalyzer for Blood Metabolites | B 1 |
| 22 | 31 | Chest Freezer (-70C) | A 1 |
| 25 | 34 | Refrigerator (150L) | A 1 |
| 33 | 42 | Freeze Dryer | A 1 |
| 35 | 44 | Vacuum Concentrator | B 1 |
| 41 | 51 | CO2 Incubator (150L;5-50C) | A 1 |
| 50 | 61 | Microfuge | A 1 |
| 51 | 62 | Centrifuge, Bench | A 1 |
| 52 | 62 | Microtitre Plate Reader | C 1 |
| 67 | 77 | Electrophoresis Apparatus, Horizontal Gel Tank | C 1 |
| 68 | 78 | Mini Gel Apparatus | B 1 |
| 69 | 79 | Electrophoresis for Protein, Verticle Gel Apparatus | A 1 |
| 71 | 81 | Transfer Apparatus for Gels | A 1 |
| 84 | 98 | Muffle Furnace (500-1000C) | A 1 |
| 101 | 120 | Parasite Sonicator | B 1 |
| 237 | 353 | Educational TV and VCR Set | A 1 |
| 244 | 367 | Desk Top Computer Set | A 1 |
| 245 | 374 | Laser Printer | A 1 |
| 259 | 399 | Magiboards | A 1 |
| 266 | 434 | Uninterrupted Power Supply (UPS) | A 2 |
| 267 | 435 | Stabilizers | A 8 |
| 273 | | Glassware Set | A 1 |

[Handwritten signature]

ANNEX-II
EQUIPMENT LIST

| Department of Pathology | | | |
|-------------------------|-----|--|------|
| New No. | No | Description | Q'ty |
| 1 | 1 | Teaching Microscope with 5 teaching attachment | B 1 |
| 2 | 2 | CCTV System with 8 monitor, video camera, deck | A 1 |
| 3 | 3 | Research Microscope, trinocular with CCTV attachment | A 1 |
| 4 | 4 | Research Microscope(FL, Ph/C, Pot Attach) with Photo system | A 3 |
| 5 | 5 | Inverted Tissue Culture Microscope | A 1 |
| 7 | 7 | Binocular Microscopes | B 60 |
| 9 | 15 | Stereoscopic Zoom Microscope | A 1 |
| 11 | 18 | Single Beam, Visible Light Spectrophotometer | B 1 |
| 14 | 22 | Autoanalyzer for Blood Metabolites | C 1 |
| 16 | 24 | Automated Coulter Full Blood Analyzer (Coulter Counter) | C 1 |
| 17 | 25 | Apparatus for Deionising Water | B 1 |
| 18 | 26 | Electronic Precision balance (Readability 0.01g) | A 1 |
| 19 | 28 | Electronic Balance (Range 0.01mg-100mg) | A 1 |
| 20 | 29 | Cryostat with Knife | C 1 |
| 21 | 30 | Ultralow Freezer (-80C) | C 1 |
| 22 | 31 | Chest Freezer (-70C) | A 1 |
| 25 | 34 | Refrigerator (150L) | A 1 |
| 37 | 46 | Incubator (150L) | A 1 |
| 42 | 53 | Safety Cabinet, Class II | C 1 |
| 44 | 55 | Fume Hood | A 1 |
| 48 | 59 | Centrifuge, Refrigerated | C 1 |
| 49 | 60 | Refrigerated Microfuge with Rotors | C 1 |
| 50 | 61 | Microfuge | A 1 |
| 51 | 62 | Centrifuge, Bench | A 1 |
| 56 | 66 | Automatic Pipettes Set | A 4 |
| 57 | 67 | Multi-channel Pipettes (8 channel) with Stand Set | A 2 |
| 60 | 70 | Vortex Mixers | A 1 |
| 61 | 71 | pH Meters | A 1 |
| 63 | 73 | Shaking Water Bath | C 1 |
| 64 | 74 | Water Bath 12-16L | A 1 |
| 67 | 77 | Electrophoresis Apparatus, Horizontal Gel Tank | C 1 |
| 69 | 79 | Electrophoresis for Protein, Verticle Gel Apparatus | A 1 |
| 71 | 81 | Transfer Apparatus for Gels | A 1 |
| 79 | 90 | Hot Air Oven (250L) | A 1 |
| 81 | 92 | Drying Cabinet for Glassware and Instruments | B 1 |
| 82 | 95 | Microwave Oven | A 1 |
| 86 | 101 | Boiling Sterilizer (100C) | A 1 |
| 88 | 103 | Front Loading Autoclave (50L) | A 1 |
| 91 | 108 | Orbital Shakers (With Auto Veverse) | A 2 |
| 92 | 110 | Rocking Platform with Base | A 1 |
| 98 | 116 | Ultrasonic Pipette Washer | A 1 |
| 100 | 118 | Washing Machine for Pipettes and Tubes with Brushes | A 1 |
| 102 | 122 | Magnetic Stirrer with Hot Plate | A 2 |

[Handwritten signature]

ANNEX-II
EQUIPMENT LIST

| Department of Pathology | | | |
|-------------------------|-----|--|------|
| New No. | No | Description | Q'ty |
| 110 | 135 | Mixer for Small Container | A2 |
| 127 | 156 | Dissecting Instrument Set | A2 |
| 129 | 158 | X-ray Viewer (Large) | C1 |
| 130 | 159 | X-ray Viewer (Illuminator) - Standard | C1 |
| 136 | 168 | Automated Slide Stainer | A1 |
| 137 | 169 | Tissue-Tek Embedding Centre | A1 |
| 138 | 170 | Tissue Preprocessing Machine | A1 |
| 139 | 171 | Paraffin Trowel | A1 |
| 140 | 172 | Shaker for Tissue Fixation | C1 |
| 141 | 173 | Paraffin Oven | A1 |
| 142 | 174 | Slide Warmer | A1 |
| 143 | 175 | Microscopic Slide and Tissue Block Cabinet | C1 |
| 144 | 176 | Microtome Knives Set | A2 |
| 145 | 181 | Automatic Microtome Knife Sharpener | A1 |
| 146 | 183 | Stop Watch/ Clock | A4 |
| 147 | 184 | Interval Timers | A4 |
| 148 | 185 | Slide Book | C4 |
| 149 | 186 | Electronic Dry Housing for Microscopes | C5 |
| 150 | 194 | Digital Haemoglobinometer | B1 |
| 152 | 196 | Haematocrit Centrifuge | C1 |
| 221 | 272 | Angle Poised Lamp | C2 |
| 232 | 329 | Magnifying Glass with Handle (Hand Type) | A4 |
| 237 | 353 | Educational TV and VCR Set | A1 |
| 239 | 356 | Overhead Projector | A1 |
| 240 | 357 | Projector Screens | A1 |
| 243 | 366 | Laser Pointer | A1 |
| 244 | 367 | Desk Top Computer Set | A1 |
| 245 | 374 | Laser Printer | A1 |
| 250 | 381 | Electronic Type Writer with Memory (English) | B1 |
| 251 | 382 | Slide Viewer | A1 |
| 255 | 393 | Paper Guillotine | A1 |
| 256 | 394 | Paper Shredder | C1 |
| 257 | 395 | Epidiascope | B1 |
| 258 | 398 | Dictaphone and Recorders | B1 |
| 259 | 399 | Magiboards | A3 |
| 262 | 402 | Dehumidifier | A1 |
| 263 | 403 | Polaroid camera | B1 |
| 264 | 432 | Bone Marrow Trepine Biopsy Needles | A3 |
| 265 | 433 | Bone Marrow Aspiration Needles | A3 |
| 266 | 434 | Uninterrupted Power Supply (UPS) | A2 |
| 267 | 435 | Stabilizers | A8 |
| 273 | | Glassware Set | A1 |
| 290 | | Liver & Kidney biopsy set | A1 |

[Handwritten signatures and initials]

ANNEX-II
EQUIPMENT LIST

| Department of Microbiology | | | |
|----------------------------|----|--|------|
| New No. | No | Description | Q'ty |
| 2 | 2 | CCTV System with 8 monitor, video camera, deck | A 1 |
| 3 | 3 | Research Microscope, trinocular with CCTV attachment | A 1 |
| 4 | 4 | Research Microscope(FL, Ph/C, Pol Attach) with Photo system | A 2 |
| 5 | 5 | Inverted Tissue Culture Microscope | A 4 |
| 6 | 6 | Inverted Tissue Coulture Research Microscope with Micromannipulato | B 1 |
| 7 | 7 | Binocular Microscopes | B 15 |
| 8 | 12 | Biological Microscope | C 2 |
| 11 | 18 | Single Beam, Visible Light Spectrophotometer | B 1 |
| 17 | 25 | Apparatus for Deionising Water | B 1 |
| 18 | 26 | Electronic Precision balance (Readability 0.01g) | A 2 |
| 19 | 28 | Electronic Balance (Range 0.01mg-100mg) | A 1 |
| 21 | 30 | Ultralow Freezer (-80C) | A 1 |
| 22 | 31 | Chest Freezer (-70C) | A 1 |
| 23 | 32 | Freezers (-30C) | A 1 |
| 24 | 33 | Refrigerator (Double Door) | A 1 |
| 25 | 34 | Refrigerator (150L) | A 1 |
| 26 | 35 | Spark Free Refrigerator (100L) | B 1 |
| 27 | 36 | Bench Top Cooler upto 2.5C | B 2 |
| 28 | 37 | Bench Cooler upto -30C | B 2 |
| 30 | 39 | Dewars for Specimen Storage in Liquid N2 | B 3 |
| 31 | 40 | Liquid N2 Storage Vessels (on Stand with Castors) | B 2 |
| 32 | 41 | Liquid N2 Flasks | B 2 |
| 34 | 43 | Manifolds for Flasks | C 1 |
| 35 | 44 | Vacuum Concentrator | B 1 |
| 36 | 45 | Incubator (200L, Double Door) | A 2 |
| 37 | 46 | Incubator (150L) | C 7 |
| 38 | 47 | Floor Standing Incubators (250L) | A 2 |
| 39 | 49 | Cold Incubators (Temp -30C to 30C), 150L | A 1 |
| 40 | 50 | CO2 Incubator with, HEPA Filtration System | B 2 |
| 41 | 51 | CO2 Incubator (150L;5-50C) | A 1 |
| 42 | 53 | Safety Cabinet, Class II | A 8 |
| 44 | 55 | Fume Hood | A 1 |
| 46 | 57 | Micro-Ultracentrifuge, 120000 rpm | C 1 |
| 48 | 59 | Centrifuge, Refrigerated | B 2 |
| 49 | 60 | Refrigerated Microfuge with Rotors | B 2 |
| 50 | 61 | Microfuge | A 1 |
| 51 | 62 | Centrifuge, Bench | A 3 |
| 52 | 62 | Microtitre Plate Reader | A 1 |
| 53 | 63 | Automatic Microtitre Plate Washer | A 1 |
| 54 | 64 | Microtitre Plate Shaker | A 1 |
| 55 | 65 | Microtitre Plate Incubator | A 1 |
| 56 | 66 | Automatic Pipettes Set | A 6 |
| 57 | 67 | Multi-channel Pipettes (8 channel) with Stand Set | A 4 |

ANNEX-II
EQUIPMENT LIST

| Department of Microbiology | | | |
|----------------------------|-----|---|------|
| New No. | No | Description | Q'ty |
| 58 | 68 | Automatic Volume Dispensers Set | A 2 |
| 60 | 70 | Vortex Mixers | A 5 |
| 61 | 71 | pH Meters | A 2 |
| 62 | 72 | Hand held pH Meters | B 4 |
| 63 | 73 | Shaking Water Bath | A 2 |
| 64 | 74 | Water Bath 12-16L | A 5 |
| 65 | 75 | Thermal Cycler | A 1 |
| 66 | 76 | UV Transilluminator with Photographic Attachment | B 1 |
| 67 | 77 | Electrophoresis Apparatus, Horizontal Gel Tank | B 2 |
| 68 | 78 | Mini Gel Apparatus | A 1 |
| 69 | 79 | Electrophoresis for Protein, Vertical Gel Apparatus | A 1 |
| 70 | 80 | Sequencing apparatus with Power Pack (3000V) | C 1 |
| 71 | 81 | Transfer Apparatus for Gels | A 1 |
| 72 | 82 | Vacuum blotting Apparatus | A 1 |
| 73 | 83 | X-ray Film Processor | C 1 |
| 74 | 84 | Dot-Blot Apparatus | C 1 |
| 75 | 85 | Southern Blot Apparatus | A 1 |
| 76 | 86 | Blotting Apparatus (large) | A 1 |
| 77 | 87 | Hybridization Oven with Shaking Platform and Rottiserie | C 1 |
| 78 | 88 | Vacuum Oven with Vacuum Pump (30L) | C 1 |
| 79 | 90 | Hot Air Oven (250L) | A 3 |
| 80 | 91 | Drying Oven (50L)(Ambient-150C) | C 1 |
| 81 | 92 | Drying Cabinet for Glassware and Instruments | A 1 |
| 82 | 95 | Microwave Oven | A 2 |
| 83 | 96 | Dry Block | A 2 |
| 86 | 101 | Boiling Sterilizer (100C) | A 1 |
| 87 | 102 | Top Loading Autoclave | A 1 |
| 88 | 103 | Front Loading Autoclave (50L) | A 2 |
| 89 | 106 | Hand Held Short Wave (254nm) UV Light | A 1 |
| 91 | 108 | Orbital Shakers (With Auto Reverse) | A 3 |
| 92 | 110 | Rocking Platform with Base | A 2 |
| 93 | 111 | Autoradiography Exposure Cassettes | C 4 |
| 95 | 113 | Gel Drying Apparatus | A 1 |
| 96 | 114 | Milli Q/RS Reagent Grade Water System | B 1 |
| 97 | 115 | Auto(Water) Still | A 1 |
| 98 | 116 | Ultrasonic Pipette Washer | A 1 |
| 99 | 117 | Ultrasonic Cleaner | C 1 |
| 100 | 118 | Washing Machine for Pipettes and Tubes with Brushes | A 1 |
| 102 | 122 | Magnetic Stirrer with Hot Plate | A 4 |
| 104 | 124 | Millipore Filter Assembly | B 2 |
| 127 | 156 | Dissecting Instrument Set | A 2 |
| 130 | 159 | X-ray Viewer (Illuminator) - Standard | A 1 |
| 132 | 161 | X-ray Accessories | A 4 |
| 133 | 162 | Cassette with intensifying screen | A 3 |
| 135 | 164 | Developing Tank | A 1 |

[Handwritten signature]

ANNEX-II
EQUIPMENT LIST

| Department of Microbiology | | | |
|----------------------------|-----|--|------|
| New No. | No | Description | Q'ty |
| 142 | 174 | Slide Warmer | A 4 |
| 146 | 183 | Stop Watch/ Clock | A 2 |
| 147 | 184 | Interval Timers | A 4 |
| 148 | 185 | Slide Book | C 1 |
| 149 | 186 | Electronic Dry Housing for Microscopes | C 5 |
| 221 | 272 | Angle Poised Lamp | C 2 |
| 232 | 329 | Magnifying Glass with Handle (Hand Type) | A 2 |
| 237 | 353 | Educational TV and VCR Set | A 1 |
| 238 | 355 | Slide Projector | A 1 |
| 239 | 356 | Overhead Projector | A 1 |
| 240 | 357 | Projector Screens | A 1 |
| 243 | 366 | Laser Pointer | A 2 |
| 244 | 367 | Desk Top Computer Set | A 1 |
| 245 | 374 | Laser Printer | A 1 |
| 250 | 381 | Electronic Type Writer with Memory (English) | B 1 |
| 251 | 382 | Slide Viewer | A 1 |
| 255 | 393 | Paper Guillotine | B 1 |
| 257 | 395 | Epidiascope | B 1 |
| 259 | 399 | Magiboards | A 3 |
| 262 | 402 | Dehumidifier | A 2 |
| 266 | 434 | Uninterrupted Power Supply (UPS) | A 2 |
| 267 | 435 | Stabilizers | A 8 |
| 268 | 436 | Automated, Electronic Colony Counter | A 1 |
| 269 | 437 | Rotary Innoculator | A 1 |
| 271 | | Fully Automatic, Computer Blood Culture | B 1 |
| 273 | | Glassware Set | A 1 |

✓

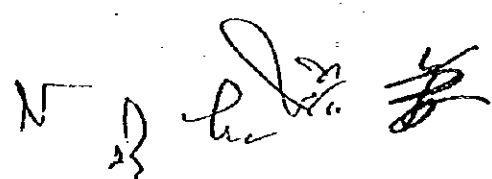

ANNEX-II
EQUIPMENT LIST

| Department of Parasitology | | | |
|----------------------------|----|--|------|
| New No. | No | Description | Q'ty |
| 2 | 2 | CCTV System with 8 monitor, video camera, deck | A 1 |
| 4 | 4 | Research Microscope(FL, Ph/C, Pol Attach) with Photo system | A 2 |
| 5 | 5 | Inverted Tissue Culture Microscope | A 1 |
| 7 | 7 | Binocular Microscopes | B 10 |
| 8 | 12 | Biological Microscope | C 4 |
| 9 | 15 | Stereoscopic Zoom Microscope | A 2 |
| 16 | 24 | Automated Coulter Full Blood Analyzer (Coulter Counter) | C 1 |
| 17 | 25 | Apparatus for Deionising Water | B 1 |
| 18 | 26 | Electronic Precision balance (Readability 0.01g) | A 1 |
| 19 | 28 | Electronic Balance (Range 0.01mg-100mg) | A 1 |
| 22 | 31 | Chest Freezer (-70C) | A 1 |
| 23 | 32 | Freezers (-30C) | A 2 |
| 24 | 33 | Refrigerator (Double Door) | A 2 |
| 25 | 34 | Refrigerator (150L) | A 1 |
| 30 | 39 | Dewars for Specimen Storage in Liquid N2 | B 2 |
| 31 | 40 | Liquid N2 Storage Vessels (on Stand with Castors) | B 2 |
| 32 | 41 | Liquid N2 Flasks | B 3 |
| 37 | 46 | Incubator (150L) | A 1 |
| 38 | 47 | Floor Standing Incubators (250L) | B 1 |
| 41 | 51 | CO2 Incubator (150L;5-50C) | A 1 |
| 42 | 53 | Safety Cabinet, Class II | C 1 |
| 44 | 55 | Fume Hood | A 1 |
| 48 | 59 | Centrifuge, Refrigerated | C 1 |
| 49 | 60 | Refrigerated Microfuge with Rotors | C 1 |
| 50 | 61 | Microfuge | A 1 |
| 51 | 62 | Centrifuge, Bench | A 1 |
| 52 | 62 | Microtitre Plate Reader | A 1 |
| 53 | 63 | Automatic Microtitre Plate Washer | A 1 |
| 54 | 64 | Microtitre Plate Shaker | A 1 |
| 56 | 66 | Automatic Pipettes Set | A 3 |
| 57 | 67 | Multi-channel Pipettes (8 channel) with Stand Set | A 2 |
| 60 | 70 | Vortex Mixers | A 1 |
| 61 | 71 | pH Meters | A 1 |
| 62 | 72 | Hand held pH Meters | A 1 |
| 63 | 73 | Shaking Water Bath | C 1 |
| 64 | 74 | Water Bath 12-16L | A 1 |
| 69 | 79 | Electrophoresis for Protein, Verticle Gel Apparatus | B 1 |
| 71 | 81 | Transfer Apparatus for Gels | A 1 |
| 76 | 86 | Blotting Apparatus (large) | B 1 |
| 79 | 90 | Hot Air Oven (250L) | A 1 |
| 80 | 91 | Drying Oven (50L)(Ambient-150C) | C 1 |
| 81 | 92 | Drying Cabinet for Glassware and Instruments | B 1 |
| 82 | 95 | Microwave Oven | A 1 |

ANNEX-II
EQUIPMENT LIST

| Department of Parasitology | | | |
|----------------------------|-----|---|------|
| New No. | No | Description | Q'ty |
| 86 | 101 | Boiling Sterilizer (100C) | A 1 |
| 87 | 102 | Top Loading Autoclave | A 1 |
| 88 | 103 | Front Loading Autoclave (50L) | A 1 |
| 90 | 107 | UV-Rays Lamp | B 1 |
| 95 | 113 | Gel Drying Apparatus | A 1 |
| 97 | 115 | Auto(Water) Still | A 1 |
| 98 | 116 | Ultrasonic Pipette Washer | A 1 |
| 100 | 118 | Washing Machine for Pipettes and Tubes with Brushes | A 1 |
| 101 | 120 | Parasite Sonicator | B 1 |
| 102 | 122 | Magnetic Stirrer with Hot Plate | A 2 |
| 104 | 124 | Millipore Filter Assembly | B 1 |
| 146 | 183 | Stop Watch/ Clock | A 2 |
| 147 | 184 | Interval Timers | A 2 |
| 149 | 186 | Electronic Dry Housing for Microscopes | C 5 |
| 232 | 329 | Magnifying Glass with Handle (Hand Type) | A 4 |
| 237 | 353 | Educational TV and VCR Set | A 1 |
| 239 | 356 | Overhead Projector | A 1 |
| 240 | 357 | Projector Screens | A 1 |
| 243 | 366 | Laser Pointer | A 2 |
| 244 | 367 | Desk Top Computer Set | A 1 |
| 245 | 374 | Laser Printer | A 1 |
| 250 | 381 | Electronic Type Writer with Memory (English) | B 1 |
| 251 | 382 | Slide Viewer | A 1 |
| 257 | 395 | Epidiascope | B 1 |
| 259 | 399 | Magiboards | A 3 |
| 262 | 402 | Dehumidifier | A 2 |
| 263 | 403 | Polaroid camera | B 1 |
| 266 | 434 | Uninterrupted Power Supply (UPS) | A 2 |
| 267 | 435 | Stabilizers | A 8 |
| 273 | | Glassware Set | A 1 |

| Student Laboratory for Parasitology and Microbiology | | | |
|--|-----|--|------|
| New No. | No | Description | Q'ty |
| 2 | 2 | CCTV System with 8 monitor, video camera, deck | A 1 |
| 3 | 3 | Research Microscope, trinocular with CCTV attachment | A 1 |
| 7 | 7 | Binocular Microscopes | A 60 |
| 259 | 399 | Magiboards | A 1 |
| 266 | 434 | Uninterrupted Power Supply (UPS) | A 2 |
| 267 | 435 | Stabilizers | A 2 |
| 273 | | Glassware Set | A 1 |

ANNEX-II
EQUIPMENT LIST

| Department of Pharmacology | | | |
|----------------------------|-----|---|------|
| New No. | No | Description | Q'ty |
| 7 | 7 | Binocular Microscopes | A 1 |
| 17 | 25 | Apparatus for Deionising Water | A 1 |
| 18 | 26 | Electronic Precision balance (Readability 0.01g) | A 1 |
| 19 | 28 | Electronic Balance (Range 0.01mg-100mg) | A 1 |
| 21 | 30 | Ultralow Freezer (-80C) | B 1 |
| 30 | 39 | Dewars for Specimen Storage in Liquid N2 | B 1 |
| 31 | 40 | Liquid N2 Storage Vessels (on Stand with Castors) | B 1 |
| 32 | 41 | Liquid N2 Flasks | B 1 |
| 35 | 44 | Vacuum Concentrator | C 1 |
| 37 | 46 | Incubator (150L) | A 1 |
| 43 | 54 | Tissue Culture Glove Box | C 1 |
| 47 | 58 | Centrifuge, Cold, High Speed | C 1 |
| 56 | 66 | Automatic Pipettes Set | A 1 |
| 57 | 67 | Multi-channel Pipettes (8 channel) with Stand Set | A 1 |
| 60 | 70 | Vortex Mixers | A 1 |
| 61 | 71 | pH Meters | A 3 |
| 62 | 72 | Hand held pH Meters | A 1 |
| 64 | 74 | Water Bath 12-16L | A 2 |
| 78 | 88 | Vacuum Oven with Vacuum Pump (30L) | C 1 |
| 79 | 90 | Hot Air Oven (250L) | A 1 |
| 80 | 91 | Drying Oven (50L)(Ambient-150C) | A 1 |
| 81 | 92 | Drying Cabinet for Glassware and Instruments | A 1 |
| 83 | 96 | Dry Block | C 1 |
| 86 | 101 | Boiling Sterilizer (100C) | A 1 |
| 87 | 102 | Top Loading Autoclave | A 1 |
| 90 | 107 | UV-Rays Lamp | B 1 |
| 91 | 108 | Orbital Shakers (With Auto Reverse) | A 1 |
| 97 | 115 | Auto(Water) Still | A 1 |
| 98 | 116 | Ultrasonic Pipette Washer | A 1 |
| 99 | 117 | Ultrasonic Cleaner | C 1 |
| 102 | 122 | Magnetic Stirrer with Hot Plate | A 3 |
| 103 | 123 | Vacuum Pump | A 4 |
| 104 | 124 | Millipore Filter Assembly | C 1 |
| 107 | 132 | ECG Machine, 3CH | C 1 |
| 108 | 133 | Cardiac Bedside Monitor | C 1 |
| 109 | 134 | Treatment Carriage | C 3 |
| 110 | 135 | Mixer for Small Container | A 10 |
| 113 | 138 | Solvent System | C 1 |
| 174 | 219 | Melting Point Apparatus | A 1 |
| 175 | 220 | Disintegration Testing System | A 1 |
| 176 | 221 | Tablet Friability and Friction Tester | A 1 |
| 177 | 222 | Hardness Tester of Tablets | A 1 |
| 178 | 223 | Sieve Shaker | A 1 |
| 179 | 224 | Sieve | A 1 |

Handwritten signature and initials

ANNEX-II
EQUIPMENT LIST

| Department of Pharmacology | | | |
|----------------------------|-----|---|------|
| New No. | No | Description | Q'ty |
| 180 | 225 | Moisture Content Measuring Equipment | A 1 |
| 181 | 226 | Small Grinding Mill | A 1 |
| 182 | 227 | Electric Ball Mill | A 1 |
| 183 | 228 | Mill for Analysis | A 1 |
| 184 | 229 | Oil Bath | A 1 |
| 185 | 230 | Trough | A 1 |
| 186 | 231 | Shaker for Separating Funnel | A 1 |
| 187 | 232 | Shaker | A 1 |
| 188 | 233 | Mantel Heater | A 1 |
| 189 | 234 | Aspirator | A 1 |
| 190 | 235 | Volt Slider | A 1 |
| 191 | 236 | Draft Chamber | B 1 |
| 192 | 239 | Electric Furnace | A 1 |
| 193 | 240 | Polarimeter | A 1 |
| 194 | 241 | Refractometer | A 1 |
| 195 | 242 | Air Compressors | C 2 |
| 196 | 244 | Colony Counter | A 1 |
| 197 | 245 | Thermal Hygrograph, With Recorder | A 1 |
| 198 | 248 | Planetary Mixer - Pilot Scale Capacity 5kg | A 1 |
| 199 | 249 | Oscillating Granulator - Pilot Scale Capacity 5kg | A 1 |
| 200 | 250 | Drum Mixture - Pilot Scale Capacity 10L | A 1 |
| 201 | 251 | Tray Drying Oven - Pilot Scale Capacity 5kg | A 1 |
| 202 | 252 | Tableting Machine | A 1 |
| 203 | 253 | Punches for Tableting Machine 10mm Flat/Beveled/Brakeline | A 1 |
| 204 | 254 | Punches for Tableting Machine 6mm Double Concave | A 1 |
| 205 | 255 | Coating Pan - Sugar - Pilot Scale Capacity 5kg | A 1 |
| 206 | 256 | Capsule filling Machine - Manual 100 Caps per Fill | A 1 |
| 207 | 257 | Volt Slider | C 1 |
| 208 | 258 | Viscometer | A 1 |
| 244 | 367 | Desk Top Computer Set | A 1 |
| 245 | 374 | Laser Printer | A 1 |
| 259 | 399 | Magiboards | A 1 |
| 262 | 402 | Dehumidifier | A 1 |
| 266 | 434 | Uninterrupted Power Supply (UPS) | A 2 |
| 267 | 435 | Stabilizers | A 8 |
| 273 | | Glassware Set | A 1 |

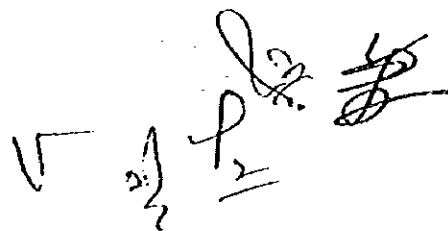

ANNEX-II
EQUIPMENT LIST

| Department of Forensic Medicine | | | |
|---------------------------------|-----|--|------|
| New No. | No | Description | Q'ty |
| 1 | 1 | Teaching Microscope with 5 teaching attachment | B 1 |
| 2 | 2 | CCTV System with 8 monitor, video camera, deck | A 1 |
| 7 | 7 | Binocular Microscopes | A 4 |
| 9 | 15 | Stereoscopic Zoom Microscope | A 1 |
| 20 | 29 | Cryostat with Knife | B 1 |
| 23 | 32 | Freezers (-30C) | A 1 |
| 25 | 34 | Refrigerator (150L) | A 2 |
| 37 | 46 | Incubator (150L) | B 1 |
| 42 | 53 | Safety Cabinet, Class II | C 1 |
| 51 | 62 | Centrifuge, Bench | A 1 |
| 56 | 66 | Automatic Pipettes Set | A 1 |
| 58 | 68 | Automatic Volume Dispensers Set | A 1 |
| 60 | 70 | Vortex Mixers | A 1 |
| 61 | 71 | pH Meters | A 1 |
| 62 | 72 | Hand held pH Meters | A 1 |
| 64 | 74 | Water Bath 12-16L | A 1 |
| 79 | 90 | Hot Air Oven (250L) | A 1 |
| 80 | 91 | Drying Oven (50L)(Ambient-150C) | A 1 |
| 81 | 92 | Drying Cabinet for Glassware and Instruments | A 1 |
| 85 | 100 | Hot Plate | A 1 |
| 86 | 101 | Boiling Sterilizer (100C) | A 1 |
| 87 | 102 | Top Loading Autoclave | A 1 |
| 97 | 115 | Auto(Water) Still | A 1 |
| 102 | 122 | Magnetic Stirrer with Hot Plate | A 1 |
| 103 | 123 | Vacuum Pump | B 1 |
| 127 | 156 | Dissecting Instrument Set | A 4 |
| 129 | 158 | X-ray Viewer (Large) | A 1 |
| 138 | 170 | Tissue Preprocessing Machine | A 1 |
| 139 | 171 | Paraffin Trowel | A 1 |
| 140 | 172 | Shaker for Tissue Fixation | A 1 |
| 141 | 173 | Paraffin Oven | A 1 |
| 143 | 175 | Microscopic Slide and Tissue Block Cabinet | C 1 |
| 144 | 176 | Microtome Knives Set | A 2 |
| 145 | 181 | Automatic Microtome Knife Sharpener | A 1 |
| 146 | 183 | Stop Watch/ Clock | A 4 |
| 147 | 184 | Interval Timers | A 2 |
| 221 | 272 | Angle Poised Lamp | C 2 |
| 232 | 329 | Magnifying Glass with Handle (Hand Type) | A 4 |
| 237 | 353 | Educational TV and VCR Set | A 1 |
| 238 | 355 | Slide Projector | A 1 |
| 239 | 356 | Overhead Projector | A 1 |
| 240 | 357 | Projector Screens | A 1 |
| 244 | 367 | Desk Top Computer Set | A 1 |
| 245 | 374 | Laser Printer | A 1 |

ANNEX-II
EQUIPMENT LIST

| Department of Forensic Medicine | | | |
|---------------------------------|-----|--|------|
| New No | No | Description | Q'ty |
| 250 | 381 | Electronic Type Writer with Memory (English) | B 1 |
| 251 | 382 | Slide Viewer | A 1 |
| 255 | 393 | Paper Guillotine | B 1 |
| 257 | 395 | Epidiascope | A 1 |
| 259 | 399 | Magiboards | A 1 |
| 262 | 402 | Dehumidifier | A 1 |
| 266 | 434 | Uninterrupted Power Supply (UPS) | A 2 |
| 267 | 435 | Stabilizers | A 4 |
| 273 | | Glassware Set | A 1 |

ANNEX-II
EQUIPMENT LIST

| Department of Family Medicine and Community Medicine | | | |
|--|-----|---|------|
| New No. | No | Description | Q'ty |
| 7 | 7 | Binocular Microscopes | A 2 |
| 11 | 18 | Single Beam, Visible Light Spectrophotometer | A 1 |
| 16 | 24 | Automated Coulter Full Blood Analyzer (Coulter Counter) | C 1 |
| 24 | 33 | Refrigerator (Double Door) | A 2 |
| 51 | 62 | Centrifuge, Bench | A 1 |
| 56 | 66 | Automatic Pipettes Set | A 1 |
| 64 | 74 | Water Bath 12-16L | A 1 |
| 79 | 90 | Hot Air Oven (250L) | A 1 |
| 86 | 101 | Boiling Sterilizer (100C) | A 1 |
| 87 | 102 | Top Loading Autoclave | A 2 |
| 152 | 196 | Haematocrit Centrifuge | A 1 |
| 155 | 200 | Instrument Tray Table with Castors | A 4 |
| 156 | 201 | Examination Table | A 4 |
| 217 | 268 | Examination Bed For Gynecology | A 1 |
| 218 | 269 | Surgical Bed for Minor Surgery, Manual | A 1 |
| 219 | 270 | Small Operating Theatre Lamp Mobile | A 1 |
| 220 | 271 | Hand Lamp | A 4 |
| 221 | 272 | Angle Poised Lamp | A 2 |
| 222 | 273 | Diagnostic Set For Community and Family Medicine | A 3 |
| 223 | 284 | Foetal Heart Detector (Doppler) | A 1 |
| 224 | 285 | Proctoscope with Light Source | A 1 |
| 225 | 294 | Small, Portable, electrically Operated Sucker | A 1 |
| 226 | 297 | Nebuliser | A 1 |
| 227 | 298 | Portable Defibrillator | B 1 |
| 228 | 300 | Electric Cautery For Skin | A 1 |
| 229 | 301 | Infra Red Lamp | A 1 |
| 236 | 352 | Observation TV and Camera Set With VER | A 1 |
| 239 | 356 | Overhead Projector | A 1 |
| 240 | 357 | Projector Screens | A 1 |
| 244 | 367 | Desk Top Computer Set | A 1 |
| 245 | 374 | Laser Printer | A 1 |
| 259 | 399 | Magiboards | A 1 |
| 266 | 434 | Uninterrupted Power Supply (UPS) | A 2 |
| 267 | 435 | Stabilizers | A 4 |
| 272 | | Blood Cell Counting Chamber (WBC,RBC) | A 5 |
| 273 | | Glassware Set | A 1 |
| 291 | 396 | Mini-bus, 20 to 30 sheets capacity | A 1 |
| 292 | 397 | Transport vehicle | A 1 |

ANNEX-II
EQUIPMENT LIST

| Department of Medicine | | | |
|------------------------|-----|--|------|
| New No. | No | Description | Q'ty |
| 7 | 7 | Binocular Microscopes | A 1 |
| 18 | 26 | Electronic Precision balance (Readability 0.01g) | A 1 |
| 19 | 28 | Electronic Balance (Range 0.01mg-100mg) | B 1 |
| 25 | 34 | Refrigerator (150L) | A 1 |
| 37 | 46 | Incubator (150L) | B 1 |
| 41 | 51 | CO2 Incubator (150L;5-50C) | B 1 |
| 42 | 53 | Safety Cabinet, Class II | C 1 |
| 48 | 59 | Centrifuge, Refrigerated | C 1 |
| 50 | 61 | Microfuge | C 1 |
| 51 | 62 | Centrifuge, Bench | A 1 |
| 56 | 66 | Automatic Pipettes Set | A 1 |
| 59 | 69 | Dilutors | C 1 |
| 61 | 71 | pH Meters | A 1 |
| 64 | 74 | Water Bath 12-16L | A 1 |
| 79 | 90 | Hot Air Oven (250L) | A 1 |
| 81 | 92 | Drying Cabinet for Glassware and Instruments | B 1 |
| 85 | 100 | Hot Plate | A 1 |
| 91 | 108 | Orbital Shakers (With Auto Reverse) | A 1 |
| 106 | 131 | Portable Echocardiograph | A 1 |
| 117 | 144 | Electroencephalogram | B 1 |
| 118 | 145 | Electroneurogram with Visual Evoked Potentials and EMG | B 1 |
| 122 | 150 | Treadmill for Exercise Testing | C 1 |
| 146 | 183 | Stop Watch/ Clock | A 1 |
| 210 | 261 | Defibrillator with monitor | A 1 |
| 211 | 262 | Portable Vitalograph Machine | A 1 |
| 212 | 263 | Pulse Oximeter | A 1 |
| 213 | 264 | Infusion Pump | A 3 |
| 214 | 265 | Oesophageal pH Monitor | C 1 |
| 215 | 266 | ECG and BP Monitor | A 1 |
| 216 | 267 | Weighing Machines | A 1 |
| 237 | 353 | Educational TV and VCR Set | A 1 |
| 239 | 356 | Overhead Projector | A 1 |
| 240 | 357 | Projector Screens | A 1 |
| 244 | 367 | Desk Top Computer Set | A 1 |
| 245 | 374 | Laser Printer | A 1 |
| 250 | 381 | Electronic Type Writer with Memory (English) | B 1 |
| 258 | 398 | Dictaphone and Recorders | B 1 |
| 259 | 399 | Magiboards | A 1 |
| 262 | 402 | Dehumidifier | A 1 |
| 266 | 434 | Uninterrupted Power Supply (UPS) | A 2 |
| 267 | 435 | Stabilizers | A 2 |
| 273 | | Glassware Set | A 1 |
| 295 | | Diagnostic set for Medicine | A 1 |

ANNEX-II
EQUIPMENT LIST

| Department of Surgery | | | |
|-----------------------|-----|--|------|
| New No. | No | Description | Q'ty |
| 7 | 7 | Binocular Microscopes | A 1 |
| 19 | 28 | Electronic Balance (Range 0.01mg-100mg) | A 1 |
| 25 | 34 | Refrigerator (150L) | A 1 |
| 37 | 46 | Incubator (150L) | B 1 |
| 41 | 51 | CO2 Incubator (150L;5-50C) | B 1 |
| 42 | 53 | Safety Cabinet, Class II | C 1 |
| 48 | 59 | Centrifuge, Refrigerated | C 1 |
| 50 | 61 | Microfuge | C 1 |
| 51 | 62 | Centrifuge, Bench | A 1 |
| 56 | 66 | Automatic Pipettes Set | A 1 |
| 59 | 69 | Dilutors | C 1 |
| 61 | 71 | pH Meters | A 1 |
| 64 | 74 | Water Bath 12-16L | A 1 |
| 79 | 90 | Hot Air Oven (250L) | A 1 |
| 81 | 92 | Drying Cabinet for Glassware and Instruments | B 1 |
| 85 | 100 | Hot Plate | A 1 |
| 91 | 108 | Orbital Shakers (With Auto Veverse) | A 1 |
| 146 | 183 | Stop Watch/ Clock | A 1 |
| 237 | 353 | Educational TV and VCR Set | A 1 |
| 239 | 356 | Overhead Projector | A 1 |
| 240 | 357 | Projector Screens | A 1 |
| 244 | 367 | Desk Top Computer Set | A 1 |
| 245 | 374 | Laser Printer | A 1 |
| 250 | 381 | Electronic Type Writer with Memory (English) | B 1 |
| 258 | 398 | Dictaphone and Recorders | B 1 |
| 259 | 399 | Magiboards | A 1 |
| 266 | 434 | Uninterrupted Power Supply (UPS) | A 2 |
| 267 | 435 | Stabilizers | A 2 |
| 273 | | Glassware Set | A 1 |
| 294 | | Diagnostic set for Surgery | A 1 |

[Handwritten signature]

ANNEX-II
EQUIPMENT LIST

| Department of Pediatrics | | | |
|--------------------------|------|---|------|
| New No. | No | Description | Q'ty |
| 7 | 7 | Binocular Microscopes | A 1 |
| 11 | 18 | Single Beam, Visible Light Spectrophotometer | B 1 |
| 19 | 28 | Electronic Balance (Range 0.01mg-100mg) | A 1 |
| 25 | 34 | Refrigerator (150L) | A 1 |
| 37 | 46 | Incubator (150L) | A 1 |
| 48 | 59 | Centrifuge, Refrigerated | C 1 |
| 50 | 61 | Microfuge | C 1 |
| 51 | 62 | Centrifuge, Bench | A 1 |
| 56 | 66 | Automatic Pipettes Set | A 1 |
| 59 | 69 | Dilutors | C 1 |
| 61 | 71 | pH Meters | A 1 |
| 64 | 74 | Water Bath 12-16L | A 1 |
| 79 | 90 | Hot Air Oven (250L) | A 1 |
| 81 | 92 | Drying Cabinet for Glassware and Instruments | B 1 |
| 85 | 100 | Hot Plate | A 1 |
| 91 | 108 | Orbital Shakers (With Auto Reverse) | A 1 |
| 146 | 183 | Stop Watch/ Clock | A 1 |
| 152 | 196 | Haematocrit Centrifuge | A 1 |
| 157 | 202 | Measuring Rod For Height | A 2 |
| 158 | 203 | Infant Length Scale | A 2 |
| 159 | 204 | Electronic Weighing Scale | A 2 |
| 160 | 205 | Infant Weighing Scale | A 2 |
| 161 | 206 | Paediatric Diagnostic Sets (Auroscope & Ophthalmoscope) | A 3 |
| 162 | 207 | Skinfold Thickness Calipers | A 2 |
| 163 | 208 | Bilirubin Analyzer | A 1 |
| 237 | 353 | Educational TV and VCR Set | A 1 |
| 238 | 355 | Slide Projector | A 1 |
| 239 | 356 | Overhead Projector | A 1 |
| 240 | 357 | Projector Screens | A 1 |
| 244 | 367 | Desk Top Computer Set | A 1 |
| 245 | 374 | Laser Printer | A 1 |
| 250 | 381 | Electronic Type Writer with Memory (English) | B 1 |
| 251 | 382 | Slide Viewer | A 1 |
| 257 | 395 | Epidiascope | B 1 |
| 258 | 398 | Dictaphone and Recorders | B 1 |
| 259 | 399 | Magiboards | A 1 |
| 266 | 434 | Uninterrupted Power Supply (UPS) | A 2 |
| 267 | 435 | Stabilizers | A 2 |
| 273 | | Glassware Set | A 1 |
| 276 | A-01 | Ultrasonic Nebulizers | A 2 |
| 277 | A-02 | Phototherapy Unit | A 3 |
| 278 | A-03 | Automatic Infusion Pumps | A 3 |
| 279 | A-04 | Syringe Infusion Pumps | A 3 |
| 280 | A-05 | Infant Resuscitator and Accessories | A 1 |
| 281 | A-06 | Infant Incubator including Infant Transport Incubators | A 2 |

ANNEX-II
EQUIPMENT LIST

| Department of Pediatrics | | | |
|--------------------------|------|-----------------------------------|------|
| New No. | No | Description | Q'ty |
| 282 | A-07 | Oxygen Tents | A 2 |
| 283 | A-08 | Suction Apparatus | A 2 |
| 284 | A-09 | Cardiac Monitor | A 2 |
| 285 | A-10 | Apnea Monitor | A 2 |
| 286 | A-11 | Infant Examination Table | A 2 |
| 287 | A-12 | Infant Pressure Cycled Ventilator | A 2 |
| 288 | A-13 | Oxygen Analyzer | A 2 |
| 289 | A-14 | Pulse Oximeter | A 2 |
| 290 | | Liver & Kidney biopsy set | A 1 |
| 296 | | Diagnostic set for Paediatrics | A 1 |

h

Handwritten signature

ANNEX-II
EQUIPMENT LIST

| Department of Obstetrics and Gynecology | | | |
|---|-----|--|------|
| New No. | No | Description | Q'ty |
| 7 | 7 | Binocular Microscopes | A 1 |
| 19 | 28 | Electronic Balance (Range 0.01mg-100mg) | A 1 |
| 25 | 34 | Refrigerator (150L) | A 1 |
| 37 | 46 | Incubator (150L) | B 1 |
| 41 | 51 | CO2 Incubator (150L;5-50C) | C 1 |
| 42 | 53 | Safety Cabinet, Class II | C 1 |
| 48 | 59 | Centrifuge, Refrigerated | C 1 |
| 49 | 60 | Refrigerated Microfuge with Rotors | C 1 |
| 50 | 61 | Microfuge | C 1 |
| 51 | 62 | Centrifuge, Bench | A 1 |
| 56 | 66 | Automatic Pipettes Set | A 1 |
| 59 | 69 | Dilutors | C 1 |
| 61 | 71 | pH Meters | A 1 |
| 64 | 74 | Water Bath 12-16L | A 1 |
| 79 | 90 | Hot Air Oven (250L) | A 1 |
| 81 | 92 | Drying Cabinet for Glassware and Instruments | B 1 |
| 85 | 100 | Hot Plate | A 1 |
| 91 | 108 | Orbital Shakers (With Auto Reverse) | A 1 |
| 146 | 183 | Stop Watch/ Clock | A 1 |
| 164 | 209 | Hysteroscope with Resection Equipment | A 1 |
| 165 | 210 | Colposcope | A 1 |
| 166 | 211 | Cryo-cautary | A 1 |
| 168 | 213 | Bipolar Diathermy | A 1 |
| 169 | 214 | Doppler Fetal Heart Monitor (Portable) | A 3 |
| 170 | 215 | Cardio-toco-graph | A 1 |
| 237 | 353 | Educational TV and VCR Set | A 1 |
| 239 | 356 | Overhead Projector | A 1 |
| 240 | 357 | Projector Screens | A 1 |
| 244 | 367 | Desk Top Computer Set | A 1 |
| 245 | 374 | Laser Printer | A 1 |
| 250 | 381 | Electronic Type Writer with Memory (English) | B 1 |
| 258 | 398 | Dictaphone and Recorders | B 1 |
| 259 | 399 | Magiboards | A 1 |
| 266 | 434 | Uninterrupted Power Supply (UPS) | A 2 |
| 267 | 435 | Stabilizers | A 2 |
| 273 | | Glassware Set | A 1 |
| 297 | | Diagnostic set for Obstetrics & Gynecology | A 1 |

h

[Handwritten signature]

ANNEX-II
EQUIPMENT LIST

| Department of Psychiatry | | | |
|--------------------------|-----|--|------|
| New No. | No | Description | Q'ty |
| 25 | 34 | Refrigerator (150L) | A 1 |
| 209 | 260 | Ophthalmoscope | A 1 |
| 230 | 306 | Camera Set | A 1 |
| 236 | 352 | Observation TV and Camera Set With VER | A 1 |
| 239 | 356 | Overhead Projector | A 1 |
| 240 | 357 | Projector Screens | A 1 |
| 244 | 367 | Desk Top Computer Set | A 1 |
| 245 | 374 | Laser Printer | A 1 |
| 250 | 381 | Electronic Type Writer with Memory (English) | B 1 |
| 258 | 398 | Dictaphone and Recorders | B 1 |
| 259 | 399 | Magiboards | A 1 |
| 266 | 434 | Uninterrupted Power Supply (UPS) | A 2 |
| 267 | 435 | Stabilizers | A 2 |
| 293 | | Diagnostic set for Psychiatry | A 1 |

| Department of Medical Education and Health Sciences | | | |
|---|----|--------------------------------------|------|
| New No. | No | Description | Q'ty |
| 275 | | Anatomical Models and Simulators Set | A 1 |

ANNEX-II
EQUIPMENT LIST

| Medical Illustration Unit | | | |
|---------------------------|-----|--|------|
| New No. | No | Description | Q'ty |
| 24 | 33 | Refrigerator (Double Door) | A 1 |
| 129 | 158 | X-ray Viewer (Large) | A 1 |
| 130 | 159 | X-ray Viewer (Illuminator) - Standard | A 1 |
| 230 | 306 | Camera Set | A 3 |
| 231 | 307 | Illustration Making Set | A 1 |
| 232 | 329 | Magnifying Glass with Handle (Hand Type) | A 1 |
| 233 | 339 | Teaching Video Making Set | A 1 |
| 234 | 342 | Computer Facility for Slide Making | A 1 |
| 238 | 355 | Slide Projector | A 1 |
| 240 | 357 | Projector Screens | A 1 |
| 244 | 367 | Desk Top Computer Set | A 1 |
| 245 | 374 | Laser Printer | A 1 |
| 250 | 381 | Electronic Type Writer with Memory (English) | B 1 |
| 252 | 387 | Electronic Stencil Scanning Machine | B 1 |
| 253 | 391 | Binding Machine(ring binding) | A 1 |
| 254 | 392 | Laminating machine | A 1 |
| 255 | 393 | Paper Guillotine | A 1 |
| 256 | 394 | Paper Shredder | C 1 |
| 259 | 399 | Magiboards | A 1 |
| 261 | 401 | Split-Type Airconditioners | B 2 |
| 266 | 434 | Uninterrupted Power Supply (UPS) | A 2 |
| 267 | 435 | Stabilizers | A 1 |

| Library | | |
|---------|--|------|
| No | Description | Q'ty |
| 367 | Desk Top Computer Set | A 5 |
| 374 | Laser Printer | A 1 |
| 381 | Electronic Type Writer with Memory (English) | B 1 |
| 387 | Electronic Stencil Scanning Machine | B 1 |
| 393 | Paper Guillotine | B 2 |
| 394 | Paper Shredder | C 1 |
| 399 | Magiboards | A 2 |
| 434 | Uninterrupted Power Supply (UPS) | A 2 |
| 435 | Stabilizers | A 2 |

[Handwritten signature]

ANNEX-II
EQUIPMENT LIST

| Auditorium | | | |
|------------|-----|----------------------------------|------|
| New No. | No | Description | Q'ty |
| 235 | 344 | Audio Visual Set For Auditorium | A 1 |
| 238 | 355 | Slide Projector | A 2 |
| 239 | 356 | Overhead Projector | A 1 |
| 240 | 357 | Projector Screens | A 1 |
| 259 | 399 | Magiboards | A 1 |
| 266 | 434 | Uninterrupted Power Supply (UPS) | A 2 |
| 267 | 435 | Stabilizers | A 2 |

| Animal House | | | |
|--------------|----|--------------------------------|------|
| New No. | No | Description | Q'ty |
| 274 | | Equipment For Animal House Set | B 1 |

| Administration | | | |
|----------------|-----|--|------|
| New No. | No | Description | Q'ty |
| 244 | 367 | Desk Top Computer Set | A 3 |
| 245 | 374 | Laser Printer | A 2 |
| 250 | 381 | Electronic Type Writer with Memory (English) | B 2 |
| 252 | 387 | Electronic Stencil Scanning Machine | B 1 |
| 255 | 393 | Paper Guillotine | C 1 |
| 256 | 394 | Paper Shredder | C 1 |
| 259 | 399 | Magiboards | A 3 |
| 266 | 434 | Uninterrupted Power Supply (UPS) | A 3 |
| 267 | 435 | Stabilizers | A 2 |

ANNEX III

Policy and Criteria for Selection of Equipment

Policy of Selection

- 1) Selection shall be made to meet with the need of curriculum and facility plan.
- 2) Appropriateness of selection shall be judged in consideration of the frequency of use and effectiveness of equipment.

Criteria of Selection

1) Principle of Priority

- a Fundamental equipment required to train doctors, nurses and other paramedicals
- b Equipment which can be easily repaired and maintained
- c Equipment which needs to be replaced because of deterioration and equipment which is in shortage in quantity

2) Principle of Exclusion

- a Equipment which is not used for educational activities
- b Facilities equipment
- c Consumable and spare parts
- d Equipment entailing considerable operational and maintenance expenses which are expected to be financial burden for Sri Lankan side
- e High-technology equipment which surpass the technical level of Sri Lankan side
- f Equipment that may cause environmental pollution
- g Equipment for which installment is considered to be difficult in view of the related infrastructural limitation

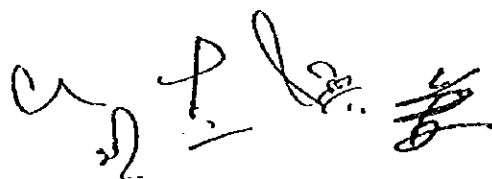

JAPAN'S GRANT AID PROGRAM

1. Japan's Grant Aid Procedures

1) The Japan's Grant Aid Program is executed by the following procedures.

- **Application** (Request made by a recipient country)
- **Study** (Preliminary Study / Basic Design Study conducted by JICA)
- **Appraisal & Approval** (Appraisal by the Government of Japan and Approval by the Cabinet of Japan)
- **Determination of Implementation** (Exchange of Notes between the both Governments)
- **Implementation** (Implementation of the Project)

2) Firstly, an application or a request for a project made by the recipient country is examined by the Government of Japan (the Ministry of Foreign Affairs) to see whether or not it is suitable for Japan's Grant Aid. If the request is deemed suitable, the Government of Japan entrusts a study on the request to JICA (Japan International Cooperation Agency).

Secondly, JICA conducts the Study (Basic Design Study), using a Japanese consulting firm. If the background and objective of the requested project are not clear, a Preliminary Study is conducted prior to a Basic Design Study.

Thirdly, the Government of Japan appraises the Project to see whether or not it is suitable for Japan's Grant Aid Program, based on the Basic Design Study report prepared by JICA and the results are then submitted to the Cabinet for approval.

Fourthly, the Project approved by the Cabinet becomes official when pledged by the Exchange of Notes signed by the both Governments.

Finally, on the implementation of the Project, JICA assists the recipient country in preparing contracts and so on.

2. Contents of the Study

1) Contents of the Study

The purpose of the Study (Preliminary Study/Basic Design Study) conducted on a project requested by JICA is to provide a basic document necessary for appraisal of the project by the Japanese Government. The contents of the Study are as follows:

- a) to confirm background, objectives, benefits of the project and also institutional capacity of agencies concerned of the recipient country necessary for project implementation,
- b) to evaluate appropriateness of the Project for the Grant Aid Scheme from a technical, social and economical point of view,
- c) to confirm items agreed on by the both parties concerning a basic concept of the project,
- d) to prepare a basic design of the project,
- e) to estimate cost involved in the project.

Final project components are subject to approval by the Government of Japan and therefore may differ from an original request.

Implementing the project, the Government of Japan requests the recipient country to take necessary measures involved which are itemized on Exchange of Notes.

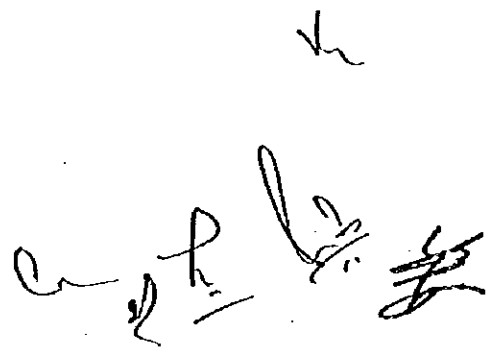

2) Selecting (a) Consulting Firm(s)

For smooth implementation of the study, JICA uses (a) consulting firm(s) registered. JICA selects (a) firm(s) through proposals submitted by firms which are interested. The firm(s) selected carry(ies) out a Basic Design Study and write(s) a report, based upon terms of reference made by JICA.

The consulting firm(s) used for the study is(are) recommended by JICA to a recipient country after Exchange of Notes, in order to maintain technical consistency and also to avoid possible undue delay in implementation caused if a new selection process is repeated.

3) Status of a Preliminary Study in the Grant Aid Program

A Preliminary Study is conducted during the second step of a project formulation & preparation as mentioned above.

A result of the study will be utilized in Japan to decide if the Project is to be suitable for a Basic Design Study.

Based on the result of the Basic Design Study, the Government would proceed to the stage of decision making process (appraisal and approval).

It is important to notice that at the stage of Preliminary Study, no commitment is made by the Japanese side concerning the realization of the Project in the scheme of Grant Aid Program.

3. Japan's Grant Aid Scheme

1) What is Grant Aid?

The Grant Aid Program provides a recipient country with non reimbursable funds needed to procure facilities, equipment and services for economic and social development of the country under the following principles in accordance with relevant laws and regulations of Japan. The Grant Aid is not in a form of donation or such.

2) Exchange of Notes (E/N)

The Japan's Grant Aid is extended in accordance with the Exchange of Notes by both Governments, in which the objectives of the Project, period of execution, conditions and amount of the Grant etc. are confirmed.

3) "The period of the Grant Aid" means one Japanese fiscal year which the Cabinet approves the Project for. Within the fiscal year, all procedure such as Exchange of Notes, concluding a contract with (a) consulting firm(s) and (a) contractor(s) and a final payment to them must be completed.

4) Under the Grant, in principle, products and services of origins of Japan or the recipient country are to be purchased.

When the two Governments deem it necessary, the Grant may be used for the purchase of products or services of a third country origin.

However the prime contractors, namely, consulting, contractor and procurement firms, are limited to "Japanese nationals". (The term "Japanese nationals" means Japanese physical persons or Japanese juridical persons controlled by Japanese physical persons.)

5) Necessity of the "Verification"

The Government of the recipient country or its designated authority will conclude into contracts in Japanese yen with Japanese nationals. Those contracts shall be verified by the Government of Japan. The "Verification" is deemed necessary to secure accountability to Japanese tax payers.

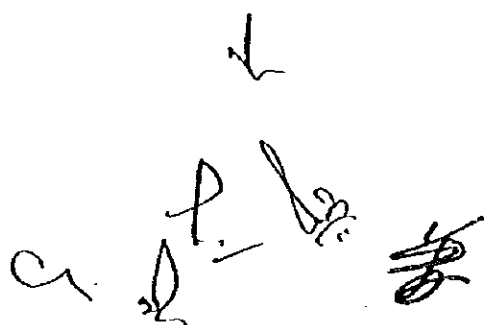

6) Undertakings required to the Government of the recipient country

In the implementation of the Grant Aid, the recipient country is required to undertake necessary measures such as the following:

a) to secure land necessary for the sites of the project and to clear and level the land prior to commencement of the construction work,

b) to provide facilities for distribution of electricity, water supply and drainage and other incidental facilities in and around the sites,

c) to secure buildings prior to the installation work in case the Project is providing equipment,

d) to ensure all the expenses and prompt execution for unloading, customs clearance at the port of disembarkation and internal transportation of the products purchased under the Grant Aid,

e) to exempt Japanese nationals from customs duties, internal taxes and other fiscal levies which will be imposed in the recipient country with respect to the supply of the products and services under the Verified Contracts,

f) to accord Japanese nationals whose services may be required in connection with the supply of the products and services under the Verified Contracts, such facilities as may be necessary for their entry into the recipient country and stay therein for the performance of their work.

7) Proper Use

The recipient country is required to maintain and use facilities constructed and equipment purchased under the Grant Aid properly and effectively and to assign staff necessary for their operation and maintenance as well as to bear all expenses other than those to be borne by the Grant Aid.

8) "Re-export"

The products purchased under the Grant Aid shall not be re-exported from the recipient country.

9) Banking Arrangement (B/A)

(a) The Government of the recipient country or its designated authority shall open an account in the name of the Government of the recipient country in an authorized foreign exchange bank in Japan (hereinafter referred to as "the Bank"). The Government of Japan will execute the Grant Aid by making payments in Japanese yen to cover the obligations incurred by Government of the recipient country or its designated authority under the contracts verified.

(b) The payments will be made when payment requests are presented by the Bank to the Government of Japan under an Authorization to Pay issued by the Government of the recipient country or its designated authority.

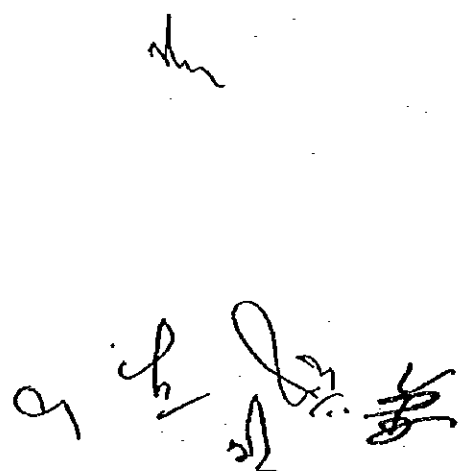

ANNEX V

NECESSARY MEASURES TO BE TAKEN BY THE SRI LANKAN SIDE

The following measures shall be taken by the Government of Sri Lanka on condition that the Grant Aid by the Government of Japan is extended to the Project.

1. To provide the temporary site office, warehouse or stock yard during the implementation period;
2. To bear two kinds of commissions to the Japanese Foreign Exchange Bank for its banking services based upon the Banking Arrangement, namely
 - the advising commission of the 'Authorization to Pay' and
 - the payment commission ;
3. To exempt taxes and to take necessary measures for customs clearance of the materials and equipment brought for the Project at port of disembarkation;
4. To accord Japanese nationals whose services may be required in connection with the supply of products and services under the verified contract such facilities as may be necessary for their entry into Sri Lanka and stay therein for the performance of their work;
5. To provide necessary permissions, licenses, and other authorization for implementing the Project, if necessary ;
6. To assign an appropriate budget and training and administrative staff for proper and effective operation and maintenance of the equipment provided under the Grant ; and
7. To bear all the expenses other than those to be borne by the Japan's Grant Aid within the scope of the Project.



ANNEX VI

The Project for the Improvement of Equipment for the Faculty of Medical Sciences, the University of Sri Jayewardenepura Narrative Summary

(Workshop 10 Oct., 1996, Moderator Mr. HANDA,
Co-moderator, Ms. ISHIZAWA)

GOAL (the project purpose is to be aimed for)

To improve and sustain the improved quality of health personnel produced by the University of Sri Jayewardenepura.



PROJECT PURPOSE (the project is intended to accomplish)

Internationally standardized medical/paramedical training is provided to all students of Faculty of Medical Sciences of University of Sri Jayewardenepura.



OUTPUTS (the project aims to achieve)

① Physical facilities for all departments is provided by University of Sri Jayewardenepura (USJW)

- * 1. Department of Anatomy
2. Department of Physiology
3. Department of Biochemistry
4. Department of Pathology
5. Department of Microbiology
6. Department of Parasitology
7. Department of Pharmacology
8. Department of Forensic Medicine
9. Department of Family Medicine and Community Medicine
10. Department of Medicine
11. Department of Surgery
12. Department of Paediatrics
13. Department of Obstetrics and Gynaecology
14. Department of Psychiatry
15. Department of Medical Education and Health Sciences

② Modern facilities (equipment/instruments) for teaching, teaching-related research and clinical activities are provided by Japanese Government / JICA.
* medical and paramedical undergraduate trainings .

③ Maintenance and administrative functions of the Faculty of Medical Sciences (FMS), USJW are strengthened further in order to meet the requirement of newly introducing equipment / instruments.

④ Academic, non-academic staff are secured enough to carry out the teaching, teaching-related research and clinical activities under the improved condition of physical facilities, facility .

⑤ Improvement of curriculum and teaching methods is further advanced in order to meet the requirement of the Project.

Handwritten signatures and initials.

Construction Schedule for the Faculty of Medical Sciences

| Building Name | 1996 | | | 1997 | | | | | | | | | | | | 1998 | | | 1999 | | |
|---|------|----|----|------|---|---|---|---|---|---|---|---|----|----|----|------|---|---|------|--|--|
| | 10 | 11 | 12 | 1 | 2 | 3 | 4 | 5 | 6 | 7 | 8 | 9 | 10 | 11 | 12 | 1 | 2 | 3 | | | |
| Stage I | | | | | | | | | | | | | | | | | | | | | |
| Interior Finishing | | | | | | | | | | | | | | | | | | | | | |
| Animal House | | | | | | | | | | | | | | | | | | | | | |
| Contract | | | | | | | | | | | | | | | | | | | | | |
| Base | | | | | | | | | | | | | | | | | | | | | |
| Structure | | | | | | | | | | | | | | | | | | | | | |
| Facility | | | | | | | | | | | | | | | | | | | | | |
| Exterior Finishing | | | | | | | | | | | | | | | | | | | | | |
| Interior Finishing | | | | | | | | | | | | | | | | | | | | | |
| Family Practice Centre | | | | | | | | | | | | | | | | | | | | | |
| Land Preparation | | | | | | | | | | | | | | | | | | | | | |
| Base | | | | | | | | | | | | | | | | | | | | | |
| Structure | | | | | | | | | | | | | | | | | | | | | |
| Facility | | | | | | | | | | | | | | | | | | | | | |
| Exterior Finishing | | | | | | | | | | | | | | | | | | | | | |
| Interior Finishing | | | | | | | | | | | | | | | | | | | | | |
| Colombo South Teaching Hospital Professional Unit | | | | | | | | | | | | | | | | | | | | | |
| Structure | | | | | | | | | | | | | | | | | | | | | |
| Facility | | | | | | | | | | | | | | | | | | | | | |
| Exterior Finishing | | | | | | | | | | | | | | | | | | | | | |
| Interior Finishing | | | | | | | | | | | | | | | | | | | | | |
| Stage II | | | | | | | | | | | | | | | | | | | | | |
| Tender | | | | | | | | | | | | | | | | | | | | | |
| Contract | | | | | | | | | | | | | | | | | | | | | |
| Land Preparation | | | | | | | | | | | | | | | | | | | | | |
| Base | | | | | | | | | | | | | | | | | | | | | |
| Structure | | | | | | | | | | | | | | | | | | | | | |
| Facility | | | | | | | | | | | | | | | | | | | | | |
| Exterior Finishing | | | | | | | | | | | | | | | | | | | | | |
| Interior Finishing | | | | | | | | | | | | | | | | | | | | | |
| Ready to Install the Equipment | | | | | | | | | | | | | | | | | | | | | |
| Central Library Building | | | | | | | | | | | | | | | | | | | | | |
| Relocation of Library Building | | | | | | | | | | | | | | | | | | | | | |
| Ready to Install the Equipment | | | | | | | | | | | | | | | | | | | | | |

Handwritten signature and date: 23/11/97

