

Scale 1:50,000 (Enlarged from 1:100,000 Map)

JAPAN INTERNATIONAL COOPERATION AGENCY (JICA)
THE STUDY ON THE DEVELOPMENT OF WATER SUPPLY SYSTEM FOR THE DAMASCUS CITY
Figure C-7.1 Location Map for Deir al Ashayer (1:50,000)
NIPPON KOEI CO., LTD.

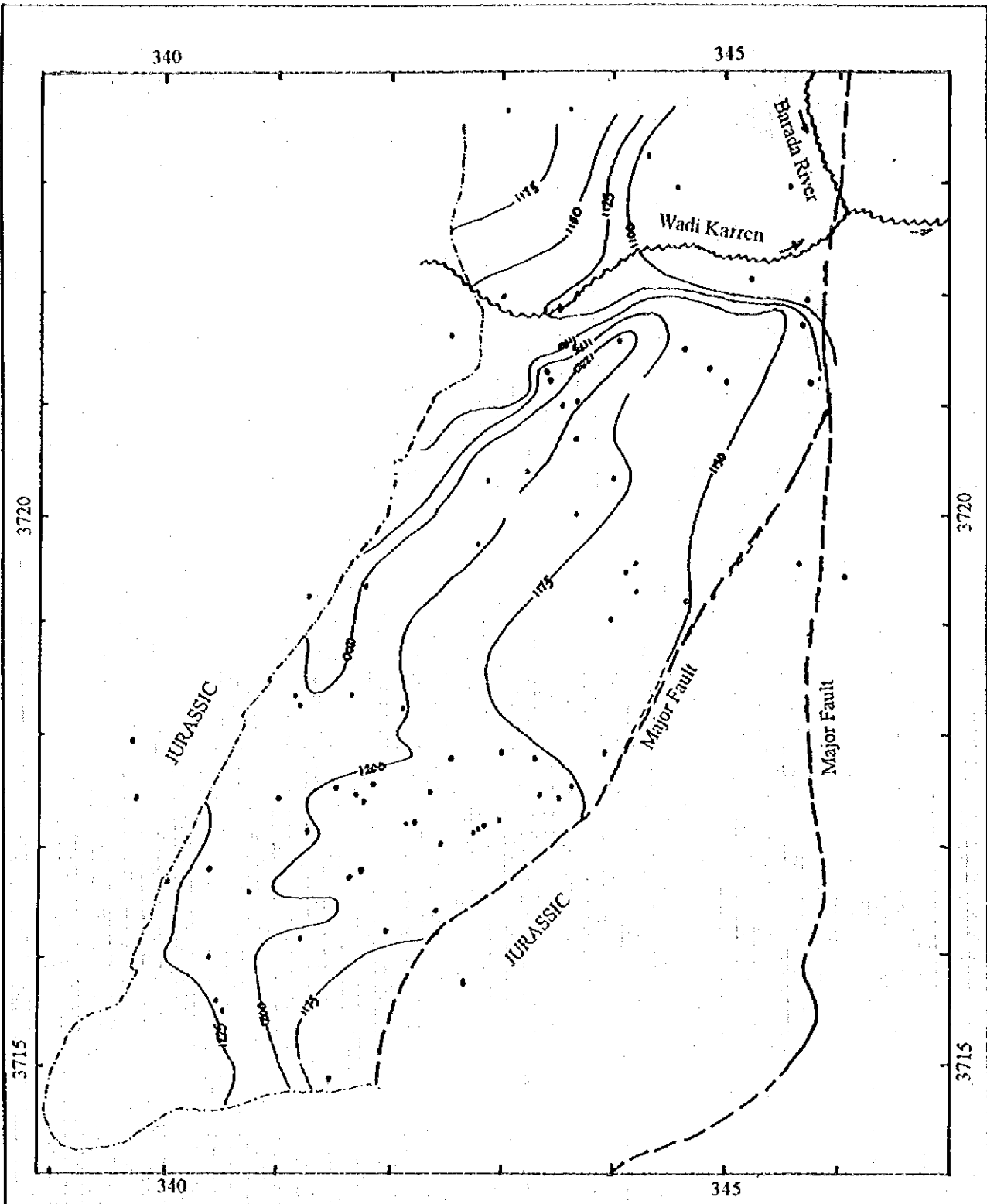

Deir el Ashayer Water Levels Sept 1989

Piezometric contours only on the Cretaceous aquifer

JAPAN INTERNATIONAL COOPERATION AGENCY (JICA)
THE STUDY ON THE DEVELOPMENT OF WATER SUPPLY SYSTEM FOR THE DAMASCUS CITY
Figure C-7.2 Piezometric Map for Deir el Ashayer 1989 (1:50,000)
NIPPON KOEI CO., LTD.

UTM Grid

Source: MOI (1994)

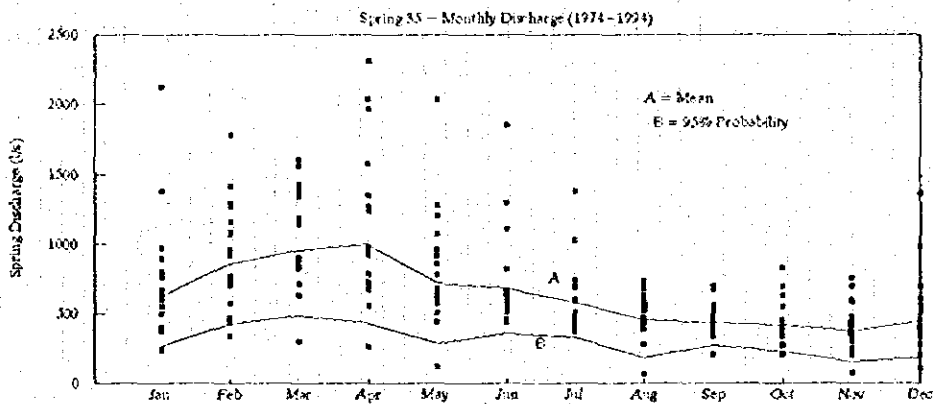
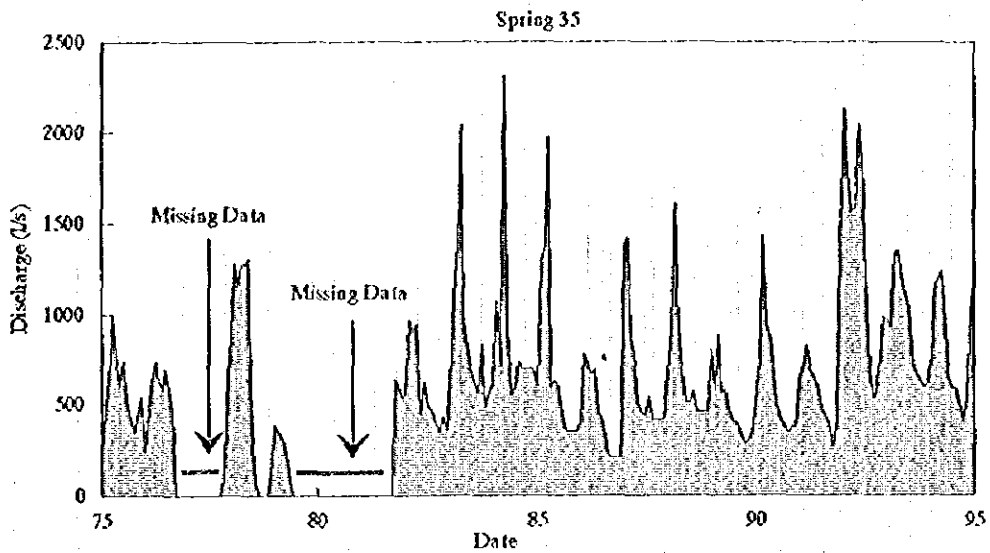

JAPAN INTERNATIONAL COOPERATION AGENCY (JICA)

THE STUDY ON THE DEVELOPMENT OF
WATER SUPPLY SYSTEM FOR THE DAMASCUS CITY

Figure C-7.3 Long Term Hydrograph Beit Jenn
Figure C-7.4 Annual Hydrograph Beit Jenn

NIPPON KOEI CO., LTD.

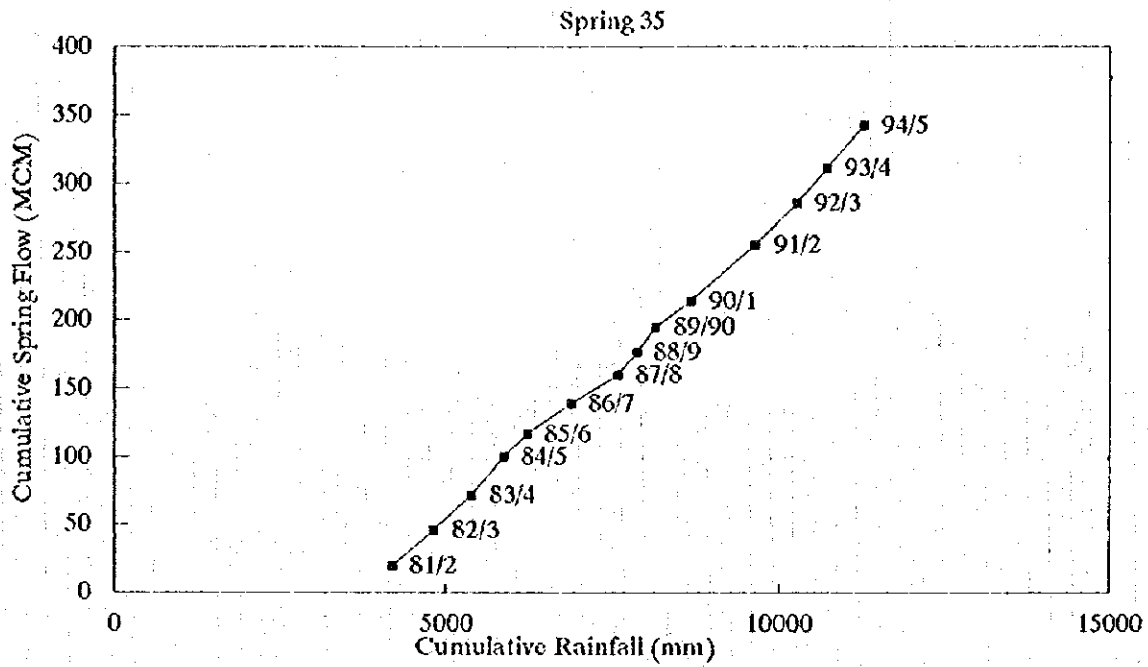

JAPAN INTERNATIONAL COOPERATION AGENCY (JICA)

THE STUDY ON THE DEVELOPMENT OF
WATER SUPPLY SYSTEM FOR THE DAMASCUS CITY

Figure C-7.5
Cumulative Rainfall & Spring Flow

NIPPON KOEI CO., LTD.

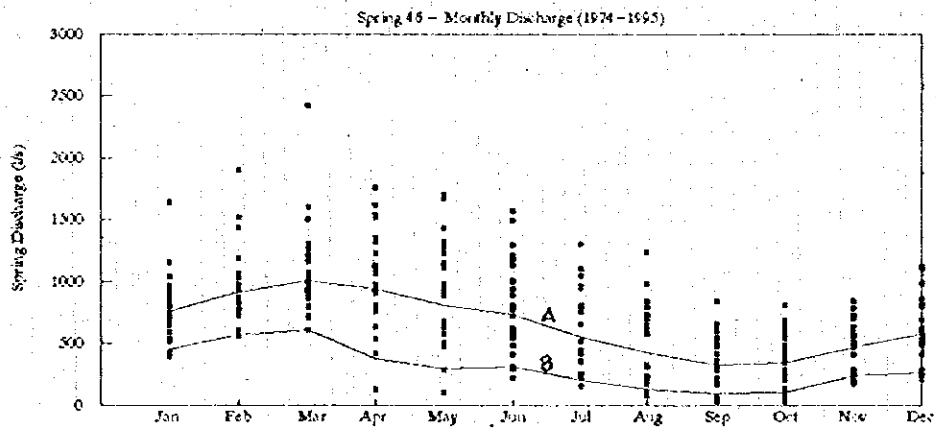
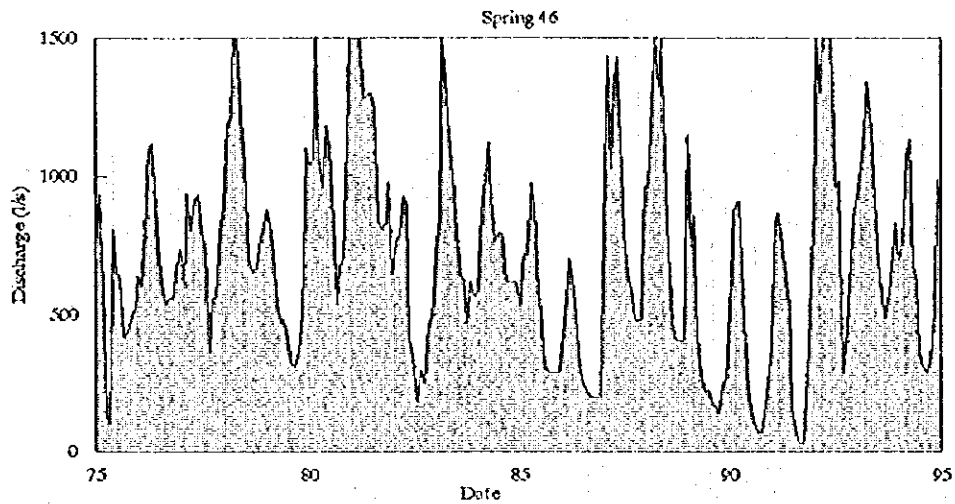

JAPAN INTERNATIONAL COOPERATION AGENCY (JICA)

THE STUDY ON THE DEVELOPMENT OF
WATER SUPPLY SYSTEM FOR THE DAMASCUS CITY

Figure C-7.6 Long Term Hydrograph Tabibiyeh
Figure C-7.7 Annual Hydrograph Tabibiyeh

HIPPON KOEI CO., LTD.

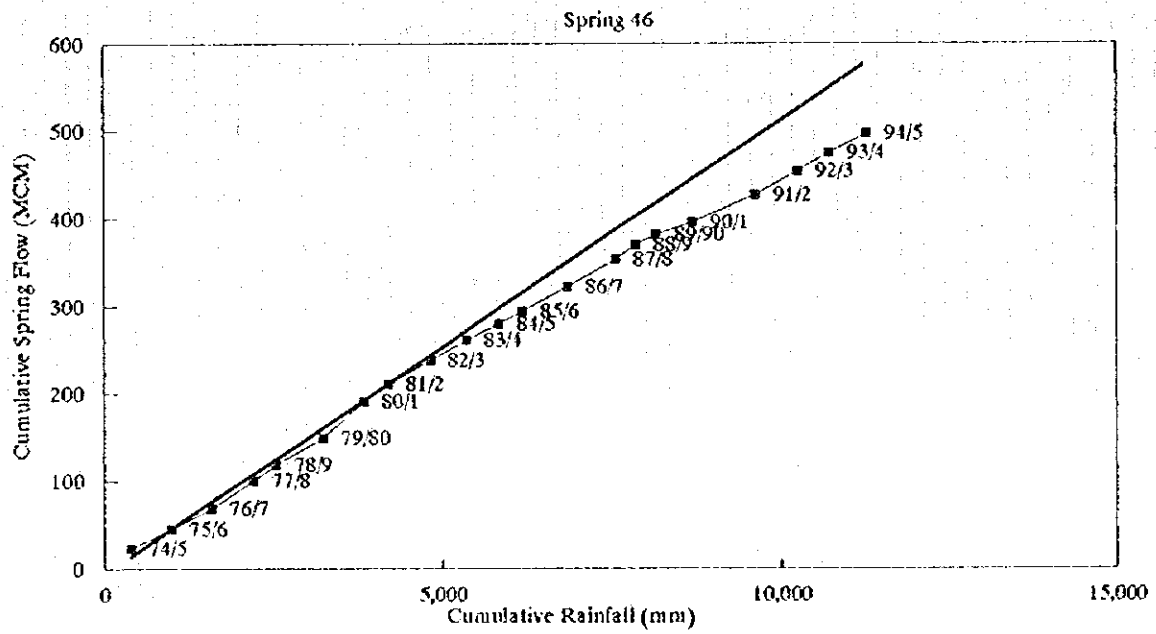

JAPAN INTERNATIONAL COOPERATION AGENCY (JICA)

THE STUDY ON THE DEVELOPMENT OF
WATER SUPPLY SYSTEM FOR THE DAMASCUS CITY

Figure C-7.8
Cumulative Rainfall & Spring Flow

NIPPON KOEI CO., LTD.

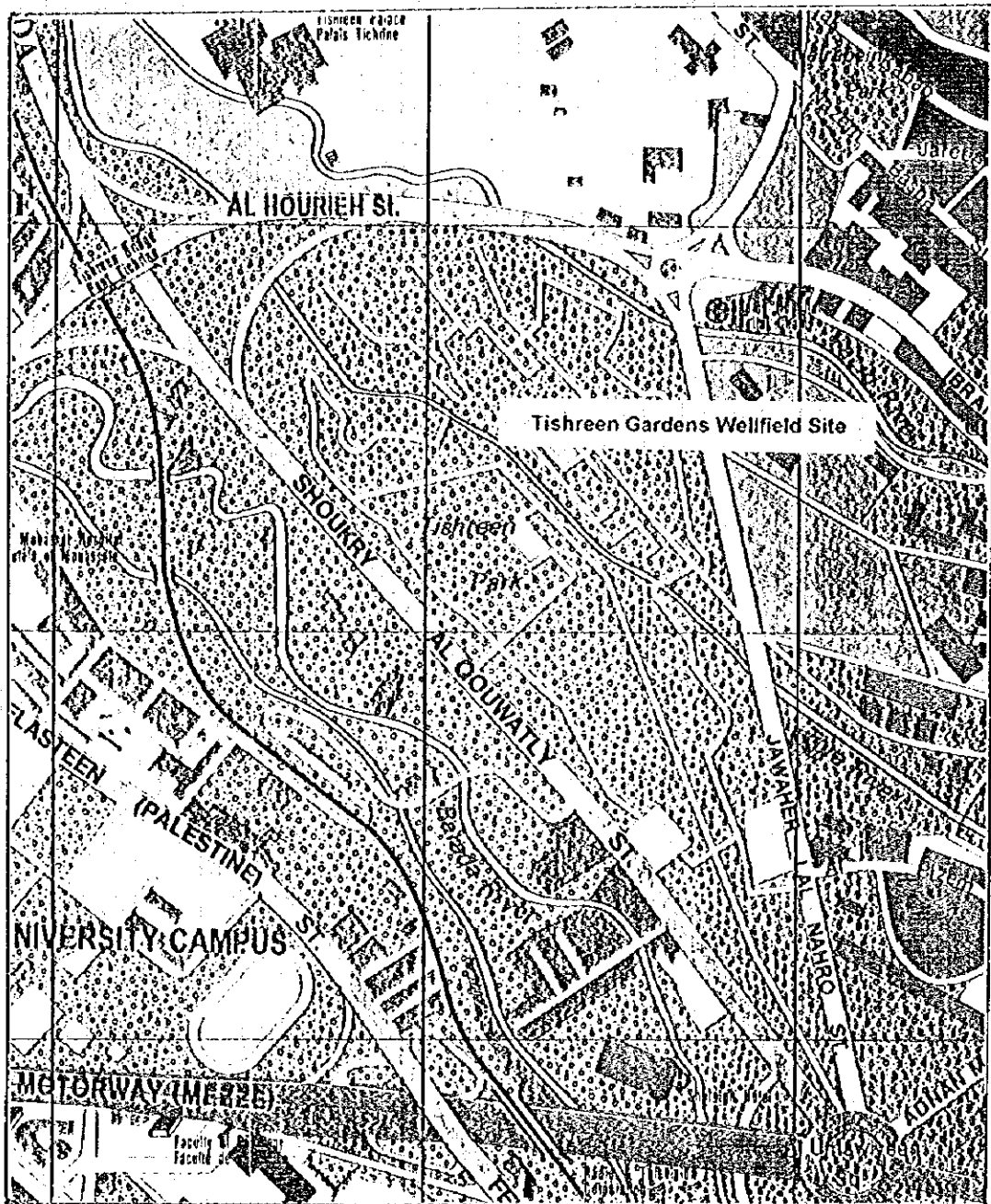

JAPAN INTERNATIONAL COOPERATION AGENCY (JICA)
THE STUDY ON THE DEVELOPMENT OF WATER SUPPLY SYSTEM FOR THE DAMASCUS CITY
Figure C-7.9 Location Map Tishreen Gardens
NIPPON KOEI CO., LTD.

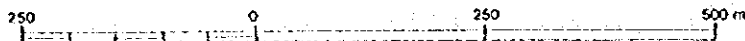
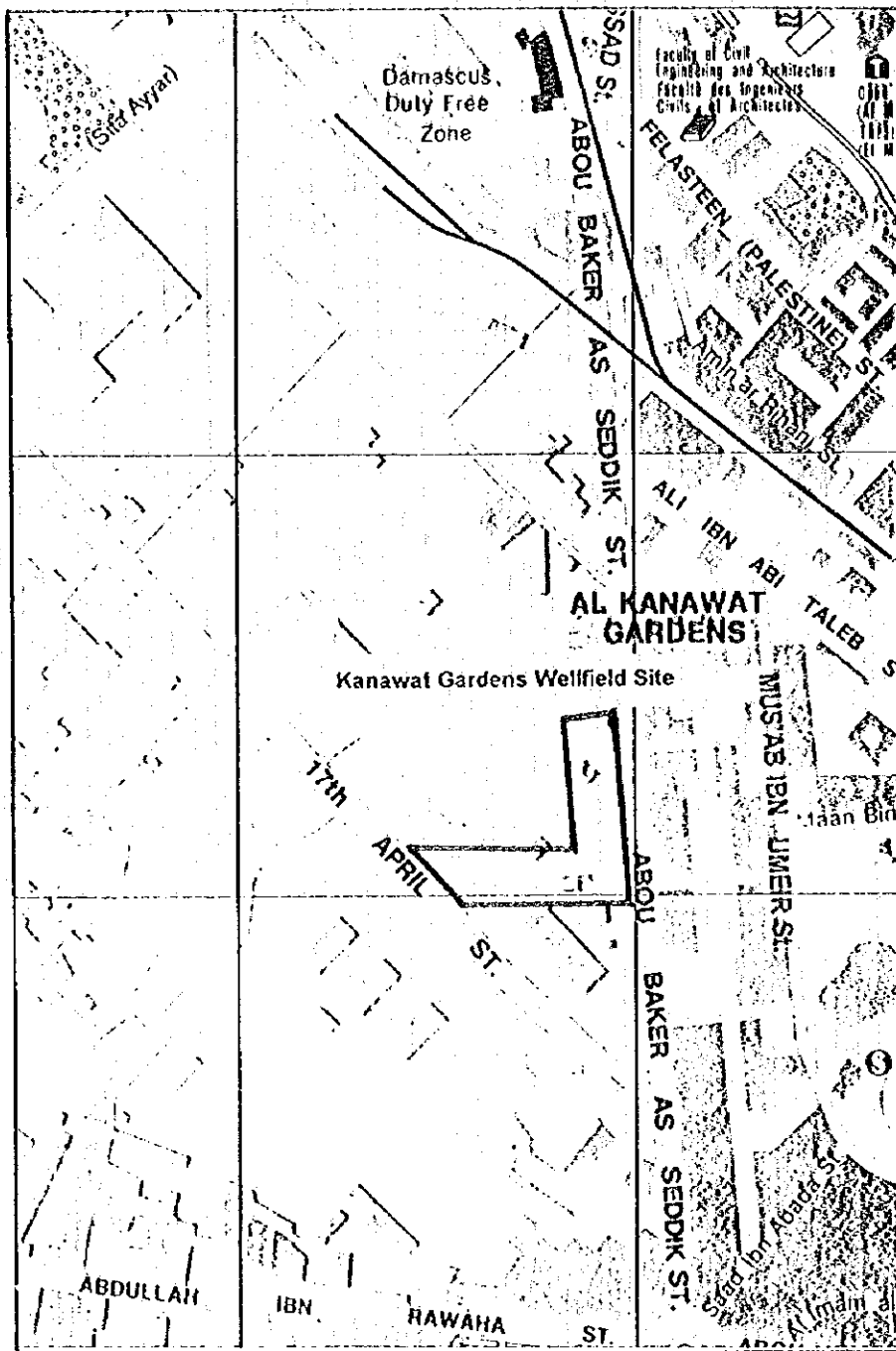

JAPAN INTERNATIONAL COOPERATION AGENCY (JICA)
 THE STUDY ON THE DEVELOPMENT OF
 WATER SUPPLY SYSTEM FOR THE DAMASCUS CITY
 Figure C-7.10
 Location Map Kanawat Gardens
 NIPPON KOEI CO., LTD.

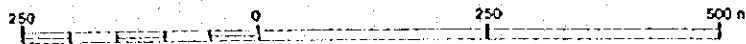
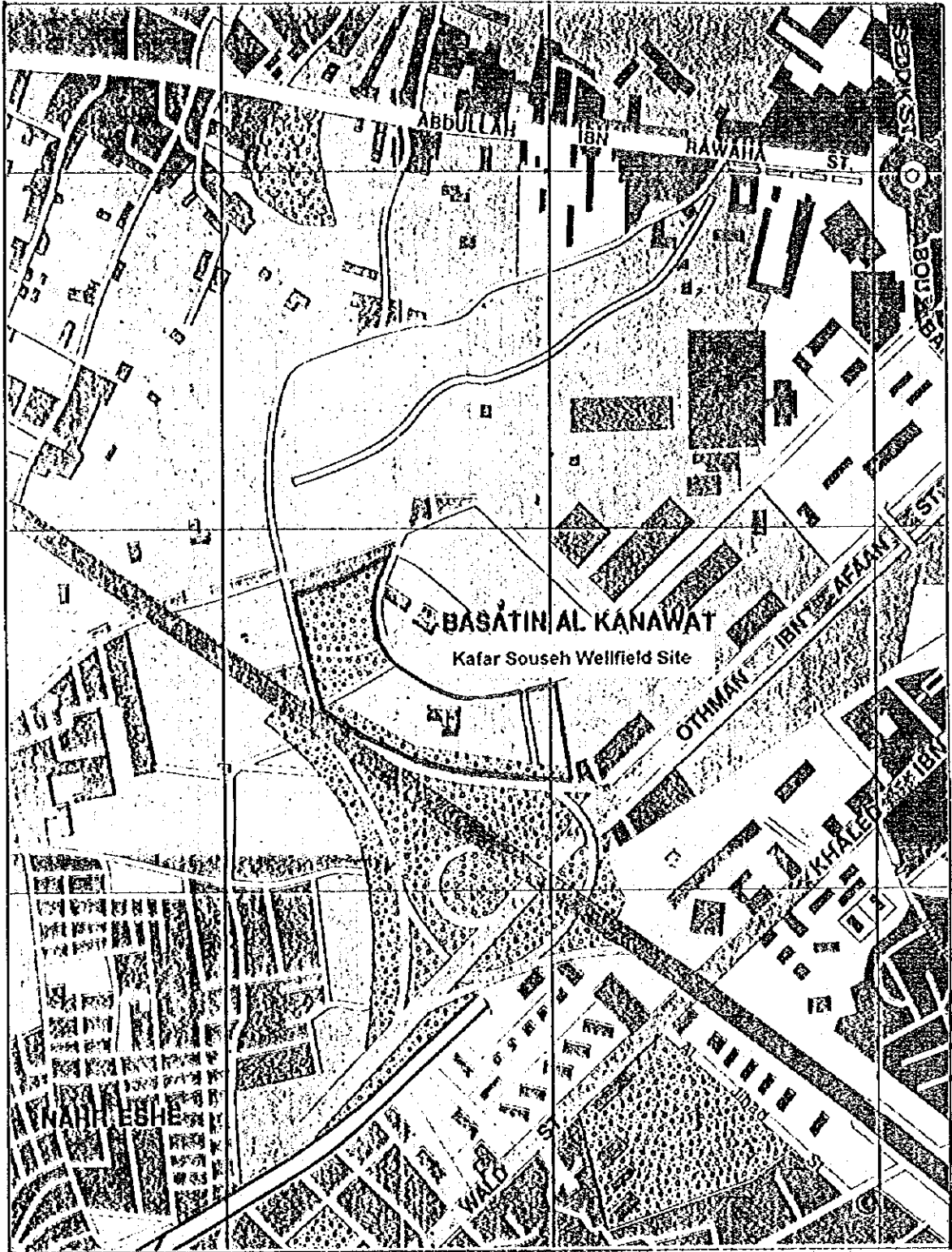

JAPAN INTERNATIONAL COOPERATION AGENCY (JICA)
 THE STUDY ON THE DEVELOPMENT OF
 WATER SUPPLY SYSTEM FOR THE DAMASCUS CITY

Figure C-7.11
 Location Map Kafar Souseh

NIPPON KOEI CO., LTD.

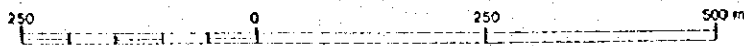
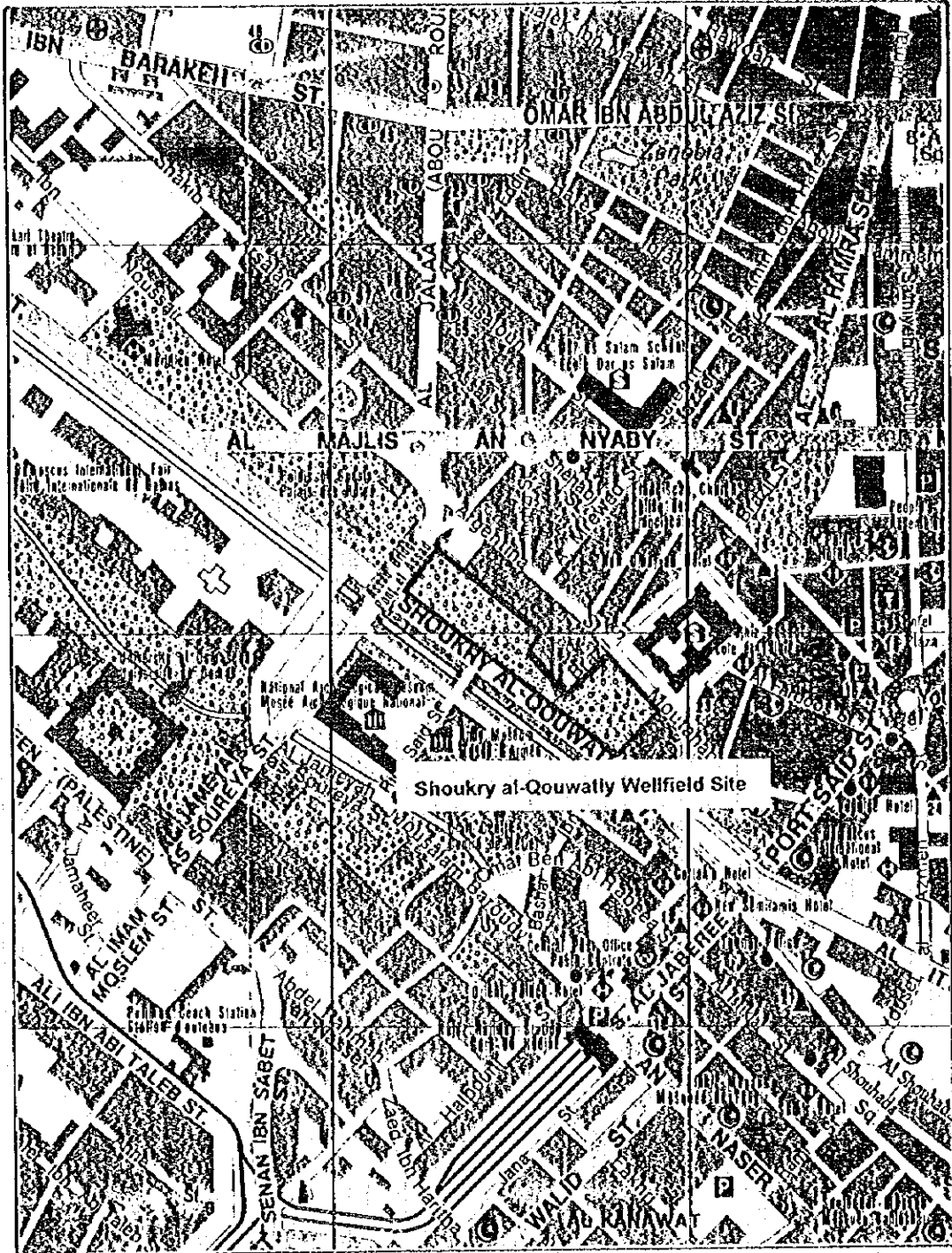

JAPAN INTERNATIONAL COOPERATION AGENCY (JICA)

THE STUDY ON THE DEVELOPMENT OF
WATER SUPPLY SYSTEM FOR THE DAMASCUS CITY

Figure C-7.12
Location Map Shoukry al Qouwatly

NIFFON KOEI CO., LTD.

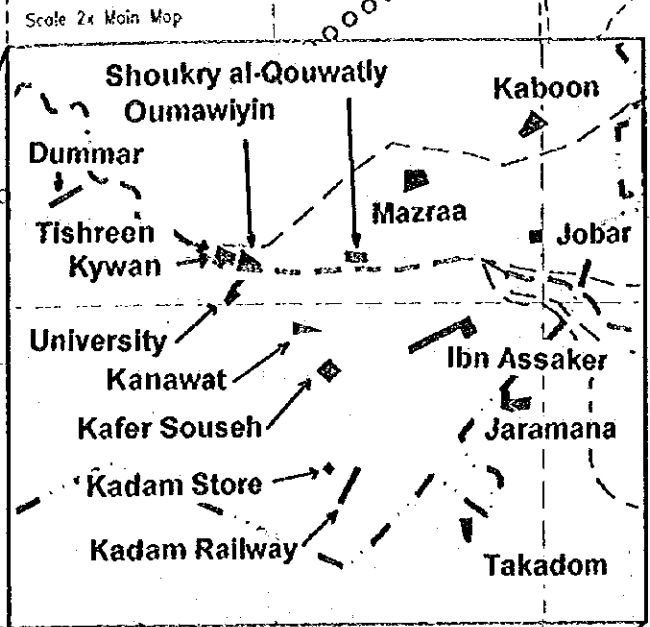
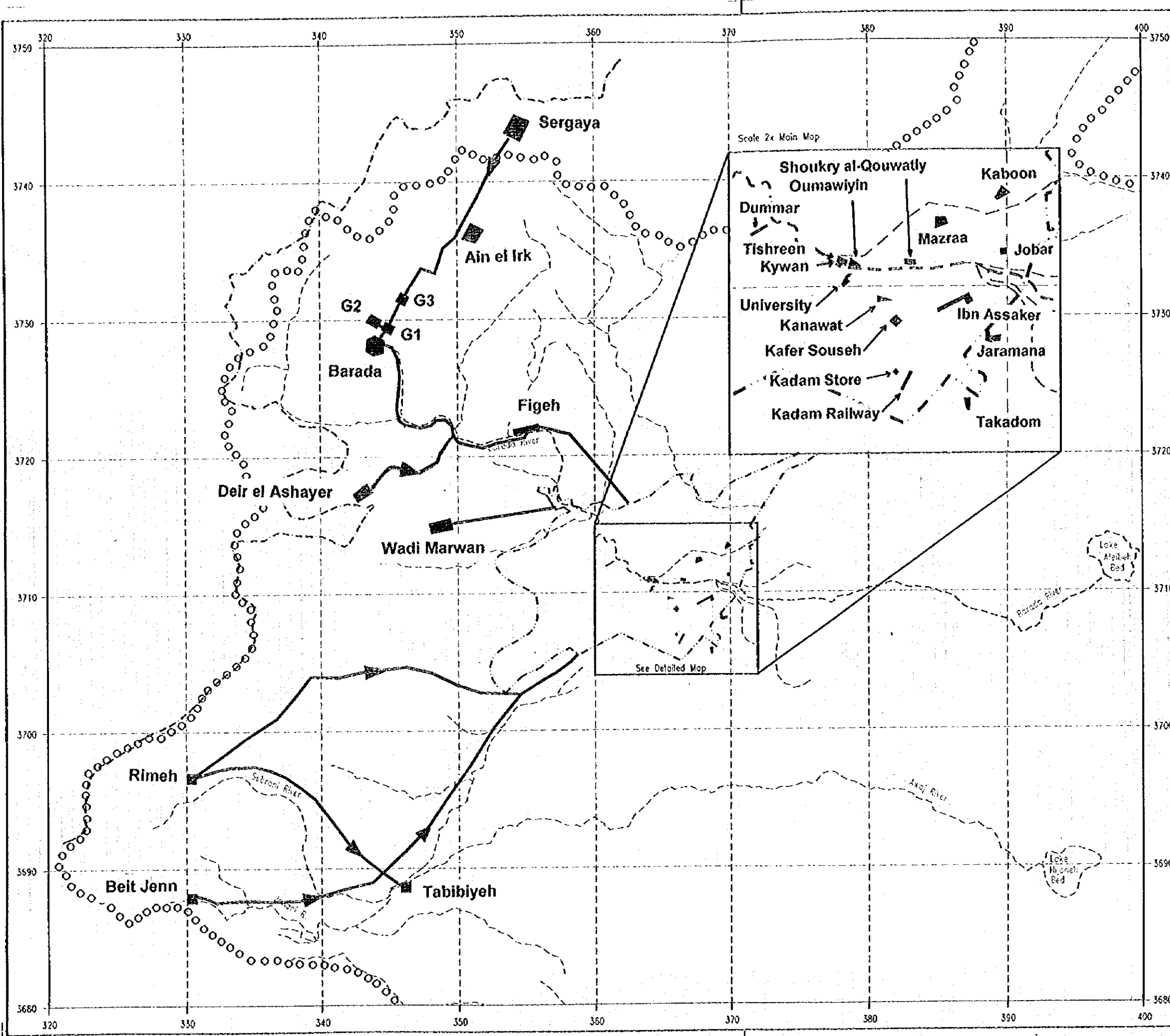

Location Map of the Current & Proposed Water Sources

- Water Course
- o o o Watersheds
- - - International border
- - - DAWSSA Supply area proposed by City Master Plan
- Existing Source
- ▣ Proposed Source
- Existing Pipeline/Tunnel
- > Proposed Pipeline

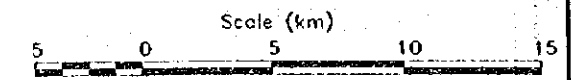

Grid: Universal Transverse Mercator
 JAPAN INTERNATIONAL COOPERATION AGENCY (JICA)
 THE STUDY ON THE DEVELOPMENT OF WATER SUPPLY SYSTEM FOR THE DAMASCUS CITY
 Figure C-7.13
 Map of Future Water Sources
 NIPPON KOEI CO., LTD.

**Minimum Perforated Casing Lengths
for a Screen Entrance Velocity of Less than 0.03 m/s**

9" Casing Material 25% of Screen Clogged

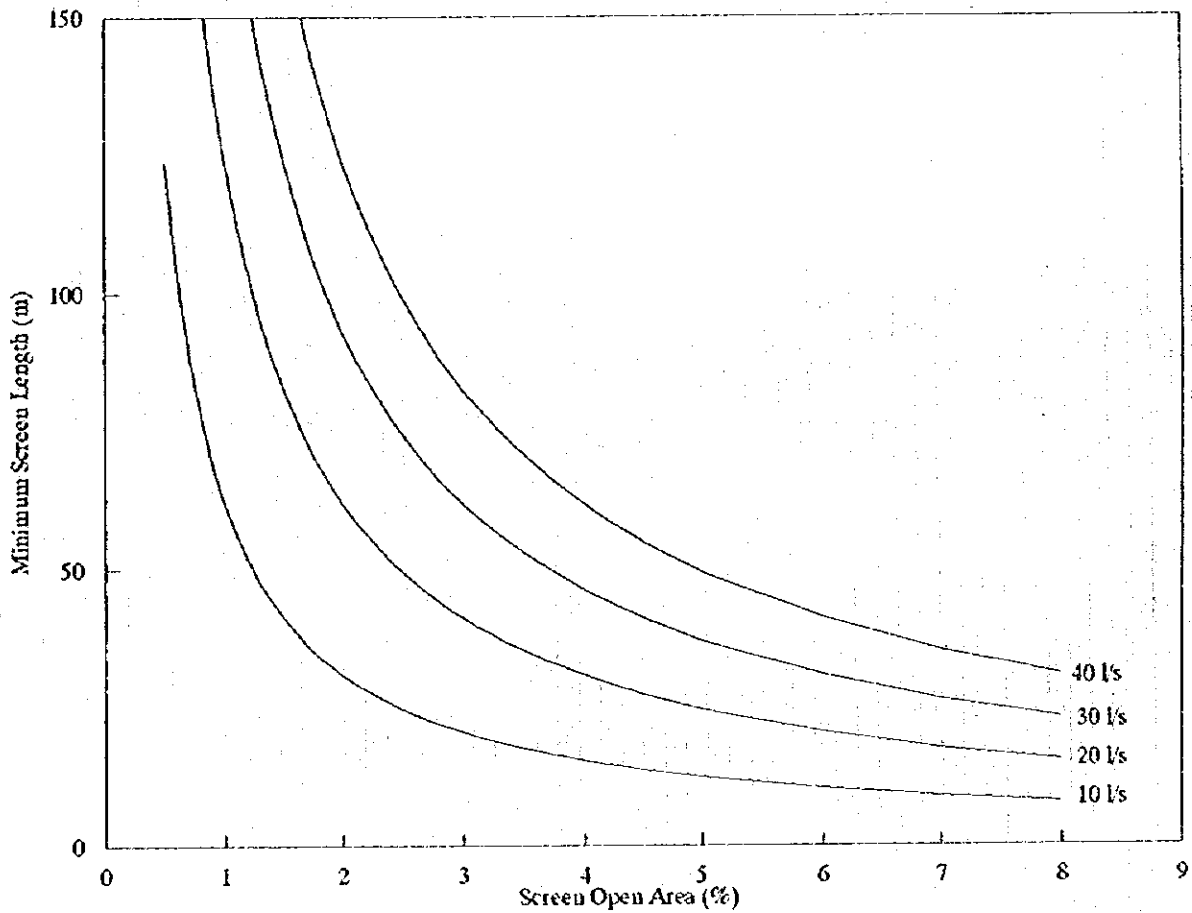

JAPAN INTERNATIONAL COOPERATION AGENCY (JICA)
 THE STUDY ON THE DEVELOPMENT OF
 WATER SUPPLY SYSTEM FOR THE DAMASCUS CITY
 Figure C-8.1
 Screen Design for Recommended Entrance Velocity
 NIPPON KOEI CO., LTD.

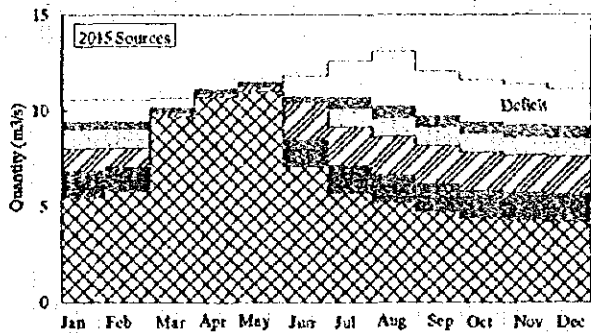
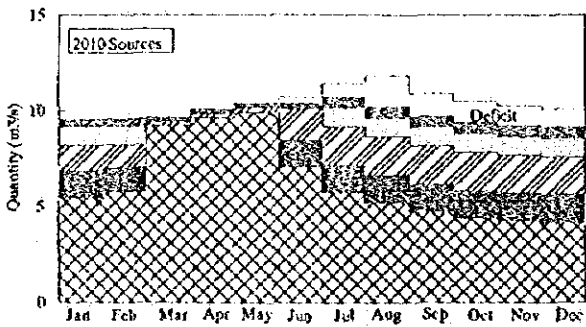
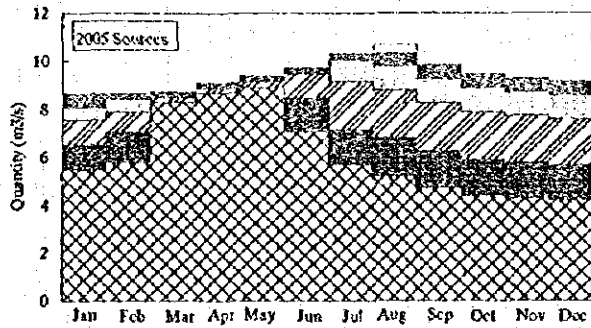
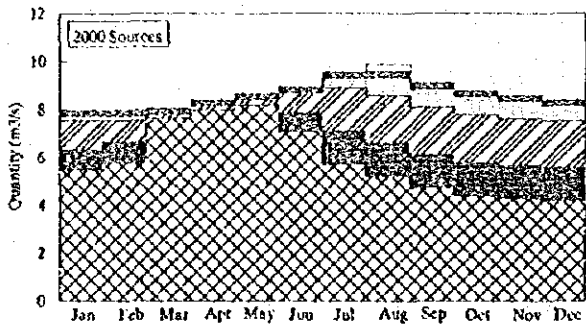
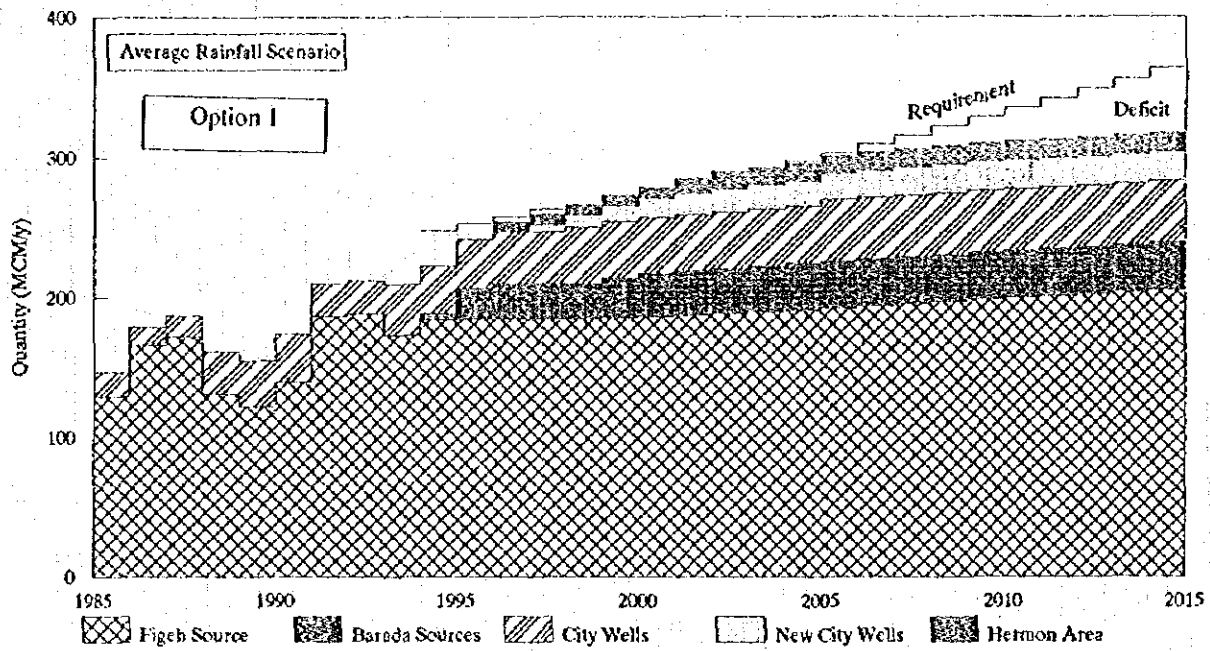

JAPAN INTERNATIONAL COOPERATION AGENCY (JICA)
THE STUDY ON THE DEVELOPMENT OF
WATER SUPPLY SYSTEM FOR THE DAMASCUS CITY

Figure C-8.2
Production Plan, Average

NIIPPON KOEI CO., LTD.

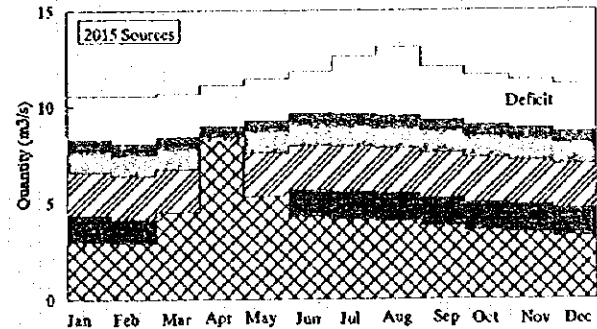
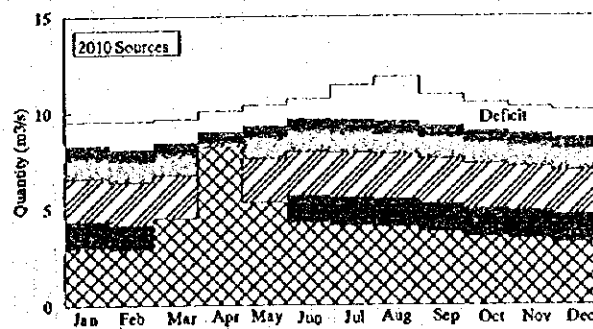
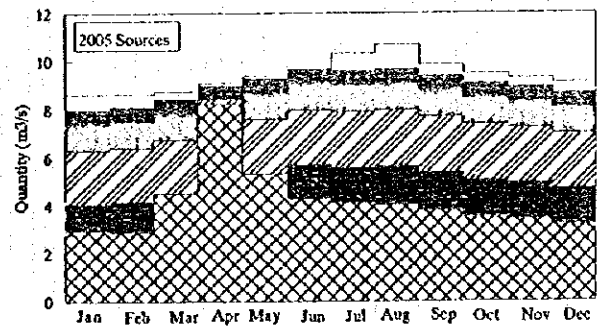
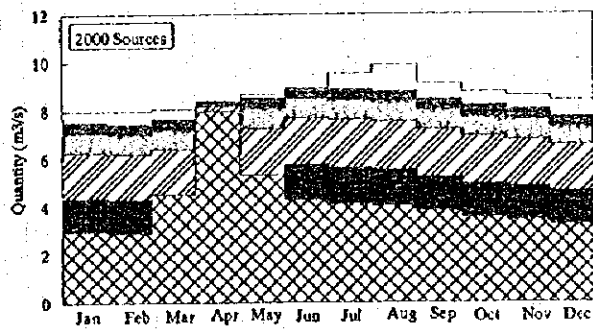
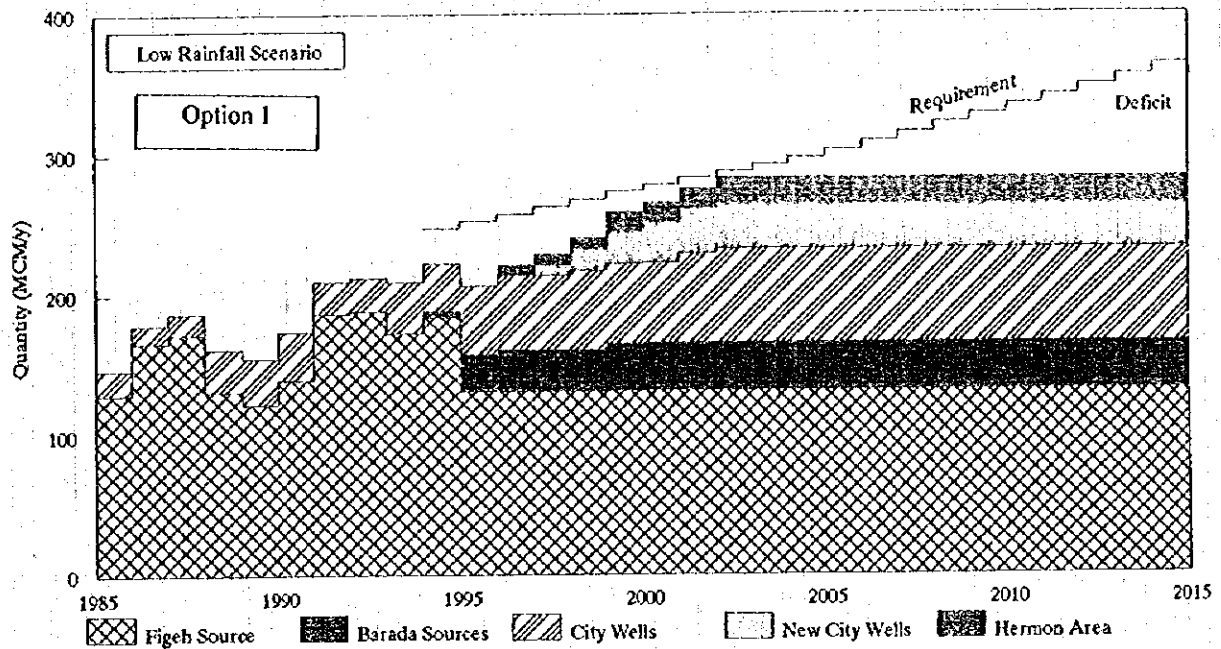

JAPAN INTERNATIONAL COOPERATION AGENCY (JICA)

THE STUDY ON THE DEVELOPMENT OF
WATER SUPPLY SYSTEM FOR THE DAMASCUS CITY

Figure C-8.3
Water Production Plan, Dry

NIPPON KOEI CO., LTD.

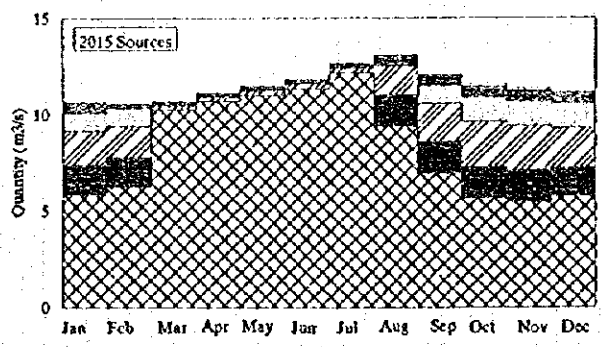
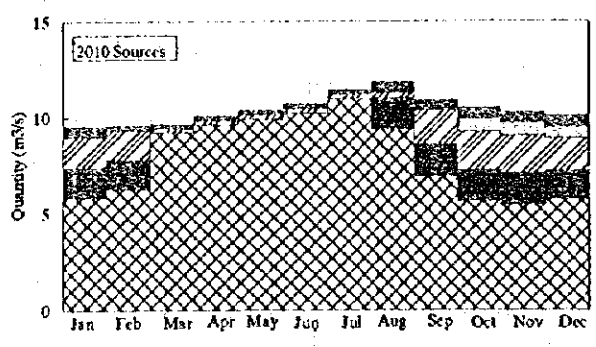
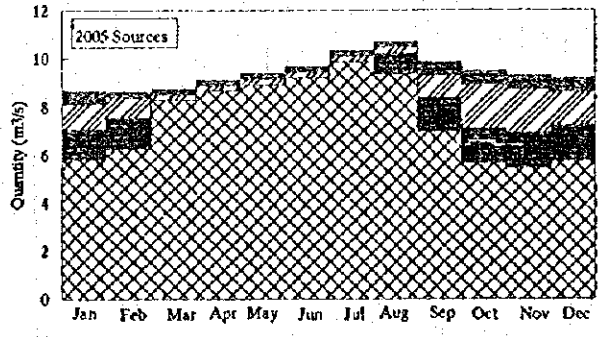
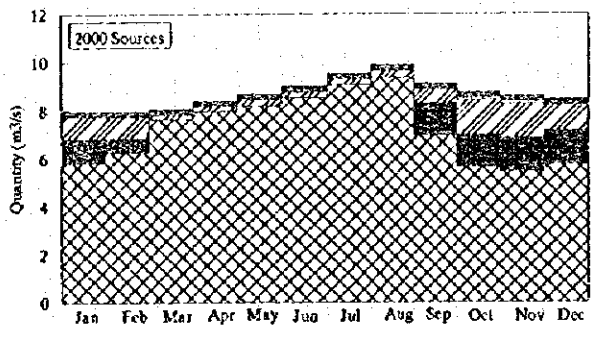
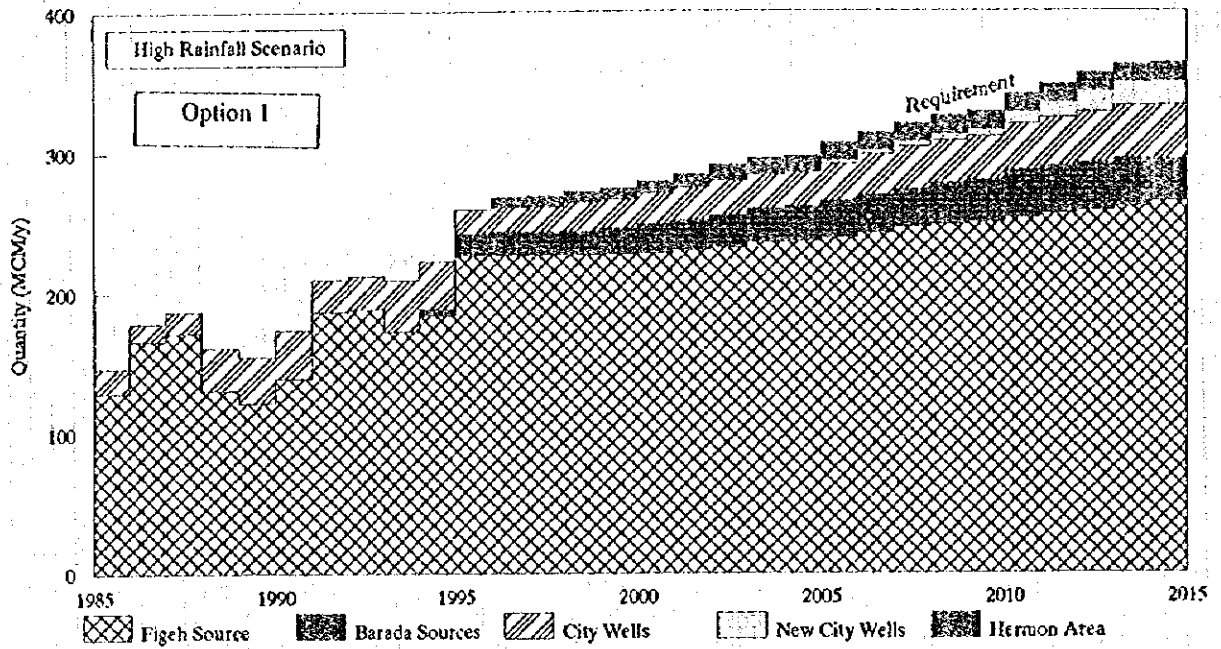

JAPAN INTERNATIONAL COOPERATION AGENCY (JICA)
 THE STUDY ON THE DEVELOPMENT OF
 WATER SUPPLY SYSTEM FOR THE DAMASCUS CITY

Figure C-8.4
 Water Production Plan, Wet

NIPPON KOEI CO., LTD.

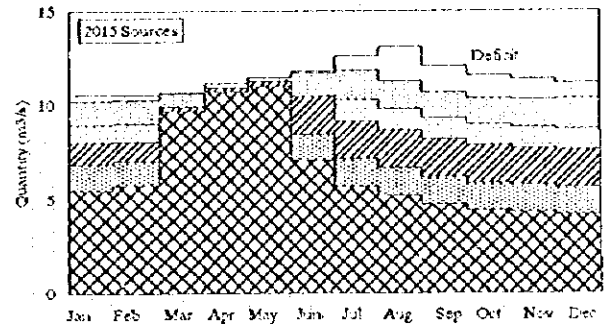
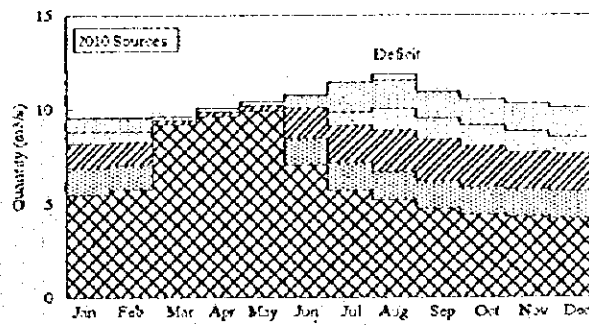
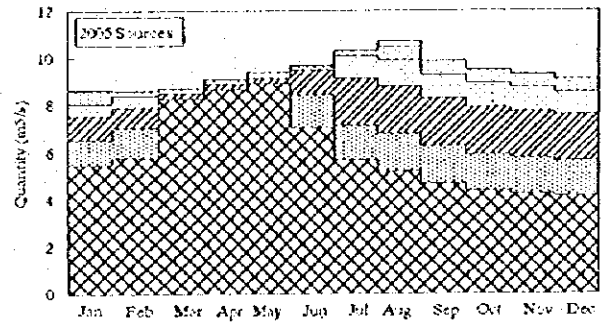
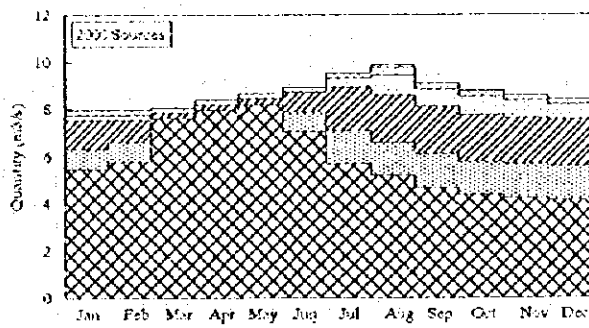
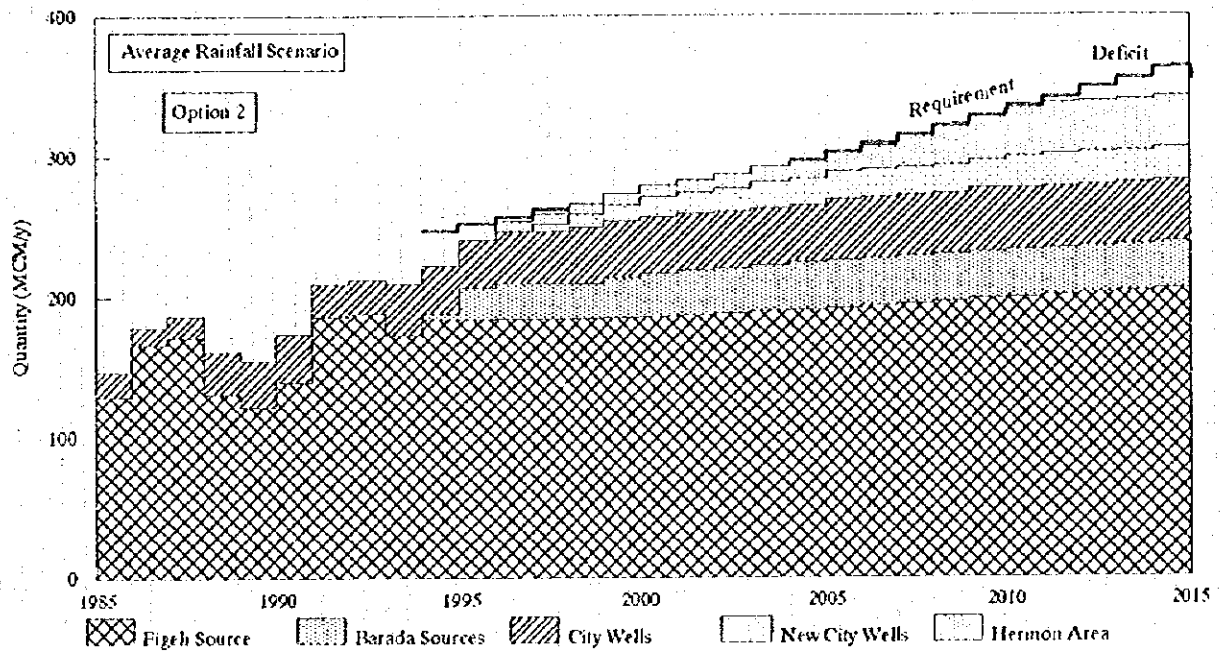

JAPAN INTERNATIONAL COOPERATION AGENCY (JICA)

THE STUDY ON THE DEVELOPMENT OF
WATER SUPPLY SYSTEM FOR THE DAMASCUS CITY

Figure C-8.5
Water Production Plan Option 2. Average

NIPPON KOEI CO., LTD.

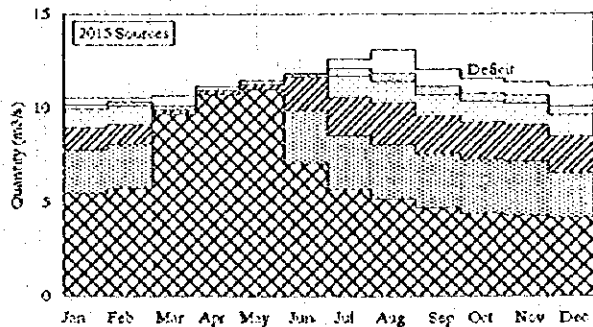
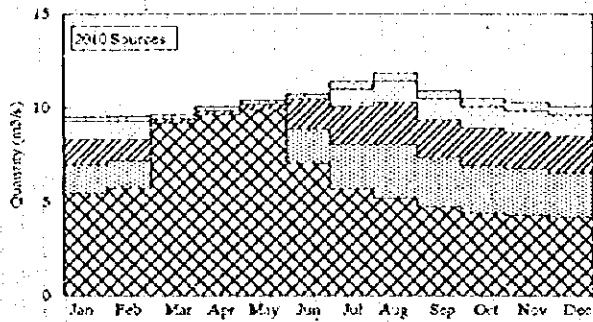
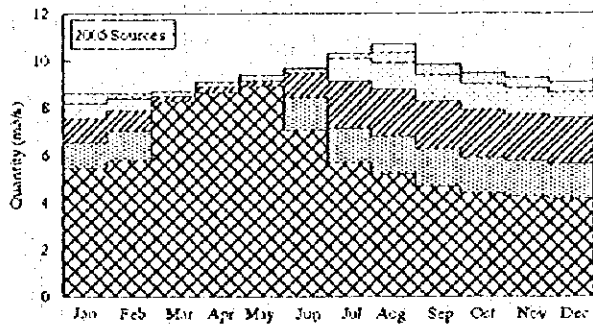
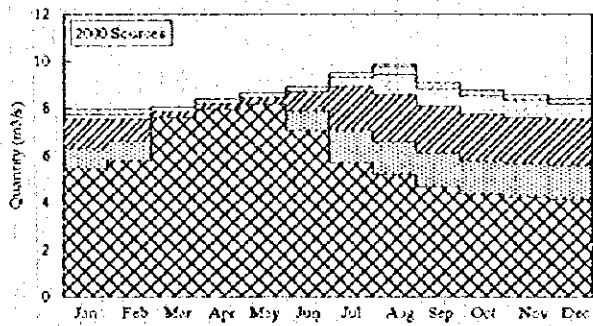
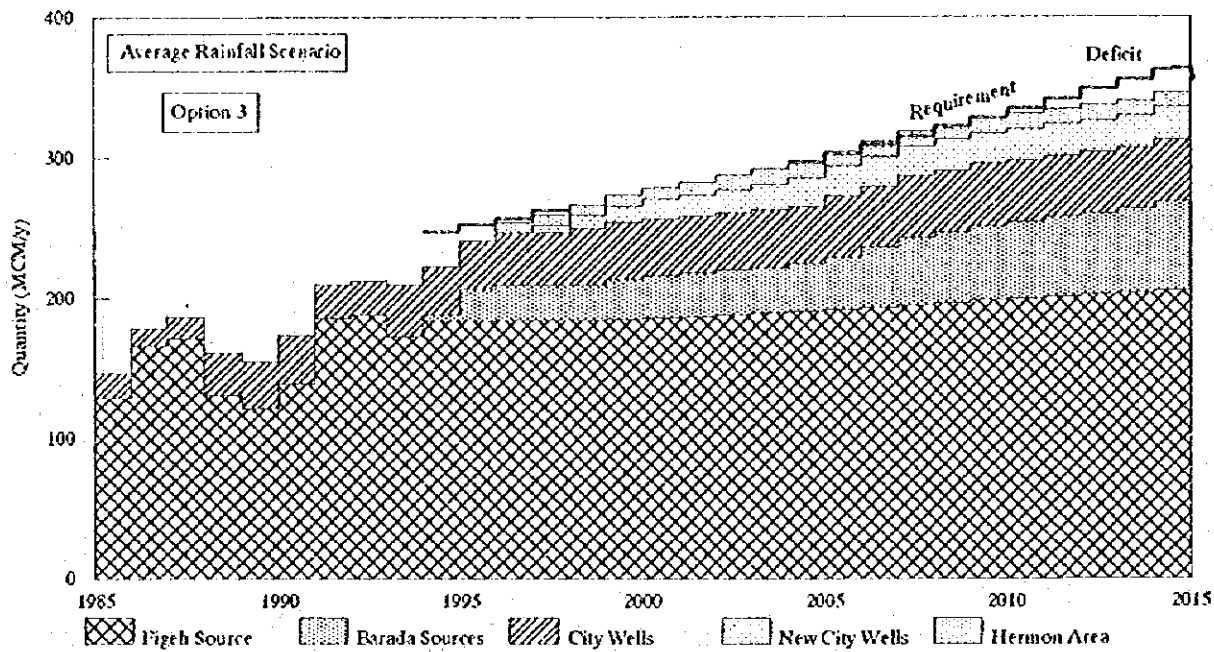

JAPAN INTERNATIONAL COOPERATION AGENCY (JICA)

THE STUDY ON THE DEVELOPMENT OF
WATER SUPPLY SYSTEM FOR THE DAMASCUS CITY

Figure C-8.6
Water Production Plan Option 3, Average

NIPPON KOEI CO., LTD.

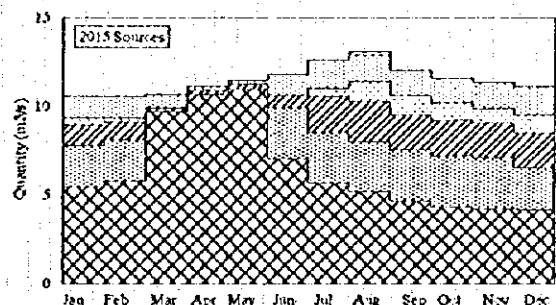
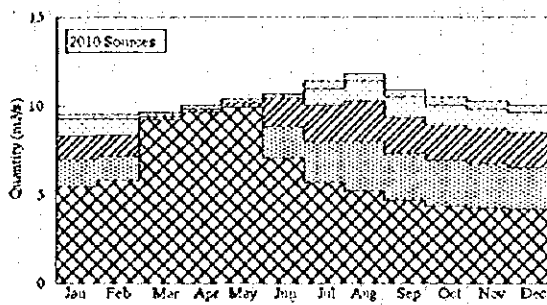
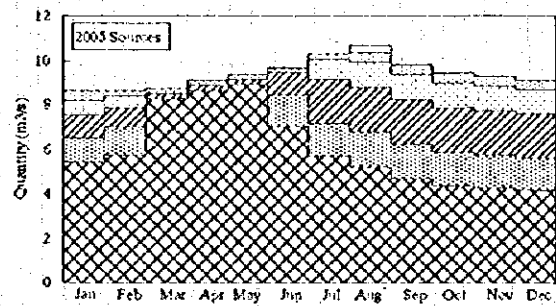
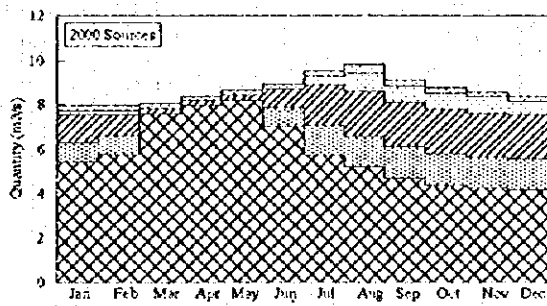
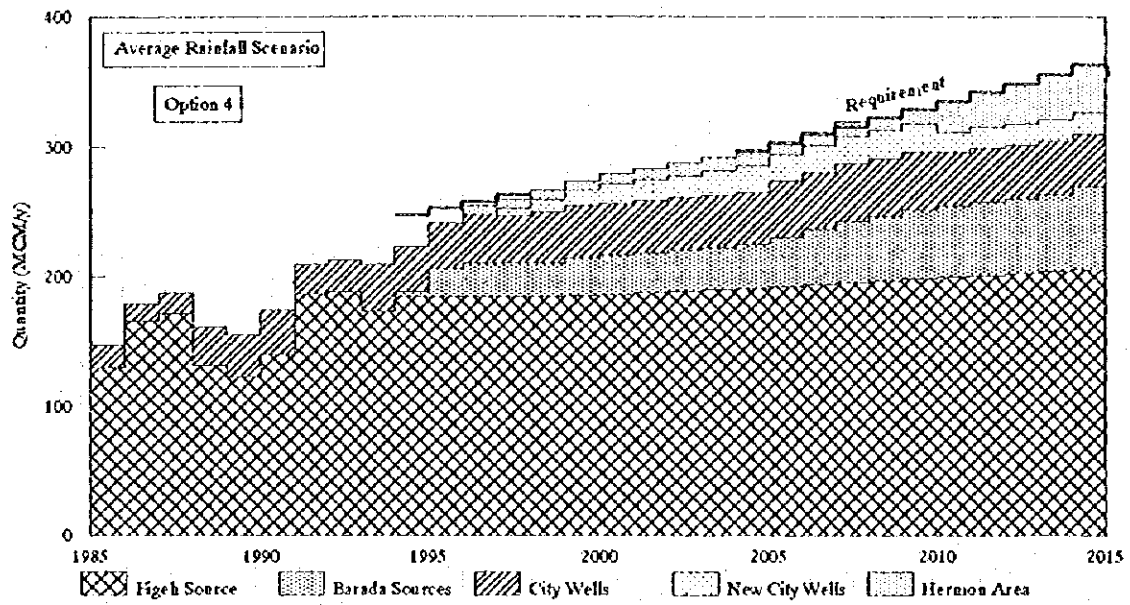

JAPAN INTERNATIONAL COOPERATION AGENCY (JICA)

THE STUDY ON THE DEVELOPMENT OF
WATER SUPPLY SYSTEM FOR THE DAMASCUS CITY

Figure C-8.7
Water Production Plan Option 4, Average

NIPPON KOEI CO., LTD.

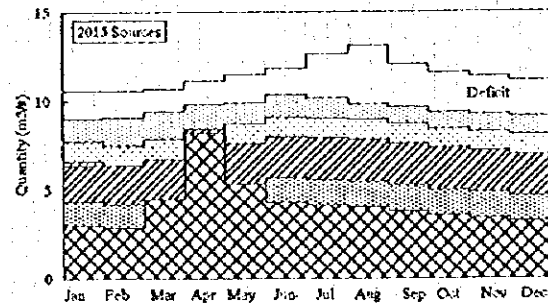
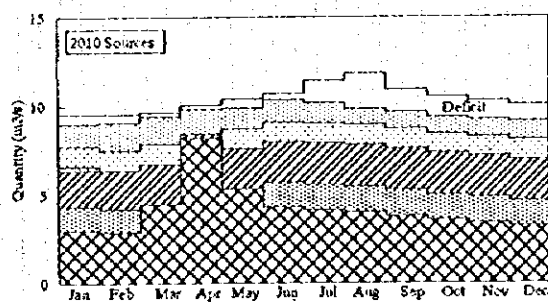
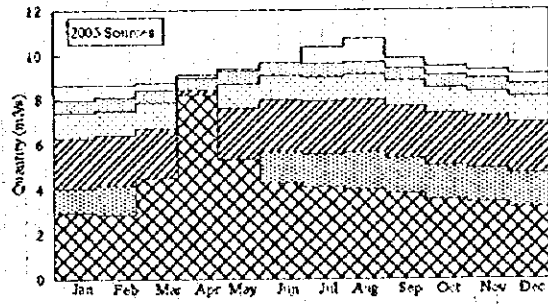
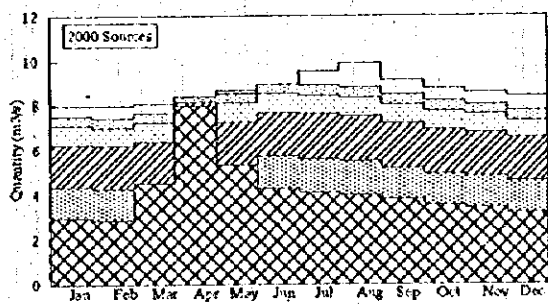
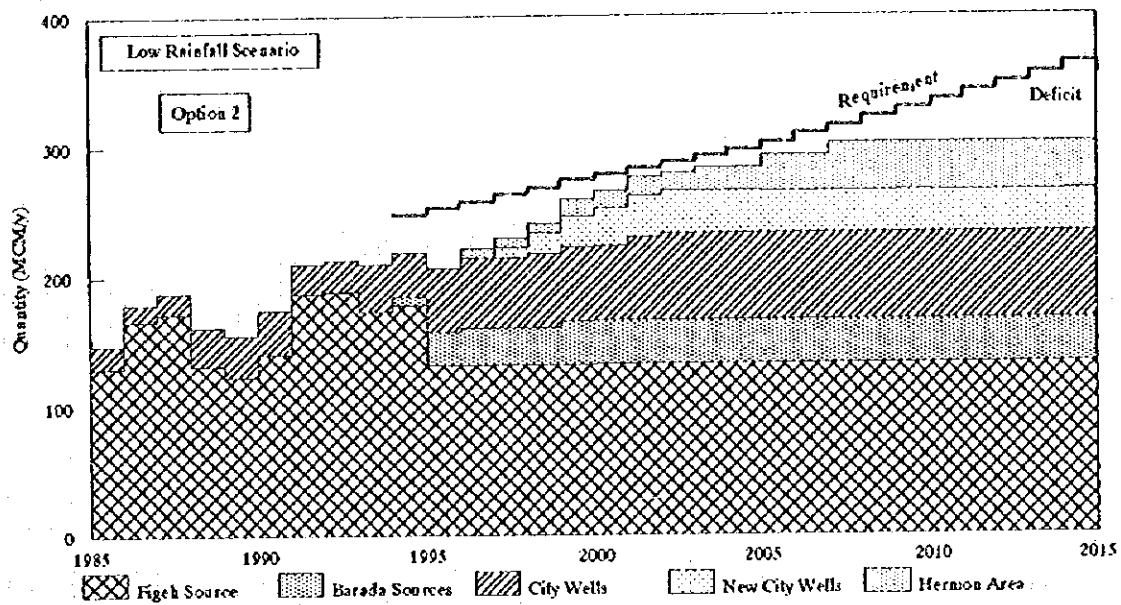

JAPAN INTERNATIONAL COOPERATION AGENCY (JICA)

THE STUDY ON THE DEVELOPMENT OF
WATER SUPPLY SYSTEM FOR THE DAMASCUS CITY

Figure C-8.8
Water Production Plan Option 2. Dry

NIPPON KOEI CO., LTD.

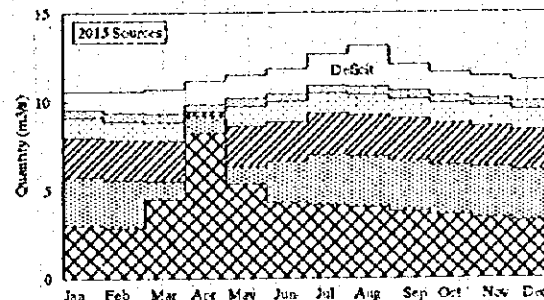
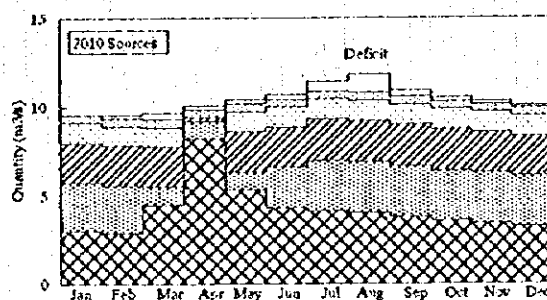
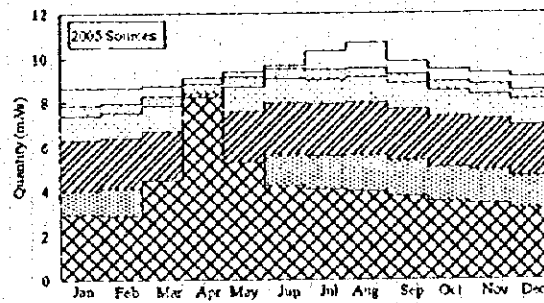
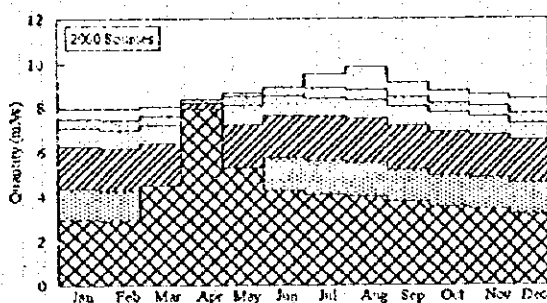
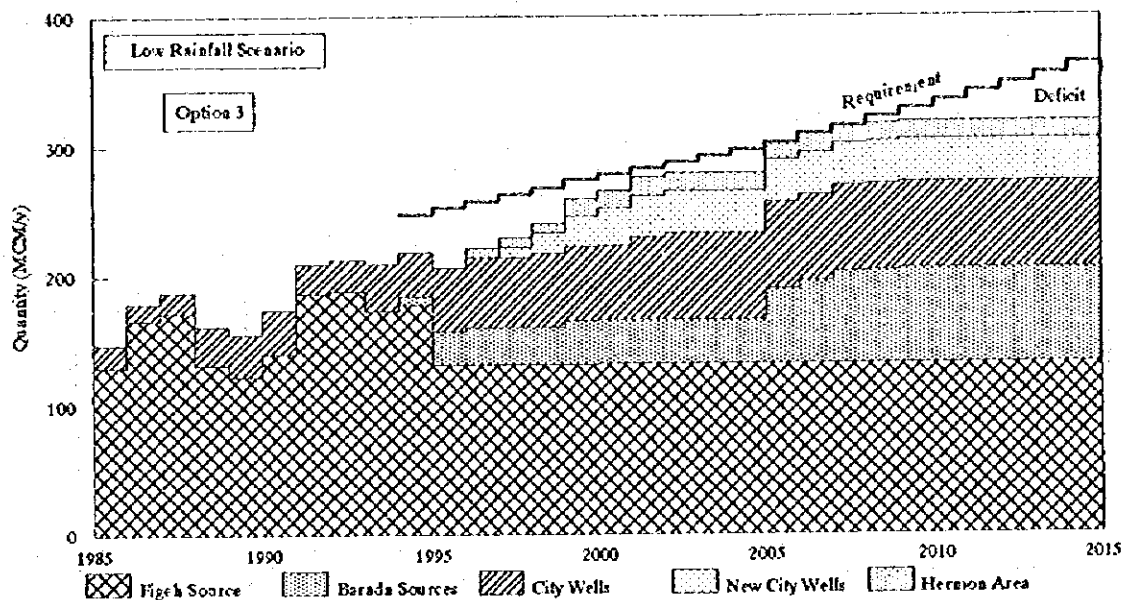

JAPAN INTERNATIONAL COOPERATION AGENCY (JICA)

THE STUDY ON THE DEVELOPMENT OF
WATER SUPPLY SYSTEM FOR THE DAMASCUS CITY

Figure C-8.9
Water Production Plan Option 3, Dry

NIPPON KOEI CO., LTD.

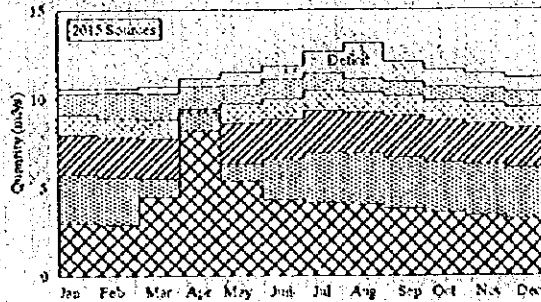
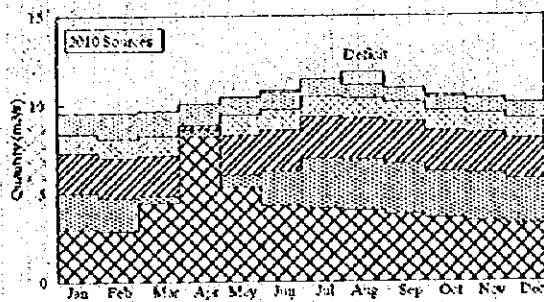
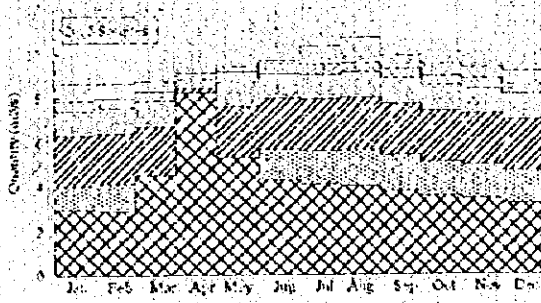
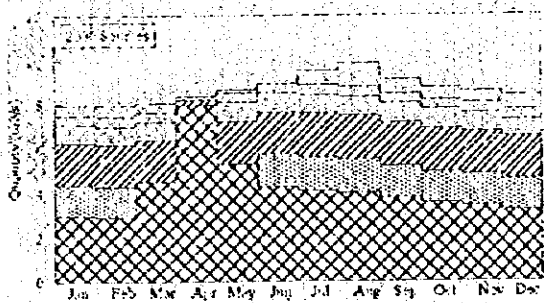
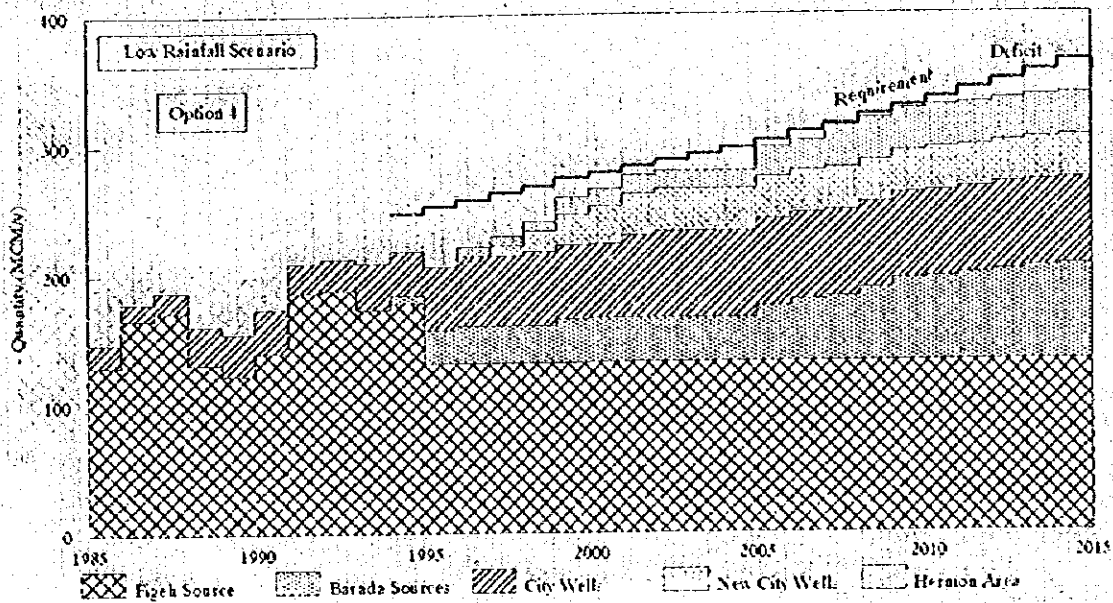

JAPAN INTERNATIONAL COOPERATION AGENCY (JICA)

THE STUDY ON THE DEVELOPMENT OF
WATER SUPPLY SYSTEM FOR THE DAMASCUS CITY

Figure C-8.10
Water Production Plan Option 4, Dry

NIPPON KOEI CO., LTD.





JICA