

6. 建設予定地状況

建設予定地状況

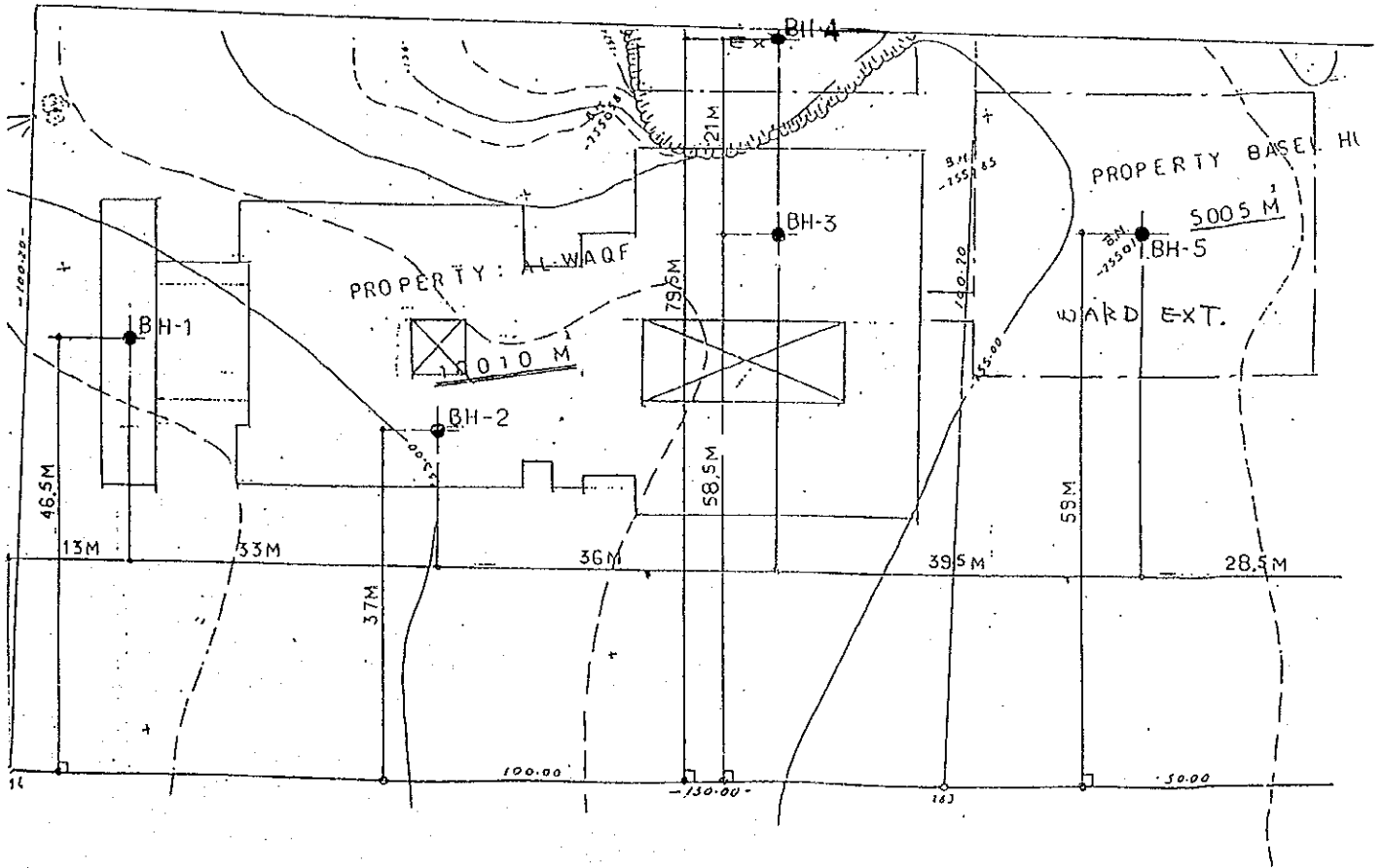

Borehole number: **BH-1**
 Job number: 65095
 Client: KUMI SEKKEI CO.,LTD.
 Co-ords (x,y): 20013.00,30046.50
 G.W. Table [m]: 0.00
 Date started: 27.6.95
 Total depth [m]: 25.00
 Supervised by: DR. WLADIMIR

Project name: NEW JERICHO HOSPITAL
 Site location: AKABAT JABER CAMP
 Vertical scale: 1:200
 Elevation (m): -252.40
 Date: 20.7.95
 Date finished: 02.7.95
 Checked by: ENG.BASIM HAZZAN
 Logged by: NAZAR KHOURY

Type of sampler: PLYETHELIN BAGS
 Remarks: Hard chalk layer appear at a depth of 25.00 m

Type of boring: AUGERING

Page 1

Depth [m]	Recovery	S a m p l e s	DESCRIPTION	S Y M B O L	U S C S	Color	Moisture	Sieving	LAB TESTS		FIELD TESTS		
									W, L, P, (%)	SPT (Blows/0.3m)	Y	Shear (KPa)	
0.00	0		L 655 2										
2.00		LOES	DRY LOES/SILT	CL- -CI		White	L- ow- M- ed- ium	F					
4.00													
6.00													
8.00													
10.00		MARL	WET MARL	CI- -CH		Yellow- Green	M- ed- ium High	F					
12.00													
14.00													
16.00													
18.00													

SPT (Blows/0.3m) $\frac{N}{H}$ Penetration

Atterberg limits $\frac{w_p}{w}$ $\frac{w_l}{w}$

Sieve analysis $\frac{Fines}{F}$ $\frac{Sand}{S}$ $\frac{Gravel}{G}$

Recovery RQD $\frac{L}{L_0}$

Thin-wall tube Cased length Split spoon Rock core Auger Wash OTHER

Legend:
 ■ - Odor
 ◆ - PH
 * - Estetic
 ▼ - Swedish Fall Cone
 □ - Originolity

25.00												
27.00												

Dry Density at 10.00 m depth is 1795 kg/cub m
 Specific gravity (Gs) at 8.0 m is 2.81

Borehole number: **BH-2**
 Job number: 65095
 Client: KUMI SEKKEI CO.,LTD.
 Co-ords (x,y): 20046.00,30037.00
 G.W. Table (m): 0.00
 Date started: 27.6.95
 Total depth (m): 25.00
 Supervised by: DR. WLADIMIR
 TROSTANOVSKY

Project name: NEW JERICHO HOSPITAL
 Site location: AKABAT JABER CAMP
 Vertical scale: 1:200
 Elevation (m): -253.20
 Date: 20.7.95
 Date finished: 02.7.95
 Checked by: ENG.BASIM HAZZAN
 Logged by: NAZAR KHOURY

Type of sampler: PLYETHELIN BAGS
 Remarks: Hard chalk layer appear at a
 depth of 25.00 m

Type of boring: AUGERING

Page 1

Depth [m]	Recovery	S a m p l e s	DESCRIPTION	S Y M B O L	U S C S	Color	Plasticity	Sieving	LAB TESTS		FIELD TESTS	
									W (L, PL) (%)	Shrinkage (%)	SPT (blows/0.3m)	Penetration (mm)
0.00	100											
2.00		LOES	DRY LOES/SILT	CI		White	Medium					
4.00												
6.00												
8.00												
10.00		MARL	WET MARL	CI-CH		Yellow-Green	Medium-High					
12.00												
14.00												
16.00												
18.00												
20.00												
22.00												
25.00												
Dry Density at 10.00 m depth is 1795 kg/cub m Specific gravity (Gs) at 8.0 m is 2.81												

Borehole number: **BH-3**
 Job number: 65095
 Client: KUMI SEKKEI CO.,LTD.
 Co-ords (x,y): 20082.00,30058.50
 G.W. Table (m): 0.00
 Date started: 27.6.95
 Total depth (m): 25.00
 Supervised by: DR. WLADIMIR
 TROSTANOVSKY

Project name: NEW JERICHO HOSPITAL
 Site location: AKABAT JABER CAMP
 Vertical scale: 1:200
 Elevation (m): -254.35
 Date: 20.7.95
 Date finished: 02.7.95
 Checked by: ENG.BASIM HAZZAN
 Logged by: NAZAR KHOURY

Type of sampler: PLYETHELIN BAGS

Type of boring: AUGERING

Remarks: Hard chalk layer appear at a depth of 23.00 m

Page 1

Depth (m)	Recovery	S a m p l e s	DESCRIPTION	S y m b o l	U S C S	Color	Plasticity	Sieving	LAB TESTS		FIELD TESTS								
									W	L	SPT (Blows/0.3m)	Other							
0.00	0																		
2.00		LOES	DRY LOES/SILT	---	Cl	White	M-ed-ium	F			30								
4.00																	10		
6.00																	30		
8.00																	30		
10.00									MARL	WET MARL	---	Cl-CH	Yellow-Green	M-ed-ium High	F			30	
12.00																			
14.00																	30		
16.00																	30		
18.00																			
20.00																			
23.00		CHALK																	

Dry density at a depth of 10.0 m is 1595 kg/cub m
 Specific Gravity at a depth of 9.0 m is 2.80

Borehole number: **BH-4**
 Job number: 65095
 Client: KUMI SEKKEI CO.,LTD.
 Co-ords (x,y): 20082.00,30079.50
 G.W. Table (m): 0.00
 Date started: 27.6.95
 Total depth (m): 17.00
 Supervised by: DR. WLADIMIR
 TROSTANOVSKY

Project name: NEW JERICHO HOSPITAL
 Site location: AKABAT JABER CAMP
 Vertical scale: 1:200
 Elevation (m): -255.06
 Date: 20.7.95
 Date finished: 02.7.95
 Checked by: ENG.BASIM HAZZAN
 Logged by: NAZAR KHOURY

Type of sampler: POLYETHELYN BAGS
 Remarks: Hard chalk layer appear at a depth of 12.00 m
 Type of boring: AUGERING

Page 1

Depth [m]	Recovery	Samples	DESCRIPTION	S Y m b o l s	U S C S	Color	Plasticity	Sieving	LAB TESTS		FIELD TESTS	
									0	100	0	100
0.00	0											
-255.06												
2.00		LOES	DRY LOES/SILT	-	Cl	White	M-ed-ium	F			4	
-257.06	10											
4.00	14											
-259.06	17											
6.00	23											
-261.06	30											
8.00	28											
-263.06	30											
10.00	28	MARL	WET MARL	-	Cl-CH	Yellow-Green	M-ed-ium	F			30	
-265.06	32											
12.00	30											
-267.06	30											
14.00		CHALK		-	CL		L-ow					
-269.06												
17.00												
-272.06												

Dry density at a depth of 9.0 m is 1705 kg/cub m
 Specific Gravity at a depth of 9.0 m is 2.80

Borehole number: **BH-5**
 Job number: 65095
 Client: KUMI SEKKEI CO.,LTD.
 Co-ords (x,y): 20121.50,30059.00
 G.W. Table (m): 0.00
 Date started: 27.6.95
 Total depth (m): 25.00
 Supervised by: DR. WLADIMIR
 TROSTANOVSKY

Project name: NEW JERICO HOSPITAL
 Site location: AKABAT JABER CAMP
 Vertical scale: 1:200
 Elevation (m): -255.01
 Date: 20.7.95
 Date finished: 02.7.95
 Checked by: ENG.BASIM HAZZAN
 Logged by: NAZAR KHOURY

Type of sampler: POLYETHELYN BAGS
 Remarks: Hard chalk layer appear at a depth of 25.00 m

Type of boring: AUGERING

Page 1

Depth [m]	Recovery	S a m p l e s	DESCRIPTION	S y m b o l	U S C S	Color	Plasticity	Sieving	LAB TESTS			FIELD TESTS			
									w, (L, PL) (%)	100	SPT (Blows/0.3m)	1	1	1	
0.00	0														
-255.01			DRY LOES/SILT		Cl	White	M- ed- ium								
2.00															
-257.01															
4.00															
-259.01															
6.00															
-261.01															
8.00															
-263.01															
10.00			WET MARL		Cl- CH	Yellow- Green	M- ed- ium Hi- gh								
-265.01															
12.00															
-267.01															
14.00															
-268.01															
16.00															
-271.01															
18.00															
-273.01															
20.00															
-275.01															
22.00															
-277.01															
25.00															
-280.01															
Specific Gravity at a depth of 9.0 m is 2.71															

7. 既存病院現有機材リスト

既存病院現有機材リスト

主な現有機材と移設検証

機材名	現有台数	機材の現状及び数量				使用年数	製造国	新設機材及び台数 確定機材及び台数 新設病院への移設	備考
		機能良好	問題あるが 使用可能	修理により 使用可能	使用不可				
(一般外来)									
輸液ポンプ	10	10				新品 日本	⑦	中村医科 FP-955	
患者モニター	1	1				新品 日本	①	日本光電 OEC-6102	
電動吸引器	1	1				新品 日本	①	アサヒメデ 103	
内視鏡用診察台	1	1				新品 日本	①	カキヌマ K-1020A	
診断用腹腔鏡	1	1				新品 日本	①	オリンパス A5259 他	
内視鏡セット	1	1				新品 日本	①	オリンパス GIF-XQ 他	
小児監視装置	3	3				新品 アメリカ	①と3次 新へ2台	Air Shields Vickers V1-S	
新生児用人工呼吸器	1	1				新品 日本	①	アコマ医科 ICV-60	
ICU 用保育器	1	1				新品 アメリカ	(3次新へ)	Air Shields Vickers C100QT	
輸液シリンジポンプ	8	8				新品 日本	④	中村医科 SP-60	
ネブライザー	2	2				新品 日本	①	中村医科 U-100	
軟性喉頭ファイバースコープ	2	2				新品 日本	②	オリンパス ENF-L3	
電動吸引器	2	2			6	ドイツ	-	ESCHMANN	
心電計	1	1			7	ドイツ	-	日本光電/MENNEN	
人工呼吸器	1			1	12	アメリカ	-	Bennet	
除細動器	2	2			2	日本/ドイツ	-	日本光電/MENNEN	
オキシメーター	1	1			1	アメリカ	-	BCI	
(産婦人科)									
胎児監視装置	1	1				新品 日本	①	トーイツ MT-430	
婦人科用手術器具セット	2	2				新品 日本	①	中村医科 N-4820	
麻酔器	2	2				新品 日本	①	木村メディカル FANCY-80M	
新生児看護ユニット	2	2				新品 日本	-	中村医科 NIW-3500	
産科用超音波診断装置	1	1				新品 アメリカ	-	GE RT-X200	
医薬冷蔵庫	1	1				新品 日本	-	萱垣医科 ER-100N	
心電計	1			1	12	ドイツ	-	MANNEN	
輸液ポンプ	1			1	10	アメリカ	-	EASYLIFE	
超音波診断装置	1		1		9	日本	-	アロカ	
胎児監視装置	1	1			5	アメリカ	-	COROMETRIC	
胎児心拍検出器	1	1			7	アメリカ	-	ECHOSOUND	
吸引器	1			1	10	ドイツ	-	DEVIBISS	
分娩台	2	2				新品 日本	-	中村医科 GD-2000	
分娩用器械	4	4				新品 日本	②	中村医科 N-4840	
分泌物吸引器	1	1				新品 日本	-	中村医科 GT-200	
分泌物吸引器	1		1		10	ドイツ	-	VACUMAT	
自動血圧測定モニター	1	1				新品 日本	①	コーリン BP-8800	
吸引器	3	3				新品 日本	②	ミズホ MSP-207M	
保育器	2	2				新品 日本	②	中村医科 H-1000D	

機材名	現有台数	機材の現状及び数量				使用年数	製造国	新設機材及び台数 病院への移設	備考
		機能良好	問題あるが 使用可能	修理により 使用可能	使用不可				
ネブライザー	1	1				新品	日本	①	アサヒメディカル 107
光線治療器	2	2				新品	日本	①	中村医科 PT-1600
アプネアアラーム	1	1				新品	日本	①	中村医科 EA-1200
保育器 (検査室)	1		1			5	アメリカ	-	AIR-SHIELDS
生物顕微鏡	2	2				新品	日本	①	ニコン LABOPHOT-2
位相差顕微鏡	1	1				新品	日本	①	ニコン LABOPHOT-2PH
ヘマトクリット遠心器	1	1				新品	日本	①	クボタ 3110
蒸留水製造装置	1	1				新品	日本	①	アドバンテック・トーヨー GS-500
純水製造装置	1	1				新品	日本	①	日本ミリポア M-RX12
オートクレーブ	1	1				新品	日本	①	アサヒメディカル 320-A
遠心器, 6000rpm	2	2				新品	日本	②	クボタ 5100
紫外/可視線分光光度計	1	1				新品	日本	①	日立 U-1100
血液ガス分析装置	1	1				新品	アメリカ	①	AVL AVL-995HB
電解質分析装置	1	1				新品	アメリカ	①	AVL AVL-988-3
電気泳動装置	1	1				新品	日本	①	常光 CTE-1000
培養器(孵卵器)	1	1				新品	日本	①	萱垣医科 KFF-35PM
血液振盪器	1	1				新品	日本	①	タイテック BR-30LF
自動血球カウンター	1	1				新品	日本	(3次競入)	東亜医用電子 F-820
自動化学分析装置	1	1				新品	アメリカ	(3次競入)	チバ・コーニング EXPRESS PLUS
マイクロレトリダ-	1	1				新品	日本	①	コロナ電子 MTP-120
遠心機、3000rpm	2		2			7	ドイツ	-	HERMLE Z-320
生物顕微鏡	1		1			10	日本	-	オリンパス CH-2
分光光度計	1	1				7	ドイツ	-	LKB/NOVASPEL
分光光度計	1		1			6	スウェーデン	-	PHARMASIA
炎光光度計	1		1			7	アメリカ	-	Corning 410C
希釈器	1		1			7	アメリカ	-	Corning 805
薬用冷蔵庫 (血液銀行)	1	1				7	アメリカ	-	Forma Scientific
血液振盪器	1	1				新品	日本	①	タイテック BR-30LF
血液バッグシーラー	1	1				新品	日本	①	テルモ ME-AC157
血液用冷蔵庫	1	1				新品	日本	①	加藤万 UB5000
血しょう用フリーザー	1	1				新品	日本	①	日本フリーザー SC-20
献血者用椅子 (放射線室)	1	1				新品	日本	①	パラマウント KD-H23
回診型X線撮影装置	1	1				新品	日本	-	アコマX線工業 MBA-200
ブッキーテーブル	1	1				新品	日本	-	大林製作所
超音波診断装置	1	1				新品	アメリカ	①	GE RT-X200
自動現像機	1	1				新品	日本	-	西本産業 S-90PLUS

機材名	現 有 台 数	機材の現状及び数量				使 用 年 数	製 造 国	新 設 病 院 へ の 移 設	確 定 機 材 及 び 台 数	備 考
		機 能 良 好	問 題 あ る が 使 用 可 能	修 理 に よ り 使 用 可 能	使 用 不 可					
(手術室)										
手術台	2	2				新品	日本	②	村中医療 OL-202P	
无影灯(天井灯)	1	1				新品	日本	-	山田照明 U63AF-60	
麻酔器	2	2				新品	日本	②	アコマ医科 KMA-1300F	
心拍数監視装置	2	2				新品	日本	①	日本光電 BSM-2101K	
除細動器	2	2				新品	日本	①	日本光電 TEC-4150K	
電気メス	4	4				新品	日本	②	オリンパス UES-10-220	
電動吸引器	1	1				新品	日本	①	ミズホ MSP-205	
手術用腹腔鏡セット	1	1				新品	日本	①	ミズホ 09-225/226	
小手術用器械一式	10	10				新品	日本	⑥	高砂医科	
患者移動ストレッチャー	4	4				新品	日本	③	村中医療 SR-650	
人工呼吸器	2	2				新品	スイス	①と (3次競入)	HAMILTON "VEOLAR"	
電気メス	1	1			10		アメリカ	-	VELLEY Lab SSE-2L	
手術台	2		2		7		ドイツ	-	SHWITZ	
麻酔器	2	2			4		アメリカ	-	BOC International	
患者監視装置	1	1			3		ドイツ	-	MENNEN H-1000	
(理学療法室)										
短波治療器	1	1				新品	オランダ	①	Dineq Brunssum C-419	
電気刺激装置	1	1				新品	日本	①	OG技研 EF-502	
マッサージ器	1	1				新品	日本	①	OG技研 CX-ST	
赤外線治療器	1	1				新品	日本	①	OG技研 EL-100	
超音波治療器	1	1				新品	日本	①	OG技研 ES-1	
(鑑安室)										
死体冷蔵庫	1				7		ドイツ	-	SGNUTZ	
(薬局)										
薬品用冷蔵庫	1	1				新品	日本	①	加藤万製作所 C-4009	

8. 自己負担医療費リスト

自己負担医療費リスト

Palestinian National Authority

Ministry of Health

Technical office - Nablus

Tel - 09-384775 - 384776

Fax - 09-384777

- a- Day care services are to be eliminated as there are no units in the Hospitals to handle such services.
- b-1- All costs incurred for surgical preparations should be redeemed in full from uninsured patients.
- 2- One In-hospital day for expecting mothers in maternity ward 100 NIS
for uninsured Patient also pays for all drugs use (Attached is a drug list).
- 3- In-Patient days for tourists 2768 NIS
Visitors of Palestinian Origin - who do not hold a West Bank I.D. card will be treated as a native Palestinian and when he / she use health services, he / she pays similar fees, However he / she is not eligible to participate in the health Insurance Plan.
- 4- Treatment in the ICU 450 NIS
- 5- One in-patient day in psychiatric hospital for non-residents 146 NIS
- 6- One in-patient day in psychiatric hospital for tourists 658 NIS
- 7- One in-patient day for kidney patients non-residents 951 NIS
- 8- Each in-patient day for car accidents 960 NIS
- 9- Medical Reports
- a- 1st report Free
- b- Each additional medical report for Insured persons 15 NIS
- c- Each additional Medical report for uninsured 30 NIS
- d- Medical report for car accidents 170 NIS
- 10- Copy of an entire medical file 500 NIS
This however is subject to an official letter of approval from the legal department of the ministry to the relevant department in the hospital allowing this copy.
- 11- Medications
- a- Medications for insured persons 3 NIS
- B- Medications for uninsured Per cost
- All prescription drugs from MOH facilities are issued to insured persons only.
All prescription drugs for children under 3 is free.

12- X-ray	
a- Normal X-ray (each)	25 NIS
b- Radiology test with contrast material	100 NIS
c- Security Deposit for X-ray	50 NIS
d- Radiology report	Free
e- CT scan	400 NIS
f- Ultrasound	345 NIS
13- Laboratory test (For each test on the form)	25 NIS
14- Blood Bank	
a- 100 ML - Unit of Blood	50 NIS
b- 500 ML - Unit of Blood	50 NIS
c- Blood test	50 NIS
15- Ambulance	
a- Within the municipality	54 NIS
b- Outside the municipality per <i>KM</i>	2 NIS
Rates for ambulance services for insured and un-insured is the same.	
16- Vaccination	
a- For travel abroad (insured and un-insured)	100 NIS
b- For Naj (insured and un-insured)	20 NIS
17- Cancer	
a- Chemotherapy	Per cost
18- Physical therapy	
a- Physical Therapy treatment	—
19- E-E-G-	50 NIS
20- Clinic visit	
a- Dr. treatment in outpatient <i>department</i>	10 NIS
b- Nurse treatment in OP clinic	10 NIS

21- Hospital visit	20 NIS
a- Treatment by Dr. in Hospital OP clinic	
b- Treatment by nurse in Hospital OP clinic	10 NIS
c- ECG in Hospital OP clinic	30 NIS
d- Treadmill test - (OP)	150 NIS
e- Echocardiography (OP)	150 NIS
f- Respiratory function test (OP)	150 NIS
g- Bronchoscopy (OP)	300 NIS
h- Gastroscopy (OP)	300 NIS
i- Colonoscopy (OP)	600 NIS
j- Laparrosopy (OP)	400 NIS

22- Emergency room treatment 50 NIS

23- Driving tests	
a- 1st test	194 NIS
b- 2nd test	194 NIS
c- Review committee for drivers	294 NIS
d- Drivers test in health clinics	100 NIS

Free Health Services

- a- Treatment of contagious diseases and epidemics - in accordance with the list of diseases as issued by the MOH.
- b- MCH clinics.
- c- All public health tests at the request of the MOH.
- d- All school tests by public school health.
- e- Oncology diagnosis.
- f- Children under 3.
- g- Army casualties.
- h- Emergency care for school children during school hours.
- i- Referral cases to medical committees from other government depts. for diagnosis.

- j- Health Insurance ^{AS}
- | | |
|--|---------|
| 1- Voluntary health insurance premiums NIS -monthly | 111 NIS |
| 2- Students 18-21 Yr. | 20 NIS |
| Students 21-30 Yr. | 40 NIS |
- 3- All referral cases from Intifada casualty association.
- a- Free medical treatment in health clinics - No. medications, however the association should secure cost of drugs from outside sources.
 - b- For Hospitalizations, members must secure a written order from the referral section of the ministry.
 - Hospitalizations for newly insured's is effective 30 days from day of joining the health insurance plan.
 - Referrals to health facilities outside the governmental health facilities is effective 4 months from the date of issuance - for all kinds of insurance.

Deputy Health Ministry
Dr. Husam Abdulhadi

Circular

Subject - Fees for health services

I am pleased to inform you that as of 18-2-95 fees for health services will be as follows

<u>Hospitalizations</u>	<u>NIS</u>
1- One day for uninsured if the health insurance is not valid	300
a- Minor operations	200
b- Medium type operations	400
c- Major surgeries	600
e- Cataract extraction and infra ocular lens implant- for insured	450
f- Cataract extraction and -intra- ocular lens implant -for uninsured	900

9. 医療施設モニター項目(Rapid Assessment用)

1. Basic Philosophy
 - Whether or not there is basic philosophy.
 - To what extent the basic philosophy has filtered into the hospital staffers.
 - Conformity of the basic philosophy to the actual situation.

2. Conformity of the Facilities
 - 2-1) Conformity of the hospital facilities to regional medical activities
 - To use patient statistics to determine the regional coverage of the medical services provided.
 - No. of patients by residential area and by type of illness
 - Investigate the scale of hospital wards and the medical departments covered by medical institutions in the region.

3. Diagnosis/Treatment Functions
 - 3-1) Medical Departments in which Diagnosis/Treatment is Provided.
 - a) Summary of activities (by month, for the past five years)
 - No. of physicians by specialty (by medical department)
 - No. of patient beds
 - Bed occupancy ratio
 - No. of inpatients (by medical department)
 - No. of outpatients (by medical department)
 - b) Quality of the activities
 - No. of Medical departments in which diagnosis and treatment is provided.
 - Special outpatient clinic
 - Emergency aid system
 - Whether or not the system of treatment by medical terms is adopted.
 - Whether or not conferences are held regularly.
 - Whether or not the hospital accepts interns.
 - Whether or not the hospital collaborates with other medical institutions.

3-2) Nursing Department

- No. of nurses (by medical department)
- Ratio of registered nurses vs. practical nurses
- Nursing system
- Average night duty days per month (average)
- System for education/training
- Time study on the work hours of nurses
- Whether or not medical clerks are allocated.
- System for delivering goods and supplies

3-3) Pharmaceutical Department

- Whether or not guidance is given on the taking of medicine.
- Whether or not the patients' history of taking medicine can be traced.
- Whether or not the system of administering medicines to inpatients through a unified channel is adopted.
- Waiting time of outpatients (average)
- Inventory system
- Establishment of a standard optimum stock
- Number of medicine items available
- Whether or not the medicines readily available in patient wards undergo regular inspection. If you have any, please show the contents.

3-4) Inspection Department

- No. of inspection items that can be carried out.
- No. of inspection specialists
- Whether or not the inspection systems are computerized. If they are computerized, please show the contents.
- Whether or not subcontractors are used.
- Whether or not the hospital carries out inspections commissioned by other hospitals. If so, please show the contents.

3-5) Radiology Department

- Contents and types of equipment
- No. of radiology specialists
- Conditions of protection measures

3-6) Meal Service Department

- No. of nutritionists
- Whether or not meals are adequately heated and served at adequate timings.
- How long is the menu cycle.
- How are the ingredients for meals preserved (place of storage, how many days' supply)

3-7) Operation Department

- No. of operation rooms and their main usage
- Whether each operation room is used exclusively for a particular department, or is used on a shared basis
- No. of operations by operation methodology
- Securing of anesthetists
- Cleanliness of the operation rooms
- Whether or not the operation schedule is managed smoothly

3-8) Material and Equipment Department

- Range and volume of the activities (per day, per month)
 - Medical equipment and materials
 - Sterilization equipment and materials
 - Sanitary equipment and materials
 - General equipment and materials
- No. of staffers
- Type and quantity of equipment
- Degree and rang of cleanliness management
- Delivery method

3-9) Others

- Whether or not the hospital has rehabilitation facilities.
- Whether or not the hospital has a visiting nurses' room.
- Whether or not the hospital adopts countermeasures against nosocomial (in-hospital) infection (if yes, the specific measures adopted).
- Management of the patients' the medical histories

- 3-10) Conformity of the hospital facilities to regional medical activities
- No. of patients consulted per physician per day (for inpatients, and for outpatients)
 - No. of medicines prepared Pharmaceutical Department staffer per day
 - No. of inspections carried out per inspection specialist per day
 - No. of radiological inspections carried out per radiology specialist per day
 - No. of meals prepared per Meal Service Department staffer per day

4. Balance of Accounts

- Income
 - Government subsidy
 - Income from pay beds
 - Income from advanced medical treatment (Heart survey, X-ray diagnosis, etc.)
 - Income from high level services (ICU, paid-basis rehabilitation care, etc.)
- Costs
 - Personnel costs
 - Equipment/material costs
 - For medicine
 - For medical equipment
 - For preparing meals
 - Expenses
 - Infrastructure (power and water supply)
 - Maintenance costs
 - Expendable supplies

5. Financial Data

- Balance Sheet

6. Services Provided to Patients

- Whether or not amenities are provided for the hospital facilities
- Degree of patient satisfaction

7. Management and Maintenance

- Organization of the hospital
- Personnel Management
- System of maintenance

8. Workplace Environment

- Whether or not dormitories for staffers are provided.
- Whether or not day nurseries for staffers are provided.
- Whether or not welfare facilities are provided.
- Whether or not a system of lending uniforms to staffers is adopted.
- Whether or not regular health checkups are carried out on staffers.
- Working hours
- To confirm whether good communication is maintained between the management and the labor by focusing on the following two points :
 - Whether or not the hospital has an in-house public relations journal.
 - Whether or not there are activities hosted by the hospital

9. Facilities and Buildings

- Perception based on external appearance (confirm the image of the hospital by visually inspecting the damages and soils on the exteriors of the hospital facilities)
- Perception based on the appearance of interiors (confirm the image of the hospital by visually inspecting the damages and soils on the exteriors of the hospital facilities)
- Sense of cleanliness
- History of the building and facilities
- Structure
- The period of durability (Physical)
- Availability of vertical transport systems
- Air-conditioning systems
- Electrical systems
- Plumbing and sanitary systems
- Existing problems

10. Machines and Devices

- Medical machines and devices (steam sterilizer, gas sterilizer, etc.)
- Future plans to renew the machines and devices.

JICA