

7 ANALYSE FINANCIERE

REPARTITION DES EQUIPEMENTS MEDICAUX ET FRAIS DE GESTION ET D'ENTRETIEN DU PROJET

No DE REQUETE	No DE PROJET	NBRE REQUIS	NOM D'EQUIPEMENT	NOM DES PIECES DE RECHANGE ET DES CONSOMMABLES	PRIX UNITAIRE	NOMBRE D'UNITES A UTILISER POUR UN AN	COUT DE CONSOMMABLE POUR UN AN	COUT DE CONSOMMABLES POUR UN AN (TOTAL)
A 1	A 1	4	POUSSE SERINGUE ELECTRIQUE	SERINGUE A USAGE UNIQUE	¥26	150	¥3,900	¥15,600
A 21	A 13	1	ELECTROCARDIOGRAPHE	PAPIER D'ENREGISTREMENT	¥900	10	¥9,000	¥9,000
B 2	B 2	1	SCIALYTIQS. LUMIERE D'OPERATION MAJEURE	AMPOULE HALOGENE	¥2,000	1	¥2,000	¥2,000
B 4	B 4	2	BISTOURI ELECTRIQUE	ELECTRODE POUR PATIENT	¥1,420	6	¥8,520	¥17,040
B 7	B 7	1	SYSTEME T.V. A RAYONS X CHIRURGICAL	FILM RADIOGRAPHIQUE	¥400	550	¥220,000	¥220,000
D 21	D 19	1	SCIALYTIQUE	CHANGEMENT DE TUBE A RAYONS X /5 ANS	¥300,000	1	¥300,000	¥300,000
D 22	D 20	1	LAMPE SUR PIED	AMPOULE HALOGENE	¥2,000	1	¥2,000	¥2,000
E 1	E 1	2	APPAREIL D'ANESTHESIE	AMPOULE HALOGENE	¥3,500	1	¥3,500	¥3,500
F 1	F 1	4	POUSSE SERINGUE ELECTRIQUE	FILTRE BACTERIOLOGIQUE, CIRCUIT PATIENT	¥23,400	5	¥117,000	¥234,000
H 19	H 12	1	CHAUFFE-BEBE	SERINGUE A USAGE UNIQUE	¥3,880	1	¥3,880	¥3,880
H 21	H 14	3	UNITE DE PHOTOTHERAPIE	MATELAS	¥1,120	10	¥11,200	¥33,600
L 9	L 2	1	UNITE MOBILE DE RADIOLOGIE	LAMPE FLUORESCENTE	¥400	1300	¥520,000	¥520,000
L 13	L 4	1	PANORAMIQUE DENTAIRE	FILM RADIOGRAPHIQUE	¥350	950	¥332,500	¥332,500
L 35	L 23	1	LAMPE SUR PIED	FILM RADIOGRAPHIQUE	¥3,500	1	¥3,500	¥3,500
M 40	M 26	1	ANALYSEUR D'ELECTROLYTES	AMPOULE HALOGENE	¥32,000	15	¥480,000	¥480,000
M 41	M 27	1	AUTOMATE HEMATOLOGIE	JEU DE REACTIFS	¥260,000	1	¥260,000	¥260,000
M 42	M 28	1	JEU D'ANALYSE SERIQUE	JEU DE REACTIFS	¥42,000	8	¥336,000	¥336,000
M 43	M 29	1	AUTOMATE HEMATOLOGIE	JEU DE REACTIFS DE MICRODIFF	¥19,800	10	¥198,000	¥198,000
O 11	O 8	1	CAMIONNETTE	ESSENCE	15km/JOURS	3600km	¥72,000	¥72,000
P 8	P 6	1	NEGATOSCOPE	LAMPE FLUORESCENTE	¥150	2	¥300	¥300
P 10	P 7	1	SCIALYTIQUE	AMPOULE HALOGENE	¥2,700	1	¥2,700	¥2,700
TOTAL							¥2,889,900	¥3,061,220

HYPOTHESE 1

(EN CAS DE MAINTIEN DU RECOURVEMENT DES COÛTS AU NIVEAU ACTUEL)

2.7% 1.027
 5.0% 1.05
 (SITUATION ACTUELLE)

DEPENSES	AVANT L'EXECUTION DU PROJET										APRES L'EXECUTION DU PROJET				
	1993	INDICE	1996	1997	1998	1999	2000	2001	2002	2003	2004	2005			
FRAIS DE PERSONNEL	124,482,456	INDEXE	130,706,579	137,241,908	144,104,003	151,309,203	158,874,663	166,818,397	175,159,316	183,917,292	193,113,146	202,768,804			
FRAIS D'ACHAT DES MEDICAMENTS	12,500,000	PATIENTS. PRIX	13,479,375	14,535,484	15,674,339	16,902,424	18,226,729	19,654,793	21,194,746	22,855,354	24,646,071	26,577,091			
FRAIS D'ACHAT DES REACTIFS ET DES CONSOMMABLES POUR EXAMEN	24,315,000	PATIENTS. PRIX	26,220,080	28,274,424	30,489,725	32,878,595	35,454,632	38,232,503	41,228,019	44,458,235	47,941,538	51,697,757			
FRAIS D'ACHAT DES MATERIAUX DE SOIN	2,000,000	PATIENTS. PRIX	2,156,700	2,325,677	2,507,894	2,704,388	2,916,277	3,144,767	3,391,159	3,656,857	3,943,371	4,252,335			
FRAIS DE GESTION ET D'ENTRETIEN DES INSTALLATIONS, DES RAUPIEDS ETC.	1,500,000	PRIX	1,575,000	1,653,750	1,736,437	1,823,259	1,914,422	2,010,143	2,110,651	2,216,189	2,326,992	2,443,342			
FRAIS DE L'ELECTRICITE ET DES EAUX	28,800,000	PRIX	30,240,000	31,752,000	33,339,600	35,006,580	36,756,909	38,594,754	40,524,492	42,550,717	44,678,253	46,912,165			
FRAIS DU CARBURANT DES VEHICULES	8,299,200	PRIX	8,714,160	9,149,868	9,607,361	10,087,729	10,592,116	11,121,722	11,677,808	12,261,698	12,874,783	13,518,522			
FRAIS DE GESTION ET D'ENTRETIEN DE LA SOURCE ELECTRIQUE DE SECOURS	1,200,000	PRIX	1,260,000	1,323,000	1,389,150	1,458,608	1,531,538	1,608,115	1,688,521	1,772,947	1,861,594	1,954,674			
FRAIS D'ADMINISTRATION GENERAUX	2,500,000	AUGMENTATION DU NOMBRE DE PATIENTS	2,567,500	2,636,823	2,708,017	2,781,133	2,856,224	2,933,342	3,012,542	3,093,681	3,177,415	3,263,206			
GESTION ET ENTRETIEN DES EQUIPEMENTS MEDICAUX DU PROJET	205,596,656	PATIENTS. PRIX	228,919,394	241,833,133	255,510,592	269,999,284	285,349,837	301,616,195	318,855,855	337,130,109	356,504,304	377,048,123			
DEPENSES TOTALES															

RECETTES	AVANT L'EXECUTION DU PROJET										APRES L'EXECUTION DU PROJET				
	1993	INDICE	1996	1997	1998	1999	2000	2001	2002	2003	2004	2005			
ANALYSE ET EXAMEN	17,205,000	AUGMENTATION DU NOMBRE DE PATIENTS	17,669,535	18,146,612	18,636,571	19,139,758	19,656,532	20,187,258	20,732,314	21,292,087	21,866,973	22,457,381			
RADIOLOGIE	8,372,000	AUGMENTATION DU NOMBRE DE PATIENTS	8,930,044	9,498,191	10,076,606	10,665,459	11,265,322	11,876,707	12,499,122	13,133,177	13,777,462	14,432,487			
ENDEMOLOGIE	6,059,000	AUGMENTATION DU NOMBRE DE PATIENTS	6,222,598	6,390,603	6,563,149	6,740,354	6,922,344	7,109,247	7,301,197	7,498,329	7,700,784	7,908,705			
GENEVOLOGIE	363,000	AUGMENTATION DU NOMBRE DE PATIENTS	372,801	382,867	393,204	403,821	414,724	425,921	437,421	449,231	461,361	473,817			
OPERATION	2,699,000	AUGMENTATION DU NOMBRE DE PATIENTS	2,765,711	2,840,395	2,917,076	2,995,837	3,076,724	3,159,796	3,245,110	3,332,728	3,422,712	3,515,125			
DETAIRES	2,116,500	AUGMENTATION DU NOMBRE DE PATIENTS	2,173,646	2,232,334	2,292,607	2,354,507	2,418,079	2,483,367	2,550,418	2,619,279	2,690,000	2,762,630			
ECG	46,000	AUGMENTATION DU NOMBRE DE PATIENTS	47,242	48,518	49,828	51,173	52,555	53,973	55,431	56,927	58,464	60,043			
TOTAL PARTIEL	36,854,500		37,849,572	38,871,510	39,921,041	40,996,909	42,105,879	43,242,738	44,410,292	45,609,370	46,840,823	48,105,525			
RECETTES REALISEES PAR LE RECOURVEMENT DES COÛTS APRES EXECUTION DU PROJET															
ANALYSE ET EXAMEN		AUGMENTATION DE CAS	7,067,814	7,258,645	7,454,628	7,655,903	7,862,613	8,074,903	8,292,926	8,516,835	8,746,789	8,982,953			
RADIOLOGIE		AUGMENTATION DE CAS	3,719,609	3,866,038	4,013,721	4,162,692	4,312,984	4,464,635	4,617,680	4,772,158	4,927,106	5,082,565			
ENDEMOLOGIE		AUGMENTATION DE CAS	4,355,815	4,473,422	4,594,205	4,718,248	4,845,641	4,976,473	5,110,838	5,248,830	5,390,549	5,536,094			
GENEVOLOGIE		AUGMENTATION DE CAS	74,560	76,573	78,641	80,764	82,945	85,184	87,484	89,846	92,272	94,763			
OPERATION		AUGMENTATION DE CAS	1,362,856	1,420,193	1,480,538	1,542,918	1,607,362	1,673,884	1,742,509	1,813,244	1,886,094	1,961,155			
DETAIRES		AUGMENTATION DE CAS	1,086,823	1,116,167	1,146,303	1,177,254	1,209,040	1,241,684	1,275,209	1,309,640	1,345,090	1,381,615			
ECG		AUGMENTATION DE CAS	37,794	38,814	39,862	40,938	42,044	43,179	44,345	45,542	46,772	48,034			
TOTAL PARTIEL (APRES PROJET)			15,725,270	16,149,852	16,585,898	17,033,718	17,493,628	17,965,956	18,451,037	18,949,215	19,460,843	19,985,286			
RECETTES TOTALES	36,854,500		53,574,841	55,021,362	56,506,939	58,032,626	59,599,507	61,208,694	62,861,329	64,558,585	66,301,666	68,091,811			

RECETTES ET DEPENSES	AVANT L'EXECUTION DU PROJET										APRES L'EXECUTION DU PROJET				
	1993	INDICE	1996	1997	1998	1999	2000	2001	2002	2003	2004	2005			
RECETTES GLOBALES (a)	205,596,656		228,919,394	241,833,133	255,510,592	269,999,284	285,349,837	301,616,195	318,855,855	337,130,109	356,504,304	377,048,123			
RECETTES GLOBALES (b)	36,854,500		53,574,841	55,021,362	56,506,939	58,032,626	59,599,507	61,208,694	62,861,329	64,558,585	66,301,666	68,091,811			
(b)-(a)	-168,742,156		-175,344,553	-186,811,771	-199,003,653	-211,966,658	-225,750,329	-240,407,501	-255,994,527	-272,571,525	-290,202,637	-308,956,312			

HYPOTHESE 2

(LES PRIX DE SOIN ACTUELS SERONT MAJORES DE 10% TOUTS LES 3 ANS.)

2. 7%
 5. 0%
 NOMBRE DE PATIENTS
 TAUX D'AJUSTEMENT DES PRIX
 MAJORATION DES PRIX DE SOIN TOUTS LES 3 ANS (DECI COMMENCERA EN 1997)
 FRAIS DES SERVICES MEDICAUX

	APRES L'EXECUTION DU PROJET										UNITE : FC	
	1993	1996	1997	1998	1999	2000	2001	2002	2003	2004		2005
DEPENSES												
FRAIS DE PERSONNEL	124.482.456	130.706.579	137.241.908	144.104.003	151.309.203	158.874.663	166.818.397	175.159.316	183.917.282	193.113.146	202.768.804	
FRAIS D'ACHAT DES MEDICAMENTS	12.500.000	13.479.375	14.535.434	15.674.339	16.902.424	18.226.729	19.654.793	21.194.745	22.855.354	24.646.071	26.577.091	
FRAIS D'ACHAT DES REACTIFS ET DES CONSOMMABLES POUR EXAMEN	24.315.000	26.220.080	28.274.424	30.489.725	32.875.595	35.454.632	38.232.503	41.228.019	44.458.285	47.941.538	51.697.757	
FRAIS D'ACHAT DES MATERIAUX DE SOIN	2.000.000	2.156.700	2.325.677	2.507.894	2.704.388	2.916.277	3.144.767	3.391.159	3.656.857	3.943.371	4.252.335	
FRAIS D'ENTRETIEN ET D'ENTRETIEN DES INSTALLATIONS, DES EQUIPEMENTS ETC.	1.500.000	1.575.000	1.653.750	1.736.437	1.823.259	1.914.422	2.010.143	2.110.651	2.216.183	2.326.992	2.443.342	
FRAIS DE L'ELECTRICITE ET DES EAUX	28.800.000	30.240.000	31.752.000	33.339.600	35.006.580	36.756.909	38.594.754	40.524.492	42.550.717	44.678.253	46.912.165	
FRAIS DU CARBURANT DES VEHICULES	8.299.200	8.714.160	9.149.868	9.607.361	10.087.729	10.592.116	11.121.722	11.677.806	12.261.698	12.874.783	13.518.522	
FRAIS DE GESTION ET D'ENTRETIEN DE LA SOURCES ELECTRIQUE DE SECOURS	1.200.000	1.260.000	1.323.000	1.389.150	1.458.608	1.531.538	1.608.115	1.688.521	1.772.947	1.861.594	1.954.674	
FRAIS D'ADMINISTRATION GENERAUX	2.500.000	2.567.500	2.636.823	2.708.017	2.781.193	2.856.224	2.933.342	3.012.542	3.093.881	3.177.415	3.263.206	
ESTIMATION D'ENTRETIEN DES EQUIPEMENTS MEDICAUX DU PROJET		12.000.000	12.940.200	13.954.065	15.047.366	16.226.327	17.497.659	18.868.601	20.346.956	21.941.140	23.660.228	
DEPENSES TOTALES	205.596.656	228.919.394	241.833.133	255.510.592	269.999.284	285.349.837	301.616.195	318.855.855	337.130.109	356.504.304	377.048.123	

	APRES L'EXECUTION DU PROJET										UNITE : FC
	1993	1996	1997	1998	1999	2000	2001	2002	2003	2004	
RECETTES											
彩券收入											
ANALYSE ET EXAMEN	17.205.000	17.669.535	19.961.274	20.500.228	21.053.734	23.784.404	24.426.582	25.086.100	28.239.767	29.104.941	29.890.775
RADIOLOGIE	8.372.000	8.598.044	9.713.210	9.975.487	10.244.805	11.573.556	11.886.042	12.206.965	13.790.203	14.162.544	14.544.933
ECHEMOGRAPHIE	6.059.000	6.222.583	7.029.663	7.219.464	7.414.390	8.376.036	8.602.189	8.834.448	9.980.276	10.249.744	10.526.487
SYNEOLOGIE	363.000	372.801	421.153	432.524	444.203	501.816	515.365	529.280	597.927	614.071	630.651
OPERATION	2.693.000	2.765.711	3.124.424	3.208.783	3.295.420	3.722.836	3.823.353	3.926.583	4.435.861	4.555.630	4.678.632
DENTAIRES	2.116.500	2.173.646	2.455.567	2.521.868	2.589.958	2.925.876	3.004.874	3.086.006	3.486.261	3.580.390	3.677.060
ECS	46.000	47.242	53.369	54.810	56.290	63.591	65.308	67.071	75.770	77.816	79.917
TOTAL PARTIEL	36.854.500	37.849.572	42.758.661	43.913.145	45.098.800	50.948.114	52.323.713	53.736.453	60.706.071	62.345.135	64.028.454
RECETTES REALISEES PAR LE RECROISEMENT DES DOTES APRES EXECUTION DU PROJET											
ANALYSE ET EXAMEN		7.067.514	7.984.509	8.200.091	8.421.484	9.513.761	9.770.633	10.034.440	11.335.907	11.641.976	11.956.310
RADIOLOGIE		1.719.609	1.942.642	1.995.093	2.048.961	2.314.711	2.377.208	2.441.393	2.758.042	2.832.509	2.908.987
ECHEMOGRAPHIE		4.355.815	4.920.764	5.093.625	5.190.073	5.863.225	6.021.532	6.184.114	6.986.193	7.174.821	7.368.541
SYNEOLOGIE		74.560	84.231	86.505	88.841	100.363	103.072	105.856	119.585	122.814	126.130
OPERATION		1.382.856	1.562.212	1.604.392	1.647.710	1.861.418	1.911.676	1.963.292	2.217.931	2.277.815	2.339.316
DENTAIRES		1.086.823	1.227.784	1.280.934	1.294.979	1.462.938	1.502.437	1.543.003	1.743.130	1.790.195	1.838.530
ECS		37.794	42.695	43.848	45.032	50.873	52.246	53.657	60.916	62.253	63.934
TOTAL PARTIEL (APRES PROJET)		15.725.270	17.764.837	18.244.488	18.737.089	21.167.290	21.733.807	22.325.754	25.221.405	25.902.383	26.601.747
RECETTES TOTALES	36.854.500	63.574.841	60.523.498	62.157.633	63.835.889	72.115.404	74.062.520	76.062.208	85.927.476	88.247.518	90.630.201

	APRES L'EXECUTION DU PROJET										UNITE : FC
	1993	1996	1997	1998	1999	2000	2001	2002	2003	2004	
RECETTES ET DEPENSES											
DEFENSES GLOBALES (a)	205.596.656	228.919.394	241.833.133	255.510.592	269.999.284	285.349.837	301.616.195	318.855.855	337.130.109	356.504.304	377.048.123
RECETTES GLOBALES (b)	36.854.500	63.574.841	60.523.498	62.157.633	63.835.889	72.115.404	74.062.520	76.062.208	85.927.476	88.247.518	90.630.201
(b)-(a)	-168.742.156	-175.344.553	-181.309.635	-193.352.959	-206.163.396	-213.234.433	-227.553.675	-242.793.648	-251.202.633	-268.256.786	-286.417.922

HYPOTHESE 3

(LE NOMBRE DE PATIENTS SERA 1,5 FOIS SUPERIEUR A CELUI ACTUEL)

NOMBRE DE PATIENTS 2.7% 1.027
 TAUX D'AUMENTATION DES PRIX 150.0% 1.5 (CECI COMMENCERA EN 1997.)
 FRAIS DES SERVICES MEDICAUX (SITUATION ACTUELLE) 5.0% 1.05

	AVANT L'EXECUTION DU PROJET										APRES L'EXECUTION DU PROJET				
	1993	1996	1997	1998	1999	2000	2001	2002	2003	2004	2005				
DEPENSES															
FRAIS DE PERSONNEL	124,482,456	130,706,579	137,241,908	144,104,003	151,309,203	158,874,663	166,818,397	175,159,316	183,917,282	193,113,146	202,768,804				
FRAIS D'ACHAT DES MEDICAMENTS	12,500,000	13,479,375	21,803,226	23,511,509	25,353,636	27,340,093	29,482,189	31,792,119	34,283,031	36,989,107	39,865,636				
FRAIS D'ACHAT DES REACTIFS ET DES CONSOMMABLES POUR EXAMEN	24,315,000	26,220,080	42,411,635	45,734,597	49,317,892	53,181,949	57,348,754	61,842,029	66,687,352	71,912,306	77,546,635				
FRAIS D'ACHAT DES MATERIAUX DE SOIN	2,000,000	2,156,700	3,488,516	3,761,841	4,056,582	4,374,415	4,717,150	5,086,739	5,486,285	5,915,057	6,378,502				
FRAIS D'INSTALLATION, DES EQUIPEMENTS ETC.	1,500,000	1,575,000	1,653,750	1,736,437	1,823,259	1,914,422	2,010,143	2,110,651	2,216,183	2,326,992	2,443,342				
FRAIS DE L'ELECTRICITE ET DES ENK	28,800,000	30,240,000	31,752,000	33,339,600	35,006,580	36,756,909	38,584,754	40,524,492	42,550,717	44,678,253	46,912,165				
FRAIS DE CARBURANT DES VEHICULES	8,299,200	8,714,160	9,149,868	9,607,361	10,087,729	10,592,116	11,121,722	11,677,808	12,261,698	12,874,783	13,518,522				
FRAIS DE GESTION ET D'ENTRETIEN DE LA SANTE ELECTRIQUE DE SECOURS	1,200,000	1,260,000	1,323,000	1,389,150	1,458,608	1,531,538	1,608,115	1,688,521	1,772,947	1,851,594	1,954,674				
FRAIS D'ADMINISTRATION GENERALE	2,500,000	2,587,500	2,636,823	2,708,017	2,781,133	2,856,224	2,933,342	3,012,542	3,093,861	3,177,415	3,263,206				
GESTION D'ENTRETIEN DES EQUIPEMENTS MEDICAUX DU PROJET		1,000,000	1,078,350	1,162,839	1,253,947	1,352,194	1,458,138	1,572,383	1,695,580	1,828,428	1,971,636				
DEPENSES TOTALES	205,596,656	217,919,394	252,539,076	267,055,345	282,448,569	298,774,523	316,092,705	334,466,600	353,963,956	374,657,082	395,623,171				

	AVANT L'EXECUTION DU PROJET										APRES L'EXECUTION DU PROJET				
	1993	1996	1997	1998	1999	2000	2001	2002	2003	2004	2005				
RECETTES															
ANALYSE ET EXAMEN	17,205,000	17,669,535	27,219,919	27,954,856	28,709,638	29,484,798	30,280,887	31,098,471	31,938,130	32,800,460	33,686,072				
RADIOLOGIE	8,372,000	8,598,044	13,245,287	13,602,910	13,970,188	14,347,383	14,734,763	15,132,601	15,541,181	15,960,793	16,391,705				
ECMOGRAPHIE	6,059,000	6,222,593	9,585,905	9,844,724	10,110,531	10,383,516	10,663,871	10,951,795	11,247,494	11,551,176	11,863,058				
GYNECOLOGIE	363,000	372,801	574,300	589,805	605,731	622,086	638,882	656,132	673,847	692,041	710,736				
OPERATION	2,693,000	2,765,711	4,260,578	4,375,613	4,493,755	4,615,086	4,739,694	4,867,655	4,999,092	5,134,068	5,272,688				
DENTAIRES	2,116,500	2,173,646	3,348,501	3,438,910	3,531,761	3,627,119	3,725,051	3,825,627	3,928,919	4,035,000	4,143,945				
ECC	46,000	47,242	72,776	74,741	76,759	78,832	80,960	83,146	85,391	87,697	90,064				
TOTAL PARTIEL	36,854,500	37,849,572	58,307,265	59,881,561	61,498,363	63,158,819	64,864,107	66,615,438	68,414,055	70,261,234	72,156,288				
RECETTES REALISEES PAR LE RECOURS AUX COUTS APRES EXECUTION DU PROJET															
INTEGRATION DE CAS		7,067,814	10,887,967	11,181,943	11,483,855	11,793,919	12,112,355	12,439,388	12,775,252	13,120,184	13,474,429				
RADIOLOGIE		1,719,609	2,649,057	2,720,582	2,794,038	2,869,477	2,946,953	3,026,520	3,108,236	3,192,159	3,278,347				
ECMOGRAPHIE		4,385,815	6,710,193	6,891,307	7,077,372	7,268,461	7,464,710	7,666,257	7,873,245	8,085,823	8,304,140				
GYNECOLOGIE		74,560	114,860	117,961	121,146	124,417	127,776	131,226	134,769	138,408	142,145				
OPERATION		1,382,856	2,130,289	2,187,807	2,246,877	2,307,543	2,369,847	2,433,833	2,499,546	2,567,034	2,636,344				
DENTAIRES		1,086,823	1,674,250	1,719,455	1,765,880	1,813,559	1,862,525	1,912,814	1,964,460	2,017,500	2,071,972				
ECC		37,794	58,221	59,793	61,407	63,085	64,768	66,517	68,313	70,157	72,052				
TOTAL PARTIEL (APRES PROJET)		15,725,270	24,224,778	24,878,847	25,550,576	26,240,442	26,948,934	27,676,555	28,423,822	29,191,265	29,979,429				
RECETTES TOTALES	36,854,500	53,574,841	82,532,043	84,780,408	87,048,399	89,399,261	91,813,041	94,291,993	96,837,877	99,452,499	102,137,717				

UNITE : FC.

	1993	1996	1997	1998	1999	2000	2001	2002	2003	2004	2005
RECETTES ET DEPENSES											
DEPENSES GLOBALES (a)	205.596.656	217.919.394	252.539.076	267.055.345	282.448.569	298.774.523	316.092.705	334.456.600	353.963.956	374.657.082	396.623.171
RECETTES GLOBALES (b)	36.854.500	53.574.841	82.532.043	84.760.408	87.048.939	89.399.261	91.813.041	94.221.993	96.837.877	99.452.499	102.137.717
(b)-(a)	-168.742.156	-164.344.553	-170.007.033	-182.294.936	-195.399.629	-209.375.262	-224.279.664	-240.174.607	-257.126.079	-275.204.583	-294.485.455

HYPOTHESE 4 (PLUS D'ACTES MEDICAUX DEVIENDRONT PAYANTS ET LE NOMBRE DE PATIENTS SERA 1,5 FOIS SUPERIEUR A CELUI ACTUEL)

NOMBRE DE PATIENTS 2.7% 1.027
 150.0% 1.5 (Ceci concerne les actes médicaux payants. Les prix de soin sera 1,5 fois supérieur à partir de 1986.)
 TAUX D'INCREMENTATION DES PRIX 5.0%
 FRAIS DES SERVICES MEDICAUX (SITUATION ACTUELLE) 1.05

DEPENSES	AVANT L'EXECUTION DU PROJET											APRES L'EXECUTION DU PROJET				UNITE : FC			
	1993	INDICE	1996	1997	1998	1999	2000	2001	2002	2003	2004	2005	2000	2001	2002	2003	2004	2005	
FRAIS DE PERSONNEL	124,482,456		130,706,579	137,241,908	144,104,003	151,309,203	158,874,663	166,818,397	175,159,316	183,917,282	193,113,146	202,768,804	158,874,663	166,818,397	175,159,316	183,917,282	193,113,146	202,768,804	
FRAIS D'AVANT DES MEDICAMENTS	12,500,000		13,479,375	21,803,226	23,511,609	25,353,636	27,340,093	29,482,189	31,792,119	34,283,091	36,969,107	39,865,636	27,340,093	29,482,189	31,792,119	34,283,091	36,969,107	39,865,636	
FRAIS D'AVANT DES REACTIFS ET DES CONSOMMABLES POUR EXAMEN	24,315,000		26,220,080	42,411,635	45,734,887	49,317,892	53,181,949	57,348,754	61,842,029	66,687,352	71,912,306	77,546,635	53,181,949	57,348,754	61,842,029	66,687,352	71,912,306	77,546,635	
FRAIS D'AVANT DES MATERIAUX DE SOIN	2,000,000		2,156,700	3,488,516	3,761,841	4,056,582	4,374,415	4,717,150	5,086,739	5,485,285	5,915,057	6,378,502	4,374,415	4,717,150	5,086,739	5,485,285	5,915,057	6,378,502	
FRAIS DE GESTION ET D'ENTRETIEN DES INSTALLATIONS, DES EQUIPEMENTS ETC.	1,500,000		1,575,000	1,653,750	1,736,437	1,823,259	1,914,422	2,010,143	2,110,551	2,216,183	2,326,992	2,443,342	1,914,422	2,010,143	2,110,551	2,216,183	2,326,992	2,443,342	
FRAIS DE L'ELECTRICITE ET DES EAUX	28,800,000		30,240,000	31,752,000	33,339,600	35,006,580	36,756,909	38,594,754	40,524,492	42,550,717	44,678,253	46,912,165	36,756,909	38,594,754	40,524,492	42,550,717	44,678,253	46,912,165	
FRAIS DU CARBURANT DES VEHICULES	8,299,200		8,714,160	9,149,898	9,607,361	10,087,729	10,592,116	11,121,722	11,677,808	12,261,698	12,874,783	13,518,522	10,592,116	11,121,722	11,677,808	12,261,698	12,874,783	13,518,522	
FRAIS DE GESTION ET D'ENTRETIEN DE LA SOURCE ELECTRIQUE DE RESERVA	1,200,000		1,260,000	1,323,000	1,389,150	1,458,608	1,531,538	1,608,115	1,688,521	1,772,947	1,861,594	1,954,674	1,531,538	1,608,115	1,688,521	1,772,947	1,861,594	1,954,674	
FRAIS D'ADMINISTRATION GENERAUX	2,500,000		2,587,500	2,686,823	2,798,017	2,921,947	3,058,224	3,207,342	3,369,342	3,544,881	3,734,415	3,938,206	3,058,224	3,207,342	3,369,342	3,544,881	3,734,415	3,938,206	
EQUIPEMENTS D'ENTRETIEN DES EQUIPEMENTS MEDICAUX DU PROJET			1,000,000	1,078,350	1,162,839	1,253,947	1,352,194	1,458,138	1,572,383	1,695,580	1,828,428	1,971,686	1,000,000	1,078,350	1,162,839	1,253,947	1,352,194	1,458,138	1,572,383
			11,000,000	17,792,775	19,136,839	20,690,128	22,311,199	24,059,282	25,944,326	27,977,064	30,169,067	32,532,814	11,000,000	17,792,775	19,136,839	20,690,128	22,311,199	24,059,282	25,944,326
DEPENSES TOTALES	205,696,656		217,919,394	252,539,076	267,055,345	282,448,569	298,774,523	316,092,705	334,466,600	353,963,956	374,657,082	396,623,171	298,774,523	316,092,705	334,466,600	353,963,956	374,657,082	396,623,171	

RECETTES	AVANT L'EXECUTION DU PROJET											APRES L'EXECUTION DU PROJET				UNITE : FC			
	1993	INDICE	1996	1997	1998	1999	2000	2001	2002	2003	2004	2005	2000	2001	2002	2003	2004	2005	
ANALYSE ET EXAMEN	17,205,000		17,669,535	27,219,919	27,954,856	28,709,638	29,484,798	30,280,887	31,098,471	31,938,130	32,800,460	33,686,072	29,484,798	30,280,887	31,098,471	31,938,130	32,800,460	33,686,072	
RADIOLOGIE	8,372,000		8,598,044	13,245,287	13,602,910	13,970,188	14,347,383	14,734,763	15,132,601	15,541,181	15,960,793	16,391,735	14,347,383	14,734,763	15,132,601	15,541,181	15,960,793	16,391,735	
ECHECROPHIE	6,059,000		6,222,593	9,585,905	9,844,724	10,110,591	10,383,516	10,663,871	10,951,795	11,247,494	11,551,176	11,863,058	10,383,516	10,663,871	10,951,795	11,247,494	11,551,176	11,863,058	
GINECOLOGIE	363,000		372,801	574,300	589,806	605,731	622,086	638,882	656,132	673,847	692,041	710,726	622,086	638,882	656,132	673,847	692,041	710,726	
OPERATION	2,693,000		2,765,711	4,260,578	4,375,613	4,493,755	4,615,086	4,739,694	4,867,665	4,999,092	5,134,068	5,272,689	4,615,086	4,739,694	4,867,665	4,999,092	5,134,068	5,272,689	
DENTAIRES	2,116,500		2,173,646	3,348,501	3,438,910	3,531,761	3,627,119	3,725,051	3,825,827	3,928,919	4,035,000	4,143,945	3,627,119	3,725,051	3,825,827	3,928,919	4,035,000	4,143,945	
ECG	46,000		47,242	72,776	74,741	76,759	78,832	80,960	83,146	85,391	87,697	90,064	78,832	80,960	83,146	85,391	87,697	90,064	
TOTAL PARTIEL	36,854,500		37,849,372	58,307,265	59,881,561	61,498,363	63,158,819	64,864,107	66,615,438	68,414,055	70,261,234	72,158,288	63,158,819	64,864,107	66,615,438	68,414,055	70,261,234	72,158,288	
RECETTES REALISEES PAR LE REDOUBLEMENT DES COUITS APRES EXECUTION DU PROJET			7,067,814	10,887,967	11,181,943	11,483,855	11,793,919	12,112,355	12,439,389	12,775,232	13,120,184	13,474,429	11,793,919	12,112,355	12,439,389	12,775,232	13,120,184	13,474,429	
ANALYSE ET EXAMEN			1,719,609	2,649,057	2,720,582	2,794,038	2,869,477	2,946,953	3,026,520	3,108,236	3,192,159	3,278,347	2,869,477	2,946,953	3,026,520	3,108,236	3,192,159	3,278,347	
RADIOLOGIE			4,355,815	6,710,133	6,891,307	7,077,372	7,268,461	7,464,710	7,666,257	7,873,246	8,085,823	8,304,140	7,268,461	7,464,710	7,666,257	7,873,246	8,085,823	8,304,140	
ECHECROPHIE			74,560	114,860	117,961	121,146	124,417	127,776	131,226	134,769	138,408	142,145	124,417	127,776	131,226	134,769	138,408	142,145	
GINECOLOGIE			1,382,856	2,130,289	2,187,807	2,246,877	2,307,543	2,369,847	2,433,833	2,499,546	2,567,034	2,636,344	2,307,543	2,369,847	2,433,833	2,499,546	2,567,034	2,636,344	
OPERATION			1,086,823	1,674,250	1,719,455	1,765,880	1,813,559	1,862,525	1,912,814	1,964,460	2,017,500	2,071,972	1,813,559	1,862,525	1,912,814	1,964,460	2,017,500	2,071,972	
DENTAIRES			37,794	58,221	59,793	61,407	63,065	64,769	66,517	68,313	70,157	72,052	63,065	64,769	66,517	68,313	70,157	72,052	
ECG			15,725,270	24,224,778	24,878,847	25,550,576	26,240,442	26,948,934	27,676,555	28,423,822	29,191,265	29,979,429	26,948,934	27,676,555	28,423,822	29,191,265	29,979,429	30,779,972	
TOTAL PARTIEL (APRES PROJET)			44,917,186	69,192,232	71,060,408	72,999,939	74,992,261	77,030,462	79,124,828	81,275,287	83,482,519	85,746,717	74,992,261	77,030,462	79,124,828	81,275,287	83,482,519	85,746,717	

	1996	1997	1998	1999	2000	2001	2002	2003	2004	2005
ACTES MEDICUX FRAITS										
EXAMEN AVEC FIBROSCOPE										
ALIMENTATION DU NRE DE PATIENTS, I.S	3,000,000	4,500,000	4,621,500	4,746,281	4,874,430	5,006,040	5,141,203	5,280,015	5,422,576	
ALIMENTATION DU NRE DE PATIENTS, I.S	2,500,000	3,750,000	3,851,250	3,955,234	4,062,025	4,171,700	4,284,336	4,400,013	4,518,813	
ALIMENTATION DU NRE DE PATIENTS, I.S	450,000	675,000	693,225	711,942	731,165	750,906	771,180	792,002	813,386	
ALIMENTATION DU NRE DE PATIENTS, I.S	9,000,000	13,500,000	13,894,500	14,238,842	14,623,290	15,018,119	15,423,608	15,840,046	16,267,727	
ALIMENTATION DU NRE DE PATIENTS, I.S	500,000	750,000	770,250	791,047	812,405	834,340	856,867	880,003	903,763	
FRAIS DU PLATRE										
ALIMENTATION DU NRE DE PATIENTS, I.S	350,000	525,000	539,175	553,733	568,684	584,038	599,807	616,002	632,634	
ALIMENTATION DU NRE DE PATIENTS, I.S	1,800,000	2,700,000	2,772,900	2,847,768	2,924,658	3,003,624	3,084,722	3,168,009	3,253,545	
PRET DE LA LITRERIE	17,600,000	26,400,000	27,112,800	27,844,846	28,596,656	29,368,766	30,161,723	30,976,089	31,812,444	
TOTAL PARTIE (APRES PROJET)	36,854,500	53,574,841	100,132,043	114,161,739	117,244,106	120,409,697	123,660,739	126,999,600	130,428,589	133,950,161

UNITE : FC

	1993	1996	1997	1998	1999	2000	2001	2002	2003	2004	2005
RECETTES ET DEPENSES											
DEFENSES GLOBALES (a)	205,596,656	217,919,394	252,539,076	267,955,345	282,448,569	298,774,523	316,092,705	334,466,600	353,963,956	374,687,082	396,623,171
RECETTES GLOBALES (b)	36,854,500	53,574,841	100,132,043	111,160,408	114,161,739	117,244,106	120,409,697	123,660,739	126,999,600	130,428,589	133,950,161
(b)-(a)	-168,742,156	-184,344,553	-152,407,033	-155,894,936	-168,286,829	-181,530,416	-195,683,008	-210,805,841	-226,964,356	-244,228,493	-262,673,011

8 PLAN DE MASSE POUR MONTAGE



L'Hôpital El Maarouf
エル・マルーフ病院

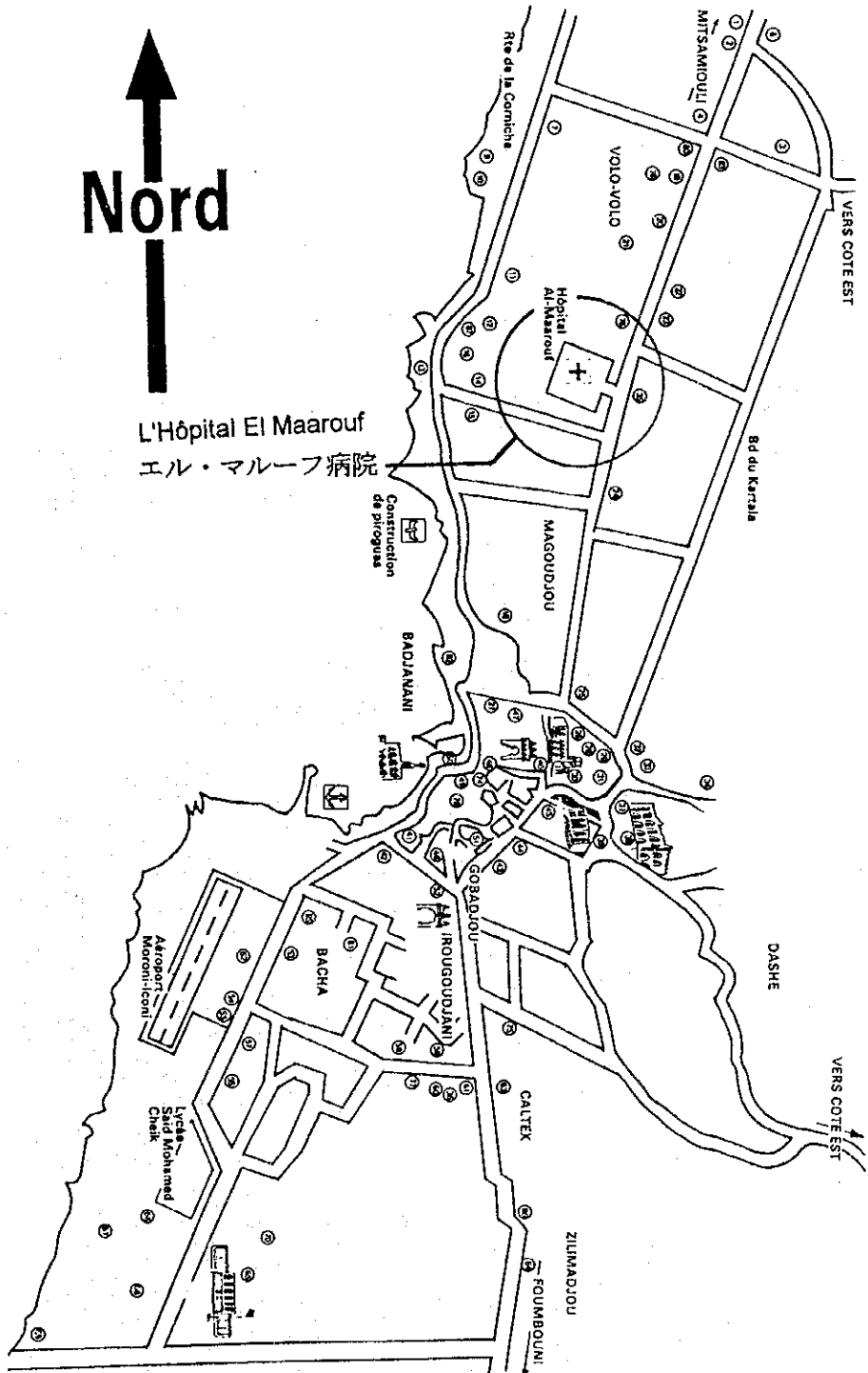

MORONI

エル・マールーフ病院配置図 (S1:1500)

Plan de Site de l'Hôpital El Maarouf

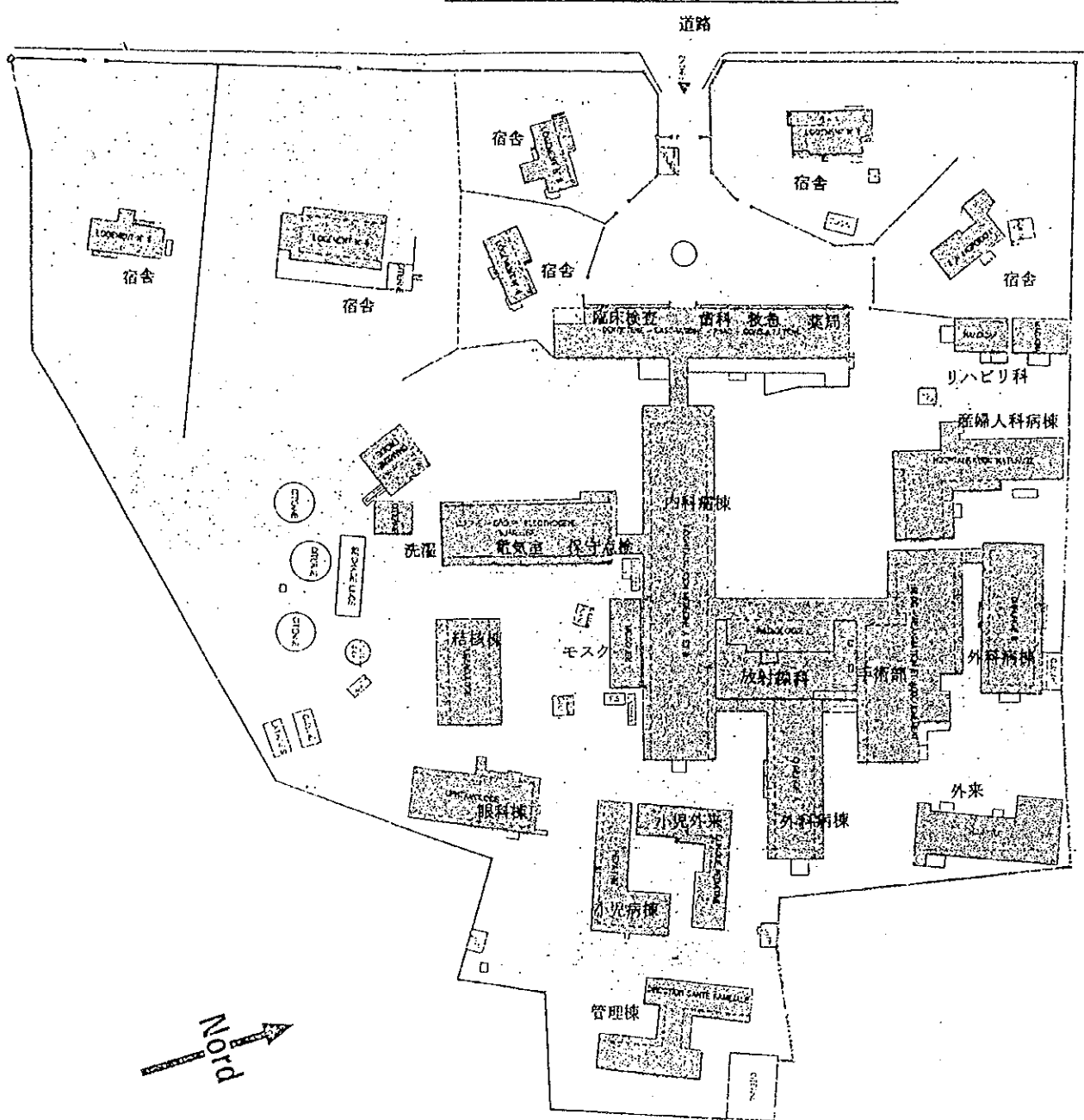



病院正面
Face de l'Hôpital



病院中庭
Cour de l'Hôpital

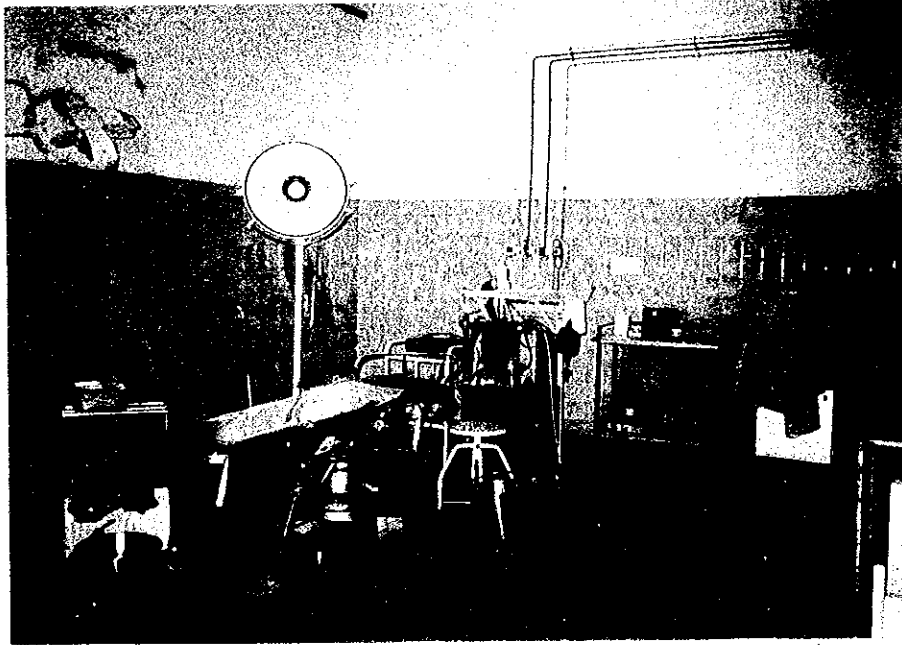

手術室
Bloc Opérateur



集中治療室
ICU

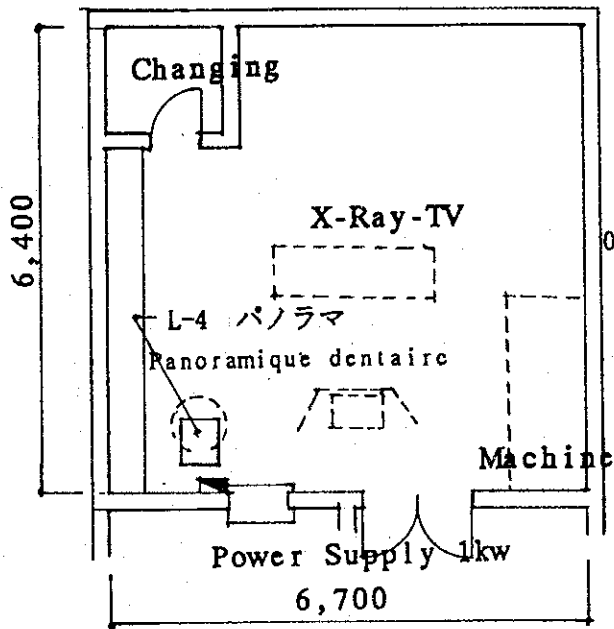

X-RAY-ROOM

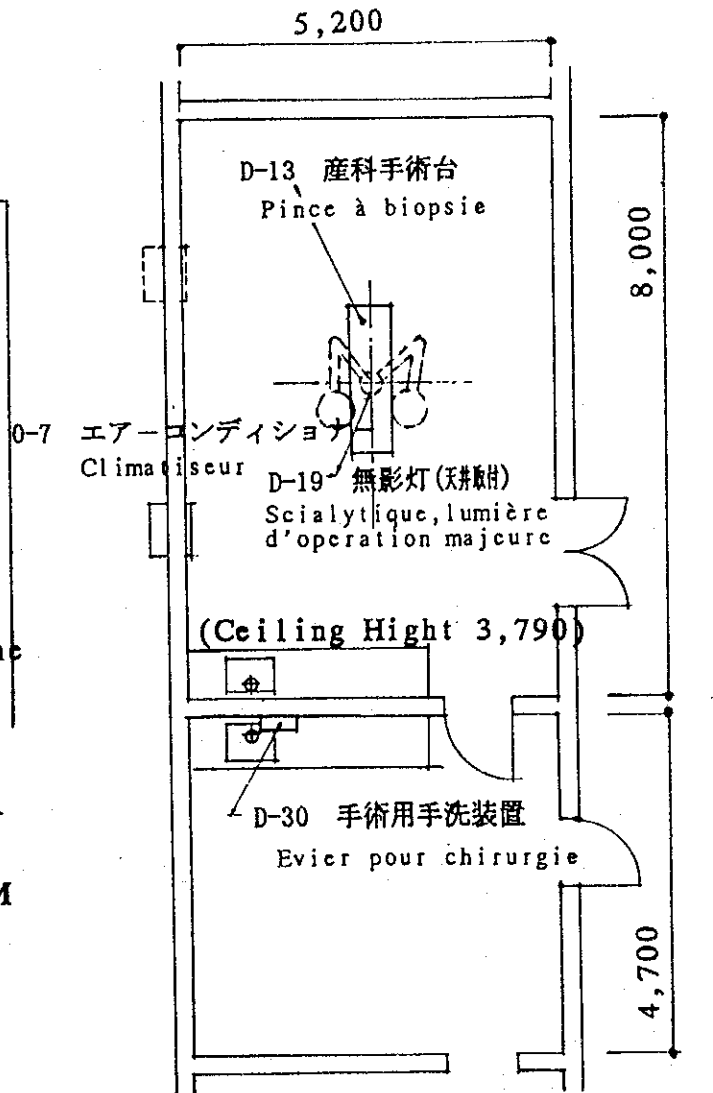

GYNECOLOGIE OPERATION ROOM

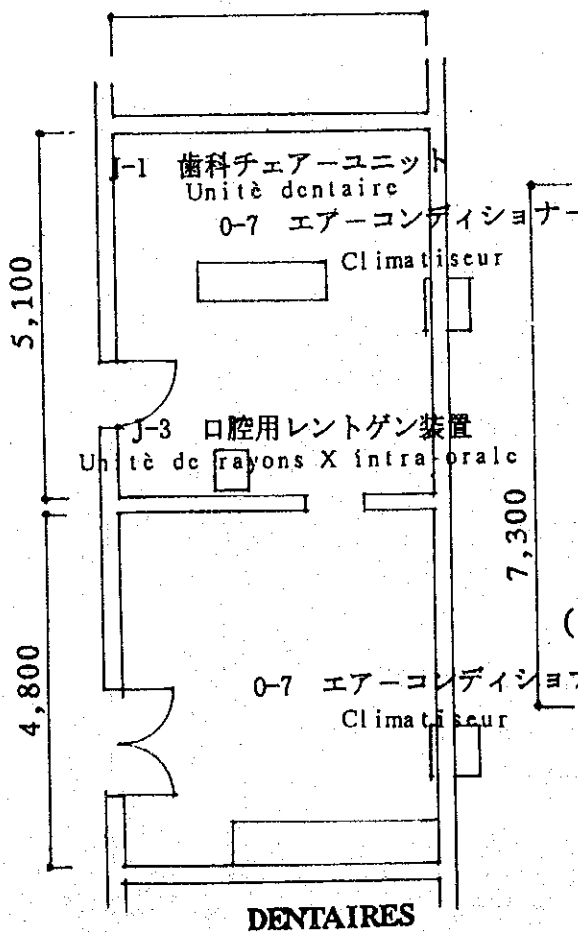

DENTAIRES

4,400

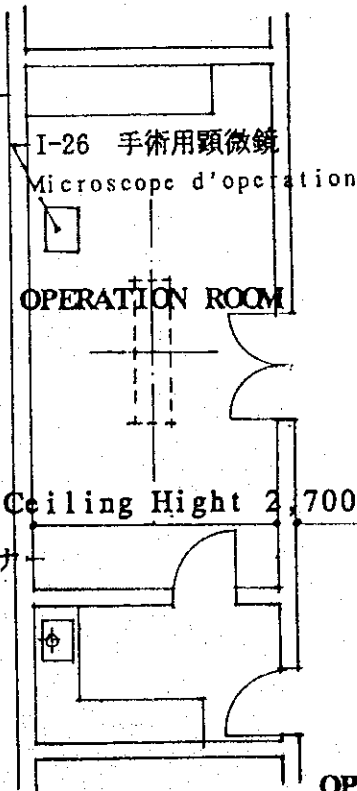

OPERATION ROOM

A-59 3,500

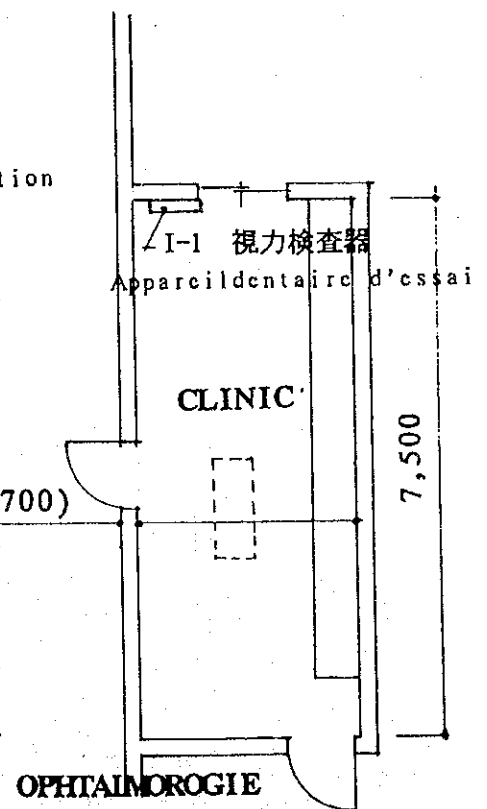

CLINIC

1,800 3,000

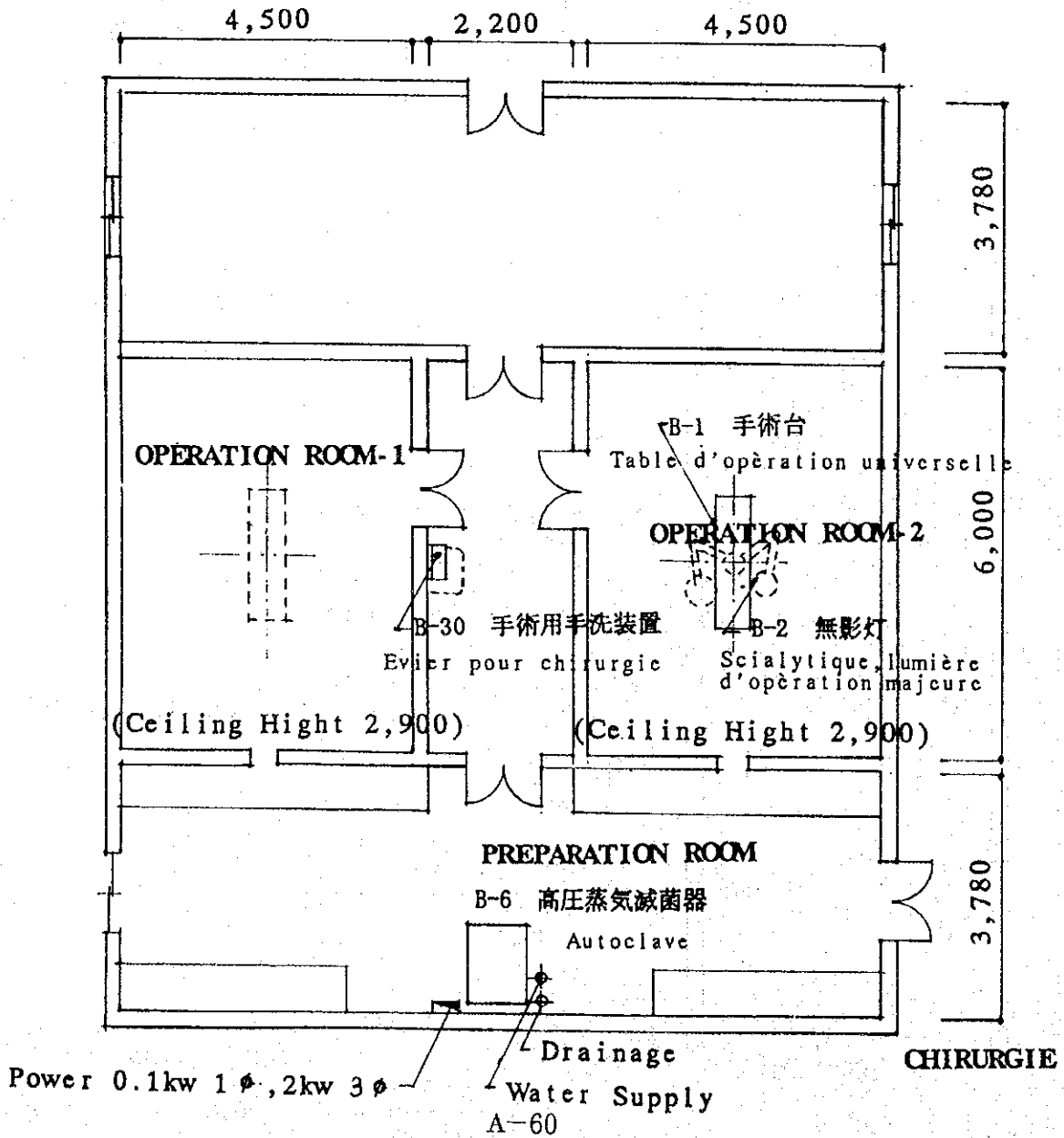
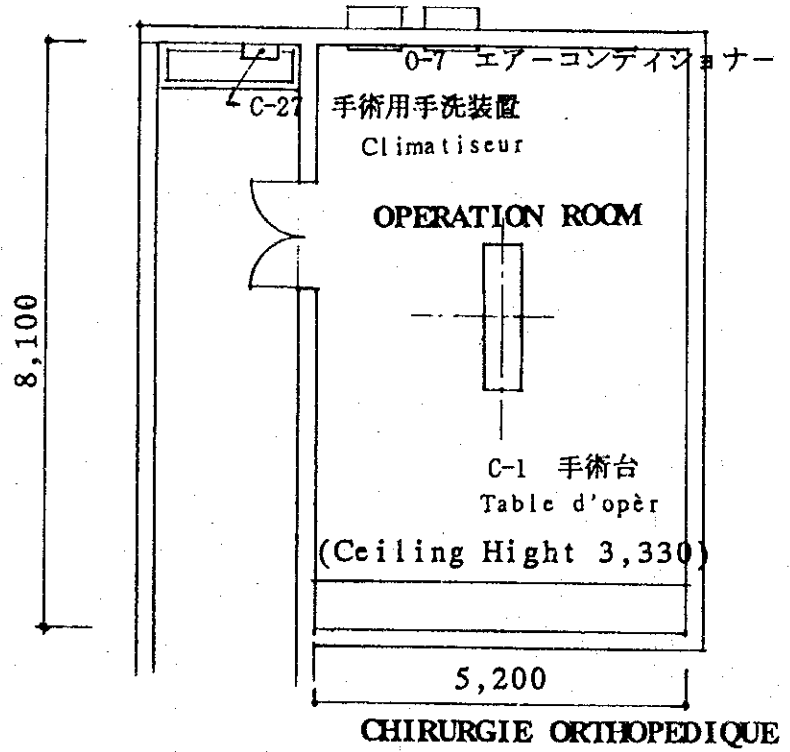

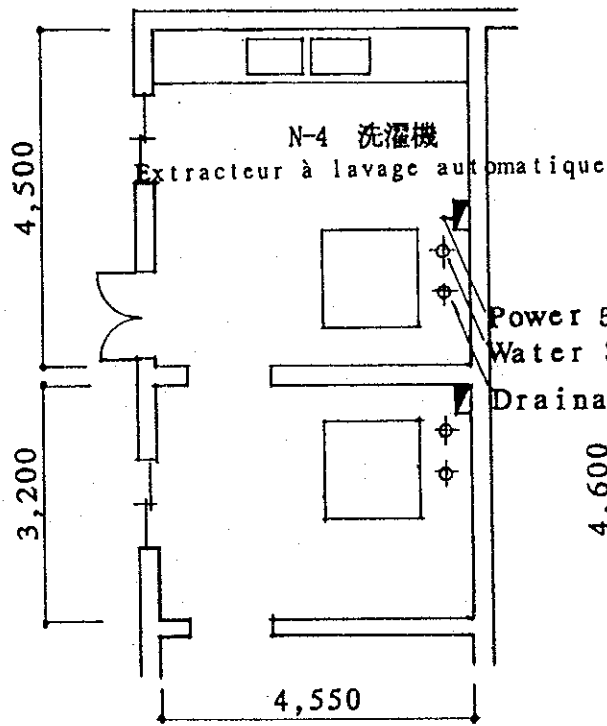

LABAGE

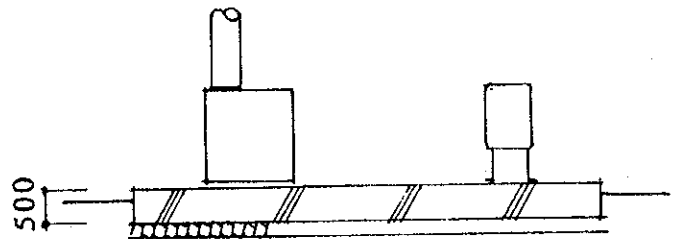
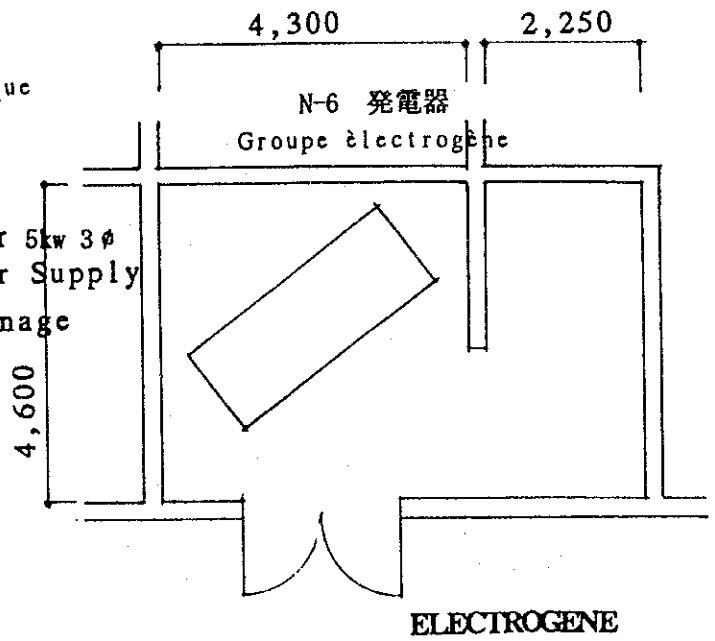

N-3 焼却炉
Incinérateur

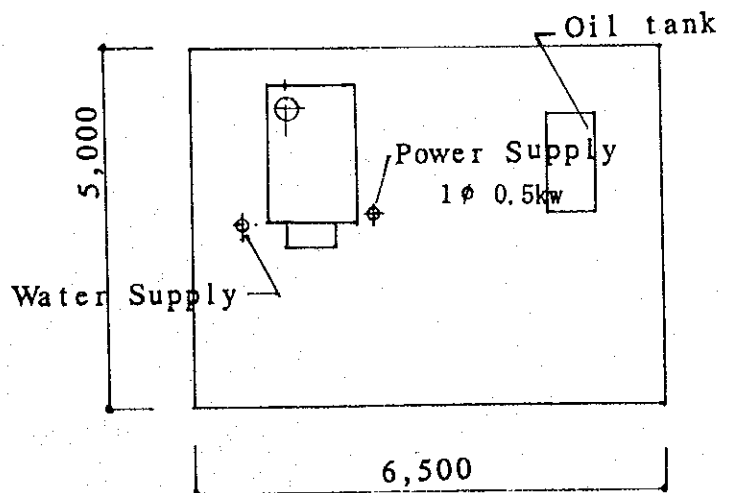

INCINERATEUR

JICA