

[付属資料2 調査日程]

年度 月	平成6年度							
	8月	9月	10月	11月	12月	1月	2月	3月
国内準備作業	—							
第1次現地調査	—	—	—					
第1次国内作業		—	—	—				
施設計画用件の検討		—	—					
施設規模・位置の検討		—	—					
施設概略計画の立案		—	—					
インテリムレポートの作成		—	—					
第2次現地調査		—	—	—				
施設概略計画の確認		—	—					
資料収集		—	—					
設計方針の確認		—	—					
測量・土質調査		—	—					
第2次国内作業		—	—	—	—	—	—	—
基本設計		—	—	—	—	—	—	—
積算		—	—	—	—	—	—	—
ドラフト報告書の作成		—	—	—	—	—	—	—
ドラフト報告書説明		—	—	—	—	—	—	—
最終報告書の作成、提出		—	—	—	—	—	—	—

[付属資料3 相手国関係者リスト]

名 前	役 職
[総理府]	
Mr. Pao Bounnaphonh	Minister
Ms. Amphowrnany	Architect
[航空局]	
Mr. Sadaphet Bodhivarn	Director General
Mr. Bounsoum Somsihakhom	Deputy Director General (Technical)
Mr. Singkham	Deputy Director General (Operation)
Mr. Bounkong Nouphongsamouth	Deputy Director General (Administration)
[航空局ラオス空港整備プロジェクト]	
Mr. Kaykeo	Director of LAIP
Mr. Somboune Chaleunith	Deputy Director of LAIP
Mr. Vanhpheng Chanth.	Deputy Director of LAIP
Mr. Khamvanh Mala	Radio Engineer/LAIP
Mr. Done S.	Electro Mechanical Engineer/LAIP
Mr. Souksavanh Sayamoungkhom	Civil Engineer/LAIP
Mr. Somphonh Sygnavong	Electrical Engineer/LAIP
Mr. Khansavanh	Financial Officer/LAIP
[航空局管理部]	
Mr. Bounkong N.	Director of Administration Division
Mr. Houmpheng T.	Deputy Director of Administration Division
Mr. Khamma	Deputy Director of Administration Division
[航空局保安部]	
Mr. Somsy Sisavath	Director of Air Navigation Division
Mr. Phouthone Phrakaysone	Deputy Director of Air Navigation Division
[航空局通信部]	
Mr. Kaykeo	Director of Telecom. Division
Mr. Bouathong	Deputy Director of Telecom. Division
[航空局交通部]	
Mr. Sompoune C.	Director of Air Transport Division
Mr. Houmphanh Nanisouk	Deputy Director of Air Transport Division
[航空局空港部]	
Mr. Vanpheng Chantahphone	Director of Aerodrome Division
Mr. Ounehuane Ditavong	Deputy Director of Aerodrome Division
[航空局経理部]	
Mr. Khansavanh	Director of Finance Division
Mr. Saykhame	Deputy Director of Finance Division

名 前	役 職
[航空局管制部]	
Mr. Pasit Kounlath	Director of ATS Division
Mr. Phouvienh	Deputy Director of ATS Division
Mr. Khamvanh	Deputy Director of ATS Division
[航空局ワットタイ国際空港部]	
Mr. Kongpheng Phanthavong	Director of Wattay International Airport
Mr. Bounnhang	Deputy Director of WIA
Mr. Manh Arounsavath	Deputy Director of WIA
[ラオス航空]	
Mr. Saysong Souksenesamlane	Commercial Director of Lao Aviation
[タイ国際航空]	
Mr. Samarn Yaicharoen	Station Manager of Thai Airways Int'l
[ラオス電力]	
Mr. Somphone Thammavongsay	Deputy Manager of Electricite du Laos

[付属資料4 討議議事録]

第1次現地調査、第2次現地調査及びドラフト報告書説明における討議議事録は、次頁以下に示すとおりである。

MINUTES OF DISCUSSIONS
OF
THE BASIC DESIGN STUDY ON THE PROJECT FOR
REHABILITATION OF WATTAY INTERNATIONAL AIRPORT
IN
THE LAO PEOPLE'S DEMOCRATIC REPUBLIC

In response to a request from the Government of the Lao People's Democratic Republic the Government of Japan decided to conduct a Basic Design Study on the Project for Rehabilitation of Wattay International Airport (hereinafter referred to as "the Project") and entrusted the study to the Japan International Cooperation Agency (JICA).

JICA sent to Lao PDR a study team, which is headed by Mr. Michio Kanda, Deputy Managing Director of Grant Aid Project Management Dept., JICA, and is scheduled to stay in the country from August 18 to August 29, 1994.

The team held discussion with the officials concerned of the Government of Lao PDR and conducted a field survey at the study area.

In the course of the discussions and field survey, both parties have confirmed the main items described on the attached sheets. The team will proceed to further works and prepare the Basic Design Study report.

Vientiane, August 24, 1994

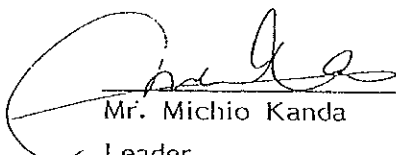
Mr. Michio Kanda
Leader
Basic Design Study Team
JICA

Mr. Bounkong Noufongsamouth
Acting Director General
Department of Civil Aviation
Prime Minister's Office

ATTACHMENT

1. Objective

The objective of the Project is to rehabilitate the airport facilities of the Wattay International Airport to meet the air traffic demand in 2005.

2. Project Site

The site of the Project is the Wattay International Airport in Vientiane. (The site map is as shown in the attached drawing.)

3. Executing Agency

The Department of Civil Aviation of the Prime Minister's Office is responsible for the administration and execution of the Project.

4. Items Requested by the Government of Lao PDR

After discussions the request listed on the Annex I was confirmed by the Basic Design Study team.

However, the final components of the Project will be decided after further studies.

5. Japan's Grant Aid system

(1) The Government of Lao PDR has understood the system of Japanese Grant Aid explained by the team.

(2) The Government of Lao PDR will take necessary measures, described in Annex II for smooth implementation of the Project, on condition that the Grant Aid Assistance by the Government of Japan is extended to the Project.

6. Schedule of the Study

JICA will prepare the Interim Report in English and dispatch mission to Lao PDR in order to explain its contents by the end of September 1994.

Handwritten signature: *Handwritten initials/signature*

Annex 1 : Facilities and Equipment requested by Lao PDR

1. Civil Works

- 1) Expansion and Rehabilitation of Car Park
- 2) Landside Road

2. Building Works

- 1) New International Passenger Terminal Building
- 2) New Control Tower and Operation Building
- 3) New Fire Station
- 4) New Power House includes a Generator
- 5) New Airport Maintenance Workshop with Garage

3. Site Utilities

- 1) Water Supply (excludes outdoor fire hydrant)
- 2) Power Supply (excludes for Nav-Aids, Airfield Lighting and Met. EQ)
- 3) Sewage Treatment

4. Procurement and Installation of ATS Equipment

- 1) Control Tower Equipment (Consoles and VHF Transmitter/Receiver)
- 2) ACC Consoles (excludes ER-VHF Equipment and Remote Control Equipment)
- 3) Voice Communication and Control System (VCCS) and Auto Message Switching System (includes TTY Equipment)
- 4) Other Miscellaneous Equipment (Master/Slave Clock System, Briefing Display System, etc.)

5. Procurement of Airport Maintenance Equipment and Others

- 1) Airport Maintenance Equipment
- 2) Fire Fighting Vehicles

Underlined items are newly requested by Lao PDR at the discussion on August 22. JICA Basic Design Study team will carefully consider whether these items shall be included in the scope of Basic Design Study.

Annex II : Necessary measures to be taken by the Government of Lao PDR
in case Japan's Grant Aid is executed

1. To secure and clear the site for the Project
2. To announce and coordinate with the airport users for the change in use of the airport facilities during the construction
3. To undertake incidental outdoor works such as gardening in the site and fencing, gates around the site
4. To construct the access road to the site prior to commencement of the construction
5. To provide facilities for distribution of electricity, water supply, telephone, drainage, sewage and other incidental facilities to the Project site
 - 1) Electricity distributing line to the site
 - 2) City water distribution main to the site
 - 3) Drainage city main to the site
 - 4) Telephone trunk line and the main distribution panel of building
 - 5) General administrative furniture such as carpets, curtains, tables, chairs and others
 - 6) Tenants' equipment and furniture such as kitchen equipment, tables and chairs in restaurants and showcases in shops
6. To bear commissions to the Japanese foreign exchange bank for the banking services based upon Banking Arrangement
7. To exempt taxes and to take necessary measures for custom clearance of the materials and equipment brought for the Project at the port of disembarkation
8. To accord Japanese Nationals whose services may required in connection with the supply of products and services under the verified contract such facilities as may be necessary for their entry into Lao PDR and stay therein for the performance of their work
9. To exempt Japanese Nationals from custom duties, internal taxes and other fiscal levies with respect to the supply of products and services under the verified contracts
10. To maintain and use properly and effectively that the facilities constructed and equipment purchased under the Grant
11. To bear all the expenses other than those to be borne by the Grant, necessary for construction of the facilities as well as for the transportation and the installation of the equipment

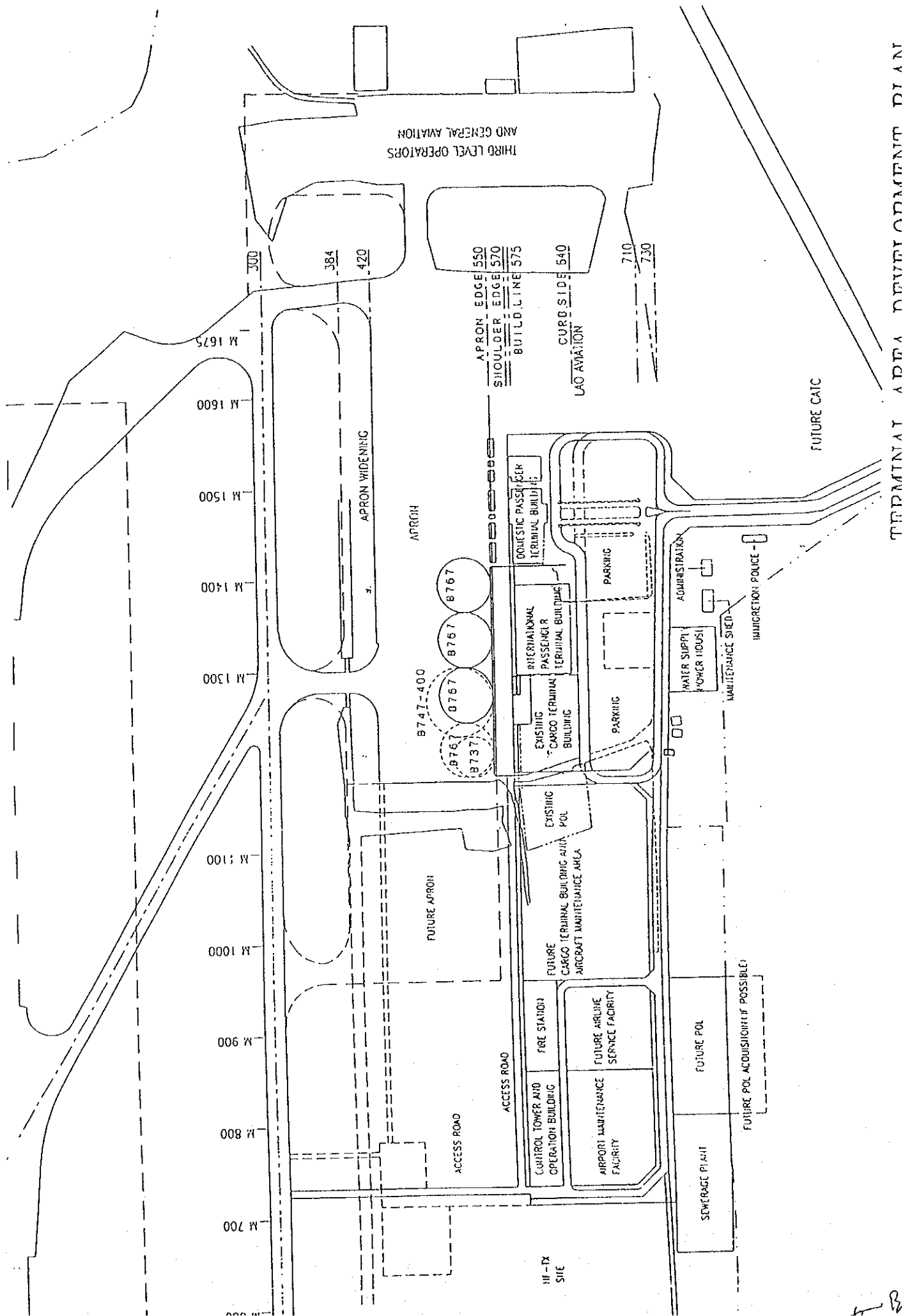

TERMINAL AREA DEVELOPMENT PLAN

4 B

MEMORANDUM

August 26, 1994

Design conditions discussed and confirmed between Lao PDR and JICA Basic Design Study team are as follows;

1. Terminal Area Layout Plan

Terminal area layout is basically correspond to the plan indicated in the ADB report. But some items as indicated below has been modified. Agreed layout plan is as shown in the attached drawing.

- 1) Apron edge (aircraft nose line) is shifted to runway side by 5m to secure the space for airside road, underground piping and towing.
- 2) New control tower is located at the place where apron can be easily expanded as shown in the attached layout plan.
- 3) New fire station is located next to the new control tower.
- 4) Existing electric substation and elevated water tank will be demolished.

2. New Passenger Terminal Building

- 1) Site : Existing operation building with control tower and fire station
- 2) Capacity : Based on the apron layout study indicated in the ADB report
- 3) Others : Possible to install two airbridges

3. New Control Tower and Operation Building

- 1) Site : As shown in the attached drawing
- 2) Height : Possible to look at whole runway area from VFR room

4. New Fire Station

- 1) Site : As shown in the attached drawing
- 2) Capacity : Possible to accommodate fire fighting vehicles and equipment recommended by ICAO

5. New Airprot Maintenance Workshop with Garage

- 1) Site : As shown in the attached drawing
- 2) Capacity : Possible to accommodate airport maintenance equipment recommended by the study team. But request of Lao PDR is as follows;

- 3 Tractors
- 3 Slasher Attachments
- 1 Suction Sweeper
- 4 Industrial Lawn Mowers
- 1 Backhoe
- 6 Whipper Snippers
- 1 Lot of Spare Parts
- 1 Set of Survey Instrument

6. Auto Message Switching System and Teleprinters

Lao PDR requested, in addition to the auto message switching system, 12 teleprinters (6 with a monitor) and 1 lot of spare parts are contained in the procurement package.

7. Implementation Schedule

Lao PDR intends to complete whole rehabilitation works by December 1998, because ADB's loan will valid until then.

JICA Basic Design Study team requested the Project is implemented according to the schedule which JICA Basic Design Study team will prepare.

8. Training

Lao PDR requested that adequate training, for operation and maintenance of equipment procured under Japan's Grant Aid, is contained in the procurement package, including for new teleprinter operators and maintenance technicians.

MINUTES OF DISCUSSIONS
OF
THE BASIC DESIGN STUDY (I) ON THE PROJECT FOR
REHABILITATION OF WATTAY INTERNATIONAL AIRPORT
IN
THE LAO PEOPLE'S DEMOCRATIC REPUBLIC

In August 1994, the Japan International Cooperation Agency (JICA) dispatched a Basic Design Study Team (I) on the Project for Rehabilitation of Wattay International Airport (hereinafter referred to as "the Project") to the Lao People's Democratic Republic, and through discussions, field survey, and technical examination of the results in Japan, has prepared the interim report of the study.

In order to explain and to consult the Lao side on the components of the interim report, JICA sent to Lao PDR a study team (II), which is headed by Mr. Yukihiro Koizumi, Second Basic Design Study Division, Grant Aid Study and Design Department, JICA, and is scheduled to stay in the country from October 4 to October 31, 1994.

As a result of discussions, both parties have confirmed the main items described on the attached sheets.

Vientiane, October 14, 1994

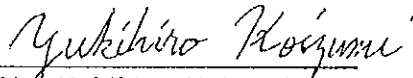
Mr. Yukihiro Koizumi
Project Coordinator
Basic Design Study Team
JICA

Mr. Sadaphet Bodhivarn
Director General
Department of Civil Aviation
Prime Minister's Office

ATTACHMENT

1. Components of Interim Report

The Government of Lao PDR has agreed and accepted in principle the components of the interim report proposed by the Team. Specific items confirmed through the discussions are as shown in ANNEX I.

Based on this Interim Report, the final components of the Project will be decided after further studies.

2. Japan's Grant Aid System

- (1) The Government of Lao PDR has understood the system of Japan's Grant Aid explained by the Team.
- (2) The Government of Lao PDR will take necessary measures, described in ANNEX II for smooth implementation of the Project, on the condition that the Grant Aid Assistance by the Government of Japan is extended to the Project.

3. Further Schedule

- (1) JICA prepare the draft final report in accordance with the confirmed items, and will dispatch a mission in order to explain its contents around February 1995.
- (2) In case that the contents of the draft final report is accepted in principle by the Government of Lao PDR, JICA will complete the final report and send it to the Government of Lao PDR by April, 1995.

y, K

18

Annex 1 : Confirmed Specific Items

Specific items on the conceptual plans confirmed between The Government of Lao PDR and the Study Team are as follows;

1. International Passenger Terminal Building

- Traditional style of Lao will be respected.
- The height of roof top is higher than that of the original conceptual plan by 2m.
- Airside concourse is not air-conditioned.
- One airbridge is installed at least. (The Government of Lao PDR requested to install at least two airbridges.)
- Escalators are not installed.
- Connection counter space is added along the airside corridor.
- Customs inspection space on the first floor is partly changed to duty free shop.
- Airport identification signs are installed at both sides of the building. Airside sign is in English and landside one is in Lao language.

2. Control Tower and Operation Building

- Flight operation room is expanded, the counters of AIS and flight plan are extended.
- Area of Meteorological Office Room is reduced.
- A door is installed between Director's room and Secretary's room.
- Weather Observation Room and Rescue Coordination Room are changed their locations each other.
- Battery and power equipment is installed in Electrical Room.
- Equipment Room, FIS Operation Room and ACC Operation Room are expanded respectively.

3. Terminal Area Layout

- South-west of landside road is shifted for north-east by 15m so as to keep space for future POL area.

4. Implementation Schedule

Implementation schedule should be changed after further studies in Japan. (The Government of Lao PDR requested to complete the Project as early as possible before the termination of ADB's loan.)

W.K

[Signature]

Annex II : Necessary measures to be taken by the Government of Lao PDR
in case Japan's Grant Aid is executed

1. To secure and clear the site for the Project
2. To announce and coordinate with the airport users for the change in use of the airport facilities during the construction
3. To undertake incidental outdoor works such as gardening in the site and fencing, gates around the site
4. To construct the access road to the site prior to commencement of the construction
5. To provide facilities for distribution of electricity, water supply, telephone, drainage, sewage and other incidental facilities to the Project site
 - 1) Electricity distributing line to the site
 - 2) City water distribution main to the site
 - 3) Drainage city main to the site
 - 4) Telephone trunk line and the main distribution panel of building
 - 5) General administrative furniture such as carpets, curtains, tables, chairs and others
 - 6) Tenants' equipment and furniture such as kitchen equipment, tables and chairs in restaurants and showcases in shops
6. To bear commissions to the Japanese foreign exchange bank for the banking services based upon Banking Arrangement
7. To exempt taxes and to take necessary measures for custom clearance of the materials and equipment brought for the Project at the port of disembarkation
8. To accord Japanese Nationals whose services may be required in connection with the supply of products and services under the verified contract such facilities as may be necessary for their entry into Lao PDR and stay therein for the performance of their work
9. To exempt Japanese Nationals from custom duties, internal taxes and other fiscal levies with respect to the supply of products and services under the verified contracts
10. To maintain and use properly and effectively that the facilities constructed and equipment purchased under the Grant
11. To bear all the expenses other than those to be borne by the Grant, necessary for construction of the facilities as well as for the transportation and the installation of the equipment

Y.K

6

MEMORANDUM

Oct 26, 1994

Design conditions discussed and confirmed between Lao PDR and JICA Basic Design Study team are as follows;

1. Terminal Area Layout Plan

- 1) Terminal area layout plan is revised, The revised plan is as shown in the attached drawing (Fig-1).
- 2) Proposed road circulation plan will be determined in consideration of the existing road alignment and topographic condition.

2. Fire Station

The floor plan is changed partially as shown in the attached drawing (Fig-2).

3. Maintenance Workshop

The floor plan is changed partially as shown in the attached drawing (Fig-3).

4. Power House

Plan and size are determined as shown in the attached drawing (Fig-4).

5. Site Utilities

1) Power supply system

Power supply system is confirmed as shown in the attached drawing (Fig-5).

2) Sewage treatment system

Proposed central sewage treatment plant is cancelled in consideration of present site condition.

Sewage treatment tank will be provided by zone, such as terminal zone, new operation zone and fire station.

6. Air Conditioning Area

Air conditioning area of each building is confirmed as shown in the attached drawing (Fig-6).

7. Communication Facilities

- 1) Communication facilities that Basic Design Study Team has proposed are confirmed.
- 2) DCA confirmed that power supply and communication cable for Transmitter Station and Receiver Station will be installed by DCA.

8. Fire Fighting and Maintenance Equipment

1) Fire Fighting Equipment

Basic idea and conceptual plan is confirmed, while the following equipment was requested by DCA.

- ① Major Vehicle (MJV)
- ② Rapid Intervention Vehicle (RIV)
- ③ Ambulance

2) Maintenance Equipment

Basic idea and conceptual plan is confirmed, while the following equipment was requested by DCA.

- ① Tractors with slasher attachments
- ② Whipper Snippers
- ③ Suction Sweeper
- ④ Backhoe
- ⑤ Industrial Lawn Mowers
- ⑥ Spare Parts
- ⑦ Survey Instrument
- ⑧ Joint Sealing Machine
- ⑨ Paint Marking Machine
- ⑩ Concrete Cutter Saw
- ⑪ Tip Trucks

⑫ 4-Wheel Drive Vehicle

⑬ Concrete Mixer

⑭ Bituminous Heater and Mixer

⑮ Plate Compactor

⑯ Motor Grader

⑰ Vibrating Roller

⑱ Compressor

9. Other

Present power supply capacity from EDL to the Wattay International Airport is not enough for future demand.

DCA should request EDL to increase power supply capacity according to the Wattay International Airport Development Program.

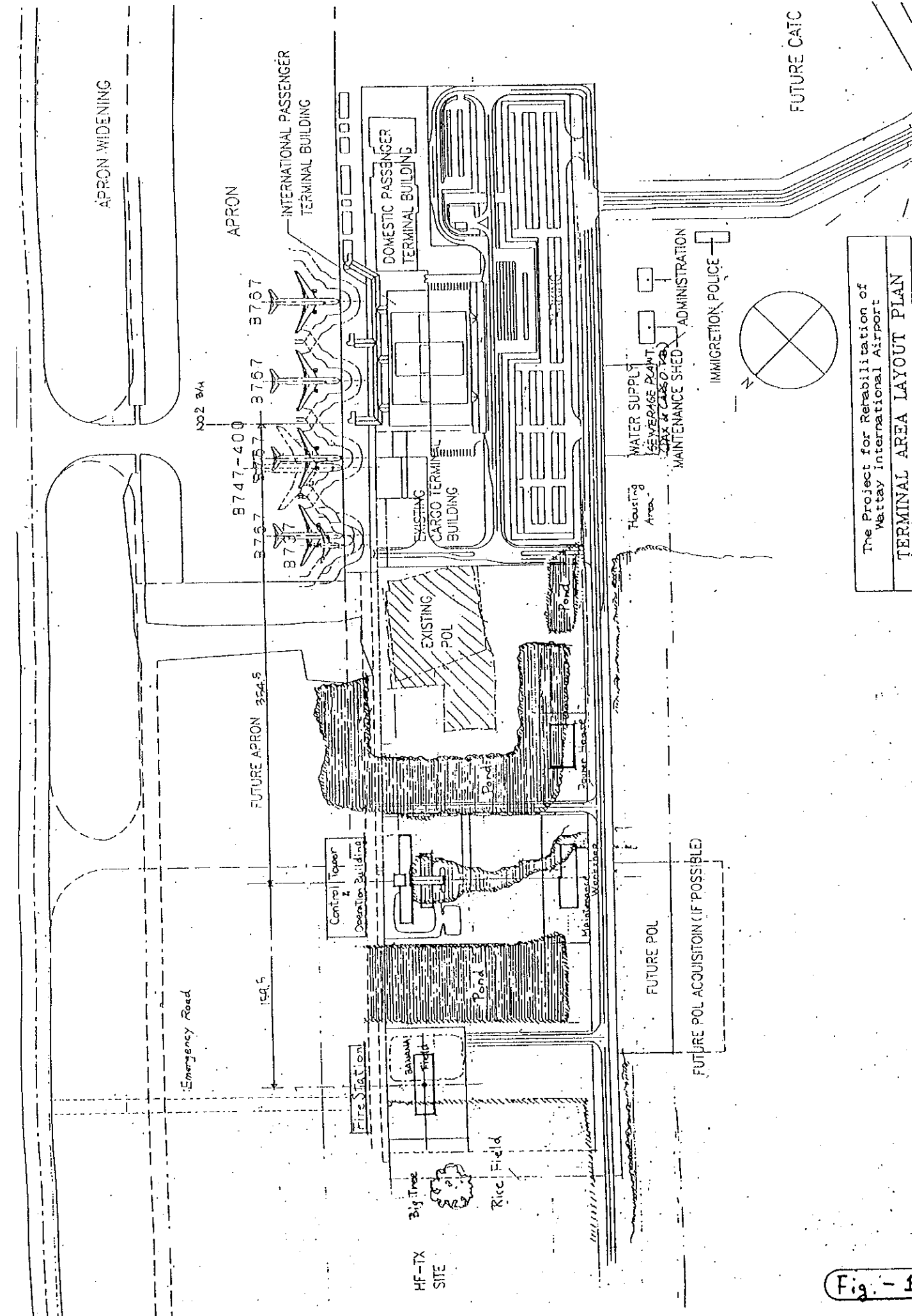

The Project for Rehabilitation of Wattay International Airport
TERMINAL AREA LAYOUT PLAN

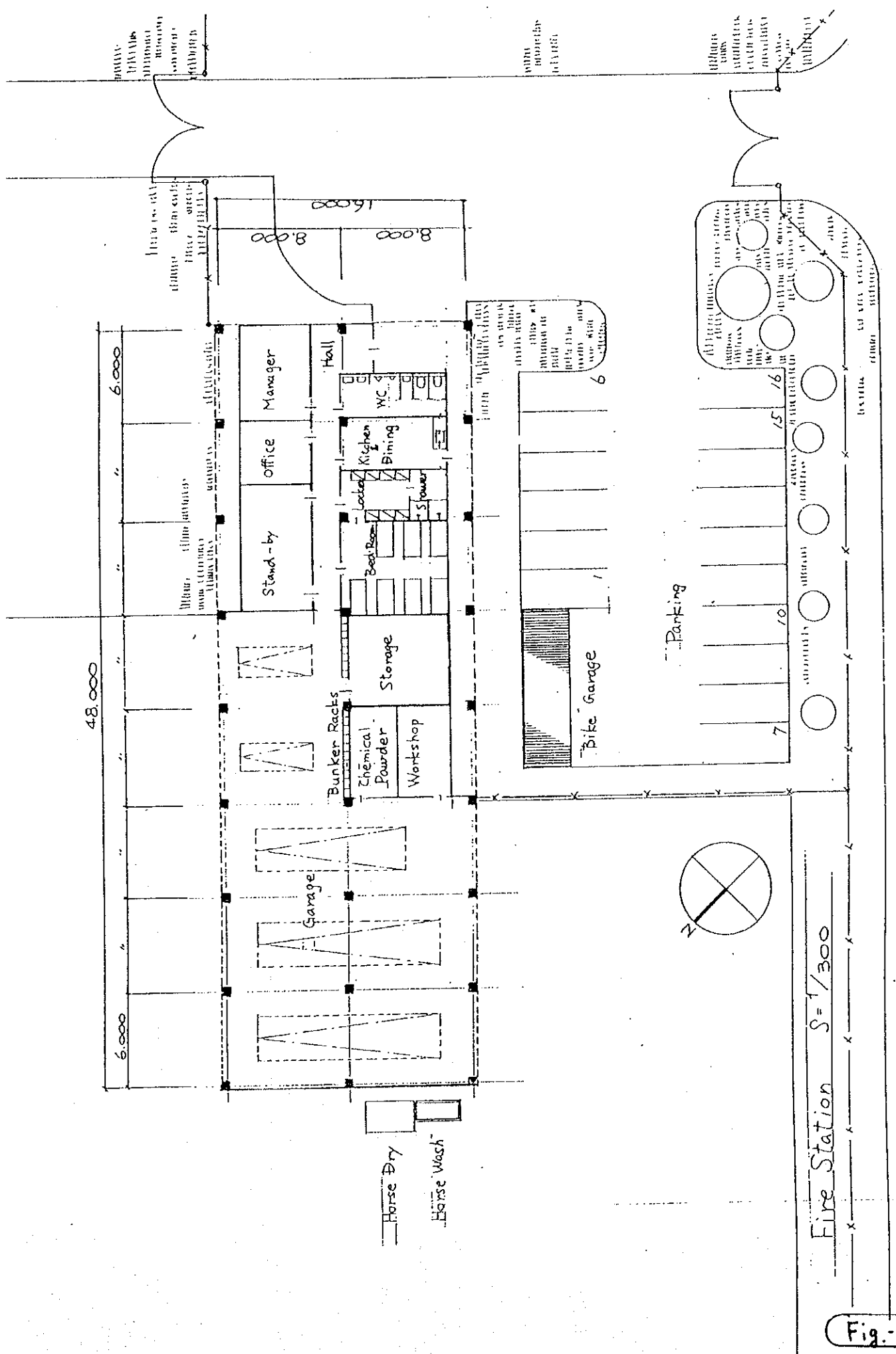
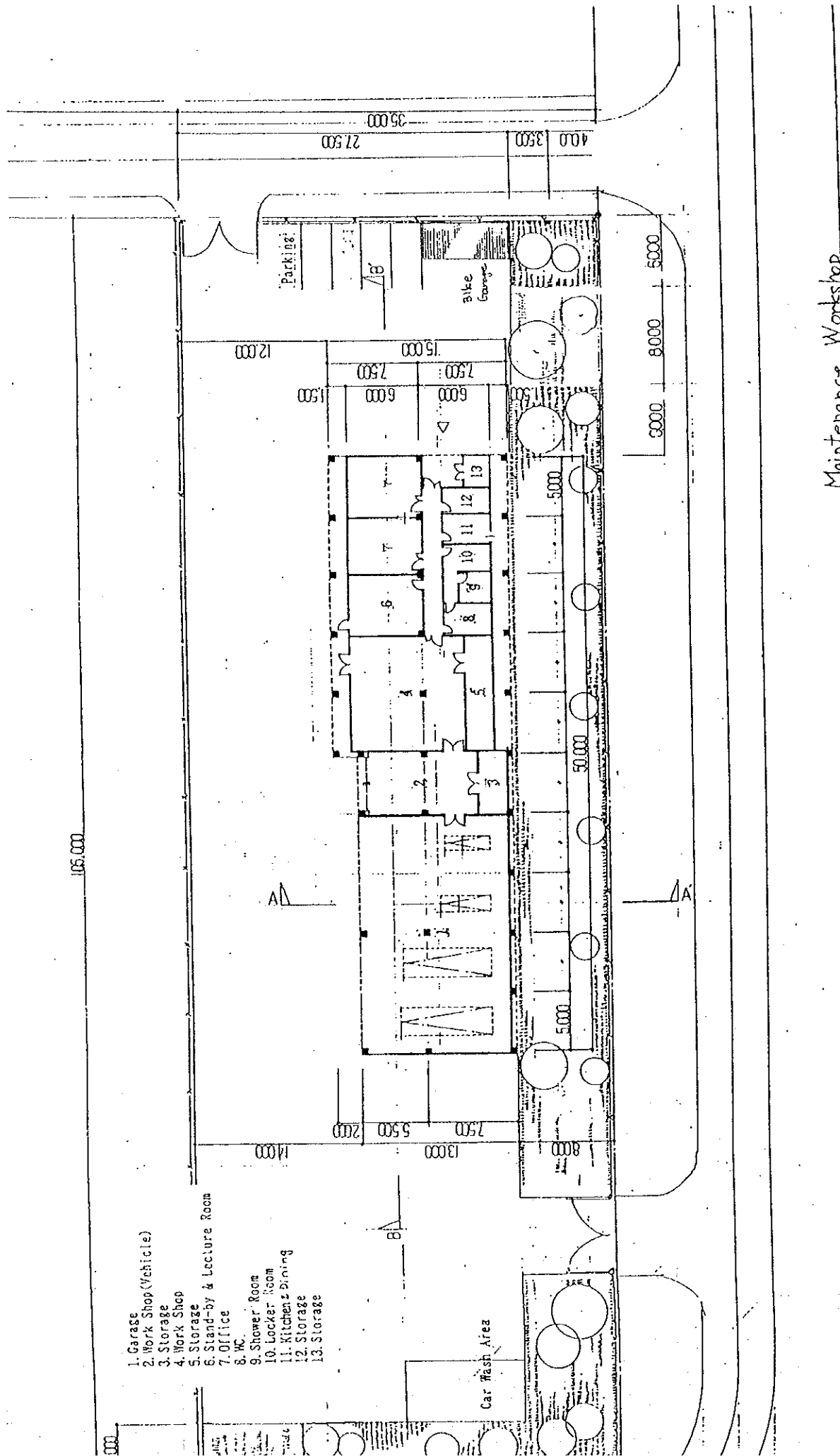

Fig. 2



- 1. Garage
- 2. Work Shop (Vehicle)
- 3. Storage
- 4. Work Shop
- 5. Storage
- 6. Stand-by & Lecture Room
- 7. Office
- 8. WC
- 9. Shower Room
- 10. Locker Room
- 11. Kitchen & Dining
- 12. Storage
- 13. Storage

Maintenance Workshop

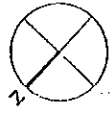

Fig. - 3

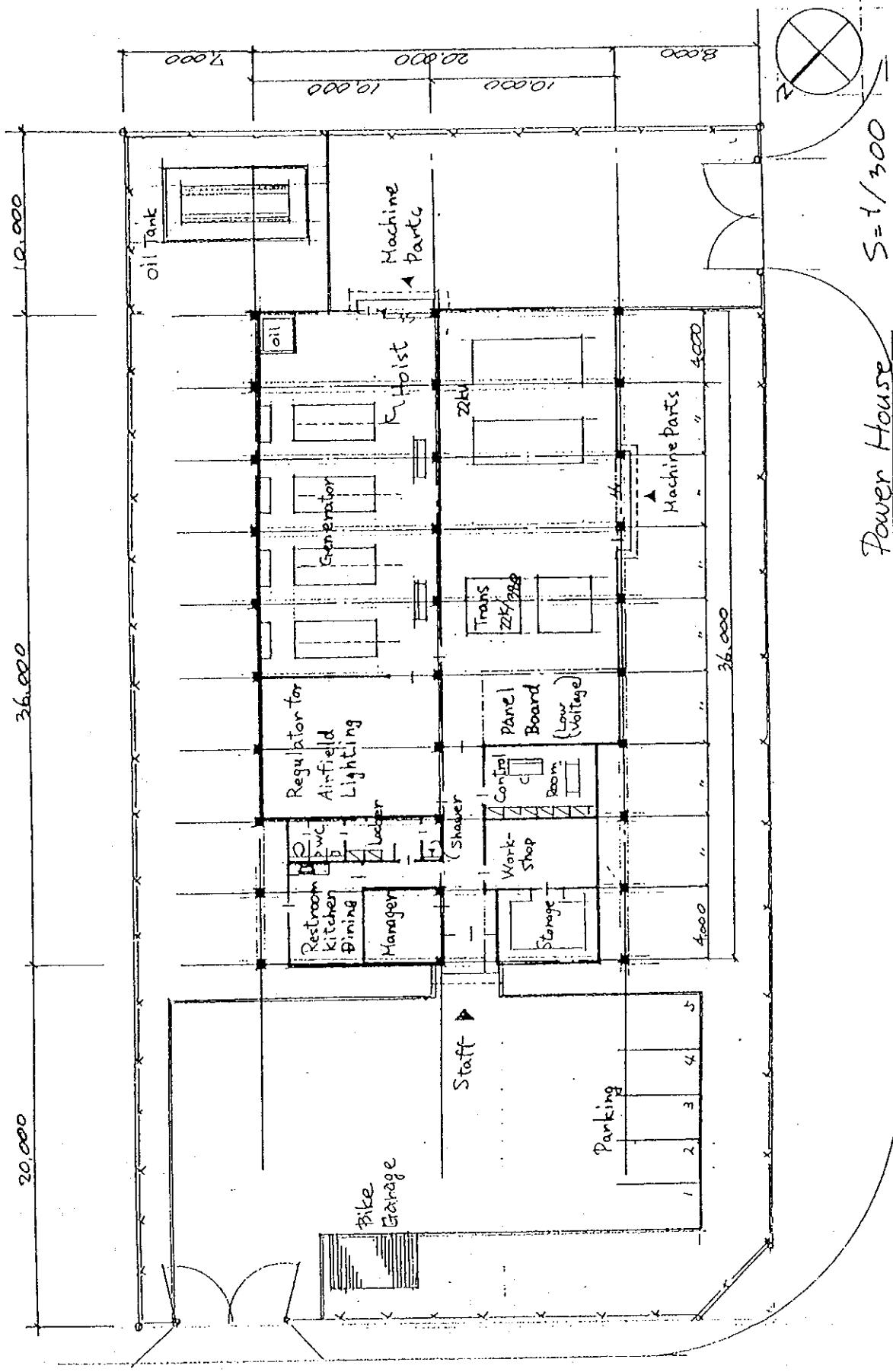
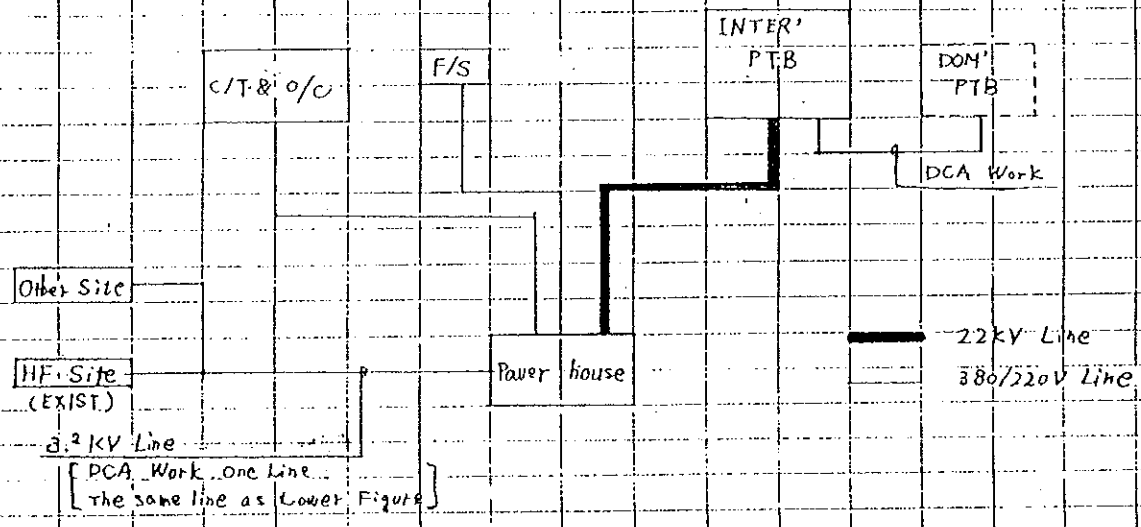

Fig.-4

GENERATOR POWER DISTRIBUTION DIAGRAM



ELECTRIC POWER DISTRIBUTION DIAGRAM

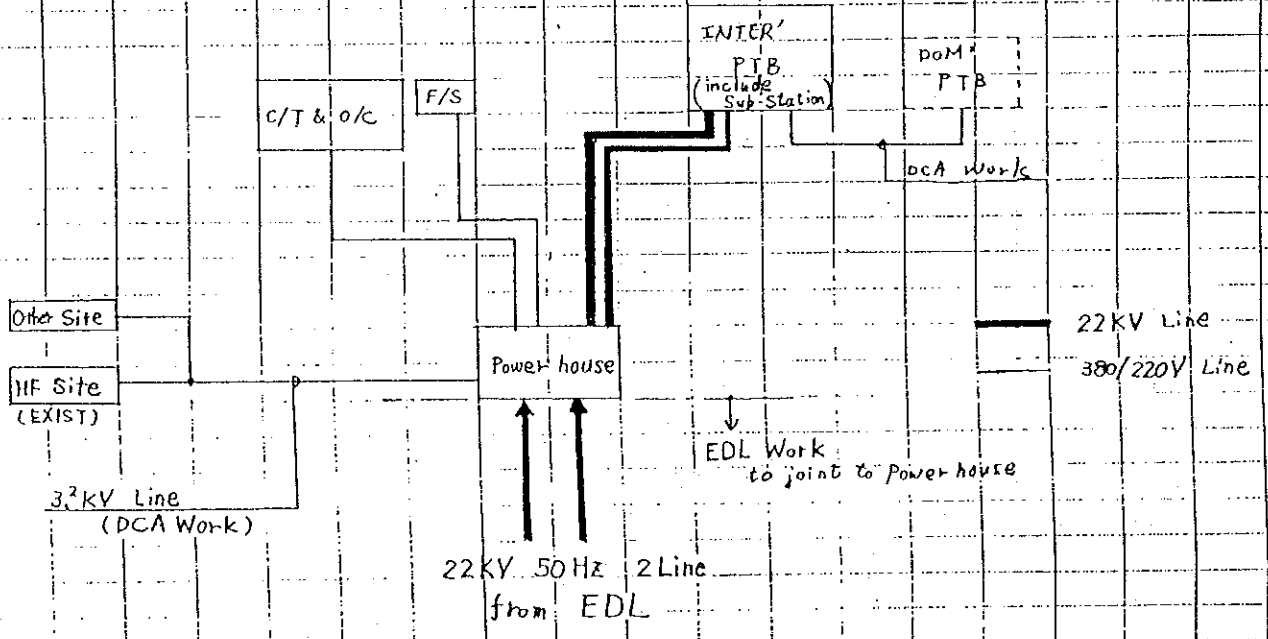
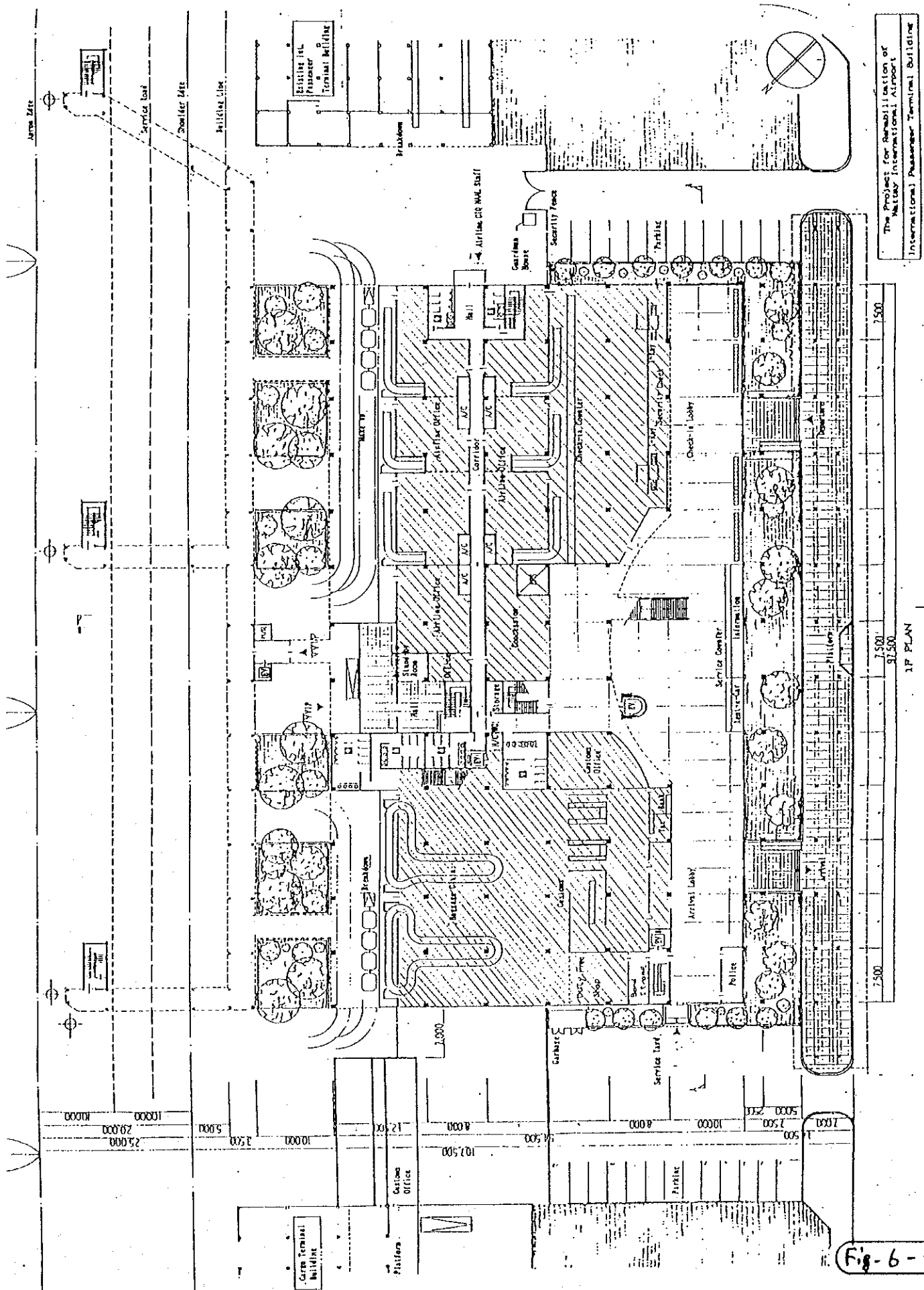

Fig.-5



The Project for Rehabilitation of Hattay International Airport International Passenger Terminal Building

7,500
91,500
7,500

1/P PLAN

Fig-6-1

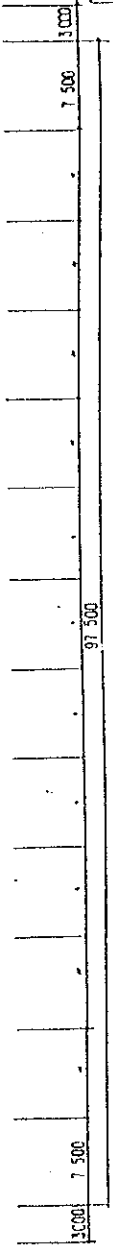
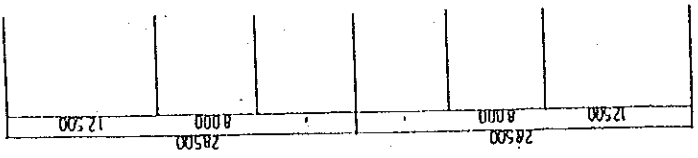
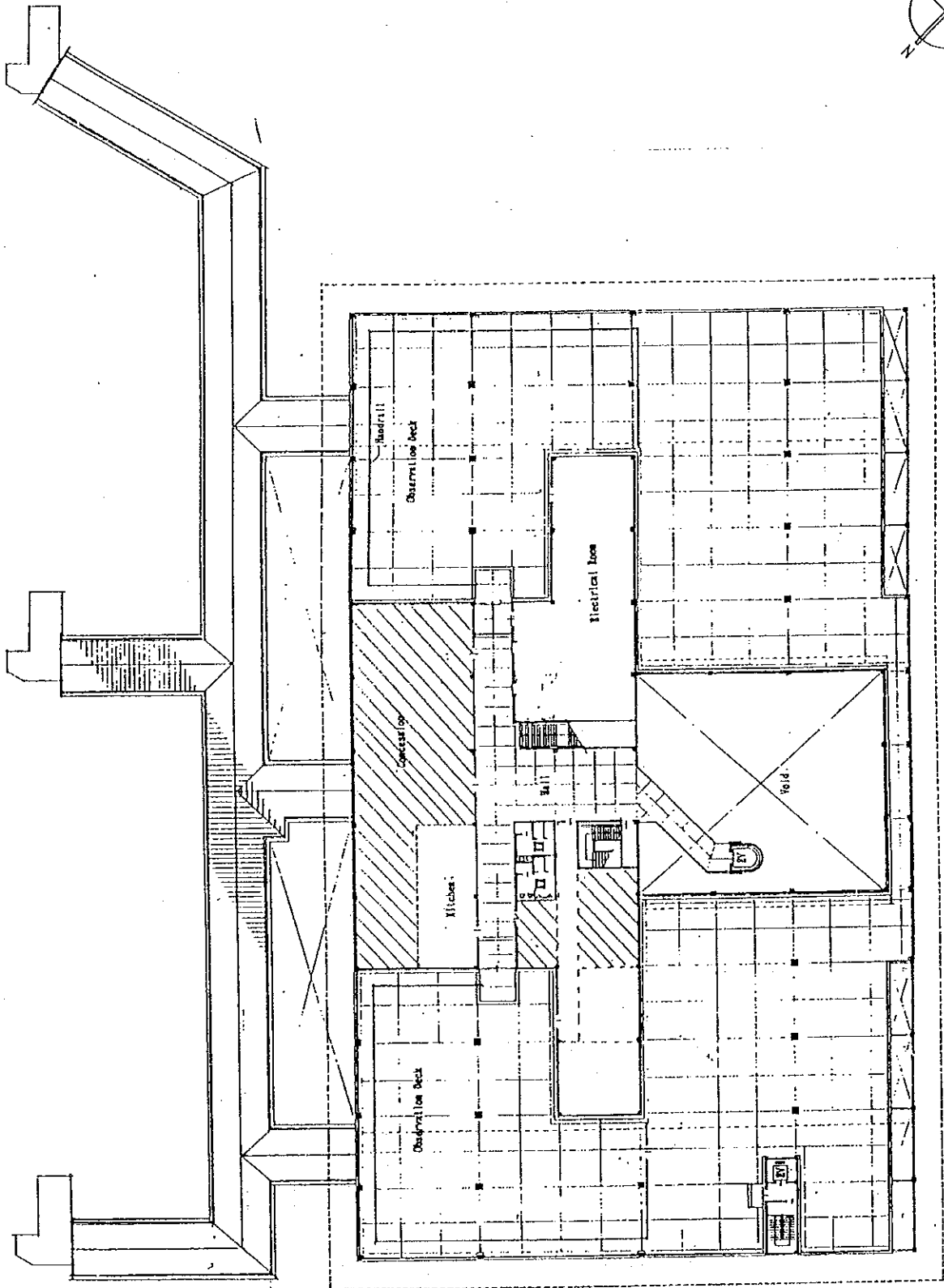

Fig.-6-3

The Project for Rehabilitation of
 Watay International Airport
 International Passenger Terminal Building

SP PLAN (A-TYPE)

- 1. Office
- 2. A.C. Space
- 3. Lounge
- 4. WC
- 5. E.P.
- 6. E.P.
- 7. Hall
- 8. A.C. Space
- 9. Reception Room
- 10. Reception Office
- 11. Reception Office
- 12. Reception Room
- 13. Parts Storage
- 14. A.C. Space
- 15. Plant
- 16. Director's Room
- 17. Secretary's Room
- 18. Deputy Director's Room
- 19. Staff Room
- 20. Training Room
- 21. Storage
- 22. Storage
- 23. Storage
- 24. Storage
- 25. Conference Room

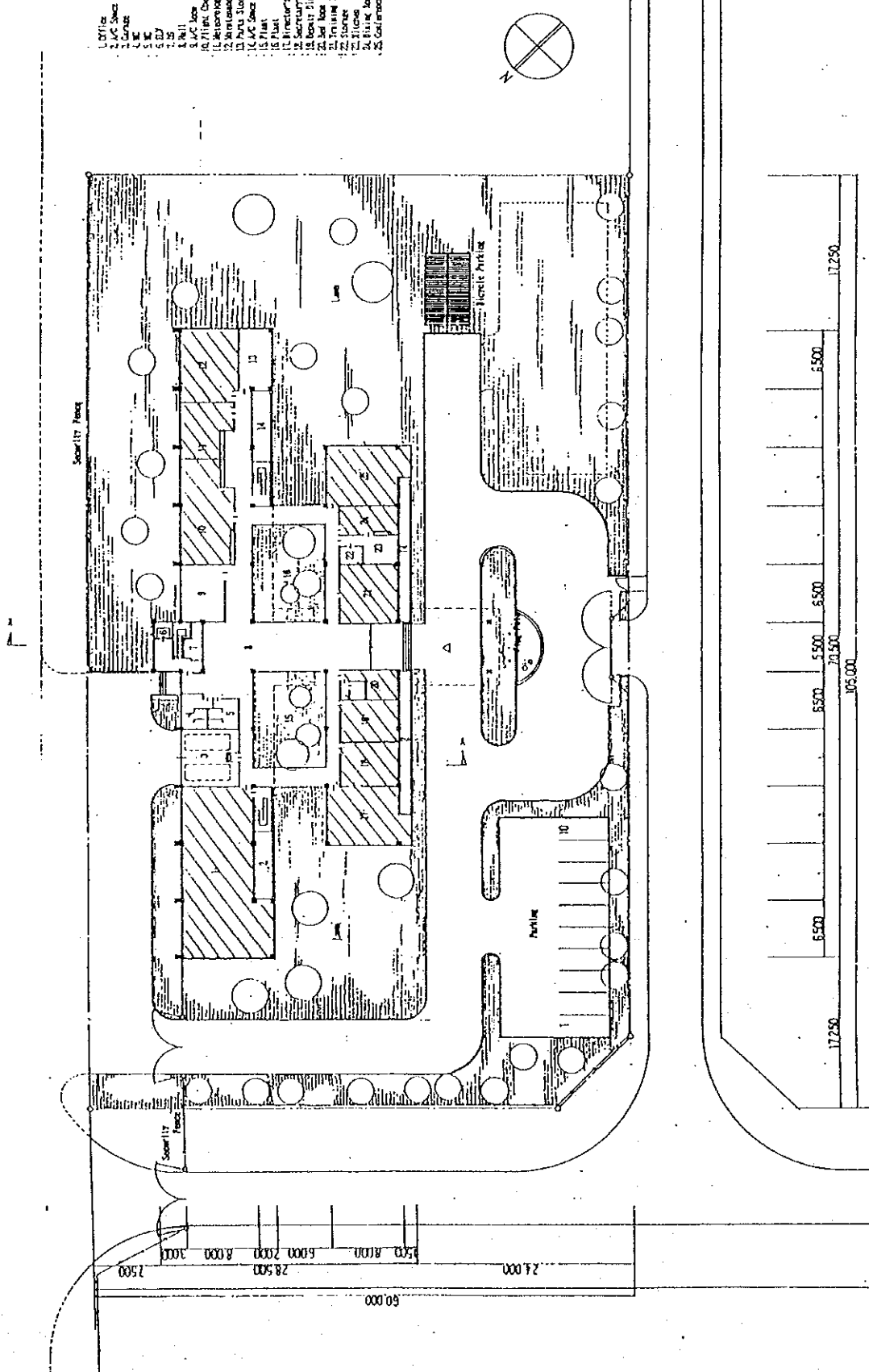

Fig-6-4

1/P PLAN

The Project for Rehabilitation of
 Malibay International Airport
 Control Tower and Operation Building

- 11 Electrical Room
- 12 Weather Observation Room
- 13 Weather Observation Room
- 14 Weather Observation Room
- 15 Weather Observation Room
- 16 Weather Observation Room
- 17 Weather Observation Room
- 18 Weather Observation Room
- 19 Weather Observation Room
- 20 Weather Observation Room
- 21 Weather Observation Room
- 22 Weather Observation Room
- 23 Weather Observation Room
- 24 Weather Observation Room
- 25 Weather Observation Room
- 26 Weather Observation Room
- 27 Weather Observation Room
- 28 Weather Observation Room
- 29 Weather Observation Room
- 30 Weather Observation Room
- 31 Weather Observation Room
- 32 Weather Observation Room
- 33 Weather Observation Room
- 34 Weather Observation Room
- 35 Weather Observation Room
- 36 Weather Observation Room
- 37 Weather Observation Room
- 38 Weather Observation Room
- 39 Weather Observation Room
- 40 Weather Observation Room
- 41 Weather Observation Room
- 42 Weather Observation Room
- 43 Weather Observation Room
- 44 Weather Observation Room
- 45 Weather Observation Room
- 46 Weather Observation Room
- 47 Weather Observation Room
- 48 Weather Observation Room
- 49 Weather Observation Room
- 50 Weather Observation Room
- 51 Weather Observation Room
- 52 Weather Observation Room
- 53 Weather Observation Room
- 54 Weather Observation Room
- 55 Weather Observation Room
- 56 Weather Observation Room
- 57 Weather Observation Room
- 58 Weather Observation Room
- 59 Weather Observation Room
- 60 Weather Observation Room
- 61 Weather Observation Room
- 62 Weather Observation Room
- 63 Weather Observation Room
- 64 Weather Observation Room
- 65 Weather Observation Room
- 66 Weather Observation Room
- 67 Weather Observation Room
- 68 Weather Observation Room
- 69 Weather Observation Room
- 70 Weather Observation Room
- 71 Weather Observation Room
- 72 Weather Observation Room
- 73 Weather Observation Room
- 74 Weather Observation Room
- 75 Weather Observation Room
- 76 Weather Observation Room
- 77 Weather Observation Room
- 78 Weather Observation Room
- 79 Weather Observation Room
- 80 Weather Observation Room
- 81 Weather Observation Room
- 82 Weather Observation Room
- 83 Weather Observation Room
- 84 Weather Observation Room
- 85 Weather Observation Room
- 86 Weather Observation Room
- 87 Weather Observation Room
- 88 Weather Observation Room
- 89 Weather Observation Room
- 90 Weather Observation Room
- 91 Weather Observation Room
- 92 Weather Observation Room
- 93 Weather Observation Room
- 94 Weather Observation Room
- 95 Weather Observation Room
- 96 Weather Observation Room
- 97 Weather Observation Room
- 98 Weather Observation Room
- 99 Weather Observation Room
- 100 Weather Observation Room



5P PLAN

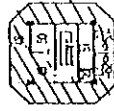

4P PLAN

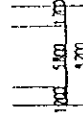

3P PLAN

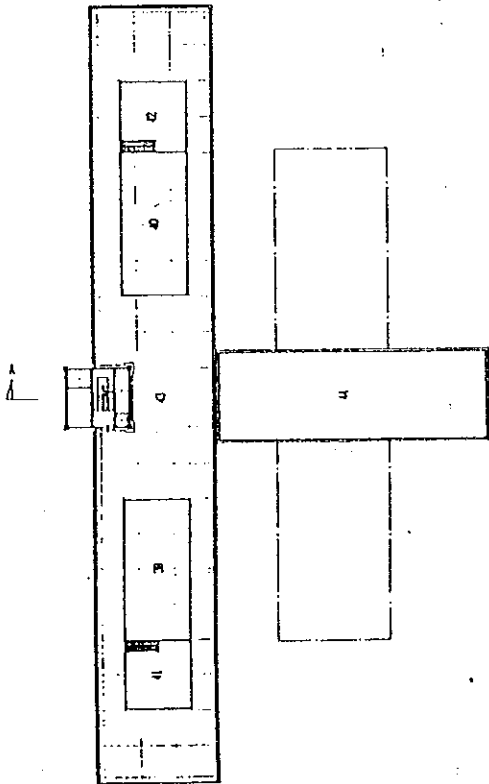

ROOF PLAN

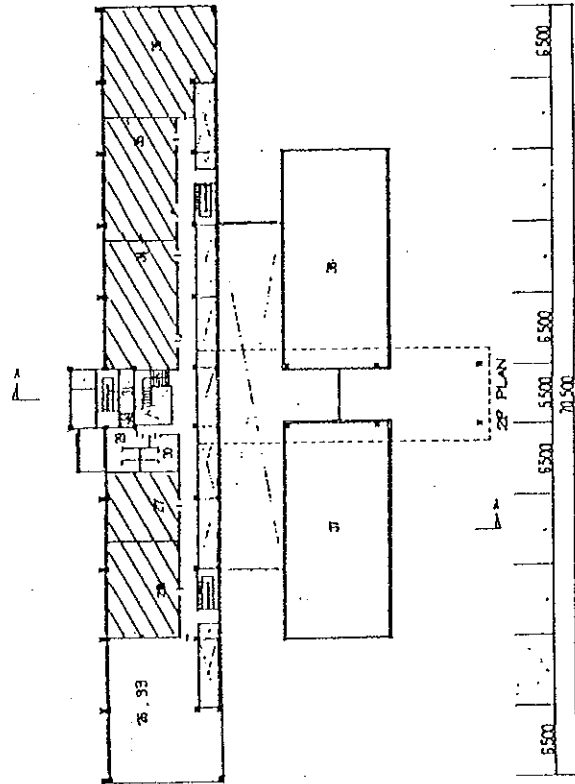

2P PLAN

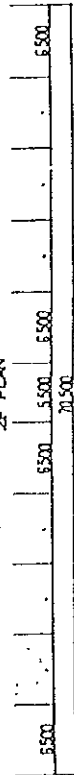
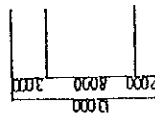
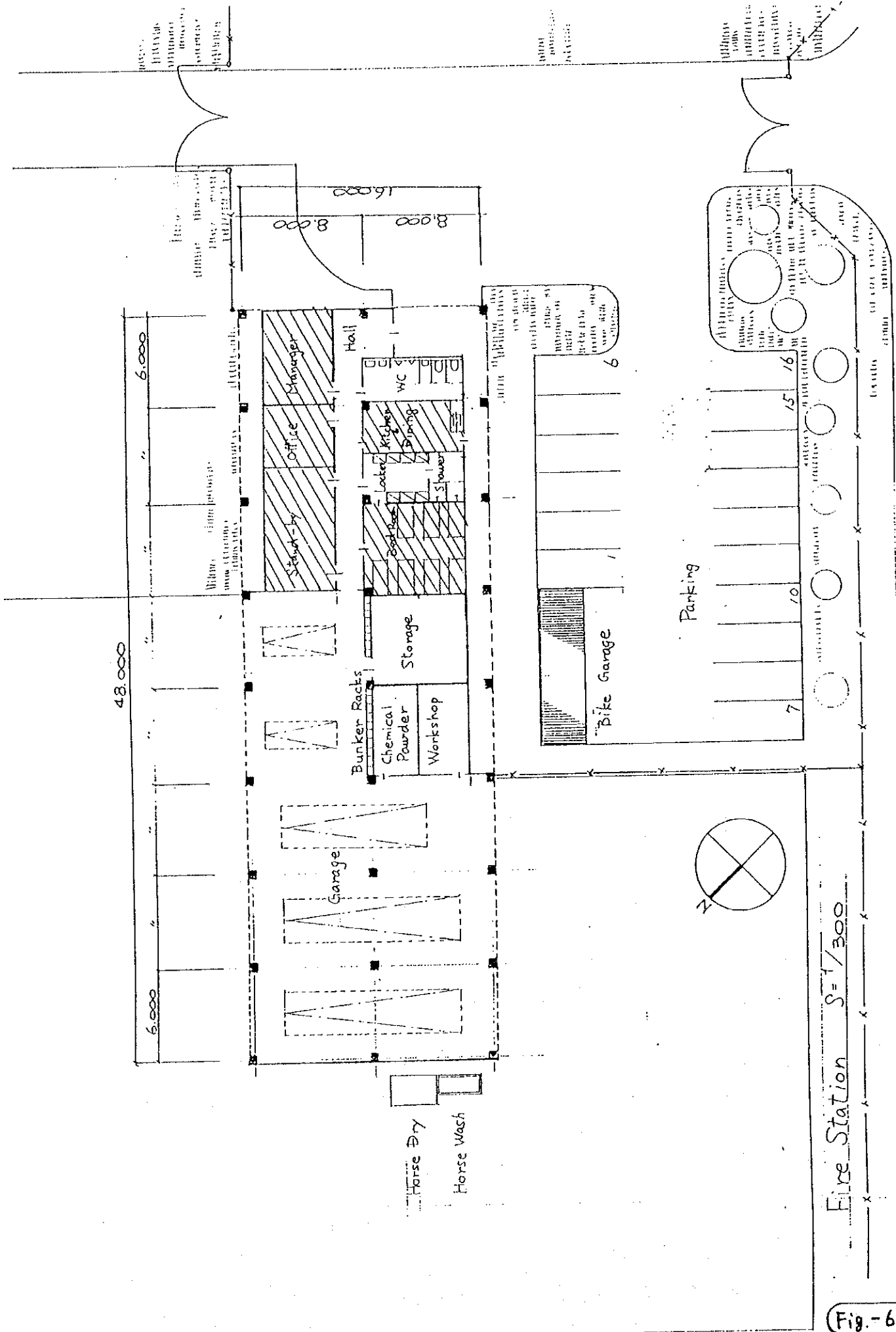
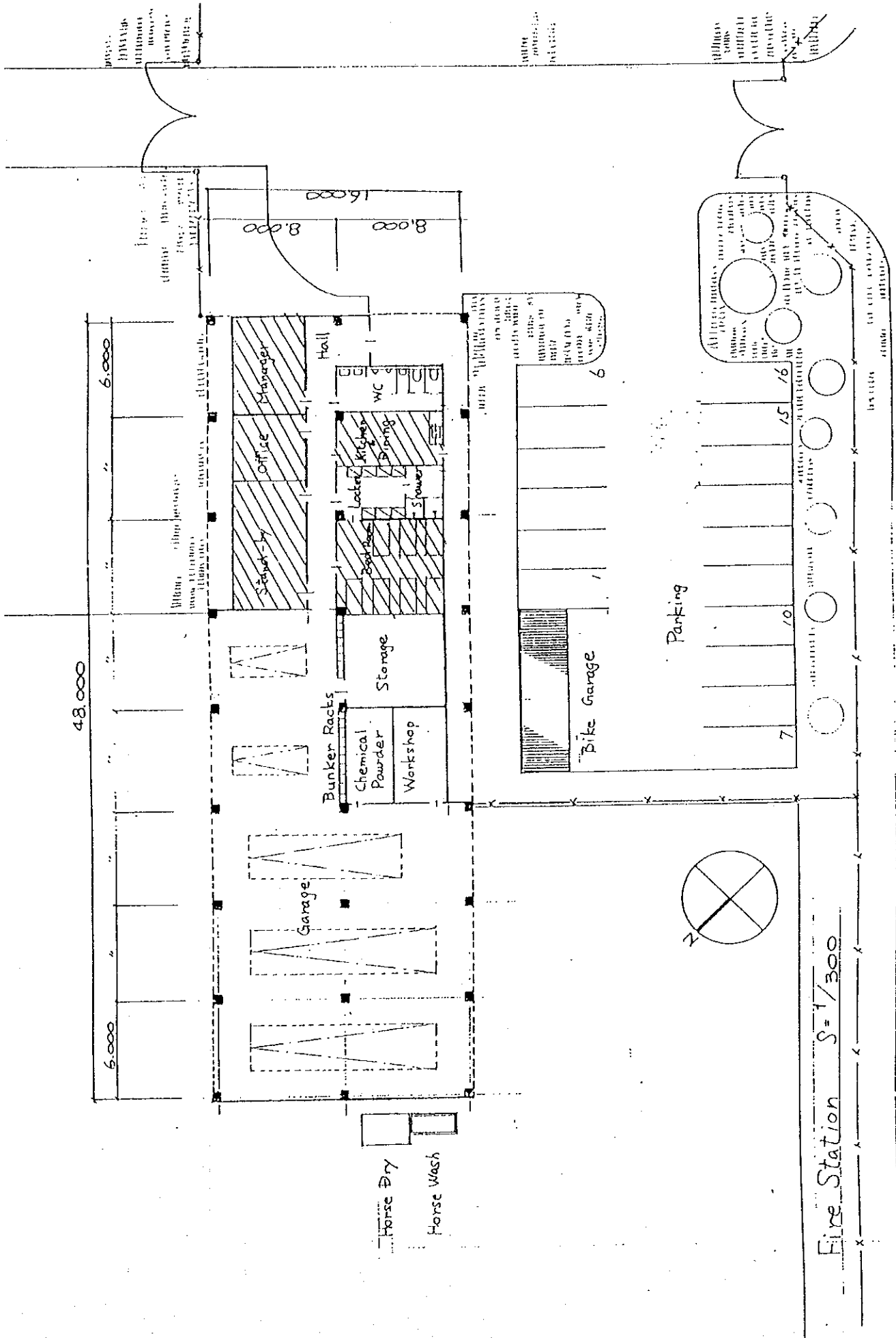

Fig.-6-5



Fire Station S-1/300

Fig.-6-1



Fire Station S-1/300

Fig.-6-6

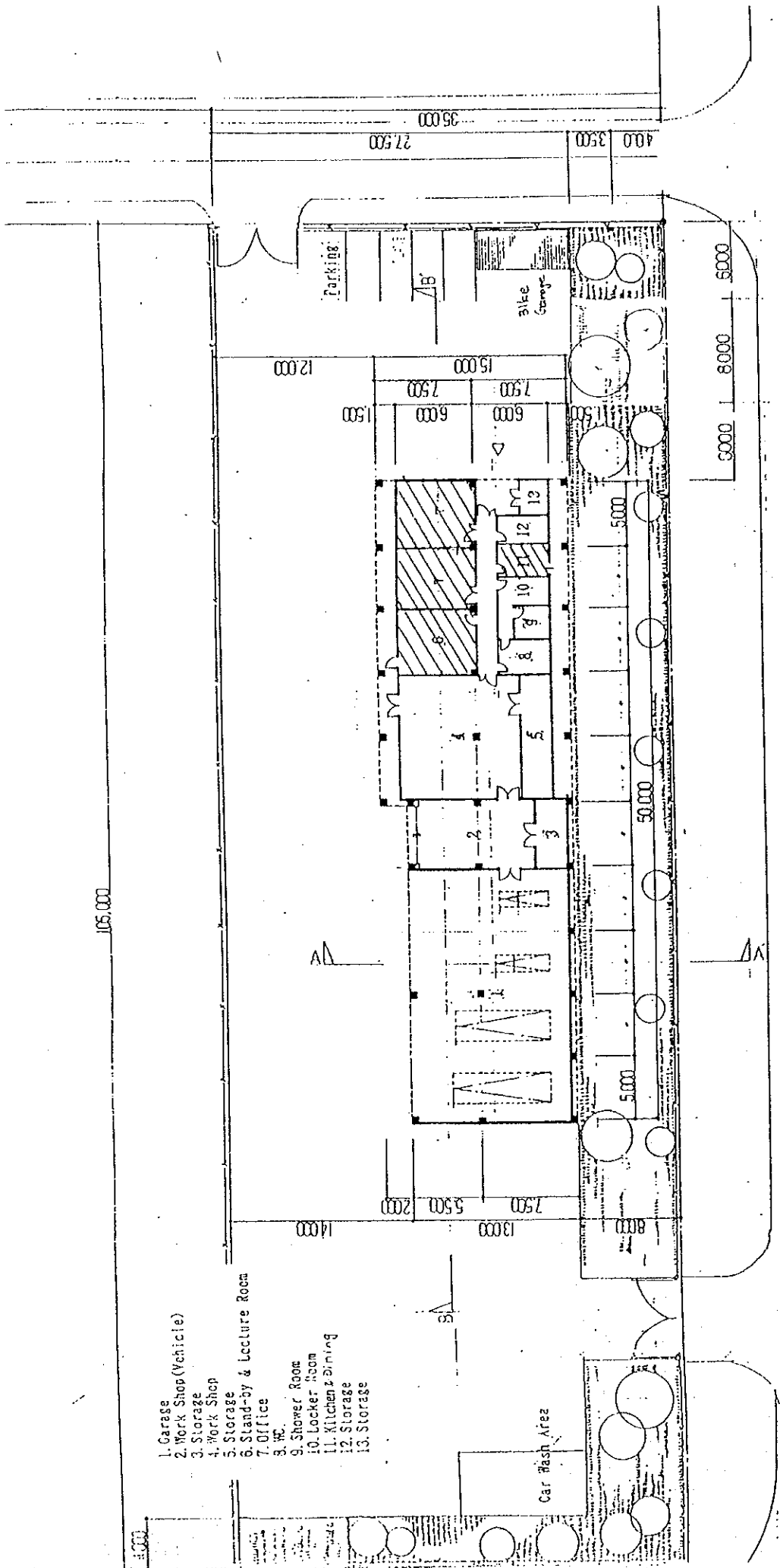

- 1. Garage
- 2. Work Shop (Vehicle)
- 3. Storage
- 4. Work Shop
- 5. Storage
- 6. Stand-by & Lecture Room
- 7. Office
- 8. WC
- 9. Shower Room
- 10. Locker Room
- 11. Kitchen & Dining
- 12. Storage
- 13. Storage

Car Wash Area

Parking

bike Garage

Maintenance Workshop

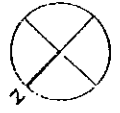

Fig-6-

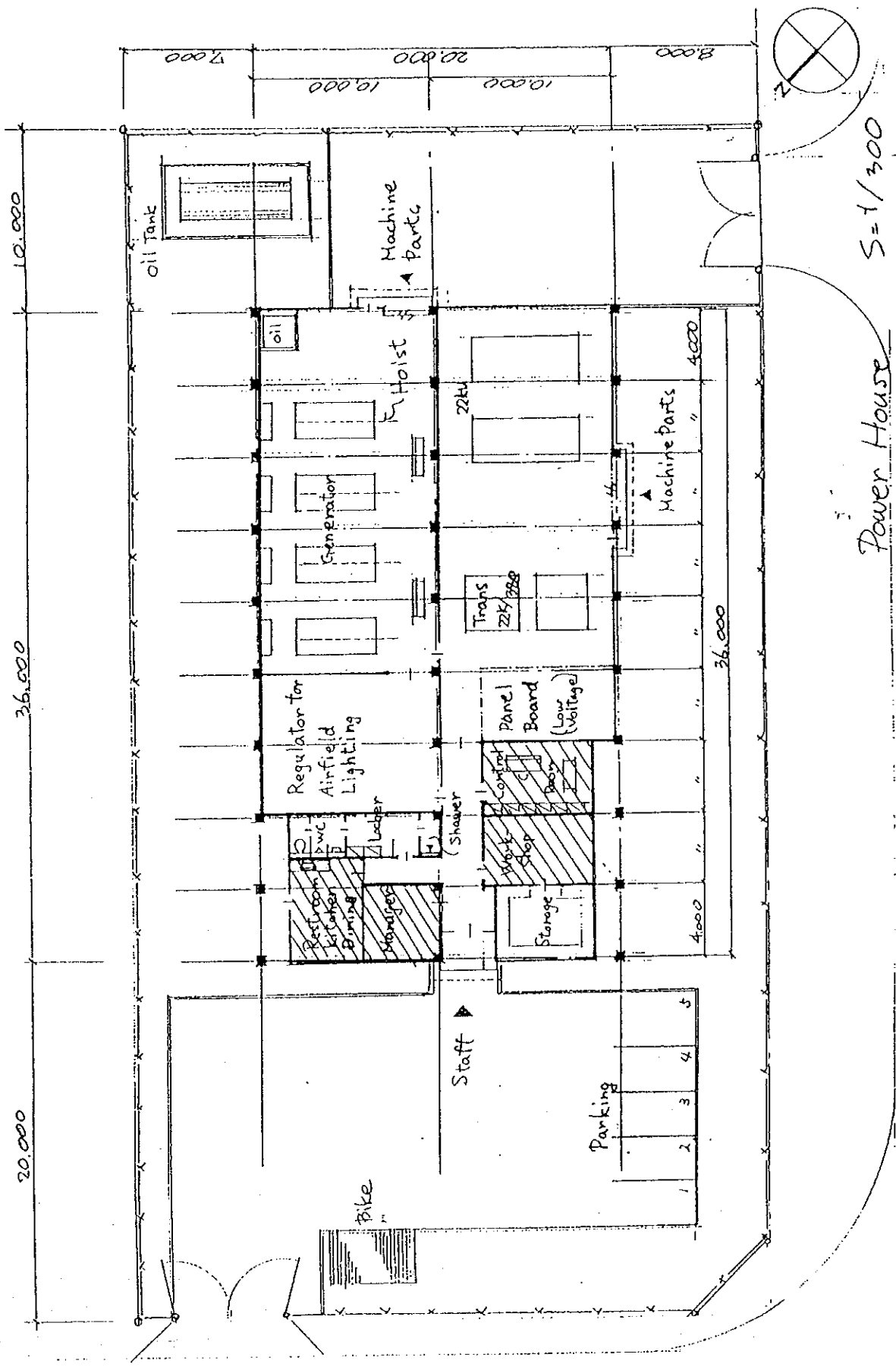

Fig.-6-8

MINUTES OF DISCUSSIONS
OF
THE BASIC DESIGN STUDY ON THE PROJECT FOR
REHABILITATION OF WATTAY INTERNATIONAL AIRPORT
IN
THE LAO PEOPLE'S DEMOCRATIC REPUBLIC
(CONSULTATION ON DRAFT FINAL REPORT)

In August and October 1994, the Japan International Cooperation Agency (JICA) dispatched the Basic Design Study Team on the Project for Rehabilitation of Wattay International Airport (hereinafter referred to as "the Project") to the Lao People's Democratic Republic. Through discussions, field survey, and technical examination of the survey results in Japan, JICA has prepared the draft final report of the study.

In order to explain and to consult the Lao side on the components of the draft final report, JICA sent to Lao PDR a study team, which is headed by Mr. Michio Kanda, Deputy Managing Director, Grant Aid Project Management Department, JICA, and is scheduled to stay in the country from February 9 to 18, 1995.

As a result of discussions, both parties have confirmed the main items described on the attached sheets.

Vientiane, February 17, 1995

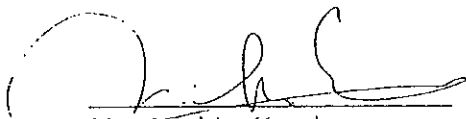

Mr. Michio Kanda
Leader
Basic Design Study Team
JICA

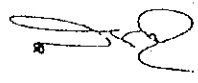

Mr. Sadaphet Bodhivarn
Director General
Department of Civil Aviation
Prime Minister's Office

ATTACHMENT

1. Components of Draft Final Report

The Government of Lao PDR has agreed and accepted in principle the components of the draft final report proposed by the Team.

Both sides have shared the view that the rehabilitation of the ILS (Instrumental Landing System) has high priority in terms of international safety standard recommended by ICAO.

2. Coordination of Other Works

For the smooth implementation of the Project, The Team recommended the Lao Government to take necessary measures to coordinate related activities by other donors implementation program.

3. Japan's Grant Aid System

(1) The Government of Lao PDR has understood the system of Japan's Grant Aid explained by the Team.

(2) The Government of Lao PDR will take necessary measures, described in ANNEX for smooth implementation of the Project, on the condition that the Grant Aid Assistance by the Government of Japan is extended to the Project.

4. Further Schedule

The Team will make the final report in accordance with the confirmed items, and send it to the Government of Lao PDR and Government of Japan by April, 1995.

b

68

Annex : Necessary measures to be taken by the Government of Lao PDR
in case Japan's Grant Aid is executed

1. To secure and clear the site for the Project
2. To announce and coordinate with the airport users for the change in use of the airport facilities during the construction
3. To undertake incidental outdoor works such as gardening in the site and fencing, gates around the site
4. To construct the access road to the site prior to commencement of the construction
5. To provide facilities for distribution of electricity, water supply, telephone, drainage, sewage and other incidental facilities to the Project site
 - 1) Electricity distributing line to the site
 - 2) City water distribution main to the site
 - 3) Drainage city main to the site
 - 4) Telephone trunk line and the main distribution panel of building
 - 5) General administrative furniture such as carpets, curtains, tables, chairs and others
 - 6) Tenants' equipment and furniture such as kitchen equipment, tables and chairs in restaurants and showcases in shops
6. To bear commissions to the Japanese foreign exchange bank for the banking services based upon Banking Arrangement
7. To exempt taxes and to take necessary measures for custom clearance of the materials and equipment brought for the Project at the port of disembarkation
8. To accord Japanese Nationals whose services may required in connection with the supply of products and services under the verified contract such facilities as may be necessary for their entry into Lao PDR and stay therein for the performance of their work
9. To exempt Japanese Nationals from custom duties, internal taxes and other fiscal levies with respect to the supply of products and services under the verified contracts
10. To maintain and use properly and effectively that the facilities constructed and equipment purchased under the Grant
11. To bear all the expenses other than those to be borne by the Grant, necessary for construction of the facilities as well as for the transportation and the installation of the equipment

Memorandum

Feb. 17 1995

1. The Lao Government commented on the following items on the draft final report;
 - to install more than two passenger boarding bridges (PBB),
 - to make the airside corridor be air-conditioned,
 - to equip CCTV system in the international passenger terminal building,
 - to prepare operation/maintenance program,
 - to relocate the sewage treatment tank apart from residential area, and to adjust the sewage treatment system with that of Vientiane city under planning,
 - to provide baggage carts,
 - to rearrange road system by providing direct return road from new domestic passenger terminal building for reducing through traffic in front of new international passenger terminal building,
 - to keep VIP loading and unloading of their car out of public sight, and
 - to change exterior sign of airport name from "Vientiane International Airport" to "Wattay International Airport" in Lao language.

The Study Team accepted to study underlined items.

2. Proposed installation of ILS in Japanese portion will not include;
 - to replace simple approach lights by approach lights, (NDF)
 - to readjust runway strip of 300m width according to ICAO recommendation, (ADB)
 - to provide conduit pipes under taxiways for installation of ILS cables, (Lao Government)
 - to provide runway visual range (RVR) and ceilometers, (NDF)
 - to prepare ground certainly graded according to ICAO recommendation in front of GS antenna and around LLZ and (Lao Government)
 - to conduct flight check on ILS facilities. (Lao Government)
3. The Study Team recommended to adopt airport category "7" instead of "8" described in the draft final report in concerned with fire fighting, as a result of that, the number of fire fighting vehicles provided in this project will be reduced by one major vehicle (MJV). The Lao Government accepted this alteration.
4. The Study Team mentioned that it is difficult to provide the survey equipment for airport maintenance purpose, which is described to be a part of airport maintenance equipment in the draft final report. The Lao Government understood the situation and accepted exclusion of the survey equipment in this project.
5. Attached sheets show draft layout plans of concessions in the international passenger terminal building.

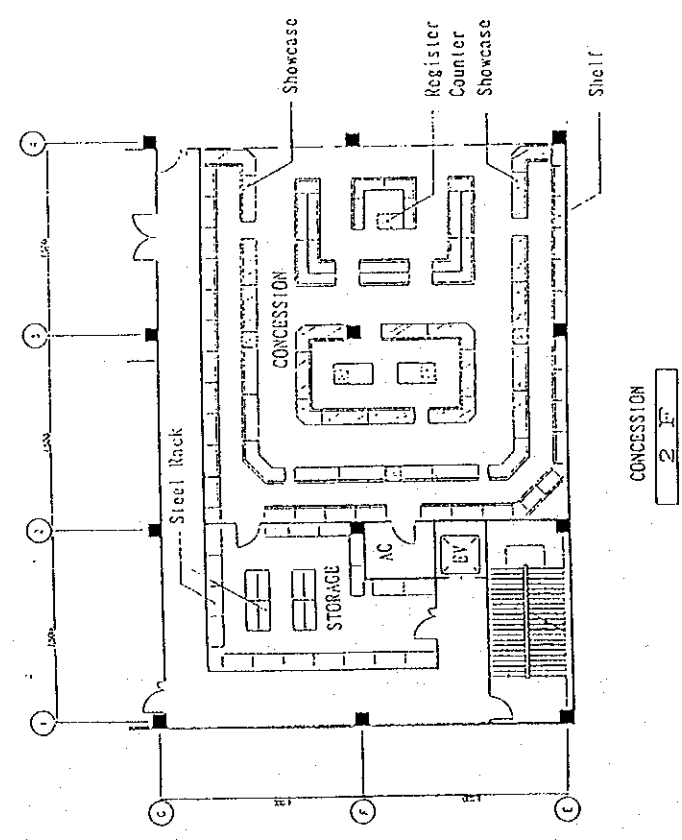
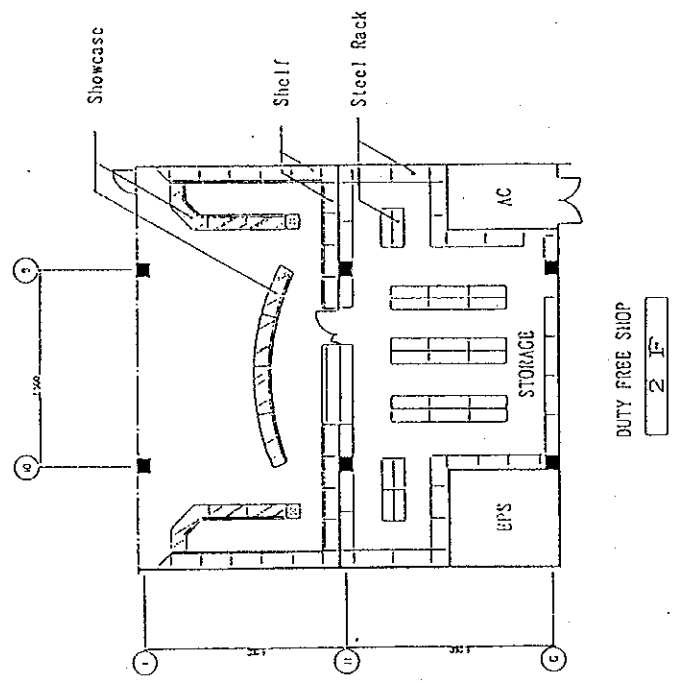
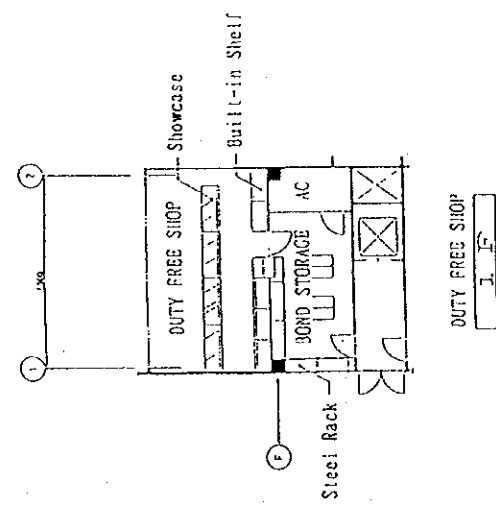
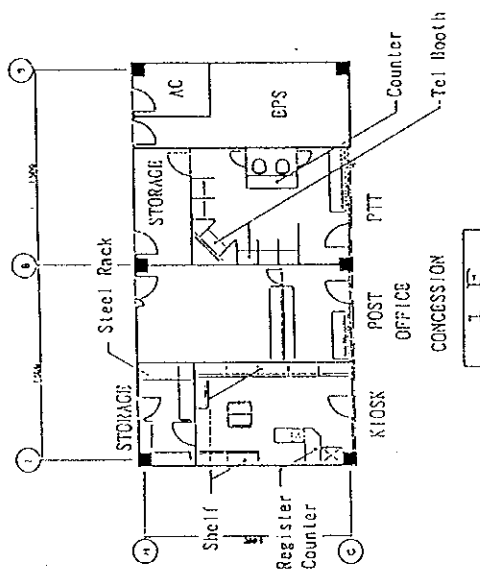
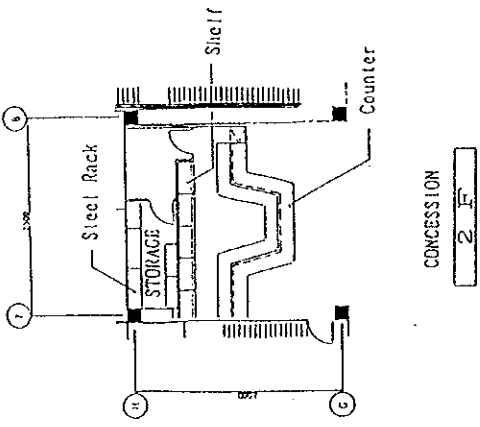

THE PROJECT FOR REHABILITATION OF WATTAY INTERNATIONAL AIRPORT

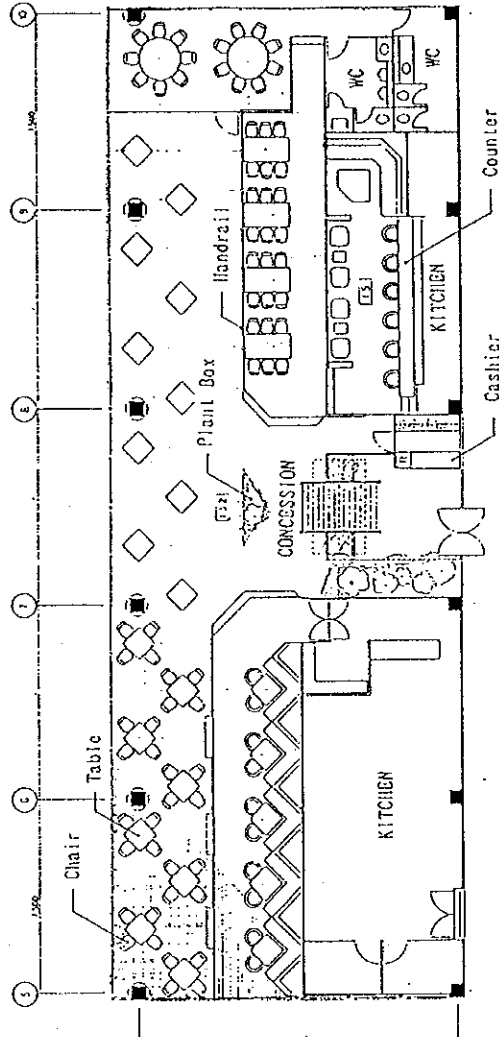
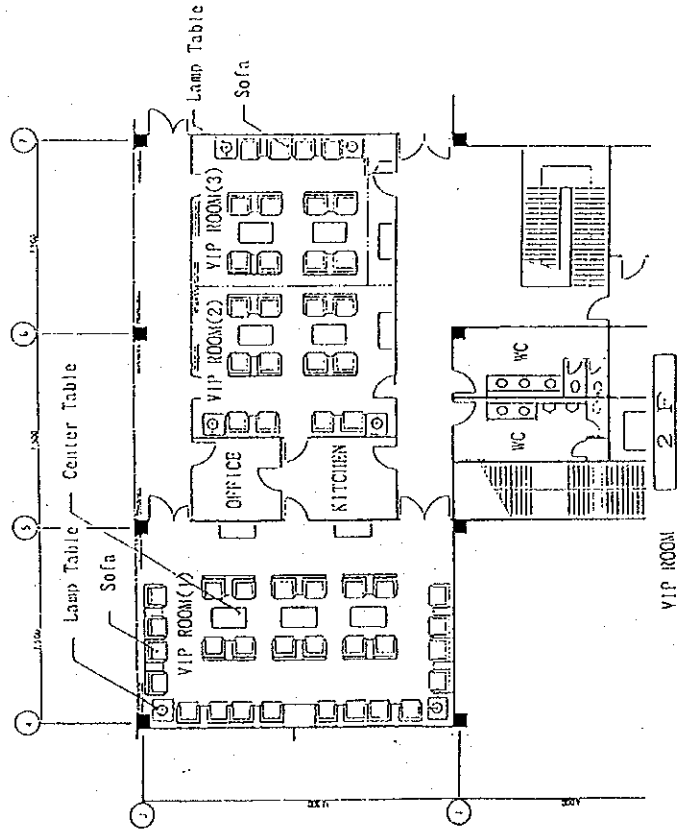
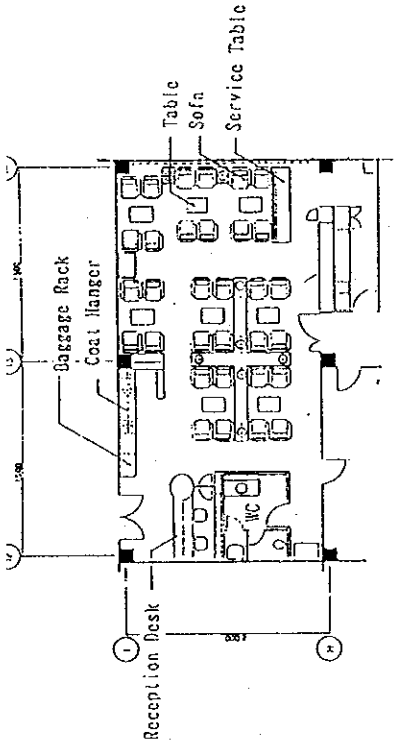
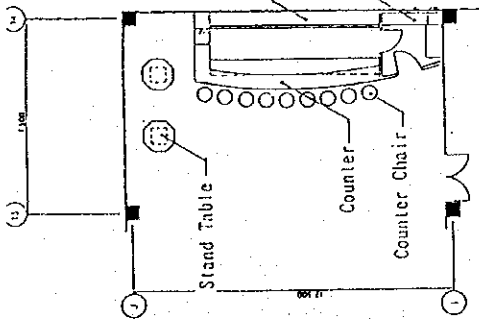

国名	ラオス人民民主共和国
	Lao People's Democratic Republic

一般指標					
政体	民主共和制	*1	面積	236.0 千Km ²	*1
元首	President NOUHAK Phoumsavan	*1	人口	4,568 千人 (1993年)	*1
独立年月日	1949年07月19日	*1	首都	ヴェンチャン	*1
人種(部族)構成	ラオ50%、ボータン15%	*1	主要都市名	サハナット	*1
		*1	経済活動可人口	— 千人	*1
言語・公用語	ラオス語	*1	義務教育年数	2 年間 (1992年)	*2
宗教	仏教85%	*1	初等教育就学率	59.0% (1990年)	*2
国連加盟	1955年12月	*1	識字率	84.0% (1985年)	*1
世銀・IMF加盟	1961年07月	*1	人口密度	19.0人/Km ² (1992年)	*2
			人口増加率	2.86% (1993年)	*2
			平均寿命	平均 51.18 男 49.7 女 52.8	*1
			5歳児未満死亡率	104.4/1000 (1993年)	*1
			カロリー供給量	2,470.0 cal/日/人 (1990年)	*2

経済指標					
通貨単位	キープ	*1	貿易量		*3
為替レート(1US\$)	1US\$= —	*3	輸出	— 百万ドル	*2
会計年度	7月～ 6月	*1	輸入	— 百万ドル	*2
国家予算		*2	輸入依存率	3.3% (1990年)	*4
歳入	— 百万ドル	*2	主要輸出品目	電気、木材製品、コーヒー	*1
歳出	— 百万ドル	*2	主要輸入品目	食品、燃料、消費財	*1
国際収支	— 百万ドル	*2	日本への輸出	12.0 百万ドル (1992年)	*5
ODA受取額	173.00 百万ドル (1992年)	*2	日本からの輸入	28.0 百万ドル (1992年)	*5
国内総生産(GDP)	1,195.00 百万ドル (1992年)	*4			
一人当たりGNP	220.0 ドル (1991年)	*2	外貨準備総額	— 百万ドル	*1
GDP産業別構成	農業 — %	*2	対外債務残高	1,922.0 百万ドル (1992年)	*4
	鉱工業 — %		対外債務返済率	8.9% (1991年)	*4
	サービス業 — %		インフレ率	10.3% (1992年)	*2
産業別雇用	農業 76.0% (1992年)	*2			
	鉱工業 7.0% (1992年)				
	サービス業 17.0% (1992年)		国家開発計画	第3次経済社会発展5ヵ年計画	*5
経済成長率	7.0% (1992年)	*4			

気象(1970年～1979年平均) 場所: Vientiane (標高 162m)													
月	1	2	3	4	5	6	7	8	9	10	11	12	平均/計
最高気温	28.0	30.0	33.0	34.0	32.0	32.0	31.0	31.0	31.0	31.0	29.0	28.0	30.8℃
最低気温	14.0	17.0	19.0	23.0	23.0	24.0	24.0	24.0	24.0	21.0	18.0	16.0	20.5℃
平均気温	21.0	23.5	26.0	28.5	27.5	28.0	27.5	27.5	27.5	26.0	23.5	22.0	25.7℃
降水量	5.0	15.0	38.0	99.0	267.0	302.0	267.0	292.0	302.0	109.0	15.0	3.0	142.8 mm
雨期/乾期	乾				雨	雨	雨	雨	雨	雨		乾	乾

*1 The World Factbook(C.I.A)(1993)
 *2 Human Development Report(UNDP)(1994)
 *3 International Financial Statistics(IMF)(1995)
 *4 World Debt Tables(WORLD)(1994)
 *5 世界の国一覽(外務省外務報道官編集)(1993)
 *6 World Weather Guide(1990)

国名	ラオス人民民主共和国
	Lao People's Democratic Republic

1995.03 2/2

*7

項目	年度	1989	1990	1991	1992
無償資金協力		2,043.46	2,382.47	2,515.30	2,699.97
技術協力		2,146.74	1,989.63	2,050.70	2,194.95
有償資金協力		5,161.42	5,676.39	7,364.47	5,852.05
総 額		9,351.62	10,048.49	11,930.47	10,746.97

*7

項目	歴年	1989	1990	1991	1992
無償資金協力		2.94	3.63	7.35	7.16
技術協力		18.29	15.48	15.09	19.62
有償資金協力		-1.84	-1.75	-1.88	-2.00
総 額		19.39	17.36	20.56	24.78

*8

	贈 与 (1)		有償資金協力 (2)	政府開発援助 (ODA) (1) + (2) = (3)	その他政府資 金及び民間資 金 (4)	経済協力総額 (3) + (4)
		技術協力				
二国間援助 (主要供与国)	78.90	32.40	-2.00	109.30	0.00	109.30
1. 日本	26.80	7.20	-2.00	32.00	0.00	32.00
2. スウェーデン	15.90	7.30	0.00	23.20	0.00	23.20
3. オーストラリア	10.60	1.80	0.00	12.40	0.00	12.40
4. フランス	8.60	5.10	0.00	13.70	0.00	13.70
多国間援助 (主要援助機関)	28.70	16.70	60.40	105.80	0.00	105.80
	0.00	0.00	0.00	0.00	0.00	0.00
	0.00	0.00	0.00	0.00	0.00	0.00
そ の 他	0.00	0.00	0.00	0.00	0.00	0.00
合 計	107.60	49.10	58.40	215.10	0.00	215.10

*9

技術	関係各省庁機関→対外経済関係省
無償	関係各省庁機関→対外経済関係省
協力隊	関係各省庁機関→対外経済関係省

*7 Japan's ODA(Annual Report)(1993)

*8 Geographical Distribution of Financial Flows of Developing Countries(OECD/OCDE)(1994)

*9 国別協力情報(JICA)

JICA