

POINT NO	0	0.20	0.40	0.60	0.80	1.00	1.20	1.40	1.60	1.80	2.00	2.20	2.40	2.60	2.80	3.00	3.20	3.40	3.60	3.80	4.00	4.20	4.40	4.60	4.80	5.00	5.20	5.40	5.60	5.80	6.00
ACTUAL DISTANCE	0.00	200	400	600	800	1000	1200	1400	1600	1800	2000	2200	2400	2600	2800	3000	3200	3400	3600	3800	4000	4200	4400	4600	4800	5000	5200	5400	5600	5800	6000
ACCUMULATED DISTANCE	0	200	400	600	800	1000	1200	1400	1600	1800	2000	2200	2400	2600	2800	3000	3200	3400	3600	3800	4000	4200	4400	4600	4800	5000	5200	5400	5600	5800	6000
LOWEST SPOT OF C/SEC																															
RIGHT BANK	0.0	0.5	0.5	0.5	0.5	0.5	0.5	0.5	0.5	0.5	0.5	0.5	0.5	0.5	0.5	0.5	0.5	0.5	0.5	0.5	0.5	0.5	0.5	0.5	0.5	0.5	0.5	0.5	0.5	0.5	0.5
LEFT BANK	0.0	-0.5	-0.5	-0.5	-0.5	-0.5	-0.5	-0.5	-0.5	-0.5	-0.5	-0.5	-0.5	-0.5	-0.5	-0.5	-0.5	-0.5	-0.5	-0.5	-0.5	-0.5	-0.5	-0.5	-0.5	-0.5	-0.5	-0.5	-0.5	-0.5	-0.5

THE REPUBLIC OF INDONESIA
 DIRECTORATE GENERAL OF WATER RESOURCES DEVELOPMENT
 MINISTRY OF PUBLIC WORKS
 THE STUDY OF THE MASTER PLAN ON WATER RESOURCES
 DEVELOPMENT AND FEASIBILITY STUDY
 FOR URGENT FLOOD CONTROL AND URBAN DRAINAGE
 FOR SEMARANG CITY AND SUBURBS
 LONGITUDINAL 0.0 — 6.0
EAST FLOOD WAY
 DECEMBER 1992 SURVEY NO. 172

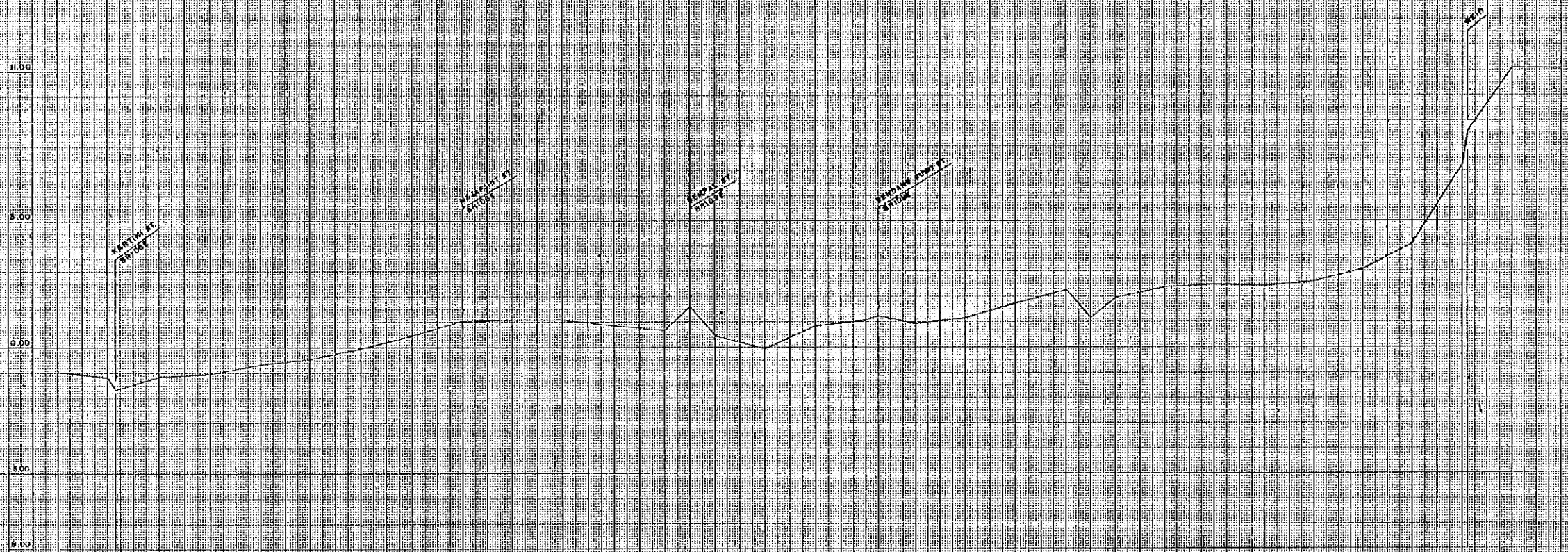

POINT NO.	0	10	20	30	40	50	60	70	80	90	100	110	120	130	140	150	160	170	180	190	200	210	220	230	240	250	260	270	280	290	300	
ACTUAL DISTANCE	0+00	100	200	300	400	500	600	700	800	900	1000	1100	1200	1300	1400	1500	1600	1700	1800	1900	2000	2100	2200	2300	2400	2500	2600	2700	2800	2900	3000	
ACCUMULATED DISTANCE		100	200	300	400	500	600	700	800	900	1000	1100	1200	1300	1400	1500	1600	1700	1800	1900	2000	2100	2200	2300	2400	2500	2600	2700	2800	2900	3000	
LOWEST SPOT OF C/SEC																																
RIGHT BANK																																
LEFT BANK																																

THE REPUBLIC OF INDONESIA
 DIRECTORATE GENERAL OF WATER RESOURCES DEVELOPMENT
 MINISTRY OF PUBLIC WORKS
 THE STUDY OF THE MASTER PLAN ON WATER RESOURCES
 DEVELOPMENT AND FEASIBILITY STUDY
 FOR URGENT FLOOD CONTROL AND URBAN DRAINAGE
 FOR SEMARANG CITY AND SUBURBS
 LONGITUDINAL 6.0 — 12.0
 EAST FLOOD WAY
 DECEMBER 1991 SHEET NO. 2/2
 JAPAN INTERNATIONAL COOPERATION AGENCY

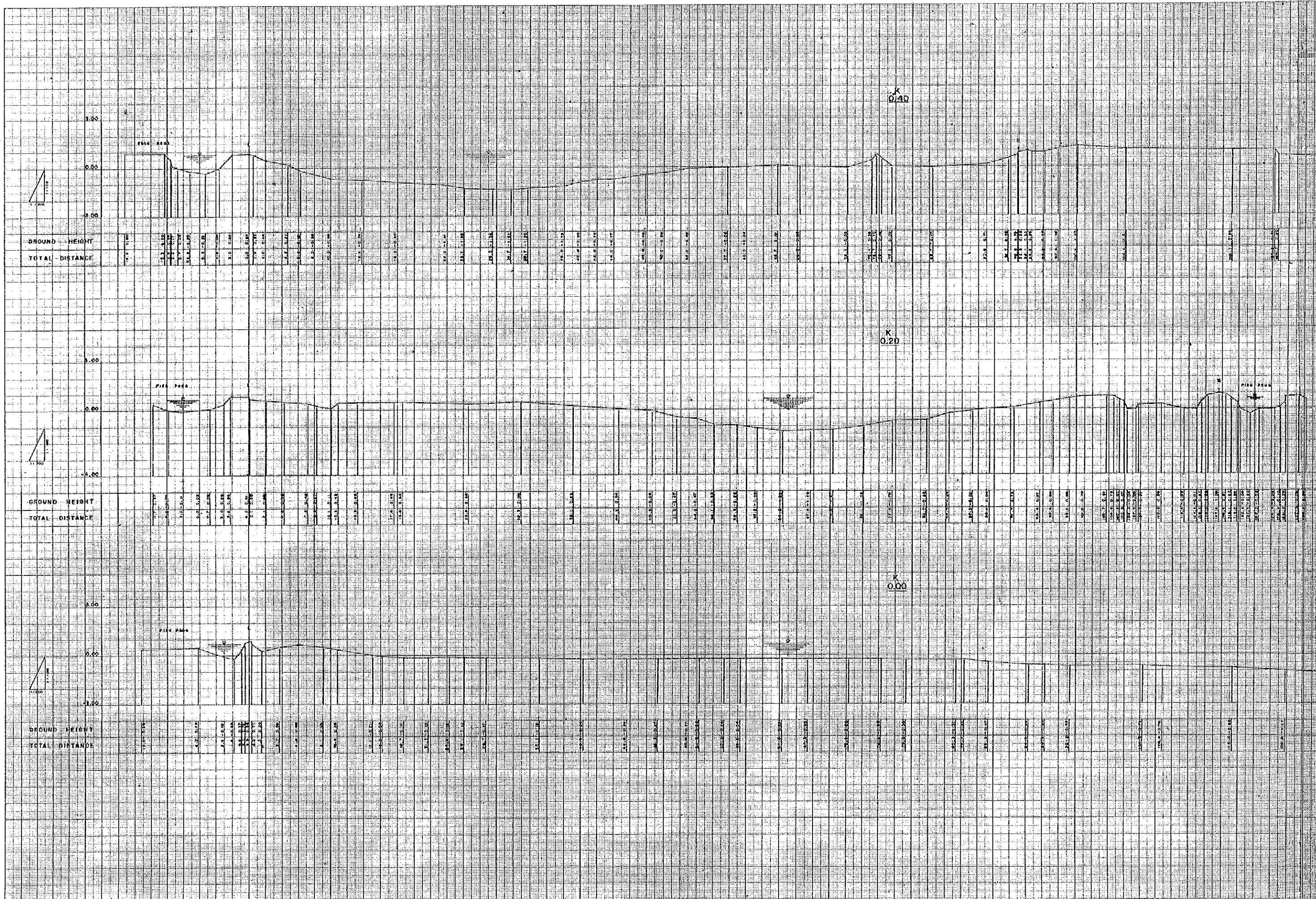

9P

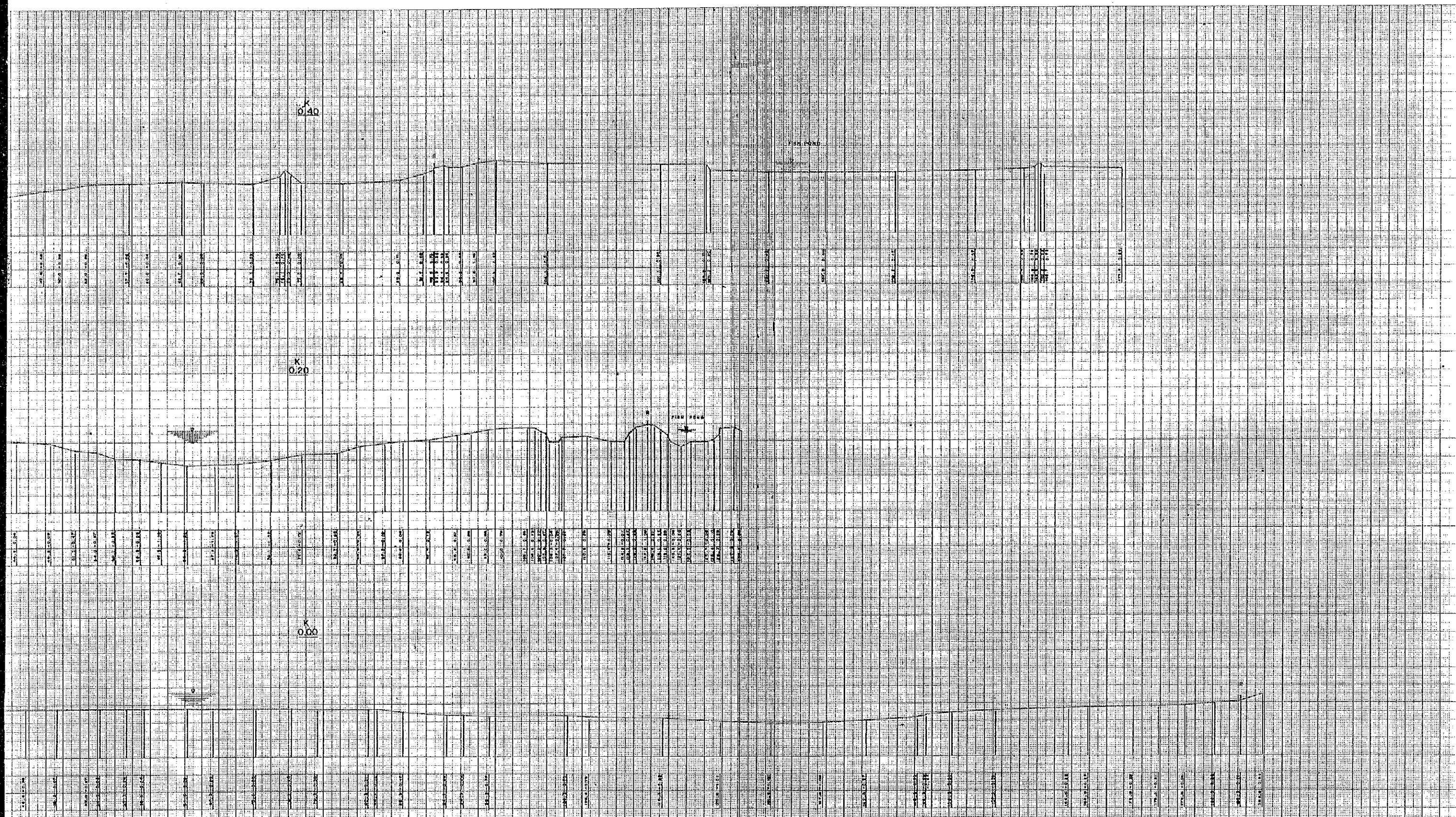

THE REPUBLIC OF INDONESIA
 DIRECTORATE GENERAL OF WATER RESOURCES DEVELOPMENT
 MINISTRY OF PUBLIC WORKS
 THE STUDY OF THE MASTER PLAN ON WATER RESOURCES
 DEVELOPMENT AND FEASIBILITY STUDY
 FOR URGENT FLOOD CONTROL AND URBAN DRAINAGE
 FOR SEMARANG CITY AND SUBURBS
 CROSS SECTION 0.0—0.4
EAST FLOOD WAY
 DECEMBER 1991 SHEET NO. 79A
 JAPAN INTERNATIONAL COOPERATION AGENCY

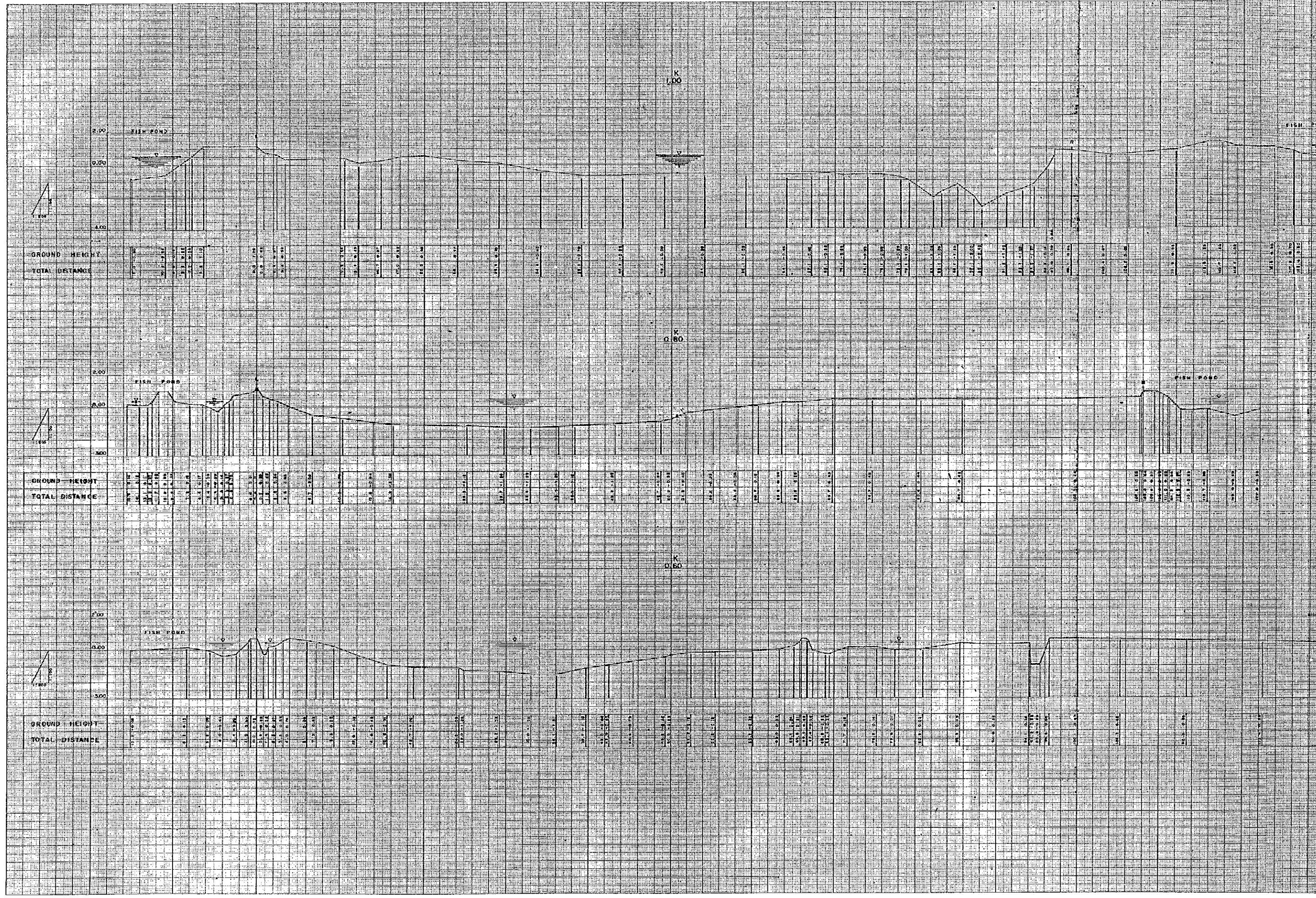

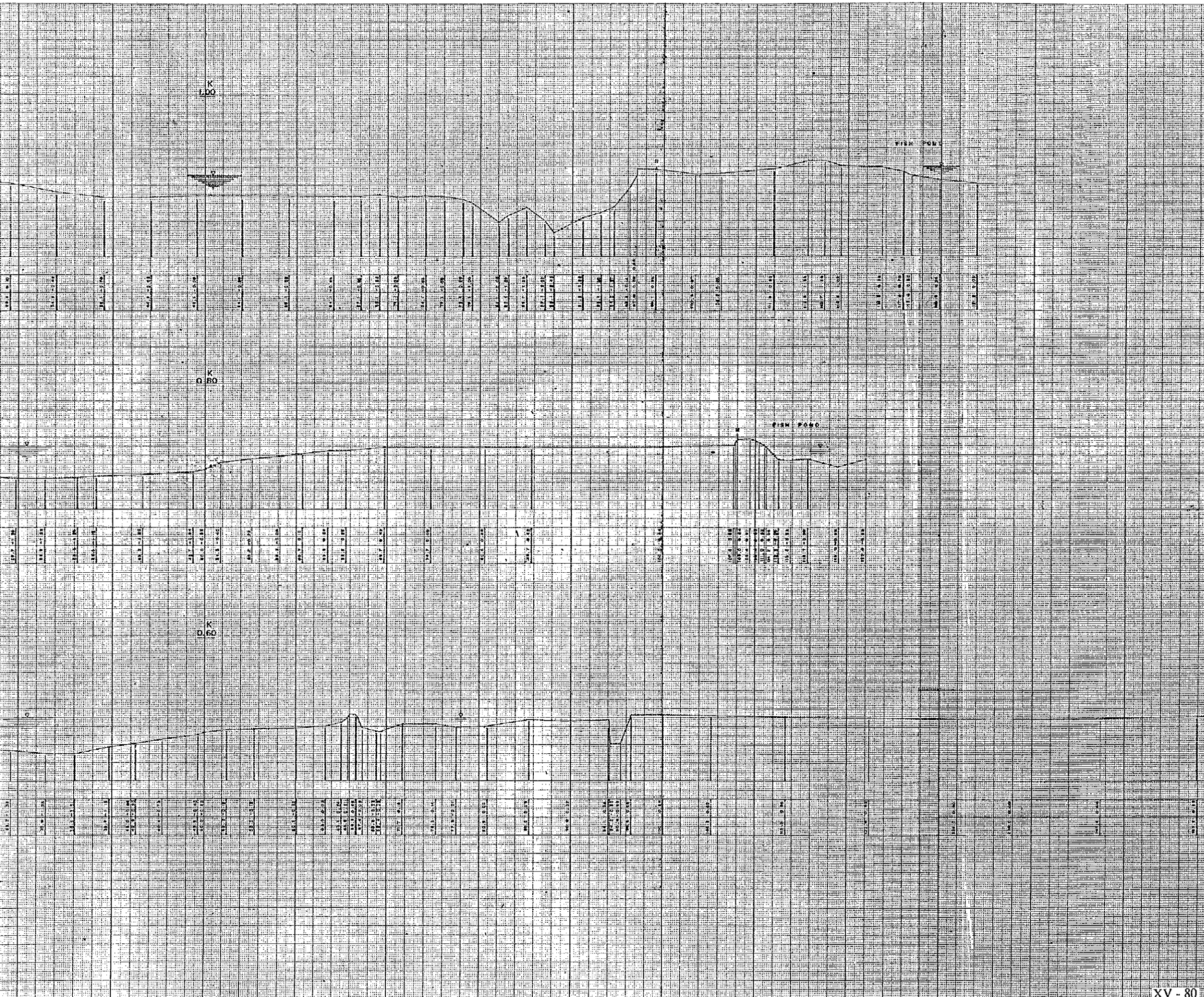

THE REPUBLIC OF INDONESIA
 DIRECTORATE GENERAL OF WATER RESOURCES DEVELOPMENT
 MINISTRY OF PUBLIC WORKS
 THE STUDY OF THE MASTER PLAN ON WATER RESOURCES
 DEVELOPMENT AND FEASIBILITY STUDY
 FOR URGENT FLOOD CONTROL AND URBAN DRAINAGE
 FOR SEMARANG CITY AND SUBURBS
 CROSS SECTION 0.6—1.0
EAST FLOOD WAY
 DECEMBER 1992 SHEET NO. 2/24
 JAPAN INTERNATIONAL COOPERATION AGENCY

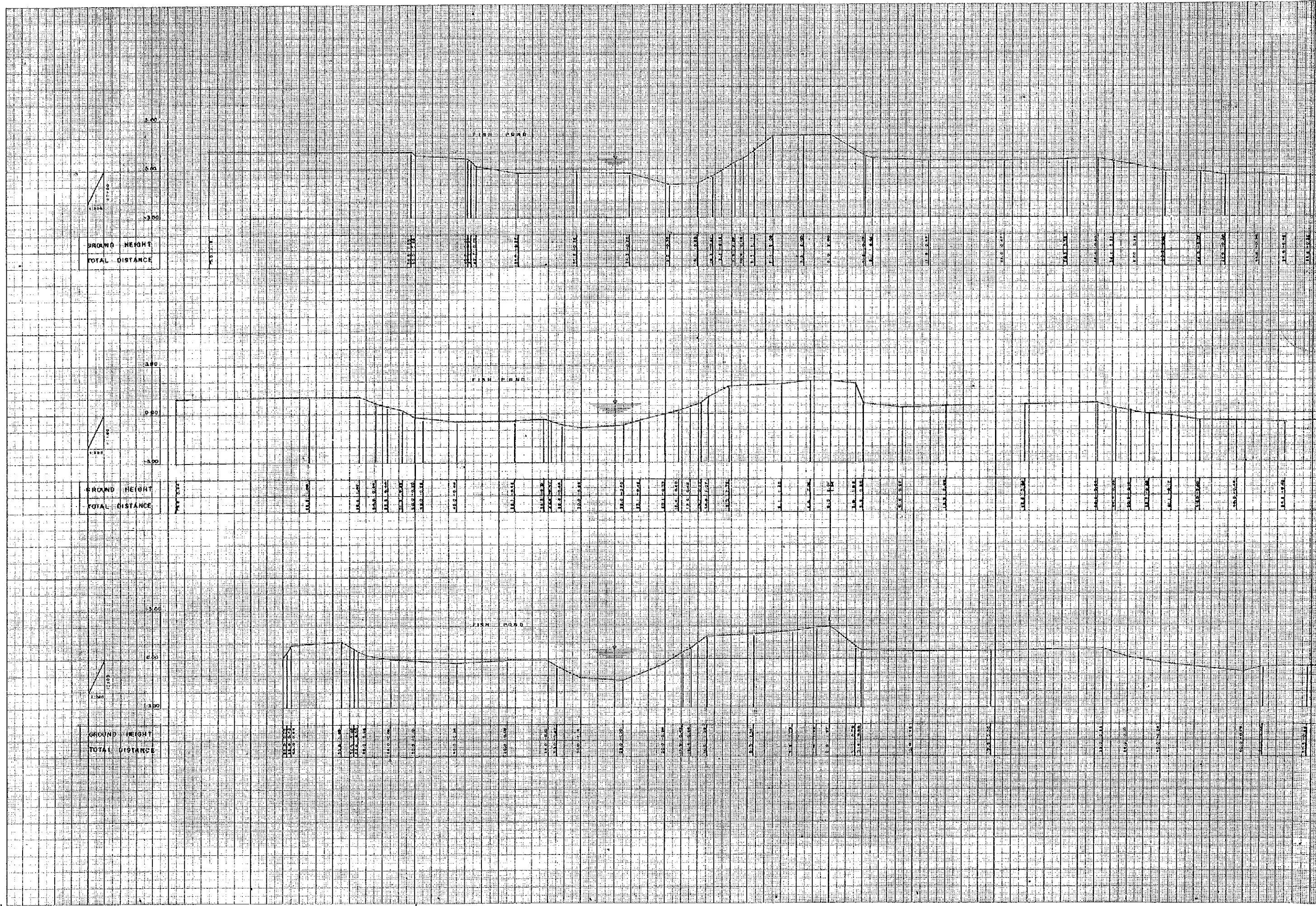

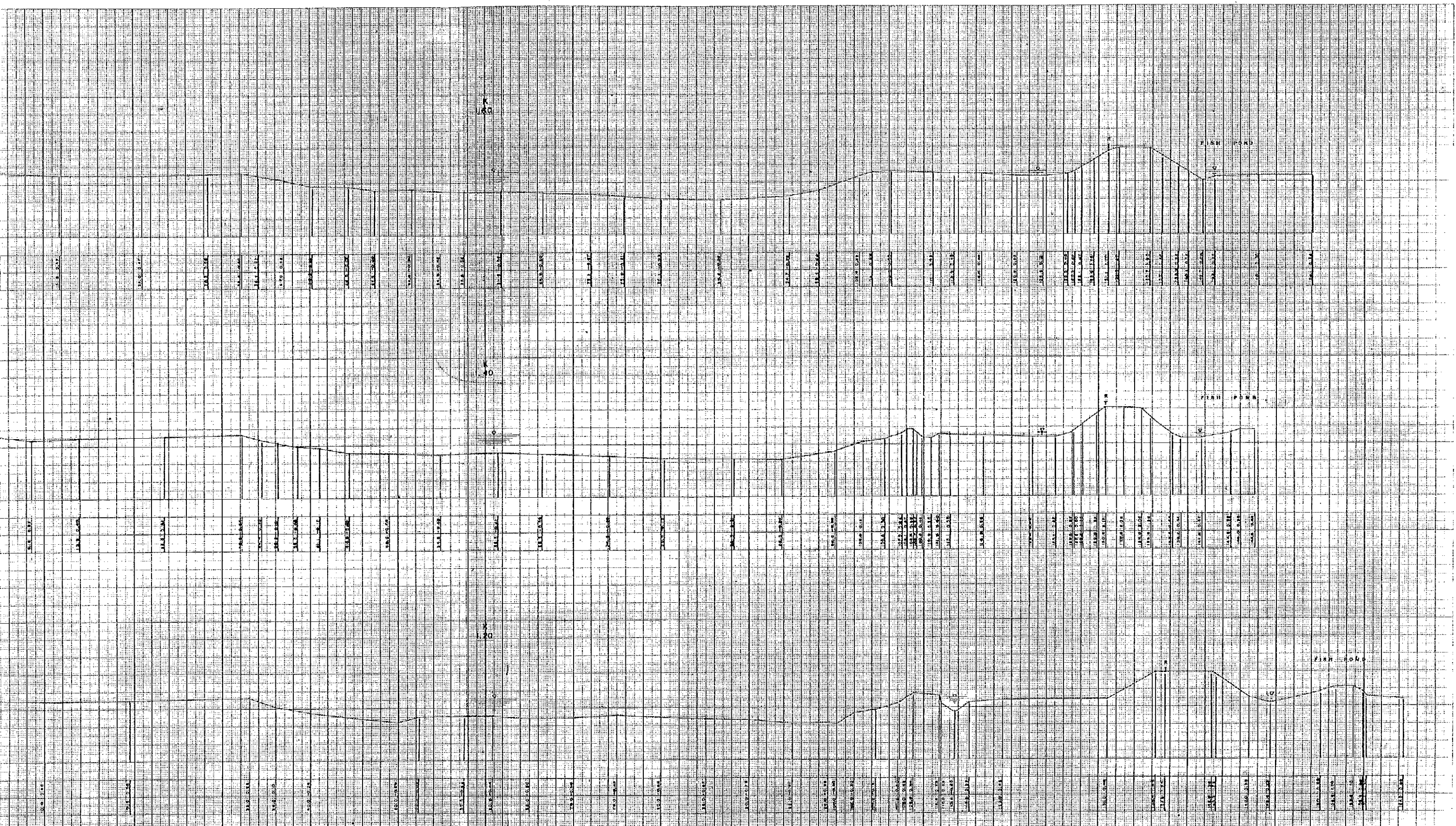

THE REPUBLIC OF INDONESIA
 DIRECTORATE GENERAL OF WATER RESOURCES DEVELOPMENT
 MINISTRY OF PUBLIC WORKS
 THE STUDY OF THE MASTER PLAN ON WATER RESOURCES
 DEVELOPMENT AND FEASIBILITY STUDY
 FOR URGENT FLOOD CONTROL AND URBAN DRAINAGE
 FOR SEMARANG CITY AND SUBURBS
 CROSS SECTION 1.2 --- 1.6
 EAST FLOOD WAY
 DECEMBER 1992 SHEET NO. 3/24

82

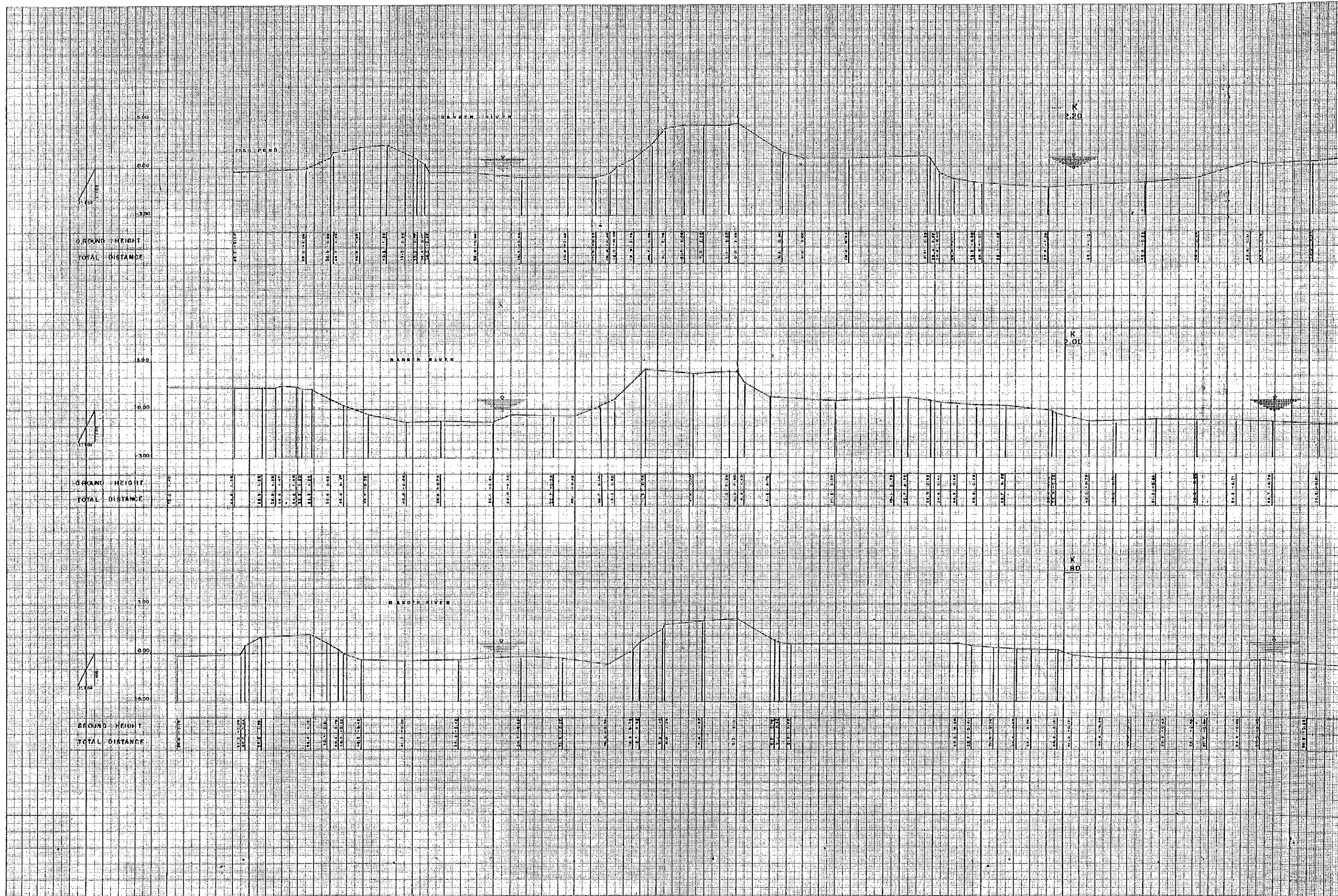

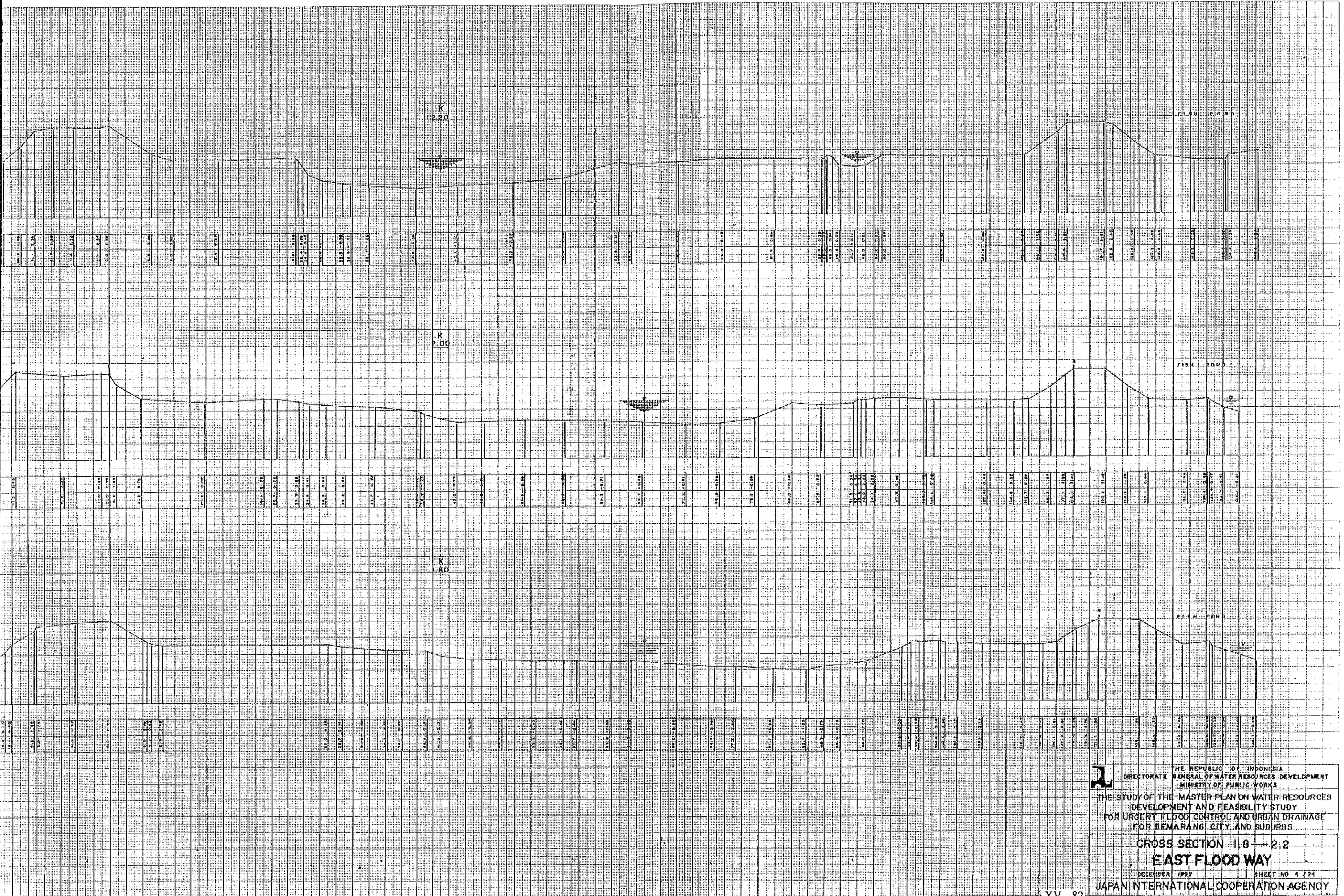

THE REPUBLIC OF INDONESIA
 DIRECTORATE GENERAL OF WATER RESOURCES DEVELOPMENT
 MINISTRY OF PUBLIC WORKS
 THE STUDY OF THE MASTER PLAN ON WATER RESOURCES
 DEVELOPMENT AND FEASIBILITY STUDY
 FOR URGENT FLOOD CONTROL AND URBAN DRAINAGE
 FOR SEMARANG CITY AND SUBURBS
 CROSS SECTION 1.0-2.2
EAST FLOOD WAY
 DECEMBER 1992 SHEET NO 4.24
 JAPAN INTERNATIONAL COOPERATION AGENCY

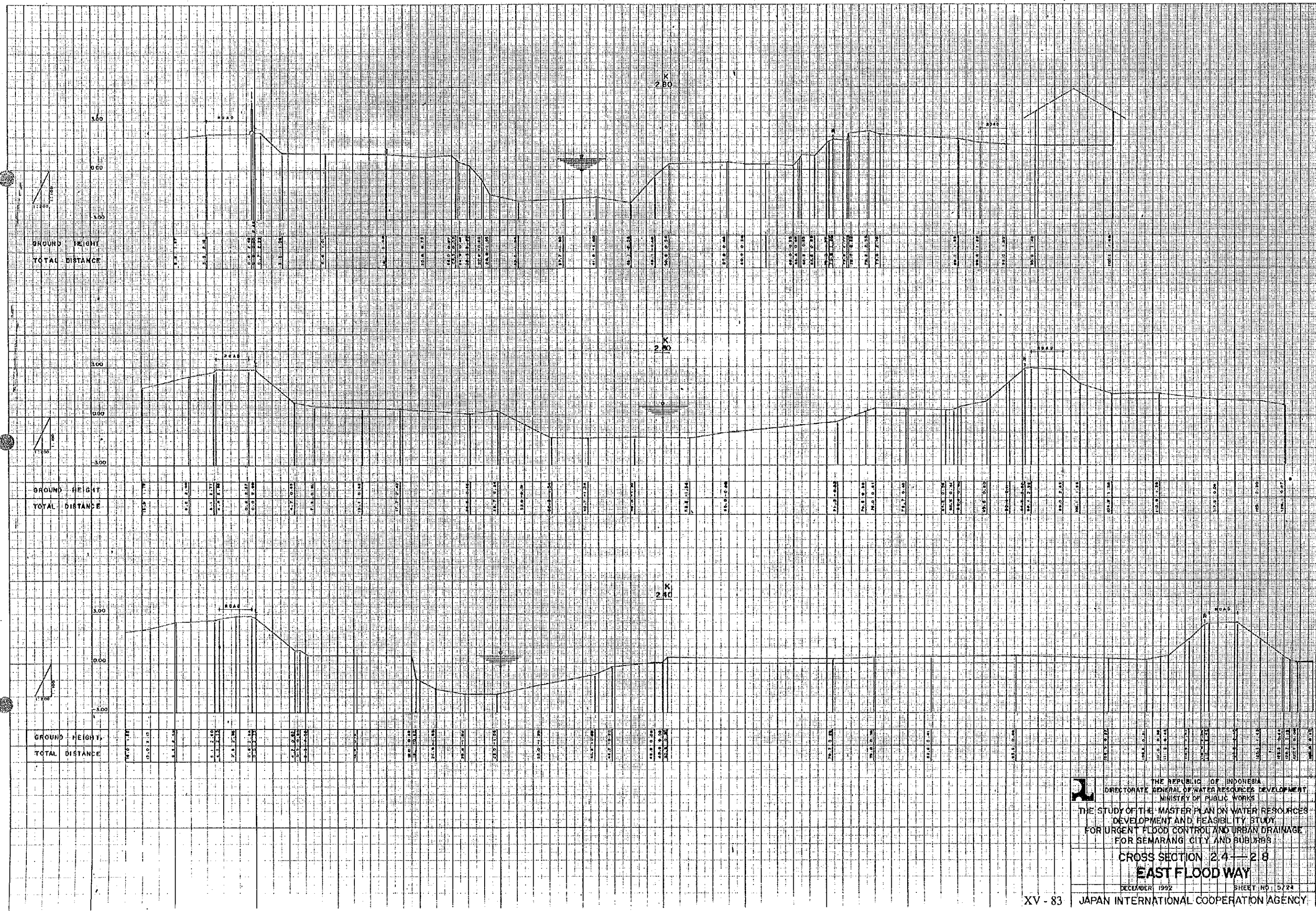

THE REPUBLIC OF INDONESIA
 DIRECTORATE GENERAL OF WATER RESOURCES DEVELOPMENT
 MINISTRY OF PUBLIC WORKS
 THE STUDY OF THE MASTER PLAN ON WATER RESOURCES
 DEVELOPMENT AND FEASIBILITY STUDY
 FOR URGENT FLOOD CONTROL AND URBAN DRAINAGE
 FOR SEMARANG CITY AND SUBURBS
 CROSS SECTION 2.4-2.8
 EAST FLOOD WAY
 DECEMBER 1992 SHEET NO. 5724

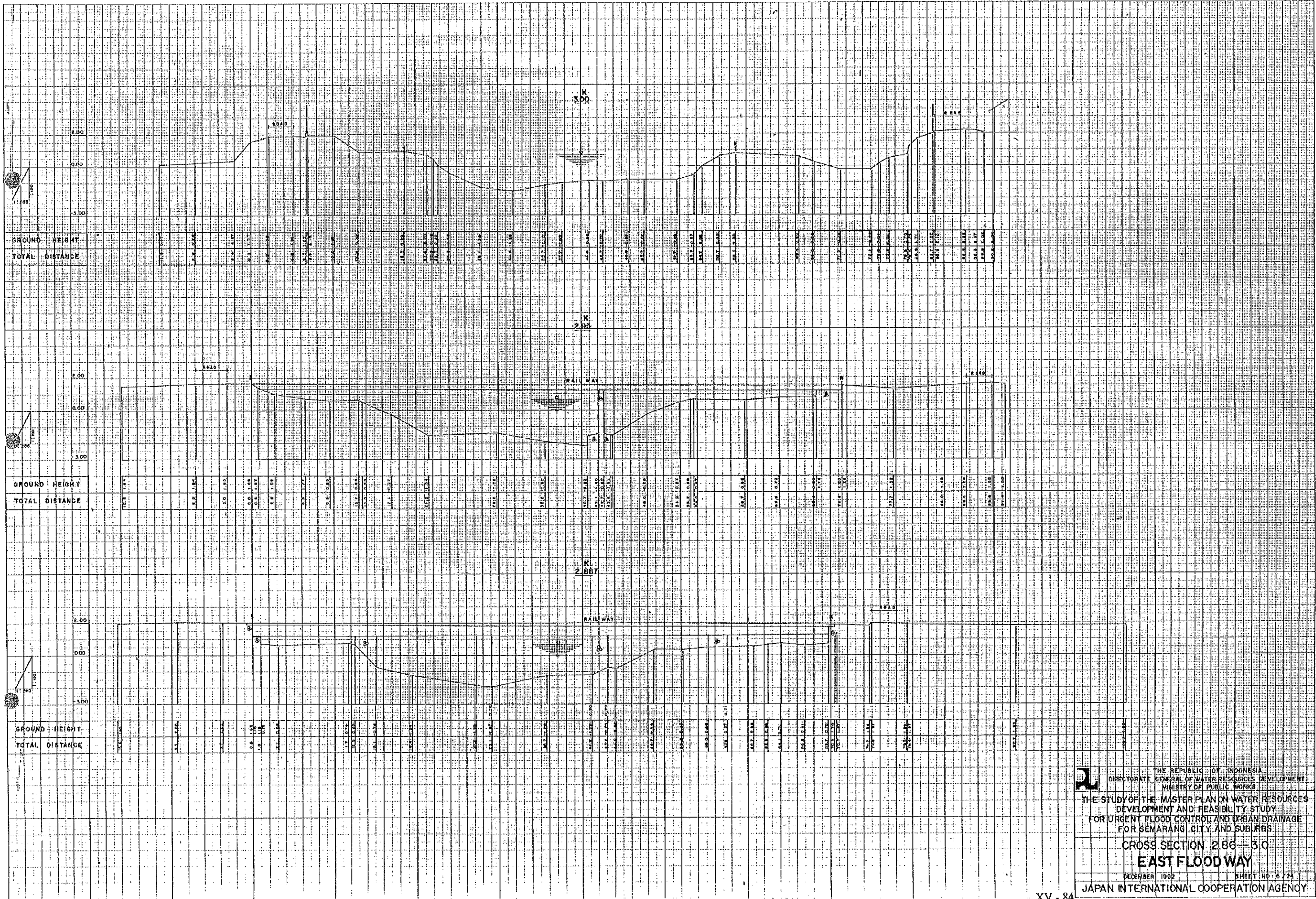

THE REPUBLIC OF INDONESIA
 DIRECTORATE GENERAL OF WATER RESOURCES DEVELOPMENT
 MINISTRY OF PUBLIC WORKS
 THE STUDY OF THE MASTER PLAN ON WATER RESOURCES
 DEVELOPMENT AND FEASIBILITY STUDY
 FOR URGENT FLOOD CONTROL AND URBAN DRAINAGE
 FOR SEMARANG CITY AND SUBURBS
 CROSS SECTION 2.86 - 3.0
EAST FLOOD WAY
 DECEMBER 1992 SHEET NO. 6/24
 JAPAN INTERNATIONAL COOPERATION AGENCY

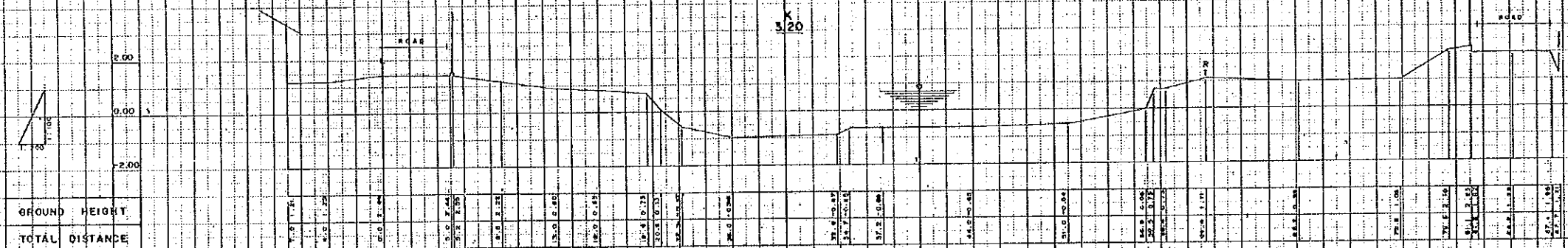
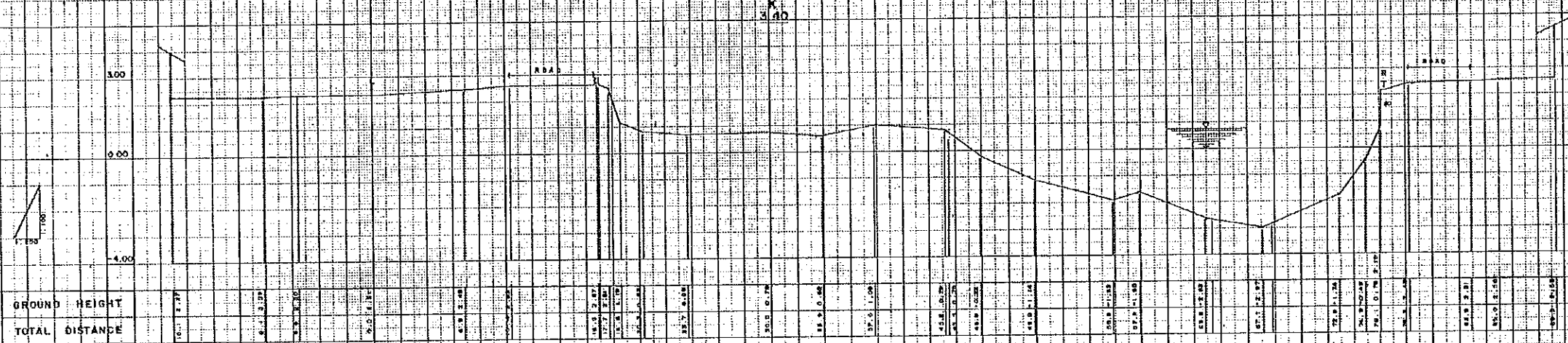
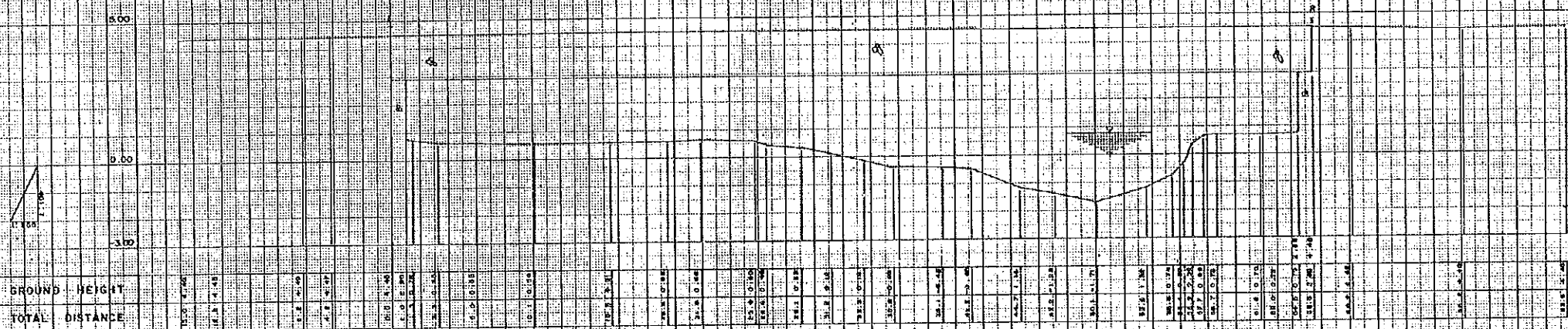

THE REPUBLIC OF INDONESIA
 DIRECTORATE GENERAL OF WATER RESOURCES DEVELOPMENT
 MINISTRY OF PUBLIC WORKS

THE STUDY OF THE MASTER PLAN ON WATER RESOURCES
 DEVELOPMENT AND FEASIBILITY STUDY
 FOR URGENT FLOOD CONTROL AND URBAN DRAINAGE
 FOR SEMARANG CITY AND SUBURBS

CROSS SECTION 3.2 - 3.42
EAST FLOOD WAY

DECEMBER 1992 SHEET NO. 7/24
 JAPAN INTERNATIONAL COOPERATION AGENCY