

PROJECT	PROVINCE	SHEET NO.	TOTAL SHEET
COASTAL ROADS IN EAST COAST OF SUMATRA	LAMPUNG	62	81
PLAN AND PROFILE		SCALE: H=1:10,000 V=1:1,000	

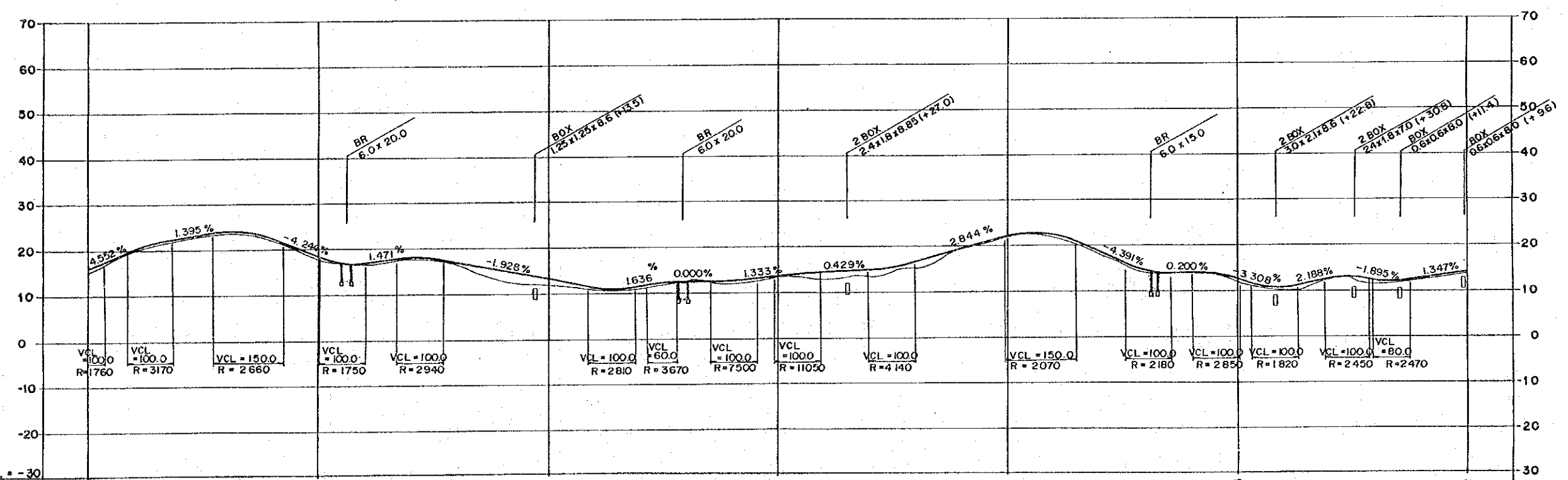

DL = -30													
FINISHED GRADE	16.01		18.33		13.20		13.56		22.10		12.65		13.92
GROUND LEVEL	14.5		18.0		42.0		13.4		21.9		12.0		13.3
STATION	188	+500	189	+500	190	+500	191						

PROJECT	PROVINCE	SHEET NO.	TOTAL SHEET
COASTAL ROADS IN EAST COAST OF SUMATRA	LAMPUNG	63	81
PLAN AND PROFILE		SCALE: H=1:10,000 V=1:1,000	

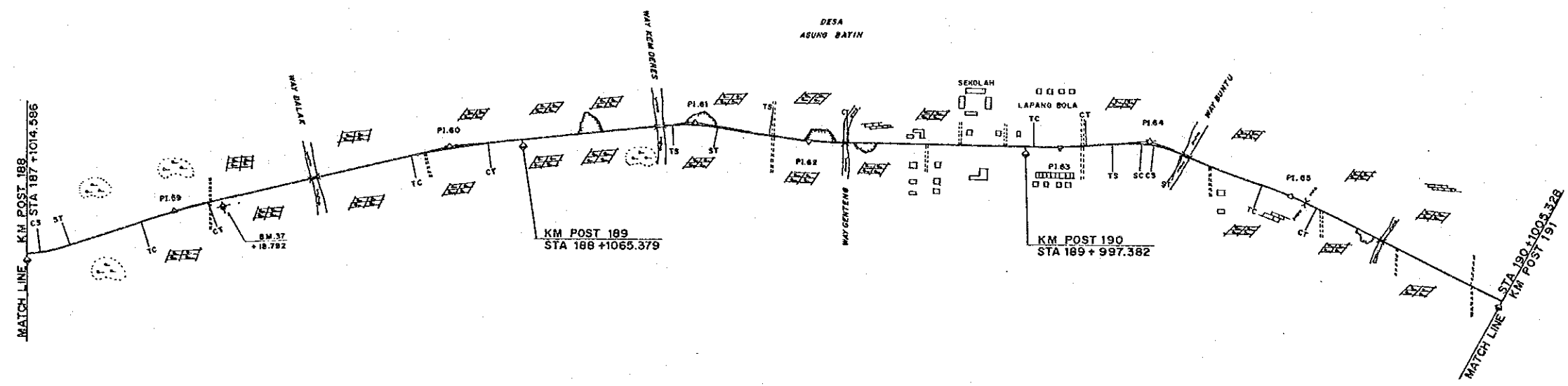
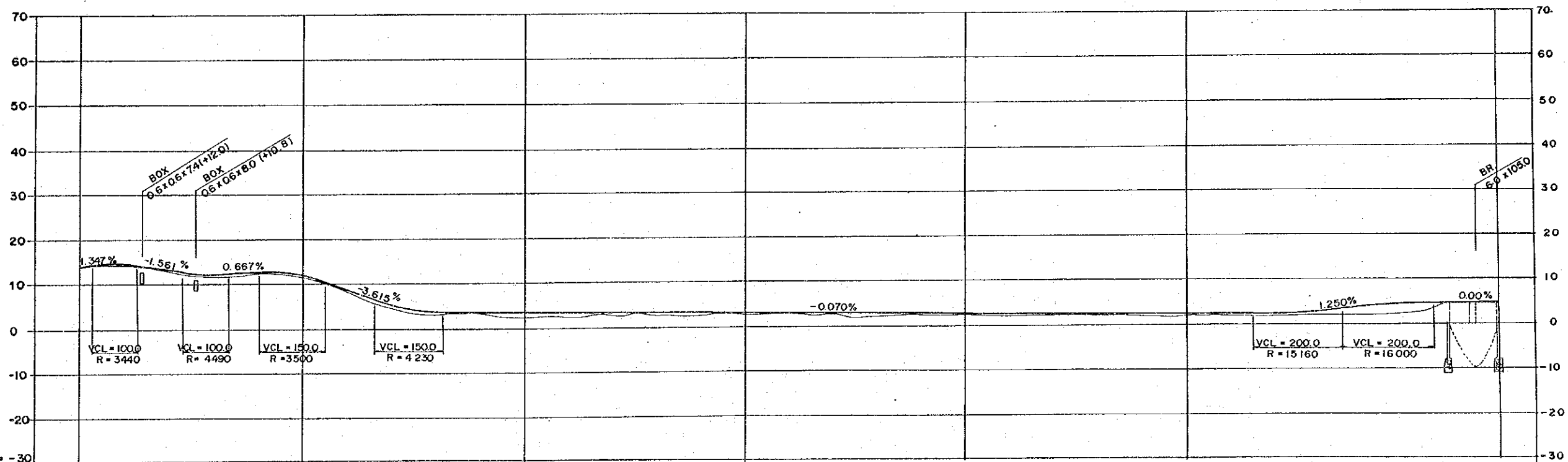
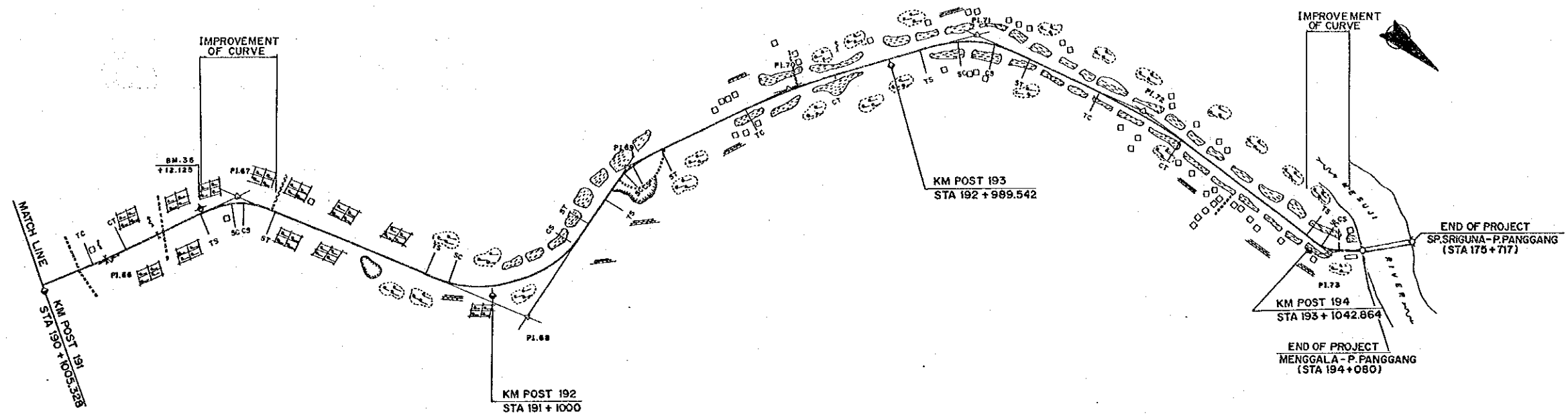

	191	+500	192	+500	193	+500	194	+2656
FINISHED GRADE	13.92	11.95	3.52	3.17	2.82	2.47	4.72	4.80
GROUND LEVEL	13.3	11.5	2.4	2.5	2.3	1.9	2.5	4.8
STATION	191	+500	192	+500	193	+500	194	+2656

PROJECT	PROVINCE	SHEET NO.	TOTAL SHEET
COASTAL ROADS IN EAST COAST OF SUMATRA	LAMPUNG	64	81
PLAN AND PROFILE		SCALE : H=1:1000 V=1:100	
BRIDGE WAY TULANG BAWANG STA127+519			

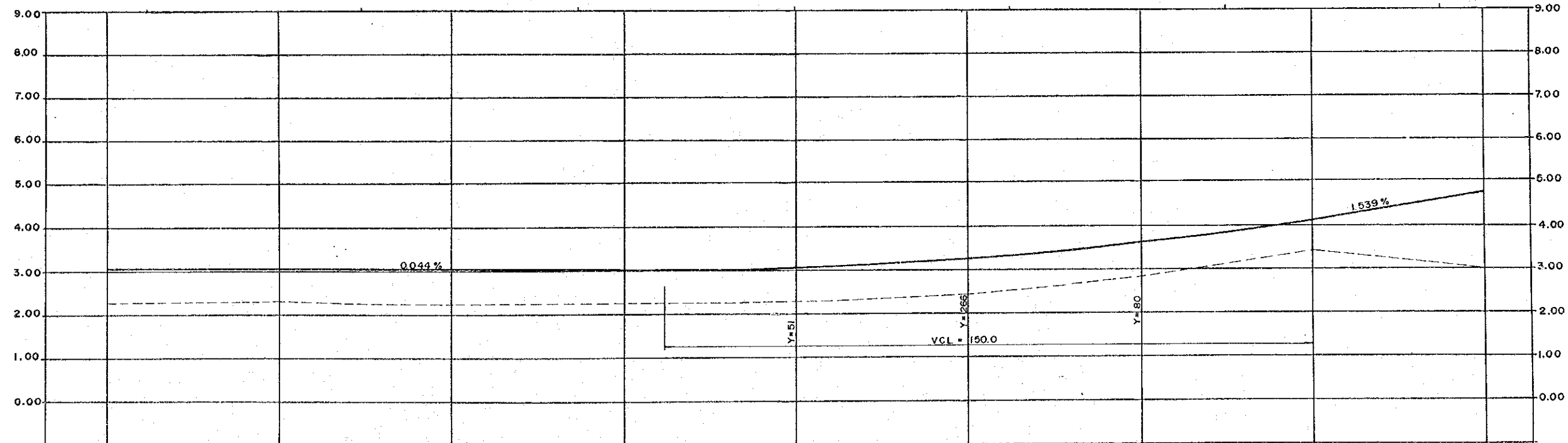
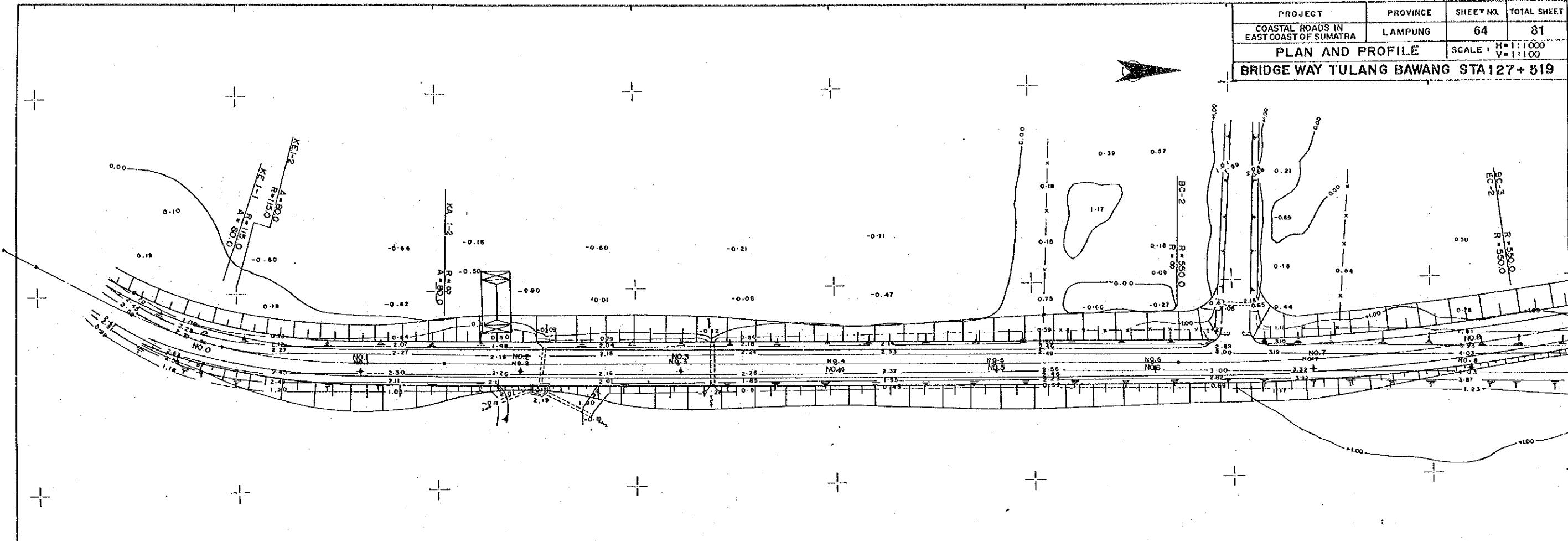

FINISHED GRADE		3.09		3.07		3.05		3.04		3.07		3.27		3.63		4.17		4.78
GROUND LEVEL		+2.300		+2.237		+2.252		+2.295		+2.311		+2.469		+2.849		+3.422		+3.000
STATION		BP		NO.1		NO.2		NO.3		NO.4		NO.5		NO.6		NO.7		NO.8

PROJECT	PROVINCE	SHEET NO.	TOTAL SHEET
COASTAL ROADS IN EAST COAST OF SUMATRA	LAMPUNG	65	81
PLAN AND PROFILE		SCALE: H=1:1000 V=1:100	
BRIDGE WAY TULANG BAWANG STA 127+519			

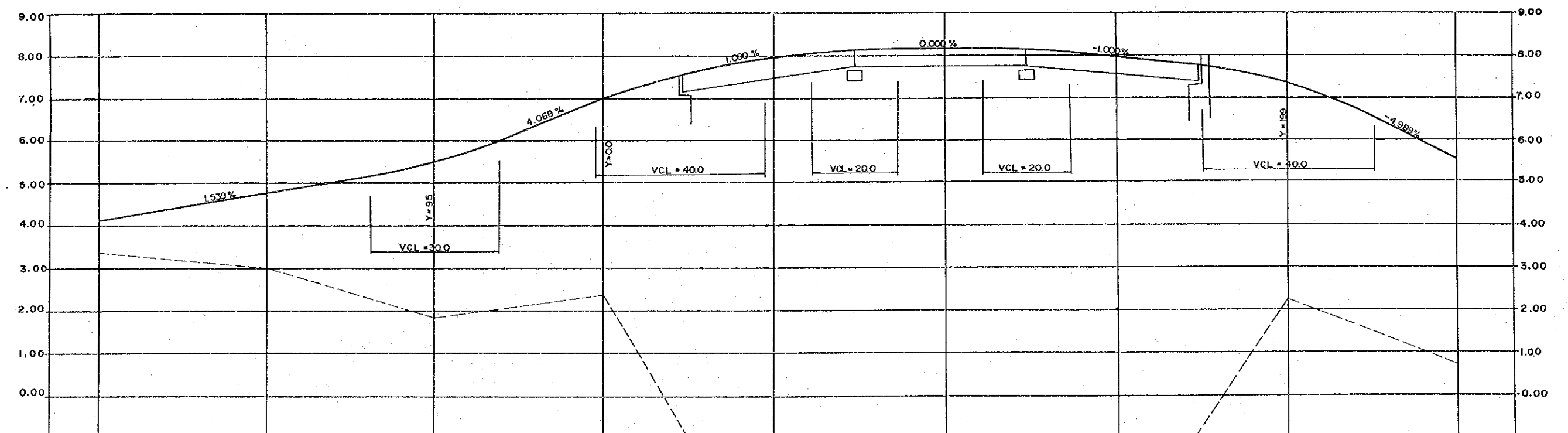
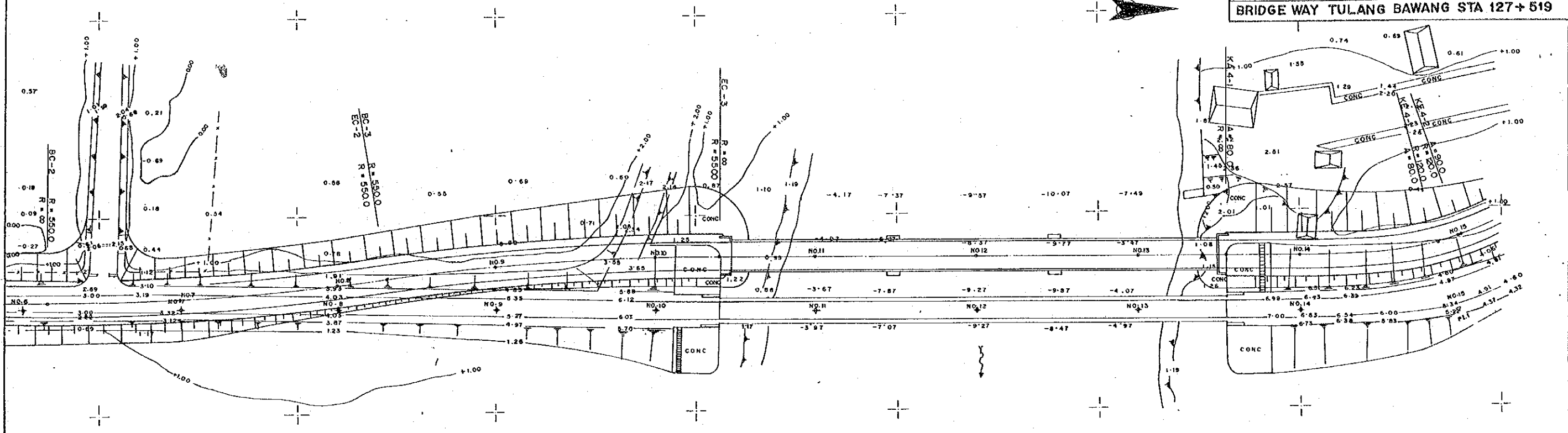

FINISHED GRADE	4.17	4.78	5.49	7.05	8.01	8.20	7.99	7.39	5.59				
GROUND LEVEL	+3.422	+3.000	+1.850	+2.350	+0.950	-4.400	-8.210	-8.650	-6.870	-3.650	+1.150	+2.250	+0.750
STATION	NO.7	NO.8	NO.9	NO.10	NO.11	NO.12	NO.13	NO.14	NO.15	PLI	NO.15		

PROJECT	PROVINCE	SHEET NO.	TOTAL SHEET
COASTAL ROADS IN EAST COAST OF SUMATRA	LAMPUNG	66	81
PLAN AND PROFILE		SCALE : H=1:1000 V=1:100	
BRIDGE WAY TULANG BAWANG STA 127 + 519			

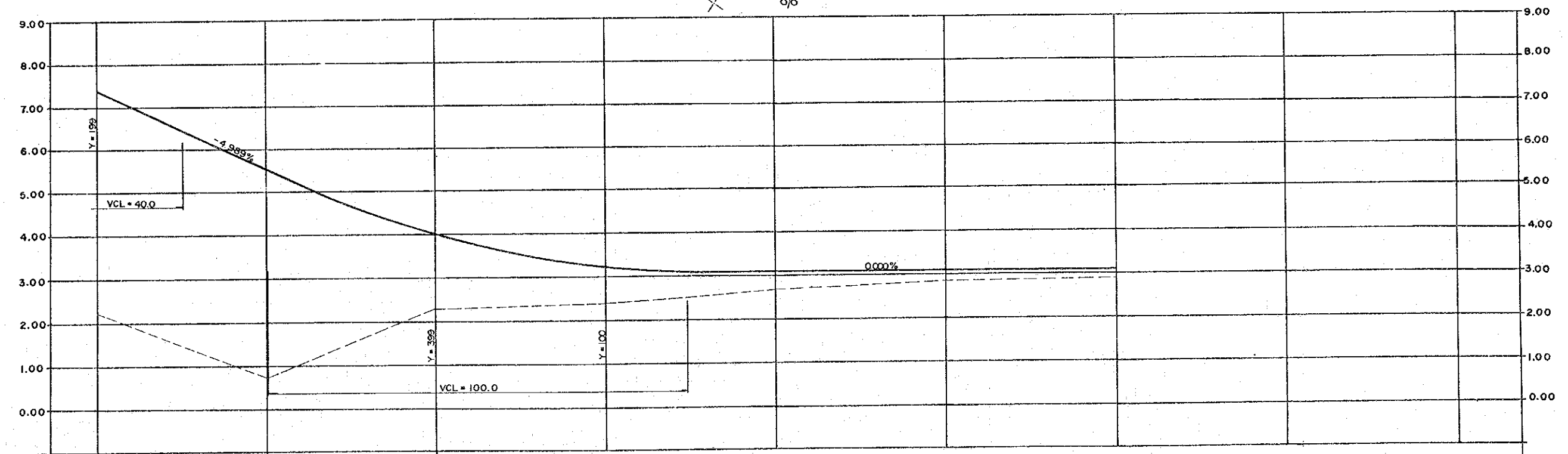
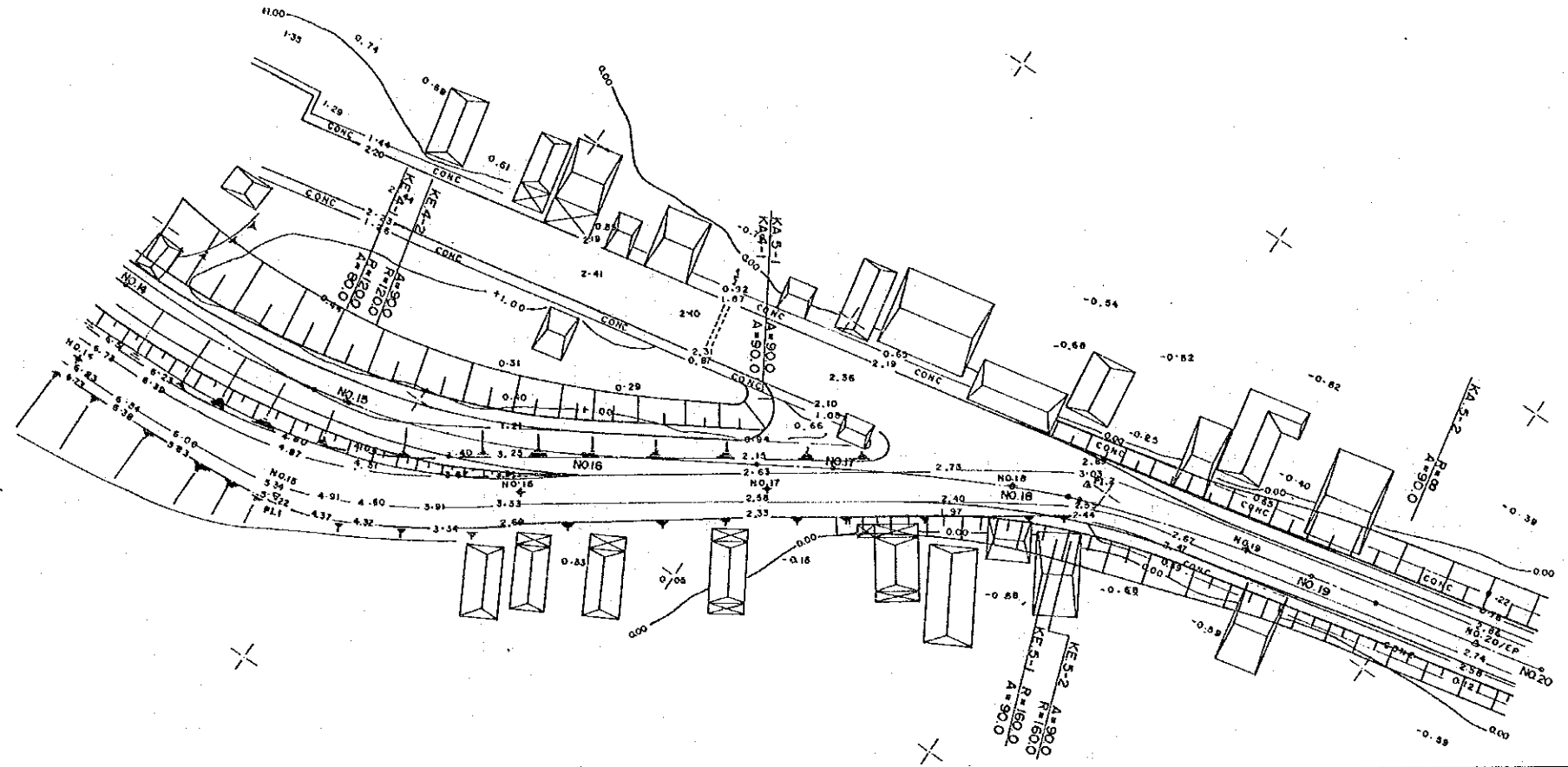

FINISHED GRADE	7.39	5.59	4.00	3.20	3.10	3.10	3.10
GROUND LEVEL	+2.250	+0.750	+2.300	+2.400	+2.698	+2.841	+2.883
STATION	NO.14	P.I. NO.15	NO.16	NO.17	NO.18	NO.19	NO.20 E.P.

PROJECT	PROVINCE	SHEET NO.	TOTAL SHEET
COASTAL ROADS IN EAST COAST OF SUMATRA	LAMPUNG	67	81
CROSS SECTION		SCALE: H=1:200 V=1:200	
BRIDGE WAY TULANG BAWANG STA 127 + 519			

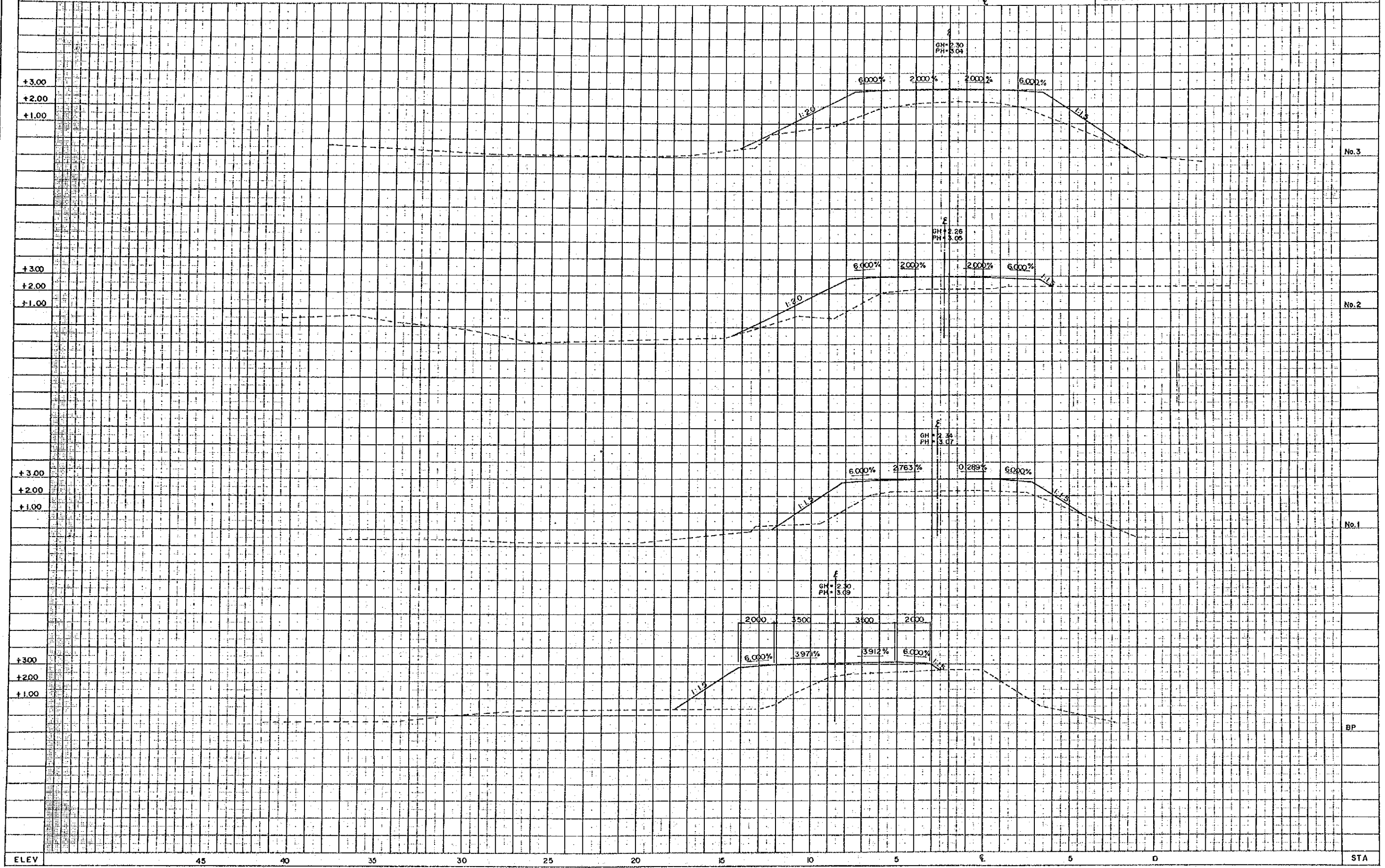

PROJECT	PROVINCE	SHEET NO.	TOTAL SHEET
COASTAL ROADS IN EAST COAST OF SUMATRA	LAMPUNG	68	81
CROSS SECTION		SCALE: H=1:200 V=1:200	
BRIDGE WAY TULANG BAWANG STA 127 + 519			

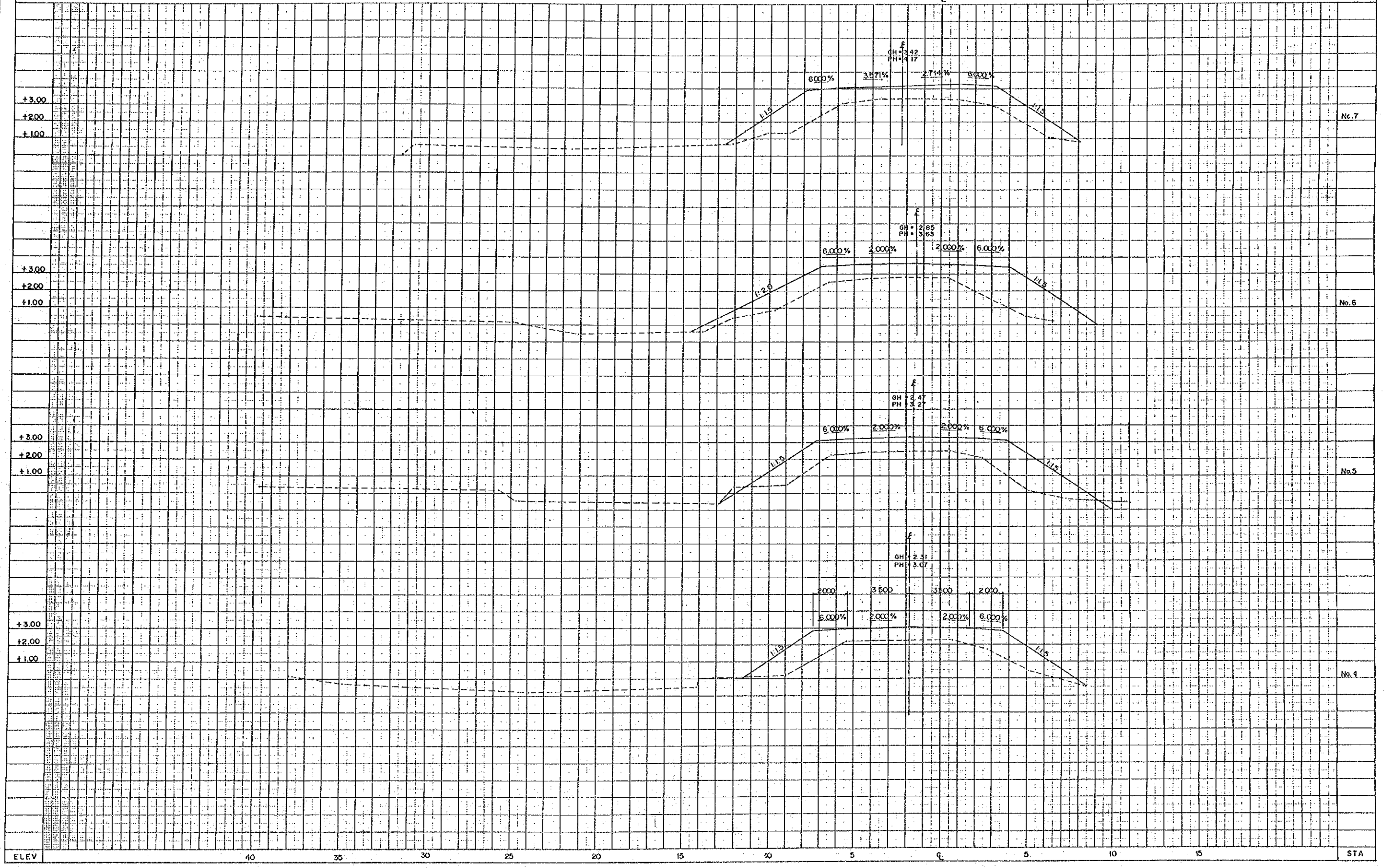

PROJECT	PROVINCE	SHEET NO.	TOTAL SHEET
COASTAL ROADS IN EAST COAST OF SUMATRA	LAMPUNG	69	81
CROSS SECTION		SCALE: H=1:200 V=1:200	
BRIDGE WAY TULANG BAWANG STA 127 + 519			

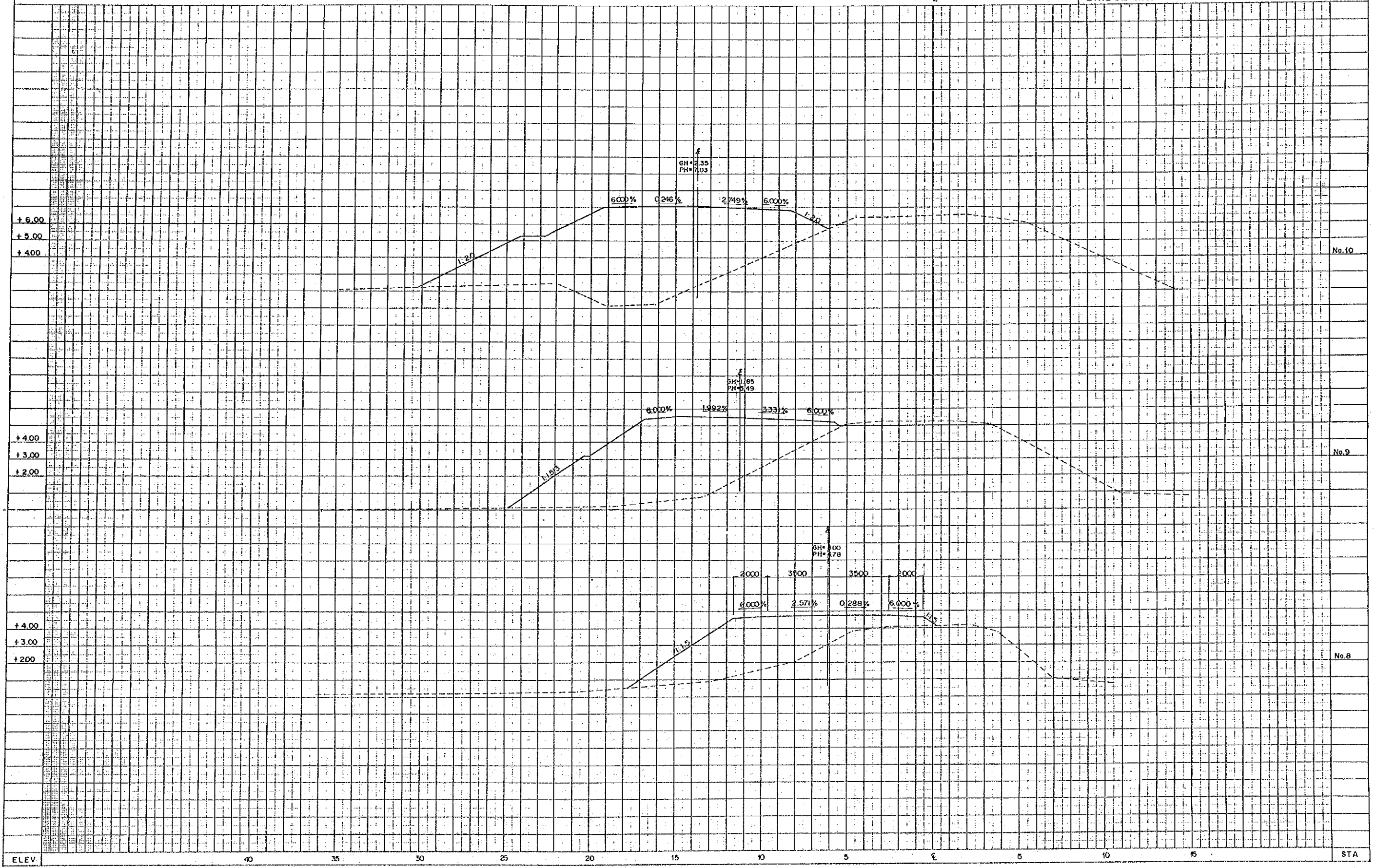

PROJECT	PROVINCE	SHEET NO.	TOTAL SHEET
COASTAL ROADS IN EAST COAST OF SUMATRA	LAMPUNG	70	81
CROSS SECTION		SCALE: H=1:200 V=1:200	
BRIDGE WAY TULANG BAWANG STA 127 + 519			

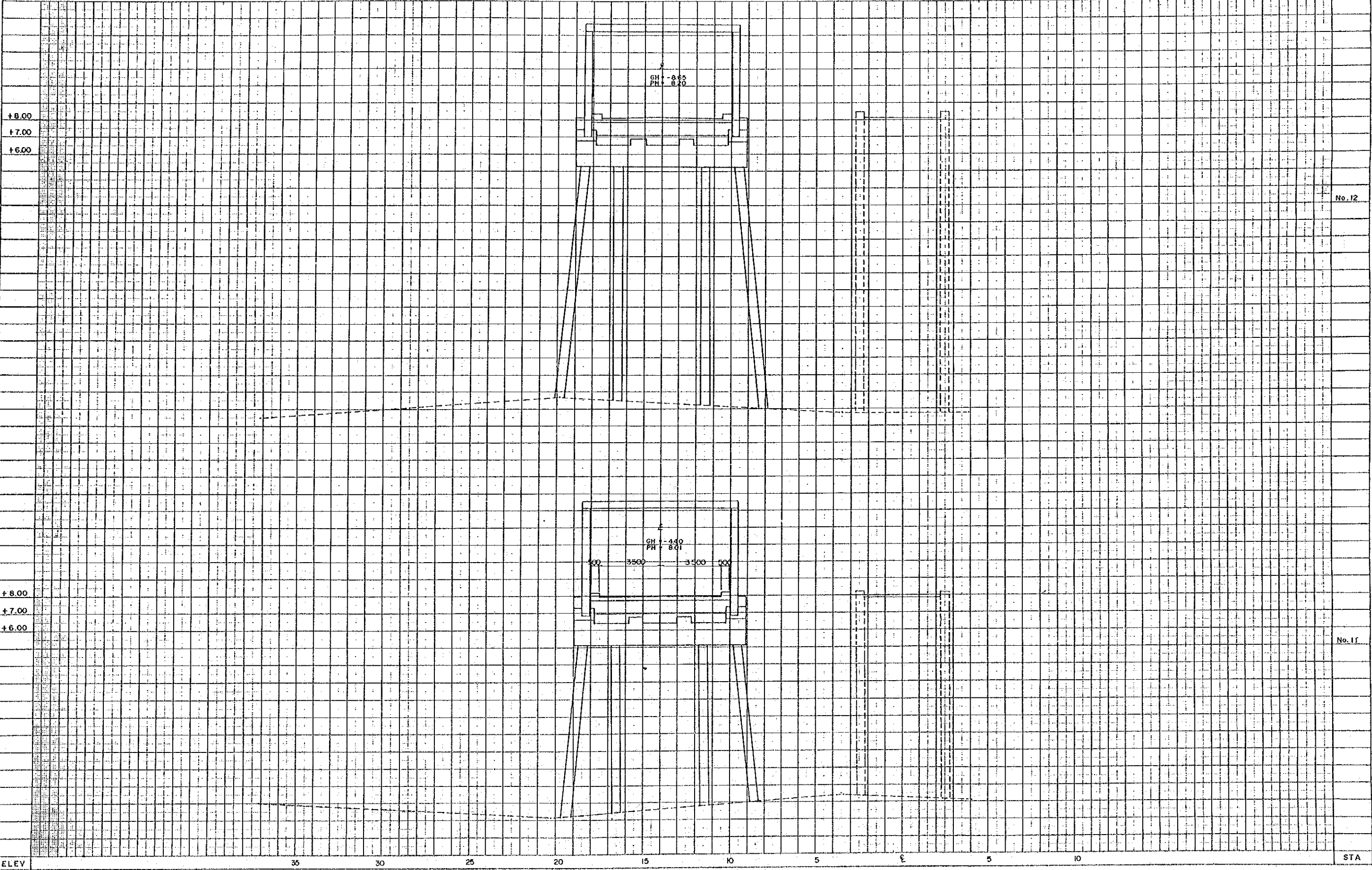

No. 12

No. 11

ELEV 35 30 25 20 15 10 5 0 5 10 STA

PROJECT	PROVINCE	SHEET NO.	TOTAL SHEET
COASTAL ROADS IN EAST COAST OF SUMATRA	LAMPUNG	71	81
CROSS SECTION		SCALE: H=1:200 V=1:200	
BRIDGE WAY TULANG BAWANG STA 127 + 519			

ε

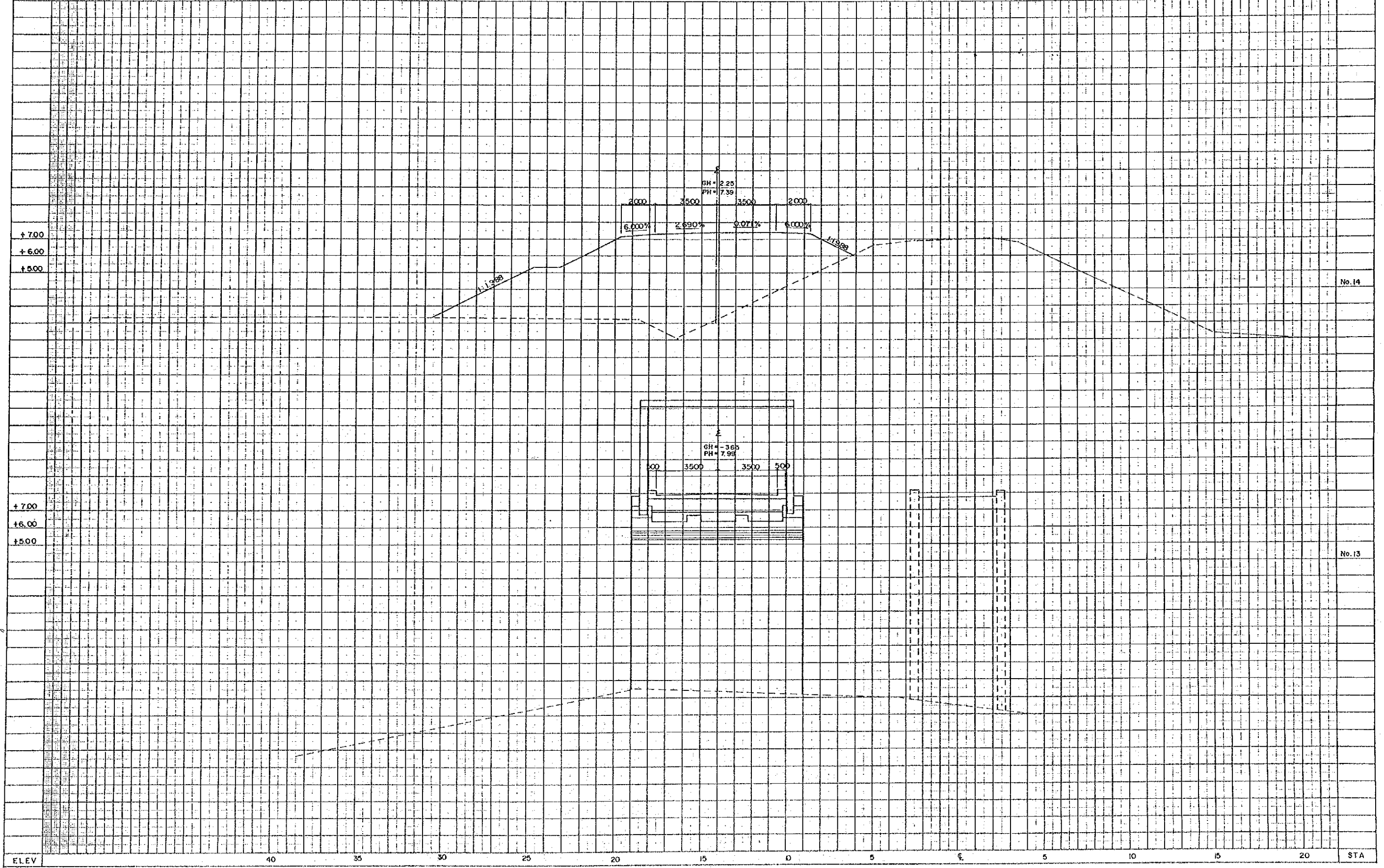

ELEV 40 35 30 25 20 15 0 5 10 15 20 STA

PROJECT	PROVINCE	SHEET NO.	TOTAL SHEET
COASTAL ROADS IN EAST COAST OF SUMATRA	LAMPUNG	72	81
CROSS SECTION		SCALE: H=1:200 V=1:200	
BRIDGE WAY TULANG BAWANG STA 127 + 519			

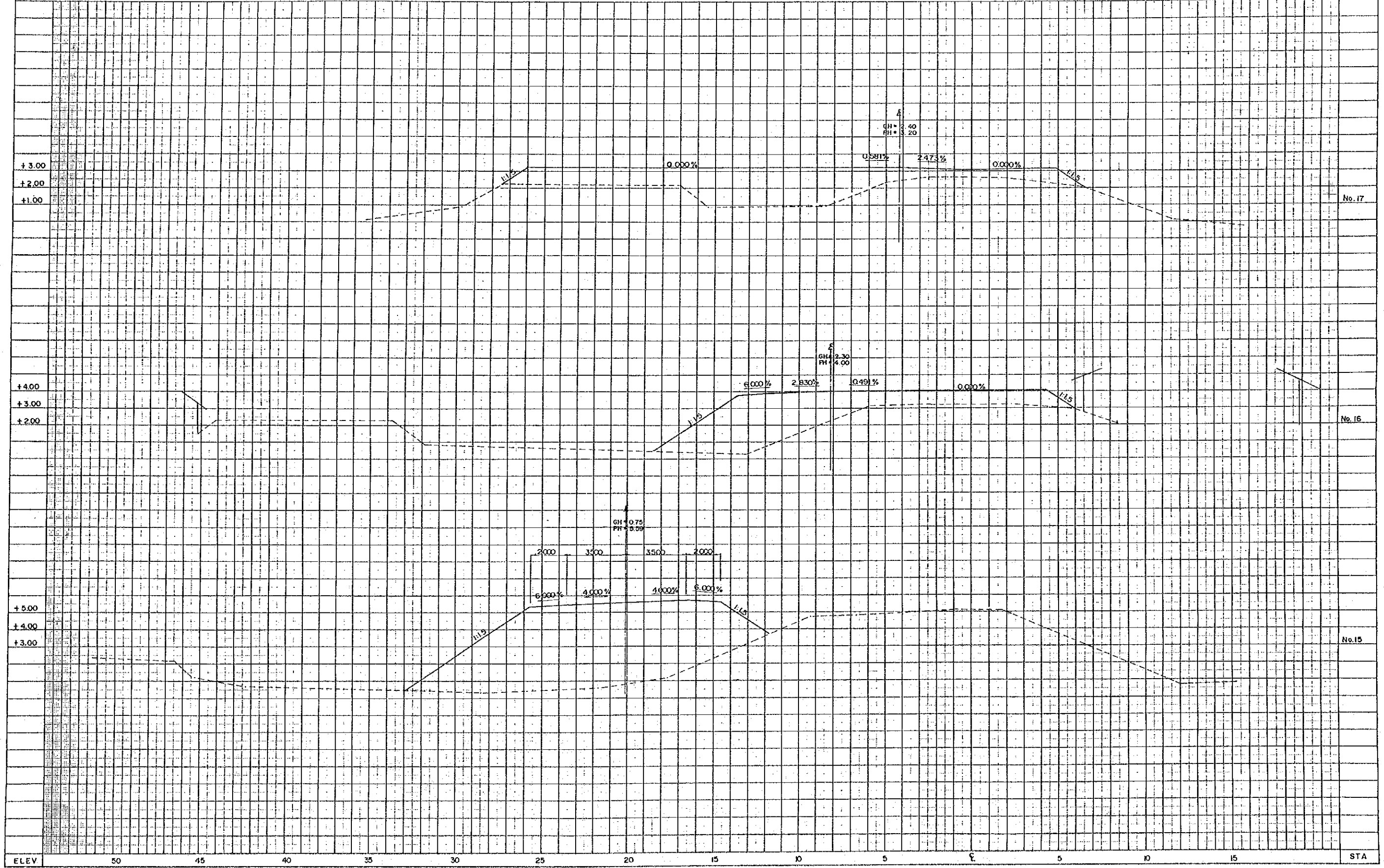

ELEV 50 45 40 35 30 25 20 15 10 5 0 5 10 15 STA

PROJECT	PROVINCE	SHEET NO.	TOTAL SHEET
COASTAL ROADS IN EAST COAST OF SUMATRA	LAMPUNG	73	81
CROSS SECTION		SCALE: H=1:200 V=1:200	
BRIDGE WAY TULANG BAWANG STA 127 + 519			

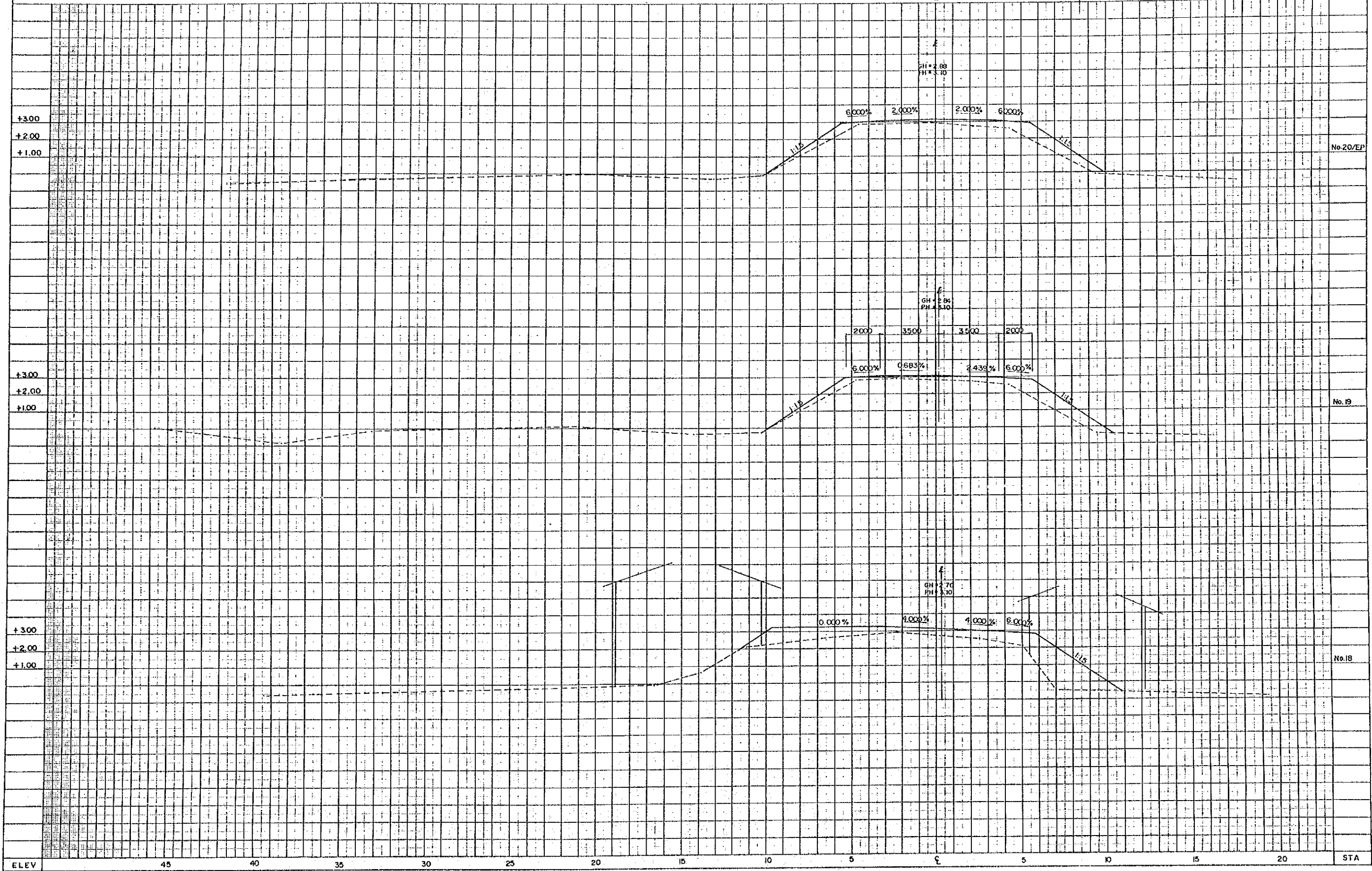

ELEV 45 40 35 30 25 20 15 10 5 C 5 10 15 20 STA

PROJECT	PROVINCE	SHEET NO.	TOTAL SHEET
COASTAL ROADS IN EAST COAST OF SUMATRA	LAMPUNG	74	81
PLAN AND PROFILE		SCALE = 1:400	
BRIDGE WAY TULANG BAWANG		STA. 127 + 519	

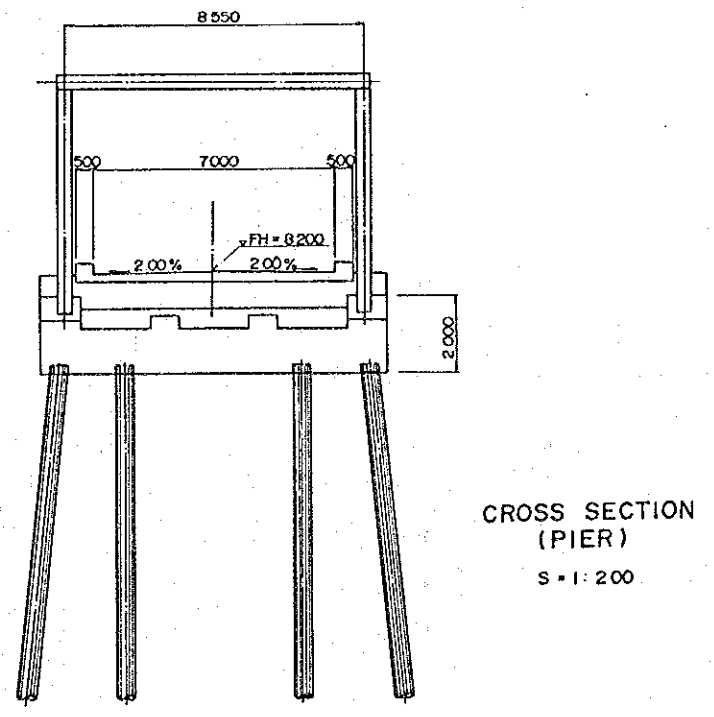
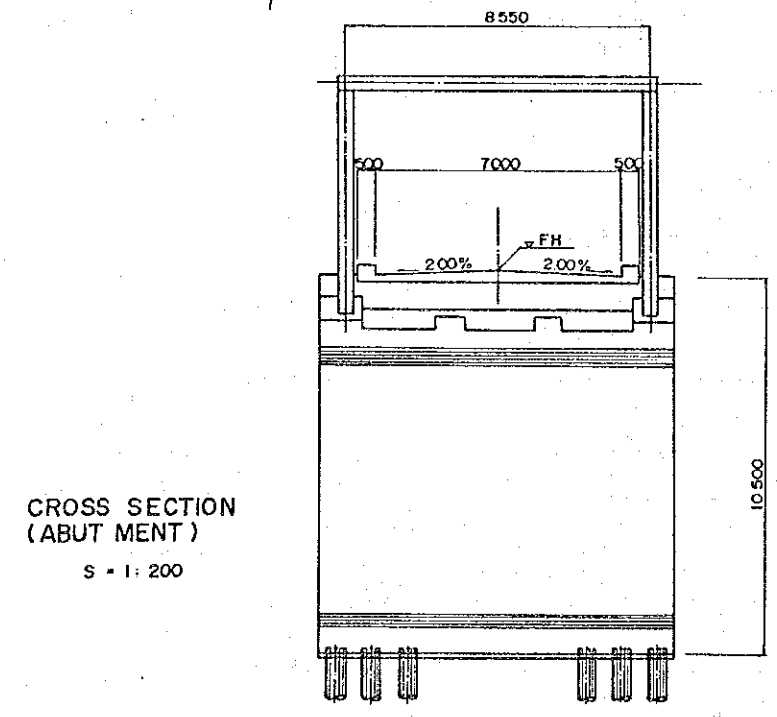
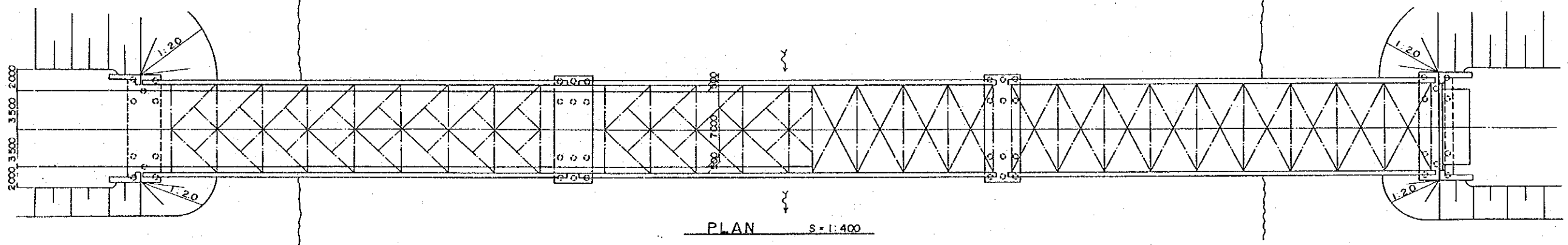
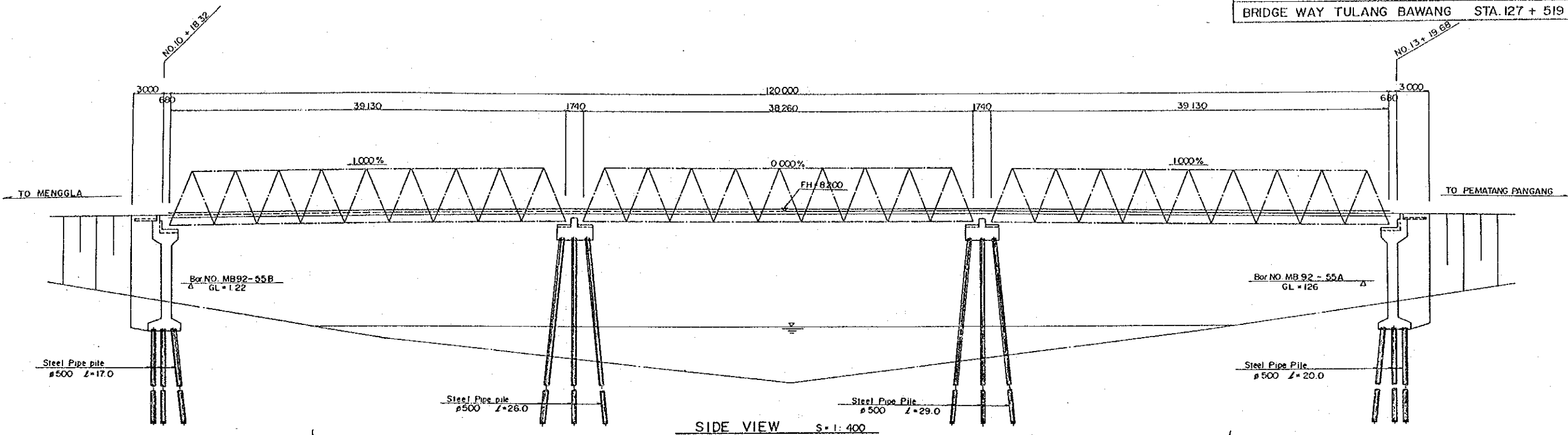

PROJECT	PROVINCE	SHEET NO.	TOTAL SHEET
COASTAL ROADS IN EAST COAST OF SUMATRA	LAMPUNG	75	81
PLAN AND PROFILE		SCALE: H=1:1000 V=1:100	
BRIDGE WAY PEDADA STA 143 + 253			

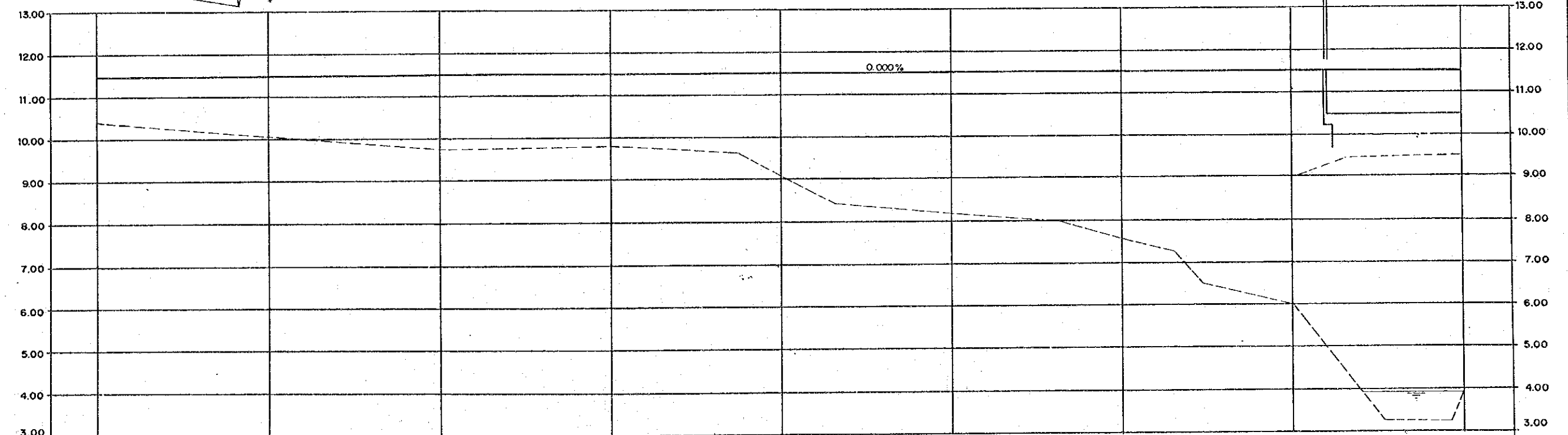
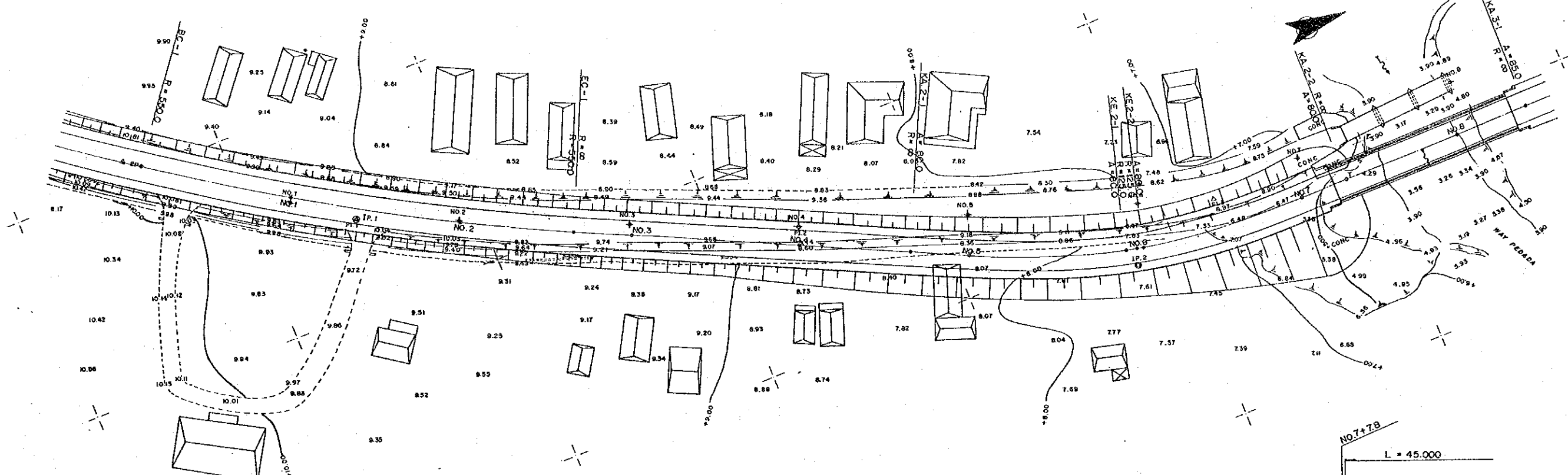

FINISHED GRADE	11.50	11.50	11.50	11.50	11.50	11.50	11.50	11.50	11.50	11.50	
GROUND LEVEL	+10.412	+10.058	+9.748	+9.796	+9.100	+8.200	+7.600	+6.000	+3.204	+3.306	+4.000
STATION	BP	NO.1	NO.2	NO.3	NO.4	NO.5	NO.6	NO.7			NO.8

PROJECT	PROVINCE	SHEET NO.	TOTAL SHEET
COASTAL ROADS IN EAST COAST OF SUMATRA	LAMPUNG	76	81
PLAN AND PROFILE		SCALE: H=1:1000 V=1:100	
BRIDGE WAY PEDADA STA 143 + 253			

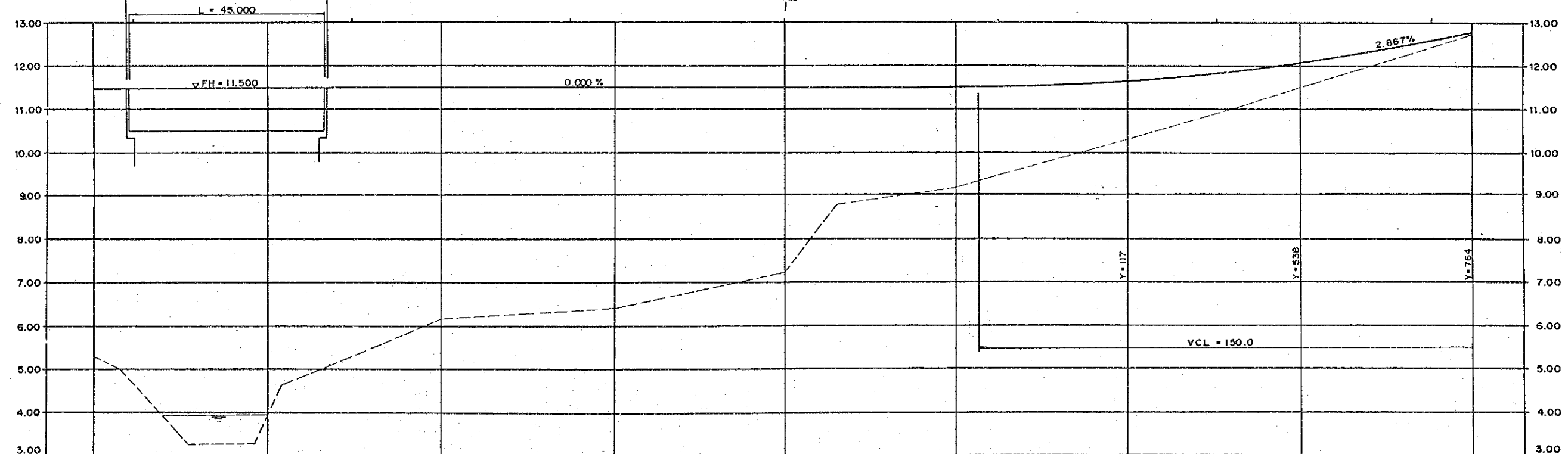
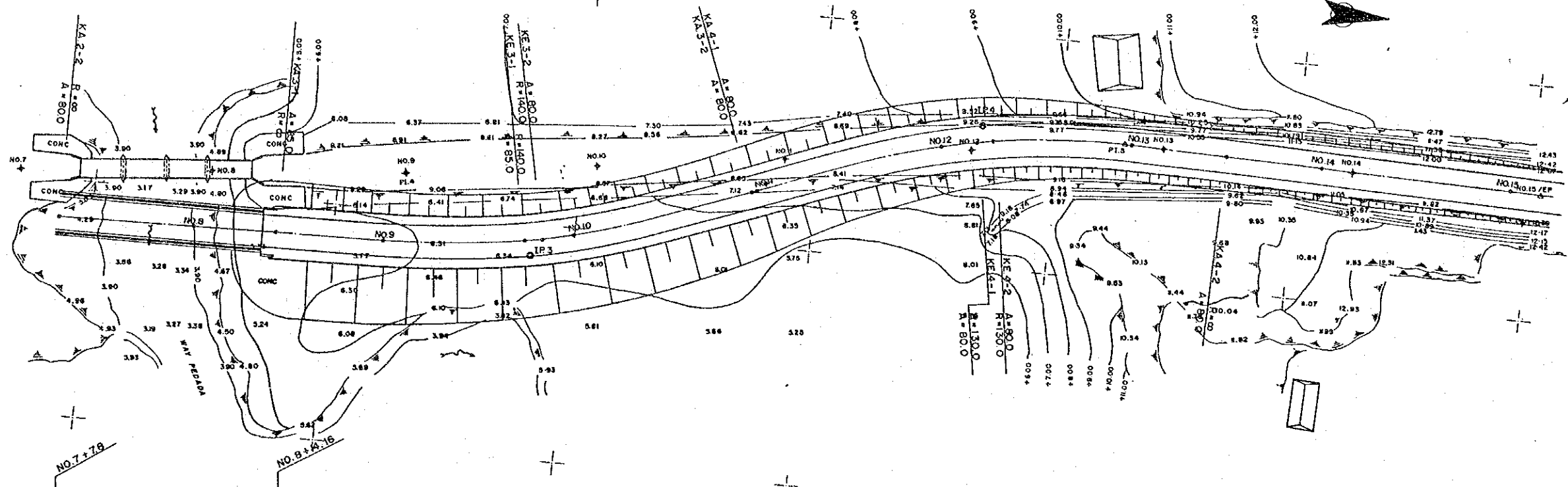

FINISHED GRADE	11.50	11.50	11.50	11.50	11.50	11.50	11.62	12.04	12.76
GROUND LEVEL	+6.000	+3.204 +3.306	+4.000 +4.903	+6.200	+6.400	+8.200	+9.179 +10.264	+11.517	+12.743
STATION	NO.7	NO.8	NO.9	NO.10	NO.11	NO.12	NO.13	NO.14	NO.15 EP

PROJECT	PROVINCE	SHEET NO.	TOTAL SHEET
COASTAL ROADS IN EAST COAST OF SUMATRA	LAMPUNG	77	81
CROSS SECTION		SCALE: H=1:200 V=1:200	
BRIDGE WAY PEDADA STA 143 + 253			

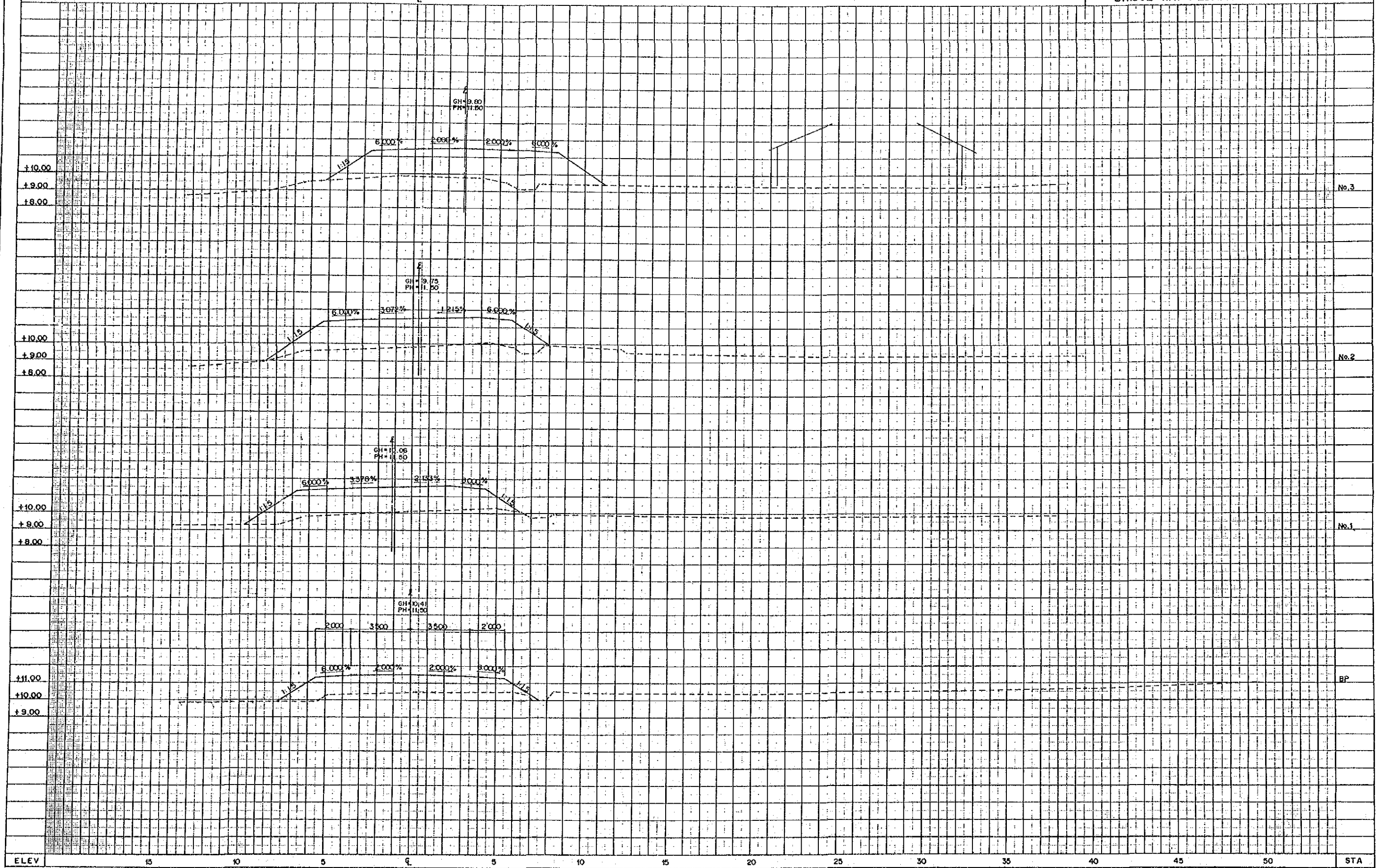

PROJECT	PROVINCE	SHEET NO.	TOTAL SHEET
COASTAL ROADS IN EAST COAST OF SUMATRA	LAMPUNG	78	81
CROSS SECTION		SCALE: H=1:200 V=1:200	
BRIDGE WAY PEDADA STA 143 + 253			

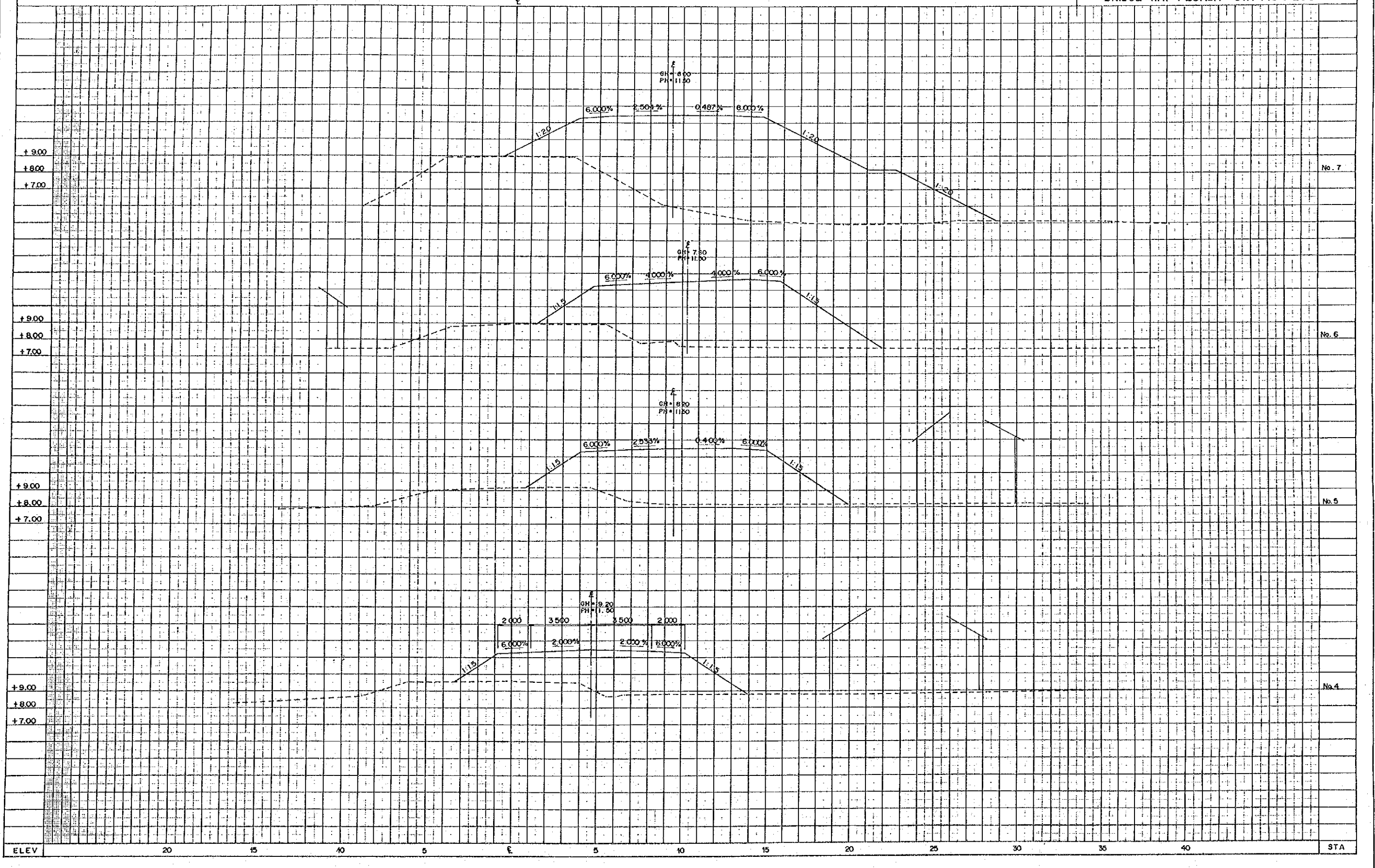

PROJECT	PROVINCE	SHEET NO.	TOTAL SHEET
COASTAL ROADS IN EAST COAST OF SUMATRA	LAMPUNG	79	81
CROSS SECTION		SCALE: H=1:200 V=1:200	
BRIDGE WAY PEDADA STA 143 + 253			

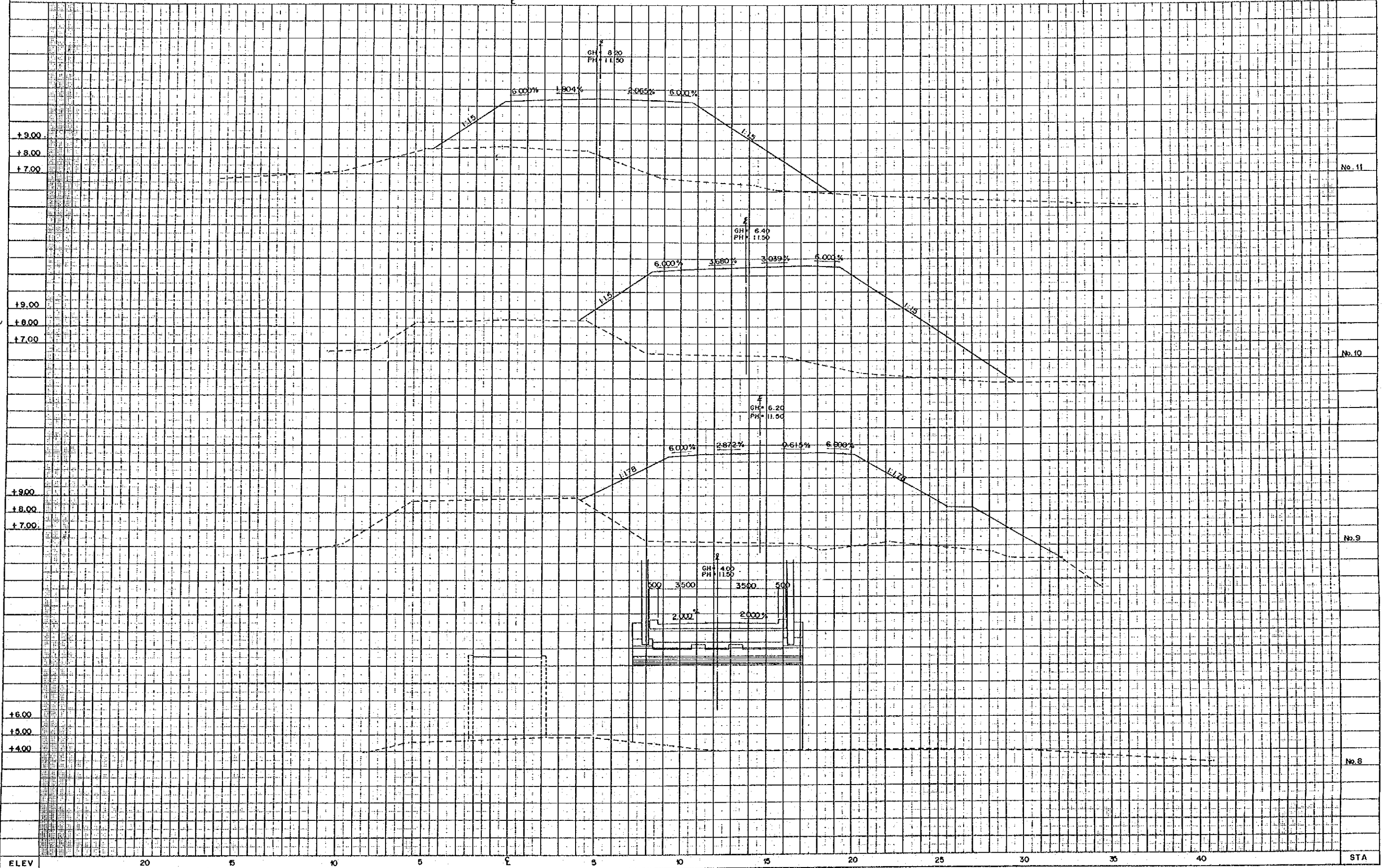

PROJECT	PROVINCE	SHEET NO.	TOTAL SHEET
COASTAL ROADS IN EAST COAST OF SUMATRA	LAMPUNG	80	81
CROSS SECTION		SCALE: H=1:200 V=1:200	
BRIDGE WAY PEDADA STA 143 + 253			

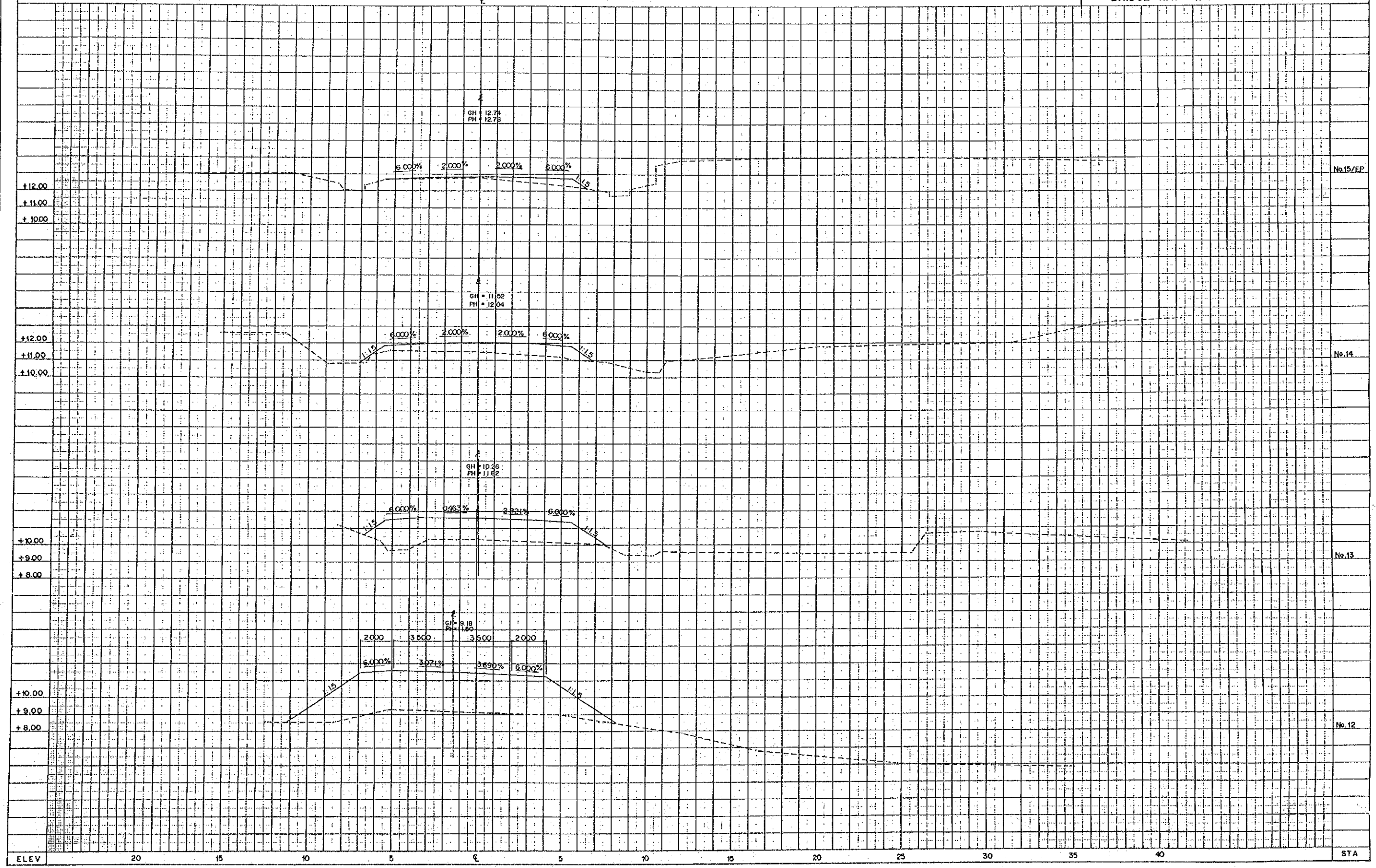

ELEV 20 15 10 5 0 5 10 15 20 25 30 35 40 STA

PROJECT	PROVINCE	SHEET NO.	TOTAL SHEET
COASTAL ROADS IN EAST COAST OF SUMATRA	LAMPUNG	81	81
PLAN AND PROFILE		SCALE = 1 : 200	
BRIDGE WAY PEDADA STA. 143 + 253			

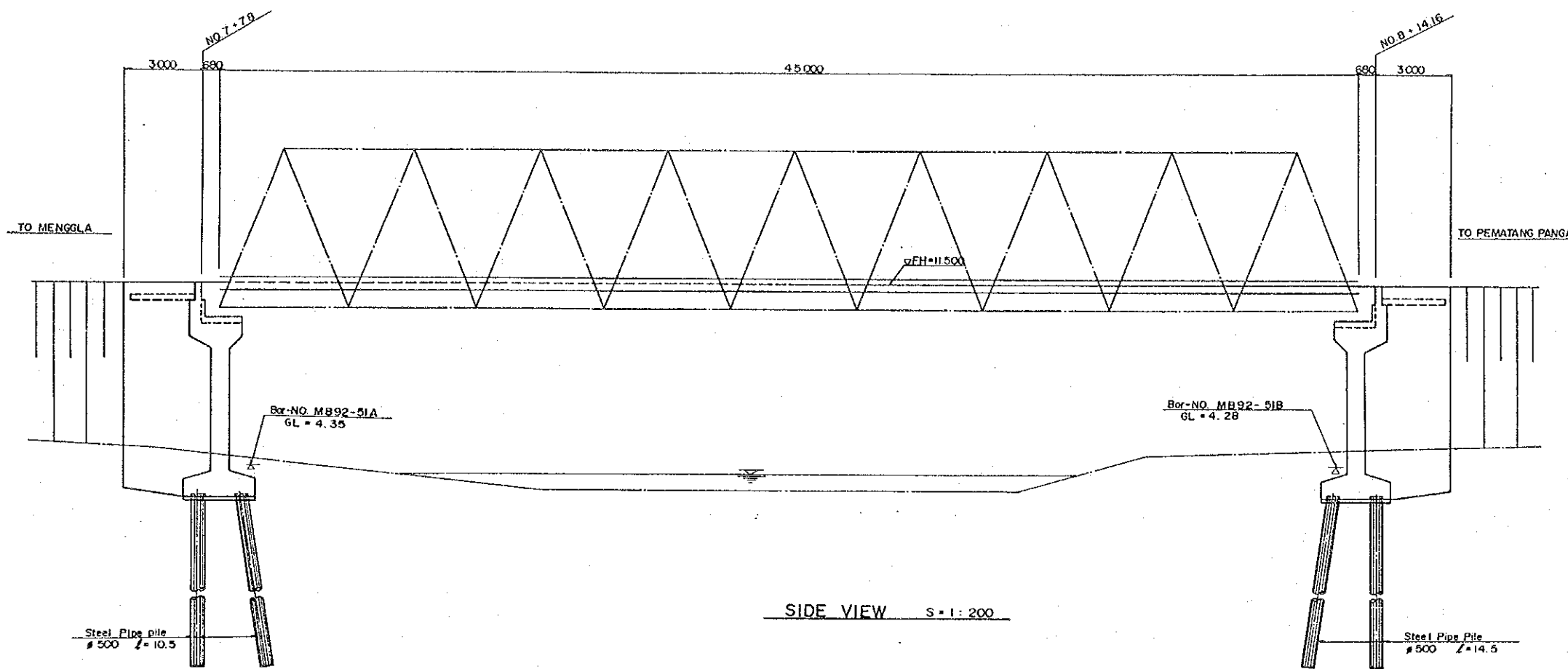

SIDE VIEW S = 1 : 200

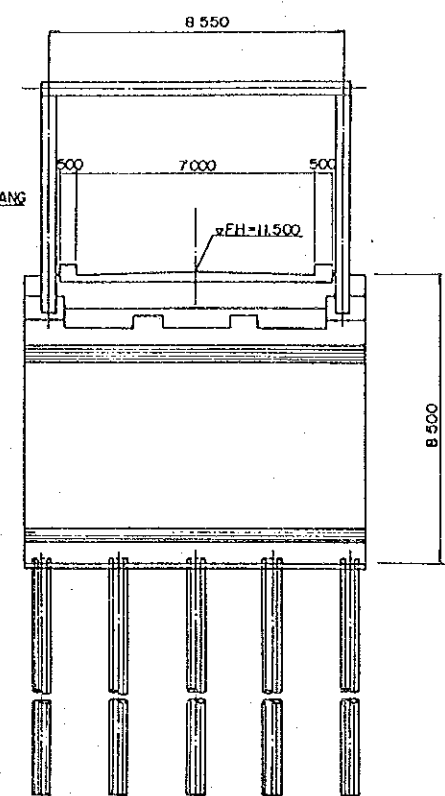

CROSS SECTION (ABUTMENT) S = 1 : 200

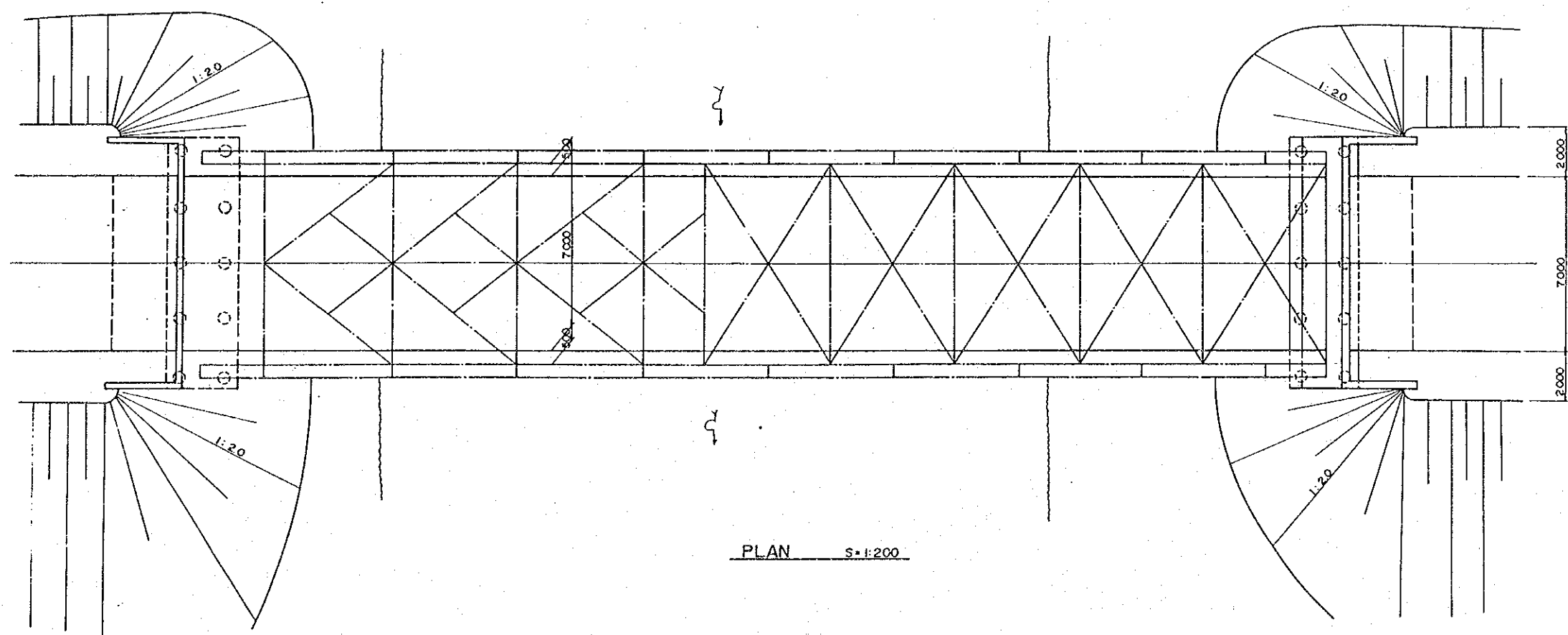

PLAN S = 1 : 200

JICA