

PROFILE SCALE 1:200

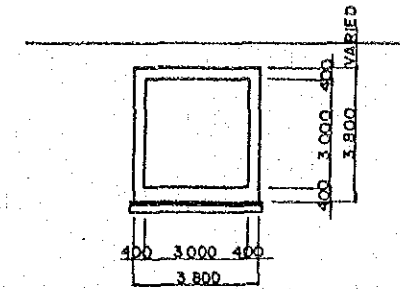

CROSS SECTION SCALE 1:100

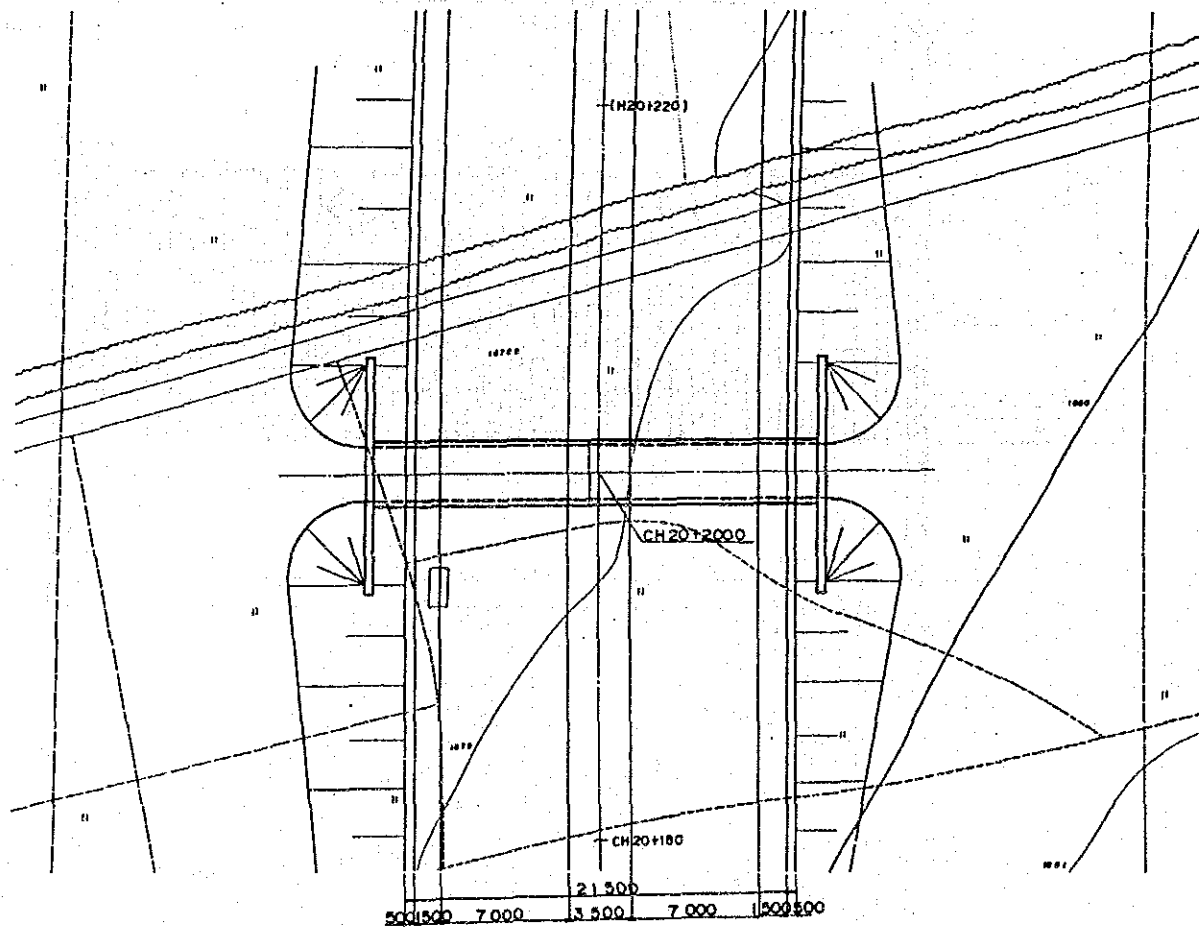

PLAN SCALE 1:200

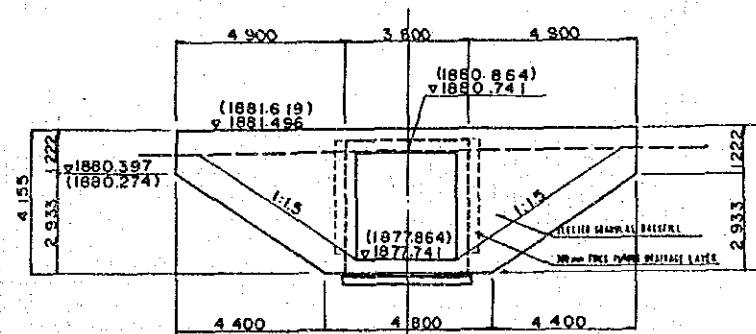

LEFT (RIGHT)
ELEVATION OF WINGWALL SCALE 1:100

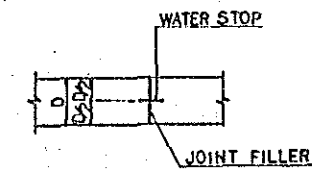

DETAIL OF JOINTS

AERIAL PHOTO BY	SURVEYED BY
MAPPING BY	TRACED BY
LOCATION BY	CHECKED BY

M.O.P.W. ROADS DEPT. DRG. NO.

REVISIONS	
DESCRIPTION	DATE

JAPAN INTERNATIONAL COOPERATION AGENCY	CHIEF ENGINEER (ROADS)
	CHIEF SUPT. ENG. (DESIGN)

SEN SUPT. ENG. (DESIGN)	
SUPT. ENGINEER (DESIGN)	
PROJECT ENGINEER	

SCALES	
1:100, 200	

NAIROBI BYPASS
PEDESTRIAN BOX CULVERTS -- NO. 2
CH 20x200, 60 R=3.00 B=3.00 (1)

SHEET 10 OF 18

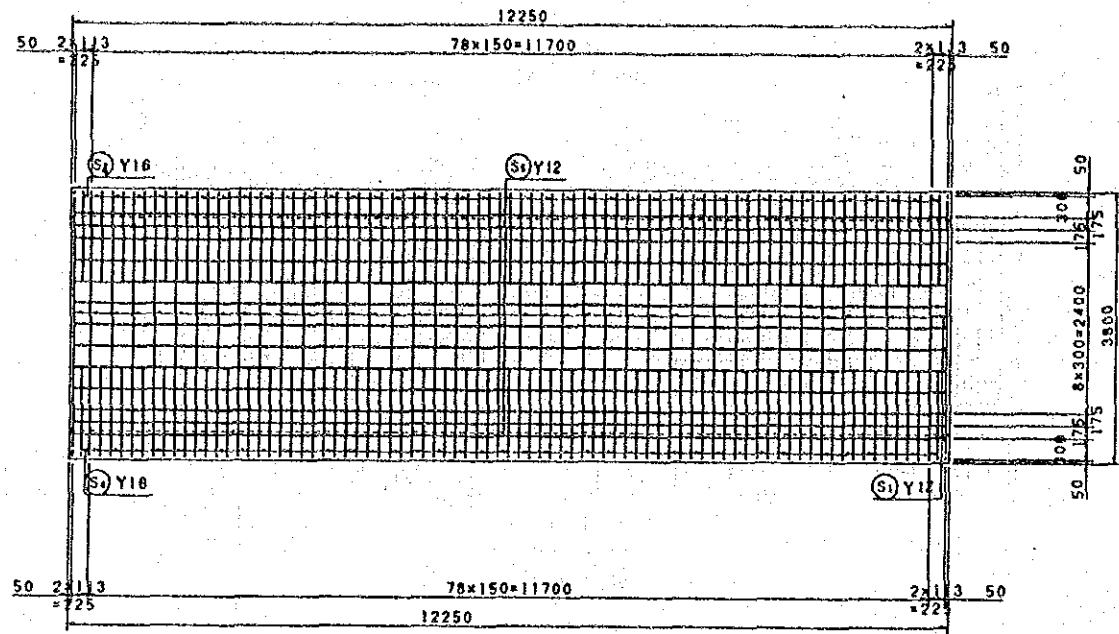

1 — 1

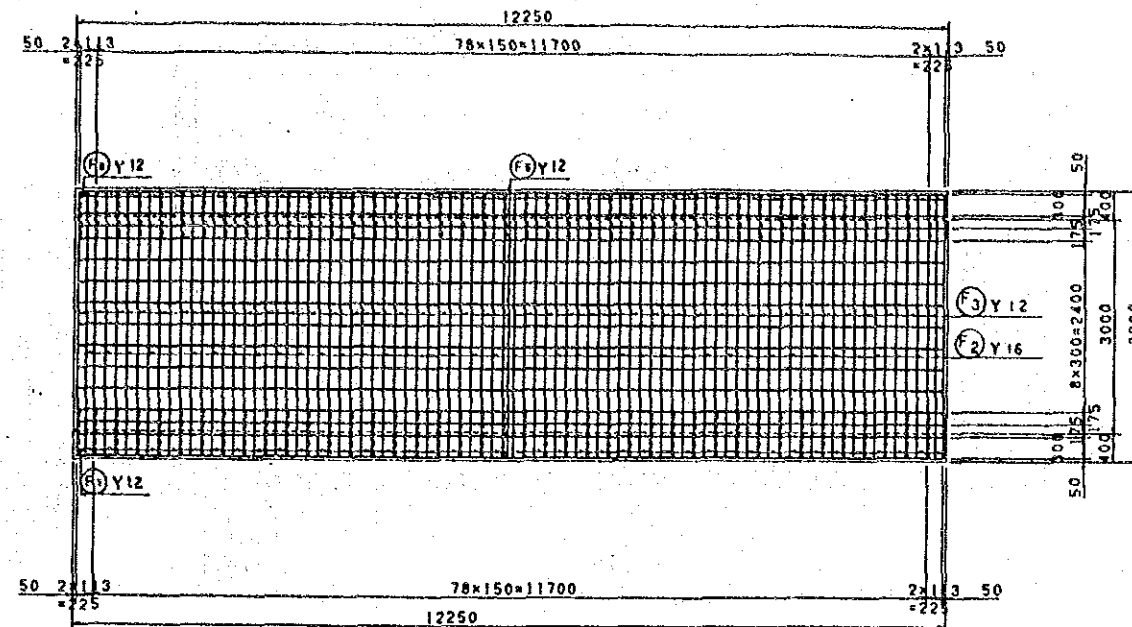

3 — 3

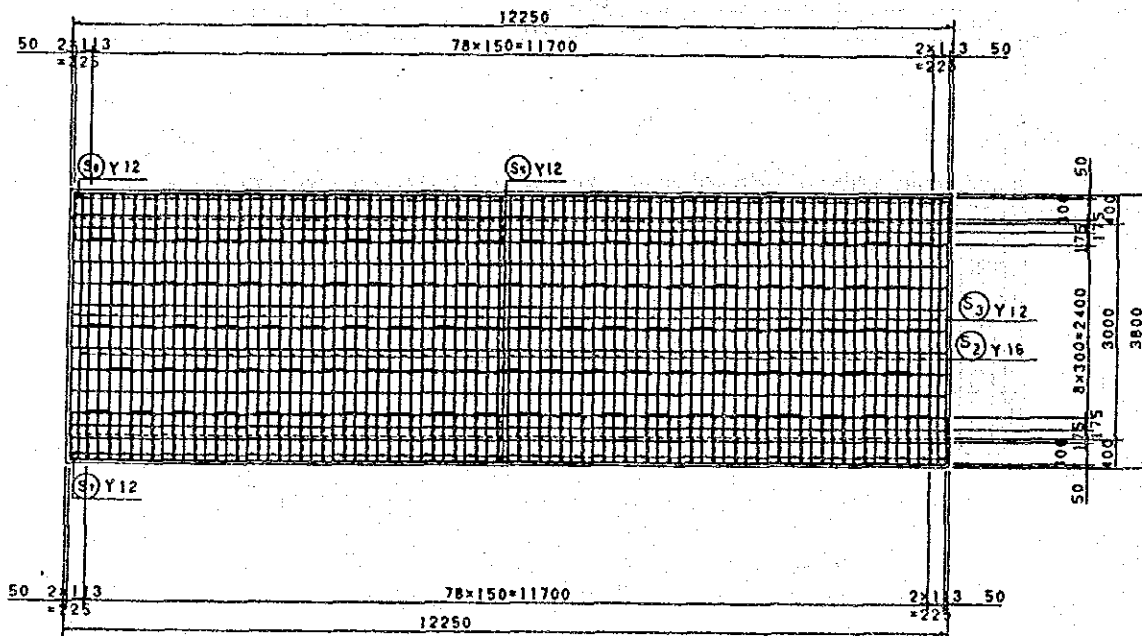

2 — 2

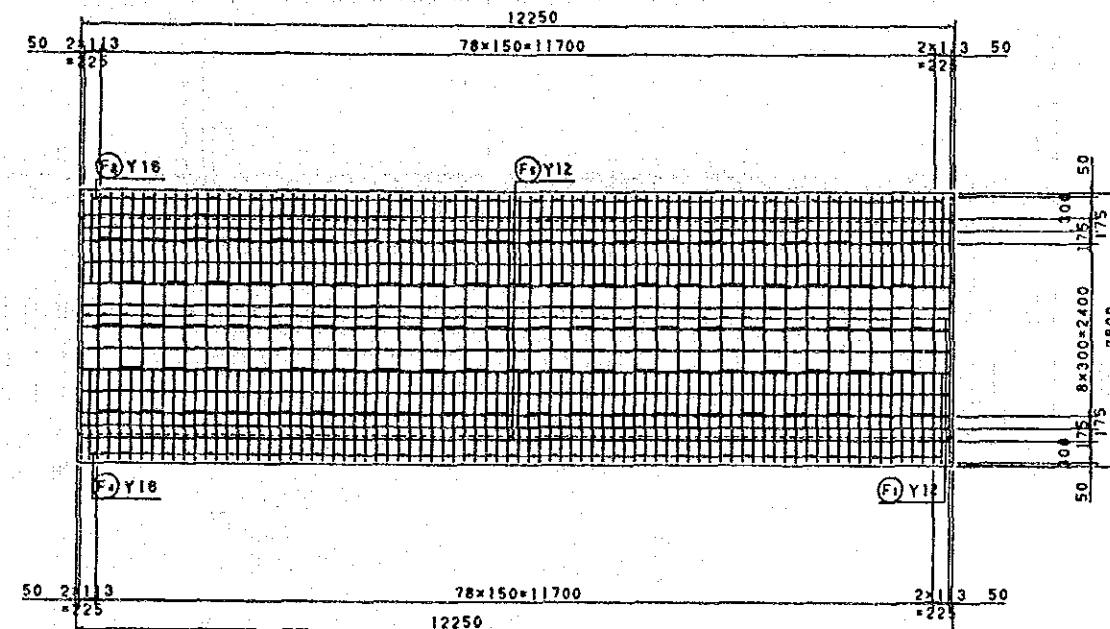

4 — 4

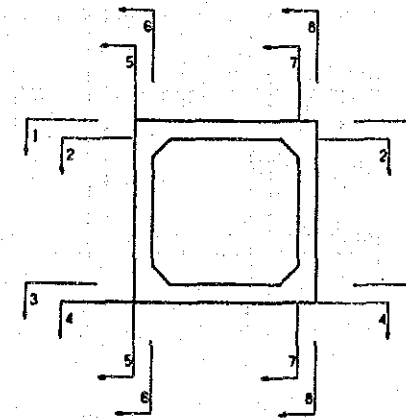

AERIAL PHOTO BY _____ SURVEYED BY _____
 MAPPING BY _____ TRACED BY _____
 LOCATION BY _____ CHECKED BY _____

M.O.P.W. ROADS DEPT. DRG. NO.

REVISIONS	
DESCRIPTION	DATE

JAPAN INTERNATIONAL COOPERATION AGENCY

CHIEF ENGINEER (ROADS)
CHIEF SUPT. ENG. (DESIGN)

SEN. SUPT. ENG. (DESIGN)
SUPT. ENGINEER (DESIGN)
PROJECT ENGINEER

SCALES
1:50

NAIROBI BYPASS
PEDESTRIAN BOX CULVERTS
CR 20+200.03 W=3.00 H=3.00 (2)

0
SHEET 1700F1 B

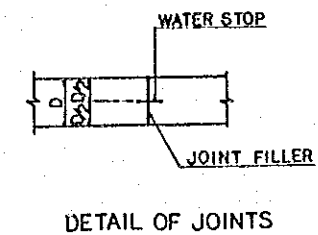
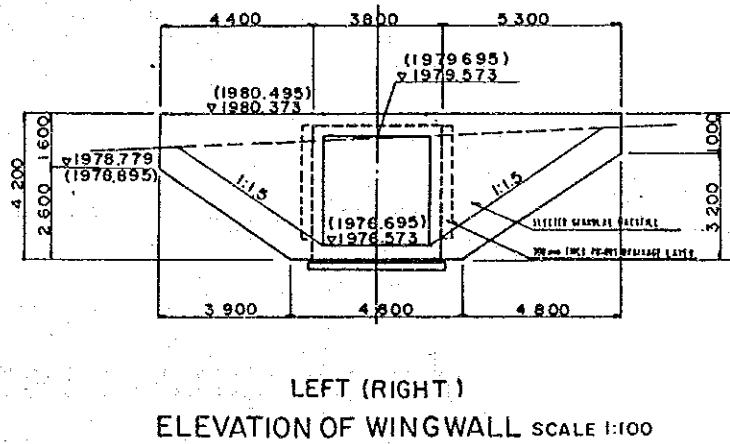
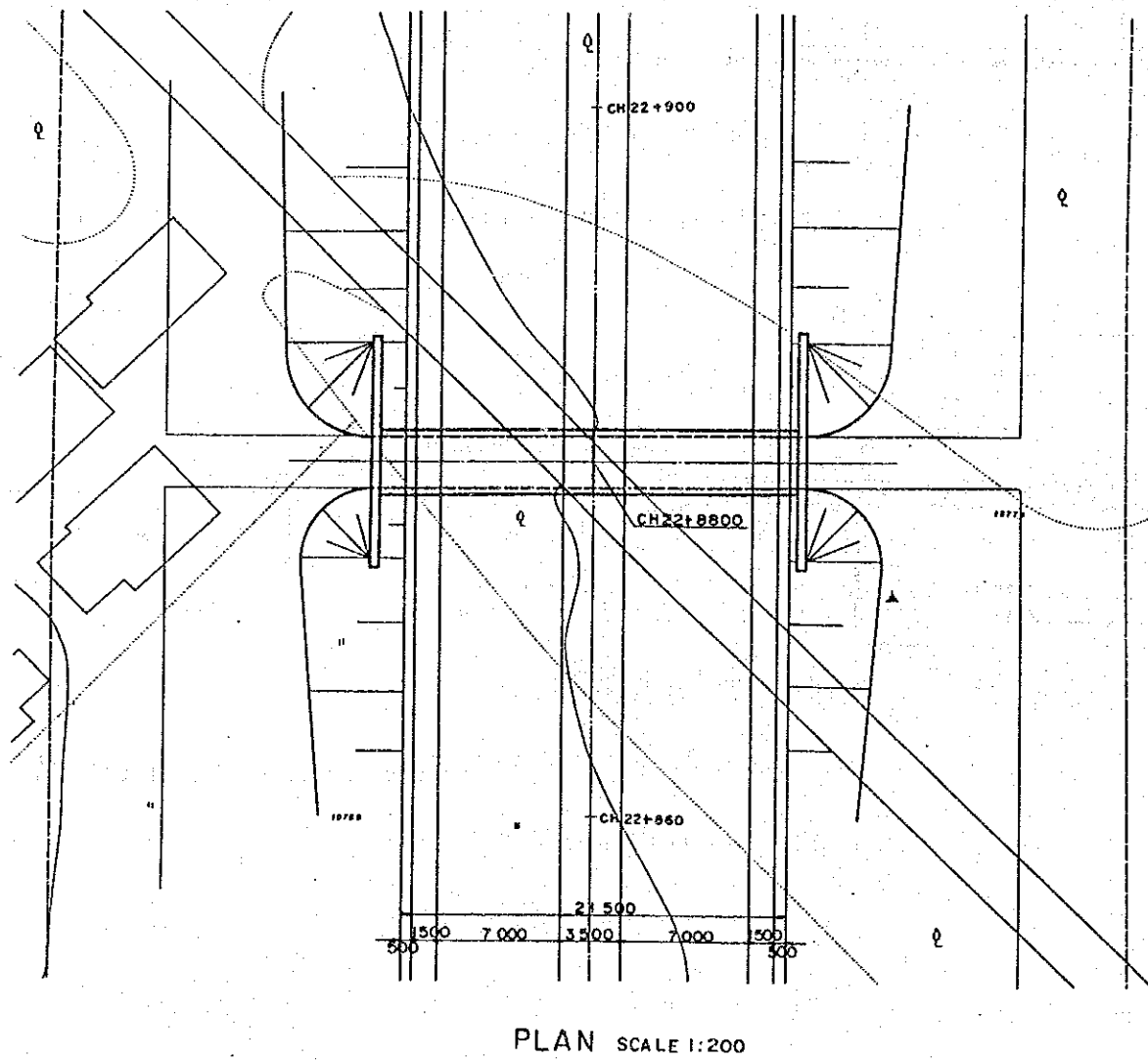
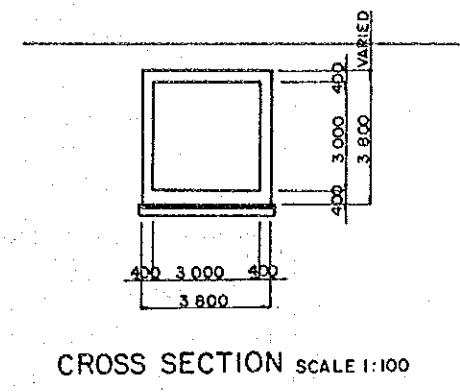
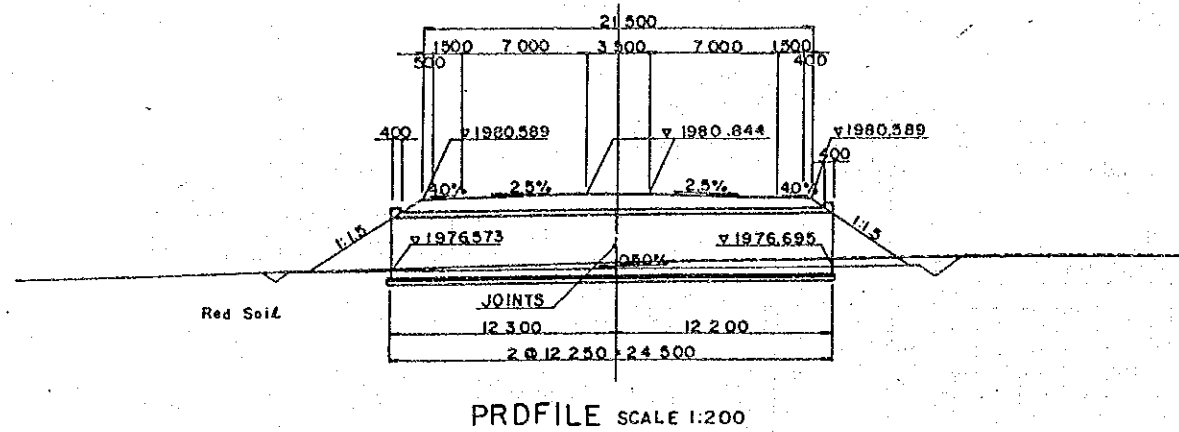

AERIAL PHOTO BY	SURVEYED BY
MAPPING BY	TRACED BY
LOCATION BY	CHECKED BY

M.P.W. ROADS DEPT. DRG. NO.

REVISIONS		JAPAN INTERNATIONAL COOPERATION AGENCY	CHIEF ENGINEER (ROADS) CHIEF SUPT. ENG. (DESIGN)	SEN SUPT. ENG. (DESIGN) SUPT. ENGINEER (DESIGN) PROJECT ENGINEER	SCALES 1:100,200	NAIROBI BYPASS PEDESTRIAN BOX CULVERTS - NO. 3 CH 22+860.00 V=3.00 H=3.00 (1)	Q SHEET 17 OF 183
DESCRIPTION	DATE						

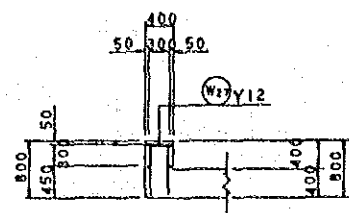

5 — 5

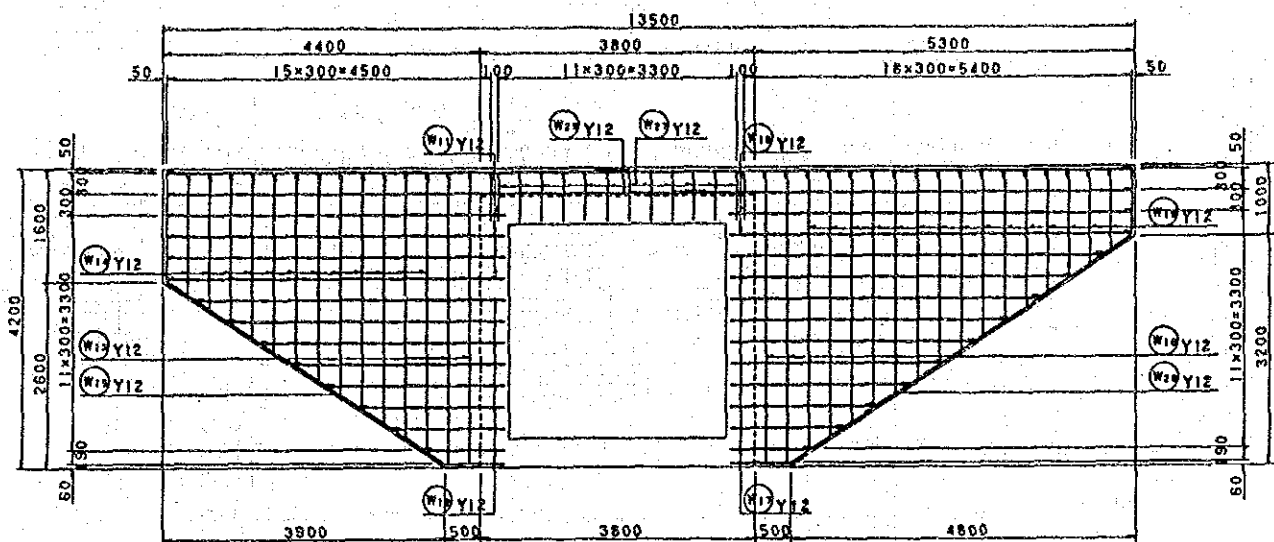

1 — 1

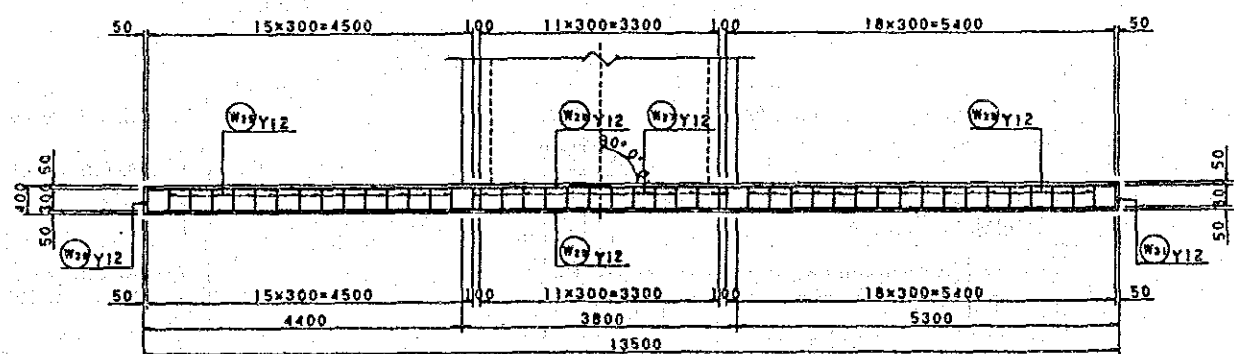
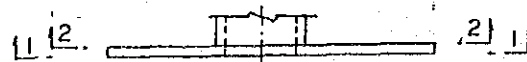
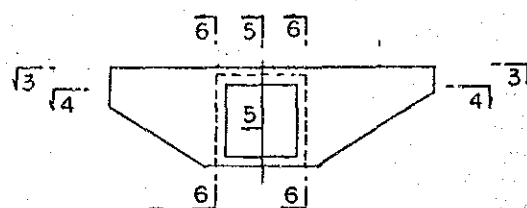

3 — 3

AERIAL PHOTO BY _____ SURVEYED BY _____
 MAPPING BY _____ TRACED BY _____
 LOCATION BY _____ CHECKED BY _____

M.O.P.W. ROADS DEPT DRG NO.

REVISIONS	
DESCRIPTION	DATE

JAPAN INTERNATIONAL COOPERATION AGENCY

CHIEF ENGINEER (ROADS)
 CHIEF SUPT ENG (DESIGN)

SEN SUPT. ENG. (DESIGN)
 SUPT ENGINEER (DESIGN)
 PROJECT ENGINEER

SCALES
 1:50

NAIROBI BYPASS
 PEDESTRIAN BOX CULVERTS
 CU 22-450, 60 9-3.00 8-3.00 (1)

SHEET 17 OF 18

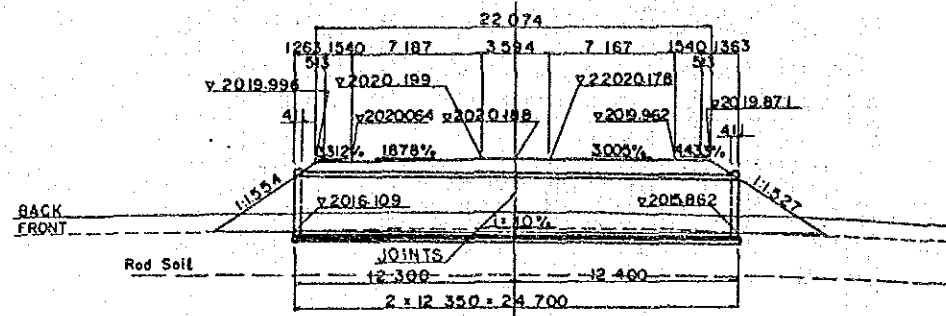

PROFILE SCALE 1:200

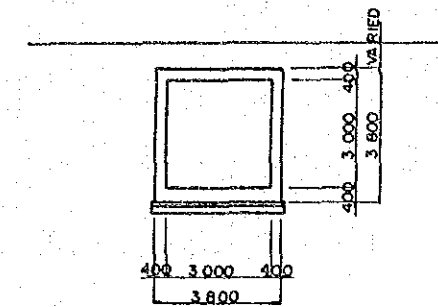

CROSS SECTION SCALE 1:100

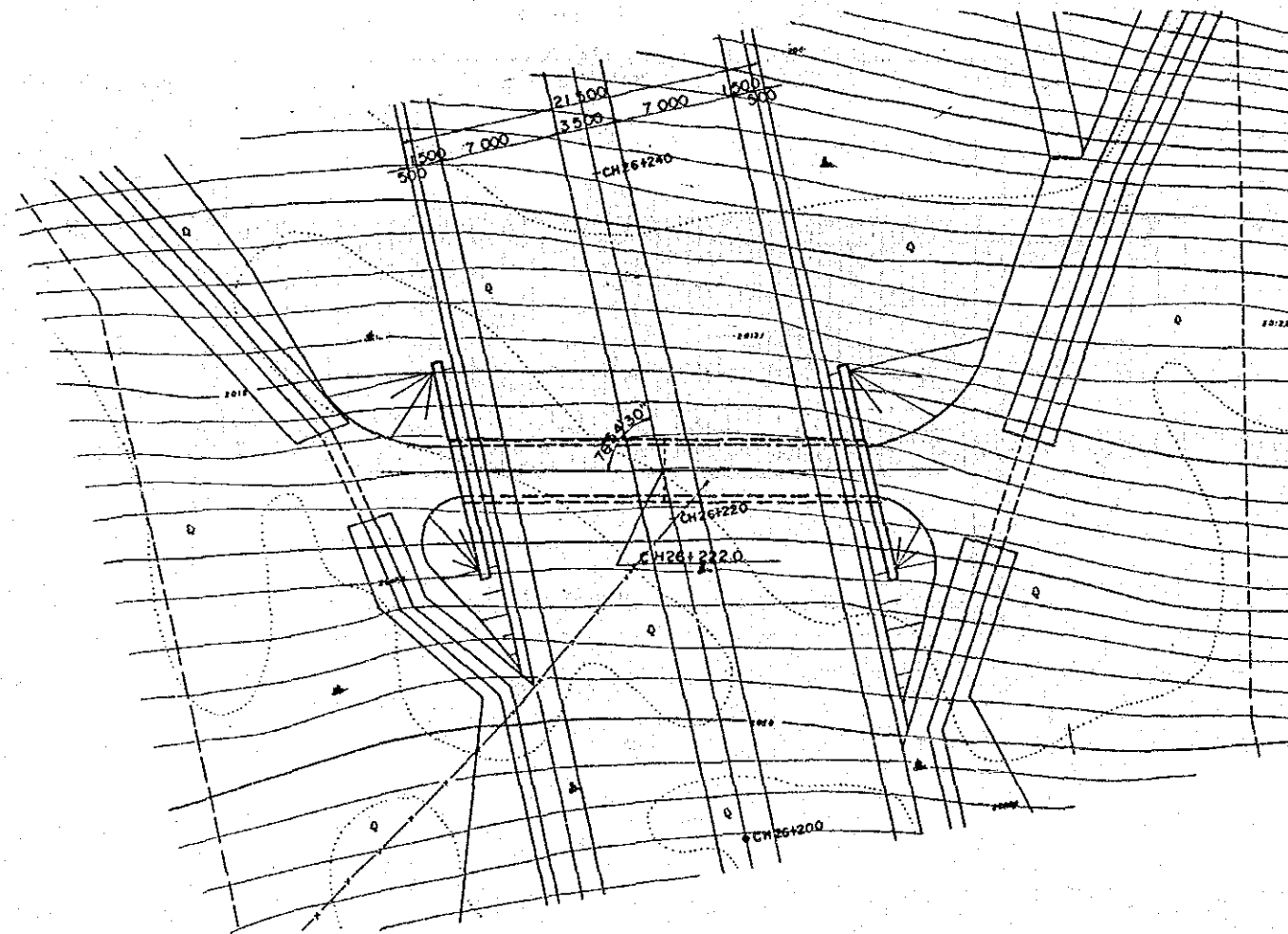

PLAN SCALE 1:200

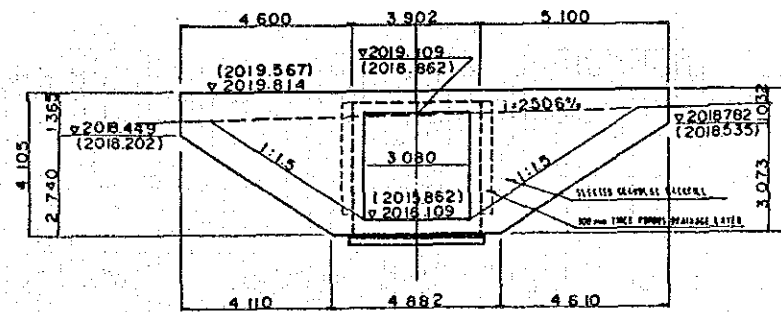

LEFT (RIGHT) ELEVATION OF WINGWALL SCALE 1:100

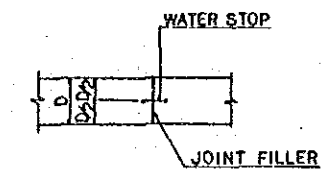

DETAIL OF JOINTS

AERIAL PHOTO BY	SURVEYED BY
MAPPING BY	TRACED BY
LOCATION BY	CHECKED BY

M.O.P.W. ROADS DEPT. DRG. NO.

REVISIONS	
DESCRIPTION	DATE

JAPAN INTERNATIONAL COOPERATION AGENCY

CHIEF ENGINEER (ROADS)
CHIEF SUPT. ENG. (DESIGN)

SEN SUPT. ENG. (DESIGN)
SUPT. ENGINEER (DESIGN)
PROJECT ENGINEER

SCALES
1:100,200

NAIROBI BYPASS
PRECAST BOX CULVERTS - NO. 4
CR 26-122.00 V=2.60 H=3.60 (1)

Q
SHEET 1770FI 83

AERIAL PHOTO BY _____ SURVEYED BY _____
 MAPPING BY _____ TRACED BY _____
 LOCATION BY _____ CHECKED BY _____

MOPW ROADS DEPT. DRG. NO.

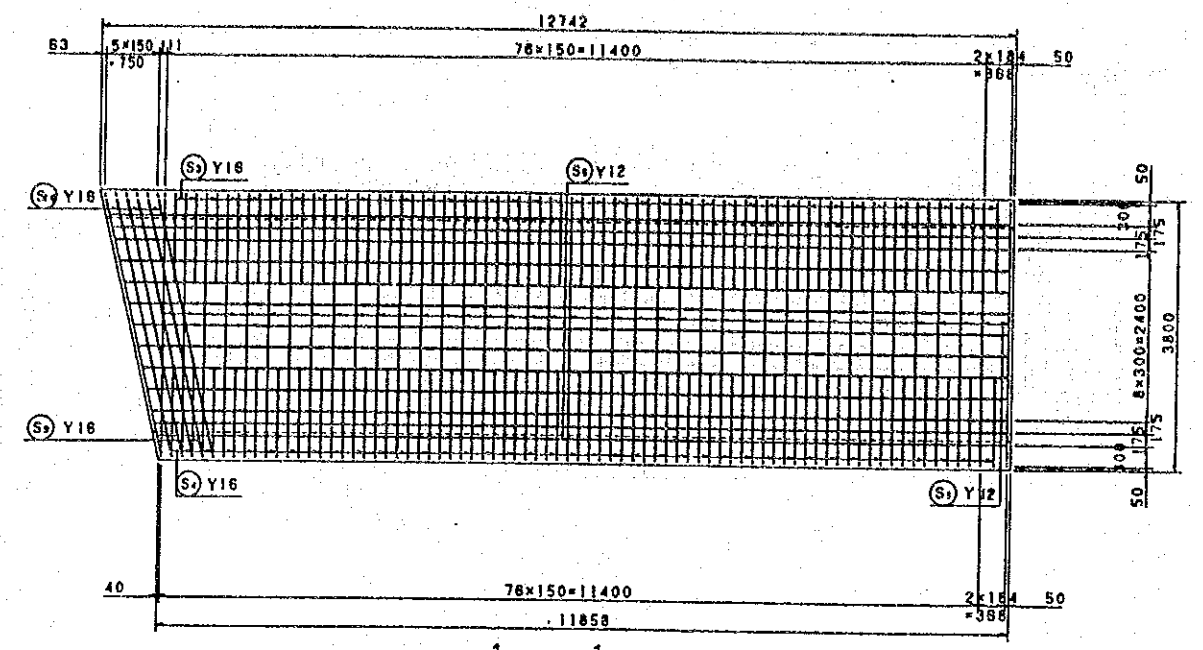

1 — 1

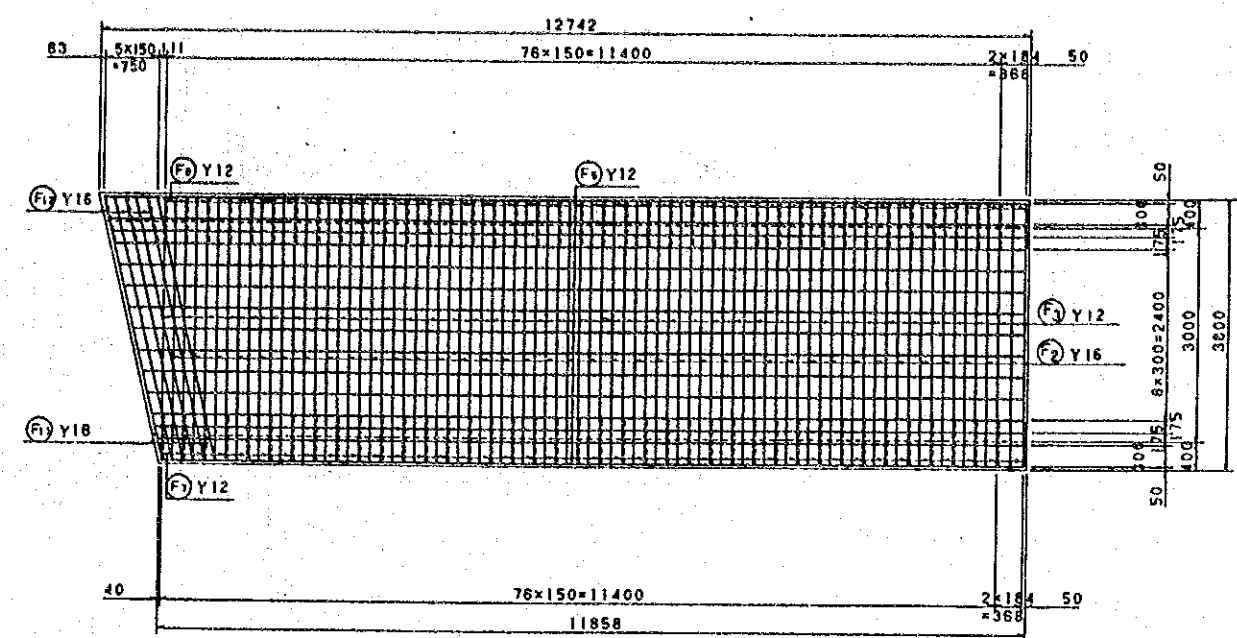

3 — 3

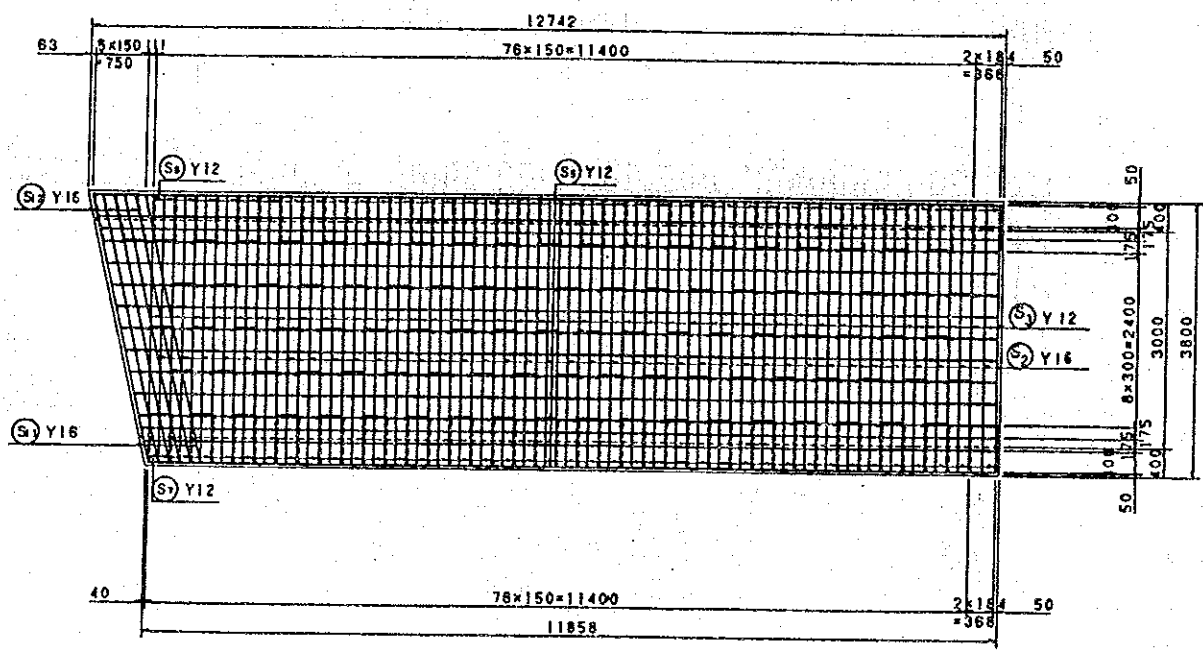

2 — 2

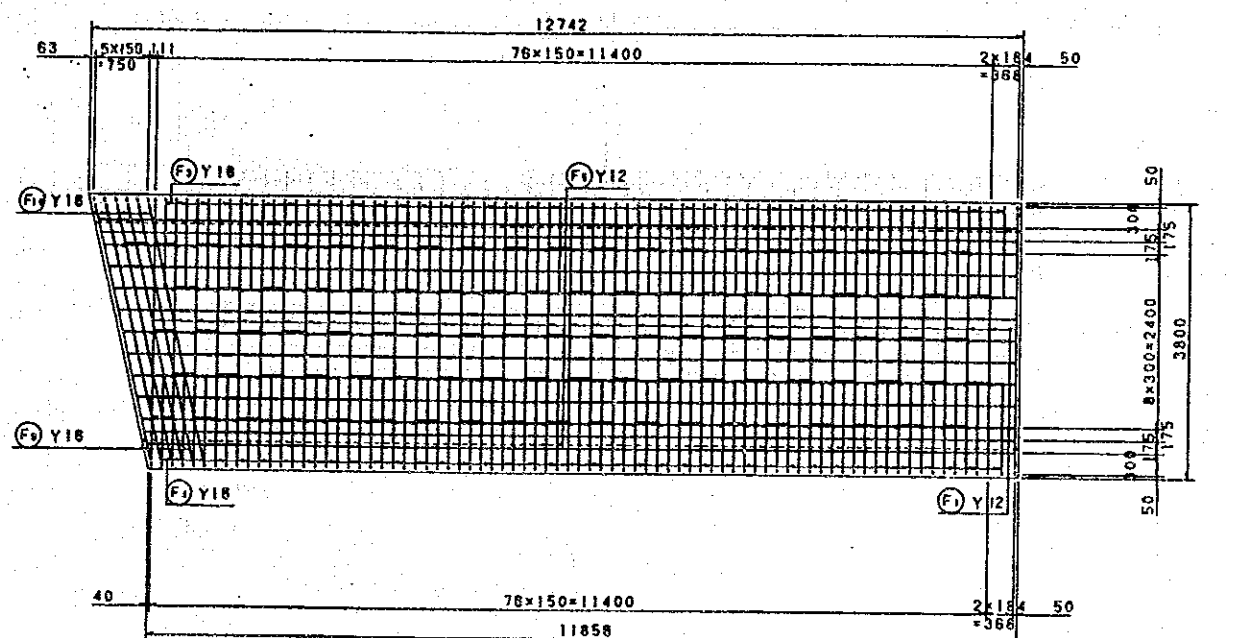

4 — 4

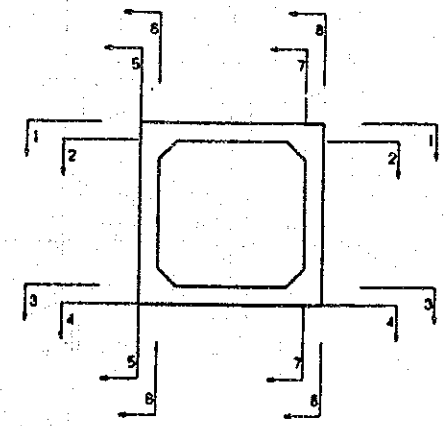

REVISIONS		JAPAN INTERNATIONAL COOPERATION AGENCY	CHIEF ENGINEER (ROADS)	SEN. SUPT. ENG. (DESIGN)	SCALES	NAIROBI BYPASS	Q
DESCRIPTION	DATE						
			CHIEF SUPT. ENG. (DESIGN)	SUPT. ENGINEER (DESIGN)	1:50	PEDESTRIAN BOX CULVERTS CR 24+227.01 R-3.00 B-3.00 (3)	SHEET 17HOF 183

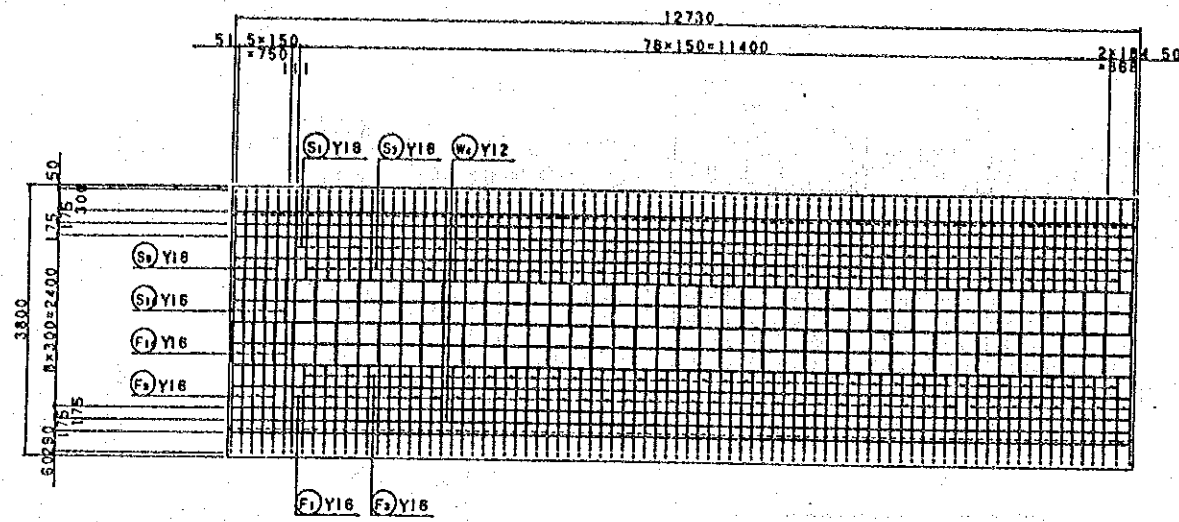

5 — 5

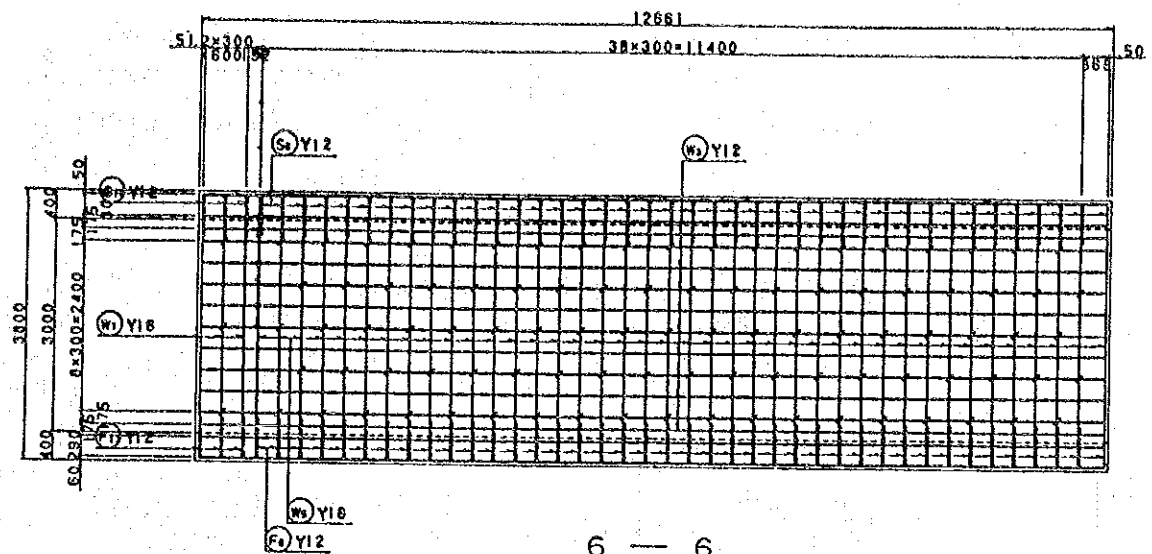

6 — 6

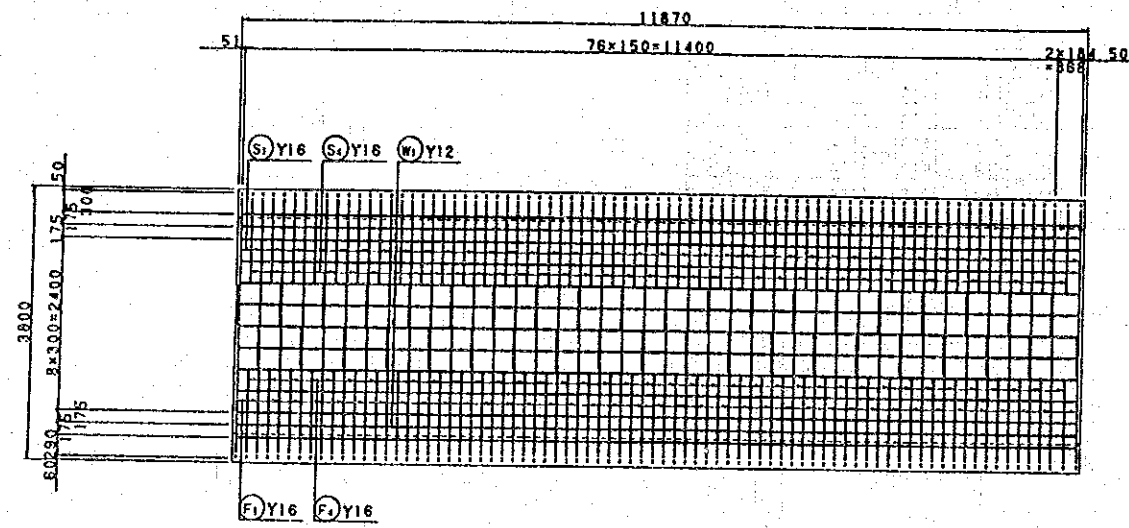

7 — 7

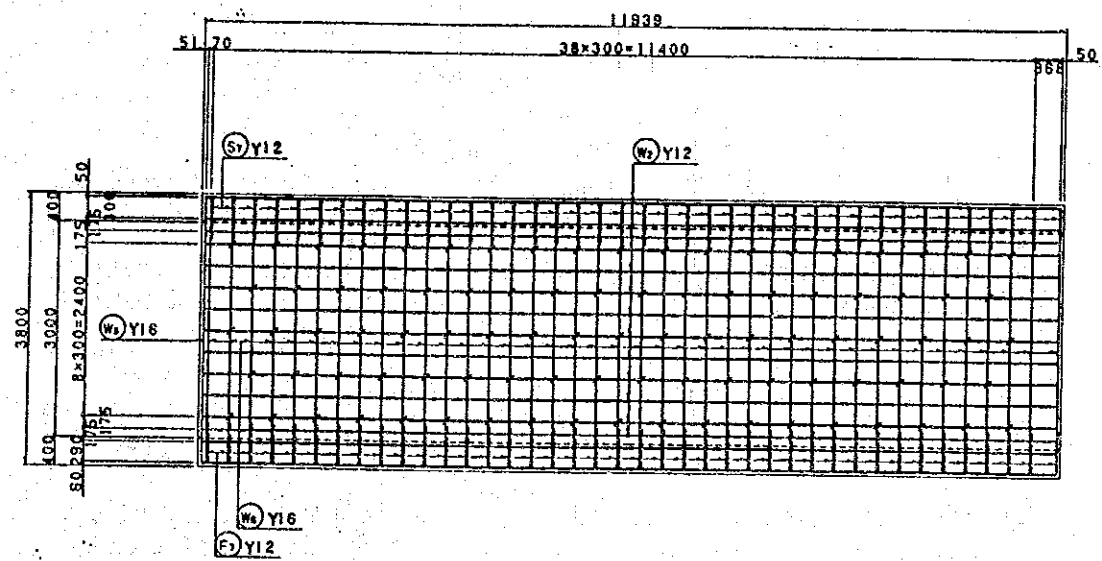

8 — 8

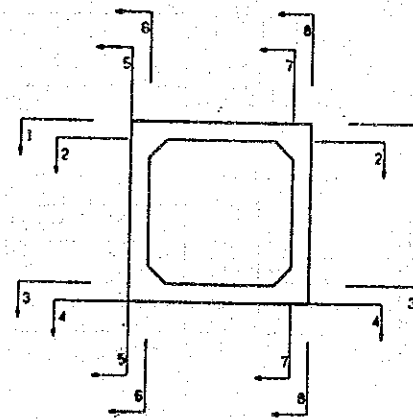

AERIAL PHOTO BY	SURVEYED BY
MAPPING BY	TRACED BY
LOCATION BY	CHECKED BY

MOPW ROADS DEPT DRG NO.

REVISIONS	
DESCRIPTION	DATE

JAPAN INTERNATIONAL COOPERATION AGENCY	CHIEF ENGINEER (ROADS)
	CHIEF-SUPT ENG (DESIGN)

SEN SUPT. ENG (DESIGN)	
SUPT ENGINEER (DESIGN)	
PROJECT ENGINEER	

SCALES	1:50
--------	------

NAIROBI BYPASS
PEDESTRIAN BOX CULVERTS
CE 26-222.01 9-3.00 R-3.00 (3)

Q
SHEET 17 OF 18

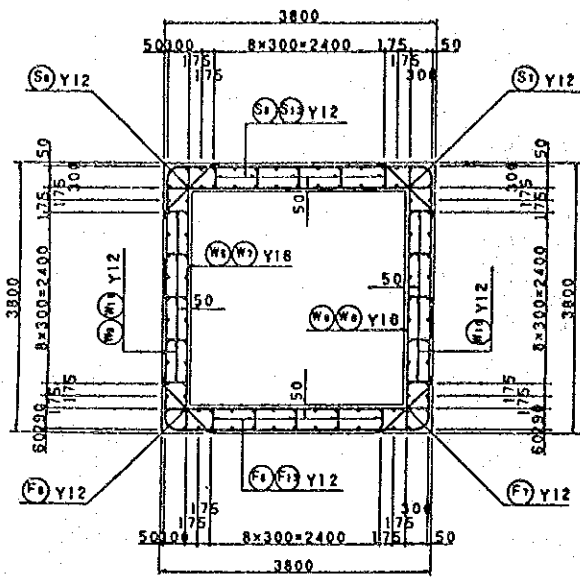

SECTION

MARK	DIA	a	b	L	REMARK
S 8	Y12	328	328	1187	
S13	*	328	328	1187	
F 8	*	328	318	1187	
F13	*	328	318	1187	
W 9	*	---	328	528	
W10	*	---	328	528	
W11	*	---	337	537	

MARK	DIA	a	H	L	NUMBER
S 6	Y12	890	628	1080	40
S 7	*	890	828	1080	40
S12	*	803	638	1103	3
F 8	*	875	618	1075	40
F 7	*	875	618	1075	40
F12	*	888	628	1088	3

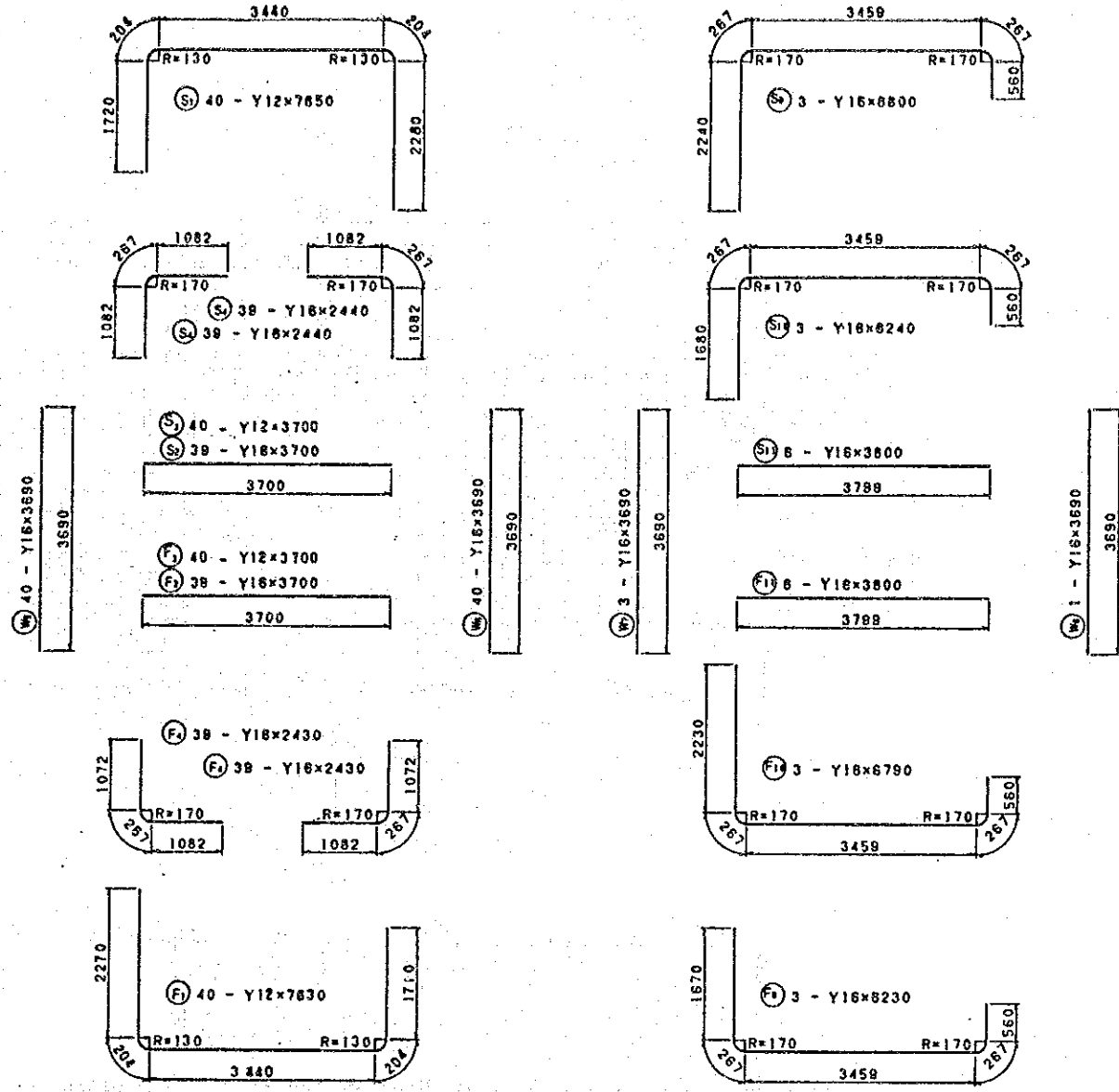
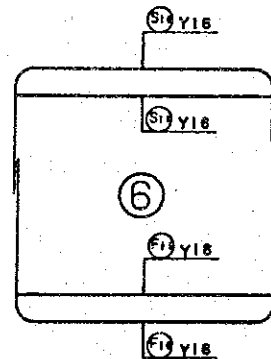
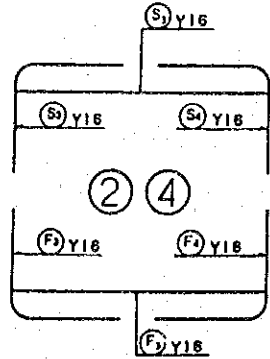
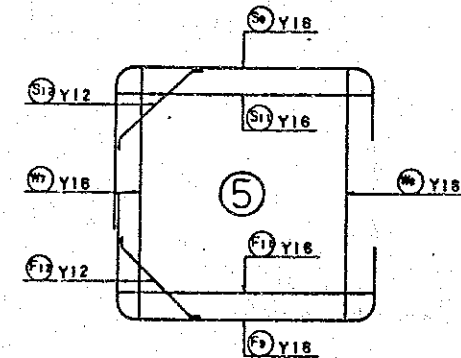
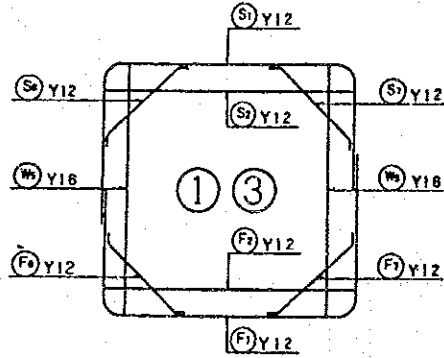

MARK	DIA	a	b	c	L = a + b	LAP	NUMBER
S 5	Y12	10000	2 189 - 3 049 (2 619)	420	12 620	1	28
F 5	*	10000	2 189 - 3 049 (2 619)	420	12 620	1	28
W 1	*	10000	2 189	420	12 190	1	11
W 2	*	10000	2 258	420	12 260	1	11
W 3	*	10000	2 960	420	12 980	1	11
W 4	*	10000	3 049	420	13 050	1	11

AERIAL PHOTO BY _____ SURVEYED BY _____
 MAPPING BY _____ TRACED BY _____
 LOCATION BY _____ CHECKED BY _____

MOPW ROADS DEPT DRG NO.

AERIAL PHOTO BY
MAPPING BY
LOCATION BY

SURVEYED BY
TRACED BY
CHECKED BY

M.C.P.W. ROADS DEPT DRG NO.

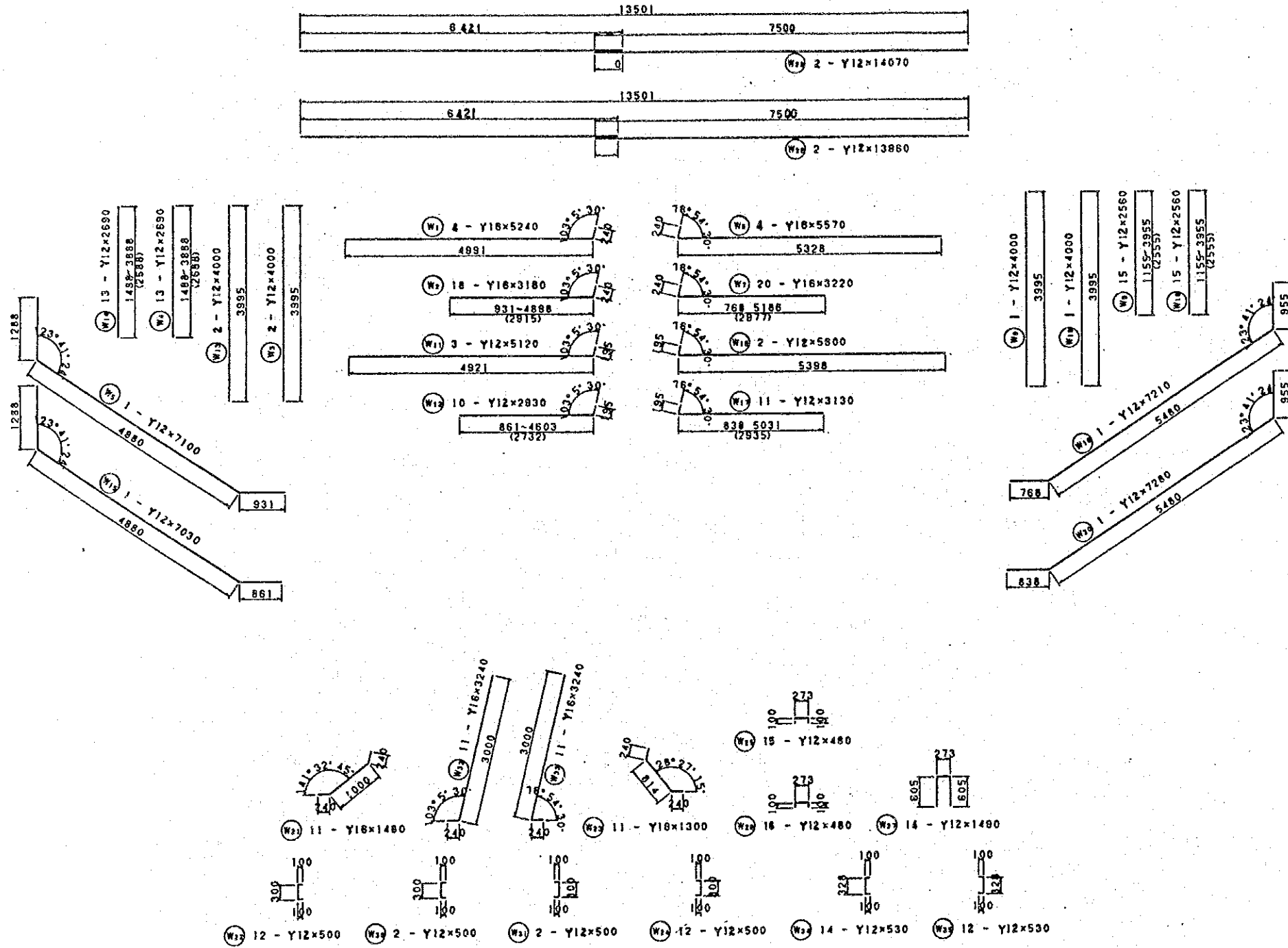

REVISIONS	
DESCRIPTION	DATE

JAPAN INTERNATIONAL COOPERATION AGENCY

CHIEF ENGINEER (ROADS)
CHIEF SUPT ENG (DESIGN)

SEN SUPT. ENG (DESIGN)
SUPT ENGINEER (DESIGN)
PROJECT ENGINEER

SCALES
1:50

NAIROBI BYPASS
PEDESTRIAN BOX CULVERTS
CH 20+222.00 R=3.00 L=3.00 (1)

Q
SHEET 18 OF 18

