

ATTACHMENT

1. Objective

The objective of the Project is to improve maternal and child health services by strengthening main and sub centers of Maternal and Child Health Training Institute (MCHTI), including the provision of necessary facilities and equipment for the following activities.

- 1) Clinical services in the field of maternal and child health
- 2) Training services for health personnel in the field of maternal and child health

2. Project Site

The Project sites are located at Azimpur, Dhaka for main center and Lalkuthi, Mirpur, Dhaka for sub center as shown in Annex I, with the total area of approximately 2,990 m² and 4,145 m² respectively.

3. Executing agency

Directorate General of Family Planning, Ministry of Health and Family Welfare is responsible for the administration and execution of the Project.

4. Activities of MCHTI

Summary of activities in MCHTI are described in Annex II (II-1 and II-2).

5. Organization of MCHTI

Organization of MCHTI is shown in Annex III.

6. Items requested by the Bangladesh side

The following items were finally requested by the Bangladesh side.

- 1) Construction of the facilities described in Annex IV
- 2) Provision of equipment related to the Project which are described in Annex IV

J. H.

Q. H.

7. Comments by the Japanese side on the requested items mentioned in 6. above

- 1) The Japanese side will review the necessary facilities and equipment for the Project according to the priority order proposed by the Bangladesh side.
- 2) The final components of the Project may differ, when considered necessary after further studies in Japan.

8. Japan's Grant Aid system

- 1) The Bangladesh side understands the system of Japan's Grant Aid as explained by the team.
- 2) The Bangladesh side will take necessary measures, as described in Annex V for the smooth implementation of the Project on condition that the Grant Aid by the Government of Japan is extended to the Project.

9. Other relevant issues

On condition that Japan's Grant Aid is extended to the Project;

- 1) the Government of Bangladesh will allocate the necessary budget to the Project with the cooperation of other donor organizations for securing proper operation and maintenance of MCHTI.
- 2) the Ministry of Health and Family Welfare will recruit the necessary personnel for MCHTI.
- 3) the Ministry of Health and Family Welfare will make efficient use of MCHTI both in clinical services and in training services.
- 4) the Ministry of Health and Family Welfare will establish a committee for promoting training activities in MCHTI, which consists of representatives from related organizations.

10. Schedule of the Study

- 1) The consultants will proceed to further studies in Bangladesh until February 13, 1992.

T. W.

[Handwritten signature]

- 2) Based on the Minutes of Discussions and the results of the study, JICA will compile a draft report and dispatch a mission in order to explain its contents in May 1992.
- 3) Upon approval of the said draft report by the Bangladesh side, JICA will complete the final report and send it to the Government of Bangladesh around July 1992.

[Handwritten mark]

T.W.

PROJECT SITE 1

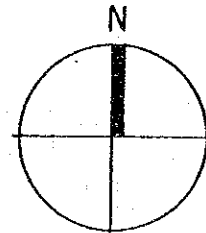
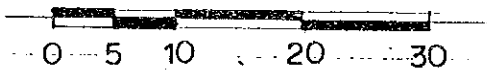
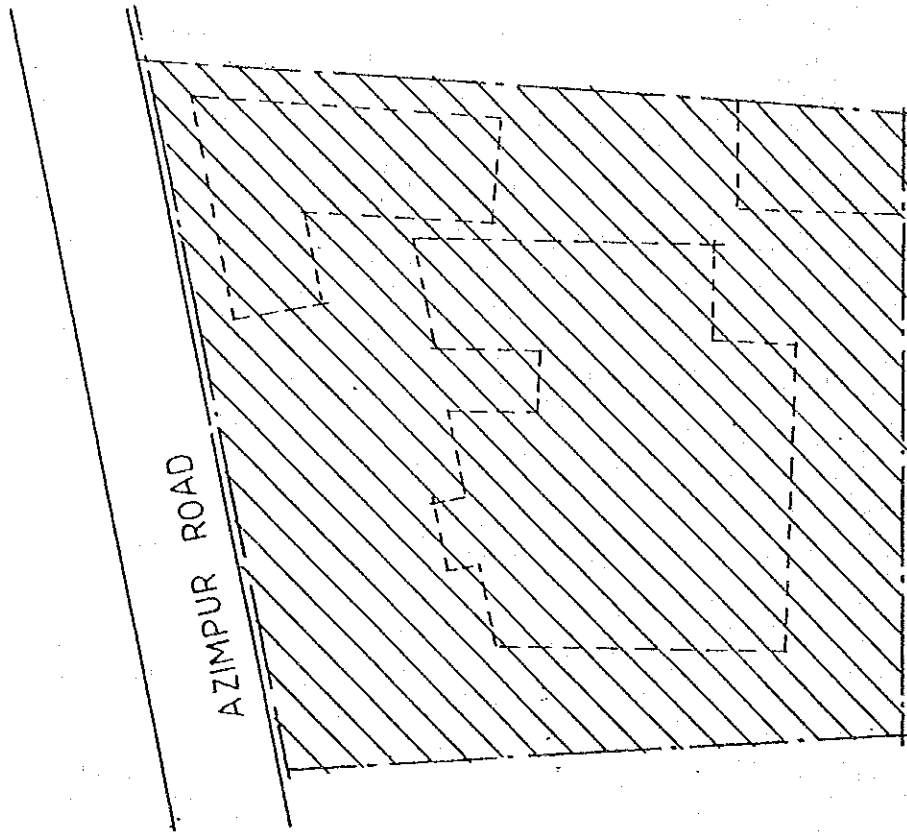

MCHTL AZIMPUR

Handwritten signature or initials

Handwritten signature or initials

PROJECT SITE 2

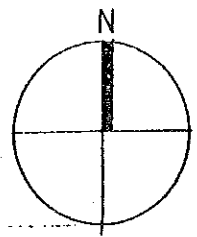
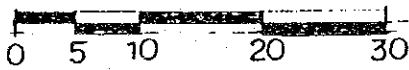
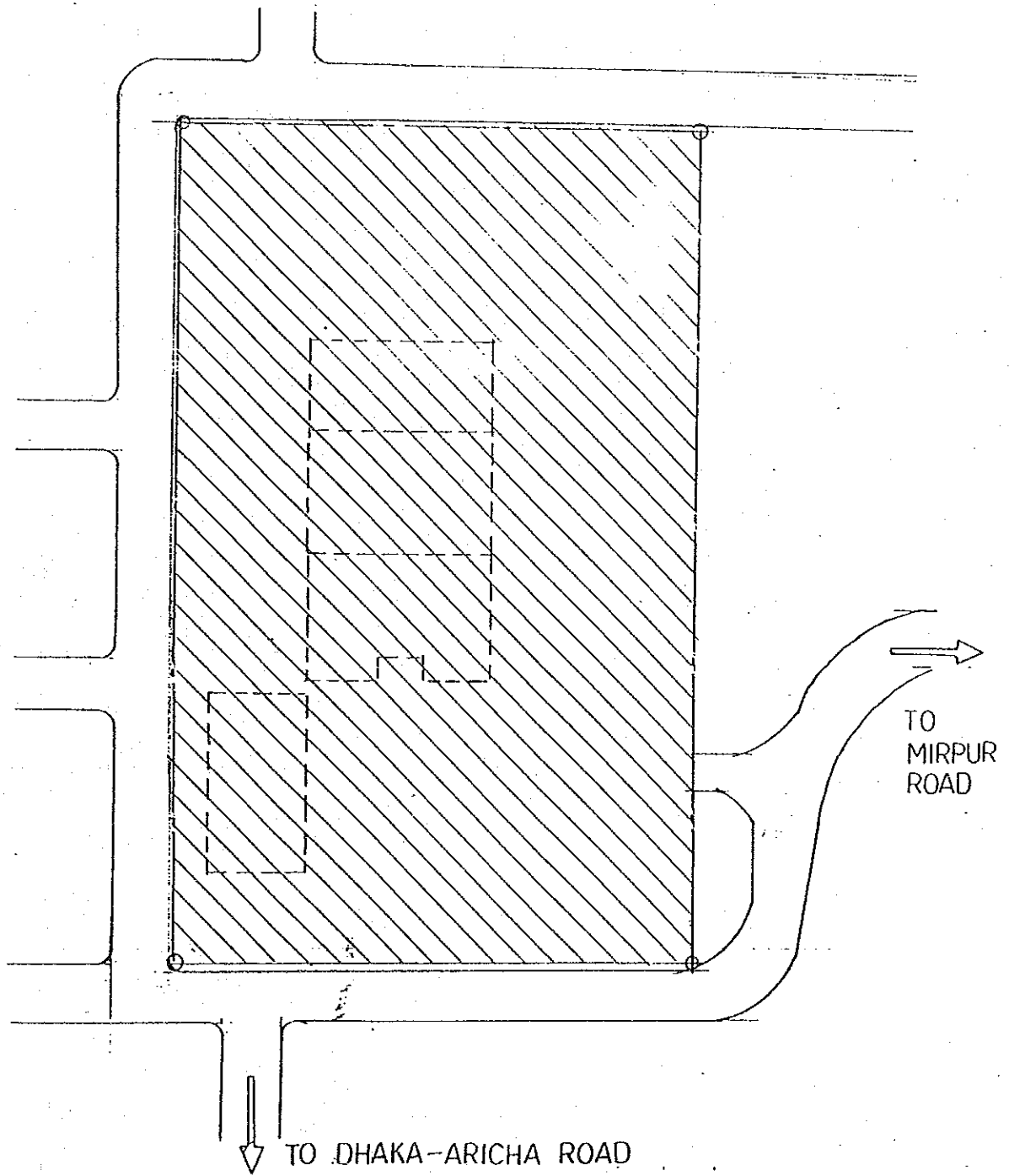

MCHTI, MIRPUR, LALKUTI

P.W.

[Signature]

Annex II-1

Summary of Activities in MCHTI

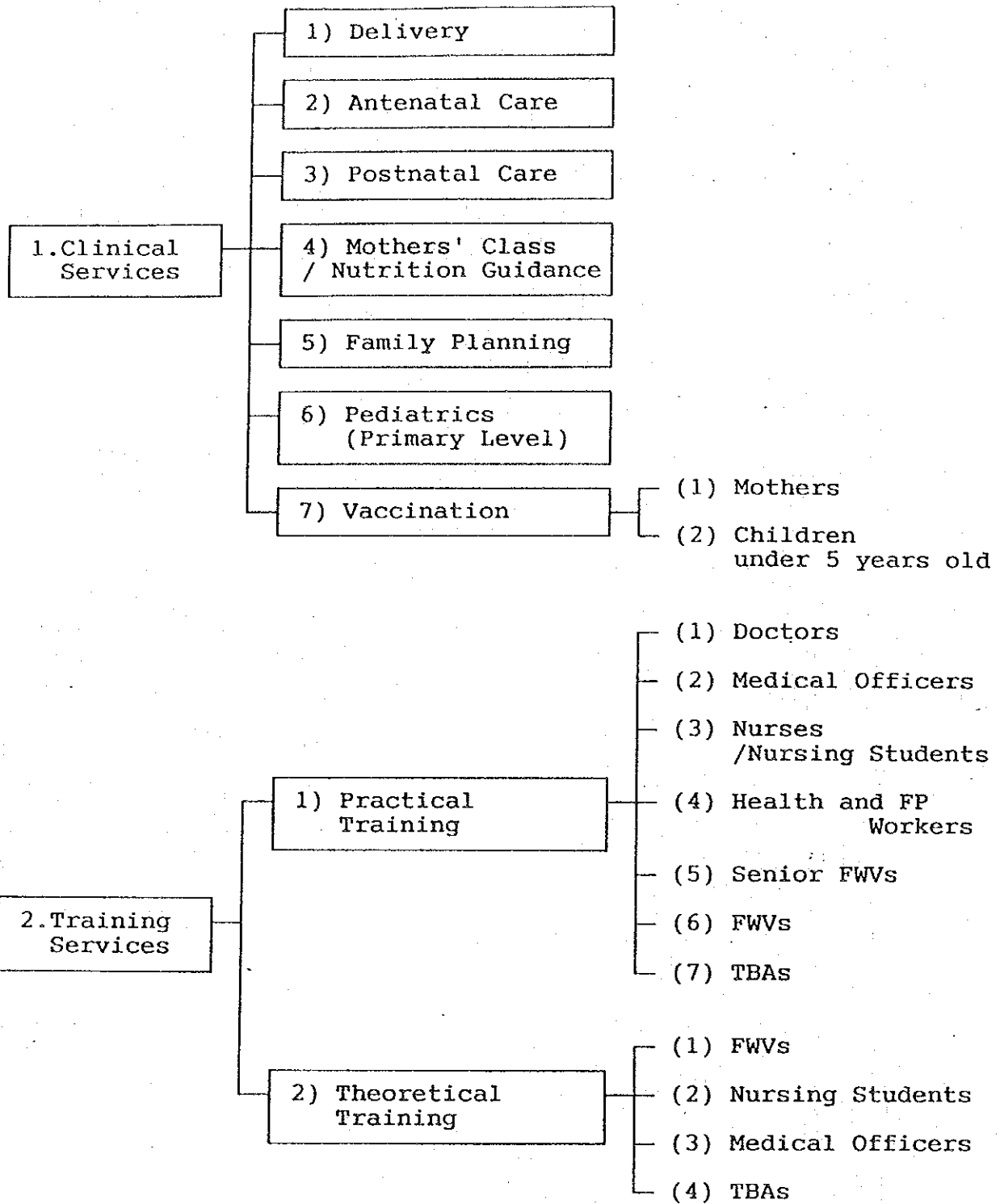

Handwritten signatures and initials.

Time Schedule for Training Course

	Apr	May	June	July	Aug	Sept	Oct	Nov	Dec	Jan	Feb	Mar	Total	Remarks
1. Sr. FWV (Refreshers)	14 days	14 days	14 days	14 days	14 days	14 days	14 days	14 days	14 days	14 days	14 days	14 days		Practical in OPD and in words
Total Number	20	20	20	20	20	20	20	20	20	20	20	20	220	
2. FWV (Refreshers)	14 days	14 days	14 days	14 days	14 days	14 days	14 days	14 days	14 days	14 days	14 days	14 days		Practical hand on skill training in OPD words
Total Number	20	20	20	20	20	20	20	20	20	20	20	20	240	
3. FWV (Basic Training)							30 days	30 days	30 days	30 days	30 days	30 days		Theory Practical
Total Number							20	20	20	20	20	20	20	
4. Midwifery Nurse	21 days	21 days												Practical in indoor and OPD
Total Number	40	40											80	
5. Nurse Students						28 days	28 days							Observe Practical work & Practical in OPD & in wards
Total Number						20	20						40	

T.D.
232

P. W.

682

Time Schedule for Training Course

	Apr	May	June	July	Aug	Sept	Oct	Nov	Dec	Jan	Feb	Mar	Total	Remarks
6. MCHFP	7													Hand on skill training in OPD and indoor
Total Number	40												80	
7. Upazila Specialist				30	30	30	30	30	30	30	30	30		Hand on skill training in OPD and indoor
Total Number				5	5	5	5	5	5	5	5	5	10	
8. TBA		21	21											Practical hand on skill training, lectures, demonstration
Total Number		15	15										30	
Grand Total													720	

Ad HOC Training program

1. DMCH & FP students from Post Graduate Instt. study tour 7 days 10 Trainees 1 batch Total 10 Visit to OPD & indoor
2. DCH students from Post Graduate Instt. IPGM&R study tour 7 days 10 Trainees 1 batch Total 10 Visit to OPD & indoor
3. Under Graduate Medical Student of 4th year study tour No specified 1 batch No specified Visit OPD

Organization Chart of MCHTI

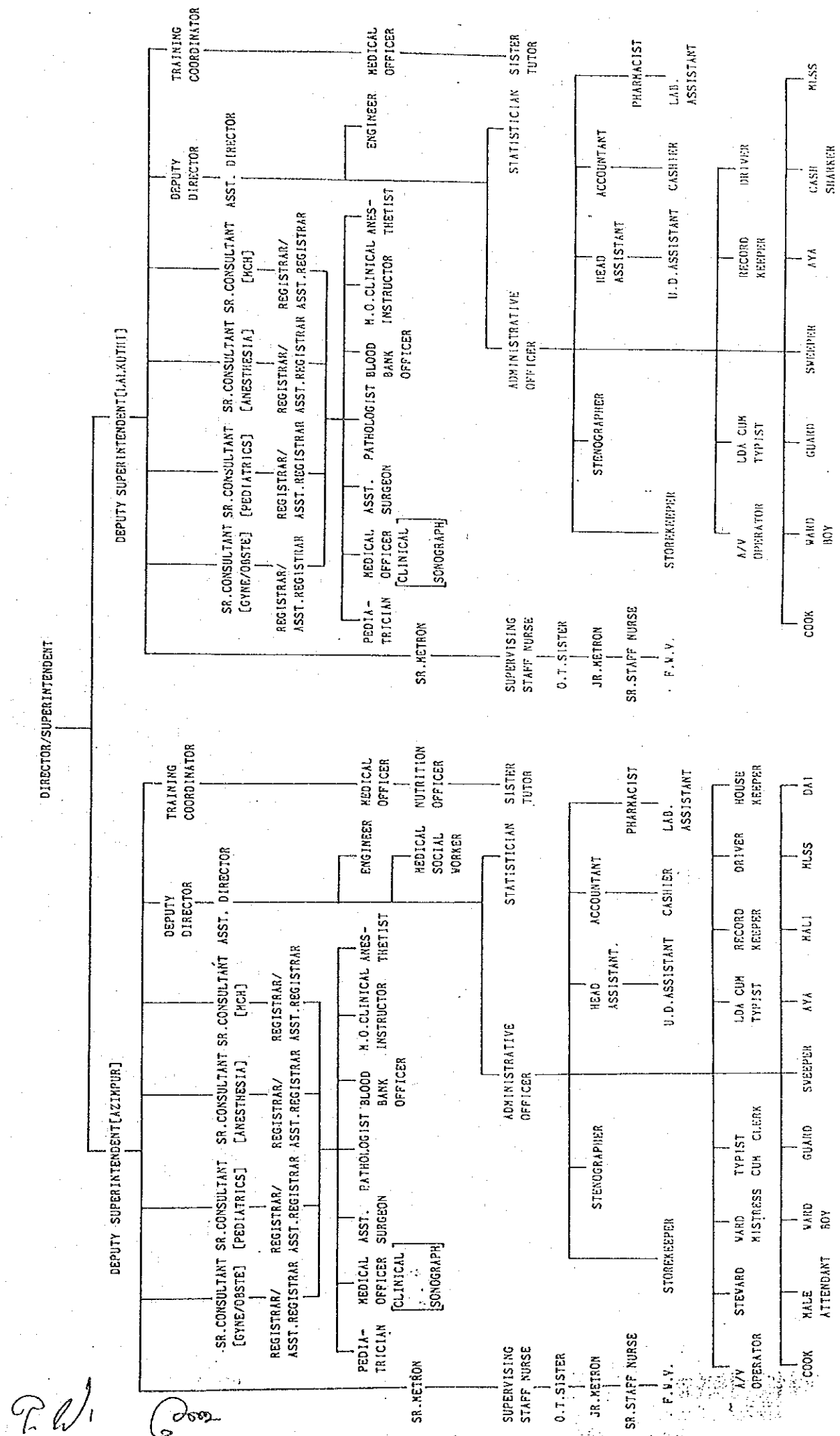

Annex IV

1. Construction of the facilities

1) Facilities for Clinical Services

(1) Outpatient Department

- a) Obstetrics Clinic
- b) Gynecology Clinic
- c) Pediatrics Clinic
- d) Maternity Class

(2) Inpatient Department

- a) Obstetrics/Gynecology Section
- b) Pediatrics Section
- c) Family Planning Section

(3) Delivery/Operation Department

(4) Central Sterilizing and Supply Department

(5) Laboratory Department

(6) X-ray Department

(7) Pharmacy Department

(8) Nutrition/Kitchen Department

2) Facilities for Training Services

(1) Lecture Room

(2) Simulation Room

3) Facilities for Administration

4) Trainees' Dormitory (only for sub center)

2. Provision of equipment related to the Project

1) Equipment for Clinical Services

2) Equipment for Training Services

3) Equipment for Administration Services

G.W. 6/20/82

Annex V

Necessary measures to be taken by the Government of Bangladesh on condition that Japan's Grant Aid is extended:

1. To secure the site for the Project
2. To demolish the present buildings and clear the site prior to commencement of the construction
3. To undertake incidental outdoor works such as gardening, fencing, gates and exterior lighting within and around the site
4. To provide facilities for distribution of water supply, drainage, sewage and other incidental facilities to the Project site
 - 1) City water distribution main to the site
 - 2) City drainage main to the site
 - 3) City gas main to the site
 - 4) General furniture such as carpets, curtains, tables, chairs, and others
5. To arrange exemption of taxes and to take the necessary measures for customs clearance of the materials and equipment brought for the Project at the port of disembarkation
6. To arrange exemption of Japanese nationals from customs duties, internal taxes and other fiscal levies which may be imposed in Bangladesh with respect to the supply of the products and services under the verified contracts

Q.W. *Q.W.*

7. To arrange entry and stay of Japanese Nationals whose services may be required in connection with the supply of products and the services under the verified contracts such facilities as may be necessary for the performance of their work
8. To use and maintain properly and effectively that the facilities constructed and equipment purchased under the Grant
9. To arrange to bear all the expenses other than those to be borne by the Grant, necessary for construction of the facilities as well as for the transportation and the installation of the equipment

Com

P.H.

MINUTES OF DISCUSSIONS
ON
THE BASIC DESIGN STUDY ON THE PROJECT FOR
STRENGTHENING OF MATERNAL AND CHILD HEALTH TRAINING INSTITUTE
IN
THE PEOPLE'S REPUBLIC OF BANGLADESH
(CONSULTATION ON DRAFT REPORT)

In January 1992, the Japan International Cooperation Agency (JICA) dispatched a Basic Design Study Team on the Project for Strengthening of Maternal and Child Health Training Institute in Azimpur and Lalkuthi in Dhaka (hereinafter referred to as "the Project") to the People's Republic of Bangladesh, and based on the discussions with the Bangladesh side and the examination of the results of the field survey, JICA has prepared the draft report of the study.

In order to explain and discuss the contents of the draft report, JICA sent to Bangladesh a study team, which is headed by MD. Katsuhiko Yoshitake, Department of International Cooperation, National Medical Center Hospital, Ministry of Health and Welfare from May 26 to June 2, 1992.

As a result of discussions, both sides have confirmed the main items described in the attached sheets.

Dhaka, June 1, 1992

MD. Katsuhiko Yoshitake

Leader

Draft Report Explanation Team

JICA

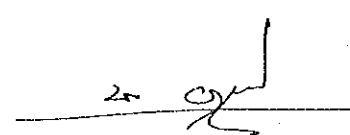
M. Fazlur Rahman

Joint Secretary

Ministry of Health

and Family Welfare

ATTACHMENT

1. Contents of the Draft Report

The Bangladesh side has agreed and accepted in principle the contents of the Draft Report proposed by the team including a phased implementation.

2. Japan's Grant Aid system

- 1) The Bangladesh side understands the system of Japan's Grant Aid as explained by the team.
- 2) The Bangladesh side will take the necessary measures, as described in the Annex I for the smooth implementation of the Project on condition that the Grant Aid by the Government of Japan is extended to the Project.

3. Other relevant issues

On condition that Japan's Grant Aid is extended to the Project;

- 1) the Government of Bangladesh will allocate the necessary budget to the Project for securing sustainable and proper operation and maintenance of Maternal and Child Health Training Institute (MCHTI).
- 2) the Ministry of Health and Family Welfare will recruit the necessary personnel for MCHTI based on the assignment schedule described in page 223 and 224 of the said Report.
- 3) MCHTI will maintain adequate performance and utilization data as described in the Annex II on the facilities included in the Project. And these data will be submitted by the end of each calendar year to the Japanese side.
- 4) MCHTI will make an inventory list on the equipment and spare parts included in the Project. And the list will be renewed in accordance with the conditions of the equipment and the consumption of the spare parts.

K.G.

2

4. Further Study

JICA will complete the final report with the confirmed items, and send it to the Government of Bangladesh around July 1992.

5. Technical Cooperation

The Bangladesh side requested the following technical cooperation to the Japanese side.

- 1) Dispatch of expert in the field of maternal and child health
- 2) Dispatch of volunteer in the field of midwifery under the scheme of Japan Overseas Cooperation Volunteers
- 3) Acceptance of trainee in Japan in operation of ultrasonic diagnosis equipment and delivery monitor equipment

K. G.

2

Annex I

Necessary measures to be taken by the Government of Bangladesh on condition that Japan's Grant Aid is extended:

1. To secure the site for the Project
2. To demolish the present buildings and clear, level and reclaim the site prior to commencement of the construction
3. To provide areas for the temporary site office, workshops and yards
4. To provide power, water and telephone facilities to the site for the Japanese work
5. To undertake incidental outdoor works such as gardening and fencing within and around the site
6. To provide facilities for distribution of electricity, water supply, telephone, drainage, sewage and other incidental facilities to the Project site
 - 1) High tension power supply line and substation
 - 2) City water lead-in pipe up to the water meter
 - 3) Telephone Central Office line up to the main distribution frame and necessary pay-telephone equipment
 - 4) Drainage city mains to the site
 - 5) City gas main to the site
 - 6) General furniture such as carpets, curtains, tables, chairs and others
7. To arrange conclusion of a Banking Arrangement (B/A) with an authorized Japanese foreign exchange bank and bearing the necessary commissions to the Japanese foreign exchange bank for the banking services based upon the B/A

K. G.

8. To arrange issue of necessary Authorization(s) to Pay (A/P) and bearing the necessary payment commissions for A/P based upon the B/A
9. To arrange tax exemption and customs clearance of imported materials and equipment for the Project at the port of disembarkation in Bangladesh
10. To arrange payment or ensure exemption of customs, internal taxes, value added taxes and other fiscal levies for unloading, customs clearance, inland transportation of imported materials and equipment for the Project
11. To arrange exemption of Japanese nationals from customs duties, internal taxes and other fiscal levies which may be imposed in Bangladesh with respect to the supply of the products and services under the verified contracts
12. To arrange entry and stay of Japanese Nationals whose services may be required in connection with the supply of products and the services under the verified contracts such facilities as may be necessary for the performance of their work
13. To obtain building permission and other necessary permission for the Project
14. To use and maintain properly and effectively the facilities constructed and equipment purchased under the Grant
15. To arrange to bear all the expenses other than those to be borne by the Grant

K. G.

3

ANNUAL DATA/PERFORMANCE OF MCHTI

ITEM		88	89	90	91	92	93	94	95	96	97
1	Outpatient Clinical Activities										
	1) Number of Outpatient (M)										
	2) Number of Outpatient (C)										
	3) Number of Antenatal care										
	4) Number of Postnatal care										
	5) Number of Family Planning										
	6) Number of Immunization (M)										
	7) Number of Immunization (C)										
2	Inpatient Clinical Activities										
	1) Number of Inpatient (M)										
	2) Number of Inpatient (C)										
	3) Number of Delivery										
	4) Number of Caesarean section										
	5) Number of Low Birthweight										
	1,500 ~ 2,500 kg										
	1,000 ~ 1,500 kg										
	< 1,000 kg										

Handwritten signature

ITEM	88	89	90	91	92	93	94	95	96	97
3	Referred Cases to Other Hospital									
	1) Number of Referred (M)									
	2) Number of Referred (C)									
	3) Number of Referred Neonate									
4	Mortality									
	1) Number of Maternal Death									
	2) Number of Child Death									
	3) Number of Stillbirth									
	4) Number of Early Neonatal Death (less than 8 days old)									
	5) Number of Neonatal Death (less than 29 days old)									
5	Training Activities (By Each Courses)									

Note: (M)=Mother (C)=Child

S. G.

SITE PLAN

SHOWING LOCATION PROFILE & LEVEL OF BOREHOLES

CLIENT: C.M.C./M.H. & F.P.

PROJECT: CONST. OF M.C.H.T.I. BUILDING.

LOCATION: AZIMPUR, DHAKA-1205.

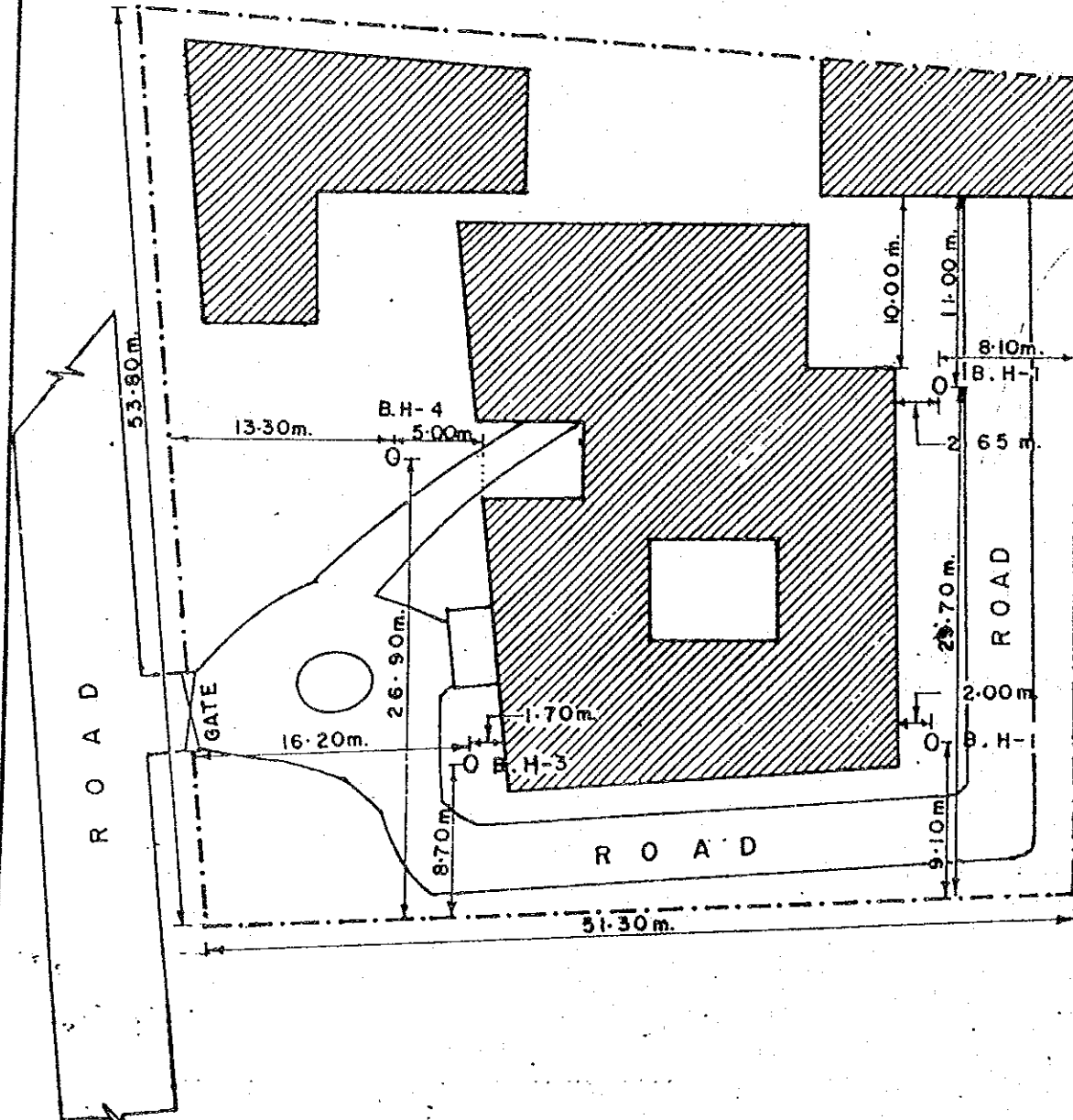
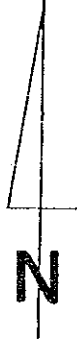

DEVELOPMENT DESIGN CONSUL. LTD

APPROVAL

ATTACHMENT - I

DEVELOPMENT DESIGN CONSULTANT LTD.

CLIENT: C.M.C./M.H & F.P. PROJECT: CONST. OF M.C.H.T.I. BUILDING.(Sub. Centre) LOCATION: LALKUTHI, MIRPUR, DHAKA. BORE HOLE NO.-1	GROUND LEVEL: (-) 1.02m. (P.L.) GROUND WATER LEVEL: (-) 3.16m. (E.G.L.) DATE: 29-01-92 TIME: 7AM
---	--

DATE	NUMBER OF SAMPLE	TYPE OF SAM	DEPTH	THICKNESS	DESCRIPTION OF MATERIALS	BLOWS ON SPOON PER 15cm PENETRATION				STANDARD PENETRATION PERSISTANCE	INDEX
						3cm	15cm	15cm	30cm	BLOWS PER METRE OF PENETRATION	UN DISTURBED

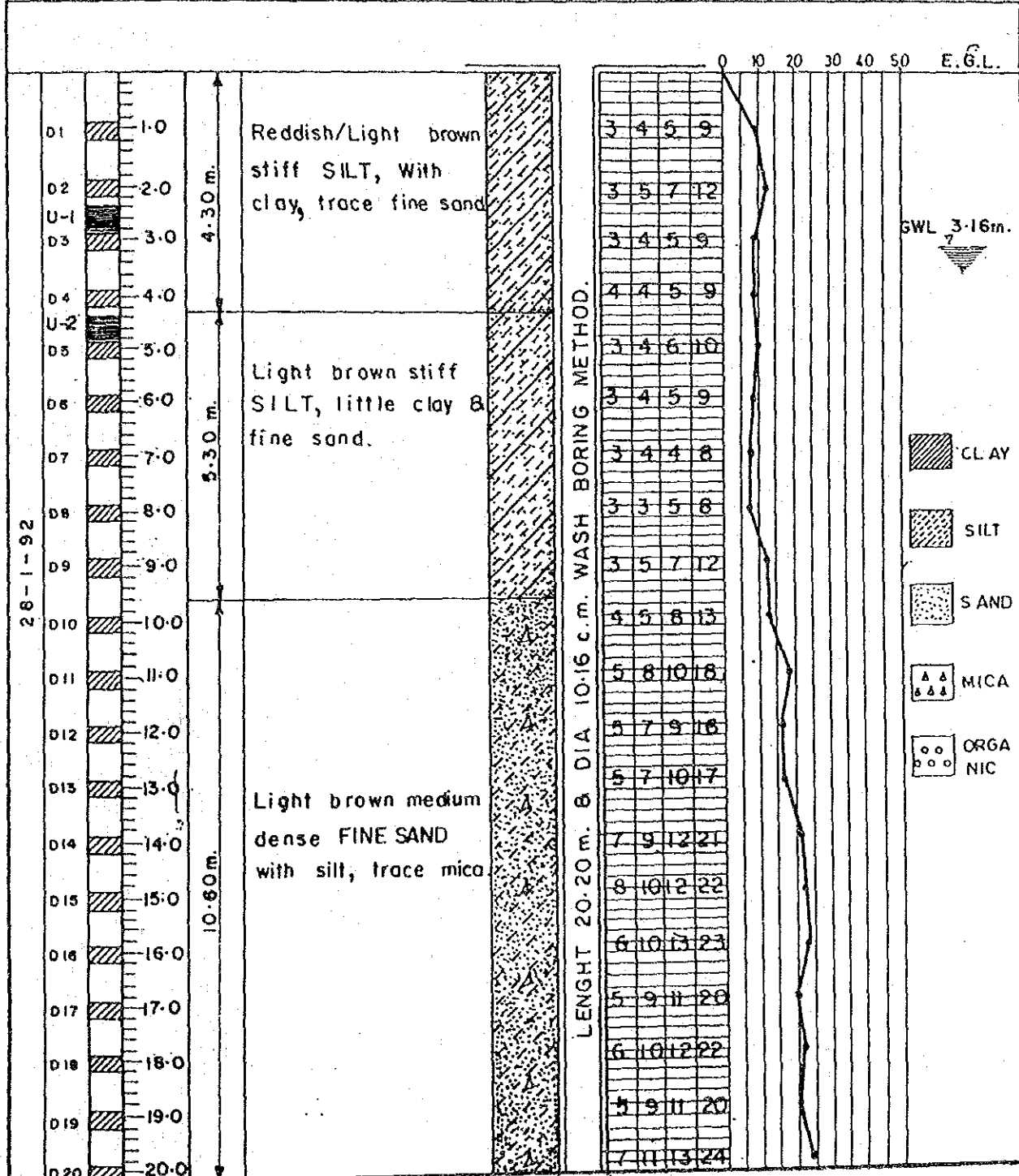

DRN. DATE: *[Signature]* SCALE: SHEET OF ATTACHMENT: II

SITE PLAN

SHOWING LOCATION PROFILE & LEVEL OF BOREHOLES

CLIENT: C. M. C / M. H & F. P

PROJECT: CONST. OF M. C. H. T. I. BUILDING. (SUB-CENTRE)

LOCATION: LALKUTHI, MIRPUR, DHAKA.

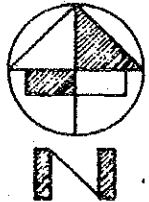
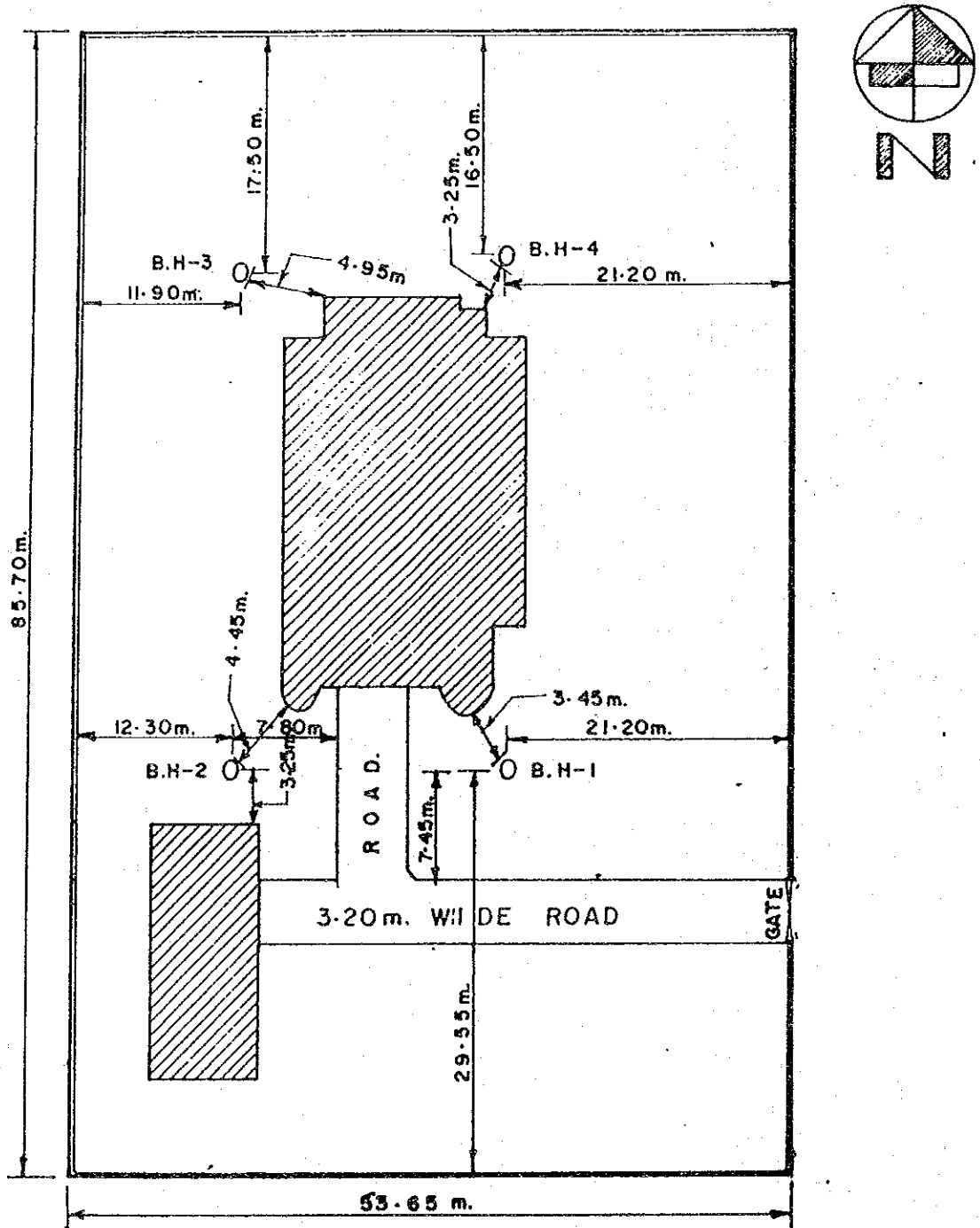

DEVELOPMENT DESIGN CONSULTANTS LTD. APPROVAL

ATTACHMENT - I

DEVELOPMENT DESIGN CONSULTANTS LTD.

CLIENT: C.M.C. / MH. & F.P. PROJECT: CONST. OF M.C.H.T.I. BUILDING. LOCATION: AZIMPUR, DHAKA-1205. BORE HOLE NO. - 1	GROUND LEVEL: (+) 0m. (Road level) GROUND WATER LEVEL: (-) 4.50m. (E.G.L.) DATE: 29-1-92 TIME: 7AM
--	--

DATE	NUMBER OF SAMPLE	TYPE OF SAM	DEPTH	THICKNESS	DESCRIPTION OF MATERIALS	BLOWS ON SPOON PER 15 cm PENETRATION				STANDARD PENETRATION PERSISTANCE	INDEX
						5cm	15cm	15cm	30cm	BLOWS PER METRE OF PENETRATION	UN DISTURBED

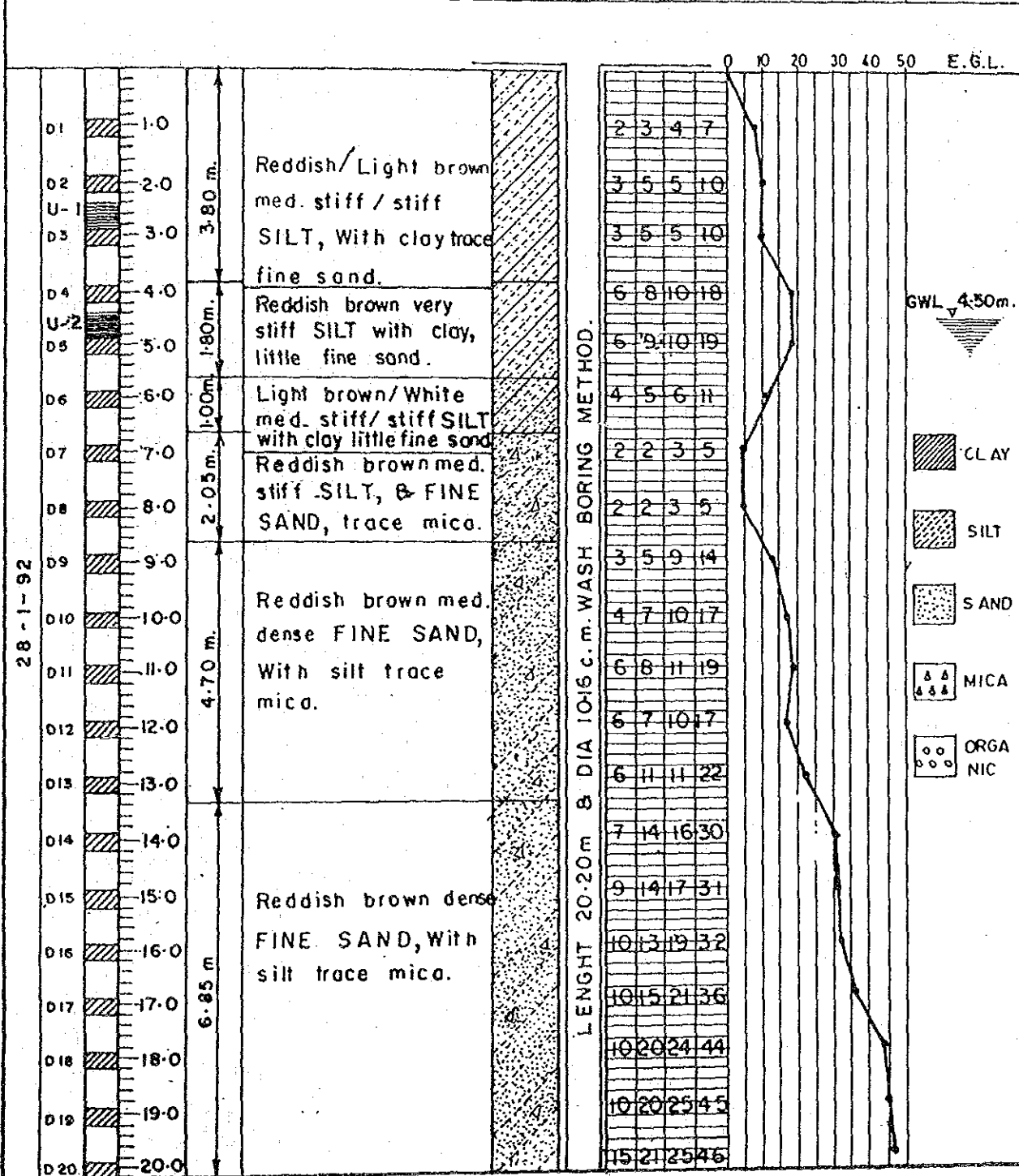

ORN. _____ DATE: 29/1/92 SCALE: _____ SHEET OF _____ ATTACHMENT: II

6. 援助機構覚書

Memorandum of Mutual Understanding

Project; Strengthening Maternal and Child Health Training
Institute in Azimpur and Lalkuthi

On condition that Japan's Grant Aid is extended to the Project for Strengthening Maternal and Child Health Training Institute (hereinafter referred to as "the Project"), the following items are agreed by the undersigned.

- 1) The Government of Bangladesh will take necessary measures as described in the Minutes of Discussion to be signed by the Bangladesh side and the Japanese side.
- 2) The Japanese side will extend its Grant Aid to the Project for the purpose of constructing the necessary buildings and providing the necessary equipment for the Project.
- 3) The World Bank/the International Development Association will monitor implementation process of the Project and coordinate the donor organizations to secure proper management and smooth operation of the Project, which includes bearing the recurring cost of the Project, if it is requested by the Government of Bangladesh.
- 4) The World Health Organization will assist the training activities of Maternal and Child Health Training Institute (MCHTI) in developing training curriculum, training materials, etc., if it is requested by the Government of Bangladesh.

2nd.

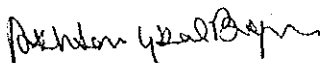
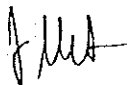



DR. AMINUL ISLAM
Director
Directorate of Family Planning
Ministry of Health and Family Welfare
Government of Bangladesh

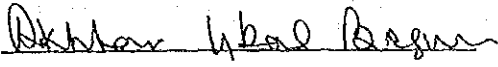

DR. A.I. BEGUM
MCH Consultant
The World Bank

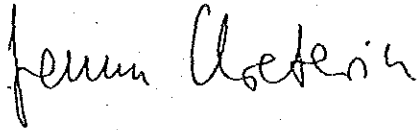

DR. J. KRETOWICZ
MCH Consultant
The World Health Organization

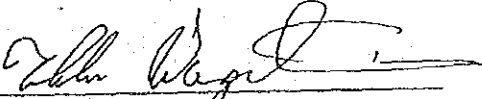

DR. TAKASHI WAGATSUMA
Leader
Basic Design Study Team
on the Project for Strengthening MCHTI
Japan International Cooperation Agency

JICA