

ANNEX I

LOCATION MAP OF THE PROJECT SITE

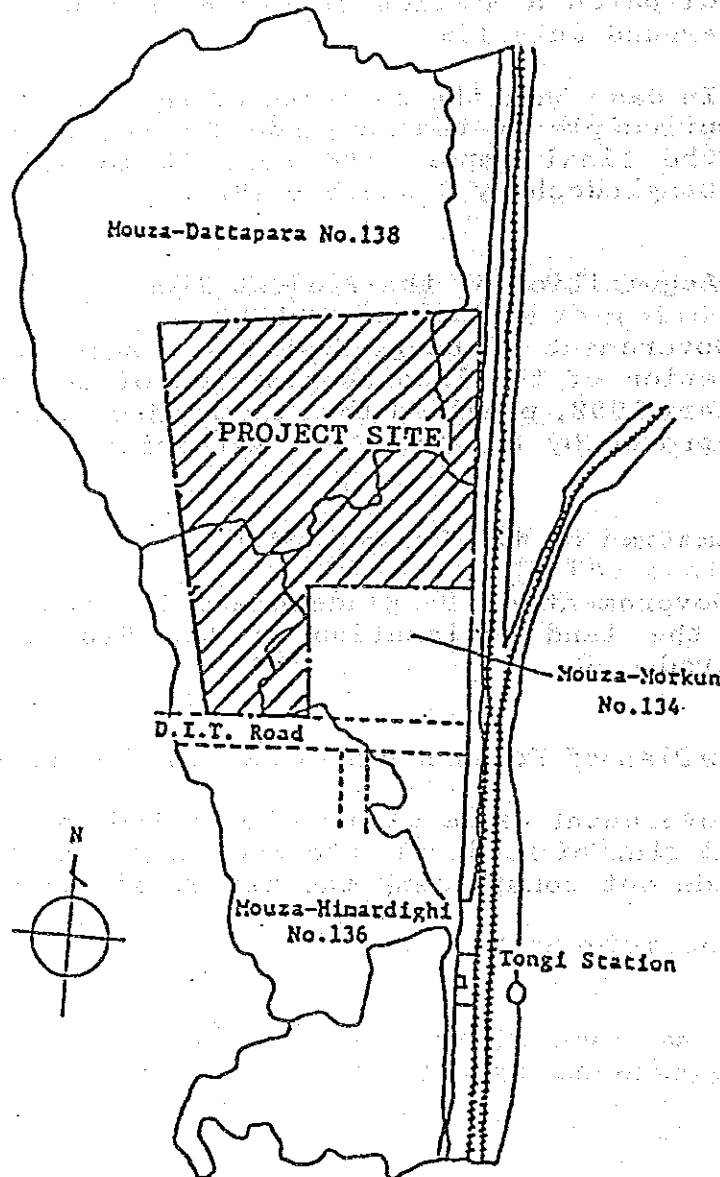

Signature



Annex II

Undertakings by the Government of Bangladesh

1. To provide data and information necessary for the Project.
2. To secure land for the construction of facilities and to clear, fill and reclaim the site before the commencement of construction.
3. To ensure speedy unloading, tax exemption, customs clearance at the port of disembarkation and prompt inland transportation, of products purchased for the Project.
4. To accord Japanese nationals whose services may be required in connection with the supply of the products and the services under the verified contracts such facilities as may be necessary for their entry into Bangladesh and stay therein for the performance of their work.
5. To exempt Japanese nationals involved in the Project from customs duties, internal taxes and other fiscal levies which may be imposed in Bangladesh with respect to the supply of equipment/machines, materials and services under the verified contracts.
6. To bear commissions to the Japanese foreign exchange bank for the banking services based upon the Banking Arrangement.
7. To bear all expenses, other than those to be borne by the Grant Aid necessary for the execution of the Project.
8. To provide proper arrangements for the construction, such as water supply, electricity, drainage of the Project.
9. To assign exclusive counterpart personnel, for the Project.
10. To maintain and use properly and effectively the facilities constructed and equipment purchased under the Grant.



APPENDIX 4-(2) MINUTES OF DISCUSSIONS
(DRAFT REPORT EXPLANATION)

MINUTES OF DISCUSSIONS

ON
THE BASIC DESIGN STUDY ON THE PROJECT

FOR
CONSTRUCTION OF FOODGRAIN STORAGES

IN
DHAKA

THE PEOPLE'S REPUBLIC OF BANGLADESH
(CONSULTATION ON DRAFT REPORT)

In March 1991, the Japan International Cooperation Agency (JICA) dispatched a basic design study team on the Project for Construction of Foodgrain Storages (hereinafter referred to as "the Project") to the People's Republic of Bangladesh and has prepared a draft report on study, through discussions with the officials concerned of the Government of Bangladesh, the field survey on the Project site, and technical examination on the results in Japan.

In order to explain the components of the draft report to the Government of Bangladesh as well as to consult with Bangladesh side on the contents of the report, JICA sent an explanation team to Bangladesh which was headed by Mr. Takeshi Naruse, Deputy Resident Representative, JICA Bangladesh Office, and scheduled to study in the country from July 13 to 22, 1991.

As a result of discussions, both parties confirmed the main items as described on the attached sheets.

Dhaka, July 18, 1991

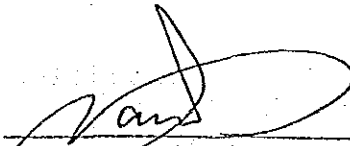
Mr. Takeshi Naruse
Leader
Draft Report Explanation Team
JICA

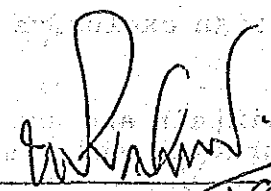
Mr. M. Mutiur Rahman
Joint Secretary
Ministry of Food

ATTACHMENT

1. Components of Draft Report

The Government of Bangladesh has agreed and accepted in principle the components of the draft report proposed by the team.

2. Japan's Grant Aid System

(1) The Government of Bangladesh has understood the system of Japan's Grant Aid explained by the team.

(2) The Government of Bangladesh will take the necessary measures subject to the Bangladesh laws and regulations, described in Annex, for smooth implementation of the Project on condition that the Grant Aid assistance by the Government of Japan is extended to the Project.

3. Further Schedule

The team will make the Final Report in accordance with the confirmed items, and send it to the Government of Bangladesh by September 1991.

4. Land Preparation of the Project Site

The Government of Bangladesh has assured the team of the completion of the land acquisition of the Project site by February 1992 subject to the Bangladesh laws and regulations and the demolition and removal of the existing buildings, etc., on the Project site by April 1992.

5. Construction of Railway Sidings

The Government of Bangladesh has assured the team of the completion of the construction of railway sidings to the Project site by Bangladesh side.

6. Budget and Personnel Allocations

The Government of Bangladesh has confirmed that the budget and personnel required for the Project will be appropriately allocated and assigned for proper and effective operation of the Project.

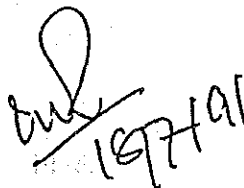

Annex

Undertakings by the Government of Bangladesh

1. To Provide data and information necessary for the Project.
2. To secure land for the construction of facilities and to clear and prepare the site before the commencement of construction.
3. To ensure speedy unloading, tax exemption, customs clearance at the port of disembarkation and prompt inland transportation, of products purchased for the Project.
4. To accord Japanese nationals whose services may be required in connection with the supply of the products and the services under the verified contracts such facilities as may be necessary for their entry into Bangladesh and stay therein for the performance of their work.
5. To exempt Japanese nationals involved in the Project from customs duties, internal taxes and other fiscal levies which may be imposed in Bangladesh with respect to the supply of equipment/machines, materials and services under the verified contracts.
6. To bear commissions to the Japanese foreign exchange bank for the banking services based upon the Banking Arrangement.
7. To bear all expenses, other than those to be borne by the Grant Aid necessary for the execution of the Project.
8. To provide proper arrangement for the construction, such as water supply, electricity, drainage of the Project.
9. To assign exclusive counterpart personnel, for the Project.
10. To maintain and use properly and effectively the facilities constructed and equipment purchased under the Grant.

APPENDIX 5

COUNTRY DATA ON BANGLADESH

A-1 Basic Indices

A-2 Socioeconomic Indices

APPENDIX 5 COUNTRY DATA ON BANGLADESH

A-1 Basic Indices

- (1) Name of the country : The People's Republic of Bangladesh
Capital : Dhaka (Dhaka Former District: 12.99 million/1990)
Independence day : March 26, 1971

(2) Land and population

- Area : 144 thousand km²
Population : 114 million (1990)
Population density : 79.1 persons/km² (1990)
Population increase rate : 2.16% (1989)
Urban population ratio : 15.5% (1981)
Average life : 56.0 years of age (1988)

(3) Political system

On the basis of a republic system, the administration right is owned by the president (office term: five years), a constitutional head, and the cabinet assists in the execution of the administration right.

(4) Religion

About 86.7% Moslem, 12.1% Hindu, with 12% Buddhists and Christians.

(5) Language

Bengali is official. English is popularized although there are differences depending upon the age and education levels, and English is spoken particularly by considerably low level people.

(6) Ethnic composition

The population is overwhelmingly Bengal consisting of various mixed races, and largely divided into Travidian, Mongolian and Aryan races although it is impossible to identify these races in a strict sense.

(7) Education

- Literacy of adult : 26% (1985)
Elementary school attendance ratio : 62% (1983)

(8) **Currency and exchange rate**

Currency unit : Taka (TK)

Exchange rate : TK 34.48 to US\$1 (As in March 1991)

(9) **Climate, geology/geography and latitude**

1) **Climate**

The climate belongs to a typical semi-tropical monsoon climate.

According to the climatic features, one year is divided into the following three seasons: namely, (1) North-western season (Summer: March through May); (2) Monsoon season (Rainy season: June through October); and (3) Dry season (November through February). The atmospheric temperature is highest in April and reaches 35.06°C in maximum in Dhaka, while the lowest temperature is 11.72°C in January in dry season. The rainfall is concentrated in rainy season as roughly 80% of yearly rainfall takes place in this season.

The rainfall is generally large in the eastern part of the country, and that in the western part is small.

2) **Geology/Geography**

Located at the eastern edge of the Indian Subcontinent, the majority of the land is occupied by the lower reaches (downstream river sections) of the big three rivers, the Ganges, Jamuna and Meghna Rivers, and featured by a typical delta zone where tributaries and distributaries flow in. The land is mostly comprised of vast, low and flat alluvial plain, and the ground consists of weak silty formations.

3) **Latitude**

Bangladesh is located within lat. 20°75' - 25°75' and long: 88°30' - 92°75'. While its western part borders West Bengal of India, its northern part borders Assam and Maharaja of the country. Moreover, its eastern part successively borders Tripura, Mizoram and other various states of India, the south-eastern part of the country faces Myanmar (Burma) on the Chittagong area hill zone.

GDP	: US\$90.4 billion
GDP per capita	: US\$848
Annual growth rate	: 2.6% (1987/88)

GNP : US\$19,325 million
GNP per capita : US\$170 (1987)

(4) Configuration of major export/import products

(5) International balance of payment (Refer to Table 3)

(7) Debt service payments on foreign loans (Refer to Table 5)

Import from Japan : US\$445 million (1986)

(9) Financial balance (Refer to Table 6)

Table 1

Sectoral shares of gross domestic product of Bangladesh at current price

(Percentage)

Sectors	1985-86	1986-87	1987-88	1988-89
Agriculture ...	40.39	40.75	38.78	37.20
i Crops ...	29.91	30.59	28.07	26.75
ii Forestry ...	4.07	3.81	4.25	3.67
iii Livestock ...	3.30	3.01	2.99	3.22
iv Fisheries ...	3.11	3.34	3.47	3.56
Mining and quarrying ...	0.001	0.001	0.001	0.001
Industry ...	9.34	8.83	8.45	8.43
i Large scale ...	5.01	4.99	4.78	4.76
ii Small scale ...	4.33	3.84	3.67	3.67
Construction ...	5.59	5.35	5.79	5.95
Power, Gas, Water and Sanitary Services ...	0.59	0.66	0.77	1.02
Transport, storage and communication ...	11.71	11.48	11.04	10.88
Trade services ...	8.90	8.51	8.44	8.34
Housing Services ...	7.95	7.60	8.37	9.08
Public Admn. and Defence ...	3.74	3.87	4.14	4.43
Banking and Insurance ...	1.92	1.88	1.93	1.99
Professional and misc. Services ...	9.87	11.07	12.29	12.68
G.D.P at market prices ...	100.00	100.00	100.00	100.00

Note : Please see note at page 501.

Source : National Income, B.B.S.

Sectoral share of gross domestic products of Bangladesh at constant Price

(Base : 1984-85 = 100)

(Percentage)

Sectors	1984-85	1985-86	1986-87	1987-88	1988-89(p)
Agriculture :	41.76	41.34	39.84	38.43	37.08
i Crops ...	33.17	32.87	31.55	30.13	28.82
ii Forestry ...	2.69	2.69	2.53	2.64	2.64
iii Livestock ...	2.90	2.86	2.89	2.84	2.86
iv Fisheries ...	3.00	2.92	2.87	2.82	2.76
Mining and Quarrying ...	0.001	0.001	0.001	0.001	0.001
Industry ...	9.86	9.69	10.04	9.82	9.84
i Large scale ...	5.23	5.20	5.67	5.55	5.56
ii Small scale ...	4.63	4.49	4.37	4.27	4.28
Construction :	5.53	5.40	5.53	6.04	6.18
Power, Gas, Water & Sanitary Services ...	0.58	0.62	0.73	0.82	1.04
Transport, Storage & Communication...	11.22	11.10	11.83	11.93	12.13
Trade Services ...	9.54	9.28	9.13	9.15	9.36
Housing Services ...	7.97	7.87	7.81	7.83	7.89
Public Administration & Defence ...	3.25	3.76	3.89	4.08	4.25
Banking and Insurance ...	1.70	2.05	2.08	2.05	2.02
Professional & Miscellaneous Services ...	8.59	8.89	9.12	9.85	10.21
GDP at Constant Market prices ...	100.00	100.00	100.00	100.00	100.0

Note : Please see note at page 501.

Source : National Income, B.B.S.

Table 2

Quantity of export of selected Items

	1984-85	1985-86	1986-87	1987-88	1988-89
	(In '000' ton)				
Jute Raw	266	387	492	250	274
Jute Manufacture	559	571	495	614	649
Tea	27	30	23	29	23
Leather	17	18	23	24	20
Frozen Fish	4	6	5	6	3
Frog legs	2	3	2	4	3
Fertilizer	—	—	—	247	370
News print	18	—	1	—	—

Source : Foreign Trade Section, BBS.

9.09 Quantity of Import of selected Items

	1984-85	1985-86	1986-87	1987-88	1988-89
	(In '000' ton)				
Rice	690	61	260	674	63
Wheat	1898	1163	1511	2331	2147
Edible oil	220	295	283	456	244
Milk powder	50	45	40	30	76
Fertilizer	678	640	152	298	403
Petroleum oil crude	992	1008	1000	1212	1019
Raw cotton	59	39	65	51	75
Pharmaceutical Prod.	6	3	2	1	2
Coal	50	118	229	192	49
Sugar	333	135	135	121	157
Cement	1286	1437	1601	1563	1652
Pig Iron	104	102	98	54	27
Old garments	31	29	24	15	3
Dyes	3	3	3	7	3
Chemical	15	19	20	22	17

Source : Foreign Trade Section, BBS.

Table 3

Balance of payments of Bangladesh

(Crore taka)

Items	1982-83	1983-84	1984-85	1985-86	1986-87	1987-88	1988-89
Current Account:							
Imports (f.o.b.)	5172.9	5408.0	6122	6353.8	7185.2	8393.2	9748.9
Exports (f.o.b.)	1860.6	2051.5	2521	2716.6	3064.3	3704.5	4116.1
Freight and Insurance—							
(a) On import	586.4	610.7	708	711.3	778.2	939.6	1063.3
(b) Earned	—	6.1	6	7.6	6.8	5.5	4.2
(c) Net	—586.4	—604.6	—701	—703.7	—771.4	—934.1	—1059.1
Other goods and services-net	—65.8	72.4	50	—4.9	—97.6	—34.0	—49.4
Balance	—3832.9	—3888.7	—4252	—4345.8	—4989.9	—5656.8	—6777.3
Investment income net	—259.0	—160.8	—172	—376.7	—372.6	—415.4	—443.1
Transfer by Bangladesh nationals	1422.4	1376.2	1034	1569.3	1927.4	2461.1	2686.0
Grants, donations etc. cash or kind	1859.5	1840.9	1828	1639.0	2032.4	2578.5	2185.4
Deficit/surplus current account	—810.0	—832.4	—1562	—1514.2	—1402.7	—1032.6	—2339.0
Capital Account:							
Aid and loan net	1107.6	1385.5	1209	1682.8	1667.7	1474.6	2489.6
a) Long-term net	1440.7	1213.2	1269	1515.8	1887.7	1900.2	2793.0
b) Short-term net	—333.1	172.3	—61	167.0	—220.0	—425.6	303.4
Other capital transactions	—457.4	—463.3	363	—185.1	—127.9	—405.1	20.4
Errors and omissions	159.8	89.8	—10	16.5	—137.1	—36.9	130.2
Surplus on capital budget	810.0	832.4	1562	1514.2	1402.7	1032.6	2339.0

Note : Trade data may differ from those compiled by B.B.S. and are shown in table 8.02 below.

Source: Bangladesh Bank.

Balance of trade of Bangladesh

(Crore taka)

Year	Export	Import	Balance
1976-77	667.0	1399.3	—732.3
1977-78	717.8	1821.6	—1103.8
1978-79	963.2	2207.3	—1244.1
1979-80	1099.7	3052.5	—1952.8
1980-81	1148.4	3728.8	—2580.4
1981-82	1238.7	3872.9	—2634.2
1982-83	1801.6	4526.5	—2724.9
1983-84	2013.6	5087.4	—3073.8
1984-85	2622.5	6826.3	—4203.8
1985-86	2739.6	6292.9	—3553.3
1986-87	3368.2	6849.6	—3481.4
1987-88	4116.1	9158.8	—5042.7
1988-89	4268.6	9507.5	—5238.9

Note : 1 crore=10 million.

Source: Foreign Trade Section, B.B.S.

Table 4

Money supply and foreign exchange reserve

(Million Taka)

	Currency outside bank	Demand Deposit	Money Supply Total money supply	Foreign exchange reserve*
1978	5043	7198	12241	4048
1979	6134	9115	15248	5940
1980	6934	10384	17318	4053
1981	9148	10715	19863	4523
1982	8775	11346	20121	2698
1983	11386	14957	26343	8765
1984	15563	19936	35499	13595
1985	17229	25089	42318	11068
1986	19531	29748	49279	14408
1987	20749	31879	52628	22151
1988	24150	26327	50477	26963
1989	26156	28451	54607	29454
1989(Dec)	27286	32718	60004	16447

Excluding inter-bank items.

Include reserve position in the IMF

Source: Bangladesh Bank Bulletin, Oct-Dec. 1989

Table 5

Debt-Service payments on foreign loans

(Million US Dollar)

	Interest	Principal*	Total
1982-83	50.8	85.3	136.1
1983-84	57.7	70.6	128.3
1984-85	64.0	106.0	170.0
1985-86	72.8	110.9	183.7
1986-87	81.1	151.7	232.8
1987-88	123.0	166.0	289.0
1988-89	123.6	170.1	293.7

* Include downpayment

a) Payment in foreign exchange means free foreign exchange remitted to the donors.

Source: External Resources Division, Ministry of Finance.

Table 6

Consolidated receipts and expenditures of the Government of Bangladesh

(Million taka)

Heads	1983-84	1984-85	1985-86	1986-87	1987-88	1988-89 (R.E.)
Revenue Receipts: ...	24288	35825	38354	46185	51519	58222
(a) Tax ...	22025	33438	32110	37253	42062	48328
(b) Non-Tax ...	2263	2387	6244	8932	9457	9894
Development Receipts ...	36476	36864	39310	45594	50856	47412
(a) Project ...	18624	17630	23278	25805	27036	27228
(b) Food and Commodities ...	16210	15390	16900	19050	26320	24924
(c) Internal Resources ...	1642	3794	(-) 868	739	(-) 2500	(-) 4740
Total Receipts:	60764	72689	77664	91779	102375	105634
Revenue Expenditure : (gross) ...	20457	25870	37085	39916	47167	62510
(a) Wages and Salaries ...	7073	9794	15276	15860	18864	20756
(b) Commodities and Services ...	7013	6981	5726	8226	10345	11158
(c) Transfer ...	5505	7800	14296	13559	15233	27450
(d) Others ...	866	1295	1787	2271	2725	3146
Development Expenditure:	29739	34837	33803	38499	40471	45590
(a) Agriculture, Flood Control, water resources and Rural Institutions. ...	11331	13785	7403	5112	8521	12725
(b) Industry ...	2873	3140	5462	7492	4615	6419
(c) Transport and Communication ...	3808	4847	4212	5445	6279	9305
(d) Other Services ...	11727	14065	16726	20480	21056	17141
Total Expenditure:	50196	60707	70888	78415	87638	108100
Real Public Expenditure (deflated) ...	11180	11753	12942	12773	13367	153111
Population of Mid Financial Year ...	95.7	99.2	101.7	104.1	106.6	109.1
Per capita Expenditure :						
(a) Constant Prices (deflated) ...	117	119	128	123	125	140
(b) Current Prices ...	525	612	697	753	822	991
Total Public Expenditure as % of GDP at current market price. ...	14.34	14.56	15.34	14.54	14.74	13.35

Notes : Real public expenditure has been obtained by deflating total expenditure in current prices by the implicit national income deflator ; (with base 1972-73=100)

Per capita expenditure in current Prices has been obtained from the real Public Expenditures.

The present figures of development receipts shown in the table indicate revised budget estimates. As the actual data are not available the receipts and expenditures on development budget may differ.

Source : Compiled by B.B.S.

APPENDIX 6

DATA ON FOODGRAIN STORAGE CONSTRUCTION

- A-1 Utilization Situation of Dhaka CSD and Tejigaon CSD Storages (1)
- A-2 Utilization Situation of Dhaka CSD and Tejigaon CSD Storages (2)
- A-3 Quantity and Ratio of Stock of Foodgrain, etc. in Dhaka CSD at the Beginning of the Month
- A-4 Quantity and Ratio of Stock of Foodgrain, etc. in Tejigaon CSD at the Beginning of the Month
- A-5 Quantity of Stock of Foodgrain, etc. in Dhaka CSD and Tejigaon CSD at the Beginning of the Month
- A-6 Destinations of Foodgrain Outgoing From Chittagong Port, and Weight of Dhaka FDA
- A-7 Transition of Incoming Situations of Grain Tejigaon CSD according to Transportation Means
- A-8 Transition of Monthly Delivery from Dhaka CSD
- A-9 Transition of Monthly Delivery from Tejigaon CSD
- A-10 Situation of Stock in the Existing CSDs in Dhaka MA at the Beginning of the Month
- A-11 Foodgrain Storage Construction Programme as of March, 1991
- A-12 Foodgrain Storage Construction Project under Foreign Aid
- A-13 Railway Network
- A-14 Road Network
- A-15 Waterways
- A-16 Boring Data on the Project Site

APPENDIX 6 DATA ON FOODGRAIN STORAGE CONSTRUCTION

A-1 Utilization Situation of Dacca CSD and Teigaon CSD Storages (1)

(Unit: 1,000 ton)

Year	Categories	Dhaka CSD				Teigaon CSD				Total		
		Initial stock	Acceptance	Delivery	End stock	Initial stock	Acceptance	Delivery	End stock	Initial stock	Acceptance	Delivery
1985/86	Rice	6.4	4.8	6.7	4.5	28.5	21.7	27.8	18.9	34.9	26.5	34.5
	Wheat	1.3	43.6	41.5	3.4	1.8	99.7	96.4	4.5	3.1	143.3	137.9
	Subtotal	7.7	48.4	48.2	7.9	30.3	121.4	124.2	23.4	38.0	169.8	172.4
	Others	0.8	8.3	11.2	0.9	8.0	18.7	3.0	3.6	8.8	27.0	34.4
	Total	8.5	56.7	59.4	8.8	38.3	140.1	147.4	27.6	46.8	196.8	206.8
1986/87	Rice	4.5	23.0	16.7	0.07	18.9	38.7	46.0	9.7	23.4	61.7	62.7
	Wheat	3.3	61.0	62.3	1.9	4.2	98.3	92.4	7.7	7.5	159.3	154.7
	Subtotal	7.8	84.0	79.0	2.0	23.1	137.0	138.4	17.4	30.9	221.0	217.4
	Others	0.9	11.2	10.7	1.4	3.7	21.6	18.0	4.6	4.6	32.8	29.3
	Total	8.7	95.2	89.7	3.4	26.8	158.6	157.0	22.0	35.5	253.8	246.7
1987/88	Rice	0.7	30.5	29.3	4.9	9.7	71.0	43.3	35.0	10.4	101.5	72.6
	Wheat	1.9	69.6	66.8	1.6	7.8	99.8	96.8	10.1	9.7	169.4	163.6
	Subtotal	2.6	100.1	96.1	6.5	17.5	170.8	140.1	45.1	20.1	270.9	236.2
	Others	1.4	15.1	15.4	1.0	4.8	20.9	24.9	0.9	0.2	36.0	40.3
	Total	4.0	115.2	111.5	7.5	22.3	191.7	165.0	46.0	26.3	306.9	276.5
1988/89	Rice	4.9	15.5	17.6	2.8	35.0	45.1	69.5	10.5	39.9	60.6	87.1
	Wheat	1.6	35.4	34.6	2.0	10.1	132.1	135.7	6.5	11.7	167.5	170.3
	Subtotal	6.5	50.9	52.2	4.8	45.1	177.2	205.2	17.0	51.6	228.1	257.4
	Others	1.5	10.7	11.3	16.2	0.9	24.7	22.6	22.6	2.4	35.4	33.9
	Total	8.0	61.6	63.5	21.0	46.0	201.9	227.8	39.6	54.0	263.5	291.3
1989/90	Rice	2.0	10.3	8.8	4.3	10.5	77.3	41.8	24.0	12.5	87.6	50.6
	Wheat	2.4	51.0	52.3	0.9	6.6	80.5	85.4	1.1	9.0	131.5	137.7
	Subtotal	4.4	61.3	61.1	5.2	17.1	157.8	127.2	25.1	21.5	219.1	188.3
	Others	0.4	10.2	9.5	1.0	3.0	25.4	20.0	20.0	3.4	35.6	29.5
	Total	4.8	71.5	70.6	6.2	20.1	183.2	147.2	45.1	24.9	254.7	217.8

A-2 Utilization Situation of Dhaka CSD and Tejgaon CSD Storages (2)

(Unit: ton, turnover)

Year	Categories	Dhaka CSD				Tejgaon CSD				Total (Average)		
		Initial stock	Acceptance	Total	Turnover	Initial stock	Acceptance	Total	Turnover	Initial stock	Acceptance	Total
1985/86	Rice	6,393	4,818	11,211		28,450	21,706	50,156		34,843	26,524	61,367
	Wheat	1,321	43,585	44,906		1,834	99,709	101,543		3,155	143,294	146,449
	Subtotal	7,714	48,403	56,117	8.6	30,284	121,415	151,699	4.9	37,998	169,818	207,816
	Others	755	8,326	9,081		8,030	18,690	26,720		8,785	27,016	35,801
	Total	8,469	56,729	65,198	8.7	38,314	140,105	178,419	5.4	46,783	196,834	243,617
1986/87	Rice	4,491	23,022	27,513		18,891	38,688	57,579		23,382	61,710	85,092
	Wheat	3,371	61,015	64,386		4,253	98,272	102,525		7,624	159,287	166,911
	Subtotal	7,862	84,037	91,899	14.1	23,144	136,960	160,104	5.1	31,006	220,997	252,003
	Others	863	11,159	12,022		3,749	21,597	25,346		4,612	32,756	37,368
	Total	8,725	95,196	103,921	13.9	26,893	158,557	185,450	5.6	35,618	253,753	289,371
1987/88	Rice	736	30,522	31,258		9,707	70,965	80,672		10,443	101,487	111,930
	Wheat	1,893	69,550	71,443		7,744	99,806	107,550		9,637	169,356	178,993
	Subtotal	2,629	100,072	102,701	15.8	17,451	170,771	188,222	6.0	20,080	267,950	290,923
	Others	1,370	15,086	16,456		4,792	20,873	25,665		6,162	35,959	42,121
	Total	3,999	115,158	119,157	15.9	22,243	191,644	213,887	6.4	26,242	306,802	333,044
1988/89	Rice	4,872	15,557	20,429		34,956	45,023	79,979		39,828	60,580	100,408
	Wheat	1,631	35,383	37,014		10,126	132,148	142,274		11,757	167,551	179,288
	Subtotal	6,503	50,940	57,443	8.8	45,082	177,171	222,253	7.1	51,585	228,111	279,696
	Others	1,504	10,665	12,169		894	24,673	25,567		2,398	35,338	37,736
	Total	8,007	61,605	69,612	9.3	45,976	201,844	247,820	7.5	53,983	263,449	317,432
1989/90	Rice	2,001	10,303	12,304		10,517	77,278	87,795		12,518	87,581	100,099
	Wheat	2,368	50,991	53,359		6,542	80,523	87,065		8,910	131,514	140,424
	Subtotal	4,369	61,294	65,663	10.1	17,059	157,801	174,860	5.6	21,428	219,095	240,523
	Others	407	10,190	10,597		2,940	25,401	28,341		3,347	35,591	38,938
	Total	4,776	71,484	76,260	10.2	19,999	183,202	203,201	6.1	24,775	254,686	279,461

Notes 1. Turnover: (Initial stock + Acceptance)/(Storage capacity)

2. Storage capacity of Dhaka CSD: 6,500 ton grain and 7,500 ton in total

3. Storage capacity of Tejgaon CSD: 31,200 ton grain and 33,200 ton in total

4. "Others" refer to sugar, cooking oil, salt, etc.

A-3 Quantity and Ratio of Stock of Foodgrain, etc. in Dhaka CSD at the Beginning of the Month

Year	Categories	July	Aug.	Sept.	Oct.	Nov.	Dec.	Jan.	Feb.	March	April	May	June	Average
1985 ~ 1986	Rice	5,842	6,365	6,244	6,215	4,826	5,472	5,975	6,879	8,224	6,646	6,208	4,621	6,127
	Wheat	2,845	1,932	1,290	1,237	888	1,179	1,233	341	777	7	1,823	4,211	1,481
	Subtotal	8,687	8,297	7,534	7,452	5,714	6,651	7,208	7,220	9,001	6,653	8,031	8,832	7,608
	Others	1,927	1,215	789	589	653	317	325	931	1,936	555	529	168	828
	Total	10,614	9,512	8,323	8,041	6,367	6,968	7,533	8,151	10,937	7,208	8,560	9,000	8,436
	Stock 1	133.6	127.6	115.9	114.6	87.9	102.3	110.9	111.1	138.5	102.4	123.6	135.9	117.0
1986 ~ 1987	Stock 2	141.5	126.8	111.0	107.2	84.9	92.9	100.4	108.1	145.8	96.1	114.1	120.0	112.5
	Rice	5,415	5,089	4,520	4,224	3,010	3,902	4,306	5,326	4,534	2,318	1,482	538	3,722
	Wheat	3,371	1,837	2,690	1,730	913	1,179	1,232	170	823	392	203	3,043	1,466
	Subtotal	8,786	6,926	7,210	5,954	3,923	5,081	5,538	5,496	5,357	2,710	1,685	3,581	5,188
	Others	333	1,325	2,785	2,585	1,938	1,036	1,296	1,152	1,215	1,376	862	1,172	1,423
	Total	9,119	8,251	9,995	8,539	5,861	6,117	6,834	6,648	6,572	4,086	2,547	4,753	6,611
1987 ~ 1988	Stock 1	135.2	106.6	110.9	91.6	60.4	78.2	85.2	84.6	82.4	41.7	25.9	46.8	79.8
	Stock 2	121.6	110.0	133.3	113.9	78.1	81.6	91.1	88.6	87.6	54.5	34.0	63.4	88.1
	Rice	735	828	1,705	1,108	554	346	778	1,209	3,008	3,187	1,969	3,153	1,456
	Wheat	1,871	20	66	3	4	0	313	1,088	338	905	630	662	492
	Subtotal	2,606	848	1,771	4,108	558	346	1,091	2,297	3,346	4,092	2,599	3,815	1,948
	Others	1,338	1,163	841	1,230	2,092	1,974	1,803	2,031	2,360	3,001	3,176	1,690	1,892
1988 ~ 1989	Total	3,944	2,011	2,612	5,338	2,650	2,320	2,894	4,328	5,706	7,093	5,775	5,505	3,840
	Stock 1	40.1	13.0	27.2	63.2	8.6	5.3	16.8	35.3	51.5	63.0	40.0	58.7	30.0
	Stock 2	52.5	26.8	34.8	71.2	35.5	30.9	38.6	57.7	76.1	94.6	17.0	73.4	51.2
	Rice	5,870	6,077	5,941	4,186	1,064	274	592	1,801	2,634	1,999	636	2,986	2,839
	Wheat	1,578	1,357	375	330	322	158	431	67	9	91	33	1,837	549
	Subtotal	7,448	7,434	6,316	4,516	1,386	432	1,023	1,868	2,643	2,090	669	4,823	3,388
1989 ~ 1990	Others	796	426	1,433	1,476	368	298	336	323	190	281	275	258	539
	Total	8,244	7,860	7,749	5,992	1,754	730	1,359	2,191	2,833	2,371	944	5,081	3,927
	Stock 1	114.6	114.4	97.2	69.5	21.3	6.6	15.7	28.7	40.7	32.2	10.3	74.2	52.1
	Stock 2	109.9	104.8	103.3	79.0	23.4	9.7	18.1	29.2	37.8	31.6	12.6	67.7	52.4
	Rice	2,801	1,240	863	5,349	6,073	6,725	6,985	6,774	6,939	6,202	4,684	4,344	4,915
	Wheat	2,354	1,583	110	1,157	1,267	924	538	23	978	0	581	2,147	973
1989 ~ 1990	Subtotal	5,155	2,828	982	6,506	7,340	7,649	7,523	6,797	7,917	6,202	5,265	6,491	5,888
	Others	139	438	695	580	521	1,733	1,244	954	1,832	1,634	139	748	888
	Total	5,294	3,266	1,677	7,086	7,861	9,382	8,767	7,751	9,749	7,836	5,404	7,239	6,776
	Stock 1	79.3	43.5	15.1	100.1	112.9	117.7	115.7	104.6	121.8	95.4	81.0	99.9	90.6
	Stock 2	70.6	43.5	22.4	94.5	104.8	125.1	116.9	103.3	130.0	104.5	72.1	96.5	90.3

Notes 1. "Others refer to sugar, salt, cooking oil, etc.

2. The stock 1 refers a percentage obtained by dividing the subtotal of rice and wheat with the storage capacity of rice and wheat (6,500 ton).

3. The stock 2 refers to a percentage obtained by dividing the total of overall food by the overall storage capacity (7,500 ton).

A-4 Quantity and Ratio of Stock of Foodgrain, etc. in Tejgaon CSD at the Beginning of the Month

Year	Categories	July	Aug.	Sept.	Oct.	Nov.	Dec.	Jan.	Feb.	March	April	May	June	Average
1985 ~ 1986	Rice	28,450	15,191	15,141	14,950	13,940	12,725	16,952	15,272	16,578	16,421	15,659	18,891	16,681
	Wheat	1,834	10,221	6,587	2,587	5,103	2,207	4,869	6,307	8,232	7,637	6,916	4,253	5,563
	Subtotal	30,284	25,412	21,728	17,537	19,043	14,932	21,821	21,579	24,810	24,058	22,575	23,144	22,244
	Others	8,030	4,253	4,076	4,055	4,362	3,927	4,720	5,576	5,060	4,158	4,104	3,749	4,673
	Total	38,314	29,665	25,804	21,592	23,405	18,859	26,541	27,155	29,866	28,226	26,679	26,893	26,917
	Stock 1	97.1	81.4	69.6	56.2	61.0	47.9	69.9	69.2	79.5	77.1	72.4	74.2	71.3
1986 ~ 1987	Stock 2	115.4	89.4	77.7	65.0	70.5	56.8	79.9	81.8	90.0	85.0	80.4	81.0	81.1
	Rice	18,891	8,927	8,528	7,156	2,269	1,774	9,990	7,534	10,232	10,109	7,629	9,707	8,563
	Wheat	4,253	3,282	5,968	1,001	1,689	1,007	5,060	2,916	731	890	39	7,783	2,893
	Subtotal	23,144	12,209	14,496	8,157	3,958	2,871	15,050	10,450	10,963	10,999	7,668	17,490	11,455
	Others	3,747	4,159	6,973	5,960	4,980	5,094	6,697	5,710	6,882	8,259	6,142	4,792	5,783
	Total	26,891	16,368	21,469	14,117	8,938	7,965	21,747	16,160	17,845	19,258	13,810	22,282	17,238
1987 ~ 1988	Stock 1	74.2	39.1	46.5	26.1	12.7	9.2	48.2	33.5	35.1	35.3	24.6	56.1	36.7
	Stock 2	81.0	49.3	64.7	42.5	26.9	24.0	65.5	48.7	53.8	58.0	41.6	67.1	51.9
	Rice	9,707	13,090	12,695	12,917	17,201	18,475	15,738	12,258	10,372	19,702	22,405	34,956	16,027
	Wheat	7,744	1,648	6,255	4,205	8,222	6,722	12,402	9,702	11,200	12,025	8,402	20,126	9,055
	Subtotal	17,451	14,738	18,950	17,122	25,423	25,197	28,140	21,960	21,572	31,727	30,807	55,082	25,081
	Others	4,692	1,779	1,301	1,853	3,037	1,817	2,503	2,541	1,482	4,113	2,549	892	2,380
1988 ~ 1989	Total	22,143	16,517	20,251	18,975	28,460	27,014	30,643	24,501	23,054	35,840	33,356	55,974	28,061
	Stock 1	55.9	47.2	60.7	54.9	81.5	80.8	90.2	70.4	69.1	101.7	98.7	176.5	82.3
	Stock 2	66.7	49.8	61.0	57.2	85.7	81.4	99.3	73.8	69.4	108.0	100.5	168.5	84.5
	Rice	34,956	21,086	11,613	6,673	4,843	15,791	13,815	12,080	15,834	14,709	8,401	10,517	13,444
	Wheat	10,126	10,126	3,134	4,629	997	160	866	620	15	1,733	3,485	6,542	3,536
	Subtotal	45,082	22,212	14,747	11,302	5,840	15,951	14,681	12,700	15,849	16,442	11,886	17,059	16,980
1989 ~ 1990	Others	892	639	1,073	761	2,324	1,998	3,338	2,041	1,832	3,235	1,834	2,940	1,909
	Total	45,974	22,851	15,820	12,063	8,164	17,949	18,019	14,741	17,681	19,677	13,720	19,999	18,889
	Stock 1	144.5	71.2	47.3	36.2	18.7	51.1	47.1	40.7	50.8	52.7	38.1	54.7	54.4
	Stock 2	138.5	68.8	47.7	36.3	24.6	54.1	54.5	44.4	53.3	59.3	41.3	60.2	56.9
	Rice	10,517	8,620	12,203	13,600	12,720	8,920	10,270	12,430	8,720	16,230	18,720	24,065	13,085
	Wheat	6,542	7,230	2,422	3,834	4,307	6,220	8,430	2,008	2,208	1,807	3,220	1,147	4,115
1989 ~ 1990	Subtotal	17,059	15,850	14,625	17,434	17,027	15,140	18,700	14,438	10,928	18,037	21,940	25,212	17,200
	Others	2,940	2,052	2,120	1,342	1,160	2,511	2,155	1,122	2,290	6,541	5,659	8,288	3,182
	Total	19,999	17,902	16,745	18,776	18,187	17,651	20,855	15,560	13,218	24,578	27,599	33,500	20,381
	Stock 1	54.7	50.8	46.9	55.9	54.6	48.5	59.9	46.3	35.0	57.8	70.3	80.8	55.1
	Stock 2	60.2	53.9	50.4	56.6	54.8	53.2	62.8	46.9	39.8	74.0	83.1	100.9	61.4

Notes 1. "Others" refer to sugar, salt and cooking oil.

2. The stock 1 refers to a percentage obtained by dividing the subtotal of rice and wheat with the storage capacity of wheat (31,200 ton).

3. The stock 2 refers to a percentage obtained by dividing the total of overall food with the total storage capacity (33,200 ton).

A-5 Quantity of Stock of Foodgrain, etc. in Dhaka CSD and Tejgaon CSD at the Beginning of the Month

Year	Categories	(Unit: ton)												
		July	Aug.	Sept.	Oct.	Nov.	Dec.	Jan.	Feb.	March	April	May	June	Average
1985 ~ 1986	Dhaka	8,687	8,297	7,534	7,452	5,714	6,651	7,208	7,220	9,001	6,053	8,031	8,832	7,608
	Tejgaon	30,284	25,412	21,728	17,537	19,043	14,932	21,821	21,570	24,810	24,058	22,575	23,144	22,244
	Total	38,971	33,709	29,262	24,989	24,757	21,583	29,029	20,799	33,811	30,711	30,606	31,976	29,852
1986 ~ 1987	Dhaka	10,614	9,512	8,323	8,041	6,367	6,968	7,533	8,151	10,937	7,208	8,560	9,000	8,436
	Tejgaon	38,314	29,665	25,804	21,592	23,405	18,859	26,541	27,155	29,866	28,226	26,679	26,893	26,917
	Total	48,928	39,177	34,127	29,633	29,772	25,827	34,074	35,306	40,803	35,434	35,239	35,873	35,353
1987 ~ 1988	Dhaka	8,786	6,926	7,210	5,954	3,923	5,081	5,538	5,496	6,357	2,710	1,685	3,581	5,188
	Tejgaon	23,144	12,209	14,496	8,157	3,958	2,871	15,050	10,450	10,903	10,999	7,668	17,490	11,455
	Total	31,930	19,135	21,706	14,111	7,881	7,952	20,588	15,946	16,320	13,709	9,353	21,071	16,643
1987 ~ 1988	Dhaka	9,119	8,251	9,995	8,539	5,861	6,117	6,834	6,648	6,572	4,086	2,547	4,753	6,611
	Tejgaon	26,891	16,368	21,469	14,117	8,938	7,965	21,747	16,160	17,845	19,258	13,810	22,282	17,238
	Total	36,010	24,619	31,464	22,656	14,799	14,082	28,581	22,808	24,417	23,344	16,357	27,035	23,849
1987 ~ 1988	Dhaka	2,606	848	1,771	4,108	558	346	1,091	2,297	3,346	4,092	2,599	3,815	1,948
	Tejgaon	17,451	14,738	18,950	17,122	25,423	25,197	28,140	21,960	21,572	31,727	30,807	55,082	25,681
	Total	20,057	15,586	20,721	21,230	25,981	25,543	29,231	24,257	24,918	35,819	33,406	58,897	27,629
1988 ~ 1989	Dhaka	3,944	2,011	2,612	5,338	2,650	2,320	2,894	4,328	5,706	7,093	5,775	5,505	3,840
	Tejgaon	22,143	16,517	20,251	18,975	28,460	27,014	30,643	24,501	23,054	35,840	33,356	55,974	28,061
	Total	26,087	18,528	22,863	24,313	31,110	29,334	33,537	28,829	28,760	42,933	39,131	61,479	31,901
1988 ~ 1989	Dhaka	7,448	7,434	6,316	4,516	1,386	432	1,023	1,868	2,643	2,090	669	4,823	3,388
	Tejgaon	45,082	22,212	14,747	11,302	5,840	15,951	14,681	12,700	15,849	16,422	11,886	17,059	16,980
	Total	52,530	29,646	21,063	15,818	7,226	16,383	15,704	14,568	18,492	18,532	12,555	21,882	20,368
1989 ~ 1990	Dhaka	8,244	7,860	7,749	5,992	1,754	730	1,359	2,191	2,833	2,371	944	5,081	3,927
	Tejgaon	45,974	22,851	15,820	12,063	8,164	17,949	18,019	14,741	17,681	19,677	13,720	19,999	18,889
	Total	54,218	30,711	23,569	18,055	9,918	18,679	19,378	16,932	20,514	22,048	14,664	25,080	22,816
1989 ~ 1990	Dhaka	5,155	2,828	982	6,506	7,340	7,649	7,523	6,797	7,917	6,202	5,265	6,491	5,888
	Tejgaon	17,050	15,850	14,625	17,434	17,027	15,140	18,700	14,438	10,928	18,037	21,940	25,212	17,200
	Total	22,214	18,678	15,607	23,940	24,367	22,789	26,223	21,235	18,845	24,239	27,205	31,703	23,088
Average	Dhaka	5,294	3,266	1,677	7,086	7,861	9,382	8,767	7,751	9,749	7,836	5,404	7,239	6,776
	Tejgaon	19,999	17,902	16,745	18,776	18,187	17,651	20,855	15,560	13,218	24,578	27,599	33,500	20,381
	Total	25,293	21,168	18,422	25,862	26,048	27,033	29,622	23,311	22,967	32,414	33,003	40,739	27,157
Average	Dhaka	6,536	5,267	4,763	7,315	3,784	4,031	4,477	4,736	5,653	4,394	3,650	5,508	4,809
	Tejgaon	26,604	18,084	16,909	14,310	14,258	14,818	19,687	16,225	16,824	20,253	18,975	27,597	18,712
	Total	33,140	23,351	21,672	21,625	18,042	18,849	24,164	20,961	22,477	24,647	22,625	33,105	23,521
Average	Dhaka	7,443	6,180	6,091	6,999	4,897	5,103	5,477	4,184	7,159	5,719	4,646	6,316	5,846
	Tejgaon	30,684	22,661	20,018	17,105	17,431	17,888	23,561	19,623	20,333	25,516	23,033	27,730	22,297
	Total	38,107	28,841	26,109	24,104	22,328	22,991	29,038	23,807	27,492	31,235	27,679	34,046	28,143

A-6 Destinations of Foodgrain Outgoing from Chittagong Port, and Weight of Dhaka FDA

Year		(Unit: ton)											
		July	Aug.	Sept.	Oct.	Nov.	Dec.	Jan.	Feb.	March	April	May	June
1985/86	Dhaka CSD	3,850	8,900	5,950	2,450	3,500	3,500	3,500	4,200	3,500	4,900	4,200	4,200
	Tejgaon CSD	5,706	7,700	7,700	4,900	3,850	8,050	3,500	6,650	4,900	5,600	10,500	7,700
	Others	94,823	63,350	155,190	113,400	128,800	75,390	53,900	63,000	103,600	163,800	177,800	140,000
	Total (1)	104,379	75,950	168,840	120,750	136,150	86,940	60,900	78,850	112,000	174,300	192,500	151,900
	Subtotal (2)	9,556	16,600	13,650	7,350	7,350	11,550	7,000	10,850	8,400	10,500	14,700	11,900
	(2)/(1) (%)	9.2	21.9	8.1	6.1	5.4	13.3	11.5	13.8	7.5	6.0	7.6	7.8
1986/87	Dhaka CSD	2,800	3,150	6,650	3,500	4,900	3,850	2,800	3,850	4,200	1,400	7,000	4,200
	Tejgaon CSD	6,300	7,700	11,900	12,600	9,800	8,400	8,050	7,000	7,700	2,100	8,050	6,300
	Others	142,100	149,100	247,800	208,600	184,800	156,100	67,200	60,620	98,280	20,020	184,800	188,300
	Total (1)	151,200	159,950	266,350	224,700	199,500	168,350	78,050	71,470	110,180	23,520	199,850	198,800
	Subtotal (2)	9,100	10,850	18,550	16,100	14,700	12,250	10,850	10,850	11,900	3,500	15,050	10,500
	(2)/(1) (%)	6.0	6.8	7.0	7.2	7.4	7.3	13.9	15.2	10.8	14.9	7.5	5.3
1987/88	Dhaka CSD	5,600	5,600	4,900	4,550	8,400	5,250	6,300	4,900	5,600	5,600	4,200	4,200
	Tejgaon CSD	11,550	8,400	4,800	6,650	6,580	8,400	8,400	9,800	9,800	9,450	5,600	9,800
	Others	219,730	242,620	186,900	175,000	59,500	157,500	156,800	199,500	199,500	216,300	98,000	105,000
	Total (1)	236,880	256,620	196,600	186,200	74,480	171,150	171,500	214,200	214,200	231,350	107,800	119,000
	Subtotal (2)	17,150	14,000	9,700	11,200	14,980	13,650	14,700	14,700	15,400	15,050	9,800	14,000
	(2)/(1) (%)	7.2	5.5	4.9	6.0	20.1	8.0	8.6	6.9	7.2	6.5	9.1	11.8
1988/89	Dhaka CSD	5,600	4,550	3,500	2,940	4,900	3,500	4,800	5,600	4,200	4,900	4,900	3,850
	Tejgaon CSD	4,200	8,400	4,200	4,900	10,500	11,200	8,400	8,400	9,800	9,100	12,600	12,250
	Others	91,700	47,600	66,290	122,500	245,000	350,000	25,680	215,600	175,000	121,800	25,500	178,500
	Total (1)	101,500	60,550	73,990	130,340	260,400	364,700	38,880	229,600	189,000	135,800	43,050	194,600
	Subtotal (2)	9,800	12,950	7,700	7,840	15,400	14,700	13,200	14,000	14,000	14,000	17,500	16,100
	(2)/(1) (%)	9.7	21.4	10.4	6.0	5.9	4.0	34.00	6.1	7.4	10.3	40.7	8.3
1989/90	Dhaka CSD	3,600	5,250	5,250	2,100	3,150	1,050	2,800	2,100	1,400	1,050	2,100	1,400
	Tejgaon CSD	7,700	12,600	12,950	3,500	5,600	5,250	7,700	5,600	5,600	2,800	7,700	4,900
	Others	140,000	175,000	140,000	231,000	84,000	29,750	19,250	36,820	22,260	49,000	156,800	81,550
	Total (1)	151,200	192,850	158,200	236,600	92,750	36,050	29,750	44,520	29,260	52,850	166,600	87,850
	Subtotal (2)	11,200	17,850	18,200	5,600	8,750	6,300	10,500	7,700	7,000	3,850	9,800	6,300
	(2)/(1) (%)	7.4	9.3	11.5	2.4	9.4	17.5	35.3	17.3	23.9	7.3	5.9	7.2

A-7 Transition of Incoming Situation of Foodgrain to Tejgaon CSD according to Transportation Means

(Unit: ton)

Items	Transportation method	1985/86	1986/87	1987/88	1988/89	1989/90	Average
Rice	Railway	21,705	19,720	35,670	32,000	37,128	29,245
	Truck	13,233	19,968	32,395	13,023	40,151	23,754
	Total	34,938	39,688	68,065	45,023	77,279	52,999
	Ratio of railway	62.2	49.7	52.4	71.1	48.0	55.2
Wheat	Railway	58,132	52,620	51,316	86,000	61,328	61,880
	Truck	41,075	46,652	48,590	52,148	19,205	41,534
	Total	99,027	99,272	99,906	138,148	80,533	103,414
	Ratio of railway	58.6	53.0	51.4	62.3	76.2	59.8
Total of rice and wheat	Railway	79,837	72,340	86,986	118,000	98,456	91,124
	Truck	54,308	65,620	80,985	65,171	59,356	65,088
	Total	134,145	138,960	167,971	183,171	157,812	156,412
	Ratio of railway	59.5	52.1	51.8	64.4	62.4	58.3

A-8 Transition of Monthly Delivery from Dhaka CSD

(Unit: ton)

Year	Categories	July	Aug.	Sept.	Oct.	Nov.	Dec.	Jan.	Feb.	March	April	May	June
1985/86	Rice	2,600	2,610	2,595	2,615	2,605	2,605	2,600	2,610	2,580	2,630	2,605	2,605
	Wheat	8,084	8,000	8,100	8,011	7,057	8,084	8,000	7,590	8,324	9,000	9,221	8,220
	Total	10,684	10,610	10,695	10,626	9,662	10,689	10,600	10,200	10,904	11,630	11,826	10,825
1986/87	Rice	3,900	4,000	3,938	3,962	3,800	4,50	3,900	4,000	3,700	4,200	3,550	4,050
	Wheat	8,895	7,000	7,890	7,900	6,820	8,890	7,000	9,990	7,695	8,000	6,920	9,860
	Total	12,795	11,000	11,828	11,862	10,620	12,940	10,900	13,900	11,395	12,200	10,470	13,910
1987/88	Rice	3,700	3,800	3,738	3,762	3,600	3,850	3,750	3,850	3,500	4,000	3,600	3,450
	Wheat	8,084	8,000	8,100	7,157	8,184	8,100	7,690	8,002	8,320	9,021	8,221	8,220
	Total	11,784	11,800	11,838	10,919	11,784	11,950	11,440	11,852	11,820	13,021	11,821	11,670
1988/89	Rice	5,950	5,910	5,830	6,030	5,550	6,210	5,930	5,900	5,960	4,830	6,130	5,730
	Wheat	12,720	11,680	10,870	11,920	11,892	8,996	10,311	12,620	13,480	9,337	10,890	12,184
	Total	18,670	17,590	167,000	17,950	17,442	15,206	16,241	18,520	19,440	14,167	17,020	17,914
1989/90	Rice	3,652	3,500	3,752	3,400	3,900	4,000	3,820	3,716	3,670	3,580	2,288	3,552
	Wheat	7,200	7,100	7,160	6,920	8,280	7,180	6,970	5,920	6,870	7,156	7,200	6,994
	Total	10,852	10,600	10,912	10,320	12,180	11,180	10,790	9,636	10,540	10,736	9,488	10,546
Average	Rice	3,960	3,964	3,971	3,954	3,891	4,143	4,000	4,015	3,882	3,843	3,635	3,358
	Wheat	8,997	8,356	8,424	8,382	8,447	8,250	7,994	8,824	8,938	8,503	8,490	9,095
	Total	12,957	12,320	12,395	12,366	12,338	12,393	11,994	12,839	12,820	12,346	12,125	12,453

A-9 Transition of Monthly Delivery from Tejgaon CSD

(Unit: ton)

Year	Categories	July	Aug.	Sept.	Oct.	Nov.	Dec.	Jan.	Feb.	March	April	May	June
1985/86	Rice	627	527	42	1,390	293	215	536	767	217	381	1,587	151
	Wheat	2,244	3,129	27	4,617	4,773	4,370	3,664	3,461	4,248	4,195	4,026	2,778
	Total	2,871	3,656	69	6,007	5,066	4,585	4,200	4,228	4,465	4,576	5,613	2,929
1986/87	Rice	676	569	296	3,714	1,718	87	130	1,706	5,484	6,615	2,609	3,027
	Wheat	4,423	3,981	5,962	5,442	6,218	5,555	5,935	6,408	5,822	5,081	3,972	4,181
	Total	5,009	4,550	6,258	9,156	7,936	15,642	6,065	8,114	11,306	11,696	6,401	7,208
1987/88	Rice	3,842	2,718	3,692	4,942	2,221	3,423	2,254	722	1,026	3,854	619	79
	Wheat	6,420	6,334	6,368	6,647	4,741	8,190	2,803	6,195	7,759	3,546	4,746	3,221
	Total	10,262	9,052	10,060	11,589	6,962	11,613	5,057	6,917	8,785	7,400	5,365	3,300
1988/89	Rice	926	1,156	2,077	5,043	521	607	1,130	1,138	1,774	3,435	531	622
	Wheat	4,980	6,102	106	337	20	51	3,823	4,136	4,713	3,773	3,174	3,571
	Total	5,906	7,258	2,183	5,380	541	658	4,953	5,274	6,487	7,208	3,705	4,193
1989/90	Rice	2,158	377	170	214	156	1,213	239	338	819	1,518	876	719
	Wheat	4,353	6,043	5,926	5,941	5,509	5,650	6,860	3,681	5,116	604	490	2,490
	Total	6,511	6,420	6,096	6,155	5,665	6,863	7,099	4,019	5,935	2,121	1,366	3,209
Average	Rice	1,645	1,694	1,255	3,061	982	1,109	858	934	1,864	3,161	1,244	917
	Wheat	4,484	5,118	3,678	4,597	4,252	4,763	4,617	4,776	5,532	3,440	3,246	3,248
	Total	6,130	6,812	4,933	7,658	5,234	5,872	5,475	5,710	7,396	6,601	4,490	4,165

A-10 Situation of Stock in Existing CSDs in Dhaka MA at the Beginning of the Month

Year	Dhaka CSD			Tejgaon CSD			Total		
	Stock at the beginning of the month	No. of months in stock	Stock ratio	Stock at the beginning of the month	No. of months in stock	Stock ratio	Stock at the beginning of the month	No. of months in stock	Stock ratio
	1000 ton	month	%	1000 ton	month	%	1000 ton	month	%
1985/86	7.6	1.9	117	22.2	2.1	71	29.8	2.1	86
1986/87	5.1	0.8	78	11.5	1.0	37	16.6	0.9	48
1987/88	1.9	0.2	29	25.6	2.2	82	27.5	1.4	79
1988/89	3.3	0.8	51	17.0	1.0	54	20.3	0.9	59
1989/90	5.8	1.1	89	17.2	1.6	55	23.0	1.5	66
Average	4.7	1.0	73	18.7	1.6	60	23.4	1.4	68

- Notes
1. Stock at the beginning of the month: Average quantity of stock at the beginning of the month in the respective years.
 2. No. of months in stock: (Stock at the beginning of the month) / (Yearly average monthly delivery).
 3. Stock ratio: (Stock at the beginning of the month) / (Storage capacity)

Storage capacity	Dhaka CSD	: 6,500
	Tejgaon CSD	: 31,200 ton
	Total	: 37,700 ton

A-11 Foodgrain Storage Construction Programme as of March, 1991
(As far as studied in Project Proforma)

	IDA	ADB	EC	NEHERLAND	CIDA	Total
<u>DHAKA DIV.</u>	27,500	—	7,000	—	12,500	47,000
Dhaka	2,000	—	—	—	6,500	8,500
Maymeshingh	15,500	—	—	—	—	15,500
Faridpur	4,500	—	5,000	—	2,500	12,000
Tangail	1,000	—	2,000	—	3,500	6,500
Jamalpur	4,500	—	—	—	—	4,500
<u>CHITTAGONG DIV.</u>	17,500	—	23,000	11,500	7,000	59,000
Chittagong	—	—	5,000	—	6,000	11,000
Chittagong H.T.	—	—	—	—	500	500
Comilla	—	—	6,000	7,000	500	13,500
Noakhali	2,000	—	7,000	4,500	—	13,500
Sylhet	15,500	—	5,000	—	—	20,500
<u>RAJSHAHI DIV.</u>	111,000	—	12,000	3,000	—	126,000
Rajshahi	26,000	—	—	—	—	26,000
Rangpur	34,500	—	5,000	1,500	—	41,000
Dinajpur	39,500	—	—	1,500	—	41,000
Bogra	9,500	—	—	—	—	9,500
Pabna	1,500	—	7,000	—	—	8,500
<u>KHULNA DIV.</u>	8,000	62,500	6,000	—	7,000	83,500
Khulna	500	—	6,000	—	—	6,500
Jessore	4,500	—	—	—	7,000	11,500
Kushitia	3,000	—	—	—	—	3,000
Barisal	—	33,000	—	—	—	33,000
Patuakhali	—	29,500	—	—	—	29,500
Total	164,000	62,500	48,000	14,500	26,500	315,500

A-12 Foodgrain Storage Construction Project under Foreign Aid

Remarks: \$1.00 = TK25

(a) Total Project Cost (d) Total Aid Cost	(c) Project Period	(d) Number of Proposed Storage (e) District and Capacity	(f) Items of the Project																																				
(1) IDA credit Second Foodgrain Storage Construction Project (Revised Scheme)																																							
TK711,508,000 (\$28,460,320)	Jul. 1, 78 5	175 LSDs (15 Districts)	1) Storage (164,000 tons)																																				
TK484,772,000 (\$19,390,880)	Jan. 30, 84	<table><tr><th>District</th><th>ton</th><th>District</th><th>tons</th></tr><tr><td>Jamalpur</td><td>4,500</td><td>Faridpur</td><td>4,500</td></tr><tr><td>Mymensingh</td><td>15,500</td><td>Tangail</td><td>1,000</td></tr><tr><td>Sylhet</td><td>15,500</td><td>Pabna</td><td>1,500</td></tr><tr><td>Rajshahi</td><td>26,000</td><td>Khulna</td><td>500</td></tr><tr><td>Bogra</td><td>9,500</td><td>Jessore</td><td>4,500</td></tr><tr><td>Dinajpur</td><td>39,500</td><td>Kushtia</td><td>3,000</td></tr><tr><td>Rangpur</td><td>34,500</td><td>Noakali</td><td>2,000</td></tr><tr><td>Dhaka</td><td>2,000</td><td></td><td></td></tr></table>	District	ton	District	tons	Jamalpur	4,500	Faridpur	4,500	Mymensingh	15,500	Tangail	1,000	Sylhet	15,500	Pabna	1,500	Rajshahi	26,000	Khulna	500	Bogra	9,500	Jessore	4,500	Dinajpur	39,500	Kushtia	3,000	Rangpur	34,500	Noakali	2,000	Dhaka	2,000			2) Rehabilitation 3) Ancillary building 4) Boundary wall 5) Drying yard 6) Zonal laboratories 7) Supply of machinaries and equipment. 8) Consultant and training
District	ton	District	tons																																				
Jamalpur	4,500	Faridpur	4,500																																				
Mymensingh	15,500	Tangail	1,000																																				
Sylhet	15,500	Pabna	1,500																																				
Rajshahi	26,000	Khulna	500																																				
Bogra	9,500	Jessore	4,500																																				
Dinajpur	39,500	Kushtia	3,000																																				
Rangpur	34,500	Noakali	2,000																																				
Dhaka	2,000																																						
(2) ADD-grant Foodgrain Storage Project (Revised Scheme)																																							
TK275,000,000 (\$11,000,000)	Jul. 1, 79 5	63 LSDs (2 Districts)	1) Storage (62,500 tons)																																				
TK213,500,000 (\$85,400,000)	Jan. 30, 84	<table><tr><td>500 tons x 125 stores = 62,500 tons</td><td></td></tr><tr><th>District</th><th>tons</th></tr><tr><td>Patuakhali</td><td>29,500</td></tr><tr><td>Barisal</td><td>33,000</td></tr></table>	500 tons x 125 stores = 62,500 tons		District	tons	Patuakhali	29,500	Barisal	33,000	2) Staff quarter 3) Darwan shed 4) Internal & approach roads, boundary wall and drying yard, etc. 5) Electrification and other facilities 6) Supply of machinaries and equipment 7) Consultant																												
500 tons x 125 stores = 62,500 tons																																							
District	tons																																						
Patuakhali	29,500																																						
Barisal	33,000																																						

(a) Total Project Cost (d) Total Aid Cost	(c) Project Period	(d) Number of Proposed Storage (e) District and Capacity	(f) Items of the Project																								
(3) EC-grant Foodgrain Storage Project (Revised Scheme)																											
TK189,941,000 (\$7,597,640)	Jul. 1, 81 }	9 Districts 1,000 tons x 48 stores = 48,000 tons	1) Storage (48,000 tons)																								
TK182,400,000 (\$7,296,000)	Jan. 30, 85	<table><tr><th>District</th><th>ton</th><th>District</th><th>tons</th></tr><tr><td>Rangpur</td><td>5,000</td><td>Pabna</td><td>7,000</td></tr><tr><td>Comilla</td><td>6,000</td><td>Chittagong</td><td>5,000</td></tr><tr><td>Noakhali</td><td>7,000</td><td>Khulna</td><td>6,000</td></tr><tr><td>Sylhet</td><td>5,000</td><td>Tangail</td><td>2,000</td></tr><tr><td>Faridpur</td><td>5,000</td><td></td><td></td></tr></table>	District	ton	District	tons	Rangpur	5,000	Pabna	7,000	Comilla	6,000	Chittagong	5,000	Noakhali	7,000	Khulna	6,000	Sylhet	5,000	Tangail	2,000	Faridpur	5,000			2) Staff quarter 3) Internal & approach roads and water and other facilities 4) Electrification 5) Railway siding 6) Consultant
District	ton	District	tons																								
Rangpur	5,000	Pabna	7,000																								
Comilla	6,000	Chittagong	5,000																								
Noakhali	7,000	Khulna	6,000																								
Sylhet	5,000	Tangail	2,000																								
Faridpur	5,000																										
(4) Dutch-grant Foodgrain Storage Project (Revised Scheme)																											
TK45,000,000 (\$1,875,000)	Aug. 8, 79 }	2 Districts 500 tons x 23 stores = 11,500 tons	1) Storage (11,500 tons)																								
TK44,000,000 (\$1,833,000)	Jan. 30, 83	<table><tr><th>District</th><th>tons</th></tr><tr><td>Comilla</td><td>7,000</td></tr><tr><td>Noakhali</td><td>5,000</td></tr></table> (Revised to 11,500 tons)	District	tons	Comilla	7,000	Noakhali	5,000	2) Staff quarters 3) Access road 4) Boundary wall and electrification																		
District	tons																										
Comilla	7,000																										
Noakhali	5,000																										
(5) CIDA-grant Foodgrain Storage Project (Revised Scheme)																											
TK89,300,000 (\$3,572,000)	Jul. 1, 81 }	30 LSDs (6 Districts) 500 tons x 50 stores = 25,000 tons	1) Storage (25,000 tons)																								
TK80,000,000 (\$3,200,000)	Mar. 31, 85	<table><tr><th>District</th><th>ton</th></tr><tr><td>Dhaka</td><td>6,500</td></tr><tr><td>Chittagong</td><td>5,500</td></tr><tr><td>Bandarban</td><td>500</td></tr><tr><td>Faridpur</td><td>2,000</td></tr><tr><td>Jessore</td><td>7,000</td></tr><tr><td>Tangail</td><td>3,500</td></tr></table>	District	ton	Dhaka	6,500	Chittagong	5,500	Bandarban	500	Faridpur	2,000	Jessore	7,000	Tangail	3,500	2) Staff quarter 3) Internal & approach roads and bridge 4) Boundary wall 5) Drying yard 6) Electrification 7) Supply of machineries and equipment 8) Consultant and training										
District	ton																										
Dhaka	6,500																										
Chittagong	5,500																										
Bandarban	500																										
Faridpur	2,000																										
Jessore	7,000																										
Tangail	3,500																										

Remarks: \$1.00 = TK34

(a) Total Project Cost (d) Total Aid Cost	(c) Project Period	(d) Number of Proposed Storage (e) District and Capacity	(f) Items of the Project
(6) Dutch-grant Food Godown Rehabilitation Project (Phase III)			
TK218,450,000 (\$6,425,000)	Aug. , 84 ✓ Jun. , 90	2 Districts Rehabilitation of 93 LSDs and New Construction of 3,000 ton godowns	1) Rehabilitation of LSDs 2) New construction of LSDs 3) New construction of staff quarters 4) New construction of boundary walls 5) New construction of drying yard 6) Other repair works of LSDs
TK216,250,000 (\$6,360,000)		A. Rehabilitation District Dinajpur 87,000 tons Rangpur 66,000 tons B. New Construction District Dinajpur 1,500 tons Rangpur 1,500 tons	
(7) CIDA-grant Foodgrain Storage Construction and Rehabilitation Project			
TK346,600,000 (\$10,194,000)	Jul. , 86 ✓ Jun. , 92	3 Districts Rehabilitation of 39 LSDs and Construction of 15,000 ton	1) Rehabilitation of 39 LSDs 2) New construction of 3 LSDs (1500 tons) 3) New construction/rehabilitation of staff guards,drying yard, jety 4) Electrification 5) Development of training facilities
TK326,200,000 (\$9,594,000)		A. Rehabilitation District Foridpur 27,000 tons Comilla 15,300 tons Chittagong 18,500 tons B. New Construction District Foridpur 500 tons Comilla 500 tons Chittagong 500 tons Completed in 500 1989.	

A-13 Railway network

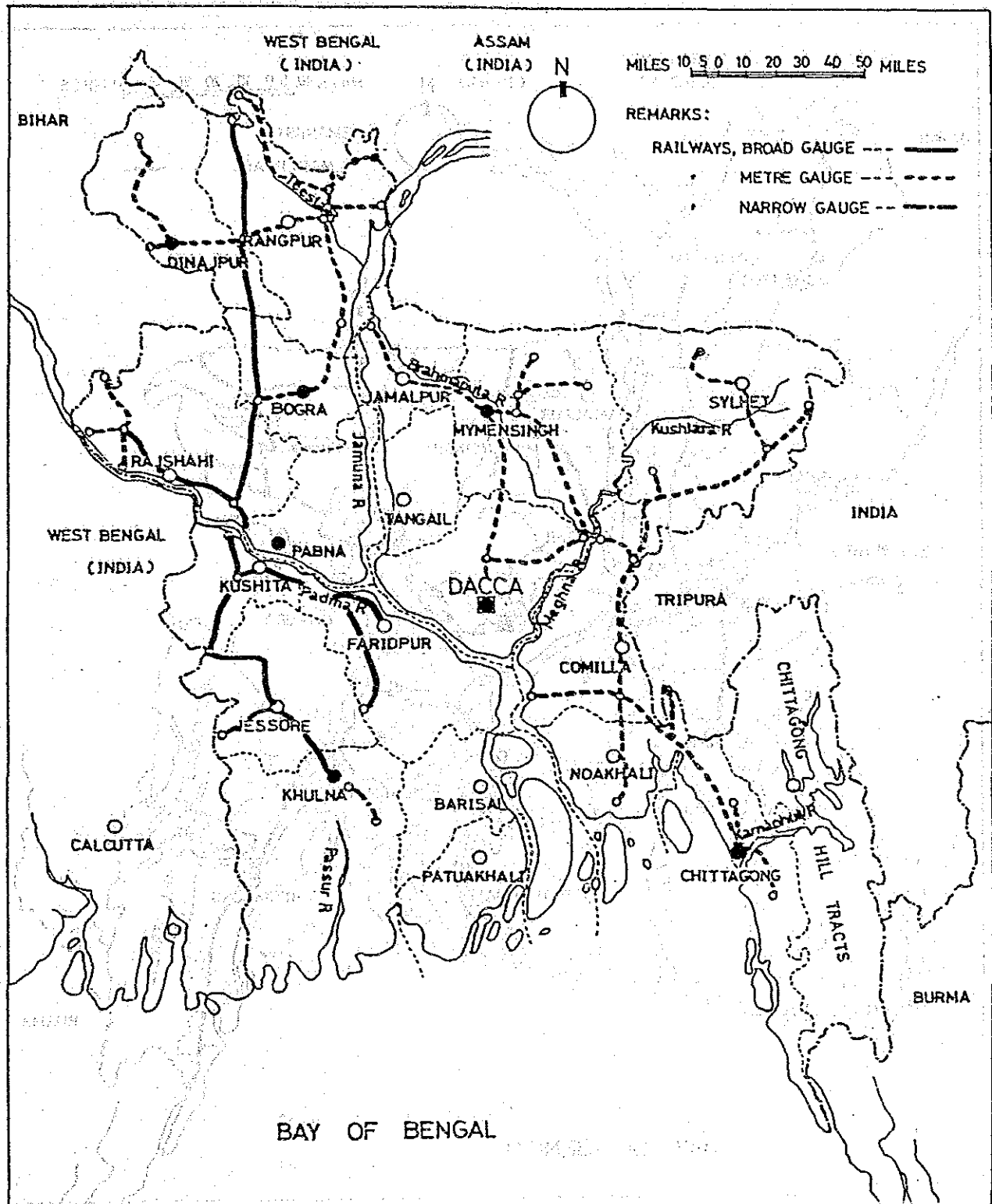

A-14 Road network

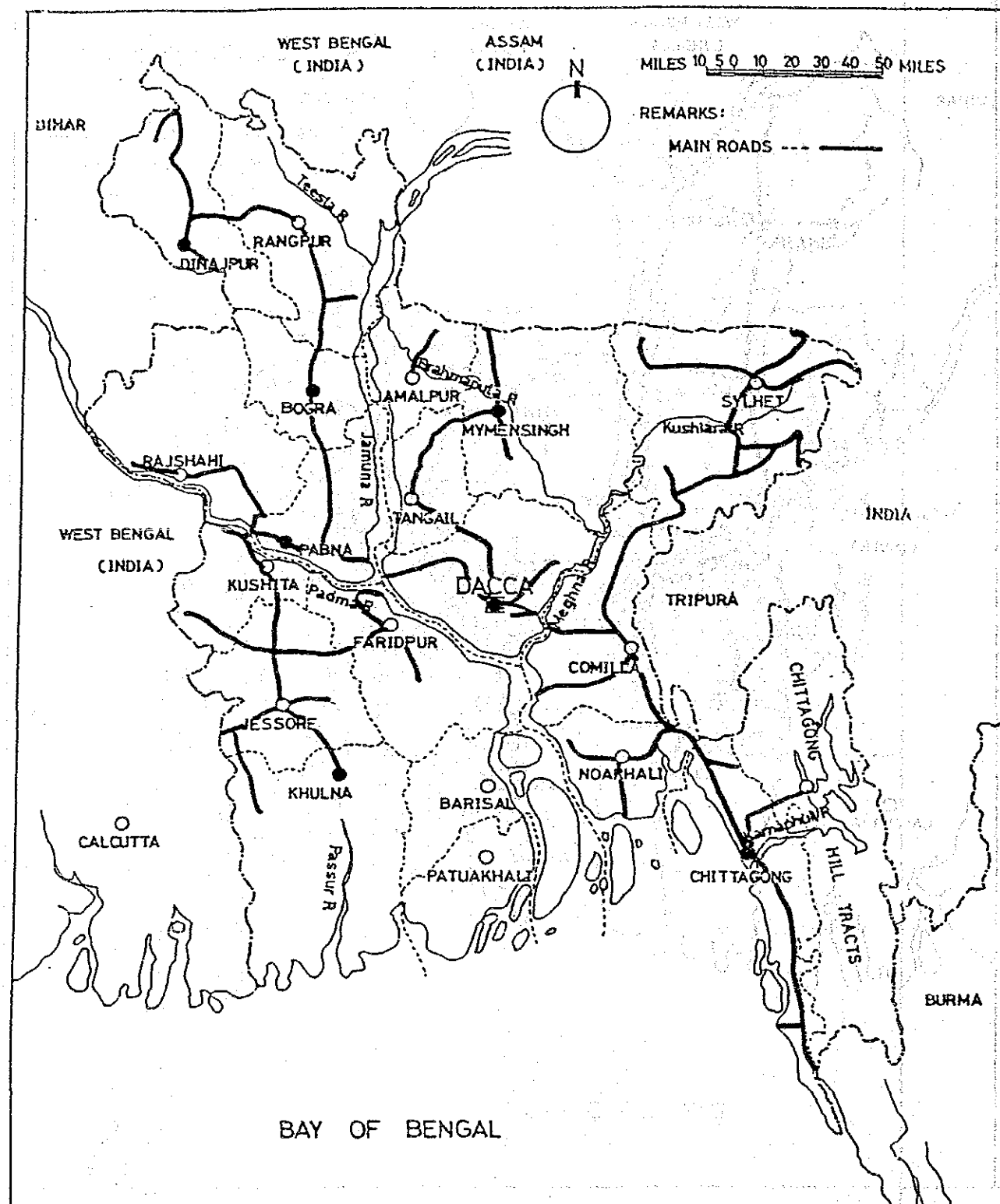

A-15 Waterways

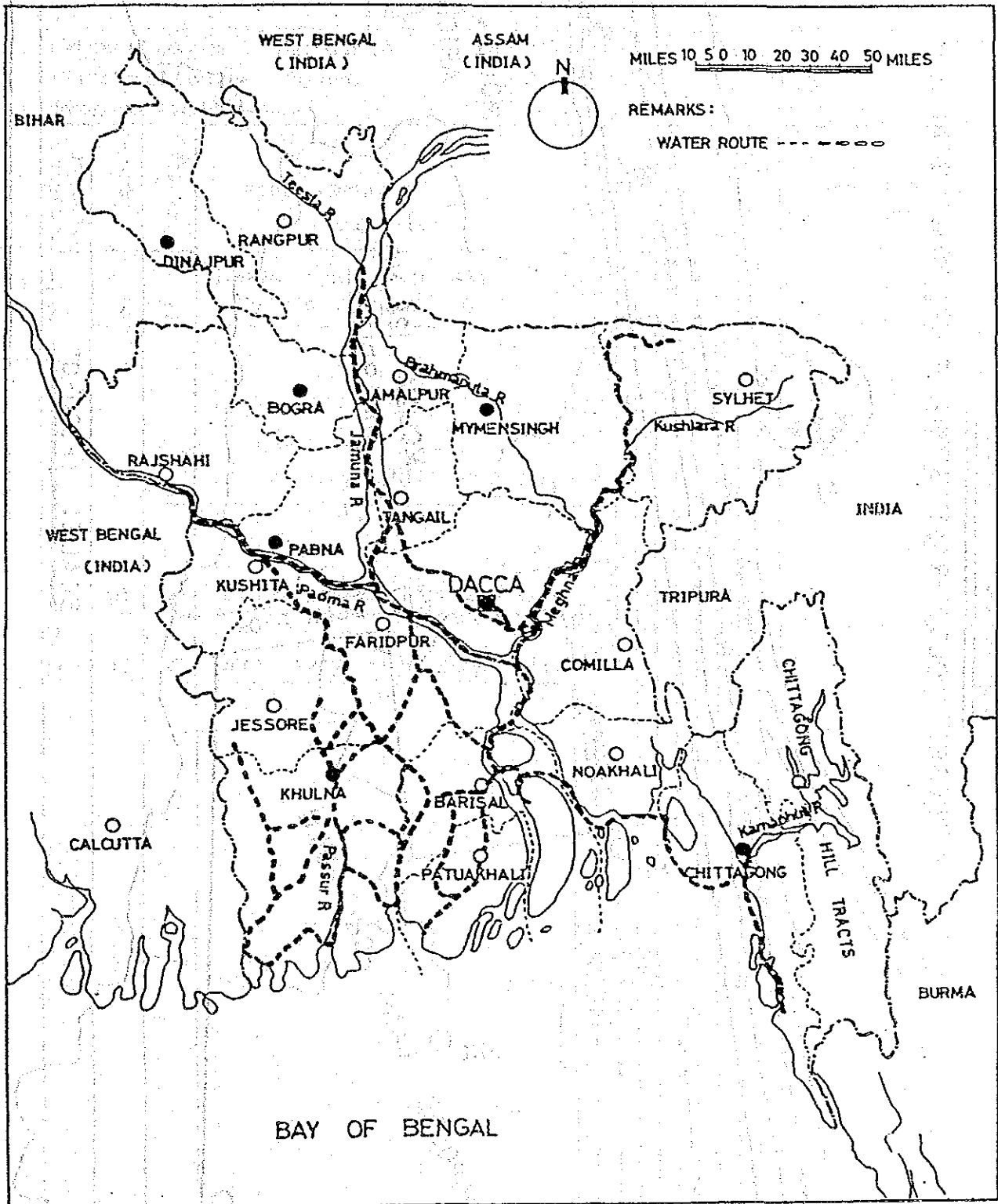

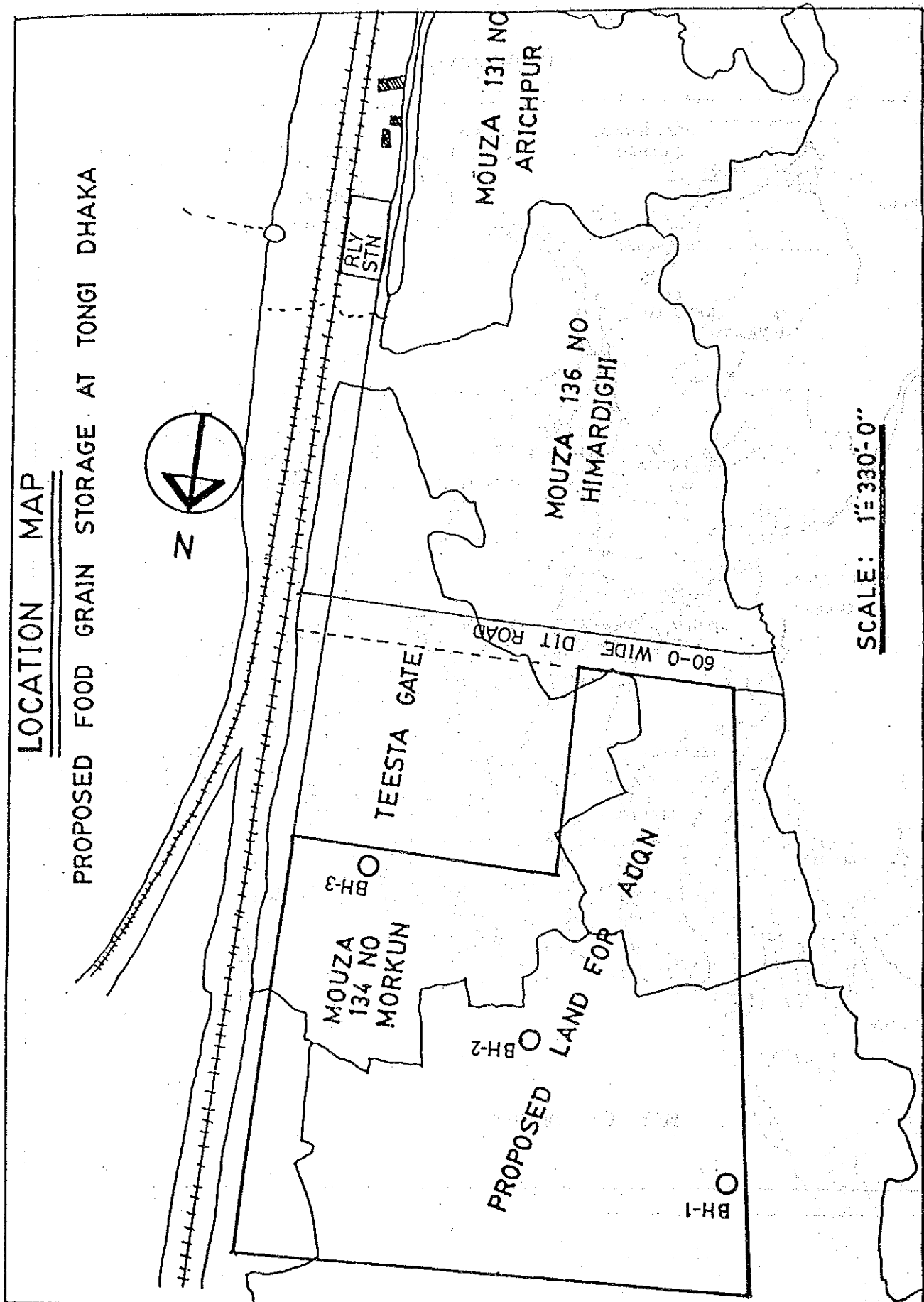

Soiltest Equipment & Engg. Ltd. 76A, Segun Bagicha Dhaka			Project:- FOOD GRAIN STORAGE Client:- Japan Engg Consultants Co Ltd. Site:- Tongi Bore chart of boring no. 1		
Method of boring:- Percussion Diameter of boring:- 70 mm Inclination:- Vertical			Date started. 29-03-91. Date completed. 31-03-91. Gr. W. Level. - 3.20 m from G.L.		
reduced elevation	depth, m	thickness, m	strata encountered ↓ Ground level	standard penetration tests blows/30 cm	remarks • No. soil samples vane shear test lbs/ft ² in.
1				10 20 30 40 50 60 70 80 90	
2	2	2	Brown medium to stiff silty clay, trace sand.	5	UDS-1
3				11	
4				14	UDS-2
5				12	
6			Grey stiff —	13	
7	7	5	to very stiff silty clay.	11	
8				14	
9				18	
10	10	3	Brown very stiff silty clay.	15	
11				18	
12	12	2	Grey very stiff clayey silt.	20	
drn- checked:- Y _h disturbed sample..... <input checked="" type="checkbox"/> undisturbed sample..... <input type="checkbox"/> date:- scale:- plan no.					

Soiltest Equipment & Engg. Ltd. 76A, Segun Bagicha, Dhaka			Project:- FOOD GRAIN STORAGE Client:- Japan Engg Consultants Co Ltd. Site:- Tongi Bore chart of boring no. 2		
Method of boring:- Percussion Diameter of boring:- 70 mm Inclination:- Vertical			Date started. 31-03-91. Date completed. 02-04-91. G.W. Level. - 1.40 m from G.L.		

reduced elevation	depth 'm'	thickness 'm'	strata encountered Ground level ↓	standard penetration tests blows/30cm											remarks No. of soil samples vane shear test lbs/sq in.
				10	20	30	40	50	60	70	80	90			
1	1	1	Brownish medium silty clay.	7											UDS-1
2															
3															
4															
5	5	4	Brown stiff to very stiff silty clay, trace mica.	16											UDS-2
6															
7															
8															
9															UDS-3
10															
11															
12															
13	12	7	Black stiff to very stiff clay with some silt.	11											UDS-4
14															
15															
16															
17	15	3	Greyish very stiff silty clay.	22											UDS-4
18															
19															
20															
21	20	5	Grey hard clayey silt with sand.	41											UDS-4
22															
23															
24															
25	25	5	Dense brown silty sand with clay.	46											UDS-4
				48											

drn:- checked:- <i>Y</i>	disturbed sample..... <input checked="" type="checkbox"/>	undisturbed sample..... <input type="checkbox"/>	date:- scale:- plan no.
-----------------------------	---	--	-------------------------------

Soiltreat Equipment & Engg.Ltd. 76A,Segun Bagicha,Dhaka			Project:- FOOD GRAIN STORAGE Client:- Japan Engg Consultants Co Ltd. Site:- Tongi Bore chart of boring no. 3									
Method of boring:- Percussion Diameter of boring:- 70 mm Inclination:-Vertical			Date started. 3-04-91. Date completed. 3-04-91. G.W. Level. -2.10 m from G.L.									
reduced elevation	depth 'm'	thickness 'm'	strata encountered ▽ Ground level	standard penetration tests blows/30cm 10 20 30 40 50 60 70 80 90								remarks (•w.r.soil samples vane shear test lbs/sq.in.
1												UDS-1
2												
3												
4	4	4	Brown stiff silty clay.									
5												UDS-2
6												
7												
8												
9												
10												
11												
12	12	8	Grey to brown stiff to very stiff clayey silt.									
drn:-			disturbed sample.....		undisturbed sample.....							
checked:- 1			date:-		scale:-		plan no.					

APPENDIX 7

LIST OF COLLECTED DATA

1. *Physical characteristics of the site*

2. *Geological and topographical features*
including the location of the site

3. *Buildings and other structures on the site*
including the location of the site

4. *Water supply and drainage*
including the location of the site

5. *Vegetation and other natural features*
including the location of the site

6. *Land use and other activities on the site*
including the location of the site

7. *Climate and weather conditions*

8. *Population and other social factors*
including the location of the site

9. *Yield and other agricultural data*
including the location of the site

APPENDIX 7 LIST OF COLLECTED DATA

1. Annual Development Programme (1990-91)
- Planning Commission -
2. List of Aid Worthy Projects, 1990
- Ministry of Planning : Planning Commission -
3. Flow of External Resources into Bangladesh (As of June 30, 1989)
- Economic Relations Division, Ministry of Finance -
4. Bangladesh Economic Survey (1989 - 90)
- Ministry of Finance, Finance Division -
5. Bangladesh Population Census, 1981 (issued in 1985)
- Bangladesh Bureau of Statistics -
6. Bangladesh: Food Policy Issues, 1979
- World Bank -
7. Year Book (1987-88)
- Ministry of Food -
8. Food Situation Report for the Month of February, 1991
- Food Planning and Monitoring Unit, Ministry of Food -
9. Study on Subsidies in Public Food Grain Distribution System in Bangladesh, 1986
- EUREKA (Bangladesh) Ltd./Ministry of Food -
10. Statistical Yearbook of Bangladesh, 1990
- Bangladesh Bureau of Statistics -
11. Yearbook of Agricultural Statistics of Bangladesh (1987-88)
- Bangladesh Bureau of Statistics -

12. Statistical Bulletin of Bangladesh, 1990
- Bangladesh Bureau of Statistics -
13. Analysis of Rate, effective from 1st July 1989
- Public Works Department (PWD) -
14. Project Proforma (Revised), Food Storage Rehabilitation and Construction along with Ancillary Facilities under Dutch Assistance (Phase III)
- Ministry of Food -
15. Project Proforma, Food Grain Storage Construction & Rehabilitation of the Existing Storage Centres under CIDA Assistance (Phase II)
- Ministry of Food -
16. Project Proforma (Revised), Development of Infrastructure of Different Storage Centres along with Rehabilitation/Replacement of Dilapidated Godowns under BEC (Phase II)
- Ministry of Food -
17. Proposals for Reorganization of the Directorate General of Food (Nov.1988)
- Food and Agriculture Organization (FAO) -
18. Capital Investment (Food) of Directorate General of Food (1986/87 - 1988/89)
- Directorate General of Food -
19. Revenue Budget of Directorate General of Food (1987/88 - 1990/91)
- Ministry of Food -
20. Sanctioned Strength of Tejgaon CSD
- Directorate General of Food -
21. Sanctioned Strength of Dhaka CSD
- Directorate General of Food -
22. Pay Scale of Gazetted and Non - Gazetted Staff of Tejgaon CSD
- Directorate General of Food -

JICA