

4.6 Leveling of C-Class Housing Sewers

Leveling of the invert levels of sewers which may affect the design of gravity trunk sewers was carried out at critical points along the C-Class Housing route. The locations of the manholes where invert levels of sewers were surveyed are shown in Figure B.20 together with the results.

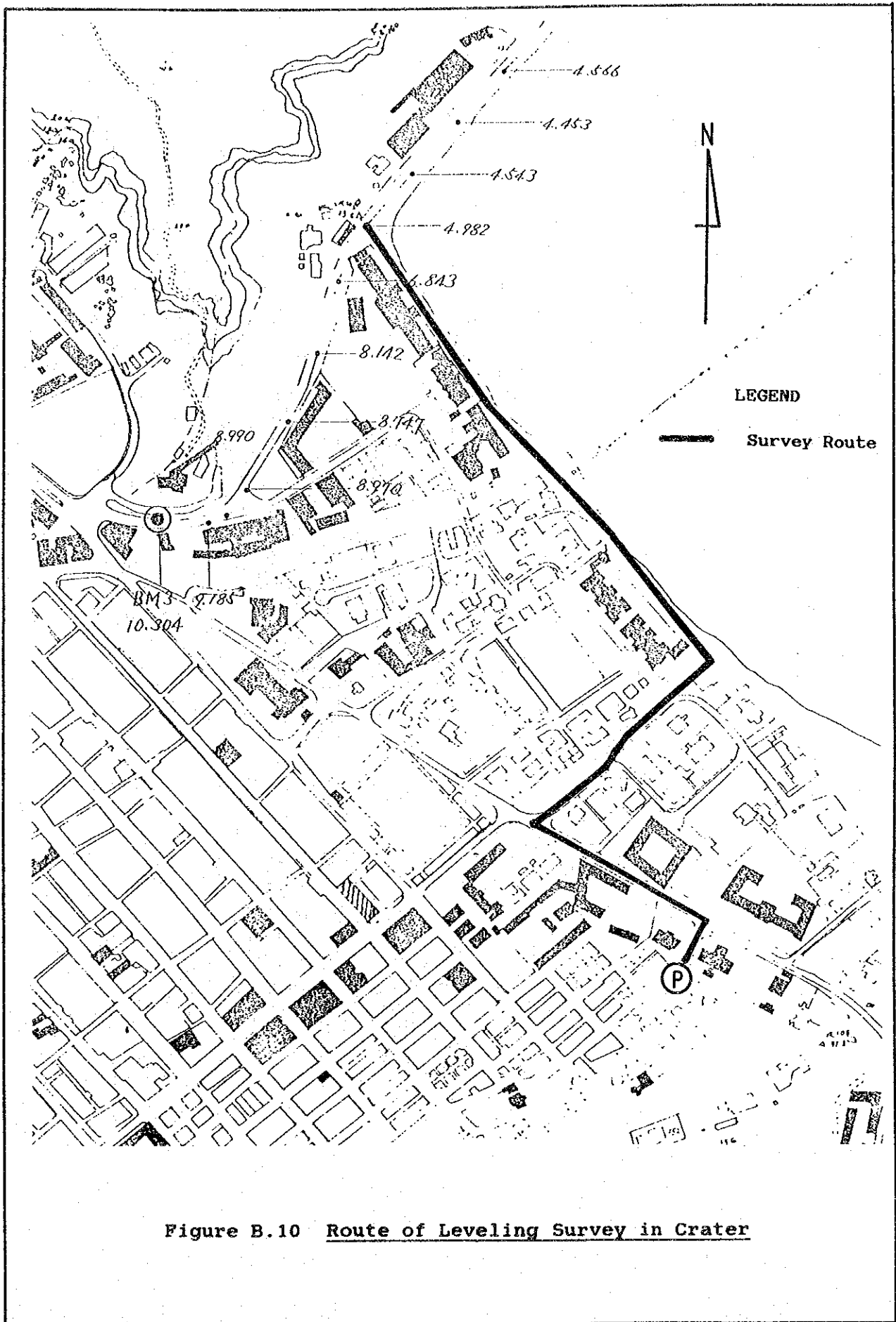

Figure B.10 Route of Leveling Survey in Crater

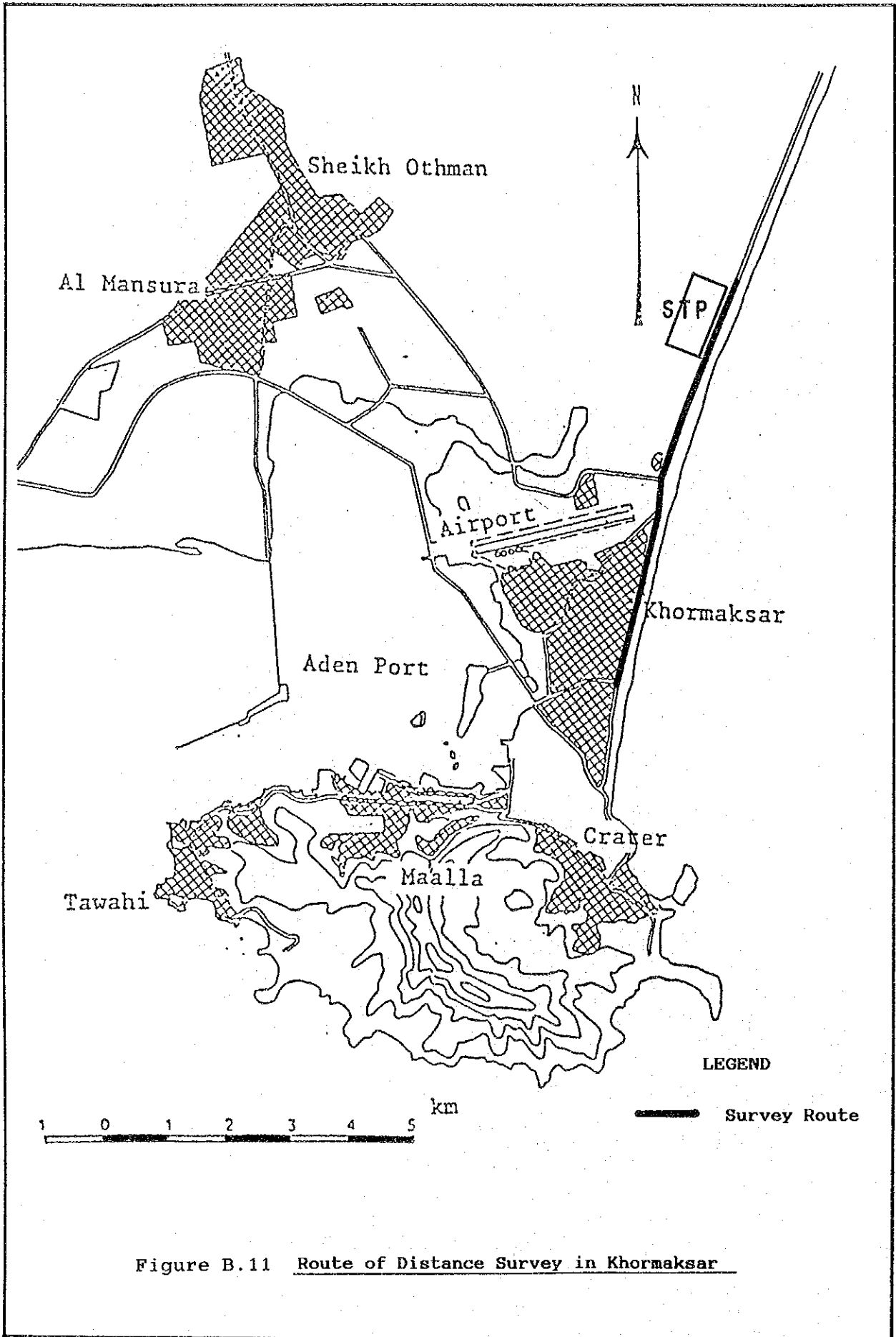

Figure B.11 Route of Distance Survey in Khormaksar

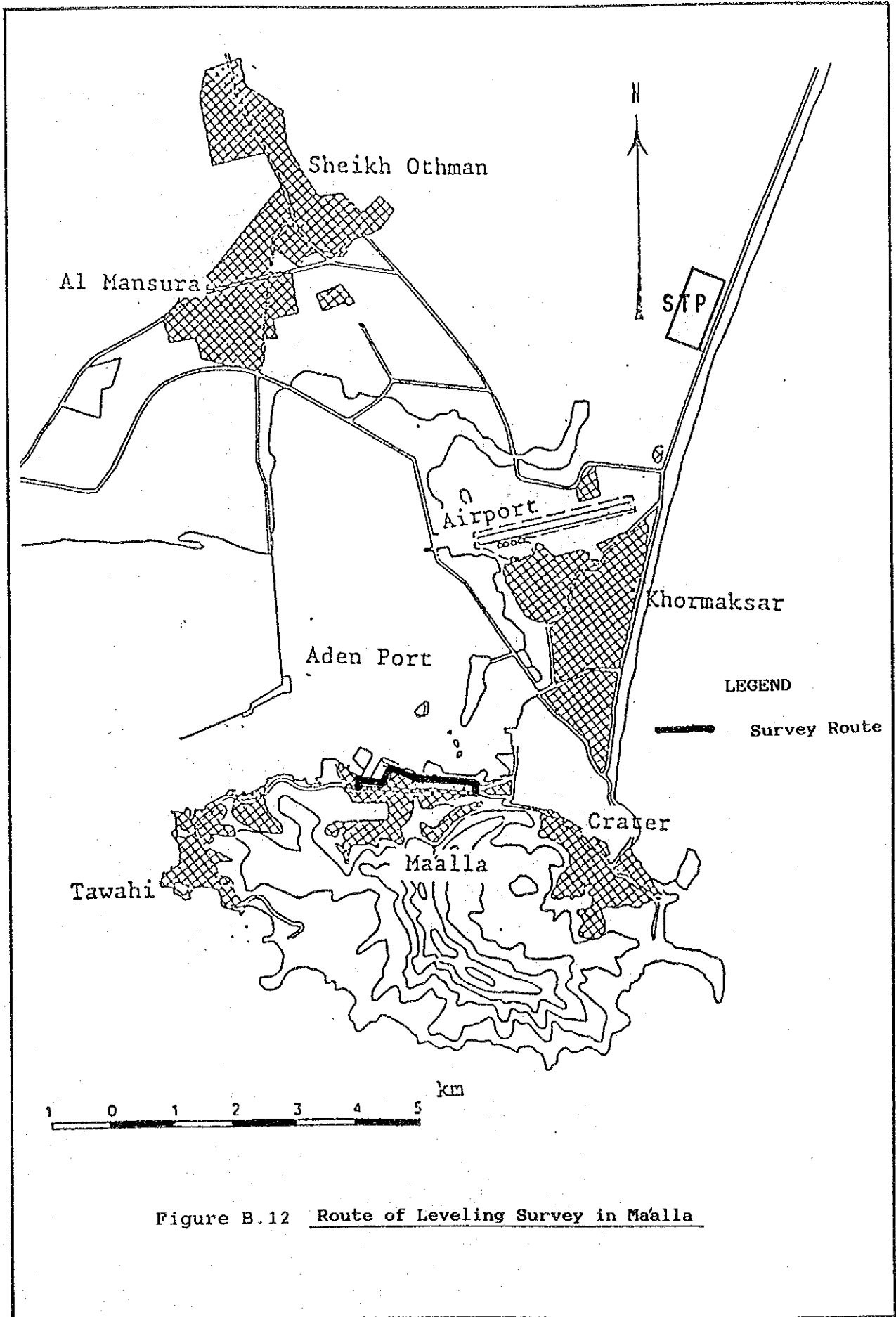

Figure B.12 Route of Leveling Survey in Maalla

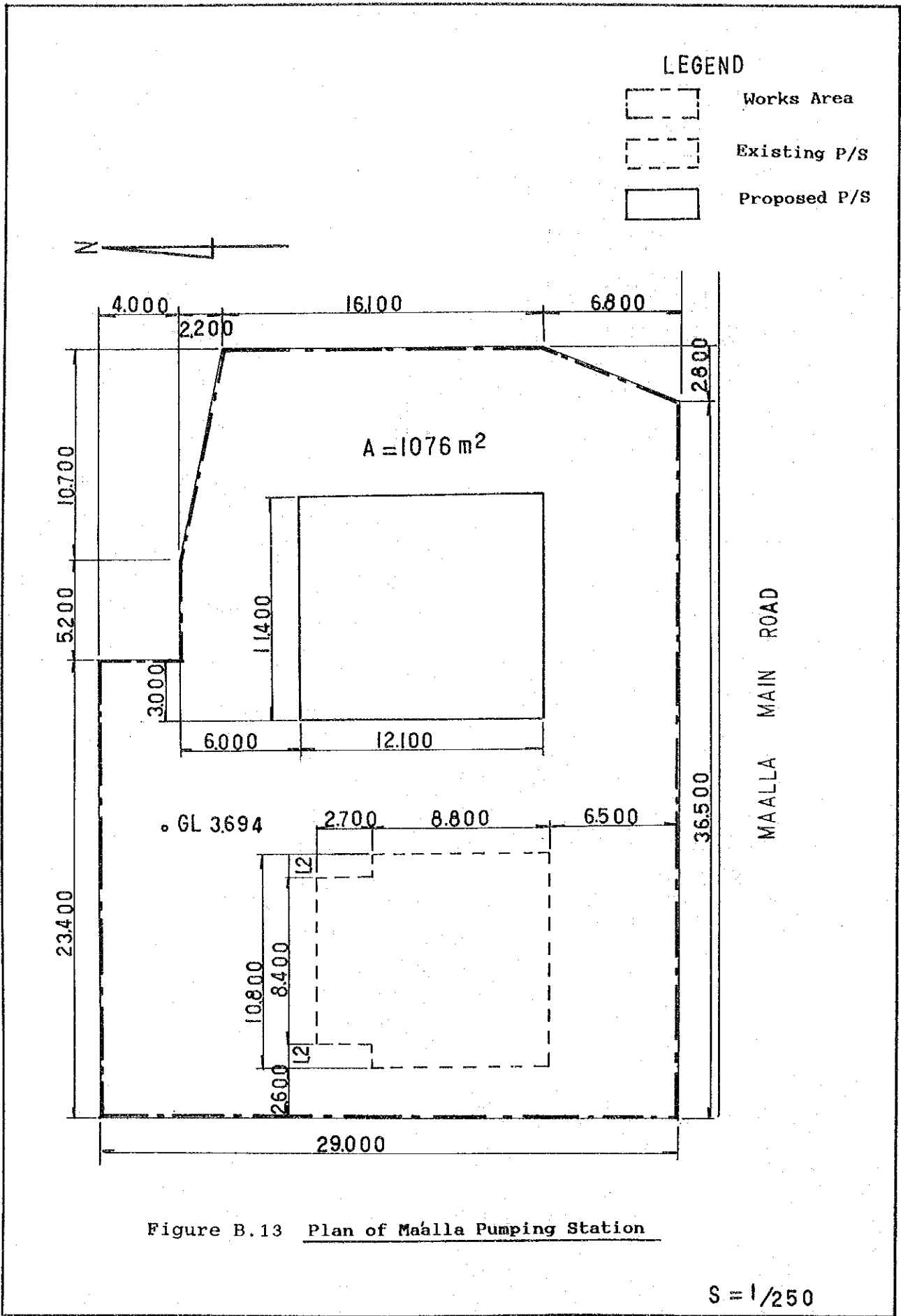

Figure B.13 Plan of Maalla Pumping Station

S = 1/250

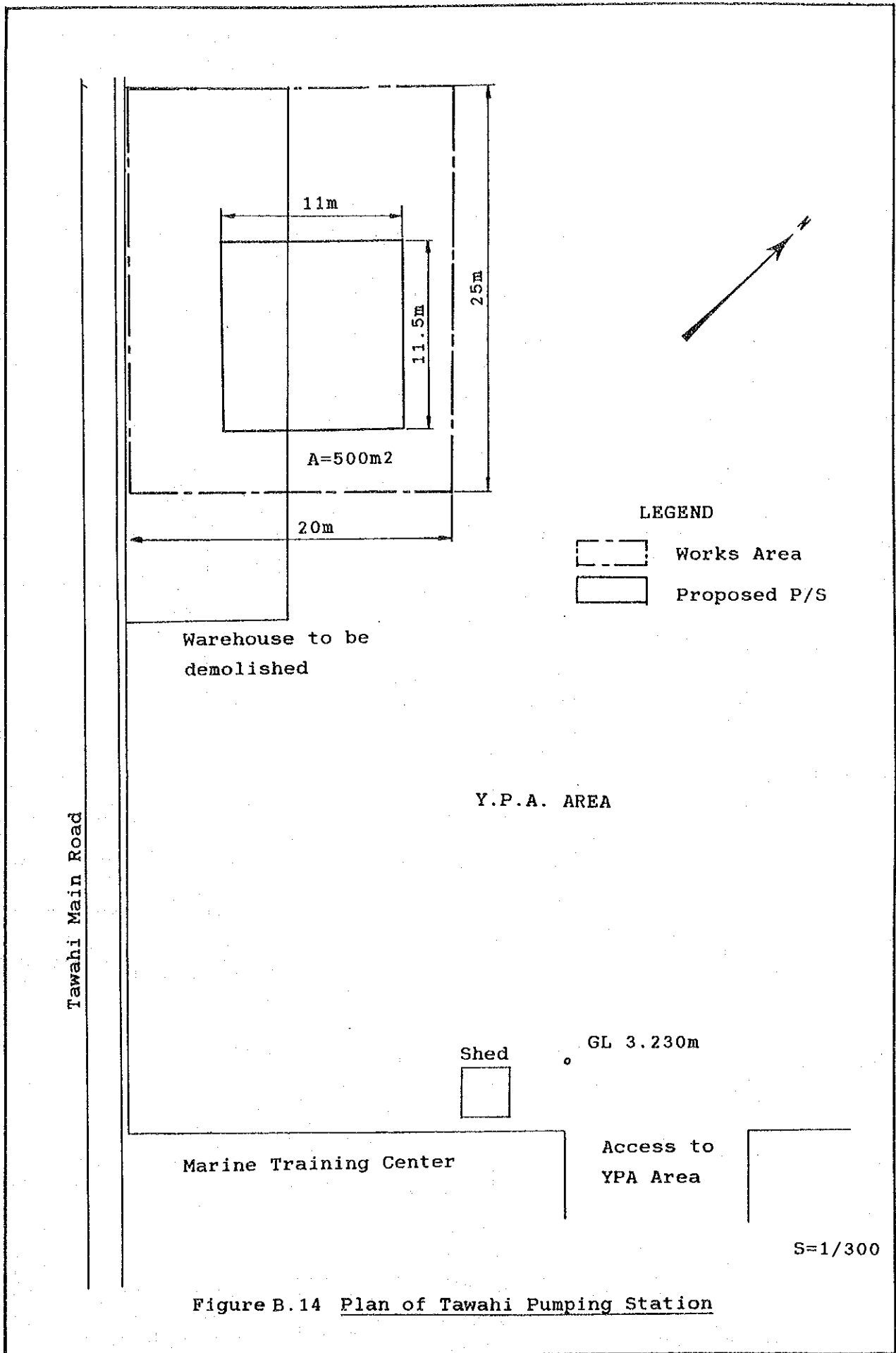

Figure B.14 Plan of Tawahi Pumping Station

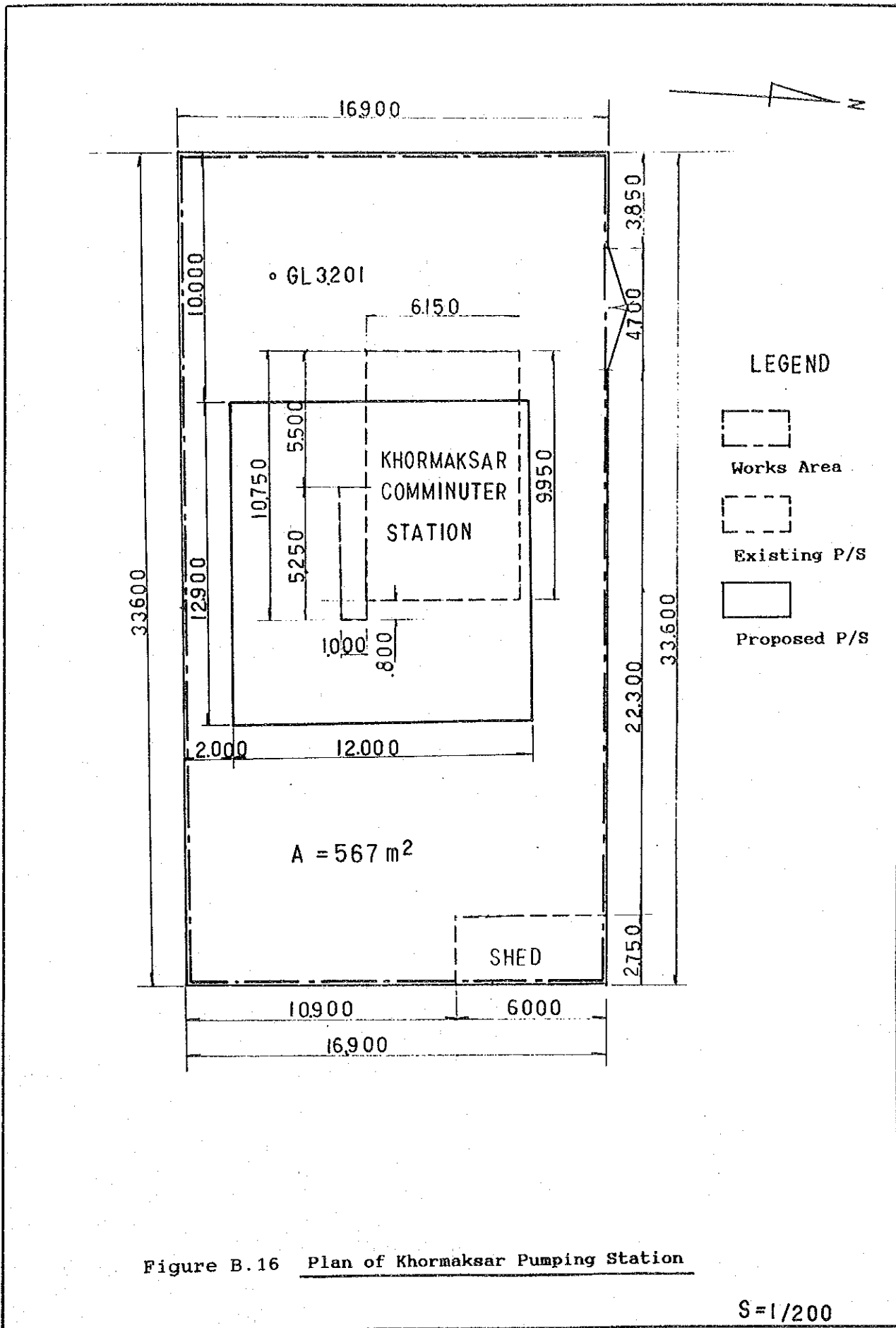

Figure B.16 Plan of Khormaksar Pumping Station

S=1/200

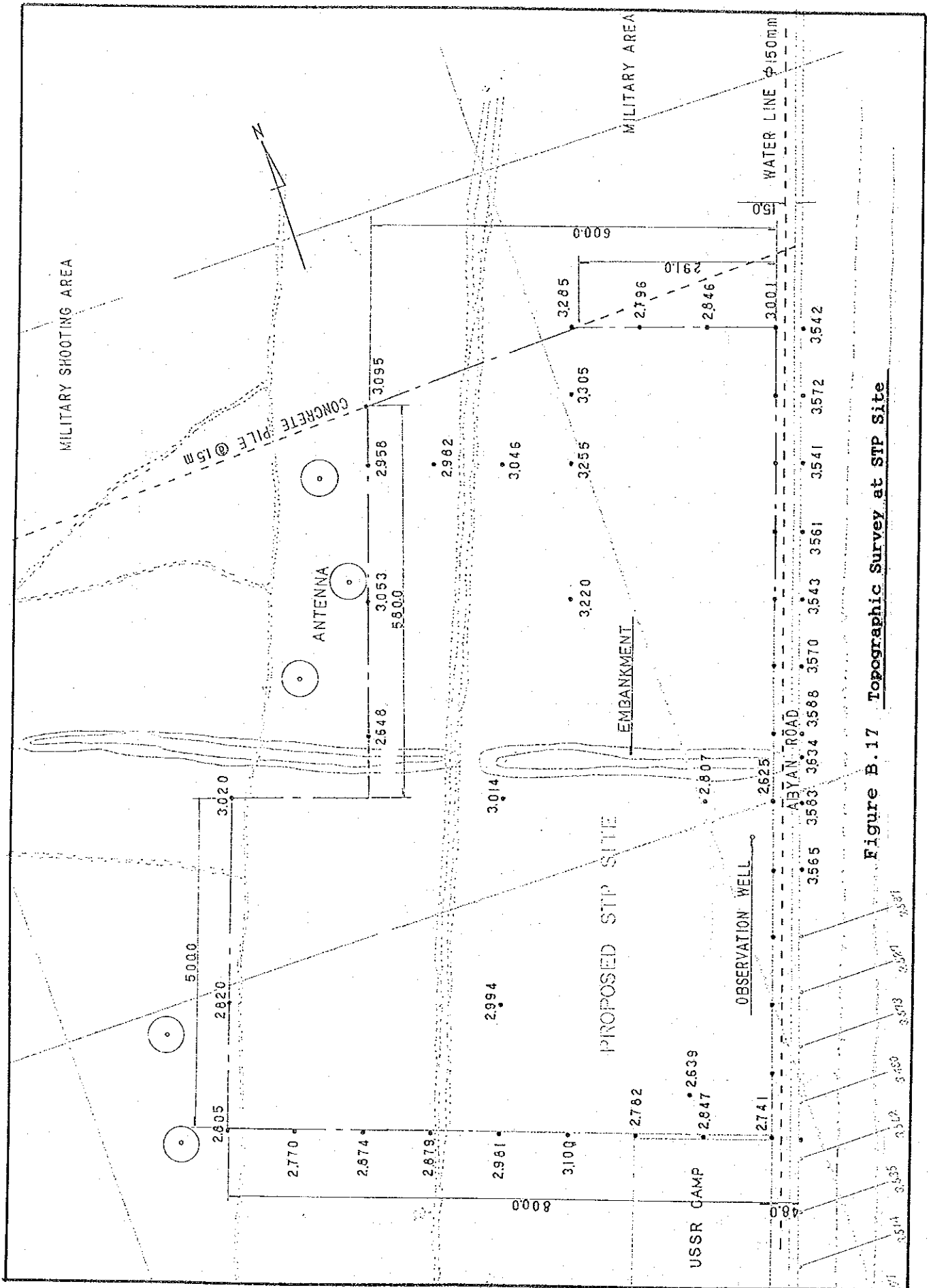
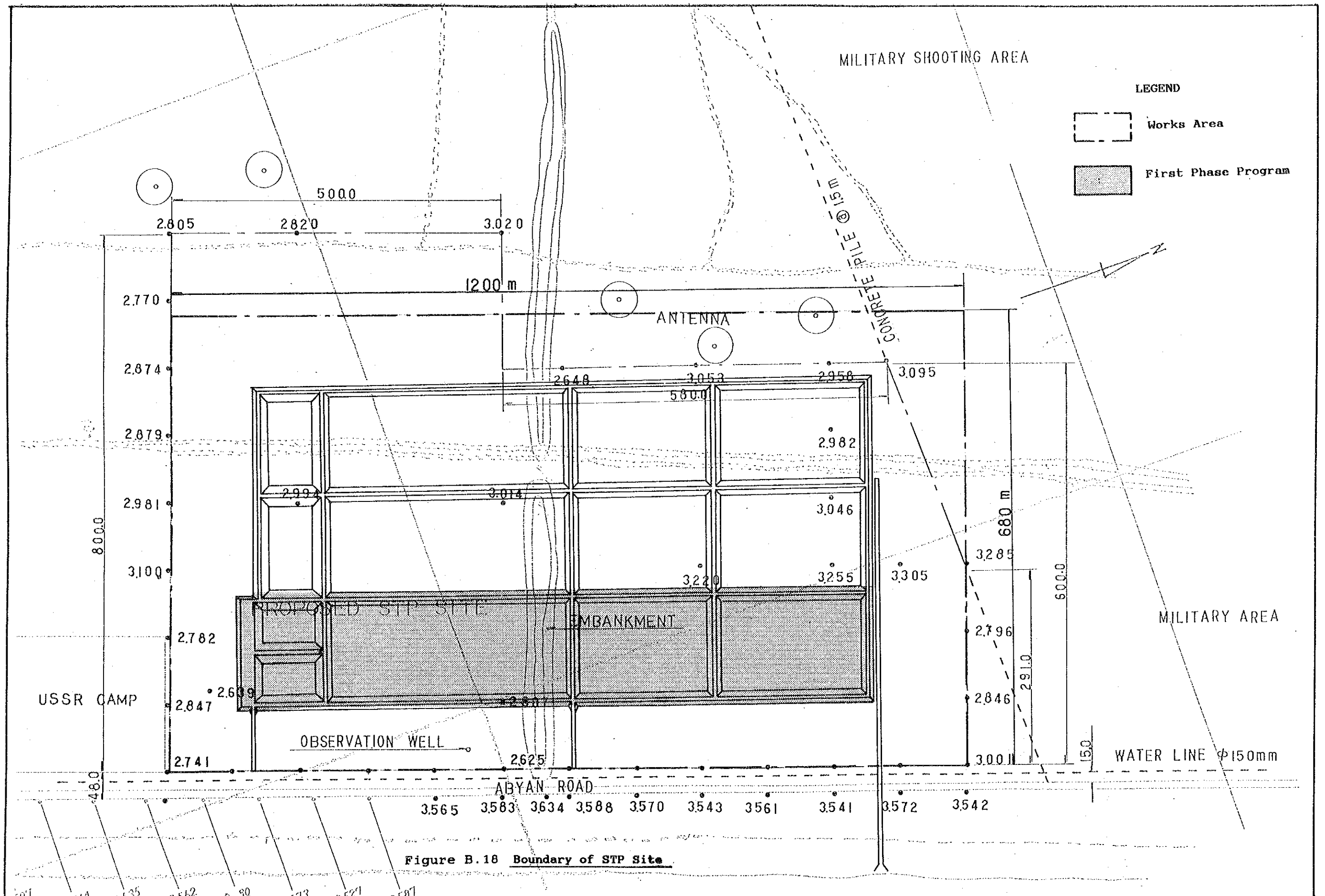

Figure B.17 Topographic Survey at STP Site



LEGEND

— TIDE LEVEL

o GROUNDWATER LEVEL

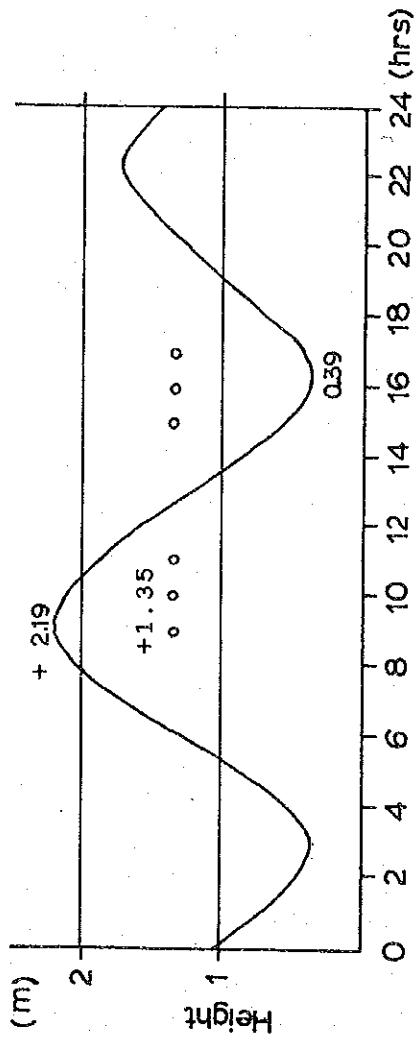

20 Aug 1989

Figure B.19 Groundwater Level at STP Site

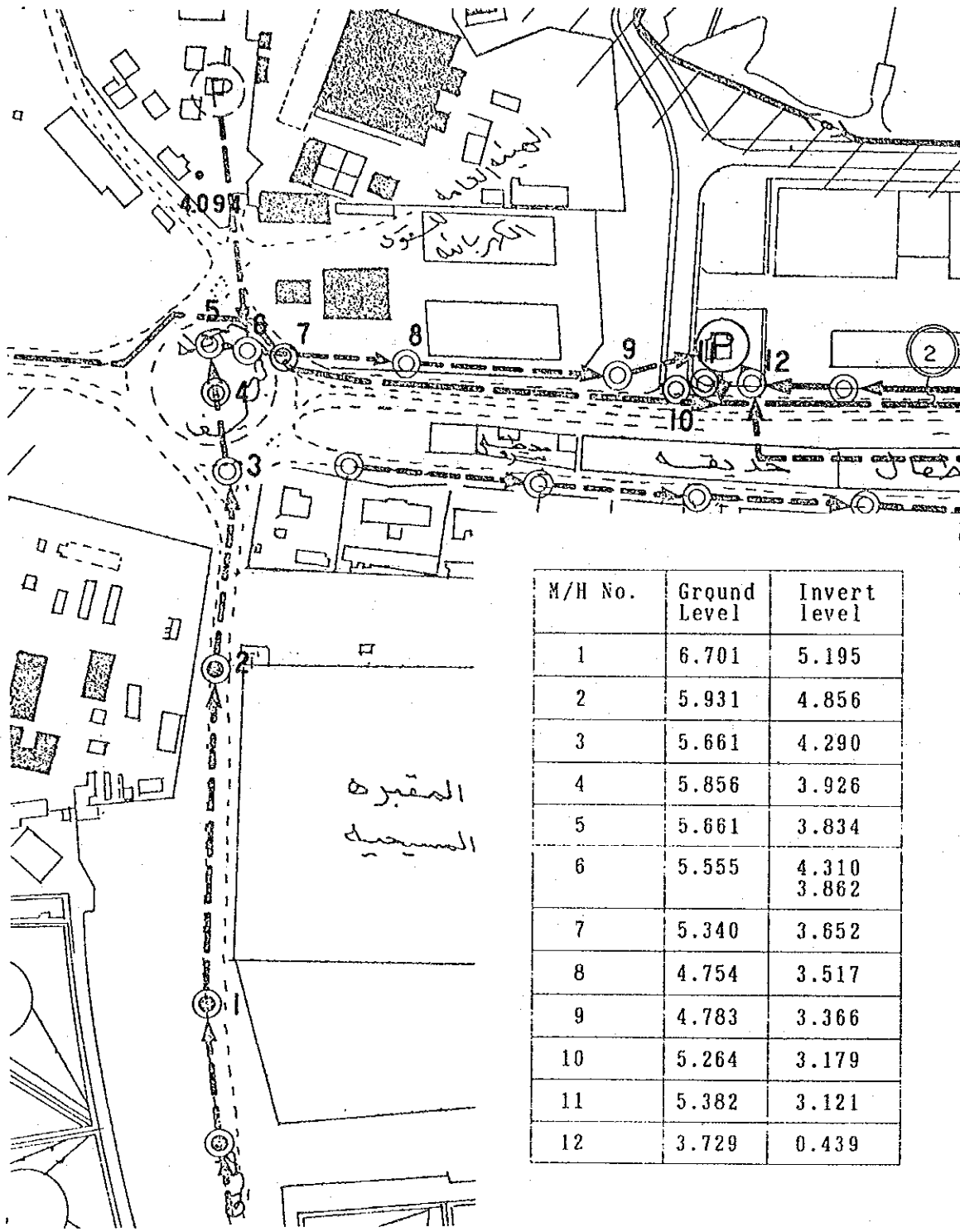

Figure B.20 Invert Levels of C-Class Housing Sewers

APPENDIX C
EXISTING SEWERAGE FACILITIES

APPENDIX C
EXISTING SEWERAGE FACILITIES

Table of Contents

1. Introduction	<u>Page</u> C-1
-----------------------	--------------------

List of Tables

Table C.1 List of Sewers in Ma'alla	C-8
Table C.2 List of Sewers in Tawahi	C-9
Table C.3 List of Sewers in Crater	C-10
Table C.4 List of Sewers in Khormaksar	C-11
Table C.5 Conditions of the Existing Pumping Stations	C-14
Table C.6 Conditions of the Existing Pumping Stations	C-15
Table C.7 Conditions of the Existing Pumping Stations	C-16
Table C.8 Conditions of the Existing Pumping Stations	C-17
Table C.9 Conditions of the Existing Pumping Stations	C-18
Table C.10 Conditions of the Existing Pumping Stations	C-19
Table C.11 Conditions of the Existing Pumping Stations	C-20
Table C.12 Conditions of the Existing Pumping Stations	C-21
Table C.13 Conditions of the Existing Pumping Stations	C-22
Table C.14 Conditions of the Existing Pumping Stations	C-23
Table C.15 Conditions of the Existing Pumping Stations	C-24
Table C.16 Conditions of the Existing Pumping Stations	C-25
Table C.17 Conditions of the Existing Pumping Stations	C-26
Table C.18 Conditions of the Existing Pumping Stations	C-27
Table C.19 Conditions of the Existing Pumping Stations	C-28
Table C.20 Conditions of the Existing Pumping Stations	C-29
Table C.21 Conditions of the Existing Pumping Stations	C-30
Table C.22 Conditions of the Existing Pumping Stations	C-31
Table C.23 Conditions of the Existing Pumping Stations	C-32
Table C.24 Conditions of the Existing Pumping Stations	C-33
Table C.25 Conditions of the Existing Pumping Stations	C-34
Table C.26 Conditions of the Existing Pumping Stations	C-35
Table C.27 Conditions of the Existing Pumping Stations	C-36
Table C.28 Conditions of the Existing Pumping Stations	C-37
Table C.29 Conditions of the Existing Pumping Stations	C-38
Table C.30 Conditions of the Existing Pumping Stations	C-39
Table C.31 Conditions of the Existing Pumping Stations	C-40

Table C.32	Conditions of the Existing Pumping Stations	C-41
Table C.33	Conditions of the Existing Pumping Stations	C-42
Table C.34	Conditions of the Existing Pumping Stations	C-43
Table C.35	Conditions of the Existing Comminutor Station	C-54
Table C.36	List of Outfalls	C-56
Table C.37	Sweeper's Passages in Ma'alla	C-59
Table C.38	Sweeper's Passages in Tawahi	C-60

List of Figures

Figure C.1	Key Map of Existing Sewerage Facilities in Ma'alla	C-4
Figure C.2	Key Map of Existing Sewerage Facilities in Tawahi	C-5
Figure C.3	Key Map of Existing Sewerage Facilities in Crater	C-6
Figure C.4	Key Map of Existing Sewerage Facilities in Khormaksar	C-7
Figure C.5	Standard Type of Manhole in Ma'alla and Tawahi	C-12
Figure C.6	Standard Type of Manhole in Crater and Khormaksar	C-13
Figure C.7	Structure of Chlorinator Station	C-44
Figure C.8	Structure of Dakka Pumping Station	C-45
Figure C.9	Structure of Dolphin Pumping Station	C-46
Figure C.10	Structure of Ejector Pumping Station	C-47
Figure C.11	Structure of Main Pumping Station	C-48
Figure C.12	Structure of Front Bay Pumping Station	C-49
Figure C.13	Structure of Type 1 Pumping Station	C-50
Figure C.14	Structure of Type 2 Pumping Station	C-51
Figure C.15	Structure of Type 3 Pumping Station	C-52
Figure C.16	Structure of Ejector Pumping Station	C-53
Figure C.17	Structure of Comminutor Station	C-55
Figure C.18	Location of Sweeper's Passages, Ma'alla	C-57
Figure C.19	Location of Sweeper's Passages, Tawahi	C-58
Figure C.20	Location of Sewer Routes for Investigation in Ma'alla	C-62
Figure C.21	Plan and Longitudinal Section of Sewer, Alshuili Route	C-63
Figure C.22	Plan and Longitudinal Section of Sewer, Football Ground Route	C-64
Figure C.23	Plan and Longitudinal Section of Sewer, Girls School and Football Ground Routes	C-65
Figure C.24	Plan and Longitudinal Section of Sewer, Main Road Route	C-66
Figure C.25	Plan and Longitudinal Section of Sewer,	

	C Class Housing Route (1)	C-67
Figure C.26	Plan and Longitudinal Section of Sewer, C Class Housing Route (2)	C-68
Figure C.27	Plan and Longitudinal Section of Sewer, Navy Area Route	C-69
Figure C.28	Plan and Longitudinal Section of Sewer, Flour Mill Route	C-70
Figure C.29	Plan and Longitudinal Section of Sewer, Kindergarten Route	C-71
Figure C.30	Location of Sewer Routes for Investigation in Tawahi	C-72
Figure C.31	Plan and Longitudinal Section of Sewer, Police Station Route	C-73
Figure C.32	Plan and Longitudinal Section of Sewer, Old Church Route	C-74
Figure C.33	Location of Manholes Surveyed in Ma'alla (1)	C-75
Figure C.34	Location of Manholes Surveyed in Ma'alla (2)	C-76
Figure C.35	Location of Manholes Surveyed in Tawahi	C-77
Figure C.36	Profile of Manhole (1)	C-78
Figure C.37	Profile of Manhole (2)	C-79
Figure C.38	Profile of Manhole (3)	C-80

