

General Plan of On-Farm

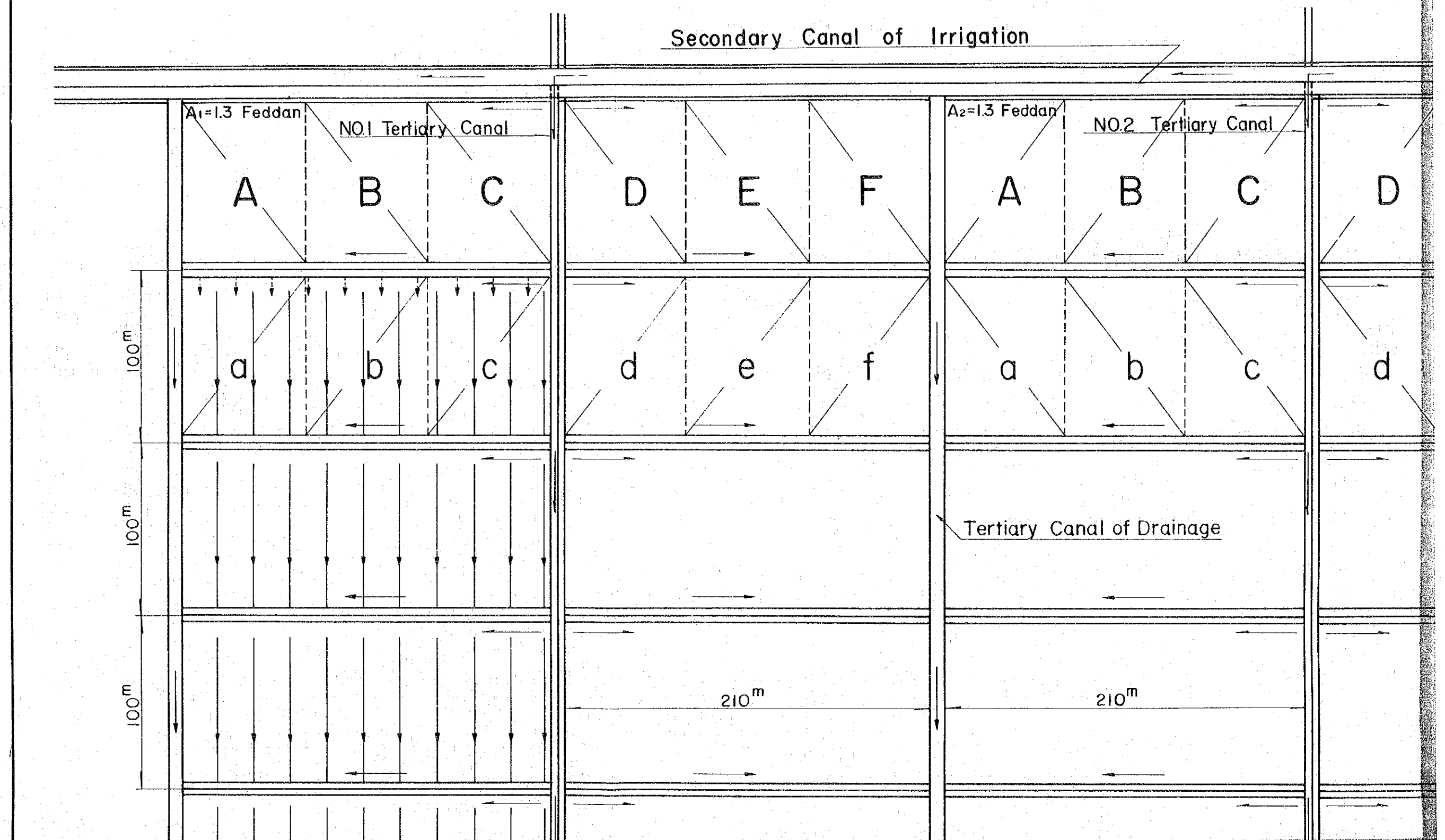

General Plan of On-Farm Development

IN THE AREA
SOUTH HOSAINIA VALLEY PROJ

Secondary Canal of Irrigation

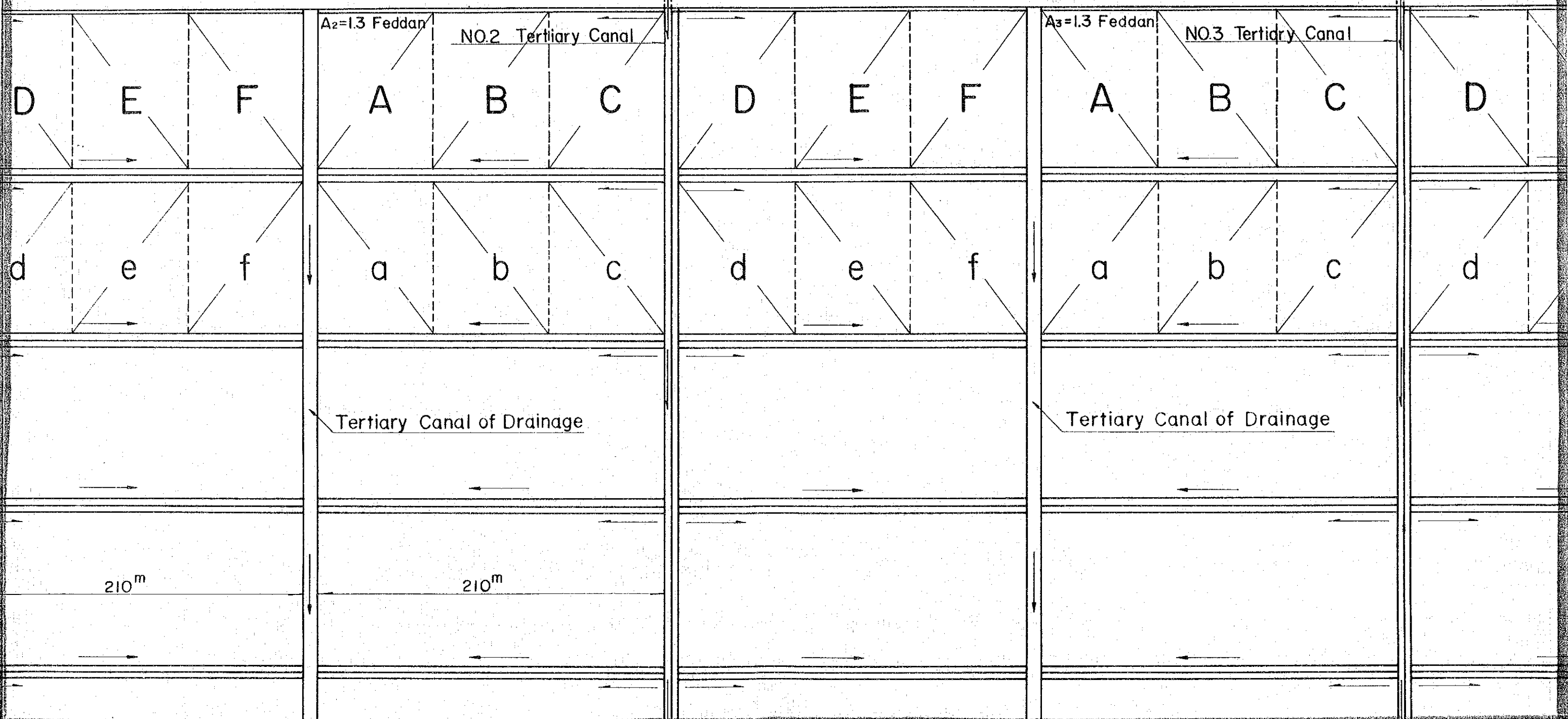

Farm Development

IN THE AREA
SOUTH HOSAINIA VALLEY PROJECT

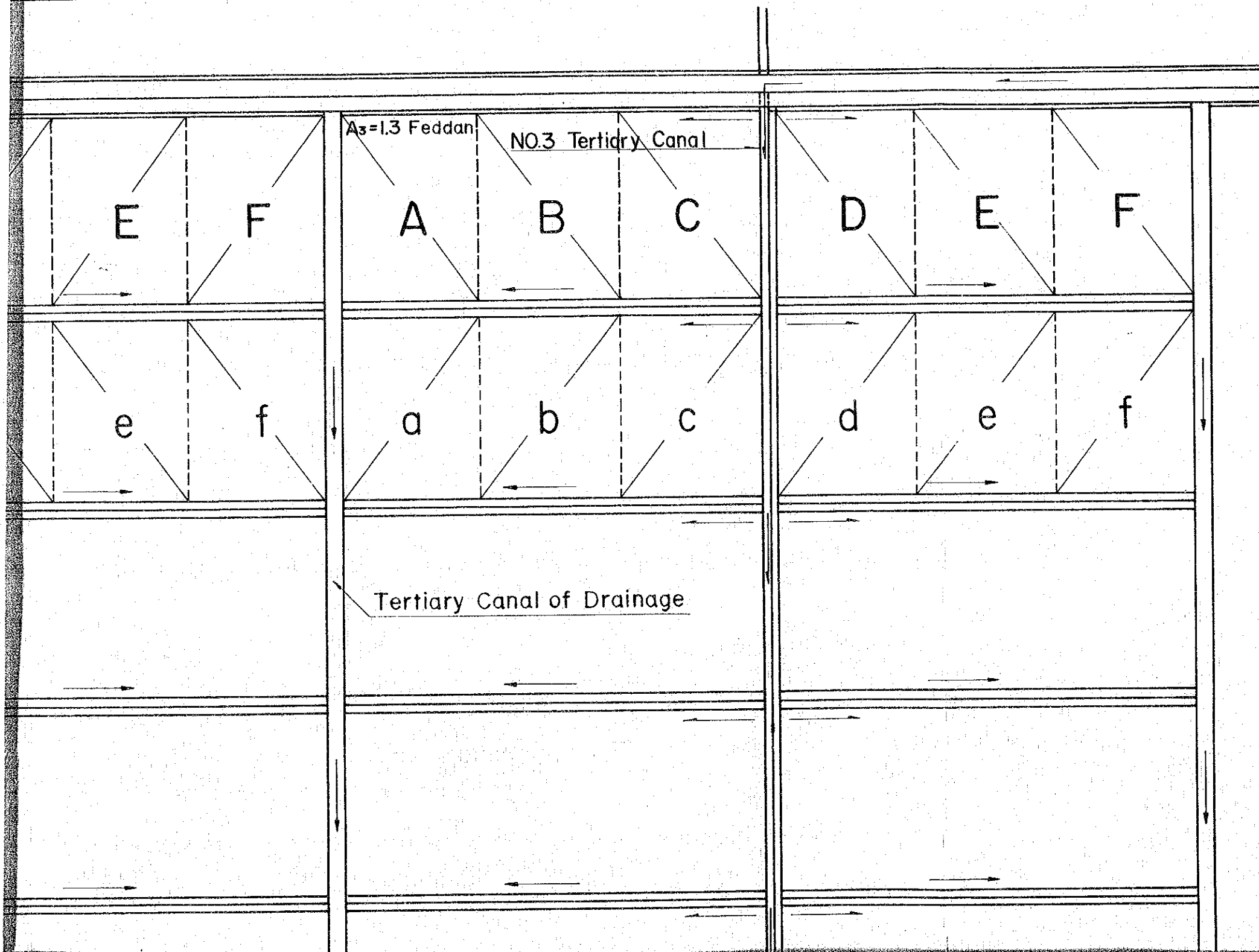

NOTE

- 1) A.B.C~F, are land-owner
- 2) NO1 NO.2 and NO.3 Tertiary canal are operated by 60 land-owner
- 3) 60 land-owner are one farmers group (234 Feddan)

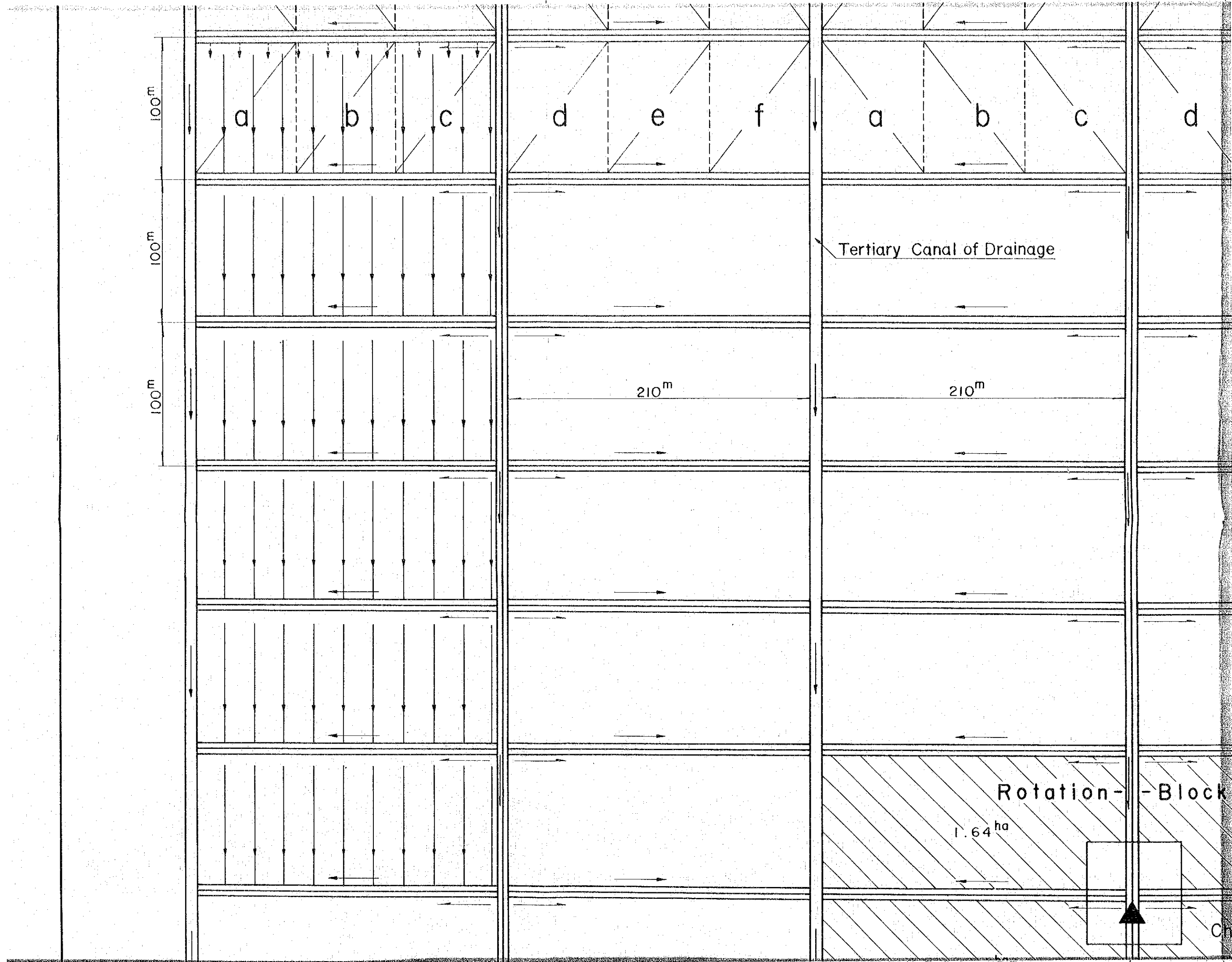

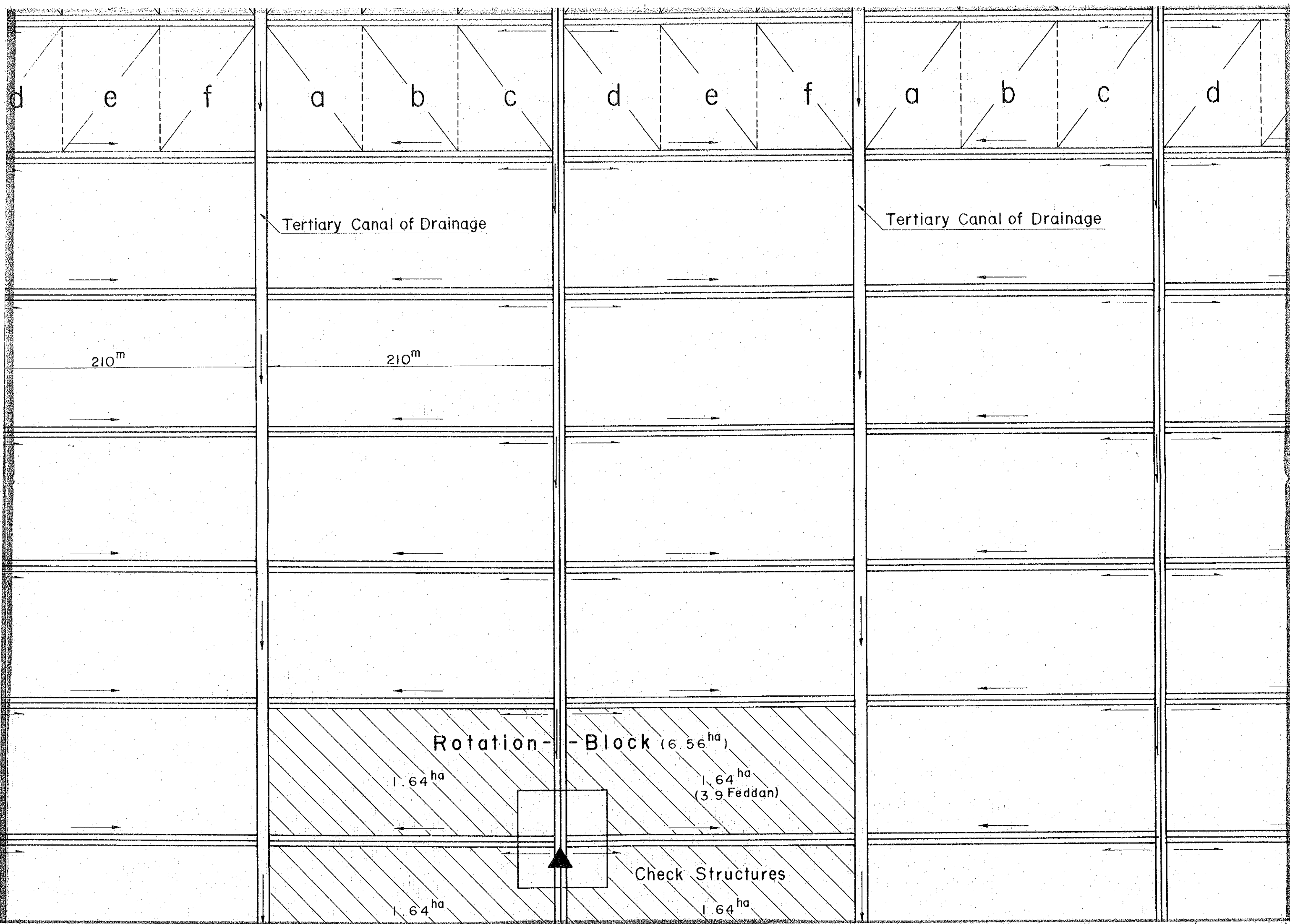

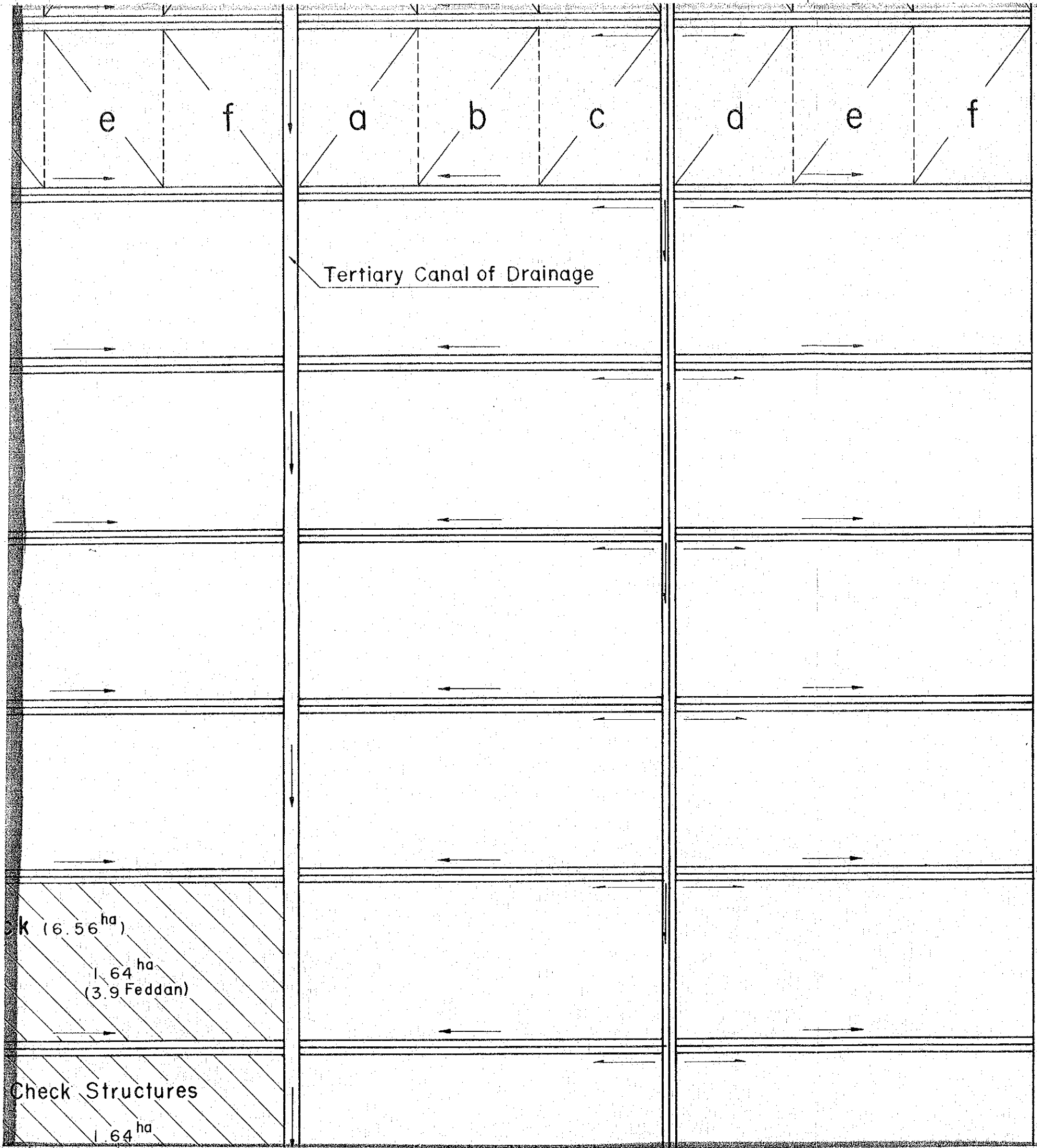

NOTE

- 1) A.B.C~F, are land-owner
- 2) NO1 NO2 and NO3 Tertiary canal are operated by 60 land-owner
- 3) 60 land-owner are one farmers group (234 Feddan)

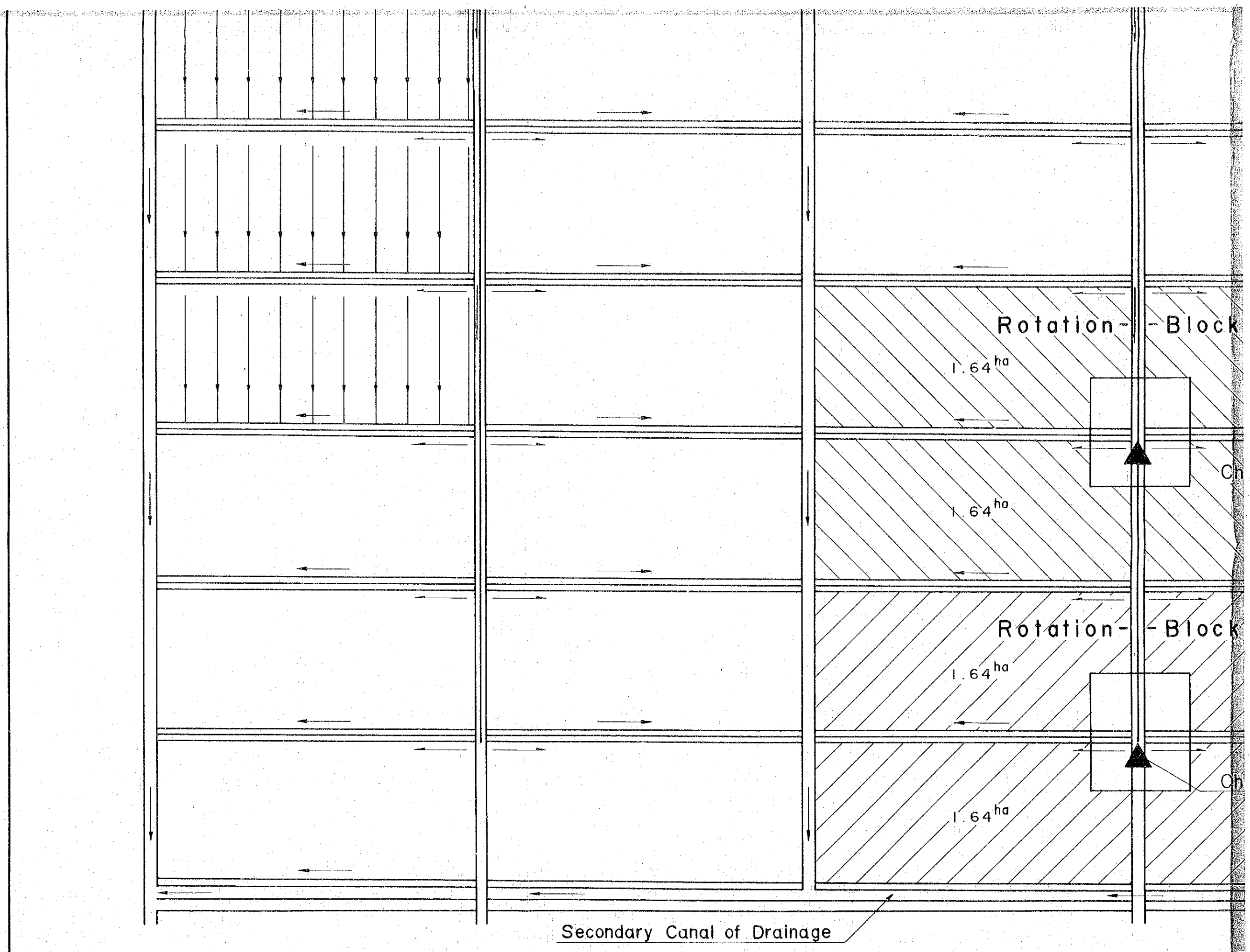

Rotation-Block (6.56^{ha})

1.64^{ha}

1.64^{ha}
(3.9 Feddan)

Check Structures

1.64^{ha}

1.64^{ha}

Rotation-Block (6.56^{ha})

1.64^{ha}

1.64^{ha}
(3.9 Feddan)

Check Structures

1.64^{ha}

1.64^{ha}

Secondary Canal of Drainage

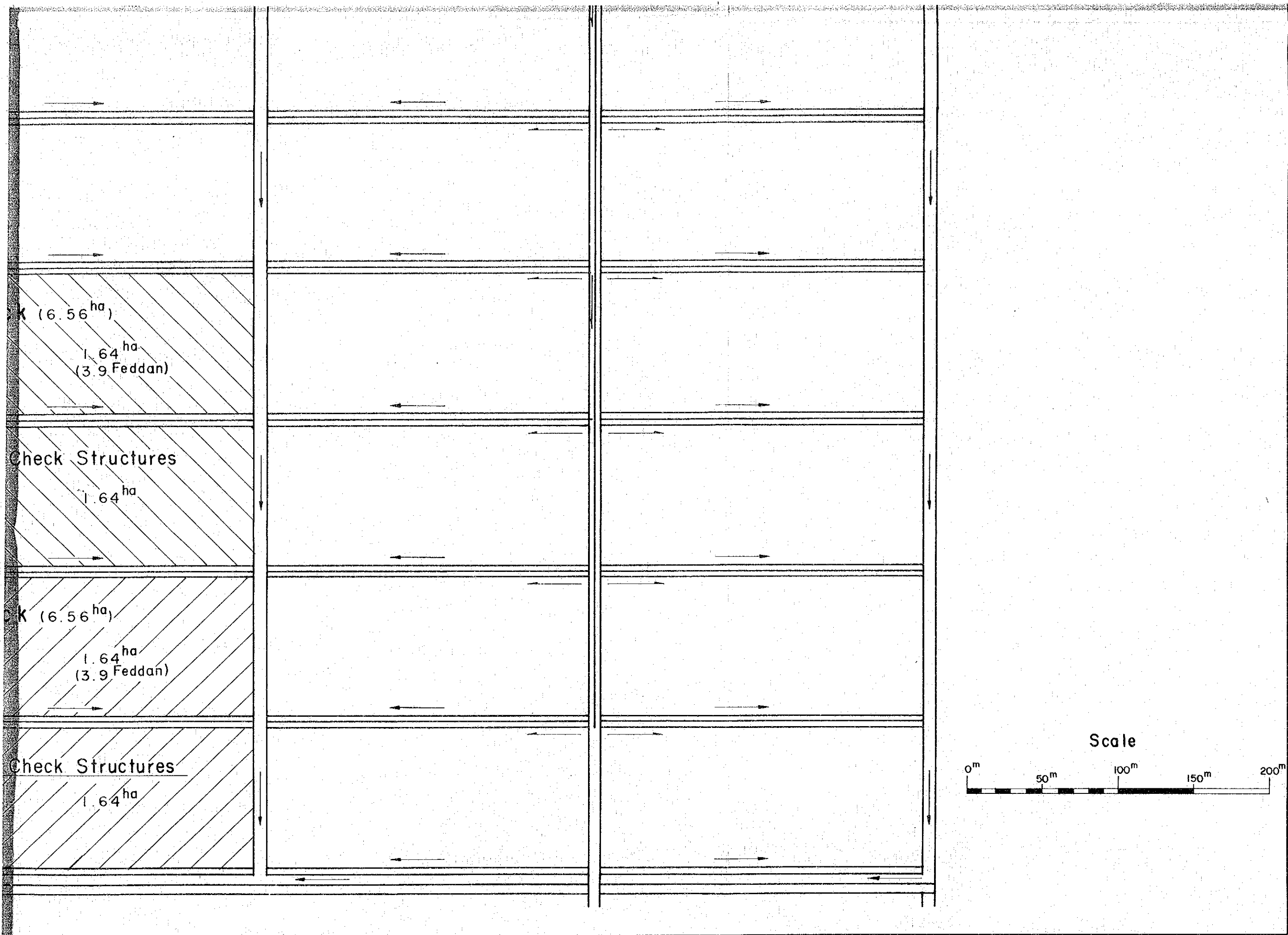

SAMPLE

SO

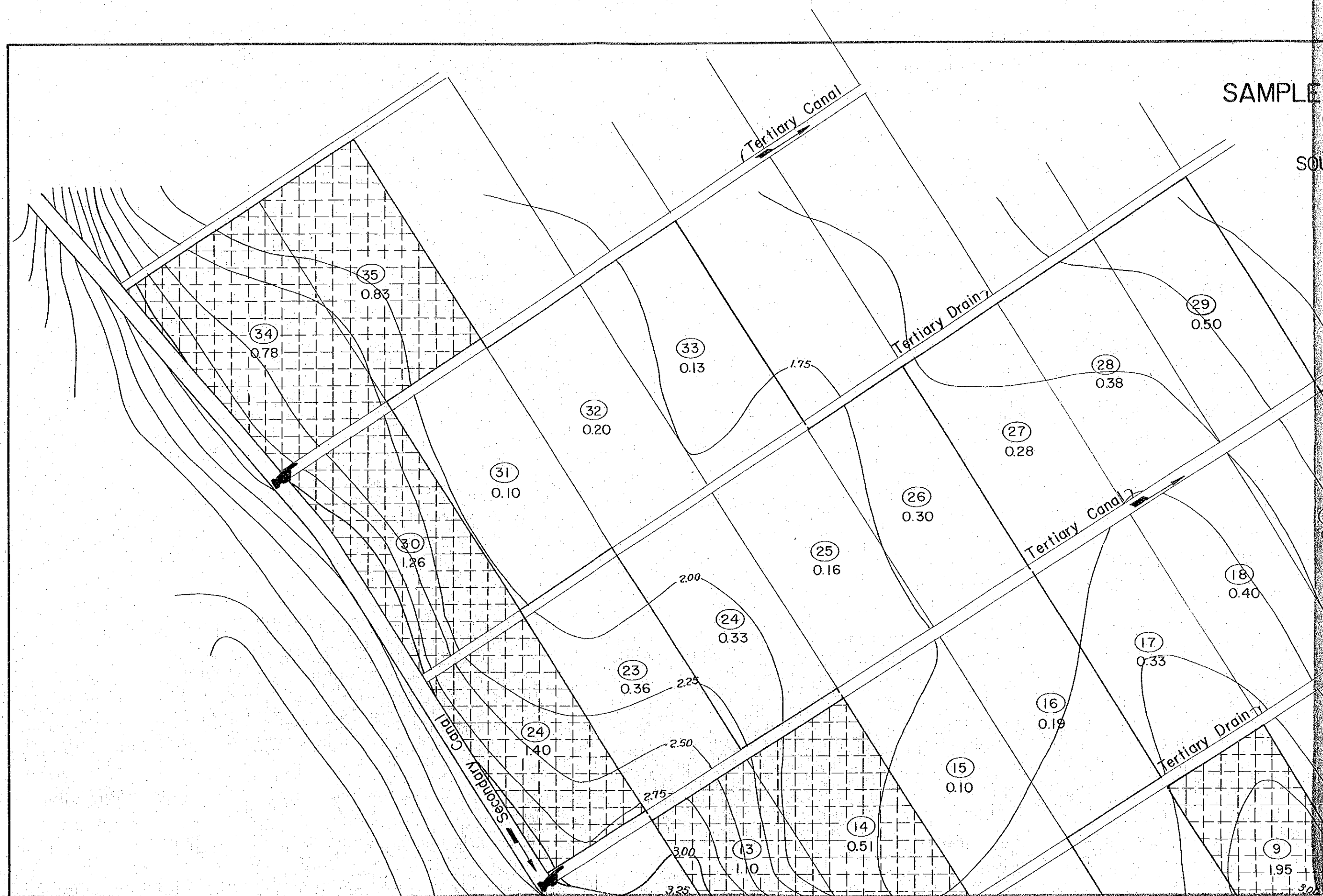

SAMPLE AREA OF LAND-LEVELING WORKS

IN THE AREA
SOUTH HOSAINIA VALLEY PROJECT

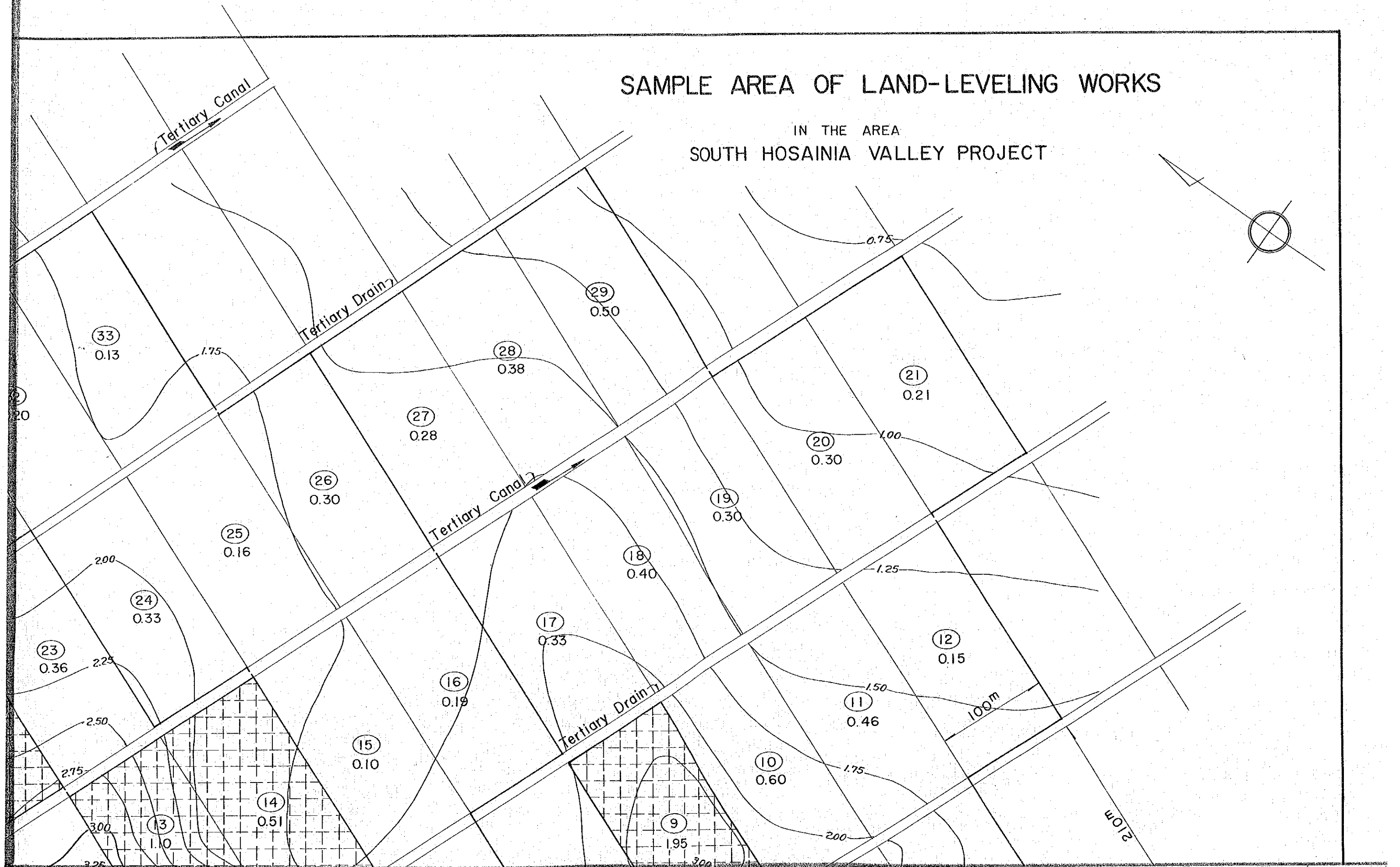
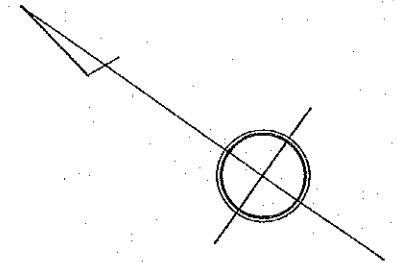

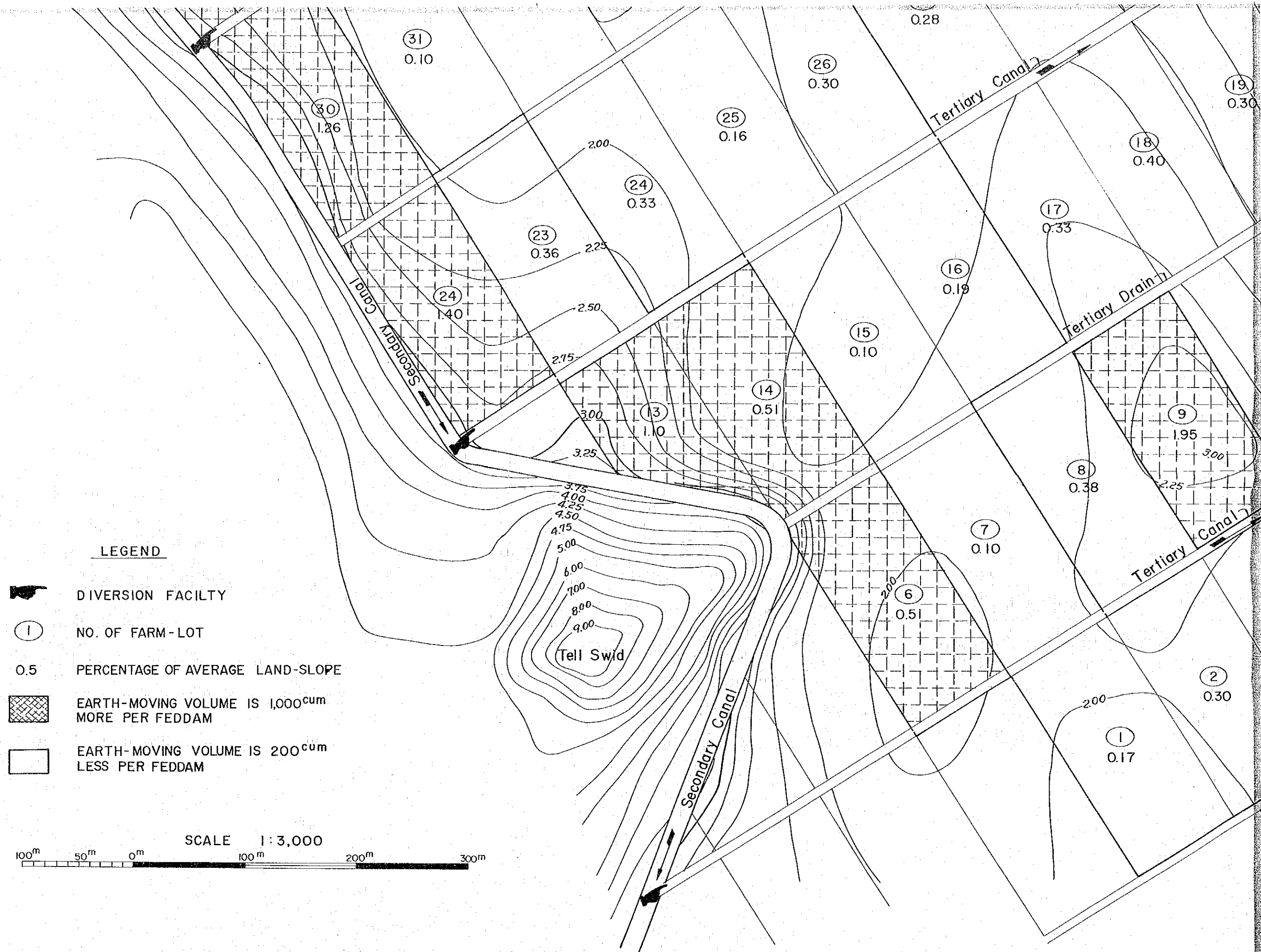

LEGEND



DIVERSION FACILITY



NO. OF FARM-LOT

0.5

PERCENTAGE OF AVERAGE LAND-SLOPE



EARTH-MOVING VOLUME IS 1,000^{cum}
MORE PER FEDDAM



EARTH-MOVING VOLUME IS 200^{cum}
LESS PER FEDDAM

SCALE 1:3,000

