

LAND CLASS OF SOIL PRODUCTIVITY

IN THE AREA

SOUTH HOSAINIA VALLEY PROJECT

Feasibility Study Survey

A.R.E.

Scale 1:50,000

1 0 1 2 3 km

Bahr Hadous Drain

Bahr E1 Saft Drain

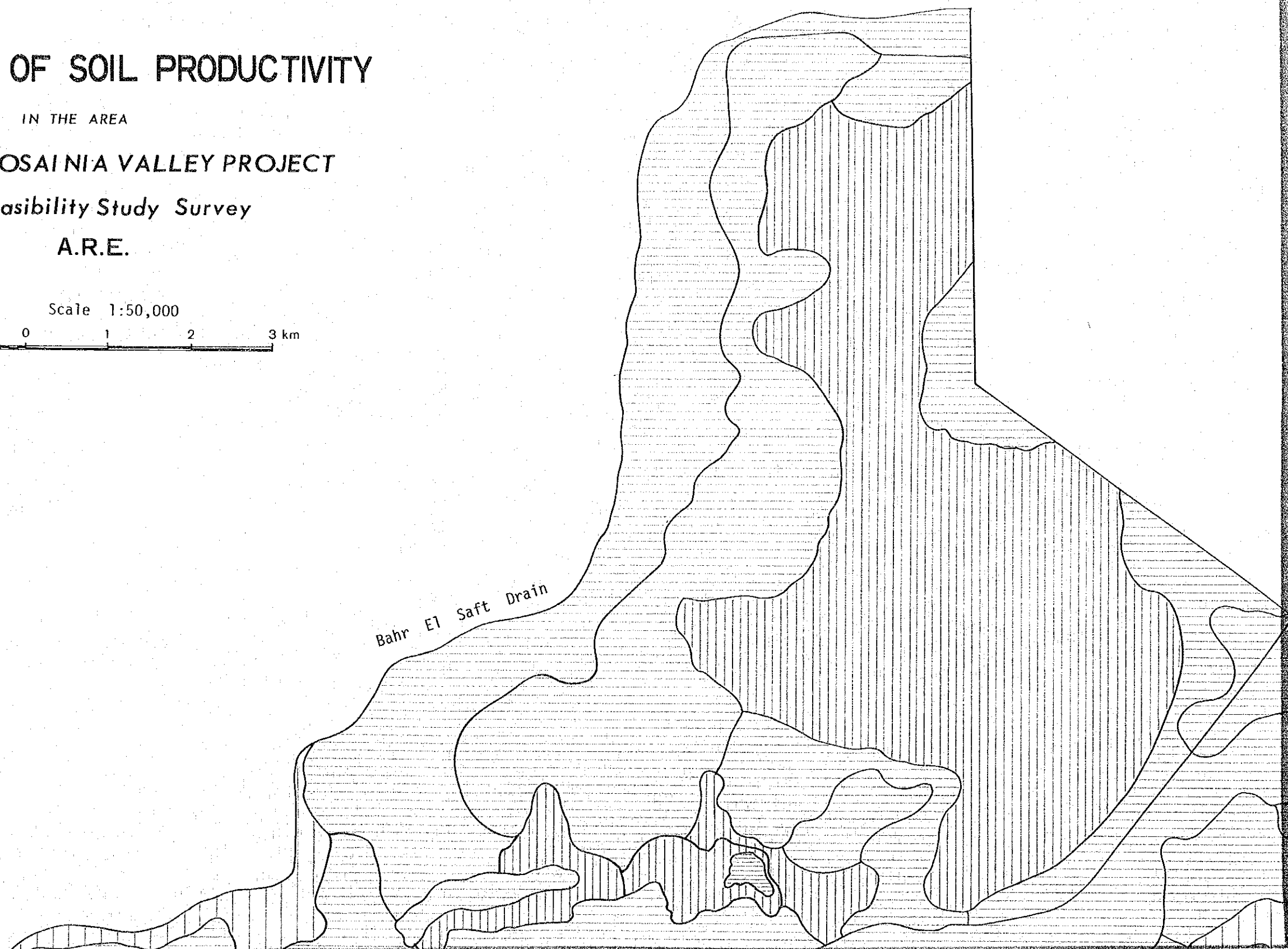

Bahr Hadous Drain

CLASS LEGEND (SOIL PRODUCTIVITY)

Class	Map Symbol	Soil Type	Area		
			ha	fed	%
III A		Ms2 Ms3 Ps1 Ps3 Ma2	18,380	43,710	58.5
III B		Ma1	2,050	4,870	6.5
III C		Ms1 Ps2 Ps4 Ps5	10,310	24,550	32.9
IV A		Ma3	660	1,570	2.1



(SOIL POTENTIALITY MAP - II)

Lake Manzala

Saft Drain

El Salam Canal (under planning)

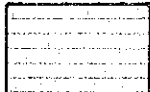
CLASS LEGEND (SOIL PRODUCTIVITY)

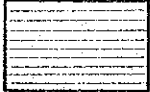
Class	Map Symbol	Soil Type	Area		
			ha	fed	%
III A		Ms2 Ms3 Ps1 Ps3 Ma2	18,380	43,710	58.5
III B		Ma1	2,050	4,870	6.5
III C		Ms1 Ps2 Ps4 Ps5	10,310	24,550	32.9
IV A		Ma3	660	1,570	2.1

(SOIL POTENTIALITY MAP - II)

Lake Manzala

El Salam Canal (under planning)

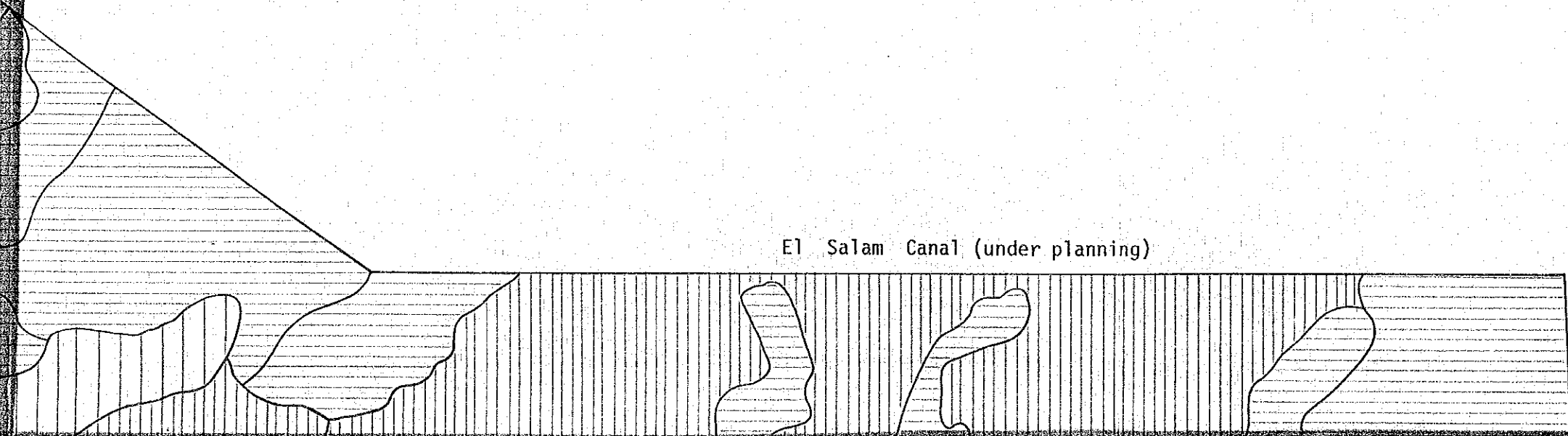

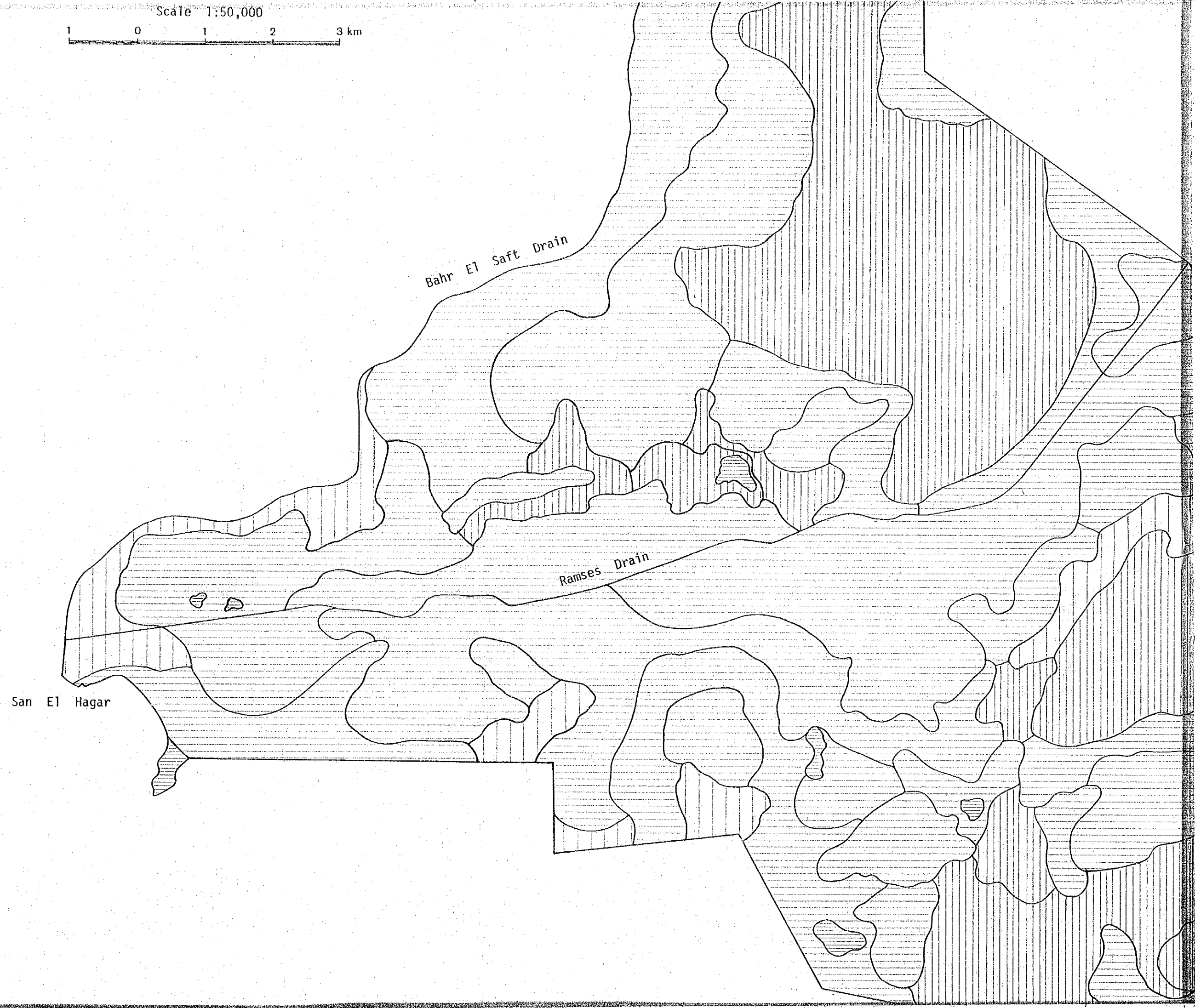
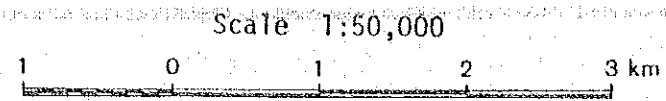

Lake Manzala

El Salam Canal (under planning)

Saft Drain

Ramses Drain



(SOIL POTENTIALITY MAP - II)

Lake Manzala

El Salam Canal (under planning)

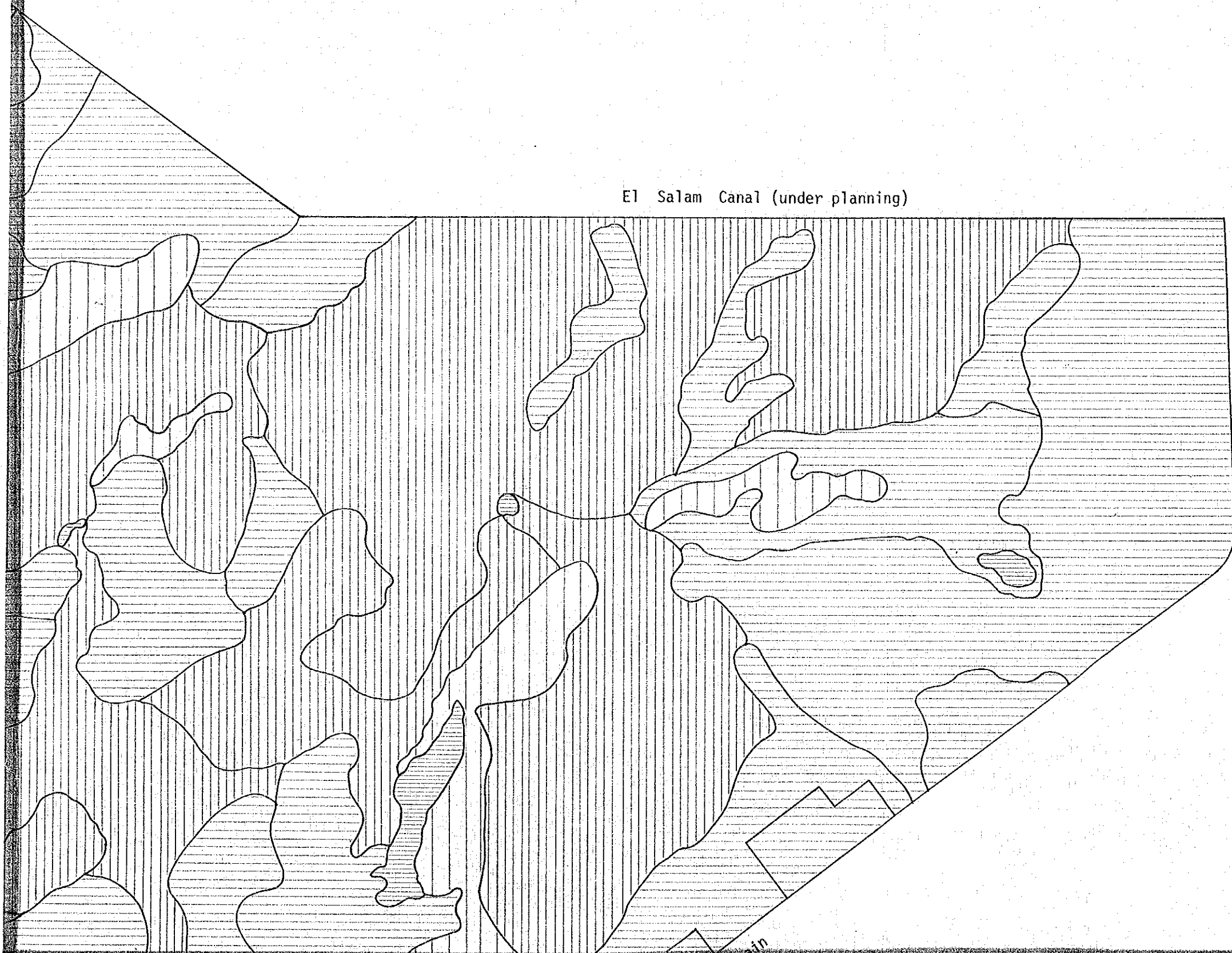

San El Hagar

Ramses Drain







THE ARAB REPUBLIC OF EGYPT			
MINISTRY OF IRRIGATION			
THE SOUTH HOSSAINIA VALLEY			
AGRICULTURAL DEVELOPMENT PROJECT			
Land Class of Soil Productivity			
DATE	February 1981	D.W.G.No.	MAP C - 4
JAPAN INTERNATIONAL COOPERATION AGENCY			

IN THE AREA
SOUTH HOSAINIA VALLEY PROJECT

IN THE AREA

SOUTH HOSAINIA VALLEY PROJECT

Scale 1 : 50,000

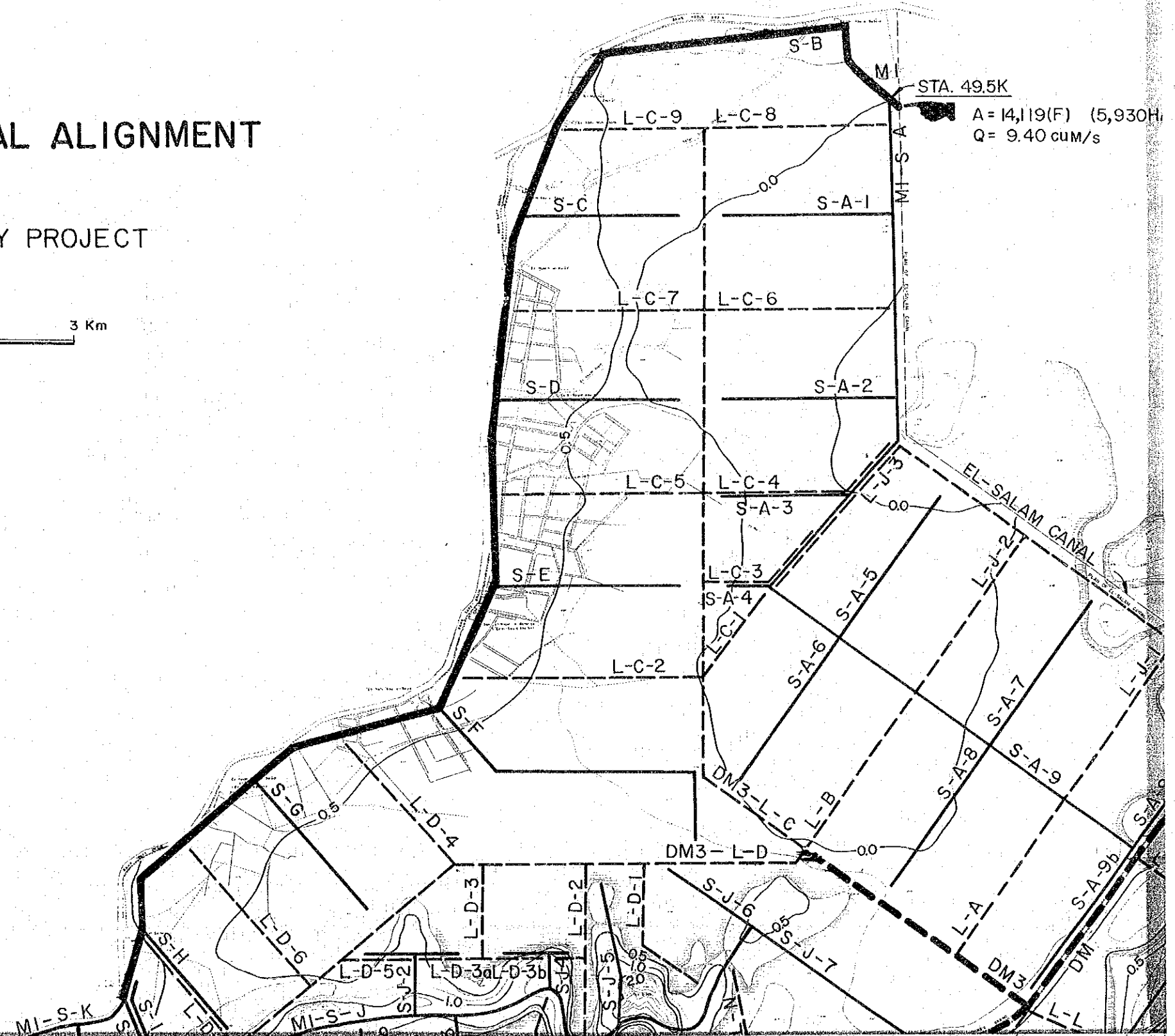

MENT

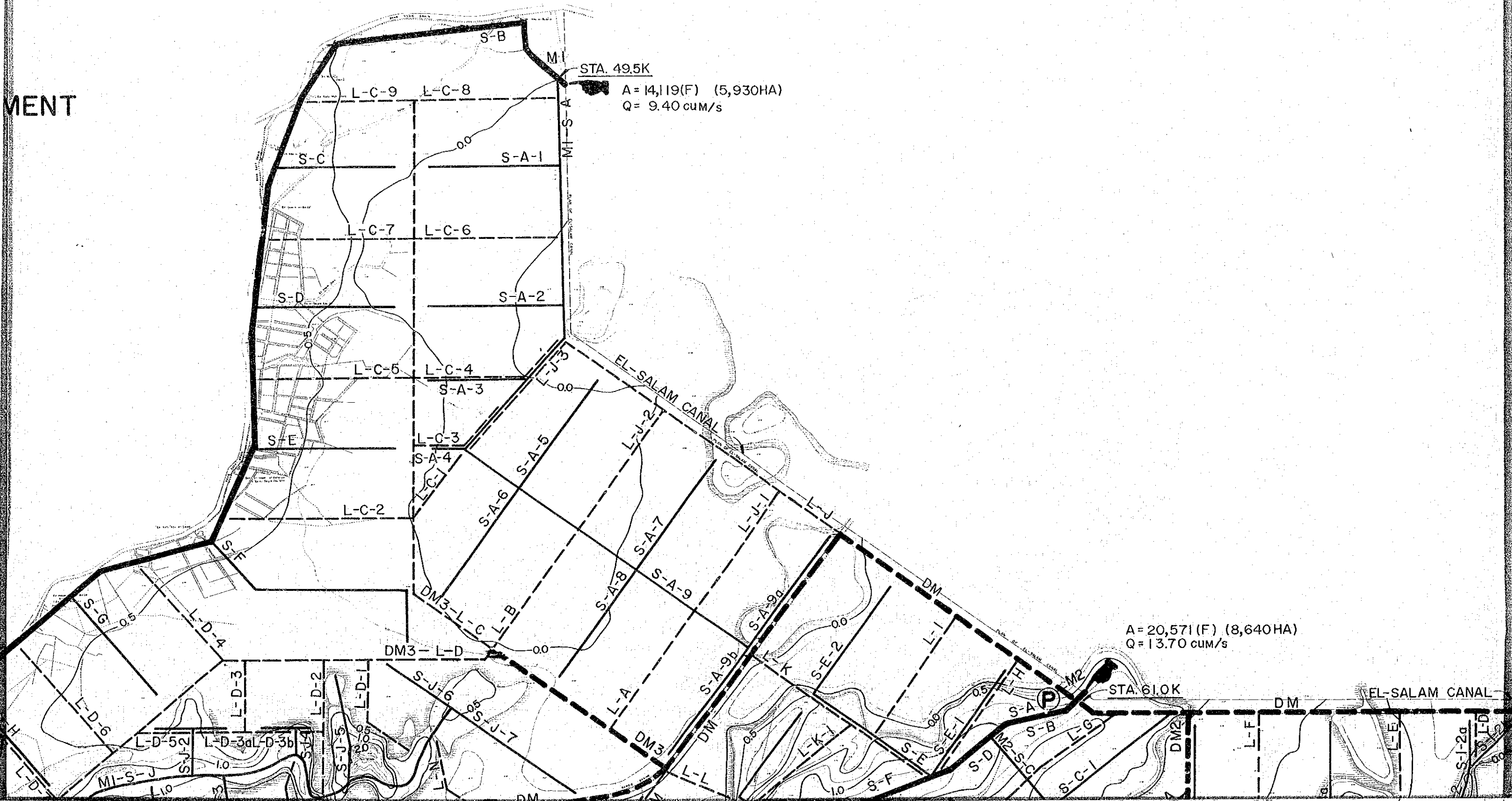

30HA)

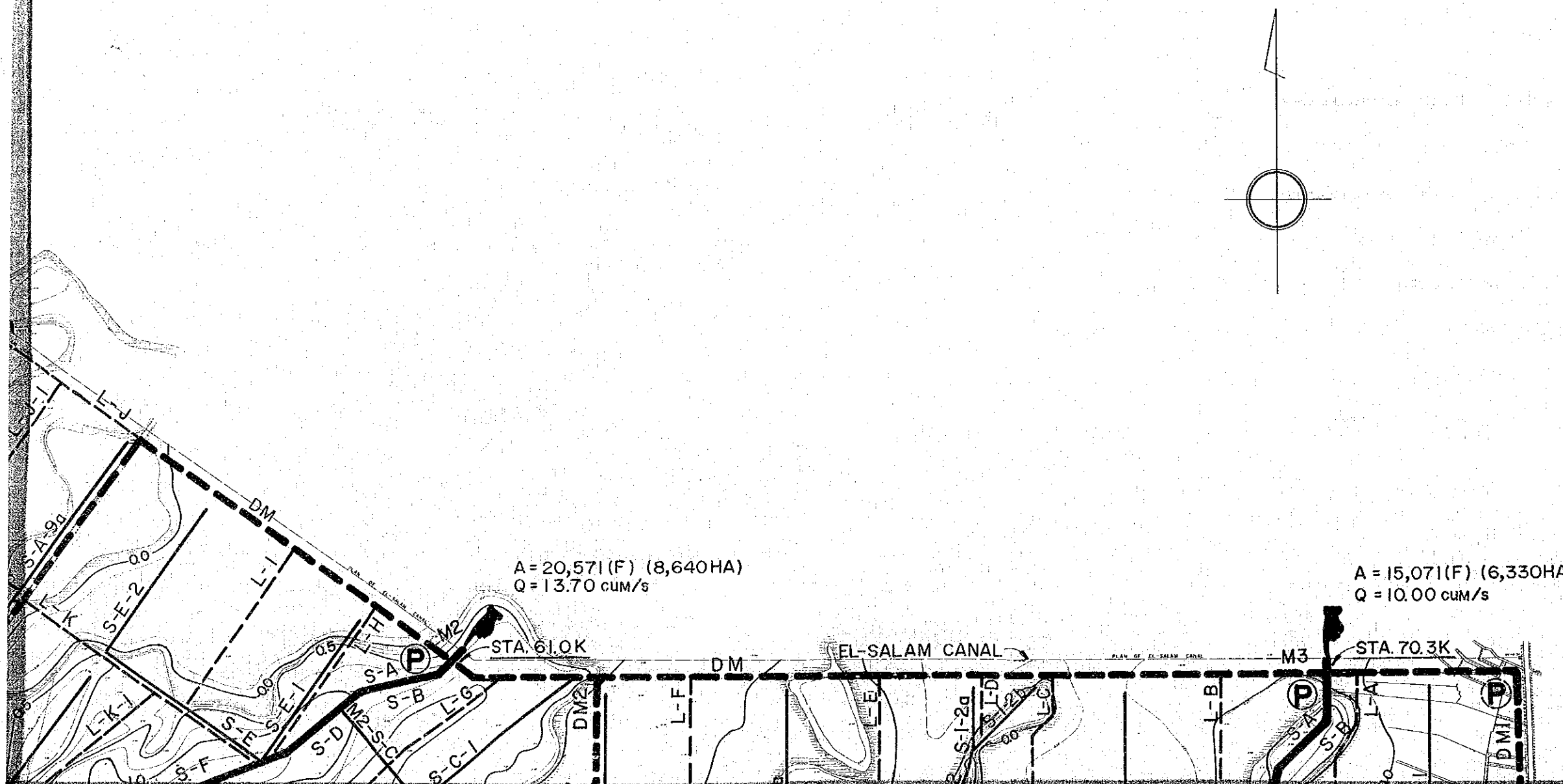

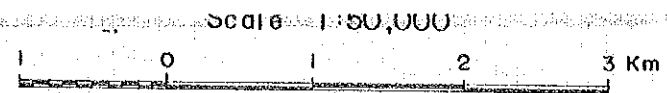

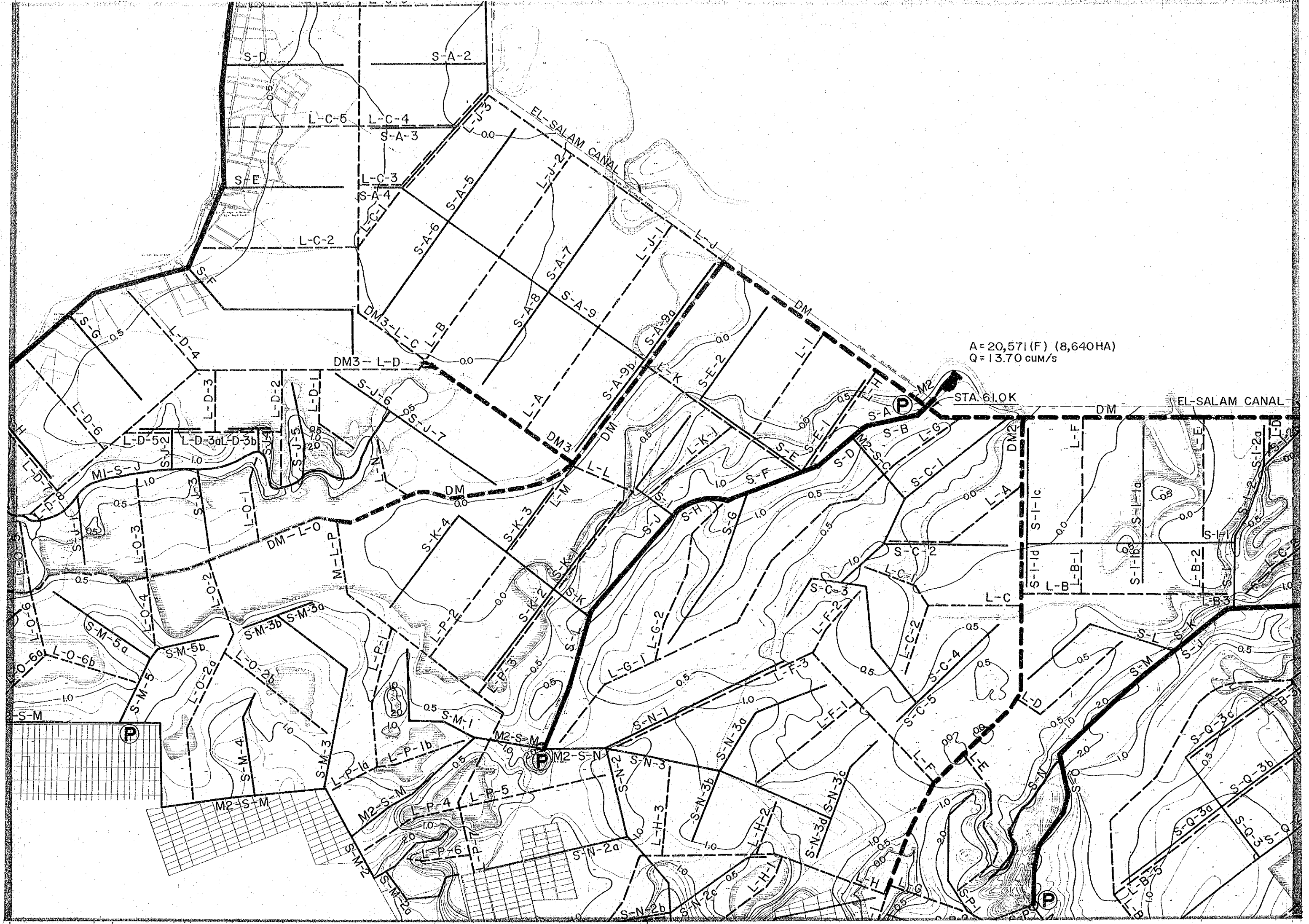

A = 20,571 (F) (8,640 HA)
Q = 13.70 cum/s

STA. 61.0K

EL-SALAM CANAL

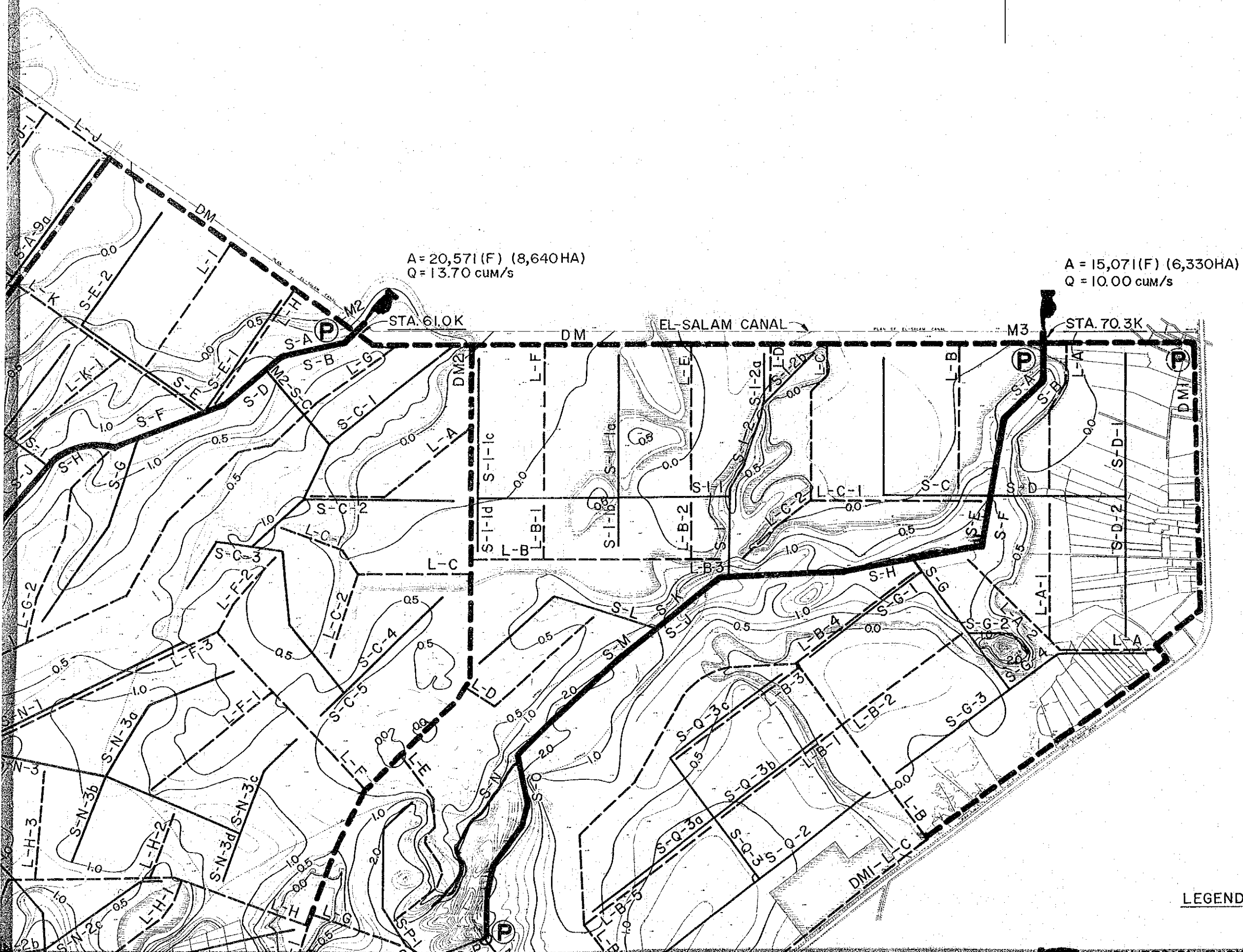
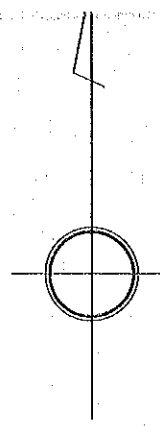

A = 20,571 (F) (8,640HA)
Q = 13.70 cum/s

A = 15,071 (F) (6,330HA)
Q = 10.00 cum/s

LEGEND

