

THE ISLAMIC REPUBLIC OF PAKISTAN  
PAKISTAN RAILWAYS  
LOCOMOTIVES MANUFACTURING FACTORY PROJECT

**PRELIMINARY DRAWINGS**

MAY 1983

JAPAN INTERNATIONAL COOPERATION AGENCY  
(JICA)

L117  
63.6  
SDF

SDF

03-41

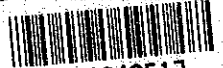
JICA LIBRARY  
  
1061049E1J

国際協力事業団	
受入 月日 84. 9. 27	L117
登録No. 09258	63.6 SDF

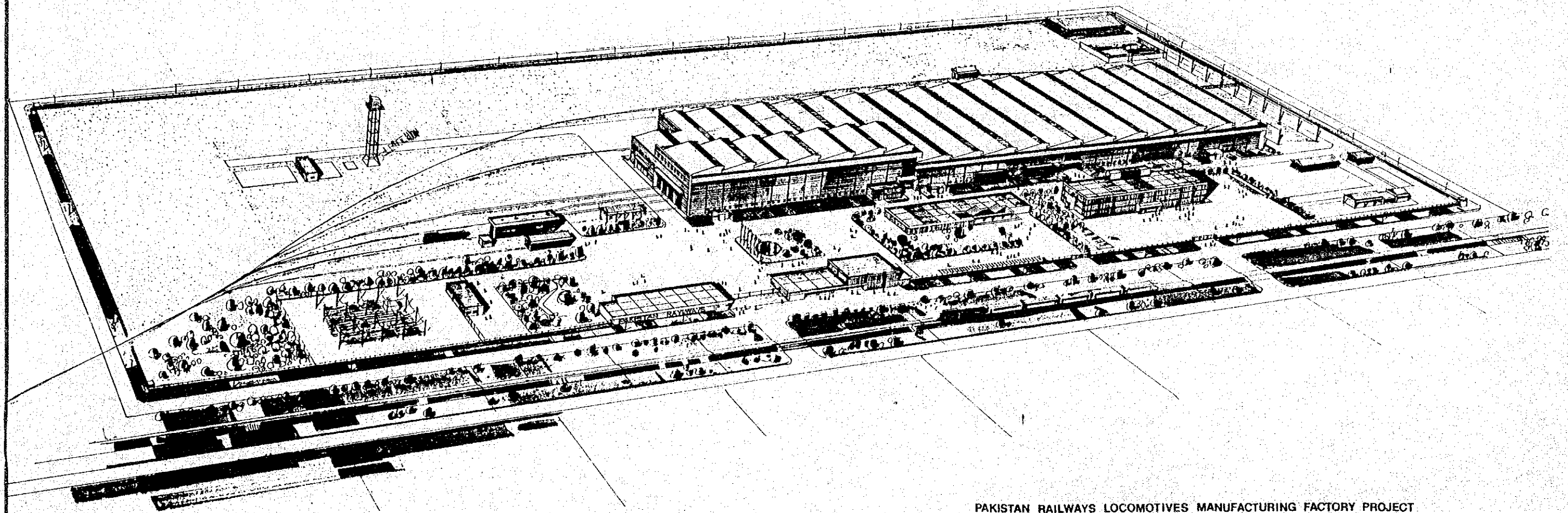

PAKISTAN RAILWAYS LOCOMOTIVES MANUFACTURING FACTORY PROJECT

LIST OF DRAWINGS

PLANNING

- FIG.0-1 GENERAL LAYOUT PLAN
- FIG.0-2 SHOP LAYOUT PLAN
- FIG.0-3 PLAN OF MAIN WORKSHOP BUILDING
- FIG.0-4 PLAN OF FINAL ADJUSTMENT AND INSPECTION SHED
- FIG.0-5 PLAN OF SHUNTING LOCOMOTIVE SHED
- FIG.0-6 PLAN OF PHOSPHATING TREATMENT SHOP

CIVIL ENGINEERING

- FIG.1-1 GRADING PLAN
- FIG.1-2 LAYOUT OF ROAD AND PLANTING
- FIG.1-3 DETAILS OF INSPECTION PIT
- FIG.1-4 UNDERGROUND WATER RESERVOIR
- FIG.1-5-1 EFFLUENT TREATMENT TANK
- FIG.1-5-2 EFFLUENT TREATMENT TANK
- FIG.1-5-3 EFFLUENT TREATMENT TANK
- FIG.1-6 CARBIDE REFUSE PIT
- FIG.1-7 UNDERGROUND FUEL TANK PIT

TRACK

- FIG.2-1 TRACK ARRANGEMENT
- FIG.2-2 PLAN OF BRANCHING SYSTEM FOR FACTORY SIDING

BUILDING

- FIG.3-1 SITE PLAN OF LOCOMOTIVE MANUFACTURING FACTORY
- FIG.3-2 FINISH SCHEDULE
- FIG.3-3-1 MAIN WORKSHOP BUILDING (PLAN)
- FIG.3-3-2 MAIN WORKSHOP BUILDING (ELEVATION)
- FIG.3-3-3 MAIN WORKSHOP BUILDING (SECTION)
- FIG.3-3-4 MAIN WORKSHOP BUILDING (DETAILS)
- FIG.3-3-5 MAIN WORKSHOP BUILDING (DETAILS)
- FIG.3-3-6 MAIN WORKSHOP BUILDING (ROOF PLAN)
- FIG.3-4-1 ADMINISTRATIVE OFFICE (PLAN 1)
- FIG.3-4-2 ADMINISTRATIVE OFFICE (PLAN 2)
- FIG.3-4-3 ADMINISTRATIVE OFFICE (ELEVATION AND SECTION)
- FIG.3-5-1 VEHICLE SHED AND TIME OFFICE (PLAN AND SECTION)
- FIG.3-5-2 VEHICLE SHED AND TIME OFFICE (SECTION)
- FIG.3-6 FOREMAN'S OFFICE AND MAINTENANCE SECTION OFFICE
- FIG.3-7 CANTEEN AND REST SHELTER
- FIG.3-8 FINAL ADJUSTMENT AND INSPECTION SHED
- FIG.3-9 SHUNTING LOCOMOTIVE SHED
- FIG.3-10 TOUCH-UP PAINTING SHED

- FIG.3-11 WEIGHBRIDGE SHED
- FIG.3-12 SUBSTATION BUILDING
- FIG.3-13 WATER PUMP ROOM AND FUEL PUMP ROOM
- FIG.3-14 AIR STATION
- FIG.3-15 ACETYLENE STATION
- FIG.3-16 INFLAMMABLE MATERIAL STORE
- FIG.3-17 EFFLUENT TREATMENT FACILITY AND CHEMICAL TANK SHED
- FIG.3-18 SCUM INCINERATOR SHED
- FIG.3-19 TOILET AND CYCLE STAND
- FIG.3-20 SWITCHMAN HUT, BOUNDARY WALL AND LOOKOUT CABIN
- FIG.3-21-1 PLAN OF AIRCONDITIONING EQUIPMENT FOR ADMINISTRATIVE OFFICE (PLAN 1)
- FIG.3-21-2 PLAN OF AIRCONDITIONING EQUIPMENT FOR ADMINISTRATIVE OFFICE (PLAN 2)
- FIG.3-22 PLAN OF AIRCONDITIONING EQUIPMENT FOR SUBSTATION BUILDING

MACHINERY

- FIG.4-1-1 MACHINE LAYOUT OF MAIN WORKSHOP BUILDING ( 1 - 13 SECTION )
- FIG.4-1-2 MACHINE LAYOUT OF MAIN WORKSHOP BUILDING ( 13 - 24 SECTION )
- FIG.4-1-3 MACHINE LAYOUT OF MAIN WORKSHOP BUILDING ( 24 - 37 SECTION )
- FIG.4-2 PLAN OF YARD CRANE

ELECTRICAL FACILITY

- FIG.5-1 NETWORK DIAGRAMME OF POWER DISTRIBUTION SYSTEM
- FIG.5-2 POWER DISTRIBUTION SYSTEM PLAN
- FIG.5-3 SINGLE LINE DIAGRAMMES
- FIG.5-4 COMMUNICATION CIRCUIT DIAGRAMMES
- FIG.5-5 COMMUNICATION SYSTEM PLAN

UTILITY SERVICE FACILITY

- FIG.6-1-1 PIPE ALLOCATION OF WATER SUPPLY
- FIG.6-1-2 ELEVATED WATER TANK
- FIG.6-2 PIPE ALLOCATION OF DRAINAGE
- FIG.6-3-1 FLOW SHEET OF GROUND WATER TREATMENT
- FIG.6-3-2 PLAN OF GROUND WATER TREATMENT FACILITY
- FIG.6-4-1 FLOW SHEET OF EFFLUENT TREATMENT AND RECYCLING
- FIG.6-4-2 PLAN OF EFFLUENT TREATMENT AND RECYCLING FACILITY
- FIG.6-4-3 PLAN OF EFFLUENT TREATMENT PIPING
- FIG.6-5 PLAN OF COMPRESSED AIR PIPING
- FIG.6-6 PLAN OF ACETYLENE GAS PIPING
- FIG.6-7 PLAN OF NATURAL GAS PIPING
- FIG.6-8 UNDERGROUND FUEL TANK AND PIPING

66KV POWER TRANSMISSION LINE

SULFUR GAS LINE

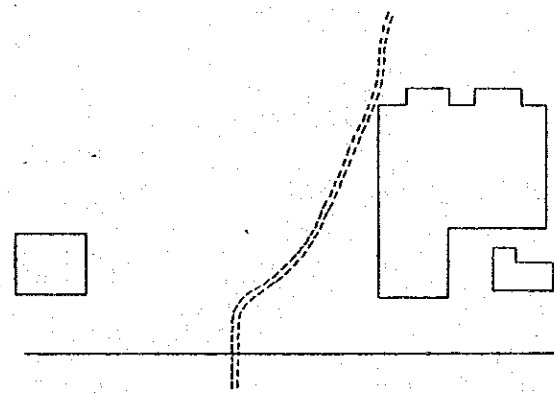
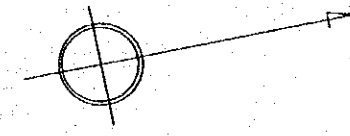

12.75  
263

SWITCHMAN'S HUT

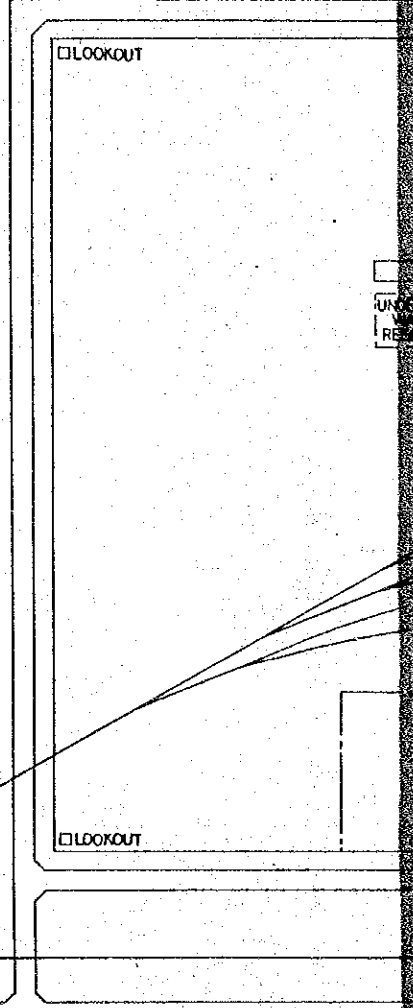

F

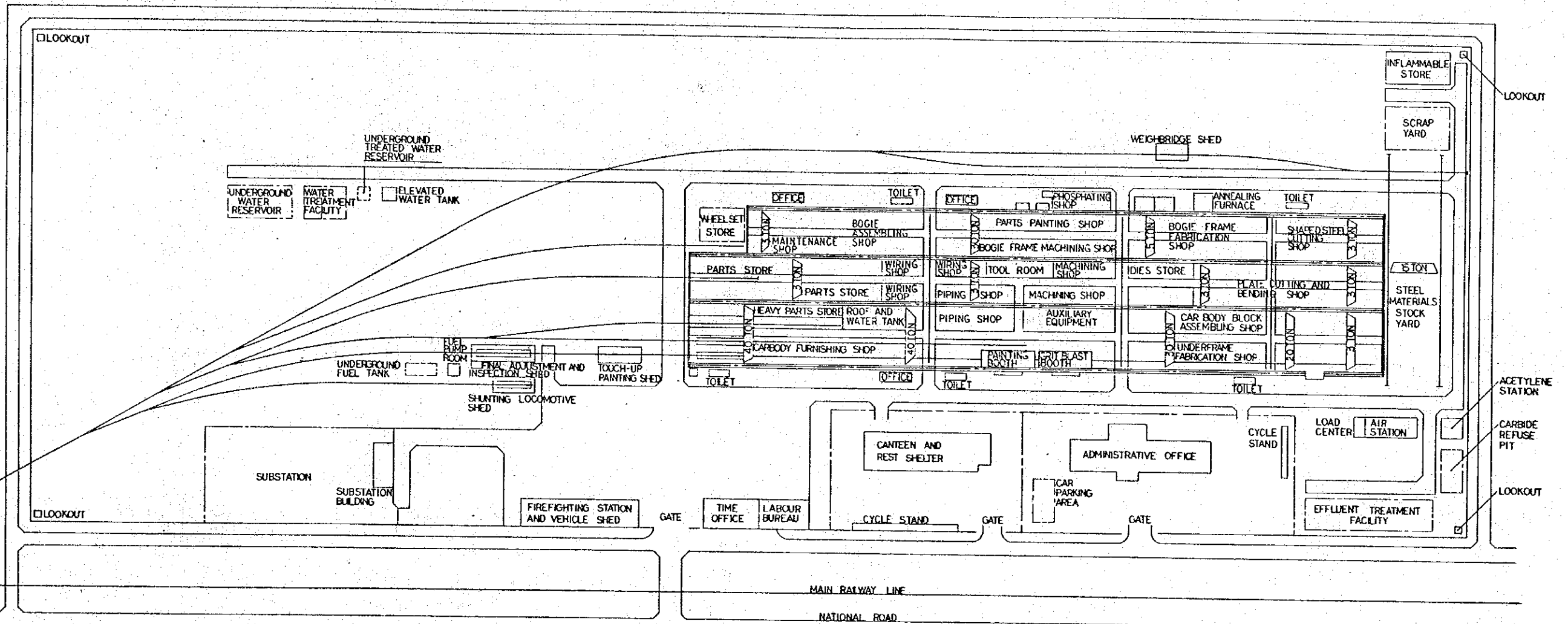
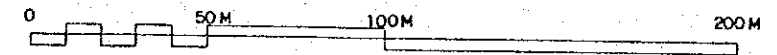

Fig. 0-1 GENERAL LAYOUT PLAN  
SCALE 1:1000



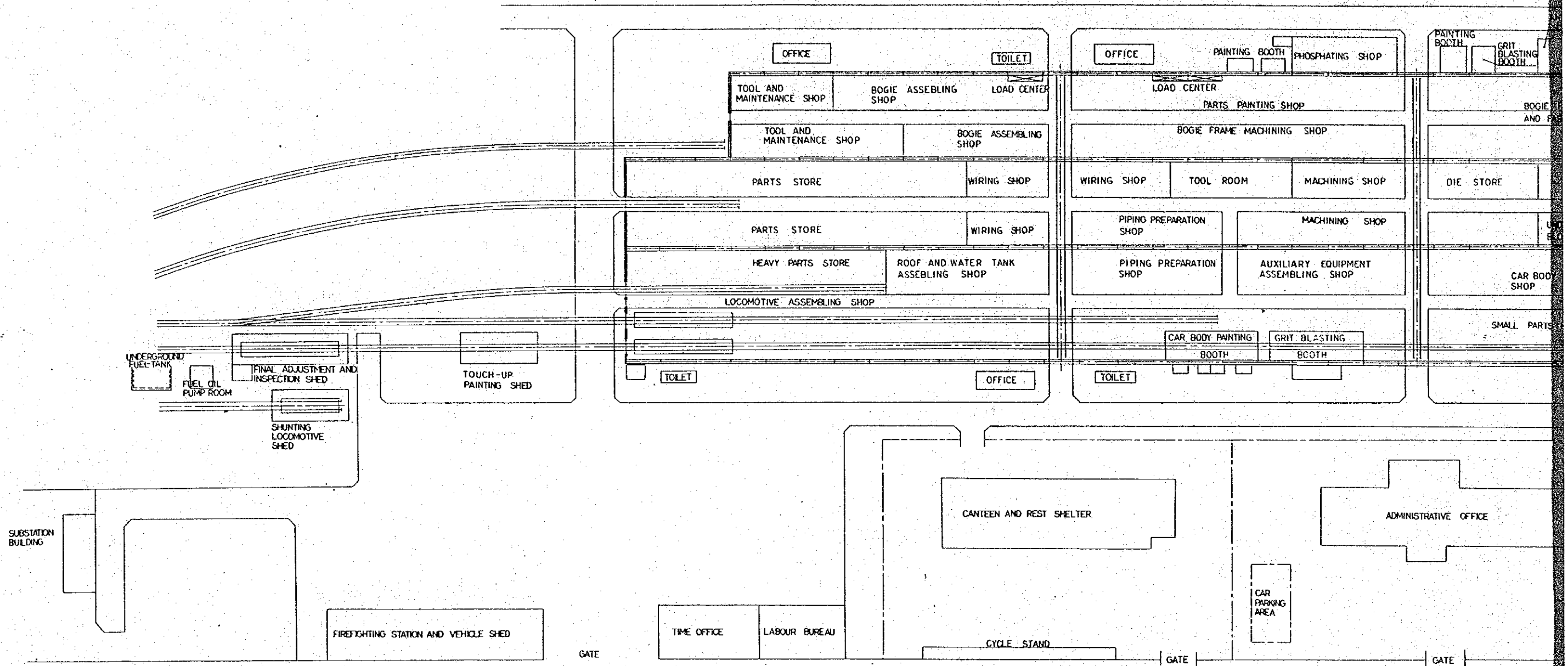
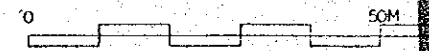

FIG. 0-2 SHOP LAYOUT PLAN  
SCALE 1:500





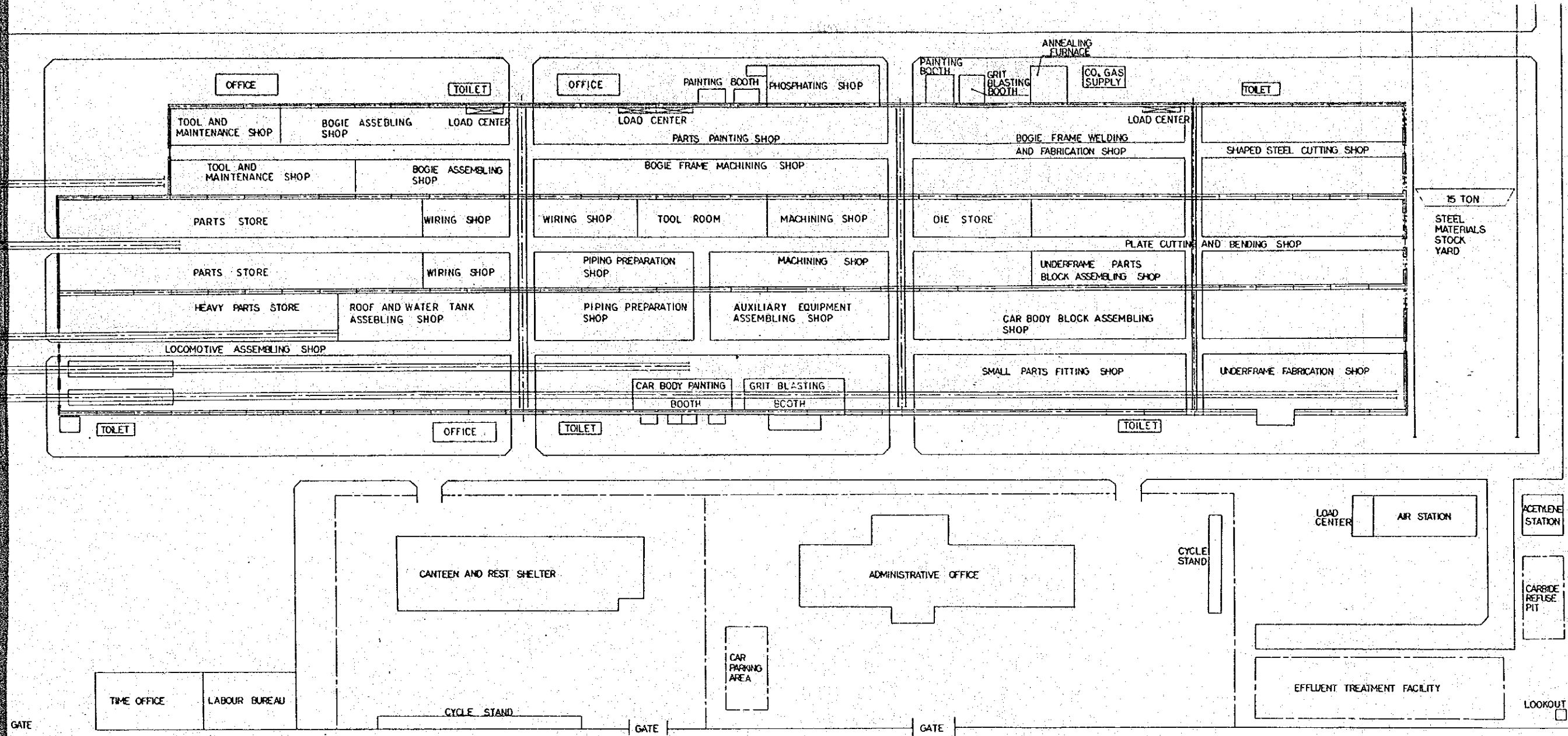
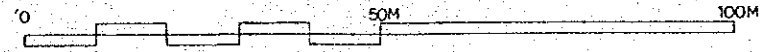

FIG. 0-2 SHOP LAYOUT PLAN  
SCALE 1:500



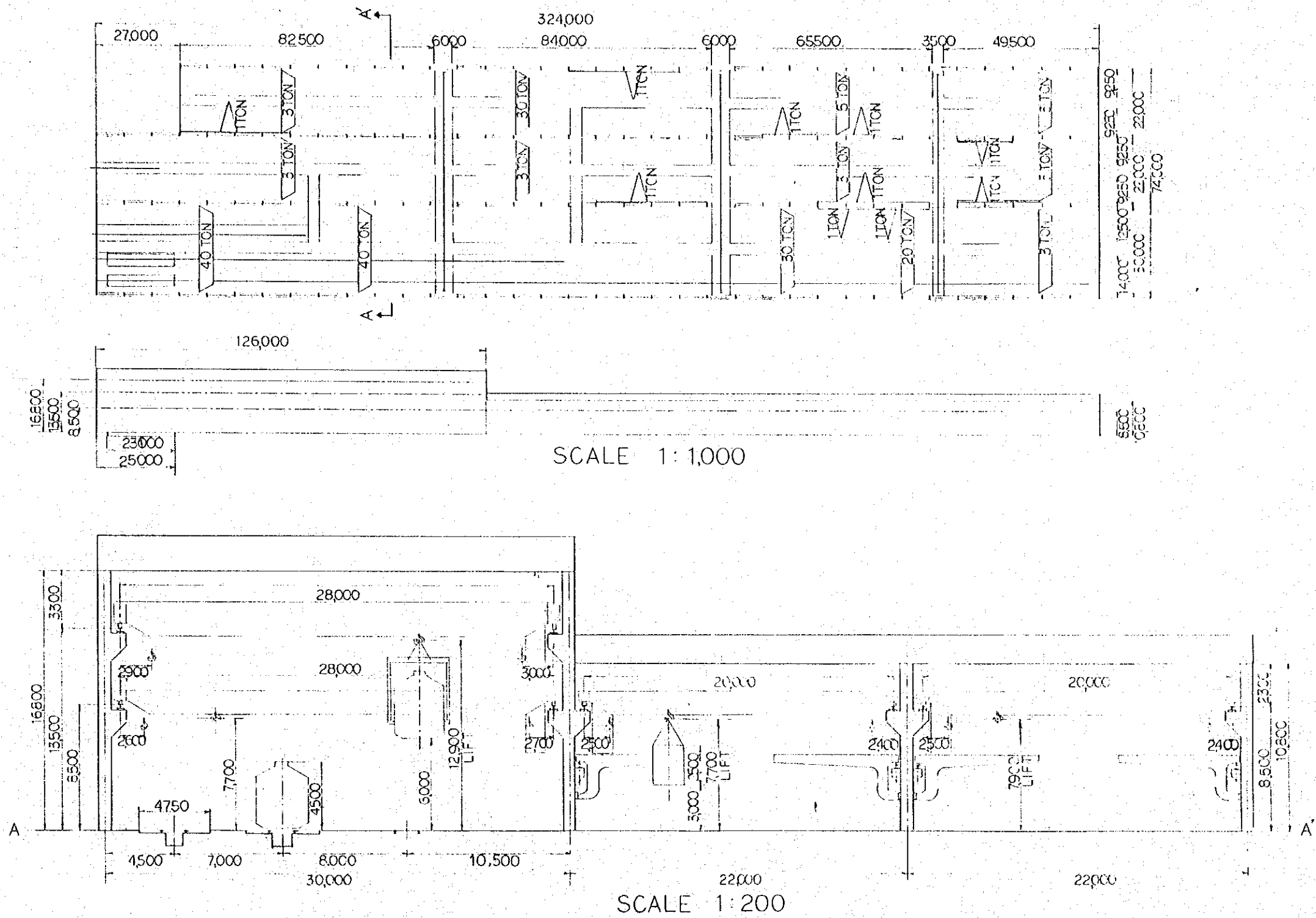
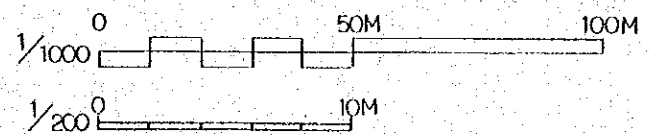

FIG. 0-3 PLAN OF MAIN WORKSHOP BUILDING  
SCALE 1:200, 1:1000



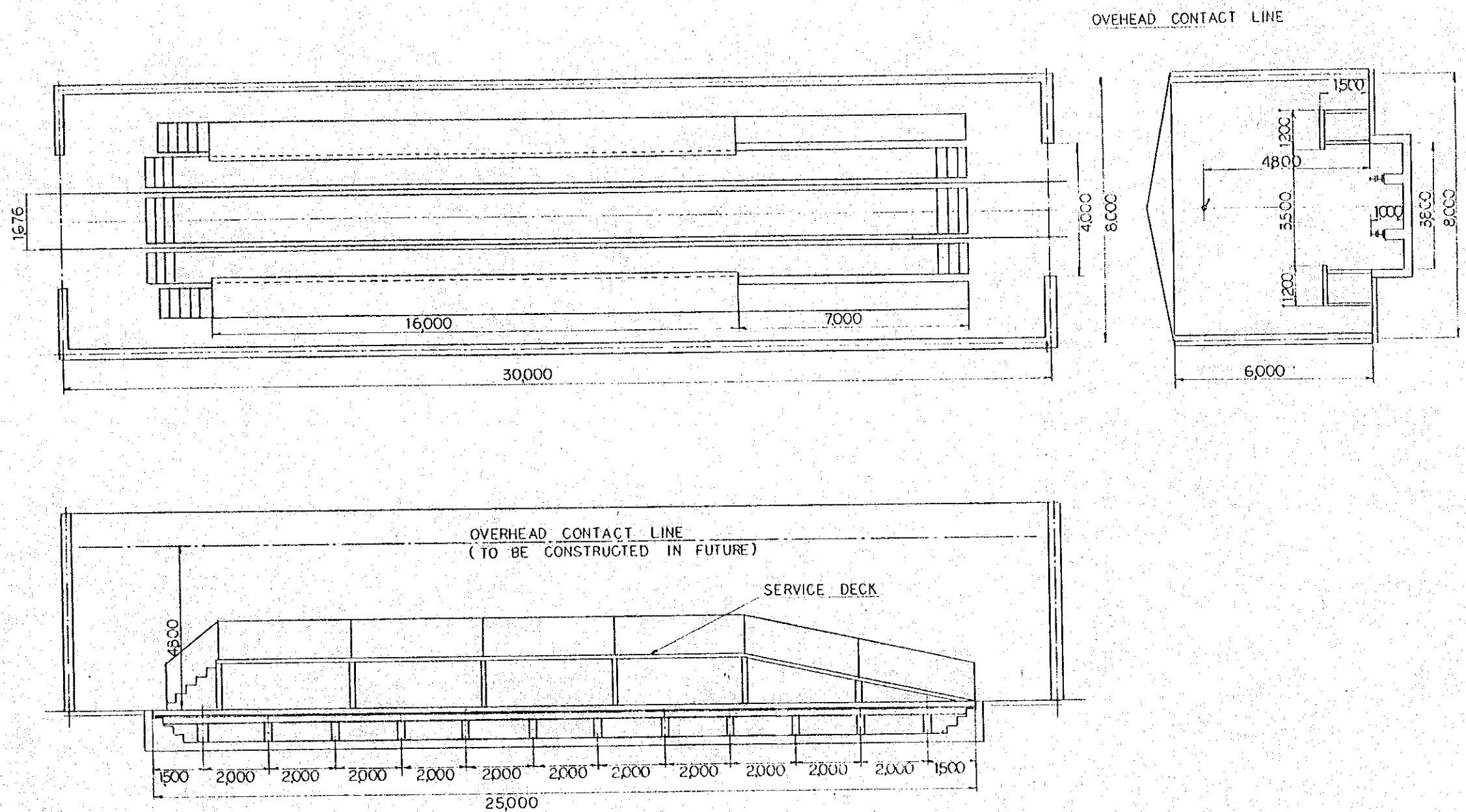
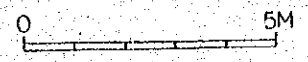

FIG.0-4 PLAN OF FINAL ADJUSTMENT AND INSPECTION SHED  
SCALE 1:100



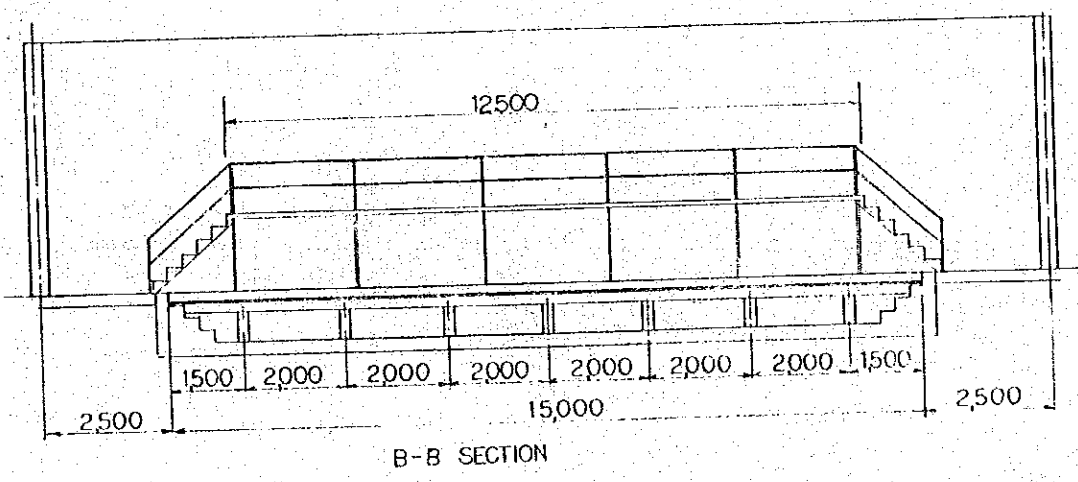
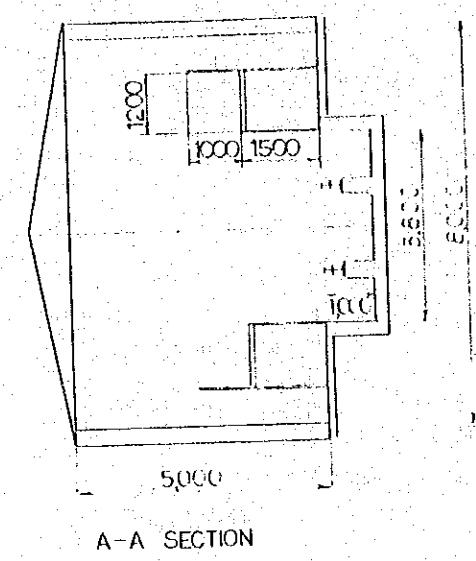
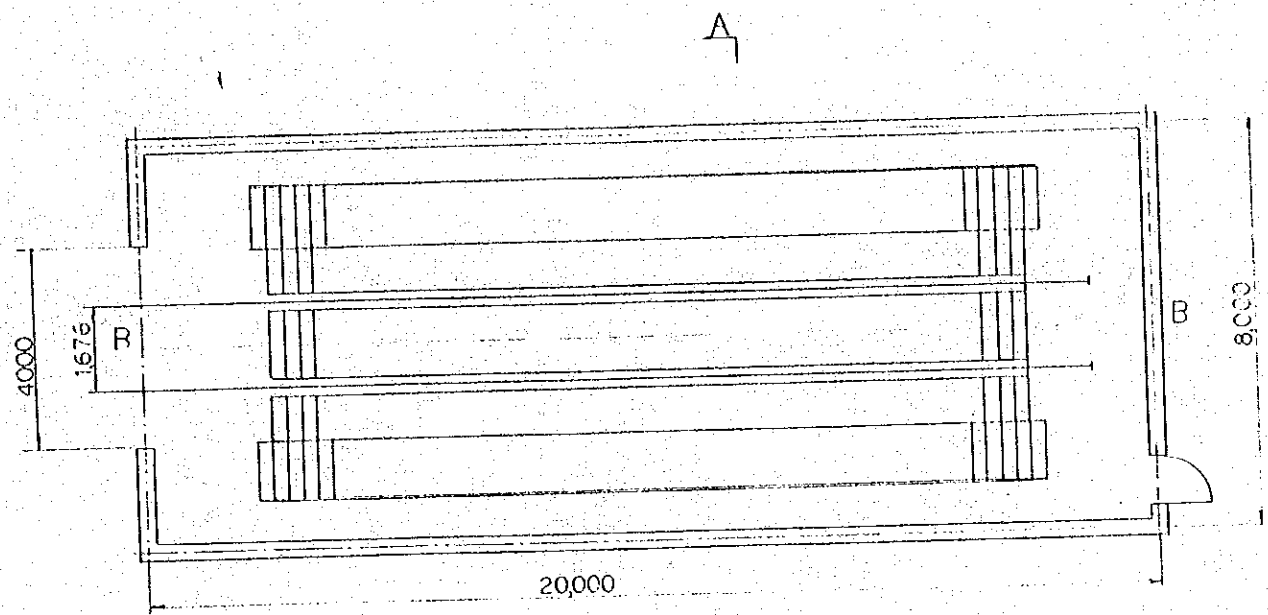

FIG.0-5 PLAN OF SHUNTING LOCOMOTIVE SHED  
SCALE 1:100

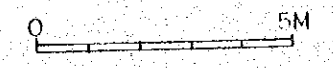

FIG.0-5

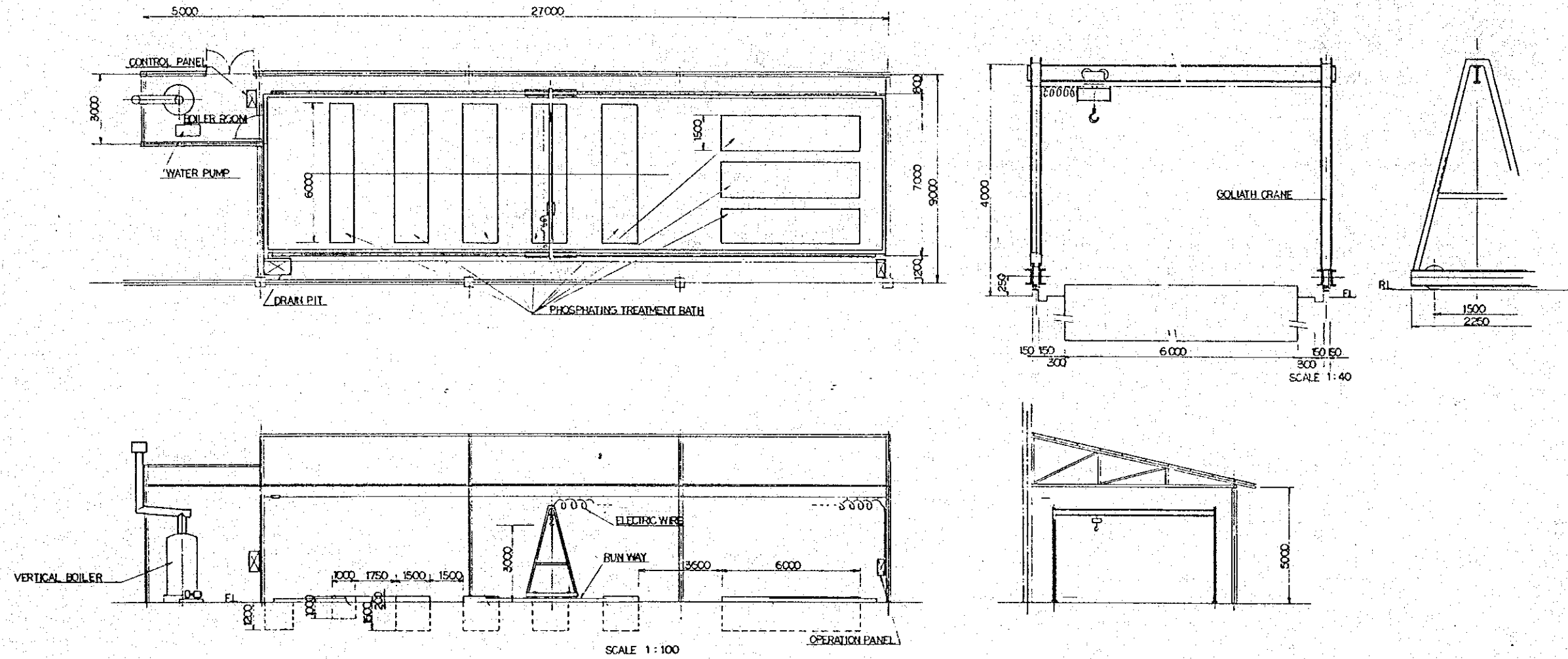

FIG. O-6 PLAN OF PHOSPHATING TREATMENT SHOP

SCALE 1:100, 1:40

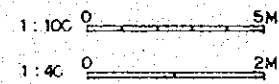
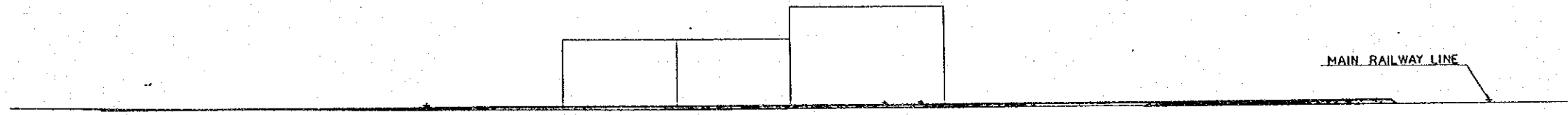
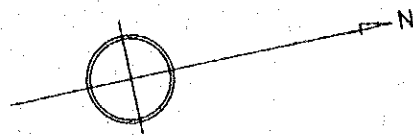
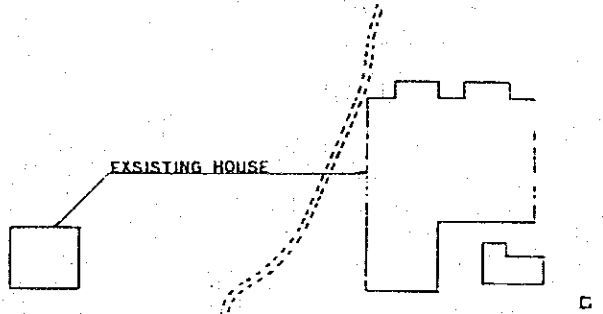

FIG. O-6



MAIN RAILWAY LINE

CROSS SECTION B-B  
SCALE-1:500



EXISTING HOUSE

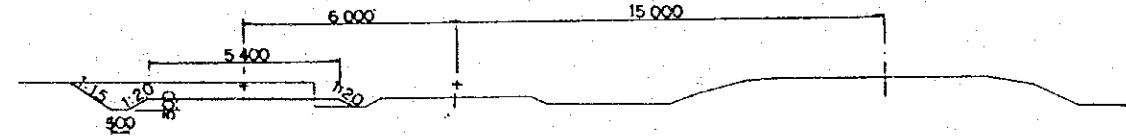

CROSS SECTION A-A  
SCALE-1:100

SWITCHMAN HUT

12.75  
263 L

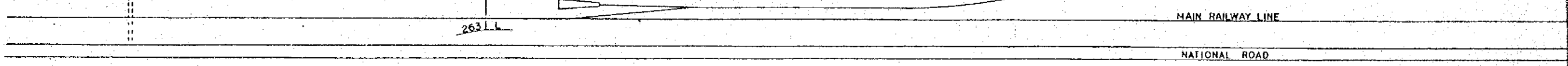

MAIN RAILWAY LINE

NATIONAL ROAD

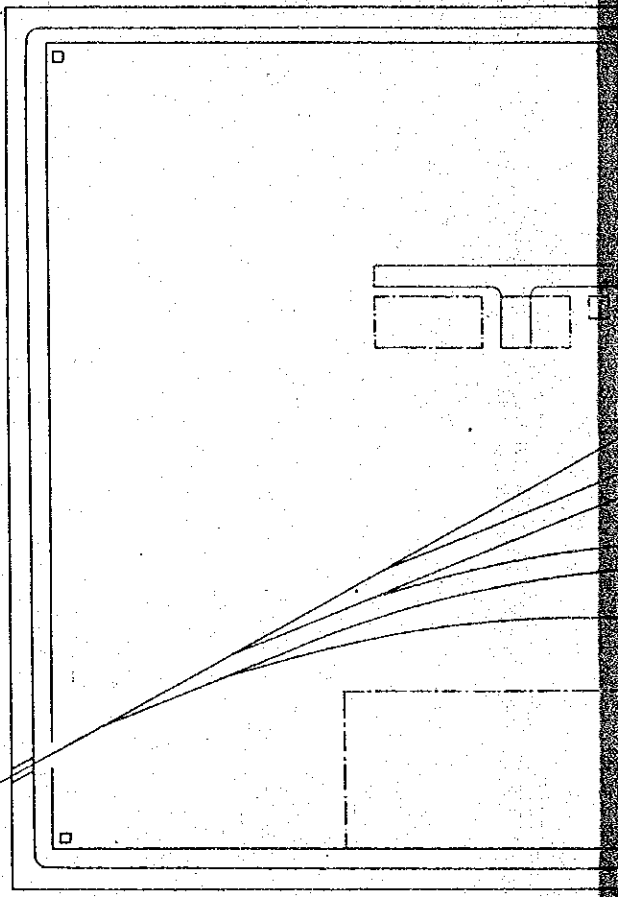

FIG.1-1 GRADING PLAN  
SCALE - 1:1000

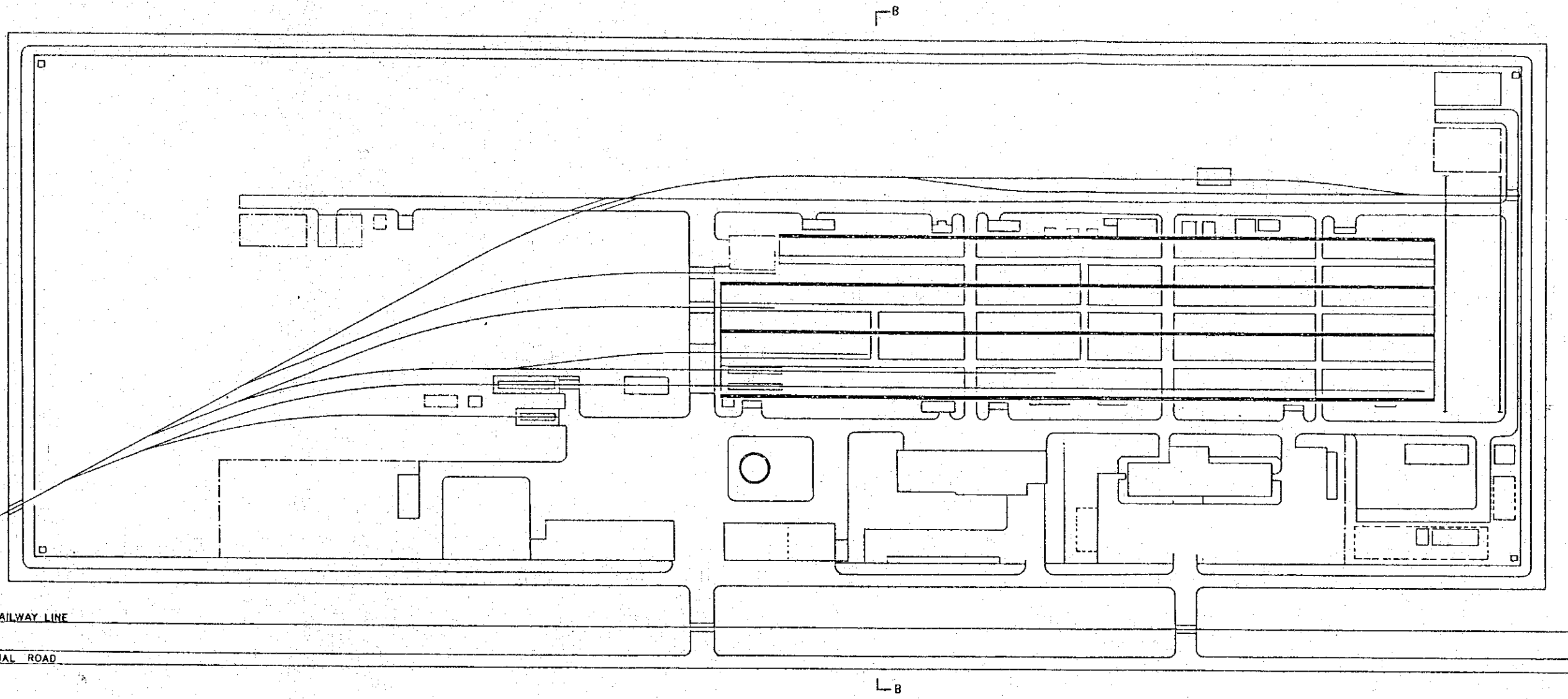
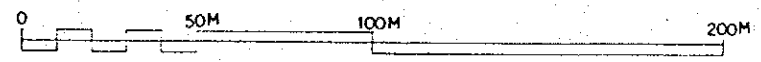
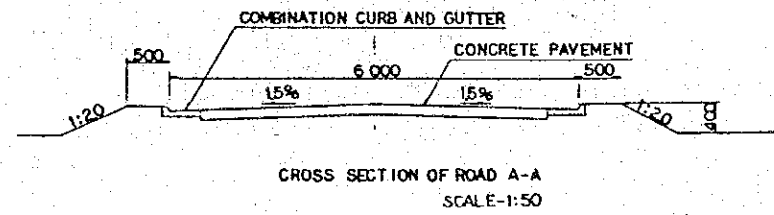
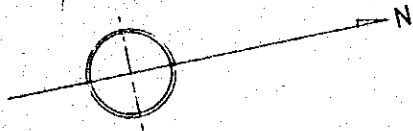

FIG.1-1 GRADING PLAN  
SCALE - 1:1000





LEGEND

- ROAD
- PLANTING AREA

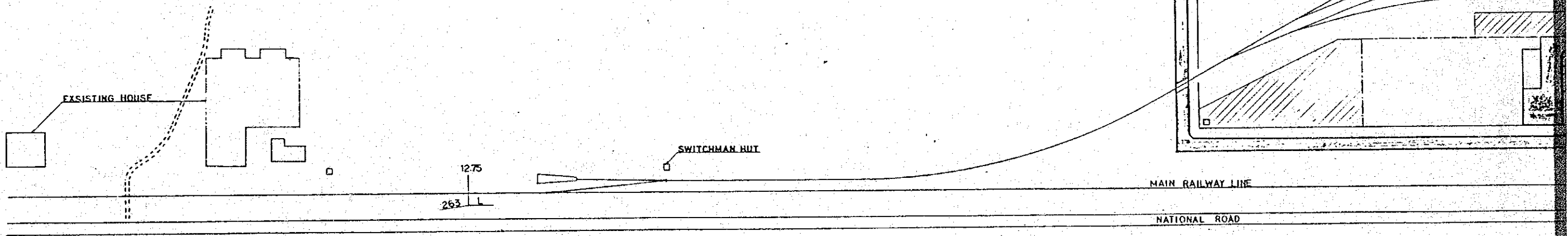
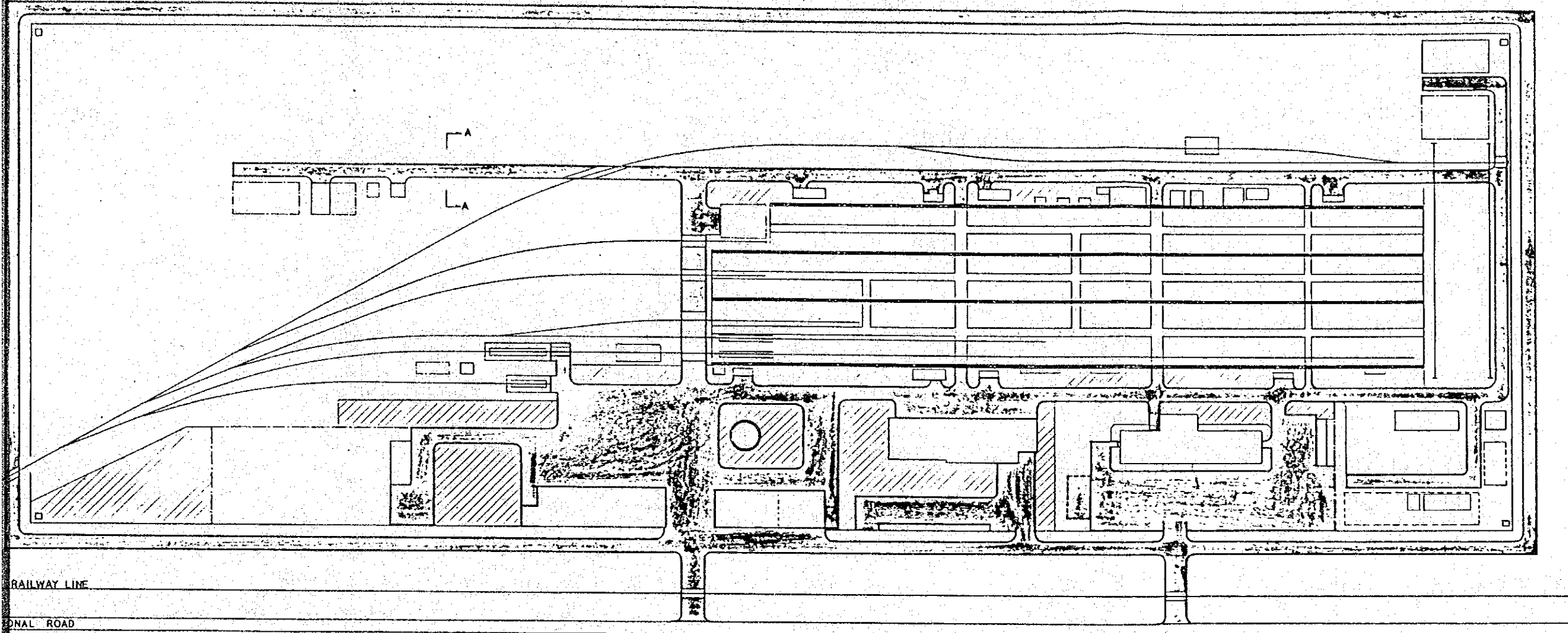

FIG.1-2 LAYOUT OF ROAD AND PLANTING  
SCALE -1:1000





LAYOUT OF ROAD AND PLANTING  
SCALE -1:1000

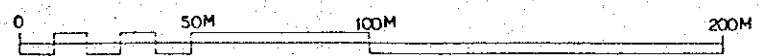
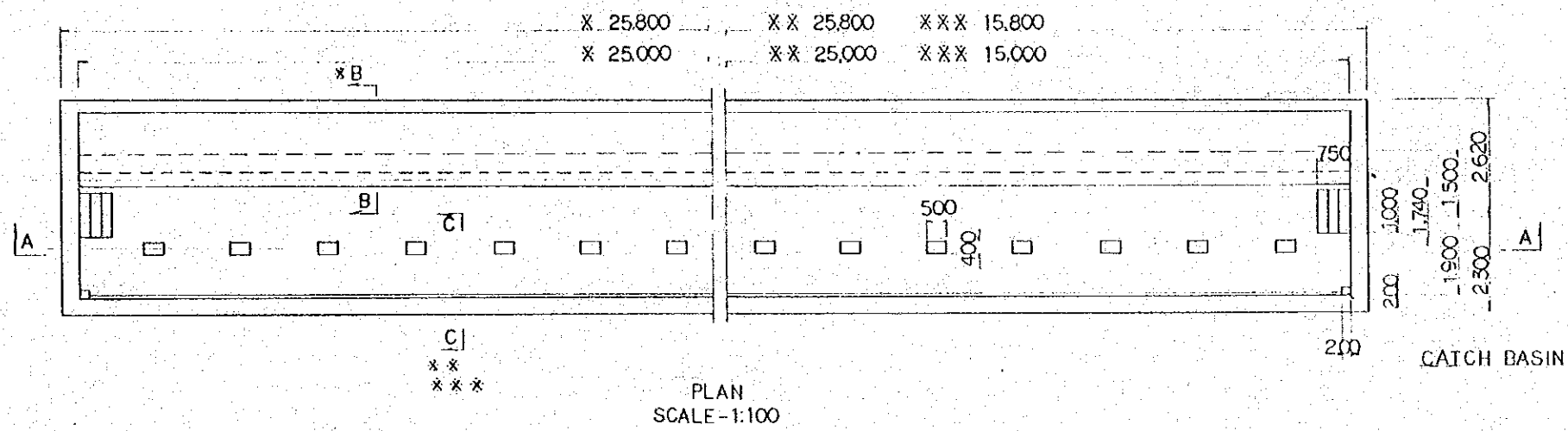
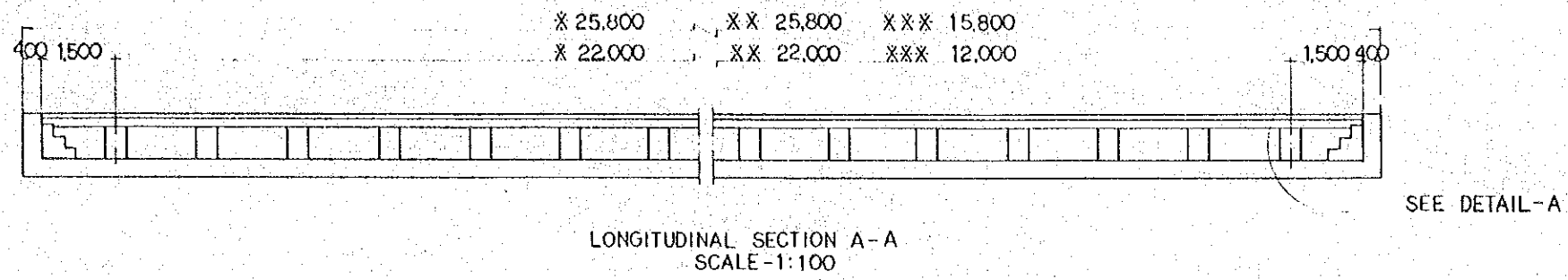

FIG. 1-2



- LEGEND
- X MAIN WORKSHOP
  - XX FINAL ADJUSTMENT AND INSPECTION SHED
  - XXX SHUNTING LOCOMOTIVE SHED

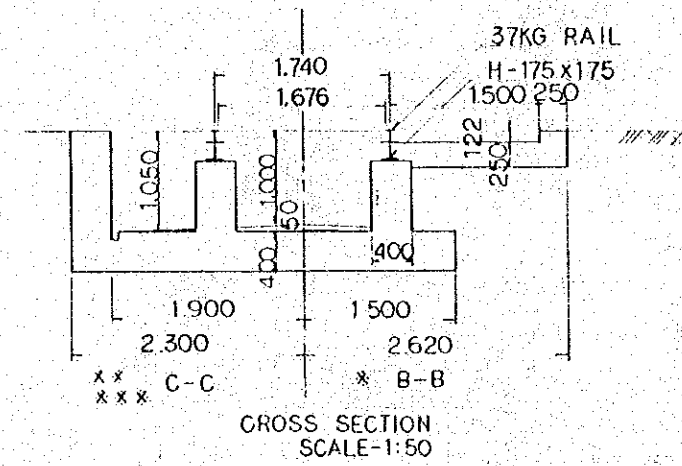
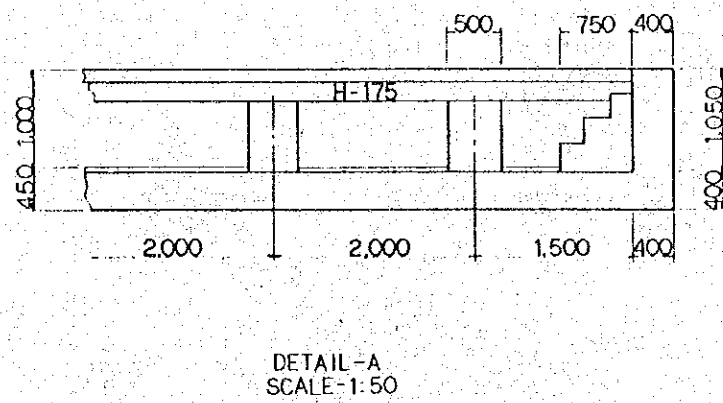

FIG 1-3 DETAILS OF INSPECTION PIT

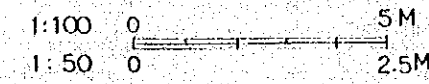
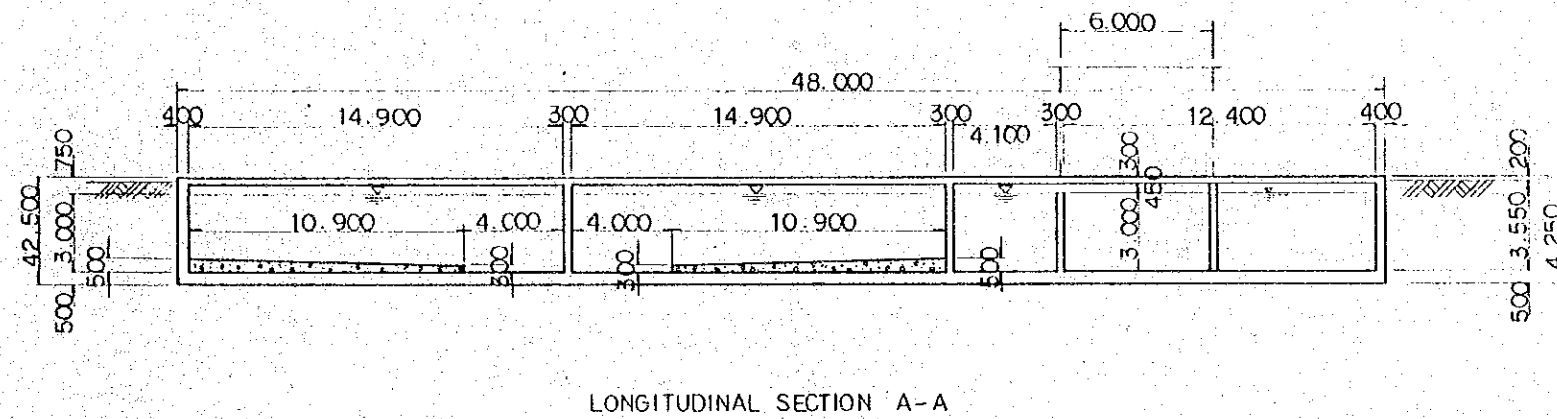
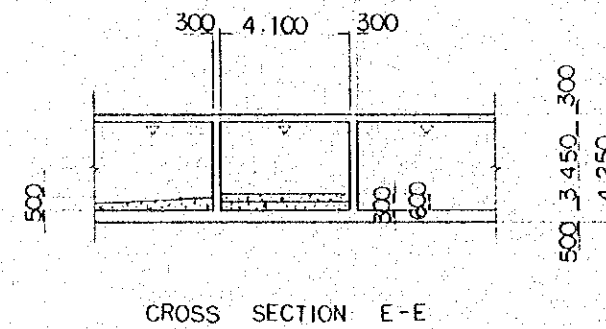
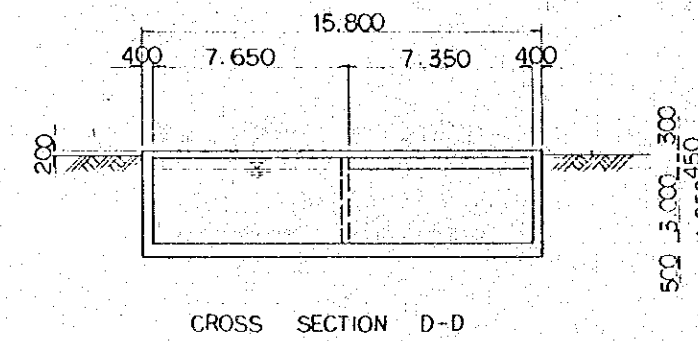
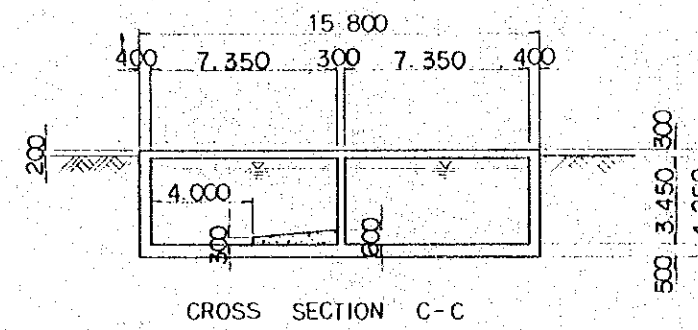
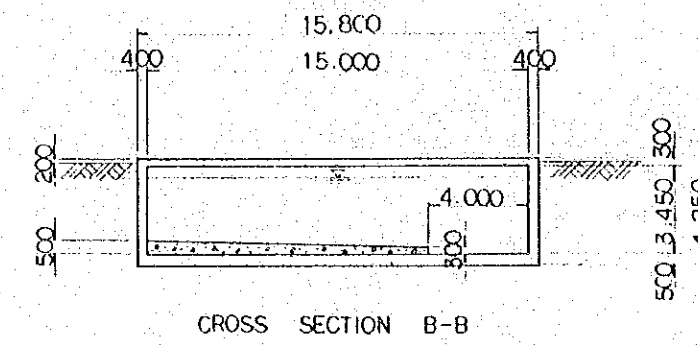
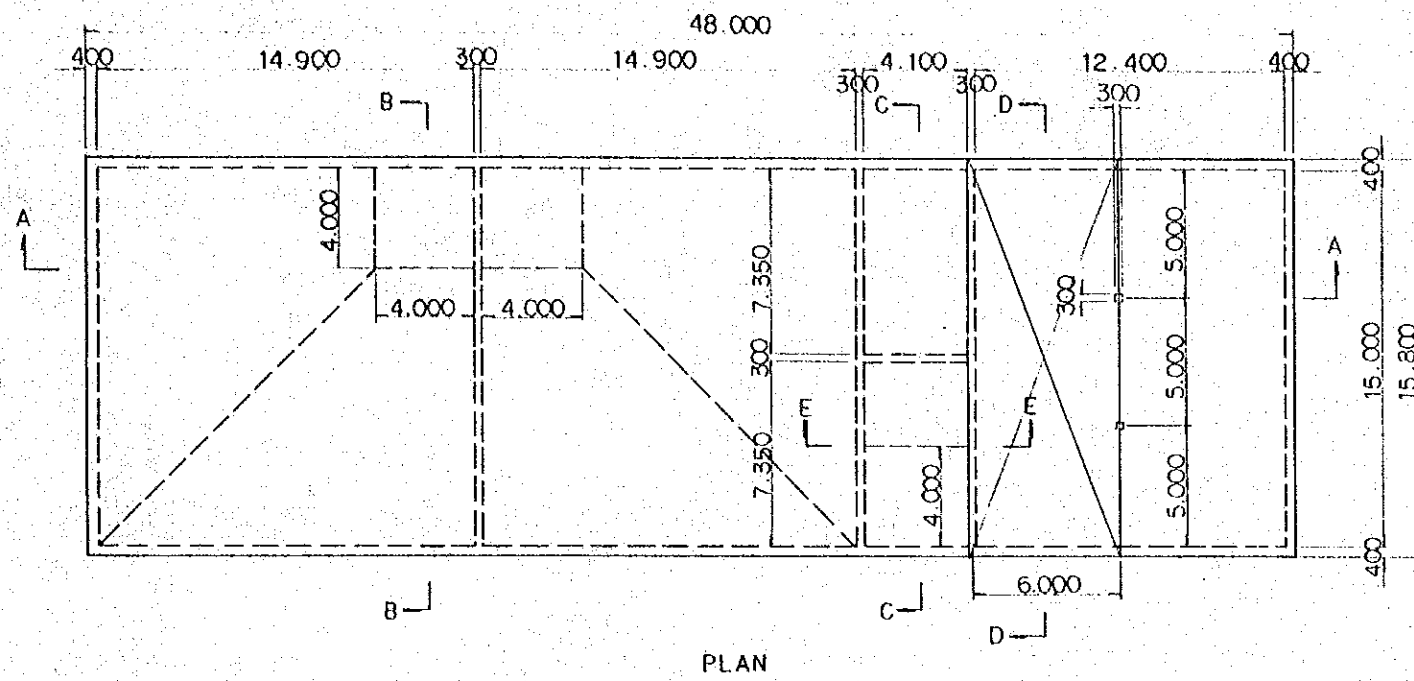

FIG. 1-3



NOTE REFER TO FIG. 6-3-2

FIG. 1-4 UNDERGROUND WATER RESERVOIR  
SCALE 1:200



FIG. 1-4

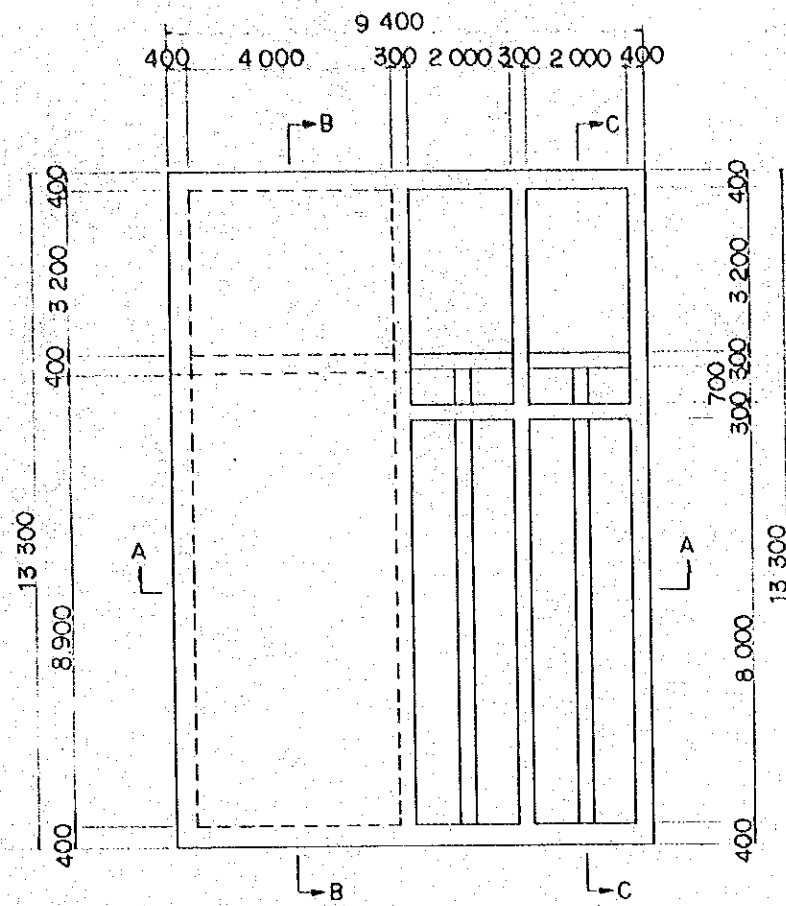

PLAN OF EFFLUENT WATER TANK

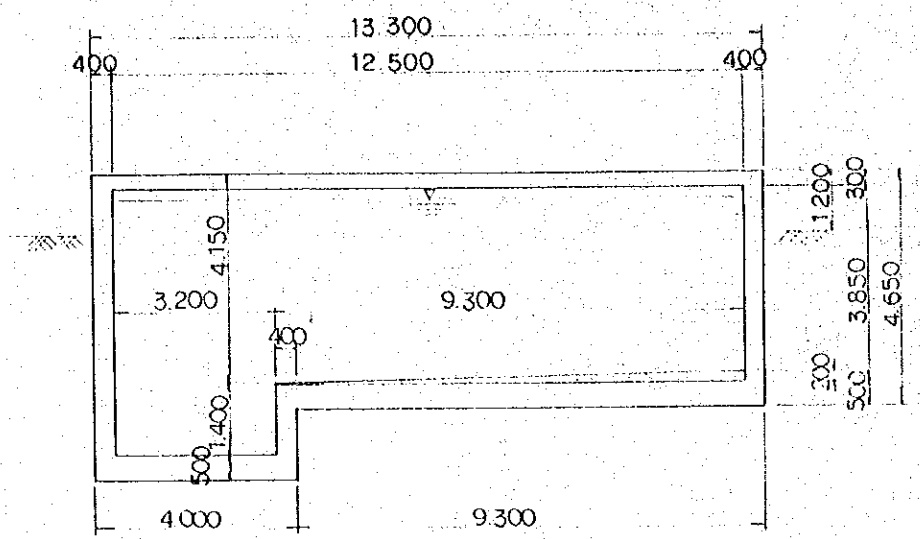

CROSS SECTION B-B

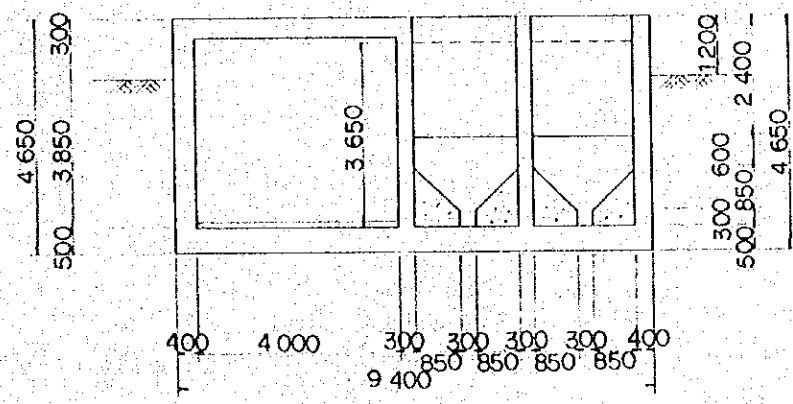

CROSS SECTION A-A

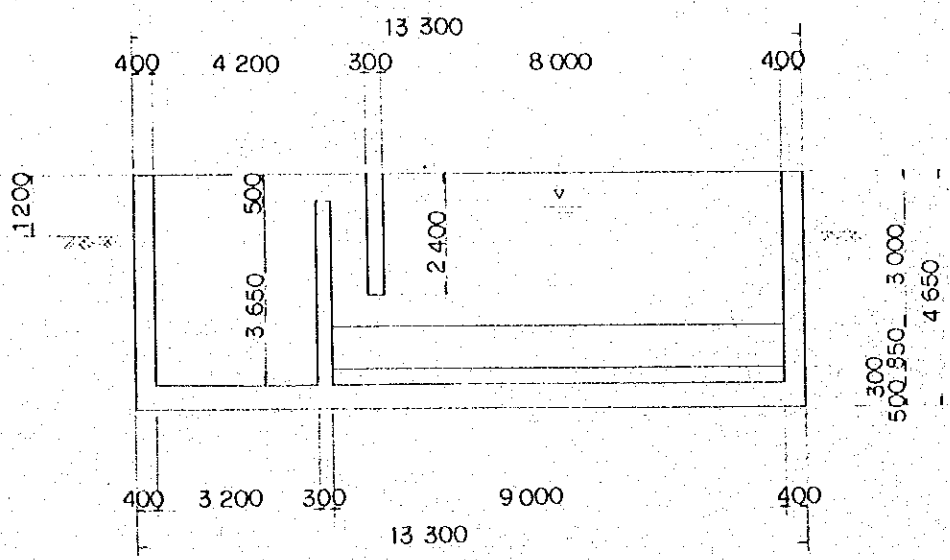

CROSS SECTION C-C

NOTE REFER TO FIG. 6-4-2

FIG. 1-5-1 EFFLUENT TREATMENT TANK PART 1  
SCALE - 1:100

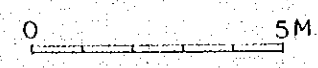
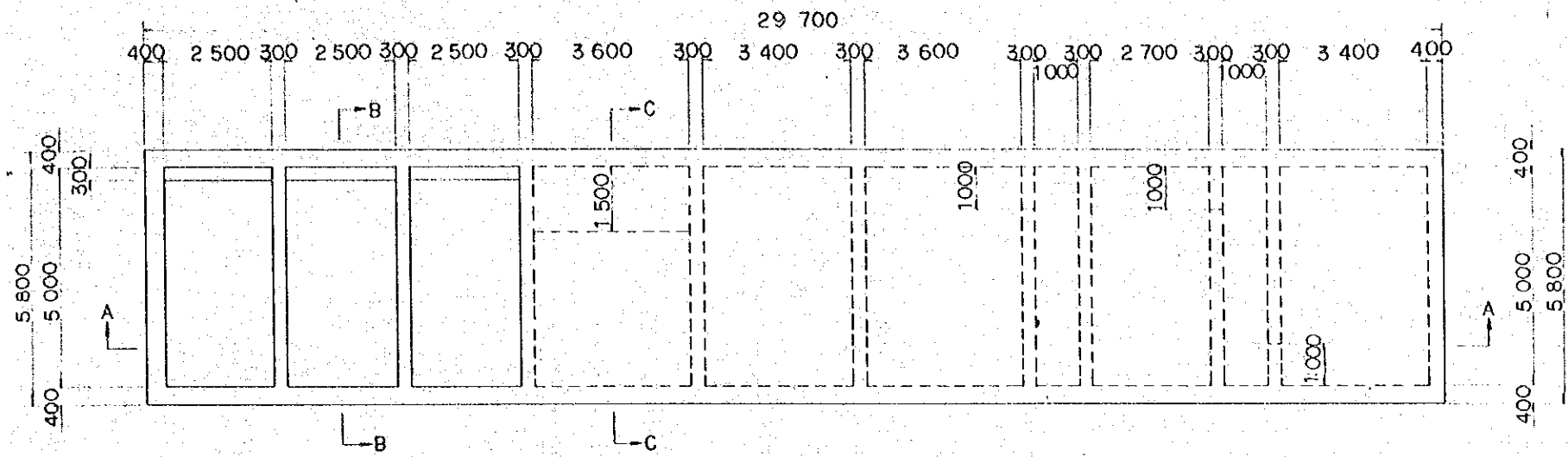
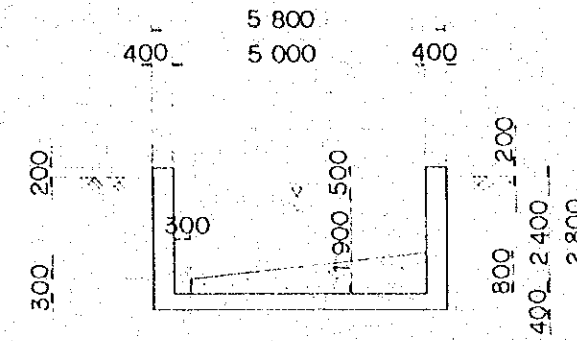

FIG. 1-5-1



PLAN OF FILTERED WATER TANK AND SCUM STORAGE TANK



CROSS SECTION B-B

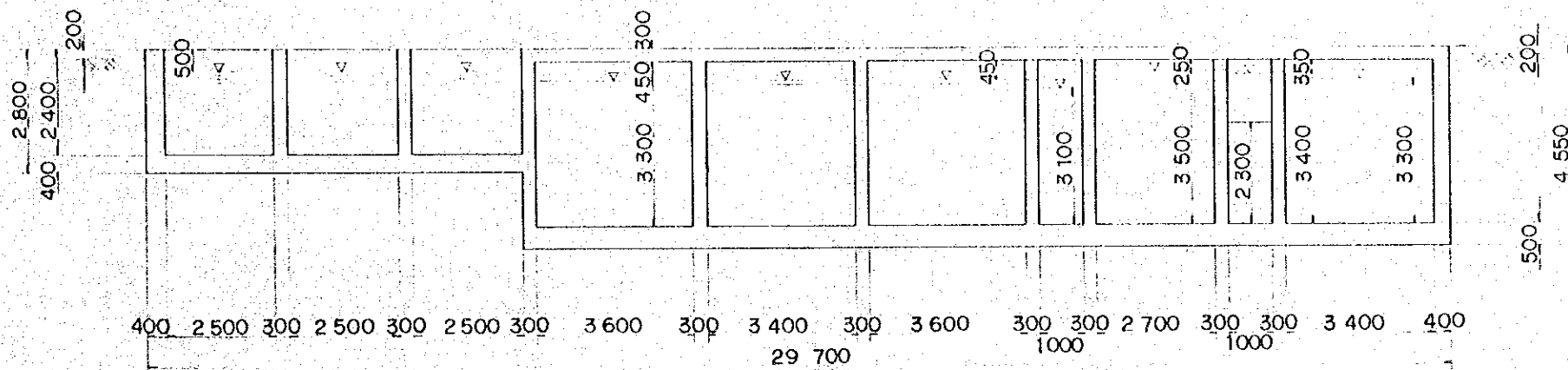

CROSS SECTION A-A

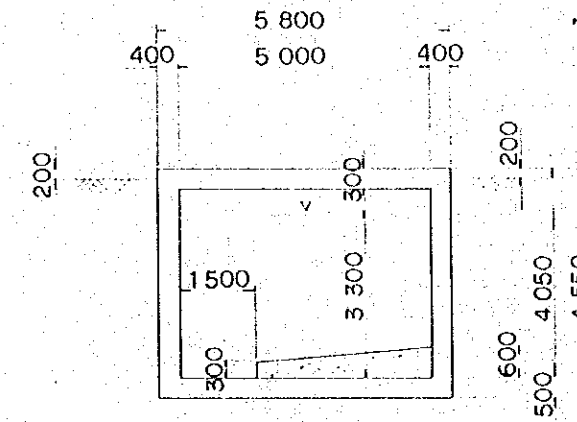

CROSS SECTION C-C

NOTE REFER TO FIG.6-4-2

FIG.1-5-2 EFFLUENT TREATMNT TANK PART 2  
SCALE - 1:100



FIG.1-5-2

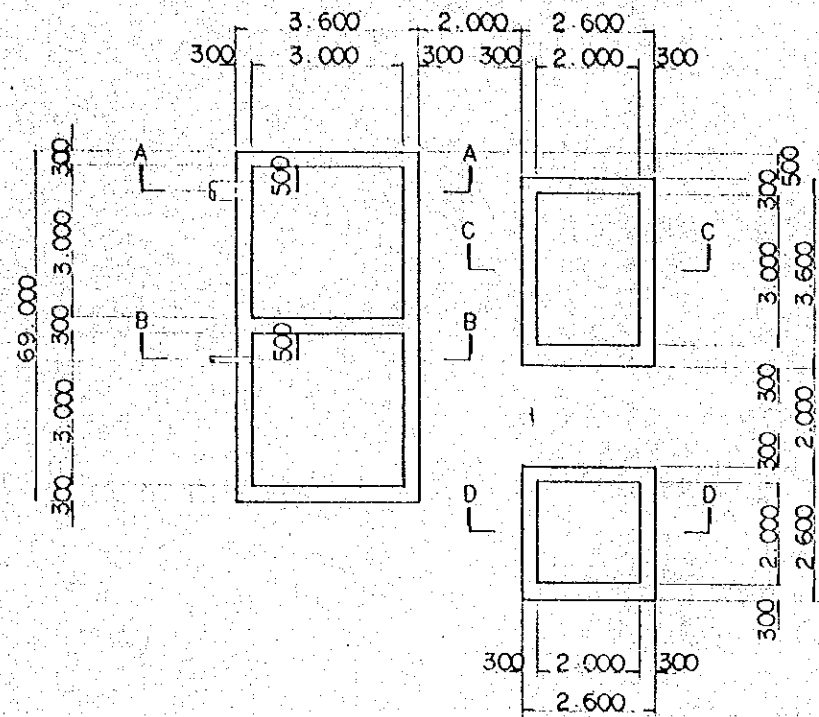

PLAN OF TANKS FOR EFFLUENT WATER FROM PHOSPHATING SHOP

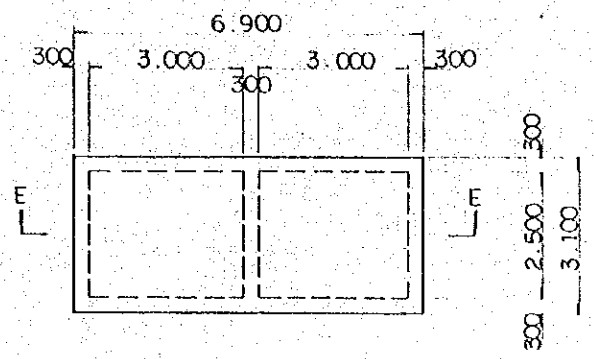

PLAN

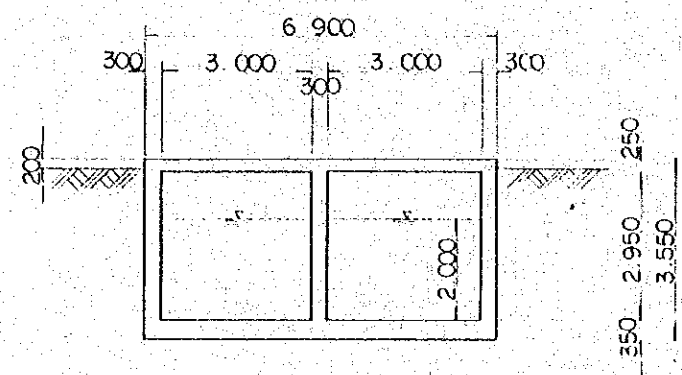

CROSS SECTION E-E

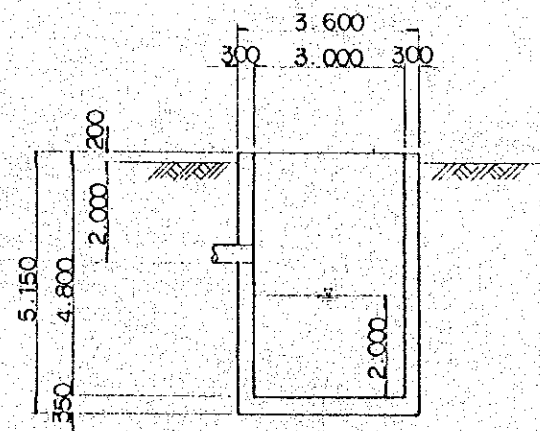

CROSS SECTION A-A

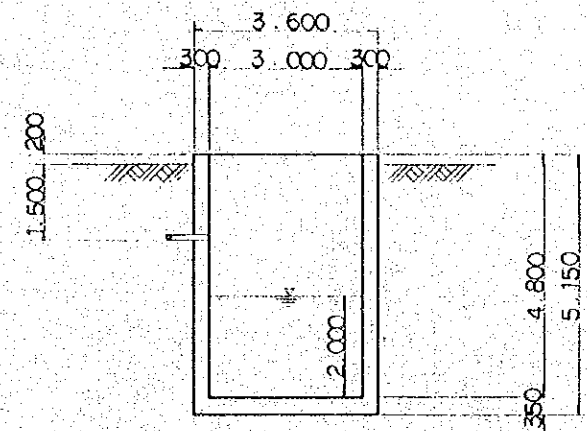

CROSS SECTION B-B

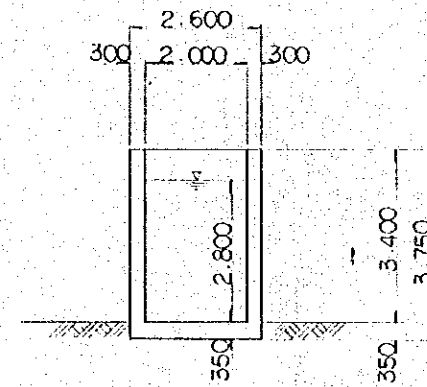

CROSS SECTION C-C

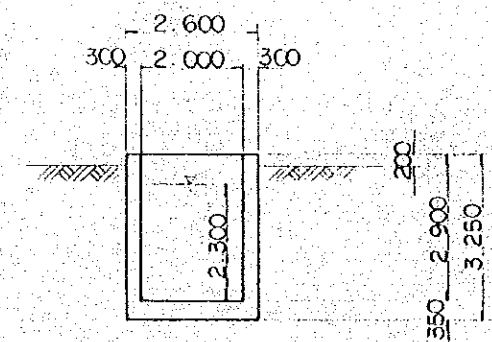

CROSS SECTION D-D

NOTE REFER TO FIG. 6-4-2

FIG. 1-5-3 EFFLUENT TREATMENT TANK PART 3  
SCALE - 1:100



FIG. 1-5-3

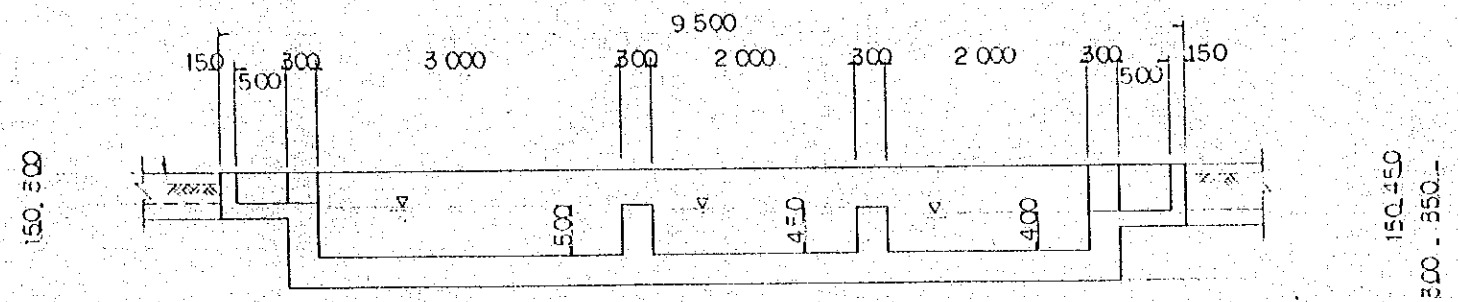

CROSS SECTION A--A

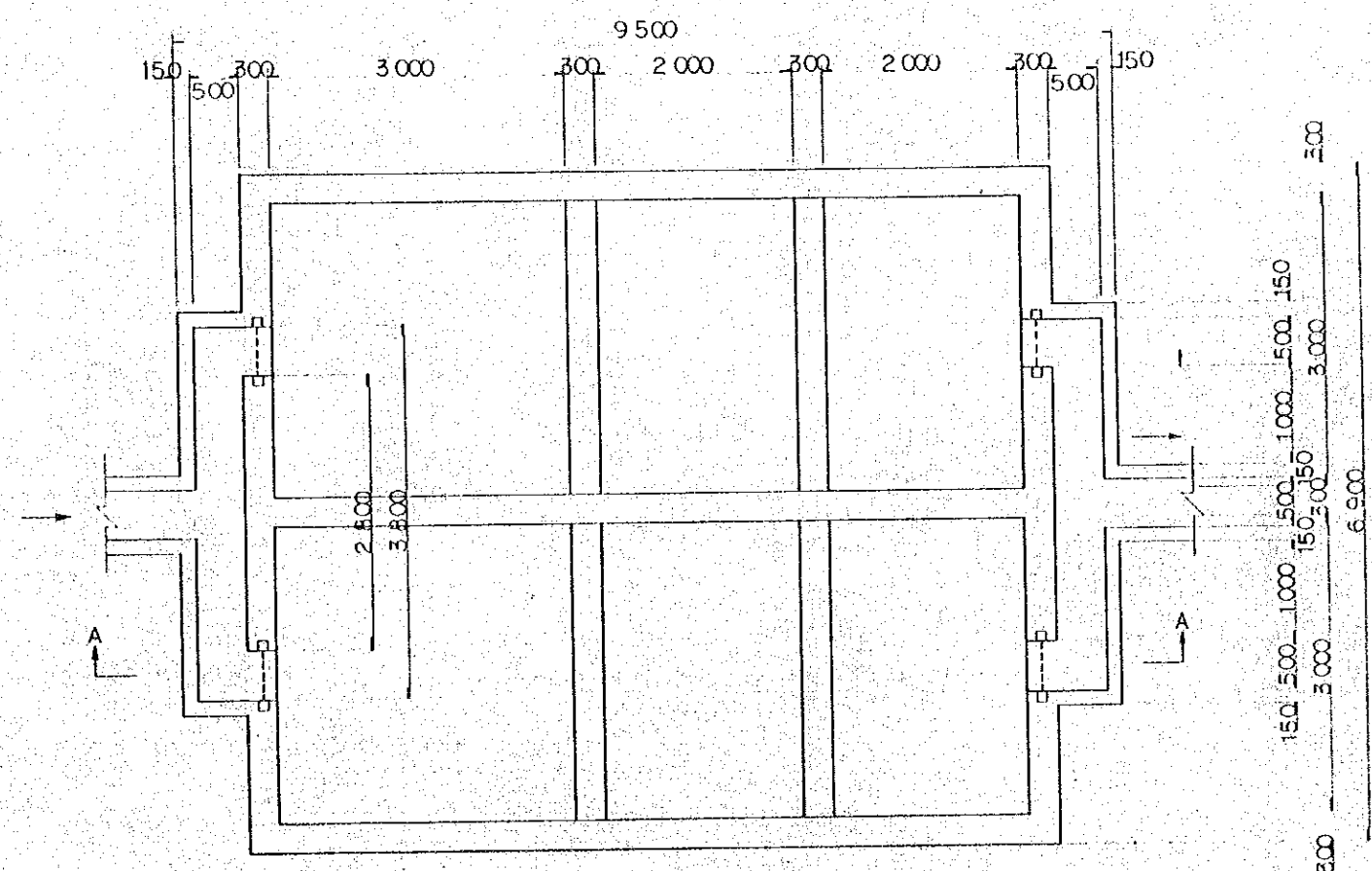

PLAN

FIG.1-6 CARBIDE REFUSE PIT  
SCALE-1:50



FIG.1-6

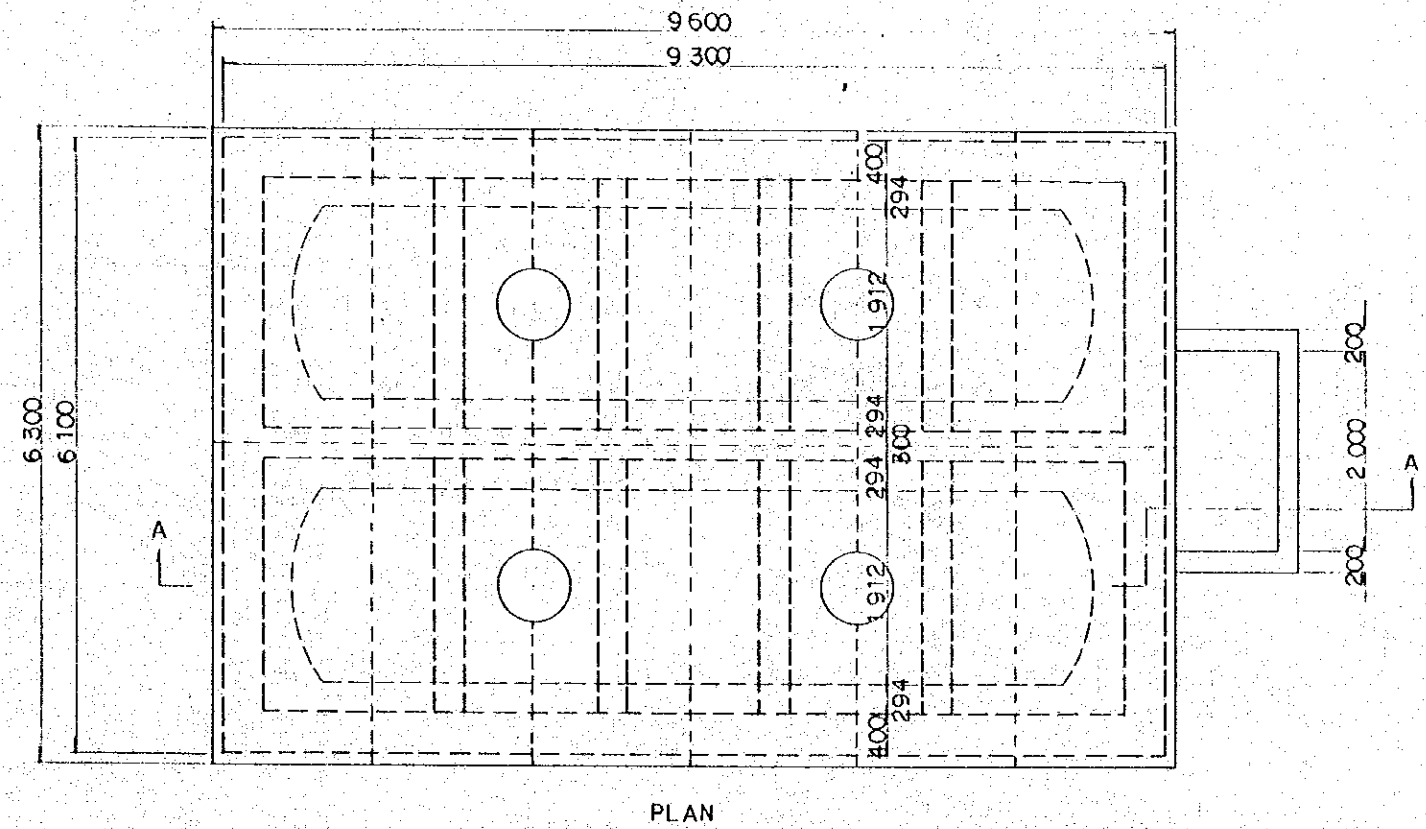
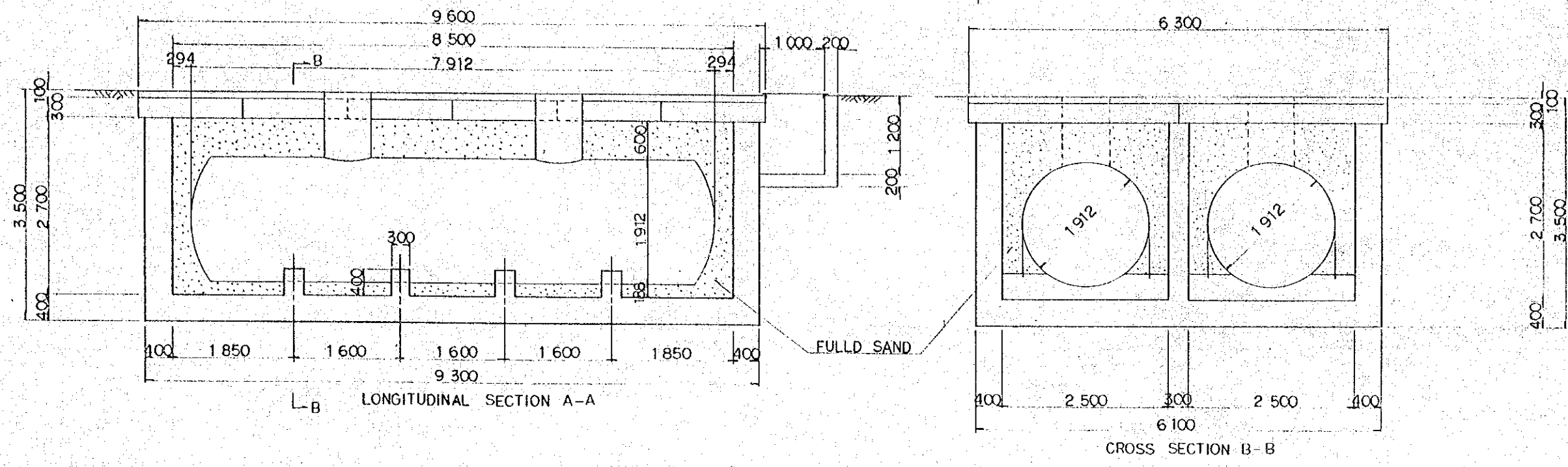

FIG.1-7 UNDERGROUND FUEL TANK PIT  
SCALE -1:50

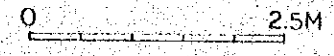
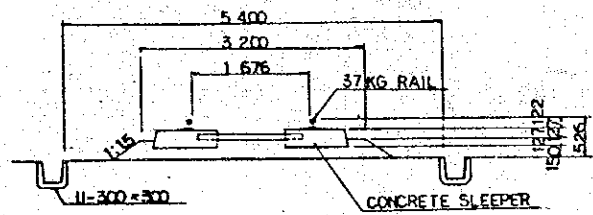
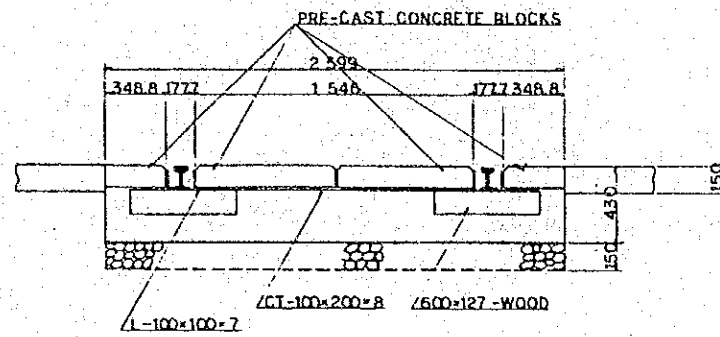
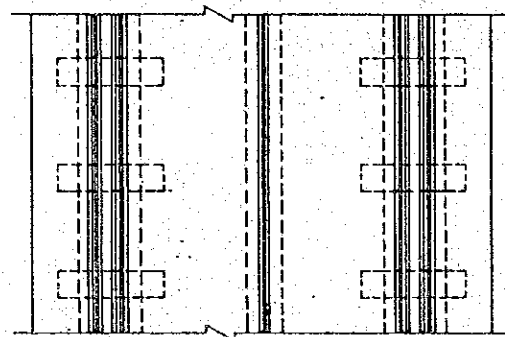

FIG 1-7





TYPICAL CROSS SECTION OF TRACK  
SCALE-1:50



PLAN

TRACK IN WORK SHOP  
SCALE 1:20

LEGEND

RAILROAD CROSSING

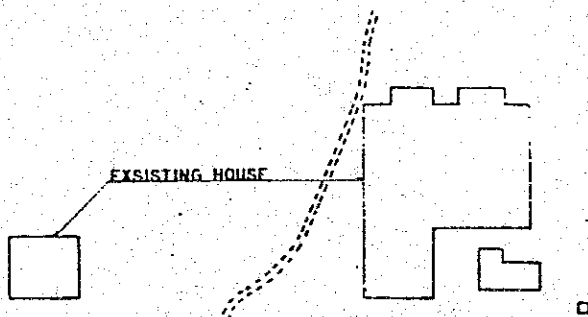

12.75  
263

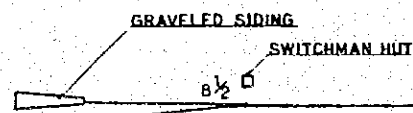

R=300

MAIN RAILWAY LINE

NATIONAL ROAD

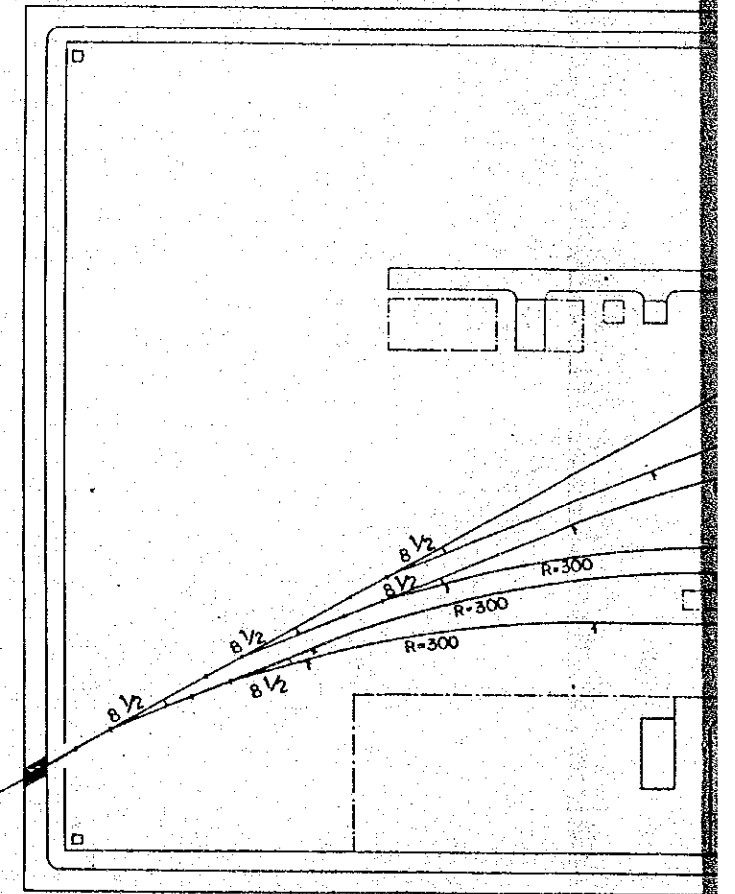

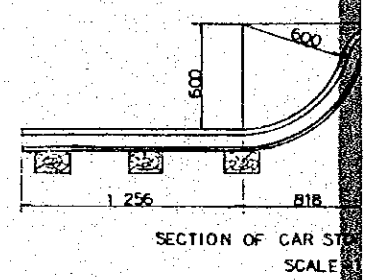
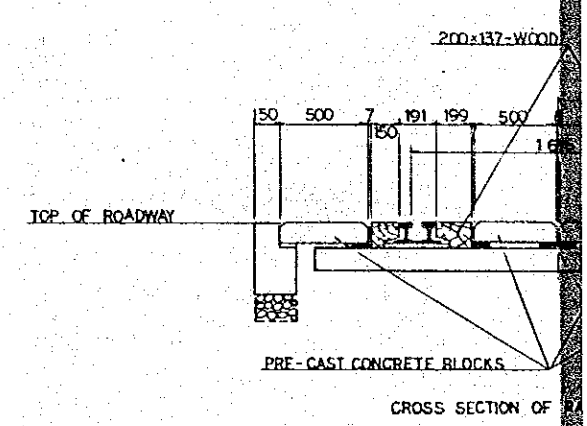
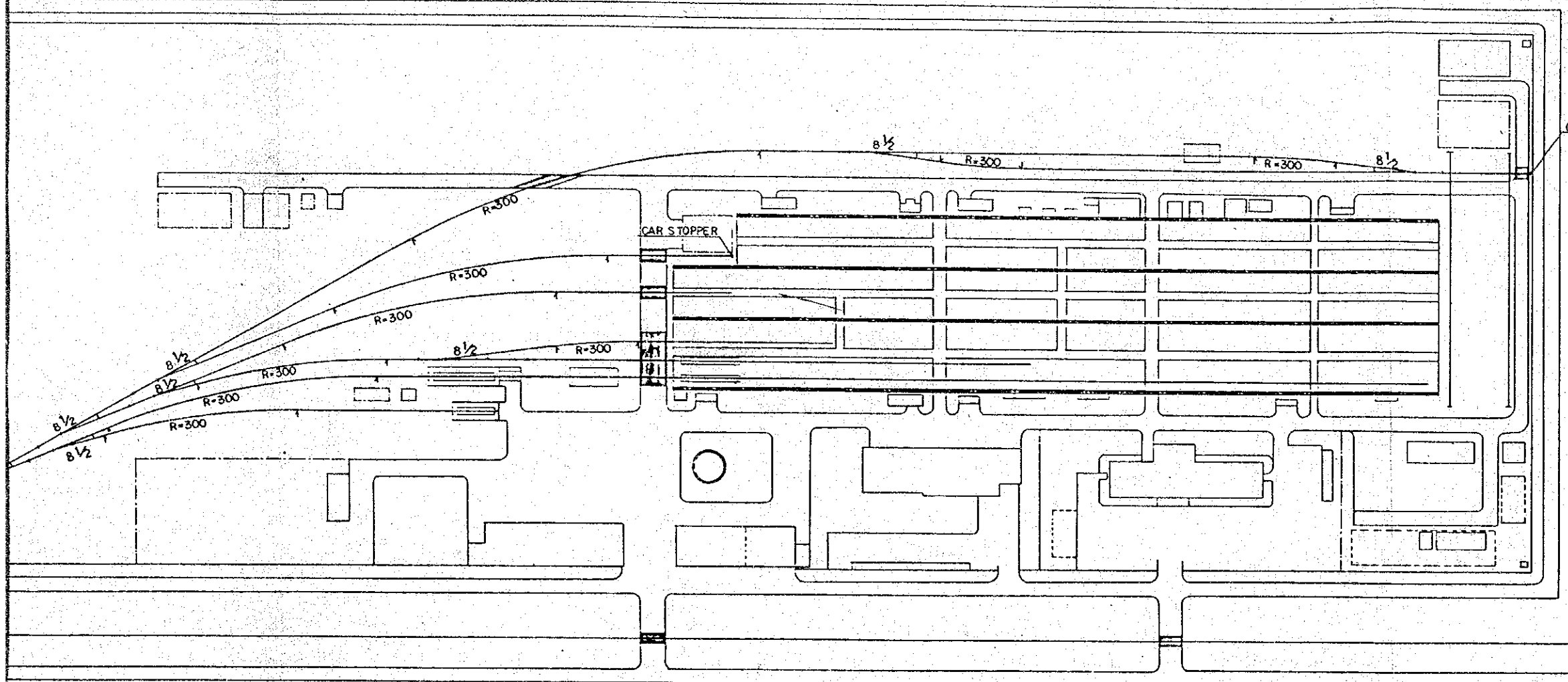
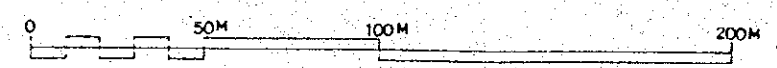
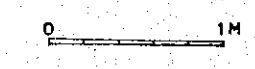
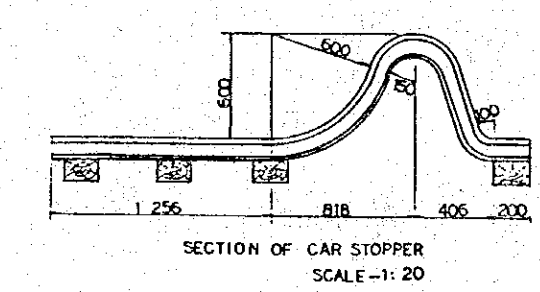
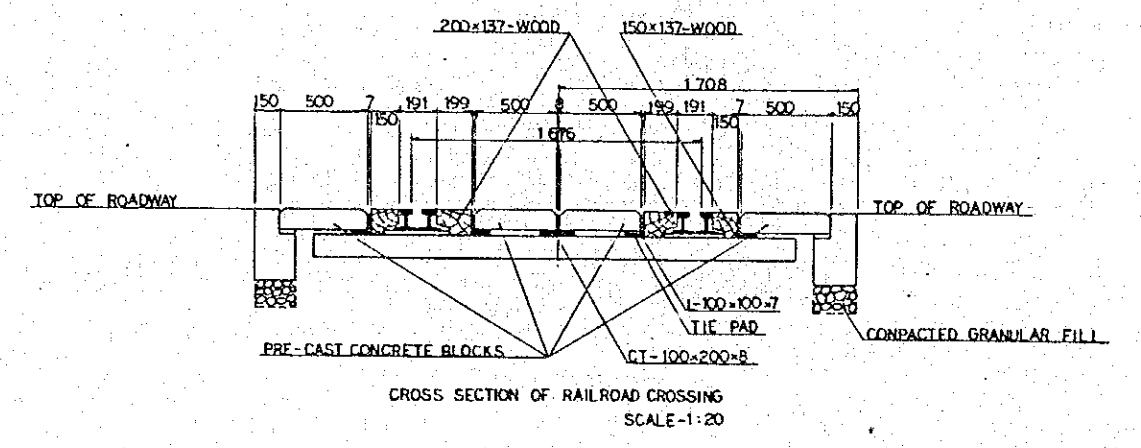
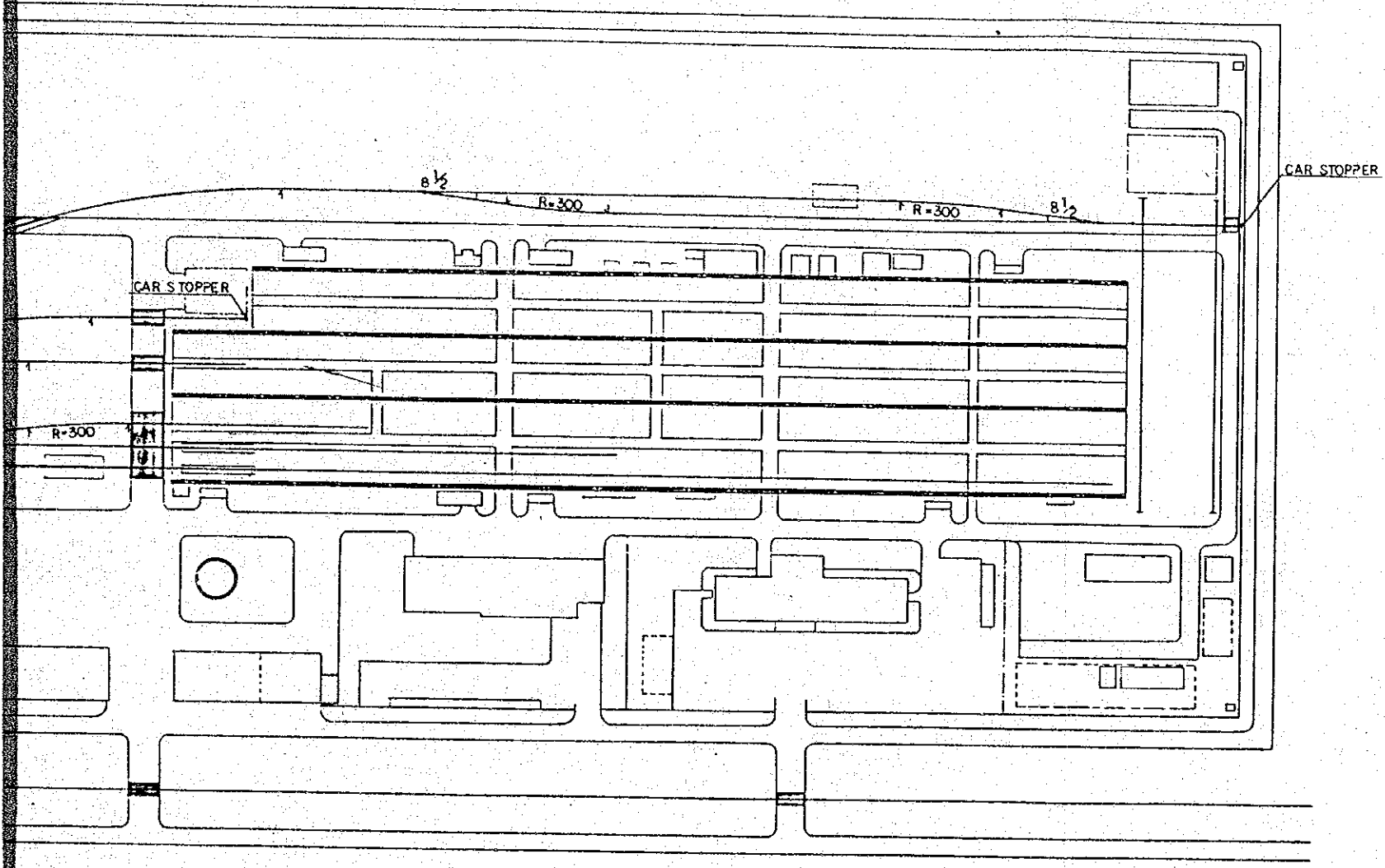

FIG. 2-1 LAYOUT OF TRACK  
SCALE - 1:1000





RACK  
1:1000

FIG. 2-1

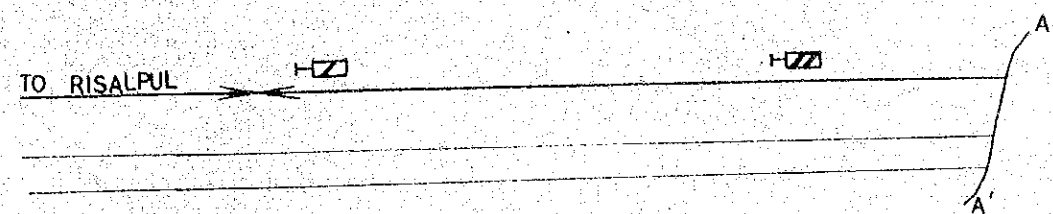

LEGEND	
SYMBOL	DESCRIPTION
⊕	CAR STOP SIGN
⌵	DUAL TYPE TURNOUT SWITCH
⌵	SWITCH INDICATOR
⌵-⌵-⌵	APPROACH WARNING SIGN

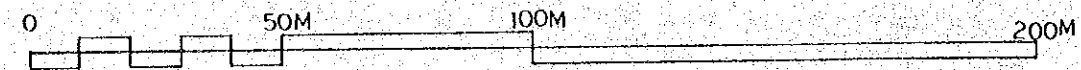
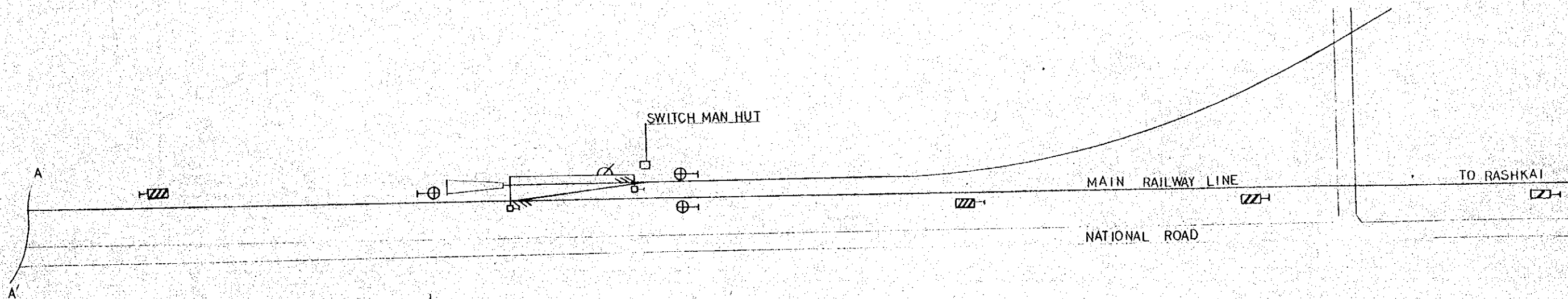

FIG 2-2 PLAN OF BRANCHING SYSTEM FOR FACTORY SIDING  
SCALE - 1 : 1000

FIG. 2-2