

SECTION 1:100

LEGEND

SYMBOLS	ITEMS
	AIR DUCT (GALVANIZED STEEL SHEET)
	AIR VOLUME DAMPER
	AIR CHAMBER
	SOUND ABSORBING AIR CHAMBER
	SOUND ABSORBING ELBOW
	SOUND ABSORBING TEE
	OUTLET
	OUTLET
	INLET
	INLET
	FLEXIBLE CANVAS DUCT
	SOUND PROOF DUCT (MORTAR 25t)

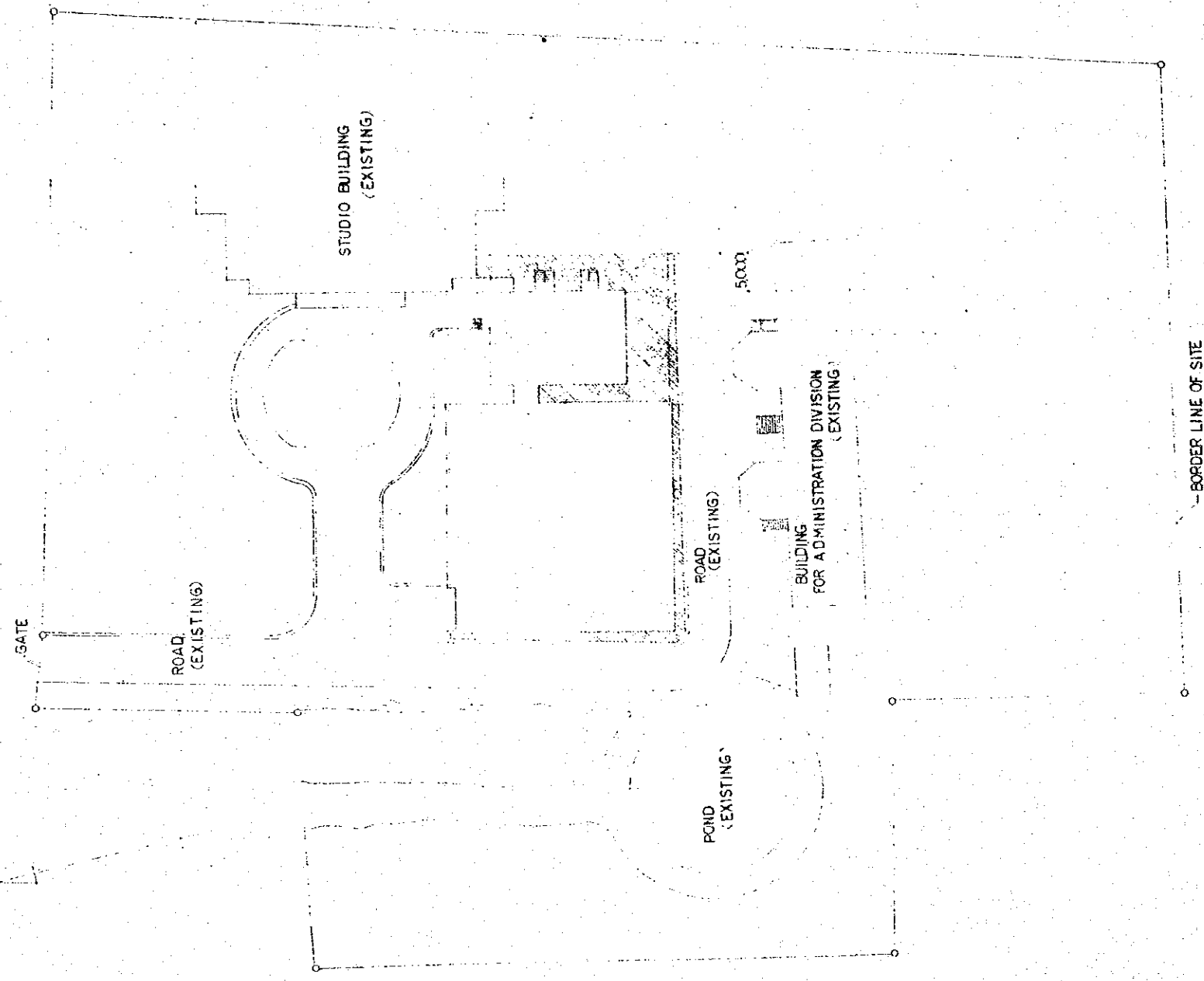

SITE PLAN 1:500

THE ESTABLISHMENT PROGRAMME OF MEDIUM WAVE BROADCASTING NETWORK IN THE KINGDOM OF NEPAL	
KATHMANDU STUDIO CENTRE	DRAWING NO. 15-102
TITLE OF DRAWING SITE PLAN, LEGEND & BUILDING SECTION	SCALE 1:100 1:500 1:1000
	DATE JAN 1981

LIST OF MACHINES

NO.	ITEM	SPECIFICATIONS	QTY	REMARKS
PAC-1	NO.1 HEAT PUMP PACKAGED AIR CONDITIONER (INDOOR UNIT)	FAN 8000 CMH x 25 MMAR (EXT. SP.) x 2.2 KW (3' 4" x 400V) COOLING CAPACITY 25910 KCAL/H HEATING CAPACITY 15810 KCAL/H COMPRESSOR 5.5 KW x 2 SUB-ELECTRIC HEATER 100 KW PAN-TYPE HUMIDIFIER 4.0 KW FAN 0.36 KW x 2	1	W/REMOTE CONTROL PANEL, REFRIGERANT PIPE, AIR FILTER VA-50S & VIBRATION PROTECTION (PAD) LOCATION: AIR CONDITIONER ROOM LOCATION: OUTDOOR (IN FRONT OF POWER ROOM)
PAC-2	NO.2 HEAT PUMP PACKAGED AIR CONDITIONER (INDOOR UNIT)	FAN 11750 CMH x 15 MMAR (EXT. SP.) x 3.7 KW (3' 4" x 400V) COOLING CAPACITY 34950 KCAL/H HEATING CAPACITY 26790 KCAL/H COMPRESSOR 7.5 KW x 2 SUB-ELECTRIC HEATER 150 KW PAN-TYPE HUMIDIFIER 4.0 KW FAN 0.36 KW x 2	1	W/REMOTE CONTROL PANEL, REFRIGERANT PIPE & AIR FILTER VA-50S LOCATION: BUILDING EQUIPMENT ROOM LOCATION: OUTDOOR (IN FRONT OF BUILDING EQUIPMENT ROOM)
AHU-1	NO.1 AIR HANDLING UNIT	FAN 3040 CMH x 70 MMAR (EXT. SP.) x 2.2 KW (3' 4" x 400V) HEATING CAPACITY 15530 KCAL/H ELECTRIC HEATER 160 KW (3' KW x 4 + 2' KW x 2) HUMIDIFYING VOLUME 167 KG/H WATER SPRAY TYPE HUMIDIFIER (HIGH PRESSURE) 1' 200V 80W	1	W/AIR FILTER VA-50S & VIBRATION PROTECTION (PAD) LOCATION: AIR CONDITIONER ROOM
AHU-2	NO.2 AIR HANDLING UNIT	FAN 6300 CMH x 55 MMAR (EXT. SP.) x 3.7 KW (3' 4" x 400V) HEATING CAPACITY 38950 KCAL/H ELECTRIC HEATER 450 KW (5' KW x 5 + 4' KW x 1) HUMIDIFYING VOLUME 133 KG/H WATER SPRAY TYPE HUMIDIFIER (HIGH PRESSURE) 1' 200V 80W	1	W/AIR FILTER VA-50S LOCATION: BUILDING EQUIPMENT ROOM
NOTE	AIR FILTER EQUAL TO 100% OF THE NUMBER OF FILTERS IN SERVICE.			

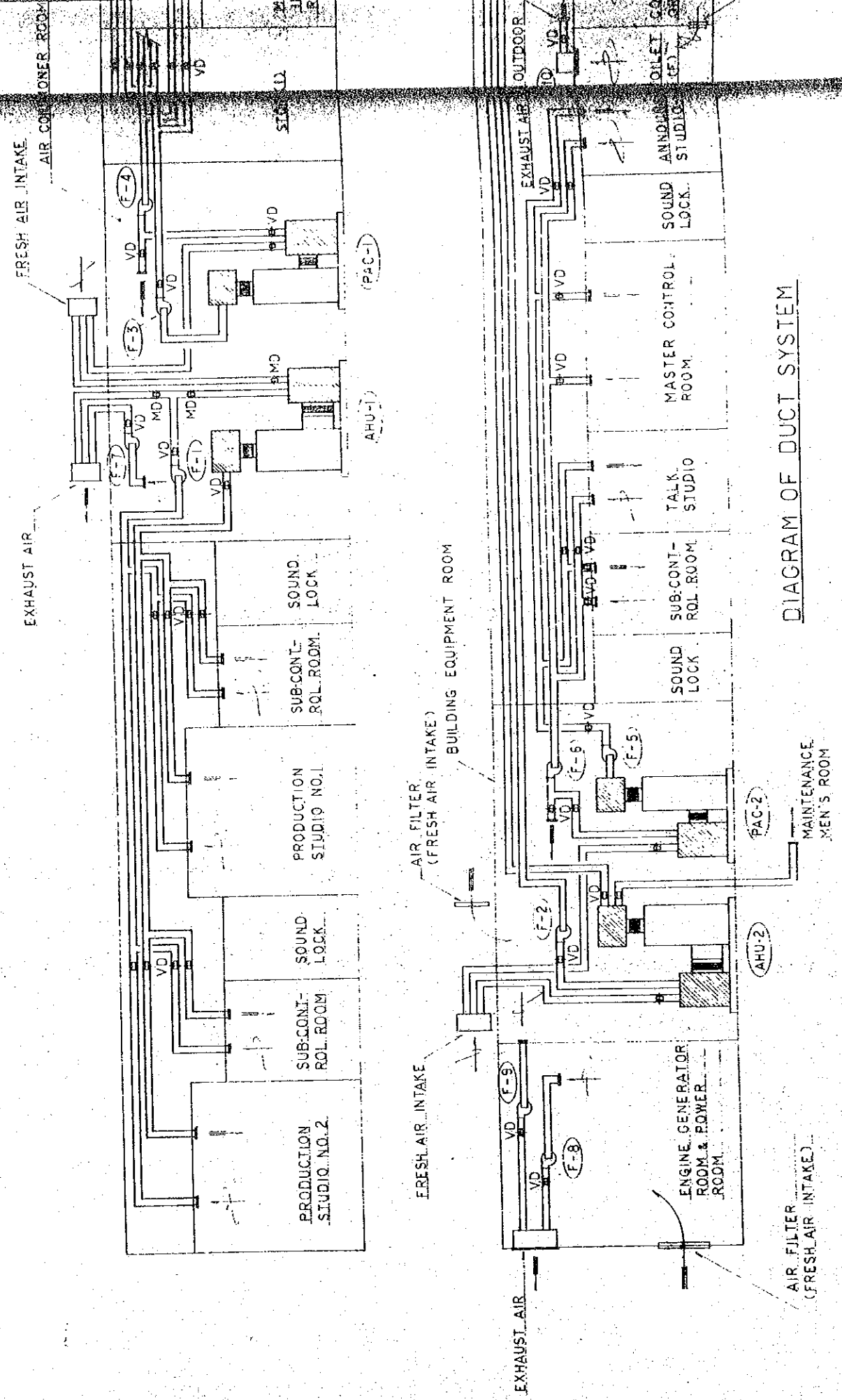
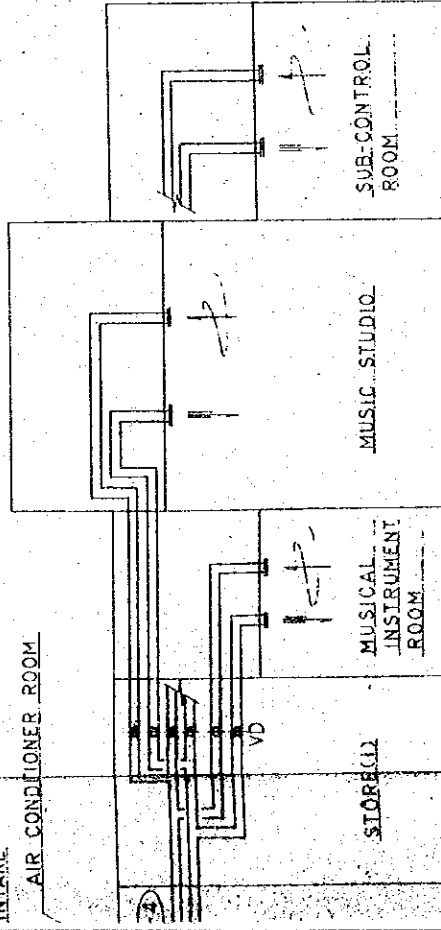

DIAGRAM OF DUCT SYSTEM

	NO.	ITEM	SPECIFICATIONS	QTY	REMARKS
PANEL, AIR FILTER PROTECTOR	F-1	NO. 1 RETURN FAN	MULTIBLADE FAN (HUNG FROM SLAB ABOVE) NO. 2 SS. x 3040 CMH x 70 MMAg (EXT. SP.) x 1.5 KW (3 ^φ 4 ^W 400V)	1	W/VIBRATION PROTECTION LOCATION: AIR CONDITIONER ROOM
FLUORESCENT LIGHT FIXTURE	F-2	NO. 2 RETURN FAN	MULTIBLADE FAN (HUNG FROM SLAB ABOVE) NO. 2 1/2 SS. x 5325 CMH x 45 MMAg (EXT. SP.) x 2.2 KW (3 ^φ 4 ^W 400V)	1	W/VIBRATION PROTECTION LOCATION: BUILDING EQUIPMENT ROOM
FLUORESCENT LIGHT FIXTURE	F-3	NO. 3 BOOSTER FAN	MULTIBLADE FAN (HUNG FROM SLAB ABOVE) NO. 2 1/2 SS. x 8000 CMH x 60 MMAg (EXT. SP.) x 5.5 KW (3 ^φ 4 ^W 400V)	1	W/VIBRATION PROTECTION LOCATION: AIR CONDITIONER ROOM
FLUORESCENT LIGHT FIXTURE	F-4	NO. 4 RETURN FAN	MULTIBLADE FAN (HUNG FROM SLAB ABOVE) NO. 3 SS. x 8000 CMH x 70 MMAg (EXT. SP.) x 5.5 KW (3 ^φ 4 ^W 400V)	1	DITTO
FLUORESCENT LIGHT FIXTURE	F-5	NO. 5 BOOSTER FAN	MULTIBLADE FAN (HUNG FROM SLAB ABOVE) NO. 3 SS. x 11750 CMH x 60 MMAg (EXT. SP.) x 5.5 KW (3 ^φ 4 ^W 400V)	1	W/VIBRATION PROTECTION LOCATION: BUILDING EQUIPMENT ROOM
FLUORESCENT LIGHT FIXTURE	F-6	NO. 6 RETURN FAN	MULTIBLADE FAN (HUNG FROM SLAB ABOVE) NO. 3 SS. x 11750 CMH x 70 MMAg (EXT. SP.) x 5.5 KW (3 ^φ 4 ^W 400V)	1	DITTO
FLUORESCENT LIGHT FIXTURE	F-7	NO. 7 EXHAUST FAN	MULTIBLADE FAN (HUNG FROM SLAB ABOVE) NO. 1 SS. x 700 CMH x 10 MMAg (EXT. SP.) x 0.2 KW (3 ^φ 4 ^W 400V)	1	W/VIBRATION PROTECTION LOCATION: AIR CONDITIONER ROOM
FLUORESCENT LIGHT FIXTURE	F-8	NO. 8 EXHAUST FAN	MULTIBLADE FAN (HUNG FROM SLAB ABOVE) NO. 2 SS. x 5240 CMH x 30 MMAg (EXT. SP.) x 1.5 KW (3 ^φ 4 ^W 400V)	1	W/VIBRATION PROTECTION LOCATION: ENGINE GENERATOR & POWER ROOM
FLUORESCENT LIGHT FIXTURE	F-9	NO. 9 EXHAUST FAN	MULTIBLADE FAN (HUNG FROM SLAB ABOVE) NO. 1 1/2 SS. x 1620 CMH x 20 MMAg (EXT. SP.) x 0.4 KW (3 ^φ 4 ^W 400V)	1	DITTO
FLUORESCENT LIGHT FIXTURE	F-10	NO. 10 EXHAUST FAN	VENTILATING FAN 265 CMH x 6 MMAg x 47 W (1 ^φ 2 ^W 230V)	1	W/GRILLE & VENICAP LOCATION: TOILET (CF)
FLUORESCENT LIGHT FIXTURE	F-11	NO. 11 EXHAUST FAN	VENTILATING FAN 410 CMH x 6 MMAg x 145 W (1 ^φ 2 ^W 230V)	1	W/GRILLE & VENICAP LOCATION: TOILET (CM)

INTAKE

AIR CONDITIONER ROOM



DESIGN CONDITION

OUTDOOR CONDITION

SEASON	D.B.(°C)	W.B.(°C)	R.H.(%)
SUMMER	29.0	21.7	65.0
WINTER	1.2	- 0.5	70.0

AIR CONDITION AT INLETS OF PAC-1 & PAC-2

PAC-1 INLET TEMPERATURE

SEASON	D.B.(°C)	W.B.(°C)
SUMMER	27.2	19.8
WINTER	18.5	12.9

PAC-2 INLET TEMPERATURE

SEASON	D.B.(°C)	W.B.(°C)
SUMMER	27.2	19.8
WINTER	19.1	13.2

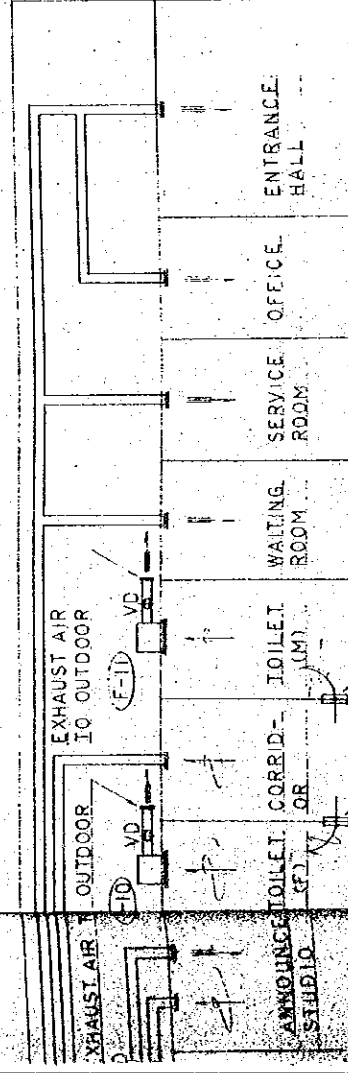

DOOR GRILLE (BUILDING WORKS)

THE ESTABLISHMENT PROGRAMME OF MEDIUM WAVE BROADCASTING NETWORK IN THE KINGDOM OF NEPAL		DRAWING NO. H-03
KATHMANDU STUDIO CENTRE		SCALE
TITLE OF DRAWING LIST OF MACHINES & DIAGRAM OF DUCT SYSTEM		DATE JAN 1981

PAC-1 SYSTEM

OUTLET	
SUB-CONTROL ROOM	
PE-30	2
880 CMH	
600x600x400H	

INLET	
SUB-CONTROL ROOM	
H-550x550	1
1360 CMH	
850x850x450H	

OUTLET	
MUSICAL INSTRUMENT ROOM	
PE-20	4
370 CMH	
400x400x350H	

INLET	
MUSICAL INSTRUMENT ROOM	
H-550x500	1
1480 CMH	
850x800x500H	

PAC-2 SYSTEM

OUTLET	
MASTER-CONTROL ROOM	
PE-30	10
765 CMH	
600x600x400H	
BL-0(2000)	4
500 CMH	
2300x400x400H	

INLET	
MASTER-CONTROL ROOM	
H-700x700	2
3220 CMH	
1000x1000x550H	
H-700x700	1
3210 CMH	
1000x1000x550H	

OUTLET	
ANNOUNCE STUDIO	
PE-25	2
200 CMH	
500x500x350H	

INLET	
ANNOUNCE STUDIO	
H-400x350	1
400 CMH	
700x650x350H	

OUTLET	
TALK STUDIO	
PE-25	4
200 CMH	
400x400x350H	

INLET	
TALK STUDIO	
H-550x550	1
800 CMH	
850x850x450H	

OUTLET	
SUB-CONTROL ROOM	
PE-25	2
450 CMH	
500x500x400H	

INLET	
SUB-CONTROL ROOM	
H-450x450	1
900 CMH	
750x750x450H	

LEGEND

ITEM	
ROOM NAME	
DIFFUSERS OR INTAKES	QTY
AIR VOLUME	
SIZE OF AIR CHAMBER	

AIR CHAMBER: W/GLASS WOOL
25 THICK

Y6 1200W x 1200L CONCRETE

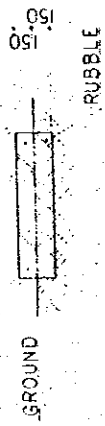

DETAIL OF CONCRETE BASE

Y5 1:40

ENGINEER ROOM POWER ROOM

OUTDOOR UNIT (PAC-1)
CONCRETE BASE
1200W x 1200L x 150H

SEE DETAIL OF BUILDING EQUIPMENT ROOM

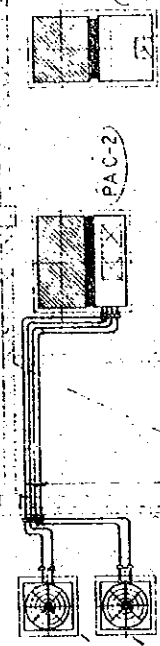

Y4

REFRIGERANT PIPE (25, 4, 19.1, 22 SETS)

SEE DETAIL OF BUILDING EQUIPMENT ROOM

OUTDOOR UNIT (PAC-2)
CONCRETE BASE
1200W x 1200L x 150H

Y3

STORE (2)

Y2

Y1

LIST OF FLEXIBLE CONNECTION MATERIAL: ASBESTOS CLOTH

NO.	SIZE	QTY
1	250 x 230 x 200 L	2
2	250 x 210 x 200 L	2
3	950 x 450 x 500 L	2
4	250 x 240 x 200 L	2
5	200 x 160 x 200 L	2
6	600 x 400 x 500 L	2

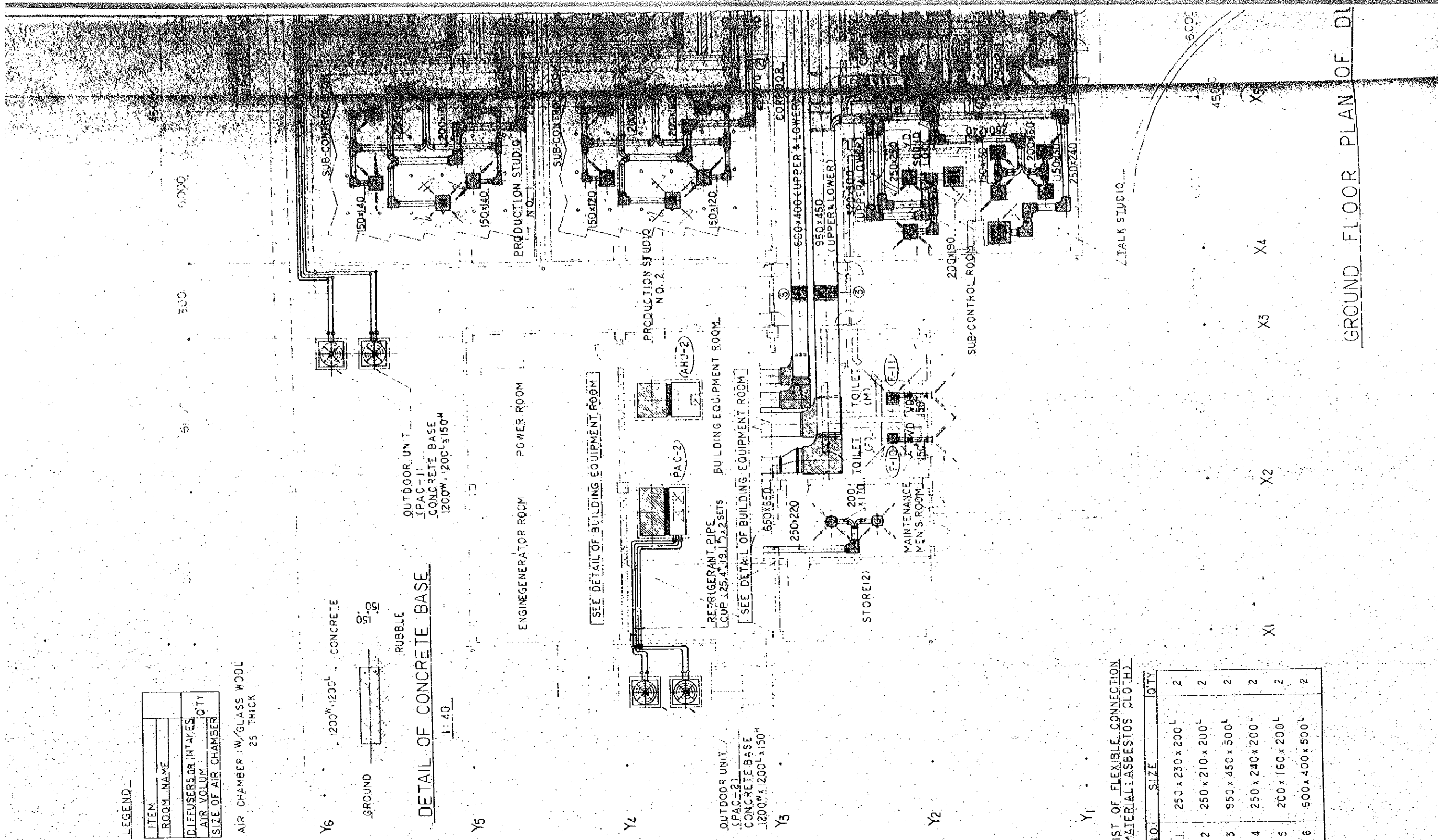

GROUND FLOOR PLAN OF DI

AHU-1 SYSTEM

OUTLET	
PRODUCTION STUDIO NO.1	
PE-25	
220 CMH	
500x500x350H	4

INLET	
PRODUCTION STUDIO NO.1	
H-300x300	
440 CMH	
600x600x400H	2

OUTLET	
SUB-CONTROL ROOM	
PE-25	
380 CMH	
500x500x350H	2

INLET	
SUB-CONTROL ROOM	
H-450x400	
750 CMH	
750x700x400H	1

OUTLET	
PRODUCTION STUDIO NO.2	
PE-25	
190 CMH	
500x500x350H	4

INLET	
PRODUCTION STUDIO NO.2	
H-300x300	
380 CMH	
600x600x400H	2

OUTLET	
SUB-CONTROL ROOM	
PE-25	
320 CMH	
500x500x350H	2

INLET	
SUB-CONTROL ROOM	
H-400x400	
840 CMH	
700x700x400H	1

AHU-2 SYSTEM

OUTLET	
ENTRANCE HALL	
PE-25	
550 CMH	
500x500x400H	4

BL-S (1500)	
150 CMH	
1800x400x500H	2

BL-S (3500)	
500 CMH	
400x400x550H	1

OUTLET	
OFFICE	
C-2-30	
660 CMH	
600x600x400H	1

OUTLET	
SERVICE ROOM	
C-2-20	
300 CMH	
400x400x350H	2

INLET	
CORRIDOR	
H-900x850	
5325 CMH	
1200x1150x700H	1

OUTLET	
WAITING ROOM	
PE-20	
450 CMH	
400x400x400H	2

OUTLET	
MAINTENANCE MEN'S ROOM	
C-2-20	
420 CMH	
400x400x400H	2

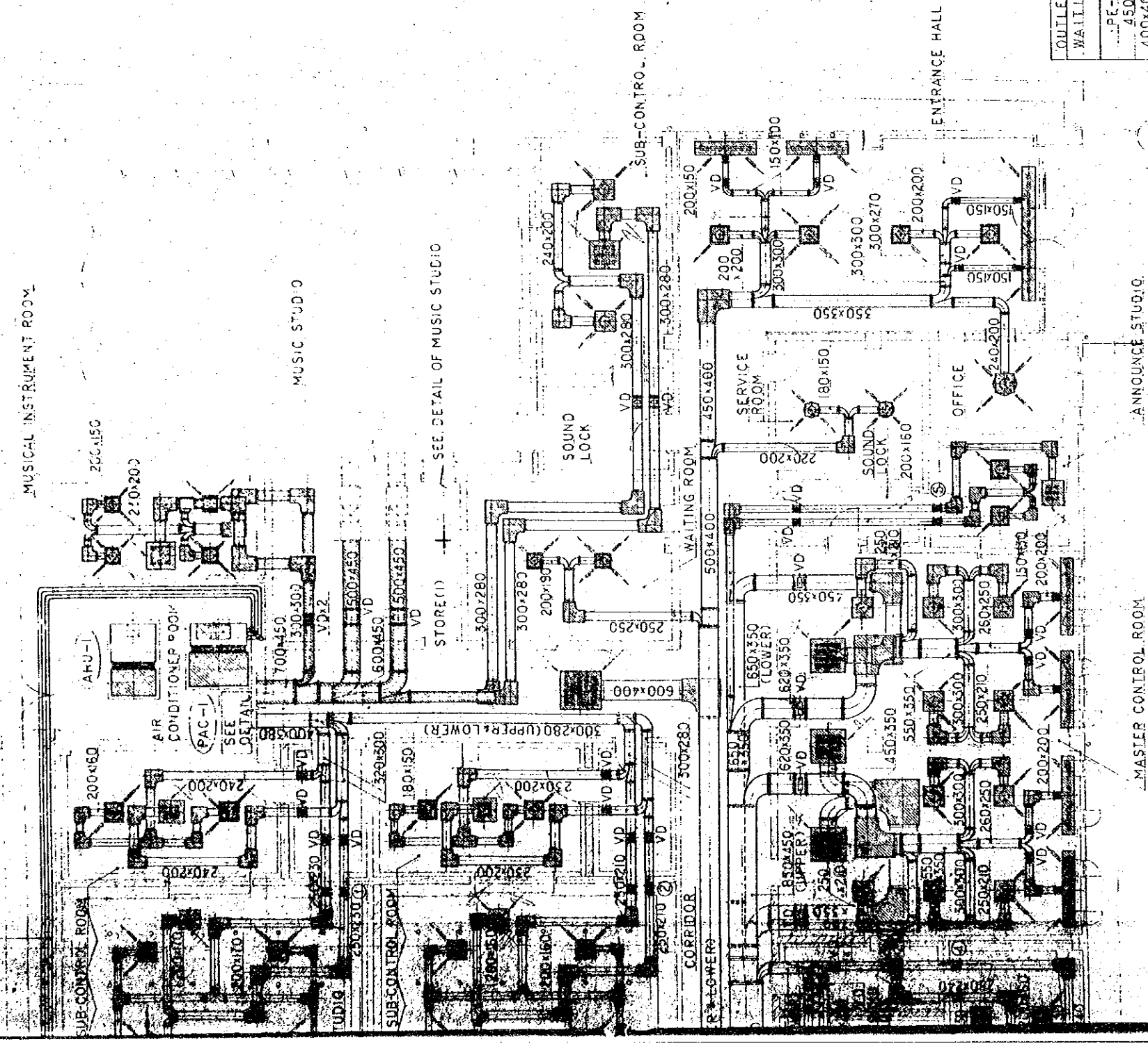

THE ESTABLISHMENT PROGRAMME
OF
MEDIUM WAVE BROADCASTING NETWORK
IN
THE KINGDOM OF NEPAL

KATHMANDU STUDIO CENTRE

DRAWING NO. H-104

SCALE 1:100 UNIT m.m

DATE JAN '1981

TITLE OF DRAWING

GROUND FLOOR PLAN OF DUCT WORK

PLAN OF DUCT WORK 1:100

X1 6000 12,000 6000

X2 6000

X3

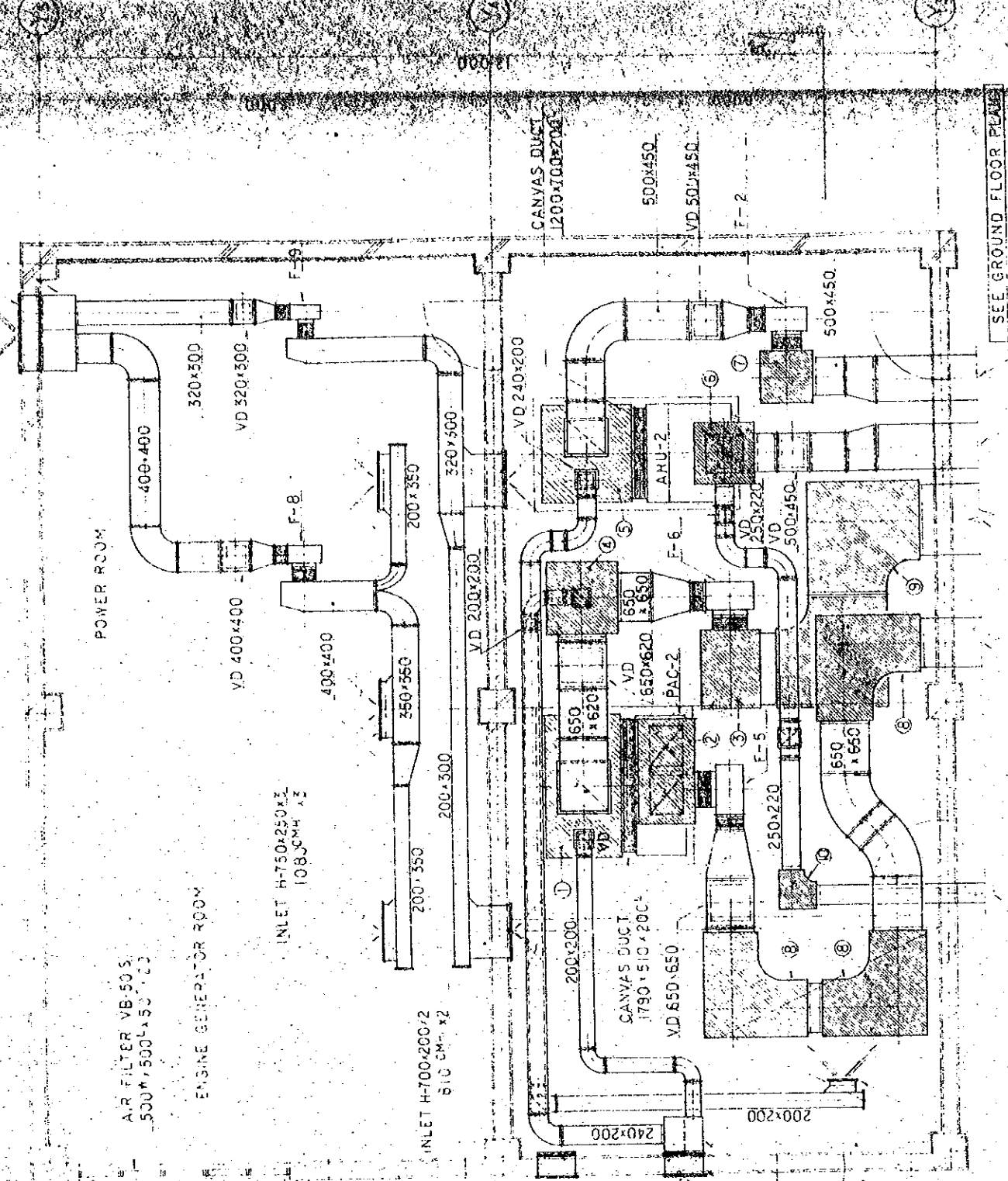

EXHAUST LOUVER
1000W x 700H (BUILDING WORKS)
CHAMBER
1000W x 500H x 700H

POWER ROOM

ENGINE GENERATOR ROOM

AIR FILTER VB-50 S.
500W x 500L x 50H

INLET H-750x250x2
108 CMH x 2

INLET H-700x200x2
810 CMH x 2

FRESH AIR INTAKE LOUVER
500W x 500H (BUILDING WORKS)

AIR FILTER VA-50 S.
500W x 500L x 50H

EXHAUST LOUVER
500W x 500H (BUILDING WORKS)

CHAMBER
500W x 500L x 500H

BUILDING EQUIPMENT ROOM

SEE GROUND FLOOR PLAN

OUTLET VHS-350x150x1
550 CMH

AHU-2 SUPPLY DUCT
FOR MAINTENANCE MEN'S
ROOM: 250x220

PAC-2 SUPPLY DUCT
650x650

PAC-2 RETURN DUCT
950x450

AHU-2 RETURN DUCT
600x400

AHU-2 SUPPLY DUCT
600x400

DETAIL OF DUCT WORK IN BUILDING EQUIPMENT ROOM & POWER ROOM 1:50

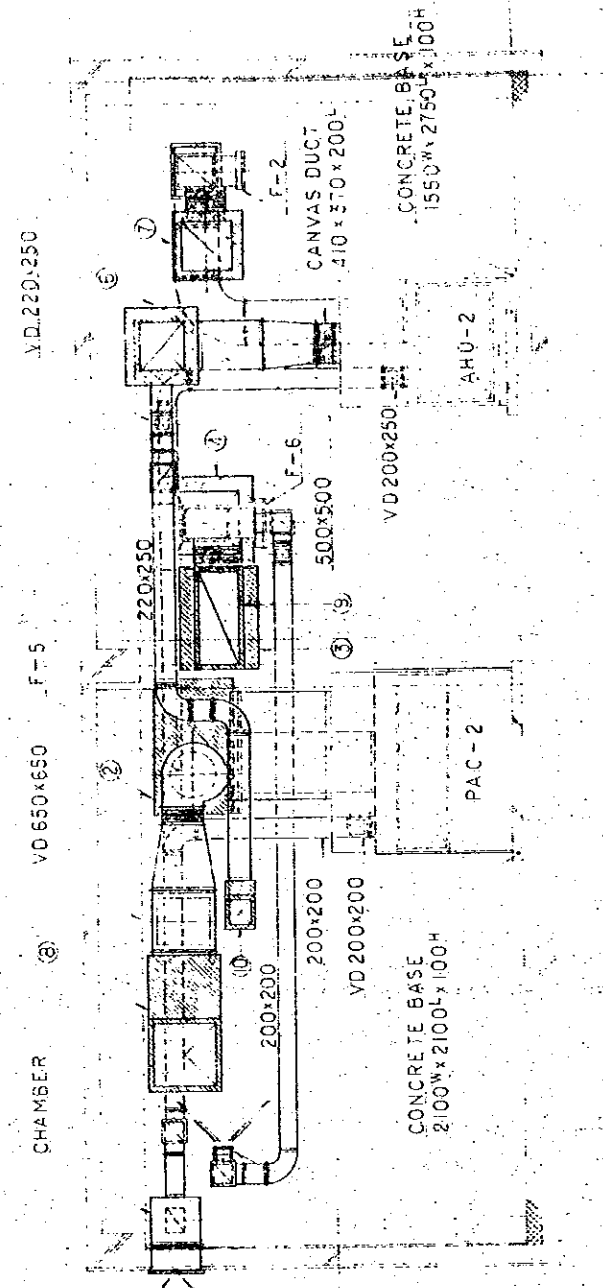

CHAMBER

VD 650x650

VD 220x250

OUTLET

CONCRETE BASE
2100W x 2100L x 100H

VD 200x200

VD 200x250

CONCRETE BEAM
1550W x 2750L x 100H

LIST

F-1
F-2
F-3
F-4
F-5
F-6
F-7
F-8
F-9

A-A SECTION DETAIL 1:50

EXHAUST LOUVER
1100W x 500H (BUILDING WORKS)

CHAMBER
1100W x 500L x 500H

FRESH AIR INTAKE LOUVER
1500W x 500H (BUILDING WORKS)

CHAMBER
1500W x 500L x 500H

LIST OF CHAMBER AND SOUND ABSORBING ELBOW

NO.	ITEM	W	L	H
1	RETURN CHAMBER	1900	1000	1400
2	SUPPLY CHAMBER	1400	700	800
3	CHAMBER	1050	800	800
4		950	950	950
5	RETURN CHAMBER	1350	1200	1000
6	SUPPLY CHAMBER	800	800	800
7	CHAMBER	700	700	700
8	SOUND ABSORBING ELBOW	1400	1400	750
9		1500	1500	550
10		500	500	320
11	RETURN CHAMBER	1700	1000	1300
12	SUPPLY CHAMBER	1300	800	600
13	CHAMBER	800	500	1000
14	RETURN CHAMBER	1350	800	1000
15	SUPPLY CHAMBER	800	800	600
16	SOUND ABSORBING ELBOW	1200	1200	650
17		830	830	480
18	CHAMBER	600	500	600

EXHAUST LOUVER
1100W x 500H (BUILDING WORKS)

CHAMBER
1100W x 500L x 500H

FRESH AIR INTAKE LOUVER
1500W x 500H (BUILDING WORKS)

CHAMBER
1500W x 500L x 500H

DETAIL OF DUCT WORK IN AIR CONDITIONER ROOM 1:50

(UPPER)
AHU-1 RETURN DUCT 400x380
(LOWER)
AHU-1 SUPPLY DUCT 400x380

(UPPER)
PAC-1 RETURN DUCT 700x450
(LOWER)
PAC-1 SUPPLY DUCT 700x450

VAS DUCT
200x250

VAS DUCT
200x250

FLOOR PLAN
DUCT

DUCT

DETAIL OF DUCT WORK IN AIR CONDITIONER ROOM 1:50

(UPPER)
AHU-1 RETURN DUCT 400x380
(LOWER)
AHU-1 SUPPLY DUCT 400x380

(UPPER)
PAC-1 RETURN DUCT 700x450
(LOWER)
PAC-1 SUPPLY DUCT 700x450

LIST OF CANVAS DUCT (FAN)

F-1	OUTLET	280x250x200L
	SUCTION	320 ϕ x200L
F-2	OUTLET	360x310x200L
	SUCTION	395 ϕ x200L
F-3	OUTLET	360x310x200L
	SUCTION	395 ϕ x200L
F-4	OUTLET	430x370x200L
	SUCTION	475 ϕ x200L
F-5	OUTLET	430x370x200L
	SUCTION	475 ϕ x200L
F-6	OUTLET	450x370x200L
	SUCTION	475 ϕ x200L
F-7	OUTLET	165x130x200L
	SUCTION	130 ϕ x200L
F-8	OUTLET	280x250x200L
	SUCTION	320 ϕ x200L
F-9	OUTLET	240x190x200L
	SUCTION	205 ϕ x200L

* AIR DUCTS IN THE AIR CONDITIONER ROOM & BUILDING EQUIPMENT ROOM SHALL BE SOUND PROOF DUCTS.

THE ESTABLISHMENT PROGRAMME OF MEDIUM WAVE BROADCASTING NETWORK IN THE KINGDOM OF NEPAL		DRAWING NO.	H-105
KATHMANDU STUDIO CENTRE		SCALE	1:50 M/F
TITLE OF DRAWING DETAIL OF DUCT WORK IN AIR CONDITIONER ROOM & POWER ROOM		DATE	JAN' 1981

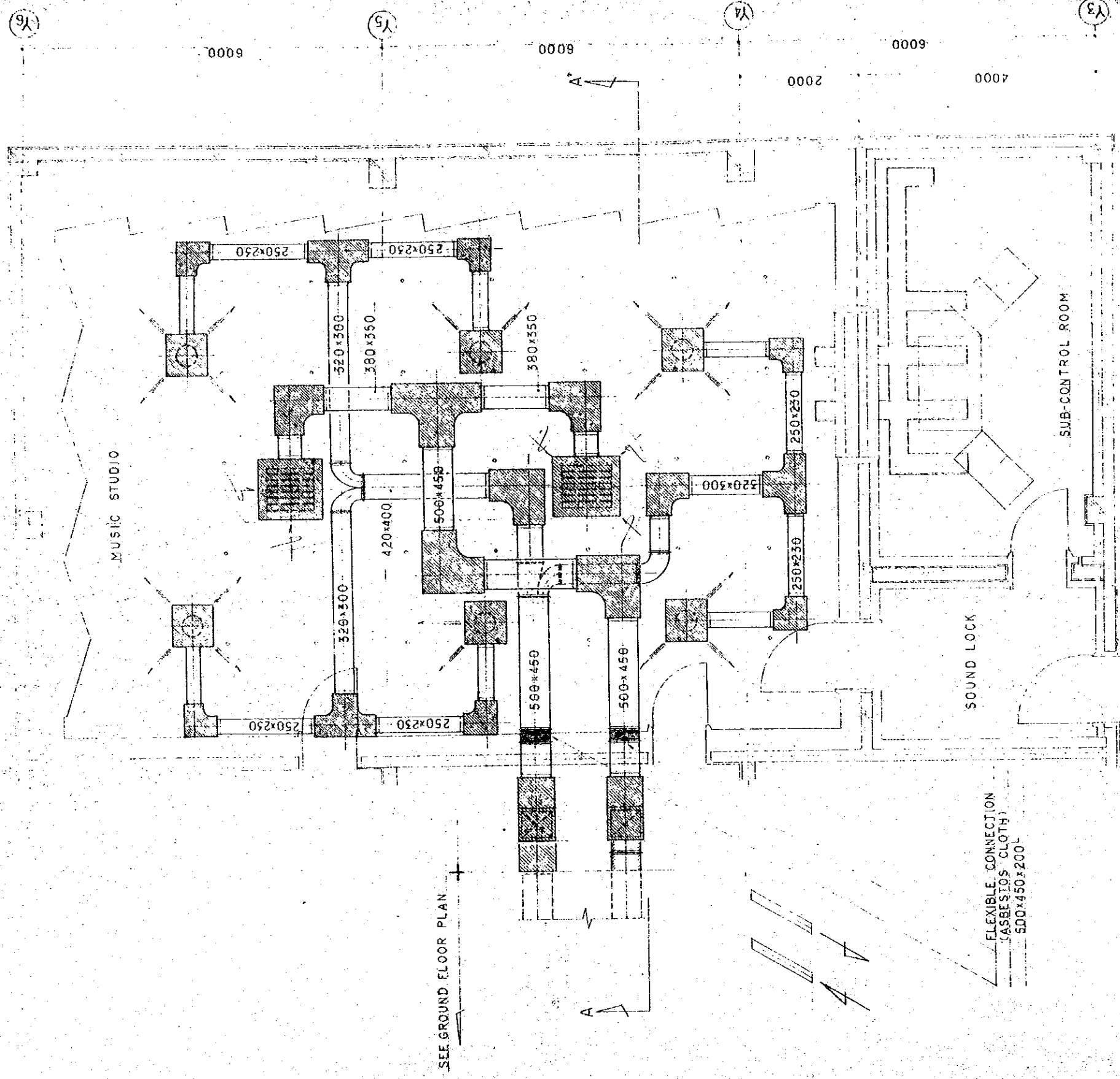

LISTS	PER. SIZE
OUTLET	PER. SIZE
INLET	PER. SIZE
VOLUME	PER. SIZE

DETAIL OF DUCT WORK IN MUSIC STUDIO 1:50

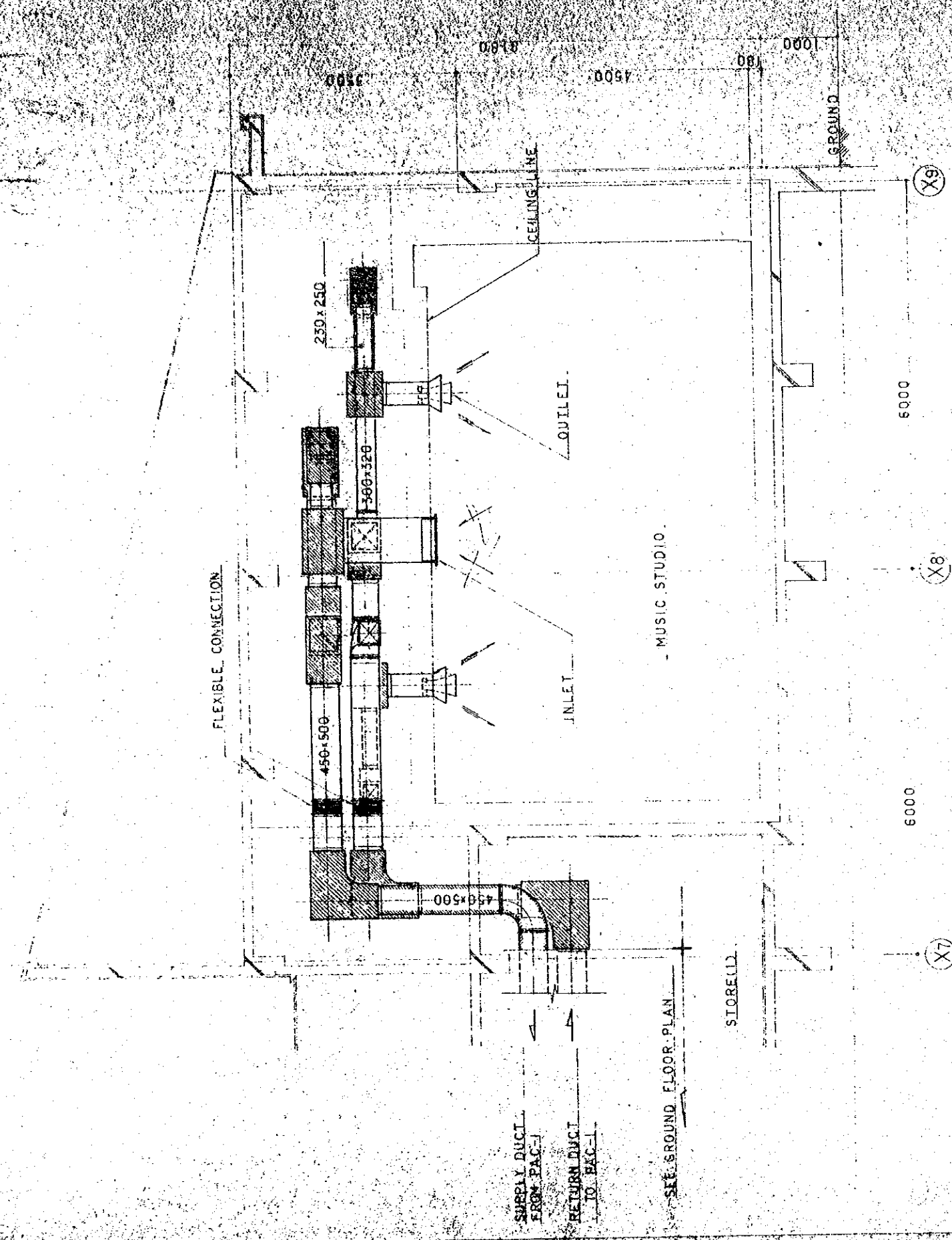

A-A SECTION DETAIL 1:50

DIFFUSER INTAKE

NOZZLE	NOZZLE 350*	QTY	6
PIPE VOLUME	860 CMH		
CHAMBER SIZE	700x700x550H		
TYPE	H-800x700		
PIPE VOLUME	2580 CMH	QTY	2
CHAMBER SIZE	1100x1000x650H		

THE ESTABLISHMENT PROGRAMME MEDIUM WAVE BROADCASTING NETWORK IN THE KINGDOM OF NEPAL		DRAWING NO. F-06
KATHMANDU STUDIO CENTRE		SCALE 1:50
TITLE OF DRAWING DETAIL OF DUCT WORK IN MUSIC STUDIO		DATE JAN 1981

A	2	(19)	LI
2 nd	x	6	(25) INT.COMPX2
2 nd	x	2	(19) T3
2 nd	x	2	(19) LI
2 nd	x	2	(19) WS
B	3	(19)	LI
2 nd	x	34	(51) T2X3.T3.HIX2
2 nd	x		EHX3.AC.INT.
C	28	(51)	TD1.D2.M01
2 nd	x	22	(51) T2X3.HLIX2
2 nd	x	5	(19) INT.COMPX2.AC
2 nd	x	18	(59) T2X3.HLIX2
2 nd	x	2	(19) INT.COMPX2.AC
2 nd	x	2	(19) WS
D	2	(19)	LI
2 nd	x	6	(25) M01
2 nd	x	6	(25) O1
2 nd	x	5	(25) M02
2 nd	x	5	(25) M02
2 nd	x	3	(19) T01
2 nd	x	5	(19) T02
2 nd	x	2	(19) WS
E	2	(19)	LI
2 nd	x	6	(25) INT.COMPX2

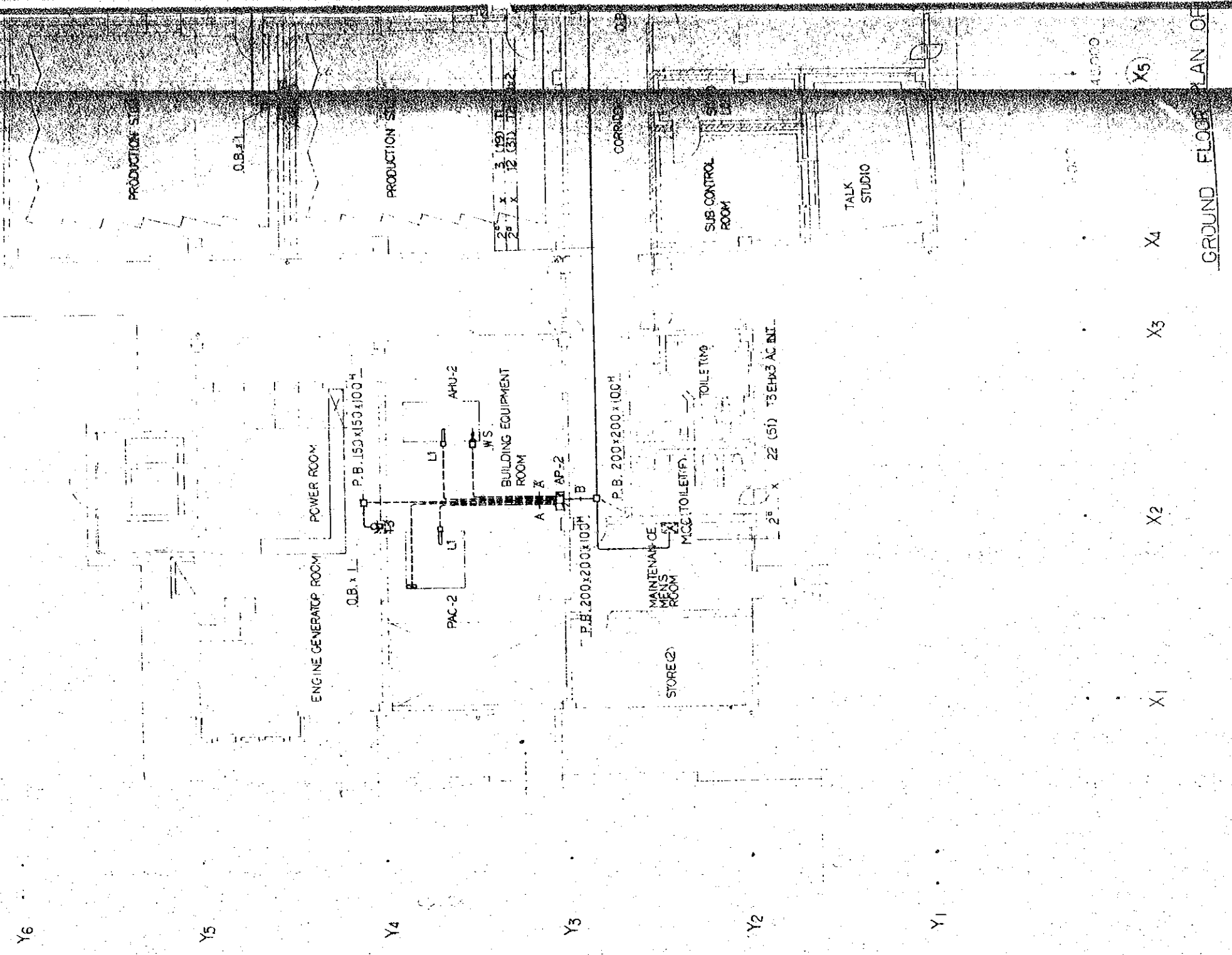

GROUND FLOOR PLAN OF

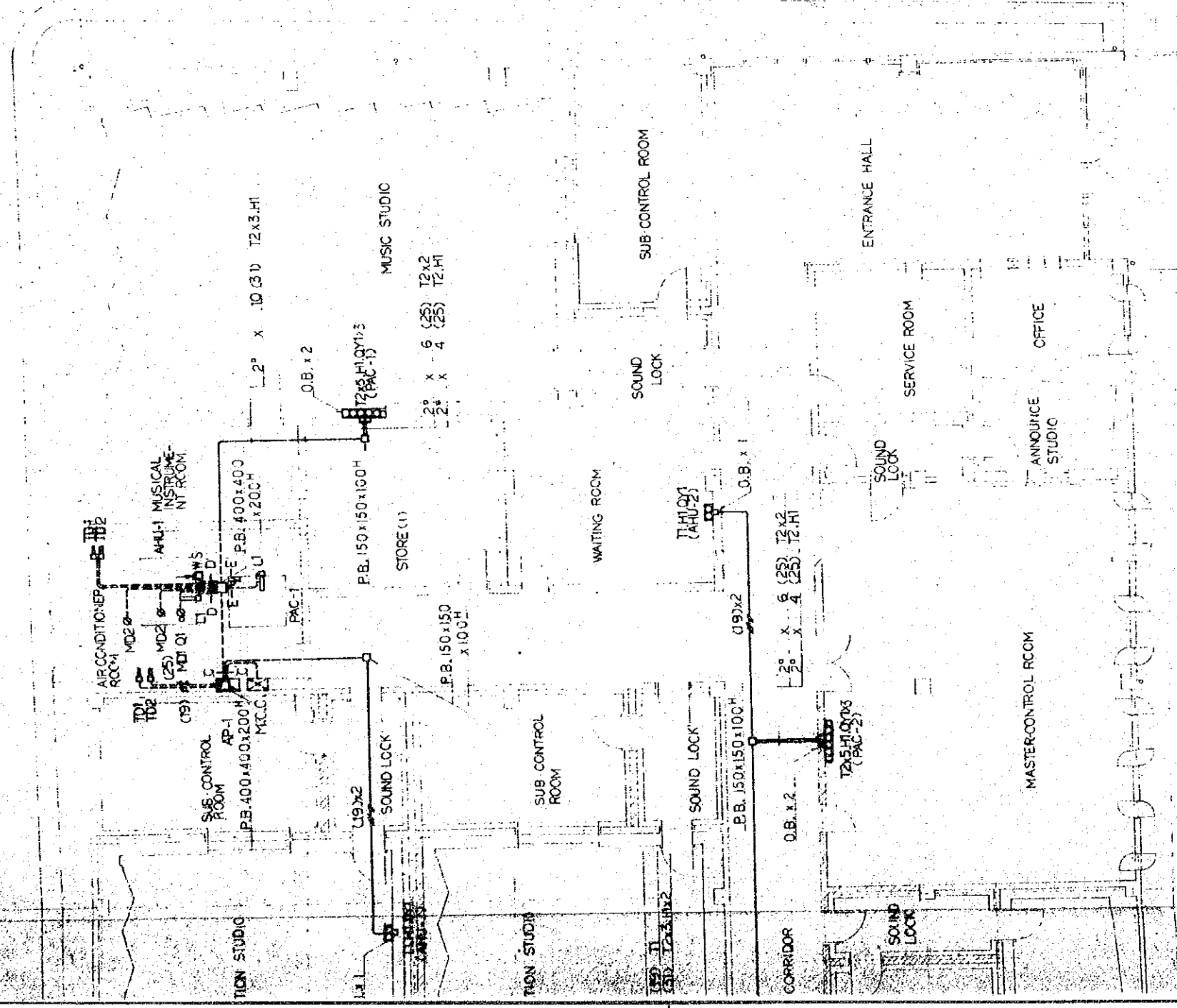

THE ESTABLISHMENT PROGRAMME OF MEDIUM WAVE BROADCASTING NETWORK IN THE KINGDOM OF NEPAL		DRAWING NO. H-107
KATHMANDU STUDIO CENTRE		SCALE 1:100
TITLE OF DRAWING GROUND FLOOR PLAN OF AUTOMATIC CONTROL SYSTEM		UNIT METRE
		DATE JAN 1981

FLOOR PLAN OF AUTOMATIC CONTROL SYSTEM 1:100

X6

X7

X6

X5

X9

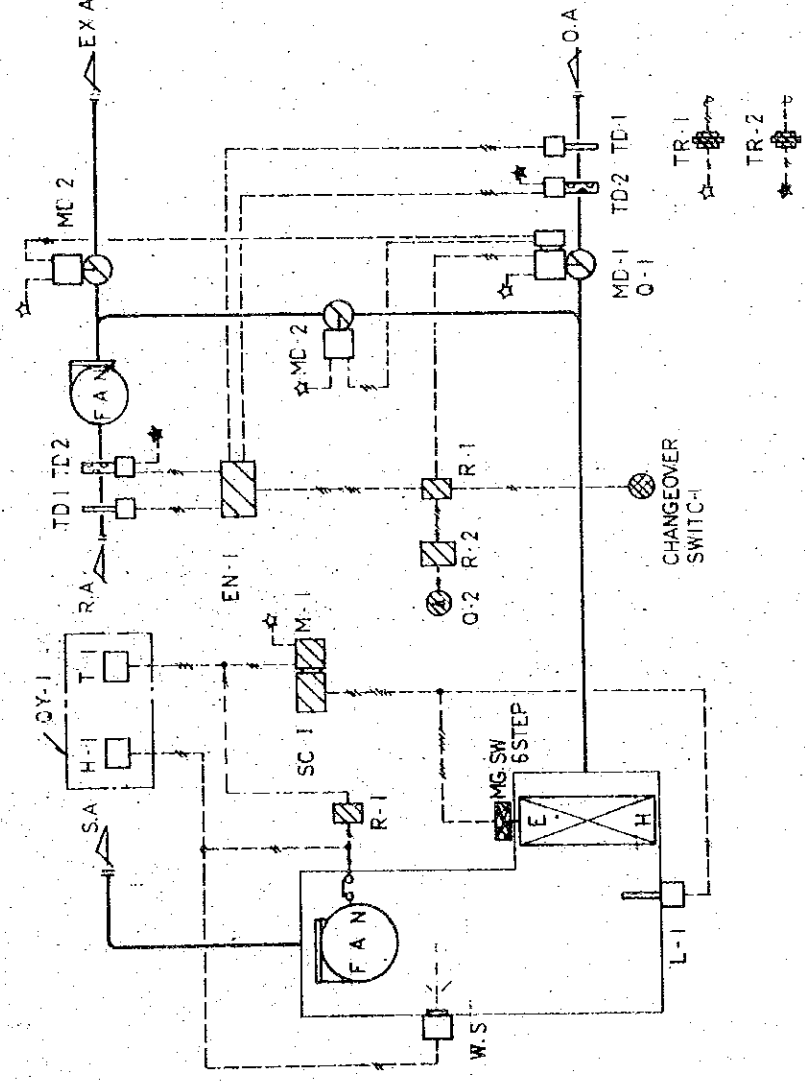

AHU-1 AIR HANDLING UNIT 1 SET

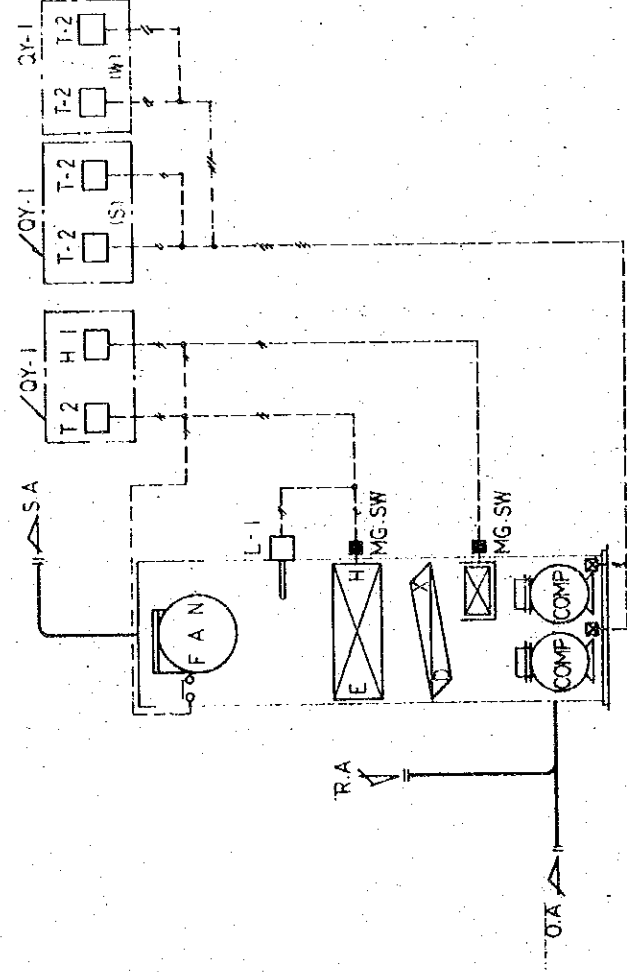

AHU-2 AIR HANDLING UNIT 1 SET

PAC-1 HEAT PUMP PACKAGED AIR CONDITIONER 1 SET
PAC-2 DITTO 1 SET

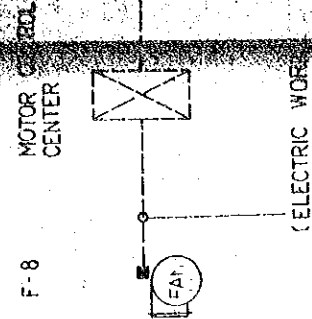

F-8 MOTOR CONTROL CENTER (ELECTRIC WORK)

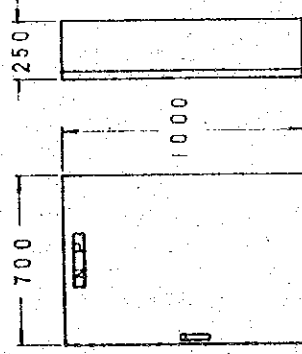

A.P.-1 1 SET

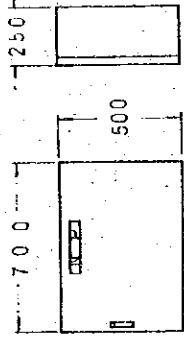

A.P.-2 1 SET

AUTOMATIC CONTROL PANEL

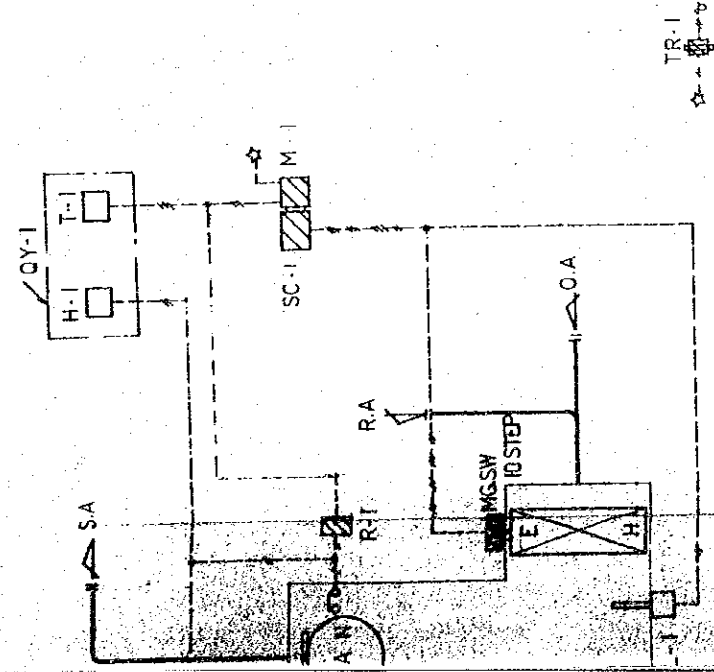

AIR HANDLING UNIT I SET

MOTOR CONTROL CENTER

ELECTRIC WORK

TEMPERATURE CONTROL SYSTEM I SET

TABLE OF CONTENTS

MARK	NAME	TYPE NO	NOTE
T-1	ROOM TYPE THERMOSTAT	T9065A	PROPORTIONAL
T-2	DITTO	T6065A	ON-OFF
T-3	DITTO	T631A	DITTO
TD-1	DRY BULB TEMPERATURE SENSOR	L7025C	
TD-2	DEWPOINT SENSOR	SSP128B	
H-1	HUMIDISTAT	H615A	ON-OFF
L-1	LIMIT CONTROLLER	L4029E	
QY-1	THERMOSTAT MOUNTING PLATE	QY20A	
R-1	RELAY	WN120C	
R-2	BALANCING RELAY	Q181A	
Q-1	AUXILIARY POTENTIOMETER	Q406B	
Q-2	MANUAL POTENTIOMETERS	S495A	
SC-1	STEP CONTROLLER	M901E	
M-1	MODUTROL MOTOR	W7540B	
EN-1	ENTHALPY CONTROLLER	M904F	
MD-1	MODUTROL MOTOR	Q605A	
MD-2	DAMPER LINKAGE	M904E	
MD-3	MODUTROL MOTOR	Q605A	
MD-4	DAMPER LINKAGE	M904E	
TR-1	TRANSFORMERS	AT12-J1	
TR-2	DITTO	ATN410J1	

NOTE

- AC 100V OR 200V
- 1/2" CABLE
- ▨ AUTOMATIC CONTROL PANEL MOUNTED EQUIPMENT
- ▩ MOTOR CONTROL CENTER MOUNTED EQUIPMENT

THE ESTABLISHMENT PROGRAMME
OF
MEDIUM WAVE BROADCASTING NETWORK
IN
THE KINGDOM OF NEPAL

KATHMANDU STUDIO CENTRE

TITLE OF DRAWING
DETAIL OF AUTOMATIC
CONTROL SYSTEM

DRAWING NO. H-108
SCALE 1/100
DATE JAN' 1981

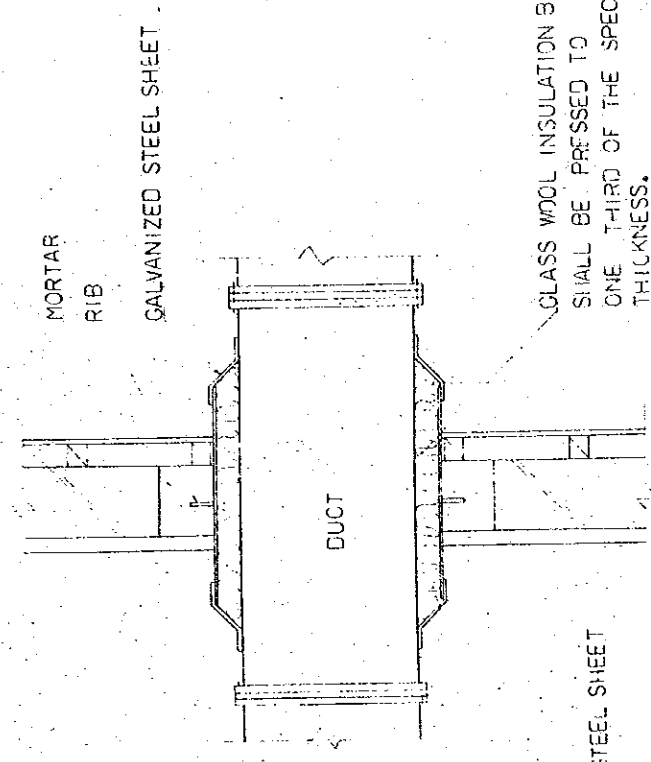
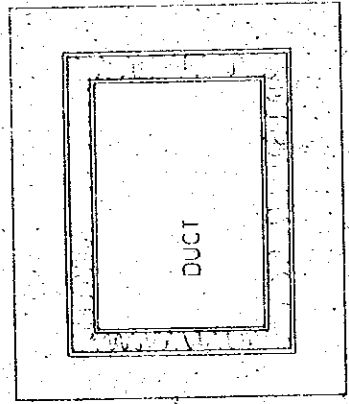

GALVANIZED STEEL SHEET

MAKE THE PASSING THROUGH DUCT IN ADVANCE
FIX IT AT THE SPECIFIED POSITION
AND THEN PACK WITH MORTAR.

GLASS WOOL INSULATION BOARD
SHALL BE PRESSED TO
ONE THIRD OF THE SPECIFIED
THICKNESS.
GALVANIZED STEEL SHEET WITH
RIB SHALL BE WOUND ON IT
FIRMLY

DETAIL OF DUCT PASSING THROUGH
THE STRUCTURAL WALL OF STUDIO, SUB-CONTROL ROOM,
BUILDING EQUIPMENT ROOM, & AIR CONDITIONER ROOM.

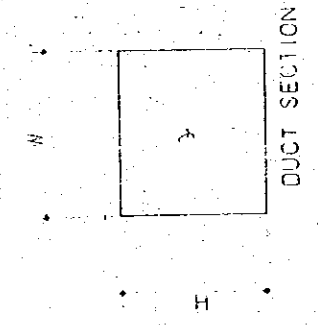

DUCT SECTION

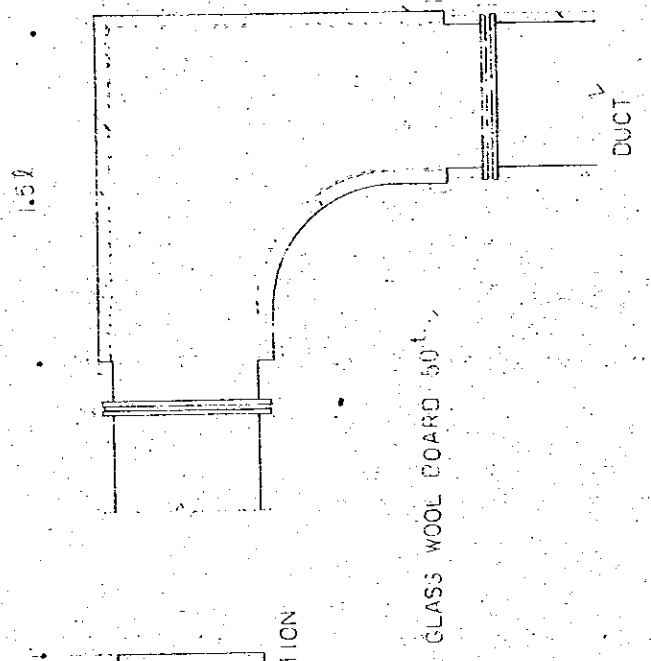

GLASS WOOL BOARD 50

GLASS WOOL BOARD 25
FOR HEAT INSULATION

DETAIL OF SOUND ABSORBING ELBOW

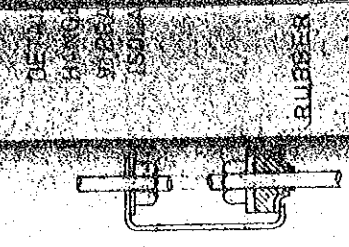

DETAIL OF JOINT

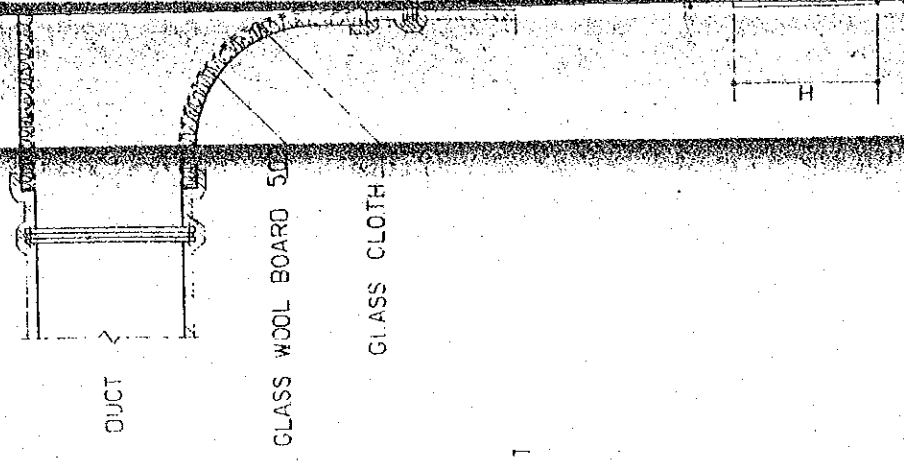

DUCT

GLASS WOOL BOARD 50

GLASS CLOTH

GLASS WOOL BOARD 50

GLASS CLOTH

DETAIL OF SOUND

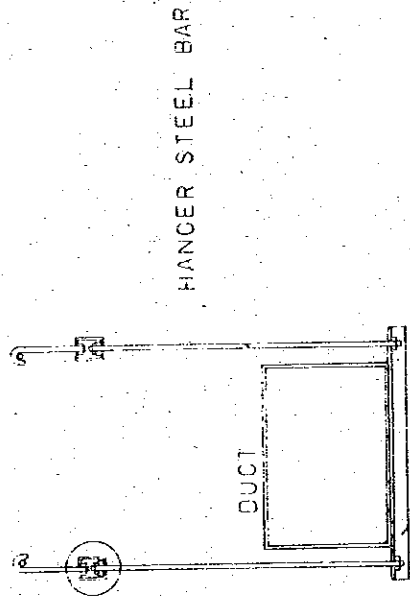

HANGER STEEL BAR

DETAIL OF HANGER TYPE VIBRATION ISOLATOR

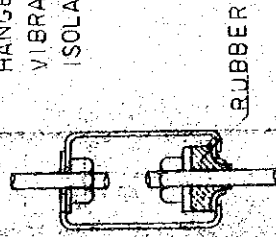

RUBBER

HANGER ANGLE STEEL

COPPER RIVET & METAL WASHER

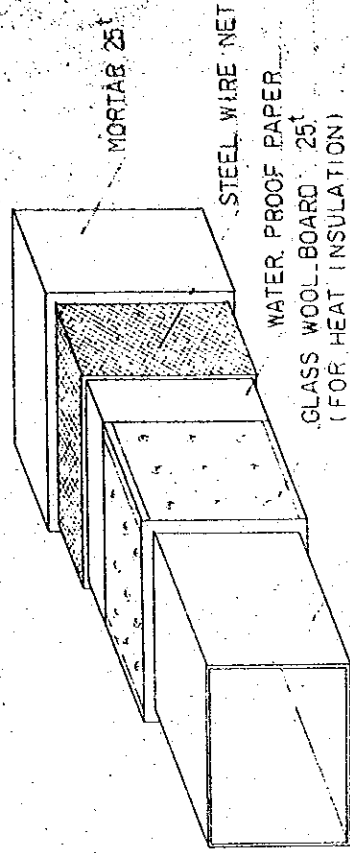

MORTAR 25

STEEL WIRE NET

WATER PROOF PAPER

GLASS WOOL BOARD 25

(FOR HEAT INSULATION)

DUCT (GALVANIZED STEEL SHEET)

DETAIL OF VIBRATION PROTECTION FOR DUCT

DETAIL OF SOUND PROOF DUCT

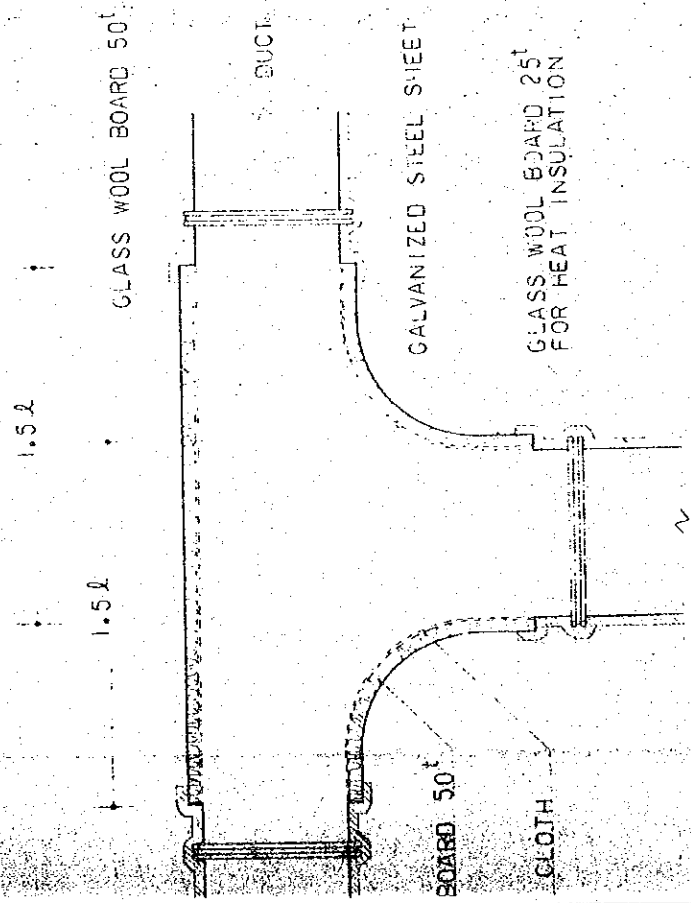

1.5λ

1.5λ

GLASS WOOL BOARD 50

DUCT

GALVANIZED STEEL SHEET

GLASS WOOL BOARD 25 FOR HEAT INSULATION

BOARD 50

CLOTH

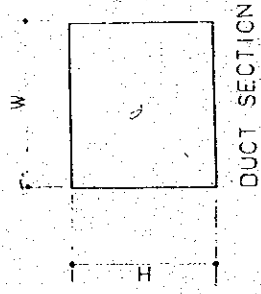

DUCT SECTION

DETAIL OF SOUND ABSORBING TEE

THE ESTABLISHMENT PROGRAMME OF MEDIUM WAVE BROADCASTING NETWORK IN THE KINGDOM OF NEPAL		DRAWING NO.	H-109
KATHMANDU STUDIO CENTRE		SCALE	—
FILE OF DRAWING DETAIL OF VIBRATION PROTECTION & SOUND ABSORBING DUCT		UNIT	MM
		DATE	JAN 1981

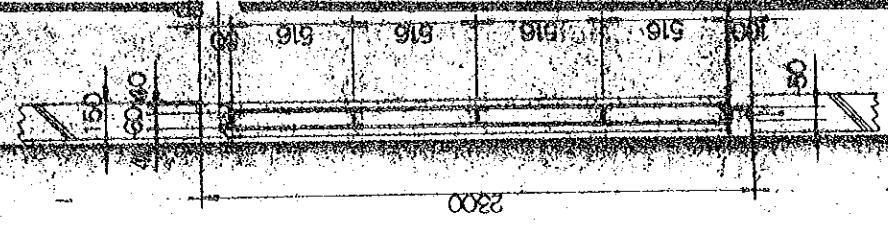
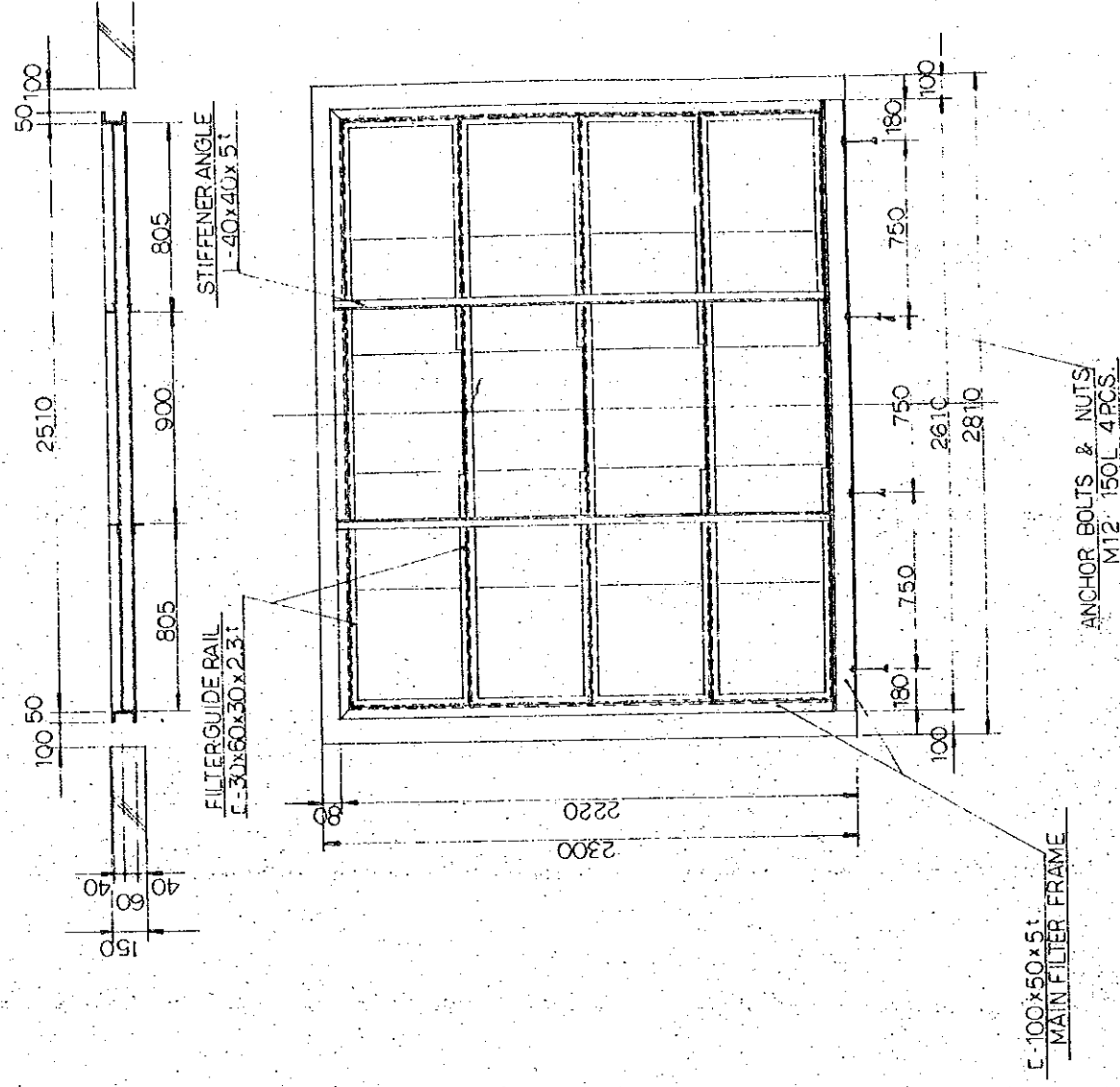

DETAIL OF AIR FILTER 1:20

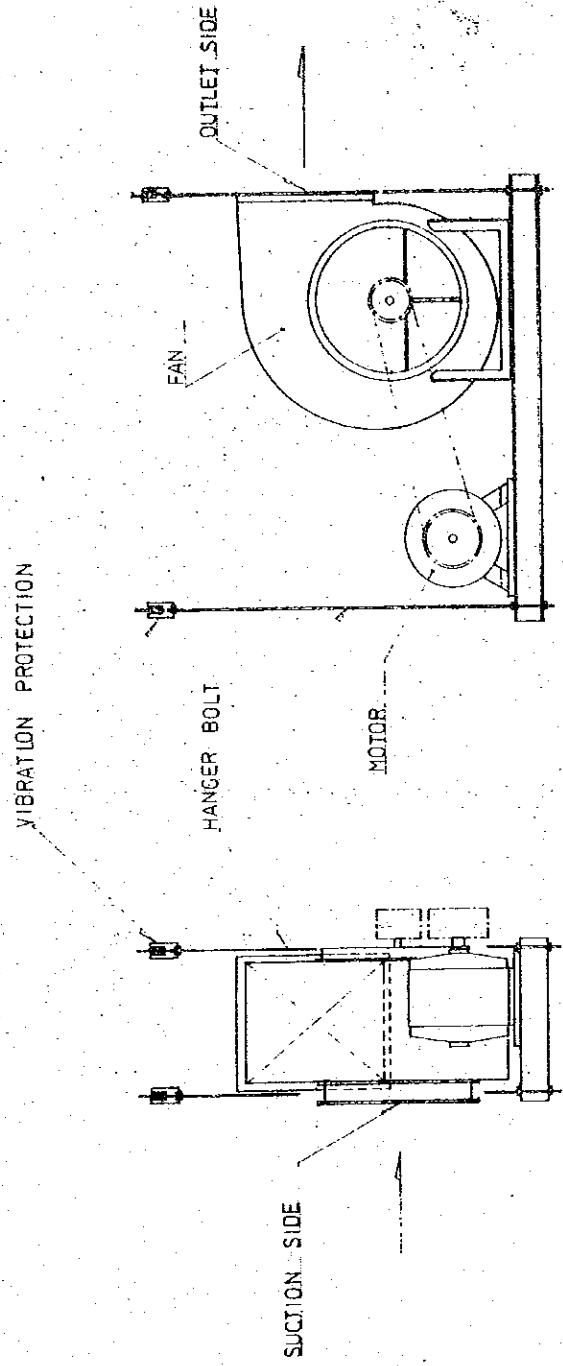

DETAIL OF FAN
(HUNG FROM SLAB ABOVE)

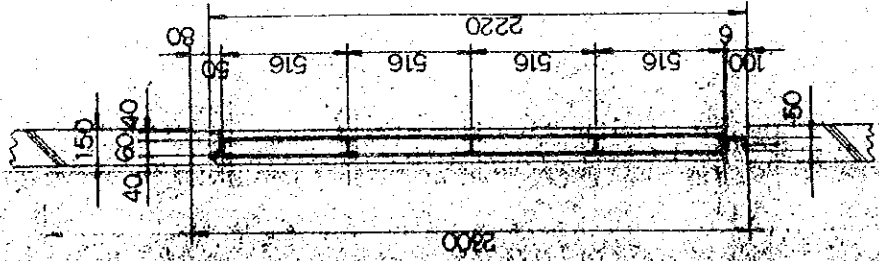

VENTILATING AIR FILTER
TYPE : VILEDON UNIT AIR FILTER VB-S
FILTER ELEMENT VILEDON PS-600
4 X 5 = 20 P.C.S.

NOTE
FOR AIR FILTER, FRAME EQUAL TO 10% OF THE NUMBER OF UNIT IN SERVICE
AND FILTER EQUAL TO 100% OF THE NUMBER OF UNIT IN SERVICE.

1:20

THE ESTABLISHMENT PROGRAMME OF MEDIUM WAVE BROADCASTING NETWORK IN THE KINGDOM OF NEPAL		DRAWING NO. H-110
KATHMANDU STUDIO CENTRE		SCALE —
TITLE OF DRAWING DETAIL OF AIR FILTER & FAN		UNIT (TRM)
DATE JAN' 1981		DATE

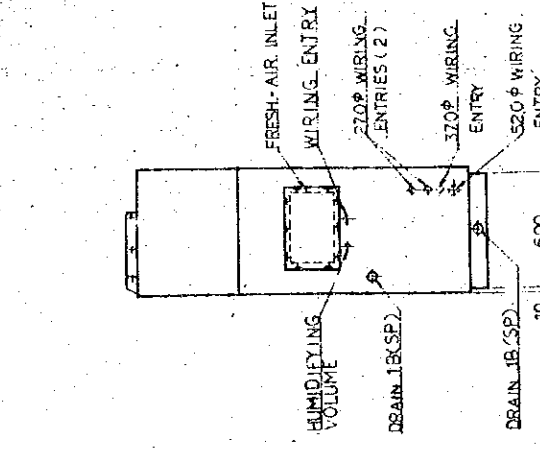
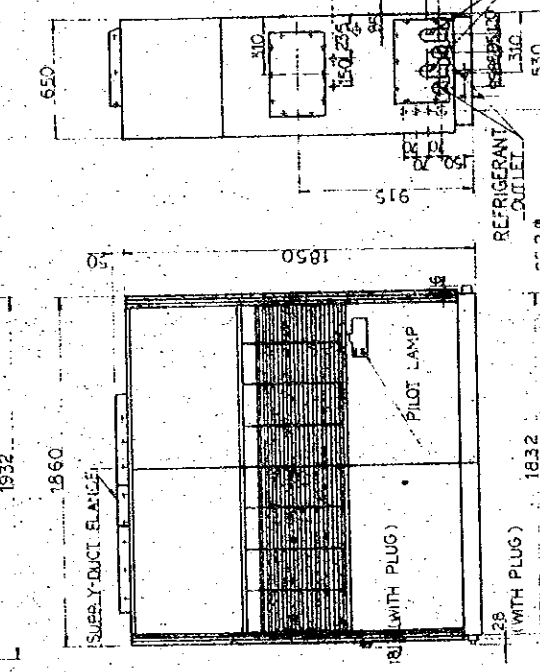
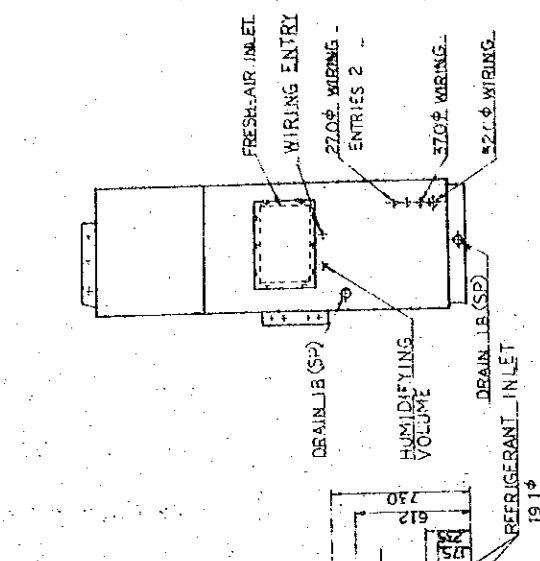
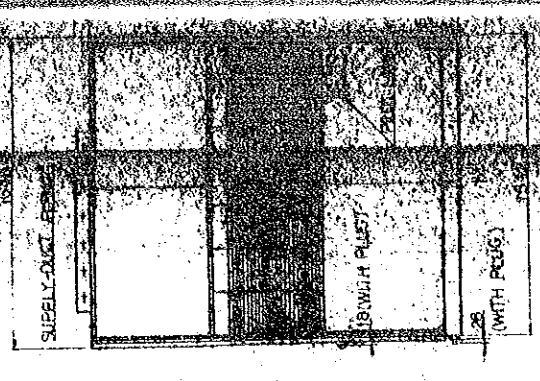
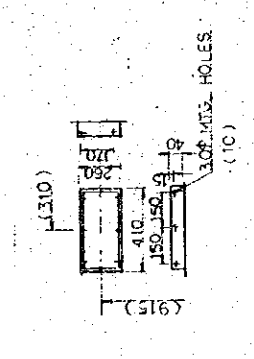
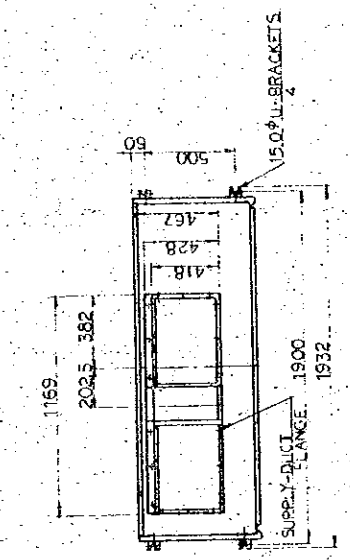
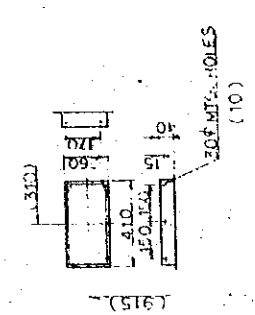
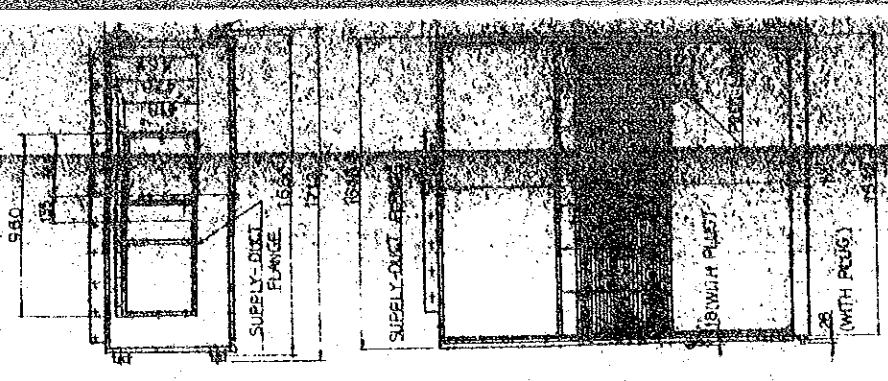

PACKAGED AIR CONDITIONER (INDOOR UNIT)

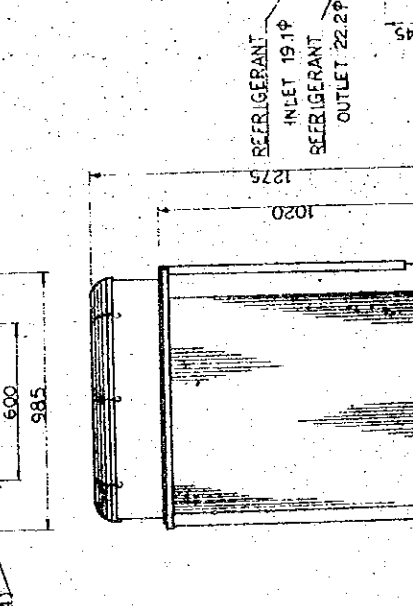
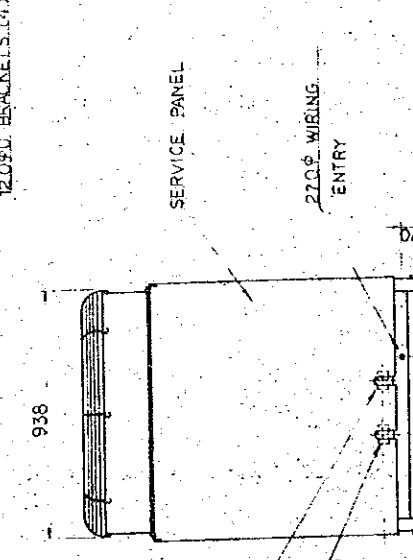
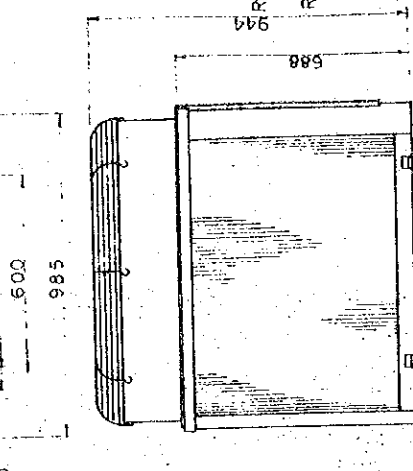
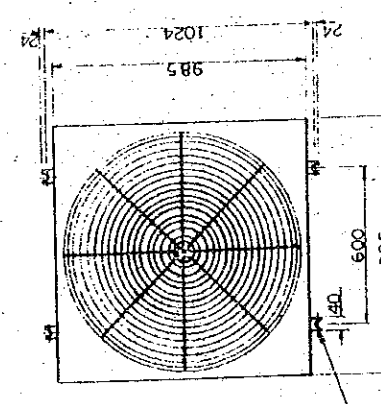
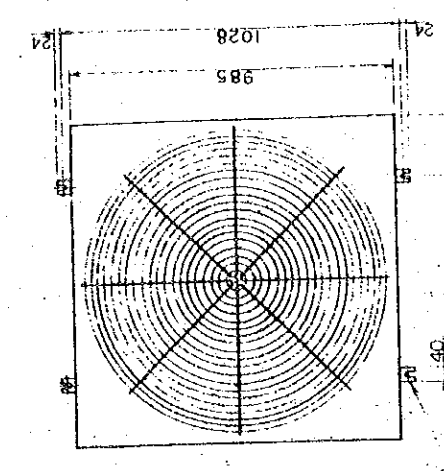

PACKAGED AIR CONDITIONER (OUTDOOR UNIT)

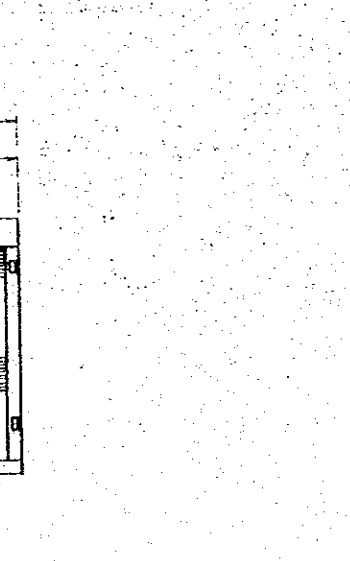
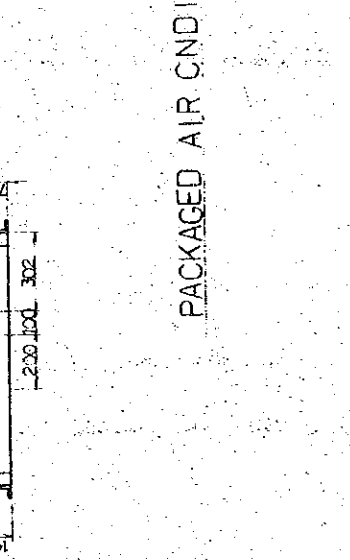
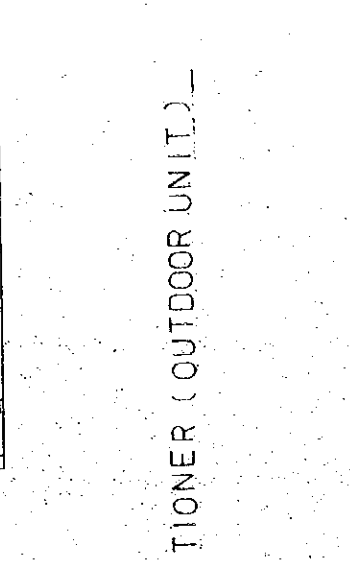
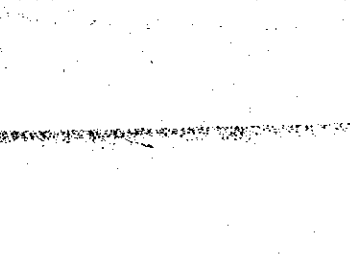

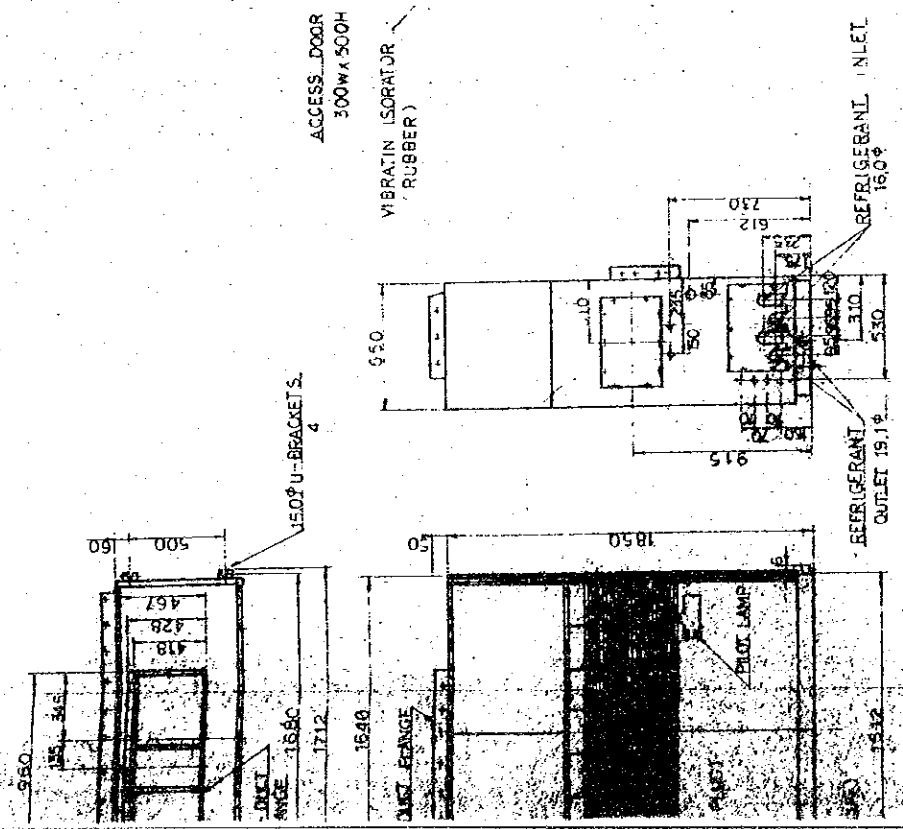
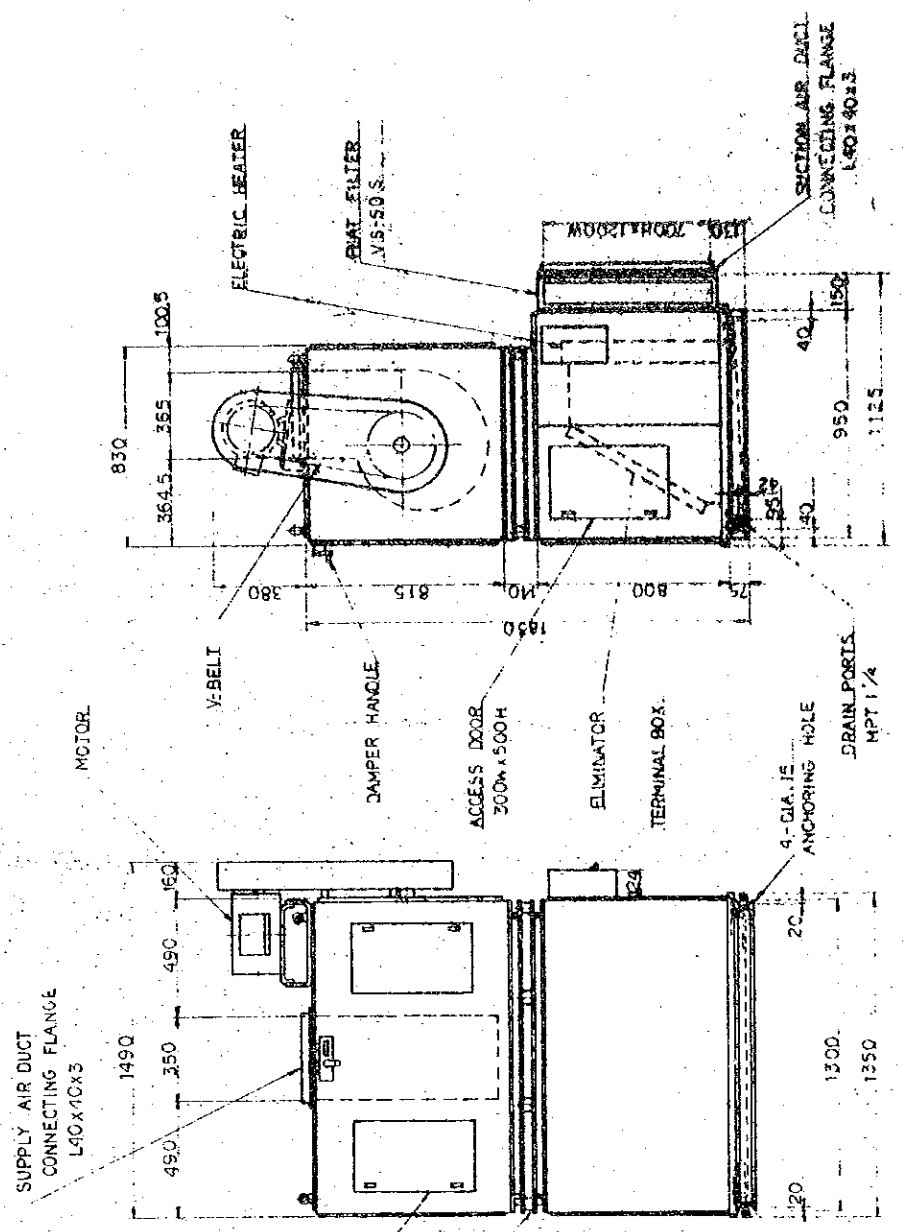

AIR HANDLING UNIT

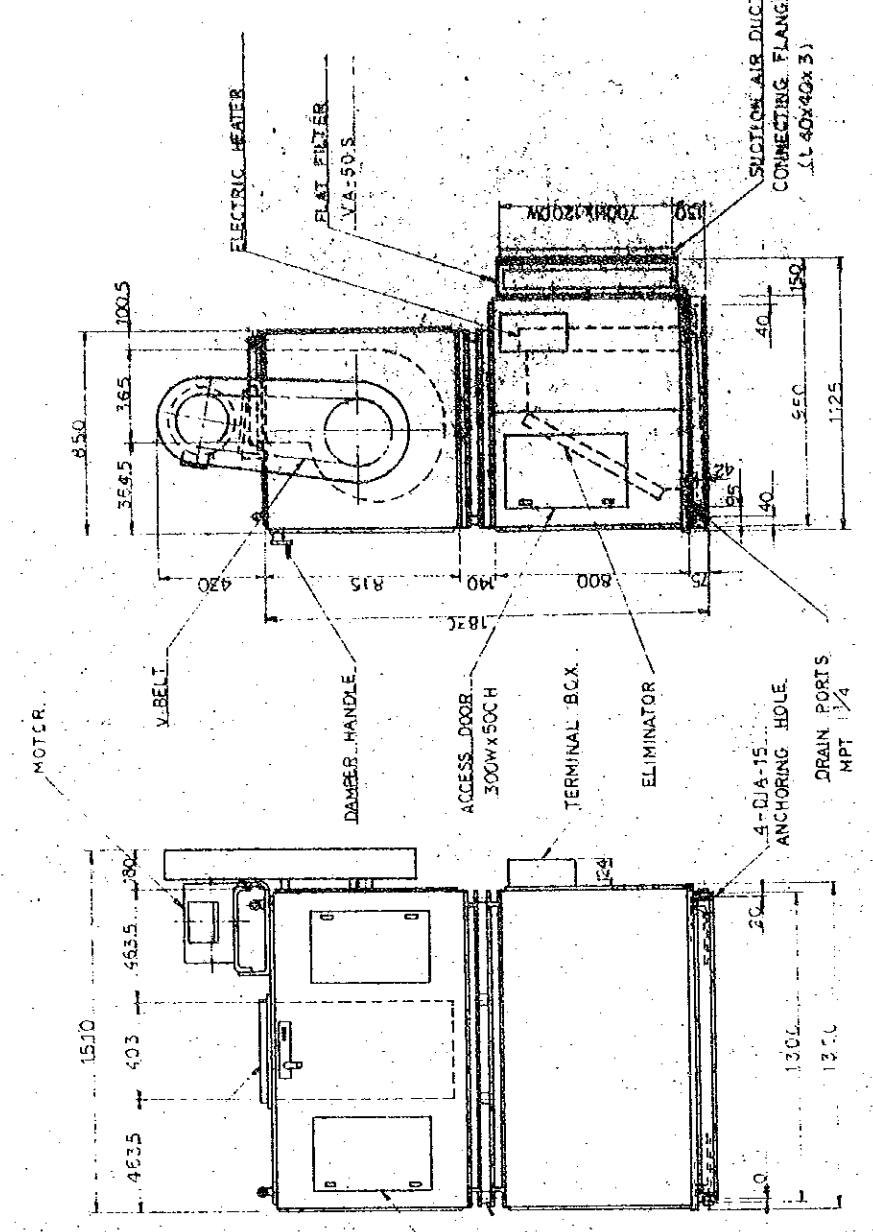

SUPPLY AIR DUCT
CONNECTING FLANGE
L 40x40x3

ACCESS DOOR
300x500 H

VIBRATION ISOLATOR
(RUBBER)

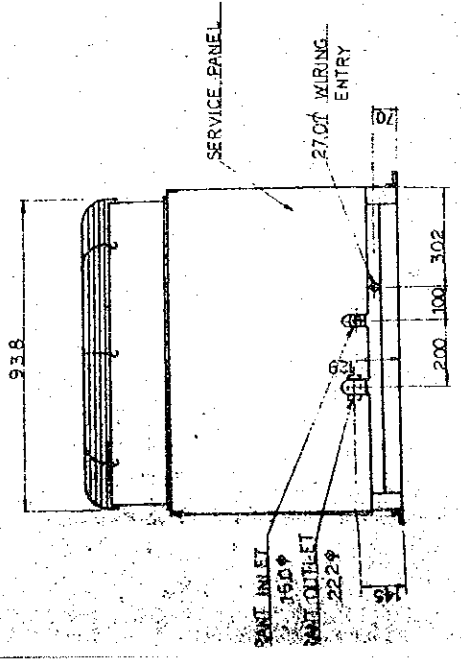

AIR HANDLING UNIT

THE ESTABLISHMENT PROGRAMME OF MEDIUM WAVE BROADCASTING NETWORK IN THE KINGDOM OF NEPAL			
KATHMANDU STUDIO CENTRE		DRAWING NO.	H-111
TITLE OF DRAWING		SCALE	UNIT
DETAIL OF AIR HANDLING UNIT & PACKAGED AIR CONDITIONER			MM
		DATE	JAN' 1981

TYPE	DETAIL	NUMBER	ROOM TO BE INSTALLED
C-2-20		2 2	SERVICE ROOM MAINTENANCE MEN'S ROOM
C-2-30		1	OFFICE
PE-20		4 2	MUSICAL INSTRUMENT ROOM WAITING ROOM
PE-25		2 4 2 4 2 4 2 4	ANNOUNCE STUDIO TALK STUDIO SUB-CONTROL ROOM PRODUCTION STUDIO NO. 1 SUB-CONTROL ROOM PRODUCTION STUDIO NO. 2 SUB-CONTROL ROOM ENTRANCE HALL
PE-30		2 10	SUB-CONTROL ROOM MASTER CONTROL ROOM

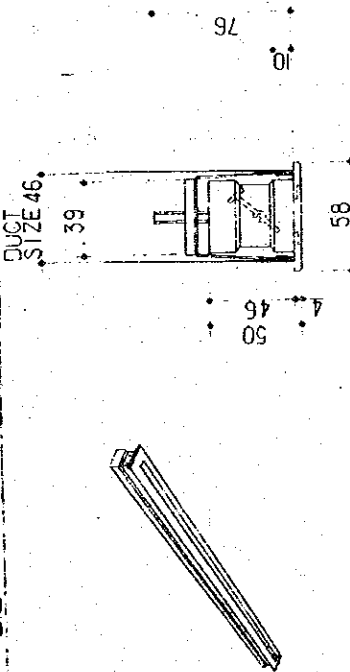
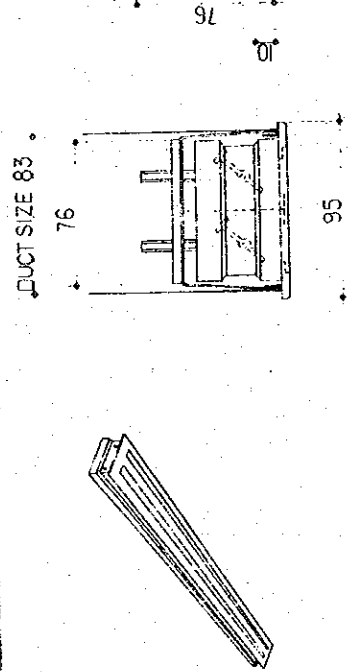
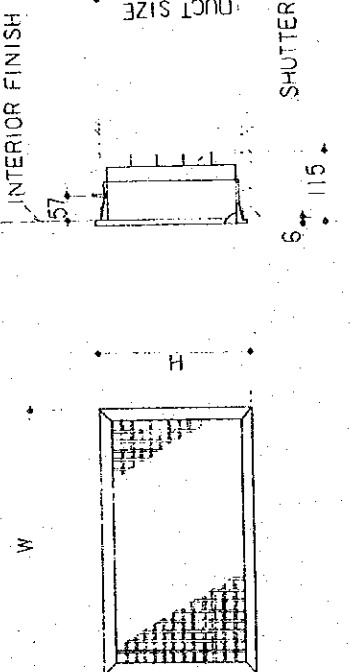
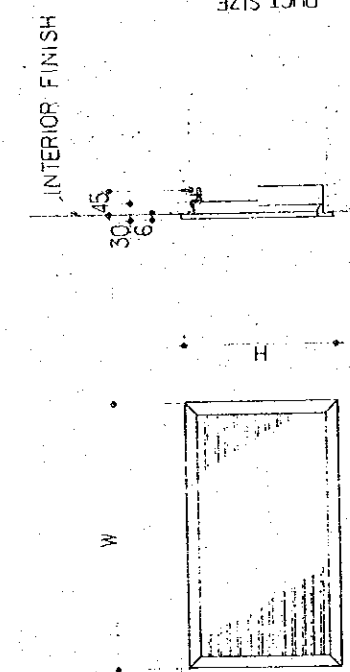
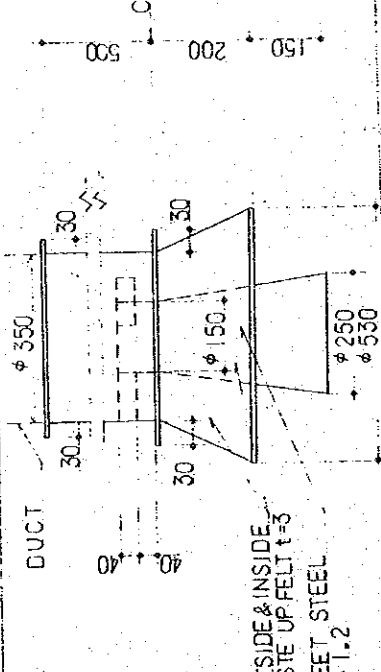
LOCATION	TYPE	DETAIL	W x H (mm)	NUMBER	ROOM TO BE INSTALLED
ROOM	BL - S		(LENGTH) L = 1 500 L = 3 500	2 1	ENTRANCE HALL
	BL - D		(LENGTH) L = 2 000	4	MASTER CONTROL ROOM
ROOM	V H S		500 x 200 350 x 150	1 1	AIR CONDITIONER ROOM BUILDING EQUIPMENT ROOM
	H		900 x 850 800 x 700 750 x 250 700 x 700 700 x 200 550 x 550 550 x 500 550 x 550 450 x 450 450 x 400 400 x 400 400 x 350 400 x 300 300 x 300	1 2 3 3 2 1 1 1 1 1 1 1 2 2	CORRIDOR MUSIC STUDIO ENGINE GENERATOR & POWER ROOM MASTER CONTROL ROOM, BUILDING EQUIPMENT ROOM SUB-CONTROL ROOM (FOR T.S.) MUSICAL INSTRUMENT ROOM TALK STUDIO SUB-CONTROL ROOM (FOR I.S.) (FOR P.S. NO.1) (FOR P.S. NO.2) ANNOUNCE STUDIO AIR CONDITIONER ROOM PRODUCTION STUDIO NO.1 NO.2
H	NOZZLE (SPECIAL TYPE FOR STUDIO)			6	MUSIC STUDIO

**THE ESTABLISHMENT PROGRAMME
OF
MEDIUM WAVE BROADCASTING NETWORK
IN
THE KINGDOM OF NEPAL**

KATHMANDU STUDIO CENTRE

DRAWING NO. H-112
SCALE — UNIT — M/M
DATE JAN 1981

TITLE OF DRAWING
DETAIL OF OUTLET, INLET

