

THE KINGDOM OF NEPAL  
DETAIL DESIGN REPORT  
ON  
THE ESTABLISHMENT PROGRAMME  
OF  
MEDIUM WAVE RADIO BROADCASTING NETWORK

VOLUME IV-3

KATHMANDU STUDIO CENTRE ELECTRICAL AND HEATING,  
VENTILATING AND AIR-CONDITIONING DRAWINGS

MARCH 1981

JAPAN INTERNATIONAL COOPERATION AGENCY



LIST OF DRAWINGS FOR ELECTRIC WORK

DRAWING NO.	TITLE OF DRAWING	
E-101	LIST OF DRAWINGS FOR ELECTRIC WORK AND SYMBOL LIST	—
E-102	SITE PLAN AND WIRING FOR LIGHTING SYSTEM	1:500 1:100
E-103	PIPING, WIRING AND OTHER CABLE RACK OF MAIN LINES	1:100
E-104	DETAIL OF CABLE RACK	1:10 1:30
E-105	PIPING AND WIRING FOR LIGHTING FIXTURES	1:100
E-106	VIEW OF LIGHTING FIXTURES	—
E-107	PIPING AND WIRING FOR PLUG SOCKET	1:100
E-108	VIEW AND CONNECTION DIAGRAM FOR LIGHTING BOARD	1:10
E-109	PIPING AND WIRING FOR POWER CIRCUITS	1:100
E-110	POWER CONTROL CONNECTIONS SYSTEM AND MAIN POWER CONNECTIONS SYSTEM	—
E-111	VIEW AND SINGLE LINE DIAGRAM FOR POWER BOARD	1:20
E-112	SEQUENCE DIAGRAM FOR POWER BOARD (1)	—
E-113	SEQUENCE DIAGRAM FOR POWER BOARD (2)	—
E-114	PIPING AND WIRING FOR COMMUNICATION SYSTEM	1:100
E-115	PIPING, WIRING FOR STUDIO AND CONTROL ROOM	1:50
E-116	PIPING AND WIRING FOR FIRE ALARM SYSTEM	1:100

国際協力事業団		
納入 月日	56.7.6	2170
登録No.	9712	6634
		SDA-7

(1) MAIN LINE SYSTEM

SYMBOLS	DESCRIPTION
	POWER PANEL BOARD
	LIGHTING PANEL BOARD
	DISTRIBUTION BOARD OF STUDIO
	DC CIRCUIT
	COMMERCIAL & GENERATOR CIRCUIT
	CABLE RACK (FOR POWER ONLY)

NOTES: 1. OPENING HOLE-A 700\*200\* (WALL) OTHER WORK (B.L.D.G WORK)

(2) LIGHTING SYSTEM

	LIGHTING FIXTURE FOR GENERATOR & COMMERCIAL CIRCUITS
	DO FOR COMMERCIAL ONLY
	BALLAST BOX (BALLAST FOR FL 40*2)
	CIRCUIT NO. COMMERCIAL ONLY
	COMMERCIAL & GENERATOR
	COMMERCIAL (SOCKET OUTLET)
	DC 24V
	PULL BOX
	SWITCH 1P ONE WAY, THREE WAY, INTERMEDIATE, 15A
	EMERGENCY LIGHT (DC 24V) & FP 2*2.9* CP 25
	CONCEALED PIPING (CEILING)
	WF 3*16mm LIGHTING FIXTURE
	IV 16mm x 5 CP 19 MOUNTED PIPING
	DO CONCEALED PIPING (CEILING)
	IV 20mm x 2 E 20mm CP 19 CONCEALED PIPING (CEILING)
	IV 16mm x 3 E 16mm CP 25 ( DO )
	IV 16mm x 4 E 16mm CP 25 ( DO )
	IV 16mm x 5 E 16mm CP 25 ( DO )
	IV 16mm x 6 E 16mm CP 25 ( DO )
	FLEXIBLE JOINT

(3) SOCKET OUTLET SYSTEM

	SOCKET OUTLET 2P E 15A
	OUTLET BOX (FOR CEILING FAN)
	SWITCH IP 15A
	DO IP 15A (WITH PILOT LAMP)
	PILOT LAMP
	LIGHTING PANEL BOARD
	IV 20mm x 3 CP 25 (CONDUIT CONCEALED IN FLOOR)
	IV 16mm x 3 CP 19 ( DO )
	IV 20mm x 3 CP 25 (CONDUIT CONCEALED IN CEILING OR WALL)
	IV 16mm x 3 CP 19 ( DO )
	IV 16mm x 4 CP 25 ( DO )
	IV 16mm x 5 CP 25 ( DO )

(4) POWER SYSTEM

	ELECTRODE & HOLDER
	MOTOR
	SWITCHING PANEL BOARD
	CP 19 (EXPOSED CONDUIT)
	CP 19 (CONDUIT CONCEALED IN FLOOR)
	CP 19 (CONDUIT CONCEALED IN CEILING OR WALL)

(5) TELEPHONE SYSTEM

SYMBOLS	DESCRIPTION
	OUTLET BOX FOR TELEPHONE (WITH NOZZLE PLATE) H-300
	JUNCTION BOX
	CP 25 (CONDUIT CONCEALED IN FLOOR)
	CP 25 (CONDUIT CONCEALED IN CEILING OR WALL)

(6) CLOCK SYSTEM

	PLUG SOCKET 2P (FOR CLOCK) H=2,000
	DO 3P ( DO ) H=2,000
	TERMINAL BOARD
	IV 125* x 2 CP 19 (CONDUIT CONCEALED IN CEILING OR WALL)
	IV 125* x 3 CP 19 ( DO )
	IV 125* x 5 CP 19 ( DO )

(7) INTERPHONE SYSTEM

	OUTLET BOX (FOR INTERPHONE)
	CP 25 (CONDUIT CONCEALED IN FLOOR)
	CP 25 (CONDUIT CONCEALED IN CEILING OR WALL)

(8) RADIO MONITOR SYSTEM

	OUTLET BOX (FOR RADIO MONITOR) CP 131
	OUTLET BOX (170* x 70* x 120*)

(9) FIRE ALARM SYSTEM

	MAIN PANEL BOARD (P.I. 5 LINES)
	COMBINATION PANEL (WITH PUSH BUTTON SW & WHITE LAMP)
	PUSH BUTTON (1ST CLASS)
	BELL (150%)
	INDICATION LAMP (DC 24V)
	RATE OF RISE DETECTOR SPOT TYPE
	FIXED TEMPERATURE DETECTOR SPOT TYPE
	RESISTOR
	PRECAUTION AREA
	PRECAUTION LINE
	IV 12mm x 2 CP 19 (CONDUIT CONCEALED IN CEILING OR WALL)
	IV 12mm x 4 CP 19 ( DO )

**THE ESTABLISHMENT PROGRAMME  
OF  
MEDIUM WAVE BROADCASTING NETWORK  
IN  
THE KINGDOM OF NEPAL**

**KATHMANDU STUDIO CENTRE**

DRAWING NO. **E-101**

SCALE **---** UNIT

TITLE OF DRAWING **FOR ELECTRIC WORK**

AND SYMBOL LIST

DATE **JAN' 1981**

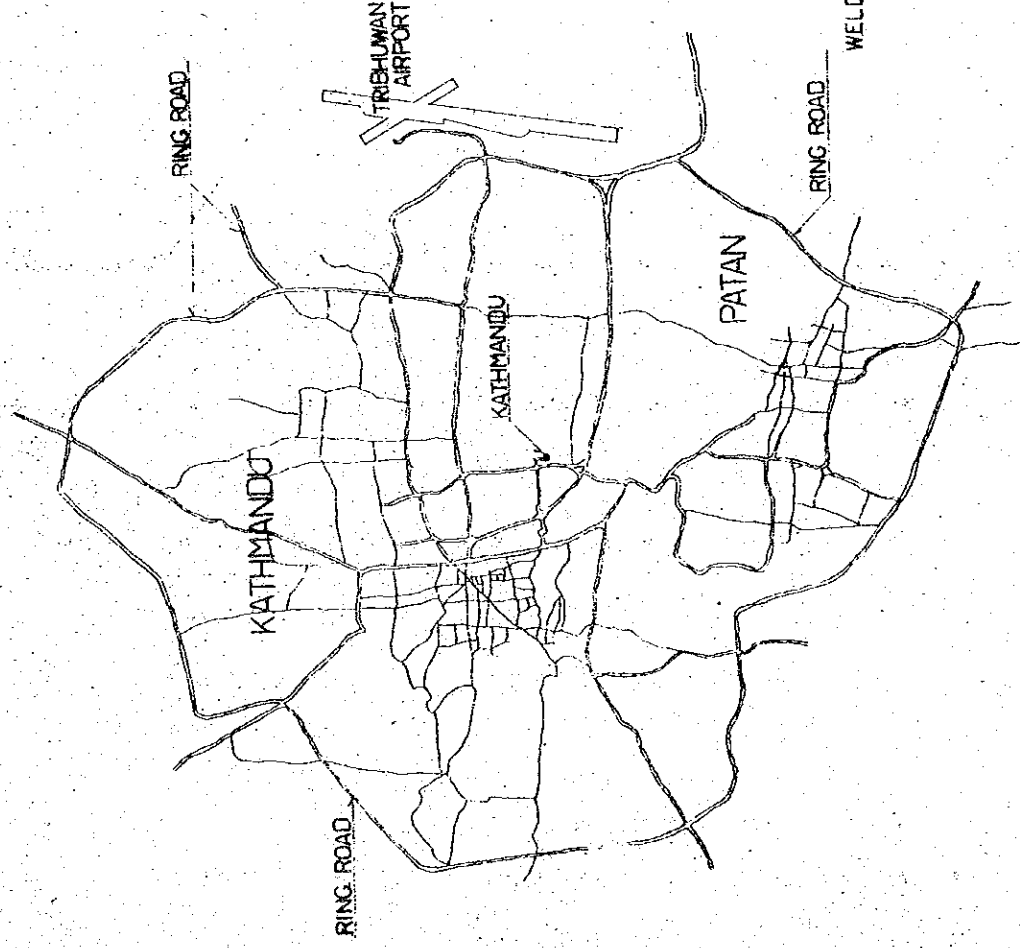

SITE LOCATION MAP 1:50,000

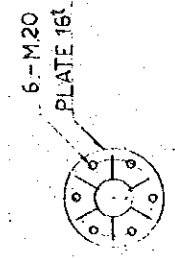
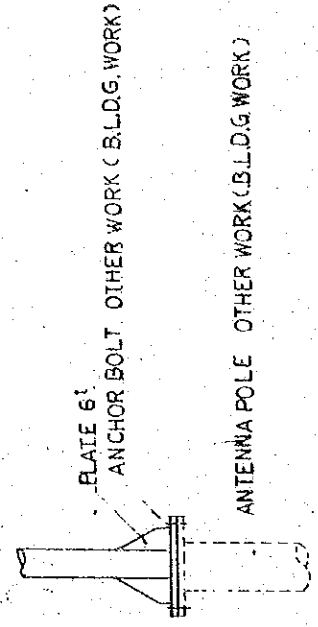

DETAIL OF HOLDER PIPE JOINING

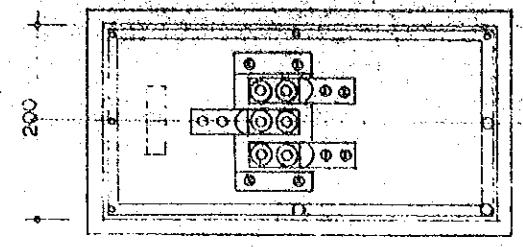
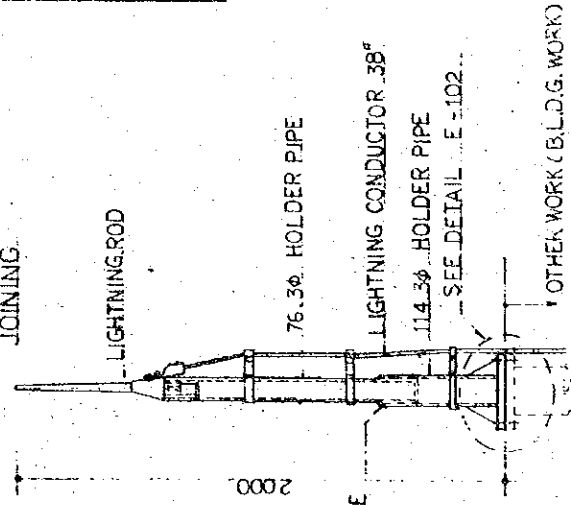

TEST TERMINAL BOX (FLUSH TYPE)

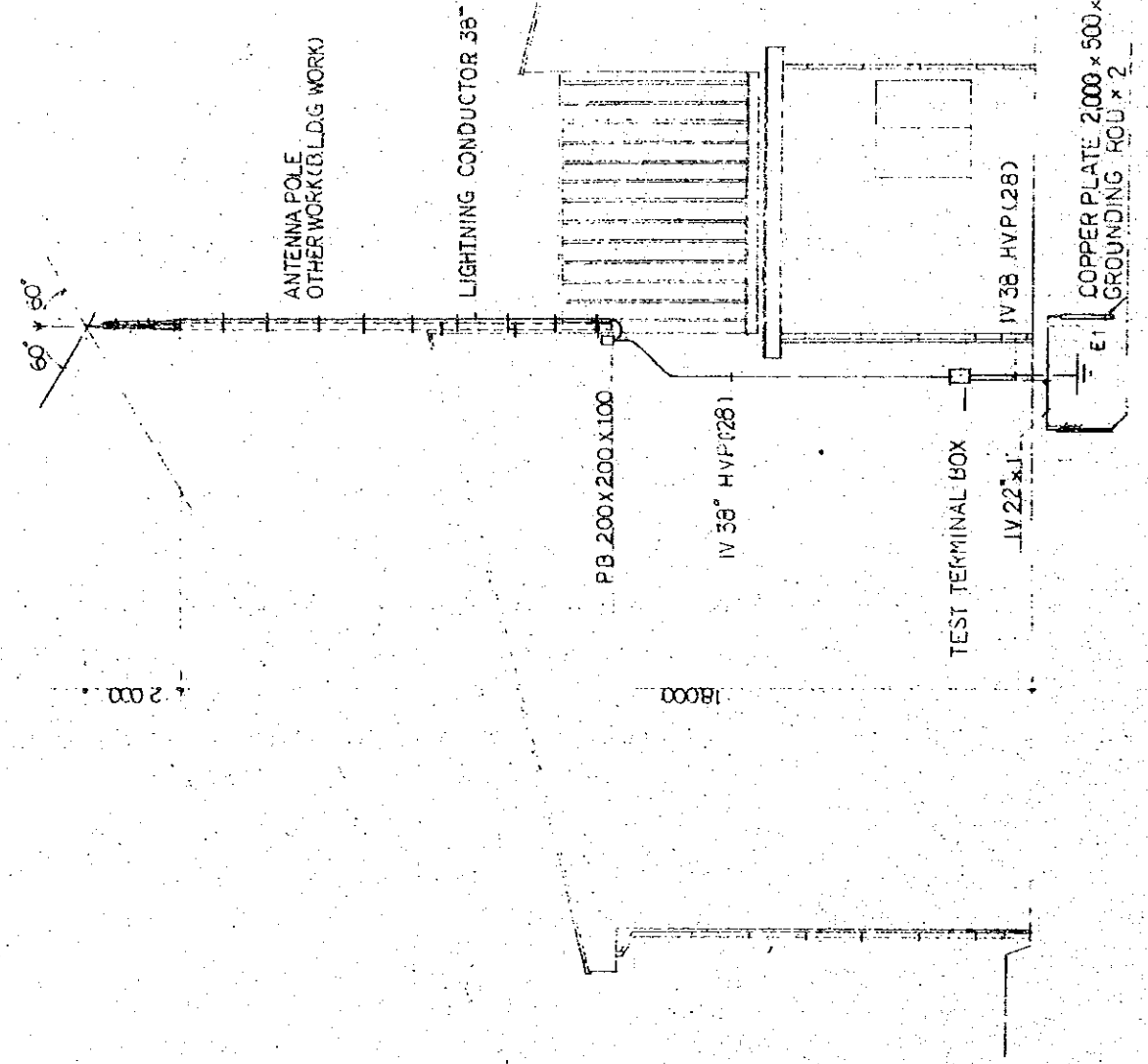



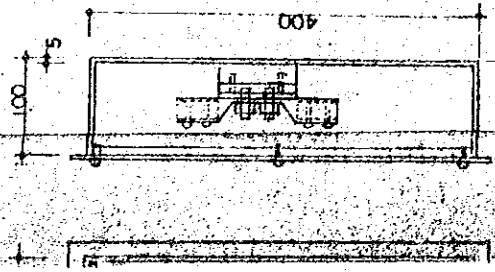

BOX - RIGID VINYL 51  
 PLATE - BRASS 231

FINAL BOX  
 TYPE 1

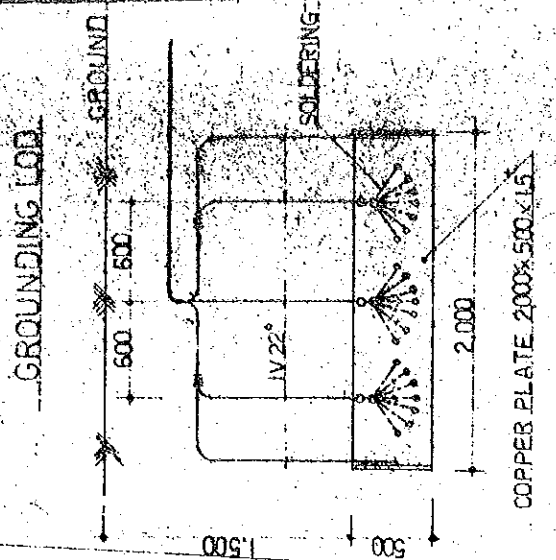
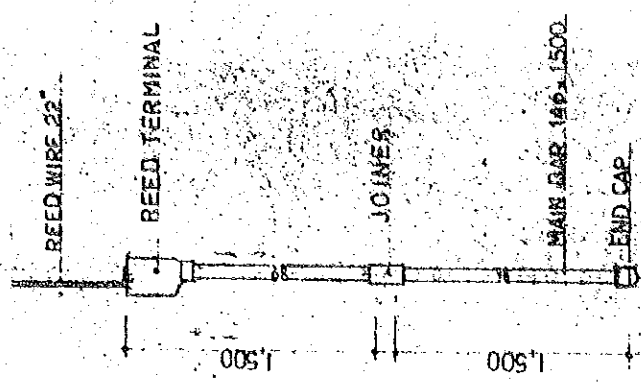
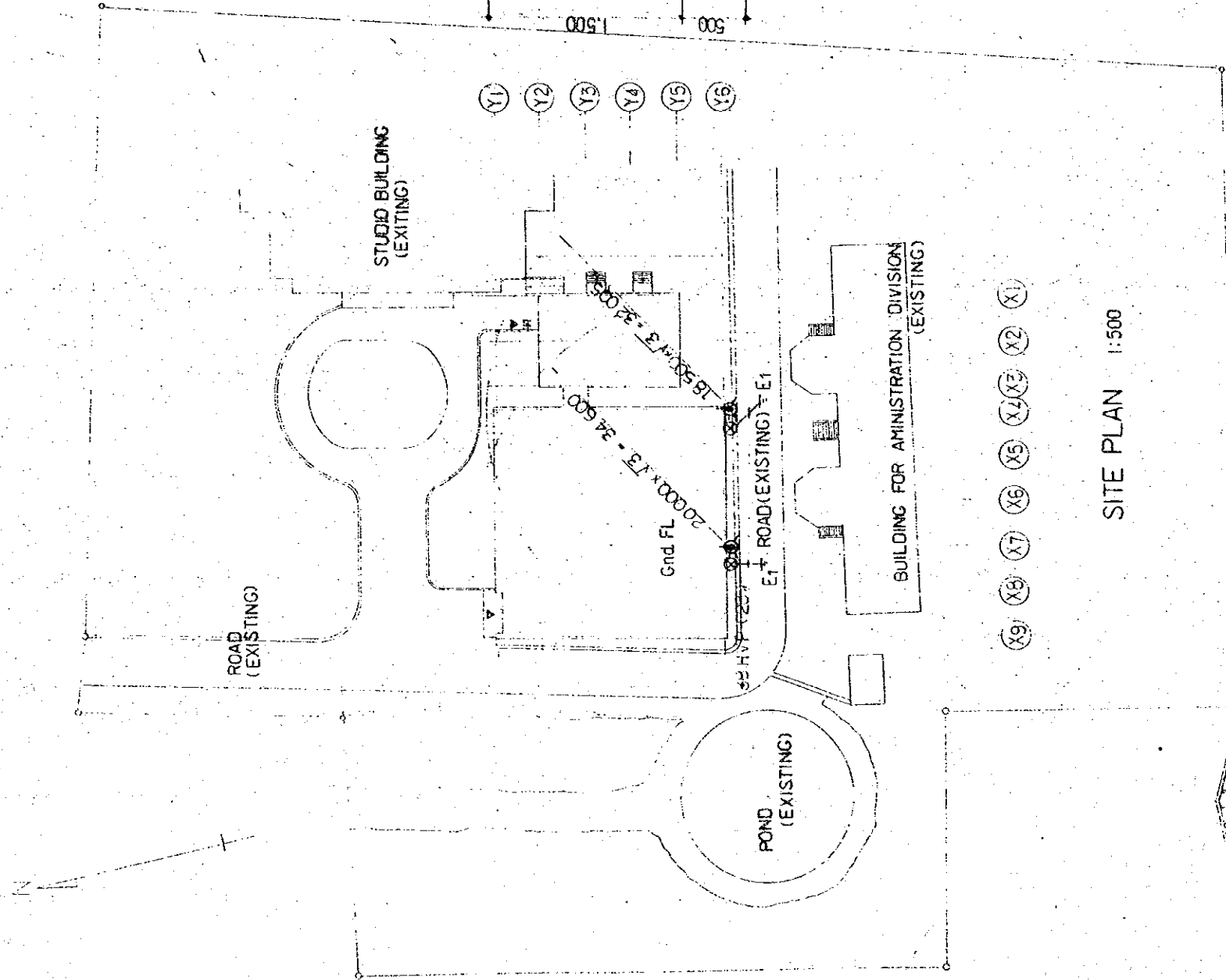
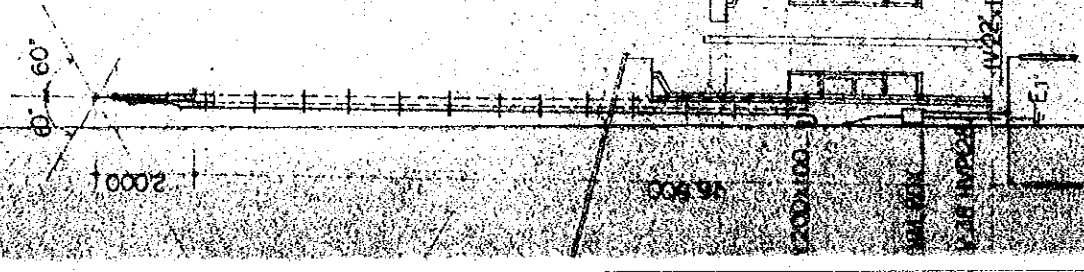

SECTION

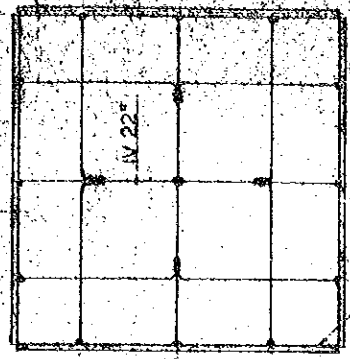

PLAN

DETAIL OF GROUNDING  
 EARTH (E1)

THE ESTABLISHMENT PROGRAMME OF MEDIUM WAVE BROADCASTING NETWORK IN THE KINGDOM OF NEPAL	
DRAWING NO. <b>E-102</b>	
TITLE OF DRAWING <b>SITE PLAN AND WIRING FOR LIGHTING SYSTEM</b>	SCALE 1:500 1:100
DATE <b>JAN 1981</b>	

WATER TANK FOR  
ENGINE DUMMY (B.L.D.S. WORK)

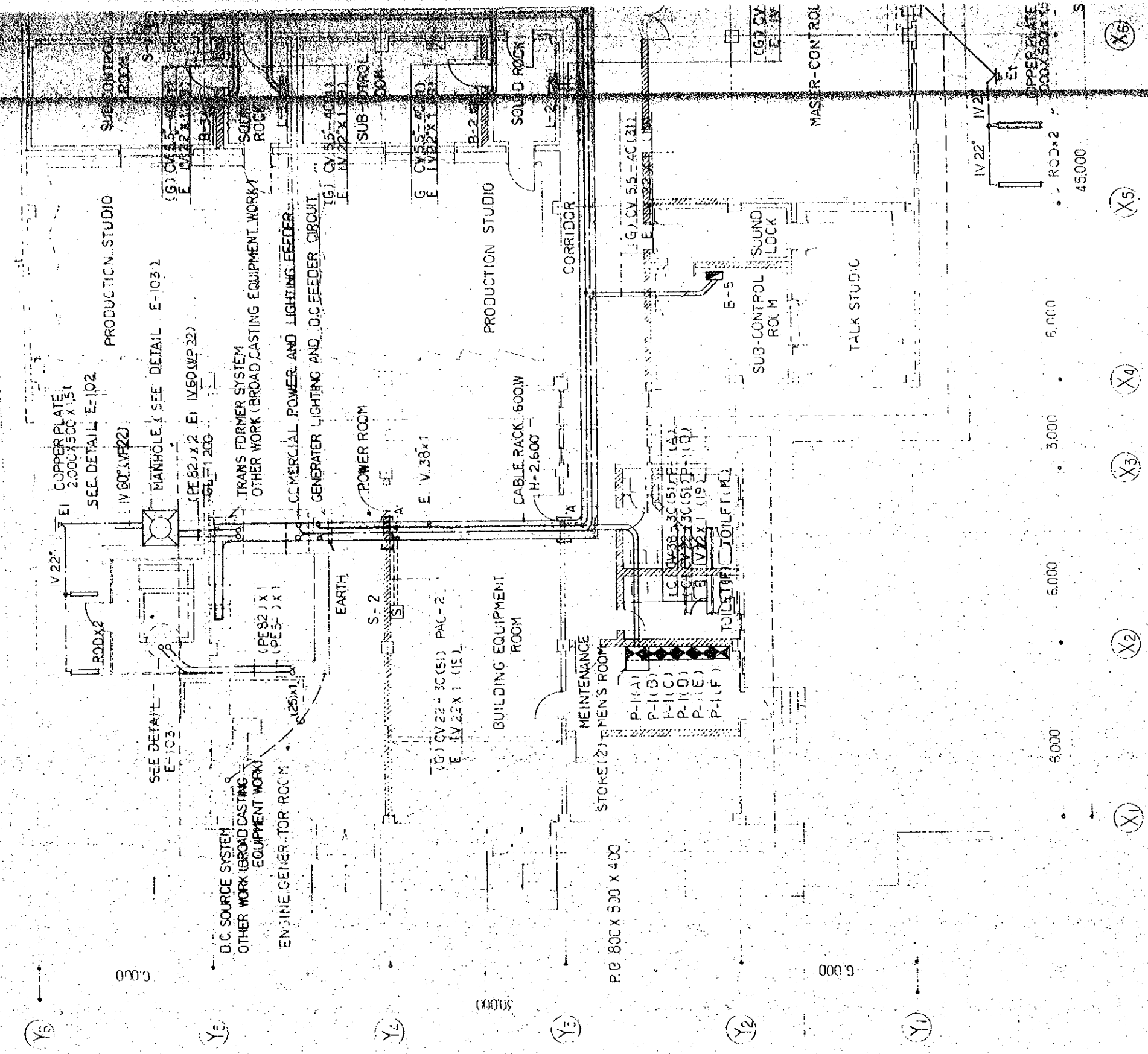

(X6)

(X5)

(X4)

(X3)

(X2)

(X1)

(Y6)

(Y5)

(Y4)

(Y3)

(Y2)

(Y1)

6,000

6,000

3,000

6,000

45,000

S

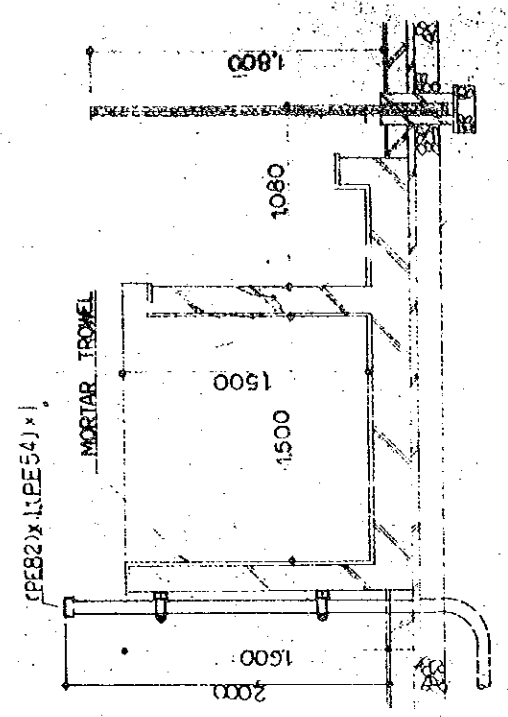

DETAIL OF WATER TANK FOR ENGINE DUMMY (1:50)

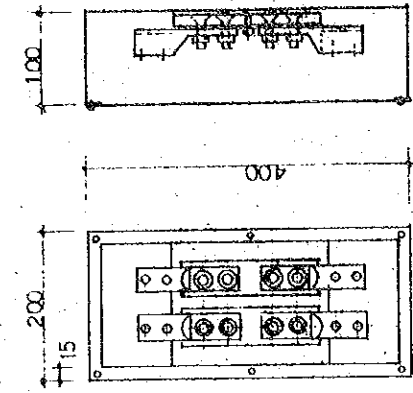

EARTH TERMINAL BOX (WALL MOUNTED TYPE)

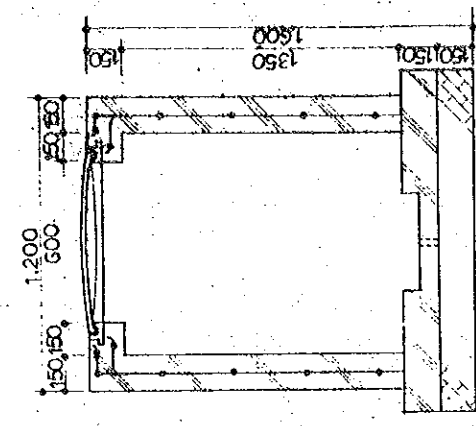

DETAIL OF MANHOLE (1:20)

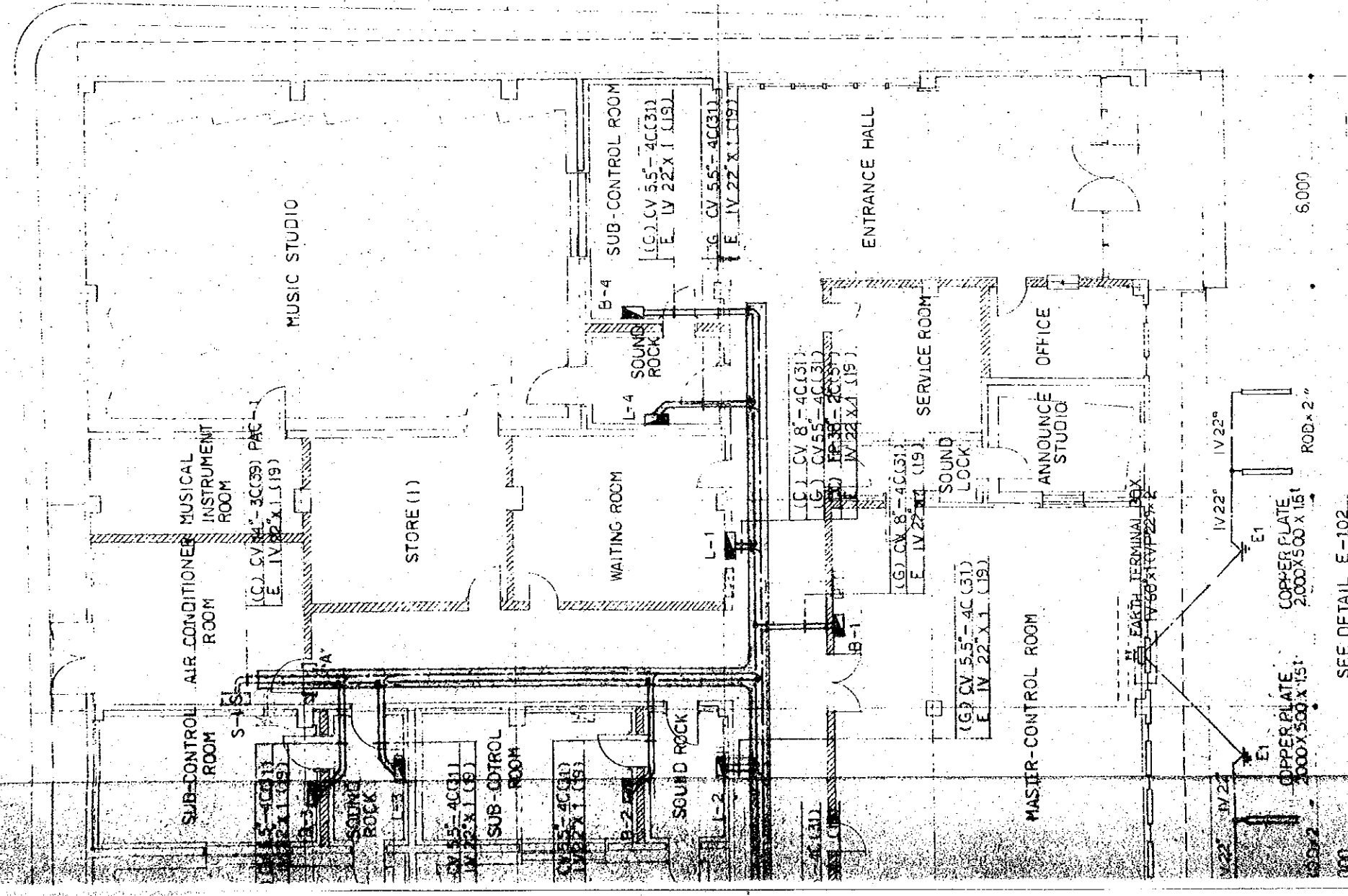

SEE DETAIL E-102

(X6) (X7) (X8) (X9)

THE ESTABLISHMENT PROGRAMME OF MEDIUM WAVE BROADCASTING NETWORK IN THE KINGDOM OF NEPAL		DRAWING NO. E-105
KATHMANDU STUDIO CENTRE		SCALE 1:100
TITLE OF DRAWING PIPING, WIRING AND OTHER CABLE RACK OF MAIN LINES		DATE JAN 1981



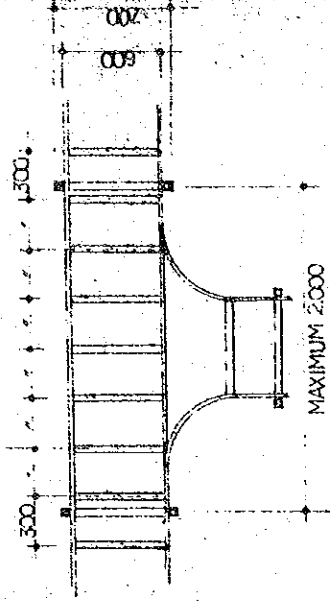
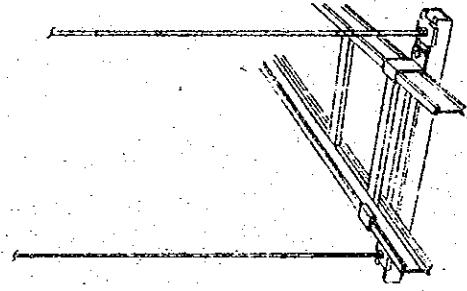

DETAIL 'A'

CABLE RACK I-TYPE (METALLIC)

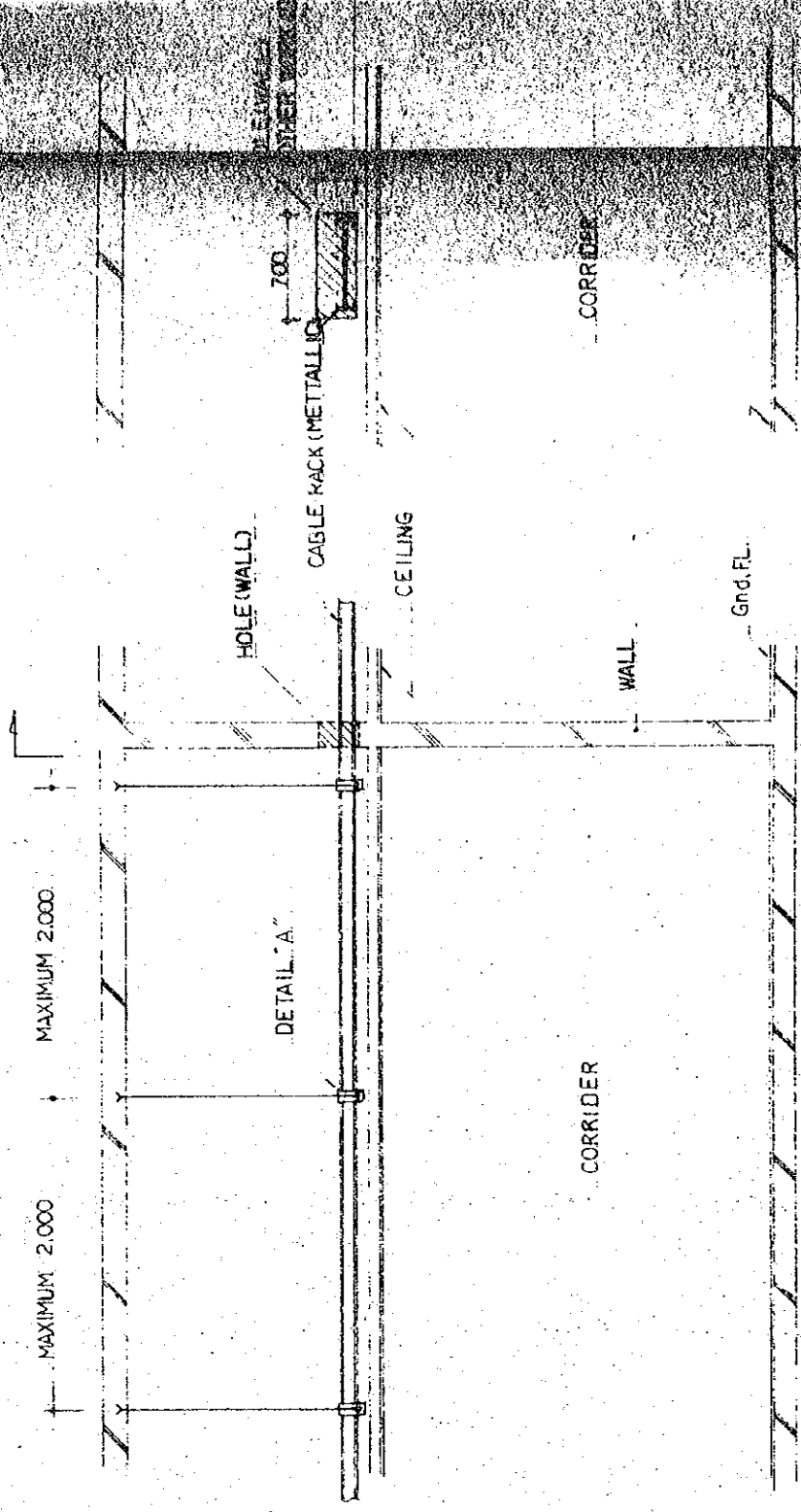

SECTION 1:30

A-A

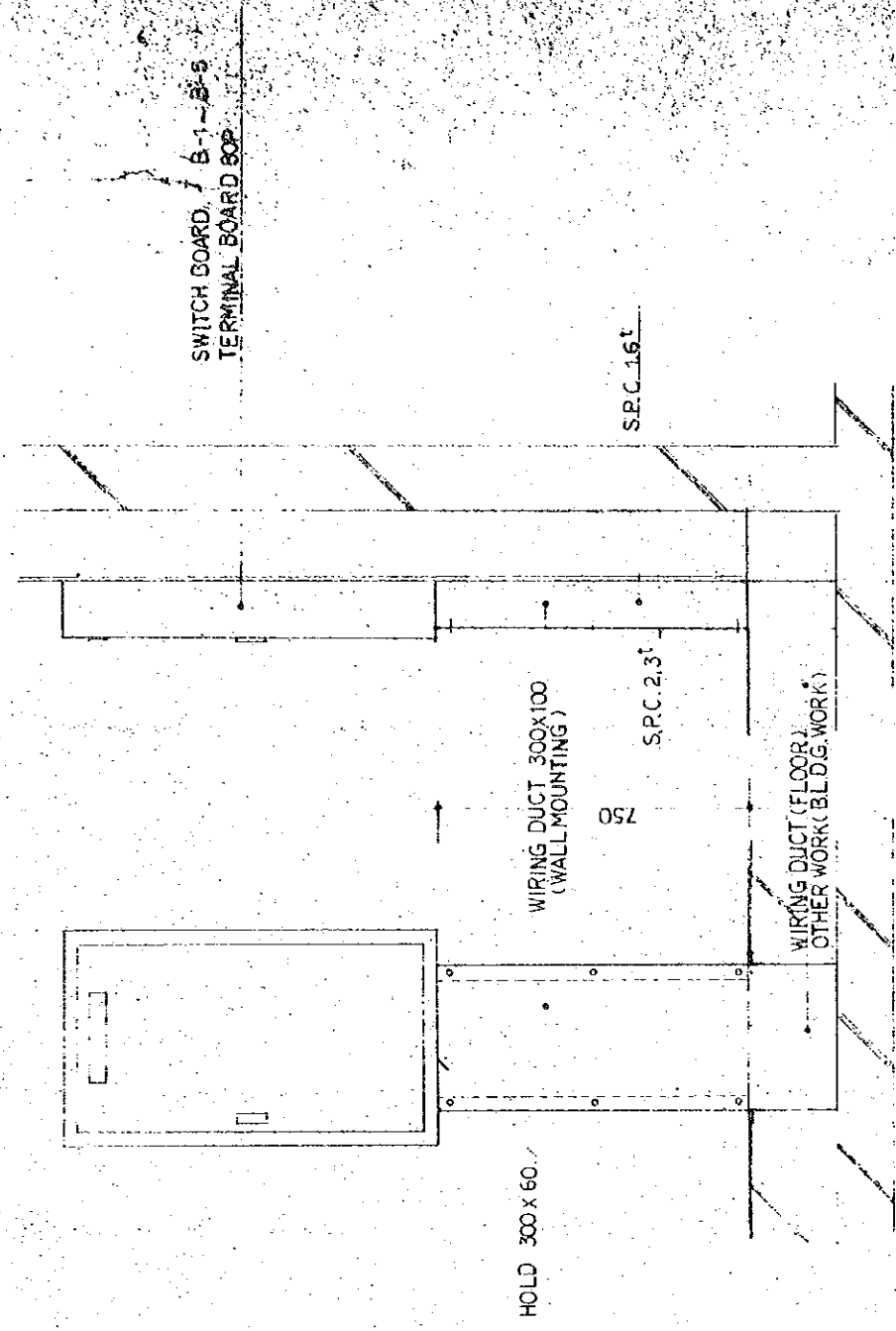

DETAIL (MASTER CONTROL & SUB CONTROL ROOM) 1:10

HOLE (WALL)  
OTHER WORK (B.L.D.G. WORK)

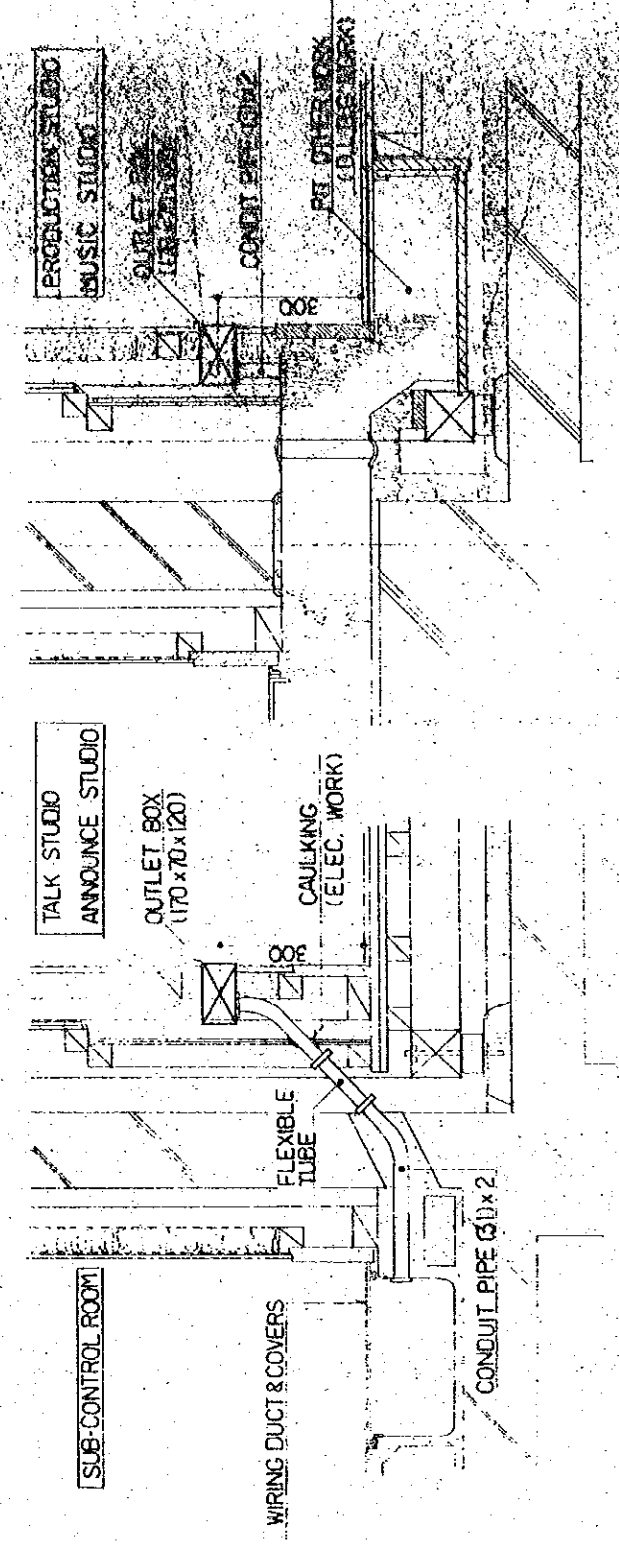

DETAIL OF OUTLET BOX & PIPING 1:10

DETAIL OF OUTLET BOX & PIPING 1:10

THE ESTABLISHMENT PROGRAMME OF MEDIUM WAVE BROADCASTING NETWORK IN THE KINGDOM OF NEPAL		DATE JAN 1981
KATHMANDU STUDIO CENTRE		DATE JAN 1981
TITLE OF DRAWING DETAIL OF CABLE RACK		DATE JAN 1981

PRODUCTION STUDIO

SUB-CONTROL

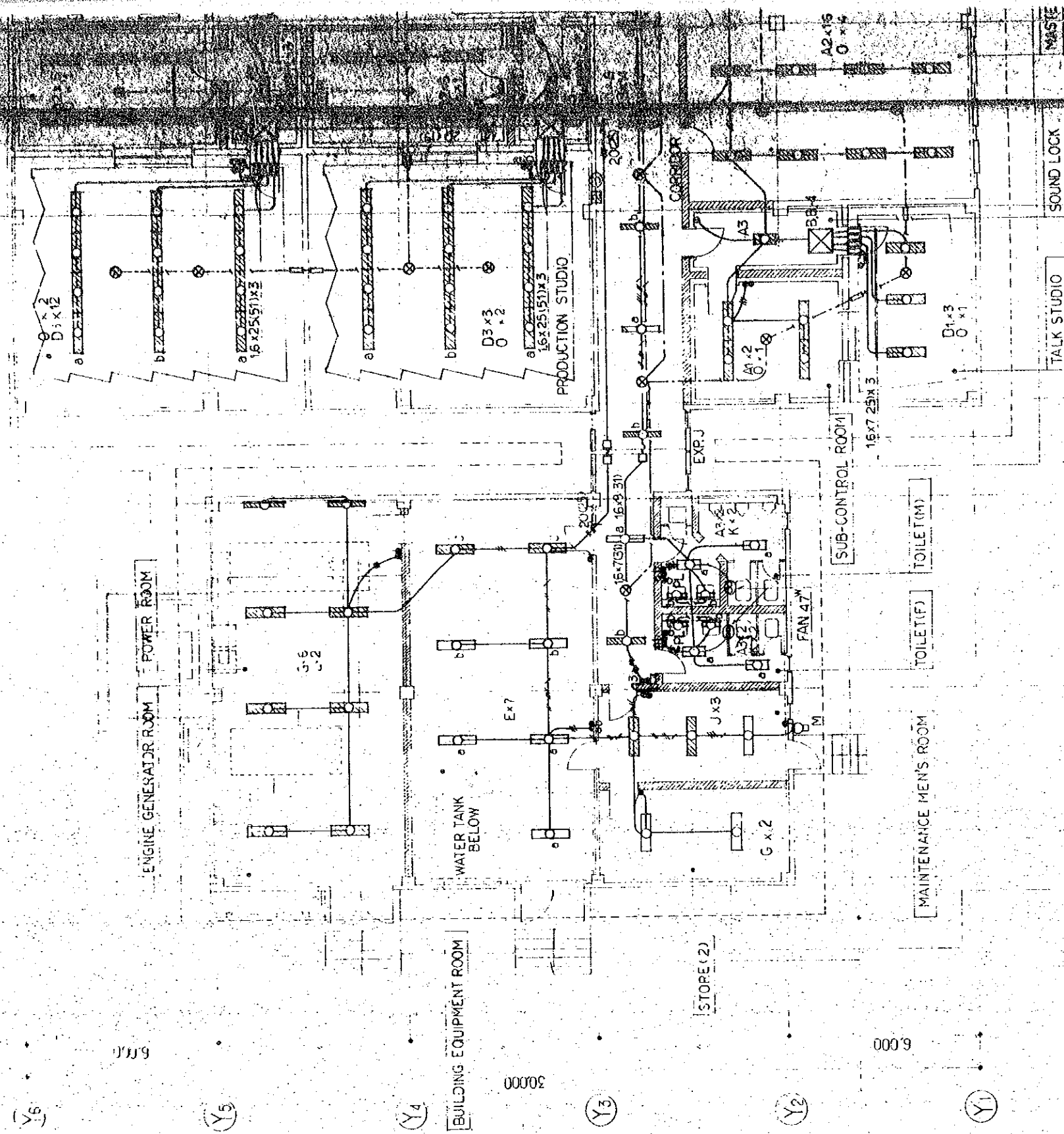

Y6

Y5

Y4

Y3

Y2

Y1

X1

X2

X3

X4

X5

X6

6.00

30.00

6.00

6.000

6.000

3.000

6.000

45.000

BUILDING EQUIPMENT ROOM

ENGINE GENERATOR ROOM

POWER ROOM

SUB-CONTROL

PRODUCTION STUDIO

PRODUCTION STUDIO

MAINTENANCE MEN'S ROOM

TOILET (F)

TOILET (M)

SUB-CONTROL ROOM

TALK STUDIO

SOUND LOCK

WASTE

STORE (2)

WATER TANK BELOW

POWER ROOM

ENGINE GENERATOR ROOM

PRODUCTION STUDIO

MAINTENANCE MEN'S ROOM

TOILET (F)

TOILET (M)

SUB-CONTROL ROOM

TALK STUDIO

SOUND LOCK

WASTE

STORE (2)

WATER TANK BELOW

POWER ROOM

ENGINE GENERATOR ROOM

PRODUCTION STUDIO





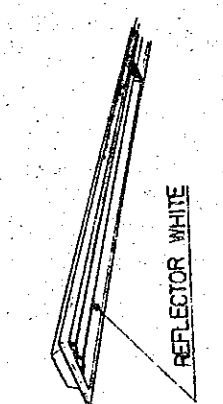
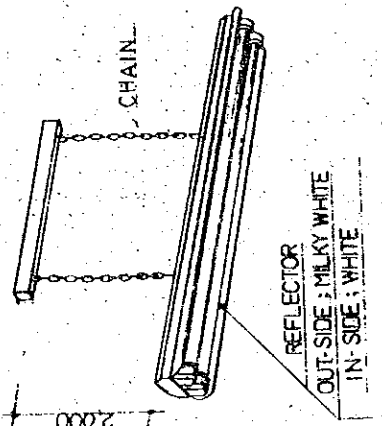
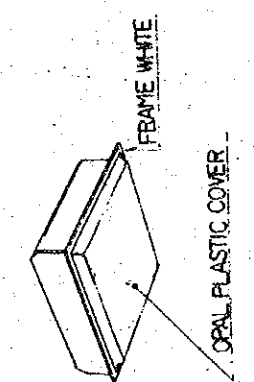
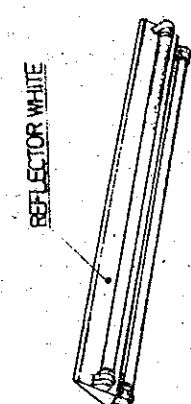
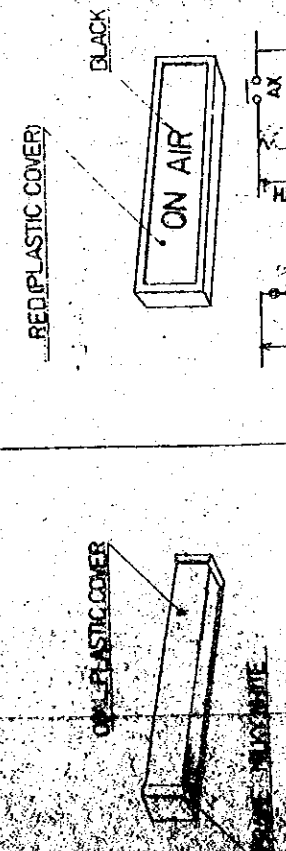
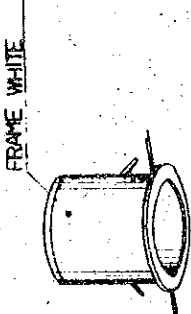

<p>D1 FLR-40"x2" (2 JOINT TYPE) DO.</p> <p>D2 FLR-40"x2" (4 JOINT TYPE) DO.</p> <p>D3 FLR-40"x2" (6 JOINT TYPE) DO.</p> <p>D4 FLR-40"x2" (8 JOINT TYPE) DO.</p>	<p>E FLR-40"x2" PENDANT MOUNTING WITH REFLECTOR</p>	<p>THE ESTABLISHMENT PROGRAMME OF MEDIUM WAVE BROADCASTING NETWORK IN THE KINGDOM OF NEPAL</p>
		<p>KATHMANDU STUDIO CENTRE TITLE OF DRAWING VIEW OF LIGHTING FIXTURES</p>
<p>* ALL BALLAST SEPARATE LOCATION</p> <p>I FL-20"x1" FLUSH TYPE</p> 	<p>J FLR-40"x2" CEILING SURFACE MOUNTING</p> 	<p>DATE JAN 1981</p>
<p>N FL-10"x1" WALL MOUNTING</p>  <p>DC 24V</p> <p>AC 230V 50/60 HZ</p> <p>AX</p> <p>LOAD</p>	<p>O FL-40"x1" RECESSED MOUNTING (DC 24V)</p> 	<p>SCALE</p> <p>FIG. NO. E-106</p>

THE ESTABLISHMENT PROGRAMME OF MEDIUM WAVE BROADCASTING NETWORK IN THE KINGDOM OF NEPAL	
KATHMANDU STUDIO CENTRE	FIG. NO. E-106
TITLE OF DRAWING VIEW OF LIGHTING FIXTURES	SCALE
	DATE JAN 1981



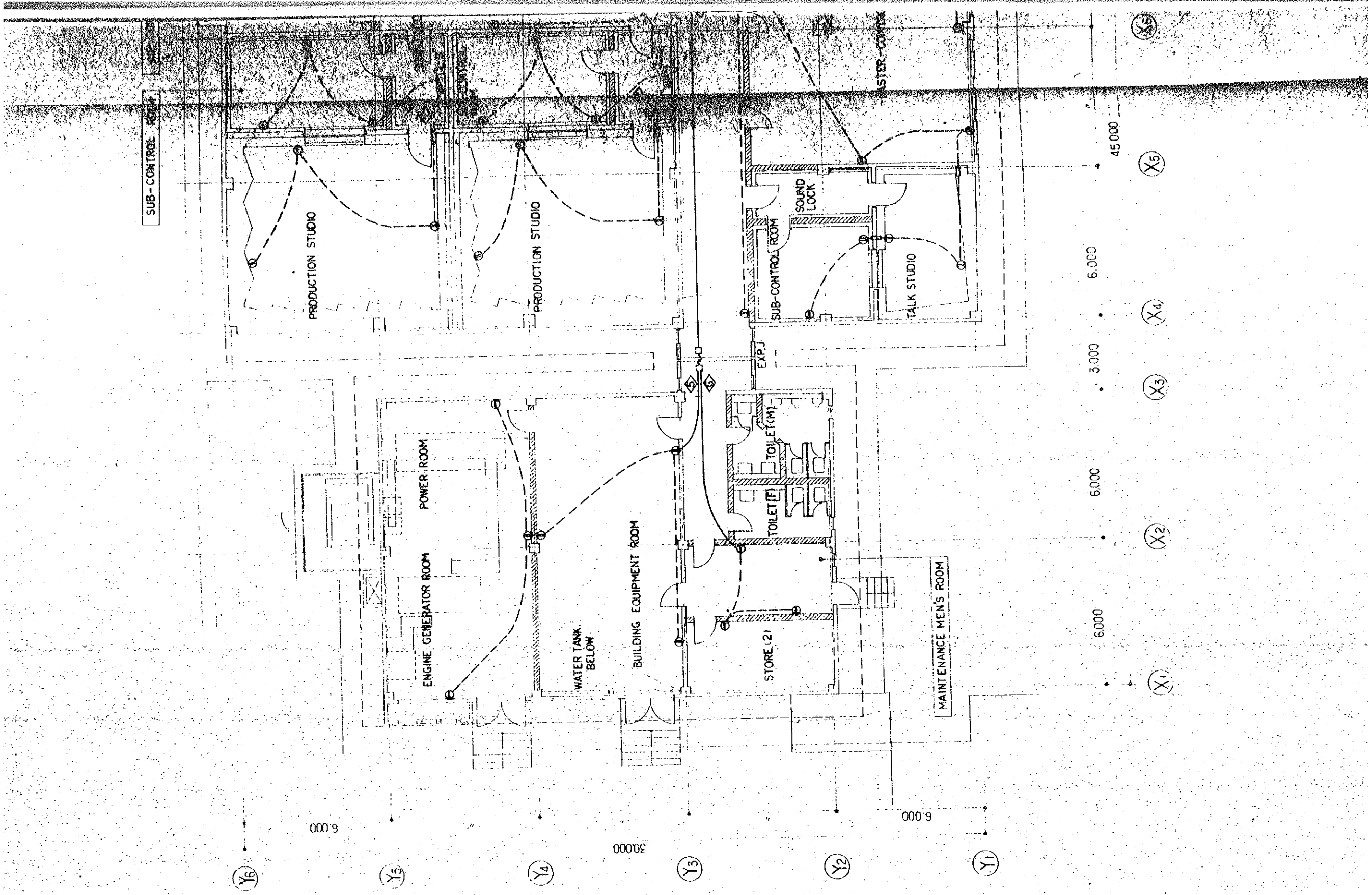

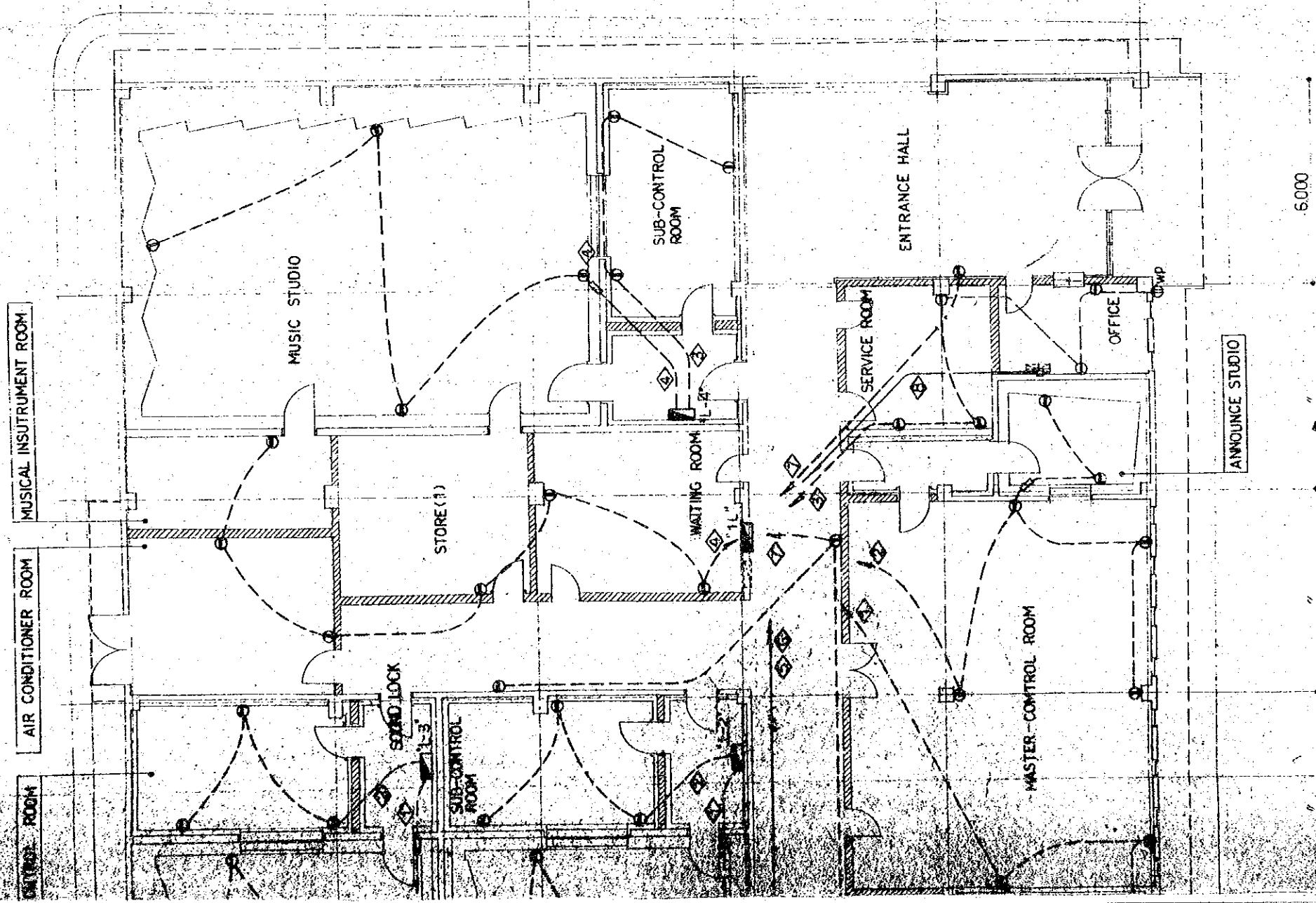

THE ESTABLISHMENT PROGRAMME OF MEDIUM WAVE BROADCASTING NETWORK IN THE KINGDOM OF NEPAL		
DRAWING NO. E-107	SCALE 1:100	DATE JAN' 1981
KATHMANDU STUDIO CENTRE		
TITLE OF DRAWING PIPING AND WIRING FOR PLUG SOCKET		

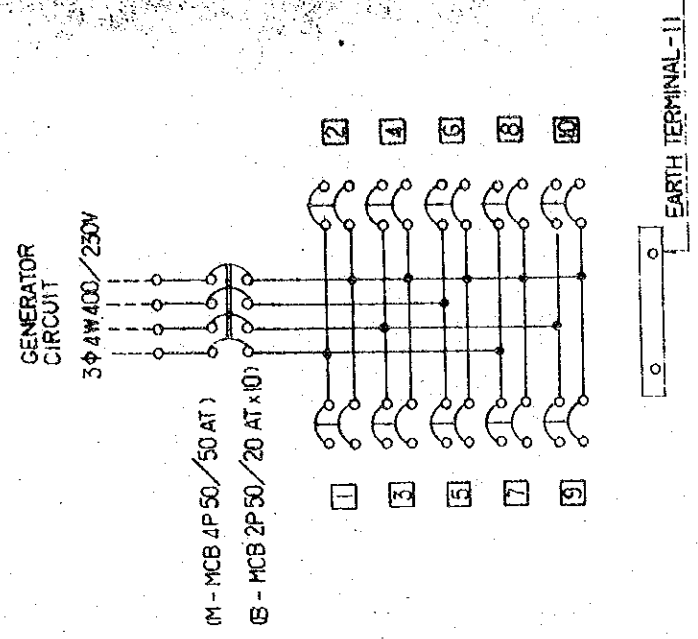
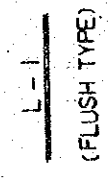
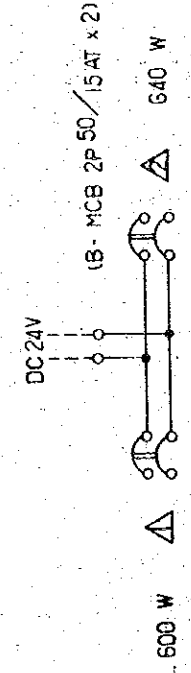
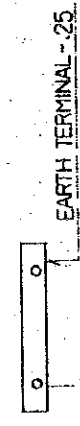
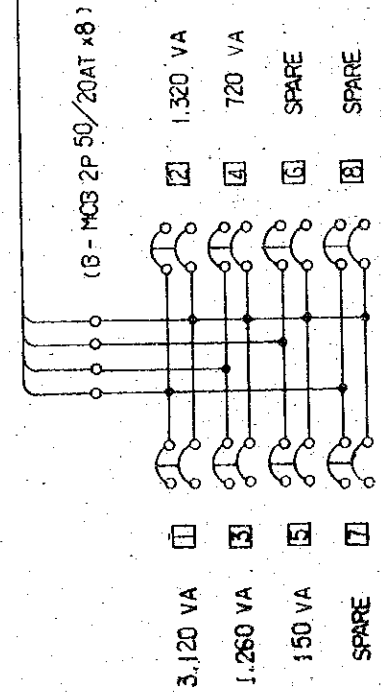
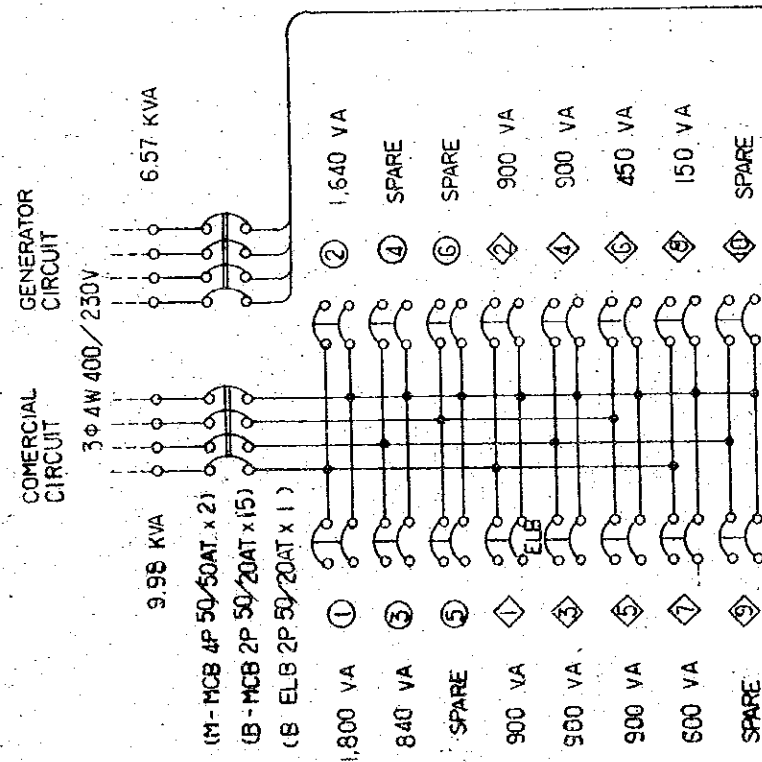

B-1 MASTER CONTROL ROOM 10 KVA  
(WALL MOUNTED TYPE)

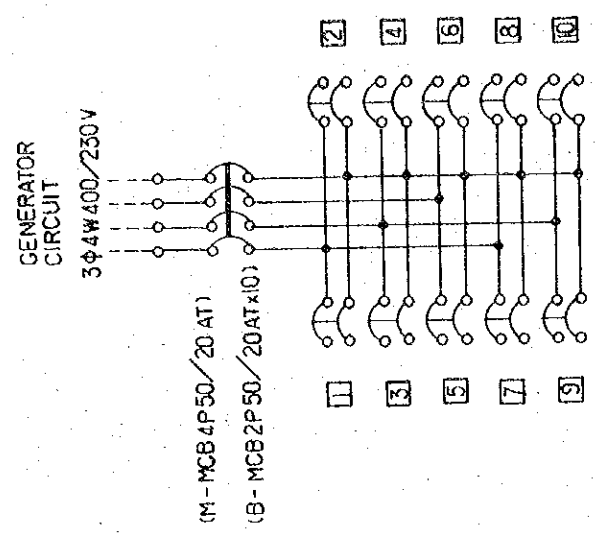

B-2 PRODUCTION SUB-CONTROL ROOM (1) 3 KVA  
B-3 DO DO (2) 3 KVA  
B-4 MUSIC STUDIO SUB CONTROL ROOM 3 KVA  
B-5 TALK STUDIO SUB CONTROL ROOM 3 KVA  
(WALL MOUNTED TYPE)

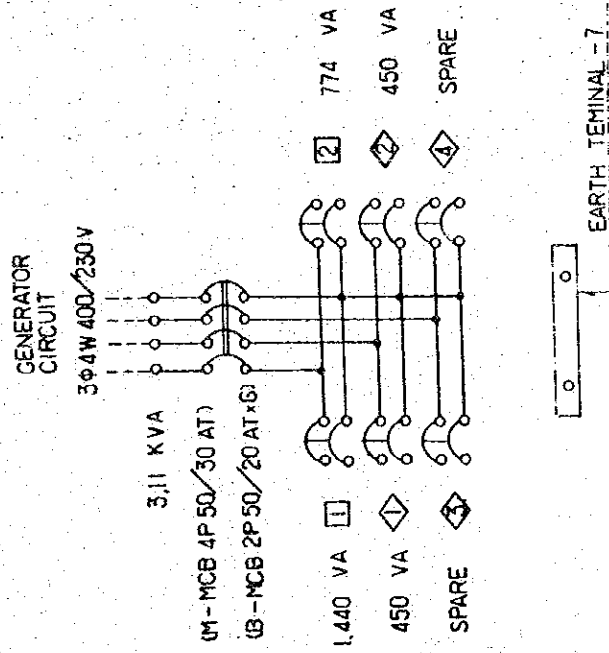

L-2 (WALL MOUNTED TYPE)

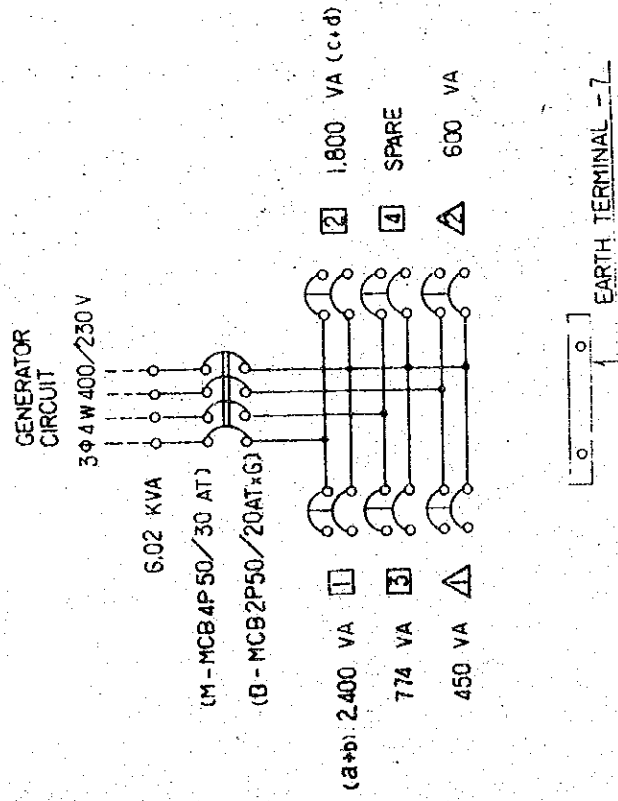

L-4 (WALL MOUNTED TYPE)

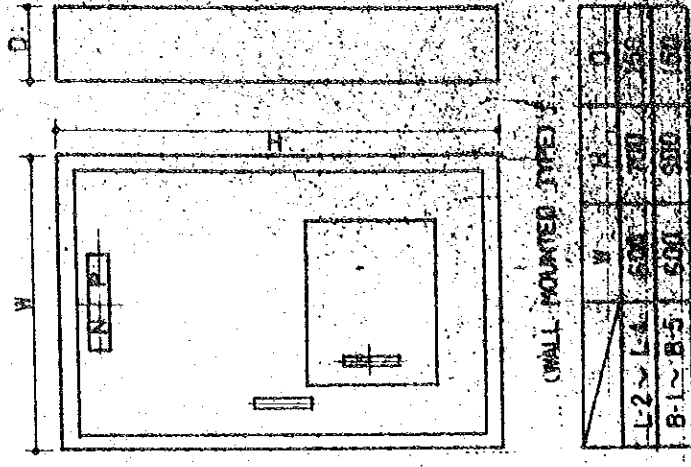
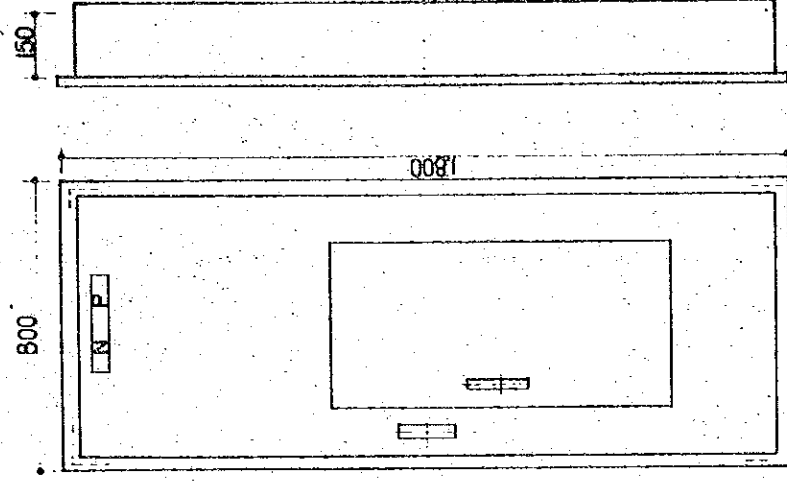

L-1 (FLUSH TYPE)

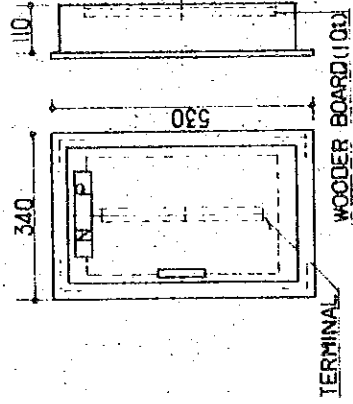

TERMINAL BOARD 20P (FLUSH TYPE)

BALLAST BOX

	W	H	D
BB-1	1500	250	300
BB-2	800	150	200
BB-3	800	150	200
BB-4	400	700	200
BB-5	300	700	200

WIRE NET

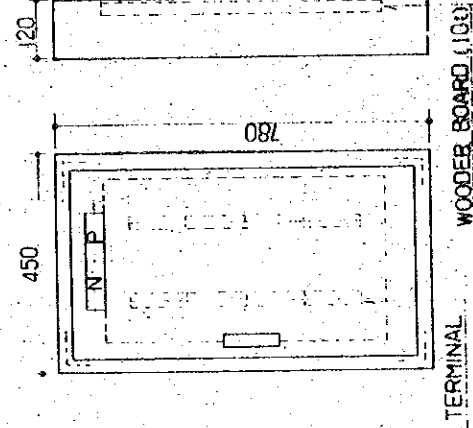
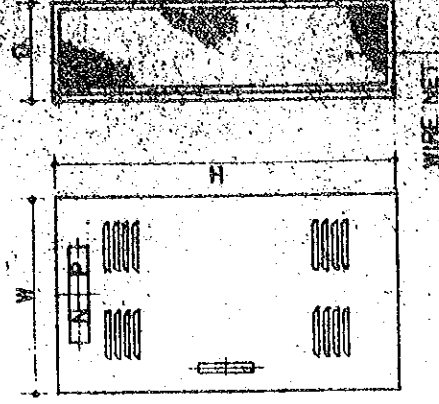

TERMINAL BOARD 80P (WALL MOUNTED TYPE)

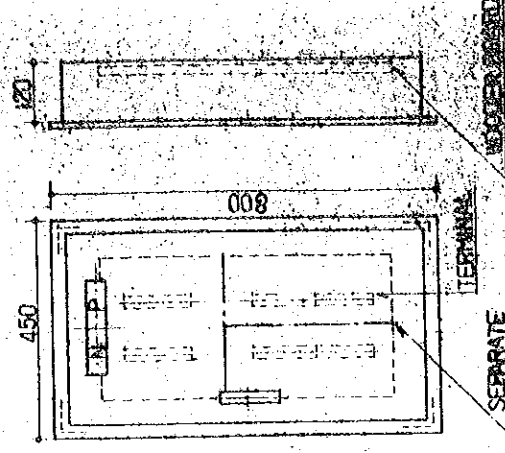

TERMINAL BOARD 80P (FLUSH TYPE)

THE ESTABLISHMENT PROGRAMME  
OF  
MEDIUM WAVE BROADCASTING NETWORK  
IN  
THE KINGDOM OF NEPAL

KATHMANDU STUDIO CENTRE

TITLE OF DRAWING  
VIEW AND CONNECTION DIAGRAM  
FOR LIGHTING BOARD, E.T.C.

DRAWING NO. E-108

SCALE 1:10

DATE JAN 1981

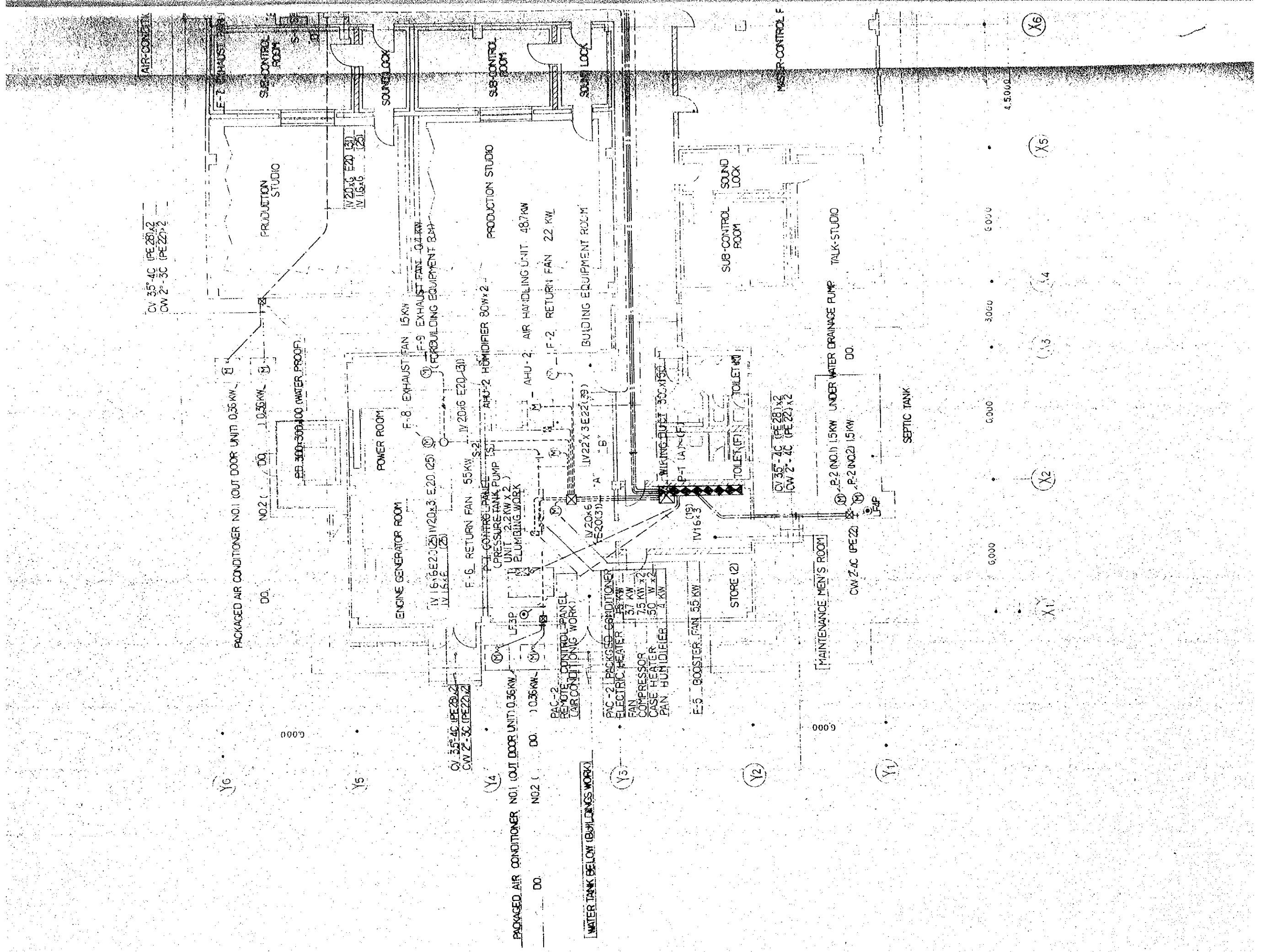

CV 35-4C (PE 28) X2  
 CW 2-3C (PE 22) X2

PACKAGED AIR CONDITIONER NO.1 (OUT DOOR UNIT) 0.36 KW  
 NO.2 ( DO. ) 1.036 KW

PEB 300-300-100 (WATER PROOF.)

POWER ROOM

F-8 EXHAUST FAN 15 KW

F-9 EXHAUST FAN 0.4 KW  
 (FOR BUILDING EQUIPMENT ROOM)

F-6 RETURN FAN 55 KW

AHU-2 HUMIDIFIER 80W X 2

AHU-2 AIR HANDLING UNIT 48.7 KW

F-2 RETURN FAN 22 KW

BUILDING EQUIPMENT ROOM

IV 15x6 E20 (25)  
 IV 15x6 E20 (25)

P-1 CONTROL PANEL  
 (PRESSURE TANK PUMP)

UNIT 2.2 KW X 2  
 (PLUMBING WORK)

IV 20x6 E20 (31)  
 IV 20x6 E20 (31)

IV 20x6 E20 (31)  
 IV 20x6 E20 (31)

IV 15x6 E20 (25)  
 IV 15x6 E20 (25)

IV 15x6 E20 (25)  
 IV 15x6 E20 (25)

IV 15x6 E20 (25)  
 IV 15x6 E20 (25)

IV 15x6 E20 (25)  
 IV 15x6 E20 (25)

IV 15x6 E20 (25)  
 IV 15x6 E20 (25)

IV 15x6 E20 (25)  
 IV 15x6 E20 (25)

IV 15x6 E20 (25)  
 IV 15x6 E20 (25)

IV 15x6 E20 (25)  
 IV 15x6 E20 (25)

IV 15x6 E20 (25)  
 IV 15x6 E20 (25)

IV 15x6 E20 (25)  
 IV 15x6 E20 (25)

IV 15x6 E20 (25)  
 IV 15x6 E20 (25)

IV 15x6 E20 (25)  
 IV 15x6 E20 (25)

IV 15x6 E20 (25)  
 IV 15x6 E20 (25)

IV 15x6 E20 (25)  
 IV 15x6 E20 (25)

IV 15x6 E20 (25)  
 IV 15x6 E20 (25)

IV 15x6 E20 (25)  
 IV 15x6 E20 (25)

IV 15x6 E20 (25)  
 IV 15x6 E20 (25)

IV 15x6 E20 (25)  
 IV 15x6 E20 (25)

IV 15x6 E20 (25)  
 IV 15x6 E20 (25)

IV 15x6 E20 (25)  
 IV 15x6 E20 (25)

IV 15x6 E20 (25)  
 IV 15x6 E20 (25)

CV 35-4C (PE 28) X2  
 CW 2-3C (PE 22) X2

PACKAGED AIR CONDITIONER NO.1 (OUT DOOR UNIT) 0.36 KW  
 NO.2 ( DO. ) 1.036 KW

WATER TANK BELOW (BUILDINGS WORK)

PAC-2 REMOTE CONTROL PANEL  
 (AIR CONDITIONING WORK)

PAC-2 PACKAGED AIR CONDITIONER  
 ELECTRIC HEATER 15 KW  
 FAN COMPRESSOR 75 KW X 2  
 CASE HEATER 50 W X 2  
 PAN HUMIDIFIER 1 KW

E-5 BOOSTER FAN 55 KW

STORE (2)

TOILET (F)

TOILET (M)

WIRING JUNCTION BOX

P-1 (A) (F)

CV 35-4C (PE 28) X2  
 CW 2-4C (PE 22) X2

P-2 (NO.1) 15 KW UNDER WATER DRAINAGE PUMP  
 P-2 (NO.2) 15 KW DO.

LF-4P

SEPTIC TANK

MAINTENANCE MEN'S ROOM

TALK STUDIO

SOUND LOCK

SUB-CONTROL ROOM

SOUND LOCK

SUB-CONTROL ROOM

SOUND LOCK

SUB-CONTROL ROOM

SOUND LOCK

SUB-CONTROL ROOM

SOUND LOCK

SUB-CONTROL ROOM

SOUND LOCK

SUB-CONTROL ROOM

SOUND LOCK

SUB-CONTROL ROOM

SOUND LOCK

SUB-CONTROL ROOM

SOUND LOCK

SUB-CONTROL ROOM

SOUND LOCK

SUB-CONTROL ROOM

SOUND LOCK

SUB-CONTROL ROOM

SOUND LOCK

SUB-CONTROL ROOM

SOUND LOCK

SUB-CONTROL ROOM

SOUND LOCK

SUB-CONTROL ROOM

CV 35-4C (PE 28) X2  
 CW 2-3C (PE 22) X2

PACKAGED AIR CONDITIONER NO.1 (OUT DOOR UNIT) 0.36 KW  
 NO.2 ( DO. ) 1.036 KW

WATER TANK BELOW (BUILDINGS WORK)

PAC-2 REMOTE CONTROL PANEL  
 (AIR CONDITIONING WORK)

PAC-2 PACKAGED AIR CONDITIONER  
 ELECTRIC HEATER 15 KW  
 FAN COMPRESSOR 75 KW X 2  
 CASE HEATER 50 W X 2  
 PAN HUMIDIFIER 1 KW

E-5 BOOSTER FAN 55 KW

STORE (2)

TOILET (F)

TOILET (M)

WIRING JUNCTION BOX

P-1 (A) (F)

CV 35-4C (PE 28) X2  
 CW 2-4C (PE 22) X2

P-2 (NO.1) 15 KW UNDER WATER DRAINAGE PUMP  
 P-2 (NO.2) 15 KW DO.

LF-4P

SEPTIC TANK

MAINTENANCE MEN'S ROOM

TALK STUDIO

SOUND LOCK

SUB-CONTROL ROOM

SOUND LOCK

SUB-CONTROL ROOM

SOUND LOCK

SUB-CONTROL ROOM

SOUND LOCK

SUB-CONTROL ROOM

SOUND LOCK

SUB-CONTROL ROOM

SOUND LOCK

SUB-CONTROL ROOM

SOUND LOCK

SUB-CONTROL ROOM

SOUND LOCK

SUB-CONTROL ROOM

SOUND LOCK

SUB-CONTROL ROOM

SOUND LOCK

SUB-CONTROL ROOM

SOUND LOCK

SUB-CONTROL ROOM

SOUND LOCK

SUB-CONTROL ROOM

SOUND LOCK

SUB-CONTROL ROOM

SOUND LOCK

SUB-CONTROL ROOM



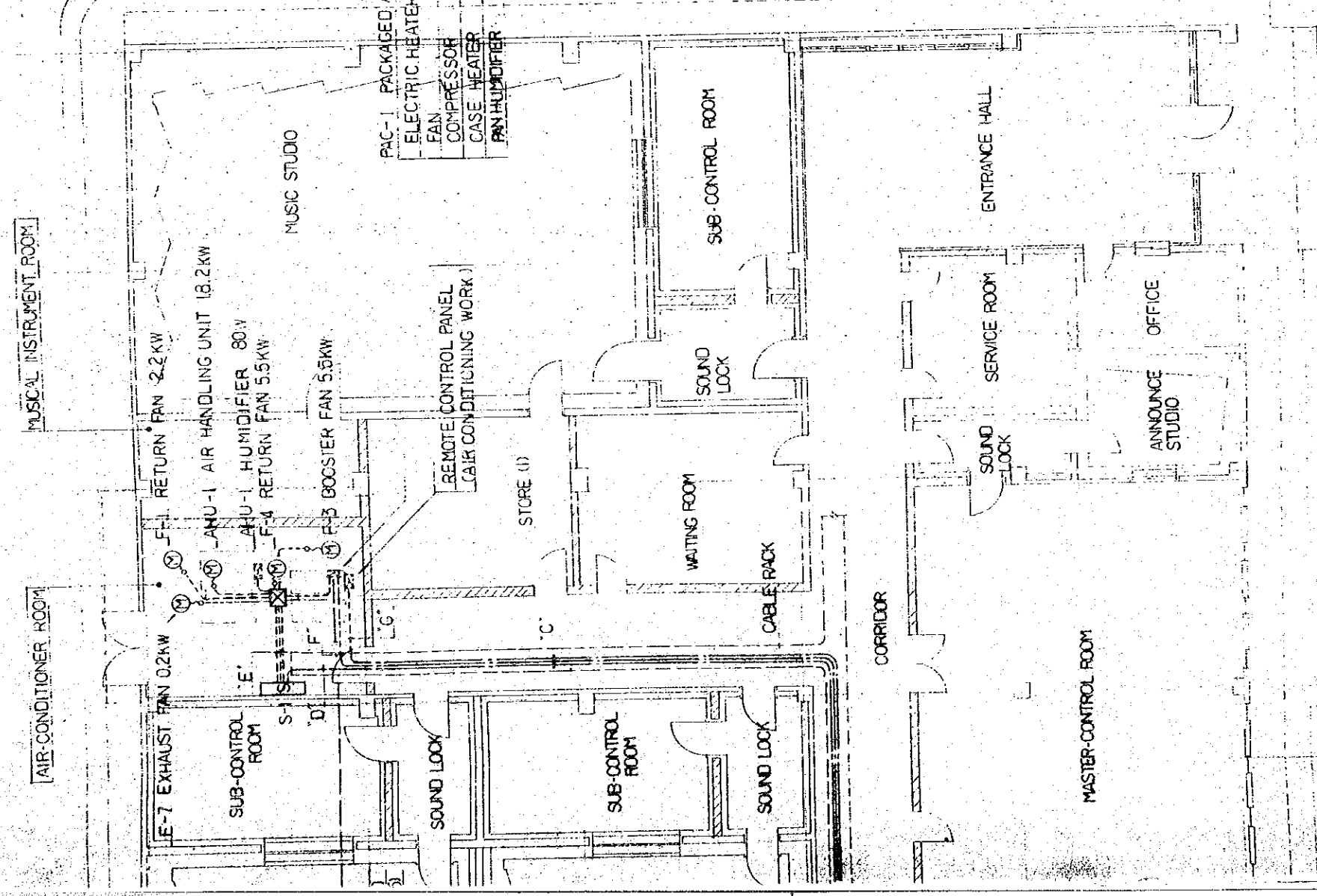

**A**

F-2	F-8	IV 20 x 9	(31)
F-5	F-6	IV 55° x 6	(25)
AHU-2		IV 20 x 3	E55° (25) FAN
DO.		IV 20 x 15	(59) x 2
DO.		IV 20 x 2	(19)
DO.		IV 16 x 2	(19)
PAC-2		IV 16 x 2	(9) DO.
DO.		IV 16 x 4	(25) ALARM & RUNNING LUMP
DO.		IV 16 x 5	(25) REMOTE CONTROL

**B**

DO	F+G
----	-----

**C**

F-1	F-7	CV 35°-3C x 2	
F-3	F-4	CV 55°-3C x 2	
AHU-1		CV 35°-3C x 7	ELECTRIC HEATER & FAN HUMIDIFIER
DO.		CV 35°-2C	INTER LOCK
DO.		CW 2°-2C	DO
PAC-1		CW 2°-2C	ALARM & RUNNING LUMP
DO.		CW 2°-2C	REMOTE CONTROL

**D**

F-1	F-7	CV 35°-3C	(25) x 2
F-3	F-4	CV 55°-3C	(31) x 2
AHU-1		CV 35°-3C	(25) x 7
DO.		CV 35°-2C	(25) x 7
DO.		CV 2°-2C	(25) x 7
DO.		CV 2°-2C	(25) x 7
DO.		CV 2°-2C	(25) x 7

**E**

F-1	F-7	IV 20 x 6	(25)
F-3	F-4	IV 55° x 6	E55° (31)
AHU-1		IV 20 x 18	(51)
DO.		IV 20 x 3	(19)
DO.		IV 20 x 2	(19)
PAC-1		IV 20 x 2	(19)
DO.		IV 16 x 2	(19)
DO.		IV 14 x 3	(31)

**F**

PAC-1		CW 2°-2C	INTER LOCK
DO.		CVV 2°-4C	ALARM & RUNNING LUMP

**G**

PAC-1		CW 2°-5C	REMOTE CONTROL
-------	--	----------	----------------

- PAC-1** PACKAGED AIR CONDITIONER  
 - ELECTRIC HEATER 10 KW  
 - FAN 2.2 KW  
 - COMPRESSOR 5.5 KW x 2  
 - CASE HEATER 50 W x 2  
 - PAN HUMIDIFIER 4 KW

6000

4.5000

(X6) (X7) (X8) (X9)

THE ESTABLISHMENT PROGRAMME  
 OF  
 MEDIUM WAVE BROADCASTING NETWORK  
 IN  
 THE KINGDOM OF NEPAL

**KATHMANDU STUDIO CENTRE**

TITLE OF DRAWING  
**PIPING AND WIRING  
 FOR POWER CIRCUITS**

PROJECT NO. **E-109**  
 SCALE **1:100**  
 DATE **JAN. 1981**



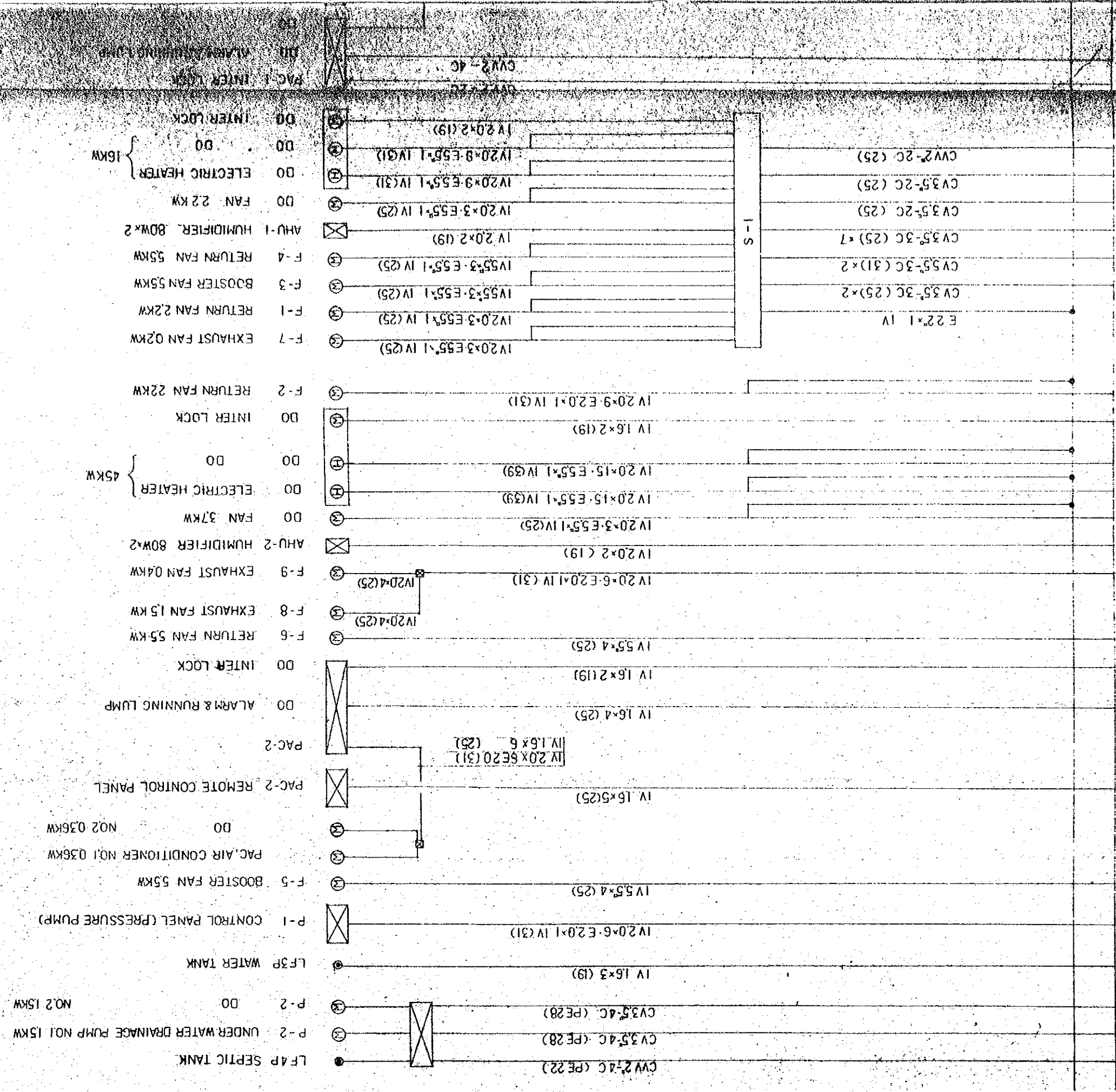

POWER CONTROL BOARD

POWER CONTROL CONNECTIONS SYSTEM

NO. 1 0.36KW  
 NO. 2 0.36KW  
 PAC. AIR CONDITIONER NO.1 0.36KW  
 PAC. AIR CONDITIONER NO.2 0.36KW  
 REMOTE CONTROL PANEL  
 ALARM RUNNING LUMP  
 FAC-1 INTER LOCK  
 INTER LOCK  
 NO. 1 0.36KW

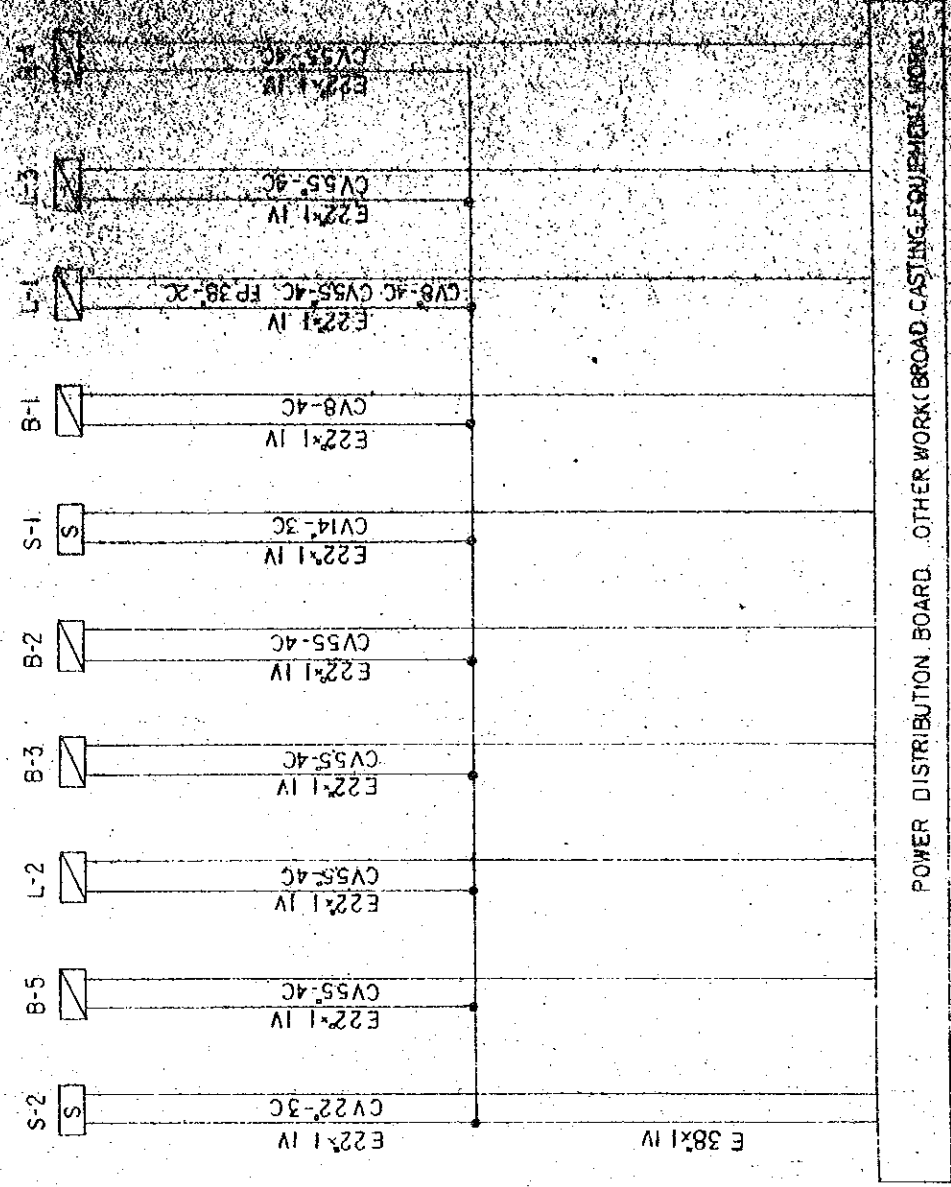
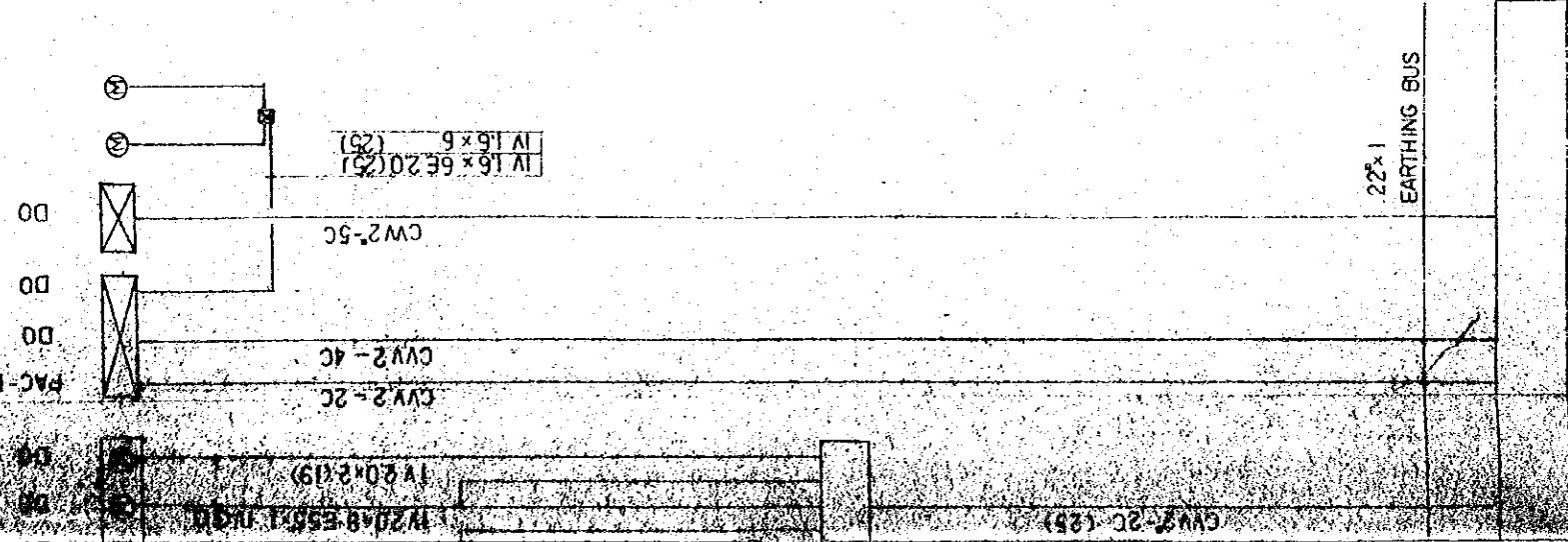

POWER DISTRIBUTION BOARD. OTHER WORK (BROAD CASTING EQUIPMENT WORKS)

MAIN POWER CONNECTIONS SYSTEM

OF THE KINGDOM OF NEPAL  
 MEDIUM WAVE BROADCASTING NETWORK  
 THE KINGDOM OF NEPAL  
**KATHMANDU STUDIO CENTRE**  
 TITLE OF DRAWING  
 POWER CONTROL CONNECTIONS SYSTEM  
 AND MAIN POWER CONNECTIONS SYSTEM  
 DATE: 15/01/88  
 DRAWN BY: J.S.P.

3P4W 400/230V 50HZ

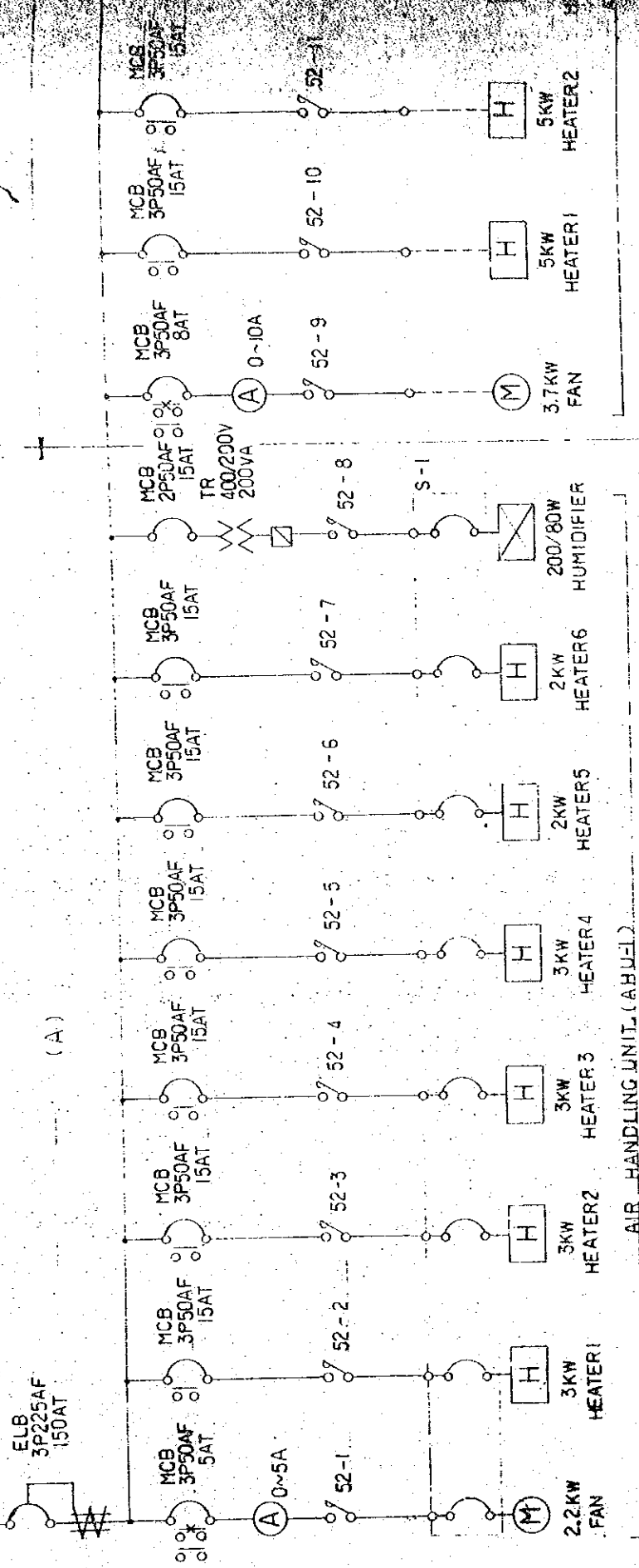

AIR HANDLING UNIT (AHU-1)

3P4W 400/200V 50HZ

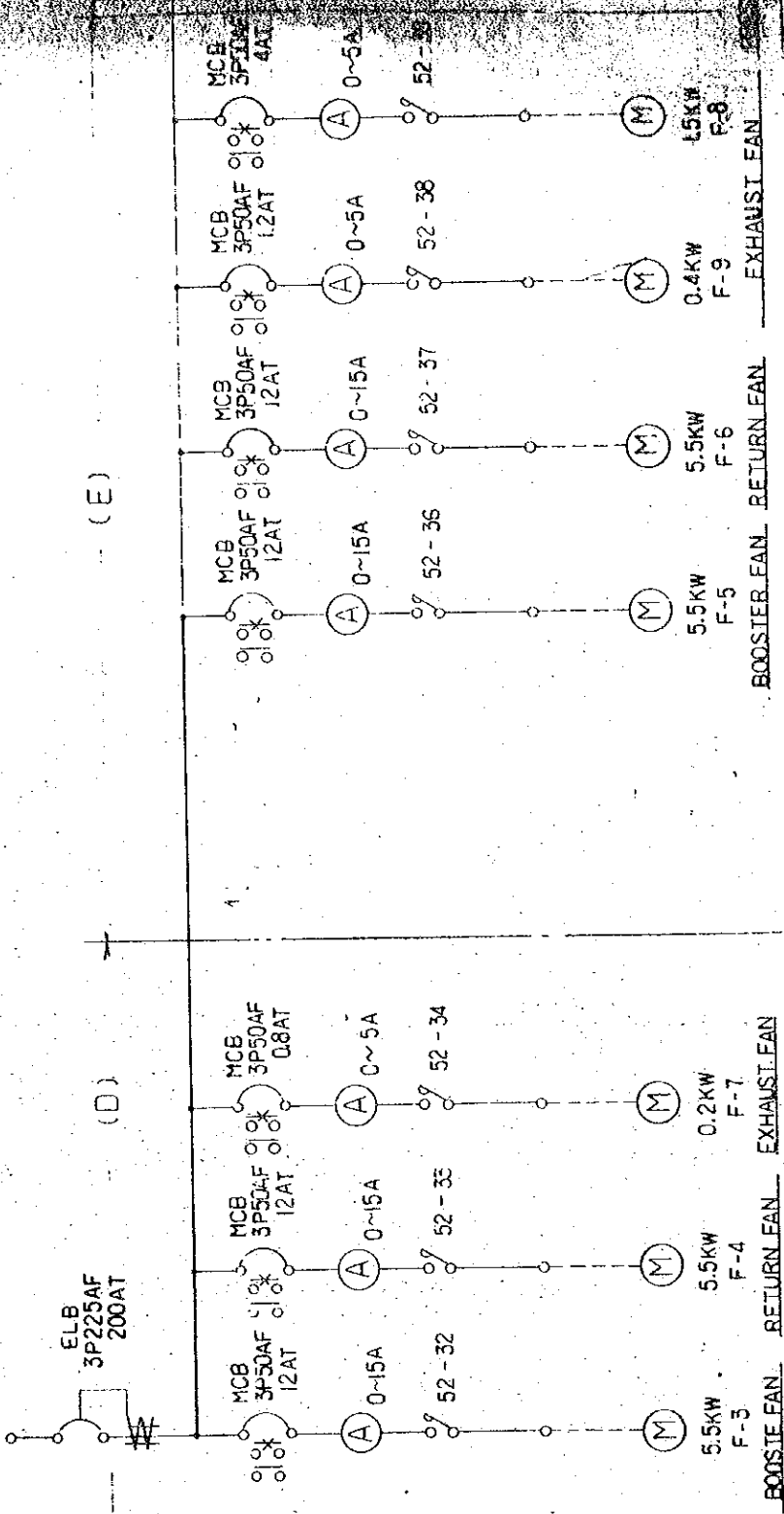

BOOSTER FAN RETURN FAN EXHAUST FAN

POWER CONTROL BOARD P-1

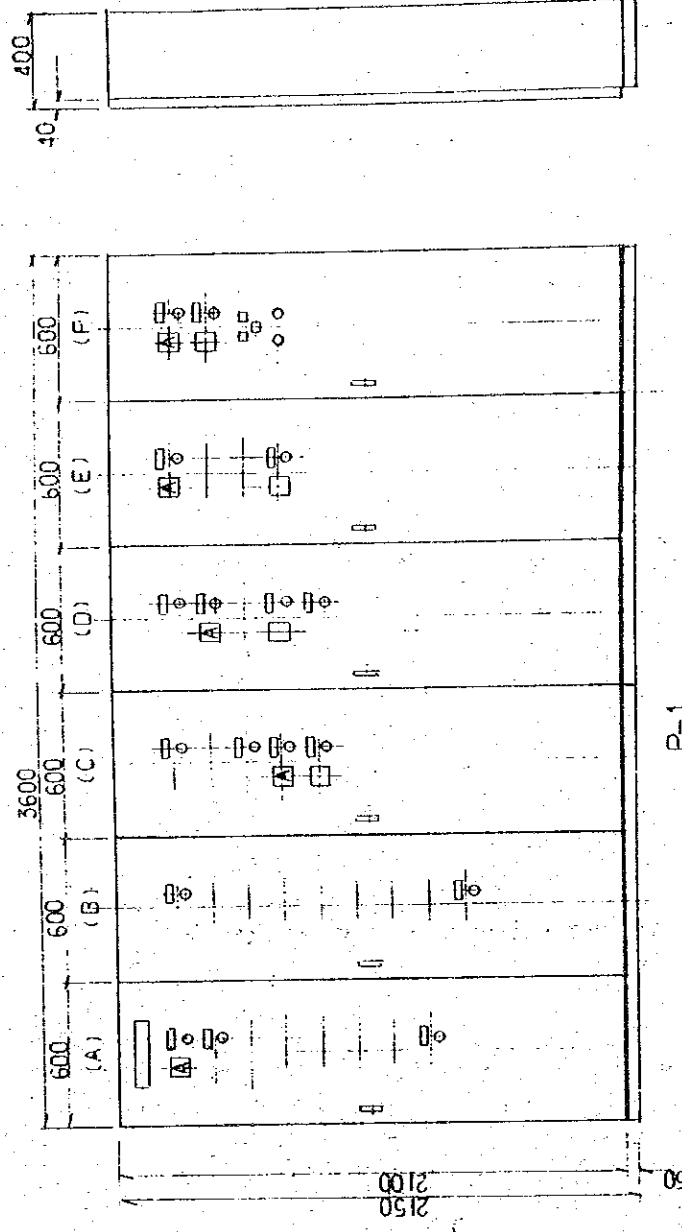

P-1

(C)

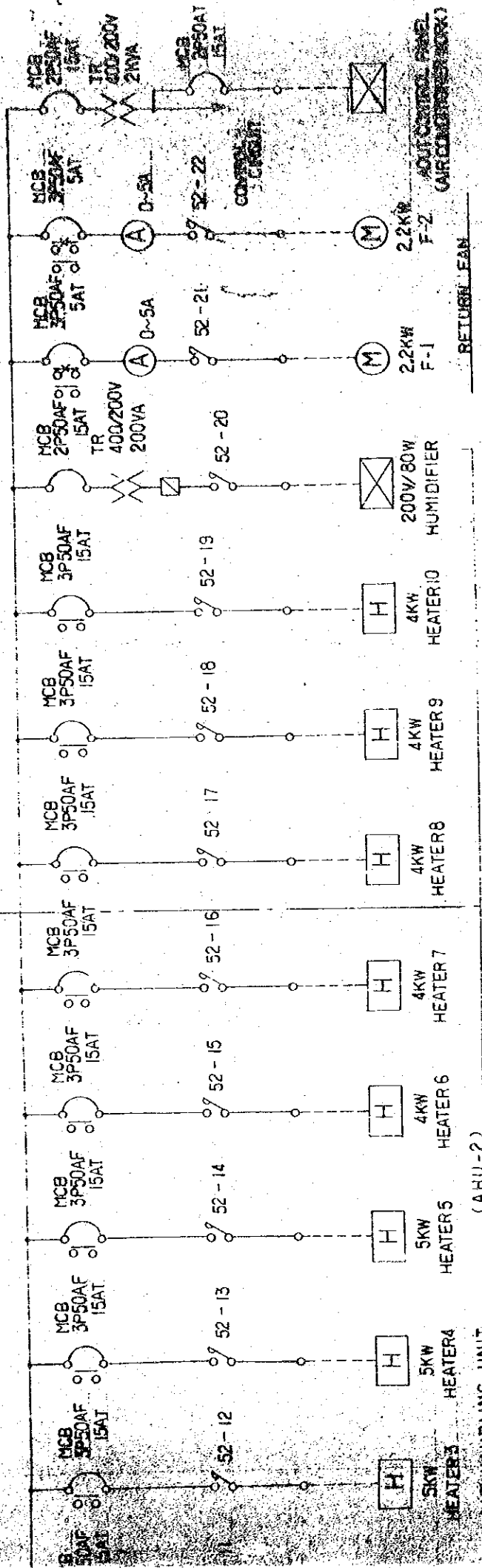

(B)

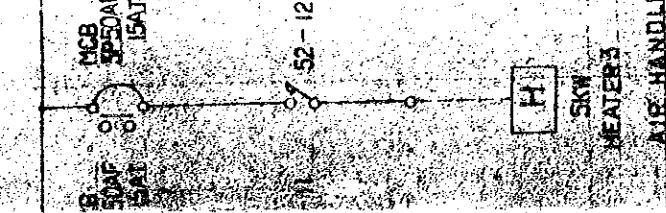

(F)

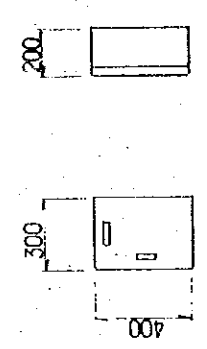
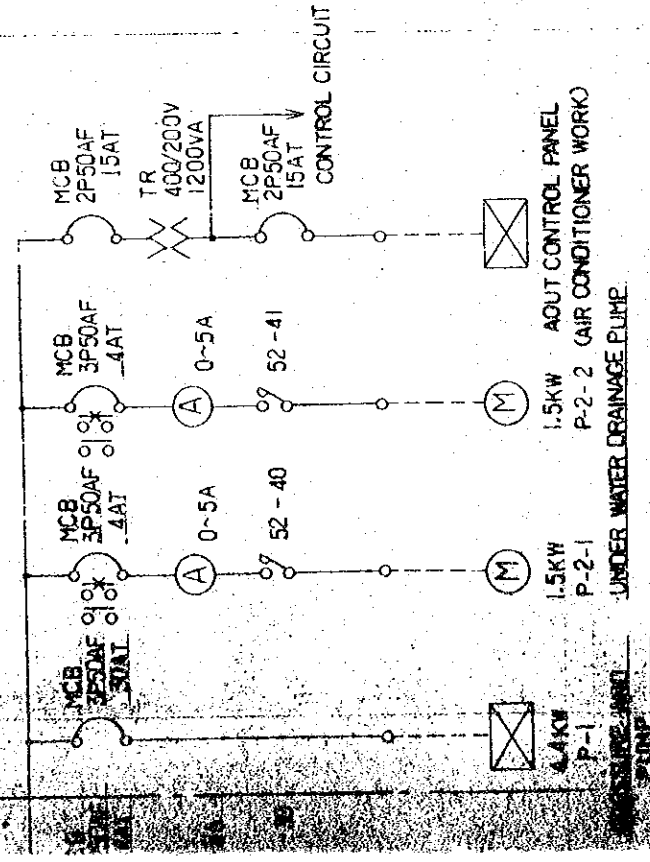

MCB BOX S-2 (PAC-1)

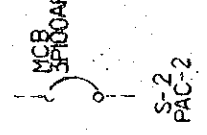

MCB BOX S-2 (PAC-2)

CV14-3C SEE E-103

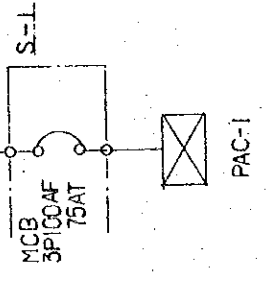

MCB BOX S-1 (PAC-1)

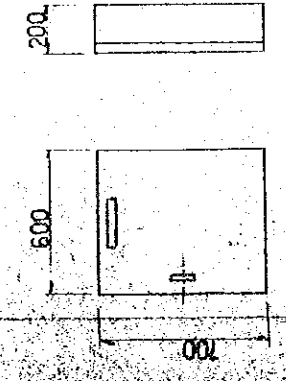

MCB BOX S-1

THE ESTABLISHMENT PROGRAMME OF MEDIUM WAVE BROADCASTING NETWORK IN THE KINGDOM OF NEPAL		DRAWING NO.	E-11
KATHMANDU STUDIO CENTRE		SCALE	1:20
TITLE OF DRAWING VIEW AND SINGLE LINE DIAGRAM FOR POWER BOARD		DATE	JAN 1981