

MINUTES OF DISCUSSIONS  
FOR THE BASIC DESIGN ON SCHOOL BUILDING CONSTRUCTION  
IN THE REPUBLIC OF MALDIVES

---

Under the instruction from the Government of Japan, Japan International Cooperation Agency (JICA) organized and despatched the basic design survey team headed by Mr. Kaeru Okabe with three architectural experts to the Republic of Maldives for a period of three weeks from 22nd October, 1979. Having completed a series of meetings, data collections and field surveys to some islands in the Atolls, and in Male', both sides confirm the following points.

岡部 薫

.....  
K. Okabe  
Japanese Survey Team Leader

محمد نوردين

.....  
Mohamed Noordeen  
Deputy Minister of Education.

1. Mr. Mohamed Zahir Hussain, Minister of Education of the Republic of Maldives briefed on the educational policy of the Government of the Republic of Maldives to the survey team. They are as follows:
  - A. Expansion of primary education to the entire primary school going age population, together with the implementation of social education to the maximum number of inhabited islands in the 19 Atolls (local provinces) is considered to be a very high priority policy of the present administration.
  - B. The Government is now planning to establish a new educational system in Maldives as shown on chart I, which will be very important part of National Development Five Year Plan (1980 - 1985) under compilation at present. The Government will be formulating laws and regulations for the purpose of executing this new educational system.
  - C. Based on the new-educational system, the Maldivian Government is endeavouring to establish as many government sponsored primary schools as on selected islands of each of the 19 Atolls. The first phase of the establishment program for the primary schools is shown in list II. The 19 primary schools requested for the Japanese aid will play a very important roll in the whole establishment program of government primary schools. These are the reasons for requesting the construction of all of the 19 primary schools, one in each of the 19 atolls, as soon as possible under the Economic aid of the Japanese Government.
  - D. Taking into account of the political, administrative and other social factors, 19 islands were selected from 19 atolls for the construction of primary schools to be aided by Japan. It is confirmed that the proposed islands will not be changed in the future.
2. Realizing the great importance of establishing this new-educational system in Maldives, especially in the isolated islands divided by long distances of sea and difficulty of transportation within the islands, both parties agree to recommend to their own Governments that primary schools are necessary and are to be constructed by Japan's aid under its

Grant Aid Programme.

3. The survey team explained that the number of schools to be constructed and the budgetary allocation will be decided by the Japanese Government from the result of cost analysis done by the present survey within the frame of laws and regulations in relation to the budgetary system of the Japanese Government. Maldivian side fully understands the above explanation.
4. The Survey Team promised to report with sincerity to the effect that the Maldivian Government hopes strongly to have the 19 primary schools constructed in whole with the economic aid from Japan.
5. The Survey team explained the general mechanism, principles, procedures, and the measures of the grant aid program under Japan's economic cooperation as given in the annex I. The Maldivian side fully understands the above explanation.
6. Construction Plan per One Primary School was agreed by both parties as follows:
  - A. Conditions for the plan.
    1. Academic Year starts from the 3rd week of February and ends at the 3rd week of December. Academic Year is divided into two terms with two week holidays in between the terms. Each term is divided into two quarter terms with one week holidays in between the quarter terms. Fridays and Saturdays are holidays. Working days are Sunday to Thursday in a week and 185 days a year.
    2. Double shift school hour system and the number per class per grade is shown in Figure III.
    3. One headmaster and 5 teachers will be attached to each school. It is planned to dispatch qualified headmasters after their training. The 5 teachers will be trained locally at the training centre in Male' from among the inhabitants of the island.
    4. The extension of education to adults and those who finished the primary education of five years also considered to be necessary.

B. Tentative Site Plan is confirmed as shown in Illustration IV.

C. Tentative Architectural Plan is composed of four block of buildings for each school based on the new educational system.

1. Class Room Building I: for 1st grade to 4th grade  
(Illustration V )
2. Class Room Building II: (a) for 5th grade  
(Illustration VI) (b) for social education
3. Administration Building. (a) for teachers office  
(Illustration VI) (b) for educational materials store.
4. Toilet Building (c) official residence of the head-  
(Illustration V ) master.

D. Tentative Installation Plan.

1. Water Supply Facilities.  
Rain water collecting system and wells with water tank and round pumping set.
2. Sewage Disposal Facilities.

E. Tentative Furniture Plan is as shown in figure VII.

F. Tentative Construction Schedule is as shown in Chart VIII.

7. Measures to be taken by the Maldivian Government:

- A. To organize planning and steering committee for the construction project of primary school as attached in List IX.
- B. To provide enough land for construction sites, its clearing and levelling.
- C. To clear approach road to construction site, where necessary.
- D. To construct sewage disposal route outside the from construction site, where necessary.
- E. To exempt from all import duties on the imported construction materials.

- F. To exempt Japanese nationals from customs duties, the income taxes and other fiscal levies which may be imposed on those who enter and work for the project.
  - G. To transport imported construction materials from the port of disembarkation in the atolls to the construction site at her expense .
  - H. To secure enough volume of sand, stone and lime which are available locally, as soon as funds for the project are available.
  - I. To select, recommend local construction parties and to secure necessary number of forman, masons, carpenters and labourers.
  - J. To secure the cooperation of all related personnels.
  - K. To offer the benefit to utilize the government owned wireless radio communication facilities.
  - L. To take up the market rate of foreign exchange at each time of calculation of construction cost.
8. List of Japanese survey team is as shown in List X, and list of Maldivian counterparts is as shown in List XI.
9. Twenty copies of basic design report for the school construction in Maldives will be submitted by the Japan International Cooperation Agency through diplomatic channel by the end of March, 1980.

# NEW EDUCATIONAL SYSTEM IN MALDIVES

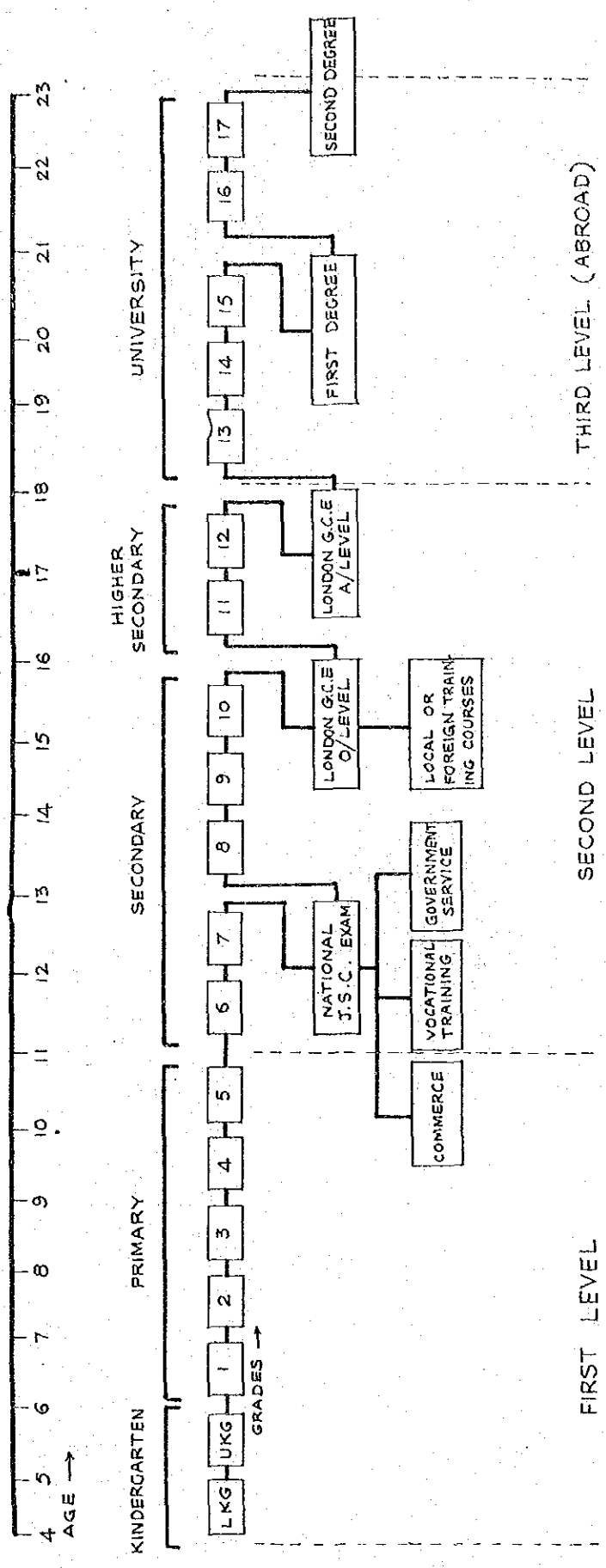

Page II

<u>ATOLL</u>	<u>GOVT. SPONSORED COMMUNITY SCHOOLS</u>	<u>GOVT. SPONSORED PRIMARY SCHOOLS</u>	<u>JAPANESE AIDED SCHOOLS</u>	<u>GOVT. AIDED MADRASAS</u>
Haa Alif	Dhidhdhoo	Huvarafushi	Huvarafushi	Dhidhdhoo Kela
Haa Dhaal	Kulhudhuffushi	Nolhivaranfuru	Vaakaradhoo	Nolhivaram Neykurendhoo Kulhudhuffushi Maknadhoo
Shaviyani	Komandoo	Maakadoodhoo	Inamagu	-
Noonu	Velidhoo	Manadhoo	Kedhikolhudhoo	Hebadhoo Fodhdhoo Kedhikolhudhoo Holludhoo Velidhoo
Raa	Alifushi	Ugocfaaru	Kadholludhoo	Rasmaadhoo Inneuaadhoo
Baa	Eydhafushi	Dharavandhoo	Hithadhoo	Eydhafushi Hithadhoo Thulhaadhoo
Ihaviyani	Kurendhoo	Hinnavaru	Hinnavaru	Naifaru " " Kurendhoo
Kaafu	Himmafushi	Maafushi	Kaashidhoo	Noraanee Makthab Madhrasathul Ifthithaah Roashanee Makthab Makthabul Najeebul h'abshee
Alif	Maanigili	Mahibadhoo	Mahibadhoo	Makthabul Ibtidhaan Makthab Guldhasthaa Makthabul Viridhaa
Vaavu	Keyodhoo	Felidhoo	Felidhoo	-
Meemu	Mulah	Muli	Vaareyaafushi	-
Faafu	Nilendhoo	Magoodhoo	Feealee	-

12/11/11 II 1517

<u>ATOLL</u>	<u>GOVT. SPONSORED COMMUNITY SCHOOLS</u>		<u>GOVT. SPONSORED PRIMARY SCHOOLS</u>		<u>JAPANESE AIDED SCHOOLS</u>		<u>GOVT. AIDED MADRISAS</u>	
		<u>SCHOOLS</u>		<u>SCHOOLS</u>	<u>Name of island</u>	<u>Name of school</u>		
Dhaal	Kudahuvadhoo	Kudahuvadhoo	Meedhoo	Ribudhoo	Makthabul Mubaarik			
Thaa	Thimarafushi	Veymendoo	Guraidhoo	Kibidhoo	Makthabul Ih'thihaadh			
Laamu	Fonadhoo	Maavah	Gan	Hirilaudhoo	Makthabul Anjaer			
Gaaf Alif	Vilingili	Kolamaafushi	Kolamaafushi	Vilafushi	Makthabul Jihaadh			
Gaaf Dhaal	Thinadhoo	Thinadhoo	Gadhoo	Maavashu	Minivan School			
Gnaviyani	Foamulah	Foamulah	Foamulah	-	-			
Seenu	Hithadhoo	Hithadhoo/Feydhoo	Hulhumeedhoo	Thinadhoo	I'Imul Nooriyaa			
				Thinadhoo	Nooraaniyyaa			
				-	-			
				Hithadhoo	Makthabul u'loom			
				Hulhudhoo	Makthabul Irshaadriyyaa			
				Hithadhoo	Makthabul Bahbatudhuhiraasaa			
				Feydhoo	Madrassathul Islam			
				Meedhoo	Madrassathul Hidhaayaa			
				Hulhudhoo	Nasiriyyaa School			
				Maradhoo/				
				Feydhoo	Madrassathul S'aafee			



Figure III

No. per class

<u>Grade</u>	<u>Morning</u>	<u>Afternoon</u>	<u>Total</u>	<u>No. of teachers</u>
1	40	40	80	1
2	40	40	80	1
3	40	40	80	1
4	40	40	80	1
5	40	40	80	1
<b>TOTAL:</b>	200	200	400	5+1 = 6 (tendmaster)

Figure VII

<u>Grade</u>	<u>Tables</u>	<u>Chairs</u>	<u>B.B</u>	<u>Shelves</u>	<u>T.Desk</u>	<u>T. Chair</u>
1	20	40	1	1	1	1
2	20	40	1	1	1	1
3	20	40	1	1	1	1
4	20	40	1	1	1	1
5	20	40	1	1	1	1
SEC	10	20	1	1	1	1
Teachers office			1	3	6	6
<b>TOTAL:</b>	110	220	7	9	12	12

SITE PLAN

Illustration IV

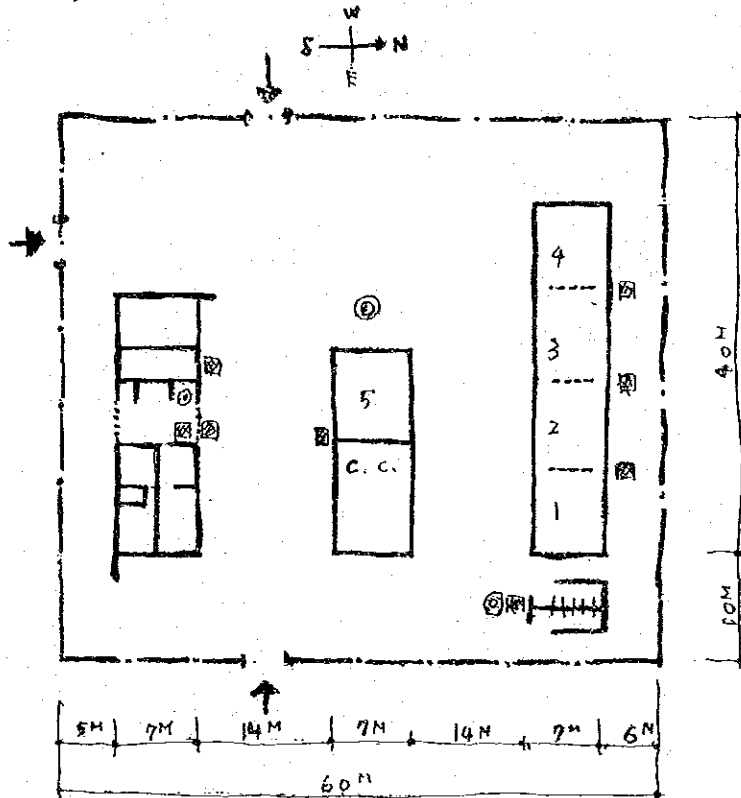

CLASS ROOM BLOCK - 1

Illustration V

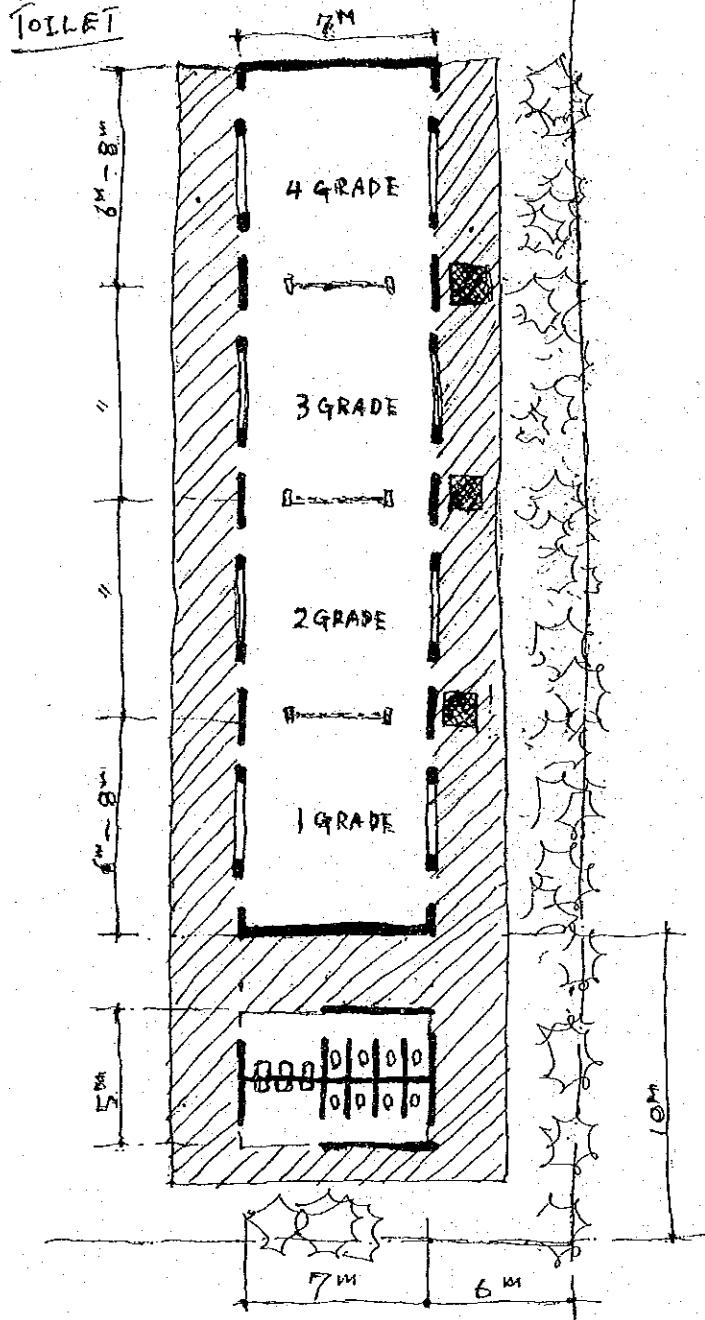
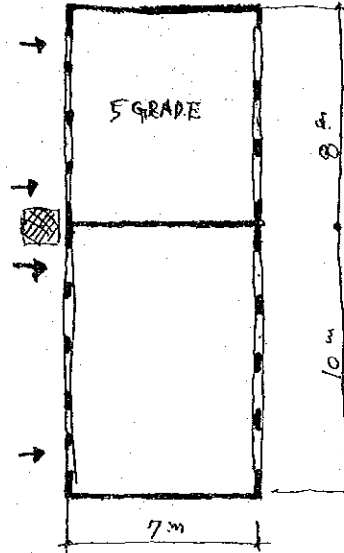
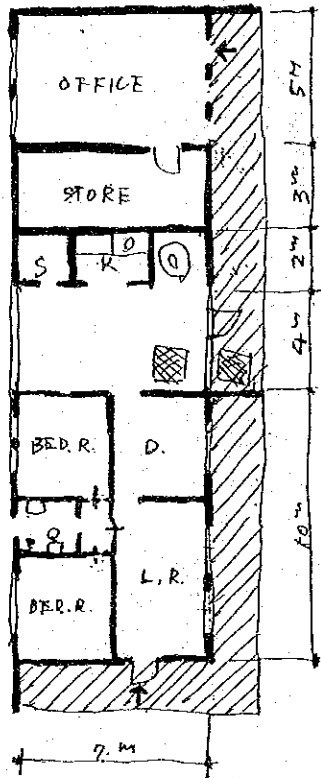

Illustration VI

ADMINISTRATION BLOCK

CLASS ROOM BLOCK II



# Tentative Construction Schedule

Chart VIII

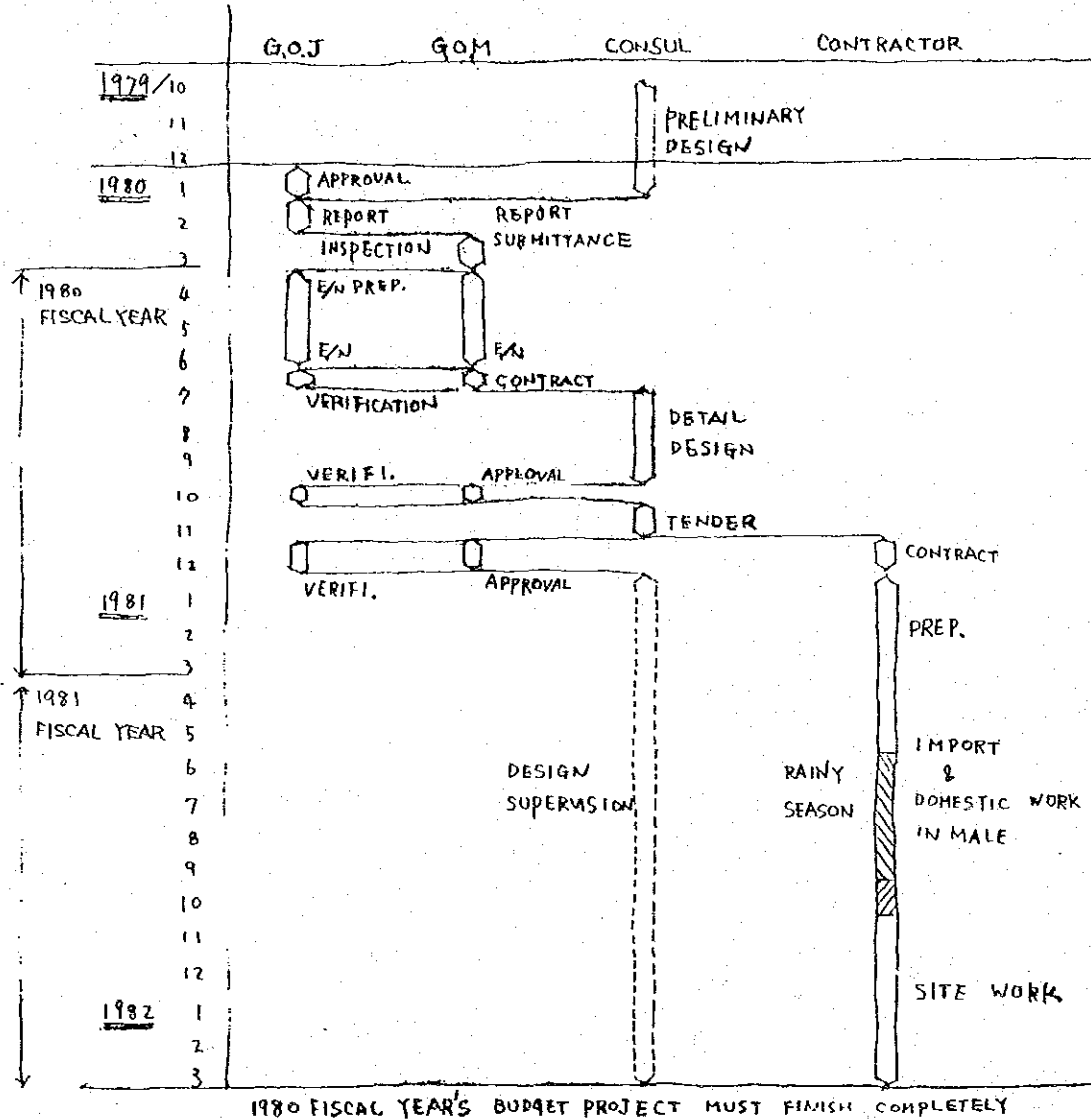

TABLE IX  
STEERING COMMITTEE

1. Under Secretary  
Aids Section  
Ministry of Education  
Male', Maldives.
2. Under Secretary,  
Schools Section,  
Ministry of Education,  
Male', Maldives.
3. Teacher/Supervisor  
Ministry of Education  
Male', Maldives.
4. Under Secretary  
Educational Development Centre  
Ministry of Education  
Male', Maldives.
5. Construction Co-ordinator  
Educational Development Centre  
Ministry of Education  
Male', Maldives.
6. Assistant Construction Coordinator  
Educational Development Centre  
Ministry of Education  
Male', Maldives.
7. Architects  
Architectural Section  
Presidents office  
Male', Maldives.

\*\*\*\*\*

LIST X

Leader	Kaoru Okabe Chief Planning Division Social Development Co-operation Dept. Japan International Co-operation Agency.
Architect	Yasahiro Fukumoto Architect Chief Design Department T. Mohri Architect & Associates.
Architect	Toshinori Minoshima Architect Director Design Department T. Mohri Architect & Associates
Architect	Akira Yokoyama Architect Design Department T. Mohri Architect & Associates

LIST XI

MALDIVIAN COUNTERPARTS

1. Mohamed Latheef  
Under Secretary  
Aids Section  
Ministry of Education  
Male', Maldives.
2. Abdul Azeez Yoosuf  
Under Secretary  
Schools Section  
Ministry of Education  
Male', Maldives.
3. Abdullah Rasheed  
Teacher/Supervisor  
Ministry of Education  
Male', Maldives.
4. Abdul Sattar Hassan  
Under Secretary  
Educational Development Centre  
Ministry of Education  
Male', Maldives.
5. Rifath Afeef  
Architect  
Architectural Section  
Presidents Office  
Male', Maldives.
6. Ahmed Saleem  
Architect  
Architectural Section  
Presidents Office  
Male', Maldives.

\*\*\*\*\*



Procedural details of Japanese Grant Aid

.....

1. Request from a recipient country for Japanese grant aid
2. Report and recommendation of the request from the Japanese Embassy
3. Study of the report and recommendation by the Ministry of Foreign Affairs of the Japanese Government  
(Technical feasibility, beneficiaries, cost-estimation, etc.)
  1. If the proposed project is deemed appropriate enough for Japanese grant aid, a technical survey team for the confirmation of the above-mentioned study of the project is to be sent to a recipient country by the Japan International Cooperation Agency.
  2. Whenever the grant assistance aims at constructing physical facilities such as a school, research institute, hospital, etc., surveys for a preliminary designing precede the signing of the notes. The survey teams are dispatched under technical assistance by the Japan International Cooperation Agency. The team usually consists of technical experts of the Government agencies as well as of consulting firms.
4. Decision-making of the Japanese Government for the extension of the grant aid
  1. Decision by the Ministry of Foreign Affairs of the projects that are to be included in a request list for the budgetary appropriation for next fiscal year (August)
  2. Explanation of each project with data to the Ministry of Finance by the Ministry of Foreign Affairs (September)
  3. Finalization of the draft budget for next fiscal year by the Ministry of Finance and its approval by the Cabinet (December or January)
5. Approval by the Diet
  1. Introduction of the budget bill to the Lower House (End of January or February)
  2. Introduction of the budget bill to the Upper House after its approval in the Lower House
  3. Coming into force of the budget with the approval of the budget bill in the Upper House at the end of March.

6. Exchange of notes between the Government of Japan and the Government of a recipient country

1. Consultation between the Ministry of Foreign Affairs and the Ministries concerned towards a final agreement of the projects to be taken up under the Japanese Government's grant assistance
2. Consultation on the notes to be exchanged between the Government of Japan and the Government of a recipient country

(1) Draft Notes are presented by the Japanese Government to the Government of a recipient country.

(2) The notes are a kind of standard pattern under which the grant assistance is extended to a recipient country

(3) Major stipulations of the notes are as follows:

Object of a grant aid

Grant amount

Period during which a grant should be extended

eligibility : Japanese or recipient's  
products and services

Banking arrangement

contract

obligations of the Government of a recipient  
country

a) bearing of expenses

b) exemption of customs duties and fiscal  
charges

c) ensuring of prompt unloading and customs  
clearance

d) bearing of banking charges

e) embargo on the re-export from a recipient  
country

etc.

3. Approval of the draft notes by the Japanese cabinet after their approval by a recipient cabinet
  4. Signature and exchange of the notes simultaneously by the both sides either in the recipient capital or in Tokyo immediately after the Japanese cabinet's approval
7. Contracts
1. The Government of a recipient country or its designated authority signs contracts with Japanese nationals or Japanese juridical persons controlled by Japanese nationals for the implementation of the notes exchanged.
  2. Japanese nationals or Japanese juridical persons controlled by Japanese nationals are able to sign subcontracts with nationals of a recipient country.
  3. In case physical facilities such as a school, research institute, hospital are to be constructed under the grant aid, the following formality is, in principle, complied with.
    - (1) Selection of an engineering consultant for architectural (or detailed) designing and supervisory services
      - a) The same consulting firm that participated in the survey team for a preliminary designing, in principle, carries out an architectural designing of the construction works.
      - b) In case another firm might be designated for the works through a normal tender, it is most probable that the firm may insist on the alteration of the designing completed by the survey team, thus resulting in an undue delay of the implementation with an additional cost for the alteration of the designing.
    - (2) Contracts on the supervisory services and architectural (or detailed) designing between the Government of a recipient country or its designated authority and the above-mentioned consulting firm

- (3) Selection of a construction firm through a tender
- (4) Contract on the construction of a facility between the Government of a recipient country or its designated authority and the Japanese construction firm

- a) If so requested, a tender may be conducted by the consulting firm on behalf of the recipient's Government. The final awarding must be given by the latter upon the recommendation of the consulting firm.

- b) In case a small-scale facility is constructed, a contract is signed both for architectural designing and for construction of a facility.)

8. Verification of the contracts by the Japanese Government

1. The Government of a recipient country presents two original contracts to the Japanese Government for their verification
2. In order to confirm that the contracts are eligible under the grant, the Japanese Government ascertains whether the contracts are in compliance with the stipulations of the Notes.
3. The contracts come into force only after they are verified by the Government of Japan.
4. The two verified contracts are returned by the Japanese Government to the Government of a recipient country, and one of them is handed over to the contractor by the Government of a recipient country.

9. The Government of a recipient country or its designated authority signs a banking arrangement with an authorized foreign exchange bank of Japan on the procedural details of the payment.

\* The commissions described below are to be paid to the Japanese foreign exchange bank by a recipient country for the banking services.

1. Advising Commission of Authorization to Pay (A/P):

about Y 2,000.- for each A/P

2. Payment commission : about 1/10% of each payment
- \* A/P is issued by the Government of a recipient country to authorize the Japanese foreign exchange bank to pay in behalf of the Government of a recipient country.
10. Issuance of Authorization to Pay (A/P) to the Japanese foreign exchange bank by the Government of a recipient country or its designated authority immediately after the verification of the contracts
11. Payment request to the Japanese foreign exchange bank by Japanese nationals or Japanese juridical persons controlled by Japanese nationals
12. Payment request to the Government of Japan by the Japanese foreign exchange bank and payment to the Japanese foreign exchange bank by the Government of Japan
13. Payment by the Japanese foreign exchange bank to Japanese nationals or Japanese juridical persons controlled by Japanese nationals
- \* The timetable indicated above is changeable according to circumstances.



REPUBLIC OF MALDIVES

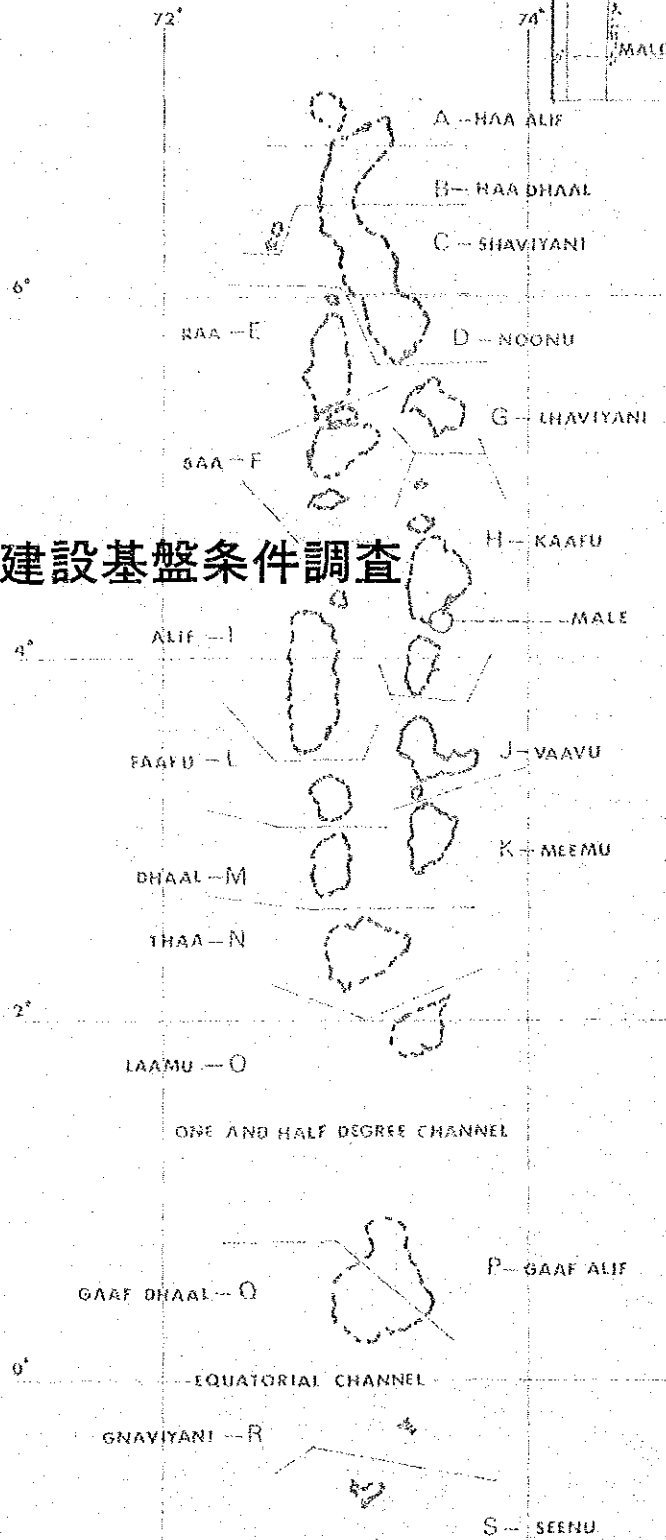
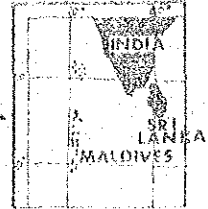

II 建設基盤条件調査





## II-1 国土概要

### II-1-1 国土の位置

モルディブ共和国はインド洋上の、北緯7度6分30秒より、南緯0度41分38秒の間、東経72度32分30秒より同73度45分54秒の間に位置する。2重鎖状のさんご環礁・島嶼より成っている。明白な境界のある環礁18、さんご島3、および小島を有する暗礁1がある。環礁及び島は南北823.9km、東西130.35kmにわたる約110,066.5km<sup>2</sup>の海域に広がっている。最北端の環礁はインドの最南端、コモリン岬(CAPE COMORIN)の南西約483km、スリランカより約644kmの地点にある。インド領ミニコイ(MINICOY)環礁はモルディブ群島の北、約112kmの地点にあり、同群島とは8度線海峡により分けられている。

### II-1-2 面積

モルディブ共和国の測量は、これまで行われていないが、全陸地面積は298km<sup>2</sup>と推定される。珊瑚礁にかこまれている面積は、約3,300km<sup>2</sup>程度である。

### II-1-3 地勢

モルディブ群島を形成する島嶼、さんご堡礁及びさんご環礁は1,111にのぼる。島は小さな砂州やさんご堡礁から真のさんご島まで様々である。長径1,609m以上のものはほとんどない。最大は、ハッドマッティ(HADDUMMATTI)環礁のガング(GANG)で、長径7,240mであり、首都マレーは長径1,609m、短径800mの島である。各島の最高地点はほとんど海拔5m以下である。環礁(ATOLL)という単語はさんご礁とさんご島の輪を意味するモルディブ語の「ATOLLAN」に由来している。群島の地質は、したがってさんご礁地質である。さんご基層の上に波の打ち上げた砂と分解又は侵食されたさんごから成っており、これが土壌である。地下水面は当然すべての島で高く、地下1.0m程度である。人の住んでいる島のほとんどに常設の井戸があるが、塩分を含んでいるため飲料水に使用することは出来ず、飲料水は雨水を利用している。

### II-1-4 人口

人の住んでいる島は202島で、残りはすべて無人島となっている。総人口は143,046人(1977年)、男75,223人、女67,823人で、都市に住む人口は20.6%、残りの79.4%は地方に住んでいる。

## II-1-5 民族

モルディブ群島の住民は、セイロン人と同じ人種に属していることは明らかである。モルディブ人は紀元前5世紀ころセイロン島と同様に、モルディブ諸島に移住したインドアーリアン族で、したがってセイロン人とは概して容姿・習慣・気性などが似ている。

言語はシンハリ原語 E I L L から派生した D I V E H I 語で文字は右から左へ書かれる。宗教は11世紀の中頃イスラム教徒の侵略を受けたため、国民のほとんど全部が回教徒（モスリム）になった。

II-1-6 DATA 1

1. モルディブ人口増加表

	合 計	男	女	人口増加率	備 考
1946年	82,068				
1963年	94,527	50,274	44,253	100トスル	
1965年	96,432			102%	ユネスコ
1972年	122,673	64,924	57,749	130%	国勢調査
1974年	128,697	68,301	60,396	136%	
1978年	143,046	75,223	67,823	151%	国勢調査
年平均 3.4%					

## DATA 2

## POPULATION CENCUS 1978

NAME	TOTAL	MALE'	FEMALE
MALDIVES	143046	75223	67823
MALE'	29555	16623	12932
REST OF MALDIVES	113491	58600	54891
Haa Alif	8603	4377	4226
Haa Dhaalu	9924	5162	4762
Shaviyani	6362	3270	3092
Noonu	6282	3302	2980
Raa	7906	4061	3845
Baa	5765	3078	2687
Lhaviyani	5691	2999	2692
Kaafu	4162	2254	1908
Alif	6223	3348	2875
Vaavu	1078	582	496
Meenu	3095	1604	1491
Faafu	2012	1087	925
Dhaalu	3003	1546	1457
Thaa	6224	3179	3045
Laamu	6163	3264	2899
Gaafu Alif	4978	2589	2389
Gaafu Dhaalu	7720	3817	3903
Seenu	14096	6963	7133

## DATA 3

TOTAL POPULATION OF REPUBLIC OF MALDIVES (1974)DETAILS OF CENSUS AND AGE GROUPS

	<u>Male</u>	<u>Female</u>	<u>Total</u>
Total population	68301	60396	128697
Under 15 years	29367	28450	57817
Between 15 - 19 years	7353	6774	14137
Between 0 - 5 years	13108	12873	25981
Between 6 - 10 years	9564	9267	18831
Between 11 - 15 years	8334	7825	16159
Between <del>21</del> - 16 - 20 years	6677	6097	12774
Between 21 - 30 years	7712	7268	14980
Between <del>31</del> - 40 years	9363	8190	17553
Between 41 - 50 years	6972	4895	11867
Between 51 - 60 years	3659	2159	6178
Between 61 - 70 years	2083	1140	3223
71 and above	824	327	1151

## DATA 4

### GOV'T RECEIPTS AND EXPENDITURE (MILLION MALDIVIAN RUPEES)

#### RECEIPTS

	1970	1971	1972	1973	1974	1975	1976	1977	1978
REVENUE									
a) TAXES									
i) CUSTOMS	3.524	4.668	4.964	3.991	5.324	5.005	0.457	0.140	2.235
ii) OTHERS	0.290	0.304	0.127	0.187	0.169	-	-	-	0.893
b) NET									
i) ENTERPRISES	27.476	21.092	19.682	25.725	11.827	17.333	15.928	19.818	7.735
c) OTHER									
i) RECEIPTS	0.658	0.595	0.360	0.387	1.413	0.635	0.786	0.771	0.898
<b>TOTAL</b>	<b>31.948</b>	<b>26.659</b>	<b>25.133</b>	<b>30.290</b>	<b>18.733</b>	<b>22.973</b>	<b>17.171</b>	<b>20.729</b>	<b>11.761</b>

### SOURCES OF FINANCE FOR EXCESS OF EXPENDITURE OVER REVENUE

	1970	1971	1972	1973	1974	1975	1976	1977	1978
a) SURPLUS OF PAST YEARS	-	-	-	-	3.394	4.415	18.512	9.248	6.175
b) EXTERNAL ASSISTANCE	-	-	-	-	-	-	-	8.412	16.725
c) OTHER ACCOUNTS	-	-	-	-	-	-	-	-	1.260
d) ISSUING NOTES	-	-	-	-	-	-	-	-	5.257
<b>TOTAL</b>	<b>-</b>	<b>-</b>	<b>-</b>	<b>-</b>	<b>3.394</b>	<b>4.415</b>	<b>18.512</b>	<b>17.660</b>	<b>29.417</b>

## EXPENDITURE

	1970	1971	1972	1973	1974	1975	1976	1977	1978
NON-DEVELOPMENTAL EXPENDITURE									
a) INTERNAL SECURITY	1.406	1.472	1.519	1.581	2.010	2.225	2.969	2.322	2.841
b) GENERAL ADMINISTRATION	4.069	3.542	4.596	4.904	5.285	5.613	5.084	5.549	5.492
c) DEBT SERVICING									3.046
d) OTHERS	2.034	2.002	3.072	2.215	2.600	1.863	1.734	1.468	3.953

## DEVELOPMENTAL EXPENDITURE

a) AGRICULTURE AND FISHERIES	0.165	0.582	0.720	0.459	0.574	0.388	0.696	0.802	0.545
b) ECONOMIC SERVICES	4.782	5.852	5.787	4.705	5.662	5.742	2.808	2.046	7.361
c) TRANSPORT AND COMMUNICATION	0.896	0.697	0.861	1.341	1.759	1.885	2.705	11.868	3.300
d) EDUCATION	0.990	1.070	1.199	1.159	1.190	1.289	1.504	1.660	2.415
e) HEALTH	0.860	0.838	0.923	1.158	1.282	1.261	1.363	1.559	2.419
f) OTHERS	0.522	1.147	1.968	1.193	1.765	7.117	16.820	11.115	9.806
TOTAL	15.724	17.202	20.645	18.715	22.127	27.388	35.683	38.389	41.178

## EXCESS OF REVENUE OVER EXPENDITURE

	16.224	9.457	4.488	11.575	-	-	-	-	-
--	--------	-------	-------	--------	---	---	---	---	---

## EXCESS OF EXPENDITURE OVER REVENUE

	-	-	-	-	3.394	4.415	18.512	17.660	29.417
TOTAL	16.224	9.457	4.488	11.575	3.394	4.415	18.512	17.660	29.417

## II-2 教育概要

### II-2-1 教育に関するデータ

- 1) 日本政府援助及びユニセフ援助による学校建設地と、既存のモルディブ政府の学校を、生徒数より比較すると、下記のとおりである。

	生徒数 200 人以上の島	生徒数 400 人以上の島
GOVT. SPONSORED PRIMARY SCHOOLS	12 島	7 島
GOVT. SPONSORED COMMUNITY SCHOOLS	17 島	11 島
JAPANESE AIDED SCHOOLS	16 島	7 島

モルディブ共和国の人の住んでいる 202 島の内、生徒数 ( $2\frac{1}{2}$  ~ 15 歳) が 400 人以上の島が 23 島、200 人以上の島が 72 島ある。モルディブ政府が 200 人以上の島の学校建設を重要視し、かつ、日本政府の援助を重視していることがわかる。

JAPANESE AIDED SCHOOLS の内、生徒数 200 人以下の島の分析

1. SHAVIYANI LHAIMAGU (171 人) この島はアトール内の生徒数が 7 番目に多い島である。LHAIMAGU より生徒数が多い島で学校建設予定のない島は 4 島である。
2. VAAVU FULIDHOO (72 人) アトール全体の生徒数は、404 人と他のアトールと比較しても最小生徒数である。アトール内では 4 番目に生徒が多い島である。
3. FAAFU FEEALEE (137 人) VAAVU アトールの次に生徒数が少ないアトールで、生徒数 801 人である。アトール内では 3 番目に生徒が多い島である。

- 2) 日本政府援助による、19 校の建設予定地の島を、各々のアトール内で生徒数 ( $2\frac{1}{2}$  ~ 15 歳) が多い順に分類する。

アトール内で 1 番目に多い島	6 島
2 番目に多い島	6 島
3 番目に多い島	4 島
4 番目に多い島	1 島 (VAAVU)



5番目に多い島 1島 (NOONU)

7番目に多い島 1島 (SHAVIYANI)

19校の建設予定地の島を、各々のアトールの中で文盲の多い順に分類する。

アトール内で文盲が1番目に多い島 5島

2番目に多い島 7島

3番目に多い島 4島

4番目に多い島 2島 (VAAVU FAAFU)

9番目に多い島 1島 (SHAVIYANI)

19校の建設予定地の島を、各々のアトール内で人口の多い順に分類する。

アトール内で人口が1番目に多い島 5島

2番目に多い島 7島

3番目に多い島 4島

4番目に多い島 1島 (VAAVU)

5番目に多い島 1島 (NOONU)

10番目に多い島 1島 (SHAVIYANI)

19校の内16校は、人口・文盲・生徒数の分析で3番目までにランクされている。

II-2-2 DATA 1

GOVT. SPONSORED COMMUNITY SCHOOLS

ATOLL	GOVT. SPONSORED COMMUNITY SCHOOLS	POPULATION	CHILDREN BETWEEN 2-1/2 - 15 YEARS	NO. OF HOUSES
HAA ALIF	DHIDHDHOO	1,873	632	252
HAA DHAAL	KULHUDHUFFUSHI	3,460	1,711	610
SHAVIYANI	KOMANDOO	857	379	163
NOONU	VELIDHOO	1,153	402	208
RAA	ALIFUSHI	1,285	478	180
BAA	EYDHAFUSHI	1,630	691	248
LHAVIYANI	KURENDHOO	885	337	146
KAAFU	HIMMAFUSHI	373	138	70
ALIF	MAAMIGILI	865	290	142
VAAVU	KEYODHOO	344	124	57
MEEMU	MULAH	673	243	101
FAAFU	NILANDHOO	674	317	102
DHAAL	KUDAHUVADHOO	949	779	157
THAA	THIMARAFUSHI	1,422	579	148
LAAMU	FONADHOO	823	237	175
GAAF ALIF	VILINGILI	1,390	448	244
GAAF DHAAL	THINADHOO	3,328	552	528
GNAVIYANI	FOAMMULAH	4,840	1,508	826
SEENU	HITHADHOO	7,051	2,708	999
TOTAL		33,875	12,553	5,356
			Average	6.3

DATA 2

GOVT. SPONSORED PRIMARY SCHOOLS

ATOLL	GOVT. SPONSORED PRIMARY SCHOOLS	POPULATION	CHILDREN BETWEEN 2-1/2 - 15 YEARS	NO. OF HOUSES
HAA ALIF	HUVARAFUSHI	1,616	533	227
HAA DHAAL	NOLHIVARANFARU	364	135	56
SHAVIYANI	MAAKADOODHOO	983	458	181
NOONU	MANADHOO	765	290	127
RAA	UGOFAARU	665	256	84
BAA	DHARAVANDHOO	506	45	99
LHAVIYANI	HINNAVARU	2,560	996	338
KAAFU	MAAFUSHI	443	137	76
ALIF	MAHIBADHOO	880	341	124
VAAVU	FELIDHOO	273	94	48
MEEMU	MULI	453	143	74
FAAFU	MAGOODHOO	298	115	180
DHAAL	KUDAHUVADHOO	949	779	157
THAA	VEYMANDOO	461	172	60
LAAMU	MAAVAH	827	252	145
GAAF ALIF	KOLAMAAFUSHI	795	255	134
GAAF DHAAL	THINADHOO	3,328	552	528
GNAVIYANI	FOAMULAH	4,840	1,508	826
SEENU	HITHADHOO/FEYDHOO	7,051 2,573	2,708 541	999 263
TOTAL		30,630	10,310	4,726

Average 6.5

DATA 3

JAPANESE AIDED SCHOOLS

ATOLL	ISLAND JAPANESE AIDED	POPULATION	CHILDREN BETWEEN 2-1/2 - YEARS	NO. OF HOUSES
HAA ALIF	HUVARAFUSHI	1,616	533	227
HAA DHAAL	VAIKARADHOO	959	365	162
SHAVIYANI	LHAIMAGU	369	171	64
NOONU	KEDHIKOLHUDHOO	625	270	115
RAA	KADHOLHUDHOO	1,693	633	296
BAA	HITHADHOO	660	236	124
LHAVIYANI	HINNAVARU	2,560	996	338
KAAFU	KAASHIDHOO	940	329	161
ALIF	MAHIBADHOO	880	341	124
VAAVU	FELIDHOO	188	72	25
MEEMU	KOLHUFUSHI	623	220	115
FAAFU	FEEALEE	425	137	67
DHALL	MEEDHOO	546	214	73
THAA	GUR AidHOO	922	302	101
LAAMU	GAN	1,103	378	160
GAAF ALIF	KOLAMA AFUSHI	795	255	134
GAAF DHAAL	GADHDHOO	1,431	482	283
GNAVIYANI	FOAMULAH	4,840	1,508	826
SEENU	HULHUM EEDHOO	3,521	1,401	563
TOTAL		24,696	8,852	3,959

Average 2

DATA 4

GOVT. AIDED MAKTHABS

ATOLL	NAME OF ISLAND	GOVT. AIDED MAKTHABS		POPULATION	CHILDREN BETWEEN 2½ - 15 YEARS	NO. OF HOUSES
		NAME OF SCHOOL				
HAA ALIF	DHIDHDHOO	MADHRASATHUL GHAAZEE MOHAMED		1,873	632	252
	KELAA	MADHRASATHUL SH. IBRAHIM		1,000	366	161
	NOLHIVARAM	MADHRASAA		894	265	209
HAA DHAAL	NEYKURENDHOO	MAKTHABUL NOOR		667	227	142
	KULHUDHUFFUSHI	MADHRASATHL AMEER AMEEN		3,460	1,711	610
	MAKUNUDHOO	MAKTHABUL HIDHAAYAA		649	232	127
SHAVIYANI	-	-		-	-	-
	HEBADHOO	MAKTHAB		302	122	49
	FODHDHOO	MAKTHAB		186	27	37
NOONU	KEDHIKOLHUDHOO	MAKTHAB		625	270	115
	HOLHUDHOO	MEYNAA SCHOOL		1,183	411	230
	VELIDHOO	MADHRASATHUL NAHZAA		1,153	402	208
RAA	RASMAADHOO	MAKTHABUL JIHAADH		442	216	83
	INNAMAADHOO	MAKTHABUL NOOR		-	114	61
	EYDHAFUSHI	BAHIYYAA SCHOOL		1,630	691	248
BAA	HITHADHOO	MAKTHAB		660	236	124
	THULHAADHOO	MAKTHAB		1,545	542	204
	NAIFARU	NOORAANEE MAKTHAB		2,808	837	451
LHAVIYANI	NAIFARU	MADHRASATHUL IFTHITHAAH		2,808	837	451
	NAIFARU	ROASHANEE MAKTHAB		2,808	837	451
	KURENDHOO	MAKTHABUL NAJEEBUL H'ABSHEE		885	337	146
KAAFU	-	-		-	-	-

GOVT. AIDED MAKTHABS

ATOLL	NAME OF ISLAND	NAME OF SCHOOL	POPULATION	CHILDREN BETWEEN 2½ - 15 YEARS	NO. OF HOUSES
	DHIGURAH	MAKTHABUL IBTHIDHAUU	296	116	88
ALIF	FENFUSHI	MAKTHAB GULDHASTHAA	361	104	82
	OMADHOO	MAKTHABUL VIRDHAA	390	122	70
VAAVU	-	-	-	-	-
MEEMU	-	-	-	-	-
FAAFU	-	-	-	-	-
DHAAL	RIBUDHOO	MAKTHABUL MUBAARIK	400	133	71
	KIBIDHOO	MAKTHABUL IH'THIHAADH	571	248	101
THAA	HIRILANDHOO	MAKTHABUL ANWAAR	435	168	74
	VILIFUSHI	MAKTHABUL JIHAADH	1,103	399	147
LAAMU	MAAVASHU	MINIVAN SCHOOL	827	252	145
GAAF ALIF	-	-	-	-	-
GAAF DHAAL	THINADHOO	I'LMUL NOORIYAA	3,328	552	528
	THINADHOO	NOORAANIYAA	3,328	552	528
GNAVIYANI	-	-	-	-	-
	HITHADHOO	MAKTHABUL U' LOOM	7,051	2,708	999
	HULHUDHOO	MAKTHABUL IRSHAADHIYAA	2,110	869	301
SEENU	HITHADHOO	MAKTHAB RAHBATHUDHDHIRAASAA	7,051	2,708	999
	FEYDHOO	MADHRASATHUL ISLAM	2,573	1,097	487
	MEEEDHOO	MADHRASATHUL HIDHAAYAA	1,411	541	263
	HULHUDHOO	NASIRIYAA SCHOOL	2,110	869	301
	MARADHOO/FEYDHOO	MADHRASATHUL S' AAFEE	845	347	152

DATA 5 Published by The Government Mar. 1947.

No.	Atoll	Name of Island	Population	Children between 2 1/2 - 15 years	No of Literate people	No of illi- torate people	No of houses
1.	Has Alii	Thurakumu	344	162	188	156	49
2.	"	Ouligea	236	65	101	135	46
3.	"	Bathifuohi	172	52	78	94	33
4.	"	Kuikandhoo	198	69	100	98	55
5.	"	Kavaraufuchi	1616	533	1015	601	227
6.	"	Ihavandhoo	1032	428	639	413	148
7.	"	Kolon	1000	366	635	365	161
8.	"	Vachafaru	428	157	243	185	60
9.	"	Dhidhdhoo	1873	632	1000	873	252
10.	"	Filidhdhoo	465	186	235	231	82
11.	"	Kaavandhoo	397	150	169	228	64
12.	"	Thakandhoo	475	191	297	178	101
13.	"	Uttheem	397	136	271	126	53
14.	"	Kureidhoo	343	119	96	247	66
15.	"	Bcarah	775	300	244	531	135
16.	"	Berimadhoo	96	31	80	16	18
17.	Has Dhaal	Hanicaadhoo	505	208	180	325	118
18.	"	Faridhoo	130	36	70	60	22
19.	"	Eodaidhoo	99	34	45	54	16
20.	"	Finey	280	79	161	119	38
21.	"	Maivadhoo	436	127	149	287	82
22.	"	Nellaidhoo	490	199	284	206	89
23.	"	Nolhivaranafaru	364	135	233	131	56
24.	"	Nolhivaram	894	265	740	-	209
25.	"	Kuribee	322	105	219	103	65
26.	"	Kuburadhoo	193	68	88	105	33
27.	"	Kulhudhuffuohi	3460	1711	2595	865	610
28.	"	Kumadhoo	721	335	202	519	120
29.	"	Meykurandhoo	667	227	248	419	142
30.	"	Vaikharadhoo	959	365	552	-	162
31.	"	Hirizaradhoo	316	98	121	-	42
32.	"	Maiyadhoo	291	96	75	216	42
33.	"	Makunadhoo	649	232	359	290	127
34.	Shavilyani	Kadithoemu	558	246	318	240	113
35.	"	Noomaraa	318	140	78	240	44
36.	"	Goidhoo	285	113	77	208	61
37.	"	Foydhee	543	136	279	264	124
38.	"	Foovah	411	160	302	109	92

No. 2	Atoll	Name of island	Population	Children between 2½ - 15 years	No of literate people	No of illi- terate people	No of houses
39.	Shaviyani	Bilefushi	328	110	224	104	53
40.	"	Fonkaidhoo	344	148	222	20	105
41.	"	Narudhoo	206	91	186	22	43
42.	"	Manakoodhoo	903	458	611	372	181
43.	"	Maroonhi	501	225	164	337	87
44.	"	Ihaimaga	359	171	195	174	64
45.	"	Firubaidhoo	397	174	198	199	71
46.	"	Komandoo	857	379	612	245	153
47.	"	Manugoodhoo	478	229	219	259	88
48.	"	Farakolhufunadhoo	257	74	127	130	52
49.	Noonu	Hobadhoo	302	122	152	150	49
50.	"	Kodhikulhuthoo	625	270	312	312	115
51.	"	Kanlhadhoo	363	151	153	210	63
52.	"	Kudafari	356	137	208	148	45
53.	"	Landhoo	423	169	181	242	84
54.	"	Kaafaru	489	174	277	212	75
55.	"	Ihohi	346	151	185	161	63
56.	"	Miladhoo	687	288	398	289	105
57.	"	Kanadhoo	765	290	454	311	127
58.	"	Holhudhoo	1183	411	982	201	230
59.	"	Fodhdhoo	185	27	102	84	37
60.	"	Velidhoo	1153	402	802	351	208
61.	"	Thelhadhoo	99	35	46	63	20
62.	"	Nagoodhoo	166	64	43	125	25
63.	Raa	Alifushi	1285	478	660	480	180
64.	"	Vaadhoo	239	94	108	102	35
65.	"	Raagethoemu	621	189	303	204	87
66.	"	Agolhithoemu	-	85	-	-	41
67.	"	Ugulu	-	108	-	-	82
68.	"	Ganudoedhoo	360	113	158	150	62
69.	"	Ugoofaaru	665	256	331	237	84
70.	"	Kadhelhadhoo	1693	633	584	1104	296
71.	"	Maafurathu	591	206	231	259	100
72.	"	Raamadhoo	442	216	191	237	83
73.	"	Ianamadhoo	-	114	-	-	61
74.	"	Kaduvvaero	978	307	818	71	160
75.	"	Iguraidhoo	767	292	546	200	151
76.	"	Fainu	-	67	-	-	27



No.	Atoll	Name of Inland	Population	Children between 2½ - 15 years	No of literate people	No of illiterate people	No of houses
77	Roa	Moadhoo	971	350	734	170	135
78	"	Kinolhas	287	99	125	124	48
79	Ban	Kadarikilu	293	99	112	181	54
80	"	Kamadhoo	216	92	127	89	Ub
81	"	Koadhoo	434	149	244	190	80
82	"	Dhonfana	242	83	118	124	44
83	"	Dharavandhoo	506	45	391	115	99
84	"	Mandhoo	242	85	165	77	44
85	"	Eydhafushi	1630	691	1178	452	248
86	"	Tthalhadhoo	1945	542	878	467	204
87	"	Kithadhadhoo	660	236	467	193	124
88	"	Falhadhoo	180	53	84	46	27
89	"	Fehandhoo	113	35	69	44	18
90	"	Goidhoo	300	123	171	129	57
91	"	Kibandhoo	153	43	91	62	39
92	Ihaviyani	Hemavaru	2560	995	1545	1015	338
93	"	Nalifaru	2808	837	1927	881	451
94	"	Kurendhoo	885	337	575	310	146
95	"	Olhuvelifushi	254	89	88	166	41
96	Kaafu	Kaachidhoo	940	329	663	277	161
97	"	Ganfaru	434	89	279	155	78
98	"	Dhifufushi	498	215	358	140	101
99	"	Tthaludhoo	409	98	358	51	63
100	"	Kurea	344	163	235	109	58
101	"	Himmafushi	373	138	279	94	70
102	"	Gulhi	300	95	221	79	48
103	"	Kaafushi	443	137	302	141	76
104	"	Guraidhoo	576	229	375	201	103
105	Alifu	Thoddoo	628	202	380	248	133
106	"	Raamandhoo	434	228	139	295	92
107	"	Ukulkha	317	113	136	181	52
108	"	Mathiveri	254	122	172	82	32
109	"	Boduholhadhoo	246	89	160	86	33
110	"	Foridhoo	341	127	105	236	57
111	"	Mandhoo	297	118	149	148	64

No 4	Atoll	Name of island	Population	Children between 2 1/2 - 15 years	No of literate people	No of illi- terate people	No of houses
112	Alifu	Himandhoo	246	99	112	174	53
113	"	Hangnamsedhoo	273	90	90	183	46
114	"	Omadhoo	390	122	182	208	70
115	"	Kaburudhoo	208	82	88	120	44
116	"	Mahitadhoo	880	341	567	313	124
117	"	Mandhoo	175	81	51	124	44
118	"	Dhagethi	388	122	218	170	79
119	"	Dhigurah	296	116	172	124	88
120	"	Fenfushi	361	104	239	122	82
121	"	Dhidhdhoo	95	20	57	38	35
122	"	Mazami gili	865	290	452	413	142
123	Vaavu	Fulidhoo	188	72	101	87	25
124	"	Mhindhoo	121	40	77	44	19
125	"	Felidhoo	273	94	171	102	48
126	"	Keyedhoo	344	124	170	174	57
127	"	Rakcedhoo	215	74	157	58	35
12							
128	Maamu	Rodyrandhoo	111	32	82	29	21
129	"	Madifushi	125	43	83	42	19
130	"	Voyrah	159	46	102	57	26
131	"	Kalah	673	243	310	363	101
132	"	Mali	453	143	246	207	74
133	"	Naalenfushi	278	93	134	144	48
134	"	Kolhufushi	623	220	387	236	115
135	"	Dhiggaru	703	216	419	284	108
136	"	Maduvaree	388	157	212	176	65
137	Faarfu	Fecalee	425	137	305	120	67
138	"	Biledhdhoo	489	186	170	319	85
139	"	Nagedhdoo	298	115	180	118	77
140	"	Dharabedhdoo	157	46	101	56	33
141	"	Milandhoo	674	317	470	204	102
142	Dhaalu	Keodhoo	546	214	218	328	73
143	"	Mhadidhoo	349	139	65	284	49
144	"	Idibushoo	400	133	233	36	71
145	"	Holhadheli	402	142	227	175	65
146	"	Gomendhoo	272	147	107	165	58

NO 5	Atoll	Name of island	Population	Children between 2½ - 15 years	No of literate people	No of illi- terate people	No of houses
147	Dhaalu	Vaance	207	70	85	122	39
148	"	Kaaboohoo	436	150	282	154	67
149	"	Kudabuvadhoo	949	779	622	328	157
150	Thaa	Burunee	356	117	181	175	58
151	"	Vilufushi	1103	399	620	483	147
152	"	Madifushi	455	188	252	203	68
153	"	Dhiyandigili	367	144	177	190	66
154	"	Guraidhoo	922	302	527	385	101
155	"	Kadoodhoo	400	152	279	121	75
156	"	Vendhoo	247	81	152	95	44
157	"	Sirilendhoo	435	168	285	150	74
158	"	Gaadhifushi	281	119	181	100	44
159	"	Thimarafushi	1422	579	874	548	148
160	"	Veyandoo	461	172	219	242	60
161	"	Kibidhoo	571	238	375	196	101
162	"	Omadhoo	400	128	223	177	76
163	Lacmu	Isdhoo	910	332	344	566	160
164	"	Dhabidhoo	412	159	214	198	66
165	"	Kaabaidhoo	340	134	196	144	61
166	"	Mundoo	292	106	112	180	51
167	"	Gan	1103	378	344	559	160
168	"	Kalhadhoo	255	99	113	142	43
169	"	Kaavah	827	252	546	281	145
170	"	Fomadhoo	823	237	391	432	175
171	"	Gandhoo	212	72	92	120	56
172	"	Kaamondhoo	472	175	277	195	80
173	"	Hithadhoo	457	125	213	244	92
174	"	Kaabandhoo	291	111	123	163	61
175	G.A	Kalmanafushi	795	255	619	176	134
176	"	Viligili	1390	443	1170	220	244
177	"	Kaamondhoo	650	227	508	142	118
178	"	Filandhoo	380	115	200	180	68
179	"	Dhaadhoo	780	200	450	330	132
180	"	Dhevvadhoo	443	132	302	141	90
181	"	Kodoy	174	38	140	34	41
182	"	Dhiyadhoo	131	34	100	31	51
183	"	Gamanafushi	498	196	297	201	102
184	"	Kaduhadhoo	343	134	195	148	60

NO.6	Atoll	Name of island	Population	Children between 2½ - 15 years	No of literate people	No of illi- terate people	No of houses
185	G.Db	Mauvel	763	273	565	198	164
186	"	Heododhoo	493	154	295	198	98
187	"	Nadallia	546	183	332	214	98
188	"	Gadhoo	1431	482	1389	42	283
189	"	Bathafandhoo	715	270	513	160	173
190	"	Fiyonri	615	237	400	109	117
191	"	Manthodaa	406	138	251	154	78
192	"	Vaadhoo	680	236	509	171	138
193	"	Fares	436	159	310	126	93
194	"	Hawardhinadhoo	3328	552	2553	775	528
195	Gnaviyani	Malch	4840	1508	3517	1323	826
196	Soenu	Kithadhoo	7051	2708	4768	2283	939
197	"	Maradhoo	1690	904	908	710	254
198	"	Maradhoo Feydhoo	845	347	763	82	152
199	"	Feydhoo	2573	1087	2191	382	487
200	"	Koedhoo	1411	541	1121	290	263
201	"	Hulladhoo	2110	859	1407	703	301

DATA 6

POPULATION, THE NUMBER OF SCHOOL CHILDREN  
ILLITERATES, AND HOUSES ON EACH ATOLL (1978)

Atoll	Population		Children between the age of 2½ - 15		Illiterate people		Houses	
	Population of each atoll	Against the whole population	Number of persons	Against the population in atoll	Number of persons	Against the population in atoll	Number of houses	Average size of family
HAA ALIF	9,868	7.8	3,597	36.4	4,477	45.5	1,551	6.4
HAA DHAAL	10,776	8.5	4,320	40.1	4,455	41.3	1,993	5.4
SHAVIYANI	7,035	5.6	2,854	40.5	3,123	44.4	1,351	5.2
NOONU	7,152	5.7	2,691	37.6	2,857	39.9	1,247	5.7
RAA	8,127	6.4	3,233	40.0	3,338	41.1	1,422	5.7
BAA	6,264	5.0	2,277	36.4	2,169	34.6	1,084	5.8
LHAVIYANI	6,507	5.2	2,259	34.7	2,372	36.4	976	6.7
KAAFU	4,317	3.4	1,493	34.6	1,247	28.9	758	5.7
ALIF	6,694	5.3	2,466	36.8	3,225	48.2	1,893	3.5
VAAVU	1,141	0.9	404	35.4	465	40.7	184	6.2
MEEMU	3,513	2.7	1,193	34.0	1,538	43.8	577	6.1
FAAFU	2,043	1.6	801	39.2	817	40.0	365	5.6
DHAALU	3,562	2.8	1,774	49.8	1,723	48.4	579	6.2
THAA	7,410	5.9	2,787	37.6	3,065	41.4	1,062	7.0
LAAMU	6,394	5.1	2,180	34.1	3,224	50.4	1,150	5.6
G.A	5,584	4.4	1,859	33.3	1,603	28.7	1,020	5.5
G.DH	9,264	7.3	2,684	29.0	2,147	23.2	1,770	5.2
CNAVIYANI	4,840	3.8	1,508	31.2	1,323	27.3	826	5.9
SEENU	15,680	12.4	6,466	41.2	4,450	28.4	2,486	6.3
TOTAL	126,171	100 %	46,846	37.1%	47,618	37.7%	22,294	5.7

Note: As for Raa Atoll, the population of 4 islands in the atoll was uncertain, and was not included in the table.

DATA 7

ENROLMENTS AT MAJEEDIYA SCHOOL

	1970	1971	1972	1973	1974	1975	1976	1977	1978	1979
Kindergarten	145	129	123	134	116	109	89	63	128	192
Grade 1	73	94	77	74	97	112	120	161	62	124
Grade 2	104	85	105	72	75	97	120	133	129	90
Grade 3	103	91	63	81	67	67	90	120	129	175
Grade 4	69	106	86	62	88	90	101	91	121	158
Grade 5	60	70	101	76	49	47	70	96	97	117
Grade 6	52	59	48	87	79	55	48	71	82	87
Grade 7	30	44	59	35	60	65	48	46	65	71
Grade 8	35	24	42	46	34	52	58	46	37	65
Grade 9	27	29	27	28	33	21	40	49	41	39
Grade 10 (Arts & Science)	37	35	36	19	19	29	15	33	48	42
Commercial	--	--	--	--	--	--	14	--	--	--
Grade 11	--	--	--	--	--	--	29	19	7	--
Grade 12	--	--	--	--	--	--	--	11	--	--
<b>TOTAL:</b>	<b>735</b>	<b>766</b>	<b>767</b>	<b>714</b>	<b>717</b>	<b>744</b>	<b>842</b>	<b>939</b>	<b>946</b>	<b>1140</b>

DATA 8

ENROLMENT AT AMINIYA SCHOOL - MALE

	1971	1972	1973	1974	1975	1976	1977	1978	1979
Kindergarten	133	151	95	91	86	63	55	122	190
Grade 1	92	109	101	82	85	80	108	82	118
Grade 2	81	45	104	98	80	90	89	108	87
Grade 3	66	74	65	99	104	82	90	82	113
Grade 4	68	52	74	74	88	107	78	89	88
Grade 5	62	62	54	69	63	75	99	72	87
Grade 6	50	52	64	57	71	77	76	82	97
Grade 7	26	33	52	44	50	52	73	72	54
Grade 8	25	28	28	49	54	39	36	51	60
Grade 9	14	24	29	24	25	34	37	26	43
Grade 10	10	9	19	21	22	17	32	25	29
Grade 11	-	-	-	-	-	26	9	7	-
Grade 12	-	5	10	-	-	-	-	5	-
Commercial Class	-	-	-	-	-	13	17	9	21
Home Science	11	-	-	-	-	-	-	-	-
<b>TOTAL:</b>	<b>643</b>	<b>649</b>	<b>685</b>	<b>708</b>	<b>728</b>	<b>655</b>	<b>799</b>	<b>832</b>	<b>987</b>

DATA 9

ENROLMENT AT ISKANDAR MONTESSORI SCHOOL

	1976	1977	1978	1979
Morning Session	359	433	425	627
Afternoon Session	343	418	428	615
TOTAL:	702	851	853	1242

age of admission : 2½ years

age of leaving school: 5 years



DATA 10

DETAILS OF THE RESULTS OF THE G.C.E. 'O' LEVEL (LONDON) EXAMINATION HELD IN JANUARY 1976

SUBJECT	Total No. of Boys Sat	No. of Boys Securing				No. of Boys Securing 'D'	No. of Boys Securing 'E'	Total No. passed
		'A'	'B'	'C'	'D'			
English	29	2	12	8	1	6	22	
Mathematics	29	12	12	5	Nil	Nil	29	
Technical Drawing	11	4	3	1	2	1	8	
Geography	18	3	5	7	3	Nil	15	
Biology	29	3	6	6	1	10	15	
Chemistry	29	1	7	9	3	4	17	
Physics	29	4	5	4	7	2	13	
History	29	11	3	6	Nil	1	20	
Economics	29	1	3	3	4	6	7	
Art	7	2	2	3	Nil	Nil	7	

NOTE: Ordinary Level (University of London)

Attainment in an Ordinary level subject is indicated by a Grade A, B, C, D or E of which Grade A is the highest and Grade E the lowest. Candidates awarded Grade A, B or C have reached the standard of the former subject pass at Ordinary level.

DATA 11

DETAILS OF THE RESULTS OF THE G.C.E. 'O' LEVEL (LONDON) EXAMINATION HELD IN JANUARY 1976

SUBJECT	Total No. of girls Sat	No. of girls Securing 'A'	No. of girls Securing 'B'	No. of girls Securing 'C'	No. of girls Securing 'D'	No. of girls Securing 'E'	No. of girls Securing 'U'	Total No. Passed
English	26	2	5	9	4	6	-	16
Mathematics	26	3	10	9	1	1	2	22
Technical Drawing	5	-	-	2	1	-	2	2
Geography	17	5	1	3	4	2	2	9
Biology	25	2	3	9	2	4	5	14
Chemistry	23	1	5	5	2	7	3	11
Physics	24	3	3	9	-	1	8	15
History	23	1	5	3	2	4	8	9
Economics	22	-	-	-	1	5	16	-
Art	1	-	-	1	-	-	-	1

SCHOOLS AT THE ATOLLS OF THE MALDIVES REPUBLIC AND THE NO. OF STUDENTSENROLLED (1975)

(1)	<u>HAA ALIFU ATOLL</u>		<u>Boys</u>	<u>Girls</u>	<u>Total</u>
	<u>Type of School</u>				
	Makthabs (Primary schools)	- 14	227	211	438
	Schools (Ordinary)	- 2	52	50	102
(2)	<u>HAA DHAALU ATOLL</u>				
	Makthabs	- 8	329	336	665
	School	- 1	130	91	221
(3)	<u>SHAVIYANI ATOLL</u>				
	Makthabs	- 1	12	8	20
	School	-	-	-	-
(4)	<u>NOONU ATOLL</u>				
	Makthabs	- 3	119	82	201
	School	- 1	34	38	72
(5)	<u>RAA ATOLL</u>				
	Makthabs	- 8	130	136	266
(6)	<u>BAA ATOLL</u>				
	Makthabs	- 3	243	232	475
	School	- 1	107	102	209
(7)	<u>LAVIYANI ATOLL</u>				
	Makthabs	- 5	144	125	269
	School	- 1	50	69	119
(8)	<u>KAAFU ATOLL</u>				
	Makthabs	- 9	242	245	487
(9)	<u>ALIFU ATOLL</u>				
	Makthabs	- 5	112	153	265
(10)	<u>DHAALU ATOLL</u>				
	Makthabs	- 1	15	15	30
	School	- 1	69	74	143
(11)	<u>THAA ATOLL</u>				
	Makthabs	- 13	638	636	1274
(12)	<u>LAAMU ATOLL</u>				
	Makthabs	- 11	249	241	490
	School	- 1	60	15	75
(13)	<u>GAAFU ALIFU ATOLL</u>				
	Makthabs	- 3	27	24	51
(14)	<u>GAAFU DHAALU ATOLL</u>				
	Makthabs	- 7	93	93	186
	School	- 1	19	23	42

(15) <u>NAVIYANI ATOLL</u>		<u>BOYS</u>	<u>GIRLS</u>	<u>TOTAL</u>
Makthabs	- 5	104	89	193
School	- 1	28	15	42
(16) <u>SEENU ATOLL</u>				
Makthabs	- 14	341	294	635
School	- 10	373	295	668

TOTAL: SCHOOL = 1694 students  
 MAKTHABS = 5945 students.

Summary:

1. Number of students in schools in the Atolls
  - Boys - 982
  - Girls - 772
2. Number of students in Makthabs in the atolls
  - Boys - 3025
  - Girls - 2920
3. Number of students in the three Government Schools in Male'
  - 2461
4. Number of students in the eight Private Schools in Male'
  - 2138

GRANT TOTAL: 12298

Note: The above enrolments do not include the enrolments at Makthabs and schools of Vaavu, Meemu and Faafu Atolls for which figures are not available with the Education Department.

SEENU ATOLL - ENROLEMENTS 1976 MALE/FEMALE

	MALE	FEMALE	TOTAL
Pre-Primary	51	62	113
I	331	254	585
II	163	160	323
III	137	100	237
IV	44	62	106
V	20	18	38
VI	11	13	24
VII	11	12	23
VIII	8	3	11
TOTAL:	776	684	1460

Note: Students enrolled at the first three levels of education is 68 percent of the relevant age group.

DATA 14 LOCATION OF THE UNICEF AIDED SCHOOL

REPUBLIC OF MALDIVES

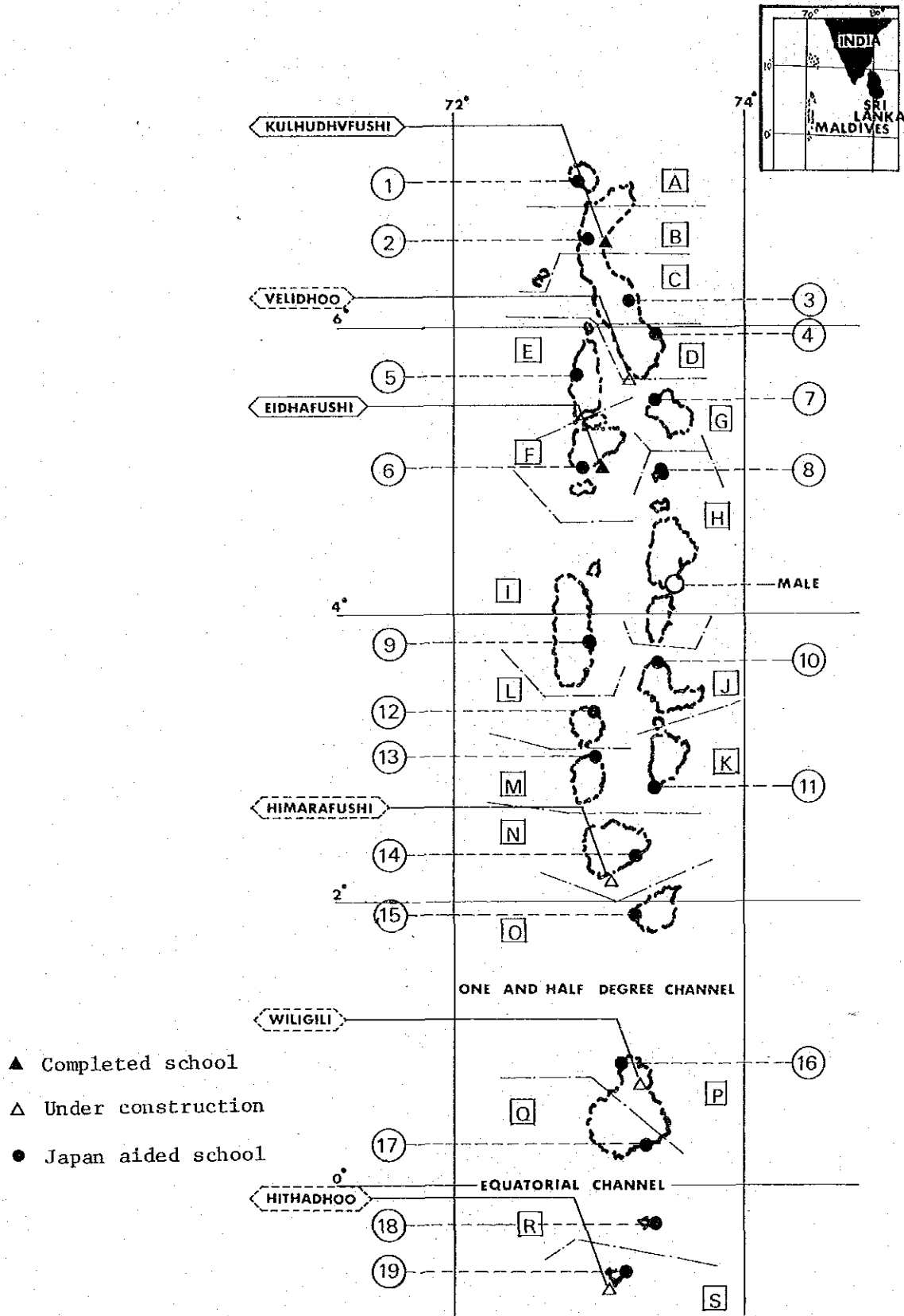

## II-3 気象概要

### II-3-1 気象概要

モルディブ共和国は、熱帯性モンスーン気候に属しインド洋特有の二大季節風に分けられる。11月から4月にかけて北東季節風、5月から10月にかけて南西季節風がそれぞれ吹く。平均気温は、年中 $27^{\circ}\text{C}\sim 29^{\circ}\text{C}$ と、ほとんど変化が見られない。日中は $30^{\circ}\text{C}$ 前後まで気温が上昇し、湿度も80%程度を示す。

年間降雨量は約 $2,000\text{mm}$ で、その大半は雨期である5月から10月に集中する。最大月は例年10月で月間 $300\text{mm}$ 前後といったところで、日降雨量は、 $176\text{mm}/\text{日}$ が過去12年間の最大値である。降雨のパターンは、熱帯スコールのそれとは異なり、1週間ほど断続するのがこの地域の特徴で、雨期の降雨日数は20日前後である。

風は、年間を通じてほぼそのパターンが定まっていて、強風方向は北東または南西、特に10月頃の強風は南西風で、風速も $8\text{m}/\text{秒}$ 前後となる。しかし平均的には、 $4\text{m}/\text{秒}$ 程度の穏やかな風で、1年中を通して大きな変化が見られない。特に、この地域一帯は暴風雨に襲われたことがないといわれている。

以上の事項は、次頁以降に記載してある気象データ(MALE及びHULULEにおける12年間の観測記録)を参考にしている。

Wind Direction of the Two Types of Monsoons

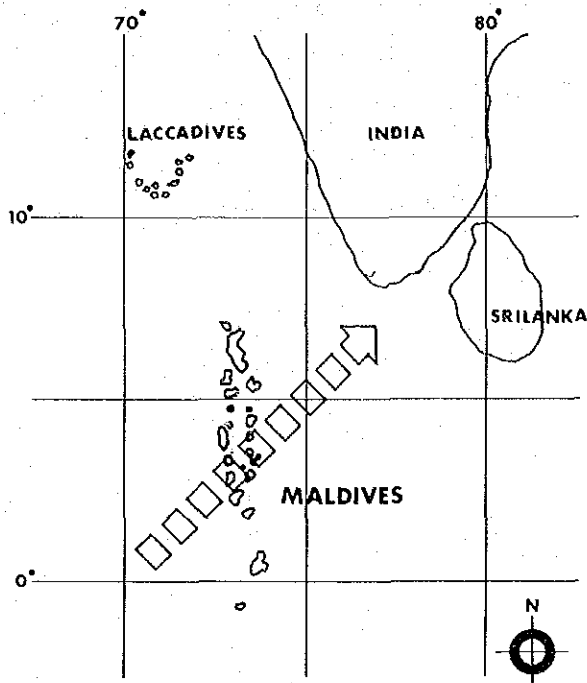

South-West Monsoon (May-Oct)

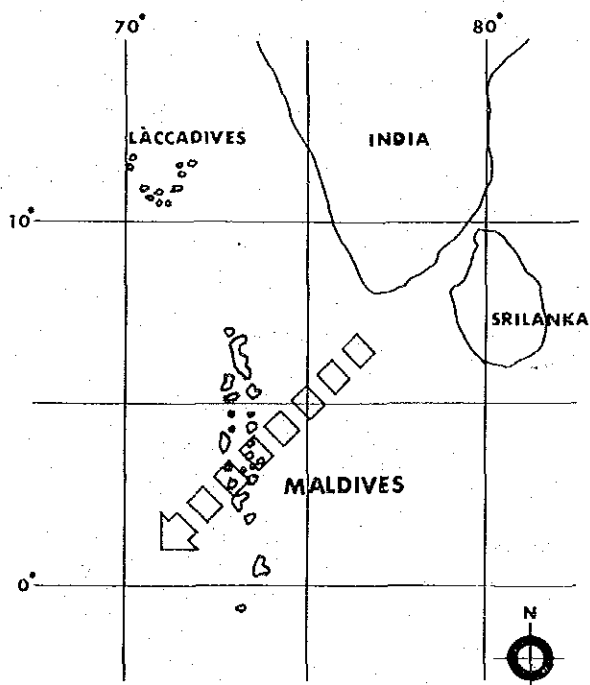

North-East Monsoon (Nov-Apr)



DATA-2

Temperature

(1967 ~ 1978. average temperature for 12 years)

Note: highest recorded temperature-34.1°C (1973.4.28)

lowest recorded temperature -17.2°C (1978.11.3)

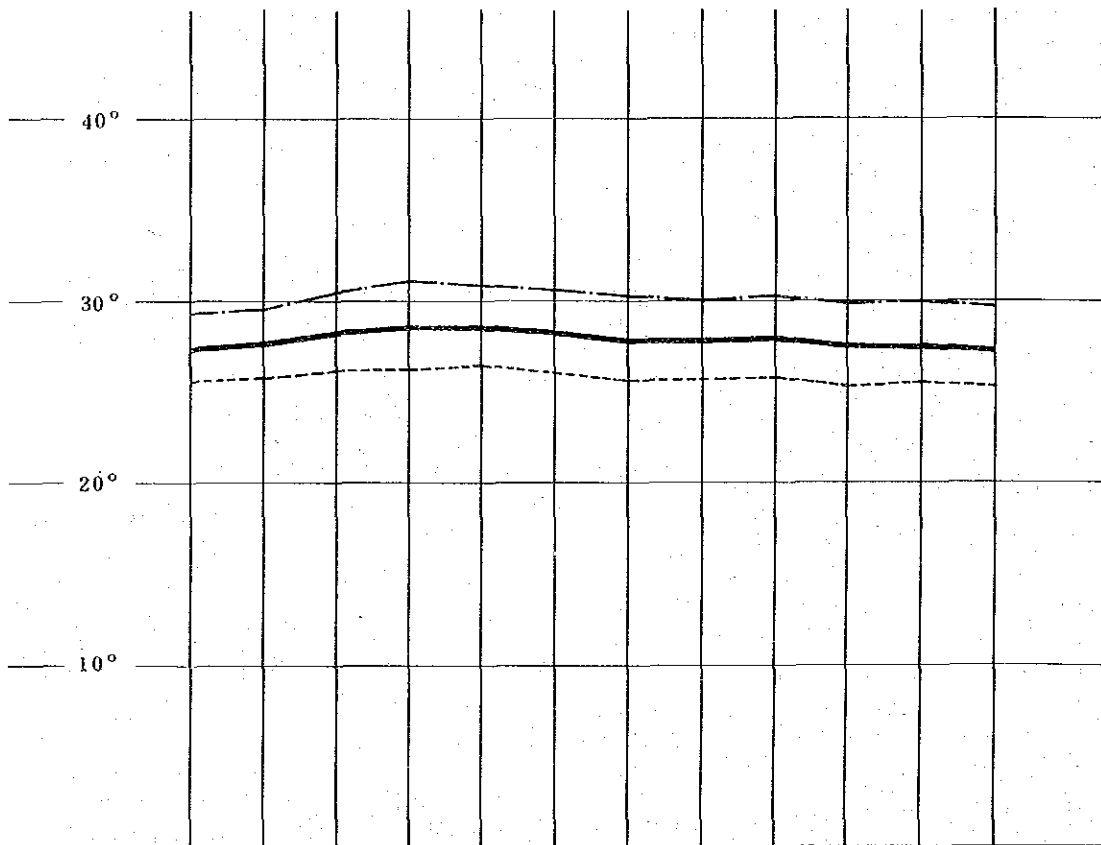

Month	1	2	3	4	5	6	7	8	9	10	11	12	Av.
Highest	29.3	29.6	30.6	31.1	30.8	30.6	30.3	30.0	30.2	29.9	30.0	29.6	30.2
Lowest	25.6	25.8	26.1	26.2	26.5	26.0	25.6	25.7	25.8	25.3	25.5	25.3	25.8
Average	27.4	27.7	28.3	28.6	28.6	28.3	27.9	27.8	28.0	27.6	27.7	27.4	28

DATA-3

Humidity

(1974 ~ 1978. Average humidity for 5 years)

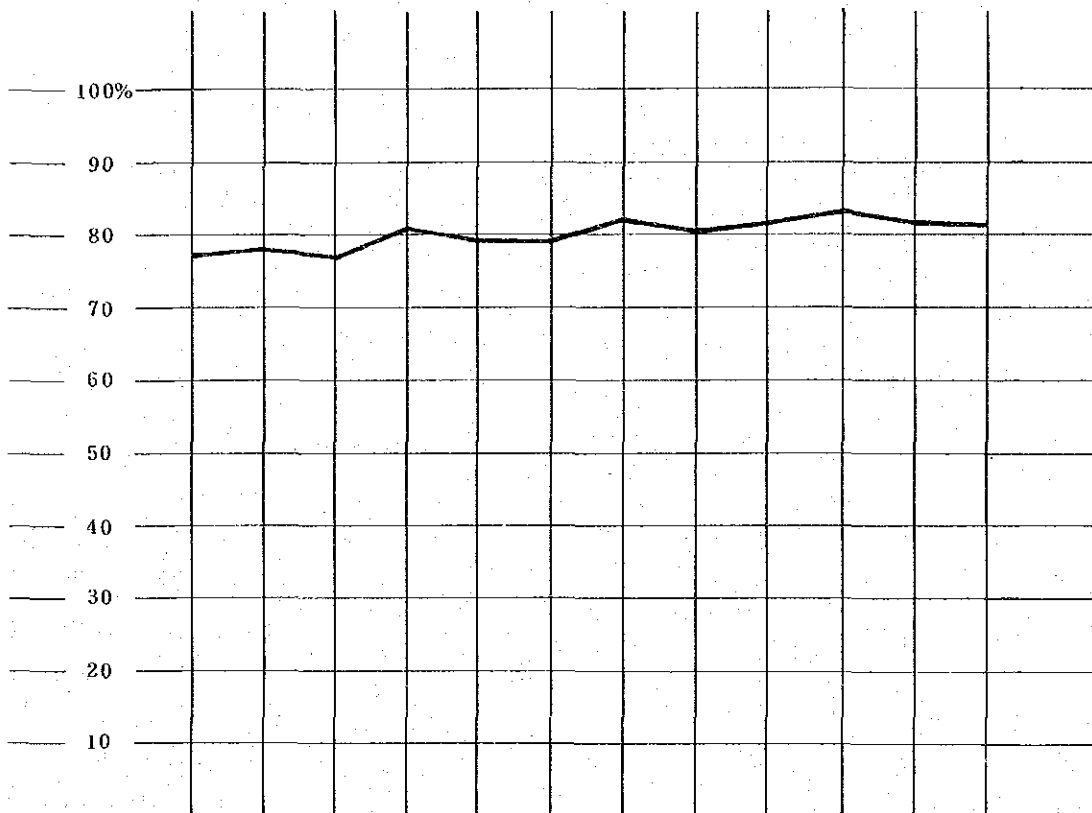

	1	2	3	4	5	6	7	8	9	10	11	12	Av.
Average	77.2	78	76.8	80.8	79.8	79.6	82.8	80.4	81.8	83.0	81.6	81.4	80.6

1974			79	87	68	75	95	80	87	83	78	82	81
75	84	82	75	87	85	85	79	85	82	85	82	79	83
76	73	73	77	80	82	75	79	78	78	85	86	83	79
77	76	79	77	74	82	80	83	78	80	81	82	82	80
78	75	78	81	76	82	83	83	81	82	81	80	81	80

DATA-4

Amount of Rainfall

(1967 ~ 1978. Average amount of rainfall for 12 years)

Note: highest recorded amount of rainfall during  
24 hours: 175.9 mm (1977.12.23)

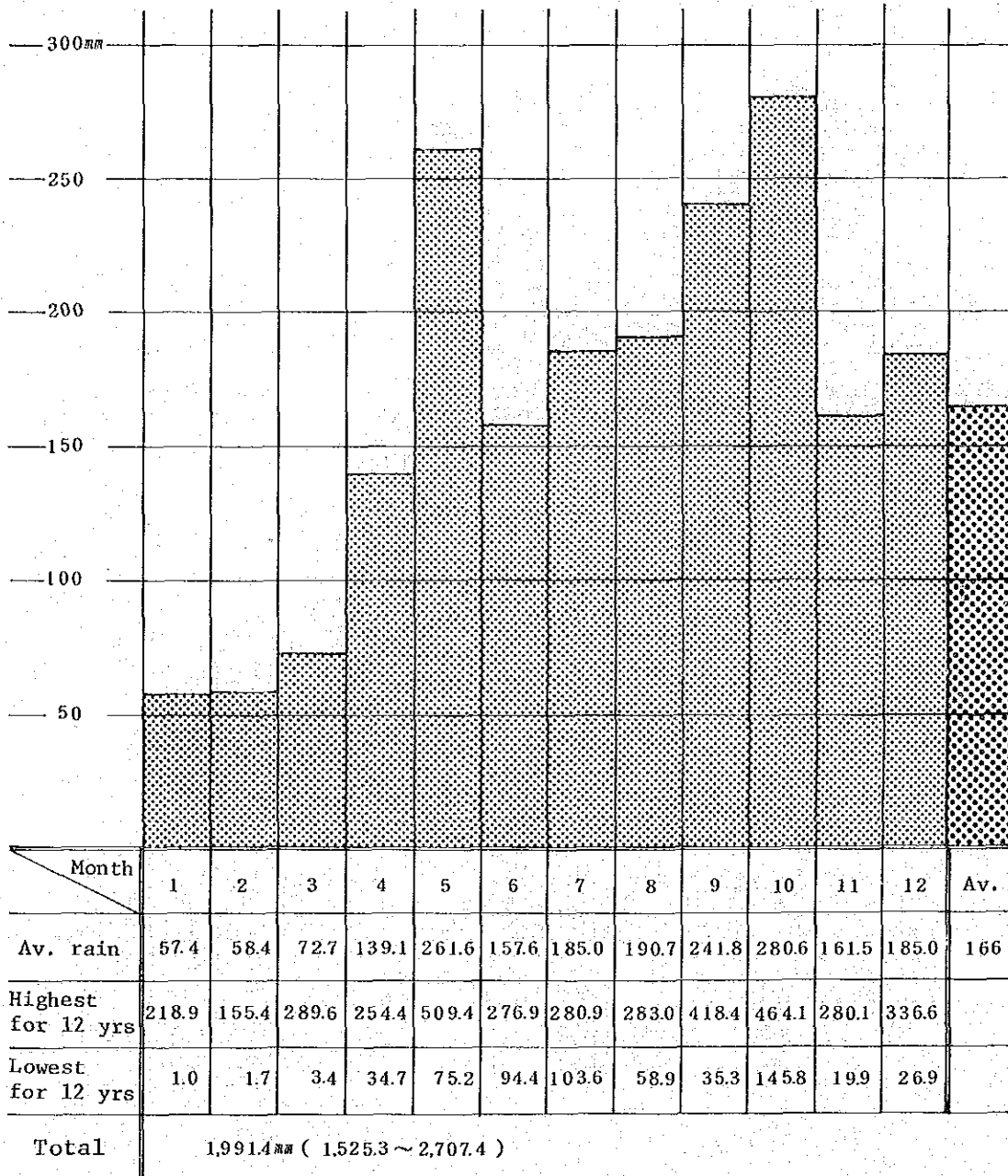

DATA-5

Number of Rainy Days

(1967 ~ 1978. Average number of rainydays for 12 years)

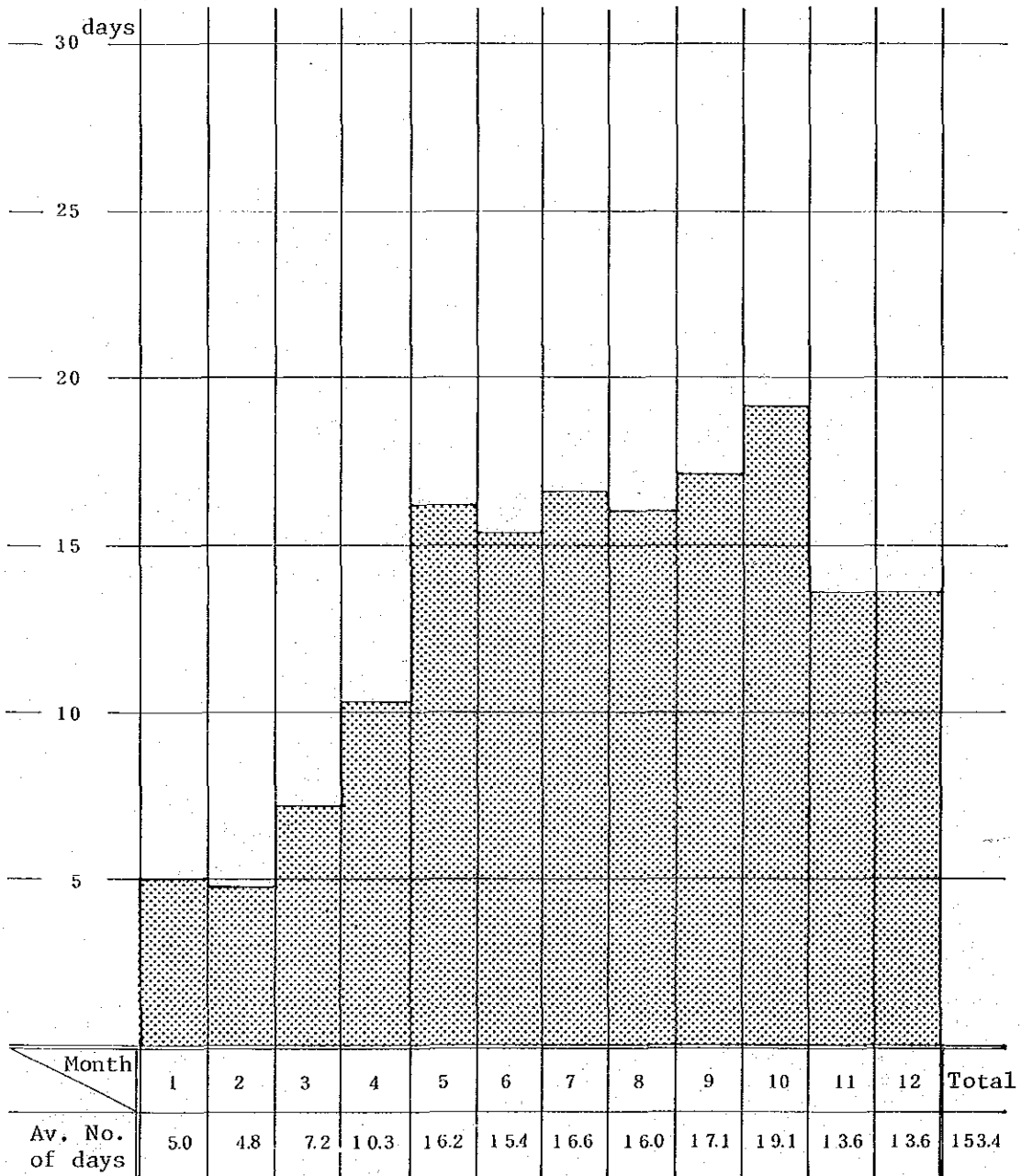

DATA-6

Wind Velocity

(1967 ~ 1978. Average velocity for 12 years)

Note: highest recorded velocity-31.9 M/S (1978.11.3)

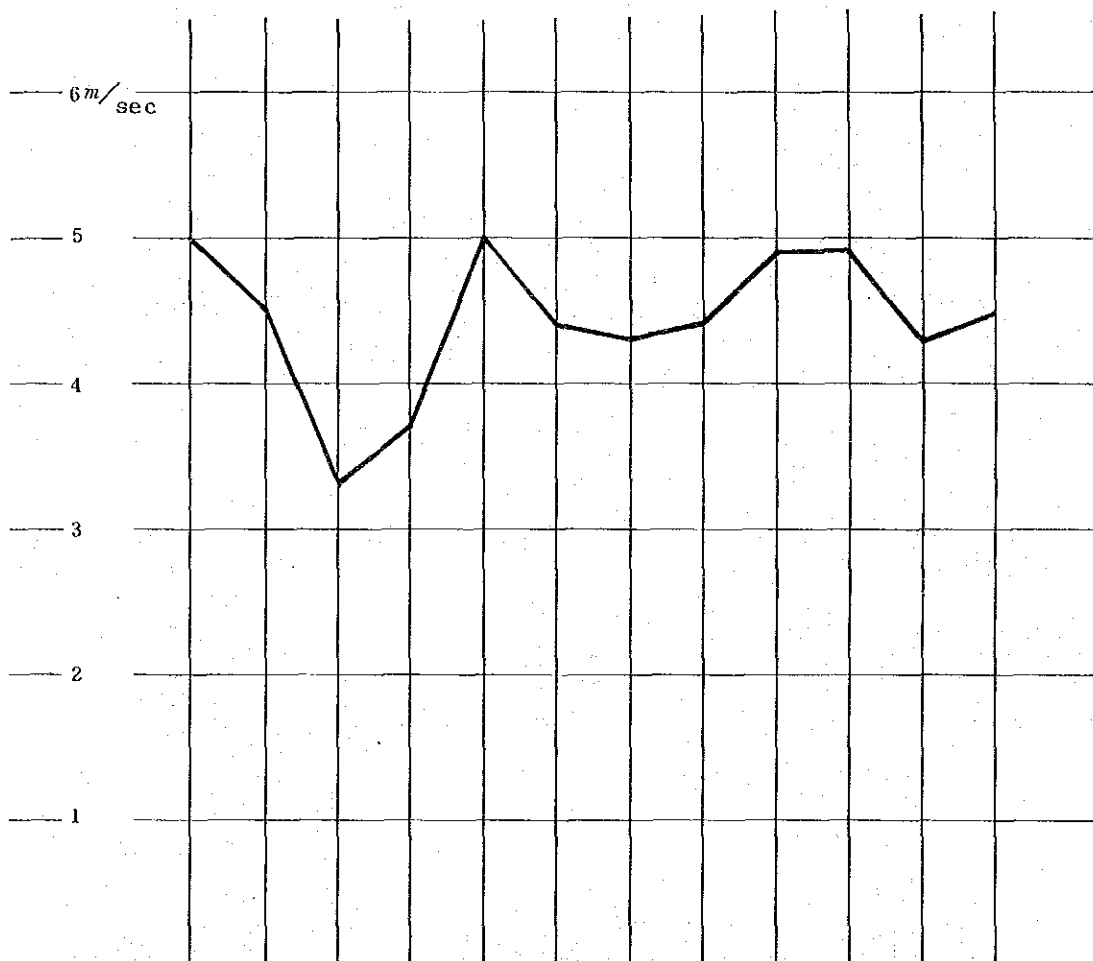

Month	1	2	3	4	5	6	7	8	9	10	11	12	Av.
Max. for 12 yrs	6.9	5.4	6.6	10.3	6.9	7.0	6.5	6.1	6.8	8.7	7.2	6.4	
Min. for 12 yrs	1.7	3.6	2.2	1.8	2.9	2.9	3.2	3.1	3.2	3.5	3.2	2.7	
Average	5.0	4.5	3.3	3.7	5.0	4.4	4.3	4.4	4.9	4.9	4.3	4.5	4.4

DATA-7

Wind Direction (1967 yrs-1978 yrs average for 12 yrs)

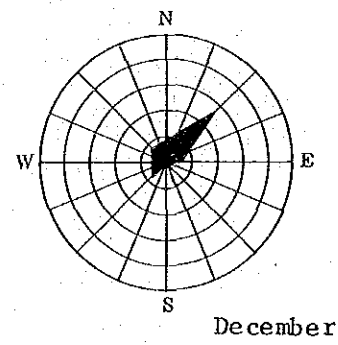
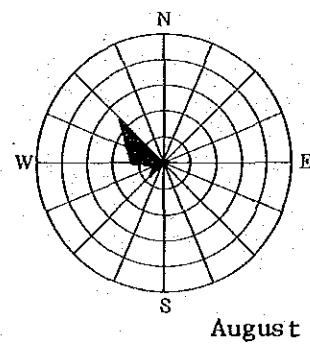
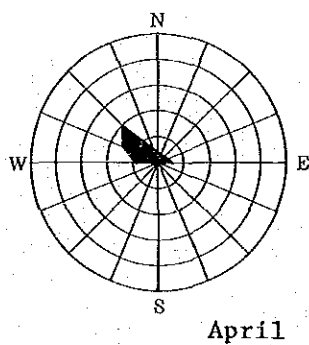
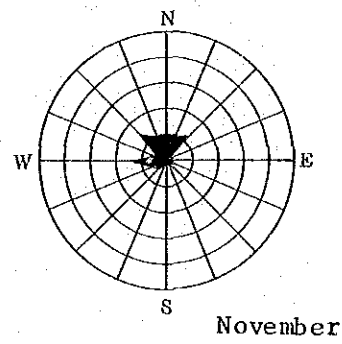
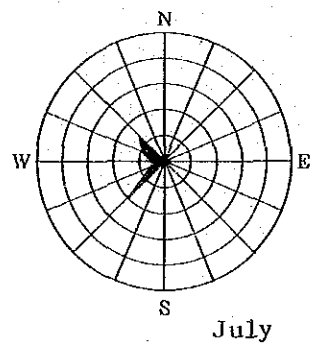
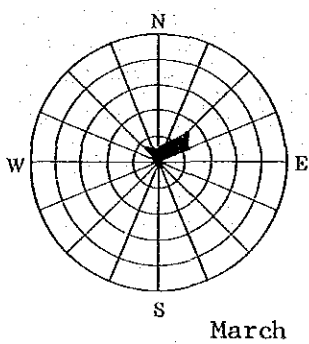
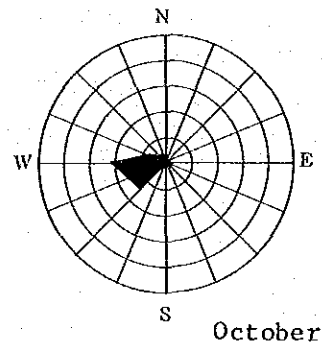
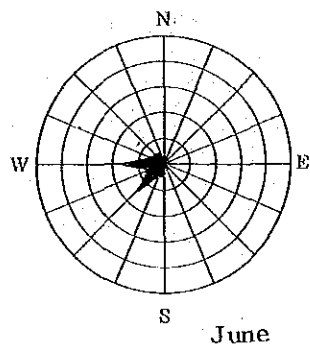
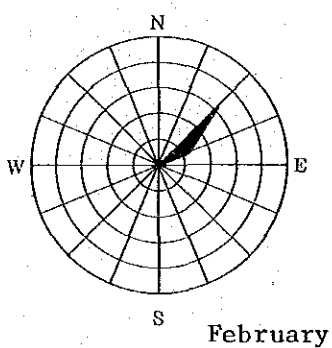
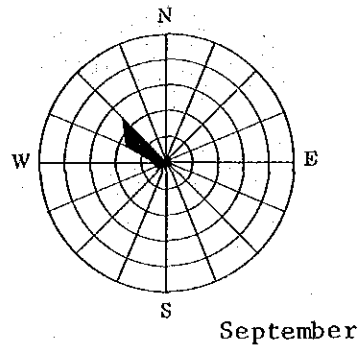
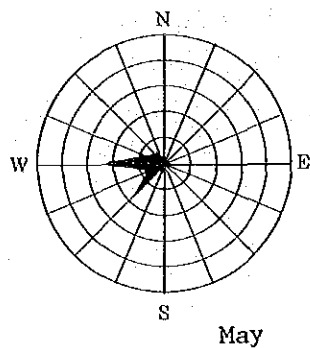
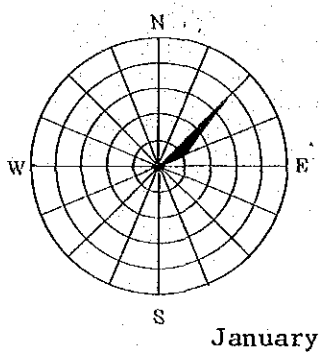

### II-3-3 Earthquakes

The Maldives have never been visited by earthquakes.  
Furthermore, there have been no records of earthquakes.

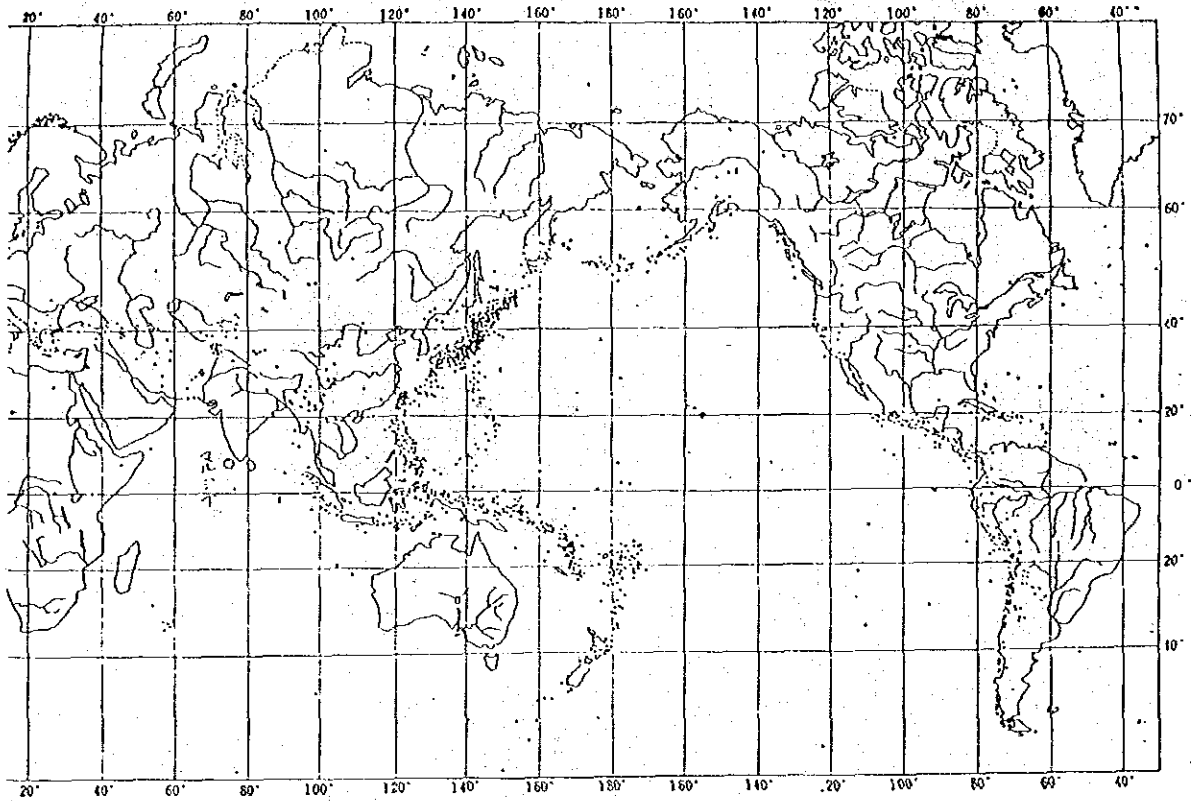

Seismic map (1900-1949)

## II-4 国内輸送

### II-4-1 国内輸送の概要

II-1-1に記したごとく南北約824km、東西約130kmの細長い海域110,067km<sup>2</sup>に小さな約2,000の島が環礁をなして点在している海洋国のため、国内輸送と言っても大変な距離間と時間的問題がある。(II-4-2, 資料1参照)

海のもつ素晴らしさと恐怖が裏腹にあり、島から島への航海は日の出と共に日没までに航海しなければならない現状である。

UNICEF 援助による建設中及び完成した学校の視察に、マレーより約150kmのNOONU アトール内のVELIDHOOは11時間、VELIDHOO島よりBAAアトールのEIDHAFUSHIへは約58km、予定では4.5時間の所要時間を6時間かかっている。船は政府所有のSilver Beam、3つのキャビンを持つ外洋クルーザーである。すぐれたクルー達(6人)と思うが、海図も羅針盤も使用出来ない様だ。そのために3人の水夫がヘサキに立って島影を確認しながら航海する。強い潮流と島の誤認を防ぐためである。海図も羅針盤も役にたたぬモルディブ国内の航海は、いかに天候に左右され、有視界航海で日中のみの航海という地理条件の国内輸送はいかに困難であるか、うかがい知れることであろう。又、天候に左右される海であるが、天気予報がない。モルディブでは、経験的天候判断と経験航海術に頼って航行している。又、特別の定期航路及びそれに類する輸送機関はない。したがって、個々の島で必要に応じ、それぞれの島のドーニーによって航行されている。主として使用されている船は、木造の漁船でドーニーと言う帆船である。最近ではエンジン付のドーニーも使用されているが全ての島にあるとは限らない。エンジンドーニーの積載能力は2 ton以下のものであり、大きさは、33~38ft位である。(II-4-2, 資料2参照)







DATA 2

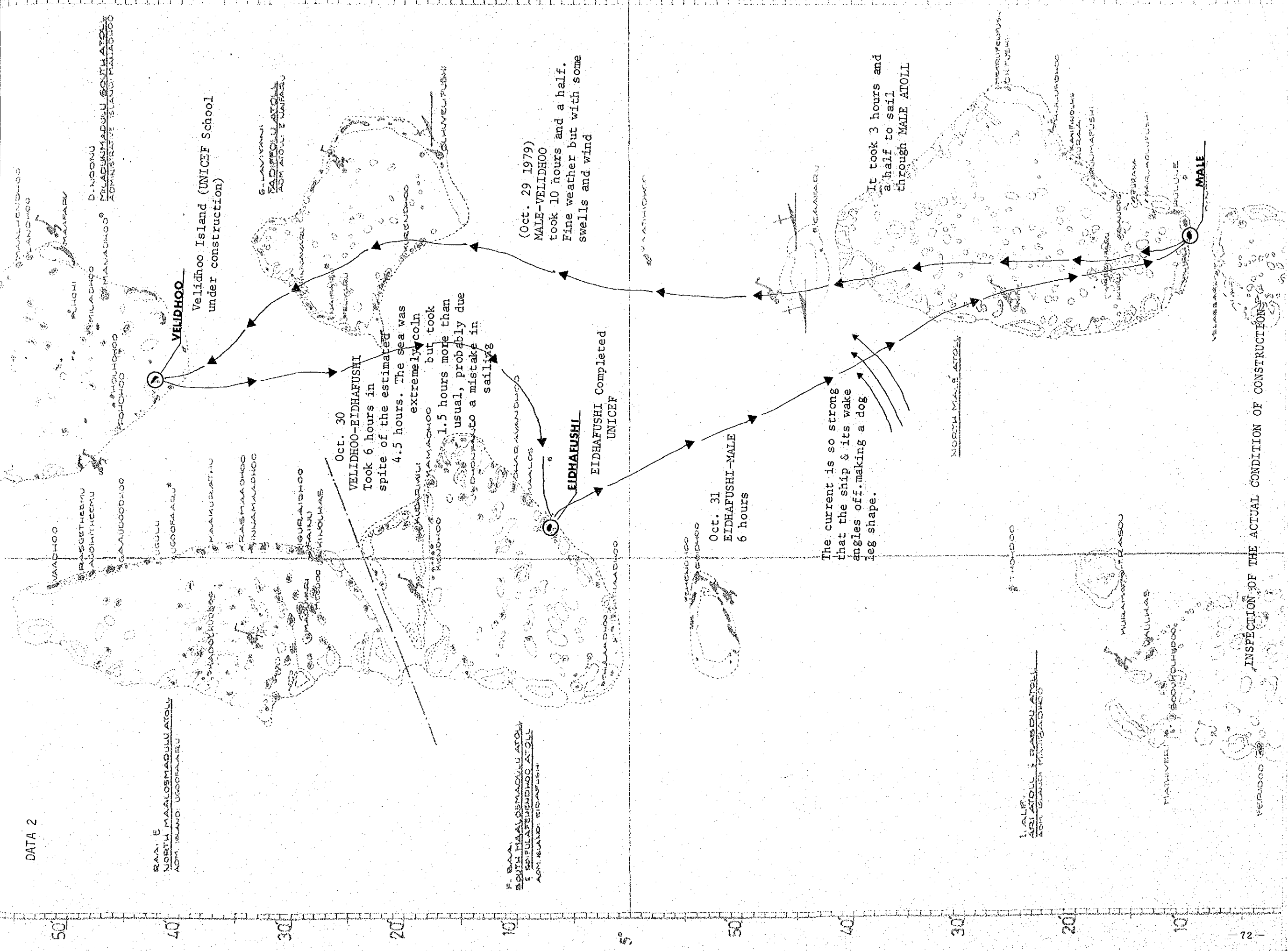

INSPECTION OF THE ACTUAL CONDITION OF CONSTRUCTIONS

II-5 Organization concerned

II-5-1 Organization of the Ministry of Education of the Maldives.

STRUCTURE OF MINISTRY OF EDUCATION

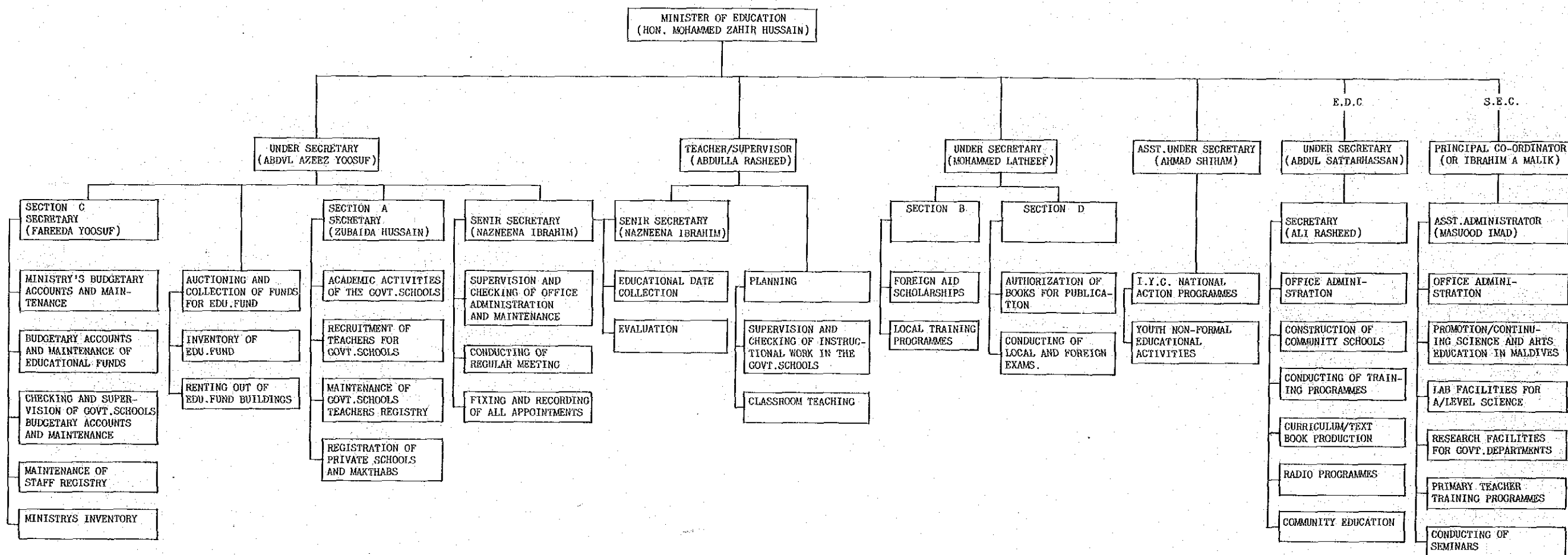



II-5-2 Organization chart of community school construction

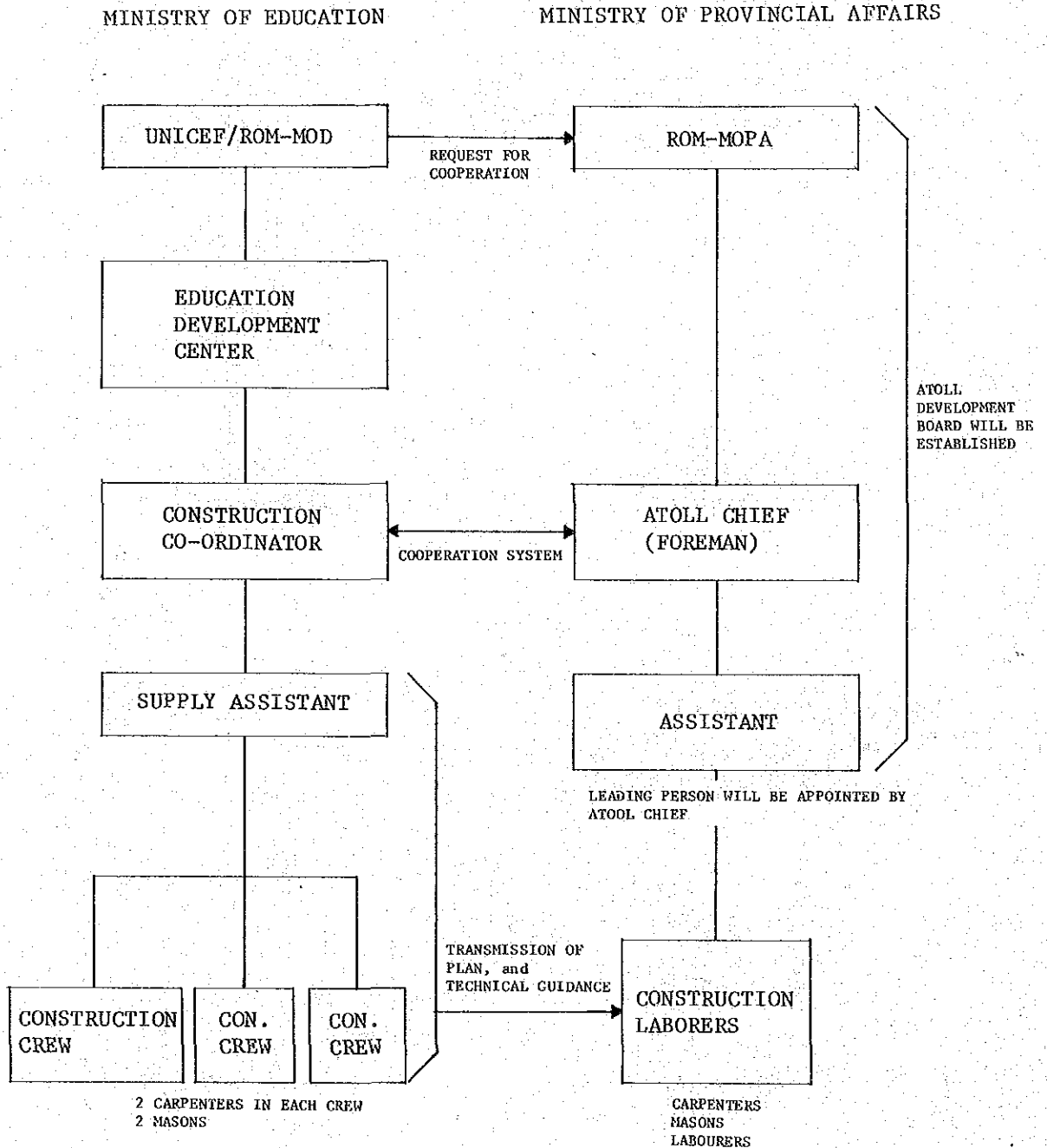

## II-6 建設工事の実態

モルディブに於ける建設工事の実態は、他の生活、文明等、同様に首都マレーとマレー以外の島では非常に格差が大きい。

電気があり、数時間の放映ではあるがカラーTVがある。映画館がある。マレーと電気もない島では全てが100年のタイムカプセルである。

マレーの建築もコーラルストーンによる組積工法の建築が90%であるが、3階建のR.C構造の建築もあり、鉄骨による大空間の映画館もある。建築の仕上がり程度は非常にきれいで、かなりの精度である。又、建設機械もクレーンあり、パワーショベルあり、3階及び中層の建築施工には対応出来る機材があるし、それだけの技術の動員は出来ると現地の2人の建築家は言っている。しかし、マレー以外の島に於いては、施工機材も鉄(輸入)とかコーラルストーンをくたくハンマー、荒い目のノコギリ程度しかない。

又、マレー以外では、荷車やモッコ類の原始的運搬器具すら見あたらない。漁民であるために、陸上においては両手に魚をさげる以外、他の物をはこぶ必要がないためかと想像出来る。以下マレー以外の島でUNICEFの建設現場を視察した建設工事の実態を記す。

### II-6-1 仮設工事

現地のヤシの丸太(直径約20cm,長さ約3m)を3~4m間隔に地立足場を採用している。原始的ではあるが足場と同時に矢板の役割もしている。(写真1, 2, 3)

仮設小屋はヤシの葉にて2~4坪前後の小屋を建て、現場小屋及び材料庫としている。セメントのストック場は考慮する必要がある。

### II-6-2 井戸

建設現場に於いて一番始めに着手するのが井戸を掘る事である。建設用水の確保のためには井戸が不可欠である。竣工後は雑用水用として使用する。

### II-6-3 組積工事

材料はコーラルストーンを方形に割ったものを現地では、ライムモルタル又はセメントモルタルにてレンガ積の様に施工している。レンガその他の材料はない。したがって、島の住居及び建造物は100%コーラルストーンによる組積工法のため、かなりの熟練された石工が島には居る。

#### II-6-4 木 工 事

木工事は、木材はヤシの木で屋根の小屋組工事程度が80%をしめ、窓及びドアはほとんどの家にはついていないため、あまり精度はのぞめない。又、工具をみても目の荒いノコギリ、造船用の大きなカンナの様なものであるため、精度ある造作はのぞめない。大工は各島1,000人位の人口の島では5~6人は居る。船大工は非常にプライドが高く、建設大工はしない。

#### II-6-5 内 装 工 事

床はセメントモルタル金コテ仕上程度。壁面はライムモルタル(プラスター)金コテ仕上が出来る。天井は90%ない(気象条件から多湿、高温のため天井を高く確保し、快適さを保つために特に必要がない)。仕上としては特にないが、気象上、又風土に適している。民家に於いての床はサンゴの白い砂で非常に清潔であり、又、湿度の調節に役立っているのではないかと推察される。

#### II-6-6 土 工 事

地勢上、標高2m前後の平らなサンゴの砂の島であるため、根伐、その他ヤシの木の抜根程度の作業である。緻で人力によって行われている。

#### II-6-7 建築労働の実態

コーラルストーンによる組積工事が主体であり、現地工法ではライムモルタル(石灰モルタル即ちプラスター)にて石積をするため、非常に硬化が悪い。晴天にて三日間要する。その間一度雨にあえばそれだけおくれる。とかく現地人の労働に関してのろずな見方があるが、このライムモルタルの性格と、かならず一日に一回以上あるスコール等風土的気象条件のもとに施工期間がおくれることが原因とみる。決して彼等がなまけているのではないと推測する。

1人の石工に2人のレーバーをつけて、幅25cm、高30~40cmの石積を30~40mを1日に行う能力を持っている。

1日8時間の実働をする。

学校建設には島民の特別な意欲がうかがえるし、現にVelidhoo島のUNICEFの建設現場の砂は、小学生が浜からかつぎ揚げたものを使用しているとの事である。







Picture No. 1 Temporary Housing and Scaffolding



Picture No. 2 Temporary Work





Picture No. 3 Stone Masonry and Mason



Picture No. 4 Stone Masonry





Picture No. 5 Branch Coral (akiri)  
(the powder made by burning akiri isllime)



Picture No. 6 Coral Stone



Picture No. 7 Coral Stone Block



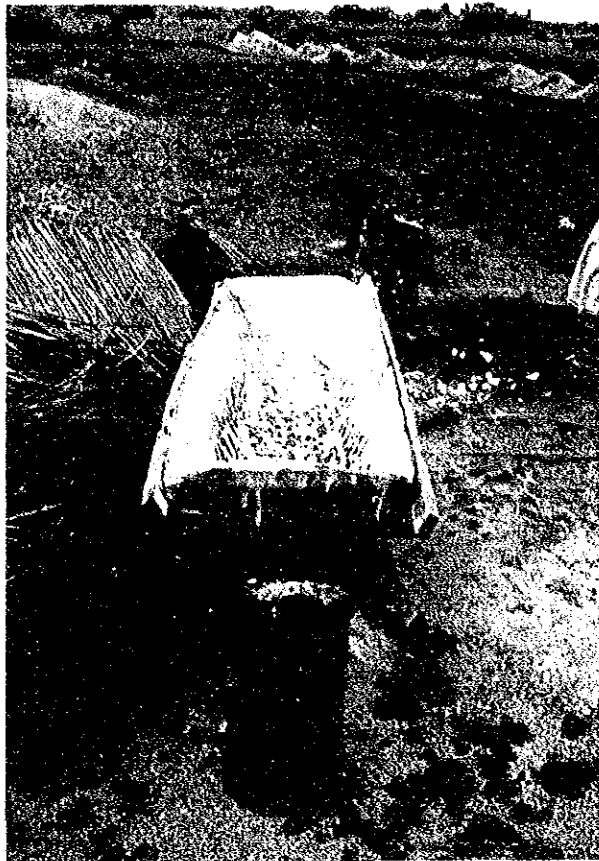

Picture No. 8 Mixing Vessel for Lime Mortar



Picture No. 9 Hoe and Vessel for Measuring Lime Mortar





II-6-8 DATA 1

QUANTITIES REQUIRED 9" THICK WALL (228 mm)/M<sup>2</sup>

< stone thickness = 7" >

Materials	Per sq.ft		Per M <sup>2</sup>	
Wall				
Stone	0.0082	Doni	0.883	Doni
	0.0005125	Golhi	0.055	Golhi
Lime	0.15	Dabiya	1.615	Dabiya
Sand	0.25	Dabiya	2.69	Dabiya
Cement 1/18	0.62	Dabiya	0.2153	Dabiya
Cement 1/16	0.025	Dabiya	0.270	Dabiya
Cement 1/12	0.035	Dabiya	0.377	Dabiya
Plastering				
Lime	0.123	Dabiya	1.324	Dabiya
Sand	0.204	Dabiya	2.196	Dabiya

1 Golhi = 2 ft x 25 ft x 75 ft (106.2 M<sup>3</sup>)

1 Golhi = 16 Doni

1 Dabiya = 0.66 cuft (0.02 M<sup>3</sup>)

1 Kandi = 18 Dabiya



REPUBLIC OF MALDIVES

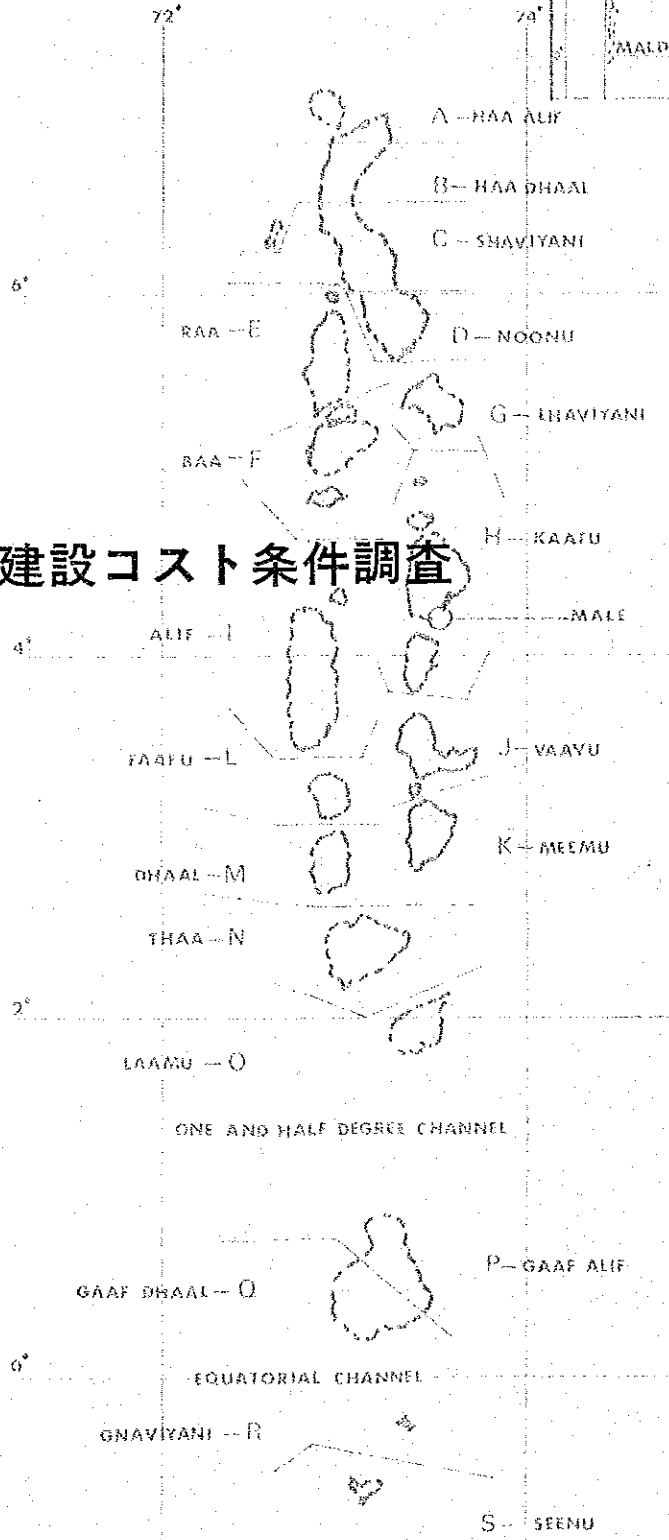

III 建設コスト条件調査



### III-1 Cost of building materials

#### III-1-1 Cost of building Materials from Singapore (from UNICEF's July, 1979 data)

<u>DESCRIPTION</u>	<u>UNIT</u>	<u>US DOLLAR</u>
Cement	50 kg bag	2.50
Timber-for Roof Trusses		
5" x 2" x 20'	ea	11.70
5" x 2" x 21' (Top cord in 1 piece rafters)	ea	12.40
4" x 2" x 16'	ea	7.20
4" x 2" x 10'	ea	4.50
4" x 2" x 8'	ea	3.70
4" x 2" x 5'	ea	2.30
4" x 2" x 4'	ea	2.00
Girders for Roofs		
4" x 4" x 9'	ea	8.20
4" x 4" x 12'	ea	11.00
Purlins		
4" x 2" x 14' (Bracing 32 pieces for Regular Purlins)	ea	6.40
4" x 2" x 11' (Regular Purlins)	ea	5.50
4" x 2" x 11'	ea	6.00
4" x 2" x 5'	ea	2.50
Valance Board		
9" x 1½" x 11' (Regular 154ft)	ea	8.50
9" x 1½" x 14' (Irregular 280 ft)	ea	10.75
9" x 1½" x 9' (45 ft)	ea	7.00
9" x 1½" x 18' (Regular 144 ft) Barge Board for all the building	ea	12.50
9" x 1½" x 23' (Regular 276 ft) Barge Board for all the building	ea	13.50

<u>DESCRIPTION</u>	<u>UNIT</u>	<u>US DOLLAR</u>
Door, Window & Room Divider		
4" x 3" x 6'6" (Window)	ea	4.70
4" x 3" x 7' (Door)	ea	5.00
4" x 3" x 4' (Door)	ea	2.80
4" x 1" x 10' (Door)	ea	2.25
4" x 1" x 2' (Window)	ea	0.50
3" x 1½" x 8' (Room Divider)	ea	2.30
3" x 1½" x 7' (Room Divider)	ea	1.90
2½" x 2½" x 8' (Room Divider)	ea	3.00
2" x 1" x 8' (Room Divider)	ea	0.50
1" x 8" x 7' (Door)	ea	3.30
1" x 4" x 4' (Window)	ea	1.00
5/16" x 4' x 4' (4 Ply Plywood Sheets Marine Type)	ea	5.20
4" x 3" x 7' (Door)	ea	5.00
4" x 3" x 3' (Door)	ea	2.00
1" x 10" x 7' (Panels)	ea	4.20
1" x 3" x 2'6" (Panels)	ea	0.50
Class Room Furniture		
7" x 1" x 10' (Desk & Chairs)	ea	3.80
6" x 1" x 10' ( - do - )	ea	2.80
6" x 1" x 8' ( - do - )	ea	2.25
5" x 1½" x 10' ( - do - )	ea	4.00
5" x 1" x 10' ( - do - )	ea	2.30
5" x 1" x 8' ( - do - )	ea	2.00
4" x 1½" x 8' ( - do - )	ea	2.20
3" x 1½" x 8' ( - do - )	ea	1.70
3" x 1" x 7' ( - do - )	ea	1.00
2½" x 1" x 10' ( - do - )	ea	1.40
2½" x 1" x 9' ( - do - )	ea	1.25
2" x 2" x 9' ( - do - )	ea	1.70
2" x 1½" x 10' ( - do - )	ea	2.00
2" x 1" x 8' ( - do - )	ea	0.80
1" x 1½" x 8' ( - do - )	ea	1.00
3" x 2" x 9' ( - do - )	ea	1.50

<u>DESCRIPTION</u>	<u>UNIT</u>	<u>US DOLLAR</u>
Swing Doors		
3" x 4" x 4'	ea	3.15
1" x 4" x 3'6"	ea	1.00
1" x 4" x 3'	ea	0.75
1/2" x 8" x 3'	ea	1.25
Bolts & Nuts		
5/8" Diameter 9" long (GI Bolts in Tup truss)	ea	0.50
1/2" Diameter 7" long (GI Bolts in Tup bolts truss)	ea	0.30
1/2" Diameter 5" long (GI 6 per Truss, 1 per rafter 2 per each cantilevar)	ea	0.25
10 mm DIA x 15cm Screw Crampe (Galvanized)	no	0.35
5/8" DIA x 30cm Galvanized Steel	no	0.85
Paints etc.		
Wood Priming Paint	gal	9.70
Oil Paint-under coat (cream or white) wood type	gal	9.60
Oil Paint-finishing high gloss (cream or white) wood type	gal	11.25
Chalk Board Paint (green)	gal	21.70
Turpentine (paint thinner)	gal	3.50
Linseed Oil	gal	8.00
Stopping (Putty)		
Zinc Chromate Paint (white metal paint type)	kg	3.75
Black Bituminous Paint for inside water tanks	gal	12.50
Miscellaneous		
Monkey Spanner 35mm	no	3.75
3mm Gauge 12" x 16" Clear Glass Sheets	no	1.40
24 Gauge 2" x 7' Corrugated galvanized Roofing Sheets	sheet	2.75
24 Gauge 2" x 8' Corrugated galvanized Roofing Sheets	sheet	3.25
3" x 12 Zinc Coated Roofing Nails	no	0.03



<u>DESCRIPTION</u>	<u>UNIT</u>	<u>US DOLLAR</u>
Screw/Nails for Doors & Windows		
1½" (40mm) x 9 Gauge Galvanized Iron Screws	Gross	2.00
3" (75mm) x 10 Gauge Nails	kg	1.25
1½" (38mm) x 10 Gauge Nails	kg	1.25
7/8" (20mm) Nails for fixing Glass Sheets	kg	1.50
2" (50mm) x 10 Gauge Wire Nails	kg	1.50
1 3/4" x 9 Gauge Iron Screws	Gross	0.70
2½" x 9 Gauge Iron Screws	Gross	2.00
1" x 6 Gauge Brass Screws	Gross	7.50
5/8" x 4 Gauge Brass Screws	Gross	1.50
4" (100mm) x 10 Gauge Iron Wire Nails (for Trusses)	kg	1.15
Hinges & Barrel Bolts, etc.		
4" (10cm) Brass Broad Butt Hinges with screws to match (1" x 8' Gau. Brass Screws 288) for Doors	nos	4.20
3" (7.5cm) Brass Butt Hinges with 576 Nos 3/4" x 7 Gauge Brass Screws to match	nos	2.80
4" (10cm) Brass Butt Hinges with 176 Nos 1" x 8 Gauge Brass Screws to match	nos	1.40
4" (10cm) Brass Barrel Bolts with Screws to match	nos	1.50
6" (15cm) Brass Barrel Bolts with Screws to match	nos	1.50
12" (30cm) Brass Casement Stays with Screws to match	nos	2.90
3" (7.5cm) Brass Cocks Pur Sash Fastners with Screws to match	nos	2.90
6" (15cm) Rim Lock and Brass Door Fastners with Screws to match	no	4.00
1½" Brass Padlock	no	1.50
3" Brass Hasps and Starles for room dividers with screws to match	no	0.50
3" Diameter Rubber Wheels for Room Divider	no	1.25

<u>DESCRIPTION</u>	<u>UNIT</u>	<u>US DOLLAR</u>
Accessories for 1" Dia Pipes		
Valve Sockets	no	0.25
Faucet Tees	no	0.65
1" x 1/2" Reducing Tee	no	0.45
1/2" Dia PVC Pipe for Water Line Taps	ft	1.20
1/2" 90 Elbow	no	0.15
1" Dia Brass Gate Valves	no	4.00
1/2" Dia Brass Bib Tap for Pipes	no	2.50
Hand Separated Double Acting Horizontal Pump (Lucky) with Joineries for Well Pipe Dia 3" & Lift Pipe Dia 3"	no	75.00
3" Dia PVC Pipes for Lifting Water (complete) with Couplings for Each Length of Pipe	m	4.40
Accessories - 90 Elbows	no	6.70
3" x 12' PVC Pipe (3mm) for Ventilating with Cowl	no	18.00
4" Dia PVC Pipe (3mm) with Couplings for each Pipe Length	ft	2.00
Accessories - 4" Elbow 90	no	9.50
4" Tees 90	no	14.00
4" End Caps	no	1.50
PVC Glue	kg	3.25
4" Dia PVC Pipes (3mm) with Couplings for each Length	ft	2.00
4" Elbows 90	no	9.50
4" End Caps 90	no	1.70
4" Tees 90	no	14.00
Indian Style Latrine Seat with Minimum Water Seal for Hand Flush with 4" Traps	no	6.00
1/2" Dia Steel Bars (for septic Tank)	ft	0.25
1/4" Dia Steel Bars (for inspection holes)	ft	0.10
Colourless Wood Preservatives for Furnitures, 4 Litre Cans	can	2.35

<u>DESCRIPTION</u>	<u>UNIT</u>	<u>US DOLLAR</u>
Miscellaneous		
1" Round Lead Washere	no	0.01
24 Gauge Plain Galvanized Iron Sheets 3' x 6'	sheet	6.85
2" Ordinary Paint Brushes	ea	2.00
1" Ordinary Paint Brushes	ea	2.00
6" (15cm) Dia PVC Half Round Gutters	ft	1.10
Accessories:- JOINTS	no	1.70
Stop Ends PVC	no	2.15
4" Dia Outlets PVC	no	11.25
4" Dia Elbows 90° PVC (2mm)	no	4.15
Galvanized Steel Gutter Brackets for 6" (15cm) Dia Gutters. PVC Brackets if Available (Please note fixing detail)	no	0.85
1" x 8 Gauge/Brass Screws for Gutter Brackets	no	0.20
4" (10cm) Dia PVC Rain Water Down Pipes (2mm)	ft	1.20
Down Pipe Bracket 4" (10cm) Dia	ea	1.40
Solvent Cement	kg	10.00
Standard Patterns 400 Gallon Galvanized Steel Water Tank with Access Cover/Lid Holder for 10cm Dia Rain Water Pipe and fitted with 1" Outlet, Overflow Outlet, Bottom Cleaning Outlet.	no	307.15
½" Brass Bibtaps with Union Connection for Fitting to Tank	no	2.30
No Leak Gum (4 Lbs. Tins) for Teaks and Roofing Screws	tin	3.75
1" Dia PVC Pipes for Water Line (Complets with couplings for each length of pipe)	ft	2.50
Accessories for 1" Dia Pipes		
Couplings	no	0.40
End Cups	no	0.25
90° Elbows	no	0.35

<u>DESCRIPTION</u>	<u>UNIT</u>	<u>US DOLLAR</u>
Accessories for 1" Dia Pipes		
Brown Wood Preservative Oil for Beams (4 Litre Cans)	no	2.35
Hinges for Swing Doors	no	1.75
½" Dia Hose, PVC Flexible for Water-ing School Garden	ft	0.25

III-1-2 建設材料等の価格（モルディブ）

1979年10月現在

	DESCRIPTION	UNIT	US\$・Rs
建設材料	CORAL STONE	cu. ft	Rs 0.50
	SAND	KANDI	Rs 8~10
	LIME (CaO)	KANDI	Rs 60
	TIMBER (100% シンガポールより輸入)	TON	US\$372
	LOUVER WINDOW (ガラスを除く)	M	Rs 45
交通機関	船 (20 TON) の賃貸料	MONTH	US\$1,000
	船 (20 TON) のクルーの賃金 (燃料費別途)	MONTH	US\$1,000
	船 (10~12 TON) の賃貸料 (クルー込み)	2WEEKS	Rs 7,500
	船 (40 feet 位のバッテリーボート) の 購入費 (補強及エンジンの取付費を含む)	台	US\$8,300
	船 (DHONI) の賃貸料 (クルー4人込み)	MONTH	Rs 3,500
	タクシー代 (片道で利用する時)	台	Rs 10
	タクシー代 (1時間借りきる時)	台	Rs 60
	自転車の購入費	台	US\$80
生活費	借家料 (2室付) ④ マレーで見つけるには時間を要する	MONTH	US\$160 US\$200
	サーバントの賃金	MONTH	US\$50
	現地人4人家族がマレーで暮すための 最低生活費	MONTH	Rs 450
	現地人4人家族が地方の島で暮すための 最低生活費	DAY	Rs 8
家具	CHAIR	個	Rs 24~30
	DESK	個	Rs 39~42
	ROOM DIVIDER	個	Rs 1,350









JICA