

ROAD WAY DIAGRAM

上工定規図 S=1:100

FROM St=0 TO Sl=1550

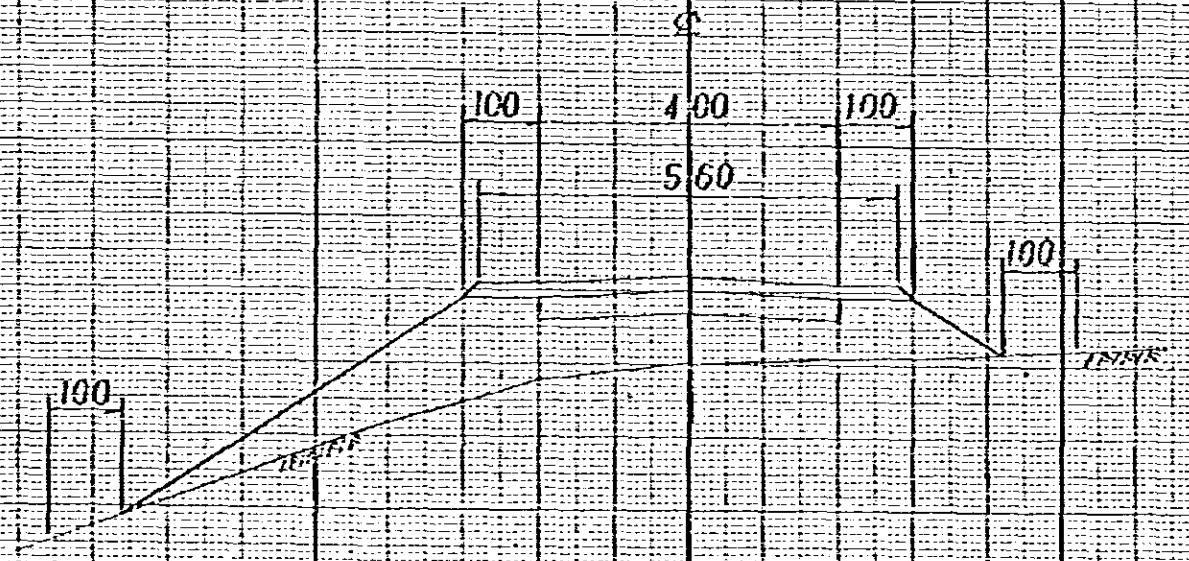
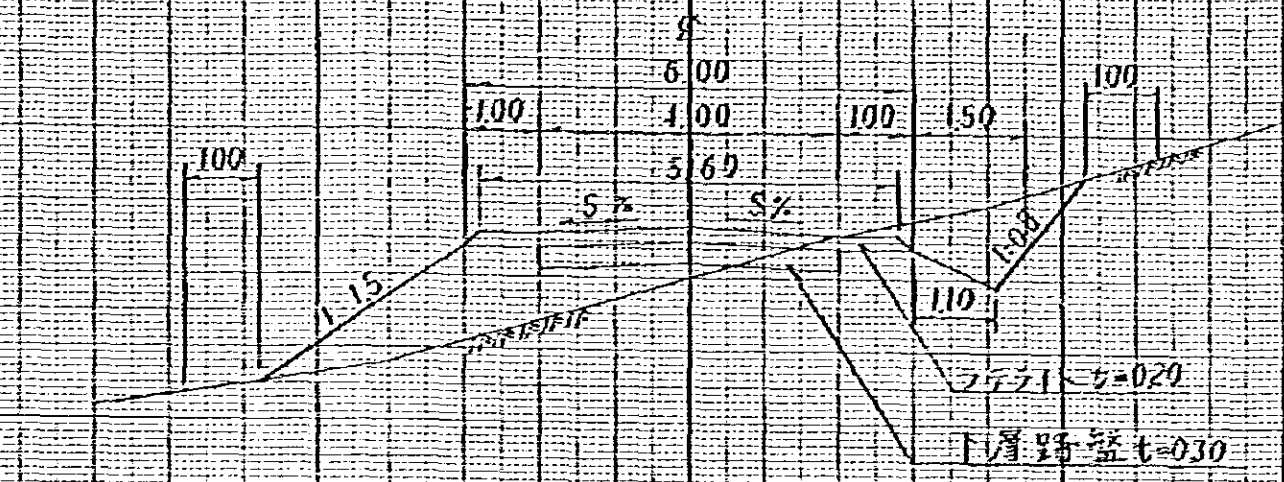

ROAD WAY DIAGRAM

NO.1



BRIDGE 橋

SP 337-307 SPAN=200

S=1:100

20.00

2.00 2.50

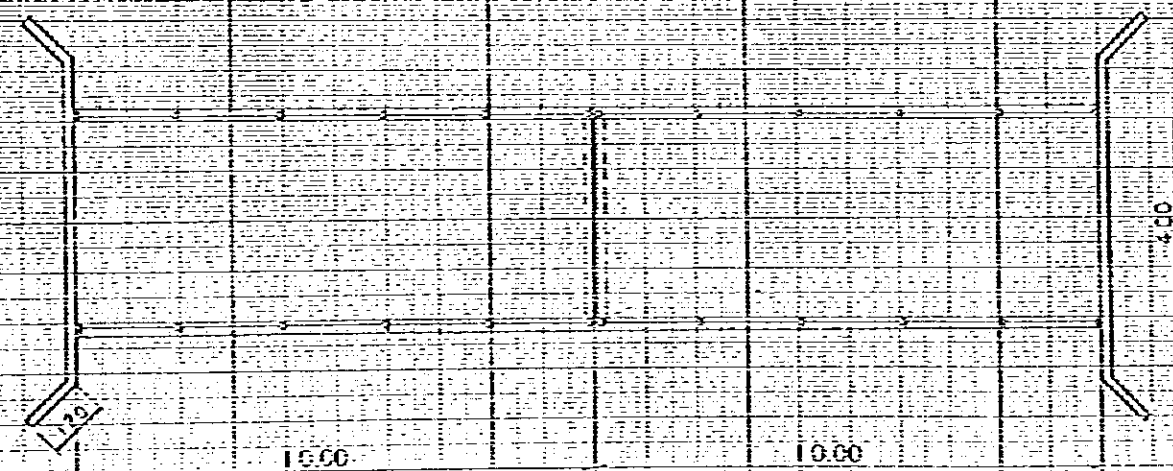
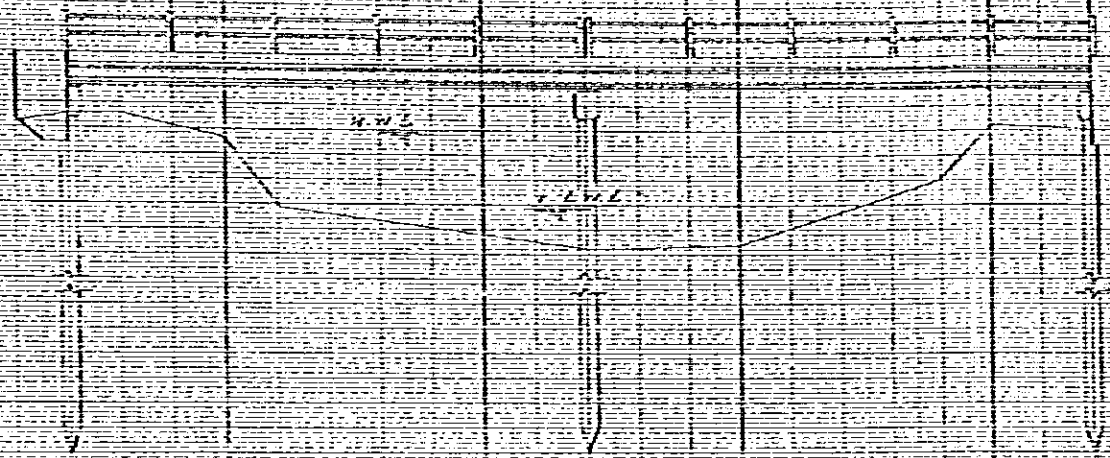

15.00

10.00

4.00

S=1:50

5.10

2.50

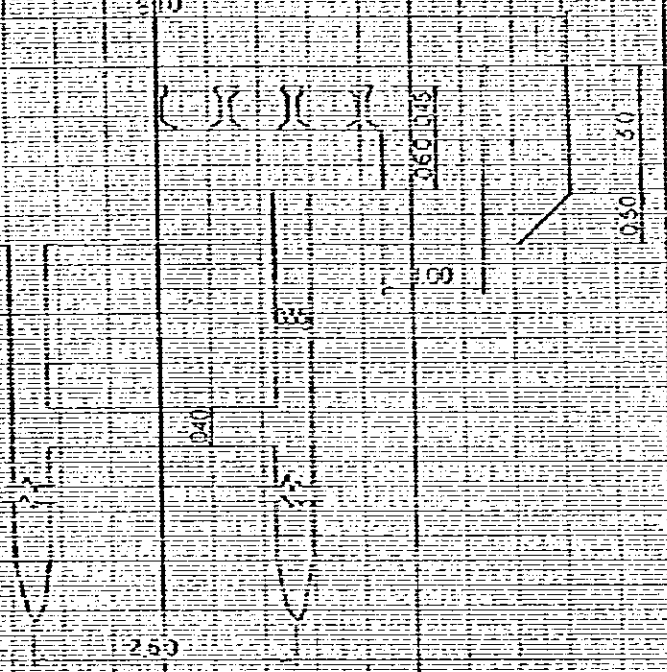

25.00

2.50

1.00

0.50 0.50

BRIDGE  
NO. 1

基础工標準圖

S = 1:50

R.C.P.  $\phi$ 0.30

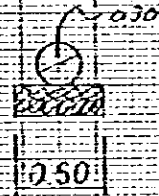

1m 當, 0.12m<sup>2</sup>

R.C.P.  $\phi$ 0.60



1m 當, 0.25m<sup>2</sup>

R.C.P.  $\phi$ 0.30

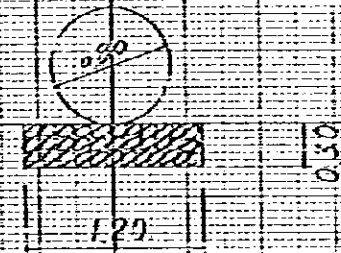

1m 當, 0.36m<sup>2</sup>

STANDARD

NO.

台北日台橋工圖

SP-0050  
S-1170  
SP-2212

SP-0020  
S-1170  
SP-2212

SP-0055  
S-1170  
SP-2212

SP-0065  
S-1170  
SP-2212

SP-0076  
S-1170  
SP-2212

SP-0077  
S-1170  
SP-2212

台坡架面圖

台坡架面圖

台坡架面圖

台坡架面圖

台坡架面圖

STONE PITCHING  
101







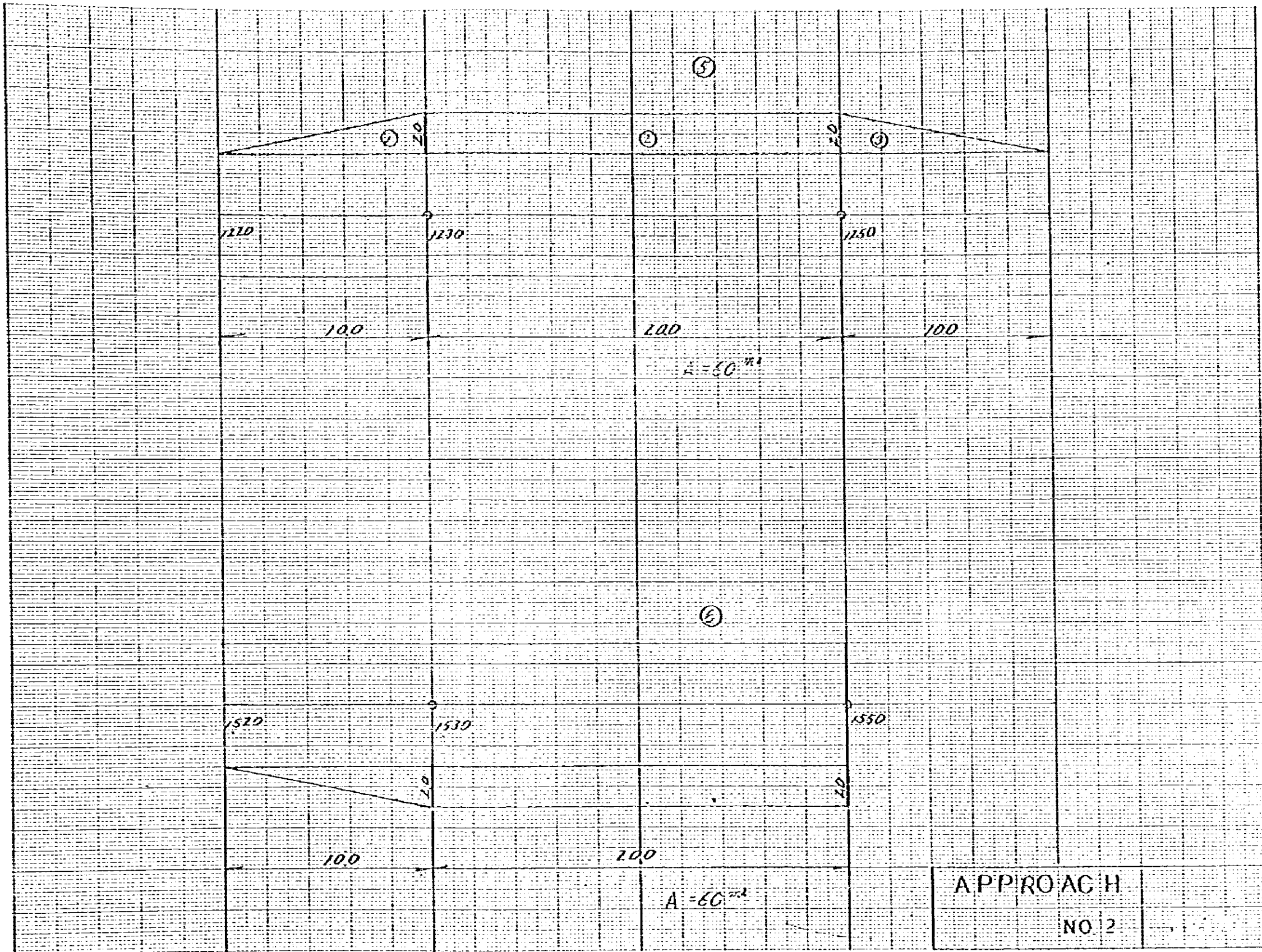

用地関係集計表

所有者	種別	番 号	面 積	備 考
Mr Rat Tanta	宅 地	① ~ ③	170.785	図面番号 ①
"	"	⑥	134.690	
"	畑	⑦	87.300	
Mr Boonta Tanta	宅 地	⑧	50.010	
Mr Ju Monta	"	⑨	666.850	
Mr Ta Meekoon	畑	⑩	223.520	
"	宅 地	⑫	25.840	
Mr Ai Auensee	"	⑬	113.830	
"	畑	⑭	85.800	
Mr Pek Lanpang	宅 地	⑮	45.880	
Mr Rean, Tnaua	"	⑯	50.520	
Mr Som Boonpan	"	⑰	30.240	
"	"	⑱	43.700	
Mr Ta Jaichuno Pom	"	⑳	78.780	
R.F.D.	チーク林		179.780	図面番号 ②
	原 野		168.260	
	"		16.800	図面番号 ③
	畑		78.180	
	田		9.980	
R.F.D.	チーク林		113.900	
計			1774.645m <sup>2</sup>	







10	Area
45	$10 \times 15 / 2 = 150$
46	$12 \times 3 \times 12 / 2 = 360$
47	$14 \times 25 \times 63 / 2 = 1250$
48	$16 \times 28 \times 22 / 2 = 548$
49	$18 \times 26 \times 18 / 2 = 516$
	2650

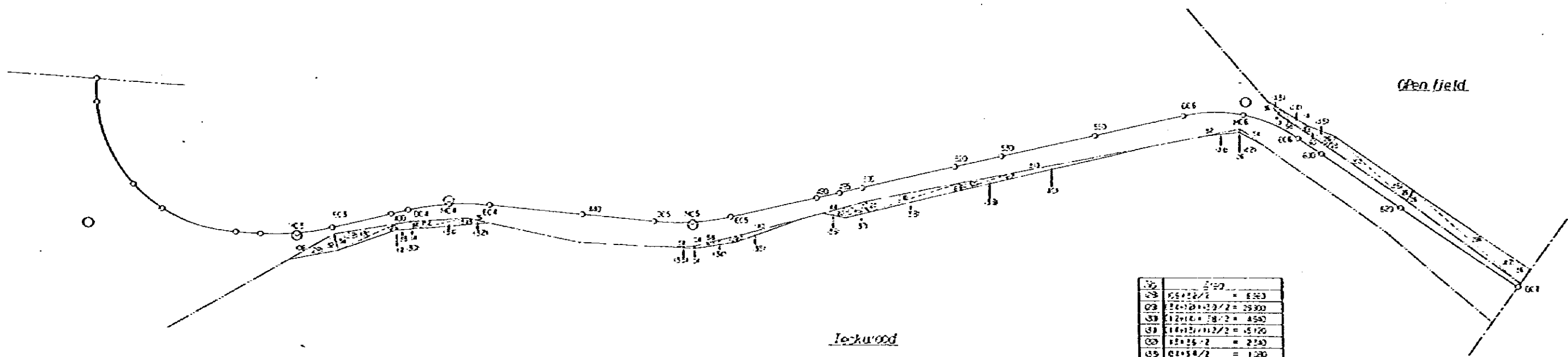

50	Area
50	$15 \times 22 / 2 = 165$
51	$24 \times 20 \times 23 / 2 = 2920$
52	$12 \times 10 \times 18 / 2 = 450$
53	$14 \times 25 \times 112 / 2 = 5120$
54	$17 \times 25 / 2 = 210$
55	$21 \times 18 / 2 = 180$
56	$24 \times 10 \times 30 / 2 = 360$
57	$14 \times 23 / 2 = 160$
58	$22 \times 11 / 2 = 120$
59	$20 \times 20 \times 56 / 2 = 1120$
60	$24 \times 10 \times 200 / 2 = 4000$
61	$14 \times 20 \times 80 / 2 = 1120$
62	$12 \times 10 / 2 = 60$
63	$16 \times 12 / 2 = 96$
64	$10 \times 14 / 2 = 70$
	1750

No	Area
69	$22 \times 50 / 2 = 550$
60	$(30+2) \times 95 / 2 = 2050$
61	$(14+29) \times 90 / 2 = 2000$
62	$(24+24) \times 80 / 2 = 1920$
63	$22 \times 64 / 2 = 704$
64	$106 \times 28 / 2 = 1484$
	7880

No	Area
65	$106 \times 65 / 2 = 3445$
66	$16 \times 100 / 2 = 800$
	9500

No	Area
29	$(32+0) \times 80 / 2 = 1280$
	16500

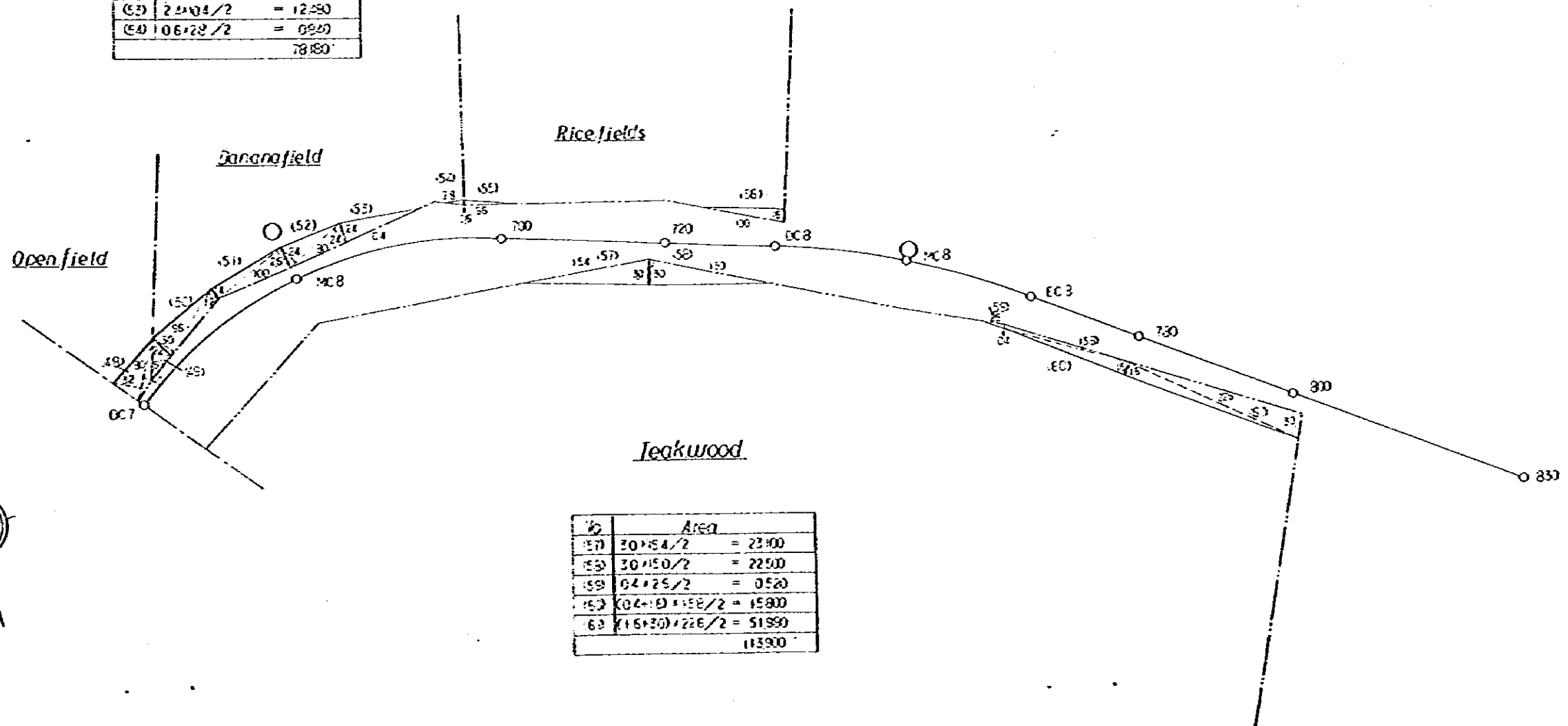



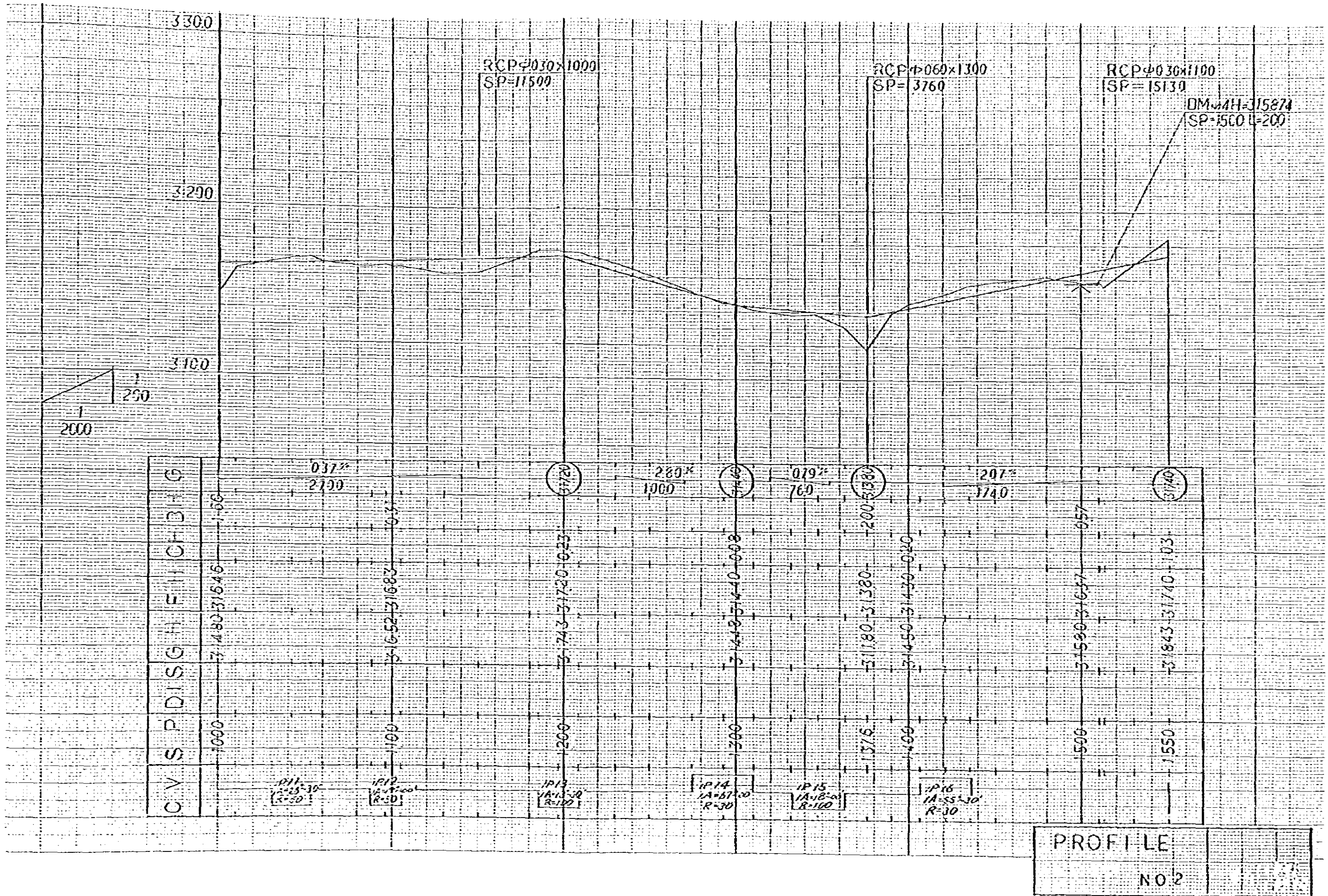

PROFILE NO. 2

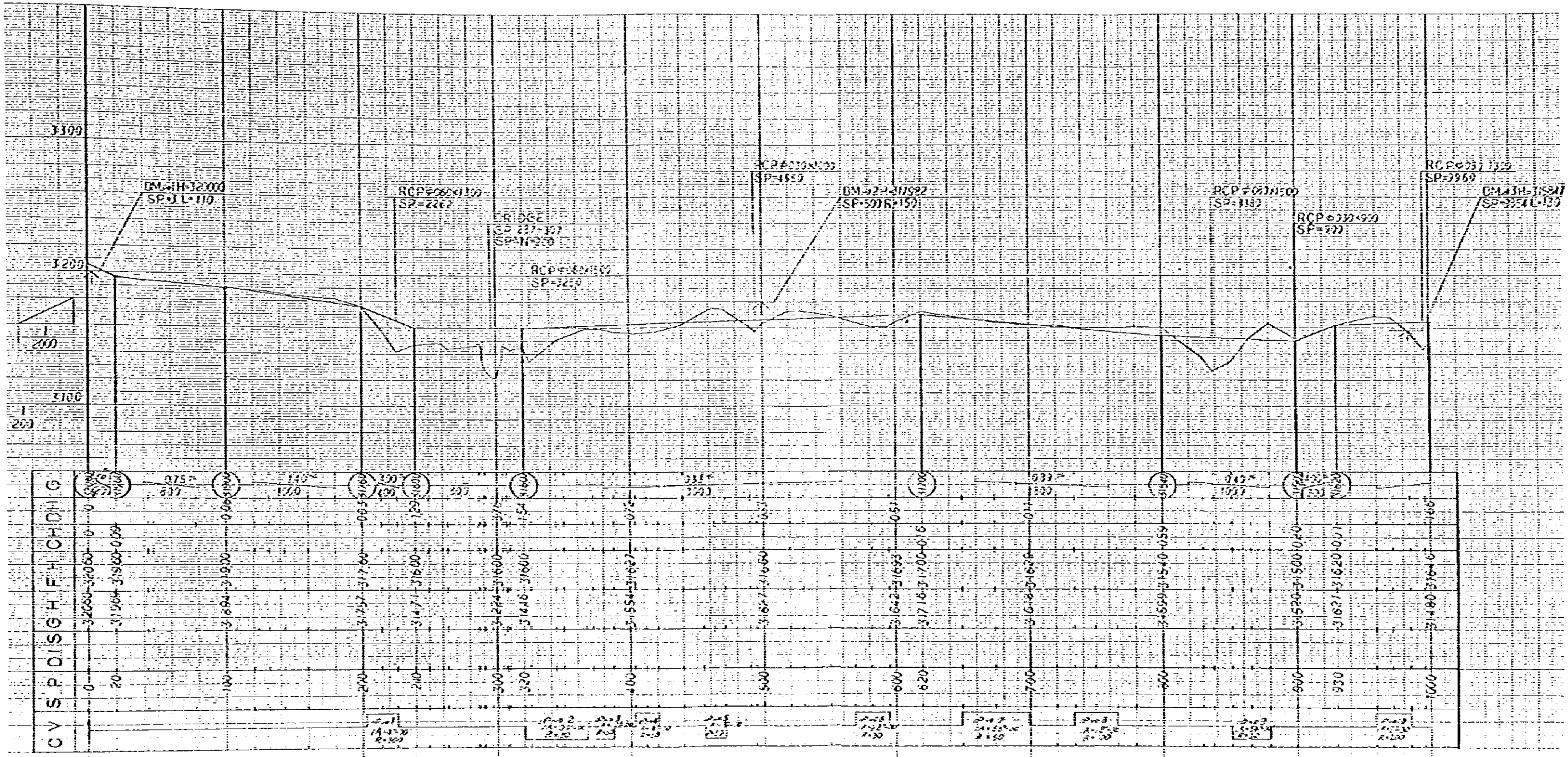

PROFILE  
NO. 1

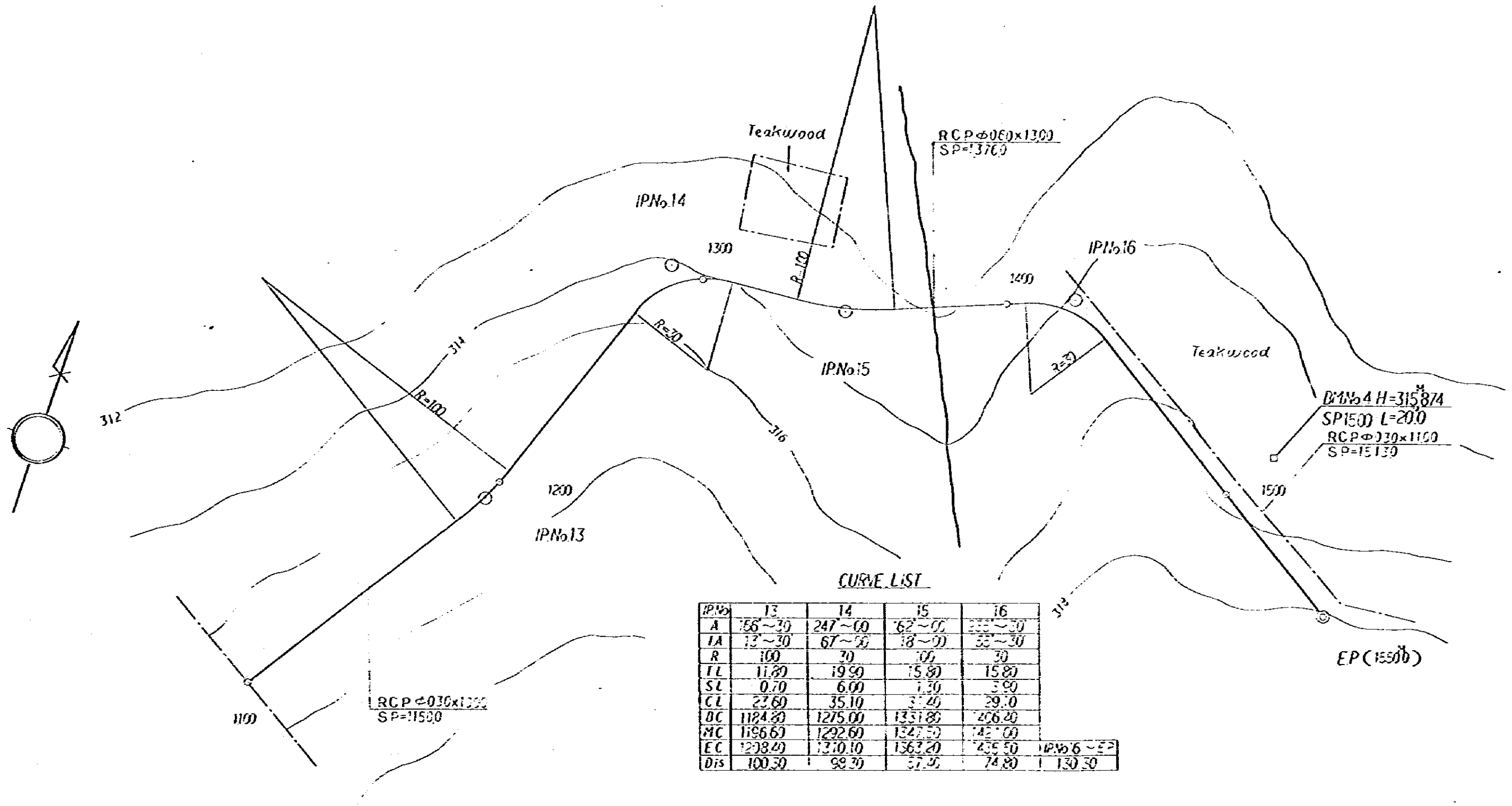

CURVE LIST

IPNo.	13	14	15	16
A	56~30	247~00	62~00	333~30
TA	13~30	67~50	18~00	55~30
R	100	70	100	70
FL	11.80	19.50	15.80	15.80
SL	0.70	6.00	1.30	3.90
CL	23.60	35.10	37.20	29.70
BC	1184.80	1275.00	1331.80	206.20
MC	1196.60	1292.60	1347.50	242.00
EC	1208.40	1310.10	1363.20	285.50
Dis	100.50	99.70	57.20	74.80

PLAN  
NO 3







JICA