

資料編



## 資料編目次

I.	協議議事録	I - 1
1.	第一次事前調査	I - 1
2.	第二次事前調査	I - 6
3.	第一次基本設計調査	I - 19
4.	第二次基本設計調査	I - 28
5.	ドラフトファイナルレポート説明調査	I - 40
II.	調査団の構成	II - 1
1.	第一次基本設計調査団	II - 1
2.	第二次基本設計調査団	II - 2
3.	ドラフトファイナルレポート説明調査団	II - 2
III.	調査日程	III - 1
1.	第一次基本設計調査	III - 1
2.	第二次基本設計調査	III - 6
3.	ドラフトファイナルレポート説明調査	III - 9
IV.	面談者リスト	IV - 1
1.	タイ国側関係者	IV - 1
2.	日本側関係者	IV - 4
3.	アユタヤ小委員会名簿	IV - 5
V.	ボーリングデータ	V - 1
VI.	基本設計検討案	VI - 1



I. 協議議事録

1. 第一次事前調査

MEMORANDUM OF DISCUSSIONS

ON

PRELIMINARY STUDY FOR AYUDHAYA HISTORICAL  
STUDY CENTER PROJECT IN THE KINGDOM OF THAILAND

Japan International Cooperation Agency (JICA), an official agency responsible for implementation of technical & economic cooperation program of the Government of Japan, has conducted the preliminary study on the Ayudhaya Historical Study Center Project (the Project) in close cooperation with the Thai authorities concerned, from August 17 to 27 1986.

The team headed by Mr. Masaharu Yoshida, Assistant Director, Grant Aid Division, Economic Cooperation Bureau, Ministry of Foreign Affairs, held a series of discussions and exchanged view with Thai authorities concerned on the Project.

The Japanese team explained that the significance of the purpose of the Project requested by the Government of Thailand as the high priority project under the Three-year Indicative Plan, is fully recognized. It also stated that the Project should primarily be considered from the stand point of Thai side's initiatives on both administrative and academic matters, especially because the Project deals with history, a very sensitive area.

The Thai side stated that it shares the same view with that of the Japanese side, and that a preparatory committee as an administrative and academic contact point should be established, under the chairmanship of the Governor of Ayudhaya Province. a tentative member list is as shown in

Annex I.

Furthermore both parties confirmed the following points:

1. The purpose of the Project is to provide opportunities to study the history of Ayudhaya for Thai people and foreigners through exhibitions.

2. The site of the Project, proposed by the Thai side, at present, is in the south of the city of Ayudhaya and its total area is about 7 rai. The Thai side will make a proposal of the definite site as soon as possible. Legal problems pointed out by the Ayudhaya government concerning the ownership of land should be settled by the Thai side.

Land preparations including infrastructures should be done by the Thai side.

Archaeological problems, pointed out by the Fine Arts Department, should be settled among the Thai Government.

3. Budget appropriation and securing necessary staff should be made by the Thai side for maintenance.

4. Basic idea of exhibition should be presented by the Thai side.

5. The Thai side should present to the Japanese side the results of its examination on the above mentioned points 2 & 4 with in two months.

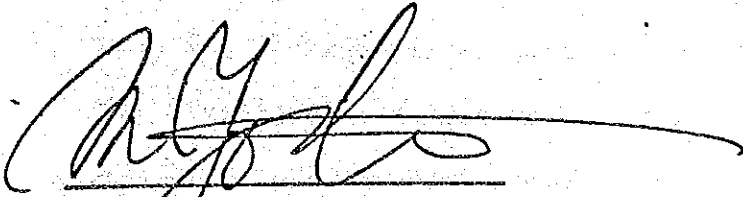

Mr. Masaharu Yoshida  
Leader of the Japanese Mission



Mr. Kitti Pratoomkaew  
Provincial Governor of  
Ayudhaya

Prof. Komei Sasaki	National Museum of Ethnology
Prof. Shigeharu Tanabe	National Museum of Ethnology
Mr. Masaharu Yoshida	Ministry of Foreign Affairs
Mr. Hideaki Hirano	Embassy of Japan
Mr. Norio Matsuoka	Ministry of Education
Mr. Naoyoshi Sasaki	Japan International Cooperation Agency



Annex I

Sub.Lt. Kitti Prateomkaew	Provincial Governor of Ayudhaya
Mr. Pisit Chaleonwong	Fine Arts Department
Mr. Patipat Pumpongpaet	Fine Arts Department
Mrs. Riam Bumpongpaet	Fine Arts Department
Mr. Prasit Lulittanon	Thai-Japanese Association
Mr. Bamroeng Hemawanakool	Chief of Finance
Mr. Prasarn Moonrasarn	Education
Mrs. Sumalee Suwangnasang	Cultural Center
Mr. Prapis Kongsompong	Chairman of City Assembly
Mr. Chatthip Nartsupha	Chulalongkorn University
Mrs. Prapprung Kongchana	Srinakharinwirot University
Mr. Wangchai Kirddan	Public Relation
Mr. Anupart Nikrodha	Secretary of the Meeting
Mr. Buntao Suksatit	Deputy Governor of Ayudhaya

2. 第二次事前調査

MINUTES OF DISCUSSIONS  
OF  
THE SECOND PRELIMINARY STUDY  
ON  
THE PROJECT FOR CONSTRUCTING THE AYUTTHAYA HISTORICAL STUDY CENTRE  
IN  
THE KINGDOM OF THAILAND

---

In response to the request of the Government of the Kingdom of Thailand, the Government of Japan decided to conduct a Second Preliminary Study on the Project for Constructing the Ayutthaya Historical Study Centre and entrusted the study to the Japan International Cooperation Agency (hereinafter referred to as "JICA"). JICA sent to the Kingdom of Thailand the study team headed by Mr. Hiroshi MANABE, official, Ministry of Foreign Affairs of Japan, from January 21 to January 30, 1987.

The study team had a series of discussions on the Project with the officials and scholars concerned of the Government of the Kingdom of Thailand headed by Prof. Dr. Phaisith Phipatanakul, Permanent Legal Advisor, Ministry of Interior and conducted the site survey.

As the result of the study both parties agreed to recommend to their respective governments that the major points of understanding reached between them, attached herewith, should be examined towards the realization of the Project.

Bangkok, January 29, 1987

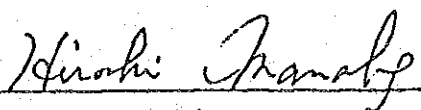
  
Mr. Hiroshi MANABE  
Leader of the Second Preliminary  
Study Team

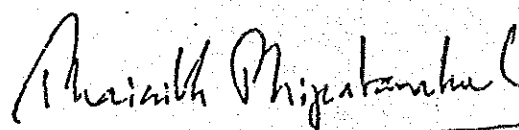
  
Prof. Dr. Phaisith Phipatanakul  
Permanent Legal Advisor of  
Ministry of Interior

ATTACHMENT

1. The Thai side informed the Japanese Team that the Task Force of the Ayutthaya Historical Study Centre Sub-Committee has already been officially established and the Cabinet of the Government of the Kingdom of Thailand gives this Task Force the full endowment to work out the project by consulting with the Japanese side. The list of the members of the Task Force is shown in Appendix I. and the list of the members of the Sub-Committee for the Construction of the Ayutthaya Historical Study Centre which is composed of twenty five members totally, is also shown in Appendix II. The Japanese Team informed the Task Force that the Government of Japan established the Supporting Committee composed of three scholars shown in appendix III.

2. The Task Force reported to Committee for the Celebration of Thai-Japanese Centennial Anniversary on January 27, 1987, the major points of understanding reached by both parties during the discussions of the second preliminary study, and Committee fully approved the report on that day.

3. The purpose of the Project is to provide the opportunities for Thai people primarily and foreign visitors to learn the history of Ayutthaya in general through the exhibitions and its activities so that they could promote their understanding on the history of the Kingdom of Thailand.

4. The implementation of the Project is under the Ayutthaya Provincial Authority, assisted by an Executive Board which might at least be composed of the officials of the Ministry of Interior and the Department of Fine Arts, Scholars, and members of the Thai-Japanese Association. The Executive Board will be formed in due course, which nominate the Director of the Centre who should be the personnel with academic background on history. The Director shall be assisted by Advisory Committee whose members shall be appointed later by the Executive Board.

5. The site of the Project is located in the area, so-called the Old Japanese Village in the south of central Ayutthaya. The total area of the village is around 7.5 rais. Taking account of the letter of

H. Gm

Thairath

Mr. Thaveesak Senanarong, the Director-General of the Department of Fine Arts, on October 15, 1986, addressed to Mr. Sommai Hoontrakool, the President of Thai-Japanese Association, both parties agreed to use land of the northern half of the proposed area that the Government of the Kingdom of Thailand has already approved in the letter mentioned-above from archaeological point of view. The construction plot of the Centre is shown in Appendix IV.

6. With regard to the use of the site, the Government of the Kingdom of Thailand through the Committee for the Celebration of Thai-Japanese Centennial Anniversary confirmed to the Team that the implementation agency, the Ayutthaya provincial authority is legally allowed to use the land as long as the Centre exists in the site. The permission was already conveyed to Mr. Chaiwat Hutacharoen, the Governor of Ayutthaya from Mr. Sommai Hoontrakool, the President of Thai-Japanese Association, on October 15, 1986 in the letter form.

7. Since this project is implemented under its responsibility, the Ayutthaya Provincial Authority is willing to appropriate the annual budget and to recruit the personnels who are indispensable for maintenance and operation of the Centre. The allocation of the budget and the assignment of the necessary numbers of the staff should be adequately determined by the provincial authority advised by the Executive Board.

8. The function of Centre, which both parties regard as the most important part of the Project, is firstly to display various exhibits relating to the history of Ayutthaya (the detailed objectives for the exhibitions will be referred to later), and secondly to act as reference centre for the information on the history of Ayutthaya as much as possible. In the future, the Centre will be expected to promote some research activities in cooperation with various research organizations such as universities and museums which are carrying out the academic research on the Ayutthaya history. The cooperation system between the Centre and these supporting organizations should be worked out in detail in the future by the Executive Board. The Team introduced to the Task Force the scheme of the cultural grant aid under which the research equipment could be probably provided, if both sides regard it necessary after such a cooperative system will be established.

H. G.

Phairat

9. With regard to the exhibitions of the Centre, the Task Force is requested by the Team that they have to supply the appropriate information and materials relating to the Ayutthaya history as much as possible to the Japanese side in order that the latter can work easily toward the realization of the Project. On the other hand, the Japanese side will inform the Thai side of the list of materials relevant to history of Ayutthaya which are held in Japan. The Task Force will give the Japanese side the list of the materials and objectives that can be displayed or used in the Centre by the middle of April.

10. The display in the Centre will be divided into the three main parts as follows: (1) Ayutthaya as the port city, (2) centralised government of the Ayutthya kingdom, and (3) the life of the people in Ayutthaya. The detailed exhibits will be shown in Appendix V.

11. The Thai side confirmed to the Team that they are fully aware that they are responsible for the plan for the improvement of the Old Japanese Village surrounding the Ayutthaya Historical Centre borne by the Government of Japan in the grant aid form. The Japanese Team expressed the views that the plan for improvement of the Old Japanese Village by the Task Force should have harmonious content with the Centre. The Task Force requested to the Japanese Team that the basic design team might work out not only the plan for the Centre itself but also for the plan for the improvement of the Old Japanese Village which is borne by the Task Force so as to have the better unified picture in the form of a master plan of the whole project.

12. With regard to the plan for the improvement of the Old Japanese Village, the Task Force expressed the views that site work (clearing and reclamation, river-side retaining) necessary for the commencement of the construction by grant aid, and the construction of the small restaurant with souvenir shop, the other necessary constructions such as fence and gate, garden landscaping, pier should be included in the plan and these things should be taken into full consideration at the time of basic design study. The Japanese side confirmed to the Task Force that the former understood the latter's request positively but also said that the cost for detailed design and the construction of the things concerned should be borne by the Task Force.

*Marshall*

*H. J.*

13. The Task Force disclosed their plan of fund-raising to cover their obligations and promised to the Japanese Team that they start collecting the fund soon and further steps for fund-raising will be taken in Tokyo as soon as possible. The Task Force showed to the Japanese Team that the amount of fund donated from private sectors expected to be one hundred fifteen million Yen. The Japanese side took note of it. The Task Force further informed the Team that the Government of Thailand is exploring the possibility in providing fund to support the project in order to promote the tourism in this area. The final result of the discussions of the Government of Thailand in this matter will be conveyed to the Japanese side in the near future.

14. With regard to the infrastructure, both sides agreed as follows: the Thai side should (1) provide electricity to the Centre, and (2) repair and expand access road to the site.

15. The Task Force expressed their desire during the discussions that they need to send Thai specialists visiting Japanese institutions in order to acquire sound knowledge and sufficient information before commencing their duties for exhibition works. They also make a request to get some Japanese experts assigned to the Project to work out the details of the exhibition during the period of display works.

It is stressed by the Task Force that research activities of the Centre is crucially needed to fulfil its primary function for social education in the country. In this connection the Task Force would be ready to organize wide range activities in cooperation with both domestic and foreign institution, provided with possible aid from the Japanese government assigned to the Centre to promote further research activities after the completion of the Project.

Id. In

Phai

TASK FORCE OF THE AYUTTHAYA HISTORICAL STUDY CENTER

- |     |  |        |
|-----|--|--------|
| 1.  | Prof. Dr. Phaisith Phipatanakul<br>Permanent Legal Advisor<br>Ministry of Interior | Head   |
| 2.  | Mr. Manas Leeviraphan<br>Inspector-General<br>Ministry of Finance                  | Member |
| 3.  | Mr. Jiroj Itharatana<br>Department of Technical and Economic Cooperation           | Member |
| 4.  | Mr. Vichien Suwatti<br>Deputy Governor<br>Ayutthaya Province                       | Member |
| 5.  | Mr. Bantau Susathit<br>Ayutthaya Provincial Secretary                              | Member |
| 6.  | Mr. Cathai Vicharnsricha<br>Ayutthaya Provincial Office                            | Member |
| 7.  | Assoc. Prof. Dr. Dhida Saraya  | Member |
| 8.  | Assoc. Prof. Srisakra Vallibhotama   | Member |
| 9.  | Asst. Prof. Plublung Kongchana   | Member |
| 10. | Mr. Junjiro Nishino<br>Thai & Japanese Association                                 | Member |
| 11. | Mr. Prasit Lulitanon<br>Thai & Japanese Association                                | Member |

Phaisith

SUB-COMMITTEE FOR THE CONSTRUCTION OF THE AYUTTHAYA HISTORICAL STUDY CENTER

- |     |  |                              |
|-----|--|------------------------------|
| 1.  | Mr. Chaiwat Hutachareon<br>Phra Nakhon Si Ayutthaya<br>Provincial Governor                               | Chairman of teamworkers      |
| 2.  | Prof. Dr. Phaisith Phipatanakul<br>Permanent Legal Advisor of<br>Ministry of Interior                    | Advisor to teamworkers       |
| 3.  | Mr. Manas Leeviraphan<br>Inspector-General of Ministry<br>of Finance                                     | - do -                       |
| 4.  | Assoc. Prof. Dr. Chatthip Narthsupa  | - do -                       |
| 5.  | Mr. Vichien Suwatti<br>Phra Nakhon Si Ayutthaya<br>Deputy Provincial Governor                            | Vice Chairman of teamworkers |
| 6.  | Mr. Bantau Susathit<br>Phra Nakhon Si Ayutthaya<br>Deputy Provincial Administrative Organization         | - do -                       |
| 7.  | Mr. Praphit Kongsompehong<br>Speaker of Phra Nakhon Si Ayutthaya<br>Provincial Council                   | - do -                       |
| 8.  | Mr. Thammasak Rotjanasoonthorn<br>(Representative) of the Tourism<br>Authority of Thailand               | a teamworker                 |
| 9.  | Mr. Junjiro Nishino<br>Mr. Prasit Lulitanon<br>(Representative) of the Thai-Japanese<br>Association      | - do -                       |
| 10. | Lecturer Sumalee Suvansang<br>(Representative) of Phra Nakhon<br>Si Ayutthaya Provincial Cultural Center | - do -                       |
| 11. | Mr. Jiroj Itharatana<br>(Representative of the Department of Technical<br>and Economic Cooperation       | - do -                       |
| 12. | Mr. Suvit Keowkase<br>Phra Nakhon Si Ayutthaya<br>Provincial Education Officer                           | - do -                       |
| 13. | Mr. Sawat Chittrong<br>Phra Nakhon Si Ayutthaya Provincial<br>Land Officer                               | - do -                       |

H. In

Phasit



- |     |  |  |
|-----|--|--|
| 14. | Mr. Patipat Pumpongpaet<br>Chief of Phra Nakhon Si Ayutthaya<br>Historical Park Project.                                   | a teamworker                                   |
| 15. | Lt. Charoon Buachum<br>Phra Nakhon Si Ayutthaya<br>District Officer  | - do -   |
| 16. | Assoc. Prof. Dr. Dhida Saraya  | - do -   |
| 17. | Assoc. Prof. Srisakra Vallibhotama   | - do -   |
| 18. | Lecturer Dr. Charnwit Kasetsiri  | - do -   |
| 19. | Lecturer Sumalee Suvansang   | - do -   |
| 20. | Asst. Prof. Kuakoon Yuenyong-anand   | - do -   |
| 21. | Mr. Piset Jiajunphong<br>Head of Administrative Section<br>Division of Archeology Department<br>of Fine Arts               | - do -   |
| 22. | Mr. Pathai Vicharnpricha<br>Chief of Phra Nakhon Si Ayutthaya<br>Provincial Officer  | a teamworker and Secretary                     |
| 23. | Asst. Prof. Plubplung Kongchana  | a teamworker and assistant<br>to the secretary |
| 24. | Mr. Bamrong Hemwanakul<br>Financial Section Chief of Phra Nakhon<br>Si Ayutthaya<br>Provincial Administrative Organization | - do -   |
| 25. | Mr. Anuparp Nixratha<br>Administrative Section Chief of<br>Phra Nakhon Si Ayutthaya Provincial Office                      | - do -   |

*On*

*Prasit*



THE JAPANESE SUPPORTING COMMITTEE

1. Prof. Dr. Komei Sasaki                      National Museum of Ethnology
2. Assoc. Prof. Dr. Shigeharu Tanabe      National Museum of Ethnology
3. Prof. Dr. Yoneo Ishii                      Kyoto University

W. Gm

*Amairik*

THE CONSTRUCTION PLOT OF THE CENTER

APPENDIX IV

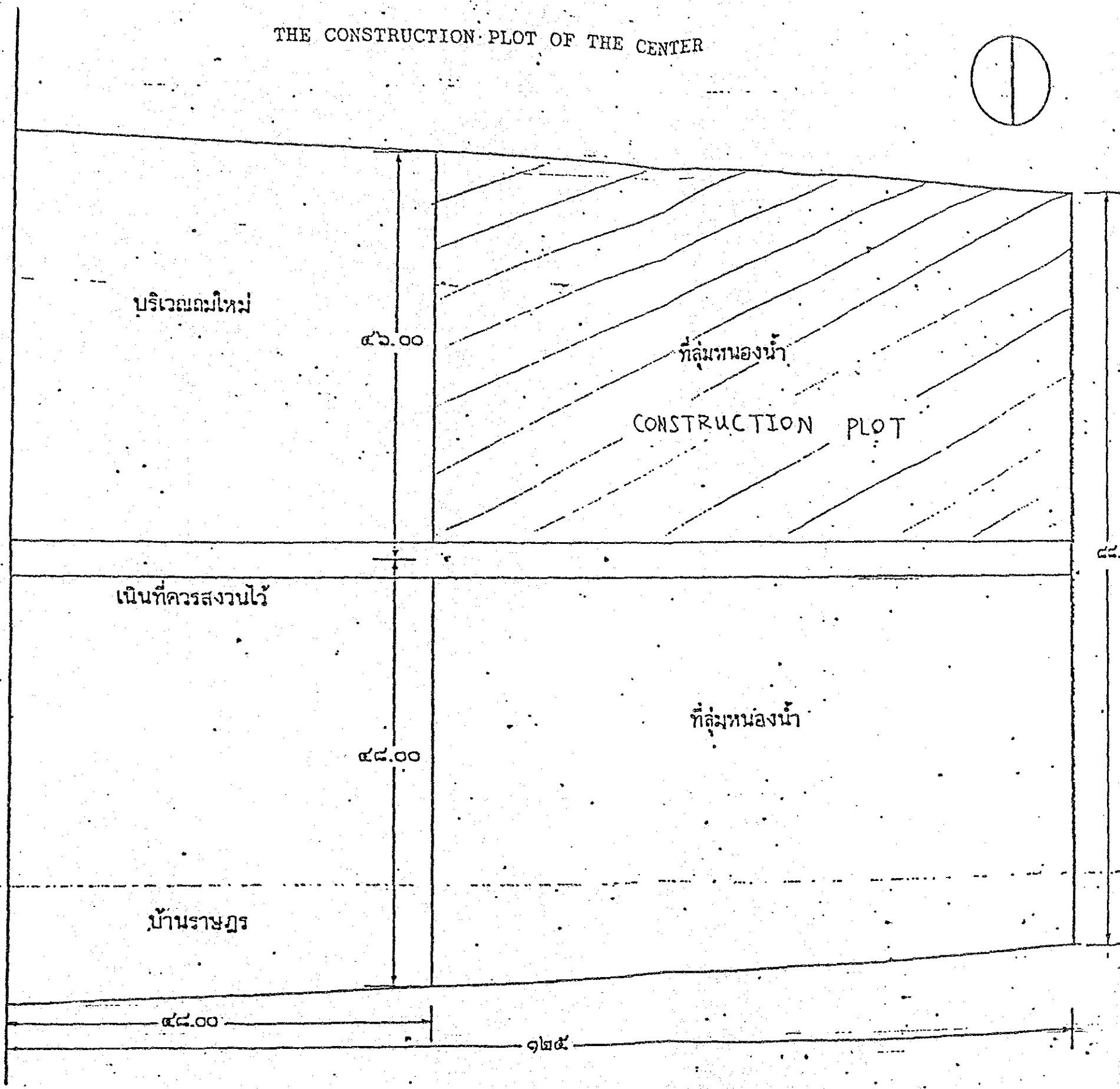
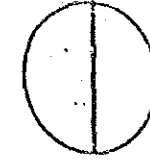

แม่น้ำเจ้าพระยา  
(๕๕-๗๖-๑๑)

ฝั่งซ้ายเขตบริเวณแหล่งประวัติ  
ศาลเจ้าบ้านญี่ปุ่น  
๑. พระนครคีรีอยุธยา

H. Gm



The Academic Basic Plan for the Ayutthaya Historical Study Centre

In response to the Thai Government's request for Japanese Government cooperation for establishing the Ayutthaya Historical Study Centre at the Japanese village of Ayutthaya province in 1986, the Japanese government has sent a second mission composed of officers from the Ministry of Foreign Affairs, JICA, technical experts and academic specialists to hold discussions with various Thai representatives from the Ministry of Interior, the Ministry of Finance, the Department of Fine Arts as well as the Thai-Japanese Association personnels and scholars between January 2 - 19, 1987.

On January 23 and 27, 1987, Thai and Japanese academic specialists exchanged points of view during the discussions dealing with the function and role of the Ayutthaya Historical Study Centre, and with the preparation for its exhibition. The basic idea of this project can be summarized as follows:

1. Function and Role of the Centre The Ayutthaya Historical Study Centre will be a centre with the purpose of providing social services for extramural education. The centre will organize an exhibition on the history of Ayutthaya on the basis of historical facts. The centre is, therefore, required to organize data collecting and research activities in preparation for the exhibition and its possible changes in the future.

Thus, the Centre will fulfill its basic role for social education, through its function as a historical information centre and its capacity to provide support for research activities on the history of Ayutthaya.

2. Thematic Exhibition From the academic point of view, the thematic exhibition should clearly show a comprehensive picture of the Ayutthaya period and some of its continual features up to the present time as in the following topics:

- 1) Ayutthaya as a Port City It is due to the fact that foreigners who came to contact Thailand during the Ayutthaya period perceived Ayutthaya as such.

Phaiyath

W. Jm

a) Details of Exhibition

The presentation of relations between Ayutthaya and foreign countries in Asia including China, Japan, and the Moors, the neighboring countries such as Burma, Laos, Khmer, Vietnam and Malaysia, as well as the European countries who travelled to Ayutthaya, namely Portugal, Holland, Great Britain and France.

b) Materials for Exhibition

There will be a city plan of Ayutthaya, old maps, trade items such as silver coins, models of different kinds of ships, pottery and jugs. These items can be studied at the National Museum, in private museums and collections, and in various libraries such as the National Library, the Siam Society Library etc.

- 2) Ayutthaya as a Centralised State Ayutthaya was not only a port city and an old capital of Siam but also a state with special features. Ayutthaya held a centralised power and administration systems dominating the entire country.

a) Details of Exhibition

This theme can be divided into some topics as follows:

Pre-Ayutthaya States

These includes Lopburi, Nakhon Prathom, Sukhothai, Chiang Mai and other muangs.

Kingship, Nobility, Religions

All the above establishments played important parts in the development of Ayutthaya culture as a great tradition.

Bureaucratic System

This consists of the central and provincial administration and the status system.

Warfare in the Ayutthaya Period

The organization of an exhibition of important wars of the period is planned.

H. M

Phai

b) Materials for Exhibition

The exhibition will consist of maps, aerial photographs, objects and pictures of royalty, nobles and religious articles, such as models of the Royal Palace, throne hall, utensils, Buddha images and paintings. There will be charts of the bureaucratic system, historical documents such as the Ayutthaya code of law and various kinds of weapons.

- 3) Life of Ayutthaya: Society and Culture This part is to show the various ways of life in the Ayutthaya period. It also includes artifacts and pictures showing the life of the people in the Ayutthaya area in various periods up to the present.

a) Details of Exhibition

This can be sub-titled as follows:

City and Village Life

To show settlements of local people, foreign settlements, industrial sections, market, farming village along riverlines and canals, etc.

Ritual and Festival

An exhibition of rituals and festivals seen as a little tradition, which were held during the Ayutthaya period, such as spirit cults and boat races, Buddhist festivals, e.g. "Thet Mahachat", "Songkarn". There will be musical instruments and popular games.

Literacy and Literature

An exhibition on Ayutthaya literature, historical documents, "Khoi" manuscripts, " Bai Lan" manuscripts

b) Materials for Exhibition

Set up models showing both city and village life and models of different types of houses; farming tools, cooking utensils, cookpots, jugs, baskets, fishing equipments; ox-carts, boats for use in rivers and canals, and music instruments.

*Phaicill*



- 4) Exhibition of large-scale model of Ayutthaya This large model will be a major symbolic object, rather independent of the individual exhibitions mentioned above, but firmly connected with each theme. It will show geographical details of the Ayutthaya area, consisting of natural environment such as the rivers, canals, and cultural aspects of the inhabitants including local and foreign settlements, community life, monasteries, commercial areas, toll gates, and inland trade.

The function, role and organization of the exhibition at the Ayutthaya Historical Study Centre, as stated above, will have a special feature, different from other educational institutions, by providing social services and facilities for extramural education. The exhibition at the centre will help bring about understanding, in a concrete form, of the history of Ayutthaya for the general public. Because this exhibition is to be planned and organized on the basis of wide range data collecting activities, the centre will become an information centre focusing on the history of Ayutthaya. Together with this function, it will also provide support for in-depth and broad research on Ayutthaya history in cooperation with other academic institutions.

The academic specialists are firmly confident that this historical study centre will be not only extremely beneficial and useful to the Thai society, but also will set up an example in establishing educational and academic institutions with similar functions and organizations in other regions of Thailand.

3. 第一次基本設計調査

MINUTES OF DISCUSSIONS  
ON  
THE BASIC DESIGN STUDY  
OF  
THE PROJECT FOR CONSTRUCTING THE AYUTTHAYA HISTORICAL STUDY CENTRE  
IN  
THE KINGDOM OF THAILAND

In response to the request of the Government of the Kingdom of Thailand for Grant Aid for the Project for Constructing the Ayutthaya Historical Study Centre (hereinafter referred to as "the Project"), the Government of Japan decided to conduct a basic design study on the Project and entrusted the Japan International Cooperation Agency (JICA) to send the Basic Design Study Team headed by Mr. Yoshitaka Hanada, Deputy Director, Grant Aid Division, Ministry of Foreign Affairs of Japan from March 25 to May 31, 1957.

The study team had a series of discussions on the Project with officials and scholars concerned of the Government of the Kingdom of Thailand headed by Prof. Dr. Phaisith Phipatanakul, Permanent Legal Advisor, Ministry of Interior and conducted the site survey

As the result of the study both parties agreed to recommend to their respective governments that the major points of understanding reached between them, attached herewith, should be examined towards the realization of the Project.

Bangkok, April 1957

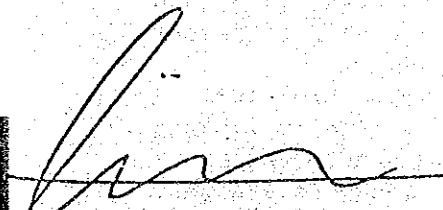

Yoshitaka Hanada  
Leader, Basic Design  
Study Team,  
JICA

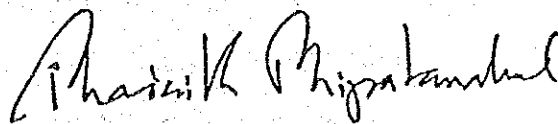

Prof. Dr. Phaisith Phipatanakul  
Permanent Legal Advisor of  
Ministry of Interior

## ATTACHMENT

1. The Basic Design Study Team (the Team) will make an appropriate basic design on the Project until the end of August, 1987.
2. With regard to the plan for improvement of the old Japanese Village the Team will make a basic design (conceptual design) with its scale of 1/500 and its layout plan in order to have harmonious contents with the Ayutthaya Historical Study Centre (the Centre) borne by the Government of Japan in the grant aid form.
3. It was confirmed by both parties that the detailed design and the site works (clearing, reclamation, and land filling) should be completed by the Thai side at latest by December, 1987.
4. The Task Force of the Ayutthaya Historical Study Centre made an explanation that they had already started collecting the fund for the plan and thirty million yen has been so far collected and the final result of the first fund-raising would come out at the end of April, 1987.
5. The Task Force confirmed to the Team that the Thai academic committee gives instructions and advices during the period of the basic design study to the Team on display from the academic point of view. The Thai academic committee is composed of the following members:

Dr. Chathip NARTSUPHA	Associate Professor Chulalongkorn University
Dr. Dhida SARAYA	Associate Professor Chulalongkorn University
Mr. Srisakra VALLIBHOTANA	Associate Professor Silpakorn University
Dr. Charnvit KASETSIRI	Lecturer Thammasat University
Mrs. Sumalee SUWANASAENG	Lecturer Ayutthaya Teachers' College
Miss Kuakun YUENYONGANANT	Lecturer Ayutthaya Teachers' College
Mr. Piset CHIACHANPONG	Archaeological Division Dept. of Fine Arts
Mrs. Plubplung KONGCHANA	Assistant Professor Srinakharinwirot University

It was also confirmed that the Thai architects give advices on architectural works to the Team.

6. Activities of collecting and identifying materials for the exhibition should be conducted exclusively under the supervision of the Thai Academic Committee, and the draft final report of the study also be approved by the Task Force around August, 1987.

7. The Centre will consist of the facilities agreed upon in the following.

- 1. EXHIBITION HALL (including entrance lobby) ca 900 m2
  - 2. STORAGE (including loading area) ca 300 m2
  - 3. LECTURE HALL, STUDY LIBRARY (multi-purpose hall) ca 150 m2
  - 4. ADMINISTRATION (including director's room) ca 100 m2
  - 5. MECHANICAL ca 70 m2
  - 6. TOILET, OTHERS ca 180 m2
- TOTAL FLOOR AREA : ca 1700 M2

8. The major equipment agreed upon will be in the following.

- 1. VIDEO SYSTEM
- 2. SLIDE PROJECTOR
- 3. COPY MACHINE
- 4. CAMERA
- 5. OTHERS

9. It is stressed by the Task Force that in order to complete the exhibition, some research work including collection of data and specimens would be necessary. In this connection the Task Force informed the Team that the Thai academic committee could play the major role in carrying out the preliminary research for the basic design, which will cost approximately 270,000 Baht.

10. The Task Force and the Team made a close examination of the basic plan of the exhibition, which was previously agreed upon at the time of the second Preliminary Study. As a result, the both sides agreed that the exhibition is to be made under the four themes i.e. Introduction: Ayutthaya as a capital, Ayutthaya as a port city, Ayutthaya as a centralised state, Life of Ayutthaya: society and culture, as shown in the Appendix I.

11. The Team proposed a schedule for the basic design and a tentative implementation schedule to the Task Force. The Task Force is fully aware of it and is ready to take necessary measures. They are shown in Appendix II.

12. The Task Force confirmed to the Team that the Thai side will take necessary measures in Appendix III on the condition that the Grant Aid would be extended to the Project.

13. The Task Force requested the Team that construction materials available in Thailand should be used for the Project as much as possible at the implementation stage.

14. The Task force strongly requested the Team that after the completion of the Project, technical cooperation (dispatch of the Japanese experts, receiving the trainees and research personnels etc.) should be continued for at least five years in order that the Centre will function effectively.

*Handwritten signature*

*Handwritten signature*

## Appendix I

Outline of the Exhibition at the Ayutthaya Historical Study CentreI. Introduction : Ayutthaya as a Capital

- 1) Large-scale Model
  - Royal Palace (Wat Phra Srisanphet)
  - Wat Mahathat
  - Front Palace
  - Back Palace
  - Wat Phukhao Thong
  - Wat Yai Chai Wattharanam
  - Phanaet Khrong Chang
  - Wat Phanan Choeng
  - Toll gates (Khanon)

II. Ayutthaya as a Port City

- 1) Trade of Ayutthaya
  - a. Trade routes (maritime and land)
    - Foreign documents
    - Official letters from governments
    - Various routes maps
  - b. Trade item
    - Coins
    - Ceramics
    - Weapons
    - Forest products, etc.
  - c. Models of ships
    - The wrecked ship at Chonburi
  - d. Diplomatic relations
    - Mural paintings
- 2) The port of Ayutthaya
  - a. Port area
    - Fortress
    - Market place
    - Custom office
    - Warehouse, etc.
  - b. Foreign communities
    - Paintings of foreigners (showing their costume and daily life)
    - Foreign peoples appeared in the Ayutthaya's bureaucratic system
    - Historical documents (eg. three Seals Law, Japanese documents)
    - Materials on the foreign communities (Dutch, French, Moor, Chinese....)

- Japanese settlements  
(Route map showing the trade routes: Japan-Okinawa-Ayutthaya)
- Deer-skinned armour (photo), the head of Kannon Buddha image

### III. Ayutthaya as a centralized states

Major symbols (replica): Royal Throne hall (inside)  
or Indra Phisek ritual

#### 1) Pre-Ayutthaya States

- Nakhon Pathom (Aerial photos)
- Sukhothai (Aerial photos)
- Lopburi (Aerial photos)
- Chiang Mai (Aerial photos)
- Nakhon Sri Thammarat (Aerial photos)
- Suphanburi (Aerial photos)
- Haripunchai (Aerial photos)
- Vientiane (Aerial photos)
- Chedi Boromathat, Nakhon Sri Thammarat (Photos)
- Wat Haripunchai, Lamphun (Photos)
- Chedi Khukham, Chiang Mai (Photos)
- Phrathat Phanom, Vientiane (Photos)
- Wat Mahathat, Sukhothai (Photos)
- Wat Mahathat, Lopburi (Photos)
- Maps and charts showing the distribution and development of Pre-Ayutthaya States
- King Uthong and the foundation of Ayutthaya (Non Sano & Wat Phutthai Sawan)

#### 2) Kingship and Religion

- Indra Phisek ritual (replica)
- Royal Throne Hall (outside) : Model
- Rituals presented by King to Phra Phutthabat
- Procession of the King to Phraphutthabat in Saraburi
- Royal Patriarch preaching (Mural painting in ch. Nan)
- Royal barge (painting)
- to refer to the style of Bot during King Songtham-Rama 5
- Oath taking ritual (painting with sound)

#### 3) SAKDINA (bureaucratic) System

- Chart showing the system centered by the King, Sangha and bureaucracy
- Models showing the relationship between the State (Government) and Peasants (village)
- Tatoo for Taxation
- Royal Store House (Lopburi)
- Hierarchy of Provinces (Muang Luang, Muang Luk Luang)

- 6
- State-village relationship (tribute & conscription of labor, constructing canals, making tribute to the king (painting))
  - "Three Seals of Law"
  - pictures are available in the works of de la Loubere, Hunchinson etc.

#### IV. Life of Ayutthaya: Society and Culture

##### 1) Life of Ayutthaya Major symbols

- a. Reconstruction of village (riverline village) models of various types of houses (Simple or complex and different types of walls)
- b. Reconstruction of peasant life in a house.
  - Buddhist rituals
  - praying (with sound)
  - musical instruments
  - healing (folk medicine)
  - peasants' travelling
  - rice planting
  - village manufacture (weaving, basketting black-smithing)
  - eating
  - clothing
  - child-rearing
  - periodical market

##### 2) Ritual & Festival

- Buddhist rituals: Cabinets and cases of Tripitaka, Preaching pavillion
- Spirit worship: shrine of spirits and sanphraphum
- healing
- playing and games: shadow play (nang-Yai), kite and cock fight

##### 3) Others

- literature: Khoi and Bai Lan manuscripts



The schedule of E/N is not fixed. According to its schedule, the others shall be rearranged.

	Mar.	Apr.	1987 Aug.	Sep.	Dec.	1988 Jan. Feb. Mar.	Sep. Dec.	1989 Mar.
Basic Design Study								
Construction Work				Exchange of Note				
Display Work				Detailed Design Tendering		Construction		
				Collecting Specimens				
				Detailed Design				
				Producing models, graphic etc.				Display Works

*Handwritten initials/signature*

*Handwritten signature*

8.

Appendix III

Major Undertakings to be taken by the Thai Side

1. To secure the site for the Project
2. To clear, level, reclaim and land fill the site prior to commencement of the construction
3. To construct the embankment and a jetty
4. To pave or improve the access road to the site
5. To provide facilities for distribution of electricity, telephone and other incidental facilities to the Project site
  - 1) Electricity distributing line to the site
  - 2) Telephone trunk line to the main distribution panel of the Center
6. To bear commissions to the Japanese foreign exchange bank for the banking services based upon the Banking Arrangement
7. To exempt taxes and to take necessary measures for customs clearance of the materials and equipment brought for the Project at the port of disembarkation
8. To accord Japanese nationals whose services may be required in connection with the supply of the products and the services under the verified contract such facilities as may be necessary for their entry into recipient country and stay therein for the performance of their work
9. To maintain and use properly and effectively that the facilities constructed and equipment and display works purchased under the Grant
10. To bear all the expenses other than those to be borne by the Grant, necessary for construction of the facilities as well

4. 第二次基本設計調査

MINUTES OF DISCUSSIONS  
ON  
THE BASIC DESIGN STUDY  
OF  
THE PROJECT FOR CONSTRUCTING THE AYUTTHAYA  
HISTORICAL STUDY CENTRE  
IN  
THE KINGDOM OF THAILAND

In response to the request of the Government of the Kingdom of Thailand for Grant Aid for the Project for constructing the Ayutthaya Historical Study Centre (hereinafter referred to as "the Project"), the Government of Japan decided to conduct a basic design study on the Project and entrusted the study to the Japan International Cooperation Agency (JICA). JICA sent the second basic design study team headed by Mr. Toshio NAKAMURA, Deputy Head, Second Basic Design Study Division, JICA, from July 2 to July 11, 1987.

The team had series of discussions on the Project with officials and scholars concerned of the Government of the Kingdom of Thailand headed by Prof. Dr. Phaisith Phipatanakul, Permanent Legal Advisor, Ministry of Interior.

As the result of the discussions both parties agreed to recommend to their respective governments that the major points of understandings reached between them, attached herewith, should be examined toward the realization of the Project.

Bangkok, July 7, 1987

中村 俊男

Mr. Toshio NAKAMURA  
Leader, Second Basic  
Design Team,  
JICA

Phaisith Phipatanakul

Prof. Dr. Phaisith Phipatanakul  
Permanent Legal Advisor of  
Ministry of Interior

2

ATTACHMENT

I. Implementation, and operation and maintenance for the Project.  
Task Force informed to the team the implementation and operation and maintenance system for the Project as follows:

1. The Office of the Ayutthaya Provincial Governor (Ministry of Interior) is to take charge of the implementation of the Project under the control of the Ayutthaya Provincial Governor.

2. The Executive Board is to be composed of the Ayutthaya Provincial Governor as a chairman, officials of the Ayutthaya Provincial Authority, officials of Department of Fine Arts, members of the Academic Committee, and members of Thai-Japanese Association.

The Executive Board is to take the responsibilities of the maintenance and operation for the Centre and such facilities as canteen, pier and others.

The timing of setting up of the Executive Board is to be fixed as soon as possible by the Ayutthaya Provincial Governor.

3. Annual budget to run the Centre will be covered by the admission fee, earnings from the other facilities, the annual allocation of the budget from the Ayutthaya Provincial Authority, and some contribution from Thai-Japanese Association.

Thai side estimates monthly 10,000 persons will visit to the Centre and the admission fee for one person will be 10 bahts.

4. The supporting fund for the Centre will be formed in order to promote the academic study in the Centre by using the balance of the annual operation and maintenance cost for the Centre.

5. Six or seven staff belonging to the Ayutthaya Provincial Authority will be assigned for the Centre at its opening.

II. Outline of the layout plan of the Centre for the basic design and the basic plan for improvement of the Old Japanese Village.

1. It is confirmed by both parties that the final draft of the basic design for the Centre and the basic plan for improvement of the Old Japanese Village is to be developed on the basis of the plan shown in Appendix I in conformity with the Minutes of Discussions signed so far.

2. Task Force requested that the team will examine the possibility to be incorporated the canteen and museum shop into the Centre, since they are the essential facilities for the Centre.

### III. Outline of the exhibition for the Centre.

It is confirmed by both parties that the final draft of the basic design of the exhibition is to be developed on the basis of the basic concept shown in Appendix 2 in conformity with the Minutes of Discussions signed so far.

### IV. Technical Cooperation

It is confirmed by both parties that the adequate technical cooperation by Japanese side should be extended so as to promote and continue the study activities of the Academic Committee as well as to function the Centre effectively.

*Prakash*

THE BASIC PLAN FOR THE ENTRE & IMPROVEMENT PLAN OF THE OLD JAPANESE VILLAGE

APPENDICS 1

D-1

1ST FL PLAN

S. 1/400



CHAO PHRAYA RIVER

PIER

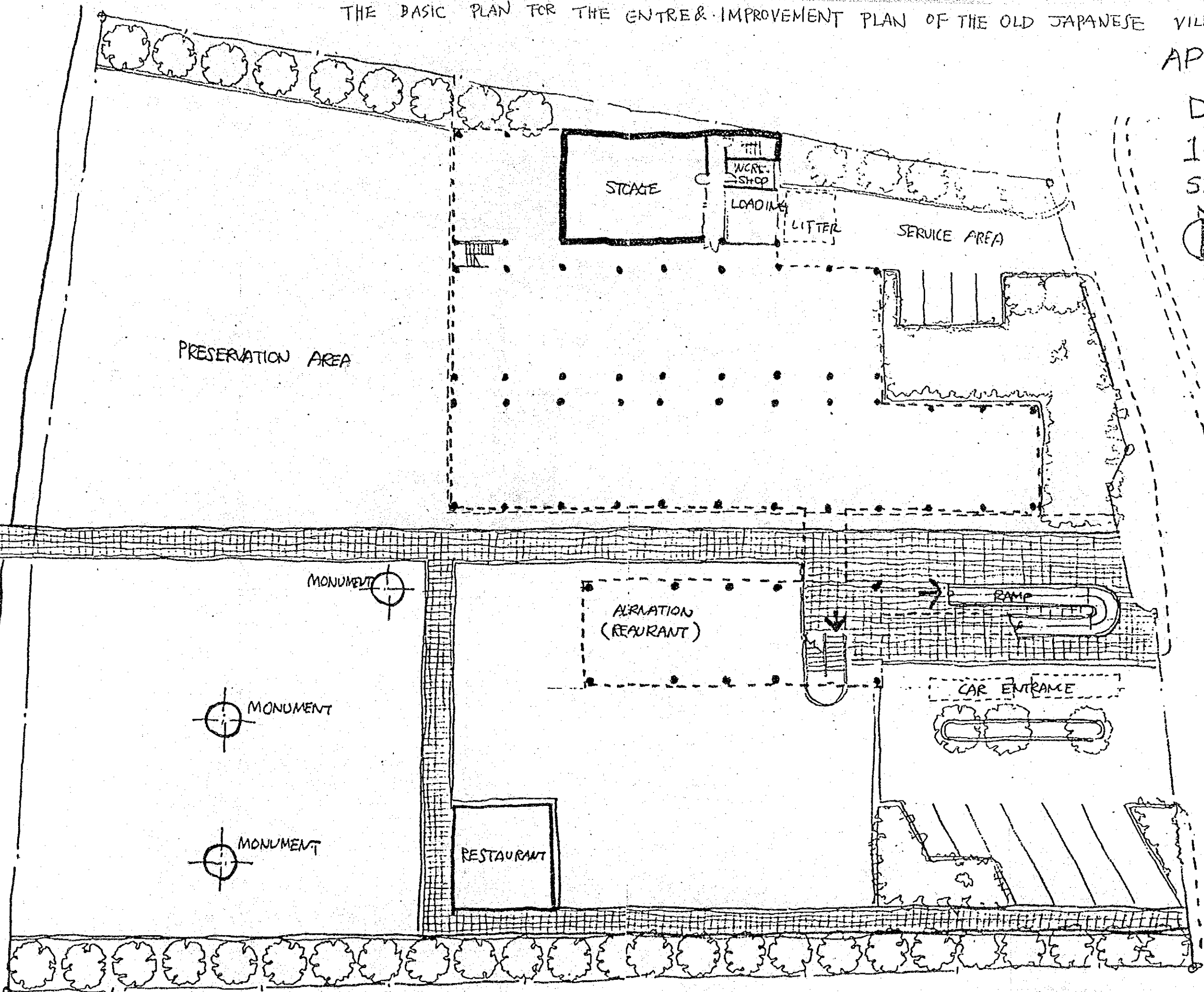

*Handwritten signature or initials.*

D-1  
2ND FL PLAN

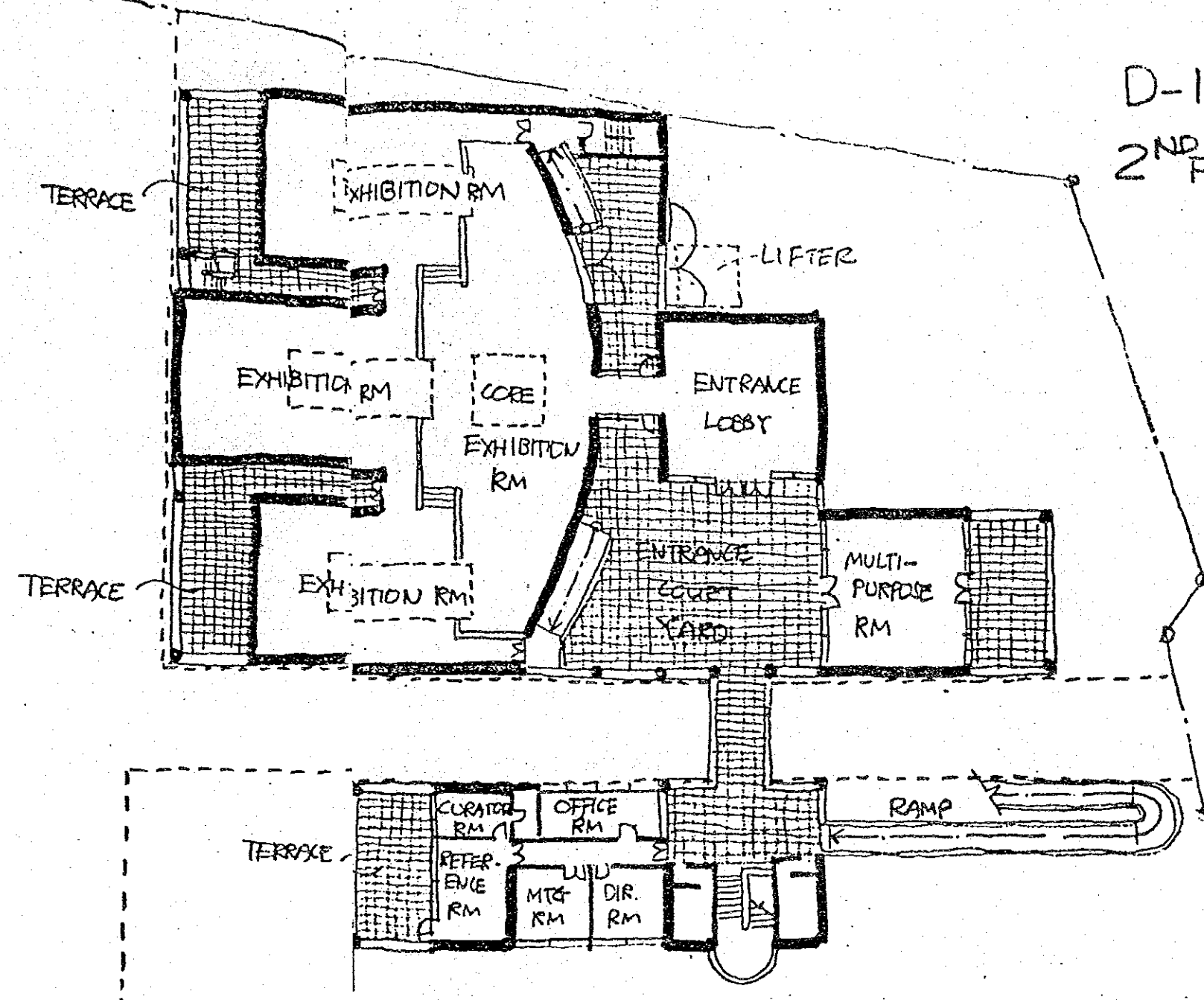

*Handwritten signature*  
 12





## APPENDIX II

### CONTENTS OF EXHIBITION

#### Theme I Ayutthaya as a capital

- i. Ayutthaya
- ii. Royal Palace
- iii. Wat Chai Watthanaram
- iv. Wat Na Phra Men
- v. Elephant Kraal
- vi. Wat Maha That
- vii. Wat Yai Chai Mongkhon

#### Theme II Ayutthaya as a port city

- i. Ayutthaya as an international port
- ii. The portrait of Ayutthaya port
- iii. Trade through Ayutthaya
- iv. The relation with foreigners
  - ⊗ Trade relation
  - ⊗ The military
  - ⊗ Diplomats
  - ⊗ Conflict
  - ⊗ Western technology

*Prasit J*

### Theme III Ayutthaya as a centralized state

- i. Indraphisek
- ii. Pre-Ayutthaya States
- iii. Kingship and bureaucracy
  - .Symbol of kingship and provincial control of the kingdom
  - .Oath taking ritual
  - .Procession of royal barge
  - .Conflict and resistance towards king's power
  - .Administration of phrai
- iv. State and Society: Social integration
  - .Idea of Traiphum among the townspeople
  - .Ten incarnation of Buddha
  - .Procession of the king to Phraputthabat at Saraburi

### Theme IV Village life of Ayutthaya

- i. Peasant community life
- ii. Life cycle 1
  - .Birth
  - .Childhood
  - .Coming of age
  - .Marriage
- iii. Inside the house
- iv. Cultivation
- v. Calamities
- vi. Life cycle 2
  - .Tetmahachat
  - .Entertainment
  - .Healing
  - .Death and after death

Phairith

8

PARTICIPANT LIST

(THAI SIDE)

- TASK FORCE -

- |                               |   |
|-------------------------------|---|
| 1. DR.PHAISITH PHIPATANAKUL   | PARMAMENT LEGAL ADVISOR<br>MINISTRY OF INTERIOR |
| 2. MR.MANAS LEEVIRAPHAN       | INSPECTOR - GENERAL<br>MINISTRY OF FINANCE      |
| 3. DR.DHIDA SARAYA            | ACADEMIC COMMITTEE MEMBER                       |
| 4. PROF.SRISAKRA VALLIBHOTAMA | - DITTO -                                       |
| 5. PROF.PLUBLUNG KONGCHANA    | - DITTO -                                       |
| 6. MR.JUNJRO NISHEYO          | THAI & JAPANESES ASSOCIATION                    |
| 7. MR.PRASIT LULITANON        | - DITTO -                                       |

- THAI ACADEMIC COMMITTEE -

- |                             |   |
|-----------------------------|---|
| 1. DR.CHATTHIP NARTHSUPA    | ASSOCIATE PROFESSOR<br>CHULALONGKORN UNIVERSITY                                     |
| 2. DR.DHIDA SARAYA          | ASSOCIATE PROFESSOR<br>CHULALONGKORN UNIVERSITY                                     |
| 3. MR.SRISAKRA VALLIBHOTAMA | ASSOCIATE PROFESSOR<br>SILPAKORN UNIVERSITY   |
| 4. MRS.SUMALEE SUVANSANG    | LECTURER<br>AYUTTHAYA 'TEACHERS' COLLEGE  |
| 5. MR.PISET JIAJUNPHONG     | HEAD OF ADMINISTRATIVE SECTION<br>DIVISION OF ARCHEOLOGY DEPARTMENT<br>OF FINE ARTS |
| 6. MRS.PLUEPLUNG KONGCHANA  | ASSISTANT PROFESSOR<br>SRINAKHARINWIROT UNIVERSITY                                  |
| 7. DR.LAE DILOKVIHYARAT     | ASSOCIATE PROFESSOR<br>CHULALONGKORN UNIVERSITY                                     |

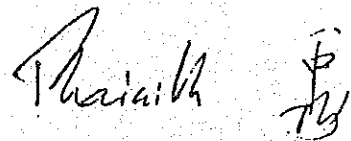

- THAI ARCHITECT -

1. MR. PICHAI VASNASONG

ARCHITECT SENATOR

- AYUTTHAYA PROVINCE -

1. MR. CHAIWAT HUTACHAROEN

GOVERNOR

2. MR. VICHEAN SUVATHIHEE

VICE GOV.

3. MR. BUNTAO SUKSATIT

DEPERTY GOV.

4. MR. CHAIYASIT SINSOMBOONHONG

CHIEF OF GOVERNOR'S OFFICE

5. MR. THONGCHAI SEHARAJNIWES

SECRETARY OF THE PROVINCE

6. MR. BAMRONG HEMAWANKUL

CHIEF OF FINANCE DIVISION

7. MR. YONGYUTTH GAWGAMOL

ACTING CHEIF OF PUBLIC WORKS DIVISION

8. MR. ANUPAHH NIRKROTHA

CHIEF OF ADMINISTRATION SECTION

*Chaiyath* 

( JAPANESE SIDE )

- MEMBERS OF MISSION -

- |                         |  |
|-------------------------|--|
| 1. MR. TOSHIO NAKAMURA  | LEADER DEPUTY HEAD<br>SECOND BASIC DESIGN DIVISION<br>GRANT AID PLANNING & SURVEY<br>DEPARTMENT JICA |
| 2. DR. YONEO ISHII      | PROFESSOR<br>DIRECTOR OF CENTRE FOR<br>SOUTH EAST ASIA STUDIES<br>KYOTO UNIVERSITY                   |
| 3. DR. SHIGEHARU TANABE | ASSISTANT PROFESSOR<br>NATIONAL MUSEUM OF ETHNOLOGY  |
| 4. MR. HIDEHARU HISANO  | PROJECT ARCHITECT<br>NIKKEN SEKKEI LTD.  |
| 5. MR. AKIHIKO HAMADA   | ARCHITECT<br>NIKKEN SEKKEI LTD   |
| 6. MR. HIROSHI TOYODA   | DISPLAY PROJECT MANAGER<br>NOMURA DISPLAY CO., LTD.  |
| 7. MR. SHINICHI AIHARA  | DISPLAY PLANNER<br>NOMURA DISPLAY CO., LTD.  |
| 8. MR. HIROYUKI TAKANO  | DISPLAY ART DIRECTOR<br>NOMURA DISPLAY CO., LTD.   |
| 9. MISS. TERUMI IIKURA  | ASSISTANT DISPLAY ENGINEER<br>NOMURA DISPLAY CO., LTD.   |

*Phairath*

*(Signature)*

- EMBASSY OF JAPAN -

1. MR. TAKEHIRO YAMAGUCHI

SECOND SECRETARY  
EMBASSY OF JAPAN

- JICA BANGKOK -

1. MR. YOSHIFUSA SHIKAMA

OFFICER  
JICA BANGKOK

*Phaisith* (P)  
75