

Table 7.3 (2) Without the Short Term Development Plan (1990)

Ship Type by Commodity	Output Data		
	Ship Calls	Service Time (hour)	Waiting Time (hour)
(Cement)			
15,000 DWT	2	1,147	198
10,000	7	1,870	1,344
6,000	10	1,752	2,049
3,500	6	705	1,081
(Minerals & Others)			
5,000	17	2,076	2,005
(Logs & Lumber)			
3,000	36	4,406	6,964
(Minerals)			
1,000	12	959	1,740
(Other General Cargo)			
150	559	2,279	23,773
500	203	7,363	19,037

Table 7.3 (3) Without the Short Term Development Plan (1990)

Ship Type by Commodity	Output Data		
	Ship Calls	Service Time (hour)	Waiting Time (hour)
(Cement)			
15,000 DWT	3	619	155
10,000	6	1,058	266
6,000	9	1,105	408
3,500	8	729	153
(Minerals & Others)			
5,000	20	2,258	796
(Logs & Lumber)			
3,000	38	4,555	750
(Minerals)			
1,000	10	811	3
(Other General Cargo)			
150	560	1,344	719
500	208	4,674	206

Table 7.3 (4) Without the Short Term Development Plan (1990)

Ship Type by Commodity	Output Data		
	Ship Calls	Service Time (hour)	Waiting Time (hour)
(Cement)			
15,000 DWT	3	691	222
10,000	7	1,179	350
6,000	10	1,152	374
3,500	8	746	92
(Minerals & Others)			
5,000	23	2,435	882
(Logs & Lumber)			
3,000	41	4,868	831
(Minerals)			
1,000	12	965	8
(Other General Cargo)			
150	597	1,431	1,259
500	254	5,675	353

Appendix 7.4 Comments of PPA on the Relocation of the Affected Squatters



Republika ng Pilipinas
PANGASIWAAN NG DAUNGAN NG PILIPINAS
(PHILIPPINE PORTS AUTHORITY)
B. F. Condominium Bldg.
Aduana, Intramuros, Manila

TELEPHONE NOS. 47-92-04
40-81-66
48-24-93

26 July 1985

Mr. J. Kano
Leader
JICA Study Team for the Batangas
Port Development Study Project
The Japan International
Cooperation Agency

Dear Mr. Kano,

Based on our consultations with the City Government of Batangas, we are pleased to furnish you herewith a copy of the letter from the Mayor of Batangas City covering the squatter problem at Barangay Sta. Clara.

On the basis of the contents of said letter, it is believed that the JICA Study Team can now proceed with the formulation of a layout plan covering the squatter area at Barangay Sta. Clara for purposes of the RoRo/Passenger Terminal and Parking Lot under the Short-Term Development Plan for the Port of Batangas.

Very truly yours,

MAXIMO S. DUMLAOG, JR.
Officer-in-Charge

Encl/:a/s

RECEIVED
D

P. O. BOX
NO. 424

CABLE ADDRESS:
"PHPORTS" MANILA

TELEX (ITT) 40404
TX BX 0203



Republic of the Philippines
BATANGAS CITY
Office of the City Mayor

PHILIPPINE PORTS AUTHORITY

RECEIVED
JUL 27 1985
REGENT

Office of the General Manager

11 July 1985

Mr. Maximo S. Dumlao, Jr.
Officer-In-Charge
Philippine Ports Authority
B. F. Condominium Bldg.
Aduana, Intramuros, Manila

S i r :

Anent your communication dated June 20, 1985, inquiring about the possibility of relocating the squatters from the affected area in Barangay Sta. Clara, it is informed that the City Government had acquired a ten-hectare (10 has.) relocation site in Barangay San Jose-Sico as early as 1974 and subsequently had acquired and constructed an access road thereto.

We wish to inform you further of the City Government's willingness to relocate the affected squatters in due time.

With our warmest regards.

Very truly yours,

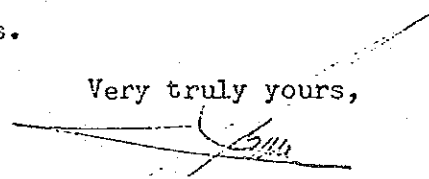
CONRADO C. BERBERABE
City Mayor

850144

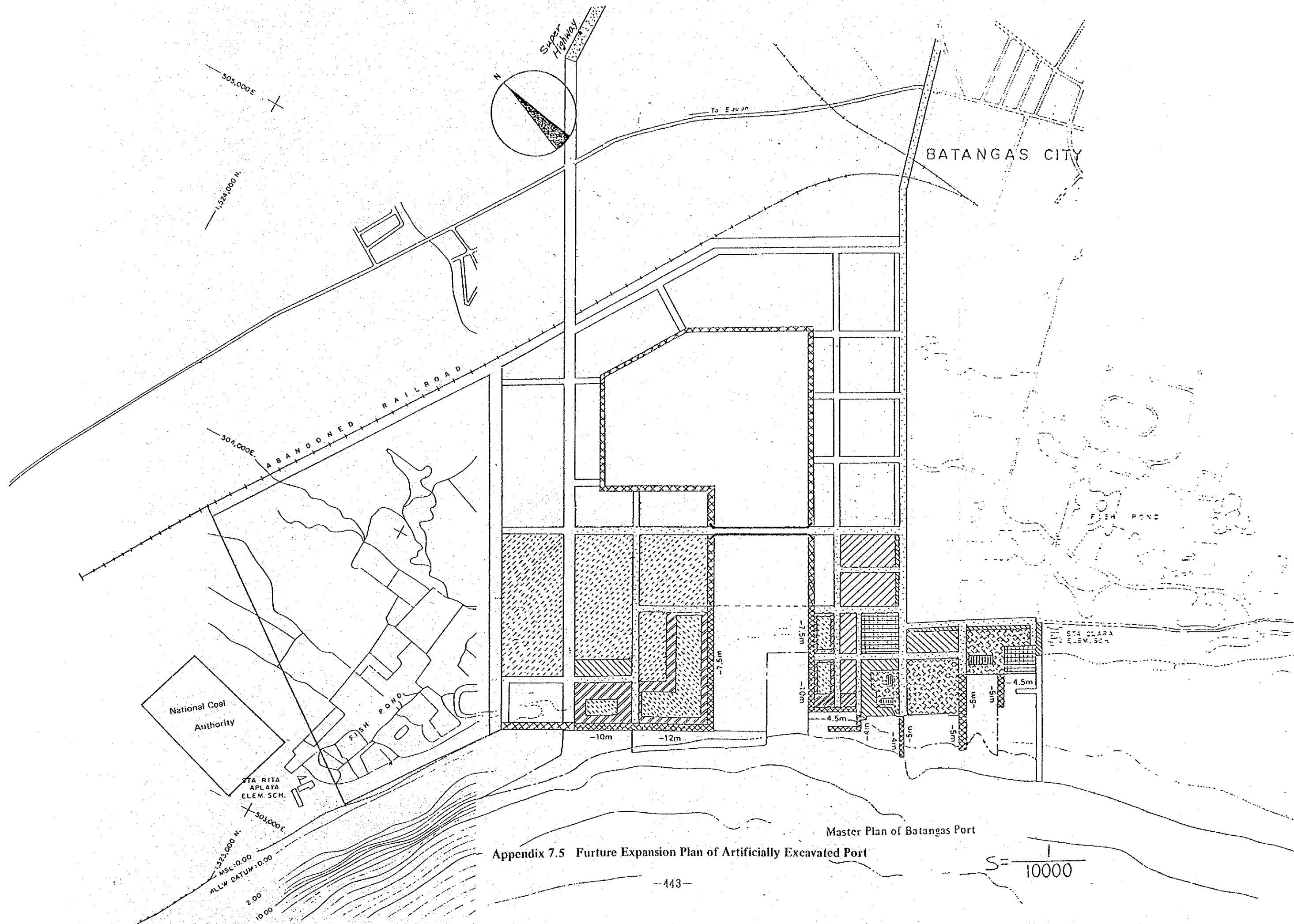

National Coal Authority

STA RITA APLAYA ELEM. SCH.

BATANGAS CITY

FISH POND

STA CLARA ELEM. SCH.

Master Plan of Batangas Port

Appendix 7.5 Future Expansion Plan of Artificially Excavated Port

S = 1/10000

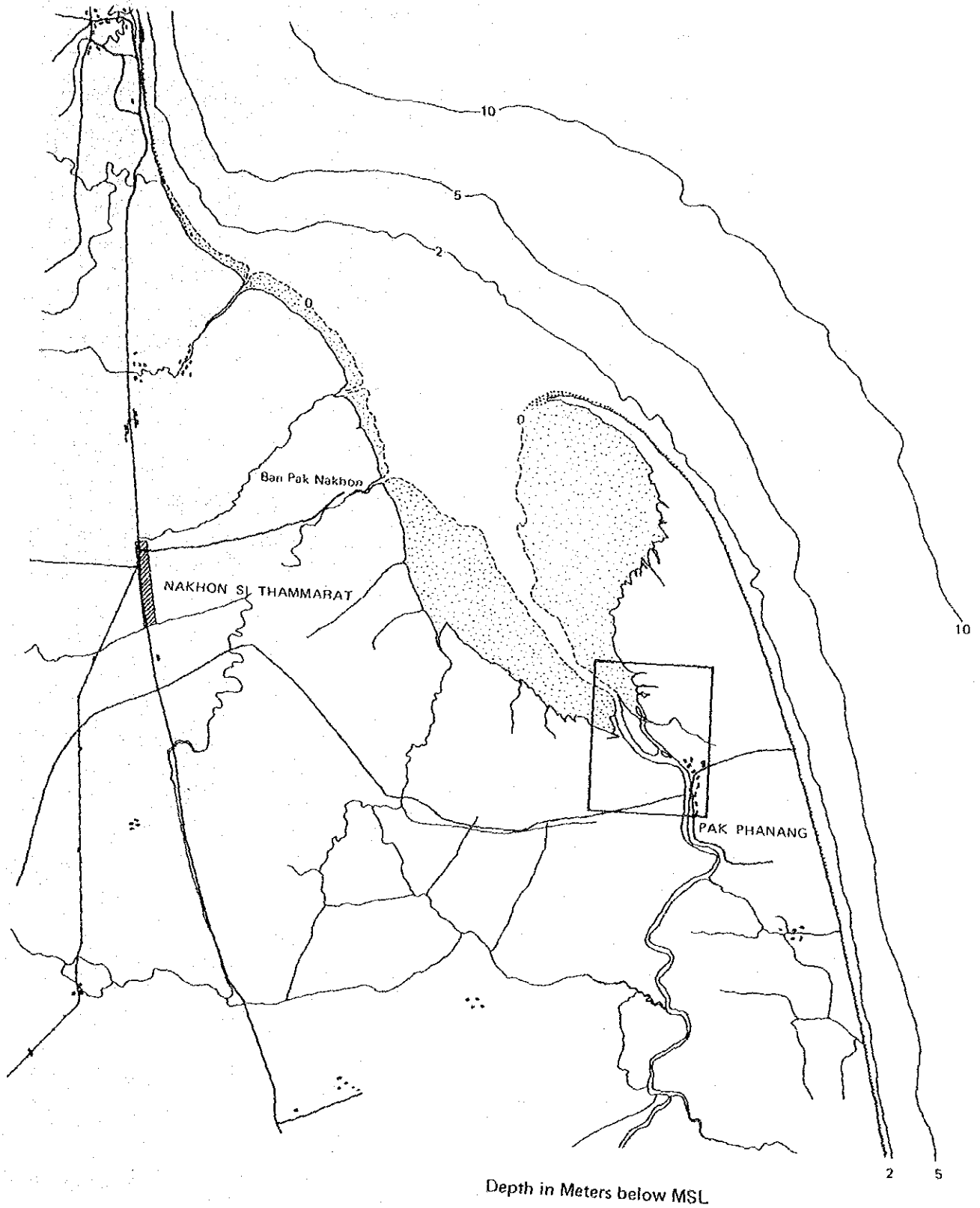

Appendix 7.6 Park Phanang

Appendix 8.2 (1) Detail Construction Cost

All costs are expressed in constant 1984, October (indicate year) prices.

In thousand units (\$1 = ₱19)

	Year 0	Year 1	Year 2	Year 3	Year 4
1. Civil Works					
a. Equipment/Machineries					
Foreign Exchange Costs	\$	8.3	8.3	926.3	315.3
Local Costs	₱	112	112	14,669	24,155
b. Materials/Supplies					
Foreign Exchange Costs	\$	10.3	10.3	3,798.0	1,743.7
Local Costs	₱	140	140	21,163	19,504
c. Labor Costs					
c1. Supervision & Consultancy Fees					
Foreign Exchange Costs	\$	84.6	84.6	56.4	56.4
Local Costs	₱	1,149	1,149	766	766
c2. Laborers					
Local Costs	₱			4,269	9,318

Appendix 8.2 (2)

In thousand units (\$1 = ₱19)

	Year 0	Year 1	Year 2	Year 3	Year 4
2. Machineries/Equipments (Cargo handling)					
Foreign Exchange Costs	\$				129.0
Local Costs	₱				10
3. Land Acquisition Costs	₱			645	
4. Other Investment Phase Costs (Specify)					
Foreign Exchange Costs	\$	10.2	10.2	473.1	222.2
Local Costs	₱	142	142	4,205	5,445
5. Total Costs (1 ~ 4)					
Total Foreign Exchange Costs	\$	113.4	113.4	5,253.8	2,466.6
Total Local Costs	₱	1,543	1,543	45,717	59,198
6. Subsidies					
What are the subsidized items?					

Prepared by : _____
 Telephone Number : _____
 Office Address : _____
 Date Prepared : _____

Appendix 9.3.2 Value Added per Ton

	Value Added Rate	Producer Price in Region IV	Value Added	
	(%)	(year) (P/ton)	(P)	Adjusted (P)
Palay	83	1,335 (1983)	1,108	
Rice	16	3,500 (1984)	560	
Palay and rice (average)			834	800
Copra	88	1,617 (1983)	1,422	1,400
Lumber	22	3,519 (1984)	774	
Plywood, veneer	53	3,662 (1984)	1,940	
Forest logging	84	1,963 (1984)	1,648	
Logs and wood Products (weighted average)			1,039	1,000
Cement	32	332 (1983)	106	100
Minerals	37	106 (1983)	39	30
Fertilizer	25	1,930 (1982)	482	480
Others (in)	1) 83%	1,602 (1983)	1,328	1,300
(out)	2) 62%	1,744 (1983)	1,081	1,000

1) 2) Made by study team referring to value added rate of each item.

Data Source: Value Added Rate: Input Output Joint Research Project of IDE & ESRA (1975)
 Producer Price in Region IV: BAECON, BOM, Phil. Year Book, FOB

Appendix 9.3.3

I.D.E. Statistical Data Series No. 41

INPUT-OUTPUT JOINT RESEARCH
PROJECT OF IDE and ESRA

INPUT-OUTPUT TABLE OF THE PHILIPPINES, 1975

March, 1983

INSTITUTE OF DEVELOPING ECONOMIES

Tokyo, Japan

(1,000 Pesos)

Input Sectors	Input Values at		Trade Margins	Input Values at Producers Prices		Input Coefficients at		
	Output Sectors	Purchaser's Prices		Producers Prices	Domestic	Imports	Purchasers Prices	Producers Prices
							Domestic	Imports
001 PADDY (Palay)								
001 PADDY	177,312	156,203	21,109	156,203	0	0.033170	0.029222	0.029222
018 O AGRS	102,725	98,641	4,084	98,564	77	0.019217	0.018453	0.018439
041 CORDGE	7,162	5,384	1,778	5,856	28	0.001340	0.001101	0.001096
044 OMUTEX	3,064	2,505	559	2,505	0	0.000573	0.000469	0.000469
045 LUMBER	439	390	49	390	0	0.000082	0.000073	0.000073
052 PRINTS	45	45	0	45	0	0.000008	0.000008	0.000008
060 FERTIL	359,203	288,794	70,409	155,476	133,318	0.067198	0.054026	0.029086
065 O CHEM	44,747	30,625	14,122	13,828	16,797	0.008371	0.005729	0.002587
066 PETROL	14,666	12,239	2,427	12,144	95	0.002744	0.002290	0.002272
073 HARDWR	327	219	108	219	0	0.000061	0.000041	0.000041
076 FABMET	2,918	2,551	367	2,551	0	0.000546	0.000477	0.000477
077 AGRMCH	11,305	10,161	1,144	4,276	5,885	0.002115	0.001901	0.000800
089 REPVCL	113	113	0	113	0	0.000021	0.000021	0.000021
092 O MANF	42,910	38,030	4,880	37,288	742	0.008027	0.007114	0.006976
097 CONSTR	12,317	12,317	0	12,317	0	0.002304	0.002304	0.002304
098 WS TRD	0	111,323	-111,323	111,323	0	0.000000	0.000026	0.000026
100 BANK	30,680	30,680	0	30,680	0	0.005739	0.005739	0.005739
101 N BANK	19,693	19,693	0	19,693	0	0.003684	0.003684	0.003684
104 RAIL T	0	536	-536	536	0	0.000000	0.000100	0.000100
104 RAIL T	0	536	-536	536	0	0.000000	0.000100	0.000100
105 OLANDT	76	4,021	-3,945	4,021	0	0.000014	0.000752	0.000752
106 WTR TR	0	4,050	-4,050	4,050	0	0.000000	0.000758	0.000758
107 AIR TR	962	1,359	-397	1,359	0	0.000180	0.000254	0.000254
108 TR SRV	0	285	-285	285	0	0.000000	0.000053	0.000053
109 WAREHS	208	208	0	208	0	0.000039	0.000039	0.000039
115 OBSSRV	59,741	59,741	0	59,741	0	0.011176	0.011176	0.011176
290 INTTTL	890,613	890,613	0	733,671	156,942	0.166611	0.166611	0.137251
301 WAGES	1,955,937	1,955,937	0	1,955,937	0	0.365905	0.365905	0.365905
302 DEPREC	152,149	152,149	0	152,149	0	0.028463	0.028463	0.028463
303 IND TAX	28,478	28,478	0	28,478	0	0.005327	0.005327	0.005327
304 OVA	2,318,300	2,318,300	0	2,318,300	0	0.433694	0.433694	0.433694
309 VA TTL	4,454,864	4,454,864	0	4,454,864	0	0.833389	0.833389	0.833389
600 CCT	5,345,477	5,345,477	0	5,345,477	0	1.000000	1.000000	1.000000
700 TI	5,345,477	5,345,477	0	5,168,535	156,942	1.000000	1.000000	0.970640

Input Sectors		Input Values at		Trade Margins	Input Values at Producers Prices		Input Coefficients at			
Output Sectors	Purchaser's Prices	Producers Prices	Domestic		Imports	Purchasers Prices	Producers Prices			
							Domestic	Imports		
003 BANANA (Bananas)										
003	BANANA	51,631	47,254	4,377	47,254	0	0.033471	0.030633	0.030633	0.000000
018	O AGRS	19,638	18,995	643	18,982	13	0.012731	0.012314	0.012305	0.000008
041	CORDE	10,323	8,549	1,774	8,519	30	0.006892	0.005542	0.005523	0.000019
045	LUMBER	1,661	1,485	178	1,485	0	0.001078	0.000963	0.000963	0.000000
048	O WOOD	953	768	185	768	0	0.000618	0.000498	0.000498	0.000000
050	PAPPRO	30,260	20,044	10,216	17,251	2,793	0.019617	0.012994	0.011183	0.001811
052	PRINTS	136	136	0	136	0	0.000088	0.000088	0.000088	0.000000
060	FERTIL	90,833	75,696	15,137	55,031	20,665	0.058884	0.049071	0.035675	0.013396
065	O CHEM	20,074	13,987	6,087	8,433	5,554	0.013013	0.009067	0.005467	0.003600
066	PETROL	7,434	6,181	1,253	6,145	36	0.004819	0.004007	0.003984	0.000023
073	HARDWR	97	65	32	65	0	0.000063	0.000042	0.000042	0.000000
076	FABMET	1,911	1,611	300	1,611	0	0.001239	0.001044	0.001044	0.000000
094	ELESUP	157	157	0	157	0	0.000102	0.000102	0.000102	0.000000
097	CONSTR	3,627	3,627	0	3,627	0	0.002351	0.002351	0.002351	0.000000
098	WS TRD	0	37,158	-37,158	37,158	0	0.000000	0.024088	0.024088	0.000000
100	BANK	6,164	6,164	0	6,164	0	0.003996	0.003996	0.003996	0.000000
101	N BANK	4,303	4,303	0	4,303	0	0.002789	0.002789	0.002789	0.000000
102	INSURA	454	454	0	454	0	0.000294	0.000294	0.000294	0.000000
103	REALES	527	527	0	527	0	0.000342	0.000342	0.000342	0.000000
104	RAIL T	0	145	-145	145	0	0.000000	0.000094	0.000094	0.000000
105	OLANDT	21	623	-602	623	0	0.000014	0.000404	0.000404	0.000000
106	WTR TR	0	2,231	-2,231	2,231	0	0.000000	0.001446	0.001446	0.000000
107	AIR TR	135	435	0	435	0	0.000282	0.000282	0.000282	0.000000
108	TR SRV	0	46	-46	46	0	0.000000	0.000039	0.000039	0.000000
109	WAREHS	225	225	0	225	0	0.000146	0.000146	0.000146	0.000000
110	COMMUN	50	50	0	50	0	0.000032	0.000032	0.000032	0.000000
112	MEDSRV	430	430	0	430	0	0.000279	0.000279	0.000279	0.000000
115	OBSSRV	10,326	10,326	0	10,326	0	0.006694	0.006694	0.006694	0.000000
290	INTTTL	261,672	261,672	0	232,581	29,091	0.169634	0.169634	0.150775	0.018859
301	WAGES	456,526	456,526	0	456,526	0	0.295951	0.295951	0.295951	0.000000
302	DEPREC	53,149	53,149	0	53,149	0	0.034455	0.034455	0.034455	0.000000
303	INDTAX	23,251	23,251	0	23,251	0	0.015073	0.015073	0.015073	0.000000
304	OVA	747,973	747,973	0	747,973	0	0.484887	0.484887	0.484887	0.000000
309	VA TTL	1,280,899	1,280,899	0	1,280,899	0	0.830366	0.830366	0.830366	0.000000
600	CCT	1,542,571	1,542,571	0	1,542,571	0	1.000000	1.000000	1.000000	0.000000
700	TI	1,542,571	1,542,571	0	1,513,488	29,091	1.000000	1.000000	0.981141	0.018859
005 O FRTS (Other fruits & nuts)										
005	O FRTS	33,884	31,341	2,543	31,320	21	0.036571	0.033827	0.033804	0.000023
018	O AGRS	987	940	47	939	1	0.001065	0.001015	0.001013	0.000001
041	CORDE	959	791	168	791	0	0.001035	0.000854	0.000854	0.000000
045	LUMBER	113	101	12	101	0	0.001122	0.001109	0.001109	0.000000
048	O WOOD	371	286	85	286	0	0.000400	0.000309	0.000309	0.000000
050	PAPPRO	15,090	9,468	5,622	8,629	839	0.016287	0.010219	0.009313	0.000906
052	PRINTS	52	52	0	52	0	0.000056	0.000056	0.000056	0.000000
060	FERTIL	29,361	23,091	6,270	13,541	9,550	0.031690	0.024922	0.014615	0.010307
064	SOAPS	44	20	24	20	0	0.000047	0.000022	0.000022	0.000000
065	O CHEM	21,854	15,008	6,846	10,522	4,486	0.023587	0.016198	0.011356	0.004842
066	PETROL	572	449	123	446	3	0.000617	0.000485	0.000481	0.000033
073	HARDWR	134	78	56	58	20	0.000145	0.000084	0.000063	0.000022
076	FABMET	739	641	98	641	0	0.000798	0.000632	0.000592	0.000000
077	AGRMCH	4,707	3,965	742	3,965	0	0.005080	0.004279	0.004279	0.000000
089	REPVL	19	19	0	19	0	0.000021	0.000021	0.000021	0.000000
092	O MANF	163	147	16	147	0	0.000176	0.000159	0.000159	0.000000
097	CONSTR	2,263	2,263	0	2,263	0	0.002442	0.002442	0.002442	0.000000
098	WS TRD	0	20,861	-20,861	20,861	0	0.000000	0.002515	0.002515	0.000000
100	BANK	857	857	0	857	0	0.000925	0.000925	0.000925	0.000000
101	N BANK	469	469	0	469	0	0.000506	0.000506	0.000506	0.000000
104	RAIL T	0	142	-142	142	0	0.000000	0.000153	0.000153	0.000000
105	OLANDT	7	441	-434	441	0	0.000008	0.000476	0.000476	0.000000
106	WTR TR	0	969	-969	969	0	0.000000	0.001046	0.001046	0.000000
107	AIR TR	43	117	-74	117	0	0.000046	0.000126	0.000126	0.000000
108	TR SRV	0	172	-172	172	0	0.000000	0.000186	0.000186	0.000000
115	OBSSRV	24	24	0	24	0	0.000026	0.000026	0.000026	0.000000
290	INTTTL	112,712	112,712	0	97,792	14,920	0.121651	0.121651	0.105548	0.016103
301	WAGES	198,920	198,920	0	198,920	0	0.214696	0.214696	0.214696	0.000000
302	DEPREC	26,019	26,019	0	26,019	0	0.028083	0.028083	0.028083	0.000000
303	INDTAX	4,869	4,869	0	4,869	0	0.005255	0.005255	0.005255	0.000000
304	OVA	583,998	583,998	0	583,998	0	0.630315	0.630315	0.630315	0.000000
309	VA TTL	813,806	813,806	0	813,806	0	0.878349	0.878349	0.878349	0.000000
600	CCT	926,518	926,518	0	926,518	0	1.000000	1.000000	1.000000	0.000000

Input Sectors		Input Values at		Trade Margins	Input Values at Producers Prices		Input Coefficients at			
Output Sectors	Purchasers Prices	Producers Prices	Domestic		Imports	Purchasers Prices	Producers Prices			
							Domestic	Imports		
006 VEGTBL (Vegetables)										
006	VEGTBL	54,140	49,381	4,759	48,474	907	0.034145	0.031143	0.000571	0.000572
018	O AGRS	4,151	1,011	110	4,005	6	0.022618	0.002530	0.002526	0.000001
041	CORDE	2,822	2,362	460	2,362	0	0.001780	0.001490	0.001490	0.000000
045	LUMBER	86	76	10	76	0	0.000334	0.000018	0.000048	0.000000
048	O WOOD	980	773	207	773	0	0.000818	0.000488	0.000188	0.000000
050	PAPPRO	1,381	792	589	773	321	0.000871	0.000499	0.000297	0.000202
052	PRINTS	14	14	0	14	0	0.000009	0.000009	0.000009	0.000000
060	FERTIL	79,053	66,134	12,919	35,489	30,685	0.049857	0.041709	0.002169	0.019740
065	O CHEM	18,848	14,023	4,825	5,317	8,706	0.011887	0.008844	0.003653	0.005491
066	PETROL	3,774	3,083	691	1,080	23	0.002380	0.001944	0.001930	0.000015
073	HARDWR	97	69	28	58	11	0.000061	0.000044	0.000037	0.000007
076	FABMET	1,284	1,101	180	1,101	0	0.000808	0.000624	0.000894	0.000000
077	AGRMCH	6,166	5,343	823	1,812	531	0.000889	0.003370	0.000655	0.000335
096	WATERS	60	60	0	60	0	0.000008	0.000038	0.000018	0.000000
097	CONSTR	3,907	3,907	0	3,907	0	0.002464	0.002464	0.002464	0.000000
098	WS TRD	0	23,653	-23,653	23,653	0	0.000000	0.014917	0.014917	0.000000
100	BANK	405	405	0	405	0	0.000255	0.000255	0.000255	0.000000
101	N BANK	859	859	0	859	0	0.000542	0.000542	0.000542	0.000000
104	RAIL T	0	248	-248	248	0	0.000000	0.000156	0.000156	0.000000
105	OLANDT	17	395	-378	395	0	0.000011	0.000249	0.000249	0.000000
106	WTR TR	0	1,154	-1,154	1,154	0	0.000000	0.000728	0.000728	0.000000
107	AIR TR	135	142	-7	142	0	0.000085	0.000090	0.000090	0.000000
108	TR SRV	0	191	-191	191	0	0.000000	0.000120	0.000120	0.000000
109	WAREHS	8	8	0	8	0	0.000005	0.000005	0.000005	0.000000
115	OBSSRV	213	213	0	213	0	0.000131	0.000134	0.000134	0.000000
290	INTTTL	178,397	178,397	0	137,227	41,170	0.112510	0.112510	0.086546	0.025965
301	WAGES	497,497	497,497	0	497,497	0	0.313758	0.313758	0.313758	0.000000
302	DEPREC	53,040	53,040	0	53,040	0	0.034451	0.034451	0.034451	0.000000
303	INDTAX	8,563	8,563	0	8,563	0	0.005400	0.005400	0.005400	0.000000
304	OVA	848,108	848,108	0	848,108	0	0.534880	0.534880	0.534880	0.000000
309	YA TTL	1,407,208	1,407,208	0	1,407,208	0	0.887490	0.887490	0.887490	0.000000
600	CCT	1,585,605	1,585,605	0	1,585,605	0	1.000000	1.000000	1.000000	0.000000
700	TI	1,585,605	1,585,605	0	1,544,435	41,170	1.000000	1.000000	0.974035	0.025965
009 SUGR C (Sugar cane)										
009	SUGR C	110,965	94,856	16,109	94,856	0	0.037181	0.031783	0.031783	0.000000
018	O AGRS	85,346	82,445	2,901	82,419	26	0.028597	0.027625	0.027616	0.000000
041	CORDE	742	616	126	616	0	0.000249	0.000206	0.000206	0.000000
044	OMUTEX	795	651	145	651	0	0.000267	0.000218	0.000218	0.000000
050	PAPPRO	1,041	853	188	853	0	0.000349	0.000286	0.000286	0.000000
052	PRINTS	193	193	0	193	0	0.000065	0.000065	0.000065	0.000000
060	FERTIL	341,171	303,314	37,857	174,994	128,320	0.114315	0.101630	0.058635	0.042996
065	O CHEM	52,626	36,133	16,493	13,469	22,564	0.017633	0.012107	0.004513	0.007594
066	PETROL	41,606	34,357	7,249	34,102	255	0.013941	0.011512	0.011476	0.000085
073	HARDWR	185	125	60	125	0	0.000062	0.000042	0.000042	0.000000
076	FABMET	3,652	3,068	584	3,068	0	0.001224	0.001028	0.001028	0.000000
077	AGRMCH	14,410	12,191	2,219	12,191	0	0.004828	0.004085	0.004085	0.000000
078	INDMCH	944	607	337	257	440	0.000303	0.000234	0.000086	0.000147
092	O MANF	1,223	1,081	142	839	242	0.000410	0.000362	0.000281	0.000081
097	CONSTR	6,929	6,929	0	6,929	0	0.002322	0.002322	0.002322	0.000000
098	WS TRD	0	77,712	-77,712	77,712	0	0.000000	0.026039	0.026039	0.000000
100	BANK	15,951	15,951	0	15,951	0	0.005345	0.005345	0.005345	0.000000
101	N BANK	9,767	9,767	0	9,767	0	0.003273	0.003273	0.003273	0.000000
104	RAIL T	0	365	-365	365	0	0.000000	0.000122	0.000122	0.000000
105	OLANDT	45	2,036	-1,991	2,036	0	0.000015	0.000682	0.000682	0.000000
106	WTR TR	0	3,041	-3,041	3,041	0	0.000000	0.001019	0.001019	0.000000
107	AIR TR	1,286	1,857	-571	1,857	0	0.000431	0.000622	0.000622	0.000000
108	TR SRV	0	600	-600	600	0	0.000000	0.000201	0.000201	0.000000
109	WAREHS	266	266	0	266	0	0.000089	0.000089	0.000089	0.000000
111	PROSRV	412	412	0	412	0	0.000178	0.000138	0.000138	0.000000
115	OBSSRV	28,391	28,391	0	28,391	0	0.009513	0.009513	0.009513	0.000000
290	INTTTL	717,907	717,907	0	565,960	151,947	0.240547	0.240547	0.189634	0.050912
301	WAGES	1,008,200	1,008,200	0	1,008,200	0	0.337814	0.337814	0.337814	0.000000
302	DEPREC	195,839	195,839	0	195,839	0	0.065619	0.065619	0.065619	0.000000
303	INDTAX	34,365	34,365	0	34,365	0	0.011515	0.011515	0.011515	0.000000
304	OVA	1,028,171	1,028,171	0	1,028,171	0	0.344506	0.344506	0.344506	0.000000
309	YA TTL	2,266,375	2,266,375	0	2,266,375	0	0.759453	0.759453	0.759453	0.000000
600	CCT	2,984,482	2,984,482	0	2,984,482	0	1.000000	1.000000	1.000000	0.000000
700	TI	2,984,482	2,984,482	0	2,832,535	151,947	1.000000	1.000000	0.949088	0.050912

(1,000 Pesos)

Input Sectors		Input Values at		Trade Margins	Input Values at Producers Prices		Input Coefficients at			
Output Sectors	Purchasers Prices	Producers Prices	Domestic		Imports	Purchasers Prices	Producers Prices			
							Domestic	Imports		
010 COCNUT (Coconut including copra in farm)										
010	COCNUT	229,230	206,476	22,754	206,476	0	0.066977	0.060329	0.060329	0.000000
018	O AGRS	20,970	20,343	627	20,327	16	0.006127	0.005944	0.005939	0.000005
021	FOREST	2,545	2,226	319	2,226	0	0.000744	0.000650	0.000650	0.000000
041	CORNGE	960	819	141	819	0	0.000280	0.000239	0.000239	0.000000
044	OMUTEX	1,028	863	165	863	0	0.000300	0.000252	0.000252	0.000000
045	LUMBER	684	615	69	615	0	0.000209	0.000180	0.000180	0.000000
048	O WOOD	1,057	869	188	869	0	0.000309	0.000254	0.000254	0.000000
052	PRINTS	64	64	0	64	0	0.000019	0.000019	0.000019	0.000000
057	B CHEM	10,886	9,401	1,482	2,351	7,053	0.003181	0.002748	0.003687	0.002561
060	FERTIL.	45,558	38,636	6,922	29,650	8,986	0.013311	0.011289	0.008653	0.002626
065	O CHEM	28,308	20,478	7,830	13,067	7,411	0.008271	0.005983	0.003818	0.002165
066	PETROL	6,803	5,758	1,045	5,718	40	0.001588	0.001682	0.001671	0.000012
073	HARDWR	237	166	71	166	0	0.000069	0.000049	0.000049	0.000000
076	FARMET	4,730	4,063	667	4,063	0	0.001382	0.001187	0.001187	0.000000
077	AGRMCH	2,525	2,365	160	1,016	1,349	0.000738	0.000691	0.000297	0.000394
089	REPVCL	19	19	0	19	0	0.000006	0.000006	0.000006	0.000000
097	CONSTR	8,975	8,975	0	8,975	0	0.002622	0.002622	0.002622	0.000000
098	WS TRD	0	39,061	- 39,061	39,061	0	0.000000	0.011413	0.011413	0.000000
100	BANK	16,237	16,237	0	16,237	0	0.004744	0.004744	0.004744	0.000000
101	N BANK	784	784	0	784	0	0.000229	0.000229	0.000229	0.000000
104	RAIL T	0	165	- 165	165	0	0.000000	0.000048	0.000048	0.000000
105	OLANDT	6	585	- 579	585	0	0.000002	0.000171	0.000171	0.000000
106	WTR TR	0	1,668	- 1,668	1,668	0	0.000000	0.000487	0.000487	0.000000
107	AIR TR	97	482	- 385	482	0	0.000028	0.000141	0.000141	0.000000
108	TR SRV	0	582	- 582	582	0	0.000000	0.000170	0.000170	0.000000
109	WAREHS	641	644	0	644	0	0.000188	0.000188	0.000188	0.000000
115	OBSSRV	555	555	0	555	0	0.000162	0.000162	0.000162	0.000000
290	INTTTL	382,902	382,902	0	358,047	24,855	0.111878	0.111878	0.104616	0.007262
301	WAGES	973,927	973,927	0	973,927	0	0.284566	0.284566	0.284566	0.000000
302	DEPREC	119,501	119,501	0	119,501	0	0.034916	0.034916	0.034916	0.000000
303	INDTAX	38,526	38,526	0	38,526	0	0.011257	0.011257	0.011257	0.000000
304	OVA	1,907,644	1,907,644	0	1,907,644	0	0.557383	0.557383	0.557383	0.000000
309	VA TTL	3,039,598	3,039,598	0	3,039,598	0	0.888122	0.888122	0.888122	0.000000
600	CCT	3,422,500	3,422,500	0	3,422,500	0	1.000000	1.000000	1.000000	0.000000
700	TI	3,422,500	3,422,500	0	3,397,645	24,855	1.000000	1.000000	0.992738	0.007262

Input Sectors		Input Values at		Trade Margins	Input Values at Producers Prices		Input Coefficients at		
Output Sectors	Purchasers Prices	Producers Prices	Domestic		Imports	Purchasers Prices	Producers Prices		
							Domestic	Imports	
021 FOREST (Forest & Logging)									
021	FOREST	23,978	21,704	2,274	21,608	98	0.006323	0.005723	0.005697
041	CORDGE	923	770	153	770	0	0.000243	0.000203	0.000203
044	OMUTEX	992	813	179	813	0	0.000262	0.000214	0.000214
045	LUMBER	4,700	4,178	522	4,178	0	0.001239	0.001102	0.001102
046	PLYWD	107	90	17	90	0	0.000028	0.000024	0.000024
049	PULPAP	89	60	29	60	0	0.000023	0.000016	0.000016
050	PAPPRO	813	673	140	673	0	0.000214	0.000177	0.000177
051	BOOKS	89	73	16	73	0	0.000023	0.000019	0.000019
052	PRINTS	643	643	0	643	0	0.000170	0.000170	0.000170
055	TIRES	13,953	10,703	3,250	8,353	2,140	0.003679	0.002252	0.002258
057	B CHEM	290	241	49	229	12	0.000076	0.000064	0.000060
061	PAINTS	2,358	1,891	467	1,876	15	0.000622	0.000399	0.000195
063	DRUGS	7,825	6,062	1,763	6,062	0	0.002061	0.001598	0.001598
064	SOAPS	339	245	94	245	0	0.000089	0.000065	0.000065
066	PETROL	317,810	261,376	56,434	259,914	1,892	0.083801	0.068921	0.068535
067	CEMENT	9,884	8,046	1,838	8,046	0	0.002606	0.002122	0.002122
070	ONMETP	1,811	1,365	446	989	376	0.000478	0.000360	0.000261
071	B IRON	698	593	105	551	42	0.000184	0.000156	0.000145
072	B OMET	2,514	2,230	284	1,667	563	0.000689	0.000588	0.000440
073	HARDWR	488	348	140	281	67	0.000129	0.000092	0.000074
076	FABMET	47,137	38,828	8,309	26,713	12,115	0.012429	0.010238	0.007044
077	AGRMCH	39,734	32,609	7,125	13,046	19,563	0.010477	0.008598	0.003440
079	GENMCH	6,410	3,865	2,545	2,324	1,541	0.001890	0.001019	0.000613
080	OFFMCH	195	127	68	51	76	0.000051	0.000033	0.000013
081	ELCMCH	158	128	30	74	54	0.000042	0.000034	0.000020
083	BATTERY	6,835	5,487	1,348	5,487	0	0.001802	0.001447	0.001447
084	ELCAPP	4,873	3,701	1,172	3,670	31	0.001285	0.000976	0.000968
086	REFRIG	3	3	0	3	0	0.000001	0.000001	0.000001
089	REPVL	355	355	0	355	0	0.000094	0.000094	0.000094
092	O MANF	89	74	15	43	31	0.000023	0.000020	0.000011
094	ELESUP	1,312	1,312	0	1,312	0	0.000346	0.000346	0.000346
096	WATERS	198	198	0	198	0	0.000052	0.000052	0.000052
097	CONSTR	8,643	8,643	0	8,643	0	0.002279	0.002279	0.002279
098	WS TRD	0	81,422	- 81,422	81,422	0	0.000000	0.021470	0.021470
100	BANK	1,578	1,578	0	1,578	0	0.000416	0.000416	0.000416
101	N BANK	199	199	0	199	0	0.000052	0.000052	0.000052
103	REALES	31,981	31,981	0	31,981	0	0.008433	0.008433	0.008433
104	RAIL T	0	235	- 235	235	0	0.000000	0.000062	0.000062
105	OLANDT	48	1,468	- 1,420	1,468	0	0.000013	0.000387	0.000387
106	WTR TR	0	2,264	- 2,264	2,264	0	0.000000	0.000597	0.000597
107	AIR TR	15,792	16,209	- 417	16,209	0	0.004164	0.004274	0.004274
108	TR SRV	0	3,154	- 3,154	3,154	0	0.000000	0.000832	0.000832
109	WAREHS	173	173	0	173	0	0.000046	0.000046	0.000046
110	COMMUN	7,665	7,665	0	7,665	0	0.002021	0.002021	0.002021
111	EDUCAT	297	297	0	297	0	0.000078	0.000078	0.000078
112	MEDSRV	8,502	8,502	0	8,502	0	0.002242	0.002242	0.002242
113	PROSRV	7,325	7,325	0	7,325	0	0.001931	0.001931	0.001931
114	ADVSRV	1,012	1,012	0	1,012	0	0.000267	0.000267	0.000267
115	OBSSRV	2,126	2,126	0	2,126	0	0.000561	0.000561	0.000561
116	RECSRV	214	214	0	214	0	0.000056	0.000056	0.000056
117	RESTRN	8,726	8,726	0	8,726	0	0.002301	0.002301	0.002301
118	HOTELS	4,091	4,091	0	4,091	0	0.001079	0.001079	0.001079
290	INTTTL	596,075	596,075	0	557,889	38,186	0.157175	0.157175	0.147166
301	WAGES	705,942	705,942	0	705,942	0	0.186145	0.186145	0.186145
302	DEPREC	690,921	690,921	0	690,921	0	0.182184	0.182184	0.182184
303	INDTAX	102,294	102,294	0	102,294	0	0.026973	0.026973	0.026973
304	OVA	1,697,195	1,697,195	0	1,697,195	0	0.447522	0.447522	0.447522
399	VA TTL	3,196,352	3,196,352	0	3,196,352	0	0.842825	0.842825	0.842825
600	CCT	3,792,427	3,792,427	0	3,792,427	0	1.000000	1.000000	1.000000
700	TI	3,792,427	3,792,427	0	3,754,241	38,186	1.000000	1.000000	0.989931

(1,000 Pesos)

Input Sectors		Input Values at		Trade Margins	Input Values at Producers Prices		Input Coefficients at			
Output Sectors	Purchaser's Prices	Producers Prices	Domestic		Imports	Purchasers Prices	Producers Prices			
							Domestic	Imports		
070 ONMETP (Order-non metallic mineral products)										
025	N METO	99,114	85,828	13,286	34,839	50,989	0.358827	0.310727	0.126129	0.184598
041	CORDGE	336	277	59	275	2	0.001216	0.001003	0.000996	0.000007
044	OMUTEX	39	30	9	30	0	0.000141	0.000109	0.000109	0.000000
045	LUMBER	3,127	2,731	396	2,731	0	0.011321	0.009887	0.009887	0.000000
046	PLYWD	97	77	20	77	0	0.000351	0.000279	0.000279	0.000000
048	O WOOD	2,142	1,652	490	1,652	0	0.007755	0.005981	0.005981	0.000000
049	PULPAP	3,268	2,075	1,193	1,565	510	0.011831	0.007512	0.005666	0.001846
050	PAPPRO	2,057	1,103	954	1,020	83	0.007447	0.003993	0.003693	0.000300
052	PRINTS	322	322	0	322	0	0.001166	0.001166	0.001166	0.000000
055	TIRES	289	213	76	205	8	0.001046	0.000771	0.000742	0.000029
057	B CHEM	14,344	11,825	2,519	5,321	6,504	0.051930	0.042811	0.019264	0.023547
061	PAINTS	3,288	2,565	723	2,332	233	0.011904	0.009286	0.008443	0.000844
062	PLASTM	1,432	1,156	276	297	859	0.005184	0.004185	0.001075	0.003110
063	DRUGS	146	107	39	107	0	0.000529	0.000387	0.000387	0.000000
064	SOAPS	12	7	5	7	0	0.000043	0.000025	0.000025	0.000000
065	O CHEM	497	432	65	72	360	0.001799	0.001564	0.000261	0.001303
066	PETROL	6,051	4,851	1,200	4,826	25	0.021907	0.017562	0.017472	0.000091
067	CEMENT	5,096	4,042	1,054	4,042	0	0.018449	0.014633	0.014633	0.000000
069	GLASS	210	174	36	152	22	0.000760	0.000630	0.000550	0.000080
070	ONMETP	10,960	8,443	2,517	2,560	5,883	0.039679	0.030567	0.009268	0.021298
071	B IRON	2,453	1,971	482	1,763	208	0.008881	0.007136	0.006383	0.000753
073	HARDWR	14	9	5	9	0	0.000051	0.000033	0.000033	0.000000
076	FABMET	540	460	80	294	166	0.001955	0.001665	0.001664	0.000601
078	INDMCH	138	95	43	24	71	0.000500	0.000344	0.000087	0.000257
079	GENMCH	135	77	58	76	1	0.000489	0.000279	0.000275	0.000004
080	OPFMCH	62	37	25	18	19	0.000224	0.000134	0.000065	0.000069
084	ELCAPP	108	78	30	78	0	0.000391	0.000282	0.000282	0.000000
089	REPVCL	316	316	0	316	0	0.001144	0.001144	0.001144	0.000000
092	O MANF	3,461	2,986	475	2,866	120	0.012530	0.010810	0.010376	0.000434
094	ELESUP	1,855	1,855	0	1,855	0	0.006716	0.006716	0.006716	0.000000
096	WATERS	101	101	0	101	0	0.000366	0.000366	0.000366	0.000000
097	CONSTR	726	726	0	726	0	0.002628	0.002628	0.002628	0.000000
098	WS TRD	0	24,068	-24,068	24,068	0	0.000000	0.087134	0.087134	0.000000
100	BANK	990	990	0	990	0	0.003584	0.003584	0.003584	0.000000
102	INSURA	722	722	0	722	0	0.002614	0.002614	0.002614	0.000000
103	REALES	758	758	0	758	0	0.002744	0.002744	0.002744	0.000000
104	RAIL T	0	120	-120	120	0	0.000000	0.000434	0.000434	0.000000
105	OLANDT	187	542	-355	542	0	0.000677	0.001962	0.001962	0.000000
106	WTR TR	0	204	-204	204	0	0.000000	0.000739	0.000739	0.000000
107	AIR TR	10	21	-11	21	0	0.000036	0.000076	0.000076	0.000000
108	TR SRV	0	1,357	-1,357	1,357	0	0.000000	0.004913	0.004913	0.000000
109	WAREHS	9	9	0	9	0	0.000033	0.000033	0.000033	0.000000
110	COMMUN	673	673	0	673	0	0.002436	0.002436	0.002436	0.000000
112	MEDSRV	235	235	0	235	0	0.000851	0.000851	0.000851	0.000000
113	PROSRV	976	976	0	976	0	0.003533	0.003533	0.003533	0.000000
114	ADVSrv	140	140	0	140	0	0.000507	0.000507	0.000507	0.000000
115	OBSSRV	1,084	1,084	0	1,084	0	0.003924	0.003924	0.003924	0.000000
116	RECSRV	142	142	0	142	0	0.000514	0.000514	0.000514	0.000000
117	RESTRN	635	635	0	635	0	0.002299	0.002299	0.002299	0.000000
118	HOTELS	208	208	0	208	0	0.000753	0.000753	0.000753	0.000000
119	PERSRV	3,110	3,110	0	3,110	0	0.011259	0.011259	0.011259	0.000000
290	INTTTL	172,615	172,615	0	106,552	66,063	0.624925	0.624925	0.385755	0.239171
301	WAGES	33,495	33,495	0	33,495	0	0.121263	0.121263	0.121263	0.000000
302	DEPREC	17,346	17,346	0	17,346	0	0.062798	0.062798	0.062798	0.000000
303	INDTAX	3,911	3,911	0	3,911	0	0.014159	0.014159	0.014159	0.000000
304	OVA	48,850	48,850	0	48,850	0	0.176854	0.176854	0.176854	0.000000
309	VA TTL	103,602	103,602	0	103,602	0	0.375075	0.375075	0.375075	0.000000
600	CCT	276,217	276,217	0	276,217	0	1.000000	1.000000	1.000000	0.000000
700	TI	276,217	276,217	0	210,154	66,063	1.000000	1.000000	0.760829	0.239171

Input Sectors		Input Values at		Trade Margins	Input Values at Producers Prices		Input Coefficients at		
Output Sectors	Purchaser's Prices	Producers Prices	Domestic		Imports	Purchasers Prices	Producers Prices		
							Domestic	Imports	
028	RICE M (Rice Milling)								
001	PADDY	5,795,837	4,995,576	800,261	4,995,576	0	0.805507	0.694286	0.000000
041	CORDEG	1,423	1,144	279	1,144	0	0.000198	0.000159	0.000000
044	OMUTEX	1,528	1,202	326	1,202	0	0.000212	0.000167	0.000000
046	PLYWD	1,053	831	222	831	0	0.000146	0.000115	0.000000
050	PAPPRO	162	125	37	125	0	0.000023	0.000017	0.000000
052	PRINTS	499	499	0	482	17	0.000069	0.000069	0.000002
055	TIRES	3,164	2,326	838	2,326	0	0.000440	0.000323	0.000000
065	O CHEM	70	56	14	2	54	0.000010	0.000008	0.000008
066	PETROL	84,474	67,287	17,187	66,552	735	0.011740	0.009352	0.009249
067	CEMENT	2,213	1,743	470	1,743	0	0.000308	0.000242	0.000000
068	STRCLP	898	662	236	472	190	0.000125	0.000092	0.000066
071	B IRON	2,621	2,087	534	1,700	387	0.000364	0.000290	0.000236
076	FABMET	2,814	2,423	391	2,423	0	0.000391	0.000337	0.000000
078	INDMCH	1,095	750	345	292	458	0.000152	0.000104	0.000064
079	GENMCH	8,180	4,559	3,621	4,559	0	0.001137	0.000634	0.000634
080	OFFMCH	1,308	782	526	782	0	0.000182	0.000109	0.000000
084	ELCAPY	669	484	185	484	0	0.000093	0.000067	0.000060
089	REPVCL	141	141	0	141	0	0.000020	0.000020	0.000000
092	O MANF	112	74	38	74	0	0.000016	0.000010	0.000010
094	ELESUP	2,097	2,097	0	2,097	0	0.000291	0.000291	0.000000
096	WATERS	118	118	0	118	0	0.000016	0.000016	0.000000
097	CONSTR	621	621	0	621	0	0.000086	0.000086	0.000000
098	WS TRD	0	755,295	-755,295	755,295	0	0.000000	0.104971	0.000000
100	BANK	10,596	10,596	0	10,596	0	0.001473	0.001473	0.000000
101	N BANK	3,045	3,045	0	3,045	0	0.000423	0.000423	0.000000
102	INSURA	7,440	7,440	0	7,440	0	0.001034	0.001034	0.000000
103	REALES	24,947	24,947	0	24,947	0	0.003467	0.003467	0.000000
104	RAIL T	0	1,959	-1,959	1,959	0	0.000000	0.000272	0.000000
105	OLANDT	570	5,494	-4,924	5,494	0	0.000079	0.000764	0.000000
106	WTR TR	0	8,410	-8,410	8,410	0	0.000000	0.001169	0.000000
107	AIR TR	555	555	0	555	0	0.000077	0.000077	0.000000
108	TR SRV	0	54,922	-54,922	54,922	0	0.000000	0.007633	0.000000
109	WAREHS	1,806	1,806	0	1,806	0	0.000251	0.000251	0.000000
110	COMMUN	2,628	2,628	0	2,628	0	0.000365	0.000365	0.000000
112	MEDSRV	617	617	0	617	0	0.000386	0.000386	0.000000
113	PROSRV	2,308	2,308	0	2,308	0	0.000321	0.000321	0.000000
114	ADVSrv	401	401	0	401	0	0.000056	0.000056	0.000000
115	OBSSRV	102	102	0	102	0	0.000014	0.000014	0.000000
116	RECSRV	316	316	0	316	0	0.000044	0.000044	0.000000
117	RESTRN	6,811	6,811	0	6,811	0	0.000947	0.000947	0.000000
290	INTTTL	5,973,239	5,973,239	0	5,971,398	1,841	0.830162	0.830162	0.829906
301	WAGES	285,040	285,040	0	285,040	0	0.039615	0.039615	0.000000
302	DEPREC	233,523	233,523	0	233,523	0	0.032455	0.032455	0.000000
303	INDTAX	43,641	43,641	0	43,641	0	0.006065	0.006065	0.000000
304	OVA	659,823	659,823	0	659,823	0	0.091702	0.091702	0.000000
399	VA TTL	1,222,027	1,222,027	0	1,222,027	0	0.169838	0.169838	0.000000
600	CCT	7,195,266	7,195,266	0	7,195,266	0	1.000000	1.000000	1.000000
700	TI	7,195,266	7,195,266	0	7,193,425	1,841	1.000000	1.000000	0.999744

Input Sectors		Input Values at		Trade Margins	Input Values at Producers Prices		Input Coefficients at			
Output Sectors	Purchasers Prices	Producers Prices	Domestic		Imports	Purchasers Prices	Producers Prices			
							Domestic	Imports		
038 SOFT D (Soft drinks & carbonated water)										
005	O-FRTS	596	547	19	546	1	0.000752	0.000690	0.000689	0.000001
027	DAIRYP	957	855	102	855	0	0.001208	0.001879	0.001073	0.000000
029	SUGMIL	85,808	74,039	11,769	74,039	0	0.108280	0.093429	0.093429	0.000000
030	FRT PR	16	14	2	14	0	0.000020	0.000018	0.000018	0.000000
032	CGRAIN	271	238	33	238	0	0.000342	0.000300	0.000300	0.000000
034	CHOCOL	1,800	1,420	180	1,420	0	0.002019	0.001792	0.001792	0.000000
036	O FOOD	11,581	10,351	1,230	10,352	9	0.014614	0.013062	0.013050	0.000011
037	ALC RV	58	55	3	55	0	0.000073	0.000069	0.000069	0.000000
045	LUMBER	193	167	26	167	0	0.000244	0.000211	0.000211	0.000000
016	PLYWD	285	230	55	230	0	0.000360	0.000290	0.000290	0.000000
018	O WOOD	11,903	9,451	2,452	9,155	296	0.015020	0.011926	0.011553	0.000374
050	PAPPRO	1,001	1,252	352	1,205	47	0.002024	0.001580	0.001521	0.000500
051	BOOKS	152	122	30	122	0	0.000192	0.000154	0.000154	0.000000
052	PRINTS	747	747	0	716	31	0.000943	0.000943	0.000943	0.000000
055	TIRES	2,971	2,217	754	1,826	391	0.003749	0.002798	0.002304	0.000493
057	B CHEM	13,317	11,015	2,302	3,650	7,365	0.016805	0.013900	0.004606	0.002294
059	O OIL	1	1	0	1	0	0.000001	0.000001	0.000001	0.000000
063	DRUGS	1,476	1,103	373	1,024	79	0.001863	0.001392	0.001292	0.000109
064	SOAPS	508	323	185	317	6	0.000641	0.000408	0.000400	0.000008
065	O CHEM	3	3	0	0	3	0.000004	0.000004	0.000000	0.000004
066	PETROL	52,121	41,948	10,173	41,597	351	0.065771	0.052934	0.052491	0.000443
067	CEMENT	1,116	913	203	913	0	0.001408	0.001152	0.001152	0.000000
069	GLASS	62,981	52,395	10,679	45,044	7,261	0.079479	0.066003	0.065841	0.000163
071	HARDWR	151	102	52	48	54	0.000194	0.000129	0.000061	0.000068
076	FABMET	60,627	51,315	9,312	48,889	2,426	0.076505	0.064754	0.061693	0.000061
078	INDMCH	112	70	42	11	59	0.000141	0.000088	0.000014	0.000074
079	GENMCH	1,019	616	433	616	0	0.001324	0.000777	0.000777	0.000000
080	OFFMCH	168	106	62	106	0	0.000212	0.000134	0.000134	0.000000
081	ELCAP	741	536	208	512	24	0.000939	0.000676	0.000646	0.000030
089	REPVCL	285	285	0	285	0	0.000360	0.000360	0.000360	0.000000
092	O MANF	544	464	80	368	96	0.000626	0.000586	0.000454	0.000121
091	ELESUP	3,056	3,056	0	3,056	0	0.003856	0.003856	0.003856	0.000000
096	WATERS	841	841	0	841	0	0.001061	0.001061	0.001061	0.000000
097	CONSTR	628	628	0	628	0	0.000792	0.000792	0.000792	0.000000
098	WS TRD	0	45,865	-45,865	45,865	0	0.000000	0.057877	0.057877	0.000000
100	BANK	4,528	4,528	0	4,528	0	0.005714	0.005714	0.005714	0.000000
101	N BANK	2,878	2,878	0	2,878	0	0.003632	0.003632	0.003632	0.000000
102	INSURA	1,713	1,713	0	1,713	0	0.002162	0.002162	0.002162	0.000000
103	REALES	6,334	6,334	0	6,334	0	0.007993	0.007993	0.007993	0.000000
104	RAIL T	0	207	-207	207	0	0.000000	0.000261	0.000261	0.000000
105	GLANDT	139	687	-548	687	0	0.000175	0.000867	0.000867	0.000000
106	WTR TR	0	954	-954	954	0	0.000000	0.001204	0.001204	0.000000
107	AIR TR	166	211	-45	211	0	0.000209	0.000266	0.000266	0.000000
108	TR SRV	0	3,522	-3,522	3,522	0	0.000000	0.004444	0.004444	0.000000
109	WAREHS	137	137	0	137	0	0.000173	0.000173	0.000173	0.000000
110	COMMUN	899	899	0	899	0	0.001134	0.001134	0.001134	0.000000
111	EDUCAT	404	404	0	404	0	0.000510	0.000510	0.000510	0.000000
112	MEDSRV	10,436	10,436	0	10,436	0	0.013169	0.013169	0.013169	0.000000
113	PROSRV	4,328	4,328	0	4,328	0	0.005461	0.005461	0.005461	0.000000
114	ADVSrv	12,711	12,711	0	12,711	0	0.016040	0.016040	0.016040	0.000000
115	ORSSRV	3,299	3,299	0	3,299	0	0.004163	0.004163	0.004163	0.000000
116	RECSRV	16,898	16,898	0	16,898	0	0.021323	0.021323	0.021323	0.000000
117	RESTRN	4,535	4,535	0	4,535	0	0.005723	0.005723	0.005723	0.000000
118	HOTELS	1,923	1,923	0	1,923	0	0.002427	0.002427	0.002427	0.000000
290	INTTTL	389,804	389,804	0	371,305	18,499	0.491890	0.491890	0.448547	0.023344
301	WAGES	81,072	81,072	0	81,072	0	0.102304	0.102304	0.102304	0.000000
302	DEPREC	63,256	63,256	0	63,256	0	0.079822	0.079822	0.079822	0.000000
303	INDTAX	13,445	13,445	0	13,445	0	0.016966	0.016966	0.016966	0.000000
304	OVA	244,884	244,884	0	244,884	0	0.309017	0.309017	0.309017	0.000000
309	VA TTL	402,657	402,657	0	402,657	0	0.508110	0.508110	0.508110	0.000000
600	CTT	792,461	792,461	0	792,461	0	1.000000	1.000000	1.000000	0.000000
700	TI	792,461	792,461	0	773,962	18,499	1.000000	1.000000	0.976656	0.023344

(1,000 Pesos)

Input Sectors		Input Values at		Trade Margins	Input Values at Producers Prices		Input Coefficients at		
Output Sectors	Purchaser's Prices	Producers Prices	Domestic		Imports	Purchasers Prices	Producers Prices		
							Domestic	Imports	
045	LUMBER								
021	FOREST	1,336,428	1,185,202	151,226	1,185,202	0	0.633782	0.562065	0.000000
041	CORDE	614	487	127	487	0	0.000291	0.000231	0.000000
044	OMUTEX	660	509	151	509	0	0.000313	0.000241	0.000000
045	LUMBER	49,624	42,848	6,776	42,527	321	0.023533	0.020320	0.000152
046	PLYWD	2,040	1,583	457	1,583	0	0.000967	0.000751	0.000000
049	PULFAP	2,849	1,726	1,123	469	1,257	0.001351	0.000819	0.000222
050	PAPPRO	960	693	267	287	406	0.000427	0.000329	0.000193
051	BOOKS	238	182	56	182	0	0.000113	0.000086	0.000000
052	PRINTS	1,027	1,027	0	985	42	0.000487	0.000487	0.000020
055	TIRES	6,653	4,792	1,861	4,287	505	0.003155	0.002273	0.000239
057	B CHEM	17,624	14,270	3,354	4,136	10,134	0.008358	0.006767	0.004806
081	PAINTS	35	26	9	23	3	0.000017	0.000012	0.000001
083	DRUGS	1,456	1,051	405	595	456	0.000690	0.000498	0.000216
084	SOAPS	1,718	1,014	704	899	115	0.000815	0.000481	0.000055
085	O CHEM	35	27	8	24	3	0.000017	0.000013	0.000001
086	PETROL	134,731	105,784	28,947	104,316	968	0.053894	0.050167	0.000459
070	ONMETP	5	4	1	4	0	0.000002	0.000002	0.000000
073	HARWR	152	89	63	89	0	0.000072	0.000042	0.000000
076	FABMET	38	30	8	9	21	0.000018	0.000014	0.000010
078	INDMCH	404	252	142	15	247	0.000192	0.000124	0.000007
079	GENMCH	9	6	3	5	1	0.000004	0.000003	0.000000
080	OFFMCH	564	328	236	328	23	0.000267	0.000156	0.000000
081	ELCMCH	44	42	2	19	23	0.000021	0.000020	0.000011
084	ELCAPP	444	314	130	314	0	0.000211	0.000149	0.000000
089	REPVCL	598	598	0	598	0	0.000284	0.000284	0.000000
092	O MANF	822	685	137	650	35	0.000390	0.000325	0.00017
094	ELESUP	14,019	14,019	0	14,019	0	0.005648	0.005648	0.000000
096	WATERS	1,198	1,198	0	1,198	0	0.000568	0.000568	0.000000
097	CONSTR	5,742	5,742	0	5,742	0	0.002723	0.002723	0.000000
098	WS TRD	0	181,560	- 181,560	181,560	0	0.000000	0.006102	0.000000
100	BANK	4,914	4,914	0	4,914	0	0.002330	0.002330	0.000000
101	N BANK	2,833	2,833	0	2,833	0	0.001344	0.001344	0.000000
102	INSURA	4,173	4,173	0	4,173	0	0.001979	0.001979	0.000000
103	REALES	4,387	4,387	0	4,387	0	0.002080	0.002080	0.000000
104	RAIL T	0	616	- 616	616	0	0.000000	0.002392	0.000000
105	OLANDT	3,130	4,248	- 1,118	4,248	0	0.001484	0.002015	0.000000
106	WTR TR	0	6,049	- 6,049	6,049	0	0.000000	0.002869	0.000000
107	AIR TR	1,694	1,694	0	1,694	0	0.000803	0.000803	0.000000
108	TR SRV	0	6,790	- 6,790	6,790	0	0.000000	0.003220	0.000000
110	COMMUN	1,113	1,113	0	1,113	0	0.000528	0.000528	0.000000
112	MEDSRV	4,307	4,307	0	4,307	0	0.002043	0.002043	0.000000
113	PROSRV	3,363	3,363	0	3,363	0	0.001595	0.001595	0.000000
114	ADVSrv	4,561	4,561	0	4,561	0	0.002163	0.002163	0.000000
115	OBSSRV	5,232	5,232	0	5,232	0	0.002481	0.002481	0.000000
117	RESTRN	6,506	6,506	0	6,506	0	0.003085	0.003085	0.000000
118	HOTELS	3,736	3,736	0	3,736	0	0.001772	0.001772	0.000000
290	INTTTL	1,636,620	1,636,620	0	1,616,063	14,537	0.773298	0.773298	0.006594
301	WAGES	142,147	142,147	0	142,147	0	0.067411	0.067411	0.000000
302	DEPREC	92,484	92,484	0	92,484	0	0.043859	0.043859	0.000000
303	INDTAX	28,813	28,813	0	28,813	0	0.013664	0.013664	0.000000
304	OVA	214,592	214,592	0	214,592	0	0.101767	0.101767	0.000000
389	VA TTL	478,838	478,838	0	478,838	0	0.226702	0.226702	0.000000
600	CCT	2,189,656	2,189,656	0	2,189,656	0	1.000000	1.000000	0.000000
706	T1	2,189,656	2,189,656	0	2,094,119	14,537	1.000000	0.093106	0.006594

(1,000 Pesos)

Input Sectors		Input Values at		Trade Margins	Input Values at Producers Prices		Input Coefficients at			
Output Sectors	Purchasers' Prices	Producers Prices	Domestic		Imports	Purchasers Prices	Producers Prices			
							Domestic	Imports		
046	PLYWD									
021	FOREST	190,926	162,266	28,660	162,266	0	0.292246	0.248377	0.248377	0.000000
032	O GRAIN	7,920	6,744	1,176	6,744	0	0.012123	0.010323	0.010323	0.000000
041	CORDGE	167	131	36	131	0	0.000256	0.000201	0.000201	0.000000
044	OMUTEX	180	138	42	138	0	0.000276	0.000211	0.000211	0.000000
045	LUMBER	1,827	1,560	267	1,555	5	0.002797	0.002388	0.002388	0.000000
046	PLYWD	2,670	2,043	627	2,043	0	0.004087	0.003127	0.003127	0.000000
048	O WOOD	1,519	1,112	407	1,092	20	0.002325	0.001702	0.001671	0.000011
049	PULPAP	1,037	600	437	494	106	0.001587	0.000918	0.000756	0.000162
050	PAPPRO	601	483	118	400	81	0.000920	0.000739	0.000612	0.000127
051	BOOKS	106	77	29	77	0	0.000162	0.000118	0.000118	0.000000
052	PRINTS	282	282	0	263	19	0.000432	0.000432	0.000403	0.000029
055	TIRES	1,926	1,353	573	1,138	215	0.002948	0.002071	0.001742	0.000329
056	O RUBP	249	241	5	56	178	0.000381	0.000373	0.000101	0.000272
057	B CHEM	10,231	8,161	2,070	681	7,480	0.015660	0.012492	0.001042	0.011449
059	O OIL	352	208	144	82	126	0.000539	0.000318	0.000126	0.000193
061	PAINTS	1,808	1,354	454	1,014	340	0.002767	0.002073	0.001552	0.000520
062	PLASTM	5,482	4,415	1,067	279	4,136	0.008391	0.006758	0.000427	0.006311
063	DRUGS	363	263	100	138	125	0.000556	0.000403	0.000211	0.000191
064	SOAPS	983	616	367	601	15	0.001505	0.000941	0.000920	0.000023
065	O CHEM	18,599	15,932	2,667	3,505	12,427	0.028469	0.021387	0.006365	0.019022
066	PETROL	36,764	28,398	8,366	28,077	321	0.056274	0.043468	0.042977	0.000491
070	ONMETP	224	153	71	92	61	0.000343	0.000231	0.000141	0.000093
073	HARDWR	120	74	46	23	51	0.000181	0.000113	0.000015	0.000078
076	FABMET	90	74	16	10	61	0.000138	0.000113	0.000015	0.000098
078	INDMCH	335	241	91	31	213	0.000513	0.000373	0.000047	0.000326
079	GENMCH	957	482	475	482	0	0.001465	0.000738	0.000738	0.000000
080	OFFMCH	153	83	70	81	0	0.000234	0.000127	0.000127	0.000000
081	ELCMCH	17	15	2	5	10	0.000026	0.000023	0.000008	0.000015
083	BATTRY	9	7	2	5	2	0.000011	0.000011	0.000008	0.000003
084	ELCAPP	203	145	58	115	0	0.000311	0.000222	0.000222	0.000000
089	REPVCL	200	200	0	200	0	0.000306	0.000306	0.000306	0.000000
092	O MANF	44	36	8	21	15	0.000067	0.000055	0.000032	0.000023
094	ELESUP	4,012	4,012	0	4,012	0	0.006141	0.006141	0.006141	0.000000
096	WATERS	279	279	0	279	0	0.000427	0.000427	0.000427	0.000000
097	CONSTR	1,560	1,560	0	1,560	0	0.002388	0.002388	0.002388	0.000000
098	WS TRD	0	44,785	-44,785	44,785	0	0.000000	0.068351	0.068351	0.000000
100	BANK	1,423	1,423	0	1,423	0	0.002178	0.002178	0.002178	0.000000
101	N BANK	500	500	0	500	0	0.000765	0.000765	0.000765	0.000000
102	INSURA	1,993	1,993	0	1,993	0	0.003051	0.003051	0.003051	0.000000
103	REALES	1,082	1,082	0	1,082	0	0.001656	0.001656	0.001656	0.000000
104	RAIL T	0	83	-83	83	0	0.000000	0.000127	0.000127	0.000000
105	OLANDT	626	1,010	-384	1,010	0	0.000958	0.001516	0.001516	0.000000
106	WTR TR	0	1,324	-1,324	1,324	0	0.000000	0.002027	0.002027	0.000000
107	AIR TR	339	339	0	339	0	0.000519	0.000519	0.000519	0.000000
108	TR SRV	0	1,875	-1,875	1,875	0	0.000000	0.002870	0.002870	0.000000
109	WAREHS	11	11	0	11	0	0.000017	0.000017	0.000017	0.000000
110	COMMUN	966	966	0	966	0	0.001479	0.001479	0.001479	0.000000
112	MEDSRV	664	664	0	664	0	0.001016	0.001016	0.001016	0.000000
113	PROSRV	1,001	1,001	0	1,001	0	0.001532	0.001532	0.001532	0.000000
114	ADVSRV	1,359	1,359	0	1,359	0	0.002080	0.002080	0.002080	0.000000
115	OBSSRV	1,455	1,455	0	1,455	0	0.002227	0.002227	0.002227	0.000000
116	RECSRV	188	188	0	188	0	0.000288	0.000288	0.000288	0.000000
117	RESTRN	1,964	1,964	0	1,964	0	0.003006	0.003006	0.003006	0.000000
118	HOTELS	647	647	0	647	0	0.000990	0.000990	0.000990	0.000000
290	INTTTL	306,413	306,413	0	280,401	26,012	0.469019	0.469019	0.429203	0.039816
301	WAGES	133,140	133,140	0	133,140	0	0.203794	0.203794	0.203794	0.000000
302	DEPREC	23,246	23,246	0	23,246	0	0.035582	0.035582	0.035582	0.000000
303	JNDTAX	7,973	7,973	0	7,973	0	0.012204	0.012204	0.012204	0.000000
304	OVA	182,534	182,534	0	182,534	0	0.279400	0.279400	0.279400	0.000000
309	VA TTL	346,893	346,893	0	346,893	0	0.530981	0.530981	0.530981	0.000000
600	CCT	653,306	653,306	0	653,306	0	1.000000	1.000000	1.000000	0.000000
700	TI	653,306	653,306	0	627,294	26,012	1.000000	1.000000	0.960184	0.039816

(1,000 Pesos)

Input Sectors		Input Values at		Trade Margins	Input Values at Producers Prices		Input Coefficients at		
Output Sectors	Purchasers Prices	Producers Prices	Domestic		Imports	Purchasers Prices	Producers Prices		
							Domestic	Imports	
060	FERTIL								
025	N-METO	261,695	231,076	30,619	5,472	225,604	0.311033	0.274642	0.006504
041	CORDEG	247	192	55	192	0	0.000294	0.000228	0.000000
044	OMUTEX	1,216	993	223	993	0	0.001445	0.001180	0.000000
045	LUMBER	47	41	6	41	0	0.000056	0.000049	0.000000
050	PAPPRO	1,150	902	248	891	11	0.001367	0.001072	0.000013
051	BOOKS	38	30	8	30	0	0.000045	0.000036	0.000000
052	PRINTS	405	405	0	375	30	0.000481	0.000481	0.000446
055	TIRES	141	104	37	104	0	0.000168	0.000124	0.000000
057	B-CHEM	265,684	217,081	48,603	49,359	167,722	0.315774	0.258008	0.058665
063	DRUGS	68	52	16	52	0	0.000081	0.000062	0.000000
064	SOAPS	16	10	6	10	0	0.000019	0.000012	0.000000
065	O-CHEM	1,604	1,441	163	806	635	0.001906	0.001713	0.000958
066	PETROL	36,694	29,121	7,573	27,977	1,144	0.043612	0.034611	0.003252
068	STRCLP	88	60	28	1	59	0.000105	0.000071	0.000001
071	B-IRON	382	306	76	255	51	0.000454	0.000364	0.000303
073	HARDWR	20	12	8	6	6	0.000024	0.000014	0.000007
076	FABMET	20,510	18,270	2,240	17,892	378	0.024177	0.021715	0.021265
078	INDMCH	176	148	28	84	64	0.000209	0.000176	0.000100
079	GENMCH	1,021	563	458	563	0	0.001213	0.000669	0.000669
080	OFFMCH	164	97	67	97	0	0.000195	0.000115	0.000000
084	ELCAPP	80	61	19	61	0	0.000095	0.000073	0.000000
089	REPVCL	93	93	0	93	0	0.000111	0.000111	0.000000
092	O-MANF	11,111	9,547	1,564	8,883	664	0.013206	0.011347	0.010558
094	ELESUP	4,254	4,254	0	4,254	0	0.005056	0.005056	0.000000
096	WATERS	25	25	0	25	0	0.000030	0.000030	0.000000
097	CONSTR	1,664	1,664	0	1,664	0	0.001978	0.001978	0.000000
098	WS-TRD	0	84,973	-84,973	84,973	0	0.000000	0.100983	0.000993
100	BANK	1,458	1,458	0	1,458	0	0.001733	0.001733	0.000000
102	INSURA	3,344	3,344	0	3,344	0	0.003974	0.003974	0.000000
103	REALES	3,904	3,904	0	3,904	0	0.004640	0.004640	0.000000
104	RAIL T	0	67	-67	67	0	0.000000	0.000080	0.000000
105	OLANDT	250	1,569	-1,319	1,569	0	0.000297	0.001855	0.000000
106	WTR-TR	0	2,332	-2,332	2,332	0	0.000000	0.002772	0.000000
107	AIR-TR	463	560	-97	560	0	0.000550	0.000666	0.000000
108	TR-SRV	0	3,257	-3,257	3,257	0	0.000000	0.003871	0.000000
109	WAREHS	4	4	0	4	0	0.000005	0.000005	0.000000
110	COMMUN	430	430	0	430	0	0.000511	0.000511	0.000000
111	EDUCAT	106	106	0	106	0	0.000126	0.000126	0.000000
112	MEDSRV	2,299	2,299	0	2,299	0	0.002732	0.002732	0.000000
113	PROSRV	2,259	2,259	0	2,259	0	0.002685	0.002685	0.000000
114	ADVSRV	1,039	1,039	0	1,039	0	0.001235	0.001235	0.000000
115	OBSSRV	1,364	1,364	0	1,364	0	0.001621	0.001621	0.000000
116	RECSRV	172	172	0	172	0	0.000204	0.000204	0.000000
117	RESTRN	619	619	0	619	0	0.000736	0.000736	0.000000
118	HOTELS	112	112	0	112	0	0.000133	0.000133	0.000000
290	INTTTL	626,416	626,416	0	230,648	396,368	0.744516	0.744516	0.273420
301	WAGES	49,914	49,914	0	49,914	0	0.059324	0.059324	0.000000
302	DEPREC	35,798	35,798	0	35,798	0	0.042547	0.042547	0.000000
303	INDTAX	9,584	9,584	0	9,584	0	0.011391	0.011391	0.000000
304	OVA	119,661	119,661	0	119,661	0	0.142221	0.142221	0.000000
399	VA-TTL	214,957	214,957	0	214,957	0	0.255484	0.255484	0.000000
600	CCT	841,373	841,373	0	841,373	0	1.000000	1.000000	0.000000
760	TI	841,373	841,373	0	445,005	396,368	1.000000	1.000000	0.526903

(1,000 Pesos)

Input Sectors		Input Values at		Trade Margins	Input Values at Producers Prices		Input Coefficients at		
Output Sectors	Purchasers Prices	Producers Prices	Domestic		Imports	Purchasers Prices	Producers Prices		
							Domestic	Imports	
067	CEMENT								
025	N METO	212,500	188,625	23,875	186,544	2,081	0.192120	0.168654	0.001881
041	CORDGE	5,769	4,822	947	4,798	24	0.005216	0.004338	0.000022
044	OMUTEX	1,403	1,128	275	1,128	0	0.001268	0.001020	0.000000
049	PULPAP	8,497	5,536	2,961	5,476	60	0.007682	0.005005	0.000054
050	PAPPRO	26,112	14,527	11,585	10,659	3,868	0.023608	0.013134	0.003497
051	BOOKS	142	115	27	115	0	0.000128	0.000104	0.000000
052	PRINTS	1,928	1,928	0	1,767	161	0.001743	0.001743	0.001598
055	TIRES	1,066	805	261	681	124	0.000964	0.000728	0.000616
057	B CHEM	8,478	7,077	1,401	2,748	4,329	0.007665	0.006398	0.003914
063	DRUGS	1,971	1,482	489	1,478	4	0.001782	0.001340	0.000004
065	O CHEM	8,598	7,279	1,319	2,371	4,908	0.007773	0.006581	0.004437
066	PETROL	389,835	315,952	73,883	306,645	9,307	0.352448	0.277236	0.008414
067	CEMENT	1,316	1,056	260	1,056	0	0.001190	0.000955	0.000000
068	STRCLP	3,637	2,581	1,056	867	1,714	0.003288	0.002333	0.001550
070	ONMETP	4,445	3,287	1,158	945	2,342	0.004019	0.002972	0.002117
072	B OMET	53	16	7	27	19	0.000048	0.000042	0.000017
073	HARDWR	11	8	3	5	3	0.000010	0.000007	0.000003
076	FABMET	821	681	140	498	183	0.000742	0.000616	0.000450
078	INDMCH	241	153	88	70	83	0.000218	0.000138	0.000075
079	GENMCH	26	16	10	11	5	0.000024	0.000014	0.000005
080	OFFMCH	82	51	31	22	29	0.000074	0.000046	0.000026
081	ELCMCH	46	41	5	16	25	0.000042	0.000037	0.000014
084	ELCAPP	541	401	140	401	0	0.000489	0.000363	0.000000
092	O MANF	247	165	82	137	28	0.000223	0.000149	0.000025
094	ELESUP	18,871	18,871	0	18,871	0	0.017061	0.017061	0.000000
096	WATERS	174	174	0	174	0	0.000157	0.000157	0.000000
097	CONSTR	393	398	0	398	0	0.000360	0.000360	0.000000
098	WS TRD	0	107,526	-107,526	107,526	0	0.000000	0.097214	0.000000
100	BANK	3,317	3,317	0	3,317	0	0.002999	0.002999	0.000000
102	INSURA	5,690	5,690	0	5,690	0	0.005144	0.005144	0.000000
103	REALES	3,707	3,707	0	3,707	0	0.003351	0.003351	0.000000
104	RAIL T	0	198	-198	198	0	0.000000	0.000179	0.000000
105	OLANDT	571	2,461	-1,890	2,461	0	0.000516	0.002225	0.000000
106	WTR TR	0	1,513	-1,513	1,513	0	0.000000	0.001368	0.000000
107	AIR TR	330	330	0	330	0	0.000298	0.000298	0.000000
108	TR SRV	0	8,876	-8,876	8,876	0	0.000000	0.000825	0.000000
109	WAREHS	21	21	0	21	0	0.000019	0.000019	0.000000
110	COMMUN	702	702	0	702	0	0.000635	0.000635	0.000000
112	MEDSRV	4,960	4,960	0	4,960	0	0.004484	0.004484	0.000000
113	PROSRV	5,991	5,991	0	5,991	0	0.005416	0.005416	0.000000
114	ADVSRV	8,134	8,134	0	8,134	0	0.007354	0.007354	0.000000
115	OBSSRV	6,713	6,713	0	6,713	0	0.006069	0.006069	0.000000
116	RECSRV	2,668	2,668	0	2,668	0	0.002412	0.002412	0.000000
117	RESTRN	3,404	3,404	0	3,404	0	0.003078	0.003078	0.000000
118	HOTELS	1,509	1,509	0	1,509	0	0.001364	0.001364	0.000000
290	INTTTL	744,925	744,925	0	715,628	29,297	0.673483	0.673483	0.646998
301	WAGES	94,302	94,302	0	94,302	0	0.085258	0.085258	0.000000
302	DEPREC	98,732	98,732	0	98,732	0	0.089263	0.089263	0.000000
303	INDTAX	12,214	12,214	0	12,214	0	0.011043	0.011043	0.000000
304	OVA	155,905	155,905	0	155,905	0	0.140953	0.140953	0.000000
309	VA TTL	361,153	361,153	0	361,153	0	0.326517	0.326517	0.000000
600	CT	1,106,078	1,106,078	0	1,106,078	0	1.000000	1.000000	0.000000
700	TI	1,106,078	1,106,078	0	1,076,781	29,297	1.000000	0.973513	0.026487

**Appendix 9.3.4 Irrigation Program in Oriental Mindoro and It Comparison
with the Batangas Development Plan**

	1985	1986	1987	1988	1989	1990	Total
A National '000 P	19,000	39,600	50,200	23,200	15,850	—	147,850
A' '000\$	3,000	7,656	3,550	3,506	—	—	17,712
B Commercial '000P	33,026	33,026	33,026	33,026	33,026	33,601	198,731
B' '000\$	6,468	6,468	6,468	6,468	6,468	6,580	38,920
C = A + B '000P	52,026	72,626	83,226	66,226	48,876	33,601	356,581
D = A' + B' '000\$	9,468	14,124	10,018	9,974	6,468	6,508	56,560
F = D × 19 (1\$ = 19P)	179,892	268,356	190,342	189,506	122,892	123,652	1,074,640
Irrigation in Mindoro F = C + E '000P	231,918	340,982	273,568	255,732	171,768	157,253	1,431,221
G Irrigation in Orie Mindoro (F × 62%*)	143,789	211,409	169,612	158,554	106,496	97,497	887,357
H Batangas ('000P) Development Plan ('000P)	—	3,699	3,700	145,539	106,062	—	259,000
H/(G + H) %	—	—	—	—	—	—	22.6

Data source: NEA

Note *) 62% is the ratio of Orie. Mindoro's area to the area of all Mindoro.

Appendix 9.3.5 Calculation Transportation Costs

According to the NTPP report, the operation cost of each vessel selected is as follows.

Unit ₱ at 1980 prices

Vessel Selected	Ro-Ro	Non Ro-Ro
Annual Operating Cost	1,098,000	2,942,000
Daily Ship Cost in Port (350 days per annum)	3,137	8,406
Daily fuel cost at sea (₱691 per hour five hours at sea)	3,455	7,944
Daily Ship Cost (A)	6,592	16,351
Trans. ton	140 t	308 t
Trans. ton-Km	88 K.M (1 x 5 x 1.6)	533 K.M
Ton Kilo-meter Per Day (B)	12,320	164,164
Ship Cost Per ton-km (A)/(B)	0.54	0.10

The following regional consumer index is used in order to convert the above ship cost per ton-Km at 1980 prices in 1984 prices.

Consumer index in Region IV (detailed in appendix 9.3.7)

	Total	Price
1980	133.8	170.9
1984	259.0	269.9
1984/1980	1.935	2.164

The result of price conversion are shown as below:

Unit: ₱ at 1984 price

	Ro-Ro	Non Ro-Ro
Ship Cost	6,070	16,265
Fuel Cost	7,477	17,191
Ship Cost at See	13,547	33,456
Ship Cost per ton-Km	0.91	0.20

Accordingly, in considering the distance between Batangas and Calapan (42 Km), the transportation costs, composed of operation costs and cargo handling costs, are calculated in the table below.

(₱ per ton)

	Ro-Ro	Non Ro-Ro
Operation Costs	38.22	8.40
Cost of Arrastre and Stevedoring	0	31.00*)
Transportation Cost between Batangas and Calapan (one way)	38.22	39.40

Note: *) Calculated at 15 ₱/ton, which is cost of arrastre and stevedoring for palay (cheapest price among all kinds in cargo)

Figure 8. TIMECHARTER RATES FOR DRY CARGO VESSELS
(Based on one-year period with fairly prompt delivery)

a— Multi-deckers 10-19,999 DWT d— Bulk carriers 50-69,999 DWT
 b— Bulk carriers 20-34,999 DWT e— Bulk carriers +120,000 DWT
 c— Bulk carriers 35-49,999 DWT

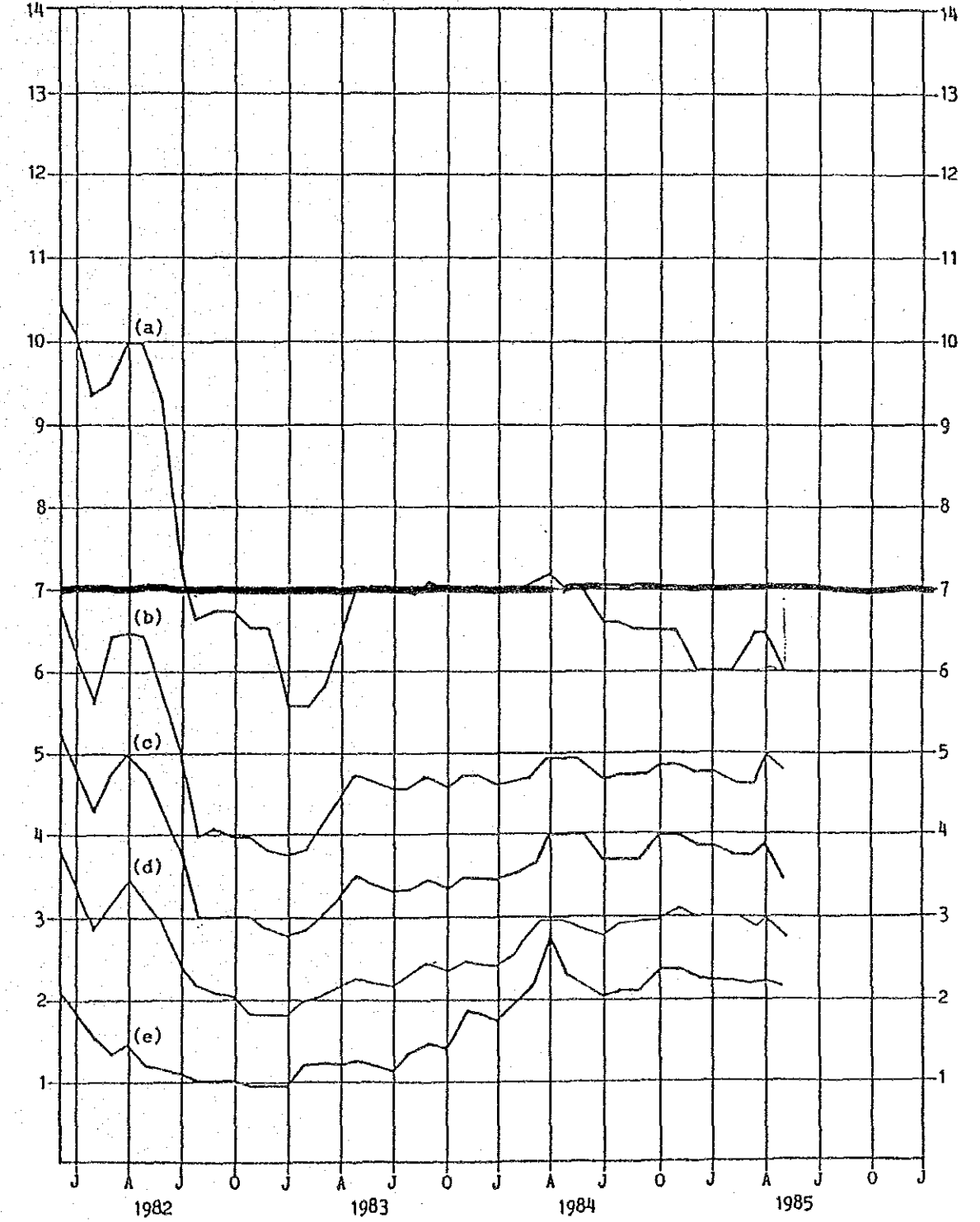

Appendix 9.3.7 Consumer Price Index for Region IV

	All Items	Food Beverages & Tobacco	Clothing	Housing & Repairs	Aid, Light & Water	Services	Miscel- lanous
1978	100	100	100	100	100	100	100
1979	114.4	113.4	115.7	110.8	121.8	116.6	166.1
1980	133.8	130.3	136.4	129.0	170.9	140.4	135.5
1981	152.7	149.6	153.2	145.2	201.4	160.7	147.2
1982	170.5	164.8	173.2	166.2	243.8	186.7	159.9
1983	187.8	179.2	192.4	183.2	284.9	204.6	175.0
1984/6	259.0	255.1	285.3	207.4	369.9	269.1	264.6

Source: Philippine Year Book

Appendix 9.5.1

IRR CALCULATION

***** Batangas Port (Base Case)

***** IRR(%) = 35.05

NO.	YEAR	COST	BENEFIT	BNFT. -COST	P. COST	P. BNFT	P. VALUE
1	1984	0.00	0.00	0.00	0.00	0.00	0.00
2	1985	0.00	0.00	0.00	0.00	0.00	0.00
3	1986	4102.00	0.00	-4102.00	2248.97	0.00	-2248.97
4	1987	4102.00	0.00	-4102.00	1665.25	0.00	-1665.25
5	1988	161617.00	0.00	-161617.00	48580.70	0.00	-48580.70
6	1989	110125.00	0.00	-110125.00	24510.80	0.00	-24510.80
7	1990	2187.00	123480.00	121293.00	360.42	20349.90	19989.50
8	1991	2187.00	123480.00	121293.00	266.88	15068.00	14801.10
9	1992	2187.00	123480.00	121293.00	197.61	11157.10	10959.50
10	1993	2187.00	123480.00	121293.00	146.32	8261.22	8114.90
11	1994	2187.00	123480.00	121293.00	108.34	6117.00	6008.66
12	1995	2187.00	123480.00	121293.00	80.22	4529.32	4449.10
13	1996	2187.00	123480.00	121293.00	59.40	3353.72	3294.32
14	1997	2187.00	123480.00	121293.00	43.98	2483.25	2439.27
15	1998	2187.00	123480.00	121293.00	32.57	1838.72	1806.15
16	1999	2187.00	123480.00	121293.00	24.11	1361.47	1337.36
17	2000	2187.00	123480.00	121293.00	17.85	1008.10	990.25
18	2001	2187.00	123480.00	121293.00	13.22	746.44	733.22
19	2002	2187.00	123480.00	121293.00	9.79	552.70	542.91
20	2003	2187.00	123480.00	121293.00	7.25	409.25	402.00
21	2004	2187.00	123480.00	121293.00	5.37	303.03	297.66
22	2005	2187.00	123480.00	121293.00	3.97	224.38	220.40
23	2006	2187.00	123480.00	121293.00	2.94	166.14	163.20
24	2007	2187.00	123480.00	121293.00	2.18	123.02	120.84
25	2008	2187.00	123480.00	121293.00	1.61	91.09	89.47
26	2009	2187.00	123480.00	121293.00	1.19	67.45	66.25
27	2010	2187.00	123480.00	121293.00	0.88	49.94	49.06
28	2011	2187.00	123480.00	121293.00	0.65	36.98	36.32
29	2012	2187.00	123480.00	121293.00	0.48	27.38	26.90
30	2013	2187.00	123480.00	121293.00	0.36	20.27	19.91
31	2014	2187.00	123480.00	121293.00	0.27	15.01	14.75
32	2015	2187.00	123480.00	121293.00	0.20	11.12	10.92
33	2016	2187.00	123480.00	121293.00	0.15	8.23	8.08
34	2017	2187.00	123480.00	121293.00	0.11	6.09	5.99
35	2018	2187.00	123480.00	121293.00	0.08	4.51	4.43
36	2019	2187.00	123480.00	121293.00	0.06	3.34	3.28
TOTAL		345556.00	3704400.00	3358840.00	78394.20	78394.10	-0.03

UNIT = 1000 Pesos

Appendix 9.6.1

IRR CALCULATION

***** Batangas Port (Case A)
 ***** IRR(%) = 19.69

NO.	YEAR	COST	BENEFIT	BNFT. -COST	P. COST	P. BNFT	P. VALUE
1	1984	0.00	0.00	0.00	0.00	0.00	0.00
2	1985	0.00	0.00	0.00	0.00	0.00	0.00
3	1986	4102.00	0.00	-4102.00	2863.22	0.00	-2863.22
4	1987	4102.00	0.00	-4102.00	2392.13	0.00	-2392.13
5	1988	161617.00	0.00	-161617.00	78741.70	0.00	-78741.70
6	1989	110125.00	0.00	-110125.00	44826.30	0.00	-44826.30
7	1990	2187.00	64798.00	62611.00	743.75	22036.30	21292.50
8	1991	2187.00	64798.00	62611.00	621.38	18410.60	17789.20
9	1992	2187.00	64798.00	62611.00	519.14	15381.50	14862.30
10	1993	2187.00	64798.00	62611.00	433.72	12850.70	12417.00
11	1994	2187.00	64798.00	62611.00	362.36	10736.30	10374.00
12	1995	2187.00	64798.00	62611.00	302.74	8969.86	8667.12
13	1996	2187.00	64798.00	62611.00	252.93	7494.03	7241.09
14	1997	2187.00	64798.00	62611.00	211.32	6261.01	6049.70
15	1998	2187.00	64798.00	62611.00	176.55	5230.87	5054.32
16	1999	2187.00	64798.00	62611.00	147.50	4370.22	4222.72
17	2000	2187.00	64798.00	62611.00	123.23	3651.18	3527.95
18	2001	2187.00	64798.00	62611.00	102.96	3050.44	2947.48
19	2002	2187.00	64798.00	62611.00	86.02	2548.54	2462.53
20	2003	2187.00	64798.00	62611.00	71.86	2129.22	2057.36
21	2004	2187.00	64798.00	62611.00	60.04	1778.90	1718.86
22	2005	2187.00	64798.00	62611.00	50.16	1486.21	1436.05
23	2006	2187.00	64798.00	62611.00	41.91	1241.68	1199.77
24	2007	2187.00	64798.00	62611.00	35.01	1037.38	1002.37
25	2008	2187.00	64798.00	62611.00	29.25	866.70	837.45
26	2009	2187.00	64798.00	62611.00	24.44	724.10	699.66
27	2010	2187.00	64798.00	62611.00	20.42	604.96	584.54
28	2011	2187.00	64798.00	62611.00	17.06	505.43	488.37
29	2012	2187.00	64798.00	62611.00	14.25	422.27	408.01
30	2013	2187.00	64798.00	62611.00	11.91	352.79	340.88
31	2014	2187.00	64798.00	62611.00	9.95	294.74	284.80
32	2015	2187.00	64798.00	62611.00	8.31	246.25	237.94
33	2016	2187.00	64798.00	62611.00	6.94	205.73	198.79
34	2017	2187.00	64798.00	62611.00	5.80	171.88	166.08
35	2018	2187.00	64798.00	62611.00	4.85	143.60	138.76
36	2019	2187.00	64798.00	62611.00	4.05	119.98	115.93
TOTAL		345556.00	1943940.00	1598380.00	133323.00	133323.00	0.15

UNIT = 1000 Pesos

Appendix 9.6.2

IRR CALCULATION

***** Batangas Port(Case B)

***** IRR(%) = 32.31

NO.	YEAR	COST	BENEFIT	BNFT. -COST	P. COST	P. BNFT	P. VALUE
1	1984	0.00	0.00	0.00	0.00	0.00	0.00
2	1985	0.00	0.00	0.00	0.00	0.00	0.00
3	1986	4512.00	0.00	-4512.00	2577.25	0.00	-2577.25
4	1987	4512.00	0.00	-4512.00	1947.83	0.00	-1947.83
5	1988	177779.00	0.00	-177779.00	58003.80	0.00	-58003.80
6	1989	121138.00	0.00	-121138.00	29871.00	0.00	-29871.00
7	1990	2367.00	123480.00	121113.00	441.13	23012.30	22571.20
8	1991	2367.00	123480.00	121113.00	333.39	17392.20	17058.80
9	1992	2367.00	123480.00	121113.00	251.97	13144.60	12892.70
10	1993	2367.00	123480.00	121113.00	190.43	9934.42	9743.99
11	1994	2367.00	123480.00	121113.00	143.93	7508.21	7364.29
12	1995	2367.00	123480.00	121113.00	108.78	5674.54	5565.76
13	1996	2367.00	123480.00	121113.00	82.21	4288.69	4206.48
14	1997	2367.00	123480.00	121113.00	62.13	3241.30	3179.16
15	1998	2367.00	123480.00	121113.00	46.96	2449.70	2402.74
16	1999	2367.00	123480.00	121113.00	35.49	1851.43	1815.94
17	2000	2367.00	123480.00	121113.00	26.82	1399.27	1372.44
18	2001	2367.00	123480.00	121113.00	20.27	1057.53	1037.26
19	2002	2367.00	123480.00	121113.00	15.32	799.26	783.94
20	2003	2367.00	123480.00	121113.00	11.58	604.06	592.48
21	2004	2367.00	123480.00	121113.00	8.75	456.54	447.79
22	2005	2367.00	123480.00	121113.00	6.61	345.04	338.43
23	2006	2367.00	123480.00	121113.00	5.00	260.77	255.78
24	2007	2367.00	123480.00	121113.00	3.78	197.09	193.31
25	2008	2367.00	123480.00	121113.00	2.86	148.95	146.10
26	2009	2367.00	123480.00	121113.00	2.16	112.58	110.42
27	2010	2367.00	123480.00	121113.00	1.63	85.08	83.45
28	2011	2367.00	123480.00	121113.00	1.23	64.30	63.07
29	2012	2367.00	123480.00	121113.00	0.93	48.60	47.67
30	2013	2367.00	123480.00	121113.00	0.70	36.73	36.03
31	2014	2367.00	123480.00	121113.00	0.53	27.76	27.23
32	2015	2367.00	123480.00	121113.00	0.40	20.98	20.58
33	2016	2367.00	123480.00	121113.00	0.30	15.86	15.55
34	2017	2367.00	123480.00	121113.00	0.23	11.98	11.75
35	2018	2367.00	123480.00	121113.00	0.17	9.06	8.88
36	2019	2367.00	123480.00	121113.00	0.13	6.85	6.71
TOTAL		378951.00	3704400.00	3325450.00	94205.80	94205.70	-0.01

UNIT = 1000 Pesos

Appendix 9.6.3

IRR CALCULATION

***** Batangas Port (Case C)

***** IRR(%) = 34.69

NO.	YEAR	COST	BENEFIT	BNFT. - COST	P. COST	P. BNFT	P. VALUE
1	1984	0.00	0.00	0.00	0.00	0.00	0.00
2	1985	0.00	0.00	0.00	0.00	0.00	0.00
3	1986	4361.00	0.00	-4361.00	2403.86	0.00	-2403.86
4	1987	4361.00	0.00	-4361.00	1784.72	0.00	-1784.72
5	1988	173596.00	0.00	-173596.00	52745.60	0.00	-52745.60
6	1989	115748.00	0.00	-115748.00	26110.90	0.00	-26110.90
7	1990	2299.00	130025.00	127726.00	385.04	21776.90	21391.90
8	1991	2299.00	130025.00	127726.00	285.87	16168.00	15882.20
9	1992	2299.00	130025.00	127726.00	212.24	12003.80	11791.60
10	1993	2299.00	130025.00	127726.00	157.58	8912.11	8754.54
11	1994	2299.00	130025.00	127726.00	116.99	6616.71	6499.72
12	1995	2299.00	130025.00	127726.00	86.86	4912.51	4825.66
13	1996	2299.00	130025.00	127726.00	64.49	3647.25	3582.76
14	1997	2299.00	130025.00	127726.00	47.88	2707.86	2659.99
15	1998	2299.00	130025.00	127726.00	35.55	2010.43	1974.88
16	1999	2299.00	130025.00	127726.00	26.39	1492.62	1466.23
17	2000	2299.00	130025.00	127726.00	19.59	1108.18	1088.59
18	2001	2299.00	130025.00	127726.00	14.55	822.76	808.21
19	2002	2299.00	130025.00	127726.00	10.80	610.85	600.05
20	2003	2299.00	130025.00	127726.00	8.02	453.52	445.50
21	2004	2299.00	130025.00	127726.00	5.95	336.71	330.76
22	2005	2299.00	130025.00	127726.00	4.42	249.99	245.57
23	2006	2299.00	130025.00	127726.00	3.28	185.60	182.32
24	2007	2299.00	130025.00	127726.00	2.44	137.80	135.36
25	2008	2299.00	130025.00	127726.00	1.81	102.31	100.50
26	2009	2299.00	130025.00	127726.00	1.34	75.96	74.61
27	2010	2299.00	130025.00	127726.00	1.00	56.39	55.40
28	2011	2299.00	130025.00	127726.00	0.74	41.87	41.13
29	2012	2299.00	130025.00	127726.00	0.55	31.08	30.54
30	2013	2299.00	130025.00	127726.00	0.41	23.08	22.67
31	2014	2299.00	130025.00	127726.00	0.30	17.13	16.83
32	2015	2299.00	130025.00	127726.00	0.22	12.72	12.50
33	2016	2299.00	130025.00	127726.00	0.17	9.44	9.28
34	2017	2299.00	130025.00	127726.00	0.12	7.01	6.89
35	2018	2299.00	130025.00	127726.00	0.09	5.21	5.11
36	2019	2299.00	130025.00	127726.00	0.07	3.87	3.80
TOTAL		367036.00	3900750.00	3533710.00	84539.80	84539.70	-0.02

UNIT = 1000 Pesos

Appendix 9.6.4

***** IRR CALCULATION *****

***** Batangas Port(Case D)

***** IRR(%) = 31.29

NO.	YEAR	COST	BENEFIT	BNFT. -COST	P. COST	P. BNFT	P. VALUE
1	1984	0.00	0.00	0.00	0.00	0.00	0.00
2	1985	0.00	0.00	0.00	0.00	0.00	0.00
3	1986	4102.00	0.00	-4102.00	2379.90	0.00	-2379.90
4	1987	4102.00	0.00	-4102.00	1812.76	0.00	-1812.76
5	1988	161617.00	0.00	-161617.00	54401.90	0.00	-54401.90
6	1989	110125.00	0.00	-110125.00	28235.50	0.00	-28235.50
7	1990	2187.00	108170.00	105983.00	427.11	21125.00	20697.90
8	1991	2187.00	108170.00	105983.00	325.33	16090.90	15765.50
9	1992	2187.00	108170.00	105983.00	247.80	12256.40	12008.50
10	1993	2187.00	108170.00	105983.00	188.75	9335.62	9146.87
11	1994	2187.00	108170.00	105983.00	143.77	7110.90	6967.13
12	1995	2187.00	108170.00	105983.00	109.51	5416.35	5306.84
13	1996	2187.00	108170.00	105983.00	83.41	4125.61	4042.20
14	1997	2187.00	108170.00	105983.00	63.53	3142.46	3078.93
15	1998	2187.00	108170.00	105983.00	48.39	2393.60	2345.21
16	1999	2187.00	108170.00	105983.00	36.86	1823.20	1786.34
17	2000	2187.00	108170.00	105983.00	28.08	1388.72	1360.65
18	2001	2187.00	108170.00	105983.00	21.39	1057.78	1036.40
19	2002	2187.00	108170.00	105983.00	16.29	805.71	789.42
20	2003	2187.00	108170.00	105983.00	12.41	613.71	601.30
21	2004	2187.00	108170.00	105983.00	9.45	467.46	458.01
22	2005	2187.00	108170.00	105983.00	7.20	356.06	348.86
23	2006	2187.00	108170.00	105983.00	5.48	271.21	265.73
24	2007	2187.00	108170.00	105983.00	4.18	206.58	202.40
25	2008	2187.00	108170.00	105983.00	3.18	157.35	154.17
26	2009	2187.00	108170.00	105983.00	2.42	119.85	117.43
27	2010	2187.00	108170.00	105983.00	1.85	91.29	89.45
28	2011	2187.00	108170.00	105983.00	1.41	69.54	68.13
29	2012	2187.00	108170.00	105983.00	1.07	52.97	51.90
30	2013	2187.00	108170.00	105983.00	0.82	40.34	39.53
31	2014	2187.00	108170.00	105983.00	0.62	30.73	30.11
32	2015	2187.00	108170.00	105983.00	0.47	23.41	22.93
33	2016	2187.00	108170.00	105983.00	0.36	17.83	17.47
34	2017	2187.00	108170.00	105983.00	0.27	13.58	13.31
35	2018	2187.00	108170.00	105983.00	0.21	10.34	10.13
36	2019	2187.00	108170.00	105983.00	0.16	7.88	7.72
TOTAL		345556.00	3245100.00	2899540.00	88621.80	88622.30	0.52

UNIT = 1000 Pesos

Appendix 9.6.5

IRR CALCULATION

***** Batangas Port(Case E)

***** IRR(%) = 33.80

NO.	YEAR	COST	BENEFIT	BNFT.-COST	P. COST	P. BNFT	P. VALUE
1	1984	0.00	0.00	0.00	0.00	0.00	0.00
2	1985	0.00	0.00	0.00	0.00	0.00	0.00
3	1986	4102.00	0.00	-4102.00	2291.40	0.00	-2291.40
4	1987	4102.00	0.00	-4102.00	1712.59	0.00	-1712.59
5	1988	161617.00	0.00	-161617.00	50431.20	0.00	-50431.20
6	1989	110125.00	0.00	-110125.00	25683.30	0.00	-25683.30
7	1990	2187.00	118310.00	116123.00	381.21	20622.40	20241.20
8	1991	2187.00	118310.00	116123.00	284.92	15413.20	15128.30
9	1992	2187.00	118310.00	116123.00	212.95	11519.80	11306.90
10	1993	2187.00	118310.00	116123.00	159.16	8609.90	8450.74
11	1994	2187.00	118310.00	116123.00	118.95	6435.04	6316.08
12	1995	2187.00	118310.00	116123.00	88.91	4809.54	4720.64
13	1996	2187.00	118310.00	116123.00	66.45	3594.65	3528.20
14	1997	2187.00	118310.00	116123.00	49.66	2686.64	2636.98
15	1998	2187.00	118310.00	116123.00	37.12	2008.00	1970.88
16	1999	2187.00	118310.00	116123.00	27.74	1500.78	1473.03
17	2000	2187.00	118310.00	116123.00	20.73	1121.68	1100.94
18	2001	2187.00	118310.00	116123.00	15.50	838.34	822.85
19	2002	2187.00	118310.00	116123.00	11.58	626.58	614.99
20	2003	2187.00	118310.00	116123.00	8.66	468.30	459.65
21	2004	2187.00	118310.00	116123.00	6.47	350.01	343.54
22	2005	2187.00	118310.00	116123.00	4.84	261.60	256.76
23	2006	2187.00	118310.00	116123.00	3.61	195.52	191.90
24	2007	2187.00	118310.00	116123.00	2.70	146.13	143.43
25	2008	2187.00	118310.00	116123.00	2.02	109.22	107.20
26	2009	2187.00	118310.00	116123.00	1.51	81.63	80.12
27	2010	2187.00	118310.00	116123.00	1.13	61.01	59.88
28	2011	2187.00	118310.00	116123.00	0.84	45.60	44.76
29	2012	2187.00	118310.00	116123.00	0.63	34.08	33.45
30	2013	2187.00	118310.00	116123.00	0.47	25.47	25.00
31	2014	2187.00	118310.00	116123.00	0.35	19.04	18.69
32	2015	2187.00	118310.00	116123.00	0.26	14.23	13.97
33	2016	2187.00	118310.00	116123.00	0.20	10.63	10.44
34	2017	2187.00	118310.00	116123.00	0.15	7.95	7.80
35	2018	2187.00	118310.00	116123.00	0.11	5.94	5.83
36	2019	2187.00	118310.00	116123.00	0.08	4.44	4.36
TOTAL		345556.00	3549300.00	3203740.00	81627.30	81627.30	-0.03

UNIT = 1000 Pesos

Appendix Table 10.3.1

PHILIPPINE PORTS AUTHORITY
Consolidated Statement of Revenue and Expenses
For the Year Ended December 31, 1984

<u>Revenue from Operations -</u>	<u>Consolidated</u>	<u>Central Office</u>	<u>All PMU'S</u>
Berthing Charges	₱ 45,920,434.73	₱ -	₱ 45,920,434.73
Anchorage Fees	10,199,915.93	-	10,199,915.93
Wharfage Dues	181,536,637.81	-	181,536,637.81
Storage Charges	26,719,361.52	-	26,719,361.52
Arrastre Income	85,920,063.52	-	85,920,063.52
Port Usage Fee	27,645,287.07	-	27,645,287.07
Lay-up Fee	1,559,053.62	-	1,559,053.62
Harbor Fee	33,250,987.13	-	33,250,987.13
Other Income	31,771,463.69	467,858.36	31,303,605.33
Fund Management Income	58,809,409.98	58,809,409.98	-
Total Revenue	₱503,332,615.00	₱ 59,277,268.34	₱444,055,346.66
Less: Operating Expenses - Note 8			
Personnel Services			
Salaries & Wages	₱ 34,291,824.78	₱ 9,748,453.55	₱ 24,543,371.23
Social Security Premium	4,158,355.27	1,225,449.62	2,932,905.65
Manpower Development	42,098.39	14,509.44	27,588.95
Professional Fees	156,763.00	156,763.00	-
Other Staff Benefits	24,222,159.77	7,108,717.00	17,113,442.77
Maintenance & Operating Expenses:			
Repairs & Maintenance - Note 9	41,837,915.33	12,039,611.65	29,798,303.68
Supplies & Materials	1,916,148.44	411,781.49	1,504,366.95
Fuel, Oil & Lubricant	1,743,246.49	667,337.97	1,075,908.52
Light, Power & Water	4,625,824.87	1,515,882.04	3,109,942.83
Rent	3,736,318.88	2,944,798.88	791,520.00
Travelling	1,050,188.87	397,645.66	652,543.21
Security Services	3,963,772.11	235,374.90	3,728,397.21
Representation	483,557.90	351,557.90	132,000.00
Communication Services	932,368.85	312,318.02	620,050.83
Athletics	51,400.00	24,700.00	26,700.00
Taxes, Licenses & Fees	15,517,695.32	1,582,219.42	13,935,475.90
Insurance	8,265,385.66	8,265,385.66	-
Advertising & Promotion	7,606.00	7,606.00	-
Donations & Contributions	5,000.00	5,000.00	-
Bank Charges	8,761.34	8,311.34	450.00
Miscellaneous	1,372,689.57	1,061,508.13	311,181.44
Auditing Services	3,481,044.02	2,732,590.71	748,453.31
Meetings & Conferences	278,148.05	39,637.76	238,510.29
Medical Expenses	705,048.65	368,591.74	336,456.91
Depreciation Expenses	88,947,969.51	31,342,715.00	57,605,254.51
Dredging Expense	50,829,720.00	50,829,720.00	-
Amortization of Vitas Project	13,705,503.29	13,705,503.29	-
Total Operating Expenses	₱306,336,514.36	₱147,103,690.17	₱159,232,824.19
Add: Other Expenses in excess of Appropriation			
Interest on Loans	₱ 93,021,565.44	₱ 93,021,565.44	-
Currency Exchange Adjustments	35,187,935.42	35,187,935.42	-
Total	₱128,209,500.86	₱128,209,500.86	₱ -
Total Operating Expenses & Other Expenses in excess of Appropriation	₱434,546,015.22	₱275,313,191.03	₱159,232,824.19
Net Income (Loss) from Operations	₱ 68,786,599.78	(₱216,035,922.69)	₱284,822,522.47

Appendix Table 10.3.2

PHILIPPINE PORTS AUTHORITY
Comparative Consolidated Balance Sheet
As of December 31, 1984 and 1983

<u>A S S E T S</u>	1984	1983	Increase (Decrease)
<u>Current Assets</u>			
Cash on hand and in banks	P 183,348,402.00	P 227,985,754.00	(P 44,637,352.00)
Temporary Investments	418,356,862.00	291,757,679.00	126,599,183.00
Accounts Receivable	49,340,162.00	44,854,572.00	4,485,590.00
Other Current Assets	123,521,770.00	125,693,418.00	(2,171,648.00)
<u>Total Current Assets</u>	<u>774,567,196.00</u>	<u>690,291,423.00</u>	<u>84,275,773.00</u>
<u>Permanent Investment</u>			
Bond Sinking Fund	10,646,276.00	10,286,258.00	360,018.00
<u>Fixed Assets</u>			
<u>Non-Depreciable Assets</u>			
Land	604,732,197.00	604,732,197.00	- 0 -
Construction in progress	948,055,517.00	716,649,204.00	231,406,313.00
<u>Total Non-Depreciable Assets</u>	<u>1,552,787,714.00</u>	<u>1,321,381,401.00</u>	<u>231,406,313.00</u>
<u>Depreciable Assets</u>			
Land Improvement	2,253,165,639.00	2,253,792,941.00	(627,302.00)
Furniture, Fixtures & Equipment	578,201,085.00	555,487,068.00	22,714,017.00
<u>Total Depreciable Assets</u>	<u>2,831,366,724.00</u>	<u>2,809,280,009.00</u>	<u>(22,086,715.00)</u>
Less: Accumulated Depreciation	1,050,374,772.00	963,086,699.00	87,288,073.00
<u>Total Net of Depreciation</u>	<u>1,780,991,952.00</u>	<u>1,846,193,310.00</u>	<u>(65,201,358.00)</u>
<u>Total Fixed Assets</u>	<u>3,333,779,666.00</u>	<u>3,167,574,711.00</u>	<u>166,204,955.00</u>
<u>Deferred Charges</u>			
Deferred Dredging	-	127,393,704.00	(127,393,704.00)
<u>Total Deferred Charges</u>	<u>-</u>	<u>127,393,704.00</u>	<u>(127,393,704.00)</u>
<u>Other Assets</u>			
Contingent Assets	3,750,622.00	4,134,989.00	(384,367.00)
<u>Total Other Assets</u>	<u>3,750,622.00</u>	<u>4,134,989.00</u>	<u>(384,367.00)</u>
<u>TOTAL ASSETS</u>	<u>P4,122,743,760.00</u>	<u>P3,999,681,085.00</u>	<u>P123,062,675.00</u>
<u>LIABILITIES AND NET WORTH</u>			
<u>Current Liabilities</u>			
Accounts Payable	P 199,875,574.00	P 240,553,818.00	(P 40,678,244.00)
Other Current Liabilities	15,149,949.00	13,157,092.00	1,992,857.00
<u>Total Current Liabilities</u>	<u>215,025,523.00</u>	<u>253,710,910.00</u>	<u>(38,685,387.00)</u>
<u>Long Term Liabilities</u>	<u>1,066,046,304.00</u>	<u>854,909,668.00</u>	<u>211,136,636.00</u>
<u>Other Liabilities</u>			
Contingent Liabilities	300,901.00	232,039.00	68,862.00
<u>TOTAL LIABILITIES</u>	<u>1,281,372,728.00</u>	<u>1,108,852,617.00</u>	<u>172,520,111.00</u>
<u>NET WORTH</u>			
Capital Contribution	P2,390,761,703.00	P2,390,768,139.00	(P 6,436.00)
Surplus Reserve	4,164,635.00	3,804,427.00	360,208.00
Retained Earnings 1983/1982	496,255,902.00	400,446,762.00	95,809,140.00
Less: Correction on Prior Year's Earning Balance	118,597,808.00	13,017,873.00	105,579,935.00
Add: Net Income from Operations	68,786,600.00	108,827,013.00	(40,040,413.00)
Retained Earnings - 1984/1983	446,444,694.00	496,255,902.00	(49,811,208.00)
<u>TOTAL NET WORTH</u>	<u>2,841,371,032.00</u>	<u>2,890,828,468.00</u>	<u>(49,457,436.00)</u>
<u>TOTAL LIABILITIES AND NET WORTH</u>	<u>P4,122,743,760.00</u>	<u>P3,999,681,085.00</u>	<u>P123,062,675.00</u>

Appendix Table 10.3.3 1985 Port Tariff Rates

A. CHARGES ON VESSELS

1. Vessels engaged in international (foreign) trade that enter any port whether private or government shall be charged a HARBOR FEE on each call based on GRT, as follows:

1 9 8 5	
April	October 1
\$ 0.054/GRT	\$ 0.062/GRT

2. Vessels engaged in international (foreign) trade that berth at any port of call shall also be charged a BERTHING FEE per GRT per calendar day or fraction, as follows, provided that, for purposes of computation, a maximum of 30,000 GRT shall be used:

1 9 8 5	
April 1	October 1
At a Government Port \$ 0.026/GRT	\$ 0.030/GRT
At a Private Port \$ 0.019/GRT	\$ 0.021/GRT

3. Vessels engaged in international (foreign) trade that do not berth but drop anchor at either a government or privately-owned port shall also be charged an ANCHORAGE FEE of one-half (1/2) of the corresponding berthing fee at a government port subject to the same maximum 30,000 GRT, as follows:

1 9 8 5

APRIL 1

OCTOBER 1

\$ 0.013/GRT

\$ 0.015/GRT

4. Vessels engaged in coastal (domestic) trade that berth or drop anchor at any port whether government or privately-owned shall be charged a port USAGE FEE, as follows:

1 9 8 5

April 1

October 1

Up to 5 GRT

NO CHARGE

6 to 100 GRT per calendar day or fraction

P 16.40

P 18.80

Over 100 GRT per GRT per calendar day or fraction

P 0.164

P 0.188

PROVIDED that the USAGE FEE shall also apply on those vessels authorized to engage in the so-called "Barter Trade" and, PROVIDED FURTHER that registered bay and river trade vessels shall pay one-half (1/2) of the required USAGE FEE but in no case less than or more than the following charges for a calendar day or fraction:

1 9 8 5

April 1

October 1

Not less than

P 16.40

P 18.80

Nor more than

P 82.00

P 94.00

5. Vessels engaged in coastal (domestic) trade that are authorized to temporarily lay up and anchor at any port shall be charged a LAY UP FEE corresponding to one-half of the applicable USAGE FEE.

	1 9 8 5	
	April 1	October 1
6 - 100 GRT per calendar day or fraction	P 8.20	P 9.40
Over 100 GRT per GRT per calendar day or fraction	P 0.082	P 0.094

B. CHARGES ON CARGOES

6. All non-containerized foreign cargoes coming from (imported), going out (exported) or transhipped through a government-owned wharf shall be charged a WHARFAGE FEE for the use of port facilities on the basis of the total revenue tonnage rounded off to the nearest ton, as follows

	1 9 8 5	
	April 1	October 1
If Imported, per revenue ton	P 20.50	P 23.50
If Exported, per revenue ton	P 10.25	P 11.75
Foreign Transhipment a single charge per revenue ton payable by the shipping/line agent	\$ 0.466	\$ 0.534

PROVIDED that the minimum charge shall be P5.00.

7. All containerized foreign cargoes wholly-owned by a single shipper/consignee (FCL) shall be charged a WHARFAGE FEE per box, as follows:

	1 9 8 5	
	April 1	October 1
<u>If Imported</u>		
20 - ft	P348.50	P399.50
35 - ft	440.75	505.25
40 - ft	522.75	599.25
45 - ft	615.00	705.00
<u>If Exported</u>		
20 - ft	P174.25	P199.75
35 - ft	221.40	253.80
40 - ft	262.40	300.80
45 - ft	307.50	352.50
<u>Foreign Transhipment</u>		
20 - ft	\$ 8.01	\$ 9.18
35 - ft	10.06	11.53
40 - ft	11.92	13.67
45 - ft	13.97	16.02

PROVIDED THAT if cargoes in a box are owned by more than one (1) shipper/consignee, that is, LCL containers, the WHARFAGE FEE for non-containerized cargoes shall apply; and PROVIDED FURTHER that NO WHARFAGE FEE shall be charged on empty containers, i.e., without contents of any sort.

8. All non-containerized domestic cargoes shall be charged a WHARFAGE FEE as they enter or leave a government-owned wharf on the basis of their total revenue tonnage rounded off to the nearest ton at rates as follows:

	1 9 8 5	
	April 1	October 1
Per revenue ton	P 1.44	P 1.65

PROVIDED that the minimum charge shall be P1.00.

9. Domestic containerized cargoes wholly-owned by a single shipper/consignee (FCL) shall be charged a WHARFAGE FEE on a box basis as the box enters or leave a government-owned wharf at the following rates.

	1 9 8 5	
	April 1	October 1
10 - ft box or shorter	P 11.48	P 13.16
20 - ft	22.96	26.32
35 - ft	28.70	32.90
40 - ft	34.44	39.48
45 - ft	40.18	46.06

PROVIDED that if cargoes in a box are owned by more than one shipper/consignee (LCL), the wharfage fee for non-containerized cargo shall apply.

PROVIDED FURTHER, that no wharfage fee shall be charged on an empty box, i.e., without contents of of any sort.

10. The WHARFAGE FEE for all foreign and domestic cargoes whether containerized or not that are loaded or discharged at a privately-owned wharf or at an anchorage area shall be one-half (1/2) of the corresponding charge for one (1) that is government-owned, as follows:

	1 9 8 5	
	April 1	October 1
a) Foreign		
<u>Non-Containerized</u>		
If Imported/R.T.	P 10.25	P 11.75
If Exported/R.T.	P 5.13	P 5.88
Transshipment/R.T.	\$ 0.23	\$ 0.27
<u>Containerized (FCL) (Per Box)</u>		
<u>If Imported:</u>		
20 - ft	P174.25	P199.75
35 - ft	221.40	253.80
40 - ft	262.40	300.80
45 - ft	307.50	352.50
<u>If Exported:</u>		
20 - ft	P 88.15	P101.05
35 - ft	110.70	126.90
40 - ft	131.20	150.40
45 - ft	153.75	176.25

1 9 8 5

April 1

October 1

Foreign Transshipment:

20 - ft	\$ 3.91	\$ 4.49
35 - ft	5.03	5.77
30 - ft	5.96	6.84
45 - ft	6.89	7.90

b) Domestic

<u>Non-Containerized</u>	P 0.72	P 0.82
--------------------------	--------	--------

Containerized (FCL)

(Per Box)

10 - ft	P 5.74	P 6.58
20 - ft	11.48	13.16
35 - ft	14.35	16.45
40 - ft	17.22	19.74
45 - ft	20.09	23.03

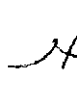
11. The WHARFAGE FEE for all foreign and domestic cargoes whether containerized or not that are loaded or discharged from a vessel at anchor without using any wharf of a government or privately-owned port shall be one-half (1/2) of the corresponding charge for one (1) that is government-owned. (Same as No. 10).
12. A STORAGE FEE shall be charged on cargoes that remain in any government-owned port beyond the "free storage period".
- 

The said period is defined for all types of cargoes as follows:

- a) For Imported cargoes 8 calendar days after the day that the last item of cargo is discharged from the carrying vessel.
- b) For Export Cargoes 5 calendar days from the day that the cargo is received at the port.
- c) For Foreign Transshipment a total of 15 calendar days from the day of arrival to the day of departure.
- d) For domestic Cargoes Entering any port 2 calendar days prior to the day that the carrying vessel is scheduled to arrive as announced and approved by the PPA Port Manager.
- e) For Domestic Cargoes discharged at any port 2 calendar days after the day that the last item of cargo is unloaded from the carrying vessel.
- f) For Domestic Cargoes that are "Shutout" (not loaded on their scheduled vessel) 2 calendar days after vessel's departure.

PROVIDED that if the cargo is not loaded as scheduled due to the fault of the vessel or its owner/agent, the resulting fee shall be paid for by the vessel or its owner/agent.

13. The STORAGE FEE for non-containerized cargoes shall be determined on the basis of the number of calendar days that the cargo stays in port after the "free storage period" and the total revenue tonnage of the cargo according to the following schedule per revenue ton per day or fraction, as follows:

	1 9 8 5	
	April 1	October 1
Imported Cargoes	P 6.56	P 7.52
Cargoes for Export	3.28	3.76
Foreign Transshipment	1.64	1.71
Domestic Cargoes	4.92	5.64

14. The STORAGE FEE of a container whether or not it contains cargo shall be determined on the basis of the number of calendar days the cargo stays in port after the prescribed "Free Storage Period", as follows:

	1 9 8 5	
	April 1	October 1
<u>Foreign Imported Box</u>		
20 - ft	P209.92	P240.64
35 - ft	367.36	421.12
40 - ft	419.84	481.28
45 - ft	472.32	541.44

	1 9 8 5	
	April 1	October 1
<u>Foreign Exported Box</u>		
20 - ft	P 52.48	P 60.16
35 - ft	91.84	105.28
40 - ft	104.96	120.32
45 - ft	117.26	134.42

R.Y.

1 9 8 5

April 1

October 1

Foreign Transhipped Box

20 - ft	\$ 4.77	\$ 5.47
35 - ft	8.35	9.57
40 - ft	9.54	10.94
45 - ft	10.66	12.22

Domestic Box

10 - ft	P 55.35	P 63.45
20 - ft	157.44	180.48
35 - ft	274.70	314.90
40 - ft	314.88	360.96

15. For those ports declared as congested by the PPA Board of Directors from time to time, the STORAGE CHARGE for the first 7 calendar days after the "Free Storage Period" shall be the rates prescribed above and thereafter shall be escalated, as follows:

- a) From 8th to the 15th calendar day, twice the prescribed rates.
- b) From the 16th to the 30th calendar day, thrice the prescribed rates.
- c) From the 31st calendar onward, four times the prescribed rates.

PROVIDED that foreign transshipment containers shall not be subject to the said escalation.

16. Extension of the prescribed "free storage period"

will be allowed only in the following cases:

- a) For reasons of force majeure as authorized by the Port Manager concerned and confirmed by the PPA General Manager or his duly authorized representative.
- b) For reasons of delay in the processing of the required entry or exit documents by the Bureau of Customs as formally attested to by the Commissioner of Customs or his duly authorized representative.
- c) For reasons beyond the control of cargo owner/ consignee and found meritorious in accordance with rules and procedures issued by the PPA Board of Directors.

EXEMPTIONS FROM PORT CHARGES

17. Notwithstanding the above provisions, cargoes of duly BOI-registered firms as well as those granted special exemptions by Presidential issuances decreed after 1 January 1976 shall be exempted from payment of port charges until otherwise revoked or amended.



Appendix Table 10.3.4 Port Development Program

(million pesos)

Project	1982	1983	1984	1985	1986	1987	1988	1989	1990	1991	1992	1993
Ongoing Projects												
(1)IBRD 3rd Project												
L/C - P -	73.742	74.254	155.046	81.885								
F/C - \$ -	7.054	18.424	20.716	14.845								
Construction Cost	126.647	212.436	541.146	370.14								
Const. in Progress	126.647	339.083	880.229	1250.369								
Depreciable Assets					1250.369	1250.369	1250.369	1250.369	1250.369	1250.369	1250.369	1250.369
Depreciation Cost					31.259225	31.259225	31.259225	31.259225	31.259225	31.259225	31.259225	31.259225
(2) Tech. Assistance(1IBRD)												
L/C - P -	0.36	1.998	2.289	0								
F/C - \$ -	0.323	0.766	1.143	1.147								
Construction Cost	2.78	7.745	22.863	21.793								
Const. in Progress	2.78	10.525	33.388	55.181								
Depreciable Assets					55.181	55.181	55.181	55.181	55.181	55.181	55.181	55.181
Depreciation Cost					1.379525	1.379525	1.379525	1.379525	1.379525	1.379525	1.379525	1.379525
(3)Manila Container												
L/C - P -	4.384	0.413	14.004	53.968	96.539	11.047						
F/C - \$ -	1.286	0.471	1.219	3.96	7.815	2.148						
Construction Cost	13.877	3.318	36.92	129.589	245.043	51.859						
Const. in Progress	13.877	17.825	54.745	184.334	429.377	481.236						
Depreciable Assets							481.236	481.236	481.236	481.236	481.236	481.236
Depreciation Cost							12.0309	12.0309	12.0309	12.0309	12.0309	12.0309
(4)Port of Irene												
L/C - P -			2	3	47.3	47.3						
F/C - \$ -			0.375	0.65	4.185	4.185						
Construction Cost			8.75	15.35	126.815	126.815						
Const. in Progress			8.75	24.1	150.915	277.73						
Depreciable Assets							277.73	277.73	277.73	277.73	277.73	277.73
Depreciation Cost							6.94325	6.94325	6.94325	6.94325	6.94325	6.94325
(5)Cargo Handling Equip.												
L/C - P -	0.111	1.889	3	1								
F/C - \$ -	0	0.171	5.093	1.273								
Construction Cost	0.111	3.257	95.003	25.187								
Const. in Progress	0.111	3.368	98.371	123.558								
Depreciable Assets					123.558	123.558	123.558	123.558	123.558	123.558	123.558	123.558
Depreciation Cost					8.2372	8.2372	8.2372	8.2372	8.2372	8.2372	8.2372	8.2372
Sub - Total												
L/C - P -	78.597	78.554	176.339	149.854	143.839	58.347	0	0	0	0	0	0
F/C - \$ -	8.643	19.832	28.546	21.695	12.001	6.333	0	0	0	0	0	0
Construction Cost	143.415	227.386	704.682	562.059	375.858	178.674	0	0	0	0	0	0
Const. in Progress	143.415	370.801	1075.483	1637.542	550.292	258.966	0	0	0	0	0	0
Depreciable Assets	0	0	0	0	1429.108	1429.108	2188.074	2188.074	2188.074	2188.074	2188.074	2188.074
Depreciation Cost	0	0	0	0	40.87595	40.87595	59.8501	59.8501	59.8501	59.8501	59.8501	59.8501
Future Projects												
(1)Manila North												
L/C - P -					66.42	132.22	94.402	28.393				
F/C - \$ -					6.545	16.96	19.065	6.43				
Construction Cost					190.775	454.46	456.837	297.563				
Const. in Progress					190.775	645.235	1101.812	1369.435				
Depreciable Assets									1369.435	1369.435	1369.435	1369.435
Depreciation Cost									87.295667	87.295667	87.295667	87.295667
(2)Port of Tacloban												
L/C - P -					3.6	15	38.9	30.6	6.5			
F/C - \$ -					0.413	2.53	2.991	2.155	0.277			
Construction Cost					11.447	63.97	95.729	71.545	11.763			
Const. in Progress					11.447	74.517	170.246	241.791	253.554			
Depreciable Assets										253.554	253.554	253.554
Depreciation Cost										6.33885	6.33885	6.33885
(3)Port of San Fernando												
L/C - P -					1.506	3.5	0	15.832	31.665	31.665	15.832	
F/C - \$ -					0.253	0.759	0	3.165	6.329	6.329	3.165	
Construction Cost					6.313	17.921	0	75.967	151.816	151.916	75.967	
Const. in Progress					6.313	24.234	24.234	100.201	252.117	404.033	480	
Depreciable Assets												480
Depreciation Cost												12
(4)IBRD 4th Project												
L/C - P -							5	59.167	118.333	118.333	59.167	
F/C - \$ -							2	6.333	12.667	12.667	6.333	
Construction Cost							43	179.494	359.005	359.005	179.494	
Const. in Progress							43	222.494	581.5	940.505	1120	
Depreciable Assets												1120
Depreciation Cost												28
Sub - Total												
L/C - P -	0	0	0	0	71.526	150.72	138.302	133.992	156.498	149.998	74.999	0
F/C - \$ -	0	0	0	0	7.211	20.249	24.056	21.083	19.273	18.996	9.498	0
Construction Cost	0	0	0	0	208.535	535.451	595.368	534.569	522.685	510.922	255.461	0
Const. in Progress	0	0	0	0	208.535	743.985	1339.352	1873.921	1887.171	1344.539	1600	0
Depreciable Assets	0	0	0	0	0	0	0	0	1369.435	1562.589	1582.989	3162.989
Depreciation Cost	0	0	0	0	0	0	0	0	87.295667	93.634517	93.634517	133.63452
Total(Without Case)												
L/C - P -	78.597	78.554	176.339	149.854	215.365	209.067	138.302	133.992	156.498	149.998	74.999	0
F/C - \$ -	8.643	19.832	28.546	21.695	19.212	26.582	24.056	21.083	19.273	18.996	9.498	0
Construction Cost	143.415	227.386	704.682	562.059	580.393	714.125	595.368	534.569	522.685	510.922	255.461	0
Const. in Progress	143.415	370.801	1075.483	1637.542	788.827	1502.952	1339.352	1873.921	1887.171	1344.539	1600	0
Depreciable Assets	0	0	0	0	1429.108	1429.108	2188.074	2188.074	3491.569	3751.063	3751.063	5351.063
Depreciation Cost	0	0	0	0	40.87595	40.87595	59.8501	59.8501	147.14377	153.48462	153.48462	193.48462
Port of Batangas												
L/C - P -					1.543	1.543	45.717	59.198				
F/C - \$ -					0.1134737	0.1134737	5.2537895	2.4665263				
Construction Cost					3.6990003	3.6999997	145.539	106.962				
Const. in Progress					3.6990003	7.399	152.938	259				
Depreciable Assets									259	259	259	259
Depreciation Cost									6.475	6.475	6.475	6.475
Total(With Case)												
L/C - P -	78.597	78.554	176.339	149.854	216.908	210.61	184.019	193.19	156.498	149.998	74.999	0
F/C - \$ -	8.643	19.832	28.546	21.695	19.325474	28.695526	29.309789	23.549526	19.273	18.996	9.498	0
Construction Cost	143.415	227.386	704.682	562.059	584.092	717.825	740.905	640.631	522.685	510.922	255.461	0
Const. in Progress	143.415	370.801	1075.483	1637.542	792.526	1516.351	1492.29	2132.921	1887.171	1344.539	1600	0
Depreciable Assets	0	0	0	0	1429.108	1429.108	2188.074	2188.074	3756.569	4010.063	4010.063	5619.063
Depreciation Cost	0	0	0	0	40.87595	40.87595	59.8501	59.8501	153.62077	159.95962	159.95962	199.95962

Appendix Table 10.4.1

PHILIPPINE PORTS AUTHORITY
 Port Management Unit - Port of Batangas
 COMPARATIVE CONSOLIDATED STATEMENT OF REVENUE & EXPENSES
 For the Years Ended December 31, 1984 & 1983

	<u>1984</u>	<u>1983</u>	<u>Increase (Decrease)</u>
Revenue From Operations:			
Harbor Fee	P 4,458,286.94	P 2,522,929.47	P 1,935,357.47
Berthing Fee	3,227,667.62	1,396,422.16	1,831,245.46
Anchorage Fee	2,526,375.64	839,769.61	1,686,606.03
Usage Fee	2,038,145.02	1,538,378.02	499,767.00
Lay-up Fee	3,980.09	11,718.17	(7,738.08)
Storage	16,437.23	21,777.76	(5,340.53)
Wharfage Dues	38,625,530.51	33,911,213.68	4,714,316.83
Share in Arrastre Income	1,365,852.25	1,191,172.38	174,679.87
Other Income	396,662.96	176,700.72	219,962.24
Total Revenue	P52,658,938.26	P41,610,081.97	P11,048,856.29
Less: Operating Expenses:			
Involving Cash:			
Regular Plantilla Items	P 716,346.14	P 715,044.01	P 1,302.13
Uniform Allowance	-	19,500.00	(19,500.00)
Salary Adjustment/Merit Increases	69,474.27	15,341.00	54,133.27
Social Security Ins. Prem.	105,596.19	99,392.18	6,204.01
Overtime Pay	24,330.85	36,265.76	(11,934.91)
Cost of Living Allowance	333,088.48	231,632.03	101,456.45
Training & Personnel Dev.	-	10,394.20	(10,394.20)
Bonuses & Incentives	188,997.30	155,438.00	33,559.30
Amelioration Pay	71,534.51	71,546.65	(12.14)
Meal Subsidy	45,329.70	46,242.00	(912.30)
Travelling	33,274.20	33,679.70	(405.50)
Communication	12,957.93	7,656.57	5,301.36
Repairs & Maintenance of Port Facilities	2,635,558.79	515,845.48	2,119,713.31
Security Services	125,711.04	166,291.34	(40,580.30)
Athletics	-	1,823.45	(1,823.45)
Advertising & Promotion	-	500.00	(500.00)
Meetings & Conferences	8,193.88	10,630.00	(2,436.12)
Journals & Subscriptions	75.25	450.25	(375.00)
Insurance, Non-Staff	-	11,992.15	(11,992.15)
Repairs & Maint. - Equip.	14,522.34	8,999.03	5,523.31
Laundry Services	592.00	500.00	92.00
Medical Supplies	9,061.73	11,824.72	(2,762.99)
Medical Attendance	-	2,000.00	(2,000.00)
Supplies & Materials	47,870.76	44,800.00	3,070.76
Water, Illum. & Power Serv.	79,873.89	70,290.94	9,582.95
Auditing Services	48,492.00	44,434.58	4,057.42
Maint. of Motor Vehicles	71,331.62	63,951.78	7,379.84
Representation	7,200.00	7,200.00	-
Taxes & Licenses	1,643,132.00	1,245,757.50	397,374.50
Bldgs. & Structures Outlay	-	48,010.00	(48,010.00)
Depreciation	692,275.39	713,131.71	(20,856.32)
Total Operating Expenses	P 6,984,820.24	P 4,410,565.03	P 2,574,255.23
	6 984 820.24		
NET INCOME FROM OPERATIONS	P45,674,118.00	P37,199,516.94	P 8,474,601.06
	*****	*****	*****

Appendix Table 10.4.2

PHILIPPINE PORTS AUTHORITY
Comparative Balance Sheet
As of December 31, 1984 & 1983
PMU - BATANGAS

<u>A S S E T S</u>	<u>1984</u>	<u>1983</u>	Increase (Decrease)
<u>Current Assets</u>			
Cash on Hand and in Banks	P 1,119,777.66	P 340,138.63	P 779,639.03
Accounts Receivable	2,460,070.78	694,050.58	1,766,020.20
Other Current Assets	26,818.65	22,044.26	4,774.39
Total Current Assets	<u>P 3,606,667.09</u>	<u>P 1,056,233.47</u>	<u>P 2,550,433.62</u>
<u>Fixed Assets</u>			
Land & Land Improvements	P 1,427,680.00	1,427,680.00	-
Buildings & Structures	30,370,391.70	30,370,391.70	-
Furniture, Fixtures & Equipt.	501,945.42	503,925.82	(1,980.40)
In-Transit	6,385.00	6,385.00	-
Total Fixed Assets	<u>P 32,306,402.12</u>	<u>P 32,308,382.52</u>	<u>P (1,980.40)</u>
Less: Accum. Depreciation	<u>6,812,679.41</u>	<u>6,120,404.02</u>	<u>P 692,275.39</u>
Total Fixed Assets	<u>P 25,493,722.71</u>	<u>P 26,187,978.50</u>	<u>(P 694,255.79)</u>
<u>Other Assets</u>			
Prepayments	P 520.42	P 539.68	(P 19.26)
Miscellaneous	1,738.45	1,738.45	-
Total Other Assets	<u>P 2,258.87</u>	<u>P 2,278.13</u>	<u>(P 19.26)</u>
TOTAL ASSETS	<u>P 29,102,648.67</u>	<u>P 27,246,400.10</u>	<u>P 1,856,158.57</u>
 <u>LIABILITIES & NET WORTH</u>			
<u>Current Liabilities</u>			
Accounts Payable	P 1,746,057.19	P 460,812.02	P 1,285,245.17
Other Current Liabilities	292,405.18	255,961.91	36,443.27
Total Current Liabilities	<u>P 2,038,462.37</u>	<u>P 716,773.93</u>	<u>P 1,321,688.44</u>
<u>Contingent Liabilities</u>			
Disallowed payment	65.45	65.45	-
Total Liabilities	<u>P 2,038,527.82</u>	<u>P 716,839.38</u>	<u>P 1,321,688.44</u>
 <u>NET WORTH</u>			
Invested Surplus	P 25,493,722.71	P 26,187,978.50	(P 694,255.79)
CO/PMU Clearing Accounts	1,570,398.14	341,672.22	1,228,725.92
Total Net worth	<u>P 27,064,120.85</u>	<u>P 26,529,650.72</u>	<u>P 534,470.13</u>
TOTAL LIABILITIES AND NET WORTH	<u>P 29,102,648.67</u>	<u>P 27,246,400.10</u>	<u>P 1,856,158.57</u>

Appendix Table 10.4.3

PMU - Batangas

Port Revenue by Tariff Items, 1984

	Base Port			Sub-Ports			Private Ports			(1,000 pesos) Total		
	Gross	Exempted	Net	Gross	Exempted	Net	Gross	Exempted	Net	Gross	Exempted	Net
	583	583	583	1,314	1,314	1,314	10,358	10,358	10,358	12,255	12,255	12,255
<u>Charges Against Vessels</u>												
(Foreign)												
Harbor Fee	66		66	181		181	4,212		4,212	4,459		4,459
Berthing Fee	38		38	482		482	2,707		2,707	3,227		3,227
Anchorage Fee	32		32	245		245	2,249		2,249	2,526		2,526
(Domestic)												
Usage Fee	446		446	404		404	1,189		1,189	2,039		2,039
Lay-Up Fee	1	1	1	2	2	2	1	1	1	4	4	4
<u>Charges Against Cargoes</u>	1,275		1,275	2,856	1,433	1,423	43,287	5,979	37,308	47,418	7,412	40,006
(Foreign)												
Wharfage Fee	102		102	1,423	1,364	59	41,916	5,948	35,968	43,441	7,312	36,129
Export	7		7	59		59	3,001	1,255	1,746	3,067	1,255	1,812
Import	95		95	1,364	1,364	0	38,915	4,693	34,222	40,374	6,057	34,317
Storage Fee												
Export												
Import												
(Domestic)												
Wharfage Fee	649		649	642	69	573	1,303	31	1,272	2,594	100	2,494
Inbound	510		510	344	3	341	531	21	510	1,385	24	1,361
Outbound	139		139	298	66	232	772	10	762	1,209	76	1,133
Storage Fee	1	1	1	16		16				17		17
Inbound	1	1	1	16		16				17		17
Outbound												
Arrastre/Stevedoring	523		523	775		775	68		68	1,366		1,366
Other Income	318		318	72		72	7		7	397		397
<u>Total Revenue</u>	2,176		2,176	4,242	1,433	2,809	53,652	5,979	47,673	60,070	7,412	52,658

Appendix Table 10.4.4 PMU – Batangas Organization Structure

	Approved	Existing	PMU Base Port	Calapan	San Jose	Siañ	Balanacan	Sta. Cruz
Office of the Port Manager	(4)	(3)	(3)					
Port Manager	1	1	1					
Corporate Attorney A	1	0	0					
Secretary	1	1	1					
Driver A	1	1	1					
Port Safety & Security Section	(7)	(7)	(7)					
Port Security Chief A	1	1	1					
Security Guards B	6	6	6					
Administrative Service Section	(12)	(8)	(6)	(1)			(1)	
Administrative Officer B	1	1	1					
Clerk B	3	1	1					
Radio Operator B	1	1	1					
Driver A	1	1	1					
External Messenger	1	1	1					
Utilityman B	5	3	1	1			1	
Port Operations Section	(23)	(18)	(7)	(4)	(2)	(1)	(1)	(3)
Port Operations Officer I	1	0	0					
Asst. Port Operations Officer I	4	4	0	1	1	1		1
Harbor Master I	1	1	1					
Asst. Harbor Master I	1	0	0					
Terminal Operations Asst. I	8	6	3	1			1	1
Statistical Assistant	3	2	1	1				
Clerk B	5	5	2	1	1			1
Engineering & Maintenance Section	(12)	(6)	(6)					
Senior Engineer B	1	1	1					
Engineer A	1	1	1					
Construction Foreman B	1	0	0					
Draftman B	1	0	0					
Clerk B	1	0	0					
Electrician A	1	0	0					
Plumber A	1	0	0					
Carpenter A	1	1	1					
Utilityman B	4	3	3					
Finance Section	(12)	(10)	(8)		(1)	(1)		
Finance Officer A	1	1	1					
Cashier B,C	2	1	1					
Corporate Bookkeeper	1	1	1					
Accounting Clerk B	5	4	2		1	1		
Clerk B	3	3	3					
Commercial Development Section	(3)	(0)	(0)					
Commercial Development Officer A	1	0	0					
Statistical Assistant	1	0	0					
Clerk B	1	0	0					
Total of PMU	(73)	(52)	(37)	(5)	(3)	(2)	(2)	(3)

Appendix Table 10.4.5 Supplementary Employees Needed at the Port of Batangas in 1990

	Supplementary Employees		Reason For Increase
	Persons	Needed	
Port Safety & Security Section	2	Security Guards	<ul style="list-style-type: none"> ◦ Setting up a new gate ◦ Construction of parking lot
Port Operations Section	4	Port Operations Officer (1) Asst. Harbor Master (1) Terminal Operations Asst. (1) Statistical Asst. (1)	<ul style="list-style-type: none"> ◦ Increase in cargo volume and number of vessel ◦ Construction of "New Ro/Ro Terminal" ◦ Improvement of port statistical records
Engineering & Maintenance Section	1	Electrician	<ul style="list-style-type: none"> ◦ Construction of lighting facilities
Commercial Development Section	3	Commercial Development Officer (1) Statistical Asst. (1) Clerk (1)	<ul style="list-style-type: none"> ◦ Promoting new facilities and service to port users ◦ Necessity of making marketing research

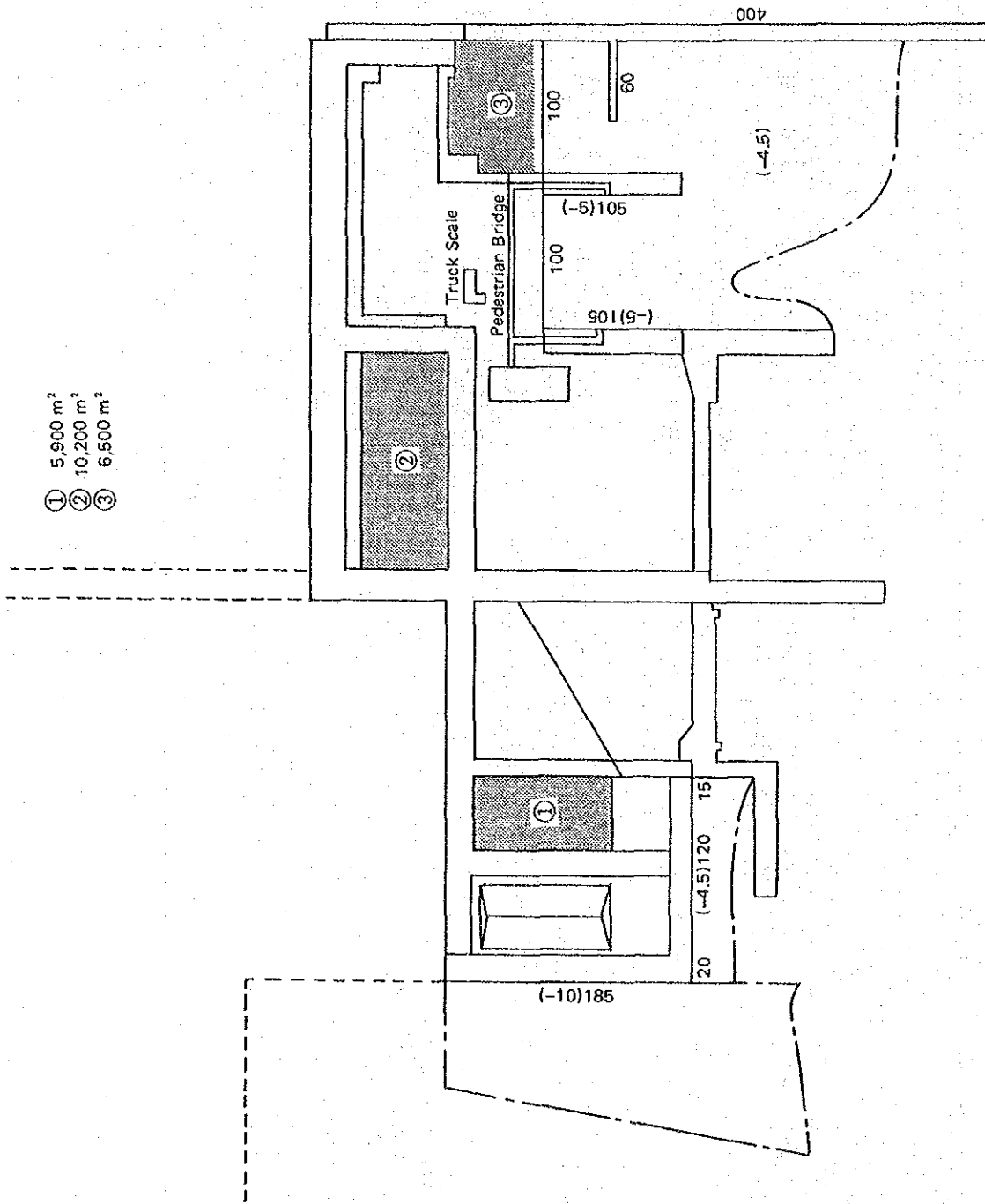

Appendix Fig. 10.4.1 Land for Port-related Activities

Appendix Table 10.6.1

FRR CALCULATION

***** Batangas Port (Peso Exchange Rate 1\$=21P)

***** FRR(%) = 0.31

NO.	YEAR	COST	BENEFIT	BNFT. -COST	P. COST	P. BNFT	P. VALUE
1	1984	0.00	0.00	0.00	0.00	0.00	0.00
2	1985	0.00	0.00	0.00	0.00	0.00	0.00
3	1986	3926.00	0.00	-3926.00	3901.99	0.00	-3901.99
4	1987	3927.00	0.00	-3927.00	3891.04	0.00	-3891.04
5	1988	156157.00	0.00	-156157.00	154253.00	0.00	-154253.00
6	1989	110995.00	0.00	-110995.00	109306.00	0.00	-109306.00
7	1990	2245.00	7015.00	4770.00	2204.07	6887.11	4683.04
8	1991	2245.00	7407.00	5162.00	2197.32	7249.69	5052.37
9	1992	2245.00	7800.00	5555.00	2190.59	7610.97	5420.38
10	1993	2245.00	8210.00	5965.00	2183.89	7986.51	5802.62
11	1994	2245.00	8584.00	6339.00	2177.20	8324.76	6147.56
12	1995	2245.00	8977.00	6732.00	2170.53	8679.23	6508.70
13	1996	2245.00	8977.00	6732.00	2163.89	8652.66	6488.77
14	1997	2245.00	8977.00	6732.00	2157.26	8626.17	6468.90
15	1998	2245.00	8977.00	6732.00	2150.66	8599.75	6449.10
16	1999	2245.00	8977.00	6732.00	2144.07	8573.42	6429.35
17	2000	2245.00	8977.00	6732.00	2137.51	8547.17	6409.67
18	2001	2245.00	8977.00	6732.00	2130.96	8521.00	6390.04
19	2002	2245.00	8977.00	6732.00	2124.44	8494.91	6370.47
20	2003	2245.00	8977.00	6732.00	2117.93	8468.90	6350.97
21	2004	2245.00	8977.00	6732.00	2111.45	8442.97	6331.52
22	2005	2245.00	8977.00	6732.00	2104.98	8417.12	6312.14
23	2006	2245.00	8977.00	6732.00	2098.54	8391.35	6292.81
24	2007	2245.00	8977.00	6732.00	2092.11	8365.65	6273.54
25	2008	2245.00	8977.00	6732.00	2085.71	8340.04	6254.33
26	2009	2245.00	8977.00	6732.00	2079.32	8314.50	6235.18
27	2010	2245.00	8977.00	6732.00	2072.95	8289.04	6216.09
28	2011	2245.00	8977.00	6732.00	2066.61	8263.66	6197.06
29	2012	2245.00	8977.00	6732.00	2060.28	8238.36	6178.08
30	2013	2245.00	8977.00	6732.00	2053.97	8213.14	6159.17
31	2014	2245.00	8977.00	6732.00	2047.68	8187.99	6140.31
32	2015	2245.00	8977.00	6732.00	2041.41	8162.92	6121.51
33	2016	2245.00	8977.00	6732.00	2035.16	8137.93	6102.76
34	2017	2245.00	8977.00	6732.00	2028.93	8113.01	6084.08
35	2018	2245.00	8977.00	6732.00	2022.72	8088.17	6065.45
36	2019	2245.00	106249.00	104004.00	2016.52	95435.90	93419.40
TOTAL		342355.00	360713.00	18358.00	334621.00	334624.00	3.02

UNIT = 1000 Pesos

Appendix Table 10.6.2

***** FRR CALCULATION *****

***** Batangas Port(Cost +10%)

***** FRR(%) = 0.08

NO.	YEAR	COST	BENEFIT	BNFT. -COST	P. COST	P. BNFT	P. VALUE
1	1984	0.00	0.00	0.00	0.00	0.00	0.00
2	1985	0.00	0.00	0.00	0.00	0.00	0.00
3	1986	4069.00	0.00	-4069.00	4062.11	0.00	-4062.11
4	1987	4070.00	0.00	-4070.00	4059.66	0.00	-4059.66
5	1988	160093.00	0.00	-160093.00	159551.00	0.00	-159551.00
6	1989	116668.00	0.00	-116668.00	116175.00	0.00	-116175.00
7	1990	2311.00	6903.00	4592.00	2299.28	6867.99	4568.71
8	1991	2311.00	7291.00	4980.00	2297.33	7247.87	4950.54
9	1992	2311.00	7680.00	5369.00	2295.38	7628.10	5332.72
10	1993	2311.00	8067.00	5756.00	2293.44	8005.70	5712.26
11	1994	2311.00	8456.00	6145.00	2291.50	8384.63	6093.14
12	1995	2311.00	8844.00	6533.00	2289.55	8761.93	6472.37
13	1996	2311.00	8844.00	6533.00	2287.61	8754.51	6466.89
14	1997	2311.00	8844.00	6533.00	2285.68	8747.09	6461.41
15	1998	2311.00	8844.00	6533.00	2283.74	8739.68	6455.94
16	1999	2311.00	8844.00	6533.00	2281.81	8732.27	6450.47
17	2000	2311.00	8844.00	6533.00	2279.87	8724.88	6445.00
18	2001	2311.00	8844.00	6533.00	2277.94	8717.48	6439.54
19	2002	2311.00	8844.00	6533.00	2276.01	8710.10	6434.09
20	2003	2311.00	8844.00	6533.00	2274.08	8702.72	6428.64
21	2004	2311.00	8844.00	6533.00	2272.16	8695.35	6423.19
22	2005	2311.00	8844.00	6533.00	2270.23	8687.98	6417.75
23	2006	2311.00	8844.00	6533.00	2268.31	8680.62	6412.31
24	2007	2311.00	8844.00	6533.00	2266.39	8673.26	6406.88
25	2008	2311.00	8844.00	6533.00	2264.47	8665.92	6401.45
26	2009	2311.00	8844.00	6533.00	2262.55	8658.57	6396.03
27	2010	2311.00	8844.00	6533.00	2260.63	8651.24	6390.61
28	2011	2311.00	8844.00	6533.00	2258.71	8643.91	6385.19
29	2012	2311.00	8844.00	6533.00	2256.80	8636.59	6379.78
30	2013	2311.00	8844.00	6533.00	2254.89	8629.27	6374.38
31	2014	2311.00	8844.00	6533.00	2252.98	8621.96	6368.98
32	2015	2311.00	8844.00	6533.00	2251.07	8614.65	6363.58
33	2016	2311.00	8844.00	6533.00	2249.16	8607.35	6358.19
34	2017	2311.00	8844.00	6533.00	2247.26	8600.06	6352.80
35	2018	2311.00	8844.00	6533.00	2245.35	8592.78	6347.42
36	2019	2311.00	108780.00	106469.00	2243.45	105600.00	103357.00
TOTAL		354230.00	359433.00	5203.00	351985.00	351985.00	-0.27

UNIT = 1000 Pesos

Appendix Table 10.6.3

***** FRR CALCULATION *****

***** Batangas Port(Cargo -10%)

***** FRR(%) = 0.05

NO.	YEAR	COST	BENEFIT	BNFT. -COST	P. COST	P. BNFT	P. VALUE
1	1984	0.00	0.00	0.00	0.00	0.00	0.00
2	1985	0.00	0.00	0.00	0.00	0.00	0.00
3	1986	3699.00	0.00	-3699.00	3695.05	0.00	-3695.05
4	1987	3700.00	0.00	-3700.00	3694.07	0.00	-3694.07
5	1988	145539.00	0.00	-145539.00	145228.00	0.00	-145228.00
6	1989	106062.00	0.00	-106062.00	105779.00	0.00	-105779.00
7	1990	2137.00	6269.00	4132.00	2130.16	6248.92	4118.77
8	1991	2137.00	6618.00	4481.00	2129.02	6593.28	4464.26
9	1992	2137.00	6968.00	4831.00	2127.88	6938.26	4810.38
10	1993	2137.00	7317.00	5180.00	2126.74	7281.88	5155.14
11	1994	2137.00	7667.00	5530.00	2125.61	7626.12	5500.52
12	1995	2137.00	8016.00	5879.00	2124.47	7969.00	5844.53
13	1996	2137.00	8016.00	5879.00	2123.33	7964.74	5841.41
14	1997	2137.00	8016.00	5879.00	2122.20	7960.48	5838.28
15	1998	2137.00	8016.00	5879.00	2121.07	7956.23	5835.16
16	1999	2137.00	8016.00	5879.00	2119.93	7951.97	5832.04
17	2000	2137.00	8016.00	5879.00	2118.80	7947.73	5828.93
18	2001	2137.00	8016.00	5879.00	2117.67	7943.48	5825.81
19	2002	2137.00	8016.00	5879.00	2116.53	7939.23	5822.70
20	2003	2137.00	8016.00	5879.00	2115.40	7934.99	5819.59
21	2004	2137.00	8016.00	5879.00	2114.27	7930.75	5816.48
22	2005	2137.00	8016.00	5879.00	2113.14	7926.51	5813.37
23	2006	2137.00	8016.00	5879.00	2112.01	7922.27	5810.26
24	2007	2137.00	8016.00	5879.00	2110.88	7918.04	5807.15
25	2008	2137.00	8016.00	5879.00	2109.76	7913.81	5804.05
26	2009	2137.00	8016.00	5879.00	2108.63	7909.58	5800.95
27	2010	2137.00	8016.00	5879.00	2107.50	7905.35	5797.85
28	2011	2137.00	8016.00	5879.00	2106.38	7901.12	5794.75
29	2012	2137.00	8016.00	5879.00	2105.25	7896.90	5791.65
30	2013	2137.00	8016.00	5879.00	2104.12	7892.68	5788.56
31	2014	2137.00	8016.00	5879.00	2103.00	7888.46	5785.46
32	2015	2137.00	8016.00	5879.00	2101.88	7884.25	5782.37
33	2016	2137.00	8016.00	5879.00	2100.75	7880.03	5779.28
34	2017	2137.00	8016.00	5879.00	2099.63	7875.82	5776.19
35	2018	2137.00	8016.00	5879.00	2098.51	7871.61	5773.10
36	2019	2137.00	98867.00	96730.00	2097.39	97034.30	94936.90
TOTAL		323110.00	326090.00	2980.00	321808.00	321808.00	-0.19

UNIT = 1000 Pesos

Appendix Table 10.7.1

Financial Plan 1985 ~ 1992

I. Assumptions:

- A. For 1985 – Projections revised per actual performance as of October 31, 1985.
- B. For 1986 – Projections per the Principal Special Budget for CY 1986.
- C. For 1987 ~ 1992
 1. Revenue
 - (a) Growth rate in cargo and vessel traffic of 6% per annum.
 - (b) Fund Management Income – yield of 15 % of the beginning cash balances.
 - (c) No Tariff rate Increase up to 1987.
 - (d) Starting 1988, tariff increase computed for amount necessary to bring DCR to 1.75 provided that increase would not exceed 30% per year.
 2. Personal Services – Full staffing in 1987; salary adjustment of 10% per annum; merit increase at 2.5% of basic pay; children's allowance at ₱30/child/month; uniform allowance of ₱500/employee/year.
 3. Repairs and Maintenance of Port Facilities – 2.5% of Asset Base in 1987, 2% of asset base starting 1988.
 4. Dredging Cost – 10% yearly increase.
 5. Taxes – contractor's tax of 4% on port revenue; no provision for realty and income tax.
 6. Depreciation charges – straight-line depreciation method; newly completed/acquired, assets are depreciated at 2.5% per annum.
 7. Other Administrative Costs –
 8. Debt Service –
 - (a) Principal Payment – based on scheduled due dates per loan agreement. Exchange rate used for principal payment computation is the current exchange rate at time of payment. Difference in exchange rate at the time of payment and at the time of avilment (at which rates the loans were booked) is charged under an expense account called Currency Exchange Adjustment.
 - (b) Interest Charges – based on outstanding balances of the loans and projected avilments of foreign-assisted projects and the interest rates stipulated in the loan contracts.
 9. Currency Exchange Rate used for US \$1.00 is ₱23.00 from 1987 to 1992.

10. Accounts Receivable (ending) is assumed at 8% of port revenue.
11. Accounts Payable (ending) is assumed at 15% of cash operating expenses.
12. Infrastructure Projects to be undertaken are the following:
 - (a) 3rd IBRD Project
 - (b) Port Cargo Handling
 - (c) Port of Irene
 - (d) International Container Terminal (ICT)
 - (e) Manila North Harbor Project
 - (f) 4th IBRD Project
 - (g) Manila South Rehabilitation
 - (h) Port of Davao
 - (i) Locally-funded Projects ₱20 M/year starting 1986
 - (j) Feasibility Studies – ₱20 M/year starting 1986
 - (k) Acquisition of Capital Assets – ₱10 M/year starting 1987

Philippine Ports Authority Projected Cash Flow Statements
CY 1985 ~ 1992

(in million pesos)

	1985	1986	1987	1988	1989	1990	1991	1992
Beginning Cash Balance	601.70	641.83	454.46	346.90	289.83	358.03	564.28	815.98
Cash-Internal Source								
Operating Revenue	599.83	691.44	732.93	956.73	1,142.16	1,210.69	1,283.33	1,360.33
Fund Management Inc.	109.26	49.60	68.17	52.03	43.47	53.70	84.64	122.40
Acct. Rec'ble-Beg.	49.34	46.69	54.93	58.63	76.54	91.37	96.86	102.67
Acct. Rec'ble-End.	-46.69	-54.93	-58.63	-76.54	-91.37	-96.86	-102.67	-108.83
Total	711.74	732.80	797.39	990.86	1,170.80	1,258.91	1,362.16	1,476.57
Cash-External Source								
Foreign Loan Avail.	533.34	356.22	338.79	428.49	431.71	278.30	255.07	255.07
Equity Contribution	0.00	0.00	0.00	0.00	0.00	0.00	0.00	0.00
Total	533.34	356.22	338.79	428.49	431.71	278.30	255.07	255.07
Total Cash Available	1,846.78	1,730.85	1,590.64	1,766.25	1,892.34	1,895.24	2,181.51	2,547.62
Application of Cash								
Administrative Costs	141.14	185.86	231.53	264.91	310.40	345.78	386.47	451.83
Repairs & Main.	30.00	116.86	62.09	63.28	66.81	75.20	84.71	88.88
Dredging	30.00	80.00	88.00	96.80	106.48	117.13	128.84	141.72
Debt Serv.-Interest	142.99	169.10	180.29	184.48	202.49	204.71	202.27	197.85
Debt Serv.-Principal	119.31	162.78	176.78	185.07	198.38	187.71	191.54	212.20
Infra Projects	677.51	496.36	503.45	689.01	661.26	408.93	390.62	390.62
Acct. Payable-Beg.	215.33	151.33	85.90	84.29	91.42	102.93	111.42	120.34
Acct. Payable-End.	-151.33	-85.90	-84.29	-91.42	-102.93	-111.42	-120.34	-132.04
Total	1,204.95	1,276.39	1,243.75	1,476.42	1,534.32	1,330.96	1,365.53	1,471.41
Ending Cash Balance	641.83	454.46	346.90	289.83	358.03	564.28	815.98	1,076.20
O/C Ratio	1.94	1.08	1.17	1.58	1.75	1.85	2.00	1.95

Philippine Ports Authority Projected Income Statement
CY 1985 ~ 1992

(in million pesos)

	1985	1986	1987	1988	1989	1990	1991	1992
Operating Revenue								
Port Charges	450.81	533.48	565.49	599.42	826.00	1,011.27	1,071.95	1,136.26
A/S Income	115.61	122.55	129.90	137.69	145.95	154.71	163.99	173.83
Non-Traditional Income	33.41	35.41	37.54	39.79	42.18	44.71	47.39	50.24
Tariff Increase				179.83	128.03			
Total Port Revenue	599.83	691.44	732.93	956.73	1,142.16	1,210.69	1,283.33	1,360.33
Operating Expenses								
Personal Services	78.48	94.24	124.16	139.02	155.79	174.73	196.13	220.31
R & M	30.00	116.86	62.09	63.28	66.81	75.20	84.71	98.89
Other Admin. Costs	62.66	91.62	107.37	125.89	154.61	171.05	190.34	231.52
Dredging Costs	30.00	80.00	88.00	96.80	106.48	117.13	128.84	141.72
Depn-Operating Assets	80.89	86.55	124.51	125.64	139.98	153.96	171.91	173.01
Total Operating Exp.	282.03	469.27	506.13	550.63	623.68	692.07	771.94	855.45
Net Operating Revenue	317.80	222.17	226.80	406.10	518.49	518.63	511.40	504.88
Other Income/Charges								
Fund Mgt Income	110.00	50.00	68.17	52.03	43.47	53.70	84.64	122.40
Interest on Loans	-142.99	-169.10	-180.29	-184.40	-202.49	-204.71	-202.27	-197.85
Currency Exchange Adj.	-44.64	-32.00	-52.62	-56.30	-64.58	-61.95	-60.20	-62.03
Depn Non-Oprtg. Assets	-7.78	-7.78	-7.78	-7.78	-7.78	-7.78	-7.78	-7.78
Amort.-Vitas Project	-14.20	0.00	0.00	0.00	0.00	0.00	0.00	0.00
Net Income	218.19	63.29	54.28	209.57	287.11	297.89	325.79	359.62
Asset Base	1,710.93	1,716.46	2,483.41	3,164.05	3,340.61	3,760.05	4,235.64	4,444.16
Return on Assets (%)	18.57	12.94	9.13	12.83	15.52	13.79	12.07	11.36

Table 2 Asset Base

	1985	1986	1987	1988	1989	1990	1991	1992
Net Oprtg Asset, Beginning	1,751.37	1,670.48	1,762.44	3,204.37	3,123.73	3,557.48	3,962.61	4,508.66
Add: Acquisitions	0.00	178.51	1,566.45	45.00	573.73	559.09	717.96	44.00
Less: Depreciation Charges								
- On Existing Assets	80.89	80.89	80.89	80.89	80.89	80.89	80.89	80.89
- On New Assets @2.5%		5.66	43.62	44.75	59.09	73.07	91.02	92.12
NBV - Oprtg Assets - End	1,670.48	1,762.44	3,204.37	3,123.73	3,557.48	3,962.61	4,508.66	4,379.66
Asset Base	1,710.93	1,716.46	2,483.41	3,164.05	3,340.61	3,760.05	4,235.64	4,444.16
R & M = 2.5% of Asset Base '86 & '87:								
2% of Asset Base for 1988 ~ 1992		42.91	62.09	63.28	66.81	75.20	84.71	88.88
Cost of Completed Assets:								
Port Cargo Handling		158.51						
3rd IBRD Projects			1,546.45					
Port of Irene						308.09		
ICT					543.73			
Manila North Harbor Proj.						221.00		
4th IBRD Project							687.96	
Port of Davao				15.00				
Feasibility Studies								14.00
Capital Assets				10.00	10.00	10.00	10.00	10.00
Other Locally-Funded Proj.		20.00	20.00	20.00	20.00	20.00	20.00	20.00
Total		178.51	1,566.45	45.00	573.73	559.09	717.96	44.00

Table 3 Infrastructure Program

(in million pesos)

	1985	1986	1987	1988	1989	1990	1991	1992
3rd IBRD Projects	566.73	247.14	—	—	—	—	—	—
Port Cargo Handling	110.61	39.68	—	—	—	—	—	—
Port of Irene	—	22.42	23.95	142.07	142.07	—	—	—
ICT	—	155.62	217.07	130.01	—	—	—	—
Manila North Harbor Project	—	—	—	110.50	110.50	—	—	—
4th IBRD Project	—	—	171.93	171.93	171.93	172.17	—	—
Manila South Rehab.	—	—	51.00	102.50	204.76	204.76	358.62	358.62
Port of Davao Proj.	—	7.50	7.50	—	—	—	—	—
Feasibility Studies	—	2.00	2.00	2.00	2.00	2.00	2.00	2.00
Acq. of Capital Assets	—	—	10.00	10.00	10.00	10.00	10.00	10.00
Locally-Funded Projs	—	20.00	20.00	20.00	20.00	20.00	20.00	20.00
Total	677.34	494.36	503.45	689.01	661.26	408.93	390.62	390.52
Funding: P Equivalent of Loan	533.34	356.22	338.79	428.49	431.71	278.30	255.07	255.07
Peso Portion-Foreign Assisted	144.00	108.64	125.16	228.52	197.55	98.63	103.55	103.55
Locally-Funded Projects	—	29.50	39.50	32.00	32.00	32.00	32.00	32.00
Total	677.34	494.36	503.45	689.01	661.26	408.93	390.62	390.62

JICA