

Classification Drug name (INN)	Dosage form	Strength	Recommended presentation and/or pack size	Remarks-Suggestions
7.4 <u>Antimycobacterial drugs</u>				
7.4.1 <u>Antileprosy drugs</u>				
dapson (E)	tablet	100mg		
rifampicin (E)	capsule	300mg		
7.4.2 <u>Antituberculosis drugs</u>				
ethambutol hydrochloride (C)	tablet	250mg, 500mg		
isoniazid (E)	tablet	100mg, 300mg		
rifampicin (E)	capsule	450mg, 600mg		
streptomycin sulfate (E)	injection	1g	vial	
pyrazinamide (C)	tablet	500mg		
7.5 <u>Antiprotozoal drugs</u>				
7.5.1 <u>Amoebicides</u>				
diloxanide furoate (C)	tablet	500mg		
dehydroemetine hydrochloride (E)	injection s.c./i.m.	60mg/ml	1ml ampoule	
metronidazole (E)	tablet,	200mg		bottles of 21 & 100

Classification <u>Drug name (INN)</u>	Dosage form	Strength	Recommended presentation and/or pack size	Remarks-Suggestions
7.5.2 <u>Antimalarials</u>				
amodiaquine hydrochloride (C)	tablet	20mg base		
chloroquine phosphate (E)	syrup	25mg base/ 5ml	60ml bottle	
primaquine phosphate (E)	tablet	150mg base		
pyrimethamine (C)	tablet	15mg base		
pyrimethamine with sulphadiazine (E)	tablet	25mg		
quinine dihydrochloride (E)	injection i.v.	60mg/ml	2ml ampoule	
quinine sulphate (E)	tablet	60mg/ml	10ml ampoule	
7.7 <u>Systemic antifungal drugs</u>				
amphotericin B (C)	injection i.v.	50mg	vial	
flucytosine (C)	capsule	250mg		
griseofulvin (E)	tablet	125mg 250mg		
nystatin (E)	suspension	100,000 units/ml	60ml bottle	
	tablet	500,000 units/ml	bottles of 100	

<u>Classification</u> <u>Drug name (INN)</u>	Dosage form	Strength	Recommended presentation and/or pack size	Remarks-Suggestions
7.8 <u>Vaginal anti-infectives</u> metronidazole (E) neomycin (E) nystatin (E)	tablet tablet tablet	500mg 500mg 100,000 units	10 per pack 10 per pack 15 per pack	
tetracycline (E)	tablet	100mg	10 per pack	
8. <u>ANTIMIGRAINE DRUGS</u> ergotamine tartrate (E)	tablet, sublingual	2mg		
9. <u>ANTINEOPLASTIC DRUGS</u> cyclophosphamide (E)	injection i.v.	200mg 1000mg	vial vial	
methotrexate (E)	tablet	25mg 50mg		
methotrexate sodium (E)	tablet injection i.m./i.v.	2.5mg 5mg 50mg	vial vial	

Classification <u>Drug name (INN)</u>	Dosage form	Strength	Recommended presentation and/or pack size	Remarks-Suggestions
10. <u>ANTIPARKINSONISM DRUGS</u>				
benztropine mesylate (E)	injection, tablet	2mg/2ml 2mg&5mg		
levodopa with carbidopa (E)	tablet	250mg+25mg		
11. <u>BLOOD, DRUGS AFFECTING THE</u>				
11.1 <u>antianaemia drugs</u>				
hydroxocobalamin injection (E)	injection i.m.	100µg/ml	1ml ampoule	
ferrous sulfate (E)	tablet	200mg		
folic acid (E)	injection i.m. tablet	5mg/ml 5mg	1ml ampoule	
iron preparations for intramuscular injection (O)	injection i.m.	50mg/ml	2ml ampoule	
11.2 <u>Anticoagulants and antagonists</u>				
heparin (C)	injection i.m./i.v.	1000IU/ml 5000IU/ml	5ml vial 5ml vial	

Classification <u>Drug name (INN)</u>	Dosage form	Strength	Recommended presentation and/or pack size	Remarks-Suggestions
11.2 (continued) phyto-menadione (C) protamine sulfate (C)	injection i.m./i.v. injection i.v.	1mg/0.5ml 10mg/ml 10mg/ml	0.5ml ampoule 5ml ampoule 5ml ampoule	
12. <u>BLOOD PRODUCTS AND BLOOD SUBSTITUTES</u>				
12.1 <u>Plasma substitute</u> dextran 40 (E)	injection i.v.	6%	500ml	
12.2 <u>Plasma fractions for specific uses</u> e.g. albumin, antihæmophilic globulin, fibrinogen (C)				
13. <u>CARDIOVASCULAR DRUGS</u>				
13.1 <u>Antianginal drugs</u> glyceryl trinitrate (E)	tablet, sublingual	0.5mg		

Classification <u>Drug name (INN)</u>	Dosage form	Strength	Recommended presentation and/or pack size	Remarks-Suggestions
13.1 (continued) propranolol hydrochloride (E)	injection i.m./i.v. tablet	1mg/ml 10mg 40mg	1ml ampoule	
13.2 <u>Antiarrhythmic drugs</u> lidocein hydrochloride (E)	injection	2%, 10%	50ml vial 10ml ampoule	
propranolol hydrochloride (E)	injection i.d./i.v. tablet	1mg/ml 80mg	1ml ampoule	
13.3 <u>Antihypertensive drugs</u> bethanidine (C) hydrochlorothiazide (E) propranolol hydrochloride (E)	tablet tablet injection i.m./i.v. tablet	10mg 50mg 1mg/ml 10mg, 40mg, 80mg	1ml ampoule	

Classification <u>Drug name (INN)</u>	Dosage form	Strength	Recommended presentation and/or pack size	Remarks-Suggestions
13.3 (continued) reserpine (E)	injection i.m./i.v. tablet	1mg/ml 0.25mg	1ml ampoule bottles of 40	
13.4 <u>Cardiac glycosides</u> digoxin (E)	tablet injection i.v.	0.25mg 0.25mg/ml	bottles of 100 2ml ampoule	
13.5 <u>Drugs used in shock or anaphylaxis</u> dopamine hydrochloride (C) epinephrine (E) noradrenaline acid tartrate (E)	injection i.v. injection injection	40mg/ml 1mg/ml 1mg/ml	5ml vial 1ml ampoule	
14. <u>DERMATOLOGICAL DRUGS, TOPICAL</u> 14.1 <u>Antiinfectives</u> chlorhexidine (E) gentian violet (E)	cream solution powder	1% 5%	500g bottle	dental use

Classification Drug name (INN)	Dosage form	Strength	Recommended presentation and/or pack size	Remarks-Suggestions
14.1 (continued)				
methylated spirit (E)	solution	19 vol.alcohol:1 vol wood naphtha	bottles of 100ml & 500ml	
proflavine (E)	jelly	0.1%	100g tube	
sulphur ointment (E)	ointment	10%	500g bottle	
14.2 <u>Antiinflammatory drugs</u>				
betamethasone ester (C)	ointment	0.1% (base)	15g tube	
hydrocortisone acetate (E)	cream	1%	15g tube	
14.3 <u>Astringents</u>				
aluminium acetate (E)	lotion solution, topical	5% 13%		
14.4 <u>Fungicides</u>				
benzoic acid with salicylic acid (E)	ointment	6% + 3%	100g tube	

THE I ENTIAL AND COMPLEMENTARY DRUGS FOR BURMA

<u>Classification</u> <u>Drug name (INN)</u>	Dosage form	Strength	Recommended presentation and/or pack size	Remarks-Suggestions
14.4 (continued)				
equinazole (C)	drops			
nystatin (C)	ointment	100,000 IU/g	15g tube	
14.5 <u>Keratoplastic agents</u>				
coal tar (E)	gel, topical solution, topical	5% 20%	100g tube	
salicylic acid (in alcohol) (E)	solution, topical	5%		
14.6 <u>Scabicides and pediculocides</u>				
gamma benzene hexachloride (E)	application	0.1%		
14.7 <u>Antipruritic agent</u>				
calamine (E)	lotion	15%	bottles of 120ml	

Classification Drug name (INN)	Dosage form	Strength	Recommended presentation and/or pack size	Remarks-Suggestions
15. DIAGNOSTIC AGENTS tuberculin, purified protein derivative (PPD) (E)	injection i. dermal	2U/dose	50 dose vial	
15.1 <u>Ophthalmic</u> fluorescein sodium (C)	eye drops	2%	single dose units	
15.2 <u>Radioccontrast media</u> barium sulfate (E)	injection (C) powder	10%	5ml 240g/pack	
16. <u>DIURETICS</u> furosemide (E)	injection i. v. tablet	10mg/ml 40mg	2ml ampoule	
hydrochlorothiazide (E) mannitol (E)	tablet injection	50mg 20%	200ml & 500ml bottles	

Classification Drug name (INN)	Dosage form	Strength	Recommended presentation and/or pack size	Remarks-Suggestions
17. GASTROINTESTINAL DRUGS				
17.1 <u>Antacids</u>		500mg		
aluminium hydroxide gel, dried (E)	tablet			
magnesium trisilicate (E)	compound powder			
sodium bicarbonate (E)	tablet	300mg		B.P.C.
17.2 <u>Antiemetics</u>				
promethazine hydrochloride (E)	elixir	5mg/5ml	60ml bottle	
	injection	25mg/ml	2ml ampoule	
	i.m./i.v.			
	tablet	25mg	bottles of 25 & 100	
17.3 <u>Antihæmorrhoidals</u>				
local anaesthetic, astringent and anti-inflammatory drug (E)		5% + 3.5% + 0.25% + 18%		
lidocaine hydrochloride + aluminium acetate + hydrocortisone acetate + zinc oxide	ointment	6% + 5% + 0.5% + 40%		
	suppository			

Classification <u>Drug name (INN)</u>	Dosage form	Strength	Recommended presentation and/or pack size	Remarks-Suggestions
17.4 <u>Antispasmodics</u> atropine sulfate (E)	injection tablet	0.5mg/ml 0.5mg	1ml ampoule	
17.5 <u>Cathartics</u> castor oil (E) magnesium sulphate (E) senna (E)	liquid crystals powder tablet	7.5mg (sennosides)	bottles of 120ml & 500ml	
17.6 <u>Diarrhoea</u> 17.6.1 <u>Antidiarrhoeal</u> codeine phosphate (E)	syrup tablet	5mg/ml 30mg	500ml	
17.6.2 <u>Replacement solution</u> modified Ringer Lactate (E) oral rehydration salts(E) (glucose-salts solution)	infusion			

<u>Classification</u> <u>Drug name (INN)</u>	Dosage form	Strength	Recommended presentation and/or pack size	Remarks-Suggestions
17.6.2 (continued) For 1 litre of water: sodium chloride sodium bicarbonate potassium chloride Glucose (dextrose)	3.5g 2.5g 1.5g 20.0g		sachet	
17.7 <u>Drugs for peptic ulcer</u> oxyphenyclimine HCl (E)	tablet	10mg	bottles of 30 & 100	
18. <u>HORMONES</u>				
18.1 <u>Adrenal hormones & synthetic substitutes</u> dexamethasone (E) dexamethasone sodium phosphate (E) hydrocortisone sodium succinate (E)	tablet injection i.m. injection i.v.	0.5mg 4mg 4mg/ml 100mg 500mg	1ml ampoule vial	

<u>Classification</u> <u>Drug name (INN)</u>	Dosage form	Strength	Recommended presentation and/or pack size	Remarks-Suggestions
18.1 (continued) prednisolone (E)	injection pallet tablet	40mg/ml 2.5mg 5mg	vial bottles of 30 bottles of 50	
18.2 <u>Androgens</u> testosterone propionate (E)	injection i.m.	25mg/ml	1ml ampoule	
18.3 <u>Estrogens</u> ethinylestradiol (C)	tablet	0.05mg		
18.4 <u>Insulins</u> compound insulin zinc suspension (lente) (E) (=3 volumes of insulin zinc suspension (amorphous) & 7 volumes of insulin zinc suspension (crystalline))	injection s.c.	100IU/ml	10ml vial	
insulin injection (soluble) (E)	injection s.c./i.v.	100IU/ml	10ml vial	

Classification <u>Drug name (INN)</u>	Dosage form	Strength	Recommended presentation and/or pack size	Remarks-Suggestions
18.4 (continued) <u>Oral hypoglycaemic agents</u> chlopropamide	tablet	100mg	bottles of 50 & 100	
18.5 <u>Oral contraceptives</u> norethisterone with ethinylestradiol (E)	tablet	0.5mg+0.035mg 1mg+0.05mg		
18.6 <u>Progestogens</u> norethisterone acetate (E)	tablet	2.5mg		
18.7 <u>Thyroid hormones and antagonists</u> levothyroxine sodium (E)	tablet	0.025mg 0.1mg 60mg		
potassium iodide (BP) (E) (iodine aqueous solution= iodine 5% w/v and potassium iodine 10% w/v in purified water 1ml contains iodine 50mg and total iodine about 130mg) carbimazole (E)	tablet	5mg		

Classification Drug name (INN)	Dosage form	Strength	Recommended presentation and/or pack size	Remarks-Suggestions
18.8 <u>Ovulation inducer</u> clomifen citrate (C)	tablet	50mg		
18.9 ACTH gel (long acting)	injection	40IU/ml		
18.10 <u>Miscellaneous</u> ethinyl oestradiol+methyl testosterone (E) menopax cream (C) (stilboestrol 0.1% w/w amethocaine 0.5% w/w benzocaine 5.0% w/w testosterone 4mg)	tablet	.002mg+4mg		
19. <u>IMMUNOLOGICALS</u>				
19.1 <u>Sera and immunoglobulins</u> antirabies hyperimmune serum (E)	injection i.m.	1000IU	5ml ampoule	
diphtheria antitoxin (E)	injection i.m.	10,000IU 20,000IU	vial vial	
snake antivenom (E)	injection i.m.	10ml	vial	
tetanus antitoxin (E)	injection	50,000IU	vial	

Classification <u>Drug name (INN)</u>	Dosage form	Strength	Recommended presentation and/or pack size	Remarks-Suggestions
19.2 Vaccines				
BCG vaccine (dried) (E)	injection i.d.		20, 50, 100 doses/vial	
diphtheria-tetanus vaccine (E)	injection i.m.		10, 20, 50, 100 doses/vial	
diphtheria-pertussis-tetanus vaccine (E)	injection i.m.		10, 20, 50, 100 doses/vial	
poliovirus vaccine (E)	oral		10, 20, 50, 100 doses/vial	
plague vaccine (E)	injection		10 & 20 doses/vial	
rabies vaccine (duck embryo) (E)	injection		1, 10 doses/vial	
smallpox vaccine (E)	multiple puncture		10, 20, 50, 100 doses/vial	
tetanus toxoid (E)	injection i.m.		10, 20, 50 doses/vial	
20. MUSCLE RELAXANTS (PERIPHERALLY ACTING) AND ANTAGONISTS				
neostigmine bromide (E)	tablet	15mg		
pancuronium bromide (C)	injection i.v.	2mg/ml	2ml ampoule	

Classification Drug name (INN)	Dosage form	Strength	Recommended presentation and/or pack size	Remarks-Suggestions
20. (continued) tubocurarine chloride (E)	injection i.v.	10mg/ml	1.5ml ampoule 10ml vial	
21. OPHTHALMOLOGICAL AND OTO-RHINOLARYNGOLOGICAL PREPARATIONS				
21.1 <u>Topical</u>				
21.1.1 <u>Antiinfective</u>				
boric acid (E)	powder		500g/pack	ear antiseptic
bismuth subnitrate (C)	powder		100g/bottle	ear dressing
compound tincture benzoin B.P.C. (E)	liquid	10%	500ml bottle	
dequalinium chloride (E)	lozenges	0.25mg	20 lozenges	throat antiseptic
framycetin sulphate (C)	solution	0.5%	8ml vial with dropper	ear/eye drops
	sterile			
	tullegras	1%	10cm x 10cm	sterile tulle dressing
framycetin sulphate + gramicidin + dexamethasone (C)	solution	0.5%+0.5%+0.05%	8ml vial with dropper	ear/eye drops

Classification Drug name (INN)	Dosage form	Strength	Recommended presentation and/or pack size	Remarks-Suggestions
21.1.1 (continued)				
iodoform (C)	crystal		100g/bottle	ear dressing
polymyxin B sulphate + neomycin sulphate + hydrocortisone (C)	solution	1000unit/ml +0.5% +1%	3ml vial with dropper	ear drops
sulfacetamide (E)	solution	5%, 10%	10ml dropper bottle	eye drops
tetracycline (E)	drops	1%	10ml dropper bottle	eye drops
	ointment	1%	5g tube	eye ointment
21.1.2 Antifungal				
iodochlorhydroxyquinoline+	cream	30%+0.02%	5g tube	ear dressing
flumethasone pivalate	solution	1%+0.02%	7.5ml vial with dropper	ear drops
21.1.3 Antiinflammatory				
hydrocortisone acetate	ointment	1%	5g tube	eye ointment
21.1.4 Decongestants				
imidazoline hydrochloride (E)	solution	0.05%	10ml nebuliser	nasal solution

<u>Classification</u> <u>Drug name (INN)</u>	Dosage form	Strength	Recommended presentation and/or pack size	Remarks-Suggestions
21.1.5 <u>Local anaesthetics</u> tetracaine hydrochloride (E)	solution	0.5%	15ml dropper bottle	eye drops
21.1.6 <u>Miotics</u> pilocarpine hydrochloride (E)	solution	2%	15ml dropper bottle	eye drops
		4%	15ml dropper bottle	eye drops
	ointment	1%	5g tube	eye ointment
21.1.7 <u>Mydriatics</u> atropine sulphate (E)	ointment	1%	5g tube	
epinephrine hydrochloride (C)	solution	1%	10ml dropper bottle	eye drops
homatropine hydrobromide (E)	solution	2%	10ml dropper bottle	eye drops
21.2 <u>Systemic</u> acetazolamide (E)	tablet	250mg	100tablets/bottle	for ophthalmology
Glycerin (C)	oral		500ml	for ophthalmology

<u>Classification</u> <u>Drug name (INN)</u>	Dosage form	Strength	Recommended presentation and/or pack size	Remarks-Suggestions
21.2 (continued) nicotinic acid + postafene + atarax (C)	tablet	50mg+12.5mg +10mg	20 tab./bottle	labrynthine sedative
22. OXYTOCICS ergometrine maleate (E)	injection i.m./i.v. tablet	0.25mg/ml 0.5mg	1ml ampoule 1ml ampoule	
23. PERITONEAL DIALYSIS SOLUTION intraperitoneal dialysis solution of appropriate composition (C)	injection i.v.	1IU/ml 10IU/ml		
24. PSYCHOTHERAPEUTIC DRUGS amitriptyline hydrochloride (E)	tablet	25mg		

Classification Drug name (INN)	Dosage form	Strength	Recommended presentation and/or pack size	Remarks-Suggestions
24.1 (continued)				
chlorpromazine hydrochloride (E)	injection i.m./i.v.	50mg/ml	2ml ampoule	
	syrup	25mg/ml	100ml	
diazepam (E)	tablet	50mg		
	tablet	2mg 5mg		
fluphenazine decanoate (E)	injection i.m.	25mg/ml	5ml vials	
lithium carbonate (C)	capsule / tablet	300mg		
	slow release			
25. RESPIRATORY TRACT, DRUGS ACTING ON THE				
25.1 <u>Antissthmatic drugs</u>				
aminophylline (E)	injection i.v.	25mg/ml	10ml ampoule	
	tablet	100mg	bottles of 100 & 1000	

Classification <u>Drug name (INN)</u>	Dosage form	Strength	Recommended presentation and/or pack size	Remarks-Suggestions
25.1 (continued)				
beclomethasone dipropionate (C)	inhalation (aerosol)	0.050mg per dose	200 doses aerosol spray pack	
epinephrine (E)	injection s.c.	1mg/ml	1ml ampoule	
salbutamol sulfate (E)	inhalation (aerosol)	0.1mg per dose	200 dose aerosol spray pack	
25.2 <u>Antitussives</u>	injection tablet	0.5mg/ml 2mg		
codeine phosphate (E)	tablet	30mg		
26. SOLUTIONS CORRECTING WATER, ELECTROLYTE AND ACID-BASE DISTURBANCES				
26.1 <u>Oral</u>				
oral rehydration salts (E) (glucose-salt solution)				See composition under 17.6.2 <u>Replacement solution</u>
26.2 <u>Parenteral</u>			500ml	
compound solution of sodium lactate (E)	infusion			

<u>Classification</u> <u>Drug name (INN)</u>	Dosage form	Strength	Recommended presentation and/or pack size	Remarks-Suggestions
26.2 (continued) glucose	infusion	5% 25% 50%	500ml 25ml 25ml	
glucose with sodium chloride (E)	infusion	5% in normal saline	500ml	
laevulose (C)	injection	20%	10ml ampoule	
magnesium sulphate or chloride (C)	injection	10%	10ml ampoule	
potassium chloride (E)	injection	8.5%	10ml ampoule	
sodium bicarbonate (E)	infusion	0.9% & other strengths	500ml	
sodium chloride (E)	injection/ infusion			
water for injection (E)	injection			
27. SURGICAL DISINFECTANTS chlorhexidine gluconate (E)	solution/cream	5%		

<u>Classification</u> <u>Drug name (INN)</u>	Dosage form	Strength	Recommended presentation and/or pack size	Remarks-Suggestions
27. (continued)	solution	2.5%	bottles of 30ml	
iodine (E)	solution		bottles of 120ml & 500ml	See composition in section 14.1
28. VITAMINS AND MINERALS	tablet	100mg	bottles of 100 & 1000 ampoule	
ascorbic acid (E)	injection	100mg/ml	10ml ampoule	
calcium gluconate (E)	injection	10%	50ml dropper bottle	
ergocalciferol (E)	oral solution	10,000IU per ml		
nicotinamide (C)	tablet	50mg		
pyridoxine hydrochloride (E)	tablet	50mg		
retinol concentrated (E)	aq. injection	20,000IU/ml		
	capsule	25,000IU	30ml	
	solution	50,000IU/ml		

Classification <u>Drug name (INN)</u>	Dosage form	Strength	Recommended presentation and/or pack size	Remarks-Suggestions
28. (continued)				
riboflavin (E)	tablet	5mg		
sodium fluoride (C)	solution	4%		
thiamine hydrochloride (E)	tablet	1.1mg		
	tablet	50mg		
	injection	50mg	ampoule	
multivitamin preparations such as Burplex, Vitazone, prenatal and Geriavit without hormones (E)	elixir injection tablet			
29. MISCELLANEOUS				
29.1 <u>Dental preparations</u>				
calcium hydroxide (E)	paste and powder			pulp dressing
camphorated mono-chlorophenol+70% gum camphor+30% chlorophenol (E)	paste			intracanal dressing
cotton points and gutta percha points (E)			packs of 100 & 1000	

<u>Classification</u> <u>Drug name (INN)</u>	Dosage form	Strength	Recommended presentation and/or pack size	Remarks-Suggestions
29.1 (continued) devitalizing paste (E) formaldehyde lidocaine HCl carmine propylene glycol carbowax	paste	1g+0.8g +0.5g+0.75ml +1.5g		
ethylenediaminetetraacetic acid (E)	solution	10 - 15%		root canal irrigant
hydrogen peroxide (E)	solution	6%, 30%	100ml	intracanal dressing
sodium hypochlorate (E) systemic haemostatic	solution	5%		root canal irrigant
adrenosem salicylate (C)	injection tablet	5mg/ml 5mg	1ml ampoule	
29.2 <u>Other preparations</u>				
chymotrypsin (C)	injection	5000 units	1ml ampoule	
ephedrine sulphate (C)	injection	25mg/ml	1ml ampoules	
pitressin (C)	injection	20 units/ml	1ml ampoules	

5. 保健省中央医藥品供給部概要

Present facilities for the Storage.

The Medical Supply System is based almost exclusively on a single storage and distribution centre at CMSD Rangoon with a Sub-Depot at Mandalay playing a minor part and a Transit Camp at Monywa.

This system has necessitated establishment of large number of godowns at CMSD, Rangoon, a few at Sub-Depot, Mandalay and one at Monywa.

(1) Present facilities for the storage at CMSD, Rangoon consist of (18) number of godowns equipped with wooden/iron racks. One of the godowns is installed with air-conditioners, for storage of film Antibiotics, Injections and others which need cool storage and one pucca building for cold storage. Table below shows the use of these godown.

S.No.	Godown No.	Size	Use	Remarks
1	13	100'x40'x16'	UNICEF Supplies	
2	14	" " "	" "	
3	18	" " "	Transit Section	
4	19	" " "	" "	
5	15	" " "	Tablet	"
6	21	" " "	" "	
7	22	" " "	Liquid	"
8	16	" " "	Ord; + Dressing	
9	21	" " "	Powder Section	
10	23	" " "	Surplus Stores	Built with Third Four Year Plan 1978-1979
11	25	" " "	Lab:Chemical Section	
12	24	80'x30'x16*	Instrument Section	
13	8	40'x20'x16'	Ord' + Dressing	
14	9	" " "	" " "	
15	7	50'x25'x16'	" " "	
16	4	76'x28'x16'	Instrument & Injection	
17	17	30'x20'x16'	Vaccine & Sera	Cold storage
18	2	75'x50'x25'	Ground Floor	Antibiotics & Injections
			First Floor	Instrument
				Air-conditioned

* See Annexure B Map of CMSD

All these godowns are normally saturated with Stores and Systematic storing and racking has not been possible thus resulting in poor stock display,

2/..

poor ventilation and lighting.

The roads leading to end in between the godowns are of fair weather type.

- (2) The storage facilities at Sub-Depot, Mandalay consist of two godowns.
1. Two story godown 150' x 60' x 30'
 2. One story godown 100' x 40' x 16' - built in 1979-80 with Third Four Year Plan.
- (3) The Transit Camp at Monywa has one godown measuring 60' x 30' x 16'.
- (4) One godown each, measuring 100' x 40' x 16', has been built at Akyab and Myitkyina in 1979-80 with the Third Four Year Plan.
- (5) One godown, 60' x 40' x 16', is under construction at Taunggyi with Third Four Year Plan.
" Godown construction with Third Four Year Plan"

S.No.	Site	Size	Remarks
1	CMSD,Rangoon	100'x40'x16'	Built in 78-79 with Third Four Year Plan.
2	CMSD,Mandalay	100'x40'x16'	Built in 79-80 with Third Four Year Plan.
3	Akyab	" " "	" " " "
4	Myitkyina	" " "	" " " "
5	Taunggyi	60'x40'x16'	Under construction"

AINDAWYA

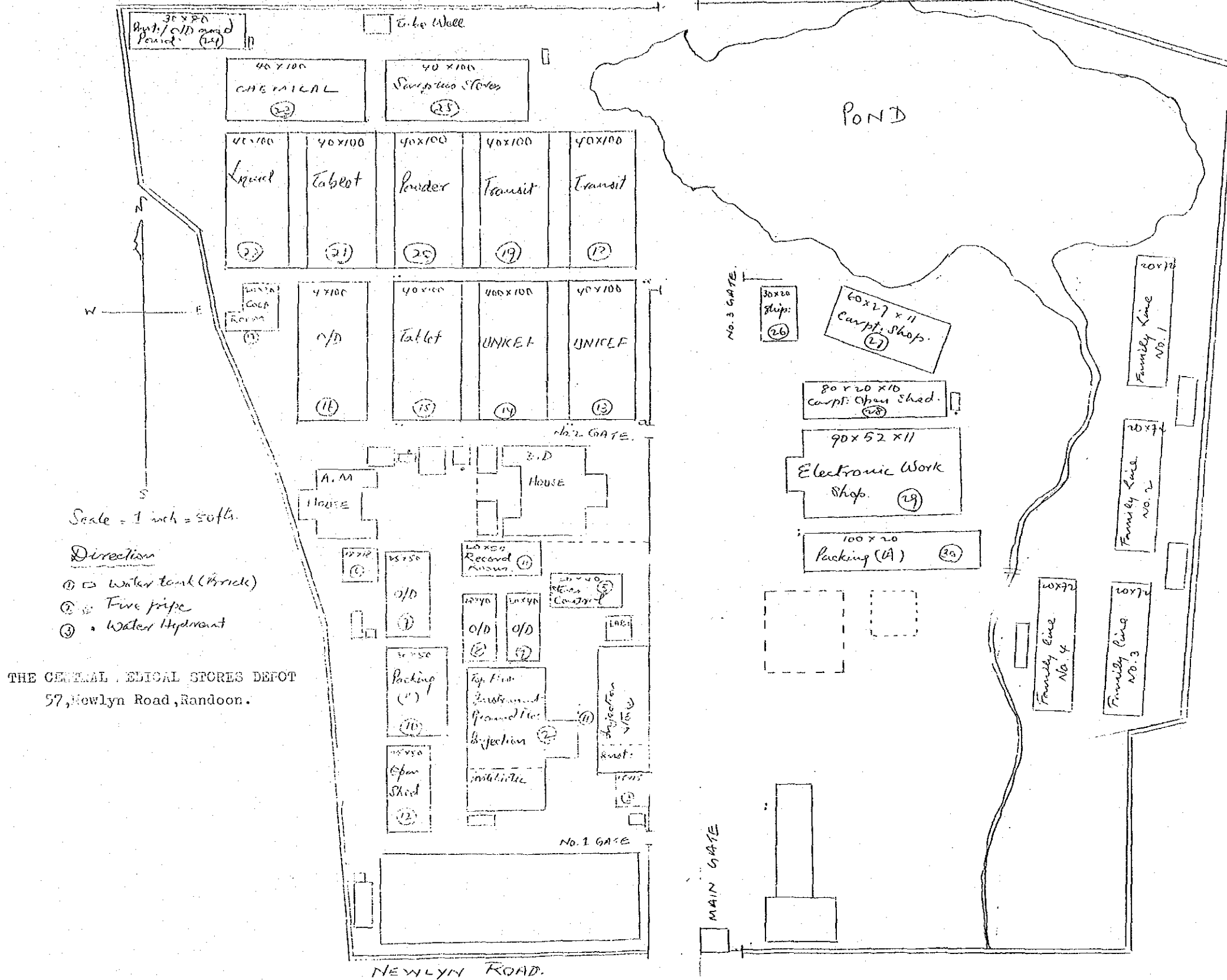

Existing Facilities For Distribution of Drugs.

The following facilities are, at present, utilized in distributing medical supplies and equipment (S & E) throughout the whole country.

- a) For Tenasserim division and Arakan state medical S & E are distributed by Burma Five Star Line Corporation's coastal going vessels and schooners.
- b) For Irrawaddy division, medical S & E are despatched by riverine transport. The S & E for the most of townships of Magwe division situated on the west and east bank of Irrawaddy river were also distributed by steamers. But at present, as the heavy pilferage occurred repeatedly during transit, the usage of this system of distribution was dropped. The medical S & E for these areas are now despatched by rail or by road to Divisional Health Director, Magwe and from there the respective townships of these areas received their S & E through personal collection.
- c) The townships in Rangoon division and some townships in Pegu division receive the medical S & E through self-service collection system.
- d) The Medical S & E for remote areas where there exists no easy access such as Kengtung, Tachileik, Mongtong, and Monghsat townships of Shan State and Papun township of Karen State are distributed by chartered planes.
- e) The medical S & E for those townships of the remaining states/divisions which are situated on the rail road are distributed direct by rail to them and the remaining townships which are not on the rail road receive the medical S & E through Mandalay sub-depot, Monywa transit camp, State/Divisional Health Directors and Township Medical Officers. Rail transportation is used in forwarding of S & E from CMSD to those sub-depot, transit camp, state/divisional Health Directors and TMO's and some of these S & E are again despatched to the respective townships by road or by steamer from them and the remaining S & E are collected by the respective townships personally.

At present one sub-depot in Mandalay and one transit camp in Monywa are in existence and they are functioning in full swing. Mandalay sub-depot is dealing with Mandalay division, Northern Shan State and Sagaing division except those areas which are near to Monywa and which are situated in upper Chindwin. Monywa transit camp is dealing with Northern chin state, upper Chindwin and those townships which are near to it. The details of responsibilities of Mandalay sub-depot and Monywa transit camp are shown below.

In addition to Monywa transit camp, two warehouses each at Myitkvina and Akyab for establishment of two transit camps there, have been constructed. But operation of these two transit camps keeps pending due to non-appointment of the required staff.

S.No.	Sub-depot/Transit camp	Responsibilities
1	Mandalay Sub-dept	<ul style="list-style-type: none"> a. Mandalay division b. Northern Shan State c. Sagaing division excluding upper Chindwin areas and those townships which are near to Monywa.
2	Monywa Transit Camp	<ul style="list-style-type: none"> a. Northern Chin state b. Sagaing division only for upper Chindwin areas and those townships which are near to Monywa.

Capital Procurement List (F.E. only) Groupwise Allotment For 1979-80 & 1980-81

Name Of Agency : - Central Medical Stores Depot, Bangalore

Sr. No.	Description	1979 - 80		1980-81		1980-81	
		Tentative F.E. Allocation	Actual F.E. Received (100% of revised)	Tentative F.E. Allocation	Revised F.E. Allocation	80%	20%
1.	Hospital Equipment and Sundries and OMSD Workshop	5,62,000	3,51,330	4,73,270	4,73,270	3,78,516	54,000
2.	X-Ray Equipment	3,00,000	1,37,560	4,60,000	4,60,000	3,68,000	92,000
3.	Anaesthetic Equipment	2,00,000	1,25,050	3,06,680	3,06,680	2,45,344	61,336
4.	Physiotherapy Equipment	2,00,000	1,25,050	1,53,340	1,53,340	1,22,672	30,668
5.	Laboratory Equipment	2,00,000	1,25,050	3,06,680	3,06,680	2,45,344	61,336
6.	Specialised Equipment for Neuro and Cardiac	-	-	20,00,000	14,82,000	14,82,000	2,96,400
Total		14,62,000	9,14,000	37,00,000	31,62,000	25,45,600	6,36,400

Groupwise T. E. Allotment (Current Items) For 1979-80 and 1980-81
 Name Of Agency: Central Medical Stores Depot, Bangalore

Sr. No.	Description	1979-80		1980-81		1980-81	
		Tentative F.P.E. Allocation	Actual % F.P.E. Received (100% of Revised)	Tentative F.P.E. Allocation	Revised F.P.E. Allocation	20%	20%
1	D.P.P. 75% W.P.P.	75,60,000	47,87,610	69,05,950	79,60,000	64,88,000	15,72,000
2	Various Drugs	18,00,000	11,25,000	20,93,020	18,00,000	14,40,000	3,60,000
3	Anesthetic Drugs and Nitrous Oxide Gas			15,85,340	12,00,000	9,60,000	2,40,000
4	X-Ray Films, X-Ray Chemicals, Contrast Media, Syringes & Needles, Fluid Giving, Blood Giving & Packing Sets.		7,50,020		12,00,000	9,60,000	2,40,000
5	P.O.P, Adhesive Plaster & Lint	5,00,000	3,12,550	3,81,440	5,00,000	4,00,000	1,00,000
6	Lab. Chemicals & Reagents, Lab. Glass-ware for all hospitals & N. H. I.	10,00,000	6,25,010	11,62,760	10,00,000	8,00,000	2,00,000
7	Radio pharmaceutical Drugs (Radioisotopes)	2,50,000	1,50,250	2,90,670	2,50,000	2,00,000	50,000
8	Compartas Rubber Gloves, Rubber Goods, Catguts, Suture Needles and Blades	15,00,000	9,37,520	17,44,160	15,00,000	12,00,000	3,00,000
9	Essential Instruments & Various Spare Parts for all hospitals, Dept, Workshop and G. I. Wire.	20,00,000	12,70,020	23,25,660	20,00,000	16,00,000	4,00,000
TOTAL		159,10,000	98,44,000	165,00,000	159,10,000	127,28,000	31,82,000

6. 薬用植物園薬草リスト

Burmese Medicinal

Plant Planted

in Kandawgalay Garden,

Agricultural Corporation,

Upper Pansodan Street,

Rangoon,

Burma.

Scientific Name

1. *Vitex trifolia*
2. *Vitex Negundo*
3. *Acalpha indica*
4. *Phyllanthus* sp:-
5. *Fumaria parviflora*
6. *Ectipta Alba*
7. *Stevia rebaudiana*
8. *Alysecarpus vaginalis*
9. *Saxifraga Virginiensis*
10. *Plumbago zeylanica*
11. *Plumbago Rosea*
12. *Artemisia Parviflora*
13. *Theobroma cacao*
14. *Tinospora* sp:-
15. *Gly Rhiza glabra*
16. *Cinnamomum tamala*
17. *Euonymus kachinensis*
18. *Cinamomum inunctum*
19. *Piper Nigrum*
20. *Plumbago* so:-
21. *Myristica Fragrans*
22. *Syzygium Aromaticum*
23. *Piper cubeba*
24. *Prox Attenuata*
25. *Piper longum*
26. *Mimosa Padica*
27. *Cassia glauca*
28. *Neptunia oleracea*
29. *Acorus Calamus*
30. *Bixa Orellana*
31. *Leucaena glauca*
32. *Desmodium triquetrum*
33. *Cassia Alata*
34. *Rauwolfia Serpentina*
35. *Datura Alba*
36. *Hydrocotyle Asiatica*
37. *Sapium Baccatum*
38. *Blumea balsamifera*
39. *Cyperus scariosus*
40. *Lawsonia inermis*
41. *Rhinacanthus communis*
42. *Barperia* sp:-
43. *Pogostemon Patcharti*
44. *Aloe vera*
45. *Mentha Ayonami*
46. *Mentha arvensis*
47. *Mentha Piperita*
48. *Eucalyptus canaldulensis*
49. *Morus Alba*
50. *Cinnamomum obtusifolium*
51. *Carcina norella*
52. *Cinnamomum camphora*
53. *Millingtonia hortensis*
54. *Anacardium occidentale*
55. *Azadirachta indica*
56. *Croton oblangifolius*
57. *Calliophyllum inophyllum*
58. *Mansonia gagei*
59. *Terminalia chebula*
60. *Aristolochia indica*

- | | |
|----------------------------------|--------------------------------------|
| 61. <i>Dregea volubilis</i> | 78. <i>Saraca indica</i> linn |
| 62. <i>Quisqualis indica</i> | 79. <i>Orthosiphon stamineus</i> |
| 63. <i>Streblus Asper</i> | 80. <i>Ocimum Sanctum</i> |
| 64. <i>Thevetia Peruviana</i> | 81. <i>Cymbopogon Nardua</i> |
| 65. <i>Bryophyllum calycinum</i> | 82. <i>Cymbopogon Citratus</i> |
| 66. <i>Bauhinia variegata</i> | 83. <i>Cassia Renigera</i> |
| 67. <i>Piper longum</i> | 84. <i>Grevillea Robusta</i> |
| 68. <i>Cassia Siamea</i> | 85. <i>Caesalpinch Digyna</i> |
| 69. <i>Linostoma decandrum</i> | 86. <i>Garcinia xanthocymus</i> |
| 70. <i>Polygonum Tomentosum</i> | 87. <i>Morinda Angustifolia</i> |
| 71. <i>Acacia Farnesiana</i> | 88. <i>Asparagus meiolados</i> |
| 72. <i>Alpinia officinarum</i> | 89. <i>Semecarpus Anacardium</i> |
| 73. <i>Alpinia conchigera</i> | 90. <i>Plumeria acutifolia</i> |
| 74. <i>Tabebuia Pallida</i> | 91. <i>Elettaria cardamomum</i> |
| 75. <i>Spathodea Campanulata</i> | 92. <i>Euphorbia Tirucatti</i> |
| 76. <i>Carissa Carandas</i> | 93. <i>Clerodendron siphonanthus</i> |
| 77. <i>Dillenia indica</i> | |

JICA

4-18